



Daily Field Report

RECEIVED

FEB 01 2016

DEPT OF ECOLOGY  
TCP - NWRO

<table border="0" style="width: 100%;"> <tr><td>Permit No:</td><td>n/a</td></tr> <tr><td>Project:</td><td>University Audi</td></tr> <tr><td>Location:</td><td>Roosevelt Way NE and NE 47th St</td></tr> <tr><td>Client Name:</td><td>Freeway Motors LLC</td></tr> <tr><td>&amp; Address:</td><td>4724 Roosevelt Way Northeast Seattle, WA 98105</td></tr> </table>	Permit No:	n/a	Project:	University Audi	Location:	Roosevelt Way NE and NE 47th St	Client Name:	Freeway Motors LLC	& Address:	4724 Roosevelt Way Northeast Seattle, WA 98105	<table border="0" style="width: 100%;"> <tr><td>Project No:</td><td>2014-0681</td></tr> <tr><td>Ecology VCP No:</td><td>NW2584</td></tr> <tr><td>RGI field rep:</td><td>Christopher French</td></tr> <tr><td>Report Date:</td><td>1/28/2016</td></tr> <tr><td>Page No.</td><td>1 of 2</td></tr> <tr><td>Subject:</td><td>Groundwater Sampling – 1<sup>st</sup> Q 2016</td></tr> <tr><td>Contractor:</td><td>n/a</td></tr> <tr><td>Superintendent:</td><td>n/a</td></tr> <tr><td>Visitors:</td><td>none</td></tr> <tr><td>Weather:</td><td>Overcast</td></tr> </table>	Project No:	2014-0681	Ecology VCP No:	NW2584	RGI field rep:	Christopher French	Report Date:	1/28/2016	Page No.	1 of 2	Subject:	Groundwater Sampling – 1 <sup>st</sup> Q 2016	Contractor:	n/a	Superintendent:	n/a	Visitors:	none	Weather:	Overcast
Permit No:	n/a																														
Project:	University Audi																														
Location:	Roosevelt Way NE and NE 47th St																														
Client Name:	Freeway Motors LLC																														
& Address:	4724 Roosevelt Way Northeast Seattle, WA 98105																														
Project No:	2014-0681																														
Ecology VCP No:	NW2584																														
RGI field rep:	Christopher French																														
Report Date:	1/28/2016																														
Page No.	1 of 2																														
Subject:	Groundwater Sampling – 1 <sup>st</sup> Q 2016																														
Contractor:	n/a																														
Superintendent:	n/a																														
Visitors:	none																														
Weather:	Overcast																														

On January 7, 2016, RGI was on-site to perform groundwater sampling of existing groundwater monitoring and dual-phase extraction (DPE) wells. RGI field personnel performed the following:

- Used a Photoionization Detector (PID) to field screen for the presence of volatile organic compounds (VOCs) from each well as they were opened (as measured from inside the well casing).
- Measured water levels and any free product (LNAPL) using an oil-water interface probe and/or electronic water level meter.
- Purge water was stored on-site in a 55 gallon drum.

Our findings are summarized below and are included in the attached Figures and Tables.

- MW10 could not be located and is presumed to have been paved over (during the recent re-asphalting).
- Of the 11 monitoring and seven DPE wells, only three had sufficient groundwater for sampling: MW2, MW11, and DPE6. Based in the limited number of wells with groundwater, no groundwater flow direction was provided during this 1<sup>st</sup> Quarter 2016 sampling event.
- Prior to groundwater sampling, wells were purged of a minimum of three well-volumes. Approximately 6.5 gallons of water was purged from MW11 prior to sampling, and approximately 0.75 gallons was purged from MW2 prior to sampling.
- DPE6 had approximately 1 foot of free product (LNAPL) floating on top of the groundwater. Due to the presence of LNAPL, no groundwater samples were collected from DPE6 for laboratory analysis.
- Groundwater samples collected from MW2 and MW11 had non-detectable concentrations of gasoline- and diesel-range Total Petroleum Hydrocarbons (TPH) and benzene, toluene, ethylbenzene, and xylenes (BTEX); or concentrations below their applicable MTCA Method A Cleanup Levels for Ground Water.
- The following table summarizes PID field readings (inside well casing) and groundwater level data:

Well ID	PID (ppmv)	Depth to Water (ft. bgs)	Depth to LNAPL (ft. bgs)	Notes
MW1	630	---	---	Dry well (not sampled).
MW2	0.4	43.97	---	Groundwater sample collected.
MW3	1.7	---	---	Dry well (not sampled).
MW4	0.5	---	---	Dry well (not sampled).

Tacoma, Washington  
Phone 253.565.0552

**Corporate Office**  
17522 Bothell Way Northeast  
Bothell, Washington 98011  
Phone 425.415.0551 ♦ Fax 425.415.0311

Kennewick, Washington  
Phone 509.586.4840

Well ID	PID (ppmv)	Depth to Water (ft. bgs)	Depth to LNAPL (ft. bgs)	Notes
MW5	530	---	---	Dry well (not sampled).
MW7	15.3	---	---	Dry well (not sampled).
MW8	3.2	---	---	Dry well (not sampled).
MW9	19.7	---	---	Dry well (not sampled).
MW10	---	---	---	Well monument presumed paved over.
MW11	754	44.31	---	Groundwater sample collected.
B3E	725	---	---	Dry well (not sampled).
DPE1	588	---	---	Dry well (not sampled).
DPE2	353	---	---	Dry well (not sampled).
DPE3	278	---	---	Dry well (not sampled).
DPE4	171	---	---	Dry well (not sampled).
DPE5	383	---	---	Dry well (not sampled).
DPE6	369	61.91	60.96	Presence of 0.98-ft. free product.
DPE7	19	---	---	Dry well (not sampled).

Attachments: Figure 1. Site Vicinity Map  
 Figure 2. Summary of Lab Results Property Plan: January 2016  
 Table 1. Summary of Groundwater Monitoring Well Sampling and Analytical Laboratory Results

RGI Field Rep.  
 sign:

  
 CHRISTOPHER FRENCH

Copies To: Washington State Department of Ecology  
NW Regional Office  
ATTN: Mr. Grant Yaney

Reviewed by

  
 PAUL RILEY

Tacoma, Washington  
 Phone 253.565.0552

Corporate Office  
 17522 Bothell Way Northeast  
 Bothell, Washington 98011  
 Phone 425.415.0551 ♦ Fax 425.415.0311

Kennewick, Washington  
 Phone 509.586.4840



# *Figures*

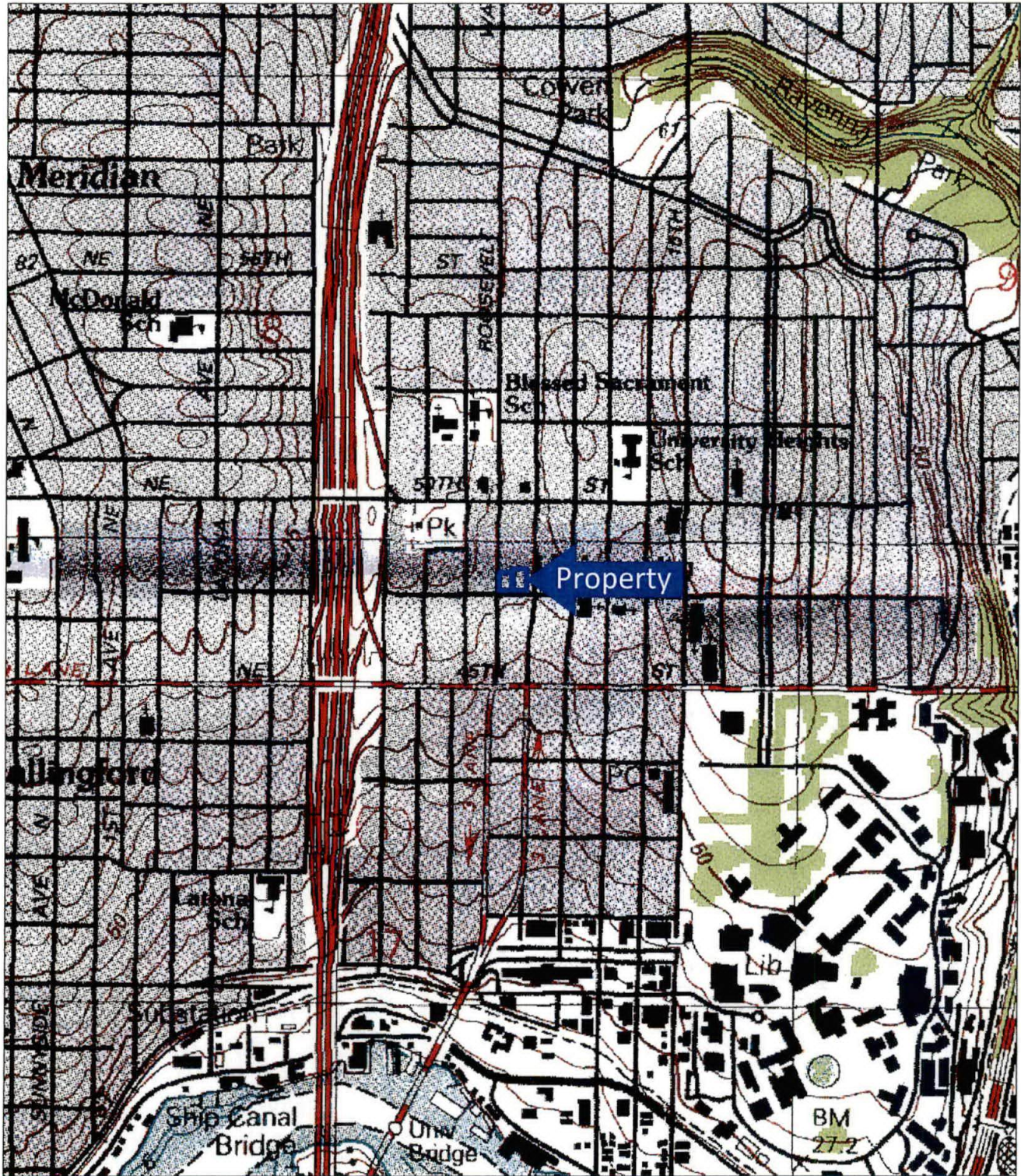

USGS, 1983, Seattle North, Washington  
7.5-Minute Quadrangle

Approximate Scale: 1"=1000'



Corporate Office  
17522 Bothell Way Northeast  
Bothell, Washington 98011  
Phone: 425.415.0551  
Fax: 425.415.0311

University VW - Audi Property

Figure 1

RGI Project Number  
2014-0681

Property Vicinity Map

Date Drawn:  
01/2016

Address: 4724 Roosevelt Way Northeast & 4701 11th Avenue Northeast, Seattle, Washington 98105

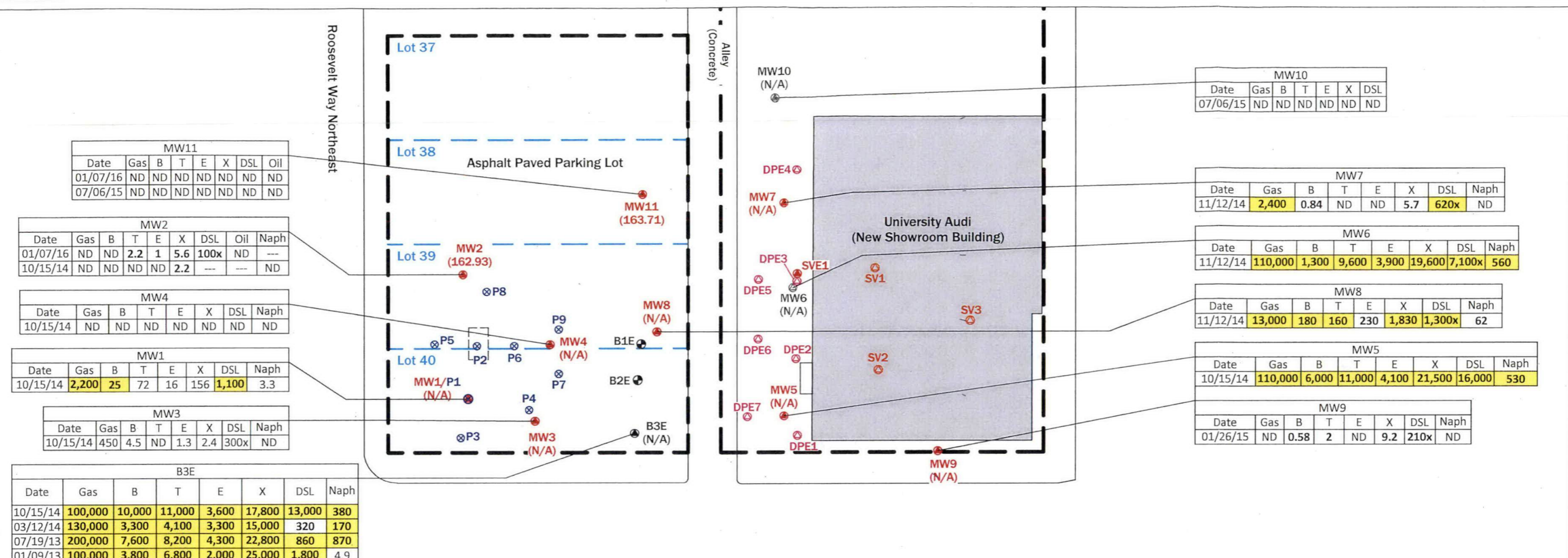

MW11							
Date	Gas	B	T	E	X	DSL	Oil
01/07/16	ND	ND	ND	ND	ND	ND	ND
07/06/15	ND	ND	ND	ND	ND	ND	ND

MW2								
Date	Gas	B	T	E	X	DSL	Oil	Naph
01/07/16	ND	ND	2.2	1	5.6	100x	ND	---
10/15/14	ND	ND	ND	ND	2.2	---	---	ND

MW4							
Date	Gas	B	T	E	X	DSL	Naph
10/15/14	ND	ND	ND	ND	ND	ND	ND

MW1							
Date	Gas	B	T	E	X	DSL	Naph
10/15/14	2,200	25	72	16	156	1,100	3.3

MW3							
Date	Gas	B	T	E	X	DSL	Naph
10/15/14	450	4.5	ND	1.3	2.4	300x	ND

B3E							
Date	Gas	B	T	E	X	DSL	Naph
10/15/14	100,000	10,000	11,000	3,600	17,800	13,000	380
03/12/14	130,000	3,300	4,100	3,300	15,000	320	170
07/19/13	200,000	7,600	8,200	4,300	22,800	860	870
01/09/13	100,000	3,800	6,800	2,000	25,000	1,800	4.9

MW10							
Date	Gas	B	T	E	X	DSL	Oil
07/06/15	ND	ND	ND	ND	ND	ND	ND

MW7							
Date	Gas	B	T	E	X	DSL	Naph
11/12/14	2,400	0.84	ND	ND	5.7	620x	ND

MW6							
Date	Gas	B	T	E	X	DSL	Naph
11/12/14	110,000	1,300	9,600	3,900	19,600	7,100x	560

MW8							
Date	Gas	B	T	E	X	DSL	Naph
11/12/14	13,000	180	160	230	1,830	1,300x	62

MW5							
Date	Gas	B	T	E	X	DSL	Naph
10/15/14	110,000	6,000	11,000	4,100	21,500	16,000	530

MW9							
Date	Gas	B	T	E	X	DSL	Naph
01/26/15	ND	0.58	2	ND	9.2	210x	ND

Northeast 47th Street

- = Abandoned (empty) UST
- = Select groundwater analytical laboratory results in ug/L (See Table 2 for complete results.)  
Gas/DSL/Oil = Gasoline/diesel/oil total petroleum hydrocarbons  
BTEX = Benzene, toluene, ethylbenzene, xylenes  
Naph = Naphthalene  
ND = Not detected above laboratory detection limits  
--- = Not analyzed  
Yellow and bold highlighted results exceed groundwater screening levels.  
x = The sample chromatographic pattern does not resemble the fuel standard used for quantitation.
- = (in gray) Decommissioned groundwater monitoring well (decommissioned on 07/23/15)
- = (in gray) Groundwater monitoring well location not observed on 01/07/16
- = (in red) Existing groundwater well location (installed by RGI between 10/08/14 and 01/16/15)
- = (in blue) Test probe location by RGI on 10/01/14
- = Previous soil boring location
- = Existing groundwater monitoring well location
- = Property boundary

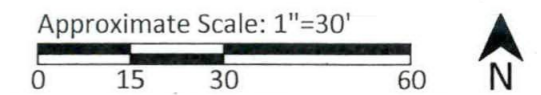

	Corporate Office 17522 Bothell Way Northeast Bothell, Washington 98011 Phone: 425.415.0551 Fax: 425.415.0311		University VW - Audi Property		Figure 2
	RGI Project Number 2014-0681	Summary of Lab Results Property Plan: January 2016			Date Drawn: 01/2016
	Address: 4724 Roosevelt Way Northeast & 4701 11th Avenue Northeast, Seattle, Washington 98105				



# ***Table***



