

ENVIRONMENTAL SAMPLING LETTER
NORTHSHORE UTILITY DISTRICT HEADQUARTERS
KENMORE, WASHINGTON
FOR
NORTHSHORE UTILITY DISTRICT

BIOLOGY	
UNIT	
INTERIM REPORT	<input type="checkbox"/>
SITE CHARACTERIZATION	<input type="checkbox"/>
FINAL CLEANUP REPORT	<input type="checkbox"/>
OTHER <u>Monitoring</u>	<input checked="" type="checkbox"/>
AFFECTED MEDIA:	<input type="checkbox"/>
OTHER	<input checked="" type="checkbox"/>
INSPECTOR (INIT.) <u>JB</u>	3/29/99



NELSON-COUVRETTE & ASSOCIATES, INC.

**CONSULTING GEOTECHNICAL ENGINEERS, GEOLOGISTS
AND ENVIRONMENTAL SCIENTISTS**

17311-135th Avenue NE, A-500
Woodinville, WA 98072
(425) 486-1669 • Fax 481-2510

Snohomish County (425) 337-1669

Wenatchee/Chelan (509) 784-2756

February 23, 1999

Mr. Ron Gehrke, Manager
Northshore Utility District
6830 NE 185TH Street
Kenmore, Washington 98028

Environmental Sampling Letter
Northshore Utility District Headquarters
Kenmore, Washington
NCA File No. 1561C97

Dear Mr. Gehrke:

INTRODUCTION

This letter presents the results of our environmental sampling services at your headquarters and service center site. The site is located at 18520 – 68th Avenue NE, in Kenmore, Washington. You have requested that we evaluate the ground water in existing wells on the site on a semi-annual basis, to fulfill an agreement made with the Washington Department of Ecology (Ecology). We have been provided with reports and letters by Dames & Moore, dated July 19, September 22, November 20, and December 27, 1995, and a letter from Ecology, dated July 9, 1997, for our use in preparing this letter.

Dames and Moore have previously installed four wells on the property as part of their surface and subsurface characterization at the site. The site is currently occupied by two recently remodeled buildings and one new structure, which make up your headquarters and service center. Ecology has reviewed the reports for this site and has required that the existing four wells be sampled on a semi-annual basis for

three years. Each ground water sample is to be analyzed for total petroleum hydrocarbons as gasoline, diesel, and heavy oil (TPH-G, TPH-D, TPH-O) and benzene, ethylbenzene and xylene (BETX). This letter presents the results of our first semiannual ground water sampling.

SCOPE

The purpose of our services is to provide environmental sampling analysis of ground water samples.

Specifically, the services to be provided by NCA are as follows:

1. Review the previous environmental reports for the project.
2. Purge and sample the four monitoring wells on the property.
3. Analyze each of the three samples for:
 - Gasoline by WTPH-G
 - Diesel and Heavy Oil by WTPH-H extended
 - BETX by EPA Method 8020
4. Document our results in a short letter.
5. Provide consultation and additional environmental services as requested.

GROUND WATER SAMPLING

Ground water samples were collected on January 19 and 20, 1999, in general accordance with the Guidance for Site Checks and Site Assessments for Underground Storage Tanks (Ecology, 1992). The location of the wells is shown on the Site Plan in Figure 1. Typically, three to four well volumes of ground water are purged from a well prior to sampling. In this case, the amount of ground water purged prior to sampling was limited due to recharge conditions. Monitoring Well 1 (MW-1), MW-2, and MW-3 were pumped dry after purging 1.2 to 1.5 well volumes prior to sampling. MW-3 had a greater recharge and four well volumes were purged prior to sampling. Ground water samples were obtained using disposable polyethylene bailers dedicated to each well to avoid cross-contamination of wells. Samples were chilled and under chain of custody until delivered to a subcontracted analytical laboratory.

We discovered that sampling conditions are not ideal during the wetter times of the year. The monitoring well monuments for wells MW-1 through MW-3 were originally above ground completions. During construction of the parking area for the NSUD offices, these wells were converted to at-grade completions. A new monument was installed around MW-4. It was found that during the wetter months, several of the monuments collected surface water and cracks in the monument base allowed high ground water to flow into the monument. Purging and sampling of the wells was performed by using the Districts large shop-vac to continuously remove accumulated water from the monument.

GROUND WATER CONDITIONS

Ground water elevations were not evaluated during our site visit due to high volumes of surface water entering the monitoring well monument boxes. The elevations will be measured later during an extended period of dry weather.

QUANTITATIVE ANALYSIS

The concentration of petroleum hydrocarbons existing in the subsurface materials were quantified by testing for:

1. Gasoline by WTPH-G
2. Diesel and Heavy Oil by WTPH-D extended
3. BETX by EPA method 8020

The results of ground water sampling indicate concentrations of WTPH-G, WTPH-D, and BETX below Model Toxics Control Act (MTCA), Method A action levels. A summary of analytical laboratory results on ground water is presented in **Table 1**. Analytical laboratory certificates are attached. MTCA, Method A cleanup levels for ground water are presented in the last row of **Table 1**. The analytical test results indicate that concentrations of petroleum products as Gasoline, Diesel, Heavy Oil, and BETX were below MTCA Method A action levels. The previous results by Dames and Moore are summarized in **Table 1**.

TABLE 1 - WATER SAMPLE ANALYSIS

Well I.D.	Date Sampled	WTPH-G (ppb)	Benzene (ppb)	Ethylbenzene (ppb)	Tolulene (ppb)	Xylenes (ppb)	WTPH-Diesel (ppb)	WTPH-Heavy Oil (ppb)
*MW-1	10-23-95	120	<0.50	<0.50	0.58	<1.0	1,500	NA
*MW-2	10-23-95	<20	<0.50	<0.50	<0.50	<0.50	1,200	NA
*MW-3	10-23-95	73	0.81	<0.50	0.78	2.6	1,000	NA
*MW-4	10-23-95	120	<0.50	<0.50	9.2	<1.0	7,100	NA
MW-1	1-19-99	ND	ND	ND	ND	ND	952	ND
MW-2	1-19-99	ND	ND	ND	ND	ND	854	874
MW-3	1-19-99	ND	ND	ND	ND	ND	331	ND
MW-4	1-20-99	ND	ND	ND	ND	ND	331	ND
MTCA Cleanup Levels		1000.0	5.0	30.0	40.0	20.0	1000.0	1000

* Sampling and analysis performed by Dames and Moore

NA - Not Analyzed

ND - Analyte not detected at or above detection limit concentrations listed in the analytical laboratory reports.

USE OF THIS LETTER

This letter has been provided for Northshore Utility District and their agents, for their use on this project. The results and conclusions presented in this letter are professional opinions based on exploration and testing accomplished for this study and should not be considered a warranty of subsurface conditions.

Within the limitations of scope, schedule and budget for our services, we have strived to take care that our work has been done in accordance with generally accepted practices in this area at the time this letter was prepared. No other conditions, expressed or implied, should be understood.

o O o

Environmental Sampling
Northshore Utility District Headquarters
NCA File No. 1561C97
February 23, 1999
Page 5

It has been a pleasure to provide service to you on this project. If you have any questions or require further information, please call.

Sincerely,

NELSON-COUVRETTE & ASSOCIATES, INC.

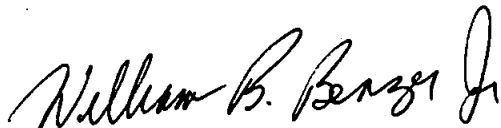
A handwritten signature in cursive script, reading "William B. Benzer, Jr.".

William B. Benzer, PE
Senior Engineer

LMR:WBB:nt

Three Copies Submitted
One Figure
Attachment – Laboratory Certificates

NELSON-COUVRETTE & ASSOCIATES, INC.

Site Plan

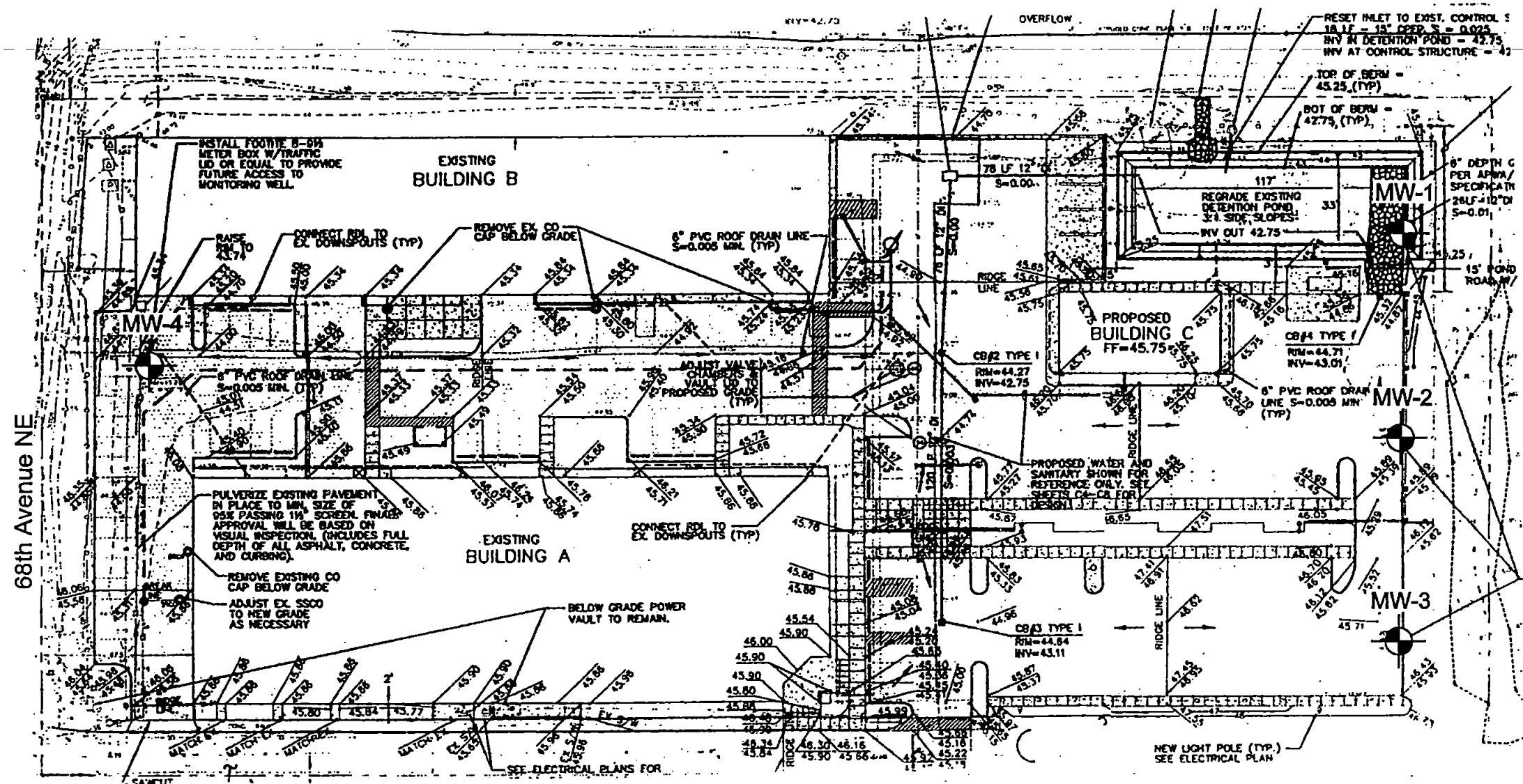

LEGEND

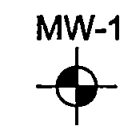

NUMBER AND APPROXIMATE LOCATION OF MONITORING WELL

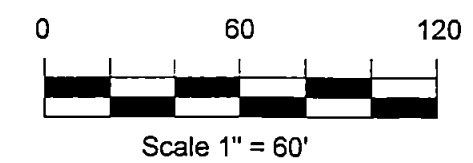

Reference: Site Plan created from a storm drainage and grading plan by Penhallegon Associates Consulting Engineers, Inc., titled "Service Center", dated July 1997.

NELSON-COUVRETTE & ASSOCIATES, INC. CONSULTING GEOTECHNICAL ENGINEERS, GEOLOGISTS AND ENVIRONMENTAL SCIENTISTS	Northshore Utility District Headquarters		FIGURE 1
	FILE NO. 1561C97	DATE February 1999	



Seattle 18939 120th Avenue NE, Suite 101, Bothell, WA 98011-9508
425.420.9200 fax 425.420.9210
Spokane East 11115 Montgomery, Suite B, Spokane, WA 99206-4776
509.924.9200 fax 509.924.9290
Portland 9405 SW Nimbus Avenue, Beaverton, OR 97008-7132
503.906.9200 fax 503.906.9210
Bend 20354 Empire Avenue, Suite E-9, Bend, OR 97708-1883
541.383.9310 fax 541.382.7588

Nelson-Couvrette and Associates, Inc.
17311-135th Ave NE, #A-500
Woodinville, WA 98072

Project: Northshore Utility District
Project Number: 1561C97
Project Manager: William Benzer

Sampled: 1/19/99
Received: 1/20/99
Reported: 1/26/99 13:28

ANALYTICAL REPORT FOR SAMPLES:

Sample Description	Laboratory Sample Number	Sample Matrix	Date Sampled
MW-2/1/99	B901306-01	Water	1/19/99
MW-3/1/99	B901306-02	Water	1/19/99
MW-1/1/99	B901306-03	Water	1/19/99
MW-4/1/99	B901306-04	Water	1/19/99

North Creek Analytical - Bothell

The results in this report apply to the samples analyzed in accordance with the chain of custody document.

This analytical report must be reproduced in its entirety.

North Creek Analytical, Inc.
Environmental Laboratory Network

Joy B Chang, Project Manager



Seattle 18939 120th Avenue NE, Suite 101, Bothell, WA 98011-3508
425.420.9200 fax 425.420.9210
Spokane East 11115 Montgomery, Suite B, Spokane, WA 99206-4776
509.924.9200 fax 509.924.9290
Portland 9405 SW Nimbus Avenue, Beaverton, OR 97008-7132
503.906.9200 fax 503.906.9210
Bend 20354 Empire Avenue, Suite E-9, Bend, OR 97708-1883
541.383.9310 fax 541.382.7588

Nelson-Couvrette and Associates, Inc. 17311-135th Ave NE, #A-500 Woodinville, WA 98072	Project: Northshore Utility District Project Number: 1561C97 Project Manager: William Benzer	Sampled: 1/19/99 Received: 1/20/99 Reported: 1/26/99 13:28
--	--	--

**Gasoline Hydrocarbons (Toluene to Dodecane) and BTEX by WTPH-G and EPA 8021B
North Creek Analytical - Bothell**

Analyte	Batch Number	Date Prepared	Date Analyzed	Surrogate Limits	Reporting Limit	Result	Units	Notes*
<u>MW-2/1/99</u>		<u>B901306-01</u>				<u>Water</u>		
Gasoline Range Hydrocarbons	0190489	1/21/99	1/21/99		50.0	ND	ug/l	
Benzene	"	"	"		0.500	ND	"	
Toluene	"	"	"		0.500	ND	"	
Ethylbenzene	"	"	"		0.500	ND	"	
Xylenes (total)	"	"	"		1.00	ND	"	
Surrogate: 4-BFB (FID)	"	"	"	50.0-150		99.8	%	
Surrogate: 4-BFB (PID)	"	"	"	50.0-150		99.8	"	
<u>MW-3/1/99</u>		<u>B901306-02</u>				<u>Water</u>		
Gasoline Range Hydrocarbons	0190457	1/20/99	1/20/99		50.0	ND	ug/l	
Benzene	"	"	"		0.500	ND	"	
Toluene	"	"	"		0.500	ND	"	
Ethylbenzene	"	"	"		0.500	ND	"	
Xylenes (total)	"	"	"		1.00	ND	"	
Surrogate: 4-BFB (FID)	"	"	"	50.0-150		96.7	%	
Surrogate: 4-BFB (PID)	"	"	"	50.0-150		99.2	"	
<u>MW-1/1/99</u>		<u>B901306-03</u>				<u>Water</u>		
Gasoline Range Hydrocarbons	0190457	1/20/99	1/20/99		50.0	ND	ug/l	
Benzene	"	"	"		0.500	ND	"	
Toluene	"	"	"		0.500	ND	"	
Ethylbenzene	"	"	"		0.500	ND	"	
Xylenes (total)	"	"	"		1.00	ND	"	
Surrogate: 4-BFB (FID)	"	"	"	50.0-150		93.5	%	
Surrogate: 4-BFB (PID)	"	"	"	50.0-150		102	"	
<u>MW-4/1/99</u>		<u>B901306-04</u>				<u>Water</u>		
Gasoline Range Hydrocarbons	0190457	1/20/99	1/20/99		50.0	ND	ug/l	
Benzene	"	"	"		0.500	ND	"	
Toluene	"	"	"		0.500	ND	"	
Ethylbenzene	"	"	"		0.500	ND	"	
Xylenes (total)	"	"	"		1.00	ND	"	
Surrogate: 4-BFB (FID)	"	"	"	50.0-150		95.6	%	
Surrogate: 4-BFB (PID)	"	"	"	50.0-150		101	"	



Seattle 18939 120th Avenue NE, Suite 101, Bothell, WA 98011-9508
425.420.9200 fax 425.420.9210
Spokane East 11115 Montgomery, Suite B, Spokane, WA 99206-4776
509.924.9200 fax 509.924.9290
Portland 9405 SW Nimbus Avenue, Beaverton, OR 97008-7132
503.906.9200 fax 503.906.9210
Bend 20354 Empire Avenue, Suite E-9, Bend, OR 97708-1883
541.383.9310 fax 541.382.7588

Nelson-Couvrette and Associates, Inc.	Project: Northshore Utility District	Sampled: 1/19/99
17311-135th Ave NE, #A-500	Project Number: 1561C97	Received: 1/20/99
Woodinville, WA 98072	Project Manager: William Benzer	Reported: 1/26/99 13:28

Diesel Hydrocarbons (C12-C24) and Heavy Oil (C24-C40) by WTPH-D (extended)
North Creek Analytical - Bothell

Analyte	Batch Number	Date Prepared	Date Analyzed	Surrogate Limits	Reporting Limit	Result	Units	Notes*
<u>MW-2/1/99</u>				<u>B901306-01</u>			<u>Water</u>	
Diesel Range Hydrocarbons	0190513	1/22/99	1/25/99		0.250	0.854	mg/l	
Heavy Oil Range Hydrocarbons	"	"	"		0.750	0.874	"	
Surrogate: 2-FBP	"	"	"	50.0-150		80.2	%	
<u>MW-3/1/99</u>				<u>B901306-02</u>			<u>Water</u>	
Diesel Range Hydrocarbons	0190513	1/22/99	1/25/99		0.250	0.331	mg/l	
Heavy Oil Range Hydrocarbons	"	"	"		0.750	ND	"	
Surrogate: 2-FBP	"	"	"	50.0-150		74.8	%	
<u>MW-1/1/99</u>				<u>B901306-03</u>			<u>Water</u>	
Diesel Range Hydrocarbons	0190513	1/22/99	1/25/99		0.250	0.952	mg/l	
Heavy Oil Range Hydrocarbons	"	"	"		0.750	ND	"	
Surrogate: 2-FBP	"	"	"	50.0-150		79.6	%	
<u>MW-4/1/99</u>				<u>B901306-04</u>			<u>Water</u>	
Diesel Range Hydrocarbons	0190513	1/22/99	1/25/99		0.250	0.331	mg/l	
Heavy Oil Range Hydrocarbons	"	"	"		0.750	ND	"	
Surrogate: 2-FBP	"	"	"	50.0-150		75.4	%	



Seattle 18939 120th Avenue NE, Suite 101, Bothell, WA 98011-9508
425.420.9200 fax 425.420.9210
Spokane East 11115 Montgomery, Suite B, Spokane, WA 99206-4776
509.924.9200 fax 509.924.9290
Portland 9405 SW Nimbus Avenue, Beaverton, OR 97008-7132
503.906.9200 fax 503.906.9210
Bend 20354 Empire Avenue, Suite E-9, Bend, OR 97708-1883
541.383.9310 fax 541.382.7588

Nelson-Couvrette and Associates, Inc. 17311-135th Ave NE, #A-500 Woodinville, WA 98072	Project: Northshore Utility District Project Number: 1561C97 Project Manager: William Benzer	Sampled: 1/19/99 Received: 1/20/99 Reported: 1/26/99 13:28
--	--	--

**Gasoline Hydrocarbons (Toluene to Dodecane) and BTEX by WTPH-G and EPA 8021B/Quality Control
North Creek Analytical - Bothell**

Analyte	Date Analyzed	Spike Level	Sample Result	QC Result	Units	Reporting Limit Recov. Limits	Recov. %	RPD Limit	RPD %	Notes*
Batch: 0190457										
Blank										
Date Prepared: 1/20/99										
Extraction Method: EPA 5030B (P/T)										
0190457-BLK1										
Gasoline Range Hydrocarbons	1/20/99			ND	ug/l	50.0				
Benzene	"			ND	"	0.500				
Toluene	"			ND	"	0.500				
Ethylbenzene	"			ND	"	0.500				
Xylenes (total)	"			ND	"	1.00				
Surrogate: 4-BFB (FID)	"	48.0		46.3	"	50.0-150	96.5			
Surrogate: 4-BFB (PID)	"	48.0		47.1	"	50.0-150	98.1			
LCS										
0190457-BS1										
Gasoline Range Hydrocarbons	1/20/99	500		500	ug/l	70.0-130	100			
Surrogate: 4-BFB (FID)	"	48.0		47.9	"	50.0-150	99.8			
Duplicate										
0190457-DUP1										
B901291-06										
Gasoline Range Hydrocarbons	1/20/99		84.5	73.3	ug/l			25.0	14.2	
Surrogate: 4-BFB (FID)	"	48.0		46.9	"	50.0-150	97.7			
Duplicate										
0190457-DUP2										
B901307-01										
Gasoline Range Hydrocarbons	1/21/99		2280	2300	ug/l			25.0	0.873	
Surrogate: 4-BFB (FID)	"	48.0		46.8	"	50.0-150	97.5			
Matrix Spike										
0190457-MS1										
B901291-03										
Benzene	1/20/99	10.0	ND	9.20	ug/l	70.0-130	92.0			
Toluene	"	10.0	ND	8.91	"	70.0-130	89.1			
Ethylbenzene	"	10.0	ND	9.33	"	70.0-130	93.3			
Xylenes (total)	"	30.0	ND	28.1	"	70.0-130	93.7			
Surrogate: 4-BFB (PID)	"	48.0		47.8	"	50.0-150	99.6			
Matrix Spike Dup										
0190457-MSD1										
B901291-03										
Benzene	1/20/99	10.0	ND	9.31	ug/l	70.0-130	93.1	15.0	1.19	
Toluene	"	10.0	ND	8.95	"	70.0-130	89.5	15.0	0.448	
Ethylbenzene	"	10.0	ND	9.32	"	70.0-130	93.2	15.0	0.107	
Xylenes (total)	"	30.0	ND	28.3	"	70.0-130	94.3	15.0	0.638	
Surrogate: 4-BFB (PID)	"	48.0		48.4	"	50.0-150	101			
Batch: 0190489										
Date Prepared: 1/21/99										
Extraction Method: EPA 5030B (P/T)										
Blank										
0190489-BLK1										
Gasoline Range Hydrocarbons	1/21/99			ND	ug/l	50.0				

North Creek Analytical - Bothell

*Refer to end of report for text of notes and definitions.

Joy B Chang, Project Manager

North Creek Analytical, Inc.
Environmental Laboratory Network

Page 4 of 7



Seattle 18939 120th Avenue NE, Suite 101, Bothell, WA 98011-9508
425.420.9200 fax 425.420.9210
Spokane East 11115 Montgomery, Suite B, Spokane, WA 99206-4776
509.924.9200 fax 509.924.9290
Portland 9405 SW Nimbus Avenue, Beaverton, OR 97008-7132
503.906.9200 fax 503.906.9210
Bend 20354 Empire Avenue, Suite E-9, Bend, OR 97708-1883
541.383.9310 fax 541.382.7588

Nelson-Couvrette and Associates, Inc. 17311-135th Ave NE, #A-500 Woodinville, WA 98072	Project: Northshore Utility District Project Number: 1561C97 Project Manager: William Benzer	Sampled: 1/19/99 Received: 1/20/99 Reported: 1/26/99 13:28
--	--	--

**Gasoline Hydrocarbons (Toluene to Dodecane) and BTEX by WTPH-G and EPA 8021B/Quality Control
North Creek Analytical - Bothell**

Analyte	Date Analyzed	Spike Level	Sample Result	QC Result	Units	Reporting Limit Recov. Limits	Recov. %	RPD Limit	RPD %	Notes*
Blank (continued)	0190489-BLK1									
Benzene	1/21/99			ND	ug/l	0.500				
Toluene	"			ND	"	0.500				
Ethylbenzene	"			ND	"	0.500				
Xylenes (total)	"			ND	"	1.00				
Surrogate: 4-BFB (FID)	"	48.0		43.6	"	50.0-150	90.8			
Surrogate: 4-BFB (PID)	"	48.0		46.8	"	50.0-150	97.5			
LCS	0190489-BS1									
Gasoline Range Hydrocarbons	1/21/99	500		504	ug/l	70.0-130	101			
Surrogate: 4-BFB (FID)	"	48.0		53.8	"	50.0-150	112			
Duplicate	0190489-DUP1		B901316-01							
Gasoline Range Hydrocarbons	1/21/99		795	779	ug/l			25.0	2.03	
Surrogate: 4-BFB (FID)	"	48.0		44.8	"	50.0-150	93.3			
Matrix Spike	0190489-MS1		B901290-02							
Benzene	1/21/99	10.0	ND	9.30	ug/l	70.0-130	93.0			
Toluene	"	10.0	ND	9.62	"	70.0-130	96.2			
Ethylbenzene	"	10.0	ND	9.52	"	70.0-130	95.2			
Xylenes (total)	"	30.0	ND	27.9	"	70.0-130	93.0			
Surrogate: 4-BFB (PID)	"	48.0		49.9	"	50.0-150	104			
Matrix Spike Dup	0190489-MSD1		B901290-02							
Benzene	1/21/99	10.0	ND	9.53	ug/l	70.0-130	95.3	15.0	2.44	
Toluene	"	10.0	ND	9.84	"	70.0-130	98.4	15.0	2.26	
Ethylbenzene	"	10.0	ND	9.57	"	70.0-130	95.7	15.0	0.524	
Xylenes (total)	"	30.0	ND	28.1	"	70.0-130	93.7	15.0	0.750	
Surrogate: 4-BFB (PID)	"	48.0		49.3	"	50.0-150	103			



Seattle 18939 120th Avenue NE, Suite 101, Bothell, WA 98011-9508
425.420.9200 fax 425.420.9210
Spokane East 11115 Montgomery, Suite B, Spokane, WA 99206-4776
509.924.9200 fax 509.924.9290
Portland 9405 SW Nimbus Avenue, Beaverton, OR 97008-7132
503.906.9200 fax 503.906.9210
Bend 20354 Empire Avenue, Suite E-9, Bend, OR 97708-1883
541.383.9310 fax 541.382.7588

Nelson-Couvrette and Associates, Inc. 17311-135th Ave NE, #A-500 Woodinville, WA 98072	Project: Northshore Utility District Project Number: 1561C97 Project Manager: William Benzer	Sampled: 1/19/99 Received: 1/20/99 Reported: 1/26/99 13:28
--	--	--

Diesel Hydrocarbons (C12-C24) and Heavy Oil (C24-C40) by WTPH-D (extended)/Quality Control
North Creek Analytical - Bothell

Analyte	Date Analyzed	Spike Level	Sample Result	QC Result	Reporting Limit Units	Recovery Limits	Recovery %	RPD Limit	RPD %	Notes*
Batch: 0190513										
Blank										
Date Prepared: 1/22/99										
Extraction Method: EPA 3520C/600 Series										
0190513-BLK1										
Diesel Range Hydrocarbons	1/25/99			ND	mg/l	0.250				
Heavy Oil Range Hydrocarbons	"			ND	"	0.750				
Surrogate: 2-FBP	"	0.332		0.236	"	50.0-150	71.1			
LCS										
0190513-BS1										
Diesel Range Hydrocarbons	1/25/99	2.00		1.54	mg/l	60.0-140	77.0			
Surrogate: 2-FBP	"	0.332		0.238	"	50.0-150	71.7			
Duplicate										
0190513-DUP1 B901306-02										
Diesel Range Hydrocarbons	1/25/99		0.331	0.295	mg/l			44.0	11.5	
Heavy Oil Range Hydrocarbons	"		ND	ND	"			44.0		
Surrogate: 2-FBP	"	0.626		0.502	"	50.0-150	80.2			



Seattle 18939 120th Avenue NE, Suite 101, Bothell, WA 98011-9508
425.420.9200 fax 425.420.9210
Spokane East 11115 Montgomery, Suite B, Spokane, WA 99206-4776
509.924.9200 fax 509.924.9290
Portland 9405 SW Nimbus Avenue, Beaverton, OR 97008-7132
503.906.9200 fax 503.906.9210
Bend 20354 Empire Avenue, Suite E-9, Bend, OR 97708-1883
541.383.9310 fax 541.382.7588

Nelson-Couvrette and Associates, Inc.	Project: Northshore Utility District	Sampled: 1/19/99
17311-135th Ave NE, #A-500	Project Number: 1561C97	Received: 1/20/99
Woodinville, WA 98072	Project Manager: William Benzer	Reported: 1/26/99 13:28

Notes and Definitions

#	Note
---	------

DET Analyte DETECTED

ND Analyte NOT DETECTED at or above the reporting limit

NR Not Reported

dry Sample results reported on a dry weight basis

Recov. Recovery

RPD Relative Percent Difference

CHAIN OF CUSTODY REPORT

Work Order #

B901306

REPORT TO: Nelson - Couvrette + Associates, Inc.				INVOICE TO:							
ATTENTION: William B. Benzer				ATTENTION: Same							
ADDRESS: 17311 - 135 th Ave NE, # A500 Woodinville, WA 98072				ADDRESS:							
PHONE: 425-486-1669 FAX: 425-481-2510				P.O. NUMBER:							
PROJECT NAME: Northshore Utility District				NCA QUOTE #:							
PROJECT NUMBER: 1561 C97				Analysis Request:							
SAMPLED BY: Bill Benzer / Lynn Ringstad											
CLIENT SAMPLE IDENTIFICATION		SAMPLING DATE/TIME	NCA SAMPLE ID <small>(Laboratory Use Only)</small>	<div style="text-align: center; font-size: 2em; transform: rotate(-45deg); opacity: 0.5;"> WTPHG/BETX WTPHD-Extended </div>							
1	MW-2/1/99	1/19/99 4:25 P	B510306 01								
2	MW-3/1/99	1/19/99 4:13 P	- 02								
3	MW-1/1/99	1/19/99 3:57 P	- 03								
4	MW-1/1/99	1/19/99 3:57 P	03								
5	MW-3/1/99	1/19/99 4:13 P	02								
6	MW-3/1/99	1/19/99 4:13 P	- 01 ? 02								
7	MW-4/1/99	1/20/99 10:15 A	- 04								
8											
9											
10											

TURNAROUND REQUEST in Business Days *

Organic & Inorganic Analyses: [10] [7] [5] [4] [3] [2] [1] [Same Day]

Fuels & Hydrocarbon Analyses: [X] [3-4] [2] [1] [Same Day]

[OTHER] Specify _____

* Turnaround Requests less than standard may incur Rush Charges.

MATRIX <small>(W, S, A, O)</small>	# OF CONTAINERS	COMMENTS
W	1	
W	1	
W	1	
W	2	
W	2	
W	2	
W	3	

RELINQUISHED BY (Signature): Lynn Ringstad		DATE: 1/20/98	RECEIVED BY (Signature): Cathy Nichols		DATE: 1/20/98
PRINT NAME: Lynn Ringstad	FIRM: Nelson-Couvrette	TIME: 11:16a	PRINT NAME: C. Nichols	FIRM: NCA	TIME: 11:16a
RFI INQUIRED BY (Signature):		DATE:	RECEIVED BY (Signature):		DATE:
PRINT NAME:	FIRM:	TIME:	PRINT NAME:	FIRM:	TIME:
ADDITIONAL REMARKS:					

PAGE ____ OF ____

NELSON-COUVRETTE & ASSOCIATES, INC.CONSULTING GEOTECHNICAL ENGINEERS, GEOLOGISTS
AND ENVIRONMENTAL SCIENTISTS17311-135th Ave. NE, A-500
Woodinville, WA 98072
Tel (425) 486-1669
Fax (425) 481-251013424 Chain Lake Rd.
Monroe, WA 98272
Tel (425) 788-5612
Fax (360) 794-4332**LETTER OF TRANSMITTAL**TO Department of Ecology - NW Region
3190 - 160th Ave SE
BELEVUE, WA 98008-5452

DATE	3/25/99	FILE NO.	1561C99
ATTENTION	Elaine Atkinson		
RE:	NSUD Headquarters Formerly known as the NESMAR site		

> WE ARE SENDING YOU ☒ Attached ☐ Under separate cover via _____ the following items:☐ Copy of letter☐ Prints☐ Plans☐ Samples☐ Specifications☐ _____

COPIES	DATE	NO.	DESCRIPTION
1	2/23/99		Semi Annual Sampling letter

RECEIVED

MAR 29 1999

DEPT. OF ECOLOGY

THESE ARE TRANSMITTED as checked below:

☐ For approval☐ Approved as submitted☒ For your use☐ Approved as noted☐ As requested☐ Returned for corrections☐ For review and comment☐ _____

RECEIVED

MAR 29 1998

DEPT. OF ECOLOGY

REMARKS

Ms. Atkinson

Dan Olson with NSUD requested we forward
a copy of our letter on to you. Please call if
you have questions

COPY TO _____

SIGNED: _____

William Benzer

If enclosures are not as noted, kindly notify us at once.