

RECEIVED

MAY 02 1997

DEPT. OF ECOLOGY

**AGRA**  
Earth & Environmental

AGRA Earth &  
Environmental, Inc.  
11335 NE 122nd Way  
Suite 100  
Kirkland, Washington  
U.S.A. 98034-6918  
Tel (206) 820-4669

26 February 1997  
6-614-08610

Mr. Wayne Pipes  
Senior Director, Corporate Engineering  
Red Lion Hotels  
P.O. Box 1027  
4001 Main Street  
Vancouver, Washington 98663

DEPARTMENT OF ECOLOGY NW / TCP TANK UNIT	
INTERIM CLEANUP REPORT	<input checked="" type="checkbox"/>
SITE CHARACTERIZATION	<input type="checkbox"/>
FINAL CLEANUP REPORT	<input type="checkbox"/>
OTHER	<input type="checkbox"/>
AFFECTED MEDIA: SOIL	<input checked="" type="checkbox"/>
OTHER GW	<input checked="" type="checkbox"/>
INSPECTOR (INIT.)	DATE 5/29/97

USE# 418509

**Subject:**      **Underground Storage Tank (UST) Removal and  
Results of Soil Sampling**  
Red-Lion Inn  
300-112th Avenue S.E.  
Bellevue, Washington

Dear Mr. Pipes:

AGRA Earth & Environmental, Inc. (AEE), is pleased to provide the following report detailing the field activities, soil sampling protocol, field observations and results of soil sample analysis for the above-referenced site (Figure 1, Vicinity Map). The 430-gallon capacity, single-walled, steel UST (used to store diesel fuel for the facility's emergency generator), was removed from the site on 5-February-1997 by CEcon Corporation (CEcon) located in Bellevue, Washington, under a direct contractual agreement with Red Lion Inns. CEcon was responsible for all necessary permitting requirements and regulatory agency notifications prior to UST removal. UST removal oversight and soil sampling was conducted by AEE personnel from our Kirkland, Washington office. The UST is registered with the Washington State Department of Ecology (Ecology) and annual registration fee payments are current.

#### UST REMOVAL

The UST was located on the south side of the hotel building inside an enclosed area which houses the hotel's generator, transformer and heat exchangers (Figure 2). Before removal activities began, all fluids and sludges in the UST were removed, and the UST was triple rinsed in place.

Backfill material surrounding the UST was pea gravel. Natural soils in the UST excavation consisted of moist to saturated, brownish-gray sandy gravel with silt. Groundwater was observed at approximately 4-feet below ground surface (bgs). The fill material (pea gravel) and native soils exhibited a slight hydrocarbon odor. Volatile organic vapors were measured using

an organic vapor meter (OVM). No significant readings were recorded from excavation materials.

After the UST and associated piping were removed from the subsurface, soil adhering to the tank was scraped away and the UST was inspected for evidence of corrosion and pitting. No significant corrosion or pitting was observed. The final excavation dimensions were approximately 5 feet wide by 8 feet long by 4 feet deep. The excavation could not be advanced further without compromising the integrity of the nearby enclosure wall. Therefore, approximately ~~1.71 tons of contaminated soil~~ were removed from the excavation for disposal. The excavation was backfilled with clean, imported fill material to original grade.

The UST was opened on site and the internal atmosphere was made inert to reduce the chances of explosion or fire. After this action, explosive vapor levels were 0 percent and the oxygen level in the UST was 20 percent when the UST was removed. CEcon then removed the UST from the site for disposal. Certificates of receipt for both the petroleum-impacted soil disposal and the UST disposal are attached as Appendix A.

A 1,000-gallon above-ground storage tank was installed at the same location on 7 February 1997.

#### **SOIL SAMPLING**

Two soil samples were collected from the sidewalls of the UST excavation at approximately 3 feet below ground surface, and a water sample was collected from the bottom of the excavation. Laboratory analysis included total petroleum hydrocarbons – diesel range (WTPH Method TPH-D). Samples were placed into glass jars with Teflon-lined plastic lids provided by the analytical laboratory and stored on ice for delivery to the laboratory. Sample containers were labeled in the field and a chain-of-custody form was completed to document delivery of the samples to a Washington State certified analytical laboratory.

#### **ANALYTICAL RESULTS**

Laboratory results for soil samples indicated that petroleum-impacted soil was below Model Toxics Control (MTCA) Method A cleanup levels. The laboratory analyses detected the presence of diesel-range hydrocarbons at concentrations of 57.1 mg/kg (parts per million [ppm]) in sidewall sample T1/W1-3'; sample T1/N1/-3' contained diesel concentrations below laboratory method reporting limits. Soil samples collected from the stockpile contained diesel-range petroleum hydrocarbon concentrations of 125 ppm and 86 ppm, respectively. Laboratory reports are attached as Appendix B.

#### **CONCLUSIONS**

Based on field observations and results of laboratory analysis, we conclude the following:

- The underground storage tank and associated piping (UST system) were removed from the property and destroyed in accordance with practices and guidelines currently employed in the State of Washington.
- The UST system appeared to be in good condition without significant corrosion or pitting.
- Samples collected from the UST excavation indicate that diesel concentrations in soil and groundwater samples were below Washington State cleanup levels.

We trust this report fulfills your current needs for the subject site. If you have any questions or comments, or require additional information, please do not hesitate to contact the undersigned.

Respectfully submitted,

AGRA Earth & Environmental, Inc.

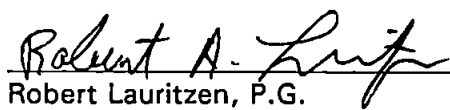
  
Robert Lauritzen, P.G.  
Project Manager

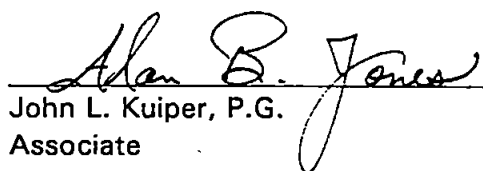
For   
John L. Kuiper, P.G.  
Associate

RAL/JLK/lad

Attachments: Figure 1 - Vicinity Map  
Figure 2 - Sample Location Map

Appendix A - Certificate of Destruction  
Appendix B - Laboratory Report  
Appendix C - UST Closure Notice and Site Assessment Notice  
Appendix D - Disposal Receipts

**Table 1: Summary of Analytical Test Results: Soil**  
**Red Lion Inn**  
**Bellevue, Washington**  
**AGRA Earth & Environmental, Inc. Project No. 6-61M-08610-0**

Sample Number	Date Collected	Depth Collected (feet)	WTPH-DX	
			Diesel (ppm)	Heavy Oil (ppm)
Excavation Samples				
T1/N1/-3'	05-Feb-97	3	<10	<25
T1/W1/-3'	05-Feb-97	3	57.1	<25
Stockpile Samples				
Diesel	07-Feb-97	-	125	-
Diesel	07-Feb-97	-	86	-
MTCA Method "A" Cleanup Level			200	200

**Notes:**

WTPH-DX = Total petroleum hydrocarbons, diesel range (C12-C24) and heavy oil range (C>24), by Washington State Method WTPH-D Extended.

MTCA = Washington State, Model Toxics Control Act, Method "A" Cleanup Guidelines.

ppm = Parts per million (equivalent to milligrams per kilogram [mg/kg]).

**Table 2: Summary of Analytical Test Results: Groundwater**  
**Red Lion Inn**  
**Bellevue, Washington**  
**AGRA Earth & Environmental, Inc. Project No. 6-61M-08610-0**

Sample Number	Date Collected	WTPH-DX	
		Diesel (ppb)	Heavy Oil (ppb)
MW-1	05-Feb-97	2.42	9.39
MTCA Method "A" Cleanup Level		1,000	1,000

*mg/l* *AK*

**Notes:**

WTPH-DX = Total petroleum hydrocarbons, diesel range (C12-C24) and heavy oil range (C>24), by Washington State Method WTPH-D Extended.

MTCA = Washington State Model Toxics Control Act, Method "A" Cleanup Guidelines.

ppb = Parts per billion (equivalent to micrograms per kilogram [ug/kg]).

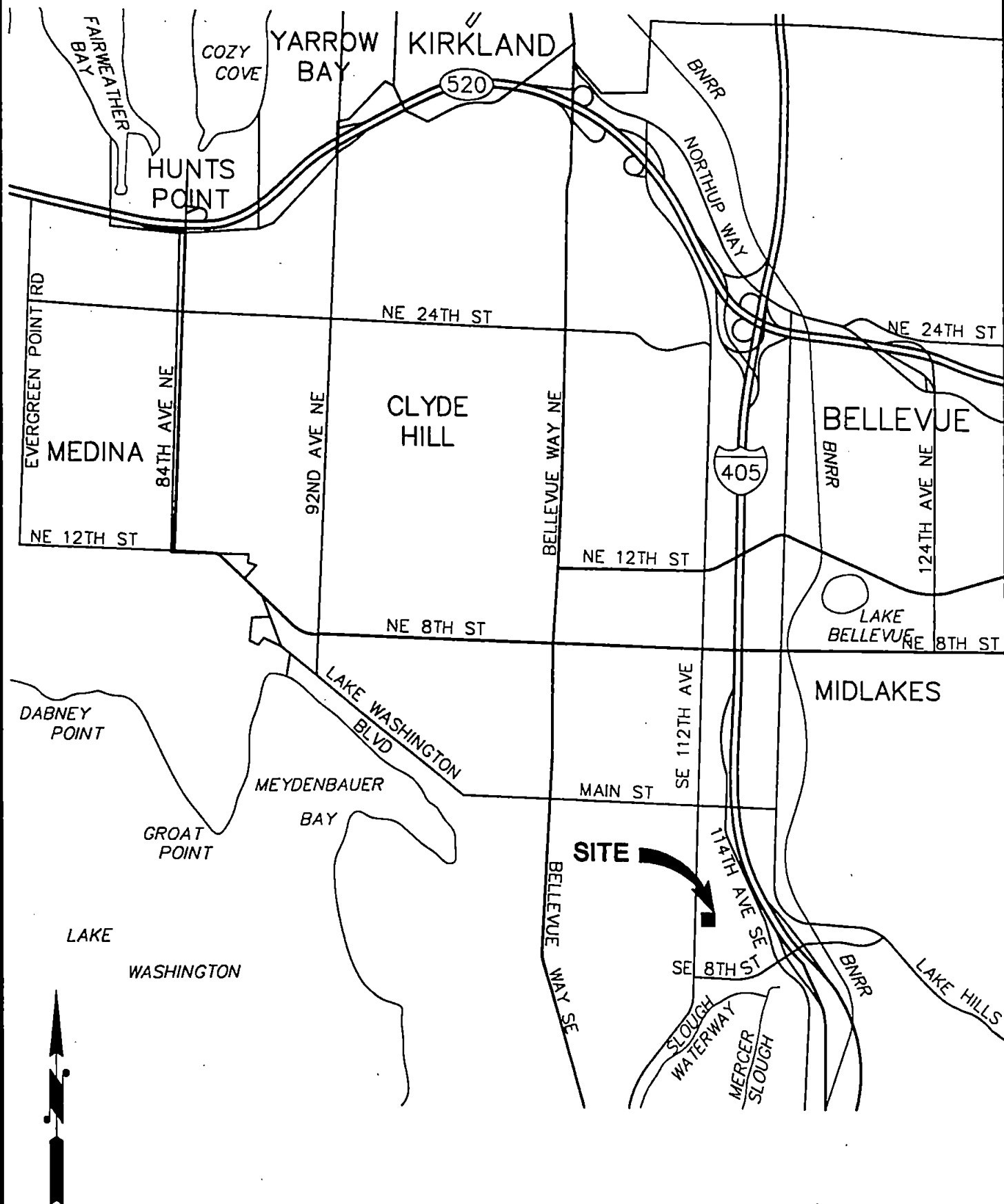

FIGURE 1

**AGRA**  
Earth & Environmental

11335 N.E. 122nd Way, Suite 100  
Kirkland, WA, U.S.A. 98034-6918

W.O.	6-61M-08610-0
DESIGN	RAL
DRAWN	JMR
DATE	FEB 1997
SCALE	N.T.S.

**RED LION (SOUTH)**  
300 112TH AVENUE SE  
BELLEVUE, WASHINGTON

**LOCATION MAP**

# HOTEL BUILDING

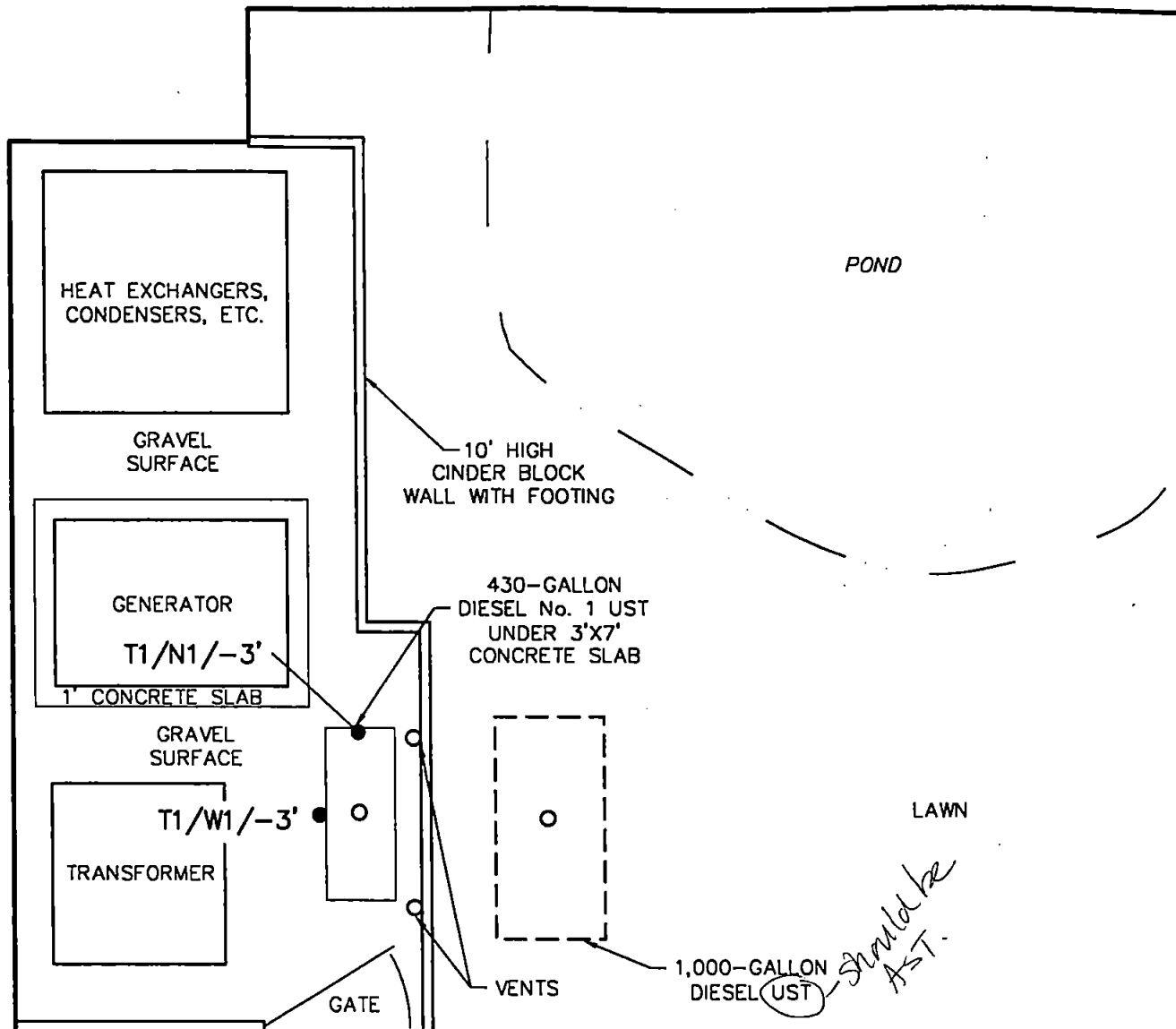

REAR ACCESS TO HOTEL

TO 114TH AVENUE SE →

## LEGEND

T1/W1/-3'

SOIL SAMPLE NUMBER AND APPROXIMATE LOCATION



FIGURE 2

**AGRA**  
Earth & Environmental

11335 N.E. 122nd Way, Suite 100  
Kirkland, WA, U.S.A. 98034-6918

W.O.	6-61M-08610-0
DESIGN	RAL
DRAWN	JMR
DATE	FEB 1997
SCALE	N.T.S.

RED LION (SOUTH)  
300 112TH AVENUE SE  
BELLEVUE, WASHINGTON

SITE PLAN

## **APPENDIX A**

### **Certificates of Receipt**

# Certificate of Destruction

This certifies that the 1.71 tons of contaminated material  
received from project:  
Red Lion - Bellevue

Has been successfully treated, recycled, and disposed of by

**THERMAL DESORPTION**

Treatment of this material was completed on

2/13/97



Associated

*Christina Jones*

SIGNED

## **APPENDIX B**

### **Laboratory Report**



# NORTH CREEK ANALYTICAL

Environmental Laboratory Services

BOTHELL ■ (206) 481-9200 ■ FAX 485-2992  
SPOKANE ■ (509) 924-9200 ■ FAX 924-9290  
PORTLAND ■ (503) 643-9200 ■ FAX 644-2202

Agra Earth and Environmental  
11335 NE 122nd Way, Ste 100  
Kirkland, WA 98034

Project: Red Lion Inn  
Project Number: 6-61408610  
Project Manager: Robert Lauritzen

Sampled: 2/5/97  
Received: 2/5/97  
Reported: 2/6/97 10:09

## ANALYTICAL REPORT FOR SAMPLES:

Sample Description	Laboratory Sample Number	Sample Matrix	Date Sampled
T1/N1/-3'	B702063-02	Soil	2/5/97
T1/W1/-3'	B702063-03	Soil	2/5/97

North Creek Analytical, Inc.

  
Shannon J Stowell, Project Manager

*The results in this report apply to the samples analyzed in accordance with the chain of custody document.  
This analytical report must be reproduced in its entirety.*

18939 120th Avenue N.E., Suite 101, Bothell, WA 98011-9508  
East 11115 Montgomery, Suite B, Spokane, WA 99206-4776  
9405 S.W. Nimous Avenue, Beaverton, OR 97008-7132



# NORTH CREEK ANALYTICAL

Environmental Laboratory Services

BOTHELL ■ (206) 481-9200 ■ FAX 485-2992  
SPOKANE ■ (509) 924-9200 ■ FAX 924-9290  
PORTLAND ■ (503) 643-9200 ■ FAX 644-2202

Agra Earth and Environmental  
11335 NE 122nd Way, Ste 100  
Kirkland, WA 98034

Project: Red Lion Inn  
Project Number: 6-61408610  
Project Manager: Robert Lauritzen

Sampled: 2/5/97  
Received: 2/5/97  
Reported: 2/6/97 10:09

**Diesel Hydrocarbons (C12-C24) and Heavy Oil (C24-C40) by WTPH-D (extended)**  
**North Creek Analytical - Bothell**

Analyte	Batch Number	Date Prepared	Date Analyzed	Surrogate Limits	Reporting Limit	Result	Units	Notes*
<u>T1/N1/-3'</u>				<u>B702063-02</u>			<u>Soil</u>	
Diesel Range Hydrocarbons	0270074	2/5/97	2/6/97		10.0	ND	mg/kg dry	
Heavy Oil Range Hydrocarbons	"	"	"		25.0	ND	"	
Surrogate: 2-FBP	"	"	"	50.0-150		79.9	%	
<u>T1/W1/-3'</u>				<u>B702063-03</u>			<u>Soil</u>	
Diesel Range Hydrocarbons	0270074	2/5/97	2/6/97		10.0	57.1	mg/kg dry	
Heavy Oil Range Hydrocarbons	"	"	"		25.0	ND	"	
Surrogate: 2-FBP	"	"	"	50.0-150		80.2	%	

North Creek Analytical, Inc.

\*Refer to end of report for text of notes and definitions.

Shannon J Stowell, Project Manager

18939 120th Avenue N.E., Suite 101, Bothell, WA 98011-9508  
East 11115 Montgomery, Suite B, Spokane, WA 99206-4776  
9405 S.W. Nimbus Avenue, Beaverton, OR 97008-7132



# NORTH CREEK ANALYTICAL

*Environmental Laboratory Services*

BOTHELL ■ (206) 481-9200 ■ FAX 485-2992  
SPOKANE ■ (509) 924-9200 ■ FAX 924-9290  
PORTLAND ■ (503) 643-9200 ■ FAX 644-2202

Agra Earth and Environmental  
11335 NE 122nd Way, Ste 100  
Kirkland, WA 98034

Project: Red Lion Inn  
Project Number: 6-61408610  
Project Manager: Robert Lauritzen

Sampled: 2/5/97  
Received: 2/5/97  
Reported: 2/6/97 10:09

## Dry Weight Determination North Creek Analytical - Bothell

Sample Name	Lab ID	Matrix	Result	Units
T1/N1/-3'	B702063-02	Soil	92.1	%
T1/W1/-3'	B702063-03	Soil	87.7	%

North Creek Analytical, Inc.

Shannon J Stowell, Project Manager

18939 120th Avenue N.E., Suite 101, Bothell, WA 98011-9508  
East 11115 Montgomery, Suite B, Spokane, WA 99206-4776  
9405 S.W. Nimbus Avenue, Beaverton, OR 97008-7132



# NORTH CREEK ANALYTICAL

Environmental Laboratory Services

BOTHELL ■ (206) 481-9200 ■ FAX 485-2992  
SPOKANE ■ (509) 924-9200 ■ FAX 924-9290  
PORTLAND ■ (503) 643-9200 ■ FAX 644-2202

Agra Earth and Environmental  
11335 NE 122nd Way, Ste 100  
Kirkland, WA 98034

Project: Red Lion Inn  
Project Number: 6-61408610  
Project Manager: Robert Lauritzen

Sampled: 2/5/97  
Received: 2/5/97  
Reported: 2/6/97 10:09

## Diesel Hydrocarbons (C12-C24) and Heavy Oil (C24-C40) by WTPH-D (extended)/Quality Control North Creek Analytical - Bothell

Analyte	Date Analyzed	Spike Level	Sample Result	QC Result	Units	Reporting Limit Recov. Limits	Recov. %	RPD Limit	RPD %	Notes*
<b>Batch: 0270074</b>										
<b>Blank</b>										
Diesel Range Hydrocarbons	2/5/97			ND	mg/kg dry	10.0				
Heavy Oil Range Hydrocarbons	"			ND	"	25.0				
Surrogate: 2-FBP	"	11.5		8.96	"	50.0-150	77.9			
<b>LCS</b>										
Diesel Range Hydrocarbons	2/5/97	68.0		66.1	mg/kg dry	59.0-135	97.2			
Surrogate: 2-FBP	"	11.5		8.49	"	50.0-150	73.8			
<b>Duplicate</b>										
Diesel Range Hydrocarbons	2/6/97		ND	ND	mg/kg dry			50.0		n/a
Surrogate: 2-FBP	"	12.6		9.37	"	50.0-150	74.4			
<b>Duplicate</b>										
Diesel Range Hydrocarbons	2/6/97			ND	mg/kg dry			50.0		n/a
Surrogate: 2-FBP	"	13.9		11.1	"	50.0-150	79.9			

North Creek Analytical, Inc.

\*Refer to end of report for text of notes and definitions.

Shannon J Stowell, Project Manager

18939 120th Avenue N.E., Suite 101, Bothell, WA 98011-9508  
East 11115 Montgomery, Suite B, Spokane, WA 99206-4776  
9405 S.W. Nimbus Avenue, Beaverton, OR 97008-7132



# NORTH CREEK ANALYTICAL

Environmental Laboratory Services

BOTHELL ■ (206) 481-9200 ■ FAX 485-2992  
SPOKANE ■ (509) 924-9200 ■ FAX 924-9290  
PORTLAND ■ (503) 643-9200 ■ FAX 644-2252

Agra Earth and Environmental  
11335 NE 122nd Way, Ste 100  
Kirkland, WA 98034

Project: Red Lion Inn  
Project Number: 6-61408610  
Project Manager: Robert Lauritzen

Sampled: 2/5/97  
Received: 2/5/97  
Reported: 2/6/97 10:09

## Notes and Definitions

#	Note
---	------

DET Analyte DETECTED

ND Analyte NOT DETECTED at or above the reporting limit

NR Not Reported

dry Sample results reported on a dry weight basis

Recov. Recovery

RPD Relative Percent Difference

North Creek Analytical, Inc.

Shannon J Stowell, Project Manager

18939 120th Avenue N.E., Suite 101, Bothell, WA 98011-9508  
East 11115 Montgomery, Suite B, Spokane, WA 99206-4776  
9405 S.W. Nimbus Avenue, Beaverton, OR 97008-7132



# NORTH CREEK ANALYTICAL

Environmental Laboratory Services

BOTHELL ■ (206) 481-9200 ■ FAX 485-2992  
SPOKANE ■ (509) 924-9200 ■ FAX 924-9290  
PORTLAND ■ (503) 643-9200 ■ FAX 644-2202

Agra Earth and Environmental  
11335 NE 122nd Way, Ste 100  
Kirkland, WA 98034

Project: Red Lion Inn  
Project Number: 6-61408610  
Project Manager: Robert Lauritzen

Sampled: 2/13/97  
Received: 2/13/97  
Reported: 2/21/97 11:14

## ANALYTICAL REPORT FOR SAMPLES:

Sample Description	Laboratory Sample Number	Sample Matrix	Date Sampled
MW-1	B702173-01	Water	2/13/97

North Creek Analytical, Inc.

*The results in this report apply to the samples analyzed in accordance with the chain of custody document.  
This analytical report must be reproduced in its entirety.*

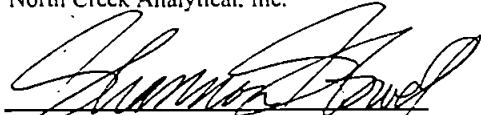
  
Shannon J Stowell, Project Manager

18939 120th Avenue N.E., Suite 101, Bothell, WA 98011-9508  
East 11115 Montgomery, Suite B, Spokane, WA 99206-4776  
9405 S.W. Nimbus Avenue, Beaverton, OR 97008-7132



# NORTH CREEK ANALYTICAL

Environmental Laboratory Services

BOTHELL ■ (206) 481-9200 ■ FAX 485-2992  
SPOKANE ■ (509) 924-9200 ■ FAX 924-9290  
PORTLAND ■ (503) 643-9200 ■ FAX 644-2202

Agra Earth and Environmental  
11335 NE 122nd Way, Ste 100  
Kirkland, WA 98034

Project: Red Lion Inn  
Project Number: 6-61408610  
Project Manager: Robert Lauritzen

Sampled: 2/13/97  
Received: 2/13/97  
Reported: 2/21/97 11:14

**Diesel Hydrocarbons (C12-C24) and Heavy Oil (C24-C40) by WTPH-D (extended)**  
**North Creek Analytical - Bothell**

Analyte	Batch Number	Date Prepared	Date Analyzed	Surrogate Limits	Reporting Limit	Result	Units	Notes*
<u>MW-1</u>				<u>B702173-01</u>			<u>Water</u>	<u>1</u>
Diesel Range Hydrocarbons	0270274	2/14/97	2/19/97		0.250	2.42	mg/l	
Heavy Oil Range Hydrocarbons	"	"	"		0.750	9.39	"	
Surrogate: 2-FBP	"	"	"	50.0-150		71.9	%	



# NORTH CREEK ANALYTICAL

Environmental Laboratory Services

BOTHELL ■ (206) 481-9200 ■ FAX 485-2992  
SPOKANE ■ (509) 924-9200 ■ FAX 924-9290  
PORTLAND ■ (503) 643-9200 ■ FAX 644-2202

Agra Earth and Environmental  
11335 NE 122nd Way, Ste 100  
Kirkland, WA 98034

Project: Red Lion Inn  
Project Number: 6-61408610  
Project Manager: Robert Lauritzen

Sampled: 2/13/97  
Received: 2/13/97  
Reported: 2/21/97 11:14

## Diesel Hydrocarbons (C12-C24) and Heavy Oil (C24-C40) by WTPH-D (extended)/Quality Control North Creek Analytical - Bothell

Analyte	Date Analyzed	Spike Level	Sample Result	QC Result	Units	Reporting Limit Recov. Limits	Recov. %	RPD Limit	RPD %	Notes*
<b>Batch: 0270274</b>										
<b>Blank</b>										
<b>Date Prepared: 2/14/97</b>										
<b>0270274-BLK1</b>										
Diesel Range Hydrocarbons	2/18/97			ND	mg/l	0.250				
Heavy Oil Range Hydrocarbons	"			ND	"	0.750				
Surrogate: 2-FBP	"	0.344		0.235	"	50.0-150	68.3			
<b>LCS</b>										
<b>0270274-BS1</b>										
Diesel Range Hydrocarbons	2/18/97	2.04		1.70	mg/l	52.0-131	83.3			
Surrogate: 2-FBP	"	0.344		0.230	"	50.0-150	66.9			
<b>Duplicate</b>										
<b>0270274-DUP1 B702173-01</b>										
Diesel Range Hydrocarbons	2/19/97		2.42	2.08	mg/l			44.0	15.1	2
Surrogate: 2-FBP	"	0.648		0.440	"	50.0-150	67.9			

North Creek Analytical, Inc.

\*Refer to end of report for text of notes and definitions.

Shannon J Stowell, Project Manager

18939 120th Avenue N.E., Suite 101, Bothell, WA 98011-9508  
East 11115 Montgomery, Suite B, Spokane, WA 99206-4776  
9405 S.W. Nimbus Avenue, Beaverton, OR 97008-7132

Page 3 of 4



# NORTH CREEK ANALYTICAL

Environmental Laboratory Services

BOTHELL ■ (206) 481-9200 ■ FAX 485-2992  
SPOKANE ■ (509) 924-9200 ■ FAX 924-9290  
PORTLAND ■ (503) 643-9200 ■ FAX 644-2202

Agra Earth and Environmental  
11335 NE 122nd Way, Ste 100  
Kirkland, WA 98034

Project: Red Lion Inn  
Project Number: 6-61408610  
Project Manager: Robert Lauritzen

Sampled: 2/13/97  
Received: 2/13/97  
Reported: 2/21/97 11:14

## Notes and Definitions

#	Note
---	------

- 1 The hydrocarbons present are a complex mixture of diesel range and heavy oil range organics.
  - 2 Analyses are not controlled on RPD values from sample concentrations less than 10 times the reporting limit.
- DET Analyte DETECTED
- ND Analyte NOT DETECTED at or above the reporting limit
- NR Not Reported
- dry Sample results reported on a dry weight basis
- Recov. Recovery
- RPD Relative Percent Difference

North Creek Analytical, Inc.

Shannon J Stowell, Project Manager

18939 120th Avenue N.E., Suite 101, Bothell, WA 98011-9508  
East 11115 Montgomery, Suite B, Spokane, WA 99206-4776  
9405 S.W. Nimbus Avenue, Beaverton, OR 97008-7132

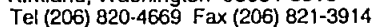

## CHAIN OF CUSTODY

SAMPLE RECEIPT		LABORATORY <i>NCA</i>		TURNAROUND TIME	SPECIAL INSTRUCTIONS / ADDITIONAL COMMENTS		
TOTAL # CONTAINERS <i>1</i>		SHIPPING I.D. / AIRBILL #		<input type="checkbox"/> 8 HOUR			
CONDITION OF CONTAINERS		CARRIER		<input type="checkbox"/> 24 HOUR			
CONDITION OF SEALS		DOT DESIGNATION		<input checked="" type="checkbox"/> 1 WEEK			
				<input type="checkbox"/> 2 WEEK (standard)			
				<input type="checkbox"/> OTHER			
RELINQUISHED BY / AFFILIATION		DATE	TIME	ACCEPTED BY / AFFILIATION		DATE	TIME
<i>W. J. [Signature] / AORA</i>		<i>2/13/97</i>	<i>11:43</i>	<i>Lisa [Signature] / NCA</i>		<i>2/13/97</i>	<i>11:43</i>

PAGE *1* OF *1*

*Associated Sand & Gravel  
Technical Services  
Analytical Laboratory*



Client: AGRA Earth & Environmental

Project: Red Lion, Bellevue

Lab Accreditation #: 11091

<i>Sample</i>	<i>Method</i>	<i>Results ppm</i>	<i>Analysis Date</i>	<i>Analysis by</i>
Diesel	WTPH-D*	125	02/07/97	CMI
Diesel	WTPH-D	86	02/10/97	CCI Analytical (see following)

<i>Quality Assurance</i>				
Blank	WTPH-D	ND<25	02/07/97	CMI
Surrogate	WTPH-D	88% Recovery	02/07/97	CMI
Duplicate	WTPH-D	97% Recovery	02/07/97	CMI

<i>Moisture Content</i>				
<i>Sample</i>	<i>Total Solids %</i>	<i>Moisture Content %</i>	<i>Date</i>	<i>Analysis by</i>
Diesel - Red Lion	89	11	02/07/97	CMI

\* Accreditation for WTPH-D pending



CCI  
ANALYTICAL  
LABORATORIES, INC.

### CERTIFICATE OF ANALYSIS

CLIENT: ASSOCIATED SAND AND GRAVEL  
P.O. BOX 2037  
EVERETT, WA 98203

DATE: 2/17/97  
CCIL JOB #: 702018  
CCIL SAMPLE #: 1  
DATE RECEIVED: 2/7/97  
WDOE ACCREDITATION #: C142

CLIENT CONTACT: CHRISTINA IVERSEN

CLIENT PROJECT ID: 9152 & RED LION  
CLIENT SAMPLE ID: RED LION 2/7/97 12:30

### DATA RESULTS

ANALYTE	METHOD	RESULTS*	UNITS**	ACTION LEVEL**	ANALYSIS DATE	ANALYSIS BY
TPH-DIESEL	WTPH-D	86	MG/KG	200MG/KG	2/10/97	AMC

\* "ND" INDICATES ANALYTE NOT DETECTED AT LEVEL ABOVE REPORTING LIMIT. REPORTING LIMIT IS GIVEN IN PARENTHESES

\*\* UNITS FOR ALL NON LIQUID SAMPLES ARE REPORTED ON A DRY WEIGHT BASIS

--- ACTIONS LEVELS ARE PROVIDED ONLY WHEN PARAMETER DATA IS USED FOR A GENERALLY  
CONSISTENT APPLICATION. WHEN PROVIDED, THEY SHOULD BE USED AS GUIDELINES ONLY.  
THE APPROPRIATE REGULATORY DOCUMENT SHOULD BE CONSULTED BEFORE MAKING ANY  
DECISIONS BASED ON ANALYTICAL DATA

APPROVED BY: CRF



CCI  
ANALYTICAL  
LABORATORIES, INC.

---

**CERTIFICATE OF ANALYSIS**

---

CLIENT: ASSOCIATED SAND AND GRAVEL  
P.O. BOX 2037  
EVERETT, WA 98203

DATE: 2/17/97  
CCIL JOB #: 702016

DATE RECEIVED: 2/7/97  
WDOE ACCREDITATION #: C142

CLIENT CONTACT: CHRISTINA IVERSEN

CLIENT PROJECT ID: 9152 & RED LION

---

**QUALITY CONTROL RESULTS**

---

**SURROGATE RECOVERY**

CCL SAMPLE ID	ANALYTE	SUR ID	% RECV
702016-01	WTPH-D	C25	94

APPROVED BY:                     

*C121*

## **APPENDIX C**

### **UST Closure Notice and Site Assessment Notice**



**APPENDIX D**  
**Disposal Receipts**



Job # 96-42

1703 Portland Avenue • Tacoma, WA 98421 • (206) 272-8851

Environmental and Industrial Contractors

No 0266

SHIPPER Red Lion InnADDRESS 300 112th AVE SE, BELLEVUEPHONE (206) 455 1300ORIGIN DIESEL STORAGE TANK

U.S. D.O.T. DESCRIPTION Including Proper Shipping Name, Hazard Class & I.D. Number	CONTAINER		QUANTITY	
	No.	Type	Wt.	Vol.
THIS MATERIAL IS NOT REGULATED UNDER WAC 173-303, 40 CFR PART 261 OR 40 CFR PART 761 NA 1993 COMBUSTIBLE LIQUID N.O.S. 3 PG III (DIESEL & WATER)		VAC-TRK		<del>200 gals.</del> 275 gals

PHYSICAL STATE (CIRCLE): SOLID LIQUID SLUDGE OTHER \_\_\_\_\_

SPECIAL INSTRUCTIONS AND ADDITIONAL INFORMATION \_\_\_\_\_

IN THE EVENT OF A SPILL, CONTACT EITHER THE DEPARTMENT OF ECOLOGY 800-258-5990 AND/OR  
THE NATIONAL RESPONSE CENTER, U.S. COAST GUARD 800-424-8802 FOR EMERGENCY ASSISTANCE.

This is to certify that the above-named materials are properly classified, described, packaged, marked, labeled and are in  
proper condition for transportation according to the applicable regulation of the U.S. Department of Transportation.

SHIPPER SIGNATURE Matt Sundry FOR RED LION INNDATE 2-5-97TRANSPORTER CEcon CorpPHONE (206) 272-8851ADDRESS 1703 Portland Ave, TACOMASIGNATURE Matt SundryDESTINATION Northwest EnviroSERVICE Inc.PHONE (206) 622-1085ADDRESS 1700 Airport Way, SeattleSIGNATURE Leo J. DavenportDATE 2-6-97

Distribution: Shipper: Goldenrod copy Transporter: Pink copy Consignee: Canary copy  
(CEcon returns original to shipper)

RED LION INN  
BELLVUE

Job# 96-42

154033

SEQ. NO.

GROSS WT.  
(LB.)

DATE

D CARLL

WDC

96

9020

09:37 09:44 06 Feb 97

CODE	MATERIAL	\$ / UNIT	TARE WT. (LB.)	NET WT. (LB.)	ADJUSTED NET WT. (LB.)	AMOUNT
26	# 2 UN-PREPARED	\$30.00/NT	8640	380	380	5.70

