



CASCADE
T H E R M A L

Update

BSCSS ERH Project – Bothell, WA

09/12/2018



TERRATHERM
a Cascade Company



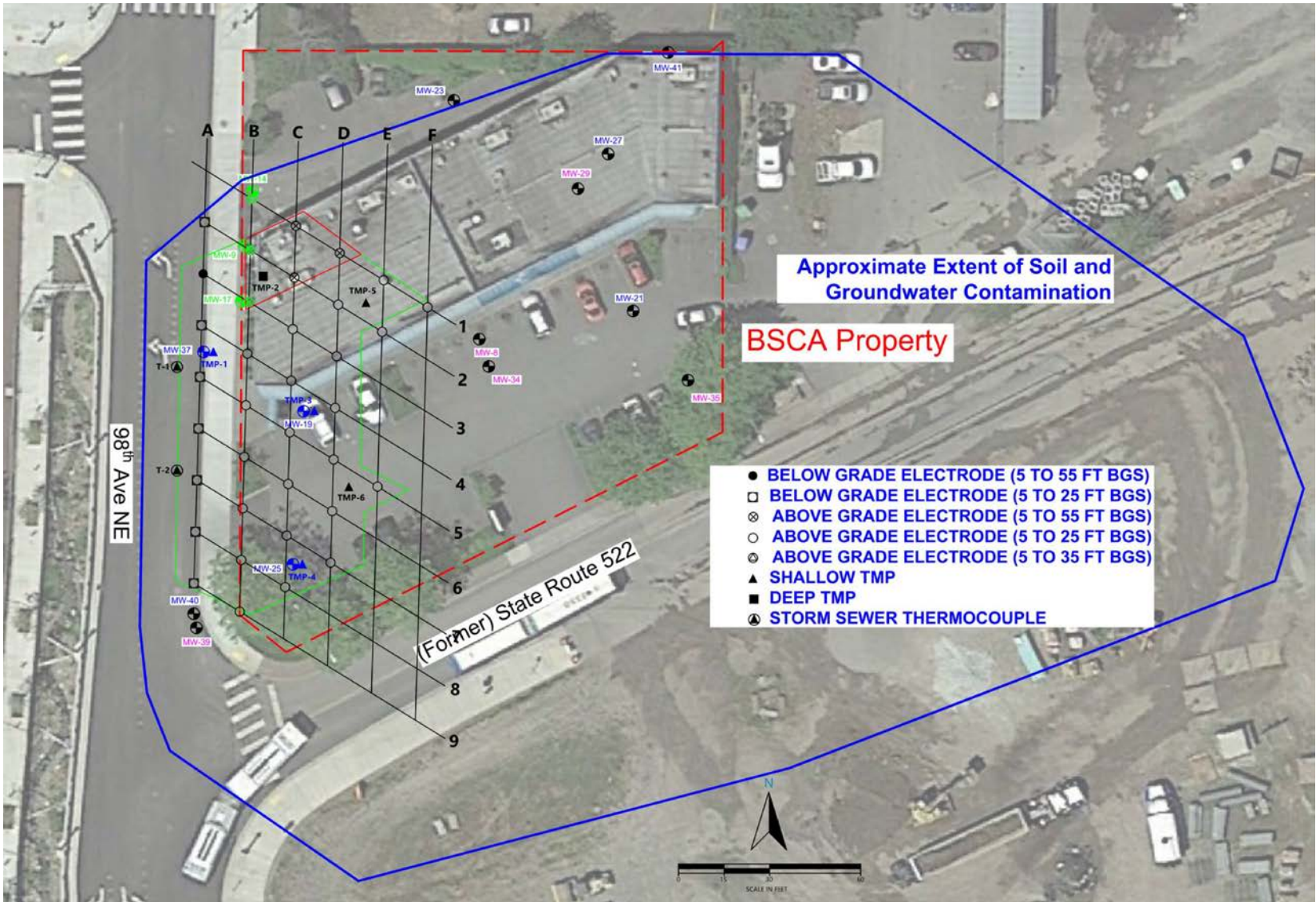

Project Summary:

The system has now been fully operational for 104-days, with average subsurface temperatures of 99.7°C across the entire treatment volume. Approximately 78% of the treatment volume is above 100 °C, with maximum temperatures reaching 119.8 °C . The system has been performing at or above projected temperatures based off of our original model outputs.

Mass removal estimates based on PID readings, and calibrated with contemporaneous quantitative analytical vapor sampling, show that approximately 1201.5-lbs of CVOC mass has been removed through the vapor stream. Furthermore, over the past 20-days of operation, during which time subsurface temperatures have averaged above the heteroazotropic boiling point of PCE (87.9 °C) , daily mass removal rates have averaged approximately 57.4-lbs/day. Assuming this current trend continues for the remaining 54-days of ERH system operation, an additional 4,301-lbs of CVOC mass will be removed from the treatment volume. Based off of these trends and anticipated 5,502-lbs of CVOC mass will be removed from the treatment volume.

BSCSS ERH Project - Bothell, WA - Cumulative Mass Removal Based on PID Readings

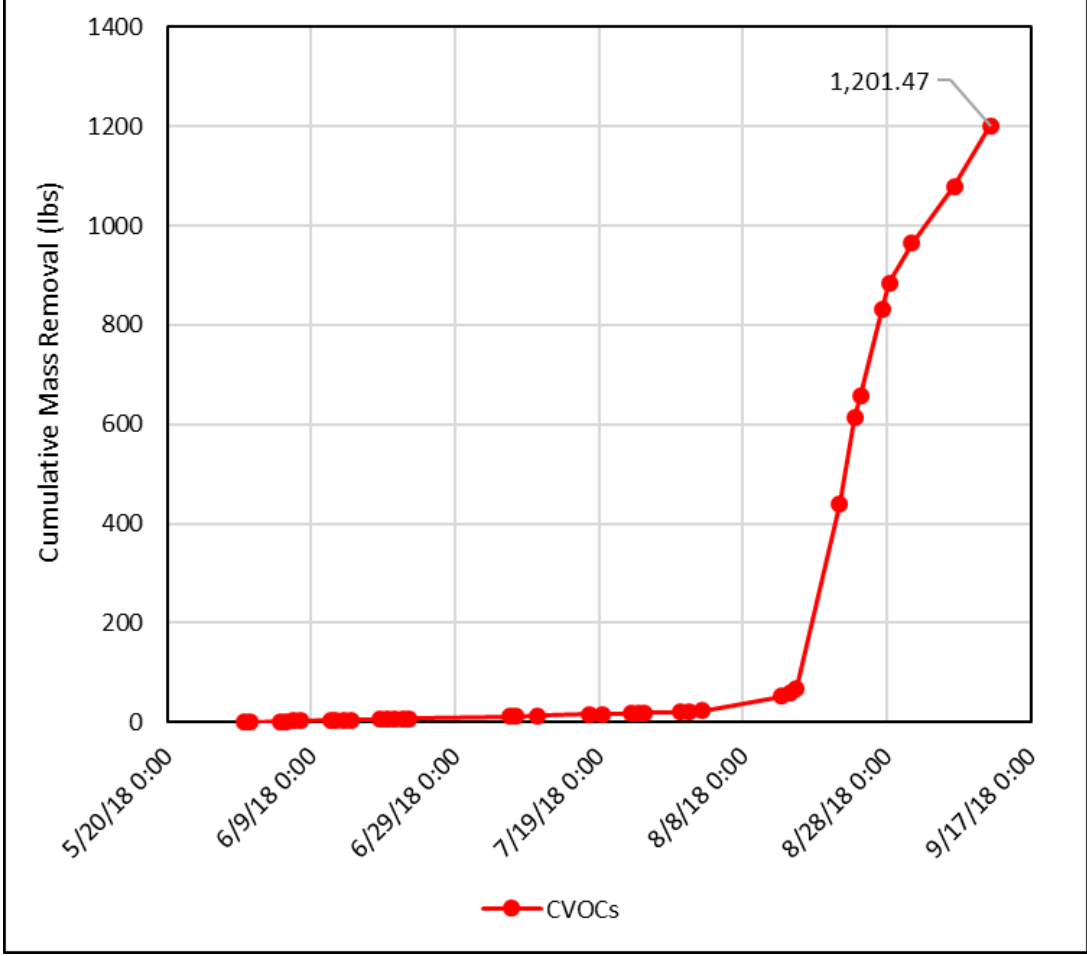

BSCSS-ERH Project - Modelled Average vs Actual Average Temperature Curves

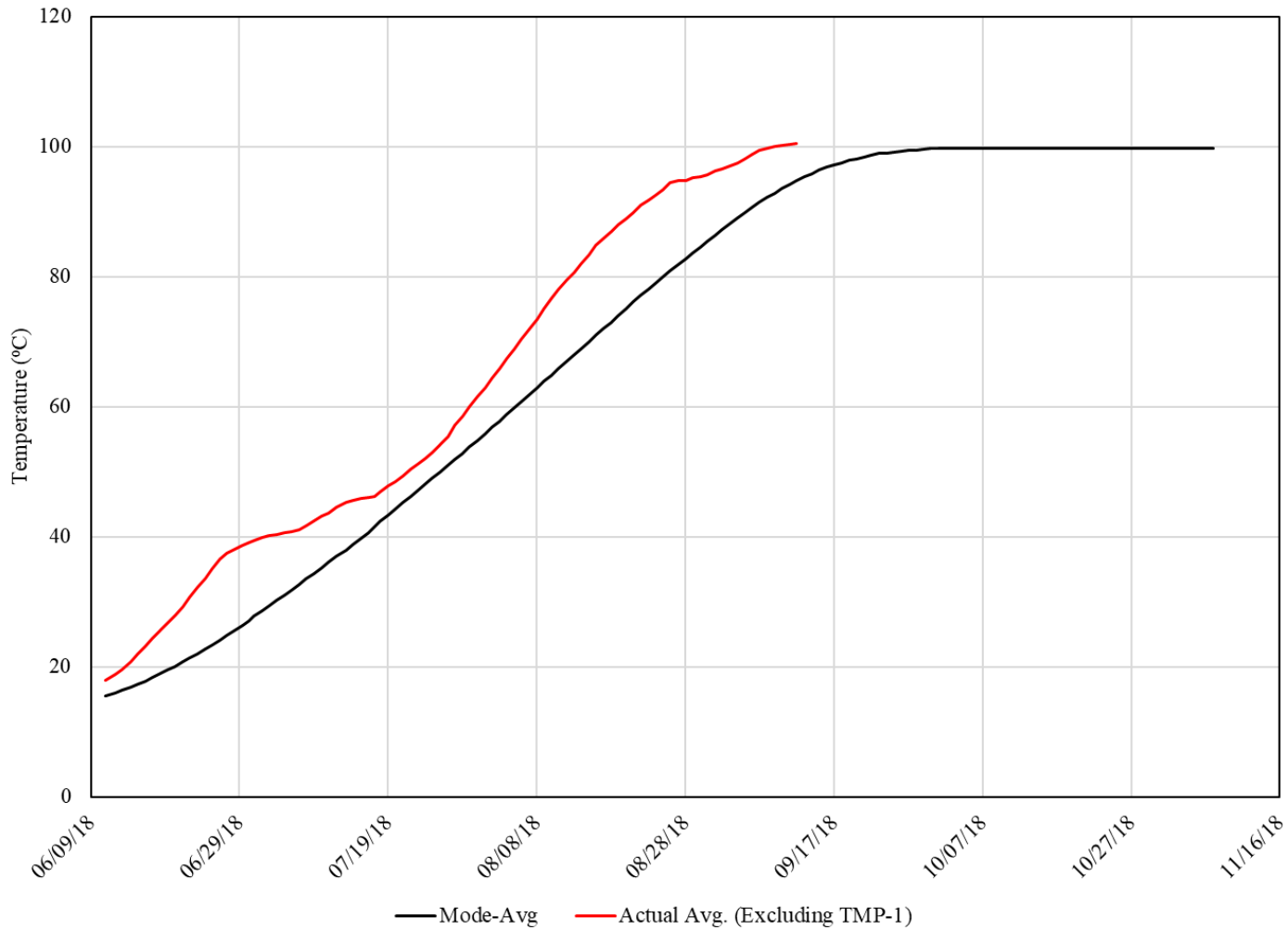

BSCSS ERH Project - Bothell, WA Average Temperature Progress

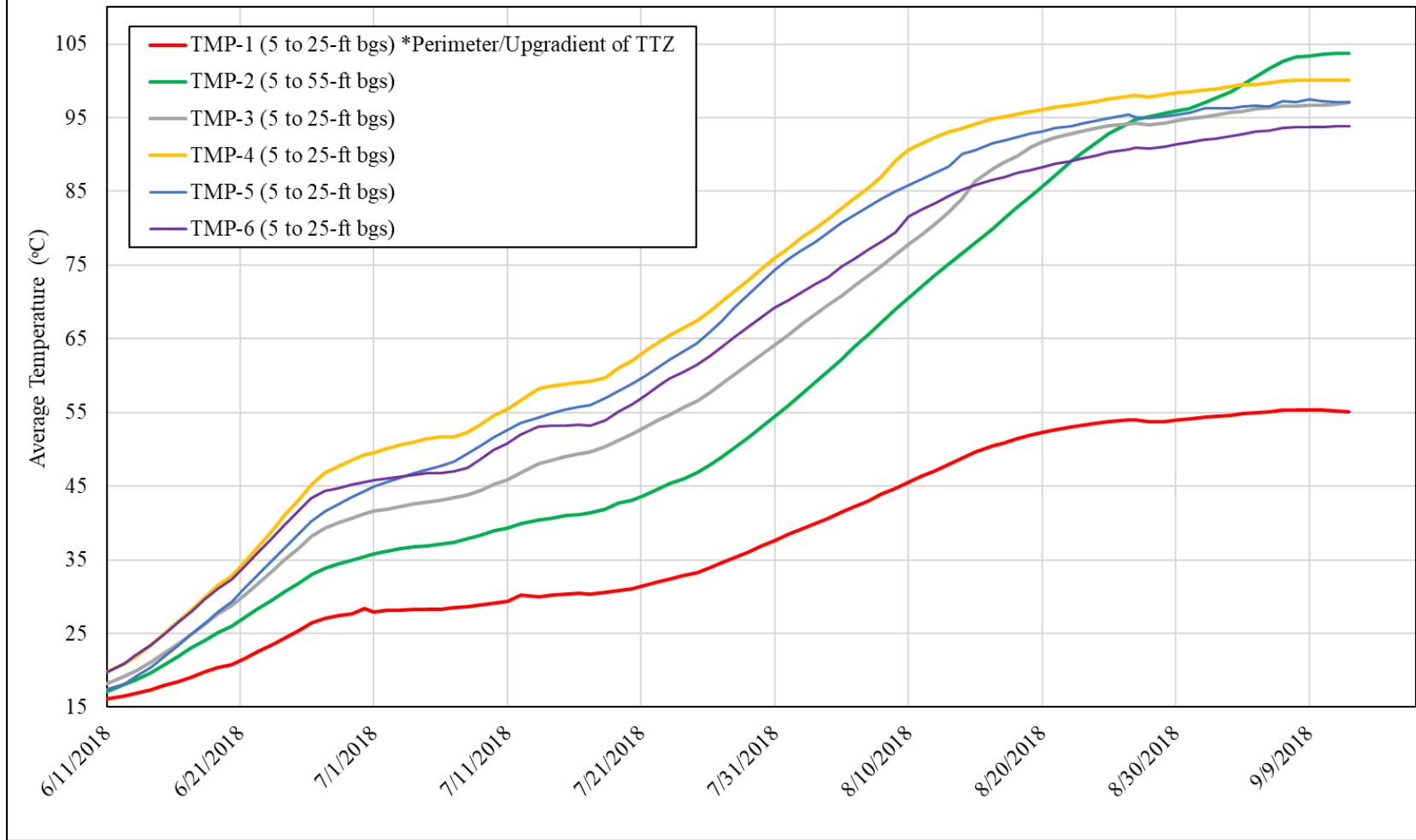

BSCSS ERH Project - Bothell, WA
Average Temperature Progress

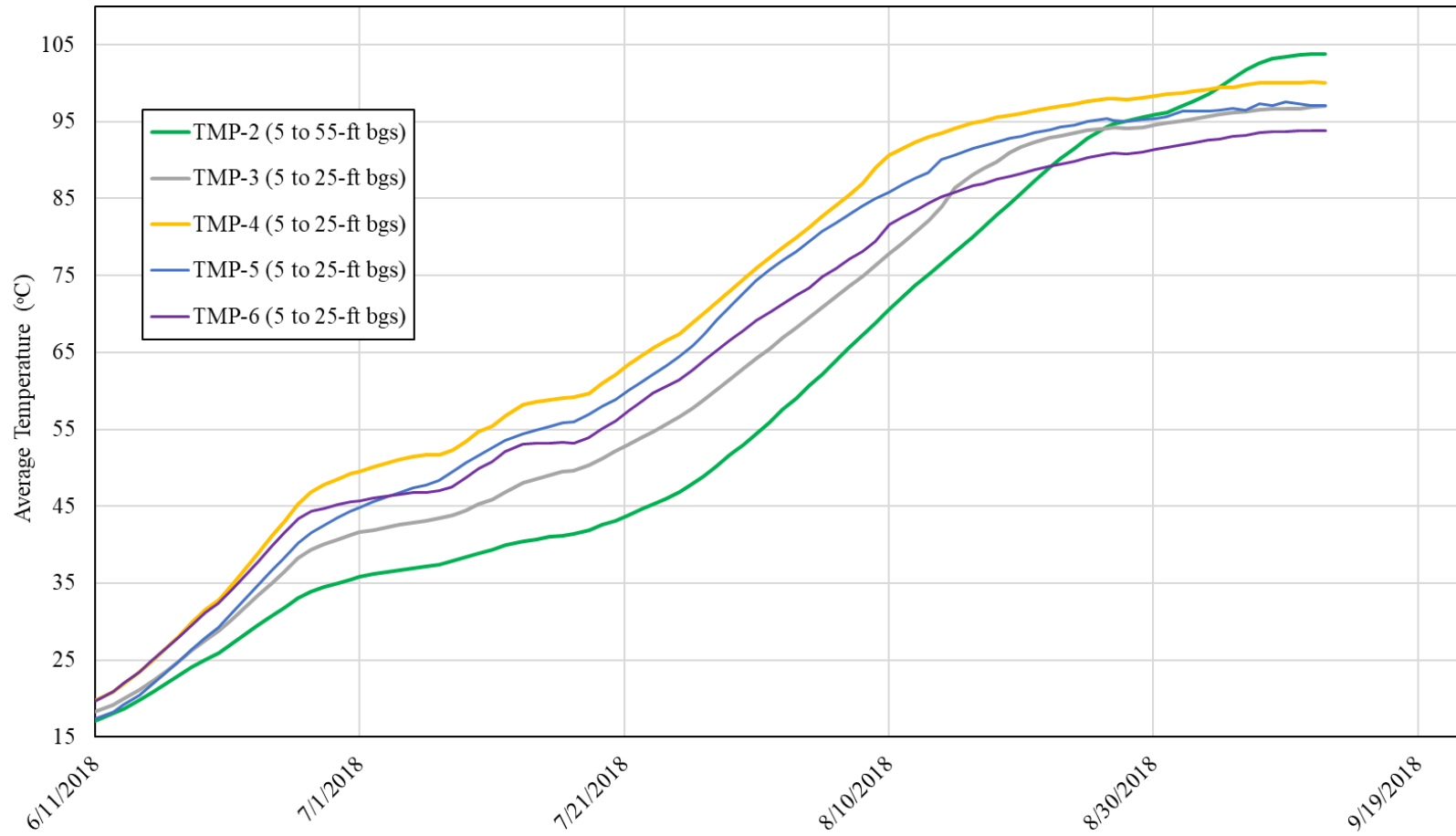

BSCSS-ERH Project - Modelled Temperature Curves

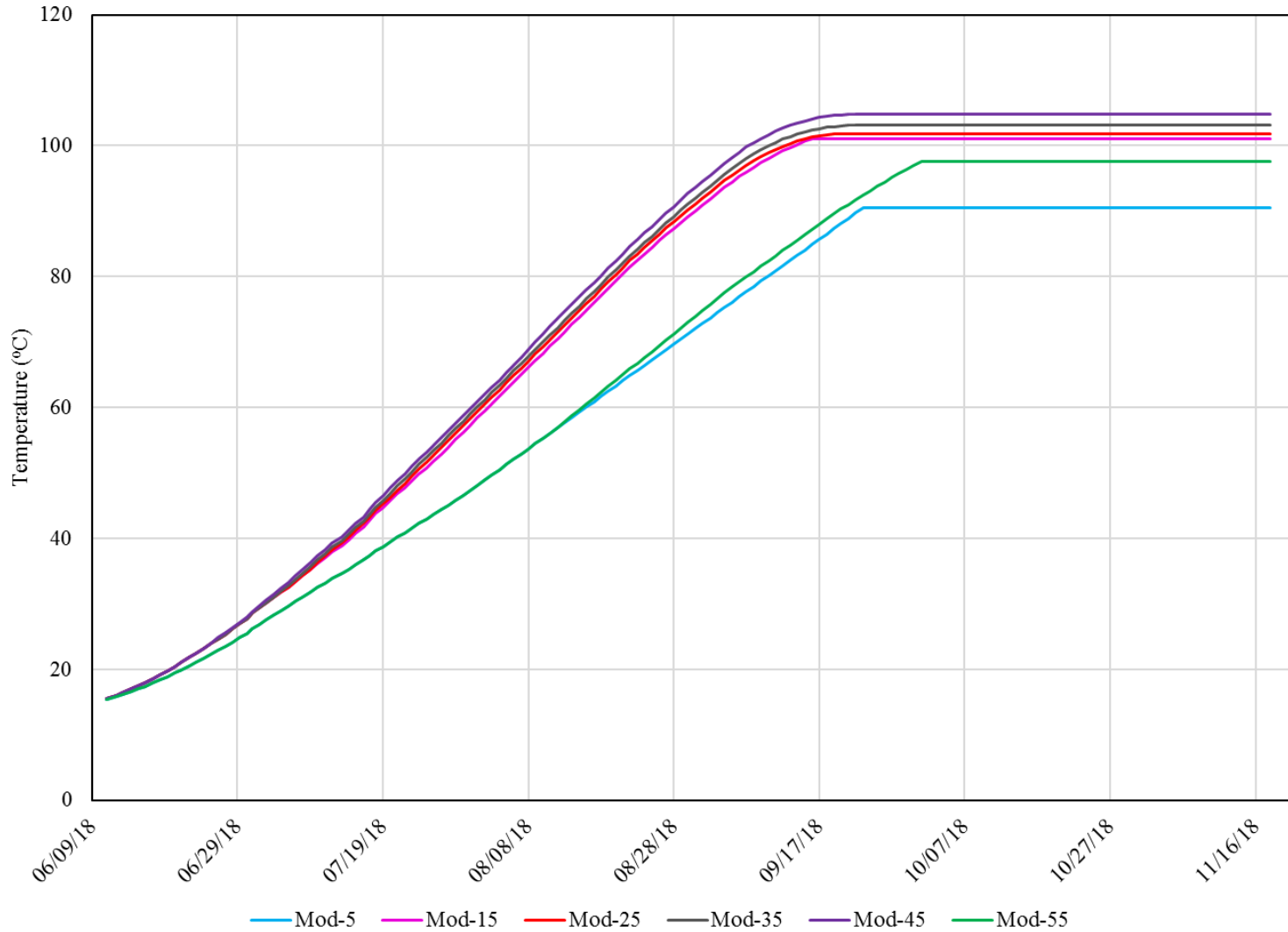

BSCSS-ERH Project - Modelled vs Achieved Temperature Curves (Excluding TMP-1)

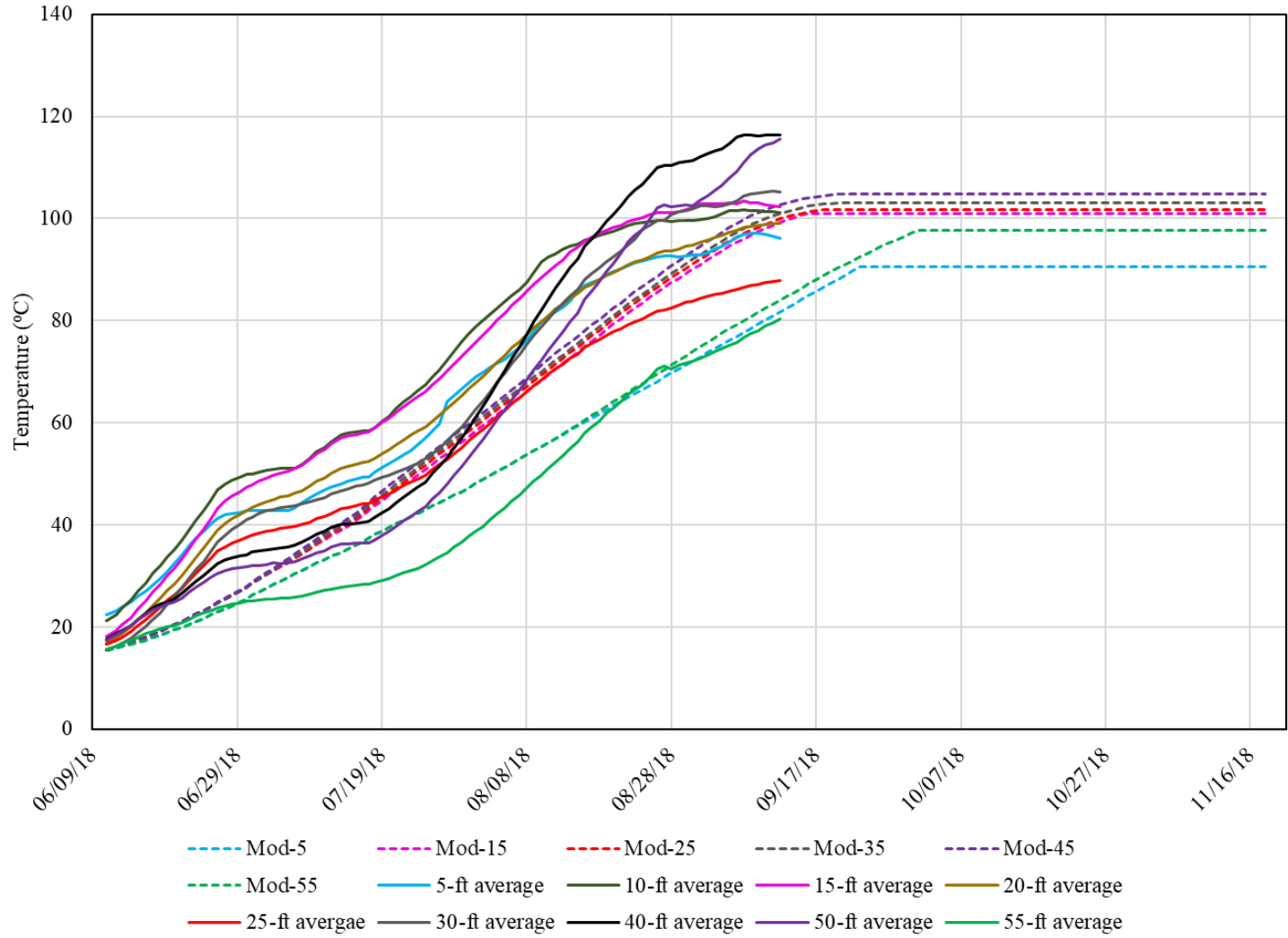

BSCSS-ERH Project - Modelled vs Achieved Temperature Curves (Excluding TMP-1)

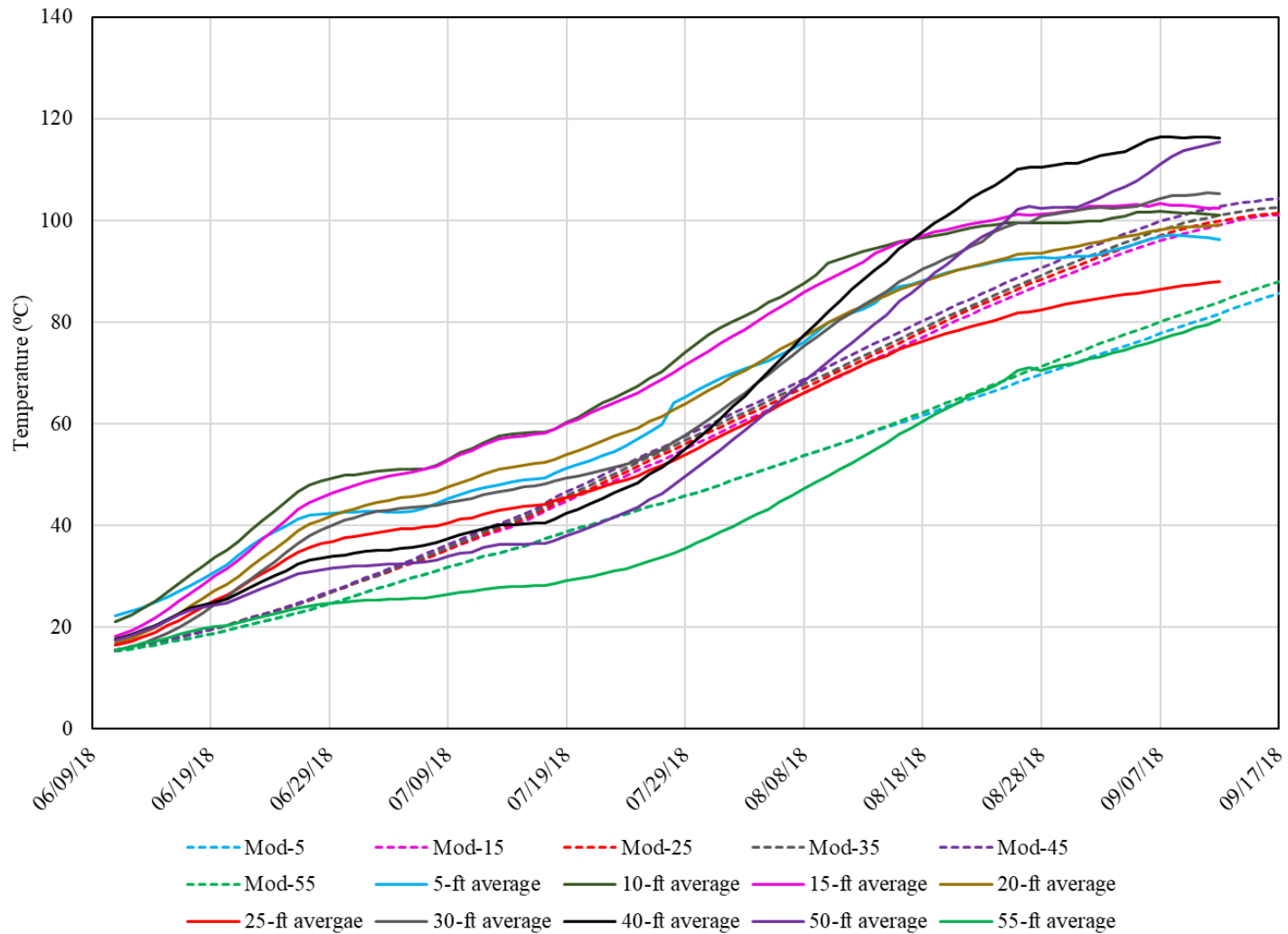

TMP-2 Temperatures (°C)											
Date/Time Stamp	TMP2-5	TMP2-10	TMP2-15	TMP2-20	TMP2-25	TMP2-30	TMP2-35	TMP2-40	TMP2-45	TMP2-50	TMP2-55
8/4/2018 0:00	44.6	57.1	63.8	66.8	69.1	66.9	66.9	68.9	62.8	58.5	42.2
8/5/2018 0:00	44.5	58.3	65.2	68.3	70.8	68.6	69.3	71.3	64.8	60.4	43.3
8/6/2018 0:00	45.1	59.3	66.6	69.9	72.8	70.6	71.7	73.6	66.9	62.2	44.7
8/7/2018 0:00	45.7	60.6	67.8	71.3	74.5	72.3	74.0	75.9	68.9	64.0	45.8
8/8/2018 0:00	46.3	61.8	69.2	72.8	76.6	74.1	76.4	78.3	70.9	65.8	47.2
8/9/2018 0:00	47.3	63.0	70.6	74.2	78.2	75.8	78.8	80.6	72.9	67.8	48.5
8/10/2018 0:00	48.2	64.0	72.0	75.7	80.1	77.5	81.2	82.8	75.0	69.4	49.8
8/11/2018 0:00	49.2	65.2	73.3	77.1	81.7	79.1	83.4	84.9	77.1	71.1	51.1
8/12/2018 0:00	50.0	66.5	74.7	78.6	83.2	80.6	85.6	87.1	79.1	72.8	52.2
8/13/2018 0:00	50.6	67.7	75.9	79.9	84.6	82.1	87.6	89.1	81.1	74.6	53.6
8/14/2018 0:00	51.1	69.0	77.1	81.1	85.7	83.7	89.6	91.0	83.1	76.4	55.0
8/15/2018 0:00	51.8	70.2	78.4	82.2	87.0	85.2	91.3	92.7	84.9	78.0	56.2
8/16/2018 8:00	53.3	71.9	80.0	83.8	88.9	87.0	93.9	95.1	87.6	80.7	58.0
8/17/2018 4:00	54.5	73.3	81.2	85.0	90.0	88.2	95.4	96.6	89.3	82.2	59.1
8/18/2018 4:00	56.0	75.2	82.4	86.3	91.2	89.6	97.2	98.2	91.2	84.1	60.4
8/19/2018 4:00	57.5	77.0	83.6	87.4	92.2	90.7	99.0	99.8	93.2	86.0	61.8
8/20/2018 0:00	59.0	78.6	84.7	88.3	93.1	91.9	100.4	101.1	94.8	87.6	62.9
8/21/2018 0:00	60.6	81.1	85.9	89.6	93.8	93.3	102.1	102.7	96.8	89.5	64.1
8/22/2018 4:00	62.7	83.7	87.3	90.8	94.8	94.8	104.2	104.4	99.1	91.6	65.6
8/23/2018 0:00	64.6	85.2	88.1	91.5	95.4	96.3	105.6	105.7	100.6	92.9	66.5
8/24/2018 0:00	66.2	86.5	89.2	92.4	96.1	99.6	106.7	106.7	102.1	93.7	67.5
8/25/2018 0:00	67.6	87.2	90.5	93.2	97.1	100.3	108.1	108.4	104.1	95.6	68.8
8/26/2018 12:00	69.0	87.9	92.2	94.5	97.8	101.2	109.9	110.1	106.4	97.9	70.5
8/27/2018 0:00	69.6	88.2	92.9	94.8	97.8	101.3	110.3	110.6	107.0	98.4	71.0
8/28/2018 0:00	69.8	88.8	94.6	95.3	99.5	102.0	110.3	110.5	107.2	97.4	70.5
8/29/2018 4:00	69.7	89.3	95.9	95.8	100.0	102.6	110.6	111.2	108.0	97.1	71.3
8/30/2018 4:00	69.8	89.7	97.3	96.1	100.2	103.0	110.7	111.6	108.3	96.9	71.6
8/31/2018 0:00	70.2	90.0	98.5	96.3	100.4	103.4	110.7	111.8	108.4	96.7	72.1
9/1/2018 4:00	70.7	90.9	99.7	97.0	100.9	104.0	111.4	112.7	109.3	97.9	72.7
9/2/2018 0:00	72.2	91.6	100.6	97.5	100.7	104.3	111.9	113.4	110.0	98.9	73.2
9/3/2018 4:00	75.1	93.6	101.2	98.2	100.2	104.5	112.4	114.0	110.9	100.3	74.0
9/4/2018 0:00	77.4	96.3	101.7	98.7	100.0	105.0	112.6	114.6	111.6	101.5	74.5
9/5/2018 0:00	80.7	99.4	101.8	99.3	100.0	105.6	113.6	115.6	112.7	102.9	75.2
9/6/2018 0:00	84.0	100.1	102.1	99.6	100.1	106.8	115.3	116.5	114.1	104.3	75.8
9/7/2018 0:00	86.3	100.5	102.2	100.1	100.3	108.4	115.4	117.3	116.0	105.9	76.6
9/8/2018 0:00	87.8	100.6	101.7	100.2	100.5	109.2	115.4	117.3	117.8	107.3	77.4
9/9/2018 0:00	87.4	100.6	101.6	100.3	100.6	109.3	115.2	117.2	119.0	108.3	78.0
9/10/2018 0:00	87.0	100.5	101.7	100.5	100.5	109.8	115.3	117.4	119.4	109.3	78.9
9/11/2018 0:00	85.9	100.5	101.6	100.4	100.6	110.2	115.3	117.4	119.6	110.2	79.6
9/12/2018 0:00	84.7	100.5	101.4	100.2	100.6	109.9	115.3	117.2	119.8	111.2	80.4

TMP-3					
Date/Time Stamp	TMP3-5	TMP3-10	TMP3-15	TMP3-20	TMP3-25
8/4/2018 0:00	63.2	82.6	77.6	67.7	56.9
8/5/2018 0:00	64.1	84.2	79.1	68.9	58.1
8/6/2018 0:00	65.3	85.9	80.5	70.1	59.3
8/7/2018 0:00	66.6	87.5	82.1	71.1	60.4
8/8/2018 0:00	68.2	89.2	83.6	72.2	61.4
8/9/2018 0:00	70.0	90.9	85.0	73.3	62.4
8/10/2018 0:00	71.9	92.6	86.4	74.3	63.5
8/11/2018 0:00	74.2	94.3	87.7	75.2	64.3
8/12/2018 0:00	76.7	95.9	89.0	76.1	65.4
8/13/2018 0:00	79.6	97.6	90.4	76.8	66.3
8/14/2018 0:00	84.0	99.2	91.9	77.7	67.2
8/15/2018 0:00	91.4	100.6	93.3	78.4	68.2
8/16/2018 8:00	94.1	102.2	95.4	79.3	69.6
8/17/2018 4:00	94.8	102.8	96.8	79.8	70.3
8/18/2018 4:00	95.8	103.3	98.4	80.2	71.3
8/19/2018 4:00	98.1	103.8	99.7	80.9	72.3
8/20/2018 0:00	99.2	104.1	100.7	81.5	73.0
8/21/2018 0:00	99.9	104.2	101.6	82.1	73.8
8/22/2018 4:00	100.0	104.6	102.5	82.7	74.5
8/23/2018 0:00	100.1	104.7	102.9	83.0	75.1
8/24/2018 0:00	100.2	104.7	103.7	83.3	75.6
8/25/2018 0:00	100.4	104.9	104.1	83.7	76.3
8/26/2018 12:00	100.4	104.9	104.6	84.0	77.0
8/27/2018 0:00	100.3	104.7	104.8	84.3	77.3
8/28/2018 0:00	100.4	104.3	104.4	84.0	77.3
8/29/2018 4:00	100.4	104.1	104.5	84.6	77.9
8/30/2018 4:00	100.4	104.0	104.7	85.3	78.7
8/31/2018 0:00	100.6	103.9	104.8	85.8	79.2
9/1/2018 4:00	100.6	103.8	104.8	86.6	79.8
9/2/2018 0:00	100.5	103.8	104.7	87.3	80.4
9/3/2018 4:00	100.6	103.8	104.6	88.4	81.0
9/4/2018 0:00	100.7	103.7	104.7	89.0	81.4
9/5/2018 0:00	100.5	103.7	104.7	90.1	81.8
9/6/2018 0:00	100.5	103.6	104.7	90.7	82.1
9/7/2018 0:00	100.5	103.6	104.7	91.6	82.5
9/8/2018 0:00	100.4	103.2	104.5	92.2	82.8
9/9/2018 0:00	100.3	103.0	104.3	92.6	83.3
9/10/2018 0:00	100.1	102.9	104.0	93.0	83.6
9/11/2018 0:00	99.9	102.7	103.9	93.9	84.0
9/12/2018 0:00	99.9	102.5	104.2	94.4	84.4

TMP-4 Temperatures (°C)					
Date/Time Stamp	TMP4-5	TMP4-10	TMP4-15	TMP4-20	TMP4-25
8/4/2018 0:00	36.5	84.4	90.3	81.8	68.8
8/5/2018 0:00	39.6	86.3	91.8	83.1	69.8
8/6/2018 0:00	41.6	88.1	93.3	84.3	70.8
8/7/2018 0:00	42.1	89.7	94.8	85.3	71.9
8/8/2018 0:00	43.9	92.1	96.4	86.7	72.9
8/9/2018 0:00	44.9	96.8	97.7	87.8	74.0
8/10/2018 0:00	45.4	99.8	98.8	88.9	75.0
8/11/2018 0:00	43.7	100.0	99.9	90.1	75.9
8/12/2018 0:00	39.2	100.2	101.0	91.2	76.9
8/13/2018 0:00	39.6	100.3	101.9	92.2	77.8
8/14/2018 0:00	41.7	100.0	102.3	93.2	78.8
8/15/2018 0:00	44.5	99.9	102.8	94.2	79.6
8/16/2018 8:00	41.4	100.1	103.3	95.3	80.6
8/17/2018 4:00	41.5	100.2	103.2	95.9	81.2
8/18/2018 4:00	42.5	100.3	103.4	96.6	81.8
8/19/2018 4:00	43.5	100.1	103.5	97.3	82.4
8/20/2018 0:00	45.5	100.1	103.5	97.8	83.0
8/21/2018 0:00	45.7	100.1	103.5	98.4	83.6
8/22/2018 4:00	44.5	100.2	103.5	98.9	84.3
8/23/2018 0:00	47.4	100.2	103.6	99.4	84.8
8/24/2018 0:00	44.1	100.3	103.6	99.8	85.2
8/25/2018 0:00	44.9	100.4	103.8	100.2	85.9
8/26/2018 12:00	41.0	100.3	104.0	100.8	86.7
8/27/2018 0:00	41.8	100.2	104.0	100.9	86.9
8/28/2018 0:00	43.5	100.2	103.3	100.9	87.0
8/29/2018 4:00	43.7	100.2	103.5	101.2	87.5
8/30/2018 4:00	44.0	100.2	103.5	101.6	88.1
8/31/2018 0:00	45.8	100.3	103.7	101.8	88.4
9/1/2018 4:00	44.1	100.2	103.8	102.2	88.9
9/2/2018 0:00	45.2	100.2	104.0	102.3	89.1
9/3/2018 4:00	44.5	100.4	104.1	102.6	89.8
9/4/2018 0:00	46.2	100.5	104.0	102.7	90.6
9/5/2018 0:00	46.7	100.3	104.1	102.9	90.6
9/6/2018 0:00	47.7	100.4	104.1	103.5	91.1
9/7/2018 0:00	48.6	100.5	104.2	103.8	91.6
9/8/2018 0:00	46.2	100.3	104.1	103.9	91.9
9/9/2018 0:00	43.9	100.3	103.8	104.1	92.2
9/10/2018 0:00	43.5	100.2	103.7	103.8	92.5
9/11/2018 0:00	43.2	100.2	103.8	103.7	92.8
9/12/2018 0:00	43.2	100.3	103.4	103.6	92.9

TMP-5					
Date/Time Stamp	TMP5-5	TMP5-10	TMP5-15	TMP5-20	TMP5-25
8/4/2018 0:00	100.3	99.5	86.3	74.1	57.6
8/5/2018 0:00	100.3	100.2	88.1	75.8	58.8
8/6/2018 0:00	100.4	100.4	89.6	77.6	59.9
8/7/2018 0:00	100.4	100.6	90.8	79.2	61.1
8/8/2018 0:00	100.2	100.8	92.1	80.9	62.2
8/9/2018 0:00	100.2	100.8	93.3	82.5	63.3
8/10/2018 0:00	100.2	100.8	94.3	84.0	64.3
8/11/2018 0:00	100.4	100.9	95.3	85.4	65.4
8/12/2018 0:00	100.4	101.0	96.2	86.8	66.4
8/13/2018 0:00	100.4	101.1	97.1	88.1	67.4
8/14/2018 0:00	100.4	101.3	101.1	89.4	68.4
8/15/2018 0:00	100.3	100.9	101.8	90.5	69.3
8/16/2018 8:00	100.5	101.1	102.5	91.8	70.6
8/17/2018 4:00	100.6	101.1	102.7	92.6	71.2
8/18/2018 4:00	100.5	101.1	102.8	93.5	72.1
8/19/2018 4:00	100.4	101.0	103.1	94.3	72.9
8/20/2018 0:00	100.5	100.9	103.2	94.9	73.5
8/21/2018 0:00	100.5	100.9	103.2	95.7	74.4
8/22/2018 4:00	100.6	100.7	103.3	96.4	75.2
8/23/2018 0:00	100.4	100.9	103.7	96.8	75.7
8/24/2018 0:00	100.4	100.9	103.3	97.4	76.6
8/25/2018 0:00	100.5	100.8	103.7	98.1	77.3
8/26/2018 12:00	100.4	100.7	103.7	98.8	78.3
8/27/2018 0:00	100.5	100.6	102.2	99.1	78.6
8/28/2018 0:00	100.3	100.5	101.9	98.9	78.7
8/29/2018 4:00	100.1	100.6	101.3	99.6	79.4
8/30/2018 4:00	100.3	100.6	100.9	100.0	80.1
8/31/2018 0:00	100.4	100.7	100.9	100.3	80.6
9/1/2018 4:00	100.3	100.7	102.9	100.6	81.1
9/2/2018 0:00	100.3	100.6	102.1	100.8	81.7
9/3/2018 4:00	100.4	100.7	101.1	101.2	82.2
9/4/2018 0:00	100.4	100.6	100.8	101.7	82.8
9/5/2018 0:00	100.2	100.5	101.4	101.7	83.2
9/6/2018 0:00	100.2	100.3	99.6	102.1	83.9
9/7/2018 0:00	100.3	100.4	101.9	102.5	84.4
9/8/2018 0:00	100.3	100.4	100.7	102.5	84.9
9/9/2018 0:00	100.2	100.3	101.7	102.7	85.4
9/10/2018 0:00	100.1	100.1	100.4	102.8	85.8
9/11/2018 0:00	100.2	100.1	99.2	102.7	86.3
9/12/2018 0:00	100.0	100.0	98.9	102.9	86.7

TMP-6 Temperatures (°C)					
Date/Time Stamp	TMP6-5	TMP6-10	TMP6-15	TMP6-20	TMP6-25
8/4/2018 0:00	78.7	88.5	82.3	68.9	53.7
8/5/2018 0:00	80.9	90.4	83.7	70.2	54.8
8/6/2018 0:00	83.3	91.2	85.1	71.4	55.8
8/7/2018 0:00	86.1	92.6	86.4	72.6	56.7
8/8/2018 0:00	89.8	93.6	87.7	73.7	57.6
8/9/2018 0:00	94.2	95.1	89.1	75.0	58.5
8/10/2018 0:00	99.1	100.8	90.3	76.1	59.3
8/11/2018 0:00	99.8	101.8	91.5	77.1	60.0
8/12/2018 0:00	99.9	102.1	92.7	78.2	60.9
8/13/2018 0:00	99.9	103.0	93.8	79.1	61.7
8/14/2018 0:00	99.7	103.4	94.8	80.1	62.6
8/15/2018 0:00	99.7	103.3	95.8	81.1	63.2
8/16/2018 8:00	99.9	103.6	96.7	82.1	64.1
8/17/2018 4:00	99.9	103.5	97.3	82.5	64.5
8/18/2018 4:00	100.1	103.6	98.0	83.3	65.1
8/19/2018 4:00	99.9	103.5	98.6	84.0	65.6
8/20/2018 0:00	99.9	103.6	98.9	84.6	66.1
8/21/2018 0:00	100.0	103.6	99.4	85.2	66.6
8/22/2018 4:00	99.9	103.6	100.0	85.9	67.2
8/23/2018 0:00	100.0	103.6	100.3	86.4	67.6
8/24/2018 0:00	100.1	103.5	100.7	87.0	68.1
8/25/2018 0:00	100.1	103.7	101.2	87.6	68.6
8/26/2018 12:00	100.1	103.8	101.6	88.4	69.2
8/27/2018 0:00	100.1	103.8	101.7	88.6	69.6
8/28/2018 0:00	100.2	103.5	101.6	88.7	69.6
8/29/2018 4:00	99.9	103.3	101.7	89.2	70.1
8/30/2018 4:00	100.2	103.3	102.2	89.7	70.5
8/31/2018 0:00	100.3	103.4	102.4	90.1	70.9
9/1/2018 4:00	100.2	103.4	102.8	90.6	71.2
9/2/2018 0:00	100.3	103.4	102.8	90.9	71.7
9/3/2018 4:00	100.2	103.4	103.2	91.4	72.2
9/4/2018 0:00	100.2	103.5	103.3	91.8	72.3
9/5/2018 0:00	100.1	103.7	103.6	92.2	72.8
9/6/2018 0:00	100.2	103.4	103.7	92.7	73.3
9/7/2018 0:00	100.2	103.6	103.9	93.1	73.7
9/8/2018 0:00	100.1	103.4	103.9	93.4	74.0
9/9/2018 0:00	100.1	103.2	103.7	93.7	74.1
9/10/2018 0:00	100.1	103.0	103.8	93.8	74.5
9/11/2018 0:00	100.1	102.7	103.7	94.1	74.8
9/12/2018 0:00	100.0	102.3	103.9	94.3	74.9

FINANCIAL OBLIGATIONS (A. Administrative)		
Provide a cost estimate to Ecology for the implementation of the CD requirements, including operation, maintenance, and compliance monitoring	<i>Feb 12, 2018 BSCSS grant submitted through Ecology EAGL with all cost estimates attached</i>	A4
Provide Ecology with proof of financial assurances in a form acceptable to Ecology	<i>Provided in CFP sheet</i>	A5
Adjust the cost estimated to reflect inflation and changes in cost estimates and provide updated financial assurances	Ongoing with EAGL, spending updated each quarter	-
Pay outstanding Ecology oversight costs of \$13,108.83	<i>Confirmed; All Ecology invoices have been processed</i>	-
Pay Ecology's future oversight costs	Within 30 days of receiving Ecology's invoice; On-going	-
PRE-CLEANUP OBLIGATIONS (B. Design)		
Notify Ecology of selected contractor name and qualifications	<i>Completed, March 13, 2018</i>	A2
Submit written monthly Progress Reports	<i>Submitted 4/10/18 (QPR1); 7/9/18 (QPR2); 10/1/18 (QPR3)</i>	A3
Submit draft Pre-Remedial Design Project Plans (PRDI) ²	<i>Completed (included in draft EDR report)</i>	B1
Submit draft PRDI Data Report and draft Engineering Design Report (EDR) ³	<i>Completed, Feb 8, 2018(v1); March 15, 2018(v2)</i>	B2
Submit final PRDI Data Report and EDR	<i>Completed, April 24, 2018(v1); July 2018 (v2, addressing ECY's 6/5/18 comments). Approved EDR - August 28, 2018</i>	B3
Submit 90% plans and specs (per WAC 173-340-400(4)(b))	<i>Completed, same time as above</i>	B4
Submit 100% plans and specs	<i>Completed, same time as above</i>	B5
FIELD CONSTRUCTION (C)		EXH D ref
Complete construction procurement	<i>Completed; Feb 13, 2018 through March 2018</i>	C1
ERH System Installation	<i>Completed; Feb 13 through May 14, 2018</i>	C2
ERH Operation	In-progress; Started May 29, 2018	
Start install and begin operation of bioremediation-groundwater recirculation /SVE systems	In-progress; Started installation May 2018. System operation started August 2018 (refer to QPR#3 items C & D)	C3
Install compliance well monitoring network	Complete; July 2018	C4
Complete construction	In-progress	C5
Conduct ERH soil performance sampling	October 2018	C6
Contingent soil excavation in ERH treatment area	October to November 2018	C7
Decommission ERH and SVE system	Within 4 to 6 weeks of ERH final system shutdown	C8
Submit Cleanup Action Report and As-Built Drawings and Report; draft Institutional Control (IC) Plan; draft Environmental Covenants (s); and an updated Title Report	Within 60 days of decommission of ERH and SVE systems	C9

POST-CONSTRUCTION (D)		
Submit final IC Plan and final Environmental Covenants(s)	Within 30 days of Ecology's comments on draft IC Plan & draft Environmental Covenant	D1
Record the restrictive covenant with the office of the King County Auditor	Within 5 days after the later of Ecology's approval of the Final IC Plan or Ecology's signature on the Final Environmental Covenant	D2
Provide the original recorded restrictive covenant to Ecology	Within 30 days of the covenant recording date	-
Indoor Air Sampling of all occupied buildings on the site	May-July 2019, 2020, 2021	D3
Performance Groundwater Monitoring	June 2018 to June 2020 - Event#1 - September 2018	D4
Quarterly Performance Monitoring	June 2018 to June 2019 - Event#1 - September 2018	
Biannual Performance Monitoring	June 2019 to June 2020	
Decommission Bioremediation/Groundwater Recirculation system and monitoring wells	2020 to 2022 (if operation of bioremediation system is extended)	D5
Soil vapor sampling	2020	D6
Groundwater Confirmation Monitoring	2020-2024	D7
Quarterly Compliance Monitoring	June 2020 to June 2022	
As-Built Drawings and Report of vapor intrusion mitigation measures (vapor barrier and passive venting systems). And other engineering and institutional controls (if any)	Within 30 days of the City's receipt from the developer	D8
PERIODIC REVIEWS		
Meet with Ecology to discuss the status of the Site	Every 5 years after initiation of cleanup action (until 10 years after termination of the CD)	D9
Five Year Compliance Monitoring and Periodic Review reports	To follow Groundwater compliance monitoring (D.7). Groundwater monitoring required once every five years for the duration of the institutional controls on groundwater (if present) under the environmental covenant.	
Submit periodic review reports to Ecology documenting whether human health and the environment are being protected	At least 90 days prior to each periodic review meeting with Ecology (until 10 years after termination of the CD)	

1) Schedule is in calendar days. Deliverable due date may be modified with Ecology concurrence without amendment to the Consent Decree.

2) Project Plans include the following: Work Plan, Sampling and Analysis Plan, Quality Assurance Project Plan, and Health and Safety Plan, to be submitted for Ecology review and approval. All plans will include a schedule for implementation as applicable.

3) The Engineering Design Report includes: a Construction Quality Assurance Project Plan, a Compliance Monitoring and Contingency Response Plan, Proposed Best Management Practices, Water Quality Monitoring Plan, and Substantive Requirements of Procedural

Exhibit D
Site Schedule of Work and Deliverables

Deliverables		Due (Calendar Days)
A. Administrative		
A.1	Consent Decree entered by the King County Superior Court (Effective Date of the CD)	Within 5 days of the execution by the Parties
A.2	Notification of selected contractor name and qualifications	Within 5 days of the effective date of Consent Decree (A.1)
A.3	Progress Reports	Quarterly on the 10 th of the month beginning after the effective date of the Consent Decree (A.1)
A.4	Financial Assurances – submit cost estimate for Ecology review and approval	Within 60 days of the effective date of Consent Decree
A.5	Financial Assurances - provide proof of financial assurances	Within 60 days after Ecology approves cost estimate (A.4)
B. Design		
B.1	Draft Pre-Remedial Design (PRDI) Project Plans ²	Within 5 days of the effective date of Consent Decree (A.1)
B.2	Draft PRDI Data Report and Draft Engineering Design Report (EDR) ³	Within 5 days of Ecology approval of Final PRDI Project Plans (B.1)
B.3	Final PRDI Data Report and EDR Report	Within 5 days of receipt of Ecology's comments on the Draft PRDI Data and EDR Reports (B.2)
B.4	90 % Plans and Specs [per WAC 173-340-400(4)(b)]	Within 5 days of receipt of Ecology comments on Final EDR Report (B.3)
B.5	100 % Plans and Specs	Within 5 days of receipt of Ecology comments on 90 % plans and specifications (B.4)
C. Field Construction		
C.1	Complete Construction Procurement	Within 5 days of completion of the 100% plans and specifications (B.1)
C.2	ERH System installation	Within 2 months of the effective date of Consent Decree
	ERH Operation	Within 6 to 8 months of the effective date of Consent Decree
C.3	Start install and begin operation of bioremediation-groundwater recirculation/SVE systems	Within 2 months of the effective date of Consent Decree
C.4	Install compliance monitoring well network	Within 2 months of the effective date of Consent Decree
C.5	Complete Construction	Within 2 months of the effective date of Consent Decree
C.6	ERH soil performance sampling	Within 6 to 8 months of the effective date of Consent Decree
C.7	Contingent soil excavation in ERH treatment area	Within 6 to 9 months of the effective date of Consent Decree

C.8	Decommission ERH and SVE system	Within 4 to 6 weeks of ERH system final shutdown
C.9	Cleanup Action Report and As-Built Drawings and Report; Draft Institutional Control (IC) Plan; Draft Environmental Covenant(s); and an updated Title Report	Within 60 days of decommission of ERH and SVE systems (C.8)
D. Post Construction Work		
D.1	Final IC Plan and Final Environmental Covenant(s)	Within 30 days of receipt of Ecology comments on the Draft IC Plan and Draft Environmental Covenant(s).
D.2	Record Final Environmental Covenant(s) with King County Auditor	Within 5 days after Ecology's approval of the Final IC Plan or Ecology's signature as grantee of the Final Environmental Covenant(s), whichever occurs last.
D.3	Indoor Air Sampling of all occupied buildings on the site	May-July 2019, 2020,2021
D.4	Performance Groundwater Monitoring Quarterly Performance Monitoring Biannual Performance Monitoring	June 2018 to June 2020 June 2018 to June 2019 June 2019 to June 2020
D.5	Decommission Bioremediation/Groundwater Recirculation system and monitoring wells	2020 to 2022 (if operation of bioremediation system is extended)
D.6	Soil Vapor Sampling	2020
D.7	Groundwater Confirmation Monitoring Quarterly Compliance Monitoring	2020-2024 June 2020 to June 2022
D.8	As Built Drawings and Report of vapor intrusion mitigation measures (vapor barrier and passive venting systems), and other engineering and institutional controls (if any).	Within 30 days of the City's receipt from the developer
D.9	Five Year Compliance Monitoring and Periodic Review reports	To follow Groundwater compliance monitoring (D.7). Groundwater monitoring required once every five years for the duration of the institutional controls on groundwater (if present) under the environmental covenant.

- 1) *Schedule is in calendar days. Deliverable due date may be modified with Ecology concurrence without amendment to the Consent Decree.*
- 2) *Project Plans include the following: Work Plan, Sampling and Analysis Plan, Quality Assurance Project Plan, and Health and Safety Plan, to be submitted for Ecology review and approval. All plans will include a schedule for implementation as applicable.*
- 3) *The Engineering Design Report includes: a Construction Quality Assurance Project Plan, a Compliance Monitoring and Contingency Response Plan, Proposed Best Management Practices, Water Quality Monitoring Plan, and Substantive Requirements of Procedurally Exempt Permits. Ecology will not approve the Final EDR until the required permits have been obtained.*