

August 27, 2021

Mr. Marc Galland  
P.O. Box 582  
Montesano, Washington 98563-0582

RE: ***July 2021 Groundwater Monitoring Report***  
*Pick Rite Thriftway*  
211 East Pioneer Avenue  
Montesano, Washington 98563-4514  
Ecology VCP No. SW116

Dear Mr. Galland:

Associated Environmental Group, LLC (AEG) has prepared this ***July 2021 Groundwater Monitoring Report***, presenting a summary of the latest activities performed at the *Pick Rite Thriftway*, located at the above-referenced address in Montesano, Washington (Site). Selected Site wells are currently being monitored on an 18-month frequency in accordance with the No Further Action Letter issued by the Washington State Department of Ecology (Ecology) on August 24, 2015. The location of the Site is illustrated on Figure 1, *Vicinity Map*. Locations of Site features, monitoring wells, and groundwater gradients determined at the time of this sampling event are detailed in Figure 2, *Groundwater Elevation Contour Map 07/29/2021*.

**WORK PERFORMED [July 2021]:**

- Obtained depth to groundwater data in six groundwater wells (MW-1R, MW-3, MW-4, MW-5, MW-7, and TSMW-13).
- Purged and sampled six groundwater monitoring wells (MW-1R, MW-3, MW-4, MW-5, MW-7, and TSMW-13).

**WORK PROPOSED:**

- No additional work is currently proposed for the Site pending Ecology's Periodic Review.

**GROUNDWATER SUMMARY:**

Sampling Event:	July 2021	Values
Range of Depths to Groundwater:	13.42 to 15.81	Feet below top of well casing (Table 1, <i>Summary of Groundwater Elevations</i> )
Range of Groundwater Elevations:	19.35 to 21.33	Feet above Mean Sea Level (Table 1, <i>Summary of Groundwater Elevations</i> )
Groundwater Gradient: (Direction / Magnitude)	Southeast / 0.01	Feet per foot (ft/ft)
Measurable NAPL Detected:	No	
Measurable NAPL Thickness:	N/A	
Current Remedial Action:	None	

**DISCUSSION:**

Constituents of concern were detected in monitoring wells MW-1R, MW-3, and MW-7 during the July 2021 sampling event. Detected concentrations are summarized below. Analytical results for this sampling event, and historical analytical results, are presented in the attached Table 2, *Summary of Groundwater Analytical Results*. Full laboratory analytical results for this sampling are presented in the attached Appendix A, Laboratory Datasheets.

July 29, 2021					
Well ID	Gasoline TPH (µg/L)	Benzene (µg/L)	Toluene (µg/L)	Ethylbenzene (µg/L)	Total Xylenes (µg/L)
MW-1R	<b>190</b>	<1.0	<2.0	<1.0	<2.0
MW-3	<b>1,400</b>	<1.0	<2.0	<1.0	<2.0
MW-7	<b>3,100</b>	<1.0	<2.0	<1.0	<2.0
MTCA Method A Cleanup Levels	800	5	1,000	700	1,000

µg/L = micrograms per liter

The calculated groundwater gradient for the July 2021 sampling event is primarily towards the southeast, with an approximate gradient of 0.01 feet per foot (Figure 2, *Groundwater Elevation Contour Map 07/29/2021*).

**CONCLUSIONS:**

A total of four groundwater monitoring events have been performed at the Site on an 18-month frequency since the NFA Letter was issued on August 24, 2015. For Sites with institutional controls, such as this one, Ecology is to perform a Periodic Review every five years to determine whether the Site is still considered protective of all exposure pathways. While MW-3 and MW-7 exceeded the MTCA Method A cleanup level for gasoline-range petroleum hydrocarbons (TPH), no benzene is present (suggesting very old gasoline), and downgradient wells MW-4 and MW-5 are non-detect. Based on this data, it appears the plume is stable.

As part of Ecology’s Periodic Review, on behalf of our client, AEG would request Ecology consider either discontinuing monitoring altogether or at least reducing the monitoring frequency. Pending Ecology Periodic review, no additional monitoring events are planned at this time.

**CLOSING:**

AEG has completed this monitoring event at the Site. Thank you for the opportunity to provide you with environmental consulting services. Should you have questions or require additional information, please contact our office at 360-352-9835.

Sincerely,

**Associated Environmental Group, LLC**



John Schenk  
Staff Scientist



Scott Rose, L.H.G.  
Senior Hydrogeologist

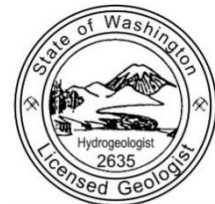

SCOTT | ROSE

- Attachments: Figure 1 – *Vicinity Map*  
Figure 2 – *Groundwater Elevation Contour Map 07/29/2021*  
Table 1 – *Summary of Groundwater Elevations*  
Table 2 – *Summary of Groundwater Analytical Results*  
Appendix A – *Supporting Documents*  
*Laboratory Datasheets*

## **FIGURES**

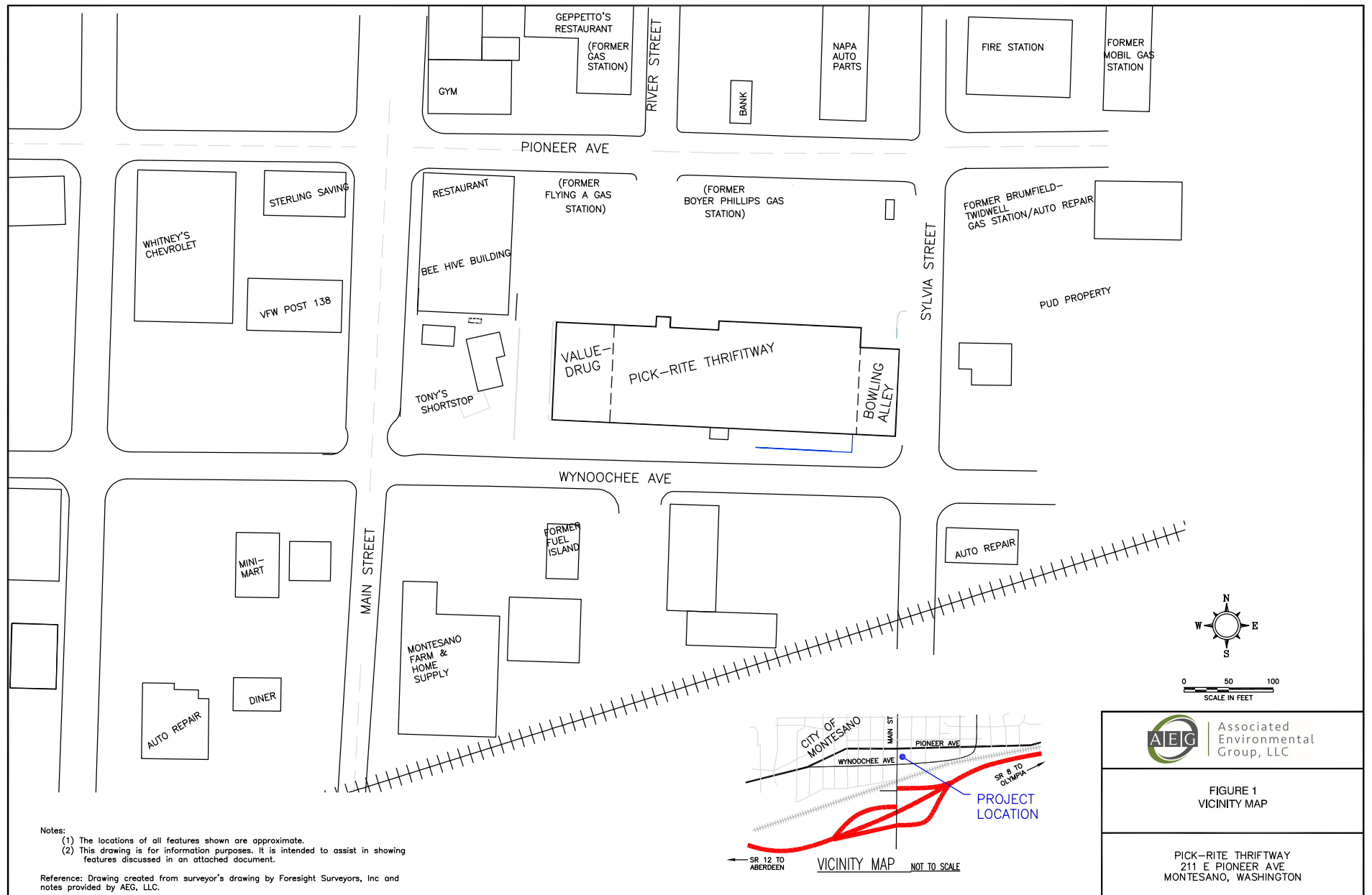

Notes:  
 (1) The locations of all features shown are approximate.  
 (2) This drawing is for information purposes. It is intended to assist in showing features discussed in an attached document.

Reference: Drawing created from surveyor's drawing by Foresight Surveyors, Inc and notes provided by AEG, LLC.

**AEG** | Associated Environmental Group, LLC

FIGURE 1  
VICINITY MAP

PICK-RITE THRIFTWAY  
 211 E PIONEER AVE  
 MONTESANO, WASHINGTON

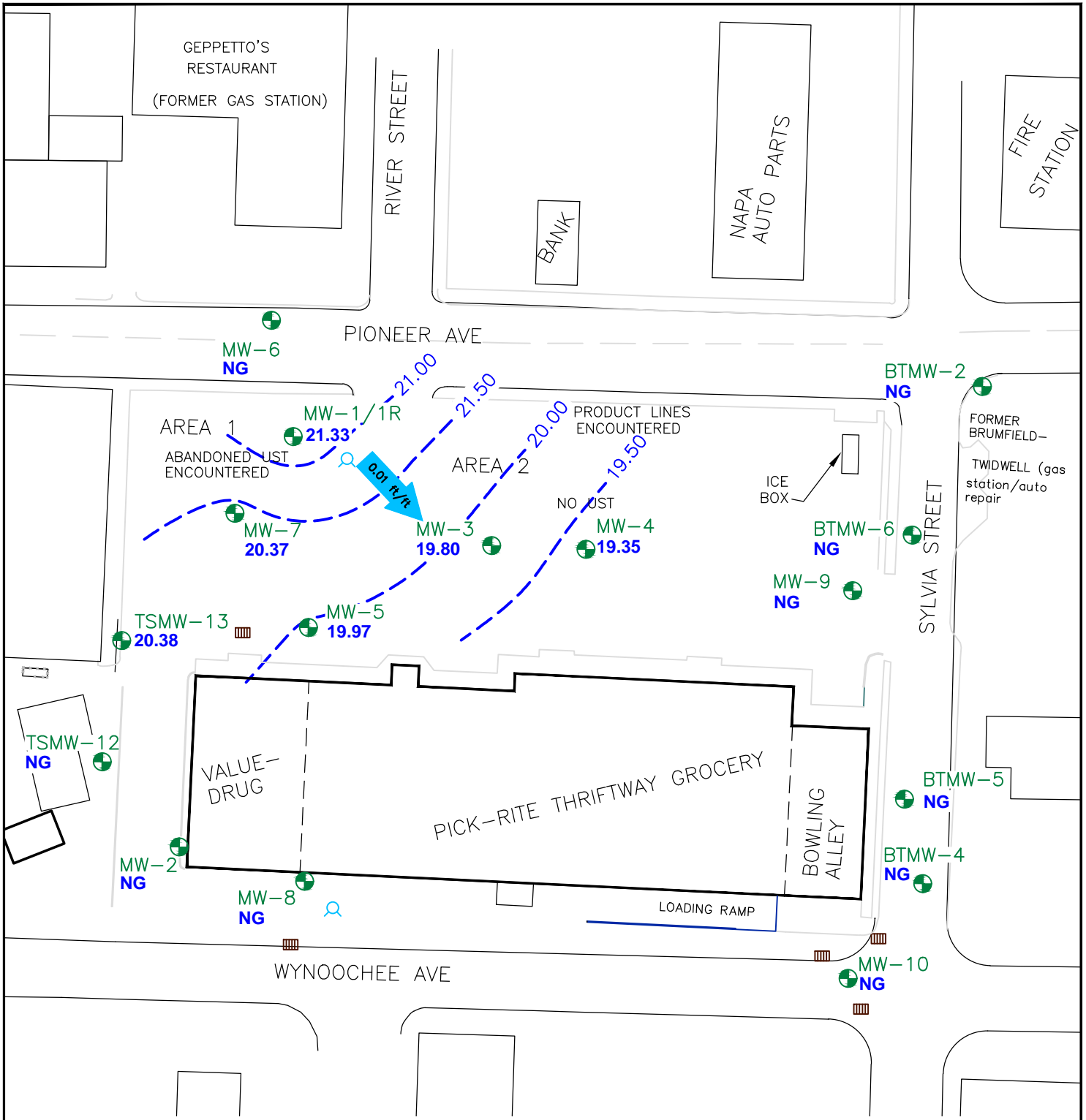

**LEGEND**

- MW-1 MONITORING WELLS BY AEG
- 20.38 GROUNDWATER ELEVATION (FEET)
- 20.00 - - - - INFERRED GROUNDWATER ELEVATION CONTOUR LINE (FEET)

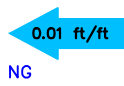

CONTOUR INTERVAL=0.50 FEET  
 APPROXIMATE GROUNDWATER GRADIENT DIRECTION (ft/ft)  
 NOT GAUGED

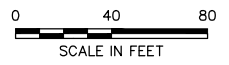
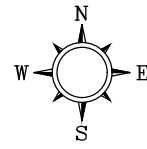

Associated Environmental Group, LLC

---

FIGURE 2  
 GROUNDWATER ELEVATION CONTOUR MAP  
 07/29/2021

---

PICK-RITE THRIFTWAY  
 211 E PIONEER AVE  
 MONTESANO, WASHINGTON

Notes:  
 (1) The locations of all features shown are approximate.  
 (2) This drawing is for information purposes. It is intended to assist in showing features discussed in an attached document.

Reference: Drawing created from surveyor's drawing by PACIFIC GEOMATIC SERVICES, Inc and notes provided by AEG, LLC.

## **TABLES**

**Table 1 - Summary of Groundwater Elevations**  
 Pick-Rite Thriftway  
 Montesano, WA

Well Number/ TOC Elevation (feet)	Date of Measurement	Depth to Water (feet)	Depth to Free Product (feet)	Free Product Thickness (feet)	Groundwater Elevation (feet)	Change in Elevation (feet)
MW-1 <sup>1,3</sup>	12/1/2010	13.62	--	--	23.52	--
<b>37.14</b>	3/8/2011	13.60	--	--	23.54	0.02
	6/9/2011	14.24	--	--	22.90	-0.64
MW-1R	1/22/2013	14.08	--	--	23.06	--
<b>37.14</b>	4/23/2013	13.86	--	--	23.28	0.22
	7/23/2013	15.37	--	--	21.77	-1.51
	10/22/2013	14.88	--	--	22.26	0.49
	1/22/2014	14.12	--	--	23.02	0.76
	6/23/2014	15.01	--	--	22.13	-0.89
	2/11/2015	13.05	--	--	24.09	1.96
	2/9/2017	12.42	--	--	24.72	0.63
	8/20/2018	16.33	--	--	20.81	-3.91
	1/9/2020	12.61	--	--	24.53	3.72
	7/29/2021	15.81	--	--	21.33	-3.20
MW-2 <sup>3,4</sup>	12/1/2010	11.85	--	--	20.53	--
<b>32.38</b>	3/8/2011	11.78	--	--	20.60	0.07
	6/9/2011	12.14	--	--	20.24	-0.36
	1/22/2013	11.52	--	--	20.86	0.62
	4/23/2013	11.41	--	--	20.97	0.11
MW-2R <sup>3,5</sup>	7/23/2013	12.35	--	--	20.05	--
<b>32.40</b>	10/22/2013	12.08	--	--	20.32	0.27
	1/22/2014	11.65	--	--	20.75	0.43
	6/23/2014	12.26	--	--	20.14	-0.61
	2/11/2015	11.06	--	--	21.34	1.20
MW-3	12/1/2010	14.52	--	--	20.86	--
<b>35.38</b>	3/8/2011	14.58	--	--	20.80	-0.06
	6/9/2011	15.32	--	--	20.06	-0.74
	1/22/2013	14.49	--	--	20.89	0.83
	4/23/2013	14.33	--	--	21.05	0.16
	7/23/2013	15.59	--	--	19.79	-1.26
	10/22/2013	15.16	--	--	20.22	0.43
	1/22/2014	14.54	--	--	20.84	0.62
	6/23/2014	15.42	--	--	19.96	-0.88
	2/11/2015	13.87	--	--	21.51	1.55
	2/9/2017	13.68	--	--	21.70	0.19
	8/20/2018	15.97	--	--	19.41	-2.29
	1/9/2020	13.00	--	--	22.38	2.97
	7/29/2021	15.58	--	--	19.80	-2.58
MW-4	12/1/2010	14.65	--	--	20.31	--
<b>34.96</b>	3/8/2011	14.84	--	--	20.12	-0.19
	6/9/2011	15.45	--	--	19.51	-0.61
	1/22/2013	13.69	--	--	21.27	1.76
	4/23/2013	14.45	--	--	20.51	-0.76
	7/23/2013	15.72	--	--	19.24	-1.27
	1/22/2014	14.86	--	--	20.10	0.86
	2/11/2015	14.27	--	--	20.69	0.59
	2/9/2017	13.61	--	--	21.35	0.66
	8/20/2018	16.14	--	--	18.82	-2.53
	1/9/2020	13.33	--	--	21.63	2.81
	7/29/2021	15.61	--	--	19.35	-2.28



**Table 1 - Summary of Groundwater Elevations**  
 Pick-Rite Thriftway  
 Montesano, WA

Well Number/ TOC Elevation (feet)	Date of Measurement	Depth to Water (feet)	Depth to Free Product (feet)	Free Product Thickness (feet)	Groundwater Elevation (feet)	Change in Elevation (feet)
MW-5	12/1/2010	12.70	--	--	20.69	--
<b>33.39</b>	3/8/2011	12.70	--	--	20.69	0.00
	6/9/2011	13.20	--	--	20.19	-0.50
	1/22/2013	12.27	--	--	21.12	0.93
	4/23/2013	12.11	--	--	21.28	0.16
	7/23/2013	13.24	--	--	20.15	-1.13
	1/22/2014	12.32	--	--	21.07	0.92
	6/23/2014	13.00	--	--	20.39	-0.68
	2/11/2015	11.71	--	--	21.68	1.29
	2/9/2017	11.65	--	--	21.74	0.06
	8/20/2018	13.83	--	--	19.56	-2.18
	1/9/2020	11.22	--	--	22.17	2.61
	7/29/2021	13.42	--	--	19.97	-2.20
MW-6 <sup>3</sup>	12/1/2010	12.98	--	--	25.38	--
<b>38.36</b>	3/8/2011	13.20	--	--	25.16	-0.22
	6/9/2011	14.08	--	--	24.28	-0.88
	1/22/2013	13.35	--	--	25.01	0.73
	4/23/2013	13.09	--	--	25.27	0.26
	7/23/2013	14.89	--	--	23.47	-1.80
	1/22/2014	13.37	--	--	24.99	1.52
	2/11/2015	12.62	--	--	25.74	0.75
MW-7	12/1/2010	14.29	--	--	21.62	--
<b>35.91</b>	3/8/2011	14.38	--	--	21.53	-0.09
	6/9/2011	14.91	--	--	21.00	-0.53
	1/22/2013	14.26	--	--	21.65	0.65
	4/23/2013	14.14	--	--	21.77	0.12
	7/23/2013	15.23	--	--	20.68	-1.09
	10/22/2013	14.89	--	--	21.02	0.34
	1/22/2014	14.38	--	--	21.53	0.51
	6/23/2014	15.10	--	--	20.81	-0.72
	2/11/2015	13.73	--	--	22.18	1.37
	2/9/2017	13.55	--	--	22.36	0.18
	8/20/2018	15.86	--	--	20.05	-2.31
	1/9/2020	13.24	--	--	22.67	2.62
	7/29/2021	15.54	--	--	20.37	-2.30
MW-8 <sup>3,4</sup>	12/1/2010	10.78	--	--	19.64	--
<b>30.42</b>	3/8/2011	10.85	--	--	19.57	-0.07
	6/9/2011	11.26	--	--	19.16	-0.41
	1/22/2013	10.62	--	--	19.80	0.64
	4/23/2013	10.43	--	--	19.99	0.19
MW-8R <sup>3,5</sup>	7/23/2013	11.33	--	--	19.24	--
<b>30.57</b>	1/22/2014	10.71	--	--	19.86	0.62
	6/23/2014	11.27	--	--	19.30	-0.56
	2/11/2015	10.05	--	--	20.52	1.22
MW-9 <sup>2,3</sup>	12/1/2010	15.29	--	--	18.64	--
<b>33.93</b>	3/8/2011	15.72	--	--	18.21	-0.43
	6/9/2011	16.29	--	--	17.64	-0.57
MW-10 <sup>2,3</sup>	12/1/2010	8.40	--	--	16.45	--
<b>24.85</b>	3/8/2011	8.80	--	--	16.05	-0.40
	6/9/2011	9.30	--	--	15.55	-0.50

**Table 1 - Summary of Groundwater Elevations**  
 Pick-Rite Thriftway  
 Montesano, WA

Well Number/ TOC Elevation (feet)	Date of Measurement	Depth to Water (feet)	Depth to Free Product (feet)	Free Product Thickness (feet)	Groundwater Elevation (feet)	Change in Elevation (feet)
TSMW-13	10/10/2007	15.23	--	--	19.71	--
<b>34.94</b>	3/11/2008	14.25	--	--	20.69	0.98
	7/30/2008	14.95	--	--	19.99	-0.70
	11/18/2008	13.88	--	--	21.06	1.07
	1/18/2010	13.34	--	--	21.60	0.54
	6/23/2014	14.25	--	--	20.69	-0.91
	2/9/2017	12.92	--	--	22.02	1.33
	8/20/2018	14.84	--	--	20.10	-1.92
	1/9/2020	12.78	--	--	22.16	2.06
	7/29/2021	14.56	--	--	20.38	-1.78

Notes:

TOC = Top of casing elevation relative to assigned benchmark.

-- = Not measured, not available, or not applicable

<sup>1</sup>Monitoring well MW-1 was removed during underground storage tank decommissioning/contaminated soil excavation and replaced with MW-1R.

<sup>2</sup>Monitored by the former Brumfield-Twidwell (BT) facility as agreed by Ecology, Pick Rite, and BT owner.

<sup>3</sup>Ceased monitoring at this well.

<sup>4</sup>Well monument damaged and was reset.

<sup>5</sup>Wells MW-2 and MW-8 were re-surveyed after repairing monuments

**Table 2 - Summary of Groundwater Analytical Results**  
 Pick-Rite Thriftway  
 Montesano, WA

Well Number	Date Sampled	Total Petroleum Hydrocarbons			Select Volatile Organic Compounds			
		Gasoline	Diesel	Heavy Oil	Benzene	Toluene	Ethylbenzene	Total Xylenes
MW-1 <sup>2,3</sup>	12/1/2010	<b>1,910</b>	--	--	<b>19.7</b>	<b>34.1</b>	<b>7.6</b>	<b>70.2</b>
	3/8/2011	<b>687</b>	--	--	<b>14.0</b>	<b>24.6</b>	<b>16.3</b>	<b>25.4</b>
	6/9/2011	<b>460</b>	--	--	<b>2.1</b>	<b>9.5</b>	<1.0	<b>26.2</b>
MW-1R	1/22/2013	<100	--	--	<1.0	<2.0	<1.0	<3.0
	4/23/2013	<100	--	--	<1.0	<2.0	<1.0	<2.0
	7/23/2013	<100	--	--	<1.0	<2.0	<1.0	<3.0
	10/22/2013	<b>972</b>	--	--	<b>1.5</b>	<2.0	<b>14.0</b>	<b>13.0</b>
	1/22/2014	<100	--	--	<1.0	<2.0	<1.0	<2.0
	6/23/2014	<100	--	--	<1.0	<2.0	<1.0	<2.0
	2/11/2015	<100	<200	<400	<1.0	<2.0	<1.0	<2.0
	2/9/2017	<100	--	--	<1.0	<2.0	<1.0	<2.0
	8/20/2018	<100	--	--	<1.0	<2.0	<1.0	<2.0
	1/9/2020	<b>1,670</b>	<200	<400	<1.0	<2.0	<1.0	<b>4.9</b>
7/29/2021	<b>190</b>	--	--	<1.0	<2.0	<1.0	<2.0	
MW-2 <sup>3</sup>	12/1/2010	<b>4,400</b>	--	--	<b>11.1</b>	<b>281</b>	<b>76.1</b>	<b>676</b>
	3/8/2011	<b>3,970</b>	--	--	<b>14.2</b>	<b>200</b>	<b>27.8</b>	<b>1,400</b>
	6/9/2011	<b>26,700</b>	--	--	<1.0	<b>1,570</b>	<b>1,710</b>	<b>6,750</b>
	1/22/2013	<b>2,950</b>	--	--	<b>10.0</b>	<b>74</b>	<b>44</b>	<b>18.0</b>
	4/23/2013	<b>37,000</b>	--	--	<1.0	<b>267</b>	<b>660</b>	<b>2,850</b>
MW-2R <sup>3</sup>	7/23/2013	<b>56,500</b>	--	--	<b>63.9</b>	<b>873</b>	<b>1,470</b>	<b>5,090</b>
	10/22/2013	<b>27,400</b>	--	--	<1.0	<b>348</b>	<b>872</b>	<b>3,440</b>
	6/23/2014	<b>13,600</b>	--	--	<1.0	<b>315</b>	<b>495</b>	<b>4,390</b>
	2/11/2015	<b>32,300</b>	<200	<400	<1.0	<b>178</b>	<b>11</b>	<b>11,300</b>
MW-3	12/1/2010	<b>1,170</b>	--	--	<b>22.4</b>	<b>7.6</b>	<b>8.2</b>	<b>18.2</b>
	3/8/2011	<b>695</b>	--	--	<b>12.3</b>	<b>2.9</b>	<b>2.7</b>	<b>11.8</b>
	6/9/2011	<b>1,550</b>	--	--	<1.0	<2.0	<b>1.8</b>	<b>4</b>
	1/22/2013	<b>1,690</b>	--	--	<b>14</b>	<b>8</b>	<b>7</b>	<b>24</b>
	4/23/2013	<b>3,890</b>	--	--	<b>1.1</b>	<b>1.3</b>	<b>4.6</b>	<b>15.5</b>
	7/23/2013	<b>5,410</b>	--	--	<b>56</b>	<b>16.2</b>	<b>10.7</b>	<b>29.5</b>
	10/23/2013	<b>1,890</b>	--	--	<1.0	<2.0	<b>3.2</b>	<b>6.2</b>
	1/22/2014	<b>1,600</b>	--	--	<1.0	<2.0	<b>3.0</b>	<b>4.2</b>
	2/11/2015	<b>4,350</b>	<200	<400	<1.0	<b>1.1</b>	<b>4.7</b>	<b>4.6</b>
	2/9/2017	<b>3,700</b>	--	--	<b>1.0</b>	<2.0	<b>3.1</b>	<b>2.4</b>
	8/20/2018	<b>3,780</b>	--	--	<b>1.5</b>	<2.0	<b>2.5</b>	<b>13</b>
	1/9/2020	<b>3,290</b>	<200	<400	<1.0	<2.0	<b>1.4</b>	<2.0
	7/29/2021	<b>1,400</b>	--	--	<1.0	<2.0	<1.0	<2.0
MW-4	12/1/2010	<100	--	--	<1.0	<2.0	<1.0	<3.0
	3/8/2011	<100	--	--	<1.0	<2.0	<1.0	<3.0
	6/9/2011	<100	--	--	<1.0	<2.0	<1.0	<3.0
	1/22/2013	<b>156</b>	--	--	<1.0	<2.0	<1.0	<b>4.0</b>
	4/23/2013	<b>197</b>	--	--	<1.0	<2.0	<1.0	<2.0
	7/23/2013	<b>105</b>	--	--	<1.0	<b>5.6</b>	<1.0	<3.0
	1/22/2014	<100	--	--	<1.0	<2.0	<1.0	<2.0
	2/9/2017	<100	--	--	<1.0	<2.0	<1.0	<2.0
	8/20/2018	<100	--	--	<1.0	<2.0	<1.0	<2.0
	1/9/2020	<b>156</b>	--	--	<1.0	<2.0	<1.0	<2.0
	7/29/2021	<100	--	--	<1.0	<2.0	<1.0	<2.0

**Table 2 - Summary of Groundwater Analytical Results**  
 Pick-Rite Thriftway  
 Montesano, WA

Well Number	Date Sampled	Total Petroleum Hydrocarbons			Select Volatile Organic Compounds			
		Gasoline	Diesel	Heavy Oil	Benzene	Toluene	Ethyl-benzene	Total Xylenes
MW-5	12/1/2010	<b>106</b>	--	--	<1.0	<b>6.6</b>	<b>6.0</b>	<b>22.1</b>
	3/8/2011	<100	--	--	<1.0	<2.0	<1.0	<3.0
	6/9/2011	<b>540</b>	--	--	<1.0	<b>5.9</b>	<b>8.6</b>	<b>34</b>
	1/22/2013	<100	--	--	<1.0	<2.0	<1.0	<3.0
	4/23/2013	<100	--	--	<1.0	<2.0	<1.0	<2.0
	7/23/2013	<b>165</b>	--	--	<1.0	<b>2.3</b>	<b>2.2</b>	<b>16.4</b>
	1/22/2014	<100	--	--	<1.0	<2.0	<1.0	<2.0
	6/23/2014	<100	--	--	<1.0	<2.0	<1.0	<2.0
	2/11/2015	<100	<200	<400	<1.0	<2.0	<1.0	<2.0
	2/9/2017	<100	--	--	<1.0	<2.0	<1.0	<2.0
	8/20/2018	<100	--	--	<1.0	<2.0	<1.0	<2.0
	1/9/2020	<100	<200	<400	<1.0	<2.0	<1.0	<2.0
	7/29/2021	<100	--	--	<1.0	<2.0	<1.0	<2.0
MW-6 <sup>3</sup>	12/1/2010	<100	--	--	<1.0	<2.0	<b>1.7</b>	<b>9.2</b>
	3/8/2011	<100	--	--	<1.0	<2.0	<1.0	<3.0
	6/9/2011	<100	--	--	<1.0	<2.0	<1.0	<3.0
	1/22/2013	<100	--	--	<1.0	<2.0	<1.0	<3.0
	4/23/2013	<100	--	--	<1.0	<2.0	<1.0	<2.0
	7/23/2013	<100	--	--	<1.0	<2.0	<1.0	<3.0
MW-7	12/1/2010	<b>2,820</b>	--	--	<b>50.9</b>	<b>19.8</b>	<b>13.2</b>	<b>48.7</b>
	3/8/2011	<b>1,740</b>	--	--	<b>36.3</b>	<b>12.1</b>	<b>14</b>	<b>31.7</b>
	6/9/2011	<b>5,450</b>	--	--	<b>9.9</b>	<b>5.5</b>	<b>3.8</b>	<b>16.8</b>
	1/22/2013	<b>5,040</b>	--	--	<b>37</b>	<b>30</b>	<b>23</b>	<b>87</b>
	4/23/2013	<b>7,640</b>	--	--	<b>4.2</b>	<b>2.5</b>	<b>6.9</b>	<b>38.8</b>
	7/23/2013	<b>13,700</b>	--	--	<b>129</b>	<b>45.4</b>	<b>37.9</b>	<b>126</b>
	10/22/2013	<b>7,330</b>	--	--	<b>2.0</b>	<2.0	<b>3.3</b>	<b>22</b>
	1/22/2014	<b>2,930</b>	--	--	<1	<2.0	<b>3.8</b>	<b>16.9</b>
	6/23/2014	<b>3,880</b>	--	--	<b>1.1</b>	<2.0	<b>4.2</b>	<b>13</b>
	2/11/2015	<b>3,650</b>	<200	<400	<1.0	<1.0	<b>5.1</b>	<b>4.8</b>
	2/9/2017	<b>2,450</b>	--	--	<1.0	<2.0	<1.0	<2.0
	8/20/2018	<b>12,300</b>	--	--	<1.0	<2.0	<1.0	<2.0
	1/9/2020	<b>2,330</b>	<200	<400	<1.0	<2.0	<1.0	<2.0
7/29/2021	<b>3,100</b>	--	--	<1.0	<2.0	<1.0	<2.0	
MW-8 <sup>3</sup>	12/1/2010	<100	--	--	<1.0	<2.0	<1.0	<3.0
	3/8/2011	<100	--	--	<1.0	<2.0	<1.0	<3.0
	6/9/2011	<100	--	--	<1.0	<2.0	<1.0	<3.0
	1/22/2013	<100	--	--	<1.0	<2.0	<1.0	<3.0
	4/23/2013	<100	--	--	<1.0	<2.0	<1.0	<2.0
	7/23/2013	<100	--	--	<1.0	<2.0	<1.0	<3.0
MW-9 <sup>1,3</sup>	12/1/2010	<b>4,133</b>	--	--	<b>43.6</b>	<b>75.8</b>	<b>232</b>	<b>413</b>
	3/8/2011	<b>5,180</b>	--	--	<b>35.8</b>	<b>63.2</b>	<b>500</b>	<b>13,300</b>
	6/9/2011	<b>9,240</b>	--	--	<1.0	<b>34.4</b>	<b>450</b>	<b>1,460</b>
	4/11/2012	<b>1,430</b>	--	--	<1.0	<1.0	<b>13.9</b>	<b>45</b>
	8/16/2012	<b>894</b>	--	--	<1.0	<1.0	<b>9.1</b>	<b>41.8</b>
	10/31/2012	<b>1,120</b>	--	--	<1.0	<1.0	<b>6.0</b>	<b>28.7</b>
	1/31/2013	<b>482</b>	--	--	<1.0	<1.0	<b>2.0</b>	<b>9.4</b>
MW-10 <sup>1,3</sup>	12/1/2010	<100	--	--	<1.0	<2.0	<1.0	<3.0
	3/8/2011	<100	--	--	<1.0	<2.0	<1.0	<3.0
	6/9/2011	<100	--	--	<1.0	<2.0	<1.0	<3.0
	4/11/2012	<100	--	--	<1.0	<1.0	<1.0	<1.0
	8/16/2012	<100	--	--	<1.0	<1.0	<1.0	<1.0
	10/31/2012	<100	--	--	<1.0	<1.0	<1.0	<1.0
	4/26/2014	<100	--	--	<1.0	<1.0	<1.0	<1.0

**Table 2 - Summary of Groundwater Analytical Results**  
 Pick-Rite Thriftway  
 Montesano, WA

Well Number	Date Sampled	Total Petroleum Hydrocarbons			Select Volatile Organic Compounds			
		Gasoline	Diesel	Heavy Oil	Benzene	Toluene	Ethyl-benzene	Total Xylenes
TSMW-13 (Tony's Short Stop Well)	10/10/2007	<100	--	--	<1.0	<1.0	<1.0	<1.0
	3/11/2008	<100	--	--	<1.0	<1.0	<1.0	<1.0
	7/30/2008	<100	--	--	<1.0	<1.0	<1.0	<1.0
	11/18/2008	<b>630</b>	--	--	<b>26.4</b>	<b>93.7</b>	<b>16.9</b>	<b>161</b>
	6/23/2014	<100	--	--	<1.0	<2.0	<1.0	<2.0
	2/9/2017	<100	--	--	<1.0	<2.0	<1.0	<2.0
	8/20/2018	<100	--	--	<1.0	<2.0	<1.0	<2.0
	1/9/2020	<100	<200	<400	<1.0	<2.0	<1.0	<2.0
	7/29/2021	<100	--	--	<1.0	<2.0	<1.0	<2.0
PQL		100	200	400	1.0	2.0	1.0	1.0 / 2.0 / 3.0
MTCA Method A Cleanup Levels		800*	500	500	5	1,000	700	1,000

Notes:

All values presented in micrograms per liter (µg/L)

-- = Not analyzed for constituent

< = Not detected at the listed laboratory detection limits

PQL = Practical Quantification Limit (laboratory detection limit)

**Red Bold** indicates the detected concentration exceeds Ecology MTCA Method A cleanup level

**Bold** indicates the detected concentration is below Ecology MTCA Method A cleanup levels

\*TPH-Gasoline Cleanup Level with the presence of Benzene anywhere at the Site

<sup>1</sup> Monitored by the former Brumfield-Twidwell (BT) facility as agreed by Ecology, Pick Rite, and BT owner.

<sup>2</sup> Monitoring well MW-1 was removed during underground storage tank decommissioning/contaminated soil excavation and replaced with MW-1R.

<sup>3</sup> Ceased monitoring at this well for this Site.

## APPENDIX A

### Supporting Documents:

*Laboratory Datasheets*



# Libby Environmental, Inc.

3322 South Bay Road NE • Olympia, WA 98506-2957

August 3, 2021

Scott Rose  
Associated Environmental Group, LLC  
2633 Parkmont Lane SW, Suite A  
Olympia, WA 98502

Dear Mr. Rose:

Please find enclosed the analytical data report for the Pick Rite Thriftway Project located in Montesano, Washington.

The results of the analyses are summarized in the attached tables. Applicable detection limits and QA/QC data are included. The sample(s) will be disposed of within 30 days unless we are contacted to arrange long term storage.

Libby Environmental, Inc. appreciates the opportunity to have provided analytical services for this project. If you have any further questions about the data report, please give me a call. It was a pleasure working with you on this project, and we are looking forward to the next opportunity to work together.

Sincerely,

Sherry L. Chilcutt  
*Senior Chemist*  
*Libby Environmental, Inc.*

# Libby Environmental, Inc.

PICK RITE THRIFTWAY PROJECT  
AEG, LLC  
Montesano, Washington  
Libby Project # L210729-1  
Client Project # 10-126

3322 South Bay Road NE  
Olympia, WA 98506  
Phone: (360) 352-2110  
FAX: (360) 352-4154  
Email: libbyenv@gmail.com

## Analyses of Gasoline (NWTPH-Gx) & BTEX (EPA Method 8260D) in Water

Sample Description	Method	MW-1R	MW-3	MW-3 Dup	MW-4	MW-5	
	Blank						
Date Sampled	N/A	7/29/2021	7/29/2021	7/29/2021	7/29/2021	7/29/2021	
Date Analyzed	PQL (µg/L)	8/2/2021 (µg/L)	8/2/2021 (µg/L)	8/2/2021 (µg/L)	8/2/2021 (µg/L)	8/2/2021 (µg/L)	
Benzene	1.0	nd	nd	nd	nd	nd	
Toluene	2.0	nd	nd	nd	nd	nd	
Ethylbenzene	1.0	nd	nd	nd	nd	nd	
Total Xylenes	2.0	nd	nd	nd	nd	nd	
Gasoline	100	nd	190	1400	1400	nd	
Surrogate Recovery							
Dibromofluoromethane	108	89	97	83	102	91	
1,2-Dichloroethane-d4	102	97	100	95	96	98	
Toluene-d8	101	99	104	103	101	99	
4-Bromofluorobenzene	91	100	101	101	93	92	

"nd" Indicates not detected at listed detection limit.

"int" Indicates that interference prevents determination.

ACCEPTABLE RECOVERY LIMITS FOR SURROGATE : 65% TO 135%

ANALYSES PERFORMED BY: Melissa Harrington



# Libby Environmental, Inc.

3322 South Bay Road NE

Olympia, WA 98506

Phone: (360) 352-2110

FAX: (360) 352-4154

Email: libbyenv@gmail.com

PICK RITE THRIFTWAY PROJECT

AEG, LLC

Montesano, Washington

Libby Project # L210729-1

Client Project # 10-126

## Analyses of Gasoline (NWTPH-Gx) & BTEX (EPA Method 8260D) in Water

Sample Description		MW-7	TSMW-13
Date Sampled		7/29/2021	7/29/2021
Date Analyzed	PQL	8/2/2021	8/2/2021
	(µg/L)	(µg/L)	(µg/L)
Benzene	1.0	nd	nd
Toluene	2.0	nd	nd
Ethylbenzene	1.0	nd	nd
Total Xylenes	2.0	nd	nd
Gasoline	100	3100	nd
Surrogate Recovery			
Dibromofluoromethane		83	103
1,2-Dichloroethane-d4		104	96
Toluene-d8		112	101
4-Bromofluorobenzene		107	92

"nd" Indicates not detected at listed detection limit.

"int" Indicates that interference prevents determination.

ACCEPTABLE RECOVERY LIMITS FOR SURROGATE : 65% TO 135%

ANALYSES PERFORMED BY: Melissa Harrington

# Libby Environmental, Inc.

3322 South Bay Road NE

Olympia, WA 98506

Phone: (360) 352-2110

FAX: (360) 352-4154

Email: libbyenv@gmail.com

PICK RITE THRIFTWAY PROJECT

AEG, LLC

Montesano, Washington

Libby Project # L210729-1

Client Project # 10-126

## QA/QC for Gasoline (NWTPH-Gx) & BTEX (EPA Method 8260D) in Water

### Matrix Spike Sample Identification: MW-3

Date Analyzed: 8/2/2021

	Spiked Conc. (µg/L)	MS Response (µg/L)	MSD Response (µg/L)	MS Recovery (%)	MSD Recovery (%)	RPD (%)	Limits Recovery (%)	Data Flag
Benzene	5.0	4.2	4.0	84	80	4.9	65-135	
Toluene	5.0	4.5	4.1	90	82	9.3	65-135	
Ethylbenzene	5.0	4.5	4.4	90	88	2.2	65-135	
Total Xylenes	15.0	14.5	13.7	97	91	5.7	65-135	

### Surrogate Recovery (%)

	MS	MSD	Limits
Dibromofluoromethane	93	98	65-135
1,2-Dichloroethane-d4	96	98	65-135
Toluene-d8	103	104	65-135
4-Bromofluorobenzene	102	108	65-135

ACCEPTABLE RPD IS 35%

ANALYSES PERFORMED BY: Melissa Harrington

### Laboratory Control Sample

Date Analyzed: 8/2/2021

	Spiked Conc. (µg/L)	LCS Response (µg/L)	LCS Recovery (%)	LCS Recovery Limits (%)	Data Flag
Benzene	5.0	4.6	92	80-120	
Toluene	5.0	4.5	90	80-120	
Ethylbenzene	5.0	4.2	84	80-120	
Total Xylenes	15.0	14.1	94	80-120	

### Surrogate Recovery

Dibromofluoromethane	101	65-135
1,2-Dichloroethane-d4	101	65-135
Toluene-d8	99	65-135
4-Bromofluorobenzene	99	65-135

ANALYSES PERFORMED BY: Melissa Harrington

# Libby Environmental, Inc.

3322 South Bay Road NE

Olympia, WA 98506

Phone: (360) 352-2110

FAX: (360) 352-4154

Email: libbyenv@gmail.com

PICK RITE THRIFTWAY PROJECT

AEG, LLC

Libby Project # L210729-1

Date Received 7/29/21 1501

Received By RJK

## Sample Receipt Checklist

### Chain of Custody

1. Is the Chain of Custody complete?  Yes  No
2. How was the sample delivered?  Hand Delivered  Picked Up  Shipped

### Log In

3. Cooler or Shipping Container is present.  Yes  No  N/A
4. Cooler or Shipping Container is in good condition.  Yes  No  N/A
5. Cooler or Shipping Container has Custody Seals present.  Yes  No  N/A
6. Was an attempt made to cool the samples?  Yes  No  N/A
7. Temperature of cooler (0°C to 8°C recommended) 6.5 °C
8. Temperature of sample(s) (0°C to 8°C recommended) 7.5 °C
9. Did all containers arrive in good condition (unbroken)?  Yes  No
10. Is it clear what analyses were requested?  Yes  No
11. Did container labels match Chain of Custody?  Yes  No
12. Are matrices correctly identified on Chain of Custody?  Yes  No
13. Are correct containers used for the analysis indicated?  Yes  No
14. Is there sufficient sample volume for indicated analysis?  Yes  No
15. Were all containers properly preserved per each analysis?  Yes  No
16. Were VOA vials collected correctly (no headspace)?  Yes  No  N/A
17. Were all holding times able to be met?  Yes  No

### Discrepancies/ Notes

18. Was client notified of all discrepancies?  Yes  No  N/A

Person Notified: \_\_\_\_\_

Date: \_\_\_\_\_

By Whom: \_\_\_\_\_

Via: \_\_\_\_\_

Regarding: \_\_\_\_\_

19. Comments. \_\_\_\_\_  
\_\_\_\_\_  
\_\_\_\_\_  
\_\_\_\_\_

# Libby Environmental, Inc.

# Chain of Custody Record

www.LibbyEnvironmental.com

3322 South Bay Road NE

Ph: 360-352-2110

Olympia, WA 98506

Fax: 360-352-4154

Date: 7/29/2021

Page: 1 of 1

Client: AEG

Project Manager: Scott Rose

Address: 211 East Pioneer Avenue 2633 Parkmont Ln

Project Name: Pick Rite Thriftway

City: Montesano Olympia State: WA Zip: 98503 Suite A

Location: 211 East Pioneer Ave City, State: Montesano, WA

Phone: (360) 352-9835 Fax: (360) 352-8164 98502

Collector: Ciara Shirey Date of Collection: 7/29/2021

Client Project # 10-126

Email: SROSE@AEGWA.com



Sample Number	Depth	Time	Sample Type	Container Type	Analytes											Field Notes		
					VOC 8260	PCE & Daughter Prod.	NWTPH-Gx	BTEX (8260) / (8021)	NWTPH-HCID	NWTPH-Dx / Dx	PCB 8082	MTCA 5 Metals	RCRA 8 Metals	PAH 8270	Semi Vol 8270			
1 MW-1R		1124	G	40mL VOA		X	X											
2 MW-3		1020	I	I		X	X											
3 MW-4		1048	I	I		X	X											
4 MW-5		1343	I	I		X	X											
5 MW-7		1149	I	I		X	X											
6 TSMW-13		1259	I	I		X	X											
7																		
8																		
9																		
10																		
11																		
12																		
13																		
14																		
15																		
16																		
17																		

Relinquished by:	Date / Time: <u>7/29/2021 / 1501</u>	Received by:	Date / Time: <u>7/29/21</u>	<b>Sample Receipt</b> Good Condition? <u>Y</u> <u>N</u> Cooler Temp. <u>    </u> °C Sample Temp. <u>    </u> °C Total Number of Containers <u>    </u>	Remarks:  TAT: 24HR 48HR <b>5-DAY</b>
Relinquished by:	Date / Time:	Received by:	Date / Time:		
Relinquished by:	Date / Time:	Received by:	Date / Time:		
Relinquished by:	Date / Time:	Received by:	Date / Time:		

LEGAL ACTION CLAUSE: In the event of default of payment and/or failure to pay, Client agrees to pay the costs of collection including court costs and reasonable attorney fees to be determined by a court of law.

Distribution: White - Lab, Yellow - Originator