

Alt Name Gull 1253
Bellevue

January 8, 2007

Ms. Carol Campagna
Shell Oil Products US
20945 S. Wilmington Avenue
Carson, California 90810-1039

Sent via Regular Mail

SUBJ: SHELL GRASP MONITORING REPORT

Shell Service Station
3670 150th Avenue SE
Bellevue, Washington
Delta Project ST36-70S-G

Shell VST ID 7736
Not VCP, PCV.



Dear Ms. Campagna:

Delta Environmental Consultants, Inc. (Delta), has prepared this Shell GRASP Monitoring Report for the above referenced site.

GRASP (GROundwater ASsessment Program) is a voluntary initiative by SHELL to install groundwater monitoring wells at numerous retail service stations nationwide that do not have any active release cases but have been identified to be in close proximity to one or more public water supply wells. The purpose of this program is to proactively monitor the groundwater beneath these sites and, in the event of a subsurface release, to respond quickly to protect public wells from this impact.

If you have any questions regarding this site, please contact Mr. Jeff Schatz (Delta) at (503) 639-8098

Sincerely,

DELTA ENVIRONMENTAL CONSULTANTS, INC.

Jamey Peterson
Staff Scientist

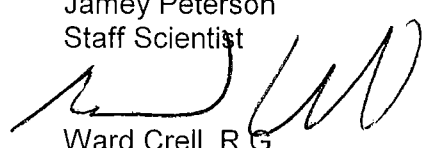
Ward Crell, R.G.
Senior Geologist

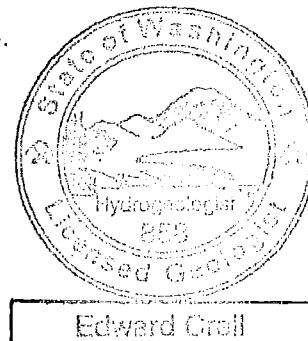

Attachments: Shell GRASP Monitoring Report

cc: John Wietfield, Department of Ecology, 3190 160th Avenue SE Bellevue, WA 98008-5452

January 8, 2007

SHELL GRASP MONITORING REPORT

Station Address: 3670 150th Avenue SE
Bellevue, Washington
SHELL GRASP Incident No.: 97420019
DELTA Project No.: ST36-70S-G
SHELL Environmental Engin./Phone No.: Carol Campagna / (707) 399-7878
DELTA Project Manager/Phone No.: Jeff Schatz / (503) 639-8098

Current Phase of Project: GRASP Groundwater Monitoring
Frequency of Sampling: Semi-Annual
Frequency of Monitoring: Semi-Annual
Is Separate Phase Hydrocarbon Present On-site ☐ Yes ☒ No
(Well #'s):
Cumulative SPH Recovered to Date : None
SPH Recovered This Quarter : None
Sensitive Receptor(s) Information: Nearest production wells are a domestic well and a municipal supply well, approximately 500 ft northeast and east-northeast of the site, respectively
Approximate Depth to Groundwater: 35.11 to 37.01 feet
Groundwater Gradient: NNE @ approximately 0.03 ft/ft
Summary of Unusual Activity: None

Jeff Schatz
Project Manager (Delta)

ATTACHED:

- Table 1 – Groundwater Gauging and Analytical Results
- Figure 1 – Site Location Map
- Figure 2 – Groundwater Elevation Contour Map
- Figure 3 – Hydrocarbon Distribution in Groundwater Map
- Appendix A – Field Data Sheets
- Appendix B – Field Procedures
- Appendix C – Laboratory Report and Chain-of-Custody Documents

TABLE

TABLE 1
GROUNDWATER GAUGING AND ANALYTICAL DATA
3670 150th Avenue SE
Bellevue, Washington

Sample I.D. TOC ¹	Sample Date	TPH-G (µg/l)	TPH-D (µg/l)	TPH-O (µg/l)	Benzene (µg/l)	Toluene (µg/l)	Ethyl- benzene (µg/l)	Xylenes (µg/l)	MTBE (µg/l)	DIPE (µg/l)	ETBE (µg/l)	TAME (µg/l)	TBA (µg/l)	Ethanol (µg/l)	Depth to GW (feet)	SPH (feet)	GW Elev. ¹ (feet)
MW-1b	01/07/03	<250	<250	<750	<1	<1	<1	<1	<1	<5	<5	<5	<50	NA	36.30	0.00	303.53
339.83	04/30/03	<250	NA	NA	<1	<1	<1	<1	<1	<5	<5	<5	<50	NA	34.31	0.00	305.52
	07/30/03	<250	NA	NA	<1	<1	<1	<1	<1	<5	<5	<5	<50	<5,000	35.61	0.00	304.22
	10/23/03	<250	NA	NA	<1	<1	<1	<1	<1	<5	<5	<5	<50	<5,000	36.69	0.00	303.14
	04/20/04	<250	NA	NA	<1	<1	<1	<1	<1	<5	<5	<5	<50	<5,000	33.61	0.00	306.22
	10/14/04	<250	NA	NA	<1	<1	<1	<1	<1	<5	<5	<5	<50	<5,000	36.61	0.00	303.22
	05/10/05	<50	NA	NA	<1	<1	<1	<1	<1	<2	<2	<5	<50	<5,000	35.03	0.00	304.8
	10/27/05	<50	<250	<500	<1	<1	<1	<1	<1	<2	<2	<5	<50	<5,000	37.03	0.00	302.80
	04/19/06	<50.0	NA	NA	<0.500	<0.500	<0.500	<3.00	<5.00	<1.00	<1.00	<1.00	<50	<150	32.48	0.00	307.35
	10/25/06	<50.0	NA	NA	<0.500	<0.500	<0.500	<3.00	<5.00	<1.00	<1.00	<1.00	<50	<250	37.01	0.00	302.82
MW-6	01/07/03	<250	<250	<750	<1	1	<1	<1	<1	<5	<5	<5	<50	NA	36.50	0.00	304.30
340.80	04/30/03	<250	NA	NA	<1	<1	<1	<1	<1	<5	<5	<5	<50	NA	34.90	0.00	305.90
	07/30/03	<250	NA	NA	<1	<1	<1	<1	<1	<5	<5	<5	<50	<5,000	35.67	0.00	305.13
	10/23/03	<250	NA	NA	<1	<1	<1	<1	<1	<5	<5	<5	<50	<5,000	36.60	0.00	304.20
	04/20/04	<250	NA	NA	<1	<1	<1	<1	<1	<5	<5	<5	<50	<5,000	33.98	0.00	306.82
	10/14/04	<250	NA	NA	<1	<1	<1	<1	<1	<5	<5	<5	<50	<5,000	36.55	0.00	304.25
	05/10/05	<50	NA	NA	<1	<1	<1	<1	<1	<2	<2	<5	<50	<5,000	35.52	0.00	305.28
	10/27/05	<50	<250	<500	<1	<1	<1	<1	<1	<2	<2	<5	<50	<5,000	36.67	0.00	304.13
	04/19/06	<50.0	NA	NA	<0.500	<0.500	<0.500	<3.00	<5.00	<1.00	<1.00	<1.00	<50	<150	33.30	0.00	307.50
	10/25/06	<50.0	NA	NA	<0.500	<0.500	<0.500	<3.00	<5.00	<1.00	<1.00	<1.00	<50	<250	36.50	0.00	304.30
MW-7	01/07/03	<250	<250	<750	<1	<1	<1	<1	<1	<5	<5	<5	<50	NA	35.17	0.00	306.79
341.96	04/30/03	<250	NA	NA	<1	<1	<1	<1	<1	<5	<5	<5	<50	NA	34.41	0.00	307.55
	07/30/03	<250	NA	NA	<1	<1	<1	<1	<1	<5	<5	<5	<50	<5,000	35.81	0.00	306.15
	10/23/03	<250	NA	NA	<1	<1	<1	<1	<1	<5	<5	<5	<50	<5,000	37.01	0.00	304.95
	04/20/04	<250	NA	NA	<1	<1	<1	<1	<1	<5	<5	<5	<50	<5,000	33.99	0.00	307.97
	10/14/04	<250	NA	NA	<1	<1	<1	<1	<1	<5	<5	<5	<50	<5,000	36.07	0.00	305.89
	05/10/05	<50	NA	NA	<1	<1	<1	<1	<1	<2	<2	<5	<50	<5,000	34.83	0.00	307.13
	10/27/05	<50	<250	<500	<1	<1	<1	<1	<1	<2	<2	<5	<50	<5,000	35.14	0.00	306.82
	04/19/06	<50.0	NA	NA	<0.500	<0.500	<0.500	<3.00	<5.00	<1.00	<1.00	<1.00	<50	<150	33.78	0.00	308.18
	10/25/06	<50.0	NA	NA	<0.500	<0.500	<0.500	<3.00	<5.00	<1.00	<1.00	<1.00	<50	<250	35.11	0.00	306.85

TABLE 1
GROUNDWATER GAUGING AND ANALYTICAL DATA
3670 150th Avenue SE
Bellevue, Washington

Sample I.D. TOC ¹	Sample Date	TPH-G (µg/l)	TPH-D (µg/l)	TPH-O (µg/l)	Benzene (µg/l)	Toluene (µg/l)	Ethyl- benzene (µg/l)	Xylenes (µg/l)	MTBE (µg/l)	DIPE (µg/l)	ETBE (µg/l)	TAME (µg/l)	TBA (µg/l)	Ethanol (µg/l)	Depth to GW (feet)	SPH (feet)	GW Elev. ¹ (feet)
MW-A	01/07/03 ²	--	--	--	--	--	--	--	--	--	--	--	--	--	36.42	0.00	304.48
340.90	04/30/03	<250	NA	NA	<1	<1	<1	<1	<1	<5	<5	<5	<50	NA	34.87	0.00	306.03
	07/30/03	<250	NA	NA	<1	<1	<1	<1	<1	<5	<5	<5	<50	<5,000	35.32	0.00	305.58
	10/23/03	<250	NA	NA	<1	<1	<1	<1	<1	<5	<5	<5	<50	<5,000	36.30	0.00	304.60
	04/20/04	<250	NA	NA	<1	<1	<1	<1	<1	<5	<5	<5	<50	<5,000	33.71	0.00	307.19
	10/14/04 ²	--	--	--	--	--	--	--	--	--	--	--	--	--	36.21	0.00	304.69
	05/10/05	<50	NA	NA	<1	<1	<1	<1	<1	<2	<2	<5	<50	<5,000	35.50	0.00	305.40
	10/27/05	<50	<250	<500	<1	<1	<1	<1	<1	<2	<2	<5	<50	<5,000	36.51	0.00	304.39
	04/19/06	<50.0	NA	NA	<0.500	<0.500	<0.500	<3.00	<5.00	<1.00	<1.00	<1.00	<50	<150	33.49	0.00	307.41
	10/25/06	<50.0	NA	NA	<0.500	<0.500	<0.500	<3.00	<5.00	<1.00	<1.00	<1.00	<50	<250	36.16	0.00	304.74

**MTCA Method A Cleanup
Levels:**

1000 ³	500	500	5	1000	700	1000	20	-	-	-	-	-	-	-	-	-	-
-------------------	-----	-----	---	------	-----	------	----	---	---	---	---	---	---	---	---	---	---

Notes:
µg/l = micrograms per liter
¹OC = Top of well casing elevation (feet)
SPH = Separate-phase hydrocarbons
TPH-G = Total Petroleum Hydrocarbons as Gasoline
TPH-D = Total Petroleum Hydrocarbons as Diesel
TPH-O = Total Petroleum Hydrocarbons as Oil
MTBE = Methyl tert-butyl ether
DIPE = Di-isopropyl ether
ETBE = Ethyl tert-butyl ether
TAME = tert-Amyl methyl ether
TBA = t-Butyl Alcohol
NA = Not analyzed
<n = Below the detection limit
TPH-D and TPH-O quantified using Northwest Method NWTPH-Dx
TPH-G quantified using Northwest Method NWTPH-Gx
BTEX Compounds, MTBE, DIPE, ETBE, TAME, and TBA analyzed using EPA Method 8260B
TOC elevation and groundwater elevation relative to Mean Sea Level
MW-A did not recharge after purging. No sample could be taken for analysis.
MTCA Method A Cleanup Level for TPH-Gasoline is 800 µg/l if benzene is detectable in groundwater.

FIGURES

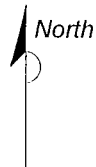
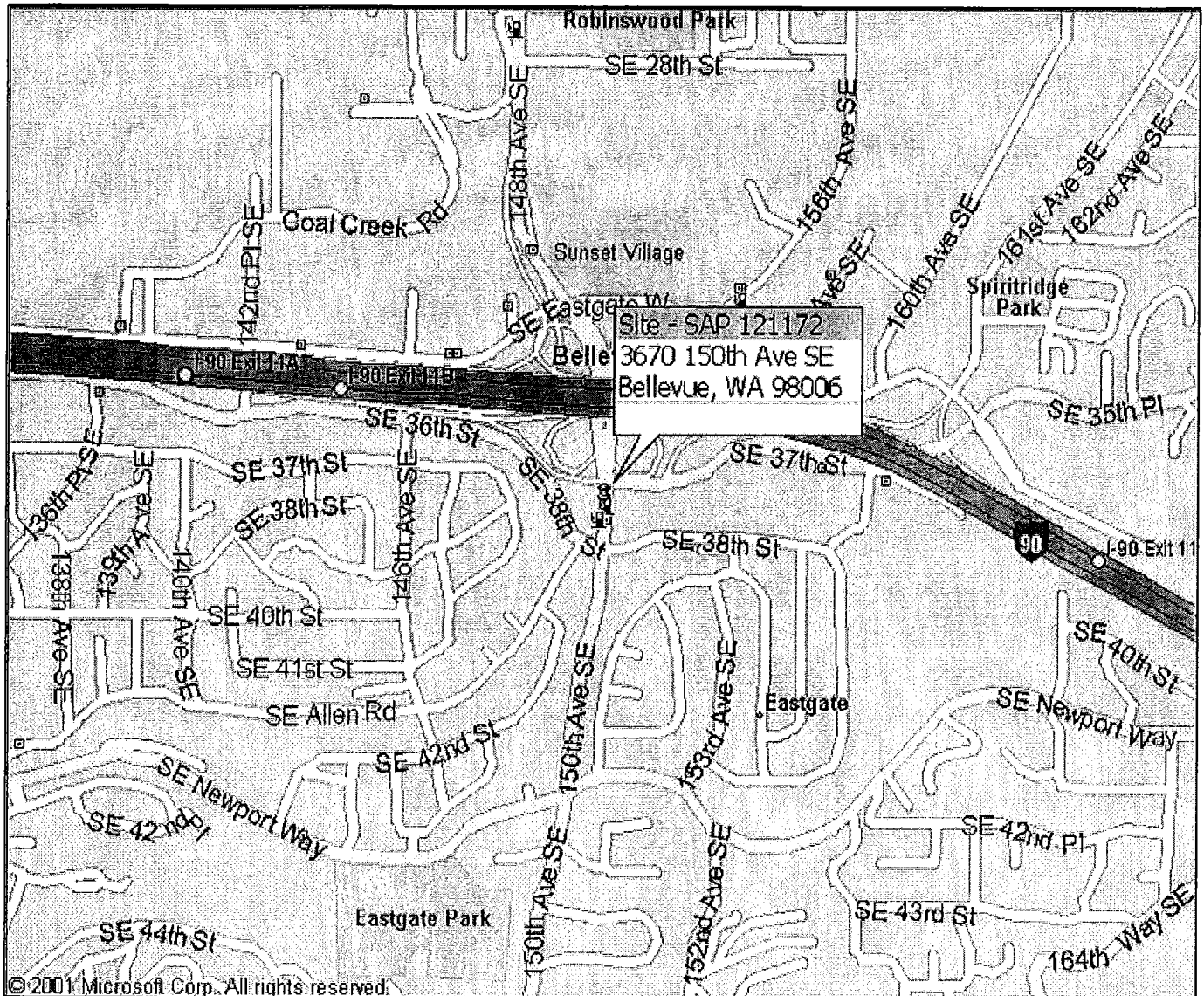

NOT TO SCALE

GENERAL NOTES:
BASE MAP FROM MICROSOFT STREETS & TRIPS 2003

FIGURE 1
SITE LOCATION MAP

SHELL / EQUIVA SITE - SAP 121172
3670 150th Avenue Southeast
Bellevue, Washington

PROJECT NO. ST36-70S-G	DRAWN BY SB 11-06-03
FILE NO. A81-3760	PREPARED BY SB
REVISION NO. 1	REVIEWED BY DL



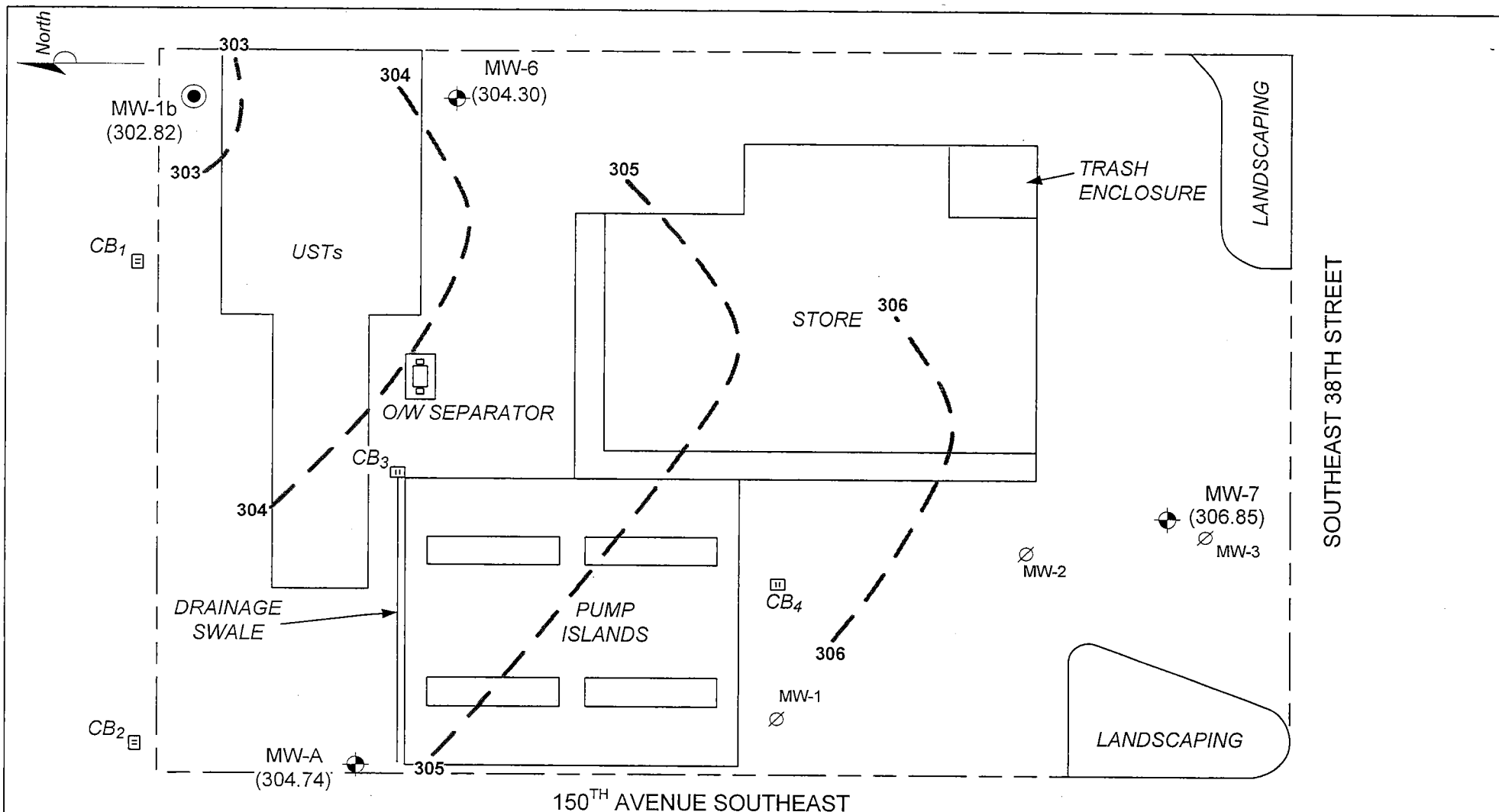

LEGEND



Groundwater Monitoring Well Installed by KHM



Groundwater Monitoring Well Installed by Others



Abandoned Monitoring Well

(302.82)

Groundwater Elevation, October 25, 2006

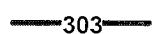

Groundwater Elevation Contour, October 25, 2006

Site map based on drawing prepared by WGR Southwest, Inc. dated 11/00



APPROX. SCALE

FIGURE 2
GROUNDWATER ELEVATION CONTOUR MAP

Shell / Equiva Site - SAP 121172
3670 150th Avenue Southeast
Bellevue, Washington

PROJECT NO. ST36-70S-G	DRAWN BY JP 11-8-06
FILE NO. ST36-70S-G	PREPARED BY JP
REVISION NO. 1	REVIEWED BY DL



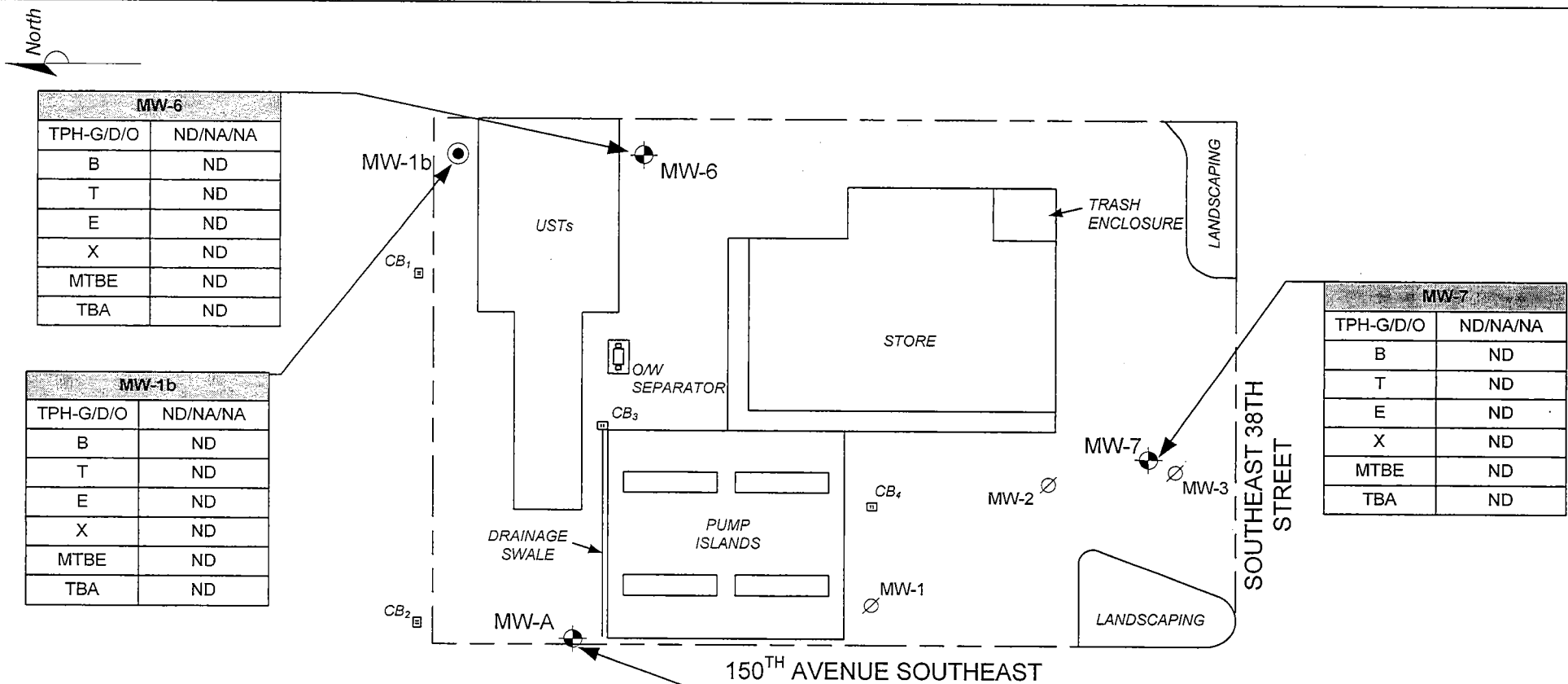

FIGURE 3
HYDROCARBON DISTRIBUTION IN GROUNDWATER,
October 25, 2006

Shell / Equiva Site - SAP 121172
3670 150th Avenue Southeast
Bellevue, Washington

PROJECT NO. ST36-70S-G	DRAWN BY JP 11-28-06
FILE NO. ST36-70S-G	PREPARED BY JP
REVISION NO. 1	REVIEWED BY DL



0 30 FT
APPROX. SCALE

APPENDIX A
FIELD DATA SHEETS

DELTA PROJECT NUMBER:						ST36-70S-6					
SITE No./JOB No.:						3670 150 th Ave SE					
SITE ADDRESS/LOCATION:						Bellevue, WA					
FIELD PERSONNEL:						Jamey Peterson					
CLIENT:						Shell Oil Products US					
PAGE						1 of 1					
DATE:						10/25/2006					
WEATHER:						Overcast - 55°F - Wind					
Well ID	Time	Well Diameter (in.)	Depth to Bottom (feet)	Depth to Water (feet)	Depth to LPH (feet)	LPH Thickness (feet)	Calc. Purge (gal)	Actual Purge (gal)	Purge Method (B/LF/P)	Dissolved Oxygen (mg/l)	Sample Appearance/Comments
MW-A	15:00	2	-	36.16	No LPH	N/A	Non-Purge Sample			3.2	cloudy
MW-1B	14:00	2	-	37.01						3.4	clear
MW-6	13:30	4	-	36.50						2.8	clear
MW-7	14:30	4	-	35.11						3.0	Clear w/biogrowth
Notes: - Site appears to have gone under recent surface/asphalt construction. Surface area around MW-A is new. Surface Area around MW-7 has been removed and gravel has been placed near and adjacent to monument. <u>MW-A</u> - Metal collar inside monument is broken; 2 bolt holes <u>MW-7</u> - missing all bolts. JMP replaced. <u>MW-1B</u> - missing all bolts. JMP replaced. <u>MW-A (additional)</u> - Went dry during sampling											
System Instructions:		Remedial System On-Site (Y/N)? No						Comments:			
		Operational Upon Arrival (Y/N)? -						Comments:			
		Shut Down System 1 / 24 hours before gauging (Y/N)? -						Time/Date Downed:			
		Re-Start System (Y/N)? -						Time/Date Restarted:			
		Purge Method: No Purge Sampling						Comments:			
Purge Water Disposal Method:		<input type="checkbox"/> Treated through mobile carbon treatment unit and discharged on-site									
		<input checked="" type="checkbox"/> N/A									
		<input type="checkbox"/> Placed in drums on site									
		<input type="checkbox"/> Transported off-site for treatment									
Measuring Device(s):		Water Level Indicator									

APPENDIX B

FIELD PROCEDURES

GROUNDWATER MONITORING AND SAMPLING

Before the sampling event, Delta measured depth to water in each groundwater monitoring well at the facility with an electronic water level meter. This information was recorded on waterproof field sheets. Groundwater elevations (GWE) were measured to an accuracy of 0.01 feet. Samples were withdrawn from each well using a disposable polyethylene bailer and placed in the appropriate laboratory-provided container. Samples were labeled, placed into ice filled coolers, logged onto chain-of-custody forms and transported to the laboratory.

APPENDIX C

LABORATORY REPORT AND CHAIN-OF-CUSTODY DOCUMENTS

November 15, 2006

Dawna Leong
Delta Environmental
4006 148th Ave NE
Redmond, WA/USA 98052

RE: Shell-3670 150th Ave SE, Bellevue

Enclosed are the results of analyses for samples received by the laboratory on 10/27/06 16:55.
The following list is a summary of the Work Orders contained in this report, generated on 11/15/06 12:30.

If you have any questions concerning this report, please feel free to contact me.

<u>Work Order</u>	<u>Project</u>	<u>ProjectNumber</u>
BPJ0635	Shell-3670 150th Ave SE, Bell	97420019

TestAmerica - Seattle, WA

Kate Haney

Kate Haney For Sandra Yakamavich, Project Manager

The results in this report apply to the samples analyzed in accordance with the chain of custody document. This analytical report shall not be reproduced except in full, without the written approval of the laboratory.



Delta Environmental

4006 148th Ave NE
Redmond, WA/USA 98052

Project Name: **Shell-3670 150th Ave SE, Bellevue**

Project Number: 97420019

Project Manager: Dawna Leong

Report Created:

11/15/06 12:30

ANALYTICAL REPORT FOR SAMPLES

Sample ID	Laboratory ID	Matrix	Date Sampled	Date Received
MW-A	BPJ0635-01	Water	10/25/06 15:00	10/27/06 16:55
MW-1B	BPJ0635-02	Water	10/25/06 14:00	10/27/06 16:55
MW-6	BPJ0635-03	Water	10/25/06 13:30	10/27/06 16:55
MW-7	BPJ0635-04	Water	10/25/06 14:30	10/27/06 16:55
TRIP BLANK	BPJ0635-05	Water	10/25/06 17:00	10/27/06 16:55

TestAmerica - Seattle, WA

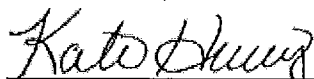

Kate Haney For Sandra Yakamavich, Project Manager

The results in this report apply to the samples analyzed in accordance with the chain of custody document. This analytical report shall not be reproduced except in full, without the written approval of the laboratory.



Delta Environmental	Project Name: Shell-3670 150th Ave SE, Bellevue	Report Created:
4006 148th Ave NE	Project Number: 97420019	11/15/06 12:30
Redmond, WA/USA 98052	Project Manager: Dawna Leong	

Volatile Petroleum Products by NWTPH-Gx

TestAmerica - Seattle, WA

Analyte	Method	Result	MDL*	MRL	Units	Dil	Batch	Prepared	Analyzed	Notes
BPJ0635-01 (MW-A)		Water						Sampled: 10/25/06 15:00		
Gasoline Range Hydrocarbons	NWTPH-Gx	ND	----	50.0	ug/l	1x	6K01018	11/01/06 10:05	11/01/06 14:04	
Surrogate(s): 4-BFB (FID)		84.7%		58 - 144 %	"				"	
BPJ0635-02 (MW-1B)		Water						Sampled: 10/25/06 14:00		
Gasoline Range Hydrocarbons	NWTPH-Gx	ND	----	50.0	ug/l	1x	6K01018	11/01/06 10:05	11/01/06 20:04	
Surrogate(s): 4-BFB (FID)		84.3%		58 - 144 %	"				"	
BPJ0635-03 (MW-6)		Water						Sampled: 10/25/06 13:30		
Gasoline Range Hydrocarbons	NWTPH-Gx	ND	----	50.0	ug/l	1x	6K01018	11/01/06 10:05	11/01/06 20:34	
Surrogate(s): 4-BFB (FID)		83.3%		58 - 144 %	"				"	
BPJ0635-04 (MW-7)		Water						Sampled: 10/25/06 14:30		
Gasoline Range Hydrocarbons	NWTPH-Gx	ND	----	50.0	ug/l	1x	6K01018	11/01/06 10:05	11/01/06 21:04	
Surrogate(s): 4-BFB (FID)		84.7%		58 - 144 %	"				"	

TestAmerica - Seattle, WA

Kate Haney

Kate Haney For Sandra Yakamavich, Project Manager

The results in this report apply to the samples analyzed in accordance with the chain of custody document. This analytical report shall not be reproduced except in full, without the written approval of the laboratory.



Delta Environmental	Project Name: Shell-3670 150th Ave SE, Bellevue	
4006 148th Ave NE	Project Number: 97420019	Report Created:
Redmond, WA/USA 98052	Project Manager: Dawna Leong	11/15/06 12:30

Oxygenates by EPA Method 8260B

TestAmerica - Seattle, WA

Analyte	Method	Result	MDL*	MRL	Units	Dil	Batch	Prepared	Analyzed	Notes
---------	--------	--------	------	-----	-------	-----	-------	----------	----------	-------

BPJ0635-01 (MW-A) Water Sampled: 10/25/06 15:00

tert-Amyl Methyl Ether	EPA 8260B	ND	----	1.00	ug/l	1x	6K02009	11/02/06 08:02	11/02/06 14:01	
Benzene	"	ND	----	0.500	"	"	"	"	"	
tert-Butyl Alcohol	"	ND	----	50.0	"	"	"	"	"	
1,2-Dibromoethane (EDB)	"	ND	----	0.500	"	"	"	"	"	
1,2-Dichloroethane (EDC)	"	ND	----	0.500	"	"	"	"	"	
Diisopropyl ether	"	ND	----	1.00	"	"	"	"	"	
Ethyl tert-butyl ether	"	ND	----	1.00	"	"	"	"	"	
Ethanol	"	ND	----	250	"	"	"	"	"	
Ethylbenzene	"	ND	----	0.500	"	"	"	"	"	
Methyl tert-butyl ether	"	ND	----	5.00	"	"	"	"	"	
Toluene	"	ND	----	0.500	"	"	"	"	"	
o-Xylene	"	ND	----	1.00	"	"	"	"	"	
m,p-Xylene	"	ND	----	2.00	"	"	"	"	"	
Xylenes (total)	"	ND	----	3.00	"	"	"	"	"	

Surrogate(s): 1,2-DCA-d4

96.0%

70 - 130 %

"

"

Toluene-d8

99.5%

75 - 125 %

"

"

4-BFB

104%

75 - 125 %

"

"

BPJ0635-02 (MW-1B) Water Sampled: 10/25/06 14:00

tert-Amyl Methyl Ether	EPA 8260B	ND	----	1.00	ug/l	1x	6K02009	11/02/06 08:02	11/02/06 14:28	
Benzene	"	ND	----	0.500	"	"	"	"	"	
tert-Butyl Alcohol	"	ND	----	50.0	"	"	"	"	"	
1,2-Dibromoethane (EDB)	"	ND	----	0.500	"	"	"	"	"	
1,2-Dichloroethane (EDC)	"	ND	----	0.500	"	"	"	"	"	
Diisopropyl ether	"	ND	----	1.00	"	"	"	"	"	
Ethyl tert-butyl ether	"	ND	----	1.00	"	"	"	"	"	
Ethanol	"	ND	----	250	"	"	"	"	"	
Ethylbenzene	"	ND	----	0.500	"	"	"	"	"	
Methyl tert-butyl ether	"	ND	----	5.00	"	"	"	"	"	
Toluene	"	ND	----	0.500	"	"	"	"	"	
o-Xylene	"	ND	----	1.00	"	"	"	"	"	
m,p-Xylene	"	ND	----	2.00	"	"	"	"	"	
Xylenes (total)	"	ND	----	3.00	"	"	"	"	"	

Surrogate(s): 1,2-DCA-d4

94.0%

70 - 130 %

"

"

Toluene-d8

99.0%

75 - 125 %

"

"

4-BFB

102%

75 - 125 %

"

"

TestAmerica - Seattle, WA

Kate Haney

Kate Haney For Sandra Yakamovich, Project Manager

The results in this report apply to the samples analyzed in accordance with the chain of custody document. This analytical report shall not be reproduced except in full, without the written approval of the laboratory.



Delta Environmental

4006 148th Ave NE
Redmond, WA/USA 98052

Project Name: Shell-3670 150th Ave SE, Bellevue

Project Number: 97420019

Project Manager: Dawna Leong

Report Created:
11/15/06 12:30

Oxygenates by EPA Method 8260B

TestAmerica - Seattle, WA

Analyte	Method	Result	MDL*	MRL	Units	Dil	Batch	Prepared	Analyzed	Notes
BPJ0635-03 (MW-6)		Water		Sampled: 10/25/06 13:30						
tert-Amyl Methyl Ether	EPA 8260B	ND	----	1.00	ug/l	1x	6J31037	10/31/06 14:25	11/01/06 03:02	
Benzene	"	ND	----	0.500	"	"	"	"	"	
tert-Butyl Alcohol	"	ND	----	50.0	"	"	"	"	"	
1,2-Dibromoethane (EDB)	"	ND	----	0.500	"	"	"	"	"	
1,2-Dichloroethane (EDC)	"	ND	----	0.500	"	"	"	"	"	
Diisopropyl ether	"	ND	----	1.00	"	"	"	"	"	
Ethyl tert-butyl ether	"	ND	----	1.00	"	"	"	"	"	
Ethanol	"	ND	----	250	"	"	"	"	"	
Ethylbenzene	"	ND	----	0.500	"	"	"	"	"	
Methyl tert-butyl ether	"	ND	----	5.00	"	"	"	"	"	
Toluene	"	ND	----	0.500	"	"	"	"	"	
o-Xylene	"	ND	----	1.00	"	"	"	"	"	
m,p-Xylene	"	ND	----	2.00	"	"	"	"	"	
Xylenes (total)	"	ND	----	3.00	"	"	"	"	"	

Surrogate(s): 1,2-DCA-d4

96.0%

70 - 130 %

"

"

Toluene-d8

93.0%

75 - 125 %

"

"

4-BFB

97.0%

75 - 125 %

"

"

BPJ0635-04 (MW-7)

Water

Sampled: 10/25/06 14:30

tert-Amyl Methyl Ether	EPA 8260B	ND	----	1.00	ug/l	1x	6J31037	10/31/06 14:25	11/01/06 03:29	
Benzene	"	ND	----	0.500	"	"	"	"	"	
tert-Butyl Alcohol	"	ND	----	50.0	"	"	"	"	"	
1,2-Dibromoethane (EDB)	"	ND	----	0.500	"	"	"	"	"	
1,2-Dichloroethane (EDC)	"	ND	----	0.500	"	"	"	"	"	
Diisopropyl ether	"	ND	----	1.00	"	"	"	"	"	
Ethyl tert-butyl ether	"	ND	----	1.00	"	"	"	"	"	
Ethanol	"	ND	----	250	"	"	"	"	"	
Ethylbenzene	"	ND	----	0.500	"	"	"	"	"	
Methyl tert-butyl ether	"	ND	----	5.00	"	"	"	"	"	
Toluene	"	ND	----	0.500	"	"	"	"	"	
o-Xylene	"	ND	----	1.00	"	"	"	"	"	
m,p-Xylene	"	ND	----	2.00	"	"	"	"	"	
Xylenes (total)	"	ND	----	3.00	"	"	"	"	"	

Surrogate(s): 1,2-DCA-d4

97.0%

70 - 130 %

"

"

Toluene-d8

94.0%

75 - 125 %

"

"

4-BFB

99.5%

75 - 125 %

"

"

TestAmerica - Seattle, WA

Kate Haney

Kate Haney For Sandra Yakamavich, Project Manager

The results in this report apply to the samples analyzed in accordance with the chain of custody document. This analytical report shall not be reproduced except in full, without the written approval of the laboratory.



Delta Environmental	Project Name: Shell-3670 150th Ave SE, Bellevue	
4006 148th Ave NE	Project Number: 97420019	Report Created:
Redmond, WA/USA 98052	Project Manager: Dawna Leong	11/15/06 12:30

Oxygenates by EPA Method 8260B

TestAmerica - Seattle, WA

Analyte	Method	Result	MDL*	MRL	Units	Dil	Batch	Prepared	Analyzed	Notes
BPJ0635-05 (TRIP BLANK)		Water		Sampled: 10/25/06 17:00						
tert-Amyl Methyl Ether	EPA 8260B	ND	----	1.00	ug/l	1x	6J31037	10/31/06 14:25	11/01/06 01:42	
Benzene	"	ND	----	0.500	"	"	"	"	"	
tert-Butyl Alcohol	"	ND	----	50.0	"	"	"	"	"	
1,2-Dibromoethane (EDB)	"	ND	----	0.500	"	"	"	"	"	
1,2-Dichloroethane (EDC)	"	ND	----	0.500	"	"	"	"	"	
Diisopropyl ether	"	ND	----	1.00	"	"	"	"	"	
Ethyl tert-butyl ether	"	ND	----	1.00	"	"	"	"	"	
Ethanol	"	ND	----	250	"	"	"	"	"	
Ethylbenzene	"	ND	----	0.500	"	"	"	"	"	
Methyl tert-butyl ether	"	ND	----	5.00	"	"	"	"	"	
Toluene	"	ND	----	0.500	"	"	"	"	"	
o-Xylene	"	ND	----	1.00	"	"	"	"	"	
m,p-Xylene	"	ND	----	2.00	"	"	"	"	"	
Xylenes (total)	"	ND	----	3.00	"	"	"	"	"	
<hr/>										
Surrogate(s): 1,2-DCA-d4			98.5%		70 - 130 %	"				"
Toluene-d8			93.0%		75 - 125 %	"				"
4-BFB			98.5%		75 - 125 %	"				"

TestAmerica - Seattle, WA

Kate Haney

Kate Haney For Sandra Yakamovich, Project Manager

The results in this report apply to the samples analyzed in accordance with the chain of custody document. This analytical report shall not be reproduced except in full, without the written approval of the laboratory.



Delta Environmental	Project Name: Shell-3670 150th Ave SE, Bellevue	Report Created:
4006 148th Ave NE	Project Number: 97420019	11/15/06 12:30
Redmond, WA/USA 98052	Project Manager: Dawna Leong	

Volatile Petroleum Products by NWTPH-Gx - Laboratory Quality Control Results
 TestAmerica - Seattle, WA

QC Batch: 6K01018	Water Preparation Method: EPA 5030B (P/T)
--------------------------	--

Analyte	Method	Result	MDL*	MRL	Units	Dil	Source Result	Spike Amt	% REC	(Limits)	% RPD	(Limits)	Analyzed	Notes
---------	--------	--------	------	-----	-------	-----	---------------	-----------	-------	----------	-------	----------	----------	-------

Blank (6K01018-BLK1)

Extracted: 11/01/06 10:05

Gasoline Range Hydrocarbons	NWTPH-Gx	ND	---	50.0	ug/l	1x	--	--	--	--	--	--	11/01/06 12:55	
Surrogate(s): 4-BFB (FID)		Recovery: 82.3%	Limits: 58-144%		"		11/01/06 12:55							

LCS (6K01018-BS1)

Extracted: 11/01/06 10:05

Gasoline Range Hydrocarbons	NWTPH-Gx	940	---	50.0	ug/l	1x	--	1000	94.0%	(80-120)	--	--	11/01/06 13:25	
Surrogate(s): 4-BFB (FID)		Recovery: 97.2%	Limits: 58-144%		"		11/01/06 13:25							

Duplicate (6K01018-DUP1)

QC Source: BPJ0635-01

Extracted: 11/01/06 10:05

Gasoline Range Hydrocarbons	NWTPH-Gx	ND	---	50.0	ug/l	1x	ND	--	--	--	NR	(25)	11/01/06 14:34	RP-4
Surrogate(s): 4-BFB (FID)		Recovery: 83.3%	Limits: 58-144%		"		11/01/06 14:34							

Duplicate (6K01018-DUP2)

QC Source: BPJ0636-04

Extracted: 11/01/06 10:05

Gasoline Range Hydrocarbons	NWTPH-Gx	ND	---	50.0	ug/l	1x	ND	--	--	--	NR	(25)	11/01/06 23:33	RP-4
Surrogate(s): 4-BFB (FID)		Recovery: 84.0%	Limits: 58-144%		"		11/01/06 23:33							

Matrix Spike (6K01018-MS1)

QC Source: BPJ0635-01

Extracted: 11/01/06 10:05

Gasoline Range Hydrocarbons	NWTPH-Gx	1040	---	50.0	ug/l	1x	17.2	1000	102%	(75-131)	--	--	11/01/06 17:05	
Surrogate(s): 4-BFB (FID)		Recovery: 97.7%	Limits: 58-144%		"		11/01/06 17:05							

Matrix Spike Dup (6K01018-MSD1)

QC Source: BPJ0635-01

Extracted: 11/01/06 10:05

Gasoline Range Hydrocarbons	NWTPH-Gx	991	---	50.0	ug/l	1x	17.2	1000	97.4%	(75-131)	4.83%	(25)	11/01/06 17:34	
Surrogate(s): 4-BFB (FID)		Recovery: 94.7%	Limits: 58-144%		"		11/01/06 17:34							

TestAmerica - Seattle, WA

Kate Haney

Kate Haney For Sandra Yakamovich, Project Manager

The results in this report apply to the samples analyzed in accordance with the chain of custody document. This analytical report shall not be reproduced except in full, without the written approval of the laboratory.



Delta Environmental	Project Name: Shell-3670 150th Ave SE, Bellevue	Report Created:
4006 148th Ave NE	Project Number: 97420019	11/15/06 12:30
Redmond, WA/USA 98052	Project Manager: Dawna Leong	

Oxygenates by EPA Method 8260B - Laboratory Quality Control Results
 TestAmerica - Seattle, WA

QC Batch: 6J31037	Water Preparation Method: EPA 5030B
--------------------------	--

Analyte	Method	Result	MDL*	MRL	Units	Dil	Source Result	Spike Amt	% REC	(Limits)	% RPD	(Limits)	Analyzed	Notes
Blank (6J31037-BLK1)										Extracted: 10/31/06 14:25				
tert-Amyl Methyl Ether	EPA 8260B	ND	---	1.00	ug/l	1x	--	--	--	--	--	--	11/01/06 01:16	
Benzene	"	ND	---	0.500	"	"	--	--	--	--	--	--	"	
tert-Butyl Alcohol	"	ND	---	50.0	"	"	--	--	--	--	--	--	"	
1,2-Dibromoethane (EDB)	"	ND	---	0.500	"	"	--	--	--	--	--	--	"	
1,2-Dichloroethane (EDC)	"	ND	---	0.500	"	"	--	--	--	--	--	--	"	
Diisopropyl ether	"	ND	---	1.00	"	"	--	--	--	--	--	--	"	
Ethyl tert-butyl ether	"	ND	---	1.00	"	"	--	--	--	--	--	--	"	
Ethanol	"	ND	---	250	"	"	--	--	--	--	--	--	"	
Ethylbenzene	"	ND	---	0.500	"	"	--	--	--	--	--	--	"	
Methyl tert-butyl ether	"	ND	---	5.00	"	"	--	--	--	--	--	--	"	
Toluene	"	ND	---	0.500	"	"	--	--	--	--	--	--	"	
o-Xylene	"	ND	---	1.00	"	"	--	--	--	--	--	--	"	
m,p-Xylene	"	ND	---	2.00	"	"	--	--	--	--	--	--	"	
Xylenes (total)	"	ND	---	3.00	"	"	--	--	--	--	--	--	"	
<hr/>														
Surrogate(s): 1,2-DCA-d4	Recovery:	97.5%	Limits:	70-130%	"								11/01/06 01:16	
Toluene-d8		95.0%		75-125%	"								"	
4-BFB		100%		75-125%	"								"	

LCS (6J31037-BS1)										Extracted: 10/31/06 14:25				
tert-Amyl Methyl Ether	EPA 8260B	21.1	---	1.00	ug/l	1x	--	20.0	106%	(75-125)	--	--	11/01/06 00:23	
Benzene	"	19.1	---	0.500	"	"	--	"	95.5%	(80-120)	--	--	"	
tert-Butyl Alcohol	"	113	---	50.0	"	"	--	100	113%	(75-125)	--	--	"	
1,2-Dibromoethane (EDB)	"	18.3	---	0.500	"	"	--	20.0	91.5%	"	--	--	"	
1,2-Dichloroethane (EDC)	"	20.6	---	0.500	"	"	--	"	103%	"	--	--	"	
Diisopropyl ether	"	21.6	---	1.00	"	"	--	"	108%	"	--	--	"	
Ethyl tert-butyl ether	"	21.1	---	1.00	"	"	--	"	106%	"	--	--	"	
Ethanol	"	1090	---	250	"	"	--	1000	109%	"	--	--	"	
Ethylbenzene	"	16.4	---	0.500	"	"	--	20.0	82.0%	"	--	--	"	
Methyl tert-butyl ether	"	20.4	---	5.00	"	"	--	"	102%	(75-126)	--	--	"	
Toluene	"	17.2	---	0.500	"	"	--	"	86.0%	(75-125)	--	--	"	
o-Xylene	"	16.9	---	1.00	"	"	--	"	84.5%	(75-130)	--	--	"	
m,p-Xylene	"	37.9	---	2.00	"	"	--	40.0	94.8%	(75-125)	--	--	"	
Xylenes (total)	"	54.8	---	3.00	"	"	--	60.0	91.3%	"	--	--	"	
<hr/>														
Surrogate(s): 1,2-DCA-d4	Recovery:	96.5%	Limits:	70-130%	"								11/01/06 00:23	
Toluene-d8		91.5%		75-125%	"								"	
4-BFB		98.0%		75-125%	"								"	

TestAmerica - Seattle, WA

 Kate Haney For Sandra Yakamovich, Project Manager

The results in this report apply to the samples analyzed in accordance with the chain of custody document. This analytical report shall not be reproduced except in full, without the written approval of the laboratory.



Delta Environmental	Project Name: Shell-3670 150th Ave SE, Bellevue	
4006 148th Ave NE	Project Number: 97420019	Report Created:
Redmond, WA/USA 98052	Project Manager: Dawna Leong	11/15/06 12:30

Oxygenates by EPA Method 8260B - Laboratory Quality Control Results
 TestAmerica - Seattle, WA

QC Batch: 6J31037 Water Preparation Method: EPA 5030B

Analyte	Method	Result	MDL*	MRL	Units	Dil	Source Result	Spike Amt	% REC	(Limits)	% RPD	(Limits)	Analyzed	Notes
LCS Dup (6J31037-BSD1)										Extracted: 10/31/06 14:25				
tert-Amyl Methyl Ether	EPA 8260B	20.2	---	1.00	ug/l	1x	--	20.0	101%	(75-125)	4.36%	(25)	11/01/06 00:49	
Benzene	"	19.0	---	0.500	"	"	--	"	95.0%	(80-120)	0.525%	(20)	"	
tert-Butyl Alcohol	"	105	---	50.0	"	"	--	100	105%	(75-125)	7.34%	(25)	"	
1,2-Dibromoethane (EDB)	"	18.5	---	0.500	"	"	--	20.0	92.5%	"	1.09%	"	"	
1,2-Dichloroethane (EDC)	"	20.4	---	0.500	"	"	--	"	102%	"	0.976%	"	"	
Diisopropyl ether	"	20.5	---	1.00	"	"	--	"	102%	"	5.23%	"	"	
Ethyl tert-butyl ether	"	19.9	---	1.00	"	"	--	"	99.5%	"	5.85%	"	"	
Ethanol	"	1020	---	250	"	"	--	1000	102%	"	6.64%	"	"	
Ethylbenzene	"	17.0	---	0.500	"	"	--	20.0	85.0%	"	3.59%	(20)	"	
Methyl tert-butyl ether	"	19.6	---	5.00	"	"	--	"	98.0%	(75-126)	4.00%	"	"	
Toluene	"	17.6	---	0.500	"	"	--	"	88.0%	(75-125)	2.30%	"	"	
o-Xylene	"	17.3	---	1.00	"	"	--	"	86.5%	(75-130)	2.34%	"	"	
m,p-Xylene	"	38.7	---	2.00	"	"	--	40.0	96.8%	(75-125)	2.09%	"	"	
Xylenes (total)	"	56.0	---	3.00	"	"	--	60.0	93.3%	"	2.17%	"	"	
Surrogate(s):														
1,2-DCA-d4		Recovery:	94.0%	Limits:	70-130%	"							11/01/06 00:49	
Toluene-d8			94.0%		75-125%	"							"	
4-BFB			99.5%		75-125%	"							"	

TestAmerica - Seattle, WA

Kate Haney

Kate Haney For Sandra Yakamovich, Project Manager

The results in this report apply to the samples analyzed in accordance with the chain of custody document. This analytical report shall not be reproduced except in full, without the written approval of the laboratory.



Delta Environmental	Project Name: Shell-3670 150th Ave SE, Bellevue	
4006 148th Ave NE	Project Number: 97420019	Report Created:
Redmond, WA/USA 98052	Project Manager: Dawna Leong	11/15/06 12:30

Oxygenates by EPA Method 8260B - Laboratory Quality Control Results

TestAmerica - Seattle, WA

QC Batch: **6K02009**

Water Preparation Method: **EPA 5030B**

Analyte	Method	Result	MDL*	MRL	Units	Dil	Source Result	Spike Amt	% REC	(Limits)	% RPD	(Limits)	Analyzed	Notes
Blank (6K02009-BLK1)										Extracted: 11/02/06 08:02				
tert-Amyl Methyl Ether	EPA 8260B	ND	---	1.00	ug/l	1x	--	--	--	--	--	--	11/02/06 10:22	
Benzene	"	ND	---	0.500	"	"	--	--	--	--	--	--	"	
tert-Butyl Alcohol	"	ND	---	50.0	"	"	--	--	--	--	--	--	"	
1,2-Dibromoethane (EDB)	"	ND	---	0.500	"	"	--	--	--	--	--	--	"	
1,2-Dichloroethane (EDC)	"	ND	---	0.500	"	"	--	--	--	--	--	--	"	
Diisopropyl ether	"	ND	---	1.00	"	"	--	--	--	--	--	--	"	
Ethyl tert-butyl ether	"	ND	---	1.00	"	"	--	--	--	--	--	--	"	
Ethanol	"	ND	---	250	"	"	--	--	--	--	--	--	"	
Ethylbenzene	"	ND	---	0.500	"	"	--	--	--	--	--	--	"	
Methyl tert-butyl ether	"	ND	---	5.00	"	"	--	--	--	--	--	--	"	
Toluene	"	ND	---	0.500	"	"	--	--	--	--	--	--	"	
o-Xylene	"	ND	---	1.00	"	"	--	--	--	--	--	--	"	
m,p-Xylene	"	ND	---	2.00	"	"	--	--	--	--	--	--	"	
Xylenes (total)	"	ND	---	3.00	"	"	--	--	--	--	--	--	"	
<i>Surrogate(s): 1,2-DCA-d4 Recovery: 94.5% Limits: 70-130% " 11/02/06 10:22</i>														
<i>Toluene-d8 93.5% 75-125% " "</i>														
<i>4-BFB 99.0% 75-125% " "</i>														

LCS (6K02009-BS1)

Extracted: 11/02/06 08:02

tert-Amyl Methyl Ether	EPA 8260B	20.7	---	1.00	ug/l	1x	--	20.0	104%	(75-125)	--	--	11/02/06 09:28	
Benzene	"	21.0	---	0.500	"	"	--	"	105%	(80-120)	--	--	"	
tert-Butyl Alcohol	"	102	---	50.0	"	"	--	100	102%	(75-125)	--	--	"	
1,2-Dibromoethane (EDB)	"	20.3	---	0.500	"	"	--	20.0	102%	"	--	--	"	
1,2-Dichloroethane (EDC)	"	21.6	---	0.500	"	"	--	"	108%	"	--	--	"	
Diisopropyl ether	"	20.6	---	1.00	"	"	--	"	103%	"	--	--	"	
Ethyl tert-butyl ether	"	19.9	---	1.00	"	"	--	"	99.5%	"	--	--	"	
Ethanol	"	898	---	250	"	"	--	1000	89.8%	"	--	--	"	
Ethylbenzene	"	19.8	---	0.500	"	"	--	20.0	99.0%	"	--	--	"	
Methyl tert-butyl ether	"	20.2	---	5.00	"	"	--	"	101%	(75-126)	--	--	"	
Toluene	"	20.1	---	0.500	"	"	--	"	100%	(75-125)	--	--	"	
o-Xylene	"	19.6	---	1.00	"	"	--	"	98.0%	(75-130)	--	--	"	
m,p-Xylene	"	44.3	---	2.00	"	"	--	40.0	111%	(75-125)	--	--	"	
Xylenes (total)	"	63.9	---	3.00	"	"	--	60.0	106%	"	--	--	"	
<i>Surrogate(s): 1,2-DCA-d4 Recovery: 91.0% Limits: 70-130% " 11/02/06 09:28</i>														
<i>Toluene-d8 92.5% 75-125% " "</i>														
<i>4-BFB 98.0% 75-125% " "</i>														

TestAmerica - Seattle, WA

Kate Haney

Kate Haney For Sandra Yakamovich, Project Manager

The results in this report apply to the samples analyzed in accordance with the chain of custody document. This analytical report shall not be reproduced except in full, without the written approval of the laboratory.



Delta Environmental	Project Name: Shell-3670 150th Ave SE, Bellevue	Report Created:
4006 148th Ave NE	Project Number: 97420019	11/15/06 12:30
Redmond, WA/USA 98052	Project Manager: Dawna Leong	

Oxygenates by EPA Method 8260B - Laboratory Quality Control Results
 TestAmerica - Seattle, WA

QC Batch: 6K02009	Water Preparation Method: EPA 5030B
--------------------------	--

Analyte	Method	Result	MDL*	MRL	Units	Dil	Source Result	Spike Amt	% REC	(Limits)	% RPD	(Limits)	Analyzed	Notes
LCS Dup (6K02009-BSD1)										Extracted: 11/02/06 08:02				
tert-Amyl Methyl Ether	EPA 8260B	20.3	---	1.00	ug/l	1x	--	20.0	102%	(75-125)	1.95%	(25)	11/02/06 10:52	
Benzene	"	20.6	---	0.500	"	"	--	"	103%	(80-120)	1.92%	(20)	"	
tert-Butyl Alcohol	"	79.8	---	50.0	"	"	--	100	79.8%	(75-125)	24.4%	(25)	"	
1,2-Dibromoethane (EDB)	"	20.1	---	0.500	"	"	--	20.0	100%	"	0.990%	"	"	
1,2-Dichloroethane (EDC)	"	21.2	---	0.500	"	"	--	"	106%	"	1.87%	"	"	
Diisopropyl ether	"	20.2	---	1.00	"	"	--	"	101%	"	1.96%	"	"	
Ethyl tert-butyl ether	"	19.8	---	1.00	"	"	--	"	99.0%	"	0.504%	"	"	
Ethanol	"	818	---	250	"	"	--	1000	81.8%	"	9.32%	"	"	
Ethylbenzene	"	19.7	---	0.500	"	"	--	20.0	98.5%	"	0.506%	(20)	"	
Methyl tert-butyl ether	"	19.8	---	5.00	"	"	--	"	99.0%	(75-126)	2.00%	"	"	
Toluene	"	20.0	---	0.500	"	"	--	"	100%	(75-125)	0.499%	"	"	
o-Xylene	"	19.5	---	1.00	"	"	--	"	97.5%	(75-130)	0.512%	"	"	
m,p-Xylene	"	43.4	---	2.00	"	"	--	40.0	108%	(75-125)	2.05%	"	"	
Xylenes (total)	"	62.9	---	3.00	"	"	--	60.0	105%	"	1.58%	"	"	
Surrogate(s):														
1,2-DCA-d4		Recovery:	91.0%	Limits:	70-130%	"							11/02/06 10:52	
Toluene-d8			92.0%		75-125%	"							"	
4-BFB			99.5%		75-125%	"							"	

TestAmerica - Seattle, WA

Kate Haney

Kate Haney For Sandra Yakamovich, Project Manager

The results in this report apply to the samples analyzed in accordance with the chain of custody document. This analytical report shall not be reproduced except in full, without the written approval of the laboratory.



Delta Environmental
4006 148th Ave NE
Redmond, WA/USA 98052

Project Name: **Shell-3670 150th Ave SE, Bellevue**
Project Number: 97420019
Project Manager: Dawna Leong

Report Created:
11/15/06 12:30

Notes and Definitions

Report Specific Notes:

RP-4 - Due to the low levels of analyte in the sample, the duplicate RPD calculation does not provide useful information.

Laboratory Reporting Conventions:

- DET - Analyte DETECTED at or above the Reporting Limit. Qualitative Analyses only.
- ND - Analyte NOT DETECTED at or above the reporting limit (MDL or MRL, as appropriate).
- NR/NA - Not Reported / Not Available
- dry - Sample results reported on a Dry Weight Basis. Results and Reporting Limits have been corrected for Percent Dry Weight.
- wet - Sample results and reporting limits reported on a Wet Weight Basis (as received). Results with neither 'wet' nor 'dry' are reported on a Wet Weight Basis.
- RPD - RELATIVE PERCENT DIFFERENCE (RPDs calculated using Results, not Percent Recoveries).
- MRL - METHOD REPORTING LIMIT. Reporting Level at, or above, the lowest level standard of the Calibration Table.
- MDL* - METHOD DETECTION LIMIT. Reporting Level at, or above, the statistically derived limit based on 40CFR, Part 136, Appendix B.
*MDLs are listed on the report only if the data has been evaluated below the MRL. Results between the MDL and MRL are reported as Estimated Results.
- Dil - Dilutions are calculated based on deviations from the standard dilution performed for an analysis, and may not represent the dilution found on the analytical raw data.
- Reporting Limits - Reporting limits (MDLs and MRLs) are adjusted based on variations in sample preparation amounts, analytical dilutions and percent solids, where applicable.
- Electronic Signature - Electronic Signature added in accordance with TestAmerica's *Electronic Reporting and Electronic Signatures Policy*.
Application of electronic signature indicates that the report has been reviewed and approved for release by the laboratory.
Electronic signature is intended to be the legally binding equivalent of a traditionally handwritten signature.

TestAmerica - Seattle, WA

Kate Haney

Kate Haney For Sandra Yakamovich, Project Manager

The results in this report apply to the samples analyzed in accordance with the chain of custody document. This analytical report shall not be reproduced except in full, without the written approval of the laboratory.



