

**Dalton, Olmsted & Fuglevand, Inc.** *Environmental Consultants*

---

10827 NE 68<sup>th</sup> St., Suite B • Kirkland, Washington 98033  
Telephone (425) 827-4588 (FAX 739-9885)

NW0161

July 31, 2004

Frank Frankini  
Equity Office  
Two North Riverside Plaza  
Suite 2200  
Chicago, IL 60606

Re: Summary of Ground-Water Sampling Events  
Through May 2004  
Buildings N (Aspenwood) & O (Magnolia) Properties  
Bellevue, Washington

Dear Frank:

This report presents the results of our ground-water monitoring conducted in May 2003 and May 2004 at the Building N (Aspenwood) & Building O (Magnolia) Properties, Bellevue, Washington (Figure 1). Well locations are shown on Figure 2. Information on the general hydrogeology of the sites is presented in DOF (1998).

The ground-water monitoring was completed consistent with the Washington State Department of Ecology (Ecology) "No Further Action" (NFA) letter dated May 21, 1999. As stated in the letter:

*"Confirmational monitoring of the permanent on-site wells BA-MW-1 and MW-K1 should be added to the on-going sampling schedule specified in the Ecology letter to Mr. Donald S. Jefferson of Spieker Properties, Inc. dated November 1, 1996, for the Bellefield Office Park at 11201 SE Eighth Street, Bellevue, Washington. The same set of analytical parameters specified in the 1996 letter is requested for the two additional wells."*

The pertinent portion of the Ecology 1996 letter concerning monitoring at the Bellefield Office Park is presented below:

*"Confirmational monitoring of the permanent on-site wells should therefore occur semi-annually for an additional three year period, then annually for another two years, at which time Ecology will review the information to ensure continued protection of human health and the environment. All monitoring wells should be tested for TPH and total arsenic, lead and zinc."*

RECEIVED  
AUG 31 2004  
DEPT OF ECOLOGY

*In addition, monitoring wells DW-2 and DW-5 should be analyzed for PAHs, while DW-3, DW-4, DW-5 and DW-6 should be tested for PCBs."*

The results of the characterization ground-water sampling are presented in DOF (1998). The first monitoring event specified in the Building N and Building O NFA letter was completed in November 1999 (DOF 2000). Data collected through May 2004 are summarized in DOF(2002). The May 2004 sampling was the last sampling round required by the Ecology May 21, 1999 NFA letter.

## **SAMPLING PROCEDURES AND FIELD MEASUREMENTS**

Ground-water samples were collected on May 15, 2003 and May 5, 2004. Low flow/low turbidity sampling procedures were used to collect the ground-water samples. Purging and sampling were completed using a peristaltic pump with a discharge rate of approximately 0.5 liters per minute. During purging, field measurements were made for depth to water, temperature, pH, specific conductivity and turbidity. Ground-water samples were collected after at least three casing volumes had been removed from the wells and the field parameters stabilized to within 10%.

Samples were collected directly into containers provided by the receiving laboratory (North Creek Analytical Inc.) that, in turn, were placed into chilled coolers for transport to the laboratory. Samples were delivered to the laboratory on the same day or the day following collection. Standard chain-of-custody procedures were used to document sampling handling.

## **GROUND-WATER QUALITY**

In accordance with the requirements of the NFA letter, analyses were made for petroleum hydrocarbons (using Method WTPH-D-extended); total arsenic, lead and zinc; polycyclic aromatic hydrocarbons (PAHs); and PCBs. The results of the ground-water quality analyses required by the NFA letter are summarized in attached Table 1 along with the results of the previous analyses. Laboratory data sheets for the May 2003 and 2004 sampling rounds are presented in Attachment 1.

**Total Petroleum Hydrocarbons.** Diesel-range (C12 to C24) and heavy-oil (>C24) range hydrocarbons were not detected in any of the samples collected in May 2003 and May 2004.

**Polychlorinated Biphenyls (PCBs).** PCBs were not detected during any sampling round in any of the water samples from the wells.

**Polynuclear Aromatic Hydrocarbons (PAHs).** The PAH analytes detected are listed in Table 1. The 2003 and 2004 PAH concentrations are similar to concentrations detected in previous samples collected/analyzed between 1997 and 2002.

**Total Metals.** Analyses were made for total arsenic, lead and zinc. The results are summarized in Table 1.

- Total arsenic concentrations, when detected, were below 0.005 mg/l. The highest reported detection in the period 2003 to 2004 was 0.003 mg/l, measured in a sample from well MW-K1 in May 2003. The May 2003 and 2004 sample concentrations ranged between less than 0.001 mg/l and 0.003 mg/l.
- Total lead concentrations were measured at concentrations generally below 0.010 mg/l. In 2003 and 2004, the highest lead concentration (0.007 mg/l) was measured in the May 2003 sample from well BA-MW-1(R). The May 2003 and 2004 sample concentrations ranged between approximately 0.003 mg/l and 0.007 mg/l.
- Total zinc was not detected in any of the samples collected in 2003 and 2004.

## COMPARISON WITH GROUND-WATER CLEANUP LEVELS

To provide perspective on the water quality data, the detected sample concentrations listed in Table 1 were compared to drinking water cleanup levels under the Model Toxics Control Act (Chapter 173-340 WAC). The maximum detected concentrations are summarized in Table 2 along with the cleanup levels. As shown in Table 2, all the maximum concentrations are below their respective cleanup levels except for diesel range hydrocarbon concentrations.

Samples collected in 2000 had diesel range hydrocarbon concentrations that ranged between 0.34 mg/l and 0.97 mg/l (Table 1). Three of the four samples exceeded the current cleanup level of 0.5 mg/l. However, diesel range hydrocarbons were not detected (reporting limit of 0.25 mg/l) in two samples collected before or five samples collected after year 2000. The results of the samples collected in the period between 2001 and 2004 indicate that the diesel range organics concentrations are below cleanup levels in the well samples.

## SCHEDULED SAMPLING ROUNDS

The required monitoring rounds specified in Ecology's May 21, 1999 NFA letter have been completed and, with submittal of this report, reported to Ecology. The requirements of the NFA letter have been met and no additional sampling rounds are scheduled or anticipated.

## REFERENCES

DOF (Dalton, Olmsted & Fuglevand, Inc.), 1998, Independent Remedial Action Report, Building N (Aspenwood) and Building O (Magnolia) Sites, Bellefield Office Park, Bellevue, Washington, October 1998.

**Dalton, Olmsted & Fuglevand, Inc.**

Frank Frankini – Equity Office  
Page 4 July 31, 2004

DOF, 2000, Summary of 1999 Ground-Water Sampling Event, Building N (Aspenwood) & O (Magnolia) Properties, Bellevue, Washington, February 23, 2000.

DOF, 2002, Summary of Ground-Water Sampling Events Through January 2002, Building N (Aspenwood) & O (Magnolia) Properties, Bellevue, Washington, February 4, 2002.

DOF, 2003, Summary of Ground-Water Sampling Events Through May 2002, Building N (Aspenwood) & O (Magnolia) Properties, Bellevue, Washington, April 23, 2003.

**CLOSING**

The services described in this report were performed consistent with generally accepted professional consulting principles and practices. No other warranty, express or implied, is made. These services were performed consistent with our agreement with our client. This report is solely for the use and information of Spieker Properties, Inc. unless otherwise noted. Any reliance on this report by a third party is at such party's sole risk.

Opinions and recommendations contained in this report apply to conditions existing when services were performed and are intended only for our client, purposes, locations, time frames, and project parameters indicated. We are not responsible for the impacts of any changes in environmental standards, practices or regulations subsequent to performance of services. We do not warrant the accuracy of information supplied by others, or the use of segregated portions of this report.

Please call if you have any questions.

Sincerely  
Dalton, Olmsted & Fuglevand, Inc.

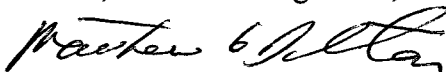

Matthew G. Dalton  
Sr. Consulting Hydrogeologist

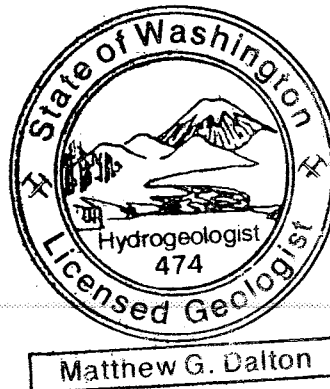

Attachments Table 1 - Summary of Water Quality Data  
Table 2 – Summary of Detected Ground-Water Quality Concentrations  
Figure 1 - Site Vicinity Map  
Figure 2 - Well Location Map

Attachment 1. Laboratory Data Sheets – May 2003 and May 2004

Cc: Mark Furse – Piper Rudnick

**Dalton, Olmsted & Fuglevand, Inc.**

---

Frank Frankini – Equity Office  
Page 5                      July 31, 2004

**ref: BldgN\_Omonrpt04**

**TABLE 1 - Summary of Ground-Water Quality Data**

Well No.	MW-K1	MW-K1	MW-K1	MW-K1	MW-K1	MW-K1	MW-K1	MW-K1	MW-K1
Screen Depth(ft)	3-13	3-13	3-13	3-13	3-13	3-13	3-13	3-13	3-13
Sample Date	12/18/1997	11/16/1999	5/4/2000	11/17/2000	6/7/2001	1/8/2002	5/30/2002	5/15/2003	5/5/2004
<b>Field Parameters</b>									
<b>Water Level (feet)</b>	---	---	+0.1	1.62	+0.1	1.8	0.1	0.05	0
<b>pH</b>	---	---	5.9	6.2	5.8	5.9	6.1	6	6.3
<b>Electrical Conductivity (uS)</b>	---	---	983	812	1012	668	989	935	830
<b>Temperature (C)</b>	---	---	10	13	11.2	11	11	11	10.9
<b>Turbidity (NTU)</b>	---	---	7.1	2.2	3.2	15	4.8	2.1	3.2
<b>Total Petroleum Hydrocarbons</b>									
TPH as Diesel (mg/l)	<0.25	<0.25	0.34	0.8	<0.25	<0.25	<0.25	<0.25	<0.25
TPH as Oil (mg/l)	<0.75	<0.75	<0.75	<0.75	<0.75	<0.75	<0.75	<0.75	<0.75
<b>PCBs (ug/l)</b>									
Aroclor 1016	<0.1	<0.1	<0.1	<0.1	<0.5	<0.5	<0.5	<0.5	<0.5
Aroclor 1221	<0.1	<0.1	<0.1	<0.1	<0.5	<0.5	<1.0	<0.5	<0.5
Aroclor 1232	<0.1	<0.1	<0.1	<0.1	<0.5	<0.5	<0.5	<0.5	<0.5
Aroclor 1242	<0.1	<0.1	<0.1	<0.1	<0.5	<0.5	<0.5	<0.5	<0.5
Aroclor 1248	<0.1	<0.1	<0.1	<0.1	<0.5	<0.5	<0.5	<0.5	<0.5
Aroclor 1254	<0.1	<0.1	<0.1	<0.1	<0.5	<0.5	<0.5	<0.5	<0.5
Aroclor 1260	<0.1	<0.1	<0.1	<0.1	<0.5	<0.5	<0.5	<0.5	<0.5
Aroclor 1262	<0.1	<0.1	<0.1	<0.1	<0.5	<0.5	---	<0.5	<0.5
Aroclor 1268	<0.1	<0.1	<0.1	<0.1	<0.5	<0.5	---	<0.5	<0.5
<b>Polynuclear Aromatic Hydrocarbons (ug/l)</b>									
Acenaphthene	1.3	2.0	2.4	1.7	<5	<5	<5	1.7	1.8
Acenaphthylene	<1.0	<0.1	<0.1	<0.1	<5	<5	<5	<0.1	<0.1
Anthracene	<1.0	0.49	0.40	0.34	<5	<5	<5	0.42	0.33
Benzo(a)anthracene	<0.10	<0.1	<0.1	<0.1	<0.1	<0.3	<0.3	<0.1	<0.1
Benzo(a)pyrene	<0.10	<0.1	<0.1	<0.1	<0.1	<0.3	<0.3	<0.1	<0.1
Benzo(b)fluoranthene	<0.10	<0.1	<0.1	<0.1	<0.1	<0.2	<0.2	<0.1	<0.1
Benzo(ghi)perylene	<0.10	<0.1	<0.1	<0.1	<0.1	<0.3	<0.3	<0.1	<0.1
Benzo(k)fluoranthene	<0.10	<0.1	<0.1	<0.1	<0.1	<0.3	<0.3	<0.1	<0.1
Chrysene	<0.10	<0.1	<0.1	<0.1	<0.1	0.34	<0.2	<0.1	<0.1
Dibenzo(a,h)anthracene	<0.10	<0.1	<0.1	<0.1	<0.2	<0.3	<0.4	<0.1	<0.1
Fluoranthene	0.28	0.49	0.40	0.32	0.25	0.93	0.23	0.89	0.33
Fluorene	1.5	1.7	2.0	1.6	1.0	1.4	0.79	1.6	1.7
Indeno(1,2,3-cd)pyrene	<0.10	<0.1	<0.1	<0.1	<0.2	<0.2	<0.2	<0.1	<0.1
Naphthalene	6.6	7.7	7.1	6.0	<5	5.6	<5	6.2	6.8
Phenanthrene	1.5	2.6	2.9	2.1	1.7	2.5	1	1.9	2.0
Pyrene	<1.0	0.44	0.32	0.28	0.21	0.92	<0.2	0.30	0.27
<b>Total Metals (mg/l)</b>									
Arsenic	<0.001	0.0024	0.0021	0.0024	0.0026	0.0024	0.0025	0.0033	0.0022
Lead	0.0089	0.0094	0.0077	0.0035	0.0013	0.0129	0.0014	0.0023	0.0022
Zinc	<0.020	<0.010	<0.010	<0.010	<0.010	0.0194	<0.01	<0.01	<0.01

< = Not detected at indicated reporting limit

--- = Not analyzed

TABLE 1 - Summary of Ground-Water Quality Data

Building N O Sites  
Bellevue, Washington

Well No.	BA-MW-1	BA-MW-1(R)	BA-MW-1(R)	BA-MW-1(R)	BA-MW-1(R)	BA-MW-1(R)	BA-MW-1(R)	BA-MW-1(R)	BA-MW-1(R)
Screen Depth(ft)	2.5-12.5	2.5-12.5	2.5-12.5	2.5-12.5	2.5-12.5	2.5-12.5	2.5-12.5	2.5-12.5	2.5-12.5
Sample Date	11/25/1996	11/16/1999	5/4/2000	11/17/2000	6/7/2001	1/8/2002	5/30/2002	5/15/2003	5/5/2004
<b>Field Parameters</b>									
Water Level (feet)	---	---	3.0	4.63	2.83	4.1	2.91	2.95	2.67
pH	---	---	6.3	6.5	6	6.5	6.5	6.3	6.6
Electrical Conductivity (uS)	---	---	1072	1193	1140	683	858	885	933
Temperature (C)	---	---	13.0	16.0	16.0	11.0	12.9	13.5	13.8
Turbidity (NTU)	---	---	2.2	0.9	1.4	5.0	2.1	1	3.2
<b>Total Petroleum Hydrocarbons</b>									
TPH as Diesel (mg/l)	<0.25	<0.50	0.96	0.57	<0.25	<0.25	<0.25	<0.25	<0.25
TPH as Oil (mg/l)	<0.75	<1.50	<0.75	<0.75	<0.75	<0.75	<0.75	<0.75	<0.75
<b>PCBs (ug/l)</b>									
Aroclor 1016	<0.1	<0.1	<0.1	<0.1	<0.5	<0.5	<0.5	<0.5	<0.5
Aroclor 1221	<0.1	<0.1	<0.1	<0.1	<0.5	<0.5	<1.0	<0.5	<0.5
Aroclor 1232	<0.1	<0.1	<0.1	<0.1	<0.5	<0.5	<0.5	<0.5	<0.5
Aroclor 1242	<0.1	<0.1	<0.1	<0.1	<0.5	<0.5	<0.5	<0.5	<0.5
Aroclor 1248	<0.1	<0.1	<0.1	<0.1	<0.5	<0.5	<0.5	<0.5	<0.5
Aroclor 1254	<0.1	<0.1	<0.1	<0.1	<0.5	<0.5	<0.5	<0.5	<0.5
Aroclor 1260	<0.1	<0.1	<0.1	<0.1	<0.5	<0.5	<0.5	<0.5	<0.5
Aroclor 1262	---	<0.1	<0.1	<0.1	<0.5	<0.5	---	<0.5	<0.5
Aroclor 1268	---	<0.1	<0.1	<0.1	<0.5	<0.5	---	<0.5	<0.5
<b>Polynuclear Aromatic Hydrocarbons (ug/l)</b>									
Acenaphthene	---	0.57	0.58	0.88	<5	<5	<5	1.2	0.58
Acenaphthylene	---	<0.20	<0.1	<0.1	<5	<5	<5	<0.1	<0.1
Anthracene	---	<0.20	<0.1	<0.1	<5	<5	<5	0.12	<0.1
Benzo(a)anthracene	---	<0.20	<0.1	<0.1	<0.1	<0.3	<0.30	<0.1	<0.1
Benzo(a)pyrene	---	<0.20	<0.1	<0.1	<0.1	<0.3	<0.30	<0.1	<0.1
Benzo(b)fluoranthene	---	<0.20	<0.1	<0.1	<0.1	<0.2	<0.20	<0.1	<0.1
Benzo(ghi)perylene	---	<0.20	<0.1	<0.1	<0.1	<0.3	<0.30	<0.1	<0.1
Benzo(k)fluoranthene	---	<0.20	<0.1	<0.1	<0.1	<0.3	<0.30	<0.1	<0.1
Chrysene	---	<0.20	<0.1	<0.1	<0.1	<0.2	<0.20	<0.1	<0.1
Dibenzo(a,h)anthracene	---	<0.20	<0.1	<0.1	<0.2	<0.3	<0.40	<0.1	<0.1
Fluoranthene	---	<0.20	<0.1	<0.1	<0.1	<0.2	<0.20	0.12	<0.1
Fluorene	---	0.38	0.32	0.71	<0.5	0.62	0.66	0.85	0.40
Indeno(1,2,3-cd)pyrene	---	<0.20	<0.1	<0.1	<0.2	<0.2	<0.20	<0.1	<0.1
Naphthalene	---	0.30	0.40	0.46	<5	<5.0	<5	<0.1	<0.1
Phenanthrene	---	<0.20	<0.1	0.44	<0.5	<0.5	<0.50	0.44	0.19
Pyrene	---	<0.20	<0.1	<0.1	<0.1	<0.2	<0.20	0.48	<0.1
<b>Total Metals (mg/l)</b>									
Arsenic	<0.004	0.0019	0.0028	<0.001	0.0012	<0.001	0.0011	<0.001	<0.001
Lead	0.0070	0.0078	0.0060	0.0016	0.0026	0.0063	0.0030	0.0074	0.0042
Zinc	<0.020	0.012	0.010	<0.010	0.013	0.014	0.010	<0.010	<0.010

&lt; = Not detected at indicated reporting limit

--- = Not analyzed

**TABLE 2 - Summary of PAH Concentrations in Ground-Water and Cleanup Levels**Bellefield Office Park  
Bellevue, Washington

Detected Constituent	Units	Highest Concentration		MTCA CUL	
		MW-K1	BA-MW-1®	Drinking Water	Method
Diesel Range Organics	mg/l	0.8	0.96	0.5	A(1)
Acenaphthene	ug/l	2.4	1.2	960	B(2)
Anthracene	ug/l	0.49	0.12	2400	B(2)
Chrysene	ug/l	0.0003(3)	<0.2	0.1	A(1)
Fluoranthene	ug/l	0.89	0.12	640	B(2)
Fluorene	ug/l	2.0	0.85	640	B(2)
Naphthalene	ug/l	7.7	0.46	160	A(1)
Phenanthrene	ug/l	2.9	0.44	na	----
Pyrene	ug/l	0.92	0.48	480	B(2)
Arsenic	mg/l	0.003	0.003	0.005	A(1)
Lead	mg/l	0.013	0.008	0.015	A(1)
Zinc	mg/l	0.019	0.014	4800	B(2)

**Notes:**

CUL - Cleanup Level

na - Not available

(1) - WAC 173-340-720

(2) - WAC 173-340-720 (CLARC 3.1)

(3) - The maximum (only) detected chrysene concentration (0.34 ug/l) was converted to benzo(a)pyrene equivalents consistent with WAC 173-340-708(8).

A toxicity equivalency factor of 0.001 was used to make the conversion based on Preliminary Remediation Goals published by U.S. EPA Region 9.



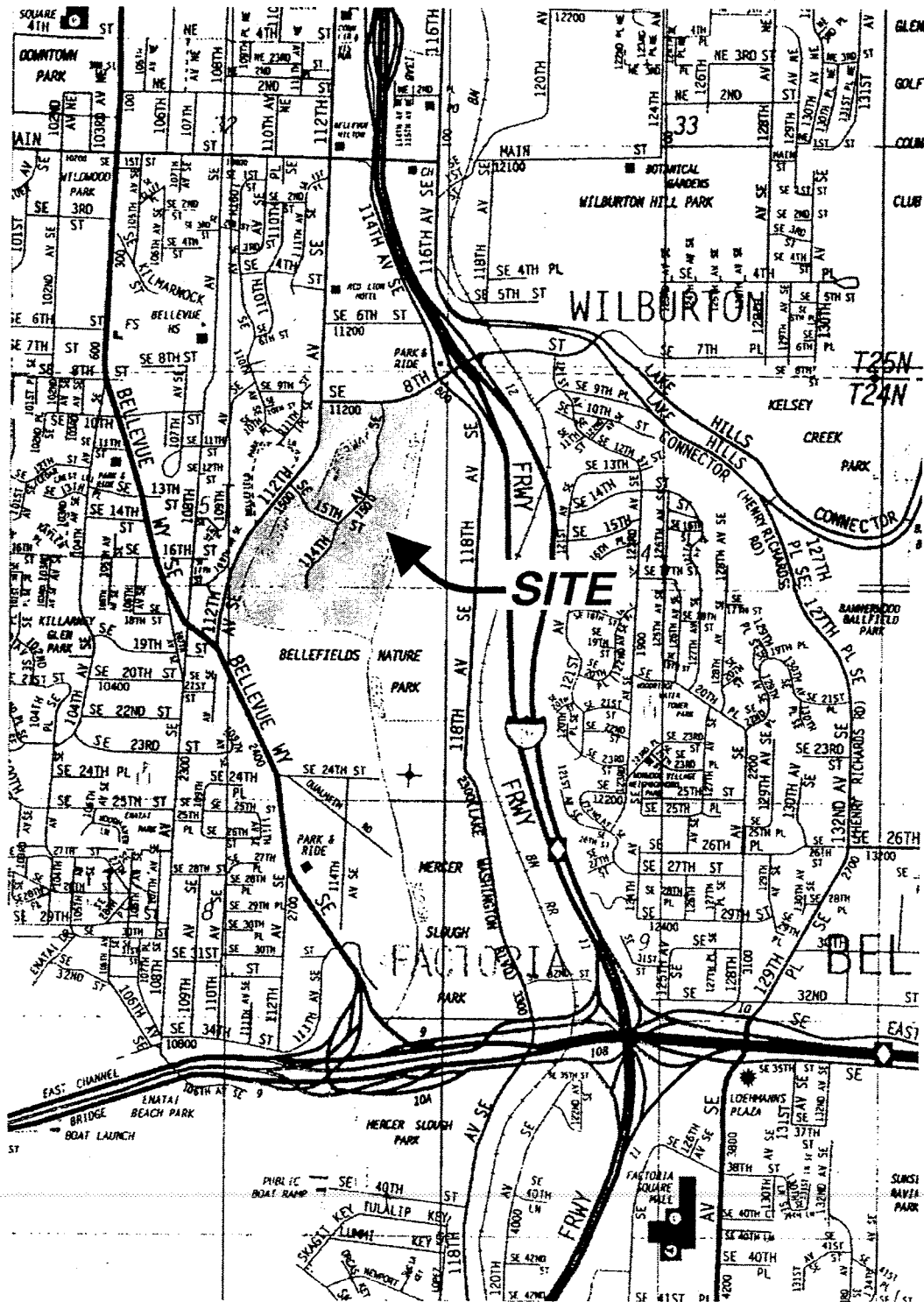

Bellefield Office Park  
Bellevue Washington

### VICINITY MAP

SPK-002

FIGURE 1

January 1998

Dalton, Olmsted & Fuglevand, Inc.

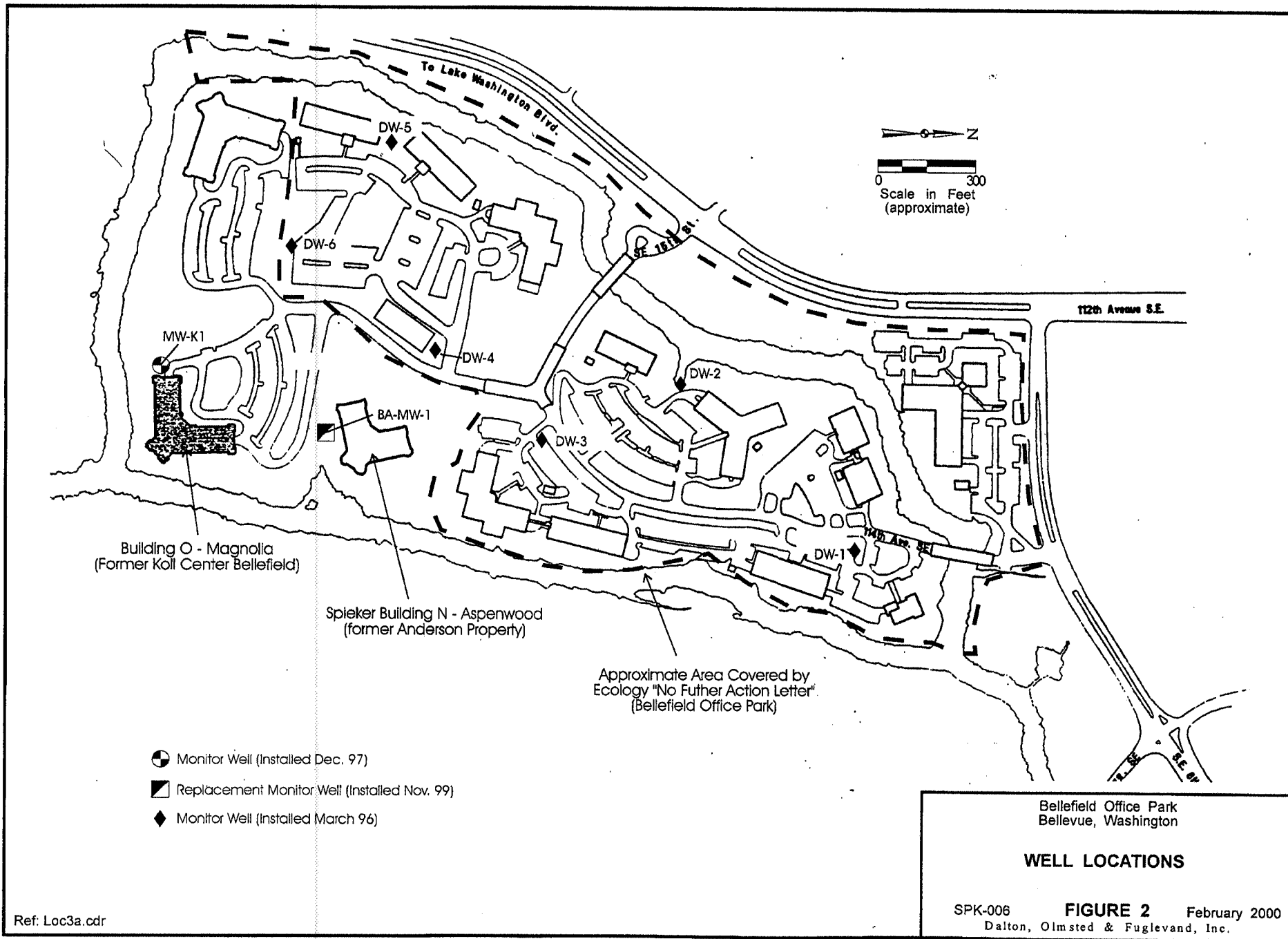

# iMAP



Highlighted Feature



County Boundary



Mountain Peaks

Highways



Forest Production District Boundary



Agricultural Production District Boundary



Urban Growth Area Line



Incorporated Area

Streets



Highway



Arterials



Local



Lakes and Large Rivers



Streams



Tribal Lands



Property sales in the last 3 years



Parcels



Parks

Unincorporated KC Zoning



A-10 - Agricultural, one DU per 10 acres



A-35 - Agricultural, one DU per 35 acres



F - Forest



M - Mineral



RA-2.5 - Rural Area, one DU per 5 acres



RA-5 - Rural Area, one DU per 5 acres



RA-10 - Rural Area, one DU per 10 acres



UR - Urban Reserve, one DU per 5 acres  
(cont)

## Legend

R-1 - Residential, one DU per acre

R-4 - Residential, 4 DU per acre

R-6 - Residential, 6 DU per acre

R-8 - Residential, 8 DU per acre

R-12 - Residential, 12 DU per acre

R-18 - Residential, 18 DU per acre

R-24 - Residential, 24 DU per acre

R-48 - Residential, 48 DU per acre

NB - Neighborhood Business

CB - Community Business

RB - Regional Business

O - Office

I - Industrial

Other

The information included on this map has been compiled by King County staff from a variety of sources and is subject to change without notice. King County makes no representations or warranties, express or implied, as to accuracy, completeness, timeliness, or rights to the use of such information. This document is not intended for use as a survey product. King County shall not be liable for any general, special, indirect, incidental, or consequential damages including, but not limited to, lost revenues or lost profits resulting from the use or misuse of the information contained on this map. Any sale of this map or information on this map is prohibited except by written permission of King County.

Date: 11/30/2009

Source: King County iMAP - Property Information (<http://www.metrokc.gov/GIS/iMAP>)



King County

**ATTACHMENT 1**  
**LABORATORY DATA SHEETS**

**BUILDING N & O PROPERTIES**  
**MAY 2003 and May 2004**  
**GROUND-WATER SAMPLING**

---



**Seattle** 11720 North Creek Pkwy N, Suite 400, Bothell, WA 98011-8244  
425.420.9200 fax 425.420.9210  
**Spokane** East 11115 Montgomery, Suite B, Spokane, WA 99206-4776  
509.924.9200 fax 509.924.9290  
**Portland** 9405 SW Nimbus Avenue, Beaverton, OR 97008-7132  
503.906.9200 fax 503.906.9210  
**Bend** 20332 Empire Avenue, Suite F-1, Bend, OR 97701-5711  
541.383.9310 fax 541.382.7588  
**Anchorage** 2000 W. International Airport Road, Suite A10, Anchorage, AK 99502-1119  
907.563.9200 fax 907.563.9210

02 June 2003

Matthew Dalton  
Dalton, Olmsted and Fuglevand  
10827 NE 68th St, Suite B  
Kirkland, WA/USA 98033  
RE: Bellfield Office Park

Enclosed are the results of analyses for samples received by the laboratory on 05/16/03 10:05. If you have any questions concerning this report, please feel free to contact me.

Sincerely,

Kortland Orr  
PM



**Seattle** 11720 North Creek Pkwy N, Suite 400, Bothell, WA 98011-8244  
425.420.9200 fax 425.420.9210  
**Spokane** East 11115 Montgomery, Suite B, Spokane, WA 99206-4776  
509.924.9200 fax 509.924.9290  
**Portland** 9405 SW Nimbus Avenue, Beaverton, OR 97008-7132  
503.906.9200 fax 503.906.9210  
**Bend** 20332 Empire Avenue, Suite F-1, Bend, OR 97701-5711  
541.383.9310 fax 541.382.7588  
**Anchorage** 2000 W. International Airport Road, Suite A10, Anchorage, AK 99502-1119  
907.563.9200 fax 907.563.9210

Dalton, Olmsted and Fuglevand  
10827 NE 68th St, Suite B  
Kirkland WA/USA, 98033

Project: Bellfield Office Park  
Project Number: SPK-004  
Project Manager: Matthew Dalton

**Reported:**  
06/02/03 19:34

### ANALYTICAL REPORT FOR SAMPLES

Sample ID	Laboratory ID	Matrix	Date Sampled	Date Received
MW-K1	B3E0393-01	Water	05/15/03 13:00	05/16/03 10:05
BA-MW-1 (R)	B3E0393-02	Water	05/15/03 14:00	05/16/03 10:05

North Creek Analytical - Bothell

*The results in this report apply to the samples analyzed in accordance with the chain of custody document. This analytical report must be reproduced in its entirety.*

Kortland Orr, PM

North Creek Analytical, Inc.  
Environmental Laboratory Network

Page 1 of 13



**Seattle** 11720 North Creek Pkwy N, Suite 400, Bothell, WA 98011-8244  
425.420.9200 fax 425.420.9210  
**Spokane** East 11115 Montgomery, Suite B, Spokane, WA 99206-4776  
509.924.9200 fax 509.924.9290  
**Portland** 9405 SW Nimbus Avenue, Beaverton, OR 97008-7132  
503.906.9200 fax 503.906.9210  
**Bend** 20332 Empire Avenue, Suite F-1, Bend, OR 97701-5711  
541.383.9310 fax 541.382.7588  
**Anchorage** 2000 W. International Airport Road, Suite A10, Anchorage, AK 99502-1119  
907.563.9200 fax 907.563.9210

Dalton, Olmsted and Fuglevand  
10827 NE 68th St, Suite B  
Kirkland WA/USA, 98033

Project: Bellfield Office Park  
Project Number: SPK-004  
Project Manager: Matthew Dalton

**Reported:**  
06/02/03 19:34

**Diesel Hydrocarbons (C12-C24) and Heavy Oil (C24-C36 by WTPH-D (extended) with Silica Gel Clean-up  
North Creek Analytical - Bothell**

Analyte	Result	Reporting Limit	Units	Dilution	Batch	Prepared	Analyzed	Method	Notes
<b>MW-K1 (B3E0393-01) Water Sampled: 05/15/03 13:00 Received: 05/16/03 10:05</b>									
Diesel Range Hydrocarbons	ND	0.250	mg/l	1	3E19005	05/19/03	05/20/03	WTPH-D	
Heavy Oil Range Hydrocarbons	ND	0.750	"	"	"	"	"	"	
Surrogate: 2-FBP	85.0 %	50-150			"	"	"	"	
Surrogate: Octacosane	58.0 %	50-150			"	"	"	"	
<b>BA-MW-1 (R) (B3E0393-02) Water Sampled: 05/15/03 14:00 Received: 05/16/03 10:05</b>									
Diesel Range Hydrocarbons	ND	0.250	mg/l	1	3E19005	05/19/03	05/21/03	WTPH-D	
Heavy Oil Range Hydrocarbons	ND	0.750	"	"	"	"	"	"	
Surrogate: 2-FBP	87.6 %	50-150			"	"	"	"	
Surrogate: Octacosane	53.9 %	50-150			"	"	"	"	

North Creek Analytical - Bothell

*The results in this report apply to the samples analyzed in accordance with the chain of custody document. This analytical report must be reproduced in its entirety.*

Kortland Orr, PM

North Creek Analytical, Inc.  
Environmental Laboratory Network



**Seattle** 11720 North Creek Pkwy N, Suite 400, Bothell, WA 98011-8244  
425.420.9200 fax 425.420.9210  
**Spokane** East 11115 Montgomery, Suite B, Spokane, WA 99206-4776  
509.924.9200 fax 509.924.9290  
**Portland** 9405 SW Nimbus Avenue, Beaverton, OR 97008-7132  
503.906.9200 fax 503.906.9210  
**Bend** 20332 Empire Avenue, Suite F-1, Bend, OR 97701-5711  
541.383.9310 fax 541.382.7588  
**Anchorage** 2000 W. International Airport Road, Suite A10, Anchorage, AK 99502-1119  
907.563.9200 fax 907.563.9210

Dalton, Olmsted and Fuglevand  
10827 NE 68th St, Suite B  
Kirkland WA/USA, 98033

Project: Bellfield Office Park  
Project Number: SPK-004  
Project Manager: Matthew Dalton

**Reported:**  
06/02/03 19:34

**Total Metals by EPA 6000/7000 Series Methods**  
**North Creek Analytical - Bothell**

Analyte	Result	Reporting Limit	Units	Dilution	Batch	Prepared	Analyzed	Method	Notes
<b>MW-K1 (B3E0393-01) Water Sampled: 05/15/03 13:00 Received: 05/16/03 10:05</b>									
Arsenic	0.00332	0.00100	mg/l	1	3E21026	05/21/03	05/22/03	EPA 6020	
Lead	0.00225	0.00100	"	"	"	"	"	"	
<b>MW-K1 (B3E0393-01RE1) Water Sampled: 05/15/03 13:00 Received: 05/16/03 10:05</b>									
Zinc	ND	0.0100	mg/l	1	3E24011	05/21/03	05/28/03	EPA 6020	
<b>BA-MW-1 (R) (B3E0393-02) Water Sampled: 05/15/03 14:00 Received: 05/16/03 10:05</b>									
Arsenic	ND	0.00100	mg/l	1	3E21026	05/21/03	05/22/03	EPA 6020	
Lead	0.00742	0.00100	"	"	"	"	"	"	
<b>BA-MW-1 (R) (B3E0393-02RE1) Water Sampled: 05/15/03 14:00 Received: 05/16/03 10:05</b>									
Zinc	ND	0.0100	mg/l	1	3E24011	05/21/03	05/28/03	EPA 6020	

North Creek Analytical - Bothell

*The results in this report apply to the samples analyzed in accordance with the chain of custody document. This analytical report must be reproduced in its entirety.*

Kortland Orr, PM

North Creek Analytical, Inc.  
Environmental Laboratory Network

Page 3 of 13





Seattle 11720 North Creek Pkwy N, Suite 400, Bothell, WA 98011-8244  
425.420.9200 fax 425.420.9210  
Spokane East 11115 Montgomery, Suite B, Spokane, WA 99206-4776  
509.924.9200 fax 509.924.9290  
Portland 9405 SW Nimbus Avenue, Beaverton, OR 97008-7132  
503.906.9200 fax 503.906.9210  
Bend 20332 Empire Avenue, Suite F-1, Bend, OR 97701-5711  
541.383.9310 fax 541.382.7588  
Anchorage 2000 W. International Airport Road, Suite A10, Anchorage, AK 99502-1119  
907.563.9200 fax 907.563.9210

Dalton, Olmsted and Fuglevand  
10827 NE 68th St, Suite B  
Kirkland WA/USA, 98033

Project: Bellfield Office Park  
Project Number: SPK-004  
Project Manager: Matthew Dalton

Reported:  
06/02/03 19:34

**Polychlorinated Biphenyls by EPA Method 8082**  
**North Creek Analytical - Bothell**

Analyte	Result	Reporting Limit	Units	Dilution	Batch	Prepared	Analyzed	Method	Notes
<b>MW-K1 (B3E0393-01) Water Sampled: 05/15/03 13:00 Received: 05/16/03 10:05</b>									
Aroclor 1016	ND	0.500	ug/l	1	3E22007	05/22/03	05/23/03	EPA 8082	
Aroclor 1221	ND	0.500	"	"	"	"	"	"	
Aroclor 1232	ND	0.500	"	"	"	"	"	"	
Aroclor 1242	ND	0.500	"	"	"	"	"	"	
Aroclor 1248	ND	0.500	"	"	"	"	"	"	
Aroclor 1254	ND	0.500	"	"	"	"	"	"	
Aroclor 1260	ND	0.500	"	"	"	"	"	"	
Aroclor 1262	ND	0.500	"	"	"	"	"	"	
Aroclor 1268	ND	0.500	"	"	"	"	"	"	
Surrogate: TCX	78.6 %	29-130			"	"	"	"	
Surrogate: Decachlorobiphenyl	18.9 %	22-112			"	"	"	"	S-03

**BA-MW-1 (R) (B3E0393-02) Water Sampled: 05/15/03 14:00 Received: 05/16/03 10:05**

Aroclor 1016	ND	0.500	ug/l	1	3E22007	05/22/03	05/23/03	EPA 8082	
Aroclor 1221	ND	0.500	"	"	"	"	"	"	
Aroclor 1232	ND	0.500	"	"	"	"	"	"	
Aroclor 1242	ND	0.500	"	"	"	"	"	"	
Aroclor 1248	ND	0.500	"	"	"	"	"	"	
Aroclor 1254	ND	0.500	"	"	"	"	"	"	
Aroclor 1260	ND	0.500	"	"	"	"	"	"	
Aroclor 1262	ND	0.500	"	"	"	"	"	"	
Aroclor 1268	ND	0.500	"	"	"	"	"	"	
Surrogate: TCX	81.4 %	29-130			"	"	"	"	
Surrogate: Decachlorobiphenyl	24.1 %	22-112			"	"	"	"	

North Creek Analytical - Bothell

The results in this report apply to the samples analyzed in accordance with the chain of custody document. This analytical report must be reproduced in its entirety.

Kortland Orr, PM

North Creek Analytical, Inc.  
Environmental Laboratory Network



Seattle 11720 North Creek Pkwy N, Suite 400, Bothell, WA 98011-8244  
425.420.9200 fax 425.420.9210  
Spokane East 11115 Montgomery, Suite B, Spokane, WA 99206-4776  
509.924.9200 fax 509.924.9290  
Portland 9405 SW Nimbus Avenue, Beaverton, OR 97008-7132  
503.906.9200 fax 503.906.9210  
Bend 20332 Empire Avenue, Suite F-1, Bend, OR 97701-5711  
541.383.9310 fax 541.382.7588  
Anchorage 2000 W. International Airport Road, Suite A10, Anchorage, AK 99502-1119  
907.563.9200 fax 907.563.9210

Dalton, Olmsted and Fuglevand  
10827 NE 68th St, Suite B  
Kirkland WA/USA, 98033

Project: Bellfield Office Park  
Project Number: SPK-004  
Project Manager: Matthew Dalton

Reported:  
06/02/03 19:34

**Polynuclear Aromatic Compounds by GC/MS with Selected Ion Monitoring**  
**North Creek Analytical - Bothell**

Analyte	Result	Reporting Limit	Units	Dilution	Batch	Prepared	Analyzed	Method	Notes
---------	--------	--------------------	-------	----------	-------	----------	----------	--------	-------

MW-K1 (B3E0393-01) Water Sampled: 05/15/03 13:00 Received: 05/16/03 10:05

Acenaphthene	1.72	0.100	ug/l	1	3E21004	05/21/03	05/23/03	8270C-SIM	
Acenaphthylene	ND	0.100	"	"	"	"	"	"	
Anthracene	0.415	0.100	"	"	"	"	"	"	
Benzo (a) anthracene	ND	0.100	"	"	"	"	"	"	
Benzo (a) pyrene	ND	0.100	"	"	"	"	"	"	
Benzo (b) fluoranthene	ND	0.100	"	"	"	"	"	"	
Benzo (ghi) perylene	ND	0.100	"	"	"	"	"	"	
Benzo (k) fluoranthene	ND	0.100	"	"	"	"	"	"	
Chrysene	ND	0.100	"	"	"	"	"	"	
Dibenz (a,h) anthracene	ND	0.100	"	"	"	"	"	"	
Fluoranthene	0.887	0.100	"	"	"	"	"	"	
Fluorene	1.55	0.100	"	"	"	"	"	"	
Indeno (1,2,3-cd) pyrene	ND	0.100	"	"	"	"	"	"	
Naphthalene	6.15	0.100	"	"	"	"	"	"	
Phenanthrene	1.87	0.100	"	"	"	"	"	"	
Pyrene	0.302	0.100	"	"	"	"	"	"	

Surrogate: p-Terphenyl-d14 39.8 % 20-117 " " " "

BA-MW-1 (R) (B3E0393-02) Water Sampled: 05/15/03 14:00 Received: 05/16/03 10:05

Acenaphthene	1.17	0.100	ug/l	1	3E21004	05/21/03	05/23/03	8270C-SIM	
Acenaphthylene	ND	0.100	"	"	"	"	"	"	
Anthracene	0.115	0.100	"	"	"	"	"	"	
Benzo (a) anthracene	ND	0.100	"	"	"	"	"	"	
Benzo (a) pyrene	ND	0.100	"	"	"	"	"	"	
Benzo (b) fluoranthene	ND	0.100	"	"	"	"	"	"	
Benzo (ghi) perylene	ND	0.100	"	"	"	"	"	"	
Benzo (k) fluoranthene	ND	0.100	"	"	"	"	"	"	
Chrysene	ND	0.100	"	"	"	"	"	"	
Dibenz (a,h) anthracene	ND	0.100	"	"	"	"	"	"	
Fluoranthene	0.115	0.100	"	"	"	"	"	"	
Fluorene	0.846	0.100	"	"	"	"	"	"	
Indeno (1,2,3-cd) pyrene	ND	0.100	"	"	"	"	"	"	
Naphthalene	ND	0.100	"	"	"	"	"	"	
Phenanthrene	0.442	0.100	"	"	"	"	"	"	
Pyrene	0.481	0.100	"	"	"	"	"	"	

North Creek Analytical - Bothell

The results in this report apply to the samples analyzed in accordance with the chain of custody document. This analytical report must be reproduced in its entirety.

Kortland Orr, PM

North Creek Analytical, Inc.  
Environmental Laboratory Network



**Seattle** 11720 North Creek Pkwy N, Suite 400, Bothell, WA 98011-8244  
425.420.9200 fax 425.420.9210  
**Spokane** East 11115 Montgomery, Suite B, Spokane, WA 99206-4776  
509.924.9200 fax 509.924.9290  
**Portland** 9405 SW Nimbus Avenue, Beaverton, OR 97008-7132  
503.906.9200 fax 503.906.9210  
**Bend** 20332 Empire Avenue, Suite F-1, Bend, OR 97701-5711  
541.383.9310 fax 541.382.7588  
**Anchorage** 2000 W. International Airport Road, Suite A10, Anchorage, AK 99502-1119  
907.563.9200 fax 907.563.9210

Dalton, Olmsted and Fuglevand  
10827 NE 68th St, Suite B  
Kirkland WA/USA, 98033

Project: Bellfield Office Park  
Project Number: SPK-004  
Project Manager: Matthew Dalton

**Reported:**  
06/02/03 19:34

**Polynuclear Aromatic Compounds by GC/MS with Selected Ion Monitoring**  
**North Creek Analytical - Bothell**

Analyte	Result	Reporting	Units	Dilution	Batch	Prepared	Analyzed	Method	Notes
		Limit							
BA-MW-1 (R) (B3E0393-02) Water    Sampled: 05/15/03 14:00    Received: 05/16/03 10:05									
Surrogate: p-Terphenyl-d14	60.1 %	20-117			3E21004	05/21/03	05/23/03	"	

North Creek Analytical - Bothell

*The results in this report apply to the samples analyzed in accordance with the chain of custody document. This analytical report must be reproduced in its entirety.*

Kortland Orr, PM

North Creek Analytical, Inc.  
Environmental Laboratory Network



**Seattle** 11720 North Creek Pkwy N, Suite 400, Bothell, WA 98011-8244  
425.420.9200 fax 425.420.9210  
**Spokane** East 11115 Montgomery, Suite B, Spokane, WA 99206-4776  
509.924.9200 fax 509.924.9290  
**Portland** 9405 SW Nimbus Avenue, Beaverton, OR 97008-7132  
503.906.9200 fax 503.906.9210  
**Bend** 20332 Empire Avenue, Suite F-1, Bend, OR 97701-5711  
541.383.9310 fax 541.382.7588  
**Anchorage** 2000 W. International Airport Road, Suite A10, Anchorage, AK 99502-1119  
907.563.9200 fax 907.563.9210

Dalton, Olmsted and Fuglevand  
10827 NE 68th St, Suite B  
Kirkland WA/USA, 98033

Project: Bellfield Office Park  
Project Number: SPK-004  
Project Manager: Matthew Dalton

**Reported:**  
06/02/03 19:34

**Diesel Hydrocarbons (C12-C24) and Heavy Oil (C24-C36 by WTPH-D (extended) with Silica Gel Clean-up -  
Quality Control  
North Creek Analytical - Bothell**

Analyte	Result	Reporting Limit	Units	Spike Level	Source Result	%REC Limits	RPD	RPD Limit	Notes
---------	--------	--------------------	-------	----------------	------------------	----------------	-----	--------------	-------

**Batch 3E19005: Prepared 05/19/03 Using EPA 3520C**

**Blank (3E19005-BLK1)**

Diesel Range Hydrocarbons	ND	0.250	mg/l						
Heavy Oil Range Hydrocarbons	ND	0.750	"						
Surrogate: 2-FBP	0.301		"	0.320		94.1	50-150		
Surrogate: Octacosane	0.134		"	0.160		83.8	50-150		

**LCS (3E19005-BS1)**

Diesel Range Hydrocarbons	1.58	0.250	mg/l	2.00		79.0	50-150		
Surrogate: 2-FBP	0.286		"	0.320		89.4	50-150		

**LCS Dup (3E19005-BSD1)**

Diesel Range Hydrocarbons	1.63	0.250	mg/l	2.00		81.5	50-150	3.12	50
Surrogate: 2-FBP	0.291		"	0.320		90.9	50-150		

North Creek Analytical - Bothell

*The results in this report apply to the samples analyzed in accordance with the chain of custody document. This analytical report must be reproduced in its entirety.*

Kortland Orr, PM

North Creek Analytical, Inc.  
Environmental Laboratory Network



Seattle 11720 North Creek Pkwy N, Suite 400, Bothell, WA 98011-8244  
425.420.9200 fax 425.420.9210  
Spokane East 11115 Montgomery, Suite B, Spokane, WA 99206-4776  
509.924.9200 fax 509.924.9290  
Portland 9405 SW Nimbus Avenue, Beaverton, OR 97008-7132  
503.906.9200 fax 503.906.9210  
Bend 20332 Empire Avenue, Suite F-1, Bend, OR 97701-5711  
541.383.9310 fax 541.382.7588  
Anchorage 2000 W. International Airport Road, Suite A10, Anchorage, AK 99502-1119  
907.563.9200 fax 907.563.9210

Dalton, Olmsted and Fuglevand  
10827 NE 68th St, Suite B  
Kirkland WA/USA, 98033

Project: Bellfield Office Park  
Project Number: SPK-004  
Project Manager: Matthew Dalton

Reported:  
06/02/03 19:34

**Total Metals by EPA 6000/7000 Series Methods - Quality Control**  
**North Creek Analytical - Bothell**

Analyte	Result	Reporting Limit	Units	Spike Level	Source Result	%REC	%REC Limits	RPD	RPD Limit	Notes
---------	--------	-----------------	-------	-------------	---------------	------	-------------	-----	-----------	-------

**Batch 3E21026: Prepared 05/21/03 Using EPA 3020A**

**Blank (3E21026-BLK1)**

Arsenic	ND	0.00100	mg/l							
Lead	ND	0.00100	"							

**LCS (3E21026-BS1)**

Arsenic	0.0821	0.00100	mg/l	0.0800		103	80-120			
Lead	0.0821	0.00100	"	0.0800		103	80-120			

**LCS Dup (3E21026-BSD1)**

Arsenic	0.0829	0.00100	mg/l	0.0800		104	80-120	0.970	20	
Lead	0.0833	0.00100	"	0.0800		104	80-120	1.45	20	

**Matrix Spike (3E21026-MS1)**

Source: B3E0407-02

Arsenic	0.0860	0.00100	mg/l	0.0800	0.00216	105	75-125			
Lead	0.0965	0.00100	"	0.0800	0.0105	108	75-125			

**Matrix Spike Dup (3E21026-MSD1)**

Source: B3E0407-02

Arsenic	0.0855	0.00100	mg/l	0.0800	0.00216	104	75-125	0.583	20	
Lead	0.0954	0.00100	"	0.0800	0.0105	106	75-125	1.15	20	

**Post Spike (3E21026-PS1)**

Source: B3E0407-02

Arsenic	0.104	0.00100	mg/l	0.100	0.00216	102	75-125			
Lead	0.114	0.00100	"	0.100	0.0105	104	75-125			

**Batch 3E24011: Prepared 05/24/03 Using EPA 3020A**

**Blank (3E24011-BLK1)**

Zinc	ND	0.0100	mg/l							
------	----	--------	------	--	--	--	--	--	--	--

North Creek Analytical - Bothell

The results in this report apply to the samples analyzed in accordance with the chain of custody document. This analytical report must be reproduced in its entirety.

Kortal Orr, PM

North Creek Analytical, Inc.  
Environmental Laboratory Network



**Seattle** 11720 North Creek Pkwy N, Suite 400, Bothell, WA 98011-8244  
425.420.9200 fax 425.420.9210  
**Spokane** East 11115 Montgomery, Suite B, Spokane, WA 99206-4776  
509.924.9200 fax 509.924.9290  
**Portland** 9405 SW Nimbus Avenue, Beaverton, OR 97008-7132  
503.906.9200 fax 503.906.9210  
**Bend** 20332 Empire Avenue, Suite F-1, Bend, OR 97701-5711  
541.383.9310 fax 541.382.7588  
**Anchorage** 2000 W. International Airport Road, Suite A10, Anchorage, AK 99502-1119  
907.563.9200 fax 907.563.9210

Dalton, Olmsted and Fuglevand  
10827 NE 68th St, Suite B  
Kirkland WA/USA, 98033

Project: Bellfield Office Park  
Project Number: SPK-004  
Project Manager: Matthew Dalton

**Reported:**  
06/02/03 19:34

**Total Metals by EPA 6000/7000 Series Methods - Quality Control**  
**North Creek Analytical - Bothell**

Analyte	Result	Reporting Limit	Units	Spike Level	Source Result	%REC	%REC Limits	RPD	RPD Limit	Notes
<b>Batch 3E24011: Prepared 05/24/03 Using EPA 3020A</b>										
<b>LCS (3E24011-BS1)</b>										
Zinc	0.0794	0.0100	mg/l	0.0800		99.3	80-120			
<b>LCS Dup (3E24011-BSD1)</b>										
Zinc	0.0828	0.0100	mg/l	0.0800		104	80-120	4.19	20	
<b>Matrix Spike (3E24011-MS1)</b>										
					<b>Source: B3E0550-01</b>					
Zinc	0.0834	0.0100	mg/l	0.0800	0.00289	101	75-131			
<b>Matrix Spike Dup (3E24011-MSD1)</b>										
					<b>Source: B3E0550-01</b>					
Zinc	0.0803	0.0100	mg/l	0.0800	0.00289	96.8	75-131	3.79	20	
<b>Post Spike (3E24011-PS1)</b>										
					<b>Source: B3E0550-01</b>					
Zinc	0.0971	0.0100	mg/l	0.100	0.00289	94.2	75-125			

North Creek Analytical - Bothell

*The results in this report apply to the samples analyzed in accordance with the chain of custody document. This analytical report must be reproduced in its entirety.*

Kortland Orr, PM

North Creek Analytical, Inc.  
Environmental Laboratory Network

Page 9 of 13



Seattle 11720 North Creek Pkwy N, Suite 400, Bothell, WA 98011-8244  
425.420.9200 fax 425.420.9210  
Spokane East 11115 Montgomery, Suite B, Spokane, WA 99206-4776  
509.924.9200 fax 509.924.9290  
Portland 9405 SW Nimbus Avenue, Beaverton, OR 97008-7132  
503.906.9200 fax 503.906.9210  
Bend 20332 Empire Avenue, Suite F-1, Bend, OR 97701-5711  
541.383.9310 fax 541.382.7588  
Anchorage 2000 W. International Airport Road, Suite A10, Anchorage, AK 99502-1119  
907.563.9200 fax 907.563.9210

Dalton, Olmsted and Fuglevand  
10827 NE 68th St, Suite B  
Kirkland WA/USA, 98033

Project: Bellfield Office Park  
Project Number: SPK-004  
Project Manager: Matthew Dalton

Reported:  
06/02/03 19:34

**Polychlorinated Biphenyls by EPA Method 8082 - Quality Control**  
**North Creek Analytical - Bothell**

Analyte	Result	Reporting Limit	Units	Spike Level	Source Result	%REC Limits	RPD	RPD Limit	Notes
---------	--------	--------------------	-------	----------------	------------------	----------------	-----	--------------	-------

**Batch 3E22007: Prepared 05/22/03 Using EPA 3520C**

**Blank (3E22007-BLK1)**

Aroclor 1016	ND	0.500	ug/l						
Aroclor 1221	ND	0.500	"						
Aroclor 1232	ND	0.500	"						
Aroclor 1242	ND	0.500	"						
Aroclor 1248	ND	0.500	"						
Aroclor 1254	ND	0.500	"						
Aroclor 1260	ND	0.500	"						
Aroclor 1262	ND	0.500	"						
Aroclor 1268	ND	0.500	"						

Surrogate: TCX 0.188 " 0.200 94.0 29-130

Surrogate: Decachlorobiphenyl 0.104 " 0.200 52.0 22-112

**LCS (3E22007-BS2)**

Aroclor 1016	2.44	0.500	ug/l	2.50		97.6	58-124		
Aroclor 1260	2.39	0.500	"	2.50		95.6	64-136		
Surrogate: TCX	0.200		"	0.200		100	29-130		
Surrogate: Decachlorobiphenyl	0.173		"	0.200		86.5	22-112		

**LCS Dup (3E22007-BSD2)**

Aroclor 1016	2.48	0.500	ug/l	2.50		99.2	58-124	1.63	30
Aroclor 1260	2.48	0.500	"	2.50		99.2	64-136	3.70	30
Surrogate: TCX	0.206		"	0.200		103	29-130		
Surrogate: Decachlorobiphenyl	0.188		"	0.200		94.0	22-112		

North Creek Analytical - Bothell

The results in this report apply to the samples analyzed in accordance with the chain of custody document. This analytical report must be reproduced in its entirety.

Kortland Orr, PM

North Creek Analytical, Inc.  
Environmental Laboratory Network Page 10 of 13



Seattle 11720 North Creek Pkwy N, Suite 400, Bothell, WA 98011-8244  
425.420.9200 fax 425.420.9210  
Spokane East 11115 Montgomery, Suite B, Spokane, WA 99206-4776  
509.924.9200 fax 509.924.9290  
Portland 9405 SW Nimbus Avenue, Beaverton, OR 97008-7132  
503.906.9200 fax 503.906.9210  
Bend 20332 Empire Avenue, Suite F-1, Bend, OR 97701-5711  
541.383.9310 fax 541.382.7588  
Anchorage 2000 W. International Airport Road, Suite A10, Anchorage, AK 99502-1119  
907.563.9200 fax 907.563.9210

Dalton, Olmsted and Fuglevand  
10827 NE 68th St, Suite B  
Kirkland WA/USA, 98033

Project: Bellfield Office Park  
Project Number: SPK-004  
Project Manager: Matthew Dalton

Reported:  
06/02/03 19:34

**Polynuclear Aromatic Compounds by GC/MS with Selected Ion Monitoring - Quality Control**  
**North Creek Analytical - Bothell**

Analyte	Result	Reporting Limit	Units	Spike Level	Source Result	%REC Limits	RPD	RPD Limit	Notes
---------	--------	--------------------	-------	----------------	------------------	----------------	-----	--------------	-------

**Batch 3E21004: Prepared 05/21/03 Using EPA 3520C**

**Blank (3E21004-BLK1)**

Acenaphthene	ND	0.100	ug/l						
Acenaphthylene	ND	0.100	"						
Anthracene	ND	0.100	"						
Benzo (a) anthracene	ND	0.100	"						
Benzo (a) pyrene	ND	0.100	"						
Benzo (b) fluoranthene	ND	0.100	"						
Benzo (ghi) perylene	ND	0.100	"						
Benzo (k) fluoranthene	ND	0.100	"						
Chrysene	ND	0.100	"						
Dibenz (a,h) anthracene	ND	0.100	"						
Fluoranthene	ND	0.100	"						
Fluorene	ND	0.100	"						
Indeno (1,2,3-cd) pyrene	ND	0.100	"						
Naphthalene	ND	0.100	"						
Phenanthrene	ND	0.100	"						
Pyrene	ND	0.100	"						
Surrogate: p-Terphenyl-d14	49.9		"	50.0		99.8	20-117		

**LCS (3E21004-BS1)**

Acenaphthene	6.26	0.100	ug/l	10.0		62.6	60-140		
Acenaphthylene	6.08	0.100	"	10.0		60.8	60-140		
Anthracene	8.44	0.100	"	10.0		84.4	60-140		
Benzo (a) anthracene	8.28	0.100	"	10.0		82.8	60-140		
Benzo (a) pyrene	8.46	0.100	"	10.0		84.6	60-140		
Benzo (b) fluoranthene	8.56	0.100	"	10.0		85.6	60-140		
Benzo (ghi) perylene	7.42	0.100	"	10.0		74.2	60-140		
Benzo (k) fluoranthene	8.66	0.100	"	10.0		86.6	60-140		
Chrysene	7.30	0.100	"	10.0		73.0	54-105		
Dibenz (a,h) anthracene	6.42	0.100	"	10.0		64.2	60-140		
Fluoranthene	8.86	0.100	"	10.0		88.6	60-140		
Fluorene	5.90	0.100	"	10.0		59.0	50-120		
Indeno (1,2,3-cd) pyrene	7.74	0.100	"	10.0		77.4	34-110		
Naphthalene	9.10	0.100	"	10.0		91.0	60-140		
Phenanthrene	8.58	0.100	"	10.0		85.8	60-140		

North Creek Analytical - Bothell

*The results in this report apply to the samples analyzed in accordance with the chain of custody document. This analytical report must be reproduced in its entirety.*

Kortland Orr, PM

North Creek Analytical, Inc.  
Environmental Laboratory Network

Page 11 of 13





Seattle 11720 North Creek Pkwy N, Suite 400, Bothell, WA 98011-8244  
425.420.9200 fax 425.420.9210  
Spokane East 11115 Montgomery, Suite B, Spokane, WA 99206-4776  
509.924.9200 fax 509.924.9290  
Portland 9405 SW Nimbus Avenue, Beaverton, OR 97008-7132  
503.906.9200 fax 503.906.9210  
Bend 20332 Empire Avenue, Suite F-1, Bend, OR 97701-5711  
541.383.9310 fax 541.382.7588  
Anchorage 2000 W. International Airport Road, Suite A10, Anchorage, AK 99502-1119  
907.563.9200 fax 907.563.9210

Dalton, Olmsted and Fuglevand  
10827 NE 68th St, Suite B  
Kirkland WA/USA, 98033

Project: Bellfield Office Park  
Project Number: SPK-004  
Project Manager: Matthew Dalton

Reported:  
06/02/03 19:34

**Polynuclear Aromatic Compounds by GC/MS with Selected Ion Monitoring - Quality Control**  
**North Creek Analytical - Bothell**

Analyte	Result	Reporting Limit	Units	Spike Level	Source Result	%REC	%REC Limits	RPD	RPD Limit	Notes
<b>Batch 3E21004: Prepared 05/21/03 Using EPA 3520C</b>										
<b>LCS (3E21004-BS1)</b>										
Pyrene	8.78	0.100	ug/l	10.0		87.8	60-140			
Surrogate: p-Terphenyl-d14	47.9		"	50.0		95.8	20-117			
<b>LCS Dup (3E21004-BSD1)</b>										
Acenaphthene	6.14	0.100	ug/l	10.0		61.4	60-140	1.94	30	
Acenaphthylene	6.06	0.100	"	10.0		60.6	60-140	0.329	30	
Anthracene	7.86	0.100	"	10.0		78.6	60-140	7.12	30	
Benzo (a) anthracene	8.76	0.100	"	10.0		87.6	60-140	5.63	30	
Benzo (a) pyrene	8.64	0.100	"	10.0		86.4	60-140	2.11	30	
Benzo (b) fluoranthene	8.82	0.100	"	10.0		88.2	60-140	2.99	30	
Benzo (ghi) perylene	7.80	0.100	"	10.0		78.0	60-140	4.99	30	
Benzo (k) fluoranthene	8.92	0.100	"	10.0		89.2	60-140	2.96	30	
Chrysene	7.38	0.100	"	10.0		73.8	54-105	1.09	27	
Dibenz (a,h) anthracene	6.66	0.100	"	10.0		66.6	60-140	3.67	30	
Fluoranthene	8.70	0.100	"	10.0		87.0	60-140	1.82	30	
Fluorene	6.02	0.100	"	10.0		60.2	50-120	2.01	36	
Indeno (1,2,3-cd) pyrene	8.06	0.100	"	10.0		80.6	34-110	4.05	31	
Naphthalene	8.96	0.100	"	10.0		89.6	60-140	1.55	30	
Phenanthrene	9.74	0.100	"	10.0		97.4	60-140	12.7	30	
Pyrene	9.12	0.100	"	10.0		91.2	60-140	3.80	30	
Surrogate: p-Terphenyl-d14	46.9		"	50.0		93.8	20-117			

North Creek Analytical - Bothell

The results in this report apply to the samples analyzed in accordance with the chain of custody document. This analytical report must be reproduced in its entirety.

Kortland Orr, PM

North Creek Analytical, Inc.  
Environmental Laboratory Network

Page 12 of 13



**Seattle** 11720 North Creek Pkwy N, Suite 400, Bothell, WA 98011-8244  
425.420.9200 fax 425.420.9210  
**Spokane** East 11115 Montgomery, Suite B, Spokane, WA 99206-4776  
509.924.9200 fax 509.924.9290  
**Portland** 9405 SW Nimbus Avenue, Beaverton, OR 97008-7132  
503.906.9200 fax 503.906.9210  
**Bend** 20332 Empire Avenue, Suite F-1, Bend, OR 97701-5711  
541.383.9310 fax 541.382.7588  
**Anchorage** 2000 W. International Airport Road, Suite A10, Anchorage, AK 99502-1119  
907.563.9200 fax 907.563.9210

Dalton, Olmsted and Fuglevand  
10827 NE 68th St, Suite B  
Kirkland WA/USA, 98033

Project: Bellfield Office Park  
Project Number: SPK-004  
Project Manager: Matthew Dalton

**Reported:**  
06/02/03 19:34

### Notes and Definitions

S-03 The surrogate recovery for this sample is outside of established control limits. Review of associated QC indicates the recovery for this surrogate does not represent an out-of-control condition.

DET Analyte DETECTED

ND Analyte NOT DETECTED at or above the reporting limit

NR Not Reported

dry Sample results reported on a dry weight basis

RPD Relative Percent Difference

North Creek Analytical - Bothell

*The results in this report apply to the samples analyzed in accordance with the chain of custody document. This analytical report must be reproduced in its entirety.*

Kortland Orr, PM

North Creek Analytical, Inc.  
Environmental Laboratory Network

## CHAIN OF CUSTODY REPORT

Work Order #:

**BZE 0393**

CLIENT: <b>DALTON OLMSIE &amp; FUGLEWAND</b>		INVOICE TO:		<b>DOF KIRKLAND</b>  P.O. NUMBER:				<b>TURNAROUND REQUEST in Business Days*</b> Organic & Inorganic Analyses <input checked="" type="checkbox"/> 7 <input type="checkbox"/> 5 <input type="checkbox"/> 4 <input type="checkbox"/> 3 <input type="checkbox"/> 2 <input type="checkbox"/> 1 <input type="checkbox"/> <1 STD. Petroleum Hydrocarbon Analyses <input checked="" type="checkbox"/> 5 <input type="checkbox"/> 4 <input type="checkbox"/> 3 <input type="checkbox"/> 2 <input type="checkbox"/> 1 <input type="checkbox"/> <1 STD. <input type="checkbox"/> OTHER Please Specify _____ <small>*Turnaround Requests less than standard may incur Rush Charges.</small>															
REPORT TO: <b>MATT DALTON</b>																							
ADDRESS: <b>DOF KIRKLAND</b>																							
PHONE:		FAX:																					
PROJECT NAME: <b>BELLEFIELD OFFICE PARK</b>		REQUESTED ANALYSES																					
PROJECT NUMBER: <b>SAC-004</b>																							
SAMPLED BY: <b>DA COOPER</b>																							
CLIENT SAMPLE IDENTIFICATION	SAMPLING DATE/TIME	WTAH-DX	TOTM	As, Pb, Zn	Pb, Cu	BOB4	Pb, As	BOB6									MATRIX (W, S, O)	# OF CONT.	COMMENTS	NCA WO ID			
1. MW-K1	5/15/03 1300	X	X	X	X												W	7		01			
2. BA-MW-1(R)	↓ 1400	X	X	X	X												↓	↓		02			
3.																							
4.																							
5.																							
6.																							
7.																							
8.																							
9.																							
10.																							
11.																							
12.																							
13.																							
14.																							
15.																							
RELINQUISHED BY: <b>DA COOPER</b>		FIRM: <b>DOF</b>		DATE: <b>5/15/03</b>		RECEIVED BY: <b>Cathy Carmale</b>		FIRM: <b>NCA</b>		DATE: <b>5/15/03</b>													
PRINT NAME:				TIME: <b>10:05</b>		PRINT NAME:				TIME: <b>10:05</b>													
RELINQUISHED BY:		FIRM:		DATE:		RECEIVED BY:		FIRM:		DATE:													
PRINT NAME:				TIME:		PRINT NAME:				TIME:													
ADDITIONAL REMARKS: <b>* WTAH-DX WITH SILICA GEL CLEANUP</b>																							
COC REV 3/99																		w/o		TEMP: <b>5.2°</b>		PAGE 1 OF 1	



**Seattle** 11720 North Creek Pkwy N, Suite 400, Bothell, WA 98011-8244  
425.420.9200 fax 425.420.9210  
**Spokane** East 11115 Montgomery, Suite B, Spokane, WA 99206-4776  
509.924.9200 fax 509.924.9290  
**Portland** 9405 SW Nimbus Avenue, Beaverton, OR 97008-7132  
503.906.9200 fax 503.906.9210  
**Bend** 20332 Empire Avenue, Suite F-1, Bend, OR 97701-5711  
541.383.9310 fax 541.382.7588  
**Anchorage** 2000 W. International Airport Road, Suite A10, Anchorage, AK 99502-1119  
907.563.9200 fax 907.563.9210

20 May 2004

Matthew Dalton  
Dalton, Olmsted and Fuglevand  
10827 NE 68th St, Suite B  
Kirkland, WA/USA 98033  
RE: Bellfield Office Park

Enclosed are the results of analyses for samples received by the laboratory on 05/06/04 10:55. If you have any questions concerning this report, please feel free to contact me.

Sincerely,

Robert Greer For Kortland Orr  
PM



Seattle 11720 North Creek Pkwy N, Suite 400, Bothell, WA 98011-8244  
425.420.9200 fax 425.420.9210  
Spokane East 11115 Montgomery, Suite B, Spokane, WA 99206-4776  
509.924.9200 fax 509.924.9290  
Portland 9405 SW Nimbus Avenue, Beaverton, OR 97008-7132  
503.906.9200 fax 503.906.9210  
Bend 20332 Empire Avenue, Suite F-1, Bend, OR 97701-5711  
541.383.9310 fax 541.382.7588  
Anchorage 2000 W. International Airport Road, Suite A10, Anchorage, AK 99502-1119  
907.563.9200 fax 907.563.9210

Dalton, Olmsted and Fuglevand  
10827 NE 68th St, Suite B  
Kirkland, WA/USA 98033

Project: Bellfield Office Park  
Project Number: SPK-004  
Project Manager: Matthew Dalton

Reported:  
05/20/04 09:06

### ANALYTICAL REPORT FOR SAMPLES

Sample ID	Laboratory ID	Matrix	Date Sampled	Date Received
BA-MW-1(R)	B4E0218-01	Water	05/05/04 11:30	05/06/04 10:55
MW-K1	B4E0218-02	Water	05/05/04 13:30	05/06/04 10:55

North Creek Analytical - Bothell

Robert Greer For Kortland Orr, PM

*The results in this report apply to the samples analyzed in accordance with the chain of custody document. This analytical report must be reproduced in its entirety.*

North Creek Analytical, Inc.  
Environmental Laboratory Network

Page 1 of 12



Seattle 11720 North Creek Pkwy N, Suite 400, Bothell, WA 98011-8244  
425.420.9200 fax 425.420.9210  
Spokane East 11115 Montgomery, Suite B, Spokane, WA 99206-4776  
509.924.9200 fax 509.924.9290  
Portland 9405 SW Nimbus Avenue, Beaverton, OR 97008-7132  
503.906.9200 fax 503.906.9210  
Bend 20332 Empire Avenue, Suite F-1, Bend, OR 97701-5711  
541.383.9310 fax 541.382.7588  
Anchorage 2000 W. International Airport Road, Suite A10, Anchorage, AK 99502-1119  
907.563.9200 fax 907.563.9210

Dalton, Olmsted and Fuglevand  
10827 NE 68th St, Suite B  
Kirkland, WA/USA 98033

Project: Bellfield Office Park  
Project Number: SPK-004  
Project Manager: Matthew Dalton

Reported:  
05/20/04 09:06

**Diesel Hydrocarbons (C12-C24) and Heavy Oil (C24-C36) by WTPH-D (extended) with Silica Gel Clean-up**  
**North Creek Analytical - Bothell**

Analyte	Result	Reporting Limit	Units	Dilution	Batch	Prepared	Analyzed	Method	Notes
<b>BA-MW-1(R) (B4E0218-01) Water</b> Sampled: 05/05/04 11:30 Received: 05/06/04 10:55									
Diesel Range Hydrocarbons	ND	0.250	mg/l	1	4E10015	05/10/04	05/11/04	WTPH-D	
Heavy Oil Range Hydrocarbons	ND	0.750	"	"	"	"	"	"	
Surrogate: 2-FBP	83.9 %	50-150			"	"	"	"	
Surrogate: Octacosane	91.1 %	50-150			"	"	"	"	
<b>MW-K1 (B4E0218-02) Water</b> Sampled: 05/05/04 13:30 Received: 05/06/04 10:55									
Diesel Range Hydrocarbons	ND	0.250	mg/l	1	4E10015	05/10/04	05/11/04	WTPH-D	
Heavy Oil Range Hydrocarbons	ND	0.750	"	"	"	"	"	"	
Surrogate: 2-FBP	73.3 %	50-150			"	"	"	"	
Surrogate: Octacosane	82.6 %	50-150			"	"	"	"	

North Creek Analytical - Bothell

*The results in this report apply to the samples analyzed in accordance with the chain of custody document. This analytical report must be reproduced in its entirety.*

Robert Greer For Kortland Orr, PM

North Creek Analytical, Inc.  
Environmental Laboratory Network



Seattle 11720 North Creek Pkwy N, Suite 400, Bothell, WA 98011-8244  
425.420.9200 fax 425.420.9210  
Spokane East 11115 Montgomery, Suite B, Spokane, WA 99206-4776  
509.924.9200 fax 509.924.9290  
Portland 9405 SW Nimbus Avenue, Beaverton, OR 97008-7132  
503.906.9200 fax 503.906.9210  
Bend 20332 Empire Avenue, Suite F-1, Bend, OR 97701-5711  
541.383.9310 fax 541.382.7588  
Anchorage 2000 W. International Airport Road, Suite A10, Anchorage, AK 99502-1119  
907.563.9200 fax 907.563.9210

Dalton, Olmsted and Fuglevand 10827 NE 68th St, Suite B Kirkland, WA/USA 98033	Project: Bellfield Office Park Project Number: SPK-004 Project Manager: Matthew Dalton	Reported: 05/20/04 09:06
--------------------------------------------------------------------------------------	----------------------------------------------------------------------------------------------	-----------------------------

**Polynuclear Aromatic Hydrocarbons by GC/MS-SIM**  
**North Creek Analytical - Bothell**

Analyte	Result	Reporting Limit	Units	Dilution	Batch	Prepared	Analyzed	Method	Notes
---------	--------	-----------------	-------	----------	-------	----------	----------	--------	-------

**BA-MW-1(R) (B4E0218-01) Water** Sampled: 05/05/04 11:30 Received: 05/06/04 10:55

1-Methylnaphthalene	0.154	0.100	ug/l	1	4E10014	05/10/04	05/13/04	EPA 8270C-SIM	
2-Methylnaphthalene	ND	0.100	"	"	"	"	"	"	
Acenaphthene	0.577	0.100	"	"	"	"	"	"	
Acenaphthylene	ND	0.100	"	"	"	"	"	"	
Anthracene	ND	0.100	"	"	"	"	"	"	
Benzo (a) anthracene	ND	0.100	"	"	"	"	"	"	
Benzo (a) pyrene	ND	0.100	"	"	"	"	"	"	
Benzo (b) fluoranthene	ND	0.100	"	"	"	"	"	"	
Benzo (ghi) perylene	ND	0.100	"	"	"	"	"	"	
Benzo (k) fluoranthene	ND	0.100	"	"	"	"	"	"	
Chrysene	ND	0.100	"	"	"	"	"	"	
Dibenz (a,h) anthracene	ND	0.100	"	"	"	"	"	"	
Fluoranthene	ND	0.100	"	"	"	"	"	"	
Fluorene	0.404	0.100	"	"	"	"	"	"	
Indeno (1,2,3-cd) pyrene	ND	0.100	"	"	"	"	"	"	
Naphthalene	ND	0.100	"	"	"	"	"	"	
Phenanthrene	0.192	0.100	"	"	"	"	"	"	
Pyrene	ND	0.100	"	"	"	"	"	"	

Surrogate: p-Terphenyl-d14 38.7 % 20-127 " " " "

**MW-K1 (B4E0218-02) Water** Sampled: 05/05/04 13:30 Received: 05/06/04 10:55

1-Methylnaphthalene	1.86	0.100	ug/l	1	4E10014	05/10/04	05/13/04	EPA 8270C-SIM	
2-Methylnaphthalene	2.00	0.100	"	"	"	"	"	"	
Acenaphthene	1.84	0.100	"	"	"	"	"	"	
Acenaphthylene	ND	0.100	"	"	"	"	"	"	
Anthracene	0.330	0.100	"	"	"	"	"	"	
Benzo (a) anthracene	ND	0.100	"	"	"	"	"	"	
Benzo (a) pyrene	ND	0.100	"	"	"	"	"	"	
Benzo (b) fluoranthene	ND	0.100	"	"	"	"	"	"	
Benzo (ghi) perylene	ND	0.100	"	"	"	"	"	"	
Benzo (k) fluoranthene	ND	0.100	"	"	"	"	"	"	
Chrysene	ND	0.100	"	"	"	"	"	"	
Dibenz (a,h) anthracene	ND	0.100	"	"	"	"	"	"	
Fluoranthene	0.330	0.100	"	"	"	"	"	"	
Fluorene	1.73	0.100	"	"	"	"	"	"	

North Creek Analytical - Bothell

*The results in this report apply to the samples analyzed in accordance with the chain of custody document. This analytical report must be reproduced in its entirety.*

Robert Greer For Kortland Orr, PM

North Creek Analytical, Inc.  
Environmental Laboratory Network

Page 3 of 12



Seattle 11720 North Creek Pkwy N, Suite 400, Bothell, WA 98011-8244

425.420.9200 fax 425.420.9210

Spokane East 11115 Montgomery, Suite B, Spokane, WA 99206-4776

509.924.9200 fax 509.924.9290

Portland 9405 SW Nimbus Avenue, Beaverton, OR 97008-7132

503.906.9200 fax 503.906.9210

Bend 20332 Empire Avenue, Suite F-1, Bend, OR 97701-5711

541.383.9310 fax 541.382.7588

Anchorage 2000 W. International Airport Road, Suite A10, Anchorage, AK 99502-1119

907.562.9200 fax 907.562.9210

Dalton, Olmsted and Fuglevand  
10827 NE 68th St, Suite B  
Kirkland, WA/USA 98033

Project: Bellfield Office Park  
Project Number: SPK-004  
Project Manager: Matthew Dalton

Reported:  
05/20/04 09:06

**Polynuclear Aromatic Hydrocarbons by GC/MS-SIM**  
**North Creek Analytical - Bothell**

Analyte	Reporting		Units	Dilution	Batch	Prepared	Analyzed	Method	Notes
	Result	Limit							
MW-K1 (B4E0218-02) Water    Sampled: 05/05/04 13:30    Received: 05/06/04 10:55									
Indeno (1,2,3-cd) pyrene	ND	0.100	ug/l	1	4E10014	05/10/04	05/13/04	"	
Naphthalene	6.83	0.100	"	"	"	"	"	"	
Phenanthrene	1.98	0.100	"	"	"	"	"	"	
Pyrene	0.272	0.100	"	"	"	"	"	"	
Surrogate: p-Terphenyl-d14	40.4 %	20-127			"	"	"	"	

North Creek Analytical - Bothell

*The results in this report apply to the samples analyzed in accordance with the chain of custody document. This analytical report must be reproduced in its entirety.*

Robert Greer For Kortland Orr, PM

North Creek Analytical, Inc.  
Environmental Laboratory Network





Seattle 11720 North Creek Pkwy N, Suite 400, Bothell, WA 98011-8244  
425.420.9200 fax 425.420.9210  
Spokane East 11115 Montgomery, Suite B, Spokane, WA 99206-4776  
509.924.9200 fax 509.924.9290  
Portland 9405 SW Nimbus Avenue, Beaverton, OR 97008-7132  
503.906.9200 fax 503.906.9210  
Bend 20332 Empire Avenue, Suite F-1, Bend, OR 97701-5711  
541.383.9310 fax 541.382.7588  
Anchorage 2000 W. International Airport Road, Suite A10, Anchorage, AK 99502-1119  
907.563.9200 fax 907.563.9210

Dalton, Olmsted and Fuglevand  
10827 NE 68th St, Suite B  
Kirkland, WA/USA 98033

Project: Bellfield Office Park  
Project Number: SPK-004  
Project Manager: Matthew Dalton

Reported:  
05/20/04 09:06

**Total Metals by EPA 6000/7000 Series Methods**  
**North Creek Analytical - Bothell**

Analyte	Result	Reporting Limit	Units	Dilution	Batch	Prepared	Analyzed	Method	Notes
<b>BA-MW-1(R) (B4E0218-01) Water Sampled: 05/05/04 11:30 Received: 05/06/04 10:55</b>									
Arsenic	ND	0.00100	mg/l	1	4E11035	05/11/04	05/12/04	EPA 6020	
Lead	0.00418	0.00100	"	"	"	"	"	"	
Zinc	ND	0.0100	"	"	"	"	"	"	
<b>MW-K1 (B4E0218-02) Water Sampled: 05/05/04 13:30 Received: 05/06/04 10:55</b>									
Arsenic	0.00217	0.00100	mg/l	1	4E11035	05/11/04	05/12/04	EPA 6020	
Lead	0.00223	0.00100	"	"	"	"	"	"	
Zinc	ND	0.0100	"	"	"	"	"	"	

North Creek Analytical - Bothell

*The results in this report apply to the samples analyzed in accordance with the chain of custody document. This analytical report must be reproduced in its entirety.*

Robert Greer For Kortland Orr, PM

North Creek Analytical, Inc.  
Environmental Laboratory Network



Seattle 11720 North Creek Pkwy N, Suite 400, Bothell, WA 98011-8244  
425.420.9200 fax 425.420.9210  
Spokane East 11115 Montgomery, Suite B, Spokane, WA 99206-4776  
509.924.9200 fax 509.924.9290  
Portland 9405 SW Nimbus Avenue, Beaverton, OR 97008-7132  
503.906.9200 fax 503.906.9210  
Bend 20332 Empire Avenue, Suite F-1, Bend, OR 97701-5711  
541.383.9310 fax 541.382.7588  
Anchorage 2000 W. International Airport Road, Suite A10, Anchorage, AK 99502-1119  
907.563.9200 fax 907.563.9210

Dalton, Olmsted and Fuglevand  
10827 NE 68th St, Suite B  
Kirkland, WA/USA 98033

Project: Bellfield Office Park  
Project Number: SPK-004  
Project Manager: Matthew Dalton

Reported:  
05/20/04 09:06

**Polychlorinated Biphenyls by EPA Method 8082**  
**North Creek Analytical - Bothell**

Analyte	Result	Reporting Limit	Units	Dilution	Batch	Prepared	Analyzed	Method	Notes
---------	--------	-----------------	-------	----------	-------	----------	----------	--------	-------

**BA-MW-1(R) (B4E0218-01) Water** Sampled: 05/05/04 11:30 Received: 05/06/04 10:55

Aroclor 1016	ND	0.500	ug/l	1	4E10011	05/10/04	05/17/04	EPA 8082	
Aroclor 1221	ND	0.500	"	"	"	"	"	"	
Aroclor 1232	ND	0.500	"	"	"	"	"	"	
Aroclor 1242	ND	0.500	"	"	"	"	"	"	
Aroclor 1248	ND	0.500	"	"	"	"	"	"	
Aroclor 1254	ND	0.500	"	"	"	"	"	"	
Aroclor 1260	ND	0.500	"	"	"	"	"	"	
Aroclor 1262	ND	0.500	"	"	"	"	"	"	
Aroclor 1268	ND	0.500	"	"	"	"	"	"	
Surrogate: TCX	45.7 %	25-129			"	"	"	"	
Surrogate: Decachlorobiphenyl	31.8 %	22-125			"	"	"	"	

**MW-K1 (B4E0218-02) Water** Sampled: 05/05/04 13:30 Received: 05/06/04 10:55

Aroclor 1016	ND	0.500	ug/l	1	4E10011	05/10/04	05/17/04	EPA 8082	
Aroclor 1221	ND	0.500	"	"	"	"	"	"	
Aroclor 1232	ND	0.500	"	"	"	"	"	"	
Aroclor 1242	ND	0.500	"	"	"	"	"	"	
Aroclor 1248	ND	0.500	"	"	"	"	"	"	
Aroclor 1254	ND	0.500	"	"	"	"	"	"	
Aroclor 1260	ND	0.500	"	"	"	"	"	"	
Aroclor 1262	ND	0.500	"	"	"	"	"	"	
Aroclor 1268	ND	0.500	"	"	"	"	"	"	
Surrogate: TCX	47.9 %	25-129			"	"	"	"	
Surrogate: Decachlorobiphenyl	24.0 %	22-125			"	"	"	"	

North Creek Analytical - Bothell

The results in this report apply to the samples analyzed in accordance with the chain of custody document. This analytical report must be reproduced in its entirety.

Robert Greer For Kortland Orr, PM

North Creek Analytical, Inc.  
Environmental Laboratory Network

Page 6 of 12



Seattle 11720 North Creek Pkwy N, Suite 400, Bothell, WA 98011-8244  
425.420.9200 fax 425.420.9210  
Spokane East 11115 Montgomery, Suite B, Spokane, WA 99206-4776  
509.924.9200 fax 509.924.9290  
Portland 9405 SW Nimbus Avenue, Beaverton, OR 97008-7132  
503.906.9200 fax 503.906.9210  
Bend 20332 Empire Avenue, Suite F-1, Bend, OR 97701-5711  
541.383.9310 fax 541.382.7588  
Anchorage 2000 W. International Airport Road, Suite A10, Anchorage, AK 99502-1119  
907.563.9290 fax 907.563.9210

Dalton, Olmsted and Fuglevand  
10827 NE 68th St, Suite B  
Kirkland, WA/USA 98033

Project: Bellfield Office Park  
Project Number: SPK-004  
Project Manager: Matthew Dalton

Reported:  
05/20/04 09:06

**Diesel Hydrocarbons (C12-C24) and Heavy Oil (C24-C36) by WTPH-D (extended) with Silica Gel Clean-up -  
Quality Control  
North Creek Analytical - Bothell**

Analyte	Result	Reporting Limit	Units	Spike Level	Source Result	%REC Limits	RPD	RPD Limit	Notes
---------	--------	--------------------	-------	----------------	------------------	----------------	-----	--------------	-------

**Batch 4E10015: Prepared 05/10/04 Using EPA 3520C**

**Blank (4E10015-BLK1)**

Diesel Range Hydrocarbons	ND	0.250	mg/l						
Heavy Oil Range Hydrocarbons	ND	0.750	"						
Surrogate: 2-FBP	0.297		"	0.320		92.8	50-150		
Surrogate: Octacosane	0.150		"	0.160		93.8	50-150		

**LCS (4E10015-BS1)**

Diesel Range Hydrocarbons	1.67	0.250	mg/l	2.00		83.5	50-150		
Surrogate: 2-FBP	0.321		"	0.320		100	50-150		

**LCS Dup (4E10015-BSD1)**

Diesel Range Hydrocarbons	1.65	0.250	mg/l	2.00		82.5	50-150	1.20	50
Surrogate: 2-FBP	0.325		"	0.320		102	50-150		

North Creek Analytical - Bothell

*The results in this report apply to the samples analyzed in accordance with the chain of custody document. This analytical report must be reproduced in its entirety.*

Robert Greer For Kortland Orr, PM

North Creek Analytical, Inc.  
Environmental Laboratory Network



Seattle 11720 North Creek Pkwy N, Suite 400, Bothell, WA 98011-8244  
425.420.9200 fax 425.420.9210  
Spokane East 11115 Montgomery, Suite B, Spokane, WA 99206-4776  
509.924.9200 fax 509.924.9290  
Portland 9405 SW Nimbus Avenue, Beaverton, OR 97008-7132  
503.906.9200 fax 503.906.9210  
Bend 20332 Empire Avenue, Suite F-1, Bend, OR 97701-5711  
541.383.9310 fax 541.382.7588  
Anchorage 2000 W. International Airport Road, Suite A10, Anchorage, AK 99502-1119  
907.563.9200 fax 907.563.9210

Dalton, Olmsted and Fuglevand  
10827 NE 68th St, Suite B  
Kirkland, WA/USA 98033

Project: Bellfield Office Park  
Project Number: SPK-004  
Project Manager: Matthew Dalton

Reported:  
05/20/04 09:06

**Polynuclear Aromatic Hydrocarbons by GC/MS-SIM - Quality Control**  
**North Creek Analytical - Bothell**

Analyte	Result	Reporting Limit	Units	Spike Level	Source Result	%REC	%REC Limits	RPD	RPD Limit	Notes
---------	--------	--------------------	-------	----------------	------------------	------	----------------	-----	--------------	-------

**Batch 4E10014: Prepared 05/10/04 Using EPA 3520C**

**Blank (4E10014-BLK1)**

1-Methylnaphthalene	ND	0.100	ug/l							
2-Methylnaphthalene	ND	0.100	"							
Acenaphthene	ND	0.100	"							
Acenaphthylene	ND	0.100	"							
Anthracene	ND	0.100	"							
Benzo (a) anthracene	ND	0.100	"							
Benzo (a) pyrene	ND	0.100	"							
Benzo (b) fluoranthene	ND	0.100	"							
Benzo (ghi) perylene	ND	0.100	"							
Benzo (k) fluoranthene	ND	0.100	"							
Chrysene	ND	0.100	"							
Dibenz (a,h) anthracene	ND	0.100	"							
Fluoranthene	ND	0.100	"							
Fluorene	ND	0.100	"							
Indeno (1,2,3-cd) pyrene	ND	0.100	"							
Naphthalene	ND	0.100	"							
Phenanthrene	ND	0.100	"							
Pyrene	ND	0.100	"							
Surrogate: p-Terphenyl-d14	39.5		"	50.0		79.0	20-127			

**LCS (4E10014-BS2)**

Acenaphthene	8.40	0.100	ug/l	10.0		84.0	34-120			
Acenaphthylene	9.30	0.100	"	10.0		93.0	36-120			
Anthracene	9.68	0.100	"	10.0		96.8	35-138			
Benzo (a) anthracene	8.72	0.100	"	10.0		87.2	41-121			
Benzo (a) pyrene	8.50	0.100	"	10.0		85.0	33-125			
Benzo (b) fluoranthene	9.56	0.100	"	10.0		95.6	35-133			
Benzo (ghi) perylene	8.62	0.100	"	10.0		86.2	25-121			
Benzo (k) fluoranthene	7.56	0.100	"	10.0		75.6	28-127			
Chrysene	8.48	0.100	"	10.0		84.8	41-120			
Dibenz (a,h) anthracene	8.80	0.100	"	10.0		88.0	24-120			
Fluoranthene	9.32	0.100	"	10.0		93.2	33-137			
Fluorene	9.48	0.100	"	10.0		94.8	42-120			
Indeno (1,2,3-cd) pyrene	9.06	0.100	"	10.0		90.6	26-122			

North Creek Analytical - Bothell

*The results in this report apply to the samples analyzed in accordance with the chain of custody document. This analytical report must be reproduced in its entirety.*

Robert Greer For Kortland Orr, PM

North Creek Analytical, Inc.  
Environmental Laboratory Network



Seattle 11720 North Creek Pkwy N, Suite 400, Bothell, WA 98011-8244  
425.420.9200 fax 425.420.9210  
Spokane East 11115 Montgomery, Suite B, Spokane, WA 99206-4776  
509.924.9200 fax 509.924.9290  
Portland 9405 SW Nimbus Avenue, Beaverton, OR 97008-7132  
503.906.9200 fax 503.906.9210  
Bend 20332 Empire Avenue, Suite F-1, Bend, OR 97701-5711  
541.383.9310 fax 541.382.7588  
Anchorage 2000 W. International Airport Road, Suite A10, Anchorage, AK 99502-1119  
907.563.9200 fax 907.563.9210

Dalton, Olmsted and Fuglevand  
10827 NE 68th St, Suite B  
Kirkland, WA/USA 98033

Project: Bellfield Office Park  
Project Number: SPK-004  
Project Manager: Matthew Dalton

Reported:  
05/20/04 09:06

**Polynuclear Aromatic Hydrocarbons by GC/MS-SIM - Quality Control**  
**North Creek Analytical - Bothell**

Analyte	Result	Reporting Limit	Units	Spike Level	Source Result	%REC %REC Limits	RPD	RPD Limit	Notes
---------	--------	-----------------	-------	-------------	---------------	------------------	-----	-----------	-------

**Batch 4E10014: Prepared 05/10/04 Using EPA 3520C**

**LCS (4E10014-BS2)**

Naphthalene	8.70	0.100	ug/l	10.0		87.0 38-120			
Phenanthrene	8.92	0.100	"	10.0		89.2 31-127			
Pyrene	8.74	0.100	"	10.0		87.4 42-125			
Surrogate: p-Terphenyl-d14	43.1		"	50.0		86.2 20-127			

**LCS Dup (4E10014-BSD2)**

Acenaphthene	7.38	0.100	ug/l	10.0		73.8 34-120	12.9	30	
Acenaphthylene	7.92	0.100	"	10.0		79.2 36-120	16.0	30	
Anthracene	9.00	0.100	"	10.0		90.0 35-138	7.28	30	
Benzo (a) anthracene	8.40	0.100	"	10.0		84.0 41-121	3.74	30	
Benzo (a) pyrene	7.92	0.100	"	10.0		79.2 33-125	7.06	30	
Benzo (b) fluoranthene	7.58	0.100	"	10.0		75.8 35-133	23.1	30	
Benzo (ghi) perylene	8.02	0.100	"	10.0		80.2 25-121	7.21	30	
Benzo (k) fluoranthene	9.26	0.100	"	10.0		92.6 28-127	20.2	30	
Chrysene	8.06	0.100	"	10.0		80.6 41-120	5.08	30	
Dibenz (a,h) anthracene	8.12	0.100	"	10.0		81.2 24-120	8.04	30	
Fluoranthene	8.90	0.100	"	10.0		89.0 33-137	4.61	30	
Fluorene	8.48	0.100	"	10.0		84.8 42-120	11.1	30	
Indeno (1,2,3-cd) pyrene	8.40	0.100	"	10.0		84.0 26-122	7.56	30	
Naphthalene	7.40	0.100	"	10.0		74.0 38-120	16.1	30	
Phenanthrene	8.40	0.100	"	10.0		84.0 31-127	6.00	30	
Pyrene	8.46	0.100	"	10.0		84.6 42-125	3.26	30	
Surrogate: p-Terphenyl-d14	41.2		"	50.0		82.4 20-127			

North Creek Analytical - Bothell

*The results in this report apply to the samples analyzed in accordance with the chain of custody document. This analytical report must be reproduced in its entirety.*

Robert Greer For Kortland Orr, PM

North Creek Analytical, Inc.  
Environmental Laboratory Network



Seattle 11720 North Creek Pkwy N, Suite 400, Bothell, WA 98011-8244  
425.420.9200 fax 425.420.9210  
Spokane East 11115 Montgomery, Suite B, Spokane, WA 99206-4776  
509.924.9200 fax 509.924.9290  
Portland 9405 SW Nimbus Avenue, Beaverton, OR 97008-7132  
503.906.9200 fax 503.906.9210  
Bend 20332 Empire Avenue, Suite F-1, Bend, OR 97701-5711  
541.383.9310 fax 541.382.7588  
Anchorage 2000 W. International Airport Road, Suite A10, Anchorage, AK 99502-1119  
907.563.9200 fax 907.563.9210

Dalton, Olmsted and Fuglevand  
10827 NE 68th St, Suite B  
Kirkland, WA/USA 98033

Project: Bellfield Office Park  
Project Number: SPK-004  
Project Manager: Matthew Dalton

Reported:  
05/20/04 09:06

**Total Metals by EPA 6000/7000 Series Methods - Quality Control**  
**North Creek Analytical - Bothell**

Analyte	Result	Reporting Limit	Units	Spike Level	Source Result	%REC	%REC Limits	RPD	RPD Limit	Notes
---------	--------	-----------------	-------	-------------	---------------	------	-------------	-----	-----------	-------

**Batch 4E11035: Prepared 05/11/04 Using EPA 3020A**

**Blank (4E11035-BLK1)**

Arsenic	ND	0.00100	mg/l							
Lead	ND	0.00100	"							
Zinc	ND	0.0100	"							

**LCS (4E11035-BS1)**

Arsenic	0.0745	0.00100	mg/l	0.0800		93.1	80-120			
Lead	0.0794	0.00100	"	0.0800		99.3	80-120			
Zinc	0.0800	0.0100	"	0.0800		100	80-120			

**LCS Dup (4E11035-BSD1)**

Arsenic	0.0758	0.00100	mg/l	0.0800		94.8	80-120	1.73	20	
Lead	0.0799	0.00100	"	0.0800		99.9	80-120	0.628	20	
Zinc	0.0822	0.0100	"	0.0800		103	80-120	2.71	20	

**Matrix Spike (4E11035-MS1)**

**Source: B4E0192-01**

Arsenic	0.0769	0.00100	mg/l	0.0800	0.000340	95.7	75-125			
Lead	0.0795	0.00100	"	0.0800	0.000760	98.4	75-125			
Zinc	0.0869	0.0100	"	0.0800	0.00779	98.9	75-131			

**Matrix Spike Dup (4E11035-MSD1)**

**Source: B4E0192-01**

Arsenic	0.0770	0.00100	mg/l	0.0800	0.000340	95.8	75-125	0.130	20	
Lead	0.0801	0.00100	"	0.0800	0.000760	99.2	75-125	0.752	20	
Zinc	0.0831	0.0100	"	0.0800	0.00779	94.1	75-131	4.47	20	

**Post Spike (4E11035-PS1)**

**Source: B4E0192-01**

Arsenic	0.0943		ug/ml	0.100	0.000340	94.0	75-125			
Lead	0.0992		"	0.100	0.000760	98.4	75-125			
Zinc	0.104		"	0.100	0.00779	96.2	75-125			

North Creek Analytical - Bothell

*The results in this report apply to the samples analyzed in accordance with the chain of custody document. This analytical report must be reproduced in its entirety.*

Robert Greer For Kortland Orr, PM

North Creek Analytical, Inc.  
Environmental Laboratory Network



Seattle 11720 North Creek Pkwy N, Suite 400, Bothell, WA 98011-8244

425.420.9200 fax 425.420.9210

Spokane East 11115 Montgomery, Suite B, Spokane, WA 99206-4776

509.924.9200 fax 509.924.9290

Portland 9405 SW Nimbus Avenue, Beaverton, OR 97008-7132

503.906.9200 fax 503.906.9210

Bend 20332 Empire Avenue, Suite F-1, Bend, OR 97701-5711

541.383.9310 fax 541.382.7588

Anchorage 2000 W. International Airport Road, Suite A10, Anchorage, AK 99502-1119

907.563.9200 fax 907.563.9210

Dalton, Olmsted and Fuglevand  
10827 NE 68th St, Suite B  
Kirkland, WA/USA 98033

Project: Bellfield Office Park  
Project Number: SPK-004  
Project Manager: Matthew Dalton

Reported:  
05/20/04 09:06

**Polychlorinated Biphenyls by EPA Method 8082 - Quality Control**  
**North Creek Analytical - Bothell**

Analyte	Result	Reporting Limit	Units	Spike Level	Source Result	%REC %REC	Limits	RPD	RPD Limit	Notes
---------	--------	-----------------	-------	-------------	---------------	-----------	--------	-----	-----------	-------

**Batch 4E10011: Prepared 05/10/04 Using EPA 3520C**

**Blank (4E10011-BLK1)**

Aroclor 1016	ND	0.500	ug/l							
Aroclor 1221	ND	0.500	"							
Aroclor 1232	ND	0.500	"							
Aroclor 1242	ND	0.500	"							
Aroclor 1248	ND	0.500	"							
Aroclor 1254	ND	0.500	"							
Aroclor 1260	ND	0.500	"							
Aroclor 1262	ND	0.500	"							
Aroclor 1268	ND	0.500	"							
Surrogate: TCX	0.166		"	0.200		83.0	25-129			
Surrogate: Decachlorobiphenyl	0.195		"	0.200		97.5	22-125			

**LCS (4E10011-BS2)**

Aroclor 1016	1.78	0.500	ug/l	2.50		71.2	57-123			
Aroclor 1260	1.99	0.500	"	2.50		79.6	56-125			
Surrogate: TCX	0.167		"	0.200		83.5	25-129			
Surrogate: Decachlorobiphenyl	0.180		"	0.200		90.0	22-125			

**LCS Dup (4E10011-BSD2)**

Aroclor 1016	1.77	0.500	ug/l	2.50		70.8	57-123	0.563	30	
Aroclor 1260	2.04	0.500	"	2.50		81.6	56-125	2.48	30	
Surrogate: TCX	0.164		"	0.200		82.0	25-129			
Surrogate: Decachlorobiphenyl	0.174		"	0.200		87.0	22-125			

North Creek Analytical - Bothell

*The results in this report apply to the samples analyzed in accordance with the chain of custody document. This analytical report must be reproduced in its entirety.*

Robert Greer For Kortland Orr, PM

North Creek Analytical, Inc.  
Environmental Laboratory Network



Seattle 11720 North Creek Pkwy N, Suite 400, Bothell, WA 98011-8244

425.420.9200 fax 425.420.9210

Spokane East 11115 Montgomery, Suite B, Spokane, WA 99206-4776

509.924.9200 fax 509.924.9290

Portland 9405 SW Nimbus Avenue, Beaverton, OR 97008-7132

503.906.9200 fax 503.906.9210

Bend 20332 Empire Avenue, Suite F-1, Bend, OR 97701-5711

541.383.9310 fax 541.382.7588

Anchorage 2000 W. International Airport Road, Suite A10, Anchorage, AK 99502-1119

907.563.9200 fax 907.563.9210

Dalton, Olmsted and Fuglevand  
10827 NE 68th St, Suite B  
Kirkland, WA/USA 98033

Project: Bellfield Office Park  
Project Number: SPK-004  
Project Manager: Matthew Dalton

Reported:  
05/20/04 09:06

### Notes and Definitions

DET Analyte DETECTED  
ND Analyte NOT DETECTED at or above the reporting limit  
NR Not Reported  
dry Sample results reported on a dry weight basis  
RPD Relative Percent Difference

North Creek Analytical - Bothell

Robert Greer For Kortland Orr, PM

*The results in this report apply to the samples analyzed in accordance with the chain of custody document. This analytical report must be reproduced in its entirety.*

North Creek Analytical, Inc.  
Environmental Laboratory Network

Page 12 of 12





11720 North Creek Pkwy N Suite 400, Bothell, WA 98011-9508  
11115 E Montgomery Suite B, Spokane, WA 99206-4776  
9405 SW Nimbus Ave, Beaverton, OR 97008-7132  
20332 Empire Ave Suite F-1, Bend, OR 99701-5711  
3209 Denali St, Anchorage, AK 99503-4030

425-420-9200 FAX 420-9210  
509-924-9200 FAX 924-9290  
503-906-9200 FAX 906-9210  
541-383-9310 FAX 382-7588  
907-334-9200 FAX 334-9210

## CHAIN OF CUSTODY REPORT

Work Order #: **B4EO218**

CLIENT: <b>MILTON OLIVIERO &amp; FUGLEMAN</b>		INVOICE TO:						
REPORT TO: <b>MATT DALTON</b>		<b>DOF KINKLAND</b>						
ADDRESS: <b>DOF KINKLAND</b>								
PHONE: FAX:		P.O. NUMBER:						
PROJECT NAME: <b>BELLEVILLE OFFICE PARK</b>		PRESERVATIVE						
PROJECT NUMBER: <b>SAK-004</b>		REQUESTED ANALYSES						
SAMPLED BY: <b>AL COOPER</b>								
CLIENT SAMPLE IDENTIFICATION	SAMPLING DATE/TIME	W/PH-DX W/SS CLEANUP	TOXIC AS Pb, Zn PCB's BOB's PAH's BOB's	MATRIX (W, S, O)	# OF CONT.	LOCATION / COMMENTS	NCA WO ID	
1 BA-MW-1 (12)	5/5/04 1130	X	X	X	X	U	6	01
2 MW-K1	↓ 1330	X	X	X	X	↓	↓	02
3								
4								
5								
6								
7								
8								
9								
10								
RELEASED BY: <b>Al Cooper</b>		DATE: <b>5/6/04</b>		RECEIVED BY: <b>Colette Weaver</b>		DATE: <b>5/6/04</b>		
PRINT NAME: <b>Al Cooper</b>		FIRM: <b>DOF</b>		PRINT NAME: <b>Colette Weaver</b>		FIRM: <b>NCA</b>		
RELEASED BY:		DATE:		RECEIVED BY:		DATE:		
PRINT NAME:		FIRM:		PRINT NAME:		FIRM:		
ADDITIONAL REMARKS:		TIME:		TIME:		TIME:		
COC REV 1/03		* W/PH-DX WITH SILICA GEL CLEANUP		TEMP: <b>3.7°C</b>		PAGE 1 OF 1		

w/o