



DATE: September 23, 1997

## TOSCO MARKETING COMPANY QUARTERLY REPORT

Site No.: 5516      Address: 1800 15<sup>th</sup> Avenue West, Seattle (15<sup>th</sup>)  
Tosco Environmental Manager: Mr. Timothy Johnson  
Consulting Co./Contact Person: Shannon & Wilson, Inc., Mr. Brian Clark  
Consultant Project No.: T-1488-12  
Primary Agency/Regulatory ID No.: Washington Department of Ecology, LUST Incidence # 4938  
Other Parties to Receive Copies: Mr. Victor Odermat, Car Wash Enterprises  
Mr. Ben Amoah-Forsen, Ecology

LUST # 4938  
BROWN BEAR CAR WASH

### WORK PERFORMED THIS QUARTER [Third - 1997]:

1. On August 21, 1997, groundwater samples were collected from MW-6, MW-7, MW-8, and MW-10 (Figure 2). Samples were submitted to Columbia Analytical Services for WTPH-G/BTEX analysis.

### WORK PROPOSED FOR NEXT QUARTER [Fourth - 1997]:

1. Collect groundwater samples from MW-6, MW-7, MW-8, and MW-10 in October 1997 for WTPH-G/BTEX analysis.
2. Begin monthly remediation system monitoring once the system is fully operational.

Current Phase of Project:	<u>Monitoring/Remediation (pending)</u>
Frequency of Sampling:	<u>Quarterly</u>
Frequency of Monitoring:	<u>Quarterly (GW)/Monthly (O&amp;M, pending)</u>
Are LPH Present On-site:	<u>No</u>
Cumulative LPH Recovered to Date:	<u></u>
LPH recovered This Quarter:	<u></u>
Bulk Soil Removed to Date:	<u></u>
Bulk Soil Removed This Quarter:	<u></u>
Water Wells or Surface Waters w/in a 1000'	<u></u>
Radius & Their Respective Directions (if known):	<u></u>
Current Remediation Techniques:	<u></u>
Permits for Discharge:	<u></u>
Approximate Depth to Groundwater	<u>Ranges from 6.08 to 7.71 feet</u>
Groundwater Gradient:	<u>Southwest, 0.01 ft/ft</u>
Maximum TPH-G/Benzene Concentrations:	<u>910/39.0 µg/L (MW-8)</u>

### Discussion:

Contaminant concentrations in MW-6 are below Washington Model Toxics Control Act (MTCA) Method A cleanup levels for the sixth consecutive sampling event. Most MW-7 contaminant concentrations decreased but remain above cleanup criteria, and contaminant concentrations in MW-8 have all decreased to below MTCA cleanup levels, with the exception of benzene. This decrease in contaminant concentrations is accompanied by an approximate 1.5-foot increase in the depth to water. In MW-10, concentrations continue to be below detection limits, with the exception of benzene.

### Summary of Unusual Activity:

No unusual observations were noted during groundwater sampling activities.

**Agency Directive Requirements:**

- Attachments:**
- Table 1 – Groundwater Sample Results
  - Figure 1 – Vicinity Map
  - Figure 2 – Site Plan
  - Analytical Laboratory Report (Columbia Analytical Services)

**Signed by:**

**Title:**

  
Principal Environmental Engineer

**TABLE 1**  
**GROUNDWATER SAMPLE RESULTS**  
**BROWN BEAR CAR WASH-15TH**  
**CIRCLE K SITE NO. 5516**

Sample Number	Date Sampled	WTPH-G (ppb)	Benzene (ppb)	Toluene (ppb)	Ethylbenzene (ppb)	Xylenes (ppb)	DTW (b) (feet)	GW Elev. (c) (feet)
<b>MW-1 (Casing Elevation = 13.96 feet)</b>								
EMW1-GW	1/7/94	22,000	2,700	4,300	1,500	7,400	--	--
14880631	1/6/95	76,000	3,600	6,300	2,700	12,800	--	--
<b>MW-2</b>								
EMW2-GW	1/7/94	1,900	190	48	85	241	--	--
<b>MW-3</b>								
14880642	3/1/95	< 50	< 1.00	< 1.00	< 1.00	< 50	--	--
<b>MW-4 (Casing Elevation = 14.46 feet)</b>								
14880625	1/5/95	< 300	< 1.00	< 1.00	< 1.00	< 1.00	5.68	8.78
165507	10/31/95	< 50	< 0.5	< 1	< 1	< 1	5.99	8.47
14881163	12/19/96	< 50	42.5	< 1	< 1	< 1	5.78	8.68
<b>MW-5 (Casing Elevation = 14.33 feet)</b>								
14880626	1/5/95	< 300	< 1.00	< 1.00	< 1.00	< 1.00	5.45	8.88
165508	10/31/95	< 50	1.1	< 1	< 1	< 1	5.75	8.58
1481164	12/19/96	< 50	< 0.5	< 1	< 1	< 1	5.75	8.58
<b>MW-6 (Casing Elevation = 14.16 feet)</b>								
14880627	1/5/95	< 300	1.2	< 1.00	< 1.00	< 1.00	5.47	8.69
165509	10/31/95	6,300	3,100	< 1	876	1,340	5.57	8.59
14881146	3/19/96	1,250	198	< 1	122	9	5.81	8.35
14881149	6/18/96	250	< 0.5	< 1	26	1	6.11	8.05
14881160	9/25/96	130	< 0.5	< 1	7	< 1	6.70	7.46
14881165	12/19/96	< 50	< 0.5	< 1	1	< 1	5.85	8.31
14881169	4/21/97	< 50	< 0.5	< 1	< 1	< 1	5.43	8.73
14881173	8/21/97	90	< 0.5	< 1	< 1	< 1	7.41	6.75
<b>MW-7 (Casing Elevation = 14.06 feet)</b>								
14880628	1/5/95	820	13	2.2	4.7	3.1	5.73	8.33
165510	10/31/95	1,920	1,990	3	247	42	5.50	8.56
14881147	3/19/96	3,820	970	29	307	67	6.09	7.97
14881150	6/18/96	5,020	733	16	514	150	6.45	7.61
14881161	9/25/96	4,500	88.0	< 5	420	87	7.03	7.03
14881166	12/19/96	970	53.5	2	9	18	6.06	8.00
14881170	4/21/97	2,160	26.5	< 1	114	8	5.70	8.36
14881174	8/21/97	1,630	56.1	1	44	8	7.71	6.35
<b>MTCA Cleanup Levels (a)</b>		1,000	5.0	40.0	30.0	20.0		

**TABLE 1**  
**GROUNDWATER SAMPLE RESULTS**  
**BROWN BEAR CAR WASH-15TH**  
**CIRCLE K SITE NO. 5516**

Sample Number	Date Sampled	WTPH-G (ppb)	Benzene (ppb)	Toluene (ppb)	Ethylbenzene (ppb)	Xylenes (ppb)	DTW (b) (feet)	GW Elev. (c) (feet)
<b>MW-8 (Casing Elevation = 13.83 feet)</b>								
14880629	1/5/95	550	280	2.6	1.9	2.7	6.08	7.75
165511	10/31/95	330	355	1	2	4	6.00	7.83
14881148	3/19/96	610	1,340	5	2	3	6.29	7.54
14881151	6/18/96	1,160	4,400	42	56	42	6.69	7.14
14881162	9/25/96	1,440	2,200	13	152	96	7.24	6.59
14881167	12/19/96	2,040	1,410	3	231	175	6.34	7.49
14881171	4/21/97	1,380	257	< 1	81	41	5.95	7.88
14881175	8/21/97	910	39.0	< 1	19	13	7.45	6.38
<b>MW-9 (Casing Elevation = 14.95 feet)</b>								
14880630	1/5/95	< 300	< 1.00	< 1.00	< 1.00	< 1.00	5.66	9.29
<b>MW-10 (Casing Elevation = 15.08 feet)</b>								
14881168	12/19/96	230	366	41	1	3	5.80	9.28
14881172	4/21/97	< 50	13.9	< 1	< 1	< 1	4.88	10.20
14881176	8/21/97	50	37.4	2	< 1	< 1	6.08	9.00
<b>MTCA Cleanup Levels (a)</b>		1,000	5.0	40.0	30.0	20.0		

**NOTES:**

(a) Washington Model Toxics Control Act (MTCA) Method A.

(b) Depth to water (DTW) measured from top of casing.

(c) Groundwater (GW) elevation relative to arbitrary datum of 20 feet.

&lt; = Less than the indicated method reporting limit (MRL) or practical quantitation limit (PQL).

ppb = parts per billion

WTPH-G = Washington Total Petroleum Hydrocarbons as Gasoline

**Boldface values indicate concentrations exceeding cleanup level.**

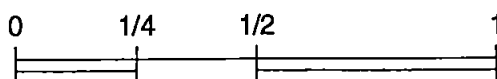

Scale in Miles

### NOTE

Map adapted from USGS metric topographic map of Seattle North, WA quadrangle, dated 1983.

Circle K Site No. 5516  
Brown Bear Car Wash - 15th  
Seattle, Washington

### VICINITY MAP

September 1997

T-1488-12

**SHANNON & WILSON, INC.**  
Geotechnical and Environmental Consultants

FIG. 1

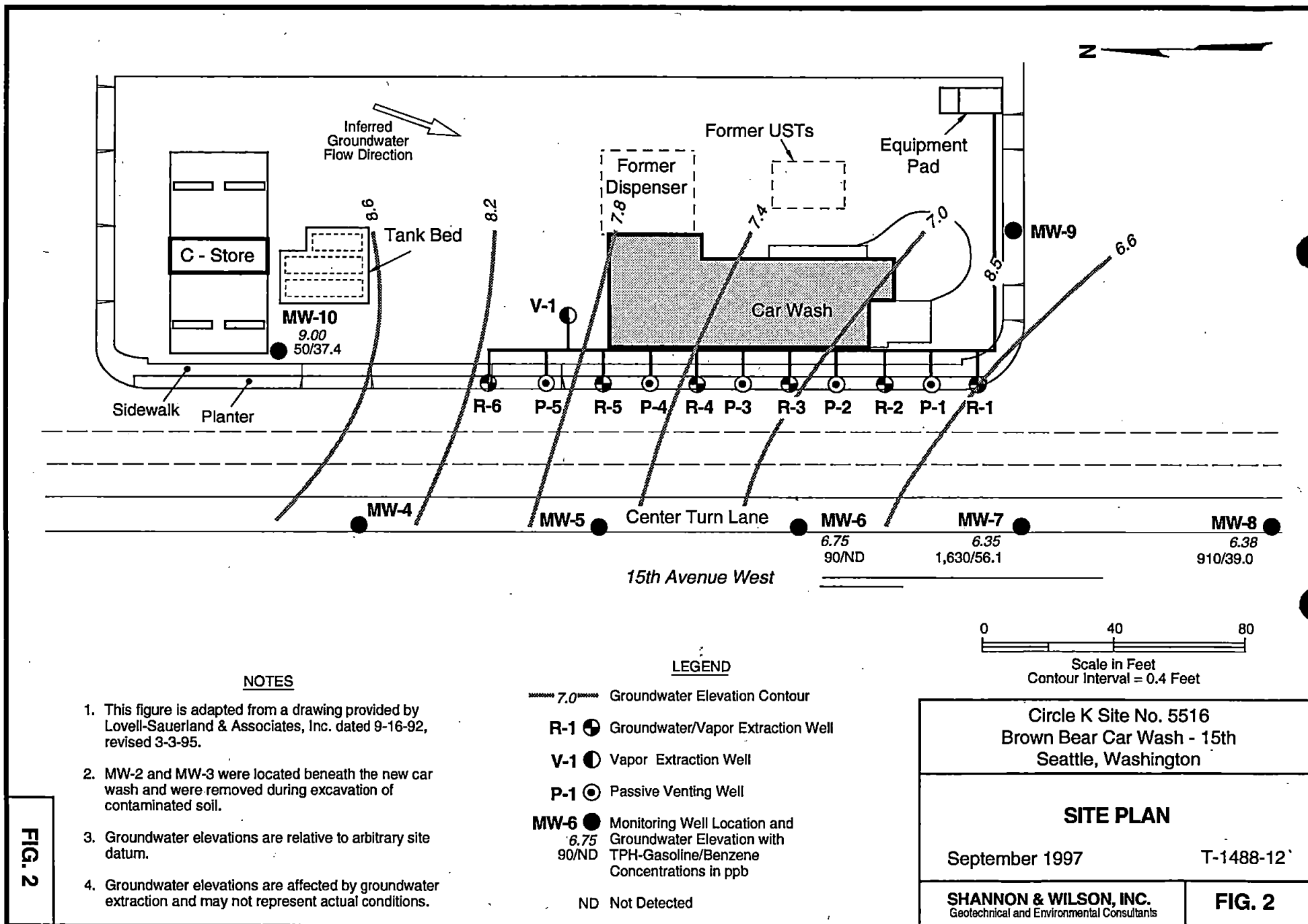



September 4, 1997

Service Request No: B9700356

Doug Carter  
Shannon & Wilson, Inc.  
400 North 34th Street, Suite 100  
Seattle, WA 98103

**Re: TOSCO 2415/T-1488-12**

Dear Doug:

Enclosed are the results of the sample(s) submitted to our laboratory on August 22, 1997. For your reference, these analyses have been assigned our service request number B9700356.

All analyses were performed according to our laboratory's quality assurance program. All results are intended to be considered in their entirety, and Columbia Analytical Services, Inc. (CAS) is not responsible for use of less than the complete report. Results apply only to the samples analyzed.

Please call if you have any questions. My extension is 281.

Respectfully submitted,

**Columbia Analytical Services, Inc.**

  
Elizabeth Schneider  
Project Chemist

ES/mc

Page 1 of 4

## Acronyms

ASTM	American Society for Testing and Materials
A2LA	American Association for Laboratory Accreditation
CARB	California Air Resources Board
CAS Number	Chemical Abstract Service registry Number
CFC	Chlorofluorocarbon
CFU	Colony-Forming Unit
DEC	Department of Environmental Conservation
DEQ	Department of Environmental Quality
DHS	Department of Health Services
DOE	Department of Ecology
DOH	Department of Health
EPA	U. S. Environmental Protection Agency
ELAP	Environmental Laboratory Accreditation Program
GC	Gas Chromatography
GC/MS	Gas Chromatography/Mass Spectrometry
J	Estimated concentration. The value is less than the method reporting limit, but greater than the method detection limit.
LUFT	Leaking Underground Fuel Tank
M	Modified
MCL	Maximum Contaminant Level is the highest permissible concentration of a substance allowed in drinking water as established by the USEPA.
MDL	Method Detection Limit
MPN	Most Probable Number
MRL	Method Reporting Limit
NA	Not Applicable
NAN	Not Analyzed
NC	Not Calculated
NCASI	National Council of the Paper Industry for Air and Stream Improvement
ND	Not Detected at or above the MRL
NIOSH	National Institute for Occupational Safety and Health
PQL	Practical Quantitation Limit
RCRA	Resource Conservation and Recovery Act
SIM	Selected Ion Monitoring
TPH	Total Petroleum Hydrocarbons
tr	Trace level is the concentration of an analyte that is less than the PQL but greater than or equal to the MDL.



**COLUMBIA ANALYTICAL SERVICES, INC.**

**Analytical Report**

**Client:** Shannon & Wilson, Inc.  
**Project:** TOSCO 2415/T-1488-12  
**Sample Matrix:** Water

**Service Request:** B9700356  
**Date Collected:** 8/21/97  
**Date Received:** 8/22/97  
**Date Extracted:** NA  
**Date Analyzed:** 8/25/97

BTEX and Total Petroleum Hydrocarbons as Gasoline  
EPA Methods 5030A/8020 and Washington DOE Method WTPH-G  
Units: µg/L (ppb)

Analyte:	Benzene	Toluene	Ethylbenzene	Total Xylenes	TPH as Gasoline
Method Reporting Limit:	0.5	1	1	1	50

Sample Name	Lab Code	Benzene	Toluene	Ethylbenzene	Total Xylenes	TPH as Gasoline
14881173	B9700356-001	ND	ND	ND	ND	90
14881174	B9700356-002	56.1	1	44	8	1630
14881175	B9700356-003	39.0	ND	19	13	910
14881176	B9700356-004	37.4	2	ND	ND	50
Method Blank	B970825-MB	ND	ND	ND	ND	ND

Approved By: \_\_\_\_\_

Date: 9/4/97 00003

COLUMBIA ANALYTICAL SERVICES, INC.

QA/QC Report

Client: Shannon & Wilson, Inc.  
Project: TOSCO 2415/T-1488-12  
Sample Matrix: Water

Service Request: B9700356  
Date Collected: 8/21/97  
Date Received: 8/22/97  
Date Extracted: NA  
Date Analyzed: 8/25/97

Surrogate Recovery Summary  
BTEX and Total Petroleum Hydrocarbons as Gasoline  
EPA Methods 5030A/8020 and Washington DOE Method WTPH-G

Sample Name	Lab Code	Percent Recovery 4-BFB (PID - BTEX)	Percent Recovery 4-BFB (FID - GAS)
14881173	B9700356-001	87	84
14881174	B9700356-002	99	86
14881175	B9700356-003	95	82
14881176	B9700356-004	96	82
Method Blank	B970825-MB	95	83

CAS Acceptance Limits: 86-113 81-120

Approved By: \_\_\_\_\_

Date: \_\_\_\_\_

Mr. Timothy D. Johnson  
Tosco Corporation  
July 31, 1996  
Page 2

SHANNON & WILSON, INC.

Please call me direct at (206) 633-6889 if you have any questions regarding this monitoring report.

Respectfully,

SHANNON & WILSON, INC.

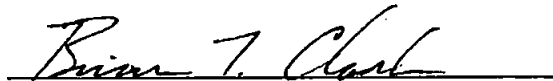
  
\_\_\_\_\_  
Brian L. Clark, P.E.  
Senior Environmental Engineer

ACT:BLC:JFZ/act

Enclosures: Table 1 - Groundwater Sample Results  
Figure 1 - Vicinity Map  
Figure 2 - Site Plan  
Appendix - Analytical Laboratory Report(s)

**TABLE 1**  
**GROUNDWATER SAMPLE RESULTS**  
**BROWN BEAR CAR WASH--15TH**  
**TOSCO FACILITY NO. 2415**

Sample Number	Date Sampled	WTPH-G (ppb)	Benzene (ppb)	Toluene (ppb)	Ethylbenzene (ppb)	Xylenes (ppb)	DTW <sup>b</sup> (feet)	GW Elev. <sup>c</sup> (feet)
<b>MW-1</b>							<b>MW-1</b>	
EMW1-GW	1/7/94	22,000	2,700	4,300	1,500	7,400	--	--
14880631	1/6/95	76,000	3,600	6,300	2,700	12,800	--	--
<b>MW-2</b>							<b>MW-2</b>	
EMW2-GW	1/7/94	1,900	190	48	85	241	--	--
<b>MW-3</b>							<b>MW-3</b>	
14880642	3/1/95	< 50	< 1.00	< 1.00	< 1.00	< 50	--	--
<b>MW-4</b>							<b>MW-4</b>	
14880625	1/5/95	< 300	< 1.00	< 1.00	< 1.00	< 1.00	5.68	8.78
165507	10/31/95	< 50	< 0.5	< 1	< 1	< 1	5.99	8.34
<b>MW-5</b>							<b>MW-5</b>	
14880626	1/5/95	< 300	< 1.00	< 1.00	< 1.00	< 1.00	5.45	8.88
165508	10/31/95	< 50	1.1	< 1	< 1	< 1	5.75	8.41
<b>MW-6</b>							<b>MW-6</b>	
14880627	1/5/95	< 300	1.2	< 1.00	< 1.00	< 1.00	5.47	8.69
165509	10/31/95	6,300	3,100	< 1	876	1,340	5.57	8.49
14881146	3/19/96	1,250	198	< 1	122	9	5.81	8.25
14881149	6/18/96	250	< 0.5	< 1	26	1	6.11	7.95
<b>MW-7</b>							<b>MW-7</b>	
14880628	1/5/95	820	13	2.2	4.7	3.1	5.73	8.33
165510	10/31/95	1,920	1,990	3	247	42	5.50	8.33
14881147	3/19/96	3,820	970	29	307	67	6.09	7.74
14881150	6/18/96	5,020	733	16	514	150	6.45	7.38
<b>MW-8</b>							<b>MW-8</b>	
14880629	1/5/95	550	280	2.6	1.9	2.7	6.08	7.75
165511	10/31/95	330	355	1	2	4	6.00	8.95
14881148	3/19/96	610	1,340	5	2	3	6.29	8.66
14881151	6/18/96	1,160	4,400	42	56	42	6.69	8.26
<b>MW-9</b>							<b>MW-9</b>	
14880630	1/5/95	< 300	< 1.00	< 1.00	< 1.00	< 1.00	5.66	9.29
<b>MTCA Cleanup Levels<sup>a</sup></b>		1,000	5.0	40.0	30.0	20.0		

**NOTES:**<sup>a</sup> Washington Model Toxics Control Act (MTCA) Method A.<sup>b</sup> Depth to water (DTW) measured from top of casing.<sup>c</sup> Groundwater (GW) elevation relative to arbitrary datum of 20 feet.

&lt; = Less than the indicated method reporting limit (MRL) or practical quantitation limit (PQL).

ppb = parts per billion

**Boldface** values indicate concentrations exceeding cleanup level.

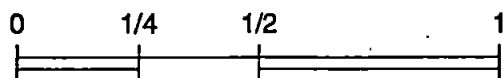
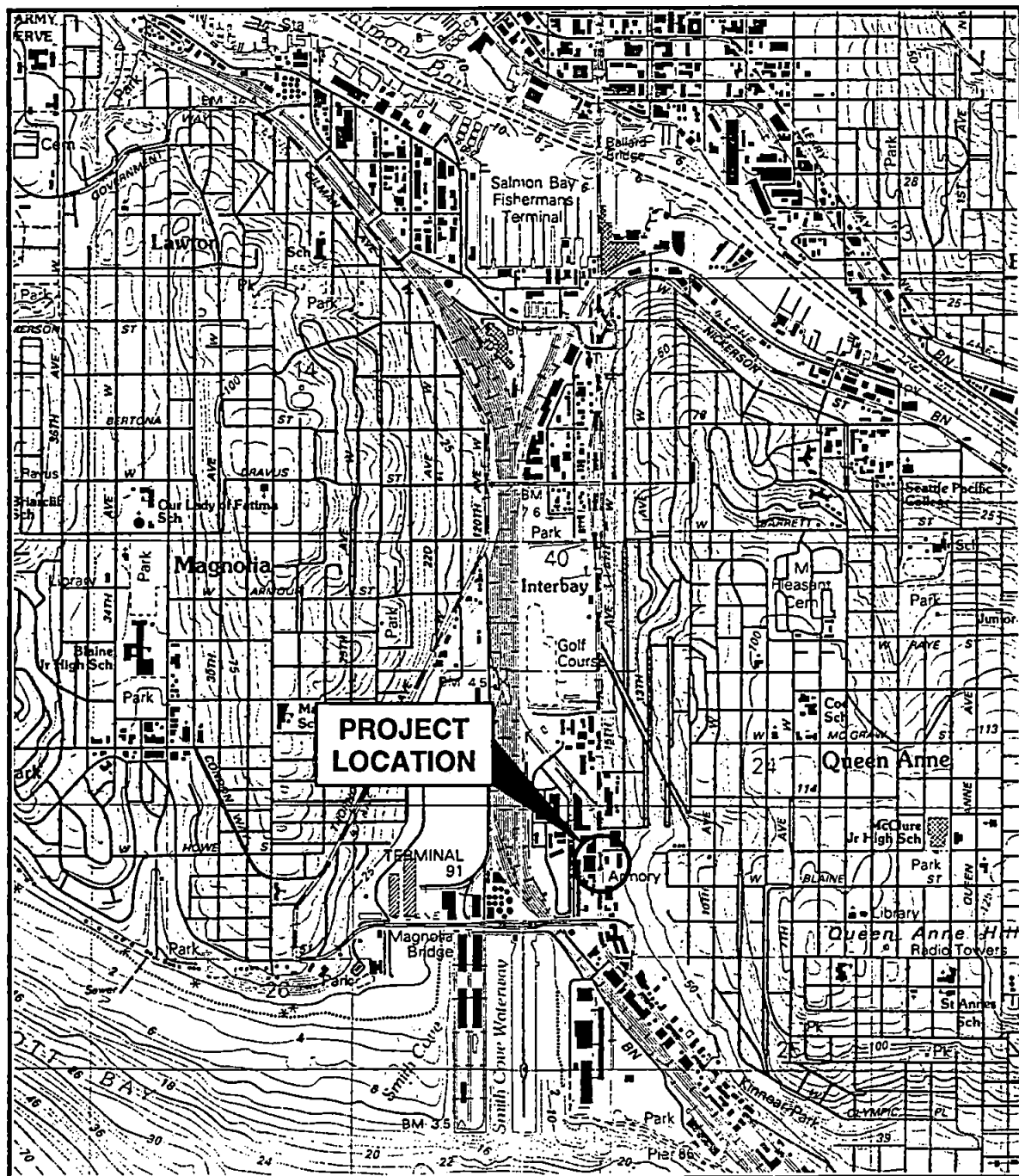

Scale in Miles

#### NOTE

Map adapted from USGS metric topographic map of Seattle North, WA quadrangle, dated 1983.

Tosco Facility No. 2415  
Brown Bear Car Wash - 15th  
Seattle, Washington

#### VICINITY MAP

July 1996

T-1488-12

SHANNON & WILSON, INC.  
Geotechnical and Environmental Consultants

FIG. 1

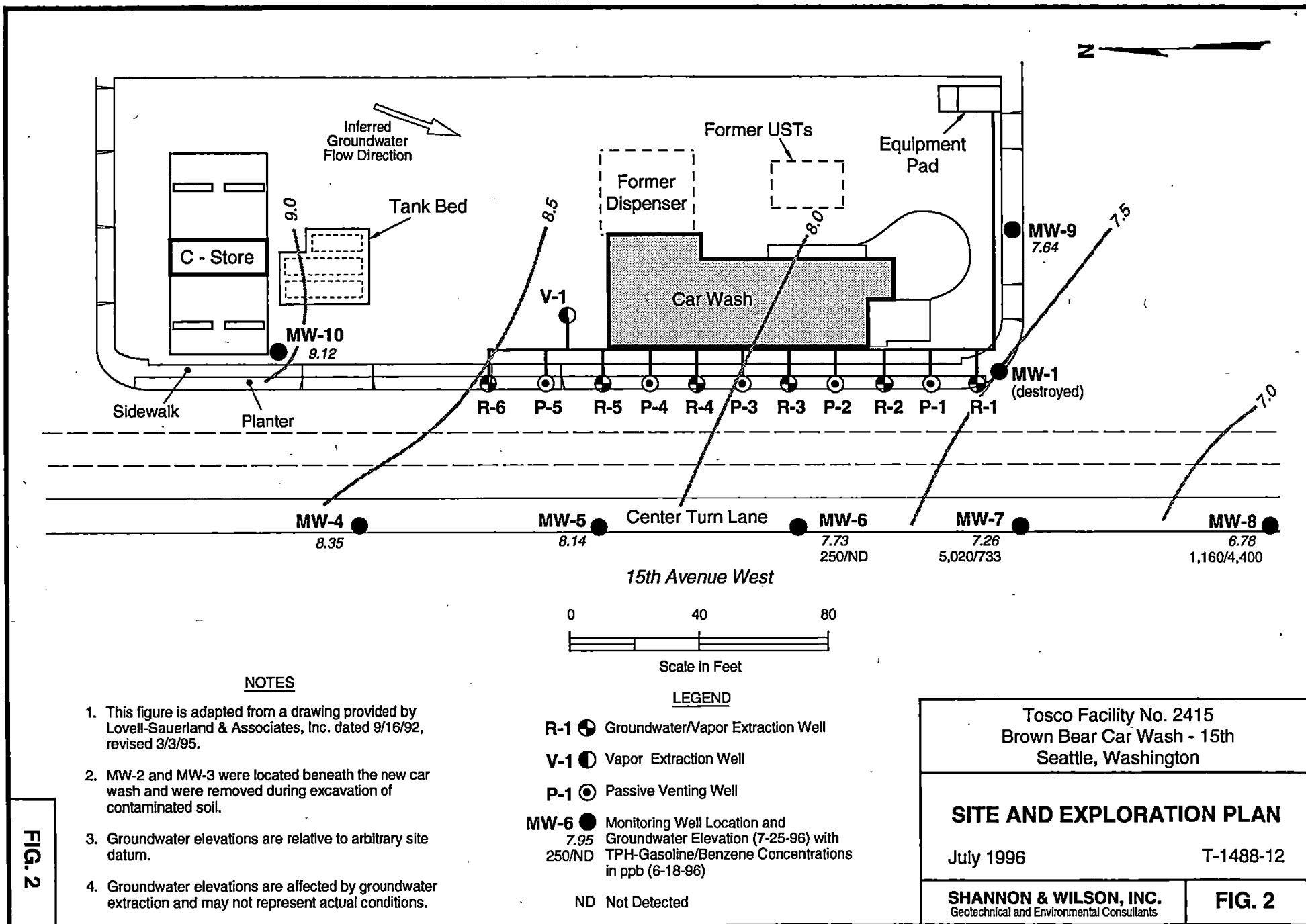

**APPENDIX**  
**ANALYTICAL LABORATORY REPORT(S)**

July 31, 1996

Mr. Timothy D. Johnson  
Tosco Corporation  
601 Union Street, Suite 2500  
Seattle, Washington 98101



**RE: JUNE 1996 GROUNDWATER MONITORING RESULTS FOR TOSCO  
FACILITY NO. 2415**

Dear Mr. Johnson:

This letter report provides you with the analytical results of the groundwater sampling event at Tosco Facility No. 2415 (Brown Bear Car Wash - 15th) located at 1800 15th Avenue West in Seattle, Washington (Figure 1).

On June 18, 1996, groundwater samples were collected from monitoring wells MW-6, MW-7, and MW-8 at the locations shown on Figure 2, and analyzed for Washington Total Petroleum Hydrocarbons as Gasoline with benzene, toluene, ethylbenzene, and xylenes distinction (WTPH-G/BTEX). Analytical results are summarized in Table 1, which includes measured depths to water, groundwater elevations, and a historical summary of previous analytical results. Laboratory reports and chain-of-custody forms are presented in the Appendix.

Contaminant concentrations detected at MW-6 and MW-8 varied greatly from earlier sampling events. WTPH-G and BTEX concentrations in MW-6 all decreased below Washington State Model Toxics Control Act (MTCA) cleanup levels; in MW-8, they increased above cleanup levels. Concentrations in MW-7 were relatively unchanged from earlier results.

On July 15, 1996, the remediation system installed at the site was turned on for the first time. Water and vapor samples were collected from the system to evaluate contaminant discharge levels and provide data to complete the air discharge permit for the system. Once the permit is obtained, the remediation system will be placed into continuous operation.



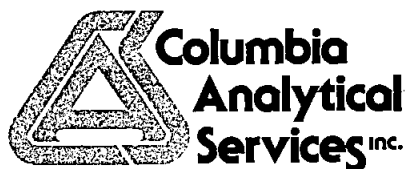

June 27, 1996

Service Request No.: B9600483

Brian Clark  
Shannon & Wilson, Inc.  
400 N. 34th St.  
Suite 100  
Seattle, WA 98103

Re: TOSCO #2415/Project #T-1488-12

Dear Brian:

Attached are the results of the sample(s) submitted to our laboratory on June 18, 1996. Preliminary results were transmitted via facsimile on June 27, 1996. For your reference, these analyses have been assigned our service request number B9600483.

All analyses were performed consistent with our laboratory's quality assurance program. All results are intended to be considered in their entirety, and CAS is not responsible for use of less than the complete report. Results only apply to samples analyzed.

Please call if you have any questions.

Respectfully submitted,

Columbia Analytical Services, Inc.

A handwritten signature in cursive script, appearing to read "Colin B. Elliott".

Colin B. Elliott  
Laboratory Manager

CBE/bdr

Page 1 of 4

**COLUMBIA ANALYTICAL SERVICES, INC.**

**Analytical Report**

**Client:** Shannon & Wilson, Inc.  
**Project:** TOSCO #2415  
**Sample Matrix:** Water

**Service Request:** B9600483  
**Date Collected:** 6/18/96  
**Date Received:** 6/18/96  
**Date Extracted:** NA  
**Date Analyzed:** 6/19/96

BTEX and Total Petroleum Hydrocarbons as Gasoline  
 EPA Methods 5030A/8020 and Washington DOE Method WTPH-G  
 Units: µg/L (ppb)

Analyte:	Benzene	Toluene	Ethylbenzene	Total Xylenes	TPH as Gasoline
Method Reporting Limit:	0.5	1	1	1	50

Sample Name	Lab Code	Benzene	Toluene	Ethylbenzene	Total Xylenes	TPH as Gasoline
14881149	B9600483-01(a)	ND	ND	26	1	250
14881150	B9600483-02	733	16	514	150	5020
14881151	B9600483-03	4400(b)	42	56	42	1160
Method Blank	B9600483-WB	ND	ND	ND	ND	ND

- (a) Result is from an analysis performed on 6/20/96.  
 (b) Result is from the analysis of a diluted sample, performed on 6/20/96. Dilution factor:10

Approved By:                     *Cur. Allott*                     Date: 6/27/96

COLUMBIA ANALYTICAL SERVICES, INC.

QA/QC Report

Client: Shannon & Wilson, Inc.  
Project: TOSCO #2415  
Sample Matrix: Water

Service Request: B9600483  
Date Collected: 6/18/96  
Date Received: 6/18/96  
Date Extracted: NA  
Date Analyzed: 6/19/96

Surrogate Recovery Summary  
BTEX and Total Petroleum Hydrocarbons as Gasoline  
EPA Methods 5030A/8020 and Washington DOE Method WTPH-G

Sample Name	Lab Code	Percent Recovery 4-BFB (PID - BTEX)	Percent Recovery 4-BFB (FID - GAS)
14881149	B9600483-01	103	97
14881150	B9600483-02	97	121(a)
14881151	B9600483-03	102	103
Method Blank	B9600483-WB	104	99

CAS Acceptance Limits: 86-117 86-117

- (a) Outside of acceptance limits because of matrix interferences. The chromatogram showed nontarget components that interfered with the analysis.

Approved By: Rich Elliott

Date: 6/27/96



400 N. 34th Street, Suite 100  
Seattle, WA 98103  
(206) 632-8020

**11500 Olive Blvd., Suite 276  
St. Louis, MO 63141  
(314) 872-8170**

2055 Hill Road  
Fairbanks, AK 99709  
(907) 479-0600

5430 Fairbanks Street, Suite 3  
Anchorage, AK 99518  
(907) 561-2120

1354 N. Grandridge Blvd.  
Kennewick, WA 99336  
(509) 735-1280

2412 N. 30th St., Suite 201  
Tacoma, WA 98407  
(206) 759-0156

## CHAIN OF CUSTODY RECORD

Page 1 of 1  
Laboratory Columbia  
Attn: Colin

**Analysis Parameters/Sample Container Description**  
(include preservative if used)

[illegible]

Project Information		Sample Receipt		Relinquished By: 1.		Relinquished By: 2.		Relinquished By: 3.	
Project Number: <u>T-1488-12</u>		Total Number of Containers: <u>          </u>		Signature: <u>Larry A. Withrow</u> Time: <u>          </u>		Signature: <u>          </u> Time: <u>          </u>		Signature: <u>          </u> Time: <u>          </u>	
Project Name: <u>Tesco 2415</u>		COC Seals/Intact? Y/N/NA <u>          </u>		Printed Name: <u>Larry A. Withrow</u> Date: <u>6/18/96</u>		Printed Name: <u>          </u> Date: <u>          </u>		Printed Name: <u>          </u> Date: <u>          </u>	
Contact: <u>Brian Clark</u>		Received Good Cond./Cold <u>          </u>		Company: <u>S &amp; W</u>		Company: <u>          </u>		Company: <u>          </u>	
Ongoing Project? Yes <input checked="" type="checkbox"/> No <input type="checkbox"/>		Delivery Method: <u>          </u>							
Sampler: <u>LAW</u>		(attach shipping bill, if any) <u>          </u>							
Instructions				Received By: 1.		Received By: 2.		Received By: 3.	
Requested Turn Around Time: <u>          </u>				Signature: <u>Eric Choiniere</u> Time: <u>4:45P</u>		Signature: <u>          </u> Time: <u>          </u>		Signature: <u>          </u> Time: <u>          </u>	
Special Instructions: <u>Lab purchase order No. HO17909</u>				Printed Name: <u>Eric Choiniere</u> Date: <u>          </u>		Printed Name: <u>          </u> Date: <u>          </u>		Printed Name: <u>          </u> Date: <u>          </u>	
Distribution: White - w/shipment - returned to Shannon & Wilson w/ Laboratory report Yellow - w/shipment - for consignee files				Company: <u>CAS</u>		Company: <u>          </u>		Company: <u>          </u>	