



STATE OF WASHINGTON

DEPARTMENT OF ECOLOGY

P.O. Box 47600 • Olympia, Washington 98504-7600
(360) 407-6000 • TDD Only (Hearing Impaired) (360) 407-6006

CERTIFIED MAIL

August 7, 2007

GREG HELLEND
SCS ENGINEERING
2405 140TH AVE NE STE 107
BELLEVUE WA 98005

Re: Termination Determination for the following Hazardous Waste Site enrolled in the Voluntary Cleanup Program:

- Site Name: MEEKER GAS STATION FORMER
- Site Address: 105 N WASHINGTON AVE KENT WA
- Facility/Site No.: 44681713
- VCP No.: NW0878

Dear: MR HELLAND

This is a follow-up to the Notification of Pending Inactive Determination letter (Notification letter) we sent to you on April 10, 2006 and the Further Action Required Determination Letter of June 12, 2006.

The Further Action Required Letter outlined substantive requirements that you needed to address to ensure your continued enrollment at the Voluntary Cleanup Program. Your response of continued groundwater monitoring did not meet the minimum requirements to address the substantive requirements at this site; as a result, **we are removing your site from the Voluntary Cleanup Program (VCP).**

The status of this site has been updated in Department of Ecology's database of contaminated sites. Once you are ready to pursue cleanup activities, you are welcome to reapply to the VCP. If you have any questions you may reach me at (360) 407-7244

Sincerely

Terminate Inactive VCP Site
Meeker Gas Station; VCP ID# NW0878
August 7, 2007

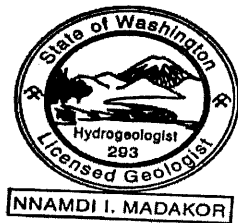
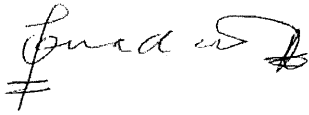

Nnamdi Madakor, VCP Coordinator
HQ - Toxic Cleanup Program

cc: Russ Olsen, NWRO VCP Unit Manager.
Sara Maser, NWRO Data Coordinator
Trish Akana, Ecology (NW0878)

SCS ENGINEERS

Date: April 12, 2000

File No: 04199031.02

To: Brian Gibson, Principal Capital Management
Patricia Spangler, Martin Smith, Incorporated

From: Greg Helland *GH*
Brian Doan *BD*

Subject: Results of Additional Direct-Push Sampling at Meeker Cleaners

This memo describes the results of soil and groundwater sampling conducted in the vicinity of the former Meeker Cleaners tenant space in the Meeker Square shopping center in Kent, Washington.

Sampling

The sampling investigation has progressed in four separate events. The first took place in December 1996 and included collecting shallow soil samples from outside and inside the dry cleaner's leased space. The second sampling event took place on February 15, 2000, and included collecting soil samples from beneath the former location of the dry cleaning machine and from surface soils outside the building to the south and east (Figure 1).

The third and fourth sampling events have involved collecting soil and groundwater samples using a direct-push sampling rig. The third sampling event took place on March 6 and 7, 2000, and involved the installation of six direct-push borings around the outside of the former Meeker Cleaners tenant space. Four of the six borings were completed as piezometers to provide groundwater elevation and flow direction data. The fourth sampling event took place on April 6, 2000, and involved collecting soil and groundwater samples from seven direct-push borings on the east side of the former dry cleaners. Six of the borings were installed in the vicinity of underground sewer and storm drain lines. The seventh boring was installed near the property boundary south of location DP4; the highest concentrations of tetrachloroethene (PCE) were identified in the soil and groundwater samples from DP4.

Results

Survey data and water table elevation data from the piezometers indicate that the groundwater flow direction is south toward West Meeker Street.

A summary of soil sample analytical data is presented below in Table 1. For comparison, the table includes cleanup levels established by the Washington State Model Toxics Control Act (MTCA). Complete analytical reports are on file, and copies will be provided with the final report.



Sample Name	Location	Tetrachloroethene (PCE)	Trichloroethene (TCE)	Cis-1,2-Dichloroethene	Sample Date
DP3	south of dumpster area	<1	<1	<5	Mar. 2000
DP4	at location of SS4	380	14	<5	Mar. 2000
DP5	west of building	<1	<1	<5	Mar. 2000
DP6	south of restaurant	<1	<1	<5	Mar. 2000
DP7	along sewer line near building	6.6	18	5.8	Apr. 2000
DP8	along sewer line NE of DP7	<1	<1	<5	Apr. 2000
DP9	along storm line near building	110	180	35	Apr. 2000
DP10	along storm line NE of DP9	<1	2.2	<5	Apr. 2000
DP11	along storm line west of DP10	14	2.9	<5	Apr. 2000
DP12	along sewer line NE of DP8	<1	<1	<5	Apr. 2000
DP15	South of DP4 and DP7 near sidewalk	<1	<1	<5	Apr. 2000
MTCA Cleanup Level		5	5	80	

Bold Indicates the concentration exceeds the MTCA cleanup level.

In groundwater samples collected on the east side of the building, concentrations of PCE and trichloroethene (TCE) exceed their MTCA Method A cleanup levels of 5 ug/L in groundwater. Elevated PCE concentrations were detected in groundwater samples collected from beneath the planting area and near where the storm drain line passes beneath the building. At locations near the south property boundary (DP3 and DP15), downgradient of the area where the groundwater contamination was discovered, chlorinated solvents were not detected.

Discussion

Laboratory analytical results of soil and groundwater samples collected at the former dry cleaner's leased space suggest a relatively limited area of contamination (Figure 2). Soil concentrations of PCE exceeding the MTCA method A cleanup level have been identified beneath the building, in surface soils outside the southeast corner of the building, east of the building in the planting area, and in subsurface soils along the storm drain line on the east side of the building. Groundwater concentrations of PCE and TCE exceeding MTCA Method A cleanup levels have been identified within 40 feet of the east side of the building.

A groundwater sample (DP5) collected near the storm drain line west of the building did not contain detectable concentrations of chlorinated solvents. This absence of groundwater contaminants west of the building suggests that groundwater contamination along the storm drain line is restricted to an area east of location DP5.

Water level measurements and survey data indicate that the groundwater flows south in the vicinity of the former Meeker Cleaners leased space. Groundwater samples collected from the southern portion of the investigated area (DP3, DP6, and DP15) did not contain detectable concentrations of chlorinated solvents. This absence of groundwater contaminants at the south property boundary indicates that the groundwater contamination is restricted to the property in the immediate vicinity of the former dry cleaner's leased space.

Future investigation activities will need to include the installation of groundwater monitoring wells to provide permanent sampling locations for on-going groundwater monitoring.

LEGEND	
⊙	Former Vapor Probe Location
•	Soil Sampling Location
⊕	Drive-Point Sampling Location
⊕	Drive-Point Sampling Location and Piezometer
---	Approximate Extent of PCE Soil Contamination over MTCA Method A

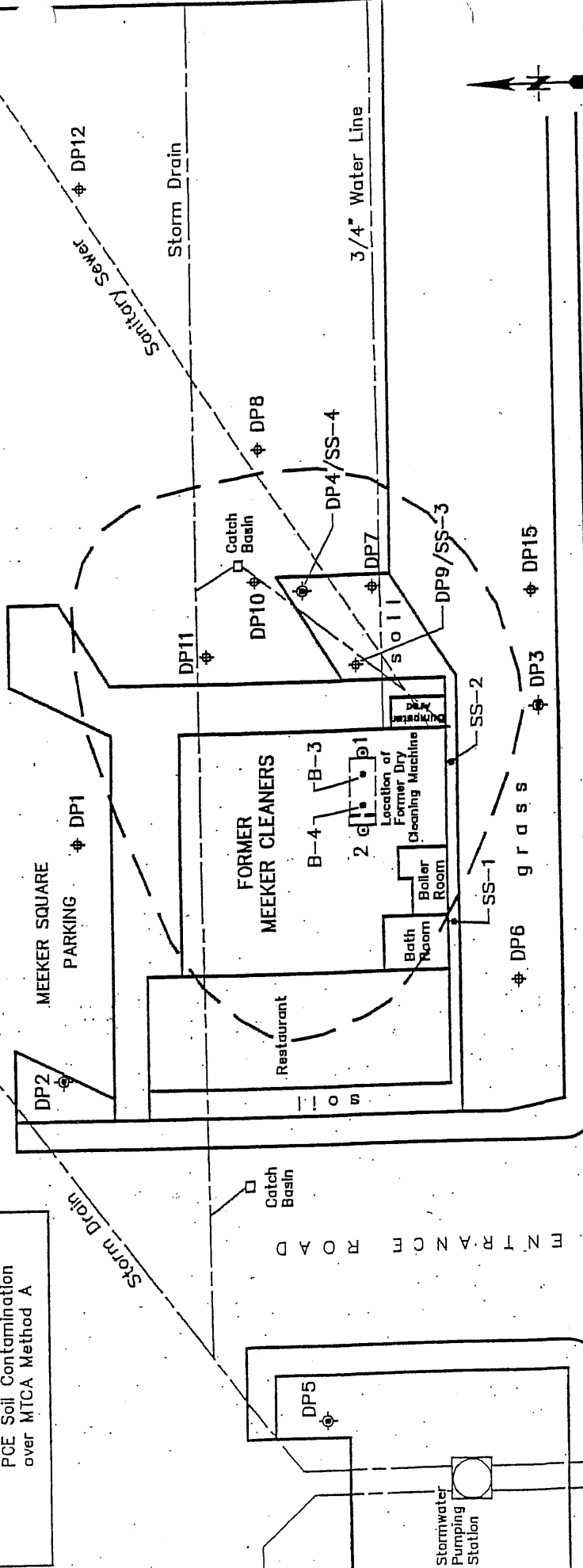

WEST MEEKER STREET

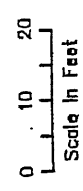

SCS ENGINEERS STEARNS, CONRAD AND SCHMIDT CONSULTING ENGINEERS 2405 140TH AVE NE, SUITE 107, BELLEVUE, WA 98005 (425) 745-4600		PROJECT NO.	DES BY	ESTIMATED EXTENT OF PCE SOIL CONTAMINATION OVER MTCA METHOD A		DATE
		SCALE	CHK BY	MEEKER CLEANERS KENT, WASHINGTON		FIGURE
		CAD FILE	APP BY			2
		XAA01694	G.H.			
		AS SHOWN	G.H.			
		04199031.02	B.J.D.			APRIL 2000

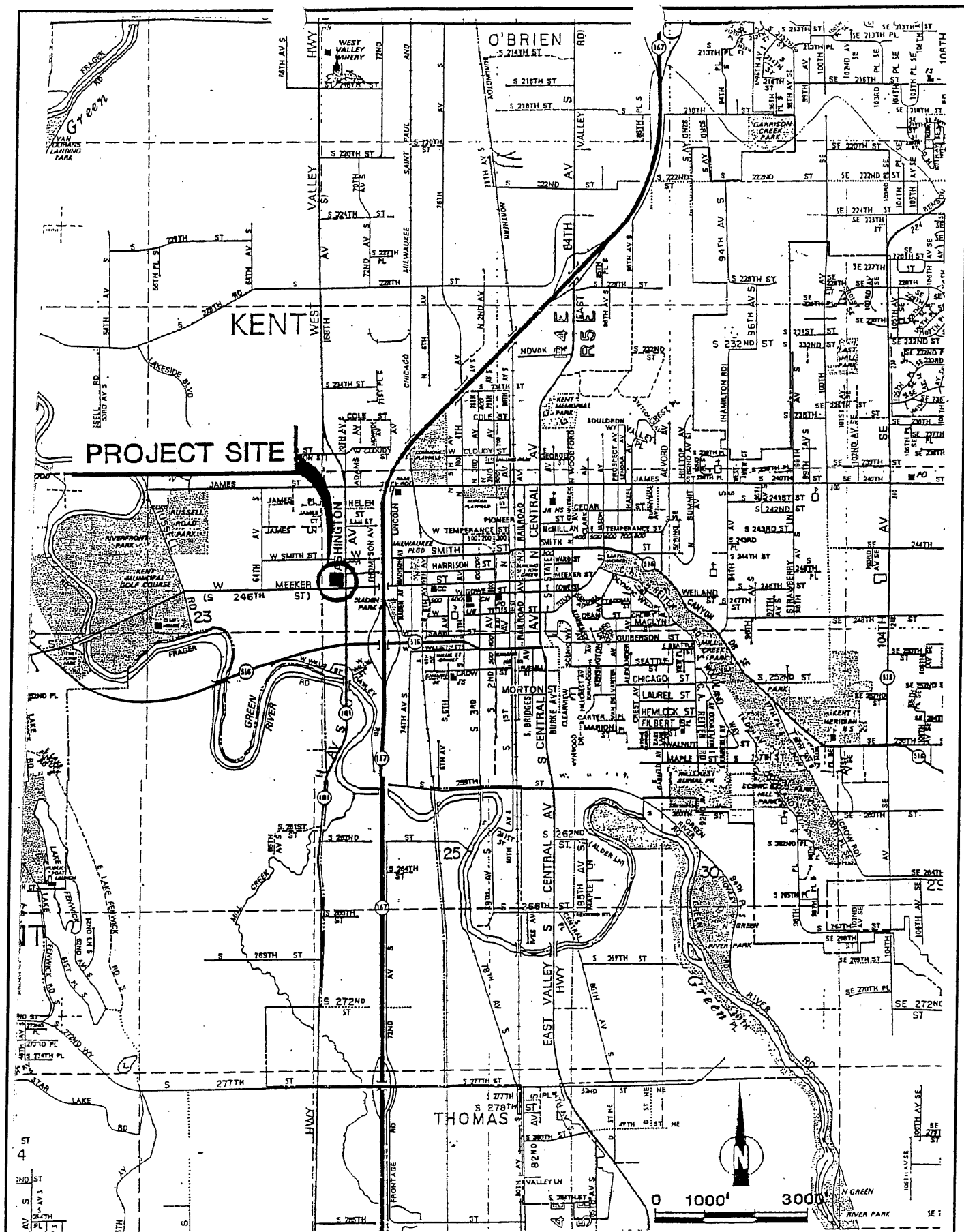

SCS ENGINEERS

STEARNS, CONRAD AND SCHMIDT
CONSULTING ENGINEERS, INC.

2405 140TH AVE NE, SUITE 107, BELLEVUE, WA 98005 (425) 746-4600

PROJECT NO.
04201049.01

SCALE
AS SHOWN

CAD FILE
FIG-FRM1

DES BY
B.D.

CHK BY
B.D.

APP BY
G.H.

PROJECT SITE LOCATION
FORMER GASOLINE SERVICE STATION

MEEKER SQUARE, KENT

DATE
FEB 2002

FIGURE

A