



Stantec

Stantec Consulting Corporation
12034 134th Court NE, Suite 102
Redmond, WA 98052
Tel: (425) 298-1000
Fax: (425) 298-1019

TOSCO 6380
Bellingham
Release 471259

Quarterly Groundwater Monitoring Report - First Quarter 2011
ConocoPhillips Service Station No. 256380 (RM&R #1571)
Washington State Department of Ecology Facility No. 11191596
200 South 36th Street
Bellingham, Washington 98225

Stantec Project No.:
212302665

Submitted to:
Ms. Donna Musa
Toxics Cleanup Program
Washington State Department of Ecology
3190 160th Avenue SE
Bellevue, WA 98008-5452

Submitted by:
Stantec Consulting Corporation
12034 134th Court NE, Suite 102
Redmond, WA 98052

Prepared on behalf of:
ConocoPhillips Company

March 25, 2011

RECEIVED

JUN 01 2011

DEPT OF ECOLOGY
TCP-NWRO



Stantec

Quarterly Groundwater Monitoring Report – First Quarter 2011

March 25, 2011

Dear Ms. Musa:

Stantec Consulting Corporation (Stantec) is pleased to present this quarterly groundwater monitoring report to the Washington State Department of Ecology (DOE) Toxics Cleanup Program (TCP) on behalf of the ConocoPhillips Company (ConocoPhillips). This report describes the results of groundwater monitoring activities performed by Stantec during the First Quarter of 2011 (the reporting period) at ConocoPhillips Facility No. 256380 (RM&R #1571; DOE Facility No. 11191596) located at 200 South 36th Street in Bellingham, Washington (the Site).

GROUNDWATER MONITORING ACTIVITIES

Groundwater monitoring activities during the reporting period were performed on February 21, 2011. Groundwater monitoring activities were performed in accordance with Stantec's protocols for groundwater monitoring events (see Appendix A).

Six groundwater monitoring wells were gauged and sampled (MW-1 through MW-4, MW-6 and MW-7). These activities are described below.

Monitoring Well Gauging

Eight groundwater monitoring wells were gauged: MW-1 through MW-8. Monitoring wells were gauged for the presence of liquid phase hydrocarbons (LPH) and depth to groundwater prior to purging and sampling. LPH was not measured in the groundwater monitoring wells at thicknesses greater than or equal to 0.01 foot. The depth to groundwater ranged from 3.79 feet (MW-5) to 7.64 feet (MW-2) below the top of casing (TOC). Depth to groundwater data was used to calculate the groundwater elevation in each well and evaluate the groundwater flow direction and gradient. Historic groundwater gauging data and gauging data from the reporting period are summarized in Table 1. Well locations and groundwater flow direction are shown on Figure 1. Based on these data, the water table at the Site is relatively flat. Groundwater flow direction appears to be divergent. Based on measured groundwater elevations at MW-3 and MW-5, there appears to be an easterly flow component on the east side of the Site, possibly due to influences from subsurface utilities or other structures associated with the adjoining roadway. Across the remainder of the Site, the groundwater flow direction is generally to the north-northwest at an approximate gradient of 0.003 feet per foot (ft/ft).

Monitoring Well Purging

Wells intended to be sampled were purged after gauging. Groundwater was purged from the wells using low-flow methods, which included using a peristaltic pump and dedicated polyethylene tubing. Water quality parameters were measured during purging and recorded on field data sheets (Appendix B). Purged groundwater and rinsate/decontamination water were

stored at the Site in a Department of Transportation (DOT)-approved, steel drum pending laboratory characterization and offsite disposal.

Monitoring Well Sampling

Following purging operations, groundwater samples were collected using a peristaltic pump and placed directly into pre-cleaned sample containers provided by a certified laboratory.

Once the sample containers were filled and sealed, they were labeled with the pertinent sampling information, and placed on ice in an insulated cooler for delivery under chain-of-custody documentation to an independent laboratory.

CHEMICAL ANALYSES AND RESULTS

Chemical Analyses

Groundwater samples collected during the reporting period were submitted to Pace Analytical Services, Inc. (Pace) in Seattle, Washington for the following chemical analyses:

- Benzene, toluene, ethylbenzene, and total xylenes (BTEX) using Environmental Protection Agency (EPA) Method 8260B;
- Total petroleum hydrocarbons (TPH) gasoline range organics (TPH-G) using DOE Northwest Method NWTPH-Gx; and,
- TPH diesel range organics (TPH-D) and TPH oil range organics (TPH-O) using DOE Northwest Method NWTPH-Dx with silica gel/acid cleanup.

Chemical analyses results are described below. A copy of the certified laboratory analytical report and chain-of-custody documentation are included in Appendix C.

Chemical Analyses Results

Historical chemical analyses results and those from the reporting period are summarized in Table 1. Analytical results for TPH-G, TPH-D, TPH-O and BTEX for the reporting period and the three previous reporting periods are illustrated on Figure 2.

Analytical results did not exceed Model Toxics Control Act (MTCA) Method A cleanup levels for any of the analyses performed during the reporting period. The TPH-D concentration in MW-7 remains below the MTCA Method A cleanup level for the third consecutive quarter. The remaining results during this reporting period are generally consistent with the results from other recent groundwater monitoring events.

Laboratory Quality Assurance/Quality Control (QA/QC)

A copy of the analytical report for the samples collected during the reporting period is included in Appendix C. Please refer to the analytical report for a description of QA/QC methods and potential concerns that were identified during chemical analysis. Potential QA/QC concerns were identified on page 12 in the analytical report.

WASTE DISPOSAL

Purge and rinse water generated during the monitoring and sampling event were temporarily stored on Site in a labeled, DOT-approved, steel drum. The drum contents will be transported off-Site to a licensed disposal or recycling facility approved by ConocoPhillips.

CONCLUSIONS

No exceedances of MTCA Method A cleanup levels were reported for any of the constituents analyzed at any of the locations sampled during the reporting period. The results during this reporting period are generally consistent with the results from other recent groundwater monitoring events.

LIMITATIONS AND CERTIFICATIONS

This report was prepared in accordance with the scope of work outlined in Stantec's contract and with generally accepted professional engineering and environmental consulting practices existing at the time this report was prepared and applicable to the location of the Site. It was prepared for the exclusive use of ConocoPhillips Company for the express purpose stated above. Any re-use of this report for a different purpose or by others not identified above shall be at the user's sole risk without liability to Stantec. To the extent that this report is based on information provided to Stantec by third parties, Stantec may have made efforts to verify this third party information, but Stantec cannot guarantee the completeness or accuracy of this information. The opinions expressed and data collected are based on the conditions of the Site existing at the time of the field investigations. No other warranties, expressed or implied are made by Stantec.

Prepared by:

Amanda Thompson Meza

Amanda Thompson Meza, E.I.T.

Staff Engineer

Reviewed by:

Chris Gdak

Chris Gdak

Senior Project Manager



Marc Sauze, P.E.

Senior Engineer

ATTACHMENTS

Table 1	Cumulative Summary of Groundwater Elevations and Sample Analytical Results
Figure 1	Site Plan with Groundwater Elevations (February 21, 2011)
Figure 2	Site Plan with Analytical Results (February 21, 2011)
Appendix A	Field and Laboratory Procedures
Appendix B	Field Data Sheets
Appendix C	Certified Laboratory Analytical Report and Chain-of-Custody Documentation

FIGURES

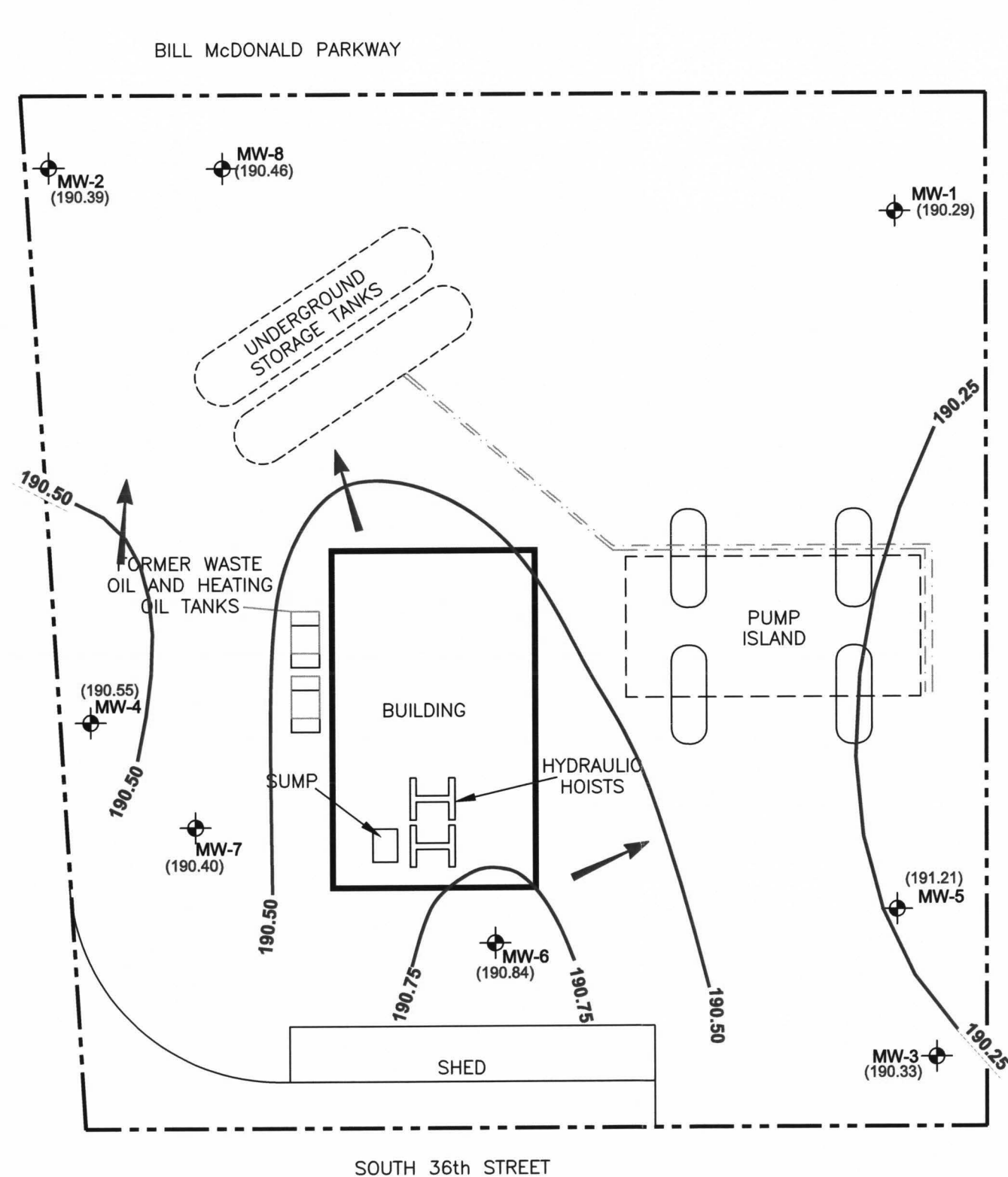

- LEGEND**
- MW-1 MONITORING WELL LOCATION AND ID
 - - - - - SITE BOUNDARY
- GROUNDWATER**
- (190.18) GROUNDWATER ELEVATION (FEET)
 - INFERRED GROUNDWATER FLOW DIRECTION
 - 190.50 GROUNDWATER ELEVATION CONTOUR (FEET)

- NOTES:**
- 1). ALL LOCATIONS ARE APPROXIMATE.
 - 2). CONTOUR INTERVAL = 0.25 FEET
 - 3). GROUNDWATER GRADIENT =
 EASTERNLY COMPONENT = 0.007 FT/FT
 NORTHWESTERNLY COMPONENT = 0.003 FT/FT

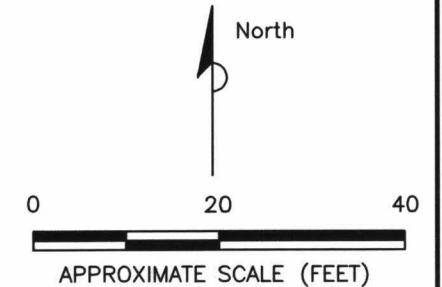

No warranty is made by Startec as to the accuracy, reliability, or completeness of these data. Original data were compiled from various sources. This information may not meet National Map Accuracy Standards. This product was developed electronically, and may be updated without notification. Any reproduction may result in a loss of scale and/or information.

SOURCE:
 BASE MAP FROM: ENVIRONMENTAL RESOLUTIONS, INC.
 (ERI) TITLED GROUNDWATER SAMPLE ANALYSIS MAP-
 06/10/03, PLATE 1, DATED 07/08/03, PROJECT
 NO. 31065. CADD FILE 31065.13.DWG

 12034 134th COURT, SUITE 102 REDMOND, WASHINGTON PHONE: (425) 298-1000 FAX: (425) 298-1020	FOR: ConocoPhillips FACILITY NO. 256380 (RM&R 1571) 200 SOUTH 36th STREET BELLINGHAM, WASHINGTON		SITE PLAN WITH GROUNDWATER ELEVATIONS (FEBRUARY 21, 2011)		FIGURE: 1
	JOB NUMBER: 212302665	DRAWN BY: DJH	CHECKED BY: ATM	APPROVED BY: CG	DATE: 3/14/11

MW-8	6/4/10	8/3/10	12/2/10	2/21/11
TPH-G	<50.0	<50.0	--	--
TPH-D	99	<76.9	--	--
TPH-O	<392	<385	--	--
B	3.8	3.0	--	--
T	<1.0	<1.0	--	--
E	<1.0	<1.0	--	--
X	<3.0	<3.0	--	--

MW-2	6/4/10	8/3/10	12/2/10	2/21/11
TPH-G	--	<50.0	<50.0	<50.0
TPH-D	--	<77.7	<78.4	<78.4
TPH-O	--	<388	<392	<392
B	--	<1.0	<1.0	<1.0
T	--	<1.0	<1.0	<1.0
E	--	<1.0	<1.0	<1.0
X	--	<3.0	<3.0	<3.0

MW-1	6/4/10	8/3/10	12/2/10	2/21/11
TPH-G	<50.0	<50.0	<50.0	<50.0
TPH-D	187	<76.9	<77.7	<78.4
TPH-O	<392	<385	<388	<392
B	<1.0	<1.0	<1.0	<1.0
T	<1.0	<1.0	<1.0	<1.0
E	<1.0	<1.0	<1.0	<1.0
X	<3.0	<3.0	<3.0	<3.0

MW-4	6/4/10	8/3/10	12/2/10	2/21/11
TPH-G	<50.0	<50.0	<50.0	<50.0
TPH-D	81.3	<76.9	<78.4	<77.7
TPH-O	<396	<385	<392	<388
B	<1.0	<1.0	<1.0	<1.0
T	<1.0	<1.0	<1.0	<1.0
E	<1.0	<1.0	<1.0	<1.0
X	<3.0	<3.0	<3.0	<3.0

MW-7	6/4/10	8/3/10	12/2/10	2/21/11
TPH-G	151	119	200	221
TPH-D	1,200	181	222	212
TPH-O	<388	<388	<388	<392
B	<1.0	<1.0	<1.0	<1.0
T	<1.0	<1.0	<1.0	<1.0
E	<1.0	<1.0	<1.0	<1.0
X	<3.0	<3.0	<3.0	<3.0

MW-6	6/4/10	8/3/10	12/2/10	2/21/11
TPH-G	<50.0	<50.0	<50.0	<50.0
TPH-D	<78.4	<76.9	<78.4	<78.4
TPH-O	<392	<385	<392	<392
B	<1.0	<1.0	<1.0	<1.0
T	<1.0	<1.0	<1.0	<1.0
E	<1.0	<1.0	<1.0	<1.0
X	<3.0	<3.0	<3.0	<3.0

MW-5	6/4/10	8/3/10	12/2/10	2/21/11
TPH-G	--	141	--	--
TPH-D	--	<76.9	--	--
TPH-O	--	<385	--	--
B	--	<1.0	--	--
T	--	<1.0	--	--
E	--	<1.0	--	--
X	--	<3.0	--	--

SOURCE:
 BASE MAP FROM: ENVIRONMENTAL RESOLUTIONS, INC.
 (ERI) TITLED GROUNDWATER SAMPLE ANALYSIS MAP-
 06/10/03, PLATE 1, DATED 07/08/03, PROJECT
 NO. 31065. CADD FILE 31065.13.DWG

LEGEND

- MONITORING WELL LOCATION
- GEOPROBE BORING LOCATION
- SITE BOUNDARY
- INFERRED GROUNDWATER FLOW DIRECTION

ANALYTES

WELL ID	ANALYTES
TPH-G	GASOLINE RANGE HYDROCARBONS
TPH-D	DIESEL RANGE HYDROCARBONS
TPH-O	HEAVY OIL RANGE HYDROCARBONS
B	BENZENE
T	TOLUENE
E	ETHYL BENZENE
X	TOTAL XYLENES

UNITS IN MICROGRAMS PER LITER (µg/L)

BOLD VALUES EQUAL OR EXCEED MTCA METHOD A CLEANUP LEVELS.

- < LESS THAN LABORATORY REPORTING LIMIT
- NOT ANALYZED OR NOT APPLICABLE

NOTE:

1). ALL LOCATIONS ARE APPROXIMATE.

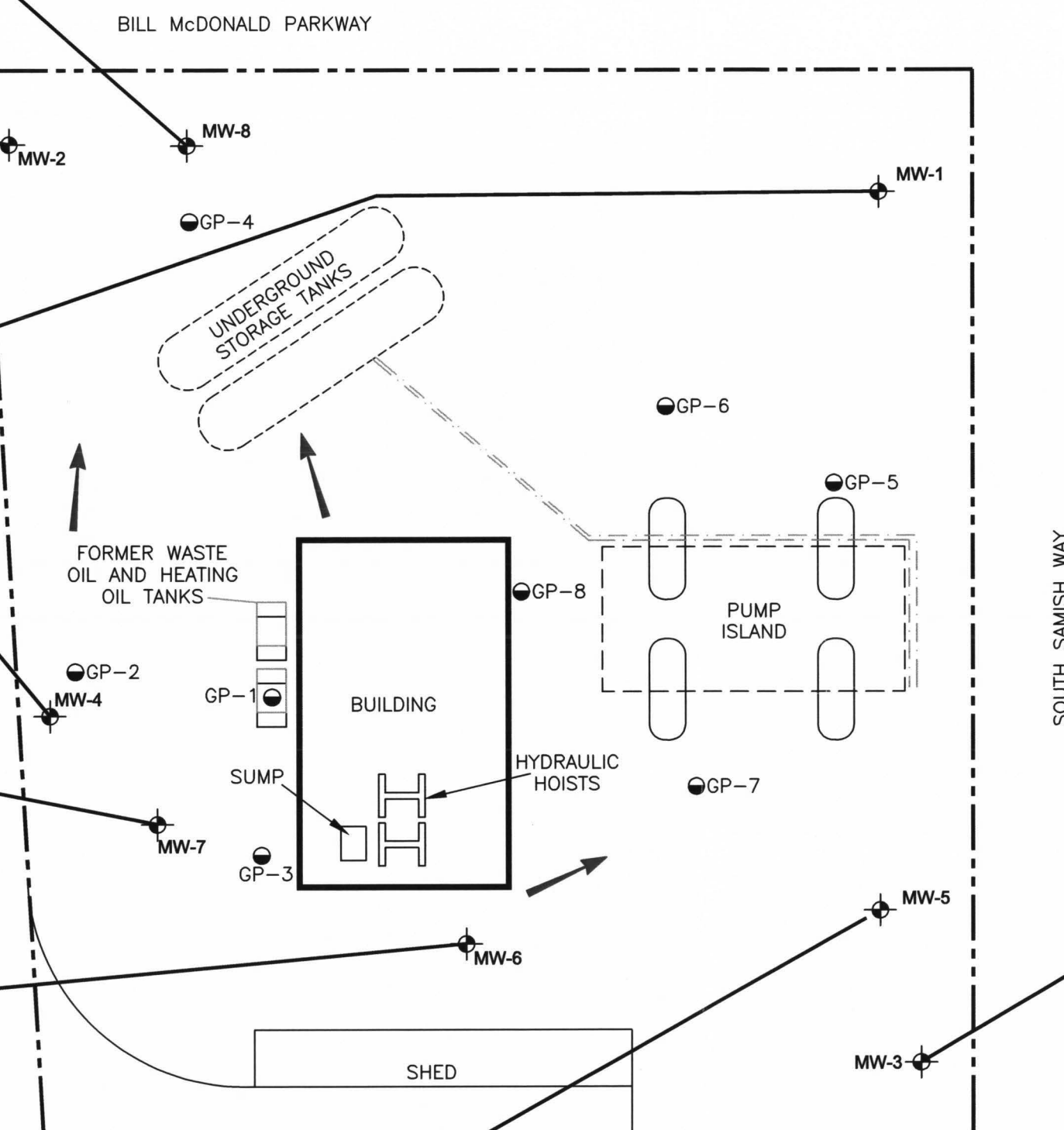

MW-3	6/4/10	8/3/10	12/2/10	2/21/11
TPH-G	<50.0	<50.0	<50.0	<50.0
TPH-D	111	<76.9	<77.7	<78.4
TPH-O	<392	<385	<388	<392
B	<1.0	<1.0	<1.0	<1.0
T	<1.0	<1.0	<1.0	<1.0
E	<1.0	<1.0	<1.0	<1.0
X	<3.0	<3.0	<3.0	<3.0

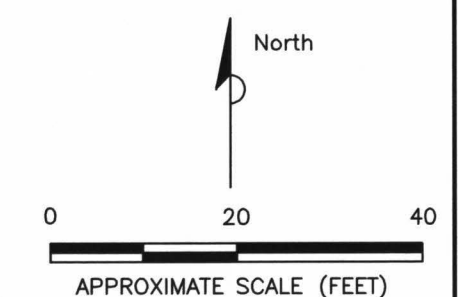

No warranty is made by Stantec as to the accuracy, reliability, or completeness of these data. Original data were compiled from various sources. This information may not meet National Map Accuracy Standards. This product was developed electronically, and may be updated without notification. Any reproduction may result in a loss of scale and/or information.

 12034 134th COURT, SUITE 102 REDMOND, WASHINGTON PHONE: (425) 298-1000 FAX: (425) 298-1019	FOR: ConocoPhillips FACILITY NO. 256380 (RM&R 1571) 200 SOUTH 36th STREET BELLINGHAM, WASHINGTON	SITE PLAN WITH ANALYTICAL RESULTS (FEBRUARY 21, 2011)		FIGURE: 2
	JOB NUMBER: 212302665	DRAWN BY: DJH	CHECKED BY: ATM	APPROVED BY: CG

TABLE

TABLE 1
CULMULATIVE SUMMARY OF GROUNDWATER ELEVATIONS AND SAMPLE ANALYTICAL RESULTS
 ConocoPhillips Facility No. 256380
 200 South 36th Street
 Bellingham, Washington

Well Name	Sample Date	Elevation Data (feet)			Total Petroleum Hydrocarbons			Aromatic Hydrocarbons							Lead		
		TOC Elevation	Depth to Water	LPH	GW Elevation	TPH-G (µg/L)	TPH-D (µg/L)	TPH-O (µg/L)	Benzene (µg/L)	Toluene (µg/L)	Ethyl-Benzene (µg/L)	Total Xylenes (µg/L)	MTBE (µg/L)	EDC (µg/L)	EDB (µg/L)	Total Pb (µg/L)	Dissolved Pb (µg/L)
MW1 98.49	03/11/99	4.96	--	93.53	<50	<250	<750 ^a	<0.500	<0.500	<0.500	<1.00	--	--	--	2.41	--	
	05/25/99	5.33	--	93.16	<50.0	<250	<750 ^a	<0.500	<0.500	<0.500	<1.00	--	--	--	--	--	
	08/12/99	6.66	--	91.83	<50.0	--	--	<0.500	<0.500	<0.500	<1.00	--	--	--	--	--	
	12/07/99	6.10	--	92.39	<50.0	<250	<750 ^a	<0.500	<0.500	<0.500	<1.00	--	--	--	6.18	--	
	02/10/00	6.10	--	92.39	<50.0	<250	<750 ^a	<0.500	<0.500	<0.500	<1.00	--	--	--	1.75	--	
	02/02/01	5.17	--	93.32	<50.0	588	<750 ^a	12.4	1.02	1.10	2.77	--	--	--	--	<1.00	
	02/08/02	5.77	--	92.72	838	1,600	<500	128	2.15	85.4	6.55	--	--	--	7.70	<1.00	
	09/20/02	6.27	--	92.22	197	1,320	<588 ^a	1.82	<0.500	33.0	<1.00	--	--	--	<1.00	--	
	12/04/02	7.05	--	91.44	373	511	<568 ^a	106	1.32	1.39	5.41	--	--	--	4.65	--	
	03/05/03	5.70	--	92.79	168	<250	<500	28.3	1.70	3.55	5.87	--	--	--	4.90	--	
	06/10/03	5.92	--	92.57	400	<250	<500	36.9	2.43	30.5	6.97	--	--	--	17.1	--	
	09/03/03	6.30	--	92.19	258	301	<588 ^a	1.91	3.22	4.30	5.25	--	--	--	8.72	--	
	12/12/03	5.530	--	92.960	204	700	304	2.45	<0.500	<0.500	<1.500	--	--	--	<5.0	--	
	03/24/04	6.11	--	92.38	163	<126	<251	12.6	<1.00	<1.00	<3.00	--	--	--	14.6	--	
	6/17/2004	5.10	--	93.39	<50.0	<118	<237	4.98	<0.500	<0.500	<1.50	--	--	--	--	<10.0	
	9/23/2004	5.28	--	93.21	190	<267	<535 ^a	<0.50	<0.50	<0.50	<1.0	--	--	--	<10.0	--	
	12/29/2004	5.42	--	93.07	<100	<241	<482	<1.00	<1.00	<1.00	<3.00	--	--	--	--	<10.0	
	3/4/2005	5.73	--	92.76	<100	<241	<482	<1.00	<1.00	<1.00	<3.00	--	--	--	<10.0	--	
	6/9/2005	6.10	--	92.39	<100	<236	<472	<1	<1	<1	<3	1.26	--	--	--	<15	
	09/15/05	6.60	--	91.89	<48	<160	<200	<0.5	<0.5	<0.5	<1.5	--	--	--	--	<0.87	
	12/15/05	5.94	--	92.55	<48	170	110	<0.2	<0.2	<0.2	<0.6	--	--	--	--	--	
	03/10/06	5.34	--	93.15	<48	<76	<95	0.6	<0.2	<0.2	<0.6	--	--	--	--	--	
	06/30/06	8.88	--	89.61	<48	<76	<95	<0.2	<0.2	<0.2	<0.6	1.3	--	--	--	--	
	03/07/07	UNABLE TO GAUGE OR SAMPLE; PUBLIC WORKS TRUCKS PARKED OVER WELL.															
	06/01/07	5.47	--	93.02	<50	--	--	<0.5	<0.7	<0.8	<0.8	1.0	--	--	--	--	
	09/06/07	6.01	--	92.48	<50	<76	<95	<0.5	<0.7	<0.8	<0.8	0.5	--	--	--	--	
	12/03/07	6.63	--	91.86	<50	<400 ^c	<500 ^c	<0.5	<0.7	<0.8	<0.8	0.6	--	--	--	--	
	03/05/08	5.34	--	93.15	<50 ^d	<800 ^{a,c,e}	<1,000 ^{b,e}	11	<0.7	<0.8	<0.8	1	--	--	--	--	
	06/11/08	5.34	--	93.15	<50	<800 ^{b,c,e}	<1,000 ^{b,c,e}	10	<0.5	<0.5	<0.5	1	--	--	--	--	
	09/10/08	5.30	--	93.19	<50	<77	<96	<0.5	<0.7	<0.8	<0.8	1	--	--	--	--	
12/10/08	5.62	--	92.87	<50	<29	<69	<0.5	<0.7	<0.8	<0.8	--	--	--	--	--		
03/31/09	5.55	--	92.94	<50.0	<83	<420	<1.0	<1.0	<1.0	<1.0	<1.0	--	--	--	--		
06/17/09	5.80	--	92.69	<50.0	<78	<390	<1.0	<1.0	<1.0	<3.0	<1.0	<1.0	<0.010	<1.0	<1.0		
195.79	09/29/09	6.67	--	189.12	<50.0	<77.7	<388	<1.0	<1.0	<1.0	<3.0	<1.0	--	--	--		
	12/09/09	6.00	--	189.79	Not part of the sampling schedule this reporting period.												
	02/26/10	5.33	--	190.46	<50.0	<77.7	<388	4.4	1.5	<1.0	7.2	--	--	--	--		
	06/04/10	5.16	--	190.63	<50.0	187	<392	<1.0	<1.0	<1.0	<3.0	--	--	--	--		
	08/03/10	6.22	--	189.57	<50.0	<78.9	<385	<1.0	<1.0	<1.0	<3.0	--	--	--	--		
	12/02/10	5.61	--	190.18	<50.0	<77.7	<388	<1.0	<1.0	<1.0	<3.0	--	--	--	--		
02/21/11	5.50	--	190.29	<50.0	<78.4	<392	<1.0	<1.0	<1.0	<3.0	--	--	--	--			

TABLE 1
CULMULATIVE SUMMARY OF GROUNDWATER ELEVATIONS AND SAMPLE ANALYTICAL RESULTS
 ConocoPhillips Facility No. 256380
 200 South 36th Street
 Bellingham, Washington

Well Name	Sample Date	Elevation Data (feet)			Total Petroleum Hydrocarbons			Aromatic Hydrocarbons						Lead		
		TOC Elevation	Depth to Water	LPH	GW Elevation	TPH-G (µg/L)	TPH-D (µg/L)	TPH-O (µg/L)	Benzene (µg/L)	Toluene (µg/L)	Ethyl-Benzene (µg/L)	Total Xylenes (µg/L)	MTBE (µg/L)	EDC (µg/L)	EDB (µg/L)	Total Pb (µg/L)
MW2	03/11/99	7.93	--	92.81	<50	<250	<750*	<0.500	<0.500	<0.500	<1.00	--	--	--	162	--
100.74	05/25/99	8.18	--	92.56	<50.0	<250	<750*	<0.500	<0.500	<0.500	<1.00	--	--	--	--	--
	08/12/99	8.94	--	91.80	<50.0	281	<750*	<0.500	<0.500	<0.500	<1.00	--	--	--	--	--
	12/07/99	8.04	--	92.70	<50.0	<250	<750*	<0.500	<0.500	<0.500	<1.00	--	--	--	17.0	--
	02/10/00	8.32	--	92.42	<50.0	<250	<750*	<0.500	<0.500	<0.500	<1.00	--	--	--	49.1	--
	02/02/01	6.40	--	94.34	<50.0	<250	<750*	<0.500	<0.500	<0.500	<1.00	--	--	--	--	<1.00
	02/08/02	7.77	--	92.97	<50.0	<250	<500	<0.500	<0.500	<0.500	<1.00	--	--	--	40.6	<1.00
	09/20/02	9.23	--	91.51	<50.0	<250	<500	<0.500	<0.500	<0.500	<1.00	--	--	--	<1.00	--
	12/04/02	9.15	--	91.59	<50.0	<250	<500	<0.500	<0.500	<0.500	<1.00	--	--	--	2.89	--
	03/05/03	8.28	--	92.46	<50.0	<250	<500	<0.500	<0.500	<0.500	<1.00	--	--	--	19.8	--
	06/10/03	8.56	--	92.18	<50.0	<284	<568*	<0.500	1.36	<0.500	2.53	--	--	--	40.1	--
	09/03/03	9.13	--	91.61	<80.0	<298	<595*	0.829	1.25	0.519	2.49	--	--	--	33.3	--
	12/12/03	8.120	--	92.62	<50.0	<119	<237	<0.250	<0.500	<0.500	<1.500	--	--	--	<5.0	--
	03/24/04	8.13	--	92.61	<100	<124	<248	<1.00	<1.00	<1.00	<3.00	--	--	--	21.3	--
	6/17/2004	8.13	--	92.61	<50.0	<119	<238	<0.250	<0.500	<0.500	<1.50	--	--	--	--	<10.0
	9/23/2004	8.33	--	92.41	<50	<271	<542*	<0.50	<0.50	<0.50	<1.0	--	--	--	<10.0	--
	12/29/2004	7.82	--	92.92	<100	<239	<478	<1.00	<1.00	<1.00	<3.00	--	--	--	--	<10.0
	3/4/2005	8.34	--	92.40	<100	<239	<478	<1.00	<1.00	<1.00	<3.00	--	--	--	<10.0	--
	6/9/2005	8.66	--	92.08	<100	<238	<475	<1	<1	<1	<3	<1	--	--	--	<15
	9/15/2005	5.40	--	95.34	<48	<75	<94	<0.5	<0.5	<0.5	<1.5	--	--	--	--	<0.87
	12/15/2005	8.44	--	92.30	<48	<75	<94	<0.2	<0.2	<0.2	<0.6	--	--	--	--	--
	3/10/2006	8.28	--	92.46	<48	<76	<95	<0.2	<0.2	<0.2	<0.6	--	--	--	--	--
	06/30/06	8.71	--	92.03	<48	<76	<95	<0.2	<0.2	<0.2	<0.6	<0.3	--	--	--	--
	03/07/07	7.80	--	92.94	<48	<76	<95	<0.5	<0.7	<0.8	<0.8	<0.5	--	--	--	--
	06/01/07	8.38	--	92.36	<50	--	--	<0.5	<0.7	<0.8	<0.8	<0.5	--	--	--	--
	09/06/07	9.06	--	91.68	<50	<76	<95	<0.5	<0.7	<0.8	<0.8	<0.5	--	--	--	--
	12/03/07	6.69	--	94.05	<50	<76	<95	<0.5	<0.7	<0.8	<0.8	<0.5	--	--	--	--
	03/05/08	8.05	--	92.69	<50	<800*	<1,000*	<0.5	<0.7	<0.8	<0.8	<0.5	--	--	--	--
06/11/08	8.25	--	92.49	<50	<76 ^b	<95 ^b	<0.5	<0.5	<0.5	<0.5	<0.5	--	--	--	--	
09/10/08	8.80	--	91.94	<50	<78	<97	<0.5	<0.7	<0.8	<0.8	<0.5	--	--	--	--	
12/10/08	Removed from sampling event this quarter.				--	--	--	--	--	--	--	--	--	--	--	--
03/31/09	7.90	--	92.84	--	--	--	--	--	--	--	--	--	--	--	--	--
06/17/09	8.53	--	92.21	<50.0	<78	<390	<1.0	<1.0	<1.0	<3.0	<1.0	<1.0	<0.010	<1.0	<1.0	
198.03	09/29/09	9.38	--	188.65	<50.0	<77.7	<388	<1.0	<1.0	<1.0	<3.0	<1.0	--	--	--	--
	12/09/09	7.99	--	190.04	Not part of the sampling schedule this reporting period.										--	--
	02/26/10	8.10	--	189.93	Not part of the sampling schedule this reporting period.										--	--
	06/04/10	7.76	--	190.27	Not part of the sampling schedule this reporting period.										--	--
	08/03/10	8.93	--	189.10	<50.0	<77.7	<388	<1.0	<1.0	<1.0	<3.0	--	--	--	--	--
	12/02/10	7.99	--	190.04	<50.0	<78.4	<392	<1.0	<1.0	<1.0	<3.0	--	--	--	--	--
	02/21/11	7.64	--	190.39	<50.0	<78.4	<392	<1.0	<1.0	<1.0	<3.0	--	--	--	--	--

TABLE 1
CULMULATIVE SUMMARY OF GROUNDWATER ELEVATIONS AND SAMPLE ANALYTICAL RESULTS
 ConocoPhillips Facility No. 256380
 200 South 36th Street
 Bellingham, Washington

Well Name	Sample Date	Elevation Data (feet)		Total Petroleum Hydrocarbons			Aromatic Hydrocarbons						Lead			
		TOC Elevation	Depth to Water	LPH	GW Elevation	TPH-G (µg/L)	TPH-D (µg/L)	TPH-O (µg/L)	Benzene (µg/L)	Toluene (µg/L)	Ethyl-Benzene (µg/L)	Total Xylenes (µg/L)	MTBE (µg/L)	EDC (µg/L)	EDB (µg/L)	Total Pb (µg/L)
MW3	03/11/99	4.93	--	92.91	<50	<250	<750 ^a	<0.500	<0.500	<0.500	<1.00	--	--	--	6.35	--
97.84	05/25/99	5.19	--	92.65	210	383	<750 ^a	<0.500	<0.500	3.04	3.93	--	--	--	--	--
	08/12/99	5.70	--	92.14	56.3	<250	<750 ^a	<0.500	<0.500	0.732	1.84	--	--	--	--	--
	12/07/99	5.03	--	92.81	94.7	<250	<750 ^a	<0.500	0.598	<0.500	<1.00	--	--	--	4.40	--
	02/10/00	4.92	--	92.92	<50.0	<250	<750 ^a	<0.500	<0.500	<0.500	<1.00	--	--	--	17.6	--
	02/02/01	4.76	--	93.08	63.0	413	<750 ^a	<0.500	<0.500	0.503	<1.00	--	--	--	--	<1.00
	02/08/02	4.59	--	93.25	91.5	410	<500	<0.500	<0.500	<0.500	<1.00	--	--	--	22.3	<1.00
	09/20/02	5.88	--	91.98	129	372	<500	<0.500	<0.500	<0.500	<1.00	--	--	--	<1.00	--
	12/04/02	5.26	--	92.58	147	371	<500	<0.500	<0.500	<0.500	<1.00	--	--	--	4.60	--
	03/05/03	4.70	--	93.14	62.2	<250	<500	<0.500	<0.500	<0.500	<1.00	--	--	--	12.5	--
	06/10/03	5.31	--	92.53	<50.0	<250	<500	<0.500	0.562	<0.500	<1.00	--	--	--	6.90	--
	09/03/03	5.66	--	92.18	<80.0	<250	<500	2.12	0.753	<0.500	<1.00	--	--	--	<1.00	--
	12/12/03	4.785	--	93.06	<50.0	<119	<237	<0.250	<0.500	<0.500	<1.500	--	--	--	<5.0	--
	03/24/04	4.81	--	93.03	<100	<128	<256	<1.00	<1.00	<1.00	<3.00	--	--	--	20.0	--
	6/17/2004	4.97	--	92.87	<50.0	<119	<238	<0.250	<0.500	<0.500	<1.50	--	--	--	--	<10.0
	9/23/2004	5.03	--	92.81	140	<255	<509 ^a	<0.50	<0.50	<0.50	<1.0	--	--	--	<10.0	--
	12/29/2004	4.53	--	93.31	<100	<239	<478	<1.00	<1.00	<1.00	<3.00	--	--	--	--	<10.0
	3/4/2005	5.02	--	92.82	<100	<241	<482	<1.00	<1.00	<1.00	<3.00	--	--	--	<10.0	--
	6/9/2005	5.25	--	92.59	<100	<238	<475	<1	<1	<1	<3	<1	--	--	--	<15
	9/15/2005	7.20	--	90.64	<48	<75	<93	<0.5	<0.5	<0.5	<1.5	--	--	--	--	<0.87
	12/15/2005	5.09	--	92.75	<48	<75	<94	<0.2	<0.2	<0.2	<0.6	--	--	--	--	--
	3/10/2006	4.75	--	93.09	<48	<75	<94	<0.2	<0.2	<0.2	<0.6	--	--	--	--	--
	06/30/06	5.40	--	92.44	<48	<76	<95	<0.2	<0.2	<0.2	<0.6	<0.3	--	--	--	--
	03/07/07	4.42	--	93.42	<48	<76	<95	<0.5	<0.7	<0.8	<0.8	<0.5	--	--	--	--
	06/01/07	4.94	--	92.90	<50	--	--	<0.5	<0.7	<0.8	<0.8	<0.5	--	--	--	--
	09/06/07	5.43	--	92.41	<50	<76	<95	<0.5	<0.7	<0.8	<0.8	<0.5	--	--	--	--
	12/03/07	4.70	--	93.14	<50	<76	<95	<0.5	<0.7	<0.8	<0.8	<0.5	--	--	--	--
	03/05/08	4.89	--	92.95	<50	<76	<95	<0.5	<0.7	<0.8	<0.8	<0.5	--	--	--	--
06/11/08	5.11	--	92.73	<50	100 ^b	560 ^b	<0.5	<0.5	<0.5	<0.5	<0.5	--	--	--	--	
09/10/08	5.30	--	92.54	<50	<78	<98	<0.5	<0.7	<0.8	<0.8	<0.5	--	--	--	--	
12/10/08	Removed from sampling event this quarter.			--	--	--	--	--	--	--	--	--	--	--	--	--
03/31/09	4.90	--	92.94	--	--	--	--	--	--	--	--	--	--	--	--	--
06/17/09	5.57	--	92.27	<50.0	<78	<390	<1.0	<1.0	<1.0	<3.0	<1.0	<1.0	<0.010	<1.0	<1.0	
195.19	09/29/09	5.91	--	189.28	<50.0	<78.4	<392	<1.0	<1.0	<1.0	<3.0	<1.0	--	--	--	--
	12/09/09	5.06	--	190.13	Not part of the sampling schedule this reporting period.										--	--
	02/26/10	5.02	--	190.17	Not part of the sampling schedule this reporting period.										--	--
	06/04/10	4.91	--	190.28	<50.0	111	<392	<1.0	<1.0	<1.0	<3.0	--	--	--	--	--
	08/03/10	5.71	--	189.48	<50.0	<76.9	<385	<1.0	<1.0	<1.0	<3.0	--	--	--	--	--
	12/02/10	4.83	--	190.36	<50.0	<77.7	<388	<1.0	<1.0	<1.0	<3.0	--	--	--	--	--
	02/21/11	4.86	--	190.33	<50.0	<78.4	<392	<1.0	<1.0	<1.0	<3.0	--	--	--	--	--

TABLE 1
CULMULATIVE SUMMARY OF GROUNDWATER ELEVATIONS AND SAMPLE ANALYTICAL RESULTS
 ConocoPhillips Facility No. 256380
 200 South 36th Street
 Bellingham, Washington

Well Name	Sample Date	Elevation Data (feet)			Total Petroleum Hydrocarbons			Aromatic Hydrocarbons							Lead			
		TOC Elevation	Depth to Water	LPH	GW Elevation	TPH-G (µg/L)	TPH-D (µg/L)	TPH-O (µg/L)	Benzene (µg/L)	Toluene (µg/L)	Ethyl-Benzene (µg/L)	Total Xylenes (µg/L)	MTBE (µg/L)	EDC (µg/L)	EDB (µg/L)	Total Pb (µg/L)	Dissolved Pb (µg/L)	
MW4	03/11/99	99.44	6.39	--	93.05	<50	<250	<750*	<0.500	<0.500	<0.500	<1.00	--	--	--	29.0	--	
	05/25/99		6.62	--	92.82	<50.0	<250	<750*	<0.500	<0.500	<0.500	<1.00	--	--	--	--	--	
	08/12/99		7.31	--	92.13	<50.0	<250	<750*	<0.500	<0.500	<0.500	<1.00	--	--	--	--	--	
	12/07/99		6.37	--	93.07	<50.0	<250	<750*	<0.500	<0.500	<0.500	<1.00	--	--	--	10.2	--	
	02/10/00		6.48	--	92.96	<50.0	<250	<750*	<0.500	<0.500	<0.500	<1.00	--	--	--	23.6	--	
	02/02/01		6.37	--	93.07	<50.0	<250	<750*	<0.500	<0.500	<0.500	<1.00	--	--	--	--	<1.00	
	02/08/02		6.03	--	93.41	<50.0	<250	<500	<0.500	<0.500	<0.500	<1.00	--	--	--	3.30	<1.00	
	09/20/02		7.37	--	92.07	<50.0	<250	<500	<0.500	<0.500	<0.500	<1.00	--	--	--	<1.00	--	
	12/04/02		7.03	--	92.41	<50.0	<250	<500	<0.500	<0.500	<0.500	<1.00	--	--	--	<1.00	--	
	03/05/03		6.33	--	93.11	<50.0	<284	<568*	<0.500	<0.500	<0.500	<1.00	--	--	--	6.81	--	
	06/10/03		6.99	--	92.45	<50.0	<250	<500	<0.500	0.687	<0.500	1.26	--	--	--	10.5	--	
	09/03/03		7.60	--	91.84	<80.0	<312	<625*	0.620	<0.500	<0.500	<1.00	--	--	--	2.75	--	
	12/12/03		6.485	--	92.96	<50.0	<118	<237	<0.250	<0.500	<0.500	<1.500	--	--	--	<5.0	--	
	03/24/04		6.54	--	92.90	<100	<133	<265	<1.00	<1.00	<1.00	<3.00	--	--	--	<5.0	--	
	6/17/2004		5.91	--	93.53	<50.0	<119	<237	<0.250	<0.500	<0.500	<1.50	--	--	--	--	<10.0	
	9/23/2004		6.52	--	92.82	<50	<259	<518*	<0.50	<0.50	<0.50	<1.0	--	--	--	<10.0	--	
	12/29/2004		6.14	--	93.30	<100	<240	<480	<1.00	<1.00	<1.00	<3.00	--	--	--	--	<10.0	
	3/4/2005		6.65	--	92.79	<100	<240	<481	<1.00	<1.00	<1.00	<3.00	--	--	--	<10.0	--	
	6/9/2005		6.91	--	92.53	<100	<237	<473	<1	<1	<1	<3	<1	--	--	--	<15	
	9/15/2005		6.10	--	93.34	<48	150	<93	<0.5	<0.5	<0.5	<1.5	--	--	--	--	<0.87	
	12/15/2005		6.73	--	92.71	<48	180	<94	<0.2	<0.2	<0.2	<0.6	--	--	--	--	--	
	3/10/2006		6.28	--	93.16	<48	<75	<94	<0.2	<0.2	<0.2	<0.6	--	--	--	--	--	
	06/03/06		6.80	--	92.64	<48	130	<95	<0.2	<0.2	<0.2	<0.6	0.8	--	--	--	--	
	03/07/07		5.81	--	93.63	<48	83	<95	<0.5	<0.7	<0.8	<0.8	<0.5	--	--	--	--	
	06/01/07		6.60	--	92.84	<50	--	--	<0.5	<0.7	<0.8	<0.8	<0.5	--	--	--	--	
	09/06/07		7.12	--	92.32	<50	170	<95	<0.5	<0.7	<0.8	<0.8	0.6	--	--	--	--	
	12/03/07		6.00	--	93.44	<50	<76	<95	<0.5	<0.7	<0.8	<0.8	<0.5	--	--	--	--	
	03/05/08		6.17	--	93.27	<50	<77	<96	<0.5	<0.7	<0.8	<0.8	<0.5	--	--	--	--	
	06/11/08		6.02	--	93.42	<50	<75 ^b	<94 ^b	<0.5	<0.5	<0.5	<0.5	<0.5	--	--	--	--	
	09/10/08		6.85	--	92.59	<50	<78	<97	<0.5	<0.7	<0.8	<0.8	<0.5	--	--	--	--	
	12/10/08		Removed from sampling event this quarter.			--	--	--	--	--	--	--	--	--	--	--	--	--
	03/31/09		6.17	--	93.27	--	--	--	--	--	--	--	--	--	--	--	--	
	06/16/09		7.09	--	92.35	<50.0	<78	<390	<1.0	<1.0	<1.0	<3.0	<1.0	<1.0	<0.010	<1.0	<1.0	
196.77	09/29/09		7.71	--	189.06	<50.0	256	<396	<1.0	<1.0	<1.0	<3.0	<1.0	--	--	--	--	
	12/09/09		6.53	--	190.24	<50.0	142	<385	<1.0	<1.0	<1.0	<3.0	--	--	--	--	--	
	2/26/2010		6.39	--	190.38	<50.0	<77.7	<388	<1.0	<1.0	<1.0	<3.0	--	--	--	--	--	
	6/4/2010		6.19	--	190.58	<50.0	81.3	<396	<1.0	<1.0	<1.0	<3.0	--	--	--	--	--	
	8/3/2010		7.38	--	189.39	<50.0	<76.9	<385	<1.0	<1.0	<1.0	<3.0	--	--	--	--	--	
	12/2/2010		6.28	--	190.49	<50.0	<78.4	<392	<1.0	<1.0	<1.0	<3.0	--	--	--	--	--	
	2/21/2011		6.22	--	190.55	<50.0	<77.7	<388	<1.0	<1.0	<1.0	<3.0	--	--	--	--	--	

TABLE 1
CULMULATIVE SUMMARY OF GROUNDWATER ELEVATIONS AND SAMPLE ANALYTICAL RESULTS
 ConocoPhillips Facility No. 256380
 200 South 36th Street
 Bellingham, Washington

Well Name	Sample Date	Elevation Data (feet)			Total Petroleum Hydrocarbons			Aromatic Hydrocarbons						Lead			
		Depth to Water	LPH	GW Elevation	TPH-G (µg/L)	TPH-D (µg/L)	TPH-O (µg/L)	Benzene (µg/L)	Toluene (µg/L)	Ethyl-Benzene (µg/L)	Total Xylenes (µg/L)	MTBE (µg/L)	EDC (µg/L)	EDB (µg/L)	Total Pb (µg/L)	Dissolved Pb (µg/L)	
MW-5 101.14	1/11/2006	4.04	--	97.10	<48	<75	<94	1.7	<0.2	<0.2	<0.6	--	--	--	<8.4	--	
	3/10/2006	3.81	--	97.33	65	<75	<94	13	0.2	<0.2	<0.6	--	--	--	--	--	
	06/30/06	4.46	--	96.68	57	<76	<95	8.6	<0.2	<0.2	<0.6	<5.0	--	--	--	--	
	03/07/07	3.48	--	97.66	<48	<76	<94	<0.5	<0.7	<0.8	<0.8	<0.5	--	--	--	--	
	06/01/07	4.10	--	97.04	<50	--	--	<0.5	<0.7	<0.8	<0.8	0.6	--	--	--	--	
	09/06/07	4.43	--	96.71	<50	<76	<95	<0.5	<0.7	<0.8	<0.8	<0.5	--	--	--	--	
	12/03/07	4.64	--	96.50	<50	99	<95	<0.5	<0.7	<0.8	<0.8	<0.5	--	--	--	--	
	03/05/08	4.36	--	96.78	<50	<76	<95	<0.5	<0.7	<0.8	<0.8	<0.5	--	--	--	--	
	06/11/08	4.21	--	96.93	<50	91	<94	<0.5	<0.5	<0.5	<0.5	<0.5	--	--	--	--	
	09/10/08	4.30	--	96.84	<50	<78	<98	<0.5	<0.7	<0.8	<0.8	<0.5	--	--	--	--	
	12/10/08	Removed from sampling event this quarter.			--	--	--	--	--	--	--	--	--	--	--	--	--
	03/31/09	4.45	--	96.69	--	--	--	--	--	--	--	--	--	--	--	--	--
	06/16/09	4.80	--	96.34	<50.0	<78	<390	<1.0	<1.0	<1.0	<3.0	<1.0	<1.0	<0.010	<1.0	<1.0	
	195.00	09/29/09	5.53	--	189.47	<50.0	183	<386	<1.0	<1.0	<1.0	<3.0	<1.0	--	--	--	--
12/09/09		4.33	--	190.67	Not part of the sampling schedule this reporting period.						--	--	--	--	--	--	
02/26/10		4.52	--	190.48	63.1	93.8	<385	<1.0	<1.0	<1.0	<3.0	--	--	--	--	--	
06/04/10		4.82	--	190.18	Not part of the sampling schedule this reporting period.						--	--	--	--	--	--	
08/03/10		5.31	--	189.69	141	<76.9	<385	<1.0	<1.0	<1.0	<3.0	--	--	--	--	--	
12/02/10		4.45	--	190.55	Not part of the sampling schedule this reporting period.						--	--	--	--	--	--	
02/21/11		3.79	--	191.21	Not part of the sampling schedule this reporting period.						--	--	--	--	--	--	
MW-6 99.74		1/11/2006	4.89	--	94.85	<48	<75	<94	<0.2	<0.2	<0.2	<0.6	--	--	--	<8.4	--
	3/10/2006	5.47	--	94.27	<48	<76	<95	<0.2	<0.2	<0.2	<0.6	--	--	--	--	--	
	06/30/06	6.50	--	93.24	<48	<80	<100	<0.2	<0.2	<0.2	<0.6	<0.3	--	--	--	--	
	03/07/07	5.08	--	94.66	<48	<76	<95	<0.5	<0.7	<0.8	<0.8	<0.5	--	--	--	--	
	06/10/07	5.73	--	94.01	<50	--	--	<0.5	<0.7	<0.8	<0.8	<0.5	--	--	--	--	
	09/06/07	6.22	--	93.52	<50	<76	<95	<0.5	<0.7	<0.8	<0.8	<0.5	--	--	--	--	
	12/03/07	5.46	--	94.28	<50	<76	<95	<0.5	<0.7	<0.8	<0.8	<0.5	--	--	--	--	
	03/05/08	5.46	--	94.28	<50	<76	<95	<0.5	<0.7	<0.8	<0.8	<0.5	--	--	--	--	
	06/11/08	5.39	--	94.35	<50	<76	250	<0.5	<0.5	<0.5	<0.5	<0.5	--	--	--	--	
	09/10/08	5.95	--	93.79	<50	<79	<98	<0.5	<0.7	<0.8	<0.8	<0.5	--	--	--	--	
	12/10/08	Removed from sampling event this quarter.			--	--	--	--	--	--	--	--	--	--	--	--	--
	03/31/09	5.75	--	93.99	--	--	--	--	--	--	--	--	--	--	--	--	--
	06/16/09	6.50	--	93.24	<50.0	<78	<390	<1.0	<1.0	<1.0	<3.0	<1.0	<1.0	<0.010	<1.0	<1.0	
	196.52	09/29/09	7.04	--	189.48	<50.0	<78.4	<392	<1.0	<1.0	<1.0	<3.0	<1.0	--	--	--	--
12/09/09		5.87	--	190.65	<50.0	121	<385	<1.0	<1.0	<1.0	<3.0	--	--	--	--	--	
02/26/10		5.91	--	190.61	<50.0	<76.9	<385	<1.0	<1.0	<1.0	<3.0	--	--	--	--	--	
06/04/10		5.69	--	190.83	<50.0	<78.4	<392	<1.0	<1.0	<1.0	<3.0	--	--	--	--	--	
08/03/10		6.68	--	189.84	<50.0	<76.9	<385	<1.0	<1.0	<1.0	<3.0	--	--	--	--	--	
12/2/2010		5.71	--	190.81	<50.0	<78.4	<392	<1.0	<1.0	<1.0	<3.0	--	--	--	--	--	
2/21/2011		5.68	--	190.84	<50.0	<78.4	<392	<1.0	<1.0	<1.0	<3.0	--	--	--	--	--	

TABLE 1
CULMULATIVE SUMMARY OF GROUNDWATER ELEVATIONS AND SAMPLE ANALYTICAL RESULTS
 ConocoPhillips Facility No. 256380
 200 South 36th Street
 Bellingham, Washington

Well Name	Sample Date	Elevation Data (feet)			Total Petroleum Hydrocarbons			Aromatic Hydrocarbons						Lead		
		Depth to Water	LPH	GW Elevation	TPH-G (µg/L)	TPH-D (µg/L)	TPH-O (µg/L)	Benzene (µg/L)	Toluene (µg/L)	Ethyl-Benzene (µg/L)	Total Xylenes (µg/L)	MTBE (µg/L)	EDC (µg/L)	EDB (µg/L)	Total Pb (µg/L)	Dissolved Pb (µg/L)
MW-7 99.64	1/11/2006	6.07	--	93.57	160	780 ^b	<94 ^b	<0.2	<0.2	<0.2	<0.6	2.5	--	--	<8.4	--
	3/10/2006	6.71	--	92.93	140	540	<94	<0.2	<0.2	<0.2	<0.6	--	--	--	--	--
	06/30/06	7.31	--	92.33	190	1,000	<480	0.2	<0.2	<0.2	<0.6	2	--	--	--	--
	03/07/07	6.00	--	93.64	340	870	<94	<0.5	<0.7	<0.8	<0.8	0.7	--	--	--	--
	06/01/07	6.99	--	92.65	210	--	--	<0.5	<0.7	<0.8	<0.8	0.8	--	--	--	--
	09/06/07	7.47	--	92.17	250	1,000	160	<0.5	<0.7	<0.8	<0.8	0.8	--	--	--	--
	12/03/07	4.97	--	94.67	400	970	140	<0.5	<0.7	<0.8	<0.8	<0.5	--	--	--	--
	03/05/08	6.47	--	93.17	240	930	100	<0.5	<0.7	<0.8	<0.8	<0.5	--	--	--	--
	06/11/08	6.13	--	93.51	240	1,300	860	<0.5	<0.5	<0.5	<0.5	<0.5	--	--	--	--
	09/10/08	7.20	--	92.44	250	580	<97	<0.5	<0.7	<0.8	<0.8	<0.5	--	--	--	--
	12/10/08	6.88	--	92.76	260	460	<68	<0.5	<0.7	<0.8	<0.8	--	--	--	--	--
	03/31/09	6.62	--	93.02	352	220	<420	<1.0	<1.0	<1.0	<1.0	<1.0	--	--	--	--
	06/16/09	7.49	--	92.15	240	440	<390	<1.0	<1.0	<1.0	<3.0	<1.0	<1.0	<0.010	<1.0	<1.0
	196.93	09/29/09	7.97	--	188.96	134	839	566	<1.0	<1.0	<1.0	<3.0	<1.0	--	--	--
12/09/09		6.97	--	189.96	169	891	<385	<1.0	<1.0	<1.0	<3.0	--	--	--	--	--
02/26/10		6.74	--	190.19	190	1,120	516	<1.0	<1.0	<1.0	<3.0	--	--	--	--	--
06/04/10		6.50	--	190.43	151	1,200	<388	<1.0	<1.0	<1.0	<3.0	--	--	--	--	--
08/03/10		7.73	--	189.20	119	181	<388	<1.0	<1.0	<1.0	<3.0	--	--	--	--	--
12/02/10		6.57	--	190.36	200	222	<388	<1.0	<1.0	<1.0	<3.0	--	--	--	--	--
02/21/11		6.53	--	190.40	221	212	<392	<1.0	<1.0	<1.0	<3.0	--	--	--	--	--
MW-8 102.7	1/11/2006	7.00	--	95.70	<48	<76	<95	<0.2	<0.2	<0.2	<0.6	--	--	--	<8.4	--
	3/10/2006	7.50	--	95.20	<48	<75	<94	<0.2	<0.2	<0.2	<0.6	--	--	--	--	--
	06/30/06	7.97	--	94.73	<48	<77	<96	<0.2	<0.2	<0.2	<0.6	<0.3	--	--	--	--
	03/07/07	6.93	--	95.77	<48	<75	<94	<0.5	<0.7	<0.8	<0.8	<0.5	--	--	--	--
	06/01/07	7.77	--	94.93	<50	--	--	<0.5	<0.7	<0.8	<0.8	<0.5	--	--	--	--
	09/06/07	8.45	--	94.25	<50	<76	<95	<0.5	<0.7	<0.8	<0.8	<0.5	--	--	--	--
	12/03/07	7.51	--	95.19	<50	<76	290	<0.5	<0.7	<0.8	<0.8	<0.5	--	--	--	--
	03/05/08	7.30	--	95.40	<50	<150	860	<0.5	<0.7	<0.8	<0.8	<0.5	--	--	--	--
	06/11/08	7.22	--	95.48	<50 ^d	240	1,000	<0.5 ^d	0.7 ^d	<0.5 ^d	<0.5 ^d	<0.5 ^d	--	--	--	--
	09/10/08	8.20	--	94.50	<50	<79	<99	<0.5	<0.7	<0.8	<0.8	<0.5	--	--	--	--
	12/10/08	7.55	--	95.15	<50	<29	180	<0.5	<0.7	<0.8	<0.8	--	--	--	--	--
	03/31/09	7.10	--	95.80	<50.0	<82	<410	<1.0	<1.0	<1.0	<1.0	<1.0	--	--	--	--
	06/17/09	8.00	--	94.70	<50.0	<78	<390	<1.0	<1.0	<1.0	<3.0	<1.0	2.8	<0.010	1.3	<1.0
	197.48	09/29/09	8.89	--	188.59	<50.0	88.5	<388	<1.0	<1.0	<1.0	<3.0	<1.0	--	--	--
12/09/09		7.40	--	190.08	57.9	112	<385	<1.0	<1.0	<1.0	<3.0	--	--	--	--	--
02/26/10		7.40	--	190.08	<50.0	136	496	<1.0	<1.0	<1.0	<3.0	--	--	--	--	--
06/04/10		7.18	--	190.30	<50.0	99	<392	3.8	<1.0	<1.0	<3.0	--	--	--	--	--
08/03/10		8.40	--	189.08	<50.0	<76.9	<385	3.0	<1.0	<1.0	<3.0	--	--	--	--	--
12/2/2010		7.40	--	190.08	Not part of the sampling schedule this reporting period.											
2/21/2011	7.08	--	190.40	Not part of the sampling schedule this reporting period.												
MTCA Method A Cleanup Levels					1000/800^a	500	500	5	1000	700	1000	20	5	0.01	15	15

**TABLE 1
CULMULATIVE SUMMARY OF GROUNDWATER ELEVATIONS AND SAMPLE ANALYTICAL RESULTS**

ConocoPhillips Facility No. 256380
200 South 36th Street
Bellingham, Washington

Well Name	Sample Date	Elevation Data (feet)			Total Petroleum Hydrocarbons			Aromatic Hydrocarbons							Lead	
		Depth to Water	LPH	GW Elevation	TPH-G (µg/L)	TPH-D (µg/L)	TPH-O (µg/L)	Benzene (µg/L)	Toluene (µg/L)	Ethyl-Benzene (µg/L)	Total Xylenes (µg/L)	MTBE (µg/L)	EDC (µg/L)	EDB (µg/L)	Total Pb (µg/L)	Dissolved Pb (µg/L)

NOTES:

TOC = Top of Casing in feet

All concentrations are in micrograms per liter (µg/L) (ppb).

Wellhead elevations in feet were taken from prior consultant's reports.

LPH = Liquid phase hydrocarbon

DTW = Depth to water in feet below top of casing

GW Elev. = Groundwater elevation in feet relative to top of casing elevation

TPH-G = Total Petroleum Hydrocarbons as Gasoline by Ecology Method NWTPH-Gx

TPH-D and TPH-O = Total Petroleum Hydrocarbons as Diesel and Oil, respectively, by Ecology Method NWTPH-Dx

B = Benzene; T = Toluene; E = Ethylbenzene; X = Total Xylenes

BTEX = Aromatic compounds by EPA Method 8020, 8021B or 8260B, refer to laboratory reports.

EDC = 1,2-Dichloroethane by EPA Method 8260B.

EDB = 1,2-Dibromoethane by EPA Method 8011.

Total Pb by EPA Method 8020; Diss Pb = Dissolved lead by EPA Method 8020

After 9/03/03 Total Pb = Total lead by ICP-USEPA Method 6010; Diss Pb = Dissolved lead by ICP-USEPA Method 6010

-- = Not Analyzed or Sampled

< = Less than the stated laboratory reporting limit

Shaded values equal or exceed MTCA Method A Cleanup Levels.

^a Concentration levels stated by MTCA Method A for TPH-G are 1000 µg/L when no benzene is present and 800 µg/L when benzene is present. Data collected before 12/12/03 are taken from prior consultants.

^b The recovery for the laboratory control sample (LCS) with this sample is below quality control limits. Since no sample remained for a reextraction the data is reported.

^c Due to the nature of the sample matrix, a reduced aliquot was used for analysis. The reporting limits were raised accordingly.

^d Preservation requirements were not met. The vial submitted for volatile analysis did not have a pH < 2 at the time of analyses. Due to the volatile nature of the analytes, it is not appropriate for the laboratory to adjust the pH at the time of sample receipt. The pH of this sample was pH=6.

^e The laboratory reporting limits (RLs) are above current MTCA Method A Cleanup levels

APPENDIX A
FIELD AND LABORATORY PROCEDURES

STANTEC MONITORING WELL GAUGING, PURGING AND SAMPLING PROCEDURES

Monitoring well purging and sampling was conducted based on USEPA approved (Puls and Barcelona, 1996) low-flow sampling techniques whenever possible.

Purging Procedures

- A. Using a decontaminated instrument (i.e., tape measure, continuity meter, or interface probe) measure the depth to groundwater in reference to the measuring point at the top of the casing. Measure the total depth of the well and diameter of the well casing to calculate the volume of water in the well casing.
- B. Based on previously obtained data, if a monitoring well is suspected of containing LPH concentrations, lower a transparent bailer into the well to evaluate the presence of a hydrocarbon sheen on the water table.
- C. Decontaminate the purge pump and/or PVC bailers by scrubbing in Alconox detergent solution, followed by a tap water rinse and then a de-ionized water rinse.
- D. Purge by low-flow pumping (less than 0.5 liters per minute) for approximately five minutes. Monitor the static water level in the well using a decontaminated instrument and adjust the pumping rate to maintain a minimal drawdown. If low-flow purging is not possible and bailing is used to purge the well, then a minimum of three well volumes will be removed. When purging 3 well volumes, parameters should be measured after each casing volume is removed. If the well goes dry, the procedure listed in step E2 (below) should be followed.
- E. Conduct field measurements (i.e., pH, specific conductivity, temperature, and oxidation-reduction potential) note clarity, color, turbidity, and odor of purge water, and measure depth to groundwater.
 1. If the well has not been purged dry and drawdown is minimal, continue to pump and conduct field measurements (including depth to water) again every three to five minutes during purging.
 - a) If the first through third series of measurements vary by less than 10 percent, the well has been adequately purged. If bailers are used to purge the well, then the water level is allowed to recover to 80 percent of its static condition, or for two hours, whichever comes first prior to beginning the sampling procedure.
 - b) If the measurements vary by 10 percent or greater, repeat Step E1 above.
 - c) If a minimum of three parameters cannot be measured during purging and or drawdown cannot be controlled to minimal, remove three well volumes with a bailer prior to sampling.
 2. If the well has been purged dry, measure the water level and allow the well to recharge to 80 percent, or for two hours, whichever occurs first. Calculate the percent recovery, and begin the sampling procedure.

Sampling Procedures

- Use the pump and a clean, dedicated section of tubing to collect the groundwater sample from the screened interval of the water column. If the pump cannot be used, collect the water sample with a clean, dedicated polyethylene disposable bailer.
- Transfer the groundwater sample into the appropriate container(s). Where applicable, some containers are completely filled to achieve zero headspace. Label the samples according to location and date of collection.
- Enter the samples into Chain-of-Custody and preserve on ice until delivery to the analytical laboratory. Complete the Well Development or Purging/Sampling Log to be stored in the project file.

Reference:

Puls, R.W., and Barcelona M.J., 1996. EPA Ground Water Issue Low-Flow (Minimal Drawdown) Ground-Water Sampling Procedures, EPA/540/S-95/504.

APPENDIX B
FIELD DATA SHEETS

Stantec Consulting Corporation
HYDROLOGIC DATA SHEET

Gauge Date: 02/21/11

Project Name: CP RM&R 1571 Bellingham

Field Technician: David Reitz

Project Number: 1571-1Q11 GUM

DTP = Depth to Free Product (FP or NAPL) Below TOC
DTW = Depth to Groundwater Below TOC
DTB = Depth to Bottom of Well Casing Below TOC

Flow through cell calibrated Y N

Wells checked for product and gauged prior to commencement of bailing or purging the wells Y N

WELL OR LOCATION	WELL SCREEN DEPTH	PROPOSED INTAKE RANGE (feet below TOC)	MEASUREMENTS				PURGE? (Y/N)	SHEEN? (Y/N)	SAMPLE? (Y/N)	COMMENTS / PROBE CALIBRATION
			TIME	DTP (feet)	DTW (feet)	DTB (feet)				
MW-1		Within the top half of the encountered water column. Top of screen interval if DTW < Depth to Screen.	1130	-	5.50	22.80	Y	N	Y	
MW-2		Within the top half of the encountered water column. Top of screen interval if DTW < Depth to Screen.	1125	-	7.64	20.80	Y	N	Y	
MW-3		Within the top half of the encountered water column. Top of screen interval if DTW < Depth to Screen.	1135	-	4.86	21.00	Y	N	Y	
MW-4		Within the top half of the encountered water column. Top of screen interval if DTW < Depth to Screen.	1140	-	6.22	20.40	Y	N	Y	
MW-5		Within the top half of the encountered water column. Top of screen interval if DTW < Depth to Screen.	1115	-	3.79	13.70	N	N	N	
MW-6		Within the top half of the encountered water column. Top of screen interval if DTW < Depth to Screen.	1145	-	5.68	13.80	Y	N	Y	
MW-7		Within the top half of the encountered water column. Top of screen interval if DTW < Depth to Screen.	1150	-	6.53	18.20	Y	N	Y	
MW-8		Within the top half of the encountered water column. Top of screen interval if DTW < Depth to Screen.	1120	-	7.08	17.50	N	N	N	

SITE VISITATION REPORT
CP 256380 (RM&R 01571) Bellingham, Washington

Name(s) D. Reitz Date: 02, 21, 11 Time of Arrival Call-In: 1100
Arrival Time: 1100 Departure Time: 1600 Time of Departure Call-In: 1640
Who did you call? C. Gdalk

DRUM INVENTORY

<u>1</u>	WATER		CARBON	TOTAL OPEN TOP	
	SOIL		EMPTY	TOTAL BUNG TOP	<u>1</u>

HEALTH AND SAFETY ASSESSMENT

Don P. P. E
Set-up Decon. Station
Review HASP & J.S.A.

DESCRIPTION OF ACTIVITIES ONSITE AND NOTES

1100 Arrive on job site. Meet with site-contact. Call-in to C. Gdalk. Purchase ice. Don appropriate P.P.E.
1110 Set-up decon. station. Conduct tailgate safety meeting.
1120 Tailgate / Q11 GWM sample procedures (gauge & sample 6 wells)
1445 Complete / Q11 GWM sample procedures. Decon. equipment and reverse purge water / decon. rinsates into staged drum. Label drum.
1500 Pack sample cooler & load equipment into truck.
1515 Check out with site-contact. Call-in to C. Gdalk.
1530 Complete daily documentation.
1600 Depart job site.

[Signature] 02, 21, 11

STANTEC Consulting Corporation

WATER SAMPLE FIELD DATA SHEET

PROJECT #: 1571-1211 GWM PURGED BY: D. Reitz WELL I.D.: MW-1
 CLIENT NAME: COP SAMPLED BY: D. Reitz SAMPLE I.D.: MW-1
 LOCATION: 200 S. 36th St Bellingham, Wa.

DATE PURGED 02, 21, 11 START (2400hr) 1220 END (2400hr) 1245
 DATE SAMPLED 02, 21, 11 SAMPLE TIME (2400hr) 1235 LOW-FLOW USED X
 SAMPLE TYPE: Groundwater X Surface Water _____ Treatment Effluent _____ Other _____

CASING DIAMETER: 2" X 3" _____ 4" _____ 5" _____ 6" _____ 8" _____ Other _____
 Casing Volume: (liters per foot) (0.64) (1.44) (2.45) (3.86) (5.68) (9.84) ()

DEPTH TO BOTTOM (feet) = 22.80
 DEPTH TO WATER (feet) = 5.50
 WATER COLUMN HEIGHT (feet) = 17.30 ACTUAL PURGE (L) = 2.5

FIELD MEASUREMENTS

DATE	TIME (2400hr)	VOLUME (mL)	TEMP. (degrees C)	CONDUCTIVITY (umhos/cm)	pH (units)	COLOR (visual)
<u>02/21/11</u>	<u>1225</u>	<u>500</u>	<u>11.3</u>	<u>0.842</u>	<u>6.03</u>	<u>Clr</u>
	<u>1228</u>	<u>500</u>	<u>11.0</u>	<u>0.854</u>	<u>6.03</u>	<u>Clr</u>
	<u>1231</u>	<u>500</u>	<u>10.7</u>	<u>0.846</u>	<u>6.04</u>	<u>Clr</u>
	<u>1234</u>	<u>500</u>	<u>10.8</u>	<u>0.837</u>	<u>6.04</u>	<u>Clr</u>
Calculated Variance of Final Three Samples:			<u>0.3</u>	<u>0.017</u>	<u>0.01</u>	
Acceptable Variance Limits:			<u>≤ 10%</u>	<u>≤ 3%</u>	<u>≤ 0.1</u>	

DEPTH TO PURGE INTAKE DURING PURGE: 20.00 SAMPLE DTW: 5.51

ANTICIPATED PURGE INTAKE DEPTH: 20.00 ANALYSES: TPH-G, TPH-D, BTEX by 8260B

SAMPLE VESSEL / PRESERVATIVE: _____

PURGING EQUIPMENT: Horiba Water meter SAMPLING EQUIPMENT: _____
Peristaltic pump Interface probe Peristaltic pump

Flow Through Cell Disconnected Prior to Sample Collection?: YES X NO _____

WELL PAD CONDITION: Fair WELL CASING CONDITION: Fair
 WELL VAULT CONDITION: Fair SEAL PRESENT?: yes BOLTS PRESENT?: yes
 WELL INTEGRITY: Fair WELL TAG: yes LOCK#: yes

REMARKS: _____

SIGNATURE: [Signature] Page 1 of 1

STANTEC Consulting Corporation

WATER SAMPLE FIELD DATA SHEET

PROJECT #: 1571-1011 GWM PURGED BY: D. Reitz WELL I.D.: MW-2
 CLIENT NAME: COP SAMPLED BY: D. Reitz SAMPLE I.D.: MW-2
 LOCATION: 200 S. 76th St. Bellingham, WA.

DATE PURGED 02/21/11 START (2400hr) 1155 END (2400hr) 1220
 DATE SAMPLED 02/21/11 SAMPLE TIME (2400hr) 1210 LOW-FLOW USED X
 SAMPLE TYPE: Groundwater X Surface Water _____ Treatment Effluent _____ Other _____

CASING DIAMETER: 2" X 3" _____ 4" _____ 5" _____ 6" _____ 8" _____ Other _____
 Casing Volume: (liters per foot) (0.64) (1.44) (2.45) (3.86) (5.68) (9.84) ()

DEPTH TO BOTTOM (feet) = 20.80
 DEPTH TO WATER (feet) = 7.64
 WATER COLUMN HEIGHT (feet) = 13.16 ACTUAL PURGE (L) = 2.5

FIELD MEASUREMENTS

DATE	TIME (2400hr)	VOLUME (L)	TEMP. (degrees F)	CONDUCTIVITY (umhos/cm)	pH (units)	COLOR (visual)
<u>02/21/11</u>	<u>1200</u>	<u>500</u>	<u>12.5</u>	<u>0.610</u>	<u>6.28</u>	<u>Clr</u>
	<u>1203</u>	<u>500</u>	<u>12.1</u>	<u>0.599</u>	<u>6.25</u>	<u>Clr</u>
	<u>1206</u>	<u>500</u>	<u>11.5</u>	<u>0.586</u>	<u>6.22</u>	<u>Clr</u>
	<u>1209</u>	<u>500</u>	<u>11.2</u>	<u>0.591</u>	<u>6.20</u>	<u>Clr</u>

Calculated Variance of Final Three Samples: 0.9 0.013 0.05
 Acceptable Variance Limits: ≤ 10% ≤ 3% ≤ 0.1

DEPTH TO PURGE INTAKE DURING PURGE: 15.00 SAMPLE DTW: 7.80

ANTICIPATED PURGE INTAKE DEPTH: 15.00 ANALYSES: TPH-G, TPH-D, BTEX by 8260B

SAMPLE VESSEL / PRESERVATIVE: _____

PURGING EQUIPMENT: Horiba Water Meter SAMPLING EQUIPMENT: _____
Peristaltic pump Interface probe Peristaltic pump
 Flow Through Cell Disconnected Prior to Sample Collection?: YES X NO _____

WELL PAD CONDITION: Fair WELL CASING CONDITION: Fair
 WELL VAULT CONDITION: Fair SEAL PRESENT?: yes BOLTS PRESENT?: yes
 WELL INTEGRITY: Fair WELL TAG: yes LOCK#: yes

REMARKS: _____

SIGNATURE: [Signature] Page 1 of 1

STANTEC Consulting Corporation

WATER SAMPLE FIELD DATA SHEET

PROJECT #: 1571 - 1 Q11 GWM PURGED BY: D. Reitz WELL I.D.: MW-4
 CLIENT NAME: COP SAMPLED BY: D. Reitz SAMPLE I.D.: MW-4
 LOCATION: 200 S. 36th St. Bellingham, WA.

DATE PURGED 02/21/11 START (2400hr) 1325 END (2400hr) 1350
 DATE SAMPLED 02/21/11 SAMPLE TIME (2400hr) 1340 LOW-FLOW USED X
 SAMPLE TYPE: Groundwater X Surface Water _____ Treatment Effluent _____ Other _____

CASING DIAMETER: 2" X 3" _____ 4" _____ 5" _____ 6" _____ 8" _____ Other _____
 Casing Volume: (liters per foot) (0.64) (1.44) (2.45) (3.86) (5.68) (9.84) ()

DEPTH TO BOTTOM (feet) = 20.40
 DEPTH TO WATER (feet) = 6.22
 WATER COLUMN HEIGHT (feet) = 14.18 ACTUAL PURGE (L) = 2.5

FIELD MEASUREMENTS

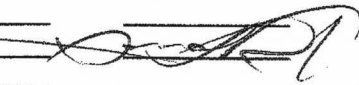
DATE	TIME (2400hr)	VOLUME (ML)	TEMP. (degrees E)	CONDUCTIVITY (umhos/cm)	pH (units)	COLOR (visual)
<u>02/21/11</u>	<u>1330</u>	<u>800</u>	<u>10.3</u>	<u>0.572</u>	<u>5.97</u>	<u>Clr</u>
	<u>1333</u>	<u>500</u>	<u>10.4</u>	<u>0.571</u>	<u>5.95</u>	<u>Clr</u>
	<u>1336</u>	<u>500</u>	<u>10.4</u>	<u>0.576</u>	<u>5.94</u>	<u>Clr</u>
	<u>1339</u>	<u>500</u>	<u>10.4</u>	<u>0.568</u>	<u>5.94</u>	<u>Clr</u>
						
						<u>02/21/11</u>
Calculated Variance of Final Three Samples:			<u>0</u>	<u>0.00%</u>	<u>0.01</u>	
Acceptable Variance Limits:			<u>≤ 10%</u>	<u>≤ 3%</u>	<u>≤ 0.1</u>	

DEPTH TO PURGE INTAKE DURING PURGE: 15.00 SAMPLE DTW: 6.37

ANTICIPATED PURGE INTAKE DEPTH: 15.00 ANALYSES: TPH-G, TPH-D, BTEX by 8260B

SAMPLE VESSEL / PRESERVATIVE: _____

PURGING EQUIPMENT:
Horiba Water Meter
Peristaltic pump
Interface probe
 Flow Through Cell Disconnected Prior to Sample Collection? YES X NO _____

SAMPLING EQUIPMENT:
Peristaltic pump
 YES X NO _____

WELL PAD CONDITION: Fair WELL CASING CONDITION: Fair
 WELL VAULT CONDITION: Fair SEAL PRESENT?: YES BOLTS PRESENT?: YES
 WELL INTEGRITY: Fair WELL TAG: YES LOCK#: YES

REMARKS: _____

SIGNATURE:  Page 1 of 1

STANTEC Consulting Corporation

WATER SAMPLE FIELD DATA SHEET

PROJECT #: 1571-1011 GWM PURGED BY: D. Reitz WELL I.D.: MW-7
 CLIENT NAME: COP SAMPLED BY: D. Reitz SAMPLE I.D.: MW-7
 LOCATION: 200 S. 36th St. Bellingham, WA.

DATE PURGED 02/21/11 START (2400hr) 1420 END (2400hr) 1445
 DATE SAMPLED 02/21/11 SAMPLE TIME (2400hr) 1435 LOW-FLOW USED X
 SAMPLE TYPE: Groundwater X Surface Water _____ Treatment Effluent _____ Other _____

CASING DIAMETER: 2" X 3" _____ 4" _____ 5" _____ 6" _____ 8" _____ Other _____
 Casing Volume: (liters per foot) (0.64) (1.44) (2.45) (3.86) (5.68) (9.84) ()

DEPTH TO BOTTOM (feet) = 18.20

DEPTH TO WATER (feet) = 6.53

WATER COLUMN HEIGHT (feet) = 11.67

ACTUAL PURGE (L) = 2.5

FIELD MEASUREMENTS

DATE	TIME (2400hr)	VOLUME (ML)	TEMP. (degrees F)	CONDUCTIVITY (umhos/cm)	pH (units)	COLOR (visual)
<u>02/21/11</u>	<u>1425</u>	<u>800</u>	<u>9.5</u>	<u>0.865</u>	<u>6.21</u>	<u>Clr</u>
	<u>1428</u>	<u>500</u>	<u>9.5</u>	<u>0.863</u>	<u>6.21</u>	<u>Clr</u>
	<u>1431</u>	<u>500</u>	<u>9.5</u>	<u>0.863</u>	<u>6.22</u>	<u>Clr</u>
	<u>1434</u>	<u>500</u>	<u>9.6</u>	<u>0.860</u>	<u>6.23</u>	<u>Clr</u>
Calculated Variance of Final Three Samples:			<u>0.1</u>	<u>0.003</u>	<u>0.02</u>	
Acceptable Variance Limits:			<u>≤ 10%</u>	<u>≤ 3%</u>	<u>≤ 0.1</u>	

DEPTH TO PURGE INTAKE DURING PURGE: 15.00 SAMPLE DTW: 6.72

ANTICIPATED PURGE INTAKE DEPTH: 15.00 ANALYSES: TPH-G, TPH-D, BTEX by 8260B

SAMPLE VESSEL / PRESERVATIVE: _____

PURGING EQUIPMENT:

SAMPLING EQUIPMENT:

Horiba Water Meter
Peristaltic pump Interface probe

Peristaltic pump

Flow Through Cell Disconnected Prior to Sample Collection?: YES X NO _____

WELL PAD CONDITION: Fair

WELL CASING CONDITION: Fair

WELL VAULT CONDITION: Fair

SEAL PRESENT?: yes BOLTS PRESENT?: yes

WELL INTEGRITY: Fair

WELL TAG: yes LOCK#: yes

REMARKS: _____

SIGNATURE: [Signature]

Chain Of Custody Record

PACE Analytical Laboratory
 940 S. Harney Street, Seattle, WA
 (206) 767-5060

INVOICE REMITTANCE ADDRESS:
 Stanlec
 Attn: Chris Gdak
 12034 134th Court NE, Suite 102
 Redmond, WA 98052

Purchase Order #
 4512896507

DATE: 02/21/11
PAGE: 1 of 1

CONOCO PHILLIPS SITE NUMBER
 AOC 01571

GLOBAL ID NO.: 01571

CONOCO PHILLIPS Manager

PHONE NO.:

E-MAIL:

LAB USE ONLY

Valid Value ID:

ADDRESS: 12034 134th Court NE, Suite 102 Redmond, WA 98052

PROJECT CONTACT (Hardcopy or PDF Report to):
 Chris Gdak
 (425) 298-1023
 E-MAIL: chris.gdak@stanlec.com

CONSULTANT PROJECT NUMBER

TURNAROUND TIME (CALENDAR DAYS):
 14 DAYS 7 DAYS 48 HOURS 24 HOURS LESS THAN 24 HOURS

SPECIAL INSTRUCTIONS OR NOTES: CHECK BOX IF EDD IS NEEDED

* Field Point name only required if different from Sample ID

LAB USE ONLY	Field Point Name	Sample ID	DATE	TIME	MATRIX	NO. OF CONT.	NWTFH-G	NWTFH-Dx w/ silica gel cleanup	BTEX by 8260B
		MW-1	02/21/11	12:35	GW	7	X	X	X
		MW-2		12:10	GW	7	X	X	X
		MW-3		12:05	GW	7	X	X	X
		MW-4		13:40	GW	7	X	X	X
		MW-6		14:05	GW	7	X	X	X
		MW-7		14:35	GW	7	X	X	X
		QCTB			DI	6	X		X

TEMPERATURE ON RECEIPT °C

FIELD NOTES:
 Container/Preservative or PID Readings or Laboratory Notes

40-mL VOAs, preserved with HCl

Received by: (Signature)  **Date:** 02/23/11 **Time:** 1000

Received by: (Signature) _____ **Date:** _____ **Time:** _____

Received by: (Signature) _____ **Date:** _____ **Time:** _____

91903 Revision

APPENDIX C
CERTIFIED LABORATORY ANALYTICAL REPORT
AND CHAIN-OF-CUSTODY DOCUMENTATION

March 09, 2011

Chris Gdak
Stantec
12034 134th Ct NE, Suite 102
Redmond, WA 98052

RE: Project: 01571 - Bellingham
Pace Project No.: 256731

Dear Chris Gdak:

Enclosed are the analytical results for sample(s) received by the laboratory on February 23, 2011. The results relate only to the samples included in this report. Results reported herein conform to the most current NELAC standards, where applicable, unless otherwise narrated in the body of the report.

If you have any questions concerning this report, please feel free to contact me.

Sincerely,

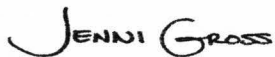

Jennifer Gross

jennifer.gross@pacelabs.com
Project Manager

Enclosures

REPORT OF LABORATORY ANALYSIS

Page 1 of 13

This report shall not be reproduced, except in full,
without the written consent of Pace Analytical Services, Inc..



CERTIFICATIONS

Project: 01571 - Bellingham
Pace Project No.: 256731

Washington Certification IDs

940 South Harney Street, Seattle, WA 98108
Alaska CS Certification #: UST-025
Alaska Drinking Water VOC Certification #: WA01230
Alaska Drinking Water Micro Certification #: WA01230

California Certification #: 01153CA
Florida/NELAP Certification #: E87617
Oregon Certification #: WA200007
Washington Certification #: C1229

REPORT OF LABORATORY ANALYSIS

Page 2 of 13

This report shall not be reproduced, except in full,
without the written consent of Pace Analytical Services, Inc..



SAMPLE ANALYTE COUNT

Project: 01571 - Bellingham
Pace Project No.: 256731

Lab ID	Sample ID	Method	Analysts	Analytes Reported	Laboratory
256731001	MW-1	NWTPH-Dx	ERB	4	PASI-S
		NWTPH-Gx	CC	3	PASI-S
		EPA 5030B/8260	LPM	8	PASI-S
256731002	MW-2	NWTPH-Dx	ERB	4	PASI-S
		NWTPH-Gx	CC	3	PASI-S
		EPA 5030B/8260	LPM	8	PASI-S
256731003	MW-3	NWTPH-Dx	ERB	4	PASI-S
		NWTPH-Gx	CC	3	PASI-S
		EPA 5030B/8260	LPM	8	PASI-S
256731004	MW-4	NWTPH-Dx	ERB	4	PASI-S
		NWTPH-Gx	CC	3	PASI-S
		EPA 5030B/8260	LPM	8	PASI-S
256731005	MW-6	NWTPH-Dx	ERB	4	PASI-S
		NWTPH-Gx	CC	3	PASI-S
		EPA 5030B/8260	LPM	8	PASI-S
256731006	MW-7	NWTPH-Dx	ERB	4	PASI-S
		NWTPH-Gx	CC	3	PASI-S
		EPA 5030B/8260	LPM	8	PASI-S
256731007	QCTB	NWTPH-Gx	CC	3	PASI-S
		EPA 5030B/8260	LPM	8	PASI-S

REPORT OF LABORATORY ANALYSIS

This report shall not be reproduced, except in full,
without the written consent of Pace Analytical Services, Inc..

ANALYTICAL RESULTS

Project: 01571 - Bellingham
Pace Project No.: 256731

Sample: MW-1		Lab ID: 256731001	Collected: 02/21/11 12:35	Received: 02/23/11 11:00	Matrix: Water			
Parameters	Results	Units	Report Limit	DF	Prepared	Analyzed	CAS No.	Qual
NWTPH-Dx GCS SG		Analytical Method: NWTPH-Dx Preparation Method: EPA 3510						
Diesel Range SG	ND ug/L		78.4	1	03/01/11 10:45	03/02/11 15:21		
Motor Oil Range SG	ND ug/L		392	1	03/01/11 10:45	03/02/11 15:21	64742-65-0	
n-Octacosane (S) SG	114 %		50-150	1	03/01/11 10:45	03/02/11 15:21	630-02-4	
o-Terphenyl (S) SG	90 %		50-150	1	03/01/11 10:45	03/02/11 15:21	84-15-1	
NWTPH-Gx GCV		Analytical Method: NWTPH-Gx						
Gasoline Range Organics	ND ug/L		50.0	1		03/01/11 18:39		
a,a,a-Trifluorotoluene (S)	124 %		50-150	1		03/01/11 18:39	98-08-8	
4-Bromofluorobenzene (S)	105 %		50-150	1		03/01/11 18:39	460-00-4	
8260 MSV		Analytical Method: EPA 5030B/8260						
Benzene	ND ug/L		1.0	1		03/01/11 06:26	71-43-2	
Ethylbenzene	ND ug/L		1.0	1		03/01/11 06:26	100-41-4	
Toluene	ND ug/L		1.0	1		03/01/11 06:26	108-88-3	
Xylene (Total)	ND ug/L		3.0	1		03/01/11 06:26	1330-20-7	
4-Bromofluorobenzene (S)	110 %		80-120	1		03/01/11 06:26	460-00-4	
Dibromofluoromethane (S)	103 %		80-122	1		03/01/11 06:26	1868-53-7	
1,2-Dichloroethane-d4 (S)	112 %		80-124	1		03/01/11 06:26	17060-07-0	
Toluene-d8 (S)	106 %		80-123	1		03/01/11 06:26	2037-26-5	

Sample: MW-2		Lab ID: 256731002	Collected: 02/21/11 12:10	Received: 02/23/11 11:00	Matrix: Water			
Parameters	Results	Units	Report Limit	DF	Prepared	Analyzed	CAS No.	Qual
NWTPH-Dx GCS SG		Analytical Method: NWTPH-Dx Preparation Method: EPA 3510						
Diesel Range SG	ND ug/L		78.4	1	03/01/11 10:45	03/02/11 15:37		
Motor Oil Range SG	ND ug/L		392	1	03/01/11 10:45	03/02/11 15:37	64742-65-0	
n-Octacosane (S) SG	115 %		50-150	1	03/01/11 10:45	03/02/11 15:37	630-02-4	
o-Terphenyl (S) SG	90 %		50-150	1	03/01/11 10:45	03/02/11 15:37	84-15-1	
NWTPH-Gx GCV		Analytical Method: NWTPH-Gx						
Gasoline Range Organics	ND ug/L		50.0	1		03/01/11 19:03		
a,a,a-Trifluorotoluene (S)	125 %		50-150	1		03/01/11 19:03	98-08-8	
4-Bromofluorobenzene (S)	107 %		50-150	1		03/01/11 19:03	460-00-4	
8260 MSV		Analytical Method: EPA 5030B/8260						
Benzene	ND ug/L		1.0	1		03/01/11 06:43	71-43-2	
Ethylbenzene	ND ug/L		1.0	1		03/01/11 06:43	100-41-4	
Toluene	ND ug/L		1.0	1		03/01/11 06:43	108-88-3	
Xylene (Total)	ND ug/L		3.0	1		03/01/11 06:43	1330-20-7	
4-Bromofluorobenzene (S)	111 %		80-120	1		03/01/11 06:43	460-00-4	
Dibromofluoromethane (S)	103 %		80-122	1		03/01/11 06:43	1868-53-7	
1,2-Dichloroethane-d4 (S)	113 %		80-124	1		03/01/11 06:43	17060-07-0	
Toluene-d8 (S)	105 %		80-123	1		03/01/11 06:43	2037-26-5	

Date: 03/09/2011 04:45 PM

REPORT OF LABORATORY ANALYSIS

Page 4 of 13

This report shall not be reproduced, except in full,
without the written consent of Pace Analytical Services, Inc..



ANALYTICAL RESULTS

Project: 01571 - Bellingham
Pace Project No.: 256731

Sample: MW-3		Lab ID: 256731003	Collected: 02/21/11 13:05	Received: 02/23/11 11:00	Matrix: Water			
Parameters	Results	Units	Report Limit	DF	Prepared	Analyzed	CAS No.	Qual
NWTPH-Dx GCS SG		Analytical Method: NWTPH-Dx Preparation Method: EPA 3510						
Diesel Range SG	ND ug/L		78.4	1	03/01/11 10:45	03/02/11 15:54		
Motor Oil Range SG	ND ug/L		392	1	03/01/11 10:45	03/02/11 15:54	64742-65-0	
n-Octacosane (S) SG	118 %		50-150	1	03/01/11 10:45	03/02/11 15:54	630-02-4	
o-Terphenyl (S) SG	94 %		50-150	1	03/01/11 10:45	03/02/11 15:54	84-15-1	
NWTPH-Gx GCV		Analytical Method: NWTPH-Gx						
Gasoline Range Organics	ND ug/L		50.0	1		03/01/11 19:27		
a,a,a-Trifluorotoluene (S)	127 %		50-150	1		03/01/11 19:27	98-08-8	
4-Bromofluorobenzene (S)	110 %		50-150	1		03/01/11 19:27	460-00-4	
8260 MSV		Analytical Method: EPA 5030B/8260						
Benzene	ND ug/L		1.0	1		03/01/11 00:39	71-43-2	
Ethylbenzene	ND ug/L		1.0	1		03/01/11 00:39	100-41-4	
Toluene	ND ug/L		1.0	1		03/01/11 00:39	108-88-3	
Xylene (Total)	ND ug/L		3.0	1		03/01/11 00:39	1330-20-7	
4-Bromofluorobenzene (S)	110 %		80-120	1		03/01/11 00:39	460-00-4	
Dibromofluoromethane (S)	104 %		80-122	1		03/01/11 00:39	1868-53-7	
1,2-Dichloroethane-d4 (S)	116 %		80-124	1		03/01/11 00:39	17060-07-0	
Toluene-d8 (S)	105 %		80-123	1		03/01/11 00:39	2037-26-5	

Sample: MW-4		Lab ID: 256731004	Collected: 02/21/11 13:40	Received: 02/23/11 11:00	Matrix: Water			
Parameters	Results	Units	Report Limit	DF	Prepared	Analyzed	CAS No.	Qual
NWTPH-Dx GCS SG		Analytical Method: NWTPH-Dx Preparation Method: EPA 3510						
Diesel Range SG	ND ug/L		77.7	1	03/01/11 10:45	03/02/11 16:11		
Motor Oil Range SG	ND ug/L		388	1	03/01/11 10:45	03/02/11 16:11	64742-65-0	
n-Octacosane (S) SG	110 %		50-150	1	03/01/11 10:45	03/02/11 16:11	630-02-4	
o-Terphenyl (S) SG	83 %		50-150	1	03/01/11 10:45	03/02/11 16:11	84-15-1	
NWTPH-Gx GCV		Analytical Method: NWTPH-Gx						
Gasoline Range Organics	ND ug/L		50.0	1		03/01/11 19:52		
a,a,a-Trifluorotoluene (S)	120 %		50-150	1		03/01/11 19:52	98-08-8	
4-Bromofluorobenzene (S)	105 %		50-150	1		03/01/11 19:52	460-00-4	
8260 MSV		Analytical Method: EPA 5030B/8260						
Benzene	ND ug/L		1.0	1		03/01/11 00:56	71-43-2	
Ethylbenzene	ND ug/L		1.0	1		03/01/11 00:56	100-41-4	
Toluene	ND ug/L		1.0	1		03/01/11 00:56	108-88-3	
Xylene (Total)	ND ug/L		3.0	1		03/01/11 00:56	1330-20-7	
4-Bromofluorobenzene (S)	113 %		80-120	1		03/01/11 00:56	460-00-4	
Dibromofluoromethane (S)	104 %		80-122	1		03/01/11 00:56	1868-53-7	
1,2-Dichloroethane-d4 (S)	116 %		80-124	1		03/01/11 00:56	17060-07-0	
Toluene-d8 (S)	106 %		80-123	1		03/01/11 00:56	2037-26-5	

Date: 03/09/2011 04:45 PM

REPORT OF LABORATORY ANALYSIS

Page 5 of 13

This report shall not be reproduced, except in full,
without the written consent of Pace Analytical Services, Inc..



ANALYTICAL RESULTS

Project: 01571 - Bellingham
Pace Project No.: 256731

Sample: MW-6		Lab ID: 256731005	Collected: 02/21/11 14:05	Received: 02/23/11 11:00	Matrix: Water			
Parameters	Results	Units	Report Limit	DF	Prepared	Analyzed	CAS No.	Qual
NWTPH-Dx GCS SG		Analytical Method: NWTPH-Dx Preparation Method: EPA 3510						
Diesel Range SG	ND ug/L		78.4	1	03/01/11 10:45	03/02/11 16:28		
Motor Oil Range SG	ND ug/L		392	1	03/01/11 10:45	03/02/11 16:28	64742-65-0	
n-Octacosane (S) SG	109 %		50-150	1	03/01/11 10:45	03/02/11 16:28	630-02-4	
o-Terphenyl (S) SG	85 %		50-150	1	03/01/11 10:45	03/02/11 16:28	84-15-1	
NWTPH-Gx GCV		Analytical Method: NWTPH-Gx						
Gasoline Range Organics	ND ug/L		50.0	1		03/01/11 20:17		
a,a,a-Trifluorotoluene (S)	123 %		50-150	1		03/01/11 20:17	98-08-8	
4-Bromofluorobenzene (S)	107 %		50-150	1		03/01/11 20:17	460-00-4	
8260 MSV		Analytical Method: EPA 5030B/8260						
Benzene	ND ug/L		1.0	1		03/01/11 01:13	71-43-2	
Ethylbenzene	ND ug/L		1.0	1		03/01/11 01:13	100-41-4	
Toluene	ND ug/L		1.0	1		03/01/11 01:13	108-88-3	
Xylene (Total)	ND ug/L		3.0	1		03/01/11 01:13	1330-20-7	
4-Bromofluorobenzene (S)	110 %		80-120	1		03/01/11 01:13	460-00-4	
Dibromofluoromethane (S)	105 %		80-122	1		03/01/11 01:13	1868-53-7	
1,2-Dichloroethane-d4 (S)	114 %		80-124	1		03/01/11 01:13	17060-07-0	
Toluene-d8 (S)	107 %		80-123	1		03/01/11 01:13	2037-26-5	

Sample: MW-7		Lab ID: 256731006	Collected: 02/21/11 14:35	Received: 02/23/11 11:00	Matrix: Water			
Parameters	Results	Units	Report Limit	DF	Prepared	Analyzed	CAS No.	Qual
NWTPH-Dx GCS SG		Analytical Method: NWTPH-Dx Preparation Method: EPA 3510						
Diesel Range SG	212 ug/L		78.4	1	03/01/11 10:45	03/02/11 16:45		
Motor Oil Range SG	ND ug/L		392	1	03/01/11 10:45	03/02/11 16:45	64742-65-0	
n-Octacosane (S) SG	112 %		50-150	1	03/01/11 10:45	03/02/11 16:45	630-02-4	
o-Terphenyl (S) SG	89 %		50-150	1	03/01/11 10:45	03/02/11 16:45	84-15-1	
NWTPH-Gx GCV		Analytical Method: NWTPH-Gx						
Gasoline Range Organics	221 ug/L		50.0	1		03/01/11 20:41		
a,a,a-Trifluorotoluene (S)	123 %		50-150	1		03/01/11 20:41	98-08-8	
4-Bromofluorobenzene (S)	111 %		50-150	1		03/01/11 20:41	460-00-4	
8260 MSV		Analytical Method: EPA 5030B/8260						
Benzene	ND ug/L		1.0	1		03/01/11 01:30	71-43-2	
Ethylbenzene	ND ug/L		1.0	1		03/01/11 01:30	100-41-4	
Toluene	ND ug/L		1.0	1		03/01/11 01:30	108-88-3	
Xylene (Total)	ND ug/L		3.0	1		03/01/11 01:30	1330-20-7	
4-Bromofluorobenzene (S)	111 %		80-120	1		03/01/11 01:30	460-00-4	
Dibromofluoromethane (S)	106 %		80-122	1		03/01/11 01:30	1868-53-7	
1,2-Dichloroethane-d4 (S)	114 %		80-124	1		03/01/11 01:30	17060-07-0	
Toluene-d8 (S)	106 %		80-123	1		03/01/11 01:30	2037-26-5	

Date: 03/09/2011 04:45 PM

REPORT OF LABORATORY ANALYSIS

Page 6 of 13

This report shall not be reproduced, except in full,
without the written consent of Pace Analytical Services, Inc..



ANALYTICAL RESULTS

Project: 01571 - Bellingham
Pace Project No.: 256731

Sample: QCTB		Lab ID: 256731007	Collected: 02/21/11 00:00	Received: 02/23/11 11:00	Matrix: Water			
Parameters	Results	Units	Report Limit	DF	Prepared	Analyzed	CAS No.	Qual
NWTPH-Gx GCV		Analytical Method: NWTPH-Gx						
Gasoline Range Organics	ND	ug/L	50.0	1		03/01/11 13:51		
a,a,a-Trifluorotoluene (S)	120	%	50-150	1		03/01/11 13:51	98-08-8	
4-Bromofluorobenzene (S)	102	%	50-150	1		03/01/11 13:51	460-00-4	
8260 MSV		Analytical Method: EPA 5030B/8260						
Benzene	ND	ug/L	1.0	1		02/28/11 22:21	71-43-2	
Ethylbenzene	ND	ug/L	1.0	1		02/28/11 22:21	100-41-4	
Toluene	ND	ug/L	1.0	1		02/28/11 22:21	108-88-3	
Xylene (Total)	ND	ug/L	3.0	1		02/28/11 22:21	1330-20-7	
4-Bromofluorobenzene (S)	110	%	80-120	1		02/28/11 22:21	460-00-4	
Dibromofluoromethane (S)	105	%	80-122	1		02/28/11 22:21	1868-53-7	
1,2-Dichloroethane-d4 (S)	113	%	80-124	1		02/28/11 22:21	17060-07-0	
Toluene-d8 (S)	105	%	80-123	1		02/28/11 22:21	2037-26-5	

QUALITY CONTROL DATA

Project: 01571 - Bellingham
Pace Project No.: 256731

QC Batch: OEXT/3365 Analysis Method: NWTPH-Dx
QC Batch Method: EPA 3510 Analysis Description: NWTPH-Dx GCS
Associated Lab Samples: 256731001, 256731002, 256731003, 256731004, 256731005, 256731006

METHOD BLANK: 60394 Matrix: Water
Associated Lab Samples: 256731001, 256731002, 256731003, 256731004, 256731005, 256731006

Parameter	Units	Blank Result	Reporting Limit	Analyzed	Qualifiers
Diesel Range SG	ug/L	ND	80.0	03/02/11 11:59	
Motor Oil Range SG	ug/L	ND	400	03/02/11 11:59	
n-Octacosane (S) SG	%	117	50-150	03/02/11 11:59	
o-Terphenyl (S) SG	%	84	50-150	03/02/11 11:59	

LABORATORY CONTROL SAMPLE: 60395

Parameter	Units	Spike Conc.	LCS Result	LCS % Rec	% Rec Limits	Qualifiers
Diesel Range SG	ug/L	5000	4130	83	51-147	
Motor Oil Range SG	ug/L	5000	4900	98	20-160	
n-Octacosane (S) SG	%			118	50-150	
o-Terphenyl (S) SG	%			89	50-150	

SAMPLE DUPLICATE: 60396

Parameter	Units	256716004 Result	Dup Result	RPD	Qualifiers
Diesel Range SG	ug/L	ND	ND		
Motor Oil Range SG	ug/L	ND	ND		
n-Octacosane (S) SG	%	119	108	10	
o-Terphenyl (S) SG	%	86	75	13	

SAMPLE DUPLICATE: 60397

Parameter	Units	256738004 Result	Dup Result	RPD	Qualifiers
Diesel Range SG	ug/L	ND	ND		
Motor Oil Range SG	ug/L	ND	ND		
n-Octacosane (S) SG	%	117	119	.2	
o-Terphenyl (S) SG	%	89	88	2	

QUALITY CONTROL DATA

Project: 01571 - Bellingham
Pace Project No.: 256731

QC Batch: GCV/2196 Analysis Method: NWTPH-Gx
QC Batch Method: NWTPH-Gx Analysis Description: NWTPH-Gx GCV Water
Associated Lab Samples: 256731001, 256731002, 256731003, 256731004, 256731005, 256731006, 256731007

METHOD BLANK: 60398 Matrix: Water
Associated Lab Samples: 256731001, 256731002, 256731003, 256731004, 256731005, 256731006, 256731007

Parameter	Units	Blank Result	Reporting Limit	Analyzed	Qualifiers
Gasoline Range Organics	ug/L	ND	50.0	03/01/11 12:39	
4-Bromofluorobenzene (S)	%	99	50-150	03/01/11 12:39	
a,a,a-Trifluorotoluene (S)	%	119	50-150	03/01/11 12:39	

LABORATORY CONTROL SAMPLE: 60399

Parameter	Units	Spike Conc.	LCS Result	LCS % Rec	% Rec Limits	Qualifiers
Gasoline Range Organics	ug/L	250	269	108	50-163	
4-Bromofluorobenzene (S)	%			111	50-150	
a,a,a-Trifluorotoluene (S)	%			132	50-150	

SAMPLE DUPLICATE: 60787

Parameter	Units	256716006 Result	Dup Result	RPD	Qualifiers
Gasoline Range Organics	ug/L	ND	ND		
4-Bromofluorobenzene (S)	%	104	105	.9	
a,a,a-Trifluorotoluene (S)	%	122	124	1	

SAMPLE DUPLICATE: 60789

Parameter	Units	256730003 Result	Dup Result	RPD	Qualifiers
Gasoline Range Organics	ug/L	ND	ND		
4-Bromofluorobenzene (S)	%	104	104	.1	
a,a,a-Trifluorotoluene (S)	%	123	122	.4	

QUALITY CONTROL DATA

Project: 01571 - Bellingham
Pace Project No.: 256731

QC Batch: MSV/3926 Analysis Method: EPA 5030B/8260
QC Batch Method: EPA 5030B/8260 Analysis Description: 8260 MSV Water 10 mL Purge
Associated Lab Samples: 256731001, 256731002

METHOD BLANK: 60242 Matrix: Water
Associated Lab Samples: 256731001, 256731002

Parameter	Units	Blank Result	Reporting Limit	Analyzed	Qualifiers
Benzene	ug/L	ND	1.0	03/01/11 05:35	
Ethylbenzene	ug/L	ND	1.0	03/01/11 05:35	
Toluene	ug/L	ND	1.0	03/01/11 05:35	
Xylene (Total)	ug/L	ND	3.0	03/01/11 05:35	
1,2-Dichloroethane-d4 (S)	%	113	80-124	03/01/11 05:35	
4-Bromofluorobenzene (S)	%	111	80-120	03/01/11 05:35	
Dibromofluoromethane (S)	%	104	80-122	03/01/11 05:35	
Toluene-d8 (S)	%	106	80-123	03/01/11 05:35	

LABORATORY CONTROL SAMPLE: 60243

Parameter	Units	Spike Conc.	LCS Result	LCS % Rec	% Rec Limits	Qualifiers
Benzene	ug/L	20	17.2	86	76-127	
Ethylbenzene	ug/L	20	17.4	87	72-125	
Toluene	ug/L	20	16.4	82	69-125	
Xylene (Total)	ug/L	60	51.6	86	74-124	
1,2-Dichloroethane-d4 (S)	%			111	80-124	
4-Bromofluorobenzene (S)	%			108	80-120	
Dibromofluoromethane (S)	%			110	80-122	
Toluene-d8 (S)	%			105	80-123	

MATRIX SPIKE & MATRIX SPIKE DUPLICATE: 60462 60463

Parameter	Units	256731001		60462		60463		% Rec	% Rec	% Rec	Limits	RPD	Qual
		Result	MS Spike Conc.	MSD Spike Conc.	MS Result	MSD Result	MS % Rec						
Benzene	ug/L	ND	20	20	16.8	16.1	84	81	75-124	4			
Ethylbenzene	ug/L	ND	20	20	16.5	15.9	82	79	76-124	4			
Toluene	ug/L	ND	20	20	16.0	15.5	80	77	75-124	3			
Xylene (Total)	ug/L	ND	60	60	48.6	46.5	80	77	76-123	4			
1,2-Dichloroethane-d4 (S)	%						112	110	80-124				
4-Bromofluorobenzene (S)	%						111	109	80-120				
Dibromofluoromethane (S)	%						109	109	80-122				
Toluene-d8 (S)	%						105	105	80-123				

QUALITY CONTROL DATA

Project: 01571 - Bellingham
Pace Project No.: 256731

QC Batch: MSV/3927 Analysis Method: EPA 5030B/8260
QC Batch Method: EPA 5030B/8260 Analysis Description: 8260 MSV Water 10 mL Purge
Associated Lab Samples: 256731003, 256731004, 256731005, 256731006, 256731007

METHOD BLANK: 60282 Matrix: Water
Associated Lab Samples: 256731003, 256731004, 256731005, 256731006, 256731007

Parameter	Units	Blank Result	Reporting Limit	Analyzed	Qualifiers
Benzene	ug/L	ND	1.0	02/28/11 21:47	
Ethylbenzene	ug/L	ND	1.0	02/28/11 21:47	
Toluene	ug/L	ND	1.0	02/28/11 21:47	
Xylene (Total)	ug/L	ND	3.0	02/28/11 21:47	
1,2-Dichloroethane-d4 (S)	%	112	80-124	02/28/11 21:47	
4-Bromofluorobenzene (S)	%	109	80-120	02/28/11 21:47	
Dibromofluoromethane (S)	%	105	80-122	02/28/11 21:47	
Toluene-d8 (S)	%	104	80-123	02/28/11 21:47	

LABORATORY CONTROL SAMPLE: 60283

Parameter	Units	Spike Conc.	LCS Result	LCS % Rec	% Rec Limits	Qualifiers
Benzene	ug/L	20	16.4	82	76-127	
Ethylbenzene	ug/L	20	16.4	82	72-125	
Toluene	ug/L	20	16.6	83	69-125	
Xylene (Total)	ug/L	60	49.3	82	74-124	
1,2-Dichloroethane-d4 (S)	%			112	80-124	
4-Bromofluorobenzene (S)	%			110	80-120	
Dibromofluoromethane (S)	%			111	80-122	
Toluene-d8 (S)	%			105	80-123	

MATRIX SPIKE & MATRIX SPIKE DUPLICATE: 60464 60465

Parameter	Units	256730001		60465		MS % Rec	MSD % Rec	% Rec Limits	RPD	Qual
		Result	MS Spike Conc.	MSD Spike Conc.	MS Result					
Benzene	ug/L	ND	20	20	16.0	17.1	80	86	75-124	7
Ethylbenzene	ug/L	ND	20	20	15.7	17.0	79	85	76-124	8
Toluene	ug/L	ND	20	20	15.7	17.2	78	85	75-124	9
Xylene (Total)	ug/L	ND	60	60	46.6	51.1	77	84	76-123	9
1,2-Dichloroethane-d4 (S)	%						112	112	80-124	
4-Bromofluorobenzene (S)	%						109	111	80-120	
Dibromofluoromethane (S)	%						110	110	80-122	
Toluene-d8 (S)	%						105	106	80-123	

QUALIFIERS

Project: 01571 - Bellingham
Pace Project No.: 256731

DEFINITIONS

DF - Dilution Factor, if reported, represents the factor applied to the reported data due to changes in sample preparation, dilution of the sample aliquot, or moisture content.

ND - Not Detected at or above adjusted reporting limit.

J - Estimated concentration above the adjusted method detection limit and below the adjusted reporting limit.

MDL - Adjusted Method Detection Limit.

S - Surrogate

1,2-Diphenylhydrazine (8270 listed analyte) decomposes to Azobenzene.

Consistent with EPA guidelines, unrounded data are displayed and have been used to calculate % recovery and RPD values.

LCS(D) - Laboratory Control Sample (Duplicate)

MS(D) - Matrix Spike (Duplicate)

DUP - Sample Duplicate

RPD - Relative Percent Difference

NC - Not Calculable.

SG - Silica Gel Clean-Up

N-Nitrosodiphenylamine decomposes and cannot be separated from Diphenylamine using Method 8270. The result reported for each analyte is a combined concentration.

Pace Analytical is NELAP accredited. Contact your Pace PM for the current list of accredited analytes.

LABORATORIES

PASI-S Pace Analytical Services - Seattle

QUALITY CONTROL DATA CROSS REFERENCE TABLE

Project: 01571 - Bellingham
Pace Project No.: 256731

Lab ID	Sample ID	QC Batch Method	QC Batch	Analytical Method	Analytical Batch
256731001	MW-1	EPA 3510	OEXT/3365	NWTPH-Dx	GCSV/2289
256731002	MW-2	EPA 3510	OEXT/3365	NWTPH-Dx	GCSV/2289
256731003	MW-3	EPA 3510	OEXT/3365	NWTPH-Dx	GCSV/2289
256731004	MW-4	EPA 3510	OEXT/3365	NWTPH-Dx	GCSV/2289
256731005	MW-6	EPA 3510	OEXT/3365	NWTPH-Dx	GCSV/2289
256731006	MW-7	EPA 3510	OEXT/3365	NWTPH-Dx	GCSV/2289
256731001	MW-1	NWTPH-Gx	GCV/2196		
256731002	MW-2	NWTPH-Gx	GCV/2196		
256731003	MW-3	NWTPH-Gx	GCV/2196		
256731004	MW-4	NWTPH-Gx	GCV/2196		
256731005	MW-6	NWTPH-Gx	GCV/2196		
256731006	MW-7	NWTPH-Gx	GCV/2196		
256731007	QCTB	NWTPH-Gx	GCV/2196		
256731001	MW-1	EPA 5030B/8260	MSV/3926		
256731002	MW-2	EPA 5030B/8260	MSV/3926		
256731003	MW-3	EPA 5030B/8260	MSV/3927		
256731004	MW-4	EPA 5030B/8260	MSV/3927		
256731005	MW-6	EPA 5030B/8260	MSV/3927		
256731006	MW-7	EPA 5030B/8260	MSV/3927		
256731007	QCTB	EPA 5030B/8260	MSV/3927		

Sample Container Count

CLIENT: Stantec



COC PAGE 1 of 1

COC ID# _____

256731

Sample Line Item	VG9H	AG1H	AG1U	BG1H	BP1U	BP2U	BP3U	BP2N	BP2S	WGFU	WGKU	Comments
1	6	12										
2	↓	↓										
3	↓											
4												
5												
6	↓	↓										
7	↓											
8												
9												
10												
11												
12												Trip Blank? <i>yes</i>

AG1H	1 liter HCL amber glass		BP2S	500mL H2SO4 plastic	JGFU	4oz unpreserved amber wide
AG1U	1 liter unpreserved amber glass		BP2U	500mL unpreserved plastic	R	terra core kit
AG2S	500mL H2SO4 amber glass		BP2Z	500mL NaOH, Zn Ac	U	Summa Can
AG2U	500mL unpreserved amber glass		BP3C	250mL NaOH plastic	VG9H	40mL HCL clear vial
AG3S	250mL H2SO4 amber glass		BP3N	250mL HNO3 plastic	VG9T	40mL Na Thio. clear vial
BG1H	1 liter HCL clear glass		BP3S	250mL H2SO4 plastic	VG9U	40mL unpreserved clear vial
BG1U	1 liter unpreserved glass		BP3U	250mL unpreserved plastic	VG9W	40mL glass vial preweighted (EPA 5035)
BP1N	1 liter HNO3 plastic		DG9B	40mL Na Bisulfate amber vial	VSG	Headspace septa vial & HCL
BP1S	1 liter H2SO4 plastic		DG9H	40mL HCL amber vial	WGFU	4oz clear soil jar
BP1U	1 liter unpreserved plastic		DG9M	40mL MeOH clear vial	WGFY	4oz wide jar w/hexane wipe
BP1Z	1 liter NaOH, Zn, Ac		DG9T	40mL Na Thio amber vial	ZPLC	Ziploc Bag
BP2N	500mL HNO3 plastic		DG9U	40mL unpreserved amber vial		
BP2O	500mL NaOH plastic		I	Wipe/Swab		



Sample Condition Upon Receipt

Client Name: Stantec Project # ~~256731~~ 1153
2/23/11

Courier: Fed Ex UPS USPS Client Commercial Pace Other _____
Tracking #: _____

Custody Seal on Cooler/Box Present: Yes No Seals intact: Yes No

Packing Material: Bubble Wrap Bubble Bags None Other _____ Temp. Blank: Yes No

Thermometer Used 132011 or 101731962 or 226099 Type of Ice: Wet Blue None Samples on ice, cooling process has begun

Cooler Temperature 3.9°C Biological Tissue is Frozen: Yes No
Temp should be above freezing ≤ 6°C

Date and Initials of person examining contents: MSJ 2/23/11

Chain of Custody Present:	<input checked="" type="checkbox"/> Yes <input type="checkbox"/> No <input type="checkbox"/> N/A	1.
Chain of Custody Filled Out:	<input checked="" type="checkbox"/> Yes <input type="checkbox"/> No <input type="checkbox"/> N/A	2.
Chain of Custody Relinquished:	<input checked="" type="checkbox"/> Yes <input type="checkbox"/> No <input type="checkbox"/> N/A	3.
Sampler Name & Signature on COC:	<input checked="" type="checkbox"/> Yes <input type="checkbox"/> No <input type="checkbox"/> N/A	4.
Samples Arrived within Hold Time:	<input checked="" type="checkbox"/> Yes <input type="checkbox"/> No <input type="checkbox"/> N/A	5.
Short Hold Time Analysis (<72hr):	<input type="checkbox"/> Yes <input checked="" type="checkbox"/> No <input type="checkbox"/> N/A	6.
Rush Turn Around Time Requested:	<input type="checkbox"/> Yes <input checked="" type="checkbox"/> No <input type="checkbox"/> N/A	7.
Follow Up / Hold Analysis Requested:	<input type="checkbox"/> Yes <input checked="" type="checkbox"/> No <input type="checkbox"/> N/A	8.
Sufficient Volume:	<input checked="" type="checkbox"/> Yes <input type="checkbox"/> No <input type="checkbox"/> N/A	9.
Correct Containers Used:	<input checked="" type="checkbox"/> Yes <input type="checkbox"/> No <input type="checkbox"/> N/A	10.
-Pace Containers Used:	<input checked="" type="checkbox"/> Yes <input type="checkbox"/> No <input type="checkbox"/> N/A	
Containers Intact:	<input checked="" type="checkbox"/> Yes <input type="checkbox"/> No <input type="checkbox"/> N/A	11.
Filtered volume received for Dissolved tests	<input type="checkbox"/> Yes <input type="checkbox"/> No <input checked="" type="checkbox"/> N/A	12.
Sample Labels match COC:	<input checked="" type="checkbox"/> Yes <input type="checkbox"/> No <input type="checkbox"/> N/A	13.
-Includes date/time/ID/Analysis Matrix: <u>water</u>		
All containers needing preservation have been checked.	<input type="checkbox"/> Yes <input type="checkbox"/> No <input type="checkbox"/> N/A	14.
All containers needing preservation are found to be in compliance with EPA recommendation.	<input checked="" type="checkbox"/> Yes <input type="checkbox"/> No <input type="checkbox"/> N/A	
Exceptions: <u>VOA</u> , coliform, TOC, O&G		Initial when completed
		Lot # of added preservative
Samples checked for dechlorination:	<input type="checkbox"/> Yes <input type="checkbox"/> No <input type="checkbox"/> N/A	15.
Headspace in VOA Vials (>6mm):	<input type="checkbox"/> Yes <input checked="" type="checkbox"/> No <input type="checkbox"/> N/A	16.
Trip Blanks Present:	<input checked="" type="checkbox"/> Yes <input type="checkbox"/> No <input type="checkbox"/> N/A	17.
Trip Blank Custody Seals Present	<input checked="" type="checkbox"/> Yes <input type="checkbox"/> No <input type="checkbox"/> N/A	
Pace Trip Blank Lot # (if purchased):		

Client Notification/ Resolution: _____ Field Data Required? Y / N
Person Contacted: _____ Date/Time: _____
Comments/ Resolution: _____

Project Manager Review: ARB Date: 2/23/11

Note: Whenever there is a discrepancy affecting North Carolina compliance samples, a copy of this form will be sent to the North Carolina DEHNR Certification Office (i.e. out of hold, incorrect preservative, out of temp, incorrect containers)