

# Voluntary Cleanup Program

Washington State Department of Ecology – Toxics Cleanup Program

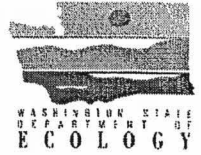

## APPLICATION TO REQUEST ASSISTANCE

This application is for individuals requesting assistance from the Voluntary Cleanup Program to plan, conduct, or evaluate an independent cleanup. The applicant may be a site owner, former site owner, site operator, or consultant on behalf of the owner or operator.

### PLEASE ANSWER THE FOLLOWING QUESTIONS TO THE BEST OF YOUR KNOWLEDGE.

Have you discussed this site with an Ecology representative? No

If yes, what is that person's name? NA

What is the approximate date? NA

Has Ecology already received reports or records pertaining to this site? Yes

If yes, what do they pertain to? The reports address groundwater monitoring and environmental investigations conducted at the site.

Is this a leaking underground storage tank site? Yes

Is this site a Brownsfield? No

*(Brownfields are properties that are abandoned or underused because of environmental contamination from past industrial or commercial practices.)*

### PLEASE DETERMINE IF PERMITS ARE REQUIRED.

Local, state, and/or federal permits may be required for cleanup activities at your site. To determine if a permit(s) is required for your cleanup action, please check with Ecology's Permit Assistance Center at 1-800-917-0043.

### APPLICANT COMPLETES THIS SECTION (NOTE: THE APPLICANT IS RESPONSIBLE FOR ALL BILLINGS.)

Applicant Name	<u>Kipp Eckert</u>	Phone	<u>206-706-2341</u>
Applicant Address	<u>ConocoPhillips Company 1144 Eastlake Avenue East Suite 201</u>		
City	<u>Seattle</u>	State	<u>Washington</u>
		Zip Code	<u>98109</u>
Site Name	<u>256380, Bellingham</u>	Alternate Name	<u>256380</u>
Site Address	<u>200 South 36<sup>th</sup> Street</u>		
City	<u>Bellingham</u>	State	<u>Washington</u>
		Zip Code	<u>98225</u>
		County	<u>Whatcom</u>
Site Owner Name	<u>ConocoPhillips Company</u>		
Site Owner Address	<u>ConocoPhillips Company 1144 Eastlake Avenue East Suite 201</u>	Phone	<u>206-706-2341</u>
City	<u>Seattle</u>	State	<u>Washington</u>
		Zip Code	<u>98109</u>

I, Kipp W. Eckert, request the assistance of the Department of Ecology. With this application, I have enclosed an initial deposit of \$500. I understand this payment is the equivalent of approximately (5) hours of staff review on the cleanup of my contaminated site. If total charges exceed \$500, I will be billed and will pay the remaining balance. Any excess payments will be refunded to me.

500<sup>00</sup> 8/8/05

30-40

[Signature]  
Signature of Applicant

7-28-05  
Date

# Voluntary Cleanup Program

Washington State Department of Ecology – Toxics Cleanup Program

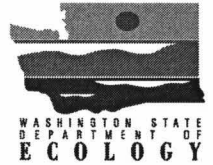

## TERRESTRIAL ECOLOGICAL EVALUATION EXCLUSION

Some contaminated sites are excluded from conducting a Terrestrial Ecological Evaluation (TEE). If your site meets the criteria for exclusion as described in WAC 173-340-7491, please complete this form.

Please note that exclusion from the TEE does not exclude the site for consideration of effects on aquatic or sediment ecological receptors.

**SITE NAME** ConocoPhillips Facility No. 256380

**SITE ADDRESS** 200 South 36<sup>th</sup> Street Bellingham, Washington, 98225

**EVALUATOR'S NAME** ALICE LARSEN

### REASONS FOR EXCLUSION:

A site is eligible for exclusion if it meets any of the following criteria:

#### 1. POINT OF COMPLIANCE WAC 173-340-7491(1)(A)

- No contamination present at site. 1-
- All contamination is below 15 feet prior to remedial activities. 2-
- All contamination is below six feet and an institutional control has been implemented, as required by WAC 173-340-440. 3-
- All contamination is below a site-specific point of compliance established in compliance with WAC 173-340-7490(4)(b) with an institutional control implemented as required by WAC 173-340-440. 4-

*Please provide documentation that describes the rationale for setting a site-specific point of compliance.*

#### 2. BARRIERS TO EXPOSURE WAC 173-340-7491(1)(B)

- All contaminated soil is or will be covered by physical barriers that prevent exposure to plants and wildlife and an institutional control has been implemented, as required by WAC 173-340-440. 5-

*An exclusion based on future land use must have a completion date for future development that is acceptable to Ecology.*



**Attachment B**  
Check for VCP \$500 Application Fee

**Attachment C**  
**Site Relevant Documents**

July 27, 2005

Mr. Dale Myers  
Washington State Department of Ecology  
Northwest Regional Office  
Voluntary Cleanup Program  
3190 160<sup>th</sup> Avenue SE  
Bellevue, WA 98008

RE: Voluntary Cleanup Program Submission  
ConocoPhillips Company Site No. 256380  
200 36<sup>th</sup> Street, Bellingham, WA 98225

Dear Mr. Myers:

SECOR International Incorporated (SECOR) on behalf of ConocoPhillips Company requests a review under the Washington State Department of Ecology (Ecology) Voluntary Cleanup Program (VCP) of a completed remediation for the ConocoPhillips Company Facility No. 256380 located at 200 36<sup>th</sup> Street Bellingham, Washington (site). The VCP request for Assistance/Review Form and Site Summary are provided in Attachment A. A check to cover the \$500 application fee is included in Attachment B.

The site is approximately 147 feet by 129 feet in size (0.43 acres) and is currently an operating retail gasoline station with an attached convenience store. The site was developed as a retail gasoline and automobile service station in 1965. Unocal purchased the site in 1971. Current site features consist of two 12,000-gallon, gasoline underground storage tanks (USTs), two dispenser islands with canopy, and a convenience store. Former site features consisted of a 500-gallon waste oil UST, a 500-gallon heating oil UST, two 5,000-gallon gasoline USTs, one 8,000-gallon gasoline UST, former dispensers and product piping.

The original gasoline USTs were replaced in 1984. No report was available for these activities.

In 1995, a Phase I Environmental Site Assessment (ESA) was performed and consisted of an historical review, title search, and well search. According to this report, the site was developed and operated in 1971 by American Oil. In 1972, Unocal leased the property between 1972 and 1995. The property was owned by the Claus family during this time. The City of Bellingham supplies water to the site and surrounding area with the exception of a private well located approximately 2,200 feet east of the site. The well is 7 feet deep and was originally constructed in 1956.

A soil and gas survey was conducted at the site in 1997 with sample locations in the vicinity of the USTs, dispenser islands, and product piping. Benzene, ethylbenzene, toluene, xylenes (BTEX), methyl tert-butyl ether (MTBE) and gasoline range hydrocarbons (TPH-g) were detected near the product piping and west dispenser island.

In 1998 the heating oil and waste oil USTs were decommissioned by removal. Following remedial excavation activities (25 cubic yards), soils impacted by diesel range hydrocarbons (TPH-d) above MTCA Method A cleanup levels were left in place on the south and east sidewalls of the excavation.

Eight soil borings (GP-1 through GP-8) were advanced and four groundwater monitoring wells (MW-1 through MW-4) were installed in 1998. Analytical laboratory results from soil samples collected from borings GP-5, GP-6, and GP-8 indicated concentrations of benzene above MTCA Method A cleanup levels in the vicinity of the dispenser islands. TPH-g was detected above MTCA Method A cleanup levels in boring GP-2, located west of the station building. Soil samples were collected from the borings advanced for the installation of wells MW-1 through MW-4. A concentration of TPH-g above MTCA Method A cleanup levels was detected at 6.5 feet below ground surface (bgs) in boring MW-3, located in the southeast corner of the site. Petroleum hydrocarbons and petroleum constituents were not detected above laboratory detection limits in soil samples from borings MW-1, MW-2, and MW-4.

Site geology consisted of silty sand over clay. The silty sand typically ended between 4 and 9 feet bgs. Static groundwater levels range between 5 and 8 feet bgs. Initial groundwater analytical results indicated the presence of total lead up to 162 µg/L. Petroleum hydrocarbons and petroleum constituents were not detected in the groundwater samples collected in 1998.

In May and June 2002 remedial soil excavation (230 cubic yards) was performed near the product lines and dispenser islands during a station upgrade. Concentrations of benzene and TPH-g were detected at concentrations exceeding the MTCA A cleanup levels in the vicinity of the product lines and dispenser islands. Concentrations of ethylbenzene and total xylenes above MTCA A cleanup levels was also reported near the east dispenser island. At that time, soil vapor extraction and air sparging piping was installed, but was not connected to equipment. According the report discussing these services, Tosco Corporation bought the property in 1997 and sold the property to Keith Oil in 2002.

A site receptor survey was conducted in September of 2003. Surrounding properties were identified as commercial north and south of the site, and residential northwest and west. The report concluded that there are no apparent drinking water receptors in the site vicinity. However, there is potential for offsite migration of lighter-end petroleum products via utility corridors. Eighteen homes with basements were identified.

Groundwater monitoring results were below cleanup levels until February 2001, at which time benzene was detected in the groundwater sample collected from Well MW-1. In

February 2002, TPH-g, TPH-d and benzene were detected above MTCA Method A cleanup levels in the groundwater sample collected from Well MW-1. During the last four quarterly monitoring events, analytical test results for all of the groundwater samples has been below MTCA Method A cleanup levels. Soil samples across the site were collected in the smear zone (below seasonal high groundwater levels), the natural attenuation demonstrated in the groundwater indicates natural attenuation has also occurred in the soil.

Based on the current use of the site (retail gasoline station) and on the overall analytical results, SECOR requests that Ecology issue a written 'No Further Action' determination for soil and groundwater at the site.

SECOR trusts that the attached submission is complete and meets your requirements. SECOR welcomes any comments or questions regarding this submittal.

Sincerely,

**SECOR International Incorporated**

A handwritten signature in black ink, appearing to read 'Alice Larsen', with a stylized flourish extending to the right.

Alice Larsen,  
Senior Project Manager

Attachments:

- Attachment A: VCP Application to Request Assistance and Site Summary
- Attachment B: Check for VCP \$500 Application Fee
- Attachment C: Site Relevant Documents

# Voluntary Cleanup Program

Washington State Department of Ecology – Toxics Cleanup Program

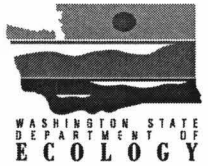

## SITE SUMMARY

This form is a required component of your request for assistance under the Voluntary Cleanup Program. Please include it with your application, consultation fee, and terrestrial ecological evaluation form (if applicable).

### WHICH OF THE FOLLOWING APPLY TO YOUR SITE?

- You are requesting assistance on a planned cleanup.
- You are requesting assistance on an ongoing cleanup.
- You are requesting review of a completed cleanup.
- You are requesting review of monitoring reports.

### PERSON/ORGANIZATION MAKING REQUEST FOR ASSISTANCE

Name: Mr. Kipp Eckert		
Firm: ConocoPhillips Company		
Mailing address: 1144 Eastlake Avenue East, Suite 201		
City: Seattle	State: Washington	Zip code: 98109
Telephone number: 206-706-2341 kipp.w.eckert@conocophillips.com	Fax number: 206-706-2339	E-mail address:

### WHICH BEST DESCRIBES YOUR INVOLVEMENT AT THIS SITE (CHECK AS MANY THAT APPLY)

Current Owner	Former Owner	Potential Purchaser	Current Operator	Former Operator	Environmental Consultant	Attorney	Insurance Carrier	Other
					x			
If other, please specify:								

### SITE IDENTIFICATION

Name of site: ConocoPhillips facility No. 256380				
Alternative name(s) for site: 76 branded service station				
Washington State Department of Ecology LUST No. 11191596				
Site address: 200 South 36 <sup>th</sup> Street				
City: Bellingham	State: Washington	Zip code: 98225	County: Whatcom	UBI Number:

Township: 38 North	Range: 3 East	Section: 31	Quarter-Quarter: SE
Latitude: 48.73292	Degrees: 48	Minutes: 43	Seconds: 58.5
Longitude: 122.4699	Degrees: 122	Minutes: 28	Seconds: 11.6
What method did you use to calculate latitude and longitude? Standard conversion for Decimals Degrees to Degrees, Minutes, Seconds.			
How many acres is the site? 0.3 acres			
Property type? Commercial <input checked="" type="checkbox"/> Industrial <input type="checkbox"/> Residential <input type="checkbox"/> Other <input type="checkbox"/> Please specify:			
Is the property currently being used? Yes, active 76 branded service station.			
Are there plans for change in use? No. If yes, please specify:			

### STANDARD INDUSTRIAL CLASSIFICATION (SIC) CODES

Please list all that apply. If you do not know the SIC code(s), list the activities conducted at the site (i.e. automotive repair and maintenance, construction equipment storage, etc.)

5541

### TANK INFORMATION

Please complete the table below for all above ground tanks (AST) and underground storage tanks (UST) existing or formerly existing on the property, including unregulated tanks.

TANK ID	AST/UST	SIZE	WAS FREE PRODUCT ENCOUNTERED?		IN EXCAVATION	**TANK STATUS & DATE
			*PRODUCT	ON GW		
	UST/ Used Oil	500	Unknown	Unknown	Unknown	Removed 1998
1	UST/ Gas	12,000	No	No	No	Active
2	UST/ Gas	12,000	No	No	No	Active
	UST	5,000	Unknown	Unknown	Unknown	Removed 1984
	UST	5,000	Unknown	Unknown	Unknown	Removed 1984
	UST	8,000	Unknown	Unknown	Unknown	Removed 1984
	UST/ Heating Oil	500	Unknown	Unknown	Unknown	Removed 1998

\* Unleaded, leaded diesel, bunker-C, waste oil, heating oil, aviation fuel, other (please identify)

\*\*Left in-place, removed, closed-in-place

### SITE MAPS

Please include an area map that shows the general location of the site (mark the site location) and a site diagram that shows sampling and well locations.

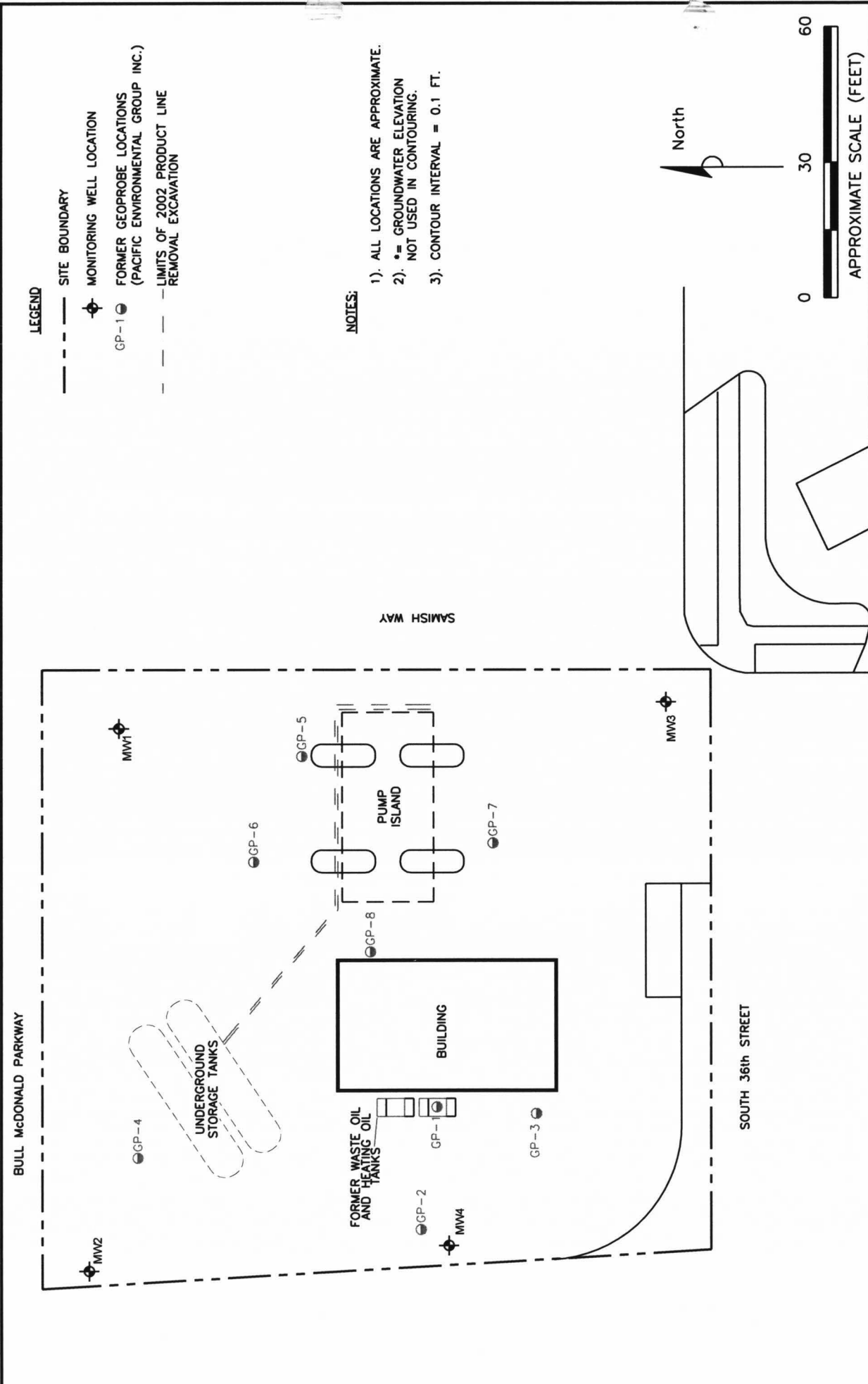

**LEGEND**

- SITE BOUNDARY
- ⊕ MONITORING WELL LOCATION
- GP-1 ○ FORMER GEOPROBE LOCATIONS (PACIFIC ENVIRONMENTAL GROUP INC.)
- LIMITS OF 2002 PRODUCT LINE REMOVAL EXCAVATION

**NOTES:**

- 1). ALL LOCATIONS ARE APPROXIMATE.
- 2). \* = GROUNDWATER ELEVATION NOT USED IN CONTOURING.
- 3). CONTOUR INTERVAL = 0.1 FT.

<p><b>PREPARED FOR:</b>  <b>ConocoPhillips</b>          FACILITY NO 6380          200 SOUTH 36th STREET          BELLINGHAM, WASHINGTON</p>		<p><b>FIGURE:</b>  <span style="font-size: 2em; font-weight: bold;">2</span></p>	
<p><b>SECOR</b>          12034 134th COURT, SUITE 102          REDMOND, WASHINGTON          PHONE: (425) 372-1600 FAX: (425) 372-1650</p>		<p><b>CHECKED BY:</b>          S. SIMMONS</p>	
<p><b>JOB NUMBER:</b>          01/CP.06380.04</p>		<p><b>APPROVED BY:</b></p>	
<p><b>DATE:</b>          2/5/04</p>		<p><b>DATE:</b>          2/5/04</p>	

**SOURCE:**  
 BASE MAP FROM: ENVIRONMENTAL RESOLUTIONS, INC.  
 (ERI) TITLED GROUNDWATER SAMPLE ANALYSIS MAP-  
 06/10/03, PLATE 1, DATED 07/08/03, PROJECT  
 NO. 31065. CADD FILE 31065.13.DWG

## **DANGEROUS WASTE FACILITY**

Does the facility have a dangerous waste identification (WAD) number? No

If yes, please specify.

### **SITE ASSESSMENT OR SITE REMEDIATION WORK COMPLETED TO-DATE**

Has site assessment work been completed at the site? Yes.
If yes, when? May 1995 to present. Were the results reported to Ecology? Unknown.
Has site cleanup work been conducted at the site? Yes.
If yes, when? 1997 Were the results reported to Ecology? Unknown.
Does contamination remain on-site after cleanup? Yes.
If yes, please describe the contamination? Benzene and TPH-g were detected in soil at concentrations exceeding the MTCA A cleanup levels in the vicinity of the product lines and dispenser islands. Concentrations of ethylbenzene and total xylenes were also detected in soil above MTCA Method A cleanup levels near the east dispenser island.

### **INSTITUTIONAL CONTROLS (I.E. RESTRICTIVE COVENANT, ENGINEERED CONTROLS, FENCING)**

Were institutional controls used at the site? If yes, please specify. No

### **DOCUMENTATION**

Please list all known assessment and/or cleanup reports completed for the site. Include the title of the report, the name of the consulting firm that did the work, and the year it was completed.

<b>TITLE</b>	<b>CONSULTING FIRM</b>	<b>DATE</b>
<b>PHASE I ENVIRONMENTAL SITE ASSESSMENT</b>	<b>GEOENGINEERS</b>	<b>MAY 4, 1995</b>
<b>SOIL GAS SURVEY RESULTS</b>	<b>PACIFIC ENVIRONMENTAL GROUP, INC.</b>	<b>OCTOBER 29, 1997</b>
<b>ENVIRONMENTAL INVESTIGATION</b>	<b>PACIFIC ENVIRONMENTAL GROUP, INC.</b>	<b>OCTOBER 9, 1998</b>
<b>ENVIRONMENTAL INVESTIGATION</b>	<b>PACIFIC ENVIRONMENTAL GROUP, INC.</b>	<b>DECEMBER 21, 1998</b>
<b>SUPPLEMENTAL ENVIRONMENTAL INVESTIGATION</b>	<b>IT CORPORATION</b>	<b>APRIL 29, 1999</b>
<b>PRODUCT LINE REMOVAL AND UNDERGROUND REMEDIATION PIPING INSTALLATION ACTIVITIES</b>	<b>GEOENGINEERS</b>	<b>JULY 18, 2002</b>
<b>SITE RECEPTOR SURVEY</b>	<b>GEOENGINEERS</b>	<b>SEPTEMBER 24, 2003</b>

<b>GROUNDWATER MONITORING REPORTS</b>	<b>VARIOUS CONSULTING FIRMS PRODUCED GROUNDWATER MONITORING REPORTS FOR THE SITE.</b>	<b>1999 TO PRESENT</b>

## AFFECTED MEDIA & CONTAMINANTS

Please list the known or suspected contaminants at the site prior to cleanup. Mark the appropriate medium (such as soil) with "C" (confirmed and above Model Toxics Control Act (MTCA) cleanup standards), "B" (confirmed but below MTCA standards), "S" (suspected), "N/A" (not applicable), "O" (tested and not present), "U" (unknown).

CONTAMINANT	SOIL	GROUND WATER	SURFACE WATER	AIR	SEDIMENT	DRINKING WATER	DATE OF RELEASE (IF KNOWN)
<b>Example: Lead</b>	<b>C</b>	<b>S</b>	<b>NA</b>	<b>U</b>	<b>S</b>	<b>S</b>	<b>1967-82</b>
TPH-g	C	C	NA	NA	NA	NA	1967-2002
TPH-d	C	C	NA	NA	NA	NA	1967-1998
TPH-o	B	B	NA	NA	NA	NA	1967-1998
Benzene	C	C	NA	NA	NA	NA	1967-1998
Toluene	B	B	NA	NA	NA	NA	NA
Ethylbenzene	C	B	NA	NA	NA	NA	1967-2002
Total Xylenes	C	B	NA	NA	NA	NA	1967-2002
MTBE	U	NA	NA	NA	NA	NA	
Total Lead	B	C	NA	NA	NA	NA	1967-1998

## METHODS & TREATMENT TECHNOLOGIES USED AT SITE

Please check all applicable boxes that apply to your site.

CLEANUP METHOD USED	SOIL	GROUND WATER	SURFACE WATER	DRINKING WATER	AIR	SEDIMENTS
Method A	x	x				
Method B						
Method C						
TREATMENT TECHNOLOGY USED	SOIL	GROUND WATER	SURFACE WATER	DRINKING WATER	AIR	SEDIMENTS
Air Sparging/Air Stripping						

Bioventing						
Capping (asphalt, concrete, topsoil, RCRA cover, soil-clay, synthetic membrane)						
Carbon Adsorption						
Containment On-Site						
Containment Off-Site						
Free-product Recovery						
In Situ Chemical Oxidation						
Natural Attenuation (dilution, volatilization, biodegradation, adsorption)	×	×				
Permeable Reactive Barriers						
Phytoremediation						
Soil Flushing						
Soil Vapor Extraction						
Thermal Desorption						
<b>Other (please specify)</b> <b>Excavation</b>	×					

## AFFECTED MEDIA & CONTAMINANTS AFTER CLEANUP

Please list the contaminants from the box on page 4 and list their status after cleanup. Mark the appropriate medium (such as soil) with "C" (confirmed and above Model Toxics Control Act (MTCA) cleanup standards but contained), "B" (confirmed but below MTCA standards), "R" (remediated and below MTCA standards), "N/A" (not applicable), "O" (tested and not present), "U" (unknown).

CONTAMINANT	SOIL	GROUND WATER	SURFACE WATER	AIR	SEDIMENT	DRINKING WATER
<b>Example: Lead</b>	<b>R</b>	<b>O</b>	<b>B</b>	<b>U</b>	<b>B</b>	<b>O</b>
TPH-g	C	O	NA	NA	NA	NA
TPH-d	B	O	NA	NA	NA	NA
TPH-o	B	O	NA	NA	NA	NA
Benzene	C	O	NA	NA	NA	NA
Toluene	B	O	NA	NA	NA	NA
Ethylbenzene	C	O	NA	NA	NA	NA
Total Xylenes	C	O	NA	NA	NA	NA
MTBE	U	NA	NA	NA	NA	NA
Total Lead	B	O	NA	NA	NA	NA

## DRINKING WATER & AQUATICS INFORMATION

Are there any drinking wells within ½ mile of the site? Yes. If yes, how many? 1
Was a drinking water system affected? No. If yes, was an alternate drinking water source provided?
Was the affected drinking water system public, private, or both? Private.
Are there any creeks, streams, ponds, wetlands, or shorelands on or adjacent to the site? No. Within ¼ mile of the site? Yes.
If yes, where are they located? Connelly Creek is located approximately ¼ mile southwest of the site.
Were they impacted by the contamination from the site? No.

## OWNER/OPERATOR HISTORY

Please complete as many of the below boxes as possible. For type of owner/operator, please use the following codes: (1) Private, (2) Municipal, (3) County, (4) Federal, (5) State, (6) Tribal, (7) Mixed, (8) Other, (9) Unknown, (10) Public Entitle Acquisition via Bankruptcy.

Current site owner:	Keith Oil	Typ:	Private
Street address: 200 36 <sup>th</sup> Street			
City:	Bellingham	State:	Washington
		Zip code:	98225
Contact person (if different than owner listed above):			
Street address:			
City:		State:	
		Zip code:	
Phone:	360-671-1625	Fax:	
		E-mail address:	
Date of ownership:	2002	to	Present

Current operator:	Keith Oil	Type:	1-Private
Street address: 200 36 <sup>th</sup> Street			
City:	Bellingham	State:	Washington
		Zip code:	98225
Contact person (if different than owner listed above):			
Street address:			
City:		State:	
		Zip code:	
Phone:		Fax:	
		E-mail address:	
Date of operation:	2002	to	Present

Former site owner:	Tosco Corporation (now ConocoPhillips Company)	Type:	Unknown
Street address: 1144 Eastlake Avenue East, Suite 201			
City:		State:	
		Zip code:	
Contact person (if different than owner listed above): Kipp Eckert			
Street address: 1144 Eastlake Avenue East, Suite 201			
City:	Seattle	State:	Washington
		Zip code:	98109
Phone:	206-706-2341	Fax:	206-706-2339
		E-mail address:	kipp.w.eckert@conocophillips.com
Date of ownership:	1997	to	2002

Former operator:	Robert Putich	Type:	NA
Street Address: 200 36 <sup>th</sup> Street			
City:	Bellingham	State:	WA
		Zip code:	98225

Phone: NA	Fax: NA	E-mail address: NA
Date of operation: 1986 to 1997		

Former operator: Howard Harris Type: NA		
Street Address: 200 36 <sup>th</sup> Street		
City: Bellingham	State: WA	Zip code: 98225
Phone: NA	Fax: NA	E-mail address: NA
Date of operation: 1982 to 1986		

Former operator: Mr. Barhart Type: NA		
Street Address: 200 36 <sup>th</sup> Street		
City: Bellingham	State: WA	Zip code: 98225
Phone: NA	Fax: NA	E-mail address: NA
Date of operation: 1972 to 1982		

Former operator: American Oil Type: NA		
Street Address: 200 36 <sup>th</sup> Street		
City: Bellingham	State: WA	Zip code: 98225
Phone: NA	Fax: NA	E-mail address: NA
Date of operation: 1967 to 1972		

Environmental consultant: Alice Larsen		Type: 1-Private
Representing: ConocoPhillips Company		
Firm: SECOR International Incorporated		
Street address: 12034 134 <sup>th</sup> Court NE, Suite 102		
City: Redmond	State: Washington	Zip code: 98052
Phone: 360-931-3608	Fax: 425-372-1650	E-mail address: alarsen@secor.com

**SITE CONTACT PERSON (IF OTHER THAN OWNER/OPERATOR)**

This is someone who is available during normal working hours and has knowledge about the site and the activities conducted at the site.

Name: Kipp Eckert
Relation to site owner/operator: Environmental Site Manager
Firm: ConocoPhillips Company
Street address: 1144 Eastlake Avenue East, Suite 201

City: Seattle	State: Washington	Zip code: 9
Phone: 206-706-2341 kipp.w.eckert@conocophillips.com	Fax: 206-706-2339	E-mail address:
Date of involvement with site: 2004 to Present		

Name: Tim Johnson		
Relation to site owner/operator: Former environmental site manager		
Firm: ConocoPhillips Company		
Street address:		
City:	State:	Zip code:
Phone:	Fax:	E-mail address: Tim.J.Johnson@conocophillips.com
Date of involvement with site: Unknown to 2004		

Name:		
Relation to site owner/operator:		
Firm:		
Street address:		
City:	State:	Zip code:
Phone:	Fax:	E-mail address:
Date of involvement with site: to		

Publication #020-73 (revised 10/02)

Ecology is an Equal Opportunity and Affirmative Action employer.