

RECEIVED APR 15 1998

Post-Net brand

Fax Transmittal Memo 7672

To: *Harry Parrin*
Company: *Geo Tech*
Location:Fax # *747-8561*

Telephone #

Comments

No. of Pages	13	Today's Date	10-1-92	Time	3 PM
From	<i>Bruce Walden</i>				
Company	<i>Cement Dist Inc</i>				
Location	<i>Everett</i>				
Dist. Charge					
Fax #	<i>406-348-9244</i>		Telephone # <i>406-355-0592</i>		
Original	<input type="checkbox"/>	Destroy	<input type="checkbox"/>	Return	<input type="checkbox"/>
Disposition	<input type="checkbox"/>		<input type="checkbox"/>	Call for pickup	

C.D.I. Property VCP#NW0463
EZ Ride Canopy - LUST #1936



Kaldveer Associates Geoscience Consultants

Oakland, CA • San Jose, CA • Bellevue, WA • Vancouver, WA

OFFICIALS

aka R-Way Leasing Inc
 Bruce Walden, P.E., G.E.
 President
 Harry Parrin, P.E., G.E.
 Executive Vice President
 Douglas E. Resnikoff, P.E., G.E.
 Vice President

ADVISORS

John E. Givens, P.E., G.E.
 Environmental, C.E.O., R.E.A.
 Anderson Burrows, P.E., S.P., A.I.A.
 Raymond L. Priddy, P.E.
 Bruce E. Smith, P.E.
 John E. Smith, P.E., G.E.
 Harry A. Amelberg, P.E.
 Andrew A. Ketch, P.E.
 Kenneth J. Dunning, R.S.P., C.I.O.
 Mr. STEPHENS
 Brian Perkins, P.E.
 Gary Thompson, P.E.
 Thomas L. Givens, C.E.G.
 Bruce E. Smith, P.E., G.E.A.
 Andrew A. Ketch, P.E.
 Kenneth J. Dunning, P.E., G.E.

April 8, 1991

WE-1032-01-038

R-Way Leasing, Inc.
 815 Olivia Park Road
 Everett, Washington 98204

Attention: Mr. Bruce Walden

Subject: Tank Removal and Soil Sampling
 1030 Highway 99
 Everett, Washington 98204

7.4.11.01

ENTERED
4/16/90

Dear Mr. Walden:

As requested, we are pleased to report the removal of the underground storage tanks and the backfilling of the excavation located at 1030 Highway 99, Everett, Washington as shown on the Vicinity Map, Figure 1.

Our efforts involved observation and soil sampling during the removal activities which were performed by A-1 Pumps, on January 10 and 11, 1991. A representative from Kaldveer Associates examined and sampled the excavation on the same day the tanks were removed.

The attached site plan, Figure 2, shows the location of the site in Everett and the orientation of the tanks when in place. The tanks removed totaled two four-thousand gallon (T1 and T2), one three thousand gallon (T3), and one three-hundred gallon (T4). Two of the tanks were used for gasoline storage, T1 and T2. Tanks, T3 and T4 were used for diesel storage.

Groundwater seepage was observed during and after the excavation was completed. The depth to the groundwater seepage was about four feet.

After the UST's were removed twenty-one (21) soil samples were obtained from the sides and bottom of the excavations. One water sample was obtained from the excavation. The location of the soil samples are shown on Figure 2. The samples were collected in sterilized glass jars with teflon sealed lids provided by the Project Laboratory, North Creek Analytical. The samples were stored on site and transported to the laboratory in an ice chest chilled to 4 degrees Celsius to minimize dissipation of volatile fraction hydrocarbons. EPA-recommended protocols for sample management, including chain-of-custody documents were followed for each stage of the project.

1555 122nd Avenue N.E., Bellevue, WA 98005
 (206) 451-1442 FAX (206) 451-0503

KALDVEER

Mr. Bruce Walden
April 8, 1991

WE-1032-01-038
Page 2

North Creek Analytical performed the chemical analysis on the soil samples. Soil samples were analyzed for potential petroleum-derived hydrocarbon contamination using EPA Method 8015 modified and 8020 for TPH as gasoline and BTEX and 8015 modified for TPH as diesel.

The result of the chemical analyses indicates hydrocarbon contamination in the order of 910 ppm (part per million) up to 1,200 ppm in three samples (T1-3, T1-4, and T2-3) with Xylenes contamination level of 60 to 110 ppm. This soil contamination level is above the allowable threshold level of 100 ppm for Total Petroleum Hydrocarbon and 20 ppm for Xylenes as referenced in "Policies and Procedures for UST Removal, by The Washington State Department of Ecology".

Based on the chemical analysis, inspection of the underground tanks, and the guidelines of The Washington Department of Ecology, it appears that the site is contaminated by residual hydrocarbons beyond State minimum requirements. The soil contamination appears confined to the southern portion of the excavation where the two gasoline tanks were present (the shaded area in Figure 2). Accordingly, additional soil excavation and testing will be required on that side of the excavation. In addition, the native soil that was used for backfilling the excavation should be also removed and the entire excavation backfilled with clean imported fill. The contaminated soil can be land farmed, tested and reused when clean. The excavations where the two diesel tanks, T3 and T4, were present do not appear to be contaminated with diesel beyond allowable limits.

The water inside the excavation appeared to be contaminated as free product was floating on the surface. One sample was obtained and tested. The results of the chemical analyses indicate contamination levels exceeding State minimum requirements. Even though this water sample is not representative of the groundwater conditions, we recommend the installation of monitoring wells around the excavations. Water samples should be obtained from these wells and remedial action taken, as needed.

We recommend that the contaminated soil be removed under supervision and that monitoring wells be designed and installed around the site to check the groundwater quality. This work may be scoped in detail upon request. Attached please find a copy of laboratory test results dated January 31, 1991, Chain of Custody, Vicinity map, and a site plan.

It has been a pleasure to be of service to you. If you have any questions, please call.

Very truly yours,

KALDVEER ASSOCIATES, INC.



R.J. Bielefeld, CEG
Manager of Geological & Environmental Services

001 01 192 10:20 WILSON

Mr. Bruce Walden
April 8, 1991

WE-1032-01-038
Page 3

Attachments:

- 1. Vicinity Map**
- 2. Site Plan**
- 3. Chain-of-Custody**
- 4. Laboratory Test Data**

cc: Ms. Anette Petrie, Department of Ecology

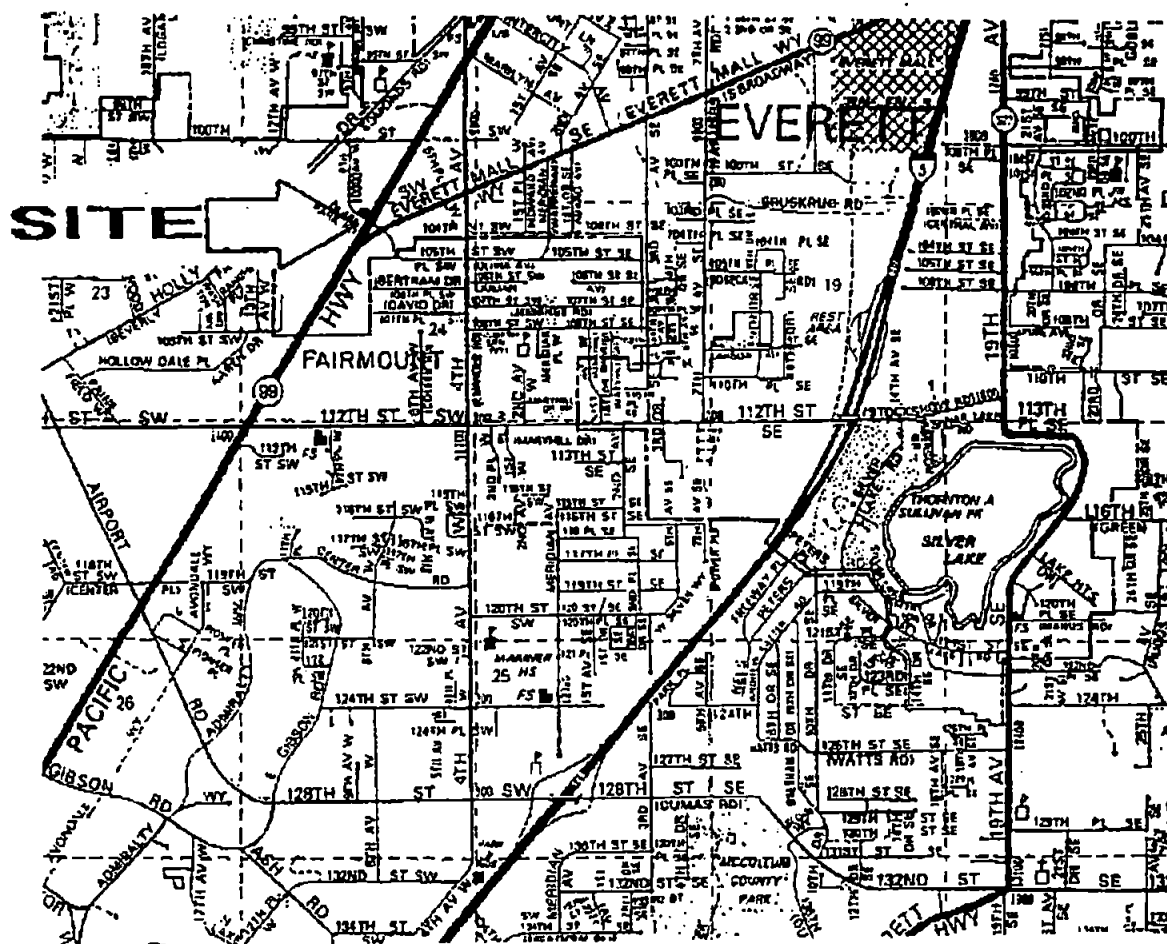

Reference:
 Snohomish County / Map 48
 The Thomas Guide, 1990 Edition
 By Thomas Bros Maps



Kaldveer Associates
 Geoscience Consultants
 Incorporated

VICINITY MAP

1030 HIGHWAY 99 TANKS
EVERETT, WASHINGTON

PROJECT NO.

DATE

FIGURE 1

WE-1032-01-038

4/8/91

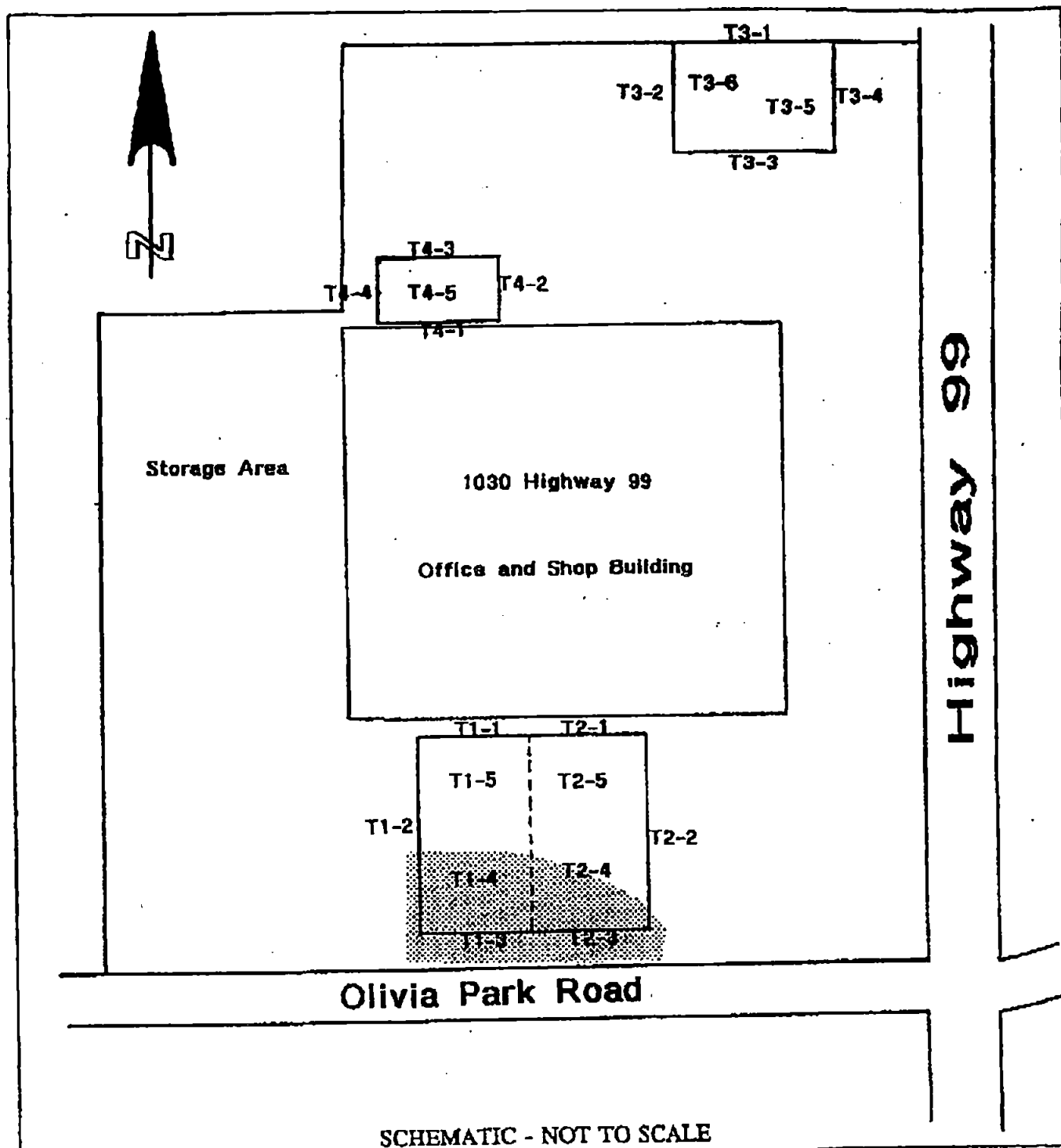

SCHEMATIC - NOT TO SCALE



Kaldveer Associates
Geoscience Consultants
Incorporated

SITE PLAN

1030 HIGHWAY 99 TANKS
EVERETT, WASHINGTON

PROJECT NO.

DATE

FIGURE 2

WE-1032-01-038

4/8/91

CHAIN-OF-CUSTODY RECORD

Project Number WE 1032-01-036		Project Name K-Way Recycling		Analytical Tests Method 8015 - TPH as Gasoline Method 8015 - TPH as Diesel Method 8240 - Volatile Organics Method 8270 - Semi-Volatiles Method 8010 - Inorganics Method 8080 - Organics Waste Oil - Metals -												Remarks			
Location Everett		Sampler's Name (printed) NABIL DBAIBO																	
KA Sample I.D. Number	Lab Sample I.D. Number	Date	Soil	Water	Number/Type of Container	Method 8015 - TPH as Gasoline	Method 8015 - TPH as Diesel	Method 8240 - Volatile Organics	Method 8270 - Semi-Volatiles	Method 8010 - Inorganics	Method 8080 - Organics	Waste Oil -	Metals -						
T3-1		11/9/91	X		Glass Jar	X													
T3-2		"	X		"	X													
T3-3		"	X		"	X													
T3-4		"	X		"	X													
T3-5		"	X		"	X													
T3-6		"	X		"	X													
T4-1		"	X		"	X													
T4-2		"	X		"	X													
T4-3		"	X		"	X													
T4-4		"	X		"	X													
T4-5		"	X		"	X													

Relinquished by: (Signature) Nabil Dbaibo	Date/Time 11/9/91	Received by: (Signature)
Relinquished by: (Signature)	Date/Time	Received by: (Signature)
Relinquished by: (Signature)	Date/Time	Received for Laboratory by: (Signature) Nabil Dbaibo 11-9-91

Ship To: _____

Attention: _____

Phone No: _____

Requested Turnaround Time: Standard

Kaldveer Assoc. Contact: Nabil Dbaibo

Please address correspondence and return cooler # _____ to:

Kaldveer Associates, Inc.
1555 132nd Avenue Northeast
Bellevue, Washington 98005
(206) 451-1442



Kaldveer Associates
Geoscience Consultants
1111 1st Avenue, Suite 1000
Seattle, WA 98101

Remarks:

ENCLOSURE



18939 120th Avenue N.E., Suite 101 • Bothell, WA 98011-2589
Phone (206) 481-9200 • FAX (206) 485-2992

Kaldveer Associates	Client Project ID: R-Way Leasing, WE1032-01-038	Sampled: Jan 10, 1991
1555 132nd Avenue NE	Matrix Descript: Soil	Received: Jan 10, 1991
Bellevue, WA 98005	Analysis Method: EPA 5030/8015/8020	Analyzed: Jan 17-18, 1991
Attention: Nabil Dbaibo	First Sample #: 101-0270	Reported: Jan 24, 1991

TOTAL PETROLEUM FUEL HYDROCARBONS with BTEX DISTINCTION (EPA 8015/8020)

Sample Number	Sample Description	Purgeable Hydrocarbons mg/kg (ppm)	Benzene mg/kg (ppm)	Toluene mg/kg (ppm)	Ethyl Benzene mg/kg (ppm)	Xylenes mg/kg (ppm)
101-0270	T1-1	N.D.	N.D.	N.D.	N.D.	N.D.
101-0271	T1-2	22	N.D.	N.D.	N.D.	1.3
101-0272	T1-3	1,200	N.D.	5.0	5.0	110
101-0273	T1-4	1,200	1.7	8.7	2.5	60
101-0274	T1-5	29	0.13	0.78	0.23	2.7
101-0276	T2-1	N.D.	N.D.	N.D.	N.D.	N.D.
101-0277	T2-2	16	N.D.	0.16	N.D.	0.90
101-0278	T2-3	910	N.D.	11	10	89
101-0279	T2-4	46	0.12	0.44	0.72	4.2
101-0280	T2-5	N.D.	N.D.	N.D.	N.D.	N.D.

Detection Limits:	1.0	0.050	0.10	0.10	0.10
--------------------------	------------	--------------	-------------	-------------	-------------

Purgeable (low to medium boiling point) Hydrocarbons are quantitated against a gasoline standard.
Analytes reported as N.D. were not present above the stated limit of detection.

NORTH CREEK ANALYTICAL

Scot Cocanour
Laboratory Director

Please Note:

The detection limits for Sample 101-0271 are as follows: Benzene = 0.25, Toluene & Ethyl Benzene = 0.5 mg/kg. The detection limits for Sample 101-0272 and -0278 are as follows: Benzene = 1.25 mg/kg.

1010270.KDA <1>

Kaldveer Associates



18939 120th Avenue N.E., Suite 101 • Bothell, WA 98011-2559
 Phone (206) 481-9200 • FAX (206) 485-2992

Kaldveer Associates	Client Project ID: R-Way Leasing, WE1032-01-038	Sampled: Jan 10, 1991
1555 132nd Avenue NE	Sample Descript.: Water, T1-W	Received: Jan 10, 1991
Bellevue, WA 98005	Analysis Method: EPA 5030/ 8015/8020	Analyzed: Jan 22, 1991
Attention: Nabil Dbaibo	Lab Number: 101-0275	Reported: Jan 24, 1991

TOTAL PETROLEUM FUEL HYDROCARBONS WITH BTEX DISTINCTION (EPA 8015/8020)

Analyte	Detection Limit µg/L (ppb)	Sample Results µg/L (ppb)
Purgeable Hydrocarbons	30	3,200,000
Benzene	10	11,000
Toluene	10	100,000
Ethyl Benzene	10	42,000
Xylenes	10	440,000

Purgeable (low to medium boiling point) Hydrocarbons are quantitated against a gasoline standard.
 Analytes reported as N.D. were not present above the stated limit of detection.

NORTH CREEK ANALYTICAL

A handwritten signature in dark ink, appearing to read "Scot Cocanour".

Scot Cocanour
 Laboratory Director

1010270.KDA <2>

Kaldveer Associates



18938 120th Avenue N.E., Suite 101 • Bothell, WA 98011-2589
Phone (206) 481-9200 • FAX (206) 485-2992

Kaldveer Associates	Client Project ID: R-Way Leasing, WE1032-01-038	Sampled: Jan 10, 1991
1555 132nd Avenue NE	Matrix Descript: Soil	Received: Jan 10, 1991
Bellevue, WA 98005	Analysis Method: EPA 3550/8015	Extracted: Jan 11, 1991
Attention: Nabil Dbaibo	First Sample #: 101-0281	Analyzed: Jan 23, 1991
		Reported: Jan 24, 1991

TOTAL PETROLEUM FUEL HYDROCARBONS (EPA 8015)

Sample Number	Sample Description	Extractable Hydrocarbons mg/kg (ppm)
101-0281	T3-1	N.D.
101-0282	T3-2	N.D.
101-0283	T3-3	N.D.
101-0284	T3-4	N.D.
101-0285	T3-5	N.D.
101-0286	T3-6	N.D.
101-0287	T4-1	100
101-0288	T4-2	200
101-0289	T4-3	N.D.
101-0290	T4-4	120

Detection Limits:

10

Extractable (high boiling point) Hydrocarbons are quantitated against a diesel fuel standard. Analytes reported as N.D. were not present above the stated limit of detection. Because matrix effects and/or other factors required additional sample dilution, detection limits for this sample have been raised.

NORTH CREEK ANALYTICAL

A handwritten signature in black ink, appearing to read "Scot Cocanour".

Scot Cocanour
Laboratory Director

1010270.KDA <3>

Kaldveer Associates

Kaldveer Associates 1555 132nd Avenue NE Bellevue, WA 98005 Attention: Nabil Dbaibo	Client Project ID: R-Way Leasing, WE1032-01-038 Matrix Descript: Soil Analysis Method: EPA 3550/8015 First Sample #: 101-0291	Sampled: Jan 10, 1991 Received: Jan 10, 1991 Extracted: Jan 11, 1991 Analyzed: Jan 23, 1991 Reported: Jan 24, 1991
--	--	--

TOTAL PETROLEUM FUEL HYDROCARBONS (EPA 8015)

Sample Number	Sample Description	Extractable Hydrocarbons mg/kg (ppm)
101-0291	T4-5	63

Detection Limits:

10

Extractable (high boiling point) Hydrocarbons are quantitated against a diesel fuel standard.
Analytes reported as N.D. were not present above the stated limit of detection. Because matrix effects and/or other factors
required additional sample dilution, detection limits for this sample have been raised.

NORTH CREEK ANALYTICAL

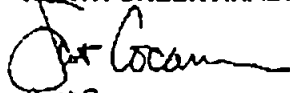
Scot Cocanour
Laboratory Director

Kaldveer Associates

1010270.KDA <4>



18939 120th Avenue N.E., Suite 101 • Bothell, WA 98011-2589
Phone (206) 481-9200 • FAX (206) 485-2992

Kaldveer Associates
1555 132nd Avenue NE
Bellevue, WA 98005
Attention: Nabil Dibaibo

Client Project ID: R-Way Leasing, WE1032-01-038

Sample Matrix: Soil
QC Sample Group: 101-0270 to -0291

Reported: Jan 24, 1991

QUALITY CONTROL DATA REPORT

ANALYTE	Benzene	Toluene	Ethyl Benzene	Xylenes	Diesel Fuel
EPA Method:	8020	8020	8020	8020	8015
Analyst:	B. Fletcher	B. Fletcher	B. Fletcher	B. Fletcher	S. Kouri
Reporting Units:	mg/kg	mg/kg	mg/kg	mg/kg	mg/kg
Date Analyzed:	Jan 18, 1991	Jan 18, 1991	Jan 18, 1991	Jan 18, 1991	Jan 23-24, 1991
QC Sample #:	101-0270	101-0270	101-0270	101-0270	BLK011191
Sample Conc.:	N.D.	N.D.	N.D.	N.D.	N.D.
Spike Conc. Added:	0.50	0.50	0.50	1.50	102
Conc. Matrix Spike:	0.39	0.44	0.47	1.45	95
Matrix Spike % Recovery:	78	88	94	97	93
Conc. Matrix Spike Dup.:	0.40	0.44	0.47	1.42	108
Matrix Spike Duplicate % Recovery:	80	88	94	95	105
Relative % Difference:	2.5	0	0	2.1	13

NORTH CREEK ANALYTICAL

Scot Cocanour
Scot Cocanour
Laboratory Director

% Recovery:	$\frac{\text{Conc. of M.S.} - \text{Conc. of Sample}}{\text{Spike Conc. Added}} \times 100$
Relative % Difference:	$\frac{\text{Conc. of M.S.} - \text{Conc. of M.S.D.}}{(\text{Conc. of M.S.} + \text{Conc. of M.S.D.}) / 2} \times 100$

1010270.KDA <5>

Kaldveer Associates

 18939 120th Avenue N.E., Suite 101 • Bothell, WA 98011-2569
 Phone (206) 481-9200 • FAX (206) 485-2992

 Kaldveer Associates
 1555 132nd Avenue NE
 Bellevue, WA 98005
 Attention: Nabil Dbalbo

Client Project ID: R-Way Leasing, WE1032-01-038

 Sample Matrix: Water
 QC Sample Group: 101-0270 to -0291

Reported: Jan 24, 1991

QUALITY CONTROL DATA REPORT

ANALYTE	Benzene	Toluene	Ethyl Benzene	Xylenes
EPA Method:	8020	8020	8020	8020
Analyst:	B. Fletcher	B. Fletcher	B. Fletcher	B. Fletcher
Reporting Units:	µg/L	µg/L	µg/L	µg/L
Date Analyzed:	Jan 20, 1991	Jan 20, 1991	Jan 20, 1991	Jan 20, 1991
QC Sample #:	101-0292	101-0292	101-0292	101-0282
Sample Conc.:	6.0	0.32	N.D.	0.48
Spike Conc. Added:	2.5	2.5	2.5	7.5
Conc. Matrix Spike:	9.3	2.8	2.8	8.2
Matrix Spike % Recovery:	132	91	112	103
Conc. Matrix Spike Dup.:	8.8	2.6	2.8	8.0
Matrix Spike Duplicate % Recovery:	112	91	112	100
Relative % Difference:	5.5	0	0	2.5

NORTH CREEK ANALYTICAL

 Scott Cocanour
 Laboratory Director

% Recovery:	$\frac{\text{Conc. of M.S.} - \text{Conc. of Sample}}{\text{Spike Conc. Added}} \times 100$
Relative % Difference:	$\frac{\text{Conc. of M.S.} - \text{Conc. of M.S.D.}}{(\text{Conc. of M.S.} + \text{Conc. of M.S.D.}) / 2} \times 100$

1010270.KCA <5>

Kaldveer Associates