



Solving environment-related business problems worldwide

17720 NE 65th Street • Suite 201  
Redmond, Washington 98052 USA

425.558.0134 800.477.7411  
Fax 425.869.7494

July 11, 2005

Mr. John Wietfeld  
Washington State Department of Ecology  
Northwest Regional Office  
Toxics Cleanup Program, UST Division  
3190 160<sup>th</sup> Avenue SE  
Bellevue, Washington 98008-5452

www.deltaenv.com

RELEASE #3481  
TEXACO - MAPLE VALLEY  
MAPLE VALLEY  
UST #3358

Sent by FedEx

SUBJ: SHELL GRASP MONITORING REPORT  
Shell Service Station  
21641 Maple Valley Highway  
Maple Valley, Washington  
Delta Project ST21-641-G

Dear Mr. Wietfeld:

Delta Environmental Consultants, Inc. (Delta), on behalf of Equilon Enterprises LLC dba Shell Oil Products US (SHELL), has prepared this Shell GRASP Monitoring Report for the above referenced site.

GRASP (GROundwater ASsessment Program) is a voluntary initiative by SHELL to install groundwater monitoring wells at numerous retail service stations nationwide that do not have any active release cases but have been identified to be in close proximity to one or more public water supply wells. The purpose of this program is to proactively monitor the groundwater beneath these sites and, in the event of a subsurface release, to respond quickly to protect public wells from this impact.

If you have any questions regarding this site, please contact Mr. Brian Pletcher (Delta) at (503) 639-8098 or Ms. Carol Campagna (SHELL) at (707) 399-7878.

Sincerely,

DELTA ENVIRONMENTAL CONSULTANTS, INC.

*J. Dawn Gray*  
for Jamey Peterson  
Staff Scientist

*Ward Crell*

Ward Crell, R.G.  
Senior Geologist



Edward Crell

Attachments: Shell GRASP Monitoring Report

cc: Ms. Carol Campagna, Shell Oil Products US, Seattle, Washington  
Shell Oil Products US, Attn: Isabel Mejia, Carson, CA 90810

RECEIVED

JUL 13 2005

A member of:  
**Inogen**  
DEPT OF ECOLOGY Environmental Alliance

July 11, 2005

### SHELL GRASP MONITORING REPORT

Station Address: 21641 Maple Valley Highway  
Maple Valley, Washington  
SHELL GRASP Incident No.: 97420022  
DELTA Project No.: ST21-641-G.2004  
SHELL Environmental Engin./Phone No.: Carol Campagna / (707) 399-7878  
DELTA Project Manager/Phone No.: Brian Pletcher / (503) 639-8098

Current Phase of Project: GRASP Groundwater Monitoring  
Frequency of Sampling: Semi-Annual  
Frequency of Monitoring: Semi-Annual  
Is Separate Phase Hydrocarbon Present On-site  Yes  No  
(Well #'s):  
Cumulative SPH Recovered to Date : None  
SPH Recovered This Quarter : None  
Sensitive Receptor(s) Information:  Nearest production well is a municipal supply well, approximately 845 ft east of the site  
Approximate Depth to Groundwater: 12.41 to 12.80 feet  
Groundwater Gradient: NNE @ approximately 0.020 ft/ft  
Summary of Unusual Activity: None

---

Brian Pletcher  
Project Manager (Delta)

**ATTACHED:**

- Table 1 – Groundwater Gauging and Analytical Results
- Figure 1 – Site Location Map
- Figure 2 – Groundwater Elevation Contour Map
- Figure 3 – Hydrocarbon Distribution in Groundwater Map
- Appendix A – Field Data Sheets
- Appendix B – Field Procedures
- Appendix C – Laboratory Report and Chain-of-Custody Documents

**TABLE**

**TABLE 1**  
**GROUNDWATER GAUGING AND ANALYTICAL DATA**  
21641 Maple Valley Highway  
Maple Valley, Washington

Sample I.D.	Sample Date	TPH-G (µg/l)	TPH-D (µg/l)	TPH-O (µg/l)	Benzene (µg/l)	Toluene (µg/l)	Ethyl-benzene (µg/l)	Xylenes (µg/l)	MTBE (µg/l)	DIPE (µg/l)	ETBE (µg/l)	TAME (µg/l)	TBA (µg/l)	Ethanol (µg/l)	Depth to GW (feet)	SPH (feet)	GW Elev. <sup>1</sup> (feet)
<b>MW-1b</b>	12/19/02	<250	<250	<750	<0.5	<0.5	<0.5	<0.5	<0.5	<0.5	<0.5	<0.5	<2.5	NA	12.53	0.00	327.50
340.03	05/13/03	<250	<250	<500	<1	<1	<1	<1	<1	<5	<5	<5	<50	NA	12.47	0.00	327.56
	08/20/03	<250	<250	<500	<1	<1	<1	<1	<1	<5	<5	<5	<50	<5,000	13.10	0.00	326.93
	12/10/03	<b>530</b>	<250	<500	<b>240</b>	<b>180</b>	<b>5.7</b>	<b>21.2</b>	<1	<5	<5	<5	<50	<5,000	12.25	0.00	327.78
	01/08/04 <sup>2</sup>	<100	NA	NA	<0.25	<0.5	<0.5	<1	NA	NA	NA	NA	NA	NA	12.35	0.00	327.68
	05/26/04	<250	<250	<500	<1	<1	<1	<1	<1	<5	<5	<5	<50	<5,000	12.75	0.00	327.28
	11/15/04	<250	<250	<500	<1	<1	<1	<1	<1	<5	<5	<5	<50	<5,000	12.95	0.00	327.08
	05/24/05	<50	<250	<500	<1	<1	<1	<1	<1	<2	<2	<5	<50	<5,000	12.44	0.00	327.59
<b>MW-2b</b>	12/19/02	<250	<250	<750	<0.5	<0.5	<0.5	<0.5	<0.5	<0.5	<0.5	<0.5	<2.5	NA	11.57	0.00	327.85
339.42	05/13/03	<250	<250	<500	<1	<1	<1	<1	<1	<5	<5	<5	<50	NA	11.51	0.00	327.91
	08/20/03	<250	<250	<500	<1	<1	<1	<1	<1	<5	<5	<5	<50	<5,000	12.50	0.00	326.92
	12/10/03	<250	<250	<500	<b>3.2</b>	<b>2.6</b>	<1	<1	<1	<5	<5	<5	<50	<5,000	11.32	0.00	328.10
	01/08/04 <sup>2</sup>	<100	NA	NA	<0.25	<0.5	<0.5	<1	NA	NA	NA	NA	NA	NA	11.41	0.00	328.01
	05/26/04	<250	<250	<500	<1	<1	<1	<1	<1	<5	<5	<5	<50	<5,000	11.78	0.00	327.64
	11/15/04	<250	<250	<500	<1	<1	<1	<1	<1	<5	<5	<5	<50	<5,000	11.97	0.00	327.45
	05/24/05	<50	<250	<500	<1	<1	<1	<1	<1	<2	<2	<5	<50	<5,000	12.41	0.00	327.01
<b>MW-12</b>	12/19/02	<250	<250	<750	<0.5	<0.5	<0.5	<0.5	<0.5	<0.5	<0.5	<0.5	<2.5	NA	12.95	0.00	327.43
340.38	05/13/03	<250	<250	<500	<1	<1	<1	<1	<1	<5	<5	<5	<50	NA	12.90	0.00	327.48
	08/20/03	<250	<250	<500	<1	<1	<1	<1	<1	<5	<5	<5	<50	<5,000	13.21	0.00	327.17
	12/10/03	<250	<250	<500	<b>32</b>	<b>24</b>	<1	<b>2.3</b>	<1	<5	<5	<5	<50	<5,000	12.66	0.00	327.72
	01/08/04 <sup>2</sup>	<100	NA	NA	<b>0.326</b>	<b>2.14</b>	<0.5	<1	NA	NA	NA	NA	NA	NA	12.83	0.00	327.55
	05/26/04	<250	<250	<500	<1	<1	<1	<1	<1	<5	<5	<5	<50	<5,000	13.10	0.00	327.28
	11/15/04	<250	<250	<500	<1	<1	<1	<1	<1	<5	<5	<5	<50	<5,000	13.29	0.00	327.09
	05/24/05	<50	<250	<500	<1	<1	<1	<1	<1	<2	<2	<5	<50	<5,000	12.80	0.00	327.58
<b>MW-13</b>	12/19/02	<250	<250	<750	<0.5	<b>0.69</b>	<0.5	<0.5	<0.5	<0.5	<0.5	<0.5	<2.5	NA	12.70	0.00	327.49
340.19	05/13/03	<250	<250	<500	<1	<1	<1	<1	<1	<5	<5	<5	<50	NA	12.62	0.00	327.57
	08/20/03	<250	<250	<500	<1	<1	<1	<1	<1	<5	<5	<5	<50	<5,000	13.52	0.00	326.67
	12/10/03	<250	<250	<500	<1	<1	<1	<1	<1	<5	<5	<5	<50	<5,000	12.37	0.00	327.82
	01/08/04 <sup>2</sup>	<100	NA	NA	<0.25	<0.5	<0.5	<1	NA	NA	NA	NA	NA	NA	12.54	0.00	327.65
	05/26/04	<250	<250	<500	<1	<1	<1	<1	<1	<5	<5	<5	<50	<5,000	12.83	0.00	327.36
	11/15/04	<250	<250	<500	<1	<1	<1	<1	<1	<5	<5	<5	<50	<5,000	13.01	0.00	327.18
	05/24/05	<50	<250	<500	<1	<1	<1	<1	<1	<2	<2	<5	<50	<5,000	12.51	0.00	327.68

**TABLE 1  
GROUNDWATER GAUGING AND ANALYTICAL DATA**

21641 Maple Valley Highway  
Maple Valley, Washington

Sample I.D.	Sample Date	TPH-G (µg/l)	TPH-D (µg/l)	TPH-O (µg/l)	Benzene (µg/l)	Toluene (µg/l)	Ethyl- benzene (µg/l)	Xylenes (µg/l)	MTBE (µg/l)	DIPE (µg/l)	ETBE (µg/l)	TAME (µg/l)	TBA (µg/l)	Ethanol (µg/l)	Depth to GW (feet)	SPH (feet)	GW Elev. <sup>1</sup> (feet)
<b>MTCA Method A Cleanup Levels:</b>		<b>1000<sup>3</sup></b>	<b>500</b>	<b>500</b>	<b>5</b>	<b>1000</b>	<b>700</b>	<b>1000</b>	<b>20</b>	<b>-</b>	<b>-</b>	<b>-</b>	<b>-</b>	<b>-</b>	<b>-</b>	<b>-</b>	<b>-</b>
<b>Notes:</b>																	
µg/l = micrograms per liter																	
TOC = Top of well casing elevation (feet)																	
SPH = Separate-phase hydrocarbons																	
TPH-G = Total Petroleum Hydrocarbons as Gasoline																	
TPH-D = Total Petroleum Hydrocarbons as Diesel																	
TPH-O = Total Petroleum Hydrocarbons as Oil																	
MTBE = Methyl tert-butyl ether																	
DIPE = Di-isopropyl ether																	
ETBE = Ethyl tert-butyl ether																	
TAME = tert-Amyl methyl ether																	
TBA = t-Butyl Alcohol																	
NA = Not analyzed																	
<n = Below the detection limit																	
TPH-D and TPH-O quantified using Northwest Method NWTPH-Dx																	
TPH-G quantified using Northwest Method NWTPH-Gx																	
BTEX Compounds, MTBE, DIPE, ETBE, TAME, and TBA analyzed using EPA Method 8260B																	
<sup>1</sup> TOC elevation and groundwater elevation relative to Mean Sea Level																	
<sup>2</sup> Well was purged prior to groundwater sampling on January 8, 2004																	
<sup>3</sup> MTCA Method A Cleanup Level for TPH-Gasoline is 800 µg/l if benzene is detectable in groundwater.																	

## FIGURES

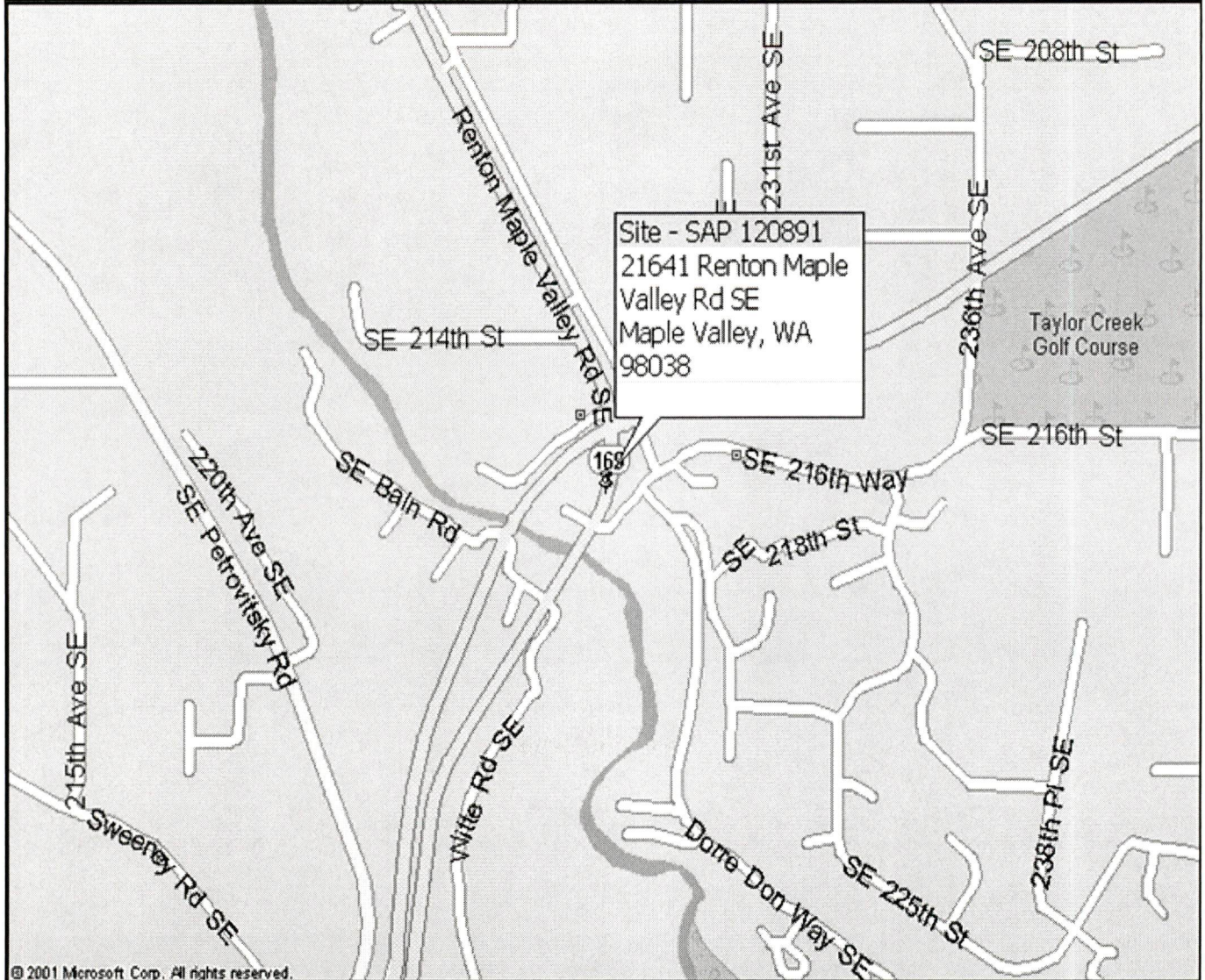

NOT TO SCALE

FIGURE 1

SITE LOCATION MAP

Shell / Equiva Site - SAP 120891  
 21641 Maple Valley Highway  
 Maple Valley, Washington

PROJECT NO. ST21-641-G	DRAWN BY SB 12-10-04
FILE NO. 1	PREPARED BY SB
REVISION NO. 1	REVIEWED BY DL





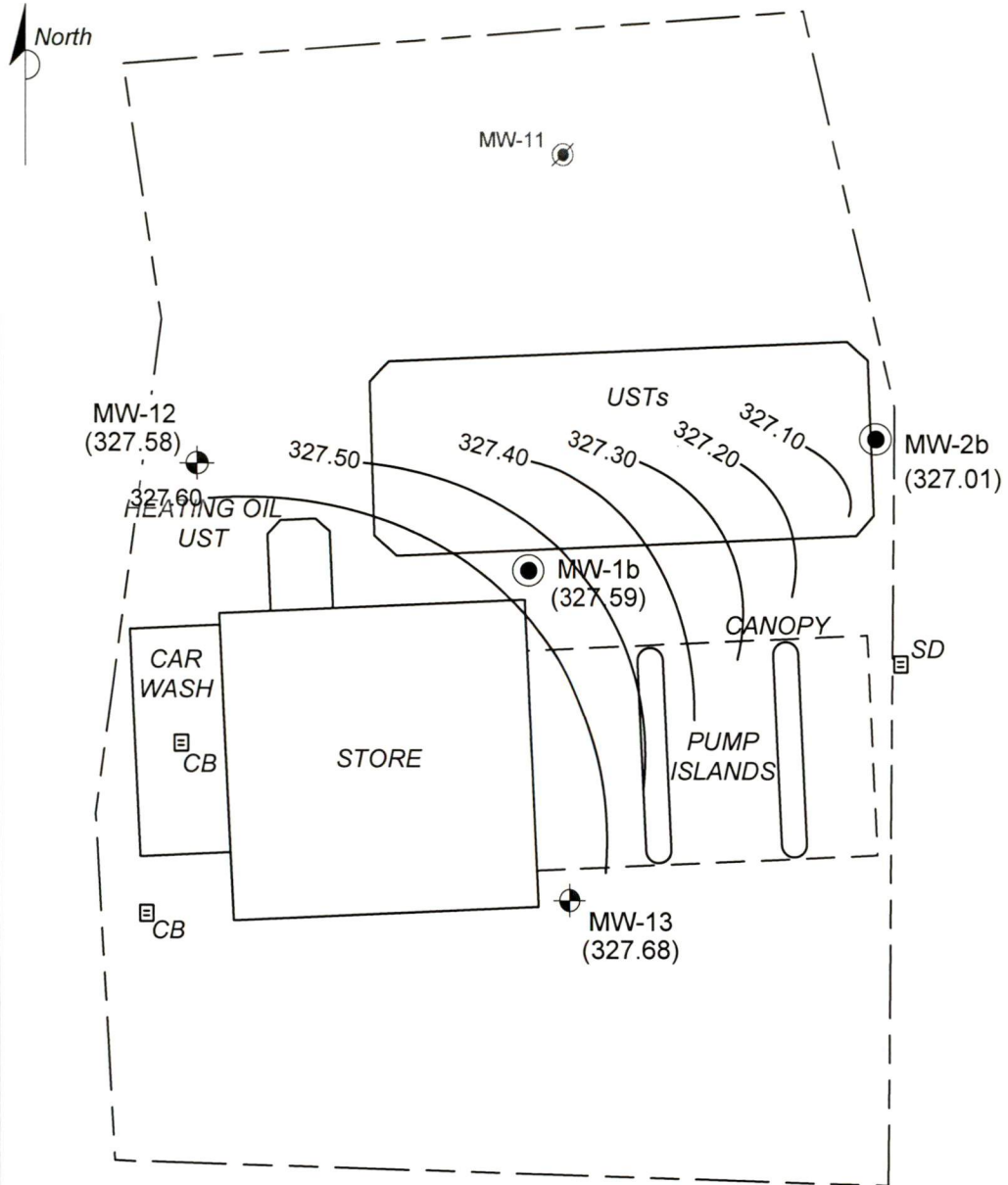

**Delta**  
 Environmental  
 Consultants, Inc.

GENERAL NOTES:  
 BASE MAP FROM MICROSOFT STREETS & TRIPS 2003



**Legend**

-  Groundwater Monitoring Well Installed by KHM
-  Groundwater Monitoring Well Installed by Others
-  Abandoned Groundwater Monitoring Well
- (327.59) Groundwater Elevation, May 24, 2005
- 327.40  Groundwater Elevation Contour, May 24, 2005

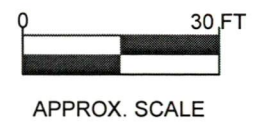

**FIGURE 2**  
GROUNDWATER ELEVATION CONTOUR MAP

Shell / Equiva Site - SAP 120891  
21641 Maple Valley Highway  
Maple Valley, Washington

PROJECT NO. ST21-641-G	DRAWN BY JP 7-01-05
FILE NO. 1	PREPARED BY JP
REVISION NO. 1	REVIEWED BY DL



Site map based on drawing prepared by WGR Southwest, Inc. dated 7/00

North

MW-12	
TPH-G/D/O	ND/ND/ND
B	ND
T	ND
E	ND
X	ND
MTBE	ND
TBA	ND

MW-1b	
TPH-G/D/O	ND/ND/ND
B	ND
T	ND
E	ND
X	ND
MTBE	ND
TBA	ND

MW-13	
TPH-G/D/O	ND/ND/ND
B	ND
T	ND
E	ND
X	ND
MTBE	ND
TBA	ND

MW-2b	
TPH-G/D/O	ND/ND/ND
B	ND
T	ND
E	ND
X	ND
MTBE	ND
TBA	ND

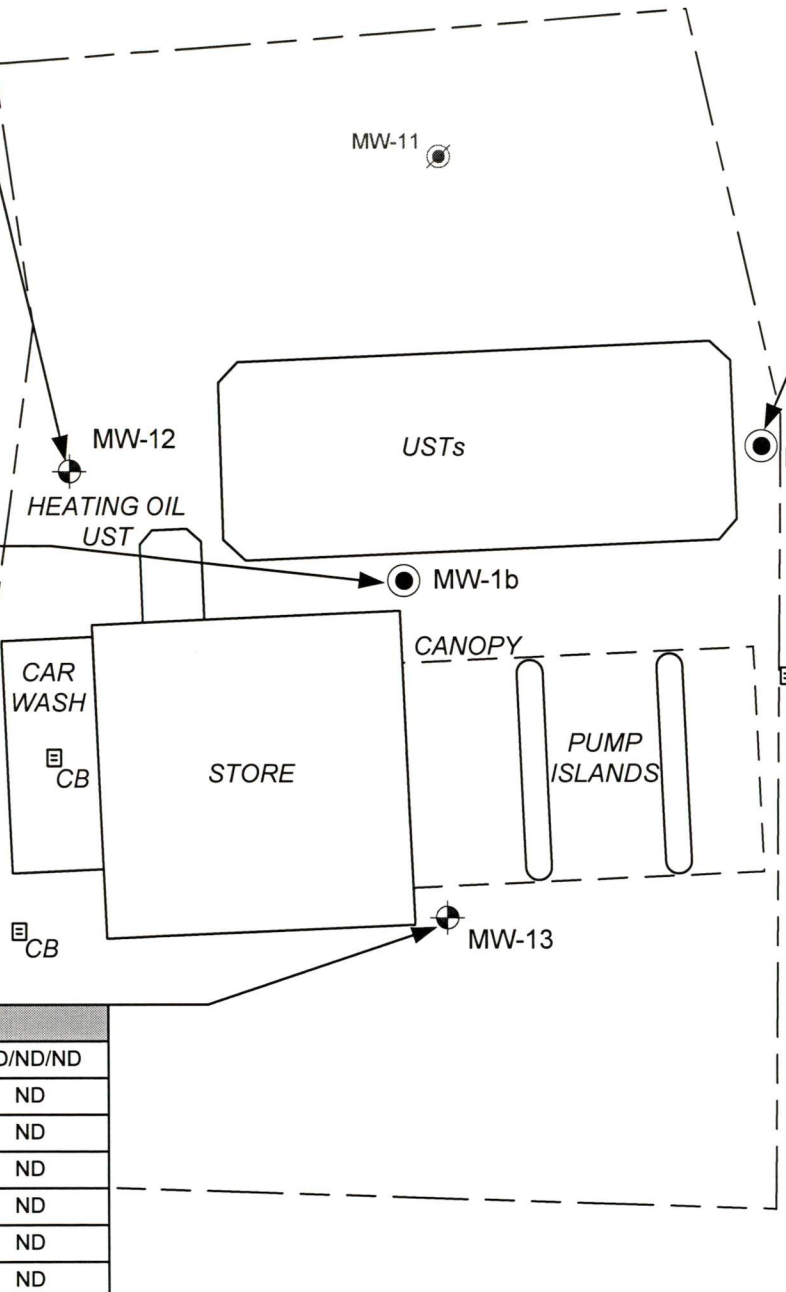

**Legend**

- Groundwater Monitoring Well Installed by KHM
- Groundwater Monitoring Well Installed by Others
- Abandoned Monitoring Well
- TPH-G/D/O Total Petroleum Hydrocarbons as Gasoline/Diesel/Oil
- B Benzene
- T Toluene
- E Ethylbenzene
- X Total Xylenes
- MTBE Methyl tert-Butyl Ether
- TBA Tert-Butyl Alcohol
- ND Not Detected

Note: All concentrations reported in micrograms per liter (ug/l).

FIGURE 3  
 HYDROCARBON DISTRIBUTION IN GROUNDWATER  
 MAY 24, 2005  
 Shell / Equiva Site - SAP 120891  
 21641 Maple Valley Highway  
 Maple Valley, Washington

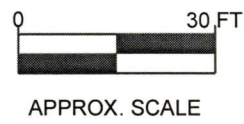

PROJECT NO. ST21-641-G	DRAWN BY JP 7-01-05
FILE NO. 1	PREPARED BY JP
REVISION NO. 1	REVIEWED BY DL



**APPENDIX A**  
**FIELD DATA SHEETS**



**APPENDIX B**

FIELD PROCEDURES

## **GROUNDWATER MONITORING AND SAMPLING**

---

Before the sampling event, Delta measured depth to water in each groundwater monitoring well at the facility with an electronic water level meter. This information was recorded on waterproof field sheets. Groundwater elevations (GWE) were measured to an accuracy of 0.01 feet. Samples were withdrawn from each well using a disposable polyethylene bailer and placed in the appropriate laboratory-provided container. Samples were labeled, placed into ice filled coolers, logged onto chain-of-custody forms and transported to the laboratory.

**APPENDIX C**

LABORATORY REPORT AND  
CHAIN-OF-CUSTODY DOCUMENTS



HOUSTON LABORATORY  
8880 INTERCHANGE DRIVE  
HOUSTON, TX 77054  
(713) 660-0901

Shell Oil Products US

Certificate of Analysis Number:

**05060023**

<b>Report To:</b> Delta Environmental Consultants, Inc. Tena Seeds 17720 NE 65th Street Suite 201 Redmond WA 98052- ph: (800) 477-7411      fax:	<b>Project Name:</b> INC#97420022 <b>Site:</b> 21641 Maple Valley Highway <b>Site Address:</b> 21641 Maple Valley Highway Maple Valley      WA <b>PO Number:</b> <b>State:</b> Washington <b>State Cert. No.:</b> C156 <b>Date Reported:</b> 6/10/2005
--	---

This Report Contains A Total Of 15 Pages

Excluding This Page, Chain Of Custody

And

Any Attachments

6/13/2005

Date

Test results meet all requirements of NELAC, unless specified in the narrative.



HOUSTON LABORATORY  
 8880 INTERCHANGE DRIVE  
 HOUSTON, TX 77054  
 (713) 660-0901

Case Narrative for:  
**Shell Oil Products US**

Certificate of Analysis Number:  
**05060023**

<p><b>Report To:</b>          Delta Environmental Consultants, Inc.          Tena Seeds          17720 NE 65th Street          Suite 201          Redmond          WA          98052-          ph: (800) 477-7411      fax:</p>	<p><b>Project Name:</b> INC#97420022  <b>Site:</b> 21641 Maple Valley Highway  <b>Site Address:</b> 21641 Maple Valley Highway          Maple Valley                      WA  <b>PO Number:</b>  <b>State:</b> Washington  <b>State Cert. No.:</b> C156  <b>Date Reported:</b> 6/10/2005</p>
---	--

Results are reported on a wet weight basis unless dry-weight correction is denoted in the units field on the analytical report (" mg/kg-dry " or " ug/kg-dry " ).

Matrix spike (MS) and matrix spike duplicate (MSD) samples are chosen and tested at random from an analytical batch of "like" matrix to check for possible matrix effect. The MS and MSD will provide site specific matrix data only for those samples which are spiked by the laboratory. Since the MS and MSD are chosen at random from an analytical batch, the sample chosen for spike purposes may or may not have been a sample submitted in this sample delivery group. The validity of the analytical procedures for which data is reported in this analytical report is determined by the Laboratory Control Sample (LCS) and the Method Blank (MB). The Laboratory Control Sample (LCS) and the Method Blank (MB) are processed with the samples and the MS/MSD to ensure method criteria are achieved throughout the entire analytical process.

Any other exceptions associated with this report will be footnoted in the analytical result page(s) or the quality control summary page(s).

Please do not hesitate to contact us if you have any questions or comments pertaining to this data report. Please reference the above Certificate of Analysis Number.

This report shall not be reproduced except in full, without the written approval of the laboratory. The reported results are only representative of the samples submitted for testing.

SPL, Inc. is pleased to be of service to you. We anticipate working with you in fulfilling all your current and future analytical needs.

6/13/2005

Erica Cardenas  
 Project Manager

Test results meet all requirements of NELAC, unless specified in the narrative.

Date



HOUSTON LABORATORY  
 8880 INTERCHANGE DRIVE  
 HOUSTON, TX 77054  
 (713) 660-0901

**Shell Oil Products US**

Certificate of Analysis Number:

**05060023**

**Report To:** Delta Environmental Consultants, Inc.  
 Tena Seeds  
 17720 NE 65th Street  
 Suite 201  
 Redmond  
 WA  
 98052-  
 ph: (800) 477-7411 fax: (425) 869-7494

**Project Name:** INC#97420022  
**Site:** 21641 Maple Valley Highway  
**Site Address:** 21641 Maple Valley Highway  
 Maple Valley WA

**PO Number:**  
**State:** Washington

**State Cert. No.:** C156

**Date Reported:** 6/10/2005

**Fax To:**

Client Sample ID	Lab Sample ID	Matrix	Date Collected	Date Received	COC ID	HOLD
MW-1b	05060023-01	Water	5/24/2005 5:15:00 PM	6/1/2005 9:30:00 AM		<input type="checkbox"/>
MW-2b	05060023-02	Water	5/24/2005 5:00:00 PM	6/1/2005 9:30:00 AM		<input type="checkbox"/>
MW-12	05060023-03	Water	5/24/2005 5:30:00 PM	6/1/2005 9:30:00 AM		<input type="checkbox"/>
MW-13	05060023-04	Water	5/24/2005 4:40:00 PM	6/1/2005 9:30:00 AM		<input type="checkbox"/>
TB	05060023-05	Water	5/24/2005	6/1/2005 9:30:00 AM		<input type="checkbox"/>

*Erica Cardenas*

6/13/2005

Erica Cardenas  
 Project Manager

Date

Joel Grice  
 Laboratory Director

Ted Yen  
 Quality Assurance Officer



HOUSTON LABORATORY  
 8880 INTERCHANGE DRIVE  
 HOUSTON, TX 77054  
 (713) 660-0901

Client Sample ID: MW-1b

Collected: 05/24/2005 17:15 SPL Sample ID: 05060023-01

Site: 21641 Maple Valley Highway

Analyses/Method	Result	QUAL	Rep.Limit	Dil. Factor	Date Analyzed	Analyst	Seq. #
<b>DIESEL RANGE ORGANICS</b>				<b>MCL</b>	<b>NWTPH-DX</b>	<b>Units: mg/L</b>	
Diesel Range Organics (C12-C24)	ND		0.25	1	06/03/05 2:16	NW	2796694
Oil Range Organics (C24-C32)	ND		0.5	1	06/03/05 2:16	NW	2796694
Surr: n-Pentacosane	62.8		% 20-131	1	06/03/05 2:16	NW	2796694

Prep Method	Prep Date	Prep Initials	Prep Factor
SW3510C	06/02/2005 9:21	K_L	1.00

<b>GASOLINE RANGE ORGANICS</b>				<b>MCL</b>	<b>NWTPH-GX</b>	<b>Units: mg/L</b>	
Gasoline Range Organics	ND		0.05	1	06/07/05 8:36	DMN	2803938
Surr: 1,4-Difluorobenzene	109		% 60-155	1	06/07/05 8:36	DMN	2803938
Surr: 4-Bromofluorobenzene	111		% 50-158	1	06/07/05 8:36	DMN	2803938

<b>SEMIVOLATILE HYDROCARBONS - ALCOHOL</b>				<b>MCL</b>	<b>SW8015B</b>	<b>Units: mg/L</b>	
Ethanol	ND		5	1	06/08/05 21:06	AE	2807000

<b>VOLATILE ORGANICS BY METHOD 8260B</b>				<b>MCL</b>	<b>SW8260B</b>	<b>Units: ug/L</b>	
Benzene	ND		1	1	06/06/05 21:15	FB	2801649
Diisopropyl Ether	ND		2	1	06/06/05 21:15	FB	2801649
Ethyl tert-butyl ether	ND		2	1	06/06/05 21:15	FB	2801649
Ethylbenzene	ND		1	1	06/06/05 21:15	FB	2801649
Methyl tert-butyl ether	ND		1	1	06/06/05 21:15	FB	2801649
t-Butyl Alcohol	ND		50	1	06/06/05 21:15	FB	2801649
tert-Amyl methyl ether	ND		5	1	06/06/05 21:15	FB	2801649
Toluene	ND		1	1	06/06/05 21:15	FB	2801649
m,p-Xylene	ND		1	1	06/06/05 21:15	FB	2801649
o-Xylene	ND		1	1	06/06/05 21:15	FB	2801649
Xylenes, Total	ND		1	1	06/06/05 21:15	FB	2801649
Surr: 1,2-Dichloroethane-d4	91.2		% 71-140	1	06/06/05 21:15	FB	2801649
Surr: 4-Bromofluorobenzene	88.1		% 70-130	1	06/06/05 21:15	FB	2801649
Surr: Toluene-d8	94.3		% 61-121	1	06/06/05 21:15	FB	2801649

**Qualifiers:** ND/U - Not Detected at the Reporting Limit >MCL - Result Over Maximum Contamination Limit(MCL)  
 B - Analyte detected in the associated Method Blank D - Surrogate Recovery Unreportable due to Dilution  
 \* - Surrogate Recovery Outside Advisable QC Limits MI - Matrix Interference  
 J - Estimated Value between MDL and PQL



HOUSTON LABORATORY  
 8880 INTERCHANGE DRIVE  
 HOUSTON, TX 77054  
 (713) 660-0901

Client Sample ID: MW-12

Collected: 05/24/2005 17:30 SPL Sample ID: 05060023-03

Site: 21641 Maple Valley Highway

Analyses/Method	Result	QUAL	Rep.Limit	Dil. Factor	Date Analyzed	Analyst	Seq. #
<b>DIESEL RANGE ORGANICS</b>				<b>MCL</b>	<b>NWTPH-DX</b>	<b>Units: mg/L</b>	
Diesel Range Organics (C12-C24)	ND		0.25	1	06/03/05 5:28	NW	2796698
Oil Range Organics (C24-C32)	ND		0.5	1	06/03/05 5:28	NW	2796698
Surr: n-Pentacosane	63.2		% 20-131	1	06/03/05 5:28	NW	2796698

Prep Method	Prep Date	Prep Initials	Prep Factor
SW3510C	06/02/2005 9:21	K_L	1.00

<b>GASOLINE RANGE ORGANICS</b>				<b>MCL</b>	<b>NWTPH-GX</b>	<b>Units: mg/L</b>	
Gasoline Range Organics	ND		0.05	1	06/07/05 9:30	DMN	2803940
Surr: 1,4-Difluorobenzene	110		% 60-155	1	06/07/05 9:30	DMN	2803940
Surr: 4-Bromofluorobenzene	109		% 50-158	1	06/07/05 9:30	DMN	2803940

<b>SEMIVOLATILE HYDROCARBONS - ALCOHOL</b>				<b>MCL</b>	<b>SW8015B</b>	<b>Units: mg/L</b>	
Ethanol	ND		5	1	06/08/05 21:53	AE	2807002

<b>VOLATILE ORGANICS BY METHOD 8260B</b>				<b>MCL</b>	<b>SW8260B</b>	<b>Units: ug/L</b>	
Benzene	ND		1	1	06/06/05 22:00	FB	2801651
Diisopropyl Ether	ND		2	1	06/06/05 22:00	FB	2801651
Ethyl tert-butyl ether	ND		2	1	06/06/05 22:00	FB	2801651
Ethylbenzene	ND		1	1	06/06/05 22:00	FB	2801651
Methyl tert-butyl ether	ND		1	1	06/06/05 22:00	FB	2801651
t-Butyl Alcohol	ND		50	1	06/06/05 22:00	FB	2801651
tert-Amyl methyl ether	ND		5	1	06/06/05 22:00	FB	2801651
Toluene	ND		1	1	06/06/05 22:00	FB	2801651
m,p-Xylene	ND		1	1	06/06/05 22:00	FB	2801651
o-Xylene	ND		1	1	06/06/05 22:00	FB	2801651
Xylenes, Total	ND		1	1	06/06/05 22:00	FB	2801651
Surr: 1,2-Dichloroethane-d4	90.1		% 71-140	1	06/06/05 22:00	FB	2801651
Surr: 4-Bromofluorobenzene	87.1		% 70-130	1	06/06/05 22:00	FB	2801651
Surr: Toluene-d8	95.2		% 61-121	1	06/06/05 22:00	FB	2801651

**Qualifiers:** ND/U - Not Detected at the Reporting Limit >MCL - Result Over Maximum Contamination Limit(MCL)  
 B - Analyte detected in the associated Method Blank D - Surrogate Recovery Unreportable due to Dilution  
 \* - Surrogate Recovery Outside Advisable QC Limits MI - Matrix Interference  
 J - Estimated Value between MDL and PQL



HOUSTON LABORATORY  
 8880 INTERCHANGE DRIVE  
 HOUSTON, TX 77054  
 (713) 660-0901

Client Sample ID: MW-2b

Collected: 05/24/2005 17:00 SPL Sample ID: 05060023-02

Site: 21641 Maple Valley Highway

Analyses/Method	Result	QUAL	Rep.Limit	Dil. Factor	Date Analyzed	Analyst	Seq. #
<b>DIESEL RANGE ORGANICS</b>				<b>MCL</b>	<b>NWTPH-DX</b>	<b>Units: mg/L</b>	
Diesel Range Organics (C12-C24)	ND		0.25	1	06/03/05 4:40	NW	2796697
Oil Range Organics (C24-C32)	ND		0.5	1	06/03/05 4:40	NW	2796697
Surr: n-Pentacosane	57.2		% 20-131	1	06/03/05 4:40	NW	2796697

Prep Method	Prep Date	Prep Initials	Prep Factor
SW3510C	06/02/2005 9:21	K_L	1.00

<b>GASOLINE RANGE ORGANICS</b>				<b>MCL</b>	<b>NWTPH-GX</b>	<b>Units: mg/L</b>	
Gasoline Range Organics	ND		0.05	1	06/07/05 9:03	DMN	2803939
Surr: 1,4-Difluorobenzene	112		% 60-155	1	06/07/05 9:03	DMN	2803939
Surr: 4-Bromofluorobenzene	111		% 50-158	1	06/07/05 9:03	DMN	2803939

<b>SEMIVOLATILE HYDROCARBONS - ALCOHOL</b>				<b>MCL</b>	<b>SW8015B</b>	<b>Units: mg/L</b>	
Ethanol	ND		5	1	06/08/05 21:38	AE	2807001

<b>VOLATILE ORGANICS BY METHOD 8260B</b>				<b>MCL</b>	<b>SW8260B</b>	<b>Units: ug/L</b>	
Benzene	ND		1	1	06/06/05 21:37	FB	2801650
Diisopropyl Ether	ND		2	1	06/06/05 21:37	FB	2801650
Ethyl tert-butyl ether	ND		2	1	06/06/05 21:37	FB	2801650
Ethylbenzene	ND		1	1	06/06/05 21:37	FB	2801650
Methyl tert-butyl ether	ND		1	1	06/06/05 21:37	FB	2801650
t-Butyl Alcohol	ND		50	1	06/06/05 21:37	FB	2801650
tert-Amyl methyl ether	ND		5	1	06/06/05 21:37	FB	2801650
Toluene	ND		1	1	06/06/05 21:37	FB	2801650
m,p-Xylene	ND		1	1	06/06/05 21:37	FB	2801650
o-Xylene	ND		1	1	06/06/05 21:37	FB	2801650
Xylenes, Total	ND		1	1	06/06/05 21:37	FB	2801650
Surr: 1,2-Dichloroethane-d4	92.6		% 71-140	1	06/06/05 21:37	FB	2801650
Surr: 4-Bromofluorobenzene	88.7		% 70-130	1	06/06/05 21:37	FB	2801650
Surr: Toluene-d8	94.9		% 61-121	1	06/06/05 21:37	FB	2801650

**Qualifiers:** ND/U - Not Detected at the Reporting Limit >MCL - Result Over Maximum Contamination Limit(MCL)  
 B - Analyte detected in the associated Method Blank D - Surrogate Recovery Unreportable due to Dilution  
 \* - Surrogate Recovery Outside Advisable QC Limits MI - Matrix Interference  
 J - Estimated Value between MDL and PQL



HOUSTON LABORATORY  
 8880 INTERCHANGE DRIVE  
 HOUSTON, TX 77054  
 (713) 660-0901

Client Sample ID: MW-13 Collected: 05/24/2005 16:40 SPL Sample ID: 05060023-04

Site: 21641 Maple Valley Highway

Analyses/Method	Result	QUAL	Rep.Limit	Dil. Factor	Date Analyzed	Analyst	Seq. #
<b>DIESEL RANGE ORGANICS</b>				<b>MCL</b>	<b>NWTPH-DX</b>	<b>Units: mg/L</b>	
Diesel Range Organics (C12-C24)	ND		0.25	1	06/03/05 6:16	NW	2796699
Oil Range Organics (C24-C32)	ND		0.5	1	06/03/05 6:16	NW	2796699
Surr: n-Pentacosane	63.8		% 20-131	1	06/03/05 6:16	NW	2796699

Prep Method	Prep Date	Prep Initials	Prep Factor
SW3510C	06/02/2005 9:21	K_L	1.00

<b>GASOLINE RANGE ORGANICS</b>				<b>MCL</b>	<b>NWTPH-GX</b>	<b>Units: mg/L</b>	
Gasoline Range Organics	ND		0.05	1	06/07/05 9:57	DMN	2803941
Surr: 1,4-Difluorobenzene	108		% 60-155	1	06/07/05 9:57	DMN	2803941
Surr: 4-Bromofluorobenzene	110		% 50-158	1	06/07/05 9:57	DMN	2803941

<b>SEMIVOLATILE HYDROCARBONS - ALCOHOL</b>				<b>MCL</b>	<b>SW8015B</b>	<b>Units: mg/L</b>	
Ethanol	ND		5	1	06/08/05 22:37	AE	2807004

<b>VOLATILE ORGANICS BY METHOD 8260B</b>				<b>MCL</b>	<b>SW8260B</b>	<b>Units: ug/L</b>	
Benzene	ND		1	1	06/06/05 22:22	FB	2801652
Diisopropyl Ether	ND		2	1	06/06/05 22:22	FB	2801652
Ethyl tert-butyl ether	ND		2	1	06/06/05 22:22	FB	2801652
Ethylbenzene	ND		1	1	06/06/05 22:22	FB	2801652
Methyl tert-butyl ether	ND		1	1	06/06/05 22:22	FB	2801652
t-Butyl Alcohol	ND		50	1	06/06/05 22:22	FB	2801652
tert-Amyl methyl ether	ND		5	1	06/06/05 22:22	FB	2801652
Toluene	ND		1	1	06/06/05 22:22	FB	2801652
m,p-Xylene	ND		1	1	06/06/05 22:22	FB	2801652
o-Xylene	ND		1	1	06/06/05 22:22	FB	2801652
Xylenes, Total	ND		1	1	06/06/05 22:22	FB	2801652
Surr: 1,2-Dichloroethane-d4	91.8		% 71-140	1	06/06/05 22:22	FB	2801652
Surr: 4-Bromofluorobenzene	88.7		% 70-130	1	06/06/05 22:22	FB	2801652
Surr: Toluene-d8	97.4		% 61-121	1	06/06/05 22:22	FB	2801652

**Qualifiers:** ND/U - Not Detected at the Reporting Limit >MCL - Result Over Maximum Contamination Limit(MCL)  
 B - Analyte detected in the associated Method Blank D - Surrogate Recovery Unreportable due to Dilution  
 \* - Surrogate Recovery Outside Advisable QC Limits MI - Matrix Interference  
 J - Estimated Value between MDL and PQL



HOUSTON LABORATORY  
8880 INTERCHANGE DRIVE  
HOUSTON, TX 77054  
(713) 660-0901

Client Sample ID: TB Collected: 05/24/2005 0:00 SPL Sample ID: 05060023-05

Site: 21641 Maple Valley Highway

Analyses/Method	Result	QUAL	Rep.Limit	Dil. Factor	Date Analyzed	Analyst	Seq. #
<b>VOLATILE ORGANICS BY METHOD 8260B</b>				<b>MCL</b>	<b>SW8260B</b>	<b>Units: ug/L</b>	
Benzene	ND		1	1	06/06/05 22:45	FB	2801653
Diisopropyl Ether	ND		2	1	06/06/05 22:45	FB	2801653
Ethyl tert-butyl ether	ND		2	1	06/06/05 22:45	FB	2801653
Ethylbenzene	ND		1	1	06/06/05 22:45	FB	2801653
Methyl tert-butyl ether	ND		1	1	06/06/05 22:45	FB	2801653
t-Butyl Alcohol	ND		50	1	06/06/05 22:45	FB	2801653
tert-Amyl methyl ether	ND		5	1	06/06/05 22:45	FB	2801653
Toluene	ND		1	1	06/06/05 22:45	FB	2801653
m,p-Xylene	ND		1	1	06/06/05 22:45	FB	2801653
o-Xylene	ND		1	1	06/06/05 22:45	FB	2801653
Xylenes, Total	ND		1	1	06/06/05 22:45	FB	2801653
Surr: 1,2-Dichloroethane-d4	91.7		% 71-140	1	06/06/05 22:45	FB	2801653
Surr: 4-Bromofluorobenzene	89.5		% 70-130	1	06/06/05 22:45	FB	2801653
Surr: Toluene-d8	93.6		% 61-121	1	06/06/05 22:45	FB	2801653

**Qualifiers:** ND/U - Not Detected at the Reporting Limit >MCL - Result Over Maximum Contamination Limit(MCL)  
B - Analyte detected in the associated Method Blank D - Surrogate Recovery Unreportable due to Dilution  
\* - Surrogate Recovery Outside Advisable QC Limits MI - Matrix Interference  
J - Estimated Value between MDL and PQL

# *Quality Control Documentation*



Quality Control Report

HOUSTON LABORATORY
8880 INTERCHANGE DRIVE
HOUSTON, TX 77054
(713) 660-0901

Shell Oil Products US

INC#97420022

Analysis: Diesel Range Organics

WorkOrder: 05060023

Method: NWTPH-Dx

Lab Batch ID: 48564

Method Blank

Samples in Analytical Batch:

RunID: HP\_V\_050602C-2796691 Units: mg/L
Analysis Date: 06/02/2005 23:56 Analyst: NW
Preparation Date: 06/02/2005 9:21 Prep By: K\_L Method: SW3510C

Lab Sample ID Client Sample ID
05060023-01B MW-1b
05060023-02B MW-2b
05060023-03B MW-12
05060023-04B MW-13

Table with 3 columns: Analyte, Result, Rep Limit. Rows include Diesel Range Organics (C12-C24), Oil Range Organics (C24-C32), and Surr: n-Pentacosane.

Laboratory Control Sample (LCS)

RunID: HP\_V\_050602C-2796692 Units: mg/L
Analysis Date: 06/03/2005 0:43 Analyst: NW
Preparation Date: 06/02/2005 9:21 Prep By: K\_L Method: SW3510C

Table with 6 columns: Analyte, Spike Added, Result, Percent Recovery, Lower Limit, Upper Limit. Row for Diesel Range Organics (C12-C24).

Matrix Spike (MS) / Matrix Spike Duplicate (MSD)

Sample Spiked: 05060023-01
RunID: HP\_V\_050602C-2796695 Units: mg/L
Analysis Date: 06/03/2005 3:04 Analyst: NW
Preparation Date: 06/02/2005 9:21 Prep By: K\_L Method: SW3510C

Table with 12 columns: Analyte, Sample Result, MS Spike Added, MS Result, MS % Recovery, MSD Spike Added, MSD Result, MSD % Recovery, RPD, RPD Limit, Low Limit, High Limit. Rows for Diesel Range Organics (C12-C24) and Oil Range Organics (C24-C32).

Qualifiers: ND/U - Not Detected at the Reporting Limit MI - Matrix Interference
B - Analyte detected in the associated Method Blank D - Recovery Unreportable due to Dilution
J - Estimated value between MDL and PQL \* - Recovery Outside Advisable QC Limits
N/C - Not Calculated - Sample concentration is greater than 4 times the amount of spike added. Control limits do not apply.

The percent recoveries for QC samples are correct as reported. Due to significant figures and rounding, the reported RPD may differ from the displayed RPD values but is correct as reported.



Quality Control Report

HOUSTON LABORATORY
8880 INTERCHANGE DRIVE
HOUSTON, TX 77054
(713) 660-0901

Shell Oil Products US
INC#97420022

Analysis: Semivolatile Hydrocarbons - Alcohol
Method: SW8015B

WorkOrder: 05060023
Lab Batch ID: R142736

Method Blank

Samples in Analytical Batch:

RunID: HP\_Q\_050608A-2804934 Units: mg/L
Analysis Date: 06/08/2005 11:45 Analyst: AE

Lab Sample ID Client Sample ID
05060023-01D MW-1b
05060023-02D MW-2b
05060023-03D MW-12
05060023-04D MW-13

Table with 3 columns: Analyte, Result, Rep Limit. Row: Ethanol, ND, 5.0

Laboratory Control Sample (LCS)

RunID: HP\_Q\_050608A-2804933 Units: mg/L
Analysis Date: 06/08/2005 11:16 Analyst: AE

Table with 6 columns: Analyte, Spike Added, Result, Percent Recovery, Lower Limit, Upper Limit. Row: Ethanol, 200, 231, 115, 49, 146

Matrix Spike (MS) / Matrix Spike Duplicate (MSD)

Sample Spiked: 05051259-11
RunID: HP\_Q\_050608A-2804941 Units: mg/L
Analysis Date: 06/08/2005 13:28 Analyst: AE

Table with 12 columns: Analyte, Sample Result, MS Spike Added, MS Result, MS % Recovery, MSD Spike Added, MSD Result, MSD % Recovery, RPD, RPD Limit, Low Limit, High Limit. Row: Ethanol, ND, 200, 220, 110, 200, 220, 110, 0.0700, 20, 57, 136

Qualifiers: ND/U - Not Detected at the Reporting Limit MI - Matrix Interference
B - Analyte detected in the associated Method Blank D - Recovery Unreportable due to Dilution
J - Estimated value between MDL and PQL \* - Recovery Outside Advisable QC Limits
N/C - Not Calculated - Sample concentration is greater than 4 times the amount of spike added. Control limits do not apply.

The percent recoveries for QC samples are correct as reported. Due to significant figures and rounding, the reported RPD may differ from the displayed RPD values but is correct as reported.



Quality Control Report

HOUSTON LABORATORY
8880 INTERCHANGE DRIVE
HOUSTON, TX 77054
(713) 660-0901

Shell Oil Products US
INC#97420022

Analysis: Volatile Organics by Method 8260B
Method: SW8260B

WorkOrder: 05060023
Lab Batch ID: R142559

Method Blank

Samples in Analytical Batch:

RunID: MSDVOA1\_050606A-28016 Units: ug/L
Analysis Date: 06/06/2005 15:36 Analyst: FB

Table with 2 columns: Lab Sample ID, Client Sample ID. Rows include 05060023-01C to 05060023-05C.

Table with 3 columns: Analyte, Result, Rep Limit. Lists various compounds like Benzene, Diisopropyl Ether, Ethyl tert-butyl ether, etc.

Laboratory Control Sample (LCS)

RunID: MSDVOA1\_050606A-28016 Units: ug/L
Analysis Date: 06/06/2005 14:51 Analyst: FB

Table with 6 columns: Analyte, Spike Added, Result, Percent Recovery, Lower Limit, Upper Limit. Shows recovery data for various analytes.

Matrix Spike (MS) / Matrix Spike Duplicate (MSD)

Qualifiers: ND/U - Not Detected at the Reporting Limit
B - Analyte detected in the associated Method Blank
J - Estimated value between MDL and PQL
N/C - Not Calculated - Sample concentration is greater than 4 times the amount of spike added. Control limits do not apply.

The percent recoveries for QC samples are correct as reported. Due to significant figures and rounding, the reported RPD may differ from the displayed RPD values but is correct as reported.



Quality Control Report

HOUSTON LABORATORY
8880 INTERCHANGE DRIVE
HOUSTON, TX 77054
(713) 660-0901

Shell Oil Products US
INC#97420022

Analysis: Volatile Organics by Method 8260B
Method: SW8260B

WorkOrder: 05060023
Lab Batch ID: R142559

Sample Spiked: 05060024-01
RunID: MSDVOA1\_050606A-28016 Units: ug/L
Analysis Date: 06/06/2005 15:59 Analyst: FB

Table with 12 columns: Analyte, Sample Result, MS Spike Added, MS Result, MS % Recovery, MSD Spike Added, MSD Result, MSD % Recovery, RPD, RPD Limit, Low Limit, High Limit. Rows include Benzene, Diisopropyl Ether, Ethyl tert-butyl ether, Ethylbenzene, Methyl tert-butyl ether, t-Butyl Alcohol, tert-Amyl methyl ether, Toluene, m,p-Xylene, o-Xylene, and Xylenes, Total.

Qualifiers: ND/U - Not Detected at the Reporting Limit MI - Matrix Interference
B - Analyte detected in the associated Method Blank D - Recovery Unreportable due to Dilution
J - Estimated value between MDL and PQL \* - Recovery Outside Advisable QC Limits
N/C - Not Calculated - Sample concentration is greater than 4 times the amount of spike added. Control limits do not apply.

The percent recoveries for QC samples are correct as reported. Due to significant figures and rounding, the reported RPD may differ from the displayed RPD values but is correct as reported.



Quality Control Report

HOUSTON LABORATORY
8880 INTERCHANGE DRIVE
HOUSTON, TX 77054
(713) 660-0901

Shell Oil Products US
INC#97420022

Analysis: Gasoline Range Organics
Method: NWTPH-Gx

WorkOrder: 05060023
Lab Batch ID: R142679

Method Blank

Samples in Analytical Batch:

RunID: VARD\_050607B-2803935 Units: mg/L
Analysis Date: 06/07/2005 6:22 Analyst: DMN

Table with 2 columns: Lab Sample ID, Client Sample ID. Rows include 05060023-01A to 05060023-04A.

Table with 3 columns: Analyte, Result, Rep Limit. Rows include Gasoline Range Organics, Surr: 1,4-Difluorobenzene, Surr: 4-Bromofluorobenzene.

Laboratory Control Sample (LCS)

RunID: VARD\_050607B-2803934 Units: mg/L
Analysis Date: 06/07/2005 5:29 Analyst: DMN

Table with 6 columns: Analyte, Spike Added, Result, Percent Recovery, Lower Limit, Upper Limit. Row for Gasoline Range Organics.

Matrix Spike (MS) / Matrix Spike Duplicate (MSD)

Sample Spiked: 05060023-02
RunID: VARD\_050607B-2803936 Units: mg/L
Analysis Date: 06/07/2005 7:43 Analyst: DMN

Table with 12 columns: Analyte, Sample Result, MS Spike Added, MS Result, MS % Recovery, MSD Spike Added, MSD Result, MSD % Recovery, RPD, RPD Limit, Low Limit, High Limit. Row for Gasoline Range Organics.

Qualifiers: ND/U - Not Detected at the Reporting Limit MI - Matrix Interference
B - Analyte detected in the associated Method Blank D - Recovery Unreportable due to Dilution
J - Estimated value between MDL and PQL \* - Recovery Outside Advisable QC Limits
N/C - Not Calculated - Sample concentration is greater than 4 times the amount of spike added. Control limits do not apply.

The percent recoveries for QC samples are correct as reported. Due to significant figures and rounding, the reported RPD may differ from the displayed RPD values but is correct as reported.

*Sample Receipt Checklist  
And  
Chain of Custody*



HOUSTON LABORATORY  
8880 INTERCHANGE DRIVE  
HOUSTON, TX 77054  
(713) 660-0901

**Sample Receipt Checklist**

Workorder:	05060023	Received By:	NB
Date and Time Received:	6/1/2005 9:30:00 AM	Carrier name:	FedEx
Temperature:	4.0/3.5°C	Chilled by:	Water Ice

- 1. Shipping container/cooler in good condition? Yes  No  Not Present
- 2. Custody seals intact on shipping container/cooler? Yes  No  Not Present
- 3. Custody seals intact on sample bottles? Yes  No  Not Present
- 4. Chain of custody present? Yes  No
- 5. Chain of custody signed when relinquished and received? Yes  No
- 6. Chain of custody agrees with sample labels? Yes  No
- 7. Samples in proper container/bottle? Yes  No
- 8. Sample containers intact? Yes  No
- 9. Sufficient sample volume for indicated test? Yes  No
- 10. All samples received within holding time? Yes  No
- 11. Container/Temp Blank temperature in compliance? Yes  No
- 12. Water - VOA vials have zero headspace? Yes  No  Not Applicable
- 13. Water - pH acceptable upon receipt? Yes  No  Not Applicable

SPL Representative:

Contact Date & Time:

Client Name Contacted:

Non Conformance Issues:

Client Instructions:

SPL, Inc.

8880 Interchange  
Houston, TX 77054

713-660-0901 800-969-6775

Shell Services LLC Chain Of Custody Record **05060023**

Equiva Project Manager to be invoiced:

- SCIENCE & ENGINEERING
- TECHNICAL SERVICES
- CRMT-HOUSTON

Anthony Palagyi

INCIDENT NUMBER (S&E ONLY)

97420022

SAP or CRMT NUMBER (TS/CRMT)

120891

DATE: 5-31-05

PAGE: 1 of 1

CONSULTANT COMPANY: <b>Delta Environmental Consultants</b>				SITE ADDRESS (Street and City): <b>21641 Maple Valley Hwy - Maple Valley, WA</b>							
ADDRESS: <b>17720 NE 65th St. Suite 201</b>				PROJECT CONTACT (Report to): <b>Tena Seeds</b>		CONSULTANT PROJECT NO.: <b>ST21-641</b>					
CITY: <b>Redmond WA 98052</b>				SAMPLER NAME(S) (Print): <b>Laura Brock</b>		LAB USE ONLY <i>[Signature]</i>					
TELEPHONE: <b>425-558-0134</b>		FAX: <b>425-869-7494</b>		E-MAIL: <b>tseeds@deltaenv.com</b>							
TURNAROUND TIME (BUSINESS DAYS): <input checked="" type="checkbox"/> 10 DAYS <input type="checkbox"/> 5 DAYS <input type="checkbox"/> 72 HOURS <input type="checkbox"/> 48 HOURS <input type="checkbox"/> 24 HOURS <input type="checkbox"/> LESS THAN 24 HOURS				REQUESTED ANALYSIS							
<input type="checkbox"/> LA - RWQCB REPORT FORMAT <input type="checkbox"/> UST AGENCY:				FIELD NOTES: Container/Preservative or PID Readings or Laboratory Notes							
GC/MS MTBE CONFIRMATION: HIGHEST _____ HIGHEST per BORING _____ ALL _____											
SPECIAL INSTRUCTIONS OR NOTES: TEMPERATURE ON RECEIPT <b>4.0</b>											
LAB USE ONLY	Field Sample Identification	SAMPLING DATE TIME	MATRIX	NO. OF CONT.	GRO-NWx	DRO-NWx	BTEX / MTBE (8021B)	BTEX / MTBE + Oxygenates (8260B)	VOCs Full List + Oxygenates (8260B)	MTBE (8260B) Confirmation, See Not	Ethanol, etc
	MW-1b	5/21/05 1715	W	9	X	X	X	X	X	X	X
	MW-2b	↓ 1700	↓	9	X	X	X	X	X	X	X
	MW-12	↓ 1730	↓	9	X	X	X	X	X	X	X
	MW-13	↓ 1640	↓	9	X	X	X	X	X	X	X
	TB			2			X				
Relinquished by: (Signature) <i>[Signature]</i> 5/31/05 1130				Received by: (Signature) <i>[Signature]</i>				Date: 6/1/05		Time: 0930	
Relinquished by: (Signature)				Received by: (Signature)				Date:		Time:	
Relinquished by: (Signature)				Received by: (Signature)				Date:		Time:	