



Solving environment-related business problems worldwide

4006 148th Avenue NE
Redmond, Washington 98052 USA
425.882.3528 800.477.7411
Fax 425.869.1892

December 12, 2005

Ms. Carol Campagna
Shell Oil Products US
20945 S. Wilmington Avenue
Carson, California 90810-1039

SUBJ: SHELL GRASP MONITORING REPORT
Shell Service Station
21641 Maple Valley Highway
Maple Valley, Washington
Delta Project ST21-641-G

Dear Ms. Campagna:

Delta Environmental Consultants, Inc. (Delta), has prepared this Shell GRASP Monitoring Report for the above referenced site.

GRASP (GROundwater ASsessment Program) is a voluntary initiative by SHELL to install groundwater monitoring wells at numerous retail service stations nationwide that do not have any active release cases but have been identified to be in close proximity to one or more public water supply wells. The purpose of this program is to proactively monitor the groundwater beneath these sites and, in the event of a subsurface release, to respond quickly to protect public wells from this impact.

If you have any questions regarding this site, please contact Mr. Brian Pletcher (Delta) at (503) 639-8098

Sincerely,

DELTA ENVIRONMENTAL CONSULTANTS, INC.

Jamey Peterson
Staff Scientist

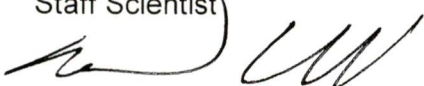
Ward Crell, R.G.
Senior Geologist



Attachments: Shell GRASP Monitoring Report Edward Crell

cc: John Wietfield, Department of Ecology, 3190 160th Avenue SE Bellevue, Washington 98008-5452
Shell Oil Products US, Seattle Terminal, 2555 13th Avenue SW, Seattle, Washington 98134

RELEASE # 3431
TEXACO - MAPLE VALLEY
MAPLE VALLEY
www.deltaenv.com
UST # 3358



December 12, 2005

SHELL GRASP MONITORING REPORT

Station Address: 21641 Maple Valley Highway
Maple Valley, Washington
SHELL GRASP Incident No.: 97420022
DELTA Project No.: ST21-641-G
SHELL Environmental Engin./Phone No.: Carol Campagna / (707) 399-7878
DELTA Project Manager/Phone No.: Brian Pletcher / (503) 639-8098

Current Phase of Project: GRASP Groundwater Monitoring
Frequency of Sampling: Semi-Annual
Frequency of Monitoring: Semi-Annual
Is Separate Phase Hydrocarbon Present On-site Yes No
(Well #'s):
Cumulative SPH Recovered to Date : None
SPH Recovered This Quarter : None
Sensitive Receptor(s) Information: Nearest production well is a municipal supply well, approximately 845 ft east of the site
Approximate Depth to Groundwater: 12.04 to 13.41 feet
Groundwater Gradient: SW @ approximately 0.008 ft/ft
Summary of Unusual Activity: None

Brian Pletcher
Project Manager (Delta)

ATTACHED:

- Table 1 – Groundwater Gauging and Analytical Results
- Figure 1 – Site Location Map
- Figure 2 – Groundwater Elevation Contour Map
- Figure 3 – Hydrocarbon Distribution in Groundwater Map
- Appendix A – Field Data Sheets
- Appendix B – Field Procedures
- Appendix C – Laboratory Report and Chain-of-Custody Documents

TABLE

**TABLE 1
GROUNDWATER GAUGING AND ANALYTICAL DATA**

21641 Maple Valley Highway
Maple Valley, Washington

Sample I.D. TOC ¹	Sample Date	TPH-G (µg/l)	TPH-D (µg/l)	TPH-O (µg/l)	Benzene (µg/l)	Toluene (µg/l)	Ethyl- benzene (µg/l)	Xylenes (µg/l)	MTBE (µg/l)	DIPE (µg/l)	ETBE (µg/l)	TAME (µg/l)	TBA (µg/l)	Ethanol (µg/l)	Depth to GW (feet)	SPH (feet)	GW Elev. ¹ (feet)
MW-1b	12/19/02	<250	<250	<750	<0.5	<0.5	<0.5	<0.5	<0.5	<0.5	<0.5	<0.5	<2.5	NA	12.53	0.00	327.50
340.03	05/13/03	<250	<250	<500	<1	<1	<1	<1	<1	<5	<5	<5	<50	NA	12.47	0.00	327.56
	08/20/03	<250	<250	<500	<1	<1	<1	<1	<1	<5	<5	<5	<50	<5,000	13.10	0.00	326.93
	12/10/03	530	<250	<500	240	180	5.7	21.2	<1	<5	<5	<5	<50	<5,000	12.25	0.00	327.78
	01/08/04 ²	<100	NA	NA	<0.25	<0.5	<0.5	<1	NA	NA	NA	NA	NA	NA	12.35	0.00	327.68
	05/26/04	<250	<250	<500	<1	<1	<1	<1	<1	<5	<5	<5	<50	<5,000	12.75	0.00	327.28
	11/15/04	<250	<250	<500	<1	<1	<1	<1	<1	<5	<5	<5	<50	<5,000	12.95	0.00	327.08
	05/24/05	<50	<250	<500	<1	<1	<1	<1	<1	<2	<2	<5	<50	<5,000	12.44	0.00	327.59
	10/26/05	<50	<250	<500	<1	<1	<1	<1	<1	<2	<2	<5	<50	<5,000	13.10	0.00	326.93
MW-2b	12/19/02	<250	<250	<750	<0.5	<0.5	<0.5	<0.5	<0.5	<0.5	<0.5	<0.5	<2.5	NA	11.57	0.00	327.85
339.42	05/13/03	<250	<250	<500	<1	<1	<1	<1	<1	<5	<5	<5	<50	NA	11.51	0.00	327.91
	08/20/03	<250	<250	<500	<1	<1	<1	<1	<1	<5	<5	<5	<50	<5,000	12.50	0.00	326.92
	12/10/03	<250	<250	<500	3.2	2.6	<1	<1	<1	<5	<5	<5	<50	<5,000	11.32	0.00	328.10
	01/08/04 ²	<100	NA	NA	<0.25	<0.5	<0.5	<1	NA	NA	NA	NA	NA	NA	11.41	0.00	328.01
	05/26/04	<250	<250	<500	<1	<1	<1	<1	<1	<5	<5	<5	<50	<5,000	11.78	0.00	327.64
	11/15/04	<250	<250	<500	<1	<1	<1	<1	<1	<5	<5	<5	<50	<5,000	11.97	0.00	327.45
	05/24/05	<50	<250	<500	<1	<1	<1	<1	<1	<2	<2	<5	<50	<5,000	12.41	0.00	327.01
	10/26/05	<50	<250	<500	<1	<1	<1	<1	<1	<2	<2	<5	<50	<5,000	12.04	0.00	327.38
MW-12	12/19/02	<250	<250	<750	<0.5	<0.5	<0.5	<0.5	<0.5	<0.5	<0.5	<0.5	<2.5	NA	12.95	0.00	327.43
340.38	05/13/03	<250	<250	<500	<1	<1	<1	<1	<1	<5	<5	<5	<50	NA	12.90	0.00	327.48
	08/20/03	<250	<250	<500	<1	<1	<1	<1	<1	<5	<5	<5	<50	<5,000	13.21	0.00	327.17
	12/10/03	<250	<250	<500	32	24	<1	2.3	<1	<5	<5	<5	<50	<5,000	12.66	0.00	327.72
	01/08/04 ²	<100	NA	NA	0.326	2.14	<0.5	<1	NA	NA	NA	NA	NA	NA	12.83	0.00	327.55
	05/26/04	<250	<250	<500	<1	<1	<1	<1	<1	<5	<5	<5	<50	<5,000	13.10	0.00	327.28
	11/15/04	<250	<250	<500	<1	<1	<1	<1	<1	<5	<5	<5	<50	<5,000	13.29	0.00	327.09
	05/24/05	<50	<250	<500	<1	<1	<1	<1	<1	<2	<2	<5	<50	<5,000	12.80	0.00	327.58
	10/26/05	<50	<250	<500	<1	<1	<1	<1	<1	<2	<2	<5	<50	<5,000	13.41	0.00	326.97
MW-13	12/19/02	<250	<250	<750	<0.5	0.69	<0.5	<0.5	<0.5	<0.5	<0.5	<0.5	<2.5	NA	12.70	0.00	327.49
340.19	05/13/03	<250	<250	<500	<1	<1	<1	<1	<1	<5	<5	<5	<50	NA	12.62	0.00	327.57
	08/20/03	<250	<250	<500	<1	<1	<1	<1	<1	<5	<5	<5	<50	<5,000	13.52	0.00	326.67
	12/10/03	<250	<250	<500	<1	<1	<1	<1	<1	<5	<5	<5	<50	<5,000	12.37	0.00	327.82
	01/08/04 ²	<100	NA	NA	<0.25	<0.5	<0.5	<1	NA	NA	NA	NA	NA	NA	12.54	0.00	327.65
	05/26/04	<250	<250	<500	<1	<1	<1	<1	<1	<5	<5	<5	<50	<5,000	12.83	0.00	327.36
	11/15/04	<250	<250	<500	<1	<1	<1	<1	<1	<5	<5	<5	<50	<5,000	13.01	0.00	327.18
	05/24/05	<50	<250	<500	<1	<1	<1	<1	<1	<2	<2	<5	<50	<5,000	12.51	0.00	327.68
	10/26/05	<50	<250	<500	<1	<1	<1	<1	<1	<2	<2	<5	<50	<5,000	13.28	0.00	326.91

**TABLE 1
GROUNDWATER GAUGING AND ANALYTICAL DATA**

21641 Maple Valley Highway
Maple Valley, Washington

Sample I.D.	Sample Date	TPH-G (µg/l)	TPH-D (µg/l)	TPH-O (µg/l)	Benzene (µg/l)	Toluene (µg/l)	Ethyl-benzene (µg/l)	Xylenes (µg/l)	MTBE (µg/l)	DIPE (µg/l)	ETBE (µg/l)	TAME (µg/l)	TBA (µg/l)	Ethanol (µg/l)	Depth to GW (feet)	SPH (feet)	GW Elev. ¹ (feet)
MTCA Method A Cleanup Levels:		1000³	500	500	5	1000	700	1000	20	-	-	-	-	-	-	-	-
<p>Notes: µg/l = micrograms per liter TOC = Top of well casing elevation (feet) SPH = Separate-phase hydrocarbons TPH-G = Total Petroleum Hydrocarbons as Gasoline TPH-D = Total Petroleum Hydrocarbons as Diesel TPH-O = Total Petroleum Hydrocarbons as Oil MTBE = Methyl tert-butyl ether DIPE = Di-isopropyl ether ETBE = Ethyl tert-butyl ether TAME = tert-Amyl methyl ether TBA = t-Butyl Alcohol NA = Not analyzed <n = Below the detection limit TPH-D and TPH-O quantified using Northwest Method NWTPH-Dx TPH-G quantified using Northwest Method NWTPH-Gx BTEX Compounds, MTBE, DIPE, ETBE, TAME, and TBA analyzed using EPA Method 8260B ¹TOC elevation and groundwater elevation relative to Mean Sea Level ²Well was purged prior to groundwater sampling on January 8, 2004 ³MTCA Method A Cleanup Level for TPH-Gasoline is 800 µg/l if benzene is detectable in groundwater.</p>																	

FIGURES

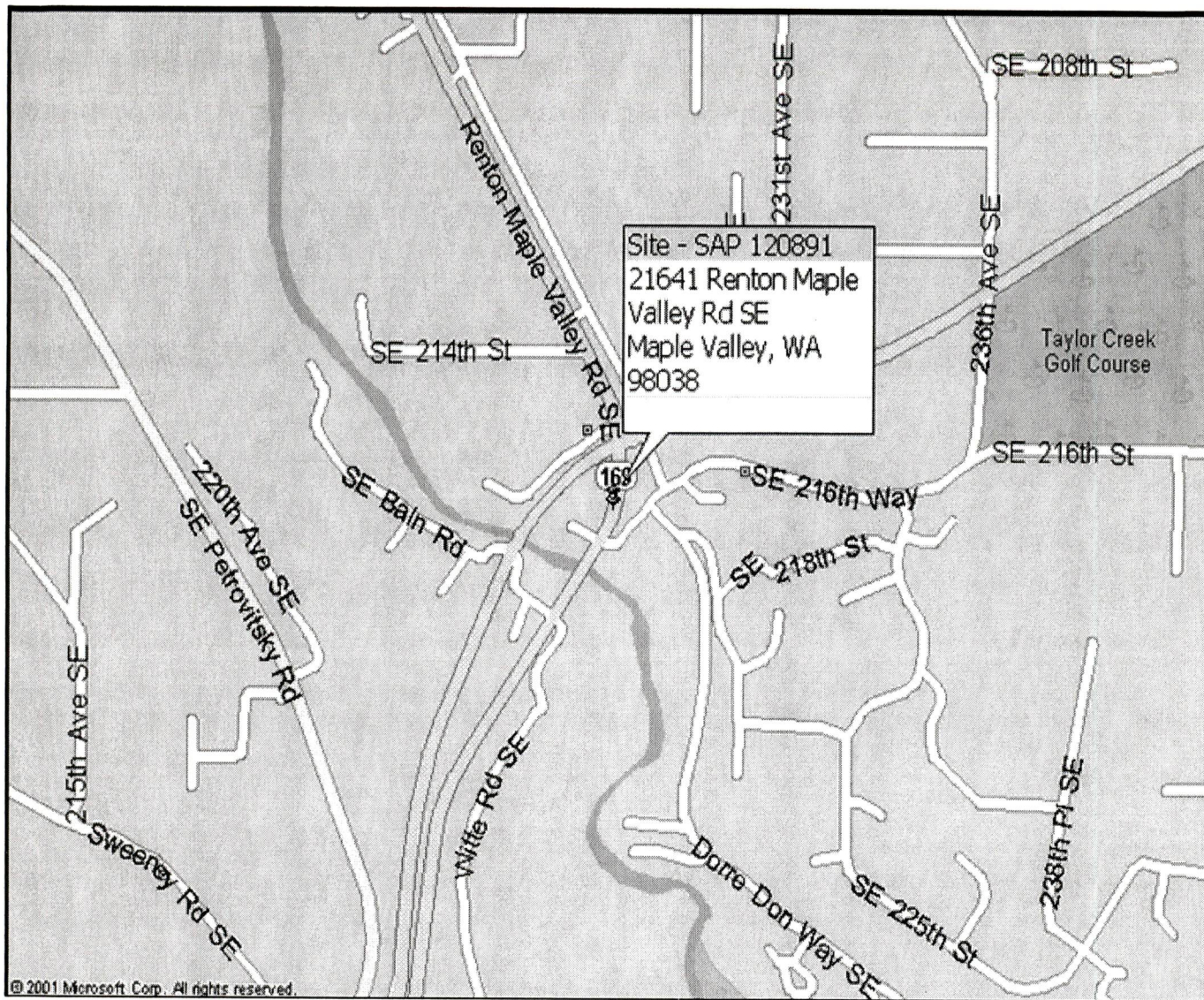

NOT TO SCALE

FIGURE 1

SITE LOCATION MAP

Shell / Equiva Site - SAP 120891
 21641 Maple Valley Highway
 Maple Valley, Washington

PROJECT NO. ST21-641-G	DRAWN BY SB 12-10-04
FILE NO. ST21-641-G	PREPARED BY SB
REVISION NO. 1	REVIEWED BY DL



Delta
 Environmental
 Consultants, Inc.

GENERAL NOTES:
 BASE MAP FROM MICROSOFT STREETS & TRIPS 2003

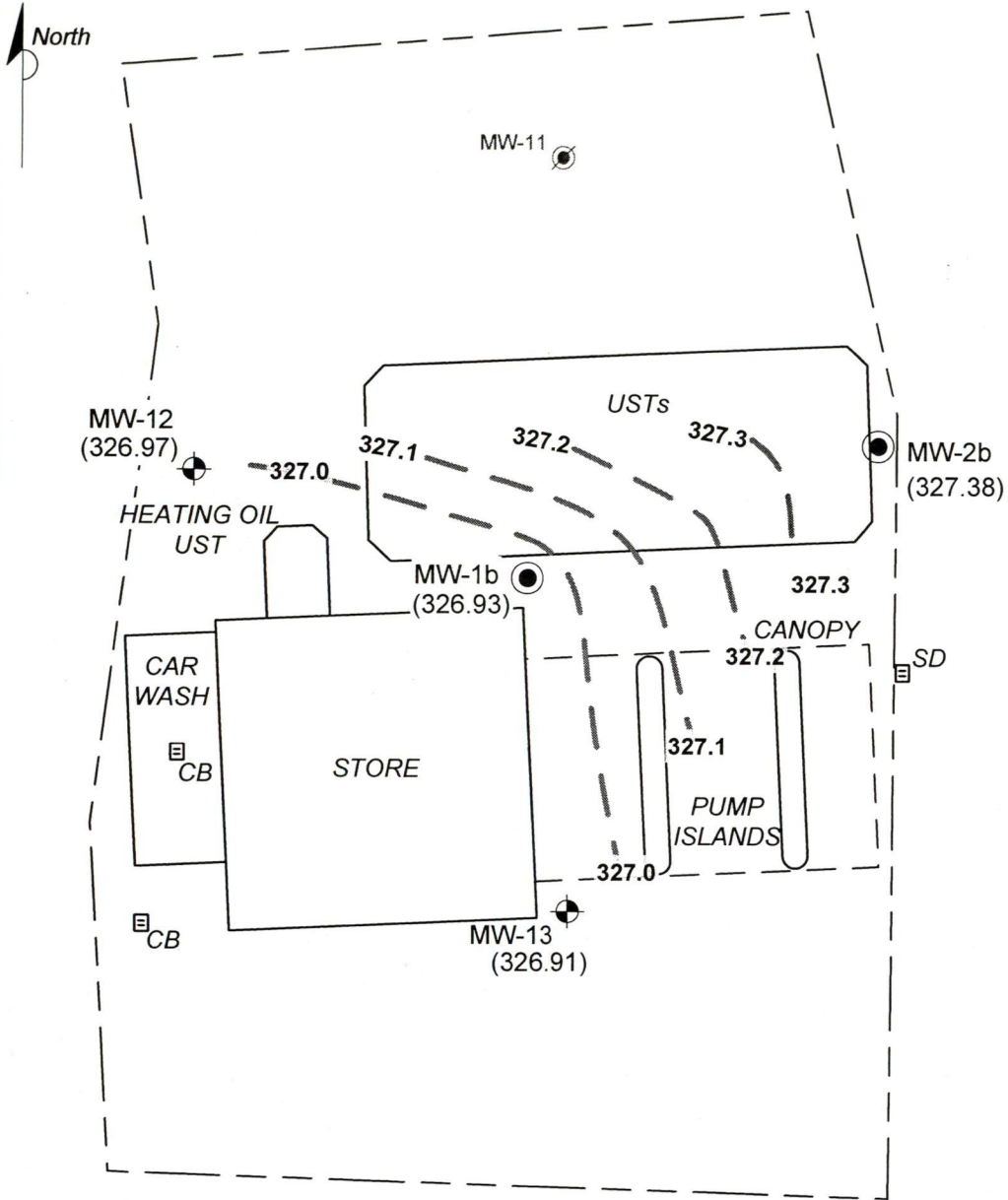

Legend

- Groundwater Monitoring Well Installed by KHM
- Groundwater Monitoring Well Installed by Others
- Abandoned Groundwater Monitoring Well
- (326.93) Groundwater Elevation, October 26, 2005
- 327.0 Groundwater Elevation Contour, October 26, 2005



APPROX. SCALE

FIGURE 2
GROUNDWATER ELEVATION CONTOUR MAP

Shell / Equiva Site - SAP 120891
21641 Maple Valley Highway
Maple Valley, Washington

PROJECT NO. ST21-641-G	DRAWN BY JP 11-10-05
FILE NO. ST21-641-G	PREPARED BY JP
REVISION NO. 1	REVIEWED BY DL



North

MW-12	
TPH-G/D/O	ND/ND/ND
B	ND
T	ND
E	ND
X	ND
MTBE	ND
TBA	ND

MW-1b	
TPH-G/D/O	ND/ND/ND
B	ND
T	ND
E	ND
X	ND
MTBE	ND
TBA	ND

MW-13	
TPH-G/D/O	ND/ND/ND
B	ND
T	ND
E	ND
X	ND
MTBE	ND
TBA	ND

MW-2b	
TPH-G/D/O	ND/ND/ND
B	ND
T	ND
E	ND
X	ND
MTBE	ND
TBA	ND

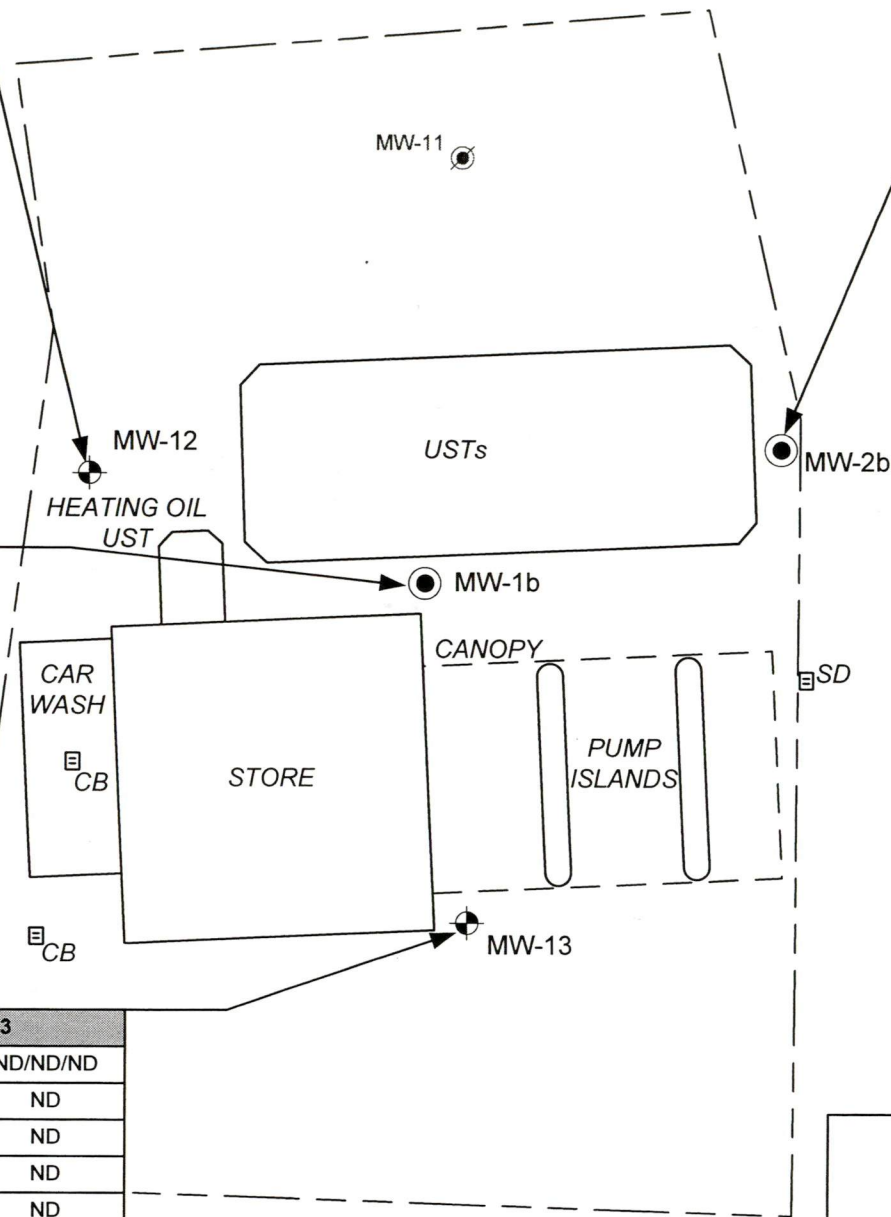

Legend

- Groundwater Monitoring Well Installed by KHM
- Groundwater Monitoring Well Installed by Others
- Abandoned Monitoring Well

TPH-G/D/O Total Petroleum Hydrocarbons as Gasoline/Diesel/Oil

- B Benzene
- T Toluene
- E Ethylbenzene
- X Total Xylenes
- MTBE Methyl tert-Butyl Ether
- TBA Tert-Butyl Alcohol
- ND Not Detected

Note: All concentrations reported in micrograms per liter (ug/l).



APPROX. SCALE

FIGURE 3
 HYDROCARBON DISTRIBUTION IN GROUNDWATER
 October 26, 2005
 Shell / Equiva Site - SAP 120891
 21641 Maple Valley Highway
 Maple Valley, Washington

PROJECT NO. ST21-641-G	DRAWN BY JP 11-14-05
FILE NO. ST21-641-G	PREPARED BY JP
REVISION NO. 1	REVIEWED BY DL

Delta
Environmental
Consultants, Inc.

APPENDIX A
FIELD DATA SHEETS

APPENDIX B

FIELD PROCEDURES

GROUNDWATER MONITORING AND SAMPLING

Before the sampling event, Delta measured depth to water in each groundwater monitoring well at the facility with an electronic water level meter. This information was recorded on waterproof field sheets. Groundwater elevations (GWE) were measured to an accuracy of 0.01 feet. Samples were withdrawn from each well using a disposable polyethylene bailer and placed in the appropriate laboratory-provided container. Samples were labeled, placed into ice filled coolers, logged onto chain-of-custody forms and transported to the laboratory.

APPENDIX C

**LABORATORY REPORT AND
CHAIN-OF-CUSTODY DOCUMENTS**



HOUSTON LABORATORY
 8880 INTERCHANGE DRIVE
 HOUSTON, TX 77054
 (713) 660-0901

Shell Oil Products US

Certificate of Analysis Number:
05101251

Report To: Delta Environmental Consultants, Inc.
 Tena Seeds
 4006 148th Avenue NE

 Redmond
 WA
 98052-
 ph: (800) 477-7411 fax: (425) 869-7494

Project Name: INC# 97420022/SAP#120891
Site: 21641 Maple Valley Highway
Site Address: 21641 Maple Valley Highway
 Maple Valley WA
PO Number:
State: Washington
State Cert. No.: C156
Date Reported:

Fax To:

Client Sample ID	Lab Sample ID	Matrix	Date Collected	Date Received	COC ID	HOLD
MW-1B	05101251-01	Water	10/26/2005 12:00:00 PM	10/27/2005 9:30:00 AM		<input type="checkbox"/>
MW-2B	05101251-02	Water	10/26/2005 2:00:00 PM	10/27/2005 9:30:00 AM		<input type="checkbox"/>
MW-12	05101251-03	Water	10/26/2005 1:30:00 PM	10/27/2005 9:30:00 AM		<input type="checkbox"/>
MW-13	05101251-04	Water	10/26/2005 12:30:00 PM	10/27/2005 9:30:00 AM		<input type="checkbox"/>
Trip Blank	05101251-05	Water	10/26/2005	10/27/2005 9:30:00 AM		<input type="checkbox"/>

Erica Cardenas

Erica Cardenas
 Project Manager

11/10/2005

Date

Joel Grice
 Laboratory Director

 Ted Yen
 Quality Assurance Officer



HOUSTON LABORATORY
 8880 INTERCHANGE DRIVE
 HOUSTON, TX 77054
 (713) 660-0901

Client Sample ID: MW-1B Collected: 10/26/2005 12:00 SPL Sample ID: 05101251-01

Site: 21641 Maple Valley Highway

Analyses/Method	Result	QUAL	Rep.Limit	Dil. Factor	Date Analyzed	Analyst	Seq. #
DIESEL RANGE ORGANICS				MCL	NWTPH-DX	Units: mg/L	
Diesel Range Organics (C12-C24)	ND		0.25	1	11/02/05 21:51	NW	3012808
Oil Range Organics (C24-C32)	ND		0.5	1	11/02/05 21:51	NW	3012808
Surr: n-Pentacosane	65.8		% 20-131	1	11/02/05 21:51	NW	3012808

Prep Method	Prep Date	Prep Initials	Prep Factor
SW3510C/3630	11/01/2005 14:32	GNT	1.00

GASOLINE RANGE ORGANICS				MCL	NWTPH-GX	Units: mg/L	
Gasoline Range Organics	ND		0.05	1	11/04/05 0:51	DMN	3009090
Surr: 1,4-Difluorobenzene	103		% 60-155	1	11/04/05 0:51	DMN	3009090
Surr: 4-Bromofluorobenzene	93.7		% 50-158	1	11/04/05 0:51	DMN	3009090

SEMIVOLATILE HYDROCARBONS - ALCOHOL				MCL	SW8015B	Units: mg/L	
Ethanol	ND		5	1	11/01/05 12:59	MNR	3003615

VOLATILE ORGANICS BY METHOD 8260B				MCL	SW8260B	Units: ug/L	
Benzene	ND		1	1	11/09/05 2:31	DO	3014856
Diisopropyl Ether	ND		2	1	11/09/05 2:31	DO	3014856
Ethyl tert-butyl ether	ND		2	1	11/09/05 2:31	DO	3014856
Ethylbenzene	ND		1	1	11/09/05 2:31	DO	3014856
Methyl tert-butyl ether	ND		1	1	11/09/05 2:31	DO	3014856
t-Butyl Alcohol	ND		50	1	11/09/05 2:31	DO	3014856
tert-Amyl methyl ether	ND		5	1	11/09/05 2:31	DO	3014856
Toluene	ND		1	1	11/09/05 2:31	DO	3014856
m,p-Xylene	ND		1	1	11/09/05 2:31	DO	3014856
o-Xylene	ND		1	1	11/09/05 2:31	DO	3014856
Xylenes, Total	ND		1	1	11/09/05 2:31	DO	3014856
Surr: 1,2-Dichloroethane-d4	95.4		% 71-140	1	11/09/05 2:31	DO	3014856
Surr: 4-Bromofluorobenzene	90.0		% 70-130	1	11/09/05 2:31	DO	3014856
Surr: Toluene-d8	94.5		% 61-121	1	11/09/05 2:31	DO	3014856

Qualifiers: ND/U - Not Detected at the Reporting Limit >MCL - Result Over Maximum Contamination Limit(MCL)
 B - Analyte detected in the associated Method Blank D - Surrogate Recovery Unreportable due to Dilution
 * - Surrogate Recovery Outside Advisable QC Limits MI - Matrix Interference
 J - Estimated Value between MDL and PQL



HOUSTON LABORATORY
 8880 INTERCHANGE DRIVE
 HOUSTON, TX 77054
 (713) 660-0901

Client Sample ID: MW-2B

Collected: 10/26/2005 14:00 SPL Sample ID: 05101251-02

Site: 21641 Maple Valley Highway

Analyses/Method	Result	QUAL	Rep.Limit	Dil. Factor	Date Analyzed	Analyst	Seq. #
DIESEL RANGE ORGANICS				MCL	NWTPH-DX	Units: mg/L	
Diesel Range Organics (C12-C24)	ND		0.25	1	11/02/05 22:06	NW	3012809
Oil Range Organics (C24-C32)	ND		0.5	1	11/02/05 22:06	NW	3012809
Surr: n-Pentacosane	64.0		% 20-131	1	11/02/05 22:06	NW	3012809

Prep Method	Prep Date	Prep Initials	Prep Factor
SW3510C/3630	11/01/2005 14:32	GNT	1.00

GASOLINE RANGE ORGANICS				MCL	NWTPH-GX	Units: mg/L	
Gasoline Range Organics	ND		0.05	1	11/04/05 1:18	DMN	3009091
Surr: 1,4-Difluorobenzene	101		% 60-155	1	11/04/05 1:18	DMN	3009091
Surr: 4-Bromofluorobenzene	98.7		% 50-158	1	11/04/05 1:18	DMN	3009091

SEMIVOLATILE HYDROCARBONS - ALCOHOL				MCL	SW8015B	Units: mg/L	
Ethanol	ND		5	1	11/01/05 13:09	MNR	3003616

VOLATILE ORGANICS BY METHOD 8260B				MCL	SW8260B	Units: ug/L	
Benzene	ND		1	1	11/09/05 2:56	DO	3014857
Diisopropyl Ether	ND		2	1	11/09/05 2:56	DO	3014857
Ethyl tert-butyl ether	ND		2	1	11/09/05 2:56	DO	3014857
Ethylbenzene	ND		1	1	11/09/05 2:56	DO	3014857
Methyl tert-butyl ether	ND		1	1	11/09/05 2:56	DO	3014857
t-Butyl Alcohol	ND		50	1	11/09/05 2:56	DO	3014857
tert-Amyl methyl ether	ND		5	1	11/09/05 2:56	DO	3014857
Toluene	ND		1	1	11/09/05 2:56	DO	3014857
m,p-Xylene	ND		1	1	11/09/05 2:56	DO	3014857
o-Xylene	ND		1	1	11/09/05 2:56	DO	3014857
Xylenes, Total	ND		1	1	11/09/05 2:56	DO	3014857
Surr: 1,2-Dichloroethane-d4	97.1		% 71-140	1	11/09/05 2:56	DO	3014857
Surr: 4-Bromofluorobenzene	93.3		% 70-130	1	11/09/05 2:56	DO	3014857
Surr: Toluene-d8	95.6		% 61-121	1	11/09/05 2:56	DO	3014857

Qualifiers: ND/U - Not Detected at the Reporting Limit >MCL - Result Over Maximum Contamination Limit(MCL)
 B - Analyte detected in the associated Method Blank D - Surrogate Recovery Unreportable due to Dilution
 * - Surrogate Recovery Outside Advisable QC Limits MI - Matrix Interference
 J - Estimated Value between MDL and PQL



HOUSTON LABORATORY
 8880 INTERCHANGE DRIVE
 HOUSTON, TX 77054
 (713) 660-0901

Client Sample ID: MW-12

Collected: 10/26/2005 13:30 SPL Sample ID: 05101251-03

Site: 21641 Maple Valley Highway

Analyses/Method	Result	QUAL	Rep.Limit	Dil. Factor	Date Analyzed	Analyst	Seq. #
DIESEL RANGE ORGANICS				MCL	NWTPH-DX	Units: mg/L	
Diesel Range Organics (C12-C24)	ND		0.25	1	11/02/05 23:04	NW	3012812
Oil Range Organics (C24-C32)	ND		0.5	1	11/02/05 23:04	NW	3012812
Surr: n-Pentacosane	54.4		% 20-131	1	11/02/05 23:04	NW	3012812

Prep Method	Prep Date	Prep Initials	Prep Factor
SW3510C/3630	11/01/2005 14:32	GNT	1.00

GASOLINE RANGE ORGANICS				MCL	NWTPH-GX	Units: mg/L	
Gasoline Range Organics	ND		0.05	1	11/04/05 1:45	DMN	3009092
Surr: 1,4-Difluorobenzene	104		% 60-155	1	11/04/05 1:45	DMN	3009092
Surr: 4-Bromofluorobenzene	91.0		% 50-158	1	11/04/05 1:45	DMN	3009092

SEMIVOLATILE HYDROCARBONS - ALCOHOL				MCL	SW8015B	Units: mg/L	
Ethanol	ND		5	1	11/01/05 13:19	MNR	3003617

VOLATILE ORGANICS BY METHOD 8260B				MCL	SW8260B	Units: ug/L	
Benzene	ND		1	1	11/09/05 3:22	DO	3014858
Diisopropyl Ether	ND		2	1	11/09/05 3:22	DO	3014858
Ethyl tert-butyl ether	ND		2	1	11/09/05 3:22	DO	3014858
Ethylbenzene	ND		1	1	11/09/05 3:22	DO	3014858
Methyl tert-butyl ether	ND		1	1	11/09/05 3:22	DO	3014858
t-Butyl Alcohol	ND		50	1	11/09/05 3:22	DO	3014858
tert-Amyl methyl ether	ND		5	1	11/09/05 3:22	DO	3014858
Toluene	ND		1	1	11/09/05 3:22	DO	3014858
m,p-Xylene	ND		1	1	11/09/05 3:22	DO	3014858
o-Xylene	ND		1	1	11/09/05 3:22	DO	3014858
Xylenes, Total	ND		1	1	11/09/05 3:22	DO	3014858
Surr: 1,2-Dichloroethane-d4	96.1		% 71-140	1	11/09/05 3:22	DO	3014858
Surr: 4-Bromofluorobenzene	91.6		% 70-130	1	11/09/05 3:22	DO	3014858
Surr: Toluene-d8	95.5		% 61-121	1	11/09/05 3:22	DO	3014858

Qualifiers: ND/U - Not Detected at the Reporting Limit >MCL - Result Over Maximum Contamination Limit(MCL)
 B - Analyte detected in the associated Method Blank D - Surrogate Recovery Unreportable due to Dilution
 * - Surrogate Recovery Outside Advisable QC Limits MI - Matrix Interference
 J - Estimated Value between MDL and PQL



HOUSTON LABORATORY
 8880 INTERCHANGE DRIVE
 HOUSTON, TX 77054
 (713) 660-0901

Client Sample ID: MW-13 Collected: 10/26/2005 12:30 SPL Sample ID: 05101251-04

Site: 21641 Maple Valley Highway

Analyses/Method	Result	QUAL	Rep.Limit	Dil. Factor	Date Analyzed	Analyst	Seq. #
DIESEL RANGE ORGANICS				MCL	NWTPH-DX	Units: mg/L	
Diesel Range Organics (C12-C24)	ND		0.25	1	11/02/05 23:19	NW	3012815
Oil Range Organics (C24-C32)	ND		0.5	1	11/02/05 23:19	NW	3012815
Surr: n-Pentacosane	78.2		% 20-131	1	11/02/05 23:19	NW	3012815

Prep Method	Prep Date	Prep Initials	Prep Factor
SW3510C/3630	11/01/2005 14:32	GNT	1.00

GASOLINE RANGE ORGANICS				MCL	NWTPH-GX	Units: mg/L	
Gasoline Range Organics	ND		0.05	1	11/04/05 2:12	DMN	3009093
Surr: 1,4-Difluorobenzene	103		% 60-155	1	11/04/05 2:12	DMN	3009093
Surr: 4-Bromofluorobenzene	98.0		% 50-158	1	11/04/05 2:12	DMN	3009093

SEMIVOLATILE HYDROCARBONS - ALCOHOL				MCL	SW8015B	Units: mg/L	
Ethanol	ND		5	1	11/01/05 13:29	MNR	3003618

VOLATILE ORGANICS BY METHOD 8260B				MCL	SW8260B	Units: ug/L	
Benzene	ND		1	1	11/09/05 3:47	DO	3014859
Diisopropyl Ether	ND		2	1	11/09/05 3:47	DO	3014859
Ethyl tert-butyl ether	ND		2	1	11/09/05 3:47	DO	3014859
Ethylbenzene	ND		1	1	11/09/05 3:47	DO	3014859
Methyl tert-butyl ether	ND		1	1	11/09/05 3:47	DO	3014859
t-Butyl Alcohol	ND		50	1	11/09/05 3:47	DO	3014859
tert-Amyl methyl ether	ND		5	1	11/09/05 3:47	DO	3014859
Toluene	ND		1	1	11/09/05 3:47	DO	3014859
m,p-Xylene	ND		1	1	11/09/05 3:47	DO	3014859
o-Xylene	ND		1	1	11/09/05 3:47	DO	3014859
Xylenes, Total	ND		1	1	11/09/05 3:47	DO	3014859
Surr: 1,2-Dichloroethane-d4	94.9		% 71-140	1	11/09/05 3:47	DO	3014859
Surr: 4-Bromofluorobenzene	91.0		% 70-130	1	11/09/05 3:47	DO	3014859
Surr: Toluene-d8	95.1		% 61-121	1	11/09/05 3:47	DO	3014859

Qualifiers: ND/U - Not Detected at the Reporting Limit >MCL - Result Over Maximum Contamination Limit(MCL)
 B - Analyte detected in the associated Method Blank D - Surrogate Recovery Unreportable due to Dilution
 * - Surrogate Recovery Outside Advisable QC Limits MI - Matrix Interference
 J - Estimated Value between MDL and PQL



HOUSTON LABORATORY
8880 INTERCHANGE DRIVE
HOUSTON, TX 77054
(713) 660-0901

Client Sample ID: Trip Blank

Collected: 10/26/2005 0:00

SPL Sample ID: 05101251-05

Site: 21641 Maple Valley Highway

Analyses/Method	Result	QUAL	Rep.Limit	Dil. Factor	Date Analyzed	Analyst	Seq. #
VOLATILE ORGANICS BY METHOD 8260B				MCL	SW8260B	Units: ug/L	
Benzene	ND		1	1	11/08/05 23:59	DO	3014850
Diisopropyl Ether	ND		2	1	11/08/05 23:59	DO	3014850
Ethyl tert-butyl ether	ND		2	1	11/08/05 23:59	DO	3014850
Ethylbenzene	ND		1	1	11/08/05 23:59	DO	3014850
Methyl tert-butyl ether	ND		1	1	11/08/05 23:59	DO	3014850
t-Butyl Alcohol	ND		50	1	11/08/05 23:59	DO	3014850
tert-Amyl methyl ether	ND		5	1	11/08/05 23:59	DO	3014850
Toluene	ND		1	1	11/08/05 23:59	DO	3014850
m,p-Xylene	ND		1	1	11/08/05 23:59	DO	3014850
o-Xylene	ND		1	1	11/08/05 23:59	DO	3014850
Xylenes, Total	ND		1	1	11/08/05 23:59	DO	3014850
Surr: 1,2-Dichloroethane-d4	95.7		% 71-140	1	11/08/05 23:59	DO	3014850
Surr: 4-Bromofluorobenzene	90.7		% 70-130	1	11/08/05 23:59	DO	3014850
Surr: Toluene-d8	95.5		% 61-121	1	11/08/05 23:59	DO	3014850

Qualifiers:
ND/U - Not Detected at the Reporting Limit
B - Analyte detected in the associated Method Blank
* - Surrogate Recovery Outside Advisable QC Limits
J - Estimated Value between MDL and PQL

>MCL - Result Over Maximum Contamination Limit(MCL)
D - Surrogate Recovery Unreportable due to Dilution
MI - Matrix Interference

11/10/2005 4:34:37 PM

50101201

450 Hughes Drive
Traverse City, MI 49606
231-947-5777 866-775-8424

Shell Oil Products U.S. Project Manager to be invoiced:
 ENGINEERING
 SPECIAL SERVICES
 PORT HOUSTON
 Carl Campaigne

MOBILE NUMBER ONLY
 97420022
 SAMPLE NUMBER (SUSPENSE)
 120291

DATE: 10/25/05
 PAGE: 1 of 1

CONSULTANT COMPANY: Delta Environmental
 ADDRESS: 4005 HSB Ave NE
 CITY: Redmond, WA 98052
 TELEPHONE: 360-874-2570 FAX: 360-874-1872 EMAIL: carl@deltaenv.com
 TURNAROUND TIME (BUSINESS DAYS):
 10 DAYS 5 DAYS 72 HOURS 48 HOURS 24 HOURS LESS THAN 24 HOURS
 LA - RWOB REPORT FORMAT USE AGENCY:
 CORES MTBE CONFIRMATION HIGHEST _____ HIGHEST per BORING _____ ft
 SPECIAL INSTRUCTIONS OR NOTES: _____ TEMPERATURE ON RECEIPT: _____

SITE ADDRESS (Street and City): 21491 Maple Valley Hwy, Maple Valley, WA
 PROJECT CONTACT (Repeat #): Tenz Seals CONSULTANT PROJECT NO.: ST-21-64
 SAMPLER NAME(S) (PLC): Janey Peterson LAB USE ONLY: PLC

REQUESTED ANALYSIS

FIELD NOTES:
 Container/Preservative
 or FID Readings
 or Laboratory Notes

NO.	Field Sample Identification	SAMPLING		MATRIX	NO. OF CONT.	GRO-MIX	DRO-MIX	BTX / MTBE (M0210)	BTX / MTBE + Oxygenates (M0202)	VOCs FOR LSL - Oxygenates (M0005)	MTBE (M0009) Confirmation; See Note	MI VLG Seal: (M2405)	MI Leaded Seal: (M0002)	GAS	OTHER	
		DATE	TIME													
1	NW-1B	10/25	12:00	W	9	X	X	X	X							
2	NW-2B	1	15:00	W	9	X	X	X	X							
3	NW-12	1	18:00	W	9	X	X	X	X							
4	NW-13	1	18:30	W	9	X	X	X	X							
5	Top Blank				2											

Requested by (Signature): [Signature] Date: 10/27/05
 Received by (Signature): [Signature] Time: 09:30
 Requested by (Signature): _____ Date: _____
 Received by (Signature): _____ Time: _____
 Requested by (Signature): _____ Date: _____
 Received by (Signature): _____ Time: _____