



21905 64th Avenue W, Ste 200
Mountlake Terrace, WA 98036
P (425) 771-3304
F (425) 771-3549
Terracon.com

November 12, 2024

Attn: Milton Huertas
Seattle Public Schools
2445 3rd Avenue South
Seattle, Washington 98134

and

Tamara Welty, LG, LHG
Department of Ecology Toxics Cleanup Program
15700 Dayton Avenue North
Shoreline, Washington 98133

Re: **John Stanford Center Environmental Summary Letter**
Seattle Public Schools John Stanford Center
2445 3rd Avenue South
Seattle, Washington 98134
Terracon Project No.: 81247068
Cleanup Site ID: 6720
Facility Site ID: 82825487

Dear Mr. Huertas and Ms. Welty:

Terracon Consultants, Inc. (Terracon) is pleased to present this letter on behalf of Seattle Public Schools (Client) in response to the Washington State Department of Ecology's (Ecology) request for a summary of the soil removal and sampling activities completed at the Seattle Public Schools John Stanford Center Site located at 2445 3rd Avenue South in Seattle, King County, Washington (King County Tax Parcel No. 766620-5235). The approximate 6.31-acre property is developed with an approximately 20,000-square-foot (sf) building on the northern portion of the property and an approximately 350,000-sf three-story building on the southern portion of the property. The property is currently occupied by Seattle Public Schools and operates as a commercial kitchen and office space. The field activities completed by Terracon were performed at the request of the Client to assess soils for export and off-site disposal during utility trenching beneath the building for a site renovation project.

Property History and Background Information

Based on previous environmental investigations conducted at the property by others from 1987 to 2008, the northern building operated as a vehicle maintenance facility (VMF) by the United States Postal Service (USPS) and the southern building operated as the USPS General Mail Facility (GMF). The VMF building had four former fueling underground storage tanks (USTs), in-ground hydraulic hoists, a waste oil UST, oil/water separators, a paint

booth, two former heating oil USTs, and a steel culvert pipe. Based on assessments by previous consultants, petroleum impacts, including carcinogenic polycyclic aromatic hydrocarbons (cPAHs), were identified in the soil and groundwater surrounding the features and were left in place. However, the property received a No Further Action (NFA) determination on March 8, 1999, and a revised NFA letter on April 5, 1999, contingent on the implementation of an Environmental Covenant (EC), dated April 13, 1999. Per the established EC on the property, a notification to Ecology regarding the potential exposure of impacted media is required when removing or damaging the Cap (buildings, paved areas, landscaping, etc). It should be noted that soil and groundwater impacts previously identified at the property, and which remain in place, are located north of the GMF building where the current utility tunneling excavation occurred. Soil or groundwater sampling does not appear to have been conducted in the vicinity of utility tunneling work under the GMF building because a source of potential contamination in this area of the property was not previously identified.

In an effort to assess soils prior to planned earthwork and utility tunneling beneath the GMF building, Krazan & Associates, Inc. (Krazan) conducted a subsurface investigation on June 22, 2023, in the vicinity of the planned utility tunnel. Krazan reported that diesel-, oil-, and gasoline-range total petroleum hydrocarbons (TPH), benzene, toluene, ethyl benzene, xylenes, select metals, and polychlorinated biphenyls (PCBs) were not identified at concentrations above laboratory method reporting limits (MRLs) and/or Washington State's Model Toxics Control Act (MTCA) cleanup levels (CULs). Benzo[a]pyrene (BAP) was detected at a concentration above the MTCA Method A CUL in the soil sample collected from boring B1 at 6 feet below the ground surface (bgs). Other cPAHs were identified, but at concentrations below their associated MTCA CULs. Based on the absence of a documented release within the limits of the GMF building, Terracon infers that the presence of BAP is likely associated with fill material present beneath the structure, which contained relic creosote timber piles and other debris.

Based on these findings and in accordance with the site's EC, Terracon prepared a Contaminated Media Management Plan (CMMP) to provide the Client's contractors guidance during earthwork performed as part of the Site renovations. Specifically, the CMMP provided guidance on the handling and disposition of contaminated soils, as well as guidance regarding the inadvertent discovery of potentially contaminated soils and/or subsurface environmental features during earthwork activities. In addition, the CMMP also provided for general guidance and notification regarding the impervious surfaces, identified as the "Cap", at the Site in accordance with the EC. A copy of the CMMP is attached to this letter.

Summary of Field Activities and Findings

Terracon personnel mobilized to the site on February 8, February 14, March 14, and March 19, 2024, to collect waste characterization soil samples during tunneling activities. Terracon personnel did not have personal protective equipment (PPE) necessary for entering confined space areas and therefore did not enter the utility tunnels to collect samples.

Representatives from Titan Earthwork (Titan), the earthwork subcontractor for the renovation project, with PPE appropriate for confined space entry collected soil from each

sampling location into buckets that were then provided to Terracon personnel for sampling. Terracon personnel screened the samples for field indications of impacts, including odor, sheen, and/or discoloration. A total of six soil samples were collected at locations where creosote timber piles were encountered by Titan during earthwork activities.

Based on the discovery of BAP-impacted soil during Krazan's June 2023 investigation and in accordance with Terracon's CMMP, the six soil samples were submitted to the laboratory for analysis of cPAHs by EPA Method 8270. Three samples (S1-20240208, S3-20240208, and S1-20240319) were reported with BAP concentrations ranging from 0.17 to 1.4 milligrams per kilogram (mg/kg), which is above the Method A CUL of 0.1 mg/kg. BAP and PAHs toxicity equivalent concentration sums were not reported at concentrations above the Method A CUL for the remaining three samples (S2-20240208, S1-20240214, and S1-20240314). Copies of the laboratory analytical reports and toxicity equivalent concentrations tables are attached to this letter.

Between February 5 and March 31, 2024, approximately 880 tons were removed during the utility excavation activities and disposed off-site by Titan. Although cPAHs were not reported above MTCA CULs in multiple sample locations, all excavated soils were considered impacted and exported as such for disposal. Excavated soils were disposed of off-site at LeFarge Seattle and Dickson Company in accordance with their material acceptance criteria. Excavation activities were completed in general accordance with the CMMP and EC. Copies of the waste disposal tickets are attached to this letter.

Closing

We trust that the information presented in this letter provides documentation of the soil removal activities conducted during the under-slab utility work completed at the site in general accordance with Terracon's CMMP and the EC for the Site.

Limited Soil Sampling
Seattle Public Schools, John Stanford Center | Seattle, Washington
September 8, 2023 | Terracon Project No. 81247068



Should you have any questions or require additional information, please do not hesitate to contact our office. If you have any questions regarding this letter, please contact us at (425) 771-3304.

Sincerely,
Terracon Consultants, Inc.

A handwritten signature in black ink, appearing to read "JD".

Jeff Dobbins, L.G.
Senior Staff Geologist

A handwritten signature in black ink, appearing to read "K.B.". The signature is written over a horizontal line.

Kyle Bennett, L.G.
Group Manager

A handwritten signature in black ink, appearing to read "Matt Wheaton".

Matt Wheaton, L.G., P.E.
Senior Principal

Attachments:

- Exhibit 1 - Site Diagram
- Summary of Calculated Total TEQ Tables
- Laboratory Reports
- Waste Disposal Tickets
- Contaminated Media Management Plan



KYLE S. BENNETT

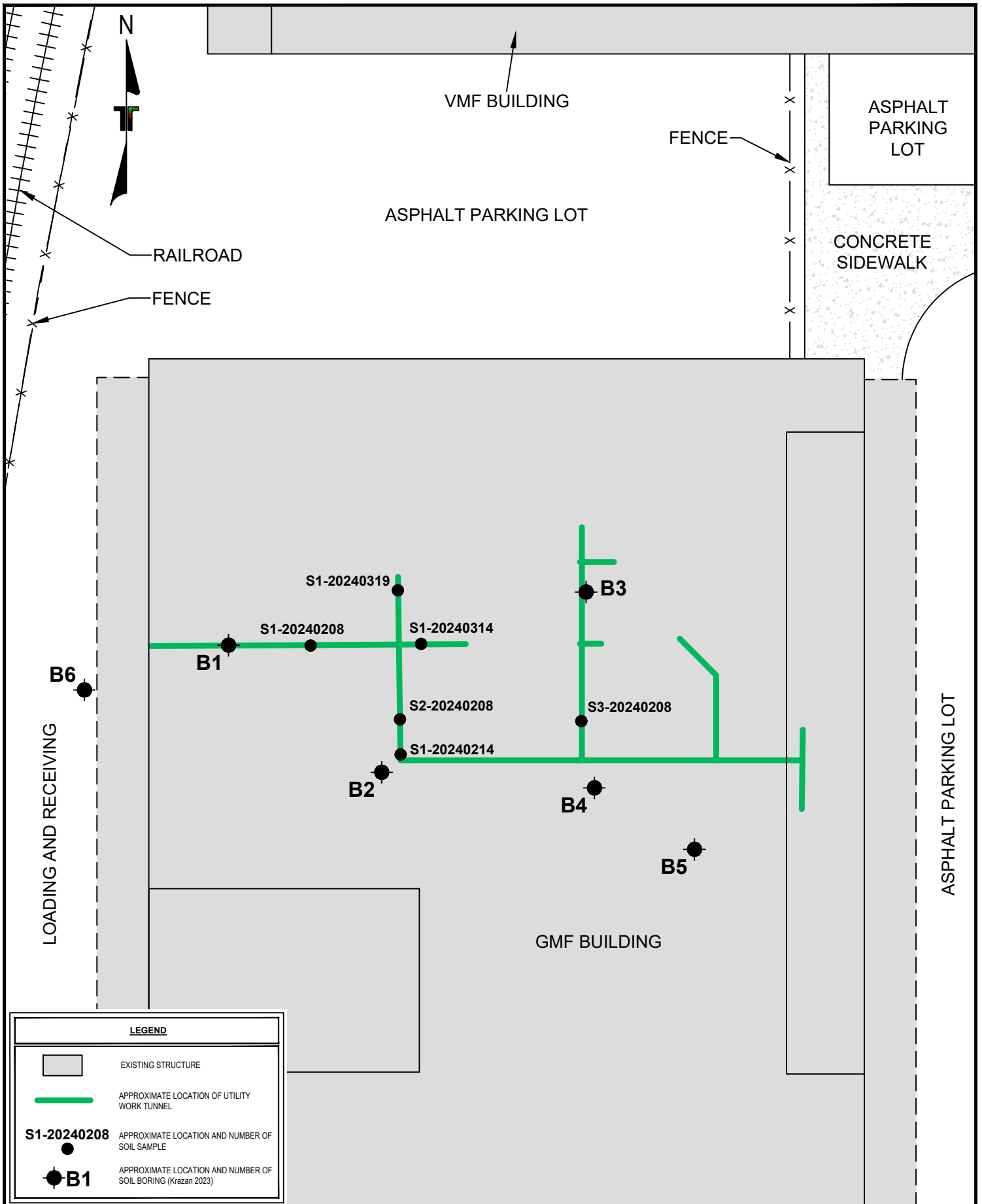

LEGEND

- EXISTING STRUCTURE
- APPROXIMATE LOCATION OF UTILITY WORK TUNNEL
- S1-20240208** APPROXIMATE LOCATION AND NUMBER OF SOIL SAMPLE
- B1** APPROXIMATE LOCATION AND NUMBER OF SOIL BORING (Krazan 2023)

Project Mngnr:	KSB
Drawn By:	JWD
Checked By:	KSB
Approved By:	MYW

Project No.	81247068
Scale:	AS SHOWN
File No.	Exhibit 1
Date:	October 2024

Terracon
Explore with us

21905 64TH AVENUE W, STE 100 MOUNTLAKE TERRACE, WA 98043
PH. (425) 771-3304 FAX. (425) 771-3549

SITE DIAGRAM

Seattle Public Schools, John Stanford Center
2445 3rd Avenue South
Seattle, Washington

EXHIBIT
1

SUMMARY OF CALCULATED Total TEQ FOR S2-20240208

all concentrations are in milligrams per kilogram (mg/kg)

PAH	Reported PAH Soil Concentration	Toxicity Equivalency Factor (unitless)	Calculated TEQ Soil Concentration
Benzo[a]pyrene	0.0480	1.00	0.048
Benzo[a]anthracene	0.0800	0.10	0.008
Benzo[b]fluoranthene	0.074	0.10	0.007
Benzo[k]fluoranthene	0.025	0.10	0.003
Chrysene	0.091	0.01	0.001
Dibenz[a,h]anthracene	0.0050	0.10	0.001
Indeno[1,2,3-cd]pyrene	0.030	0.10	0.003
Total Toxicity Equivalency Concentration			0.070
MTCA Method A Cleanup Level			0.1

Note: For the concentration of analytes reported below method reporting limits (MRLs), half of the detection limit is used as the reported concentration.

TEF - Toxicity Equivalent Factor

TEQ - Toxicity Equivalency Concentration

MTCA - Model Toxics Control Act

PAH - Polycyclic aromatic hydrocarbons

SUMMARY OF CALCULATED Total TEQ FOR S1-20240214

all concentrations are in milligrams per kilogram (mg/kg)

PAH	Reported PAH Soil Concentration	Toxicity Equivalency Factor (unitless)	Calculated TEQ Soil Concentration
Benzo[a]pyrene	0.0430	1.00	0.043
Benzo[a]anthracene	0.1200	0.10	0.012
Benzo[b]fluoranthene	0.073	0.10	0.007
Benzo[k]fluoranthene	0.027	0.10	0.003
Chrysene	0.130	0.01	0.001
Dibenz[a,h]anthracene	0.0050	0.10	0.001
Indeno[1,2,3-cd]pyrene	0.005	0.10	0.001
Total Toxicity Equivalency Concentration			0.067
MTCA Method A Cleanup Level			0.1

Note: For the concentration of analytes reported below method reporting limits (MRLs), half of the detection limit is used as the reported concentration.

TEF - Toxicity Equivalent Factor

TEQ - Toxicity Equivalency Concentration

MTCA - Model Toxics Control Act

PAH - Polycyclic aromatic hydrocarbons

SUMMARY OF CALCULATED Total TEQ FOR S1-20240314

all concentrations are in milligrams per kilogram (mg/kg)

PAH	Reported PAH Soil Concentration	Toxicity Equivalency Factor (unitless)	Calculated TEQ Soil Concentration
Benzo[a]pyrene	0.0320	1.00	0.032
Benzo[a]anthracene	0.0290	0.10	0.003
Benzo[b]fluoranthene	0.054	0.10	0.005
Benzo[k]fluoranthene	0.017	0.10	0.002
Chrysene	0.042	0.01	0.000
Dibenz[a,h]anthracene	0.0050	0.10	0.001
Indeno[1,2,3-cd]pyrene	0.014	0.10	0.001
Total Toxicity Equivalency Concentration			0.044
MTCA Method A Cleanup Level			0.1

Note: For the concentration of analytes reported below method reporting limits (MRLs), half of the detection limit is used as the reported concentration.

TEF - Toxicity Equivalent Factor

TEQ - Toxicity Equivalency Concentration

MTCA - Model Toxics Control Act

PAH - Polycyclic aromatic hydrocarbons

FRIEDMAN & BRUYA, INC.

ENVIRONMENTAL CHEMISTS

James E. Bruya, Ph.D.
Yelena Aravkina, M.S.
Michael Erdahl, B.S.
Vineta Mills, M.S.
Eric Young, B.S.

5500 4th Ave South
Seattle, WA 98108-2419
(206) 285-8282
office@friedmanandbruya.com
www.friedmanandbruya.com

February 13, 2024

Kyle Bennett, Project Manager
Terracon
Pacific Cascade Building
21905 64th Ave. W., Suite 100
Mountlake Terrace, WA 98043

Dear Mr Bennett:

Included are the results from the testing of material submitted on February 8, 2024 from the JSCEE 81247068, F&BI 402119 project. There are 8 pages included in this report. Any samples that may remain are currently scheduled for disposal in 30 days, or as directed by the Chain of Custody document. If you would like us to return your samples or arrange for long term storage at our offices, please contact us as soon as possible.

We appreciate this opportunity to be of service to you and hope you will call if you should have any questions.

Sincerely,

FRIEDMAN & BRUYA, INC.



Michael Erdahl
Project Manager

Enclosures

c: Terracon A/P (TRR)
TRR0213R.DOC

FRIEDMAN & BRUYA, INC.

ENVIRONMENTAL CHEMISTS

CASE NARRATIVE

This case narrative encompasses samples received on February 8, 2024 by Friedman & Bruya, Inc. from the Terracon JSCEE 81247068, F&BI 402119 project. Samples were logged in under the laboratory ID's listed below.

<u>Laboratory ID</u>	<u>Terracon</u>
402119 -01	S1-20240208
402119 -02	S2-20240208
402119 -03	S3-20240208

Benzo(g,h,i)perylene in the 8270E laboratory control sample did not meet the acceptance criteria. The data were flagged accordingly.

All other quality control requirements were acceptable.

FRIEDMAN & BRUYA, INC.

ENVIRONMENTAL CHEMISTS

Analysis For Semivolatile Compounds By EPA Method 8270E

Client Sample ID:	S1-20240208	Client:	Terracon
Date Received:	02/08/24	Project:	JSCEE 81247068, F&BI 402119
Date Extracted:	02/08/24	Lab ID:	402119-01 1/25
Date Analyzed:	02/08/24	Data File:	020814.D
Matrix:	Soil	Instrument:	GCMS9
Units:	mg/kg (ppm) Dry Weight	Operator:	VM

Surrogates:	% Recovery:	Lower Limit:	Upper Limit:
Nitrobenzene-d5	68 d	10	198
2-Fluorobiphenyl	81 d	45	117
2,4,6-Tribromophenol	80 d	11	158
Terphenyl-d14	85 d	50	124

Compounds:	Concentration mg/kg (ppm)
Naphthalene	<0.05
2-Methylnaphthalene	<0.05
1-Methylnaphthalene	<0.05
Acenaphthylene	<0.05
Acenaphthene	<0.05
Fluorene	<0.05
Phenanthrene	0.14
Anthracene	<0.05
Fluoranthene	0.19
Pyrene	0.22
Benz(a)anthracene	0.12
Chrysene	0.18
Benzo(a)pyrene	0.17
Benzo(b)fluoranthene	0.21
Benzo(k)fluoranthene	0.071
Indeno(1,2,3-cd)pyrene	0.12
Dibenz(a,h)anthracene	<0.05
Benzo(g,h,i)perylene	0.13 jl

FRIEDMAN & BRUYA, INC.

ENVIRONMENTAL CHEMISTS

Analysis For Semivolatile Compounds By EPA Method 8270E

Client Sample ID:	S2-20240208	Client:	Terracon
Date Received:	02/08/24	Project:	JSCEE 81247068, F&BI 402119
Date Extracted:	02/08/24	Lab ID:	402119-02 1/5
Date Analyzed:	02/08/24	Data File:	020813.D
Matrix:	Soil	Instrument:	GCMS9
Units:	mg/kg (ppm) Dry Weight	Operator:	VM

Surrogates:	% Recovery:	Lower Limit:	Upper Limit:
Nitrobenzene-d5	67	10	198
2-Fluorobiphenyl	74	45	117
2,4,6-Tribromophenol	77	11	158
Terphenyl-d14	80	50	124

Compounds:	Concentration mg/kg (ppm)
Naphthalene	0.55
2-Methylnaphthalene	0.26
1-Methylnaphthalene	0.13
Acenaphthylene	<0.01
Acenaphthene	0.35
Fluorene	0.32
Phenanthrene	0.97
Anthracene	0.10
Fluoranthene	0.45
Pyrene	0.29
Benz(a)anthracene	0.080
Chrysene	0.091
Benzo(a)pyrene	0.048
Benzo(b)fluoranthene	0.074
Benzo(k)fluoranthene	0.025
Indeno(1,2,3-cd)pyrene	0.030
Dibenz(a,h)anthracene	<0.01
Benzo(g,h,i)perylene	0.027 jl

FRIEDMAN & BRUYA, INC.

ENVIRONMENTAL CHEMISTS

Analysis For Semivolatile Compounds By EPA Method 8270E

Client Sample ID:	S3-20240208	Client:	Terracon
Date Received:	02/08/24	Project:	JSCEE 81247068, F&BI 402119
Date Extracted:	02/08/24	Lab ID:	402119-03 1/25
Date Analyzed:	02/08/24	Data File:	020815.D
Matrix:	Soil	Instrument:	GCMS9
Units:	mg/kg (ppm) Dry Weight	Operator:	VM

Surrogates:	% Recovery:	Lower Limit:	Upper Limit:
Nitrobenzene-d5	69 d	10	198
2-Fluorobiphenyl	82 d	45	117
2,4,6-Tribromophenol	90 d	11	158
Terphenyl-d14	88 d	50	124

Compounds:	Concentration mg/kg (ppm)
Naphthalene	13
2-Methylnaphthalene	4.4
1-Methylnaphthalene	7.8
Acenaphthylene	<0.05
Acenaphthene	21
Fluorene	20
Phenanthrene	43 ve
Anthracene	4.3
Fluoranthene	16
Pyrene	9.9
Benz(a)anthracene	1.9
Chrysene	1.6
Benzo(a)pyrene	0.50
Benzo(b)fluoranthene	0.79
Benzo(k)fluoranthene	0.27
Indeno(1,2,3-cd)pyrene	0.16
Dibenz(a,h)anthracene	0.053
Benzo(g,h,i)perylene	0.13 jl

FRIEDMAN & BRUYA, INC.

ENVIRONMENTAL CHEMISTS

Analysis For Semivolatile Compounds By EPA Method 8270E

Client Sample ID:	S3-20240208	Client:	Terracon
Date Received:	02/08/24	Project:	JSCEE 81247068, F&BI 402119
Date Extracted:	02/08/24	Lab ID:	402119-03 1/250
Date Analyzed:	02/09/24	Data File:	020908.D
Matrix:	Soil	Instrument:	GCMS9
Units:	mg/kg (ppm) Dry Weight	Operator:	VM

Surrogates:	% Recovery:	Lower Limit:	Upper Limit:
Nitrobenzene-d5	65	10	198
2-Fluorobiphenyl	75	45	117
2,4,6-Tribromophenol	154	11	158
Terphenyl-d14	75	50	124

Compounds:	Concentration mg/kg (ppm)
Phenanthrene	46

FRIEDMAN & BRUYA, INC.

ENVIRONMENTAL CHEMISTS

Analysis For Semivolatile Compounds By EPA Method 8270E

Client Sample ID:	Method Blank	Client:	Terracon
Date Received:	Not Applicable	Project:	JSCEE 81247068, F&BI 402119
Date Extracted:	02/08/24	Lab ID:	04-0330 mb2 1/5
Date Analyzed:	02/08/24	Data File:	020812.D
Matrix:	Soil	Instrument:	GCMS9
Units:	mg/kg (ppm) Dry Weight	Operator:	VM

Surrogates:	% Recovery:	Lower Limit:	Upper Limit:
Nitrobenzene-d5	75	10	198
2-Fluorobiphenyl	81	45	117
2,4,6-Tribromophenol	73	11	158
Terphenyl-d14	91	50	124

Compounds:	Concentration mg/kg (ppm)
Naphthalene	<0.01
2-Methylnaphthalene	<0.01
1-Methylnaphthalene	<0.01
Acenaphthylene	<0.01
Acenaphthene	<0.01
Fluorene	<0.01
Phenanthrene	<0.01
Anthracene	<0.01
Fluoranthene	<0.01
Pyrene	<0.01
Benz(a)anthracene	<0.01
Chrysene	<0.01
Benzo(a)pyrene	<0.01
Benzo(b)fluoranthene	<0.01
Benzo(k)fluoranthene	<0.01
Indeno(1,2,3-cd)pyrene	<0.01
Dibenz(a,h)anthracene	<0.01
Benzo(g,h,i)perylene	<0.01 jl

FRIEDMAN & BRUYA, INC.

ENVIRONMENTAL CHEMISTS

Date of Report: 02/13/24

Date Received: 02/08/24

Project: JSCEE 81247068, F&BI 402119

**QUALITY ASSURANCE RESULTS FOR THE ANALYSIS OF SOIL SAMPLES
FOR SEMIVOLATILES BY EPA METHOD 8270E**

Laboratory Code: 402101-01 1/5 (Matrix Spike)

Analyte	Reporting Units	Spike Level	Sample Result (Wet wt)	Percent Recovery MS	Percent Recovery MSD	Acceptance Criteria	RPD (Limit 20)
Naphthalene	mg/kg (ppm)	0.83	<0.01	70	73	50-150	4
2-Methylnaphthalene	mg/kg (ppm)	0.83	<0.01	74	76	50-150	3
1-Methylnaphthalene	mg/kg (ppm)	0.83	<0.01	71	73	50-150	3
Acenaphthylene	mg/kg (ppm)	0.83	<0.01	75	75	50-150	0
Acenaphthene	mg/kg (ppm)	0.83	<0.01	74	75	50-150	1
Fluorene	mg/kg (ppm)	0.83	<0.01	75	75	50-150	0
Phenanthrene	mg/kg (ppm)	0.83	<0.01	76	73	10-170	4
Anthracene	mg/kg (ppm)	0.83	<0.01	74	75	37-139	1
Fluoranthene	mg/kg (ppm)	0.83	<0.01	76	78	10-203	3
Pyrene	mg/kg (ppm)	0.83	<0.01	77	78	10-208	1
Benzo(a)anthracene	mg/kg (ppm)	0.83	<0.01	78	78	37-146	0
Chrysene	mg/kg (ppm)	0.83	<0.01	81	80	36-144	1
Benzo(a)pyrene	mg/kg (ppm)	0.83	<0.01	80	83	40-150	4
Benzo(b)fluoranthene	mg/kg (ppm)	0.83	<0.01	78	82	45-157	5
Benzo(k)fluoranthene	mg/kg (ppm)	0.83	<0.01	77	83	50-150	7
Indeno(1,2,3-cd)pyrene	mg/kg (ppm)	0.83	<0.01	75	71	24-145	5
Dibenz(a,h)anthracene	mg/kg (ppm)	0.83	<0.01	75	71	31-137	5
Benzo(g,h,i)perylene	mg/kg (ppm)	0.83	<0.01	66	64	14-141	3

Laboratory Code: Laboratory Control Sample 1/5

Analyte	Reporting Units	Spike Level	Percent Recovery LCS	Acceptance Criteria
Naphthalene	mg/kg (ppm)	0.83	77	59-105
2-Methylnaphthalene	mg/kg (ppm)	0.83	82	62-108
1-Methylnaphthalene	mg/kg (ppm)	0.83	79	62-108
Acenaphthylene	mg/kg (ppm)	0.83	84	61-111
Acenaphthene	mg/kg (ppm)	0.83	85	61-110
Fluorene	mg/kg (ppm)	0.83	84	62-114
Phenanthrene	mg/kg (ppm)	0.83	83	64-112
Anthracene	mg/kg (ppm)	0.83	82	63-111
Fluoranthene	mg/kg (ppm)	0.83	82	66-115
Pyrene	mg/kg (ppm)	0.83	80	65-112
Benzo(a)anthracene	mg/kg (ppm)	0.83	83	64-116
Chrysene	mg/kg (ppm)	0.83	88	66-119
Benzo(a)pyrene	mg/kg (ppm)	0.83	89	62-116
Benzo(b)fluoranthene	mg/kg (ppm)	0.83	87	61-118
Benzo(k)fluoranthene	mg/kg (ppm)	0.83	88	65-119
Indeno(1,2,3-cd)pyrene	mg/kg (ppm)	0.83	73	64-130
Dibenz(a,h)anthracene	mg/kg (ppm)	0.83	72	67-131
Benzo(g,h,i)perylene	mg/kg (ppm)	0.83	60 vo	67-126

FRIEDMAN & BRUYA, INC.

ENVIRONMENTAL CHEMISTS

Data Qualifiers & Definitions

- a - The analyte was detected at a level less than five times the reporting limit. The RPD results may not provide reliable information on the variability of the analysis.
- b - The analyte was spiked at a level that was less than five times that present in the sample. Matrix spike recoveries may not be meaningful.
- ca - The calibration results for the analyte were outside of acceptance criteria, biased low; or, the calibration results for the analyte were outside of acceptance criteria, biased high, with a detection for the analyte in the sample. The value reported is an estimate.
- c - The presence of the analyte may be due to carryover from previous sample injections.
- cf - The sample was centrifuged prior to analysis.
- d - The sample was diluted. Detection limits were raised and surrogate recoveries may not be meaningful.
- dv - Insufficient sample volume was available to achieve normal reporting limits.
- f - The sample was laboratory filtered prior to analysis.
- fb - The analyte was detected in the method blank.
- fc - The analyte is a common laboratory and field contaminant.
- hr - The sample and duplicate were reextracted and reanalyzed. RPD results were still outside of control limits. Variability is attributed to sample inhomogeneity.
- hs - Headspace was present in the container used for analysis.
- ht - The analysis was performed outside the method or client-specified holding time requirement.
- ip - Recovery fell outside of control limits due to sample matrix effects.
- j - The analyte concentration is reported below the standard reporting limit. The value reported is an estimate.
- J - The internal standard associated with the analyte is out of control limits. The reported concentration is an estimate.
- jl - The laboratory control sample(s) percent recovery and/or RPD were out of control limits. The reported concentration should be considered an estimate.
- js - The surrogate associated with the analyte is out of control limits. The reported concentration should be considered an estimate.
- k - The calibration results for the analyte were outside of acceptance criteria, biased high, and the analyte was not detected in the sample.
- lc - The presence of the analyte is likely due to laboratory contamination.
- L - The reported concentration was generated from a library search.
- nm - The analyte was not detected in one or more of the duplicate analyses. Therefore, calculation of the RPD is not applicable.
- pc - The sample was received with incorrect preservation or in a container not approved by the method. The value reported should be considered an estimate.
- ve - The analyte response exceeded the valid instrument calibration range. The value reported is an estimate.
- vo - The value reported fell outside the control limits established for this analyte.
- x - The sample chromatographic pattern does not resemble the fuel standard used for quantitation.

FRIEDMAN & BRUYA, INC.

ENVIRONMENTAL CHEMISTS

James E. Bruya, Ph.D.
Yelena Aravkina, M.S.
Michael Erdahl, B.S.
Vineta Mills, M.S.
Eric Young, B.S.

5500 4th Ave South
Seattle, WA 98108-2419
(206) 285-8282
office@friedmanandbruya.com
www.friedmanandbruya.com

February 16, 2024

Kyle Bennett, Project Manager
Terracon
Pacific Cascade Building
21905 64th Ave. W., Suite 100
Mountlake Terrace, WA 98043

Dear Mr Bennett:

Included are the results from the testing of material submitted on February 14, 2024 from the JSCEE 81247068, F&BI 402193 project. There are 5 pages included in this report. Any samples that may remain are currently scheduled for disposal in 30 days, or as directed by the Chain of Custody document. If you would like us to return your samples or arrange for long term storage at our offices, please contact us as soon as possible.

We appreciate this opportunity to be of service to you and hope you will call if you should have any questions.

Sincerely,

FRIEDMAN & BRUYA, INC.



Michael Erdahl
Project Manager

Enclosures

c: Terracon A/P (TRR), Jeff Dobbins
TRR0216R.DOC

FRIEDMAN & BRUYA, INC.

ENVIRONMENTAL CHEMISTS

CASE NARRATIVE

This case narrative encompasses samples received on February 14, 2024 by Friedman & Bruya, Inc. from the Terracon JSCEE 81247068, F&BI 402193 project. Samples were logged in under the laboratory ID's listed below.

<u>Laboratory ID</u>	<u>Terracon</u>
402193 -01	S1-20240214

All quality control requirements were acceptable.

FRIEDMAN & BRUYA, INC.

ENVIRONMENTAL CHEMISTS

Analysis For Semivolatile Compounds By EPA Method 8270E

Client Sample ID:	S1-20240214	Client:	Terracon
Date Received:	02/14/24	Project:	JSCEE 81247068, F&BI 402193
Date Extracted:	02/14/24	Lab ID:	402193-01 1/5
Date Analyzed:	02/14/24	Data File:	021420.D
Matrix:	Soil	Instrument:	GCMS12
Units:	mg/kg (ppm) Dry Weight	Operator:	VM

Surrogates:	% Recovery:	Lower Limit:	Upper Limit:
Nitrobenzene-d5	84	16	137
2-Fluorobiphenyl	79	46	122
2,4,6-Tribromophenol	87	17	154
Terphenyl-d14	81	31	167

Compounds:	Concentration mg/kg (ppm)
Naphthalene	0.055
2-Methylnaphthalene	0.028
1-Methylnaphthalene	0.16
Acenaphthylene	<0.01
Acenaphthene	0.95
Fluorene	0.76
Phenanthrene	2.0
Anthracene	0.24
Fluoranthene	0.83
Pyrene	0.51
Benz(a)anthracene	0.12
Chrysene	0.13
Benzo(a)pyrene	0.043
Benzo(b)fluoranthene	0.073
Benzo(k)fluoranthene	0.027
Indeno(1,2,3-cd)pyrene	<0.01
Dibenz(a,h)anthracene	<0.01
Benzo(g,h,i)perylene	<0.01

FRIEDMAN & BRUYA, INC.

ENVIRONMENTAL CHEMISTS

Analysis For Semivolatile Compounds By EPA Method 8270E

Client Sample ID:	Method Blank	Client:	Terracon
Date Received:	Not Applicable	Project:	JSCEE 81247068, F&BI 402193
Date Extracted:	02/14/24	Lab ID:	04-0343 mb 1/5
Date Analyzed:	02/14/24	Data File:	021408.D
Matrix:	Soil	Instrument:	GCMS12
Units:	mg/kg (ppm) Dry Weight	Operator:	VM

Surrogates:	% Recovery:	Lower Limit:	Upper Limit:
Nitrobenzene-d5	88	16	137
2-Fluorobiphenyl	84	46	122
2,4,6-Tribromophenol	85	17	154
Terphenyl-d14	85	31	167

Compounds:	Concentration mg/kg (ppm)
Naphthalene	<0.01
2-Methylnaphthalene	<0.01
1-Methylnaphthalene	<0.01
Acenaphthylene	<0.01
Acenaphthene	<0.01
Fluorene	<0.01
Phenanthrene	<0.01
Anthracene	<0.01
Fluoranthene	<0.01
Pyrene	<0.01
Benz(a)anthracene	<0.01
Chrysene	<0.01
Benzo(a)pyrene	<0.01
Benzo(b)fluoranthene	<0.01
Benzo(k)fluoranthene	<0.01
Indeno(1,2,3-cd)pyrene	<0.01
Dibenz(a,h)anthracene	<0.01
Benzo(g,h,i)perylene	<0.01

FRIEDMAN & BRUYA, INC.

ENVIRONMENTAL CHEMISTS

Date of Report: 02/16/24

Date Received: 02/14/24

Project: JSCEE 81247068, F&BI 402193

**QUALITY ASSURANCE RESULTS FOR THE ANALYSIS OF SOIL SAMPLES
FOR SEMIVOLATILES BY EPA METHOD 8270E**

Laboratory Code: 402176-01 1/5 (Matrix Spike)

Analyte	Reporting Units	Spike Level	Sample Result (Wet wt)	Percent Recovery MS	Percent Recovery MSD	Acceptance Criteria	RPD (Limit 20)
Naphthalene	mg/kg (ppm)	0.83	<0.01	75	78	50-150	4
2-Methylnaphthalene	mg/kg (ppm)	0.83	<0.01	80	84	50-150	5
1-Methylnaphthalene	mg/kg (ppm)	0.83	<0.01	76	79	50-150	4
Acenaphthylene	mg/kg (ppm)	0.83	<0.01	81	83	50-150	2
Acenaphthene	mg/kg (ppm)	0.83	<0.01	78	81	50-150	4
Fluorene	mg/kg (ppm)	0.83	<0.01	83	84	50-150	1
Phenanthrene	mg/kg (ppm)	0.83	<0.01	82	86	10-170	5
Anthracene	mg/kg (ppm)	0.83	<0.01	82	84	37-139	2
Fluoranthene	mg/kg (ppm)	0.83	<0.01	87	89	10-203	2
Pyrene	mg/kg (ppm)	0.83	<0.01	84	86	10-208	2
Benz(a)anthracene	mg/kg (ppm)	0.83	<0.01	88	91	37-146	3
Chrysene	mg/kg (ppm)	0.83	<0.01	87	89	36-144	2
Benzo(a)pyrene	mg/kg (ppm)	0.83	<0.01	99	103	40-150	4
Benzo(b)fluoranthene	mg/kg (ppm)	0.83	<0.01	91	93	45-157	2
Benzo(k)fluoranthene	mg/kg (ppm)	0.83	<0.01	98	100	50-150	2
Indeno(1,2,3-cd)pyrene	mg/kg (ppm)	0.83	<0.01	81	82	24-145	1
Dibenz(a,h)anthracene	mg/kg (ppm)	0.83	<0.01	73	74	31-137	1
Benzo(g,h,i)perylene	mg/kg (ppm)	0.83	<0.01	66	65	14-141	2

Laboratory Code: Laboratory Control Sample 1/5

Analyte	Reporting Units	Spike Level	Percent Recovery LCS	Acceptance Criteria
Naphthalene	mg/kg (ppm)	0.83	82	59-105
2-Methylnaphthalene	mg/kg (ppm)	0.83	85	62-108
1-Methylnaphthalene	mg/kg (ppm)	0.83	81	62-108
Acenaphthylene	mg/kg (ppm)	0.83	87	61-111
Acenaphthene	mg/kg (ppm)	0.83	85	61-110
Fluorene	mg/kg (ppm)	0.83	87	62-114
Phenanthrene	mg/kg (ppm)	0.83	92	64-112
Anthracene	mg/kg (ppm)	0.83	91	63-111
Fluoranthene	mg/kg (ppm)	0.83	93	66-115
Pyrene	mg/kg (ppm)	0.83	89	65-112
Benz(a)anthracene	mg/kg (ppm)	0.83	94	64-116
Chrysene	mg/kg (ppm)	0.83	95	66-119
Benzo(a)pyrene	mg/kg (ppm)	0.83	106	62-116
Benzo(b)fluoranthene	mg/kg (ppm)	0.83	98	61-118
Benzo(k)fluoranthene	mg/kg (ppm)	0.83	102	65-119
Indeno(1,2,3-cd)pyrene	mg/kg (ppm)	0.83	103	64-130
Dibenz(a,h)anthracene	mg/kg (ppm)	0.83	100	67-131
Benzo(g,h,i)perylene	mg/kg (ppm)	0.83	93	67-126

FRIEDMAN & BRUYA, INC.

ENVIRONMENTAL CHEMISTS

Data Qualifiers & Definitions

- a - The analyte was detected at a level less than five times the reporting limit. The RPD results may not provide reliable information on the variability of the analysis.
- b - The analyte was spiked at a level that was less than five times that present in the sample. Matrix spike recoveries may not be meaningful.
- ca - The calibration results for the analyte were outside of acceptance criteria, biased low; or, the calibration results for the analyte were outside of acceptance criteria, biased high, with a detection for the analyte in the sample. The value reported is an estimate.
- c - The presence of the analyte may be due to carryover from previous sample injections.
- cf - The sample was centrifuged prior to analysis.
- d - The sample was diluted. Detection limits were raised and surrogate recoveries may not be meaningful.
- dv - Insufficient sample volume was available to achieve normal reporting limits.
- f - The sample was laboratory filtered prior to analysis.
- fb - The analyte was detected in the method blank.
- fc - The analyte is a common laboratory and field contaminant.
- hr - The sample and duplicate were reextracted and reanalyzed. RPD results were still outside of control limits. Variability is attributed to sample inhomogeneity.
- hs - Headspace was present in the container used for analysis.
- ht - The analysis was performed outside the method or client-specified holding time requirement.
- ip - Recovery fell outside of control limits due to sample matrix effects.
- j - The analyte concentration is reported below the standard reporting limit. The value reported is an estimate.
- J - The internal standard associated with the analyte is out of control limits. The reported concentration is an estimate.
- jl - The laboratory control sample(s) percent recovery and/or RPD were out of control limits. The reported concentration should be considered an estimate.
- js - The surrogate associated with the analyte is out of control limits. The reported concentration should be considered an estimate.
- k - The calibration results for the analyte were outside of acceptance criteria, biased high, and the analyte was not detected in the sample.
- lc - The presence of the analyte is likely due to laboratory contamination.
- L - The reported concentration was generated from a library search.
- nm - The analyte was not detected in one or more of the duplicate analyses. Therefore, calculation of the RPD is not applicable.
- pc - The sample was received with incorrect preservation or in a container not approved by the method. The value reported should be considered an estimate.
- ve - The analyte response exceeded the valid instrument calibration range. The value reported is an estimate.
- vo - The value reported fell outside the control limits established for this analyte.
- x - The sample chromatographic pattern does not resemble the fuel standard used for quantitation.

SAMPLE CHAIN OF CUSTODY 02/14/24 01

402193

Report To Kyle Bennett

Company Terrason

Address 21905 64th Ave W, Skedoo

City, State, ZIP Mountlake Terrace, WA

Phone 425-771-3304 Email kyle.bennett@terrason

SAMPLERS (signature) 	
PROJECT NAME	PO #
<u>ISCEE</u>	<u>81247068</u>
REMARKS	INVOICE TO
Project specific RIs? - Yes / No	

Page # 1 of 1

TURNAROUND TIME

Standard turnaround
 RUSH 24-hr
 Rush charges authorized by:

SAMPLE DISPOSAL

Archive samples
 Other
 Default: Dispose after 30 days

Sample ID	Lab ID	Date Sampled	Time Sampled	Sample Type	# of Jars	ANALYSES REQUESTED							Notes					
						NWTPH-Dx	NWTPH-Gx	BTEX EPA 8021	NWTPH-HCID	VOCs EPA 8260	PAHs EPA 8270	PCBs EPA 8082						
<u>51-20240214</u>	<u>01</u>	<u>2/14/24</u>	<u>1205</u>	<u>soil</u>	<u>1</u>					<u>X</u>								
Samples received at <u>0</u> °C																		

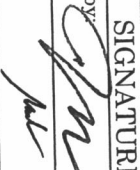
SIGNATURE		PRINT NAME		COMPANY		DATE	TIME
		<u>Jeff Dobkins</u>		<u>TC</u>		<u>2/14/24</u>	<u>1250</u>
Relinquished by:		ANHPHAN		<u>ESB</u>		<u>02/14/24</u>	<u>12:50</u>
Received by:							

Friedman & Bruya, Inc.
 Ph. (306) 285-8282

FRIEDMAN & BRUYA, INC.

ENVIRONMENTAL CHEMISTS

James E. Bruya, Ph.D.
Yelena Aravkina, M.S.
Michael Erdahl, B.S.
Vineta Mills, M.S.
Eric Young, B.S.

5500 4th Ave South
Seattle, WA 98108-2419
(206) 285-8282
office@friedmanandbruya.com
www.friedmanandbruya.com

March 15, 2024

Kyle Bennett, Project Manager
Terracon
Pacific Cascade Building
21905 64th Ave. W., Suite 100
Mountlake Terrace, WA 98043

Dear Mr Bennett:

Included are the results from the testing of material submitted on March 14, 2024 from the JSCEE 81247068, F&BI 403218 project. There are 5 pages included in this report. Any samples that may remain are currently scheduled for disposal in 30 days, or as directed by the Chain of Custody document. If you would like us to return your samples or arrange for long term storage at our offices, please contact us as soon as possible.

We appreciate this opportunity to be of service to you and hope you will call if you should have any questions.

Sincerely,

FRIEDMAN & BRUYA, INC.



Michael Erdahl
Project Manager

Enclosures

c: Terracon A/P (TRR), Jeff Dobbins
TRR0315R.DOC

FRIEDMAN & BRUYA, INC.

ENVIRONMENTAL CHEMISTS

CASE NARRATIVE

This case narrative encompasses samples received on March 14, 2024 by Friedman & Bruya, Inc. from the Terracon JSCEE 81247068, F&BI 403218 project. Samples were logged in under the laboratory ID's listed below.

Laboratory ID

403218 -01

Terracon

S1-20240314

All quality control requirements were acceptable.

FRIEDMAN & BRUYA, INC.

ENVIRONMENTAL CHEMISTS

Analysis For Semivolatile Compounds By EPA Method 8270E

Client Sample ID:	S1-20240314	Client:	Terracon
Date Received:	03/14/24	Project:	JSCEE 81247068, F&BI 403218
Date Extracted:	03/14/24	Lab ID:	403218-01 1/5
Date Analyzed:	03/15/24	Data File:	031506.D
Matrix:	Soil	Instrument:	GCMS9
Units:	mg/kg (ppm) Dry Weight	Operator:	VM

Surrogates:	% Recovery:	Lower Limit:	Upper Limit:
Nitrobenzene-d5	81 ca	10	198
2-Fluorobiphenyl	75	45	117
2,4,6-Tribromophenol	77	11	158
Terphenyl-d14	84	50	124

Compounds:	Concentration mg/kg (ppm)
Naphthalene	<0.01
2-Methylnaphthalene	<0.01
1-Methylnaphthalene	<0.01
Acenaphthylene	<0.01
Acenaphthene	<0.01
Fluorene	<0.01
Phenanthrene	0.048
Anthracene	0.031
Fluoranthene	0.080
Pyrene	0.10
Benz(a)anthracene	0.029
Chrysene	0.042
Benzo(a)pyrene	0.032
Benzo(b)fluoranthene	0.054
Benzo(k)fluoranthene	0.017
Indeno(1,2,3-cd)pyrene	0.014
Dibenz(a,h)anthracene	<0.01
Benzo(g,h,i)perylene	0.013

FRIEDMAN & BRUYA, INC.

ENVIRONMENTAL CHEMISTS

Analysis For Semivolatile Compounds By EPA Method 8270E

Client Sample ID:	Method Blank	Client:	Terracon
Date Received:	Not Applicable	Project:	JSCEE 81247068, F&BI 403218
Date Extracted:	03/14/24	Lab ID:	04-0589 mb2 1/5
Date Analyzed:	03/15/24	Data File:	031505.D
Matrix:	Soil	Instrument:	GCMS9
Units:	mg/kg (ppm) Dry Weight	Operator:	VM

Surrogates:	% Recovery:	Lower Limit:	Upper Limit:
Nitrobenzene-d5	78 ca	10	198
2-Fluorobiphenyl	78	45	117
2,4,6-Tribromophenol	75	11	158
Terphenyl-d14	86	50	124

Compounds:	Concentration mg/kg (ppm)
Naphthalene	<0.01
2-Methylnaphthalene	<0.01
1-Methylnaphthalene	<0.01
Acenaphthylene	<0.01
Acenaphthene	<0.01
Fluorene	<0.01
Phenanthrene	<0.01
Anthracene	<0.01
Fluoranthene	<0.01
Pyrene	<0.01
Benz(a)anthracene	<0.01
Chrysene	<0.01
Benzo(a)pyrene	<0.01
Benzo(b)fluoranthene	<0.01
Benzo(k)fluoranthene	<0.01
Indeno(1,2,3-cd)pyrene	<0.01
Dibenz(a,h)anthracene	<0.01
Benzo(g,h,i)perylene	<0.01

FRIEDMAN & BRUYA, INC.

ENVIRONMENTAL CHEMISTS

Date of Report: 03/15/24

Date Received: 03/14/24

Project: JSCEE 81247068, F&BI 403218

**QUALITY ASSURANCE RESULTS FOR THE ANALYSIS OF SOIL SAMPLES
FOR SEMIVOLATILES BY EPA METHOD 8270E**

Laboratory Code: Laboratory Control Sample 1/5

Analyte	Reporting Units	Spike Level	Percent Recovery LCS	Percent Recovery LCSD	Acceptance Criteria	RPD (Limit 20)
Naphthalene	mg/kg (ppm)	0.83	89	88	57-107	1
2-Methylnaphthalene	mg/kg (ppm)	0.83	88	88	63-112	0
1-Methylnaphthalene	mg/kg (ppm)	0.83	88	88	63-113	0
Acenaphthylene	mg/kg (ppm)	0.83	95	91	70-130	4
Acenaphthene	mg/kg (ppm)	0.83	94	91	66-112	3
Fluorene	mg/kg (ppm)	0.83	93	92	67-117	1
Phenanthrene	mg/kg (ppm)	0.83	95	91	70-130	4
Anthracene	mg/kg (ppm)	0.83	93	89	70-130	4
Fluoranthene	mg/kg (ppm)	0.83	98	93	70-130	5
Pyrene	mg/kg (ppm)	0.83	90	89	70-130	1
Benz(a)anthracene	mg/kg (ppm)	0.83	93	92	70-130	1
Chrysene	mg/kg (ppm)	0.83	96	94	70-130	2
Benzo(a)pyrene	mg/kg (ppm)	0.83	95	93	68-120	2
Benzo(b)fluoranthene	mg/kg (ppm)	0.83	97	97	67-128	0
Benzo(k)fluoranthene	mg/kg (ppm)	0.83	98	96	70-130	2
Indeno(1,2,3-cd)pyrene	mg/kg (ppm)	0.83	101	93	67-129	8
Dibenz(a,h)anthracene	mg/kg (ppm)	0.83	100	92	67-128	8
Benzo(g,h,i)perylene	mg/kg (ppm)	0.83	98	89	65-130	10

FRIEDMAN & BRUYA, INC.

ENVIRONMENTAL CHEMISTS

Data Qualifiers & Definitions

- a - The analyte was detected at a level less than five times the reporting limit. The RPD results may not provide reliable information on the variability of the analysis.
- b - The analyte was spiked at a level that was less than five times that present in the sample. Matrix spike recoveries may not be meaningful.
- ca - The calibration results for the analyte were outside of acceptance criteria, biased low; or, the calibration results for the analyte were outside of acceptance criteria, biased high, with a detection for the analyte in the sample. The value reported is an estimate.
- c - The presence of the analyte may be due to carryover from previous sample injections.
- cf - The sample was centrifuged prior to analysis.
- d - The sample was diluted. Detection limits were raised and surrogate recoveries may not be meaningful.
- dv - Insufficient sample volume was available to achieve normal reporting limits.
- f - The sample was laboratory filtered prior to analysis.
- fb - The analyte was detected in the method blank.
- fc - The analyte is a common laboratory and field contaminant.
- hr - The sample and duplicate were reextracted and reanalyzed. RPD results were still outside of control limits. Variability is attributed to sample inhomogeneity.
- hs - Headspace was present in the container used for analysis.
- ht - The analysis was performed outside the method or client-specified holding time requirement.
- ip - Recovery fell outside of control limits due to sample matrix effects.
- j - The analyte concentration is reported below the standard reporting limit. The value reported is an estimate.
- J - The internal standard associated with the analyte is out of control limits. The reported concentration is an estimate.
- jl - The laboratory control sample(s) percent recovery and/or RPD were out of control limits. The reported concentration should be considered an estimate.
- js - The surrogate associated with the analyte is out of control limits. The reported concentration should be considered an estimate.
- k - The calibration results for the analyte were outside of acceptance criteria, biased high, and the analyte was not detected in the sample.
- lc - The presence of the analyte is likely due to laboratory contamination.
- L - The reported concentration was generated from a library search.
- nm - The analyte was not detected in one or more of the duplicate analyses. Therefore, calculation of the RPD is not applicable.
- pc - The sample was received with incorrect preservation or in a container not approved by the method. The value reported should be considered an estimate.
- ve - The analyte response exceeded the valid instrument calibration range. The value reported is an estimate.
- vo - The value reported fell outside the control limits established for this analyte.
- x - The sample chromatographic pattern does not resemble the fuel standard used for quantitation.

FRIEDMAN & BRUYA, INC.

ENVIRONMENTAL CHEMISTS

James E. Bruya, Ph.D.
Yelena Aravkina, M.S.
Michael Erdahl, B.S.
Vineta Mills, M.S.
Eric Young, B.S.

5500 4th Ave South
Seattle, WA 98108-2419
(206) 285-8282
office@friedmanandbruya.com
www.friedmanandbruya.com

March 25, 2024

Kyle Bennett, Project Manager
Terracon
Pacific Cascade Building
21905 64th Ave. W., Suite 100
Mountlake Terrace, WA 98043

Dear Mr Bennett:

Included are the results from the testing of material submitted on March 19, 2024 from the JSCEE 81247068, F&BI 403272 project. There are 6 pages included in this report. Any samples that may remain are currently scheduled for disposal in 30 days, or as directed by the Chain of Custody document. If you would like us to return your samples or arrange for long term storage at our offices, please contact us as soon as possible.

We appreciate this opportunity to be of service to you and hope you will call if you should have any questions.

Sincerely,

FRIEDMAN & BRUYA, INC.



Michael Erdahl
Project Manager

Enclosures

c: Terracon A/P (TRR)
TRR0325R.DOC

FRIEDMAN & BRUYA, INC.

ENVIRONMENTAL CHEMISTS

CASE NARRATIVE

This case narrative encompasses samples received on March 19, 2024 by Friedman & Bruya, Inc. from the Terracon JSCEE 81247068, F&BI 403272 project. Samples were logged in under the laboratory ID's listed below.

Laboratory ID

403272 -01

Terracon

S1-20240319

All quality control requirements were acceptable.

FRIEDMAN & BRUYA, INC.

ENVIRONMENTAL CHEMISTS

Analysis For Semivolatile Compounds By EPA Method 8270E

Client Sample ID:	S1-20240319	Client:	Terracon
Date Received:	03/19/24	Project:	JSCEE 81247068, F&BI 403272
Date Extracted:	03/19/24	Lab ID:	403272-01 1/25
Date Analyzed:	03/19/24	Data File:	031910.D
Matrix:	Soil	Instrument:	GCMS9
Units:	mg/kg (ppm) Dry Weight	Operator:	VM

Surrogates:	% Recovery:	Lower Limit:	Upper Limit:
Nitrobenzene-d5	89 d	10	198
2-Fluorobiphenyl	100 d	45	117
2,4,6-Tribromophenol	115 d	11	158
Terphenyl-d14	114 d	50	124

Compounds:	Concentration mg/kg (ppm)
1-Methylnaphthalene	22
Acenaphthylene	<0.05
Anthracene	11
Benz(a)anthracene	6.3
Chrysene	5.1
Benzo(a)pyrene	1.4
Benzo(b)fluoranthene	2.3
Benzo(k)fluoranthene	0.83
Indeno(1,2,3-cd)pyrene	0.29
Dibenz(a,h)anthracene	0.089
Benzo(g,h,i)perylene	0.23

FRIEDMAN & BRUYA, INC.

ENVIRONMENTAL CHEMISTS

Analysis For Semivolatile Compounds By EPA Method 8270E

Client Sample ID:	S1-20240319	Client:	Terracon
Date Received:	03/19/24	Project:	JSCEE 81247068, F&BI 403272
Date Extracted:	03/19/24	Lab ID:	403272-01 1/1000
Date Analyzed:	03/21/24	Data File:	032126.D
Matrix:	Soil	Instrument:	GCMS9
Units:	mg/kg (ppm) Dry Weight	Operator:	VM

Surrogates:	% Recovery:	Lower Limit:	Upper Limit:
Nitrobenzene-d5	0 d	10	198
2-Fluorobiphenyl	80 d	45	117
2,4,6-Tribromophenol	0 d ca	11	158
Terphenyl-d14	100 d	50	124

Compounds:	Concentration mg/kg (ppm)
Naphthalene	97
2-Methylnaphthalene	40
Acenaphthene	61
Fluorene	53
Phenanthrene	140
Fluoranthene	52
Pyrene	28

FRIEDMAN & BRUYA, INC.

ENVIRONMENTAL CHEMISTS

Analysis For Semivolatile Compounds By EPA Method 8270E

Client Sample ID:	Method Blank	Client:	Terracon
Date Received:	Not Applicable	Project:	JSCEE 81247068, F&BI 403272
Date Extracted:	03/19/24	Lab ID:	04-0658 mb 1/5
Date Analyzed:	03/19/24	Data File:	031908.D
Matrix:	Soil	Instrument:	GCMS9
Units:	mg/kg (ppm) Dry Weight	Operator:	VM

Surrogates:	% Recovery:	Lower Limit:	Upper Limit:
Nitrobenzene-d5	108	10	198
2-Fluorobiphenyl	111	45	117
2,4,6-Tribromophenol	104	11	158
Terphenyl-d14	118	50	124

Compounds:	Concentration mg/kg (ppm)
Naphthalene	<0.01
2-Methylnaphthalene	<0.01
1-Methylnaphthalene	<0.01
Acenaphthylene	<0.01
Acenaphthene	<0.01
Fluorene	<0.01
Phenanthrene	<0.01
Anthracene	<0.01
Fluoranthene	<0.01
Pyrene	<0.01
Benz(a)anthracene	<0.01
Chrysene	<0.01
Benzo(a)pyrene	<0.01
Benzo(b)fluoranthene	<0.01
Benzo(k)fluoranthene	<0.01
Indeno(1,2,3-cd)pyrene	<0.01
Dibenz(a,h)anthracene	<0.01
Benzo(g,h,i)perylene	<0.01

FRIEDMAN & BRUYA, INC.

ENVIRONMENTAL CHEMISTS

Date of Report: 03/25/24

Date Received: 03/19/24

Project: JSCEE 81247068, F&BI 403272

**QUALITY ASSURANCE RESULTS FOR THE ANALYSIS OF SOIL SAMPLES
FOR SEMIVOLATILES BY EPA METHOD 8270E**

Laboratory Code: 403260-01 1/5 (Matrix Spike)

Analyte	Reporting Units	Spike Level	Sample Result (Wet wt)	Percent Recovery MS	Percent Recovery MSD	Acceptance Criteria	RPD (Limit 20)
Naphthalene	mg/kg (ppm)	0.83	<0.01	74	82	28-125	10
2-Methylnaphthalene	mg/kg (ppm)	0.83	<0.01	77	83	10-192	7
1-Methylnaphthalene	mg/kg (ppm)	0.83	<0.01	76	81	10-163	6
Acenaphthylene	mg/kg (ppm)	0.83	<0.01	86	90	45-128	5
Acenaphthene	mg/kg (ppm)	0.83	<0.01	84	89	36-125	6
Fluorene	mg/kg (ppm)	0.83	<0.01	87	91	48-121	4
Phenanthrene	mg/kg (ppm)	0.83	<0.01	89	90	46-122	1
Anthracene	mg/kg (ppm)	0.83	<0.01	92	91	30-144	1
Fluoranthene	mg/kg (ppm)	0.83	<0.01	99	98	50-150	1
Pyrene	mg/kg (ppm)	0.83	<0.01	92	92	40-134	0
Benz(a)anthracene	mg/kg (ppm)	0.83	<0.01	91	91	50-150	0
Chrysene	mg/kg (ppm)	0.83	<0.01	89	90	50-150	1
Benzo(a)pyrene	mg/kg (ppm)	0.83	<0.01	94	97	50-150	3
Benzo(b)fluoranthene	mg/kg (ppm)	0.83	<0.01	97	98	50-150	1
Benzo(k)fluoranthene	mg/kg (ppm)	0.83	<0.01	93	97	50-150	4
Indeno(1,2,3-cd)pyrene	mg/kg (ppm)	0.83	<0.01	104	110	40-140	6
Dibenz(a,h)anthracene	mg/kg (ppm)	0.83	<0.01	101	109	41-136	8
Benzo(g,h,i)perylene	mg/kg (ppm)	0.83	<0.01	99	107	29-139	8

Laboratory Code: Laboratory Control Sample 1/5

Analyte	Reporting Units	Spike Level	Percent Recovery LCS	Acceptance Criteria
Naphthalene	mg/kg (ppm)	0.83	88	57-107
2-Methylnaphthalene	mg/kg (ppm)	0.83	90	63-112
1-Methylnaphthalene	mg/kg (ppm)	0.83	88	63-113
Acenaphthylene	mg/kg (ppm)	0.83	95	70-130
Acenaphthene	mg/kg (ppm)	0.83	93	66-112
Fluorene	mg/kg (ppm)	0.83	97	67-117
Phenanthrene	mg/kg (ppm)	0.83	95	70-130
Anthracene	mg/kg (ppm)	0.83	96	70-130
Fluoranthene	mg/kg (ppm)	0.83	103	70-130
Pyrene	mg/kg (ppm)	0.83	98	70-130
Benz(a)anthracene	mg/kg (ppm)	0.83	98	70-130
Chrysene	mg/kg (ppm)	0.83	96	70-130
Benzo(a)pyrene	mg/kg (ppm)	0.83	102	68-120
Benzo(b)fluoranthene	mg/kg (ppm)	0.83	104	67-128
Benzo(k)fluoranthene	mg/kg (ppm)	0.83	102	70-130
Indeno(1,2,3-cd)pyrene	mg/kg (ppm)	0.83	99	67-129
Dibenz(a,h)anthracene	mg/kg (ppm)	0.83	98	67-128
Benzo(g,h,i)perylene	mg/kg (ppm)	0.83	96	65-130

FRIEDMAN & BRUYA, INC.

ENVIRONMENTAL CHEMISTS

Data Qualifiers & Definitions

- a - The analyte was detected at a level less than five times the reporting limit. The RPD results may not provide reliable information on the variability of the analysis.
- b - The analyte was spiked at a level that was less than five times that present in the sample. Matrix spike recoveries may not be meaningful.
- ca - The calibration results for the analyte were outside of acceptance criteria, biased low; or, the calibration results for the analyte were outside of acceptance criteria, biased high, with a detection for the analyte in the sample. The value reported is an estimate.
- c - The presence of the analyte may be due to carryover from previous sample injections.
- cf - The sample was centrifuged prior to analysis.
- d - The sample was diluted. Detection limits were raised and surrogate recoveries may not be meaningful.
- dv - Insufficient sample volume was available to achieve normal reporting limits.
- f - The sample was laboratory filtered prior to analysis.
- fb - The analyte was detected in the method blank.
- fc - The analyte is a common laboratory and field contaminant.
- hr - The sample and duplicate were reextracted and reanalyzed. RPD results were still outside of control limits. Variability is attributed to sample inhomogeneity.
- hs - Headspace was present in the container used for analysis.
- ht - The analysis was performed outside the method or client-specified holding time requirement.
- ip - Recovery fell outside of control limits due to sample matrix effects.
- j - The analyte concentration is reported below the standard reporting limit. The value reported is an estimate.
- J - The internal standard associated with the analyte is out of control limits. The reported concentration is an estimate.
- jl - The laboratory control sample(s) percent recovery and/or RPD were out of control limits. The reported concentration should be considered an estimate.
- js - The surrogate associated with the analyte is out of control limits. The reported concentration should be considered an estimate.
- k - The calibration results for the analyte were outside of acceptance criteria, biased high, and the analyte was not detected in the sample.
- lc - The presence of the analyte is likely due to laboratory contamination.
- L - The reported concentration was generated from a library search.
- nm - The analyte was not detected in one or more of the duplicate analyses. Therefore, calculation of the RPD is not applicable.
- pc - The sample was received with incorrect preservation or in a container not approved by the method. The value reported should be considered an estimate.
- ve - The analyte response exceeded the valid instrument calibration range. The value reported is an estimate.
- vo - The value reported fell outside the control limits established for this analyte.
- x - The sample chromatographic pattern does not resemble the fuel standard used for quantitation.

HW

Load# 4602



Material Load Form

Lafarge Seattle

Date: 2-8-24

Carrier / Truck No: 470

Time:

Weighmaster: [Signature]

Generator Titan Earth Works - b

Job No. Seattle Schools

Material Name: Utility excavation

Profile # 24-TEW-UEP-07

Seattle plant discharge location: B2

Bill: Titan Earth Works - b

To: (Consignee)

1585 Valentine Ave. SE
Pacific WA 98047

Name: Lafarge PNW, Inc.
Address: PO Box 732101
Dallas, TX 75373-2101

Chris Pierce - 253-720-0523

Phone: (206) 336-0966

Trucked: Olson Brothers Pro-Vac LLC DBA Provac LLC

Authorized Signature
[Signature]

Coy McElderry / Dan Waldron

[Signature]

Lafarge Weighmaster Signature

[Signature]

Truck Driver Signature

Not Valid After
March 31st 2024

Lafarge Scale Mass
Gross: 64,440
Tare: 48,840
Net:

DO NOT DUPLICATE THIS FORM

This form is INVALID without an original authorized signature.

13M

Load# 4604



Material Load Form

Lafarge Seattle

Date: 2-5-24

Carrier / Truck No: 470

Time:

Weighmaster:

Generator Titan Earth Works - b

Job No. Seattle Schools

Material Name: Utility excavation

Profile # 24-TEW-UEP-07

Seattle plant discharge location: B2

Bill: Titan Earth Works - b

To: (Consignee)

1585 Valentine Ave. SE
Pacific WA 98047

Name: Lafarge PNW, Inc.
Address: PO Box 732101
Dallas, TX 75373-2101

Chris Pierce - 253-720-0523

Phone: (206) 336-0966

Trucked: Olson Brothers Pro-Vac LLC DBA Provac LLC

Authorized Signature

Coy McElderry / Dan Waldron

Lafarge Weighmaster Signature

Truck Driver Signature

Not Valid After

March 31st 2024

Lafarge Scale Mass
Gross: 57,500
Tare: 47,500
Net:

DO NOT DUPLICATE THIS FORM

This form is INVALID without an original authorized signature.

HM



Load# 4605

Material Load Form

Lafarge Seattle

Date: 2-6-24

Carrier / Truck No: 470

Time: 11 am

Weighmaster: [Signature]

Generator Titan Earth Works - b

Job No. Seattle Schools

Material Name: Utility excavation

Profile # 24-TEW-UEP-07

Seattle plant discharge location: B2

Bill: Titan Earth Works - b

To: (Consignee)

1585 Valentine Ave. SE
Pacific WA 98047

Name: Lafarge PNW, Inc.
Address: PO Box 732101
Dallas, TX 75373-2101

Chris Pierce - 253-720-0523

Phone: (206) 336-0966

Trucked: Olson Brothers Pro-Vac LLC DBA Provac LLC

Authorized Signature
[Signature: Daniel Waldron]

Coy McElderry / Dan Waldron

[Signature]

Lafarge Weighmaster Signature

[Signature]

Truck Driver Signature

Not Valid After
March 31st 2024

Lafarge Scale Mass
Gross: 70,040
Tare: 49,560
Net:

DO NOT DUPLICATE THIS FORM

This form is INVALID without an original authorized signature.

[Signature]

DW



Load# 4606

Material Load Form

Lafarge Seattle

Date: 2-8-24

Carrier / Truck No: 470

Time:

Weighmaster:

Generator Titan Earth Works - b

Job No. Seattle Schools

Material Name: Utility excavation

Profile # 24-TEW-UEP-07

Seattle plant discharge location: B2

Bill: Titan Earth Works - b

To: (Consignee)

1585 Valentine Ave. SE
Pacific WA 98047

Name: Lafarge PNW, Inc.
Address: PO Box 732101
Dallas, TX 75373-2101

Chris Pierce - 253-720-0523

Phone: (206) 336-0966

Trucked: Olson Brothers Pro-Vac LLC DBA Provac LLC

Authorized Signature

Coy McElderry / Dan Waldron

Lafarge Weighmaster Signature

Truck Driver Signature

Not Valid After
March 31st 2024

Lafarge Scale Mass
Gross: 170,480
Tare: 50,040
Net:

DO NOT DUPLICATE THIS FORM

This form is INVALID without an original authorized signature.

DW



Load# 4607

Material Load Form

Lafarge Seattle

Date: 2-8-24

Carrier / Truck No: Jeff M. / 485

Time: 14:35

Weighmaster: [Signature]

Generator Titan Earth Works - b

Job No. Seattle Schools

Material Name: Utility excavation

Profile # 24-TEW-UEP-07

Seattle plant discharge location: B2

Bill: Titan Earth Works - b

To: (Consignee)

1585 Valentine Ave. SE
Pacific WA 98047

Name: Lafarge PNW, Inc.
Address: PO Box 732101
Dallas, TX 75373-2101

Chris Pierce - 253-720-0523

Phone: (206) 336-0966

Trucked: Olson Brothers Pro-Vac LLC DBA Provac LLC

Authorized Signature
[Signature]

Coy McElderry / Dan Waldron

[Signature]

Lafarge Weighmaster Signature

[Signature]

Truck Driver Signature

Not Valid After
March 31st 2024

Lafarge Scale Mass
Gross: 66,980
Tare: 51,540
Net: 15,440

DO NOT DUPLICATE THIS FORM

This form is INVALID without an original authorized signature.

DW



Load# 4608

Material Load Form

Lafarge Seattle

Date: 2-8-24

Carrier / Truck No: 4700

Time:

Weighmaster:

Generator Titan Earth Works - b

Job No. Seattle Schools

Material Name: Utility excavation

Profile # 24-TEW-UEP-07

Seattle plant discharge location: B2

Bill: Titan Earth Works - b

To: (Consignee)

1585 Valentine Ave. SE
Pacific WA 98047

Name: Lafarge PNW, Inc.
Address: PO Box 732101
Dallas, TX 75373-2101

Chris Pierce - 253-720-0523

Phone: (206) 336-0966

Trucked: Olson Brothers Pro-Vac LLC DBA Provac LLC

Authorized Signature

Coy McElderry / Dan Waldron

Lafarge Weighmaster Signature

Truck Driver Signature

Not Valid After
March 31st 2024

Lafarge Scale Mass
Gross: 56,520
Tare: 46,020
Net:

DO NOT DUPLICATE THIS FORM

This form is INVALID without an original authorized signature.

12

Load# 4609



Material Load Form

Lafarge Seattle

Date: 2-13-24

Carrier / Truck No: 4670

Time: 10:06 am

Weighmaster: [Signature]

Generator Titan Earth Works - b

Job No. Seattle Schools

Material Name: Utility excavation

Profile # 24-TEW-UEP-07

Seattle plant discharge location: B2

Bill: Titan Earth Works - b

To: (Consignee)

1585 Valentine Ave. SE
Pacific WA 98047

Name: Lafarge PNW, Inc.
Address: PO Box 732101
Dallas, TX 75373-2101

Chris Pierce - 253-720-0523

Phone: (206) 336-0966

Trucked: Olson Brothers Pro-Vac LLC DBA Provac LLC

Authorized Signature
[Signature]

Coy McElderry / Dan Waldron

[Signature]

Lafarge Weighmaster Signature

[Signature]

Truck Driver Signature

Not Valid After
March 31st 2024

Lafarge Scale Mass

Gross: 67,040

Tare: 49,200

Net:

DO NOT DUPLICATE THIS FORM

This form is INVALID without an original authorized signature.



Load# 4669

Material Load Form

Lafarge Seattle

Date: 2-13-24

Carrier / Truck No: 470

Time: 2:15 pm

~~Weighmaster~~

Generator Titan Earth Works - b

Job No. Seattle Schools

Material Name: Utility excavation

Profile # 24-TEW-UEP-07

Seattle plant discharge location: B2

Bill: Titan Earth Works - b

To: (Consignee)

1585 Valentine Ave. SE
Pacific WA 98047

Name: Lafarge PNW, Inc.
Address: PO Box 732101
Dallas, TX 75373-2101

Chris Pierce - 253-720-0523

Phone: (206) 336-0966

Trucked: Titan Earth Works - b

Authorized Signature

Coy McElderry / Dan Waldron

Not Valid After
March 31st 2024

Lafarge Weighmaster Signature

Lafarge Scale Mass
Gross: 67,320
Tare: 46,720
Net:

Truck Driver Signature

DO NOT DUPLICATE THIS FORM

This form is INVALID without an original authorized signature.

DW



Load# 4670

Material Load Form

Lafarge Seattle

Date: 2-14-24

Carrier / Truck No: 470

Time: 8:45

Weighmaster: [Signature]

Generator Titan Earth Works - b

Job No. Seattle Schools

Material Name: Utility excavation

Profile # 24-TEW-UEP-07

Seattle plant discharge location: B2

Bill: Titan Earth Works - b

To: (Consignee)

1585 Valentine Ave. SE
Pacific WA 98047

Name: Lafarge PNW, Inc.
Address: PO Box 732101
Dallas, TX 75373-2101

Chris Pierce - 253-720-0523

Phone: (206) 336-0966

Trucked: Titan Earth Works - b

Authorized Signature
[Signature: Dan Waldron]

Coy McElderry / Dan Waldron

[Signature]

Lafarge Weighmaster Signature

[Signature]

Truck Driver Signature

Not Valid After
March 31st 2024

Lafarge Scale Mass
Gross: 68,000
Tare: 49,300
Net:

DO NOT DUPLICATE THIS FORM

This form is INVALID without an original authorized signature.

722

Load# 4672



Material Load Form

Lafarge Seattle

Date: 2-15-24

Carrier / Truck No: ProVac / PV425

Time: 10:55

Weighmaster: _____

Generator Titan Earth Works - b

Job No. Seattle Schools

Material Name: Utility excavation

Profile # 24-TEW-UEP-07

Seattle plant discharge location: B2

Bill: Titan Earth Works - b

To: (Consignee)

1585 Valentine Ave. SE
Pacific WA 98047

Name: Lafarge PNW, Inc.
Address: PO Box 732101
Dallas, TX 75373-2101

Chris Pierce - 253-720-0523

Phone: (206) 336-0966

Trucked: Titan Earth Works - b

Authorized Signature

Coy McElderry / Dan Waldron

Lafarge Weighmaster Signature

Truck Driver Signature

Not Valid After

March 31st 2024

Lafarge Scale Mass

Gross: 71480

Tare: 49620

Net: 21860

DO NOT DUPLICATE THIS FORM

This form is INVALID without an original authorized signature.



Load# 4673

Material Load Form

Lafarge Seattle

Date: 2-15-24

Carrier / Truck No: ProVal / PV425

Time: 3:05

Weighmaster: [Signature]

Generator Titan Earth Works - b

Job No. Seattle Schools

Material Name: Utility excavation

Profile # 24-TEW-UEP-07

Seattle plant discharge location: B2

Bill: Titan Earth Works - b

To: (Consignee)

1585 Valentine Ave. SE
Pacific WA 98047

Name: Lafarge PNW, Inc.
Address: PO Box 732101
Dallas, TX 75373-2101

Chris Pierce - 253-720-0523

Phone: (206) 336-0966

Trucked: Titan Earth Works - b

Authorized Signature
[Signature]

Coy McElderry / Dan Waldron

[Signature]

Lafarge Weighmaster Signature

[Signature]

Truck Driver Signature

Not Valid After

March 31st 2024

Lafarge Scale Mass
Gross: 21680
Tare: 43120
Net: 25560

DO NOT DUPLICATE THIS FORM

This form is INVALID without an original authorized signature.



Load# 4674

Material Load Form

Lafarge Seattle

Date: 2-19-24

Carrier / Truck No: ProVac / PV425

Time: 09:00 AM

Weighmaster: [Signature]

Generator Titan Earth Works - b

Job No. Seattle Schools

Material Name: Utility excavation

Profile # 24-TEW-UEP-07

Seattle plant discharge location: B2

Bill: Titan Earth Works - b

To: (Consignee)

1585 Valentine Ave. SE
Pacific WA 98047

Name: Lafarge PNW, Inc.
Address: PO Box 732101
Dallas, TX 75373-2101

Chris Pierce - 253-720-0523

Phone: (206) 336-0966

Trucked: Titan Earth Works - b

Authorized Signature
[Signature: Dan Waldron]

Coy McElderry / Dan Waldron

[Signature]

Lafarge Weighmaster Signature

[Signature]

Truck Driver Signature

Not Valid After
March 31st 2024

Lafarge Scale Mass
Gross: 68120
Tare: 46860
Net: 21,260

DO NOT DUPLICATE THIS FORM

This form is INVALID without an original authorized signature.



Load# 4675

Material Load Form

Lafarge Seattle

Date: 2-19-24

Carrier / Truck No: ProVac / PV 425

Time: 12:00 pm

Weighmaster:

Generator Titan Earth Works - b

Job No. Seattle Schools

Material Name: Utility excavation

Profile # 24-TEW-UEP-07

Seattle plant discharge location: B2

Bill: Titan Earth Works - b

To: (Consignee)

1585 Valentine Ave. SE
Pacific WA 98047

Name: Lafarge PNW, Inc.
Address: PO Box 732101
Dallas, TX 75373-2101

Chris Pierce - 253-720-0523

Phone: (206) 336-0966

Trucked: Titan Earth Works - b

Authorized Signature

Coy McElderry / Dan Waldron

Lafarge Weighmaster Signature

Truck Driver Signature

Not Valid After
March 31st 2024

Lafarge Scale Mass
Gross: 69460
Tare: 47480
Net: 21980

DO NOT DUPLICATE THIS FORM

This form is INVALID without an original authorized signature.



Load# 4671

Material Load Form

Lafarge Seattle

Date: 7-14-76

Carrier / Truck No: 12

Time:

Weighmaster:

Generator Titan Earth Works - b

Job No. Seattle Schools

Material Name: Utility excavation

Profile # 24-TEW-UEP-07

Seattle plant discharge location: B2

Bill: Titan Earth Works - b

To: (Consignee)

1585 Valentine Ave. SE
Pacific WA 98047

Name: Lafarge PNW, Inc.
Address: PO Box 732101
Dallas, TX 75373-2101

Chris Pierce - 253-720-0523

Phone: (206) 336-0966

Trucked: Titan Earth Works - b

Authorized Signature
Daniel Waldron

Coy McElerry / Dan Waldron
Lafarge Weighmaster Signature

Truck Driver Signature

Not Valid After
March 31st 2024

Lafarge Scale Mass
Gross: 59,620
Tare: 56,080
Net:

DO NOT DUPLICATE THIS FORM

This form is INVALID without an original authorized signature.



Load# 4676

Material Load Form

Lafarge Seattle

Date: 2-19-24

Carrier / Truck No: ProVac / PV425

Time: 2:55

Weighmaster: [Signature]

Generator Titan Earth Works - b

Job No. Seattle Schools

Material Name: Utility excavation

Profile # 24-TEW-UEP-07

Seattle plant discharge location: B2

Bill: Titan Earth Works - b

To: (Consignee)

1585 Valentine Ave. SE
Pacific WA 98047

Name: Lafarge PNW, Inc.
Address: PO Box 732101
Dallas, TX 75373-2101

Chris Pierce - 253-720-0523

Phone: (206) 336-0966

Trucked: Titan Earth Works - b

Authorized Signature
[Signature]

Coy McElderry / Dan Waldron

[Signature]

Lafarge Weighmaster Signature

[Signature]

Truck Driver Signature

Not Valid After
March 31st 2024

Lafarge Scale Mass
Gross: 68 940
Tare: 46 200
Net: 22,660

DO NOT DUPLICATE THIS FORM

This form is INVALID without an original authorized signature.

[Handwritten mark]

DW



Load# 4677

Material Load Form

Lafarge Seattle

Date: 2-20-24

Carrier / Truck No: 470

Time: 8:30

Weighmaster: Michael Checkay

Generator Titan Earth Works - b

Job No. Seattle Schools

Material Name: Utility excavation

Profile # 24-TEW-UEP-07

Seattle plant discharge location: B2

Bill: Titan Earth Works - b

To: (Consignee)

1585 Valentine Ave. SE
Pacific WA 98047

Name: Lafarge PNW, Inc.
Address: PO Box 732101
Dallas, TX 75373-2101

Chris Pierce - 253-720-0523

Phone: (206) 336-0966

Trucked: Titan Earth Works - b

Authorized Signature

Coy McElderry / Dan Waldron

Lafarge Weighmaster Signature

Truck Driver Signature

Not Valid After
March 31st 2024

Lafarge Scale Mass
Gross: 127,000
Tare: 50,860
Net:

DO NOT DUPLICATE THIS FORM

This form is INVALID without an original authorized signature.



Load# 4678

Material Load Form

Lafarge Seattle

Date: 2-20-24

Carrier / Truck No: 470

Time: 10:50 am

Weighmaster:

Generator Titan Earth Works - b

Job No. Seattle Schools

Material Name: Utility excavation

Profile # 24-TEW-UEP-07

Seattle plant discharge location: B2

Bill: Titan Earth Works - b

To: (Consignee)

1585 Valentine Ave. SE
Pacific WA 98047

Name: Lafarge PNW, Inc.
Address: PO Box 732101
Dallas, TX 75373-2101

Chris Pierce - 253-720-0523

Phone: (206) 336-0966

Trucked: Titan Earth Works - b

Authorized Signature

Coy McElderry / Dan Waldron

Lafarge Weighmaster Signature

Truck Driver Signature

Not Valid After

March 31st 2024

Lafarge Scale Mass
Gross: 64,480
Tare: 46,800
Net:

DO NOT DUPLICATE THIS FORM

This form is INVALID without an original authorized signature.

DW



Load# 4679

Material Load Form

Lafarge Seattle

Date: 2-20-24

Carrier / Truck No: 470

Time: 3:00 pm

Weighmaster: DRyher

Generator Titan Earth Works - b

Job No. Seattle Schools

Material Name: Utility excavation

Profile # 24-TEW-UEP-07

Seattle plant discharge location: B2

Bill: Titan Earth Works - b

To: (Consignee)

1585 Valentine Ave. SE
Pacific WA 98047

Name: Lafarge PNW, Inc.
Address: PO Box 732101
Dallas, TX 75373-2101

Chris Pierce - 253-720-0523

Phone: (206) 336-0966

Trucked: Titan Earth Works - b

Authorized Signature
[Signature: Dan Waldron]

Coy McElderry / Dan Waldron

[Signature: DRyher]
Lafarge Weighmaster Signature

[Signature: Truck Driver]
Truck Driver Signature

Not Valid After
March 31st 2024

Lafarge Scale Mass
Gross: 73,340
Tare: 49,620
Net:

DO NOT DUPLICATE THIS FORM

This form is INVALID without an original authorized signature.

22



Load# 4680

Material Load Form

Lafarge Seattle

Date: 7-21-24

Carrier / Truck No: 470

Time: 9:50 am

Weighmaster:

Generator Titan Earth Works - b

Job No. Seattle Schools

Material Name: Utility excavation

Profile # 24-TEW-UEP-07

Seattle plant discharge location: B2

Bill: Titan Earth Works - b

To: (Consignee)

1585 Valentine Ave. SE
Pacific WA 98047

Name: Lafarge PNW, Inc.
Address: PO Box 732101
Dallas, TX 75373-2101

Chris Pierce - 253-720-0523

Phone: (206) 336-0966

Trucked: Titan Earth Works - b

Authorized Signature

Coy McElderry / Dan Waldron

Lafarge Weighmaster Signature

Truck Driver Signature

Not Valid After

March 31st 2024

Lafarge Scale Mass

Gross: 69,300

Tare: 49,020

Net:

DO NOT DUPLICATE THIS FORM

This form is INVALID without an original authorized signature.

DW



Load# 4681

Material Load Form

Lafarge Seattle

Date: 2-21-24

Carrier / Truck No: 470

Time: 1:05 PM

Weighmaster:

Generator Titan Earth Works - b

Job No. Seattle Schools

Material Name: Utility excavation

Profile # 24-TEW-UEP-07

Seattle plant discharge location: B2

Bill: Titan Earth Works - b

To: (Consignee)

1585 Valentine Ave. SE
Pacific WA 98047

Name: Lafarge PNW, Inc.
Address: PO Box 732101
Dallas, TX 75373-2101

Chris Pierce - 253-720-0523

Phone: (206) 336-0966

Trucked: Titan Earth Works - b

Authorized Signature

Coy McElderry / Dan Waldron

Lafarge Weighmaster Signature

Truck Driver Signature

Not Valid After
March 31st 2024

Lafarge Scale Mass
Gross: 54,720
Tare: 45,960
Net:

DO NOT DUPLICATE THIS FORM

This form is INVALID without an original authorized signature.



Load# 4683

Material Load Form

Lafarge Seattle

Date: Feb 27-24

Carrier / Truck No: PV 130

Time: 11:18 AM

Weighmaster: [Signature]

Generator Titan Earth Works - b

Job No. Seattle Schools

Material Name: Utility excavation

Profile # 24-TEW-UEP-07

Seattle plant discharge location: B2

Bill: Titan Earth Works - b

To: (Consignee)

1585 Valentine Ave. SE
Pacific WA 98047

Name: Lafarge PNW, Inc.
Address: PO Box 732101
Dallas, TX 75373-2101

Chris Pierce - 253-720-0523

Phone: (206) 336-0966

Trucked: Titan Earth Works - b

Authorized Signature
[Signature]

Coy McElderry / Dan Waldron

[Signature]

Lafarge Weighmaster Signature

[Signature]

Truck Driver Signature

Not Valid After
March 31st 2024

Lafarge Scale Mass
Gross: 72000
Tare: 51700
Net:

DO NOT DUPLICATE THIS FORM

This form is INVALID without an original authorized signature.

003



Load# 4684

Material Load Form

Lafarge Seattle

Date: 2-27-24

Carrier / Truck No: PV 130

Time: 4:21 PM

Weighmaster: Michael [Signature]

Generator Titan Earth Works - b

Job No. Seattle Schools

Material Name: Utility excavation

Profile # 24-TEW-UEP-07

Seattle plant discharge location: B2

Bill: Titan Earth Works - b

To: (Consignee)

1585 Valentine Ave. SE
Pacific WA 98047

Name: Lafarge PNW, Inc.
Address: PO Box 732101
Dallas, TX 75373-2101

Chris Pierce - 253-720-0523

Phone: (206) 336-0966

Trucked: Titan Earth Works - b

Authorized Signature
[Signature]

Coy McElderry / Dan Waldron

Not Valid After
March 31st 2024

[Signature]

Lafarge Weighmaster Signature

Lafarge Scale Mass
Gross: 77460
Tare: 52640
Net: 24820

[Signature]

Truck Driver Signature

DO NOT DUPLICATE THIS FORM

This form is INVALID without an original authorized signature.

m



Load# 4682

Material Load Form

Lafarge Seattle

Date: 2-28-24

Carrier / Truck No: Pro-Vac PV130

Time: FOOAM

Weighmaster: _____

Generator Titan Earth Works - b

Job No. Seattle Schools

Material Name: Utility excavation

Profile # 24-TEW-UEP-07

Seattle plant discharge location: **B2**

Bill: Titan Earth Works - b

To: (Consignee)

1585 Valentine Ave. SE
Pacific WA 98047

Name: Lafarge PNW, Inc.
Address: PO Box 732101
Dallas, TX 75373-2101

Chris Pierce - 253-720-0523

Phone: (206) 336-0966

Trucked: Titan Earth Works - b

Authorized Signature

Coy McElderry / Dan Waldron

Not Valid After
March 31st 2024

Lafarge Weighmaster Signature

Lafarge Scale Mass
Gross: 75,420
Tare: 51,680
Net: 23,740

Truck Driver Signature

DO NOT DUPLICATE THIS FORM

This form is INVALID without an original authorized signature.

12



Load# 4685

Material Load Form

Lafarge Seattle

Date: 2-28-24

Carrier / Truck No: Pro-Vac PV130

Time: 130 pm

Weighmaster: [Signature]

Generator Titan Earth Works - b

Job No. Seattle Schools

Material Name: Utility excavation

Profile # 24-TEW-UEP-07

Seattle plant discharge location: B2

Bill: Titan Earth Works - b

To: (Consignee)

1585 Valentine Ave. SE
Pacific WA 98047

Name: Lafarge PNW, Inc.
Address: PO Box 732101
Dallas, TX 75373-2101

Chris Pierce - 253-720-0523

Phone: (206) 336-0966

Trucked: Titan Earth Works - b

Authorized Signature
[Signature: Daniel Waldron]

Coy McElderry / Dan Waldron

[Signature]

Lafarge Weighmaster Signature

[Signature]

Truck Driver Signature

Not Valid After
March 31st 2024

Lafarge Scale Mass
Gross: 74060
Tare: 53820
Net: 20240

DO NOT DUPLICATE THIS FORM

This form is INVALID without an original authorized signature.



Load# 4686

Material Load Form

Lafarge Seattle

Date: 2-28-24

Carrier / Truck No: Pro-Vue

Time: 4:25 pm

Weighmaster: _____

Generator Titan Earth Works - b

Job No. Seattle Schools

Material Name: Utility excavation

Profile # 24-TEW-UEP-07

Seattle plant discharge location: **B2**

Bill: Titan Earth Works - b

To: (Consignee)

1585 Valentine Ave. SE
Pacific WA 98047

Name: Lafarge PNW, Inc.
Address: PO Box 732101
Dallas, TX 75373-2101

Chris Pierce - 253-720-0523

Phone: (206) 336-0966

Trucked: Titan Earth Works - b

Authorized Signature

Coy McElderry / Dan Waldron

Lafarge Weighmaster Signature

Lafarge Weighmaster Signature

Truck Driver Signature

Truck Driver Signature

Not Valid After
March 31st 2024

Lafarge Scale Mass
Gross: 60,860
Tare: 55,440
Net: 5,420

DO NOT DUPLICATE THIS FORM

This form is INVALID without an original authorized signature.



Load# 4687

Material Load Form

Lafarge Seattle

Date: 2/29/24

Carrier / Truck No: pro vac/615

Time: 9:30 am

Weighmaster: [Signature]

Generator Titan Earth Works - b

Job No. Seattle Schools

Material Name: Utility excavation

Profile # 24-TEW-UEP-07

Seattle plant discharge location: B2

Bill: Titan Earth Works - b

To: (Consignee)

1585 Valentine Ave. SE
Pacific WA 98047

Name: Lafarge PNW, Inc.
Address: PO Box 732101
Dallas, TX 75373-2101

Chris Pierce - 253-720-0523

Phone: (206) 336-0966

Trucked: Titan Earth Works - b

Authorized Signature
[Signature]

Coy McElderry / Dan Waldron

[Signature]

Lafarge Weighmaster Signature

[Signature]

Truck Driver Signature

Not Valid After
March 31st 2024

Lafarge Scale Mass
Gross: 76,340
Tare: 49,660
Net: _____

DO NOT DUPLICATE THIS FORM

This form is INVALID without an original authorized signature.

22



Load# 4688

Material Load Form

Lafarge Seattle

Date: 2/29/24

Carrier / Truck No: PRO VCC / 615

Time: 12:45 pm

Weighmaster: James

Generator Titan Earth Works - b

Job No. Seattle Schools

Material Name: Utility excavation

Profile # 24-TEW-UEP-07

Seattle plant discharge location: **B2**

Bill: Titan Earth Works - b

To: (Consignee)

1585 Valentine Ave. SE
Pacific WA 98047

Name: Lafarge PNW, Inc.
Address: PO Box 732101
Dallas, TX 75373-2101

Chris Pierce - 253-720-0523

Phone: (206) 336-0966

Trucked: Titan Earth Works - b

Authorized Signature

Coy McElderry / Dan Waldron

Lafarge Weighmaster Signature

Truck Driver Signature

Not Valid After
March 31st 2024

Lafarge Scale Mass
Gross: 73460
Tare: 50720
Net: _____

DO NOT DUPLICATE THIS FORM

This form is INVALID without an original authorized signature.

bw



Load# 4689

Material Load Form

Lafarge Seattle

Date: 2/29/24

Carrier / Truck No: pro vac / 615

Time: 4:00 pm

Weighmaster: [Signature]

Generator Titan Earth Works - b

Job No. Seattle Schools

Material Name: Utility excavation

Profile # 24-TEW-UEP-07

Seattle plant discharge location: B2

Bill: Titan Earth Works - b

To: (Consignee)

1585 Valentine Ave. SE
Pacific WA 98047

Name: Lafarge PNW, Inc.
Address: PO Box 732101
Dallas, TX 75373-2101

Chris Pierce - 253-720-0523

Phone: (206) 336-0966

Trucked: Titan Earth Works - b

Authorized Signature
[Signature]

Coy McElderry / Dan Waldron

[Signature]

Lafarge Weighmaster Signature

[Signature]

Truck Driver Signature

Not Valid After
March 31st 2024

Lafarge Scale Mass
Gross: 70460
Tare: 51040
Net:

DO NOT DUPLICATE THIS FORM

This form is INVALID without an original authorized signature.

20



Load# 4690

Material Load Form

Lafarge Seattle

Date: 03/01/24

Carrier / Truck No: PV485

Time: 9:30 am

Weighmaster: [Signature]

Generator Titan Earth Works - b

Job No. Seattle Schools

Material Name: Utility excavation

Profile # 24-TEW-UEP-07

Seattle plant discharge location: B2

Bill: Titan Earth Works - b

To: (Consignee)

1585 Valentine Ave. SE
Pacific WA 98047

Name: Lafarge PNW, Inc.
Address: PO Box 732101
Dallas, TX 75373-2101

Chris Pierce - 253-720-0523

Phone: (206) 336-0966

Trucked: Titan Earth Works - b

Authorized Signature
[Signature: Daniel Waldron]

Coy McElderry / Dan Waldron

[Signature]

Lafarge Weighmaster Signature

[Signature]

Truck Driver Signature

Not Valid After
March 31st 2024

Lafarge Scale Mass
Gross: 72900
Tare: 49500
Net:

DO NOT DUPLICATE THIS FORM

This form is INVALID without an original authorized signature.



Load# 4692

Material Load Form

Lafarge Seattle

Date: 03/01/24

Carrier / Truck No: PV485

Time: 4:30 pm

Weighmaster:

Generator Titan Earth Works - b

Job No. Seattle Schools

Material Name: Utility excavation

Profile # 24-TEW-UEP-07

Seattle plant discharge location: B2

Bill: Titan Earth Works - b

To: (Consignee)

1585 Valentine Ave. SE
Pacific WA 98047

Name: Lafarge PNW, Inc.
Address: PO Box 732101
Dallas, TX 75373-2101

Chris Pierce - 253-720-0523

Phone: (206) 336-0966

Trucked: Titan Earth Works - b

Authorized Signature

Coy McElderry / Dan Waldron

Lafarge Weighmaster Signature

Truck Driver Signature

Not Valid After
March 31st 2024

Lafarge Scale Mass
Gross: 65500
Tare: 54000
Net:

DO NOT DUPLICATE THIS FORM

This form is INVALID without an original authorized signature.



Load# 4691

Material Load Form

Lafarge Seattle

Date: 03/01/24

Carrier / Truck No: PV485

Time: 1:30pm

Weighmaster: [Signature]

Generator Titan Earth Works - b

Job No. Seattle Schools

Material Name: Utility excavation

Profile # 24-TEW-UEP-07

Seattle plant discharge location: B2

Bill: Titan Earth Works - b

To: (Consignee)

1585 Valentine Ave. SE
Pacific WA 98047

Name: Lafarge PNW, Inc.
Address: PO Box 732101
Dallas, TX 75373-2101

Chris Pierce - 253-720-0523

Phone: (206) 336-0966

Trucked: Titan Earth Works - b

Authorized Signature
[Signature: Daniel Waldron]

Coy McElderry / Dan Waldron

[Signature]

Lafarge Weighmaster Signature

[Signature]

Truck Driver Signature

Not Valid After
March 31st 2024

Lafarge Scale Mass
Gross: 77700
Tare: 54000
Net:

DO NOT DUPLICATE THIS FORM

This form is INVALID without an original authorized signature.



Load# 4753

Material Load Form

Lafarge Seattle

Date: 3-4-24

Carrier / Truck No: 470

Time: 3:30 pm

Weighmaster: Ryher

Generator Titan Earth Works - b

Job No. Seattle Schools

Material Name: Utility excavation

Profile # 24-TEW-UEP-07

Seattle plant discharge location: B2

Bill: Titan Earth Works - b

To: (Consignee)

1585 Valentine Ave. SE
Pacific WA 98047

Name: Lafarge PNW, Inc.
Address: PO Box 732101
Dallas, TX 75373-2101

Chris Pierce - 253-720-0523

Phone: (206) 336-0966

Trucked: Titan Earth Works - b

Authorized Signature
Daniel Waldron

Coy McElderry / Dan Waldron

Ryher

Lafarge Weighmaster Signature

Truck Driver Signature

Truck Driver Signature

Not Valid After

April 30th 2024

Lafarge Scale Mass

Gross: 68,400

Tare: 45,100

Net:

DO NOT DUPLICATE THIS FORM

This form is INVALID without an original authorized signature.

PNW



Load# 4752

Material Load Form

Lafarge Seattle

Date: 3-4-24

Carrier / Truck No: 470

Time: 10:45

Weighmaster: [Signature]

Generator Titan Earth Works - b

Job No. Seattle Schools

Material Name: Utility excavation

Profile # 24-TEW-UEP-07

Seattle plant discharge location: B2

Bill: Titan Earth Works - b

To: (Consignee)

1585 Valentine Ave. SE
Pacific WA 98047

Name: Lafarge PNW, Inc.
Address: PO Box 732101
Dallas, TX 75373-2101

Chris Pierce - 253-720-0523

Phone: (206) 336-0966

Trucked: Titan Earth Works - b

Authorized Signature
[Signature: Daniel Waldron]

Coy McElderry / Dan Waldron
Lafarge Weighmaster Signature

[Signature: Truck Driver]

Truck Driver Signature

Not Valid After
April 30th 2024

Lafarge Scale Mass
Gross: 67,760
Tare: 49,720
Net:

DO NOT DUPLICATE THIS FORM

This form is INVALID without an original authorized signature.

PW



Load# 4755

Material Load Form

Lafarge Seattle

Date: 2/5/24

Carrier / Truck No: 470

Time: 3:00 pm

Weighmaster:

Generator Titan Earth Works - b

Job No. Seattle Schools

Material Name: Utility excavation

Profile # 24-TEW-UEP-07

Seattle plant discharge location: B2

Bill: Titan Earth Works - b

To: (Consignee)

1585 Valentine Ave. SE
Pacific WA 98047

Name: Lafarge PNW, Inc.
Address: PO Box 732101
Dallas, TX 75373-2101

Chris Pierce - 253-720-0523

Phone: (206) 336-0966

Trucked: Titan Earth Works - b

Authorized Signature
Daniel Waldron

Coy McElderry / Dan Waldron

Lafarge Weighmaster Signature

Lafarge Weighmaster Signature

Truck Driver Signature

Truck Driver Signature

Not Valid After
April 30th 2024

Lafarge Scale Mass
Gross: 66,920
Tare: 44,480
Net:

DO NOT DUPLICATE THIS FORM

This form is INVALID without an original authorized signature.

Handwritten mark



Load# 4754

Material Load Form

Lafarge Seattle

Date: 3-4-24

Carrier / Truck No: 470

Time: 10:15

Weighmaster: _____

Generator Titan Earth Works - b

Job No. Seattle Schools

Material Name: Utility excavation

Profile # 24-TEW-UEP-07

Seattle plant discharge location: **B2**

Bill: Titan Earth Works - b

To: (Consignee)

1585 Valentine Ave. SE
Pacific WA 98047

Name: Lafarge PNW, Inc.
Address: PO Box 732101
Dallas, TX 75373-2101

Chris Pierce - 253-720-0523

Phone: (206) 336-0966

Trucked: Titan Earth Works - b

Authorized Signature

Coy McElderry / Dan Waldron

Lafarge Weighmaster Signature

Truck Driver Signature

Not Valid After

April 30th 2024

Lafarge Scale Mass
Gross: 69,540
Tare: 48,620
Net: _____

DO NOT DUPLICATE THIS FORM

This form is INVALID without an original authorized signature.



Load# 4756

Material Load Form

Lafarge Seattle

Date: 3-6-24

Carrier / Truck No: 425

Time: 3:49

Weighmaster: _____

Generator Titan Earth Works - b

Job No. Seattle Schools

Material Name: Utility excavation

Profile # 24-TEW-UEP-07

Seattle plant discharge location: **B2**

Bill: Titan Earth Works - b

To: (Consignee)

1585 Valentine Ave. SE
Pacific WA 98047

Name: Lafarge PNW, Inc.
Address: PO Box 732101
Dallas, TX 75373-2101

Chris Pierce - 253-720-0523

Phone: (206) 336-0966

Trucked: Titan Earth Works - b

Authorized Signature

Coy McElderry / Dan Waldron

Lafarge Weighmaster Signature

Truck Driver Signature

Not Valid After

April 30th 2024

Lafarge Scale Mass
Gross: 674860
Tare: 49400
Net: 25460

DO NOT DUPLICATE THIS FORM

This form is INVALID without an original authorized signature.



Load# 4757

Material Load Form

Lafarge Seattle

Date: 10:30
Time: 3-7-24

Carrier / Truck No: 425

Weighmaster: Michael Mire

Generator Titan Earth Works - b

Job No. Seattle Schools

Material Name: Utility excavation

Profile # 24-TEW-UEP-07

Seattle plant discharge location: B2

Bill: Titan Earth Works - b

To: (Consignee)

1585 Valentine Ave. SE
Pacific WA 98047

Name: Lafarge PNW, Inc.
Address: PO Box 732101
Dallas, TX 75373-2101

Chris Pierce - 253-720-0523

Phone: (206) 336-0966

Trucked: Titan Earth Works - b

Authorized Signature
Daniel Waldron

Coy McElderry / Dan Waldron

Lafarge Weighmaster Signature

Lafarge Weighmaster Signature

Truck Driver Signature

Truck Driver Signature

Not Valid After
April 30th 2024

Lafarge Scale Mass
Gross: 72700
Tare: 50440
Net: 22260

DO NOT DUPLICATE THIS FORM

This form is INVALID without an original authorized signature.

202

Load# 4758



Material Load Form

Lafarge Seattle

Date: 3-7-24

Carrier / Truck No: 425

Time: 1:30

Weighmaster: [Signature]

Generator Titan Earth Works - b

Job No. Seattle Schools

Material Name: Utility excavation

Profile # 24-TEW-UEP-07

Seattle plant discharge location: B2

Bill: Titan Earth Works - b

To: (Consignee)

1585 Valentine Ave. SE
Pacific WA 98047

Name: Lafarge PNW, Inc.
Address: PO Box 732101
Dallas, TX 75373-2101

Chris Pierce - 253-720-0523

Phone: (206) 336-0966

Trucked: Titan Earth Works - b

Authorized Signature
[Signature: Daniel Waldron]

Coy McElderry / Dan Waldron

[Signature]

Lafarge Weighmaster Signature

[Signature]

Truck Driver Signature

Not Valid After

April 30th 2024

Lafarge Scale Mass
Gross: 82000
Tare: 46240
Net:

DO NOT DUPLICATE THIS FORM

This form is INVALID without an original authorized signature.

TW



Load# 4759

Material Load Form

Lafarge Seattle

Date: 3-12-24

Carrier / Truck No: L170

Time: 9 am

Weighmaster: [Signature]

Generator Titan Earth Works - b

Job No. Seattle Schools

Material Name: Utility excavation

Profile # 24-TEW-UEP-07

Seattle plant discharge location: B2

Bill: Titan Earth Works - b

To: (Consignee)

1585 Valentine Ave. SE
Pacific WA 98047

Name: Lafarge PNW, Inc.
Address: PO Box 732101
Dallas, TX 75373-2101

Chris Pierce - 253-720-0523

Phone: (206) 336-0966

Trucked: Titan Earth Works - b

Authorized Signature
[Signature]

Coy McElderry / Dan Waldron

[Signature]

Lafarge Weighmaster Signature

[Signature]

Truck Driver Signature

Not Valid After

April 30th 2024

Lafarge Scale Mass
Gross: 74,900
Tare: 49,800
Net:

DO NOT DUPLICATE THIS FORM

This form is INVALID without an original authorized signature.



Load# 4760

Material Load Form

Lafarge Seattle

Date: 3-12-24

Carrier / Truck No: 470

Time: 12:30 pm

Weighmaster:

Generator Titan Earth Works - b

Job No. Seattle Schools

Material Name: Utility excavation

Profile # 24-TEW-UEP-07

Seattle plant discharge location: B2

Bill: Titan Earth Works - b

To: (Consignee)

1585 Valentine Ave. SE
Pacific WA 98047

Name: Lafarge PNW, Inc.
Address: PO Box 732101
Dallas, TX 75373-2101

Chris Pierce - 253-720-0523

Phone: (206) 336-0966

Trucked: Titan Earth Works - b

Authorized Signature

Coy McElderry / Dan Waldron

Lafarge Weighmaster Signature

Truck Driver Signature

Not Valid After

April 30th 2024

Lafarge Scale Mass
Gross: 69,848
Tare: 45,760
Net: 24,080

DO NOT DUPLICATE THIS FORM

This form is INVALID without an original authorized signature.

DW



Load# 4761

Material Load Form

Lafarge Seattle

Date: 3-12-24

Carrier / Truck No: 470

Time: 4:15 pm

Weighmaster: [Signature]

Generator Titan Earth Works - b

Job No. Seattle Schools

Material Name: Utility excavation

Profile # 24-TEW-UEP-07

Seattle plant discharge location: B2

Bill: Titan Earth Works - b

To: (Consignee)

1585 Valentine Ave. SE
Pacific WA 98047

Name: Lafarge PNW, Inc.
Address: PO Box 732101
Dallas, TX 75373-2101

Chris Pierce - 253-720-0523

Phone: (206) 336-0966

Trucked: Titan Earth Works - b

Authorized Signature
[Signature]

Coy McElderry / Dan Waldron

[Signature]

Lafarge Weighmaster Signature

[Signature]

Truck Driver Signature

Not Valid After

April 30th 2024

Lafarge Scale Mass
Gross: 73,520
Tare: 51,380
Net: 22,140

DO NOT DUPLICATE THIS FORM

This form is INVALID without an original authorized signature.

DW



Load# 4763

Material Load Form

Lafarge Seattle

Date: 3-13-24

Carrier / Truck No: 470

Time: 1:15 pm

Weighmaster:

Generator Titan Earth Works - b

Job No. Seattle Schools

Material Name: Utility excavation

Profile # 24-TEW-UEP-07

Seattle plant discharge location: B2

Bill: Titan Earth Works - b

To: (Consignee)

1585 Valentine Ave. SE
Pacific WA 98047

Name: Lafarge PNW, Inc.
Address: PO Box 732101
Dallas, TX 75373-2101

Chris Pierce - 253-720-0523

Phone: (206) 336-0966

Trucked: Titan Earth Works - b

Authorized Signature

Coy McElderry / Dan Waldron

Lafarge Weighmaster Signature

Truck Driver Signature

Not Valid After

April 30th 2024

Lafarge Scale Mass
Gross: 69,580
Tare: 45,080
Net: 24,500

DO NOT DUPLICATE THIS FORM

This form is INVALID without an original authorized signature.

22



Load# 4813

Material Load Form

Lafarge Seattle

Date: 3-13-24

Carrier / Truck No: 470

Time: 4:00 pm

Weighmaster: Dryden

Generator Titan Earth Works - b

Job No. Seattle Schools

Material Name: Utility excavation

Profile # 24-TEW-UEP-07

Seattle plant discharge location: B2

Bill: Titan Earth Works - b

To: (Consignee)

1585 Valentine Ave. SE
Pacific WA 98047

Name: Lafarge PNW, Inc.
Address: PO Box 732101
Dallas, TX 75373-2101

Chris Pierce - 253-720-0523

Phone: (206) 336-0966

Trucked: Titan Earth Works - b

Authorized Signature
Daniel Waldron

Coy McElderry / Dan Waldron

Dryden

Lafarge Weighmaster Signature

Truck Driver Signature

Truck Driver Signature

Not Valid After
May 30th 2024

Lafarge Scale Mass	
Gross 1:	65,870
Gross 2:	47,480
Tare:	18,340
Net 1:	
Net 2:	

DO NOT DUPLICATE THIS FORM

This form is INVALID without an original authorized signature.

baw



Load# 4762

Material Load Form

Lafarge Seattle

Date: 3-13-24

Carrier / Truck No: 470

Time: 9 am

Weighmaster: [Signature]

Generator Titan Earth Works - b

Job No. Seattle Schools

Material Name: Utility excavation

Profile # 24-TEW-UEP-07

Seattle plant discharge location: B2

Bill: Titan Earth Works - b

To: (Consignee)

1585 Valentine Ave. SE
Pacific WA 98047

Name: Lafarge PNW, Inc.
Address: PO Box 732101
Dallas, TX 75373-2101

Chris Pierce - 253-720-0523

Phone: (206) 336-0966

Trucked: Titan Earth Works - b

Authorized Signature
[Signature: Daniel Waldron]

Coy McEldeery / Dan Waldron

[Signature]

Lafarge Weighmaster Signature

[Signature]

Truck Driver Signature

Not Valid After

April 30th 2024

Lafarge Scale Mass
Gross: 74,920
Tare: 49,920
Net: 25,000

DO NOT DUPLICATE THIS FORM

This form is INVALID without an original authorized signature.

7ms

Load# 4814



Material Load Form

Lafarge Seattle

Date: 3-14-24

Carrier / Truck No: 9V-470

Time: 8:55 Am

Weighmaster:

Generator Titan Earth Works - b

Job No. Seattle Schools

Material Name: Utility excavation

Profile # 24-TEW-UEP-07

Seattle plant discharge location: B2

Bill: Titan Earth Works - b

To: (Consignee)

1585 Valentine Ave. SE
Pacific WA 98047

Name: Lafarge PNW, Inc.
Address: PO Box 732101
Dallas, TX 75373-2101

Chris Pierce - 253-720-0523

Phone: (206) 336-0966

Trucked: Titan Earth Works - b

Authorized Signature

Coy McElderry / Dan Waldren

Lafarge Weighmaster Signature

Truck Driver Signature

Not Valid After
May 30th 2024

Lafarge Scale Mass	
Gross 1:	74,900
Gross 2:	49,960
Tare:	
Net 1:	
Net 2:	

DO NOT DUPLICATE THIS FORM

This form is INVALID without an original authorized signature.

b-0



Load# 4815

Material Load Form

Lafarge Seattle

Date: 3-14-24

Carrier / Truck No: PV-470

Time: 12:15 pm

Weighmaster: [Signature]

Generator Titan Earth Works - b

Job No. Seattle Schools

Material Name: Utility excavation

Profile # 24-TEW-UEP-07

Seattle plant discharge location: B2

Bill: Titan Earth Works - b

To: (Consignee)

1585 Valentine Ave. SE
Pacific WA 98047

Name: Lafarge PNW, Inc.
Address: PO Box 732101
Dallas, TX 75373-2101

Chris Pierce - 253-720-0523

Phone: (206) 336-0966

Trucked: Titan Earth Works - b

Authorized Signature
[Signature: Daniel Waldron]

Coy McElderry / Dan Waldron
[Signature]

Lafarge Weighmaster Signature
[Signature: Steve K. Pott]

Truck Driver Signature

Not Valid After
May 30th 2024

Lafarge Scale Mass	
Gross 1:	69.160
Gross 2:	45.900
Tare:	
Net 1:	
Net 2:	

DO NOT DUPLICATE THIS FORM

This form is INVALID without an original authorized signature.

DW

Load# 4816



Material Load Form

Lafarge Seattle

Date: 3-14-24

Carrier / Truck No: PV-470

Time: 4:30 pm

Weighmaster: [Signature]

Generator Titan Earth Works - b

Job No. Seattle Schools

Material Name: Utility excavation

Profile # 24-TEW-UEP-07

Seattle plant discharge location: B2

Bill: Titan Earth Works - b

To: (Consignee)

1585 Valentine Ave. SE
Pacific WA 98047

Name: Lafarge PNW, Inc.
Address: PO Box 732101
Dallas, TX 75373-2101

Chris Pierce - 253-720-0523

Phone: (206) 336-0966

Trucked: Titan Earth Works - b

Authorized Signature
[Signature]

Coy McElderry / Dan Waldron

[Signature]

Lafarge Weighmaster Signature

[Signature]

Truck Driver Signature

Not Valid After
May 30th 2024

Lafarge Scale Mass	
Gross 1:	70,080
Gross 2:	50,720
Tare:	
Net 1:	
Net 2:	

DO NOT DUPLICATE THIS FORM

This form is INVALID without an original authorized signature.



Load# 4817

Material Load Form

Lafarge Seattle

Date: 15 Mar 2024

Carrier / Truck No: _____

Time: 10 Am

Weighmaster: _____

Generator Titan Earth Works - b

Job No. Seattle Schools

Material Name: Utility excavation

Profile # 24-TEW-UEP-07

Seattle plant discharge location: B2

Bill: Titan Earth Works - b

To: (Consignee)

1585 Valentine Ave. SE
Pacific WA 98047

Name: Lafarge PNW, Inc.
Address: PO Box 732101
Dallas, TX 75373-2101

Chris Pierce - 253-720-0523

Phone: (206) 336-0966

Trucked: Titan Earth Works - b

Authorized Signature

Coy McElderry / Dan Waldron

Lafarge Weighmaster Signature

Truck Driver Signature

Not Valid After
May 30th 2024

Lafarge Scale Mass

Gross 1: 73,000

Gross 2:

Tare: 50,100

Net 1: 23,100 22840

Net 2:

DO NOT DUPLICATE THIS FORM

This form is INVALID without an original authorized signature.

AJ



Load# 4818

Material Load Form

Lafarge Seattle

Date: 15 Mar 2024

Carrier / Truck No: PU470

Time: 1:45 pm

Weighmaster:

Generator Titan Earth Works - b

Job No. Seattle Schools

Material Name: Utility excavation

Profile # 24-TEW-UEP-07

Seattle plant discharge location: B2

Bill: Titan Earth Works - b

To: (Consignee)

1585 Valentine Ave. SE
Pacific WA 98047

Name: Lafarge PNW, Inc.
Address: PO Box 732101
Dallas, TX 75373-2101

Chris Pierce - 253-720-0523

Phone: (206) 336-0966

Trucked: Titan Earth Works - b

Authorized Signature
Daniel Waldron

Coy McElderry / Dan Waldron

Lafarge Weighmaster Signature

Truck Driver Signature

Not Valid After
May 30th 2024

Lafarge Scale Mass	
Gross 1:	72.800
Gross 2:	
Tare:	48.700
Net 1:	24.100
Net 2:	

DO NOT DUPLICATE THIS FORM

This form is INVALID without an original authorized signature.



Load# 4820

Material Load Form

Lafarge Seattle

Date: 4-18-24

Carrier / Truck No: PROVAC PJ670

Time: 2:08pm

Weighmaster: [Signature]

Generator Titan Earth Works - b

Job No. Seattle Schools

Material Name: Utility excavation

Profile # 24-TEW-UEP-07

Seattle plant discharge location: **B2**

Bill: Titan Earth Works - b

To: (Consignee)

1585 Valentine Ave. SE
Pacific WA 98047

Name: Lafarge PNW, Inc.
Address: PO Box 732101
Dallas, TX 75373-2101

Chris Pierce - 253-720-0523

Phone: (206) 336-0966

Trucked: Titan Earth Works - b

Authorized Signature
[Signature]

Coy McElderry / Dan Waldron

[Signature]

Lafarge Weighmaster Signature

[Signature]

Truck Driver Signature

**Not Valid After
May 30th 2024**

Lafarge Scale Mass

Gross 1: 71,720

Gross 2: 48,140

Tare: 23,680

Net 1:

Net 2:

DO NOT DUPLICATE THIS FORM

This form is INVALID without an original authorized signature.



Load# 4819

Material Load Form

Lafarge Seattle

Date: 4-18-24

Time: 10:35 am

Carrier / Truck No: PROVAC PUS70

Weighmaster: [Signature]

Generator Titan Earth Works - b

Job No. Seattle Schools

Material Name: Utility excavation

Profile # 24-TEW-UEP-07

Seattle plant discharge location: **B2**

Bill: Titan Earth Works - b

To: (Consignee)

1585 Valentine Ave. SE
Pacific WA 98047

Name: Lafarge PNW, Inc.
Address: PO Box 732101
Dallas, TX 75373-2101

Chris Pierce - 253-720-0523

Phone: (206) 336-0966

Trucked: Titan Earth Works - b

Authorized Signature
[Signature: Daniel Waldron]

Coy McElderry / Dan Waldron

[Signature]

Lafarge Weighmaster Signature

[Signature]

Truck Driver Signature

Not Valid After
May 30th 2024

Lafarge Scale Mass	
Gross 1:	71,020
Gross 2:	48,740
Tare:	22,280
Net 1:	
Net 2:	

DO NOT DUPLICATE THIS FORM

This form is INVALID without an original authorized signature.



Load# 4821

Material Load Form

Lafarge Seattle

Date: 4-18-24

Time: 4:25 pm

Carrier / Truck No: PROVAC PV670

Weighmaster: [Signature]

Generator Titan Earth Works - b

Job No. Seattle Schools

Material Name: Utility excavation

Profile # 24-TEW-UEP-07

Seattle plant discharge location: **B2**

Bill: Titan Earth Works - b

To: (Consignee)

1585 Valentine Ave. SE
Pacific WA 98047

Name: Lafarge PNW, Inc.
Address: PO Box 732101
Dallas, TX 75373-2101

Chris Pierce - 253-720-0523

Phone: (206) 336-0966

Trucked: Titan Earth Works - b

Authorized Signature
[Signature]

Coy McElderry / Dan Waldron
[Signature]

Lafarge Weighmaster Signature
[Signature]

Truck Driver Signature
[Signature]

Not Valid After
May 30th 2024

Lafarge Scale Mass	
Gross 1:	59,900
Gross 2:	48,940
Tare:	11,360
Net 1:	
Net 2:	

DO NOT DUPLICATE THIS FORM

This form is INVALID without an original authorized signature.

DM

Load# 4822



Material Load Form

Lafarge Seattle

Date: 4-19-24

Carrier / Truck No: PROVAC DV670

Time: 9:05 am

Weighmaster: _____

Generator Titan Earth Works - b

Job No. Seattle Schools

Material Name: Utility excavation

Profile # 24-TEW-UEP-07

Seattle plant discharge location: **B2**

Bill: Titan Earth Works - b

To: (Consignee)

1585 Valentine Ave. SE
Pacific WA 98047

Name: Lafarge PNW, Inc.
Address: PO Box 732101
Dallas, TX 75373-2101

Chris Pierce - 253-720-0523

Phone: (206) 336-0966

Trucked: Titan Earth Works - b

Authorized Signature

Coy McElderry / Dan Waldron

Lafarge Weighmaster Signature

Truck Driver Signature

**Not Valid After
May 30th 2024**

Lafarge Scale Mass	
Gross 1:	<u>63,660</u>
Gross 2:	<u>50,640</u>
Tare:	<u>13,020</u>
Net 1:	
Net 2:	

DO NOT DUPLICATE THIS FORM

This form is INVALID without an original authorized signature.

tw

Load# 4823



Material Load Form

Lafarge Seattle

Date: ^{3 DW} ~~11-19-24~~

Carrier / Truck No: PROVAC PJ670

Time: 12:10 pm

Weighmaster:

Generator Titan Earth Works - b

Job No. Seattle Schools

Material Name: Utility excavation

Profile # 24-TEW-UEP-07

Seattle plant discharge location: **B2**

Bill: Titan Earth Works - b

To: (Consignee)

1585 Valentine Ave. SE
Pacific WA 98047

Name: Lafarge PNW, Inc.
Address: PO Box 732101
Dallas, TX 75373-2101

Chris Pierce - 253-720-0523

Phone: (206) 336-0966

Trucked: Titan Earth Works - b

Authorized Signature

Coy McElderry / Dan Waldron

Lafarge Weighmaster Signature

Truck Driver Signature

Not Valid After
May 30th 2024

Lafarge Scale Mass	
Gross 1:	68,680
Gross 2:	46,020
Tare:	22,660
Net 1:	
Net 2:	

DO NOT DUPLICATE THIS FORM

This form is INVALID without an original authorized signature.

72



Load# 4824

Material Load Form

Lafarge Seattle

Date: 11-19-24

Carrier / Truck No: Prouac PV670

Time: 11:00 am

Weighmaster: Joel Miller

Generator Titan Earth Works - b

Job No. Seattle Schools

Material Name: Utility excavation

Profile # 24-TEW-UEP-07

Seattle plant discharge location: B2

Bill: Titan Earth Works - b

To: (Consignee)

1585 Valentine Ave. SE
Pacific WA 98047

Name: Lafarge PNW, Inc.
Address: PO Box 732101
Dallas, TX 75373-2101

Chris Pierce - 253-720-0523

Phone: (206) 336-0966

Trucked: Titan Earth Works - b

Authorized Signature
Daniel Waldron

Coy McElderry / Dan Waldron

Joel Miller

Lafarge Weighmaster Signature

[Signature]

Truck Driver Signature

Not Valid After
May 30th 2024

Lafarge Scale Mass	
Gross 1:	71,880
Gross 2:	48,140
Tare:	23,740
Net 1:	
Net 2:	

DO NOT DUPLICATE THIS FORM

This form is INVALID without an original authorized signature.

Handwritten mark



Load# 4832

Material Load Form

Lafarge Seattle

Date: 3-20-24

Carrier / Truck No: PV-130

Time: 9:25

Weighmaster: Michael Checkeye

Generator Titan Earth Works - b

Job No. Seattle Schools

Material Name: Utility excavation

Profile # 24-TEW-UEP-07

Seattle plant discharge location: B2

Bill: Titan Earth Works - b

To: (Consignee)

1585 Valentine Ave. SE
Pacific WA 98047

Name: Lafarge PNW, Inc.
Address: PO Box 732101
Dallas, TX 75373-2101

Chris Pierce - 253-720-0523

Phone: (206) 336-0966

Trucked: Titan Earth Works - b

Authorized Signature
Daniel Waldron

Coy McElderry / Dan Waldron

Lafarge Weighmaster Signature

Lafarge Weighmaster Signature

Truck Driver Signature

Truck Driver Signature

Not Valid After
May 30th 2024

Lafarge Scale Mass	
Gross 1:	76700
Gross 2:	
Tare:	51380
Net 1:	25320
Net 2:	

DO NOT DUPLICATE THIS FORM

This form is INVALID without an original authorized signature.

DW



Load# 4833

Material Load Form

Lafarge Seattle

Date: 3-20-24

Carrier / Truck No: PV-130

Time: 1:15 PM

Weighmaster: [Signature]

Generator Titan Earth Works - b

Job No. Seattle Schools

Material Name: Utility excavation

Profile # 24-TEW-UEP-07

Seattle plant discharge location: B2

Bill: Titan Earth Works - b

To: (Consignee)

1585 Valentine Ave. SE
Pacific WA 98047

Name: Lafarge PNW, Inc.
Address: PO Box 732101
Dallas, TX 75373-2101

Chris Pierce - 253-720-0523

Phone: (206) 336-0966

Trucked: Titan Earth Works - b

Authorized Signature
[Signature: Daniel Waldron]

Coy McElderry / Dan Waldron

[Signature: Weighmaster]

Lafarge Weighmaster Signature

[Signature: Driver]

Truck Driver Signature

Not Valid After
May 30th 2024

Lafarge Scale Mass	
Gross 1:	78,280
Gross 2:	
Tare:	52,520
Net 1:	25,760
Net 2:	

DO NOT DUPLICATE THIS FORM

This form is INVALID without an original authorized signature.

DW

Load# 4834



Material Load Form

Lafarge Seattle

Date: 3-20-24

Carrier / Truck No: PK-130

Time: 4:02 pm

Weighmaster: [Signature]

Generator Titan Earth Works - b

Job No. Seattle Schools

Material Name: Utility excavation

Profile # 24-TEW-UEP-07

Seattle plant discharge location: B2

Bill: Titan Earth Works - b

To: (Consignee)

1585 Valentine Ave. SE
Pacific WA 98047

Name: Lafarge PNW, Inc.
Address: PO Box 732101

Dallas, TX 75373-2101

Chris Pierce - 253-720-0523

Phone: (206) 336-0966

Trucked: Titan Earth Works - b

Authorized Signature
[Signature]

Coy McElderry / Dan Waldron

[Signature]

Lafarge Weighmaster Signature

[Signature]

Truck Driver Signature

Not Valid After
May 30th 2024

Lafarge Scale Mass	
Gross 1:	70800
Gross 2:	70800
Tare:	53500
Net 1:	17280
Net 2:	

DO NOT DUPLICATE THIS FORM

This form is INVALID without an original authorized signature.

PW

Load# 4835



Material Load Form

Lafarge Seattle

Date: 3-21-24

Carrier / Truck No: ProVac / PV425

Time: 12:30

Weighmaster: [Signature]

Generator Titan Earth Works - b

Job No. Seattle Schools

Material Name: Utility excavation

Profile # 24-TEW-UEP-07

Seattle plant discharge location: B2

Bill: Titan Earth Works - b

To: (Consignee)

1585 Valentine Ave. SE
Pacific WA 98047

Name: Lafarge PNW, Inc.
Address: PO Box 732101
Dallas, TX 75373-2101

Chris Pierce - 253-720-0523

Phone: (206) 336-0966

Trucked: Titan Earth Works - b

Authorized Signature
[Signature: Daniel Waldron]

Coy McElderry / Dan Waldron

[Signature]

Lafarge Weighmaster Signature

[Signature]

Truck Driver Signature

Not Valid After
May 30th 2024

Lafarge Scale Mass

Gross 1: 72248

Gross 2:

Tare: 47540

Net 1: 24708

Net 2:

DO NOT DUPLICATE THIS FORM

This form is INVALID without an original authorized signature.



REPRINT **R Ticket 1449562**

2/6/2024 3:55:04PM

Location: 1 Waller Rd. Gravel Pit

Carrier PROVAC Pro-Vac
Vehicle PV470 PV470
Customer TITEAR Titan Earthwork LLC
Order 2350 Central Kitchen
 2445 Third Ave S., Seattle
Product 1400 Clean Vactor Mud

P.O. Job #2350 - Central Kitch
Note

Weighmaster JWS Ticket System
Received

	Qty	Rate	Amount
Product	8.06 Ton	30.00	241.80
Fee			0.00
Other			15.00
Tax	REFUSE	3.6000	9.24
Total			266.04

	Pounds	Tons	Metric
Gross	60340	30.17	27.37
Tare	44220	22.11	20.06
Net	16120	8.06	7.31



REPRINT **R Ticket 1449562**

2/6/2024 3:55:04PM

Location: 1 Waller Rd. Gravel Pit

Carrier PROVAC Pro-Vac
Vehicle PV470 PV470
Customer TITEAR Titan Earthwork LLC
Order 2350 Central Kitchen
 2445 Third Ave S., Seattle
Product 1400 Clean Vactor Mud

P.O. Job #2350 - Central Kitch
Note

Weighmaster JWS Ticket System
Received

	Qty	Rate	Amount
Product	8.06 Ton	30.00	241.80
Fee			0.00
Other			15.00
Tax	REFUSE	3.6000	9.24
Total			266.04

	Pounds	Tons	Metric
Gross	60340	30.17	27.37
Tare	44220	22.11	20.06
Net	16120	8.06	7.31



REPRINT **R Ticket 1449642**

2/7/2024 12:04:10PM

Location: 1 Waller Rd. Gravel Pit

Carrier PROVAC Pro-Vac
Vehicle PV470 PV470
Customer TITEAR Titan Earthwork LLC
Order 2350 Central Kitchen
 2445 Third Ave S., Seattle
Product 1400 Clean Vactor Mud

P.O. Note Job #2350 - Central Kitch

Weighmaster JWS Ticket System
Received

	Qty	Rate	Amount
Product	10.92 Ton	30.00	327.60
Fee			0.00
Other			15.00
Tax	REFUSE	3.6000	12.33
Total			354.93

	Pounds	Tons	Metric
Gross	71340	35.67	32.36
Tare	49500	24.75	22.45
Net	21840	10.92	9.91



REPRINT **R Ticket 1449642**

2/7/2024 12:04:10PM

Location: 1 Waller Rd. Gravel Pit

Carrier PROVAC Pro-Vac
Vehicle PV470 PV470
Customer TITEAR Titan Earthwork LLC
Order 2350 Central Kitchen
 2445 Third Ave S., Seattle
Product 1400 Clean Vactor Mud

P.O. Note Job #2350 - Central Kitch

Weighmaster JWS Ticket System
Received

	Qty	Rate	Amount
Product	10.92 Ton	30.00	327.60
Fee			0.00
Other			15.00
Tax	REFUSE	3.6000	12.33
Total			354.93

	Pounds	Tons	Metric
Gross	71340	35.67	32.36
Tare	49500	24.75	22.45
Net	21840	10.92	9.91



REPRINT **R Ticket 1449679**

2/7/2024 3:19:55PM

Location: 1 Waller Rd. Gravel Pit

Carrier PROVAC Pro-Vac
Vehicle PV615 PV615
Customer TITEAR Titan Earthwork LLC
Order 2350 Central Kitchen
 2445 Third Ave S., Seattle
Product 1400 Clean Vactor Mud

P.O. Job #2350 - Central Kitch
Note

Weighmaster JWS Ticket System
Received

	Qty	Rate	Amount
Product	13.70 Ton	30.00	411.00
Fee			0.00
Other			15.00
Tax	REFUSE	3.6000	15.34
Total			441.34

	Pounds	Tons	Metric
Gross	74720	37.36	33.89
Tare	47320	23.66	21.46
Net	27400	13.70	12.43



REPRINT **R Ticket 1449679**

2/7/2024 3:19:55PM

Location: 1 Waller Rd. Gravel Pit

Carrier PROVAC Pro-Vac
Vehicle PV615 PV615
Customer TITEAR Titan Earthwork LLC
Order 2350 Central Kitchen
 2445 Third Ave S., Seattle
Product 1400 Clean Vactor Mud

P.O. Job #2350 - Central Kitch
Note

Weighmaster JWS Ticket System
Received

	Qty	Rate	Amount
Product	13.70 Ton	30.00	411.00
Fee			0.00
Other			15.00
Tax	REFUSE	3.6000	15.34
Total			441.34

	Pounds	Tons	Metric
Gross	74720	37.36	33.89
Tare	47320	23.66	21.46
Net	27400	13.70	12.43



REPRINT **R Ticket 1449873**

2/12/2024 10:45:23AM

Location: 1 Waller Rd. Gravel Pit

Carrier PROVAC Pro-Vac
Vehicle PV470 PV470
Customer TITEAR Titan Earthwork LLC
Order 2350 Central Kitchen
 2445 Third Ave S., Seattle
Product 1400 Clean Vactor Mud

P.O. Job #2350 - Central Kitch
Note

Weighmaster JWS Ticket System
Received

	Qty	Rate	Amount
Product	9.16 Ton	30.00	274.80
Fee			0.00
Other			15.00
Tax	REFUSE	3.6000	10.43
Total			300.23

	Pounds	Tons	Metric
Gross	67320	33.66	30.54
Tare	49000	24.50	22.23
Net	18320	9.16	8.31



REPRINT **R Ticket 1449873**

2/12/2024 10:45:23AM

Location: 1 Waller Rd. Gravel Pit

Carrier PROVAC Pro-Vac
Vehicle PV470 PV470
Customer TITEAR Titan Earthwork LLC
Order 2350 Central Kitchen
 2445 Third Ave S., Seattle
Product 1400 Clean Vactor Mud

P.O. Job #2350 - Central Kitch
Note

Weighmaster JWS Ticket System
Received

	Qty	Rate	Amount
Product	9.16 Ton	30.00	274.80
Fee			0.00
Other			15.00
Tax	REFUSE	3.6000	10.43
Total			300.23

	Pounds	Tons	Metric
Gross	67320	33.66	30.54
Tare	49000	24.50	22.23
Net	18320	9.16	8.31



REPRINT **R Ticket 1449897**

2/12/2024 1:36:12PM

Location: 1 Waller Rd. Gravel Pit

Carrier PROVAC Pro-Vac
Vehicle PV615 PV615
Customer TITEAR Titan Earthwork LLC
Order 2350 Central Kitchen
 2445 Third Ave S., Seattle
Product 1400 Clean Vactor Mud

	Qty	Rate	Amount
Product	5.41 Ton	30.00	162.30
Fee			0.00
Other			15.00
Tax	REFUSE	3.6000	6.38
Total			183.68

P.O. Job #2350 - Central Kitch
Note

	Pounds	Tons	Metric
Gross	61880	30.94	28.07
Tare	51060	25.53	23.16
Net	10820	5.41	4.91

Weighmaster JWS Ticket System
Received



REPRINT **R Ticket 1449897**

2/12/2024 1:36:12PM

Location: 1 Waller Rd. Gravel Pit

Carrier PROVAC Pro-Vac
Vehicle PV615 PV615
Customer TITEAR Titan Earthwork LLC
Order 2350 Central Kitchen
 2445 Third Ave S., Seattle
Product 1400 Clean Vactor Mud

	Qty	Rate	Amount
Product	5.41 Ton	30.00	162.30
Fee			0.00
Other			15.00
Tax	REFUSE	3.6000	6.38
Total			183.68

P.O. Job #2350 - Central Kitch
Note

	Pounds	Tons	Metric
Gross	61880	30.94	28.07
Tare	51060	25.53	23.16
Net	10820	5.41	4.91

Weighmaster JWS Ticket System
Received



REPRINT **R Ticket 1449917**

2/12/2024 3:58:05PM

Location: 1 Waller Rd. Gravel Pit

Carrier PROVAC Pro-Vac
Vehicle PV470 PV470
Customer TITEAR Titan Earthwork LLC
Order 2350 Central Kitchen
 2445 Third Ave S., Seattle
Product 1400 Clean Vactor Mud

P.O. Job #2350 - Central Kitch
Note

Weighmaster JWS Ticket System
Received

	Qty	Rate	Amount
Product	8.04 Ton	30.00	241.20
Fee			0.00
Other			15.00
Tax	REFUSE	3.6000	9.22
Total			265.42

	Pounds	Tons	Metric
Gross	60800	30.40	27.58
Tare	44720	22.36	20.28
Net	16080	8.04	7.29



REPRINT **R Ticket 1449917**

2/12/2024 3:58:05PM

Location: 1 Waller Rd. Gravel Pit

Carrier PROVAC Pro-Vac
Vehicle PV470 PV470
Customer TITEAR Titan Earthwork LLC
Order 2350 Central Kitchen
 2445 Third Ave S., Seattle
Product 1400 Clean Vactor Mud

P.O. Job #2350 - Central Kitch
Note

Weighmaster JWS Ticket System
Received

	Qty	Rate	Amount
Product	8.04 Ton	30.00	241.20
Fee			0.00
Other			15.00
Tax	REFUSE	3.6000	9.22
Total			265.42

	Pounds	Tons	Metric
Gross	60800	30.40	27.58
Tare	44720	22.36	20.28
Net	16080	8.04	7.29



REPRINT **R Ticket 1449919**

2/13/2024 7:21:13AM

Location: 1 Waller Rd. Gravel Pit

Carrier PROVAC Pro-Vac
Vehicle PV615 PV615
Customer TITEAR Titan Earthwork LLC
Order 2350 Central Kitchen
 2445 Third Ave S., Seattle
Product 1400 Clean Vector Mud

P.O. Job #2350 - Central Kitch
Note

Weighmaster JWS Ticket System
Received

	Qty	Rate	Amount
Product	2.86 Ton	30.00	100.00
Fee			0.00
Other			15.00
Tax	REFUSE	3.6000	4.14
Total			119.14

	Pounds	Tons	Metric
Gross	60000	30.00	27.22
Tare	54280	27.14	24.62
Net	5720	2.86	2.59



REPRINT **R Ticket 1449919**

2/13/2024 7:21:13AM

Location: 1 Waller Rd. Gravel Pit

Carrier PROVAC Pro-Vac
Vehicle PV615 PV615
Customer TITEAR Titan Earthwork LLC
Order 2350 Central Kitchen
 2445 Third Ave S., Seattle
Product 1400 Clean Vector Mud

P.O. Job #2350 - Central Kitch
Note

Weighmaster JWS Ticket System
Received

	Qty	Rate	Amount
Product	2.86 Ton	30.00	100.00
Fee			0.00
Other			15.00
Tax	REFUSE	3.6000	4.14
Total			119.14

	Pounds	Tons	Metric
Gross	60000	30.00	27.22
Tare	54280	27.14	24.62
Net	5720	2.86	2.59

Contaminated Media Management Plan

Seattle Public Schools, John Stanford Center

2445 3rd Avenue South

Seattle, King County, Washington

February 26, 2024 | Terracon Project No. 81247068

Prepared for:

Seattle Public Schools
Seattle, Washington

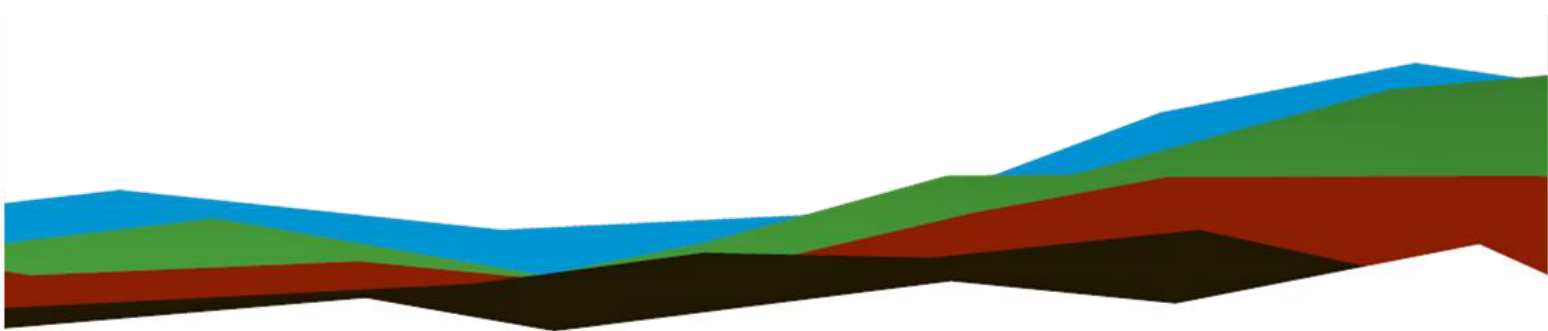

Prepared by:

Terracon Consultant, Inc.
Mountlake Terrace, Washington



Nationwide
Terracon.com

- Facilities
- Environmental
- Geotechnical
- Materials



21905 64th Ave W, Ste 100
Mountlake Terrace, WA 98043-2251
P 425-771-3304
F 425-771-3549
Terracon.com

February 26, 2024

Seattle Public Schools
2445 3rd Avenue South
Seattle, Washington 98134

Attn: Mr. Milton Huertas
D: (206) 252-0661
E: mjhuertas@seattleschools.org

Re: Contaminated Media Management Plan
Seattle Public Schools, John Stanford Center
2445 3rd Avenue South
Seattle, King County, Washington 98134
Terracon Proposal No. P81247068

Dear Mr. Huertas:

Terracon Consultants, Inc. (Terracon) has prepared this Contaminated Media Management Plan (CMMP) for the above-referenced Site. Per your request, this plan was prepared to provide guidance on the handling and disposition of documented contaminated soils, other potentially contaminated soils and/or subsurface environmental features that may be encountered at the Site during earthwork activities. In addition, this plan also provides for general guidance regarding the impervious surfaces, identified as the "Cap", at the property in accordance with the Environmental Covenant, dated April 13, 1999.

Terracon appreciates the opportunity to perform these services for Seattle Public Schools. These services were performed in general accordance with Terracon Proposal No. P81247069, dated February 2, 2024.

Please contact us if you have questions regarding this information or if we can provide any other services.

Sincerely,

Terracon Consultants, Inc.

A handwritten signature in blue ink that reads 'Madeleine Hummer'.

Madeleine Hummer, L.G.
Senior Staff Geologist

A handwritten signature in black ink that reads 'Kyle Bennett'.

Kyle Bennett, L.G.
Project Manager

A handwritten signature in black ink that reads 'Matt Wheaton'.

Matt Wheaton, L.G., P.E.
Senior Principal

Table of Contents

- 1.0 INTRODUCTION 1
 - 1.1 Purpose..... 1
 - 1.2 Site Description and Project Information 2
 - 1.3 Nature and Extent of Soil Contamination 2
- 2.0 TERRACON REPRESENTATIVE CONTACT AND NOTIFICATION INFORMATION 3
- 3.0 COMPLIANCE WITH APPLICABLE ENVIRONMENTAL LAWS AND REGULATIONS 4
 - 3.1 Planned Cap Disturbance—Notification, Repair Reporting..... 4
- 4.0 WATER MANAGEMENT 5
- 5.0 EARTHWORK 5
 - 5.1 Excavation Activities 5
 - 5.2 Sampling and Analysis Plan 6
 - 5.3 Disposition of Excavation Spoils 7
 - 5.3.1 Disposition of Contaminated Soil..... 7
 - 5.4 Transport of Contaminated Media..... 8
 - 5.5 Decontamination..... 8
- 6.0 REPORTING AND RECORD KEEPING 8
- 7.0 STANDARD OF CARE 9

APPENDICES

APPENDIX A EXHIBITS

Exhibit 1 – Site Diagram

APPENDIX B SUPPORTING DOCUMENTATION

CONTAMINATED MEDIA MANAGEMENT PLAN

Seattle Public Schools, John Stanford Center

2445 3rd Avenue South

Seattle, King County, Washington

Terracon Project No. 81247068

February 26, 2024

1.0 INTRODUCTION

Terracon Consultants, Inc. (Terracon) has prepared this Contaminated Media Management Plan (CMMP) for Seattle Public Schools (Client) to govern earthwork performed in association with the on-going renovation at the Site. Terracon understands that Client will retain a general and/or remediation contractor (Contractor) for the project, and the Client will provide them with a copy of this CMMP. Terracon will discuss the components of this CMMP during future preconstruction meetings to beginning earthwork so that all stakeholders are aware of the guidelines and requirements detailed herein. Should questions arise regarding the content of this CMMP, Terracon contact information is provided in Section 2.0.

1.1 Purpose

The objective of this CMMP is to provide guidance for the removal and disposal of the documented carcinogenic polycyclic aromatic hydrocarbon (cPAH)-contaminated soil, as well as characterization, handling, and disposal of cPAH-contaminated soil and/or other potentially contaminated soil, and/or other environmental related items (to be referenced as environmental features throughout this document) that may be encountered during earthwork activities at the Site that will require special handling or disposal at approved receiving facilities.

This CMMP has been prepared based on our understanding of proposed Site renovation, which includes tunnelling under the south building for utility replacement and is not intended to cover all potential future development activities at the Site and/or in the adjacent rights-of-way (ROW). However, this CMMP is intended to provide a basis for soil management, and to alert the construction contractor and related parties of the presence of contaminated soil that will be encountered during earthwork activities in specific areas of the Site, to provide guidance regarding handling, staging, sampling, transport, and disposition, and as a notification and guidance for the Cap in accordance with the Environmental Covenant (EC).

1.2 Site Description and Project Information

Terracon has prepared this CMMP for the property located at 2445 3rd Avenue South, and 230 South Lander, Seattle, Washington (King County Tax Parcel No. 766620-5235). The approximately 6.31-acre property is developed with an approximately 20,000-sf building on the north of the property and an approximately 350,000-square-foot (sf) three-story building on the south of the property. The property is currently occupied by the Seattle Public Schools and operates as a commercial kitchen and office space. It is Terracon's understanding that utility work is being completed beneath the south building via an approximately 350 feet tunnel, hereinafter the Site.

Based on previous investigations, the anticipated depth to groundwater at the Site ranges approximately 10 to 12 feet below ground surface (bgs), which is below the anticipated maximum depth of the planned utility work and is not anticipated to be encountered during the earthwork activities. The general location of the utility work is depicted on Exhibit 1.

1.3 Nature and Extent of Soil Contamination

Based on the previous environmental investigations conducted at the property, the northern building operated as a vehicle maintenance facility (VMF) by the United States Postal Service and the southern building operated as the USPS General Mail Facility (GMF). The VMF building had four former fueling underground storage tanks (USTs), in-ground hydraulic hoists, a waste oil UST, oil/water separators, a paint booth, two former heating oil USTs, and a steel culvert pipe. The features were assessed by previous consultants and petroleum impacts including cPAHs were identified in the soil and groundwater surrounding the features and were left-in-place. However, the property received a No Further Action (NFA) determination on March 8, 1999, and a revised NFA letter on April 5, 1999, contingent on the implementation of an EC, dated April 13, 1999. Per the established EC on the property, a notification to Ecology regarding the potential exposure of impacted media is required when removing or damaging the Cap (buildings, paved areas, landscaping, etc). It should be noted that soil and groundwater impacts previously identified at the property, and which remain in-place, are located to the north of the GMF building and soil or groundwater sampling does not appear to have been conducted in the vicinity of utility tunneling work under the GMF building as a source of potential contamination in this area of the property was not identified.

Prior to the utility tunneling at the Site, in an effort to assess soils ahead of the planned earthwork, on June 22, 2023, Krazan & Associates, Inc. (Krazan) conducted subsurface investigation at the site in the vicinity of the planned utility tunnel. Based on the findings of Krazan's investigation, concentrations of diesel-, oil-, and gasoline-range total petroleum hydrocarbons (TPH), benzene, toluene, ethyl benzene, xylenes, select metals, and polychlorinated biphenyls (PCBs) were not identified above laboratory

method reporting limits (MRLs) and/or Washington State's Model Toxics Control Act (MTCA) cleanup levels, with the exception of cPAHs (i.e. benzo[a]pyrene) in soil at a concentration exceeding MTCA Method A cleanup level in soil boring B1 at 6 feet bgs. This exceedance is likely associated with the fill material used beneath the structure, which includes creosote piles and building material debris. Furthermore, former creosote piles have been identified during the utility work and there is a potential that additional creosote piles will be discovered as utility work continues. The Krazan report is included in Appendix B

Based on these findings, this CMMP is intended to provide guidance for the handling and disposal of documented cPAH-contaminated soil that will be encountered at the Site during the under-slab utility work that is being completed beneath the southern building only and is not intended to cover all media management procedures for all areas of the property. This CMMP also provides a general guidance for notification, repair, and reporting for disturbance/damage to the Cap (e.g., impervious surfaces) in accordance with the EC.

2.0 TERRACON REPRESENTATIVE CONTACT AND NOTIFICATION INFORMATION

At least 72 hours prior to earthwork activities within the documented areas of environmental impacts, the Contractor will contact the Client (or authorized representative) and Terracon, so that proper documentation and observations may be performed. As necessary, a Terracon field representative will mobilize to the Site to observe and document excavation activities and collect excavation soil samples, as necessary. Details of sampling procedures will be determined by Terracon based on the conditions encountered, this CMMP and/or in accordance with local rules and regulations.

- **Primary Terracon contact**

Kyle Bennett (425) 697-1128 office, (360) 913-5649 cell

- **Secondary Terracon contact**

Matt Wheaton (425) 361-0360 office, (425) 218-4607 cell

Should Terracon personnel not be on-Site when contaminated or suspect soils/materials are encountered, or other environment features, the Contractor shall be prepared to document the work completed noting the location, approximate depth and elevation, as well as photographs of the material, and follow the procedures detailed herein.

3.0 COMPLIANCE WITH APPLICABLE ENVIRONMENTAL LAWS AND REGULATIONS

The Contractor and all subcontractors working at the Site shall at all times comply with all applicable environmental laws. Management and handling of contaminated media shall be conducted in accordance with Resource Conservation and Recovery Act (RCRA), 42 U.S.C. § 6901 et seq, and the Hazardous Waste Management Act (HWMA), RCW 70.105 and WAC 173-303, as necessary.

Washington OSHA is codified in Chapter 296-843 WAC. According to 29 CFR 1910.120(e), workers that could be potentially exposed to hazardous substances, health hazards, or safety hazards and their supervisors and management responsible for the Site work shall receive 40-hour HAZWOPER training under a qualified vendor. The Contractor's workers engaged in subsurface tunneling or other activities within the locations with soil impacts (described in Sections 1.3 and 5.1), and which may be potentially exposed to the contaminants and health hazards, shall receive a minimum of 40 hours of HAZWOPER instruction.

3.1 Planned Cap Disturbance—Notification, Repair Reporting

As previously mentioned, cPAH-contaminated soil was identified and left-in-place at the property and an EC, dated April 13, 1999, was signed. As per the EC, a notification to Ecology regarding the potential exposure of impacted media is required when removing or damaging the Cap (buildings, paved areas, landscaping, etc). The EC is included in Appendix B.

Property activities may require disturbance in the Cap and excavation of contaminated soil beneath the Cap, for example to install new utilities. Disturbance of the Cap for planned development activities is allowed if the work is conducted in accordance with this CMMP.

At least 30 days before the planned Cap disturbance, notification shall be provided to Ecology, including a description and diagrams of the work to be performed, and confirmation that the work will be performed in accordance with this CMMP. Ecology will need to approve any development within the restricted area in accordance with the EC.

In the event that the Cap is disturbed/damaged, it must be repaired, replaced, and/or reconstructed and restored to near original surface completion or with Ecology approved alternative surfaces.

After disturbance and repair activities are complete, as-built documentation, photographs of the work, and a letter summarizing that work was conducted according to the EC shall be submitted to Ecology within 45 days of completion.

4.0 WATER MANAGEMENT

Groundwater has been previously encountered at the Site at depths ranging from approximately 10 to 12 feet bgs. The tunneling is unlikely to encounter groundwater as the depth of the tunnel will be approximately 6 feet bgs. In the event that groundwater is encountered, the Contractor shall be prepared to manage the accumulated water.

The Contractor shall obtain necessary permits for the storage, treatment, and/or disposal of water collected and stored at the Site during construction, as necessary. The Contractor shall manage, treat, discharge, and/or dispose accumulated water in accordance with the requirements of local, state, and federal regulations.

5.0 EARTHWORK

During the utility tunneling activities, the Contractor will be on Site to observe and document handling and management of contaminated soils in accordance with the CMMP. Notably, the Contractor will monitor earthwork activities including excavation, utility replacement, and general earthwork phases of construction. Terracon will provide guidance regarding the segregation, export of excavation spoils and/or soil staging as necessary, during earthwork phases of construction. In addition, Terracon will be responsible for collecting soil samples, as necessary.

The Contractor will be responsible for coordinating with Terracon and the Client (or Client's representative), as detailed in Section 2.0, and to secure the necessary permits for disposal of contaminated excavation spoils, and the appropriate handling and management of spoils while following the requirements of this CMMP and all other applicable local, state, and federal rules and regulations.

5.1 Excavation Activities

As a general requirement, soil excavated from the tunnel shall be direct loaded into truck and/or containers to be exported from the Site as discussed in Section 5.4. It is Terracon's understanding that the soil will be removed using vacuum truck methods. During disposition, in order to unload the soil from the vacuum truck, a water rinse is included, and the final material made for disposition is a soil/water mix. Based on the information provided by the Contractor, the estimated total volume of soil that would be excavated is approximately 630 bank cubic yards (cy), roughly 882 tons, of which it is anticipated that a portion of this will likely be considered cPAH-contaminated soil. The location of the utility work is depicted on Exhibit 1.

CPAHs are not typically apparent during excavation activities (i.e., odors and sheens are not commonly observed with cPAH-contaminated soil associated with uncontrolled fill).

Therefore, throughout the earthwork activities, waste characterization soil samples will be collected from the excavation sidewalls and/or bottom, as necessary (i.e., in the event that “pockets” of construction debris or additional creosote-treated timbers are encountered during excavation activities), to further characterize the soils removed during tunneling activities for waste disposal purposes.

Furthermore, there is a potential that creosote piles will be encountered during the utility work and they should be properly removed and managed prior to disposition.

In addition, in the event that soils exhibiting visual and/or olfactory indications of impacts, such as staining, sheens, and/or odors, which may be indications of other impacts, such as petroleum releases, are encountered during excavation activities, waste characterization soil samples will be collected from the excavation sidewalls and/or bottom, as necessary. Samples will be submitted to a Washington-state accredited analytical laboratory on standard laboratory turnaround time. As necessary, sample analysis can be completed on an expedited 24-hour turnaround time to maintain construction schedule and minimize delays.

5.2 Sampling and Analysis Plan

To the extent sampling is required, excavation sampling of suspected or contaminated soil will be conducted in general accordance with the Ecology requirements presented in Guidance for Remediation of Petroleum Contaminated Sites, dated 2016, and/or the landfill disposal acceptance criteria. The following frequencies will apply for samples collected during excavation and generation of excavation spoils.

Cubic Yards of Soil	Number of Samples for Chemical Analysis
0-100	3
101-500	5
501-1000	7
1001-2000	10
>2000	10 + 1 for each additional 500 cubic yards

Source: Table 6.9, Typical Number of Samples Needed to Adequately Characterize Stockpiled Soil, Guidance for Remediation of Petroleum Contaminated Soils, June 2016

5.3 Disposition of Excavation Spoils

Based on the information provided by the contractor, it is estimated approximately 630 cy, roughly 882 tons of soil, of which it is anticipated that a portion of this will likely be considered cPAH-contaminated soil. **It should be noted that this volumetric estimate is not to be considered the actual amount of soil and the actual volume of soil generated during excavation could be greater or less than the predicted estimate.**

Since the soil will be removed using vacuum truck methods, the free liquid generated during the water rinse needed for unloading the soil from the vacuum truck requires special handling and may be restricted at select receiving facilities, such as Republic Services Transfer Station at 3rd Ave S and S Lander St in Seattle, Washington, and Cadman at 17 East Marine View Drive in Everett, Washington. Therefore, the Contractor should provide proper notification and coordinate with appropriate receiving facilities based on their acceptance criteria.

5.3.1 Disposition of Contaminated Soil

Potential disposal facilities for soil generated from the utility work managed as non-hazardous waste include the following examples:

- Dickson Company at Waller Road Inert Waste Landfill at 2839 48th St E in Tacoma, Washington.
- Lafarge North America, at 5400 W Marginal Way SW in Seattle, Washington, and transfer for disposal at the Columbia Ridge Landfill, a Subtitle D landfill at 18177 Cedar Springs Road, Arlington, Oregon 97812.

Potential disposal facilities for creosote pile waste generated from the utility work managed as non-hazardous waste include the following:

- Republic Services Black River Transfer Station at 501 Monster Road SW in Renton, Washington for disposal at the Roosevelt Regional Landfill, at 500 Roosevelt Grade Road, Roosevelt, Washington 99356.

Terracon will coordinate with the Contractor, Client, and selected disposal facility to prepare the soil waste characterization profile. In addition, the Contractor will coordinate with Terracon and Client to obtain a bill of lading to document transportation and disposal of contaminated soils slated for off-Site disposition. The Client will be responsible for signing the waste profile application as the generator. The Contractor will provide Terracon with the waste manifests/waste bill(s) of lading, truck scale tickets, waste profile submittals, and any other documentation provided to the Contractor by the permitted receiving facility. The Contractor is responsible for providing complete documentation of all off-Site disposition of soil on a daily basis.

5.4 Transport of Contaminated Media

Transport and disposal of contaminated media by the Contractor shall comply with all applicable federal, state, or local laws, codes, and ordinances that govern or regulate contaminated substance transportation and disposal. A manifest or bill of lading will be included for each load of contaminated media transported off-Site for disposal or treatment.

Contaminated media shall be loaded into transport vehicles in a manner that prevents the spilling or tracking of contaminated media into on-Site and off-Site uncontaminated areas. Media that spills or falls onto the ground shall be placed back into the truck immediately or into its original container/stockpile, and the affected area shall be cleaned immediately using appropriate equipment. Under no circumstances should contaminated media be washed into a catch basin or surface water area. If loading areas are paved, any loose media shall be cleaned from the pavement at the conclusion of the loading activities.

5.5 Decontamination

In the event that contaminated or suspect soil or other media are encountered, equipment that has come into contact with the impaired media must be decontaminated before use in areas without known environmental impacts to reduce the possibility of cross-contamination. The Contractor shall prepare a written description of planned worker or equipment decontamination procedures, location, and plan for characterization (if appropriate or necessary) and disposal of any decontamination wastes generated. The Contractor shall provide adequate wash basins for both personnel and equipment immediately adjacent to the work area and shall ensure that all personnel exposed to contaminated soils and/or water within the project Site thoroughly wash their hands, face, and exposed body parts prior to breaks and at the end of every work shift. Number, type, and location of wash basins shall be consistent with local, state and federal requirements.

The Contractor shall decontaminate equipment that has come into contact with contaminated soil by scraping soil off of equipment with a shovel, if possible, or by scrub washing or high temperature pressure wash (supplied by the Contractor).

6.0 REPORTING AND RECORD KEEPING

The Contractor shall prepare daily field reports (DFRs) in order to document all earthwork activities on the Site and verbal communications, as they pertain to contaminated media and this Plan. DFRs shall be completed on Site prior to leaving the

Site for the day. The Contractor shall provide the DFRs to Terracon and Client daily, as appropriate.

After completion of all tasks as discussed above, Terracon will provide Ecology with the pertinent information regarding field activities and methodologies, documenting the utility work, and final disposition or end use of all contaminated soils generated from the Site. Copies of all permits, soil recycling certificates, transportation manifest(s), and truck scale tickets will also be provided, as well as appropriate construction drawings and figures, as necessary, to reference the work performed relative to existing and future Site features.

The Contractor shall provide complete documentation related to any off-Site disposal of media at any disposal facility as described in Section 5.4 including, but not limited to the following: waste profile submittals, waste manifests/waste bill(s) of lading, truck scale tickets and any other documentation provided to the Contractor by the permitted receiving facility. The Contractor is responsible for providing complete documentation of off-Site disposition of soil and maintain records of earthwork activities, soil stockpiling, sampling, and off-Site disposal loading while present in the field. The Contractor shall provide complete documentation related to any on Site re-use/re-positioning of soil including but not limited to strict horizontal and vertical (elevation) control prior to and after re-positioning of said soil from both borrow and placement areas of the Site, and accurate quantity records of any soil subject to re-positioning/re-use on Site.

The Contractor shall keep daily records of Site safety briefings regarding work described in Section 5.0 and prepare daily reports to document management of contaminated media. The Contractor shall use a manifest or bill of lading for each off-Site shipment of contaminated media. The manifest or bill of lading shall include among other information, the date and time of shipment, the name of the transportation company, the name of the truck driver, the disposal Site, and a brief description of the contaminated media (e.g., soil).

7.0 STANDARD OF CARE

This CMMP was prepared in a manner consistent with generally accepted practices of the profession undertaken and with regard to similar projects in a similar geographic area during a similar time period. It is intended to be used a guidance document, as no CMMP can wholly eliminate uncertainty regarding the presence of contaminated media in connection with a property in recognition of reasonable limits of time, cost, and inferred risk. There are a number of unknown variables associated with construction projects with environmentally impaired media. This CMMP should therefore be considered a dynamic document, modification to which could be recommended by Terracon in

response to the results of conditions encountered in the field. The information used to develop this CMMP is based solely on the Client provided information.

The data, interpretations, findings, and our recommendations are based solely upon data obtained at the time and within the scope of these services. The limitations herein must be considered when the user of this report formulates opinions as to risks associated with the Site or otherwise uses the report for any other purpose.

APPENDIX A
EXHIBITS

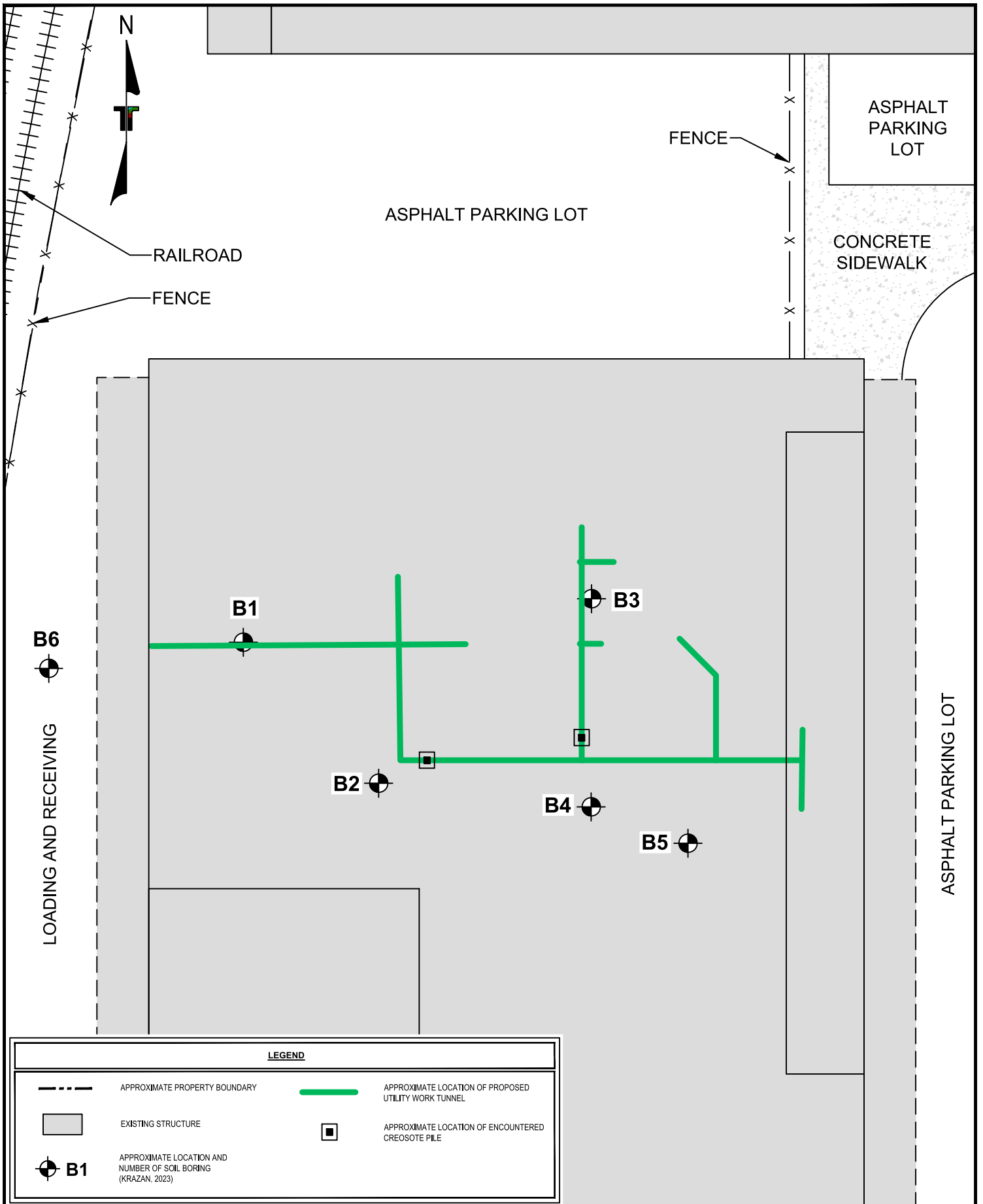

LEGEND			
	APPROXIMATE PROPERTY BOUNDARY		APPROXIMATE LOCATION OF PROPOSED UTILITY WORK TUNNEL
	EXISTING STRUCTURE		APPROXIMATE LOCATION OF ENCOUNTERED CREOSOTE PILE
	B1 APPROXIMATE LOCATION AND NUMBER OF SOIL BORING (KRAZAN, 2023)		

Project Mngr:	KSB
Drawn By:	MMH
Checked By:	KSB
Approved By:	MYW

Project No.	81247068
Scale:	AS SHOWN
File No.	Exhibit 1
Date:	February 2024

21905 64TH AVENUE W, STE 100 MOUNTLAKE TERRACE, WA 98043
 PH. (425) 771-3304 FAX. (425) 771-3549

SITE DIAGRAM
 Seattle Public Schools, John Stanford Center
 2445 3rd Avenue South
 Seattle, Washington

EXHIBIT	1
---------	---