



Kennedy Equipment Company Inc.

UST # 6606
RELEASE ID 519023

510 THIRD STREET
CLARKSTON, WASHINGTON 99403

Phone 1 (509) 758-2493
Fax 1 (509) 758-6960
January 29, 1999

SITE INVESTIGATION REPORT

Site Assessment With Tank Removal



Guy Bennett Lumber Company-----Elm Street Site
P.O. Box 670
Clarkston, Washington 99403
(509) 758 - 5558

Contact: Mr. Mitch Dimke

As requested, we have performed investigation and assessment services during the underground storage tank closure with removal. Excavation work involved two separate holes with two tanks each. In the hole containing the gas and diesel tanks, contamination was encountered. Much of it was removed but there are a couple of areas where contamination is still above target levels. Please review the conclusions in this report. The other hole containing the waste oil tanks is considered to be clean. A copy of this report has been sent to the Washington Department of Ecology.

Report submitted by,

Taren L. Nelson

Installation/Retrofitting #0873668-25

Decommissioning #0873668-26

Underground Storage Tank Tightness Testing #0873668-27

Washington State Underground Storage Tank Site Assessment (ASI #32002217)



Site Description

Guy Bennett Lumber Company owns many acres of land at this Elm Street site. Much of its current operations has been moved to the Port of Wilma site but the tire shop and mechanics shop are still here. Guy Bennett grew his enterprise beginning in the late 1930's and early 1940's. At some time, two fuel tanks were installed and used to store and dispense gas and diesel. In the 1970's two more tanks were installed over at the side of the mechanics shop and were used to store and dispense gas and diesel. The pumps were removed from the original tanks in the main drive area and these tanks began use for waste oil storage.

Site Inspection

- Tank excavation hole number one. These tanks are the ones that had been recently in use to dispense gas and diesel. They were covered with asphalt with a concrete island and drive slab on one end. There was some noticable contamination underneath the fuel pumps where occasional leaks had collected. Upon excavation, the tanks and piping were free from corrosion and everything appeared tight. The soil had a definite gasoline odor, though, and was stockpiled in preparation for bioremediation.
- Tank excavation hole number two. These tanks are the ones that had been recently in use to store waste oil. They were covered with asphalt. Upon excavation, the tanks and piping did not have any deep corrosion and everything appeared to be tight. The soil in this hole appeared clean but was stockpiled with the soil from the other hole anyway.
- Overexcavation of hole number one. Sample analysis showed large amounts of contamination on this area. As we had already excavated as deep as our equipment would allow, a larger machine was brought in. We removed soil as deep as we could go and began to work our way back in all directions to see if all of the noticeably contaminated soil could be removed. This hole is bordered on one side by the mechanics shop building, and indications such as fire hydrants and water manways limited how far we could go in all three other directions. The soil rapidly became cleaner but due to the underground obstructions we stopped digging until we could see how the sample test results came back.
- Stockpile/Bioremediation site. As this site is a lumber mill, a short distance away is a large, flat, log storage deck. All excavated soils, including a small amount from Bennett Lumber's other tank removal site at the Port of Wilma, was taken to this deck.



Field Sampling Plan

All soil encountered at this site was fine sand. As I have learned at other site around Clarkston, a small leak can go a long way. Samples were collected at the recommended locations in each hole. All samples were collected by hand from either the backhoe bucket or by entering the hole and using a new vinyl surgical type glove to pack it into the container. Containers were supplied by Anatek Labs of Moscow, Idaho. Each sample was put in a cooler under cold pack and delivered to the lab with chain of custody records. Groundwater was not encountered.

- Tank hole number one. In the original excavation, sample one was taken four feet down on the northern wall next to the mechanics shop. Sample two was taken underneath the west (gas) tank eight feet down. Sample three was underneath the east (diesel) tank eight feet down. Sample four was four feet down on the south wall. This would place the sample underneath where the fuel island was located.
- Tank hole number two. Sample number one was taken from the south wall four feet down. I chose this wall because at one time in the past there had been pumps here. Sample two was underneath the west waste oil tank eight feet down. Sample three was taken four feet down on the north wall. Sample four was taken underneath the east waste oil tank eight feet down.
- Overexcavation of tank hole number one. Sample five was collected from the center of the excavation at the deepest point we could dig (seventeen feet). Sample six was taken from the western excavation wall ten feet down. Sample seven was taken from the south wall, ten feet down. Sample eight was taken from the east wall ten feet down.

Conclusions

The source of contamination at Bennett Lumber's Elm Street site has been removed. Most of the contamination itself has been removed. The waste oil tank hole is clean. The gasoline and diesel tank hole has gone from 8,850-11,800 at eight feet to 6,530 ppm of gasoline contamination remaining at seventeen feet. There is also 3,090 ppm of contamination still on the western wall. The three sides toward the building, the street, and the south are all clean.

To continue to excavate deeper, we would have to build a ramp to get the machine into the hole. This would be quite difficult as there are buried obstructions on all sides. We would also create a very deep hole in sandy soil right next to a building. If the overhead power line was disconnected to the tire shop, we would be able to excavate the wall with the 3,090ppm for an additional ten feet horizontally before running into the water line servicing the fire hydrants. The site is outside of the ten year effect range for all the city water wells and Bennett Lumber owns acres of land in all directions.

Due to the depth of the hole and proximity to the building, I instructed Bennett Lumber to fill the hole with clean material immediately after taking the last set of soil samples. Since the tanks and piping was tight, I do not believe that there is that much actual volume of contaminated soil left remaining.



TABLE OF ATTACHMENTS

Page Five-----	Vicinity map
Page Six-----	Site map
Page Seven-----	Fuel excavation map
Page Eight-----	Waste oil excavation map
Page Nine-Twenty three-----	Sample analysis reports
Page Twenty Four-----	Site assessment notice
Page Twenty Five-----	Site assessment checklist



Kennedy Equipment Company Inc.

510 THIRD STREET
CLARKSTON, WASHINGTON 99403

Phone 1 (509) 758-2493

Fax 1 (509) 758-6960

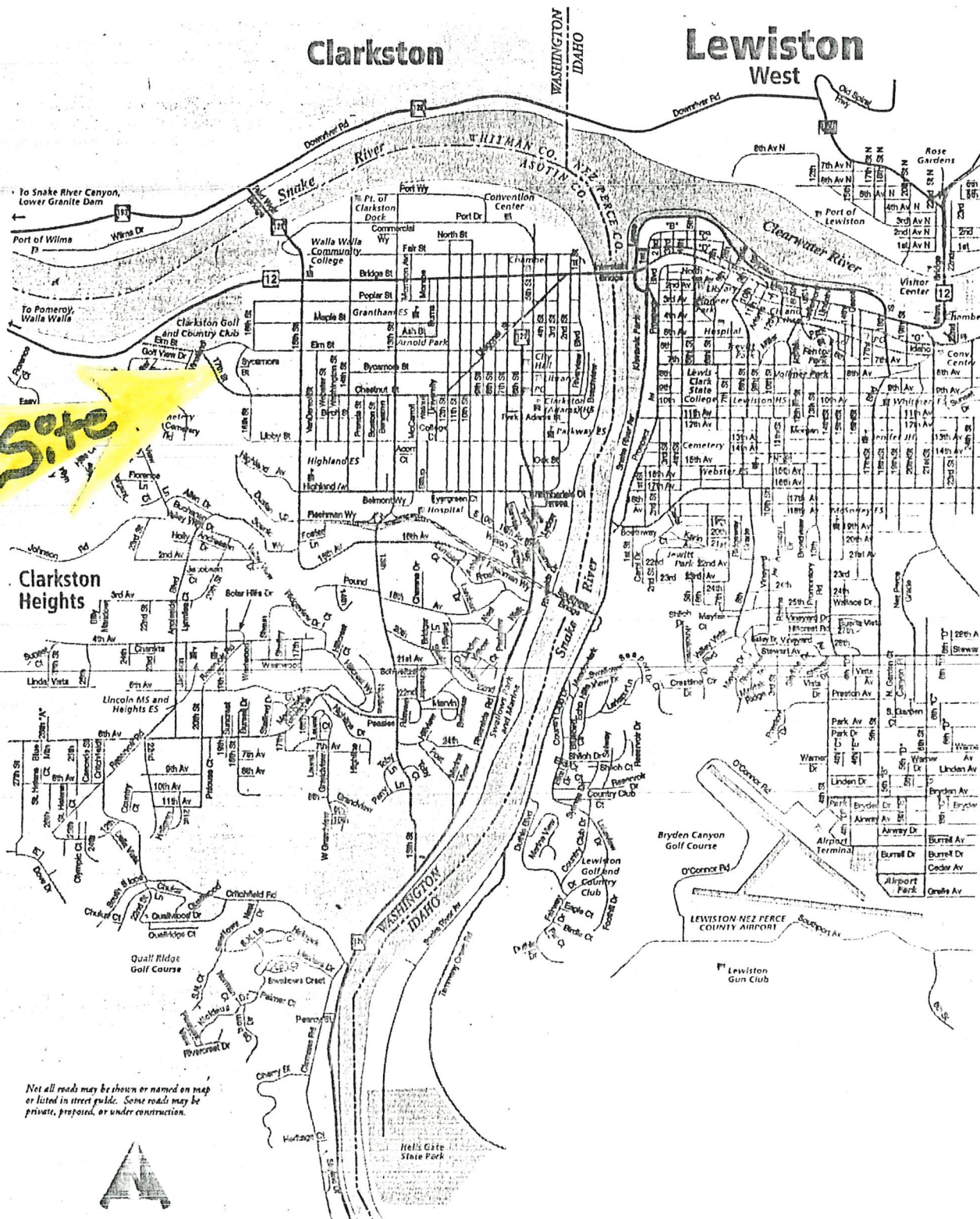

11m St

17m St

17m St

11m St

Mechanics Shop

Fuel tank hole

Waste oil tank hole

(M)

(W)

O₂

Tire hoist

Tire shop

Office

Hay Shed

Compressor shed

Filing room

WV

WV

GUY BENNETT LUMBER COMPANY
MECHANICS SHOP
ELM STREET, CLARKSTON, WASHINGTON

FUEL TANK HOLE MAP

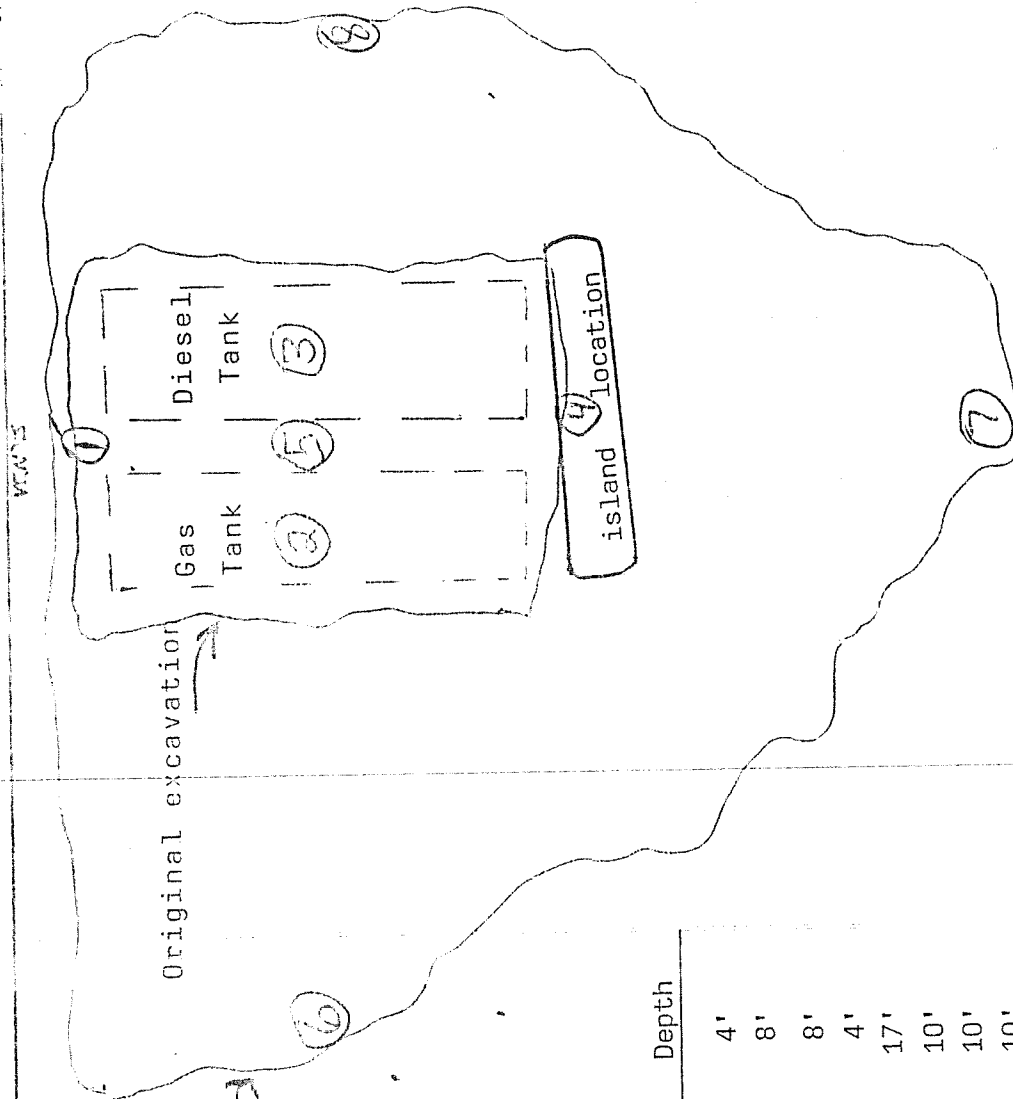

Sample	Gas	Diesel	Depth
One	13	N.D.	4'
Two	8850	N.D.	8'
Three	11800	N.D.	8'
Four	21700	5091	4'
Five	6530	113.2	17'
Six	3090	103.4	10'
Seven	N.D.	N.D.	10'
Eight	11.4	N.D.	10'

Fire hydrant

GUY BENNETT LUMBER COMPANY
 ELM STREET
 CLARKSTON, WASHINGTON

MECHANICS SHOP

Fire
 hydrant

WASTE OIL TANK HOLE MAP

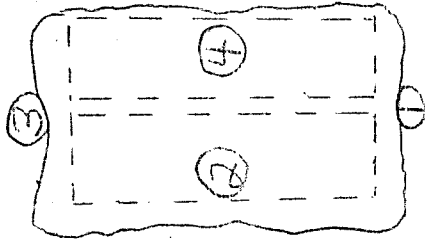

Sample	Gas	Diesel	Lube Oil	Depth
One	N.D.	N.D.	N.D.	4'
Two	N.D.	N.D.	N.D.	8'
Three	N.D.	N.D.	N.D.	4'
Four	N.D.	61	N.D.	8'
Stockpile	N.D.	200	N.D.	

FILING
 ROOM

TIRE SHOP



Anatek Labs, Inc.

1917 South Main St • Moscow, ID 83843 • (208) 883-2839 • Fax (208) 882-9246 • email anatekid@moscow.com
 504 E Sprague Ste. D • Spokane WA 99202 • (509) 838-3999 • Fax (509) 838-4433 • email anatekwa@moscow.com

KENNEDY EQUIPMENT COMPANY

TAREN NELSON
 510 3RD STREET
 CLARKSTON WA 99403

Project: BENNETT AND ELM

Certificate of Analysis

Petroleum - Gasoline by NWTPH-G BTEX by EPA 602/8021B(MOD)

Sample Name:	1	Analyte	Result	Units	PQL
Sample Location:	NBW	Gasoline	13	mg/Kg	5.0
Sampling Date:	12/18/98	NWTPH-G Surrogate (BFB) Percent Recovery 92.1			
Sampling Time:					
Date Received:	12/18/98	Benzene	0.032	mg/Kg	0.005
Lab #:	25788-01	Toluene	0.128	mg/Kg	0.005
Matrix:	SOIL	Ethylbenzene	0.053	mg/Kg	0.005
Analysis Date TPH-G/BTEX:	12/22/98	Xylene (total)	0.454	mg/Kg	0.010
Percent Solids	83.2	BTEX Surrogate (CB-d5) Percent Recovery 100.5			

Sample Name:	2	Analyte	Result	Units	PQL
Sample Location:	WS	Gasoline	8850	mg/Kg	125.0
Sampling Date:	12/18/98	NWTPH-G Surrogate (BFB) Percent Recovery 92.1			
Sampling Time:					
Date Received:	12/18/98	Benzene	20.7	mg/Kg	0.125
Lab #:	25788-02	Toluene	334	mg/Kg	0.125
Matrix:	SOIL	Ethylbenzene	84.2	mg/Kg	0.125
Analysis Date TPH-G/BTEX:	12/22/98	Xylene (total)	477	mg/Kg	0.250
Percent Solids	94.9	BTEX Surrogate (CB-d5) Percent Recovery 99.2			

Sample Name:	3	Analyte	Result	Units	PQL
Sample Location:	EW	Gasoline	11800	mg/Kg	250.0
Sampling Date:	12/18/98	NWTPH-G Surrogate (BFB) Percent Recovery 92.1			
Sampling Time:					
Date Received:	12/18/98	Benzene	111	mg/Kg	0.250
Lab #:	25788-03	Toluene	794	mg/Kg	0.250
Matrix:	SOIL	Ethylbenzene	165	mg/Kg	0.250
Analysis Date TPH-G/BTEX:	12/22/98	Xylene (total)	869	mg/Kg	0.500
Percent Solids	93.7	BTEX Surrogate (CB-d5) Percent Recovery 98.4			

Anatek Labs, Inc.

1917 South Main St • Moscow, ID 83843 • (208) 883-2839 • Fax (208) 882-9246 • email anatekid@moscow.com
504 E Sprague Ste. D • Spokane WA 99202 • (509) 838-3999 • Fax (509) 838-4433 • email anatekwa@moscow.com

KENNEDY EQUIPMENT COMPANY

TAREN NELSON

510 3RD STREET

CLARKSTON WA 99403

PROJECT: BENNETT AND ELM

Certificate of Analysis

Petroleum -NWTPH-D by GC/FID (8015 modified)

Sample Name:	1	Analyte	Result	Units	PQL
Sample Location:	NBW	Diesel	ND	mg/Kg	25.0
Sampling Date:	12/18/98				
Sampling Time:		<i>NWTPH-D Surrogate (Hexacosane) Percent Recovery</i> 111.3			
Date Received:	12/18/98				
Lab #:	25788-01				
Matrix:	SOIL	Comments:			
Analysis Date NWTPH-D:	12/23/98				
Percent Solids:	83.2				

Sample Name:	2	Analyte	Result	Units	PQL
Sample Location:	WS	Diesel	ND	mg/Kg	25.0
Sampling Date:	12/18/98				
Sampling Time:		<i>NWTPH-D Surrogate (Hexacosane) Percent Recovery</i> 111.9			
Date Received:	12/18/98				
Lab #:	25788-02				
Matrix:	SOIL	Comments:			
Analysis Date NWTPH-D:	12/23/98				
Percent Solids:	94.9				

Sample Name:	3	Analyte	Result	Units	PQL
Sample Location:	EW	Diesel	ND	mg/Kg	25.0
Sampling Date:	12/18/98				
Sampling Time:		<i>NWTPH-D Surrogate (Hexacosane) Percent Recovery</i> 120.5			
Date Received:	12/18/98				
Lab #:	25788-03				
Matrix:	SOIL	Comments:			
Analysis Date NWTPH-D:	12/23/98				
Percent Solids:	93.7				

Anatek Labs, Inc.

1917 South Main St • Moscow, ID 83843 • (208) 883-2839 • Fax (208) 882-9246 • email anatekid@moscow.com
504 E Sprague Ste. D • Spokane WA 99202 • (509) 838-3999 • Fax (509) 838-4433 • email anatekwa@moscow.com

KENNEDY EQUIPMENT COMPANY

TAREN NELSON
510 3RD STREET
CLARKSTON WA 99403

Project: BENNETT AND ELM

Certificate of Analysis

Petroleum - Gasoline by NWTPH-G BTEX by EPA 602/8021B(MOD)

Sample Name:	4	Analyte	Result	Units	PQL
Sample Location:	SSW	Gasoline	21700	mg/Kg	250.0
Sampling Date:	12/18/98	NWTPH-G Surrogate (BFB) Percent Recovery		92.1	
Sampling Time:					
Date Received:	12/18/98	Benzene	247	mg/Kg	0.250
Lab #:	25788-04	Toluene	1600	mg/Kg	0.250
Matrix:	SOIL	Ethylbenzene	384	mg/Kg	0.250
Analysis Date TPH-G/BTEX:	12/22/98	Xylene (total)	2060	mg/Kg	0.500
Percent Solids	83.2				
		BTEX Surrogate (CB-d5) Percent Recovery		95.2	

Sample Name:	SP	Analyte	Result	Units	PQL
Sample Location:		Gasoline	9950	mg/Kg	125.0
Sampling Date:	12/18/98	NWTPH-G Surrogate (BFB) Percent Recovery		92.1	
Sampling Time:					
Date Received:	12/18/98	Benzene	53.4	mg/Kg	0.125
Lab #:	25788-05	Toluene	500	mg/Kg	0.125
Matrix:	SOIL	Ethylbenzene	128	mg/Kg	0.125
Analysis Date TPH-G/BTEX:	12/22/98	Xylene (total)	722	mg/Kg	0.250
Percent Solids	87.2				
		BTEX Surrogate (CB-d5) Percent Recovery		97.5	

Lab Supervisor:

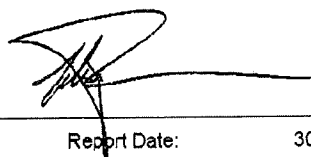

Report Date:

30-Dec-98

Anatek Labs, Inc.

1917 South Main St • Moscow, ID 83843 • (208) 883-2839 • Fax (208) 882-9246 • email anatekid@moscow.com
504 E Sprague Ste. D • Spokane WA 99202 • (509) 838-3999 • Fax (509) 838-4433 • email anatekwa@moscow.com

KENNEDY EQUIPMENT COMPANY

TAREN NELSON
510 3RD STREET
CLARKSTON WA 99403

PROJECT: BENNETT AND ELM

Certificate of Analysis

Petroleum -NWTPH-D by GC/FID (8015 modified)

Sample Name: 4

Sample Location: SSW

Sampling Date: 12/18/98

Sampling Time:

Date Received: 12/18/98

Lab #: 25788-04

Matrix: SOIL

Analysis Date NWTPH-D: 12/23/98

Percent Solids: 83.2

Analyte	Result	Units	PQL
---------	--------	-------	-----

Diesel	5091	mg/Kg	25.0
--------	------	-------	------

NWTPH-D Surrogate (Hexacosane) Percent Recovery 107.3

Comments: Contamination appears to be primarily gasoline with some diesel.

Sample Name: SP

Sample Location:

Sampling Date: 12/18/98

Sampling Time:

Date Received: 12/18/98

Lab #: 25788-05

Matrix: SOIL

Analysis Date NWTPH-D: 12/23/98

Percent Solids: 87.2

Analyte	Result	Units	PQL
---------	--------	-------	-----

Diesel	2080	mg/Kg	25.0
--------	------	-------	------

NWTPH-D Surrogate (Hexacosane) Percent Recovery 115.1

Comments: Contamination appears to be primarily gasoline with some diesel.

Lab Supervisor:

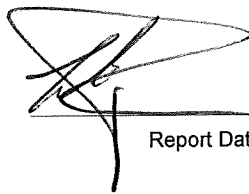

Report Date:

30-Dec-98

1917 S Main Street, Moscow ID 83843 (208) 883-2839 FAX 883-9246
504 E Sprague Ste D, Spokane WA 99202 (509) 838-3999 FAX 838-443-

Chain of Custody Record

25783 KEN C

Die Received

12/18/98

[illegible]

Anatek Labs, Inc.

1917 South Main St • Moscow, ID 83843 • (208) 883-2839 • Fax (208) 882-9246 • email anatekid@moscow.com
504 E Sprague Ste. D • Spokane WA 99202 • (509) 838-3999 • Fax (509) 838-4433 • email anatekwa@moscow.com

KENNEDY EQUIPMENT COMPANY

TAREN NELSON
510 3RD STREET
CLARKSTON WA 99403

Project: BENNETT - ELM TWO

Certificate of Analysis

Petroleum - Gasoline by NWTPH-G

Sample Name:	1	Analyte	Result	Units	PQL
Sample Location:		Gasoline	ND	mg/Kg	5.0
Sampling Date:	12/28/98	<i>NWTPH-G Surrogate (BFB) Percent Recovery</i>			
Sampling Time:	15:15				
Date Received:	12/29/98				
Lab #:	25813-01				
Matrix:	SOIL				
Analysis Date NWTPH-G:	12/29/98				
Percent Solids	87.2				

Sample Name:	2	Analyte	Result	Units	PQL
Sample Location:		Gasoline	ND	mg/Kg	5.0
Sampling Date:	12/28/98	<i>NWTPH-G Surrogate (BFB) Percent Recovery</i>			
Sampling Time:	15:19				
Date Received:	12/29/98				
Lab #:	25813-02				
Matrix:	SOIL				
Analysis Date NWTPH-G:	12/29/98				
Percent Solids	85.4				

Sample Name:	3	Analyte	Result	Units	PQL
Sample Location:		Gasoline	ND	mg/Kg	5.0
Sampling Date:	12/28/98	<i>NWTPH-G Surrogate (BFB) Percent Recovery</i>			
Sampling Time:	15:30				
Date Received:	12/29/98				
Lab #:	25813-03				
Matrix:	SOIL				
Analysis Date NWTPH-G:	12/29/98				
Percent Solids	83.5				

Anatek Labs, Inc.

1917 South Main St • Moscow, ID 83843 • (208) 883-2839 • Fax (208) 882-9246 • email anatekid@moscow.com
504 E Sprague Ste. D • Spokane WA 99202 • (509) 838-3999 • Fax (509) 838-4433 • email anatekwa@moscow.com

KENNEDY EQUIPMENT COMPANY

TAREN NELSON
510 3RD STREET
CLARKSTON WA 99403

PROJECT: BENNETT - ELM TWO

Certificate of Analysis

Petroleum -NWTPH-D Extended by GC/FID (8015 modified)

Sample Name:	1	Analyte	Result	Units	PQL
Sample Location:		Diesel	ND	mg/Kg	25.0
Sampling Date:	12/28/98	Lube Oil	ND	mg/Kg	100.0
Date Received:	12/29/98				
Lab #:	25813-01	<i>NWTPH-D Surrogate (Hexacosane) Percent Recovery 104.8</i>			
Matrix:	SOIL				
Analysis Date NWTPH-D:	12/30/98				
Percent Solids:	87.2				
Weight Basis:	Dry wt Basis	Comments:			

Sample Name:	2	Analyte	Result	Units	PQL
Sample Location:		Diesel	ND	mg/Kg	25.0
Sampling Date:	12/28/98	Lube Oil	ND	mg/Kg	100.0
Date Received:	12/29/98				
Lab #:	25813-02	<i>NWTPH-D Surrogate (Hexacosane) Percent Recovery 103.5</i>			
Matrix:	SOIL				
Analysis Date NWTPH-D:	12/30/98				
Percent Solids:	85.4				
Weight Basis:	Dry wt Basis	Comments:			

Sample Name:	3	Analyte	Result	Units	PQL
Sample Location:		Diesel	ND	mg/Kg	25.0
Sampling Date:	12/28/98	Lube Oil	ND	mg/Kg	100.0
Date Received:	12/29/98				
Lab #:	25813-03	<i>NWTPH-D Surrogate (Hexacosane) Percent Recovery 100.7</i>			
Matrix:	SOIL				
Analysis Date NWTPH-D:	12/30/98				
Percent Solids:	83.5				
Weight Basis:	Dry wt Basis	Comments:			

Anatek Labs, Inc.

1917 South Main St • Moscow, ID 83843 • (208) 883-2839 • Fax (208) 882-9246 • email anatekid@moscow.com
504 E Sprague Ste. D • Spokane WA 99202 • (509) 838-3999 • Fax (509) 838-4433 • email anatekwa@moscow.com

KENNEDY EQUIPMENT COMPANY

TAREN NELSON
510 3RD STREET
CLARKSTON WA 99403

Project: BENNETT - ELM TWO

Certificate of Analysis

Petroleum - Gasoline by NWTPH-G

Sample Name:	4	Analyte	Result	Units	PQL
Sample Location:		Gasoline	ND	mg/Kg	5.0
Sampling Date:	12/28/98	<i>NWTPH-G Surrogate (BFB) Percent Recovery</i>			
Sampling Time:	15:35				
Date Received:	12/29/98				
Lab #:	25813-04				
Matrix:	SOIL				
Analysis Date NWTPH-G:	12/29/98				
Percent Solids	88.7				

Sample Name:	SP	Analyte	Result	Units	PQL
Sample Location:		Gasoline	ND	mg/Kg	5.0
Sampling Date:	12/28/98	<i>NWTPH-G Surrogate (BFB) Percent Recovery</i>			
Sampling Time:	15:55				
Date Received:	12/29/98				
Lab #:	25813-05				
Matrix:	SOIL				
Analysis Date NWTPH-G:	12/29/98				
Percent Solids	65.2				

Lab Supervisor:

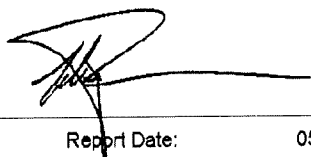

Report Date:

05-Jan-99

Anatek Labs, Inc.

1917 South Main St • Moscow, ID 83843 • (208) 883-2839 • Fax (208) 882-9246 • email anatekid@moscow.com
504 E Sprague Ste. D • Spokane WA 99202 • (509) 838-3999 • Fax (509) 838-4433 • email anatekwa@moscow.com

KENNEDY EQUIPMENT COMPANY

TAREN NELSON
510 3RD STREET
CLARKSTON WA 99403

PROJECT: BENNETT - ELM TWO

Certificate of Analysis

Petroleum -NWTPH-D Extended by GC/FID (8015 modified)

Sample Name:	4	Analyte	Result	Units	PQL
Sample Location:		Diesel	61	mg/Kg	25.0
Sampling Date:	12/28/98	Lube Oil	ND	mg/Kg	100.0
Date Received:	12/29/98				
Lab #:	25813-04	<i>NWTPH-D Surrogate (Hexacosane) Percent Recovery 103.1</i>			
Matrix:	SOIL				
Analysis Date NWTPH-D:	12/30/98				
Percent Solids:	88.7				
Weight Basis:	Dry wt Basis	Comments:			

Sample Name:	SP	Analyte	Result	Units	PQL
Sample Location:		Diesel	200	mg/Kg	25.0
Sampling Date:	12/28/98	Lube Oil	ND	mg/Kg	100.0
Date Received:	12/29/98				
Lab #:	25813-05	<i>NWTPH-D Surrogate (Hexacosane) Percent Recovery 99.6</i>			
Matrix:	SOIL				
Analysis Date NWTPH-D:	12/30/98				
Percent Solids:	85.2				
Weight Basis:	Dry wt Basis	Comments:			

Lab Supervisor:

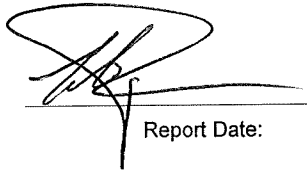

Report Date:

31-Dec-98



五
四
三
二
一

1917 S Main Street, Moscow ID 83843 (208) 883-2839 FAX 882-9246 (208) 882-9246
504 E Sprague Ste D, Spokane WA 99202 (509) 838-3999 FAX 838-4433

RECEIVED

1705

Company Name: James H. Kov, Jr.			Project Manager: TAREN NELSON		
Address: 10101 1st St. N			Project Name & #: Benford 07-100		
City: Benford State: MD Zip: 21015			Purchase Order #: 100		
Phone: 410-321-1111			Sampler Signature: Taren Nelson		
Fax: 410-321-1111			Shipped Via/Other: UPS		
Sample Description			Analyses Requested		
Lab ID	Sample Identification	Sampling Date/Time	Matrix	# of Containers	Sample Volume
1	1	10/28 3:15	5081	1	1000
2	2	10/28 3:19	5081	1	1000
3	3	10/28 3:30	5081	1	1000
4	4	10/28 3:35	5081	1	1000
5	5	10/28 3:55	5081	1	1000
Printed Name			Signature	Company	Date
TAREN NELSON			Taren Nelson	Benford 07-100	10/29 4:00
Relinquished by			Relinquished by	Relinquished by	Relinquished by
TAREN NELSON			Taren Nelson	Benford 07-100	10/29 4:00
Received by			Received by	Received by	Received by
TAREN NELSON			Taren Nelson	Benford 07-100	10/29 4:00
Relinquished by			Relinquished by	Relinquished by	Relinquished by
TAREN NELSON			Taren Nelson	Benford 07-100	10/29 4:00
Received by			Received by	Received by	Received by
TAREN NELSON			Taren Nelson	Benford 07-100	10/29 4:00
Relinquished by			Relinquished by	Relinquished by	Relinquished by
TAREN NELSON			Taren Nelson	Benford 07-100	10/29 4:00
Received by			Received by	Received by	Received by
TAREN NELSON			Taren Nelson	Benford 07-100	10/29 4:00
Relinquished by			Relinquished by	Relinquished by	Relinquished by
TAREN NELSON			Taren Nelson	Benford 07-100	10/29 4:00
Received by			Received by	Received by	Received by
TAREN NELSON			Taren Nelson	Benford 07-100	10/29 4:00
Relinquished by			Relinquished by	Relinquished by	Relinquished by
TAREN NELSON			Taren Nelson	Benford 07-100	10/29 4:00
Received by			Received by	Received by	Received by
TAREN NELSON			Taren Nelson	Benford 07-100	10/29 4:00
Relinquished by			Relinquished by	Relinquished by	Relinquished by
TAREN NELSON			Taren Nelson	Benford 07-100	10/29 4:00
Received by			Received by	Received by	Received by
TAREN NELSON			Taren Nelson	Benford 07-100	10/29 4:00
Relinquished by			Relinquished by	Relinquished by	Relinquished by
TAREN NELSON			Taren Nelson	Benford 07-100	10/29 4:00
Received by			Received by	Received by	Received by
TAREN NELSON			Taren Nelson	Benford 07-100	10/29 4:00
Relinquished by			Relinquished by	Relinquished by	Relinquished by
TAREN NELSON			Taren Nelson	Benford 07-100	10/29 4:00
Received by			Received by	Received by	Received by
TAREN NELSON			Taren Nelson	Benford 07-100	10/29 4:00
Relinquished by			Relinquished by	Relinquished by	Relinquished by
TAREN NELSON			Taren Nelson	Benford 07-100	10/29 4:00
Received by			Received by	Received by	Received by
TAREN NELSON			Taren Nelson	Benford 07-100	10/29 4:00
Relinquished by			Relinquished by	Relinquished by	Relinquished by
TAREN NELSON			Taren Nelson	Benford 07-100	10/29 4:00
Received by			Received by	Received by	Received by
TAREN NELSON			Taren Nelson	Benford 07-100	10/29 4:00
Relinquished by			Relinquished by	Relinquished by	Relinquished by
TAREN NELSON			Taren Nelson	Benford 07-100	10/29 4:00
Received by			Received by	Received by	Received by
TAREN NELSON			Taren Nelson	Benford 07-100	10/29 4:00
Relinquished by			Relinquished by	Relinquished by	Relinquished by
TAREN NELSON			Taren Nelson	Benford 07-100	10/29 4:00
Received by			Received by	Received by	Received by
TAREN NELSON			Taren Nelson	Benford 07-100	10/29 4:00
Relinquished by			Relinquished by	Relinquished by	Relinquished by
TAREN NELSON			Taren Nelson	Benford 07-100	10/29 4:00
Received by			Received by	Received by	Received by
TAREN NELSON			Taren Nelson	Benford 07-100	10/29 4:00
Relinquished by			Relinquished by	Relinquished by	Relinquished by
TAREN NELSON			Taren Nelson	Benford 07-100	10/29 4:00
Received by			Received by	Received by	Received by
TAREN NELSON			Taren Nelson	Benford 07-100	10/29 4:00
Relinquished by			Relinquished by	Relinquished by	Relinquished by
TAREN NELSON			Taren Nelson	Benford 07-100	10/29 4:00
Received by			Received by	Received by	Received by
TAREN NELSON			Taren Nelson	Benford 07-100	10/29 4:00
Relinquished by			Relinquished by	Relinquished by	Relinquished by
TAREN NELSON			Taren Nelson	Benford 07-100	10/29 4:00
Received by			Received by	Received by	Received by
TAREN NELSON			Taren Nelson	Benford 07-100	10/29 4:00
Relinquished by			Relinquished by	Relinquished by	Relinquished by
TAREN NELSON			Taren Nelson	Benford 07-100	10/29 4:00
Received by			Received by	Received by	Received by
TAREN NELSON			Taren Nelson	Benford 07-100	10/29 4:00
Relinquished by			Relinquished by	Relinquished by	Relinquished by
TAREN NELSON			Taren Nelson	Benford 07-100	10/29 4:00
Received by			Received by	Received by	Received by
TAREN NELSON			Taren Nelson	Benford 07-100	10/29 4:00
Relinquished by			Relinquished by	Relinquished by	Relinquished by
TAREN NELSON			Taren Nelson	Benford 07-100	10/29 4:00
Received by			Received by	Received by	

Anatek Labs, Inc.

1917 South Main St • Moscow, ID 83843 • (208) 883-2839 • Fax (208) 882-9246 • email anatekid@moscow.com
504 E Sprague Ste. D • Spokane WA 99202 • (509) 838-3999 • Fax (509) 838-4433 • email anatekwa@moscow.com

KENNEDY EQUIPMENT COMPANY

TAREN NELSON
510 3RD STREET
CLARKSTON WA 99403

Project: BENNETT ELM THREE

Certificate of Analysis

Petroleum - Gasoline by NWTPH-G BTEX by EPA 602/8021B(MOD)

Sample Name:	5	Analyte	Result	Units	PQL
Sample Location:		Gasoline	6530	mg/Kg	5.0
Sampling Date:	1/5/99	NWTPH-G Surrogate (BFB) Percent Recovery		92.2	
Sampling Time:	15:50				
Date Received:	1/7/99				
Lab #:	25837-01	Benzene	49.1	mg/Kg	0.005
Matrix:	SOIL	Toluene	454	mg/Kg	0.005
Analysis Date TPH-G/BTEX:	1/13/99	Ethylbenzene	107	mg/Kg	0.005
Percent Solids	90.9	Xylene (total)	622	mg/Kg	0.010
		BTEX Surrogate (CB-d5) Percent Recovery		103.9	

Sample Name:	6	Analyte	Result	Units	PQL
Sample Location:		Gasoline	3090	mg/Kg	5.0
Sampling Date:	1/5/99	NWTPH-G Surrogate (BFB) Percent Recovery		98.4	
Sampling Time:	16:12				
Date Received:	1/7/99				
Lab #:	25837-02	Benzene	7.52	mg/Kg	0.005
Matrix:	SOIL	Toluene	89.0	mg/Kg	0.005
Analysis Date TPH-G/BTEX:	1/13/99	Ethylbenzene	37.1	mg/Kg	0.005
Percent Solids	88.5	Xylene (total)	245	mg/Kg	0.010
		BTEX Surrogate (CB-d5) Percent Recovery		111.2	

Sample Name:	7	Analyte	Result	Units	PQL
Sample Location:		Gasoline	ND	mg/Kg	5.0
Sampling Date:	1/5/99	NWTPH-G Surrogate (BFB) Percent Recovery		103.7	
Sampling Time:	17:00				
Date Received:	1/7/99				
Lab #:	25837-03	Benzene	0.018	mg/Kg	0.005
Matrix:	SOIL	Toluene	0.029	mg/Kg	0.005
Analysis Date TPH-G/BTEX:	1/13/99	Ethylbenzene	ND	mg/Kg	0.005
Percent Solids	90.4	Xylene (total)	0.112	mg/Kg	0.010
		BTEX Surrogate (CB-d5) Percent Recovery		99.2	

Anatek Labs, Inc.

1917 South Main St • Moscow, ID 83843 • (208) 883-2839 • Fax (208) 882-9246 • email anatekid@moscow.com
504 E Sprague Ste. D • Spokane WA 99202 • (509) 838-3999 • Fax (509) 838-4433 • email anatekwa@moscow.com

KENNEDY EQUIPMENT COMPANY

TAREN NELSON

510 3RD STREET

CLARKSTON WA 99403

PROJECT: BENNETT ELM THREE

Certificate of Analysis

Petroleum -NWTPH-D by GC/FID (8015 modified)

Sample Name:	5	Analyte	Result	Units	PQL
Sample Location:		Diesel	113.2	mg/Kg	25.0
Sampling Date:	1/5/99				
Sampling Time:	15:50	<i>NWTPH-D Surrogate (Hexacosane) Percent Recovery</i>			
Date Received:	1/7/99				
Lab #:	25837-01				
Matrix:	SOIL	Comments:			
Analysis Date NWTPH-D:	1/9/99				
Percent Solids:	90.9				

Sample Name:	6	Analyte	Result	Units	PQL
Sample Location:		Diesel	103.4	mg/Kg	25.0
Sampling Date:	1/5/99				
Sampling Time:	16:12	<i>NWTPH-D Surrogate (Hexacosane) Percent Recovery</i>			
Date Received:	1/7/99				
Lab #:	25837-02				
Matrix:	SOIL	Comments:			
Analysis Date NWTPH-D:	1/9/99				
Percent Solids:	88.5				

Sample Name:	7	Analyte	Result	Units	PQL
Sample Location:		Diesel	ND	mg/Kg	25.0
Sampling Date:	1/5/99				
Sampling Time:	17:00	<i>NWTPH-D Surrogate (Hexacosane) Percent Recovery</i>			
Date Received:	1/7/99				
Lab #:	25837-03				
Matrix:	SOIL	Comments:			
Analysis Date NWTPH-D:	1/9/99				
Percent Solids:	90.4				

Anatek Labs, Inc.

1917 South Main St • Moscow, ID 83843 • (208) 883-2839 • Fax (208) 882-9246 • email anatekid@moscow.com
504 E Sprague Ste. D • Spokane WA 99202 • (509) 838-3999 • Fax (509) 838-4433 • email anatekwa@moscow.com

KENNEDY EQUIPMENT COMPANY

TAREN NELSON
510 3RD STREET
CLARKSTON WA 99403

Project: BENNETT ELM THREE

Certificate of Analysis

Petroleum - Gasoline by NWTPH-G BTEX by EPA 602/8021B(MOD)

Sample Name:	8	Analyte	Result	Units	PQL
Sample Location:		Gasoline	11.4	mg/Kg	5.0
Sampling Date:	1/5/99	<i>NWTPH-G Surrogate (BFB) Percent Recovery</i>		99.0	
Sampling Time:	17:40				
Date Received:	1/7/99				
Lab #:	25837-04	Benzene	0.057	mg/Kg	0.005
Matrix:	SOIL	Toluene	0.118	mg/Kg	0.005
Analysis Date TPH-G/BTEX:	1/13/99	Ethylbenzene	0.184	mg/Kg	0.005
Percent Solids	79.4	Xylene (total)	0.917	mg/Kg	0.010
		<i>BTEX Surrogate (CB-d5) Percent Recovery</i>		99.1	

Lab Supervisor:

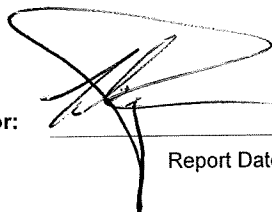

Report Date:

22-Jan-99

Anatek Labs, Inc.

1917 South Main St • Moscow, ID 83843 • (208) 883-2839 • Fax (208) 882-9246 • email anatekid@moscow.com
504 E Sprague Ste. D • Spokane WA 99202 • (509) 838-3999 • Fax (509) 838-4433 • email anatekwa@moscow.com

KENNEDY EQUIPMENT COMPANY

TAREN NELSON
510 3RD STREET
CLARKSTON WA 99403

PROJECT: BENNETT ELM THREE

Certificate of Analysis

Petroleum -NWTPH-D by GC/FID (8015 modified)

Sample Name:	8	Analyte	Result	Units	PQL
Sample Location:		Diesel	ND	mg/Kg	25.0
Sampling Date:	1/5/99				
Sampling Time:	17:40				
Date Received:	1/7/99				
Lab #:	25837-04				
Matrix:	SOIL				
Analysis Date NWTPH-D:	1/9/99				
Percent Solids:	79.4				
		Comments:			
		<i>NWTPH-D Surrogate (Hexacosane) Percent Recovery 107.7</i>			

Lab Supervisor:

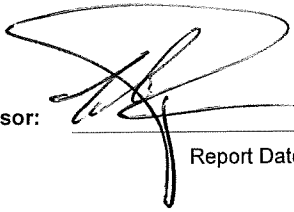

Report Date:

22-Jan-99

1917 S Main Street, Moscow ID 83843 (208) 883-2839 FAX 882-9246
504 E Sprague Ste D, Spokane WA 99202 (509) 838-3999 FAX 838-4433

Chain of Custody Record

Date Received _____

117199

25837 KENC

[illegible]