

DEPARTMENT OF ECOLOGY  
INSPECTION REPORT

TO: Dan Cargill, file  
DATE OF VISIT: 8-3-87  
NEW INDUSTRY: No

INSPECTOR: Lee Dorigan  
PERMIT NO: None  
PERMIT EXPIRES:

TYPE OF INSPECTION

PERMIT APPLICATION _____	COMPLAINT _____
PERMIT RENEWAL _____	ENFORCEMENT _____
PERMIT COMPLIANCE _____	DROP IN ___xx___

FACILITY: Longview Fiber  
ADDRESS: 5901 E. Marginal Wy. S.  
CITY: Seattle ZIP: COUNTY:

PERSON CONTACTED: Gary Smith  
TYPE OF FACILITY: cardboard packaging

RECEIVING WATER: Duwamish and METRO  
TYPE TREATMENT SYSTEM: None

OPERATION Satisfactory

DESCRIPTION: Leigh Starlin of CH2M Hill call me to ask me to work with her on the removal of three underground storage tanks at Longview Fiber. The construction company on the removal was O'Sullivan Construction. I went out on the morning of the 4th with Richard Koch since he had planned to inspect Longview later in the year. We met Leigh and John Polk at the first tank site.

Tank #1 is at the front on the north side of the building. It is 12,000 gal. and was used for bunker. The excavation was visually the cleanest I have ever seen. A composite sample was taken and analyzed for total hydrocarbons to verify the HNU readings. I allowed the fill to be returned to the same hole. Groundwater was barely hit at about 20' at the bottom of the hole.

Tank #2 is at the center and on the north side also. It is under the truck dock area. It is 7,500 gal. and contained gasoline, then diesel. The soil was visually contaminated and several loads of soil went to Cedar Hills. The HNU readings were 0 on the soil where the excavation stopped. The area was very moist and there were problems with slope stability. The tank itself was intact so we assumed all leaks had come from the pipe. Clean fill was used to rebuild the area. During the time this work was being done, Incon did steam cleaning and the discharge came out into the street end. I went to Mr. Coburn's office and showed him the problem. He had his staff clean the area.

Tank #3 is at the rear of the building. It is close to the building itself but only about fifty feet from the river. It is a 600 gal. tank which was used for gasoline, then diesel. The soil was visually contaminated and the contaminated soil went to Cedar Hills. The tank was intact. The visual contamination clearly followed the pipe. Excavation

was stopped before the area was shown to be clean by the HNU, because the contaminated area was under the building itself. Clean fill was put in the hole.

The staff from Longview Fiber and CH2M Hill met and agreed to install three wells. One well is to be between the river and #3. One well is to be between the river and #2. A third well is to be installed at the front of the building as a control. Richard and I agreed to this plan.

- FOLLOW UP:
1. Get the written plan from Leigh Starlin.
  2. Monitor the results from the wells for one year.

  
Lee Dorigan  
Field Inspector

1" = 1'-0"

1" = 1'-0"

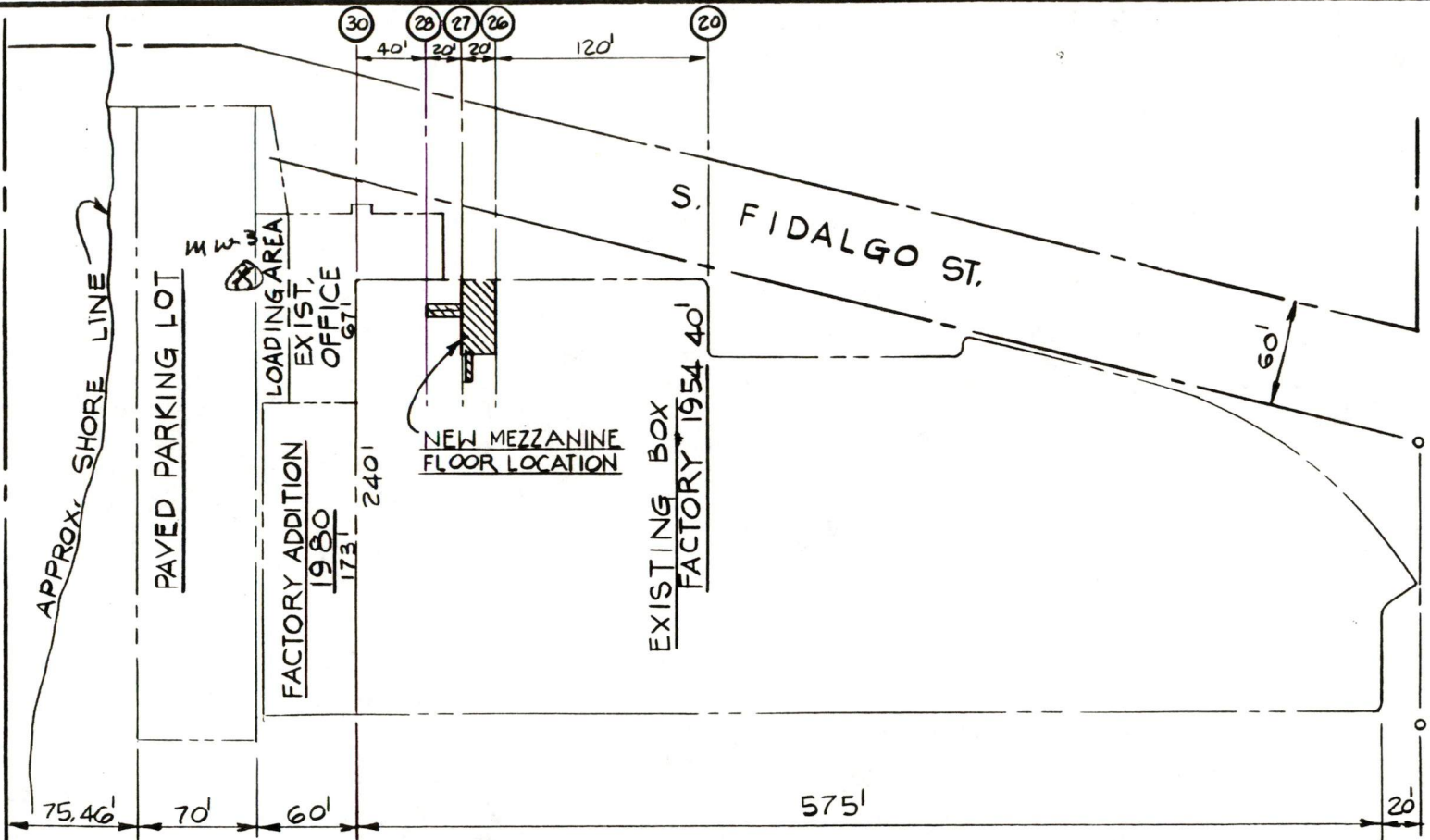

# SITE PLAN

1" = 100'-0"



### APPROVED

By \_\_\_\_\_ DATE \_\_\_\_\_

By \_\_\_\_\_ DATE \_\_\_\_\_

W. O. No.

CHARGE

PEARSON, PAPE, ALLEN & HUGGINS, INC. - JOB NO. 81-11

APPD.	No.	REVISIONS	BY	DATE

## LONGVIEW FIBRE COMPANY

LONGVIEW, WASHINGTON

SEATTLE BOX PLANT

MEZZANINE FLOOR ADDITION