

# FIGURES

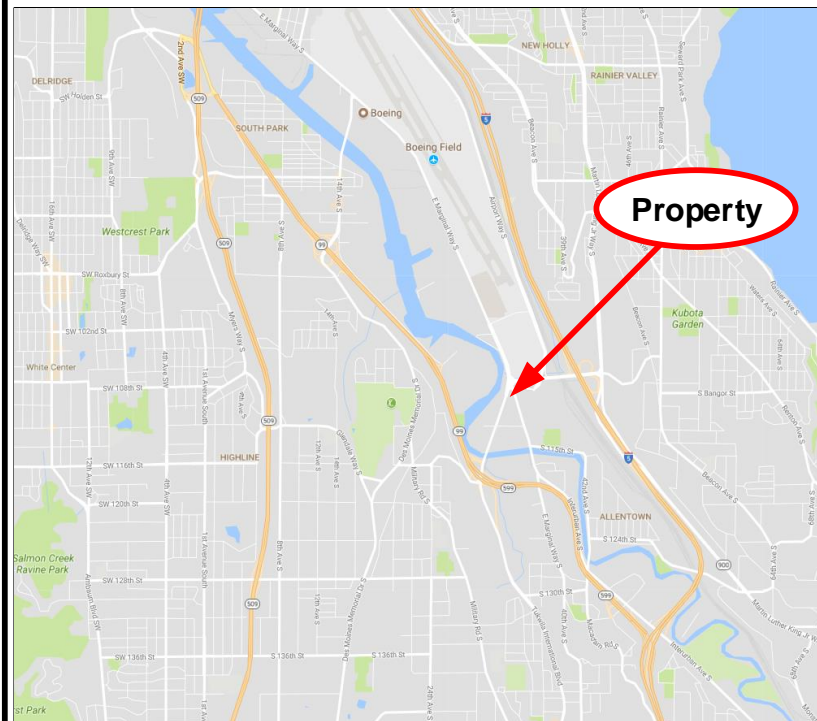

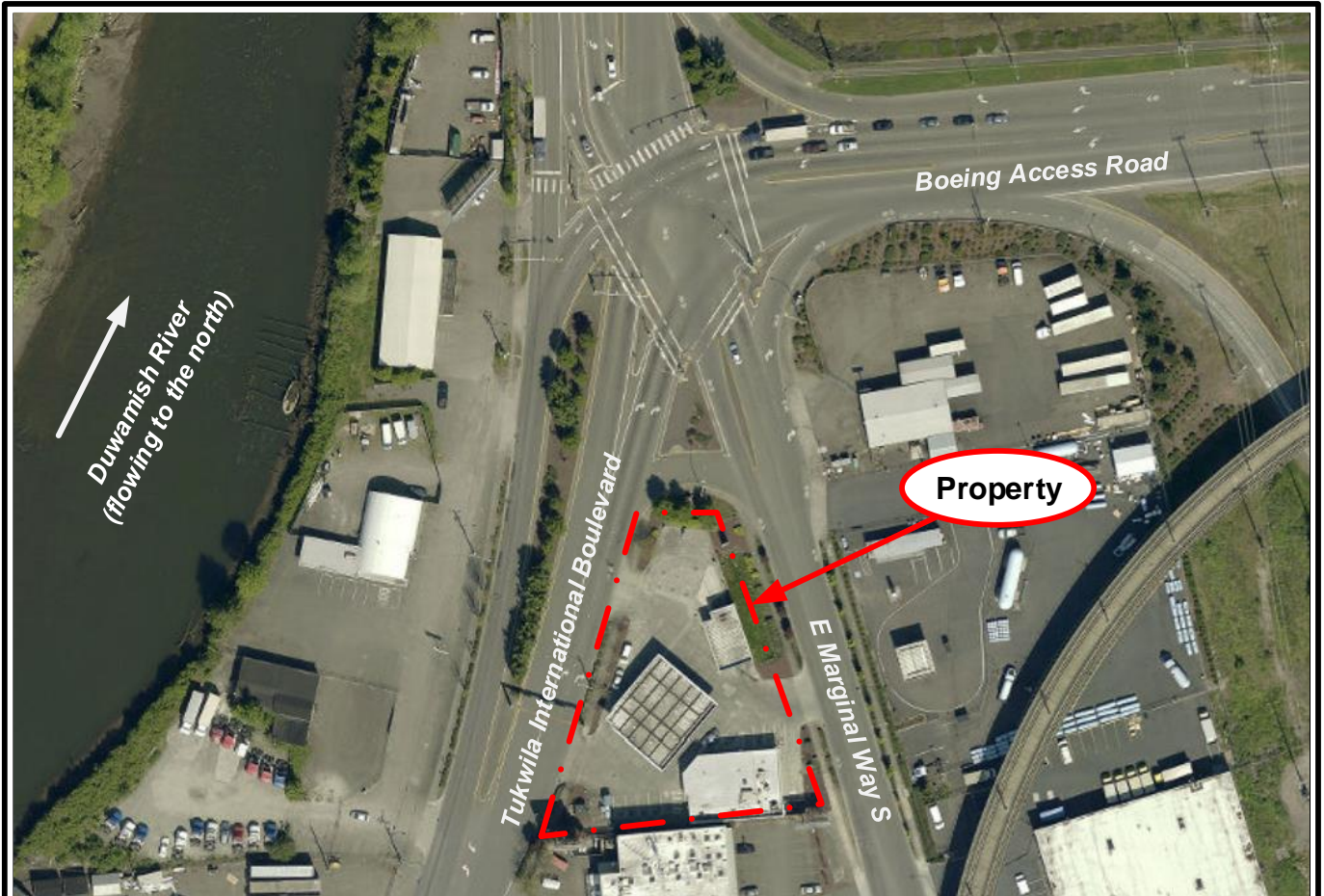









Project File: 01-0410-R-F1.vsdX

**g-logics** |  **ATLAS**  
AN  
GEOSCIENCES NW  
COMPANY

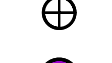
**Site Location Maps**  
**Boeing Field Chevron**  
**10805 East Marginal Way South**  
**Tukwila, Washington**

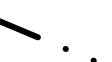
**Figure**  
**1**

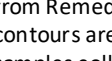
**Legend**

-  GRO/Benzene Detected Greater than Site Cleanup Levels (800/1.6 µg/L)
-  GRO/Benzene Detected Greater than 8,000/50 µg/L
-  Area of Possible LNAPL
-  Area of LNAPL
-  Upper Saturated Zone Monitoring Well
-  Lower Saturated Zone Monitoring Well
-  ISCO Injection Location (Numeral Indicates Injection Event)
-  Group 1 - 09/07/2022
-  Group 2 - 10/18/2022
-  Group 3 - 12/20/2022
-  Property Boundary
-  Understood Utility Trench Locations (Adjacent to Property)

Note: Concentration contours and area of possible NAPL, developed from Remedial Investigation Report (October 2020). Interpreted contours are based on available analytical data for groundwater samples collected in November 2018 and April 2019.

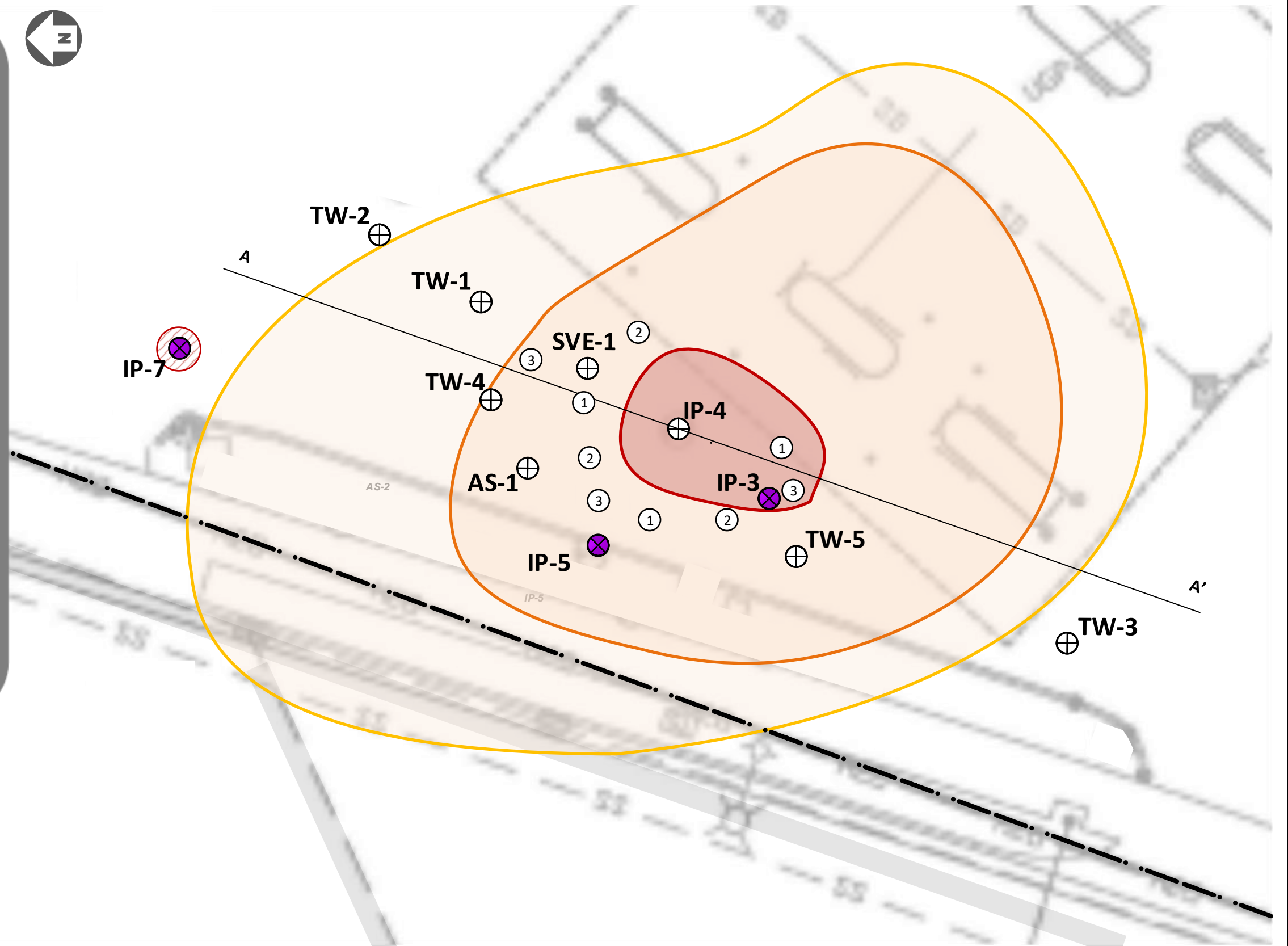

The contours represent an interpretation of available data for the indicated date. Site groundwater contours may change with additional measurements and/or data points, weather changes, construction activities, and/or other influences.

Note: This figure contains information in color. Black & white photocopies may not be suitable for review.

**ISCO Injection and Monitoring Schematic**  
**Boeing Field Chevron**  
 10805 East Marginal Way South  
 Tukwila, Washington

Figure  
2



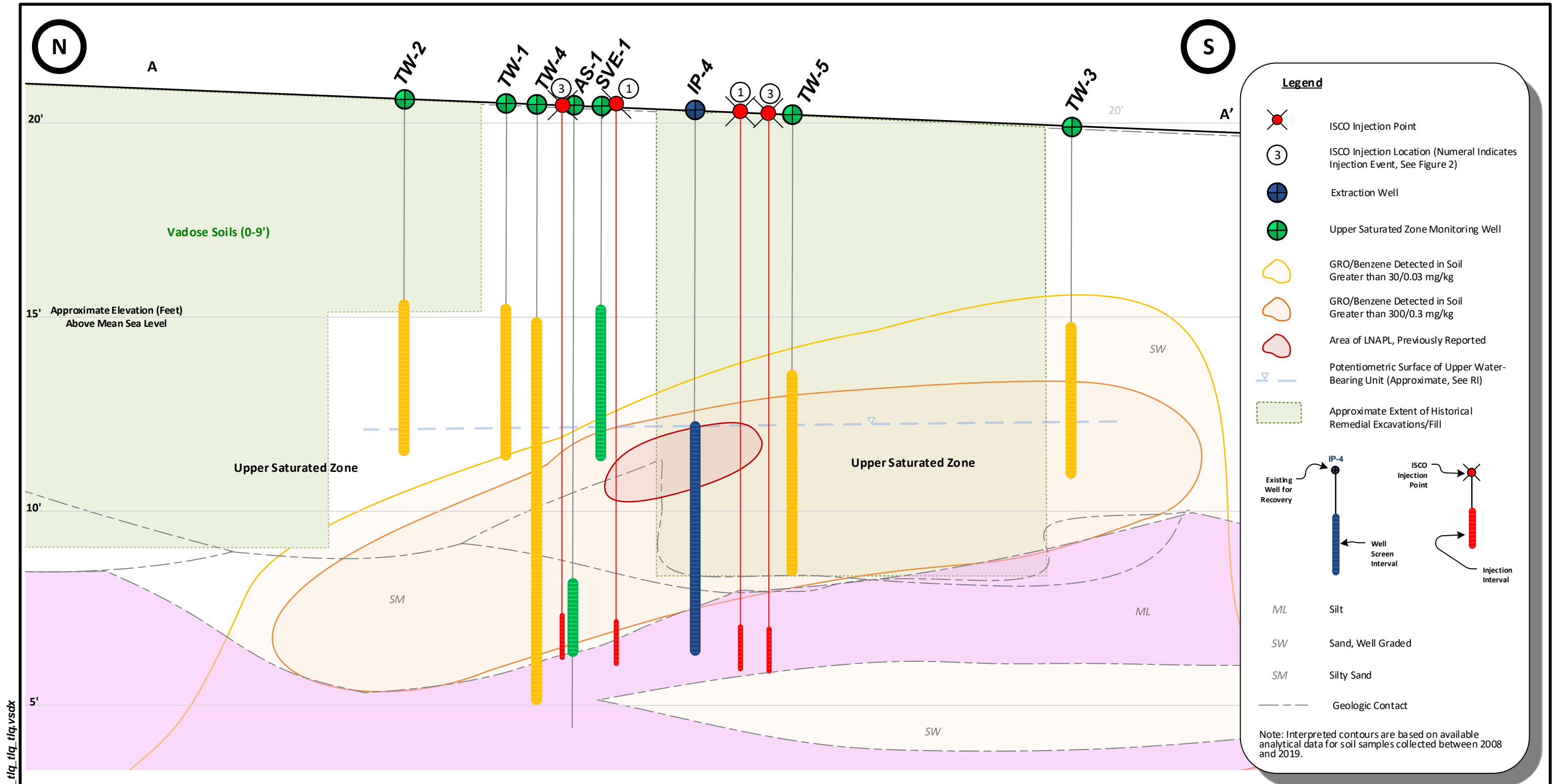

The contours represent an interpretation of available data for the indicated date. Site groundwater contours may change with additional measurements and/or data points, weather changes, construction activities, and/or other influences.

Project File: 01-0410-R F3\_tiq\_tjc\_tiq\_tiq\_tiq\_vsd



Approximate Horizontal Drawing Scale: 1" = 10'  
 0 ft. 6 ft. 10 ft. 20 ft.  
 4X Vertical Exaggeration

Note: This figure contains information in color. Black & white photocopies may not be suitable for review.

**ISCO Injection and Monitoring Cross Section, A-A'**  
 Upper Saturated Zone, Boeing Field Chevron  
 10805 East Marginal Way South  
 Tukwila, Washington

**Figure 3**