



## **PERIODIC REVIEW**

**Elliot Tire Center  
Facility/Site ID #: 547**

**1 East Lincoln Street  
Yakima, Washington 98902**

**Central Regional Office**

**TOXICS CLEANUP PROGRAM**

**September 19, 2008**

<b>1.0 INTRODUCTION.....</b>	<b>1</b>
<b>2.0 SUMMARY OF SITE CONDITIONS .....</b>	<b>2</b>
2.1 Site History .....	2
2.2 Site Investigations and Remedial Activities .....	2
2.2.1 Test Pit Investigation and Soil Removal .....	2
2.2.2 Underground Storage Tank Investigation .....	2
2.2.3 Dry Well Sampling and Cleanup .....	3
2.2.4 Interior Bay Investigation .....	3
2.3 Groundwater Investigation.....	3
2.4 Restrictive Covenant.....	3
2.5 Consent Decree .....	4
<b>3.0 PERIODIC REVIEW.....</b>	<b>5</b>
3.1 Effectiveness of completed cleanup actions .....	5
3.2 New scientific information for individual hazardous substances for mixtures present at the Site .....	5
3.3 New applicable state and federal laws for hazardous substances present at the Site .....	5
3.4 Current and projected Site use .....	6
3.5 Availability and practicability of higher preference technologies .....	6
3.6 Availability of improved analytical techniques to evaluate compliance with cleanup levels .....	6
<b>4.0 CONCLUSIONS.....</b>	<b>7</b>
4.1 Next Review.....	7
<b>5.0 REFERENCES.....</b>	<b>8</b>
<b>6.0 APPENDICES.....</b>	<b>9</b>
6.1 Vicinity Map .....	10
6.2 Site Plan .....	11
6.3 Groundwater Monitoring Data.....	12
6.4 Environmental Covenant .....	13
6.5 Photo log .....	17

## 1.0 INTRODUCTION

This document is a review by the Washington State Department of Ecology (Ecology) of post-cleanup site conditions and monitoring data to ensure that human health and the environment are being protected at the Elliot Tire Center (Site). Cleanup at this Site was implemented under the Model Toxics Control Act (MTCA) regulations, Chapter 173-340 Washington Administrative Code (WAC).

Cleanup activities at this Site were completed under the Independent Remedial Action Program. The cleanup actions resulted in concentrations of petroleum hydrocarbons exceeding MTCA Method A cleanup levels remaining at the Site. The MTCA Method A cleanup levels for soil are established under WAC 173-340-740(2). WAC 173-340-420 (1) requires that “if the department selects or approves a cleanup action that results in hazardous substances remaining at a site at concentrations which exceed Method A or Method B cleanup levels established under WAC 173-340-700 through 173-340-760 or if conditional points of compliance have been established, the department shall review the cleanup action no less frequently than every five years after the initiation of such cleanup action to ensure that human health and the environment are being protected”.

When evaluating whether human health and the environment are being protected, the factors the department shall consider include [WAC 173-340-420(2)]:

- (a) The effectiveness of ongoing or completed cleanup actions;
- (b) New scientific information for individual hazardous substances of mixtures present at the Site;
- (c) New applicable state and federal laws for hazardous substances present at the Site;
- (d) Current and projected Site use;
- (e) Availability and practicability of higher preference technologies; and
- (f) The availability of improved analytical techniques to evaluate compliance with cleanup levels.

The department shall publish a notice of all periodic reviews in the site register and provide an opportunity for public comment.

## **2.0 SUMMARY OF SITE CONDITIONS**

### **2.1 Site History**

The Elliot Tire facility is located in the City of Yakima in Yakima County, Washington (Vicinity Map - Appendix 6.1). Following remedial activities, a restrictive covenant was recorded for the property in 1996. A Consent Decree was entered into with Ecology in 2001, and the Site received a No Further Action determination.

Elliot Tire is an operating retail tire center and automotive repair shop (Site Plan – Appendix 6.2). Historical maps indicate that the Site was occupied by service stations and residences between 1921 and 1961. In 1961, the property was acquired by the current owners. A tire service center was constructed at the Site by 1968.

### **2.2 Site Investigations and Remedial Activities**

Phase I and Phase II Environmental Site Assessments (ESAs) were conducted at the Site during 1994 and 1995. Two dry wells were observed on the property. Samples collected from the sludge within these dry wells indicated the presence of tetrachloroethene (PCE) at a maximum concentration of 2.3 parts per million (ppm). In addition, TPH-G and diesel-range petroleum hydrocarbon (TPH-D) contamination was detected in soil and groundwater in the vicinity of the former gasoline and oil sales area.

In 1996, additional investigation work was conducted at the Site. Fifty-four soil samples were collected from a combination of test pits and soil borings across the Site, additional samples were collected from both dry wells at the Site, 24 samples were collected through the floor of the service center adjacent to hydraulic equipment, and 5 groundwater sampling events were conducted from three monitoring wells installed at the Site. The results of this investigation are detailed below:

#### **2.2.1 Test Pit Investigation and Soil Removal**

Test pits were conducted on a 35-foot grid across the Site parking lot and on a 70-foot grid around the perimeter of the building. Samples were collected from each test pit at 3, 6, and 10 feet below ground surface (bgs), or until groundwater was encountered at approximately 11 feet bgs. Samples were analyzed for volatile organic compounds (VOCs), TPH-G, TPH-D, and heavy oil-range petroleum hydrocarbons (TPH-O). Excavation of contaminated soil was conducted concurrently with the test pit excavation with the assistance of an on-site laboratory. Excavation occurred in the vicinity of two USTs and in the vicinity of the two dry wells.

#### **2.2.2 Underground Storage Tank Investigation**

During test pit sampling activities, two 1,000-gallon gasoline USTs were discovered in the parking lot. These USTs had been abandoned in place and filled with sand. The USTs were removed along with 180 tons of impacted soil.

### **2.2.3 Dry Well Sampling and Cleanup**

Two dry wells were located in the tire center parking lot. One well was used to collect stormwater runoff from the parking lot; the second was abandoned and covered with concrete and asphalt. Both wells contained sludge with a petroleum hydrocarbon-like odor. Analysis of the sludge indicated the presence of PCE at concentrations of 2.0 ppm in the active dry well. Soils in the vicinity of the dry wells were excavated down to the groundwater table. A total of 308 tons of impacted soil were excavated and transported to Anderson Pit in Yakima, Washington. A new dry well was installed to collect stormwater runoff from the parking lot.

### **2.2.4 Interior Bay Investigation**

Soil samples were collected from the interior of the building through cores cut into the concrete floor. Twelve sample locations were selected in the vicinity of hydraulic equipment in the building. Samples were collected between 1.5 and 6 feet bgs and analyzed for petroleum hydrocarbons, VOCs, and PCE. Petroleum hydrocarbon impacted soil was detected over approximately 1,200 square feet of area under the building. It was determined that this material could not be excavated without damaging the structural integrity of the facility. PCE was detected in the immediate vicinity of two of the sample points. Approximately one cubic yard of material was excavated from this area.

## **2.3 Groundwater Investigation**

Three groundwater monitoring wells were installed at the Site in 1995. All wells were screened from 10 to 25 feet bgs. Five quarterly sampling events were conducted at the Site and samples were analyzed for TPH and VOCs. Detectable levels of PCE (0.64 to 1 parts per billion) were detected in all three wells during winter sampling events with low water tables. PCE was not detected above method detection limits in any of the samples collected during summer and fall sampling events.

TPH-G was detected at a maximum concentration of 2,400 ppb in MW-3, adjacent to the former dry well location. TPH-G was not detected in samples collected from the two downgradient wells, MW-1 and MW-2. Groundwater monitoring data is available as Appendix 6.3.

## **2.4 Restrictive Covenant**

Following remediation, a Restrictive Covenant was recorded for the Site in 2001. The Restrictive Covenant imposes the following limitations:

1. If the building is ever removed from the Site, remaining contamination under the foundation must be remediated at that time.
2. The quarterly groundwater monitoring program must be continued for a total of 8 events.
3. Corrective measures to prevent accidental spills into the replacement dry well shall be implemented.
4. The owner or successor owner of the Site must give written notice of intent to convey any interest in the Site.
5. The owner or successor owner shall grant Ecology the right to enter the site at reasonable times.
6. The owner or successor owner reserves the right to remove this Covenant with Ecology's approval.

The Restrictive Covenant is available as Appendix 6.4.

## **2.5 Consent Decree**

In 2000, the property owner requested to enter into a *de minimus* consent decree for the property in response to its potential contribution to PCE contamination of groundwater in the Yakima Railroad Area. The consent decree stated that the release or potential release of hazardous substances at the property had been resolved, and that a settlement is appropriate. A No Further Action determination was issued for the Site in 2001.

## **3.0 PERIODIC REVIEW**

### **3.1 Effectiveness of completed cleanup actions**

Based upon the site visit conducted on September 19, 2008, the building and asphalt cover at the Site continue to eliminate exposure pathways (ingestion, contact) to contaminated soils. The asphalt appears in satisfactory condition and no repair, maintenance, or contingency actions have been required. The Site is still operating as a tire service and automotive repair business. A photo log is available as Appendix 6.5.

The Restrictive Covenant for the Site was recorded and is in place. This Restrictive Covenant prohibits activities that will result in the release of contaminants contained as part of the cleanup without Ecology's approval, and prohibits any use of the property that is inconsistent with the Covenant. This Restrictive Covenant serves to ensure the long term integrity of the cap.

Conclusions:

Soils with TPH concentrations higher than MTCA Method A cleanup levels are still present at the Site. However, the Site structures and asphalt surface prevent human exposure to this contamination by ingestion and direct contact with soils. The Restrictive Covenant for the property will ensure that the integrity of the cap will be protected through maintaining the current use of the Site.

### **3.2 New scientific information for individual hazardous substances for mixtures present at the Site**

There is no new scientific information for the petroleum contaminants related to the Site.

### **3.3 New applicable state and federal laws for hazardous substances present at the Site**

The cleanup at the site was governed by Chapter 173-340 WAC (1996 ed.). WAC 173-340-702(12) (c) [2001 ed.] provides that,

“A release cleaned up under the cleanup levels determined in (a) or (b) of this subsection shall not be subject to further cleanup action due solely to subsequent amendments to the provision in this chapter on cleanup levels, unless the department determines, on a case-by-case basis, that the previous cleanup action is no longer sufficiently protective of human health and the environment.”

Although cleanup levels changed for gasoline, diesel, and volatile organic compounds as a result of modifications to MTCA in 2001, contamination remains at the site above MTCA Method A cleanup levels and the cleanup action is still protective of human health and the environment.

### **3.4 Current and projected Site use**

The site is currently used for commercial and industrial purposes. There have been no changes in current or projected future Site or resource uses.

### **3.5 Availability and practicability of higher preference technologies**

The remedy implemented included containment of hazardous substances, and it continues to be protective of human health and the environment. While higher preference cleanup technologies may be available, they are still not practicable at this Site.

### **3.6 Availability of improved analytical techniques to evaluate compliance with cleanup levels**

The analytical methods used at the time of the remedial action were capable of detection below MTCA Method A cleanup levels. The presence of improved analytical techniques would not affect decisions or recommendations made for the Site.



## 4.0 CONCLUSIONS

- The cleanup actions completed at the Site appear to be protective of human health and the environment.
- Soils cleanup levels have not been met at the Site; however, under WAC 173-340-740(6)(d), the cleanup action is determined to comply with cleanup standards since the long-term integrity of the containment system is ensured, and the requirements for containment technologies in WAC 173-340-360(8) have been met.
- The Restrictive Covenant for the property is in place and will be effective in protecting public health and the environment from exposure to hazardous substances and protecting the integrity of the cleanup action.

Based on this periodic review, the Department of Ecology has determined that the requirements of the Restrictive Covenant have been satisfactorily completed. No additional actions are required by the property owner. It is the property owner's responsibility to continue to inspect the site to ensure that the integrity of the cap is maintained.

### 4.1 Next Review

The next review for the site will be scheduled five years from the date of this periodic review. In the event that additional cleanup actions or institutional controls are required, the next periodic review will be scheduled five years from the completion of those activities.

## **5.0 REFERENCES**

Maxim Technologies, 1996, Independent Remedial Action Program Report of Phase III Investigation and Remediation.

Maxim Technologies, 1998, Independent Remedial Action Program Quarterly Groundwater Monitoring Report.

Ecology, 2001, Consent Decree

Ecology, 2001, Restrictive Covenant

Ecology, 2008, Site Visit

## **6.0 APPENDICES**

## 6.1 Vicinity Map

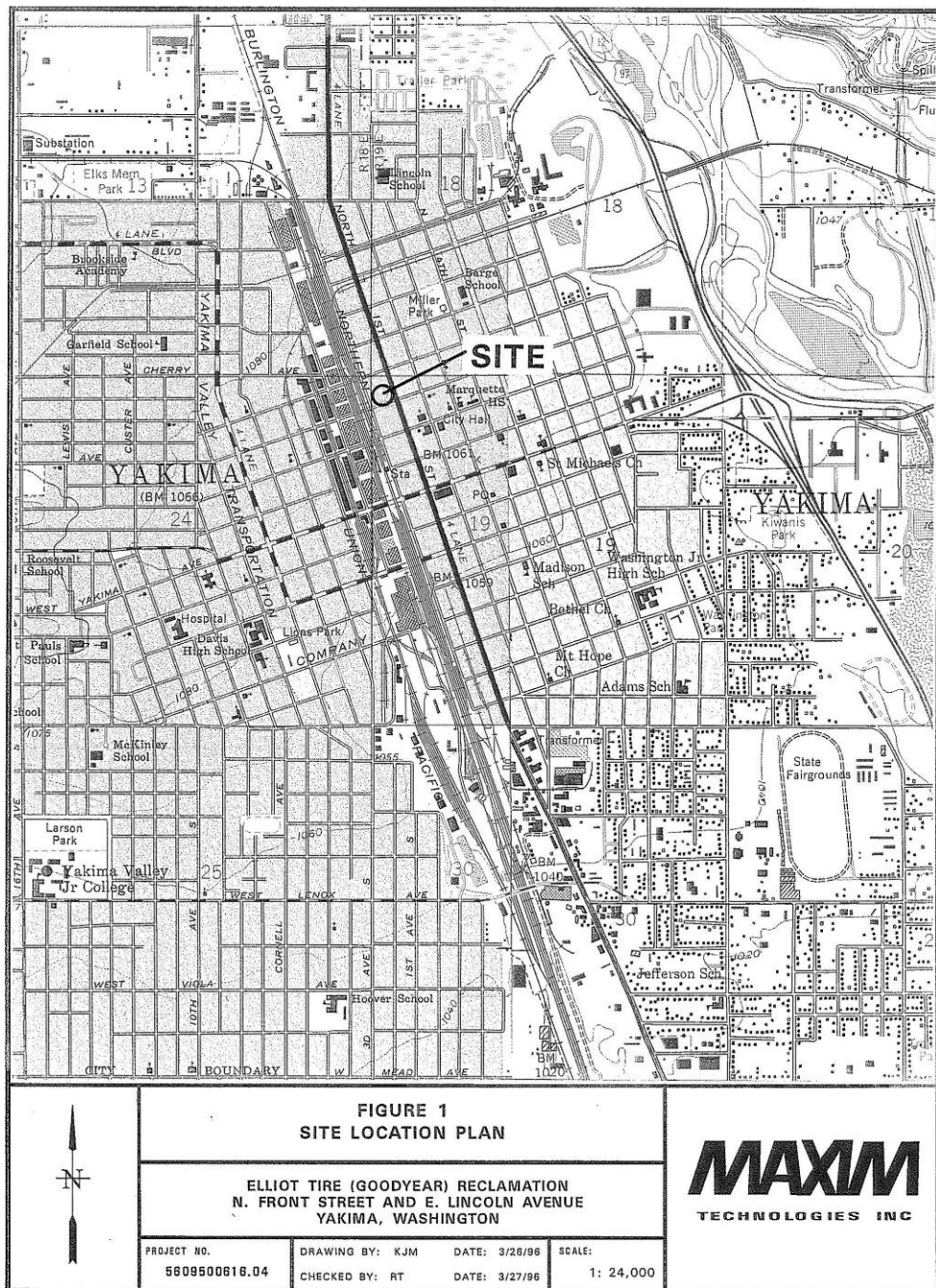

## 6.2 Site Plan

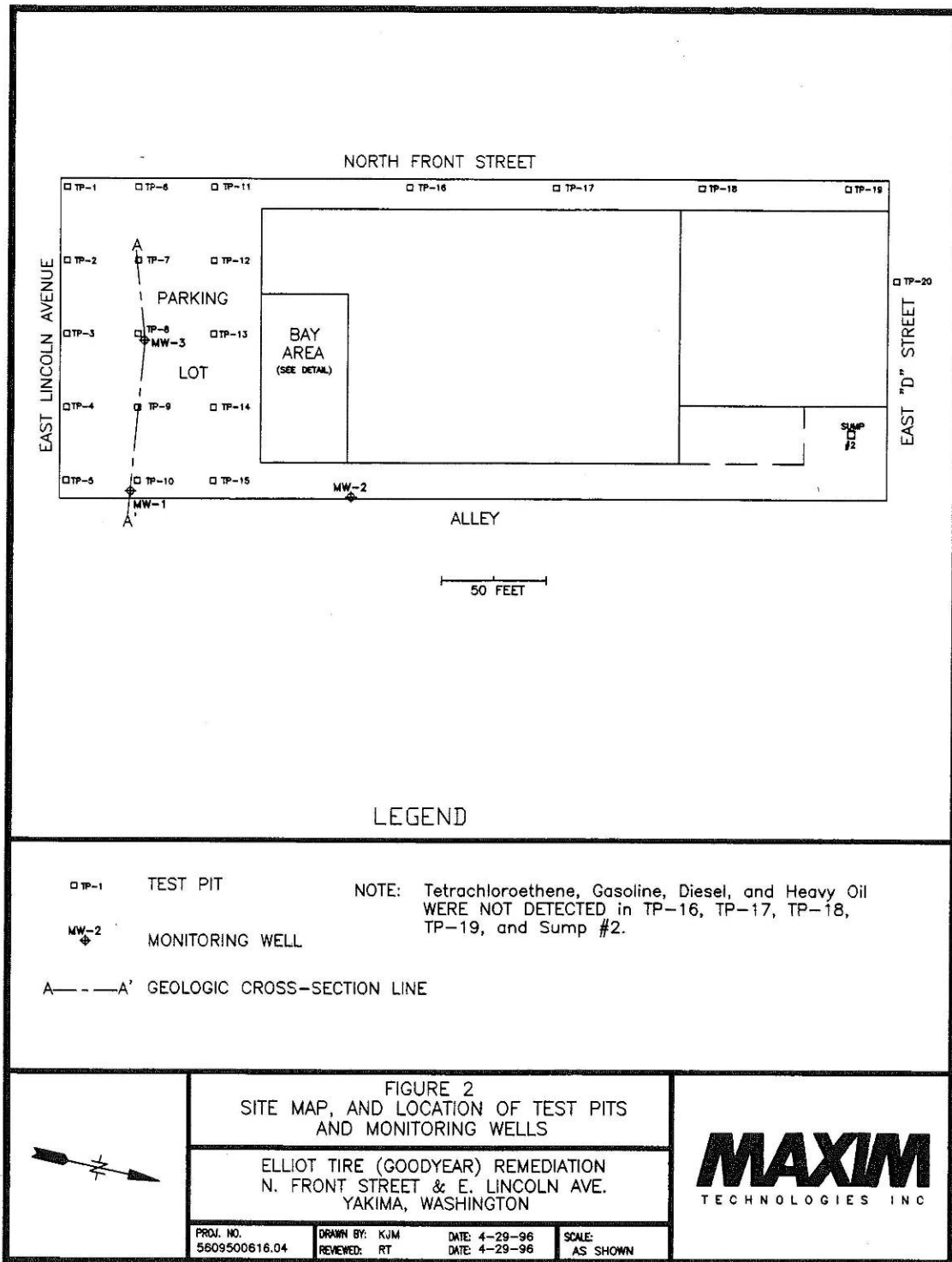

### 6.3 Groundwater Monitoring Data

Elliot (Goodyear) Tire Center, Yakima, WA - Independent Remedial Action Program (IRAP) Groundwater Report

TABLE 1 ELLIOT TIRE (GOODYEAR) REMEDIATION Summary of Water Table Elevations and Groundwater Samples Analyses Results										
Well No.	Elevation of Reference Point (ft)	Event No.	Depth to Water (ft)	Elevation of Water Table (ft)	PCE (µg/L)	BTEX (µg/L)	Gasoline (µg/L)	Diesel (µg/L)	Heavy Oil (µg/L)	Date Collected
MW-1	1088.51	1	18.18	1070.33	0.64 <sup>1</sup>	ND	ND	ND	NA	2/21/95
		2	13.05	1075.46	ND	ND	ND	ND	ND	8/15/95
		3	17.11	1071.40	ND	ND	ND	ND	ND	11/20/95
		4	18.12	1070.39	1.0	ND	ND	ND	ND	2/20/96
		5	13.51	1075.00	ND	ND	ND	ND	ND	8/5/96
		6	16.81	1071.70	1.3	ND	ND	ND	ND	11/12/96
		7	17.22	1071.29	2.1	ND	ND	ND	ND	2/4/97
		8	14.03	1074.48	2.6	NA	ND	NA	NA	7/4/97
		9	13.75	1074.76	ND	NA	ND	NA	NA	9/17/97
MW-2	1089.42	1	19.06	1070.36	NA	ND	ND	ND	NA	2/21/95
		2	13.03	1076.39	ND	ND	ND	ND	ND	8/15/95
		3	17.64	1071.78	ND	ND	ND	ND	ND	11/20/95
		4	19.0	1070.42	1.0	ND	ND	ND	ND	2/20/96
		5	13.53	1075.89	ND	ND	ND	ND	ND	8/5/96
		6	17.36	1072.06	1.8	ND	ND	ND	ND	11/12/96
		7	17.86	1071.56	1.5	ND	ND	ND	ND	2/4/97
		8	14.16	1075.26	ND	NA	ND	NA	NA	7/4/97
		9	13.89	1075.53	ND	NA	ND	NA	NA	9/17/97
MW-3	1087.77	1	17.11	1070.66	NA	25.9	2500	ND	NA	2/21/95
		2	11.61	1076.16	ND	ND	ND	ND	ND	8/15/95
		3	15.90	1071.87	ND	ND	ND	ND	ND	11/20/95
		4	16.98	1070.79	1.0	189	2420	ND	ND	2/20/96
		5	12.04	1075.73	ND	ND	200	ND	ND	8/5/96
		6	15.64	1072.13	0.8	4.1	ND	ND	ND	11/12/96
		7	16.02	1071.75	2.4	ND	ND	ND	ND	2/4/97
		8	12.59	1075.18	ND	NA	ND	NA	NA	7/4/97
		9	12.30	1075.47	ND	NA	ND	NA	NA	9/17/97

NOTES:

- ND = Not Detected
- NA = Not Analyzed
- <sup>1</sup> PCE Analyzed Using EPA Method 8240
- PCE Analyzed Using EPA Method 8010/8020

Maxim Technologies, Inc.

---

## 6.4 Environmental Covenant

**Return Address:**

Michael F. Shinn  
Halverson & Applegate, P.S.  
P.O. Box 22730  
Yakima, WA 98907-2715

### RESTRICTIVE COVENANT

**Grantor(s):**

1. Pleas J. Green and Paula J. Green

**Legal Description:**

Lots 17-32, inclusive, Block 7, TOWN OF NORTH YAKIMA, now Yakima, Washington, per Plat recorded in Volume E of Plats, page 1, records of Yakima County, Washington. (See attached site map, Exhibit A.)

**Assessor's Property Tax Parcel Number(s):**

Parcel No. 191319 22406

This document is part of the official  
Administrative Record for the  
Yakima Railroad Area,  
Washington State  
Department of Ecology



## RESTRICTIVE COVENANT

The property subject to this Restrictive Covenant ("site" herein) was the subject of an Independent Remedial Action Program ("IRAP") undertaken by Maxim Technologies, Inc. on property known as the Goodyear Tire Center, 1 East Lincoln Avenue, Yakima, Washington, legally described as follows:

Lots 17-32, inclusive, Block 7, TOWN OF NORTH YAKIMA, now Yakima, Washington, per Plat recorded in Volume E of Plats, page 1, records of Yakima County, Washington. (See attached site map, Exhibit A.)

The remedial action taken to clean up the site is described in the IRAP Report dated August 1996, and the IRAP Quarterly Groundwater Monitoring Report dated October 1997, submitted to the Washington State Department of Ecology ("DOE") at its Yakima, Washington Central Regional Office. The clean up action did not remediate approximately 1,300 square feet of petroleum contamination located up to a depth of two feet below the concrete slab floor of the existing building on the site. See attached Exhibit B. As that petroleum contamination does not result in any groundwater contamination, however, and as the other potential sources of groundwater contamination have been successfully removed from the site, it has been recommended that the under slab contamination be left in place until the existing building and slab are demolished, with remediation to be required at that point in time. The DOE is requesting this Restrictive Covenant to that effect, pursuant to WAC 173-340-440. Accordingly:

This document is part of the official  
Administrative Record for the  
Yakima Railroad Area.  
Washington State  
Department of Ecology

1



7232378  
Page: 2 of 6  
08/27/2001 03:15P  
Yakima Co, WA

HALVERSON & APPLGATE COV \$13.69



The undersigned owners of the site hereby make the following declaration which shall constitute a covenant to run with the land, as provided by law, and which shall be binding on all parties and all persons claiming under them, including all current and future owners of any portion of or any interest in the site, to-wit:

1. At such time as the improvements and slab on the site are demolished or removed, remediation, pursuant to then applicable standards, of any remaining petroleum contamination located under the slab shall be required.

2. Corrective measures to prevent accidental spills in the newly installed dry well on the site and under the floors of the improvements on the site have been implemented. Absorbents presently installed and in the dry well should be regularly maintained and replaced to minimize the potential for new releases of contaminants to groundwater.

3. Any transferee of an interest in the site shall give DOE written notice of its acquisition of an interest within 30 days of the date of conveyance.

4. The owner or any successor owner of the site shall allow authorized representatives of DOE, or any successor agency, the right to enter the site at reasonable times for the purposes of evaluating compliance with the IRAP Reports and this Restrictive Covenant, including the right to take samples, inspect any remedial action taken at the site, and to inspect records that are related thereto, as long as it does not damage the property or interfere with the reasonable continuation of business operations on the premises in doing so.

This document is part of the official  
Administrative Record for the  
Yakima Railroad Area,  
Washington State  
Department of Ecology

2

  
HALVERSON & APPLGATE COV \$13.00 7232378  
Page: 3 of 6  
08/27/2001 03:15P  
Yakima Co, WA

5. The owner and successor owners of the site reserve the right under WAC 173-340-440 to record an instrument which provides that this Restrictive Covenant shall no longer be of any further force or effect. This Restrictive Covenant, however, shall be removed only if DOE, after public notice and opportunity for comment, concurs.

DATED this 12 day of July, 2001.

Pleas J. Green  
Pleas J. Green  
Paula J. Green  
Paula J. Green

STATE OF WASHINGTON )  
 ) ss:  
County of YAKIMA )

On this day personally appeared before me PLEAS J. GREEN and PAULA J. GREEN, husband and wife, to me known to be the individuals described in and who executed the within and foregoing instrument, and acknowledged that they signed

the same as their free and voluntary act and deed, for the uses and purposes therein mentioned.

Given under my hand and official seal this 12 day of July, 2001.



Karen A. Hill  
NOTARY PUBLIC in and for the  
State of Washington,  
Residing at Yakima  
My commission expires: 9-10-03

tbg\loving\restric.co4  
011201 mfs:mfs

This document is part of the official  
Administrative Record for the  
Yakima Railroad Area,  
Washington State  
Department of Ecology

3



7232378  
Page: 4 of 6  
08/27/2001 03:15P  
Yakima Co, WA

---

## 6.5 Photo log

**Photo 1: Front of Facility - from the southeast**



**Photo 2: East Interior Bay - from the southeast**



**Photo 3: South Side of Building w/ Monitoring Well in Fore shot- from the northeast**



**Photo 4: West Side of the Building – from the northwest**

