



Voluntary Cleanup Program

Washington State Department of Ecology
Toxics Cleanup Program

TERRESTRIAL ECOLOGICAL EVALUATION FORM

Under the Model Toxics Control Act (MTCA), a terrestrial ecological evaluation is necessary if hazardous substances are released into the soils at a Site. In the event of such a release, you must take one of the following three actions as part of your investigation and cleanup of the Site:

1. Document an exclusion from further evaluation using the criteria in WAC 173-340-7491.
2. Conduct a simplified evaluation as set forth in WAC 173-340-7492.
3. Conduct a site-specific evaluation as set forth in WAC 173-340-7493.

When requesting a written opinion under the Voluntary Cleanup Program (VCP), you must complete this form and submit it to the Department of Ecology (Ecology). The form documents the type and results of your evaluation. You still need to submit your evaluation as part of your cleanup plan or report.

If you have questions about how to conduct a terrestrial ecological evaluation, please contact the Ecology site manager assigned to your Site. For additional guidance, please refer to www.ecy.wa.gov/programs/tcp/policies/terrestrial/TEHome.htm.

Step 1: IDENTIFY HAZARDOUS WASTE SITE

Please identify below the hazardous waste site for which you are documenting an evaluation.

Facility/Site Name:	FORMER PLAID PANTRY STORE #324	
Facility/Site Address:	10645 16 th AVENUE SW	
Facility/Site No:	18113462	VCP Project No.: NW 2585

Step 2: IDENTIFY EVALUATOR

Please identify below the person who conducted the evaluation and their contact information.

Name:	REGINA SKARZINSKAS		Title:	TOXICOLOGIST	
Organization:	TECHNICAL ASSESSMENT SERVICES / EES				
Mailing address:	7870 SW BRISTOL CT				
City:	BEAVERTON	State:	OR	Zip code:	97007
Phone:	503-970-9538	Fax:	503-641-8622	E-mail:	regina@tas-tox.com

Step 3: DOCUMENT EVALUATION TYPE AND RESULTS

A. Exclusion from further evaluation.

1. Does the Site qualify for an exclusion from further evaluation?

☒ Yes If you answered "YES," then answer **Question 2**.

☐ No or Unknown If you answered "NO" or "UNKNOWN," then skip to **Step 3B** of this form.

2. What is the basis for the exclusion? Check all that apply. Then skip to **Step 4** of this form.

Point of Compliance: WAC 173-340-7491(1)(a)

- ☐ All soil contamination is, or will be,* at least 15 feet below the surface.
- ☐ All soil contamination is, or will be,* at least 6 feet below the surface (or alternative depth if approved by Ecology), and institutional controls are used to manage remaining contamination.

Barriers to Exposure: WAC 173-340-7491(1)(b)

- ☐ All contaminated soil, is or will be,* covered by physical barriers (such as buildings or paved roads) that prevent exposure to plants and wildlife, and institutional controls are used to manage remaining contamination.

Undeveloped Land: WAC 173-340-7491(1)(c)

- ☐ There is less than 0.25 acres of contiguous[#] undeveloped[±] land on or within 500 feet of any area of the Site and any of the following chemicals is present: chlorinated dioxins or furans, PCB mixtures, DDT, DDE, DDD, aldrin, chlordane, dieldrin, endosulfan, endrin, heptachlor, heptachlor epoxide, benzene hexachloride, toxaphene, hexachlorobenzene, pentachlorophenol, or pentachlorobenzene.

- ☒ For sites not containing any of the chemicals mentioned above, there is less than 1.5 acres of contiguous[#] undeveloped[±] land on or within 500 feet of any area of the Site.

Background Concentrations: WAC 173-340-7491(1)(d)

- ☐ Concentrations of hazardous substances in soil do not exceed natural background levels as described in WAC 173-340-200 and 173-340-709.

* An exclusion based on future land use must have a completion date for future development that is acceptable to Ecology.

[±] "Undeveloped land" is land that is not covered by building, roads, paved areas, or other barriers that would prevent wildlife from feeding on plants, earthworms, insects, or other food in or on the soil.

[#] "Contiguous" undeveloped land is an area of undeveloped land that is not divided into smaller areas of highways, extensive paving, or similar structures that are likely to reduce the potential use of the overall area by wildlife.

B. Simplified evaluation.

N/A

1. Does the Site qualify for a simplified evaluation?

- ☐ Yes *If you answered "YES," then answer **Question 2** below.*
- ☐ No or Unknown *If you answered "NO" or "UNKNOWN," then skip to **Step 3C** of this form.*

2. Did you conduct a simplified evaluation?

- ☐ Yes *If you answered "YES," then answer **Question 3** below.*
- ☐ No *If you answered "NO," then skip to **Step 3C** of this form.*

3. Was further evaluation necessary?

- ☐ Yes *If you answered "YES," then answer **Question 4** below.*
- ☐ No *If you answered "NO," then answer **Question 5** below.*

4. If further evaluation was necessary, what did you do?

- ☐ Used the concentrations listed in Table 749-2 as cleanup levels. *If so, then skip to **Step 4** of this form.*
- ☐ Conducted a site-specific evaluation. *If so, then skip to **Step 3C** of this form.*

5. If no further evaluation was necessary, what was the reason? Check all that apply. Then skip to **Step 4 of this form.**

Exposure Analysis: WAC 173-340-7492(2)(a)

- ☐ Area of soil contamination at the Site is not more than 350 square feet.
- ☐ Current or planned land use makes wildlife exposure unlikely. Used Table 749-1.

Pathway Analysis: WAC 173-340-7492(2)(b)

- ☐ No potential exposure pathways from soil contamination to ecological receptors.

Contaminant Analysis: WAC 173-340-7492(2)(c)

- ☐ No contaminant listed in Table 749-2 is, or will be, present in the upper 15 feet at concentrations that exceed the values listed in Table 749-2.
- ☐ No contaminant listed in Table 749-2 is, or will be, present in the upper 6 feet (or alternative depth if approved by Ecology) at concentrations that exceed the values listed in Table 749-2, and institutional controls are used to manage remaining contamination.
- ☐ No contaminant listed in Table 749-2 is, or will be, present in the upper 15 feet at concentrations likely to be toxic or have the potential to bioaccumulate as determined using Ecology-approved bioassays.
- ☐ No contaminant listed in Table 749-2 is, or will be, present in the upper 6 feet (or alternative depth if approved by Ecology) at concentrations likely to be toxic or have the potential to bioaccumulate as determined using Ecology-approved bioassays, and institutional controls are used to manage remaining contamination.

C. Site-specific evaluation. A site-specific evaluation process consists of two parts: (1) formulating the problem, and (2) selecting the methods for addressing the identified problem. Both steps require consultation with and approval by Ecology. See WAC 173-340-7493(1)(c). N/A

1. Was there a problem? See WAC 173-340-7493(2).

- ☐ Yes *If you answered "YES," then answer **Question 2** below.*
- ☐ No *If you answered "NO," then identify the reason here and then skip to **Question 5** below:*
- ☐ No issues were identified during the problem formulation step.
- ☐ While issues were identified, those issues were addressed by the cleanup actions for protecting human health.

2. What did you do to resolve the problem? See WAC 173-340-7493(3).

- ☐ Used the concentrations listed in Table 749-3 as cleanup levels. *If so, then skip to **Question 5** below.*
- ☐ Used one or more of the methods listed in WAC 173-340-7493(3) to evaluate and address the identified problem. *If so, then answer **Questions 3 and 4** below.*

3. If you conducted further site-specific evaluations, what methods did you use?
Check all that apply. See WAC 173-340-7493(3).

- ☐ Literature surveys.
- ☐ Soil bioassays.
- ☐ Wildlife exposure model.
- ☐ Biomarkers.
- ☐ Site-specific field studies.
- ☐ Weight of evidence.
- ☐ Other methods approved by Ecology. *If so, please specify:*

4. What was the result of those evaluations?

- ☐ Confirmed there was no problem.
- ☐ Confirmed there was a problem and established site-specific cleanup levels.

5. Have you already obtained Ecology's approval of both your problem formulation and problem resolution steps?

- ☐ Yes *If so, please identify the Ecology staff who approved those steps:*
- ☐ No

King County

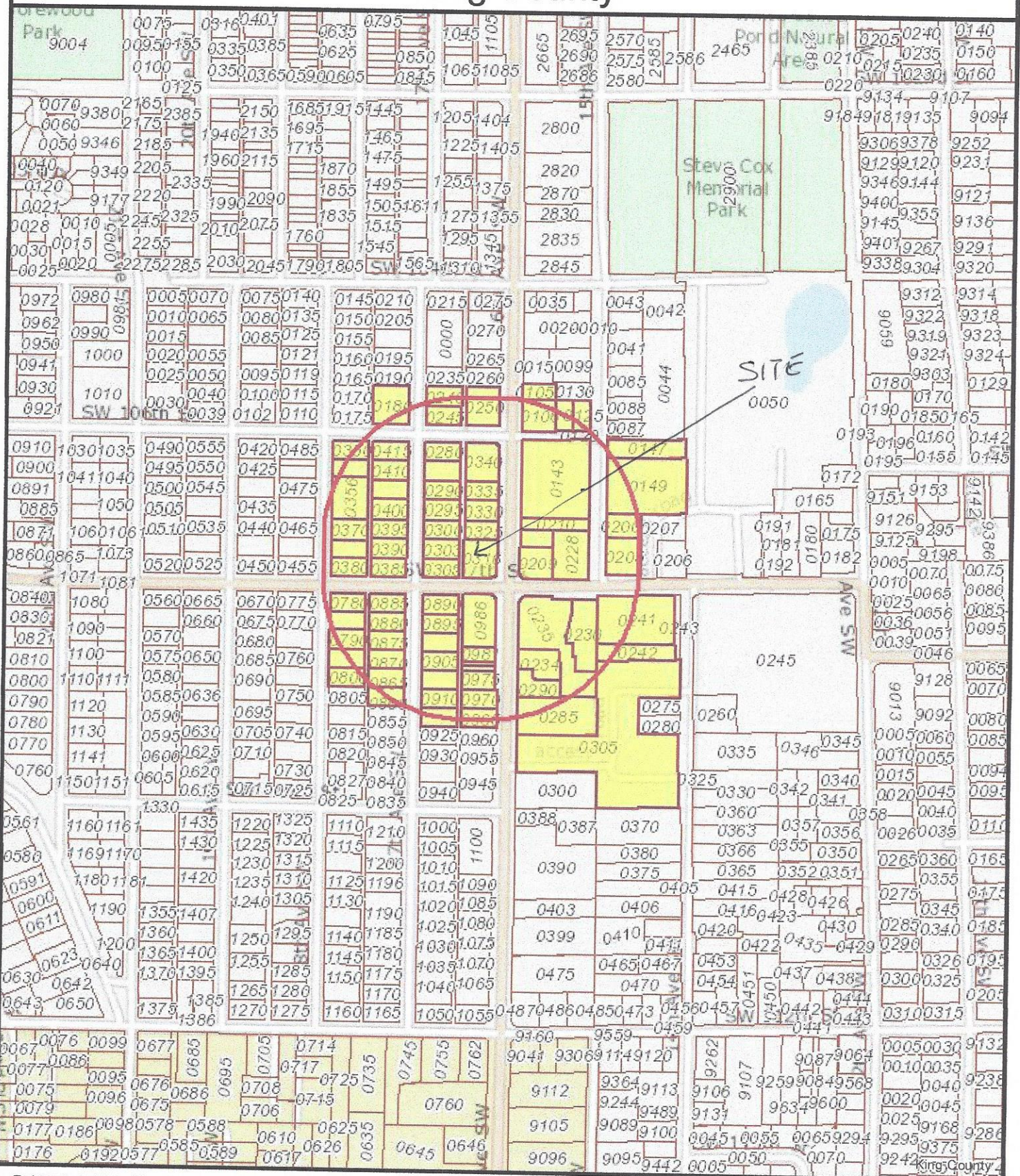

The information included on this map has been compiled by King County staff from a variety of sources and is subject to change without notice. King County makes no representations or warranties, express or implied, as to accuracy, completeness, timeliness, or rights to the use of such information. This document is not intended for use as a survey product. King County shall not be liable for any general, special, indirect, incidental, or consequential damages including, but not limited to, lost revenues or lost profits resulting from the use or misuse of the information contained on this map. Any sale of this map or information on this map is prohibited except by written permission of King County.

Date: 8/28/2014

1 in : 671 feet

0 0.075 0.15 ft



King County
GIS CENTER

FORMER PLAIN PASTRY #324

VCP # NW2585