



GROUNDWATER SAMPLING REPORT

**GLENN DISTRIBUTOR INC.
MILLER CHERRY BP
former MILLER CHERRY EXXON
531 South Miller Street
Wenatchee, Washington 98801**

April 30, 2001
#3183

Prepared for: Ms. Debra Kroon, Environmental Specialist
Washington State Department of Ecology
15 West Yakima, Suite 200
Yakima, Washington 98902-3452

Prepared by: KLBehrens & Assoc.
P.O. Box 594
Ephrata, Washington 98823

On Behalf Of: Mr. Ray Glenn
Glenn Distributor Inc.
1301 North Wenatchee Avenue
Wenatchee, Washington 98801

Authored/Reviewed
and Investigated by:

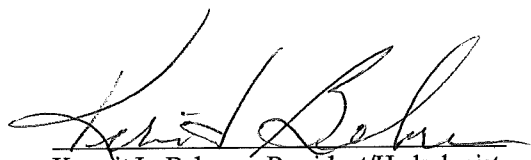
Kermit L. Behrens, President/Hydrologist
ASI/ICFI Certified Site Assessor
KLBehrens & Assoc.

Date: *4/30/01*



K.L. Behrens & Associates
Consulting Hydrologist
WDOE Registered Site Assessor

P.O. Box 594
Ephrata, WA 98823
(509) 754-0979

April 30, 2001

Ms. Debra Kroon
Environmental Specialist
Department of Ecology
13 West Yakima, Suite 200
Yakima, Washington 98902-3452

Re: Water Sample Results
Miller Cherry Exxon
531 South Miller Street
Wenatchee, Washington 98801

Dear Ms. Kroon:

Please find enclosed the final report for water sample results from the three (3) monitor wells located at the Miller Cherry Exxon service station, 531 South Miller Street, Wenatchee, Washington. This facility is owned and operated by GLENN Distributor Inc., 1301 North Wenatchee Avenue, Wenatchee, Washington. Mr. Glenn intends to commence with the required paperwork for a No Further Action (NFA) from the Washington Department of Ecology (WDOE).

If you have any questions, please contact me at (509) 754-0979

Sincerely,

A handwritten signature in black ink, appearing to read 'Kermit L. Behrens', written in a cursive style.

Kermit L. Behrens
Hydrologist

Encl: Groundwater Sampling Report



K.L. Behrens & Associates
Consulting Hydrologist
WDOE Registered Site Assessor

P.O. Box 594
Ephrata, WA 98823
(509) 754-0979

April 30, 2001

Mr. Ray E. Glenn
GLENN Distributing Inc.
1301 North Wenatchee Avenue
Wenatchee, Washington 98801

Re: Results of Groundwater Sampling
Miller Cherry BP Service Station (former - Miller Cherry Exxon)
531 South Miller Avenue, Wenatchee, Washington

Dear Mr. Glenn:

Enclosed is a report providing test results from the latest water samples taken on April 12, 2001. This is in response to the Early Notice Letter Regarding the Release of Hazardous Substances on property located at Miller Cherry Exxon, 531 South Miller Street, Wenatchee, Washington, ERTS #C509656, dated March 30, 2000. Based on this latest data, we recommend commencing with the required paperwork for a No Further Action (NFA) from the Washington Department of Ecology (WDOE).

If you have any questions, please contact me at (509) 754-0979.

Sincerely,

A handwritten signature in black ink, appearing to read 'Kermit L. Behrens', written in a cursive style.

Kermit L. Behrens
Hydrologist

cc: Debra Kroon
Environmental Specialist
WDOE

**GLENN Distributing Inc., Miller/Cherry BP
Results of Groundwater Sampling, April 12, 2001**

1.0 INTRODUCTION

This report provides test results from the latest samples taken at the former Miller Cherry Exxon, now known as the Miller Cherry BP located at 531 South Miller Avenue, Wenatchee, Washington. This firm performed our site work presented in this report on April 12, 2001.

2.0 INVESTIGATION

On April 12, 2001, Mr. Kermit Behrens, KLBehrens & Assoc., collected groundwater samples from three (3) existing groundwater monitoring wells located at the Miller Cherry Exxon facility located at 531 South Miller Street, Wenatchee, Washington. KLBehrens & Assoc. submitted the water samples to Anatek Labs, Inc., East 504 Sprague Avenue, Spokane, Washington for independent laboratory analyses.

The groundwater samples collected from the monitor wells were submitted to Anatek Labs, Inc. to be analyzed for Total Petroleum Hydrocarbons using Washington State Method WTPH-G, plus Benzene, Toluene, Ethyl Benzene and Xylenes (BTEX) using method NWTPH-G BTEX by EPA 8260. The water sample results and the Chain of Custody documents are included under Appendix A.

Prior to collecting the water samples, the monitor wells were purged with approximately three (3) gallon of water bailed from each monitor well. The three (3) existing groundwater monitor wells were then sampled using protocol consistent with Washington Department of Ecology (WDOE). The water samples were immediately refrigerated and submitted to the laboratory with Chain of Custody documents for analyses.

Analytical results are tabulated on the attached table. We have also included water sample results from July 1, 1993, October 5, 1994, May 15, 2000, August 15, 2000 and November 4, 2000. The results of the latest samples continue to indicate a substantial reduction in hydrocarbon concentrations with all three (3) monitor wells being non-detect for TPH-G/BTEX.

TABLE I

**ANALYTICAL RESULTS FOR WATER SAMPLES
 BP SERVICE STATION, 531 S. MILLER AVE., WENATCHEE, WA**

Sample ID	Date Collected	TPH-G	B	T	E	X
APE-MW-1	07/01/93	ND	ND	ND	ND	ND
	10/05/94	15,000	370	2,300	74	2,100
	05/15/00	ND	ND	ND	ND	ND
	08/15/00	ND	ND	ND	ND	ND
	11/04/00	ND	ND	ND	ND	ND
	04/12/01	ND	ND	ND	ND	ND
APE-MW-2	07/01/93	ND	0.5	ND	ND	ND
	10/05/94	52	3.8	ND	ND	3.7
	05/15/00	ND	ND	ND	ND	ND
	08/15/00	ND	ND	ND	ND	ND
	11/04/00	ND	ND	ND	ND	ND
	04/12/01	ND	ND	ND	ND	ND
APE-MW-3	07/01/93	6,200	226	54	ND	632
	10/05/94	1,300	46	62	9.0	160
	05/15/00	ND	ND	ND	ND	ND
	08/15/00	ND	ND	ND	ND	ND
	11/04/00	ND	ND	ND	ND	ND
	04/12/01	ND	ND	ND	ND	ND
MTCA Cleanup Levels		1,000	5.0	40.0	30.0	20.0

Notes:

All values reported in ug/L (ppb)

TPH = Total Petroleum Hydrocarbons, B = benzene, T = toluene, E = ethyl benzene, and X = xylenes. TPH-G using Ecology Method WTPH-G, BTEX using EPA Method 8260.

ND = Analyte not present at or in excess of the practical reporting limit.

Values in **bold** exceed the respective MTCA Method A Groundwater Cleanup Level.

MTCA = Model Toxics Control Act Method A Groundwater Cleanup Levels, Washington Administrative Code (WAC) Chapter 173-340-720 (2) (a) (i), dated February 1991.

3.0 RECOMMENDATION:

This firm recommends that GLENN Distributing Inc. commence with the required paperwork for a No Further Action (NFA) from the Washington Department of Ecology. No further groundwater sampling is required pending recommendations from the Washington Department of Ecology (WDOE).

Field/Office investigations and report completed by:

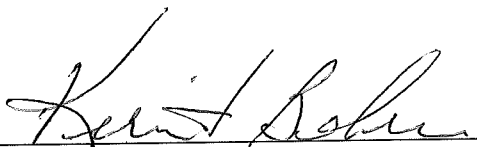

Kermit L. Behrens, Hydrologist

4/30/01
Date

APPENDIX A

Water Sample Results & Chain of Custody Document

Anatek Labs, Inc.

1282 Alturas • Moscow, ID 83843 • (208) 883-2839 • Fax (208) 882-9246 • email moscow@anateklabs.com
504 E Sprague Ste. D • Spokane, WA 99202 • (509) 838-3999 • Fax (509) 838-4433 • email spokane@anateklabs.com

K.L. BEHRENS AND ASSOCIATES

Project: MILLER/CHERRY EXXON

KERMIT BEHRENS
P.O. BOX 594
EPHRATA WA 98823

Certificate of Analysis

Petroleum - Gasoline by NWTPH-G BTEX by EPA 8021B(MOD)

Sample Name:	Analyte	Result	Units	PQL
APE-MW-1	Gasoline	ND	mg/L	0.100
Sampling Date: 4/12/01	NWTPH-G Surrogate (CB-d5) Percent Recovery	88.4		
Sampling Time: 9:00				
Date Received: 4/13/01	Benzene	ND	mg/L	0.001
Lab #: 1041302-01	Toluene	ND	mg/L	0.005
Matrix: WW	Ethylbenzene	ND	mg/L	0.005
Analysis Date: 4/19/01	Xylene (total)	ND	mg/L	0.010
	BTEX Surrogate (CB-d5) Percent Recovery	103.5		

Sample Name:	Analyte	Result	Units	PQL
APE-MW-2	Gasoline	ND	mg/L	0.100
Sampling Date: 4/12/01	NWTPH-G Surrogate (CB-d5) Percent Recovery	88.7		
Sampling Time: 9:30				
Date Received: 4/13/01	Benzene	ND	mg/L	0.001
Lab #: 1041302-02	Toluene	ND	mg/L	0.005
Matrix: WW	Ethylbenzene	ND	mg/L	0.005
Analysis Date: 4/19/01	Xylene (total)	ND	mg/L	0.010
	BTEX Surrogate (CB-d5) Percent Recovery	103.3		

Sample Name:	Analyte	Result	Units	PQL
APE-MW-3	Gasoline	ND	mg/L	0.100
Sampling Date: 4/12/01	NWTPH-G Surrogate (CB-d5) Percent Recovery	90.5		
Sampling Time: 10:00				
Date Received: 4/13/01	Benzene	ND	mg/L	0.001
Lab #: 1041302-03	Toluene	ND	mg/L	0.005
Matrix: WW	Ethylbenzene	ND	mg/L	0.005
Analysis Date: 4/19/01	Xylene (total)	ND	mg/L	0.010
	BTEX Surrogate (CB-d5) Percent Recovery	101.1		

Lab Supervisor:



Report Date:

20-Apr-01

APPENDIX B

Site Location Maps

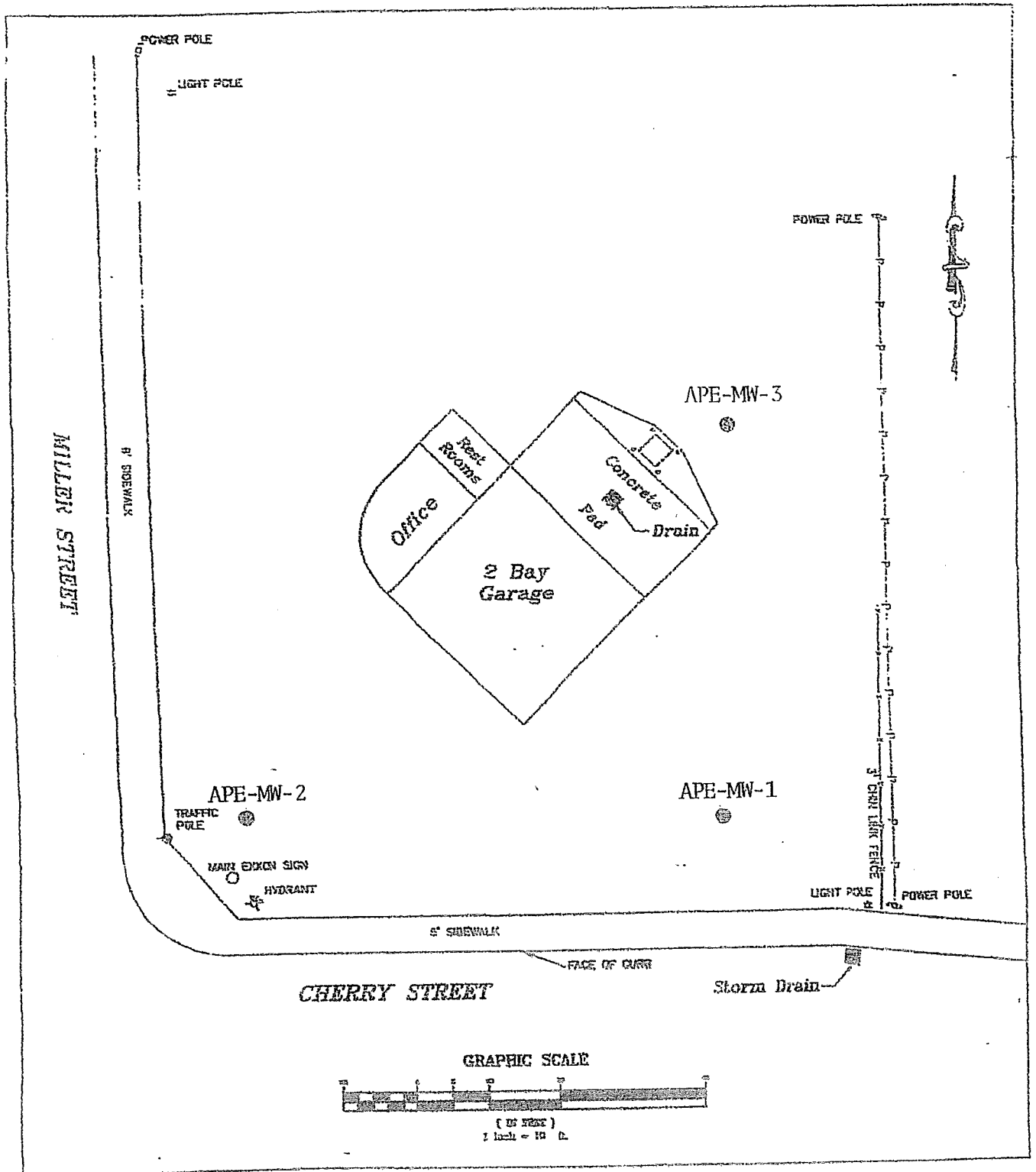

Groundwater Monitoring Well and Groundwater Sampling Locations

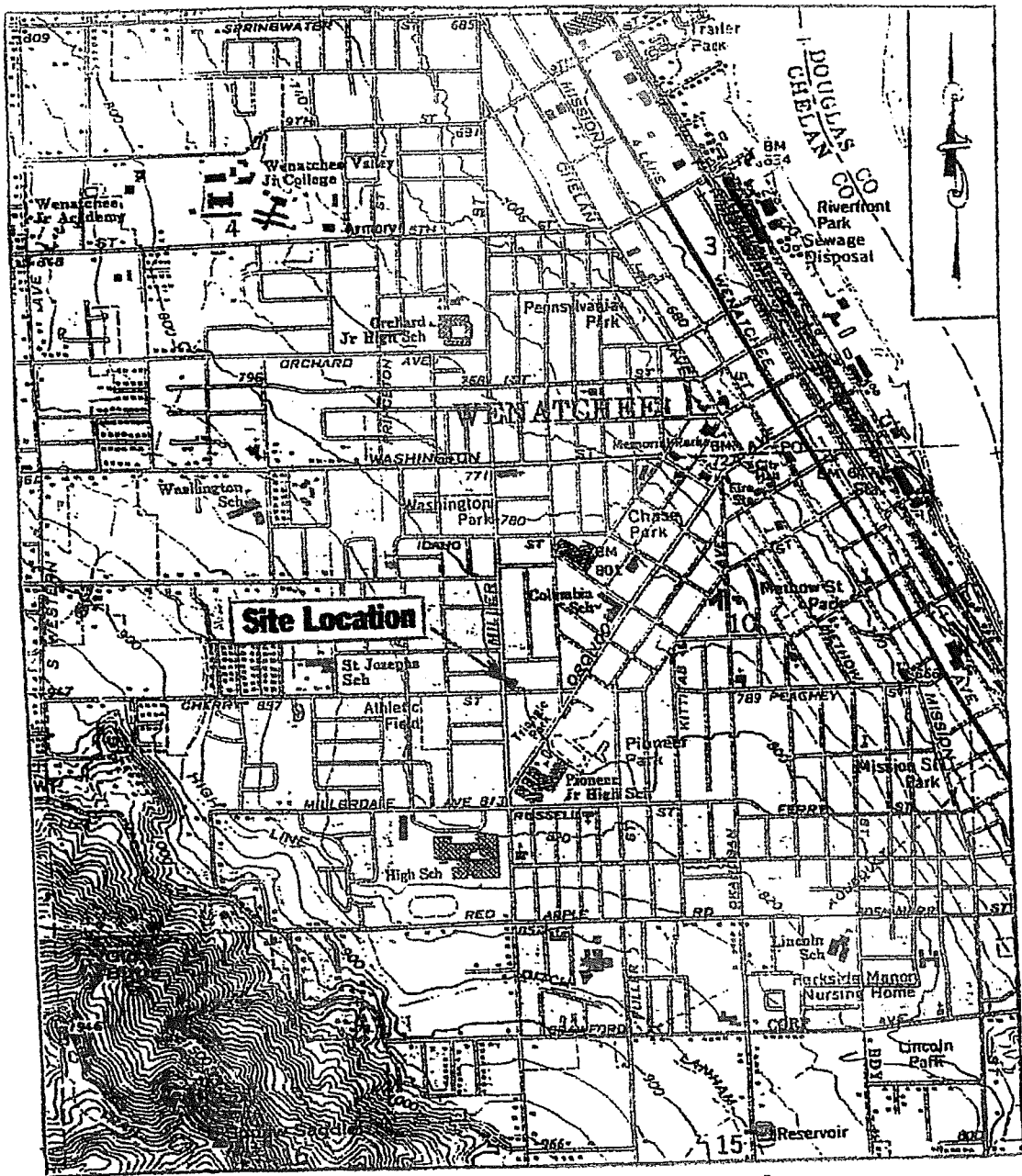

SCALE 1:24000

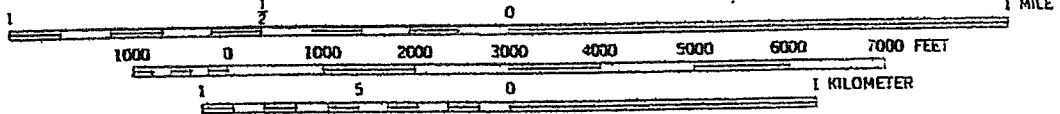

CONTOUR INTERVAL 20 FEET
 NATIONAL GEODETIC VERTICAL DATUM OF 1929

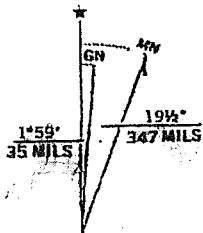

UTM GRID AND 1987 MAGNETIC NORTH
 DECLINATION AT CENTER OF SHEET

