

SITE HAZARD ASSESSMENT
WORKSHEET 1
Summary Score Sheet

SITE INFORMATION:

Name: 7-Eleven Food Store 230325983H
Address: 3541 Martin Way E, Olympia, Thurston County, WA 98506
Section/Township/Range: S18/T18N/R1W
Latitude/Longitude: 47.04700, -122.84491
Parcel Number: 41701900100 (real) & 99000990600
Ecology FSID: 5465157
Date Scored: June 17, 2015

Site assessed/ranked for the August 2015 update.

SITE DESCRIPTION:

This site is a 1.45 acre parcel located at 3541 Martin Way East in Olympia, Washington. It is situated in the southwest corner of the Martin Way E and Lilly Road NE intersection in an area known as Sunshine Plaza. This plaza is a multi-unit commercial development that is primarily paved with some landscaped areas. The area is zoned for mixed commercial and residential properties, and is surrounded by commercial developments on all sides excluding to the south, where there is a private residence.

7-eleven currently leases the property as a convenience store (#25983). In 1984, three 12,000-gallon, single-walled fiberglass underground storage tanks (USTs) were installed directly north of the building for the retail sale of leaded and unleaded gasoline. Records indicate that diesel fuel was never stored or sold on site. This work included installing two fuel dispensers, a canopy, and associated underground piping. These three USTs and associated accessories were removed in 2014 (see details below).

The topography of this site generally slopes towards the southeast, to a storm water catch basin. The site is about 200 feet above mean sea level and with Woodland Creek located approximately 1,000 feet to the west, which drains into Henderson Inlet and the Puget Sound. Soils on this site are gravelly sand overlaying gravel with a foot wide silty layer that is approximately 15 to 16 feet below ground surface (bgs). Groundwater is generally around 25 feet bgs with a westerly flow.

PREVIOUS INVESTIGATIONS:

Please see attachments for lab results and sampling locations. Notes and symbols in red were added during this SHA process.

June 1995: McCon Building and Petroleum Services, Inc. (from Vancouver, WA) conducted a product piping upgrade for this facility. This work included contracting Fluor Daniel-GTI, Inc. to collect soil samples from the tank pit and dispensing area. These samples were tested for gasoline-range total petroleum hydrocarbons (TPH-gasoline), benzene, toluene, ethyl benzene, and xylenes (BTEX), and total lead. While chemicals of concern were not detected in the vicinity of the tank pit, two samples from the dispensing area came back with levels of TPH-gasoline above the MTCA Method A Soil Cleanup Levels for Unrestricted Land Uses (MTCA Cleanup Levels). One of these samples also contained elevated levels of toluene, ethyl benzene, and total xylenes above their corresponding MTCA Cleanup Levels.

September 1997: During an upgrade of the UST system, Fluor Daniel-GTI, Inc. conducted a limited site assessment that included soil sampling. Out of four samples, one sample contained elevated levels of toluene, ethyl benzene, total xylenes, and TPH-Gasoline above their respective MTCA Cleanup Levels.

June 1999: IT Corporation advanced four onsite soil borings and corresponding ground water monitoring wells around the UST system (MW-1 through 4). Eight soil samples were collected and analyzed for BTEX, TPH-gasoline, methyl tertiary butyl ether (MtBE), and total lead. No contamination above MTCA Cleanup Levels was detected.

June 2001: IT Corporation personnel installed one additional monitoring well MW-5 west of property in the down gradient direction. Two soil samples were collected from the borings and analyzed for BTEX and TPH-gasoline. No contamination above MTCA Cleanup Levels was detected.

Ground water monitoring (July 1999 through May 2015): Starting in 1999, groundwater monitoring was conducted quarterly on all available Monitoring Wells (MW) through 2008, and then continued yearly through 2015. Samples were tested for BTEX and TPH-gasoline every time in addition to 1,2-Dibromoethane (EDC), 1,2-Dichloroethane (EDB), and total lead in 2009 and 2014. MW-1 and MW-3 were not found to have the analytes of concern above their respective MTCA Cleanup Levels. MW-2 had only one sample with an elevated TPH-gasoline level (in 2001). MW-4 consistently had TPH-gasoline and varying levels of BTEX above MTCA Cleanup Levels through 2007. In 2001, MW-5 had elevated TPH-gasoline levels and in 2005 showed elevated benzene levels. Since the end of 2007, no samples from any of the five wells have contained contamination above the MTCA Cleanup Levels.

May 2002: IT Corporation conducted an additional subsurface assessment, which included advancing three soil boreholes to roughly 25 feet bgs. Nine soil samples and one grab groundwater sample were collected for analysis. Only one of the soil samples collected demonstrated TPH-gasoline, benzene, ethyl benzene, and xylenes above the MTCA Cleanup Levels.

August 2009: Santec Consulting Services, Inc. from Bellevue, WA advanced eight boreholes (SB 1-8) to depths between 16 and 32 feet bgs. Twenty-three unique soil samples were field screened for contamination and analyzed for TPH-gasoline and BTEX. Two of these samples were additionally tested for MtBE, EDB, and EDC. Results showed that three boreholes had contained soil contaminated with TPH-gasoline, benzene, and/or xylenes above their respective MTCA Cleanup Levels at around 15 feet bgs. Seven unique groundwater samples were also collected and tested for TPH-gasoline and BTEX. Two of these samples were also tested for MtBE, EDB, EDC, and total lead. Two of these groundwater samples demonstrated contamination with xylene and TPH-gasoline above their respective MTCA Cleanup Levels.

September & October 2014: Santec Consulting Services, Inc. oversaw the removal and site remediation of the UST system which included the three USTs, dispensers, associated piping, concrete dispenser island, canopy, and vent risers. MW-1 and 4 were abandoned by Environmental Services Network Northwest (Olympia, WA) in preparation for UST removal due to their proximity to anticipated excavation boundaries. Saybr Construction, Inc. (Tacoma, WA) rendered the USTs inert and then pumped and triple rinsed them (1,200 gallons of rinsate water and 100 gallons of sludge was removed by Marine Vacuum, Inc. of Seattle, WA). Santec inspected the USTs and product line and they appeared to be in good condition with no apparent failures. These USTs were then crushed and transferred off site for disposal.

During this excavation, visual observations, headspace analysis for volatile organic compounds using a photoionization detector, and soil samples were analyzed to identify the presence of any contaminated soils onsite. Soil samples were collected from beneath each UST, the dispenser island, and product lines. Contamination was identified at about 15 feet bgs under the dispenser island, the USTs, and west of the facility. This contamination extended to a depth of 26 feet bgs and extended roughly 80 feet by 40 feet horizontally. Additional samples were collected from the excavation's final limits using an approximate 10 foot by 10 foot horizontal grid. A total of 48 soil samples were collected throughout this process, and were submitted for analysis of TPH-gasoline (NWTPH-Gx), BTEX (EPA Method 8260C), and total lead (EPA Method 6020). A few samples exhibiting the highest PID readings were submitted for additional analysis of EDB, EDC, and MtBE (EPA Method 8260C), naphthalene (EPA Method 8270 SIM), and volatile petroleum hydrocarbons (EPA Method NWVPH). Groundwater was encountered at 25 feet bgs along with additional perched water at 16 feet bgs above the lens of silty sand in the area just west of the USTs.

The excavation was expanded until a utility corridor was encountered, clean excavation limits were reached, or other safety concerns prevented further expansion. Sample analysis results at the final limits of the excavation indicated that

presence of TPH-gasoline contaminated soils remains on the north, west, and south walls of the excavation (see chart below).

Contaminated Confirmation Samples Not Removed from Site:								
Sample Name	Depth (feet bgs)	Date Sampled	Benzene (mg/kg)	Toluene (mg/kg)	Ethyl Benzene (mg/kg)	Total Xylenes (mg/kg)	TPH-gasoline (mg/kg)	Total Lead (mg/kg)
NORTH WALL @ 16'	16	10/15/14	<0.02	<0.05	<0.05	<0.15	63	<5.0
SOUTH WALL @ 18'	18	10/15/14	<0.02	<0.05	0.09	1.8	280	<5.0
CSS-6 @ 18'	18	10/16/14	<0.0104	<0.0104	0.0452	0.3304	84.2	1.80
CSS-3 @ 15'	15	10/10/14	<0.0141	<0.0141	0.146	0.660	86.9	2.13
SB-3 @ 16'	16	10/16/14	<0.0112	<0.0112	0.451	4.02	756	2.04
MTCA Method A Cleanup Level:			0.03	7	6	9	30	250

A total of 1,393 tons of PCS was removed from the site during remedial activities and disposed of at Allied Waste Landfill in Roosevelt, WA (236 tons) and the Cowlitz County Landfill in Castle Rock, WA (1,157 tons). The site was backfilled with clean overburden and imported fill by the end of October 2014. The area is currently paved and used for parking.

Santec summarized their belief that the source of contamination was the release near the dispenser island, reported in 1995. They also stated that a future Cleanup Action Report would include MTCA Method B Cleanup Limits for TPH-gasoline and a submitted requested for a NFA determination.

CONCLUSION:

This commercial 7-Eleven retail site contained three gasoline 12,000-gallon fiberglass USTs from 1984 until 2014 when they were decommissioned. In 1995 onsite sampling first confirmed that contamination existed in soils related to these USTs onsite. This contamination prompted numerous other studies, in which both soil and groundwater samples were collected and analyzed indicating TPH-gasoline and BTEX contamination was present on site above MTCA Cleanup Levels.

The decommissioning of these USTs included a remediation project that involved removing 1,393 tons of petroleum contaminated soils from the site. However, due to safety concerns and the location of a utility corridor, five soil samples from the final limits of the excavation indicated that contamination of TPH-gasoline remained on site on the north, south, and west excavation side walls. Therefore, soil contamination has not been fully delineated laterally at this site.

Five monitoring wells have been installed on site since the late 1990's and early 2000's. Of these five, three have shown contamination of groundwater from TPH-gasoline and/or BTEX concentrations above their respective MTCA Cleanup Levels. However, since 2007, no groundwater contamination has been reported in any monitoring well.

Santec states that they plan to submit a future cleanup action report that will include a site closure argument based on site-specific method B cleanup limits for TPH-gasoline.

SPECIAL CONSIDERATIONS:

Due to the contamination documented on-site being primarily subsurface, the surface water and air routes are not applicable for WARM scoring for this site.

ROUTE SCORES:

Surface Water/Human Health:	<u>NS</u>	Surface Water/Environmental:	<u>NS</u>
Air/Human Health:	<u>NS</u>	Air/Environmental:	<u>NS</u>
Groundwater/Human Health:	<u>38.5</u> → 3		
Overall Rank:	3		

WORKSHEET 2
Route Documentation

1. SURFACE WATER ROUTE – NOT SCORED

- a. List those substances to be considered for scoring: Source:

- b. Explain basis for choice of substance(s) to be used in scoring.

- c. List those management units to be considered for scoring: Source:

- d. Explain basis for choice of unit to be used in scoring:

2. AIR ROUTE – NOT SCORED

- a. List those substances to be considered for scoring: Source:

- b. Explain basis for choice of substance(s) to be used in scoring:

- c. List those management units to be considered for scoring: Source:

- d. Explain basis for choice of unit to be used in scoring:

3. GROUNDWATER ROUTE

- a. List those substances to be considered for scoring: Sources: 1, 2, 8
TPH-gasoline remains above MTCA Cleanup Levels in soils at this site.

- b. Explain basis for choice of substance(s) to be used in scoring:
TPH-Gasoline is currently the only chemical of concern.

- c. List those management units to be considered for scoring: Source: 1, 2, 8
UST storage, soil contamination, and groundwater contamination.

- d. Explain basis for choice of unit to be used in scoring:
Soil and groundwater contamination have been confirmed on this site in correlation to USTs kept on site.

WORKSHEET 6
Groundwater Route

1.0 SUBSTANCE CHARACTERISTICS

1.2 HUMAN TOXICITY

Substance		Drinking Water Standard (µg/L)	Value	Acute Toxicity (mg/ kg-bw)	Value	Chronic Toxicity (mg/kg/day)	Value	Carcinogenicity		Value
								WOE	PF*	
1	TPH-gasoline	5	8	3306 (rat)	3	ND	--	A	0.029 *1.0= 0.029	5

* Potency Factor, ND-No Data

Source: 1, 2, 8
Highest Value: 8
(Max = 10)
Plus 2 Bonus Points? No
Final Toxicity Value: 8
(Max = 12)

1.2 MOBILITY (USE NUMBERS TO REFER TO ABOVE LISTED SUBSTANCES)

Cations/Anions [Coefficient of Aqueous Migration (K)]	Solubility (mg/L)
1=	1= 1000 = 3 (TPH-gasoline)

Source: 1, 2, 8
Value: 3
(Max = 3)

1.1 SUBSTANCE QUANTITY (VOLUME):

Explain basis: Three 12,000 gallon USTs were stored onsite = 36,000 gallons.	Source: 1, 2, 8 Value: 6 (Max=10)
---	--

1.0 MIGRATION POTENTIAL

		Source	Value
2.1	Containment (explain basis): Landfill: no liner (3), cover (0), no leachate collection system (2), potential historic disposal of free liquids (1)	2, 8	6 (Max = 10)
2.2	Net precipitation: (November through April average total precipitation) – (November through April average evapotranspiration rate) = 38.58” – 5.33” = 33.25”	2, 3	4 (Max = 5)
2.3	Subsurface hydraulic conductivity: Gravelly sand overlaying gravel with a foot wide silty layer that is approximately 15 to 16 feet bgs	2, 8	3 (Max = 4)
2.4	Vertical depth to groundwater: The shallowest groundwater has been recorded at 21 feet bgs.	2, 8, 15	8 (Max = 8)

2.0 TARGETS

		Source	Value
3.1	Groundwater usage: Private supply, but alternate sources available with minimum hookup requirements.	2, 5, 8	4 (Max = 10)
3.2	Distance to nearest drinking water well: 410 feet NW (DOE Well Log)	2, 6, 7	5 (Max = 5)
3.3	Population served within 2 miles: $\sqrt{\text{population} = 630 \text{ private wells} * 3 \text{ people/private well} + 128,677 \text{ people served on public wells (which includes the Lacey Water Department and the City of Olympia Hoffman Well\#3)}} > 10,000 = 100$	2, 6, 7	100 (Max = 100)
3.4	Area irrigated by (groundwater) wells within 2 miles: $0.75\sqrt{(1,029 \text{ acres irrigated})} = 24$	2, 6, 7	24 (Max = 50)

3.0 RELEASE

		Source	Value
	Explain basis for scoring a release to groundwater: No groundwater contamination has been detected on site for the past 7 years.	2, 8, 15	0 (Max = 5)

SOURCES USED IN SCORING

1. Washington Department of Ecology, *Toxicology Database for Use in Washington Ranking Method Scoring*, January 1992.
2. Washington Department of Ecology, *WARM Scoring Manual*, April 1992.
3. Western Regional Climate Center, *Precipitation data from the Olympia, Washington Airport, June 1948 to September 2005*.
4. Thurston County Environmental Monitoring, Thurston County Courthouse West Olympia, *All data from 2009-2014*, December 2014.
5. Thurston County Geodata Center, Roads and Transportation Division, October 2013.
6. Washington State Department of Health, Drinking Water Division, *Sentry Database*, November 2012.
7. Washington Department of Ecology, Water Resources Program, *Water Right Tracking System (WRTS)*, October 2012.
8. Stantec Consulting Services Inc, *UST System Removal Report 7-Eleven Store No. 25983 3541 Martin Way, Olympia, WA* January 6, 2015
9. Washington State Department of Ecology *Re: Further Action at the following Site: Site Name: 7-Eleven Store #25983 Letter to Mr. Ken Hilliard*, July 8, 2010.
10. Santec Consulting Services *7-Eleven No 25983 Groundwater Monitoring and Sampling Report 4Q14 to 1Q15*, May 15, 2015
11. Washington State Department of Ecology, *Re: Opinion of Proposed Cleanup of the following Site: Site Name: 7-Eleven Store #25983*, July 23, 2009.
12. Washington State Department of Ecology, *Re: Opinion of Proposed Cleanup of the following Site: Site Name: 7-Eleven Store #25983*, July 23, 2009.
13. IT Corporation, *Remediation Progress and Well Installation Report Second Quarter 2001 7-Eleven, Inc. Store #25983 3541 Martin Way East Olympia, Washington*, May 8, 2010.
14. IT Corporation, *Site Assessment Report 7-Eleven Facility #25983 3541 Martin Way East Olympia, Washington*, February 29, 2000.
15. Santec Consulting Corporation, *Additional Subsurface Investigation Report 7-Eleven Facility No. 25983, 3541 Martin Way East Olympia, Washington*, December 16, 2009.

2 Mile Radius Map

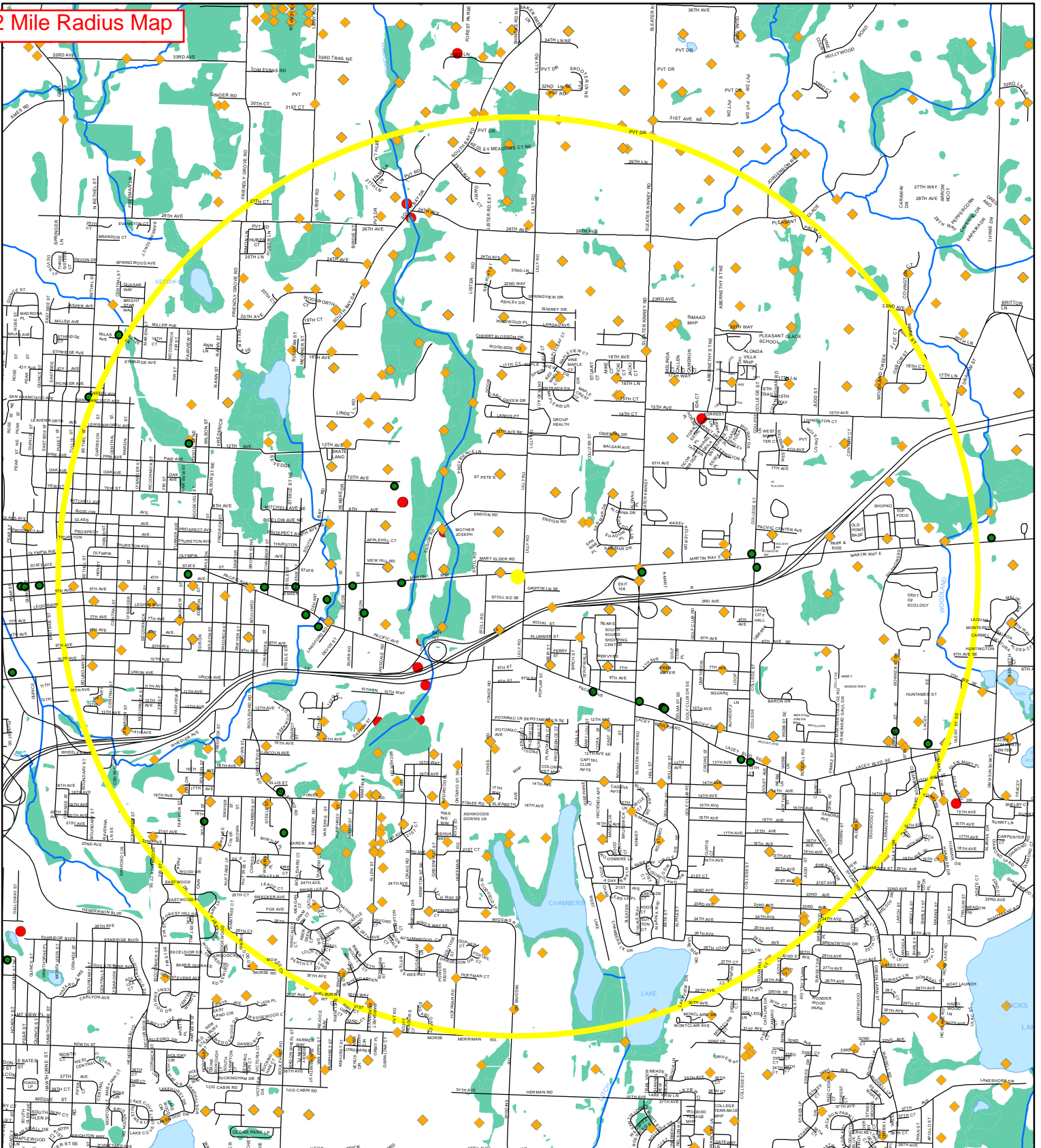

THURSTON COUNTY

7-ELEVEN FOOD STORE 230325983H

Ecology FSID# 5465157

Two Mile Radius Analysis

2010 US Census Population within Radius: 33,150

0 0.25 0.5 1 Miles

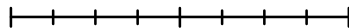

- Site Location
- Radius Boundary
- Wetland
- Sensitive Species & Habitats
- ◆ Well
- ~ Stream
- Roads



Thurston County makes every effort to ensure that this map is a true and accurate representation of the work of County government. However, the County and all related personnel make no warranty, expressed or implied, regarding the accuracy, completeness or convenience of any information disclosed on this map. Nor does the County accept liability for any damage or injury caused by the use of this map.

To the fullest extent permissible pursuant to applicable law, Thurston County disclaims all warranties, express or implied, including, but not limited to, implied warranties of merchantability, data fitness for a particular purpose, and non-infringements of proprietary rights.

Under no circumstances, including, but not limited to, negligence, shall Thurston County be liable for any direct, indirect, incidental, special or consequential damages that result from the use of, or the inability to use, Thurston County materials.

Map Created on 6/15/2015 kah

Half Mile Radius Map

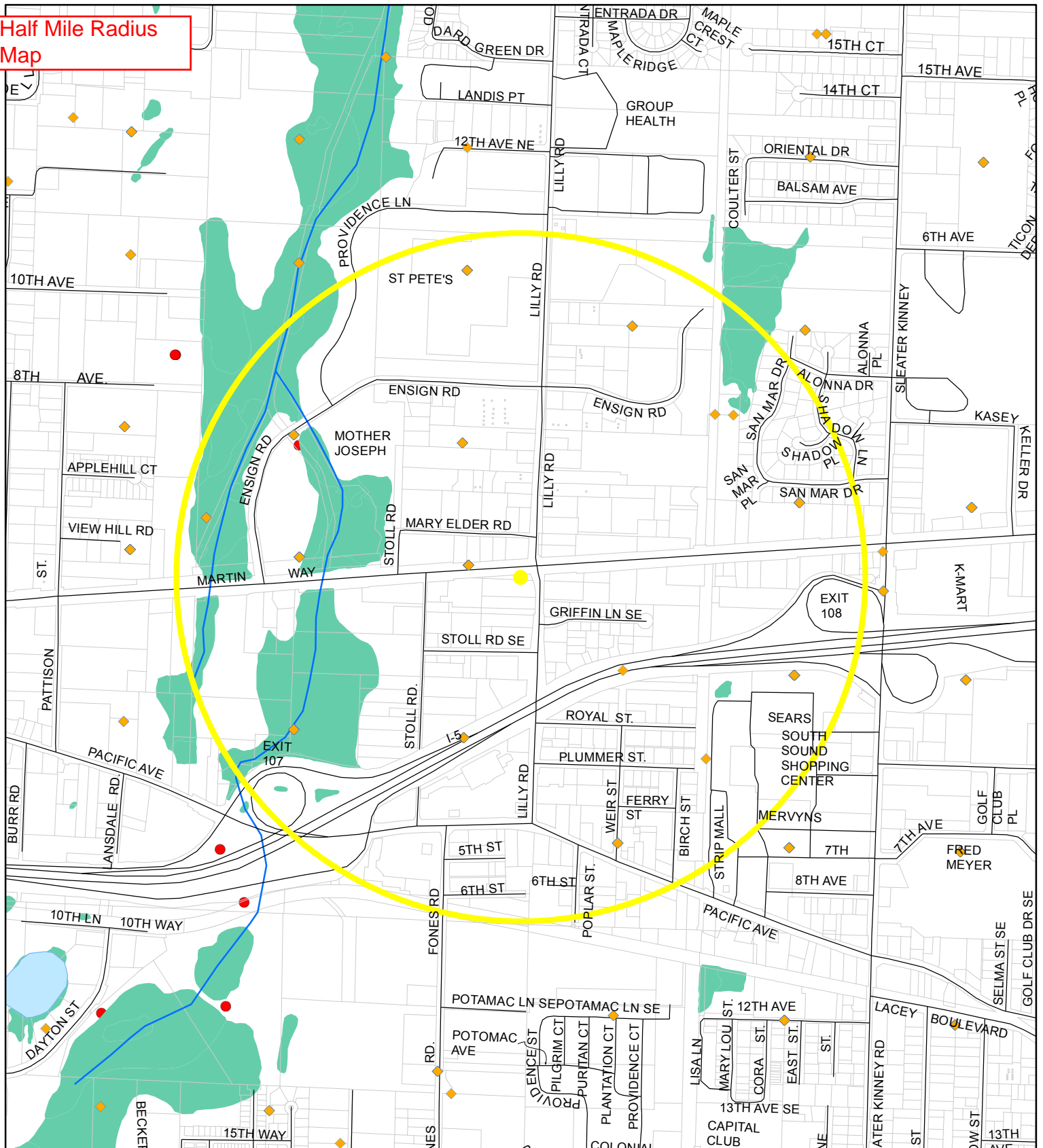

THURSTON COUNTY

7-ELEVEN FOOD STORE 230325983H
Ecology FSID# 5465157
Half Mile Radius Analysis

2010 US Census Population within Radius: 3,400

- Site Location
- Radius Boundary
- Wetland
- Sensitive Species & Habitats
- ◆ Well
- ~ Stream
- Roads

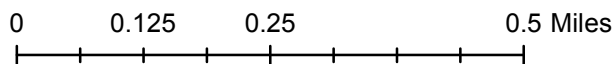

Thurston County makes every effort to ensure that this map is a true and accurate representation of the work of County government. However, the County and all related personnel make no warranty, expressed or implied, regarding the accuracy, completeness or convenience of any information disclosed on this map. Nor does the County accept liability for any damage or injury caused by the use of this map.

To the fullest extent permissible pursuant to applicable law, Thurston County disclaims all warranties, express or implied, including, but not limited to, implied warranties of merchant ability, data fitness for a particular purpose, and non-infringements of proprietary rights.

Under no circumstances, including, but not limited to, negligence, shall Thurston County be liable for any direct, indirect, incidental, special or consequential damages that result from the use of, or the inability to use, Thurston County materials.

Aerial Map

3541 Martin Way E

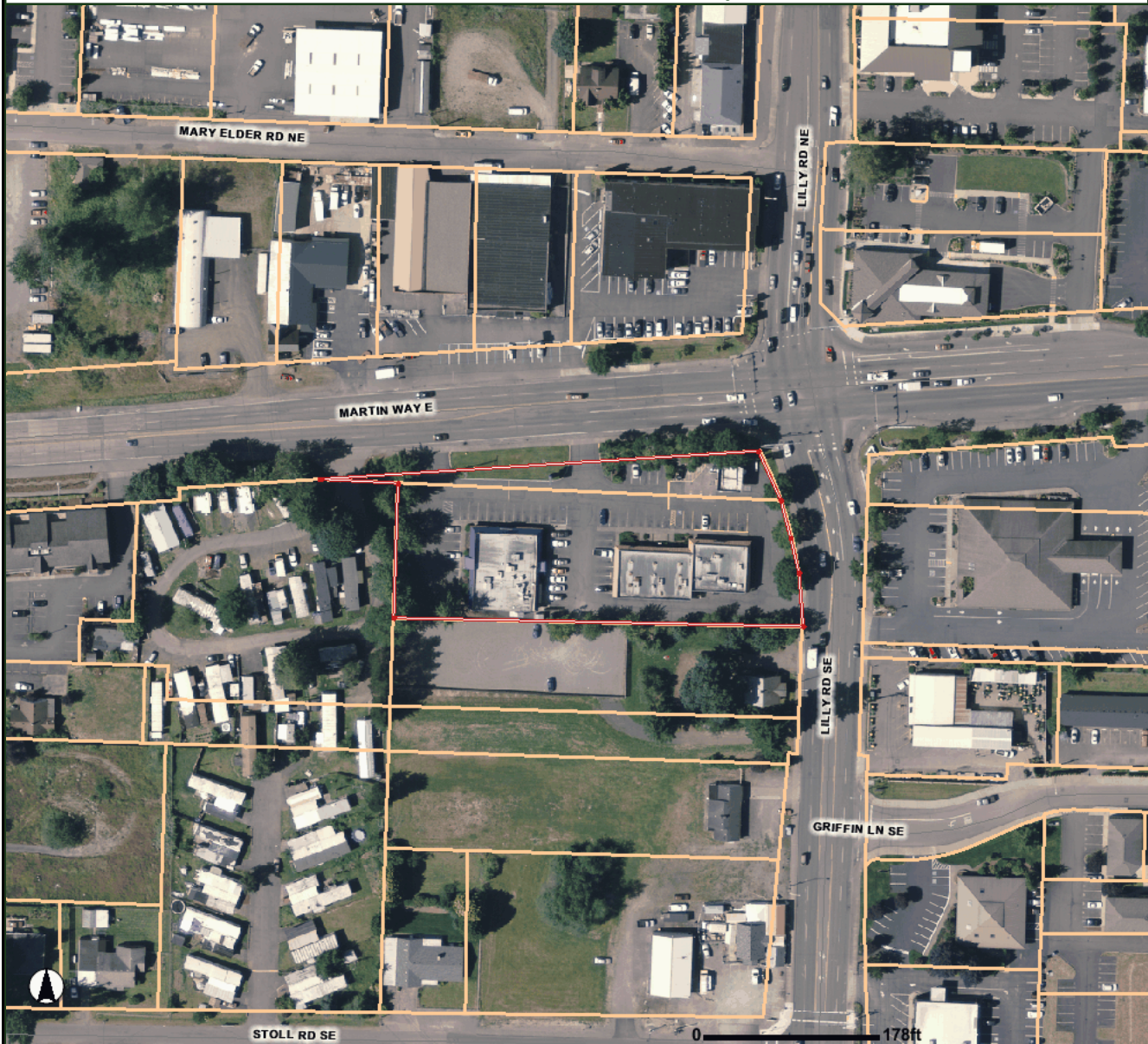

Disclaimer: Thurston County makes every effort to ensure that this map is a true and accurate representation of the work of County government. However, the County and all related personnel make no warranty, expressed or implied, regarding the accuracy, completeness or convenience of any information disclosed on this map. Nor does the County accept liability for any damage or injury caused by the use of this map.

To the fullest extent permissible pursuant to applicable law, Thurston County disclaims all warranties, express or implied, including, but not limited to, implied warranties of merchant ability, data fitness for a particular purpose, and non-infringements of proprietary rights. Under no circumstances, including, but not limited to, negligence, shall Thurston County be liable for any direct, indirect, incidental, special or consequential damages that result from the use of, or the inability to use, Thurston County materials.



© 2015 - Thurston County GeoData Center
 929 Lakeridge Drive SW, Suite 216, 2nd Floor
 Olympia, WA 98502-6031

LEGEND

- | | |
|-----------------|--------------|
| Major Roads | Flood Zones |
| Roads | Water Bodies |
| Streams | Zoning |
| Contours | Cities |
| Wetlands | Parcels |
| Wetland Buffers | |

Site Map

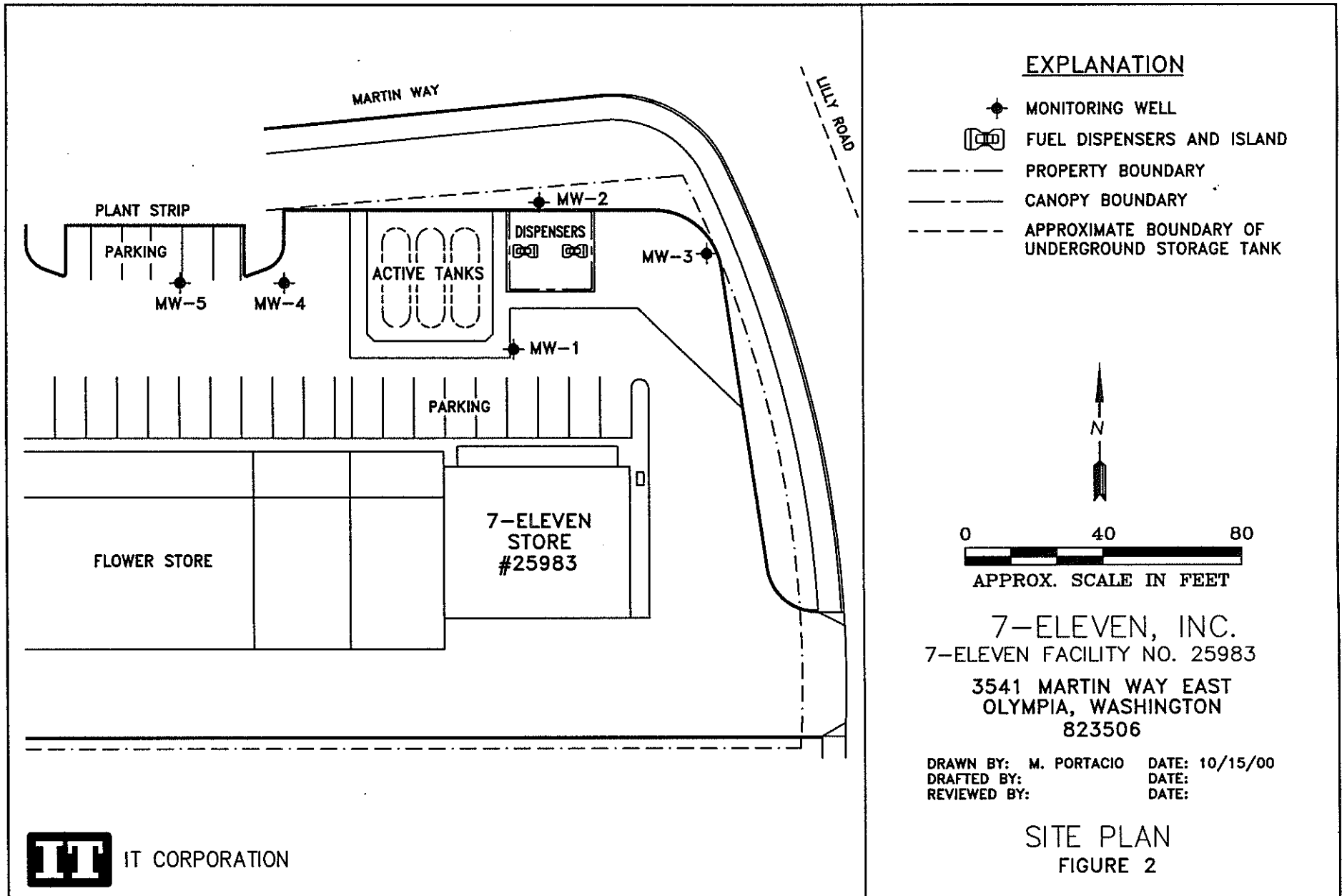

Contaminates Left On Site Map

Typo, actually 0.0182

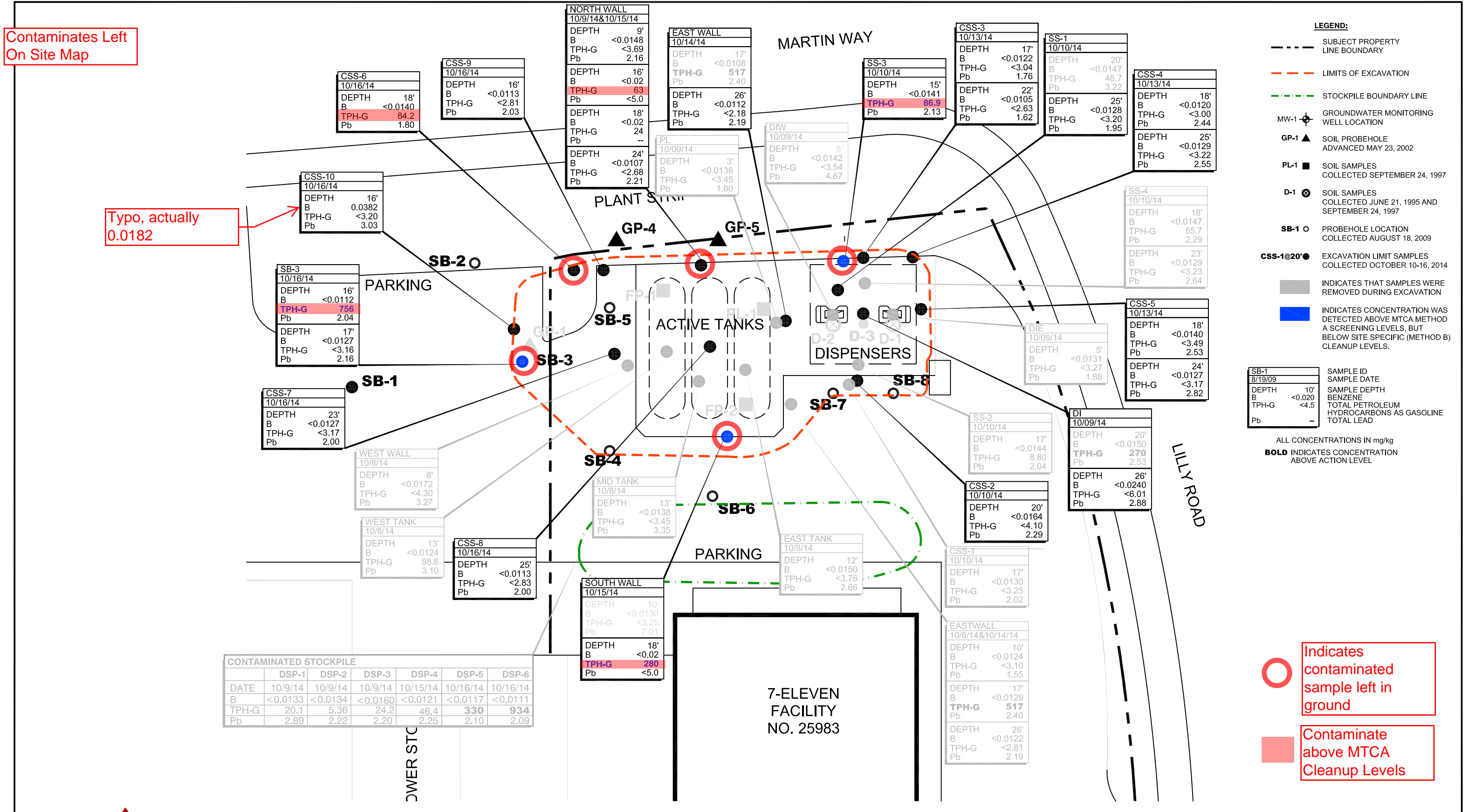

○ Indicates contaminated sample left in ground

■ Contaminate above MTCA Cleanup Levels

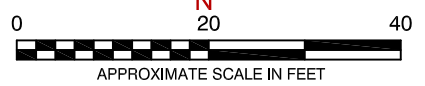

<p>11130 NE 33RD PLACE, SUITE 200 BELLEVUE, WASHINGTON PHONE: (425) 869-9448 FAX: (425) 869-1190</p>	FOR:	<p>STORE NO. 25983 3541 MARTIN WAY EAST OLYMPIA, WASHINGTON</p>	SITE PLAN WITH SOIL ANALYTICAL RESULTS		FIGURE: 3
	JOB NUMBER: 185750263		DRAWN BY: BLG	CHECKED BY: EH	APPROVED BY: PF

Property Layout
after 2014
remediation actions

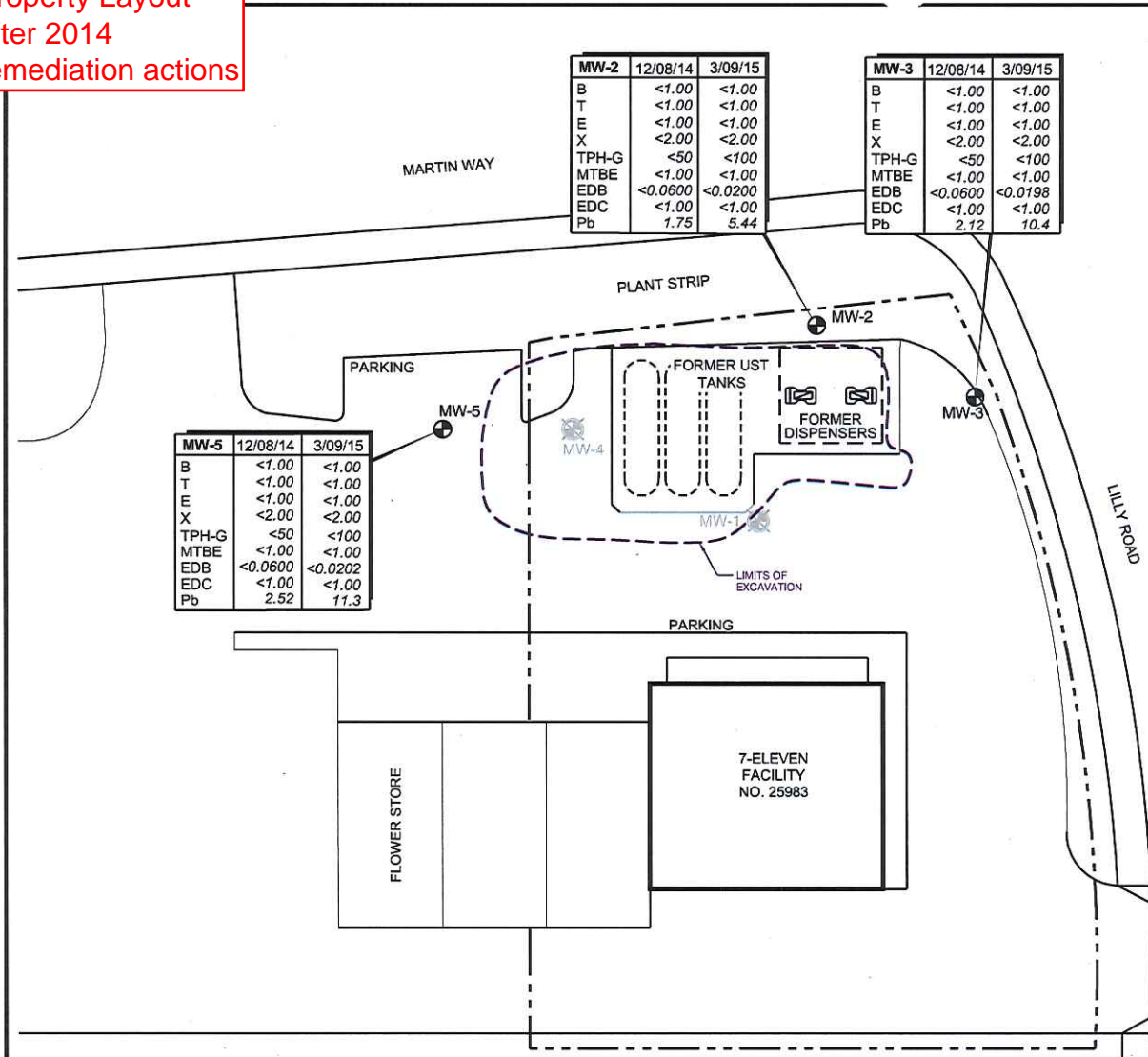

MW-2	12/08/14	3/09/15
B	<1.00	<1.00
T	<1.00	<1.00
E	<1.00	<1.00
X	<2.00	<2.00
TPH-G	<50	<100
MTBE	<1.00	<1.00
EDB	<0.0600	<0.0200
EDC	<1.00	<1.00
Pb	1.75	5.44

MW-3	12/08/14	3/09/15
B	<1.00	<1.00
T	<1.00	<1.00
E	<1.00	<1.00
X	<2.00	<2.00
TPH-G	<50	<100
MTBE	<1.00	<1.00
EDB	<0.0600	<0.0198
EDC	<1.00	<1.00
Pb	2.12	10.4

MW-5	12/08/14	3/09/15
B	<1.00	<1.00
T	<1.00	<1.00
E	<1.00	<1.00
X	<2.00	<2.00
TPH-G	<50	<100
MTBE	<1.00	<1.00
EDB	<0.0600	<0.0202
EDC	<1.00	<1.00
Pb	2.52	11.3

- LEGEND:**
- SUBJECT PROPERTY LINE BOUNDARY
 - MW-1 GROUNDWATER MONITORING WELL LOCATION
 - MW-4 MONITORING WELL ABANDONED (DESTROYED IN PLACE SEPTEMBER 23, 2014)

SAMPLE ID	SAMPLE DATE		ANALYTES	μg/L
	12/08/14	3/09/15		
B	<1.00	<1.00		
T	<1.00	<1.00		
E	<1.00	<1.00		
X	<2.00	<2.00		
TPH-G	<50	<100		
MTBE	<1.00	<1.00		
EDB	<0.0600	<0.0202		
EDC	<1.00	<1.00		
Pb	2.52	11.3		

< NOT DETECTED AT OR ABOVE THE LABORATORY REPORTING LIMIT MICROGRAMS PER LITER

BOLD VALUES EXCEED MTCA METHOD A CLEANUP LEVELS

- ANALYTES:**
- B BENZENE
 - T TOLUENE
 - E ETHYLBENZENE
 - X TOTAL XYLENES
 - TPH-G TOTAL PETROLEUM HYDROCARBONS AS GASOLINE
 - MTBE METHYL TERTIARY BUTYL ETHER
 - EDB 1,2-DIBROMOETHANE
 - EDC 1,2-DICHLOROETHANE
 - Pb TOTAL LEAD IN WATER

No warranty is made by Stantec as to the accuracy, reliability, or completeness of these data. Original data were compiled from various sources. This information may not meet National Map Accuracy Standards. This product was developed electronically, and may be updated without notification. Any reproduction may result in a loss of scale and or information.

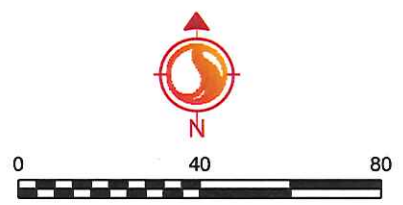

<p>11130 NE 33RD PLACE, SUITE 200 BELLEVUE, WASHINGTON PHONE: (425) 869-9448 FAX: (425) 869-1190</p>	FOR: STORE NO. 25983 3541 MARTIN WAY EAST OLYMPIA, WASHINGTON	GROUNDWATER ANALYTICAL RESULTS DECEMBER 8, 2014 AND MARCH 9, 2015		FIGURE: <h1>4</h1>
	JOB NUMBER: 185750040	DRAWN BY: MDR	CHECKED BY: EWB	APPROVED BY: PF

Graph 1 Groundwater Flow Direction Rose Diagram

7-Eleven Store No. 25983
3541 Martin Way East
Olympia, Washington

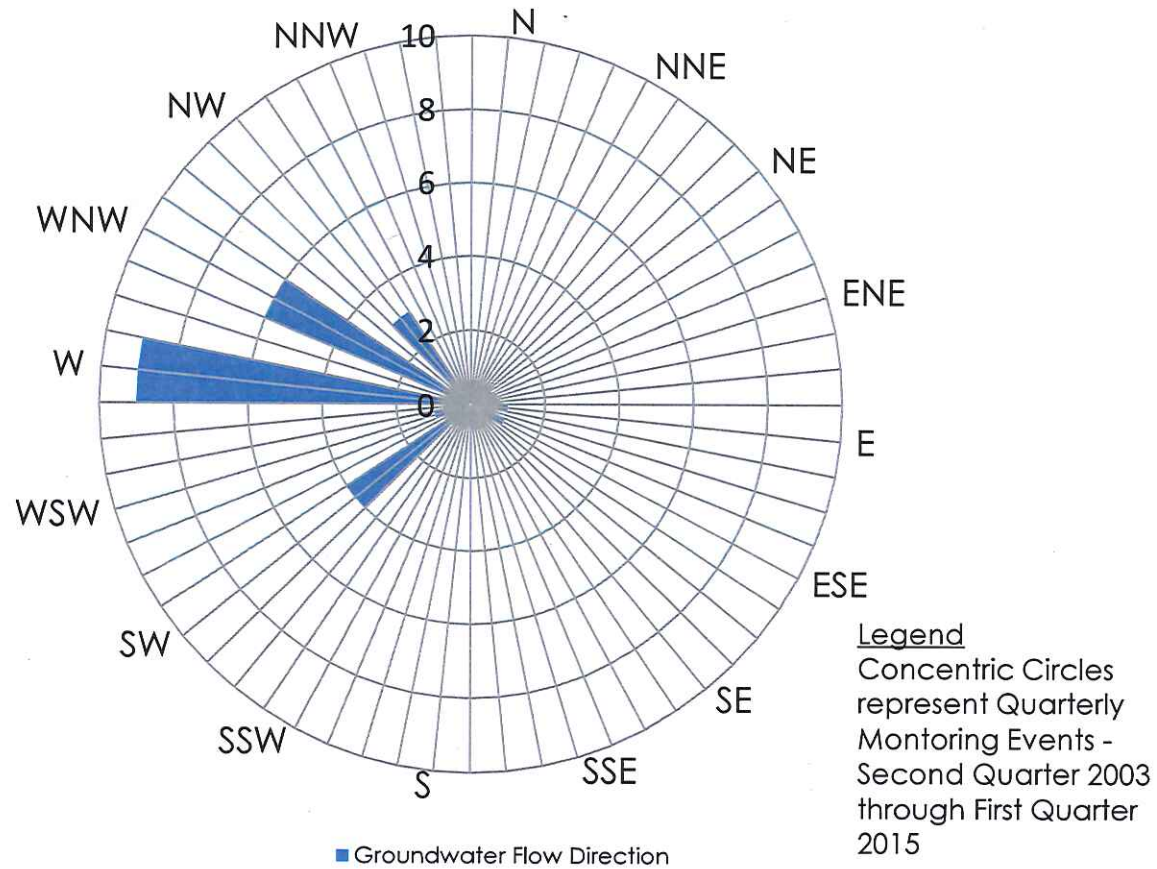

**Monitoring Well-1
groundwater
monitoring**

**TABLE 1
GROUNDWATER MONITORING AND ANALYTICAL RESULTS**

7-Eleven Store No. 25983
3541 Martin Way East, Olympia, Washington
All results in micrograms per liter (µg/L), except where noted.

Well ID (TOC)	Sample Date	MtBE	Benzene	Toluene	Ethyl-benzene	Total Xylenes	TPH-G	EDC	EDB	Total Lead	Depth To Groundwater	Groundwater Elevation (feet)
MW-1	07/08/99	--	--	--	--	--	--	--	--	--	26.00	172.33
198.33	07/15/99	--	<0.3	<0.3	<0.5	<0.6	<100	--	--	<5	26.02	172.31
	03/14/00	--	<0.3	<0.3	<0.5	<0.6	<100	--	--	--	25.38	172.95
	06/27/00	--	<0.5	<0.5	<0.5	<1.0	<100	--	--	--	25.97	172.36
	09/25/00	--	<0.5	2.90	0.56	2.8	100	--	--	--	26.52	171.81
	11/13/00	--	<0.5	<0.5	<0.5	<1.5	<100	--	--	--	26.30	172.03
	02/14/01	--	<0.5	<0.5	0.56 ^a	<1.0	<100	--	--	--	26.09	172.24
	06/07/01	--	<0.5	<0.5	<0.5	<1.0	<100	--	--	--	26.13	172.20
	08/01/01	--	<0.5	<0.5	<0.5	<1.0	<50	--	--	--	26.29	172.04
	11/15/01	--	<0.5	<0.5	<0.5	<1.0	<100	--	--	--	26.36	171.97
	03/25/02	--	<0.5	<1.0	<1.0	<3.0	<100	--	--	--	25.34	172.99
	06/21/02	--	--	--	--	--	--	--	--	--	--	--
	09/23/02	--	<0.5	<1.0	<1.0	1.01	<100	--	--	--	26.20	172.13
	12/10/02	--	--	--	--	--	--	--	--	--	26.37	171.96
	04/02/03	--	<1.0	<1.0	<1.0	<2.0	<100	--	--	--	25.41	172.92
	06/11/03	--	--	--	--	--	--	--	--	--	26.05	172.28
	09/15/03	--	<1.0	<1.0	<1.0	<2.0	<100	--	--	--	27.34	170.99
	12/04/03	--	--	--	--	--	--	--	--	--	25.51	172.82
	03/04/04	--	<1.0	<1.0	<1.0	<2.0	<100	--	--	--	26.64	171.69
	05/10/04	--	--	--	--	--	--	--	--	--	27.02	171.31
	08/11/04	--	<1.0	<1.0	<1.0	<2.0	<100	--	--	--	27.27	171.06
	11/17/04	--	--	--	--	--	--	--	--	--	27.16	171.17
	02/21/05	--	<1.0	<1.0	<1.0	<2.0	<100	--	--	--	26.94	171.39
	05/16/05	--	--	--	--	--	--	--	--	--	28.96	169.37
	08/19/05	--	--	--	--	--	--	--	--	--	27.03	171.30
	10/26/05	--	--	--	--	--	--	--	--	--	27.16	171.17
	01/26/06	--	<1.0	<1.0	<1.0	<2.0	<100	--	--	--	25.79	172.54
	05/11/06	--	<1.0	<1.0	<1.0	<2.0	<100	--	--	--	--	--
	07/26/06	--	--	--	--	--	--	--	--	--	--	--
	11/09/06	--	--	--	--	--	--	--	--	--	24.18	174.15
	04/11/07	--	--	--	--	--	--	--	--	--	25.36	172.97
	08/27/07	--	--	--	--	--	--	--	--	--	26.15	172.18
	02/06/08	--	--	--	--	--	--	--	--	--	26.35	171.98
	08/18/08	--	--	--	--	--	--	--	--	--	25.05	173.28
	11/12/08	--	--	--	--	--	--	--	--	--	24.28	174.05
	02/05/09	--	<1.0	<1.0	<1.0	<2.0	<100	--	--	--	25.56	172.77
	01/12/10	--	<1.0	<1.0	<1.0	<2.0	<100	--	--	--	25.30	173.03
	02/14/11	--	<0.5	<0.5	<0.5	<0.5	<250	--	--	--	25.48	172.85
	02/09/12	--	<0.50	<0.50	<0.50	<0.50	<250	--	--	--	25.23	173.10
	01/18/13	--	<0.50	<0.50	<0.50	<0.50	<250	--	--	--	24.51	173.82
	04/08/14	<1.00	<1.00	<1.00	<1.00	<2.00	<50.0	<1.00	<0.00922	1.77	25.25	173.08
	09/23/14	<1.00	<1.00	<1.00	<1.00	<2.00	<50.0	--	--	--	26.14	172.19
Well Abandoned 9/23/14												
MTCA Method A Cleanup Level		20	5	1,000	700	1,000	800/1,000 ^b	5	0.01	15		

**Monitoring Well-2
groundwater
monitoring**

**TABLE 1
GROUNDWATER MONITORING AND ANALYTICAL RESULTS**
7-Eleven Store No. 25983
3541 Martin Way East, Olympia, Washington
All results in micrograms per liter (µg/L), except where noted.

Well ID (TOC)	Sample Date	MtBE	Benzene	Toluene	Ethyl-benzene	Total Xylenes	TPH-G	EDC	EDB	Total Lead	Depth To Groundwater	Groundwater Elevation (feet)
MW-2	07/08/99	--	--	--	--	--	--	--	--	--	25.89	172.42
198.31	07/15/99	--	<0.3	<0.3	<0.5	44	725	--	--	<5	26.00	172.31
	03/14/00	--	<0.3	<0.3	0.78	1.12	104	--	--	--	25.34	172.97
	06/27/00	--	<0.5	<0.5	<0.5	<1.0	<100	--	--	--	25.94	172.37
	09/25/00	--	<0.5	2.70	0.58	2.3	<100	--	--	--	26.33	171.98
	11/13/00	--	<0.5	<0.5	<0.5	2.2	<100	--	--	--	26.32	171.99
	02/14/01	--	<0.5	<0.5	0.58 ^a	<1.0	<100	--	--	--	26.33	171.98
	06/07/01	--	<0.5	<0.5	<0.5	<1.0	<100	--	--	--	26.21	172.10
	08/01/01	--	<0.5	<0.5	<0.5	<1.0	<50	--	--	--	26.37	171.94
	11/15/01	--	<0.5	5.7 ^a	12 ^a	43 ^a	1,900	--	--	--	26.50	171.81
	03/25/02	--	<0.5	<1.0	<1.0	1.66	<100	--	--	--	25.29	173.02
	06/21/02	--	--	--	--	--	--	--	--	--	--	--
	09/23/02	--	0.317	<1.0	<1.0	1.01	<100	--	--	--	26.25	172.06
	12/10/02	--	--	--	--	--	--	--	--	--	26.41	171.90
	04/02/03	--	<1.0	<1.0	<1.0	<2.0	<100	--	--	--	25.40	172.91
	06/11/03	--	--	--	--	--	--	--	--	--	26.05	172.26
	09/15/03	--	<1.0	<1.0	<1.0	<1.0	<100	--	--	--	27.40	170.91
	12/04/03	--	--	--	--	--	--	--	--	--	25.51	172.80
	03/04/04	--	<1.0	<1.0	<1.0	<2.0	<100	--	--	--	26.64	171.67
	05/10/04	--	--	--	--	--	--	--	--	--	27.05	171.26
	08/11/04	--	<1.0	<1.0	<1.0	<2.0	<100	--	--	--	27.34	170.97
	11/17/04	--	--	--	--	--	--	--	--	--	27.23	171.08
	02/21/05	--	<1.0	<1.0	<1.0	<2.0	<100	--	--	--	26.95	171.36
	05/17/05	--	--	--	--	--	--	--	--	--	29.21	169.10
	08/19/05	--	--	--	--	--	--	--	--	--	28.91	169.40
	10/26/05	--	--	--	--	--	--	--	--	--	29.68	168.63
	01/26/06	--	<1.0	<1.0	<1.0	<2.0	<100	--	--	--	25.72	172.59
	05/11/06	--	--	--	--	--	--	--	--	--	25.90	172.41
	07/26/06	--	--	--	--	--	--	--	--	--	--	--
	11/09/06	--	--	--	--	--	--	--	--	--	22.96	175.35
	04/11/07	--	--	--	--	--	--	--	--	--	23.35	174.96
	08/27/07	--	--	--	--	--	--	--	--	--	26.22	172.09
	02/06/08	--	--	--	--	--	--	--	--	--	26.38	171.93
	08/18/08	--	--	--	--	--	--	--	--	--	25.12	173.19
	11/12/08	--	--	--	--	--	--	--	--	--	23.06	175.25
	02/05/09	--	<1.0	<1.0	<1.0	<2.0	<100	--	--	--	24.98	173.33
	01/12/10	--	<1.0	<1.0	<1.0	<2.0	<100	--	--	--	25.23	173.08
	02/14/11	--	<0.5	<0.5	<0.5	<0.5	<250	--	--	--	25.45	172.86
	02/09/12	--	<0.50	<0.50	<0.50	<0.50	<250	--	--	--	25.18	173.13
	01/18/13	--	<0.50	<0.50	<0.50	<0.50	<250	--	--	--	25.13	173.18
	04/08/14	<1.00	<1.00	<1.00	<1.00	<2.00	<50.0	<1.00	<0.00932	13.2	25.25	173.06
	09/23/14	<1.00	<1.00	<1.00	<1.00	<2.00	<50.0	--	--	--	26.18	172.13
	12/08/14	<1.00	<1.00	<1.00	<1.00	<2.00	<50.0	<1.00	<0.0600	1.75	25.54	172.77
	03/09/15	<1.00	<1.00	<1.00	<1.00	<2.00	<100	<1.00	<0.0200	5.44	25.49	172.82
MTCA Method A Cleanup Level		20	5	1,000	700	1,000	800/1,000^b	5	0.01	15		

**Monitoring Well-3
groundwater
monitoring**

**TABLE 1
GROUNDWATER MONITORING AND ANALYTICAL RESULTS**
7-Eleven Store No. 25983
3541 Martin Way East, Olympia, Washington
All results in micrograms per liter (µg/L), except where noted.

Well ID (TOC)	Sample Date	MtBE	Benzene	Toluene	Ethyl-benzene	Total Xylenes	TPH-G	EDC	EDB	Total Lead	Depth To Groundwater	Groundwater Elevation (feet)	
MW-3	07/08/99	--	--	--	--	--	--	--	--	--	25.60	172.59	
198.19	07/15/99	--	<0.3	<0.3	<0.5	<0.6	<100	--	--	<5	26.10	172.09	
	03/14/00	--	<0.3	<0.3	<0.5	<0.6	<100	--	--	--	24.89	173.30	
	06/27/00	--	<0.5	<0.5	<0.5	<1.0	<100	--	--	--	25.56	172.63	
	09/25/00	--	<0.5	2.10	<0.5	1.7	<100	--	--	--	25.98	172.21	
	11/13/00	--	<0.5	<0.5	<0.5	<1.5	<100	--	--	--	25.94	172.25	
	02/14/01	--	<0.5	<0.5	<0.57 ^a	<1.0	<100	--	--	--	26.15	172.04	
	06/07/01	--	<0.5	<0.5	<0.5	<1.0	<100	--	--	--	25.87	172.32	
	08/01/01	--	<0.5	<0.5	<0.5	<1.0	<50	--	--	--	26.01	172.18	
	11/15/01	--	<0.5	<0.5	<0.5	<1.0	<100	--	--	--	26.20	171.99	
	03/25/02	--	<0.5	<1.0	<1.0	<3.0	<100	--	--	--	23.89	174.30	
	06/21/02	--	<0.5	<1.0	<1.0	<3.0	<100	--	--	--	25.59	172.60	
	09/23/02	--	0.299	<1.0	<1.0	<1.0	<100	--	--	--	25.88	172.31	
	12/10/02	--	<0.5	<1.0	<1.0	<3.0	<100	--	--	--	26.00	172.19	
	04/02/03	--	<1.0	<1.0	<1.0	<2.0	<100	--	--	--	25.98	172.21	
	06/11/03	--	<1.0	<1.0	<1.0	<2.0	<100	--	--	--	25.68	172.51	
	09/15/03	--	<1.0	<1.0	<1.0	<2.0	<100	--	--	--	27.05	171.14	
	12/04/03	--	--	--	--	--	--	--	--	--	25.09	173.10	
	03/04/04	--	<1.0	<1.0	<1.0	<2.0	<100	--	--	--	26.23	171.96	
	05/10/04	--	--	--	--	--	--	--	--	--	26.68	171.51	
	08/11/04	--	<1.0	<1.0	<1.0	<2.0	<100	--	--	--	26.97	171.22	
	11/17/04	--	--	--	--	--	--	--	--	--	26.84	171.35	
	02/21/05	--	<1.0	<1.0	<1.0	<2.0	<100	--	--	--	26.61	171.58	
	05/17/05	--	--	--	--	--	--	--	--	--	28.46	169.73	
	08/19/05	--	--	--	--	--	--	--	--	--	27.68	170.51	
	10/26/05	--	--	--	--	--	--	--	--	--	24.68	173.51	
	01/26/06	--	<1.0	<1.0	<1.0	<2.0	<100	--	--	--	25.27	172.92	
	05/11/06	--	--	--	--	--	--	--	--	--	25.40	172.79	
	07/26/06	--	--	--	--	--	--	--	--	--	--	--	
	11/09/06	--	--	--	--	--	--	--	--	--	21.14	177.05	
	04/11/07	--	--	--	--	--	--	--	--	--	24.92	173.27	
	08/27/07	--	--	--	--	--	--	--	--	--	25.83	172.36	
	02/06/08	--	--	--	--	--	--	--	--	--	--	--	
	08/18/08	--	--	--	--	--	--	--	--	--	24.73	173.46	
	02/05/09	--	<1.0	<1.0	<1.0	<2.0	<100	--	--	--	25.14	173.05	
	01/12/10	Unable to access well										--	--
	02/14/11	Unable to access well										--	--
	02/09/12	Unable to access well										--	--
	01/18/13	Unable to access well										--	--
	04/08/14	<1.00	<1.00	<1.00	<1.00	<2.00	<50.0	<1.00	<0.00969	6.10	--	--	
	09/23/14	<1.00	<1.00	<1.00	<1.00	<2.00	<50.0	--	--	--	25.81	172.38	
	12/08/14	<1.00	<1.00	<1.00	<1.00	<2.00	<50.0	<1.00	<0.0600	2.12	25.15	173.04	
	03/09/15	<1.00	<1.00	<1.00	<1.00	<2.00	<100	<1.00	<0.0198	10.4	25.11	173.08	
MTCA Method A Cleanup Level		20	5	1,000	700	1,000	800/1,000^b	5	0.01	15			

**Monitoring Well-4
groundwater
monitoring**

**TABLE 1
GROUNDWATER MONITORING AND ANALYTICAL RESULTS**

7-Eleven Store No. 25983

3541 Martin Way East, Olympia, Washington

All results in micrograms per liter (µg/L), except where noted.

Well ID (TOC)	Sample Date	MtBE	Benzene	Toluene	Ethyl-benzene	Total Xylenes	TPH-G	EDC	EDB	Total Lead	Depth To Groundwater	Groundwater Elevation (feet)
MW-4	07/08/99	--	--	--	--	--	--	--	--	--	26.12	172.43
198.55	07/15/99	--	<30	5,150	<50	23,900	90,800	--	--	<5	26.10	172.45
	03/14/00	--	<30	1,870	3,030	27,500	67,000	--	--	--	25.41	173.14
	06/27/00	--	100	2,500	3,400	27,000	91,000	--	--	--	26.81	171.74
	09/25/00	--	10,000	4,800	4,200	4,200	68,000	--	--	--	26.70	171.85
	11/13/00	--	<120	780	1,800	17,000	70,000	--	--	--	26.77	171.78
	02/14/01	--	<120	660	1,300 ^a	21,000	99,000	--	--	--	25.74	172.81
	06/07/01	--	<25	97	360	4,800	23,000	--	--	--	26.34	172.21
	08/01/01	--	20.5	329	300	12,100	39,900	--	--	--	26.53	172.02
	11/15/01	--	<10	97 ^a	350 ^a	4,700 ^a	30,000	--	--	--	27.37	171.18
	03/25/02	--	1.7	74.8	143	1,489	34,100	--	--	--	25.45	173.10
	06/21/02	--	<0.5	5.28	349	1,867	22,600	--	--	--	26.54	172.01
	09/25/02	--	1.0	7.97	77.3	438	6,090	--	--	--	26.65	171.90
	12/10/02	--	<5.0	7.38	225.0	1,788	14,500	--	--	--	26.67	171.88
	04/02/03	--	7.7	7.9	350	1,950	30,000	--	--	--	26.44	172.11
	06/11/03	--	5.9	6.5	160	580	7,600	--	--	--	26.54	172.01
	09/15/03	--	<5.0	<5.0	76.0	460	5,800	--	--	--	27.67	170.88
	12/04/03	--	4.9	2.1	140	332	5,200	--	--	--	26.41	172.14
	03/04/04	--	4.5	3.2	75	259	3,800	--	--	--	27.11	171.44
	05/10/04	--	1.6	<1.0	24	100	2,300	--	--	--	27.65	170.90
	08/11/04	--	1.7	<1.0	10	38	1,100	--	--	--	27.76	170.79
	11/17/04	--	5.3	15	580	4,500	43,000	--	--	--	27.12	171.43
	02/21/05	--	3.8	1.8	93	630	16,000	--	--	--	27.61	170.94
	05/17/05	--	2.2	<1.0	49	190	6,600	--	--	--	27.51	171.04
	08/19/05	--	1,100	580	1,600	5,330	30,000	--	--	--	29.99	168.56
	10/26/05	--	<1.0	<1.0	<1.0	<2.0	<100	--	--	--	26.10	172.45
	01/26/06	--	1.9	<1.0	120	139	3,400	--	--	--	26.65	171.90
	05/11/06	--	<1.0	<1.0	75	37	2,400	--	--	--	27.40	171.15
	07/26/06	--	350	2,900	750	2,740	24,000	--	--	--	28.56	169.99
	11/09/06	--	170	<4.0	91	55	3,300	--	--	--	26.68	171.87
	04/11/07	--	<4.0	<4.0	59	50	3,100	--	--	--	26.11	172.44
	08/27/07	--	<1.0	<1.0	<1.0	<2.0	<100	--	--	--	27.05	171.50
	02/06/08	--	<1.0	<1.0	6.9	<2.0	160	--	--	--	26.28	172.27
	08/18/08	--	<1.0	<1.0	<1.0	<2.0	<100	--	--	--	26.95	171.60
	11/12/08	--	<1.0	<1.0	<1.0	<2.0	<100	--	--	--	26.78	171.77
	02/05/09	<0.20	<1.0	<1.0	<1.0	<2.0	<100	<0.20	<0.0095	--	26.28	172.27
	01/12/10	--	<1.0	<1.0	<1.0	<2.0	<100	--	--	--	24.95	173.60
	02/14/11	--	<0.5	<0.5	<0.5	<0.5	<250	--	--	--	26.13	172.42
	02/09/12	--	<0.50	<0.50	<0.50	<0.50	<250	--	--	--	25.79	172.76
	01/18/13	--	<0.50	<0.50	<0.50	<0.50	<250	--	--	--	24.32	174.23
	04/08/14	<1.00	<1.00	<1.00	<1.00	<2.00	<50.0	<1.00	<0.00952	6.48	26.95	171.60
	09/23/14	<1.00	<1.00	<1.00	<1.00	<2.00	<50.0	--	--	--	26.62	171.93
Well Abandoned 9/23/14												
MTCA Method A Cleanup Level		20	5	1,000	700	1,000	800/1,000 ^b	5	0.01	15		

**Monitoring Well-5
groundwater
monitoring**

**TABLE 1
GROUNDWATER MONITORING AND ANALYTICAL RESULTS**
7-Eleven Store No. 25983
3541 Martin Way East, Olympia, Washington
All results in micrograms per liter (µg/L), except where noted.

Well ID (TOC)	Sample Date	MtBE	Benzene	Toluene	Ethyl-benzene	Total Xylenes	TPH-G	EDC	EDB	Total Lead	Depth To Groundwater	Groundwater Elevation (feet)
MW-5	06/07/01	--	<0.5	<0.5	2.1	26	950	--	--	--	26.48	171.88
198.36	08/01/01	--	1.4	<0.5	3.0	4.3	899	--	--	--	26.76	171.60
	11/15/01	--	<0.5	<0.5	6.5^a	20^a	1,500	--	--	--	27.08	171.28
	03/25/02	--	<0.5	<1.0	0.6	1.6	188	--	--	--	26.10	172.26
	06/21/02	--	<0.5	<1.0	<1.0	<3.0	<100	--	--	--	26.59	171.77
	09/23/02	--	0.304	<1.0	<1.0	1.6	<100	--	--	--	26.65	171.71
	12/10/02	--	<0.5	<1.0	<1.0	<3.0	<100	--	--	--	26.70	171.66
	04/02/03	--	<1.0	<1.0	<1.0	<2.0	<100	--	--	--	26.24	172.12
	06/11/03	--	<1.0	<1.0	<1.0	<2.0	<100	--	--	--	26.70	171.66
	09/15/03	--	<1.0	<1.0	<1.0	<2.0	<100	--	--	--	27.67	170.69
	12/04/03	--	<1.0	<1.0	<1.0	<2.0	<100	--	--	--	26.32	172.04
	03/04/04	--	<1.0	<1.0	<1.0	<2.0	<100	--	--	--	27.48	170.88
	05/10/04	--	<1.0	<1.0	<1.0	<2.0	<100	--	--	--	27.58	170.78
	08/11/04	--	<1.0	<1.0	<1.0	<2.0	<100	--	--	--	27.71	170.65
	11/17/04	--	<1.0	<1.0	<1.0	<2.0	<100	--	--	--	27.68	170.68
	02/21/05	--	<1.0	<1.0	<1.0	<2.0	<100	--	--	--	27.31	171.05
	05/17/05	--	<1.0	<1.0	<1.0	<2.0	<100	--	--	--	31.26	167.10
	08/19/05	--	<1.0	<1.0	<1.0	<2.0	<100	--	--	--	28.46	169.90
	10/26/05	--	7.50	<1.0	<1.0	1.1	410	--	--	--	24.25	174.11
	01/26/06	--	<1.0	<1.0	<1.0	<2.0	<100	--	--	--	26.55	171.81
	05/11/06	--	<1.0	<1.0	<1.0	<2.0	<100	--	--	--	26.60	171.76
	07/26/06	--	<1.0	<1.0	<1.0	<2.0	<100	--	--	--	31.68	166.68
	11/09/06	--	--	--	--	--	--	--	--	--	22.90	175.46
	04/11/07	--	<1.0	<1.0	<1.0	<2.0	<100	--	--	--	26.17	172.19
	08/27/07	--	<1.0	<1.0	<1.0	<2.0	<100	--	--	--	26.70	171.66
	02/06/08	--	<1.0	<1.0	<1.0	<2.0	<100	--	--	--	26.12	172.24
	08/18/08	--	<1.0	<1.0	<1.0	<2.0	<100	--	--	--	25.65	172.71
	11/12/08	--	<1.0	<1.0	<1.0	<2.0	<100	--	--	--	26.65	171.71
	02/05/09	--	<1.0	<1.0	<1.0	<2.0	<100	--	--	--	26.37	171.99
	01/12/10	--	<1.0	<1.0	<1.0	<2.0	<100	--	--	--	24.90	173.46
	02/14/11	--	<0.5	<0.5	<0.5	<0.5	<250	--	--	--	26.25	172.11
	02/09/12	--	<0.50	<0.50	<0.50	<0.50	<250	--	--	--	26.00	172.36
	01/18/13	--	<0.50	0.60	<0.50	<0.50	<250	--	--	--	26.00	172.36
	04/08/14	<1.00	<1.00	<1.00	<1.00	<2.00	<50.0	<1.00	<0.00962	2.51	26.05	172.31
	09/23/14	<1.00	<1.00	<1.00	<1.00	<2.00	<50.0	--	--	--	26.65	171.71
	12/08/14	<1.00	<1.00	<1.00	<1.00	<2.00	<50.0	<1.00	<0.0600	2.52	26.39	171.97
	03/09/15	<1.00	<1.00	<1.00	<1.00	<2.00	<100	<1.00	<0.0202	11.3	26.34	172.02
MTCA Method A Cleanup Level		20	5	1,000	700	1,000	800/1,000^b	5	0.01	15		

Explanation of Abbreviations:

- TOC = top of casing elevation
- MtBE = methyl tertiary butyl ether
- TPH-G = total petroleum hydrocarbons as gasoline
- EDC = 1,2-Dichloroethane
- EDB = 1,2-Dibromoethane
- = not sampled, not measured, or not available
- < = less than the reporting limit
- MTCA = Model Toxics Control Act

Notes:

- ^a Method blank contamination
- ^b The TPH-G cleanup level is reduced from 1,000 µg/L to 800 µg/L if benzene is present in the sample

Bold values exceed the MTCA Method A Cleanup Level

Groundwater
results from soil
boring "SB"

TABLE 2
GROUNDWATER MONITORING AND ANALYTICAL RESULTS
7-Eleven Store No. 25983
3541 Martin Way East, Olympia, Washington
All results in micrograms per liter (µg/L), except where noted

Well ID (TOC)	Sample Date	MtBE	Benzene	Toluene	Ethyl-benzene	Total Xylenes	TPH-G	EDC	EDB	Total Lead	Depth To Groundwater	Groundwater Elevation (feet)
SB-1	08/20/09	--	<1.0	<1.0	<1.0	<2.0	<100	--	--	--	--	--
SB-3	08/20/09	<0.20	<4.0	<4.0	230	1,560	20,000	<0.20	<0.010	140	--	--
SB-4	08/20/09	--	<1.0	<1.0	<1.0	<2.0	<100	--	--	--	--	--
SB-5	08/21/09	<0.20	<1.0	1.6	8.1	40	320	<0.20	<0.010	59	--	--
SB-6	08/21/09	--	<1.0	<1.0	<1.0	<2.0	<100	--	--	--	--	--
SB-7	08/21/09	--	<1.0	<1.0	<1.0	2.5	<100	--	--	--	--	--
SB-4 FD	08/20/09	--	<1.0	<1.0	<1.0	<2.0	<100	--	--	--	--	--
SB-5 FD	08/21/09	--	<1.0	2.0	11	70	540	--	--	--	--	--
MTCA Method A Cleanup Level		20	5	1,000	700	1,000	800/1,000^b	5	0.01	15		

Explanation of Abbreviations:

- TOC = top of casing elevation
- MtBE = methyl tertiary butyl ether
- TPH-G = total petroleum hydrocarbons as gasoline
- EDC = 1,2-Dichloroethane
- EDB = 1,2-Dibromoethane
- = not sampled, not measured or not available
- < = less than the reporting limit
- MTCA = Model Toxics Control Act

Bold values exceed the MTCA Method A Cleanup Level

Notes:

- ^a Method blank contamination
- ^b The TPH-G cleanup level is reduced from 1,000 µg/L to 800 µg/L if benzene is present in the sample

Soil sample results from 2014 remediation actions

TABLE 2A
Soil Analytical Results - TPH-G, BTEX, MtBE & Total Lead
7-Eleven Store No. 25983
3541 Martin Way East
Olympia, Washington
All concentrations are in milligrams per kilogram (mg/kg).

Sample Type	Sample Name	Depth (feet bgs)	USCS	PID (ppm)	Date Sampled	BTEX Compounds (mg/Kg)				TPH-G (mg/Kg)	MtBE (mg/Kg)	Total Lead (mg/Kg)
						Benzene	Toluene	Ethyl Benzene	Total Xylenes			
2014 UST Removal - Stantec												
Stockpile Samples	CSP-1	--	--	7	10/07/14	<0.0135	<0.0135	<0.0203	<0.0270	<3.38	--	9.75
	CSP-2	--	--	0	10/08/14	<0.0139	<0.0139	<0.0208	<0.0278	<3.46	--	9.73
	CSP-3	--	--	0	10/09/14	<0.0137	<0.0137	<0.0205	<0.0274	<3.42	--	6.61
	DSP-1	--	--	1,874	10/09/14	<0.0133	<0.0133	<0.0199	0.0542	20.1	--	2.89
	DSP-2	--	--	1,546	10/09/14	<0.0134	<0.0134	<0.0202	<0.0268	5.36	--	2.22
	DSP-3	--	--	2,426	10/09/14	<0.0160	<0.0160	<0.0240	0.153	24.2	--	2.20
	DSP-4	--	--	2,130	10/15/14	<0.0121	<0.0121	0.160	1.178	46.4	--	2.25
Below Tank Samples	DSP-5	--	--	1,647	10/16/14	<0.0117	0.0225	1.28	8.59	330	--	2.10
	DSP-6	--	--	1,866	10/16/14	<0.0111	0.260	5.31	40.4	934	--	2.09
Side Wall Samples	WEST TANK@13'	13'	--	794	10/08/14	<0.0124	<0.0124	0.0799	0.542	98.6	--	3.10
	MID TANK@13'	13'	--	7	10/08/14	<0.0138	<0.0138	<0.0207	<0.0276	<3.45	--	3.35
Side Wall Samples	EAST TANK@12'	12'	--	0	10/08/14	<0.0150	<0.0150	<0.0226	<0.0300	<3.76	--	2.66
	WEST WALL@8'	8'	--	1	10/08/14	<0.0172	<0.0172	<0.0258	<0.0344	<4.30	--	3.27
	EAST WALL@10'	10'	--	3	10/08/14	<0.0124	<0.0124	<0.0186	<0.0248	<3.10	--	1.55
	EAST WALL@17'	17'	--	2,285	10/14/14	<0.0108	4.07	6.38	40.9	517	--	2.40
	EAST WALL@26'	26'	--	3	10/14/14	<0.0112	0.0152	<0.0169	0.0219	<2.81	--	2.19
	NORTH WALL@9'	9'	--	0	10/09/14	<0.0148	<0.0148	<0.0221	<0.0296	<3.69	--	2.16
	NORTH WALL@16'	16'	--	250	10/15/14	<0.02	<0.05	<0.05	<0.15	63	--	<5.0
	NORTH WALL@18'	18'	--	448	10/15/14	<0.02	<0.05	<0.05	<0.15	24	--	--
	NORTH WALL@24'	24'	--	2	10/15/14	<0.0107	<0.0107	<0.0161	0.0214	<2.68	--	2.21
	SOUTH WALL@10'	10'	--	1	10/15/14	<0.0130	<0.0130	<0.195	<0.026	<3.25	--	7.01
Product Line Sample	SOUTH WALL@18'	18'	--	1,389	10/15/14	<0.02	<0.05	0.09	1.8	280	<0.05	<5.0
Dispenser Island Samples	PL@3'	3'	--	0	10/09/14	<0.0138	<0.0138	<0.0207	<0.0276	<3.45	--	1.60
	DIW@5'	5'	--	0	10/09/14	<0.0142	<0.0142	<0.0213	<0.0284	<3.54	--	4.67
Dispenser Island Samples	DIE@5'	5'	--	1	10/09/14	<0.0131	<0.0131	<0.0196	<0.0262	<3.27	--	1.88
	DI@20'	20'	--	2,176	10/09/14	<0.0150	0.0467	0.586	5.68	270	--	2.53
Excavation Samples	DI@26'	26'	--	0	10/09/14	<0.0240	<0.0240	<0.0361	0.0562	<6.01	--	2.88
	CSS-1@17'	17'	--	5	10/10/14	<0.0130	<0.0130	<0.0195	<0.0260	<3.25	--	2.02
	CSS-2@20'	20'	--	5	10/10/14	<0.0164	<0.0164	<0.0246	<0.0328	<4.10	--	2.29
	CSS-3@17'	17'	--	2	10/13/14	<0.0122	<0.0122	<0.0182	<0.0244	<3.04	--	1.76
	CSS-3@22'	22'	--	2	10/13/14	<0.0105	<0.0105	<0.0158	<0.0210	<2.63	--	1.62
	CSS-4@18'	18'	--	3	10/13/14	<0.0120	<0.0120	<0.0180	<0.0240	<3.00	--	2.44
	CSS-4@25'	25'	--	4	10/13/14	<0.0129	<0.0129	<0.0193	<0.0258	<3.22	--	2.55
	CSS-5@18'	18'	--	0	10/13/14	<0.0140	<0.0140	<0.0210	<0.0280	<3.49	--	2.53
	CSS-5@24'	24'	--	0	10/13/14	<0.0127	<0.0127	<0.0190	<0.0254	<3.17	--	2.82
	CSS-6@18'	18'	--	1,752	10/16/14	<0.0104	<0.0104	0.0452	0.3304	84.2	<0.0260	1.80
	CSS-7@23'	23'	--	30	10/16/14	<0.0127	<0.0127	<0.0190	<0.0254	<3.17	<0.0317	2.00
	CSS-8@25'	25'	--	12	10/16/14	<0.0113	<0.0113	<0.0170	<0.0226	<2.83	--	2.00
	CSS-9@16'	16'	--	4	10/16/14	<0.0113	<0.0113	<0.0169	0.0531	<2.81	<0.0281	2.03
	CSS-10@16'	16'	--	0	10/16/14	<0.0128	0.0382	<0.0192	0.0304	<3.20	<0.316	3.03
	SS-1@20'	20'	--	2,440	10/10/14	<0.0147	0.0247	0.0690	0.507	48.7	--	3.22
	SS-1@25'	25'	--	1	10/10/14	<0.0128	<0.0128	<0.0192	<0.0256	<3.20	--	1.95
	SS-2@17'	17'	--	970	10/10/14	<0.0144	<0.0144	<0.0216	<0.0288	8.80	--	2.04
	SS-3@15'	15'	--	1,904	10/10/14	<0.0141	<0.0141	0.146	0.660	86.9	--	2.13
	SS-4@18'	18'	--	2,022	10/10/14	<0.0147	<0.0147	<0.0220	0.1933	85.7	--	2.29
	SS-4@23'	23'	--	4	10/10/14	<0.0129	<0.0129	<0.0194	<0.0258	<3.23	--	2.64
SB-3@16'	16'	--	1,750	10/16/14	<0.0112	<0.0112	0.451	4.02	756	--	2.04	
SB-3@17'	17'	--	141	10/16/14	<0.0127	<0.0127	<0.0190	<0.0254	<3.16	--	2.16	
MTCA Method A Cleanup Levels						0.03	7	6	9	30^b	0.01	250

Explanation of Abbreviations:

- TPH-G = total petroleum hydrocarbons in the gasoline range
- MtBE = methyl tertiary butyl ether
- bgs = below ground surface
- USCS = Unified Soil Classification System
- PID = photoionization detector
- ppm = parts per million
- BTEX = benzene, toluene, ethyl benzene, and total xylenes
- mg/Kg = milligrams per kilogram or approximately ppm
- MtBE = methyl tertiary butyl ether
- MTCA = Model Toxics Control Act

Notes:

- ^a = D-1 and D-2 samples were collected during the September 24, 1997 investigation and are separate samples from D-1 and D-2
- ^b = gasoline mixtures without benzene and where the total of the other BTEX constituents are less than 1% of the gasoline mixture have a cleanup level of 100 mg/Kg; all other mixtures are 30 mg/Kg
- bold** = samples removed from Site during 2014 excavation
- bold** = analytical result exceeds the specified MTCA Method A Cleanup Level

Indicates contaminated soils not removed during remedial activities.

Additional soil
sample results
from 2014
remediation actions

TABLE 2B
Soil Analytical Results - Naphthalene, VPH, EDB, and EDC
Former 7-Eleven Store No. 25983
3541 Martin Way East
Olympia, Washington
All concentrations are in milligrams per kilogram (mg/kg).

Sample Location and Depth (feet bgs)	Date Sampled	Naphthalenes* (mg/Kg)			Volatile Petroleum Hydrocarbons (mg/Kg)							EDB (mg/Kg)	EDC (mg/Kg)
		Naphthalene	2-Methyl Naphthalene	1-Methyl Naphthalene	Aliphatic				Aromatic				
					C5-C6	C6-C8	C8-C10	C10-C12	C8-C10	C10-C12	C12-C13		
2009 Subsurface Assessment - Stantec													
SB-3@16'	08/19/09	0.11	0.43	0.18	<9.8	25	<9.8	14	31	27	<9.8	<0.10	<0.10
SB-5@15'	08/21/09	--	--	--	--	--	--	--	--	--	--	<0.099	<0.099
2014 UST Removal - Stantec													
South Wall @ 18'	10/15/14	0.02	0.22	0.12	<5.0	6.3	6.0	<5.0	26	64	48	<0.01	<0.05
CSS-6 @ 18'	10/16/14	<0.0533	<0.0533	<0.0533	<1.18	1.88	1.70	9.87	8.28	44.4	24.1	<0.00260	<0.0156
CSS-7 @ 23'	10/16/14	<0.0530	<0.0530	<0.0530	<1.59	<1.59	<1.59	<1.59	<1.59	<1.59	<1.59	<0.0317	<0.0190
CSS-9 @ 16'	10/16/14	<0.0521	<0.0521	<0.0521	<1.12	<1.12	<1.12	<1.12	<1.12	1.67	1.32	<0.00281	<0.0169
CSS-10 @ 16'	10/16/14	<0.0564	<0.0564	<0.0564	<1.26	<1.26	<1.26	<1.26	<1.26	<1.26	<1.26	<0.00320	<0.0192
MTCA Method A Cleanup Levels		5	--	--	--	--	--	--	--	--	--	--	--

Explanation of Abbreviations

- VPH = volatile petroleum hydrocarbons
- EDB = 1,2-Dibromoethane
- EDC = 1,2-Dichloroethane
- bgs = below ground surface
- mg/Kg = milligrams per kilogram or approximately ppm
- MTCA = Model Toxics Control Act
- * = Naphthalenes by EPA Method 8270
- = Sample has been removed from site
- bold** = analytical result exceeds the specified MTCA Method A Cleanup Level

Soil sample results
from samples
taken prior to 2014

TABLE 2A
Soil Analytical Results - TPH-G, BTEX, MtBE & Total Lead
7-Eleven Store No. 25983
3541 Martin Way East
Olympia, Washington
All concentrations are in milligrams per kilogram (mg/kg).

Sample Type	Sample Name	Depth (feet bgs)	USCS	PID (ppm)	Date Sampled	BTEX Compounds (mg/Kg)				TPH-G (mg/Kg)	MtBE (mg/Kg)	Total Lead (mg/Kg)	
						Benzene	Toluene	Ethyl Benzene	Total Xylenes				
1995 Product Piping Upgrade - Fluor Daniel GTI													
Dispenser Area Samples	D-1	--	--	--	06/21/95	<0.05	<0.05	<0.05	0.56	140	--	<10	
	D-2	--	--	--	06/21/95	<0.40	16	11	120	1,400	--	<10	
Tank Area Samples	T-1	--	--	--	06/21/95	<0.05	<0.05	<0.05	<0.10	<1.0	--	<10	
	T-2	--	--	--	06/21/95	<0.05	<0.05	<0.05	<0.10	<1.0	--	<10	
1997 Limited Site Assessment - Fluor Daniel GTI													
Dispenser Area Samples	D-1 ^a	--	--	--	09/24/97	<0.05	0.0934	<0.05	0.289	10.7	--	18.4	
	D-2 ^a	--	--	--	09/24/97	<10.0	188	60.4	1,060	11,100	--	<10	
Fill Port Sample	FP-1	--	--	--	09/24/97	<0.05	0.223	<0.05	0.242	5.63	--	<10	
Product Line Sample	PL-1	--	--	--	09/24/97	<0.05	0.0527	<0.05	<0.1	<5.0	--	13.7	
1999 Well Install - IT Corporation													
Soil Boring Samples	MW-1	12.5-15.5	GM	0.0	06/07/99	<0.05	<0.05	<0.05	<0.10	<10	<0.05	31.7	
		24.5-27.5	SM	0.0	06/07/99	<0.05	<0.05	<0.05	<0.10	<10	<0.05	15.3	
	MW-2	11.5-14.5	SP	0.0	06/07/99	<0.05	<0.05	<0.05	<0.10	<10	<0.05	16.7	
		26.5-29.5	SP-GP	0.0	06/07/99	<0.05	<0.05	<0.05	<0.10	<10	<0.05	17.8	
	MW-3	11.5-14.5	SM	0.0	06/07/99	<0.05	<0.05	<0.05	<0.10	<10	<0.05	28.7	
		26.5-29.5	GP	0.0	06/07/99	<0.05	<0.05	<0.05	<0.10	<10	<0.05	15.2	
	MW-4	6.5-9.5	ML	0.0	06/07/99	<0.05	<0.05	<0.05	<0.10	<10	<0.05	43.3	
		11.5-14.5	SM	--	06/07/99	<0.05	<0.05	<0.05	0.117	<10	<0.05	29	
2001 Well Install - IT Corporation													
Soil Boring Samples	MW-5	15	GM	113	04/26/01	<0.005	<0.005	<0.005	<0.015	<1.0	--	--	
		25	GP	27	04/26/01	<0.005	<0.005	<0.005	0.0097	<1.0	--	--	
2002 Subsurface Assessment - IT Corporation													
Soil Boring Samples	GP-1	13-15	GW	442	05/23/02	0.55	1.23	17.2	148	2,230	--	--	
		15-18	GW	730	05/23/02	0.192	0.15	0.342	1.789	236	--	--	
	GP-4	12-16	GW	190	05/23/02	<0.0213	0.01	<0.0425	0.067	<4.25	--	--	
		16-20	GP	0.0	05/23/02	<0.0214	0.01	0.0084	0.067	<4.28	--	--	
		24-28	SP	10	05/23/02	<0.0209	<0.0419	<0.0419	0.053	<4.19	--	--	
		28-32	GP	8.0	05/23/02	<0.0261	<0.0522	<0.0522	0.057	<5.22	--	--	
	GP-5	16-20	SP	0.0	05/23/02	<0.0213	0.03	0.0087	0.047	<4.26	--	--	
		24-28	SP	0.0	05/23/02	<0.0206	<0.0413	<0.0413	0.1238	<4.13	--	--	
			28-32	SP	0.0	05/23/02	<0.0219	<0.0437	<0.0437	0.052	<4.37	--	--
	2009 Subsurface Assessment - Stantec												
Soil Boring Samples	SB-1	15-15.5	ML	0.0	08/19/09	<0.020	<0.045	<0.045	<0.090	<4.5	--	--	
		24-25	GP	0.0	08/20/09	<0.020	<0.049	<0.049	<0.098	<4.9	--	--	
	SB-2	5-5.5	SM	0.0	08/18/09	<0.020	<0.069	<0.069	<0.138	<6.9	--	--	
		5-5.5	SM	0.0	08/18/09	<0.020	<0.073	<0.073	<0.146	<7.3	--	--	
	SB-3	10-10.5	GP	0.0	08/19/09	<0.020	<0.064	<0.064	<0.128	<6.4	--	--	
		16-16.5	GW	760	08/19/09	1.3	0.15	5.1	29.8	980	<0.10	<5.6	
		25-26	GP	0.0	08/20/09	<0.020	<0.044	0.048	0.291	6.6	--	--	
	SB-4	14-15	GP	0.0	08/20/09	0.080	<0.11	0.49	0.79	140	--	--	
		24-25	GP	0.0	08/20/09	<0.020	<0.054	<0.054	<0.108	<5.4	--	--	
	SB-5	9-10	SM	0.0	08/21/09	<0.020	<0.056	<0.056	<0.112	<5.6	--	--	
		14-15	SM	40	08/21/09	0.33	0.41	3.5	24.2	530	<0.099	<5.6	
		24-25	GP	0.0	08/21/09	<0.020	<0.049	<0.049	<0.098	<4.9	--	--	
	SB-6	14-15	ML	0.0	08/21/09	<0.020	<0.047	<0.047	<0.094	<4.7	--	--	
		19-20	GP	0.0	08/21/09	<0.020	<0.062	<0.062	<0.124	<6.2	--	--	
	SB-7	5-5.5	ML	0.0	08/18/09	<0.020	<0.055	<0.055	<0.110	<5.5	--	--	
		14-15	GP	0.0	08/21/09	<0.020	<0.054	<0.054	<0.108	<5.4	--	--	
		24-25	GP	0.0	08/21/09	<0.020	<0.062	<0.062	<0.124	<6.2	--	--	
	SB-8	5-5.5	ML	0.0	08/18/09	<0.020	<0.067	<0.067	<0.134	<6.7	--	--	
		15-16	ML	0.0	08/21/09	<0.020	<0.063	<0.063	<0.126	<6.3	--	--	
		24-25	GP	0.0	08/21/09	<0.020	<0.048	<0.048	<0.096	<4.8	--	--	
	SB-3 FD	16-16.5	GW	834	08/19/09	0.039	<0.050	<0.49	3.01	92	--	--	
		26	GP	0.0	08/20/09	<0.020	<0.061	<0.061	0.094	<6.1	--	--	
	SB-5 FD	15	SM	40	08/21/09	0.54	0.49	4.4	33.6	640	--	--	
MTCA Method A Cleanup Levels						0.03	7	6	9	30 ^b	0.01	250	

Soil sample results
from monitoring
well installations

TABLE 2
SUMMARY OF LABORATORY RESULTS - SOIL
7-ELEVEN FACILITY #25983
3541 MARTIN WAY EAST, OLYMPIA, WASHINGTON
(Results in milligrams per kilogram)

Sample ID	Sample Date	Sample Interval (feet)	Benzene	Toluene	Ethyl-benzene	MTBE	Xylene	TPH-G	Total Lead
Method Reporting Limit			0.05	0.05	0.05	0.05	0.10	5.0	250.0
MW1-12.5	06/07/99	12.5-15.5	<0.05	<0.05	<0.05	<0.05	<0.05	<10	31.7
MW1-27.5	06/07/99	24.5-27.5	<0.05	<0.05	<0.05	<0.05	<0.05	<10	15.3
MW2-11.5	06/07/99	11.5-14.5	<0.05	<0.05	<0.05	<0.05	<0.05	<10	16.7
MW2-26.5	06/07/99	26.5-29.5	<0.05	<0.05	<0.05	<0.05	<0.05	<10	17.8
MW3-11.5	06/07/99	11.5-14.5	<0.05	<0.05	<0.05	<0.05	<0.05	<10	28.7
MW3-26.5	06/07/99	26.5-29.5	<0.05	<0.05	<0.05	<0.05	<0.05	<10	15.2
MW4-6.5	06/07/99	6.5-9.5	<0.05	<0.05	<0.05	<0.05	<0.05	<10	43.3
MW4-12.5	06/07/99	11.5-14.5	<0.05	<0.05	<0.05	<0.05	0.117	<10	29.0
MTCA-CCL (a)			0.5	40	20	--	20	100	1,000

TPH-G = Total petroleum hydrocarbons-as-gasoline
 MTCA-CCL[a] = Model Toxics Control Act Method A Compliance Cleanup Level
 < = Less than the method detection limit
 -- = None established.
 Bold values exceed the CCL.

Soil sample results
from monitor well
installations

TABLE 3 SOIL ANALYTICAL RESULTS 7-ELEVEN, INC. STORE #25983 3541 MARTIN WAY EAST, OLYMPIA, WASHINGTON							
Well ID	Sample Date	Benzene (mg/kg)	Toluene (mg/kg)	Ethylbenzene (mg/kg)	Total Xylenes (mg/kg)	TPH-G (mg/kg)	Total Lead (mg/kg)
MW-5-15	07/15/99	<0.005	<0.005	<0.005	<0.015	<1.0	--
MW-5-25	04/26/01	<0.005	<0.005	<0.005	0.0097	<1.0	--
MTCA-CCL(a)		0.5	20	20	20	100	250

TPH-G = total petroleum hydrocarbons-as-gasoline
 MTCA-CCL(a) = Model Toxics Control Act Method A Compliance Cleanup Level
 mg/kg = milligrams per kilogram
 < 0.005 = less than the reporting limit of 0.005 mg/kg
 -- = not sampled or not available
 Bold values exceed MTCA-CCL(a)

Parcel Info Pg. 1



Data for Parcel No. 41701900100

[Zoom Map to Parcel](#)

[View Assessor's Data for Parcel](#) or look at [Parcel Summary Page](#)

Owner(s):
SUNSHINE PLAZA LLC

Address: PO BOX 1066
City: OLYMPIA
State: WA, 98507

Parcel No.: 41701900100
Site Address: 3519 MARTIN WAY E
Site City: OLYMPIA
Site Zip: 98503

Section: S18181W
Section 18 Township 18 Range 1W Plat
Abbreviated Legal: APPRAISAL COMBINATION FOR TAX
PURPOSES ONLY; Parcel 1: COLLEGE CITY
BERRY TRS N HLF BLK 19 Document 009/07;
Parcel 2: COM E4 COR N 54F WLY ON HW 472F E

Usecode: 54
Tax Code Area: 114
Taxable: Yes
Annual Tax: [View Property Taxes for Parcel](#)
Property Type: RTL
Total Acres: 1.45
Land Value: [View Assessor's Data for Parcel](#)
Building Value: [View Assessor's Data for Parcel](#)
Total Value: [View Assessor's Data for Parcel](#)
Current Use: N
Exemptions: None

Wetlands: Unknown
Floodzone: OUT
Flood of 1999: Unknown
Winter Flooding of 1996: Unknown
High Groundwater Flood Hazards: Unknown

Zoning: HDC-4,

Parcel Info Pg 2

Commissioner District:	Cathy Wolfe - District 1
Historic Site:	No
Permitting Jurisdiction:	OLYMPIA
Jurisdiction of Influence:	Same as Permitting Jurisdiction
Stormwater Rate:	Yes
No Shooting Zone:	No
Animal Control:	OLYMPIA
Weed Containment Zone:	No
Landslide Hazard Review Area - Slope A:	Yes - Check with Permit Assistance Center
Landslide Hazard Review Area - Slope B:	Unknown
Landslide Hazard Review Area - Slope C, D, E:	Not mapped by GeoData
Ground Water Sensitive Areas:	No
DNR Natural Heritage Data:	Unknown
Mazama Pocket Gopher Indicator Soils:	Yes - Check with Permit Assistance Center
Mazama Pocket Gopher Soils Review Area:	Yes - Check with Permit Assistance Center
Marine Riparian Review Area - 300':	Unknown
Stream Riparian Review Area - 300':	Unknown
Wetland Review Area - 300':	Unknown
In 100 ft buffer of Shoreline Management Areas:	No
FEMA Panel No.:	0186
Wellhead Protection Area:	No
Area of Groundwater Concern:	No
Elevated Nitrates:	No
Soil Type:	Yelm fine sandy loam, 3 to 15% slopes
Hydric Soil:	Unknown
Watershed:	
Water Service Area:	Unknown
School Attendance District:	NORTH THURSTON
Elementary School:	PLEASANT GLADE
Middle School:	CHINOOK
High School:	NORTH THURSTON
School Taxing District:	View Assessor's Data for Parcel
Fire Response District:	Olympia
Unconsolidated Fire Response District:	Olympia
Fire Taxing District:	View Assessor's Data for Parcel
Medic Response District:	Medic 4
Residential Outdoor Burning:	Residential Outdoor Burning is banned within the city limits and urban growth areas.
Planning Region:	1
Census Tract:	010300
Radio or Cell Tower:	No
Airport Zone:	No