



GLACIER

ENVIRONMENTAL SERVICES, INCORPORATED

June 1, 1992

Mr. Joseph M. Hickey
State of Washington Department of Ecology
Northwest Regional Office
3190 160th Ave. S.E.
Bellevue, Washington 98008-5452

RE: Report of First Phase Activity at Former Circle K #1461,
2350 24th Avenue East, Seattle, Washington.

Dear Mr. Hickey,

Glacier Environmental Services, Inc. (GES) submits the following report pertaining to the State of Washington Field Order F130956 for site activities at the above referenced site.

The former Circle K gasoline station is located at 2350 24th Avenue East in Seattle, Washington (see attached site vicinity map). The property was used as a gasoline station and convenience store from 1968 to 1990. The property is now used as a retail dry cleaning business.

GES understands that leaking underground storage tanks have resulted in a release of hazardous substances at the site. We further understand that Ecology and Mr. Kuk Jin Choung (owner of the property) have entered into a consent decree to begin investigation and remediation of contamination at the site.

GES site activity for the first month included: 1) sampling all existing groundwater monitor wells for the presence of free floating product, 2) sampling wells without free product for dissolved gasoline product, including benzene, toluene, ethylbenzene, xylenes, and total petroleum hydrocarbons (gasoline and diesel range), 3) re-starting and maintaining the existing groundwater/product recovery system including replacement and disposal of activated carbon filters.

GROUNDWATER MONITOR WELL SAMPLING

On April 9, 1992 groundwater samples were collected from nine (9) of the existing 14 wells (MW-1, MW-5, MW-6, MW-7, MW-11, MW-12, M-13, MW-14, and MW-16) at the former Circle K property. A Monitor Well Location Map is attached as figure 1. Free product (gasoline) was found in four (4) of the existing wells (MW-4, MW-8, MW-9, and MW-15), groundwater samples were not collected from these wells. Additionally, the well monument for MW-10 was damaged preventing access to the well.

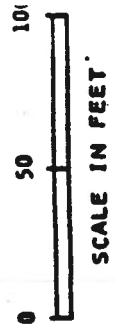
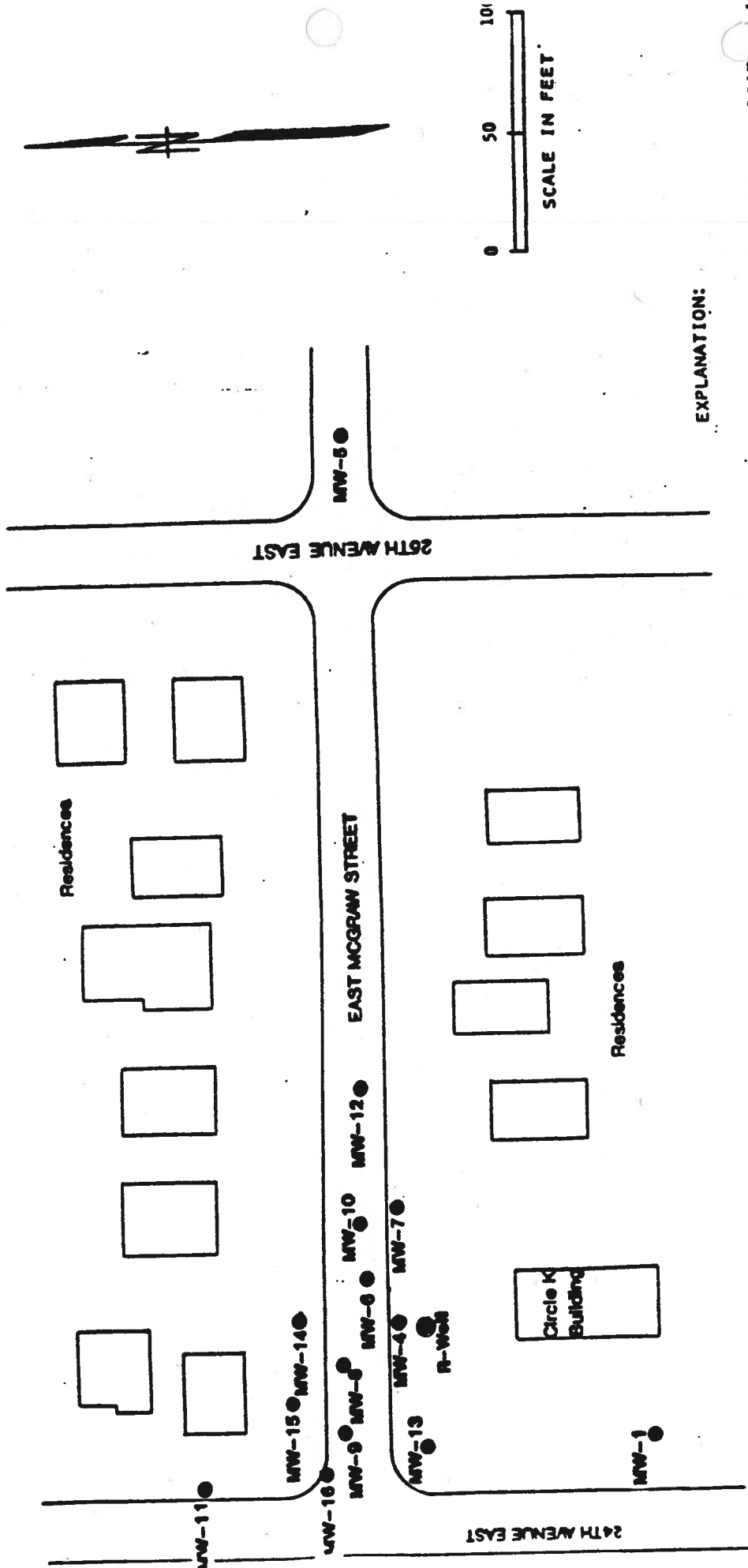

EXPLANATION:

- MW-1 ● MONITOR WELL LOCATION NUMBER
- R-Well ● RECOVERY WELL LOCATION

FIGURE 1
MONITOR WELL LOCATION MAP

TABLE 2: ANALYTICAL RESULTS

WELL NO.	TPH-gasoline (ppb)¹	TPH- diesel (ppb)	Benzene (ppb)	Toluene (ppb)	Ethyl Benzene (ppb)	Total Xylenes (ppb)
MW-1	<100	710	51	14	14	9
MW-5	<100	<250	<1	1	<1	3
MW-6	<100	<250	4	1	<1	3
MW-7	<100	<250	4	<1	5	9
MW-11	<100	<250	1	<1	<1	<1
MW-12	<100	<250	4	<1	<1	3
MW-13 ²	56,000	11,000	5,900	5,700	1,200	6,400
MW-14	<100	720	4	2	5	8
MW-16	<100	690	5	2	5	9
WATER STAND. (ppb)¹	1,000	1,000	5	30	30	40

¹Parts per billion (ug/L)

² Washington Department of Ecology, Guidance for Remediation of Releases From Underground Storage Tanks; Model Toxics Control Act, Method A Cleanup Standards; July, 1991.