



STATE OF WASHINGTON
DEPARTMENT OF ECOLOGY

P.O. Box 47775 • Olympia, Washington 98504-7775 • (360) 407-6300

September 26, 2001

File Name FOSS CAR ALIDID

County PIERCE

File Type TCP

Your Name PANJINI BALARAJU

Mr. Dennis K. Smart
2930 76th Avenue SE #301
Mercer Island, WA 98040

Re: Interim No Further Action Letter, Foss Car Audio 3732 South Cedar Street,
Tacoma, Washington

Dear Mr. Smart:

This letter is in follow-up to the Department of Ecology's (Ecology) letter of April 6, 2001 to you regarding the above site investigation (Enclosure 1). Thank you for submitting the additional information regarding the site groundwater (as requested by Ecology during our telephone conversation of July 5, 2001) and Voluntary Cleanup Action Reports for the Foss Car Audio Site located at 3732 South Cedar Street, Tacoma, Washington 98409 for Ecology's review. Ecology appreciates your initiative in pursuing this administrative option under the Model Toxics Control Act (MTCA).

Ecology's Toxics Cleanup Program has reviewed the following reports regarding the Foss Car Audio site located at 3732 South Cedar Street, Tacoma, Washington 98409:

1. Limited Soils Sampling and Testing, The 3732 South Cedar Project, Tacoma, Washington 98409, October 18, 1999, Saltbush Environmental Services, Inc.
2. Contamination Delineation Assessment Report, The 3732 South Cedar Project, Tacoma, Washington 98409, May 7, 2001, Saltbush Environmental Services, Inc. and
3. Signed Restrictive Covenant with a cover letter dated September 12, 2001

The above-listed reports will be kept in the Central Files of the Southwest Regional Office (SWRO) of Ecology for review by appointment only. Appointments can be made by calling the SWRO resource person at (360) 407-6365.



Mr. Dennis Smart
September 26, 2001
Page 2

Ecology reviewed the above cited reports and understands that the results of soil samples collected from borings BH-2 through BH-5 and BH-7 through BH-9 are all non-detects. However, results of the soil samples collected from borings BH-1 and BH-10 exceed the MTCA Method-A cleanup standards of 2000 mg/kg for TPH (diesel). These exceedences were detected at 12 to 15 feet and 9 to 12 feet below ground level in boring BH-1 and BH-10 respectively. No contamination was detected from surface to 4 feet below ground level. The enclosed Figure and Table 1 and 2 show boring locations and results of soil samples collected from these borings.

Ecology also recognizes that the contamination that is present in the vicinity of and west of boring location BH-1, BH-10 and BH-6 is not accessible at this time, since it is underneath the existing building.

The additional information submitted to Ecology regarding the site groundwater show that the groundwater is approximately at 83 feet below ground level in the vicinity of the site. Since the soil contamination extends to a maximum depth of about 15 feet, it is Ecology's opinion that, it is highly unlikely that the groundwater is impacted by this contamination.

Based upon the above listed information, Ecology has determined that, at this time, the release of contaminants in the soil no longer poses a threat to human health, since the contamination is present at 10 to 15 feet below ground level (no exposure pathway to the humans who work in the building).

In addition, the soil contamination poses no threat to the groundwater at this time, since the existing building acts as a cover to the soil contamination, preventing its mobilization (downward migration) through infiltration. Therefore, Ecology is issuing this determination that no further remedial action is necessary at this site under MTCA, Chapter 70.105D RCW at this time. However, please note that because your actions were not conducted under a consent decree with Ecology, this letter is written pursuant to RCW 70.105D.030(1)(i) and does not constitute a settlement by the state under RCW 70.105D.040(4) and is not binding on Ecology.

This interim NFA determination is contingent upon the following:

- Meeting the requirements of the Restrictive Covenant (Enclosure 2), and
- Once the building is demolished, the aerial and vertical extent of soil contamination must be defined. The contaminated soils must be remediated to an appropriate cleanup level. This is required, since the soil contamination will be accessible and potentially mobile through infiltration after the building demolition.

This interim NFA letter is void, if the above requirements are not met. You can obtain a final NFA letter by cleaning up the contaminated soils to appropriate cleanup levels, once the building is demolished.

Mr. Dennis Smart
September 26, 2001
Page 3

Ecology's interim no further action determination is made only with respect to the releases identified in the reports listed above and applies only to the area of the property affected by the releases at the Foss Car Audio site located at 3732 South Cedar Street, Tacoma, Washington 98409 as identified in the reports. It does not apply to any other release or potential release at the property, any other areas on the property, nor any other properties owned or operated by the Foss Car Audio.

The State, Ecology, and its officers and employees are immune from all liability and no cause of action of any nature may arise from any act or omission in providing this determination.

If you have any questions about any of the information presented in this letter, please contact me at (360) 407-6243.

Sincerely,



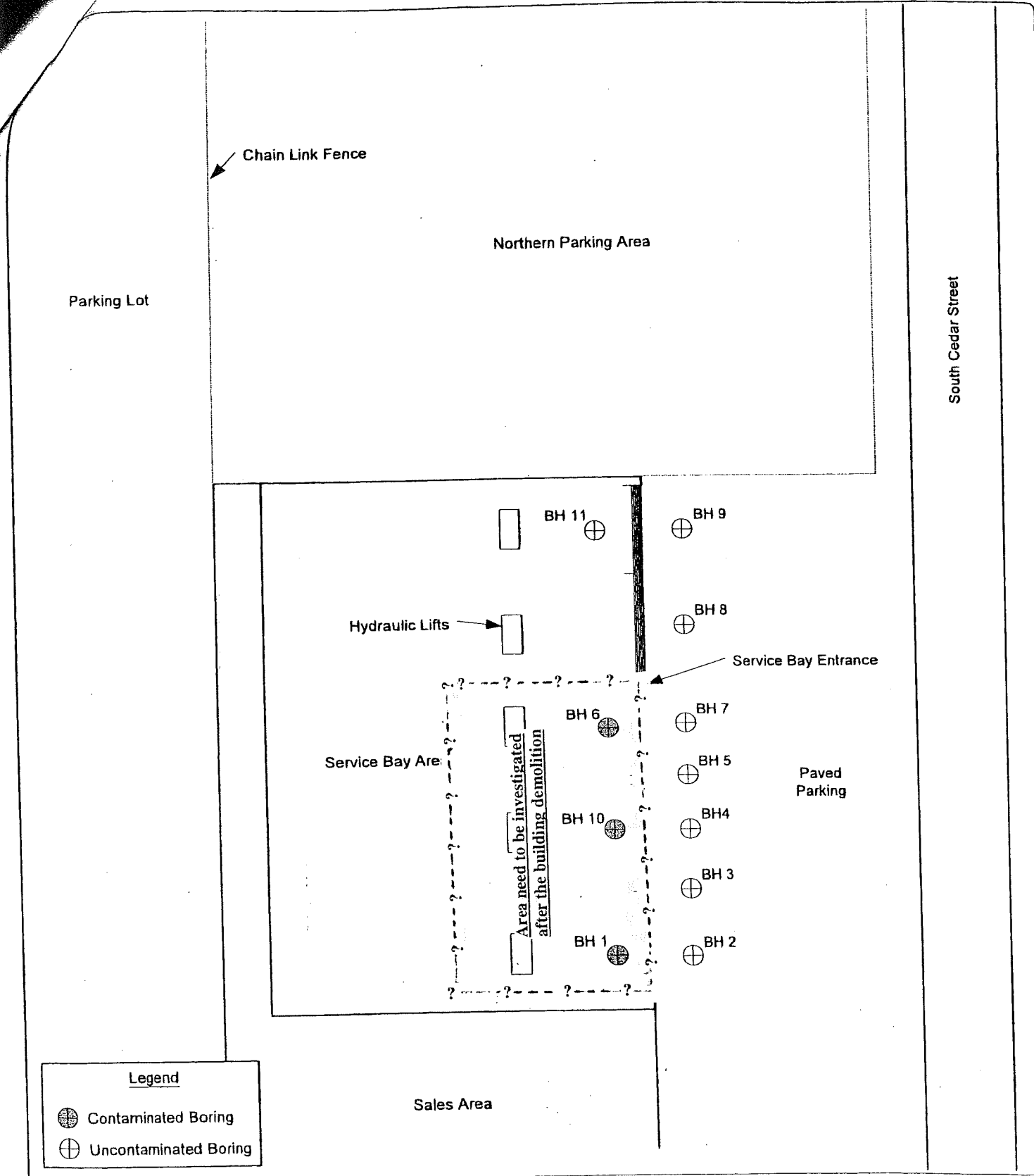

Panjini Balaraju
Project Manager
Toxics Cleanup Program
Southwest Regional Office

Pierce
cc: ~~King~~ Pierce County Assessors Office
Pierce ~~King~~ Pierce County Planning Office
LaFaye Smart
Chuck Cline, Ecology



Legend

-  Contaminated Boring
-  Uncontaminated Boring



Saltbush Environmental Services, Inc.
 805 Pacific Avenue
 P.O. Box 505
 Tacoma, WA 98401-0505
 Tel. (253) 383-1914 Fax (253) 383-4525
 Operations@Saltbush.com

Boring Location Diagram
The 3732 South Cedar Street Project
Tacoma, Washington 98409

Project Number:
010421047

Drawn By:
Franz A. Carmine

Date:
April 25, 2001

No Scale
Locations Estimated

Diagram #1 of 1
1047-2/Diagram 1

the deepest boring, Boring 1, at 15 feet. Borings 4, 5, 8, and 10 were terminated due to excessive sloughing. The Borehole Location Diagram can be found in Appendix 1; the Boring Logs are located in Appendix 5.

Table 1
Soil Sample Results (mg/Kg) Diesel and Oil Range Hydrocarbons

Sample ID / Depth (Feet)	TPH-D (Diesel Range)	Heavy Oils	Boring
S2-41901 / 4'-8'	1,980	Nd	BH-1
S4-41901 / 12'-15'	2,700	Nd	BH-1
S7-41901 / 8'-12'	Nd	Nd	BH-2
S11-41901 / 5'-7'	Nd	Nd	BH-3
S12-41901 / 0'-3'	Nd	Nd	BH-4
S17-41901 / 3'-6'	Nd	Nd	BH-5
S20-41901 / 3'-6'	Nd	Nd	BH-6
S21-41901 / 6'-9'	530	1,100	BH-6
S27-41901 / 9'-12'	Nd	Nd	BH-7
S29-41901 / 6'-10'	Nd	Nd	BH-8
S32-41901 / 9'-12'	Nd	Nd	BH-9
S34-41901 / 3'-6'	135	630	BH-10
S36-41901 / 9'-12'	2,700	350	BH-10
S38-41901 / 3'-6'	Nd	Nd	BH-11
2001 MTCA Cleanup Standards	2,000	2,000	-

Bold indicates the results over the MTCA Method A cleanup levels.
Nd indicates analytes were not detected above the method detection limits of 20 and 40 mg/Kg for Diesel and heavy oil, respectively.
Laboratory Test Results are located in Appendix 2.
2001 MTCA Cleanup Standards are effective 8/15/2001

Table 2
Soil Sample Results (mg/Kg) Gasoline Range Hydrocarbons

Sample ID / Depth (Feet)	TPH-G (Gasoline Range)	Benzene	Toluene	Ethylbenzene	Xylenes	Mineral Spirits	Boring
S2-41901 / 4'-8'	Nd	Nd	Nd	Nd	Nd	270	BH-1
S4-41901 / 12'-15'	Nd	Nd	Nd	Nd	0.26	77	BH-1
S36-41901 / 9'-12'	Nd	Nd	0.06	Nd	Nd	640	BH-10
2001 MTCA Cleanup Standards	100	.03	7	6	9	100	-

Bold indicates the results over the MTCA Method A cleanup levels.
Nd indicates analytes were not detected above the method detection limits stated.
Laboratory Test Results are located in Appendix 2.
2001 MTCA Cleanup Standards are effective 8/15/2001

Two of the samples, S4-41901 and S36-41901, exceeded the 2001 Washington Model Toxics Control Act (MTCA) Method A cleanup level for diesel-range petroleum hydrocarbons.

Samples S2-41901 and S36-41901 also exhibited mineral spirit concentrations above 2001 MTCA Method A levels (100 mg/Kg) for gasoline mixtures without Benzene and a total concentration of Toluene, Ethylbenzene and Xylenes below 1% of the total gasoline mixture. Mineral spirits are considered a 'gasoline mixture' for the purposes of determining applicable