

SEATTLE
TACOMA
PORTLAND
STOCKTON
RENO
RICHMOND
LOS ANGELES



T
E
N
T
O
N
E
I
T
S
T
I
M
E

TIME OIL CO.

2737 WEST COMMODORE WAY
P.O. BOX 24447

SEATTLE, WA 98199-1233
SEATTLE, WA 98124-0447

PHONE 285-2400
CABLE ADDRESS: TIMOIL
(FAX) 206-283-8036

Mr. Norm Hepner
Washington State Department of Ecology
Central Region
15 West Yakima Avenue
Yakima, WA 98902-3387



Yakima Co
UST 4108
Closed

RE: Transmittal of UST Removal Site Assessment Report
Time Oil Co. Property 01-068; Valley View Market
107 W. Lincoln Avenue; Sunnyside, Washington

Dear Mr. Hepner,

Please find enclosed herewith a copy of the above referenced report produced for Time Oil Co. by GeoEngineers, Inc. The following paragraphs present a brief summary of previous environmental work at the site, a summary of actions undertaken and conditions observed during the recent underground storage tank (UST) removal, our conclusions, and our plans for future work. The enclosed report contains a more detailed description of the project. Please contact me should you require any additional information.

Previous Environmental Work:

Significant soil and groundwater impacts were identified beneath the subject site and neighboring properties during site assessment activities conducted between 1997 and 1999. The site assessment activities identified a large plume of gasoline affected groundwater which emanated from the on-site UST system and extended off-site to the southeast, under South First Street, and beneath a neighboring property owned by Washington Hills Cellars (WHC). Remedial pilot testing activities conducted in 1999 determined that dual phase extraction (DPE) would be a suitable technology to remediate soil and groundwater impacts beneath the site. The remedial test data was used to develop a Cleanup Action Plan (CAP) for installation and operation of a DPE system to address both on-site and off-site impacts.

A dual-phase extraction soil and groundwater remediation system was installed at the site between May and July 2000. The remediation system commenced full-time operation in early August 2000. The remediation system configuration and operating parameters have been discussed in detail in several previously submitted groundwater monitoring and operation & maintenance reports. Operation of the DPE system has resulted in nearly complete removal of free product accumulations and significant reductions in dissolved-phase groundwater contaminant concentrations over the past three years. With the recent completion of several remediation system enhancements we expect that remedial progress will accelerate over the upcoming quarters.

Time Oil Co. discontinued retail fuel sales at the site in early 2003 and the UST system was removed in April 2003. Information contained within the following paragraphs and enclosed report documents the UST decommissioning activities and environmental excavation work that followed. Please refer to the enclosed report for a more detailed description of the work.

UST Decommissioning:

Two gasoline USTs, one dispenser island, and all corresponding product piping were removed from the site between April 15 and 17, 2003. The former UST and dispenser island locations are shown on Figure 2 of

the enclosed report. Each of the USTs displayed signs of minor pitting and scaling; however, no signs of advanced corrosion or tank failure were observed. All product lines removed from the excavation appeared to be in good condition. Field screening indicated the presence of hydrocarbon affected soil located near the UST fill ports and dispenser island. Thus, impacted soil was excavated from beneath the former UST system location prior to the collection of confirmation soil samples. Approximately 524 tons of petroleum impacted soil was excavated from beneath the site. The remedial excavation measured approximately 45 feet by 25 feet and was 23 feet deep at it's deepest point. The impacted soil was transported to Remtech Remediation Technologies, Inc.'s facility in Spokane, Washington for treatment by thermal desorbtion.

A total of seventeen soil samples were collected from the limits of the remedial excavation. The dimensions of the remedial excavation and soil sampling locations are shown on Figure 2 of the enclosed report. All recovered soil samples were analyzed for gasoline range petroleum hydrocarbons (GRPH); benzene, toluene, ethylbenzene, and total xylenes (BTEX), ethylene dibromide (EDB), ethylene dichloride (EDC), naphthalene, and methyl t-butyl ether (MTBE).

With the exception of 0.0031 mg/kg of toluene detected in a bottom sample collected from a depth of 23 feet below ground surface, none of the target analytes were detected in soil samples collected from the limits of the remedial excavation. The detected toluene concentration is significantly below it's State of Washington Model Toxics Control Act (MTCA) Method A Cleanup Level – Soil (Soil Cleanup Level).

Conclusions:

Analytical testing of soil samples collected from the limits of the remedial excavation indicates that petroleum hydrocarbons were either not detected, or detected at concentrations below Soil Cleanup Levels, in all soil samples collected. These results indicate that the remedial excavation and in-situ remedial measures underway at the site since 2000 appear to have been successful in remediating soils beneath the former UST location.

Future Work:

Significant groundwater impacts remain present beneath the site. Thus, the in-situ DPE remediation system will continue to operate for the foreseeable future. As noted above, we expect that remedial progress will accelerate due to several recently completed remediation system enhancements.

Quarterly groundwater monitoring and remediation system operation & maintenance activities will continue. Results of groundwater monitoring events conducted in April and July 2003 will be presented in forthcoming reports. The next groundwater monitoring event is scheduled for October 2003.

If you have any questions or comments concerning this letter, the report, or the information contained within either , please call me at (206) 286-6457.

Sincerely,
Time Oil Co.



Scott B. Sloan, R.G., L.Hg.
Sr. Environmental Project Manager

Encl: "UST Removal Site Assessment" Report, July 29, 2003

cc: Mr. Bruce Williams – GeoEngineers, Inc. (w/o enclosure)



UST 4108 - Closed

Report
UST Removal Site Assessment
Time Oil Property 01-068
107 West Lincoln
Sunnyside, Washington

July 29, 2003

For
Time Oil Co.

July 29, 2003

Time Oil Co.
2737 West Commodore Way
Seattle, Washington 98199-1233

Attention: Scott Sloan

Report
UST Removal Site Assessment
Time Oil Property 01-068
107 West Lincoln
Sunnyside, Washington
File No. 1957-063-03

INTRODUCTION

This report summarizes our observations during the removal of two underground storage tanks (USTs), a fuel dispenser island, and associated piping, and presents soil sampling results conducted at Time Oil Co. Property 01-068 (site). The site is located at 107 West Lincoln in Sunnyside, Washington, as shown on Vicinity Map, Figure 1. Key site features, including buildings, former site fueling equipment locations, and approximate sample locations are shown on Site and Exploration Map, Figure 2. The UST removal and sampling activities were conducted from April 15 through April 17, 2003.

SITE BACKGROUND

Time Oil operated an underground storage tank (UST) system at the subject site since 1972 under a Special Purpose Agreement. Two gasoline USTs and a fuel dispenser island were installed in 1972 and were located in the north-northeast portion of the site.

Petroleum-impacted soil was encountered in 1996 during cathodic protection installation. In 1997, Time Oil Co. authorized site assessment activities including: a drive point assessment on-site and in First Street (east of the site); installation of eight groundwater monitoring wells (MW-1 through MW-8); soil and groundwater sampling and analysis; aquifer and soil vapor extraction (SVE) testing; and a limited sensitive receptor survey. Results of the assessment

activities indicated: soil and groundwater beneath the site and east of the site were impacted with gasoline-range petroleum hydrocarbons (GRPH); groundwater flowed towards the southeast; liquid-phase hydrocarbons (LPH) were observed in several wells/drivepoints; SVE appeared to be a viable option to remediate vadose-zone soil; and use of the shallow aquifer within 0.5 miles of the site was limited to resource protection wells.

In August 1997, an SVE system was installed on-site. The SVE system consisted of underground piping connected to four on-site wells manifolded to a treatment compound located on the south side of the convenience store. A regenerative blower withdrew soil vapors from the four wells and directed the vapors through activated carbon scrub canisters. The remedial system operated until July 1998.

In 1998, Time Oil Co. authorized continued site assessment activities focused on the Washington Hills Cellars (WHC) property located east of First Street. In July and August 1998, several temporary well points (B-1 through B-11) and four additional groundwater monitoring wells (MW-9 through MW-12) were installed on the WHC property located east of the subject site. Soil and groundwater sampling was completed as part of the exploration activities. Results of the additional assessment activities indicated the gasoline plume in groundwater extended beneath the property and the downgradient extent of soil and groundwater contamination was identified.

On April 13 and 14, 1999, five additional 2-inch-diameter monitoring wells (MW-13 through MW-16 and SW-1) were installed. Wells MW-13, MW-14, and MW-15 are located on the WHC property, and MW-16 and SW-1 are located on the subject site. On May 1 and 2, 2000, two additional 2-inch-diameter monitoring wells (MW-17 and MW-18) and four, 4-inch-diameter recovery wells (RW-2 through RW-5) were installed on the WHC property; two 4-inch-diameter recovery wells (RW-6 and RW-7) were installed on First Avenue; and one 4-inch-diameter recovery well (RW-1) was installed on the subject property.

In May 2000, a bioslurp remedial system was installed at the site utilizing recovery wells RW-1 through RW-7 and monitoring wells MW-4, MW-5, and MW-9. The remediation system equipment is located on the WHC property within a locked remediation shed and fenced enclosure. The bioslurp remediation system was tested for operation on July 10, 2000, and began continuous operation on August 8, 2000.

Groundwater monitoring has been conducted at the site on a quarterly basis since March 1997. Prior to remedial system startup, LPH was observed in wells MW-4, MW-5, MW-6, MW-9, MW-13, RW-1, RW-2, RW-3, and RW-4. LPH thickness has ranged from a trace (iridescent sheen) to 3.11 feet (MW-6, 10/10/00). Petroleum hydrocarbons in groundwater samples in excess of Model Toxics Control Act (MTCA) Method A cleanup levels historically have been limited to wells MW-3, MW-14, MW-15, and MW-16, excluding wells with LPH. Following remedial startup, LPH has not been detected in remedial wells, and the thickness of LPH in monitoring well MW-6 has been reduced to approximately 0.10 feet. Monitoring well MW-6 has been purged during every site visit to remove petroleum-impacted groundwater.

The date of initial reporting of suspected or confirmed product release is unknown. The presence of the on-site monitoring well network since 1997 suggests that a suspected or confirmed release was reported to the Washington State Department of Ecology (Ecology) by Time Oil at or before that time. The Ecology site identification number is 004109. Time Oil is in the process of discontinuing the Special Purpose Agreement; hence, existing USTs and associated distribution equipment were scheduled to be removed in April 2003. We understand that the current quarterly groundwater monitoring schedule and remediation system operation and maintenance activities are expected to continue pending groundwater quality trends.

PROJECT UNDERSTANDING

The purpose of our services was to document site conditions with respect to potential petroleum hydrocarbon impact following removal of the USTs and associated fueling equipment. Results of our activities can be utilized to document UST closure and to assist in the identification of potential hydrocarbon impacts.

SCOPE OF SERVICES

Our activities included preparing a health and safety plan, observing UST removal, assessing potential petroleum-hydrocarbon impacts to soil, and providing UST closure documentation. Our services were performed in general accordance with the terms and conditions outlined in our environmental services contract between Time Oil Co. and GeoEngineers dated April 4, 2003. Our scope of services included the following:

1. Prepare a health and safety plan for GeoEngineers' field representatives to conduct UST removal observation and sampling activities.
2. Contact the one-call utility locating service prior to excavation of the USTs, dispenser island, and associated piping.
3. Observe removal of two USTs, fuel dispenser island, and product lines. Maintain a daily log of UST removal activities; documenting the condition of the tanks, fuel dispensers and product lines; and record soil conditions encountered.
4. Field screen soil for the potential presence of petroleum hydrocarbons using visual observations, water sheen tests, and/or headspace vapor testing.
5. Prepare a scaled site plan showing approximate locations of UST system components and soil and water samples.
6. Collect soil samples from: beneath the USTs, the UST excavation sidewalls, beneath the product line excavation, beneath the fuel dispenser island, clean fill stockpile, and the stockpile of petroleum-impacted soil.
7. Submit selected soil samples to North Creek Analytical (NCA) in Bothell, Washington for chemical analysis of gasoline-range petroleum hydrocarbons (GRPH) by Northwest Method NWTPH-Gx and aromatic compounds benzene, toluene, ethylbenzene and total xylenes (BTEX) by Environmental Protection Agency (EPA) Method 8021B or 8260B. Additionally,

submit selected soil samples to be analyzed for EDB, EDC, MTBE, naphthalene by EPA Method 8260B and lead by EPA Method 6020.

8. Compile and complete UST closure documentation.
9. Arrange and document petroleum-impacted soil transport activities with Pacific Environmental Services (PESCO) and off-site treatment activities with RemTech in Spokane, Washington.
10. Prepare a written report summarizing our field observations, analytical test results, and conclusions.

SITE CONDITIONS AND ACTIVITIES

SURFACE CONDITIONS

Time Oil Company Property No. 01-068 is located at 107 West Lincoln Avenue in Sunnyside, Washington. Two underground storage tanks (USTs) and product dispensers were located in the northern portion of the property. A convenience store and associated paved parking area occupy the remainder of the site. The ground surface at the site is paved with asphalt. The USTs were covered with concrete prior to their removal. The former locations of USTs and other site features are included in Figure 2.

SUBSURFACE CONDITIONS

Upon our arrival at the site on April 15, 2003, the pavement over the USTs, portions of the fuel dispenser lines, and fuel dispenser pumps and islands had been removed by PESCO using a track-mounted excavator and rubber tire backhoe. Concrete and asphalt debris was removed from the site prior to excavation activities.

We observed the native soil on the sides of the UST and dispensing island excavations during the removal operations. The exposed soil generally consisted of a loose, brown fine sand with silt. No groundwater was encountered in the excavations. Native, undisturbed soil was encountered from a depth of 1-foot to the bottom of the excavations at approximately 13 feet below ground service (bgs) in the UST excavation and approximately 23 feet bgs in the dispenser island excavation.

UST REMOVAL ACTIVITIES

Two USTs were located in the northern portion of the site. The single-wall steel tanks stored supreme unleaded, and regular unleaded gasoline. The regular unleaded gasoline tank (Tank # 316) was approximately 30-feet-long, 8-feet-diameter and had a capacity of approximately 12,000 gallons. The supreme unleaded fuel tank (Tank # 5) was approximately 20-feet-long and 8-feet in diameter and had a capacity of approximately 8,000 gallons.

PESCO excavated the surface material from the top of the tanks and removed portions of the product and vent lines prior to our arrival on April 15, 2003. PESCO performed the tank cleaning activities. On April 15, 2003, we observed PESCO inert and remove the two USTs using a track-mounted excavator under the supervision of the Sunnyside Fire Inspector. Both

USTs appeared to be in good condition and no discernable holes were observed. The USTs were loaded onto a flatbed trailer and transported by Mountain Oil to their facility in Walla Walla, Washington for destruction. UST closure documentation and tank destruction certificates are attached in Appendix A.

Field screening indicated the presence of petroleum-impacted soil near the southeast end of the 12,000 gallon UST and the dispensing island area. Field screening consisted of visual observation and headspace vapor measurements and was conducted during soil excavation to aid in identifying hydrocarbon-impacted soil. Attempts were then made to excavate areas of apparently petroleum-impacted soil. Soil excavated from the UST and dispensing island areas was stockpiled separately from the clean backfill material. Approximately 524 tons of soil were transported to RemTech in Spokane, Washington, for treatment by thermal desorption.

SOIL SAMPLING ACTIVITIES

Following soil excavation, two composite samples of the imported backfill material (Backfill-1 and Backfill-2) were collected and submitted for laboratory analysis of NWTPH-Gx. Analytical results of the sample collected from the backfill material were below the MTCA Method A cleanup levels; therefore, the material was used as fill. The backfill was placed in the excavation in 18-inch lifts and compacted utilizing a double drum rolling compactor.

Six stockpile samples (P-1 through P-6) were collected from the hydrocarbon-impacted soil removed from the UST and dispensing island excavations. The profile samples were submitted for analysis of GRPH by NWTPH-Gx, BETX by EPA Method 8021B, and lead by EPA Method 6020. Seventeen soil samples were collected from bottom and sidewalls of the excavation and submitted for chemical analysis. Soil sample locations in the UST and fuel dispensing island locations are shown on Figure 2. Soil sampling procedures are included as Appendix B.

SOIL ANALYTICAL RESULTS

Analytical results for soil profile samples P-1, P-2, P-5 and P-6 indicated the presence of one or more compounds exceeding MTCA Method A cleanup levels. Analytical results for all backfill and confirmation soil samples indicated that GRPH, BETX, naphthalene and MTBE were either not detected or detected at concentrations below applicable MTCA Method A cleanup levels. Results of soil sample analyses are presented in Table 1. A review of the analytical data quality and analytical certificates are included in Appendix C.

CONCLUSIONS

Two USTs and associated fuel dispensing and product lines were removed from the site in April 2003. Field observations and analytical data from the UST removal activities conducted in April 2003 indicate the site meets the MTCA Method A cleanup criteria. No groundwater was encountered during site excavation activities.

LIMITATIONS

We have prepared this report for use by the Time Oil Co., for the UST Removal and Site Assessment of Time Oil Property 01-068 in Sunnyside, Washington.

Within the limitations of scope, schedule and budget, our services have been executed in accordance with generally accepted environmental science practices in this area at the time this report was prepared. No warranty or other conditions, express or implied, should be understood.

We appreciate the opportunity to provide these services to Time Oil Co. Please call if you have questions regarding this report.

Respectfully submitted,

GeoEngineers, Inc.

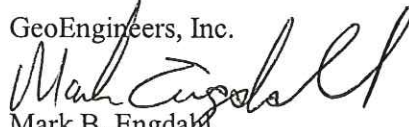

Mark B. Engdahl
Staff Geologist



Bruce D. Williams
Associate

EAH: MBE: tlm

Docid: Spok: P:\01\1957063\03\Finals\195706303 UST Removal Rpt.doc

Attachments

- Figure 1 – Vicinity Map
- Figure 2 – Site and Exploration Map
- Table 1 – Summary of Chemical Analytical Results - Soil
- Attachment A – UST Closure Documentation, Destruction Certificates and Soil Disposal Scale Logs
- Attachment B – Soil Sampling Procedures
- Attachment C – Chemical Analytical Data

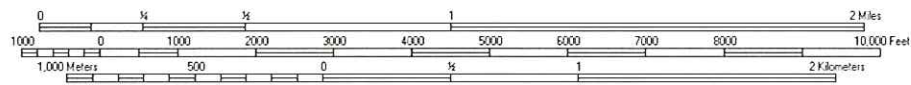
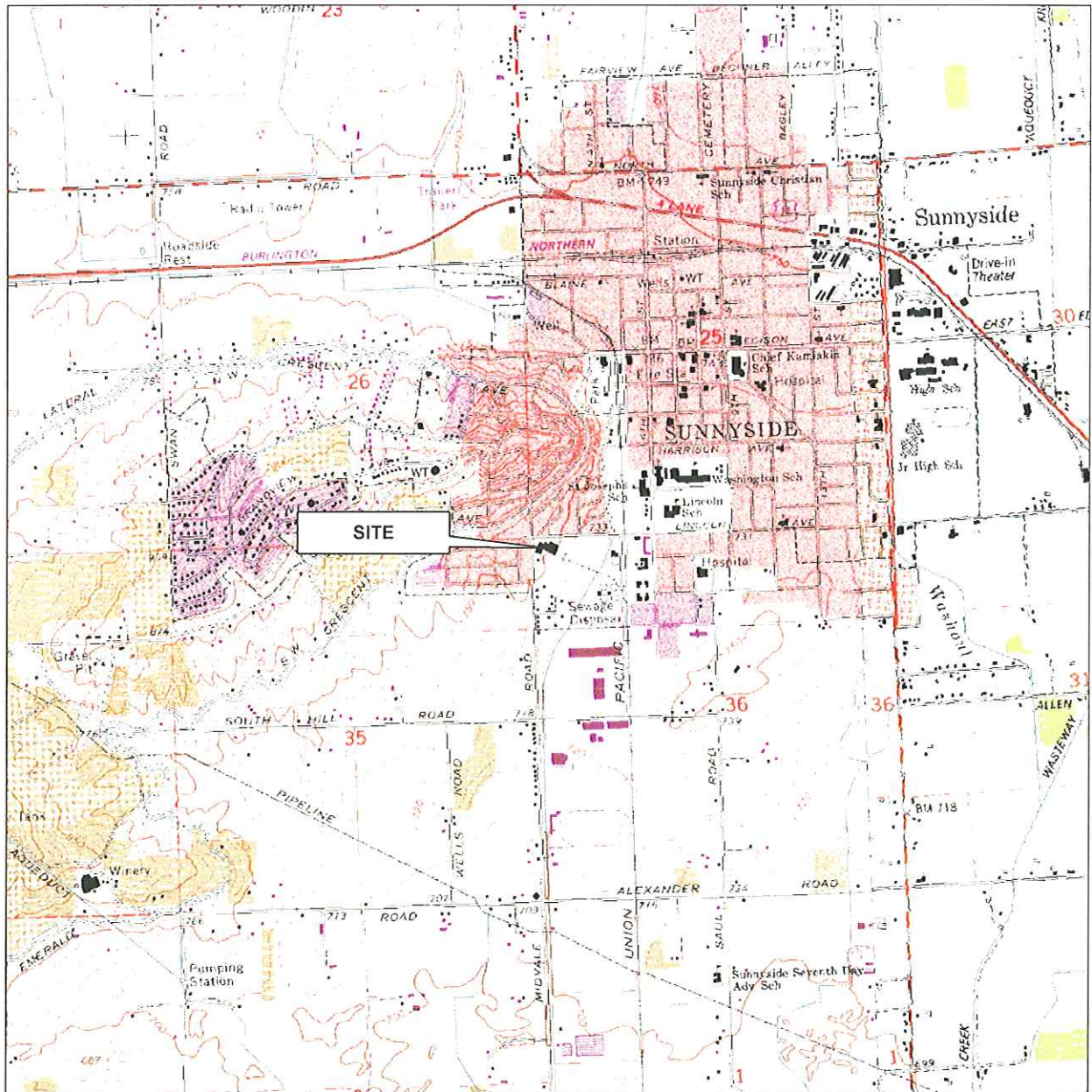

Reference; All Topo Maps "Sunnyside and Grandview, WA"



VICINITY MAP

FIGURE 1

EAH: TLM
 195706303-FIG2.DWG
 195706303:072303

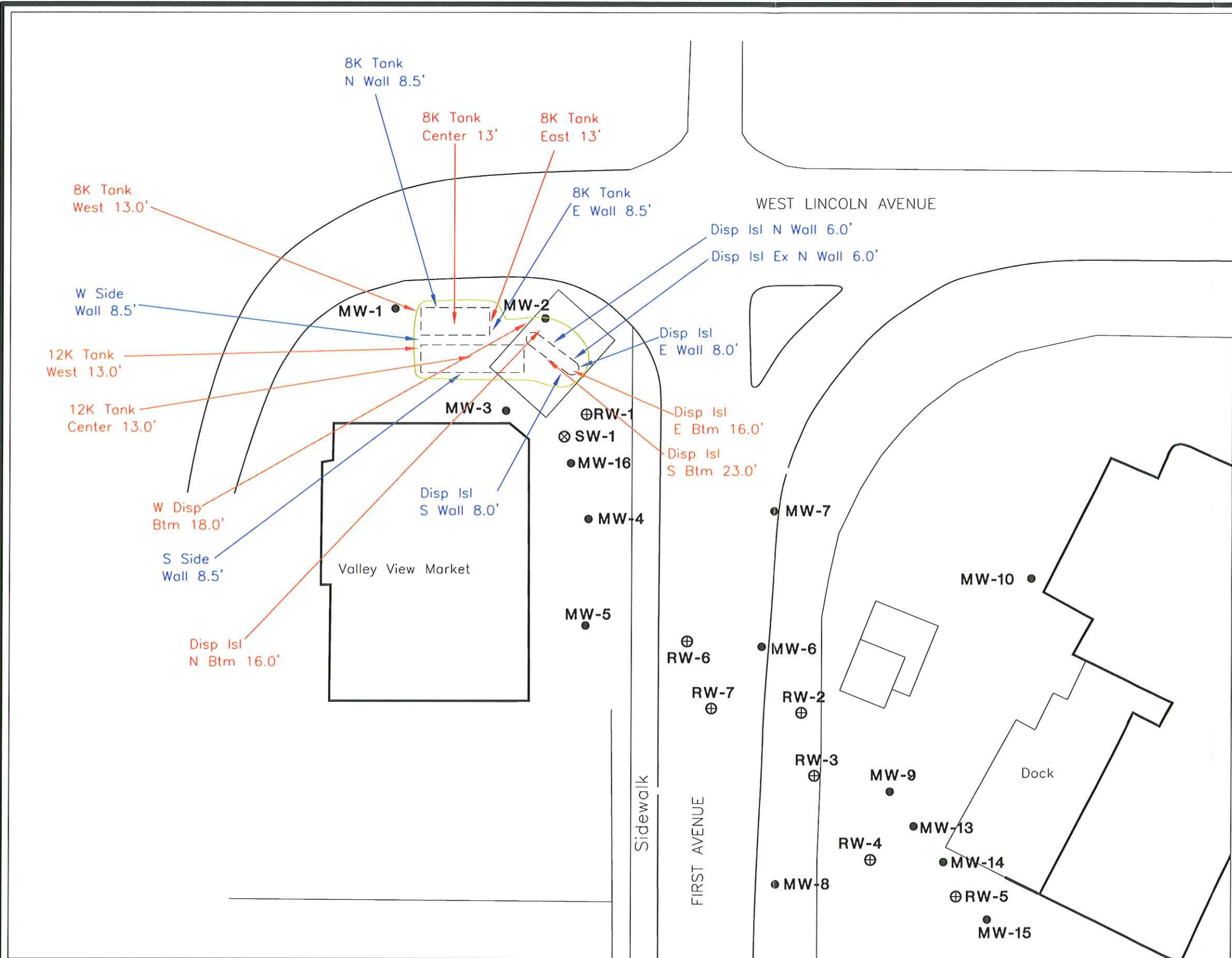

EXPLANATION:

	EXCAVATION LIMITS
	8K TANK CENTER 13.0' SAMPLE LOCATION AT BASE OF EXCAVATION
	8K TANK N WALL 8.5' SAMPLE LOCATION FROM SIDEWALL OF EXCAVATION
	FORMER TANK LOCATION
	FORMER DISPENSER ISLAND LOCATION

- Notes:**
1. The locations of all features shown are approximate.
 2. This drawing is for information purposes. It is intended to assist in showing features discussed in an attached document. GeoEngineers, Inc. can not guarantee the accuracy and content of electronic files. The master file is stored by GeoEngineers, Inc. and will serve as the official record of this communication.

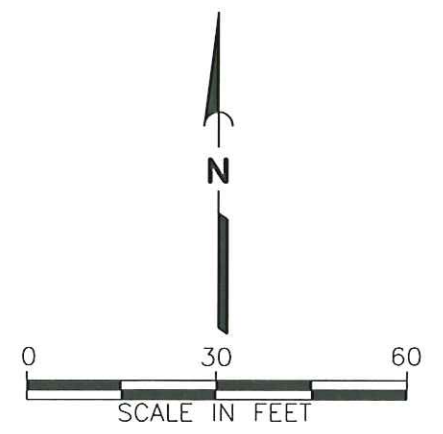

SITE AND EXPLORATION MAP

FIGURE 2

TABLE 1

SUMMARY OF CHEMICAL ANALYTICAL RESULTS - SOIL¹
 TIME OIL COMPANY PROPERTY 01-068
 SUNNYSIDE, WASHINGTON

SAMPLE NUMBER	DATE SAMPLED	GRP ² (mg/kg)	BENZENE ³ (mg/kg)	TOLUENE ³ (mg/kg)	ETHYL-BENZENE ³ (mg/kg)	TOTAL XYLENES ³ (mg/kg)	EDB ⁴ (mg/kg)	EDC ⁵ (mg/kg)	NAPH-THALENE ⁶ (mg/kg)	METHYL TERT-BUTYL ETHER ⁶ (mg/kg)	LEAD ⁷ (mg/kg)
P-1	4/15/2003	11,600	<0.600	72.6	52.5	1,180	--	--	--	--	9.48
P-2	4/15/2003	8,620	<0.300	45.4	49.7	676	--	--	--	--	33.8
P-3	4/15/2003	35.9	<0.0300	0.275	0.235	2.82	--	--	--	--	12.6
P-4	4/15/2003	6.14	<0.0300	<0.0500	<0.0500	0.454	--	--	--	--	12.5
P-5	4/16/2003	1,300	0.468	45.2	15.4	239	--	--	--	--	18.2
P-6	4/16/2003	4,070	<0.600	85.1	54	738	--	--	--	--	9.69
Backfill-1	4/15/2003	<5.00	<0.0300	<0.0500	<0.0500	<0.100	--	--	--	--	--
Backfill-2	4/15/2003	<5.00	<0.0300	<0.0500	<0.0500	<0.100	--	--	--	--	--
8 K Tank Center 13'	4/15/2003	<5.00	<0.00150	<0.00150	<0.00400	<0.0100	<0.00500	<0.00125	<0.00500	<0.00100	--
8 K Tank West 13'	4/15/2003	<5.00	<0.00150	<0.00150	<0.00400	<0.0100	<0.00500	<0.00125	<0.00500	<0.00100	--
8 K Tank East 13'	4/15/2003	<5.00	<0.00150	<0.00150	<0.00400	<0.0100	<0.00500	<0.00125	<0.00500	<0.00100	--
8 K Tank N Wall 8.5'	4/15/2003	<5.00	<0.00150	<0.00150	<0.00400	<0.0100	<0.00500	<0.00125	<0.00500	<0.00100	--
S. Side Wall 8.5'	4/15/2003	<5.00	<0.00150	<0.00150	<0.00400	<0.0100	<0.00500	<0.00125	<0.00500	<0.00100	--
12 K Tank Center 13'	4/15/2003	<5.00	<0.00150	<0.00150	<0.00400	<0.0100	<0.00500	<0.00125	<0.00500	<0.00100	--
W Side Wall 8.5'	4/15/2003	<5.00	<0.00150	<0.00150	<0.00400	<0.0100	<0.00500	<0.00125	<0.00500	<0.00100	--
12 K Tank West 13'	4/15/2003	<5.00	<0.00150	<0.00150	<0.00400	<0.0100	<0.00500	<0.00125	<0.00500	<0.00100	--
8 K Tank E Wall 8.5'	4/16/2003	<5.00	<0.00150	<0.00150	<0.00400	<0.0100	<0.00500	<0.00125	<0.00500	<0.00100	--
Disp Isl N Wall 6.0'	4/16/2003	<5.00	<0.00150	<0.00150	<0.00400	<0.0100	<0.00500	<0.00125	<0.00500	<0.00100	--
Disp Isl Ex N Wall 10.0'	4/16/2003	<5.00	<0.00150	<0.00150	<0.00400	<0.0100	<0.00500	<0.00125	<0.00500	<0.00100	--
Disp Isl E Wall 8.0'	4/16/2003	<5.00	<0.00150	<0.00150	<0.00400	<0.0100	<0.00500	<0.00125	<0.00500	0.00904	--
Disp Isl S Wall 8.0'	4/16/2003	<5.00	<0.00150	<0.00150	<0.00400	<0.0100	<0.00500	<0.00125	<0.00500	<0.00100	--
Disp Isl E Btm 16.0'	4/16/2003	<5.00	<0.00150	<0.00150	<0.00400	<0.0100	<0.00500	<0.00125	<0.00500	<0.00100	--
Disp Isl N Btm 16.0'	4/16/2003	<5.00	<0.00150	<0.00150	<0.00400	<0.0100	<0.00500	<0.00125	<0.00500	<0.00100	--
Disp Isl S Btm 23.0'	4/16/2003	<5.00	<0.00150	0.00311	<0.00400	<0.0100	<0.00500	<0.00125	<0.00500	<0.00100	--
W Disp Btm 18.0	4/16/2003	<5.00	<0.00150	<0.00150	<0.00400	<0.0100	<0.00500	<0.00125	<0.00500	<0.00100	--
MTCA ⁸ Method A cleanup levels		100/30 ⁹	0.03	7	6	9	0.005	N/L ¹⁰	5	0.1	250

TABLE 1

Notes:

1. Chemical analyses conducted by North Creek Analytical of Bothell, Washington.
2. GRPH = Gasoline-range petroleum hydrocarbons by Northwest Method NWTPH-Gx.
3. Benzene, toluene, ethylbenzene, and total xylenes as analyzed by EPA Method 8021B or 8260B.
4. EDB = 1,2-Dibromoethane as analyzed by EPA Method 8260B.
5. EDC = 1,2-Dichloroethane as analyzed by EPA Method 8260B.
6. Methyl tert-butyl ether and Naphthalene analyzed by EPA 8260B.
7. Lead analyzed by EPA 6020.
8. MTCA = Washington State, Model Toxics Control Act, Method A Cleanup levels
9. 100 mg/kg when benzene is not present and 30 mg/kg when benzene is present.
10. N/L = Not Listed

Bold indicates analyte detection above cleanup criteria.

mg/kg = milligrams per kilogram.

-- = not analyzed

ATTACHMENT A

ATTACHMENT A

**UST CLOSURE DOCUMENTATION, DESTRUCTION CERTIFICATES AND SOIL
DISPOSAL SCALE LOGS**



UNDERGROUND STORAGE TANK Site Check/Site Assessment Checklist

FOR OFFICE USE ONLY
 Site #: _____
 Owner #: _____

INSTRUCTIONS

When a release has not been confirmed and reported, this Site Check/Site Assessment Checklist must be completed and signed by a person certified by IFCI or a Washington registered professional engineer who is competent, by means of examination, experience, or education, to perform site assessments. **The results of the site check or site assessment must be included with this checklist.** This form must be submitted to Ecology at the address shown below within 30 days after completion of the site check/site assessment.

SITE INFORMATION: Include the Ecology site ID number if the tanks are registered with Ecology. This number may be found on the tank owner's invoice or tank permit.

TANK INFORMATION: Please list all tanks for which the site check or site assessment is being conducted. Use the owner's tank ID numbers if available, and indicate tank capacity and substance stored.

REASON FOR CONDUCTING SITE CHECK/SITE ASSESSMENT: Please check the appropriate item.

CHECKLIST: Please initial each item in the appropriate box.

SITE ASSESSOR INFORMATION: This information must be signed by the registered site assessor who is responsible for conducting the site check/site assessment.

Underground Storage Tank Section
 Department of Ecology
 PO Box 47655
 Olympia WA 98504-7655

SITE INFORMATION

Site ID Number (Available from Ecology if the tanks are registered): 02821-03
004109 4108
 Site/Business Name: Valley View Market
 Site Address: 107 W Lincoln Ave Telephone: (509) 837-3817
Sunnyside Street
 City State Zip Code
WA
98944

TANK INFORMATION

Tank ID No.	Tank Capacity	Substance Stored
<u>5</u>	<u>8,000 Gallon</u>	<u>Gasoline</u>
<u>316</u>	<u>12,000 Gallon</u>	<u>Gasoline</u>

REASON FOR CONDUCTING SITE CHECK/SITE ASSESSMENT

Check one:

- Investigate suspected release due to on-site environmental contamination.
- Investigate suspected release due to off-site environmental contamination.
- Extend temporary closure of UST system for more than 12 months.
- UST system undergoing change-in-service.
- UST system permanently closed with tank removed.
- Abandoned tank containing product.
- Required by Ecology or delegated agency for UST system closed before 12/22/88.
- Other (describe): _____

CHECKLIST

Each item of the following checklist shall be initiated by the person registered with the Department of Ecology whose signature appears below.

	YES	NO
1. The location of the UST site is shown on a vicinity map.	ME	
2. A brief summary of information obtained during the site inspection is provided. (see Section 3.2 in site assessment guidance)	ME	
3. A summary of UST system data is provided. (see Section 3.1.)	ME	
4. The soils characteristics at the UST site are described. (see Section 5.2)	ME	
5. Is there any apparent groundwater in the tank excavation?		ME
6. A brief description of the surrounding land use is provided. (see Section 3.1)	ME	
7. Information has been provided indicating the number and types of samples collected, methods used to collect and analyze the samples, and the name and address of the laboratory used to perform the analyses.	ME	
8. A sketch or sketches showing the following items is provided:		
- location and ID number for all field samples collected	ME	
- groundwater samples distinguished from soil samples (if applicable)	NA	
- samples collected from stockpiled excavated soil	ME	
- tank and piping locations and limits of excavation pit	ME	
- adjacent structures and streets	ME	
- approximate locations of any on-site and nearby utilities	ME	
9. If sampling procedures different from those specified in the guidance were used, has justification for using these alternative sampling procedures been provided? (see Section 3.4)	NA	
10. A table is provided showing laboratory results for each sample collected including; sample ID number, constituents analyzed for and corresponding concentration, analytical method and detection limit for that method.	ME	
11. Any factors that may have compromised the quality of the data or validity of the results are described.	ME	
12. The results of this site check/site assessment indicate that a confirmed release of a regulated substance has occurred.	ME	

SITE ASSESSOR INFORMATION

Mark Engdahl
Person registered with Ecology

Geo Engineers
Firm Affiliated with

Business Address: 523 E 2nd Ave
Street

Telephone: () _____

Spokane
City

WA
State

99202
Zip Code

I hereby certify that I have been in responsible charge of performing the site check/site assessment described above. Persons submitting false information are subject to penalties under Chapter 173.360 WAC.

4/28/03
Date

Mark Engdahl
Signature of Person Registered with Ecology



UNDERGROUND STORAGE TANK Closure and Site Assessment Notice

FOR OFFICE USE ONLY

Site ID #: _____

Owner ID #: _____

See back of form for instructions

Please the appropriate box(es)

Temporary Tank Closure Change-In-Service Permanent Tank Closure Site Check/ Site Assessment

Site Information

Site ID Number 98168651
(Available from Ecology if the tanks are registered)

Site/Business Name Valley View Market

Site Address 107 W. Lincoln
Street

City/State Sunnyside, WA

Zip Code 98944 Telephone (509) 837-3817

Owner Information

(This form will be returned to this address)

UST Owner/Operator Time Oil Company

Mailing Address 2737 W. Commodore Way
Street

P.O. Box 24447
P.O. Box

City/State Seattle, WA

Zip Code 98124 Telephone (206) 285-2400

Tank Closure/Change-In-Service Company

Service Company Pacific Environmental Services Company

Certified Supervisor Thomas E. Cusick Decommissioning Certification No. 1044663-26

Supervisor's Signature *Thomas E. Cusick*

Address 13022 W. 18th Avenue
Street

Airway Heights, WA 99001
City State Zip Code

P.O. Box 639
P.O. Box

Telephone (509) 244-4898

Site Check/Site Assessor

Certified Site Assessor GEO Engineers - Bruce Williams

Address 523 E. 2nd Avenue
Street

Spokane, WA 99202
City State Zip Code

P.O. Box
P.O. Box

Telephone (509) 363-3125

Tank Information

Tank ID	Closure Date	Closure Method	Tank Capacity	Substance Stored
1	4-15-03	Removal	8,000	Gasoline
2	4-15-03	Removal	12,000	Gasoline

Contamination Present at the Time of Closure

Yes No Unknown

Check unknown if no obvious contamination was observed and sample results have not yet been received from analytical lab.

Yes No

If contamination is present, has the release been reported to the appropriate regional office?

1205 North 11th
P.O. Box 2216
Walla Walla, WA 99362-0362
FAX: (509) 529-9064



Phone (509) 527-3400
WA 800-572-8900
Out of State 800-541-7808

4-21-2003

**PACIFIC ENVIRONMENTAL
SERVICES COMPANY**

8585 Highway 20

PO Box 2049

Port Townsend, Wa. 98368-0239

Phone: 1-800-222-9219

Fax: 1-509-244-4690

Attn: Bill

Re: TANK DISPOSAL

This is to certify that 1-8,000 gallon & 1-12,000 tanks were removed from Time Oil's facility located at 107 W. Lincoln, Sunnyside, Wa. on April 15, 2003. These tanks were hauled to Walla Walla, Washington, cleaned & recycled to scrap.

Sincerely,

**Roger Dillon
Sales Manager**

REMTECH

SCALE LOG

Contract No. _____

Sheet 1 of _____ MARK

Date 4-16 ~~17~~ 2003

TRUCK NO.	GROSS WEIGHT	TARE WEIGHT	NET WEIGHT
T# 23	54760	25260	29500
P# 23	45320	12360	32960
T# 17	43060	24140	18920
P# 17	28940	11280	17660
T# 3	50820	24200	26620
P# 3	43880	12900	30980
T# 20	47280	23560	23720
P# 20	43460	13220	30240
T# 15	48740	24280	24460
P# 15	48540	12680	35860

TRUCK NO.	GROSS WEIGHT	TARE WEIGHT	NET WEIGHT

COMMENTS

TIME OUT PCS
GEO-ENGINEERS

SUNNYSIDE, WA

TOTAL NO. OF TRUCKS 5
TOTAL NET WEIGHT 270,920

ATTENDANT BRUCE HAVENS
SIGNATURE Bruce Havens

REMTECH

SCALE LOG

Contract No. _____

Sheet 2 of _____

Date 4-17-2003

TRUCK NO.	GROSS WEIGHT	TARE WEIGHT	NET WEIGHT
T# 15	55820	24420	31400
P# 15	46060	12720	33340
T# 16	54380	25640	28740
P# 16	48340	12640	35700
T# 18	56520	24780	31740
P# 18	48920	12800	36120
T# 23	51800	24820	26980
P# 23	42460	12380	30080
T# 3	51280	23940	27340
P# 3	41660	13220	28440
T# 20	47500	23800	23700
P# 20	40900	12560	28340
T# 8	54800	28100	26700
P# 8	36460	11860	24600
T# 6	49120	23480	25640
P# 6	38440	12300	26140

TRUCK NO.	GROSS WEIGHT	TARE WEIGHT	NET WEIGHT

COMMENTS

TIME OIL

PCS

GEO-ENGINEERS

SUNNYSIDE, USA

TOTAL NO. OF TRUCKS 8

ATTENDANT BRUCE HAVENS

TOTAL NET WEIGHT 465,000

SIGNATURE Bruce Havens

REMTECH

SCALE LOG

Contract No. _____

Sheet 4 of _____

Date 4-21, 2003

TRUCK NO.	GROSS WEIGHT	TARE WEIGHT	NET WEIGHT
<u>T# 2</u>	<u>53160</u>	<u>26320</u>	<u>26840</u>
<u>P# 2</u>	<u>40580</u>	<u>12100</u>	<u>28480</u>

TRUCK NO.	GROSS WEIGHT	TARE WEIGHT	NET WEIGHT

COMMENTS

TIME OIL

PCS

GEO ENGINEERS

SUNNYSIDE, WA

TOTAL NO. OF TRUCKS 1

ATTENDANT BRUCE HAVENS

TOTAL NET WEIGHT 55,320

SIGNATURE Bruce Havens

REMTECH

SCALE LOG

Contract No. 03-002

Sheet 1 of 1

Date 4-22-2003

TRUCK NO.	GROSS WEIGHT	TARE WEIGHT	NET WEIGHT
1	44,960	23,280	21,680

TRUCK NO.	GROSS WEIGHT	TARE WEIGHT	NET WEIGHT

COMMENTS

Hauled By Downing.
Geo Engineers / Time Oil, Sunnyside, WA

TOTAL NO. OF TRUCKS 1

ATTENDANT R. Carpenter

TOTAL NET WEIGHT 21,680

SIGNATURE [Signature]

ATTACHMENT B

ATTACHMENT B

SOIL SAMPLING PROCEDURES

A geologist from our staff selected the soil sample locations and documented site conditions encountered during the UST removal activities.

Discrete soil samples were obtained from the limits of the excavation and from the soil stockpiles. Soil samples were obtained directly from the excavation or stockpile using clean, new, disposable nitrile gloves or were obtained with the aid of the contractor's excavation equipment. Samples retrieved with the contractor's equipment were obtained from the center of the excavator bucket. New nitrile gloves were used before each sample collection. The samples were obtained from 1 foot below the surface of the soil stockpile.

Field screening was performed on a portion of each soil sample. The remaining portion of each soil sample selected for chemical analysis was transferred to sample jars provided by the laboratory. The sample jars were filled completely to minimize headspace. The samples were placed in a cooler with blue ice and packing material for transportation to the laboratory.

FIELD SCREENING OF SOIL SAMPLES

Soil samples obtained from the excavations and stockpiles were screened in the field for evidence of petroleum-related impact using (1) visual observation, and (2) headspace vapor screening with a PhotoVac photoionization detector (PID).

Visual screening consists of evaluating the soil for stains indicative of petroleum-related contamination. Visual screening is generally more effective when contamination is related to heavy petroleum hydrocarbons such as motor oil or when hydrocarbon concentrations are high. Headspace vapor screening is a more sensitive method that has been effective in detecting contamination at concentrations less than regulatory cleanup guidelines.

Headspace vapor screening involves placing a soil sample in a plastic sample bag. Air is captured in the bag and the bag is shaken to expose the soil to the air trapped in the bag. The probe of a PhotoVac PID sample tube is inserted in the bag and the PID measures the concentration of combustible vapor in the air removed from the sample headspace. The PID measures vapor concentrations in parts per million (ppm) and is calibrated to isobutylene. The PID quantification range is between 0 and 2,000 ppm.

Field screening results are site-specific and vary with soil type, soil moisture content, temperature and type of contaminant.

ATTACHMENT C

ATTACHMENT C

CHEMICAL ANALYTICAL DATA

SAMPLES

Chain-of-custody procedures were followed during the transport of the field samples to the accredited analytical laboratory. Soil samples were held in cold storage pending extraction and/or analysis. The analytical results and quality control records are included in this appendix.

ANALYTICAL DATA REVIEW

The laboratory maintains an internal quality assurance/quality control (QA/QC) program as documented in its laboratory quality assurance manual. The laboratory uses a combination of blanks, surrogate recoveries, duplicates, matrix spike recoveries, matrix spike duplicate recoveries, blank spike recoveries and blank spike duplicate recoveries to evaluate the analytical results. The laboratory also uses data quality goals for individual chemicals or groups of chemicals based on the long-term performance of the test methods. The data quality goals were included in the laboratory reports. The laboratory compared each group of samples with the existing data quality goals and noted any exceptions in the laboratory report. Any data quality exceptions documented by the accredited laboratory were reviewed by GeoEngineers and are addressed in the data quality exception section of this appendix.

DATA QUALITY EXCEPTION SUMMARY

The laboratory noted the following data quality exceptions:

Soil Sample Results

- The primary and secondary surrogate recoveries for samples P-1, P-2 and P-6 were not available due to the dilution required from high analyte concentrations and/or matrix interference.
- The primary surrogate recovery for sample P-5 could not be accurately quantified due to interference from coeluting compounds.
- The secondary surrogate recovery for sample P-5 was outside of established control limits due to matrix interference.
- The spike recovery for benzene in the matrix spike duplicate (3D16024-MSD1) was outside of established control limits; however, a review of the associated batch QC indicates the recovery does not represent an out-of-control condition for the batch.

Based on our data quality review, it is our opinion that the analytical data are of acceptable quality for their intended use.



Seattle 11720 North Creek Pkwy N, Suite 400, Bothell, WA 98011-8244
425.420.9200 fax 425.420.9210
Spokane East 11115 Montgomery, Suite B, Spokane, WA 99206-4776
509.924.9200 fax 509.924.9290
Portland 9405 SW Nimbus Avenue, Beaverton, OR 97008-7132
503.906.9200 fax 503.906.9210
Bend 20332 Empire Avenue, Suite F-1, Bend, OR 97701-5711
541.383.9310 fax 541.382.7588
Anchorage 3209 Denali Street, Anchorage, AK 99503
907.334.9200 fax 907.334.9210

17 April 2003

Mark Engdahl
Geo Engineers - Spokane
523 East 2nd
Spokane, WA/USA 99202
RE: Time Oil-Sunnyside

Enclosed are the results of analyses for samples received by the laboratory on 04/16/03 09:00. If you have any questions concerning this report, please feel free to contact me.

Sincerely,

Amar Gill
Project Manager



Seattle 11720 North Creek Pkwy N, Suite 400, Bothell, WA 98011-8244
425.420.9200 fax 425.420.9210

Spokane East 11115 Montgomery, Suite B, Spokane, WA 99206-4776
509.924.9200 fax 509.924.9290

Portland 9405 SW Nimbus Avenue, Beaverton, OR 97008-7132
503.906.9200 fax 503.906.9210

Bend 20332 Empire Avenue, Suite F-1, Bend, OR 97701-5711
541.383.9310 fax 541.382.7588

Anchorage 3209 Denali Street, Anchorage, AK 99503
907.334.9200 fax 907.334.9210

Geo Engineers - Spokane
523 East 2nd
Spokane WA/USA, 99202

Project: Time Oil-Sunnyside
Project Number: 19063-003-01
Project Manager: Mark Engdahl

Reported:
04/17/03 15:30

ANALYTICAL REPORT FOR SAMPLES

Sample ID	Laboratory ID	Matrix	Date Sampled	Date Received
P-1	B3D0346-01	Soil	04/15/03 08:00	04/16/03 09:00
P-2	B3D0346-02	Soil	04/15/03 08:30	04/16/03 09:00
P-3	B3D0346-03	Soil	04/15/03 09:15	04/16/03 09:00
P-4	B3D0346-04	Soil	04/15/03 09:30	04/16/03 09:00
Backfill-1	B3D0346-05	Soil	04/15/03 08:45	04/16/03 09:00
Backfill-2	B3D0346-06	Soil	04/15/03 09:00	04/16/03 09:00

North Creek Analytical - Bothell

The results in this report apply to the samples analyzed in accordance with the chain of custody document. This analytical report must be reproduced in its entirety.

Amar Gill, Project Manager

North Creek Analytical, Inc.
Environmental Laboratory Network



Seattle 11720 North Creek Pkwy N, Suite 400, Bothell, WA 98011-8244
 425.420.9200 fax 425.420.9210
 Spokane East 11115 Montgomery, Suite B, Spokane, WA 99206-4776
 509.924.9200 fax 509.924.9290
 Portland 9405 SW Nimbus Avenue, Beaverton, OR 97008-7132
 503.906.9200 fax 503.906.9210
 Bend 20332 Empire Avenue, Suite F-1, Bend, OR 97701-5711
 541.383.9310 fax 541.382.7588
 Anchorage 3209 Denali Street, Anchorage, AK 99503
 907.334.9200 fax 907.334.9210

Geo Engineers - Spokane
 523 East 2nd
 Spokane WA/USA, 99202

Project: Time Oil-Sunnyside
 Project Number: 19063-003-01
 Project Manager: Mark Engdahl

Reported:
 04/17/03 15:30

Volatile Petroleum Products and BTEX by NWTPH-Gx and EPA 8021B
North Creek Analytical - Bothell

Analyte	Result	Reporting Limit	Units	Dilution	Batch	Prepared	Analyzed	Method	Notes
P-1 (B3D0346-01) Soil Sampled: 04/15/03 08:00 Received: 04/16/03 09:00									
Gasoline Range Hydrocarbons	11600	100	mg/kg dry	20	3D16024	04/16/03	04/16/03	NWTPH-Gx/8021B	
Benzene	ND	0.600	"	"	"	"	"	"	
Toluene	72.6	1.00	"	"	"	"	"	"	
Ethylbenzene	52.5	1.00	"	"	"	"	"	"	
Xylenes (total)	1180	10.0	"	100	"	"	04/16/03	"	
Surrogate: 4-BFB (FID)	%	59-125			"	"	04/16/03	"	S-01
Surrogate: 4-BFB (PID)	%	64-125			"	"	"	"	S-01
P-2 (B3D0346-02) Soil Sampled: 04/15/03 08:30 Received: 04/16/03 09:00									
Gasoline Range Hydrocarbons	8620	500	mg/kg dry	100	3D16024	04/16/03	04/16/03	NWTPH-Gx/8021B	
Benzene	ND	0.300	"	10	"	"	04/16/03	"	
Toluene	45.4	0.500	"	"	"	"	"	"	
Ethylbenzene	49.7	0.500	"	"	"	"	"	"	
Xylenes (total)	676	10.0	"	100	"	"	04/16/03	"	
Surrogate: 4-BFB (FID)	%	59-125			"	"	"	"	S-01
Surrogate: 4-BFB (PID)	%	64-125			"	"	04/16/03	"	S-01
P-3 (B3D0346-03) Soil Sampled: 04/15/03 09:15 Received: 04/16/03 09:00									
Gasoline Range Hydrocarbons	35.9	5.00	mg/kg dry	1	3D16024	04/16/03	04/16/03	NWTPH-Gx/8021B	
Benzene	ND	0.0300	"	"	"	"	"	"	
Toluene	0.275	0.0500	"	"	"	"	"	"	
Ethylbenzene	0.235	0.0500	"	"	"	"	"	"	
Xylenes (total)	2.82	0.100	"	"	"	"	"	"	
Surrogate: 4-BFB (FID)	94.3 %	59-125			"	"	"	"	
Surrogate: 4-BFB (PID)	102 %	64-125			"	"	"	"	

North Creek Analytical - Bothell

Amar Gill, Project Manager

The results in this report apply to the samples analyzed in accordance with the chain of custody document. This analytical report must be reproduced in its entirety.



Seattle 11720 North Creek Pkwy N, Suite 400, Bothell, WA 98011-8244
 425.420.9200 fax 425.420.9210
 Spokane East 11115 Montgomery, Suite B, Spokane, WA 99206-4776
 509.924.9200 fax 509.924.9290
 Portland 9405 SW Nimbus Avenue, Beaverton, OR 97008-7132
 503.906.9200 fax 503.906.9210
 Bend 20332 Empire Avenue, Suite F-1, Bend, OR 97701-5711
 541.383.9310 fax 541.382.7588
 Anchorage 3209 Denali Street, Anchorage, AK 99503
 907.334.9200 fax 907.334.9210

Geo Engineers - Spokane 523 East 2nd Spokane WA/USA, 99202	Project: Time Oil-Sunnyside Project Number: 19063-003-01 Project Manager: Mark Engdahl	Reported: 04/17/03 15:30
--	--	-----------------------------

**Volatile Petroleum Products and BTEX by NWTPH-Gx and EPA 8021B
 North Creek Analytical - Bothell**

Analyte	Result	Reporting Limit	Units	Dilution	Batch	Prepared	Analyzed	Method	Notes
P-4 (B3D0346-04) Soil Sampled: 04/15/03 09:30 Received: 04/16/03 09:00									
Gasoline Range Hydrocarbons	6.14	5.00	mg/kg dry	1	3D16024	04/16/03	04/16/03	NWTPH-Gx/8021B	
Benzene	ND	0.0300	"	"	"	"	"	"	"
Toluene	ND	0.0500	"	"	"	"	"	"	"
Ethylbenzene	ND	0.0500	"	"	"	"	"	"	"
Xylenes (total)	0.454	0.100	"	"	"	"	"	"	"
Surrogate: 4-BFB (FID)	79.7 %	59-125			"	"	"	"	"
Surrogate: 4-BFB (PID)	91.2 %	64-125			"	"	"	"	"
Backfill-1 (B3D0346-05) Soil Sampled: 04/15/03 08:45 Received: 04/16/03 09:00									
Gasoline Range Hydrocarbons	ND	5.00	mg/kg dry	1	3D16024	04/16/03	04/16/03	NWTPH-Gx/8021B	
Benzene	ND	0.0300	"	"	"	"	"	"	"
Toluene	ND	0.0500	"	"	"	"	"	"	"
Ethylbenzene	ND	0.0500	"	"	"	"	"	"	"
Xylenes (total)	ND	0.100	"	"	"	"	"	"	"
Surrogate: 4-BFB (FID)	74.2 %	59-125			"	"	"	"	"
Surrogate: 4-BFB (PID)	87.1 %	64-125			"	"	"	"	"
Backfill-2 (B3D0346-06) Soil Sampled: 04/15/03 09:00 Received: 04/16/03 09:00									
Gasoline Range Hydrocarbons	ND	5.00	mg/kg dry	1	3D16024	04/16/03	04/16/03	NWTPH-Gx/8021B	
Benzene	ND	0.0300	"	"	"	"	"	"	"
Toluene	ND	0.0500	"	"	"	"	"	"	"
Ethylbenzene	ND	0.0500	"	"	"	"	"	"	"
Xylenes (total)	ND	0.100	"	"	"	"	"	"	"
Surrogate: 4-BFB (FID)	74.8 %	59-125			"	"	"	"	"
Surrogate: 4-BFB (PID)	94.6 %	64-125			"	"	"	"	"

North Creek Analytical - Bothell

The results in this report apply to the samples analyzed in accordance with the chain of custody document. This analytical report must be reproduced in its entirety.

Amar Gill, Project Manager

North Creek Analytical, Inc.
 Environmental Laboratory Network



Seattle 11720 North Creek Pkwy N, Suite 400, Bothell, WA 98011-8244
 425.420.9200 fax 425.420.9210
 Spokane East 11115 Montgomery, Suite B, Spokane, WA 99206-4776
 509.924.9200 fax 509.924.9290
 Portland 9405 SW Nimbus Avenue, Beaverton, OR 97008-7132
 503.906.9200 fax 503.906.9210
 Bend 20332 Empire Avenue, Suite F-1, Bend, OR 97701-5711
 541.383.9310 fax 541.382.7588
 Anchorage 3209 Denali Street, Anchorage, AK 99503
 907.334.9200 fax 907.334.9210

Geo Engineers - Spokane 523 East 2nd Spokane WA/USA, 99202	Project: Time Oil-Sunnyside Project Number: 19063-003-01 Project Manager: Mark Engdahl	Reported: 04/17/03 15:30
--	--	-----------------------------

**Total Metals by EPA 6000/7000 Series Methods
 North Creek Analytical - Bothell**

Analyte	Result	Reporting Limit	Units	Dilution	Batch	Prepared	Analyzed	Method	Notes
P-1 (B3D0346-01) Soil Sampled: 04/15/03 08:00 Received: 04/16/03 09:00									
Lead	9.48	0.500	mg/kg dry	1	3D16034	04/16/03	04/17/03	EPA 6020	
P-2 (B3D0346-02) Soil Sampled: 04/15/03 08:30 Received: 04/16/03 09:00									
Lead	33.8	0.500	mg/kg dry	1	3D16034	04/16/03	04/17/03	EPA 6020	
P-3 (B3D0346-03) Soil Sampled: 04/15/03 09:15 Received: 04/16/03 09:00									
Lead	12.6	0.500	mg/kg dry	1	3D16034	04/16/03	04/17/03	EPA 6020	
P-4 (B3D0346-04) Soil Sampled: 04/15/03 09:30 Received: 04/16/03 09:00									
Lead	12.5	0.500	mg/kg dry	1	3D16034	04/16/03	04/17/03	EPA 6020	

North Creek Analytical - Bothell

The results in this report apply to the samples analyzed in accordance with the chain of custody document. This analytical report must be reproduced in its entirety.

Amar Gill, Project Manager

**North Creek Analytical, Inc.
 Environmental Laboratory Network**



Seattle 11720 North Creek Pkwy N, Suite 400, Bothell, WA 98011-8244
 425.420.9200 fax 425.420.9210
 Spokane East 11115 Montgomery, Suite B, Spokane, WA 99206-4776
 509.924.9200 fax 509.924.9290
 Portland 9405 SW Nimbus Avenue, Beaverton, OR 97008-7132
 503.906.9200 fax 503.906.9210
 Bend 20332 Empire Avenue, Suite F-1, Bend, OR 97701-5711
 541.383.9310 fax 541.382.7588
 Anchorage 3209 Denali Street, Anchorage, AK 99503
 907.334.9200 fax 907.334.9210

Geo Engineers - Spokane 523 East 2nd Spokane WA/USA, 99202	Project: Time Oil-Sunnyside Project Number: 19063-003-01 Project Manager: Mark Engdahl	Reported: 04/17/03 15:30
--	--	-----------------------------

**Physical Parameters by APHA/ASTM/EPA Methods
 North Creek Analytical - Bothell**

Analyte	Result	Reporting Limit	Units	Dilution	Batch	Prepared	Analyzed	Method	Notes
P-1 (B3D0346-01) Soil Sampled: 04/15/03 08:00 Received: 04/16/03 09:00									
Dry Weight	84.9	1.00	%	1	3D16025	04/16/03	04/16/03	BSOPSPL003R07	
P-2 (B3D0346-02) Soil Sampled: 04/15/03 08:30 Received: 04/16/03 09:00									
Dry Weight	74.7	1.00	%	1	3D16025	04/16/03	04/16/03	BSOPSPL003R07	
P-3 (B3D0346-03) Soil Sampled: 04/15/03 09:15 Received: 04/16/03 09:00									
Dry Weight	78.1	1.00	%	1	3D16025	04/16/03	04/16/03	BSOPSPL003R07	
P-4 (B3D0346-04) Soil Sampled: 04/15/03 09:30 Received: 04/16/03 09:00									
Dry Weight	77.9	1.00	%	1	3D16025	04/16/03	04/16/03	BSOPSPL003R07	
Backfill-1 (B3D0346-05) Soil Sampled: 04/15/03 08:45 Received: 04/16/03 09:00									
Dry Weight	79.4	1.00	%	1	3D16025	04/16/03	04/16/03	BSOPSPL003R07	
Backfill-2 (B3D0346-06) Soil Sampled: 04/15/03 09:00 Received: 04/16/03 09:00									
Dry Weight	82.7	1.00	%	1	3D16025	04/16/03	04/16/03	BSOPSPL003R07	

North Creek Analytical - Bothell

The results in this report apply to the samples analyzed in accordance with the chain of custody document. This analytical report must be reproduced in its entirety.

Amar Gill, Project Manager

**North Creek Analytical, Inc.
 Environmental Laboratory Network**



Seattle 11720 North Creek Pkwy N, Suite 400, Bothell, WA 98011-8244
 425.420.9200 fax 425.420.9210
 Spokane East 11115 Montgomery, Suite B, Spokane, WA 99206-4776
 509.924.9200 fax 509.924.9290
 Portland 9405 SW Nimbus Avenue, Beaverton, OR 97008-7132
 503.906.9200 fax 503.906.9210
 Bend 20332 Empire Avenue, Suite F-1, Bend, OR 97701-5711
 541.383.9310 fax 541.382.7588
 Anchorage 3209 Denali Street, Anchorage, AK 99503
 907.334.9200 fax 907.334.9210

Geo Engineers - Spokane Project: Time Oil-Sunnyside
 523 East 2nd Project Number: 19063-003-01
 Spokane WA/USA, 99202 Project Manager: Mark Engdahl Reported:
 04/17/03 15:30

**Volatile Petroleum Products and BTEX by NWTPH-Gx and EPA 8021B - Quality Control
 North Creek Analytical - Bothell**

Analyte	Result	Reporting Limit	Units	Spike Level	Source Result	%REC	%REC Limits	RPD	RPD Limit	Notes
---------	--------	-----------------	-------	-------------	---------------	------	-------------	-----	-----------	-------

Batch 3D16024: Prepared 04/16/03 Using EPA 5030B (MeOH)

Blank (3D16024-BLK1)

Gasoline Range Hydrocarbons	ND	5.00	mg/kg							
Benzene	ND	0.0300	"							
Toluene	ND	0.0500	"							
Ethylbenzene	ND	0.0500	"							
Xylenes (total)	ND	0.100	"							
Surrogate: 4-BFB (FID)	3.75		"	4.00		93.8	59-125			
Surrogate: 4-BFB (PID)	4.35		"	4.00		109	64-125			

LCS (3D16024-BS1)

Gasoline Range Hydrocarbons	26.5	5.00	mg/kg	27.5		96.4	80-120			
Benzene	0.377	0.0300	"	0.400		94.2	80-120			
Toluene	1.93	0.0500	"	1.86		104	80-120			
Ethylbenzene	0.515	0.0500	"	0.435		118	80-120			
Xylenes (total)	2.50	0.100	"	2.10		119	80-120			
Surrogate: 4-BFB (FID)	4.38		"	4.00		110	59-125			
Surrogate: 4-BFB (PID)	4.38		"	4.00		110	64-125			

LCS Dup (3D16024-BSD1)

Gasoline Range Hydrocarbons	26.1	5.00	mg/kg	27.5	6.14	94.9	80-120	1.52	40	
Benzene	0.370	0.0300	"	0.400	ND	92.5	80-120	1.87	40	
Toluene	1.90	0.0500	"	1.86	0.0424	102	80-120	1.57	40	
Ethylbenzene	0.507	0.0500	"	0.435	0.0250	117	80-120	1.57	40	
Xylenes (total)	2.46	0.100	"	2.10	0.454	117	80-120	1.61	40	
Surrogate: 4-BFB (FID)	4.35		"	4.00		109	59-125			
Surrogate: 4-BFB (PID)	4.39		"	4.00		110	64-125			

Matrix Spike (3D16024-MS1)

Source: B3D0346-04

Gasoline Range Hydrocarbons	36.9	5.00	mg/kg dry	35.3	6.14	87.1	53-120			
Benzene	0.384	0.0300	"	0.513	ND	74.9	71-119			
Toluene	2.14	0.0500	"	2.38	0.0424	88.1	57-108			
Ethylbenzene	0.594	0.0500	"	0.558	0.0250	102	72-114			
Xylenes (total)	3.34	0.100	"	2.70	0.454	107	68-112			
Surrogate: 4-BFB (FID)	4.43		"	5.13		86.4	59-125			
Surrogate: 4-BFB (PID)	4.71		"	5.13		91.8	64-125			

North Creek Analytical - Bothell

The results in this report apply to the samples analyzed in accordance with the chain of custody document. This analytical report must be reproduced in its entirety.

Mark Gill, Project Manager

North Creek Analytical, Inc.
 Environmental Laboratory Network



Seattle 11720 North Creek Pkwy N, Suite 400, Bothell, WA 98011-8244
 425.420.9200 fax 425.420.9210
 Spokane East 11115 Montgomery, Suite B, Spokane, WA 99206-4776
 509.924.9200 fax 509.924.9290
 Portland 9405 SW Nimbus Avenue, Beaverton, OR 97008-7132
 503.906.9200 fax 503.906.9210
 Bend 20332 Empire Avenue, Suite F-1, Bend, OR 97701-5711
 541.383.9310 fax 541.382.7588
 Anchorage 3209 Denali Street, Anchorage, AK 99503
 907.334.9200 fax 907.334.9210

Geo Engineers - Spokane 523 East 2nd Spokane WA/USA, 99202	Project: Time Oil-Sunnyside Project Number: 19063-003-01 Project Manager: Mark Engdahl	Reported: 04/17/03 15:30
--	--	-----------------------------

**Volatile Petroleum Products and BTEX by NWTPH-Gx and EPA 8021B - Quality Control
 North Creek Analytical - Bothell**

Analyte	Result	Reporting Limit	Units	Spike Level	Source Result	%REC	Limit	RPD	RPD Limit	Notes
---------	--------	-----------------	-------	-------------	---------------	------	-------	-----	-----------	-------

Batch 3D16024: Prepared 04/16/03 Using EPA 5030B (MeOH)

Matrix Spike Dup (3D16024-MSD1)

Source: B3D0346-04

Gasoline Range Hydrocarbons	33.2	5.00	mg/kg dry	35.3	6.14	76.7	53-120	10.6	40	
Benzene	0.334	0.0300	"	0.513	ND	65.1	71-119	13.9	40	Q-01
Toluene	1.89	0.0500	"	2.38	0.0424	77.6	57-108	12.4	40	
Ethylbenzene	0.531	0.0500	"	0.558	0.0250	90.7	72-114	11.2	40	
Xylenes (total)	3.05	0.100	"	2.70	0.454	96.1	68-112	9.08	40	
Surrogate: 4-BFB (FID)	4.86		"	5.13		94.7	59-125			
Surrogate: 4-BFB (PID)	5.29		"	5.13		103	64-125			

North Creek Analytical - Bothell

The results in this report apply to the samples analyzed in accordance with the chain of custody document. This analytical report must be reproduced in its entirety.

Amar Gill, Project Manager

North Creek Analytical, Inc.
 Environmental Laboratory Network

Page 7 of 10



Seattle 11720 North Creek Pkwy N, Suite 400, Bothell, WA 98011-8244
 425.420.9200 fax 425.420.9210
 Spokane East 11115 Montgomery, Suite B, Spokane, WA 99206-4776
 509.924.9200 fax 509.924.9290
 Portland 9405 SW Nimbus Avenue, Beaverton, OR 97008-7132
 503.906.9200 fax 503.906.9210
 Bend 20332 Empire Avenue, Suite F-1, Bend, OR 97701-5711
 541.383.9310 fax 541.382.7588
 Anchorage 3209 Denali Street, Anchorage, AK 99503
 907.334.9200 fax 907.334.9210

Geo Engineers - Spokane 523 East 2nd Spokane WA/USA, 99202	Project: Time Oil-Sunnyside Project Number: 19063-003-01 Project Manager: Mark Engdahl	Reported: 04/17/03 15:30
--	--	-----------------------------

Total Metals by EPA 6000/7000 Series Methods - Quality Control
North Creek Analytical - Bothell

Analyte	Result	Reporting Limit	Units	Spike Level	Source Result	%REC	%REC Limits	RPD	RPD Limit	Notes
Batch 3D16034: Prepared 04/16/03 Using EPA 3050B										
Blank (3D16034-BLK1)										
Lead	ND	0.500	mg/kg							
LCS (3D16034-BS1)										
Lead	38.8	0.500	mg/kg	40.4		96.0	80-120			
LCS Dup (3D16034-BSD1)										
Lead	41.5	0.500	mg/kg	42.6		97.4	80-120	6.72	20	
Matrix Spike (3D16034-MS1) Source: B3D0346-01										
Lead	55.3	0.500	mg/kg dry	49.1	9.48	93.3	62-137			
Matrix Spike Dup (3D16034-MSD1) Source: B3D0346-01										
Lead	52.8	0.500	mg/kg dry	48.1	9.48	90.1	62-137	4.63	30	
Post Spike (3D16034-PS1) Source: B3D0346-01										
Lead	69.6	0.500	mg/kg dry	62.7	9.48	95.9	75-125			

North Creek Analytical - Bothell

The results in this report apply to the samples analyzed in accordance with the chain of custody document. This analytical report must be reproduced in its entirety.

Amar Gill, Project Manager

North Creek Analytical, Inc.
Environmental Laboratory Network



Seattle 11720 North Creek Pkwy N, Suite 400, Bothell, WA 98011-8244
 425.420.9200 fax 425.420.9210
 Spokane East 11115 Montgomery, Suite B, Spokane, WA 99206-4776
 509.924.9200 fax 509.924.9290
 Portland 9405 SW Nimbus Avenue, Beaverton, OR 97008-7132
 503.906.9200 fax 503.906.9210
 Bend 20332 Empire Avenue, Suite F-1, Bend, OR 97701-5711
 541.383.9310 fax 541.382.7588
 Anchorage 3209 Denali Street, Anchorage, AK 99503
 907.334.9200 fax 907.334.9210

Geo Engineers - Spokane 523 East 2nd Spokane WA/USA, 99202	Project: Time Oil-Sunnyside Project Number: 19063-003-01 Project Manager: Mark Engdahl	Reported: 04/17/03 15:30
--	--	-----------------------------

**Physical Parameters by APHA/ASTM/EPA Methods - Quality Control
 North Creek Analytical - Bothell**

Analyte	Result	Reporting Limit	Units	Spike Level	Source Result	%REC	%REC Limits	RPD	RPD Limit	Notes
Batch 3D16025: Prepared 04/16/03 Using Dry Weight										
Blank (3D16025-BLK1)										
Dry Weight	100	1.00	%							

North Creek Analytical - Bothell

The results in this report apply to the samples analyzed in accordance with the chain of custody document. This analytical report must be reproduced in its entirety.

Amar Gill, Project Manager

**North Creek Analytical, Inc.
 Environmental Laboratory Network**



Seattle 11720 North Creek Pkwy N, Suite 400, Bothell, WA 98011-8244
 425.420.9200 fax 425.420.9210
 Spokane East 11115 Montgomery, Suite B, Spokane, WA 99206-4776
 509.924.9200 fax 509.924.9290
 Portland 9405 SW Nimbus Avenue, Beaverton, OR 97008-7132
 503.906.9200 fax 503.906.9210
 Bend 20332 Empire Avenue, Suite F-1, Bend, OR 97701-5711
 541.383.9310 fax 541.382.7588
 Anchorage 3209 Denali Street, Anchorage, AK 99503
 907.334.9200 fax 907.334.9210

Geo Engineers - Spokane 523 East 2nd Spokane WA/USA, 99202	Project: Time Oil-Sunnyside Project Number: 19063-003-01 Project Manager: Mark Engdahl	Reported: 04/17/03 15:30
--	--	-----------------------------

Notes and Definitions

- Q-01 The spike recovery for this QC sample is outside of established control limits. Review of associated batch QC indicates the recovery for this analyte does not represent an out-of-control condition for the batch.
- S-01 The surrogate recovery for this sample is not available due to sample dilution required from high analyte concentration and/or matrix interferences.
- DET Analyte DETECTED
- ND Analyte NOT DETECTED at or above the reporting limit
- NR Not Reported
- dry Sample results reported on a dry weight basis
- RPD Relative Percent Difference

North Creek Analytical - Bothell

The results in this report apply to the samples analyzed in accordance with the chain of custody document. This analytical report must be reproduced in its entirety.

Amar Gill, Project Manager

**North Creek Analytical, Inc.
 Environmental Laboratory Network**



11740 INDIAN LIGEN FERRY LN, SUITE 400, DUNDICH, WA 90011-0644
 FAX 424-7400
 (509) 924-9200
 (503) 906-9200
 (541) 383-9310
 FAX 924-9290
 FAX 906-9210
 FAX 382-7588

CHAIN OF CUSTODY REPORT

Work Order #: **B3D0346**

CLIENT: *Geo Engineers, Inc*
 REPORT TO: *Mark Engdahl*
 ADDRESS: *523 E 2nd Ave Spokane, WA 99202*

INVOICE TO: *Time Oil Co*
Attn: Scott Spear

PHONE: *509-363-3125* FAX: *773-3126*

P.O. NUMBER:

PROJECT NAME: *Sunayside*

REQUESTED ANALYSES

PROJECT NUMBER: *19063-002-03*

OTHER

SAMPLED BY: *Mark Engdahl 003701*

STANDARDIZATION

CLIENT SAMPLE IDENTIFICATION	SAMPLING DATE/TIME	BTX	TPH	10/19	MATRIX (W, S, O)	# OF CONT.	COMMENTS	NCA WO ID
1. P-1	4/15/03 0800	X	X	X	S	2	B3D0346	01
2. P-2	0830	X	X	X		1		02
3. P-3	0915	X	X	X		1		03
4. P-4	0930	X	X	X		1		04
5. Backfill-1	0845	X	X	X		1		05
6. Backfill-2	4/15/03 0900	X	X	X	S	2		06
7.								
8.								
9.								
10.								
11.								
12.								
13.								
14.								
15.								

RELINQUISHED BY: *Mark Engdahl* FIRM: *GEI* DATE: *4/15/03* TIME: *1400*

PRINT NAME: *Mark Engdahl* RECEIVED BY: *Don Nunn* FIRM: *NCA* DATE: *4/16/03* TIME: *0900*

RELINQUISHED BY: FIRM: DATE: TIME:

PRINT NAME: FIRM: DATE: TIME:

ADDITIONAL REMARKS: *w/o*

COC REV 3/99 PAGE 1 OF 1

TURNAROUND REQUEST in Business Days*

Organic & Inorganic Analyses

Petroleum Hydrocarbon Analyses

STD. 5 4 3 2 1 <1

STD. 10 7 5 4 3 2 1 <1

OTHER: Please Specify

*Turnaround Requests less than standard may incur Rush Charges.



Seattle 11720 North Creek Pkwy N, Suite 400, Bothell, WA 98011-8244
425.420.9200 fax 425.420.9210
Spokane East 11115 Montgomery, Suite B, Spokane, WA 99206-4776
509.924.9200 fax 509.924.9290
Portland 9405 SW Nimbus Avenue, Beaverton, OR 97008-7132
503.906.9200 fax 503.906.9210
Bend 20332 Empire Avenue, Suite F-1, Bend, OR 97701-5711
541.383.9310 fax 541.382.7588
Anchorage 3209 Denali Street, Anchorage, AK 99503
907.334.9200 fax 907.334.9210

21 April 2003

Mark Engdahl
Geo Engineers - Spokane
523 East 2nd
Spokane, WA/USA 99202
RE: Time Oil-Sunnyside

Enclosed are the results of analyses for samples received by the laboratory on 04/18/03 09:00. If you have any questions concerning this report, please feel free to contact me.

Sincerely,

Amar Gill
Project Manager



Seattle 11720 North Creek Pkwy N, Suite 400, Bothell, WA 98011-8244
 425.420.9200 fax 425.420.9210
 Spokane East 11115 Montgomery, Suite B, Spokane, WA 99206-4776
 509.924.9200 fax 509.924.9290
 Portland 9405 SW Nimbus Avenue, Beaverton, OR 97008-7132
 503.906.9200 fax 503.906.9210
 Bend 20332 Empire Avenue, Suite F-1, Bend, OR 97701-5711
 541.383.9310 fax 541.382.7588
 Anchorage 3209 Denali Street, Anchorage, AK 99503
 907.334.9200 fax 907.334.9210

Geo Engineers - Spokane 523 East 2nd Spokane WA/USA, 99202	Project: Time Oil-Sunnyside Project Number: 19063-003-01 Project Manager: Mark Engdahl	Reported: 04/21/03 18:03
--	--	-----------------------------

ANALYTICAL REPORT FOR SAMPLES

Sample ID	Laboratory ID	Matrix	Date Sampled	Date Received
P-5	B3D0422-01	Soil	04/16/03 13:30	04/18/03 09:00
P-6	B3D0422-02	Soil	04/16/03 15:30	04/18/03 09:00

North Creek Analytical - Bothell

The results in this report apply to the samples analyzed in accordance with the chain of custody document. This analytical report must be reproduced in its entirety.

Amar Gill, Project Manager

**North Creek Analytical, Inc.
Environmental Laboratory Network**



Seattle 11720 North Creek Pkwy N, Suite 400, Bothell, WA 98011-8244
 425.420.9200 fax 425.420.9210
 Spokane East 11115 Montgomery, Suite B, Spokane, WA 99206-4776
 509.924.9200 fax 509.924.9290
 Portland 9405 SW Nimbus Avenue, Beaverton, OR 97008-7132
 503.906.9200 fax 503.906.9210
 Bend 20332 Empire Avenue, Suite F-1, Bend, OR 97701-5711
 541.383.9310 fax 541.382.7588
 Anchorage 3209 Denali Street, Anchorage, AK 99503
 907.334.9200 fax 907.334.9210

Geo Engineers - Spokane 523 East 2nd Spokane WA/USA, 99202	Project: Time Oil-Sunnyside Project Number: 19063-003-01 Project Manager: Mark Engdahl	Reported: 04/21/03 18:03
--	--	-----------------------------

**Volatile Petroleum Products and BTEX by NWTPH-Gx and EPA 8021B
 North Creek Analytical - Bothell**

Analyte	Result	Reporting		Units	Dilution	Batch	Prepared	Analyzed	Method	Notes
		Limit								
P-5 (B3D0422-01) Soil Sampled: 04/16/03 13:30 Received: 04/18/03 09:00										
Gasoline Range Hydrocarbons	1300	20.0		mg/kg dry	4	3D18002	04/18/03	04/18/03	NWTPH-Gx/8021B	
Benzene	0.468	0.120		"	"	"	"	"	"	
Toluene	45.2	1.00		"	20	"	"	04/18/03	"	
Ethylbenzene	15.4	0.200		"	4	"	"	04/18/03	"	
Xylenes (total)	239	2.00		"	20	"	"	04/18/03	"	
Surrogate: 4-BFB (FID)	%	59-125				"	"	04/18/03	"	S-02
Surrogate: 4-BFB (PID)	126 %	64-125				"	"	"	"	S-04
P-6 (B3D0422-02) Soil Sampled: 04/16/03 15:30 Received: 04/18/03 09:00										
Gasoline Range Hydrocarbons	4070	100		mg/kg dry	20	3D18002	04/18/03	04/18/03	NWTPH-Gx/8021B	
Benzene	ND	0.600		"	"	"	"	"	"	
Toluene	85.1	1.00		"	"	"	"	"	"	
ylbenzene	54.0	1.00		"	"	"	"	"	"	
xylenes (total)	738	10.0		"	100	"	"	04/21/03	"	
Surrogate: 4-BFB (FID)	%	59-125				"	"	04/18/03	"	S-01
Surrogate: 4-BFB (PID)	%	64-125				"	"	"	"	S-01

North Creek Analytical - Bothell

The results in this report apply to the samples analyzed in accordance with the chain of custody document. This analytical report must be reproduced in its entirety.

Amar Gill, Project Manager



Seattle 11720 North Creek Pkwy N, Suite 400, Bothell, WA 98011-8244
 425.420.9200 fax 425.420.9210
 Spokane East 11115 Montgomery, Suite B, Spokane, WA 99206-4776
 509.924.9200 fax 509.924.9290
 Portland 9405 SW Nimbus Avenue, Beaverton, OR 97008-7132
 503.906.9200 fax 503.906.9210
 Bend 20332 Empire Avenue, Suite F-1, Bend, OR 97701-5711
 541.383.9310 fax 541.382.7588
 Anchorage 3209 Denali Street, Anchorage, AK 99503
 907.334.9200 fax 907.334.9210

Geo Engineers - Spokane
 523 East 2nd
 Spokane WA/USA, 99202

Project: Time Oil-Sunnyside
 Project Number: 19063-003-01
 Project Manager: Mark Engdahl

Reported:
 04/21/03 18:03

Total Metals by EPA 6000/7000 Series Methods
North Creek Analytical - Bothell

Analyte	Result	Reporting Limit	Units	Dilution	Batch	Prepared	Analyzed	Method	Notes
P-5 (B3D0422-01) Soil Sampled: 04/16/03 13:30 Received: 04/18/03 09:00									
Lead	18.2	0.500	mg/kg dry	1	3D18018	04/18/03	04/20/03	EPA 6020	
P-6 (B3D0422-02) Soil Sampled: 04/16/03 15:30 Received: 04/18/03 09:00									
Lead	9.69	0.500	mg/kg dry	1	3D18018	04/18/03	04/20/03	EPA 6020	

North Creek Analytical - Bothell

The results in this report apply to the samples analyzed in accordance with the chain of custody document. This analytical report must be reproduced in its entirety.

Amar Gill, Project Manager

North Creek Analytical, Inc.
 Environmental Laboratory Network



Seattle 11720 North Creek Pkwy N, Suite 400, Bothell, WA 98011-8244
 425.420.9200 fax 425.420.9210
 Spokane East 11115 Montgomery, Suite B, Spokane, WA 99206-4776
 509.924.9200 fax 509.924.9290
 Portland 9405 SW Nimbus Avenue, Beaverton, OR 97008-7132
 503.906.9200 fax 503.906.9210
 Bend 20332 Empire Avenue, Suite F-1, Bend, OR 97701-5711
 541.383.9310 fax 541.382.7588
 Anchorage 3209 Denali Street, Anchorage, AK 99503
 907.334.9200 fax 907.334.9210

Geo Engineers - Spokane
 523 East 2nd
 Spokane WA/USA, 99202

Project: Time Oil-Sunnyside
 Project Number: 19063-003-01
 Project Manager: Mark Engdahl

Reported:
 04/21/03 18:03

**Physical Parameters by APHA/ASTM/EPA Methods
 North Creek Analytical - Bothell**

Analyte	Result	Reporting		Units	Dilution	Batch	Prepared	Analyzed	Method	Notes
		Limit								
P-5 (B3D0422-01) Soil Sampled: 04/16/03 13:30 Received: 04/18/03 09:00										
Dry Weight	86.1	1.00		%	1	3D18019	04/18/03	04/19/03	BSOPSPL003R07	
P-6 (B3D0422-02) Soil Sampled: 04/16/03 15:30 Received: 04/18/03 09:00										
Dry Weight	80.7	1.00		%	1	3D18019	04/18/03	04/19/03	BSOPSPL003R07	

North Creek Analytical - Bothell

The results in this report apply to the samples analyzed in accordance with the chain of custody document. This analytical report must be reproduced in its entirety.

Amar Gill, Project Manager

**North Creek Analytical, Inc.
 Environmental Laboratory Network**



Seattle 11720 North Creek Pkwy N, Suite 400, Bothell, WA 98011-8244
 425.420.9200 fax 425.420.9210
 Spokane East 11115 Montgomery, Suite B, Spokane, WA 99206-4776
 509.924.9200 fax 509.924.9290
 Portland 9405 SW Nimbus Avenue, Beaverton, OR 97008-7132
 503.906.9200 fax 503.906.9210
 Bend 20332 Empire Avenue, Suite F-1, Bend, OR 97701-5711
 541.383.9310 fax 541.382.7588
 Anchorage 3209 Denali Street, Anchorage, AK 99503
 907.334.9200 fax 907.334.9210

Geo Engineers - Spokane
 523 East 2nd
 Spokane WA/USA, 99202

Project: Time Oil-Sunnyside
 Project Number: 19063-003-01
 Project Manager: Mark Engdahl

Reported:
 04/21/03 18:03

**Volatile Petroleum Products and BTEX by NWTPH-Gx and EPA 8021B - Quality Control
 North Creek Analytical - Bothell**

Analyte	Result	Reporting Limit	Units	Spike Level	Source Result	%REC	%REC Limits	RPD	RPD Limit	Notes
---------	--------	-----------------	-------	-------------	---------------	------	-------------	-----	-----------	-------

Batch 3D18002: Prepared 04/18/03 Using EPA 5030B (MeOH)

Blank (3D18002-BLK1)

Gasoline Range Hydrocarbons	ND	5.00	mg/kg							
Benzene	ND	0.0300	"							
Toluene	ND	0.0500	"							
Ethylbenzene	ND	0.0500	"							
Xylenes (total)	ND	0.100	"							
Surrogate: 4-BFB (FID)	3.90		"	4.00		97.5	59-125			
Surrogate: 4-BFB (PID)	4.06		"	4.00		102	64-125			

LCS (3D18002-BS1)

Gasoline Range Hydrocarbons	26.3	5.00	mg/kg	27.5		95.6	80-120			
Benzene	0.354	0.0300	"	0.400		88.5	80-120			
Toluene	1.96	0.0500	"	1.86		105	80-120			
Ethylbenzene	0.508	0.0500	"	0.435		117	80-120			
Xylenes (total)	2.42	0.100	"	2.10		115	80-120			
Surrogate: 4-BFB (FID)	3.95		"	4.00		98.8	59-125			
Surrogate: 4-BFB (PID)	3.83		"	4.00		95.8	64-125			

LCS Dup (3D18002-BSD1)

Gasoline Range Hydrocarbons	25.5	5.00	mg/kg	27.5		92.7	80-120	3.09	40	
Benzene	0.330	0.0300	"	0.400		82.5	80-120	7.02	40	
Toluene	1.88	0.0500	"	1.86		101	80-120	4.17	40	
Ethylbenzene	0.490	0.0500	"	0.435		113	80-120	3.61	40	
Xylenes (total)	2.33	0.100	"	2.10		111	80-120	3.79	40	
Surrogate: 4-BFB (FID)	4.02		"	4.00		100	59-125			
Surrogate: 4-BFB (PID)	3.85		"	4.00		96.2	64-125			

Matrix Spike (3D18002-MS1)

Source: B3D0360-03

Gasoline Range Hydrocarbons	26.4	5.00	mg/kg dry	29.8	0.371	87.3	53-120			
Benzene	0.348	0.0300	"	0.434	ND	80.2	71-119			
Toluene	2.00	0.0500	"	2.01	0.00663	99.2	57-108			
Ethylbenzene	0.526	0.0500	"	0.471	ND	112	72-114			
Xylenes (total)	2.49	0.100	"	2.28	ND	109	68-112			
Surrogate: 4-BFB (FID)	4.01		"	4.34		92.4	59-125			
Surrogate: 4-BFB (PID)	3.95		"	4.34		91.0	64-125			

North Creek Analytical - Bothell

The results in this report apply to the samples analyzed in accordance with the chain of custody document. This analytical report must be reproduced in its entirety.

Amar Gill, Project Manager

North Creek Analytical, Inc.
 Environmental Laboratory Network

Page 5 of 9



Seattle 11720 North Creek Pkwy N, Suite 400, Bothell, WA 98011-8244
 425.420.9200 fax 425.420.9210
 Spokane East 11115 Montgomery, Suite B, Spokane, WA 99206-4776
 509.924.9200 fax 509.924.9290
 Portland 9405 SW Nimbus Avenue, Beaverton, OR 97008-7132
 503.906.9200 fax 503.906.9210
 Bend 20332 Empire Avenue, Suite F-1, Bend, OR 97701-5711
 541.383.9310 fax 541.382.7588
 Anchorage 3209 Denali Street, Anchorage, AK 99503
 907.334.9200 fax 907.334.9210

Geo Engineers - Spokane
 523 East 2nd
 Spokane WA/USA, 99202

Project: Time Oil-Sunnyside
 Project Number: 19063-003-01
 Project Manager: Mark Engdahl

Reported:
 04/21/03 18:03

**Volatile Petroleum Products and BTEX by NWTPH-Gx and EPA 8021B - Quality Control
 North Creek Analytical - Bothell**

Analyte	Result	Reporting Limit	Units	Spike Level	Source Result	%REC %REC	%REC Limits	RPD	RPD Limit	Notes
---------	--------	-----------------	-------	-------------	---------------	-----------	-------------	-----	-----------	-------

Batch 3D18002: Prepared 04/18/03 Using EPA 5030B (MeOH)

Matrix Spike Dup (3D18002-MSD1)

Source: B3D0360-03

Gasoline Range Hydrocarbons	25.8	5.00	mg/kg dry	29.8	0.371	85.3	53-120	2.30	40	
Benzene	0.343	0.0300	"	0.434	ND	79.0	71-119	1.45	40	
Toluene	1.98	0.0500	"	2.01	0.00663	98.2	57-108	1.01	40	
Ethylbenzene	0.539	0.0500	"	0.471	ND	114	72-114	2.44	40	
Xylenes (total)	2.46	0.100	"	2.28	ND	108	68-112	1.21	40	
Surrogate: 4-BFB (FID)	4.07		"	4.34		93.8	59-125			
Surrogate: 4-BFB (PID)	3.96		"	4.34		91.2	64-125			

North Creek Analytical - Bothell

The results in this report apply to the samples analyzed in accordance with the chain of custody document. This analytical report must be reproduced in its entirety.

Amar Gill, Project Manager

North Creek Analytical, Inc.
 Environmental Laboratory Network

Page 6 of 9



Seattle 11720 North Creek Pkwy N, Suite 400, Bothell, WA 98011-8244
 425.420.9200 fax 425.420.9210
 Spokane East 11115 Montgomery, Suite B, Spokane, WA 99206-4776
 509.924.9200 fax 509.924.9290
 Portland 9405 SW Nimbus Avenue, Beaverton, OR 97008-7132
 503.906.9200 fax 503.906.9210
 Bend 20332 Empire Avenue, Suite F-1, Bend, OR 97701-5711
 541.383.9310 fax 541.382.7588
 Anchorage 3209 Denali Street, Anchorage, AK 99503
 907.334.9200 fax 907.334.9210

Geo Engineers - Spokane 523 East 2nd Spokane WA/USA, 99202	Project: Time Oil-Sunnyside Project Number: 19063-003-01 Project Manager: Mark Engdahl	Reported: 04/21/03 18:03
--	--	-----------------------------

Total Metals by EPA 6000/7000 Series Methods - Quality Control
North Creek Analytical - Bothell

Analyte	Result	Reporting Limit	Units	Spike Level	Source Result	%REC	%REC Limits	RPD	RPD Limit	Notes
Batch 3D18018: Prepared 04/18/03 Using EPA 3050B										
Blank (3D18018-BLK1)										
Lead	ND	0.500	mg/kg							
LCS (3D18018-BS1)										
Lead	40.6	0.500	mg/kg	40.8		99.5	80-120			
LCS Dup (3D18018-BSD1)										
Lead	40.0	0.500	mg/kg	40.0		100	80-120	1.49	20	
Matrix Spike (3D18018-MS1) Source: B3D0382-58										
Lead	64.2	0.500	mg/kg dry	49.5	17.1	95.2	62-137			
Matrix Spike Dup (3D18018-MSD1) Source: B3D0382-58										
Lead	71.6	0.500	mg/kg dry	50.6	17.1	108	62-137	10.9	30	
Post Spike (3D18018-PS1) Source: B3D0382-58										
Lead	127	0.500	mg/kg dry	114	17.1	96.4	75-125			

North Creek Analytical - Bothell

The results in this report apply to the samples analyzed in accordance with the chain of custody document. This analytical report must be reproduced in its entirety.

Amar Gill, Project Manager

North Creek Analytical, Inc.
Environmental Laboratory Network



Seattle 11720 North Creek Pkwy N, Suite 400, Bothell, WA 98011-8244
 425.420.9200 fax 425.420.9210
 Spokane East 11115 Montgomery, Suite B, Spokane, WA 99206-4776
 509.924.9200 fax 509.924.9290
 Portland 9405 SW Nimbus Avenue, Beaverton, OR 97008-7132
 503.906.9200 fax 503.906.9210
 Bend 20332 Empire Avenue, Suite F-1, Bend, OR 97701-5711
 541.383.9310 fax 541.382.7588
 Anchorage 3209 Denali Street, Anchorage, AK 99503
 907.334.9200 fax 907.334.9210

Geo Engineers - Spokane 523 East 2nd Spokane WA/USA, 99202	Project: Time Oil-Sunnyside Project Number: 19063-003-01 Project Manager: Mark Engdahl	Reported: 04/21/03 18:03
--	--	-----------------------------

**Physical Parameters by APHA/ASTM/EPA Methods - Quality Control
 North Creek Analytical - Bothell**

Analyte	Result	Reporting Limit	Units	Spike Level	Source Result	%REC	%REC Limits	RPD	RPD Limit	Notes
Batch 3D18019: Prepared 04/18/03 Using Dry Weight										
Blank (3D18019-BLK1)										
Dry Weight	99.8	1.00	%							

North Creek Analytical - Bothell

The results in this report apply to the samples analyzed in accordance with the chain of custody document. This analytical report must be reproduced in its entirety.

Amar Gill, Project Manager

**North Creek Analytical, Inc.
 Environmental Laboratory Network**



Seattle 11720 North Creek Pkwy N, Suite 400, Bothell, WA 98011-8244
425.420.9200 fax 425.420.9210
Spokane East 11115 Montgomery, Suite B, Spokane, WA 99206-4776
509.924.9200 fax 509.924.9290
Portland 9405 SW Nimbus Avenue, Beaverton, OR 97008-7132
503.906.9200 fax 503.906.9210
Bend 20332 Empire Avenue, Suite F-1, Bend, OR 97701-5711
541.383.9310 fax 541.382.7588
Anchorage 3209 Denali Street, Anchorage, AK 99503
907.334.9200 fax 907.334.9210

Geo Engineers - Spokane
523 East 2nd
Spokane WA/USA, 99202

Project: Time Oil-Sunnyside
Project Number: 19063-003-01
Project Manager: Mark Engdahl

Reported:
04/21/03 18:03

Notes and Definitions

- S-01 The surrogate recovery for this sample is not available due to sample dilution required from high analyte concentration and/or matrix interferences.
- S-02 The surrogate recovery for this sample cannot be accurately quantified due to interference from coeluting organic compounds present in the sample.
- S-04 The surrogate recovery for this sample is outside of established control limits due to a sample matrix effect.
- DET Analyte DETECTED
- ND Analyte NOT DETECTED at or above the reporting limit
- NR Not Reported
- dry Sample results reported on a dry weight basis
- RPD Relative Percent Difference

North Creek Analytical - Bothell

The results in this report apply to the samples analyzed in accordance with the chain of custody document. This analytical report must be reproduced in its entirety.

Amar Gill, Project Manager

North Creek Analytical, Inc.
Environmental Laboratory Network

Page 9 of 9



11200 North Creek Valley Ln, Suite 500, Bunker WA 98011-0544 FAX: (509) 924-9200
 East 1115 Montgomery, Suite B, Spokane, WA 99206-4776 (509) 924-9200 FAX: 924-9290
 9405 S.W. Nimbus Avenue, Beaverton, OR 97008-7132 (503) 906-9200 FAX: 906-9210
 20332 Empire Avenue, Suite F-1, Bend, OR 97701-5711 (541) 383-9310 FAX: 382-7588

CHAIN OF CUSTODY REPORT

Work Order #: **B3D0422**

CLIENT: **Geo Engineers**
 REPORT TO: **Mark Engdahl**
 ADDRESS: **523 E 2nd Ave Spokane, WA 99202**

INVOICE TO: **Time Oil Co**
 Attn: **Scott Siskin**

TURNAROUND REQUEST in Business Days*
 Organic & Inorganic Analyses
 10 7 5 4 3 2 1 <1
 STD. 5 4 3 2 <1

PHONE: **509-363-3125** FAX: **363-3126**
 PROJECT NAME: **Sump Side**

P.O. NUMBER:
 REQUESTED ANALYSES

PROJECT NUMBER: **19063-003-01**
 SAMPLED BY: **Mark Engdahl**

Petroleum Hydrocarbon Analyses
 5 4 3 2 <1
 STD. 5 4 3 2 <1
 OTHER
 Please Specify

CLIENT SAMPLE IDENTIFICATION	SAMPLING DATE/TIME	WVPH	STEX	Total Pb	REQUESTED ANALYSES	MATRIX (W, S, O)	# OF CONT.	COMMENTS	NCA WO ID
1. P-5	3/16/03 1330	X	(-)	X		S	2	B3D0422	01
2. P-6	3/16/03 1530	X	X	X		S	2		02
3.									
4.									
5.									
6.									
7.									
8.									
9.									
10.									
11.									
12.									
13.									
14.									
15.									

RELINQUISHED BY: **Mark Engdahl** FIRM: **662**
 PRINT NAME: **Mark Engdahl** FIRM: **NCA**
 DATE: **3/17/03** TIME: **1400**
 RECEIVED BY: **Scott Siskin** FIRM: **NCA**
 PRINT NAME: **Scott Siskin** FIRM: **NCA**
 DATE: **4/18/03** TIME: **0901**

RECEIVED BY: **Scott Siskin** FIRM: **NCA**
 PRINT NAME: **Scott Siskin** FIRM: **NCA**
 DATE: **4/18/03** TIME: **0901**

ADDITIONAL REMARKS:
 COC REV 3/99

TEMP: **W/O** 3.0
 PAGE **1** OF **1**



Seattle 11720 North Creek Pkwy N, Suite 400, Bothell, WA 98011-8244
425.420.9200 fax 425.420.9210
Spokane East 11115 Montgomery, Suite B, Spokane, WA 99206-4776
509.924.9200 fax 509.924.9290
Portland 9405 SW Nimbus Avenue, Beaverton, OR 97008-7132
503.906.9200 fax 503.906.9210
Bend 20332 Empire Avenue, Suite F-1, Bend, OR 97701-5711
541.383.9310 fax 541.382.7588
Anchorage 3209 Denali Street, Anchorage, AK 99503
907.334.9200 fax 907.334.9210

23 April 2003

Mark Engdahl
Geo Engineers - Spokane
523 East 2nd
Spokane, WA/USA 99202
RE: Time Oil-Sunnyside

Enclosed are the results of analyses for samples received by the laboratory on 04/16/03 09:40. If you have any questions concerning this report, please feel free to contact me.

Sincerely,

Amar Gill
Project Manager



Seattle 11720 North Creek Pkwy N, Suite 400, Bothell, WA 98011-8244
 425.420.9200 fax 425.420.9210
 Spokane East 11115 Montgomery, Suite B, Spokane, WA 99206-4776
 509.924.9200 fax 509.924.9290
 Portland 9405 SW Nimbus Avenue, Beaverton, OR 97008-7132
 503.906.9200 fax 503.906.9210
 Bend 20332 Empire Avenue, Suite F-1, Bend, OR 97701-5711
 541.383.9310 fax 541.382.7588
 Anchorage 3209 Denali Street, Anchorage, AK 99503
 907.334.9200 fax 907.334.9210

Geo Engineers - Spokane
 523 East 2nd
 Spokane WA/USA, 99202

Project: Time Oil-Sunnyside
 Project Number: 19063-003-01
 Project Manager: Mark Engdahl

Reported:
 04/23/03 15:57

ANALYTICAL REPORT FOR SAMPLES

Sample ID	Laboratory ID	Matrix	Date Sampled	Date Received
8 K Tank Center 13'	B3D0372-01	Soil	04/15/03 11:30	04/16/03 09:40
8 K Tank West 13'	B3D0372-02	Soil	04/15/03 11:50	04/16/03 09:40
8 K Tank East 13'	B3D0372-03	Soil	04/15/03 12:00	04/16/03 09:40
8 K Tank N Wall 8.5'	B3D0372-04	Soil	04/15/03 11:40	04/16/03 09:40

North Creek Analytical - Bothell

The results in this report apply to the samples analyzed in accordance with the chain of custody document. This analytical report must be reproduced in its entirety.

Amar Gill, Project Manager

North Creek Analytical, Inc.
 Environmental Laboratory Network



Seattle 11720 North Creek Pkwy N, Suite 400, Bothell, WA 98011-8244
 425.420.9200 fax 425.420.9210
 Spokane East 11115 Montgomery, Suite B, Spokane, WA 99206-4776
 509.924.9200 fax 509.924.9290
 Portland 9405 SW Nimbus Avenue, Beaverton, OR 97008-7132
 503.906.9200 fax 503.906.9210
 Bend 20332 Empire Avenue, Suite F-1, Bend, OR 97701-5711
 541.383.9310 fax 541.382.7588
 Anchorage 3209 Denali Street, Anchorage, AK 99503
 907.334.9200 fax 907.334.9210

Geo Engineers - Spokane
 523 East 2nd
 Spokane WA/USA, 99202

Project: Time Oil-Sunnyside
 Project Number: 19063-003-01
 Project Manager: Mark Engdahl

Reported:
 04/23/03 15:57

**Volatile Petroleum Products by NWTPH-Gx
 North Creek Analytical - Bothell**

Analyte	Result	Reporting Limit	Units	Dilution	Batch	Prepared	Analyzed	Method	Notes
8 K Tank Center 13' (B3D0372-01) Soil Sampled: 04/15/03 11:30 Received: 04/16/03 09:40									
Gasoline Range Hydrocarbons	ND	5.00	mg/kg dry	1	3D18002	04/18/03	04/18/03	NWTPH-Gx	
Surrogate: 4-BFB (FID)	76.9 %	59-125			"	"	"	"	
8 K Tank West 13' (B3D0372-02) Soil Sampled: 04/15/03 11:50 Received: 04/16/03 09:40									
Gasoline Range Hydrocarbons	ND	5.00	mg/kg dry	1	3D18002	04/18/03	04/18/03	NWTPH-Gx	
Surrogate: 4-BFB (FID)	78.6 %	59-125			"	"	"	"	
8 K Tank East 13' (B3D0372-03) Soil Sampled: 04/15/03 12:00 Received: 04/16/03 09:40									
Gasoline Range Hydrocarbons	ND	5.00	mg/kg dry	1	3D18002	04/18/03	04/18/03	NWTPH-Gx	
Surrogate: 4-BFB (FID)	78.9 %	59-125			"	"	"	"	
8 K Tank N Wall 8.5' (B3D0372-04) Soil Sampled: 04/15/03 11:40 Received: 04/16/03 09:40									
Gasoline Range Hydrocarbons	ND	5.00	mg/kg dry	1	3D18002	04/18/03	04/18/03	NWTPH-Gx	
Surrogate: 4-BFB (FID)	74.8 %	59-125			"	"	"	"	

North Creek Analytical - Bothell

The results in this report apply to the samples analyzed in accordance with the chain of custody document. This analytical report must be reproduced in its entirety.

Amar Gill, Project Manager

North Creek Analytical, Inc.
 Environmental Laboratory Network



Seattle 11720 North Creek Pkwy N, Suite 400, Bothell, WA 98011-8244
 425.420.9200 fax 425.420.9210
 Spokane East 11115 Montgomery, Suite B, Spokane, WA 99206-4776
 509.924.9200 fax 509.924.9290
 Portland 9405 SW Nimbus Avenue, Beaverton, OR 97008-7132
 503.906.9200 fax 503.906.9210
 Bend 20332 Empire Avenue, Suite F-1, Bend, OR 97701-5711
 541.383.9310 fax 541.382.7588
 Anchorage 3209 Denali Street, Anchorage, AK 99503
 907.334.9200 fax 907.334.9210

Geo Engineers - Spokane
 523 East 2nd
 Spokane WA/USA, 99202

Project: Time Oil-Sunnyside
 Project Number: 19063-003-01
 Project Manager: Mark Engdahl

Reported:
 04/23/03 15:57

Volatile Organic Compounds (Special List) per EPA Method 8260B (Low Soil Method)
North Creek Analytical - Bothell

Analyte	Result	Reporting Limit	Units	Dilution	Batch	Prepared	Analyzed	Method	Notes
K Tank Center 13' (B3D0372-01) Soil Sampled: 04/15/03 11:30 Received: 04/16/03 09:40									
Benzene	ND	0.00150	mg/kg dry	1	3D21051	04/21/03	04/21/03	EPA 8260B	
1,2-Dibromoethane (EDB)	ND	0.00500	"	"	"	"	"	"	
1,2-Dichloroethane	ND	0.00125	"	"	"	"	"	"	
Ethylbenzene	ND	0.00400	"	"	"	"	"	"	
Naphthalene	ND	0.00500	"	"	"	"	"	"	
Toluene	ND	0.00150	"	"	"	"	"	"	
Total Xylenes	ND	0.0100	"	"	"	"	"	"	
Methyl tert-butyl ether	ND	0.00100	"	"	"	"	"	"	
Surrogate: 1,2-DCA-d4	106 %	60-140			"	"	"	"	
Surrogate: Toluene-d8	99.6 %	60-140			"	"	"	"	
Surrogate: 4-BFB	92.6 %	60-140			"	"	"	"	

K Tank West 13' (B3D0372-02) Soil Sampled: 04/15/03 11:50 Received: 04/16/03 09:40									
Benzene	ND	0.00150	mg/kg dry	1	3D21051	04/21/03	04/21/03	EPA 8260B	
1,2-Dibromoethane (EDB)	ND	0.00500	"	"	"	"	"	"	
1,2-Dichloroethane	ND	0.00125	"	"	"	"	"	"	
Ethylbenzene	ND	0.00400	"	"	"	"	"	"	
Naphthalene	ND	0.00500	"	"	"	"	"	"	
Toluene	ND	0.00150	"	"	"	"	"	"	
Total Xylenes	ND	0.0100	"	"	"	"	"	"	
Methyl tert-butyl ether	ND	0.00100	"	"	"	"	"	"	
Surrogate: 1,2-DCA-d4	94.8 %	60-140			"	"	"	"	
Surrogate: Toluene-d8	101 %	60-140			"	"	"	"	
Surrogate: 4-BFB	91.2 %	60-140			"	"	"	"	

North Creek Analytical - Bothell

The results in this report apply to the samples analyzed in accordance with the chain of custody document. This analytical report must be reproduced in its entirety.

Mark Gill, Project Manager

North Creek Analytical, Inc.
 Environmental Laboratory Network



Seattle 11720 North Creek Pkwy N, Suite 400, Bothell, WA 98011-8244
 425.420.9200 fax 425.420.9210
 Spokane East 11115 Montgomery, Suite B, Spokane, WA 99206-4776
 509.924.9200 fax 509.924.9290
 Portland 9405 SW Nimbus Avenue, Beaverton, OR 97008-7132
 503.906.9200 fax 503.906.9210
 Bend 20332 Empire Avenue, Suite F-1, Bend, OR 97701-5711
 541.383.9310 fax 541.382.7588
 Anchorage 3209 Denali Street, Anchorage, AK 99503
 907.334.9200 fax 907.334.9210

Geo Engineers - Spokane
 523 East 2nd
 Spokane WA/USA, 99202

Project: Time Oil-Sunnyside
 Project Number: 19063-003-01
 Project Manager: Mark Engdahl

Reported:
 04/23/03 15:57

Volatile Organic Compounds (Special List) per EPA Method 8260B (Low Soil Method)
North Creek Analytical - Bothell

Analyte	Result	Reporting Limit	Units	Dilution	Batch	Prepared	Analyzed	Method	Notes
8 K Tank East 13' (B3D0372-03) Soil Sampled: 04/15/03 12:00 Received: 04/16/03 09:40									
Benzene	ND	0.00150	mg/kg dry	1	3D21051	04/21/03	04/21/03	EPA 8260B	
1,2-Dibromoethane (EDB)	ND	0.00500	"	"	"	"	"	"	
1,2-Dichloroethane	ND	0.00125	"	"	"	"	"	"	
Ethylbenzene	ND	0.00400	"	"	"	"	"	"	
Naphthalene	ND	0.00500	"	"	"	"	"	"	
Toluene	ND	0.00150	"	"	"	"	"	"	
Total Xylenes	ND	0.0100	"	"	"	"	"	"	
Methyl tert-butyl ether	ND	0.00100	"	"	"	"	"	"	
Surrogate: 1,2-DCA-d4	102 %	60-140			"	"	"	"	
Surrogate: Toluene-d8	101 %	60-140			"	"	"	"	
Surrogate: 4-BFB	92.4 %	60-140			"	"	"	"	
8 K Tank N Wall 8.5' (B3D0372-04) Soil Sampled: 04/15/03 11:40 Received: 04/16/03 09:40									
Benzene	ND	0.00150	mg/kg dry	1	3D21051	04/21/03	04/21/03	EPA 8260B	
1,2-Dibromoethane (EDB)	ND	0.00500	"	"	"	"	"	"	
1,2-Dichloroethane	ND	0.00125	"	"	"	"	"	"	
Ethylbenzene	ND	0.00400	"	"	"	"	"	"	
Naphthalene	ND	0.00500	"	"	"	"	"	"	
Toluene	ND	0.00150	"	"	"	"	"	"	
Total Xylenes	ND	0.0100	"	"	"	"	"	"	
Methyl tert-butyl ether	ND	0.00100	"	"	"	"	"	"	
Surrogate: 1,2-DCA-d4	101 %	60-140			"	"	"	"	
Surrogate: Toluene-d8	100 %	60-140			"	"	"	"	
Surrogate: 4-BFB	91.8 %	60-140			"	"	"	"	

North Creek Analytical - Bothell

The results in this report apply to the samples analyzed in accordance with the chain of custody document. This analytical report must be reproduced in its entirety.

Amar Gill, Project Manager

North Creek Analytical, Inc.
 Environmental Laboratory Network



Seattle 11720 North Creek Pkwy N, Suite 400, Bothell, WA 98011-8244
 425.420.9200 fax 425.420.9210
 Spokane East 11115 Montgomery, Suite B, Spokane, WA 99206-4776
 509.924.9200 fax 509.924.9290
 Portland 9405 SW Nimbus Avenue, Beaverton, OR 97008-7132
 503.906.9200 fax 503.906.9210
 Bend 20332 Empire Avenue, Suite F-1, Bend, OR 97701-5711
 541.383.9310 fax 541.382.7588
 Anchorage 3209 Denali Street, Anchorage, AK 99503
 907.334.9200 fax 907.334.9210

Geo Engineers - Spokane 523 East 2nd Spokane WA/USA, 99202	Project: Time Oil-Sunnyside Project Number: 19063-003-01 Project Manager: Mark Engdahl	Reported: 04/23/03 15:57
--	--	-----------------------------

**Physical Parameters by APHA/ASTM/EPA Methods
 North Creek Analytical - Bothell**

Analyte	Reporting		Units	Dilution	Batch	Prepared	Analyzed	Method	Notes
	Result	Limit							
8 K Tank Center 13' (B3D0372-01) Soil Sampled: 04/15/03 11:30 Received: 04/16/03 09:40									
Dry Weight	75.8	1.00	%	1	3D20007	04/20/03	04/21/03	BSOPSPL003R07	
8 K Tank West 13' (B3D0372-02) Soil Sampled: 04/15/03 11:50 Received: 04/16/03 09:40									
Dry Weight	73.7	1.00	%	1	3D20007	04/20/03	04/21/03	BSOPSPL003R07	
8 K Tank East 13' (B3D0372-03) Soil Sampled: 04/15/03 12:00 Received: 04/16/03 09:40									
Dry Weight	74.6	1.00	%	1	3D20007	04/20/03	04/21/03	BSOPSPL003R07	
8 K Tank N Wall 8.5' (B3D0372-04) Soil Sampled: 04/15/03 11:40 Received: 04/16/03 09:40									
Dry Weight	77.7	1.00	%	1	3D20007	04/20/03	04/21/03	BSOPSPL003R07	

North Creek Analytical - Bothell

The results in this report apply to the samples analyzed in accordance with the chain of custody document. This analytical report must be reproduced in its entirety.

Amar Gill, Project Manager

**North Creek Analytical, Inc.
 Environmental Laboratory Network**



Seattle 11720 North Creek Pkwy N, Suite 400, Bothell, WA 98011-8244
 425.420.9200 fax 425.420.9210
 Spokane East 11115 Montgomery, Suite B, Spokane, WA 99206-4776
 509.924.9200 fax 509.924.9290
 Portland 9405 SW Nimbus Avenue, Beaverton, OR 97008-7132
 503.906.9200 fax 503.906.9210
 Bend 20332 Empire Avenue, Suite F-1, Bend, OR 97701-5711
 541.383.9310 fax 541.382.7588
 Anchorage 3209 Denali Street, Anchorage, AK 99503
 907.334.9200 fax 907.334.9210

Geo Engineers - Spokane
 523 East 2nd
 Spokane WA/USA, 99202

Project: Time Oil-Sunnyside
 Project Number: 19063-003-01
 Project Manager: Mark Engdahl

Reported:
 04/23/03 15:57

Volatile Petroleum Products by NWTPH-Gx - Quality Control
North Creek Analytical - Bothell

Analyte	Result	Reporting Limit	Units	Spike Level	Source Result	%REC	%REC Limits	RPD	RPD Limit	Notes
Batch 3D18002: Prepared 04/18/03 Using EPA 5030B (MeOH)										
Blank (3D18002-BLK1)										
Gasoline Range Hydrocarbons	ND	5.00	mg/kg							
Surrogate: 4-BFB (FID)	3.90		"	4.00		97.5	59-125			
LCS (3D18002-BS1)										
Gasoline Range Hydrocarbons	26.3	5.00	mg/kg	27.5		95.6	80-120			
Surrogate: 4-BFB (FID)	3.95		"	4.00		98.8	59-125			
LCS Dup (3D18002-BSD1)										
Gasoline Range Hydrocarbons	25.5	5.00	mg/kg	27.5		92.7	80-120	3.09	40	
Surrogate: 4-BFB (FID)	4.02		"	4.00		100	59-125			
Matrix Spike (3D18002-MS1) Source: B3D0360-03										
Gasoline Range Hydrocarbons	26.4	5.00	mg/kg dry	29.8	0.371	87.3	53-120			
Surrogate: 4-BFB (FID)	4.01		"	4.34		92.4	59-125			
Matrix Spike Dup (3D18002-MSD1) Source: B3D0360-03										
Gasoline Range Hydrocarbons	25.8	5.00	mg/kg dry	29.8	0.371	85.3	53-120	2.30	40	
Surrogate: 4-BFB (FID)	4.07		"	4.34		93.8	59-125			

North Creek Analytical - Bothell

The results in this report apply to the samples analyzed in accordance with the chain of custody document. This analytical report must be reproduced in its entirety.

Amar Gill, Project Manager

North Creek Analytical, Inc.
 Environmental Laboratory Network



Seattle 11720 North Creek Pkwy N, Suite 400, Bothell, WA 98011-8244
 425.420.9200 fax 425.420.9210
 Spokane East 11115 Montgomery, Suite B, Spokane, WA 99206-4776
 509.924.9200 fax 509.924.9290
 Portland 9405 SW Nimbus Avenue, Beaverton, OR 97008-7132
 503.906.9200 fax 503.906.9210
 Bend 20332 Empire Avenue, Suite F-1, Bend, OR 97701-5711
 541.383.9310 fax 541.382.7588
 Anchorage 3209 Denali Street, Anchorage, AK 99503
 907.334.9200 fax 907.334.9210

Geo Engineers - Spokane
 523 East 2nd
 Spokane WA/USA, 99202

Project: Time Oil-Sunnyside
 Project Number: 19063-003-01
 Project Manager: Mark Engdahl

Reported:
 04/23/03 15:57

Volatile Organic Compounds (Special List) per EPA Method 8260B (Low Soil Method) - Quality Control
North Creek Analytical - Bothell

Analyte	Result	Reporting Limit	Units	Spike Level	Source Result	%REC	%REC Limits	RPD	RPD Limit	Notes
---------	--------	-----------------	-------	-------------	---------------	------	-------------	-----	-----------	-------

Batch 3D21051: Prepared 04/21/03 Using EPA 5035M

Blank (3D21051-BLK1)

n-Hexane	ND	0.00100	mg/kg							
Benzene	ND	0.00150	"							
Chlorobenzene	ND	0.00200	"							
1,2-Dibromoethane (EDB)	ND	0.00500	"							
1,2-Dichloroethane	ND	0.00125	"							
1,1-Dichloroethene	ND	0.00300	"							
Ethylbenzene	ND	0.00400	"							
Naphthalene	ND	0.00500	"							
Toluene	ND	0.00150	"							
Trichloroethene	ND	0.00250	"							
Total Xylenes	ND	0.0100	"							
Ethyl tert-butyl ether	ND	0.00100	"							
Surrogate: 1,2-DCA-d4	0.0425		"	0.0400		106	60-140			
Surrogate: Toluene-d8	0.0394		"	0.0400		98.5	60-140			
Surrogate: 4-BFB	0.0387		"	0.0400		96.8	60-140			

LCS (3D21051-BS1)

Benzene	0.0212	0.00150	mg/kg	0.0200		106	70-130			
Chlorobenzene	0.0207	0.00200	"	0.0200		104	70-130			
1,1-Dichloroethene	0.0250	0.00300	"	0.0200		125	70-130			
Ethylbenzene	0.0211	0.00400	"	0.0200		106	70-130			
Toluene	0.0208	0.00150	"	0.0200		104	70-130			
Trichloroethene	0.0205	0.00250	"	0.0200		102	70-130			
Surrogate: 1,2-DCA-d4	0.0365		"	0.0400		91.2	60-140			
Surrogate: Toluene-d8	0.0409		"	0.0400		102	60-140			
Surrogate: 4-BFB	0.0371		"	0.0400		92.8	60-140			

LCS Dup (3D21051-BSD1)

Benzene	0.0204	0.00150	mg/kg	0.0200		102	70-130	3.85	30	
Chlorobenzene	0.0198	0.00200	"	0.0200		99.0	70-130	4.44	30	
1,1-Dichloroethene	0.0247	0.00300	"	0.0200		124	70-130	1.21	30	
Ethylbenzene	0.0212	0.00400	"	0.0200		106	70-130	0.473	30	
Toluene	0.0206	0.00150	"	0.0200		103	70-130	0.966	30	
Trichloroethene	0.0203	0.00250	"	0.0200		102	70-130	0.980	30	
Surrogate: 1,2-DCA-d4	0.0332		"	0.0400		83.0	60-140			

North Creek Analytical - Bothell

The results in this report apply to the samples analyzed in accordance with the chain of custody document. This analytical report must be reproduced in its entirety.

Amar Gill, Project Manager

North Creek Analytical, Inc.
 Environmental Laboratory Network



Seattle 11720 North Creek Pkwy N, Suite 400, Bothell, WA 98011-8244
 425.420.9200 fax 425.420.9210
 Spokane East 11115 Montgomery, Suite B, Spokane, WA 99206-4776
 509.924.9200 fax 509.924.9290
 Portland 9405 SW Nimbus Avenue, Beaverton, OR 97008-7132
 503.906.9200 fax 503.906.9210
 Bend 20332 Empire Avenue, Suite F-1, Bend, OR 97701-5711
 541.383.9310 fax 541.382.7588
 Anchorage 3209 Denali Street, Anchorage, AK 99503
 907.334.9200 fax 907.334.9210

Geo Engineers - Spokane 523 East 2nd Spokane WA/USA, 99202	Project: Time Oil-Sunnyside Project Number: 19063-003-01 Project Manager: Mark Engdahl	Reported: 04/23/03 15:57
--	--	-----------------------------

Volatile Organic Compounds (Special List) per EPA Method 8260B (Low Soil Method) - Quality Control
North Creek Analytical - Bothell

Analyte	Result	Reporting Limit	Units	Spike Level	Source Result	%REC	%REC Limits	RPD	RPD Limit	Notes
---------	--------	-----------------	-------	-------------	---------------	------	-------------	-----	-----------	-------

Batch 3D21051: Prepared 04/21/03 Using EPA 5035M

LCS Dup (3D21051-BSD1)

Surrogate: Toluene-d8	0.0424		mg/kg	0.0400		106	60-140			
Surrogate: 4-BFB	0.0368		"	0.0400		92.0	60-140			

Matrix Spike (3D21051-MS1)

Source: B3D0190-01

Benzene	0.0230	0.00150	mg/kg dry	0.0214	ND	107	60-140			
Chlorobenzene	0.0214	0.00200	"	0.0214	ND	100	60-140			
1,1-Dichloroethene	0.0274	0.00300	"	0.0214	ND	128	60-140			
Ethylbenzene	0.0230	0.00400	"	0.0214	ND	107	60-140			
Toluene	0.0221	0.00150	"	0.0214	ND	103	60-140			
Trichloroethene	0.0228	0.00250	"	0.0214	ND	107	60-140			

Surrogate: 1,2-DCA-d4	0.0418		"	0.0427		97.9	60-140			
Surrogate: Toluene-d8	0.0436		"	0.0427		102	60-140			
Surrogate: 4-BFB	0.0392		"	0.0427		91.8	60-140			

Matrix Spike Dup (3D21051-MSD1)

Source: B3D0190-01

Benzene	0.0246	0.00150	mg/kg dry	0.0214	ND	115	60-140	6.72	30	
Chlorobenzene	0.0228	0.00200	"	0.0214	ND	107	60-140	6.33	30	
1,1-Dichloroethene	0.0292	0.00300	"	0.0214	ND	136	60-140	6.36	30	
Ethylbenzene	0.0232	0.00400	"	0.0214	ND	108	60-140	0.866	30	
Toluene	0.0229	0.00150	"	0.0214	ND	107	60-140	3.56	30	
Trichloroethene	0.0238	0.00250	"	0.0214	ND	111	60-140	4.29	30	

Surrogate: 1,2-DCA-d4	0.0476		"	0.0427		111	60-140			
Surrogate: Toluene-d8	0.0419		"	0.0427		98.1	60-140			
Surrogate: 4-BFB	0.0404		"	0.0427		94.6	60-140			

North Creek Analytical - Bothell

The results in this report apply to the samples analyzed in accordance with the chain of custody document. This analytical report must be reproduced in its entirety.

Amar Gill, Project Manager

North Creek Analytical, Inc.
Environmental Laboratory Network



Seattle 11720 North Creek Pkwy N, Suite 400, Bothell, WA 98011-8244
 425.420.9200 fax 425.420.9210
 Spokane East 11115 Montgomery, Suite B, Spokane, WA 99206-4776
 509.924.9200 fax 509.924.9290
 Portland 9405 SW Nimbus Avenue, Beaverton, OR 97008-7132
 503.906.9200 fax 503.906.9210
 Bend 20332 Empire Avenue, Suite F-1, Bend, OR 97701-5711
 541.383.9310 fax 541.382.7588
 Anchorage 3209 Denali Street, Anchorage, AK 99503
 907.334.9200 fax 907.334.9210

Geo Engineers - Spokane 523 East 2nd Spokane WA/USA, 99202	Project: Time Oil-Sunnyside Project Number: 19063-003-01 Project Manager: Mark Engdahl	Reported: 04/23/03 15:57
--	--	-----------------------------

**Physical Parameters by APHA/ASTM/EPA Methods - Quality Control
 North Creek Analytical - Bothell**

Analyte	Result	Reporting Limit	Units	Spike Level	Source Result	%REC	Limit	RPD	Limit	Notes
Batch 3D20007: Prepared 04/20/03 Using Dry Weight										
Blank (3D20007-BLK1)										
Dry Weight	100	1.00	%							

North Creek Analytical - Bothell

The results in this report apply to the samples analyzed in accordance with the chain of custody document. This analytical report must be reproduced in its entirety.

Amar Gill, Project Manager

**North Creek Analytical, Inc.
 Environmental Laboratory Network**



Seattle 11720 North Creek Pkwy N, Suite 400, Bothell, WA 98011-8244

425.420.9200 fax 425.420.9210

Spokane East 11115 Montgomery, Suite B, Spokane, WA 99206-4776

509.924.9200 fax 509.924.9290

Portland 9405 SW Nimbus Avenue, Beaverton, OR 97008-7132

503.906.9200 fax 503.906.9210

Bend 20332 Empire Avenue, Suite F-1, Bend, OR 97701-5711

541.383.9310 fax 541.382.7588

Anchorage 3209 Denali Street, Anchorage, AK 99503

907.334.9200 fax 907.334.9210

Geo Engineers - Spokane
523 East 2nd
Spokane WA/USA, 99202

Project: Time Oil-Sunnyside

Project Number: 19063-003-01

Project Manager: Mark Engdahl

Reported:

04/23/03 15:57

Notes and Definitions

- DET Analyte DETECTED
- ND Analyte NOT DETECTED at or above the reporting limit
- NR Not Reported
- dry Sample results reported on a dry weight basis
- RPD Relative Percent Difference

North Creek Analytical - Bothell

Amar Gill, Project Manager

The results in this report apply to the samples analyzed in accordance with the chain of custody document. This analytical report must be reproduced in its entirety.



North Creek Analytical, Inc.
Environmental Laboratory Network
www.ncalabs.com

East 11115 Montgomery, Suite B, Spokane, WA 99206-4776
9405 S.W. Nimbus Avenue, Beaverton, OR 97008-7132
20332 Empire Avenue, Suite F-1, Bend, OR 97701-5711

(509) 924-9200
(503) 906-9200
(541) 383-9310

(509) 924-9200
(503) 906-9210
(541) 383-7588

CHAIN OF CUSTODY REPORT

Work Order #: **B3DO372**

CLIENT: Geo Engineers
 REPORT TO: Mark Engdahl
 ADDRESS: 523 E 2nd Ave Spokane, WA 99202
 PHONE: 509-363-3125 FAX: 363-3126
 PROJECT NAME: Sunnyside
 PROJECT NUMBER: 19063-003-01
 SAMPLED BY: Mark Engdahl

INVOICE TO: Time Oil Co

Attn: Scott Sloan

P.O. NUMBER:

REQUESTED ANALYSES

CLIENT SAMPLE IDENTIFICATION	SAMPLING DATE/TIME	NUPH-6	BTEX	MTBE	Naphthalene	EDB/EDC	EPH*	HPH*
1. 8k Tank Center 13'	4/15/03 1130	X	X	X	X	X	X	X
2. 8k Tank West 13'	1150	X	X	X	X	X	X	X
3. 8k Tank East 13'	1200	X	X	X	X	X	X	X
4. 8k Tank Well 8.5'	4/15/03 1140	X	X	X	X	X	X	X
5.								
6.								
7.								
8.								
9.								
10.								
11.								
12.								
13.								
14.								
15.								

TURNAROUND REQUEST in Business Days*

Organic & Inorganic Analyses
 10 7 5 4 3 2 1 <1

Petroleum Hydrocarbon Analyses
 STD. 4 3 2 1 <1

OTHER Please Specify _____

*Turnaround Requests less than standard may incur Rush Charges.

MATRIX (W, S, O)	# OF CONT.	COMMENTS	NCA WO ID
S	2	B3DO372	01
S	2		02
S	2		03
S	2		04

RELINQUISHED BY: Mark Engdahl RECEIVED BY: Mark Sloan
 PRINT NAME: Mark Engdahl PRINT NAME: Mark Sloan
 DATE: 4/15/03 DATE: 4/15/03
 TIME: 1406 TIME: 0900
 FIRM: GET FIRM: NCA
 ADDITIONAL REMARKS: Hold for potential analysis - call prior to analysis



Seattle 11720 North Creek Pkwy N, Suite 400, Bothell, WA 98011-8244
425.420.9200 fax 425.420.9210
Spokane East 11115 Montgomery, Suite B, Spokane, WA 99206-4776
509.924.9200 fax 509.924.9290
Portland 9405 SW Nimbus Avenue, Beaverton, OR 97008-7132
503.906.9200 fax 503.906.9210
Bend 20332 Empire Avenue, Suite F-1, Bend, OR 97701-5711
541.383.9310 fax 541.382.7588
Anchorage 3209 Denali Street, Anchorage, AK 99503
907.334.9200 fax 907.334.9210

02 May 2003

Mark Engdahl
Geo Engineers - Spokane
523 East 2nd
Spokane, WA/USA 99202
RE: Time Oil-Sunnyside

Enclosed are the results of analyses for samples received by the laboratory on 04/18/03 09:00. If you have any questions concerning this report, please feel free to contact me.

Sincerely,

Amar Gill
Project Manager



Seattle 11720 North Creek Pkwy N, Suite 400, Bothell, WA 98011-8244
 425.420.9200 fax 425.420.9210
 Spokane East 11115 Montgomery, Suite B, Spokane, WA 99206-4776
 509.924.9200 fax 509.924.9290
 Portland 9405 SW Nimbus Avenue, Beaverton, OR 97008-7132
 503.906.9200 fax 503.906.9210
 Bend 20332 Empire Avenue, Suite F-1, Bend, OR 97701-5711
 541.383.9310 fax 541.382.7588
 Anchorage 3209 Denali Street, Anchorage, AK 99503
 907.334.9200 fax 907.334.9210

Geo Engineers - Spokane 523 East 2nd Spokane WA/USA, 99202	Project: Time Oil-Sunnyside Project Number: 19063-003-01 Project Manager: Mark Engdahl	Reported: 05/02/03 10:34
--	--	-----------------------------

ANALYTICAL REPORT FOR SAMPLES

Sample ID	Laboratory ID	Matrix	Date Sampled	Date Received
S.Side Wall 8.5'	B3D0424-01	Soil	04/15/03 14:40	04/18/03 09:00
12 K Tank Center 13'	B3D0424-02	Soil	04/15/03 14:30	04/18/03 09:00
W Side Wall 8.5'	B3D0424-03	Soil	04/15/03 14:20	04/18/03 09:00
12 K Tank West 13'	B3D0424-04	Soil	04/15/03 14:10	04/18/03 09:00
8 K Tank EWall 8.5'	B3D0424-05	Soil	04/16/03 08:00	04/18/03 09:00
Disp Isl N Wall 6.0'	B3D0424-06	Soil	04/16/03 08:10	04/18/03 09:00
Disp Isl Ex N Wall 10.0'	B3D0424-07	Soil	04/16/03 08:20	04/18/03 09:00
Disp Isl E Wall 8.0'	B3D0424-08	Soil	04/16/03 11:00	04/18/03 09:00
Disp Isl S Wall 8.0'	B3D0424-09	Soil	04/16/03 12:40	04/18/03 09:00
Disp Isl E Btm 16.0'	B3D0424-10	Soil	04/16/03 13:00	04/18/03 09:00
Disp Isl N Btm 16.0'	B3D0424-11	Soil	04/16/03 14:10	04/18/03 09:00
Disp Isl S Btm 23.0'	B3D0424-12	Soil	04/16/03 14:20	04/18/03 09:00
W Disp Btm 18.0'	B3D0424-14	Soil	04/16/03 15:00	04/18/03 09:00

North Creek Analytical - Bothell

The results in this report apply to the samples analyzed in accordance with the chain of custody document. This analytical report must be reproduced in its entirety.

Amar Gill, Project Manager

North Creek Analytical, Inc.
Environmental Laboratory Network



Seattle 11720 North Creek Pkwy N, Suite 400, Bothell, WA 98011-8244
 425.420.9200 fax 425.420.9210
 Spokane East 11115 Montgomery, Suite B, Spokane, WA 99206-4776
 509.924.9200 fax 509.924.9290
 Portland 9405 SW Nimbus Avenue, Beaverton, OR 97008-7132
 503.906.9200 fax 503.906.9210
 Bend 20332 Empire Avenue, Suite F-1, Bend, OR 97701-5711
 541.383.9310 fax 541.382.7588
 Anchorage 3209 Denali Street, Anchorage, AK 99503
 907.334.9200 fax 907.334.9210

Geo Engineers - Spokane
 523 East 2nd
 Spokane WA/USA, 99202

Project: Time Oil-Sunnyside
 Project Number: 19063-003-01
 Project Manager: Mark Engdahl

Reported:
 05/02/03 10:34

**Volatile Petroleum Products by NWTPH-Gx
 North Creek Analytical - Bothell**

Analyte	Result	Reporting Limit	Units	Dilution	Batch	Prepared	Analyzed	Method	Notes
S.Side Wall 8.5' (B3D0424-01) Soil Sampled: 04/15/03 14:40 Received: 04/18/03 09:00									
Gasoline Range Hydrocarbons	ND	5.00	mg/kg dry	1	3D22004	04/22/03	04/23/03	NWTPH-Gx	
Surrogate: 4-BFB (FID)	77.1 %	59-125			"	"	"	"	
12 K Tank Center 13' (B3D0424-02) Soil Sampled: 04/15/03 14:30 Received: 04/18/03 09:00									
Gasoline Range Hydrocarbons	ND	5.00	mg/kg dry	1	3D22004	04/22/03	04/23/03	NWTPH-Gx	
Surrogate: 4-BFB (FID)	75.5 %	59-125			"	"	"	"	
W Side Wall 8.5' (B3D0424-03) Soil Sampled: 04/15/03 14:20 Received: 04/18/03 09:00									
Gasoline Range Hydrocarbons	ND	5.00	mg/kg dry	1	3D22004	04/22/03	04/23/03	NWTPH-Gx	
Surrogate: 4-BFB (FID)	80.3 %	59-125			"	"	"	"	
12 K Tank West 13' (B3D0424-04) Soil Sampled: 04/15/03 14:10 Received: 04/18/03 09:00									
Gasoline Range Hydrocarbons	ND	5.00	mg/kg dry	1	3D22004	04/22/03	04/23/03	NWTPH-Gx	
Surrogate: 4-BFB (FID)	73.8 %	59-125			"	"	"	"	
8 K Tank EWall 8.5' (B3D0424-05) Soil Sampled: 04/16/03 08:00 Received: 04/18/03 09:00									
Gasoline Range Hydrocarbons	ND	5.00	mg/kg dry	1	3D22004	04/22/03	04/23/03	NWTPH-Gx	
Surrogate: 4-BFB (FID)	75.5 %	59-125			"	"	"	"	
Disp Isl N Wall 6.0' (B3D0424-06) Soil Sampled: 04/16/03 08:10 Received: 04/18/03 09:00									
Gasoline Range Hydrocarbons	ND	5.00	mg/kg dry	1	3D22004	04/22/03	04/23/03	NWTPH-Gx	
Surrogate: 4-BFB (FID)	84.5 %	59-125			"	"	"	"	
Disp Isl Ex N Wall 10.0' (B3D0424-07) Soil Sampled: 04/16/03 08:20 Received: 04/18/03 09:00									
Gasoline Range Hydrocarbons	ND	5.00	mg/kg dry	1	3D22004	04/22/03	04/23/03	NWTPH-Gx	
Surrogate: 4-BFB (FID)	80.3 %	59-125			"	"	"	"	

North Creek Analytical - Bothell

The results in this report apply to the samples analyzed in accordance with the chain of custody document. This analytical report must be reproduced in its entirety.

Amar Gill, Project Manager

North Creek Analytical, Inc.
 Environmental Laboratory Network

Page 2 of 24



Seattle 11720 North Creek Pkwy N, Suite 400, Bothell, WA 98011-8244
 425.420.9200 fax 425.420.9210
 Spokane East 11115 Montgomery, Suite B, Spokane, WA 99206-4776
 509.924.9200 fax 509.924.9290
 Portland 9405 SW Nimbus Avenue, Beaverton, OR 97008-7132
 503.906.9200 fax 503.906.9210
 Bend 20332 Empire Avenue, Suite F-1, Bend, OR 97701-5711
 541.383.9310 fax 541.382.7588
 Anchorage 3209 Denali Street, Anchorage, AK 99503
 907.334.9200 fax 907.334.9210

Geo Engineers - Spokane
 523 East 2nd
 Spokane WA/USA, 99202

Project: Time Oil-Sunnyside
 Project Number: 19063-003-01
 Project Manager: Mark Engdahl

Reported:
 05/02/03 10:34

**Volatile Petroleum Products by NWTPH-Gx
 North Creek Analytical - Bothell**

Analyte	Result	Reporting Limit	Units	Dilution	Batch	Prepared	Analyzed	Method	Notes
Disp Isl E Wall 8.0' (B3D0424-08) Soil Sampled: 04/16/03 11:00 Received: 04/18/03 09:00									
Gasoline Range Hydrocarbons	ND	5.00	mg/kg dry	1	3D22004	04/22/03	04/23/03	NWTPH-Gx	
Surrogate: 4-BFB (FID)	74.5 %	59-125			"	"	"	"	
Disp Isl S Wall 8.0' (B3D0424-09) Soil Sampled: 04/16/03 12:40 Received: 04/18/03 09:00									
Gasoline Range Hydrocarbons	ND	5.00	mg/kg dry	1	3D22004	04/22/03	04/23/03	NWTPH-Gx	
Surrogate: 4-BFB (FID)	80.4 %	59-125			"	"	"	"	
Disp Isl E Btm 16.0' (B3D0424-10) Soil Sampled: 04/16/03 13:00 Received: 04/18/03 09:00									
Gasoline Range Hydrocarbons	ND	5.00	mg/kg dry	1	3D22004	04/22/03	04/24/03	NWTPH-Gx	
Surrogate: 4-BFB (FID)	80.0 %	59-125			"	"	"	"	
Disp Isl N Btm 16.0' (B3D0424-11) Soil Sampled: 04/16/03 14:10 Received: 04/18/03 09:00									
Gasoline Range Hydrocarbons	ND	5.00	mg/kg dry	1	3D22004	04/22/03	04/24/03	NWTPH-Gx	
Surrogate: 4-BFB (FID)	77.5 %	59-125			"	"	"	"	
Disp Isl S Btm 23.0' (B3D0424-12) Soil Sampled: 04/16/03 14:20 Received: 04/18/03 09:00									
Gasoline Range Hydrocarbons	ND	5.00	mg/kg dry	1	3D22004	04/22/03	04/24/03	NWTPH-Gx	
Surrogate: 4-BFB (FID)	78.7 %	59-125			"	"	"	"	
W Disp Btm 18.0' (B3D0424-14) Soil Sampled: 04/16/03 15:00 Received: 04/18/03 09:00									
Gasoline Range Hydrocarbons	ND	5.00	mg/kg dry	1	3D22004	04/22/03	04/24/03	NWTPH-Gx	
Surrogate: 4-BFB (FID)	75.2 %	59-125			"	"	"	"	

North Creek Analytical - Bothell

The results in this report apply to the samples analyzed in accordance with the chain of custody document. This analytical report must be reproduced in its entirety.

Amar Gill, Project Manager

North Creek Analytical, Inc.
 Environmental Laboratory Network



Seattle 11720 North Creek Pkwy N, Suite 400, Bothell, WA 98011-8244
 425.420.9200 fax 425.420.9210
 Spokane East 11115 Montgomery, Suite B, Spokane, WA 99206-4776
 509.924.9200 fax 509.924.9290
 Portland 9405 SW Nimbus Avenue, Beaverton, OR 97008-7132
 503.906.9200 fax 503.906.9210
 Bend 20332 Empire Avenue, Suite F-1, Bend, OR 97701-5711
 541.383.9310 fax 541.382.7588
 Anchorage 3209 Denali Street, Anchorage, AK 99503
 907.334.9200 fax 907.334.9210

Geo Engineers - Spokane
 523 East 2nd
 Spokane WA/USA, 99202

Project: Time Oil-Sunnyside
 Project Number: 19063-003-01
 Project Manager: Mark Engdahl

Reported:
 05/02/03 10:34

Volatile Organic Compounds (Special List) per EPA Method 8260B (Low Soil Method)
North Creek Analytical - Bothell

Analyte	Result	Reporting Limit	Units	Dilution	Batch	Prepared	Analyzed	Method	Notes
---------	--------	-----------------	-------	----------	-------	----------	----------	--------	-------

S.Side Wall 8.5' (B3D0424-01) Soil Sampled: 04/15/03 14:40 Received: 04/18/03 09:00

Benzene	ND	0.00150	mg/kg dry	1	3D25005	04/24/03	04/25/03	EPA 8260B	
1,2-Dibromoethane (EDB)	ND	0.00500	"	"	"	"	"	"	
1,2-Dichloroethane	ND	0.00125	"	"	"	"	"	"	
Ethylbenzene	ND	0.00400	"	"	"	"	"	"	
Naphthalene	ND	0.00500	"	"	"	"	"	"	
Toluene	ND	0.00150	"	"	"	"	"	"	
Total Xylenes	ND	0.0100	"	"	"	"	"	"	
Methyl tert-butyl ether	ND	0.00100	"	"	"	"	"	"	
Surrogate: 1,2-DCA-d4	93.5 %	60-140			"	"	"	"	
Surrogate: Toluene-d8	98.7 %	60-140			"	"	"	"	
Surrogate: 4-BFB	101 %	60-140			"	"	"	"	

12 K Tank Center 13' (B3D0424-02) Soil Sampled: 04/15/03 14:30 Received: 04/18/03 09:00

Benzene	ND	0.00150	mg/kg dry	1	3D25005	04/24/03	04/25/03	EPA 8260B	
1,2-Dibromoethane (EDB)	ND	0.00500	"	"	"	"	"	"	
1,2-Dichloroethane	ND	0.00125	"	"	"	"	"	"	
Ethylbenzene	ND	0.00400	"	"	"	"	"	"	
Naphthalene	ND	0.00500	"	"	"	"	"	"	
Toluene	ND	0.00150	"	"	"	"	"	"	
Total Xylenes	ND	0.0100	"	"	"	"	"	"	
Methyl tert-butyl ether	ND	0.00100	"	"	"	"	"	"	
Surrogate: 1,2-DCA-d4	79.7 %	60-140			"	"	"	"	
Surrogate: Toluene-d8	102 %	60-140			"	"	"	"	
Surrogate: 4-BFB	101 %	60-140			"	"	"	"	

North Creek Analytical - Bothell

The results in this report apply to the samples analyzed in accordance with the chain of custody document. This analytical report must be reproduced in its entirety.

Amar Gill, Project Manager

North Creek Analytical, Inc.
 Environmental Laboratory Network

Page 4 of 24



Seattle 11720 North Creek Pkwy N, Suite 400, Bothell, WA 98011-8244
 425.420.9200 fax 425.420.9210
 Spokane East 11115 Montgomery, Suite B, Spokane, WA 99206-4776
 509.924.9200 fax 509.924.9290
 Portland 9405 SW Nimbus Avenue, Beaverton, OR 97008-7132
 503.906.9200 fax 503.906.9210
 Bend 20332 Empire Avenue, Suite F-1, Bend, OR 97701-5711
 541.383.9310 fax 541.382.7588
 Anchorage 3209 Denali Street, Anchorage, AK 99503
 907.334.9200 fax 907.334.9210

Geo Engineers - Spokane
 523 East 2nd
 Spokane WA/USA, 99202

Project: Time Oil-Sunnyside
 Project Number: 19063-003-01
 Project Manager: Mark Engdahl

Reported:
 05/02/03 10:34

Volatile Organic Compounds (Special List) per EPA Method 8260B (Low Soil Method)
North Creek Analytical - Bothell

Analyte	Result	Reporting Limit	Units	Dilution	Batch	Prepared	Analyzed	Method	Notes
---------	--------	-----------------	-------	----------	-------	----------	----------	--------	-------

W Side Wall 8.5' (B3D0424-03) Soil Sampled: 04/15/03 14:20 Received: 04/18/03 09:00

Benzene	ND	0.00150	mg/kg dry	1	3D25005	04/24/03	04/25/03	EPA 8260B	
1,2-Dibromoethane (EDB)	ND	0.00500	"	"	"	"	"	"	
1,2-Dichloroethane	ND	0.00125	"	"	"	"	"	"	
Ethylbenzene	ND	0.00400	"	"	"	"	"	"	
Naphthalene	ND	0.00500	"	"	"	"	"	"	
Toluene	ND	0.00150	"	"	"	"	"	"	
Total Xylenes	ND	0.0100	"	"	"	"	"	"	
Methyl tert-butyl ether	ND	0.00100	"	"	"	"	"	"	
Surrogate: 1,2-DCA-d4	84.1 %	60-140			"	"	"	"	
Surrogate: Toluene-d8	102 %	60-140			"	"	"	"	
Surrogate: 4-BFB	103 %	60-140			"	"	"	"	

K Tank West 13' (B3D0424-04) Soil Sampled: 04/15/03 14:10 Received: 04/18/03 09:00

Benzene	ND	0.00150	mg/kg dry	1	3D25005	04/24/03	04/25/03	EPA 8260B	
1,2-Dibromoethane (EDB)	ND	0.00500	"	"	"	"	"	"	
1,2-Dichloroethane	ND	0.00125	"	"	"	"	"	"	
Ethylbenzene	ND	0.00400	"	"	"	"	"	"	
Naphthalene	ND	0.00500	"	"	"	"	"	"	
Toluene	ND	0.00150	"	"	"	"	"	"	
Total Xylenes	ND	0.0100	"	"	"	"	"	"	
Methyl tert-butyl ether	ND	0.00100	"	"	"	"	"	"	
Surrogate: 1,2-DCA-d4	99.4 %	60-140			"	"	"	"	
Surrogate: Toluene-d8	98.3 %	60-140			"	"	"	"	
Surrogate: 4-BFB	102 %	60-140			"	"	"	"	

North Creek Analytical - Bothell

The results in this report apply to the samples analyzed in accordance with the chain of custody document. This analytical report must be reproduced in its entirety.

Amar Gill, Project Manager

North Creek Analytical, Inc.
 Environmental Laboratory Network



Seattle 11720 North Creek Pkwy N, Suite 400, Bothell, WA 98011-8244
 425.420.9200 fax 425.420.9210
 Spokane East 11115 Montgomery, Suite B, Spokane, WA 99206-4776
 509.924.9200 fax 509.924.9290
 Portland 9405 SW Nimbus Avenue, Beaverton, OR 97008-7132
 503.906.9200 fax 503.906.9210
 Bend 20332 Empire Avenue, Suite F-1, Bend, OR 97701-5711
 541.383.9310 fax 541.382.7588
 Anchorage 3209 Denali Street, Anchorage, AK 99503
 907.334.9200 fax 907.334.9210

Geo Engineers - Spokane
 523 East 2nd
 Spokane WA/USA, 99202

Project: Time Oil-Sunnyside
 Project Number: 19063-003-01
 Project Manager: Mark Engdahl

Reported:
 05/02/03 10:34

Volatile Organic Compounds (Special List) per EPA Method 8260B (Low Soil Method)
North Creek Analytical - Bothell

Analyte	Result	Reporting Limit	Units	Dilution	Batch	Prepared	Analyzed	Method	Notes
---------	--------	-----------------	-------	----------	-------	----------	----------	--------	-------

8 K Tank EWall 8.5' (B3D0424-05) Soil Sampled: 04/16/03 08:00 Received: 04/18/03 09:00

Benzene	ND	0.00150	mg/kg dry	1	3D25005	04/24/03	04/25/03	EPA 8260B	
1,2-Dibromoethane (EDB)	ND	0.00500	"	"	"	"	"	"	
1,2-Dichloroethane	ND	0.00125	"	"	"	"	"	"	
Ethylbenzene	ND	0.00400	"	"	"	"	"	"	
Naphthalene	ND	0.00500	"	"	"	"	"	"	
Toluene	ND	0.00150	"	"	"	"	"	"	
Total Xylenes	ND	0.0100	"	"	"	"	"	"	
Methyl tert-butyl ether	ND	0.00100	"	"	"	"	"	"	
Surrogate: 1,2-DCA-d4	102 %	60-140			"	"	"	"	
Surrogate: Toluene-d8	97.1 %	60-140			"	"	"	"	
Surrogate: 4-BFB	99.8 %	60-140			"	"	"	"	

Disp Isl N Wall 6.0' (B3D0424-06) Soil Sampled: 04/16/03 08:10 Received: 04/18/03 09:00

Benzene	ND	0.00150	mg/kg dry	1	3D25014	04/25/03	04/25/03	EPA 8260B	
1,2-Dibromoethane (EDB)	ND	0.00500	"	"	"	"	"	"	
1,2-Dichloroethane	ND	0.00125	"	"	"	"	"	"	
Ethylbenzene	ND	0.00400	"	"	"	"	"	"	
Naphthalene	ND	0.00500	"	"	"	"	"	"	
Toluene	ND	0.00150	"	"	"	"	"	"	
Total Xylenes	ND	0.0100	"	"	"	"	"	"	
Methyl tert-butyl ether	ND	0.00100	"	"	"	"	"	"	
Surrogate: 1,2-DCA-d4	90.4 %	60-140			"	"	"	"	
Surrogate: Toluene-d8	99.6 %	60-140			"	"	"	"	
Surrogate: 4-BFB	101 %	60-140			"	"	"	"	

North Creek Analytical - Bothell

Amar Gill, Project Manager

The results in this report apply to the samples analyzed in accordance with the chain of custody document. This analytical report must be reproduced in its entirety.

North Creek Analytical, Inc.
 Environmental Laboratory Network



Seattle 11720 North Creek Pkwy N, Suite 400, Bothell, WA 98011-8244
 425.420.9200 fax 425.420.9210
 Spokane East 11115 Montgomery, Suite B, Spokane, WA 99206-4776
 509.924.9200 fax 509.924.9290
 Portland 9405 SW Nimbus Avenue, Beaverton, OR 97008-7132
 503.906.9200 fax 503.906.9210
 Bend 20332 Empire Avenue, Suite F-1, Bend, OR 97701-5711
 541.383.9310 fax 541.382.7588
 Anchorage 3209 Denali Street, Anchorage, AK 99503
 907.334.9200 fax 907.334.9210

Geo Engineers - Spokane Project: Time Oil-Sunnyside
 523 East 2nd Project Number: 19063-003-01
 Spokane WA/USA, 99202 Project Manager: Mark Engdahl Reported:
 05/02/03 10:34

Volatile Organic Compounds (Special List) per EPA Method 8260B (Low Soil Method)
North Creek Analytical - Bothell

Analyte	Result	Reporting Limit	Units	Dilution	Batch	Prepared	Analyzed	Method	Notes
---------	--------	-----------------	-------	----------	-------	----------	----------	--------	-------

Disp Isl Ex N Wall 10.0' (B3D0424-07) Soil Sampled: 04/16/03 08:20 Received: 04/18/03 09:00

Benzene	ND	0.00150	mg/kg dry	1	3D25014	04/25/03	04/25/03	EPA 8260B	
1,2-Dibromoethane (EDB)	ND	0.00500	"	"	"	"	"	"	
1,2-Dichloroethane	ND	0.00125	"	"	"	"	"	"	
Ethylbenzene	ND	0.00400	"	"	"	"	"	"	
Naphthalene	ND	0.00500	"	"	"	"	"	"	
Toluene	ND	0.00150	"	"	"	"	"	"	
Total Xylenes	ND	0.0100	"	"	"	"	"	"	
Methyl tert-butyl ether	0.00904	0.00100	"	"	"	"	"	"	
Surrogate: 1,2-DCA-d4	99.0 %	60-140			"	"	"	"	
Surrogate: Toluene-d8	98.0 %	60-140			"	"	"	"	
Surrogate: 4-BFB	109 %	60-140			"	"	"	"	

Disp Isl E Wall 8.0' (B3D0424-08) Soil Sampled: 04/16/03 11:00 Received: 04/18/03 09:00

Benzene	ND	0.00150	mg/kg dry	1	3D29046	04/29/03	04/29/03	EPA 8260B	
1,2-Dibromoethane (EDB)	ND	0.00500	"	"	"	"	"	"	
1,2-Dichloroethane	ND	0.00125	"	"	"	"	"	"	
Ethylbenzene	ND	0.00400	"	"	"	"	"	"	
Naphthalene	ND	0.00500	"	"	"	"	"	"	
Toluene	ND	0.00150	"	"	"	"	"	"	
Total Xylenes	ND	0.0100	"	"	"	"	"	"	
Methyl tert-butyl ether	ND	0.00100	"	"	"	"	"	"	
Surrogate: 1,2-DCA-d4	92.9 %	60-140			"	"	"	"	
Surrogate: Toluene-d8	99.0 %	60-140			"	"	"	"	
Surrogate: 4-BFB	96.9 %	60-140			"	"	"	"	

North Creek Analytical - Bothell

The results in this report apply to the samples analyzed in accordance with the chain of custody document. This analytical report must be reproduced in its entirety.

Amar Gill, Project Manager

North Creek Analytical, Inc.
Environmental Laboratory Network



Seattle 11720 North Creek Pkwy N, Suite 400, Bothell, WA 98011-8244
 425.420.9200 fax 425.420.9210
 Spokane East 11115 Montgomery, Suite B, Spokane, WA 99206-4776
 509.924.9200 fax 509.924.9290
 Portland 9405 SW Nimbus Avenue, Beaverton, OR 97008-7132
 503.906.9200 fax 503.906.9210
 Bend 20332 Empire Avenue, Suite F-1, Bend, OR 97701-5711
 541.383.9310 fax 541.382.7588
 Anchorage 3209 Denali Street, Anchorage, AK 99503
 907.334.9200 fax 907.334.9210

Geo Engineers - Spokane
 523 East 2nd
 Spokane WA/USA, 99202

Project: Time Oil-Sunnyside
 Project Number: 19063-003-01
 Project Manager: Mark Engdahl

Reported:
 05/02/03 10:34

Volatile Organic Compounds (Special List) per EPA Method 8260B (Low Soil Method)
North Creek Analytical - Bothell

Analyte	Result	Reporting Limit	Units	Dilution	Batch	Prepared	Analyzed	Method	Notes
Disp Isl S Wall 8.0' (B3D0424-09) Soil Sampled: 04/16/03 12:40 Received: 04/18/03 09:00									
Benzene	ND	0.00150	mg/kg dry	1	3D29046	04/29/03	04/29/03	EPA 8260B	
1,2-Dibromoethane (EDB)	ND	0.00500	"	"	"	"	"	"	
1,2-Dichloroethane	ND	0.00125	"	"	"	"	"	"	
Ethylbenzene	ND	0.00400	"	"	"	"	"	"	
Naphthalene	ND	0.00500	"	"	"	"	"	"	
Toluene	ND	0.00150	"	"	"	"	"	"	
Total Xylenes	ND	0.0100	"	"	"	"	"	"	
Methyl tert-butyl ether	ND	0.00100	"	"	"	"	"	"	
Surrogate: 1,2-DCA-d4	100 %	60-140			"	"	"	"	
Surrogate: Toluene-d8	97.5 %	60-140			"	"	"	"	
Surrogate: 4-BFB	95.8 %	60-140			"	"	"	"	
Disp Isl E Btm 16.0' (B3D0424-10) Soil Sampled: 04/16/03 13:00 Received: 04/18/03 09:00									
Benzene	ND	0.00150	mg/kg dry	1	3D29046	04/29/03	04/29/03	EPA 8260B	
1,2-Dibromoethane (EDB)	ND	0.00500	"	"	"	"	"	"	
1,2-Dichloroethane	ND	0.00125	"	"	"	"	"	"	
Ethylbenzene	ND	0.00400	"	"	"	"	"	"	
Naphthalene	ND	0.00500	"	"	"	"	"	"	
Toluene	ND	0.00150	"	"	"	"	"	"	
Total Xylenes	ND	0.0100	"	"	"	"	"	"	
Methyl tert-butyl ether	ND	0.00100	"	"	"	"	"	"	
Surrogate: 1,2-DCA-d4	107 %	60-140			"	"	"	"	
Surrogate: Toluene-d8	95.9 %	60-140			"	"	"	"	
Surrogate: 4-BFB	96.5 %	60-140			"	"	"	"	

North Creek Analytical - Bothell

Amar Gill, Project Manager

The results in this report apply to the samples analyzed in accordance with the chain of custody document. This analytical report must be reproduced in its entirety.

North Creek Analytical, Inc.
 Environmental Laboratory Network



Seattle 11720 North Creek Pkwy N, Suite 400, Bothell, WA 98011-8244
 425.420.9200 fax 425.420.9210
 Spokane East 11115 Montgomery, Suite B, Spokane, WA 99206-4776
 509.924.9200 fax 509.924.9290
 Portland 9405 SW Nimbus Avenue, Beaverton, OR 97008-7132
 503.906.9200 fax 503.906.9210
 Bend 20332 Empire Avenue, Suite F-1, Bend, OR 97701-5711
 541.383.9310 fax 541.382.7588
 Anchorage 3209 Denali Street, Anchorage, AK 99503
 907.334.9200 fax 907.334.9210

Geo Engineers - Spokane
 523 East 2nd
 Spokane WA/USA, 99202

Project: Time Oil-Sunnyside
 Project Number: 19063-003-01
 Project Manager: Mark Engdahl

Reported:
 05/02/03 10:34

Volatile Organic Compounds (Special List) per EPA Method 8260B (Low Soil Method)
North Creek Analytical - Bothell

Analyte	Result	Reporting Limit	Units	Dilution	Batch	Prepared	Analyzed	Method	Notes
Disp Isl N Btm 16.0' (B3D0424-11) Soil Sampled: 04/16/03 14:10 Received: 04/18/03 09:00									
Benzene	ND	0.00150	mg/kg dry	1	3D29046	04/29/03	04/29/03	EPA 8260B	
1,2-Dibromoethane (EDB)	ND	0.00500	"	"	"	"	"	"	"
1,2-Dichloroethane	ND	0.00125	"	"	"	"	"	"	"
Ethylbenzene	ND	0.00400	"	"	"	"	"	"	"
Naphthalene	ND	0.00500	"	"	"	"	"	"	"
Toluene	ND	0.00150	"	"	"	"	"	"	"
Total Xylenes	ND	0.0100	"	"	"	"	"	"	"
Methyl tert-butyl ether	ND	0.00100	"	"	"	"	"	"	"
Surrogate: 1,2-DCA-d4	93.3 %	60-140			"	"	"	"	"
Surrogate: Toluene-d8	97.9 %	60-140			"	"	"	"	"
Surrogate: 4-BFB	98.1 %	60-140			"	"	"	"	"
Disp Isl S Btm 23.0' (B3D0424-12) Soil Sampled: 04/16/03 14:20 Received: 04/18/03 09:00									
Benzene	ND	0.00150	mg/kg dry	1	3D23008	04/22/03	04/22/03	EPA 8260B	
1,2-Dibromoethane (EDB)	ND	0.00500	"	"	"	"	"	"	"
1,2-Dichloroethane	ND	0.00125	"	"	"	"	"	"	"
Ethylbenzene	ND	0.00400	"	"	"	"	"	"	"
Naphthalene	ND	0.00500	"	"	"	"	"	"	"
Toluene	0.00311	0.00150	"	"	"	"	"	"	"
Total Xylenes	ND	0.0100	"	"	"	"	"	"	"
Methyl tert-butyl ether	ND	0.00100	"	"	"	"	"	"	"
Surrogate: 1,2-DCA-d4	108 %	60-140			"	"	"	"	"
Surrogate: Toluene-d8	108 %	60-140			"	"	"	"	"
Surrogate: 4-BFB	97.2 %	60-140			"	"	"	"	"

North Creek Analytical - Bothell

The results in this report apply to the samples analyzed in accordance with the chain of custody document. This analytical report must be reproduced in its entirety.

Amar Gill, Project Manager

North Creek Analytical, Inc.
 Environmental Laboratory Network



Seattle 11720 North Creek Pkwy N, Suite 400, Bothell, WA 98011-8244
 425.420.9200 fax 425.420.9210
 Spokane East 11115 Montgomery, Suite B, Spokane, WA 99206-4776
 509.924.9200 fax 509.924.9290
 Portland 9405 SW Nimbus Avenue, Beaverton, OR 97008-7132
 503.906.9200 fax 503.906.9210
 Bend 20332 Empire Avenue, Suite F-1, Bend, OR 97701-5711
 541.383.9310 fax 541.382.7588
 Anchorage 3209 Denali Street, Anchorage, AK 99503
 907.334.9200 fax 907.334.9210

Geo Engineers - Spokane 523 East 2nd Spokane WA/USA, 99202	Project: Time Oil-Sunnyside Project Number: 19063-003-01 Project Manager: Mark Engdahl	Reported: 05/02/03 10:34
--	--	-----------------------------

Volatile Organic Compounds (Special List) per EPA Method 8260B (Low Soil Method)
North Creek Analytical - Bothell

Analyte	Result	Reporting Limit	Units	Dilution	Batch	Prepared	Analyzed	Method	Notes
W Disp Btm 18.0' (B3D0424-14) Soil Sampled: 04/16/03 15:00 Received: 04/18/03 09:00									
Benzene	ND	0.00150	mg/kg dry	1	3D23008	04/22/03	04/22/03	EPA 8260B	
1,2-Dibromoethane (EDB)	ND	0.00500	"	"	"	"	"	"	
1,2-Dichloroethane	ND	0.00125	"	"	"	"	"	"	
Ethylbenzene	ND	0.00400	"	"	"	"	"	"	
Naphthalene	ND	0.00500	"	"	"	"	"	"	
Toluene	ND	0.00150	"	"	"	"	"	"	
Total Xylenes	ND	0.0100	"	"	"	"	"	"	
Methyl tert-butyl ether	ND	0.00100	"	"	"	"	"	"	
Surrogate: 1,2-DCA-d4	113 %	60-140			"	"	"	"	
Surrogate: Toluene-d8	106 %	60-140			"	"	"	"	
Surrogate: 4-BFB	100 %	60-140			"	"	"	"	

North Creek Analytical - Bothell

Amar Gill, Project Manager

The results in this report apply to the samples analyzed in accordance with the chain of custody document. This analytical report must be reproduced in its entirety.

North Creek Analytical, Inc.
Environmental Laboratory Network



Seattle 11720 North Creek Pkwy N, Suite 400, Bothell, WA 98011-8244
 425.420.9200 fax 425.420.9210
 Spokane East 11115 Montgomery, Suite B, Spokane, WA 99206-4776
 509.924.9200 fax 509.924.9290
 Portland 9405 SW Nimbus Avenue, Beaverton, OR 97008-7132
 503.906.9200 fax 503.906.9210
 Bend 20332 Empire Avenue, Suite F-1, Bend, OR 97701-5711
 541.383.9310 fax 541.382.7588
 Anchorage 3209 Denali Street, Anchorage, AK 99503
 907.334.9200 fax 907.334.9210

Geo Engineers - Spokane
 523 East 2nd
 Spokane WA/USA, 99202

Project: Time Oil-Sunnyside
 Project Number: 19063-003-01
 Project Manager: Mark Engdahl

Reported:
 05/02/03 10:34

**Physical Parameters by APHA/ASTM/EPA Methods
 North Creek Analytical - Bothell**

Analyte	Result	Reporting Limit	Units	Dilution	Batch	Prepared	Analyzed	Method	Notes
S.Side Wall 8.5' (B3D0424-01) Soil Sampled: 04/15/03 14:40 Received: 04/18/03 09:00									
Dry Weight	76.2	1.00	%	1	3D22026	04/22/03	04/23/03	BSOPSPL003R07	
12 K Tank Center 13' (B3D0424-02) Soil Sampled: 04/15/03 14:30 Received: 04/18/03 09:00									
Dry Weight	73.7	1.00	%	1	3D22026	04/22/03	04/23/03	BSOPSPL003R07	
W Side Wall 8.5' (B3D0424-03) Soil Sampled: 04/15/03 14:20 Received: 04/18/03 09:00									
Dry Weight	73.0	1.00	%	1	3D22026	04/22/03	04/23/03	BSOPSPL003R07	
12 K Tank West 13' (B3D0424-04) Soil Sampled: 04/15/03 14:10 Received: 04/18/03 09:00									
Dry Weight	74.9	1.00	%	1	3D22026	04/22/03	04/23/03	BSOPSPL003R07	
8 K Tank EWall 8.5' (B3D0424-05) Soil Sampled: 04/16/03 08:00 Received: 04/18/03 09:00									
Dry Weight	83.1	1.00	%	1	3D22026	04/22/03	04/23/03	BSOPSPL003R07	
Disp Isl N Wall 6.0' (B3D0424-06) Soil Sampled: 04/16/03 08:10 Received: 04/18/03 09:00									
Dry Weight	87.2	1.00	%	1	3D22026	04/22/03	04/23/03	BSOPSPL003R07	
Disp Isl Ex N Wall 10.0' (B3D0424-07) Soil Sampled: 04/16/03 08:20 Received: 04/18/03 09:00									
Dry Weight	78.1	1.00	%	1	3D22026	04/22/03	04/23/03	BSOPSPL003R07	
Disp Isl E Wall 8.0' (B3D0424-08) Soil Sampled: 04/16/03 11:00 Received: 04/18/03 09:00									
Dry Weight	81.4	1.00	%	1	3D22026	04/22/03	04/23/03	BSOPSPL003R07	
Disp Isl S Wall 8.0' (B3D0424-09) Soil Sampled: 04/16/03 12:40 Received: 04/18/03 09:00									
Dry Weight	83.6	1.00	%	1	3D22026	04/22/03	04/23/03	BSOPSPL003R07	

North Creek Analytical - Bothell

Amar Gill, Project Manager

The results in this report apply to the samples analyzed in accordance with the chain of custody document. This analytical report must be reproduced in its entirety.



Seattle 11720 North Creek Pkwy N, Suite 400, Bothell, WA 98011-8244
 425.420.9200 fax 425.420.9210
 Spokane East 11115 Montgomery, Suite B, Spokane, WA 99206-4776
 509.924.9200 fax 509.924.9290
 Portland 9405 SW Nimbus Avenue, Beaverton, OR 97008-7132
 503.906.9200 fax 503.906.9210
 Bend 20332 Empire Avenue, Suite F-1, Bend, OR 97701-5711
 541.383.9310 fax 541.382.7588
 Anchorage 3209 Denali Street, Anchorage, AK 99503
 907.334.9200 fax 907.334.9210

Geo Engineers - Spokane
 523 East 2nd
 Spokane WA/USA, 99202

Project: Time Oil-Sunnyside
 Project Number: 19063-003-01
 Project Manager: Mark Engdahl

Reported:
 05/02/03 10:34

Physical Parameters by APHA/ASTM/EPA Methods
North Creek Analytical - Bothell

Analyte	Result	Reporting Limit	Units	Dilution	Batch	Prepared	Analyzed	Method	Notes
Disp Isl E Btm 16.0' (B3D0424-10) Soil Sampled: 04/16/03 13:00 Received: 04/18/03 09:00									
Dry Weight	74.6	1.00	%	1	3D22026	04/22/03	04/23/03	BSOPSPL003R07	
Disp Isl N Btm 16.0' (B3D0424-11) Soil Sampled: 04/16/03 14:10 Received: 04/18/03 09:00									
Dry Weight	76.8	1.00	%	1	3D22026	04/22/03	04/23/03	BSOPSPL003R07	
Disp Isl S Btm 23.0' (B3D0424-12) Soil Sampled: 04/16/03 14:20 Received: 04/18/03 09:00									
Dry Weight	75.4	1.00	%	1	3D22026	04/22/03	04/23/03	BSOPSPL003R07	
W Disp Btm 18.0' (B3D0424-14) Soil Sampled: 04/16/03 15:00 Received: 04/18/03 09:00									
Dry Weight	78.6	1.00	%	1	3D22026	04/22/03	04/23/03	BSOPSPL003R07	

North Creek Analytical - Bothell

Amar Gill, Project Manager

The results in this report apply to the samples analyzed in accordance with the chain of custody document. This analytical report must be reproduced in its entirety.



Seattle 11720 North Creek Pkwy N, Suite 400, Bothell, WA 98011-8244
 425.420.9200 fax 425.420.9210
 Spokane East 11115 Montgomery, Suite B, Spokane, WA 99206-4776
 509.924.9200 fax 509.924.9290
 Portland 9405 SW Nimbus Avenue, Beaverton, OR 97008-7132
 503.906.9200 fax 503.906.9210
 Bend 20332 Empire Avenue, Suite F-1, Bend, OR 97701-5711
 541.383.9310 fax 541.382.7588
 Anchorage 3209 Denali Street, Anchorage, AK 99503
 907.334.9200 fax 907.334.9210

Geo Engineers - Spokane
 523 East 2nd
 Spokane WA/USA, 99202

Project: Time Oil-Sunnyside
 Project Number: 19063-003-01
 Project Manager: Mark Engdahl

Reported:
 05/02/03 10:34

Volatile Petroleum Products by NWTPH-Gx - Quality Control
North Creek Analytical - Bothell

Analyte	Result	Reporting Limit	Units	Spike Level	Source Result	%REC	%REC Limits	RPD	RPD Limit	Notes
Batch 3D22004: Prepared 04/22/03 Using EPA 5030B (MeOH)										
Blank (3D22004-BLK1)										
Gasoline Range Hydrocarbons	ND	5.00	mg/kg							
Surrogate: 4-BFB (FID)	3.72		"	4.00		93.0	59-125			
LCS (3D22004-BS1)										
Gasoline Range Hydrocarbons	25.1	5.00	mg/kg	27.5		91.3	80-120			
Surrogate: 4-BFB (FID)	3.91		"	4.00		97.8	59-125			
LCS Dup (3D22004-BSD1)										
Gasoline Range Hydrocarbons	25.1	5.00	mg/kg	27.5		91.3	80-120	0.00	40	
Surrogate: 4-BFB (FID)	3.92		"	4.00		98.0	59-125			
Matrix Spike (3D22004-MS1) Source: B3D0424-01										
Gasoline Range Hydrocarbons	26.3	5.00	mg/kg dry	36.1	0.654	71.0	53-120			
Surrogate: 4-BFB (FID)	3.83		"	5.25		73.0	59-125			
Matrix Spike Dup (3D22004-MSD1) Source: B3D0424-01										
Gasoline Range Hydrocarbons	24.2	5.00	mg/kg dry	36.1	0.654	65.2	53-120	8.32	40	
Surrogate: 4-BFB (FID)	4.23		"	5.25		80.6	59-125			

North Creek Analytical - Bothell

The results in this report apply to the samples analyzed in accordance with the chain of custody document. This analytical report must be reproduced in its entirety.

Amar Gill, Project Manager

North Creek Analytical, Inc.
 Environmental Laboratory Network



Seattle: 11720 North Creek Pkwy N, Suite 400, Bothell, WA 98011-8244
 425.420.9200 fax 425.420.9210
 Spokane: East 11115 Montgomery, Suite B, Spokane, WA 99206-4776
 509.924.9200 fax 509.924.9290
 Portland: 9405 SW Nimbus Avenue, Beaverton, OR 97008-7132
 503.906.9200 fax 503.906.9210
 Bend: 20332 Empire Avenue, Suite F-1, Bend, OR 97701-5711
 541.383.9310 fax 541.382.7588
 Anchorage: 3209 Denali Street, Anchorage, AK 99503
 907.334.9200 fax 907.334.9210

Geo Engineers - Spokane
 523 East 2nd
 Spokane WA/USA, 99202

Project: Time Oil-Sunnyside
 Project Number: 19063-003-01
 Project Manager: Mark Engdahl

Reported:
 05/02/03 10:34

Volatile Organic Compounds (Special List) per EPA Method 8260B (Low Soil Method) - Quality Control
North Creek Analytical - Bothell

Analyte	Result	Reporting Limit	Units	Spike Level	Source Result	%REC	%REC Limits	RPD	RPD Limit	Notes
---------	--------	-----------------	-------	-------------	---------------	------	-------------	-----	-----------	-------

Batch 3D23008: Prepared 04/22/03 Using EPA 5035M

Blank (3D23008-BLK1)

Benzene	ND	0.00150	mg/kg							
Chlorobenzene	ND	0.00200	"							
1,2-Dibromoethane (EDB)	ND	0.00500	"							
1,2-Dichloroethane	ND	0.00125	"							
1,1-Dichloroethene	ND	0.00300	"							
Ethylbenzene	ND	0.00400	"							
Naphthalene	ND	0.00500	"							
Toluene	ND	0.00150	"							
Trichloroethene	ND	0.00250	"							
Total Xylenes	ND	0.0100	"							
Methyl tert-butyl ether	ND	0.00100	"							
Surrogate: 1,2-DCA-d4	0.0440		"	0.0400		110	60-140			
Surrogate: Toluene-d8	0.0423		"	0.0400		106	60-140			
Surrogate: 4-BFB	0.0391		"	0.0400		97.8	60-140			

LCS (3D23008-BS1)

Benzene	0.0183	0.00150	mg/kg	0.0200		91.5	70-130			
Chlorobenzene	0.0182	0.00200	"	0.0200		91.0	70-130			
1,1-Dichloroethene	0.0205	0.00300	"	0.0200		102	70-130			
Ethylbenzene	0.0181	0.00400	"	0.0200		90.5	70-130			
Toluene	0.0181	0.00150	"	0.0200		90.5	70-130			
Trichloroethene	0.0174	0.00250	"	0.0200		87.0	70-130			
Surrogate: 1,2-DCA-d4	0.0411		"	0.0400		103	60-140			
Surrogate: Toluene-d8	0.0437		"	0.0400		109	60-140			
Surrogate: 4-BFB	0.0402		"	0.0400		100	60-140			

LCS Dup (3D23008-BSD1)

Benzene	0.0216	0.00150	mg/kg	0.0200		108	70-130	16.5	30	
Chlorobenzene	0.0209	0.00200	"	0.0200		104	70-130	13.8	30	
1,1-Dichloroethene	0.0246	0.00300	"	0.0200		123	70-130	18.2	30	
Ethylbenzene	0.0206	0.00400	"	0.0200		103	70-130	12.9	30	
Toluene	0.0206	0.00150	"	0.0200		103	70-130	12.9	30	
Trichloroethene	0.0207	0.00250	"	0.0200		104	70-130	17.3	30	
Surrogate: 1,2-DCA-d4	0.0485		"	0.0400		121	60-140			
Surrogate: Toluene-d8	0.0421		"	0.0400		105	60-140			

North Creek Analytical - Bothell

The results in this report apply to the samples analyzed in accordance with the chain of custody document. This analytical report must be reproduced in its entirety.

Amar Gill, Project Manager

North Creek Analytical, Inc.
 Environmental Laboratory Network



Seattle 11720 North Creek Pkwy N, Suite 400, Bothell, WA 98011-8244
 425.420.9200 fax 425.420.9210
 Spokane East 11115 Montgomery, Suite B, Spokane, WA 99206-4776
 509.924.9200 fax 509.924.9290
 Portland 9405 SW Nimbus Avenue, Beaverton, OR 97008-7132
 503.906.9200 fax 503.906.9210
 Bend 20332 Empire Avenue, Suite F-1, Bend, OR 97701-5711
 541.383.9310 fax 541.382.7588
 Anchorage 3209 Denali Street, Anchorage, AK 99503
 907.334.9200 fax 907.334.9210

Geo Engineers - Spokane
 523 East 2nd
 Spokane WA/USA, 99202

Project: Time Oil-Sunnyside
 Project Number: 19063-003-01
 Project Manager: Mark Engdahl

Reported:
 05/02/03 10:34

Volatile Organic Compounds (Special List) per EPA Method 8260B (Low Soil Method) - Quality Control
North Creek Analytical - Bothell

Analyte	Result	Reporting Limit	Units	Spike Level	Source Result	%REC	%REC Limits	RPD	RPD Limit	Notes
---------	--------	-----------------	-------	-------------	---------------	------	-------------	-----	-----------	-------

Batch 3D23008: Prepared 04/22/03 Using EPA 5035M

LCS Dup (3D23008-BSD1)

Surrogate: 4-BFB	0.0389		mg/kg	0.0400		97.2	60-140			
------------------	--------	--	-------	--------	--	------	--------	--	--	--

Batch 3D25005: Prepared 04/24/03 Using EPA 5035M

Blank (3D25005-BLK1)

Benzene	ND	0.00150	mg/kg							
Chlorobenzene	ND	0.00200	"							
1,2-Dibromoethane (EDB)	ND	0.00500	"							
1,2-Dichloroethane	ND	0.00125	"							
1,1-Dichloroethene	ND	0.00300	"							
Ethylbenzene	ND	0.00400	"							
Naphthalene	ND	0.00500	"							
Toluene	ND	0.00150	"							
Total Xylenes	ND	0.0100	"							
Methyl tert-butyl ether	ND	0.00100	"							

Surrogate: 1,2-DCA-d4	0.0365		"	0.0400		91.2	60-140			
Surrogate: Toluene-d8	0.0398		"	0.0400		99.5	60-140			
Surrogate: 4-BFB	0.0398		"	0.0400		99.5	60-140			

LCS (3D25005-BS1)

Benzene	0.0206	0.00150	mg/kg	0.0200		103	70-130			
Chlorobenzene	0.0203	0.00200	"	0.0200		102	70-130			
1,1-Dichloroethene	0.0209	0.00300	"	0.0200		104	70-130			
Ethylbenzene	0.0199	0.00400	"	0.0200		99.5	70-130			
Toluene	0.0195	0.00150	"	0.0200		97.5	70-130			
Surrogate: 1,2-DCA-d4	0.0437		"	0.0400		109	60-140			
Surrogate: Toluene-d8	0.0393		"	0.0400		98.2	60-140			
Surrogate: 4-BFB	0.0399		"	0.0400		99.8	60-140			

North Creek Analytical - Bothell

The results in this report apply to the samples analyzed in accordance with the chain of custody document. This analytical report must be reproduced in its entirety.

Amar Gill, Project Manager

North Creek Analytical, Inc.
 Environmental Laboratory Network



Seattle 11720 North Creek Pkwy N, Suite 400, Bothell, WA 98011-8244
 425.420.9200 fax 425.420.9210
 Spokane East 11115 Montgomery, Suite B, Spokane, WA 99206-4776
 509.924.9200 fax 509.924.9290
 Portland 9405 SW Nimbus Avenue, Beaverton, OR 97008-7132
 503.906.9200 fax 503.906.9210
 Bend 20332 Empire Avenue, Suite F-1, Bend, OR 97701-5711
 541.383.9310 fax 541.382.7588
 Anchorage 3209 Denali Street, Anchorage, AK 99503
 907.334.9200 fax 907.334.9210

Geo Engineers - Spokane
 523 East 2nd
 Spokane WA/USA, 99202

Project: Time Oil-Sunnyside
 Project Number: 19063-003-01
 Project Manager: Mark Engdahl

Reported:
 05/02/03 10:34

Volatile Organic Compounds (Special List) per EPA Method 8260B (Low Soil Method) - Quality Control
North Creek Analytical - Bothell

Analyte	Result	Reporting Limit	Units	Spike Level	Source Result	%REC	%REC Limits	RPD	RPD Limit	Notes
---------	--------	-----------------	-------	-------------	---------------	------	-------------	-----	-----------	-------

Batch 3D25005: Prepared 04/24/03 Using EPA 5035M

LCS Dup (3D25005-BSD1)

Benzene	0.0187	0.00150	mg/kg	0.0200		93.5	70-130	9.67	30	
Chlorobenzene	0.0188	0.00200	"	0.0200		94.0	70-130	7.67	30	
1,1-Dichloroethene	0.0189	0.00300	"	0.0200		94.5	70-130	10.1	30	
Ethylbenzene	0.0182	0.00400	"	0.0200		91.0	70-130	8.92	30	
Toluene	0.0179	0.00150	"	0.0200		89.5	70-130	8.56	30	
Surrogate: 1,2-DCA-d4	0.0412		"	0.0400		103	60-140			
Surrogate: Toluene-d8	0.0393		"	0.0400		98.2	60-140			
Surrogate: 4-BFB	0.0398		"	0.0400		99.5	60-140			

Matrix Spike (3D25005-MS1)

Source: B3D0522-22

Benzene	0.0214	0.00150	mg/kg dry	0.0216	ND	99.1	60-140			
Chlorobenzene	0.0206	0.00200	"	0.0216	ND	95.4	60-140			
1,1-Dichloroethene	0.0214	0.00300	"	0.0216	ND	99.1	60-140			
Ethylbenzene	0.0212	0.00400	"	0.0216	ND	98.1	60-140			
Toluene	0.0207	0.00150	"	0.0216	ND	95.8	60-140			
Surrogate: 1,2-DCA-d4	0.0421		"	0.0432		97.5	60-140			
Surrogate: Toluene-d8	0.0433		"	0.0432		100	60-140			
Surrogate: 4-BFB	0.0431		"	0.0432		99.8	60-140			

Matrix Spike Dup (3D25005-MSD1)

Source: B3D0522-22

Benzene	0.0226	0.00150	mg/kg dry	0.0216	ND	105	60-140	5.45	30	
Chlorobenzene	0.0218	0.00200	"	0.0216	ND	101	60-140	5.66	30	
1,1-Dichloroethene	0.0225	0.00300	"	0.0216	ND	104	60-140	5.01	30	
Ethylbenzene	0.0222	0.00400	"	0.0216	ND	103	60-140	4.61	30	
Toluene	0.0216	0.00150	"	0.0216	ND	100	60-140	4.26	30	
Surrogate: 1,2-DCA-d4	0.0416		"	0.0432		96.3	60-140			
Surrogate: Toluene-d8	0.0430		"	0.0432		99.5	60-140			
Surrogate: 4-BFB	0.0430		"	0.0432		99.5	60-140			

North Creek Analytical - Bothell

Amar Gill, Project Manager

The results in this report apply to the samples analyzed in accordance with the chain of custody document. This analytical report must be reproduced in its entirety.

North Creek Analytical, Inc.
 Environmental Laboratory Network



Seattle 11720 North Creek Pkwy N, Suite 400, Bothell, WA 98011-8244
 425.420.9200 fax 425.420.9210
 Spokane East 11115 Montgomery, Suite B, Spokane, WA 99206-4776
 509.924.9200 fax 509.924.9290
 Portland 9405 SW Nimbus Avenue, Beaverton, OR 97008-7132
 503.906.9200 fax 503.906.9210
 Bend 20332 Empire Avenue, Suite F-1, Bend, OR 97701-5711
 541.383.9310 fax 541.382.7588
 Anchorage 3209 Denali Street, Anchorage, AK 99503
 907.334.9200 fax 907.334.9210

Geo Engineers - Spokane
 523 East 2nd
 Spokane WA/USA, 99202

Project: Time Oil-Sunnyside
 Project Number: 19063-003-01
 Project Manager: Mark Engdahl

Reported:
 05/02/03 10:34

Volatile Organic Compounds (Special List) per EPA Method 8260B (Low Soil Method) - Quality Control
North Creek Analytical - Bothell

Analyte	Result	Reporting Limit	Units	Spike Level	Source Result	%REC	%REC Limits	RPD	RPD Limit	Notes
---------	--------	-----------------	-------	-------------	---------------	------	-------------	-----	-----------	-------

Batch 3D25014: Prepared 04/25/03 Using EPA 5035M

Blank (3D25014-BLK1)

Benzene	ND	0.00150	mg/kg							
Chlorobenzene	ND	0.00200	"							
1,2-Dibromoethane (EDB)	ND	0.00500	"							
1,2-Dichloroethane	ND	0.00125	"							
1,1-Dichloroethene	ND	0.00300	"							
Ethylbenzene	ND	0.00400	"							
Naphthalene	ND	0.00500	"							
Toluene	ND	0.00150	"							
Trichloroethene	ND	0.00250	"							
Total Xylenes	ND	0.0100	"							
Methyl tert-butyl ether	ND	0.00100	"							
Surrogate: 1,2-DCA-d4	0.0405		"	0.0400		101	60-140			
Surrogate: Toluene-d8	0.0391		"	0.0400		97.8	60-140			
Surrogate: 4-BFB	0.0406		"	0.0400		102	60-140			

LCS (3D25014-BS1)

Acetone	0.117	0.0300	mg/kg	0.100		117	70-130			
Benzene	0.0217	0.00150	"	0.0200		108	70-130			
2-Butanone	0.104	0.0150	"	0.100		104	70-130			
Carbon disulfide	0.0211	0.00300	"	0.0200		106	70-130			
Chlorobenzene	0.0212	0.00200	"	0.0200		106	70-130			
1,1-Dichloroethane	0.0213	0.00200	"	0.0200		106	70-130			
1,1-Dichloroethene	0.0220	0.00300	"	0.0200		110	70-130			
cis-1,2-Dichloroethene	0.0217	0.00300	"	0.0200		108	70-130			
Ethylbenzene	0.0209	0.00400	"	0.0200		104	70-130			
4-Methyl-2-pentanone	0.121	0.0200	"	0.100		121	70-130			
Tetrachloroethene	0.0221	0.00200	"	0.0200		110	70-130			
Toluene	0.0205	0.00150	"	0.0200		102	70-130			
1,1,1-Trichloroethane	0.0217	0.00250	"	0.0200		108	70-130			
Trichloroethene	0.0217	0.00250	"	0.0200		108	70-130			
Surrogate: 1,2-DCA-d4	0.0430		"	0.0400		108	60-140			
Surrogate: Toluene-d8	0.0392		"	0.0400		98.0	60-140			
Surrogate: 4-BFB	0.0401		"	0.0400		100	60-140			

North Creek Analytical - Bothell

The results in this report apply to the samples analyzed in accordance with the chain of custody document. This analytical report must be reproduced in its entirety.

Amar Gill, Project Manager

North Creek Analytical, Inc.
 Environmental Laboratory Network



Seattle 11720 North Creek Pkwy N, Suite 400, Bothell, WA 98011-8244
 425.420.9200 fax 425.420.9210
 Spokane East 11115 Montgomery, Suite B, Spokane, WA 99206-4776
 509.924.9200 fax 509.924.9290
 Portland 9405 SW Nimbus Avenue, Beaverton, OR 97008-7132
 503.906.9200 fax 503.906.9210
 Bend 20332 Empire Avenue, Suite F-1, Bend, OR 97701-5711
 541.383.9310 fax 541.382.7588
 Anchorage 3209 Denali Street, Anchorage, AK 99503
 907.334.9200 fax 907.334.9210

Geo Engineers - Spokane
 523 East 2nd
 Spokane WA/USA, 99202

Project: Time Oil-Sunnyside
 Project Number: 19063-003-01
 Project Manager: Mark Engdahl

Reported:
 05/02/03 10:34

Volatile Organic Compounds (Special List) per EPA Method 8260B (Low Soil Method) - Quality Control
North Creek Analytical - Bothell

Analyte	Result	Reporting Limit	Units	Spike Level	Source Result	%REC	%REC Limits	RPD	RPD Limit	Notes
---------	--------	-----------------	-------	-------------	---------------	------	-------------	-----	-----------	-------

Batch 3D25014: Prepared 04/25/03 Using EPA 5035M

LCS Dup (3D25014-BSD1)

Acetone	0.0951	0.0300	mg/kg	0.100		95.1	70-130	20.7	30	
Benzene	0.0220	0.00150	"	0.0200		110	70-130	1.37	30	
2-Butanone	0.0895	0.0150	"	0.100		89.5	70-130	15.0	30	
Carbon disulfide	0.0211	0.00300	"	0.0200		106	70-130	0.00	30	
Chlorobenzene	0.0213	0.00200	"	0.0200		106	70-130	0.471	30	
1,1-Dichloroethane	0.0213	0.00200	"	0.0200		106	70-130	0.00	30	
1,1-Dichloroethene	0.0220	0.00300	"	0.0200		110	70-130	0.00	30	
cis-1,2-Dichloroethene	0.0211	0.00300	"	0.0200		106	70-130	2.80	30	
Ethylbenzene	0.0216	0.00400	"	0.0200		108	70-130	3.29	30	
4-Methyl-2-pentanone	0.102	0.0200	"	0.100		102	70-130	17.0	30	
Tetrachloroethene	0.0229	0.00200	"	0.0200		114	70-130	3.56	30	
Toluene	0.0210	0.00150	"	0.0200		105	70-130	2.41	30	
1,1,1-Trichloroethane	0.0214	0.00250	"	0.0200		107	70-130	1.39	30	
Trichloroethene	0.0222	0.00250	"	0.0200		111	70-130	2.28	30	
Surrogate: 1,2-DCA-d4	0.0392		"	0.0400		98.0	60-140			
Surrogate: Toluene-d8	0.0398		"	0.0400		99.5	60-140			
Surrogate: 4-BFB	0.0403		"	0.0400		101	60-140			

Batch 3D29046: Prepared 04/29/03 Using EPA 5035

Blank (3D29046-BLK1)

Acetone	ND	0.0300	mg/kg							
Benzene	ND	0.00150	"							
Bromochloromethane	ND	0.00500	"							
Bromodichloromethane	ND	0.00500	"							
Bromoform	ND	0.00500	"							
Bromomethane	ND	0.0100	"							
2-Butanone	ND	0.0150	"							
n-Butylbenzene	ND	0.00500	"							
sec-Butylbenzene	ND	0.00500	"							
tert-Butylbenzene	ND	0.00500	"							
Carbon disulfide	ND	0.00300	"							
Carbon tetrachloride	ND	0.00500	"							
Chlorobenzene	ND	0.00200	"							
Chloroethane	ND	0.00500	"							

North Creek Analytical - Bothell

The results in this report apply to the samples analyzed in accordance with the chain of custody document. This analytical report must be reproduced in its entirety.

Amar Gill, Project Manager

North Creek Analytical, Inc.
 Environmental Laboratory Network

Page 18 of 24



Seattle 11720 North Creek Pkwy N, Suite 400, Bothell, WA 98011-8244
 425.420.9200 fax 425.420.9210
 Spokane East 11115 Montgomery, Suite B, Spokane, WA 99206-4776
 509.924.9200 fax 509.924.9290
 Portland 9405 SW Nimbus Avenue, Beaverton, OR 97008-7132
 503.906.9200 fax 503.906.9210
 Bend 20332 Empire Avenue, Suite F-1, Bend, OR 97701-5711
 541.383.9310 fax 541.382.7588
 Anchorage 3209 Denali Street, Anchorage, AK 99503
 907.334.9200 fax 907.334.9210

Geo Engineers - Spokane
 523 East 2nd
 Spokane WA/USA, 99202

Project: Time Oil-Sunnyside
 Project Number: 19063-003-01
 Project Manager: Mark Engdahl

Reported:
 05/02/03 10:34

Volatile Organic Compounds (Special List) per EPA Method 8260B (Low Soil Method) - Quality Control
North Creek Analytical - Bothell

Analyte	Result	Reporting Limit	Units	Spike Level	Source Result	%REC	%REC Limits	RPD	RPD Limit	Notes
---------	--------	-----------------	-------	-------------	---------------	------	-------------	-----	-----------	-------

Batch 3D29046: Prepared 04/29/03 Using EPA 5035

Blank (3D29046-BLK1)

Chloroform	ND	0.00250	mg/kg							
Chloromethane	ND	0.0100	"							
2-Chlorotoluene	ND	0.00500	"							
4-Chlorotoluene	ND	0.00500	"							
Dibromochloromethane	ND	0.00500	"							
1,2-Dibromo-3-chloropropane	ND	0.0100	"							
1,2-Dibromoethane (EDB)	ND	0.00500	"							
Dibromomethane	ND	0.00500	"							
1,2-Dichlorobenzene	ND	0.00500	"							
1,3-Dichlorobenzene	ND	0.00500	"							
1,4-Dichlorobenzene	ND	0.00500	"							
1,1,1-Trichloroethane	ND	0.00500	"							
1,1-Dichloroethane	ND	0.00200	"							
1,2-Dichloroethane	ND	0.00125	"							
1,1-Dichloroethene	ND	0.00300	"							
cis-1,2-Dichloroethene	ND	0.00300	"							
trans-1,2-Dichloroethene	ND	0.00250	"							
1,2-Dichloropropane	ND	0.00500	"							
1,3-Dichloropropane	ND	0.00500	"							
2,2-Dichloropropane	ND	0.0100	"							
1,1-Dichloropropene	ND	0.00500	"							
cis-1,3-Dichloropropene	ND	0.00500	"							
trans-1,3-Dichloropropene	ND	0.00125	"							
Ethylbenzene	ND	0.00400	"							
Hexachlorobutadiene	ND	0.00500	"							
2-Hexanone	ND	0.0200	"							
Isopropylbenzene	ND	0.00500	"							
p-Isopropyltoluene	ND	0.00500	"							
Methylene chloride	ND	0.00350	"							
4-Methyl-2-pentanone	ND	0.0200	"							
Naphthalene	ND	0.00500	"							
n-Propylbenzene	ND	0.00500	"							
Styrene	ND	0.00100	"							
1,1,1,2-Tetrachloroethane	ND	0.00500	"							

North Creek Analytical - Bothell

The results in this report apply to the samples analyzed in accordance with the chain of custody document. This analytical report must be reproduced in its entirety.

Amar Gill, Project Manager

North Creek Analytical, Inc.
 Environmental Laboratory Network



Seattle 11720 North Creek Pkwy N, Suite 400, Bothell, WA 98011-8244
 425.420.9200 fax 425.420.9210
 Spokane East 11115 Montgomery, Suite B, Spokane, WA 99206-4776
 509.924.9200 fax 509.924.9290
 Portland 9405 SW Nimbus Avenue, Beaverton, OR 97008-7132
 503.906.9200 fax 503.906.9210
 Bend 20332 Empire Avenue, Suite F-1, Bend, OR 97701-5711
 541.383.9310 fax 541.382.7588
 Anchorage 3209 Denali Street, Anchorage, AK 99503
 907.334.9200 fax 907.334.9210

Geo Engineers - Spokane
 523 East 2nd
 Spokane WA/USA, 99202

Project: Time Oil-Sunnyside
 Project Number: 19063-003-01
 Project Manager: Mark Engdahl

Reported:
 05/02/03 10:34

Volatile Organic Compounds (Special List) per EPA Method 8260B (Low Soil Method) - Quality Control
North Creek Analytical - Bothell

Analyte	Result	Reporting Limit	Units	Spike Level	Source Result	%REC	%REC Limits	RPD	RPD Limit	Notes
---------	--------	-----------------	-------	-------------	---------------	------	-------------	-----	-----------	-------

Batch 3D29046: Prepared 04/29/03 Using EPA 5035

Blank (3D29046-BLK1)

1,1,2-Tetrachloroethane	ND	0.00500	mg/kg							
Tetrachloroethene	ND	0.00200	"							
Toluene	ND	0.00150	"							
1,2,3-Trichlorobenzene	ND	0.00500	"							
1,2,4-Trichlorobenzene	ND	0.00500	"							
1,1,1-Trichloroethane	ND	0.00250	"							
1,1,2-Trichloroethane	ND	0.00125	"							
Trichloroethene	ND	0.00250	"							
Trichlorofluoromethane	ND	0.00500	"							
1,2,3-Trichloropropane	ND	0.00500	"							
1,2,4-Trimethylbenzene	ND	0.00500	"							
1,3,5-Trimethylbenzene	ND	0.00500	"							
Vinyl chloride	ND	0.00250	"							
Total Xylenes	ND	0.0100	"							
Methyl tert-butyl ether	ND	0.00100	"							
Surrogate: 1,2-DCA-d4	0.0374		"	0.0400		93.5	60-140			
Surrogate: Toluene-d8	0.0391		"	0.0400		97.8	60-140			
Surrogate: 4-BFB	0.0392		"	0.0400		98.0	60-140			

LCS (3D29046-BS1)

Acetone	0.0916	0.0300	mg/kg	0.100		91.6	70-130			
Benzene	0.0227	0.00150	"	0.0200		114	70-130			
2-Butanone	0.0855	0.0150	"	0.100		85.5	70-130			
Carbon disulfide	0.0223	0.00300	"	0.0200		112	70-130			
Chlorobenzene	0.0222	0.00200	"	0.0200		111	70-130			
1,1-Dichloroethane	0.0224	0.00200	"	0.0200		112	70-130			
1,1-Dichloroethene	0.0233	0.00300	"	0.0200		116	70-130			
cis-1,2-Dichloroethene	0.0220	0.00300	"	0.0200		110	70-130			
Ethylbenzene	0.0228	0.00400	"	0.0200		114	70-130			
4-Methyl-2-pentanone	0.0940	0.0200	"	0.100		94.0	70-130			
Tetrachloroethene	0.0242	0.00200	"	0.0200		121	70-130			
Toluene	0.0221	0.00150	"	0.0200		110	70-130			
1,1,1-Trichloroethane	0.0226	0.00250	"	0.0200		113	70-130			
Trichloroethene	0.0226	0.00250	"	0.0200		113	70-130			

North Creek Analytical - Bothell

The results in this report apply to the samples analyzed in accordance with the chain of custody document. This analytical report must be reproduced in its entirety.

Amar Gill, Project Manager

North Creek Analytical, Inc.
 Environmental Laboratory Network

Page 20 of 24



Seattle 11720 North Creek Pkwy N, Suite 400, Bothell, WA 98011-8244
 425.420.9200 fax 425.420.9210
 Spokane East 11115 Montgomery, Suite B, Spokane, WA 99206-4776
 509.924.9200 fax 509.924.9290
 Portland 9405 SW Nimbus Avenue, Beaverton, OR 97008-7132
 503.906.9200 fax 503.906.9210
 Bend 20332 Empire Avenue, Suite F-1, Bend, OR 97701-5711
 541.383.9310 fax 541.382.7588
 Anchorage 3209 Denali Street, Anchorage, AK 99503
 907.334.9200 fax 907.334.9210

Geo Engineers - Spokane
 523 East 2nd
 Spokane WA/USA, 99202

Project: Time Oil-Sunnyside
 Project Number: 19063-003-01
 Project Manager: Mark Engdahl

Reported:
 05/02/03 10:34

Volatile Organic Compounds (Special List) per EPA Method 8260B (Low Soil Method) - Quality Control
North Creek Analytical - Bothell

Analyte	Result	Reporting Limit	Units	Spike Level	Source Result	%REC	%REC Limits	RPD	RPD Limit	Notes
---------	--------	-----------------	-------	-------------	---------------	------	-------------	-----	-----------	-------

Batch 3D29046: Prepared 04/29/03 Using EPA 5035

LCS (3D29046-BS1)

Surrogate: 1,2-DCA-d4	0.0362		mg/kg	0.0400		90.5	60-140			
Surrogate: Toluene-d8	0.0397		"	0.0400		99.3	60-140			
Surrogate: 4-BFB	0.0389		"	0.0400		97.2	60-140			

LCS Dup (3D29046-BSD1)

Acetone	0.0955	0.0300	mg/kg	0.100		95.5	70-130	4.17	30	
Benzene	0.0202	0.00150	"	0.0200		101	70-130	11.7	30	
2-Butanone	0.0930	0.0150	"	0.100		93.0	70-130	8.40	30	
Carbon disulfide	0.0192	0.00300	"	0.0200		96.0	70-130	14.9	30	
Chlorobenzene	0.0203	0.00200	"	0.0200		102	70-130	8.94	30	
1,1-Dichloroethane	0.0200	0.00200	"	0.0200		100	70-130	11.3	30	
1,1-Dichloroethene	0.0202	0.00300	"	0.0200		101	70-130	14.3	30	
cis-1,2-Dichloroethene	0.0200	0.00300	"	0.0200		100	70-130	9.52	30	
Ethylbenzene	0.0203	0.00400	"	0.0200		102	70-130	11.6	30	
4-Methyl-2-pentanone	0.105	0.0200	"	0.100		105	70-130	11.1	30	
Tetrachloroethene	0.0209	0.00200	"	0.0200		104	70-130	14.6	30	
Toluene	0.0199	0.00150	"	0.0200		99.5	70-130	10.5	30	
1,1,1-Trichloroethane	0.0201	0.00250	"	0.0200		100	70-130	11.7	30	
Trichloroethene	0.0203	0.00250	"	0.0200		102	70-130	10.7	30	
Surrogate: 1,2-DCA-d4	0.0376		"	0.0400		94.0	60-140			
Surrogate: Toluene-d8	0.0395		"	0.0400		98.8	60-140			
Surrogate: 4-BFB	0.0371		"	0.0400		92.8	60-140			

Matrix Spike (3D29046-MS1)

Source: B3D0626-01

Acetone	0.0874	0.0300	mg/kg wet	0.100	0.0156	71.8	60-140			
Benzene	0.0223	0.00150	"	0.0200	ND	112	60-140			
2-Butanone	0.0901	0.0150	"	0.100	ND	90.1	60-140			
Carbon disulfide	0.0226	0.00300	"	0.0200	ND	113	60-140			
Chlorobenzene	0.0223	0.00200	"	0.0200	ND	112	60-140			
1,1-Dichloroethane	0.0226	0.00200	"	0.0200	ND	113	60-140			
1,1-Dichloroethene	0.0235	0.00300	"	0.0200	ND	118	60-140			
cis-1,2-Dichloroethene	0.0224	0.00300	"	0.0200	ND	112	60-140			
Ethylbenzene	0.0229	0.00400	"	0.0200	ND	114	60-140			
4-Methyl-2-pentanone	0.0984	0.0200	"	0.100	ND	98.4	60-140			
Tetrachloroethene	0.0237	0.00200	"	0.0200	ND	118	60-140			

North Creek Analytical - Bothell

The results in this report apply to the samples analyzed in accordance with the chain of custody document. This analytical report must be reproduced in its entirety.

Amar Gill, Project Manager

North Creek Analytical, Inc.
 Environmental Laboratory Network

Page 21 of 24



Seattle 11720 North Creek Pkwy N, Suite 400, Bothell, WA 98011-8244
 425.420.9200 fax 425.420.9210
 Spokane East 11115 Montgomery, Suite B, Spokane, WA 99206-4776
 509.924.9200 fax 509.924.9290
 Portland 9405 SW Nimbus Avenue, Beaverton, OR 97008-7132
 503.906.9200 fax 503.906.9210
 Bend 20332 Empire Avenue, Suite F-1, Bend, OR 97701-5711
 541.383.9310 fax 541.382.7588
 Anchorage 3209 Denali Street, Anchorage, AK 99503
 907.334.9200 fax 907.334.9210

Geo Engineers - Spokane 523 East 2nd Spokane WA/USA, 99202	Project: Time Oil-Sunnyside Project Number: 19063-003-01 Project Manager: Mark Engdahl	Reported: 05/02/03 10:34
--	--	-----------------------------

Volatile Organic Compounds (Special List) per EPA Method 8260B (Low Soil Method) - Quality Control
North Creek Analytical - Bothell

Analyte	Result	Reporting Limit	Units	Spike Level	Source Result	%REC	Limit	RPD	RPD Limit	Notes
---------	--------	-----------------	-------	-------------	---------------	------	-------	-----	-----------	-------

Batch 3D29046: Prepared 04/29/03 Using EPA 5035

Matrix Spike (3D29046-MS1)

Source: B3D0626-01

Toluene	0.0221	0.00150	mg/kg wet	0.0200	0.00112	105	60-140			
1,1,1-Trichloroethane	0.0228	0.00250	"	0.0200	ND	114	60-140			
Trichloroethene	0.0226	0.00250	"	0.0200	ND	113	60-140			
Surrogate: 1,2-DCA-d4	0.0370		"	0.0400		92.5	60-140			
Surrogate: Toluene-d8	0.0397		"	0.0400		99.3	60-140			
Surrogate: 4-BFB	0.0393		"	0.0400		98.2	60-140			

Matrix Spike Dup (3D29046-MSD1)

Source: B3D0626-01

Acetone	0.0877	0.0300	mg/kg wet	0.100	0.0156	72.1	60-140	0.343	30	
Benzene	0.0220	0.00150	"	0.0200	ND	110	60-140	1.35	30	
2-Butanone	0.0914	0.0150	"	0.100	ND	91.4	60-140	1.43	30	
Carbon disulfide	0.0220	0.00300	"	0.0200	ND	110	60-140	2.69	30	
Chlorobenzene	0.0215	0.00200	"	0.0200	ND	108	60-140	3.65	30	
1,1-Dichloroethane	0.0222	0.00200	"	0.0200	ND	111	60-140	1.79	30	
1,1-Dichloroethene	0.0230	0.00300	"	0.0200	ND	115	60-140	2.15	30	
cis-1,2-Dichloroethene	0.0218	0.00300	"	0.0200	ND	109	60-140	2.71	30	
Ethylbenzene	0.0218	0.00400	"	0.0200	ND	109	60-140	4.92	30	
4-Methyl-2-pentanone	0.101	0.0200	"	0.100	ND	101	60-140	2.61	30	
Tetrachloroethene	0.0230	0.00200	"	0.0200	ND	115	60-140	3.00	30	
Toluene	0.0215	0.00150	"	0.0200	0.00112	102	60-140	2.75	30	
1,1,1-Trichloroethane	0.0223	0.00250	"	0.0200	ND	112	60-140	2.22	30	
Trichloroethene	0.0221	0.00250	"	0.0200	ND	110	60-140	2.24	30	
Surrogate: 1,2-DCA-d4	0.0380		"	0.0400		95.0	60-140			
Surrogate: Toluene-d8	0.0395		"	0.0400		98.8	60-140			
Surrogate: 4-BFB	0.0398		"	0.0400		99.5	60-140			

North Creek Analytical - Bothell

Amar Gill, Project Manager

The results in this report apply to the samples analyzed in accordance with the chain of custody document. This analytical report must be reproduced in its entirety.

North Creek Analytical, Inc.
Environmental Laboratory Network



Seattle 11720 North Creek Pkwy N, Suite 400, Bothell, WA 98011-8244
 425.420.9200 fax 425.420.9210
 Spokane East 11115 Montgomery, Suite B, Spokane, WA 99206-4776
 509.924.9200 fax 509.924.9290
 Portland 9405 SW Nimbus Avenue, Beaverton, OR 97008-7132
 503.906.9200 fax 503.906.9210
 Bend 20332 Empire Avenue, Suite F-1, Bend, OR 97701-5711
 541.383.9310 fax 541.382.7588
 Anchorage 3209 Denali Street, Anchorage, AK 99503
 907.334.9200 fax 907.334.9210

Geo Engineers - Spokane 523 East 2nd Spokane WA/USA, 99202	Project: Time Oil-Sunnyside Project Number: 19063-003-01 Project Manager: Mark Engdahl	Reported: 05/02/03 10:34
--	--	-----------------------------

**Physical Parameters by APHA/ASTM/EPA Methods - Quality Control
 North Creek Analytical - Bothell**

Analyte	Result	Reporting Limit	Units	Spike Level	Source Result	%REC	%REC Limits	RPD	RPD Limit	Notes
Batch 3D22026: Prepared 04/22/03 Using Dry Weight										
Blank (3D22026-BLK1)										
Dry Weight	100	1.00	%							

North Creek Analytical - Bothell

The results in this report apply to the samples analyzed in accordance with the chain of custody document. This analytical report must be reproduced in its entirety.

Amar Gill, Project Manager



Seattle 11720 North Creek Pkwy N, Suite 400, Bothell, WA 98011-8244
 425.420.9200 fax 425.420.9210
 Spokane East 11115 Montgomery, Suite B, Spokane, WA 99206-4776
 509.924.9200 fax 509.924.9290
 Portland 9405 SW Nimbus Avenue, Beaverton, OR 97008-7132
 503.906.9200 fax 503.906.9210
 Bend 20332 Empire Avenue, Suite F-1, Bend, OR 97701-5711
 541.383.9310 fax 541.382.7588
 Anchorage 3209 Denali Street, Anchorage, AK 99503
 907.334.9200 fax 907.334.9210

Geo Engineers - Spokane 523 East 2nd Spokane WA/USA, 99202	Project: Time Oil-Sunnyside Project Number: 19063-003-01 Project Manager: Mark Engdahl	Reported: 05/02/03 10:34
--	--	-----------------------------

Notes and Definitions

- DET Analyte DETECTED
- ND Analyte NOT DETECTED at or above the reporting limit
- NR Not Reported
- dry Sample results reported on a dry weight basis
- RPD Relative Percent Difference

North Creek Analytical - Bothell

Amar Gill, Project Manager

The results in this report apply to the samples analyzed in accordance with the chain of custody document. This analytical report must be reproduced in its entirety.



11201 NW 10th Creek Pkwy N, Suite 400, Bonnell, WA 98011-8244
 East 11115 Montgomery, Suite B, Spokane, WA 99206-4776
 9405 S.W. Nimbus Avenue, Beaverton, OR 97008-7132
 20332 Empire Avenue, Suite F-1, Bend, OR 97701-5711

(425) 420-9200 X 420-9210
 (509) 924-9200 FAX 924-9290
 (503) 906-9200 FAX 906-9210
 (541) 383-9310 FAX 382-7588

CHAIN OF CUSTODY REPORT

Work Order #: **B3D0424**

CLIENT: *GeoEngineers*
 REPORT TO: *Mark Engdahl*
 ADDRESS: *523 E 2nd Ave Spokane, WA 99202*

INVOICE TO:

Time Oil Co
Attn: Scott S/orn

PHONE: *509-263-3125* FAX: *363-3126*

PROJECT NAME: *Sunnyside*

PROJECT NUMBER: *19063-003-01*

SAMPLED BY: *Mark Engdahl*

CLIENT SAMPLE IDENTIFICATION	SAMPLING DATE/TIME
1. S. Side wall 8.5'	7/15/03 1440
2. 12k Tank center 13'	1430
3. W Side wall 8.5'	1420
4. 12k Tank west 13'	1410
5. 8k Tank East 8.5'	4/16/03 0800
6. Disp Isl N wall 6.0'	0810
7. Disp Isl E wall 10.0'	0820
8. Disp Isl E wall 8.0'	1100
9. Disp Isl S wall 8.0'	1240
10. Disp Isl E Btm 16.0'	1300
11. Disp Isl N Btm 15.0'	1410
12. Disp Isl S Btm 23.0'	1420
13. 12k Tank E Btm	c
14. W Disp Btm 18'	7/16/03 1500
15.	

P.O. NUMBER:

REQUESTED ANALYSES

WSPH-G
 BTEX
 MTBE
 Naphthalene
 Total Lead
 SPH*
 UPH*
 EOB/EDC

TURNAROUND REQUEST in Business Days*

Organic & Inorganic Analyses
 10 7 5 4 3 2 1 <1

Petroleum Hydrocarbon Analyses
 4 3 2 1 <1

OTHER Please Specify

*Turnaround/Requests less than standard may incur Rush Charges.

MATRIX (W, S, O)	# OF CONT.	COMMENTS	NCA WO ID
S	2	B3D0424	01
			02
			03
			04
			05
			06
			07
			08
			09
			10
			11
			12
S	2		13
			14
			15

RELINQUISHED BY: *Mark Engdahl* FIRM: *GEE* DATE: *7/17/03* TIME: *1400*
 PRINT NAME: *Mark Engdahl* FIRM: *NCA* DATE: *4/07/03* TIME: *0900*
 RECEIVED BY: *Scott S/orn* FIRM: *NCA* DATE: *4/07/03* TIME: *0900*
 RECEIVED BY: *Scott S/orn* FIRM: *NCA* DATE: *4/07/03* TIME: *0900*

ADDITIONAL REMARKS: *Hold for analysis. Call prior to analyzing.*