

KLICKITAT COUNTY PORT DISTRICT No. 1

DIP RAMCO SITE CAP PROJECT

DALLESPORT, WASHINGTON

DECEMBER 2015

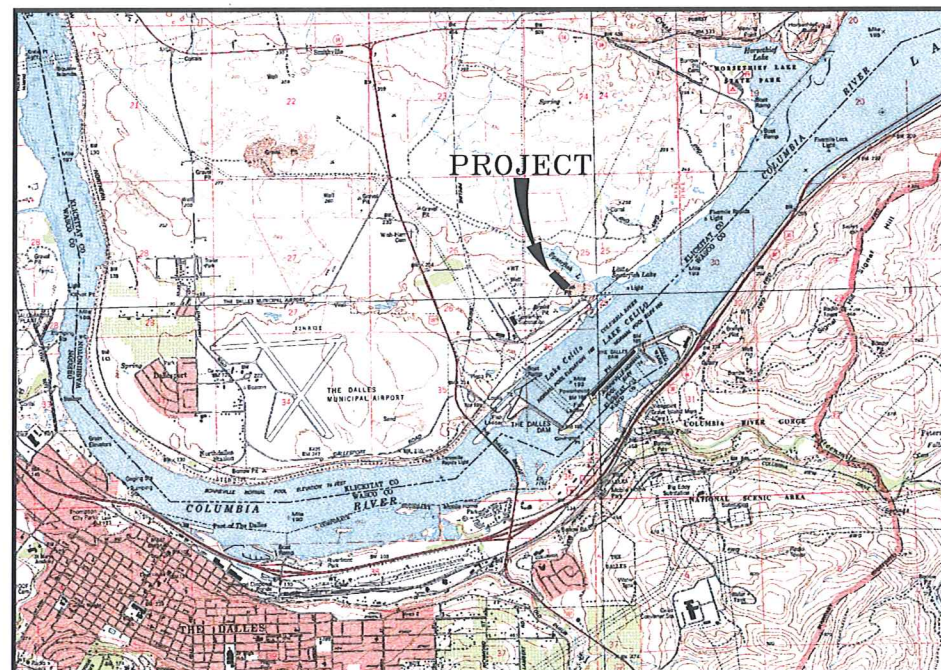

VICINITY MAP
SCALE: 1" = 3200'



AREA MAP
SCALE: 1" = 300'

SHEET INDEX	
SHEET	DESCRIPTION
C-000	COVER SHEET
C-101	OVERALL SITE
C-102	ESC PLAN
C-103	FILL PLAN
C-104	SECTIONS
C-105	GENERAL NOTES

OWNER:

KLICKITAT COUNTY PORT DISTRICT No. 1
154-A EAST BINGEN POINT WAY
BINGEN, WA 98605
PH: 509-493-1655
FX: 509-493-4257
MARC THORNSBURY (Executive Director)

ENGINEER:

TENNESON ENGINEERING CORP.
3775 CRATES WAY
THE DALLES, OR. 97058
PH. 541-296-9177
FAX 541-296-6657
DARRIN O. ECKMAN (PROJECT MANAGER)
KEVIN W. CHRISMAN (PROJECT DESIGNER)

Design	K.W.C./D.O.E.	Survey	T.E.C.
DWG. No.	K:\WORK ORDERS\14600\14625\DRAWINGS\02-14625_Record.DWG	Drawn	K.W.C.
Date	12/14/2015	Scale	AS NOTED
Work Order No.	14625		

COVER SHEET
FOR THE
DIP RAMCO SITE CAP PROJECT
DALLESPORT, WASHINGTON
Plot Date: 12/14/2015

TENNESON ENGINEERING CORP.
CONSULTING ENGINEERS
3775 CRATES WAY
THE DALLES, OREGON 97058
TEL: 541-296-9177 FAX 541-296-6657

RECORD DRAWING

IF THIS BAR IS NOT ONE INCH,
THEN ADJUST SCALES ACCORDINGLY

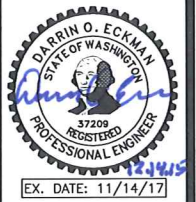

SHEET
C-000

Work Order No.
14625

SET No. _____

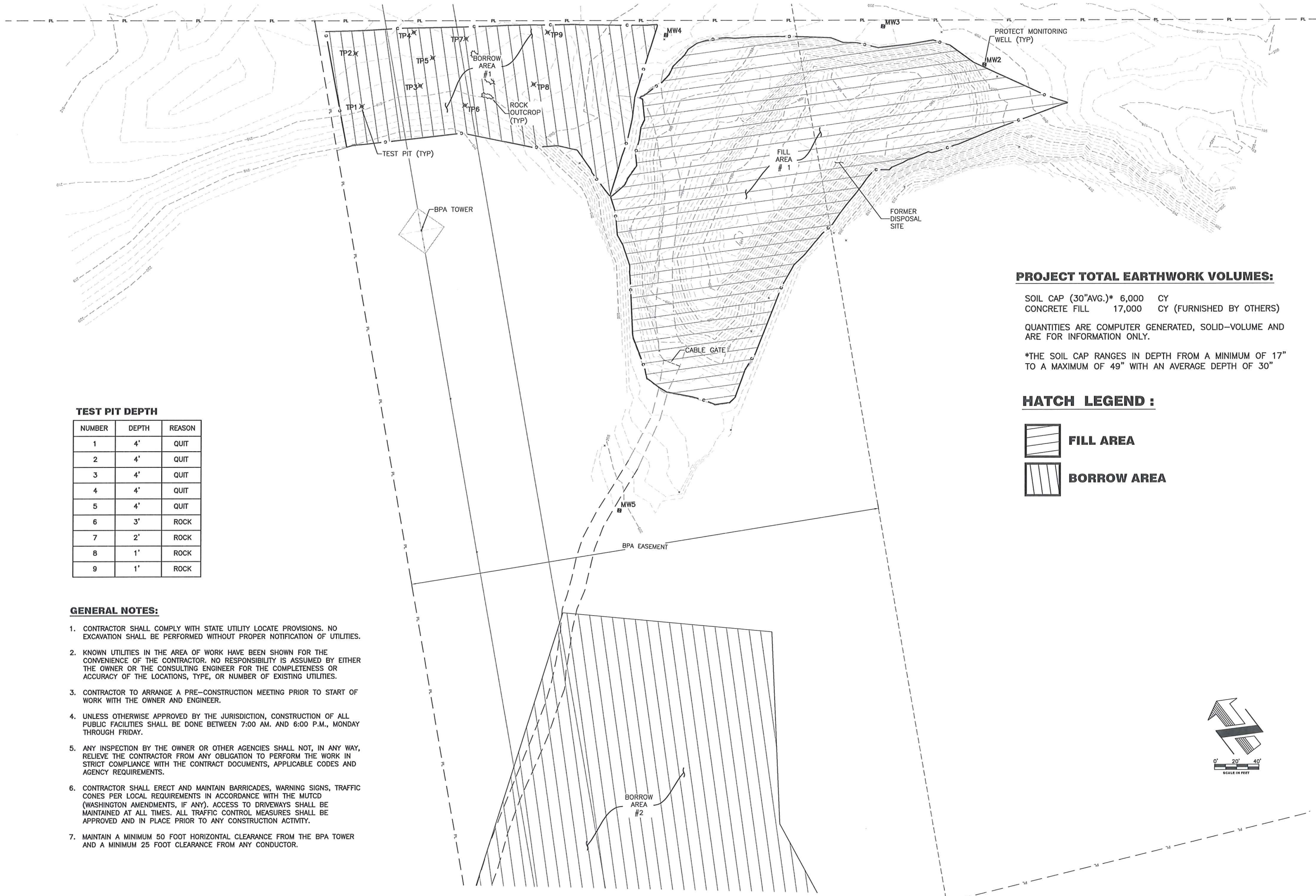

TEST PIT DEPTH

NUMBER	DEPTH	REASON
1	4'	QUIT
2	4'	QUIT
3	4'	QUIT
4	4'	QUIT
5	4'	QUIT
6	3'	ROCK
7	2'	ROCK
8	1'	ROCK
9	1'	ROCK

GENERAL NOTES:

1. CONTRACTOR SHALL COMPLY WITH STATE UTILITY LOCATE PROVISIONS. NO EXCAVATION SHALL BE PERFORMED WITHOUT PROPER NOTIFICATION OF UTILITIES.
2. KNOWN UTILITIES IN THE AREA OF WORK HAVE BEEN SHOWN FOR THE CONVENIENCE OF THE CONTRACTOR. NO RESPONSIBILITY IS ASSUMED BY EITHER THE OWNER OR THE CONSULTING ENGINEER FOR THE COMPLETENESS OR ACCURACY OF THE LOCATIONS, TYPE, OR NUMBER OF EXISTING UTILITIES.
3. CONTRACTOR TO ARRANGE A PRE-CONSTRUCTION MEETING PRIOR TO START OF WORK WITH THE OWNER AND ENGINEER.
4. UNLESS OTHERWISE APPROVED BY THE JURISDICTION, CONSTRUCTION OF ALL PUBLIC FACILITIES SHALL BE DONE BETWEEN 7:00 AM. AND 6:00 P.M., MONDAY THROUGH FRIDAY.
5. ANY INSPECTION BY THE OWNER OR OTHER AGENCIES SHALL NOT, IN ANY WAY, RELIEVE THE CONTRACTOR FROM ANY OBLIGATION TO PERFORM THE WORK IN STRICT COMPLIANCE WITH THE CONTRACT DOCUMENTS, APPLICABLE CODES AND AGENCY REQUIREMENTS.
6. CONTRACTOR SHALL ERECT AND MAINTAIN BARRICADES, WARNING SIGNS, TRAFFIC CONES PER LOCAL REQUIREMENTS IN ACCORDANCE WITH THE MUTCD (WASHINGTON AMENDMENTS, IF ANY). ACCESS TO DRIVEWAYS SHALL BE MAINTAINED AT ALL TIMES. ALL TRAFFIC CONTROL MEASURES SHALL BE APPROVED AND IN PLACE PRIOR TO ANY CONSTRUCTION ACTIVITY.
7. MAINTAIN A MINIMUM 50 FOOT HORIZONTAL CLEARANCE FROM THE BPA TOWER AND A MINIMUM 25 FOOT CLEARANCE FROM ANY CONDUCTOR.

PROJECT TOTAL EARTHWORK VOLUMES:

SOIL CAP (30"AVG.)* 6,000 CY
 CONCRETE FILL 17,000 CY (FURNISHED BY OTHERS)

QUANTITIES ARE COMPUTER GENERATED, SOLID-VOLUME AND ARE FOR INFORMATION ONLY.

*THE SOIL CAP RANGES IN DEPTH FROM A MINIMUM OF 17" TO A MAXIMUM OF 49" WITH AN AVERAGE DEPTH OF 30"

HATCH LEGEND :

-  **FILL AREA**
-  **BORROW AREA**

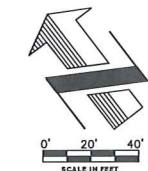

Design	K.W.C./D.O.E.	Survey	T.E.C.
DWG. No.	14625	Drawn	K.W.C.
Date	12/14/2015	Scale	AS NOTED
Work Order No.	14625		

OVERALL SITE
 FOR THE
DIP RAMCO SITE CAP PROJECT
 DALLESPORT, WASHINGTON
 Plot Date: 12/14/2015

TENNESON ENGINEERING CORP.
 CONSULTING ENGINEERS
 3775 CRATES WAY
 THE DALLES, OREGON 97058
 TEL: 541-296-9177 FAX 541-296-6657

RECORD DRAWING

IF THIS BAR IS NOT ONE INCH, THEN ADJUST SCALES ACCORDINGLY

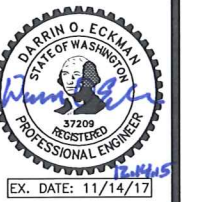

SHEET C-101

Work Order No. 14625



Survey T.E.C.
 Design K.W.C./D.O.E.
 DWG. No. 14625
 (C:\WORK ORDERS\14600\14625 DRAWINGS\0612_14625_Rev.dwg)
 Date 12/14/2015
 Work Order No. 14625
 Scale AS NOTED

ESC PLAN
 FOR THE
DIP RAMCO SITE CAP PROJECT
 DALLESPORT, WASHINGTON
 Plot Date: 12/14/2015

TENNESON ENGINEERING CORP.
 CONSULTING ENGINEERS
 3775 CRATES WAY
 THE DALLES, OREGON 97058
 TEL: 541-296-9177 FAX 541-296-6657

RECORD DRAWING

IF THIS BAR IS NOT ONE INCH, THEN ADJUST SCALES ACCORDINGLY



SHEET C-102

Work Order No. 14625

DRAWN BY: BILL BERGENS

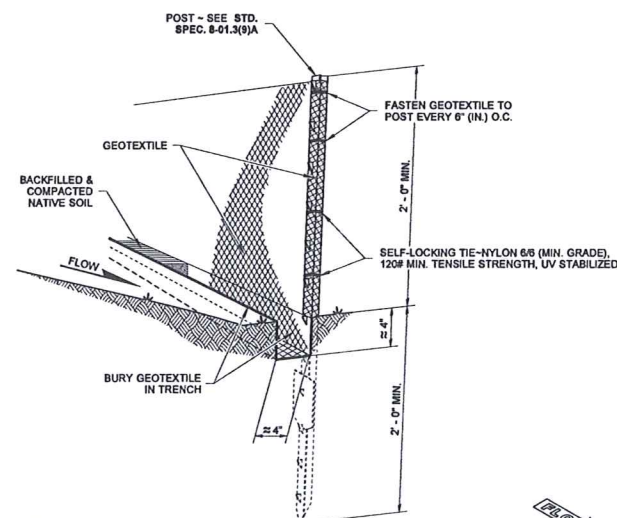

NOTE
 DURING EXCAVATION, MINIMIZE DISTURBING THE GROUND AROUND TRENCH AS MUCH AS IS FEASIBLE, AND SMOOTH SURFACE FOLLOWING EXCAVATION TO AVOID CONCENTRATING FLOWS. COMPACTION MUST BE ADEQUATE TO PREVENT UNDERCUTTING FLOWS.

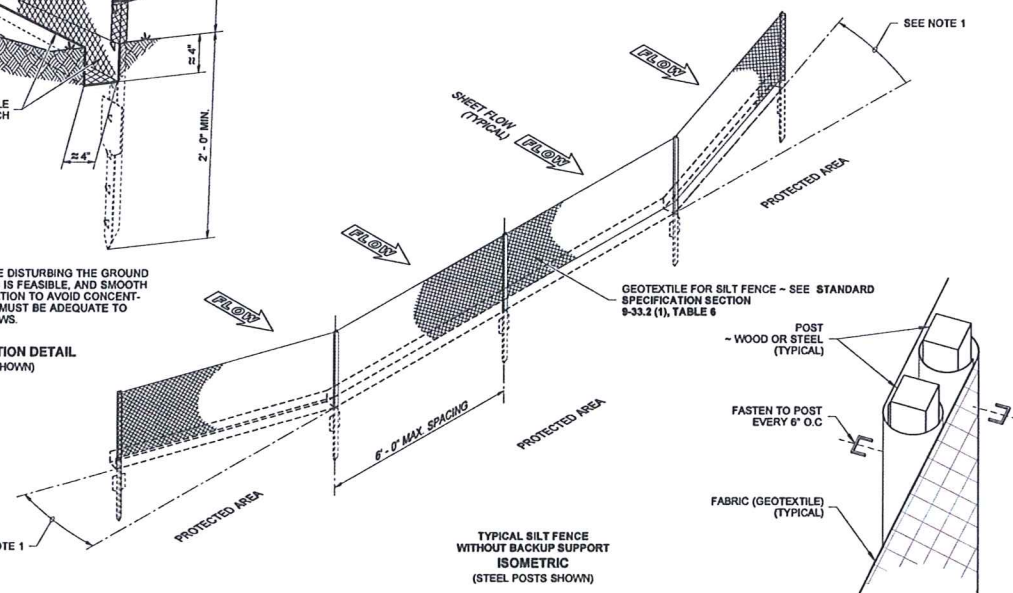

- NOTES**
1. Install the ends of the silt fence to point slightly upslope to prevent sediment from flowing around the ends of the fence.
 2. Perform maintenance in accordance with Standard Specifications 8-01.3(9)A and 8-01.3(16).
 3. Splices shall never be placed in low spots or sump locations. If splices are located in low or sump areas, the fence may need to be reinstalled unless the Project Engineer approves the installation.
 4. Install silt fencing parallel to mapped contour lines.

GRADING EROSION AND SEDIMENT CONSTRUCTION NOTES:

SILT FENCE TO BE INSTALLED AT DOWNSLOPE PERIMETER OF BORROW AREAS IF REQUIRED AT THE ENGINEER'S SOLE DISCRETION.

GRADING EROSION AND SEDIMENT CONSTRUCTION NOTES:

1. ALL DISTURBED AREAS SHALL BE PREPARED BY CONTRACTOR AND SEEDED BY OWNER.
2. SLOPE TO RECEIVE TEMPORARY OR PERMANENT SEEDING SHALL HAVE THE SURFACE ROUGHENED BY MEANS OF TRACK-WALKING OR THE USE OF OTHER APPROVED IMPLEMENTS. SURFACE ROUGHENING IMPROVES SEED BEDDING AND REDUCES RUN-OFF VELOCITY.
3. LONG TERM STABILIZATION MEASURES SHALL INCLUDE THE ESTABLISHMENT OF PERMANENT VEGETATIVE COVER.
4. AREAS SUBJECT TO WIND EROSION SHALL USE APPROPRIATE DUST CONTROL MEASURES INCLUDING THE APPLICATION OF A FINE SPRAY OF WATER, PLASTIC SHEETING OR OTHER APPROVED MEASURES.
5. USE BMPs SUCH AS CHECK-DAMS, BERMS, AND INLET PROTECTION TO PREVENT RUN-OFF FROM REACHING DISCHARGE POINTS.

STATE OF WASHINGTON
 REGISTERED LANDSCAPE ARCHITECT
 SANDRA L. SALISBURY
 CERTIFICATE NO. 000860
NOTE: THIS PLAN IS NOT A LEGAL ENGINEERING DOCUMENT BUT AN ELECTRONIC DUPLICATE. THE ORIGINAL, SIGNED BY THE ENGINEER AND APPROVED FOR PUBLICATION, MUST BE ON FILE AT THE WASHINGTON STATE DEPARTMENT OF TRANSPORTATION. A COPY MAY BE OBTAINED UPON REQUEST.

SILT FENCE
 STANDARD PLAN I-30.15-02
 SHEET 1 OF 1 SHEET

APPROVED FOR PUBLICATION
Pasco Bakotich III 3/22/13
 STATE DESIGN ENGINEER DATE
 Washington State Department of Transportation

SPLICED FENCE SECTIONS SHALL BE CLOSE ENOUGH TOGETHER TO PREVENT SILT LADEN WATER FROM ESCAPING THROUGH THE FENCE AT THE OVERLAP.
SPLICE DETAIL
 (WOOD POSTS SHOWN)

EROSION AND SEDIMENT CONTROL BMP IMPLEMENTATION:

1. ALL BASE ESCP MEASURES (INLET PROTECTION, PERIMETER SEDIMENT CONTROL, GRAVEL CONSTRUCTION ENTRANCES, ETC.) MUST BE IN PLACE, FUNCTIONAL, AND APPROVED IN AN INITIAL INSPECTION, PRIOR TO COMMENCEMENT OF CONSTRUCTION ACTIVITIES IN EACH PHASE.
2. LONG TERM SLOPE STABILIZATION MEASURES SHALL BE IN PLACE OVER ALL EXPOSED SOILS UPON COMPLETION OF FINAL GRADING.

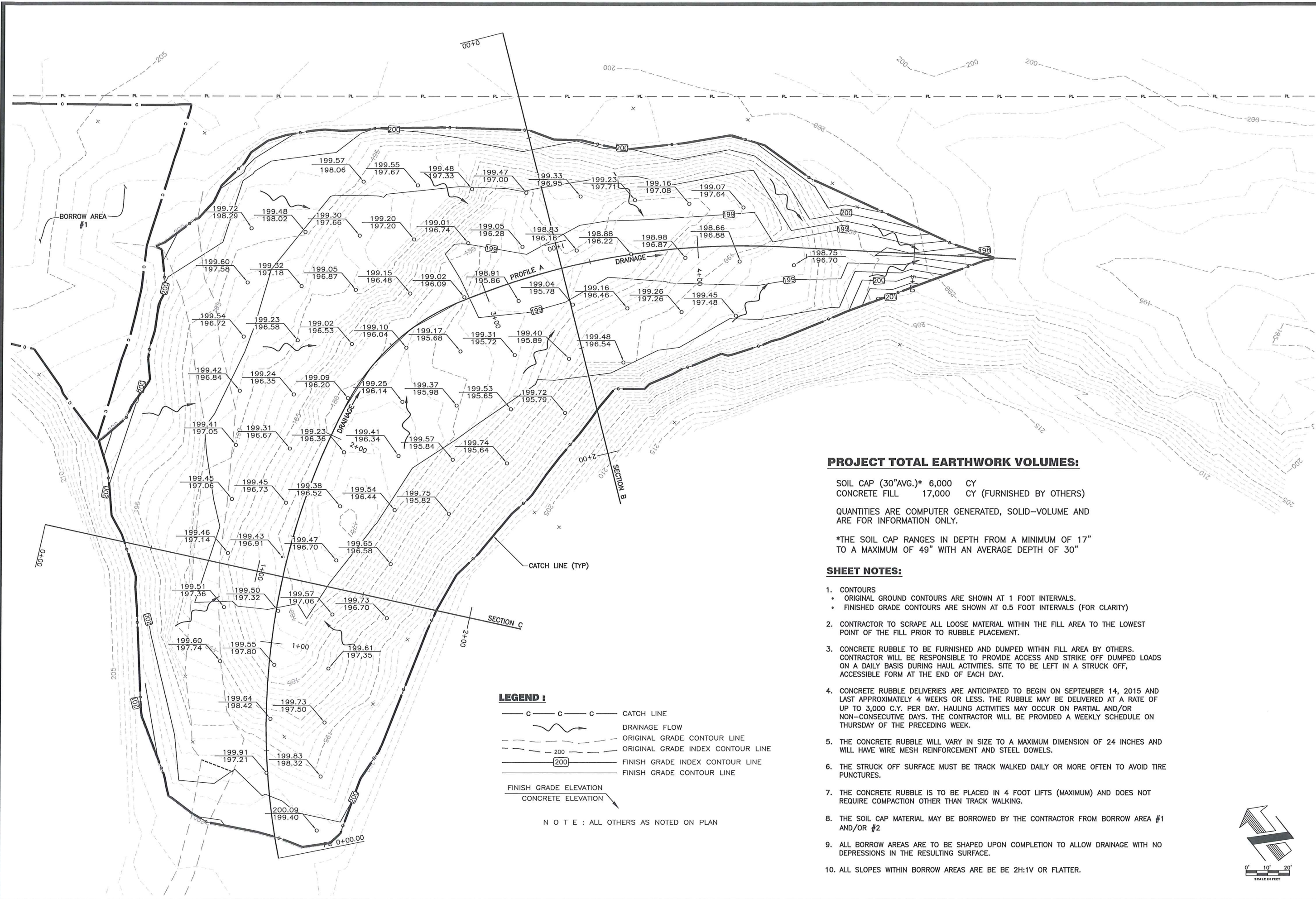

PROJECT TOTAL EARTHWORK VOLUMES:

SOIL CAP (30"AVG.)* 6,000 CY
 CONCRETE FILL 17,000 CY (FURNISHED BY OTHERS)

QUANTITIES ARE COMPUTER GENERATED, SOLID-VOLUME AND ARE FOR INFORMATION ONLY.

*THE SOIL CAP RANGES IN DEPTH FROM A MINIMUM OF 17" TO A MAXIMUM OF 49" WITH AN AVERAGE DEPTH OF 30"

SHEET NOTES:

1. CONTOURS
 - ORIGINAL GROUND CONTOURS ARE SHOWN AT 1 FOOT INTERVALS.
 - FINISHED GRADE CONTOURS ARE SHOWN AT 0.5 FOOT INTERVALS (FOR CLARITY)
2. CONTRACTOR TO SCRAPE ALL LOOSE MATERIAL WITHIN THE FILL AREA TO THE LOWEST POINT OF THE FILL PRIOR TO RUBBLE PLACEMENT.
3. CONCRETE RUBBLE TO BE FURNISHED AND DUMPED WITHIN FILL AREA BY OTHERS. CONTRACTOR WILL BE RESPONSIBLE TO PROVIDE ACCESS AND STRIKE OFF DUMPED LOADS ON A DAILY BASIS DURING HAUL ACTIVITIES. SITE TO BE LEFT IN A STRUCK OFF, ACCESSIBLE FORM AT THE END OF EACH DAY.
4. CONCRETE RUBBLE DELIVERIES ARE ANTICIPATED TO BEGIN ON SEPTEMBER 14, 2015 AND LAST APPROXIMATELY 4 WEEKS OR LESS. THE RUBBLE MAY BE DELIVERED AT A RATE OF UP TO 3,000 C.Y. PER DAY. HAULING ACTIVITIES MAY OCCUR ON PARTIAL AND/OR NON-CONSECUTIVE DAYS. THE CONTRACTOR WILL BE PROVIDED A WEEKLY SCHEDULE ON THURSDAY OF THE PRECEDING WEEK.
5. THE CONCRETE RUBBLE WILL VARY IN SIZE TO A MAXIMUM DIMENSION OF 24 INCHES AND WILL HAVE WIRE MESH REINFORCEMENT AND STEEL DOWELS.
6. THE STRUCK OFF SURFACE MUST BE TRACK WALKED DAILY OR MORE OFTEN TO AVOID TIRE PUNCTURES.
7. THE CONCRETE RUBBLE IS TO BE PLACED IN 4 FOOT LIFTS (MAXIMUM) AND DOES NOT REQUIRE COMPACTION OTHER THAN TRACK WALKING.
8. THE SOIL CAP MATERIAL MAY BE BORROWED BY THE CONTRACTOR FROM BORROW AREA #1 AND/OR #2
9. ALL BORROW AREAS ARE TO BE SHAPED UPON COMPLETION TO ALLOW DRAINAGE WITH NO DEPRESSIONS IN THE RESULTING SURFACE.
10. ALL SLOPES WITHIN BORROW AREAS ARE BE BE 2H:1V OR FLATTER.

LEGEND :

- C — C — C — CATCH LINE
- DRAINAGE FLOW
- - - ORIGINAL GRADE CONTOUR LINE
- - - ORIGINAL GRADE INDEX CONTOUR LINE
- - - 200 - - - FINISH GRADE INDEX CONTOUR LINE
- 200 — FINISH GRADE CONTOUR LINE
- FINISH GRADE ELEVATION
- CONCRETE ELEVATION

N O T E : ALL OTHERS AS NOTED ON PLAN

Survey	T.E.C.
Design	K.W.C./D.O.E.
DWG. No.	(K.WORK ORDER) 14001405 DRAINING (S&L) 1405 - REARLINE
Date	12/14/2015
Work Order No.	14625
Scale	AS NOTED

FILL PLAN
 FOR THE
DIP RAMCO SITE CAP PROJECT
 DALLESFORT, WASHINGTON
 Plot Date: 12/14/2015

TENNESON ENGINEERING CORP.
 CONSULTING ENGINEERS
 3775 CRATES WAY
 THE DALLES, OREGON 97058
 TEL: 541-296-9177 FAX 541-296-6657

RECORD DRAWING

IF THIS BAR IS NOT ONE INCH, THEN ADJUST SCALES ACCORDINGLY

SHEET C-103

Work Order No. 14625

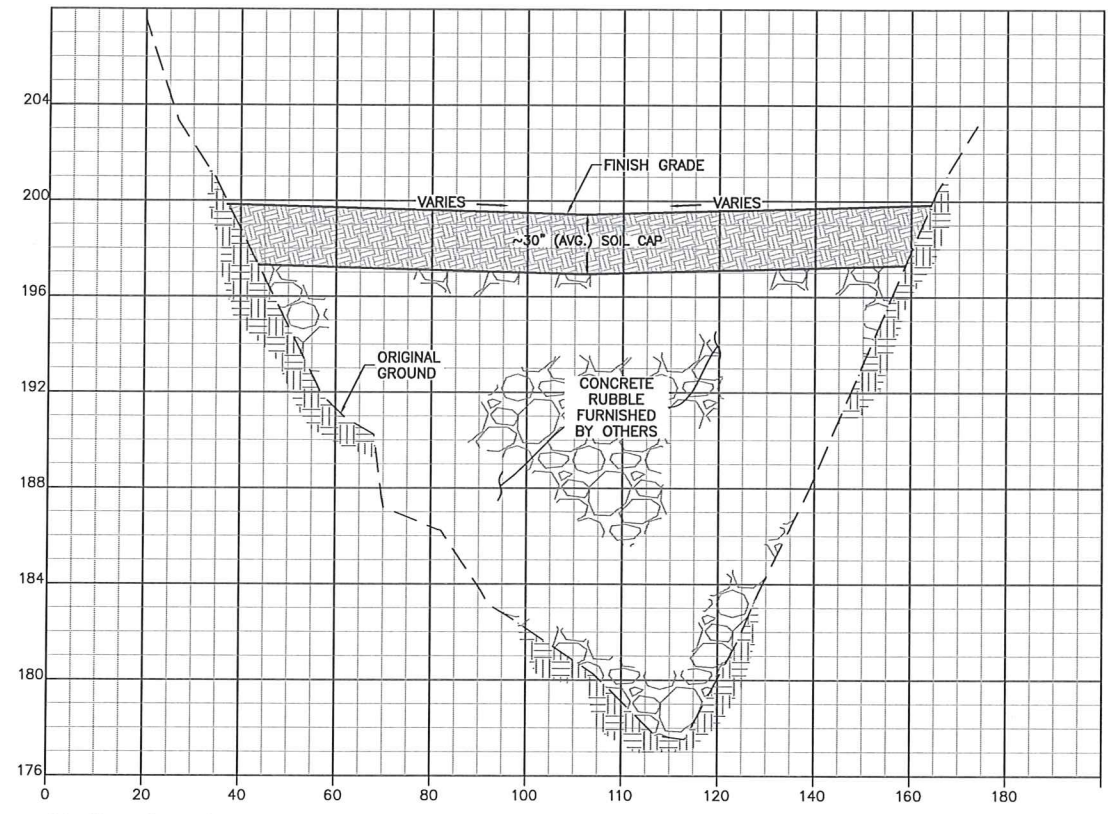

SECTION C
 SCALE: 1"=20' HORZ
 1"=4' VERT

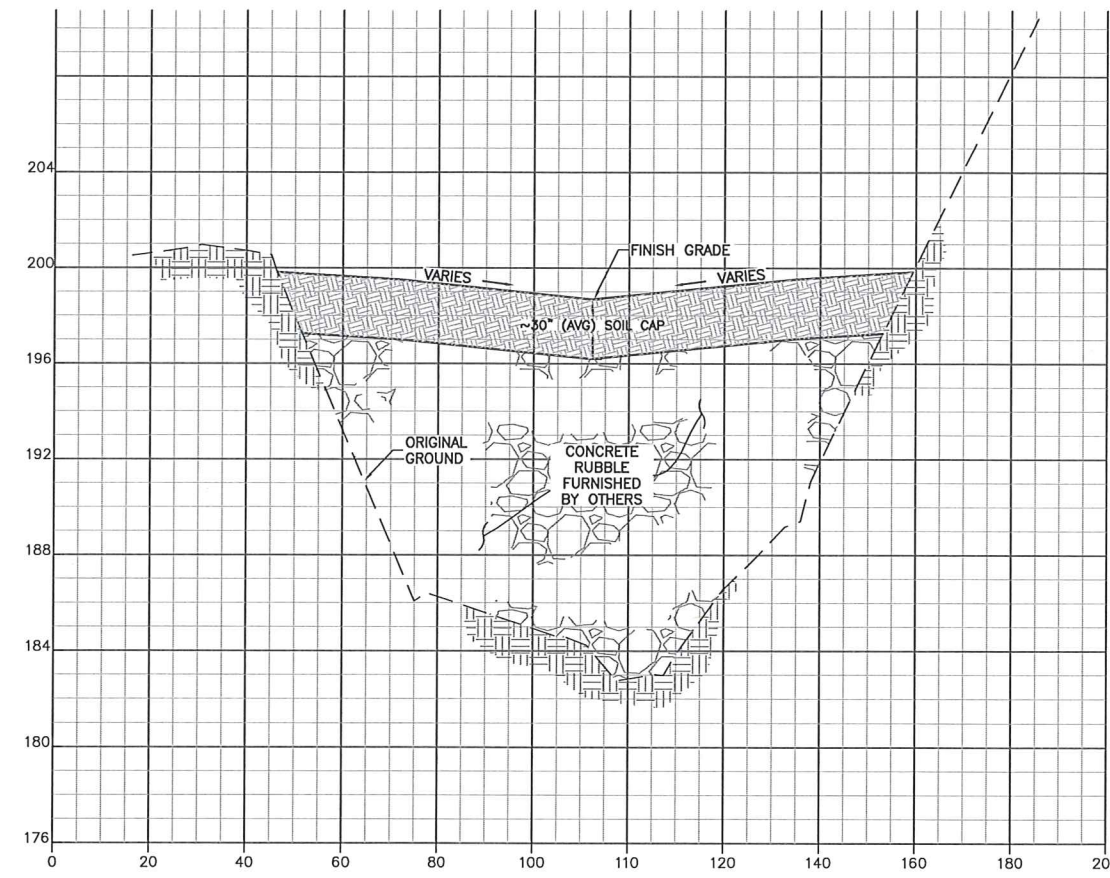

SECTION B
 SCALE: 1"=20' HORZ
 1"=4' VERT

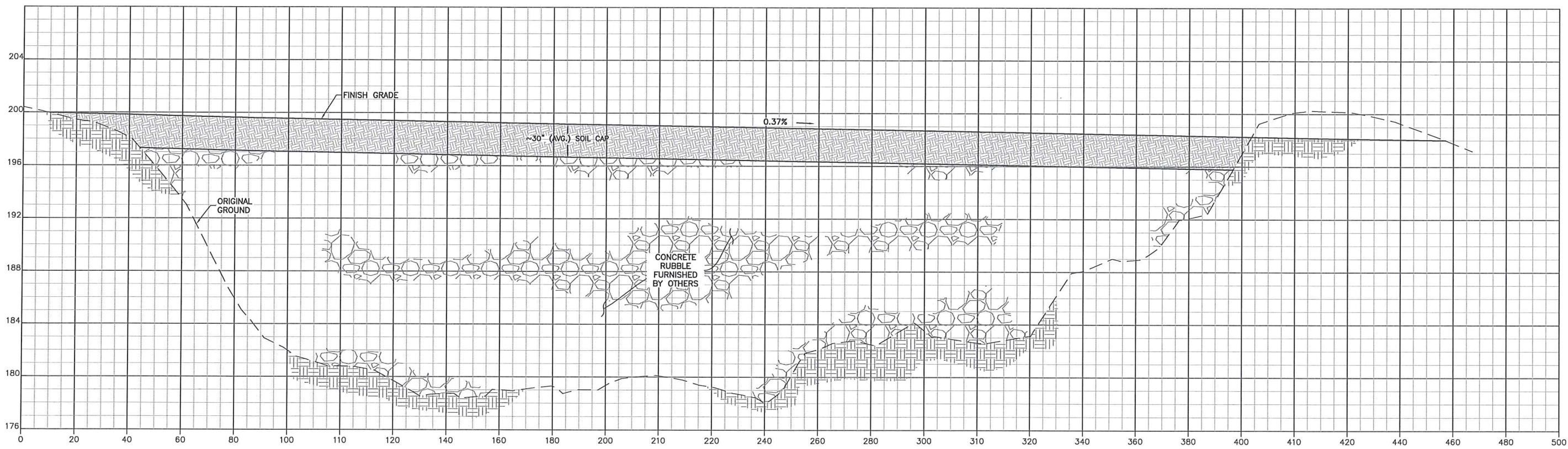

PROFILE A
 SCALE: 1"=20' HORZ
 1"=4' VERT

Design	K.W.C./D.O.E.	Survey	T.E.C.
DWG. No.	14625	Drawn	K.W.C.
DATE	12/14/2015	Work Order No.	14625
Scale	AS NOTED		

SECTIONS FOR THE
DIP RAMCO SITE CAP PROJECT
 DALLESPORT, WASHINGTON
 Plot Date: 12/14/2015

TENNESON ENGINEERING CORP.
 CONSULTING ENGINEERS
 3775 CRATES WAY
 THE DALLES, OREGON 97058
 TEL: 541-296-9177 FAX 541-296-6657

RECORD DRAWING

IF THIS BAR IS NOT ONE INCH, THEN ADJUST SCALES ACCORDINGLY

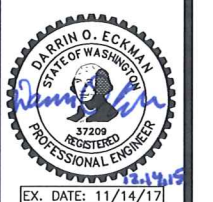

SHEET C-104

Work Order No. 14625

GENERAL NOTES:

- A) CONTRACTOR SHALL CONFORM TO ALL CONSTRUCTION PERMITS REQUIRED BY THE COUNTY. OWNER TO PAY ALL PROJECT PERMIT COSTS.
- B) CONTRACTOR SHALL PROVIDE ALL BONDS AND INSURANCE REQUIRED BY PUBLIC AND/OR PRIVATE AGENCIES HAVING JURISDICTION.
- C) UNLESS OTHERWISE APPROVED BY THE JURISDICTION, CONSTRUCTION OF ALL PUBLIC FACILITIES SHALL BE DONE BETWEEN 7:00 AM. AND 6:00 P.M., MONDAY THROUGH FRIDAY.
- D) THE CONTRACTOR SHALL PERFORM ALL WORK NECESSARY TO COMPLETE THE PROJECT IN ACCORDANCE WITH THE APPROVED CONSTRUCTION DRAWINGS INCLUDING SUCH INCIDENTALS AS MAY BE NECESSARY TO MEET APPLICABLE AGENCY REQUIREMENTS AND PROVIDE A COMPLETED PROJECT.
- E) THE CONTRACTOR SHALL NOTIFY ALL UTILITY COMPANIES A MINIMUM OF 48 BUSINESS HOURS (2 BUSINESS DAYS) PRIOR TO START OF CONSTRUCTION AND COMPLY WITH ALL OTHER REQUIREMENTS OF THE SERVING UTILITIES.
- F) ANY INSPECTION BY THE OWNER OR OTHER AGENCIES SHALL NOT, IN ANY WAY, RELIEVE THE CONTRACTOR FROM ANY OBLIGATION TO PERFORM THE WORK IN STRICT COMPLIANCE WITH THE CONTRACT DOCUMENTS, APPLICABLE CODES AND AGENCY REQUIREMENTS.
- G) CONTRACTOR SHALL ERECT AND MAINTAIN BARRICADES, WARNING SIGNS, TRAFFIC CONES PER LOCAL REQUIREMENTS IN ACCORDANCE WITH THE MUTCD (WASHINGTON AMENDMENTS). ACCESS TO DRIVEWAYS SHALL BE MAINTAINED AT ALL TIMES. ALL TRAFFIC CONTROL MEASURES SHALL BE APPROVED AND IN PLACE PRIOR TO ANY CONSTRUCTION ACTIVITY.
- H) CONTRACTOR SHALL BE PROPERLY LICENSED BY THE APPROPRIATE STATE AGENCY.
- I) ELEVATIONS ARE BASED ON AN ASSUMED DATUM AS SHOWN ON THE PLANS.
- J) STATIONING IS BASED ON PRIMARY MAINLINE SHOWN.

EXISTING UTILITIES & FACILITIES:

- A) THE CONTRACTOR SHALL MAINTAIN ONE COMPLETE SET OF APPROVED DRAWINGS ON THE CONSTRUCTION SITE AT ALL TIMES WHEREON HE WILL RECORD ANY APPROVED DEVIATIONS IN CONSTRUCTION FROM THE APPROVED DRAWINGS, AS WELL AS THE STATION LOCATIONS AND DEPTHS OF ALL EXISTING UTILITIES ENCOUNTERED. THESE FIELD RECORD DRAWINGS SHALL BE KEPT UP TO DATE AT ALL TIMES AND SHALL BE AVAILABLE FOR INSPECTION BY THE COUNTY UPON REQUEST. FAILURE TO CONFORM TO THIS REQUIREMENT MAY RESULT IN DELAY OF PAYMENT AND/OR FINAL ACCEPTANCE OF THE PROJECT.
- B) THE LOCATION AND DESCRIPTIONS OF EXISTING UTILITIES SHOWN ON THE DRAWING, ARE COMPILED FROM AVAILABLE RECORDS AND/OR FIELD SURVEYS. THE ENGINEER OR UTILITY COMPANIES DO NOT GUARANTEE THE ACCURACY OR THE COMPLETENESS OF SUCH RECORDS. CONTRACTOR SHALL FIELD VERIFY LOCATIONS AND SIZES OF ALL EXISTING UTILITIES PRIOR TO CONSTRUCTION.
- C) THE CONTRACTOR SHALL LOCATE AND MARK ALL EXISTING PROPERTY AND STREET MONUMENTS PRIOR TO CONSTRUCTION. ANY MONUMENTS DISTURBED DURING CONSTRUCTION OF THE PROJECT SHALL BE REPLACED BY A REGISTERED LAND SURVEYOR AT THE CONTRACTORS EXPENSE.
- D) CONTRACTOR SHALL FIELD VERIFY LOCATION AND DEPTH OF ALL EXISTING UTILITIES WHERE NEW FACILITIES CROSS. CONTRACTOR SHALL BE RESPONSIBLE FOR EXPOSING POTENTIAL UTILITY CONFLICTS FAR ENOUGH AHEAD OF CONSTRUCTION TO MAKE NECESSARY GRADE MODIFICATIONS WITHOUT DELAYING THE WORK. IF GRADE MODIFICATION IS NECESSARY, CONTRACTOR SHALL NOTIFY THE DESIGN ENGINEER, AND THE DESIGN ENGINEER SHALL OBTAIN APPROVAL FROM THE CITY PRIOR TO CONSTRUCTION. ALL UTILITY CROSSINGS SHALL BE POTHOLED AS NECESSARY PRIOR TO EXCAVATING OR BORING TO ALLOW THE CONTRACTOR TO PREVENT GRADE OR ALIGNMENT CONFLICTS.
- E) ALL FACILITIES SHALL BE MAINTAINED IN-PLACE BY THE CONTRACTOR UNLESS OTHERWISE SHOWN OR DIRECTED. CONTRACTOR SHALL TAKE ALL PRECAUTIONS NECESSARY TO SUPPORT, MAINTAIN, OR OTHERWISE PROTECT EXISTING UTILITIES AND OTHER FACILITIES AT ALL TIMES DURING CONSTRUCTION. CONTRACTOR TO LEAVE EXISTING FACILITIES IN AN EQUAL OR BETTER-THAN-ORIGINAL CONDITION AND TO THE SATISFACTION OF THE COUNTY ENGINEER.
- F) THE CONTRACTOR SHALL BE RESPONSIBLE FOR MANAGING CONSTRUCTION ACTIVITIES TO ENSURE THAT PUBLIC STREETS AND RIGHT-OF-WAYS ARE KEPT CLEAN OF MUD, DUST OR DEBRIS. DUST ABATEMENT SHALL BE MAINTAINED BY ADEQUATE WATERING OF THE SITE BY THE CONTRACTOR.

GRADING, PAVING & DRAINAGE:

- A) UNLESS OTHERWISE NOTED, ALL GRADING, ROCKING AND PAVING TO CONFORM TO WSDOT/APAWA STANDARD SPECIFICATIONS FOR ROADS, BRIDGES AND MUNICIPAL CONSTRUCTION, CURRENT EDITION.
- B) CLEAR AND GRUB WITHIN WORK LIMITS ALL SURFACE VEGETATION, TREES, STUMPS, BRUSH, ETC. DO NOT DAMAGE OR REMOVE TREES EXCEPT AS APPROVED BY THE ENGINEER SHOWN ON THE DRAWINGS. PROTECT ALL ROOTS TWO INCHES IN DIAMETER OR LARGER.
- C) STRIP FILL AREA LIMITS AND PLACE MATERIAL AT BOTTOM OF FILL. ALL TREES, BRUSH AND DEBRIS ASSOCIATED WITH CLEARING, STRIPPING OR GRADING SHALL BE REMOVED AND DISPOSED OF OFF-SITE.
- D) UNLESS OTHERWISE SHOWN ON THE DRAWINGS, STRAIGHT GRADES SHALL BE RUN BETWEEN ALL FINISH GRADE ELEVATIONS AND/OR FINISH CONTOUR LINES SHOWN.
- E) UNLESS OTHERWISE SHOWN ON THE DRAWINGS, NO CUT OR FILL SLOPES SHALL BE CONSTRUCTED STEEPER THAN 2H:1V.

Design	K.W.C./D.O.E.	Survey	T.E.C.
Drawn	No. 14625	Drawn	K.W.C.
Date	12/14/2015	Scale	AS NOTED
Work Order No.	14625		

GENERAL NOTES
FOR THE
DIP RAMCO SITE CAP PROJECT
DALLESPORT, WASHINGTON
Plot Date: 12/14/2015

TENNESON ENGINEERING CORP.
CONSULTING ENGINEERS
3775 CRATES WAY
THE DALLES, OREGON 97058
TEL: 541-296-9177 FAX 541-296-6657

**RECORD
DRAWING**

IF THIS BAR IS NOT ONE INCH,
THEN ADJUST SCALES ACCORDINGLY

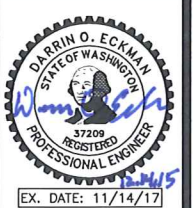

**SHEET
C-105**

Work Order No.
14625