

BASEMAP MODIFIED FROM DRAWING PROVIDED BY GEOENGINEERS AND DUNCANSON CO., INC. SURVEYING

241739-2014(014)GN-WA002 SEP 12/2014

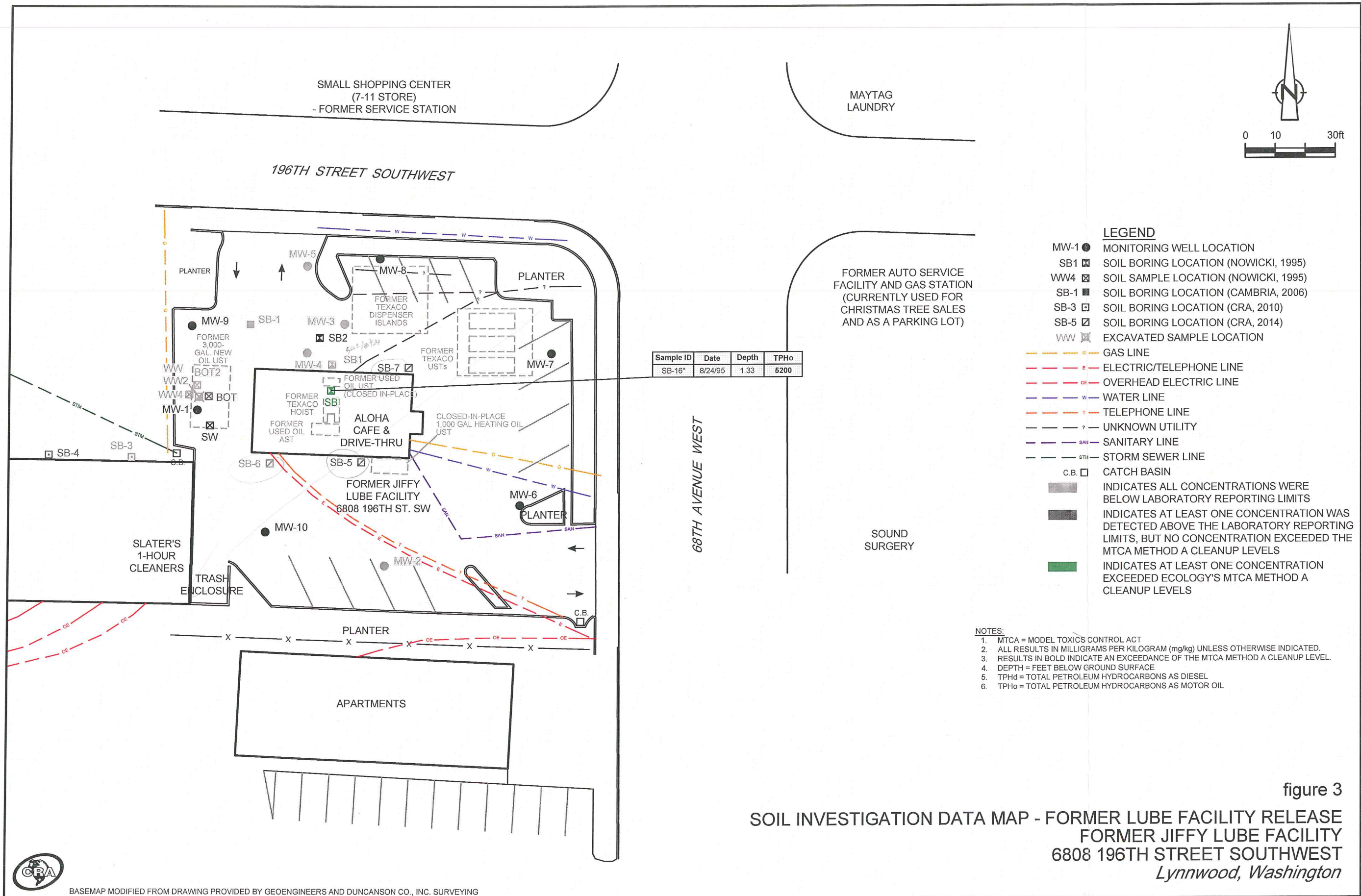

**LEGEND**

- MW-1 ● MONITORING WELL LOCATION
- SB1 ☒ SOIL BORING LOCATION (NOWICKI, 1995)
- WW4 ☒ SOIL SAMPLE LOCATION (NOWICKI, 1995)
- SB-1 ☒ SOIL BORING LOCATION (CAMBRIA, 2006)
- SB-3 ☒ SOIL BORING LOCATION (CRA, 2010)
- SB-5 ☒ SOIL BORING LOCATION (CRA, 2014)
- WW ☒ EXCAVATED SAMPLE LOCATION
- GAS LINE
- E — ELECTRIC/TELEPHONE LINE
- OE — OVERHEAD ELECTRIC LINE
- W — WATER LINE
- T — TELEPHONE LINE
- ? — UNKNOWN UTILITY
- SAN — SANITARY LINE
- STM — STORM SEWER LINE
- C.B. ☐ CATCH BASIN
- INDICATES ALL CONCENTRATIONS WERE BELOW LABORATORY REPORTING LIMITS
- INDICATES AT LEAST ONE CONCENTRATION WAS DETECTED ABOVE THE LABORATORY REPORTING LIMITS, BUT NO CONCENTRATION EXCEEDED THE MTCA METHOD A CLEANUP LEVELS
- INDICATES AT LEAST ONE CONCENTRATION EXCEEDED ECOLOGY'S MTCA METHOD A CLEANUP LEVELS

- NOTES:**
1. MTCA = MODEL TOXICS CONTROL ACT
  2. ALL RESULTS IN MILLIGRAMS PER KILOGRAM (mg/kg) UNLESS OTHERWISE INDICATED.
  3. RESULTS IN BOLD INDICATE AN EXCEEDANCE OF THE MTCA METHOD A CLEANUP LEVEL.
  4. DEPTH = FEET BELOW GROUND SURFACE
  5. TPHd = TOTAL PETROLEUM HYDROCARBONS AS DIESEL
  6. TPHo = TOTAL PETROLEUM HYDROCARBONS AS MOTOR OIL

figure 3  
**SOIL INVESTIGATION DATA MAP - FORMER LUBE FACILITY RELEASE**  
**FORMER JIFFY LUBE FACILITY**  
**6808 196TH STREET SOUTHWEST**  
*Lynnwood, Washington*