

# FINAL

## SITE HAZARD ASSESSMENT RECOMMENDATION OF NO FURTHER ACTION

January 9, 2003

**Site Name/Location** (Street, City, County, Section /Township/Range, ID Number):

Site Name: **Mission Ridge Ski Area**

Property owner: Harbor Properties

Location: 7500 Mission Ridge Rd.

Wenatchee, WA

Township: 21N

Range: 19E

Section: 24

Longitude: 120° 23' 57"

Latitude: 47° 17' 35"

Facility Site ID: 364

TCP ID C-04-2021-000

**Site Description and History** (Include management areas, substances of concern, and quantities):

Mission Ridge is a privately-owned ski area located on 2300 acres of Forest Service land at the end of Mission Ridge Road. It is located 13 miles from the City of Wenatchee and several miles from any residences. Those residences are served by the Chelan County PUD Public Water system. There is a drinking water well which serves the ski area located about 320 feet uphill from the fuel tanks. A wastewater treatment plant is located about 100 feet below the fuel tanks.

On March 7, 1995 a complaint was filed with the Washington Dept. of Ecology (Ecology) from a former Mission Ridge employee. The complaint alleged that there was an illegal fuel delivery system near the maintenance garage that had resulted in spillage of several hundred gallons of diesel fuel less than 100 yards from Squilchuck Creek.

On March 9, 1995 an Initial Investigation was conducted by Dick Bassett and Nicole McCoy, Ecology Central Regional Office. After meeting with the complainant they traveled to Mission Ridge where they met with the Vice President Don Etherington and looked at the site. Mr. Etherington admitted to having some equipment problems that resulted in small spills of less than 5 gallons, but he claimed that there were no large spills. The Ecology staff noted a strong petroleum odor near the alleged spill area and a visible sheen on the ground. Dick Bassett advised Mr. Etherington that an independent cleanup was the easiest and cheapest way to take care of any spills that may have occurred. Mr. Etherington told Dick that they would contact their consultant regarding this approach.

On March 24, 1995 Dick Bassett recommended that the site receive a Site Hazard Assessment (SHA) based upon the fact that statements from both the complainant and the Mission Ridge vice-president indicated that diesel spillage did occur. An Early Notice Letter was sent by Dick Bassett to Mission Ridge on July 20, 1995 advising them of their options under the Model Toxics Control Act (MTCA).

On October 2, 2002 a letter was sent by Michael Spencer (Ecology) to Mission Ridge advising them that an SHA would be conducted by the Chelan Douglas Health District (CDHD).

On October 16, 2002 a preliminary site visit was made by Tom Guthrie (CDHD) and Michael Spencer. They met with Operations Manager Mike Bourton and viewed the site. As a result of this visit the following facts were discovered:

1. The old underground storage tank (UST) which had caused problems had been replaced with an above ground tank (see enclosed photo).
2. An independent cleanup had been done in 1996 by a consultant, Forsgren Associates (report enclosed).

The new above ground tank appeared to be well maintained and in good condition. There were no petroleum odors or other signs of any fuel spillage.

The Forsgren Associates' report stated that soil was removed from the spill area and spread out over an area of approximately 18 by 88 feet on a portion of the ski area's paved parking lot. After about 18 months, four samples were taken and analyzed by Anatek Labs for diesel range petroleum hydrocarbons. Results for all four samples were below detection (<25 mg/kg). Following this testing the soil was placed in an embankment near the ski area parking lot.

## **CONCLUSIONS**

The Chelan-Douglas Health District recommends that this site receive no further action (NFA) under MCTA, based on its documented insignificant threat to human health and the environment. This is based on the results of this SHA and the results from Forsgren Associates' report. CDHD also recommends the site should be removed from the Confirmed and Suspected Contaminated Sites list as awaiting assessment.

Enclosures: Site map, copy of Forsgren Associates report 11/6/96, UST closure confirmation

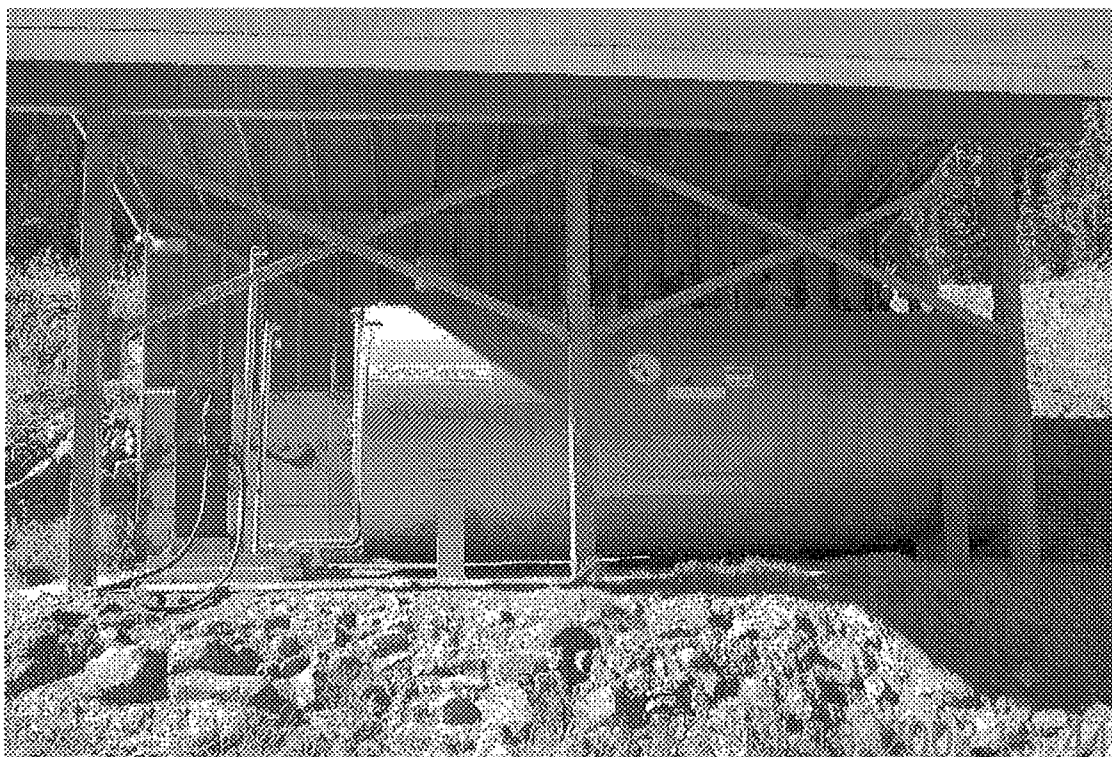

Mission Ridge diesel/gasoline storage tank October 16, 2002



**F O R S G R E N**  
**ASSOCIATES, INC.**

OCT 17 2002

November 6, 1996

896-995  
SKILTR

Washington State Department of Ecology  
Central Regional Office  
15 West Yakima Avenue, Suite 200  
Yakima, WA 98902-3401

Subject: Mission Ridge Ski Resort; Site No. 1310

Dear Sirs,

Enclosed, please find laboratory test results for soil at the Mission Ridge Ski Resort.

An above ground, release of diesel product was confirmed in the winter of 1994 due to a fueling problem with a piece of equipment. An area for excavation was identified and the contaminated soil removed to be remediated through "land farming". Previous analysis results of soil samples have been submitted to Department of Ecology concerning this site.

The soil samples collected for analysis on October 16, 1996 demonstrate that the soil has been remediated. This letter is submitted to Department of Ecology as a final follow-up for this site. All of the soil has been remediated and will be placed in an embankment near the parking lot of the ski resort.

If you have any further inquiries regarding this site please feel free to contact me.

Sincerely,

FORSGREN ASSOCIATES, INC.

Scott K. Morrill, P.E.  
Project Manager

SKM/jm

Enclosures

cc: Gavin Hamilton, Mission Ridge



# Anatek Labs, Inc.

1917 S. Main Moscow, ID 83843 (208) 883-BTEX (2839) FAX: (208) 882-9246

October 22, 1996

**Forsgren Associates, Inc.**  
125 McGee Street S.E.  
East Wenatchee, WA 98802  
Attn: Scott Morrill

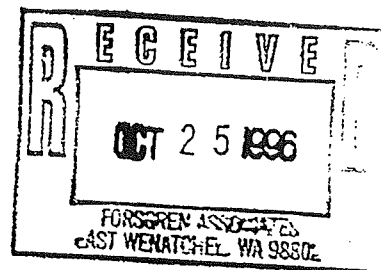

Items: Results of analysis for samples received 10/18/96.  
Sample Log-in number: **22776**  
Project Name: Mission Ridge  
Date Sampled: 10/16/96  
Report # 96-1022-FAP

Diesel by WTPH-D; mg/Kg = ppm

<b>Sample Name</b>	<b>Matrix</b>	<b>Analysis Date</b>	<b>Analyte</b>	<b>Concentration</b>
# 1	Soil	10/21/96	Diesel	< 25 mg/Kg
# 2	Soil	10/21/96	Diesel	< 25 mg/Kg
# 3	Soil	10/21/96	Diesel	< 25 mg/Kg
# 4	Soil	10/21/96	Diesel	< 25 mg/Kg

Mike Pearson  
Laboratory Director





**F O R S G R E N**  
**ASSOCIATES, INC.**

RECEIVED  
OCT 17 2002

October 16, 1996

896-995  
ANATEK15.LTR

Anatek Labs  
1917 South Main Street  
Moscow, Id 83843

Dear Sir:

Enclosed please find four soil samples to be screened. The samples need to be screened for WTPH-D.

Name: Scott Morrill  
Address: 125 McGee Street SE  
East Wenatchee, WA 98802

Project Name: Mission Ridge  
Sample Nos: 1 through 4  
Date Sample Taken: October 16, 1996  
Location: Wenatchee, WA  
No. Of Containers: 4

Billing Information: Forsgren Associates, Inc.  
Attn: Scott Morrill  
125 McGee Street SE  
East Wenatchee, WA 98802

Also, I am completely out of sample containers; please send me two cases.

Sincerely,  
FORSGREN ASSOCIATES, INC.

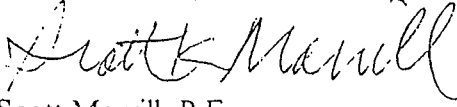
  
Scott Morrill, P.E.  
Project Manager

22776

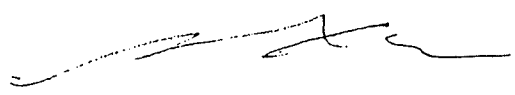

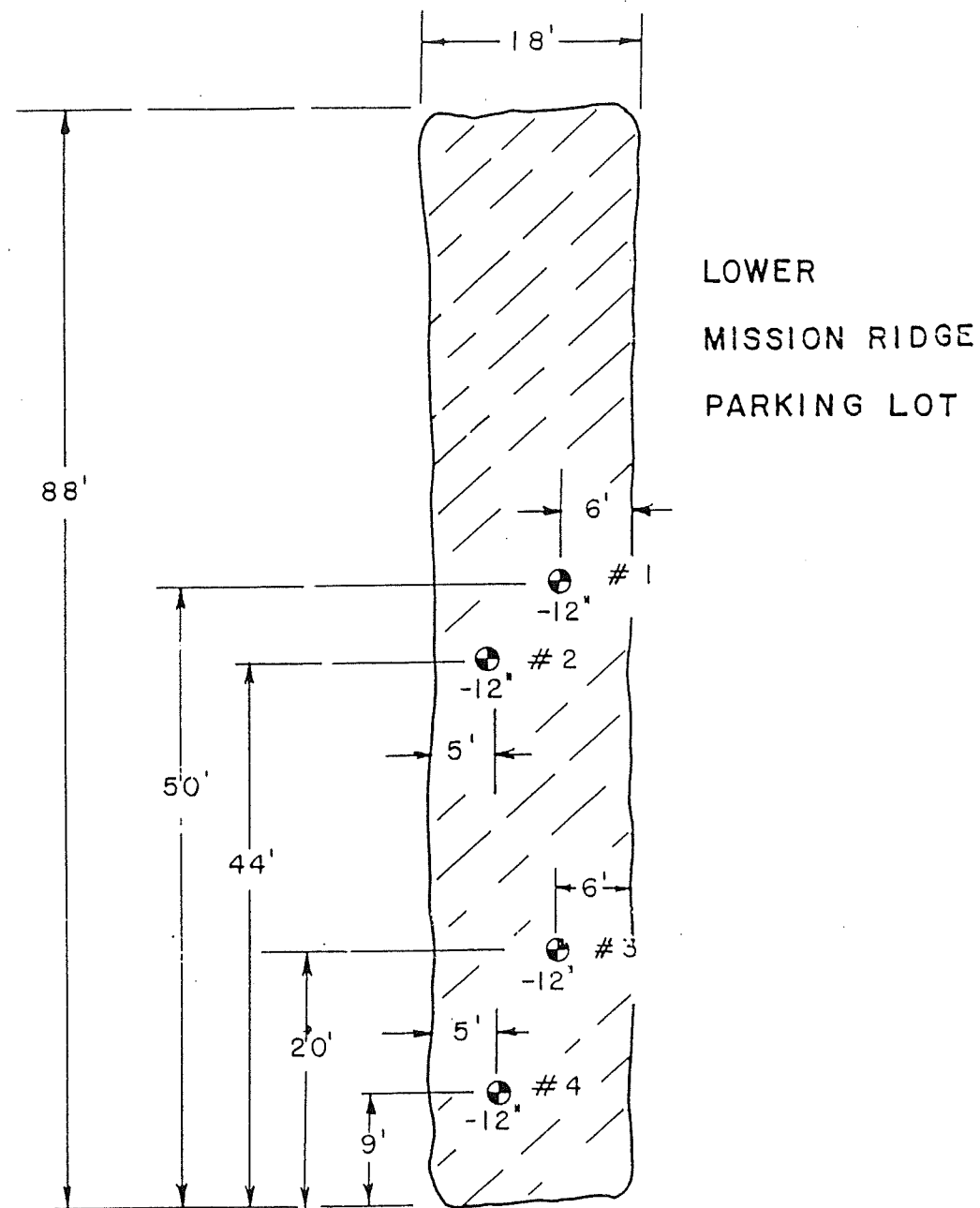

MISSION RIDGE  
SOIL REMEDIATION PILE  
SAMPLING 10-16-96

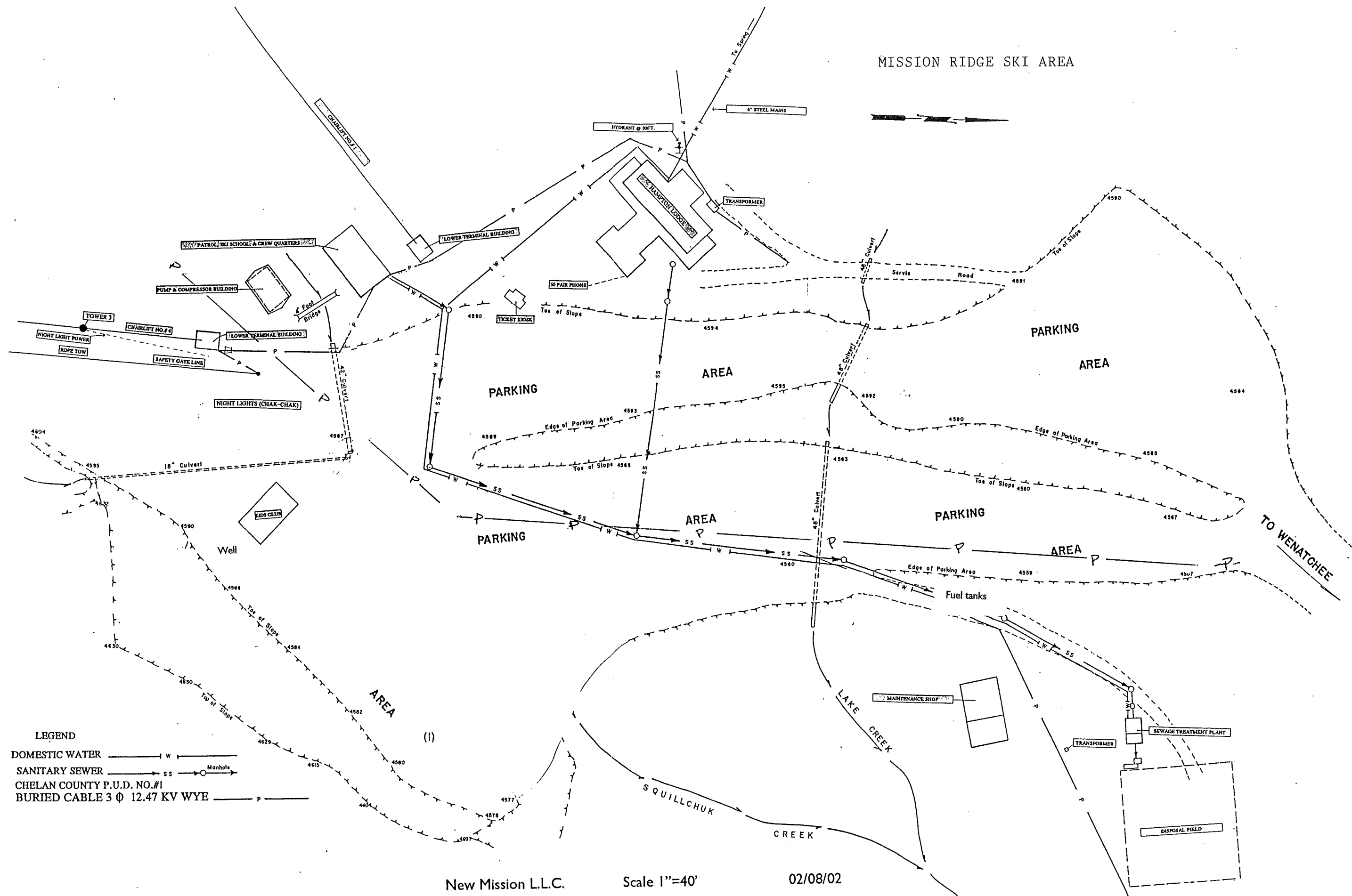

02/08/02



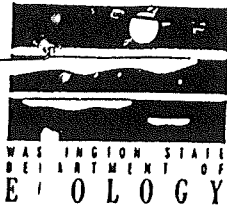

**UNDERGROUND STORAGE TANK  
TEMPORARY/PERMANENT CLOSURE  
and SITE ASSESSMENT NOTICE**

See back of form for instructions  
Please ☒ the appropriate box(es)  
Please type or print information

☐ Temporary Tank Closure ☒ Permanent Tank Closure ☐ Change-In-Service ☐ Site Assessment/Site Check

Office Use Only

Owner #

Site #

007 17 2002

**SITE INFORMATION:**

Site ID Number (on invoice or available from Ecology if the tanks are registered): 001310  
Site/Business Name: Mission Ridge Ski Area  
Site Address: P. O. Box 1668 S<sup>1</sup>/<sub>2</sub>Sec24 T21N R19E WM Telephone: (509) 663-6453  
Wenatchee WA 98801  
City State ZIP-Code

**TANK INFORMATION:**

Tank ID	Closure Date	Tank Capacity	Substance Stored
4	2-14-94	10000	Gasoline
3	7-14-94	10000	Diesel

**CONTAMINATION  
PRESENT AT THE  
TIME OF CLOSURE**



Yes



No



Unknown

Check unknown if no obvious contamination was observed and sample results have not yet been received from analytical lab.

**UST SYSTEM OWNER/OPERATOR:**

UST Owner/Operator: same as above

Owners Signature: Jim Hamilton Telephone: ( )

Address: Street P.O. Box  
City State ZIP-Code

**TANK CLOSURE/CHANGE-IN-SERVICE PERFORMED BY:**

Service Provider: Appleland Pump & Equipment License Number: S000118  
Licensed Supervisor: Jim Gamel Decommissioning License Number: W000765  
Supervisors Signature: Jim Gamel  
Address: 500 Ohme Garden Road 3011  
Wenatchee WA 98807  
City State ZIP-Code  
Telephone: (509) 662-0832

**SITE CHECK/SITE ASSESSMENT CONDUCTED BY:**

Name of Registered Site Assessor: Faragun & Associates

Telephone: ( )

Address: Street P.O. Box  
City State ZIP-Code