



## **SECOND PERIODIC REVIEW REPORT DRAFT**

**Freighthouse Square  
Facility Site ID#: 1351  
Cleanup Site ID#: 719**

**430 East 25<sup>th</sup> Street  
Tacoma, Washington 98421**

**Southwest Regional Office  
TOXICS CLEANUP PROGRAM**

**May 2017**

## **TABEL OF CONTENTS**

<b>1.0 INTRODUCTION.....</b>	<b>1</b>
<b>2.0 SUMMARY OF SITE CONDITIONS.....</b>	<b>3</b>
2.1 Site History .....	3
2.2 Cleanup Levels.....	3
2.3 Summary of Cleanup Actions .....	3
2.4 Phase II Environmental Site Assessment – 2014 and 2015 .....	5
2.5 Restrictive Covenant.....	6
<b>3.0 FIVE-YEAR REVIEW.....</b>	<b>7</b>
3.1 Effectiveness of completed cleanup actions .....	7
3.2 New scientific information for individual hazardous substances for mixtures present at the site. ....	7
3.3 New applicable state and federal laws for hazardous substances present at the Site .....	7
3.4 Current and projected site use.....	8
3.5 Availability and practicability of higher preference technologies .....	8
3.6 Availability of improved analytical techniques to evaluate compliance with cleanup levels. ....	8
<b>4.0 CONCLUSIONS .....</b>	<b>9</b>
4.1 Next Review.....	9
<b>5.0 REFERENCES.....</b>	<b>10</b>
<b>6.0 APPENDICIES .....</b>	<b>11</b>
6.1 Vicinity Map .....	12
6.2 Site Plan .....	13
6.3 Sampling Locations and Remediation Areas .....	14
6.4 November 2014 and 2015-Phase II Environmental Site Assessment-Soil and Groundwater Sampling Locations and Results .....	15
6.5 Restrictive Covenant.....	22
6.6 Photo log .....	37

## 1.0 INTRODUCTION

This document is a review by the Washington State Department of Ecology (Ecology) of post-cleanup site conditions and monitoring data to assure that human health and the environment are being protected at the Freighthouse Square (Site). Cleanup at this Site was implemented under the Model Toxics Control Act (MTCA), Chapter 173-340 WAC. The first periodic review was conducted in March 2012 and this periodic review evaluates the period from April 2012 through April 2017.

Cleanup activities at this Site were completed under the Voluntary Cleanup Program. The cleanup actions resulted in residual concentrations of petroleum hydrocarbons, cadmium and lead exceeding MTCA Method A cleanup levels for groundwater. The MTCA Method A cleanup levels for soil are established under WAC 173-340-740(2). The MTCA Method A cleanup levels for groundwater are established under WAC 173-340-720(3). WAC 173-340-420 (2) requires that Ecology conduct a periodic review of a site every five years under the following conditions:

- (a) Whenever the department conducts a cleanup action.
- (b) Whenever the department approves a cleanup action under an order, agreed order or consent decree.
- (c) Or, as resources permit, whenever the department issues a no further action opinion and one of the following conditions exists:
  - 1. Institutional controls or financial assurance are required as part of the cleanup.
  - 2. Where the cleanup level is based on a practical quantitation limit.
  - 3. Where, in the department's judgment, modifications to the default equations or assumptions using site-specific information would significantly increase the concentration of hazardous substances remaining at the site after cleanup or the uncertainty in the ecological evaluation or the reliability of the cleanup action is such that additional review is necessary to assure long-term protection of human health and the environment.

When evaluating whether human health and the environment are being protected, the factors the department shall consider include [WAC 173-340-420(4)]:

- (a) The effectiveness of ongoing or completed cleanup actions, including the effectiveness of engineered controls and institutional controls in limiting exposure to hazardous substances remaining at the Site.
- (b) New scientific information for individual hazardous substances or mixtures present at the Site.
- (c) New applicable state and federal laws for hazardous substances present at the Site.
- (d) Current and projected Site use.
- (e) Availability and practicability of higher preference technologies.
- (f) The availability of improved analytical techniques to evaluate compliance with cleanup levels.

The department shall publish a notice of all periodic reviews in the Site Register and provide an opportunity for public comment.

## **2.0 SUMMARY OF SITE CONDITIONS**

### **2.1 Site History**

The Freighthouse Square property is located at 430 E 25<sup>th</sup> Street, Tacoma in Pierce County, Washington. Remedial activities were conducted at the Site under the Voluntary Cleanup Program. A No Further Action (NFA) determination was issued for the Site on June 27, 2003. A Restrictive Covenant was recorded for the property on July 29, 2003. Vicinity and Site maps are available as Appendix 6.1 and Appendix 6.2, respectively.

The Site occupies a three-block area bounded by East 25<sup>th</sup> Street to the North, East D Street to the West, East 26<sup>th</sup> Street to the South, and East G Street to the East. Historically, the Site was occupied by West Coast Bottling Works, Olympic Ice and Machine Company, and Lundgren Dealer Supply. Olympic Ice and Machine Company occupied the Site in 1912 and likely stored and used diesel fuel and Bunker C oil for an industrial boiler in the facility.

In 1993, heavy petroleum hydrocarbon contamination was encountered by BP Construction, Inc. during excavation for the lower level of the Freighthouse Square building.

### **2.2 Cleanup Levels**

MTCA Method A cleanup levels for unrestricted land use were used for the Site. Current MTCA Method A cleanup levels have changed significantly since remedial activities were conducted in 1993. However, WAC 173-340-702(12) (c) [2001 ed.] provides that,

“A release cleaned up under the cleanup levels determined in (a) or (b) of this subsection shall not be subject to further cleanup action due solely to subsequent amendments to the provision in this chapter on cleanup levels”

A NFA determination was issued for the Site in 2003. However, since the remedial actions were conducted in 1993, MTCA Method A cleanup levels prior to 2001 will be used to determine whether or not the remedial activities at the Site have been effective in protecting human health and the environment. Nonetheless, for the contaminants of concern, the current MTCA Method A cleanup levels are either unchanged or higher than the previous cleanup levels.

### **2.3 Summary of Cleanup Actions**

In August 1993, heavy petroleum hydrocarbon contamination was encountered by BP Construction Inc. during excavation activities for the lower level of the new Freighthouse Square building. Small rectangular metal containers and pipes were found in fill material in the vicinity of contaminated soils. Six initial soil samples were analyzed for heavy petroleum hydrocarbons by WTPH-418.1, and three samples were analyzed for diesel and heavy petroleum hydrocarbons by WTPH-D and WTPH-D extended. Sample results indicated the presence of heavy oil-range petroleum hydrocarbons (TPH-O) at concentrations exceeding MTCA Method A cleanup levels.

Remedial excavation was conducted prior to construction activities. Soil was screened for excavation using thin layer chromatography. TPH-O contaminated soil was excavated at the Site using a backhoe. The clean soil was segregated from contaminated soil and stored on visqueen prior to disposal. Approximately 12 cubic yards of contaminated soil were hauled in dump trucks to Rabanco Disposal Company in Seattle. A total of six post excavation soil samples were collected and the results were below MTCA Method A cleanup levels. However, some TPH-O contaminated soils may remain on the Site.

**Table 1: Confirmation Soil Sample Results and Soil Cleanup Levels**

<b>Sample Number</b>	<b>Diesel (mg/kg) WTPH-D</b>	<b>&gt;Diesel (mg/kg) WTPH-Dx</b>	<b>WTPH-418.1 (mg/kg)</b>
<b>S-4</b>	NA	NA	ND
<b>S-6/7</b>	NA	16	150
<b>S-11</b>	NA	31	88
<b>S-12</b>	NA	NA	ND
<b>S-16</b>	NA	NA	35
<b>S-21</b>	ND	153	109
<b>Cleanup Level</b>	<b>200</b>	<b>200</b>	

NA: Not analyzed

ND: Non-detect

mg/kg: milligrams per kilogram

In addition, soil samples were also analyzed for metals. None of the metal concentrations exceeded MTCA Method A cleanup levels.

**Table 2: Maximum Soil Metal Concentrations and Cleanup Levels**

<b>Contaminant</b>	<b>Arsenic (mg/kg)</b>	<b>Cadmium (mg/kg)</b>	<b>Chromium (mg/kg)</b>	<b>Lead (mg/kg)</b>
	7.4	1.6	19	150
<b>Cleanup Level</b>	<b>20</b>	<b>2</b>	<b>21</b>	<b>250</b>

Grab samples of ground water were also collected from the remedial excavation. These grab samples included sampling of sheens on the water surface and "black globs" suspended in ground water. Laboratory results for these samples indicated TPH-O contamination that exceeded the Method A Ground Water Cleanup level of one (1) micrograms per liter ( $\mu\text{g/L}$ ) at locations next to leaking buried containers and pipes. Cadmium ( $27 \mu\text{g/L}$ ), chromium ( $260 \mu\text{g/L}$ ) and lead ( $2700 \mu\text{g/L}$ ) were also detected in ground water from a grab sample collected from the excavation. These concentrations exceeded the MTCA Method A Ground Water Cleanup level of 5, 50 and  $5 \mu\text{g/L}$ , respectively.

**Table 3: Groundwater Grab Sample Results and Cleanup Levels**

<b>Contaminant</b>	<b>TPH-O (µg/L)</b>	<b>Cadmium (µg/L)</b>	<b>Chromium (µg/L)</b>	<b>Lead (µg/L)</b>
	<b>&gt;1000</b>	<b>27</b>	<b>260</b>	<b>2700</b>
<b>Cleanup Levels</b>	<b>1000</b>	<b>5</b>	<b>50</b>	<b>5</b>

Due to the heavy-oil nature of petroleum-oil contamination, the limited metals concentrations, and the groundwater is not being used as a drinking water source, it was determined that ground water contamination did not pose a significant threat to human health or the environment. The Site was deemed eligible for a NFA determination by Ecology if institutional controls were used to limit groundwater and property use.

## **2.4 Phase II Environmental Site Assessment – 2014 and 2015**

During November 2014 and 2015, the Department of Transportation (DOT) hired Shannon and Wilson for conducting a Phase II Environmental Site Assessment (ESA) as part of Point Defiance Bypass Project to construct a new Amtrak Train Station on a portion of the property. Twelve geoprobe and fourteen auger borings were drilled at the Site and a total of 88 soil samples were collected at different depths. In addition, 11 groundwater samples were also collected for laboratory analysis. All samples were analyzed for diesel-and oil-range total petroleum hydrocarbons (TPH-D and TPH-O), total dissolved priority pollutant metals, semivolatile organic compounds (SVOCs), and volatile organic compounds (VOCs). Results of soil samples indicated that cPAHs (0.58 mg/kg – 15 mg/kg) and TPH-O (4,300 mg/kg) exceeding the current MTCA Method A cleanup levels of 1 mg/kg and 2000 mg/kg, respectively. Arsenic (7.5 µg/L – 13 µg/L) and TPH-D (670 µg/L) concentrations in groundwater also exceeded the current MTCA Method A cleanup levels of 5 µg/L and 500 µg/L, respectively.

In June 2016, the DOT demolished part of the above ground structure/building and started the construction of a new Amtrak Train Station. However, no excavation was involved in the construction and the new Amtrak Train Station is being built on the existing foundation. Once the DOT legally owns the new Amtrak Train Station portion of the property, Ecology will coordinate with DOT and owner of other portion the property for recording Amended Restrictive Covenants implementing the restrictions on the soil and groundwater at the Site. Soil and groundwater sampling locations and results are available as Appendix 6.4. Photos 4, 5, and 6, in Appendix 6.6 (Photo Log) shows the construction of the new Amtrak Train Station.

## 2.5 Restrictive Covenant

A Restrictive Covenant was recorded for the Site on July 29, 2003. The Restrictive Covenant imposes the following limitations:

**Section 1:** No groundwater may be taken for any use from the property.

**Section 2:** Any activity on the property that may interfere with the integrity of the remedial action and continued protection of human health and the environment is prohibited.

**Section 3:** Any activity on the Property that may result in the release or exposure to the environment of groundwater containing a hazardous substance that remains on the Property as part of the Remedial Action, or create a new exposure pathway, is prohibited without prior written approval from Ecology.

**Section 4:** The owner of the property must give thirty (30) day advance written notice to Ecology of the owner's intent to convey any interest in the Property. No conveyance of title, easement, lease, or other interest in the Property shall be consummated by the owner without adequate and complete provision for continued monitoring, operation, and maintenance of the Remedial Action.

**Section 5:** The owner must restrict leases to uses and activities consistent with the Restrictive Covenant and notify all lessees of the restrictions on the use of the Property.

**Section 6:** The Owner must notify and obtain approval from Ecology prior to any use of the Property that may be inconsistent with the terms of this Restrictive Covenant. Ecology may approve any inconsistent use only after public notice and comment.

**Section 7:** The Owner shall allow authorized representatives of Ecology the right to enter the Property at reasonable times for the purpose of evaluating the Remedial Action, to take samples, to inspect remedial actions conducted at the Property, and to inspect records that are related to the Remedial Action.

**Section 8:** The Owner of the Property reserves the right under WAC 173-340-440 to record an instrument that provides that this Restrictive Covenant shall no longer limit use of the Property or be of any further force of effect. However, such an instrument may be recorded only if Ecology, after public notice and opportunity for comment, concurs.

The Restrictive Covenant is available as Appendix 6.5.



## **3.0 FIVE-YEAR REVIEW**

### **3.1 Effectiveness of completed cleanup actions**

Cleanup actions at the Site were intended to eliminate human exposure to contaminated soils and groundwater. The exposure pathway to any remaining residual contaminated soils (ingestion, direct contact) has been reduced by the presence of asphalt surface and buildings on the Site, as well as the excavation conducted during the initial cleanup. Property restrictions imposed by a Restrictive Covenant were used to close this pathway.

The Site visit conducted on May 17, 2017 showed no indications of Site surface integrity being compromised, no signs of undocumented Site excavation or disturbance activities, and no visual signs of possible disturbance of the asphalt surface. All asphalt and concrete surfaces were in excellent condition.

The groundwater with TPH-O, cadmium, and lead concentrations higher than MTCA Method A cleanup levels may still be present at the Site. The deed restriction, structures and asphalt surface prevent human exposure to soil and groundwater contamination by ingestion and direct contact.

The remedy implemented for this site remains protective of human health and the environment.

### **3.2 New scientific information for individual hazardous substances for mixtures present at the site.**

There is no new relevant scientific information for the petroleum contaminants related to the Site.

### **3.3 New applicable state and federal laws for hazardous substances present at the Site**

This cleanup is governed by Chapter 173-340 WAC (1996 ed.). This regulation was amended in 2001. Although TPH cleanup levels changed as a result of this modification, Site cleanup levels will not change. WAC 173-340-702(12) (c) [2001 ed.] provides that,

“A release cleaned up under the cleanup levels determined in (a) or (b) of this subsection shall not be subject to further cleanup action due solely to subsequent amendments to the provision in this chapter on cleanup levels, unless the department determines, on a case-by-case basis, that the previous cleanup action is no longer sufficiently protective of human health and the environment.”

---

Although cleanup levels changed for lead and petroleum hydrocarbons as a result of modifications to MTCA in 2001, contamination remains at the Site above MTCA Method A cleanup levels and the cleanup action is still protective of human health and the environment.

### **3.4 Current and projected site use**

The Site is currently used for commercial purposes. There have been no changes in current or projected future site or resource uses.

### **3.5 Availability and practicability of higher preference technologies**

The remedy implemented included containment of hazardous substances and it continues to be protective of human health and the environment. While higher preference cleanup technologies may be available, they are still not practicable at this Site.

### **3.6 Availability of improved analytical techniques to evaluate compliance with cleanup levels.**

The analytical methods used at the time of the remedial action were capable of detection below MTCA Method A cleanup levels. The presence of improved analytical techniques would not effect decisions or recommendations made for the Site.

## **4.0 CONCLUSIONS**

- The remedial action conducted at the Site appears to be protective of human health and the environment.
- Some TPH-O and cPAHs soil cleanup levels have not been met at the Site; however, under WAC 173-340-740(6) (f), the cleanup action is determined to comply with cleanup standards, since the long-term integrity of the containment system is ensured and the requirements for containment technologies in have been met.
- The groundwater cleanup levels for TPH-O, arsenic, cadmium, chromium and lead may not have been met at the Site. However, the Freighthouse and other areas in the vicinity have the City Water Supply and it is extremely low probability that the Site groundwater will be used for drinking water purposes.
- The Restrictive Covenant for the property is in place and will be effective in protecting public health from exposure to hazardous substances and protecting the integrity of the cleanup action.

Based on this review, Ecology has determined that the remedial actions conducted at the Site continue to be protective of human health and the environment. The requirements of the Restrictive Covenant are being satisfactorily followed and no additional remedial actions are required at this time. It is the property owner's responsibility to continue to inspect the Site to assure that the limitations of the Restrictive Covenant are being followed and no new exposure pathways are created at the Site.

### **4.1 Next Review**

The next review for the site will be scheduled five years from the date of this periodic review. In the event that additional cleanup actions or institutional controls are required, the next periodic review will be scheduled five years from the completion of those activities.

## **5.0 REFERENCES**

Shannon and Wilson, Inc. September 15, 2015. Phase II Environmental Site Assessment and Remedial Cost Estimate, Freighthouse Square, Tacoma, Washington.

Engineering Geosciences, Inc. 1993. Site Remediation Report – Freighthouse Square.

Ecology. 2003. No Further Action Letter.

Ecology. 2003. Restrictive Covenant.

Ecology. May 17, 2017 Site Visit.

## **6.0 APPENDICIES**

## 6.1 Vicinity Map

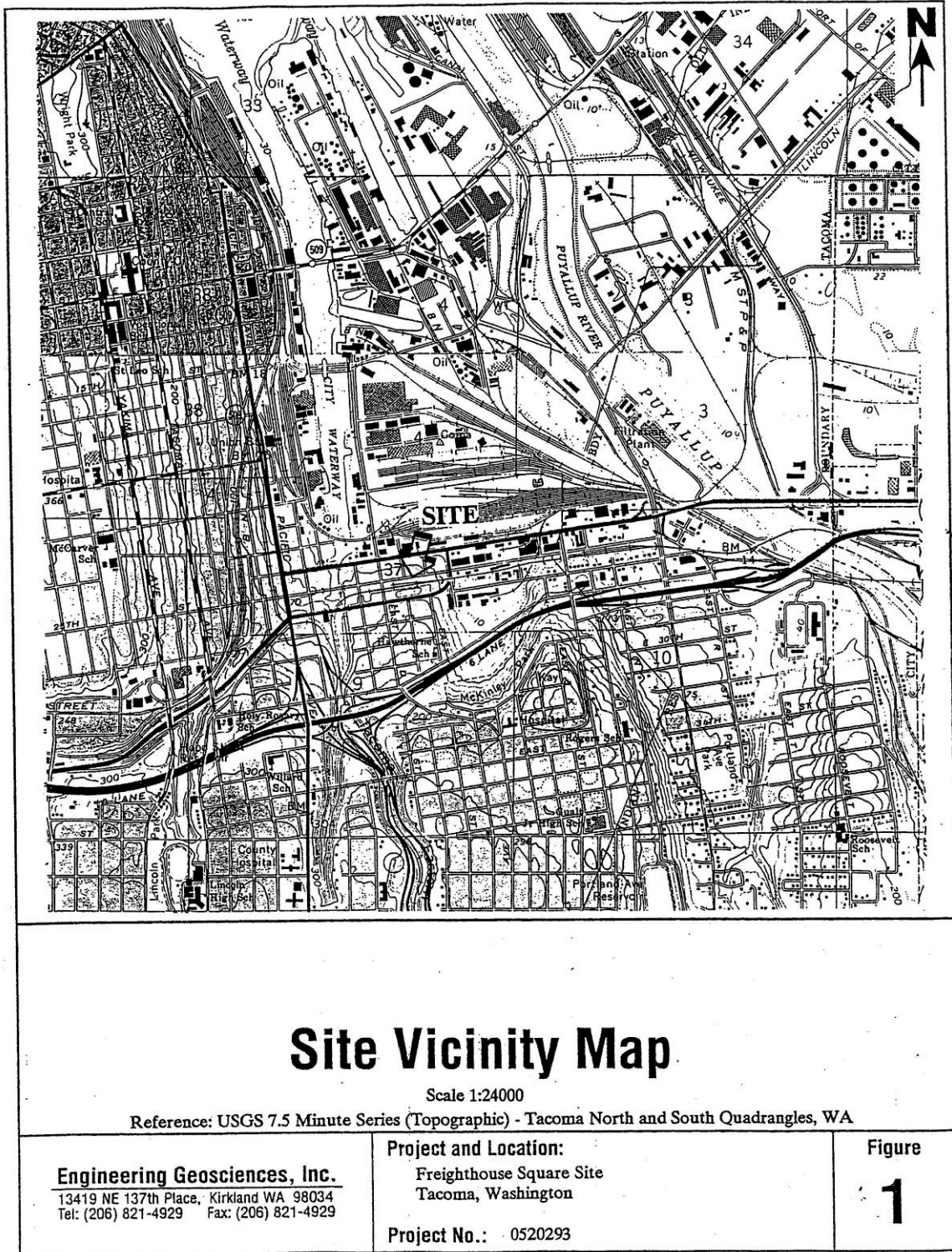

## 6.2 Site Plan

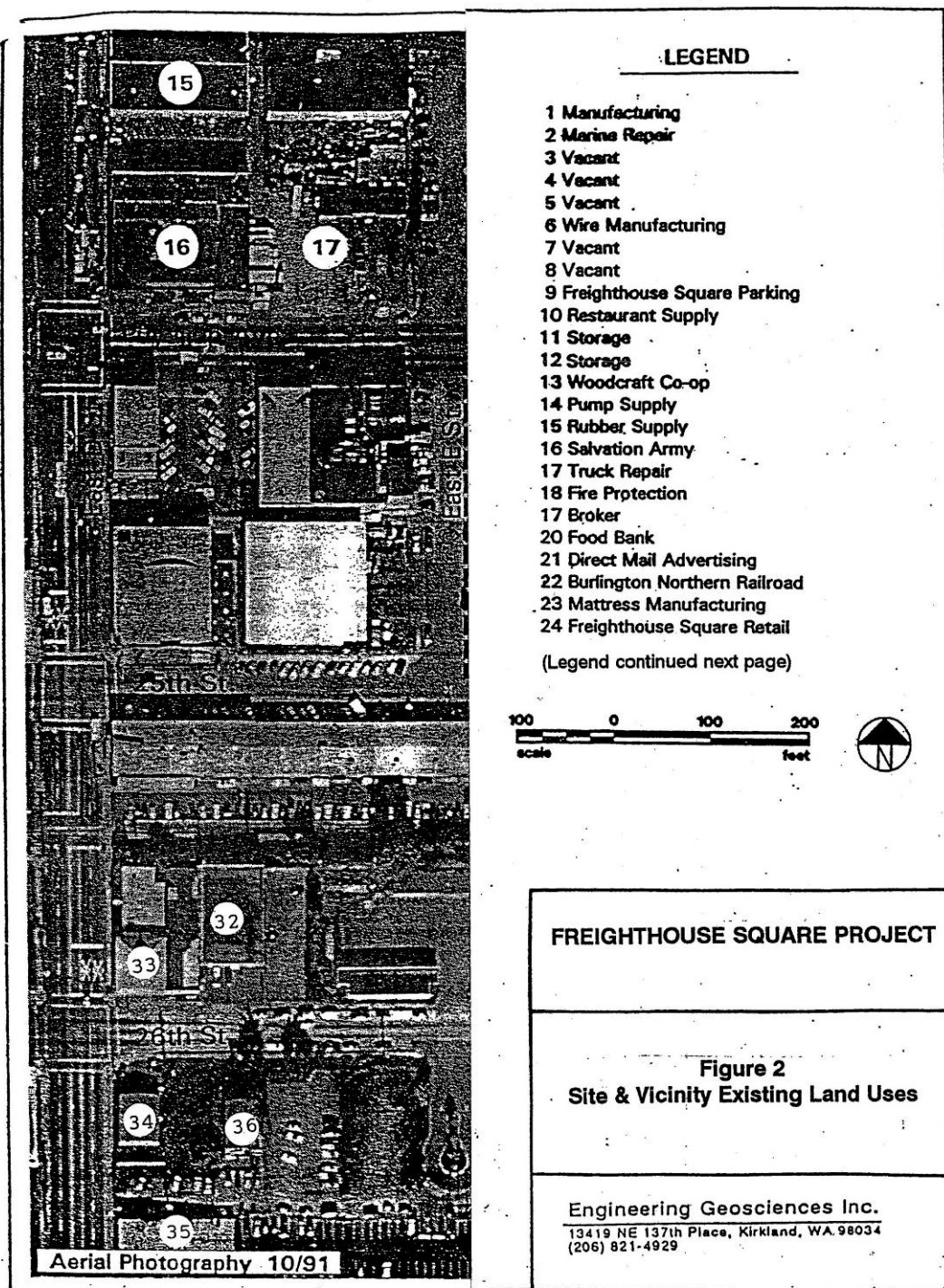

## 6.3 Sampling Locations and Remediation Areas

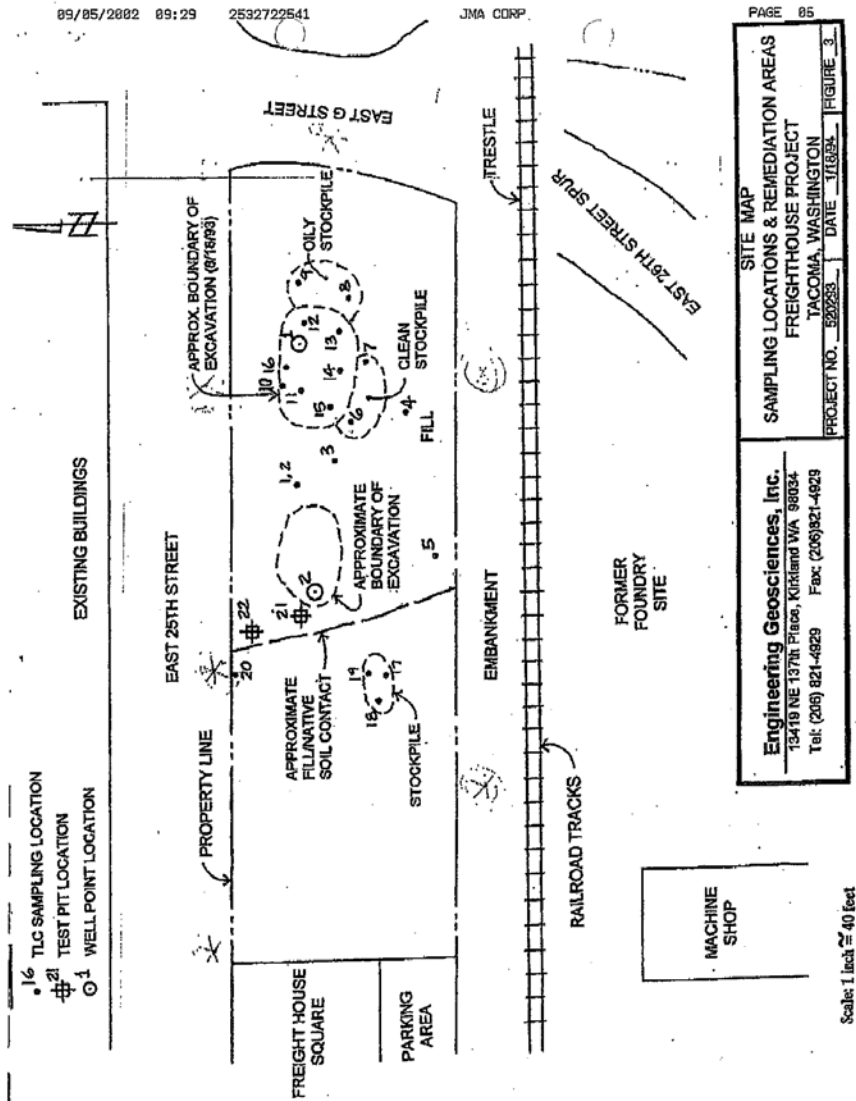



## 6.4 November 2014 and 2015 Phase II Environmental Site Assessment – Soil and Groundwater Sampling Locations and Results

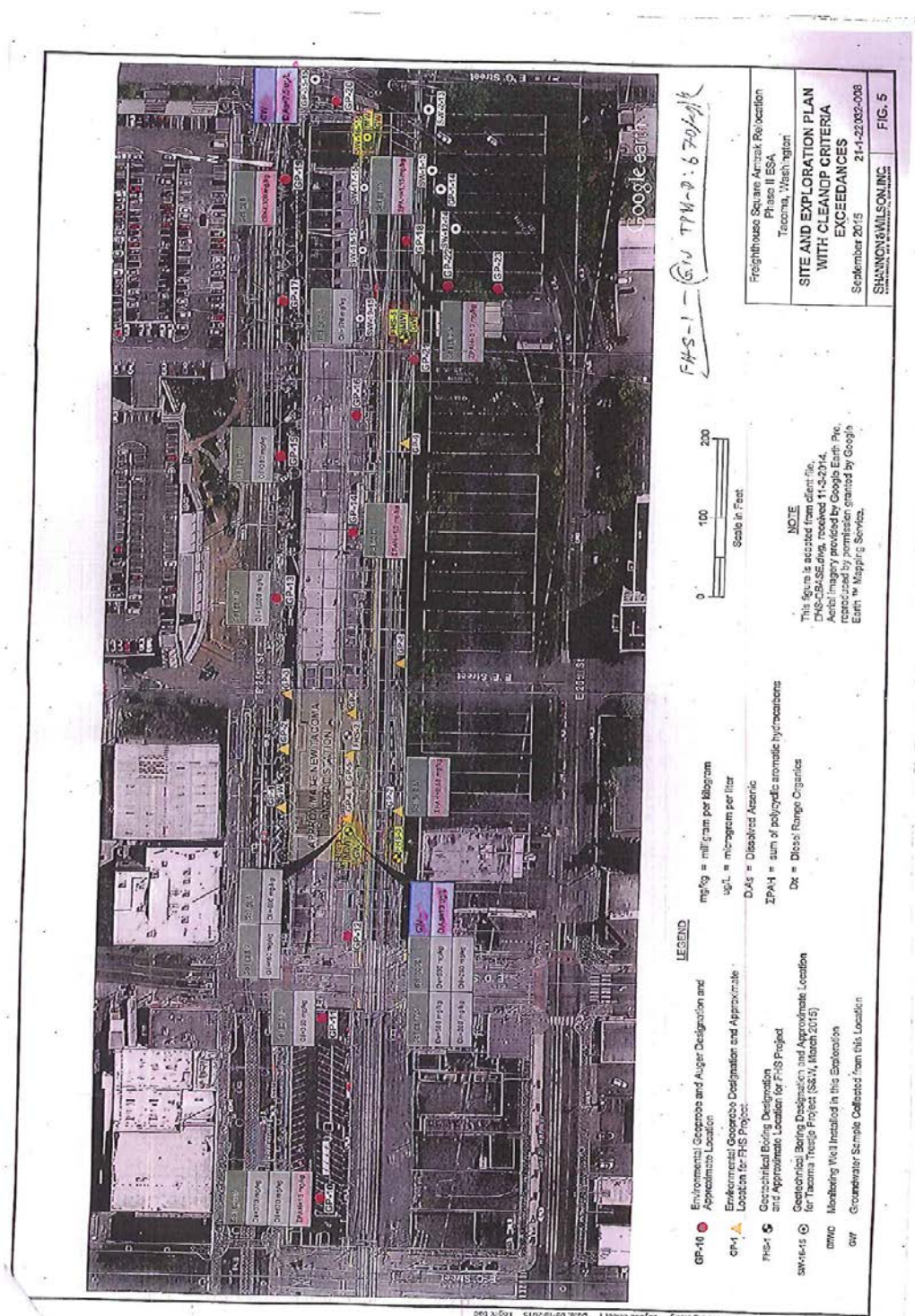



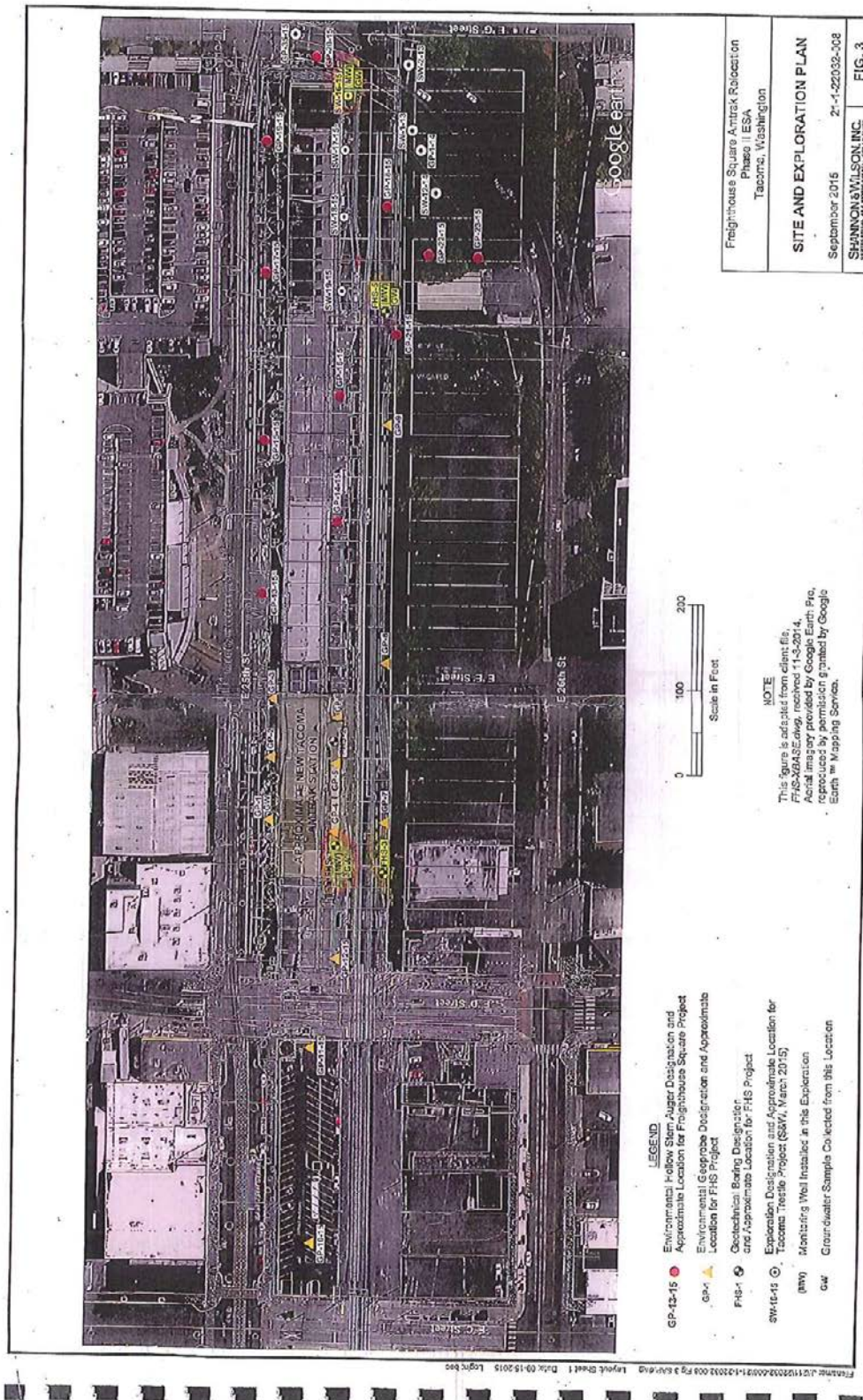

**TABLE 2**  
**SUMMARY OF SOIL ANALYTICAL RESULTS**  
**PARCEL #2075200011 (FHS PARKING LOT)**

Parameter	Method	Model Toxics Control Act Method A Soil Cleanup Levels (1996), milligrams per kilogram		Model Toxics Control Act Method B Soil Cleanup Levels (2015), milligrams per kilogram		GP-10 8/19/2015			GP-11 8/19/2015			(DUP) 13.5 feet
		Unrestricted	Industrial	Non-Cancer	Cancer	0.5 foot	6 feet	13 feet	0.5 foot	6 feet	13.5 feet	
Petroleum Hydrocarbons												
Gasoline-Range	NWTPH-Gx	100	100	NE	NE	< 7.9	--	< 4.6	< 4.9	--	< 5.3	< 4.4
Diesel-Range	NWTPH-Dx	200	200	NE	NE	370	< 33	< 29	< 28	< 30	< 32	< 28
Oil-Range	NWTPH-Dx	200	200	NE	NE	870	< 65	< 58	< 55	< 59	350	< 56
Metals												
Arsenic	EPA 6010C/7471B	20	200	24	0.67	< 13	--	< 12	< 11	--	< 13	< 11
Barium		NE	NE	16,000	NE	1100	--	60	75	--	150	55
Cadmium		2	10	80	NE	< 0.64	--	< 0.58	< 0.55	--	< 0.64	< 0.56
Chromium <sup>A</sup>		100	500	120,000	NE	18 (J)	--	46 (J)	41 (J)	--	150 (J)	26
Chromium <sup>A,B</sup> - TCLP	EPA 1311/ 6010C	--	--	--	--	--	--	--	--	--	0.020	--
Lead	EPA 6010C/ 7471B	250	1,000	NE	NE	8.0	--	< 5.8	28	--	< 6.4	< 5.6
Mercury	EPA 6010C/7471B	1	1	NE	NE	< 0.32	--	< 0.29	< 0.28	--	< 0.32	< 0.28
Selenium		NE	NE	400	NE	< 13	--	< 12	< 11	--	< 13	< 11
Silver		NE	NE	400	NE	< 1.3	--	< 1.2	< 1.1	--	< 1.3	< 1.1
Detected VOCs												
Acetone	EPA 8260C	NE	NE	72,000	NE	< 0.015	--	< 0.0052	< 0.0055	0.0078	0.021	< 0.0076
Carbon Disulfide		NE	NE	8,000	NE	0.0045	--	0.0025	< 0.00095	< 0.00068	0.0013	0.00096
2-Butanone		NE	NE	48,000	NE	< 0.0077	--	< 0.0031	< 0.0018	< 0.0034	< 0.0047	< 0.0038
All other VOCs		NA	NA	NA	NA	< RL	--	< RL	< RL	< RL	< RL	< RL
Detected SVOCs and/or PAHs												
Naphthalene	EPA 8270D SIM	NE	NE	1,600	NE	1.2	< 0.0087	< 0.0077	< 0.0074	--	< 0.0085	< 0.0075
2-Methylnaphthalene		NE	NE	320	NE	0.52	< 0.0087	< 0.0077	< 0.0074	--	< 0.0085	< 0.0075
1-Methylnaphthalene		NE	NE	5,600	34.48	0.40	< 0.0087	< 0.0077	< 0.0074	--	< 0.0085	< 0.0075
Acenaphthylene	EPA 8270D	NE	NE	NE	NE	0.99	< 0.0087	< 0.0077	< 0.0074	--	< 0.0085	< 0.0075
Acenaphthene		NE	NE	4,800	NE	0.12	< 0.0087	< 0.0077	< 0.0074	--	< 0.0085	< 0.0075
Dibenzofuran		NE	NE	80	NE	< 0.43	< 0.014	< 0.038	< 0.037	--	< 0.043	< 0.037
Fluorene	EPA 8270D SIM	NE	NE	3,200	NE	0.72	< 0.0087	< 0.0077	< 0.0074	--	< 0.0085	< 0.0075
Phenanthrene		NE	NE	NE	NE	9.2	< 0.0087	< 0.0077	0.0085	--	< 0.0085	< 0.0075
Anthracene		NE	NE	24,000	NE	2.4	< 0.0087	< 0.0077	< 0.0074	--	< 0.0085	< 0.0075
Fluoranthene	EPA 8270D SIM	NE	NE	3,200	NE	21	< 0.0087	< 0.0077	0.026	--	< 0.0085	< 0.0075
Pyrene		NE	NE	2,400	NE	24	0.0098	< 0.0077	0.029	--	0.011	< 0.0075
Benzo(a)anthracene		NE	NE	NE	1.37	11	< 0.0087	< 0.0077	0.020	--	< 0.0085	< 0.0075
Chrysene	EPA 8270D	NE	NE	NE	136.99	11	< 0.0087	< 0.0077	0.020	--	< 0.0085	< 0.0075
bis(2-Ethylhexyl)phthalate		NE	NE	1,600	71.43	< 0.43	< 0.044	< 0.038	< 0.037	--	< 0.043	< 0.037
Benzo(b)fluoranthene		NE	NE	NE	1.37	12	< 0.0087	< 0.0077	0.019	--	< 0.0085	< 0.0075
Benzo(k)fluoranthene	EPA 8270D SIM	NE	NE	NE	13.7	4.3	< 0.0087	< 0.0077	< 0.0074	--	< 0.0085	< 0.0075
Benzo(a)pyrene		NE	NE	NE	0.14	11	< 0.0087	< 0.0077	0.021	--	< 0.0085	< 0.0075
Indeno(1,2,3-cd)pyrene		NE	NE	NE	1.37	6.0	< 0.0087	< 0.0077	0.011	--	< 0.0085	< 0.0075
Dibenz(a,h)anthracene	EPA 8270D SIM	NE	NE	NE	0.14	1.7	< 0.0087	< 0.0077	< 0.0074	--	< 0.0085	< 0.0075
Benzo(g,h,i)perylene		NE	NE	NE	NE	6.6	< 0.0087	< 0.0077	0.010	--	< 0.0085	< 0.0075
All other SVOCs/PAHs		NA	NA	NA	NA	NE	< RL	< RL	< RL	--	< RL	< RL
TEP-adjusted cPAHs		1	20	NA	NA	15	< RL	< RL	0.028	--	< RL	< RL
PCBs												
All PCBs	EPA 8082A	1	10	1.6 to 5.6	0.50 to 14.29	< 0.064	< 0.050	--	--	--	< 0.064	--

Notes:

<sup>A</sup> Screening criteria are for chromium (III)

<sup>B</sup> Dangerous Waste criteria for chromium is 1 milligram per liter

-- = not analyzed

< = parameter not detected above the method detection limit shown

NE indicates parameter detected above method detection limits.

Shaded cell indicates parameter detected above one or more screening criterion.

cPAHs = carcinogenic polycyclic aromatic hydrocarbons

DUP = duplicate sample

EPA = US Environmental Protection Agency

J = estimated value following data quality review

NA = not applicable

NE = no criterion established

NWTPH-Dx = analysis for diesel- and oil-range hydrocarbons by method Northwest Total Petroleum Hydrocarbon Distillate

NWTPH-Gx = analysis for gasoline-range hydrocarbons by method Northwest Total Petroleum Hydrocarbon Gasoline

PAHs = polycyclic aromatic hydrocarbons

PCBs = polychlorinated biphenyls

RL = parameter not detected above their respective method detection limits

SIM = Selective Ion Monitoring

TCLP = analysis for Toxicity Characteristic Leaching Procedure compounds by U.S. Environmental Protection Agency method 1311/6910C

TEP = toxicity equivalence factor

VOCs = volatile organic compounds



SHANNON & WILSON, INC.

TABLE 3  
SUMMARY OF SOIL ANALYTICAL RESULTS  
PARCEL #075220011 (PHS WEST PARCEL)

Sample ID	Sample Description	Sample Depth	Sample Type	Sample Size	Sample Date	Sample Location	Sample Method	Sample Result	Sample Unit	Sample Comment	Sample Status	Sample Notes
001	Topsoil	0-10 cm	Soil	100 g	5/15/17	West Parcel	Hand	0.15	g/g	Lead	Pass	
002	Topsoil	0-10 cm	Soil	100 g	5/15/17	West Parcel	Hand	0.15	g/g	Cadmium	Pass	
003	Topsoil	0-10 cm	Soil	100 g	5/15/17	West Parcel	Hand	0.15	g/g	Copper	Pass	
004	Topsoil	0-10 cm	Soil	100 g	5/15/17	West Parcel	Hand	0.15	g/g	Chromium	Pass	
005	Topsoil	0-10 cm	Soil	100 g	5/15/17	West Parcel	Hand	0.15	g/g	Mercury	Pass	
006	Topsoil	0-10 cm	Soil	100 g	5/15/17	West Parcel	Hand	0.15	g/g	Barium	Pass	
007	Topsoil	0-10 cm	Soil	100 g	5/15/17	West Parcel	Hand	0.15	g/g	Strontium	Pass	
008	Topsoil	0-10 cm	Soil	100 g	5/15/17	West Parcel	Hand	0.15	g/g	Vanadium	Pass	
009	Topsoil	0-10 cm	Soil	100 g	5/15/17	West Parcel	Hand	0.15	g/g	Antimony	Pass	
010	Topsoil	0-10 cm	Soil	100 g	5/15/17	West Parcel	Hand	0.15	g/g	Thallium	Pass	
011	Topsoil	0-10 cm	Soil	100 g	5/15/17	West Parcel	Hand	0.15	g/g	Fluoride	Pass	
012	Topsoil	0-10 cm	Soil	100 g	5/15/17	West Parcel	Hand	0.15	g/g	Chloride	Pass	
013	Topsoil	0-10 cm	Soil	100 g	5/15/17	West Parcel	Hand	0.15	g/g	Sulfate	Pass	
014	Topsoil	0-10 cm	Soil	100 g	5/15/17	West Parcel	Hand	0.15	g/g	Phosphate	Pass	
015	Topsoil	0-10 cm	Soil	100 g	5/15/17	West Parcel	Hand	0.15	g/g	Nitrate	Pass	
016	Topsoil	0-10 cm	Soil	100 g	5/15/17	West Parcel	Hand	0.15	g/g	Ammonium	Pass	
017	Topsoil	0-10 cm	Soil	100 g	5/15/17	West Parcel	Hand	0.15	g/g	Calcium	Pass	
018	Topsoil	0-10 cm	Soil	100 g	5/15/17	West Parcel	Hand	0.15	g/g	Magnesium	Pass	
019	Topsoil	0-10 cm	Soil	100 g	5/15/17	West Parcel	Hand	0.15	g/g	Potassium	Pass	
020	Topsoil	0-10 cm	Soil	100 g	5/15/17	West Parcel	Hand	0.15	g/g	Sodium	Pass	
021	Topsoil	0-10 cm	Soil	100 g	5/15/17	West Parcel	Hand	0.15	g/g	Zinc	Pass	
022	Topsoil	0-10 cm	Soil	100 g	5/15/17	West Parcel	Hand	0.15	g/g	Aluminum	Pass	
023	Topsoil	0-10 cm	Soil	100 g	5/15/17	West Parcel	Hand	0.15	g/g	Iron	Pass	
024	Topsoil	0-10 cm	Soil	100 g	5/15/17	West Parcel	Hand	0.15	g/g	Manganese	Pass	
025	Topsoil	0-10 cm	Soil	100 g	5/15/17	West Parcel	Hand	0.15	g/g	Cobalt	Pass	
026	Topsoil	0-10 cm	Soil	100 g	5/15/17	West Parcel	Hand	0.15	g/g	Nickel	Pass	
027	Topsoil	0-10 cm	Soil	100 g	5/15/17	West Parcel	Hand	0.15	g/g	Silver	Pass	
028	Topsoil	0-10 cm	Soil	100 g	5/15/17	West Parcel	Hand	0.15	g/g	Platinum	Pass	
029	Topsoil	0-10 cm	Soil	100 g	5/15/17	West Parcel	Hand	0.15	g/g	Palladium	Pass	
030	Topsoil	0-10 cm	Soil	100 g	5/15/17	West Parcel	Hand	0.15	g/g	Rhodium	Pass	
031	Topsoil	0-10 cm	Soil	100 g	5/15/17	West Parcel	Hand	0.15	g/g	Ruthenium	Pass	
032	Topsoil	0-10 cm	Soil	100 g	5/15/17	West Parcel	Hand	0.15	g/g	Barium	Pass	
033	Topsoil	0-10 cm	Soil	100 g	5/15/17	West Parcel	Hand	0.15	g/g	Strontium	Pass	
034	Topsoil	0-10 cm	Soil	100 g	5/15/17	West Parcel	Hand	0.15	g/g	Vanadium	Pass	
035	Topsoil	0-10 cm	Soil	100 g	5/15/17	West Parcel	Hand	0.15	g/g	Antimony	Pass	
036	Topsoil	0-10 cm	Soil	100 g	5/15/17	West Parcel	Hand	0.15	g/g	Thallium	Pass	
037	Topsoil	0-10 cm	Soil	100 g	5/15/17	West Parcel	Hand	0.15	g/g	Fluoride	Pass	
038	Topsoil	0-10 cm	Soil	100 g	5/15/17	West Parcel	Hand	0.15	g/g	Chloride	Pass	
039	Topsoil	0-10 cm	Soil	100 g	5/15/17	West Parcel	Hand	0.15	g/g	Sulfate	Pass	
040	Topsoil	0-10 cm	Soil	100 g	5/15/17	West Parcel	Hand	0.15	g/g	Phosphate	Pass	
041	Topsoil	0-10 cm	Soil	100 g	5/15/17	West Parcel	Hand	0.15	g/g	Nitrate	Pass	
042	Topsoil	0-10 cm	Soil	100 g	5/15/17	West Parcel	Hand	0.15	g/g	Ammonium	Pass	
043	Topsoil	0-10 cm	Soil	100 g	5/15/17	West Parcel	Hand	0.15	g/g	Calcium	Pass	
044	Topsoil	0-10 cm	Soil	100 g	5/15/17	West Parcel	Hand	0.15	g/g	Magnesium	Pass	
045	Topsoil	0-10 cm	Soil	100 g	5/15/17	West Parcel	Hand	0.15	g/g	Potassium	Pass	
046	Topsoil	0-10 cm	Soil	100 g	5/15/17	West Parcel	Hand	0.15	g/g	Sodium	Pass	
047	Topsoil	0-10 cm	Soil	100 g	5/15/17	West Parcel	Hand	0.15	g/g	Zinc	Pass	
048	Topsoil	0-10 cm	Soil	100 g	5/15/17	West Parcel	Hand	0.15	g/g	Aluminum	Pass	
049	Topsoil	0-10 cm	Soil	100 g	5/15/17	West Parcel	Hand	0.15	g/g	Iron	Pass	
050	Topsoil	0-10 cm	Soil	100 g	5/15/17	West Parcel	Hand	0.15	g/g	Manganese	Pass	
051	Topsoil	0-10 cm	Soil	100 g	5/15/17	West Parcel	Hand	0.15	g/g	Cobalt	Pass	
052	Topsoil	0-10 cm	Soil	100 g	5/15/17	West Parcel	Hand	0.15	g/g	Nickel	Pass	
053	Topsoil	0-10 cm	Soil	100 g	5/15/17	West Parcel	Hand	0.15	g/g	Silver	Pass	
054	Topsoil	0-10 cm	Soil	100 g	5/15/17	West Parcel	Hand	0.15	g/g	Platinum	Pass	
055	Topsoil	0-10 cm	Soil	100 g	5/15/17	West Parcel	Hand	0.15	g/g	Palladium	Pass	
056	Topsoil	0-10 cm	Soil	100 g	5/15/17	West Parcel	Hand	0.15	g/g	Rhodium	Pass	
057	Topsoil	0-10 cm	Soil	100 g	5/15/17	West Parcel	Hand	0.15	g/g	Ruthenium	Pass	
058	Topsoil	0-10 cm	Soil	100 g	5/15/17	West Parcel	Hand	0.15	g/g	Barium	Pass	
059	Topsoil	0-10 cm	Soil	100 g	5/15/17	West Parcel	Hand	0.15	g/g	Strontium	Pass	
060	Topsoil	0-10 cm	Soil	100 g	5/15/17	West Parcel	Hand	0.15	g/g	Vanadium	Pass	
061	Topsoil	0-10 cm	Soil	100 g	5/15/17	West Parcel	Hand	0.15	g/g	Antimony	Pass	
062	Topsoil	0-10 cm	Soil	100 g	5/15/17	West Parcel	Hand	0.15	g/g	Thallium	Pass	
063	Topsoil	0-10 cm	Soil	100 g	5/15/17	West Parcel	Hand	0.15	g/g	Fluoride	Pass	
064	Topsoil	0-10 cm	Soil	100 g	5/15/17	West Parcel	Hand	0.15	g/g	Chloride	Pass	
065	Topsoil	0-10 cm	Soil	100 g	5/15/17	West Parcel	Hand	0.15	g/g	Sulfate	Pass	
066	Topsoil	0-10 cm	Soil	100 g	5/15/17	West Parcel	Hand	0.15	g/g	Phosphate	Pass	
067	Topsoil	0-10 cm	Soil	100 g	5/15/17	West Parcel	Hand	0.15	g/g	Nitrate	Pass	
068	Topsoil	0-10 cm	Soil	100 g	5/15/17	West Parcel	Hand	0.15	g/g	Ammonium	Pass	
069	Topsoil	0-10 cm	Soil	100 g	5/15/17	West Parcel	Hand	0.15	g/g	Calcium	Pass	
070	Topsoil	0-10 cm	Soil	100 g	5/15/17	West Parcel	Hand	0.15	g/g	Magnesium	Pass	
071	Topsoil	0-10 cm	Soil	100 g	5/15/17	West Parcel	Hand	0.15	g/g	Potassium	Pass	
072	Topsoil	0-10 cm	Soil	100 g	5/15/17	West Parcel	Hand	0.15	g/g	Sodium	Pass	
073	Topsoil	0-10 cm	Soil	100 g	5/15/17	West Parcel	Hand	0.15	g/g	Zinc	Pass	
074	Topsoil	0-10 cm	Soil	100 g	5/15/17	West Parcel	Hand	0.15	g/g	Aluminum	Pass	
075	Topsoil	0-10 cm	Soil	100 g	5/15/17	West Parcel	Hand	0.15	g/g	Iron	Pass	
076	Topsoil	0-10 cm	Soil	100 g	5/15/17	West Parcel	Hand	0.15	g/g	Manganese	Pass	
077	Topsoil	0-10 cm	Soil	100 g	5/15/17	West Parcel	Hand	0.15	g/g	Cobalt	Pass	
078	Topsoil	0-10 cm	Soil	100 g	5/15/17	West Parcel	Hand	0.15	g/g	Nickel	Pass	
079	Topsoil	0-10 cm	Soil	100 g	5/15/17	West Parcel	Hand	0.15	g/g	Silver	Pass	
080	Topsoil	0-10 cm	Soil	100 g	5/15/17	West Parcel	Hand	0.15	g/g	Platinum	Pass	
081	Topsoil	0-10 cm	Soil	100 g	5/15/17	West Parcel	Hand	0.15	g/g	Palladium	Pass	
082	Topsoil	0-10 cm	Soil	100 g	5/15/17	West Parcel	Hand	0.15	g/g	Rhodium	Pass	
083	Topsoil	0-10 cm	Soil	100 g	5/15/17	West Parcel	Hand	0.15	g/g	Ruthenium	Pass	
084	Topsoil	0-10 cm	Soil	100 g	5/15/17	West Parcel	Hand	0.15	g/g	Barium	Pass	
085	Topsoil	0-10 cm	Soil	100 g	5/15/17	West Parcel	Hand	0.15	g/g	Strontium	Pass	
086	Topsoil	0-10 cm	Soil	100 g	5/15/17	West Parcel	Hand	0.15	g/g	Vanadium	Pass	
087	Topsoil	0-10 cm	Soil	100 g	5/15/17	West Parcel	Hand	0.15	g/g	Antimony	Pass	
088	Topsoil	0-10 cm	Soil	100 g	5/15/17	West Parcel	Hand	0.15	g/g	Thallium	Pass	
089	Topsoil	0-10 cm	Soil	100 g	5/15/17	West Parcel	Hand	0.15	g/g	Fluoride	Pass	
090	Topsoil	0-10 cm	Soil	100 g	5/15/17	West Parcel	Hand	0.15	g/g	Chloride	Pass	
091	Topsoil	0-10 cm	Soil	100 g	5/15/17	West Parcel	Hand	0.15	g/g	Sulfate	Pass	
092	Topsoil	0-10 cm	Soil	100 g	5/15/17	West Parcel	Hand	0.15	g/g	Phosphate	Pass	
093	Topsoil	0-10 cm	Soil	100 g	5/15/17	West Parcel	Hand	0.15	g/g	Nitrate	Pass	
094	Topsoil	0-10 cm	Soil	100 g	5/15/17	West Parcel	Hand	0.15	g/g	Ammonium	Pass	
095	Topsoil	0-10 cm	Soil	100 g	5/15/17	West Parcel	Hand	0.15	g/g	Calcium	Pass	
096	Topsoil	0-10 cm	Soil	100 g	5/15/17	West Parcel	Hand	0.15	g/g	Magnesium	Pass	
097	Topsoil	0-10 cm	Soil	100 g	5/15/17	West Parcel	Hand	0.15	g/g	Potassium	Pass	
098	Topsoil	0-10 cm	Soil	100 g	5/15/17	West Parcel	Hand	0.15	g/g	Sodium	Pass	
099	Topsoil	0-10 cm	Soil	100 g	5/15/17	West Parcel	Hand	0.15	g/g	Zinc	Pass	
100	Topsoil	0-10 cm	Soil	100 g	5/15/17	West Parcel	Hand	0.15	g/g	Aluminum	Pass	

21-22002-008









## 6.5 Restrictive Covenant

Return Address:  
MR. BOB DEIGERT  
FREIGHTHOUSE SQUARE MANAGEMENT, LLC  
9138 189<sup>TH</sup> PLACE SOUTHWEST  
EDMONDS, WA 98026

200307240850 16 PGS  
07-24-2003 03:36pm \$34.00  
PIERCE COUNTY, WASHINGTON

**RECEIVED**  
JUL 29 2003  
Washington State  
Department of Ecology

Document Title: RESTRICTIVE COVENANT	<b>TICOR</b> <i>W-C</i>
Grantor(s): WINDERS FREIGHTHOUSE LLC, TACOMA FREIGHTHOUSE LLC, WORLD FAMOUS FREIGHTHOUSE LLC, BARRY'S FREIGHTHOUSE LLC, BEA'S FREIGHTHOUSE LLC; FREIGHTHOUSE SQUARE ____ Additional Names on Page ____ of Document.	<b>THIS IS A TRUE AND CERTIFIED COPY OF THE ORIGINAL.</b> BY: <i>[Signature]</i>
Grantee(s): THE PUBLIC ____ Additional Names on Page ____ of Document.	<i>[Circular Notary Seal: HUNG T. NGUYEN, COMMISSION EXPIRES 07-12-07, STATE OF WASHINGTON]</i>
Legal Description (abbreviated: i.e. lot, block, plat or section, township range) PORTION OF BLOCK 7520, 7522, 7524, 7526, TACOMA LAND COMPANY'S FIRST ADD- TO TACOMA ____ Legal Description is on Page ____ of Document.	
Reference Number(s) of Documents Assigned or Released: N/A ____ Additional Reference Numbers on Page ____ of Document.	
Assessor's Property Tax Parcel/Account Number: 2075240013, 0011, 2075220011, 2075200011, 0015	
The Auditor/Recorder will rely on the information provided on this cover sheet. The staff will not read the document to verify the accuracy or completeness of the indexing information provided herein.	

84



I am requesting an emergency nonstandard recording for an additional fee as provided in RCW 36.18.010. I understand that the recording processing requirements may cover up or otherwise obscure some part of the text of the original document.

*Ellena Nevish*

Signature of Requesting Party (Required for non-standard recordings only)  
Gpcovst.doc rev 4/02

MODEL RESTRICTIVE COVENANT  
Page 1

RESTRICTIVE COVENANT

WINDERS FREIGHTHOUSE LLC, TACOMA FREIGHTHOUSE LLC, WORLD FAMOUS  
FREIGHTHOUSE LLC, BARRY'S FREIGHTHOUSE LLC, BEA'S FREIGHTHOUSE  
LLC; Freighthouse Square

This Declaration of Restrictive Covenant is made pursuant to RCW 70.105D.030(1)(f) and (g) and WAC 173-340-440 by K & M Commercial Development, its successors and assigns, and the State of Washington Department of Ecology, its successors and assigns (hereafter "Ecology").

An independent remedial action (hereafter "Remedial Action") occurred at the property that is the subject of this Restrictive Covenant. The Remedial Action conducted at the property is described in the following document[s]:

- Engineering Geosciences Inc., Site Remediation Report Freighthouse Square, January, 7, 1994.
- Archived Freighthouse Square file, and associated correspondence

These documents are on file at Ecology's Southwest Regional Office. They can be reviewed by appointment by calling the Southwest Regional Office Resource Person at (360) 407-6365.

This Restrictive Covenant is required because the Remedial Action resulted in residual concentrations of Total Petroleum Hydrocarbons as diesel and heavy oil, and lead and cadmium which

07/21/03  
mdl\_rc.doc

MODEL RESTRICTIVE COVENANT  
Page 2

exceed the Model Toxics Control Act Method A Residential Cleanup Level(s) for Groundwater established under WAC 173-340-720.

The undersigned, Winders Freighthouse LLC, Tacoma Freighthouse LLC, Worldfamous Freighthouse LLC, Barry's Freighthouse LLC, and Bea's Freighthouse LLC, are the fee owners of real property (hereafter "Property") in the County of Pierce, State of Washington, that is subject to this Restrictive Covenant. The Property is legally described IN ATTACHMENT A OF THIS RESTRICTIVE COVENANT AND MADE A PART HEREOF BY REFERENCE.

Winders Freighthouse LLC, Tacoma Freighthouse LLC, Worldfamous Freighthouse LLC, Barry's Freighthouse LLC, and Bea's Freighthouse LLC, make the following declaration as to limitations, restrictions, and uses to which the Property may be put and specifies that such declarations shall constitute covenants to run with the land, as provided by law and shall be binding on all parties and all persons claiming under them, including all current and future owners of any portion of or interest in the Property (hereafter "Owner").

Section 1. No groundwater may be taken for any use from the Property.

Section 2. Any activity on the Property that may interfere with the integrity of the Remedial Action and continued protection of

07/21/03  
modl\_rc.doc

MODEL RESTRICTIVE COVENANT  
Page 3

human health and the environment is prohibited.

Section 3. Any activity on the Property that may result in the release or exposure to the environment of groundwater containing a hazardous substance that remains on the Property as part of the Remedial Action, or create a new exposure pathway, is prohibited without prior written approval from Ecology.

Section 4. The Owner of the property must give thirty (30) day advance written notice to Ecology of the Owner's intent to convey any interest in the Property. No conveyance of title, easement, lease, or other interest in the Property shall be consummated by the Owner without adequate and complete provision for continued monitoring, operation, and maintenance of the Remedial Action.

Section 5. The Owner must restrict leases to uses and activities consistent with the Restrictive Covenant and notify all lessees of the restrictions on the use of the Property.

Section 6. The Owner must notify and obtain approval from Ecology prior to any use of the Property that is inconsistent with the terms of this Restrictive Covenant. Ecology may approve any inconsistent use only after public notice and comment.

Section 7. The Owner shall allow authorized representatives of Ecology the right to enter the Property at reasonable times for the purpose of evaluating the Remedial Action; to take samples,

07/21/03  
modl\_rc.doc

MODEL RESTRICTIVE COVENANT

Page 4

to inspect remedial actions conducted at the property, and to inspect records that are related to the Remedial Action.

Section 8. The Owner of the Property reserves the right under WAC 173-340-440 to record an instrument that provides that this Restrictive Covenant shall no longer limit use of the Property or be of any further force or effect. However, such an instrument may be recorded only if Ecology, after public notice and opportunity for comment, concurs.

---

[NAME OF PROPERTY OWNER AND DATE SIGNED]

07/21/03  
modl\_rc.doc

*Legal for Freighthouse Square.*  
COMMONWEALTH TITLE COMPANY

STANDARD OWNER POLICY  
SCHEDULE A

Policy No.: 3013262

(Continued)

LEGAL DESCRIPTION

PARCEL A:

THE NORTHERLY 77 FEET OF THE EASTERLY 135 FEET OF BLOCK 7524, AND THE NORTHERLY 77 FEET OF BLOCK 7526, TACOMA LAND COMPANY'S FIRST ADDITION TO TACOMA, ACCORDING TO PLAT FILED FOR RECORD JULY 7, 1884 IN THE OFFICE OF THE COUNTY AUDITOR, IN PIERCE COUNTY, WASHINGTON.

TOGETHER WITH THAT PORTION OF EAST "F" STREET, VACATED BY CITY OF TACOMA ORDINANCE NOS. 3128 AND 23949, ADJOINING THE NORTHERLY 77 FEET OF SAID BLOCKS 7524 AND 7526.

EXCEPT FROM SAID BLOCK 7526, THAT PORTION APPROPRIATED BY THE CITY OF TACOMA FOR THE CONSTRUCTION AND MAINTENANCE OF A PUBLIC STREET, BY DECREE ENTERED SEPTEMBER 12, 1928 IN PIERCE COUNTY SUPERIOR COURT CAUSE NO. 61287, AND BEING DESCRIBED AS FOLLOWS:

BEGINNING AT THE SOUTHEAST CORNER OF SAID BLOCK 7526; THENCE NORTHERLY ALONG THE EAST LINE OF SAID BLOCK, A DISTANCE OF 119.73 FEET; THENCE IN A SOUTHWESTERLY DIRECTION ON A CURVE TO THE RIGHT HAVING A RADIUS OF 538 FEET AND CONCENTRIC WITH A CURVE HAVING A RADIUS OF 573 FEET, WHOSE TANGENT AT A POINT ON THE CENTER LINE OF EAST "G" STREET, 36.80 FEET SOUTH OF THE CENTER LINE OF EAST 25TH STREET, MAKING AN ANGLE OF 14°22' TO THE SOUTHWEST WITH THE SAID CENTER LINE OF EAST "G" STREET, A DISTANCE OF 130.04 FEET TO A POINT OF COMPOUND CURVE; THENCE CONTINUING SOUTHWESTERLY ON A CURVE TO THE RIGHT HAVING A RADIUS OF 283 FEET, A DISTANCE OF 1.32 FEET TO A POINT ON THE SOUTH LINE OF SAID BLOCK 7526, SAID POINT BEING 2.84 FEET WEST OF THE SOUTHEAST CORNER OF LOT 10, IN SAID BLOCK 7526; THENCE EASTERLY ALONG THE SOUTH LINE OF SAID BLOCK, A DISTANCE OF 52.84 FEET TO THE PLACE OF BEGINNING.

EXCEPT ALL TRACK MATERIAL, INCLUDING, BUT NOT LIMITED TO RAILS, FASTENINGS, ANGLE BARS, TIE PLATES, TIES AND OTHER IMPROVEMENTS, AS EXCEPTED IN DEED FROM RICHARD B. OGILVIE AS TRUSTEE OF THE PROPERTY OF CHICAGO, MILWAUKEE, ST. PAUL AND PACIFIC RAILROAD COMPANY AND RECORDED UNDER AUDITOR'S NO. 8109020105.

PARCEL B:

THE NORTHERLY 77 FEET OF BLOCK 7522 AND 7524 OF TACOMA LAND COMPANY'S FIRST ADDITION TO TACOMA, W.T., ACCORDING TO PLAT FILED FOR RECORD JULY 7, 1884 IN THE OFFICE OF THE COUNTY AUDITOR, IN PIERCE COUNTY, WASHINGTON.

EXCEPT THE EAST 135 FEET OF SAID BLOCK 7524.

TOGETHER WITH THAT PORTION OF EAST "E" STREET ADJOINING SAID NORTHERLY 77 FEET OF BLOCKS 7522 AND 7524, VACATED BY CITY OF TACOMA ORDINANCE NOS. 3127 AND 23949.

ALTAOPAS/RDA/999

COMMONWEALTH TITLE COMPANY

STANDARD OWNER POLICY  
SCHEDULE A

Policy No.: 3013262

(Continued)

LEGAL DESCRIPTION

PARCEL C:

THE NORTHERLY 77 FEET OF BLOCK 7520, TACOMA LAND COMPANY'S FIRST ADDITION, ACCORDING TO PLAT FILED FOR RECORD JULY 7, 1884 IN THE OFFICE OF THE COUNTY AUDITOR, IN PIERCE COUNTY, WASHINGTON.

PARCEL D:

THE SOUTH 20 FEET OF THE NORTH 97 FEET OF BLOCKS 7520, 7522, 7524 AND 7526, IN THE TACOMA LAND COMPANY'S FIRST ADDITION TO TACOMA, W.T., ACCORDING TO PLAT FILED FOR RECORD JULY 7, 1884, IN THE OFFICE OF THE COUNTY AUDITOR, IN PIERCE COUNTY, WASHINGTON.

EXCEPT THAT PORTION OF LOTS 11 AND 12, SAID BLOCK 7526 TAKEN BY THE CITY OF TACOMA BY DECREE OF APPROPRIATION ENTERED SEPTEMBER 12, 1928 IN PIERCE COUNTY SUPERIOR COURT CASE NO. 61287.

ALTAOPAS/UDA/0999

Notorized signature attachment to Dept of Ecology Restrictive Covenant:

Signed *Glen R. Winders, Trustee* Date 7/22/03  
Winders Freighthouse, LLC  
Glen R. & Elizabeth L. Winders Trust, Member  
By Glen R. Winders, Trustee

STATE OF WASHINGTON     )  
  ) ss.  
COUNTY OF KITSAP     )

I hereby certify that I know or have satisfactory evidence that GLEN R. WINDERS is the person who appeared before me and said person acknowledges that he signed this instrument and acknowledges it to be his free and voluntary act for purposes mentioned in this instrument.

Dated July 22, 2003

*Antonia M. Fahey*  
Notary Public in and for the State of Washington  
Residing in Kingston  
My appointment expires: 4-02-06





RESTRICTIVE COVENANT  
Page 4

may be recorded only if Ecology, after public notice and  
opportunity for comment, concurs.

John L. Griffith sole member Barry's Freighthouse, LLC  
[NAME OF PROPERTY OWNER AND DATE SIGNED]

Patricia Griffith SOLE MEMBER Barry's Freighthouse, LLC  
[NAME OF PROPERTY OWNER AND DATE SIGNED]

\_\_\_\_\_  
[NAME OF PROPERTY OWNER AND DATE SIGNED]

03/04/03

NOTARIAL ACKNOWLEDGMENT

STATE OF WASHINGTON )  
 ) ss.  
County of KING )

On this 22nd day of July 2003, before me personally appeared Beatrice A. Griffiths and \_\_\_\_\_  
\_\_\_\_\_ to me known to be the SOLE MEMBER  
OF Bea's Freighthouse, LLC, that executed the within and foregoing  
instrument, and acknowledged said instrument to be the free and voluntary act and deed of said LLC, for  
the uses and purposes therein mentioned, and on oath stated that they were authorized to execute said  
instrument.

IN WITNESS WHEREOF, I have hereunto set my hand and affixed my official seal the day and year first above  
written.

Sue Butka

(Notarial Seal) Notary Public in and for the State of Washington

residing at Ring A.

June 19, 2005

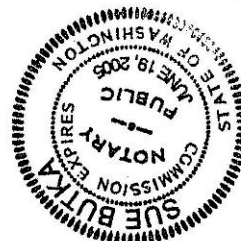

NOTARIAL ACKNOWLEDGMENT

STATE OF WASHINGTON )  
County of KING ) ss.

On this 22nd day of JULY 2003, before me personally appeared  
JOHN E. CRIFEITHS and \_\_\_\_\_  
to me known to be the SOLE MEMBER OF  
BARRY'S FREIGHT HOUSE, LLC, that executed the within and foregoing  
instrument, and acknowledged said instrument to be the free and voluntary act and deed of said LLC, for  
the uses and purposes therein mentioned, and on oath stated that they were authorized to execute said  
instrument.

IN WITNESS WHEREOF, I have hereunto set my hand and affixed my official seal the day and year first above  
written.

Sue Butka  
(Notarial Seal) Notary Public in and for the State of Washington

residing at Kingd

June 19, 2005



MODEL RESTRICTIVE COVENANT

Page 5

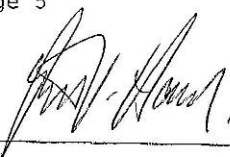
 WORLD FAMOUS FREIGHT HOUSE  
SOLE MEMBER 7/21/03

[NAME OF PROPERTY OWNER AND DATE SIGNED]

 TACOMA FREIGHT HOUSE LLC  
SOLE MEMBER 7/24/03

[NAME OF PROPERTY OWNER AND DATE SIGNED]

[NAME OF PROPERTY OWNER AND DATE SIGNED]

[NAME OF PROPERTY OWNER AND DATE SIGNED]

[NOTE: The Property Owners must have this Restrictive Covenant  
notarized.]

07/21/03  
modl\_rc.doc

Notary Page

State of Washington }  
County of Snohomish } ss.

On this 21<sup>st</sup> day of July, 2003, before me, the undersigned, a Notary Public in and for the State of Washington, duly commissioned and sworn, personally appeared Robert V. Hardy, to me known to be the Sole Member of World Famous Freighthouse LLC, the Limited Liability Corporation that executed the foregoing instrument, and acknowledged the said instrument to be the free and voluntary act and deed of said corporation, for the uses and purposes therein mentioned and on oath stated that they were authorized to execute the said instrument and that the seal affixed is the corporate seal of said corporation.

WITNESS my hand and official seal hereto affixed the day and year first above written.

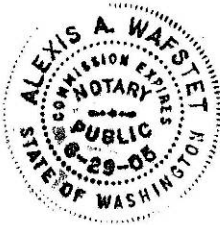

Alexis A. Wafstet  
Notary Public in and for the State of Washington  
Residing at Everett  
My appointment expires: June 29, 2005

STATE OF WASHINGTON

COUNTY OF PIERCE

I certify that I know or have satisfactory evidence that ROBERT DEIGERT, SOLE MEMBER OF  
THE TACOMA FREIGHTHOUSE LLC the person who appeared before me, and said person  
acknowledged that HE signed this instrument, on

oath stated that HE IS authorized to execute the instrument and acknowledged it as  
SOLE MEMBER OF THE TACOMA FREIGHTHOUSE SQUARE LLC to be the free and voluntary act of  
such party for the uses and purposes mentioned in the instrument.

DATED: July 24<sup>th</sup> 2003

Notary Public

HUNG THE NGUYEN

My appointment expires 7-12-2007

A-7 -Representative Capacity



## 6.6 Photo log

**Photo 1: Southwest Corner of Freighthouse Square Building – from the Southwest**



**Photo 2: North Side of Freighthouse Square Building- from the Northeast**





**Photo 3: South Side of Building, Train Tracks and Platform - from the East**



**Photo 4: South Side of Building, New Amtrak Train Station Construction—from the Southwest**





**Photo 5: North Side of Building, New Amtrak Train Station Construction—from the Southeast**



**Photo 6: North Side of Building, New Amtrak Train Station Construction—from the Southeast of 25<sup>th</sup> Street**

