

Madakor, Nnamdi (ECY)

7/6 1hr

From: Madakor, Nnamdi (ECY)
Sent: Monday, July 06, 2015 8:02 AM
To: Pederson, Carrie (PLIA)
Subject: RE: Lake Chelan - Colony Claim 208188 - VERTEX Project 31384

Importance: High

Work Plan for additional site investigation per Colony Claim 208188 is hereby approved

Nnamdi Madakor, P.G., P.HG
Headquarters VCP Policy & Technical Manager
Department of Ecology
Toxics Cleanup Program HQ
P. O. Box 47600
Lacey WA 98504
Phone: (360) 407-7244
Fax: (360) 407-7154
email: nmad461@ecy.wa.gov

From: Pederson, Carrie (PLIA)
Sent: Thursday, July 02, 2015 12:35 PM
To: Madakor, Nnamdi (ECY)
Subject: FW: Lake Chelan - Colony Claim 208188 - VERTEX Project 31384

FYI, need comments but I think I may have forgot to forward to you.

Carrie Pederson
Agency Planner
Pollution Liability Insurance Agency
P) 360-407-0519
carrie.pederson@plia.wa.gov

From: Annica Brown -- Vertex [<mailto:abrown@vertexeng.com>]
Sent: Wednesday, June 24, 2015 3:12 PM
To: Pederson, Carrie (PLIA)
Cc: Lybeer, Carol; Matt Miller; Heather Knowlton--Vertex
Subject: Lake Chelan - Colony Claim 208188 - VERTEX Project 31384

Carrie,

Attached is the Work Plan and cover letter requesting Ecology Opinion on the Work Plan prepared by Antea Group (Antea) for the Lake Chelan Boat Company site in Chelan, Washington (Colony claim 208188). The Work Plan is being submitted as discussed during the meeting on March 30, 2015 with you, Russ, Nnamdi, Matt Miller, Carol, and myself. Antea has also prepared the attached Terrestrial Ecological Evaluation form. Please enter this site in the PLIA VCP Management program as the site is not enrolled through the regional office. Please submit the Work Plan and cover letter to Nnamdi as Antea is requesting an Ecology Opinion on this Work Plan. Based on Colony and PLIA's verbal agreement, we understand that an Ecology Opinion will be provided in 30 days. You may email the opinion letter to all parties on this email, or just to myself and I will distribute it.

Please let me know if you have any questions or need anything additional.

Thank you for supporting Colony insureds' efforts to continue moving LUST sites through the MTCA process.

2011 4/15
Regards,

~~~~~  
**Annica Brown, L.G.**  
Senior Project Manager



The Vertex Companies, Inc.  
705 Second Avenue, Suite 901 | Seattle, WA 98104 | USA

**OFFICE** 206.357.0435 | **MOBILE** 206.471.1637

[Website](#) | [LinkedIn](#) | [Map](#)

If you are not an intended recipient of confidential and privileged information in this email, please delete it, notify us immediately at [info@vertexeng.com](mailto:info@vertexeng.com), and do not use or disseminate such information.

## Madakor, Nnamdi (ECY)

---

**From:** Pederson, Carrie (PLIA)  
**Sent:** Thursday, July 02, 2015 12:35 PM  
**To:** Madakor, Nnamdi (ECY)  
**Subject:** FW: Lake Chelan - Colony Claim 208188 - VERTEX Project 31384  
**Attachments:** 208188\_STCG04222 Chelan 2015 Well Installation Workplan Agency.pdf; Ecology Letter for Workplan.pdf; Chelan,VCP's TEE form.pdf

**Follow Up Flag:** Follow up  
**Flag Status:** Flagged

FYI, need comments but I think I may have forgot to forward to you.

Carrie Pederson  
Agency Planner  
Pollution Liability Insurance Agency  
P) 360-407-0519  
[carrie.pederson@plia.wa.gov](mailto:carrie.pederson@plia.wa.gov)

---

**From:** Annica Brown -- Vertex [<mailto:abrown@vertexeng.com>]  
**Sent:** Wednesday, June 24, 2015 3:12 PM  
**To:** Pederson, Carrie (PLIA)  
**Cc:** Lybeer, Carol; Matt Miller; Heather Knowlton--Vertex  
**Subject:** Lake Chelan - Colony Claim 208188 - VERTEX Project 31384

Carrie,

Attached is the Work Plan and cover letter requesting Ecology Opinion on the Work Plan prepared by Antea Group (Antea) for the Lake Chelan Boat Company site in Chelan, Washington (Colony claim 208188). The Work Plan is being submitted as discussed during the meeting on March 30, 2015 with you, Russ, Nnamdi, Matt Miller, Carol, and myself. Antea has also prepared the attached Terrestrial Ecological Evaluation form. Please enter this site in the PLIA VCP Management program as the site is not enrolled through the regional office. Please submit the Work Plan and cover letter to Nnamdi as Antea is requesting an Ecology Opinion on this Work Plan. Based on Colony and PLIA's verbal agreement, we understand that an Ecology Opinion will be provided in 30 days. You may email the opinion letter to all parties on this email, or just to myself and I will distribute it.

Please let me know if you have any questions or need anything additional.

Thank you for supporting Colony insureds' efforts to continue moving LUST sites through the MTCA process.

Regards,

~~~~~  
Annica Brown, L.G.
Senior Project Manager

VERTEX

The Vertex Companies, Inc.
705 Second Avenue, Suite 901 | Seattle, WA 98104 | USA

OFFICE 206.357.0435 | MOBILE 206.471.1637
[Website](#) | [LinkedIn](#) | [Map](#)

If you are not an intended recipient of confidential and privileged information in this email, please delete it, notify us immediately at info@vertexeng.com, and do not use or disseminate such information.

FILENAME	DRAWN BY	CHECKED BY	APPROVED BY	PROJECT NUMBER
STCG-422_1501_4_1.DWG	ICD	6/17/2015		STCG-422

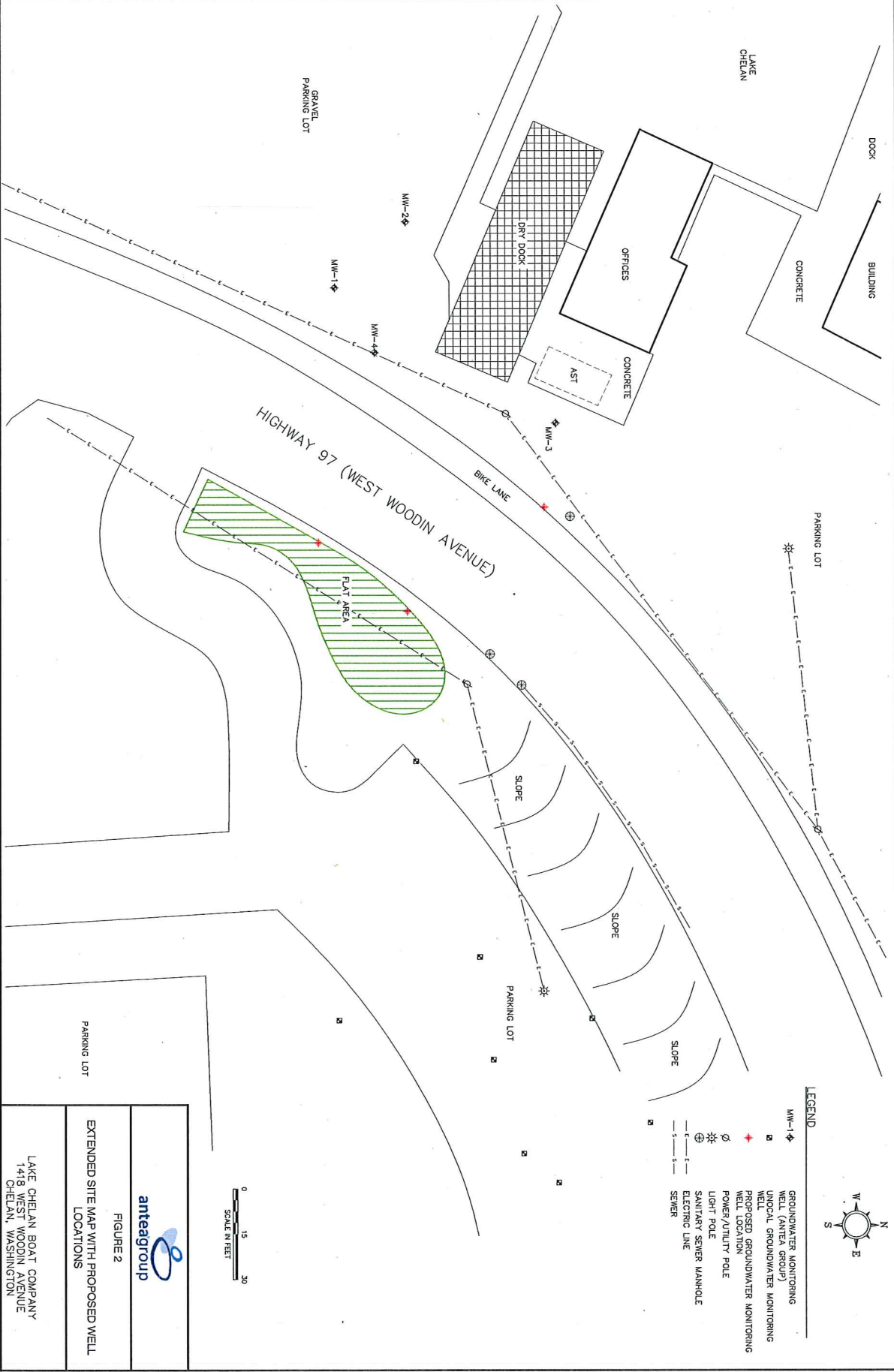

LEGEND

◆	GROUNDWATER MONITORING WELL (ANTEA GROUP)
□	METAL GROUNDWATER MONITORING WELL
+	PROPOSED GROUNDWATER MONITORING WELL LOCATION
⊙	POWER/UTILITY POLE
⊕	LIGHT POLE
⊗	SMART/RT SEWER MANHOLE
—	ELECTRIC LINE
- - -	SEWER

0 15 30
SCALE IN FEET

anteagroup

FIGURE 2

EXTENDED SITE MAP WITH PROPOSED WELL LOCATIONS

LAKE CHELAN BOAT COMPANY
1418 WEST WOODIN AVENUE
CHELAN, WASHINGTON

