

MEMORANDUM

DATE November 11, 2015
TO Rodger Noel, Noel Corporation
FROM Ryan K. Mathews, CIH, CHMM, Principal
RE **Southgate Shopping Center – Vapor Intrusion Monitoring**
SUBJECT Indoor Air Quality Sampling In-Progress Summary

Fulcrum Environmental Consulting, Inc. (Fulcrum) has completed five Indoor Air Sampling events during 2015 of localized areas of the Southgate Shopping Center located in Yakima, Washington. The purpose of sampling was to evaluate indoor air concentrations for tetrachloroethene (PCE) and associated breakdown or daughter products connected to the former Southgate Laundry.

Background

Sub-slab concentrations were evaluated during the initial 1990s site investigation. For comparative purposes, Fulcrum reviewed the historic sub-slab data and determined that the 1990s data represented worst-case concentrations. Sub-slab sampling was followed by initial indoor air sampling in April 2014 which identified elevated levels of tetrachloroethene (PCE), trichloroethene (TCE), and trans-1,2-Dichloroethene, with the maximum PCE concentration measured at 25.5 $\mu\text{g}/\text{m}^3$.

No building areas lay immediately downgradient of the tenant spaces with respect to reported groundwater flow. Similarly, no utilities at the three tenant spaces are known to have changed since completion of the investigation and interim actions in the 1990s.

Routes of potential vapor intrusion into the indoor air include releases from the concrete slab, movement through cracks and seams in the concrete slabs, and around piping penetrations, etc. During Spring 2015, the former Southgate Laundry space was renovated prior to occupancy by Boost Mobile. As a portion of the agreed new tenant improvements, existing carpet floor coverings were removed and replaced. Following good practices, noticeable cracks were sealed and a concrete sealant was applied prior to the installation of the new floor coverings.

Sampling Approach

The vapor intrusion monitoring approach consist of testing air quality with the former Southgate Laundry tenant space on a monthly schedule and adjacent spaces quarterly. Fulcrum April 2014 testing did not identify presence of contaminants in the adjacent spaces above applicable Washington State Department of Ecology (Ecology) Model Toxics Control Act (MTCA) Method B Cancer based risk level for indoor air.

Air Sampling Events

Sampling events were completed on June 24, July 23, August 25, September 29, and November 10, 2015. Fulcrum utilized industry standard of care, including those of the industrial hygiene and indoor air quality



industry and as specified in the U.S. Environmental Protection Agency Method TO-151, for the collection of 24-hour air samples.¹

Air samples were collected with 6-liter Summa canisters with an approximate 24-hour sampling regulator per the sampling process specified in EPA's TO-15 methodology. A Summa canister is used to maintain a sub-atmospheric pressure resulting in vacuum sampling wherein the canister is opened to the atmosphere; the differential pressure causes the sample air to flow into the canister. The Summa canisters are reusable stainless steel containment vessels that are certified clean and purged with nitrogen prior to reuse.

The Summa canister sampling process consists of attaching the sampling regulator to the canister, recording the starting pressure on the regulator, opening the valve, allowing the air sample to be collected, recording the ending pressure, closing the valve, and removing the regulator from the canister. The canisters are each uniquely labeled with a manufacturer's serial number to aid in identification.

Air sampling was completed during standard operation of the tenant. No effort was made to modify the heating, ventilation, and air conditioning (HVAC) system operations from their settings and schedules with the exception of Fulcrum's recommendation to complete a recent change to a pleated activated charcoal filter installed in the former Southgate Laundry central ventilation system prior to the June 24, 2015 sampling event. Filters are scheduled for replacement on about a quarterly basis. Fulcrum has not notified facility maintenance staff of the sampling schedule or requested replaced of charcoal filters prior to the sample event(s).

Results

Samples were submitted by commercial carrier under chain-of-custody to Fremont Analytical, Inc. (Fremont) of Seattle, Washington for analysis by EPA Method TO-15. All laboratory results and regulatory criteria are reported in micrograms per cubic meter ($\mu\text{g}/\text{m}^3$). No 1,1-Dichloroethene (DCE), cis-1,2-Dichloroethene, trans-1,2-Dichloroethene, or Vinyl Chloride have been identified in any of the collected air samples.

Concentration of tetrachloroethene (PCE) and trichloroethene (TCE) have been below the MTCA Method B Cancer based risk level for indoor air, including the MTCA levels for PCE of $9.62 \mu\text{g}/\text{m}^3$ and TCE of $0.37 \mu\text{g}/\text{m}^3$, during each of the five 2015 sampling events. See Table 1 for a summary of all laboratory results.

Furthermore, as compared to the 2014 sampling results, indoor air concentrations of PCE have dropped 99.9% since the April 2014 sampling event. TCE, previously present in both the former Southgate Laundry and the Wray's spaces was not detected during all three events at the method reporting limit.

If you have any questions, please contact me at 509.574.0839.

¹ *Compendium of Methods for the Determination of Toxic Organic Compounds in Ambient Air*, Second Edition, (EPA/625/R-96/010b), *Compendium Method TO-15, Determination of Volatile Organic Compounds (VOCs) in Air Collected in Specially-Prepared Canisters And Analyzed by Gas Chromatography/Mass Spectrometry (GC/MS)*, Center for Environmental research Information, Office of Research and Development, U.S. Environmental Protection Agency, Cincinnati, Ohio, January 1999.

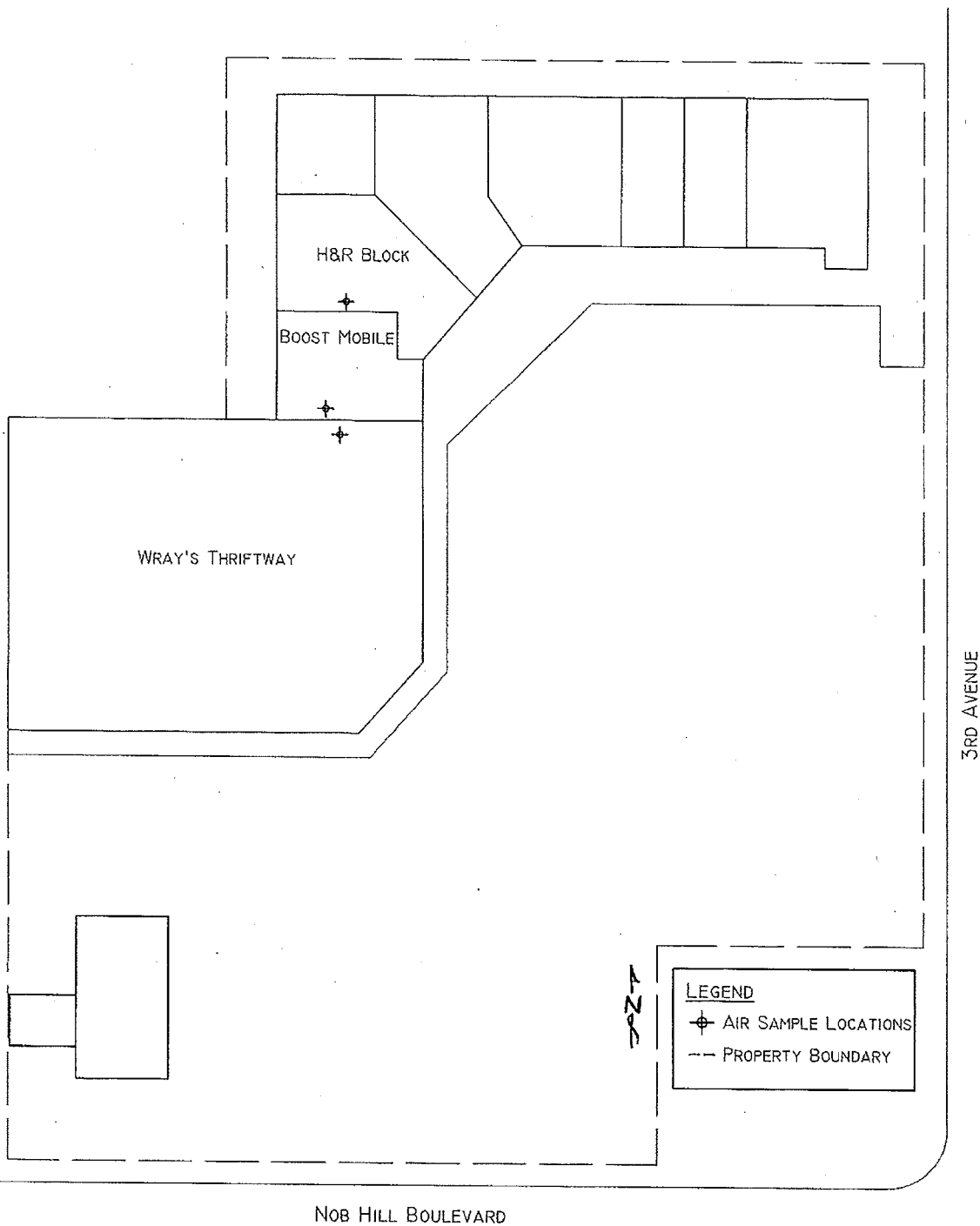

<p>Fulcrum Environmental Consulting, Inc. 5 North Second Street, Yakima, Washington 98901 . 509.574.0839 f. 509.575.8453 efulcrum.net Southgate Shopping Center. 141205. A.L.S. 022515</p>	<p>Southgate Shopping Center 1320 South 3rd Street Yakima, Washington</p>	<p>Site Sampling Locations Map</p> <p style="text-align: right;">FIGURE 1</p>
---	---	--

Table 1. Laboratory Analytical Summary

Constituent	1,1-Dichloro ethene (DCE)	cis-1,2-Dichloro ethene	Tetrachloro ethene (PCE)	trans-1,2-Dichloro ethene	Trichloro ethene (TCE)	Vinyl chloride
CAS	75-35-4	156-59-2	127-18-4	156-60-5	79-01-6	75-01-4
062515-02 (Boost)	<0.0357	<0.0793	0.594	<0.0238	<0.0914	<0.217
June 25, 2015 062515-03 (H&R)	<0.0357	<0.0793	4.48	<0.0238	<0.0914	<0.217
062515-01 (Wray's)	<0.0357	<0.0793	4.5	<0.0238	<0.0914	<0.217
July 23, 2015 072315-01 (Boost)	<0.0357	<0.0793	0.407	<0.0238	<0.0914	<0.217
August 25, 2015 082515-01 (Boost)	<0.0357	<0.0793	0.356	<0.0238	<0.0914	<0.217
092915-01 (Boost)	<0.0357	<0.0793	0.95	<0.0238	<0.0914	<0.217
September 29, 2015 092915-02 (H&R)	<0.0357	<0.0793	0.543	<0.0238	<0.0914	<0.217
092915-03 (Wray's)	<0.0357	<0.0793	3.05	<0.0238	<0.0914	<0.217
November 10, 2015 103015-01 (Boost)	<0.0357	<0.0793	0.543	<0.0238	<0.0914	<0.217
MITCA Method B Cancer Level	-	-	9.62	-	0.37	2.8



3600 Fremont Ave. N.
Seattle, WA 98103
T: (206) 352-3790
F: (206) 352-7178
info@fremontanalytical.com

Fulcrum Environmental
Ryan Mathews
406 N. 2nd Street
Yakima, WA 98901

RE: Southgate
Lab ID: 1506306

July 02, 2015

Attention Ryan Mathews:

Fremont Analytical, Inc. received 3 sample(s) on 6/26/2015 for the analyses presented in the following report.

Volatile Organic Compounds-EPA Method TO-15 (SIM)

This report consists of the following:

- Case Narrative
- Analytical Results
- Applicable Quality Control Summary Reports
- Chain of Custody

All analyses were performed consistent with the Quality Assurance program of Fremont Analytical, Inc. Please contact the laboratory if you should have any questions about the results.

Thank you for using Fremont Analytical.

Sincerely,

Chelsea Ward
Project Manager



CLIENT: Fulcrum Environmental
Project: Southgate
Lab Order: 1506306

Work Order Sample Summary

Lab Sample ID	Client Sample ID	Date/Time Collected	Date/Time Received
1506306-001	062515-02 (Boost)	06/25/2015 2:06 PM	06/26/2015 2:51 PM
1506306-002	062515-03 (H+R)	06/25/2015 2:11 PM	06/26/2015 2:51 PM
1506306-003	062515-01 (Wrays)	06/25/2015 1:55 PM	06/26/2015 2:51 PM

Note: If no "Time Collected" is supplied, a default of 12:00AM is assigned



Qualifiers:

- * - Flagged value is not within established control limits
- B - Analyte detected in the associated Method Blank
- D - Dilution was required
- E - Value above quantitation range
- H - Holding times for preparation or analysis exceeded
- I - Analyte with an internal standard that does not meet established acceptance criteria
- J - Analyte detected below LOQ
- N - Tentatively Identified Compound (TIC)
- Q - Analyte with an initial or continuing calibration that does not meet established acceptance criteria (<20%RSD, <20% Drift or minimum RRF)
- S - Spike recovery outside accepted recovery limits
- ND - Not detected at the Reporting Limit

Acronyms:

- %Rec - Percent Recovery
- CCB - Continued Calibration Blank
- CCV - Continued Calibration Verification
- DF - Dilution Factor
- HEM - Hexane Extractable Material
- ICV - Initial Calibration Verification
- LCS/LCSD - Laboratory Control Sample / Laboratory Control Sample Duplicate
- MB or MBLANK - Method Blank
- MDL - Method Detection Limit
- MS/MSD - Matrix Spike / Matrix Spike Duplicate
- PDS - Post Digestion Spike
- Ref Val - Reference Value
- RL - Reporting Limit
- RPD - Relative Percent Difference
- SD - Serial Dilution
- SGT - Silica Gel Treatment
- SPK - Spike
- Surr - Surrogate



Fremont

ANALYTICAL

Client: Fulcrum Environmental
 WorkOrder: 1506306
 Project: Southgate
 Client Sample ID: 062515-02 (Boost)
 Lab ID: 1506306-001A
 Sample Type: Summa Canister

Date Sampled: 6/25/2015
 Date Received: 6/26/2015

Analyte	Concentration		Reporting Limit		Qual	Method	Date/Analyst
<u>Volatile Organic Compounds-EPA Method TO-15 (SIM)</u>							
	(ppbv)	(ug/m ³)	(ppbv)	(ug/m ³)			
1,1-Dichloroethene (DCE)	<0.00900	<0.0357	0.00900	0.0357		TO-15	06/27/2015 JY
cis-1,2-Dichloroethene	<0.0200	<0.0793	0.0200	0.0793		TO-15	06/27/2015 JY
Tetrachloroethene (PCE)	0.0875	0.594	0.0500	0.339		TO-15	06/27/2015 JY
trans-1,2-Dichloroethene	<0.00600	<0.0238	0.00600	0.0238		TO-15	06/27/2015 JY
Trichloroethene (TCE)	<0.0170	<0.0914	0.0170	0.0914		TO-15	06/27/2015 JY
Vinyl chloride	<0.0850	<0.217	0.0850	0.217		TO-15	06/27/2015 JY
Surr: 4-Bromofluorobenzene	97.5 %Rec	--	70-130	-		TO-15	06/27/2015 JY



Fremont

Analytical

Client: Fulcrum Environmental
WorkOrder: 1506306
Project: Southgate

Client Sample ID: 062515-03 (H+R)
Lab ID: 1506306-002A
Sample Type: Summa Canister

Date Sampled: 6/25/2015
Date Received: 6/26/2015

Analyte	Concentration	Reporting Limit	Qual	Method	Date/Analyst
---------	---------------	-----------------	------	--------	--------------

Volatile Organic Compounds-EPA Method TO-15 (SIM)

	(ppbv)	(ug/m ³)	(ppbv)	(ug/m ³)			
1,1-Dichloroethene (DCE)	<0.00900	<0.0357	0.00900	0.0357	TO-15	06/27/2015	JY
cis-1,2-Dichloroethene	<0.0200	<0.0793	0.0200	0.0793	TO-15	06/27/2015	JY
Tetrachloroethene (PCE)	0.660	4.48	0.0500	0.339	TO-15	06/27/2015	JY
trans-1,2-Dichloroethene	<0.00600	<0.0238	0.00600	0.0238	TO-15	06/27/2015	JY
Trichloroethene (TCE)	<0.0170	<0.0914	0.0170	0.0914	TO-15	06/27/2015	JY
Vinyl chloride	<0.0850	<0.217	0.0850	0.217	TO-15	06/27/2015	JY
Surr: 4-Bromofluorobenzene	94.4 %Rec	--	70-130	--	TO-15	06/27/2015	JY



Fremont

Client: Fulcrum Environmental
 WorkOrder: 1506306
 Project: Southgate

Client Sample ID: 062515-01 (Wrays)
 Lab ID: 1506306-003A
 Sample Type: Summa Canister

Date Sampled: 6/25/2015
 Date Received: 6/26/2015

Analyte	Concentration	Reporting Limit	Qual	Method	Date/Analyst
---------	---------------	-----------------	------	--------	--------------

Volatile Organic Compounds-EPA Method TO-15 (SIM)

	(ppbv)	(ug/m ³)	(ppbv)	(ug/m ³)			
1,1-Dichloroethene (DCE)	<0.00900	<0.0357	0.00900	0.0357	TO-15	06/27/2015	JY
cis-1,2-Dichloroethene	<0.0200	<0.0793	0.0200	0.0793	TO-15	06/27/2015	JY
Tetrachloroethene (PCE)	0.664	4.50	0.0500	0.339	TO-15	06/27/2015	JY
trans-1,2-Dichloroethene	<0.00600	<0.0238	0.00600	0.0238	TO-15	06/27/2015	JY
Trichloroethene (TCE)	<0.0170	<0.0914	0.0170	0.0914	TO-15	06/27/2015	JY
Vinyl chloride	<0.0850	<0.217	0.0850	0.217	TO-15	06/27/2015	JY
Surr: 4-Bromofluorobenzene	93.5 %Rec	--	70-130	--	TO-15	06/27/2015	JY



Date: 7/2/2015

QC SUMMARY REPORT
Volatile Organic Compounds-EPA Method TO-15 (SIM)

Work Order: 1506306
 CLIENT: Fulcrum Environmental
 Project: Southgate

Sample ID	1506306-001AREP	SampType: REP	Batch ID: R23349	Units: ppbv	Prep Date: 6/27/2015	RunNo: 23349					
Client ID:	062515-02 (Boost)		R23349		Analysis Date: 6/27/2015	SeqNo: 442243					
Analyte	Result	RL	SPK value	SPK RefVal	%REC	LowLimit	HighLimit	RPD RefVal	%RPD	RPDLimit	Qual
Vinyl chloride	ND	0.0850						0		30	
1,1-Dichloroethene (DCE)	ND	0.00900						0		30	
trans-1,2-Dichloroethene	ND	0.00600						0		30	
cis-1,2-Dichloroethene	ND	0.0200						0		30	
Trichloroethene (TCE)	ND	0.0170						0		30	
Tetrachloroethene (PCE)	0.0868	0.0500						0.08750	0.803	30	
Surr: 4-Bromofluorobenzene	9.56		10.00		95.6	70	130		0		

Sample ID	LCS-R23349	SampType: LCS	Batch ID: R23349	Units: ppbv	Prep Date: 6/27/2015	RunNo: 23349					
Client ID:	LCSW		R23349		Analysis Date: 6/27/2015	SeqNo: 442247					
Analyte	Result	RL	SPK value	SPK RefVal	%REC	LowLimit	HighLimit	RPD RefVal	%RPD	RPDLimit	Qual
Vinyl chloride	2.63	0.0850	2.500	0	105	70	130				
1,1-Dichloroethene (DCE)	2.61	0.00900	2.500	0	105	70	130				
trans-1,2-Dichloroethene	2.52	0.00600	2.500	0	101	70	130				
cis-1,2-Dichloroethene	2.66	0.0200	2.500	0	107	70	130				
Trichloroethene (TCE)	2.59	0.0170	2.500	0	104	70	130				
Tetrachloroethene (PCE)	2.71	0.0500	2.500	0	108	70	130				
Surr: 4-Bromofluorobenzene	10.4		10.00		104	70	130				

Sample ID	MB-R23349	SampType: MBLK	Batch ID: R23349	Units: ppbv	Prep Date: 6/27/2015	RunNo: 23349					
Client ID:	MBLKW		R23349		Analysis Date: 6/27/2015	SeqNo: 442248					
Analyte	Result	RL	SPK value	SPK RefVal	%REC	LowLimit	HighLimit	RPD RefVal	%RPD	RPDLimit	Qual
Vinyl chloride	ND	0.0850									
1,1-Dichloroethene (DCE)	ND	0.00900									
trans-1,2-Dichloroethene	ND	0.00600									
cis-1,2-Dichloroethene	ND	0.0200									
Trichloroethene (TCE)	ND	0.0170									
Tetrachloroethene (PCE)	ND	0.0500									



Fremont
ANALYTICAL

Date: 7/2/2015

QC SUMMARY REPORT
Volatile Organic Compounds-EPA Method TO-15 (SIM)

Work Order: 1506306
 CLIENT: Fulcrum Environmental
 Project: Southgate

Sample ID: MB-R23349	Sample Type: MBLK	Units: ppbv	Prep Date: 6/27/2015	RunNo: 23349							
Client ID: MBLKW	Batch ID: R23349		Analysis Date: 6/27/2015	SeqNo: 442248							
Analyte	Result	RL	SPK value	SPK Ref Val	%REC	LowLimit	HighLimit	RPD Ref Val	%RPD	RPDLimit	Qual

Surr: 4-Bromofluorobenzene 9.74 10.00 97.4 70 130



Client Name: FE	Work Order Number: 1506306
Logged by: Erica Silva	Date Received: 6/26/2015 2:51:00 PM

Chain of Custody

1. Is Chain of Custody complete? Yes No Not Present
2. How was the sample delivered? UPS

Log In

3. Coolers are present? Yes No NA
- Air samples
4. Shipping container/cooler in good condition? Yes No
5. Custody Seals present on shipping container/cooler?
(Refer to comments for Custody Seals not intact) Yes No Not Required
6. Was an attempt made to cool the samples? Yes No NA
7. Were all items received at a temperature of >0°C to 10.0°C* Yes No NA
8. Sample(s) in proper container(s)? Yes No
9. Sufficient sample volume for indicated test(s)? Yes No
10. Are samples properly preserved? Yes No
11. Was preservative added to bottles? Yes No NA
12. Is there headspace in the VOA vials? Yes No NA
13. Did all samples containers arrive in good condition(unbroken)? Yes No
14. Does paperwork match bottle labels? Yes No
15. Are matrices correctly identified on Chain of Custody? Yes No
16. Is it clear what analyses were requested? Yes No
17. Were all holding times able to be met? Yes No

Special Handling (if applicable)

18. Was client notified of all discrepancies with this order? Yes No NA

Person Notified:	_____	Date:	_____
By Whom:	_____	Via:	<input type="checkbox"/> eMail <input type="checkbox"/> Phone <input type="checkbox"/> Fax <input type="checkbox"/> In Person
Regarding:	_____		
Client Instructions:	_____		

19. Additional remarks:

Item Information

* Note: DoD/ELAP and TNI require items to be received at 4°C +/- 2°C



3400 Fremont Ave N.
Seattle, WA 98105
Tel: 206-352-3790
Fax: 206-352-7178

Air Chain of Custody Record - Whole Air Sample

Laboratory Project No (Internal): 15016306

Page: 1 of 1

Date: 6/25/2015

Client: Fulcrum Environmental Consulting, Inc.
Address: 400 North 7th Street
City, State, Zip: Yakima, WA 98901
Telephone: 509-574-0887 Fax:

Project Name: Southgate
Project No: 141285
Location: Yakima, WA
Report to (PM): Ryan Matthews
PM Email: rmatthews@fulcrum.net

* Gas Matrix Codes: I = Indoor SS = Subsoil L = Lanthfill SG = Soil Gas M = Plume Mapping Q = Fuel Gas Quality L = LEED (Consult Client Services)
* Container Codes: 6L = Six Liter Canister (Summa) TB = Tearable Bag 8V = 1 Liter Bottle Vial MC = 1 Liter MiniCan HP = High Pressure Cylinder NI = Glass Headspace Jar

Sample Name	Cylinder / Flow Reg Serial #	Sample Date & Time	Gas Matrix Code *	Anticipated Fill Time	Sample Volume	Container Type **	Evacuation Pressure (torr)	Field Initial Sample Pressure (PSI)	Equipment Certification Code	Field Final Sample Pressure (PSI)	Analysis Requested	Receipt Date	Intense
062515-02 (HAP)	12669	6-25-15 1400	I	23 hr	6L	Summa	10torr 52715 10-30	29	1526	3	1,1-Dichloroethane (DCE) cis-1,2-Dichloroethane Tetra chloroethane (PCE)	6/25/15	4
062515-05 (HAP)	13973	6-25-15 1411	I	23 hr	6L	Summa	10torr 52715 10-30	28.5	1541	0	trans-1,2-Dichloroethane Trichloroethane (TCE) Vinyl Chloride	6/25/15	2
062515-01 (HAP)	17244	6-25-15 1555	I	23 hr	6L	Summa	10torr 52715 10-30	29.5	154	0	by EPA Method TO-15 (Sim)	6/26/15	0

Rental Equipment (Check all that apply): Manifold Mini-pump Fittings Tearable Bags Canister Flow Controller Heisen Cylinder Fluorinated Tubing Yench

Condition: Seals intact: Y N N/A

Relinquished Date/Time: 6/25/15 @ 1600
Date/Time: 6/26/15 1451

Special Remarks: Please see results to: rmatthews@fulcrum.net

TAT -> STD -> RUBB (specify)



Fremont

3600 Fremont Ave. N.
Seattle, WA 98103
T: (206) 352-3790
F: (206) 352-7178
info@fremontanalytical.com

Fulcrum Environmental
Ryan Mathews
406 N. 2nd Street
Yakima, WA 98901

RE: Southgate Shopping Center Vapor Intrusion
Lab ID: 1507258

July 31, 2015

Attention Ryan Mathews:

Fremont Analytical, Inc. received 1 sample(s) on 7/24/2015 for the analyses presented in the following report.

Volatile Organic Compounds-EPA Method TO-15 (SIM)

This report consists of the following:

- Case Narrative
- Analytical Results
- Applicable Quality Control Summary Reports
- Chain of Custody

All analyses were performed consistent with the Quality Assurance program of Fremont Analytical, Inc. Please contact the laboratory if you should have any questions about the results.

Thank you for using Fremont Analytical.

Sincerely,

Chelsea Ward
Project Manager

CC:
Norm Hepner

www.fremontanalytical.com



Fremont
Analytical

Date: 07/31/2015

CLIENT: Fulcrum Environmental
Project: Southgate Shopping Center Vapor Intrusion
Lab Order: 1507258

Work Order Sample Summary

Lab Sample ID	Client Sample ID	Date/Time Collected	Date/Time Received
1507258-001	072315-01 (Boost)	07/22/2015 3:40 PM	07/24/2015 1:06 PM

Note: If no "Time Collected" is supplied, a default of 12:00AM is assigned



CLIENT: Fulcrum Environmental
Project: Southgate Shopping Center Vapor Intrusion

I. SAMPLE RECEIPT:

Samples receipt information is recorded on the attached Sample Receipt Checklist.

II. GENERAL REPORTING COMMENTS:

Air samples are reported in ppbv and ug/m3.

The validity of the analytical procedures for which data is reported in this analytical report is determined by the Laboratory Control Sample (LCS) and the Method Blank (MB). The LCS and the MB are processed with the samples to ensure method criteria are achieved throughout the entire analytical process.

III. ANALYSES AND EXCEPTIONS:

Exceptions associated with this report will be footnoted in the analytical results page(s) or the quality control summary page(s) and/or noted below.

Standard temperature and pressure assumes 24.45 = (25C and 1 atm).



Qualifiers & Acronyms

WO#: 1507258

Date Reported: 7/31/2015

Qualifiers:

- * - Flagged value is not within established control limits
- B - Analyte detected in the associated Method Blank
- D - Dilution was required
- E - Value above quantitation range
- H - Holding times for preparation or analysis exceeded
- I - Analyte with an internal standard that does not meet established acceptance criteria
- J - Analyte detected below LOQ
- N - Tentatively Identified Compound (TIC)
- Q - Analyte with an initial or continuing calibration that does not meet established acceptance criteria (<20%RSD, <20% Drift or minimum RRF)
- S - Spike recovery outside accepted recovery limits
- ND - Not detected at the Reporting Limit

Acronyms:

- %Rec - Percent Recovery
- CCB - Continued Calibration Blank
- CCV - Continued Calibration Verification
- DF - Dilution Factor
- HEM - Hexane Extractable Material
- ICV - Initial Calibration Verification
- LCS/LCSD - Laboratory Control Sample / Laboratory Control Sample Duplicate
- MB or MBLANK - Method Blank
- MDL - Method Detection Limit
- MS/MSD - Matrix Spike / Matrix Spike Duplicate
- PDS - Post Digestion Spike
- Ref Val - Reference Value
- RL - Reporting Limit
- RPD - Relative Percent Difference
- SD - Serial Dilution
- SGT - Silica Gel Treatment
- SPK - Spike
- Surr - Surrogate



Fremont

Analytical

Client: Fulcrum Environmental
WorkOrder: 1507258
Project: Southgate Shopping Center Vapor Intrusion

Client Sample ID: 072315-01 (Boost)
Lab ID: 1507258-001A
Sample Type: Summa Canister

Date Sampled: 7/22/2015
Date Received: 7/24/2015

Analyte	Concentration		Reporting Limit		Qual	Method	Date/Analyst
<u>Volatile Organic Compounds-EPA Method TO-15 (SIM)</u>							
	(ppbv)	(ug/m ³)	(ppbv)	(ug/m ³)			
1,1-Dichloroethene (DCE)	<0.00900	<0.0357	0.00900	0.0357		TO-15	07/28/2015 JY
cis-1,2-Dichloroethene	<0.0200	<0.0793	0.0200	0.0793		TO-15	07/28/2015 JY
Tetrachloroethene (PCE)	0.0600	0.407	0.0500	0.339		TO-15	07/28/2015 JY
trans-1,2-Dichloroethene	<0.00600	<0.0238	0.00600	0.0238		TO-15	07/28/2015 JY
Trichloroethene (TCE)	<0.0170	<0.0914	0.0170	0.0914		TO-15	07/28/2015 JY
Vinyl chloride	<0.0850	<0.217	0.0850	0.217		TO-15	07/28/2015 JY
Surr: 4-Bromofluorobenzene	104 %Rec	--	70-130	--		TO-15	07/28/2015 JY



Date: 7/31/2015

QC SUMMARY REPORT
Volatile Organic Compounds-EPA Method TO-15 (SIM)

Work Order: 1507258
 CLIENT: Fulcrum Environmental
 Project: Southgate Shopping Center Vapor Intrusion

Sample ID: 1507214-001AREP	SampType: REP	Units: ppbv	Prep Date: 7/28/2015	RunNo: 23864							
Client ID: BATCH	Batch ID: R23864		Analysis Date: 7/28/2015	SeqNo: 452043							
Analyte	Result	RL	SPK value	SPK Ref Val	%REC	LowLimit	HighLimit	RPD Ref Val	%RPD	RPDLimit	Qual
Vinyl chloride	ND	0.0850						0		30	
1,1-Dichloroethene (DCE)	ND	0.00900						0		30	
trans-1,2-Dichloroethene	ND	0.00600						0		30	
cis-1,2-Dichloroethene	ND	0.0200						0		30	
Trichloroethene (TCE)	ND	0.0170						0		30	
Tetrachloroethene (PCE)	0.210	0.0500						0.2100	0	30	
Surr: 4-Bromofluorobenzene	10.3		10.00		103	70	130		0	0	

Sample ID: LCS-R23864	SampType: LCS	Units: ppbv	Prep Date: 7/28/2015	RunNo: 23864							
Client ID: LCSW	Batch ID: R23864		Analysis Date: 7/28/2015	SeqNo: 452045							
Analyte	Result	RL	SPK value	SPK Ref Val	%REC	LowLimit	HighLimit	RPD Ref Val	%RPD	RPDLimit	Qual
Vinyl chloride	2.91	0.0850	2.500	0	116	70	130				
1,1-Dichloroethene (DCE)	3.03	0.00900	2.500	0	121	70	130				
trans-1,2-Dichloroethene	3.09	0.00600	2.500	0	124	70	130				
cis-1,2-Dichloroethene	3.07	0.0200	2.500	0	123	70	130				
Trichloroethene (TCE)	3.19	0.0170	2.500	0	128	70	130				
Tetrachloroethene (PCE)	2.98	0.0500	2.500	0	119	70	130				
Surr: 4-Bromofluorobenzene	9.78		10.00		97.8	70	130				

Sample ID: MB 400 2-2	SampType: MBLK	Units: ppbv	Prep Date: 7/28/2015	RunNo: 23864							
Client ID: MBLKW	Batch ID: R23864		Analysis Date: 7/28/2015	SeqNo: 452046							
Analyte	Result	RL	SPK value	SPK Ref Val	%REC	LowLimit	HighLimit	RPD Ref Val	%RPD	RPDLimit	Qual
Vinyl chloride	ND	0.0850									
1,1-Dichloroethene (DCE)	ND	0.00900									
trans-1,2-Dichloroethene	ND	0.00600									
cis-1,2-Dichloroethene	ND	0.0200									
Trichloroethene (TCE)	ND	0.0170									
Tetrachloroethene (PCE)	ND	0.0500									



Fremont
ANALYTICAL

Date: 7/31/2015

Work Order: 1507258

CLIENT: Fulcrum Environmental

Project: Southgate Shopping Center Vapor Intrusion

QC SUMMARY REPORT

Volatile Organic Compounds-EPA Method TO-15 (SIM)

Sample ID	MB 400 2-2	SampType:	MBLK	Units:	ppbv	Prep Date:	7/29/2015	RunNo:	23864				
Client ID:	MBLKW	Batch ID:	R23864	Analysis Date:	7/28/2015	SeqNo:	452046						
Analyte		Result		RL	SPK value	SPK Ref Val	%REC	LowLimit	HighLimit	RPD Ref Val	%RPD	RPDLimit	Qual

Surr: 4-Bromofluorobenzene

9.81

10.00

98.1

70

130



Sample Log-In Check List

Client Name: FE	Work Order Number: 1507258
Logged by: Erica Silva	Date Received: 7/24/2015 1:06:00 PM

Chain of Custody

1. Is Chain of Custody complete? Yes No Not Present
2. How was the sample delivered? UPS

Log In

3. Coolers are present? Yes No NA
- Air sample
4. Shipping container/cooler in good condition? Yes No
5. Custody Seals present on shipping container/cooler? (Refer to comments for Custody Seals not intact) Yes No Not Required
6. Was an attempt made to cool the samples? Yes No NA
7. Were all items received at a temperature of >0°C to 10.0°C* Yes No NA
8. Sample(s) in proper container(s)? Yes No
9. Sufficient sample volume for indicated test(s)? Yes No
10. Are samples properly preserved? Yes No
11. Was preservative added to bottles? Yes No NA
12. Is there headspace in the VOA vials? Yes No NA
13. Did all samples containers arrive in good condition(unbroken)? Yes No
14. Does paperwork match bottle labels? Yes No
15. Are matrices correctly identified on Chain of Custody? Yes No
16. Is it clear what analyses were requested? Yes No
17. Were all holding times able to be met? Yes No

Special Handling (if applicable)

18. Was client notified of all discrepancies with this order? Yes No NA

Person Notified:	<input type="text"/>	Date	<input type="text"/>
By Whom:	<input type="text"/>	Via:	<input type="checkbox"/> eMail <input type="checkbox"/> Phone <input type="checkbox"/> Fax <input type="checkbox"/> In Person
Regarding:	<input type="text"/>		
Client Instructions:	<input type="text"/>		

19. Additional remarks:

Item Information

* Note: DoD/ELAP and TNI require items to be received at 4°C +/- 2°C



Fremont

ANALYTICAL

3600 Fremont Ave N.
Seattle, WA 98109

Tel: 206-532-3790
Fax: 206-452-2178

Date: 7/23/15

Laboratory Project No (Internal):

1507258

Air Chain of Custody Record - Whole Air Sample

Page: 1 of: 1

Project Name: Southgate Shopping Center Vapor Intrusion
Project No: 14120
Collected by: A. Seffer

Location: Bellevue, WA
Reports To (PM): Ryan M. Stevens

Email (PM): rma@fremontanalytical.com

Client: Fulcrum Environmental Consulting, Inc.
Address: 406 N. 24th St.
Bellevue, WA

Telephone: 809.574.0839 Fax:

* Container Codes: 1 = Indoor SS = Substrate 1 = On-Duff 5G = Soil Gas M = Plume (Mop) Q = Post-Gas Quality L = LEED (Consult Client Services)
** Container Codes: 6L = Six Liter Canister (Normal) T3 = Tedlar Bag BV = 1 Liter Bottle Vae MC = 1 Liter Minidom H9 = High Pressure Cylinder HI = Glass Headspace Jar

Sample Name	Container / Flow Rtg Serial #	Sample Date & Time	Gas Matrix Code *	Adsorbed Fill Time	Sample Volume	Container Type **	Evacuation Pressure (Inscr)	Internal		Field Initial Sample Pressure (1" Hg)	Field Final Sample Pressure (1" Hg)	Analysis Requested	Receipt Date	Final Pressure (1" Hg)
								Pressure at Time of Peak Up (" Hg)	Equipment Certification Code					
072315-01 (Boost)	17238	7/23/15 15:40	I	2hr	6L	Summa	772015 030	30	2			1,1-Dichloroethene (DCE) 1,2-Dichloroethene Tetrachloroethene (PCE) Trans-1,2-Dichloroethene Trichloroethene (TCE) Vinyl Chloride by EPA Method TO-15 (SMA)	07/24/15	-4-

Rental Equipment (Circle all that apply): Manifold Mini-Pump Fittings Tedlar Bags Canisters Low Concentrator 1 Liter Cylinder Equilibrated Tubing Membrane

Conditions: Leak/Inlet Y N N/A

Relinquished: Asbury Date/Time: 7/23/15 01:00 Relinquished: Paula Date/Time: 7/24/15 13:15

Relinquished: Asbury Date/Time: 7/23/15 01:00 Relinquished: Paula Date/Time: 7/24/15 13:15

Special Remarks: Please cc: Fill time = 23 hrs 40 min



3600 Fremont Ave. N.
Seattle, WA 98103
T: (206) 352-3790
F: (206) 352-7178
info@fremontanalytical.com

Fulcrum Environmental
Ryan Mathews
406 N. 2nd Street
Yakima, WA 98901

RE: Southgate Vapor Intrusion
Lab ID: 1508293

August 28, 2015

Attention Ryan Mathews:

Fremont Analytical, Inc. received 1 sample(s) on 8/26/2015 for the analyses presented in the following report.

Volatile Organic Compounds-EPA Method TO-15 (SIM)

This report consists of the following:

- Case Narrative
- Analytical Results
- Applicable Quality Control Summary Reports
- Chain of Custody

All analyses were performed consistent with the Quality Assurance program of Fremont Analytical, Inc. Please contact the laboratory if you should have any questions about the results.

Thank you for using Fremont Analytical.

Sincerely,

Chelsea Ward
Project Manager



Fremont
ANALYTICAL

Date: 08/28/2015

CLIENT: Fulcrum Environmental
Project: Southgate Vapor Intrusion
Lab Order: 1508293

Work Order Sample Summary

Lab Sample ID	Client Sample ID	Date/Time Collected	Date/Time Received
1508293-001	082515-01 (Boost)	08/25/2015 2:55 PM	08/26/2015 2:00 PM

Note: If no "Time Collected" is supplied, a default of 12:00AM is assigned



CLIENT: Fulcrum Environmental
Project: Southgate Vapor Intrusion

I. SAMPLE RECEIPT:

Samples receipt information is recorded on the attached Sample Receipt Checklist.

II. GENERAL REPORTING COMMENTS:

Air samples are reported in ppbv and ug/m3.

The validity of the analytical procedures for which data is reported in this analytical report is determined by the Laboratory Control Sample (LCS) and the Method Blank (MB). The LCS and the MB are processed with the samples to ensure method criteria are achieved throughout the entire analytical process.

III. ANALYSES AND EXCEPTIONS:

Exceptions associated with this report will be footnoted in the analytical results page(s) or the quality control summary page(s) and/or noted below.

Standard temperature and pressure assumes 24.45 = (25C and 1 atm).



Qualifiers & Acronyms

WO#: 1508293

Date Reported: 8/28/2016

Qualifiers:

- * - Flagged value is not within established control limits
- B - Analyte detected in the associated Method Blank
- D - Dilution was required
- E - Value above quantitation range
- H - Holding times for preparation or analysis exceeded
- I - Analyte with an internal standard that does not meet established acceptance criteria
- J - Analyte detected below LOQ
- N - Tentatively Identified Compound (TIC)
- Q - Analyte with an initial or continuing calibration that does not meet established acceptance criteria (<20%RSD, <20% Drift or minimum RRF)
- S - Spike recovery outside accepted recovery limits
- ND - Not detected at the Reporting Limit

Acronyms:

- %Rec - Percent Recovery
- CCB - Continued Calibration Blank
- CCV - Continued Calibration Verification
- DF - Dilution Factor
- HEM - Hexane Extractable Material
- ICV - Initial Calibration Verification
- LCS/LCSD - Laboratory Control Sample / Laboratory Control Sample Duplicate
- MB or MBLANK - Method Blank
- MDL - Method Detection Limit
- MS/MSD - Matrix Spike / Matrix Spike Duplicate
- PDS - Post Digestion Spike
- Ref Val - Reference Value
- RL - Reporting Limit
- RPD - Relative Percent Difference
- SD - Serial Dilution
- SGT - Silica Gel Treatment
- SPK - Spike
- Surr - Surrogate



Fremont

ANALYTICAL

Client: Fulcrum Environmental
WorkOrder: 1508293
Project: Southgate Vapor Intrusion
Client Sample ID: 082515-01 (Boost)
Lab ID: 1508293-001A
Sample Type: Summa Canister

Date Sampled: 8/25/2015
Date Received: 8/26/2015

Analyte	Concentration	Reporting Limit	Qual	Method	Date/Analyst
---------	---------------	-----------------	------	--------	--------------

Volatile Organic Compounds-EPA Method TO-15 (SIM)

	(ppbv)	(ug/m ³)	(ppbv)	(ug/m ³)			
1,1-Dichloroethene (DCE)	<0.00900	<0.0357	0.00900	0.0357	TO-15	08/27/2015	JY
cis-1,2-Dichloroethene	<0.0200	<0.0793	0.0200	0.0793	TO-15	08/27/2015	JY
Tetrachloroethene (PCE)	0.0525	0.356	0.0500	0.339	TO-15	08/27/2015	JY
trans-1,2-Dichloroethene	<0.00600	<0.0238	0.00600	0.0238	TO-15	08/27/2015	JY
Trichloroethene (TCE)	<0.0170	<0.0914	0.0170	0.0914	TO-15	08/27/2015	JY
Vinyl chloride	<0.0850	<0.217	0.0850	0.217	TO-15	08/27/2015	JY
Surr: 4-Bromofluorobenzene	119 %Rec	--	70-130	--	TO-15	08/27/2015	JY



Date: 8/28/2015

QC SUMMARY REPORT
Volatile Organic Compounds-EPA Method TO-15 (SIM)

Work Order: 1508293

CLIENT: Fulcrum Environmental

Project: Southgate Vapor Intrusion

Sample ID:	LCS-R24574	Samp Type:	LCS	Batch ID:	R24574	Units:	ppbv	Prep Date:	8/27/2015	RunNo:	24574
Client ID:	LCSW	Result	RL	SPK value	SPK Ref Val	%REC	LowLimit	HighLimit	RPD Ref Val	%RPD	RPDLimit
Analyte	Result	RL	SPK value	SPK Ref Val	%REC	LowLimit	HighLimit	RPD Ref Val	Qual		
Vinyl chloride	2.47	0.0850	2.500	0	98.7	70	130				
1,1-Dichloroethene (DCE)	2.61	0.00900	2.500	0	104	70	130				
trans-1,2-Dichloroethene	2.26	0.00600	2.500	0	90.3	70	130				
cis-1,2-Dichloroethene	2.55	0.0200	2.500	0	102	70	130				
Trichloroethene (TCE)	2.76	0.0170	2.500	0	111	70	130				
Tetrachloroethene (PCE)	2.46	0.0500	2.500	0	98.6	70	130				
Surr: 4-Bromofluorobenzene	11.8		10.00		118	70	130				

Sample ID:	MB-R24574	Samp Type:	MBLK	Batch ID:	R24574	Units:	ppbv	Prep Date:	8/27/2015	RunNo:	24574
Client ID:	MBLKW	Result	RL	SPK value	SPK Ref Val	%REC	LowLimit	HighLimit	RPD Ref Val	%RPD	RPDLimit
Analyte	Result	RL	SPK value	SPK Ref Val	%REC	LowLimit	HighLimit	RPD Ref Val	Qual		
Vinyl chloride	ND	0.0850									
1,1-Dichloroethene (DCE)	ND	0.00900									
trans-1,2-Dichloroethene	ND	0.00600									
cis-1,2-Dichloroethene	ND	0.0200									
Trichloroethene (TCE)	ND	0.0170									
Tetrachloroethene (PCE)	ND	0.0500									
Surr: 4-Bromofluorobenzene	11.7		10.00		117	70	130				

Sample ID:	1508262-001AREP	Samp Type:	REP	Batch ID:	R24574	Units:	ppbv	Prep Date:	8/27/2015	RunNo:	24574
Client ID:	BATCH	Result	RL	SPK value	SPK Ref Val	%REC	LowLimit	HighLimit	RPD Ref Val	%RPD	RPDLimit
Analyte	Result	RL	SPK value	SPK Ref Val	%REC	LowLimit	HighLimit	RPD Ref Val	Qual		
Vinyl chloride	ND	0.0850									
1,1-Dichloroethene (DCE)	ND	0.00900									
trans-1,2-Dichloroethene	ND	0.00600									
cis-1,2-Dichloroethene	ND	0.0200									
Trichloroethene (TCE)	ND	0.0170									
Tetrachloroethene (PCE)	ND	0.0500									
Surr: 4-Bromofluorobenzene											

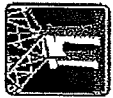

Fremont
ANALYTICAL

Date: 8/28/2015

Work Order: 1508293
CLIENT: Fulcrum Environmental
Project: Southgate Vapor Intrusion

QC SUMMARY REPORT
Volatile Organic Compounds-EPA Method TO-15 (SIM)

Sample ID: 1508262-001AREP	SampType: REP	Units: ppbv	Prep Date: 8/27/2015	RunNo: 24574
Client ID: BATCH	Batch ID: R24574		Analysis Date: 8/27/2015	SeqNo: 463148
Analyte	Result	RL	SPK value	SPK RefVal
Surr: 4-Bromofluorobenzene	10.5		10.00	
		%REC	LowLimit	HighLimit
		105	70	130
			%RPD	RPDLimit
			0	0
			RPD RefVal	Qual



Client Name: FE	Work Order Number: 1508293
Logged by: Clare Griggs	Date Received: 8/26/2015 2:00:00 PM

Chain of Custody

1. Is Chain of Custody complete? Yes No Not Present
2. How was the sample delivered? UPS

Log In

3. Coolers are present? Yes No NA
4. Shipping container/cooler in good condition? Air Sample
Yes No
5. Custody Seals present on shipping container/cooler?
(Refer to comments for Custody Seals not intact) Yes No Not Required
6. Was an attempt made to cool the samples? Yes No NA
7. Were all Items received at a temperature of >0°C to 10.0°C* Yes No NA
8. Sample(s) in proper container(s)? Yes No
9. Sufficient sample volume for indicated test(s)? Yes No
10. Are samples properly preserved? Yes No
11. Was preservative added to bottles? Yes No NA
12. Is there headspace in the VOA vials? Yes No NA
13. Did all samples containers arrive in good condition(unbroken)? Yes No
14. Does paperwork match bottle labels? Yes No
15. Are matrices correctly identified on Chain of Custody? Yes No
16. Is it clear what analyses were requested? Yes No
17. Were all holding times able to be met? Yes No

Special Handling (if applicable)

18. Was client notified of all discrepancies with this order? Yes No NA

Person Notified:	<input type="text"/>	Date:	<input type="text"/>
By Whom:	<input type="text"/>	Via:	<input type="checkbox"/> eMail <input type="checkbox"/> Phone <input type="checkbox"/> Fax <input type="checkbox"/> In Person
Regarding:	<input type="text"/>		
Client Instructions:	<input type="text"/>		

19. Additional remarks:

Item Information

* Note: DoD/ELAP and TNI require items to be received at 4°C +/- 2°C



Fremont
 2000 Fremont Ave N
 Seattle, WA 98103

Tel: 206-535-3700
 Fax: 206-535-2178

Date: 8.25.15

Laboratory Project No Internal:

15089993

Air Chain of Custody Record - Whole Air Sample

Page: 1 of 1

Project Name: Seabrook Vapor Extraction
 Project No: 14120500 Collected by: A. Setton

Location: Seabrook
 Reports To (PM): R. Matthews

Event (PM): Matthews, R. Matthews

Client: Fulcrum Environmental
 Address: 406 North 2nd Street
 City, State, Zip: Bellevue WA 98001
 Telephone: 206-574-0239 Fax: _____

* Gas Matrix Codes: L=Indoor S=Soil Gas L=Landfill SG=Soil Gas M=Flume Mapping Q=Flow Gas Quality L=LEED (Leanne client services)
 ** Container Codes: RL=Six liter Container (Summit) TS=Teal Bag BV=1 Liter Bottle Use MC=1 Liter MiniCan HP=High Pressure Cylinder HI=Gas Headspace Jar

Sample Name	Cylinder / How Rec'd Serial #	Sample Date & Time	Gas Matrix Code *	Anticipated Fill Time	Sample Volume	Container Type **	Pressure		Equipment Certification Code	Field Initial Pressure (TSP)	Field Final Sample Pressure (TSP)	Analysis Requested	Attended	
							Evacuated Pressure (mmHg)	Pressure at Time of Pack-up (TSP)					Field Pressure (TSP)	Field Pressure (TSP)
082515-01 (Box 2)	17636	8/25/15	I	24 hr	6L	Summit	0.715/0.30	10 mbar	07/15/030	30	05	1,1-Dichloroethene (DCE) 0,5-1,1-Dichloroethane Tetrachloroethene (PCE)		-1
		14:55								15:22	14:55	Wingl carbide trans-1,2-Dichloroethane Tetrachloroethene (TCE) by EPA Method TD-15 (SIM)		

Rental Equipment (Circle all that apply): Air Method Mini-Pump Fitting Tester Bag Container Gas Cylinder Helium Cylinder Bourdoned Tubing Summits

Conditions: Seal Intact Y N N/A

Requisitioned: 8/25/15 @ 1600 Date/Time: 8/25/15 @ 1600

Requisitioned: [Signature] Date/Time: 8/25/15 @ 1600

Special Remarks: Please see results to reprocessor @ Fulcrum via astop@fem.com

TAT: STD Rush: None



Fremont
ANALYTICAL

3600 Fremont Ave. N.
Seattle, WA 98103
T: (206) 352-3790
F: (206) 352-7178
info@fremontanalytical.com

Fulcrum Environmental
Ryan Mathews
406 N. 2nd Street
Yakima, WA 98901

RE: Southgate Vapor Intrusion
Lab ID: 1510016

October 08, 2015

Attention Ryan Mathews:

Fremont Analytical, Inc. received 3 sample(s) on 10/1/2015 for the analyses presented in the following report.

Volatile Organic Compounds-EPA Method TO-15 (SIM)

This report consists of the following:

- Case Narrative
- Analytical Results
- Applicable Quality Control Summary Reports
- Chain of Custody

All analyses were performed consistent with the Quality Assurance program of Fremont Analytical, Inc. Please contact the laboratory if you should have any questions about the results.

Thank you for using Fremont Analytical.

Sincerely,

Chelsea Ward
Project Manager

CC:
Ashley Steffen
Norm Hepner

www.fremontanalytical.com



Fremont

ANALYTICAL

Date: 10/09/2015

CLIENT: Fulcrum Environmental
Project: Southgate Vapor Intrusion
Lab Order: 1510016

Work Order Sample Summary

Lab Sample ID	Client Sample ID	Date/Time Collected	Date/Time Received
1510016-001	092915-03 (Wrays)	09/29/2015 5:00 PM	10/01/2015 1:16 PM
1510016-002	092915-02 (H&R)	09/29/2015 5:15 PM	10/01/2015 1:16 PM
1510016-003	092915-01 (Boost)	09/29/2015 4:55 PM	10/01/2015 1:16 PM

Note: If no "Time Collected" is supplied, a default of 12:00AM is assigned



CLIENT: Fulcrum Environmental
Project: Southgate Vapor Intrusion

I. SAMPLE RECEIPT:

Samples receipt information is recorded on the attached Sample Receipt Checklist.

II. GENERAL REPORTING COMMENTS:

Air samples are reported in ppbv and ug/m³.

The validity of the analytical procedures for which data is reported in this analytical report is determined by the Laboratory Control Sample (LCS) and the Method Blank (MB). The LCS and the MB are processed with the samples to ensure method criteria are achieved throughout the entire analytical process.

III. ANALYSES AND EXCEPTIONS:

Exceptions associated with this report will be footnoted in the analytical results page(s) or the quality control summary page(s) and/or noted below.

Standard temperature and pressure assumes 24.45 = (25C and 1 atm).



Qualifiers:

- * - Flagged value is not within established control limits
- B - Analyte detected in the associated Method Blank
- D - Dilution was required
- E - Value above quantitation range
- H - Holding times for preparation or analysis exceeded
- I - Analyte with an internal standard that does not meet established acceptance criteria
- J - Analyte detected below LOQ
- N - Tentatively Identified Compound (TIC)
- Q - Analyte with an initial or continuing calibration that does not meet established acceptance criteria (<20%RSD, <20% Drift or minimum RRF)
- S - Spike recovery outside accepted recovery limits
- ND - Not detected at the Reporting Limit

Acronyms:

- %Rec - Percent Recovery
- CCB - Continued Calibration Blank
- CCV - Continued Calibration Verification
- DF - Dilution Factor
- HEM - Hexane Extractable Material
- ICV - Initial Calibration Verification
- LCS/LCSD - Laboratory Control Sample / Laboratory Control Sample Duplicate
- MB or MBLANK - Method Blank
- MDL - Method Detection Limit
- MS/MSD - Matrix Spike / Matrix Spike Duplicate
- PDS - Post Digestion Spike
- Ref Val - Reference Value
- RL - Reporting Limit
- RPD - Relative Percent Difference
- SD - Serial Dilution
- SGT - Silica Gel Treatment
- SPK - Spike
- Surr - Surrogate



Fremont

ANALYTICAL

Client: Fulcrum Environmental
WorkOrder: 1510016
Project: Southgate Vapor Intrusion
Client Sample ID: 092915-03 (Wrays)
Lab ID: 1510016-001A
Sample Type: Summa Canister

Date Sampled: 9/29/2015
Date Received: 10/1/2015

Analyte	Concentration		Reporting Limit		Qual	Method	Date/Analyst
<u>Volatile Organic Compounds-EPA Method TO-15 (SIM)</u>							
	(ppbv)	(ug/m ³)	(ppbv)	(ug/m ³)			
1,1-Dichloroethene (DCE)	<0.00900	<0.0357	0.00900	0.0357		EPA-TO-15SIM	10/07/2015 JY
cis-1,2-Dichloroethene	<0.0200	<0.0793	0.0200	0.0793		EPA-TO-15SIM	10/07/2015 JY
Tetrachloroethene (PCE)	0.450	3.05	0.0500	0.339		EPA-TO-15SIM	10/07/2015 JY
trans-1,2-Dichloroethene	<0.00600	<0.0238	0.00600	0.0238		EPA-TO-15SIM	10/07/2015 JY
Trichloroethene (TCE)	<0.0170	<0.0914	0.0170	0.0914		EPA-TO-15SIM	10/07/2015 JY
Vinyl chloride	<0.0850	<0.217	0.0850	0.217		EPA-TO-15SIM	10/07/2015 JY
Surr: 4-Bromofluorobenzene	92.6 %Rec	--	70-130	--		EPA-TO-15SIM	10/07/2015 JY



Client: Fulcrum Environmental
 WorkOrder: 1510016
 Project: Southgate Vapor Intrusion

Client Sample ID: 092915-02 (H&R)
 Lab ID: 1510016-002A
 Sample Type: Summa Canister

Date Sampled: 9/29/2015
 Date Received: 10/1/2015

Analyte	Concentration		Reporting Limit		Qual	Method	Date/Analyst
<u>Volatile Organic Compounds-EPA Method TO-15 (SIM)</u>							
	(ppbv)	(ug/m ³)	(ppbv)	(ug/m ³)			
1,1-Dichloroethene (DCE)	<0.00900	<0.0357	0.00900	0.0357		EPA-TO-15SIM	10/07/2015 JY
cis-1,2-Dichloroethene	<0.0200	<0.0793	0.0200	0.0793		EPA-TO-15SIM	10/07/2015 JY
Tetrachloroethene (PCE)	0.0800	0.543	0.0500	0.339		EPA-TO-15SIM	10/07/2015 JY
trans-1,2-Dichloroethene	<0.00600	<0.0238	0.00600	0.0238		EPA-TO-15SIM	10/07/2015 JY
Trichloroethene (TCE)	<0.0170	<0.0914	0.0170	0.0914		EPA-TO-15SIM	10/07/2015 JY
Vinyl chloride	<0.0850	<0.217	0.0850	0.217		EPA-TO-15SIM	10/07/2015 JY
Surr: 4-Bromofluorobenzene	93.7 %Rec	--	70-130	--		EPA-TO-15SIM	10/07/2015 JY



Fremont

Client: Fulcrum Environmental
 WorkOrder: 1510016
 Project: Southgate Vapor Intrusion
 Client Sample ID: 092915-01 (Boost)
 Lab ID: 1510016-003A
 Sample Type: Summa Canister

Date Sampled: 9/29/2015
 Date Received: 10/1/2015

Analyte	Concentration		Reporting Limit		Qual	Method	Date/Analyst
<u>Volatile Organic Compounds-EPA Method TO-15 (SIM)</u>							
	(ppbv)	(ug/m ³)	(ppbv)	(ug/m ³)			
1,1-Dichloroethene (DCE)	<0.00900	<0.0357	0.00900	0.0357		EPA-TO-15SIM	10/07/2015 JY
cis-1,2-Dichloroethene	<0.0200	<0.0793	0.0200	0.0793		EPA-TO-15SIM	10/07/2015 JY
Tetrachloroethene (PCE)	0.140	0.950	0.0500	0.339		EPA-TO-15SIM	10/07/2015 JY
trans-1,2-Dichloroethene	<0.00600	<0.0238	0.00600	0.0238		EPA-TO-15SIM	10/07/2015 JY
Trichloroethene (TCE)	<0.0170	<0.0914	0.0170	0.0914		EPA-TO-15SIM	10/07/2015 JY
Vinyl chloride	<0.0850	<0.217	0.0850	0.217		EPA-TO-15SIM	10/07/2015 JY
Surr: 4-Bromofluorobenzene	90.3 %Rec	--	70-130	--		EPA-TO-15SIM	10/07/2015 JY



Date: 10/8/2015

QC SUMMARY REPORT
Volatle Organic Compounds-EPA Method TO-15 (SIM)

Work Order: 1510016
 CLIENT: Fulcrum Environmental
 Project: Southgate Vapor Intrusion

Sample ID	LCS-R25367	SampType: LCS	Units: ppbv	Prep Date: 10/7/2015	RunNo: 25367						
Client ID:	LCSW	Batch ID: R25367		Analysis Date: 10/7/2015	SeqNo: 478644						
Analyte	Result	RL	SPK value	SPK RefVal	%REC	LowLimit	HighLimit	RPD RefVal	%RPD	RPDLimit	Qual
Vinyl chloride	2.37	0.0850	2.500	0	94.8	70	130				
1,1-Dichloroethene (DCE)	2.40	0.00900	2.500	0	96.0	70	130				
trans-1,2-Dichloroethene	2.37	0.00600	2.500	0	94.8	70	130				
cis-1,2-Dichloroethene	2.39	0.0200	2.500	0	95.6	70	130				
Trichloroethene (TCE)	2.45	0.0170	2.500	0	98.0	70	130				
Tetrachloroethene (PCE)	2.42	0.0500	2.500	0	96.8	70	130				
Surr: 4-Bromofluorobenzene	10.2		10.00		102	70	130				

Sample ID	MB-R25367	SampType: MBLK	Units: ppbv	Prep Date: 10/7/2015	RunNo: 25367						
Client ID:	MBLKW	Batch ID: R25367		Analysis Date: 10/7/2015	SeqNo: 478645						
Analyte	Result	RL	SPK value	SPK RefVal	%REC	LowLimit	HighLimit	RPD RefVal	%RPD	RPDLimit	Qual
Vinyl chloride	ND	0.0850									
1,1-Dichloroethene (DCE)	ND	0.00900									
trans-1,2-Dichloroethene	ND	0.00600									
cis-1,2-Dichloroethene	ND	0.0200									
Trichloroethene (TCE)	ND	0.0170									
Tetrachloroethene (PCE)	ND	0.0500									
Surr: 4-Bromofluorobenzene	9.17		10.00		91.7	70	130				

Sample ID	1510016-001AREP	SampType: REP	Units: ppbv	Prep Date: 10/7/2015	RunNo: 25367						
Client ID:	092915-03 (Wtrays)	Batch ID: R25367		Analysis Date: 10/7/2015	SeqNo: 478636						
Analyte	Result	RL	SPK value	SPK RefVal	%REC	LowLimit	HighLimit	RPD RefVal	%RPD	RPDLimit	Qual
Vinyl chloride	ND	0.0850									30
1,1-Dichloroethene (DCE)	ND	0.00900									30
trans-1,2-Dichloroethene	ND	0.00600									30
cis-1,2-Dichloroethene	ND	0.0200									30
Trichloroethene (TCE)	ND	0.0170									30
Tetrachloroethene (PCE)	0.460	0.0500						0.4500	2.20		30



Fremont
ANALYTICAL

Date: 10/8/2015

QC SUMMARY REPORT
Volatile Organic Compounds-EPA Method TO-15 (SIM)

Work Order: 1510016
CLIENT: Fulcrum Environmental
Project: Southgate Vapor Intrusion

Sample ID: 1510016-001AREP SampType: REP Units: ppbv Prep Date: 10/7/2015 RunNo: 25367
Client ID: 092915-03 (Wrays) Batch ID: R25367 Analysis Date: 10/7/2015 SeqNo: 478636

Analyte: Surr. 4-Bromofluorobenzene Result: 9.34 RL: SPK value: 10.00 %REC: 93.4 LowLimit: 70 HighLimit: 130 RPD RefVal: %RPD: RPDLimit: 0 Qual:



Client Name: FE	Work Order Number: 1510016
Logged by: Erica Silva	Date Received: 10/1/2015 1:16:00 PM

Chain of Custody

1. Is Chain of Custody complete? Yes No Not Present
2. How was the sample delivered? UPS

Log In

3. Coolers are present? Yes No NA
- Air Samples
4. Shipping container/cooler in good condition? Yes No
5. Custody Seals present on shipping container/cooler? (Refer to comments for Custody Seals not intact) Yes No Not Required
6. Was an attempt made to cool the samples? Yes No NA
7. Were all items received at a temperature of >0°C to 10.0°C* Yes No NA
8. Sample(s) in proper container(s)? Yes No
9. Sufficient sample volume for indicated test(s)? Yes No
10. Are samples properly preserved? Yes No
11. Was preservative added to bottles? Yes No NA
12. Is there headspace in the VOA vials? Yes No NA
13. Did all samples containers arrive in good condition(unbroken)? Yes No
14. Does paperwork match bottle labels? Yes No
15. Are matrices correctly identified on Chain of Custody? Yes No
16. Is it clear what analyses were requested? Yes No
17. Were all holding times able to be met? Yes No

Special Handling (if applicable)

18. Was client notified of all discrepancies with this order? Yes No NA

Person Notified:	<u>Ahsley Steffen</u>	Date:	<u>10/1/2015</u>
By Whom:	<u>Erica Silva</u>	Via:	<input checked="" type="checkbox"/> eMail <input type="checkbox"/> Phone <input type="checkbox"/> Fax <input type="checkbox"/> In Person
Regarding:	<u>Sampling dates/times</u>		
Client Instructions:	<u>9/29/15, 16:55, 17:15, and 17:00</u>		

19. Additional remarks:

Item Information

* Note: DoD/ELAP and TNI require items to be received at 4°C +/- 2°C



Fremont
ANALYTICAL

3000 Fremont Ave. N.
Seattle, WA 98105
Tel: 206-352-3290
Fax: 206-352-3278

Date: _____

Air Chain of Custody Record - Whole Air Sample

Laboratory Project No (Internal): 1510016

Page 1 of 1

Client: Fulcrum Environmental Consulting, Inc.
Address: 406 N. 2nd St.
City, State, Zip: Yakima, WA 99201
Telephone: 509.579.0759 Fax: _____

Project Name: Southgate Labor Inspection
Project No: 14205 Collected by: Yakima, WA
Location: Yakima, WA
Reports to (PM): Ron Mathews
Email (PM): Rmathews@fulcrum.com

QA Marker Codes: I=Inlet SS=Substrate L=Landfill SG=Soil Gas M=Pinpoint Mapping Q=Real Gas Quality L=LEAD (Containment Area Service)
** Container Codes: EL=Seal/Leak Check (Summit) TB=Teal Bag BR=1 liter Bottle V=V MC=1 liter Minicon HP=High Pressure Cylinder HI=Glass Heatspacer

Sample Name	Container / Flow Rig Serial #	Sample Date & Time	Gas Matrix Code *	Anticipated Fill Time	Sample Volume	Container Type **	Assembly		Equipment Certification Code	Final Initial Sample Pressure (Psi)	Final Final Sample Pressure (Psi)	Analysis Requested	Receipt	
							Evacuation Pressure (Psi)	Pressure at Time of Pack-up (Psi)					Date	Initial Pressure (Psi)
092915-01 (BOST)	15422	FRB-07	I	24hr	6L	Summa	10 mbar	90MS 12-30	30	2	11-Dichloroethene (DCE) 015-1/2 Dichloroethene	15	10	
092915-02 (H&R)	15898	FRB-14	I	24hr	6L	Summa	10 mbar	90MS 12-30	30	4	Tetra chloroethene (PCE) trans-1,2 Dichloroethane (TCDE) Vinyl Chloride	15	10	
092915-03 (Woods)	17242	FRB-25	I	24hr	6L	Summa	10 mbar	90MS 12-30	30	9	by EPA Method 8210-15 (SM)	15	4	

Revised equipment (Check all that apply): Manifold Mini-Pump fittings Teal Bag Carriers Fuge Containers Helium Cylinder Fluorinated Tubing Wrench
Condition: _____ Seal Intact: Y N N/A
Date/Time: 9.30.15
Date/Time: 10/15/15
Date/Time: 13/10

Special Remarks: Please see results to: rmathews@fulcrum.com
TAT: ETD (Next Sample)

11 of 11

Updated 08-10-8-15 AS

Air Chain of Custody Record - Whole Air Sample

Inventory Number No. (optional): 151006

Project Name: Southgate Vapor Ingression Page: 1 of 1
 Project No: 14205 Collected by: _____
 Location: Yakima, WA
 Reports To (RW): Ryan Matthews
 Email (PM): r.matthews@deflamm.net

Client: Fulcrum Environmental Consulting, Inc.
Address: 406 N 2nd St
Yakima, WA 98901
City, State, Zip: _____
Telephone: 509.574.0839 Fax: _____

Site Information: **Weather:** _____
Instrument: _____
Operator/Technician: _____
Sample Date & Time: _____
Sample Time: _____
Sample Time: _____

Sample No.	Container Tag	Sample Time	Filter	Filter No.	Filter Status	Filter Type	Filter Size	Filter Material	Filter Price	Filter Notes	Filter Status	
092915-01 (Blank)	19242	9:29:15 4:55 PM	I	24N	6	Summa	20	Summa	1435	1055	11-Dichloroethane (DCE) 615-13 Dichloroethane	-10
092915-02 (H+B)	15898	4:29:15 5:15 PM	I	24N	2	Summa	30	Summa	30	4	Tetra chloroethane (PCE) Arans-12 Dichloroethane Trichloroethylene (TCE) Vinyl Chloride by EPA Method TO-15 (014)	-0
092915-03 (Witness)	15422	9:29:15 5:00 PM	I	24N	8	Summa	30	Summa	1715	9		-4

Analyst: _____
Analyst Title: _____
Company: _____
Signature: _____
Date: _____

Witness: _____
Witness Title: _____
Company: _____
Signature: _____
Date: _____

Comments: _____

Notes: _____



3600 Leacock Ave N.
Seattle, WA 98105
Tel: 206-352-3200
Fax: 206-352-7275

Air Chain of Custody Record - Whole Air Sample

Laboratory Project No (Internet): 15100116

Page 1 of 1

Project Name: Southgate Vapor Intrusion
 Project No: 14205
 Collected by: Yakima, WA
 Location: Yakima, WA
 Reports To (PM): Ryan Mathews
 Email (PM): r.mathews@efci.com.net

Client: Fulcrum Environmental Consulting, Inc.
 Address: 406 N. 2nd St.
 City, State, Zip: Yakima, WA 98901
 Telephone: 509.576.0239 Fax:

* Gas Matrix Codes: I = Indoor SS = Subsoils L = Landfill SC = Soil Gas VI = Vapor Mapping D = Fuel Gas Quality L = LEED (Comwall Client Services)
 ** Container Codes: 4L = 4L (liter) Canister (Sampling) TB = Teflon Bag BF = 1 Liter Bottle VAC = MC = 1 Liter M-Can NP = High Pressure Cylinder 30 = Glass Headspace Jar

Sample Name	Canister / Flow Reg Serial #	Sample Date & Time	Gas Matrix Code *	Acceptor Bag Fill Time	Sample Volume	Container Type **	Evacuation Pressure (psia)	Pressure at Time of Pk. (psia)	Equipment Certification Code	Field Final Sample Pressure (PSI)	Analysis Requested	Receipt Date	Final Pressure (PSI)
092915-013 (800ft) Mtrays	15422 FRB-07	9/15/15 6:00pm	I	24hr	6L	Summa	10 mbars 9/15 12:30	30 1715	1715	79	1,1-Dichloroethene (DCE) o,1s - 1,2 Dichloroethene	9/15	-10
092915-012 (114ft)	15898 FRB-14	9/15/15 5:55pm	I	24hr	6L	Summa	10 mbars 9/15 12:30	30 1899	1899	79	Tetra chloroethene (PCE) trans-1,2 Dichloroethene Trichloroethene (TCE) Vinyl Chloride	9/15	-10
092915-011 Boost (400ft)	17242 FRB-26	9/15/15 4:55pm	I	24hr	6L	Summa	10 mbars 9/15 12:30	30 1735	1735	92	by EPA Method TO-15 (GM)	9/15	-4

Special Equipment (Circle all that apply): Manifold Mini-Pump Fittings Fester Bags Canisters High Controllers Helium Cylinder Fouled Tubing Weighs

Condition: Reinspected Retest/Label

Date/Time: 9.30.15
 Date/Time: 9/30/15

Seals Intact: Y N N/A

Turn-around times for samples received after 4:00pm will begin on the following business day.

Special Remarks: Please see results to: nheper @efci.com.net as per attachment

TAT → STD (Rush Fee)



Fremont

3600 Fremont Ave. N.
Seattle, WA 98103
T: (206) 352-3790
F: (206) 352-7178
info@fremontanalytical.com

Fulcrum Environmental
Ryan Mathews
406 N. 2nd Street
Yakima, WA 98901

RE: Southgate Vapor Intrusion
Lab ID: 1511105

November 11, 2015

Attention Ryan Mathews:

Fremont Analytical, Inc. received 1 sample(s) on 11/11/2015 for the analyses presented in the following report.

Volatile Organic Compounds-EPA Method TO-15 (SIM)

This report consists of the following:

- Case Narrative
- Analytical Results
- Applicable Quality Control Summary Reports
- Chain of Custody

All analyses were performed consistent with the Quality Assurance program of Fremont Analytical, Inc. Please contact the laboratory if you should have any questions about the results.

Thank you for using Fremont Analytical.

Sincerely,

Chelsea Ward
Project Manager

www.fremontanalytical.com



Date: 11/11/2015

CLIENT: Fulcrum Environmental
Project: Southgate Vapor Intrusion
Lab Order: 1511105

Work Order Sample Summary

Lab Sample ID	Client Sample ID	Date/Time Collected	Date/Time Received
1511105-001	111015-01 (Boost)	11/10/2015 12:00 AM	11/11/2015 9:53 AM

Note: If no "Time Collected" is supplied, a default of 12:00AM is assigned



CLIENT: Fulcrum Environmental
Project: Southgate Vapor Intrusion

I. SAMPLE RECEIPT:

Samples receipt information is recorded on the attached Sample Receipt Checklist.

II. GENERAL REPORTING COMMENTS:

Air samples are reported in ppbv and ug/m3.

The validity of the analytical procedures for which data is reported in this analytical report is determined by the Laboratory Control Sample (LCS) and the Method Blank (MB). The LCS and the MB are processed with the samples to ensure method criteria are achieved throughout the entire analytical process.

III. ANALYSES AND EXCEPTIONS:

Exceptions associated with this report will be footnoted in the analytical results page(s) or the quality control summary page(s) and/or noted below.

Standard temperature and pressure assumes 24.45 = (25C and 1 atm).



Qualifiers:

- * - Flagged value is not within established control limits
- B - Analyte detected in the associated Method Blank
- D - Dilution was required
- E - Value above quantitation range
- H - Holding times for preparation or analysis exceeded
- I - Analyte with an internal standard that does not meet established acceptance criteria
- J - Analyte detected below Reporting Limit
- N - Tentatively Identified Compound (TIC)
- Q - Analyte with an initial or continuing calibration that does not meet established acceptance criteria (<20%RSD, <20% Drift or minimum RRF)
- S - Spike recovery outside accepted recovery limits
- ND - Not detected at the Reporting Limit
- R - High relative percent difference observed

Acronyms:

- %Rec - Percent Recovery
- CCB - Continued Calibration Blank
- CCV - Continued Calibration Verification
- DF - Dilution Factor
- HEM - Hexane Extractable Material
- ICV - Initial Calibration Verification
- LCS/LCSD - Laboratory Control Sample / Laboratory Control Sample Duplicate
- MB or MBLANK - Method Blank
- MDL - Method Detection Limit
- MS/MSD - Matrix Spike / Matrix Spike Duplicate
- PDS - Post Digestion Spike
- Ref Val - Reference Value
- RL - Reporting Limit
- RPD - Relative Percent Difference
- SD - Serial Dilution
- SGT - Silica Gel Treatment
- SPK - Spike
- Surr - Surrogate



Fremont

Client: Fulcrum Environmental
 WorkOrder: 1511105
 Project: Southgate Vapor Intrusion
 Client Sample ID: 111015-01 (Boost)
 Lab ID: 1511105-001A
 Sample Type: Summa Canister

Date Sampled: 11/10/2015
 Date Received: 11/11/2015

Analyte	Concentration		Reporting Limit		Qual	Method	Date/Analyst
<u>Volatile Organic Compounds-EPA Method TO-15 (SIM)</u>							
	(ppbv)	(ug/m ³)	(ppbv)	(ug/m ³)			
1,1-Dichloroethene (DCE)	<0.00900	<0.0357	0.00900	0.0357		EPA-TO-15SIM	11/11/2015 JY
cis-1,2-Dichloroethene	<0.0200	<0.0793	0.0200	0.0793		EPA-TO-15SIM	11/11/2015 JY
Tetrachloroethene (PCE)	0.0800	0.543	0.0500	0.339		EPA-TO-15SIM	11/11/2015 JY
trans-1,2-Dichloroethene	<0.00600	<0.0238	0.00600	0.0238		EPA-TO-15SIM	11/11/2015 JY
Trichloroethene (TCE)	<0.0170	<0.0914	0.0170	0.0914		EPA-TO-15SIM	11/11/2015 JY
Vinyl chloride	<0.0850	<0.217	0.0850	0.217		EPA-TO-15SIM	11/11/2015 JY
Surr: 4-Bromofluorobenzene	102 %Rec	--	70-130	--		EPA-TO-15SIM	11/11/2015 JY



Date: 11/11/2015

QC SUMMARY REPORT
Volatile Organic Compounds-EPA Method TO-15 (SIM)

Work Order: 1511105
 CLIENT: Fulcrum Environmental
 Project: Southgate Vapor Intrusion

Sample ID	LCS-R26038	SampType: LCS	Units: ppbv	Prep Date: 11/11/2015	RunNo: 26038						
Client ID:	LCSW	Batch ID: R26038		Analysis Date: 11/11/2015	SeqNo: 491834						
Analyte	Result	RL	SPK value	SPK Ref Val	%REC	LowLimit	HighLimit	RPD Ref Val	%RPD	RPDLimit	Qual
Vinyl chloride	1.78	0.0850	2.500	0	71.2	70	130				
1,1-Dichloroethene (DCE)	1.95	0.00900	2.500	0	78.0	70	130				
trans-1,2-Dichloroethene	2.29	0.00600	2.500	0	91.6	70	130				
cis-1,2-Dichloroethene	2.30	0.0200	2.500	0	92.0	70	130				
Trichloroethene (TCE)	2.47	0.0170	2.500	0	98.8	70	130				
Tetrachloroethene (PCE)	2.69	0.0500	2.500	0	108	70	130				
Surr: 4-Bromofluorobenzene	9.84		10.00		98.4	70	130				

Sample ID	MB-R26038	SampType: MBLK	Units: ppbv	Prep Date: 11/11/2015	RunNo: 26038						
Client ID:	MBLKW	Batch ID: R26038		Analysis Date: 11/11/2015	SeqNo: 491835						
Analyte	Result	RL	SPK value	SPK Ref Val	%REC	LowLimit	HighLimit	RPD Ref Val	%RPD	RPDLimit	Qual
Vinyl chloride	ND	0.0850									
1,1-Dichloroethene (DCE)	ND	0.00900									
trans-1,2-Dichloroethene	ND	0.00600									
cis-1,2-Dichloroethene	ND	0.0200									
Trichloroethene (TCE)	ND	0.0170									
Tetrachloroethene (PCE)	ND	0.0500									
Surr: 4-Bromofluorobenzene	9.85		10.00		98.5	70	130				

Sample ID	1511105-001AREP	SampType: REP	Units: ppbv	Prep Date: 11/11/2015	RunNo: 26038						
Client ID:	111015-01 (Boost)	Batch ID: R26038		Analysis Date: 11/11/2015	SeqNo: 491833						
Analyte	Result	RL	SPK value	SPK Ref Val	%REC	LowLimit	HighLimit	RPD Ref Val	%RPD	RPDLimit	Qual
Vinyl chloride	ND	0.0850						0		30	
1,1-Dichloroethene (DCE)	ND	0.00900						0		30	
trans-1,2-Dichloroethene	ND	0.00600						0		30	
cis-1,2-Dichloroethene	ND	0.0200						0		30	
Trichloroethene (TCE)	ND	0.0170						0		30	
Tetrachloroethene (PCE)	0.0800	0.0500						0.08000	0	30	



Date: 11/11/2015

QC SUMMARY REPORT
Volatile Organic Compounds-EPA Method TO-15 (SIM)

Work Order: 1511105
CLIENT: Fulcrum Environmental
Project: Southgate Vapor Intrusion

Sample ID 1511105-001AREP SampType: REP Units: ppbv Prep Date: 11/11/2015 RunNo: 26038
Client ID: 111015-01 (Boost) Batch ID: R26038 Analysis Date: 11/11/2015 SeqNo: 491833

Analyte	Result	RL	SPK value	SPK Ref Val	%REC	LowLimit	HighLimit	RPD Ref Val	%RPD	RPDLimit	Qual
Surf: 4-Bromofluorobenzene	10.1		10.00		101	70	130			0	



Client Name: FE	Work Order Number: 1511105
Logged by: Erica Silva	Date Received: 11/11/2015 9:53:00 AM

Chain of Custody

1. Is Chain of Custody complete? Yes No Not Present
2. How was the sample delivered? UPS

Log In

3. Coolers are present? Yes No NA
- Air Sample
4. Shipping container/cooler in good condition? Yes No
5. Custody Seals present on shipping container/cooler?
(Refer to comments for Custody Seals not intact) Yes No Not Required
6. Was an attempt made to cool the samples? Yes No NA
7. Were all items received at a temperature of >0°C to 10.0°C* Yes No NA
8. Sample(s) in proper container(s)? Yes No
9. Sufficient sample volume for indicated test(s)? Yes No
10. Are samples properly preserved? Yes No
11. Was preservative added to bottles? Yes No NA
12. Is there headspace in the VOA vials? Yes No NA
13. Did all samples containers arrive in good condition(unbroken)? Yes No
14. Does paperwork match bottle labels? Yes No
15. Are matrices correctly identified on Chain of Custody? Yes No
16. Is it clear what analyses were requested? Yes No
17. Were all holding times able to be met? Yes No

Special Handling (if applicable)

18. Was client notified of all discrepancies with this order? Yes No NA

Person Notified:	_____	Date:	_____
By Whom:	_____	Via:	<input type="checkbox"/> eMail <input type="checkbox"/> Phone <input type="checkbox"/> Fax <input type="checkbox"/> In Person
Regarding:	_____		
Client Instructions:	_____		

19. Additional remarks:

Item Information

* Note: DoD/ELAP and TNI require items to be received at 4°C +/- 2°C



Fremont
ANALYTICAL

3800 Fremont Ave N.
Seattle, WA 98108

Tel: 206-332-3790
Fax: 206-352-3178

Date: 11/15

Laboratory Project No. (Internally)

1511105

Air Chain of Custody Record - Whole Air Sample

Page: 1 of 1

Client: **Fulcrum Environmental**
Address: 406 North 2nd Street
City, State, Zip: Yakima, WA 98908
Telephone: 509-574-0835 Fax: _____

Project Name: Southgate Lower Indusion
Project No: 151105 Collected by: AVY
Location: Yakima, WA
Reports to (PM): Ryan Matthews
Email (PM): rmatthews@fulcrum.com

* Gas Matrix Codes: 1 = Indoor 35 = Substrate L = Landfill 55 = Soil Gas M = Plume Mapping Q = Fluid Gas Quality L = LEFD (Donnell Client Specific)
** Container Codes: 64 = 5L User Container (Normal) 78 = Tedlar Bag 8V = 1 Liter Bottle Vac MC = 1 Liter MiniCan HP = High Pressure Cylinder HJ = Glass Headspace Jar

Sample Name	Container / Flow Reg. Serial #	Sample Date & Time	Gas Matrix Code *	Anticongelated Kill Time	Sample Volume	Container Type **	Miscellaneous			Field Final Sample Pressure (Torr)	Analysis Requested	Receipt Date	Final Pressure (Torr)
							Evacuation Pressure (Torr)	Pressure at Time of Field (Torr)	Equipment Certification Code				
11/15-01 (Box)	15024	11/15		I	24hr	6L	Summa	10500	1458	1470	11/15	15	2

Special Remarks: Please see results to: nhepner@fulcrum.com as per letter

Requested by: Asley Ytic Date/Time: 11/15 @ 11:00

Requested by: [Signature] Date/Time: 11/15 09:53

Requested by: [Signature] Date/Time: [Signature]

Requested by: [Signature] Date/Time: [Signature]

Requested by: [Signature] Date/Time: [Signature]

Requested by: [Signature] Date/Time: [Signature]

Requested by: [Signature] Date/Time: [Signature]

Requested by: [Signature] Date/Time: [Signature]

Requested by: [Signature] Date/Time: [Signature]