

January 14, 2016



Mr. Roger Nye
Washington State Department of Ecology
3190 160th Ave SE
Bellevue, Washington 98008-5452

Subject: **Second Semi-annual 2015 Groundwater Monitoring and Sampling Report**
Former Standard Oil Service Station, Chevron Site No. 209335
1225 North 45th Street
Seattle, Washington

Dear Mr. Nye:

Leidos Inc. (Leidos), on behalf of Chevron Environmental Management Company (CEMC), prepared this letter summarizing the second semi-annual 2015 groundwater monitoring and sampling event at former Standard Oil Service Station, Chevron Site No. 209335 (the site) located in Seattle, Washington (Figure 1).

FIELD ACTIVITIES

Gettler-Ryan, Inc. (Gettler-Ryan) conducted the groundwater monitoring and sampling field event on October 21, 2015. Gettler-Ryan collected depth-to-groundwater measurements and checked for the presence of separate-phase hydrocarbons (SPH) in monitoring wells MW-6, MW-7, MW-8, MW-9, and MW-10. SPH were observed in monitoring well MW-7. Groundwater flow direction was toward the south at a gradient of approximately 0.002 to 0.009 feet per foot. A potentiometric map is provided as Figure 2.

Groundwater samples were collected from all monitoring wells and submitted under chain of custody (COC) procedures to Eurofins Lancaster Laboratories, Inc. in Lancaster, Pennsylvania for the following analyses:

- Total petroleum hydrocarbons (TPH) as gasoline-range organics by Northwest Method NWTPH-Gx;
- TPH as diesel-range organics and TPH as heavy oil-range organics by Northwest Method NWTPH-Dx extended with silica-gel cleanup;
- Benzene, toluene, ethylbenzene, and total xylenes by United States Environmental Protection Agency (USEPA) Method 8021B; and
- Total lead by USEPA Method 6020.

Field data sheets and COC documentation are provided in the Gettler-Ryan groundwater monitoring and sampling data package (Attachment A).

RESULTS

Groundwater elevations and flow direction during this event are consistent with historical data. Historical groundwater elevation data, SPH thickness data, and laboratory analytical results are summarized in Table 1. The laboratory analysis report is provided as Attachment B and hydrographs are included in Attachment C.

The results of the second semi-annual 2015 sampling event indicate that petroleum-hydrocarbon constituent concentrations have been below Model Toxics Control Act (MTCA) Method A cleanup levels for at least four consecutive quarters in monitoring wells MW-6, MW-8, and MW-9. Total lead concentration in monitoring well MW-10 was above the MTCA Method A cleanup level during this sampling event.

This event was the ninth monitoring and sampling event completed following the surfactant treatment activities conducted on March 18, 2013. SPH were detected in monitoring well MW-7 at a thickness of 0.40 feet, the highest observed since the post-surfactant extraction groundwater sample was collected on March 22, 2013.

If you have any questions or comments, please contact Ruth Otteman at (425) 482-3328 or via email at ottemanr@leidos.com.

Sincerely,

Leidos Inc.



Ruth Otteman, LG
Project Manager

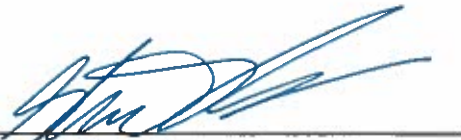

Stuart Brown
Environmental Scientist

Enclosures:

Figure 1 – Vicinity Map

Figure 2 – Potentiometric Map

Table 1 – Groundwater Monitoring Data and Analytical Results

Attachment A – Groundwater Monitoring and Sampling Data Package

Attachment B – Laboratory Analysis Report

Attachment C – Hydrographs

cc: Mr. Mark Horne – Chevron Environmental Management Company
6101 Bollinger Canyon Road, San Ramon, CA 94583
Ms. Veronica Redstone – Bellwether
1651 Bellevue Avenue, Seattle, WA 98122-2014
Project File

REPORT LIMITATIONS

This technical document was prepared on behalf of CEMC and is intended for its sole use and for use by the local, state or federal regulatory agency that the technical document was sent to by Leidos. Any other person or entity obtaining, using, or relying on this technical document hereby acknowledges that they do so at their own risk, and that Leidos shall have no responsibility or liability for the consequences thereof.

Site history and background information provided in this technical document are based on sources that may include interviews with environmental regulatory agencies and property management personnel and a review of acquired environmental regulatory agency documents and property information obtained from CEMC and others. Leidos has not made, nor has it been asked to make, any independent investigation concerning the accuracy, reliability, or completeness of such information beyond that described in this technical document.

Recognizing reasonable limits of time and cost, this technical document cannot wholly eliminate uncertainty regarding the vertical and lateral extent of impacted environmental media.

Opinions and recommendations presented in this technical document apply only to site conditions and features as they existed at the time of Leidos site visits or site work and cannot be applied to conditions and features of which Leidos is unaware and has not had the opportunity to evaluate.

All sources of information on which Leidos has relied in making its conclusions (including direct field observations) are identified by reference in this technical document or in appendices attached to this technical document. Any information not listed by reference or in appendices has not been evaluated or relied upon by Leidos in the context of this technical document. The conclusions, therefore, represent our professional opinion based on the identified sources of information.

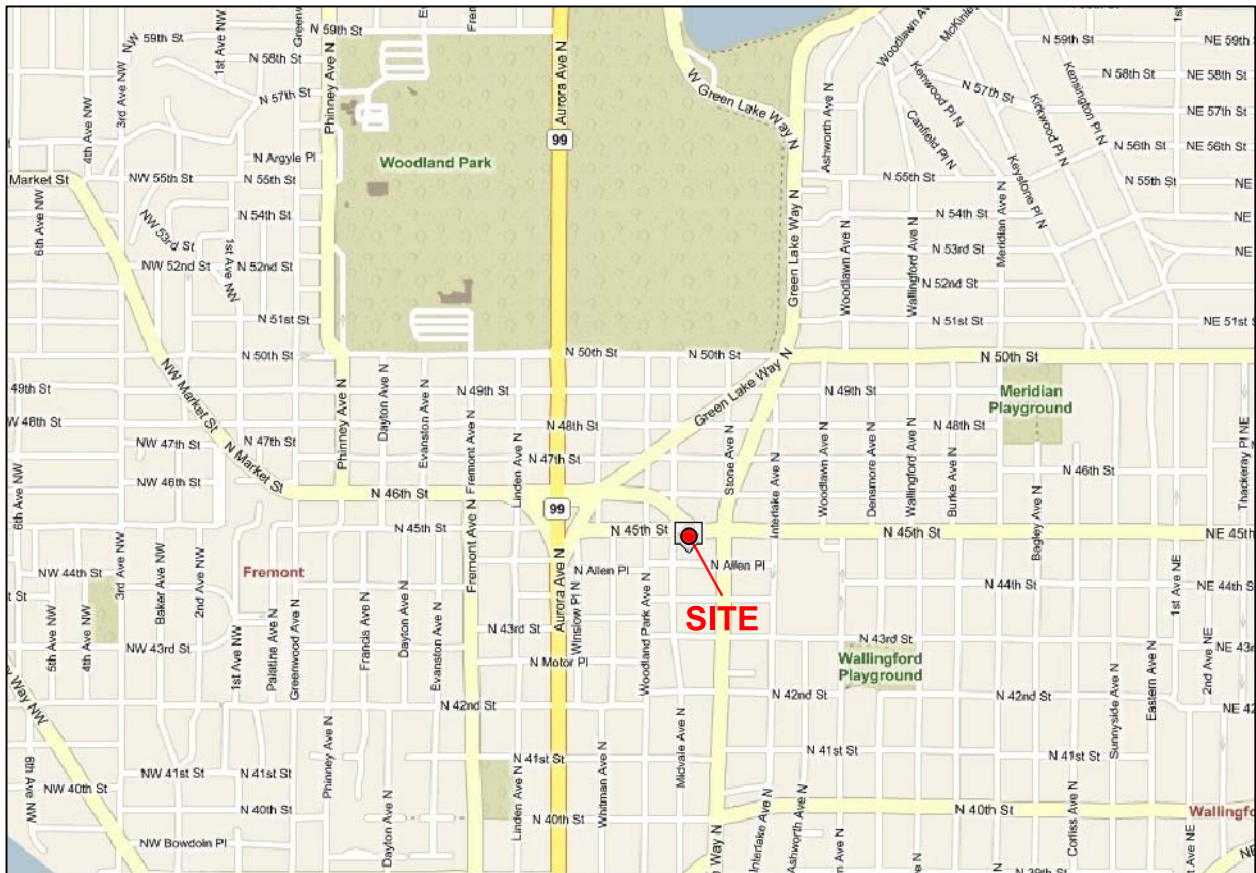

Maps Provided by Seattle.gov



Former Standard Oil Service Station
Chevron No. 209335
1225 North 45th Street
Seattle, Washington

FIGURE 1
Vicinity Map



FILE NAME:
209335 Vicinity Map.dwg

DATE:
8/7/2014

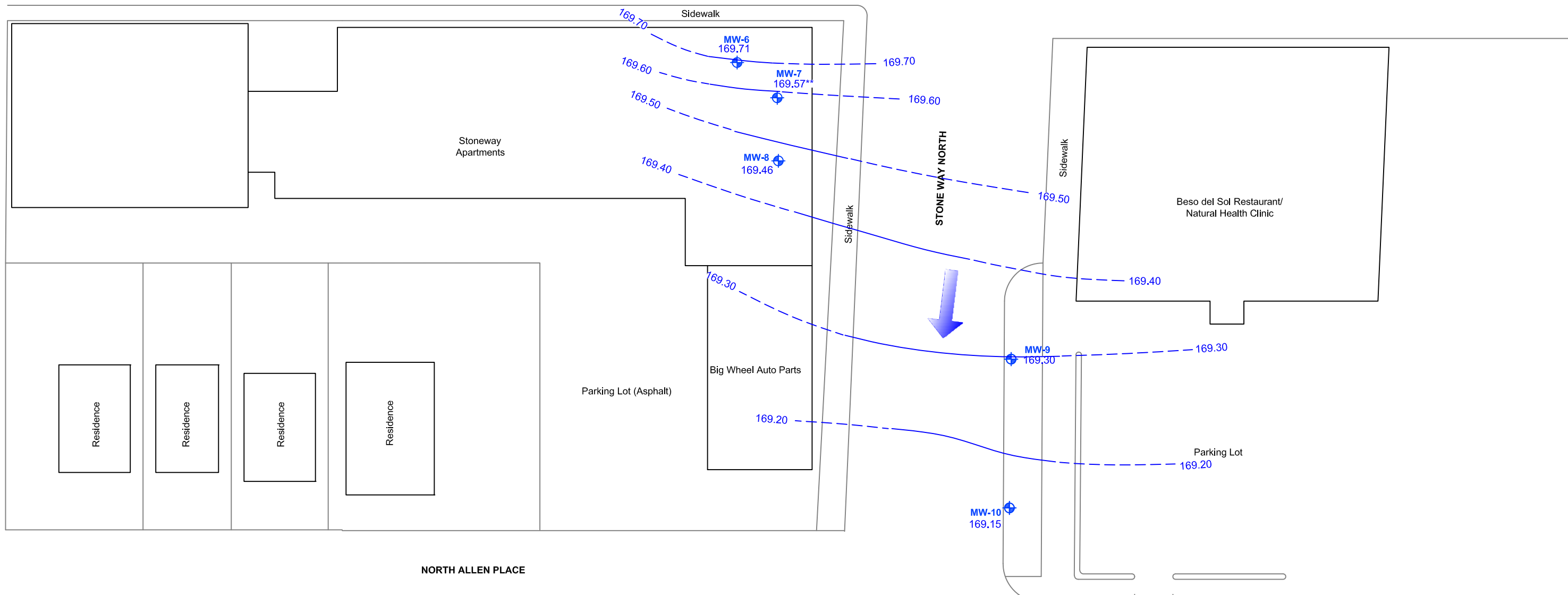
NORTH 45TH STREET



Legend

-  Groundwater Monitoring Well
- 169.46 Groundwater Elevation in Feet
- 169.57** Groundwater Elevation Corrected for SPH Presence
- 170.00 — Groundwater Elevation Contour at an 0.1-Foot Interval (Dashed Where Inferred)
-  Approximate Groundwater Flow Direction at a Gradient of 0.002 to 0.009 feet per foot

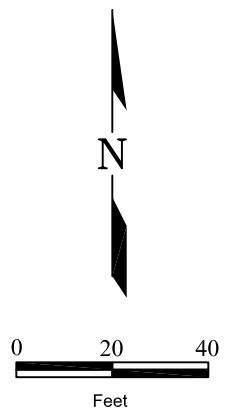

Former Standard Oil Service Station
 Chevron No. 209335
 1225 North 45th Street
 Seattle, Washington

FIGURE 2
 Potentiometric Map
 October 21, 2015

TABLE 1
GROUNDWATER MONITORING DATA AND ANALYTICAL RESULTS¹
FORMER STANDARD OIL SERVICE STATION, CHEVRON SITE NO. 209335
1225 North 45th Street
Seattle, Washington
Concentrations reported in µg/L

Well ID/ Date	Purge Method	TOC ² (ft.)	DTP (ft.)	DTW (ft.)	SPHT (ft.)	GWE ³ (ft.)	TPH-DRO	TPH-HRO	TPH-GRO	Benzene	Toluene	Ethyl- benzene	Total Xylenes	MTBE	Total Lead
MW-1															
10/11/00		97.95	--	34.50	--	63.45	--	--	--	--	--	--	--	--	--
12/16/00		97.95	--	35.91	0.00	62.04	ND	ND	74.4	ND	ND	ND	ND	ND	ND
03/26/01		97.95	--	36.54	0.00	61.41	ND	ND	ND	ND	ND	ND	ND	ND	--
06/25/01		97.95	--	36.78	0.00	61.17	<281	<842	<50.0	<0.500	<0.500	<0.500	<1.00	--	--
09/24/01		97.95	--	37.14	0.00	60.81	<250	<500	<50.0	<0.500	<0.500	<0.500	<1.00	--	--
12/13/01		97.95	--	37.25	0.00	60.70	<250	<500	<80.0	<0.500	<0.500	<0.500	<1.00	--	--
03/08/02	NP	97.95	--	36.79	0.00	61.16	<250	<750	<50	<0.50	<0.50	<0.50	<1.5	--	--
05/29/02		97.95	--	36.44	0.00	61.51	SAMPLED SEMIANNUALLY			--	--	--	--	--	--
09/16/02	NP	97.95	--	36.71	0.00	61.24	<250	<250	<50	<0.50	<0.50	<0.50	<1.5	--	--
12/05/02		97.95	--	37.09	0.00	60.86	SAMPLED SEMIANNUALLY			--	--	--	--	--	--
03/04/03	NP	97.95	--	37.26	0.00	60.69	<250	<250	100	<0.50	<0.50	<0.50	<3.0	--	--
06/03/03		97.95	--	37.09	0.00	60.86	SAMPLED SEMI-ANNUALLY			--	--	--	--	--	--
10/27/03		97.95	--	37.42	0.00	60.53	NOT SAMPLED DUE TO INSUFFICIENT WATER			--	--	--	--	--	--
03/31/04	NP	97.95	--	37.12	0.00	60.83	<800	<1,000	<50	<0.5	<0.5	<0.5	<1.5	--	--
06/28/04		97.95	--	37.14	0.00	60.81	SAMPLED SEMIANNUALLY			--	--	--	--	--	--
09/29/04		97.95	--	37.50	0.00	60.45	NOT SAMPLED DUE TO INSUFFICIENT WATER			--	--	--	--	--	--
01/04/05		97.95	--	37.61	0.00	60.34	SAMPLED SEMIANNUALLY			--	--	--	--	--	--
ABANDONED															
MW-2															
10/11/00		98.70	--	34.50	--	64.20	--	--	--	--	--	--	--	--	--
12/16/00		98.70	--	36.46	0.00	62.24	1,000	ND	28,100	283	2,560	693	4,020	ND	0.00194
03/26/01		98.70	--	37.12	0.00	61.58	1,180	ND	17,000	143	1,450	378	2,180	ND	--
06/25/01		98.70	--	37.37	0.00	61.33	418	<750	11,700	92.3	547	181	1,010	--	--
09/24/01		98.70	--	37.72	0.00	60.98	4,840	<557	22,100	120	1,380	658	4,100	--	--
12/13/01		98.70	--	37.89	0.00	60.81	5,540	<500	84,000	185	3,960	1,590	9,950	--	--
03/08/02		98.70	37.24	38.00	0.76	61.31	NOT SAMPLED DUE TO THE PRESENCE OF SPH			--	--	--	--	--	--
05/29/02		98.70	36.81	37.54	0.73	61.74	NOT SAMPLED DUE TO THE PRESENCE OF SPH			--	--	--	--	--	--
09/16/02		98.70	37.19	37.61	0.42	61.43	NOT SAMPLED DUE TO THE PRESENCE OF SPH			--	--	--	--	--	--
10/15/02		98.70	37.24	37.68	0.44	61.37	--	--	--	--	--	--	--	--	--
11/22/02		98.70	37.12	37.63	0.51	61.48	--	--	--	--	--	--	--	--	--
12/05/02		98.70	37.51	38.10	0.59	61.07	NOT SAMPLED DUE TO THE PRESENCE OF SPH			--	--	--	--	--	--
01/28/03		98.70	36.77	37.33	0.56	61.82	--	--	--	--	--	--	--	--	--
02/13/03		98.70	37.44	38.02	0.58	61.14	--	--	--	--	--	--	--	--	--
03/04/03		98.70	INACCESSIBLE - VEHICLE PARKED OVER WELL			--	--	--	--	--	--	--	--	--	--

TABLE 1
GROUNDWATER MONITORING DATA AND ANALYTICAL RESULTS¹
FORMER STANDARD OIL SERVICE STATION, CHEVRON SITE NO. 209335
1225 North 45th Street
Seattle, Washington
Concentrations reported in µg/L

Well ID/ Date	Purge Method	TOC ² (ft.)	DTP (ft.)	DTW (ft.)	SPHT (ft.)	GWE ³ (ft.)	TPH-DRO	TPH-HRO	TPH-GRO	Benzene	Toluene	Ethyl- benzene	Total Xylenes	MTBE	Total Lead
MW-2 (cont.)															
04/21/03		98.70	37.21	37.78	0.57	61.38	--	--	--	--	--	--	--	--	--
05/08/03		98.70	37.43	37.94	0.51	61.17	--	--	--	--	--	--	--	--	--
06/03/03		98.70	37.37	37.91	0.54	61.22	NOT SAMPLED DUE TO THE PRESENCE OF SPH				--	--	--		
07/06/03		98.70	36.96	37.51	0.55	61.63	--	--	--	--	--	--	--	--	--
08/18/03		98.70	37.49	38.02	0.53	61.10	--	--	--	--	--	--	--	--	--
10/27/03		98.70	37.54	39.98	2.44	60.67	NOT SAMPLED DUE TO THE PRESENCE OF SPH				--	--	--		
11/17/03		98.70	37.10	37.58	0.48	61.50	--	--	--	--	--	--	--	--	--
12/31/03		98.70	36.18	38.19	2.01	62.12	--	--	--	--	--	--	--	--	--
02/09/04		98.70	37.00	37.49	0.49	61.60	--	--	--	--	--	--	--	--	--
03/04/04		98.70	35.85	37.06	1.21	62.61	--	--	--	--	--	--	--	--	--
03/31/04		98.70	37.32	39.05	1.73	61.03	NOT SAMPLED DUE TO THE PRESENCE OF SPH				--	--	--		
06/28/04		98.70	37.32	39.05	1.73	61.03	NOT SAMPLED DUE TO THE PRESENCE OF SPH				--	--	--		
09/11/04		98.70	37.65	39.10	1.45	60.76	--	--	--	--	--	--	--	--	--
09/29/04		98.70	37.71	39.39	1.68	60.65	NOT SAMPLED DUE TO THE PRESENCE OF SPH				--	--	--		
11/22/04		98.70	36.89	38.16	1.27	61.56	--	--	--	--	--	--	--	--	--
01/04/05		98.70	37.88	39.80	1.92	60.44	NOT SAMPLED DUE TO THE PRESENCE OF SPH				--	--	--		
01/14/05		98.70	37.49	39.02	1.53	60.90	--	--	--	--	--	--	--	--	--
ABANDONED															
MW-3															
10/11/00		98.76	--	34.00	--	64.76	--	--	--	--	--	--	--	--	--
12/16/00		98.76	--	36.39	0.00	62.37	ND	ND	ND	ND	0.612	ND	1.95	ND	ND
03/26/01		98.76	--	37.05	0.00	61.71	ND	ND	ND	ND	ND	ND	ND	ND	--
06/25/01		98.76	--	37.29	0.00	61.47	<250	<750	<50.0	<0.500	<0.500	<0.500	<1.00	--	--
09/24/01		98.76	--	37.64	0.00	61.12	<250	<500	<50.0	<0.500	<0.500	<0.500	<1.00	--	--
12/13/01		98.76	--	37.78	0.00	60.98	<250	<500	<80.0	<0.500	<0.500	<0.500	<1.00	--	--
03/08/02	NP	98.76	--	37.28	0.00	61.48	<250	<750	320	<0.50	0.64	2.1	15	--	--
05/29/02		98.76	--	36.92	0.00	61.84	SAMPLED SEMIANNUALLY				--	--	--	--	
09/16/02	NP	98.76	--	37.21	0.00	61.55	<250	<250	<50	<0.50	<0.50	<0.50	<1.5	--	--
12/05/02		98.76	--	37.58	0.00	61.18	SAMPLED SEMIANNUALLY				--	--	--	--	
03/04/03	NP	98.76	--	37.79	0.00	60.97	<250	<250	<50	<0.50	<0.50	<0.50	<1.5	--	--
06/03/03		98.76	--	37.68	0.00	61.08	SAMPLED SEMIANNUALLY				--	--	--	--	
10/27/03	NP	98.76	--	38.00	0.00	60.76	<250	<250	<50	<0.5	<0.5	<0.5	<1.5	--	--
03/31/04	NP	98.76	--	37.65	0.00	61.11	<800	<1,000	<50	<0.5	<0.5	<0.5	<1.5	--	--

TABLE 1
GROUNDWATER MONITORING DATA AND ANALYTICAL RESULTS¹
FORMER STANDARD OIL SERVICE STATION, CHEVRON SITE NO. 209335
1225 North 45th Street
Seattle, Washington
Concentrations reported in µg/L

Well ID/ Date	Purge Method	TOC ² (ft.)	DTP (ft.)	DTW (ft.)	SPHT (ft.)	GWE ³ (ft.)	TPH-DRO	TPH-HRO	TPH-GRO	Benzene	Toluene	Ethyl- benzene	Total Xylenes	MTBE	Total Lead
MW-3 (cont.)															
06/28/04		98.76	--	37.68	0.00	61.08	SAMPLED SEMIANNUALLY			--	--	--	--	--	--
09/29/04	NP	98.76	--	38.01	0.00	60.75	<250	<250	<50	<0.5	<0.5	<0.5	<1.5	--	--
01/04/05		98.76	--	38.19	0.00	60.57	SAMPLED SEMIANNUALLY			--	--	--	--	--	--
ABANDONED															
MW-4															
10/11/00		98.52	--	35.00	--	63.52	--	--	--	--	--	--	--	--	--
12/16/00		98.52	--	36.35	0.00	62.17	ND	ND	58,200	326	5,520	1,430	8,520	ND	0.0123
03/26/01		98.52	--	37.00	0.00	61.52	266	ND	27,200	178	2,160	785	4,160	ND	--
06/25/01		98.52	--	37.25	0.00	61.27	<250	<750	12,300	69.0	654	416	1,910	--	--
09/24/01		98.52	--	37.60	0.00	60.92	<250	<500	4,130	30.1	154	197	684	--	--
12/13/01		98.52	--	37.72	0.00	60.80	<250	<500	5,490	30.3	175	177	679	--	--
03/08/02	NP	98.52	--	38.36	0.00	60.16	<250	<750	9,000	<50	150	170	710	--	--
05/29/02	NP	98.52	--	36.86	0.00	61.66	<250	<750	6,700	22	150	190	780	--	--
08/07/02		98.52	--	36.92	0.00	61.60	--	--	--	--	--	--	--	--	--
09/16/02	NP	98.52	--	37.16	0.00	61.36	<250	<250	7,500	46	230	240	630	--	--
12/05/02	NP	98.52	--	37.53	0.00	60.99	<250	<250	14,000	73	400	540	1,500	--	--
03/04/03		98.52	36.68	36.71	0.03	61.83	NOT SAMPLED DUE TO THE PRESENCE OF SPH			--	--	--	--	--	--
06/03/03		98.52	36.59	36.63	0.04	61.92	NOT SAMPLED DUE TO THE PRESENCE OF SPH			--	--	--	--	--	--
07/06/03		98.52	36.90	36.93	0.03	61.61	--	--	--	--	--	--	--	--	--
08/18/03		98.52	36.76	36.80	0.04	61.75	--	--	--	--	--	--	--	--	--
10/27/03	NP	98.52	--	37.96	0.00	60.56	<400	<500	2,200	16	55	76	170	--	--
11/17/03		98.52	36.34	36.37	0.03	62.17	--	--	--	--	--	--	--	--	--
12/31/03		98.52	--	36.88	0.00	61.64	--	--	--	--	--	--	--	--	--
02/09/04		98.52	36.14	36.17	0.03	62.37	--	--	--	--	--	--	--	--	--
03/04/04		98.52	--	36.74	0.00	61.78	--	--	--	--	--	--	--	--	--
03/31/04	NP	98.52	--	37.59	0.00	60.93	<250	<250	3,900	14	96	110	340	--	--
06/28/04	NP	98.52	--	37.54	0.00	60.98	<250	<250	1,600	8.5	15	59	110	--	--
09/11/04		98.52	37.78	37.81	0.03	60.73	--	--	--	--	--	--	--	--	--
09/29/04	NP	98.52	--	37.86	0.00	60.66	<250	<250	1,500	18	40	76	170	--	--
11/22/04		98.52	--	36.81	0.00	61.71	--	--	--	--	--	--	--	--	--
01/04/05	NP	98.52	--	38.11	0.00	60.41	1,600	<250	1,600	10	13	60	110	--	--
01/14/05		98.52	--	37.58	0.00	60.94	--	--	--	--	--	--	--	--	--
ABANDONED															

TABLE 1
GROUNDWATER MONITORING DATA AND ANALYTICAL RESULTS¹
FORMER STANDARD OIL SERVICE STATION, CHEVRON SITE NO. 209335
1225 North 45th Street
Seattle, Washington
Concentrations reported in µg/L

Well ID/ Date	Purge Method	TOC ² (ft.)	DTP (ft.)	DTW (ft.)	SPHT (ft.)	GWE ³ (ft.)	TPH-DRO	TPH-HRO	TPH-GRO	Benzene	Toluene	Ethyl- benzene	Total Xylenes	MTBE	Total Lead
MW-5															
10/11/00		99.42	--	34.50	--	64.92	--	--	--	--	--	--	--	--	--
12/16/00		99.42	--	37.18	0.00	62.24	5,080	ND	146,000	ND	15,100	4,160	24,100	ND	0.0200
03/26/01		99.42	--	37.91	0.00	61.51	77,900	ND	149,000	256	10,600	4,000	24,200	ND	--
06/25/01		99.42	--	38.14	0.00	61.28	109,000	<18,100	127,000	210	9,580	3,730	21,500	--	--
09/24/01		99.42	38.40	38.44	0.04	61.01	NOT SAMPLED DUE TO THE PRESENCE OF SPH				--	--	--	--	
12/13/01		99.42	38.55	38.59	0.04	60.86	NOT SAMPLED DUE TO THE PRESENCE OF SPH				--	--	--	--	
03/08/02		99.42	37.96	38.46	0.50	61.36	NOT SAMPLED DUE TO THE PRESENCE OF SPH				--	--	--	--	
05/29/02		99.42	37.60	38.05	0.45	61.73	NOT SAMPLED DUE TO THE PRESENCE OF SPH				--	--	--	--	
08/07/02		99.42	37.73	38.12	0.39	61.61	--	--	--	--	--	--	--	--	--
09/16/02		99.42	38.00	38.39	0.39	61.34	NOT SAMPLED DUE TO THE PRESENCE OF SPH				--	--	--	--	
10/15/02		99.42	38.09	38.47	0.38	61.25	--	--	--	--	--	--	--	--	--
11/22/02		99.42	37.84	38.26	0.42	61.50	--	--	--	--	--	--	--	--	--
12/05/02		99.42	38.42	38.78	0.36	60.93	NOT SAMPLED DUE TO THE PRESENCE OF SPH				--	--	--	--	
01/28/03		99.42	37.88	38.24	0.36	61.47	--	--	--	--	--	--	--	--	--
02/13/03		99.42	38.33	38.68	0.35	61.02	--	--	--	--	--	--	--	--	--
03/04/03		99.42	37.54	37.89	0.35	61.81	NOT SAMPLED DUE TO THE PRESENCE OF SPH				--	--	--	--	
04/21/03		99.42	37.96	38.29	0.33	61.39	--	--	--	--	--	--	--	--	--
05/08/03		99.42	38.50	38.82	0.32	60.86	--	--	--	--	--	--	--	--	--
06/03/03		99.42	37.42	37.76	0.34	61.93	NOT SAMPLED DUE TO THE PRESENCE OF SPH				--	--	--	--	
07/06/03		99.42	37.77	38.11	0.34	61.58	--	--	--	--	--	--	--	--	--
08/18/03		99.42	38.54	38.86	0.32	60.82	--	--	--	--	--	--	--	--	--
10/27/03		99.42	WELL DRY/OBSTRUCTED			--	--	--	--	--	--	--	--	--	--
11/17/03		99.42	37.87	38.17	0.30	61.49	--	--	--	--	--	--	--	--	--
12/31/03		99.42	WELL DRY/OBSTRUCTED			--	--	--	--	--	--	--	--	--	--
02/09/04		99.42	WELL DRY/OBSTRUCTED			--	--	--	--	--	--	--	--	--	--
03/04/04		99.42	WELL DRY/OBSTRUCTED			--	--	--	--	--	--	--	--	--	--
03/31/04		99.42	WELL DRY/OBSTRUCTED			--	--	--	--	--	--	--	--	--	--
06/28/04		99.42	WELL DRY/OBSTRUCTED			--	--	--	--	--	--	--	--	--	--
09/11/04		99.42	WELL DRY/OBSTRUCTED			--	--	--	--	--	--	--	--	--	--
09/29/04		99.42	WELL DRY/OBSTRUCTED			--	--	--	--	--	--	--	--	--	--
11/22/04		99.42	WELL DRY/OBSTRUCTED			--	--	--	--	--	--	--	--	--	--
01/04/05		99.42	WELL DRY/OBSTRUCTED			--	--	--	--	--	--	--	--	--	--
01/14/05		99.42	WELL DRY/OBSTRUCTED			--	--	--	--	--	--	--	--	--	--
ABANDONED															
MW-6															
02/09/06		197.18	--	36.74	0.00	160.44	680	98	1,500	<0.5	0.7	1.2	37	--	--
05/03/07		197.18	--	36.74	0.00	160.44	1,000	130	380	29	1	4	30	--	--

TABLE 1
GROUNDWATER MONITORING DATA AND ANALYTICAL RESULTS¹
FORMER STANDARD OIL SERVICE STATION, CHEVRON SITE NO. 209335
1225 North 45th Street
Seattle, Washington
Concentrations reported in µg/L

Well ID/ Date	Purge Method	TOC ² (ft.)	DTP (ft.)	DTW (ft.)	SPHT (ft.)	GWE ³ (ft.)	TPH-DRO	TPH-HRO	TPH-GRO	Benzene	Toluene	Ethyl- benzene	Total Xylenes	MTBE	Total Lead
MW-6 (cont.)															
06/16/09		197.18	INACCESSIBLE	--	--	--	--	--	--	--	--	--	--	--	--
07/01/09	NP	197.18	--	27.46	0.00	169.72	270	<70	<50	<0.5	<0.5	<0.5	<1.5	--	22.9
12/11/09	NP	197.18	--	27.55	0.00	169.63	35	<69	<50	<0.5	<0.5	<0.5	<1.5	--	0.76
06/09/10	NP	197.18	--	26.84	0.00	170.34	360	<340	5,900	<0.5	<0.5	<0.5	350	--	13.2
11/19/10	NP	197.18	--	26.97	0.00	170.21	240	81	750	<0.5	<0.5	<0.5	11	--	3.7
06/21/11	NP	197.18	--	25.77	0.00	171.41	270	88	2,400	<0.5	<0.5	0.6	9.2	--	3.2
09/22/11	NP	197.18	--	25.90	0.00	171.28	<29	<69	660	<0.5	<0.5	<0.5	4.1	--	3.3
12/09/11	NP	197.18	--	27.34	0.00	169.84	<29	<69	64	140	0.5	<0.5	<1.5	--	0.44
03/30/12	NP	197.18	--	26.80	0.00	170.38	<30	<69	90	<0.5	<0.5	<0.5	<1.5	--	2.5
06/20/12	NP	197.18	--	26.56	0.00	170.62	<30	<70	<50	<0.5	<0.5	<0.5	<1.5	--	<0.034
10/05/12	NP	197.18	--	27.08	0.00	170.10	<32	<74	<50	<0.5	<0.5	<0.5	<1.5	--	1.2
12/27/12	NP	197.18	--	27.13	0.00	170.05	<29	<67	<50	<0.5	<0.5	<0.5	<1.5	--	2.0
03/18/13 ⁸		197.18	--	26.63	0.00	170.55	<30	<71	120	<0.5	<0.5	<0.5	<1.5	--	--
03/22/13 ⁹		197.18	--	26.71	0.00	170.47	<31	<72	100	<0.5	<0.5	<0.5	<1.5	--	--
03/28/13	NP	197.18	--	26.61	0.00	170.57	<29	<67	79	<0.5	<0.5	<0.5	<1.5	--	3.7
06/27/13	NP	197.18	--	26.42	0.00	170.76	<29	<68	120	<0.5	<0.5	<0.5	<1.5	--	1.3
10/17/13	NP	197.18	--	26.64	0.00	170.54	<29	<68	<50	<0.5	<0.5	<0.5	<1.5	--	0.3
03/20/14	NP	197.18	--	26.68	0.00	170.50	<30	<70	<50	<0.5	<0.5	<0.5	<1.5	--	4.0
06/25/14	NP	197.18	--	26.85	0.00	170.33	<29	<67	<50	<0.5	<0.5	<0.5	<1.5	--	2.1
09/24/14	NP	197.18	--	27.19	0.00	169.99	<28	<66	<50	<0.2	<0.2	<0.2	<0.2	--	0.00048
12/11/14	NP	197.18	--	27.16	0.00	170.02	<28	<66	<50	<0.5	<0.5	<0.5	<1.5	--	1.5
03/11/15	NP	197.18	--	26.66	0.00	170.52	<30	<71	<50	<0.5	0.5	<0.5	<1.5	--	0.0063
10/21/15	NP	197.18	--	27.47	0.00	169.71	<28	<66	<50	<0.5	<0.5	<0.5	<1.5	--	10.9
MW-7															
02/09/06		197.42	37.87	38.17	0.30	159.49	--	--	--	--	--	--	--	--	--
05/03/07		197.42	26.55	27.80	0.00	169.62	--	--	--	--	--	--	--	--	--
06/16/09		197.42	INACCESSIBLE	--	--	--	--	--	--	--	--	--	--	--	--
07/01/09 ⁶		197.42	27.39	-- ⁷	-- ⁷	-- ⁷	NOT SAMPLED DUE TO THE PRESENCE OF SPH					--	--	--	--
12/11/09 ⁶		197.42	27.50	-- ⁷	-- ⁷	-- ⁷	NOT SAMPLED DUE TO THE PRESENCE OF SPH					--	--	--	--
06/09/10 ⁶		197.42	27.03	28.20	1.17	170.16	NOT SAMPLED DUE TO THE PRESENCE OF SPH					--	--	--	--
11/19/10		197.42	27.08	28.34	1.26	170.09	NOT SAMPLED DUE TO THE PRESENCE OF SPH					--	--	--	--
06/21/11		197.42	--	26.12	0.00	171.30	11,000	<1,800	150,000	45	4,800	2,600	18,000	--	310
09/22/11		197.42	--	26.25	0.00	171.17	2,000	<340	100,000	29	4,300	1,900	17,000	--	94.4

TABLE 1
GROUNDWATER MONITORING DATA AND ANALYTICAL RESULTS¹
FORMER STANDARD OIL SERVICE STATION, CHEVRON SITE NO. 209335
1225 North 45th Street
Seattle, Washington
Concentrations reported in µg/L

Well ID/ Date	Purge Method	TOC ² (ft.)	DTP (ft.)	DTW (ft.)	SPHT (ft.)	GWE ³ (ft.)	TPH-DRO	TPH-HRO	TPH-GRO	Benzene	Toluene	Ethyl- benzene	Total Xylenes	MTBE	Total Lead
MW-7 (cont.)															
12/09/11		197.42	27.45	27.80	0.35	169.90	NOT SAMPLED DUE TO THE PRESENCE OF SPH					--	--	--	--
03/30/12		197.42	27.15	27.35	0.20	170.23	NOT SAMPLED DUE TO THE PRESENCE OF SPH					--	--	--	--
06/20/12		197.42	26.90	27.05	0.15	170.49	NOT SAMPLED DUE TO THE PRESENCE OF SPH					--	--	--	--
10/05/12		197.42	27.38	27.76	0.38	169.96	NOT SAMPLED DUE TO THE PRESENCE OF SPH					--	--	--	--
12/27/12		197.42	27.46	27.65	0.19	169.92	NOT SAMPLED DUE TO THE PRESENCE OF SPH					--	--	--	--
03/18/13 ⁸		197.42	27.01	27.18	0.17	170.38	NOT SAMPLED DUE TO THE PRESENCE OF SPH					--	--	--	--
03/22/13 ⁹		197.42	--	27.03	0.00	170.39	5,200	<69	99,000	12	1,600	1,700	17,000	--	--
03/28/13		197.42	26.91	27.00	0.09	170.49	NOT SAMPLED DUE TO THE PRESENCE OF SPH					--	--	--	--
06/27/13		197.42	26.77	26.79	0.02	170.65	NOT SAMPLED DUE TO THE PRESENCE OF SPH					--	--	--	--
10/17/13		197.42	27.03	27.05	0.02	170.39	NOT SAMPLED DUE TO THE PRESENCE OF SPH					--	--	--	--
03/20/14		197.42	26.99	27.11	0.12	170.41	NOT SAMPLED DUE TO THE PRESENCE OF SPH					--	--	--	--
06/25/14		197.42	27.26	27.28	0.02	170.16	NOT SAMPLED DUE TO THE PRESENCE OF SPH					--	--	--	--
09/24/14		197.42	27.56	27.61	0.05	169.85	NOT SAMPLED DUE TO THE PRESENCE OF SPH					--	--	--	--
12/11/14	NP	197.42	--	27.50	0.00	169.92	55,000	<6,900	96,000	<13	600	660	14,000	--	168
03/11/15	NP	197.42	--	26.96	0.00	170.46	200,000	<17,000	65,000	<5.0	470	570	6,700	--	0.0717
10/21/15		197.42	27.77	28.17	0.40	169.57	NOT SAMPLED DUE TO THE PRESENCE OF SPH					--	--	--	--
MW-8															
02/09/06		197.35	--	36.74	0.00	160.61	280	<96	440	<0.5	1.1	3.3	28	--	--
05/03/07		197.35	--	36.74	0.00	160.61	940	<200	2,600	<0.5	<0.5	<0.5	<0.5	--	--
06/16/09		197.35	INACCESSIBLE			--	--	--	--	--	--	--	--	--	--
07/01/09	NP	197.35	--	27.84	0.00	169.51	390	<700	430	<0.5	<0.5	<0.5	2.2	--	3.5
12/11/09	NP	197.35	--	27.91	0.00	169.44	300	<69	<50	<0.5	<0.5	<0.5	<1.5	--	7.3
06/09/10	NP	197.35	--	27.21	0.00	170.14	280	180	350	<0.5	<0.5	<0.5	<1.5	--	16.5
11/19/10	NP	197.35	--	27.34	0.00	170.01	320	120	94	<0.5	<0.5	<0.5	<1.5	--	3.4
06/21/11	NP	197.35	--	26.18	0.00	171.17	94	150	54	<0.5	<0.5	1.0	<1.5	--	3.6
09/22/11	NP	197.35	--	26.30	0.00	171.05	<29	<68	140	<0.5	<0.5	2.9	1.70	--	1.8
12/09/11	NP	197.35	--	27.70	0.00	169.65	70	<69	320	<2.0	<2.0	<0.5	3.0	--	0.30
03/30/12	NP	197.35	--	27.20	0.00	170.15	<30	<70	2,000	3.0	3.9	45	120	--	2.9
06/20/12	NP	197.35	--	27.00	0.00	170.35	<30	<70	170	0.7	0.7	1.3	2.2	--	1.8
10/05/12	NP	197.35	--	27.49	0.00	169.86	<31	<71	490	1.0	1.7	19	32	--	1.3
12/27/12	NP	197.35	--	27.49	0.00	169.86	<29	<68	280	0.6	0.7	4.7	6.8	--	1.1
03/18/13 ⁸		197.35	--	27.06	0.00	170.29	<30	<70	320	<0.5	<0.5	29	22	--	--
03/22/13 ⁹		197.35	--	27.13	0.00	170.22	<29	<68	360	<0.5	<0.5	29	22	--	--
03/28/13	NP	197.35	--	27.09	0.00	170.26	<29	<67	80	<0.5	<0.5	<0.5	<1.5	--	1.9

TABLE 1
GROUNDWATER MONITORING DATA AND ANALYTICAL RESULTS¹
FORMER STANDARD OIL SERVICE STATION, CHEVRON SITE NO. 209335
1225 North 45th Street
Seattle, Washington
Concentrations reported in µg/L

Well ID/ Date	Purge Method	TOC ² (ft.)	DTP (ft.)	DTW (ft.)	SPHT (ft.)	GWE ³ (ft.)	TPH-DRO	TPH-HRO	TPH-GRO	Benzene	Toluene	Ethyl- benzene	Total Xylenes	MTBE	Total Lead
MW-8 (cont.)															
06/27/13	NP	197.35	--	26.86	0.00	170.49	<30	<69	<50	<0.5	<0.5	<0.5	<1.5	--	2.0
10/17/13	NP	197.35	--	27.05	0.00	170.30	<29	<68	<50	<0.5	<0.5	<0.5	<1.5	--	0.4
03/20/14	NP	197.35	--	27.01	0.00	170.34	<29	<67	<50	<0.5	<0.5	<0.5	<1.5	--	1.4
06/25/14	NP	197.35	--	27.31	0.00	170.04	<30	<69	<50	<0.5	<0.5	<0.5	<1.5	--	0.24
09/24/14	NP	197.35	--	27.63	0.00	169.72	<29	<67	93	<0.2	<0.2	2.9	1	--	0.00013
12/11/14	NP	197.35	--	27.46	0.00	169.89	<30	<70	59	<0.5	0.5	0.6	<1.5	--	0.12
03/11/15	NP	197.35	--	27.18	0.00	170.17	<29	<68	<50	<0.5	<0.5	<0.5	<1.5	--	0.00032
10/21/15	NP	197.35	--	27.89	0.00	169.46	<28	<66	110	<0.5	<0.5	1.1	3.9	--	0.63
MW-9															
05/03/07		208.11	--	36.74	0.00	171.37	<400	<500	<50	<0.5	<0.5	4	18	--	--
06/16/09		208.11	--	38.72	0.00	169.39	--	--	<50	<0.5	<0.5	<0.5	<1.5	--	19.3
07/01/09	NP	208.11	--	38.03	0.00	170.08	<31	<71	--	--	--	--	--	--	--
12/11/09	NP	208.11	--	38.86	0.00	169.25	76	<69	<50	<0.5	<0.5	<0.5	<1.5	--	14.5
06/09/10	NP	208.11	--	38.17	0.00	169.94	42	110	<50	<0.5	<0.5	<0.5	<1.5	--	21.2
11/19/10	NP	208.11	--	38.23	0.00	169.88	<29	130	<50	<0.5	<0.5	<0.5	<1.5	--	18.7
06/21/11	NP	208.11	--	37.15	0.00	170.96	<30	<70	<50	<0.5	<0.5	<0.5	<1.5	--	4.7
09/22/11	NP	208.11	--	37.25	0.00	170.86	<300	<700	<50	<0.5	<0.5	<0.5	<1.5	--	12.4
12/09/11	NP	208.11	--	38.66	0.00	169.45	<29	<68	<50	<0.5	<0.5	<0.5	<1.5	--	2.8
03/30/12	NP	208.11	--	29.60	0.00	178.51	<29	<68	<50	<0.5	<0.5	<0.5	<1.5	--	114
06/20/12	NP	208.11	--	38.00	0.00	170.11	<30	<70	<50	<0.5	<0.5	<0.5	<1.5	--	3.8
10/05/12	NP	208.11	--	38.44	0.00	169.67	<30	<70	<50	<0.5	<0.5	<0.5	<1.5	--	10.6
12/27/12	NP	208.11	--	38.50	0.00	169.61	<31	<73	<50	<0.5	<0.5	<0.5	<1.5	--	5.3
03/28/13	NP	208.11	--	29.73	0.00	178.38	<28	<66	<50	<0.5	<0.5	<0.5	<1.5	--	<0.073
06/27/13	NP	208.11	--	37.81	0.00	170.30	<29	<67	<50	<0.5	<0.5	<0.5	<1.5	--	5.4
10/17/13	NP	208.11	--	37.77	0.00	170.34	<29	<67	<50	<0.5	<0.5	<0.5	<1.5	--	0.34
03/20/14	NP	208.11	--	29.58	0.00	178.53	<29	<68	<50	<0.5	<0.5	<0.5	<1.5	--	4.1
06/25/14	NP	208.11	--	34.92	0.00	173.19	<30	<69	<50	<0.5	<0.5	<0.5	<1.5	--	2.5
09/24/14	NP	208.11	--	38.56	0.00	169.55	<29	<67	<50	<0.2	<0.2	<0.2	<0.2	--	0.0015
12/11/14	NP	208.11	--	38.53	0.00	169.58	<28	<66	<50	<0.5	<0.5	<0.5	<1.5	--	<0.082
03/11/15	NP	208.11	--	29.63	0.00	178.48	<28	<66	<50	<0.5	0.5	<0.5	<1.5	--	0.00020
10/21/15	NP	208.11	--	38.81	0.00	169.30	<28	<66	<50	<0.5	0.5	<0.5	<1.5	--	12.4
MW-10															
05/03/07		207.29	--	36.74	0.00	170.55	<0.5	<0.5	<0.5	<0.5	<0.5	<0.5	<0.5	--	--
06/16/09		207.29	INACCESSIBLE	--	--	--	--	--	--	--	--	--	--	--	--
07/01/09	NP	207.29	--	38.72	0.00	168.57	<30	<69	<50	<0.5	<0.5	<0.5	<1.5	--	10.9
12/11/09	NP	207.29	--	35.91	0.00	171.38	49	<69	<50	<0.5	<0.5	<0.5	<1.5	--	13.4
06/09/10	NP	207.29	--	37.48	0.00	169.81	50	88	<50	<0.5	<0.5	<0.5	<1.5	--	7.2

TABLE 1
GROUNDWATER MONITORING DATA AND ANALYTICAL RESULTS¹
FORMER STANDARD OIL SERVICE STATION, CHEVRON SITE NO. 209335
1225 North 45th Street
Seattle, Washington
Concentrations reported in µg/L

Well ID/ Date	Purge Method	TOC ² (ft.)	DTP (ft.)	DTW (ft.)	SPHT (ft.)	GWE ³ (ft.)	TPH-DRO	TPH-HRO	TPH-GRO	Benzene	Toluene	Ethyl- benzene	Total Xylenes	MTBE	Total Lead
MW-10 (cont.)															
11/19/10	NP	207.29	--	37.53	0.00	169.76	<29	74	<50	<0.5	<0.5	<0.5	<1.5	--	18.8
06/21/11	NP	207.29	--	36.46	0.00	170.83	<31	180	<50	<0.5	<0.5	<0.5	<1.5	--	5.7
09/22/11	NP	207.29	--	36.60	0.00	170.69	<300	<700	<50	<0.5	<0.5	<0.5	<1.5	--	6.6
12/09/11	NP	207.29	--	35.71	0.00	171.58	<29	<69	<50	<0.5	<0.5	<0.5	<1.5	--	2.1
03/30/12	NP	207.29	--	29.80	0.00	177.49	<30	<69	<50	<0.5	<0.5	<0.5	<1.5	--	110
06/20/12	NP	207.29	--	37.35	0.00	169.94	<31	<71	<50	<0.5	<0.5	<0.5	<1.5	--	0.23
10/05/12	NP	207.29	--	37.79	0.00	169.50	45	<70	<50	<0.5	<0.5	<0.5	<1.5	--	3.7
12/27/12	NP	207.29	--	37.84	0.00	169.45	<29	<67	<50	<0.5	<0.5	<0.5	<1.5	--	2.2
03/28/13	NP	207.29	--	27.36	0.00	179.93	<29	<67	<50	<0.5	<0.5	<0.5	<1.5	--	<0.073
06/27/13	NP	207.29	--	37.16	0.00	170.13	<29	<67	<50	<0.5	<0.5	<0.5	<1.5	--	1.8
10/17/13	NP	207.29	--	37.78	0.00	169.51	<28	<66	<50	<0.5	<0.5	<0.5	<1.5	--	0.34
03/20/14	NP	207.29	--	29.77	0.00	177.52	<30	<69	<50	<0.5	<0.5	<0.5	<1.5	--	<0.085
06/25/14	NP	207.29	--	35.03	0.00	172.26	<30	<71	<50	<0.5	<0.5	<0.5	<1.5	--	2.5
09/24/14	NP	207.29	--	37.88	0.00	169.41	<30	<70	<50	<0.2	<0.2	<0.2	<0.2	--	0.00095
12/11/14	NP	207.29	--	37.88	0.00	169.41	<29	<67	<50	<0.5	<0.5	<0.5	<1.5	--	<0.082
03/11/15	NP	207.29	--	29.71	0.00	177.58	<29	<69	<50	<0.5	<0.5	<0.5	<1.5	--	0.00020
10/21/15	NP	207.29	--	38.14	0.00	169.15	<28	<66	<50	<0.5	<0.5	<0.5	<1.5	--	20.1
QA															
12/16/00		--	--	--	--	--	--	--	ND	ND	ND	ND	ND	ND	--
03/26/01		--	--	--	--	--	--	--	ND	ND	ND	ND	ND	ND	--
06/25/01		--	--	--	--	--	--	--	<50.0	<0.500	<0.500	<0.500	<1.00	--	--
09/24/01		--	--	--	--	--	--	--	<50.0	<0.500	<0.500	<0.500	<1.00	--	--
12/13/01		--	--	--	--	--	--	--	<80.0	<0.500	<0.500	<0.500	<1.00	--	--
03/08/02		--	--	--	--	--	--	--	<50	<0.50	<0.50	<0.50	<1.5	--	--
05/29/02		--	--	--	--	--	--	--	<50	<0.50	<0.50	<0.50	<1.5	--	--
09/16/02		--	--	--	--	--	--	--	<50	<0.50	<0.50	<0.50	<1.5	--	--
12/05/02		--	--	--	--	--	--	--	<50	<0.50	<0.50	<0.50	<1.5	--	--
03/04/03		--	--	--	--	--	--	--	<50	<0.50	<0.50	<0.50	<1.5	--	--
10/27/03		--	--	--	--	--	--	--	<50	<0.5	<0.5	<0.5	<1.5	--	--
03/31/04		--	--	--	--	--	--	--	<50	<0.5	<0.5	<0.5	<1.5	--	--
06/28/04		--	--	--	--	--	--	--	<50	<0.5	<0.5	<0.5	<1.5	--	--
09/29/04		--	--	--	--	--	--	--	<50	<0.5	<0.5	<0.5	<1.5	--	--
01/04/05		--	--	--	--	--	--	--	<50	<0.5	<0.5	<0.5	<1.5	--	--
06/16/09		--	--	--	--	--	--	--	<50	<0.5	<0.5	<0.5	<1.5	--	--
07/01/09		--	--	--	--	--	--	--	<50	<0.5	<0.5	<0.5	<1.5	--	--
12/11/09		--	--	--	--	--	--	--	<50	<0.5	<0.5	<0.5	<1.5	--	--

TABLE 1
GROUNDWATER MONITORING DATA AND ANALYTICAL RESULTS¹
FORMER STANDARD OIL SERVICE STATION, CHEVRON SITE NO. 209335
1225 North 45th Street
Seattle, Washington
Concentrations reported in µg/L

Well ID/ Date	Purge Method	TOC ² (ft.)	DTP (ft.)	DTW (ft.)	SPHT (ft.)	GWE ³ (ft.)	TPH-DRO	TPH-HRO	TPH-GRO	Benzene	Toluene	Ethyl- benzene	Total Xylenes	MTBE	Total Lead
QA (cont.)															
06/09/10		--	--	--	--	--	--	--	<50	<0.5	<0.5	<0.5	<1.5	--	--
11/19/10		--	--	--	--	--	--	--	<50	<0.5	<0.5	<0.5	<1.5	--	--
06/21/11		--	--	--	--	--	--	--	<50	<0.5	<0.5	<0.5	<1.5	--	--
09/22/11		--	--	--	--	--	--	--	<50	<0.5	<0.5	<0.5	<1.5	--	--
12/09/11		--	--	--	--	--	--	--	<50	<0.5	<0.5	<0.5	<1.5	--	--
03/30/12		--	--	--	--	--	--	--	<50	<0.5	<0.5	<0.5	<1.5	--	--
06/20/12	QA Vials Not Received by the Laboratory														
10/05/12		--	--	--	--	--	--	--	<50	<0.5	<0.5	<0.5	<1.5	--	--
12/27/12		--	--	--	--	--	--	--	<50	<0.5	<0.5	<0.5	<1.5	--	--
03/28/13		--	--	--	--	--	--	--	<50	<0.5	<0.5	<0.5	<1.5	--	--
06/27/13		--	--	--	--	--	--	--	<50	<0.5	<0.5	<0.5	<1.5	--	--
10/17/13		--	--	--	--	--	--	--	<50	<0.5	<0.5	<0.5	<1.5	--	--
03/20/14		--	--	--	--	--	--	--	<50	<0.5	<0.5	<0.5	<1.5	--	--
06/25/14		--	--	--	--	--	--	--	<50	<0.5	<0.5	<0.5	<1.5	--	--
09/24/14		--	--	--	--	--	--	--	<50	<0.2	<0.2	<0.2	<0.2	--	--
12/11/14		--	--	--	--	--	--	--	<50	<0.5	<0.5	<0.5	<1.5	--	--
03/11/15		--	--	--	--	--	--	--	<50	<0.5	<0.5	<0.5	<1.5	--	--
10/23/15		--	--	--	--	--	--	--	<50	<0.5	<0.5	<0.5	<1.5	--	--
MTCA Method A Cleanup Levels:							500	500	800/1,000	5	1,000	700	1,000	20	15
Current Method ⁵ :							NWTPH-Dx + Extended ⁴		NWTPH-Gx	USEPA 8021B					USEPA 6020

Abbreviations:

DTP = Depth to Product

DTW = Depth to Water

ft. = Feet

GWE = Groundwater Elevation

MTBE = Methyl Tertiary Butyl Ether

MTCA = Model Toxics Control Act

ND = Not Detected

NP = No Purge

QA = Quality Assurance/Trip Blank

SPH = Separate Phase Hydrocarbon

SPHT = Separate Phase Hydrocarbon Thickness

TOC = Top of Casing

TPH = Total Petroleum Hydrocarbons

TPH-DRO = TPH as Diesel-Range Organics

TPH-GRO = TPH as Gasoline-Range Organics

TPH-HRO = TPH as Heavy Oil-Range Organics

USEPA = United States Environmental Protection Agency

µg/L = Micrograms per liter

-- = Not Measured/Not Analyzed

Notes:

1 Analytical results in bold font indicate concentrations exceed MTCA Method A Cleanup Levels.

2 TOC elevations have been surveyed in feet relative to the 1988 North American Vertical Datum. MW-1 through MW-5 TOC elevations are reference to an arbitrary benchmark of 100 feet.

3 When SPH is present, GWE has been corrected using the following formula: $GWE = [(TOC - DTW) + (SPHT \times 0.80)]$.

4 Analyzed with silica-gel cleanup.

5 Laboratory analytical methods for historical data may not be consistent with list of current analytical methods. When necessary, consult original laboratory reports to verify methods used.

6 Skimmer in well.

7 Interface probe could not detect SPH/Groundwater Interface, unable to gauge hydrocarbon thickness and calculate corrected GWE.

8 Pre-surfactant injection groundwater sample.

9 Post-surfactant extraction groundwater sample.

Attachment A:
Groundwater Monitoring and Sampling Data Package



GETTLER-RYAN INC.



TRANSMITTAL

October 30, 2015
G-R #386750

TO: Ms. Ruth A. Otteman
Leidos, Inc.
18912 North Creek Parkway, Suite 101
Bothell, WA 98011

FROM: Deanna L. Harding
Project Coordinator
Gettler-Ryan Inc.
6805 Sierra Court, Suite G
Dublin, California 94568

RE: **Former Chevron Service Station
#209335
1225 North 45th Street
Seattle, Washington**

WE HAVE ENCLOSED THE FOLLOWING:

COPIES	DESCRIPTION
VIA PDF	Groundwater Monitoring and Sampling Data Package Second Semi-Annual Event of October 21, 2015

COMMENTS:

Pursuant to your request, we are providing you with copies of the above referenced data for your use.

Please provide us the updated historical data prior to the next monitoring and sampling event for our field use.

Please feel free to contact me if you have any comments/questions.

trans/209335



GETTLER - RYAN INC.

CHEVRON - SITE CHECK LIST

Facility#: **Chevron #209335**

Date: 10/21/15

Address: **1225 N. 45th Street**

City/St.: **Seattle, WA**

Status of Site: APARTMENT PARKING GARAGE / SIDE WALK

DRUMS:

Please list below ALL DRUMS on site:

(i.e., drum description, condition, labeling, contents and location of drums)



#	Description	Condition	Labeling	Contents/Capacity	Location
	NO DRUMS				

WELLS:

Please check the condition of ALL WELLS on site:

(i.e., gaskets, bolts, replaced well plug and/or well lock, well box condition and etc.)

Well ID	Gaskets (M) Missing (R) Replaced	Bolts (M) Missing (R) Replaced	Replaced Plug Y/N	Replaced Lock Y/N	Well Box Manufacturer/Size/# of Bolts	Other
MW-6	OK	OK	NO	NO	MOORE (3/1)	
MW-7	↓	↓	↓	↓	↓ ↓ ↓	
MW-8	↓	↓	↓	↓	↓ ↓ ↓	
MW-9	↓	↓	↓	↓	↓ ↓ ↓	
MW-10	↓	↓	↓	↓	↓ ↓ ↓	

Additional Comments/Observations: _____

STANDARD OPERATING PROCEDURE - GROUNDWATER SAMPLING

Gettler-Ryan Inc. (GR) field personnel adhere to the following procedures for the collection and handling of groundwater samples prior to analysis by the analytical laboratory. All work is performed in accordance with the GR Health & Safety Plan and all client-specific programs. The scope of work and type of analysis to be performed is determined prior to commencing field work.

Prior to sampling, the presence or absence of free-phase hydrocarbons is determined using an interface probe. Product thickness, if present, is measured to the nearest 0.01 foot and is noted in the field notes. In addition, all depth to water level measurements are collected with a static water level indicator and are also recorded in the field notes, prior to purging and sampling any wells.

After water levels are collected and prior to sampling, if purging is to occur, each well is purged a minimum of three well casing volumes of water using pre-cleaned pumps (stack, peristaltic or Grundfos), or disposable bailers. Temperature, pH and electrical conductivity are measured a minimum of three times during the purging (additional parameters such as dissolved oxygen, oxidation reduction potential, turbidity may also be measured, depending on specific scope of work.). Purging continues until these parameters stabilize. Purge water is treated by filtering the water through granular activated carbon and is subsequently discharged to the ground surface at the site.

Groundwater samples are collected using disposable bailers. The water samples are transferred from the bailer into appropriate containers. Pre-preserved containers, supplied by analytical laboratories, are used. When pre-preserved containers are not available, the laboratory is instructed to preserve the sample as appropriate. Duplicate samples are collected for the laboratory to use in maintaining quality assurance/quality control standards, as directed by the scope of work. The samples are labeled to include the job number, sample identification, collection date and time, analysis, preservation (if any), and the sample collector's initials. The water samples are placed in a cooler, maintained at 4°C for transport to the laboratory. Once collected in the field, all samples are maintained under chain of custody until delivered to the laboratory.

The chain of custody document includes the job number, type of preservation, if any, analysis requested, sample identification, date and time collected, and the sample collector's name. The chain of custody is signed and dated (including time of transfer) by each person who receives or surrenders the samples, beginning with the field personnel and ending with the laboratory personnel.

A laboratory supplied trip blank accompanies each sampling set. The trip blank is analyzed for some or all of the same compounds as the groundwater samples.



GETTLER-RYAN INC.

WELL MONITORING/SAMPLING FIELD DATA SHEET

Client/Facility#: Chevron #209335
 Site Address: 1225 N. 45th Street
 City: Seattle, WA

Job Number: 386750
 Event Date: 10/21/15 (inclusive)
 Sampler: GM

Well ID: MW-6
 Well Diameter: 2 in.
 Total Depth: 34.11 ft.
 Depth to Water: 27.47 ft.

Date Monitored: 10/21/15

Volume	3/4"= 0.02	1"= 0.04	2"= 0.17	3"= 0.38
Factor (VF)	4"= 0.66	5"= 1.02	6"= 1.50	12"= 5.80

Check if water column is less than 0.50 ft.
6.64 xVF _____ = _____ x3 case volume = Estimated Purge Volume: _____ gal.

Depth to Water w/ 80% Recharge [(Height of Water Column x 0.20) + DTW]: _____

Purge Equipment:

Disposable Bailer _____
 Stainless Steel Bailer _____
 Stack Pump _____
 Peristaltic Pump _____
 QED Bladder Pump _____
 Other: _____

Sampling Equipment:

Disposable Bailer 6
 Pressure Bailer _____
 Metal Filters _____
 Peristaltic Pump _____
 QED Bladder Pump _____
 Other: _____

Time Started: _____ (2400 hrs)
 Time Completed: _____ (2400 hrs)
 Depth to Product: _____ ft
 Depth to Water: _____ ft
 Hydrocarbon Thickness: 0 ft
 Visual Confirmation/Description: _____
 Skimmer / Absorbent Sock (circle one)
 Amt Removed from Skimmer: _____ ltr
 Amt Removed from Well: _____ ltr
 Water Removed: _____ ltr
 Product Transferred to: _____

Start Time (purge): _____ Weather Conditions: Sunny
 Sample Time/Date: 1040 10/21/15 Water Color: Cloudy Odor: (N) MODERATE
 Approx. Flow Rate: _____ gpm. Sediment Description: SILT
 Did well de-water? NA If yes, Time: _____ Volume: _____ gal. DTW @ Sampling: 27.47

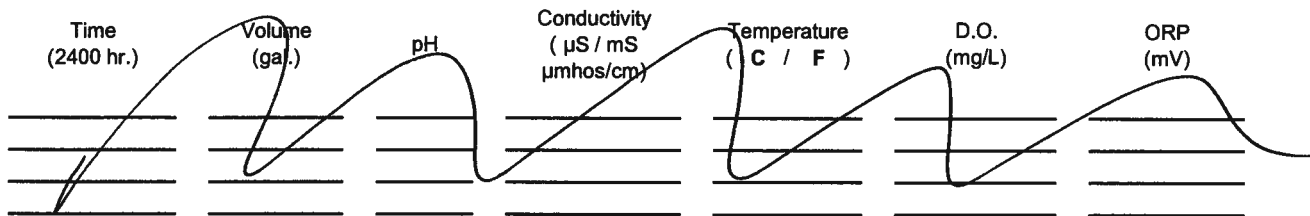

LABORATORY INFORMATION

SAMPLE ID	(#) CONTAINER	REFRIG.	PRESERV. TYPE	LABORATORY	ANALYSES
MW-6	3 x voa vial	YES	HCL	LANCASTER	NWTPH-Gx/BTEX(8021)
	2 x 1 liter ambers	YES	HCL	LANCASTER	NWTPH-Dx w/sgc
	1 x 250ml poly	YES	HNO3	LANCASTER	TOTAL LEAD(6020)

COMMENTS: _____

Add/Replaced Gasket: _____ Add/Replaced Bolt: _____ Add/Replaced Plug: _____ Add/Replaced Lock: _____



GETTLER-RYAN INC.

WELL MONITORING/SAMPLING FIELD DATA SHEET

Client/Facility#: Chevron #209335
 Site Address: 1225 N. 45th Street
 City: Seattle, WA

Job Number: 386750
 Event Date: 10/21/15 (inclusive)
 Sampler: GM

Well ID: MW-7
 Well Diameter: 2 in.
 Total Depth: 33.53 ft.
 Depth to Water: 28.17 ft.
5.36 xVF = _____ x3 case volume = Estimated Purge Volume: _____ gal.

Date Monitored: 10/21/15

Volume	3/4"= 0.02	1"= 0.04	2"= 0.17	3"= 0.38
Factor (VF)	4"= 0.66	5"= 1.02	6"= 1.50	12"= 5.80

Check if water column is less than 0.50 ft.

Depth to Water w/ 80% Recharge [(Height of Water Column x 0.20) + DTW]: _____

Purge Equipment:

Disposable Bailer _____
 Stainless Steel Bailer _____
 Stack Pump _____
 Peristaltic Pump _____
 QED Bladder Pump _____
 Other: _____

Sampling Equipment:

Disposable Bailer _____
 Pressure Bailer _____
 Metal Filters _____
 Peristaltic Pump _____
 QED Bladder Pump _____
 Other: _____

Time Started:	_____ (2400 hrs)
Time Completed:	_____ (2400 hrs)
Depth to Product:	<u>27.77</u> ft
Depth to Water:	<u>28.17</u> ft
Hydrocarbon Thickness:	<u>0.40</u> ft
Visual Confirmation/Description:	<u>Brown oily</u>
Skimmer / Absorbent Sock (circle one)	
Amt Removed from Skimmer:	_____ ltr
Amt Removed from Well:	_____ ltr
Water Removed:	_____ ltr
Product Transferred to:	_____

Start Time (purge): _____
 Sample Time/Date: _____ / _____
 Approx. Flow Rate: _____ gpm
 Did well de-water? _____ If yes, Time: _____

Weather Conditions: _____
 Water Color: _____ Odor: Y / N
 Sediment Description: _____
 Volume: _____ gal. DTW @ Sampling: _____

Time (2400 hr.)	Volume (gal.)	pH	Conductivity (µS / mS µmhos/cm)	Temperature (C / F)	D.O. (mg/L)	ORP (mV)
_____	_____	_____	_____	_____	_____	_____
_____	_____	_____	_____	_____	_____	_____
_____	_____	_____	_____	_____	_____	_____
_____	_____	_____	_____	_____	_____	_____

LABORATORY INFORMATION

SAMPLE ID	(#) CONTAINER	REFRIG.	PRESERV. TYPE	LABORATORY	ANALYSES
MW-	x voa vial	YES	HCL	LANCASTER	NWTPH-Gx/BTEX(8021)
	x 1 liter ambers	YES	HCL	LANCASTER	NWTPH-Dx w/sgc
	x 250ml poly	YES	HNO3	LANCASTER	TOTAL LEAD(6020)

COMMENTS: SPA

Add/Replaced Gasket: _____ Add/Replaced Bolt: _____ Add/Replaced Plug: _____ Add/Replaced Lock: _____



GETTLER-RYAN INC.

WELL MONITORING/SAMPLING FIELD DATA SHEET

Client/Facility#: Chevron #209335 Job Number: 386750
 Site Address: 1225 N. 45th Street Event Date: 10/21/15 (inclusive)
 City: Seattle, WA Sampler: GM

Well ID: MW-8 Date Monitored: 10/21/15
 Well Diameter: 2 in.
 Total Depth: 35.00 ft.
 Depth to Water: 27.89 ft. Check if water column is less than 0.50 ft.
7.11 xVF = x3 case volume = Estimated Purge Volume: gal.

Volume	3/4"= 0.02	1"= 0.04	2"= 0.17	3"= 0.38
Factor (VF)	4"= 0.66	5"= 1.02	6"= 1.50	12"= 5.80

Depth to Water w/ 80% Recharge [(Height of Water Column x 0.20) + DTW]:

Purge Equipment:

Disposable Bailer
 Stainless Steel Bailer
 Stack Pump
 Peristaltic Pump
 QED Bladder Pump
 Other:

Sampling Equipment:

Disposable Bailer
 Pressure Bailer
 Metal Filters
 Peristaltic Pump
 QED Bladder Pump
 Other:

Time Started: (2400 hrs)
 Time Completed: (2400 hrs)
 Depth to Product: ft
 Depth to Water: ft
 Hydrocarbon Thickness: ft
 Visual Confirmation/Description:
 Skimmer / Absorbant Sock (circle one)
 Amt Removed from Skimmer: ltr
 Amt Removed from Well: ltr
 Water Removed: ltr
 Product Transferred to:

Start Time (purge): Weather Conditions: Sunny
 Sample Time/Date: 1110 10/21/15 Water Color: Cloudy Odor: PTN MODERATE
 Approx. Flow Rate: gpm. Sediment Description: SILT
 Did well de-water? NA If yes, Time: Volume: gal. DTW @ Sampling:

Time (2400 hr.)	Volume (gal.)	pH	Conductivity (µS / mS / umhos/cm)	Temperature (C / F)	D.O. (mg/L)	ORP (mV)
<u> </u>	<u> </u>	<u> </u>	<u> </u>	<u> </u>	<u> </u>	<u> </u>
<u> </u>	<u> </u>	<u> </u>	<u> </u>	<u> </u>	<u> </u>	<u> </u>
<u> </u>	<u> </u>	<u> </u>	<u> </u>	<u> </u>	<u> </u>	<u> </u>
<u> </u>	<u> </u>	<u> </u>	<u> </u>	<u> </u>	<u> </u>	<u> </u>

LABORATORY INFORMATION

SAMPLE ID	(#) CONTAINER	REFRIG.	PRESERV. TYPE	LABORATORY	ANALYSES
MW-8	3 x vov vial	YES	HCL	LANCASTER	NWTPH-Gx/BTEX(8021)
	2 x 1 liter ambers	YES	HCL	LANCASTER	NWTPH-Dx w/sgc
	1 x 250ml poly	YES	HNO3	LANCASTER	TOTAL LEAD(6020)

COMMENTS:

Add/Replaced Gasket: Add/Replaced Bolt: Add/Replaced Plug: Add/Replaced Lock:



GETTLER-RYAN INC.

WELL MONITORING/SAMPLING FIELD DATA SHEET

Client/Facility#: Chevron #209335 Job Number: 386750
 Site Address: 1225 N. 45th Street Event Date: 10/21/15 (inclusive)
 City: Seattle, WA Sampler: GM

Well ID: MW-9 Date Monitored: 10/21/15
 Well Diameter: 2 in.
 Total Depth: 44.00 ft.
 Depth to Water: 38.81 ft. Check if water column is less than 0.50 ft.
5.25 xVF = x3 case volume = Estimated Purge Volume: gal.

Volume	3/4" = 0.02	1" = 0.04	2" = 0.17	3" = 0.38
Factor (VF)	4" = 0.66	5" = 1.02	6" = 1.50	12" = 5.80

Depth to Water w/ 80% Recharge [(Height of Water Column x 0.20) + DTW]:

Purge Equipment:

Disposable Bailer _____
 Stainless Steel Bailer _____
 Stack Pump _____
 Peristaltic Pump _____
 QED Bladder Pump _____
 Other: _____

Sampling Equipment:

Disposable Bailer x
 Pressure Bailer _____
 Metal Filters _____
 Peristaltic Pump _____
 QED Bladder Pump _____
 Other: _____

Time Started: _____ (2400 hrs)
 Time Completed: _____ (2400 hrs)
 Depth to Product: _____ ft
 Depth to Water: _____ ft
 Hydrocarbon Thickness: 0 ft
 Visual Confirmation/Description: _____
 Skimmer / Absorbant Sock (circle one)
 Amt Removed from Skimmer: _____ ltr
 Amt Removed from Well: _____ ltr
 Water Removed: _____ ltr
 Product Transferred to: _____

Start Time (purge): Weather Conditions: SUNNY
 Sample Time/Date: 0900 / 10/21/15 Water Color: BROWN Odor: (Y) N SLIGHT
 Approx. Flow Rate: gpm. Sediment Description: SLT / ROOTS
 Did well de-water? NA If yes, Time: Volume: gal. DTW @ Sampling: 38.81

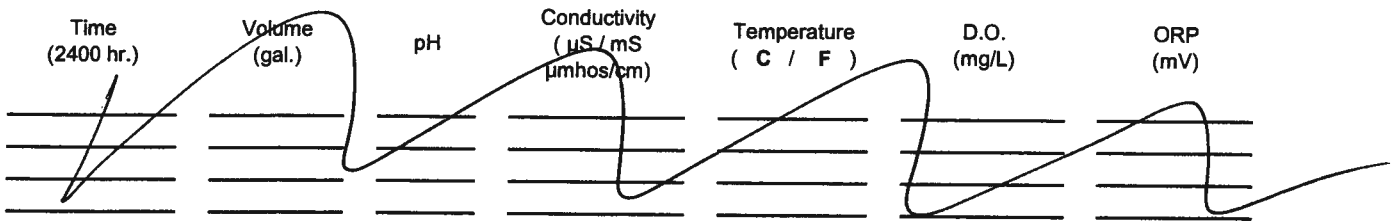

LABORATORY INFORMATION

SAMPLE ID	(#) CONTAINER	REFRIG.	PRESERV. TYPE	LABORATORY	ANALYSES
MW-9	2 x vov vial	YES	HCL	LANCASTER	NWTPH-Gx/BTEX(8021)
	2 x 1 liter ambers	YES	HCL	LANCASTER	NWTPH-Dx w/sgc
	1 x 250ml poly	YES	HNO3	LANCASTER	TOTAL LEAD(6020)

COMMENTS: ROOTS IN WELL HAD TO BREAK UP WITH STAINLESS STEEL BAILER

Add/Replaced Gasket: _____ Add/Replaced Bolt: _____ Add/Replaced Plug: _____ Add/Replaced Lock: _____



GETTLER-RYAN INC.

WELL MONITORING/SAMPLING FIELD DATA SHEET

Client/Facility#: Chevron #209335
 Site Address: 1225 N. 45th Street
 City: Seattle, WA

Job Number: 386750
 Event Date: 10/21/15 (inclusive)
 Sampler: GM

Well ID: MW-10
 Well Diameter: 2 in.
 Total Depth: 44.37 ft.
 Depth to Water: 38.14 ft.
6.23 xVF = _____ x3 case volume = Estimated Purge Volume: _____ gal.

Date Monitored: 10/21/15

Volume	3/4" = 0.02	1" = 0.04	2" = 0.17	3" = 0.38
Factor (VF)	4" = 0.66	5" = 1.02	6" = 1.50	12" = 5.80

Check if water column is less than 0.50 ft.

Depth to Water w/ 80% Recharge [(Height of Water Column x 0.20) + DTW]: _____

Purge Equipment:

- Disposable Bailer _____
- Stainless Steel Bailer _____
- Stack Pump _____
- Peristaltic Pump _____
- QED Bladder Pump _____
- Other: _____

Sampling Equipment:

- Disposable Bailer _____ X
- Pressure Bailer _____
- Metal Filters _____
- Peristaltic Pump _____
- QED Bladder Pump _____
- Other: _____

Time Started:	_____ (2400 hrs)
Time Completed:	_____ (2400 hrs)
Depth to Product:	_____ ft
Depth to Water:	_____ ft
Hydrocarbon Thickness:	<u>0</u> ft
Visual Confirmation/Description:	_____
Skimmer / Absorbant Sock (circle one)	_____
Amt Removed from Skimmer:	_____ ltr
Amt Removed from Well:	_____ ltr
Water Removed:	_____ ltr
Product Transferred to:	_____

Start Time (purge): _____
 Sample Time/Date: 0930 10/21/15
 Approx. Flow Rate: _____ gpm.
 Did well de-water? NA If yes, Time: _____

Weather Conditions: Sunny
 Water Color: BROWN Odor: D/N GLIGHT
 Sediment Description: SILT/ROOTS
 Volume: _____ gal. DTW @ Sampling: 38.14

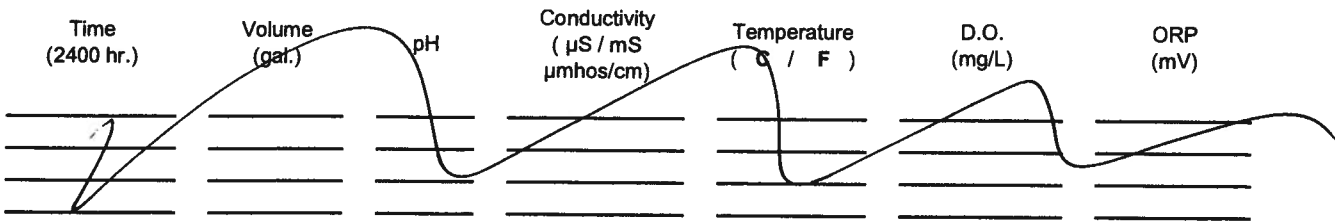

LABORATORY INFORMATION

SAMPLE ID	(#) CONTAINER	REFRIG.	PRESERV. TYPE	LABORATORY	ANALYSES
MW-10	3 x vov vial	YES	HCL	LANCASTER	NWTPH-Gx/BTEX(8021)
	2 x 1 liter ambers	YES	HCL	LANCASTER	NWTPH-Dx w/sgc
	1 x 250ml poly	YES	HNO3	LANCASTER	TOTAL LEAD(6020)

COMMENTS: ROOTS IN WELL HAD TO BREAK UP WITH STAINLESS STEEL BAILEY.

Add/Replaced Gasket: _____ Add/Replaced Bolt: _____ Add/Replaced Plug: _____ Add/Replaced Lock: _____

Chevron Northwest Region Analysis Request/Chain of Custody



Lancaster Laboratories

Acct. # _____ Group # _____ Sample # _____
 For Eurofins Lancaster Laboratories use only
 Instructions on reverse side correspond with circled numbers.

1 Client Information			4 Matrix			5 Analyses Requested													
Facility # SS#209335-OML G-R#386750 WBS			Total Number of Containers	Soil <input type="checkbox"/>	Water <input type="checkbox"/>	Oil <input type="checkbox"/>	BTEX <input type="checkbox"/>	8260 <input type="checkbox"/>	Oxygenates <input type="checkbox"/>		NWTPH-Gx <input type="checkbox"/>	NWTPH-Dx with Silica Gel Cleanup <input checked="" type="checkbox"/>	NWTPH-Dx without Silica Gel Cleanup <input type="checkbox"/>	WA VPH <input type="checkbox"/>	WA EPH <input type="checkbox"/>	Lead <input type="checkbox"/>	Diss. <input type="checkbox"/>	Method <input checked="" type="checkbox"/>	
Site Address 1225 N. 45th Street, SEATTLE, WA				Ground <input checked="" type="checkbox"/>	Potable <input type="checkbox"/>	NPDES <input type="checkbox"/>	8021 <input checked="" type="checkbox"/>	8260 <input type="checkbox"/>											
Chevron PM MHO LEIDOSRO Lead Consultant Ruth Otteman				Surface <input type="checkbox"/>	Air <input type="checkbox"/>														
Consultant/Office Gettler-Ryan Inc., 6805 Sierra Court, Suite G, Dublin, CA 94568																			
Consultant Project Mgr. Deanna L. Harding, (deanna@grinc.com)																			
Consultant Phone # (925) 551-7444 x180																			
Sampler G. Medina			3 Composite																
2 Sample Identification		Collected		Grab															
		Date	Time																
SA		10/21/15	-	X															
MW-6		↓	1040	↓															
MW-8		↓	1110	↓															
MW-9		↓	0900	↓															
MW-10		↓	0930	↓															

SCR #: _____

- Results in Dry Weight
- J value reporting needed
- Must meet lowest detection limits possible for 8260 compounds
- 8021 MTBE Confirmation
- Confirm MTBE + Naphthalene
- Confirm highest hit by 8260
- Confirm all hits by 8260
- Run _____ oxy's on highest hit
- Run _____ oxy's on all hits

6 Remarks

Please forward the lab results directly to the Lead Consultant and cc: G-R.

7 Turnaround Time Requested (TAT) (please circle)

Standard 5 day 4 day **EDF/EDD**

72 hour 48 hour 24 hour

Relinquished by	Date 10/22/15	Time 1020	Received by	Date 10/22/15	Time 10:20
Relinquished by	Date 10/22/15	Time	Received by	Date	Time

8 Data Package (circle if required)

Type I - Full EDD (circle if required)

Type VI (Raw Data) CVX-RTBU-FL_05 (default) Other: _____

Relinquished by Commercial Carrier:

UPS _____ FedEx _____ Other _____

Temperature Upon Receipt _____ °C Custody Seals Intact? Yes No

Attachment B:
Laboratory Analysis Report

ANALYTICAL RESULTS

Prepared by:

Eurofins Lancaster Laboratories Environmental
2425 New Holland Pike
Lancaster, PA 17601

Prepared for:

Chevron
6001 Bollinger Canyon Road
L4310
San Ramon CA 94583

November 20, 2015

Project: 209335

Submittal Date: 10/23/2015
Group Number: 1603311
PO Number: 0015179981
Release Number: HORNE
State of Sample Origin: WA

<u>Client Sample Description</u>	<u>Lancaster Labs (LL) #</u>
QA Water	8101670
MW-6 Grab Groundwater	8101671
MW-8 Grab Groundwater	8101672
MW-9 Grab Groundwater	8101673
MW-10 Grab Groundwater	8101674

The specific methodologies used in obtaining the enclosed analytical results are indicated on the Laboratory Sample Analysis Record.

Regulatory agencies do not accredit laboratories for all methods, analytes, and matrices. Our scopes of accreditation can be viewed at <http://www.eurofinsus.com/environment-testing/laboratories/eurofins-lancaster-laboratories-environmental/resources/certifications/>.

ELECTRONIC Leidos

Attn: Ruth Otteman

COPY TO

ELECTRONIC Leidos

Attn: Jamalyn Agyei

COPY TO

ELECTRONIC Gettler-Ryan Inc.

Attn: Gettler Ryan

COPY TO

Respectfully Submitted,



Amek Carter
Specialist

(717) 556-7252

Sample Description: QA Water
Facility# 209335 Job# 386750
1225 N 45th St - Seattle, WA

LL Sample # WW 8101670
LL Group # 1603311
Account # 11260

Project Name: 209335

Collected: 10/21/2015

Chevron

Submitted: 10/23/2015 09:20

6001 Bollinger Canyon Road

Reported: 11/20/2015 09:17

L4310

San Ramon CA 94583

45SQA

CAT No.	Analysis Name	CAS Number	Result	Method Detection Limit	Dilution Factor
GC Volatiles					
08274	NWTPH-Gx water C7-C12	ECY 97-602 n.a.	NWTPH-Gx N.D.	ug/l 50	1
GC Volatiles					
02102	Benzene	SW-846 8021B 71-43-2	N.D.	ug/l 0.5	1
02102	Ethylbenzene	100-41-4	N.D.	0.5	1
02102	Toluene	108-88-3	N.D.	0.5	1
02102	Total Xylenes	1330-20-7	N.D.	1.5	1

General Sample Comments

State of Washington Lab Certification No. C457

All QC is compliant unless otherwise noted. Please refer to the Quality Control Summary for overall QC performance data and associated samples.

Laboratory Sample Analysis Record

CAT No.	Analysis Name	Method	Trial#	Batch#	Analysis Date and Time	Analyst	Dilution Factor
08274	NWTPH-Gx water C7-C12	ECY 97-602 NWTPH-Gx	1	15298A94A	10/26/2015 15:46	Marie D Beamenderfer	1
02102	Method 8021 Water Master	SW-846 8021B	1	15298A94A	10/26/2015 15:46	Marie D Beamenderfer	1
01146	GC VOA Water Prep	SW-846 5030B	1	15298A94A	10/26/2015 15:46	Marie D Beamenderfer	1

Sample Description: MW-6 Grab Groundwater
Facility# 209335 Job# 386750
1225 N 45th St - Seattle, WA

LL Sample # WW 8101671
LL Group # 1603311
Account # 11260

Project Name: 209335

Collected: 10/21/2015 10:40 by GM

Chevron

6001 Bollinger Canyon Road

Submitted: 10/23/2015 09:20

L4310

Reported: 11/20/2015 09:17

San Ramon CA 94583

45SM6

CAT No.	Analysis Name	CAS Number	Result	Method Detection Limit	Dilution Factor
GC Volatiles					
	ECY 97-602 NWTPH-Gx		ug/l	ug/l	
08274	NWTPH-Gx water C7-C12	n.a.	N.D.	50	1
GC Volatiles					
	SW-846 8021B		ug/l	ug/l	
02102	Benzene	71-43-2	N.D.	0.5	1
02102	Ethylbenzene	100-41-4	N.D.	0.5	1
02102	Toluene	108-88-3	N.D.	0.5	1
02102	Total Xylenes	1330-20-7	N.D.	1.5	1
GC Petroleum					
	ECY 97-602 NWTPH-Dx		ug/l	ug/l	
Hydrocarbons w/Si modified					
12005	DRO C12-C24 w/Si Gel	n.a.	N.D.	28	1
12005	HRO C24-C40 w/Si Gel	n.a.	N.D.	66	1
The reverse surrogate, capric acid, is present at <1%.					
Metals					
	SW-846 6020		ug/l	ug/l	
06035	Lead	7439-92-1	10.9	0.13	1

General Sample Comments

State of Washington Lab Certification No. C457

All QC is compliant unless otherwise noted. Please refer to the Quality Control Summary for overall QC performance data and associated samples.

Laboratory Sample Analysis Record

CAT No.	Analysis Name	Method	Trial#	Batch#	Analysis Date and Time	Analyst	Dilution Factor
08274	NWTPH-Gx water C7-C12	ECY 97-602	1	15298A94A	10/26/2015 22:35	Marie D	1
		NWTPH-Gx				Beamenderfer	
02102	Method 8021 Water Master	SW-846 8021B	1	15298A94A	10/26/2015 22:35	Marie D	1
						Beamenderfer	
01146	GC VOA Water Prep	SW-846 5030B	1	15298A94A	10/26/2015 22:35	Marie D	1
						Beamenderfer	
12005	NWTPH-Dx water w/ 10g Si Gel	ECY 97-602	1	153060010A	11/04/2015 12:00	Christine E Dolman	1
		NWTPH-Dx modified					
12007	NW Dx water w/ 10g column	ECY 97-602	1	153060010A	11/02/2015 20:00	Samantha L Bronder	1
		NWTPH-Dx 06/97					
06035	Lead	SW-846 6020	1	152996050002A	10/27/2015 21:14	Mallory L Clark	1
06050	ICPMS-Water, 3020A - U3	SW-846 3010A	1	152996050002	10/27/2015 09:26	Katlin N Cataldi	1
		modified					

Sample Description: MW-8 Grab Groundwater
Facility# 209335 Job# 386750
1225 N 45th St - Seattle, WA

LL Sample # WW 8101672
LL Group # 1603311
Account # 11260

Project Name: 209335

Collected: 10/21/2015 11:10 by GM

Chevron

6001 Bollinger Canyon Road

Submitted: 10/23/2015 09:20

L4310

Reported: 11/20/2015 09:17

San Ramon CA 94583

45SM8

CAT No.	Analysis Name	CAS Number	Result	Method Detection Limit	Dilution Factor
GC Volatiles ECY 97-602 NWTPH-Gx ug/1					
08274	NWTPH-Gx water C7-C12	n.a.	110	50	1
GC Volatiles SW-846 8021B ug/1					
02102	Benzene	71-43-2	N.D.	0.5	1
02102	Ethylbenzene	100-41-4	1.1	0.5	1
02102	Toluene	108-88-3	N.D.	0.5	1
02102	Total Xylenes	1330-20-7	3.9	1.5	1
GC Petroleum ECY 97-602 NWTPH-Dx ug/1					
Hydrocarbons w/Si modified					
12005	DRO C12-C24 w/Si Gel	n.a.	N.D.	28	1
12005	HRO C24-C40 w/Si Gel	n.a.	N.D.	66	1
The reverse surrogate, capric acid, is present at <1%.					
Metals SW-846 6020 ug/1					
06035	Lead	7439-92-1	0.63	0.13	1

General Sample Comments

State of Washington Lab Certification No. C457

All QC is compliant unless otherwise noted. Please refer to the Quality Control Summary for overall QC performance data and associated samples.

Laboratory Sample Analysis Record

CAT No.	Analysis Name	Method	Trial#	Batch#	Analysis Date and Time	Analyst	Dilution Factor
08274	NWTPH-Gx water C7-C12	ECY 97-602	1	15298A94A	10/26/2015 23:00	Marie D	1
		NWTPH-Gx				Beamenderfer	
02102	Method 8021 Water Master	SW-846 8021B	1	15298A94A	10/26/2015 23:00	Marie D	1
						Beamenderfer	
01146	GC VOA Water Prep	SW-846 5030B	1	15298A94A	10/26/2015 23:00	Marie D	1
						Beamenderfer	
12005	NWTPH-Dx water w/ 10g Si Gel	ECY 97-602	1	153060010A	11/04/2015 12:21	Christine E Dolman	1
		NWTPH-Dx modified					
12007	NW Dx water w/ 10g column	ECY 97-602	1	153060010A	11/02/2015 20:00	Samantha L Bronder	1
		NWTPH-Dx 06/97					
06035	Lead	SW-846 6020	1	153006050002A	10/29/2015 19:32	Mallory L Clark	1
06050	ICPMS-Water, 3020A - U3	SW-846 3010A	1	153006050002	10/29/2015 08:16	Katlin N Cataldi	1
		modified					

Sample Description: MW-9 Grab Groundwater
Facility# 209335 Job# 386750
1225 N 45th St - Seattle, WA

LL Sample # WW 8101673
LL Group # 1603311
Account # 11260

Project Name: 209335

Collected: 10/21/2015 09:00 by GM

Chevron

6001 Bollinger Canyon Road

Submitted: 10/23/2015 09:20

L4310

Reported: 11/20/2015 09:17

San Ramon CA 94583

45SM9

CAT No.	Analysis Name	CAS Number	Result	Method Detection Limit	Dilution Factor
GC Volatiles					
08274	NWTPH-Gx water C7-C12	ECY 97-602 NWTPH-Gx n.a.	ug/l N.D.	ug/l 50	1
GC Volatiles					
02102	Benzene	SW-846 8021B 71-43-2	ug/l N.D.	ug/l 0.5	1
02102	Ethylbenzene	100-41-4	N.D.	0.5	1
02102	Toluene	108-88-3	N.D.	0.5	1
02102	Total Xylenes	1330-20-7	N.D.	1.5	1
GC Petroleum					
Hydrocarbons w/Si					
12005	DRO C12-C24 w/Si Gel	ECY 97-602 NWTPH-Dx modified n.a.	ug/l N.D.	ug/l 28	1
12005	HRO C24-C40 w/Si Gel	n.a.	N.D.	66	1
The reverse surrogate, capric acid, is present at <1%.					
Metals					
06035	Lead	SW-846 6020 7439-92-1	ug/l 12.4	ug/l 0.13	1

General Sample Comments

State of Washington Lab Certification No. C457

All QC is compliant unless otherwise noted. Please refer to the Quality Control Summary for overall QC performance data and associated samples.

Laboratory Sample Analysis Record

CAT No.	Analysis Name	Method	Trial#	Batch#	Analysis Date and Time	Analyst	Dilution Factor
08274	NWTPH-Gx water C7-C12	ECY 97-602	1	15298A94A	10/26/2015 23:26	Marie D	1
		NWTPH-Gx				Beamenderfer	
02102	Method 8021 Water Master	SW-846 8021B	1	15298A94A	10/26/2015 23:26	Marie D	1
						Beamenderfer	
01146	GC VOA Water Prep	SW-846 5030B	1	15298A94A	10/26/2015 23:26	Marie D	1
						Beamenderfer	
12005	NWTPH-Dx water w/ 10g Si Gel	ECY 97-602	1	153060010A	11/04/2015 12:43	Christine E Dolman	1
		NWTPH-Dx modified					
12007	NW Dx water w/ 10g column	ECY 97-602	1	153060010A	11/02/2015 20:00	Samantha L Bronder	1
		NWTPH-Dx 06/97					
06035	Lead	SW-846 6020	1	153006050002A	10/29/2015 19:34	Mallory L Clark	1
06050	ICPMS-Water, 3020A - U3	SW-846 3010A	1	153006050002	10/29/2015 08:16	Katlin N Cataldi	1
		modified					

Sample Description: MW-10 Grab Groundwater
Facility# 209335 Job# 386750
1225 N 45th St - Seattle, WA

LL Sample # WW 8101674
LL Group # 1603311
Account # 11260

Project Name: 209335

Collected: 10/21/2015 09:30 by GM

Chevron

6001 Bollinger Canyon Road

Submitted: 10/23/2015 09:20

L4310

Reported: 11/20/2015 09:17

San Ramon CA 94583

45S10

CAT No.	Analysis Name	CAS Number	Result	Method Detection Limit	Dilution Factor
GC Volatiles					
08274	NWTPH-Gx water C7-C12	ECY 97-602 NWTPH-Gx n.a.	ug/l N.D.	ug/l 50	1
GC Volatiles					
02102	Benzene	SW-846 8021B 71-43-2	ug/l N.D.	ug/l 0.5	1
02102	Ethylbenzene	100-41-4	N.D.	0.5	1
02102	Toluene	108-88-3	N.D.	0.5	1
02102	Total Xylenes	1330-20-7	N.D.	1.5	1
GC Petroleum Hydrocarbons w/Si					
ECY 97-602 NWTPH-Dx modified					
12005	DRO C12-C24 w/Si Gel	n.a.	N.D.	28	1
12005	HRO C24-C40 w/Si Gel	n.a.	N.D.	66	1
The reverse surrogate, capric acid, is present at <1%.					
Metals					
06035	Lead	SW-846 6020 7439-92-1	ug/l 20.1	ug/l 0.13	1

General Sample Comments

State of Washington Lab Certification No. C457

All QC is compliant unless otherwise noted. Please refer to the Quality Control Summary for overall QC performance data and associated samples.

Laboratory Sample Analysis Record

CAT No.	Analysis Name	Method	Trial#	Batch#	Analysis Date and Time	Analyst	Dilution Factor
08274	NWTPH-Gx water C7-C12	ECY 97-602	1	15298A94A	10/26/2015 23:52	Marie D	1
		NWTPH-Gx				Beamenderfer	
02102	Method 8021 Water Master	SW-846 8021B	1	15298A94A	10/26/2015 23:52	Marie D	1
						Beamenderfer	
01146	GC VOA Water Prep	SW-846 5030B	1	15298A94A	10/26/2015 23:52	Marie D	1
						Beamenderfer	
12005	NWTPH-Dx water w/ 10g Si Gel	ECY 97-602	1	153060010A	11/04/2015 13:04	Christine E Dolman	1
		NWTPH-Dx modified					
12007	NW Dx water w/ 10g column	ECY 97-602	1	153060010A	11/02/2015 20:00	Samantha L Bronder	1
		NWTPH-Dx 06/97					
06035	Lead	SW-846 6020	1	153006050002A	10/29/2015 19:35	Mallory L Clark	1
06050	ICPMS-Water, 3020A - U3	SW-846 3010A	1	153006050002	10/29/2015 08:16	Katlin N Cataldi	1
		modified					

Quality Control Summary

Client Name: Chevron
Reported: 11/20/2015 09:17

Group Number: 1603311

Matrix QC may not be reported if insufficient sample or site-specific QC samples were not submitted. In these situations, to demonstrate precision and accuracy at a batch level, a LCS/LCSD was performed, unless otherwise specified in the method.

All Inorganic Initial Calibration and Continuing Calibration Blanks met acceptable method criteria unless otherwise noted on the Analysis Report.

Laboratory Compliance Quality Control

<u>Analysis Name</u>	<u>Blank Result</u>	<u>Blank MDL</u>	<u>Report Units</u>	<u>LCS %REC</u>	<u>LCSD %REC</u>	<u>LCS/LCSD Limits</u>	<u>RPD</u>	<u>RPD Max</u>
Batch number: 15298A94A	Sample number(s): 8101670-8101674							
Benzene	N.D.	0.2	ug/l	97	94	80-120	4	30
Ethylbenzene	N.D.	0.2	ug/l	101	95	80-120	6	30
NWTPH-Gx water C7-C12	N.D.	50.	ug/l	96	92	80-123	4	30
Toluene	N.D.	0.2	ug/l	102	97	80-120	6	30
Total Xylenes	N.D.	0.2	ug/l	104	98	80-120	6	30
Batch number: 153060010A	Sample number(s): 8101671-8101674							
DRO C12-C24 w/Si Gel	N.D.	30.	ug/l	53	54	32-117	2	20
HRO C24-C40 w/Si Gel	N.D.	70.	ug/l					
Batch number: 152996050002A	Sample number(s): 8101671							
Lead	N.D.	0.13	ug/l	102		80-120		
Batch number: 153006050002A	Sample number(s): 8101672-8101674							
Lead	N.D.	0.13	ug/l	100		80-120		

Sample Matrix Quality Control

Unspiked (UNSPK) = the sample used in conjunction with the matrix spike
Background (BKG) = the sample used in conjunction with the duplicate

<u>Analysis Name</u>	<u>MS %REC</u>	<u>MSD %REC</u>	<u>MS/MSD Limits</u>	<u>RPD</u>	<u>RPD MAX</u>	<u>BKG Conc</u>	<u>DUP Conc</u>	<u>DUP RPD</u>	<u>Dup RPD Max</u>
Batch number: 152996050002A	Sample number(s): 8101671 UNSPK: 8101671 BKG: 8101671								
Lead	101	105	75-125	2	20	10.9	11.1	2	20
Batch number: 153006050002A	Sample number(s): 8101672-8101674 UNSPK: P099488 BKG: P099488								
Lead	106	110	75-125	3	20	N.D.	N.D.	0 (1)	20

Surrogate Quality Control

Surrogate recoveries which are outside of the QC window are confirmed unless attributed to dilution or otherwise noted on the Analysis Report.

*- Outside of specification

- (1) The result for one or both determinations was less than five times the LOQ.
- (2) The unspiked result was more than four times the spike added.

P##### is indicative of a Background or Unspiked sample that is batch matrix QC and was not performed using a sample from this submission group.

Quality Control Summary

Client Name: Chevron
Reported: 11/20/2015 09:17

Group Number: 1603311

Surrogate Quality Control

Analysis Name: Method 8021 Water Master
Batch number: 15298A94A

	Trifluorotoluene-P	Trifluorotoluene-F
8101670	86	73
8101671	86	74
8101672	86	78
8101673	86	74
8101674	85	74
Blank	85	75
LCS	85	93
LCSD	83	92
Limits:	51-120	63-135

Analysis Name: NWTPH-Dx water w/ 10g Si Gel
Batch number: 153060010A

	Orthoterphenyl
8101671	78
8101672	84
8101673	73
8101674	79
Blank	80
LCS	82
LCSD	83
Limits:	50-150

*- Outside of specification

- (1) The result for one or both determinations was less than five times the LOQ.
- (2) The unspiked result was more than four times the spike added.

P##### is indicative of a Background or Unspiked sample that is batch matrix QC and was not performed using a sample from this submission group.

Chevron Northwest Region Analysis Request/Chain of Custody



Lancaster Laboratories

Acct. # 11260

For Eurofins Lancaster Laboratories use only
 Group # 1603311 Sample # 8101670-74
 Instructions on reverse side correspond with circled numbers.

1 Client Information				4 Matrix				5 Analyses Requested										6 Remarks						
Facility # SS#209335-OML G-R#386750 WBS Site Address 1225 N. 45th Street, SEATTLE, WA Chevron PM MHO LEIDOSRO Lead Consultant Ruth Otteman Consultant/Office Gettler-Ryan Inc., 6805 Sierra Court, Suite G, Dublin, CA 94568 Consultant Project Mgr. Deanna L. Harding, (deanna@grinc.com) Consultant Phone # (925) 551-7444 x180 Sampler G. Medina				<input type="checkbox"/> Sediment <input checked="" type="checkbox"/> Ground <input type="checkbox"/> Surface <input type="checkbox"/> Potable <input type="checkbox"/> NPDES <input type="checkbox"/> Air <input type="checkbox"/> Oil				Total Number of Containers BTEX # 8021 <input checked="" type="checkbox"/> 8021 <input type="checkbox"/> 8260 <input type="checkbox"/> Naphth 8260 full scan Oxygenates NWTPH-Gx NWTPH-Dx with Silica Gel Cleanup <input checked="" type="checkbox"/> NWTPH-Dx without Silica Gel Cleanup <input type="checkbox"/> WA VPH <input type="checkbox"/> WA EPH <input type="checkbox"/> Lead <input checked="" type="checkbox"/> Total <input checked="" type="checkbox"/> Diss. <input type="checkbox"/> Method <u>ICP/MS (6020)</u>										SCR #: _____ <input type="checkbox"/> Results in Dry Weight <input type="checkbox"/> J value reporting needed <input type="checkbox"/> Must meet lowest detection limits possible for 8260 compounds <input type="checkbox"/> 8021 MTBE Confirmation <input type="checkbox"/> Confirm MTBE + Naphthalene <input type="checkbox"/> Confirm highest hit by 8260 <input type="checkbox"/> Confirm all hits by 8260 <input type="checkbox"/> Run _____ oxy's on highest hit <input type="checkbox"/> Run _____ oxy's on all hits						
2 Sample Identification		Collected		3 Grab	Composite	Soil	Water	Oil	Total Number of Containers	BTEX #	8260 full scan	Oxygenates	NWTPH-Gx	NWTPH-Dx with Silica Gel Cleanup	NWTPH-Dx without Silica Gel Cleanup	WA VPH	WA EPH	Lead	Total	Diss.	Method	6 Remarks		
Date	Time	Please forward the lab results directly to the Lead Consultant and cc: G-R.																						
SA		10/21/15		X			3		2	X			X											
MW-6			1040						6				X											
MW-8			1110						6				X											
MW-9			0900						6				X											
MW-10			0930						6				X											
7 Turnaround Time Requested (TAT) (please circle) <input checked="" type="radio"/> Standard 5 day <input type="radio"/> 4 day <input type="radio"/> 72 hour 48 hour EDF/EDD <input type="radio"/> 24 hour				Relinquished by <i>[Signature]</i> Date <u>10/22/15</u> Time <u>1020</u>		Received by <i>[Signature]</i> Date <u>10/22/15</u> Time <u>10:20</u>		Relinquished by <i>[Signature]</i> Date <u>10/22/15</u>		Received by <i>[Signature]</i>		Relinquished by Commercial Carrier: UPS _____ FedEx _____ Other <input checked="" type="checkbox"/>		Received by <i>[Signature]</i> Date <u>10/23/15</u> Time <u>0920</u>		Temperature Upon Receipt <u>05.09°C</u>		Custody Seals Intact? <input checked="" type="checkbox"/> Yes <input type="checkbox"/> No						
8 Data Package (circle if required) Type I - Full Type VI (Raw Data)				EDD (circle if required) CVX-RTBU-FL_05 (default) Other: _____																				

Explanation of Symbols and Abbreviations

The following defines common symbols and abbreviations used in reporting technical data:

RL	Reporting Limit	BMQL	Below Minimum Quantitation Level
N.D.	none detected	MPN	Most Probable Number
TNTC	Too Numerous To Count	CP Units	cobalt-chloroplatinate units
IU	International Units	NTU	nephelometric turbidity units
umhos/cm	micromhos/cm	ng	nanogram(s)
C	degrees Celsius	F	degrees Fahrenheit
meq	milliequivalents	lb.	pound(s)
g	gram(s)	kg	kilogram(s)
µg	microgram(s)	mg	milligram(s)
mL	milliliter(s)	L	liter(s)
m³	cubic meter(s)	µL	microliter(s)
		pg/L	picogram/liter
<	less than		
>	greater than		
ppm	parts per million - One ppm is equivalent to one milligram per kilogram (mg/kg) or one gram per million grams. For aqueous liquids, ppm is usually taken to be equivalent to milligrams per liter (mg/l), because one liter of water has a weight very close to a kilogram. For gases or vapors, one ppm is equivalent to one microliter per liter of gas.		
ppb	parts per billion		
Dry weight basis	Results printed under this heading have been adjusted for moisture content. This increases the analyte weight concentration to approximate the value present in a similar sample without moisture. All other results are reported on an as-received basis.		

Laboratory Data Qualifiers:

- B - Analyte detected in the blank
- C - Result confirmed by reanalysis
- E - Concentration exceeds the calibration range
- J (or G, I, X) - estimated value \geq the Method Detection Limit (MDL or DL) and $<$ the Limit of Quantitation (LOQ or RL)
- P - Concentration difference between the primary and confirmation column $>40\%$. The lower result is reported.
- U - Analyte was not detected at the value indicated
- V - Concentration difference between the primary and confirmation column $>100\%$. The reporting limit is raised due to this disparity and evident interference...

Additional Organic and Inorganic CLP qualifiers may be used with Form 1 reports as defined by the CLP methods. Qualifiers specific to Dioxin/Furans and PCB Congeners are detailed on the individual Analysis Report.

Analytical test results meet all requirements of the associated regulatory program (i.e., NELAC (TNI), DoD, and ISO 17025) unless otherwise noted under the individual analysis.

Measurement uncertainty values, as applicable, are available upon request.

Tests results relate only to the sample tested. Clients should be aware that a critical step in a chemical or microbiological analysis is the collection of the sample. Unless the sample analyzed is truly representative of the bulk of material involved, the test results will be meaningless. If you have questions regarding the proper techniques of collecting samples, please contact us. We cannot be held responsible for sample integrity, however, unless sampling has been performed by a member of our staff.

This report shall not be reproduced except in full, without the written approval of the laboratory.

Times are local to the area of activity. Parameters listed in the 40 CFR Part 136 Table II as "analyze immediately" are not performed within 15 minutes.

WARRANTY AND LIMITS OF LIABILITY - In accepting analytical work, we warrant the accuracy of test results for the sample as submitted. THE FOREGOING EXPRESS WARRANTY IS EXCLUSIVE AND IS GIVEN IN LIEU OF ALL OTHER WARRANTIES, EXPRESSED OR IMPLIED. WE DISCLAIM ANY OTHER WARRANTIES, EXPRESSED OR IMPLIED, INCLUDING A WARRANTY OF FITNESS FOR PARTICULAR PURPOSE AND WARRANTY OF MERCHANTABILITY. IN NO EVENT SHALL EUROFINS LANCASTER LABORATORIES ENVIRONMENTAL, LLC BE LIABLE FOR INDIRECT, SPECIAL, CONSEQUENTIAL, OR INCIDENTAL DAMAGES INCLUDING, BUT NOT LIMITED TO, DAMAGES FOR LOSS OF PROFIT OR GOODWILL REGARDLESS OF (A) THE NEGLIGENCE (EITHER SOLE OR CONCURRENT) OF EUROFINS LANCASTER LABORATORIES ENVIRONMENTAL AND (B) WHETHER EUROFINS LANCASTER LABORATORIES ENVIRONMENTAL HAS BEEN INFORMED OF THE POSSIBILITY OF SUCH DAMAGES. We accept no legal responsibility for the purposes for which the client uses the test results. No purchase order or other order for work shall be accepted by Eurofins Lancaster Laboratories Environmental which includes any conditions that vary from the Standard Terms and Conditions, and Eurofins Lancaster Laboratories Environmental hereby objects to any conflicting terms contained in any acceptance or order submitted by client.

Attachment C:
Hydrographs

**Monitoring Well MW-7
Hydrograph - SPH Thickness
Former Standard Oil Service Station, Chevron Site No. 209335
1225 North 45th Street, Seattle, Washington**

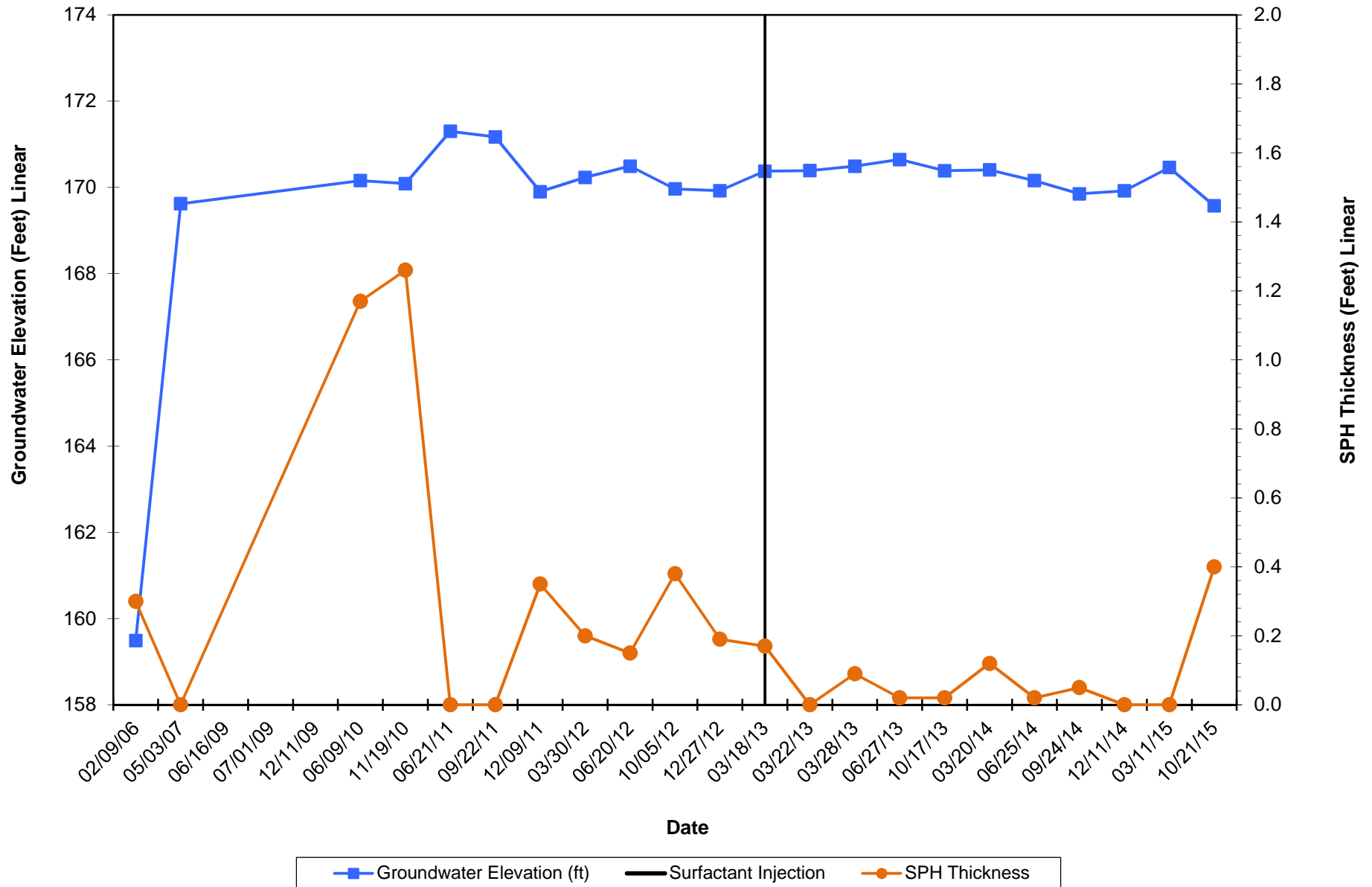

Monitoring Well MW-6
Hydrograph - Gasoline-Range Hydrocarbons
Former Standard Oil Service Station, Chevron Site No. 209335
1225 North 45th Street, Seattle, Washington

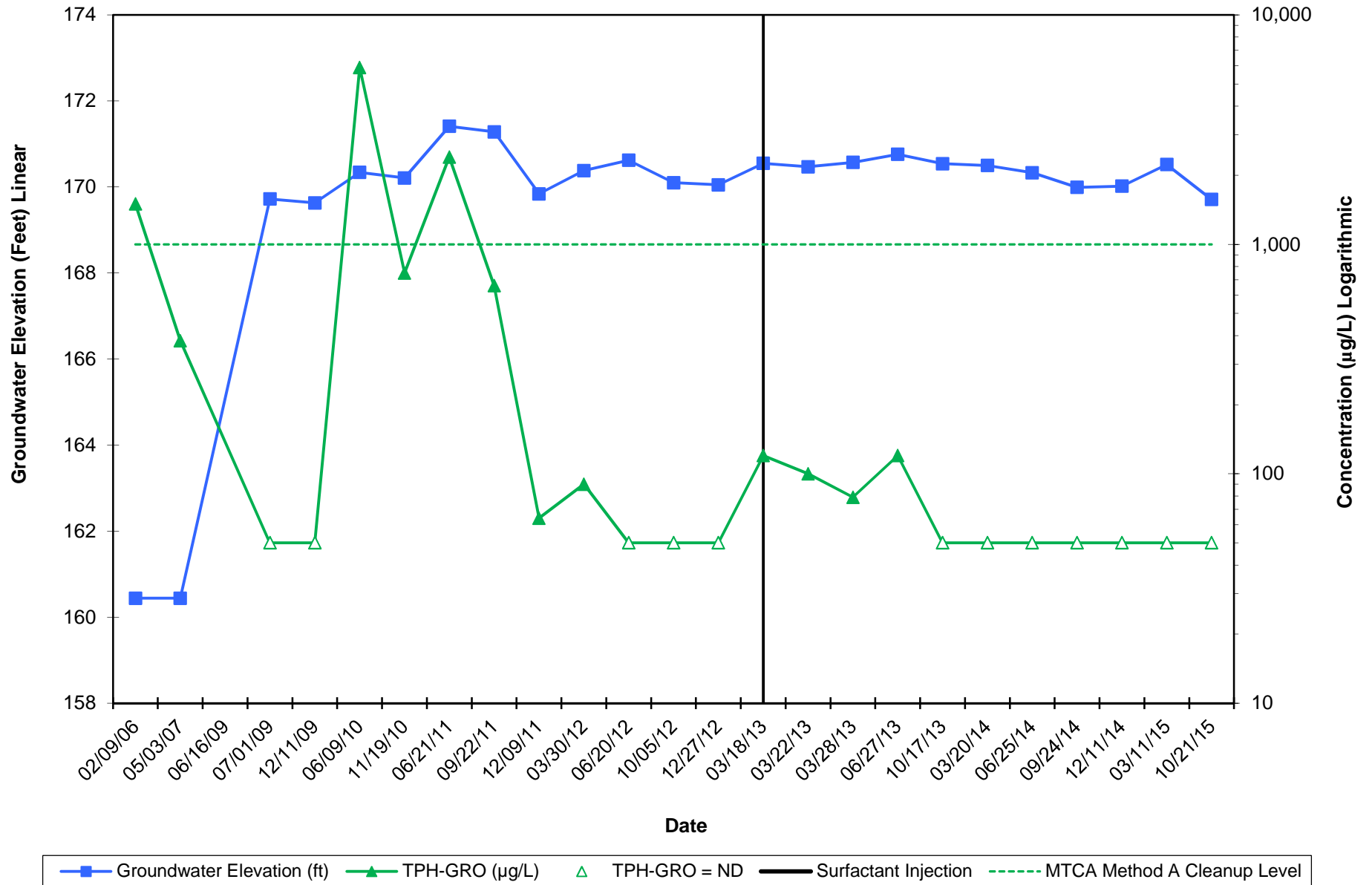

**Monitoring Well MW-8
Hydrograph - Gasoline-Range Hydrocarbons
Former Standard Oil Service Station, Chevron Site No. 209335
1225 North 45th Street, Seattle, Washington**

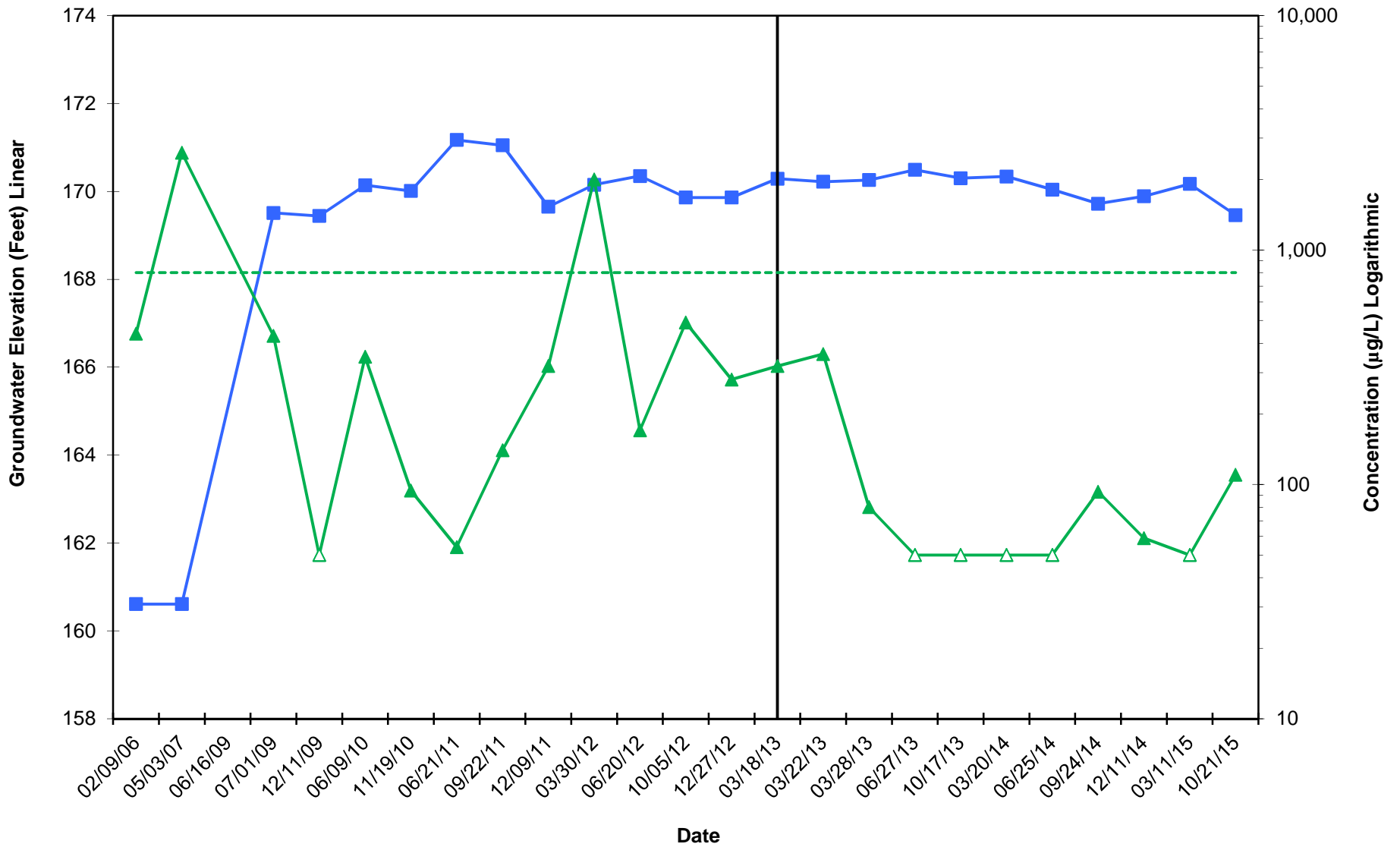

■ Groundwater Elevation (ft)
▲ TPH-GRO (µg/L)
△ TPH-GRO = ND
 Surfactant Injection
- - - MTCA Method A Cleanup Level