



# **QUARTERLY GROUNDWATER MONITORING REPORT**

*Third Quarter of 2015*

*Miller's Market*

*VCP# SW1380*

*Antea Group Project No. STCG-047-2  
September 21, 2015*

*Prepared for:*  
**Miller's Market**  
3152 Washington Way  
Longview, WA 98632

*Prepared by:*  
**Antea Group**  
4006 148<sup>th</sup> Avenue NE  
Redmond, WA 98052  
800 477 7411

**RECEIVED**

SEP 23 2015

**WA State Department  
of Ecology (SWRO)**



September 21, 2015

Mr. Mike Bauman  
Miller's Market  
3152 Washington Way  
Longview, WA 98632

Subject: Quarterly Groundwater Monitoring Report- Third Quarter of 2015  
Miller's Market  
3152 Washington Way  
Longview, Washington  
Antea Project No. STCG-047-2  
Colony Claim No. 21164

Dear Mr. Bauman:

Antea\*Group (Antea Group) has prepared this report to summarize groundwater monitoring performed at the above referenced site on August 13, 2015. A site location map is included on Figure 1.

## **GROUNDWATER SAMPLING AND ANALYSES**

---

Before the August sampling event, Antea Group measured depth to water in monitoring wells MW-1, MW-3 through MW-8, and RW-1 using an electronic water level meter. Groundwater elevations (GWE) were recorded on waterproof field sheets and measured to an accuracy of 0.01 feet. Samples were withdrawn from wells MW-3 and MW-6 through MW-8 using a low-flow/ low-purge technique with a peristaltic pump. Field parameters of temperature, conductivity, dissolved oxygen, oxygen reduction potential (ORP), and pH were collected during low-flow/low-purge procedures. The samples were placed in the appropriate laboratory-provided containers. Samples were labeled, placed into ice filled coolers, logged onto chain-of-custody forms and transported to the laboratory. No separate-phase hydrocarbons were observed in any of the monitoring wells.

During the August groundwater sampling event, the groundwater flow direction was generally to the south at an approximate gradient of 0.02 feet/linear foot. A summary of current and historical groundwater elevations with natural attenuation parameters is included in Table 1. A site map showing well locations and groundwater elevations is included on Figure 2.

All Groundwater samples were submitted to ALS Laboratory Group in Everett, Washington. During the August event, samples from MW-3 and MW-6 through MW-8 were analyzed for total petroleum hydrocarbons in the gasoline



range (TPH-G) using Northwest Method NWTPH-Gx; and benzene, toluene, ethylbenzene, total xylenes (BTEX), and methyl-tert-butyl ether (MTBE) using USEPA Method 8021.

## GROUNDWATER ANALYTICAL RESULTS

---

Analytical results indicate that concentrations of TPH-G were detected in the groundwater samples collected from wells MW-3 and MW-8 at 220 micrograms per liter (ug/L) and 59 ug/L, respectively. Concentrations of benzene and ethylbenzene were detected in the groundwater sample collected from well MW-3 at 2.4 ug/L and 3.4 ug/L, respectively. None of the detected concentrations exceeded the Washington State Department of Ecology's Model Toxics Control Act (MTCA) Method A cleanup levels. All other analytical results were below the laboratory reporting limits and MTCA Method A cleanup levels. A summary of current and historical groundwater analytical results are presented in Table 2. A site map, showing TPH-G, BTEX, and MTBE concentrations, is included on Figure 3. The analytical report and chain-of-custody documentation are presented as Appendix A.

## SULFATE INJECTION

---

Sulfate injection was proposed as a remediation strategy to address the TPH-G and benzene impacts remaining at the site and commenced during the third quarter of 2012. During initial events, 150 gallons of 2% magnesium sulfate solution was injected into the injection trench (IT-1) after completion of groundwater sampling. Following repeated attempts of injecting sulfate into IT-1, it became apparent that sulfate was not migrating to well MW-3. Antea Group therefore began injecting a portion of the sulfate solution into well MW-3, in addition to the injection trench. Sulfate injections had been temporarily suspended following the May 2013 injection event. Though sulfate was not detected in the down gradient compliance well, it remained high in well MW-3. Antea Group received approval on the request to renew the UIC injection permit (#31710) and since sulfate concentrations in well MW-3 decreased, injections resumed during the third and into the fourth quarters of 2013. No injections have occurred since 2013.

## CONCLUSIONS

---

This sampling event represents four consecutive quarterly groundwater monitoring events in which well MW-3 did not exceed MTCA Method A cleanup levels. Wells MW-1, MW-2, MW-4, MW-5 and MW-6 have been non-detect or below MTCA Method A cleanup levels for petroleum constituents for 10 years or more. Well MW-7 exceeded the MTCA Method A cleanup level for TPH-G in March of 2012, but has not exceeded this cleanup level during any of the other sampling events going back to 2005 or since then. Well MW-7 has never exceeded the MTCA Method A cleanup levels for BTEX compounds. Well MW-8 has been below the MTCA Method A cleanup levels for TPH-G and benzene for eight years.



Based on the historical groundwater data, and the current groundwater conditions, Antea Group has suspended groundwater sampling at this Site. Antea Group proposes that the groundwater sampling to date has met the intent of MTCA, and groundwater concentrations no longer present a risk to human health or the environment. We request an opinion from Ecology on whether they concur with this interpretation and agree that groundwater sampling is no longer required at this site. If we do not hear back from Ecology within 60 days, we will assume that Ecology agrees with the evaluation, and we will remove this site from the quarterly sampling program.

## **REMARKS**

---

The recommendations contained in this report represent Antea USA, Inc.'s professional opinions based upon the currently available information and are arrived at in accordance with currently accepted professional standards. This report is based upon a specific scope of work requested by the client. The contract between Antea USA, Inc. and its client outlines the scope of work, and only those tasks specifically authorized by that contract or outlined in this report were performed. This report is intended only for the use of Antea USA, Inc.'s client and anyone else specifically identified in writing by Antea USA, Inc. as a user of this report. Antea USA, Inc. will not and cannot be liable for unauthorized reliance by any other third party. Other than as contained in this paragraph, Antea USA, Inc. makes no express or implied warranty as to the contents of this report.



Antea Group appreciates the opportunity to provide environmental services to you. Please call Matthew Miller, Senior Project Manager, at 425-498-7722 if you have any questions regarding the contents of this letter.

Prepared by:

Handwritten signature of Lauren Hamilton in cursive.

Lauren Hamilton  
Staff Professional

Date: September 21, 2015

Reviewed by:

Handwritten signature of Jaime KC in cursive.

Jaime KC  
Project Professional

Date: September 21, 2015

Handwritten signature of Matthew R. Miller in cursive.

Matthew R. Miller, LG  
Senior Project Manager

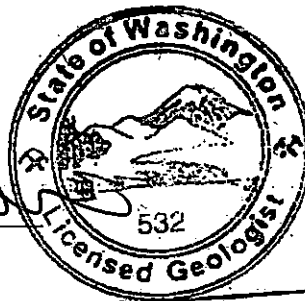

Matthew Miller

Date: September 21, 2015

cc:

- Ms. Heather Knowlton, The Vertex Companies, Inc., Seattle, Washington (Electronic Copy)
  - Ms. Carrie Pederson, Pollution Liability Insurance Agency, Olympia, Washington (Electronic copy issued by Vertex)
  - Argo Pro /Colony Insurance, San Antonio, Texas (Electronic copy issued by Vertex)
  - Mr. Nnamdi Madakor, Washington State Department of Ecology, Olympia, Washington (Electronic copy issued by PLIA)
- File, Antea Group



## ***Enclosures***

### ***Tables***

Table 1	Groundwater Elevation Measurements – Natural Attenuation Parameters
Table 2	Groundwater Analytical Results

### ***Figures***

Figure 1	Site Location Map
Figure 2	Well Locations and Groundwater Elevation Contour Map
Figure 3	Analytical Concentration Map

### ***Appendices***

Appendix A	Analytical Lab Report and Chain-of-Custody Documentation
------------	--



## **Tables**

Table 1	Groundwater Elevation Measurements - Natural Attenuation Parameters
Table 2	Groundwater Analytical Results

**TABLE 1**  
**GROUNDWATER ELEVATION MEASUREMENTS**  
**NATURAL ATTENUATION PARAMETERS**

Miller's Market  
3152 Washington Way  
Longview, Washington

Well I.D. (TOC)	Sample Date	TOC (feet)	Depth to Groundwater (feet)	Groundwater Elevation (feet)	Dissolved Oxygen (mg/L)	pH (0 to 14 units)	Conductivity (uS)	ORP (mV)	Temp. (Celsius)
MW-1	11/17/03	49.37	5.36	44.01	--	--	--	--	--
MW-1	03/15/04	49.37	5.49	43.88	--	--	--	--	--
MW-1	06/17/04	49.37	5.15	44.22	--	--	--	--	--
MW-1	09/15/04	49.37	5.31	44.06	--	--	--	--	--
MW-1	12/16/04	49.37	4.99	44.38	--	--	--	--	--
MW-1	03/18/05	49.37	5.48	43.89	--	--	--	--	--
MW-1	06/14/05	49.37	5.33	44.04	--	--	--	--	--
MW-1	09/26/05	49.37	6.12	43.25	--	--	--	--	--
MW-1	11/28/05	49.37	4.80	44.57	--	--	--	--	--
MW-1	03/22/06	49.37	4.96	44.41	--	--	--	--	--
MW-1	06/27/06	49.37	4.90	44.47	--	--	--	--	--
MW-1	09/22/06	49.37	4.64	44.73	--	--	--	--	--
MW-1	12/05/06	49.37	4.87	44.50	--	--	--	--	--
MW-1	03/13/07	49.37	5.00	44.37	--	--	--	--	--
MW-1	06/04/07	49.37	5.23	44.14	--	--	--	--	--
MW-1	09/10/07	49.37	5.95	43.42	--	--	--	--	--
MW-1	01/07/08	49.37	4.27	45.10	--	--	--	--	--
MW-1	03/20/08	49.37	4.80	44.57	--	--	--	--	--
MW-1	06/16/08	49.37	4.45	44.92	--	--	--	--	--
MW-1	09/08/08	49.37	5.89	43.48	--	--	--	--	--
MW-1	12/08/08	49.37	5.04	44.33	--	--	--	--	--
MW-1	03/05/09	49.37	4.78	44.59	--	--	--	--	--
MW-1	06/19/09	49.37	4.87	44.50	--	--	--	--	--
MW-1	09/28/09	49.37	6.30	43.07	--	--	--	--	--
MW-1	12/29/09	49.37	5.08	44.29	--	--	--	--	--
MW-1	03/26/10	49.37	5.10	44.27	--	--	--	--	--
MW-1	06/09/10	49.37	4.13	45.24	--	--	--	--	--
MW-1	09/22/10	49.37	5.66	43.71	--	--	--	--	--
MW-1	12/17/10	49.37	4.14	45.23	--	--	--	--	--
MW-1	03/25/11	49.37	4.41	44.96	--	--	--	--	--
MW-1	06/21/11	49.37	4.39	44.98	--	--	--	--	--
MW-1	09/13/11	49.37	5.75	43.62	--	--	--	--	--
MW-1	12/28/11	49.37	4.80	44.57	--	--	--	--	--
MW-1	03/19/12	49.37	3.91	45.46	--	--	--	--	--
MW-1	06/06/12	49.37	4.37	45.00	--	--	--	--	--
MW-1	09/17/12	49.37	5.73	43.64	--	--	--	--	--
MW-1*	11/29/12	49.38	4.73	44.65	--	--	--	--	--
MW-1	12/21/12	49.38	4.05	45.33	--	--	--	--	--
MW-1	03/27/13	49.38	5.22	44.16	--	--	--	--	--
MW-1	06/24/13	49.38	4.65	44.73	--	--	--	--	--
MW-1	10/30/13	49.38	5.61	43.77	--	--	--	--	--
MW-1	12/20/13	49.38	6.50	42.88	0.91	6.05	306	--	14.38
MW-1	03/12/14	49.38	4.50	44.88	--	--	--	--	--

**TABLE 1**  
**GROUNDWATER ELEVATION MEASUREMENTS**  
**NATURAL ATTENUATION PARAMETERS**  
 Miller's Market  
 3152 Washington Way  
 Longview, Washington

Well I.D. (TOC)	Sample Date	TOC (feet)	Depth to Groundwater (feet)	Groundwater Elevation (feet)	Dissolved Oxygen (mg/L)	pH (0 to 14 units)	Conductivity (uS)	ORP (mV)	Temp. (Celsius)
MW-1	06/16/14	49.38	4.86	44.52	--	--	--	--	--
MW-1	09/11/14	49.38	6.11	43.27	--	--	--	--	--
MW-1	12/17/14	49.38	4.80	44.58	--	--	--	--	--
MW-1	03/16/15	49.38	4.60	44.78	--	--	--	--	--
MW-1	05/13/15	49.38	5.32	44.06	--	--	--	--	--
MW-1	08/13/15	49.38	5.87	43.51	--	--	--	--	--

**TABLE 1**  
**GROUNDWATER ELEVATION MEASUREMENTS**  
**NATURAL ATTENUATION PARAMETERS**  
 Miller's Market  
 3152 Washington Way  
 Longview, Washington

Well I.D. (TOC)	Sample Date	TOC (feet)	Depth to Groundwater (feet)	Groundwater Elevation (feet)	Dissolved Oxygen (mg/L)	pH (0 to 14 units)	Conductivity (uS)	ORP (mV)	Temp. (Celsius)
MW-2	11/17/03	48.36	4.45	43.91	--	--	--	--	--
MW-2	03/15/04	48.36	4.47	43.89	--	--	--	--	--
MW-2	06/17/04	48.36	4.20	44.16	--	--	--	--	--
MW-2	09/15/04	48.36	4.31	44.05	--	--	--	--	--
MW-2	12/16/04	48.36	4.02	44.34	--	--	--	--	--
MW-2	03/18/05	48.36	4.47	43.89	--	--	--	--	--
MW-2	06/14/05	48.36	4.36	44.00	--	--	--	--	--
MW-2	09/26/05	48.36	5.15	43.21	--	--	--	--	--
MW-2	11/28/05	48.36	3.84	44.52	--	--	--	--	--
MW-2	03/22/06	48.36	4.01	44.35	--	--	--	--	--
MW-2	06/27/06	48.36	3.85	44.51	--	--	--	--	--
MW-2	09/22/06	48.36	4.59	43.77	--	--	--	--	--
MW-2	12/05/06	48.36	3.91	44.45	--	--	--	--	--
MW-2	03/13/07	48.36	NG	48.36	--	--	--	--	--
MW-2	06/04/07	48.36	4.21	44.15	--	--	--	--	--
MW-2	09/10/07	48.36	4.98	43.38	--	--	--	--	--
MW-2	01/07/08	48.36	3.25	45.11	--	--	--	--	--
MW-2	03/20/08	48.36	3.80	44.56	--	--	--	--	--
MW-2	06/16/08	48.36	3.56	44.80	--	--	--	--	--
MW-2	09/08/08	48.36	4.41	43.95	--	--	--	--	--
MW-2	12/08/08	48.36	4.08	44.28	--	--	--	--	--
MW-2	03/05/09	48.36	3.79	44.57	--	--	--	--	--
MW-2	06/19/09	48.36	3.96	44.40	--	--	--	--	--
MW-2	09/28/09	48.36	5.11	43.25	--	--	--	--	--
MW-2	12/29/09	48.36	4.15	44.21	--	--	--	--	--
MW-2	03/26/10	48.36	4.21	44.15	--	--	--	--	--
MW-2	06/09/10	48.36	3.17	45.19	--	--	--	--	--
MW-2	09/22/10	48.36	4.64	43.72	--	--	--	--	--
MW-2	12/17/10	48.36	3.25	45.11	--	--	--	--	--
MW-2	03/25/11	48.36	3.37	44.99	--	--	--	--	--
MW-2	06/21/11	48.36	3.42	44.94	--	--	--	--	--
MW-2	09/13/11	48.36	4.78	43.58	--	--	--	--	--
MW-2	12/28/11	48.36	3.62	44.74	--	--	--	--	--
MW-2	03/19/12	48.36	2.93	45.43	--	--	--	--	--
MW-2	06/08/12	48.36	3.44	44.92	--	--	--	--	--
MW-2	09/17/12	48.36	--	--	--	--	--	--	--
MW-2	12/21/12	48.36	3.13	45.23	--	--	--	--	--
MW-2	03/27/13	48.36	4.20	44.16	--	--	--	--	--
MW-2	06/24/13	48.36	3.77	44.59	--	--	--	--	--
MW-2	10/30/13	48.36	--	--	--	--	--	--	--
MW-2	12/20/13	48.36	5.63	42.73	0.46	6.28	155	--	12.47

**TABLE 1  
GROUNDWATER ELEVATION MEASUREMENTS  
NATURAL ATTENUATION PARAMETERS**

Miller's Market  
3152 Washington Way  
Longview, Washington

Well I.D. (TOC)	Sample Date	TOC (feet)	Depth to Groundwater (feet)	Groundwater Elevation (feet)	Dissolved Oxygen (mg/L)	pH (0 to 14 units)	Conductivity (uS)	ORP (mV)	Temp. (Celsius)
MW-3	11/17/03	49.20	5.34	43.86	--	--	--	--	--
MW-3	03/15/04	49.20	5.24	43.96	--	--	--	--	--
MW-3	06/17/04	49.20	5.48	43.72	--	--	--	--	--
MW-3	09/15/04	49.20	5.55	43.65	--	--	--	--	--
MW-3	12/16/04	49.20	5.12	44.08	--	--	--	--	--
MW-3	03/18/05	49.20	5.61	43.59	--	--	--	--	--
MW-3	06/14/05	49.20	5.26	43.94	--	--	--	--	--
MW-3	09/26/05	49.20	6.02	43.18	--	--	--	--	--
MW-3	11/28/05	49.20	5.01	44.19	--	--	--	--	--
MW-3	03/22/06	49.20	4.85	44.35	--	--	--	--	--
MW-3	06/27/06	49.20	4.86	44.34	--	--	--	--	--
MW-3	09/22/06	49.20	5.50	43.70	--	--	--	--	--
MW-3	12/05/06	49.20	4.90	44.30	--	--	--	--	--
MW-3	03/13/07	49.20	5.06	44.14	--	--	--	--	--
MW-3	06/04/07	49.20	5.36	43.84	--	--	--	--	--
MW-3	09/10/07	49.20	5.90	43.30	--	--	--	--	--
MW-3	01/07/08	49.20	4.42	44.78	--	--	--	--	--
MW-3	03/20/08	49.20	4.90	44.30	--	--	--	--	--
MW-3	06/16/08	49.20	4.47	44.73	--	--	--	--	--
MW-3	09/08/08	49.20	5.72	43.48	--	--	--	--	--
MW-3	12/08/08	49.20	5.10	44.10	--	--	--	--	--
MW-3	03/05/09	49.20	4.16	45.04	--	--	--	--	--
MW-3	06/19/09	49.20	5.74	43.46	--	--	--	--	--
MW-3	09/28/09	49.20	6.13	43.07	--	--	--	--	--
MW-3	12/29/09	49.20	5.27	43.93	--	--	--	--	--
MW-3	03/26/10	49.20	5.03	44.17	--	--	--	--	--
MW-3	06/09/10	49.20	4.12	45.08	--	--	--	--	--
MW-3	09/22/10	49.20	5.67	43.53	--	--	--	--	--
MW-3	12/17/10	49.20	4.10	45.10	--	--	--	--	--
MW-3	03/25/11	49.20	4.30	44.90	--	--	--	--	--
MW-3	06/21/11	49.20	5.07	44.13	--	--	--	--	--
MW-3	09/13/11	49.20	5.71	43.49	--	--	--	--	--
MW-3	12/28/11	49.20	4.90	44.30	--	--	--	--	--
MW-3	03/19/12	49.20	3.92	45.28	--	--	--	--	--
MW-3	04/12/12	49.20	4.19	45.01	--	--	--	--	--
MW-3	06/08/12	49.20	4.43	44.77	--	--	--	--	--
MW-3	09/17/12	49.20	5.63	43.57	--	--	--	--	--
MW-3	10/01/12	49.20	5.87	43.33	--	--	--	--	--
MW-3	10/25/12	49.20	5.58	43.62	--	--	--	--	--
MW-3	11/29/12	49.20	4.68	44.52	--	--	--	--	--
MW-3	12/21/12	49.20	3.13	46.07	--	--	--	--	--
MW-3	02/19/13	49.20	5.33	43.87	--	--	--	--	--
MW-3	03/27/13	49.20	5.19	44.01	--	--	--	--	--

**TABLE 1**  
**GROUNDWATER ELEVATION MEASUREMENTS**  
**NATURAL ATTENUATION PARAMETERS**  
 Miller's Market  
 3152 Washington Way  
 Longview, Washington

Well I.D. (TOC)	Sample Date	TOC (feet)	Depth to Groundwater (feet)	Groundwater Elevation (feet)	Dissolved Oxygen (mg/L)	pH (0 to 14 units)	Conductivity (uS)	ORP (mV)	Temp. (Celsius)
MW-3	04/24/13	49.20	4.95	44.25	--	--	--	--	--
MW-3	05/30/13	49.20	4.46	44.74	--	--	--	--	--
MW-3	06/24/13	49.20	4.79	44.41	--	--	--	--	--
MW-3	07/31/13	49.20	5.75	43.45	--	--	--	--	--
MW-3	08/28/13	49.20	5.76	43.44	--	--	--	--	--
MW-3	09/20/13	49.20	5.20	44.00	--	--	--	--	--
MW-3	10/30/13	49.20	5.40	43.80	--	--	--	--	--
MW-3	11/26/13	49.20	7.51	41.69	--	6.56	646	--	16.5
MW-3	12/20/13	49.20	6.56	42.64	0.34	5.09	1392	--	12.96
MW-3	03/12/14	49.20	4.49	44.71	1.81	6.52	151.7	--	13.9
MW-3	06/16/14	49.20	4.85	44.35	2.84	6.24	814	-66.5	15.97
MW-3	09/11/14	49.20	6.04	43.16	0.39	6.17	572	-106.1	17.05
MW-3	12/17/14	49.20	4.70	44.50	0.80	6.94	457	-168.1	14.20
MW-3	03/16/15	49.20	4.62	44.58	0.50	6.50	334	-72.0	13.30
MW-3	05/13/15	49.20	5.27	43.93	--	6.36	102.1	--	15.9
MW-3	08/13/15	49.20	5.76	43.44	--	6.20	273	-24.0	18.26

**TABLE 1**  
**GROUNDWATER ELEVATION MEASUREMENTS**  
**NATURAL ATTENUATION PARAMETERS**

Miller's Market  
3152 Washington Way  
Longview, Washington

Well I.D. (TOC)	Sample Date	TOC (feet)	Depth to Groundwater (feet)	Groundwater Elevation (feet)	Dissolved Oxygen (mg/L)	pH (0 to 14 units)	Conductivity (uS)	ORP (mV)	Temp. (Celsius)
MW-4	11/28/05	48.38	4.52	43.86	--	--	--	--	--
MW-4	03/22/06	48.38	4.44	43.94	--	--	--	--	--
MW-4	06/27/06	48.38	4.30	44.08	--	--	--	--	--
MW-4	09/22/06	48.38	4.64	43.74	--	--	--	--	--
MW-4	12/05/06	48.38	4.01	44.37	--	--	--	--	--
MW-4	03/13/07	48.38	4.23	44.15	--	--	--	--	--
MW-4	06/04/07	48.38	4.41	43.97	--	--	--	--	--
MW-4	09/10/07	48.38	5.06	43.32	--	--	--	--	--
MW-4	01/07/08	48.38	3.23	45.15	--	--	--	--	--
MW-4	03/20/08	48.38	3.78	44.60	--	--	--	--	--
MW-4	06/16/08	48.38	3.79	44.59	--	--	--	--	--
MW-4	09/08/08	48.38	4.93	43.45	--	--	--	--	--
MW-4	12/08/08	48.38	4.40	43.98	--	--	--	--	--
MW-4	03/05/09	48.38	4.35	44.03	--	--	--	--	--
MW-4	06/19/09	48.38	4.29	44.09	--	--	--	--	--
MW-4	09/28/09	48.38	5.26	43.12	--	--	--	--	--
MW-4	12/29/09	48.38	4.56	43.82	--	--	--	--	--
MW-4	03/26/10	48.38	4.59	43.79	--	--	--	--	--
MW-4	06/09/10	48.38	3.49	44.89	--	--	--	--	--
MW-4	09/22/10	48.38	4.71	43.67	--	--	--	--	--
MW-4	12/17/10	48.38	3.38	45.00	--	--	--	--	--
MW-4	03/25/11	48.38	3.78	44.60	--	--	--	--	--
MW-4	06/21/11	48.38	3.66	44.72	--	--	--	--	--
MW-4	09/13/11	48.38	4.95	43.43	--	--	--	--	--
MW-4	12/28/11	48.38	3.75	44.63	--	--	--	--	--
MW-4	03/19/12	48.38	3.46	44.92	--	--	--	--	--
MW-4	06/06/12	48.38	3.90	44.48	--	--	--	--	--
MW-4	09/17/12	48.38	4.89	43.49	--	--	--	--	--
MW-4*	11/29/12	48.40	4.06	44.34	--	--	--	--	--
MW-4	12/21/12	48.40	3.41	44.99	--	--	--	--	--
MW-4	03/27/13	48.40	4.76	43.64	--	--	--	--	--
MW-4	06/24/13	48.40	4.22	44.18	--	--	--	--	--
MW-4	10/30/13	48.40	4.75	43.65	--	--	--	--	--
MW-4	12/20/13	48.40	5.82	42.58	0.91	5.99	386	--	14.04
MW-4	03/12/14	48.40	4.47	43.93	--	--	--	--	--
MW-4	06/16/14	48.40	4.55	43.85	--	--	--	--	--
MW-4	09/11/14	48.40	5.45	42.95	--	--	--	--	--
MW-4	12/17/14	48.40	4.22	44.18	--	--	--	--	--
MW-4	03/16/15	48.40	4.31	44.09	--	--	--	--	--
MW-4	05/13/15	48.40	4.86	43.54	--	--	--	--	--
MW-4	08/13/15	48.40	5.28	43.12	--	--	--	--	--

**TABLE 1**  
**GROUNDWATER ELEVATION MEASUREMENTS**  
**NATURAL ATTENUATION PARAMETERS**  
 Miller's Market  
 3152 Washington Way  
 Longview, Washington

Well I.D. (TOC)	Sample Date	TOC (feet)	Depth to Groundwater (feet)	Groundwater Elevation (feet)	Dissolved Oxygen (mg/L)	pH (0 to 14 units)	Conductivity (uS)	ORP (mV)	Temp. (Celsius)
MW-5	11/28/05	48.62	4.30	44.32	--	--	--	--	--
MW-5	03/22/06	48.62	4.42	44.20	--	--	--	--	--
MW-5	06/27/06	48.62	4.32	44.30	--	--	--	--	--
MW-5	09/22/06	48.62	4.94	43.68	--	--	--	--	--
MW-5	12/05/06	48.62	4.20	44.42	--	--	--	--	--
MW-5	03/13/07	48.62	4.42	44.20	--	--	--	--	--
MW-5	06/04/07	48.62	4.67	43.95	--	--	--	--	--
MW-5	09/10/07	48.62	5.23	43.39	--	--	--	--	--
MW-5	01/07/08	48.62	3.52	45.10	--	--	--	--	--
MW-5	03/20/08	48.62	4.06	44.56	--	--	--	--	--
MW-5	06/16/08	48.62	3.80	44.82	--	--	--	--	--
MW-5	09/08/08	48.62	5.08	43.54	--	--	--	--	--
MW-5	12/08/08	48.62	4.63	43.99	--	--	--	--	--
MW-5	03/05/09	48.62	4.39	44.23	--	--	--	--	--
MW-5	06/19/09	48.62	4.43	44.19	--	--	--	--	--
MW-5	09/28/09	48.62	5.14	43.48	--	--	--	--	--
MW-5	12/29/09	48.62	4.61	44.01	--	--	--	--	--
MW-5	03/26/10	48.62	4.77	43.85	--	--	--	--	--
MW-5	06/09/10	48.62	3.61	45.01	--	--	--	--	--
MW-5	09/22/10	48.62	4.94	43.68	--	--	--	--	--
MW-5	12/17/10	48.62	3.61	45.01	--	--	--	--	--
MW-5	03/25/11	48.62	3.85	44.77	--	--	--	--	--
MW-5	06/21/11	48.62	3.82	44.80	--	--	--	--	--
MW-5	09/13/11	48.62	5.23	43.39	--	--	--	--	--
MW-5	12/28/11	48.62	4.43	44.19	--	--	--	--	--
MW-5	03/19/12	48.62	3.31	45.31	--	--	--	--	--
MW-5	04/12/12	48.62	3.50	45.12	--	--	--	--	--
MW-5	06/06/12	48.62	4.00	44.62	--	--	--	--	--
MW-5	09/17/12	48.62	5.19	43.43	--	--	--	--	--
MW-5*	10/01/12	48.63	5.28	43.35	--	--	--	--	--
MW-5	10/25/12	48.63	4.83	43.80	--	--	--	--	--
MW-5	11/29/12	48.63	4.04	44.59	--	--	--	--	--
MW-5	12/21/12	48.63	4.05	44.58	--	--	--	--	--
MW-5	02/19/13	48.63	4.86	43.77	--	--	--	--	--
MW-5	03/27/13	48.63	4.65	43.98	--	--	--	--	--
MW-5	04/24/13	48.63	4.42	44.21	--	--	--	--	--
MW-5	05/30/13	48.63	3.97	44.66	--	--	--	--	--
MW-5	06/24/13	48.63	4.55	44.08	--	--	--	--	--
MW-5	07/31/13	48.63	5.16	43.47	--	--	--	--	--
MW-5	08/28/13	48.63	5.18	43.45	--	--	--	--	--
MW-5	09/20/13	48.63	4.92	43.71	--	--	--	--	--
MW-5	10/30/13	48.63	4.95	43.68	--	--	--	--	--
MW-5	11/26/13	48.63	6.54	42.09	--	6.67	107.1	--	18.1

**TABLE 1**  
**GROUNDWATER ELEVATION MEASUREMENTS**  
**NATURAL ATTENUATION PARAMETERS**  
 Miller's Market  
 3152 Washington Way  
 Longview, Washington

Well I.D. (TOC)	Sample Date	TOC (feet)	Depth to Groundwater (feet)	Groundwater Elevation (feet)	Dissolved Oxygen (mg/L)	pH (0 to 14 units)	Conductivity (uS)	ORP (mV)	Temp. (Celsius)
MW-5	12/20/13	48.63	5.93	42.70	0.34	6.20	104	--	13.67
MW-5	06/16/14	48.63	4.34	44.29	--	--	--	--	--
MW-5	03/12/14	48.63	3.83	44.80	--	--	--	--	--
MW-5	09/11/14	48.63	6.06	42.57	--	--	--	--	--
MW-5	12/17/14	48.63	4.13	44.50	--	--	--	--	--
MW-5	03/16/15	48.63	4.33	44.30	--	--	--	--	--
MW-5	05/13/15	48.63	4.85	43.78	--	--	--	--	--
MW-5	08/13/15	48.63	5.21	43.42	--	--	--	--	--

**TABLE 1**  
**GROUNDWATER ELEVATION MEASUREMENTS**  
**NATURAL ATTENUATION PARAMETERS**  
 Miller's Market  
 3152 Washington Way  
 Longview, Washington

Well I.D. (TOC)	Sample Date	TOC (feet)	Depth to Groundwater (feet)	Groundwater Elevation (feet)	Dissolved Oxygen (mg/L)	pH (0 to 14 units)	Conductivity (uS)	ORP (mV)	Temp. (Celsius)
MW-6	11/28/05 <sup>c</sup>	48.99	4.86	44.13	--	--	--	--	--
MW-6	03/22/06	48.99	4.69	44.30	--	--	--	--	--
MW-6	06/27/06	48.99	5.36	43.63	--	--	--	--	--
MW-6	09/22/06	48.99	5.16	43.83	--	--	--	--	--
MW-6	12/05/06	48.99	4.79	44.20	--	--	--	--	--
MW-6	03/13/07	48.99	4.75	44.24	--	--	--	--	--
MW-6	06/04/07	48.99	5.19	43.80	--	--	--	--	--
MW-6	09/10/07	48.99	5.47	43.52	--	--	--	--	--
MW-6	01/07/08	48.99	4.93	44.06	--	--	--	--	--
MW-6	03/20/08	48.99	4.86	44.13	--	--	--	--	--
MW-6	06/16/08	48.99	4.38	44.61	--	--	--	--	--
MW-6	09/08/08	48.99	5.17	43.82	--	--	--	--	--
MW-6	12/08/08	48.99	5.12	43.87	--	--	--	--	--
MW-6	03/05/09	48.99	4.75	44.24	--	--	--	--	--
MW-6	06/19/09	48.99	5.80	43.19	--	--	--	--	--
MW-6	09/28/09	48.99	5.28	43.71	--	--	--	--	--
MW-6	12/29/09	48.99	5.26	43.73	--	--	--	--	--
MW-6	03/26/10	48.99	4.84	44.15	--	--	--	--	--
MW-6	06/09/10	48.99	3.94	45.05	--	--	--	--	--
MW-6	09/22/10	48.99	5.07	43.92	--	--	--	--	--
MW-6	12/17/10	48.99	3.97	45.02	--	--	--	--	--
MW-6	03/25/11	48.99	4.45	44.54	--	--	--	--	--
MW-6	06/21/11	48.99	4.23	44.76	--	--	--	--	--
MW-6	09/13/11	48.99	5.51	43.48	--	--	--	--	--
MW-6	12/28/11	48.99	5.30	43.69	--	--	--	--	--
MW-6	03/19/12	48.99	3.91	45.08	--	--	--	--	--
MW-6	04/12/12	48.99	4.65	44.34	--	--	--	--	--
MW-6	06/06/12	48.99	5.04	43.95	--	--	--	--	--
MW-6	09/17/12	48.99	5.50	43.49	--	--	--	--	--
MW-6*	10/01/12	49.00	5.75	43.25	--	--	--	--	--
MW-6	10/25/12	49.00	5.76	43.24	--	--	--	--	--
MW-6	11/29/12	49.00	4.87	44.13	--	--	--	--	--
MW-6	12/21/12	49.00	2.14	46.86	--	--	--	--	--
MW-6	02/19/13	49.00	5.60	43.40	--	--	--	--	--
MW-6	03/27/13	49.00	5.21	43.79	--	--	--	--	--
MW-6	04/24/13	49.00	5.83	43.17	--	--	--	--	--
MW-6	05/30/13	49.00	4.55	44.45	--	--	--	--	--
MW-6	06/24/13	49.00	4.90	44.10	--	--	--	--	--
MW-6	07/31/13	49.00	5.82	43.18	--	--	--	--	--
MW-6	08/28/13	49.00	6.10	42.90	--	--	--	--	--
MW-6	09/20/13	49.00	6.15	42.85	--	--	--	--	--
MW-6	10/30/13	49.00	5.65	43.35	--	--	--	--	--
MW-6	11/26/13	49.00	7.50	41.50	--	6.67	110.1	--	16.2

**TABLE 1**  
**GROUNDWATER ELEVATION MEASUREMENTS**  
**NATURAL ATTENUATION PARAMETERS**  
 Miller's Market  
 3152 Washington Way  
 Longview, Washington

Well I.D. (TOC)	Sample Date	TOC (feet)	Depth to Groundwater (feet)	Groundwater Elevation (feet)	Dissolved Oxygen (mg/L)	pH (0 to 14 units)	Conductivity (uS)	ORP (mV)	Temp. (Celsius)
MW-6	12/20/13	49.00	6.70	42.30	0.12	6.31	182	--	12.84
MW-6	03/12/14	49.00	5.78	43.22	0.85	6.55	100.1	--	14.0
MW-6	06/16/14	49.00	5.75	43.25	6.99	5.26	285	-27.9	15.07
MW-6	09/11/14	49.00	6.14	42.86	0.77	5.97	241	-60.4	17.42
MW-6	12/17/14	49.00	5.77	43.23	2.13	6.94	213	-118.7	13.79
MW-6	03/16/15	49.00	4.79	44.21	1.14	6.55	214	-70.9	11.83
MW-6	05/13/15	49.00	5.15	43.85	--	6.23	82.1	--	15.6
MW-6	08/13/15	49.00	5.77	43.23	0.21	6.37	194	-57.9	17.42

**TABLE 1**  
**GROUNDWATER ELEVATION MEASUREMENTS**  
**NATURAL ATTENUATION PARAMETERS**  
 Miller's Market  
 3152 Washington Way  
 Longview, Washington

Well I.D. (TOC)	Sample Date	TOC (feet)	Depth to Groundwater (feet)	Groundwater Elevation (feet)	Dissolved Oxygen (mg/L)	pH (0 to 14 units)	Conductivity (uS)	ORP (mV)	Temp. (Celsius)
MW-7	11/28/05	49.07	4.16	44.91	--	--	--	--	--
MW-7	03/22/06	49.07	3.59	45.48	--	--	--	--	--
MW-7	06/27/06	49.07	3.77	45.30	--	--	--	--	--
MW-7	09/22/06	49.07	4.84	44.23	--	--	--	--	--
MW-7	12/05/06	49.07	3.35	45.72	--	--	--	--	--
MW-7	03/13/07	49.07	3.54	45.53	--	--	--	--	--
MW-7	06/04/07	49.07	4.23	44.84	--	--	--	--	--
MW-7	09/10/07	49.07	4.90	44.17	--	--	--	--	--
MW-7	01/07/08	49.07	3.39	45.68	--	--	--	--	--
MW-7	03/20/08	49.07	3.83	45.24	--	--	--	--	--
MW-7	06/16/08	49.07	3.66	45.41	--	--	--	--	--
MW-7	09/08/08	49.07	4.10	44.97	--	--	--	--	--
MW-7	12/08/08	49.07	4.21	44.86	--	--	--	--	--
MW-7	03/05/09	49.07	3.80	45.27	--	--	--	--	--
MW-7	06/19/09	49.07	3.84	45.23	--	--	--	--	--
MW-7	09/28/09	49.07	4.95	44.12	--	--	--	--	--
MW-7	12/29/09	49.07	4.02	45.05	--	--	--	--	--
MW-7	03/26/10	49.07	3.89	45.18	--	--	--	--	--
MW-7	06/09/10	49.07	3.19	45.88	--	--	--	--	--
MW-7	09/22/10	49.07	4.45	44.62	--	--	--	--	--
MW-7	12/17/10	49.07	3.41	45.66	--	--	--	--	--
MW-7	03/25/11	49.07	2.92	46.15	--	--	--	--	--
MW-7	06/21/11	49.07	3.10	45.97	--	--	--	--	--
MW-7	09/13/11	49.07	4.46	44.61	--	--	--	--	--
MW-7	12/28/11	49.07	4.18	44.89	--	--	--	--	--
MW-7	03/19/12	49.07	2.84	46.23	--	--	--	--	--
MW-7	04/12/12	49.07	2.47	46.60	--	--	--	--	--
MW-7	06/06/12	49.07	2.71	46.36	--	--	--	--	--
MW-7	09/17/12	49.07	4.35	44.72	--	--	--	--	--
MW-7*	10/01/12	49.04	4.61	44.43	--	--	--	--	--
MW-7	10/25/12	49.04	4.35	44.69	--	--	--	--	--
MW-7	11/29/12	49.04	3.22	45.82	--	--	--	--	--
MW-7	12/21/12	49.04	2.45	46.59	--	--	--	--	--
MW-7	02/19/13	49.04	3.40	45.64	--	--	--	--	--
MW-7	03/27/13	49.04	3.46	45.58	--	--	--	--	--
MW-7	04/24/13	49.04	3.20	45.84	--	--	--	--	--
MW-7	05/30/13	49.04	3.26	45.78	--	--	--	--	--
MW-7	06/24/13	49.04	3.57	45.47	--	--	--	--	--
MW-7	07/31/13	49.04	4.19	44.85	--	--	--	--	--
MW-7	08/28/13	49.04	4.60	44.44	--	--	--	--	--
MW-7	09/20/13	49.04	4.52	44.52	--	--	--	--	--
MW-7	10/30/13	49.04	4.12	44.92	--	--	--	--	--
MW-7	11/26/13	49.04	4.46	44.58	--	7.16	615	--	16.8

**TABLE 1**  
**GROUNDWATER ELEVATION MEASUREMENTS**  
**NATURAL ATTENUATION PARAMETERS**  
 Miller's Market  
 3152 Washington Way  
 Longview, Washington

Well I.D. (TOC)	Sample Date	TOC (feet)	Depth to Groundwater (feet)	Groundwater Elevation (feet)	Dissolved Oxygen (mg/L)	pH (0 to 14 units)	Conductivity (uS)	ORP (mV)	Temp. (Celsius)
MW-7	12/20/13	49.04	4.80	44.24	0.72	6.61	763	--	12.10
MW-7	03/12/14	49.04	4.25	44.79	1.13	7.21	174.2	--	14.2
MW-7	06/16/14	49.04	4.33	44.71	1.17	6.34	707	-56.9	15.73
MW-7	09/11/14	49.04	5.97	43.07	0.49	6.82	400	-147.9	19.04
MW-7	12/17/14	49.04	4.03	45.01	0.56	7.23	675	-173.7	15.02
MW-7	03/16/15	49.04	3.59	45.45	0.41	6.95	382	-31.1	11.96
MW-7	05/13/15	49.04	4.05	44.99	--	6.90	132.3	--	16.1
<b>MW-7</b>	<b>08/13/15</b>	<b>49.04</b>	<b>5.05</b>	<b>43.99</b>	<b>0.84</b>	<b>7.11</b>	<b>350</b>	<b>-92.9</b>	<b>20.48</b>

**TABLE 1  
GROUNDWATER ELEVATION MEASUREMENTS  
NATURAL ATTENUATION PARAMETERS**

Miller's Market  
3152 Washington Way  
Longview, Washington

Well I.D. (TOC)	Sample Date	TOC (feet)	Depth to Groundwater (feet)	Groundwater Elevation (feet)	Dissolved Oxygen (mg/L)	pH (0 to 14 units)	Conductivity (uS)	ORP (mV)	Temp. (Celsius)
MW-8	11/28/05	48.55	3.62	44.93	--	--	--	--	--
MW-8	03/22/06	48.55	3.11	45.44	--	--	--	--	--
MW-8	06/27/06	48.55	3.25	45.30	--	--	--	--	--
MW-8	09/22/06	48.55	4.30	44.25	--	--	--	--	--
MW-8	12/05/06	48.55	2.80	45.75	--	--	--	--	--
MW-8	03/13/07	48.55	3.01	45.54	--	--	--	--	--
MW-8	06/04/07	48.55	3.71	44.84	--	--	--	--	--
MW-8	09/10/07	48.55	4.38	44.17	--	--	--	--	--
MW-8	01/07/08	48.55	3.76	44.79	--	--	--	--	--
MW-8	03/20/08	48.55	3.29	45.26	--	--	--	--	--
MW-8	06/16/08	48.55	3.13	45.42	--	--	--	--	--
MW-8	09/08/08	48.55	3.80	44.75	--	--	--	--	--
MW-8	12/08/08	48.55	3.68	44.87	--	--	--	--	--
MW-8	03/05/09	48.55	3.37	45.18	--	--	--	--	--
MW-8	06/19/09	48.55	3.39	45.16	--	--	--	--	--
MW-8	09/28/09	48.55	4.42	44.13	--	--	--	--	--
MW-8	12/29/09	48.55	3.46	45.09	--	--	--	--	--
MW-8	03/26/10	48.55	3.35	45.20	--	--	--	--	--
MW-8	06/09/10	48.55	2.63	45.92	--	--	--	--	--
MW-8	09/22/10	48.55	3.90	44.65	--	--	--	--	--
MW-8	12/17/10	48.55	2.91	45.64	--	--	--	--	--
MW-8	03/25/11	48.55	2.40	46.15	--	--	--	--	--
MW-8	06/21/11	48.55	2.60	45.95	--	--	--	--	--
MW-8	09/13/11	48.55	3.95	44.60	--	--	--	--	--
MW-8	12/28/11	48.55	3.67	44.88	--	--	--	--	--
MW-8	03/19/12	48.55	2.32	46.23	--	--	--	--	--
MW-8	06/06/12	48.55	2.12	46.43	--	--	--	--	--
MW-8	09/17/12	48.55	3.85	44.70	--	--	--	--	--
MW-8*	11/29/12	48.53	2.73	45.80	--	--	--	--	--
MW-8	12/21/12	48.53	1.93	46.60	--	--	--	--	--
MW-8	03/27/13	48.53	2.93	45.60	--	--	--	--	--
MW-8	06/24/13	48.53	3.07	45.46	--	--	--	--	--
MW-8	10/30/13	48.53	3.62	44.91	--	--	--	--	--
MW-8	12/20/13	48.53	4.29	44.24	0.57	6.99	158	--	12.31
MW-8	03/12/14	48.53	3.73	44.80	0.69	7.27	116.3	--	13.7
MW-8	06/16/14	48.53	3.83	44.70	2.36	6.86	340	-99.1	17.08
MW-8	09/11/14	48.53	5.45	43.08	0.33	6.60	283	-136.1	18.70
MW-8	12/17/14	48.53	3.54	44.99	0.46	7.32	422	-100.2	14.51
MW-8	03/16/15	48.53	3.09	45.44	1.02	7.09	352	36.7	12.04
MW-8	05/13/15	48.53	3.54	44.99	--	7.02	108.2	--	16.1
MW-8	08/13/15	48.53	4.55	43.98	3.06	6.91	379	-111.7	18.28

**TABLE 1**  
**GROUNDWATER ELEVATION MEASUREMENTS**  
**NATURAL ATTENUATION PARAMETERS**

Miller's Market  
3152 Washington Way  
Longview, Washington

Well I.D. (TOC)	Sample Date	TOC (feet)	Depth to Groundwater (feet)	Groundwater Elevation (feet)	Dissolved Oxygen (mg/L)	pH (0 to 14 units)	Conductivity (uS)	ORP (mV)	Temp. (Celsius)
RW-1	11/17/03	48.35	4.58	43.77	--	--	--	--	--
RW-1	03/15/04	48.35	4.50	43.85	--	--	--	--	--
RW-1	06/17/04	48.35	4.34	44.01	--	--	--	--	--
RW-1	09/15/04	48.35	4.47	43.88	--	--	--	--	--
RW-1	12/16/04	48.35	3.88	44.47	--	--	--	--	--
RW-1	03/18/05	48.35	4.70	43.65	--	--	--	--	--
RW-1	06/14/05	48.35	4.41	43.94	--	--	--	--	--
RW-1	09/26/05	48.35	5.06	43.29	--	--	--	--	--
RW-1	11/28/05	48.35	4.03	44.32	--	--	--	--	--
RW-1	03/22/06	48.35	4.15	44.20	--	--	--	--	--
RW-1	06/27/06	48.35	4.02	44.33	--	--	--	--	--
RW-1	09/22/06	48.35	4.64	43.71	--	--	--	--	--
RW-1	12/05/06	48.35	3.91	44.44	--	--	--	--	--
RW-1	03/13/07	48.35	4.13	44.22	--	--	--	--	--
RW-1	06/04/07	48.35	4.43	43.92	--	--	--	--	--
RW-1	09/10/07	48.35	4.94	43.41	--	--	--	--	--
RW-1	01/07/08	48.35	3.51	44.84	--	--	--	--	--
RW-1	03/20/08	48.35	3.74	44.61	--	--	--	--	--
RW-1	06/16/08	48.35	3.51	44.84	--	--	--	--	--
RW-1	09/08/08	48.35	4.71	43.64	--	--	--	--	--
RW-1	12/08/08	48.35	4.37	43.98	--	--	--	--	--
RW-1	03/05/09	48.35	4.07	44.28	--	--	--	--	--
RW-1	06/19/09	48.35	4.13	44.22	--	--	--	--	--
RW-1	09/28/09	48.35	4.96	43.39	--	--	--	--	--
RW-1	12/29/09	48.35	4.35	44.00	--	--	--	--	--
RW-1	03/26/10	48.35	4.55	43.80	--	--	--	--	--
RW-1	06/09/10	48.35	3.40	44.95	--	--	--	--	--
RW-1	09/22/10	48.35	4.65	43.70	--	--	--	--	--
RW-1	12/17/10	48.35	3.30	45.05	--	--	--	--	--
RW-1	03/25/11	48.35	3.50	44.85	--	--	--	--	--
RW-1	06/21/11	48.35	3.50	44.85	--	--	--	--	--
RW-1	09/13/11	48.35	4.96	43.39	--	--	--	--	--
RW-1	12/28/11	48.35	4.02	44.33	--	--	--	--	--
RW-1	03/19/12	48.35	2.93	45.42	--	--	--	--	--
RW-1	06/06/12	48.35	3.69	44.66	--	--	--	--	--
RW-1	09/17/12	48.35	4.93	43.42	--	--	--	--	--
RW-1*	11/29/12	48.35	3.72	44.63	--	--	--	--	--
RW-1	12/21/12	48.32	3.15	45.17	--	--	--	--	--
RW-1	03/27/13	48.32	4.40	43.92	--	--	--	--	--
RW-1	06/24/13	48.32	4.29	44.03	--	--	--	--	--
RW-1	10/30/13	48.32	4.73	43.59	--	--	--	--	--
RW-1	12/20/13	48.32	5.45	42.87	0.62	6.06	767	--	10.66
RW-1	03/12/14	48.32	3.52	44.80	--	--	--	--	--

**TABLE 1**  
**GROUNDWATER ELEVATION MEASUREMENTS**  
**NATURAL ATTENUATION PARAMETERS**  
 Miller's Market  
 3152 Washington Way  
 Longview, Washington

Well I.D. (TOC)	Sample Date	TOC (feet)	Depth to Groundwater (feet)	Groundwater Elevation (feet)	Dissolved Oxygen (mg/L)	pH (0 to 14 units)	Conductivity (uS)	ORP (mV)	Temp. (Celsius)
RW-1	06/16/14	48.32	4.03	44.29	--	--	--	--	--
RW-1	09/11/14	48.32	6.23	42.09	--	--	--	--	--
RW-1	12/17/14	48.32	3.81	44.51	--	--	--	--	--
RW-1	03/16/15	48.32	4.03	44.29	--	--	--	--	--
RW-1	05/13/15	48.32	4.55	43.77	--	--	--	--	--
RW-1	08/13/15	48.32	4.96	43.36	--	--	--	--	--

**Notes:**

(TOC) = top of casing elevation

\*TOC re-surveyed relative to MW-3' elevation on 11/29/12

Dissolved Oxygen, pH, Conductivity and Temperature measurements taken with a Y-SI 556 water quality field instrument

**TABLE 2  
GROUNDWATER ANALYTICAL RESULTS**

Miller's Market  
3152 Washington Way  
Longview, Washington

Well I.D. (TOC)	Sample Date	TPH- Gasoline (µg/L)	TPH- Diesel (µg/L)	TPH- Oil (µg/L)	Benzene (µg/L)	Toluene (µg/L)	Ethyl- benzene (µg/L)	Xylenes (µg/L)	MTBE (µg/L)	EDC (µg/L)	EDB (µg/L)	Lead (µg/L)	Nitrate (mg/L)	Sulfate (mg/L)
MW-1	11/17/03	ND	-	-	ND(<1)	ND(<1)	ND(<1)	ND(<3)	-	-	-	-	-	-
MW-1	03/15/04	ND	-	-	ND(<1)	ND(<1)	ND(<1)	ND(<3)	ND(<3)	-	-	-	-	-
MW-1	06/17/04	ND(<50)	-	-	ND(<1)	ND(<1)	ND(<1)	ND(<3)	ND(<3)	-	-	-	-	-
MW-1	09/15/04	ND	-	-	ND(<1)	ND(<1)	ND(<1)	ND(<3)	ND(<3)	-	-	-	-	-
MW-1	12/16/04	ND	-	-	ND(<1)	ND(<1)	ND(<1)	ND(<3)	ND(<3)	-	-	-	-	-
MW-1	03/18/05	ND	-	-	ND(<1)	ND(<1)	ND(<1)	ND(<3)	ND(<3)	-	-	-	-	-
MW-1	06/14/05	ND	-	-	ND(<1)	ND(<1)	ND(<1)	ND(<3)	ND(<3)	-	-	-	-	-
MW-1	09/26/05	ND	-	-	ND(<1)	ND(<1)	ND(<1)	ND(<3)	ND(<3)	-	-	-	-	-
MW-1	11/28/05	ND(<50)	ND(<130)	ND(<250)	ND(<1)	ND(<1)	ND(<1)	ND(<3)	ND(<3)	-	-	-	-	-
MW-1	03/22/06	ND(<50)	ND(<130)	ND(<250)	ND(<1)	ND(<1)	ND(<1)	ND(<3)	ND(<2)	-	-	-	-	-
MW-1	06/27/06	ND(<50)	ND(<130)	ND(<250)	ND(<1)	ND(<1)	ND(<1)	ND(<3)	ND(<3)	-	-	-	-	-
MW-1	09/22/06	ND(<50)	ND(<130)	ND(<250)	ND(<1)	ND(<1)	ND(<1)	ND(<3)	ND(<3)	-	-	-	-	-
MW-1	12/05/06	ND(<50)	ND(<130)	ND(<250)	ND(<1)	ND(<1)	ND(<1)	ND(<3)	ND(<3)	-	-	-	-	-
MW-1	03/13/07	ND(<50)	-	-	ND(<1)	ND(<1)	ND(<1)	ND(<3)	ND(<3)	-	-	-	-	-
MW-1	06/04/07	ND(<50)	-	-	ND(<1)	ND(<1)	ND(<1)	ND(<3)	ND(<3)	-	-	-	-	-
MW-1	09/10/07	ND(<50)	-	-	ND(<1)	ND(<1)	ND(<1)	ND(<3)	ND(<3)	-	-	-	-	-
MW-1	01/07/08	ND(<50)	-	-	ND(<1)	ND(<1)	ND(<1)	ND(<3)	ND(<3)	-	-	-	-	-
MW-1	03/20/08	ND(<50)	-	-	ND(<1)	ND(<1)	ND(<1)	ND(<3)	ND(<3)	-	-	-	-	-
MW-1	06/16/08	ND(<50)	-	-	ND(<1)	ND(<1)	ND(<1)	ND(<3)	ND(<3)	-	-	-	-	-
MW-1	09/08/08	ND(<50)	-	-	ND(<1)	ND(<1)	ND(<1)	ND(<3)	ND(<3)	-	-	-	-	-
MW-1	12/08/08	ND(<50)	-	-	ND(<1)	ND(<1)	ND(<1)	ND(<3)	ND(<3)	-	-	-	-	-
MW-1	03/05/09	ND(<50)	-	-	ND(<1)	ND(<1)	ND(<1)	ND(<3)	ND(<3)	-	-	-	-	-
MW-1	06/19/09	ND(<50)	-	-	ND(<1)	ND(<1)	ND(<1)	ND(<3)	ND(<3)	-	-	-	-	-
MW-1	09/28/09	ND(<50)	-	-	ND(<1.0)	ND(<1.0)	ND(<1.0)	ND(<3.0)	ND(<3.0)	-	-	-	-	-
MW-1	12/29/09	ND(<50)	-	-	ND(<1.0)	ND(<1.0)	ND(<1.0)	ND(<3.0)	ND(<1.0)	-	-	-	-	-
MW-1	03/26/10	ND(<50)	-	-	ND(<1.0)	ND(<1.0)	ND(<1.0)	ND(<3.0)	ND(<3.0)	-	-	-	-	-
MW-1	06/09/10	ND(<50)	-	-	ND(<1.0)	ND(<1.0)	ND(<1.0)	ND(<3.0)	ND(<3.0)	-	-	-	-	-
MW-1	09/22/10	ND(<50)	-	-	ND(<1.0)	ND(<1.0)	ND(<1.0)	ND(<3.0)	ND(<3.0)	-	-	-	-	-
MW-1	12/17/10	ND(<50)	-	-	ND(<1.0)	ND(<1.0)	ND(<1.0)	ND(<3.0)	ND(<3.0)	-	-	-	-	-
MW-1	03/25/11	ND(<50)	-	-	ND(<1.0)	ND(<1.0)	ND(<1.0)	ND(<3.0)	ND(<3.0)	-	-	-	-	-
MW-1	06/21/11	ND(<50)	-	-	ND(<1.0)	ND(<1.0)	ND(<1.0)	ND(<3.0)	ND(<3.0)	-	-	-	-	-
MW-1	09/13/11	ND(<50)	-	-	ND(<1.0)	ND(<1.0)	ND(<1.0)	ND(<3.0)	ND(<2.0)	-	-	-	-	-
MW-1	12/28/11	ND(<50)	-	-	ND(<1.0)	ND(<1.0)	ND(<1.0)	ND(<3.0)	ND(<3.0)	-	-	-	-	-
MW-1	03/19/12	ND(<50)	-	-	ND(<1.0)	ND(<1.0)	ND(<1.0)	ND(<3.0)	ND(<3.0)	-	-	-	-	-
MW-1	06/06/12	ND(<50)	-	-	ND(<1.0)	ND(<1.0)	ND(<1.0)	ND(<3.0)	ND(<3.0)	ND(<0.020)	ND(<0.010)	ND(<1.0)	-	-
MW-1	09/17/12	ND(<50)	-	-	ND(<1.0)	ND(<1.0)	ND(<1.0)	ND(<3.0)	ND(<3.0)	ND(<0.020)	ND(<0.010)	ND(<1.0)	-	-
MW-1	12/21/12	ND(<50)	-	-	ND(<1.0)	ND(<1.0)	ND(<1.0)	ND(<3.0)	ND(<3.0)	ND(<0.020)	ND(<0.010)	ND(<1.0)	-	-
MW-1	03/27/13	ND(<50)	-	-	ND(<1.0)	ND(<1.0)	ND(<1.0)	ND(<3.0)	ND(<3.0)	-	-	ND(<1.0)	-	-
MW-1	06/24/13	ND(<50)	-	-	ND(<1.0)	ND(<1.0)	ND(<1.0)	ND(<3.0)	ND(<3.0)	-	-	-	-	-
MW-1	10/30/13	ND(<50)	-	-	ND(<1.0)	ND(<1.0)	ND(<1.0)	ND(<3.0)	ND(<3.0)	-	-	-	-	-
MW-1	12/20/13	ND(<50)	-	-	ND(<1.0)	ND(<1.0)	ND(<1.0)	ND(<3.0)	ND(<3.0)	-	-	-	-	-

**TABLE 2  
GROUNDWATER ANALYTICAL RESULTS**

Miller's Market  
3152 Washington Way  
Longview, Washington

Well I.D. (TOC)	Sample Date	TPH- Gasoline (µg/L)	TPH- Diesel (µg/L)	TPH- Oil (µg/L)	Benzene (µg/L)	Toluene (µg/L)	Ethyl- benzene (µg/L)	Xylenes (µg/L)	MTBE (µg/L)	EDC (µg/L)	EDB (µg/L)	Lead (µg/L)	Nitrate (mg/L)	Sulfate (mg/L)
MW-2	11/17/03	ND	-	-	ND(<1)	ND(<1)	ND(<1)	ND(<3)	-	-	-	-	-	-
MW-2	03/15/04	ND	-	-	ND(<1)	ND(<1)	ND(<1)	ND(<3)	ND(<3)	-	-	-	-	-
MW-2	06/17/04	ND(<50)	-	-	ND(<1)	ND(<1)	ND(<1)	ND(<3)	ND(<3)	-	-	-	-	-
MW-2	09/15/04	ND	-	-	ND(<1)	ND(<1)	ND(<1)	ND(<3)	ND(<3)	-	-	-	-	-
MW-2	12/16/04	ND	-	-	ND(<1)	ND(<1)	ND(<1)	ND(<3)	ND(<3)	-	-	-	-	-
MW-2	03/18/05	ND	-	-	ND(<1)	ND(<1)	ND(<1)	ND(<3)	ND(<3)	-	-	-	-	-
MW-2	06/14/05	ND	-	-	ND(<1)	ND(<1)	ND(<1)	ND(<3)	ND(<3)	-	-	-	-	-
MW-2	09/26/05	ND	-	-	ND(<1)	ND(<1)	ND(<1)	ND(<3)	ND(<3)	-	-	-	-	-
MW-2	11/28/05	ND(<50)	ND(<130)	ND(<250)	ND(<1)	ND(<1)	ND(<1)	ND(<3)	ND(<3)	-	-	-	-	-
MW-2	03/22/06	ND(<50)	ND(<130)	ND(<250)	ND(<1)	ND(<1)	ND(<1)	ND(<3)	ND(<3)	-	-	-	-	-
MW-2	06/27/06	ND(<50)	ND(<130)	ND(<250)	ND(<1)	ND(<1)	ND(<1)	ND(<3)	ND(<3)	-	-	-	-	-
MW-2	09/22/06	ND(<50)	ND(<130)	ND(<250)	ND(<1)	ND(<1)	ND(<1)	ND(<3)	ND(<3)	-	-	-	-	-
MW-2	12/05/06	ND(<50)	ND(<130)	ND(<250)	ND(<1)	ND(<1)	ND(<1)	ND(<3)	ND(<3)	-	-	-	-	-
MW-2	03/13/07	NA	-	-	NA	NA	NA	NA	NA	-	-	-	-	-
MW-2	06/04/07	ND(<50)	-	-	ND(<1)	ND(<1)	ND(<1)	ND(<3)	ND(<3)	-	-	-	-	-
MW-2	09/10/07	ND(<50)	-	-	ND(<1)	ND(<1)	ND(<1)	ND(<3)	ND(<3)	-	-	-	-	-
MW-2	01/07/08	ND(<50)	-	-	ND(<1)	ND(<1)	ND(<1)	ND(<3)	ND(<3)	-	-	-	-	-
MW-2	03/20/08	ND(<50)	-	-	ND(<1)	ND(<1)	ND(<1)	ND(<3)	ND(<3)	-	-	-	-	-
MW-2	06/16/08	ND(<50)	-	-	ND(<1)	ND(<1)	ND(<1)	ND(<3)	ND(<3)	-	-	-	-	-
MW-2	09/08/08	ND(<50)	-	-	ND(<1)	ND(<1)	ND(<1)	ND(<3)	ND(<3)	-	-	-	-	-
MW-2	12/08/08	ND(<50)	-	-	ND(<1)	ND(<1)	ND(<1)	ND(<3)	ND(<3)	-	-	-	-	-
MW-2	03/05/09	ND(<50)	-	-	ND(<1)	ND(<1)	ND(<1)	ND(<3)	ND(<3)	-	-	-	-	-
MW-2	06/19/09	ND(<50)	-	-	ND(<1)	ND(<1)	ND(<1)	ND(<3)	ND(<3)	-	-	-	-	-
MW-2	09/28/09	ND(<50)	-	-	ND(<1.0)	ND(<1.0)	ND(<1.0)	ND(<3.0)	ND(<3.0)	-	-	-	-	-
MW-2	12/29/09	ND(<50)	-	-	ND(<1.0)	ND(<1.0)	ND(<1.0)	ND(<3.0)	ND(<1.0)	-	-	-	-	-
MW-2	03/26/10	ND(<50)	-	-	ND(<1.0)	ND(<1.0)	ND(<1.0)	ND(<3.0)	ND(<3.0)	-	-	-	-	-
MW-2	06/09/10	ND(<50)	-	-	ND(<1.0)	ND(<1.0)	ND(<1.0)	ND(<3.0)	ND(<3.0)	-	-	-	-	-
MW-2	09/22/10	ND(<50)	-	-	ND(<1.0)	ND(<1.0)	ND(<1.0)	ND(<3.0)	ND(<3.0)	-	-	-	-	-
MW-2	12/17/10	ND(<50)	-	-	ND(<1.0)	ND(<1.0)	ND(<1.0)	ND(<3.0)	ND(<3.0)	-	-	-	-	-
MW-2	03/25/11	ND(<50)	-	-	ND(<1.0)	ND(<1.0)	ND(<1.0)	ND(<3.0)	ND(<3.0)	-	-	-	-	-
MW-2	06/21/11	ND(<50)	-	-	ND(<1.0)	ND(<1.0)	ND(<1.0)	ND(<3.0)	ND(<3.0)	-	-	-	-	-
MW-2	09/13/11	ND(<50)	-	-	ND(<1.0)	ND(<1.0)	ND(<1.0)	ND(<3.0)	ND(<3.0)	-	-	-	-	-
MW-2	12/28/11	ND(<50)	-	-	ND(<1.0)	ND(<1.0)	ND(<1.0)	ND(<3.0)	ND(<3.0)	-	-	-	-	-
MW-2	03/19/12	ND(<50)	-	-	ND(<1.0)	ND(<1.0)	ND(<1.0)	ND(<3.0)	ND(<3.0)	-	-	-	-	-
MW-2	06/08/12	ND(<50)	-	-	ND(<1.0)	ND(<1.0)	ND(<1.0)	ND(<3.0)	ND(<3.0)	ND(<0.020)	ND(<0.010)	ND(<1.0)	-	-
MW-2	09/17/12	-	-	-	-	-	-	-	-	-	-	-	-	-
MW-2	12/21/12	ND(<50)	-	-	ND(<1.0)	ND(<1.0)	ND(<1.0)	ND(<3.0)	ND(<3.0)	ND(<0.020)	ND(<0.010)	ND(<1.0)	-	-
MW-2	03/27/13	ND(<50)	-	-	ND(<1.0)	ND(<1.0)	ND(<1.0)	ND(<3.0)	ND(<3.0)	-	-	ND(<1.0)	-	-
MW-2	06/24/13	ND(<50)	-	-	ND(<1.0)	ND(<1.0)	ND(<1.0)	ND(<3.0)	ND(<3.0)	-	-	-	-	-
MW-2	10/30/13	-	-	-	-	-	-	-	-	-	-	-	-	-
MW-2	12/20/13	ND(<50)	-	-	ND(<1.0)	ND(<1.0)	ND(<1.0)	ND(<3.0)	ND(<3.0)	-	-	-	-	-

**TABLE 2  
GROUNDWATER ANALYTICAL RESULTS**

Miller's Market  
3152 Washington Way  
Longview, Washington

Well I.D. (TOC)	Sample Date	TPH- Gasoline (µg/L)	TPH- Diesel (µg/L)	TPH- Oil (µg/L)	Benzene (µg/L)	Toluene (µg/L)	Ethyl- benzene (µg/L)	Xylenes (µg/L)	MTBE (µg/L)	EDC (µg/L)	EDB (µg/L)	Lead (µg/L)	Nitrate (mg/L)	Sulfate (mg/L)
MW-3	11/17/03	4,900	-	-	100	12	170	250	-	-	-	-	-	-
MW-3	03/15/04	5,000	-	-	92	16	150	130	66	-	-	-	-	-
MW-3	06/17/04	5,900	-	-	78	16	190	120	41	-	-	-	-	-
MW-3	09/15/04	4,400	-	-	15	12	100	71	ND<8	-	-	-	-	-
MW-3	12/16/04	5,500	-	-	96	16	240	170	ND(<15)	-	-	-	-	-
MW-3	03/18/05	5,600	-	-	93	15	220	172	ND(<15)	-	-	-	-	-
MW-3	06/14/05	5,200	-	-	43	15	170	130	ND(<15)	-	-	-	-	-
MW-3	09/26/05	6,000	-	-	41	16	200	120	ND(<30)	-	-	-	-	-
MW-3	11/28/05	5,300	ND(<130)	ND(<250)	81	13	200	160	ND(<30)	-	-	-	-	-
MW-3	03/22/06	1,900	ND(<250)	ND(<250)	45	7	42	29	ND(<2)	-	-	-	-	-
MW-3	06/27/06	1,900	ND(<130)	ND(<250)	53	ND(<10)	57	30	ND(<30)	-	-	-	-	-
MW-3	09/22/06	1,800	ND(<250)	ND(<250)	45	7	42	29	ND(<6)	-	-	-	-	-
MW-3	12/05/06	2,300	ND(<250)	ND(<250)	52	9	64	29	8	-	-	-	-	-
MW-3	03/13/07	1,700	-	-	62	8	30	28	4	-	-	-	-	-
MW-3	06/04/07	1,900	-	-	54	5	23	24	ND(<3)	-	-	-	-	-
MW-3	09/10/07	2,800	-	-	63	10	67	28	40	-	-	-	-	-
MW-3	01/07/08	2,000	-	-	63	9	58	34	39	-	-	-	-	-
MW-3	03/20/08	2,800	-	-	80	14	86	42	43	-	-	-	-	-
MW-3	06/16/08	1,800	-	-	64	9	26	27	37	-	-	-	-	-
MW-3	09/08/08	2,400	-	-	ND(<5)	14	64	19	40	-	-	-	-	-
MW-3	12/08/08	2,400	-	-	21	10	28	21	ND(<2)	-	-	-	-	-
MW-3	03/05/09	1,700	-	-	48	8	43	23	29	-	-	-	-	-
MW-3	06/19/09	1,000	-	-	39	5	8	13	24	-	-	-	-	-
MW-3	09/28/09	1,200	-	-	19	5.1	34	19	13	-	-	-	-	-
MW-3	12/29/09	1700 <sup>a</sup>	-	-	51	9.3	65	36	ND(<8.0)	-	-	-	-	-
MW-3	03/26/10	3000 <sup>a</sup>	-	-	ND(<5.0)	13	100	48	ND(<15)	-	-	-	-	-
MW-3	06/09/10	2000 <sup>a</sup>	-	-	45	6.6	40	27	ND(<3.0)	-	-	-	-	-
MW-3	09/22/10	2800 <sup>b</sup>	-	-	69	13.0	80	42	ND(<3.0)	-	-	-	-	-
MW-3	12/17/10	2300 <sup>a</sup>	-	-	ND(<5.0)	7.5	40	28	ND(<15)	-	-	-	-	-
MW-3	03/25/11	1,300	-	-	44	4.3	20	22	ND(<3.0)	-	-	-	-	-
MW-3	06/21/11	1,400	-	-	8.1	2.8	19	17	ND(<3.0)	-	-	-	-	-
MW-3	09/13/11	2,900	-	-	14	10	58	30	ND(<3.0)	-	-	-	-	-
MW-3	12/28/11	2,800	-	-	55	10	61	33	7.0	-	-	-	-	-
MW-3	03/19/12	2,000	-	-	7.3	5.1	37	22	ND(<3.0)	-	-	-	-	-
MW-3	04/12/12	-	-	-	-	-	-	-	-	-	-	-	ND(<0.15)	ND(<0.26)
MW-3	06/08/12	1,300	-	-	5.4	3.3	29	12	ND(<3.0)	ND(<0.020)	ND(<0.010)	12	0.19	ND(<0.52)
MW-3	09/17/12	1,600	-	-	31 <sup>c</sup>	5.3	28	19	ND(<3.0)	ND(<0.020)	ND(<0.010)	ND(<1.0)	-	0.37
MW-3	10/01/12	1,700	-	-	35 <sup>c</sup>	6.2	32	19	-	-	-	-	-	ND(<0.26)
MW-3	10/25/12	1,900	-	-	12	5.9	27	19	-	-	-	-	-	ND(<0.26)
MW-3	11/29/12	2,000	-	-	ND(<5.0)	8.1	38	26	-	-	-	-	-	ND(<0.26)
MW-3	12/21/12	1,700	-	-	41 <sup>c</sup>	7.5	57	24	ND(<3.0)	ND(<0.020)	ND(<0.010)	ND(<1.0)	-	1,100
MW-3	02/19/13	3,300	-	-	<10	<10	120	120	-	-	-	-	-	2,700
MW-3	03/27/13	2,500	-	-	ND(<5.0)	7.8	110	93	ND(<15)	-	-	ND(<1.0)	-	2,300
MW-3	04/24/13	2,800	-	-	16	5.1	77	69	-	-	-	-	-	1,700
MW-3	05/30/13	1,500	-	-	26 <sup>c</sup>	4.5	39	20	-	-	-	-	-	4,000

**TABLE 2  
GROUNDWATER ANALYTICAL RESULTS**

Miller's Market  
3152 Washington Way  
Longview, Washington

Well I.D. (TOC)	Sample Date	TPH- Gasoline (µg/L)	TPH- Diesel (µg/L)	TPH- Oil (µg/L)	Benzene (µg/L)	Toluene (µg/L)	Ethyl- benzene (µg/L)	Xylenes (µg/L)	MTBE (µg/L)	EDC (µg/L)	EDB (µg/L)	Lead (µg/L)	Nitrate (mg/L)	Sulfate (mg/L)
MW-3	06/24/13	1,200	-	-	22	4.0	31	23	ND(<3.0)	-	-	-	-	7,700
MW-3	07/31/13	1,200	-	-	10	2.1	19	8.9	-	-	-	-	-	3,300
MW-3	08/30/13	1,600	-	-	23	4.8	52	11	-	-	-	-	-	2,200
MW-3	09/20/13	1,300	-	-	ND(<1.0)	3.4	23	6.3	-	-	-	-	-	1,700
MW-3	10/30/13	1,500	-	-	18	5.3	82	14	ND(<3.0)	-	-	-	-	840
MW-3	11/26/13	1,800	-	-	13	3.2	57	9.3	-	-	-	-	-	750
MW-3	12/20/13	2,600	-	-	16	4.5	130	23	ND(<3.0)	-	-	-	-	1,100
MW-3	03/12/14	800	-	-	3.1	ND(<1.0)	15	4.8	ND(<3.0)	-	-	-	-	-
MW-3	06/16/14	300	-	-	1.4	ND(<1.0)	1.3	ND(<3.0)	ND(<3.0)	-	-	-	-	-
MW-3	09/11/14	690	-	-	16	ND(<1.0)	14	7.3	ND(<3.0)	-	-	-	-	-
MW-3 <sup>1</sup>	09/11/14	630	-	-	16	ND(<1.0)	13	4.3	ND(<3.0)	-	-	-	-	-
MW-3	12/17/14	490	-	-	ND(<1.0)	1.6	6.4	ND(<3.0)	ND(<3.0)	-	-	-	-	-
MW-3	03/16/15	200	-	-	1.7	ND(<1.0)	ND(<1.0)	ND(<3.0)	ND(<3.0)	-	-	-	-	-
DUP	03/16/15	180	-	-	1.6	ND(<1.0)	ND(<1.0)	ND(<3.0)	ND(<3.0)	-	-	-	-	-
MW-3	05/13/15	130	-	-	ND(<1.0)	ND(<1.0)	ND(<1.0)	ND(<3.0)	ND(<3.0)	-	-	-	-	-
DUP	05/13/15	120	-	-	ND(<1.0)	ND(<1.0)	ND(<1.0)	ND(<3.0)	ND(<3.0)	-	-	-	-	-
MW-3	08/13/15	220	-	-	2.4	ND(<1.0)	3.4	ND(<3.0)	ND(<3.0)	-	-	-	-	-
DUP	08/13/15	210	-	-	3.1	ND(<1.0)	4.1	ND(<3.0)	ND(<3.0)	-	-	-	-	-

**TABLE 2  
GROUNDWATER ANALYTICAL RESULTS**

Miller's Market  
3152 Washington Way  
Longview, Washington

Well I.D. (TOC)	Sample Date	TPH- Gasoline (µg/L)	TPH- Diesel (µg/L)	TPH- Oil (µg/L)	Benzene (µg/L)	Toluene (µg/L)	Ethyl- benzene (µg/L)	p-Xylenes (µg/L)	MTBE (µg/L)	EDC (µg/L)	EDB (µg/L)	Lead (µg/L)	Nitrate (mg/L)	Sulfate (mg/L)
MW-4	11/28/05	ND	ND(<130)	ND(<250)	ND(<1)	ND(<1)	ND(<1)	ND(<3)	ND(<3)	-	-	-	-	-
MW-4	03/22/06	ND(<50)	ND(<130)	ND(<250)	ND(<1)	ND(<1)	ND(<1)	ND(<3)	ND(<3)	-	-	-	-	-
MW-4	06/27/06	ND(<50)	ND(<130)	ND(<250)	ND(<1)	ND(<1)	ND(<1)	ND(<3)	ND(<3)	-	-	-	-	-
MW-4	09/22/06	ND(<50)	ND(<130)	ND(<250)	ND(<1)	ND(<1)	ND(<1)	ND(<3)	ND(<3)	-	-	-	-	-
MW-4	12/05/06	ND(<50)	ND(<130)	ND(<250)	ND(<1)	ND(<1)	ND(<1)	ND(<3)	ND(<3)	-	-	-	-	-
MW-4	03/13/07	ND(<50)	-	-	ND(<1)	ND(<1)	ND(<1)	ND(<3)	ND(<3)	-	-	-	-	-
MW-4	06/04/07	ND(<50)	-	-	ND(<1)	ND(<1)	ND(<1)	ND(<3)	ND(<3)	-	-	-	-	-
MW-4	09/10/07	ND(<50)	-	-	ND(<1)	ND(<1)	ND(<1)	ND(<3)	ND(<3)	-	-	-	-	-
MW-4	01/07/08	ND(<50)	-	-	ND(<1)	ND(<1)	ND(<1)	ND(<3)	ND(<3)	-	-	-	-	-
MW-4	03/20/08	100	-	-	4	6	1	6	ND(<3)	-	-	-	-	-
MW-4	06/16/08	ND(<50)	-	-	ND(<1)	ND(<1)	ND(<1)	ND(<3)	ND(<3)	-	-	-	-	-
MW-4	09/08/08	ND(<50)	-	-	ND(<1)	ND(<1)	ND(<1)	ND(<3)	ND(<3)	-	-	-	-	-
MW-4	12/08/08	ND(<50)	-	-	ND(<1)	ND(<1)	ND(<1)	ND(<3)	ND(<3)	-	-	-	-	-
MW-4	03/05/09	ND(<50)	-	-	ND(<1)	ND(<1)	ND(<1)	ND(<3)	ND(<3)	-	-	-	-	-
MW-4	06/19/09	ND(<50)	-	-	ND(<1)	ND(<1)	ND(<1)	ND(<3)	ND(<3)	-	-	-	-	-
MW-4	09/28/09	ND(<50)	-	-	ND(<1.0)	ND(<1.0)	ND(<1.0)	ND(<3.0)	ND(<3.0)	-	-	-	-	-
MW-4	12/29/09	ND(<50)	-	-	ND(<1.0)	ND(<1.0)	ND(<1.0)	ND(<3.0)	ND(<1.0)	-	-	-	-	-
MW-4	03/26/10	ND(<50)	-	-	ND(<1.0)	ND(<1.0)	ND(<1.0)	ND(<3.0)	ND(<3.0)	-	-	-	-	-
MW-4	06/09/10	ND(<50)	-	-	ND(<1.0)	ND(<1.0)	ND(<1.0)	ND(<3.0)	ND(<3.0)	-	-	-	-	-
MW-4	09/22/10	ND(<50)	-	-	ND(<1.0)	ND(<1.0)	ND(<1.0)	ND(<3.0)	ND(<3.0)	-	-	-	-	-
MW-4	12/17/10	ND(<50)	-	-	ND(<1.0)	ND(<1.0)	ND(<1.0)	ND(<3.0)	ND(<3.0)	-	-	-	-	-
MW-4	03/25/11	ND(<50)	-	-	ND(<1.0)	ND(<1.0)	ND(<1.0)	ND(<3.0)	ND(<3.0)	-	-	-	-	-
MW-4	06/21/11	ND(<50)	-	-	ND(<1.0)	ND(<1.0)	ND(<1.0)	ND(<3.0)	ND(<3.0)	-	-	-	-	-
MW-4	09/13/11	ND(<50)	-	-	ND(<1.0)	ND(<1.0)	ND(<1.0)	ND(<3.0)	ND(<3.0)	-	-	-	-	-
MW-4	12/28/11	ND(<50)	-	-	ND(<1.0)	ND(<1.0)	ND(<1.0)	ND(<3.0)	ND(<3.0)	-	-	-	-	-
MW-4	03/19/12	ND(<50)	-	-	ND(<1.0)	ND(<1.0)	ND(<1.0)	ND(<3.0)	ND(<3.0)	-	-	-	-	-
MW-4	06/06/12	ND(<50)	-	-	ND(<1.0)	ND(<1.0)	ND(<1.0)	ND(<3.0)	ND(<3.0)	ND(<0.020)	ND(<0.010)	1.8	-	-
MW-4	09/17/12	ND(<50)	-	-	ND(<1.0)	ND(<1.0)	ND(<1.0)	ND(<3.0)	ND(<3.0)	ND(<0.020)	ND(<0.010)	ND(<1.0)	-	-
MW-4	12/21/12	ND(<50)	-	-	ND(<1.0)	ND(<1.0)	ND(<1.0)	ND(<3.0)	ND(<3.0)	ND(<0.020)	ND(<0.010)	ND(<1.0)	-	-
MW-4	03/27/13	ND(<50)	-	-	ND(<1.0)	ND(<1.0)	ND(<1.0)	ND(<3.0)	ND(<3.0)	-	-	ND(<1.0)	-	-
MW-4	06/24/13	ND(<50)	-	-	ND(<1.0)	ND(<1.0)	ND(<1.0)	ND(<3.0)	ND(<3.0)	-	-	-	-	-
MW-4	10/30/13	ND(<50)	-	-	ND(<1.0)	ND(<1.0)	ND(<1.0)	ND(<3.0)	ND(<3.0)	-	-	-	-	-
MW-4	12/20/13	ND(<50)	-	-	ND(<1.0)	ND(<1.0)	ND(<1.0)	ND(<3.0)	ND(<3.0)	-	-	-	-	-

**TABLE 2  
GROUNDWATER ANALYTICAL RESULTS**

Miller's Market  
3152 Washington Way  
Longview, Washington

Well I.D. (TOC)	Sample Date	TPH- Gasoline (µg/L)	TPH- Diesel (µg/L)	TPH- Oil (µg/L)	Benzene (µg/L)	Toluene (µg/L)	Ethyl- benzene (µg/L)	Xylenes (µg/L)	MTBE (µg/L)	EDC (µg/L)	EDB (µg/L)	Lead (µg/L)	Nitrate (mg/L)	Sulfate (mg/L)
MW-5	11/28/05	ND	ND(<130)	ND(<250)	ND(<1)	ND(<1)	ND(<1)	ND(<3)	ND(<3)	-	-	-	-	-
MW-5	03/22/06	ND(<50)	ND(<130)	ND(<250)	ND(<1)	ND(<1)	ND(<1)	ND(<3)	ND(<2)	-	-	-	-	-
MW-5	06/27/06	ND(<50)	ND(<130)	ND(<250)	ND(<1)	ND(<1)	ND(<1)	ND(<3)	ND(<3)	-	-	-	-	-
MW-5	09/22/06	ND(<50)	ND(<130)	ND(<250)	ND(<1)	ND(<1)	ND(<1)	ND(<3)	ND(<3)	-	-	-	-	-
MW-5	12/05/06	ND(<50)	ND(<130)	ND(<250)	ND(<1)	ND(<1)	ND(<1)	ND(<3)	ND(<3)	-	-	-	-	-
MW-5	03/13/07	ND(<50)	-	-	ND(<1)	ND(<1)	ND(<1)	ND(<3)	ND(<3)	-	-	-	-	-
MW-5	06/04/07	ND(<50)	-	-	ND(<1)	ND(<1)	ND(<1)	ND(<3)	ND(<3)	-	-	-	-	-
MW-5	09/10/07	ND(<50)	-	-	ND(<1)	ND(<1)	ND(<1)	ND(<3)	ND(<3)	-	-	-	-	-
MW-5	01/07/08	ND(<50)	-	-	ND(<1)	ND(<1)	ND(<1)	ND(<3)	ND(<3)	-	-	-	-	-
MW-5	03/20/08	ND(<50)	-	-	11	2	ND(<1)	ND(<3)	ND(<3)	-	-	-	-	-
MW-5	06/16/08	ND(<50)	-	-	ND(<1)	ND(<1)	ND(<1)	ND(<3)	ND(<3)	-	-	-	-	-
MW-5	09/08/08	ND(<50)	-	-	ND(<1)	ND(<1)	ND(<1)	ND(<3)	ND(<3)	-	-	-	-	-
MW-5	12/08/08	ND(<50)	-	-	ND(<1)	ND(<1)	ND(<1)	ND(<3)	ND(<3)	-	-	-	-	-
MW-5	03/05/09	ND(<50)	-	-	ND(<1)	ND(<1)	ND(<1)	ND(<3)	ND(<3)	-	-	-	-	-
MW-5	06/19/09	ND(<50)	-	-	ND(<1)	ND(<1)	ND(<1)	ND(<3)	ND(<3)	-	-	-	-	-
MW-5	09/28/09	ND(<50)	-	-	ND(<1.0)	ND(<1.0)	ND(<1.0)	ND(<3.0)	ND(<3.0)	-	-	-	-	-
MW-5	12/29/09	ND(<50)	-	-	ND(<1.0)	ND(<1.0)	ND(<1.0)	ND(<3.0)	ND(<1.0)	-	-	-	-	-
MW-5	03/26/10	ND(<50)	-	-	ND(<1.0)	ND(<1.0)	ND(<1.0)	ND(<3.0)	ND(<3.0)	-	-	-	-	-
MW-5	06/09/10	ND(<50)	-	-	ND(<1.0)	ND(<1.0)	ND(<1.0)	ND(<3.0)	ND(<3.0)	-	-	-	-	-
MW-5	09/22/10	ND(<50)	-	-	ND(<1.0)	ND(<1.0)	ND(<1.0)	ND(<3.0)	ND(<3.0)	-	-	-	-	-
MW-5	12/17/10	ND(<50)	-	-	ND(<1.0)	ND(<1.0)	ND(<1.0)	ND(<3.0)	ND(<3.0)	-	-	-	-	-
MW-5	03/25/11	ND(<50)	-	-	ND(<1.0)	ND(<1.0)	ND(<1.0)	ND(<3.0)	ND(<3.0)	-	-	-	-	-
MW-5	06/21/11	ND(<50)	-	-	ND(<1.0)	ND(<1.0)	ND(<1.0)	ND(<3.0)	ND(<3.0)	-	-	-	-	-
MW-5	09/13/11	ND(<50)	-	-	ND(<1.0)	ND(<1.0)	ND(<1.0)	ND(<3.0)	ND(<3.0)	-	-	-	-	-
MW-5	12/28/11	ND(<50)	-	-	ND(<1.0)	ND(<1.0)	ND(<1.0)	ND(<3.0)	ND(<3.0)	-	-	-	-	-
MW-5	03/19/12	ND(<50)	-	-	ND(<1.0)	ND(<1.0)	ND(<1.0)	ND(<3.0)	ND(<3.0)	-	-	-	-	-
MW-5	04/12/12	-	-	-	-	-	-	-	-	-	-	-	ND(<0.15)	3.1
MW-5	06/06/12	ND(<50)	-	-	ND(<1.0)	ND(<1.0)	ND(<1.0)	ND(<3.0)	ND(<3.0)	ND(<0.020)	ND(<0.010)	ND(<1.0)	ND(<0.15)	ND(<0.26)
MW-5	09/17/12	ND(<50)	-	-	ND(<1.0)	ND(<1.0)	ND(<1.0)	ND(<3.0)	ND(<3.0)	ND(<0.020)	ND(<0.010)	ND(<1.0)	-	ND(<0.26)
MW-5	10/01/12	-	-	-	-	-	-	-	-	-	-	-	-	ND(<0.26)
MW-5	10/25/12	-	-	-	-	-	-	-	-	-	-	-	-	ND(<0.26)
MW-5	11/29/12	-	-	-	-	-	-	-	-	-	-	-	-	1.8
MW-5	12/21/12	ND(<50)	-	-	ND(<1.0)	ND(<1.0)	ND(<1.0)	ND(<3.0)	ND(<3.0)	ND(<0.020)	ND(<0.010)	ND(<1.0)	-	0.49
MW-5	02/19/13	-	-	-	-	-	-	-	-	-	-	-	-	0.64
MW-5	03/27/13	ND(<50)	-	-	ND(<1.0)	ND(<1.0)	ND(<1.0)	ND(<3.0)	ND(<3.0)	-	-	ND(<1.0)	-	ND(<0.26)
MW-5	04/24/13	-	-	-	-	-	-	-	-	-	-	-	-	ND(<0.26)
MW-5	05/30/13	-	-	-	-	-	-	-	-	-	-	-	-	ND(<0.26)
MW-5	06/24/13	ND(<50)	-	-	ND(<1.0)	ND(<1.0)	ND(<1.0)	ND(<3.0)	ND(<3.0)	-	-	-	-	ND(<0.26)
MW-5	07/31/13	-	-	-	-	-	-	-	-	-	-	-	-	ND(<0.26)
MW-5	08/28/13	-	-	-	-	-	-	-	-	-	-	-	-	ND(<0.26)
MW-5	09/20/13	-	-	-	-	-	-	-	-	-	-	-	-	ND(<0.26)
MW-5	10/30/13	ND(<50)	-	-	ND(<1.0)	ND(<1.0)	ND(<1.0)	ND(<3.0)	ND(<3.0)	-	-	-	-	ND(<0.26)
MW-5	11/26/13	-	-	-	-	-	-	-	-	-	-	-	-	1.6
MW-5	12/20/13	ND(<50)	-	-	ND(<1.0)	ND(<1.0)	ND(<1.0)	ND(<3.0)	ND(<3.0)	-	-	-	-	8.7

**TABLE 2  
GROUNDWATER ANALYTICAL RESULTS**

Miller's Market  
3152 Washington Way  
Longview, Washington

Well I.D. (TOC)	Sample Date	TPH- Gasoline (µg/L)	TPH- Diesel (µg/L)	TPH- Oil (µg/L)	Benzene (µg/L)	Toluene (µg/L)	Ethyl- benzene (µg/L)	Xylenes (µg/L)	MTBE (µg/L)	EDC (µg/L)	EDB (µg/L)	Lead (µg/L)	Nitrate (mg/L)	Sulfate (mg/L)
MW-6	11/28/05 <sup>c</sup>	480	ND(<130)	ND(<250)	1	ND(<1)	2	ND(<3)	ND(<3)	-	-	-	-	-
MW-6	03/22/06	ND(<50)	ND(<130)	ND(<250)	ND(<1)	ND(<1)	ND(<1)	ND(<3)	ND(<3)	-	-	-	-	-
MW-6	06/27/06	ND(<50)	ND(<130)	ND(<250)	ND(<1)	ND(<1)	ND(<1)	ND(<3)	ND(<3)	-	-	-	-	-
MW-6	09/22/06	ND(<50)	ND(<130)	ND(<250)	ND(<1)	ND(<1)	ND(<1)	ND(<3)	ND(<3)	-	-	-	-	-
MW-6	12/05/06	ND(<50)	ND(<130)	ND(<250)	ND(<1)	ND(<1)	ND(<1)	ND(<3)	ND(<3)	-	-	-	-	-
MW-6	03/13/07	ND(<50)	-	-	ND(<1)	ND(<1)	ND(<1)	ND(<3)	ND(<3)	-	-	-	-	-
MW-6	06/04/07	ND(<50)	-	-	ND(<1)	ND(<1)	ND(<1)	ND(<3)	ND(<3)	-	-	-	-	-
MW-6	09/10/07	ND(<50)	-	-	ND(<1)	ND(<1)	ND(<1)	ND(<3)	ND(<3)	-	-	-	-	-
MW-6	01/07/08	ND(<50)	-	-	ND(<1)	ND(<1)	ND(<1)	ND(<3)	ND(<3)	-	-	-	-	-
MW-6	03/20/08	240	-	-	7	2	5	ND(<3)	4	-	-	-	-	-
MW-6	06/16/08	ND(<50)	-	-	ND(<1)	ND(<1)	ND(<1)	ND(<3)	ND(<3)	-	-	-	-	-
MW-6	09/08/08	ND(<50)	-	-	ND(<1)	ND(<1)	ND(<1)	ND(<3)	ND(<3)	-	-	-	-	-
MW-6	12/08/08	ND(<50)	-	-	ND(<1)	ND(<1)	ND(<1)	ND(<3)	ND(<3)	-	-	-	-	-
MW-6	03/05/09	ND(<50)	-	-	ND(<1)	ND(<1)	ND(<1)	ND(<3)	ND(<3)	-	-	-	-	-
MW-6	06/19/09	ND(<50)	-	-	ND(<1)	ND(<1)	ND(<1)	ND(<3)	ND(<3)	-	-	-	-	-
MW-6	09/28/09	ND(<50)	-	-	ND(<1.0)	ND(<1.0)	ND(<1.0)	ND(<3.0)	ND(<3.0)	-	-	-	-	-
MW-6	12/29/09	ND(<50)	-	-	ND(<1.0)	ND(<1.0)	ND(<1.0)	ND(<3.0)	ND(<1.0)	-	-	-	-	-
MW-6	03/26/10	ND(<50)	-	-	ND(<1.0)	ND(<1.0)	ND(<1.0)	ND(<3.0)	ND(<3.0)	-	-	-	-	-
MW-6	06/09/10	ND(<50)	-	-	ND(<1.0)	ND(<1.0)	ND(<1.0)	ND(<3.0)	ND(<3.0)	-	-	-	-	-
MW-6	09/22/10	ND(<50)	-	-	ND(<1.0)	ND(<1.0)	ND(<1.0)	ND(<3.0)	ND(<3.0)	-	-	-	-	-
MW-6	12/17/10	ND(<50)	-	-	ND(<1.0)	ND(<1.0)	ND(<1.0)	ND(<3.0)	ND(<3.0)	-	-	-	-	-
MW-6	03/25/11	ND(<50)	-	-	ND(<1.0)	ND(<1.0)	ND(<1.0)	ND(<3.0)	ND(<3.0)	-	-	-	-	-
MW-6	06/21/11	ND(<50)	-	-	ND(<1.0)	ND(<1.0)	ND(<1.0)	ND(<3.0)	ND(<3.0)	-	-	-	-	-
MW-6	09/13/11	ND(<50)	-	-	ND(<1.0)	ND(<1.0)	ND(<1.0)	ND(<3.0)	ND(<3.0)	-	-	-	-	-
MW-6	12/28/11	ND(<50)	-	-	ND(<1.0)	ND(<1.0)	ND(<1.0)	ND(<3.0)	ND(<3.0)	-	-	-	-	-
MW-6	03/19/12	ND(<50)	-	-	ND(<1.0)	ND(<1.0)	ND(<1.0)	ND(<3.0)	ND(<3.0)	-	-	-	-	-
MW-6	04/12/12	-	-	-	-	-	-	-	-	-	-	-	ND(<0.15)	ND(<0.26)
MW-6	06/06/12	ND(<50)	-	-	ND(<1.0)	ND(<1.0)	ND(<1.0)	ND(<3.0)	ND(<3.0)	ND(<0.020)	ND(<0.010)	ND(<1.0)	ND(<0.15)	ND(<0.26)
MW-6	09/17/12	ND(<50)	-	-	ND(<1.0)	ND(<1.0)	ND(<1.0)	ND(<3.0)	ND(<3.0)	ND(<0.020)	ND(<0.010)	ND(<1.0)	-	ND(<0.26)
MW-6	10/01/12	-	-	-	-	-	-	-	-	-	-	-	-	ND(<0.26)
MW-6	10/25/12	-	-	-	-	-	-	-	-	-	-	-	-	ND(<0.26)
MW-6	11/29/12	-	-	-	-	-	-	-	-	-	-	-	-	ND(<0.26)
MW-6	12/21/12	ND(<50)	-	-	ND(<1.0)	ND(<1.0)	ND(<1.0)	ND(<3.0)	ND(<3.0)	ND(<0.020)	ND(<0.010)	ND(<1.0)	-	6.5
MW-6	02/19/13	-	-	-	-	-	-	-	-	-	-	-	-	ND(<0.26)
MW-6	03/27/13	ND(<50)	-	-	ND(<1.0)	ND(<1.0)	ND(<1.0)	ND(<3.0)	ND(<3.0)	-	-	ND(<1.0)	-	ND(<0.26)
MW-6	04/24/13	-	-	-	-	-	-	-	-	-	-	-	-	ND(<0.26)
MW-6	05/30/13	-	-	-	-	-	-	-	-	-	-	-	-	ND(<0.26)
MW-6	06/24/13	ND(<50)	-	-	ND(<1.0)	ND(<1.0)	ND(<1.0)	ND(<3.0)	ND(<3.0)	-	-	-	-	ND(<0.26)
MW-6	07/31/13	-	-	-	-	-	-	-	-	-	-	-	-	ND(<0.26)
MW-6	08/28/13	-	-	-	-	-	-	-	-	-	-	-	-	ND(<0.26)
MW-6	09/20/13	-	-	-	-	-	-	-	-	-	-	-	-	ND(<0.26)
MW-6	10/30/13	ND(<50)	-	-	ND(<1.0)	ND(<1.0)	ND(<1.0)	ND(<3.0)	ND(<3.0)	-	-	-	-	ND(<0.26)
MW-6	11/26/13	-	-	-	-	-	-	-	-	-	-	-	-	0.41
MW-6	12/20/13	ND(<50)	-	-	ND(<1.0)	ND(<1.0)	ND(<1.0)	ND(<3.0)	ND(<3.0)	-	-	-	-	0.47
MW-6	03/12/14	ND(<50)	-	-	ND(<1.0)	ND(<1.0)	ND(<1.0)	ND(<3.0)	ND(<3.0)	-	-	-	-	-

**TABLE 2**  
**GROUNDWATER ANALYTICAL RESULTS**  
 Miller's Market  
 3152 Washington Way  
 Longview, Washington

Well I.D. (TOC)	Sample Date	TPH- Gasoline (µg/L)	TPH- Diesel (µg/L)	TPH- Oil (µg/L)	Benzene (µg/L)	Toluene (µg/L)	Ethyl- benzene (µg/L)	Xylenes (µg/L)	MTBE (µg/L)	EDC (µg/L)	EDB (µg/L)	Lead (µg/L)	Nitrate (mg/L)	Sulfate (mg/L)
MW-6	06/16/14	ND(<50)	-	-	ND(<1.0)	ND(<1.0)	ND(<1.0)	ND(<3.0)	ND(<3.0)	-	-	-	-	-
MW-6	09/11/14	ND(<50)	-	-	ND(<1.0)	ND(<1.0)	ND(<1.0)	ND(<3.0)	ND(<3.0)	-	-	-	-	-
MW-6	12/17/14	ND(<50)	-	-	ND(<1.0)	ND(<1.0)	ND(<1.0)	ND(<3.0)	ND(<3.0)	-	-	-	-	-
MW-6	03/16/15	56	-	-	ND(<1.0)	ND(<1.0)	ND(<1.0)	ND(<3.0)	ND(<3.0)	-	-	-	-	-
MW-6	05/13/15	ND(<50)	-	-	ND(<1.0)	ND(<1.0)	ND(<1.0)	ND(<3.0)	ND(<3.0)	-	-	-	-	-
MW-6	08/13/15	ND(<50)	-	-	ND(<1.0)	ND(<1.0)	ND(<1.0)	ND(<3.0)	ND(<3.0)	-	-	-	-	-

**TABLE 2  
GROUNDWATER ANALYTICAL RESULTS**

Miller's Market  
3152 Washington Way  
Longview, Washington

Well I.D. (TOC)	Sample Date	TPH- Gasoline (µg/L)	TPH- Diesel (µg/L)	TPH- Oil (µg/L)	Benzene (µg/L)	Toluene (µg/L)	Ethyl- benzene (µg/L)	Xylenes (µg/L)	MTBE (µg/L)	EDC (µg/L)	EDB (µg/L)	Lead (µg/L)	Nitrate (mg/L)	Sulfate (mg/L)
MW-7	11/28/05	390	ND(<130)	ND(<250)	ND(<1)	ND(<1)	ND(<1)	ND(<3)	ND(<3)	-	-	-	-	-
MW-7	03/22/06	700	ND(<130)	ND(<250)	ND(<1)	ND(<1)	6	18	ND(<2)	-	-	-	-	-
MW-7	06/27/06	710	ND(<130)	ND(<250)	ND(<1)	ND(<1)	7	14	ND(<3)	-	-	-	-	-
MW-7	09/22/06	380	ND(<130)	ND(<250)	ND(<1)	ND(<1)	7	14	ND(<3)	-	-	-	-	-
MW-7	12/05/06	570	ND(<130)	ND(<250)	1	ND(<1)	7	14	ND(<3)	-	-	-	-	-
MW-7	03/13/07	750	-	-	1	ND(<1)	4	4	ND(<3)	-	-	-	-	-
MW-7	06/04/07	ND(<50)	-	-	1	ND(<1)	ND(<1)	ND(<3)	ND(<3)	-	-	-	-	-
MW-7	09/10/07	530	-	-	1	ND(<1)	1	ND(<3)	ND(<3)	-	-	-	-	-
MW-7	01/07/08	580	-	-	ND(<1)	ND(<1)	ND(<1)	ND(<3)	ND(<3)	-	-	-	-	-
MW-7	03/20/08	320	-	-	ND(<1)	ND(<1)	ND(<1)	ND(<3)	ND(<3)	-	-	-	-	-
MW-7	06/16/08	310	-	-	ND(<1)	ND(<1)	ND(<1)	ND(<3)	ND(<3)	-	-	-	-	-
MW-7	09/08/08	370	-	-	ND(<1)	ND(<1)	ND(<1)	ND(<3)	ND(<3)	-	-	-	-	-
MW-7	12/08/08	530	-	-	1	ND(<1)	ND(<1)	ND(<3)	ND(<3)	-	-	-	-	-
MW-7	03/05/09	680	-	-	2	ND(<1)	ND(<1)	ND(<3)	ND(<3)	-	-	-	-	-
MW-7	06/19/09	130	-	-	ND(<1)	ND(<1)	ND(<1)	ND(<3)	ND(<3)	-	-	-	-	-
MW-7	09/28/09	53	-	-	ND(<1.0)	ND(<1.0)	ND(<1.0)	ND(<3.0)	ND(<3.0)	-	-	-	-	-
MW-7	12/29/09	73 <sup>a</sup>	-	-	ND(<1.0)	ND(<1.0)	ND(<1.0)	ND(<3.0)	ND(<1.0)	-	-	-	-	-
MW-7	03/26/10	140 <sup>a</sup>	-	-	ND(<1.0)	ND(<1.0)	ND(<1.0)	ND(<3.0)	ND(<3.0)	-	-	-	-	-
MW-7	06/09/10	ND(<50)	-	-	ND(<1.0)	ND(<1.0)	ND(<1.0)	ND(<3.0)	ND(<3.0)	-	-	-	-	-
MW-7	09/22/10	ND(<50)	-	-	ND(<1.0)	ND(<1.0)	ND(<1.0)	ND(<3.0)	ND(<3.0)	-	-	-	-	-
MW-7	12/17/10	ND(<50)	-	-	ND(<1.0)	ND(<1.0)	ND(<1.0)	ND(<3.0)	ND(<3.0)	-	-	-	-	-
MW-7	03/25/11	280	-	-	ND(<1.0)	ND(<1.0)	ND(<1.0)	ND(<3.0)	ND(<3.0)	-	-	-	-	-
MW-7	06/21/11	130	-	-	ND(<1.0)	ND(<1.0)	ND(<1.0)	ND(<3.0)	ND(<3.0)	-	-	-	-	-
MW-7	09/13/11	58	-	-	ND(<1.0)	ND(<1.0)	ND(<1.0)	ND(<3.0)	ND(<2.0)	-	-	-	-	-
MW-7	12/28/11	260	-	-	ND(<1.0)	ND(<1.0)	ND(<1.0)	ND(<3.0)	ND(<3.0)	-	-	-	-	-
MW-7	03/19/12	1,500	-	-	ND(<1.0)	ND(<1.0)	ND(<1.0)	ND(<3.0)	ND(<3.0)	-	-	-	-	-
MW-7	04/12/12	-	-	-	-	-	-	-	-	-	-	-	1.1	8.9
MW-7	06/06/12	330	-	-	ND(<1.0)	ND(<1.0)	ND(<1.0)	ND(<3.0)	ND(<3.0)	ND(<0.020)	ND(<0.010)	ND(<1.0)	4.1	14
MW-7	09/17/12	190	-	-	ND(<1.0)	ND(<1.0)	ND(<1.0)	ND(<3.0)	ND(<3.0)	ND(<0.020)	ND(<0.010)	ND(<1.0)	-	190
MW-7	10/01/12	210	-	-	ND(<1.0)	ND(<1.0)	ND(<1.0)	ND(<3.0)	-	-	-	-	-	81
MW-7	10/25/12	120	-	-	ND(<1.0)	ND(<1.0)	ND(<1.0)	ND(<3.0)	-	-	-	-	-	990
MW-7	11/29/12	ND(<50)	-	-	ND(<1.0)	ND(<1.0)	ND(<1.0)	ND(<3.0)	-	-	-	-	-	1,000
MW-7	12/21/12	ND(<50)	-	-	ND(<1.0)	ND(<1.0)	ND(<1.0)	ND(<3.0)	ND(<3.0)	ND(<0.020)	ND(<0.010)	ND(<1.0)	-	1,100
MW-7	02/19/13	ND(<50)	-	-	ND(<1.0)	ND(<1.0)	ND(<1.0)	ND(<3.0)	-	-	-	-	-	720
MW-7	03/27/13	70	-	-	ND(<1.0)	ND(<1.0)	ND(<1.0)	ND(<3.0)	ND(<3.0)	-	-	ND(<1.0)	-	400
MW-7	04/26/13	ND(<50)	-	-	ND(<1.0)	ND(<1.0)	ND(<1.0)	ND(<3.0)	-	-	-	-	-	760
MW-7	05/30/13	ND(<50)	-	-	ND(<1.0)	ND(<1.0)	ND(<1.0)	ND(<3.0)	-	-	-	-	-	310
MW-7	06/24/13	ND(<50)	-	-	ND(<1.0)	ND(<1.0)	ND(<1.0)	ND(<3.0)	ND(<3.0)	-	-	-	-	790
MW-7	07/31/13	83	-	-	ND(<1.0)	ND(<1.0)	ND(<1.0)	ND(<3.0)	-	-	-	-	-	160
MW-7	08/28/13	120	-	-	ND(<1.0)	ND(<1.0)	ND(<1.0)	ND(<3.0)	-	-	-	-	-	74
MW-7	09/20/13	190	-	-	ND(<1.0)	ND(<1.0)	ND(<1.0)	ND(<3.0)	-	-	-	-	-	180
MW-7	10/30/13	ND(<50)	-	-	ND(<1.0)	ND(<1.0)	ND(<1.0)	ND(<3.0)	ND(<3.0)	-	-	-	-	870
MW-7	11/26/13	280	-	-	ND(<1.0)	ND(<1.0)	ND(<1.0)	ND(<3.0)	-	-	-	-	-	440
MW-7	12/20/13	84	-	-	ND(<1.0)	ND(<1.0)	ND(<1.0)	ND(<3.0)	ND(<3.0)	-	-	-	-	460
MW-7	03/12/14	ND(<50)	-	-	ND(<1.0)	ND(<1.0)	ND(<1.0)	ND(<3.0)	ND(<3.0)	-	-	-	-	-

**TABLE 2  
GROUNDWATER ANALYTICAL RESULTS**

Miller's Market  
3152 Washington Way  
Longview, Washington

Well I.D. (TOC)	Sample Date	TPH- Gasoline (µg/L)	TPH- Diesel (µg/L)	TPH- Oil (µg/L)	Benzene (µg/L)	Toluene (µg/L)	Ethyl- benzene (µg/L)	Xylenes (µg/L)	MTBE (µg/L)	EDC (µg/L)	EDB (µg/L)	Lead (µg/L)	Nitrate (mg/L)	Sulfate (mg/L)
MW-7	06/16/14	ND(<50)	-	-	ND(<1.0)	ND(<1.0)	ND(<1.0)	ND(<3.0)	ND(<3.0)	-	-	-	-	-
MW-7	09/11/14	130	-	-	ND(<1.0)	ND(<1.0)	ND(<1.0)	ND(<3.0)	ND(<3.0)	-	-	-	-	-
MW-7	12/17/14	ND(<50)	-	-	ND(<1.0)	ND(<1.0)	ND(<1.0)	ND(<3.0)	ND(<3.0)	-	-	-	-	-
MW-7	03/16/15	100	-	-	ND(<1.0)	ND(<1.0)	ND(<1.0)	ND(<3.0)	ND(<3.0)	-	-	-	-	-
MW-7	05/13/15	62	-	-	ND(<1.0)	ND(<1.0)	ND(<1.0)	ND(<3.0)	ND(<3.0)	-	-	-	-	-
MW-7	08/13/15	ND(<50)	-	-	ND(<1.0)	ND(<1.0)	ND(<1.0)	ND(<3.0)	ND(<3.0)	-	-	-	-	-

**TABLE 2  
GROUNDWATER ANALYTICAL RESULTS**

Miller's Market  
3152 Washington Way  
Longview, Washington

Well I.D. (TOC)	Sample Date	TPH- Gasoline (µg/L)	TPH- Diesel (µg/L)	TPH- Oil (µg/L)	Benzene (µg/L)	Toluene (µg/L)	Ethyl- benzene (µg/L)	Xylenes (µg/L)	MTBE (µg/L)	EDC (µg/L)	EDB (µg/L)	Lead (µg/L)	Nitrate (mg/L)	Sulfate (mg/L)
MW-8	11/28/05	820	ND(<130)	ND(<250)	3	ND(<1)	1	ND(<3)	ND(<3)	-	-	-	-	-
MW-8	03/22/06	69	ND(<130)	ND(<250)	ND(<1)	ND(<1)	2	ND(<3)	ND(<2)	-	-	-	-	-
MW-8	06/27/06	ND(<50)	ND(<130)	ND(<250)	ND(<1)	ND(<1)	ND(<1)	ND(<3)	ND(<3)	-	-	-	-	-
MW-8	09/22/06	2,400	ND(<250)	ND(<250)	12	1	60	4	ND(<3)	-	-	-	-	-
MW-8	12/05/06	ND(<50)	ND(<130)	ND(<250)	ND(<1)	ND(<1)	ND(<1)	ND(<3)	ND(<3)	-	-	-	-	-
MW-8	03/13/07	1,000	-	-	4	ND(<1)	37	13	ND(<3)	-	-	-	-	-
MW-8	06/04/07	ND(<50)	-	-	ND(<1)	ND(<1)	ND(<1)	ND(<3)	ND(<3)	-	-	-	-	-
MW-8	09/10/07	3,300	-	-	13	ND(<5)	55	ND(<15)	ND(<15)	-	-	-	-	-
MW-8	01/07/08	79	-	-	ND(<1)	ND(<1)	ND(<1)	ND(<3)	ND(<3)	-	-	-	-	-
MW-8	03/20/08	ND(<50)	-	-	ND(<1)	ND(<1)	ND(<1)	ND(<3)	ND(<3)	-	-	-	-	-
MW-8	06/16/08	ND(<50)	-	-	ND(<1)	ND(<1)	ND(<1)	ND(<3)	ND(<3)	-	-	-	-	-
MW-8	09/08/08	300	-	-	1	ND(<1)	3	ND(<3)	ND(<3)	-	-	-	-	-
MW-8	12/08/08	80	-	-	ND(<1)	ND(<1)	ND(<1)	ND(<3)	ND(<3)	-	-	-	-	-
MW-8	03/05/09	70	-	-	ND(<1)	ND(<1)	ND(<1)	ND(<3)	ND(<3)	-	-	-	-	-
MW-8	06/19/09	ND(<50)	-	-	ND(<1)	ND(<1)	ND(<1)	ND(<3)	ND(<3)	-	-	-	-	-
MW-8	09/28/09	260	-	-	1.2	ND(<1.0)	1.5	ND(<3.0)	ND(<3.0)	-	-	-	-	-
MW-8	12/29/09	62 <sup>a</sup>	-	-	ND(<1.0)	ND(<1.0)	ND(<1.0)	ND(<3.0)	ND(<1.0)	-	-	-	-	-
MW-8	03/26/10	ND(<50)	-	-	ND(<1.0)	ND(<1.0)	ND(<1.0)	ND(<3.0)	ND(<3.0)	-	-	-	-	-
MW-8	06/09/10	ND(<50)	-	-	ND(<1.0)	ND(<1.0)	ND(<1.0)	ND(<3.0)	ND(<3.0)	-	-	-	-	-
MW-8	09/22/10	ND(<50)	-	-	ND(<1.0)	ND(<1.0)	ND(<1.0)	ND(<3.0)	ND(<3.0)	-	-	-	-	-
MW-8	12/17/10	ND(<50)	-	-	ND(<1.0)	ND(<1.0)	ND(<1.0)	ND(<3.0)	ND(<3.0)	-	-	-	-	-
MW-8	03/25/11	ND(<50)	-	-	ND(<1.0)	ND(<1.0)	ND(<1.0)	ND(<3.0)	ND(<3.0)	-	-	-	-	-
MW-8	06/21/11	ND(<50)	-	-	ND(<1.0)	ND(<1.0)	ND(<1.0)	ND(<3.0)	ND(<3.0)	-	-	-	-	-
MW-8	09/13/11	410	-	-	ND(<1.0)	ND(<1.0)	ND(<1.0)	ND(<3.0)	ND(<3.0)	-	-	-	-	-
MW-8	12/28/11	130	-	-	ND(<1.0)	ND(<1.0)	ND(<1.0)	ND(<3.0)	ND(<3.0)	-	-	-	-	-
MW-8	03/19/12	ND(<50)	-	-	ND(<1.0)	ND(<1.0)	ND(<1.0)	ND(<3.0)	ND(<3.0)	-	-	-	-	-
MW-8	06/06/12	ND(<50)	-	-	ND(<1.0)	ND(<1.0)	ND(<1.0)	ND(<3.0)	ND(<3.0)	ND(<0.020)	ND(<0.010)	ND(<1.0)	-	-
MW-8	09/17/12	ND(<50)	-	-	ND(<1.0)	ND(<1.0)	ND(<1.0)	ND(<3.0)	ND(<3.0)	ND(<0.020)	ND(<0.010)	ND(<1.0)	-	-
MW-8	12/21/12	ND(<50)	-	-	ND(<1.0)	ND(<1.0)	ND(<1.0)	ND(<3.0)	ND(<3.0)	ND(<0.020)	ND(<0.010)	ND(<1.0)	-	-
MW-8	03/27/13	ND(<50)	-	-	ND(<1.0)	ND(<1.0)	ND(<1.0)	ND(<3.0)	ND(<3.0)	-	-	ND(<1.0)	-	-
MW-8	06/24/13	ND(<50)	-	-	ND(<1.0)	ND(<1.0)	ND(<1.0)	ND(<3.0)	ND(<3.0)	-	-	-	-	-
MW-8	10/30/13	200	-	-	ND(<1.0)	ND(<1.0)	ND(<1.0)	ND(<3.0)	ND(<3.0)	-	-	-	-	-
MW-8	12/20/13	ND(<50)	-	-	ND(<1.0)	ND(<1.0)	ND(<1.0)	ND(<3.0)	ND(<3.0)	-	-	-	-	-
MW-8	03/12/14	660	-	-	2.0	ND(<1.0)	ND(<1.0)	ND(<3.0)	ND(<3.0)	-	-	-	-	-
MW-8	06/16/14	ND(<50)	-	-	ND(<1.0)	ND(<1.0)	ND(<1.0)	ND(<3.0)	ND(<3.0)	-	-	-	-	-
MW-8	09/11/14	360	-	-	ND(<1.0)	ND(<1.0)	ND(<1.0)	ND(<3.0)	ND(<3.0)	-	-	-	-	-
MW-8	12/17/14	160	-	-	ND(<1.0)	ND(<1.0)	ND(<1.0)	ND(<3.0)	ND(<3.0)	-	-	-	-	-
MW-8	03/16/15	ND(<50)	-	-	ND(<1.0)	ND(<1.0)	ND(<1.0)	ND(<3.0)	ND(<3.0)	-	-	-	-	-
MW-8	05/13/15	ND(<50)	-	-	ND(<1.0)	ND(<1.0)	ND(<1.0)	ND(<3.0)	ND(<3.0)	-	-	-	-	-
MW-8	08/13/15	59	-	-	ND(<1.0)	ND(<1.0)	ND(<1.0)	ND(<3.0)	ND(<3.0)	-	-	-	-	-

**TABLE 2**  
**GROUNDWATER ANALYTICAL RESULTS**  
 Miller's Market  
 3152 Washington Way  
 Longview, Washington

Well I.D. (TOC)	Sample Date	TPH- Gasoline (µg/L)	TPH- Diesel (µg/L)	TPH- Oil (µg/L)	Benzene (µg/L)	Toluene (µg/L)	Ethyl- benzene (µg/L)	Xylenes (µg/L)	MTBE (µg/L)	EDC (µg/L)	EDB (µg/L)	Lead (µg/L)	Nitrate (mg/L)	Sulfate (mg/L)
RW-1	11/17/03	23,000	-	-	970	1,200	460	3,400	-	-	-	-	-	-
RW-1	03/15/04	5,100	-	-	91	82	60	190	ND(<15)	-	-	-	-	-
RW-1	06/17/04	1,100	-	-	21	ND(<1)	16	17	ND(<3)	-	-	-	-	-
RW-1	09/15/04	3,000	-	-	50	ND(<5)	47	94	ND(<15)	-	-	-	-	-
RW-1	12/16/04	200	-	-	3	ND(<1)	2	ND(<3)	ND(<3)	-	-	-	-	-
RW-1	03/18/05	310	-	-	2	ND(<1)	2	ND(<3)	ND(<3)	-	-	-	-	-
RW-1	06/14/05	3,900	-	-	4	1,900	1	ND(<3)	ND(<3)	-	-	-	-	-
RW-1	09/26/05	280	-	-	4	ND(<1)	ND(<1)	ND(<3)	ND(<3)	-	-	-	-	-
RW-1	11/28/05	ND	ND(<130)	ND(<250)	ND(<1)	ND(<1)	ND(<1)	ND(<3)	ND(<3)	-	-	-	-	-
RW-1	03/22/06	ND(<50)	ND(<130)	ND(<250)	ND(<1)	ND(<1)	ND(<1)	ND(<3)	ND(<2)	-	-	-	-	-
RW-1	06/27/06	ND(<50)	ND(<130)	ND(<250)	ND(<1)	ND(<1)	ND(<1)	ND(<3)	ND(<3)	-	-	-	-	-
RW-1	09/22/06	ND(<50)	ND(<130)	250	ND(<1)	ND(<1)	ND(<1)	ND(<3)	ND(<3)	-	-	-	-	-
RW-1	12/05/06	ND(<50)	ND(<130)	250	ND(<1)	ND(<1)	ND(<1)	ND(<3)	ND(<3)	-	-	-	-	-
RW-1	03/13/07	ND(<50)	-	-	ND(<1)	ND(<1)	ND(<1)	ND(<3)	ND(<3)	-	-	-	-	-
RW-1	06/04/07	ND(<50)	-	-	ND(<1)	ND(<1)	ND(<1)	ND(<3)	ND(<3)	-	-	-	-	-
RW-1	09/10/07	ND(<50)	-	-	ND(<1)	ND(<1)	ND(<1)	ND(<3)	ND(<3)	-	-	-	-	-
RW-1	01/07/08	ND(<50)	-	-	ND(<1)	ND(<1)	ND(<1)	ND(<3)	ND(<3)	-	-	-	-	-
RW-1	03/20/08	56	-	-	6	1	ND(<1)	ND(<3)	ND(<3)	-	-	-	-	-
RW-1	06/16/08	ND(<50)	-	-	ND(<1)	ND(<1)	ND(<1)	ND(<3)	ND(<3)	-	-	-	-	-
RW-1	09/08/08	ND(<50)	-	-	ND(<1)	ND(<1)	ND(<1)	ND(<3)	ND(<3)	-	-	-	-	-
RW-1	12/08/08	ND(<50)	-	-	ND(<1)	ND(<1)	ND(<1)	ND(<3)	ND(<3)	-	-	-	-	-
RW-1	03/05/09	ND(<50)	-	-	ND(<1)	ND(<1)	ND(<1)	ND(<3)	ND(<3)	-	-	-	-	-
RW-1	06/19/09	ND(<50)	-	-	ND(<1)	1	ND(<1)	ND(<3)	ND(<3)	-	-	-	-	-
RW-1	09/28/09	ND(<50)	-	-	ND(<1.0)	ND(<1.0)	ND(<1.0)	ND(<3.0)	ND(<3.0)	-	-	-	-	-
RW-1	12/29/09	ND(<50)	-	-	ND(<1.0)	ND(<1.0)	ND(<1.0)	ND(<3.0)	ND(<1.0)	-	-	-	-	-
RW-1	03/26/10	ND(<50)	-	-	ND(<1.0)	ND(<1.0)	ND(<1.0)	ND(<3.0)	ND(<3.0)	-	-	-	-	-
RW-1	06/09/10	ND(<50)	-	-	ND(<1.0)	ND(<1.0)	ND(<1.0)	ND(<3.0)	ND(<3.0)	-	-	-	-	-
RW-1	09/22/10	ND(<50)	-	-	ND(<1.0)	ND(<1.0)	ND(<1.0)	ND(<3.0)	ND(<3.0)	-	-	-	-	-
RW-1	12/17/10	ND(<50)	-	-	ND(<1.0)	ND(<1.0)	ND(<1.0)	ND(<3.0)	ND(<3.0)	-	-	-	-	-
RW-1	03/25/11	ND(<50)	-	-	ND(<1.0)	ND(<1.0)	ND(<1.0)	ND(<3.0)	ND(<3.0)	-	-	-	-	-
RW-1	06/21/11	ND(<50)	-	-	ND(<1.0)	ND(<1.0)	ND(<1.0)	ND(<3.0)	ND(<3.0)	-	-	-	-	-
RW-1	09/13/11	ND(<50)	-	-	ND(<1.0)	ND(<1.0)	ND(<1.0)	ND(<3.0)	ND(<3.0)	-	-	-	-	-
RW-1	12/28/11	ND(<50)	-	-	ND(<1.0)	ND(<1.0)	ND(<1.0)	ND(<3.0)	ND(<3.0)	-	-	-	-	-
RW-1	03/19/12	ND(<50)	-	-	ND(<1.0)	ND(<1.0)	ND(<1.0)	ND(<3.0)	ND(<3.0)	-	-	-	-	-
RW-1	06/06/12	ND(<50)	-	-	ND(<1.0)	ND(<1.0)	ND(<1.0)	ND(<3.0)	ND(<3.0)	ND(<0.020)	ND(<0.010)	3.2	-	-
RW-1	09/17/12	ND(<50)	-	-	ND(<1.0)	ND(<1.0)	ND(<1.0)	ND(<3.0)	ND(<3.0)	ND(<0.020)	ND(<0.010)	4.5	-	-
RW-1	12/21/12	ND(<50)	-	-	ND(<1.0)	ND(<1.0)	ND(<1.0)	ND(<3.0)	ND(<3.0)	ND(<0.020)	ND(<0.010)	3.8	-	-
RW-1	03/27/13	ND(<50)	-	-	ND(<1.0)	ND(<1.0)	ND(<1.0)	ND(<3.0)	ND(<3.0)	-	-	1.4	-	-
RW-1	06/24/13	ND(<50)	-	-	ND(<1.0)	ND(<1.0)	ND(<1.0)	ND(<3.0)	ND(<3.0)	-	-	-	-	-
RW-1	10/30/13	ND(<50)	-	-	ND(<1.0)	ND(<1.0)	ND(<1.0)	ND(<3.0)	ND(<3.0)	-	-	-	-	-
RW-1	12/20/13	ND(<50)	-	-	ND(<1.0)	ND(<1.0)	ND(<1.0)	ND(<3.0)	ND(<3.0)	-	-	-	-	-

**TABLE 2  
GROUNDWATER ANALYTICAL RESULTS**

Miller's Market  
3152 Washington Way  
Longview, Washington

Well I.D. (TOC)	Sample Date	TPH- Gasoline (µg/L)	TPH- Diesel (µg/L)	TPH- Oil (µg/L)	Benzene (µg/L)	Toluene (µg/L)	Ethyl- benzene (µg/L)	Xylenes (µg/L)	MTBE (µg/L)	EDC (µg/L)	EDB (µg/L)	Lead (µg/L)	Nitrate (mg/L)	Sulfate (mg/L)
Trip Blank	05/13/15	ND<50	-	-	ND(<1.0)	ND(<1.0)	ND(<1.0)	ND(<3.0)	ND(<3.0)	-	-	-	-	-
Trip Blank	08/13/15	ND<50	-	-	ND(<1.0)	ND(<1.0)	ND(<1.0)	ND(<3.0)	ND(<3.0)	-	-	-	-	-
<b>MTCA Method A Cleanup Levels:</b>		<b>800*</b>	<b>500</b>	<b>500</b>	<b>5</b>	<b>1000</b>	<b>700</b>	<b>1000</b>	<b>20</b>	<b>5</b>	<b>0.01</b>	<b>15</b>	-	-

**Notes:**

µg/L = micrograms per liter

mg/L = milligrams per liter

ND = Not detected at or above the laboratory reporting limits. Reporting limit in parentheses.

-- = Not sampled, not measured, or not analyzed

TPH - Gasoline - Analysis by Northwest Method NWTPH-G

TPH - Diesel - Analysis by Northwest Method NWTPH-Dx with Silica Gel Cleanup

TPH - Oil - Analysis by Northwest Method NWTPH-Dx with Silica Gel Cleanup

BTEX Compounds - Analysis by EPA Method 8021B

Methyl-tert-Butyl Ether Analysis by EPA Method 8021B or 8260B

EDC (1,2 Dichloroethane) and EDB (1,2 Ethylene dibromide) - Analysis by EPA Method 8260 SIM

Lead - Analysis by EPA 6020

Nitrate and Sulfate - analysis by EPA Method 300.0

\*MTCA Method A Cleanup Level for TPH-Gasoline is 1000 µg/L if benzene is not detectable in groundwater.

<sup>a</sup> Chromatogram indicates that it is likely that sample contains weathered gasoline.

<sup>b</sup> Chromatogram indicates that it is likely that sample contains weathered gasoline. TPH Benzene results bias high due to coeluting compound.

<sup>c</sup> Benzene results bias high due to coeluting compound.

<sup>1</sup> Duplicate sample, noted as MW-13 on the COC.



## ***Figures***

- Figure 1      Site Location Map
- Figure 2      Well Locations and Groundwater Elevation Contour Map
- Figure 3      Analytical Concentration Map

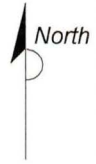
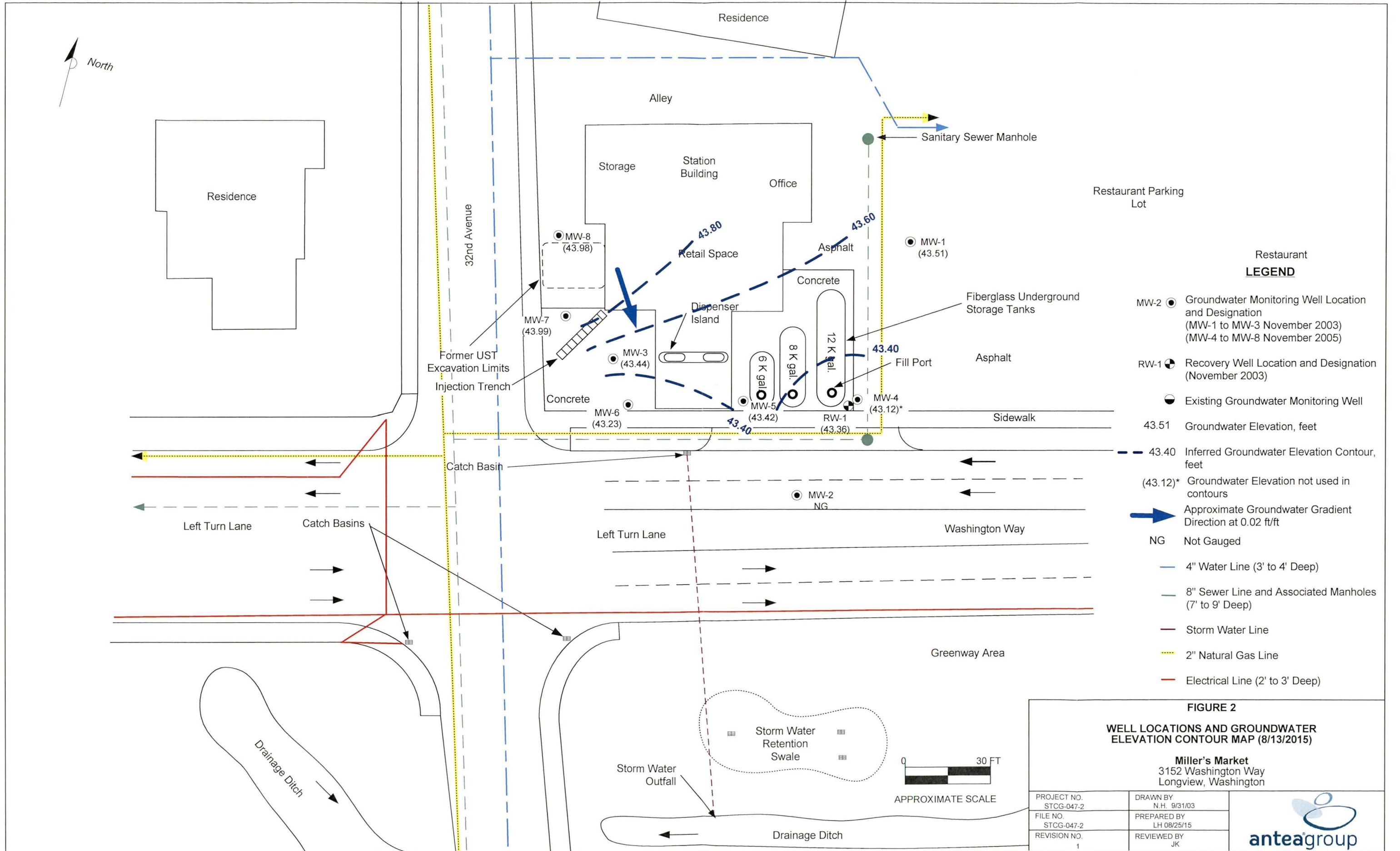

**FIGURE 1**  
**SITE LOCATION MAP**

MILLER'S MARKET  
3152 WASHINGTON WAY  
LONGVIEW, WASHINGTON

PROJECT NO. STCG-047-2	DRAWN BY JK 5-12-12
FILE NO. STCG-047-2	PREPARED BY JK
REVISION NO.	REVIEWED BY MM





- Restaurant LEGEND**
- MW-2 ● Groundwater Monitoring Well Location and Designation (MW-1 to MW-3 November 2003) (MW-4 to MW-8 November 2005)
  - RW-1 ● Recovery Well Location and Designation (November 2003)
  - Existing Groundwater Monitoring Well
  - 43.51 Groundwater Elevation, feet
  - - - 43.40 Inferred Groundwater Elevation Contour, feet
  - (43.12)\* Groundwater Elevation not used in contours
  - ➔ Approximate Groundwater Gradient Direction at 0.02 ft/ft
  - NG Not Gauged
  - 4" Water Line (3' to 4' Deep)
  - 8" Sewer Line and Associated Manholes (7' to 9' Deep)
  - Storm Water Line
  - - - 2" Natural Gas Line
  - Electrical Line (2' to 3' Deep)

**FIGURE 2**  
**WELL LOCATIONS AND GROUNDWATER ELEVATION CONTOUR MAP (8/13/2015)**

**Miller's Market**  
 3152 Washington Way  
 Longview, Washington

PROJECT NO. STCG-047-2	DRAWN BY N.H. 9/31/03
FILE NO. STCG-047-2	PREPARED BY LH 08/25/15
REVISION NO. 1	REVIEWED BY JK

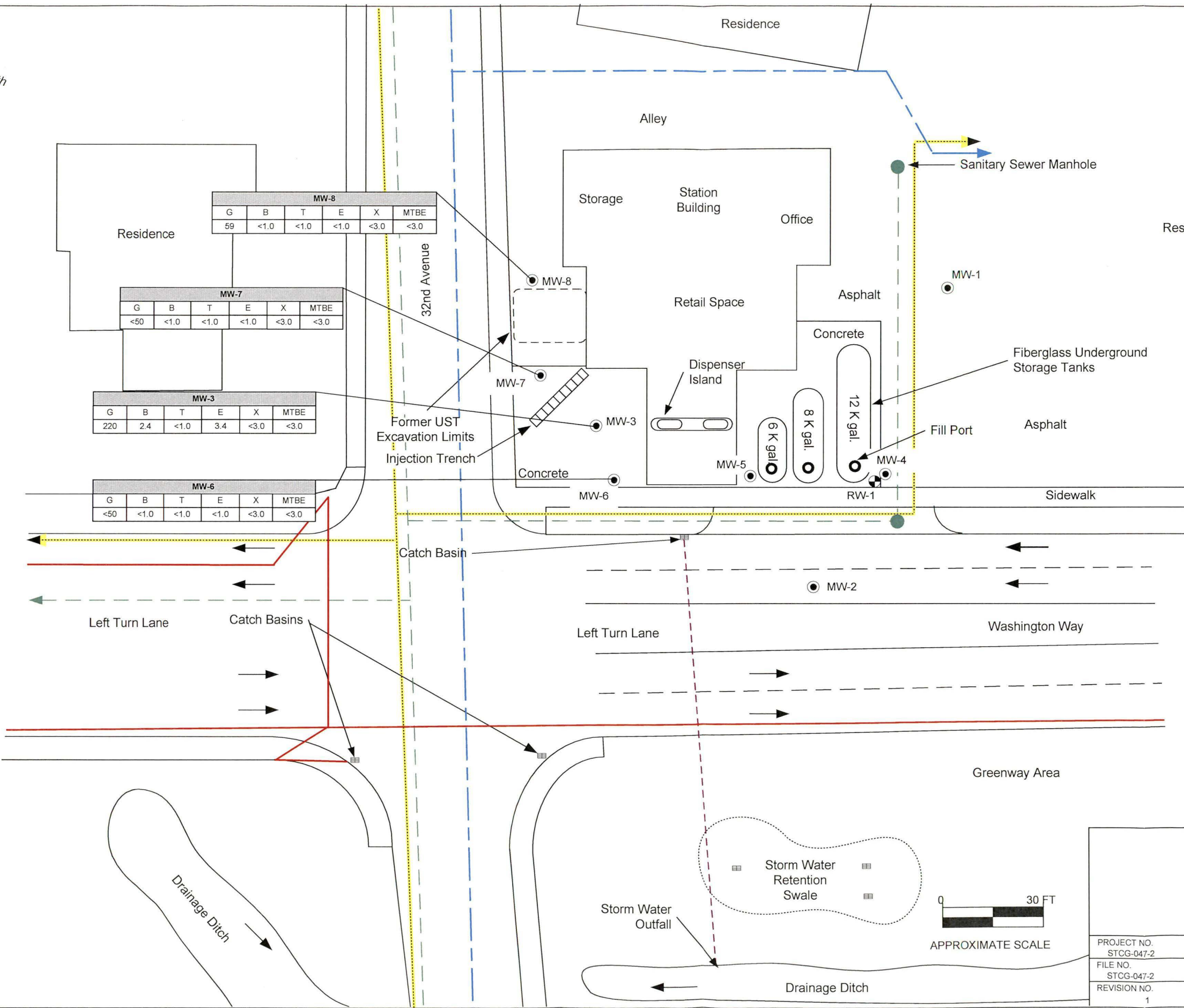

MW-8					
G	B	T	E	X	MTBE
59	<1.0	<1.0	<1.0	<3.0	<3.0

MW-7					
G	B	T	E	X	MTBE
<50	<1.0	<1.0	<1.0	<3.0	<3.0

MW-3					
G	B	T	E	X	MTBE
220	2.4	<1.0	3.4	<3.0	<3.0

MW-6					
G	B	T	E	X	MTBE
<50	<1.0	<1.0	<1.0	<3.0	<3.0

- LEGEND**
- MW-2 ● Groundwater Monitoring Well Location and Designation (MW-1 to MW-3 November 2003) (MW-4 to MW-8 November 2005)
  - RW-1 ● Recovery Well Location and Designation (November 2003)
  - Existing Groundwater Monitoring Well
  - G Gasoline  $\mu\text{g/L}$
  - B Benzene  $\mu\text{g/L}$
  - T Toluene  $\mu\text{g/L}$
  - E Ethylbenzene  $\mu\text{g/L}$
  - X Xylenes  $\mu\text{g/L}$
  - MTBE Methyl T-Butyl Ether  $\mu\text{g/L}$
  - <N Non Detect
  - $\mu\text{g/L}$  Micrograms per Liter
  - 4" Water Line (3' to 4' Deep)
  - 8" Sewer Line and Associated Manholes (7' to 9' Deep)
  - Storm Water Line
  - 2" Natural Gas Line
  - Electrical Line (2' to 3' Deep)

**FIGURE 3**  
**ANALYTICAL CONCENTRATION MAP**  
 (8/13/2015)

**Miller's Market**  
 3152 Washington Way  
 Longview, Washington



PROJECT NO. STCG-047-2	DRAWN BY N.H. 9/31/03
FILE NO. STCG-047-2	PREPARED BY LH 08/25/15
REVISION NO. 1	REVIEWED BY JK



*Quarterly Groundwater Monitoring Report - Third Quarter 2015*  
*Miller's Market*  
*3152 Washington Way, Longview, WA*



## ***Appendix A***

Analytical Lab Report and Chain-of-Custody Documentation



August 20, 2015

Mr. Matt Miller  
Antea Group  
4006 - 148th Ave NE  
Redmond, WA 98052

Dear Mr. Miller,

On August 18th, 6 samples were received by our laboratory and assigned our laboratory project number EV15080089. The project was identified as your STCG 0472 Claim #21164 Millers Market. The sample identification and requested analyses are outlined on the attached chain of custody record.

Our sample number -01 was re-analyzed and is being re-issued with new results. No other abnormalities or nonconformances were observed during the analyses of the project samples.

Please do not hesitate to call me if you have any questions or if I can be of further assistance.

Sincerely,

ALS Laboratory Group

Rick Bagan  
Laboratory Director



**CERTIFICATE OF ANALYSIS**

CLIENT:	Antea Group 4006 - 148th Ave NE Redmond, WA 98052	DATE:	8/20/2015
CLIENT CONTACT:	Matt Miller	ALS JOB#:	EV15080089
CLIENT PROJECT:	STCG 0472 Claim #21164 Millers Market	ALS SAMPLE#:	EV15080089-01
CLIENT SAMPLE ID	MW 3-5.76	DATE RECEIVED:	08/18/2015
		COLLECTION DATE:	8/13/2015 1:10:00 PM
		WDOE ACCREDITATION:	C601

**SAMPLE DATA RESULTS**

ANALYTE	METHOD	RESULTS	REPORTING LIMITS	DILUTION FACTOR	UNITS	ANALYSIS DATE	ANALYSIS BY
TPH-Volatile Range	NWTPH-GX	220	50	1	UG/L	08/20/2015	PAB
Methyl T-Butyl Ether	EPA-8021	U	3.0	1	UG/L	08/20/2015	PAB
Benzene	EPA-8021	2.4	1.0	1	UG/L	08/20/2015	PAB
Toluene	EPA-8021	U	1.0	1	UG/L	08/20/2015	PAB
Ethylbenzene	EPA-8021	3.4	1.0	1	UG/L	08/20/2015	PAB
Xylenes	EPA-8021	U	3.0	1	UG/L	08/20/2015	PAB

SURROGATE	METHOD	%REC	ANALYSIS DATE	ANALYSIS BY
TFT	NWTPH-GX	119	08/20/2015	PAB
TFT	EPA-8021	109	08/20/2015	PAB

U - Analyte analyzed for but not detected at level above reporting limit.  
Chromatogram indicates that it is likely that sample contains highly weathered gasoline.





**CERTIFICATE OF ANALYSIS**

<b>CLIENT:</b>	Antea Group 4006 - 148th Ave NE Redmond, WA 98052	<b>DATE:</b>	8/20/2015
<b>CLIENT CONTACT:</b>	Matt Miller	<b>ALS JOB#:</b>	EV15080089
<b>CLIENT PROJECT:</b>	STCG 0472 Claim #21164 Millers Market	<b>ALS SAMPLE#:</b>	EV15080089-02
<b>CLIENT SAMPLE ID</b>	MW 6-5.77	<b>DATE RECEIVED:</b>	08/18/2015
		<b>COLLECTION DATE:</b>	8/13/2015 12:40:00 PM
		<b>WDOE ACCREDITATION:</b>	C601

**SAMPLE DATA RESULTS**

ANALYTE	METHOD	RESULTS	REPORTING LIMITS	DILUTION FACTOR	UNITS	ANALYSIS DATE	ANALYSIS BY
TPH-Volatile Range	NWTPH-GX	U	50	1	UG/L	08/18/2015	PAB
Methyl T-Butyl Ether	EPA-8021	U	3.0	1	UG/L	08/18/2015	PAB
Benzene	EPA-8021	U	1.0	1	UG/L	08/18/2015	PAB
Toluene	EPA-8021	U	1.0	1	UG/L	08/18/2015	PAB
Ethylbenzene	EPA-8021	U	1.0	1	UG/L	08/18/2015	PAB
Xylenes	EPA-8021	U	3.0	1	UG/L	08/18/2015	PAB

SURROGATE	METHOD	%REC	ANALYSIS DATE	ANALYSIS BY
TFT	NWTPH-GX	90.1	08/18/2015	PAB
TFT	EPA-8021	93.8	08/18/2015	PAB

U - Analyte analyzed for but not detected at level above reporting limit.





**CERTIFICATE OF ANALYSIS**

**CLIENT:** Antea Group  
 4006 - 148th Ave NE  
 Redmond, WA 98052  
**CLIENT CONTACT:** Matt Miller  
**CLIENT PROJECT:** STCG 0472 Claim #21164 Millers Market  
**CLIENT SAMPLE ID:** MW 7-5.05  
**DATE:** 8/20/2015  
**ALS JOB#:** EV15080089  
**ALS SAMPLE#:** EV15080089-03  
**DATE RECEIVED:** 08/18/2015  
**COLLECTION DATE:** 8/13/2015 12:20:00 PM  
**WDOE ACCREDITATION:** C601

**SAMPLE DATA RESULTS**

ANALYTE	METHOD	RESULTS	REPORTING LIMITS	DILUTION FACTOR	UNITS	ANALYSIS DATE	ANALYSIS BY
TPH-Volatile Range	NWTPH-GX	U	50	1	UG/L	08/18/2015	PAB
Methyl T-Butyl Ether	EPA-8021	U	3.0	1	UG/L	08/18/2015	PAB
Benzene	EPA-8021	U	1.0	1	UG/L	08/18/2015	PAB
Toluene	EPA-8021	U	1.0	1	UG/L	08/18/2015	PAB
Ethylbenzene	EPA-8021	U	1.0	1	UG/L	08/18/2015	PAB
Xylenes	EPA-8021	U	3.0	1	UG/L	08/18/2015	PAB

SURROGATE	METHOD	%REC	ANALYSIS DATE	ANALYSIS BY
TFT	NWTPH-GX	88.6	08/18/2015	PAB
TFT	EPA-8021	92.3	08/18/2015	PAB

U - Analyte analyzed for but not detected at level above reporting limit.



**CERTIFICATE OF ANALYSIS**

<b>CLIENT:</b>	Antea Group 4006 - 148th Ave NE Redmond, WA 98052	<b>DATE:</b>	8/20/2015
<b>CLIENT CONTACT:</b>	Matt Miller	<b>ALS JOB#:</b>	EV15080089
<b>CLIENT PROJECT:</b>	STCG 0472 Claim #21164 Millers Market	<b>ALS SAMPLE#:</b>	EV15080089-04
<b>CLIENT SAMPLE ID</b>	MW 8-4.55	<b>DATE RECEIVED:</b>	08/18/2015
		<b>COLLECTION DATE:</b>	8/13/2015 11:50:00 AM
		<b>WDOE ACCREDITATION:</b>	C601

**SAMPLE DATA RESULTS**

ANALYTE	METHOD	RESULTS	REPORTING LIMITS	DILUTION FACTOR	UNITS	ANALYSIS DATE	ANALYSIS BY
TPH-Volatile Range	NWTPH-GX	59	50	1	UG/L	08/18/2015	PAB
Methyl T-Butyl Ether	EPA-8021	U	3.0	1	UG/L	08/18/2015	PAB
Benzene	EPA-8021	U	1.0	1	UG/L	08/18/2015	PAB
Toluene	EPA-8021	U	1.0	1	UG/L	08/18/2015	PAB
Ethylbenzene	EPA-8021	U	1.0	1	UG/L	08/18/2015	PAB
Xylenes	EPA-8021	U	3.0	1	UG/L	08/18/2015	PAB

SURROGATE	METHOD	%REC	ANALYSIS DATE	ANALYSIS BY
TFT	NWTPH-GX	89.6	08/18/2015	PAB
TFT	EPA-8021	92.7	08/18/2015	PAB

U - Analyte analyzed for but not detected at level above reporting limit.  
Chromatogram indicates that it is likely that sample contains highly weathered gasoline.





**CERTIFICATE OF ANALYSIS**

**CLIENT:** Antea Group  
 4006 - 148th Ave NE  
 Redmond, WA 98052  
**CLIENT CONTACT:** Matt Miller  
**CLIENT PROJECT:** STCG 0472 Claim #21164 Millers Market  
**CLIENT SAMPLE ID:** DUP  
**DATE:** 8/20/2015  
**ALS JOB#:** EV15080089  
**ALS SAMPLE#:** EV15080089-05  
**DATE RECEIVED:** 08/18/2015  
**COLLECTION DATE:** 8/13/2015  
**WDOE ACCREDITATION:** C601

**SAMPLE DATA RESULTS**

ANALYTE	METHOD	RESULTS	REPORTING LIMITS	DILUTION FACTOR	UNITS	ANALYSIS DATE	ANALYSIS BY
TPH-Volatile Range	NWTPH-GX	210	50	1	UG/L	08/18/2015	PAB
Methyl T-Butyl Ether	EPA-8021	U	3.0	1	UG/L	08/18/2015	PAB
Benzene	EPA-8021	3.1	1.0	1	UG/L	08/18/2015	PAB
Toluene	EPA-8021	U	1.0	1	UG/L	08/18/2015	PAB
Ethylbenzene	EPA-8021	4.1	1.0	1	UG/L	08/18/2015	PAB
Xylenes	EPA-8021	U	3.0	1	UG/L	08/18/2015	PAB

SURROGATE	METHOD	%REC	ANALYSIS DATE	ANALYSIS BY
TFT	NWTPH-GX	112	08/18/2015	PAB
TFT	EPA-8021	119	08/18/2015	PAB

U - Analyte analyzed for but not detected at level above reporting limit.





**CERTIFICATE OF ANALYSIS**

**CLIENT:** Antea Group **DATE:** 8/20/2015  
 4006 - 148th Ave NE **ALS JOB#:** EV15080089  
 Redmond, WA 98052 **ALS SAMPLE#:** EV15080089-06  
**CLIENT CONTACT:** Matt Miller **DATE RECEIVED:** 08/18/2015  
**CLIENT PROJECT:** STCG 0472 Claim #21164 Millers **COLLECTION DATE:** 8/13/2015  
 Market  
**CLIENT SAMPLE ID** TB\_96229 **WDOE ACCREDITATION:** C601

**SAMPLE DATA RESULTS**

ANALYTE	METHOD	RESULTS	REPORTING LIMITS	DILUTION FACTOR	UNITS	ANALYSIS DATE	ANALYSIS BY
TPH-Volatile Range	NWTPH-GX	U	50	1	UG/L	08/18/2015	PAB
Methyl T-Butyl Ether	EPA-8021	U	3.0	1	UG/L	08/18/2015	PAB
Benzene	EPA-8021	U	1.0	1	UG/L	08/18/2015	PAB
Toluene	EPA-8021	U	1.0	1	UG/L	08/18/2015	PAB
Ethylbenzene	EPA-8021	U	1.0	1	UG/L	08/18/2015	PAB
Xylenes	EPA-8021	U	3.0	1	UG/L	08/18/2015	PAB

SURROGATE	METHOD	%REC	ANALYSIS DATE	ANALYSIS BY
TFT	NWTPH-GX	90.0	08/18/2015	PAB
TFT	EPA-8021	94.8	08/18/2015	PAB

U - Analyte analyzed for but not detected at level above reporting limit.





**CERTIFICATE OF ANALYSIS**

**CLIENT:** Antea Group  
 4006 - 148th Ave NE  
 Redmond, WA 98052  
**CLIENT CONTACT:** Matt Miller  
**CLIENT PROJECT:** STCG 0472 Claim #21164 Millers Market

**DATE:** 8/20/2015  
**ALS SDG#:** EV15080089  
**WDOE ACCREDITATION:** C601

**LABORATORY BLANK RESULTS**

**MBG-081415W - Batch 96229 - Water by NWTPH-GX**

ANALYTE	METHOD	RESULTS	QUAL	UNITS	REPORTING LIMITS	ANALYSIS DATE	ANALYSIS BY
TPH-Volatile Range	NWTPH-GX	U		UG/L	50	08/14/2015	PAB

U - Analyte analyzed for but not detected at level above reporting limit.

**MB-081415W - Batch 96229 - Water by EPA-8021**

ANALYTE	METHOD	RESULTS	QUAL	UNITS	REPORTING LIMITS	ANALYSIS DATE	ANALYSIS BY
Methyl T-Butyl Ether	EPA-8021	U		UG/L	3.0	08/14/2015	PAB
Benzene	EPA-8021	U		UG/L	1.0	08/14/2015	PAB
Toluene	EPA-8021	U		UG/L	1.0	08/14/2015	PAB
Ethylbenzene	EPA-8021	U		UG/L	1.0	08/14/2015	PAB
Xylenes	EPA-8021	U		UG/L	3.0	08/14/2015	PAB

U - Analyte analyzed for but not detected at level above reporting limit.





CERTIFICATE OF ANALYSIS

CLIENT: Antea Group DATE: 8/20/2015  
4006 - 148th Ave NE ALS SDG#: EV15080089  
Redmond, WA 98052 WDOE ACCREDITATION: C601  
CLIENT CONTACT: Matt Miller  
CLIENT PROJECT: STCG 0472 Claim #21164 Millers  
Market

LABORATORY CONTROL SAMPLE RESULTS

ALS Test Batch ID: 96229 - Water by NWTPH-GX

SPIKED COMPOUND	METHOD	%REC	RPD	QUAL	ANALYSIS DATE	ANALYSIS BY
TPH-Volatile Range - BS	NWTPH-GX	88.3			08/14/2015	PAB
TPH-Volatile Range - BSD	NWTPH-GX	89.0	1		08/14/2015	PAB

ALS Test Batch ID: 96229 - Water by EPA-8021

SPIKED COMPOUND	METHOD	%REC	RPD	QUAL	ANALYSIS DATE	ANALYSIS BY
Methyl T-Butyl Ether - BS	EPA-8021	93.9			08/14/2015	PAB
Methyl T-Butyl Ether - BSD	EPA-8021	96.0	2		08/14/2015	PAB
Benzene - BS	EPA-8021	96.6			08/14/2015	PAB
Benzene - BSD	EPA-8021	97.1	0		08/14/2015	PAB
Toluene - BS	EPA-8021	96.4			08/14/2015	PAB
Toluene - BSD	EPA-8021	96.2	0		08/14/2015	PAB
Ethylbenzene - BS	EPA-8021	96.4			08/14/2015	PAB
Ethylbenzene - BSD	EPA-8021	97.2	1		08/14/2015	PAB
Xylenes - BS	EPA-8021	98.9			08/14/2015	PAB
Xylenes - BSD	EPA-8021	101	2		08/14/2015	PAB

APPROVED BY

Laboratory Director

