

QUARTERLY GROUNDWATER MONITORING REPORT

Third Quarter of 2011

College Way Foods

2120 East College Way, Mount Vernon, Washington

*AnteaTM Group Project No. STCG-403-2
January 30, 2012*

Prepared for:
College Way Foods
2120 East College Way
Mount Vernon, WA 98273-2320

Prepared by:
AnteaTM Group
4006 148th Avenue NE
Redmond, WA 98052
800 477 7411



Antea USA, Inc.
4006 148th Avenue NE
Redmond, Washington 98052 USA
www.anteagroup.com

January 30, 2012
Ms. Darla Maney
College Way Foods
2120 East College Way
Mount Vernon, WA 98273-2320

Subject: Quarterly Groundwater Monitoring Report - Third Quarter of 2011
College Way Foods
2120 East College Way
Mount Vernon, Washington
Antea Project STCG-403-2
Colony Claim No. 214322-140

Dear Ms. Maney:

Antea™ Group (formerly Delta Consultants) has prepared this report to summarize groundwater monitoring performed at the above referenced site on September 23, 2011.

GROUNDWATER SAMPLING AND ANALYSES

Before the sampling event, Antea Group measured depth to water in monitoring wells MW-1 through MW-5, MW-7, MW-8, TW-1 through TW-3, and B-2; and injection well IW-1 and IW-2 using an electronic water level meter. Groundwater elevations (GWE) were recorded on waterproof field sheets and measured to an accuracy of 0.01 feet. Samples were withdrawn from each well using a low-flow/ low-purge technique with a peristaltic pump. Field parameters of dissolved oxygen (DO), temperature, oxygen reduction potential (ORP), conductivity, and pH were collected during low-flow/low-purge procedures. The samples were placed in the appropriate laboratory-provided containers. Samples were labeled, placed into ice filled coolers, logged onto chain-of-custody forms and transported to the laboratory. No separate-phase hydrocarbons were observed in any of the monitoring wells.

During this monitoring event, the groundwater flow direction was generally toward the southwest at an approximate gradient of 0.048 feet/foot. A summary of current and historical groundwater elevations is included in Table 1. A site map showing well locations and groundwater elevations is included as Figure 1.

Groundwater samples were submitted to ALS Laboratory Group in Everett, Washington, and were analyzed for: total petroleum hydrocarbons in the gasoline range (TPH-G) using Northwest Method NWTPH-Gx; benzene, toluene, ethylbenzene, total xylenes (BTEX), and methyl tert-butyl ether (MTBE) using Method SW8021; Lead using Method SW6020; and sulfate using Method EPA300.0. MTBE confirmations were made using Method SW8260B.

GROUNDWATER ANALYTICAL RESULTS

Laboratory analysis indicate that concentrations of TPH-G, BTEX, MTBE, and lead were not detected above MTCA Method A cleanup levels in the groundwater samples collected from monitoring wells MW-1, through MW-5, MW-7, TW-1 and TW-3. The concentration of MTBE exceeded the MTCA Method A cleanup level in the groundwater sample collected from monitoring well MW-8. TPH-G, MTBE, and benzene concentrations exceeded the MTCA Method A cleanup levels in the groundwater sample collected from monitoring well TW-2. The concentration of benzene exceeded the MTCA Method A cleanup level in the groundwater sample collected from monitoring well B-2. A summary of current and historic hydrocarbon analytical results is presented in Table 2. A summary of natural attenuation parameter measurements and analytical results is presented in Table 3. The analytical report and chain-of-custody documentation are included in Appendix A.

ENHANCED LIQUID RECOVERY

Based on the historic and current groundwater data, three wells (MW-8, TW-2, and B-2) remain above MTCA Method A cleanup levels. A program of enhance liquid recovery (ELR) events commenced in December 2009 to remove residual TPH-G and BTEX compounds from the vicinity of TW-2 and B-2. ELR events were conducted on December 11, 2009, December 30, 2009, and January 20, 2010. During the first event, TW-2 was inaccessible due to ice. Extraction was performed on wells MW-1 and B-2. During the second and third events, ELR was performed on wells TW-2, MW-1, and B-2. However, the volume of water extracted from TW-2 was very low. A total of 7,203 gallons of groundwater was removed during the three ELR events. Quarterly groundwater monitoring was performed after the last ELR event. Based on the results of this first quarter 2011 groundwater monitoring, no additional ELR events are planned.

SULFATE INJECTION

Sulfate injection has been proposed as an alternative remediation strategy to ELR and commenced during the second quarter of 2011. This quarter, sulfate injections took place on July 13, 2011, August 2, 2011, and September 7, 2011. During each event, 250 gallons of solution was injected into IW-1. Additional sulfate injection events are planned for 2012. Antea Group also attempted to inject sulfate solution into injection well IW-2. Well IW-2 did not accept the solution, most likely due to tight clays in this area. Antea Group proposed an injection

trench in place of well IW-2 and installed the trench in October 2011. Injection into the trench commenced in the fourth quarter of 2011.

REMARKS

The recommendations contained in this report represent Antea USA, Inc.'s professional opinions based upon the currently available information and are arrived at in accordance with currently accepted professional standards. This report is based upon a specific scope of work requested by the client. The contract between Antea USA, Inc. and its client outlines the scope of work, and only those tasks specifically authorized by that contract or outlined in this report were performed. This report is intended only for the use of Antea USA, Inc.'s client and anyone else specifically identified in writing by Antea USA, Inc. as a user of this report. Antea USA, Inc. will not and cannot be liable for unauthorized reliance by any other third party. Other than as contained in this paragraph, Antea USA, Inc. makes no express or implied warranty as to the contents of this report.

Antea Group appreciates the opportunity to provide environmental services to you. Please call Joe Rounds, Project Manager, at 425-498-7724 if you have any questions regarding the contents of this letter.

Sincerely,

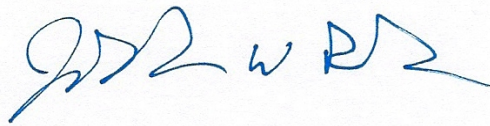

Joe Rounds
Project Manager
ANTEA GROUP

Enclosure:	Table 1	Groundwater Elevations
	Table 2	Groundwater Analytical Results
	Table 3	Groundwater Analytical Results - Natural Attenuation Parameters
	Figure 1	Site Map
	Appendix A	Analytical Report and Chain-of-Custody Documentation

cc: Ms. Heather Vick, Washington State Department of Ecology, Bellevue, Washington
Ms. Renae Mc Fadden, Mount Vernon Washington
Colony Group, Richmond, Virginia
File, Antea Group

Tables

Table 1	Groundwater Elevations
Table 2	Groundwater Analytical Results
Table 3	Groundwater Analytical Results – Natural Attenuation Parameters

TABLE 1
GROUNDWATER ELEVATIONS
COLLEGE WAY FOODS
2120 EAST COLLEGE WAY
MOUNT VERNON, WASHINGTON

Well Identification	Date	TOC Elevation (feet)	Depth to Groundwater (feet)	SPH Thickness (feet)	Groundwater Elevation (feet)
MW-1 (EW-1)	12/16/92	77.33	2.95	0.00	74.38
MW-1 (EW-1)	01/20/93	77.33	3.23	0.00	74.10
MW-1 (EW-1)	03/23/93	77.33	3.48	0.00	73.85
MW-1 (EW-1)	10/18/94	77.33	7.98	0.00	69.35
MW-1 (EW-1)	03/26/96	77.33	3.58	0.00	73.75
MW-1 (EW-1)	06/27/96	77.33	3.42	0.00	73.91
MW-1 (EW-1)	09/19/96	77.33	2.92	0.00	74.41
MW-1 (EW-1)	08/14/97	77.33	3.85	0.00	73.48
MW-1 (EW-1)	07/30/02	77.33	3.37	0.00	73.96
MW-1 (EW-1)	05/07/03	77.33	3.21	0.00	74.12
MW-1 (EW-1)	10/20/03	77.33	3.80	0.00	73.53
MW-1 (EW-1)	12/26/03	77.33	3.02	0.00	74.31
MW-1 (EW-1)	03/23/04	77.33	3.29	0.00	74.04
MW-1 (EW-1)	06/21/04	77.33	3.00	0.00	74.33
MW-1 (EW-1)	09/16/04	77.33	4.57	0.00	72.76
MW-1 (EW-1)	12/16/04	77.33	3.40	0.00	73.93
MW-1 (EW-1)	03/22/05	77.33	3.81	0.00	73.52
MW-1 (EW-1)	08/15/05	77.33	3.89	0.00	73.44
MW-1 (EW-1)	11/22/05	77.33	3.14	0.00	74.19
MW-1 (EW-1)	02/20/06	77.33	3.51	0.00	73.82
MW-1 (EW-1)	05/23/06	77.33	3.97	0.00	73.36
MW-1 (EW-1)	11/07/06	77.33	3.54	0.00	73.79
MW-1 (EW-1)	06/06/07	77.33	3.93	0.00	73.40
MW-1 (EW-1)	11/29/07	77.33	3.80	0.00	73.53
MW-1 (EW-1)	06/11/08	77.33	--	0.00	--
MW-1 (EW-1)	12/03/08	77.33	3.71	0.00	73.62
MW-1 (EW-1)	03/12/09	77.33	3.64	0.00	73.69
MW-1 (EW-1)	06/30/09	77.33	4.16	0.00	73.17
MW-1 (EW-1)	09/25/09	77.33	4.80	0.00	72.53
MW-1 (EW-1)	12/22/09	77.33	3.91	0.00	73.42
MW-1 (EW-1)	03/19/10	77.33	4.46	0.00	72.87
MW-1 (EW-1)	06/10/10	77.33	3.20	0.00	74.13
MW-1 (EW-1)	09/16/10	77.33	3.57	0.00	73.76
MW-1 (EW-1)	12/22/10	77.33	3.54	0.00	73.79
MW-1 (EW-1)	03/10/11	77.33	3.15	0.00	74.18
MW-1 (EW-1)	06/07/11	77.33	3.35	0.00	73.98
MW-1 (EW-1)	07/13/11	77.33	3.68	0.00	73.65
MW-1 (EW-1)	07/25/11	77.33	3.53	0.00	73.80
MW-1 (EW-1)	09/23/11	77.33	4.13	0.00	73.20

TABLE 1
GROUNDWATER ELEVATIONS
COLLEGE WAY FOODS
2120 EAST COLLEGE WAY
MOUNT VERNON, WASHINGTON

Well Identification	Date	TOC Elevation (feet)	Depth to Groundwater (feet)	SPH Thickness (feet)	Groundwater Elevation (feet)
MW-2 (IW-1)	12/16/92	76.84	2.45	0.00	74.39
MW-2 (IW-1)	06/07/11		2.45	0.00	-2.45
MW-2 (IW-1)	01/20/93	76.84	2.73	0.00	74.11
MW-2 (IW-1)	03/23/93	76.84	2.98	0.00	73.86
MW-2 (IW-1)	10/18/94	76.84	7.19	0.00	69.65
MW-2 (IW-1)	03/26/96	76.84	2.96	0.00	73.88
MW-2 (IW-1)	06/27/96	76.84	2.80	0.00	74.04
MW-2 (IW-1)	09/19/96	76.84	2.15	0.00	74.69
MW-2 (IW-1)	12/19/96	76.84	2.35	0.00	74.49
MW-2 (IW-1)	05/29/97	76.84	2.97	0.00	73.87
MW-2 (IW-1)	07/30/02	76.84	2.90	0.00	73.94
MW-2 (IW-1)	05/07/03	76.84	2.42	0.00	74.42
MW-2 (IW-1)	10/20/03	76.84	2.95	0.00	73.89
MW-2 (IW-1)	12/26/03	76.84	2.32	0.00	74.52
MW-2 (IW-1)	03/23/04	76.84	2.47	0.00	74.37
MW-2 (IW-1)	06/21/04	76.84	2.28	0.00	74.56
MW-2 (IW-1)	09/16/04	76.84	1.42	0.00	75.42
MW-2 (IW-1)	12/16/04	76.84	2.66	0.00	74.18
MW-2 (IW-1)	03/22/05	76.84	3.01	0.00	73.83
MW-2 (IW-1)	08/15/05	76.84	3.01	0.00	73.83
MW-2 (IW-1)	11/22/05	76.84	2.38	0.00	74.46
MW-2 (IW-1)	06/07/11	230.00	<3.0	79	16
MW-2 (IW-1)	02/20/06	76.84	2.78	0.00	74.06
MW-2 (IW-1)	05/23/06	76.84	3.00	0.00	73.84
MW-2 (IW-1)	11/07/06	76.84	2.63	0.00	74.21
MW-2 (IW-1)	06/06/07	76.84	3.19	0.00	73.65
MW-2 (IW-1)	11/29/07	76.84	3.03	0.00	73.81
MW-2 (IW-1)	06/11/08	76.84	2.46	0.00	74.38
MW-2 (IW-1)	12/03/08	76.84	2.92	0.00	73.92
MW-2 (IW-1)	03/12/09	76.84	3.29	0.00	73.55
MW-2 (IW-1)	06/30/09	76.84	3.38	0.00	73.46
MW-2 (IW-1)	09/25/09	76.84	4.02	0.00	72.82
MW-2 (IW-1)	12/22/09	76.84	3.15	0.00	73.69
MW-2 (IW-1)	03/19/10	76.84	3.69	0.00	73.15
MW-2 (IW-1)	06/10/10	76.84	2.40	0.00	74.44
MW-2 (IW-1)	09/16/10	76.84	2.79	0.00	74.05
MW-2 (IW-1)	12/22/10	76.84	2.75	0.00	74.09
MW-2 (IW-1)	03/10/11	76.84	2.40	0.00	74.44
MW-2 (IW-1)	06/07/11	76.84	2.55	0.00	74.29
MW-2 (IW-1)	09/23/11	76.84	3.34	0.00	73.50

TABLE 1
GROUNDWATER ELEVATIONS
COLLEGE WAY FOODS
2120 EAST COLLEGE WAY
MOUNT VERNON, WASHINGTON

Well Identification	Date	TOC Elevation (feet)	Depth to Groundwater (feet)	SPH Thickness (feet)	Groundwater Elevation (feet)
MW-3	03/23/93	77.07	6.44	0.00	70.63
MW-3	06/07/11		6.44	0.00	-6.44
MW-3	10/18/94	77.07	8.41	0.00	68.66
MW-3	03/26/96	77.07	6.03	0.00	71.04
MW-3	06/27/96	77.07	6.59	0.00	70.48
MW-3	09/19/96	77.07	6.60	0.00	70.47
MW-3	12/19/96	77.07	6.44	0.00	70.63
MW-3	05/29/97	77.07	6.83	0.00	70.24
MW-3	07/30/02	77.07	5.00	0.00	72.07
MW-3	05/07/03	77.07	5.97	0.00	71.10
MW-3	10/20/03	77.07	8.38	0.00	68.69
MW-3	12/26/03	77.07	6.68	0.00	70.39
MW-3	03/23/04	77.07	5.81	0.00	71.26
MW-3	06/21/04	77.07	6.17	0.00	70.90
MW-3	09/16/04	77.07	6.35	0.00	70.72
MW-3	12/16/04	77.07	5.34	0.00	71.73
MW-3	03/22/05	77.07	6.04	0.00	71.03
MW-3	08/15/05	77.07	6.60	0.00	70.47
MW-3	11/22/05	77.07	9.93	0.00	67.14
MW-3	02/20/06	77.07	6.88	0.00	70.19
MW-3	05/23/06	77.07	9.40	0.00	67.67
MW-3	11/07/06	77.07	10.01	0.00	67.06
MW-3	06/06/07	77.07	10.83	0.00	66.24
MW-3	11/29/07	77.07	10.39	0.00	66.68
MW-3	06/11/08	77.07	5.74	0.00	71.33
MW-3	12/03/08	77.07	5.91	0.00	71.16
MW-3	03/12/09	77.07	6.32	0.00	70.75
MW-3	06/30/09	77.07	7.36	0.00	69.71
MW-3	09/25/09	77.07	9.63	0.01	67.45
MW-3	12/22/09	77.07	8.80	0.00	68.27
MW-3	03/19/10	77.07	8.86	0.00	68.21
MW-3	06/10/10	77.07	8.97	0.00	68.10
MW-3	09/16/10	77.07	7.29	0.00	69.78
MW-3	12/22/10	77.07	8.82	0.00	68.25
MW-3	03/10/11	77.07	8.01	0.00	69.06
MW-3	06/07/11	77.07	5.87	0.00	71.20
MW-3	09/23/11	77.07	8.65	0.00	68.42

TABLE 1
GROUNDWATER ELEVATIONS
COLLEGE WAY FOODS
2120 EAST COLLEGE WAY
MOUNT VERNON, WASHINGTON

Well Identification	Date	TOC Elevation (feet)	Depth to Groundwater (feet)	SPH Thickness (feet)	Groundwater Elevation (feet)
MW-4	03/23/93	77.12	6.30	0.00	70.82
MW-4	10/18/94	77.12	8.64	0.00	68.48
MW-4	03/26/96	77.12	5.62	0.00	71.50
MW-4	06/27/96	77.12	6.22	0.00	70.90
MW-4	09/19/96	77.12	6.46	0.00	70.66
MW-4	12/19/96	77.12	5.82	0.00	71.30
MW-4	07/30/02	77.12	6.45	0.00	70.67
MW-4	05/07/03	77.12	7.53	0.00	69.59
MW-4	10/20/03	77.12	7.95	0.00	69.17
MW-4	12/26/03	77.12	8.41	0.00	68.71
MW-4	03/23/04	77.12	7.63	0.00	69.49
MW-4	06/21/04	77.12	6.60	0.00	70.52
MW-4	09/16/04	77.12	6.35	0.00	70.77
MW-4	12/16/04	77.12	4.83	0.00	72.29
MW-4	03/22/05	77.12	5.46	0.00	71.66
MW-4	08/15/05	77.12	9.78	0.00	67.34
MW-4	11/22/05	77.12	6.29	0.00	70.83
MW-4	02/20/06	77.12	6.50	0.00	70.62
MW-4	05/23/06	77.12	6.14	0.00	70.98
MW-4	11/07/06	77.12	9.62	0.00	67.50
MW-4	06/06/07	77.12	10.30	0.00	66.82
MW-4	11/29/07	77.12	7.71	0.00	69.41
MW-4	06/11/08	77.12	8.71	0.00	68.41
MW-4	12/03/08	77.12	7.48	0.00	69.64
MW-4	03/12/09	77.12	9.11	0.00	68.01
MW-4	06/30/09	77.12	6.59	0.00	70.53
MW-4	09/25/09	77.12	8.44	0.00	68.68
MW-4	12/22/09	77.12	7.85	0.00	69.27
MW-4	03/19/10	77.12	6.29	0.00	70.83
MW-4	06/10/10	77.12	6.42	0.00	70.70
MW-4	09/16/10	77.12	7.75	0.00	69.37
MW-4	12/22/10	77.12	7.20	0.00	69.92
MW-4	03/10/11	77.12	6.76	0.00	70.36
MW-4	06/07/11	77.12	6.95	0.00	70.17
MW-4	09/23/11	77.12	6.69	0.00	70.43

TABLE 1
GROUNDWATER ELEVATIONS
COLLEGE WAY FOODS
2120 EAST COLLEGE WAY
MOUNT VERNON, WASHINGTON

Well Identification	Date	TOC Elevation (feet)	Depth to Groundwater (feet)	SPH Thickness (feet)	Groundwater Elevation (feet)
MW-5	03/23/93	75.56	3.84	0.00	71.72
MW-5	10/18/94	75.56	4.74	0.00	70.82
MW-5	03/26/96	75.56	4.48	0.00	71.08
MW-5	06/27/96	75.56	4.59	0.00	70.97
MW-5	09/19/96	75.56	4.04	0.00	71.52
MW-5	12/19/96	75.56	4.30	0.00	71.26
MW-5	05/29/97	75.56	4.50	0.00	71.06
MW-5	07/30/02	75.56	4.80	0.00	70.76
MW-5	05/07/03	75.56	5.11	0.00	70.45
MW-5	10/20/03	75.56	5.12	0.00	70.44
MW-5	12/26/03	75.56	5.41	0.00	70.15
MW-5	03/23/04	75.56	5.39	0.00	70.17
MW-5	06/21/04	75.56	5.56	0.00	70.00
MW-5	09/16/04	75.56	4.60	0.00	70.96
MW-5	12/16/04	75.56	4.88	0.00	70.68
MW-5	03/22/05	75.56	5.61	0.00	69.95
MW-5	08/15/05	75.56	5.44	0.00	70.12
MW-5	11/22/05	75.56	5.10	0.00	70.46
MW-5	02/20/06	75.56	5.06	0.00	70.50
MW-5	05/23/06	75.56	4.85	0.00	70.71
MW-5	11/07/06	75.56	4.36	0.00	71.20
MW-5	06/06/07	75.56	5.16	0.00	70.40
MW-5	11/29/07	75.56	5.17	0.00	70.39
MW-5	06/11/08	75.56	4.35	0.00	71.21
MW-5	12/03/08	75.56	4.68	0.00	70.88
MW-5	03/12/09	75.56	4.99	0.00	70.57
MW-5	06/30/09	75.56	5.20	0.00	70.36
MW-5	06/07/11	75.56	5.20	0.00	70.36
MW-5	09/25/09	75.56	5.31	0.00	70.25
MW-5	12/22/09	75.56	4.58	0.00	70.98
MW-5	03/19/10	75.56	4.90	0.00	70.66
MW-5	06/10/10	75.56	4.10	0.00	71.46
MW-5	09/16/10	75.56	4.89	0.00	70.67
MW-5	12/22/10	75.56	4.83	0.00	70.73
MW-5	03/10/11	75.56	4.17	0.00	71.39
MW-5	06/07/11	75.56	4.74	0.00	70.82
MW-5	09/23/11	75.56	5.48	0.00	70.08
MW-7	06/07/11	--	3.09	0.00	--
MW-7	07/13/11	75.42	3.35	0.00	72.07
MW-7	07/25/11	75.42	3.74	0.00	71.68
MW-7	09/23/11	75.42	3.92	0.00	71.50
MW-8	06/07/11	--	2.81	0.00	--
MW-8	07/13/11	76.43	3.63	0.00	72.80
MW-8	07/25/11	76.43	3.36	0.00	73.07
MW-8	09/23/11	76.43	4.08	0.00	72.35

TABLE 1
GROUNDWATER ELEVATIONS
COLLEGE WAY FOODS
2120 EAST COLLEGE WAY
MOUNT VERNON, WASHINGTON

Well Identification	Date	TOC Elevation (feet)	Depth to Groundwater (feet)	SPH Thickness (feet)	Groundwater Elevation (feet)
TW-1	12/16/92	75.51	3.03	0.00	72.48
TW-1	01/20/93	75.51	1.80	0.00	73.71
TW-1	03/23/93	75.51	1.45	0.00	74.06
TW-1	10/18/94	75.51	3.20	0.00	72.31
TW-1	06/29/95	75.51	3.91	0.00	71.60
TW-1	03/26/96	75.51	2.02	0.00	73.49
TW-1	06/27/96	75.51	1.20	0.00	74.31
TW-1	09/19/96	75.51	1.63	0.00	73.88
TW-1	08/14/97	75.51	4.23	0.00	71.28
TW-1	07/30/02	75.51	2.45	0.00	73.06
TW-1	05/07/03	75.51	2.07	0.00	73.44
TW-1	10/20/03	75.51	1.50	0.00	74.01
TW-1	12/26/03	75.51	2.41	0.00	73.10
TW-1	03/23/04	75.51	2.40	0.00	73.11
TW-1	06/21/04	75.51	2.38	0.00	73.13
TW-1	09/16/04	75.51	1.12	0.00	74.39
TW-1	12/16/04	75.51	2.49	0.00	73.02
TW-1	03/22/05	75.51	2.73	0.00	72.78
TW-1	08/15/05	75.51	3.33	0.00	72.18
TW-1	11/22/05	75.51	2.45	0.00	73.06
TW-1	02/20/06	75.51	2.62	0.00	72.89
TW-1	05/23/06	75.51	2.37	0.00	73.14
TW-1	11/07/06	75.51	1.09	0.00	74.42
TW-1	06/07/11	75.51	1.09	0.00	74.42
TW-1	06/06/07	75.51	2.18	0.00	73.33
TW-1	11/29/07	75.51	2.65	0.00	72.86
TW-1	06/11/08	75.51	2.21	0.00	73.30
TW-1	12/03/08	75.51	2.58	0.00	72.93
TW-1	03/12/09	75.51	2.95	0.00	72.56
TW-1	06/30/09	75.51	3.36	0.00	72.15
TW-1	09/25/09	75.51	3.15	0.00	72.36
TW-1	12/22/09	75.51	1.94	0.00	73.57
TW-1	03/19/10	75.51	2.79	0.00	72.72
TW-1	06/10/10	75.51	1.76	0.00	73.75
TW-1	09/16/10	75.51	2.45	0.00	73.06
TW-1	12/22/10	75.51	2.59	0.00	72.92
TW-1	03/10/11	75.51	1.90	0.00	73.61
TW-1	06/07/11	75.51	2.55	0.00	72.96
TW-1	07/13/11	75.51	2.81	0.00	72.70
TW-1	07/25/11	75.51	2.37	0.00	73.14
TW-1	09/23/11	75.51	2.91	0.00	72.60

TABLE 1
GROUNDWATER ELEVATIONS
COLLEGE WAY FOODS
2120 EAST COLLEGE WAY
MOUNT VERNON, WASHINGTON

Well Identification	Date	TOC Elevation (feet)	Depth to Groundwater (feet)	SPH Thickness (feet)	Groundwater Elevation (feet)
TW-2	12/16/92	76.62	3.87	0.00	72.75
TW-2	01/20/93	76.62	2.89	0.00	73.73
TW-2	03/23/93	76.62	3.12	0.00	73.50
TW-2	10/18/94	76.62	6.86	0.00	69.76
TW-2	06/29/95	76.62	5.80	0.00	70.82
TW-2	03/26/96	76.62	3.01	0.00	73.61
TW-2	06/27/96	76.62	2.87	0.00	73.75
TW-2	09/19/96	76.62	3.21	0.00	73.41
TW-2	12/19/96	76.62	2.65	0.00	73.97
TW-2	05/29/97	76.62	3.40	0.00	73.22
TW-2	08/14/97	76.62	3.56	0.00	73.06
TW-2	07/30/02	76.62	2.40	0.00	74.22
TW-2	05/07/03	76.62	2.71	0.00	73.91
TW-2	10/20/03	76.62	3.09	0.00	73.53
TW-2	12/26/03	76.62	1.93	0.00	74.69
TW-2	03/23/04	76.62	2.81	0.00	73.81
TW-2	06/21/04	76.62	2.50	0.00	74.12
TW-2	09/16/04	76.62	2.02	0.00	74.60
TW-2	12/16/04	76.62	2.96	0.00	73.66
TW-2	03/22/05	76.62	3.31	0.00	73.31
TW-2	08/15/05	76.62	3.01	0.00	73.61
TW-2	11/22/05	76.62	2.81	0.00	73.81
TW-2	02/20/06	76.62	3.08	0.00	73.54
TW-2	05/23/06	76.62	3.18	0.00	73.44
TW-2	11/07/06	76.62	2.62	0.00	74.00
TW-2	06/06/07	76.62	3.33	0.00	73.29
TW-2	11/29/07	76.62	3.48	0.00	73.14
TW-2	06/11/08	76.62	2.75	0.00	73.87
TW-2	12/03/08	76.62	3.38	0.00	73.24
TW-2	03/12/09	76.62	3.64	0.00	72.98
TW-2	06/30/09	76.62	3.42	0.00	73.20
TW-2	09/25/09	76.62	3.60	0.00	73.02
TW-2	12/22/09	76.62	2.62	0.00	74.00
TW-2	03/19/10	76.62	3.93	0.00	72.69
TW-2	06/10/10	76.62	2.89	0.00	73.73
TW-2	09/16/10	76.62	2.89	0.00	73.73
TW-2	12/22/10	76.62	3.18	0.00	73.44
TW-2	03/10/11	76.62	2.79	0.00	73.83
TW-2	06/07/11	76.62	2.86	0.00	73.76
TW-2	07/13/11	76.62	2.84	0.00	73.78
TW-2	07/25/11	76.62	2.93	0.00	73.69
TW-2	09/23/11	76.62	3.06	0.00	73.56

TABLE 1
GROUNDWATER ELEVATIONS
COLLEGE WAY FOODS
2120 EAST COLLEGE WAY
MOUNT VERNON, WASHINGTON

Well Identification	Date	TOC Elevation (feet)	Depth to Groundwater (feet)	SPH Thickness (feet)	Groundwater Elevation (feet)
TW-3	01/20/93	77.88	4.84	0.00	73.04
TW-3	03/23/93	77.88	4.80	0.00	73.08
TW-3	10/18/94	77.88	6.68	0.00	71.20
TW-3	03/26/96	77.88	4.79	0.00	73.09
TW-3	06/27/96	77.88	4.63	0.00	73.25
TW-3	09/19/96	77.88	5.03	0.00	72.85
TW-3	12/19/96	77.88	4.16	0.00	73.72
TW-3	07/30/02	77.88	5.02	0.00	72.86
TW-3	05/07/03	77.88	4.60	0.00	73.28
TW-3	10/20/03	77.88	5.92	0.00	71.96
TW-3	12/26/03	77.88	4.41	0.00	73.47
TW-3	03/23/04	77.88	4.51	0.00	73.37
TW-3	06/21/04	77.88	4.49	0.00	73.39
TW-3	09/16/04	77.88	4.28	0.00	73.60
TW-3	12/16/04	77.88	4.16	0.00	73.72
TW-3	03/22/05	77.88	5.09	0.00	72.79
TW-3	08/15/05	77.88	5.13	0.00	72.75
TW-3	11/22/05	77.88	4.42	0.00	73.46
TW-3	02/20/06	77.88	4.39	0.00	73.49
TW-3	05/23/06	77.88	4.91	0.00	72.97
TW-3	11/07/06	77.88	5.20	0.00	72.68
TW-3	06/06/07	77.88	5.10	0.00	72.78
TW-3	11/29/07	77.88	4.93	0.00	72.95
TW-3	06/11/08	77.88	4.41	0.00	73.47
TW-3	12/03/08	77.88	4.68	0.00	73.20
TW-3	03/12/09	77.88	4.99	0.00	72.89
TW-3	06/30/09	77.88	5.28	0.00	72.60
TW-3	09/25/09	77.88	6.15	0.00	71.73
TW-3	12/22/09	77.88	4.71	0.00	73.17
TW-3	03/19/10	77.88	5.44	0.00	72.44
TW-3	06/10/10	77.88	4.38	0.00	73.50
TW-3	09/16/10	77.88	5.09	0.00	72.79
TW-3	12/22/10	77.88	4.33	0.00	73.55
TW-3	03/10/11	77.88	4.33	0.00	73.55
TW-3	06/07/11	77.88	4.38	0.00	73.50
TW-3	09/23/11	77.88	5.57	0.00	72.31

TABLE 1
GROUNDWATER ELEVATIONS
COLLEGE WAY FOODS
2120 EAST COLLEGE WAY
MOUNT VERNON, WASHINGTON

Well Identification	Date	TOC Elevation (feet)	Depth to Groundwater (feet)	SPH Thickness (feet)	Groundwater Elevation (feet)
B-2	12/16/92	76.82	4.00	0.00	72.82
B-2	01/20/93	76.82	4.14	0.00	72.68
B-2	03/23/93	76.82	3.80	0.00	73.02
B-2	10/18/94	76.82	5.06	0.00	71.76
B-2	06/29/95	76.82	6.23	0.00	70.59
B-2	03/26/96	76.82	3.76	0.00	73.06
B-2	06/27/96	76.82	3.52	0.00	73.30
B-2	09/19/96	76.82	2.95	0.00	73.87
B-2	12/19/96	76.82	2.90	0.00	73.92
B-2	05/29/97	76.82	3.92	0.00	72.90
B-2	08/14/97	76.82	4.11	0.00	72.71
B-2	07/30/02	76.82	3.53	0.00	73.29
B-2	05/07/03	76.82	2.95	0.00	73.87
B-2	10/20/03	76.82	4.15	0.00	72.67
B-2	12/26/03	76.82	3.62	0.00	73.20
B-2	03/23/04	76.82	3.21	0.00	73.61
B-2	06/21/04	76.82	3.15	0.00	73.67
B-2	09/16/04	76.82	2.89	0.00	73.93
B-2	12/16/04	76.82	3.30	0.00	73.52
B-2	03/22/05	76.82	3.71	0.00	73.11
B-2	08/15/05	76.82	3.90	0.00	72.92
B-2	11/22/05	76.82	3.00	0.00	73.82
B-2	02/20/06	76.82	3.39	0.00	73.43
B-2	05/23/06	76.82	3.60	0.00	73.22
B-2	11/07/06	76.82	3.18	0.00	73.64
B-2	06/06/07	76.82	3.76	0.00	73.06
B-2	11/29/07	76.82	3.66	0.00	73.16
B-2	06/11/08	76.82	3.13	0.00	73.69
B-2	12/03/08	76.82	3.38	0.00	73.44
B-2	03/12/09	76.82	3.80	0.00	73.02
B-2	06/30/09	76.82	3.96	0.00	72.86
B-2	09/25/09	76.82	4.62	0.01	72.21
B-2	12/22/09	76.82	3.55	0.00	73.27
B-2	03/19/10	76.82	4.18	0.00	72.64
B-2	06/10/10	76.82	2.88	0.00	73.94
B-2	12/22/10	76.82	3.31	0.00	73.51
B-2	03/10/11	76.82	2.92	0.00	73.90
B-2	06/07/11	76.82	3.31	0.00	73.51
B-2	09/23/11	76.82	3.98	0.00	72.84
IW-1	06/07/11	--	1.39	0.00	--
IW-1	09/23/11	--	3.42	0.00	--
IW-2	06/07/11	--	1.02	0.00	--
IW-2	09/23/11	--	2.90	0.00	--

Notes:

TOC = Top of well casing

-- = Not Measured

TOC elevation information obtained from previous reports prepared by Environmental Science & Engineering, Inc.

TABLE 2
GROUNDWATER ANALYTICAL RESULTS
COLLEGE WAY FOODS
2120 EAST COLLEGE WAY
MOUNT VERNON, WASHINGTON

Well/Sample Identification	Date Sampled	TPH Gasoline (ppb)	MTBE (ppb)	Benzene (ppb)	Toluene (ppb)	Ethyl-benzene (ppb)	Xylenes (ppb)	EDC (ppb)	EDB (ppb)	Lead (ppb)
MW-1 (EW-1)	12/09/92 ^a	120,000	NA	6,100	13,000	1,600	19,000	--	--	--
MW-1 (EW-1)	08/27/93	90,000	NA	4,100	11,000	1,100	15,000	--	--	--
MW-1 (EW-1)	09/29/93	91,000	NA	3,200	10,000	1,100	14,000	--	--	--
MW-1 (EW-1)	12/01/93	76,000	NA	5,100	8,300	1,300	16,000	--	--	--
MW-1 (EW-1)	12/01/93 ^b	73,000	NA	5,000	7,900	1,200	15,000	--	--	--
MW-1 (EW-1)	01/12/94	89,000	NA	3,800	4,800	880	10,000	--	--	--
MW-1 (EW-1)	02/07/94 ^c	69,000	NA	3,700	5,900	1,500	14,000	--	--	--
MW-1 (EW-1)	02/25/94	54,000	NA	4,600	4,500	1,500	13,000	--	--	--
MW-1 (EW-1)	04/11/94 ^d	41,000	NA	1,300	350	500	4,000	--	--	--
MW-1 (EW-1)	04/11/94 ^e	42,000	NA	1,200	540	620	5,000	--	--	--
MW-1 (EW-1)	05/09/94	29,000	NA	1,700	90	570	3,300	--	--	--
MW-1 (EW-1)	05/26/94 ^d	23,000	NA	1,400	150	500	4,000	--	--	--
MW-1 (EW-1)	05/26/94 ^e	19,000	NA	910	79	370	2,000	--	--	--
MW-1 (EW-1)	07/07/94	22,000	NA	1,200	69	400	2,100	--	--	--
MW-1 (EW-1)	08/29/94 ^d	3,700	NA	310	57	89	510	--	--	--
MW-1 (EW-1)	08/29/94 ^e	4,900	NA	330	30	76	420	--	--	--
MW-1 (EW-1)	10/18/94 ^d	4,700	NA	710	45	100	180	--	--	--
MW-1 (EW-1)	10/18/94 ^e	4,900	NA	270	150	71	340	--	--	--
MW-1 (EW-1)	12/14/94 ^d	420	NA	57	0.76	0.86	14	--	--	--
MW-1 (EW-1)	12/14/94 ^e	1,500	NA	100	7	16	36	--	--	--
MW-1 (EW-1)	03/30/95 ^d	99	NA	15	7	<0.50	3.8	--	--	--
MW-1 (EW-1)	06/29/95 ^d	350	NA	190	1.9	0.53	9.8	--	--	--
MW-1 (EW-1)	09/28/95 ^d	<50	NA	<0.50	<0.50	<0.50	<1.0	--	--	--
MW-1 (EW-1)	12/21/95 ^d	<50	NA	11	<0.50	<0.50	<1.0	--	--	--
MW-1 (EW-1)	03/25/96	56	NA	36	<0.50	<0.50	4.3	--	--	--
MW-1 (EW-1)	06/29/96	1,450	NA	51.9	3.43	10.3	67.6	--	--	--
MW-1 (EW-1)	09/19/96	306	NA	53.2	22.2	3.12	14.9	--	--	--
MW-1 (EW-1)	08/15/97	310	NA	61	<1.0	21	15.5	--	--	--
MW-1 (EW-1)	07/30/02	6,400	NA	92	5	30	140	--	--	--
MW-1 (EW-1)	05/07/03	880	NA	35	15	2	15	--	--	--
MW-1 (EW-1)	10/20/03	1,100	NA	44	1	<1	11	--	--	--
MW-1 (EW-1)	12/26/03	700	NA	28	1	<1	<3	--	--	--
MW-1 (EW-1)	03/23/04	250	NA	3	<1	<1	<3	--	--	--

TABLE 2
GROUNDWATER ANALYTICAL RESULTS
COLLEGE WAY FOODS
2120 EAST COLLEGE WAY
MOUNT VERNON, WASHINGTON

Well/Sample Identification	Date Sampled	TPH Gasoline (ppb)	MTBE (ppb)	Benzene (ppb)	Toluene (ppb)	Ethyl-benzene (ppb)	Xylenes (ppb)	EDC (ppb)	EDB (ppb)	Lead (ppb)
MW-1 (EW-1)	06/21/04	79	NA	<1	<1	<1	<3	--	--	--
MW-1 (EW-1)	09/16/04	<50	NA	<1	<1	<1	<3	--	--	--
MW-1 (EW-1)	12/16/04	180	NA	15	8	<1	<3	--	--	--
MW-1 (EW-1)	06/07/11		NA	15	8	--	<3	--	--	
MW-1 (EW-1)	03/22/05	<50	NA	2	<1	<1	<3	--	--	--
MW-1 (EW-1)	08/15/05	92	<3	2	<1	<1	<3	--	--	--
MW-1 (EW-1)	11/22/05	130	<3	9	<1	<1	<3	--	--	--
MW-1 (EW-1)	02/20/06	<50	<3	9	<1	<1	<3	--	--	--
MW-1 (EW-1)	05/23/06	59	<3	15	<1	<1	<3	--	--	--
MW-1 (EW-1)	11/07/06	ND	<3	1	<1	<1	<3	--	--	--
MW-1 (EW-1)	06/06/07	<50	<3	3	<1	<1	<3	--	--	--
MW-1 (EW-1)	11/29/07	63	<3	<1	<1	<1	<3	--	--	--
MW-1 (EW-1)	06/11/08	--	--	--	--	--	--	--	--	--
MW-1 (EW-1)	12/03/08	<50	<3	<1	<1	1	<3	--	--	--
MW-1 (EW-1)	03/12/09	73	<3	<1	<1	<1	<3	--	--	--
MW-1 (EW-1)	06/30/09	5,100	<15	130	880	36	1,300	--	--	--
MW-1 (EW-1)	09/25/09	150	<3.0	<1.0	<1.0	<1.0	<3.0	--	--	--
MW-1 (EW-1)	12/22/09	63	<1.0	<1.0	<1.0	<1.0	<3.0	--	--	--
MW-1 (EW-1)	03/19/10	<50	<3.0	1.8	<1.0	<1.0	<3.0	--	--	--
MW-1 (EW-1)	06/10/10	<50	<3.0	5.8	2.2	2.4	7.6	<0.020	<0.010	--
MW-1 (EW-1)	09/16/10	230	<3.0	<1.0	1.5	22	28	--	--	--
MW-1 (EW-1)	12/22/10	57	<3.0	<1.0	<1.0	<1.0	<3.0	--	--	--
MW-1 (EW-1)	03/10/11	75	<3.0	2.2	<1.0	<1.0	<3.0	<0.020	<0.010	<0.62
MW-1 (EW-1)	06/07/11	230	<3.0	79	16	1.8	20	--	--	<0.62
MW-1 (EW-1)	07/13/11	200	<3.0	<1.0	<1.0	1.7	6.7	--	--	--
MW-1 (EW-1)	07/25/01	94	<3.0	<1.0	<1.0	<1.0	<3.0	--	--	<0.26
MW-1 (EW-1)	09/23/11	250	<3.0	<1.0	<1.0	1.5	<3.0	--	--	<0.30

TABLE 2
GROUNDWATER ANALYTICAL RESULTS
COLLEGE WAY FOODS
2120 EAST COLLEGE WAY
MOUNT VERNON, WASHINGTON

Well/Sample Identification	Date Sampled	TPH Gasoline (ppb)	MTBE (ppb)	Benzene (ppb)	Toluene (ppb)	Ethyl-benzene (ppb)	Xylenes (ppb)	EDC (ppb)	EDB (ppb)	Lead (ppb)
MW-2 (IW-2)	12/09/92 ^a	14,000	NA	140	900	160	1,500	--	--	--
MW-2 (IW-2)	10/18/93	14,000	NA	130	320	36	1,600	--	--	--
MW-2 (IW-2)	12/01/93 ^b	4,100	NA	32	20	5.2	250	--	--	--
MW-2 (IW-2)	04/11/94 ^d	12,000	NA	430	150	140	1,600	--	--	--
MW-2 (IW-2)	04/11/94 ^e	6,000	NA	100	84	46	610	--	--	--
MW-2 (IW-2)	05/09/94	4,300	NA	50	88	39	430	--	--	--
MW-2 (IW-2)	05/26/94 ^d	790	NA	50	4.3	17	61	--	--	--
MW-2 (IW-2)	05/26/94 ^e	9,400	NA	470	100	250	1,400	--	--	--
MW-2 (IW-2)	07/07/94	330	NA	0.96	<0.50	<0.50	<1.0	--	--	--
MW-2 (IW-2)	08/29/94 ^d	460	NA	11	1.8	1.3	8.1	--	--	--
MW-2 (IW-2)	08/29/94 ^e	1,600	NA	38	22	18	120	--	--	--
MW-2 (IW-2)	10/18/94 ^d	<50	NA	<0.50	<0.50	<0.50	<1.0	--	--	--
MW-2 (IW-2)	10/18/94 ^e	<50	NA	<0.50	<0.50	<0.50	<1.0	--	--	--
MW-2 (IW-2)	12/14/94 ^d	<50	NA	3.7	<0.50	<0.50	<1.0	--	--	--
MW-2 (IW-2)	12/14/94 ^e	<50	NA	0.89	<0.50	<0.50	<1.0	--	--	--
MW-2 (IW-2)	03/30/95 ^d	<50	NA	94	<0.50	<0.50	1.5	--	--	--
MW-2 (IW-2)	06/29/95 ^d	<50	NA	1.7	<0.50	<0.50	<1.0	--	--	--
MW-2 (IW-2)	09/28/95 ^d	<50	NA	3.6	<0.50	<0.50	<0.50	--	--	--
MW-2 (IW-2)	12/21/95	<50	NA	<0.50	<0.50	<0.50	<1.0	--	--	--
MW-2 (IW-2)	03/25/96	51	NA	17	<0.50	<0.50	3.2	--	--	--
MW-2 (IW-2)	06/29/96	<50	NA	1.46	<0.50	<0.50	<1.0	--	--	--
MW-2 (IW-2)	12/19/96	<50	NA	8.26	<0.50	<0.50	<1.0	--	--	--
MW-2 (IW-2)	01/15/97	<50	NA	14.4	<0.50	<0.50	<1.0	--	--	--
MW-2 (IW-2)	07/30/02	40,000	NA	13,000	190	1,900	7,200	--	--	--
MW-2 (IW-2)	05/07/03	<50	NA	<1	<1	<1	<3	--	--	--
MW-2 (IW-2)	10/20/03	160	NA	7	13	3	21	--	--	--
MW-2 (IW-2)	12/26/03	520	NA	16	14	12	50	--	--	--
MW-2 (IW-2)	03/23/04	<50	NA	<1	<1	<1	<3	--	--	--
MW-2 (IW-2)	06/21/04	<50	NA	<1	<1	<1	<3	--	--	--
MW-2 (IW-2)	09/16/04	130	NA	49	38	2	11	--	--	--
MW-2 (IW-2)	12/16/04	<50	NA	2	<1	<1	<3	--	--	--
MW-2 (IW-2)	03/22/05	<50	NA	<1	<1	<1	<3	--	--	--
MW-2 (IW-2)	08/15/05	58	<3	<1	<1	<1	<3	--	--	--

TABLE 2
GROUNDWATER ANALYTICAL RESULTS
COLLEGE WAY FOODS
2120 EAST COLLEGE WAY
MOUNT VERNON, WASHINGTON

Well/Sample Identification	Date Sampled	TPH Gasoline (ppb)	MTBE (ppb)	Benzene (ppb)	Toluene (ppb)	Ethyl-benzene (ppb)	Xylenes (ppb)	EDC (ppb)	EDB (ppb)	Lead (ppb)
MW-2 (IW-2)	11/22/05	<50	<3	2	<1	<1	<3	--	--	--
MW-2 (IW-2)	02/20/06	<50	<3	<1	<1	<1	<3	--	--	--
MW-2 (IW-2)	06/07/11		<3	<1	<1	--	<3	--		
MW-2 (IW-2)	05/23/06	<50	<3	2	<1	<1	<3	--	--	--
MW-2 (IW-2)	11/07/06	<50	<3	1	<1	<1	<3	--	--	--
MW-2 (IW-2)	06/06/07	<50	<3	<1	<1	<1	<3	--	--	--
MW-2 (IW-2)	11/29/07	<50	<3	8	<1	<1	<3	--	--	--
MW-2 (IW-2)	06/11/08	<50	<3	<1	<1	<1	<3	--	--	--
MW-2 (IW-2)	12/03/08	78	<3	14	<1	<1	<3	--	--	--
MW-2 (IW-2)	03/12/09	<50	<3	<1	<1	<1	<3	--	--	--
MW-2 (IW-2)	06/30/09	<50	<3.0	<1.0	<1.0	<1.0	<3.0	--	--	--
MW-2 (IW-2)	09/25/09	<50	<3.0	<1.0	<1.0	<1.0	<3.0	--	--	--
MW-2 (IW-2)	12/22/09	<50	<1.0	<1.0	<1.0	<1.0	<3.0	--	--	--
MW-2 (IW-2)	03/19/10	<50	<3.0	<1.0	<1.0	<1.0	<3.0	--	--	--
MW-2 (IW-2)	06/10/10	<50	<3.0	<1.0	<1.0	<1.0	<3.0	0.050	<0.010	--
MW-2 (IW-2)	09/16/10	52	<3.0	<1.0	<1.0	<1.0	<3.0	--	--	--
MW-2 (IW-2)	12/22/10	<50	<3.0	<1.0	<1.0	<1.0	<3.0	--	--	--
MW-2 (IW-2)	03/10/11	<50	<3.0	4.7	<1.0	<1.0	<3.0	<0.020	<0.010	19
MW-2 (IW-2)	06/07/11	<50	<2.0	<1.0	<1.0	<1.0	<3.0	--	--	14
MW-2 (IW-2)	09/23/11	<50	<3.0	<1.0	<1.0	<1.0	<3.0	--	--	12

TABLE 2
GROUNDWATER ANALYTICAL RESULTS
COLLEGE WAY FOODS
2120 EAST COLLEGE WAY
MOUNT VERNON, WASHINGTON

Well/Sample Identification	Date Sampled	TPH Gasoline (ppb)	MTBE (ppb)	Benzene (ppb)	Toluene (ppb)	Ethyl-benzene (ppb)	Xylenes (ppb)	EDC (ppb)	EDB (ppb)	Lead (ppb)
MW-3	03/23/93	<50	NA	<0.50	<0.50	<0.50	<1.0	--	--	--
MW-3	05/09/94	<50	NA	1.8	<0.50	<0.50	<1.0	--	--	--
MW-3	10/18/94	<50	NA	<0.50	<0.50	<0.50	<1.0	--	--	--
MW-3	07/30/02	<50	NA	<1	<1	<1	<3	--	--	--
MW-3	05/07/03	<50	NA	<1	1.0	<1	<3	--	--	--
MW-3	10/20/03	<50	NA	<1	<1	<1	<3	--	--	--
MW-3	12/26/03	<50	NA	<1	<1	<1	<3	--	--	--
MW-3	03/23/04	<50	NA	<1	<1	<1	<3	--	--	--
MW-3	06/21/04	<50	NA	<1	<1	<1	<3	--	--	--
MW-3	09/16/04	<50	NA	<1	<1	<1	<3	--	--	--
MW-3	12/16/04	<50	NA	<1	<1	<1	<3	--	--	--
MW-3	03/22/05	<50	NA	<1	<1	<1	<3	--	--	--
MW-3	08/15/05	<50	5	<1	<1	<1	<3	--	--	--
MW-3	11/22/05	<50	<3	<1	<1	<1	<3	--	--	--
MW-3	02/20/06	<50	3	<1	<1	<1	<3	--	--	--
MW-3	05/23/06	<50	4 ^g	<1	<1	<1	<3	--	--	--
MW-3	11/07/06	<50	<3	<1	<1	<1	<3	--	--	--
MW-3	06/06/07	<50	<3	<1	<1	<1	<3	--	--	--
MW-3	11/29/07	<50	<3	<1	<1	<1	<3	--	--	--
MW-3	06/11/08	<50	<3	<1	<1	<1	<3	--	--	--
MW-3	12/03/08	<50	3	<1	<1	<1	<3	--	--	--
MW-3	03/12/09	<50	<3	<1	<1	<1	<3	--	--	--
MW-3	06/30/09	<50	<3.0	<1.0	<1.0	<1.0	<3.0	--	--	--
MW-3	09/25/09	<50	<3.0	<1.0	<1.0	<1.0	<3.0	--	--	--
MW-3	12/22/09	<50	<1.0	<1.0	<1.0	<1.0	<3.0	--	--	--
MW-3	03/19/10	<50	<3.0	<1.0	<1.0	<1.0	<3.0	--	--	--
MW-3	06/10/10	<50	<3.0	<1.0	<1.0	<1.0	<3.0	<0.020	<0.010	--
MW-3	09/16/10	<50	<3.0	<1.0	<1.0	<1.0	<3.0	--	--	--
MW-3	12/22/10	<50	<3.0	<1.0	<1.0	<1.0	<3.0	--	--	--
MW-3	03/10/11	<50	<3.0	<1.0	<1.0	<1.0	<3.0	<0.020	<0.010	<0.62
MW-3	06/07/11	<50	<2.0	<1.0	<1.0	<1.0	<3.0	--	--	<0.62
MW-3	09/23/11	<50	<3.0	<1.0	<1.0	<1.0	<3.0	--	--	<0.30

TABLE 2
GROUNDWATER ANALYTICAL RESULTS
COLLEGE WAY FOODS
2120 EAST COLLEGE WAY
MOUNT VERNON, WASHINGTON

Well/Sample Identification	Date Sampled	TPH Gasoline (ppb)	MTBE (ppb)	Benzene (ppb)	Toluene (ppb)	Ethyl-benzene (ppb)	Xylenes (ppb)	EDC (ppb)	EDB (ppb)	Lead (ppb)
MW-4	03/23/93	<50	NA	2.8	2.9	<0.50	2.8	--	--	--
MW-4	05/09/94	<50	NA	<0.50	<0.50	<0.50	<1.0	--	--	--
MW-4	10/18/94	<50	NA	<0.50	<0.50	<0.50	<1.0	--	--	--
MW-4	07/30/02	<50	NA	<1	<1	<1	<3	--	--	--
MW-4	05/07/03	<50	NA	<1	<1	<1	<3	--	--	--
MW-4	10/20/03	<50	NA	<1	<1	<1	<3	--	--	--
MW-4	12/26/03	<50	NA	<1	<1	<1	<3	--	--	--
MW-4	03/23/04	<50	NA	<1	<1	<1	<3	--	--	--
MW-4	06/21/04	<50	NA	<1	<1	<1	<3	--	--	--
MW-4	09/16/04	<50	NA	<1	<1	<1	<3	--	--	--
MW-4	12/16/04	<50	NA	<1	<1	<1	<3	--	--	--
MW-4	03/22/05	<50	NA	<1	<1	<1	<3	--	--	--
MW-4	08/15/05	<50	4	<1	<1	<1	<3	--	--	--
MW-4	11/22/05	<50	<3	<1	<1	<1	<3	--	--	--
MW-4	02/20/06	<50	<3	<1	<1	<1	<3	--	--	--
MW-4	05/23/06	<50	<3	<1	<1	<1	<3	--	--	--
MW-4	11/07/06	<50	<3	<1	<1	<1	<3	--	--	--
MW-4	06/06/07	<50	<3	<1	<1	<1	<3	--	--	--
MW-4	11/29/07	<50	<3	<1	<1	<1	<3	--	--	--
MW-4	06/11/08	<50	<3	<1	<1	<1	<3	--	--	--
MW-4	12/03/08	<50	<3	<1	<1	<1	<3	--	--	--
MW-4	03/12/09	<50	<3	<1	<1	<1	<3	--	--	--
MW-4	06/30/09	<50	<3.0	<1.0	<1.0	<1.0	<3.0	--	--	--
MW-4	09/25/09	<50	<3.0	<1.0	<1.0	<1.0	<3.0	--	--	--
MW-4	12/22/09	<50	<1.0	<1.0	<1.0	<1.0	<3.0	--	--	--
MW-4	03/19/10	<50	<3.0	<1.0	<1.0	<1.0	<3.0	--	--	--
MW-4	06/10/10	<50	<3.0	<1.0	<1.0	<1.0	<3.0	<0.020	<0.010	--
MW-4	09/16/10	<50	<3.0	<1.0	<1.0	<1.0	<3.0	--	--	--
MW-4	12/22/10	<50	<3.0	<1.0	<1.0	<1.0	<3.0	--	--	--
MW-4	03/10/11	<50	<3.0	<1.0	<1.0	<1.0	<3.0	<0.020	<0.010	<0.62
MW-4	06/07/11	<50	<3.0	<1.0	<1.0	<1.0	<3.0	--	--	<0.62
MW-4	09/23/11	<50	<3.0	<1.0	<1.0	<1.0	<3.0	--	--	<0.30

TABLE 2
GROUNDWATER ANALYTICAL RESULTS
COLLEGE WAY FOODS
2120 EAST COLLEGE WAY
MOUNT VERNON, WASHINGTON

Well/Sample Identification	Date Sampled	TPH Gasoline (ppb)	MTBE (ppb)	Benzene (ppb)	Toluene (ppb)	Ethyl-benzene (ppb)	Xylenes (ppb)	EDC (ppb)	EDB (ppb)	Lead (ppb)
MW-5	03/23/93	<50	NA	2.7	<0.50	<0.50	<1.0	--	--	--
MW-5	05/09/94	<50	NA	<0.50	<0.50	<0.50	<1.0	--	--	--
MW-5	10/18/94	<50	NA	<0.50	<0.50	<0.50	<1.0	--	--	--
MW-5	07/30/02	<50	NA	<1	<1	<1	<3	--	--	--
MW-5	05/07/03	<50	NA	<1	<1	<1	<3	--	--	--
MW-5	10/20/03	<50	NA	<1	<1	<1	<3	--	--	--
MW-5	12/26/03	<50	NA	<1	<1	<1	<3	--	--	--
MW-5	03/23/04	<50	NA	5	<1	<1	<3	--	--	--
MW-5	06/21/04	<50	NA	<1	<1	<1	<3	--	--	--
MW-5	09/16/04	<50	NA	<1	<1	<1	<3	--	--	--
MW-5	12/16/04	<50	NA	<1	<1	<1	<3	--	--	--
MW-5	03/22/05	<50	NA	3	<1	<1	<3	--	--	--
MW-5	08/15/05	<50	<3	<1	<1	<1	<3	--	--	--
MW-5	11/22/05	<50	<3	<1	<1	<1	<3	--	--	--
MW-5	02/20/06	<50	<3	<1	<1	<1	<3	--	--	--
MW-5	05/23/06	<50	<3	<1	<1	<1	<3	--	--	--
MW-5	11/07/06	<50	<3	<1	<1	<1	<3	--	--	--
MW-5	06/06/07	<50	<3	<1	<1	<1	<3	--	--	--
MW-5	11/29/07	<50	<3	<1	<1	<1	<3	--	--	--
MW-5	06/11/08	<50	<3	<1	<1	<1	<3	--	--	--
MW-5	12/03/08	<50	<3	<1	<1	<1	<3	--	--	--
MW-5	03/12/09	<50	<3	6	<1	<1	<3	--	--	--
MW-5	06/30/09	<50	<3.0	<1.0	<1.0	<1.0	<3.0	--	--	--
MW-5	09/25/09	<50	<3.0	<1.0	<1.0	<1.0	<3.0	--	--	--
MW-5	12/22/09	<50	<1.0	<1.0	<1.0	<1.0	<3.0	--	--	--
MW-5	03/19/10	<50	<3.0	<1.0	<1.0	<1.0	<3.0	--	--	--
MW-5	06/10/10	<50	<3.0	<1.0	<1.0	<1.0	<3.0	1.3	<0.010	--
MW-5	09/16/10	<50	<3.0	<1.0	<1.0	<1.0	<3.0	--	--	--
MW-5	12/22/10	<50	<3.0	<1.0	<1.0	<1.0	<3.0	--	--	--
MW-5	03/10/11	<50	<3.0	<1.0	<1.0	<1.0	<3.0	<0.020	<0.010	<0.62
MW-5	06/07/11	<50	<3.0	<1.0	<1.0	<1.0	<3.0	--	--	<0.62
MW-5	09/23/11	<50	<3.0	<1.0	<1.0	<1.0	<3.0	--	--	--

TABLE 2
GROUNDWATER ANALYTICAL RESULTS
COLLEGE WAY FOODS
 2120 EAST COLLEGE WAY
 MOUNT VERNON, WASHINGTON

Well/Sample Identification	Date Sampled	TPH Gasoline (ppb)	MTBE (ppb)	Benzene (ppb)	Toluene (ppb)	Ethyl-benzene (ppb)	Xylenes (ppb)	EDC (ppb)	EDB (ppb)	Lead (ppb)
MW-7	06/07/11	<50	<3.0	1.0	<1.0	<1.0	<3.0	--	--	<0.62
MW-7	07/13/11	<50	<3.0	<1.0	<1.0	<1.0	<3.0	--	--	--
MW-7	07/25/11	58	<3.0	<1.0	<1.0	<1.0	<3.0	--	--	<0.62
MW-7	09/23/11	<50	<3.0	<1.0	<1.0	<1.0	<3.0	--	--	<0.30

TABLE 2
GROUNDWATER ANALYTICAL RESULTS
COLLEGE WAY FOODS
 2120 EAST COLLEGE WAY
 MOUNT VERNON, WASHINGTON

Well/Sample Identification	Date Sampled	TPH Gasoline (ppb)	MTBE (ppb)	Benzene (ppb)	Toluene (ppb)	Ethyl-benzene (ppb)	Xylenes (ppb)	EDC (ppb)	EDB (ppb)	Lead (ppb)
MW-8	06/07/11	120	3.0	<1.0	<1.0	1.4	<3.0	--	--	<0.62
MW-8	07/13/11	<50	25	<1.0	<1.0	<1.0	<3.0	--	--	--
MW-8	07/25/11	<50	7.7	<1.0	<1.0	<1.0	<3.0	--	--	<0.62
MW-8	09/23/11	<50	42	<1.0	<1.0	<1.0	<3.0	--	--	<0.30

TABLE 2
GROUNDWATER ANALYTICAL RESULTS
COLLEGE WAY FOODS
2120 EAST COLLEGE WAY
MOUNT VERNON, WASHINGTON

Well/Sample Identification	Date Sampled	TPH Gasoline (ppb)	MTBE (ppb)	Benzene (ppb)	Toluene (ppb)	Ethyl-benzene (ppb)	Xylenes (ppb)	EDC (ppb)	EDB (ppb)	Lead (ppb)
TW-1	12/09/92	24,000	NA	2,700	1,800	500	3,000	--	--	--
TW-1	05/09/94	540	NA	34	1.8	12	36	--	--	--
TW-1	10/18/94	150	NA	16	0.76	4.1	13	--	--	--
TW-1	06/29/95	260	NA	13	1.4	10	5.4	--	--	--
TW-1	12/21/95	170	NA	2.8	3.3	4.6	3.7	--	--	--
TW-1	03/26/96	1,900	NA	34	18	33	85	--	--	--
TW-1	08/15/97	720	NA	27	11	5.8	66	--	--	--
TW-1	07/30/02	<50	NA	<1	<1	<1	<3	--	--	--
TW-1	05/07/03	<50	NA	<1	<1	<1	<3	--	--	--
TW-1	10/20/03	<50	NA	<1	<1	<1	<3	--	--	--
TW-1	12/26/03	<50	NA	<1	<1	<1	<3	--	--	--
TW-1	03/23/04	<50	NA	<1	<1	<1	<3	--	--	--
TW-1	06/21/04	120	NA	4	<1	<1	<3	--	--	--
TW-1	09/16/04	<50	NA	2	<1	<1	<3	--	--	--
TW-1	12/16/04	910	NA	32	2	3	9	--	--	--
TW-1	03/22/05	430	NA	48	2	3	<3	--	--	--
TW-1	08/15/05	910	26	77	4	5	12	--	--	--
TW-1	11/22/05	1,300	<2 ^g	140	5	6	13	--	--	--
TW-1	02/20/06	780	<6	85	2	5	<6	--	--	--
TW-1	05/23/06	1,800	<20 ^g	420	4	6	22	--	--	--
TW-1	11/07/06	330	<3	47	1	1	<3	--	--	--
TW-1	06/06/07	310	<3	49	1	<1	<3	--	--	--
TW-1	11/29/07	75	<3	<1	<1	<1	<3	--	--	--
TW-1	06/11/08	300	<3	54	1	15	4	--	--	--
TW-1	12/03/08	130	<3	2	<1	<1	<3	--	--	--
TW-1	03/12/09	200	<3	<1	<1	<1	<3	--	--	--
TW-1	06/30/09	230	<3.0	21	<1.0	<1.0	<3.0	--	--	--
TW-1	09/25/09	<50	<3.0	<1.0	<1.0	<1.0	<3.0	--	--	--
TW-1	12/22/09	<50	<1.0	<1.0	<1.0	<1.0	<3.0	--	--	--
TW-1	03/19/10	<50	<3.0	<1.0	<1.0	<1.0	<3.0	--	--	--
TW-1	06/10/10	770	<3.0	43	1.7	4.4	9.2	<0.020	<0.010	--
TW-1	09/16/10	340	<3.0	13	<1.0	18	<3.0	--	--	--
TW-1	12/22/10	150	<3.0	2.0	<1.0	<1.0	<3.0	--	--	--
TW-1	03/10/11	95	<3.0	2.4	<1.0	<1.0	<3.0	<0.020	<0.010	11
TW-1	06/07/11	580	<3.0	14	<1.0	12	<3.0	--	--	4.0
TW-1	07/13/11	230	<3.0	7.1	<1.0	5.4	<3.0	--	--	--

TABLE 2
GROUNDWATER ANALYTICAL RESULTS
COLLEGE WAY FOODS
 2120 EAST COLLEGE WAY
 MOUNT VERNON, WASHINGTON

Well/Sample Identification	Date Sampled	TPH Gasoline (ppb)	MTBE (ppb)	Benzene (ppb)	Toluene (ppb)	Ethyl-benzene (ppb)	Xylenes (ppb)	EDC (ppb)	EDB (ppb)	Lead (ppb)
TW-1	07/25/11	410	<3.0	14.0	<1.0	7.6	<3.0	--	--	2.2
TW-1	09/23/11	<50	<3.0	<1.0	<1.0	<1.0	<3.0	--	--	2.0

TABLE 2
GROUNDWATER ANALYTICAL RESULTS
COLLEGE WAY FOODS
2120 EAST COLLEGE WAY
MOUNT VERNON, WASHINGTON

Well/Sample Identification	Date Sampled	TPH Gasoline (ppb)	MTBE (ppb)	Benzene (ppb)	Toluene (ppb)	Ethyl-benzene (ppb)	Xylenes (ppb)	EDC (ppb)	EDB (ppb)	Lead (ppb)
TW-2	12/09/92	59,000	NA	8,800	12,000	1,300	7,300	--	--	--
TW-2	05/09/94	26,000	NA	5,700	4,500	490	3,600	--	--	--
TW-2	10/18/94	34,000	NA	7,300	5,600	670	3,700	--	--	--
TW-2	03/30/95	32,000	NA	7,300	4,100	590	4,200	--	--	--
TW-2	06/29/95	2,200	NA	260	14	89	120	--	--	--
TW-2	12/21/95	25,000	NA	3,500	4,400	510	4,300	--	--	--
TW-2	03/25/96	23,000	NA	5,300	1,500	360	4,300	--	--	--
TW-2	06/29/96	21,100	NA	4,840	2,060	194	2,940	--	--	--
TW-2	09/19/96	10,800	NA	5,780	1,210	86.7	1,560	--	--	--
TW-2	12/19/96	15,100	NA	5,670	2,000	181	2,020	--	--	--
TW-2	01/15/97	6,180	NA	3,030	438	84.2	1,170	--	--	--
TW-2	05/29/97	4,900	NA	5,500	440	<100	1,210	--	--	--
TW-2	08/15/97	5,200	NA	4,000	240	<50	710	--	--	--
TW-2	07/30/02	650	NA	22	22	6	39	--	--	--
TW-2	05/07/03	29,000	NA	15,000	420	1,600	6,000	--	--	--
TW-2	10/20/03	21,000	NA	8,200	270	1,500	3,400	--	--	--
TW-2	12/26/03	14,000	NA	4,700	140	480	1,600	--	--	--
TW-2	03/23/04	11,000	NA	6,700	120	560	1,300	--	--	--
TW-2	06/21/04	6,700	NA	6,500	90	330	930	--	--	--
TW-2	09/16/04	4,900	NA	550	400	89	1,100	--	--	--
TW-2	12/16/04	6,900	NA	820	76	110	1,300	--	--	--
TW-2	03/22/05	6,400	NA	2,200	120	300	1,300	--	--	--
TW-2	08/15/05	2,300	14	1,800	20	130	270	--	--	--
TW-2	11/22/05	3,300	<30	1,300	21	220	320	--	--	--
TW-2	02/20/06	4,200	<15	1,500	36	330	530	--	--	--
TW-2	05/23/06	600	<3	250	4	37	56	--	--	--
TW-2	11/07/06	120	<3	73	<1	13	13	--	--	--
TW-2	06/06/07	590	<3	180	4	54	63	--	--	--
TW-2	11/29/07	5,800	<2 ⁹	2,000	34	920	580	--	--	--
TW-2	06/11/08	4,600	<15	870	26	360	700	--	--	--
TW-2	12/03/08	4,100	<15	1,100	20	420	530	--	--	--
TW-2	03/12/09	200	<3	53	1	23	19	--	--	--
TW-2	06/30/09	710	<2.0	240	4.6	81	95	--	--	--
TW-2	09/25/09	1,300	17	380	9.9	180	170	--	--	--
TW-2	12/22/09	1,200	<2.0	300	3.1	120	79	--	--	--
TW-2	03/19/10	3,300	<3.0	860	18	400	270	--	--	--
TW-2	06/10/10	3,600	<15	1,000	23	500	300	<0.020	<0.010	--

TABLE 2
GROUNDWATER ANALYTICAL RESULTS
COLLEGE WAY FOODS
 2120 EAST COLLEGE WAY
 MOUNT VERNON, WASHINGTON

Well/Sample Identification	Date Sampled	TPH Gasoline (ppb)	MTBE (ppb)	Benzene (ppb)	Toluene (ppb)	Ethyl-benzene (ppb)	Xylenes (ppb)	EDC (ppb)	EDB (ppb)	Lead (ppb)
TW-2	09/16/10	2,600	<15	570	13	370	190	--	--	--
TW-2	12/22/10	3,800	<30	670	15	420	380	--	--	--
TW-2	03/10/11	4,000	<3.0	890	30	510	450	<0.020	<0.010	4.0
TW-2	06/07/11	10,000	<3.0	1,500	72	950	1,600	--	--	12
TW-2	07/13/11	6,200	<30	1,300	48	660	880	--	--	--
TW-2	07/25/11	5,900	<30	1,200	38	650	750	--	--	6.1
TW-2	09/23/11	3,600	23	1,000	19	520	260	--	--	5.3

TABLE 2
GROUNDWATER ANALYTICAL RESULTS
COLLEGE WAY FOODS
2120 EAST COLLEGE WAY
MOUNT VERNON, WASHINGTON

Well/Sample Identification	Date Sampled	TPH Gasoline (ppb)	MTBE (ppb)	Benzene (ppb)	Toluene (ppb)	Ethyl-benzene (ppb)	Xylenes (ppb)	EDC (ppb)	EDB (ppb)	Lead (ppb)
TW-3	12/09/92	<50	NA	2.6	<0.50	<0.50	<1.0	--	--	--
TW-3	05/09/94	<50	NA	<0.50	<0.50	<0.50	<1.0	--	--	--
TW-3	10/18/94	<50	NA	<0.50	<0.50	<0.50	<1.0	--	--	--
TW-3	07/30/02	<50	NA	<1	<1	<1	<3	--	--	--
TW-3	05/07/03	<50	NA	<1	<1	<1	<3	--	--	--
TW-3	10/20/03	<50	NA	<1	<1	<1	<3	--	--	--
TW-3	12/26/03	<50	NA	<1	<1	<1	<3	--	--	--
TW-3	03/23/04	<50	NA	<1	<1	<1	<3	--	--	--
TW-3	06/21/04	<50	NA	<1	<1	<1	<3	--	--	--
TW-3	09/16/04	<50	NA	<1	<1	<1	<3	--	--	--
TW-3	12/16/04	<50	NA	<1	<1	<1	<3	--	--	--
TW-3	03/22/05	<50	NA	<1	<1	<1	<3	--	--	--
TW-3	08/15/05	<50	<3	<1	<1	<1	<3	--	--	--
TW-3	11/22/05	<50	<3	<1	<1	<1	<3	--	--	--
TW-3	02/20/06	<50	<3	<1	<1	<1	<3	--	--	--
TW-3	05/23/06	<50	<3	<1	<1	<1	<3	--	--	--
TW-3	11/07/06	<50	<3	<1	<1	<1	<3	--	--	--
TW-3	06/06/07	<50	<3	<1	<1	<1	<3	--	--	--
TW-3	11/29/07	<50	<3	<1	<1	<1	<3	--	--	--
TW-3	06/11/08	<50	<3	<1	<1	<1	<3	--	--	--
TW-3	03/12/09	<50	<3	<1	<1	<1	<3	--	--	--
TW-3	06/30/09	<50	<3.0	<1.0	<1.0	<1.0	<3.0	--	--	--
TW-3	09/25/09	<50	<3.0	<1.0	<1.0	<1.0	<3.0	--	--	--
TW-3	12/22/09	<50	<1.0	<1.0	<1.0	<1.0	<3.0	--	--	--
TW-3	03/19/10	<50	<1.0	<1.0	<1.0	<1.0	<3.0	--	--	--
TW-3	06/10/10	<50	<3.0	<1.0	<1.0	<1.0	<3.0	<0.020	<0.010	--
TW-3	09/16/10	<50	<3.0	<1.0	<1.0	<1.0	<3.0	--	--	--
TW-3	12/22/10	<50	<3.0	<1.0	<1.0	<1.0	<3.0	--	--	--
TW-3	03/10/11	<50	<3.0	<1.0	<1.0	<1.0	<3.0	<0.020	<0.010	<0.62
TW-3	06/07/11	<50	<3.0	<1.0	<1.0	<1.0	<3.0	--	--	1.3
TW-3	09/23/11	<50	<3.0	<1.0	<1.0	<1.0	<3.0	--	--	<0.30

TABLE 2
GROUNDWATER ANALYTICAL RESULTS
COLLEGE WAY FOODS
2120 EAST COLLEGE WAY
MOUNT VERNON, WASHINGTON

Well/Sample Identification	Date Sampled	TPH Gasoline (ppb)	MTBE (ppb)	Benzene (ppb)	Toluene (ppb)	Ethyl-benzene (ppb)	Xylenes (ppb)	EDC (ppb)	EDB (ppb)	Lead (ppb)
B-2	08/12/92	20,000	NA	5,700	3,500	390	1,600	--	--	--
B-2	12/09/92	27,000	NA	5,100	640	760	5,500	--	--	--
B-2	05/09/94	2,900	NA	560	55	100	280	--	--	--
B-2	10/18/94	430	NA	70	8.1	25	34	--	--	--
B-2	06/29/95	19,000	NA	5,000	2,900	500	3,000	--	--	--
B-2	12/21/95	1,100	NA	52	1.7	60	37	--	--	--
B-2	03/25/96	360	NA	50	2.6	6.8	14	--	--	--
B-2	06/29/96	409	NA	32.7	0.647	12.3	14.2	--	--	--
B-2	09/19/96	88.3	NA	7.29	0.689	0.667	3.71	--	--	--
B-2	12/19/96	502	NA	48.8	0.933	16.2	20.5	--	--	--
B-2	05/29/97	580	NA	35	1.2	30	16.9	--	--	--
B-2	08/15/97	910	NA	170	4.5	35	47	--	--	--
B-2	07/30/02	3,900	NA	270	14	20	100	--	--	--
B-2	05/07/03	600	NA	28	3	1	7	--	--	--
B-2	10/20/03	23,000	NA	1,800	3,200	500	2,900	--	--	--
B-2	12/26/03	6,800	NA	530	230	120	530	--	--	--
B-2	03/23/04	1,200	NA	38	5	8	28	--	--	--
B-2	06/21/04	1,100	NA	50	18	6	50	--	--	--
B-2	09/16/04	540	NA	10	3	4	13	--	--	--
B-2	12/16/04	670	NA	8	6	9	46	--	--	--
B-2	03/22/05	2,300	NA	88	16	39	150	--	--	--
B-2	08/15/05	1,500	8	42	5	25	51	--	--	--
B-2	11/22/05	1,400	<2 ^g	35	6	18	37	--	--	--
B-2	02/20/06	200	<3	4	<1	2	4	--	--	--
B-2	05/23/06	570	<3	32	7	11	37	--	--	--
B-2	11/07/06	240	<3	17	1	3	5	--	--	--
B-2	06/06/07	5,200	<30	890	84	290	550	--	--	--
B-2	11/29/07	650	<2 ^g	16	2	15	19	--	--	--
B-2	06/11/08	970	<3	62	7	25	40	--	--	--
B-2	12/03/08	900	<3	49	6	25	47	--	--	--
B-2	03/12/09	94	<3	2	2	1	<3	--	--	--
B-2	06/30/09	560	<3.0	84	48	11	11	--	--	--
B-2	09/25/09	880	19	170	16	47	69	--	--	--
B-2	12/22/09	53	<1.0	2.5	<1.0	1.2	<3.0	--	--	--
B-2	03/19/10	630	<3.0	69	11	26	71	--	--	--
B-2	06/10/10	<50	<3.0	4.5	1.1	2.3	5.2	<0.020	<0.010	--

TABLE 2
GROUNDWATER ANALYTICAL RESULTS
COLLEGE WAY FOODS
2120 EAST COLLEGE WAY
MOUNT VERNON, WASHINGTON

Well/Sample Identification	Date Sampled	TPH Gasoline (ppb)	MTBE (ppb)	Benzene (ppb)	Toluene (ppb)	Ethyl-benzene (ppb)	Xylenes (ppb)	EDC (ppb)	EDB (ppb)	Lead (ppb)
B-2	09/16/10	Not Sample - Well covered with large puddle								
B-2	12/22/10	190	<3.0	40	3.9	11	21	--	--	--
B-2	03/10/11	530	<3.0	69	10	29	48	<0.020	<0.010	<0.62
B-2	06/07/11	550	<3.0	6.5	1.2	21	7.3	--	--	<0.62
B-2	09/23/11	730	<3.0	35	3.3	18	13	--	--	0.83
MTCA Method A Cleanup Levels:		800^f	20	5	1,000	700	1,000	5	0.01	15
Notes: "<50" - not detected above laboratory reporting limit of 50 ppb MTBE= Methyl Tert-Butyl Ether EDC= 1,2- Dichloroethane EDB= 1,2- Dibromoethane TPH as Gasoline (Toluene to Dodecane) - Analysis by Method NWTPH-Gx MTBE - Analysis by EPA 8021B BTEX - Analysis by EPA Method 8021B EDC and EDB- Analysis by EPA Method 8260 ^a Sample collected prior to startup of the air sparging system. ^b Sample was collected at six feet below the water surface. ^c Duplicate sample reported 81,000 ppb for TPH-G. ^d Before pumping. ^e After pumping. ^f MTCA Method A Cleanup Level for TPH-Gasoline is 1,000 ppb if benzene is not detectable in groundwater. ^g Samples containing detectable concentrations of MTBE by USEPA Method 8021B were also analyzed by USEPA 8260 to confirm MTBE concentrations.										

TABLE 3
GROUNDWATER ANALYTICAL RESULTS
NATURAL ATTENUATION PARAMETERS
COLLEGE WAY FOODS
2120 EAST COLLEGE WAY
MOUNT VERNON, WASHINGTON

Sample I.D.	Date	Dissolved	Methane	Ferrous	Nitrate	Sulfate	Sulfide	Alkalinity	ph	ORP	Conductivity	Temp.
		Oxygen	(Head	Iron								
		(mg/L)	Space)	(mg/L)	(mg/L)	(mg/L)	(mg/L)	(mg/L)	(0 to 14 units)	(mV)	(mS/cm ³)	(Celsius)
MW-1	08/15/05	0.20	0.01	2.2	<0.28	<0.16	<0.05	120	6.59	-20.2	0.234	21.07
MW-1	11/22/05	0.54	--	--	--	--	--	--	7.17	64	0.326	14.46
MW-1	02/20/06	0.58	6.4	2.8	0.14	2.8	<0.05	140	7.58	57.9	0.333	11.20
MW-1	05/23/06	1.16	0.06	2.4	<0.14	1.6	<0.05	100	5.83	-21.2	0.278	14.80
MW-1	11/07/06	0.63	0.23	2.2	<0.14	1.8	NA ¹	NA ¹	6.96	-18.0	0.310	16.98
MW-1	06/06/07	1.33	0.26	2.0	<0.14	3.4	<0.05	110	6.93	-26.9	0.217	16.30
MW-1	11/29/07	1.73	2.10	2.6	0.22	2.2	0.10	160	7.07	-84.4	0.342	12.99
MW-1	06/11/08	--	--	--	--	--	--	--	--	--	--	--
MW-1	12/03/08	2.10	0.22	0.90	<0.14	1.0	<0.05	170	--	--	--	11.5
MW-1	03/12/09	4.0	0.12	--	<0.3	<1.0	<0.05	190	--	--	--	9.1
MW-1	06/30/09	0.87	--	--	--	--	--	--	--	--	--	--
MW-1	09/25/09	0.55	--	--	--	--	--	--	--	--	--	19.77
MW-1	12/22/09	2.28	--	--	--	--	--	--	--	--	--	12.56
MW-1	03/19/10	2.94	--	--	--	--	--	--	6.77	--	--	12.28
MW-1	06/10/10	4.26	--	--	--	--	--	--	--	--	--	15.24
MW-1	09/16/10	4.01	--	1.8 ²	<0.15	0.42	--	--	6.8	183.7	0.330	18.64
MW-1	12/22/10	0.40	--	--	--	--	--	--	6.63	234.2	0.083	12.53
MW-1	03/10/11	0.49	--	--	--	6.3	--	--	6.69	343.3	0.283	10.17
MW-1	06/07/11	0.71	--	--	--	<0.26	--	--	6.73	158.3	0.281	13.16
MW-1	07/13/11	0.43	--	--	--	0.41	--	--	6.62	97.5	0.466	15.92
MW-1	07/25/11	--	--	--	--	2.70	--	--	--	--	--	--
MW-1	09/30/11	0.38	--	--	--	1.4	--	--	6.61	40.6	0.392	18.51

TABLE 3
GROUNDWATER ANALYTICAL RESULTS
NATURAL ATTENUATION PARAMETERS
COLLEGE WAY FOODS
2120 EAST COLLEGE WAY
MOUNT VERNON, WASHINGTON

Sample I.D.	Date	Dissolved	Methane	Ferrous	Nitrate	Sulfate	Sulfide	Alkalinity	ph	ORP	Conductivity	Temp.
		Oxygen	(Head Space)	Iron								
		(mg/L)	(mg/L)	(mg/L)	(mg/L)	(mg/L)	(mg/L)	(mg/L)				
MW-2	08/15/05	0.13	0.82	4	<0.70	<0.40	<0.05	120	6.86	-117.9	0.292	20.62
MW-2	11/22/05	0.52	--	--	--	--	--	--	7.28	47.7	0.205	13
MW-2	02/20/06	0.39	8.0	4.2	2.5	<0.08	<0.05	81	7.51	37.7	0.281	10.16
MW-2	05/23/06	0.66	0.37	2.4	<0.14	<0.08	<0.05	120	6.04	-41.5	0.268	16.99
MW-2	11/07/06	0.47	<0.01	2.6	<0.14	1.6	NA ¹	NA ¹	7.22	-128.1	0.213	14.20
MW-2	06/06/07	0.88	0.59	2.2	0.38	0.84	<0.05	72	7.11	-127.1	0.422	18.99
MW-2	11/29/07	1.16	0.69	3.4	<0.14	3.1	<0.05	59	7.15	-108.1	1.000	12.39
MW-2	06/11/08	--	<0.01	1.8	<0.14	0.91	<0.05	160	6.5	-93	86.000	14.80
MW-2	12/03/08	2.41	0.03	1.2	<0.14	1.7	<0.05	100	--	--	--	10.1
MW-2	03/12/09	6.0	0.10	--	<0.3	1.3	<0.05	130	--	--	--	7.6
MW-2	06/30/09	0.8	--	--	--	--	--	--	--	--	--	--
MW-2	09/25/09	0.66	--	--	--	--	--	--	--	--	--	19.48
MW-2	12/22/09	1.37	--	--	--	--	--	--	--	--	--	10.92
MW-2	03/19/10	2.02	--	--	--	--	--	--	7.22	--	--	12.29
MW-2	06/10/10	4.96	--	--	--	--	--	--	--	--	--	15.19
MW-2	09/16/10	3.45	--	7.4 ²	<0.15	1.4	--	--	7.23	89.1	0.360	18.75
MW-2	12/22/10	0.51	--	--	--	--	--	--	7.04	168.9	0.085	11.66
MW-2	03/10/11	0.19	--	--	--	4.8	--	--	6.82	91.9	0.518	8.76
MW-2	06/07/11	0.58	--	--	--	--	--	--	6.99	96.5	0.521	13.91
MW-2	09/23/11	0.19	--	--	--	--	--	--	7.04	42.6	0.590	19.44

TABLE 3
GROUNDWATER ANALYTICAL RESULTS
NATURAL ATTENUATION PARAMETERS
COLLEGE WAY FOODS
2120 EAST COLLEGE WAY
MOUNT VERNON, WASHINGTON

Sample I.D.	Date	Dissolved	Methane	Ferrous	Nitrate	Sulfate	Sulfide	Alkalinity	ph	ORP	Conductivity	Temp.
		Oxygen	(Head	Iron								
		(mg/L)	Space)	(mg/L)	(mg/L)	(mg/L)	(mg/L)	(mg/L)				
MW-3	08/15/05	0.52	--	--	--	--	--	--	7.03	9.3	0.715	15.66
MW-3	11/22/05	0.66	--	--	--	--	--	--	7.16	62.3	0.684	16.99
MW-3	02/20/06	1.08	--	--	--	--	--	--	7.51	48.9	0.732	12.63
MW-3	05/23/06	0.71	--	1.0	--	--	--	--	5.68	18.9	0.580	14.27
MW-3	11/07/06	1.42	--	--	--	--	--	--	7.05	59.6	0.627	17.09
MW-3	06/06/07	1.37	--	--	--	--	--	--	6.93	-15.3	0.612	13.93
MW-3	11/29/07	2.38	0.76	1.1	<0.14	1.9	<0.05	400	6.92	-79.6	0.616	13.41
MW-3	06/11/08	--	<0.01	0.2	<0.14	2.0	<0.05	380	6.28	-16.0	0.100	14.30
MW-3	12/03/08	4.3	0.01	0.4	<0.14	1.5	<0.05	520	--	--	--	12.8
MW-3	03/12/09	4.90	<0.01	--	<0.3	1.5	<0.05	500	--	--	--	11.4
MW-3	06/30/09	1.31	--	--	--	--	--	--	--	--	--	--
MW-3	09/25/09	1.01	--	--	--	--	--	--	--	--	--	--
MW-3	12/22/09	4.61	--	--	--	--	--	--	--	--	--	15.97
MW-3	03/19/10	2.85	--	--	--	--	--	--	6.77	--	--	14.63
MW-3	06/10/10	4.42	--	--	--	--	--	--	--	--	--	14.69
MW-3	09/16/10	3.96	--	<0.22 ²	<0.15	0.9	--	--	6.62	333.1	0.598	17.69
MW-3	12/22/10	0.82	--	--	--	--	--	--	6.56	--	0.183	15.35
MW-3	03/10/11	0.85	--	--	--	1.6	--	--	6.61	206.0	0.492	13.16
MW-3	06/07/11	0.71	--	--	--	--	--	--	6.45	156.3	0.511	13.79
MW-3	09/23/11	0.33	--	--	--	--	--	--	6.44	173.0	0.595	16.01

TABLE 3
GROUNDWATER ANALYTICAL RESULTS
NATURAL ATTENUATION PARAMETERS
COLLEGE WAY FOODS
2120 EAST COLLEGE WAY
MOUNT VERNON, WASHINGTON

Sample I.D.	Date	Dissolved	Methane	Ferrous	Nitrate	Sulfate	Sulfide	Alkalinity	ph	ORP	Conductivity	Temp.
		Oxygen	(Head Space)	Iron								
		(mg/L)	(mg/L)	(mg/L)	(mg/L)	(mg/L)	(mg/L)	(mg/L)				
MW-4	08/15/05	0.24	<0.01	0.6	7.3	<0.40	<0.05	450	7.06	-25.3	0.759	14.33
MW-4	06/07/11	230	<3.0	79	16	1.8	20	--	--	<0.62	0.759	14.33
MW-4	11/22/05	2.66	--	--	--	--	--	--	7.47	52.9	0.715	16.98
MW-4	02/20/06	1.00	<0.01	0.2	<0.14	5.7	<0.05	390	7.52	46.6	0.726	12.75
MW-4	05/23/06	0.88	<0.01	0.2	<0.14	3.2	<0.05	390	5.84	13.2	0.566	13.72
MW-4	11/07/06	3.04	<0.01	2.0	<0.14	4.7	NA ¹	NA ¹	7.11	-26.7	0.664	16.20
MW-4	06/06/07	1.34	<0.01	1.8	<0.14	3.6	<0.05	640	7.06	-23.4	0.65	13.58
MW-4	11/29/07	1.70	<0.01	0.2	<0.14	4.5	<0.05	400	7.08	-70.7	0.630	14.37
MW-4	06/11/08	--	<0.01	0.1	<0.14	3.9	<0.05	380	6.32	-11	0.750	14.70
MW-4	12/03/08	2.49	<0.01	0.1	<0.14	2.3	<0.05	450	--	--	--	10.7
MW-4	03/12/09	4.7	<0.01	--	<0.3	3.2	<0.05	540	--	--	--	10.4
MW-4	06/30/09	1.15	--	--	--	--	--	--	--	--	--	--
MW-4	09/25/09	1.32	--	--	--	--	--	--	--	--	--	--
MW-4	12/22/09	6.28	--	--	--	--	--	--	--	--	--	15.17
MW-4	03/19/10	2.86	--	--	--	--	--	--	7.11	--	--	13.74
MW-4	06/10/10	4.57	--	--	--	--	--	--	--	--	--	14.76
MW-4	09/16/10	3.71	--	<0.22 ²	<0.15	3.3	--	--	7.27	368.9	0.694	18.97
MW-4	12/22/10	5.06	--	--	--	--	--	--	7.19	246.5	0.193	15.20
MW-4	03/10/11	4.14	--	--	--	3.6	--	--	7.03	154.5	0.566	11.73
MW-4	06/07/11	0.91	--	--	--	--	--	--	6.33	194.1	0.610	13.53
MW-4	09/23/11	0.30	--	--	--	--	--	--	6.98	83.8	0.666	17.00

TABLE 3
GROUNDWATER ANALYTICAL RESULTS
NATURAL ATTENUATION PARAMETERS
COLLEGE WAY FOODS
2120 EAST COLLEGE WAY
MOUNT VERNON, WASHINGTON

Sample I.D.	Date	Dissolved	Methane	Ferrous	Nitrate	Sulfate	Sulfide	Alkalinity	ph	ORP	Conductivity	Temp.
		Oxygen	(Head	Iron								
		(mg/L)	(mg/L)	(mg/L)	(mg/L)	(mg/L)	(mg/L)	(mg/L)	(0 to 14 units)	(mV)	(mS/cm ³)	(Celsius)
MW-5	08/15/05	0.57	--	--	--	--	--	--	6.94	-11.4	0.851	16.02
MW-5	11/22/05	1.11	--	--	--	--	--	--	7.13	76.5	0.404	14.65
MW-5	02/20/06	2.91	--	--	--	--	--	--	7.36	8.13	0.444	9.44
MW-5	05/23/06	3.39	--	1.4	--	--	--	--	5.79	13.4	0.345	14.40
MW-5	11/07/06	1.78	--	1.8	--	--	--	--	6.87	90.1	0.418	15.39
MW-5	06/06/07	3.63	--	--	--	--	--	--	6.97	2.2	0.421	16.44
MW-5	11/29/07	2.06	<0.01	0.2	0.9	24	<0.05	250	7.27	-76.2	0.368	10.37
MW-5	06/11/08	--	<0.01	0.10	1.9	22	<0.05	200	6.31	-11	0.78	14.20
MW-5	12/03/08	6.0	<0.01	0.6	0.71	19	<0.05	260	--	--	--	11.60
MW-5	03/12/09	8.6	<0.01	--	<0.3	16	<0.05	280	--	--	--	7.0
MW-5	06/30/09	1.79	--	--	--	--	--	--	--	--	--	--
MW-5	09/25/09	1.64	--	--	--	--	--	--	--	--	--	--
MW-5	12/22/09	6.96	--	--	--	--	--	--	--	--	--	11.07
MW-5	03/19/10	2.91	--	--	--	--	--	--	6.60	--	--	12.01
MW-5	06/10/10	7.56	--	--	--	--	--	--	--	--	--	15.25
MW-5	09/16/10	3.26	--	<0.22 ²	1.1	13	--	--	6.79	556.8	0.799	18.36
MW-5	12/22/10	3.81	--	--	--	--	--	--	6.81	314.9	0.110	12.34
MW-5	03/10/11	4.89	--	--	--	13	--	--	6.44	559.3	0.416	10.03
MW-5	06/07/11	2.53	--	--	--	--	--	--	6.73	128.2	0.595	13.87
MW-5	09/23/11	0.39	--	--	--	--	--	--	6.78	94.6	0.775	17.99

TABLE 3
GROUNDWATER ANALYTICAL RESULTS
NATURAL ATTENUATION PARAMETERS
COLLEGE WAY FOODS
 2120 EAST COLLEGE WAY
 MOUNT VERNON, WASHINGTON

Sample I.D.	Date	Dissolved	Methane	Ferrous	Nitrate	Sulfate	Sulfide	Alkalinity	ph	ORP	Conductivity	Temp.
		Oxygen	(Head	Iron								
		(mg/L)	(mg/L)	(mg/L)	(mg/L)	(mg/L)	(mg/L)	(mg/L)	(0 to 14 units)	(mV)	(mS/cm ³)	(Celsius)
MW-7	06/07/11	0.71	--	--	--	50	--	--	6.59	165.0	1.127	15.16
MW-7	07/13/11	0.63	--	--	--	26	--	--	6.50	251.0	1.039	18.86
MW-7	07/25/11	--	--	--	--	17	--	--	--	--	--	--
MW-7	09/23/11	0.20	--	--	--	12	--	--	6.51	41.1	1.045	19.22

TABLE 3
GROUNDWATER ANALYTICAL RESULTS
NATURAL ATTENUATION PARAMETERS
COLLEGE WAY FOODS
 2120 EAST COLLEGE WAY
 MOUNT VERNON, WASHINGTON

Sample I.D.	Date	Dissolved	Methane	Ferrous	Nitrate	Sulfate	Sulfide	Alkalinity	ph	ORP	Conductivity	Temp.
		Oxygen	(Head	Iron								
		(mg/L)	(mg/L)	(mg/L)	(mg/L)	(mg/L)	(mg/L)	(mg/L)				
MW-8	06/07/11	0.85	--	--	--	49	--	--	7.03	179.1	0.461	17.43
MW-8	07/13/11	1.16	--	--	--	42	--	--	7.42	281.3	0.811	20.36
MW-8	07/25/11	--	--	--	--	70	--	--	--	--	--	--
MW-8	09/23/11	0.66	--	--	--	82	--	--	6.49	188.5	1.067	21.96

TABLE 3
GROUNDWATER ANALYTICAL RESULTS
NATURAL ATTENUATION PARAMETERS
COLLEGE WAY FOODS
2120 EAST COLLEGE WAY
MOUNT VERNON, WASHINGTON

Sample I.D.	Date	Dissolved	Methane	Ferrous	Nitrate	Sulfate	Sulfide	Alkalinity	ph	ORP	Conductivity	Temp.
		Oxygen	(Head	Iron								
		(mg/L)	Space)	(mg/L)	(mg/L)	(mg/L)	(mg/L)	(mg/L)				
TW-1	08/15/05	0.28	0.02	1.2	<0.70	20	0.24	470	7.56	-133.8	1.497	17.16
TW-1	11/22/05	0.59	--	--	--	--	--	--	7.1	72.1	0.46	13.38
TW-1	02/20/06	0.65	2.0	1.6	<0.14	14	0.14	380	7.7	60.3	0.491	9.76
TW-1	05/23/06	0.93	0.23	1.0	<0.14	2.8	0.22	570	5.73	13.6	0.309	15.71
TW-1	11/07/06	1.22	0.20	1.6	<0.14	9.4	NA ¹	NA ¹	7.04	105.6	0.301	14.26
TW-1	06/06/07	1.27	0.31	1.8	<0.14	4.7	<0.05	460	6.73	-52.3	0.398	17.17
TW-1	11/29/07	2.44	0.30	1.8	0.24	9.3	<0.05	250	7.24	-108.7	0.396	11.05
TW-1	06/11/08	--	<0.01	0.9	0.79	15	<0.05	180	6.29	-44	6.29	15.30
TW-1	12/03/08	5.6	0.08	1.3	<0.14	8.2	<0.05	280	--	--	--	11.6
TW-1	03/12/09	5.2	0.01	--	<0.3	9.7	0.12	280	--	--	--	6.3
TW-1	06/30/09	1.10	--	--	--	--	--	--	--	--	--	--
TW-1	09/25/09	0.74	--	--	--	--	--	--	--	--	--	--
TW-1	12/22/09	4.00	--	--	--	--	--	--	--	--	--	10.5
TW-1	03/19/10	3.28	--	--	--	--	--	--	6.21	--	--	10.7
TW-1	06/10/10	4.76	--	--	--	--	--	--	--	--	--	15.2
TW-1	06/07/11	4.76	<2.0	<1.0	<1.0	--	--	--	--	14.0	--	15.2
TW-1	09/16/10	2.34	--	0.28 ²	1.6	13	--	--	6.61	173.5	0.440	20.37
TW-1	12/22/10	0.41	--	--	--	--	--	--	6.50	272.6	0.090	11.50
TW-1	03/10/11	0.89	--	--	--	6.9	--	--	6.45	475.8	0.314	9.15
TW-1	06/07/11	1.29	--	--	--	66	--	--	6.45	179.1	0.492	15.46
TW-1	07/13/11	0.95	--	--	--	120	--	--	5.93	210.1	0.709	16.53
TW-1	07/25/11	--	--	--	--	150	--	--	--	--	--	--
TW-1	09/23/11	0.33	--	--	--	210	--	--	6.36	22.4	1.083	19.83

TABLE 3
GROUNDWATER ANALYTICAL RESULTS
NATURAL ATTENUATION PARAMETERS
COLLEGE WAY FOODS
2120 EAST COLLEGE WAY
MOUNT VERNON, WASHINGTON

Sample I.D.	Date	Dissolved	Methane	Ferrous	Nitrate	Sulfate	Sulfide	Alkalinity	ph	ORP	Conductivity	Temp.
		Oxygen	(Head	Iron								
		(mg/L)	(mg/L)	(mg/L)	(mg/L)	(mg/L)	(mg/L)	(mg/L)	(0 to 14 units)	(mV)	(mS/cm ³)	(Celsius)
TW-2	08/15/05	0.29	0.02	2.2	27	42	0.1	820	7.1	-129.2	1.802	18.39
TW-2	11/22/05	0.86	--	--	--	--	--	--	7.2	51.9	0.908	14.37
TW-2	02/20/06	0.51	5.4	2.2	8.3	27	0.10	640	7.71	39.5	0.978	9.40
TW-2	05/23/06	0.80	<0.01	2.2	33	1.4	0.12	900	5.87	-29.2	0.540	15.24
TW-2	11/07/06	0.66	<0.01	2.2	12	3.6	NA ¹	NA ¹	7.34	-92.9	0.572	15.32
TW-2	06/06/07	1.18	0.22	1.4	5.2	1	<0.05	800	6.77	-113.9	0.844	18.63
TW-2	11/29/07	1.19	1.1	1.2	0.24	9.3	0.10	660	7.09	-118.6	0.987	11.18
TW-2	06/11/08	--	<0.01	1.2	<0.14	2.5	0.16	210	6.60	-68	47.000	15.20
TW-2	12/03/08	0.72	0.33	--	<0.14	<1.00	0.06	600	--	--	--	11.2
TW-2	03/12/09	2.12	0.59	--	<0.3	6.0	0.16	590	--	--	--	7.2
TW-2	06/30/09	0.99	--	--	--	--	--	--	--	--	--	--
TW-2	09/25/09	0.80	--	--	--	--	--	--	--	--	--	--
TW-2	12/22/09	3.22	--	--	--	--	--	--	--	--	--	11.59
TW-2	03/19/10	2.11	--	--	--	--	--	--	6.51	--	--	10.99
TW-2	06/10/10	5.65	--	--	--	--	--	--	--	--	--	15.41
TW-2	09/16/10	125.0	--	8.6 ²	0.27	1.5	--	--	6.66	125.0	1.515	20.35
TW-2	12/22/10	0.26	--	--	--	--	--	--	6.70	121.6	0.342	12.18
TW-2	03/10/11	0.10	--	--	--	0.78	--	--	6.49	135.3	1.103	8.64
TW-2	06/07/11	0.86	--	--	--	0.61	--	--	6.48	115.8	1.074	14.93
TW-2	07/13/11	0.53	--	--	--	0.30	--	--	6.29	119.4	1.256	16.72
TW-2	07/25/11	--	--	--	--	<0.26	--	--	--	--	--	--
TW-2	09/23/11	0.10	--	--	--	2.1	--	--	6.68	35.4	1.606	19.42

TABLE 3
GROUNDWATER ANALYTICAL RESULTS
NATURAL ATTENUATION PARAMETERS
COLLEGE WAY FOODS
2120 EAST COLLEGE WAY
MOUNT VERNON, WASHINGTON

Sample I.D.	Date	Dissolved	Methane	Ferrous	Nitrate	Sulfate	Sulfide	Alkalinity	ph	ORP	Conductivity	Temp.
		Oxygen	(Head	Iron								
		(mg/L)	Space)	(mg/L)	(mg/L)	(mg/L)	(mg/L)	(mg/L)	(0 to 14 units)	(mV)	(mS/cm ³)	(Celsius)
TW-3	08/15/05	0.43	--	--	--	--	--	--	6.52	-30.8	0.688	18.85
TW-3	11/22/05	0.60	--	--	--	--	--	--	7.07	58.5	0.69	16.83
TW-3	02/20/06	0.39	--	--	--	--	--	--	7.72	44.8	0.684	11.94
TW-3	05/23/06	0.82	--	1.6	--	--	--	--	5.79	-7.1	0.548	14.58
TW-3	11/07/06	0.91	--	--	--	--	--	--	7.17	-29.2	0.680	18.20
TW-3	06/06/07	1.26	--	--	--	--	--	--	6.57	-36.2	0.640	14.69
TW-3	11/29/07	2.39	0.55	3.6	<0.14	0.34	<0.05	380	6.85	-67.8	0.621	13.00
TW-3	06/11/08	--	<0.01	1.59	<0.14	0.29	0.06	370	6.26	-30	0.220	14.30
TW-3	12/03/08	4.7	0.10	2.0	<0.14	<1.0	<0.50	380	--	--	--	13.6
TW-3	06/07/11	4.7	<2.0	2.0	<0.14	<1.0	<0.50	--	--	--	--	13.6
TW-3	03/12/09	4.7	0.01	--	<0.3	<1.0	<0.05	420	--	--	--	10.6
TW-3	06/30/09	0.93	--	--	--	--	--	--	--	--	--	--
TW-3	09/25/09	0.77	--	--	--	--	--	--	--	--	--	21.76
TW-3	12/22/09	2.87	--	--	--	--	--	--	--	--	--	13.21
TW-3	03/19/10	2.89	--	--	--	--	--	--	6.45	--	--	12.77
TW-3	06/10/10	5.65	--	--	--	--	--	--	--	--	--	16.49
TW-3	09/16/10	5.73	--	8.9 ²	0.42	0.67	--	--	6.38	363.0	0.690	21.41
TW-3	12/22/10	0.35	--	--	--	--	--	--	6.35	217.1	0.194	13.69
TW-3	03/10/11	6.49	--	--	--	2.0	--	--	6.21	246.1	0.504	10.03
TW-3	06/07/11	0.71	--	--	--	--	--	--	6.25	209.8	0.598	15.57
TW-3	09/23/11	162.9	--	--	--	--	--	--	6.36	162.9	0.739	20.97

Figures

Figure 1 Site Map

EAST COLLEGE WAY

sidewalk

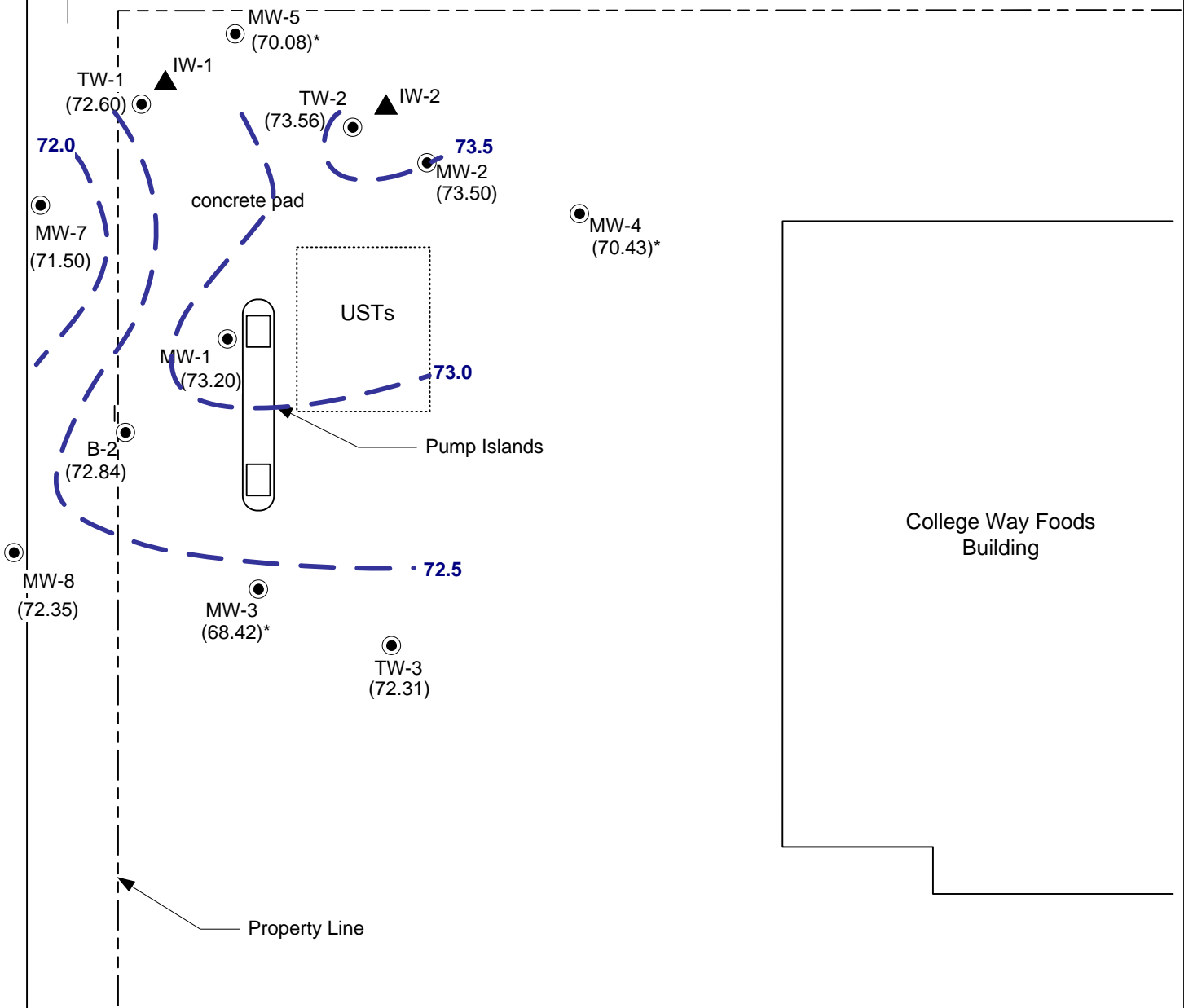

LEGEND

- MW-1 Groundwater monitoring well
- (73.20) Groundwater elevation, September 23, 2011
- 74.00— Inferred Groundwater elevation contour, September 23, 2011
- * Groundwater elevations represent a deeper water-bearing unit and were not included in generation of this contour map.
- ▲ IW-2 Injection Well
- NS Not Surveyed



APPROX. SCALE

FIGURE 1

SITE MAP

COLLEGE WAY FOODS
2120 EAST COLLEGE WAY
MOUNT VERNON, WASHINGTON

PROJECT NO. STCG-403-2	DRAWN BY JP
FILE NO. A20-77A	PREPARED BY JK 11/12/11
REVISION NO. 0	REVIEWED BY MM



Appendix A

Analytical Report and Chain-of-Custody Documentation



CERTIFICATE OF ANALYSIS

CLIENT: Antea Group DATE: 7/15/2011
4006 - 148th Ave NE ALS JOB#: 1107042
Redmond, WA 98052 ALS SAMPLE#: -01
CLIENT CONTACT: Matt Miller DATE RECEIVED: 7/13/2011
CLIENT PROJECT: STCG-0403 COLLECTION DATE: 7/13/2011 11:00
CLIENT SAMPLE ID MW-1 WDOE ACCREDITATION: C601

DATA RESULTS

ANALYTE	METHOD	RESULTS	REPORTING LIMITS	DILUTION FACTOR	UNITS	ANALYSIS DATE	ANALYSIS BY
TPH-Volatile Range	NWTPH-GX	200	50	1	UG/L	07/13/2011	DLC
Methyl T-Butyl Ether	EPA-8021	U	3.0	1	UG/L	07/13/2011	DLC
Benzene	EPA-8021	U	1.0	1	UG/L	07/13/2011	DLC
Toluene	EPA-8021	U	1.0	1	UG/L	07/13/2011	DLC
Ethylbenzene	EPA-8021	1.7	1.0	1	UG/L	07/13/2011	DLC
Xylenes	EPA-8021	6.7	3.0	1	UG/L	07/13/2011	DLC
Sulfate	EPA-300.0	0.41	0.26	1	MG/L	07/14/2011	GAP

SURROGATE	METHOD	%REC	ANALYSIS DATE	ANALYSIS BY
TFT	NWTPH-GX	89.0	07/13/2011	DLC
TFT	EPA-8021	108	07/13/2011	DLC

U - Analyte analyzed for but not detected at level above reporting limit.
Chromatogram indicates that it is likely that sample contains highly weathered gasoline.



CERTIFICATE OF ANALYSIS

CLIENT:	Antea Group 4006 - 148th Ave NE Redmond, WA 98052	DATE:	7/15/2011
CLIENT CONTACT:	Matt Miller	ALS JOB#:	1107042
CLIENT PROJECT:	STCG-0403	ALS SAMPLE#:	-02
CLIENT SAMPLE ID	TW-1	DATE RECEIVED:	7/13/2011
		COLLECTION DATE:	7/13/2011 10:20
		WDOE ACCREDITATION:	C601

DATA RESULTS

ANALYTE	METHOD	RESULTS	REPORTING LIMITS	DILUTION FACTOR	UNITS	ANALYSIS DATE	ANALYSIS BY
TPH-Volatile Range	NWTPH-GX	230	50	1	UG/L	07/13/2011	DLC
Methyl T-Butyl Ether	EPA-8021	U	3.0	1	UG/L	07/13/2011	DLC
Benzene	EPA-8021	7.1	1.0	1	UG/L	07/13/2011	DLC
Toluene	EPA-8021	U	1.0	1	UG/L	07/13/2011	DLC
Ethylbenzene	EPA-8021	5.4	1.0	1	UG/L	07/13/2011	DLC
Xylenes	EPA-8021	U	3.0	1	UG/L	07/13/2011	DLC
Sulfate	EPA-300.0	120	5.2	20	MG/L	07/14/2011	GAP

SURROGATE	METHOD	%REC	ANALYSIS DATE	ANALYSIS BY
TFT	NWTPH-GX	93.2	07/13/2011	DLC
TFT	EPA-8021	112	07/13/2011	DLC

U - Analyte analyzed for but not detected at level above reporting limit.
Chromatogram indicates that it is likely that sample contains highly weathered gasoline.



CERTIFICATE OF ANALYSIS

CLIENT:	Antea Group 4006 - 148th Ave NE Redmond, WA 98052	DATE:	7/15/2011
CLIENT CONTACT:	Matt Miller	ALS JOB#:	1107042
CLIENT PROJECT:	STCG-0403	ALS SAMPLE#:	-03
CLIENT SAMPLE ID	TW-2	DATE RECEIVED:	7/13/2011
		COLLECTION DATE:	7/13/2011 10:35
		WDOE ACCREDITATION:	C601

DATA RESULTS

ANALYTE	METHOD	RESULTS	REPORTING LIMITS	DILUTION FACTOR	UNITS	ANALYSIS DATE	ANALYSIS BY
TPH-Volatile Range	NWTPH-GX	6200	500	10	UG/L	07/14/2011	DLC
Methyl T-Butyl Ether	EPA-8021	U	30	10	UG/L	07/14/2011	DLC
Benzene	EPA-8021	1300	20	20	UG/L	07/14/2011	DLC
Toluene	EPA-8021	48	10	10	UG/L	07/14/2011	DLC
Ethylbenzene	EPA-8021	660	10	10	UG/L	07/14/2011	DLC
Xylenes	EPA-8021	880	30	10	UG/L	07/14/2011	DLC
Sulfate	EPA-300.0	0.30	0.26	1	MG/L	07/14/2011	GAP

SURROGATE	METHOD	%REC	ANALYSIS DATE	ANALYSIS BY
TFT 10X Dilution	NWTPH-GX	99.0	07/14/2011	DLC
TFT 10X Dilution	EPA-8021	122	07/14/2011	DLC
TFT 20X Dilution	EPA-8021	119	07/14/2011	DLC

U - Analyte analyzed for but not detected at level above reporting limit.
Chromatogram indicates that it is likely that sample contains weathered gasoline.



CERTIFICATE OF ANALYSIS

CLIENT:	Antea Group 4006 - 148th Ave NE Redmond, WA 98052	DATE:	7/15/2011
CLIENT CONTACT:	Matt Miller	ALS JOB#:	1107042
CLIENT PROJECT:	STCG-0403	ALS SAMPLE#:	-04
CLIENT SAMPLE ID	MW-7	DATE RECEIVED:	7/13/2011
		COLLECTION DATE:	7/13/2011 10:05
		WDOE ACCREDITATION:	C601

DATA RESULTS

ANALYTE	METHOD	RESULTS	REPORTING LIMITS	DILUTION FACTOR	UNITS	ANALYSIS DATE	ANALYSIS BY
TPH-Volatile Range	NWTPH-GX	U	50	1	UG/L	07/13/2011	DLC
Methyl T-Butyl Ether	EPA-8021	U	3.0	1	UG/L	07/13/2011	DLC
Benzene	EPA-8021	U	1.0	1	UG/L	07/13/2011	DLC
Toluene	EPA-8021	U	1.0	1	UG/L	07/13/2011	DLC
Ethylbenzene	EPA-8021	U	1.0	1	UG/L	07/13/2011	DLC
Xylenes	EPA-8021	U	3.0	1	UG/L	07/13/2011	DLC
Sulfate	EPA-300.0	26	1.3	5	MG/L	07/14/2011	GAP

SURROGATE	METHOD	%REC	ANALYSIS DATE	ANALYSIS BY
TFT	NWTPH-GX	88.4	07/13/2011	DLC
TFT	EPA-8021	115	07/13/2011	DLC

U - Analyte analyzed for but not detected at level above reporting limit.



CERTIFICATE OF ANALYSIS

CLIENT:	Antea Group 4006 - 148th Ave NE Redmond, WA 98052	DATE:	7/15/2011
CLIENT CONTACT:	Matt Miller	ALS JOB#:	1107042
CLIENT PROJECT:	STCG-0403	ALS SAMPLE#:	-05
CLIENT SAMPLE ID	MW-8	DATE RECEIVED:	7/13/2011
		COLLECTION DATE:	7/13/2011 09:45
		WDOE ACCREDITATION:	C601

DATA RESULTS

ANALYTE	METHOD	RESULTS	REPORTING LIMITS	DILUTION FACTOR	UNITS	ANALYSIS DATE	ANALYSIS BY
TPH-Volatile Range	NWTPH-GX	U	50	1	UG/L	07/13/2011	DLC
Methyl T-Butyl Ether	EPA-8021	27	3.0	1	UG/L	07/13/2011	DLC
Benzene	EPA-8021	U	1.0	1	UG/L	07/13/2011	DLC
Toluene	EPA-8021	U	1.0	1	UG/L	07/13/2011	DLC
Ethylbenzene	EPA-8021	U	1.0	1	UG/L	07/13/2011	DLC
Xylenes	EPA-8021	U	3.0	1	UG/L	07/13/2011	DLC
Methyl T-Butyl Ether	EPA-8260	25	2.0	1	UG/L	07/14/2011	GAP
Sulfate	EPA-300.0	42	2.6	10	MG/L	07/14/2011	GAP

SURROGATE	METHOD	%REC	ANALYSIS DATE	ANALYSIS BY
TFT	NWTPH-GX	105	07/13/2011	DLC
TFT	EPA-8021	130	07/13/2011	DLC
1,2-Dichloroethane-d4	EPA-8260	96.8	07/14/2011	GAP
Toluene-d8	EPA-8260	106	07/14/2011	GAP
4-Bromofluorobenzene	EPA-8260	88.7	07/14/2011	GAP

U - Analyte analyzed for but not detected at level above reporting limit.



CERTIFICATE OF ANALYSIS

CLIENT: Antea Group DATE: 7/15/2011
 4006 - 148th Ave NE ALS SDG#: 1107042
 Redmond, WA 98052 WDOE ACCREDITATION: C601

CLIENT CONTACT: Matt Miller
 CLIENT PROJECT: STCG-0403

LABORATORY BLANK RESULTS

MBG-071211W - Batch 1929 - Water by NWTPH-GX

ANALYTE	METHOD	RESULTS	REPORTING LIMITS	DILUTION FACTOR	UNITS	ANALYSIS DATE	ANALYSIS BY
TPH-Volatile Range	NWTPH-GX	U	50	1	UG/L	07/12/2011	DLC

MB-071211W - Batch 1929 - Water by EPA-8021

ANALYTE	METHOD	RESULTS	REPORTING LIMITS	DILUTION FACTOR	UNITS	ANALYSIS DATE	ANALYSIS BY
Methyl T-Butyl Ether	EPA-8021	U	3.0	1	UG/L	07/12/2011	DLC
Benzene	EPA-8021	U	1.0	1	UG/L	07/12/2011	DLC
Toluene	EPA-8021	U	1.0	1	UG/L	07/12/2011	DLC
Ethylbenzene	EPA-8021	U	1.0	1	UG/L	07/12/2011	DLC
Xylenes	EPA-8021	U	3.0	1	UG/L	07/12/2011	DLC

MB-071111W - Batch 1923 - Water by EPA-8260

ANALYTE	METHOD	RESULTS	REPORTING LIMITS	DILUTION FACTOR	UNITS	ANALYSIS DATE	ANALYSIS BY
1,1-Dichloroethene	EPA-8260	U	2.0	1	UG/L	07/11/2011	GAP
Methyl T-Butyl Ether	EPA-8260	U	2.0	1	UG/L	07/11/2011	GAP
Toluene	EPA-8260	U	2.0	1	UG/L	07/11/2011	GAP

MBLK-7142011 - Batch R74099 - Water by EPA-300.0

ANALYTE	METHOD	RESULTS	REPORTING LIMITS	DILUTION FACTOR	UNITS	ANALYSIS DATE	ANALYSIS BY
Sulfate	EPA-300.0	U	0.26	1	MG/L	07/14/2011	GAP



CERTIFICATE OF ANALYSIS

CLIENT: Antea Group
4006 - 148th Ave NE
Redmond, WA 98052

DATE: 7/15/2011
ALS SDG#: 1107042
WDOE ACCREDITATION: C601

CLIENT CONTACT: Matt Miller
CLIENT PROJECT: STCG-0403

LABORATORY CONTROL SAMPLE RESULTS

ALS Test Batch ID: 1929 - Water by NWTPH-GX

SPIKED COMPOUND	METHOD	%REC	RPD	QUAL	ANALYSIS DATE	ANALYSIS BY
TPH-Volatile Range - BS	NWTPH-GX	74.9			07/12/2011	DLC
TPH-Volatile Range - BSD	NWTPH-GX	83.9	11		07/12/2011	DLC

ALS Test Batch ID: 1929 - Water by EPA-8021

SPIKED COMPOUND	METHOD	%REC	RPD	QUAL	ANALYSIS DATE	ANALYSIS BY
Methyl T-Butyl Ether - BS	EPA-8021	96.4			07/12/2011	DLC
Methyl T-Butyl Ether - BSD	EPA-8021	97.0	1		07/12/2011	DLC
Benzene - BS	EPA-8021	104			07/12/2011	DLC
Benzene - BSD	EPA-8021	104	0		07/12/2011	DLC
Toluene - BS	EPA-8021	99.8			07/12/2011	DLC
Toluene - BSD	EPA-8021	100	0		07/12/2011	DLC
Ethylbenzene - BS	EPA-8021	96.5			07/12/2011	DLC
Ethylbenzene - BSD	EPA-8021	96.9	0		07/12/2011	DLC
Xylenes - BS	EPA-8021	97.7			07/12/2011	DLC
Xylenes - BSD	EPA-8021	98.1	0		07/12/2011	DLC

ALS Test Batch ID: 1923 - Water by EPA-8260

SPIKED COMPOUND	METHOD	%REC	RPD	QUAL	ANALYSIS DATE	ANALYSIS BY
1,1-Dichloroethene - BS	EPA-8260	117			07/11/2011	GAP
1,1-Dichloroethene - BSD	EPA-8260	116	1		07/11/2011	GAP
Toluene - BS	EPA-8260	101			07/11/2011	GAP
Toluene - BSD	EPA-8260	89.8	12		07/11/2011	GAP

ALS Test Batch ID: R74099 - Water by EPA-300.0

SPIKED COMPOUND	METHOD	%REC	RPD	QUAL	ANALYSIS DATE	ANALYSIS BY
Sulfate - BS	EPA-300.0	93.0			07/14/2011	GAP
Sulfate - BSD	EPA-300.0	96.0	3		07/14/2011	GAP

APPROVED BY

Laboratory Director



ALS Environmental
 8620 Holly Drive, Suite 100
 Everett, WA 98208
 Phone (425) 356-2600
 (206) 292-9059 Seattle
 (425) 356-2626 Fax
 http://www.alsglobal.com

Chain Of Custody/ Laboratory Analysis Request

ALS Job# (Laboratory Use Only)

1107042

Date 7/13/11 Page 1 Of 1

PROJECT ID: STWT - 0403 REPORT TO COMPANY: Antea Group PROJECT MANAGER: Matt Miller ADDRESS: 4006 148th Ave NE Redmond, WA PHONE: 425-498-7722 FAX: P.O. NUMBER: E-MAIL: INVOICE TO COMPANY: Sam ATTENTION: ADDRESS:					ANALYSIS REQUESTED										OTHER (Specify)								
					NWTPH-HCID	NWTPH-DX	NWTPH-GX	BTEX by EPA-8021	MTBE by EPA-8021 <input checked="" type="checkbox"/> EPA-8260	Halogenated Volatiles by EPA 8260	Volatile Organic Compounds by EPA 8260	EDB / EDC by EPA 8260 SIM (water)	EDB / EDC by EPA 8260 (soil)	Semivolatile Organic Compounds by EPA 8270	Polycyclic Aromatic Hydrocarbons (PAH) by EPA-8270 SIM	PCB <input type="checkbox"/> Pesticides <input type="checkbox"/> by EPA 8081/8082	Metals-MTCA-5 <input type="checkbox"/> RCRA-8 <input type="checkbox"/> Pri Pol <input type="checkbox"/> TAL <input type="checkbox"/>	Metals Other (Specify)	TCLP-Metals <input type="checkbox"/> VOA <input type="checkbox"/> Semi-Vol <input type="checkbox"/> Pest <input type="checkbox"/> Herbs <input type="checkbox"/>			NUMBER OF CONTAINERS	RECEIVED IN GOOD CONDITION?
SAMPLE I.D. DATE TIME TYPE LAB#																							
1. TW-1					7/13/11	1100	W		1													3	
2. TW-1					7/13/11	1020	W		2													3	
3. TW-2					7/13/11	1035	W		3													3	
4. MW-7					7/13/11	1005	W		4													3	
5. MW-8					7/13/11	0945	W		5													3	
6.																							
7.																							
8.																							
9.																							
10.																							

LABORATORY COPY

SPECIAL INSTRUCTIONS: Please confirm MTBE via 8260 3 Addl per CDC

SIGNATURES (Name, Company, Date, Time):
 1. Relinquished By: [Signature] 7/13/11 2:05pm
 Received By: [Signature] ACS, 7/13/11 2:05pm
 2. Relinquished By:
 Received By:

TURNAROUND REQUESTED in Business Days*
 Organic, Metals & Inorganic Analysis OTHER:
 10 5 3 2 1 SAME DAY Specify:
 Standard
 Fuels & Hydrocarbon Analysis
 2 3 1 SAME DAY
 Standard

* Turnaround request less than standard may incur Rush Charges



August 3, 2011

Mr. Matt Miller
Antea Group
4006 - 148th Ave NE
Redmond, WA 98052

Dear Mr. Miller,

On July 27th, 5 water samples were received by our laboratory and assigned our laboratory project number 1107100. The project was identified as your SGTC-4032. The sample identification and requested analyses are outlined on the attached chain of custody record.

No abnormalities or nonconformances were observed during the analyses of the project samples.

Please do not hesitate to call me if you have any questions or if I can be of further assistance.

Sincerely,

ALS Laboratory Group

Rick Bagan
Laboratory Director



CERTIFICATE OF ANALYSIS

CLIENT: Antea Group DATE: 8/3/2011
4006 - 148th Ave NE ALS JOB#: 1107100
Redmond, WA 98052 ALS SAMPLE#: -01
CLIENT CONTACT: Matt Miller DATE RECEIVED: 7/27/2011
CLIENT PROJECT: SGTC-4032 COLLECTION DATE: 7/25/2011 14:00
CLIENT SAMPLE ID MW-1 WDOE ACCREDITATION: C601

DATA RESULTS

ANALYTE	METHOD	RESULTS	REPORTING LIMITS	DILUTION FACTOR	UNITS	ANALYSIS DATE	ANALYSIS BY
TPH-Volatile Range	NWTPH-GX	94	50	1	UG/L	07/28/2011	DLC
Methyl T-Butyl Ether	EPA-8021	U	3.0	1	UG/L	07/28/2011	DLC
Benzene	EPA-8021	U	1.0	1	UG/L	07/28/2011	DLC
Toluene	EPA-8021	U	1.0	1	UG/L	07/28/2011	DLC
Ethylbenzene	EPA-8021	U	1.0	1	UG/L	07/28/2011	DLC
Xylenes	EPA-8021	U	3.0	1	UG/L	07/28/2011	DLC
Sulfate	EPA-300.0	2.7	0.26	1	MG/L	07/28/2011	GAP
Lead	EPA-6020	U	0.62	1	UG/L	08/01/2011	RAL

SURROGATE	METHOD	%REC	ANALYSIS DATE	ANALYSIS BY
TFT	NWTPH-GX	109	07/28/2011	DLC
TFT	EPA-8021	121	07/28/2011	DLC

U - Analyte analyzed for but not detected at level above reporting limit.
Chromatogram indicates that it is likely that sample contains highly weathered gasoline.



CERTIFICATE OF ANALYSIS

CLIENT:	Antea Group 4006 - 148th Ave NE Redmond, WA 98052	DATE:	8/3/2011
CLIENT CONTACT:	Matt Miller	ALS JOB#:	1107100
CLIENT PROJECT:	SGTC-4032	ALS SAMPLE#:	-02
CLIENT SAMPLE ID	MW-7	DATE RECEIVED:	7/27/2011
		COLLECTION DATE:	7/25/2011 13:15
		WDOE ACCREDITATION:	C601

DATA RESULTS

ANALYTE	METHOD	RESULTS	REPORTING LIMITS	DILUTION FACTOR	UNITS	ANALYSIS DATE	ANALYSIS BY
TPH-Volatile Range	NWTPH-GX	58	50	1	UG/L	07/28/2011	DLC
Methyl T-Butyl Ether	EPA-8021	U	3.0	1	UG/L	07/28/2011	DLC
Benzene	EPA-8021	U	1.0	1	UG/L	07/28/2011	DLC
Toluene	EPA-8021	U	1.0	1	UG/L	07/28/2011	DLC
Ethylbenzene	EPA-8021	U	1.0	1	UG/L	07/28/2011	DLC
Xylenes	EPA-8021	U	3.0	1	UG/L	07/28/2011	DLC
Sulfate	EPA-300.0	17	0.26	1	MG/L	07/28/2011	GAP
Lead	EPA-6020	U	0.62	1	UG/L	08/01/2011	RAL

SURROGATE	METHOD	%REC	ANALYSIS DATE	ANALYSIS BY
TFT	NWTPH-GX	100	07/28/2011	DLC
TFT	EPA-8021	114	07/28/2011	DLC

U - Analyte analyzed for but not detected at level above reporting limit.
Chromatogram indicates that it is likely that sample contains highly weathered gasoline.



CERTIFICATE OF ANALYSIS

CLIENT:	Antea Group 4006 - 148th Ave NE Redmond, WA 98052	DATE:	8/3/2011
CLIENT CONTACT:	Matt Miller	ALS JOB#:	1107100
CLIENT PROJECT:	SGTC-4032	ALS SAMPLE#:	-03
CLIENT SAMPLE ID	MW-8	DATE RECEIVED:	7/27/2011
		COLLECTION DATE:	7/25/2011 13:00
		WDOE ACCREDITATION:	C601

DATA RESULTS

ANALYTE	METHOD	RESULTS	REPORTING LIMITS	DILUTION FACTOR	UNITS	ANALYSIS DATE	ANALYSIS BY
TPH-Volatile Range	NWTPH-GX	U	50	1	UG/L	07/28/2011	DLC
Methyl T-Butyl Ether	EPA-8021	6.7	3.0	1	UG/L	07/28/2011	DLC
Benzene	EPA-8021	U	1.0	1	UG/L	07/28/2011	DLC
Toluene	EPA-8021	U	1.0	1	UG/L	07/28/2011	DLC
Ethylbenzene	EPA-8021	U	1.0	1	UG/L	07/28/2011	DLC
Xylenes	EPA-8021	U	3.0	1	UG/L	07/28/2011	DLC
Methyl T-Butyl Ether	EPA-8260	7.7	2.0	1	UG/L	08/02/2011	GAP
Sulfate	EPA-300.0	70	26	100	MG/L	07/29/2011	GAP
Lead	EPA-6020	U	0.62	1	UG/L	08/01/2011	RAL

SURROGATE	METHOD	%REC	ANALYSIS DATE	ANALYSIS BY
TFT	NWTPH-GX	98.2	07/28/2011	DLC
TFT	EPA-8021	114	07/28/2011	DLC
1,2-Dichloroethane-d4	EPA-8260	112	08/02/2011	GAP
Toluene-d8	EPA-8260	88.3	08/02/2011	GAP
4-Bromofluorobenzene	EPA-8260	105	08/02/2011	GAP

U - Analyte analyzed for but not detected at level above reporting limit.



CERTIFICATE OF ANALYSIS

CLIENT:	Antea Group 4006 - 148th Ave NE Redmond, WA 98052	DATE:	8/3/2011
CLIENT CONTACT:	Matt Miller	ALS JOB#:	1107100
CLIENT PROJECT:	SGTC-4032	ALS SAMPLE#:	-04
CLIENT SAMPLE ID	TW-1	DATE RECEIVED:	7/27/2011
		COLLECTION DATE:	7/25/2011 13:30
		WDOE ACCREDITATION:	C601

DATA RESULTS

ANALYTE	METHOD	RESULTS	REPORTING LIMITS	DILUTION FACTOR	UNITS	ANALYSIS DATE	ANALYSIS BY
TPH-Volatile Range	NWTPH-GX	410	50	1	UG/L	07/28/2011	DLC
Methyl T-Butyl Ether	EPA-8021	U	3.0	1	UG/L	07/28/2011	DLC
Benzene	EPA-8021	14	1.0	1	UG/L	07/28/2011	DLC
Toluene	EPA-8021	U	1.0	1	UG/L	07/28/2011	DLC
Ethylbenzene	EPA-8021	7.6	1.0	1	UG/L	07/28/2011	DLC
Xylenes	EPA-8021	U	3.0	1	UG/L	07/28/2011	DLC
Sulfate	EPA-300.0	150	5.2	20	MG/L	07/29/2011	GAP
Lead	EPA-6020	2.2	0.62	1	UG/L	08/01/2011	RAL

SURROGATE	METHOD	%REC	ANALYSIS DATE	ANALYSIS BY
TFT	NWTPH-GX	92.4	07/28/2011	DLC
TFT	EPA-8021	113	07/28/2011	DLC

U - Analyte analyzed for but not detected at level above reporting limit.
Chromatogram indicates that it is likely that sample contains weathered gasoline.



CERTIFICATE OF ANALYSIS

CLIENT:	Antea Group 4006 - 148th Ave NE Redmond, WA 98052	DATE:	8/3/2011
CLIENT CONTACT:	Matt Miller	ALS JOB#:	1107100
CLIENT PROJECT:	SGTC-4032	ALS SAMPLE#:	-05
CLIENT SAMPLE ID	TW-2	DATE RECEIVED:	7/27/2011
		COLLECTION DATE:	7/25/2011 13:45
		WDOE ACCREDITATION:	C601

DATA RESULTS

ANALYTE	METHOD	RESULTS	REPORTING LIMITS	DILUTION FACTOR	UNITS	ANALYSIS DATE	ANALYSIS BY
TPH-Volatile Range	NWTPH-GX	5900	500	10	UG/L	07/29/2011	DLC
Methyl T-Butyl Ether	EPA-8021	U	30	10	UG/L	07/29/2011	DLC
Benzene	EPA-8021	1200	50	50	UG/L	07/29/2011	DLC
Toluene	EPA-8021	38	10	10	UG/L	07/29/2011	DLC
Ethylbenzene	EPA-8021	650	10	10	UG/L	07/29/2011	DLC
Xylenes	EPA-8021	750	30	10	UG/L	07/29/2011	DLC
Sulfate	EPA-300.0	U	0.26	1	MG/L	07/29/2011	GAP
Lead	EPA-6020	6.1	0.62	1	UG/L	08/01/2011	RAL

SURROGATE	METHOD	%REC	ANALYSIS DATE	ANALYSIS BY
TFT 10X Dilution	NWTPH-GX	85.5	07/29/2011	DLC
TFT 10X Dilution	EPA-8021	105	07/29/2011	DLC
TFT 50X Dilution	EPA-8021	105	07/29/2011	DLC

U - Analyte analyzed for but not detected at level above reporting limit.
Chromatogram indicates that it is likely that sample contains weathered gasoline.



CERTIFICATE OF ANALYSIS

CLIENT: Antea Group DATE: 8/3/2011
 4006 - 148th Ave NE ALS SDG#: 1107100
 Redmond, WA 98052 WDOE ACCREDITATION: C601

CLIENT CONTACT: Matt Miller
 CLIENT PROJECT: SGTC-4032

LABORATORY BLANK RESULTS

MBG-072811W - Batch 1967 - Water by NWTPH-GX

ANALYTE	METHOD	RESULTS	REPORTING LIMITS	DILUTION FACTOR	UNITS	ANALYSIS DATE	ANALYSIS BY
TPH-Volatile Range	NWTPH-GX	U	50	1	UG/L	07/28/2011	DLC

MB-072811W - Batch 1967 - Water by EPA-8021

ANALYTE	METHOD	RESULTS	REPORTING LIMITS	DILUTION FACTOR	UNITS	ANALYSIS DATE	ANALYSIS BY
Methyl T-Butyl Ether	EPA-8021	U	3.0	1	UG/L	07/28/2011	DLC
Benzene	EPA-8021	U	1.0	1	UG/L	07/28/2011	DLC
Toluene	EPA-8021	U	1.0	1	UG/L	07/28/2011	DLC
Ethylbenzene	EPA-8021	U	1.0	1	UG/L	07/28/2011	DLC
Xylenes	EPA-8021	U	3.0	1	UG/L	07/28/2011	DLC

MB-080111W2 - Batch 1977 - Water by EPA-8260

ANALYTE	METHOD	RESULTS	REPORTING LIMITS	DILUTION FACTOR	UNITS	ANALYSIS DATE	ANALYSIS BY
1,1-Dichloroethene	EPA-8260	U	2.0	1	UG/L	08/01/2011	GAP
Methyl T-Butyl Ether	EPA-8260	U	2.0	1	UG/L	08/01/2011	GAP
Toluene	EPA-8260	U	2.0	1	UG/L	08/01/2011	GAP

MBLK-7282011 - Batch R74231 - Water by EPA-300.0

ANALYTE	METHOD	RESULTS	REPORTING LIMITS	DILUTION FACTOR	UNITS	ANALYSIS DATE	ANALYSIS BY
Sulfate	EPA-300.0	U	0.26	1	MG/L	07/28/2011	GAP

MB-072911W - Batch 1968 - Water by EPA-6020

ANALYTE	METHOD	RESULTS	REPORTING LIMITS	DILUTION FACTOR	UNITS	ANALYSIS DATE	ANALYSIS BY
Lead	EPA-6020	U	0.62	1	UG/L	08/01/2011	RAL



CERTIFICATE OF ANALYSIS

CLIENT: Antea Group
4006 - 148th Ave NE
Redmond, WA 98052

DATE: 8/3/2011
ALS SDG#: 1107100
WDOE ACCREDITATION: C601

CLIENT CONTACT: Matt Miller
CLIENT PROJECT: SGTC-4032

LABORATORY CONTROL SAMPLE RESULTS

ALS Test Batch ID: 1967 - Water by NWTPH-GX

SPIKED COMPOUND	METHOD	%REC	RPD	QUAL	ANALYSIS DATE	ANALYSIS BY
TPH-Volatile Range - BS	NWTPH-GX	73.4			07/28/2011	DLC
TPH-Volatile Range - BSD	NWTPH-GX	78.1	6		07/28/2011	DLC

ALS Test Batch ID: 1967 - Water by EPA-8021

SPIKED COMPOUND	METHOD	%REC	RPD	QUAL	ANALYSIS DATE	ANALYSIS BY
Methyl T-Butyl Ether - BS	EPA-8021	90.9			07/28/2011	DLC
Methyl T-Butyl Ether - BSD	EPA-8021	92.8	2		07/28/2011	DLC
Benzene - BS	EPA-8021	99.5			07/28/2011	DLC
Benzene - BSD	EPA-8021	102	3		07/28/2011	DLC
Toluene - BS	EPA-8021	95.2			07/28/2011	DLC
Toluene - BSD	EPA-8021	97.3	2		07/28/2011	DLC
Ethylbenzene - BS	EPA-8021	92.5			07/28/2011	DLC
Ethylbenzene - BSD	EPA-8021	94.8	2		07/28/2011	DLC
Xylenes - BS	EPA-8021	92.8			07/28/2011	DLC
Xylenes - BSD	EPA-8021	95.4	3		07/28/2011	DLC

ALS Test Batch ID: 1977 - Water by EPA-8260

SPIKED COMPOUND	METHOD	%REC	RPD	QUAL	ANALYSIS DATE	ANALYSIS BY
1,1-Dichloroethene - BS	EPA-8260	80.6			08/01/2011	GAP
1,1-Dichloroethene - BSD	EPA-8260	85.7	6		08/01/2011	GAP
Toluene - BS	EPA-8260	109			08/01/2011	GAP
Toluene - BSD	EPA-8260	111	2		08/01/2011	GAP

ALS Test Batch ID: R74231 - Water by EPA-300.0

SPIKED COMPOUND	METHOD	%REC	RPD	QUAL	ANALYSIS DATE	ANALYSIS BY
Sulfate - BS	EPA-300.0	93.0			07/28/2011	GAP
Sulfate - BSD	EPA-300.0	93.0	0		07/28/2011	GAP

ALS Test Batch ID: 1968 - Water by EPA-6020

SPIKED COMPOUND	METHOD	%REC	RPD	QUAL	ANALYSIS DATE	ANALYSIS BY
Lead - BS	EPA-6020	95.2			08/01/2011	RAL
Lead - BSD	EPA-6020	94.7	1		08/01/2011	RAL

CERTIFICATE OF ANALYSIS

APPROVED BY



Laboratory Director



ALS Laboratory Group
 8620 Holly Drive, Suite 100
 Everett, WA 98208
 Phone (425) 356-2600
 (206) 292-9059 Seattle
 (425) 356-2626 Fax
 http://www.alsenviro.com

Chain Of Custody/ Laboratory Analysis Request

ALS Job# _____ (Laboratory Use Only)

1107100

Date 7/27/11 Page 1 Of 1

PROJECT ID: STUT - 0403 4032
 REPORT TO COMPANY: Antea Group
 PROJECT MANAGER: Matt Miller
 ADDRESS: 4006 148th Ave NE
Redmond, WA
 PHONE: 425-498-7722 FAX: _____
 P.O. NUMBER: _____ E-MAIL: _____
 INVOICE TO COMPANY: Antea Group
 ATTENTION: Matt Miller
 ADDRESS: _____

ANALYSIS REQUESTED

OTHER (Specify) _____

NWTPH-HCID
 NWTPH-DX
 NWTPH-GX
 BTEX by EPA-8021
 MTBE by EPA-8021 EPA-8260
 Halogenated Volatiles by EPA 8260
 Volatile Organic Compounds by EPA 8260
 EDB / EDC by EPA 8260 SIM (water)
 EDB / EDC by EPA 8260 (soil)
 Semivolatile Organic Compounds by EPA 8270
 Polycyclic Aromatic Hydrocarbons (PAH) by EPA-8270 SIM
 PCB Pesticides by EPA 8081/8082
 Metals-MTCA-5 RCRA-8 Pri Po TAL
 Metals Other (Specify) _____
 TCLP-Metals VOA Semi-Vol Pest Herbs

LABORATORY COPY

SAMPLE I.D.	DATE	TIME	TYPE	LAB#
1. MW-1	7/25/11	1400	W	1
2. MW-7	7/25/11	1315	W	2
3. MW-8	7/25/11	1300	W	3
4. TW-1	7/25/11	1330	W	4
5. TW-2	7/25/11	1345	W	5
6.				
7.				
8.				
9.				
10.				

	NWTPH-HCID	NWTPH-DX	NWTPH-GX	BTEX by EPA-8021	MTBE by EPA-8021 <input type="checkbox"/> EPA-8260	Halogenated Volatiles by EPA 8260	Volatile Organic Compounds by EPA 8260	EDB / EDC by EPA 8260 SIM (water)	EDB / EDC by EPA 8260 (soil)	Semivolatile Organic Compounds by EPA 8270	Polycyclic Aromatic Hydrocarbons (PAH) by EPA-8270 SIM <input type="checkbox"/>	PCB <input type="checkbox"/> Pesticides <input type="checkbox"/> by EPA 8081/8082	Metals-MTCA-5 <input type="checkbox"/> RCRA-8 <input type="checkbox"/> Pri Po <input type="checkbox"/> TAL <input type="checkbox"/>	Metals Other (Specify)	TCLP-Metals <input type="checkbox"/> VOA <input type="checkbox"/> Semi-Vol <input type="checkbox"/> Pest <input type="checkbox"/> Herbs <input type="checkbox"/>	NUMBER OF CONTAINERS	RECEIVED IN GOOD CONDITION?		
1. MW-1				X	X											X	X	3	
2. MW-7				X	X											X	X	3	
3. MW-8				X	X											X	X	3	⊗
4. TW-1				X	X											X	X	3	
5. TW-2				X	X											X	X	3	

SPECIAL INSTRUCTIONS please confirm MTBE via 8260 B ⊗ Added 8/1/11

SIGNATURES (Name, Company, Date, Time):
 1. Relinquished By: [Signature] 7/27/11
 Received By: [Signature] ALS 7/27/11 1250
 2. Relinquished By: _____
 Received By: _____

TURNAROUND REQUESTED in Business Days*
 Organic, Metals & Inorganic Analysis
 Standard 5 3 2 1 SAME DAY
 Fuels & Hydrocarbon Analysis
 Standard 3 1 SAME DAY

OTHER:
 Specify: added lead per Matt
7/27/11. S

* Turnaround request less than standard may incur Rush Charges



September 30, 2011

Mr. Joe Rounds
Antea Group
4006 - 148th Ave NE
Redmond, WA 98052

Dear Mr. Rounds,

On September 23rd, 11 samples were received by our laboratory and assigned our laboratory project number 1109104. The project was identified as your STCG-403. The sample identification and requested analyses are outlined on the attached chain of custody record.

No abnormalities or nonconformances were observed during the analyses of the project samples.

Please do not hesitate to call me if you have any questions or if I can be of further assistance.

Sincerely,

ALS Laboratory Group

Rick Bagan
Laboratory Director



CERTIFICATE OF ANALYSIS

CLIENT:	Antea Group	DATE:	9/30/2011
	4006 - 148th Ave NE	ALS JOB#:	1109104
	Redmond, WA 98052	ALS SAMPLE#:	-01
CLIENT CONTACT:	Joe Rounds	DATE RECEIVED:	9/23/2011
CLIENT PROJECT:	STCG-403	COLLECTION DATE:	9/23/2011 08:50
CLIENT SAMPLE ID	MW-1	WDOE ACCREDITATION:	C601

DATA RESULTS

ANALYTE	METHOD	RESULTS	REPORTING LIMITS	DILUTION FACTOR	UNITS	ANALYSIS DATE	ANALYSIS BY
TPH-Volatile Range	NWTPH-GX	250	50	1	UG/L	09/24/2011	DLC
Methyl T-Butyl Ether	EPA-8021	U	3.0	1	UG/L	09/24/2011	DLC
Benzene	EPA-8021	U	1.0	1	UG/L	09/24/2011	DLC
Toluene	EPA-8021	U	1.0	1	UG/L	09/24/2011	DLC
Ethylbenzene	EPA-8021	1.5	1.0	1	UG/L	09/24/2011	DLC
Xylenes	EPA-8021	U	3.0	1	UG/L	09/24/2011	DLC
Sulfate	EPA-300.0	1.4	0.26	1	MG/L	09/23/2011	GAP
Lead	EPA-6020	U	0.30	1	UG/L	09/28/2011	RAL

SURROGATE	METHOD	%REC	ANALYSIS DATE	ANALYSIS BY
TFT	NWTPH-GX	76.0	09/24/2011	DLC
TFT	EPA-8021	100	09/24/2011	DLC

U - Analyte analyzed for but not detected at level above reporting limit.
 Chromatogram indicates that it is likely that sample contains highly weathered gasoline.



CERTIFICATE OF ANALYSIS

CLIENT:	Antea Group 4006 - 148th Ave NE Redmond, WA 98052	DATE:	9/30/2011
CLIENT CONTACT:	Joe Rounds	ALS JOB#:	1109104
CLIENT PROJECT:	STCG-403	ALS SAMPLE#:	-02
CLIENT SAMPLE ID	MW-2	DATE RECEIVED:	9/23/2011
		COLLECTION DATE:	9/23/2011 10:40
		WDOE ACCREDITATION:	C601

DATA RESULTS

ANALYTE	METHOD	RESULTS	REPORTING LIMITS	DILUTION FACTOR	UNITS	ANALYSIS DATE	ANALYSIS BY
TPH-Volatile Range	NWTPH-GX	U	50	1	UG/L	09/24/2011	DLC
Methyl T-Butyl Ether	EPA-8021	U	3.0	1	UG/L	09/24/2011	DLC
Benzene	EPA-8021	U	1.0	1	UG/L	09/24/2011	DLC
Toluene	EPA-8021	U	1.0	1	UG/L	09/24/2011	DLC
Ethylbenzene	EPA-8021	U	1.0	1	UG/L	09/24/2011	DLC
Xylenes	EPA-8021	U	3.0	1	UG/L	09/24/2011	DLC
Lead	EPA-6020	12	0.30	1	UG/L	09/28/2011	RAL

SURROGATE	METHOD	%REC	ANALYSIS DATE	ANALYSIS BY
TFT	NWTPH-GX	87.3	09/24/2011	DLC
TFT	EPA-8021	103	09/24/2011	DLC

U - Analyte analyzed for but not detected at level above reporting limit.



CERTIFICATE OF ANALYSIS

CLIENT:	Antea Group 4006 - 148th Ave NE Redmond, WA 98052	DATE:	9/30/2011
CLIENT CONTACT:	Joe Rounds	ALS JOB#:	1109104
CLIENT PROJECT:	STCG-403	ALS SAMPLE#:	-03
CLIENT SAMPLE ID	MW-3	DATE RECEIVED:	9/23/2011
		COLLECTION DATE:	9/23/2011 08:00
		WDOE ACCREDITATION:	C601

DATA RESULTS

ANALYTE	METHOD	RESULTS	REPORTING LIMITS	DILUTION FACTOR	UNITS	ANALYSIS DATE	ANALYSIS BY
TPH-Volatile Range	NWTPH-GX	U	50	1	UG/L	09/24/2011	DLC
Methyl T-Butyl Ether	EPA-8021	U	3.0	1	UG/L	09/24/2011	DLC
Benzene	EPA-8021	U	1.0	1	UG/L	09/24/2011	DLC
Toluene	EPA-8021	U	1.0	1	UG/L	09/24/2011	DLC
Ethylbenzene	EPA-8021	U	1.0	1	UG/L	09/24/2011	DLC
Xylenes	EPA-8021	U	3.0	1	UG/L	09/24/2011	DLC
Lead	EPA-6020	U	0.30	1	UG/L	09/28/2011	RAL

SURROGATE	METHOD	%REC	ANALYSIS DATE	ANALYSIS BY
TFT	NWTPH-GX	79.4	09/24/2011	DLC
TFT	EPA-8021	94.5	09/24/2011	DLC

U - Analyte analyzed for but not detected at level above reporting limit.



CERTIFICATE OF ANALYSIS

CLIENT:	Antea Group 4006 - 148th Ave NE Redmond, WA 98052	DATE:	9/30/2011
CLIENT CONTACT:	Joe Rounds	ALS JOB#:	1109104
CLIENT PROJECT:	STCG-403	ALS SAMPLE#:	-04
CLIENT SAMPLE ID	MW-4	DATE RECEIVED:	9/23/2011
		COLLECTION DATE:	9/23/2011 11:00
		WDOE ACCREDITATION:	C601

DATA RESULTS

ANALYTE	METHOD	RESULTS	REPORTING LIMITS	DILUTION FACTOR	UNITS	ANALYSIS DATE	ANALYSIS BY
TPH-Volatile Range	NWTPH-GX	U	50	1	UG/L	09/24/2011	DLC
Methyl T-Butyl Ether	EPA-8021	U	3.0	1	UG/L	09/24/2011	DLC
Benzene	EPA-8021	U	1.0	1	UG/L	09/24/2011	DLC
Toluene	EPA-8021	U	1.0	1	UG/L	09/24/2011	DLC
Ethylbenzene	EPA-8021	U	1.0	1	UG/L	09/24/2011	DLC
Xylenes	EPA-8021	U	3.0	1	UG/L	09/24/2011	DLC
Lead	EPA-6020	U	0.30	1	UG/L	09/28/2011	RAL

SURROGATE	METHOD	%REC	ANALYSIS DATE	ANALYSIS BY
TFT	NWTPH-GX	79.0	09/24/2011	DLC
TFT	EPA-8021	95.9	09/24/2011	DLC

U - Analyte analyzed for but not detected at level above reporting limit.

CERTIFICATE OF ANALYSIS

CLIENT:	Antea Group 4006 - 148th Ave NE Redmond, WA 98052	DATE:	9/30/2011
CLIENT CONTACT:	Joe Rounds	ALS JOB#:	1109104
CLIENT PROJECT:	STCG-403	ALS SAMPLE#:	-05
CLIENT SAMPLE ID	MW-5	DATE RECEIVED:	9/23/2011
		COLLECTION DATE:	9/23/2011 09:55
		WDOE ACCREDITATION:	C601

DATA RESULTS

ANALYTE	METHOD	RESULTS	REPORTING LIMITS	DILUTION FACTOR	UNITS	ANALYSIS DATE	ANALYSIS BY
TPH-Volatile Range	NWTPH-GX	U	50	1	UG/L	09/24/2011	DLC
Methyl T-Butyl Ether	EPA-8021	U	3.0	1	UG/L	09/24/2011	DLC
Benzene	EPA-8021	U	1.0	1	UG/L	09/24/2011	DLC
Toluene	EPA-8021	U	1.0	1	UG/L	09/24/2011	DLC
Ethylbenzene	EPA-8021	U	1.0	1	UG/L	09/24/2011	DLC
Xylenes	EPA-8021	U	3.0	1	UG/L	09/24/2011	DLC

SURROGATE	METHOD	%REC	ANALYSIS DATE	ANALYSIS BY
TFT	NWTPH-GX	80.4	09/24/2011	DLC
TFT	EPA-8021	98.6	09/24/2011	DLC

U - Analyte analyzed for but not detected at level above reporting limit.



CERTIFICATE OF ANALYSIS

CLIENT:	Antea Group 4006 - 148th Ave NE Redmond, WA 98052	DATE:	9/30/2011
CLIENT CONTACT:	Joe Rounds	ALS JOB#:	1109104
CLIENT PROJECT:	STCG-403	ALS SAMPLE#:	-06
CLIENT SAMPLE ID	MW-7	DATE RECEIVED:	9/23/2011
		COLLECTION DATE:	9/23/2011 09:10
		WDOE ACCREDITATION:	C601

DATA RESULTS

ANALYTE	METHOD	RESULTS	REPORTING LIMITS	DILUTION FACTOR	UNITS	ANALYSIS DATE	ANALYSIS BY
TPH-Volatile Range	NWTPH-GX	U	50	1	UG/L	09/24/2011	DLC
Methyl T-Butyl Ether	EPA-8021	U	3.0	1	UG/L	09/24/2011	DLC
Benzene	EPA-8021	U	1.0	1	UG/L	09/24/2011	DLC
Toluene	EPA-8021	U	1.0	1	UG/L	09/24/2011	DLC
Ethylbenzene	EPA-8021	U	1.0	1	UG/L	09/24/2011	DLC
Xylenes	EPA-8021	U	3.0	1	UG/L	09/24/2011	DLC
Sulfate	EPA-300.0	12	0.26	1	MG/L	09/23/2011	GAP
Lead	EPA-6020	U	0.30	1	UG/L	09/28/2011	RAL

SURROGATE	METHOD	%REC	ANALYSIS DATE	ANALYSIS BY
TFT	NWTPH-GX	74.8	09/24/2011	DLC
TFT	EPA-8021	101	09/24/2011	DLC

U - Analyte analyzed for but not detected at level above reporting limit.



CERTIFICATE OF ANALYSIS

CLIENT:	Antea Group 4006 - 148th Ave NE Redmond, WA 98052	DATE:	9/30/2011
CLIENT CONTACT:	Joe Rounds	ALS JOB#:	1109104
CLIENT PROJECT:	STCG-403	ALS SAMPLE#:	-07
CLIENT SAMPLE ID	MW-8	DATE RECEIVED:	9/23/2011
		COLLECTION DATE:	9/23/2011 08:20
		WDOE ACCREDITATION:	C601

DATA RESULTS

ANALYTE	METHOD	RESULTS	REPORTING LIMITS	DILUTION FACTOR	UNITS	ANALYSIS DATE	ANALYSIS BY
TPH-Volatile Range	NWTPH-GX	U	50	1	UG/L	09/24/2011	DLC
Benzene	EPA-8021	U	1.0	1	UG/L	09/24/2011	DLC
Toluene	EPA-8021	U	1.0	1	UG/L	09/24/2011	DLC
Ethylbenzene	EPA-8021	U	1.0	1	UG/L	09/24/2011	DLC
Xylenes	EPA-8021	U	3.0	1	UG/L	09/24/2011	DLC
Methyl T-Butyl Ether	EPA-8260	42	8.0	4	UG/L	09/26/2011	GAP
Sulfate	EPA-300.0	82	2.6	10	MG/L	09/23/2011	GAP
Lead	EPA-6020	U	0.30	1	UG/L	09/28/2011	RAL

SURROGATE	METHOD	%REC	ANALYSIS DATE	ANALYSIS BY
TFT	NWTPH-GX	85.7	09/24/2011	DLC
TFT	EPA-8021	100	09/24/2011	DLC
1,2-Dichloroethane-d4 4X Dilution	EPA-8260	110	09/26/2011	GAP
Toluene-d8 4X Dilution	EPA-8260	92.8	09/26/2011	GAP
4-Bromofluorobenzene 4X Dilution	EPA-8260	99.4	09/26/2011	GAP

U - Analyte analyzed for but not detected at level above reporting limit.



CERTIFICATE OF ANALYSIS

CLIENT:	Antea Group 4006 - 148th Ave NE Redmond, WA 98052	DATE:	9/30/2011
CLIENT CONTACT:	Joe Rounds	ALS JOB#:	1109104
CLIENT PROJECT:	STCG-403	ALS SAMPLE#:	-08
CLIENT SAMPLE ID	TW-1	DATE RECEIVED:	9/23/2011
		COLLECTION DATE:	9/23/2011 09:35
		WDOE ACCREDITATION:	C601

DATA RESULTS

ANALYTE	METHOD	RESULTS	REPORTING LIMITS	DILUTION FACTOR	UNITS	ANALYSIS DATE	ANALYSIS BY
TPH-Volatile Range	NWTPH-GX	U	50	1	UG/L	09/24/2011	DLC
Methyl T-Butyl Ether	EPA-8021	U	3.0	1	UG/L	09/24/2011	DLC
Benzene	EPA-8021	U	1.0	1	UG/L	09/24/2011	DLC
Toluene	EPA-8021	U	1.0	1	UG/L	09/24/2011	DLC
Ethylbenzene	EPA-8021	U	1.0	1	UG/L	09/24/2011	DLC
Xylenes	EPA-8021	U	3.0	1	UG/L	09/24/2011	DLC
Sulfate	EPA-300.0	210	26	100	MG/L	09/23/2011	GAP
Lead	EPA-6020	2.0	0.30	1	UG/L	09/28/2011	RAL

SURROGATE	METHOD	%REC	ANALYSIS DATE	ANALYSIS BY
TFT	NWTPH-GX	80.4	09/24/2011	DLC
TFT	EPA-8021	99.3	09/24/2011	DLC

U - Analyte analyzed for but not detected at level above reporting limit.



CERTIFICATE OF ANALYSIS

CLIENT:	Antea Group 4006 - 148th Ave NE Redmond, WA 98052	DATE:	9/30/2011
CLIENT CONTACT:	Joe Rounds	ALS JOB#:	1109104
CLIENT PROJECT:	STCG-403	ALS SAMPLE#:	-09
CLIENT SAMPLE ID	TW-2	DATE RECEIVED:	9/23/2011
		COLLECTION DATE:	9/23/2011 10:15
		WDOE ACCREDITATION:	C601

DATA RESULTS

ANALYTE	METHOD	RESULTS	REPORTING LIMITS	DILUTION FACTOR	UNITS	ANALYSIS DATE	ANALYSIS BY
TPH-Volatile Range	NWTPH-GX	3600	500	10	UG/L	09/26/2011	DLC
Methyl T-Butyl Ether	EPA-8021	23	3.0	1	UG/L	09/24/2011	DLC
Benzene	EPA-8021	1000	50	50	UG/L	09/26/2011	DLC
Toluene	EPA-8021	19	1.0	1	UG/L	09/24/2011	DLC
Ethylbenzene	EPA-8021	520	10	10	UG/L	09/26/2011	DLC
Xylenes	EPA-8021	260	30	10	UG/L	09/26/2011	DLC
Sulfate	EPA-300.0	2.1	0.26	1	MG/L	09/23/2011	GAP
Lead	EPA-6020	5.3	0.30	1	UG/L	09/28/2011	RAL

SURROGATE	METHOD	%REC	ANALYSIS DATE	ANALYSIS BY
TFT 10X Dilution	NWTPH-GX	92.2	09/26/2011	DLC
TFT	EPA-8021	106	09/24/2011	DLC
TFT 10X Dilution	EPA-8021	120	09/26/2011	DLC
TFT 50X Dilution	EPA-8021	116	09/26/2011	DLC

Chromatogram indicates that it is likely that sample contains weathered gasoline.



CERTIFICATE OF ANALYSIS

CLIENT:	Antea Group 4006 - 148th Ave NE Redmond, WA 98052	DATE:	9/30/2011
CLIENT CONTACT:	Joe Rounds	ALS JOB#:	1109104
CLIENT PROJECT:	STCG-403	ALS SAMPLE#:	-10
CLIENT SAMPLE ID	TW-3	DATE RECEIVED:	9/23/2011
		COLLECTION DATE:	9/23/2011 07:45
		WDOE ACCREDITATION:	C601

DATA RESULTS

ANALYTE	METHOD	RESULTS	REPORTING LIMITS	DILUTION FACTOR	UNITS	ANALYSIS DATE	ANALYSIS BY
TPH-Volatile Range	NWTPH-GX	U	50	1	UG/L	09/24/2011	DLC
Methyl T-Butyl Ether	EPA-8021	U	3.0	1	UG/L	09/24/2011	DLC
Benzene	EPA-8021	U	1.0	1	UG/L	09/24/2011	DLC
Toluene	EPA-8021	U	1.0	1	UG/L	09/24/2011	DLC
Ethylbenzene	EPA-8021	U	1.0	1	UG/L	09/24/2011	DLC
Xylenes	EPA-8021	U	3.0	1	UG/L	09/24/2011	DLC
Lead	EPA-6020	U	0.30	1	UG/L	09/28/2011	RAL

SURROGATE	METHOD	%REC	ANALYSIS DATE	ANALYSIS BY
TFT	NWTPH-GX	84.6	09/24/2011	DLC
TFT	EPA-8021	97.1	09/24/2011	DLC

U - Analyte analyzed for but not detected at level above reporting limit.



CERTIFICATE OF ANALYSIS

CLIENT:	Antea Group 4006 - 148th Ave NE Redmond, WA 98052	DATE:	9/30/2011
CLIENT CONTACT:	Joe Rounds	ALS JOB#:	1109104
CLIENT PROJECT:	STCG-403	ALS SAMPLE#:	-11
CLIENT SAMPLE ID	B-2	DATE RECEIVED:	9/23/2011
		COLLECTION DATE:	9/23/2011 08:35
		WDOE ACCREDITATION:	C601

DATA RESULTS

ANALYTE	METHOD	RESULTS	REPORTING LIMITS	DILUTION FACTOR	UNITS	ANALYSIS DATE	ANALYSIS BY
TPH-Volatile Range	NWTPH-GX	730	50	1	UG/L	09/24/2011	DLC
Methyl T-Butyl Ether	EPA-8021	U	3.0	1	UG/L	09/24/2011	DLC
Benzene	EPA-8021	35	1.0	1	UG/L	09/24/2011	DLC
Toluene	EPA-8021	3.3	1.0	1	UG/L	09/24/2011	DLC
Ethylbenzene	EPA-8021	18	1.0	1	UG/L	09/24/2011	DLC
Xylenes	EPA-8021	13	3.0	1	UG/L	09/24/2011	DLC
Sulfate	EPA-300.0	U	0.26	1	MG/L	09/23/2011	GAP
Lead	EPA-6020	0.83	0.30	1	UG/L	09/28/2011	RAL

SURROGATE	METHOD	%REC	ANALYSIS DATE	ANALYSIS BY
TFT	NWTPH-GX	92.7	09/24/2011	DLC
TFT	EPA-8021	105	09/24/2011	DLC

U - Analyte analyzed for but not detected at level above reporting limit.
Chromatogram indicates that it is likely that sample contains weathered gasoline.



CERTIFICATE OF ANALYSIS

CLIENT:	Antea Group 4006 - 148th Ave NE Redmond, WA 98052	DATE:	9/30/2011
CLIENT CONTACT:	Joe Rounds	ALS SDG#:	1109104
CLIENT PROJECT:	STCG-403	WDOE ACCREDITATION:	C601

LABORATORY CONTROL SAMPLE RESULTS

ALS Test Batch ID: 2129 - Water by NWTPH-GX

SPIKED COMPOUND	METHOD	%REC	RPD	QUAL	ANALYSIS DATE	ANALYSIS BY
TPH-Volatile Range - BS	NWTPH-GX	71.4			09/24/2011	DLC
TPH-Volatile Range - BSD	NWTPH-GX	76.8	7		09/24/2011	DLC

ALS Test Batch ID: 2129 - Water by EPA-8021

SPIKED COMPOUND	METHOD	%REC	RPD	QUAL	ANALYSIS DATE	ANALYSIS BY
Methyl T-Butyl Ether - BS	EPA-8021	90.0			09/24/2011	DLC
Methyl T-Butyl Ether - BSD	EPA-8021	92.2	2		09/24/2011	DLC
Benzene - BS	EPA-8021	104			09/24/2011	DLC
Benzene - BSD	EPA-8021	105	1		09/24/2011	DLC
Toluene - BS	EPA-8021	100			09/24/2011	DLC
Toluene - BSD	EPA-8021	101	1		09/24/2011	DLC
Ethylbenzene - BS	EPA-8021	97.0			09/24/2011	DLC
Ethylbenzene - BSD	EPA-8021	98.1	1		09/24/2011	DLC
Xylenes - BS	EPA-8021	97.9			09/24/2011	DLC
Xylenes - BSD	EPA-8021	99.1	1		09/24/2011	DLC

ALS Test Batch ID: 2118 - Water by EPA-8260

SPIKED COMPOUND	METHOD	%REC	RPD	QUAL	ANALYSIS DATE	ANALYSIS BY
1,1-Dichloroethene - BS	EPA-8260	106			09/20/2011	GAP
1,1-Dichloroethene - BSD	EPA-8260	114	7		09/20/2011	GAP
Toluene - BS	EPA-8260	96.3			09/20/2011	GAP
Toluene - BSD	EPA-8260	105	9		09/20/2011	GAP

ALS Test Batch ID: R74905 - Water by EPA-300.0

SPIKED COMPOUND	METHOD	%REC	RPD	QUAL	ANALYSIS DATE	ANALYSIS BY
Sulfate - BS	EPA-300.0	97.0			09/23/2011	GAP
Sulfate - BSD	EPA-300.0	97.0	0		09/23/2011	GAP

ALS Test Batch ID: 2135 - Water by EPA-6020

SPIKED COMPOUND	METHOD	%REC	RPD	QUAL	ANALYSIS DATE	ANALYSIS BY
Lead - BS	EPA-6020	94.1			09/28/2011	RAL



ALS Environmental
 8620 Holly Drive, Suite 100
 Everett, WA 98208
 Phone (425) 356-2600
 (206) 292-9059 Seattle
 (425) 356-2626 Fax
 http://www.alsglobal.com

Chain Of Custody/ Laboratory Analysis Request

ALS Job# (Laboratory Use Only)

1109104

Date 9-23-11 Page 1 Of 2

PROJECT ID: STCG - 403					ANALYSIS REQUESTED										OTHER (Specify)								
REPORT TO COMPANY: ANTEA GROUP					NWTPH-HCID	NWTPH-DX	NWTPH-GX	BTEX by EPA-8021	MTBE by EPA-8021 <input checked="" type="checkbox"/> EPA-8260 <input type="checkbox"/>	Halogenated Volatiles by EPA 8260	Volatile Organic Compounds by EPA 8260	EDB / EDC by EPA 8260 SIM (water)	EDB / EDC by EPA 8260 (soil)	Semivolatile Organic Compounds by EPA 8270	Polycyclic Aromatic Hydrocarbons (PAH) by EPA-8270 SIM <input type="checkbox"/>	PCB <input type="checkbox"/> Pesticides <input type="checkbox"/> by EPA 8081/8082	Metals-MTCA-5 <input type="checkbox"/> RCRA-8 <input type="checkbox"/> Pri Pol <input type="checkbox"/> TAL <input type="checkbox"/>	Metals Other (Specify) Total Pb	TCLP-Metals <input type="checkbox"/> VOA <input type="checkbox"/> Semi-Vol <input type="checkbox"/> Pest <input type="checkbox"/> Herbs <input type="checkbox"/>	SULFATE	MTBE by 8260 Confm	NUMBER OF CONTAINERS	RECEIVED IN GOOD CONDITION?
PROJECT MANAGER: JOE ROUNDS																							
ADDRESS: 4006 148 Ave NE																							
REDMOND, WA 98052																							
PHONE: 425-498-7724 FAX:																							
P.O. NUMBER: STCG - 403-2 E-MAIL: Joe.Rounds@antea group.com																							
INVOICE TO COMPANY: Same																							
ATTENTION: Colony Claim: 214322-140																							
ADDRESS:																							
SAMPLE I.D.	DATE	TIME	TYPE	LAB#																			
1. MW-1	9-23-11	850	W	1			X	X	X								X	X					
2. MW-2		1040		2			X	X	X								X						
3. MW-3		800		3			X	X	X								X						
4. MW-4		1100		4			X	X	X								X						
5. MW-5		955		5			X	X	X								X						
6. MW-7		910		6			X	X	X								X	X					
7. MW-8		820		7			X	X	X								X	X					
8. TW-1		935		8			X	X	X								X	X					
9. TW-2		1015		9			X	X	X								X	X					
10. TW-3		745		10			X	X	X								X						

LABORATORY COPY

SPECIAL INSTRUCTIONS **PLEASE confirm MTBE detections with 8260**

SIGNATURES (Name, Company, Date, Time)
 1. Relinquished By: Dan Rahl ANTEA 9-23-11 12:25
 Received By: Shawn Robinson AU 9/23/11 12:25
 2. Relinquished By: _____
 Received By: _____

TURNAROUND REQUESTED in Business Days*
 Organic, Metals & Inorganic Analysis
 Standard 5 3 2 1 SAME DAY
 Fuels & Hydrocarbon Analysis
 Standard 3 1 SAME DAY
 OTHER: Added 9/26/11. a
 Specify: _____

* Turnaround request less than standard may incur Rush Charges



ALS Environmental
 8620 Holly Drive, Suite 100
 Everett, WA 98208
 Phone (425) 356-2600
 (206) 292-9059 Seattle
 (425) 356-2626 Fax
 http://www.alsglobal.com

Chain Of Custody/ Laboratory Analysis Request

ALS Job# (Laboratory Use Only)

1109104

Date 9-23-11 Page 2 Of 2

PROJECT ID: STCG-403					ANALYSIS REQUESTED												OTHER (Specify)														
REPORT TO COMPANY: ANTEA GROUP					NWTPH-HCID NWTPH-DX NWTPH-GX BTEX by EPA-8021 MTBE by EPA-8021 <input checked="" type="checkbox"/> EPA-8260 Halogenated Volatiles by EPA 8260 Volatile Organic Compounds by EPA 8260 EDB / EDC by EPA 8260 SIM (water) EDB / EDC by EPA 8260 (soil) Semivolatile Organic Compounds by EPA 8270 Polycyclic Aromatic Hydrocarbons (PAH) by EPA-8270 SIM <input type="checkbox"/> PCB <input type="checkbox"/> Pesticides <input type="checkbox"/> by EPA 8081/8082 Metals-MTCA-5 <input type="checkbox"/> RCRA-8 <input type="checkbox"/> PFI Pol <input type="checkbox"/> TAL <input type="checkbox"/> Metals Other (Specify) Total Pb TCLP-Metals <input type="checkbox"/> VOA <input type="checkbox"/> Semi-Vol <input type="checkbox"/> Pest <input type="checkbox"/> Herbs <input type="checkbox"/> Sulfate																										
PROJECT MANAGER: Joe Rounds																															
ADDRESS: 4006 148 AVE NE																															
REDMOND, WA 98053																															
PHONE: 425-418-7724 FAX:																															
P.O. NUMBER: STCG-403 E-MAIL:																															
INVOICE TO COMPANY: same																															
ATTENTION: Colony Claim: 214322-140																															
ADDRESS:																															
SAMPLE I.D.						DATE	TIME	TYPE	LAB#	NWTPH-HCID	NWTPH-DX	NWTPH-GX	BTEX by EPA-8021	MTBE by EPA-8021 <input checked="" type="checkbox"/> EPA-8260	Halogenated Volatiles by EPA 8260	Volatile Organic Compounds by EPA 8260	EDB / EDC by EPA 8260 SIM (water)	EDB / EDC by EPA 8260 (soil)	Semivolatile Organic Compounds by EPA 8270	Polycyclic Aromatic Hydrocarbons (PAH) by EPA-8270 SIM <input type="checkbox"/>	PCB <input type="checkbox"/> Pesticides <input type="checkbox"/> by EPA 8081/8082	Metals-MTCA-5 <input type="checkbox"/> RCRA-8 <input type="checkbox"/> PFI Pol <input type="checkbox"/> TAL <input type="checkbox"/>	Metals Other (Specify) Total Pb	TCLP-Metals <input type="checkbox"/> VOA <input type="checkbox"/> Semi-Vol <input type="checkbox"/> Pest <input type="checkbox"/> Herbs <input type="checkbox"/>	Sulfate	NUMBER OF CONTAINERS	RECEIVED IN GOOD CONDITION?				
1.	B-2	9-23-11	835	W	11																										
2.																															
3.																															
4.																															
5.																															
6.																															
7.																															
8.																															
9.																															
10.																															

LABORATORY COPY

SPECIAL INSTRUCTIONS

SIGNATURES (Name, Company, Date, Time):

1. Relinquished By: Don White ANTEA 9-23-11 12:25
 Received By: Shawn Robinson ALU 9/23/11 12:25

2. Relinquished By: _____
 Received By: _____

TURNAROUND REQUESTED in Business Days*
 Organic, Metals & Inorganic Analysis
 5 3 2 1 SAME DAY
 Standard

Fuels & Hydrocarbon Analysis
 3 1 SAME DAY
 Standard

OTHER: _____
 Specify: _____

* Turnaround request less than standard may incur Rush Charges