

QUARTERLY GROUNDWATER MONITORING/SULFATE INJECTION REPORT

Fourth Quarter of 2011

College Way Foods

2120 East College Way, Mount Vernon, Washington

*AnteaTM Group Project No. STCG-403-2
March 6, 2012*

Prepared for:
College Way Foods
2120 East College Way
Mount Vernon, WA 98273-2320

Prepared by:
AnteaTM Group
4006 148th Avenue NE
Redmond, WA 98052
800 477 7411



Antea USA, Inc.
4006 148th Avenue NE
Redmond, Washington 98052 USA
www.anteagroup.com

March 6, 2012
Ms. Darla Maney
College Way Foods
2120 East College Way
Mount Vernon, WA 98273-2320

Subject: Quarterly Groundwater Monitoring/Sulfate Injection Report - Fourth Quarter
of 2011
College Way Foods
2120 East College Way
Mount Vernon, Washington
Antea Project STCG-403-2
Colony Claim No. 214322-140

Dear Ms. Maney:

Antea™ Group (formerly Delta Consultants) has prepared this report to summarize groundwater monitoring and monthly sulfate injections performed at the above referenced site on October 31, November 28, and December 20, 2011.

GROUNDWATER SAMPLING AND ANALYSES

Before the October and December sampling events, Antea Group measured depth to water in monitoring wells MW-1, MW-7, MW-8, TW-1, and TW-2 using an electronic water level meter. Before the November sampling event, Antea Group measured depth to water in monitoring wells MW-1 through MW-5, MW-7, MW-8, TW-1 through TW-3, and B-2. Groundwater elevations (GWE) were recorded on waterproof field sheets and measured to an accuracy of 0.01 feet. Samples were withdrawn from each well using a low-flow/ low-purge technique with a peristaltic pump. Field parameters of dissolved oxygen (DO), temperature, oxygen reduction potential (ORP), conductivity, total dissolved solids, and pH were collected during low-flow/low-purge procedures. The samples were placed in the appropriate laboratory-provided containers. Samples were labeled, placed into ice filled coolers, logged onto chain-of-custody forms and transported to the laboratory. No separate-phase hydrocarbons were observed in any of the monitoring wells during each event.

During the November monitoring event, the groundwater flow direction was generally toward the west at an approximate gradient of 0.094 feet/foot. A summary of current and historical groundwater elevations is included in Table 1. A site map showing well locations and the November groundwater elevations is included as Figure 1.

All Groundwater samples were submitted to ALS Laboratory Group in Everett, Washington, and November samples were analyzed for: total petroleum hydrocarbons in the gasoline range (TPH-G) using Northwest Method NWTPH-Gx; benzene, toluene, ethylbenzene, total xylenes (BTEX), and methyl tert-butyl ether (MTBE) using Method SW8021; lead using Method SW6020; 1,2-dichloroethane (EDC) and 1,2-dibromoethane (EDB) using Method EPA-8260 SIM; naphthalene, 1-methylnaphthalene, and 2-methylnaphthalene using Method EPA-8270 SIM; and sulfate using Method EPA-300.0. October and December samples were analyzed for: TPH-G, BTEX, MTBE, and sulfate using the same methods listed above. Confirmation analysis of MTBE was run on one October sample using Method EPA-8260.

GROUNDWATER ANALYTICAL RESULTS

Laboratory analysis indicate that concentrations of TPH-G, BTEX, MTBE, lead, and naphthalene were not detected above MTCA Method A cleanup levels in the groundwater samples collected from monitoring wells MW-1, MW-3, MW-4, and MW-5, MW-8, and TW-3 during the November 28, 2011 sampling event. The concentration of TPH-G exceeded the MTCA Method A cleanup level in the groundwater samples collected from monitoring well TW-2. Benzene concentrations exceeded the MTCA Method A cleanup levels in groundwater samples collected from monitoring wells MW-2, MW-7, TW-1, TW-2, and B-2. The concentration of ethylbenzene exceeded the MTCA Method A cleanup level in groundwater samples collected from monitoring well TW-2. A summary of current and historic hydrocarbon analytical results is presented in Table 2. A summary of natural attenuation parameter measurements and analytical results is presented in Table 3. The analytical report and chain-of-custody documentation are included in Appendix A.

ENHANCED LIQUID RECOVERY

A program of enhanced liquid recovery (ELR) events commenced in December 2009 to remove residual TPH-G and BTEX compounds from the vicinity of TW-2 and B-2. ELR events were conducted on December 11, 2009, December 30, 2009, and January 20, 2010. During the first event, TW-2 was inaccessible due to ice. Extraction was performed on wells MW-1 and B-2. During the second and third events, ELR was performed on wells TW-2, MW-1, and B-2. However, the volume of water extracted from TW-2 was very low. A total of 7,203 gallons of groundwater was removed during the three ELR events. Quarterly groundwater monitoring was performed after the last ELR event. Based on the results of this first quarter 2011 groundwater monitoring, no additional ELR events were planned.

SULFATE INJECTION

Sulfate injection was proposed as an alternative remediation strategy to ELR and commenced during the second quarter of 2011. This quarter, sulfate injections took place on October 12, 2011, November 10, 2011, and December 21, 2011. During each event, 250 gallons of solution was injected into IW-1 and the injection trench. Additional sulfate injection events are planned for 2012. During past events, Antea Group attempted to inject sulfate solution into injection well IW-2. Well IW-2 did not accept the solution, most likely due to tight clays in this area. Antea Group proposed an injection trench in place of well IW-2 and installed the trench in October 2011.

REMARKS

The recommendations contained in this report represent Antea USA, Inc.'s professional opinions based upon the currently available information and are arrived at in accordance with currently accepted professional standards. This report is based upon a specific scope of work requested by the client. The contract between Antea USA, Inc. and its client outlines the scope of work, and only those tasks specifically authorized by that contract or outlined in this report were performed. This report is intended only for the use of Antea USA, Inc.'s client and anyone else specifically identified in writing by Antea USA, Inc. as a user of this report. Antea USA, Inc. will not and cannot be liable for unauthorized reliance by any other third party. Other than as contained in this paragraph, Antea USA, Inc. makes no express or implied warranty as to the contents of this report.

Antea Group appreciates the opportunity to provide environmental services to you. Please call Joe Rounds, Project Manager, at 425-498-7724 if you have any questions regarding the contents of this letter.

Antea Group appreciates the opportunity to provide environmental services to you. Please call Joe Rounds, Project Manager, at 425-498-7724 if you have any questions regarding the contents of this letter.

Sincerely,

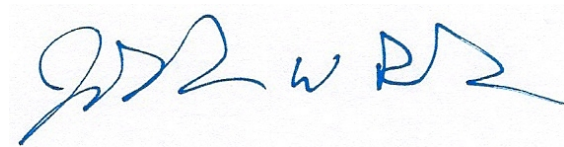

Joe Rounds
Project Manager
ANTEA GROUP



Matthew Miller, LG
Project Manager
ANTEA GROUP





Enclosure: Table 1 Groundwater Elevations
 Table 2 Groundwater Analytical Results
 Table 3 Groundwater Analytical Results - Natural Attenuation Parameters
 Figure 1 Site Map
 Appendix A Analytical Report and Chain-of-Custody Documentation

cc: Ms. Heather Vick, Washington State Department of Ecology, Bellevue, Washington
 Ms. Renae Mc Fadden, Mount Vernon Washington
 Colony Group, Richmond, Virginia
 File, Antea Group

Tables

Table 1	Groundwater Elevations
Table 2	Groundwater Analytical Results
Table 3	Groundwater Analytical Results – Natural Attenuation Parameters

TABLE 1
GROUNDWATER ELEVATIONS
COLLEGE WAY FOODS
2120 EAST COLLEGE WAY
MOUNT VERNON, WASHINGTON

Well Identification	Date	TOC Elevation (feet)	Depth to Groundwater (feet)	SPH Thickness (feet)	Groundwater Elevation (feet)
MW-1 (EW-1)	12/16/92	77.33	2.95	0.00	74.38
MW-1 (EW-1)	01/20/93	77.33	3.23	0.00	74.10
MW-1 (EW-1)	03/23/93	77.33	3.48	0.00	73.85
MW-1 (EW-1)	10/18/94	77.33	7.98	0.00	69.35
MW-1 (EW-1)	03/26/96	77.33	3.58	0.00	73.75
MW-1 (EW-1)	06/27/96	77.33	3.42	0.00	73.91
MW-1 (EW-1)	09/19/96	77.33	2.92	0.00	74.41
MW-1 (EW-1)	08/14/97	77.33	3.85	0.00	73.48
MW-1 (EW-1)	07/30/02	77.33	3.37	0.00	73.96
MW-1 (EW-1)	05/07/03	77.33	3.21	0.00	74.12
MW-1 (EW-1)	10/20/03	77.33	3.80	0.00	73.53
MW-1 (EW-1)	12/26/03	77.33	3.02	0.00	74.31
MW-1 (EW-1)	03/23/04	77.33	3.29	0.00	74.04
MW-1 (EW-1)	06/21/04	77.33	3.00	0.00	74.33
MW-1 (EW-1)	09/16/04	77.33	4.57	0.00	72.76
MW-1 (EW-1)	12/16/04	77.33	3.40	0.00	73.93
MW-1 (EW-1)	03/22/05	77.33	3.81	0.00	73.52
MW-1 (EW-1)	08/15/05	77.33	3.89	0.00	73.44
MW-1 (EW-1)	11/22/05	77.33	3.14	0.00	74.19
MW-1 (EW-1)	02/20/06	77.33	3.51	0.00	73.82
MW-1 (EW-1)	05/23/06	77.33	3.97	0.00	73.36
MW-1 (EW-1)	11/07/06	77.33	3.54	0.00	73.79
MW-1 (EW-1)	06/06/07	77.33	3.93	0.00	73.40
MW-1 (EW-1)	11/29/07	77.33	3.80	0.00	73.53
MW-1 (EW-1)	06/11/08	77.33	--	0.00	--
MW-1 (EW-1)	12/03/08	77.33	3.71	0.00	73.62
MW-1 (EW-1)	03/12/09	77.33	3.64	0.00	73.69
MW-1 (EW-1)	06/30/09	77.33	4.16	0.00	73.17
MW-1 (EW-1)	09/25/09	77.33	4.80	0.00	72.53
MW-1 (EW-1)	12/22/09	77.33	3.91	0.00	73.42
MW-1 (EW-1)	03/19/10	77.33	4.46	0.00	72.87
MW-1 (EW-1)	06/10/10	77.33	3.20	0.00	74.13
MW-1 (EW-1)	09/16/10	77.33	3.57	0.00	73.76
MW-1 (EW-1)	12/22/10	77.33	3.54	0.00	73.79
MW-1 (EW-1)	03/10/11	77.33	3.15	0.00	74.18
MW-1 (EW-1)	06/07/11	77.33	3.35	0.00	73.98
MW-1 (EW-1)	07/13/11	77.33	3.68	0.00	73.65
MW-1 (EW-1)	07/25/11	77.33	3.53	0.00	73.80
MW-1 (EW-1)	09/23/11	77.33	4.13	0.00	73.20

TABLE 1
GROUNDWATER ELEVATIONS
COLLEGE WAY FOODS
 2120 EAST COLLEGE WAY
 MOUNT VERNON, WASHINGTON

Well Identification	Date	TOC Elevation (feet)	Depth to Groundwater (feet)	SPH Thickness (feet)	Groundwater Elevation (feet)
MW-1 (EW-1)	10/31/11	77.33	3.91	0.00	73.42
MW-1 (EW-1)	11/28/11	77.33	4.46	0.00	72.87
MW-1 (EW-1)	12/20/11	77.33	3.92	0.00	73.41

TABLE 1
GROUNDWATER ELEVATIONS
COLLEGE WAY FOODS
2120 EAST COLLEGE WAY
MOUNT VERNON, WASHINGTON

Well Identification	Date	TOC Elevation (feet)	Depth to Groundwater (feet)	SPH Thickness (feet)	Groundwater Elevation (feet)
MW-2 (IW-1)	12/16/92	76.84	2.45	0.00	74.39
MW-2 (IW-1)	06/07/11		2.45	0.00	-2.45
MW-2 (IW-1)	01/20/93	76.84	2.73	0.00	74.11
MW-2 (IW-1)	03/23/93	76.84	2.98	0.00	73.86
MW-2 (IW-1)	10/18/94	76.84	7.19	0.00	69.65
MW-2 (IW-1)	03/26/96	76.84	2.96	0.00	73.88
MW-2 (IW-1)	06/27/96	76.84	2.80	0.00	74.04
MW-2 (IW-1)	09/19/96	76.84	2.15	0.00	74.69
MW-2 (IW-1)	12/19/96	76.84	2.35	0.00	74.49
MW-2 (IW-1)	05/29/97	76.84	2.97	0.00	73.87
MW-2 (IW-1)	07/30/02	76.84	2.90	0.00	73.94
MW-2 (IW-1)	05/07/03	76.84	2.42	0.00	74.42
MW-2 (IW-1)	10/20/03	76.84	2.95	0.00	73.89
MW-2 (IW-1)	12/26/03	76.84	2.32	0.00	74.52
MW-2 (IW-1)	03/23/04	76.84	2.47	0.00	74.37
MW-2 (IW-1)	06/21/04	76.84	2.28	0.00	74.56
MW-2 (IW-1)	09/16/04	76.84	1.42	0.00	75.42
MW-2 (IW-1)	12/16/04	76.84	2.66	0.00	74.18
MW-2 (IW-1)	03/22/05	76.84	3.01	0.00	73.83
MW-2 (IW-1)	08/15/05	76.84	3.01	0.00	73.83
MW-2 (IW-1)	11/22/05	76.84	2.38	0.00	74.46
MW-2 (IW-1)	06/07/11	230.00	<3.0	79	16
MW-2 (IW-1)	02/20/06	76.84	2.78	0.00	74.06
MW-2 (IW-1)	05/23/06	76.84	3.00	0.00	73.84
MW-2 (IW-1)	11/07/06	76.84	2.63	0.00	74.21
MW-2 (IW-1)	06/06/07	76.84	3.19	0.00	73.65
MW-2 (IW-1)	11/29/07	76.84	3.03	0.00	73.81
MW-2 (IW-1)	06/11/08	76.84	2.46	0.00	74.38
MW-2 (IW-1)	12/03/08	76.84	2.92	0.00	73.92
MW-2 (IW-1)	03/12/09	76.84	3.29	0.00	73.55
MW-2 (IW-1)	06/30/09	76.84	3.38	0.00	73.46
MW-2 (IW-1)	09/25/09	76.84	4.02	0.00	72.82
MW-2 (IW-1)	12/22/09	76.84	3.15	0.00	73.69
MW-2 (IW-1)	03/19/10	76.84	3.69	0.00	73.15
MW-2 (IW-1)	06/10/10	76.84	2.40	0.00	74.44
MW-2 (IW-1)	09/16/10	76.84	2.79	0.00	74.05
MW-2 (IW-1)	12/22/10	76.84	2.75	0.00	74.09
MW-2 (IW-1)	03/10/11	76.84	2.40	0.00	74.44
MW-2 (IW-1)	06/07/11	76.84	2.55	0.00	74.29
MW-2 (IW-1)	09/23/11	76.84	3.34	0.00	73.50
MW-2 (IW-1)	11/28/11	76.84	2.67	0.00	74.17

TABLE 1
GROUNDWATER ELEVATIONS
COLLEGE WAY FOODS
2120 EAST COLLEGE WAY
MOUNT VERNON, WASHINGTON

Well Identification	Date	TOC Elevation (feet)	Depth to Groundwater (feet)	SPH Thickness (feet)	Groundwater Elevation (feet)
MW-3	03/23/93	77.07	6.44	0.00	70.63
MW-3	06/07/11		6.44	0.00	-6.44
MW-3	10/18/94	77.07	8.41	0.00	68.66
MW-3	03/26/96	77.07	6.03	0.00	71.04
MW-3	06/27/96	77.07	6.59	0.00	70.48
MW-3	09/19/96	77.07	6.60	0.00	70.47
MW-3	12/19/96	77.07	6.44	0.00	70.63
MW-3	05/29/97	77.07	6.83	0.00	70.24
MW-3	07/30/02	77.07	5.00	0.00	72.07
MW-3	05/07/03	77.07	5.97	0.00	71.10
MW-3	10/20/03	77.07	8.38	0.00	68.69
MW-3	12/26/03	77.07	6.68	0.00	70.39
MW-3	03/23/04	77.07	5.81	0.00	71.26
MW-3	06/21/04	77.07	6.17	0.00	70.90
MW-3	09/16/04	77.07	6.35	0.00	70.72
MW-3	12/16/04	77.07	5.34	0.00	71.73
MW-3	03/22/05	77.07	6.04	0.00	71.03
MW-3	08/15/05	77.07	6.60	0.00	70.47
MW-3	11/22/05	77.07	9.93	0.00	67.14
MW-3	02/20/06	77.07	6.88	0.00	70.19
MW-3	05/23/06	77.07	9.40	0.00	67.67
MW-3	11/07/06	77.07	10.01	0.00	67.06
MW-3	06/06/07	77.07	10.83	0.00	66.24
MW-3	11/29/07	77.07	10.39	0.00	66.68
MW-3	06/11/08	77.07	5.74	0.00	71.33
MW-3	12/03/08	77.07	5.91	0.00	71.16
MW-3	03/12/09	77.07	6.32	0.00	70.75
MW-3	06/30/09	77.07	7.36	0.00	69.71
MW-3	09/25/09	77.07	9.63	0.01	67.45
MW-3	12/22/09	77.07	8.80	0.00	68.27
MW-3	03/19/10	77.07	8.86	0.00	68.21
MW-3	06/10/10	77.07	8.97	0.00	68.10
MW-3	09/16/10	77.07	7.29	0.00	69.78
MW-3	12/22/10	77.07	8.82	0.00	68.25
MW-3	03/10/11	77.07	8.01	0.00	69.06
MW-3	06/07/11	77.07	5.87	0.00	71.20
MW-3	09/23/11	77.07	8.65	0.00	68.42
MW-3	11/28/11	77.07	9.10	0.00	67.97

TABLE 1
GROUNDWATER ELEVATIONS
COLLEGE WAY FOODS
2120 EAST COLLEGE WAY
MOUNT VERNON, WASHINGTON

Well Identification	Date	TOC Elevation (feet)	Depth to Groundwater (feet)	SPH Thickness (feet)	Groundwater Elevation (feet)
MW-4	03/23/93	77.12	6.30	0.00	70.82
MW-4	10/18/94	77.12	8.64	0.00	68.48
MW-4	03/26/96	77.12	5.62	0.00	71.50
MW-4	06/27/96	77.12	6.22	0.00	70.90
MW-4	09/19/96	77.12	6.46	0.00	70.66
MW-4	12/19/96	77.12	5.82	0.00	71.30
MW-4	07/30/02	77.12	6.45	0.00	70.67
MW-4	05/07/03	77.12	7.53	0.00	69.59
MW-4	10/20/03	77.12	7.95	0.00	69.17
MW-4	12/26/03	77.12	8.41	0.00	68.71
MW-4	03/23/04	77.12	7.63	0.00	69.49
MW-4	06/21/04	77.12	6.60	0.00	70.52
MW-4	09/16/04	77.12	6.35	0.00	70.77
MW-4	12/16/04	77.12	4.83	0.00	72.29
MW-4	03/22/05	77.12	5.46	0.00	71.66
MW-4	08/15/05	77.12	9.78	0.00	67.34
MW-4	11/22/05	77.12	6.29	0.00	70.83
MW-4	02/20/06	77.12	6.50	0.00	70.62
MW-4	05/23/06	77.12	6.14	0.00	70.98
MW-4	11/07/06	77.12	9.62	0.00	67.50
MW-4	06/06/07	77.12	10.30	0.00	66.82
MW-4	11/29/07	77.12	7.71	0.00	69.41
MW-4	06/11/08	77.12	8.71	0.00	68.41
MW-4	12/03/08	77.12	7.48	0.00	69.64
MW-4	03/12/09	77.12	9.11	0.00	68.01
MW-4	06/30/09	77.12	6.59	0.00	70.53
MW-4	09/25/09	77.12	8.44	0.00	68.68
MW-4	12/22/09	77.12	7.85	0.00	69.27
MW-4	03/19/10	77.12	6.29	0.00	70.83
MW-4	06/10/10	77.12	6.42	0.00	70.70
MW-4	09/16/10	77.12	7.75	0.00	69.37
MW-4	12/22/10	77.12	7.20	0.00	69.92
MW-4	03/10/11	77.12	6.76	0.00	70.36
MW-4	06/07/11	77.12	6.95	0.00	70.17
MW-4	09/23/11	77.12	6.69	0.00	70.43
MW-4	11/28/11	77.12	6.81	0.00	70.31

TABLE 1
GROUNDWATER ELEVATIONS
COLLEGE WAY FOODS
2120 EAST COLLEGE WAY
MOUNT VERNON, WASHINGTON

Well Identification	Date	TOC Elevation (feet)	Depth to Groundwater (feet)	SPH Thickness (feet)	Groundwater Elevation (feet)
MW-5	03/23/93	75.56	3.84	0.00	71.72
MW-5	10/18/94	75.56	4.74	0.00	70.82
MW-5	03/26/96	75.56	4.48	0.00	71.08
MW-5	06/27/96	75.56	4.59	0.00	70.97
MW-5	09/19/96	75.56	4.04	0.00	71.52
MW-5	12/19/96	75.56	4.30	0.00	71.26
MW-5	05/29/97	75.56	4.50	0.00	71.06
MW-5	07/30/02	75.56	4.80	0.00	70.76
MW-5	05/07/03	75.56	5.11	0.00	70.45
MW-5	10/20/03	75.56	5.12	0.00	70.44
MW-5	12/26/03	75.56	5.41	0.00	70.15
MW-5	03/23/04	75.56	5.39	0.00	70.17
MW-5	06/21/04	75.56	5.56	0.00	70.00
MW-5	09/16/04	75.56	4.60	0.00	70.96
MW-5	12/16/04	75.56	4.88	0.00	70.68
MW-5	03/22/05	75.56	5.61	0.00	69.95
MW-5	08/15/05	75.56	5.44	0.00	70.12
MW-5	11/22/05	75.56	5.10	0.00	70.46
MW-5	02/20/06	75.56	5.06	0.00	70.50
MW-5	05/23/06	75.56	4.85	0.00	70.71
MW-5	11/07/06	75.56	4.36	0.00	71.20
MW-5	06/06/07	75.56	5.16	0.00	70.40
MW-5	11/29/07	75.56	5.17	0.00	70.39
MW-5	06/11/08	75.56	4.35	0.00	71.21
MW-5	12/03/08	75.56	4.68	0.00	70.88
MW-5	03/12/09	75.56	4.99	0.00	70.57
MW-5	06/30/09	75.56	5.20	0.00	70.36
MW-5	06/07/11	75.56	5.20	0.00	70.36
MW-5	09/25/09	75.56	5.31	0.00	70.25
MW-5	12/22/09	75.56	4.58	0.00	70.98
MW-5	03/19/10	75.56	4.90	0.00	70.66
MW-5	06/10/10	75.56	4.10	0.00	71.46
MW-5	09/16/10	75.56	4.89	0.00	70.67
MW-5	12/22/10	75.56	4.83	0.00	70.73
MW-5	03/10/11	75.56	4.17	0.00	71.39
MW-5	06/07/11	75.56	4.74	0.00	70.82
MW-5	09/23/11	75.56	5.48	0.00	70.08
MW-5	11/28/11	75.56	4.38	0.00	71.18

TABLE 1
GROUNDWATER ELEVATIONS
COLLEGE WAY FOODS
 2120 EAST COLLEGE WAY
 MOUNT VERNON, WASHINGTON

Well Identification	Date	TOC Elevation (feet)	Depth to Groundwater (feet)	SPH Thickness (feet)	Groundwater Elevation (feet)
MW-7	06/07/11	--	3.09	0.00	--
MW-7	07/13/11	75.42	3.35	0.00	72.07
MW-7	07/25/11	75.42	3.74	0.00	71.68
MW-7	09/23/11	75.42	3.92	0.00	71.50
MW-7	10/31/11	75.42	4.28	0.00	71.14
MW-7	11/28/11	75.42	4.52	0.00	70.90
MW-7	12/20/11	75.42	3.71	0.00	71.71

TABLE 1
GROUNDWATER ELEVATIONS
COLLEGE WAY FOODS
 2120 EAST COLLEGE WAY
 MOUNT VERNON, WASHINGTON

Well Identification	Date	TOC Elevation (feet)	Depth to Groundwater (feet)	SPH Thickness (feet)	Groundwater Elevation (feet)
MW-8	06/07/11	--	2.81	0.00	--
MW-8	07/13/11	76.43	3.63	0.00	72.80
MW-8	07/25/11	76.43	3.36	0.00	73.07
MW-8	09/23/11	76.43	4.08	0.00	72.35
MW-8	10/31/11	76.43	3.86	0.00	72.57
MW-8	11/28/11	76.43	3.09	0.00	73.34
MW-8	12/20/11	76.43	3.49	0.00	72.94

TABLE 1
GROUNDWATER ELEVATIONS
COLLEGE WAY FOODS
2120 EAST COLLEGE WAY
MOUNT VERNON, WASHINGTON

Well Identification	Date	TOC Elevation (feet)	Depth to Groundwater (feet)	SPH Thickness (feet)	Groundwater Elevation (feet)
TW-1	12/16/92	75.51	3.03	0.00	72.48
TW-1	01/20/93	75.51	1.80	0.00	73.71
TW-1	03/23/93	75.51	1.45	0.00	74.06
TW-1	10/18/94	75.51	3.20	0.00	72.31
TW-1	06/29/95	75.51	3.91	0.00	71.60
TW-1	03/26/96	75.51	2.02	0.00	73.49
TW-1	06/27/96	75.51	1.20	0.00	74.31
TW-1	09/19/96	75.51	1.63	0.00	73.88
TW-1	08/14/97	75.51	4.23	0.00	71.28
TW-1	07/30/02	75.51	2.45	0.00	73.06
TW-1	05/07/03	75.51	2.07	0.00	73.44
TW-1	10/20/03	75.51	1.50	0.00	74.01
TW-1	12/26/03	75.51	2.41	0.00	73.10
TW-1	03/23/04	75.51	2.40	0.00	73.11
TW-1	06/21/04	75.51	2.38	0.00	73.13
TW-1	09/16/04	75.51	1.12	0.00	74.39
TW-1	12/16/04	75.51	2.49	0.00	73.02
TW-1	03/22/05	75.51	2.73	0.00	72.78
TW-1	08/15/05	75.51	3.33	0.00	72.18
TW-1	11/22/05	75.51	2.45	0.00	73.06
TW-1	02/20/06	75.51	2.62	0.00	72.89
TW-1	05/23/06	75.51	2.37	0.00	73.14
TW-1	11/07/06	75.51	1.09	0.00	74.42
TW-1	06/07/11	75.51	1.09	0.00	74.42
TW-1	06/06/07	75.51	2.18	0.00	73.33
TW-1	11/29/07	75.51	2.65	0.00	72.86
TW-1	06/11/08	75.51	2.21	0.00	73.30
TW-1	12/03/08	75.51	2.58	0.00	72.93
TW-1	03/12/09	75.51	2.95	0.00	72.56
TW-1	06/30/09	75.51	3.36	0.00	72.15
TW-1	09/25/09	75.51	3.15	0.00	72.36
TW-1	12/22/09	75.51	1.94	0.00	73.57
TW-1	03/19/10	75.51	2.79	0.00	72.72
TW-1	06/10/10	75.51	1.76	0.00	73.75
TW-1	09/16/10	75.51	2.45	0.00	73.06
TW-1	12/22/10	75.51	2.59	0.00	72.92
TW-1	03/10/11	75.51	1.90	0.00	73.61
TW-1	06/07/11	75.51	2.55	0.00	72.96
TW-1	07/13/11	75.51	2.81	0.00	72.70
TW-1	07/25/11	75.51	2.37	0.00	73.14
TW-1	09/23/11	75.51	2.91	0.00	72.60

TABLE 1
GROUNDWATER ELEVATIONS
COLLEGE WAY FOODS
 2120 EAST COLLEGE WAY
 MOUNT VERNON, WASHINGTON

Well Identification	Date	TOC Elevation (feet)	Depth to Groundwater (feet)	SPH Thickness (feet)	Groundwater Elevation (feet)
TW-1	10/31/11	75.51	2.25	0.00	73.26
TW-1	11/28/11	75.51	2.03	0.00	73.48
TW-1	12/20/11	75.51	2.92	0.00	72.59

TABLE 1
GROUNDWATER ELEVATIONS
COLLEGE WAY FOODS
2120 EAST COLLEGE WAY
MOUNT VERNON, WASHINGTON

Well Identification	Date	TOC Elevation (feet)	Depth to Groundwater (feet)	SPH Thickness (feet)	Groundwater Elevation (feet)
TW-2	12/16/92	76.62	3.87	0.00	72.75
TW-2	01/20/93	76.62	2.89	0.00	73.73
TW-2	03/23/93	76.62	3.12	0.00	73.50
TW-2	10/18/94	76.62	6.86	0.00	69.76
TW-2	06/29/95	76.62	5.80	0.00	70.82
TW-2	03/26/96	76.62	3.01	0.00	73.61
TW-2	06/27/96	76.62	2.87	0.00	73.75
TW-2	09/19/96	76.62	3.21	0.00	73.41
TW-2	12/19/96	76.62	2.65	0.00	73.97
TW-2	05/29/97	76.62	3.40	0.00	73.22
TW-2	08/14/97	76.62	3.56	0.00	73.06
TW-2	07/30/02	76.62	2.40	0.00	74.22
TW-2	05/07/03	76.62	2.71	0.00	73.91
TW-2	10/20/03	76.62	3.09	0.00	73.53
TW-2	12/26/03	76.62	1.93	0.00	74.69
TW-2	03/23/04	76.62	2.81	0.00	73.81
TW-2	06/21/04	76.62	2.50	0.00	74.12
TW-2	09/16/04	76.62	2.02	0.00	74.60
TW-2	12/16/04	76.62	2.96	0.00	73.66
TW-2	03/22/05	76.62	3.31	0.00	73.31
TW-2	08/15/05	76.62	3.01	0.00	73.61
TW-2	11/22/05	76.62	2.81	0.00	73.81
TW-2	02/20/06	76.62	3.08	0.00	73.54
TW-2	05/23/06	76.62	3.18	0.00	73.44
TW-2	11/07/06	76.62	2.62	0.00	74.00
TW-2	06/06/07	76.62	3.33	0.00	73.29
TW-2	11/29/07	76.62	3.48	0.00	73.14
TW-2	06/11/08	76.62	2.75	0.00	73.87
TW-2	12/03/08	76.62	3.38	0.00	73.24
TW-2	03/12/09	76.62	3.64	0.00	72.98
TW-2	06/30/09	76.62	3.42	0.00	73.20
TW-2	09/25/09	76.62	3.60	0.00	73.02
TW-2	12/22/09	76.62	2.62	0.00	74.00
TW-2	03/19/10	76.62	3.93	0.00	72.69
TW-2	06/10/10	76.62	2.89	0.00	73.73
TW-2	09/16/10	76.62	2.89	0.00	73.73
TW-2	12/22/10	76.62	3.18	0.00	73.44
TW-2	03/10/11	76.62	2.79	0.00	73.83
TW-2	06/07/11	76.62	2.86	0.00	73.76
TW-2	07/13/11	76.62	2.84	0.00	73.78
TW-2	07/25/11	76.62	2.93	0.00	73.69

TABLE 1
GROUNDWATER ELEVATIONS
COLLEGE WAY FOODS
 2120 EAST COLLEGE WAY
 MOUNT VERNON, WASHINGTON

Well Identification	Date	TOC Elevation (feet)	Depth to Groundwater (feet)	SPH Thickness (feet)	Groundwater Elevation (feet)
TW-2	09/23/11	76.62	3.06	0.00	73.56
TW-2	10/31/11	76.62	2.61	0.00	74.01
TW-2	11/28/11	76.62	2.09	0.00	74.53
TW-2	12/20/11	76.62	3.12	0.00	73.50

TABLE 1
GROUNDWATER ELEVATIONS
COLLEGE WAY FOODS
2120 EAST COLLEGE WAY
MOUNT VERNON, WASHINGTON

Well Identification	Date	TOC Elevation (feet)	Depth to Groundwater (feet)	SPH Thickness (feet)	Groundwater Elevation (feet)
TW-3	01/20/93	77.88	4.84	0.00	73.04
TW-3	03/23/93	77.88	4.80	0.00	73.08
TW-3	10/18/94	77.88	6.68	0.00	71.20
TW-3	03/26/96	77.88	4.79	0.00	73.09
TW-3	06/27/96	77.88	4.63	0.00	73.25
TW-3	09/19/96	77.88	5.03	0.00	72.85
TW-3	12/19/96	77.88	4.16	0.00	73.72
TW-3	07/30/02	77.88	5.02	0.00	72.86
TW-3	05/07/03	77.88	4.60	0.00	73.28
TW-3	10/20/03	77.88	5.92	0.00	71.96
TW-3	12/26/03	77.88	4.41	0.00	73.47
TW-3	03/23/04	77.88	4.51	0.00	73.37
TW-3	06/21/04	77.88	4.49	0.00	73.39
TW-3	09/16/04	77.88	4.28	0.00	73.60
TW-3	12/16/04	77.88	4.16	0.00	73.72
TW-3	03/22/05	77.88	5.09	0.00	72.79
TW-3	08/15/05	77.88	5.13	0.00	72.75
TW-3	11/22/05	77.88	4.42	0.00	73.46
TW-3	02/20/06	77.88	4.39	0.00	73.49
TW-3	05/23/06	77.88	4.91	0.00	72.97
TW-3	11/07/06	77.88	5.20	0.00	72.68
TW-3	06/06/07	77.88	5.10	0.00	72.78
TW-3	11/29/07	77.88	4.93	0.00	72.95
TW-3	06/11/08	77.88	4.41	0.00	73.47
TW-3	12/03/08	77.88	4.68	0.00	73.20
TW-3	03/12/09	77.88	4.99	0.00	72.89
TW-3	06/30/09	77.88	5.28	0.00	72.60
TW-3	09/25/09	77.88	6.15	0.00	71.73
TW-3	12/22/09	77.88	4.71	0.00	73.17
TW-3	03/19/10	77.88	5.44	0.00	72.44
TW-3	06/10/10	77.88	4.38	0.00	73.50
TW-3	09/16/10	77.88	5.09	0.00	72.79
TW-3	12/22/10	77.88	4.33	0.00	73.55
TW-3	03/10/11	77.88	4.33	0.00	73.55
TW-3	06/07/11	77.88	4.38	0.00	73.50
TW-3	09/23/11	77.88	5.57	0.00	72.31
TW-3	11/28/11	77.88	4.48	0.00	73.40

TABLE 1
GROUNDWATER ELEVATIONS
COLLEGE WAY FOODS
2120 EAST COLLEGE WAY
MOUNT VERNON, WASHINGTON

Well Identification	Date	TOC Elevation (feet)	Depth to Groundwater (feet)	SPH Thickness (feet)	Groundwater Elevation (feet)
B-2	12/16/92	76.82	4.00	0.00	72.82
B-2	01/20/93	76.82	4.14	0.00	72.68
B-2	03/23/93	76.82	3.80	0.00	73.02
B-2	10/18/94	76.82	5.06	0.00	71.76
B-2	06/29/95	76.82	6.23	0.00	70.59
B-2	03/26/96	76.82	3.76	0.00	73.06
B-2	06/27/96	76.82	3.52	0.00	73.30
B-2	09/19/96	76.82	2.95	0.00	73.87
B-2	12/19/96	76.82	2.90	0.00	73.92
B-2	05/29/97	76.82	3.92	0.00	72.90
B-2	08/14/97	76.82	4.11	0.00	72.71
B-2	07/30/02	76.82	3.53	0.00	73.29
B-2	05/07/03	76.82	2.95	0.00	73.87
B-2	10/20/03	76.82	4.15	0.00	72.67
B-2	12/26/03	76.82	3.62	0.00	73.20
B-2	03/23/04	76.82	3.21	0.00	73.61
B-2	06/21/04	76.82	3.15	0.00	73.67
B-2	09/16/04	76.82	2.89	0.00	73.93
B-2	12/16/04	76.82	3.30	0.00	73.52
B-2	03/22/05	76.82	3.71	0.00	73.11
B-2	08/15/05	76.82	3.90	0.00	72.92
B-2	11/22/05	76.82	3.00	0.00	73.82
B-2	02/20/06	76.82	3.39	0.00	73.43
B-2	05/23/06	76.82	3.60	0.00	73.22
B-2	11/07/06	76.82	3.18	0.00	73.64
B-2	06/06/07	76.82	3.76	0.00	73.06
B-2	11/29/07	76.82	3.66	0.00	73.16
B-2	06/11/08	76.82	3.13	0.00	73.69
B-2	12/03/08	76.82	3.38	0.00	73.44
B-2	03/12/09	76.82	3.80	0.00	73.02
B-2	06/30/09	76.82	3.96	0.00	72.86
B-2	09/25/09	76.82	4.62	0.01	72.21
B-2	12/22/09	76.82	3.55	0.00	73.27
B-2	03/19/10	76.82	4.18	0.00	72.64
B-2	06/10/10	76.82	2.88	0.00	73.94
B-2	12/22/10	76.82	3.31	0.00	73.51
B-2	03/10/11	76.82	2.92	0.00	73.90

TABLE 1
GROUNDWATER ELEVATIONS
COLLEGE WAY FOODS
 2120 EAST COLLEGE WAY
 MOUNT VERNON, WASHINGTON

Well Identification	Date	TOC Elevation (feet)	Depth to Groundwater (feet)	SPH Thickness (feet)	Groundwater Elevation (feet)
B-2	06/07/11	76.82	3.31	0.00	73.51
B-2	09/23/11	76.82	3.98	0.00	72.84
B-2	11/28/11	76.82	3.24	0.00	73.58

TABLE 1
GROUNDWATER ELEVATIONS
COLLEGE WAY FOODS
 2120 EAST COLLEGE WAY
 MOUNT VERNON, WASHINGTON

Well Identification	Date	TOC Elevation (feet)	Depth to Groundwater (feet)	SPH Thickness (feet)	Groundwater Elevation (feet)
IW-1	06/07/11	--	1.39	0.00	--
IW-1	09/23/11	--	3.42	0.00	--
IW-2	06/07/11	--	1.02	0.00	--
IW-2	09/23/11	--	2.90	0.00	--
<p>Notes: TOC = Top of well casing -- = Not Measured TOC elevation information obtained from previous reports prepared by Environmental Science & Engineering, Inc.</p>					

TABLE 2
GROUNDWATER ANALYTICAL RESULTS
COLLEGE WAY FOODS
2120 EAST COLLEGE WAY
MOUNT VERNON, WASHINGTON

Well/Sample Identification	Date Sampled	TPH Gasoline (ppb)	MTBE (ppb)	Benzene (ppb)	Toluene (ppb)	Ethyl-benzene (ppb)	Xylenes (ppb)	EDC (ppb)	EDB (ppb)	Lead (ppb)	Naphthalene (ppb)	1-Methyl-naphthalene (ppb)	2-Methyl-naphthalene (ppb)
MW-1 (EW-1)	12/09/92 ^a	120,000	NA	6,100	13,000	1,600	19,000	--	--	--	--	--	--
MW-1 (EW-1)	08/27/93	90,000	NA	4,100	11,000	1,100	15,000	--	--	--	--	--	--
MW-1 (EW-1)	09/29/93	91,000	NA	3,200	10,000	1,100	14,000	--	--	--	--	--	--
MW-1 (EW-1)	12/01/93	76,000	NA	5,100	8,300	1,300	16,000	--	--	--	--	--	--
MW-1 (EW-1)	12/01/93 ^b	73,000	NA	5,000	7,900	1,200	15,000	--	--	--	--	--	--
MW-1 (EW-1)	01/12/94	89,000	NA	3,800	4,800	880	10,000	--	--	--	--	--	--
MW-1 (EW-1)	02/07/94 ^c	69,000	NA	3,700	5,900	1,500	14,000	--	--	--	--	--	--
MW-1 (EW-1)	02/25/94	54,000	NA	4,600	4,500	1,500	13,000	--	--	--	--	--	--
MW-1 (EW-1)	04/11/94 ^d	41,000	NA	1,300	350	500	4,000	--	--	--	--	--	--
MW-1 (EW-1)	04/11/94 ^e	42,000	NA	1,200	540	620	5,000	--	--	--	--	--	--
MW-1 (EW-1)	05/09/94	29,000	NA	1,700	90	570	3,300	--	--	--	--	--	--
MW-1 (EW-1)	05/26/94 ^d	23,000	NA	1,400	150	500	4,000	--	--	--	--	--	--
MW-1 (EW-1)	05/26/94 ^e	19,000	NA	910	79	370	2,000	--	--	--	--	--	--
MW-1 (EW-1)	07/07/94	22,000	NA	1,200	69	400	2,100	--	--	--	--	--	--
MW-1 (EW-1)	08/29/94 ^d	3,700	NA	310	57	89	510	--	--	--	--	--	--
MW-1 (EW-1)	08/29/94 ^e	4,900	NA	330	30	76	420	--	--	--	--	--	--
MW-1 (EW-1)	10/18/94 ^d	4,700	NA	710	45	100	180	--	--	--	--	--	--
MW-1 (EW-1)	10/18/94 ^e	4,900	NA	270	150	71	340	--	--	--	--	--	--
MW-1 (EW-1)	12/14/94 ^d	420	NA	57	0.76	0.86	14	--	--	--	--	--	--
MW-1 (EW-1)	12/14/94 ^e	1,500	NA	100	7	16	36	--	--	--	--	--	--
MW-1 (EW-1)	03/30/95 ^d	99	NA	15	7	<0.50	3.8	--	--	--	--	--	--
MW-1 (EW-1)	06/29/95 ^d	350	NA	190	1.9	0.53	9.8	--	--	--	--	--	--
MW-1 (EW-1)	09/28/95 ^d	<50	NA	<0.50	<0.50	<0.50	<1.0	--	--	--	--	--	--
MW-1 (EW-1)	12/21/95 ^d	<50	NA	11	<0.50	<0.50	<1.0	--	--	--	--	--	--
MW-1 (EW-1)	03/25/96	56	NA	36	<0.50	<0.50	4.3	--	--	--	--	--	--
MW-1 (EW-1)	06/29/96	1,450	NA	51.9	3.43	10.3	67.6	--	--	--	--	--	--
MW-1 (EW-1)	09/19/96	306	NA	53.2	22.2	3.12	14.9	--	--	--	--	--	--
MW-1 (EW-1)	08/15/97	310	NA	61	<1.0	21	15.5	--	--	--	--	--	--

TABLE 2
GROUNDWATER ANALYTICAL RESULTS
COLLEGE WAY FOODS
2120 EAST COLLEGE WAY
MOUNT VERNON, WASHINGTON

Well/Sample Identification	Date Sampled	TPH Gasoline (ppb)	MTBE (ppb)	Benzene (ppb)	Toluene (ppb)	Ethyl-benzene (ppb)	Xylenes (ppb)	EDC (ppb)	EDB (ppb)	Lead (ppb)	Naphthalene (ppb)	1-Methyl-naphthalene (ppb)	2-Methyl-naphthalene (ppb)
MW-1 (EW-1)	07/30/02	6,400	NA	92	5	30	140	--	--	--	--	--	--
MW-1 (EW-1)	05/07/03	880	NA	35	15	2	15	--	--	--	--	--	--
MW-1 (EW-1)	10/20/03	1,100	NA	44	1	<1	11	--	--	--	--	--	--
MW-1 (EW-1)	12/26/03	700	NA	28	1	<1	<3	--	--	--	--	--	--
MW-1 (EW-1)	03/23/04	250	NA	3	<1	<1	<3	--	--	--	--	--	--
MW-1 (EW-1)	06/21/04	79	NA	<1	<1	<1	<3	--	--	--	--	--	--
MW-1 (EW-1)	09/16/04	<50	NA	<1	<1	<1	<3	--	--	--	--	--	--
MW-1 (EW-1)	12/16/04	180	NA	15	8	<1	<3	--	--	--	--	--	--
MW-1 (EW-1)	06/07/11		NA	15	8	--	<3	--	--	--	--	--	--
MW-1 (EW-1)	03/22/05	<50	NA	2	<1	<1	<3	--	--	--	--	--	--
MW-1 (EW-1)	08/15/05	92	<3	2	<1	<1	<3	--	--	--	--	--	--
MW-1 (EW-1)	11/22/05	130	<3	9	<1	<1	<3	--	--	--	--	--	--
MW-1 (EW-1)	02/20/06	<50	<3	9	<1	<1	<3	--	--	--	--	--	--
MW-1 (EW-1)	05/23/06	59	<3	15	<1	<1	<3	--	--	--	--	--	--
MW-1 (EW-1)	11/07/06	ND	<3	1	<1	<1	<3	--	--	--	--	--	--
MW-1 (EW-1)	06/06/07	<50	<3	3	<1	<1	<3	--	--	--	--	--	--
MW-1 (EW-1)	11/29/07	63	<3	<1	<1	<1	<3	--	--	--	--	--	--
MW-1 (EW-1)	06/11/08	--	--	--	--	--	--	--	--	--	--	--	--
MW-1 (EW-1)	12/03/08	<50	<3	<1	<1	1	<3	--	--	--	--	--	--
MW-1 (EW-1)	03/12/09	73	<3	<1	<1	<1	<3	--	--	--	--	--	--
MW-1 (EW-1)	06/30/09	5,100	<15	130	880	36	1,300	--	--	--	--	--	--
MW-1 (EW-1)	09/25/09	150	<3.0	<1.0	<1.0	<1.0	<3.0	--	--	--	--	--	--
MW-1 (EW-1)	12/22/09	63	<1.0	<1.0	<1.0	<1.0	<3.0	--	--	--	--	--	--
MW-1 (EW-1)	03/19/10	<50	<3.0	1.8	<1.0	<1.0	<3.0	--	--	--	--	--	--
MW-1 (EW-1)	06/10/10	<50	<3.0	5.8	2.2	2.4	7.6	<0.020	<0.010	--	--	--	--
MW-1 (EW-1)	09/16/10	230	<3.0	<1.0	1.5	22	28	--	--	--	--	--	--
MW-1 (EW-1)	12/22/10	57	<3.0	<1.0	<1.0	<1.0	<3.0	--	--	--	--	--	--
MW-1 (EW-1)	03/10/11	75	<3.0	2.2	<1.0	<1.0	<3.0	<0.020	<0.010	<0.62	--	--	--

TABLE 2
GROUNDWATER ANALYTICAL RESULTS
COLLEGE WAY FOODS
2120 EAST COLLEGE WAY
MOUNT VERNON, WASHINGTON

Well/Sample Identification	Date Sampled	TPH		Benzene (ppb)	Toluene (ppb)	Ethyl-		EDC (ppb)	EDB (ppb)	Lead (ppb)	Naphthalene (ppb)	1-Methyl-naphthalene (ppb)	2-Methyl-naphthalene (ppb)
		Gasoline (ppb)	MTBE (ppb)			benzene (ppb)	Xylenes (ppb)						
MW-1 (EW-1)	06/07/11	230	<3.0	79	16	1.8	20	--	--	<0.62	--	--	--
MW-1 (EW-1)	07/13/11	200	<3.0	<1.0	<1.0	1.7	6.7	--	--	--	--	--	--
MW-1 (EW-1)	07/25/01	94	<3.0	<1.0	<1.0	<1.0	<3.0	--	--	<0.26	--	--	--
MW-1 (EW-1)	09/23/11	250	<3.0	<1.0	<1.0	1.5	<3.0	--	--	<0.30	--	--	--
MW-1 (EW-1)	10/31/11	120	<3.0	<1.0	<1.0	<1.0	<3.0	--	--	--	--	--	--
MW-1 (EW-1)	11/28/11	100	<3.0	<1.0	<1.0	<1.0	<3.0	<0.020	<0.010	<0.30	0.051	0.90	<0.020
MW-1 (EW-1)	12/20/11	64	<3.0	<1.0	<1.0	<1.0	<3.0	--	--	--	--	--	--

TABLE 2
GROUNDWATER ANALYTICAL RESULTS
COLLEGE WAY FOODS
2120 EAST COLLEGE WAY
MOUNT VERNON, WASHINGTON

Well/Sample Identification	Date Sampled	TPH Gasoline (ppb)	MTBE (ppb)	Benzene (ppb)	Toluene (ppb)	Ethyl-benzene (ppb)	Xylenes (ppb)	EDC (ppb)	EDB (ppb)	Lead (ppb)	Naphthalene (ppb)	1-Methyl-naphthalene (ppb)	2-Methyl-naphthalene (ppb)
MW-2 (IW-2)	12/09/92 ^a	14,000	NA	140	900	160	1,500	--	--	--	--	--	--
MW-2 (IW-2)	10/18/93	14,000	NA	130	320	36	1,600	--	--	--	--	--	--
MW-2 (IW-2)	12/01/93 ^b	4,100	NA	32	20	5.2	250	--	--	--	--	--	--
MW-2 (IW-2)	04/11/94 ^d	12,000	NA	430	150	140	1,600	--	--	--	--	--	--
MW-2 (IW-2)	04/11/94 ^e	6,000	NA	100	84	46	610	--	--	--	--	--	--
MW-2 (IW-2)	05/09/94	4,300	NA	50	88	39	430	--	--	--	--	--	--
MW-2 (IW-2)	05/26/94 ^d	790	NA	50	4.3	17	61	--	--	--	--	--	--
MW-2 (IW-2)	05/26/94 ^e	9,400	NA	470	100	250	1,400	--	--	--	--	--	--
MW-2 (IW-2)	07/07/94	330	NA	0.96	<0.50	<0.50	<1.0	--	--	--	--	--	--
MW-2 (IW-2)	08/29/94 ^d	460	NA	11	1.8	1.3	8.1	--	--	--	--	--	--
MW-2 (IW-2)	08/29/94 ^e	1,600	NA	38	22	18	120	--	--	--	--	--	--
MW-2 (IW-2)	10/18/94 ^d	<50	NA	<0.50	<0.50	<0.50	<1.0	--	--	--	--	--	--
MW-2 (IW-2)	10/18/94 ^e	<50	NA	<0.50	<0.50	<0.50	<1.0	--	--	--	--	--	--
MW-2 (IW-2)	12/14/94 ^d	<50	NA	3.7	<0.50	<0.50	<1.0	--	--	--	--	--	--
MW-2 (IW-2)	12/14/94 ^e	<50	NA	0.89	<0.50	<0.50	<1.0	--	--	--	--	--	--
MW-2 (IW-2)	03/30/95 ^d	<50	NA	94	<0.50	<0.50	1.5	--	--	--	--	--	--
MW-2 (IW-2)	06/29/95 ^d	<50	NA	1.7	<0.50	<0.50	<1.0	--	--	--	--	--	--
MW-2 (IW-2)	09/28/95 ^d	<50	NA	3.6	<0.50	<0.50	<0.50	--	--	--	--	--	--
MW-2 (IW-2)	12/21/95	<50	NA	<0.50	<0.50	<0.50	<1.0	--	--	--	--	--	--
MW-2 (IW-2)	03/25/96	51	NA	17	<0.50	<0.50	3.2	--	--	--	--	--	--
MW-2 (IW-2)	06/29/96	<50	NA	1.46	<0.50	<0.50	<1.0	--	--	--	--	--	--
MW-2 (IW-2)	12/19/96	<50	NA	8.26	<0.50	<0.50	<1.0	--	--	--	--	--	--
MW-2 (IW-2)	01/15/97	<50	NA	14.4	<0.50	<0.50	<1.0	--	--	--	--	--	--
MW-2 (IW-2)	07/30/02	40,000	NA	13,000	190	1,900	7,200	--	--	--	--	--	--
MW-2 (IW-2)	05/07/03	<50	NA	<1	<1	<1	<3	--	--	--	--	--	--
MW-2 (IW-2)	10/20/03	160	NA	7	13	3	21	--	--	--	--	--	--
MW-2 (IW-2)	12/26/03	520	NA	16	14	12	50	--	--	--	--	--	--
MW-2 (IW-2)	03/23/04	<50	NA	<1	<1	<1	<3	--	--	--	--	--	--

TABLE 2
GROUNDWATER ANALYTICAL RESULTS
COLLEGE WAY FOODS
2120 EAST COLLEGE WAY
MOUNT VERNON, WASHINGTON

Well/Sample Identification	Date Sampled	TPH Gasoline (ppb)	MTBE (ppb)	Benzene (ppb)	Toluene (ppb)	Ethyl-benzene (ppb)	Xylenes (ppb)	EDC (ppb)	EDB (ppb)	Lead (ppb)	Naphthalene (ppb)	1-Methyl-naphthalene (ppb)	2-Methyl-naphthalene (ppb)
MW-2 (IW-2)	06/21/04	<50	NA	<1	<1	<1	<3	--	--	--	--	--	--
MW-2 (IW-2)	09/16/04	130	NA	49	38	2	11	--	--	--	--	--	--
MW-2 (IW-2)	12/16/04	<50	NA	2	<1	<1	<3	--	--	--	--	--	--
MW-2 (IW-2)	03/22/05	<50	NA	<1	<1	<1	<3	--	--	--	--	--	--
MW-2 (IW-2)	08/15/05	58	<3	<1	<1	<1	<3	--	--	--	--	--	--
MW-2 (IW-2)	11/22/05	<50	<3	2	<1	<1	<3	--	--	--	--	--	--
MW-2 (IW-2)	02/20/06	<50	<3	<1	<1	<1	<3	--	--	--	--	--	--
MW-2 (IW-2)	06/07/11		<3	<1	<1	--	<3	--					
MW-2 (IW-2)	05/23/06	<50	<3	2	<1	<1	<3	--	--	--	--	--	--
MW-2 (IW-2)	11/07/06	<50	<3	1	<1	<1	<3	--	--	--	--	--	--
MW-2 (IW-2)	06/06/07	<50	<3	<1	<1	<1	<3	--	--	--	--	--	--
MW-2 (IW-2)	11/29/07	<50	<3	8	<1	<1	<3	--	--	--	--	--	--
MW-2 (IW-2)	06/11/08	<50	<3	<1	<1	<1	<3	--	--	--	--	--	--
MW-2 (IW-2)	12/03/08	78	<3	14	<1	<1	<3	--	--	--	--	--	--
MW-2 (IW-2)	03/12/09	<50	<3	<1	<1	<1	<3	--	--	--	--	--	--
MW-2 (IW-2)	06/30/09	<50	<3.0	<1.0	<1.0	<1.0	<3.0	--	--	--	--	--	--
MW-2 (IW-2)	09/25/09	<50	<3.0	<1.0	<1.0	<1.0	<3.0	--	--	--	--	--	--
MW-2 (IW-2)	12/22/09	<50	<1.0	<1.0	<1.0	<1.0	<3.0	--	--	--	--	--	--
MW-2 (IW-2)	03/19/10	<50	<3.0	<1.0	<1.0	<1.0	<3.0	--	--	--	--	--	--
MW-2 (IW-2)	06/10/10	<50	<3.0	<1.0	<1.0	<1.0	<3.0	0.050	<0.010	--	--	--	--
MW-2 (IW-2)	09/16/10	52	<3.0	<1.0	<1.0	<1.0	<3.0	--	--	--	--	--	--
MW-2 (IW-2)	12/22/10	<50	<3.0	<1.0	<1.0	<1.0	<3.0	--	--	--	--	--	--
MW-2 (IW-2)	03/10/11	<50	<3.0	4.7	<1.0	<1.0	<3.0	<0.020	<0.010	19	--	--	--
MW-2 (IW-2)	06/07/11	<50	<2.0	<1.0	<1.0	<1.0	<3.0	--	--	14	--	--	--
MW-2 (IW-2)	09/23/11	<50	<3.0	<1.0	<1.0	<1.0	<3.0	--	--	12	--	--	--
MW-2 (IW-2)	11/28/12	120	<3.0	6.8	<1.0	11	11	<0.020	<0.010	2.1	1.2	0.12	<0.020

TABLE 2
GROUNDWATER ANALYTICAL RESULTS
COLLEGE WAY FOODS
2120 EAST COLLEGE WAY
MOUNT VERNON, WASHINGTON

Well/Sample Identification	Date Sampled	TPH Gasoline (ppb)	MTBE (ppb)	Benzene (ppb)	Toluene (ppb)	Ethyl-benzene (ppb)	Xylenes (ppb)	EDC (ppb)	EDB (ppb)	Lead (ppb)	Naphthalene (ppb)	1-Methyl-naphthalene (ppb)	2-Methyl-naphthalene (ppb)
MW-3	03/23/93	<50	NA	<0.50	<0.50	<0.50	<1.0	--	--	--	--	--	--
MW-3	05/09/94	<50	NA	1.8	<0.50	<0.50	<1.0	--	--	--	--	--	--
MW-3	10/18/94	<50	NA	<0.50	<0.50	<0.50	<1.0	--	--	--	--	--	--
MW-3	07/30/02	<50	NA	<1	<1	<1	<3	--	--	--	--	--	--
MW-3	05/07/03	<50	NA	<1	1.0	<1	<3	--	--	--	--	--	--
MW-3	10/20/03	<50	NA	<1	<1	<1	<3	--	--	--	--	--	--
MW-3	12/26/03	<50	NA	<1	<1	<1	<3	--	--	--	--	--	--
MW-3	03/23/04	<50	NA	<1	<1	<1	<3	--	--	--	--	--	--
MW-3	06/21/04	<50	NA	<1	<1	<1	<3	--	--	--	--	--	--
MW-3	09/16/04	<50	NA	<1	<1	<1	<3	--	--	--	--	--	--
MW-3	12/16/04	<50	NA	<1	<1	<1	<3	--	--	--	--	--	--
MW-3	03/22/05	<50	NA	<1	<1	<1	<3	--	--	--	--	--	--
MW-3	08/15/05	<50	5	<1	<1	<1	<3	--	--	--	--	--	--
MW-3	11/22/05	<50	<3	<1	<1	<1	<3	--	--	--	--	--	--
MW-3	02/20/06	<50	3	<1	<1	<1	<3	--	--	--	--	--	--
MW-3	05/23/06	<50	4 ^g	<1	<1	<1	<3	--	--	--	--	--	--
MW-3	11/07/06	<50	<3	<1	<1	<1	<3	--	--	--	--	--	--
MW-3	06/06/07	<50	<3	<1	<1	<1	<3	--	--	--	--	--	--
MW-3	11/29/07	<50	<3	<1	<1	<1	<3	--	--	--	--	--	--
MW-3	06/11/08	<50	<3	<1	<1	<1	<3	--	--	--	--	--	--
MW-3	12/03/08	<50	3	<1	<1	<1	<3	--	--	--	--	--	--
MW-3	03/12/09	<50	<3	<1	<1	<1	<3	--	--	--	--	--	--
MW-3	06/30/09	<50	<3.0	<1.0	<1.0	<1.0	<3.0	--	--	--	--	--	--
MW-3	09/25/09	<50	<3.0	<1.0	<1.0	<1.0	<3.0	--	--	--	--	--	--
MW-3	12/22/09	<50	<1.0	<1.0	<1.0	<1.0	<3.0	--	--	--	--	--	--
MW-3	03/19/10	<50	<3.0	<1.0	<1.0	<1.0	<3.0	--	--	--	--	--	--
MW-3	06/10/10	<50	<3.0	<1.0	<1.0	<1.0	<3.0	<0.020	<0.010	--	--	--	--
MW-3	09/16/10	<50	<3.0	<1.0	<1.0	<1.0	<3.0	--	--	--	--	--	--

TABLE 2
GROUNDWATER ANALYTICAL RESULTS
COLLEGE WAY FOODS
2120 EAST COLLEGE WAY
MOUNT VERNON, WASHINGTON

Well/Sample Identification	Date Sampled	TPH		Benzene (ppb)	Toluene (ppb)	Ethyl-		EDC (ppb)	EDB (ppb)	Lead (ppb)	Naphthalene (ppb)	1-Methyl-naphthalene (ppb)	2-Methyl-naphthalene (ppb)
		Gasoline (ppb)	MTBE (ppb)			benzene (ppb)	Xylenes (ppb)						
MW-3	12/22/10	<50	<3.0	<1.0	<1.0	<1.0	<3.0	--	--	--	--	--	--
MW-3	03/10/11	<50	<3.0	<1.0	<1.0	<1.0	<3.0	<0.020	<0.010	<0.62	--	--	--
MW-3	06/07/11	<50	<2.0	<1.0	<1.0	<1.0	<3.0	--	--	<0.62	--	--	--
MW-3	09/23/11	<50	<3.0	<1.0	<1.0	<1.0	<3.0	--	--	<0.30	--	--	--
MW-3	11/28/11	<50	<3.0	<1.0	<1.0	<1.0	<3.0	<0.020	<0.010	<0.30	0.037	<0.020	<0.020

TABLE 2
GROUNDWATER ANALYTICAL RESULTS
COLLEGE WAY FOODS
2120 EAST COLLEGE WAY
MOUNT VERNON, WASHINGTON

Well/Sample Identification	Date Sampled	TPH Gasoline (ppb)	MTBE (ppb)	Benzene (ppb)	Toluene (ppb)	Ethyl-benzene (ppb)	Xylenes (ppb)	EDC (ppb)	EDB (ppb)	Lead (ppb)	Naphthalene (ppb)	1-Methyl-naphthalene (ppb)	2-Methyl-naphthalene (ppb)
MW-4	03/23/93	<50	NA	2.8	2.9	<0.50	2.8	--	--	--	--	--	--
MW-4	05/09/94	<50	NA	<0.50	<0.50	<0.50	<1.0	--	--	--	--	--	--
MW-4	10/18/94	<50	NA	<0.50	<0.50	<0.50	<1.0	--	--	--	--	--	--
MW-4	07/30/02	<50	NA	<1	<1	<1	<3	--	--	--	--	--	--
MW-4	05/07/03	<50	NA	<1	<1	<1	<3	--	--	--	--	--	--
MW-4	10/20/03	<50	NA	<1	<1	<1	<3	--	--	--	--	--	--
MW-4	12/26/03	<50	NA	<1	<1	<1	<3	--	--	--	--	--	--
MW-4	03/23/04	<50	NA	<1	<1	<1	<3	--	--	--	--	--	--
MW-4	06/21/04	<50	NA	<1	<1	<1	<3	--	--	--	--	--	--
MW-4	09/16/04	<50	NA	<1	<1	<1	<3	--	--	--	--	--	--
MW-4	12/16/04	<50	NA	<1	<1	<1	<3	--	--	--	--	--	--
MW-4	03/22/05	<50	NA	<1	<1	<1	<3	--	--	--	--	--	--
MW-4	08/15/05	<50	4	<1	<1	<1	<3	--	--	--	--	--	--
MW-4	11/22/05	<50	<3	<1	<1	<1	<3	--	--	--	--	--	--
MW-4	02/20/06	<50	<3	<1	<1	<1	<3	--	--	--	--	--	--
MW-4	05/23/06	<50	<3	<1	<1	<1	<3	--	--	--	--	--	--
MW-4	11/07/06	<50	<3	<1	<1	<1	<3	--	--	--	--	--	--
MW-4	06/06/07	<50	<3	<1	<1	<1	<3	--	--	--	--	--	--
MW-4	11/29/07	<50	<3	<1	<1	<1	<3	--	--	--	--	--	--
MW-4	06/11/08	<50	<3	<1	<1	<1	<3	--	--	--	--	--	--
MW-4	12/03/08	<50	<3	<1	<1	<1	<3	--	--	--	--	--	--
MW-4	03/12/09	<50	<3	<1	<1	<1	<3	--	--	--	--	--	--
MW-4	06/30/09	<50	<3.0	<1.0	<1.0	<1.0	<3.0	--	--	--	--	--	--
MW-4	09/25/09	<50	<3.0	<1.0	<1.0	<1.0	<3.0	--	--	--	--	--	--
MW-4	12/22/09	<50	<1.0	<1.0	<1.0	<1.0	<3.0	--	--	--	--	--	--
MW-4	03/19/10	<50	<3.0	<1.0	<1.0	<1.0	<3.0	--	--	--	--	--	--
MW-4	06/10/10	<50	<3.0	<1.0	<1.0	<1.0	<3.0	<0.020	<0.010	--	--	--	--
MW-4	09/16/10	<50	<3.0	<1.0	<1.0	<1.0	<3.0	--	--	--	--	--	--

TABLE 2
GROUNDWATER ANALYTICAL RESULTS
COLLEGE WAY FOODS
2120 EAST COLLEGE WAY
MOUNT VERNON, WASHINGTON

Well/Sample Identification	Date Sampled	TPH		Benzene (ppb)	Toluene (ppb)	Ethyl-		EDC (ppb)	EDB (ppb)	Lead (ppb)	Naphthalene (ppb)	1-Methyl-naphthalene (ppb)	2-Methyl-naphthalene (ppb)
		Gasoline (ppb)	MTBE (ppb)			benzene (ppb)	Xylenes (ppb)						
MW-4	12/22/10	<50	<3.0	<1.0	<1.0	<1.0	<3.0	--	--	--	--	--	--
MW-4	03/10/11	<50	<3.0	<1.0	<1.0	<1.0	<3.0	<0.020	<0.010	<0.62	--	--	--
MW-4	06/07/11	<50	<3.0	<1.0	<1.0	<1.0	<3.0	--	--	<0.62	--	--	--
MW-4	09/23/11	<50	<3.0	<1.0	<1.0	<1.0	<3.0	--	--	<0.30	--	--	--
MW-4	11/28/11	<50	<3.0	<1.0	<1.0	<1.0	<3.0	<0.020	<0.010	<0.30	<0.020	<0.020	<0.020

TABLE 2
GROUNDWATER ANALYTICAL RESULTS
COLLEGE WAY FOODS
2120 EAST COLLEGE WAY
MOUNT VERNON, WASHINGTON

Well/Sample Identification	Date Sampled	TPH Gasoline (ppb)	MTBE (ppb)	Benzene (ppb)	Toluene (ppb)	Ethyl-benzene (ppb)	Xylenes (ppb)	EDC (ppb)	EDB (ppb)	Lead (ppb)	Naphthalene (ppb)	1-Methyl-naphthalene (ppb)	2-Methyl-naphthalene (ppb)
MW-5	03/23/93	<50	NA	2.7	<0.50	<0.50	<1.0	--	--	--	--	--	--
MW-5	05/09/94	<50	NA	<0.50	<0.50	<0.50	<1.0	--	--	--	--	--	--
MW-5	10/18/94	<50	NA	<0.50	<0.50	<0.50	<1.0	--	--	--	--	--	--
MW-5	07/30/02	<50	NA	<1	<1	<1	<3	--	--	--	--	--	--
MW-5	05/07/03	<50	NA	<1	<1	<1	<3	--	--	--	--	--	--
MW-5	10/20/03	<50	NA	<1	<1	<1	<3	--	--	--	--	--	--
MW-5	12/26/03	<50	NA	<1	<1	<1	<3	--	--	--	--	--	--
MW-5	03/23/04	<50	NA	5	<1	<1	<3	--	--	--	--	--	--
MW-5	06/21/04	<50	NA	<1	<1	<1	<3	--	--	--	--	--	--
MW-5	09/16/04	<50	NA	<1	<1	<1	<3	--	--	--	--	--	--
MW-5	12/16/04	<50	NA	<1	<1	<1	<3	--	--	--	--	--	--
MW-5	03/22/05	<50	NA	3	<1	<1	<3	--	--	--	--	--	--
MW-5	08/15/05	<50	<3	<1	<1	<1	<3	--	--	--	--	--	--
MW-5	11/22/05	<50	<3	<1	<1	<1	<3	--	--	--	--	--	--
MW-5	02/20/06	<50	<3	<1	<1	<1	<3	--	--	--	--	--	--
MW-5	05/23/06	<50	<3	<1	<1	<1	<3	--	--	--	--	--	--
MW-5	11/07/06	<50	<3	<1	<1	<1	<3	--	--	--	--	--	--
MW-5	06/06/07	<50	<3	<1	<1	<1	<3	--	--	--	--	--	--
MW-5	11/29/07	<50	<3	<1	<1	<1	<3	--	--	--	--	--	--
MW-5	06/11/08	<50	<3	<1	<1	<1	<3	--	--	--	--	--	--
MW-5	12/03/08	<50	<3	<1	<1	<1	<3	--	--	--	--	--	--
MW-5	03/12/09	<50	<3	6	<1	<1	<3	--	--	--	--	--	--
MW-5	06/30/09	<50	<3.0	<1.0	<1.0	<1.0	<3.0	--	--	--	--	--	--
MW-5	09/25/09	<50	<3.0	<1.0	<1.0	<1.0	<3.0	--	--	--	--	--	--
MW-5	12/22/09	<50	<1.0	<1.0	<1.0	<1.0	<3.0	--	--	--	--	--	--
MW-5	03/19/10	<50	<3.0	<1.0	<1.0	<1.0	<3.0	--	--	--	--	--	--
MW-5	06/10/10	<50	<3.0	<1.0	<1.0	<1.0	<3.0	1.3	<0.010	--	--	--	--
MW-5	09/16/10	<50	<3.0	<1.0	<1.0	<1.0	<3.0	--	--	--	--	--	--

TABLE 2
GROUNDWATER ANALYTICAL RESULTS
COLLEGE WAY FOODS
2120 EAST COLLEGE WAY
MOUNT VERNON, WASHINGTON

Well/Sample Identification	Date Sampled	TPH		Benzene (ppb)	Toluene (ppb)	Ethyl-		EDC (ppb)	EDB (ppb)	Lead (ppb)	Naphthalene (ppb)	1-Methyl-naphthalene (ppb)	2-Methyl-naphthalene (ppb)
		Gasoline (ppb)	MTBE (ppb)			benzene (ppb)	Xylenes (ppb)						
MW-5	12/22/10	<50	<3.0	<1.0	<1.0	<1.0	<3.0	--	--	--	--	--	--
MW-5	03/10/11	<50	<3.0	<1.0	<1.0	<1.0	<3.0	<0.020	<0.010	<0.62	--	--	--
MW-5	06/07/11	<50	<3.0	<1.0	<1.0	<1.0	<3.0	--	--	<0.62	--	--	--
MW-5	09/23/11	<50	<3.0	<1.0	<1.0	<1.0	<3.0	--	--	--	--	--	--
MW-5	11/28/11	<50	<3.0	<1.0	<1.0	<1.0	<3.0	<0.020	<0.010	<0.30	<0.020	<0.020	<0.020

TABLE 2
GROUNDWATER ANALYTICAL RESULTS
COLLEGE WAY FOODS
2120 EAST COLLEGE WAY
MOUNT VERNON, WASHINGTON

Well/Sample Identification	Date Sampled	TPH		Benzene (ppb)	Toluene (ppb)	Ethyl-		EDC (ppb)	EDB (ppb)	Lead (ppb)	Naphthalene (ppb)	1-Methyl-naphthalene (ppb)	2-Methyl-naphthalene (ppb)
		Gasoline (ppb)	MTBE (ppb)			benzene (ppb)	Xylenes (ppb)						
MW-7	06/07/11	<50	<3.0	1.0	<1.0	<1.0	<3.0	--	--	<0.62	--	--	--
MW-7	07/13/11	<50	<3.0	<1.0	<1.0	<1.0	<3.0	--	--	--	--	--	--
MW-7	07/25/11	58	<3.0	<1.0	<1.0	<1.0	<3.0	--	--	<0.62	--	--	--
MW-7	09/23/11	<50	<3.0	<1.0	<1.0	<1.0	<3.0	--	--	<0.30	--	--	--
MW-7	10/31/11	<50	<3.0	<1.0	<1.0	<1.0	<3.0	--	--	--	--	--	--
MW-7	11/28/11	65	<3.0	2.7	<1.0	3.3	<3.0	<0.020	<0.010	<3.0	0.042	<0.020	<0.020
MW-7	12/20/11	110	<3.0	6.4	<1.0	3.0	6.7	--	--	--	--	--	--

TABLE 2
GROUNDWATER ANALYTICAL RESULTS
COLLEGE WAY FOODS
2120 EAST COLLEGE WAY
MOUNT VERNON, WASHINGTON

Well/Sample Identification	Date Sampled	TPH		Benzene (ppb)	Toluene (ppb)	Ethyl-		EDC (ppb)	EDB (ppb)	Lead (ppb)	Naphthalene (ppb)	1-Methyl-naphthalene (ppb)	2-Methyl-naphthalene (ppb)
		Gasoline (ppb)	MTBE (ppb)			benzene (ppb)	Xylenes (ppb)						
MW-8	06/07/11	120	3.0	<1.0	<1.0	1.4	<3.0	--	--	<0.62	--	--	--
MW-8	07/13/11	<50	25	<1.0	<1.0	<1.0	<3.0	--	--	--	--	--	--
MW-8	07/25/11	<50	7.7	<1.0	<1.0	<1.0	<3.0	--	--	<0.62	--	--	--
MW-8	09/23/11	<50	42	<1.0	<1.0	<1.0	<3.0	--	--	<0.30	--	--	--
MW-8	10/31/11	<50	2.9	<1.0	<1.0	<1.0	<3.0	--	--	--	--	--	--
MW-8	11/28/11	<50	<3.0	<1.0	<1.0	<1.0	<3.0	<0.020	<0.010	0.86	<0.020	<0.020	<0.020
MW-8	12/20/11	<50	<3.0	<1.0	<1.0	<1.0	<3.0	--	--	--	--	--	--

TABLE 2
GROUNDWATER ANALYTICAL RESULTS
COLLEGE WAY FOODS
2120 EAST COLLEGE WAY
MOUNT VERNON, WASHINGTON

Well/Sample Identification	Date Sampled	TPH Gasoline (ppb)	MTBE (ppb)	Benzene (ppb)	Toluene (ppb)	Ethyl-benzene (ppb)	Xylenes (ppb)	EDC (ppb)	EDB (ppb)	Lead (ppb)	Naphthalene (ppb)	1-Methyl-naphthalene (ppb)	2-Methyl-naphthalene (ppb)
TW-1	12/09/92	24,000	NA	2,700	1,800	500	3,000	--	--	--	--	--	--
TW-1	05/09/94	540	NA	34	1.8	12	36	--	--	--	--	--	--
TW-1	10/18/94	150	NA	16	0.76	4.1	13	--	--	--	--	--	--
TW-1	06/29/95	260	NA	13	1.4	10	5.4	--	--	--	--	--	--
TW-1	12/21/95	170	NA	2.8	3.3	4.6	3.7	--	--	--	--	--	--
TW-1	03/26/96	1,900	NA	34	18	33	85	--	--	--	--	--	--
TW-1	08/15/97	720	NA	27	11	5.8	66	--	--	--	--	--	--
TW-1	07/30/02	<50	NA	<1	<1	<1	<3	--	--	--	--	--	--
TW-1	05/07/03	<50	NA	<1	<1	<1	<3	--	--	--	--	--	--
TW-1	10/20/03	<50	NA	<1	<1	<1	<3	--	--	--	--	--	--
TW-1	12/26/03	<50	NA	<1	<1	<1	<3	--	--	--	--	--	--
TW-1	03/23/04	<50	NA	<1	<1	<1	<3	--	--	--	--	--	--
TW-1	06/21/04	120	NA	4	<1	<1	<3	--	--	--	--	--	--
TW-1	09/16/04	<50	NA	2	<1	<1	<3	--	--	--	--	--	--
TW-1	12/16/04	910	NA	32	2	3	9	--	--	--	--	--	--
TW-1	03/22/05	430	NA	48	2	3	<3	--	--	--	--	--	--
TW-1	08/15/05	910	26	77	4	5	12	--	--	--	--	--	--
TW-1	11/22/05	1,300	<2 ^g	140	5	6	13	--	--	--	--	--	--
TW-1	02/20/06	780	<6	85	2	5	<6	--	--	--	--	--	--
TW-1	05/23/06	1,800	<20 ^g	420	4	6	22	--	--	--	--	--	--
TW-1	11/07/06	330	<3	47	1	1	<3	--	--	--	--	--	--
TW-1	06/06/07	310	<3	49	1	<1	<3	--	--	--	--	--	--
TW-1	11/29/07	75	<3	<1	<1	<1	<3	--	--	--	--	--	--
TW-1	06/11/08	300	<3	54	1	15	4	--	--	--	--	--	--
TW-1	12/03/08	130	<3	2	<1	<1	<3	--	--	--	--	--	--
TW-1	03/12/09	200	<3	<1	<1	<1	<3	--	--	--	--	--	--
TW-1	06/30/09	230	<3.0	21	<1.0	<1.0	<3.0	--	--	--	--	--	--
TW-1	09/25/09	<50	<3.0	<1.0	<1.0	<1.0	<3.0	--	--	--	--	--	--

TABLE 2
GROUNDWATER ANALYTICAL RESULTS
COLLEGE WAY FOODS
2120 EAST COLLEGE WAY
MOUNT VERNON, WASHINGTON

Well/Sample Identification	Date Sampled	TPH		Benzene (ppb)	Toluene (ppb)	Ethyl-		EDC (ppb)	EDB (ppb)	Lead (ppb)	Naphthalene (ppb)	1-Methyl-naphthalene (ppb)	2-Methyl-naphthalene (ppb)
		Gasoline (ppb)	MTBE (ppb)			benzene (ppb)	Xylenes (ppb)						
TW-1	12/22/09	<50	<1.0	<1.0	<1.0	<1.0	<3.0	--	--	--	--	--	--
TW-1	03/19/10	<50	<3.0	<1.0	<1.0	<1.0	<3.0	--	--	--	--	--	--
TW-1	06/10/10	770	<3.0	43	1.7	4.4	9.2	<0.020	<0.010	--	--	--	--
TW-1	09/16/10	340	<3.0	13	<1.0	18	<3.0	--	--	--	--	--	--
TW-1	12/22/10	150	<3.0	2.0	<1.0	<1.0	<3.0	--	--	--	--	--	--
TW-1	03/10/11	95	<3.0	2.4	<1.0	<1.0	<3.0	<0.020	<0.010	11	--	--	--
TW-1	06/07/11	580	<3.0	14	<1.0	12	<3.0	--	--	4.0	--	--	--
TW-1	07/13/11	230	<3.0	7.1	<1.0	5.4	<3.0	--	--	--	--	--	--
TW-1	07/25/11	410	<3.0	14.0	<1.0	7.6	<3.0	--	--	2.2	--	--	--
TW-1	09/23/11	<50	<3.0	<1.0	<1.0	<1.0	<3.0	--	--	2.0	--	--	--
TW-1	10/31/11	72	<3.0	<1.0	<1.0	<1.0	<3.0	--	--	--	--	--	--
TW-1	11/28/11	540	<3.0	78	3.9	25	61	<0.020	<0.010	2.8	3.6	1.0	0.45
TW-1	12/20/11	150	<3.0	16	<1.0	2.1	<3.0	--	--	--	--	--	--

TABLE 2
GROUNDWATER ANALYTICAL RESULTS
COLLEGE WAY FOODS
2120 EAST COLLEGE WAY
MOUNT VERNON, WASHINGTON

Well/Sample Identification	Date Sampled	TPH Gasoline (ppb)	MTBE (ppb)	Benzene (ppb)	Toluene (ppb)	Ethyl-benzene (ppb)	Xylenes (ppb)	EDC (ppb)	EDB (ppb)	Lead (ppb)	Naphthalene (ppb)	1-Methyl-naphthalene (ppb)	2-Methyl-naphthalene (ppb)
TW-2	12/09/92	59,000	NA	8,800	12,000	1,300	7,300	--	--	--	--	--	--
TW-2	05/09/94	26,000	NA	5,700	4,500	490	3,600	--	--	--	--	--	--
TW-2	10/18/94	34,000	NA	7,300	5,600	670	3,700	--	--	--	--	--	--
TW-2	03/30/95	32,000	NA	7,300	4,100	590	4,200	--	--	--	--	--	--
TW-2	06/29/95	2,200	NA	260	14	89	120	--	--	--	--	--	--
TW-2	12/21/95	25,000	NA	3,500	4,400	510	4,300	--	--	--	--	--	--
TW-2	03/25/96	23,000	NA	5,300	1,500	360	4,300	--	--	--	--	--	--
TW-2	06/29/96	21,100	NA	4,840	2,060	194	2,940	--	--	--	--	--	--
TW-2	09/19/96	10,800	NA	5,780	1,210	86.7	1,560	--	--	--	--	--	--
TW-2	12/19/96	15,100	NA	5,670	2,000	181	2,020	--	--	--	--	--	--
TW-2	01/15/97	6,180	NA	3,030	438	84.2	1,170	--	--	--	--	--	--
TW-2	05/29/97	4,900	NA	5,500	440	<100	1,210	--	--	--	--	--	--
TW-2	08/15/97	5,200	NA	4,000	240	<50	710	--	--	--	--	--	--
TW-2	07/30/02	650	NA	22	22	6	39	--	--	--	--	--	--
TW-2	05/07/03	29,000	NA	15,000	420	1,600	6,000	--	--	--	--	--	--
TW-2	10/20/03	21,000	NA	8,200	270	1,500	3,400	--	--	--	--	--	--
TW-2	12/26/03	14,000	NA	4,700	140	480	1,600	--	--	--	--	--	--
TW-2	03/23/04	11,000	NA	6,700	120	560	1,300	--	--	--	--	--	--
TW-2	06/21/04	6,700	NA	6,500	90	330	930	--	--	--	--	--	--
TW-2	09/16/04	4,900	NA	550	400	89	1,100	--	--	--	--	--	--
TW-2	12/16/04	6,900	NA	820	76	110	1,300	--	--	--	--	--	--
TW-2	03/22/05	6,400	NA	2,200	120	300	1,300	--	--	--	--	--	--
TW-2	08/15/05	2,300	14	1,800	20	130	270	--	--	--	--	--	--
TW-2	11/22/05	3,300	<30	1,300	21	220	320	--	--	--	--	--	--
TW-2	02/20/06	4,200	<15	1,500	36	330	530	--	--	--	--	--	--
TW-2	05/23/06	600	<3	250	4	37	56	--	--	--	--	--	--
TW-2	11/07/06	120	<3	73	<1	13	13	--	--	--	--	--	--
TW-2	06/06/07	590	<3	180	4	54	63	--	--	--	--	--	--

TABLE 2
GROUNDWATER ANALYTICAL RESULTS
COLLEGE WAY FOODS
2120 EAST COLLEGE WAY
MOUNT VERNON, WASHINGTON

Well/Sample Identification	Date Sampled	TPH		Benzene (ppb)	Toluene (ppb)	Ethyl-benzene (ppb)	Xylenes (ppb)	EDC (ppb)	EDB (ppb)	Lead (ppb)	Naphthalene (ppb)	1-Methyl-naphthalene (ppb)	2-Methyl-naphthalene (ppb)
		Gasoline (ppb)	MTBE (ppb)										
TW-2	11/29/07	5,800	<2 ^g	2,000	34	920	580	--	--	--	--	--	--
TW-2	06/11/08	4,600	<15	870	26	360	700	--	--	--	--	--	--
TW-2	12/03/08	4,100	<15	1,100	20	420	530	--	--	--	--	--	--
TW-2	03/12/09	200	<3	53	1	23	19	--	--	--	--	--	--
TW-2	06/30/09	710	<2.0	240	4.6	81	95	--	--	--	--	--	--
TW-2	09/25/09	1,300	17	380	9.9	180	170	--	--	--	--	--	--
TW-2	12/22/09	1,200	<2.0	300	3.1	120	79	--	--	--	--	--	--
TW-2	03/19/10	3,300	<3.0	860	18	400	270	--	--	--	--	--	--
TW-2	06/10/10	3,600	<15	1,000	23	500	300	<0.020	<0.010	--	--	--	--
TW-2	09/16/10	2,600	<15	570	13	370	190	--	--	--	--	--	--
TW-2	12/22/10	3,800	<30	670	15	420	380	--	--	--	--	--	--
TW-2	03/10/11	4,000	<3.0	890	30	510	450	<0.020	<0.010	4.0	--	--	--
TW-2	06/07/11	10,000	<3.0	1,500	72	950	1,600	--	--	12	--	--	--
TW-2	07/13/11	6,200	<30	1,300	48	660	880	--	--	--	--	--	--
TW-2	07/25/11	5,900	<30	1,200	38	650	750	--	--	6.1	--	--	--
TW-2	09/23/11	3,600	23	1,000	19	520	260	--	--	5.3	--	--	--
TW-2	10/31/11	5,700	<30	1,100	28	710	290	--	--	--	--	--	--
TW-2	11/28/11	5,300	<30	960	18	740	210	<0.020	<0.010	12	33	7.8	2.3
TW-2	12/20/11	3,500	<30	530	11	500	100	--	--	--	--	--	--

TABLE 2
GROUNDWATER ANALYTICAL RESULTS
COLLEGE WAY FOODS
2120 EAST COLLEGE WAY
MOUNT VERNON, WASHINGTON

Well/Sample Identification	Date Sampled	TPH Gasoline (ppb)	MTBE (ppb)	Benzene (ppb)	Toluene (ppb)	Ethyl-benzene (ppb)	Xylenes (ppb)	EDC (ppb)	EDB (ppb)	Lead (ppb)	Naphthalene (ppb)	1-Methyl-naphthalene (ppb)	2-Methyl-naphthalene (ppb)
TW-3	12/09/92	<50	NA	2.6	<0.50	<0.50	<1.0	--	--	--	--	--	--
TW-3	05/09/94	<50	NA	<0.50	<0.50	<0.50	<1.0	--	--	--	--	--	--
TW-3	10/18/94	<50	NA	<0.50	<0.50	<0.50	<1.0	--	--	--	--	--	--
TW-3	07/30/02	<50	NA	<1	<1	<1	<3	--	--	--	--	--	--
TW-3	05/07/03	<50	NA	<1	<1	<1	<3	--	--	--	--	--	--
TW-3	10/20/03	<50	NA	<1	<1	<1	<3	--	--	--	--	--	--
TW-3	12/26/03	<50	NA	<1	<1	<1	<3	--	--	--	--	--	--
TW-3	03/23/04	<50	NA	<1	<1	<1	<3	--	--	--	--	--	--
TW-3	06/21/04	<50	NA	<1	<1	<1	<3	--	--	--	--	--	--
TW-3	09/16/04	<50	NA	<1	<1	<1	<3	--	--	--	--	--	--
TW-3	12/16/04	<50	NA	<1	<1	<1	<3	--	--	--	--	--	--
TW-3	03/22/05	<50	NA	<1	<1	<1	<3	--	--	--	--	--	--
TW-3	08/15/05	<50	<3	<1	<1	<1	<3	--	--	--	--	--	--
TW-3	11/22/05	<50	<3	<1	<1	<1	<3	--	--	--	--	--	--
TW-3	02/20/06	<50	<3	<1	<1	<1	<3	--	--	--	--	--	--
TW-3	05/23/06	<50	<3	<1	<1	<1	<3	--	--	--	--	--	--
TW-3	11/07/06	<50	<3	<1	<1	<1	<3	--	--	--	--	--	--
TW-3	06/06/07	<50	<3	<1	<1	<1	<3	--	--	--	--	--	--
TW-3	11/29/07	<50	<3	<1	<1	<1	<3	--	--	--	--	--	--
TW-3	06/11/08	<50	<3	<1	<1	<1	<3	--	--	--	--	--	--
TW-3	03/12/09	<50	<3	<1	<1	<1	<3	--	--	--	--	--	--
TW-3	06/30/09	<50	<3.0	<1.0	<1.0	<1.0	<3.0	--	--	--	--	--	--
TW-3	09/25/09	<50	<3.0	<1.0	<1.0	<1.0	<3.0	--	--	--	--	--	--
TW-3	12/22/09	<50	<1.0	<1.0	<1.0	<1.0	<3.0	--	--	--	--	--	--
TW-3	03/19/10	<50	<1.0	<1.0	<1.0	<1.0	<3.0	--	--	--	--	--	--
TW-3	06/10/10	<50	<3.0	<1.0	<1.0	<1.0	<3.0	<0.020	<0.010	--	--	--	--
TW-3	09/16/10	<50	<3.0	<1.0	<1.0	<1.0	<3.0	--	--	--	--	--	--
TW-3	12/22/10	<50	<3.0	<1.0	<1.0	<1.0	<3.0	--	--	--	--	--	--

TABLE 2
GROUNDWATER ANALYTICAL RESULTS
COLLEGE WAY FOODS
 2120 EAST COLLEGE WAY
 MOUNT VERNON, WASHINGTON

Well/Sample Identification	Date Sampled	TPH		Benzene (ppb)	Toluene (ppb)	Ethyl-		EDC (ppb)	EDB (ppb)	Lead (ppb)	Naphthalene (ppb)	1-Methyl-naphthalene (ppb)	2-Methyl-naphthalene (ppb)
		Gasoline (ppb)	MTBE (ppb)			benzene (ppb)	Xylenes (ppb)						
TW-3	03/10/11	<50	<3.0	<1.0	<1.0	<1.0	<3.0	<0.020	<0.010	<0.62	--	--	--
TW-3	06/07/11	<50	<3.0	<1.0	<1.0	<1.0	<3.0	--	--	1.3	--	--	--
TW-3	09/23/11	<50	<3.0	<1.0	<1.0	<1.0	<3.0	--	--	<0.30	--	--	--
TW-3	11/28/11	<50	<3.0	<1.0	<1.0	<1.0	<3.0	<0.020	<0.010	<0.30	<0.020	<0.020	<0.020

TABLE 2
GROUNDWATER ANALYTICAL RESULTS
COLLEGE WAY FOODS
2120 EAST COLLEGE WAY
MOUNT VERNON, WASHINGTON

Well/Sample Identification	Date Sampled	TPH Gasoline (ppb)	MTBE (ppb)	Benzene (ppb)	Toluene (ppb)	Ethyl-benzene (ppb)	Xylenes (ppb)	EDC (ppb)	EDB (ppb)	Lead (ppb)	Naphthalene (ppb)	1-Methyl-naphthalene (ppb)	2-Methyl-naphthalene (ppb)
B-2	08/12/92	20,000	NA	5,700	3,500	390	1,600	--	--	--	--	--	--
B-2	12/09/92	27,000	NA	5,100	640	760	5,500	--	--	--	--	--	--
B-2	05/09/94	2,900	NA	560	55	100	280	--	--	--	--	--	--
B-2	10/18/94	430	NA	70	8.1	25	34	--	--	--	--	--	--
B-2	06/29/95	19,000	NA	5,000	2,900	500	3,000	--	--	--	--	--	--
B-2	12/21/95	1,100	NA	52	1.7	60	37	--	--	--	--	--	--
B-2	03/25/96	360	NA	50	2.6	6.8	14	--	--	--	--	--	--
B-2	06/29/96	409	NA	32.7	0.647	12.3	14.2	--	--	--	--	--	--
B-2	09/19/96	88.3	NA	7.29	0.689	0.667	3.71	--	--	--	--	--	--
B-2	12/19/96	502	NA	48.8	0.933	16.2	20.5	--	--	--	--	--	--
B-2	05/29/97	580	NA	35	1.2	30	16.9	--	--	--	--	--	--
B-2	08/15/97	910	NA	170	4.5	35	47	--	--	--	--	--	--
B-2	07/30/02	3,900	NA	270	14	20	100	--	--	--	--	--	--
B-2	05/07/03	600	NA	28	3	1	7	--	--	--	--	--	--
B-2	10/20/03	23,000	NA	1,800	3,200	500	2,900	--	--	--	--	--	--
B-2	12/26/03	6,800	NA	530	230	120	530	--	--	--	--	--	--
B-2	03/23/04	1,200	NA	38	5	8	28	--	--	--	--	--	--
B-2	06/21/04	1,100	NA	50	18	6	50	--	--	--	--	--	--
B-2	09/16/04	540	NA	10	3	4	13	--	--	--	--	--	--
B-2	12/16/04	670	NA	8	6	9	46	--	--	--	--	--	--
B-2	03/22/05	2,300	NA	88	16	39	150	--	--	--	--	--	--
B-2	08/15/05	1,500	8	42	5	25	51	--	--	--	--	--	--
B-2	11/22/05	1,400	<2 ^g	35	6	18	37	--	--	--	--	--	--
B-2	02/20/06	200	<3	4	<1	2	4	--	--	--	--	--	--
B-2	05/23/06	570	<3	32	7	11	37	--	--	--	--	--	--
B-2	11/07/06	240	<3	17	1	3	5	--	--	--	--	--	--
B-2	06/06/07	5,200	<30	890	84	290	550	--	--	--	--	--	--
B-2	11/29/07	650	<2 ^g	16	2	15	19	--	--	--	--	--	--

TABLE 2
GROUNDWATER ANALYTICAL RESULTS
COLLEGE WAY FOODS
2120 EAST COLLEGE WAY
MOUNT VERNON, WASHINGTON

Well/Sample Identification	Date Sampled	TPH		Benzene (ppb)	Toluene (ppb)	Ethyl- benzene Xylenes (ppb)		EDC (ppb)	EDB (ppb)	Lead (ppb)	Naphthalene (ppb)	1-Methyl-naphthalene (ppb)	2-Methyl-naphthalene (ppb)
		Gasoline (ppb)	MTBE (ppb)			benzene	Xylenes						
B-2	06/11/08	970	<3	62	7	25	40	--	--	--	--	--	--
B-2	12/03/08	900	<3	49	6	25	47	--	--	--	--	--	--
B-2	03/12/09	94	<3	2	2	1	<3	--	--	--	--	--	--
B-2	06/30/09	560	<3.0	84	48	11	11	--	--	--	--	--	--
B-2	09/25/09	880	19	170	16	47	69	--	--	--	--	--	--
B-2	12/22/09	53	<1.0	2.5	<1.0	1.2	<3.0	--	--	--	--	--	--
B-2	03/19/10	630	<3.0	69	11	26	71	--	--	--	--	--	--
B-2	06/10/10	<50	<3.0	4.5	1.1	2.3	5.2	<0.020	<0.010	--	--	--	--
B-2	09/16/10	Not Sample - Well covered with large puddle											
B-2	12/22/10	190	<3.0	40	3.9	11	21	--	--	--	--	--	--
B-2	03/10/11	530	<3.0	69	10	29	48	<0.020	<0.010	<0.62	--	--	--
B-2	06/07/11	550	<3.0	6.5	1.2	21	7.3	--	--	<0.62	--	--	--
B-2	09/23/11	730	<3.0	35	3.3	18	13	--	--	0.83	--	--	--
B-2	11/28/11	620	<3.0	27	3.6	17	30	<0.020	<0.010	0.40	4.4	2.1	2.0
MTCA Method A Cleanup Levels:		800^f	20	5	1,000	700	1,000	5	0.01	15	160	-	-

TABLE 2
GROUNDWATER ANALYTICAL RESULTS
COLLEGE WAY FOODS
2120 EAST COLLEGE WAY
MOUNT VERNON, WASHINGTON

Well/Sample Identification	Date Sampled	TPH		Benzene (ppb)	Toluene (ppb)	Ethyl- benzene Xylenes (ppb)		EDC (ppb)	EDB (ppb)	Lead (ppb)	Naphthalene (ppb)	1-Methyl-naphthalene (ppb)	2-Methyl-naphthalene (ppb)
		Gasoline (ppb)	MTBE (ppb)			benzene (ppb)	Xylenes (ppb)						

Notes:
"<50" - not detected above laboratory reporting limit of 50 ppb
MTBE= Methyl Tert-Butyl Ether
EDC= 1,2- Dichloroethane
EDB= 1,2- Dibromoethane
TPH as Gasoline (Toluene to Dodecane) - Analysis by Method NWTPH-Gx
MTBE - Analysis by EPA 8021B
BTEX - Analysis by EPA Method 8021B
EDC and EDB - Analysis by EPA Method 8260
Lead - Analysis by EPA Method 6020
Naphthalene, 1-Methylnaphthalene, & 2-Methylnaphthalene - Analysis by EPA Method 8270 SIM
^a Sample collected prior to startup of the air sparging system.
^b Sample was collected at six feet below the water surface.
^c Duplicate sample reported 81,000 ppb for TPH-G.
^d Before pumping.
^e After pumping.
^f MTCA Method A Cleanup Level for TPH-Gasoline is 1,000 ppb if benzene is not detectable in groundwater.
^g Samples containing detectable concentrations of MTBE by USEPA Method 8021B were also analyzed by USEPA 8260 to confirm MTBE concentrations.

TABLE 3
GROUNDWATER ANALYTICAL RESULTS
NATURAL ATTENUATION PARAMETERS
COLLEGE WAY FOODS
2120 EAST COLLEGE WAY
MOUNT VERNON, WASHINGTON

Sample I.D.	Date	Dissolved Oxygen (mg/L)	Methane (Head) (mg/L)	Ferrous Iron (mg/L)	Nitrate (mg/L)	Sulfate (mg/L)	Sulfide (mg/L)	Alkalinity (mg/L)	ph (0 to 14 units)	ORP (mV)	Conductivity (mS/cm ³)	Temp. (Celsius)
MW-1	08/15/05	0.20	0.01	2.2	<0.28	<0.16	<0.05	120	6.59	-20.2	0.234	21.07
MW-1	11/22/05	0.54	--	--	--	--	--	--	7.17	64	0.326	14.46
MW-1	02/20/06	0.58	6.4	2.8	0.14	2.8	<0.05	140	7.58	57.9	0.333	11.20
MW-1	05/23/06	1.16	0.06	2.4	<0.14	1.6	<0.05	100	5.83	-21.2	0.278	14.80
MW-1	11/07/06	0.63	0.23	2.2	<0.14	1.8	NA ¹	NA ¹	6.96	-18.0	0.310	16.98
MW-1	06/06/07	1.33	0.26	2.0	<0.14	3.4	<0.05	110	6.93	-26.9	0.217	16.30
MW-1	11/29/07	1.73	2.10	2.6	0.22	2.2	0.10	160	7.07	-84.4	0.342	12.99
MW-1	06/11/08	--	--	--	--	--	--	--	--	--	--	--
MW-1	12/03/08	2.10	0.22	0.90	<0.14	1.0	<0.05	170	--	--	--	11.5
MW-1	03/12/09	4.0	0.12	--	<0.3	<1.0	<0.05	190	--	--	--	9.1
MW-1	06/30/09	0.87	--	--	--	--	--	--	--	--	--	--
MW-1	09/25/09	0.55	--	--	--	--	--	--	--	--	--	19.77
MW-1	12/22/09	2.28	--	--	--	--	--	--	--	--	--	12.56
MW-1	03/19/10	2.94	--	--	--	--	--	--	6.77	--	--	12.28
MW-1	06/10/10	4.26	--	--	--	--	--	--	--	--	--	15.24
MW-1	09/16/10	4.01	--	1.8 ²	<0.15	0.42	--	--	6.8	183.7	0.330	18.64
MW-1	12/22/10	0.40	--	--	--	--	--	--	6.63	234.2	0.083	12.53
MW-1	03/10/11	0.49	--	--	--	6.3	--	--	6.69	343.3	0.283	10.17
MW-1	06/07/11	0.71	--	--	--	<0.26	--	--	6.73	158.3	0.281	13.16
MW-1	07/13/11	0.43	--	--	--	0.41	--	--	6.62	97.5	0.466	15.92
MW-1	07/25/11	--	--	--	--	2.70	--	--	--	--	--	--
MW-1	09/30/11	0.38	--	--	--	1.4	--	--	6.61	40.6	0.392	18.51
MW-1	10/31/11	0.76	--	--	--	14	--	--	6.48	0.76	0.380	16.00
MW-1	11/28/11	0.39	--	--	--	57	--	--	13.18	8.4	0.385	13.18
MW-1	12/20/11	0.29	--	--	--	48	--	--	6.92	19.9	0.378	11.13

TABLE 3
GROUNDWATER ANALYTICAL RESULTS
NATURAL ATTENUATION PARAMETERS
COLLEGE WAY FOODS
2120 EAST COLLEGE WAY
MOUNT VERNON, WASHINGTON

Sample I.D.	Date	Dissolved Oxygen (mg/L)	Methane (Head) (mg/L)	Ferrous Iron (mg/L)	Nitrate (mg/L)	Sulfate (mg/L)	Sulfide (mg/L)	Alkalinity (mg/L)	ph (0 to 14 units)	ORP (mV)	Conductivity (mS/cm ³)	Temp. (Celsius)
MW-2	08/15/05	0.13	0.82	4	<0.70	<0.40	<0.05	120	6.86	-117.9	0.292	20.62
MW-2	11/22/05	0.52	--	--	--	--	--	--	7.28	47.7	0.205	13
MW-2	02/20/06	0.39	8.0	4.2	2.5	<0.08	<0.05	81	7.51	37.7	0.281	10.16
MW-2	05/23/06	0.66	0.37	2.4	<0.14	<0.08	<0.05	120	6.04	-41.5	0.268	16.99
MW-2	11/07/06	0.47	<0.01	2.6	<0.14	1.6	NA ¹	NA ¹	7.22	-128.1	0.213	14.20
MW-2	06/06/07	0.88	0.59	2.2	0.38	0.84	<0.05	72	7.11	-127.1	0.422	18.99
MW-2	11/29/07	1.16	0.69	3.4	<0.14	3.1	<0.05	59	7.15	-108.1	1.000	12.39
MW-2	06/11/08	--	<0.01	1.8	<0.14	0.91	<0.05	160	6.5	-93	86.000	14.80
MW-2	12/03/08	2.41	0.03	1.2	<0.14	1.7	<0.05	100	--	--	--	10.1
MW-2	03/12/09	6.0	0.10	--	<0.3	1.3	<0.05	130	--	--	--	7.6
MW-2	06/30/09	0.8	--	--	--	--	--	--	--	--	--	--
MW-2	09/25/09	0.66	--	--	--	--	--	--	--	--	--	19.48
MW-2	12/22/09	1.37	--	--	--	--	--	--	--	--	--	10.92
MW-2	03/19/10	2.02	--	--	--	--	--	--	7.22	--	--	12.29
MW-2	06/10/10	4.96	--	--	--	--	--	--	--	--	--	15.19
MW-2	09/16/10	3.45	--	7.4 ²	<0.15	1.4	--	--	7.23	89.1	0.360	18.75
MW-2	12/22/10	0.51	--	--	--	--	--	--	7.04	168.9	0.085	11.66
MW-2	03/10/11	0.19	--	--	--	4.8	--	--	6.82	91.9	0.518	8.76
MW-2	06/07/11	0.58	--	--	--	--	--	--	6.99	96.5	0.521	13.91
MW-2	09/23/11	0.19	--	--	--	--	--	--	7.04	42.6	0.590	19.44
MW-2	11/01/11	0.17	--	--	--	--	--	--	7.11	- 29.6	0.452	12.40

TABLE 3
GROUNDWATER ANALYTICAL RESULTS
NATURAL ATTENUATION PARAMETERS
COLLEGE WAY FOODS
2120 EAST COLLEGE WAY
MOUNT VERNON, WASHINGTON

Sample I.D.	Date	Dissolved Oxygen (mg/L)	Methane (Head) (mg/L)	Ferrous Iron (mg/L)	Nitrate (mg/L)	Sulfate (mg/L)	Sulfide (mg/L)	Alkalinity (mg/L)	ph (0 to 14 units)	ORP (mV)	Conductivity (mS/cm ³)	Temp. (Celsius)
MW-3	08/15/05	0.52	--	--	--	--	--	--	7.03	9.3	0.715	15.66
MW-3	11/22/05	0.66	--	--	--	--	--	--	7.16	62.3	0.684	16.99
MW-3	02/20/06	1.08	--	--	--	--	--	--	7.51	48.9	0.732	12.63
MW-3	05/23/06	0.71	--	1.0	--	--	--	--	5.68	18.9	0.580	14.27
MW-3	11/07/06	1.42	--	--	--	--	--	--	7.05	59.6	0.627	17.09
MW-3	06/06/07	1.37	--	--	--	--	--	--	6.93	-15.3	0.612	13.93
MW-3	11/29/07	2.38	0.76	1.1	<0.14	1.9	<0.05	400	6.92	-79.6	0.616	13.41
MW-3	06/11/08	--	<0.01	0.2	<0.14	2.0	<0.05	380	6.28	-16.0	0.100	14.30
MW-3	12/03/08	4.3	0.01	0.4	<0.14	1.5	<0.05	520	--	--	--	12.8
MW-3	03/12/09	4.90	<0.01	--	<0.3	1.5	<0.05	500	--	--	--	11.4
MW-3	06/30/09	1.31	--	--	--	--	--	--	--	--	--	--
MW-3	09/25/09	1.01	--	--	--	--	--	--	--	--	--	--
MW-3	12/22/09	4.61	--	--	--	--	--	--	--	--	--	15.97
MW-3	03/19/10	2.85	--	--	--	--	--	--	6.77	--	--	14.63
MW-3	06/10/10	4.42	--	--	--	--	--	--	--	--	--	14.69
MW-3	09/16/10	3.96	--	<0.22 ²	<0.15	0.9	--	--	6.62	333.1	0.598	17.69
MW-3	12/22/10	0.82	--	--	--	--	--	--	6.56	--	0.183	15.35
MW-3	03/10/11	0.85	--	--	--	1.6	--	--	6.61	206.0	0.492	13.16
MW-3	06/07/11	0.71	--	--	--	--	--	--	6.45	156.3	0.511	13.79
MW-3	09/23/11	0.33	--	--	--	--	--	--	6.44	173.0	0.595	16.01
MW-3	11/28/11	0.59	--	--	--	--	--	--	6.47	13.0	0.554	15.26

TABLE 3
GROUNDWATER ANALYTICAL RESULTS
NATURAL ATTENUATION PARAMETERS
COLLEGE WAY FOODS
2120 EAST COLLEGE WAY
MOUNT VERNON, WASHINGTON

Sample I.D.	Date	Dissolved Oxygen (mg/L)	Methane (Head) (mg/L)	Ferrous Iron (mg/L)	Nitrate (mg/L)	Sulfate (mg/L)	Sulfide (mg/L)	Alkalinity (mg/L)	ph (0 to 14 units)	ORP (mV)	Conductivity (mS/cm ³)	Temp. (Celsius)
MW-4	08/15/05	0.24	<0.01	0.6	7.3	<0.40	<0.05	450	7.06	-25.3	0.759	14.33
MW-4	06/07/11	230	<3.0	79	16	1.8	20	--	--	<0.62	0.759	14.33
MW-4	11/22/05	2.66	--	--	--	--	--	--	7.47	52.9	0.715	16.98
MW-4	02/20/06	1.00	<0.01	0.2	<0.14	5.7	<0.05	390	7.52	46.6	0.726	12.75
MW-4	05/23/06	0.88	<0.01	0.2	<0.14	3.2	<0.05	390	5.84	13.2	0.566	13.72
MW-4	11/07/06	3.04	<0.01	2.0	<0.14	4.7	NA ¹	NA ¹	7.11	-26.7	0.664	16.20
MW-4	06/06/07	1.34	<0.01	1.8	<0.14	3.6	<0.05	640	7.06	-23.4	0.65	13.58
MW-4	11/29/07	1.70	<0.01	0.2	<0.14	4.5	<0.05	400	7.08	-70.7	0.630	14.37
MW-4	06/11/08	--	<0.01	0.1	<0.14	3.9	<0.05	380	6.32	-11	0.750	14.70
MW-4	12/03/08	2.49	<0.01	0.1	<0.14	2.3	<0.05	450	--	--	--	10.7
MW-4	03/12/09	4.7	<0.01	--	<0.3	3.2	<0.05	540	--	--	--	10.4
MW-4	06/30/09	1.15	--	--	--	--	--	--	--	--	--	--
MW-4	09/25/09	1.32	--	--	--	--	--	--	--	--	--	--
MW-4	12/22/09	6.28	--	--	--	--	--	--	--	--	--	15.17
MW-4	03/19/10	2.86	--	--	--	--	--	--	7.11	--	--	13.74
MW-4	06/10/10	4.57	--	--	--	--	--	--	--	--	--	14.76
MW-4	09/16/10	3.71	--	<0.22 ²	<0.15	3.3	--	--	7.27	368.9	0.694	18.97
MW-4	12/22/10	5.06	--	--	--	--	--	--	7.19	246.5	0.193	15.20
MW-4	03/10/11	4.14	--	--	--	3.6	--	--	7.03	154.5	0.566	11.73
MW-4	06/07/11	0.91	--	--	--	--	--	--	6.33	194.1	0.610	13.53
MW-4	09/23/11	0.30	--	--	--	--	--	--	6.98	83.8	0.666	17.00
MW-4	11/28/11	1.78	--	--	--	--	--	--	7.27	-15.5	0.604	15.72

TABLE 3
GROUNDWATER ANALYTICAL RESULTS
NATURAL ATTENUATION PARAMETERS
COLLEGE WAY FOODS
2120 EAST COLLEGE WAY
MOUNT VERNON, WASHINGTON

Sample I.D.	Date	Dissolved Oxygen (mg/L)	Methane (Head) (mg/L)	Ferrous Iron (mg/L)	Nitrate (mg/L)	Sulfate (mg/L)	Sulfide (mg/L)	Alkalinity (mg/L)	ph (0 to 14 units)	ORP (mV)	Conductivity (mS/cm ³)	Temp. (Celsius)
MW-5	08/15/05	0.57	--	--	--	--	--	--	6.94	-11.4	0.851	16.02
MW-5	11/22/05	1.11	--	--	--	--	--	--	7.13	76.5	0.404	14.65
MW-5	02/20/06	2.91	--	--	--	--	--	--	7.36	8.13	0.444	9.44
MW-5	05/23/06	3.39	--	1.4	--	--	--	--	5.79	13.4	0.345	14.40
MW-5	11/07/06	1.78	--	1.8	--	--	--	--	6.87	90.1	0.418	15.39
MW-5	06/06/07	3.63	--	--	--	--	--	--	6.97	2.2	0.421	16.44
MW-5	11/29/07	2.06	<0.01	0.2	0.9	24	<0.05	250	7.27	-76.2	0.368	10.37
MW-5	06/11/08	--	<0.01	0.10	1.9	22	<0.05	200	6.31	-11	0.78	14.20
MW-5	12/03/08	6.0	<0.01	0.6	0.71	19	<0.05	260	--	--	--	11.60
MW-5	03/12/09	8.6	<0.01	--	<0.3	16	<0.05	280	--	--	--	7.0
MW-5	06/30/09	1.79	--	--	--	--	--	--	--	--	--	--
MW-5	09/25/09	1.64	--	--	--	--	--	--	--	--	--	--
MW-5	12/22/09	6.96	--	--	--	--	--	--	--	--	--	11.07
MW-5	03/19/10	2.91	--	--	--	--	--	--	6.60	--	--	12.01
MW-5	06/10/10	7.56	--	--	--	--	--	--	--	--	--	15.25
MW-5	09/16/10	3.26	--	<0.22 ²	1.1	13	--	--	6.79	556.8	0.799	18.36
MW-5	12/22/10	3.81	--	--	--	--	--	--	6.81	314.9	0.110	12.34
MW-5	03/10/11	4.89	--	--	--	13	--	--	6.44	559.3	0.416	10.03
MW-5	06/07/11	2.53	--	--	--	--	--	--	6.73	128.2	0.595	13.87
MW-5	09/23/11	0.39	--	--	--	--	--	--	6.78	94.6	0.775	17.99
MW-5	11/28/11	0.397	--	--	--	--	--	--	6.79	16.0	0.461	12.18

TABLE 3
GROUNDWATER ANALYTICAL RESULTS
NATURAL ATTENUATION PARAMETERS
COLLEGE WAY FOODS
2120 EAST COLLEGE WAY
MOUNT VERNON, WASHINGTON

Sample I.D.	Date	Dissolved Oxygen (mg/L)	Methane (Head) (mg/L)	Ferrous Iron (mg/L)	Nitrate (mg/L)	Sulfate (mg/L)	Sulfide (mg/L)	Alkalinity (mg/L)	ph (0 to 14 units)	ORP (mV)	Conductivity (mS/cm ³)	Temp. (Celsius)
MW-7	06/07/11	0.71	--	--	--	50	--	--	6.59	165.0	1.127	15.16
MW-7	07/13/11	0.63	--	--	--	26	--	--	6.50	251.0	1.039	18.86
MW-7	07/25/11	--	--	--	--	17	--	--	--	--	--	--
MW-7	09/23/11	0.20	--	--	--	12	--	--	6.51	41.1	1.045	19.22
MW-7	10/31/11	0.73	--	--	--	6.4	--	--	6.40	- 7.1	0.869	16.73
MW-7	11/28/11	0.47	--	--	--	12	--	--	6.60	12.9	0.743	13.76
MW-7	12/20/11	0.72	--	--	--	6.9	--	--	6.85	21.6	0.736	11.98

TABLE 3
GROUNDWATER ANALYTICAL RESULTS
NATURAL ATTENUATION PARAMETERS
COLLEGE WAY FOODS
2120 EAST COLLEGE WAY
MOUNT VERNON, WASHINGTON

Sample I.D.	Date	Dissolved Oxygen (mg/L)	Methane (Head) (mg/L)	Ferrous Iron (mg/L)	Nitrate (mg/L)	Sulfate (mg/L)	Sulfide (mg/L)	Alkalinity (mg/L)	ph (0 to 14 units)	ORP (mV)	Conductivity (mS/cm ³)	Temp. (Celsius)
MW-8	06/07/11	0.85	--	--	--	49	--	--	7.03	179.1	0.461	17.43
MW-8	07/13/11	1.16	--	--	--	42	--	--	7.42	281.3	0.811	20.36
MW-8	07/25/11	--	--	--	--	70	--	--	--	--	--	--
MW-8	09/23/11	0.66	--	--	--	82	--	--	6.49	188.5	1.067	21.96
MW-8	10/31/11	0.32	--	--	--	130	--	--	6.48	- 8.2	0.624	17.10
MW-8	11/28/11	2.07	--	--	--	82	--	--	6.93	18.8	0.307	12.29
MW-8	12/20/11	1.40	--	--	--	80	--	--	7.20	22.9	0.349	10.46

TABLE 3
GROUNDWATER ANALYTICAL RESULTS
NATURAL ATTENUATION PARAMETERS
COLLEGE WAY FOODS
2120 EAST COLLEGE WAY
MOUNT VERNON, WASHINGTON

Sample I.D.	Date	Dissolved Oxygen (mg/L)	Methane (Head) (mg/L)	Ferrous Iron (mg/L)	Nitrate (mg/L)	Sulfate (mg/L)	Sulfide (mg/L)	Alkalinity (mg/L)	ph (0 to 14 units)	ORP (mV)	Conductivity (mS/cm ³)	Temp. (Celsius)
TW-1	08/15/05	0.28	0.02	1.2	<0.70	20	0.24	470	7.56	-133.8	1.497	17.16
TW-1	11/22/05	0.59	--	--	--	--	--	--	7.1	72.1	0.46	13.38
TW-1	02/20/06	0.65	2.0	1.6	<0.14	14	0.14	380	7.7	60.3	0.491	9.76
TW-1	05/23/06	0.93	0.23	1.0	<0.14	2.8	0.22	570	5.73	13.6	0.309	15.71
TW-1	11/07/06	1.22	0.20	1.6	<0.14	9.4	NA ¹	NA ¹	7.04	105.6	0.301	14.26
TW-1	06/06/07	1.27	0.31	1.8	<0.14	4.7	<0.05	460	6.73	-52.3	0.398	17.17
TW-1	11/29/07	2.44	0.30	1.8	0.24	9.3	<0.05	250	7.24	-108.7	0.396	11.05
TW-1	06/11/08	--	<0.01	0.9	0.79	15	<0.05	180	6.29	-44	6.29	15.30
TW-1	12/03/08	5.6	0.08	1.3	<0.14	8.2	<0.05	280	--	--	--	11.6
TW-1	03/12/09	5.2	0.01	--	<0.3	9.7	0.12	280	--	--	--	6.3
TW-1	06/30/09	1.10	--	--	--	--	--	--	--	--	--	--
TW-1	09/25/09	0.74	--	--	--	--	--	--	--	--	--	--
TW-1	12/22/09	4.00	--	--	--	--	--	--	--	--	--	10.5
TW-1	03/19/10	3.28	--	--	--	--	--	--	6.21	--	--	10.7
TW-1	06/10/10	4.76	--	--	--	--	--	--	--	--	--	15.2
TW-1	06/07/11	4.76	<2.0	<1.0	<1.0	--	--	--	--	14.0	--	15.2
TW-1	09/16/10	2.34	--	0.28 ²	1.6	13	--	--	6.61	173.5	0.440	20.37
TW-1	12/22/10	0.41	--	--	--	--	--	--	6.50	272.6	0.090	11.50
TW-1	03/10/11	0.89	--	--	--	6.9	--	--	6.45	475.8	0.314	9.15
TW-1	06/07/11	1.29	--	--	--	66	--	--	6.45	179.1	0.492	15.46
TW-1	07/13/11	0.95	--	--	--	120	--	--	5.93	210.1	0.709	16.53
TW-1	07/25/11	--	--	--	--	150	--	--	--	--	--	--
TW-1	09/23/11	0.33	--	--	--	210	--	--	6.36	22.4	1.083	19.83
TW-1	10/31/11	0.76	--	--	--	190	--	--	5.97	7.7	0.827	15.27
TW-1	11/28/11	0.98	--	--	--	260	--	--	6.51	18.0	0.577	11.19
TW-1	12/20/11	0.54	--	--	--	180	--	--	6.79	19.9	0.533	10.11

TABLE 3
GROUNDWATER ANALYTICAL RESULTS
NATURAL ATTENUATION PARAMETERS
COLLEGE WAY FOODS
2120 EAST COLLEGE WAY
MOUNT VERNON, WASHINGTON

Sample I.D.	Date	Dissolved Oxygen (mg/L)	Methane (Head) (mg/L)	Ferrous Iron (mg/L)	Nitrate (mg/L)	Sulfate (mg/L)	Sulfide (mg/L)	Alkalinity (mg/L)	ph (0 to 14 units)	ORP (mV)	Conductivity (mS/cm ³)	Temp. (Celsius)
TW-2	08/15/05	0.29	0.02	2.2	27	42	0.1	820	7.1	-129.2	1.802	18.39
TW-2	11/22/05	0.86	--	--	--	--	--	--	7.2	51.9	0.908	14.37
TW-2	02/20/06	0.51	5.4	2.2	8.3	27	0.10	640	7.71	39.5	0.978	9.40
TW-2	05/23/06	0.80	<0.01	2.2	33	1.4	0.12	900	5.87	-29.2	0.540	15.24
TW-2	11/07/06	0.66	<0.01	2.2	12	3.6	NA ¹	NA ¹	7.34	-92.9	0.572	15.32
TW-2	06/06/07	1.18	0.22	1.4	5.2	1	<0.05	800	6.77	-113.9	0.844	18.63
TW-2	11/29/07	1.19	1.1	1.2	0.24	9.3	0.10	660	7.09	-118.6	0.987	11.18
TW-2	06/11/08	--	<0.01	1.2	<0.14	2.5	0.16	210	6.60	-68	47.000	15.20
TW-2	12/03/08	0.72	0.33	--	<0.14	<1.00	0.06	600	--	--	--	11.2
TW-2	03/12/09	2.12	0.59	--	<0.3	6.0	0.16	590	--	--	--	7.2
TW-2	06/30/09	0.99	--	--	--	--	--	--	--	--	--	--
TW-2	09/25/09	0.80	--	--	--	--	--	--	--	--	--	--
TW-2	12/22/09	3.22	--	--	--	--	--	--	--	--	--	11.59
TW-2	03/19/10	2.11	--	--	--	--	--	--	6.51	--	--	10.99
TW-2	06/10/10	5.65	--	--	--	--	--	--	--	--	--	15.41
TW-2	09/16/10	125.0	--	8.6 ²	0.27	1.5	--	--	6.66	125.0	1.515	20.35
TW-2	12/22/10	0.26	--	--	--	--	--	--	6.70	121.6	0.342	12.18
TW-2	03/10/11	0.10	--	--	--	0.78	--	--	6.49	135.3	1.103	8.64
TW-2	06/07/11	0.86	--	--	--	0.61	--	--	6.48	115.8	1.074	14.93
TW-2	07/13/11	0.53	--	--	--	0.30	--	--	6.29	119.4	1.256	16.72
TW-2	07/25/11	--	--	--	--	<0.26	--	--	--	--	--	--
TW-2	09/23/11	0.10	--	--	--	2.1	--	--	6.68	35.4	1.606	19.42
TW-2	10/31/11	0.41	--	--	--	5.6	--	--	6.33	-48.7	1.077	15.55
TW-2	11/28/11	0.32	--	--	--	39	--	--	6.56	7.6	1.063	11.79
TW-2	12/20/11	0.41	--	--	--	94	--	--	6.79	14.2	1.070	10.42

TABLE 3
GROUNDWATER ANALYTICAL RESULTS
NATURAL ATTENUATION PARAMETERS
COLLEGE WAY FOODS
2120 EAST COLLEGE WAY
MOUNT VERNON, WASHINGTON

Sample I.D.	Date	Dissolved Oxygen (mg/L)	Methane (Head) (mg/L)	Ferrous Iron (mg/L)	Nitrate (mg/L)	Sulfate (mg/L)	Sulfide (mg/L)	Alkalinity (mg/L)	ph (0 to 14 units)	ORP (mV)	Conductivity (mS/cm ³)	Temp. (Celsius)
TW-3	08/15/05	0.43	--	--	--	--	--	--	6.52	-30.8	0.688	18.85
TW-3	11/22/05	0.60	--	--	--	--	--	--	7.07	58.5	0.69	16.83
TW-3	02/20/06	0.39	--	--	--	--	--	--	7.72	44.8	0.684	11.94
TW-3	05/23/06	0.82	--	1.6	--	--	--	--	5.79	-7.1	0.548	14.58
TW-3	11/07/06	0.91	--	--	--	--	--	--	7.17	-29.2	0.680	18.20
TW-3	06/06/07	1.26	--	--	--	--	--	--	6.57	-36.2	0.640	14.69
TW-3	11/29/07	2.39	0.55	3.6	<0.14	0.34	<0.05	380	6.85	-67.8	0.621	13.00
TW-3	06/11/08	--	<0.01	1.59	<0.14	0.29	0.06	370	6.26	-30	0.220	14.30
TW-3	12/03/08	4.7	0.10	2.0	<0.14	<1.0	<0.50	380	--	--	--	13.6
TW-3	06/07/11	4.7	<2.0	2.0	<0.14	<1.0	<0.50	--	--	--	--	13.6
TW-3	03/12/09	4.7	0.01	--	<0.3	<1.0	<0.05	420	--	--	--	10.6
TW-3	06/30/09	0.93	--	--	--	--	--	--	--	--	--	--
TW-3	09/25/09	0.77	--	--	--	--	--	--	--	--	--	21.76
TW-3	12/22/09	2.87	--	--	--	--	--	--	--	--	--	13.21
TW-3	03/19/10	2.89	--	--	--	--	--	--	6.45	--	--	12.77
TW-3	06/10/10	5.65	--	--	--	--	--	--	--	--	--	16.49
TW-3	09/16/10	5.73	--	8.9 ²	0.42	0.67	--	--	6.38	363.0	0.690	21.41
TW-3	12/22/10	0.35	--	--	--	--	--	--	6.35	217.1	0.194	13.69
TW-3	03/10/11	6.49	--	--	--	2.0	--	--	6.21	246.1	0.504	10.03
TW-3	06/07/11	0.71	--	--	--	--	--	--	6.25	209.8	0.598	15.57
TW-3	09/23/11	0.91	--	--	--	--	--	--	6.36	162.9	0.739	20.97
TW-3	11/28/11	1.41							6.39	17.4	0.587	13.85

TABLE 3
GROUNDWATER ANALYTICAL RESULTS
NATURAL ATTENUATION PARAMETERS
COLLEGE WAY FOODS
2120 EAST COLLEGE WAY
MOUNT VERNON, WASHINGTON

Sample I.D.	Date	Dissolved Oxygen (mg/L)	Methane (Head) (mg/L)	Ferrous Iron (mg/L)	Nitrate (mg/L)	Sulfate (mg/L)	Sulfide (mg/L)	Alkalinity (mg/L)	ph (0 to 14 units)	ORP (mV)	Conductivity (mS/cm ³)	Temp. (Celsius)
B-2	08/15/05	0.39	2.6	3.8	<0.70	<0.40	0.22	270	6.92	-47.6	0.370	20.49
B-2	11/22/05	0.4	--	--	--	--	--	--	6.96	57.0	0.391	15.45
B-2	02/20/06	0.31	16	2.6	0.53	<0.08	0.12	140	7.68	40.9	0.354	11.68
B-2	05/23/06	0.94	2.7	3.0	<0.14	<0.08	<0.05	130	5.71	9.8	0.254	14.26
B-2	11/07/06	2.75	0.5	1.8	0.31	1.8	NA ¹	NA ¹	6.98	174.2	0.530	16.09
B-2	06/06/07	1.36	2.0	2.2	<0.14	0.4	<0.05	130	7.09	-67.1	0.297	17.04
B-2	11/29/07	4.87	3.7	4.0	<0.14	0.99	<0.05	170	6.87	-70.9	0.357	11.80
B-2	06/11/08	--	<0.01	0.8	<0.14	0.53	<0.05	160	6.58	-82	0.950	14.30
B-2	12/03/08	3.75	0.91	0.70	<0.14	<1.0	<0.05	150	--	--	--	11.2
B-2	03/12/09	4.7	0.55	--	<0.3	<1.0	<0.05	160	--	--	--	10.6
B-2	06/30/09	1.11	--	--	--	--	--	--	--	--	--	--
B-2	09/25/09	0.74	--	--	--	--	--	--	--	--	--	20.79
B-2	12/22/09	2.74	--	--	--	--	--	--	--	--	--	12.26
B-2	03/19/10	2.52	--	--	--	--	--	--	6.67	--	--	12.45
B-2	06/10/10	5.90	--	--	--	--	--	--	--	--	--	15.32
B-2	12/22/10	0.35	--	--	--	--	--	--	6.60	160.7	0.045	13.56
B-2	03/10/11	0.35	--	--	--	1.6	--	--	6.64	215.5	0.297	10.03
B-2	06/07/11	0.91	--	--	--	0.31	--	--	6.53	140.1	0.325	14.34
B-2	09/23/11	0.27	--	--	--	<0.26	--	--	6.63	119.7	0.459	19.65
B-2	11/28/11	0.51	--	--	--	6.9	--	--	6.61	22.4	0.343	13.20

Figures

Figure 1 Site Map

EAST COLLEGE WAY

sidewalk

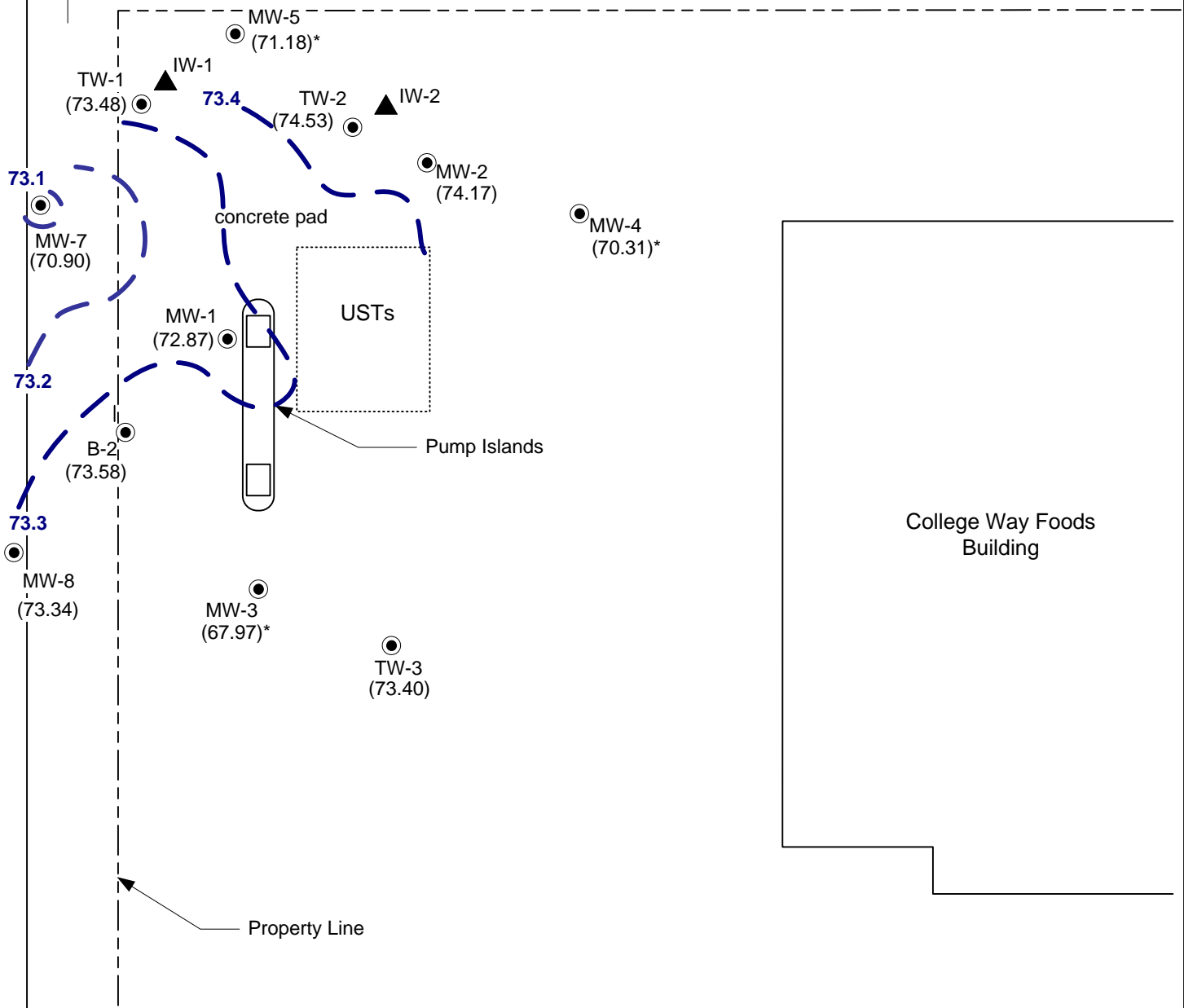

College Way Foods Building

LEGEND

- MW-1 Groundwater monitoring well
- (72.87) Groundwater elevation, November 28, 2011
- 73.3— Inferred Groundwater elevation contour, November 23, 2011
- * Groundwater elevations represent a deeper water-bearing unit and were not included in generation of this contour map.
- ▲ IW-2 Injection Well
- NS Not Surveyed



APPROX. SCALE

FIGURE 1

SITE MAP

COLLEGE WAY FOODS
2120 EAST COLLEGE WAY
MOUNT VERNON, WASHINGTON

PROJECT NO. STCG-403-2	DRAWN BY JP
FILE NO. A20-77A	PREPARED BY JK 1/25/12
REVISION NO. 0	REVIEWED BY JR



Appendix A

Analytical Report and Chain-of-Custody Documentation



November 7, 2011

Mr. Joe Rounds
Antea Group
4006 - 148th Ave NE
Redmond, WA 98052

Dear Mr. Rounds,

On October 31st, 5 samples were received by our laboratory and assigned our laboratory project number 1110188. The project was identified as your STCG-403. The sample identification and requested analyses are outlined on the attached chain of custody record.

No abnormalities or nonconformances were observed during the analyses of the project samples.

Please do not hesitate to call me if you have any questions or if I can be of further assistance.

Sincerely,

ALS Laboratory Group

Rick Bagan
Laboratory Director



CERTIFICATE OF ANALYSIS

CLIENT:	Antea Group	DATE:	11/7/2011
	4006 - 148th Ave NE	ALS JOB#:	1110188
	Redmond, WA 98052	ALS SAMPLE#:	-01
CLIENT CONTACT:	Joe Rounds	DATE RECEIVED:	10/31/2011
CLIENT PROJECT:	STCG-403	COLLECTION DATE:	10/31/2011 10:40
CLIENT SAMPLE ID	MW-1	WDOE ACCREDITATION:	C601

DATA RESULTS

ANALYTE	METHOD	RESULTS	REPORTING LIMITS	DILUTION FACTOR	UNITS	ANALYSIS DATE	ANALYSIS BY
TPH-Volatile Range	NWTPH-GX	120	50	1	UG/L	11/03/2011	DLC
Methyl T-Butyl Ether	EPA-8021	U	3.0	1	UG/L	11/03/2011	DLC
Benzene	EPA-8021	U	1.0	1	UG/L	11/03/2011	DLC
Toluene	EPA-8021	U	1.0	1	UG/L	11/03/2011	DLC
Ethylbenzene	EPA-8021	U	1.0	1	UG/L	11/03/2011	DLC
Xylenes	EPA-8021	U	3.0	1	UG/L	11/03/2011	DLC
Sulfate	EPA-300.0	14	0.26	1	MG/L	11/01/2011	GAP

SURROGATE	METHOD	%REC	ANALYSIS DATE	ANALYSIS BY
TFT	NWTPH-GX	113	11/03/2011	DLC
TFT	EPA-8021	104	11/03/2011	DLC

U - Analyte analyzed for but not detected at level above reporting limit.
 Chromatogram indicates that it is likely that sample contains highly weathered gasoline.



CERTIFICATE OF ANALYSIS

CLIENT:	Antea Group 4006 - 148th Ave NE Redmond, WA 98052	DATE:	11/7/2011
CLIENT CONTACT:	Joe Rounds	ALS JOB#:	1110188
CLIENT PROJECT:	STCG-403	ALS SAMPLE#:	-02
CLIENT SAMPLE ID	MW-7	DATE RECEIVED:	10/31/2011
		COLLECTION DATE:	10/31/2011 11:15
		WDOE ACCREDITATION:	C601

DATA RESULTS

ANALYTE	METHOD	RESULTS	REPORTING LIMITS	DILUTION FACTOR	UNITS	ANALYSIS DATE	ANALYSIS BY
TPH-Volatile Range	NWTPH-GX	U	50	1	UG/L	11/03/2011	DLC
Methyl T-Butyl Ether	EPA-8021	U	3.0	1	UG/L	11/03/2011	DLC
Benzene	EPA-8021	U	1.0	1	UG/L	11/03/2011	DLC
Toluene	EPA-8021	U	1.0	1	UG/L	11/03/2011	DLC
Ethylbenzene	EPA-8021	U	1.0	1	UG/L	11/03/2011	DLC
Xylenes	EPA-8021	U	3.0	1	UG/L	11/03/2011	DLC
Sulfate	EPA-300.0	6.4	0.26	1	MG/L	11/01/2011	GAP

SURROGATE	METHOD	%REC	ANALYSIS DATE	ANALYSIS BY
TFT	NWTPH-GX	104	11/03/2011	DLC
TFT	EPA-8021	106	11/03/2011	DLC

U - Analyte analyzed for but not detected at level above reporting limit.



CERTIFICATE OF ANALYSIS

CLIENT:	Antea Group 4006 - 148th Ave NE Redmond, WA 98052	DATE:	11/7/2011
CLIENT CONTACT:	Joe Rounds	ALS JOB#:	1110188
CLIENT PROJECT:	STCG-403	ALS SAMPLE#:	-03
CLIENT SAMPLE ID	MW-8	DATE RECEIVED:	10/31/2011
		COLLECTION DATE:	10/31/2011 10:15
		WDOE ACCREDITATION:	C601

DATA RESULTS

ANALYTE	METHOD	RESULTS	REPORTING LIMITS	DILUTION FACTOR	UNITS	ANALYSIS DATE	ANALYSIS BY
TPH-Volatile Range	NWTPH-GX	U	50	1	UG/L	11/03/2011	DLC
Benzene	EPA-8021	U	1.0	1	UG/L	11/03/2011	DLC
Toluene	EPA-8021	U	1.0	1	UG/L	11/03/2011	DLC
Ethylbenzene	EPA-8021	U	1.0	1	UG/L	11/03/2011	DLC
Xylenes	EPA-8021	U	3.0	1	UG/L	11/03/2011	DLC
Methyl T-Butyl Ether	EPA-8260	2.9	2.0	1	UG/L	11/04/2011	GAP
Sulfate	EPA-300.0	130	13	50	MG/L	11/02/2011	GAP

SURROGATE	METHOD	%REC	ANALYSIS DATE	ANALYSIS BY
TFT	NWTPH-GX	111	11/03/2011	DLC
TFT	EPA-8021	102	11/03/2011	DLC
1,2-Dichloroethane-d4	EPA-8260	101	11/04/2011	GAP
Toluene-d8	EPA-8260	92.2	11/04/2011	GAP
4-Bromofluorobenzene	EPA-8260	100	11/04/2011	GAP

U - Analyte analyzed for but not detected at level above reporting limit.



CERTIFICATE OF ANALYSIS

CLIENT:	Antea Group 4006 - 148th Ave NE Redmond, WA 98052	DATE:	11/7/2011
CLIENT CONTACT:	Joe Rounds	ALS JOB#:	1110188
CLIENT PROJECT:	STCG-403	ALS SAMPLE#:	-04
CLIENT SAMPLE ID	TW-1	DATE RECEIVED:	10/31/2011
		COLLECTION DATE:	10/31/2011 11:40
		WDOE ACCREDITATION:	C601

DATA RESULTS

ANALYTE	METHOD	RESULTS	REPORTING LIMITS	DILUTION FACTOR	UNITS	ANALYSIS DATE	ANALYSIS BY
TPH-Volatile Range	NWTPH-GX	72	50	1	UG/L	11/03/2011	DLC
Methyl T-Butyl Ether	EPA-8021	U	3.0	1	UG/L	11/03/2011	DLC
Benzene	EPA-8021	U	1.0	1	UG/L	11/03/2011	DLC
Toluene	EPA-8021	U	1.0	1	UG/L	11/03/2011	DLC
Ethylbenzene	EPA-8021	U	1.0	1	UG/L	11/03/2011	DLC
Xylenes	EPA-8021	U	3.0	1	UG/L	11/03/2011	DLC
Sulfate	EPA-300.0	190	26	100	MG/L	11/02/2011	GAP

SURROGATE	METHOD	%REC	ANALYSIS DATE	ANALYSIS BY
TFT	NWTPH-GX	125	11/03/2011	DLC
TFT	EPA-8021	108	11/03/2011	DLC

U - Analyte analyzed for but not detected at level above reporting limit.
Chromatogram indicates that it is likely that sample contains highly weathered gasoline.



CERTIFICATE OF ANALYSIS

CLIENT: Antea Group
 4006 - 148th Ave NE
 Redmond, WA 98052

CLIENT CONTACT: Joe Rounds
 CLIENT PROJECT: STCG-403
 CLIENT SAMPLE ID TW-2

DATE: 11/7/2011
 ALS JOB#: 1110188
 ALS SAMPLE#: -05
 DATE RECEIVED: 10/31/2011
 COLLECTION DATE: 10/31/2011 12:15
 WDOE ACCREDITATION: C601

DATA RESULTS

ANALYTE	METHOD	RESULTS	REPORTING LIMITS	DILUTION FACTOR	UNITS	ANALYSIS DATE	ANALYSIS BY
TPH-Volatile Range	NWTPH-GX	5700	500	10	UG/L	11/03/2011	DLC
Methyl T-Butyl Ether	EPA-8021	U	30	10	UG/L	11/03/2011	DLC
Benzene	EPA-8021	1100	10	10	UG/L	11/03/2011	DLC
Toluene	EPA-8021	28	10	10	UG/L	11/03/2011	DLC
Ethylbenzene	EPA-8021	710	10	10	UG/L	11/03/2011	DLC
Xylenes	EPA-8021	290	30	10	UG/L	11/03/2011	DLC
Sulfate	EPA-300.0	5.6	0.26	1	MG/L	11/02/2011	GAP

SURROGATE	METHOD	%REC	ANALYSIS DATE	ANALYSIS BY
TFT 10X Dilution	NWTPH-GX	128	11/03/2011	DLC
TFT 10X Dilution	EPA-8021	158 GS3	11/03/2011	DLC

U - Analyte analyzed for but not detected at level above reporting limit.
 GS3 - Surrogate outside of control limits due to coeluting compounds.
 Chromatogram indicates that it is likely that sample contains weathered gasoline.



CERTIFICATE OF ANALYSIS

CLIENT: Antea Group
4006 - 148th Ave NE
Redmond, WA 98052

DATE: 11/7/2011
ALS SDG#: 1110188
WDOE ACCREDITATION: C601

CLIENT CONTACT: Joe Rounds
CLIENT PROJECT: STCG-403

LABORATORY CONTROL SAMPLE RESULTS

ALS Test Batch ID: 2255 - Water by NWTPH-GX

SPIKED COMPOUND	METHOD	%REC	RPD	QUAL	ANALYSIS DATE	ANALYSIS BY
TPH-Volatile Range - BS	NWTPH-GX	82.6			11/01/2011	DLC
TPH-Volatile Range - BSD	NWTPH-GX	83.1	1		11/01/2011	DLC

ALS Test Batch ID: 2255 - Water by EPA-8021

SPIKED COMPOUND	METHOD	%REC	RPD	QUAL	ANALYSIS DATE	ANALYSIS BY
Methyl T-Butyl Ether - BS	EPA-8021	99.9			11/01/2011	DLC
Methyl T-Butyl Ether - BSD	EPA-8021	104	4		11/01/2011	DLC
Benzene - BS	EPA-8021	107			11/01/2011	DLC
Benzene - BSD	EPA-8021	115	7		11/01/2011	DLC
Toluene - BS	EPA-8021	103			11/01/2011	DLC
Toluene - BSD	EPA-8021	111	7		11/01/2011	DLC
Ethylbenzene - BS	EPA-8021	94.6			11/01/2011	DLC
Ethylbenzene - BSD	EPA-8021	102	8		11/01/2011	DLC
Xylenes - BS	EPA-8021	101			11/01/2011	DLC
Xylenes - BSD	EPA-8021	109	8		11/01/2011	DLC

ALS Test Batch ID: 2238 - Water by EPA-8260

SPIKED COMPOUND	METHOD	%REC	RPD	QUAL	ANALYSIS DATE	ANALYSIS BY
1,1-Dichloroethene - BS	EPA-8260	103			10/28/2011	GAP
1,1-Dichloroethene - BSD	EPA-8260	96.4	7		10/28/2011	GAP
Toluene - BS	EPA-8260	94.1			10/28/2011	GAP
Toluene - BSD	EPA-8260	93.6	0		10/28/2011	GAP

ALS Test Batch ID: R75333 - Water by EPA-300.0

SPIKED COMPOUND	METHOD	%REC	RPD	QUAL	ANALYSIS DATE	ANALYSIS BY
Sulfate - BS	EPA-300.0	89.0			11/01/2011	GAP
Sulfate - BSD	EPA-300.0	89.0	0		11/01/2011	GAP

APPROVED BY

Laboratory Director



ALS Environmental
 8620 Holly Drive, Suite 100
 Everett, WA 98208
 Phone (425) 356-2600
 (206) 292-9059 Seattle
 (425) 356-2626 Fax
 http://www.alsglobal.com

Chain Of Custody/ Laboratory Analysis Request

ALS Job# (Laboratory Use Only)

1110188

Date 10/31/11 Page 1 Of 1

PROJECT ID: STCG-403 REPORT TO COMPANY: ANTEA GROUP PROJECT MANAGER: JOE ROUNDS ADDRESS: 4006 148 Ave NE REDMOND, WA 98052 PHONE: 425- FAX: P.O. NUMBER: E-MAIL: INVOICE TO COMPANY: Same ATTENTION: ADDRESS:	ANALYSIS REQUESTED NMTPH-HCID NMTPH-DX NMTPH-GX BTEX by EPA-8021 MTBE by EPA-8021 <input checked="" type="checkbox"/> EPA-8260 Halogenated Volatiles by EPA 8260 Volatile Organic Compounds by EPA 8260 EDB / EDC by EPA 8260 SIM (water) EDB / EDC by EPA 8260 (soil) Semivolatile Organic Compounds by EPA 8270 Polycyclic Aromatic Hydrocarbons (PAH) by EPA-8270 SIM PCB Pesticides by EPA 8081/8082 Metals-MTCA-5 RCRA-8 Pri Pol TAL Metals Other (Specify) TCLP-Metals VOA Semi-Vol Pest Herbs Sulfate MTBE Conf by 8260	OTHER (Specify) NUMBER OF CONTAINERS RECEIVED IN GOOD CONDITION?
---	--	---

LABORATORY COPY

SAMPLE I.D.	DATE	TIME	TYPE	LAB#	NMTPH-HCID	NMTPH-DX	NMTPH-GX	BTEX by EPA-8021	MTBE by EPA-8021 <input checked="" type="checkbox"/> EPA-8260	Halogenated Volatiles by EPA 8260	Volatile Organic Compounds by EPA 8260	EDB / EDC by EPA 8260 SIM (water)	EDB / EDC by EPA 8260 (soil)	Semivolatile Organic Compounds by EPA 8270	Polycyclic Aromatic Hydrocarbons (PAH) by EPA-8270 SIM	PCB Pesticides by EPA 8081/8082	Metals-MTCA-5 RCRA-8 Pri Pol TAL	Metals Other (Specify)	TCLP-Metals VOA Semi-Vol Pest Herbs	Sulfate	MTBE Conf by 8260	NUMBER OF CONTAINERS	RECEIVED IN GOOD CONDITION?
1. MW-1	10/31/11	1040	W	1				X	X	X										X			
2. MW-7	↓	11:15	↓	2				↓	↓	↓													
3. MW-8	↓	1015	↓	3				↓	↓	↓													
4. TW-1	↓	1140	↓	4				↓	↓	↓													
5. TW-2	↓	1215	↓	5				↓	↓	↓													
6.																							
7.																							
8.																							
9.																							
10.																							

SPECIAL INSTRUCTIONS **PLEASE CONFIRM MTBE DETECTIONS WITH 8260**

SIGNATURES (Name, Company, Date, Time):
 1. Relinquished By: Dan Rounde, ANTEA, 10/31/11 13:30
 Received By: Shawn Robus, ALS 10/31/11 13:30
 2. Relinquished By:
 Received By:

TURNAROUND REQUESTED in Business Days*
 Organic, Metals & Inorganic Analysis
 10 5 3 2 1 SAME DAY
 Fuels & Hydrocarbon Analysis
 5 3 1 SAME DAY
 OTHER:
 Specify: Add MTBE Cfm by 8260 11/4/11

* Turnaround request less than standard may incur Rush Charges



December 5, 2011

Mr. Joe Rounds
Antea Group
4006 - 148th Ave NE
Redmond, WA 98052

Dear Mr. Rounds,

On November 28th, 11 samples were received by our laboratory and assigned our laboratory project number 1111150. The project was identified as your STCG-403. The sample identification and requested analyses are outlined on the attached chain of custody record.

No abnormalities or nonconformances were observed during the analyses of the project samples.

Please do not hesitate to call me if you have any questions or if I can be of further assistance.

Sincerely,

ALS Laboratory Group

Rick Bagan
Laboratory Director



CERTIFICATE OF ANALYSIS

CLIENT: Antea Group
 4006 - 148th Ave NE
 Redmond, WA 98052

DATE: 12/5/2011
 ALS JOB#: 1111150
 ALS SAMPLE#: -01
 DATE RECEIVED: 11/28/2011
 COLLECTION DATE: 11/28/2011 10:30
 WDOE ACCREDITATION: C601

CLIENT CONTACT: Joe Rounds
 CLIENT PROJECT: STCG-403
 CLIENT SAMPLE ID: MW-1

DATA RESULTS

ANALYTE	METHOD	RESULTS	REPORTING LIMITS	DILUTION FACTOR	UNITS	ANALYSIS DATE	ANALYSIS BY
TPH-Volatile Range	NWTPH-GX	100	50	1	UG/L	11/30/2011	DLC
Methyl T-Butyl Ether	EPA-8021	U	3.0	1	UG/L	11/30/2011	DLC
Benzene	EPA-8021	U	1.0	1	UG/L	11/30/2011	DLC
Toluene	EPA-8021	U	1.0	1	UG/L	11/30/2011	DLC
Ethylbenzene	EPA-8021	U	1.0	1	UG/L	11/30/2011	DLC
Xylenes	EPA-8021	U	3.0	1	UG/L	11/30/2011	DLC
1,2-Dichloroethane	EPA-8260 SIM	U	0.020	1	UG/L	11/29/2011	GAP
1,2-Dibromoethane	EPA-8260 SIM	U	0.010	1	UG/L	11/29/2011	GAP
Naphthalene	EPA-8270 SIM	0.051	0.020	1	UG/L	11/30/2011	LAP
2-Methylnaphthalene	EPA-8270 SIM	U	0.020	1	UG/L	11/30/2011	LAP
1-Methylnaphthalene	EPA-8270 SIM	0.90	0.020	1	UG/L	11/30/2011	LAP
Sulfate	EPA-300.0	57	2.6	10	MG/L	12/01/2011	GAP
Lead	EPA-6020	U	0.30	1	UG/L	11/30/2011	RAL

SURROGATE	METHOD	%REC	ANALYSIS DATE	ANALYSIS BY
TFT	NWTPH-GX	105	11/30/2011	DLC
TFT	EPA-8021	118	11/30/2011	DLC
1,2-Dichloroethane-d4	EPA-8260 SIM	80.7	11/29/2011	GAP
Terphenyl-d14	EPA-8270 SIM	66.3	11/30/2011	LAP

U - Analyte analyzed for but not detected at level above reporting limit.
 Chromatogram indicates that it is likely that sample contains highly weathered gasoline.



CERTIFICATE OF ANALYSIS

CLIENT:	Antea Group 4006 - 148th Ave NE Redmond, WA 98052	DATE:	12/5/2011
CLIENT CONTACT:	Joe Rounds	ALS JOB#:	1111150
CLIENT PROJECT:	STCG-403	ALS SAMPLE#:	-02
CLIENT SAMPLE ID	MW-2	DATE RECEIVED:	11/28/2011
		COLLECTION DATE:	11/28/2011 13:20
		WDOE ACCREDITATION:	C601

DATA RESULTS

ANALYTE	METHOD	RESULTS	REPORTING LIMITS	DILUTION FACTOR	UNITS	ANALYSIS DATE	ANALYSIS BY
TPH-Volatile Range	NWTPH-GX	120	50	1	UG/L	11/30/2011	DLC
Methyl T-Butyl Ether	EPA-8021	U	3.0	1	UG/L	11/30/2011	DLC
Benzene	EPA-8021	6.8	1.0	1	UG/L	11/30/2011	DLC
Toluene	EPA-8021	U	1.0	1	UG/L	11/30/2011	DLC
Ethylbenzene	EPA-8021	11	1.0	1	UG/L	11/30/2011	DLC
Xylenes	EPA-8021	11	3.0	1	UG/L	11/30/2011	DLC
1,2-Dichloroethane	EPA-8260 SIM	U	0.020	1	UG/L	11/29/2011	GAP
1,2-Dibromoethane	EPA-8260 SIM	U	0.010	1	UG/L	11/29/2011	GAP
Naphthalene	EPA-8270 SIM	1.2	0.020	1	UG/L	11/29/2011	LAP
2-Methylnaphthalene	EPA-8270 SIM	U	0.020	1	UG/L	11/29/2011	LAP
1-Methylnaphthalene	EPA-8270 SIM	0.12	0.020	1	UG/L	11/29/2011	LAP
Lead	EPA-6020	2.1	0.30	1	UG/L	11/30/2011	RAL

SURROGATE	METHOD	%REC	ANALYSIS DATE	ANALYSIS BY
TFT	NWTPH-GX	84.4	11/30/2011	DLC
TFT	EPA-8021	109	11/30/2011	DLC
1,2-Dichloroethane-d4	EPA-8260 SIM	82.0	11/29/2011	GAP
Terphenyl-d14	EPA-8270 SIM	67.5	11/29/2011	LAP

U - Analyte analyzed for but not detected at level above reporting limit.
Chromatogram indicates that it is likely that sample contains highly weathered gasoline.



CERTIFICATE OF ANALYSIS

CLIENT: Antea Group
 4006 - 148th Ave NE
 Redmond, WA 98052

DATE: 12/5/2011

ALS JOB#: 1111150

ALS SAMPLE#: -03

CLIENT CONTACT: Joe Rounds

DATE RECEIVED: 11/28/2011

CLIENT PROJECT: STCG-403

COLLECTION DATE: 11/28/2011 09:20

CLIENT SAMPLE ID MW-3

WDOE ACCREDITATION: C601

DATA RESULTS

ANALYTE	METHOD	RESULTS	REPORTING LIMITS	DILUTION FACTOR	UNITS	ANALYSIS DATE	ANALYSIS BY
TPH-Volatile Range	NWTPH-GX	U	50	1	UG/L	11/30/2011	DLC
Methyl T-Butyl Ether	EPA-8021	U	3.0	1	UG/L	11/30/2011	DLC
Benzene	EPA-8021	U	1.0	1	UG/L	11/30/2011	DLC
Toluene	EPA-8021	U	1.0	1	UG/L	11/30/2011	DLC
Ethylbenzene	EPA-8021	U	1.0	1	UG/L	11/30/2011	DLC
Xylenes	EPA-8021	U	3.0	1	UG/L	11/30/2011	DLC
1,2-Dichloroethane	EPA-8260 SIM	U	0.020	1	UG/L	11/29/2011	GAP
1,2-Dibromoethane	EPA-8260 SIM	U	0.010	1	UG/L	11/29/2011	GAP
Naphthalene	EPA-8270 SIM	0.037	0.020	1	UG/L	11/29/2011	LAP
2-Methylnaphthalene	EPA-8270 SIM	U	0.020	1	UG/L	11/29/2011	LAP
1-Methylnaphthalene	EPA-8270 SIM	U	0.020	1	UG/L	11/29/2011	LAP
Lead	EPA-6020	U	0.30	1	UG/L	11/30/2011	RAL

SURROGATE	METHOD	%REC	ANALYSIS DATE	ANALYSIS BY
TFT	NWTPH-GX	94.0	11/30/2011	DLC
TFT	EPA-8021	112	11/30/2011	DLC
1,2-Dichloroethane-d4	EPA-8260 SIM	81.9	11/29/2011	GAP
Terphenyl-d14	EPA-8270 SIM	70.2	11/29/2011	LAP

U - Analyte analyzed for but not detected at level above reporting limit.



CERTIFICATE OF ANALYSIS

CLIENT: Antea Group
 4006 - 148th Ave NE
 Redmond, WA 98052

CLIENT CONTACT: Joe Rounds
 CLIENT PROJECT: STCG-403
 CLIENT SAMPLE ID: MW-4

DATE: 12/5/2011
 ALS JOB#: 1111150
 ALS SAMPLE#: -04
 DATE RECEIVED: 11/28/2011
 COLLECTION DATE: 11/28/2011 13:40
 WDOE ACCREDITATION: C601

DATA RESULTS

ANALYTE	METHOD	RESULTS	REPORTING LIMITS	DILUTION FACTOR	UNITS	ANALYSIS DATE	ANALYSIS BY
TPH-Volatile Range	NWTPH-GX	U	50	1	UG/L	11/30/2011	DLC
Methyl T-Butyl Ether	EPA-8021	U	3.0	1	UG/L	11/30/2011	DLC
Benzene	EPA-8021	U	1.0	1	UG/L	11/30/2011	DLC
Toluene	EPA-8021	U	1.0	1	UG/L	11/30/2011	DLC
Ethylbenzene	EPA-8021	U	1.0	1	UG/L	11/30/2011	DLC
Xylenes	EPA-8021	U	3.0	1	UG/L	11/30/2011	DLC
1,2-Dichloroethane	EPA-8260 SIM	U	0.020	1	UG/L	11/29/2011	GAP
1,2-Dibromoethane	EPA-8260 SIM	U	0.010	1	UG/L	11/29/2011	GAP
Naphthalene	EPA-8270 SIM	U	0.020	1	UG/L	11/30/2011	LAP
2-Methylnaphthalene	EPA-8270 SIM	U	0.020	1	UG/L	11/30/2011	LAP
1-Methylnaphthalene	EPA-8270 SIM	U	0.020	1	UG/L	11/30/2011	LAP
Lead	EPA-6020	U	0.30	1	UG/L	11/30/2011	RAL

SURROGATE	METHOD	%REC	ANALYSIS DATE	ANALYSIS BY
TFT	NWTPH-GX	97.6	11/30/2011	DLC
TFT	EPA-8021	109	11/30/2011	DLC
1,2-Dichloroethane-d4	EPA-8260 SIM	82.4	11/29/2011	GAP
Terphenyl-d14	EPA-8270 SIM	70.1	11/30/2011	LAP

U - Analyte analyzed for but not detected at level above reporting limit.



CERTIFICATE OF ANALYSIS

CLIENT:	Antea Group 4006 - 148th Ave NE Redmond, WA 98052	DATE:	12/5/2011
CLIENT CONTACT:	Joe Rounds	ALS JOB#:	1111150
CLIENT PROJECT:	STCG-403	ALS SAMPLE#:	-05
CLIENT SAMPLE ID	MW-5	DATE RECEIVED:	11/28/2011
		COLLECTION DATE:	11/28/2011 12:00
		WDOE ACCREDITATION:	C601

DATA RESULTS

ANALYTE	METHOD	RESULTS	REPORTING LIMITS	DILUTION FACTOR	UNITS	ANALYSIS DATE	ANALYSIS BY
TPH-Volatile Range	NWTPH-GX	U	50	1	UG/L	11/30/2011	DLC
Methyl T-Butyl Ether	EPA-8021	U	3.0	1	UG/L	11/30/2011	DLC
Benzene	EPA-8021	U	1.0	1	UG/L	11/30/2011	DLC
Toluene	EPA-8021	U	1.0	1	UG/L	11/30/2011	DLC
Ethylbenzene	EPA-8021	U	1.0	1	UG/L	11/30/2011	DLC
Xylenes	EPA-8021	U	3.0	1	UG/L	11/30/2011	DLC
1,2-Dichloroethane	EPA-8260 SIM	U	0.020	1	UG/L	11/29/2011	GAP
1,2-Dibromoethane	EPA-8260 SIM	U	0.010	1	UG/L	11/29/2011	GAP
Naphthalene	EPA-8270 SIM	U	0.020	1	UG/L	11/30/2011	LAP
2-Methylnaphthalene	EPA-8270 SIM	U	0.020	1	UG/L	11/30/2011	LAP
1-Methylnaphthalene	EPA-8270 SIM	U	0.020	1	UG/L	11/30/2011	LAP
Lead	EPA-6020	U	0.30	1	UG/L	11/30/2011	RAL

SURROGATE	METHOD	%REC	ANALYSIS DATE	ANALYSIS BY
TFT	NWTPH-GX	112	11/30/2011	DLC
TFT	EPA-8021	122	11/30/2011	DLC
1,2-Dichloroethane-d4	EPA-8260 SIM	83.1	11/29/2011	GAP
Terphenyl-d14	EPA-8270 SIM	63.7	11/30/2011	LAP

U - Analyte analyzed for but not detected at level above reporting limit.



CERTIFICATE OF ANALYSIS

CLIENT: Antea Group
4006 - 148th Ave NE
Redmond, WA 98052

DATE: 12/5/2011

ALS JOB#: 1111150

ALS SAMPLE#: -06

CLIENT CONTACT: Joe Rounds

DATE RECEIVED: 11/28/2011

CLIENT PROJECT: STCG-403

COLLECTION DATE: 11/28/2011 11:00

CLIENT SAMPLE ID MW-7

WDOE ACCREDITATION: C601

DATA RESULTS

ANALYTE	METHOD	RESULTS	REPORTING LIMITS	DILUTION FACTOR	UNITS	ANALYSIS	ANALYSIS
						DATE	BY
TPH-Volatile Range	NWTPH-GX	65	50	1	UG/L	11/30/2011	DLC
Methyl T-Butyl Ether	EPA-8021	U	3.0	1	UG/L	11/30/2011	DLC
Benzene	EPA-8021	2.7	1.0	1	UG/L	11/30/2011	DLC
Toluene	EPA-8021	U	1.0	1	UG/L	11/30/2011	DLC
Ethylbenzene	EPA-8021	3.3	1.0	1	UG/L	11/30/2011	DLC
Xylenes	EPA-8021	U	3.0	1	UG/L	11/30/2011	DLC
1,2-Dichloroethane	EPA-8260 SIM	U	0.020	1	UG/L	11/29/2011	GAP
1,2-Dibromoethane	EPA-8260 SIM	U	0.010	1	UG/L	11/29/2011	GAP
Naphthalene	EPA-8270 SIM	0.042	0.020	1	UG/L	11/30/2011	LAP
2-Methylnaphthalene	EPA-8270 SIM	U	0.020	1	UG/L	11/30/2011	LAP
1-Methylnaphthalene	EPA-8270 SIM	U	0.020	1	UG/L	11/30/2011	LAP
Sulfate	EPA-300.0	12	2.6	10	MG/L	12/01/2011	GAP
Lead	EPA-6020	U	0.30	1	UG/L	11/30/2011	RAL

SURROGATE	METHOD	%REC	ANALYSIS	ANALYSIS
			DATE	BY
TFT	NWTPH-GX	109	11/30/2011	DLC
TFT	EPA-8021	127	11/30/2011	DLC
1,2-Dichloroethane-d4	EPA-8260 SIM	82.2	11/29/2011	GAP
Terphenyl-d14	EPA-8270 SIM	66.1	11/30/2011	LAP

U - Analyte analyzed for but not detected at level above reporting limit.
Chromatogram indicates that it is likely that sample contains highly weathered gasoline.



CERTIFICATE OF ANALYSIS

CLIENT: Antea Group
 4006 - 148th Ave NE
 Redmond, WA 98052

DATE: 12/5/2011

ALS JOB#: 1111150

ALS SAMPLE#: -07

CLIENT CONTACT: Joe Rounds

DATE RECEIVED: 11/28/2011

CLIENT PROJECT: STCG-403

COLLECTION DATE: 11/28/2011 09:40

CLIENT SAMPLE ID MW-8

WDOE ACCREDITATION: C601

DATA RESULTS

ANALYTE	METHOD	RESULTS	REPORTING LIMITS	DILUTION FACTOR	UNITS	ANALYSIS DATE	ANALYSIS BY
TPH-Volatile Range	NWTPH-GX	U	50	1	UG/L	11/30/2011	DLC
Methyl T-Butyl Ether	EPA-8021	U	3.0	1	UG/L	11/30/2011	DLC
Benzene	EPA-8021	U	1.0	1	UG/L	11/30/2011	DLC
Toluene	EPA-8021	U	1.0	1	UG/L	11/30/2011	DLC
Ethylbenzene	EPA-8021	U	1.0	1	UG/L	11/30/2011	DLC
Xylenes	EPA-8021	U	3.0	1	UG/L	11/30/2011	DLC
1,2-Dichloroethane	EPA-8260 SIM	U	0.020	1	UG/L	11/29/2011	GAP
1,2-Dibromoethane	EPA-8260 SIM	U	0.010	1	UG/L	11/29/2011	GAP
Naphthalene	EPA-8270 SIM	U	0.020	1	UG/L	11/30/2011	LAP
2-Methylnaphthalene	EPA-8270 SIM	U	0.020	1	UG/L	11/30/2011	LAP
1-Methylnaphthalene	EPA-8270 SIM	U	0.020	1	UG/L	11/30/2011	LAP
Sulfate	EPA-300.0	82	2.6	10	MG/L	12/01/2011	GAP
Lead	EPA-6020	0.86	0.30	1	UG/L	11/30/2011	RAL

SURROGATE	METHOD	%REC	ANALYSIS DATE	ANALYSIS BY
TFT	NWTPH-GX	78.9	11/30/2011	DLC
TFT	EPA-8021	97.5	11/30/2011	DLC
1,2-Dichloroethane-d4	EPA-8260 SIM	82.7	11/29/2011	GAP
Terphenyl-d14	EPA-8270 SIM	61.5	11/30/2011	LAP

U - Analyte analyzed for but not detected at level above reporting limit.



CERTIFICATE OF ANALYSIS

CLIENT: Antea Group
4006 - 148th Ave NE
Redmond, WA 98052

DATE: 12/5/2011

ALS JOB#: 1111150

ALS SAMPLE#: -08

CLIENT CONTACT: Joe Rounds

DATE RECEIVED: 11/28/2011

CLIENT PROJECT: STCG-403

COLLECTION DATE: 11/28/2011 11:30

CLIENT SAMPLE ID TW-1

WDOE ACCREDITATION: C601

DATA RESULTS

ANALYTE	METHOD	RESULTS	REPORTING LIMITS	DILUTION FACTOR	UNITS	ANALYSIS DATE	ANALYSIS BY
TPH-Volatile Range	NWTPH-GX	540	50	1	UG/L	11/30/2011	DLC
Methyl T-Butyl Ether	EPA-8021	U	3.0	1	UG/L	11/30/2011	DLC
Benzene	EPA-8021	78	1.0	1	UG/L	11/30/2011	DLC
Toluene	EPA-8021	3.9	1.0	1	UG/L	11/30/2011	DLC
Ethylbenzene	EPA-8021	25	1.0	1	UG/L	11/30/2011	DLC
Xylenes	EPA-8021	61	3.0	1	UG/L	11/30/2011	DLC
1,2-Dichloroethane	EPA-8260 SIM	U	0.020	1	UG/L	11/29/2011	GAP
1,2-Dibromoethane	EPA-8260 SIM	U	0.010	1	UG/L	11/29/2011	GAP
Naphthalene	EPA-8270 SIM	3.6	0.020	1	UG/L	11/30/2011	LAP
2-Methylnaphthalene	EPA-8270 SIM	0.45	0.020	1	UG/L	11/30/2011	LAP
1-Methylnaphthalene	EPA-8270 SIM	1.0	0.020	1	UG/L	11/30/2011	LAP
Sulfate	EPA-300.0	260	13	50	MG/L	12/01/2011	GAP
Lead	EPA-6020	2.8	0.30	1	UG/L	11/30/2011	RAL

SURROGATE	METHOD	%REC	ANALYSIS DATE	ANALYSIS BY
TFT	NWTPH-GX	94.0	11/30/2011	DLC
TFT	EPA-8021	109	11/30/2011	DLC
1,2-Dichloroethane-d4	EPA-8260 SIM	81.4	11/29/2011	GAP
Terphenyl-d14	EPA-8270 SIM	67.6	11/30/2011	LAP

U - Analyte analyzed for but not detected at level above reporting limit.
Chromatogram indicates that it is likely that sample contains weathered gasoline.



CERTIFICATE OF ANALYSIS

CLIENT:	Antea Group 4006 - 148th Ave NE Redmond, WA 98052	DATE:	12/5/2011
CLIENT CONTACT:	Joe Rounds	ALS JOB#:	1111150
CLIENT PROJECT:	STCG-403	ALS SAMPLE#:	-09
CLIENT SAMPLE ID	TW-2	DATE RECEIVED:	11/28/2011
		COLLECTION DATE:	11/28/2011 13:00
		WDOE ACCREDITATION:	C601

DATA RESULTS

ANALYTE	METHOD	RESULTS	REPORTING LIMITS	DILUTION FACTOR	UNITS	ANALYSIS DATE	ANALYSIS BY
TPH-Volatile Range	NWTPH-GX	5300	500	10	UG/L	11/30/2011	DLC
Methyl T-Butyl Ether	EPA-8021	U	30	10	UG/L	11/30/2011	DLC
Benzene	EPA-8021	960	10	10	UG/L	11/30/2011	DLC
Toluene	EPA-8021	18	10	10	UG/L	11/30/2011	DLC
Ethylbenzene	EPA-8021	740	10	10	UG/L	11/30/2011	DLC
Xylenes	EPA-8021	210	30	10	UG/L	11/30/2011	DLC
1,2-Dichloroethane	EPA-8260 SIM	U	0.020	1	UG/L	11/29/2011	GAP
1,2-Dibromoethane	EPA-8260 SIM	U	0.010	1	UG/L	11/29/2011	GAP
Naphthalene	EPA-8270 SIM	33	0.080	4	UG/L	11/30/2011	LAP
2-Methylnaphthalene	EPA-8270 SIM	2.3	0.080	4	UG/L	11/30/2011	LAP
1-Methylnaphthalene	EPA-8270 SIM	7.8	0.080	4	UG/L	11/30/2011	LAP
Sulfate	EPA-300.0	39	2.6	10	MG/L	12/01/2011	GAP
Lead	EPA-6020	12	0.30	1	UG/L	11/30/2011	RAL

SURROGATE	METHOD	%REC	ANALYSIS DATE	ANALYSIS BY
TFT 10X Dilution	NWTPH-GX	97.2	11/30/2011	DLC
TFT 10X Dilution	EPA-8021	121	11/30/2011	DLC
1,2-Dichloroethane-d4	EPA-8260 SIM	82.3	11/29/2011	GAP
Terphenyl-d14 4X Dilution	EPA-8270 SIM	72.4	11/30/2011	LAP

U - Analyte analyzed for but not detected at level above reporting limit.
Chromatogram indicates that it is likely that sample contains weathered gasoline.



CERTIFICATE OF ANALYSIS

CLIENT:	Antea Group 4006 - 148th Ave NE Redmond, WA 98052	DATE:	12/5/2011
CLIENT CONTACT:	Joe Rounds	ALS JOB#:	1111150
CLIENT PROJECT:	STCG-403	ALS SAMPLE#:	-10
CLIENT SAMPLE ID	TW-3	DATE RECEIVED:	11/28/2011
		COLLECTION DATE:	11/28/2011 09:00
		WDOE ACCREDITATION:	C601

DATA RESULTS

ANALYTE	METHOD	RESULTS	REPORTING LIMITS	DILUTION FACTOR	UNITS	ANALYSIS DATE	ANALYSIS BY
TPH-Volatile Range	NWTPH-GX	U	50	1	UG/L	11/30/2011	DLC
Methyl T-Butyl Ether	EPA-8021	U	3.0	1	UG/L	11/30/2011	DLC
Benzene	EPA-8021	U	1.0	1	UG/L	11/30/2011	DLC
Toluene	EPA-8021	U	1.0	1	UG/L	11/30/2011	DLC
Ethylbenzene	EPA-8021	U	1.0	1	UG/L	11/30/2011	DLC
Xylenes	EPA-8021	U	3.0	1	UG/L	11/30/2011	DLC
1,2-Dichloroethane	EPA-8260 SIM	U	0.020	1	UG/L	11/29/2011	GAP
1,2-Dibromoethane	EPA-8260 SIM	U	0.010	1	UG/L	11/29/2011	GAP
Naphthalene	EPA-8270 SIM	U	0.020	1	UG/L	11/30/2011	LAP
2-Methylnaphthalene	EPA-8270 SIM	U	0.020	1	UG/L	11/30/2011	LAP
1-Methylnaphthalene	EPA-8270 SIM	U	0.020	1	UG/L	11/30/2011	LAP
Lead	EPA-6020	U	0.30	1	UG/L	11/30/2011	RAL

SURROGATE	METHOD	%REC	ANALYSIS DATE	ANALYSIS BY
TFT	NWTPH-GX	82.8	11/30/2011	DLC
TFT	EPA-8021	105	11/30/2011	DLC
1,2-Dichloroethane-d4	EPA-8260 SIM	84.2	11/29/2011	GAP
Terphenyl-d14	EPA-8270 SIM	53.8	11/30/2011	LAP

U - Analyte analyzed for but not detected at level above reporting limit.



CERTIFICATE OF ANALYSIS

CLIENT: Antea Group
4006 - 148th Ave NE
Redmond, WA 98052

DATE: 12/5/2011

ALS JOB#: 1111150

ALS SAMPLE#: -11

CLIENT CONTACT: Joe Rounds

DATE RECEIVED: 11/28/2011

CLIENT PROJECT: STCG-403

COLLECTION DATE: 11/28/2011 10:00

CLIENT SAMPLE ID B-2

WDOE ACCREDITATION: C601

DATA RESULTS

ANALYTE	METHOD	RESULTS	REPORTING LIMITS	DILUTION FACTOR	UNITS	ANALYSIS DATE	ANALYSIS BY
TPH-Volatile Range	NWTPH-GX	620	50	1	UG/L	11/30/2011	DLC
Methyl T-Butyl Ether	EPA-8021	U	3.0	1	UG/L	11/30/2011	DLC
Benzene	EPA-8021	27	1.0	1	UG/L	11/30/2011	DLC
Toluene	EPA-8021	3.6	1.0	1	UG/L	11/30/2011	DLC
Ethylbenzene	EPA-8021	17	1.0	1	UG/L	11/30/2011	DLC
Xylenes	EPA-8021	30	3.0	1	UG/L	11/30/2011	DLC
1,2-Dichloroethane	EPA-8260 SIM	U	0.020	1	UG/L	11/30/2011	GAP
1,2-Dibromoethane	EPA-8260 SIM	U	0.010	1	UG/L	11/30/2011	GAP
Naphthalene	EPA-8270 SIM	4.4	0.020	1	UG/L	11/30/2011	LAP
2-Methylnaphthalene	EPA-8270 SIM	2.0	0.020	1	UG/L	11/30/2011	LAP
1-Methylnaphthalene	EPA-8270 SIM	2.1	0.020	1	UG/L	11/30/2011	LAP
Sulfate	EPA-300.0	6.9	2.6	10	MG/L	12/01/2011	GAP
Lead	EPA-6020	0.40	0.30	1	UG/L	11/30/2011	RAL

SURROGATE	METHOD	%REC	ANALYSIS DATE	ANALYSIS BY
TFT	NWTPH-GX	106	11/30/2011	DLC
TFT	EPA-8021	117	11/30/2011	DLC
1,2-Dichloroethane-d4	EPA-8260 SIM	84.6	11/30/2011	GAP
Terphenyl-d14	EPA-8270 SIM	70.4	11/30/2011	LAP

U - Analyte analyzed for but not detected at level above reporting limit.
Chromatogram indicates that it is likely that sample contains weathered gasoline.



CERTIFICATE OF ANALYSIS

CLIENT: Antea Group DATE: 12/5/2011
 4006 - 148th Ave NE ALS SDG#: 1111150
 Redmond, WA 98052 WDOE ACCREDITATION: C601

CLIENT CONTACT: Joe Rounds
 CLIENT PROJECT: STCG-403

LABORATORY BLANK RESULTS

MBG-113011W - Batch 2333 - Water by NWTPH-GX

ANALYTE	METHOD	RESULTS	REPORTING LIMITS	DILUTION FACTOR	UNITS	ANALYSIS DATE	ANALYSIS BY
TPH-Volatile Range	NWTPH-GX	U	50	1	UG/L	11/30/2011	DLC

MB-113011W - Batch 2333 - Water by EPA-8021

ANALYTE	METHOD	RESULTS	REPORTING LIMITS	DILUTION FACTOR	UNITS	ANALYSIS DATE	ANALYSIS BY
Methyl T-Butyl Ether	EPA-8021	U	3.0	1	UG/L	11/30/2011	DLC
Benzene	EPA-8021	U	1.0	1	UG/L	11/30/2011	DLC
Toluene	EPA-8021	U	1.0	1	UG/L	11/30/2011	DLC
Ethylbenzene	EPA-8021	U	1.0	1	UG/L	11/30/2011	DLC
Xylenes	EPA-8021	U	3.0	1	UG/L	11/30/2011	DLC

MB-112911W - Batch 2331 - Water by EPA-8260 SIM

ANALYTE	METHOD	RESULTS	REPORTING LIMITS	DILUTION FACTOR	UNITS	ANALYSIS DATE	ANALYSIS BY
1,1-Dichloroethene	EPA-8260 SIM	U	0.020	1	UG/L	11/29/2011	GAP
1,2-Dichloroethane	EPA-8260 SIM	U	0.10	1	UG/L	11/29/2011	GAP
1,2-Dibromoethane	EPA-8260 SIM	U	0.010	1	UG/L	11/29/2011	GAP

MB-112911W - Batch 2328 - Water by EPA-8270 SIM

ANALYTE	METHOD	RESULTS	REPORTING LIMITS	DILUTION FACTOR	UNITS	ANALYSIS DATE	ANALYSIS BY
Naphthalene	EPA-8270 SIM	U	0.020	1	UG/L	11/29/2011	LAP
2-Methylnaphthalene	EPA-8270 SIM	U	0.020	1	UG/L	11/29/2011	LAP
1-Methylnaphthalene	EPA-8270 SIM	U	0.020	1	UG/L	11/29/2011	LAP
Benzo[G,H,I]Perylene	EPA-8270 SIM	U	0.020	1	UG/L	11/29/2011	LAP

MBLK-1212011 - Batch R75609 - Water by EPA-300.0

ANALYTE	METHOD	RESULTS	REPORTING LIMITS	DILUTION FACTOR	UNITS	ANALYSIS DATE	ANALYSIS BY
Sulfate	EPA-300.0	U	0.26	1	MG/L	12/01/2011	GAP

MB-112911W - Batch 2323 - Water by EPA-6020

ANALYTE	METHOD	RESULTS	REPORTING LIMITS	DILUTION FACTOR	UNITS	ANALYSIS DATE	ANALYSIS BY
Lead	EPA-6020	U	0.30	1	UG/L	11/30/2011	RAL



CERTIFICATE OF ANALYSIS

CLIENT:	Antea Group 4006 - 148th Ave NE Redmond, WA 98052	DATE:	12/5/2011
CLIENT CONTACT:	Joe Rounds	ALS SDG#:	1111150
CLIENT PROJECT:	STCG-403	WDOE ACCREDITATION:	C601

LABORATORY CONTROL SAMPLE RESULTS

ALS Test Batch ID: 2333 - Water by NWTPH-GX

SPIKED COMPOUND	METHOD	%REC	RPD	QUAL	ANALYSIS DATE	ANALYSIS BY
TPH-Volatile Range - BS	NWTPH-GX	79.9			12/01/2011	DLC
TPH-Volatile Range - BSD	NWTPH-GX	83.8	0		11/30/2011	DLC

ALS Test Batch ID: 2333 - Water by EPA-8021

SPIKED COMPOUND	METHOD	%REC	RPD	QUAL	ANALYSIS DATE	ANALYSIS BY
Methyl T-Butyl Ether - BS	EPA-8021	120			11/30/2011	DLC
Methyl T-Butyl Ether - BSD	EPA-8021	122	2		11/30/2011	DLC
Benzene - BS	EPA-8021	113			11/30/2011	DLC
Benzene - BSD	EPA-8021	115	2		11/30/2011	DLC
Toluene - BS	EPA-8021	108			11/30/2011	DLC
Toluene - BSD	EPA-8021	110	2		11/30/2011	DLC
Ethylbenzene - BS	EPA-8021	104			11/30/2011	DLC
Ethylbenzene - BSD	EPA-8021	106	2		11/30/2011	DLC
Xylenes - BS	EPA-8021	105			11/30/2011	DLC
Xylenes - BSD	EPA-8021	107	2		11/30/2011	DLC

ALS Test Batch ID: 2331 - Water by EPA-8260 SIM

SPIKED COMPOUND	METHOD	%REC	RPD	QUAL	ANALYSIS DATE	ANALYSIS BY
1,1-Dichloroethene - BS	EPA-8260 SIM	115			11/29/2011	GAP
1,1-Dichloroethene - BSD	EPA-8260 SIM	115	0		11/29/2011	GAP

ALS Test Batch ID: 2328 - Water by EPA-8270 SIM

SPIKED COMPOUND	METHOD	%REC	RPD	QUAL	ANALYSIS DATE	ANALYSIS BY
Naphthalene - BS	EPA-8270 SIM	51.1			11/29/2011	LAP
Naphthalene - BSD	EPA-8270 SIM	69.4	30		11/29/2011	LAP
Benzo[G,H,I]Perylene - BS	EPA-8270 SIM	60.0			11/29/2011	LAP
Benzo[G,H,I]Perylene - BSD	EPA-8270 SIM	64.4	7		11/29/2011	LAP

ALS Test Batch ID: R75609 - Water by EPA-300.0

SPIKED COMPOUND	METHOD	%REC	RPD	QUAL	ANALYSIS DATE	ANALYSIS BY
Sulfate - BS	EPA-300.0	91.0			12/01/2011	GAP
Sulfate - BSD	EPA-300.0	97.0	6		12/01/2011	GAP



CERTIFICATE OF ANALYSIS

CLIENT: Antea Group
4006 - 148th Ave NE
Redmond, WA 98052
DATE: 12/5/2011
ALS SDG#: 1111150
WDOE ACCREDITATION: C601
CLIENT CONTACT: Joe Rounds
CLIENT PROJECT: STCG-403

LABORATORY CONTROL SAMPLE RESULTS

ALS Test Batch ID: 2323 - Water by EPA-6020

SPIKED COMPOUND	METHOD	%REC	RPD	QUAL	ANALYSIS DATE	ANALYSIS BY
Lead - BS	EPA-6020	98.1			11/30/2011	RAL
Lead - BSD	EPA-6020	99.5	1		11/30/2011	RAL

APPROVED BY

Laboratory Director



ALS Environmental
 8620 Holly Drive, Suite 100
 Everett, WA 98208
 Phone (425) 356-2600
 (206) 292-9059 Seattle
 (425) 356-2626 Fax
 http://www.alsglobal.com

Chain Of Custody/ Laboratory Analysis Request

ALS Job# (Laboratory Use Only) **1111150**

1111150

Date **11-28-11** Page **1** of **2**

PROJECT ID: STCG-403 REPORT TO COMPANY: ANTEA GROUP PROJECT MANAGER: JOE ROUNDS ADDRESS: 4006 148 AVE NE REDMOND, WA 98052 PHONE: 425-498-7724 FAX: PO. NUMBER: STCG-403 E-MAIL: joe.pounds@antegrp.com INVOICE TO COMPANY: Same ATTENTION: Colony Claim # 214322-140 ADDRESS:	ANALYSIS REQUESTED							OTHER (Specify)								
	NWTPH-HCID	NWTPH-DX	NWTPH-GX	BTEX by EPA-8021	MTBE by EPA-8021 EPA-8260	Halogenated Volatiles by EPA 8260	Volatile Organic Compounds by EPA 8260	EDB / EDC by EPA 8260 SIM (water)	EDB / EDC by EPA 8260 (soil)	Semivolatile Organic Compounds by EPA 8270	Polycyclic Aromatic Hydrocarbons (PAH) by EPA-8270 SIM	PCB Pesticides by EPA 8081/8082	Metals-MTCA-5 RCRA-8 Pri Pol TAL	Metals Other (Specify) Total Pb	TCLP-Metals VOA Semi-Vol Pest Herbs	NUMBER OF CONTAINERS RECEIVED IN GOOD CONDITION?

	SAMPLE I.D.	DATE	TIME	TYPE	LAB#	NWTPH-HCID	NWTPH-DX	NWTPH-GX	BTEX by EPA-8021	MTBE by EPA-8021 EPA-8260	Halogenated Volatiles by EPA 8260	Volatile Organic Compounds by EPA 8260	EDB / EDC by EPA 8260 SIM (water)	EDB / EDC by EPA 8260 (soil)	Semivolatile Organic Compounds by EPA 8270	Polycyclic Aromatic Hydrocarbons (PAH) by EPA-8270 SIM	PCB Pesticides by EPA 8081/8082	Metals-MTCA-5 RCRA-8 Pri Pol TAL	Metals Other (Specify) Total Pb	TCLP-Metals VOA Semi-Vol Pest Herbs	NUMBER OF CONTAINERS RECEIVED IN GOOD CONDITION?	
1.	MW-1	11-28-11	1030	W	1				X	X		X									X	8
2.	MW-2		1320		2																	7
3.	MW-3		920		3																	7
4.	MW-4		1340		4																	7
5.	MW-5		1200		5																	7
6.	MW-7		1100		6																X	8
7.	MW-8		940		7																X	8
8.	TW-1		1130		8																X	8
9.	TW-2		1300		9																X	8
10.	TW-3		900		10																X	7

LABORATORY COPY

SPECIAL INSTRUCTIONS **Please confirm MTBE detections with 8260**

SIGNATURES (Name, Company, Date, Time):
 1. Relinquished By: *[Signature]* ANTEA 11-28-11 1520
 Received By: *[Signature]* ALS 11/28/11 1520
 2. Relinquished By: _____
 Received By: _____

TURNAROUND REQUESTED in Business Days*
 Organic, Metals & Inorganic Analysis
 Fuels & Hydrocarbon Analysis
 OTHER: Specify: _____
 * Turnaround request less than standard may incur Rush Charges



ALS Environmental
 8620 Holly Drive, Suite 100
 Everett, WA 98208
 Phone (425) 356-2600
 (206) 292-9059 Seattle
 (425) 356-2626 Fax
 http://www.alsglobal.com

Chain Of Custody/ Laboratory Analysis Request

ALS Job# (Laboratory Use Only)

1111150

Date 11-28-11 Page 2 Of 2

PROJECT ID: REPORT TO COMPANY: PROJECT MANAGER: ADDRESS: PHONE: P.O. NUMBER: INVOICE TO COMPANY: ATTENTION: ADDRESS:	<u>STCG-403</u> <u>ANTEA GROUP</u> <u>JOE ROUNDS</u> <u>4006 148 AVE NE</u> <u>REDMOND, WA 98052</u> <u>425-448-7724</u> <u>STCG-403</u> <u>same</u> <u>Colony Claim # 214 322-140</u>	ANALYSIS REQUESTED	OTHER (Specify)
		<input type="checkbox"/> NWTPH-HCID <input type="checkbox"/> NWTPH-DX <input type="checkbox"/> NWTPH-GX <input type="checkbox"/> BTEX by EPA-8021 <input type="checkbox"/> MTBE by EPA-8021 <input type="checkbox"/> EPA-8260 <input type="checkbox"/> Halogenated Volatiles by EPA 8260 <input type="checkbox"/> Volatile Organic Compounds by EPA 8260 <input type="checkbox"/> EDB / EDC by EPA 8260 SIM (water) <input type="checkbox"/> EDB / EDC by EPA 8260 (soil) <input type="checkbox"/> Semivolatile Organic Compounds by EPA 8270 <input type="checkbox"/> Polycyclic Aromatic Hydrocarbons (PAH) by EPA-8270 SIM <input type="checkbox"/> PCB Pesticides by EPA 8081/8082 <input type="checkbox"/> Metals-MTCA-5 <input type="checkbox"/> RCRA-8 <input type="checkbox"/> Pri Pol <input type="checkbox"/> TAL <input type="checkbox"/> Metals Other (Specify) <u>Total Pb</u> <input type="checkbox"/> TCLP-Metals <input type="checkbox"/> VOA <input type="checkbox"/> Semi-Vol <input type="checkbox"/> Pest <input type="checkbox"/> Herbs <u>Sulfate</u> <u>Naphthalene</u>	NUMBER OF CONTAINERS RECEIVED IN GOOD CONDITION?

LABORATORY COPY

	SAMPLE I.D.	DATE	TIME	TYPE	LAB#	NWTPH-HCID	NWTPH-DX	NWTPH-GX	BTEX by EPA-8021	MTBE by EPA-8021 <input type="checkbox"/> EPA-8260	Halogenated Volatiles by EPA 8260	Volatile Organic Compounds by EPA 8260	EDB / EDC by EPA 8260 SIM (water)	EDB / EDC by EPA 8260 (soil)	Semivolatile Organic Compounds by EPA 8270	Polycyclic Aromatic Hydrocarbons (PAH) by EPA-8270 SIM	PCB Pesticides by EPA 8081/8082	Metals-MTCA-5 <input type="checkbox"/> RCRA-8 <input type="checkbox"/> Pri Pol <input type="checkbox"/> TAL	Metals Other (Specify)	TCLP-Metals <input type="checkbox"/> VOA <input type="checkbox"/> Semi-Vol <input type="checkbox"/> Pest <input type="checkbox"/> Herbs	NUMBER OF CONTAINERS	RECEIVED IN GOOD CONDITION?	
1.	<u>B-2</u>	<u>11-28-11</u>	<u>1000</u>	<u>W</u>	<u>11</u>																		<u>8</u>
2.																							
3.																							
4.																							
5.																							
6.																							
7.																							
8.																							
9.																							
10.																							

SPECIAL INSTRUCTIONS

SIGNATURES (Name, Company, Date, Time):
 1. Relinquished By: [Signature] ANTEA 11-28-11 1520
 Received By: [Signature] 11/28/11 1520
 2. Relinquished By:
 Received By:

TURNAROUND REQUESTED in Business Days*

Organic, Metals & Inorganic Analysis	10	5	3	2	1	SAME DAY	Specify:
<input checked="" type="radio"/> Standard							
Fuels & Hydrocarbon Analysis	5	3	1	SAME DAY			
<input checked="" type="radio"/> Standard							

* Turnaround request less than standard may incur Rush Charges



December 28, 2011

Mr. Joe Rounds
Antea Group
4006 - 148th Ave NE
Redmond, WA 98052

Dear Mr. Rounds,

On December 20th, 5 samples were received by our laboratory and assigned our laboratory project number 1112127. The project was identified as your STCG-4032 College Way. The sample identification and requested analyses are outlined on the attached chain of custody record.

No abnormalities or nonconformances were observed during the analyses of the project samples.

Please do not hesitate to call me if you have any questions or if I can be of further assistance.

Sincerely,

ALS Laboratory Group

Rick Bagan
Laboratory Director



CERTIFICATE OF ANALYSIS

CLIENT: Antea Group DATE: 12/28/2011
4006 - 148th Ave NE ALS JOB#: 1112127
Redmond, WA 98052 ALS SAMPLE#: -01
CLIENT CONTACT: Joe Rounds DATE RECEIVED: 12/20/2011
CLIENT PROJECT: STCG-4032 College Way COLLECTION DATE: 12/20/2011 11:40
CLIENT SAMPLE ID MW-1 WDOE ACCREDITATION: C601

DATA RESULTS

ANALYTE	METHOD	RESULTS	REPORTING LIMITS	DILUTION FACTOR	UNITS	ANALYSIS DATE	ANALYSIS BY
TPH-Volatile Range	NWTPH-GX	64	50	1	UG/L	12/20/2011	DLC
Methyl T-Butyl Ether	EPA-8021	U	3.0	1	UG/L	12/20/2011	DLC
Benzene	EPA-8021	U	1.0	1	UG/L	12/20/2011	DLC
Toluene	EPA-8021	U	1.0	1	UG/L	12/20/2011	DLC
Ethylbenzene	EPA-8021	U	1.0	1	UG/L	12/20/2011	DLC
Xylenes	EPA-8021	U	3.0	1	UG/L	12/20/2011	DLC
Sulfate	EPA-300.0	48	2.6	10	MG/L	12/22/2011	GAP

SURROGATE	METHOD	%REC	ANALYSIS DATE	ANALYSIS BY
TFT	NWTPH-GX	101	12/20/2011	DLC
TFT	EPA-8021	98.5	12/20/2011	DLC

U - Analyte analyzed for but not detected at level above reporting limit.
Chromatogram indicates that it is likely that sample contains highly weathered gasoline.



CERTIFICATE OF ANALYSIS

CLIENT:	Antea Group 4006 - 148th Ave NE Redmond, WA 98052	DATE:	12/28/2011
CLIENT CONTACT:	Joe Rounds	ALS JOB#:	1112127
CLIENT PROJECT:	STCG-4032 College Way	ALS SAMPLE#:	-02
CLIENT SAMPLE ID	MW-7	DATE RECEIVED:	12/20/2011
		COLLECTION DATE:	12/20/2011 11:00
		WDOE ACCREDITATION:	C601

DATA RESULTS

ANALYTE	METHOD	RESULTS	REPORTING LIMITS	DILUTION FACTOR	UNITS	ANALYSIS DATE	ANALYSIS BY
TPH-Volatile Range	NWTPH-GX	110	50	1	UG/L	12/20/2011	DLC
Methyl T-Butyl Ether	EPA-8021	U	3.0	1	UG/L	12/20/2011	DLC
Benzene	EPA-8021	6.4	1.0	1	UG/L	12/20/2011	DLC
Toluene	EPA-8021	U	1.0	1	UG/L	12/20/2011	DLC
Ethylbenzene	EPA-8021	3.0	1.0	1	UG/L	12/20/2011	DLC
Xylenes	EPA-8021	6.7	3.0	1	UG/L	12/20/2011	DLC
Sulfate	EPA-300.0	6.9	0.26	1	MG/L	12/22/2011	GAP

SURROGATE	METHOD	%REC	ANALYSIS DATE	ANALYSIS BY
TFT	NWTPH-GX	97.6	12/20/2011	DLC
TFT	EPA-8021	114	12/20/2011	DLC

U - Analyte analyzed for but not detected at level above reporting limit.
Chromatogram indicates that it is likely that sample contains weathered gasoline.



CERTIFICATE OF ANALYSIS

CLIENT:	Antea Group 4006 - 148th Ave NE Redmond, WA 98052	DATE:	12/28/2011
CLIENT CONTACT:	Joe Rounds	ALS JOB#:	1112127
CLIENT PROJECT:	STCG-4032 College Way	ALS SAMPLE#:	-03
CLIENT SAMPLE ID	MW-8	DATE RECEIVED:	12/20/2011
		COLLECTION DATE:	12/20/2011 11:20
		WDOE ACCREDITATION:	C601

DATA RESULTS

ANALYTE	METHOD	RESULTS	REPORTING LIMITS	DILUTION FACTOR	UNITS	ANALYSIS DATE	ANALYSIS BY
TPH-Volatile Range	NWTPH-GX	U	50	1	UG/L	12/20/2011	DLC
Methyl T-Butyl Ether	EPA-8021	U	3.0	1	UG/L	12/20/2011	DLC
Benzene	EPA-8021	U	1.0	1	UG/L	12/20/2011	DLC
Toluene	EPA-8021	U	1.0	1	UG/L	12/20/2011	DLC
Ethylbenzene	EPA-8021	U	1.0	1	UG/L	12/20/2011	DLC
Xylenes	EPA-8021	U	3.0	1	UG/L	12/20/2011	DLC
Sulfate	EPA-300.0	80	2.6	10	MG/L	12/22/2011	GAP

SURROGATE	METHOD	%REC	ANALYSIS DATE	ANALYSIS BY
TFT	NWTPH-GX	88.5	12/20/2011	DLC
TFT	EPA-8021	101	12/20/2011	DLC

U - Analyte analyzed for but not detected at level above reporting limit.



CERTIFICATE OF ANALYSIS

CLIENT:	Antea Group 4006 - 148th Ave NE Redmond, WA 98052	DATE:	12/28/2011
CLIENT CONTACT:	Joe Rounds	ALS JOB#:	1112127
CLIENT PROJECT:	STCG-4032 College Way	ALS SAMPLE#:	-04
CLIENT SAMPLE ID	TW-1	DATE RECEIVED:	12/20/2011
		COLLECTION DATE:	12/20/2011 12:10
		WDOE ACCREDITATION:	C601

DATA RESULTS

ANALYTE	METHOD	RESULTS	REPORTING LIMITS	DILUTION FACTOR	UNITS	ANALYSIS DATE	ANALYSIS BY
TPH-Volatile Range	NWTPH-GX	150	50	1	UG/L	12/20/2011	DLC
Methyl T-Butyl Ether	EPA-8021	U	3.0	1	UG/L	12/20/2011	DLC
Benzene	EPA-8021	16	1.0	1	UG/L	12/20/2011	DLC
Toluene	EPA-8021	U	1.0	1	UG/L	12/20/2011	DLC
Ethylbenzene	EPA-8021	2.1	1.0	1	UG/L	12/20/2011	DLC
Xylenes	EPA-8021	U	3.0	1	UG/L	12/20/2011	DLC
Sulfate	EPA-300.0	180	5.2	20	MG/L	12/22/2011	GAP

SURROGATE	METHOD	%REC	ANALYSIS DATE	ANALYSIS BY
TFT	NWTPH-GX	90.4	12/20/2011	DLC
TFT	EPA-8021	104	12/20/2011	DLC

U - Analyte analyzed for but not detected at level above reporting limit.
Chromatogram indicates that it is likely that sample contains highly weathered gasoline.

CERTIFICATE OF ANALYSIS

CLIENT:	Antea Group 4006 - 148th Ave NE Redmond, WA 98052	DATE:	12/28/2011
CLIENT CONTACT:	Joe Rounds	ALS JOB#:	1112127
CLIENT PROJECT:	STCG-4032 College Way	ALS SAMPLE#:	-05
CLIENT SAMPLE ID	TW-2	DATE RECEIVED:	12/20/2011
		COLLECTION DATE:	12/20/2011 12:30
		WDOE ACCREDITATION:	C601

DATA RESULTS

ANALYTE	METHOD	RESULTS	REPORTING LIMITS	DILUTION FACTOR	UNITS	ANALYSIS DATE	ANALYSIS BY
TPH-Volatile Range	NWTPH-GX	3500	500	10	UG/L	12/21/2011	DLC
Methyl T-Butyl Ether	EPA-8021	U	30	10	UG/L	12/21/2011	DLC
Benzene	EPA-8021	530	10	10	UG/L	12/21/2011	DLC
Toluene	EPA-8021	11	10	10	UG/L	12/21/2011	DLC
Ethylbenzene	EPA-8021	500	10	10	UG/L	12/21/2011	DLC
Xylenes	EPA-8021	100	30	10	UG/L	12/21/2011	DLC
Sulfate	EPA-300.0	94	2.6	10	MG/L	12/22/2011	GAP

SURROGATE	METHOD	%REC	ANALYSIS DATE	ANALYSIS BY
TFT 10X Dilution	NWTPH-GX	94.8	12/21/2011	DLC
TFT 10X Dilution	EPA-8021	108	12/21/2011	DLC

U - Analyte analyzed for but not detected at level above reporting limit.
Chromatogram indicates that it is likely that sample contains weathered gasoline.



CERTIFICATE OF ANALYSIS

CLIENT:	Antea Group 4006 - 148th Ave NE Redmond, WA 98052	DATE:	12/28/2011
CLIENT CONTACT:	Joe Rounds	ALS SDG#:	1112127
CLIENT PROJECT:	STCG-4032 College Way	WDOE ACCREDITATION:	C601

LABORATORY CONTROL SAMPLE RESULTS

ALS Test Batch ID: 2387 - Water by NWTPH-GX

SPIKED COMPOUND	METHOD	%REC	RPD	QUAL	ANALYSIS DATE	ANALYSIS BY
TPH-Volatile Range - BS	NWTPH-GX	88.7			12/19/2011	DLC
TPH-Volatile Range - BSD	NWTPH-GX	91.6	3		12/19/2011	DLC

ALS Test Batch ID: 2387 - Water by EPA-8021

SPIKED COMPOUND	METHOD	%REC	RPD	QUAL	ANALYSIS DATE	ANALYSIS BY
Methyl T-Butyl Ether - BS	EPA-8021	122			12/19/2011	DLC
Methyl T-Butyl Ether - BSD	EPA-8021	114	7		12/19/2011	DLC
Benzene - BS	EPA-8021	115			12/19/2011	DLC
Benzene - BSD	EPA-8021	108	7		12/19/2011	DLC
Toluene - BS	EPA-8021	109			12/19/2011	DLC
Toluene - BSD	EPA-8021	103	6		12/19/2011	DLC
Ethylbenzene - BS	EPA-8021	106			12/19/2011	DLC
Ethylbenzene - BSD	EPA-8021	99.9	6		12/19/2011	DLC
Xylenes - BS	EPA-8021	107			12/19/2011	DLC
Xylenes - BSD	EPA-8021	100	6		12/19/2011	DLC

ALS Test Batch ID: R75867 - Water by EPA-300.0

SPIKED COMPOUND	METHOD	%REC	RPD	QUAL	ANALYSIS DATE	ANALYSIS BY
Sulfate - BS	EPA-300.0	87.0			12/22/2011	GAP
Sulfate - BSD	EPA-300.0	88.0	1		12/22/2011	GAP

APPROVED BY

Laboratory Director



ALS Environmental
8620 Holly Drive, Suite 100
Everett, WA 98208
Phone (425) 356-2600
(425) 356-2626 Fax
http://www.alsglobal.com

Chain Of Custody/ Laboratory Analysis Request

ALS Job# (Laboratory Use Only)

11/2/27

Date 12/20/11 Page 1 Of 1

PROJECT ID: STCG-4032 College Way					ANALYSIS REQUESTED										OTHER (Specify)			
REPORT TO COMPANY: ANTEA GROUP					<input type="checkbox"/> NWTPH-HCID <input type="checkbox"/> NWTPH-DX <input type="checkbox"/> NWTPH-GX <input type="checkbox"/> BTEX by EPA-8021 <input checked="" type="checkbox"/> MTBE by EPA-8021 <input type="checkbox"/> EPA-8260 <input type="checkbox"/> Halogenated Volatiles by EPA 8260 <input type="checkbox"/> Volatile Organic Compounds by EPA 8260 <input type="checkbox"/> EDB / EDC by EPA 8260 SIM (water) <input type="checkbox"/> EDB / EDC by EPA 8260 (soil) <input type="checkbox"/> Semivolatile Organic Compounds by EPA 8270 <input type="checkbox"/> Polycyclic Aromatic Hydrocarbons (PAH) by EPA-8270 SIM <input type="checkbox"/> PCB <input type="checkbox"/> Pesticides <input type="checkbox"/> by EPA 8081/8082 <input type="checkbox"/> Metals-MTCA-5 <input type="checkbox"/> RCRA-8 <input type="checkbox"/> Pri Pol <input type="checkbox"/> TAL <input type="checkbox"/> Metals Other (Specify) <input type="checkbox"/> TCLP-Metals <input type="checkbox"/> VOA <input type="checkbox"/> Semi-Vol <input type="checkbox"/> Pest <input type="checkbox"/> Herbs SULFATE												NUMBER OF CONTAINERS RECEIVED IN GOOD CONDITION?	
PROJECT MANAGER: JOE ROUNDS																		
ADDRESS: 4006 148th AVE NE																		
REDMOND, WA 98052																		
PHONE: (425) 488-7724 FAX:																		
P.O. NUMBER: 214322-140 E-MAIL:																		
INVOICE TO COMPANY: Same																		
ATTENTION:																		
ADDRESS:																		
SAMPLE I.D.	DATE	TIME	TYPE	LAB#														
1. MW-1	12/20/11	1140	W	1				X	X	X							X	5
2. MW-7	↓	1100	↓	2				↓	↓	↓							↓	↓
3. MW-8	↓	1120	↓	3				↓	↓	↓							↓	↓
4. TW-1	↓	1210	↓	4				↓	↓	↓							↓	↓
5. TW-2	↓	1230	↓	5				↓	↓	↓							↓	↓
6.																		
7.																		
8.																		
9.																		
10.																		

LABORATORY COPY

SPECIAL INSTRUCTIONS PLEASE CONFIRM MTBE DETECTIONS WITH 8260

SIGNATURES (Name, Company, Date, Time):
 1. Relinquished By: [Signature] 12-20-11 1400
 Received By: [Signature] ALS 12-20-11 1400
 2. Relinquished By: _____
 Received By: _____

TURNAROUND REQUESTED in Business Days*
 Organic, Metals & Inorganic Analysis OTHER:
 10 Standard 5 3 2 1 SAME DAY
 Fuels & Hydrocarbon Analysis
 5 Standard 3 1 SAME DAY
 Specify: _____

* Turnaround request less than standard may incur Rush Charges