

MATCH POINT D

MATCH POINT C

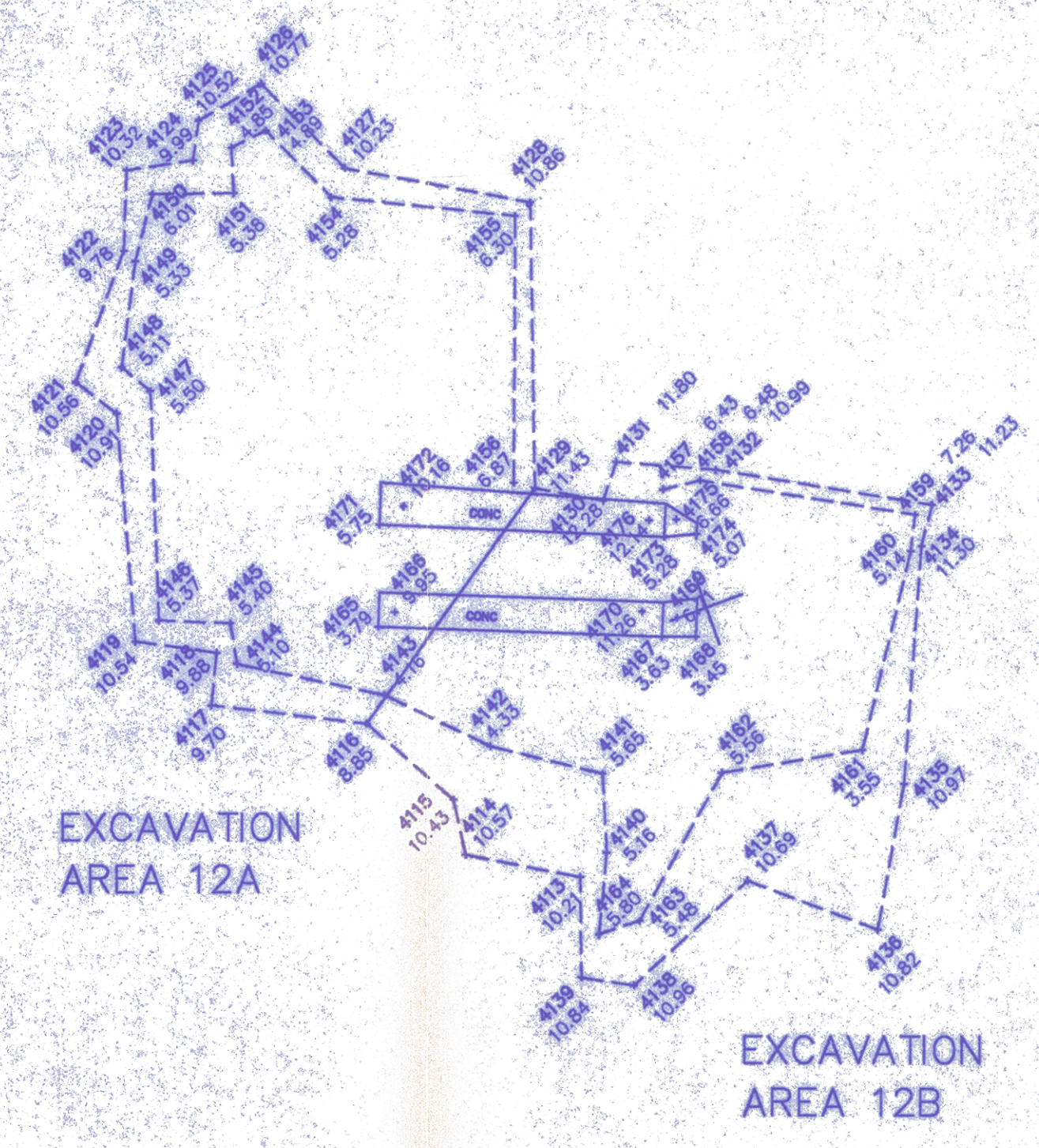

LEGEND:

- ORIGINAL PLAN LOCATION
- HUB & TACK OFFSET POINT
- PK NAIL OFFSET POINT
- COORDINATE POINT "A" FROM PLAN

ELEVATIONS SHOWN: NATIONAL GEODETIC VERTICAL DATUM -- 1929.

COORDINATE GRID IS WASHINGTON GRID SYSTEM, NORTH ZONE, BASED ON GPS SURVEY BY CLARK M. LEEMAN LAND SURVEYING ON JANUARY 6, 1994, DATUM IS NAD-83/91 USING HPGN CONTROL.

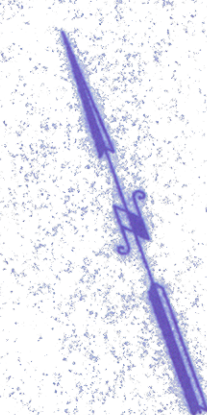
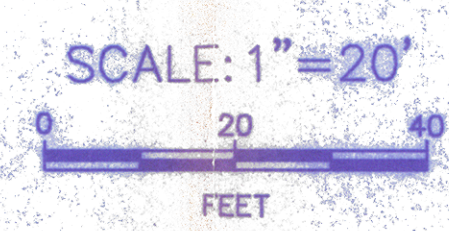

0044000  
E N 373400

0026000  
E

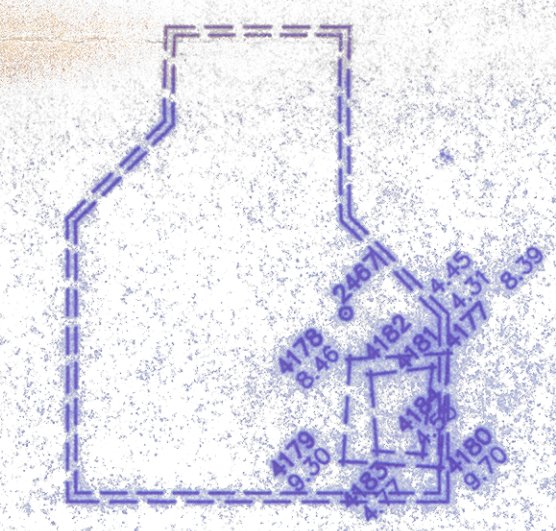

EXCAVATION AREA 11

EMCON NOTE: CLARK LEEMAN'S SURVEY OF AREA 11 INADVERTENTLY DID NOT INCLUDE THE ENTIRE EXCAVATED AREA. THE LARGER AREA SHOWN ABOVE IS AN APPROXIMATION OF THE EXCAVATED AREA BASED ON INFORMATION FROM FIELD NOTES.

REV	DATE	DESCRIPTION	OWN BY	DES BY	CHK BY	APP BY



WEST SITE REMEDIATION  
 SURVEY AS--EXCAVATED  
 WEYERHAEUSER CO. EVERETT MILL  
 IN SEC. 8, T 29 N, R 5 E WM  
 FOR OLYMPUS ENVIRONMENTAL, INC.

DRAWING NO  
**3**  
 PROJECT NO  
 0141-037.69