



Electronic Copy

STATE OF WASHINGTON  
DEPARTMENT OF ECOLOGY  
PO Box 47775 • Olympia, Washington 98504-7775 • 360-407-6300  
Call 711 for Washington Relay Service • Persons with a speech disability can call 877-833-6341

April 25, 2019

Ryan Cain  
Gramor Development  
19767 SW 72nd Avenue, Suite 100  
Tualatin, OR 97062

**Re: Termination of VCP Agreement for the following Site:**

- **Site Name:** Larsons Dry Cleaner
- **Site Address:** 501 NE 78th St, Vancouver, Clark County, WA 98665
- **Facility/Site No.:** 75243248
- **Cleanup Site ID No.:** 4622
- **VCP Project No.:** SW0582

Dear Ryan Cain:

The Department of Ecology (Ecology) is terminating the Voluntary Cleanup Program (VCP) Agreement governing Project No. SW0582. The project involved the cleanup of the Larsons Dry Cleaner facility (Site; Figure 1). The effective date of termination is the date of this letter. We are providing this notice in accordance with the terms of the Agreement.

## Reason

---

Ecology is terminating the Agreement because we understand that you are not actively cleaning up the Site. On February 27, 2019, we sent you a letter requesting an update on the status of your cleanup and your plan for completing the cleanup. You did not respond to that request. Since we have not heard from you, we have decided to terminate the Agreement.

## Next Steps

---

Based on this decision, Ecology may take one or more of the following steps:

1. Send you an invoice for any costs remaining on your account. In accordance with the terms of the Agreement, you remain responsible for any costs incurred by us before the effective date of termination.

2. Identify those persons we find potentially liable for cleanup of the Site.
3. Initiate discussions for an agreed order or consent decree that will govern further action at the Site.

You may apply to reenter the VCP if you decide to conduct further action at the Site.

### Contact Information

---

Ecology is committed to working with you to accomplish the prompt and effective cleanup of the Site. If you have any questions about this notice, please contact me at (360) 407-6241.

Sincerely,



Rebecca S. Lawson, P.E., LHG  
Section Manager  
Toxics Cleanup Program  
Southwest Regional Office

Enclosure: Figure 1

By certified mail: 9489 0090 0027 6066 6675 66

cc: Hazel Dell LCT, LLC, (property owner)  
Nick Acklam, Ecology (by email)  
Joanna Richards, Ecology (by email)  
Ecology Site File

## **Enclosure A**

---

### **Figure 1**

*This page intentionally left blank  
for double-sided copying.*

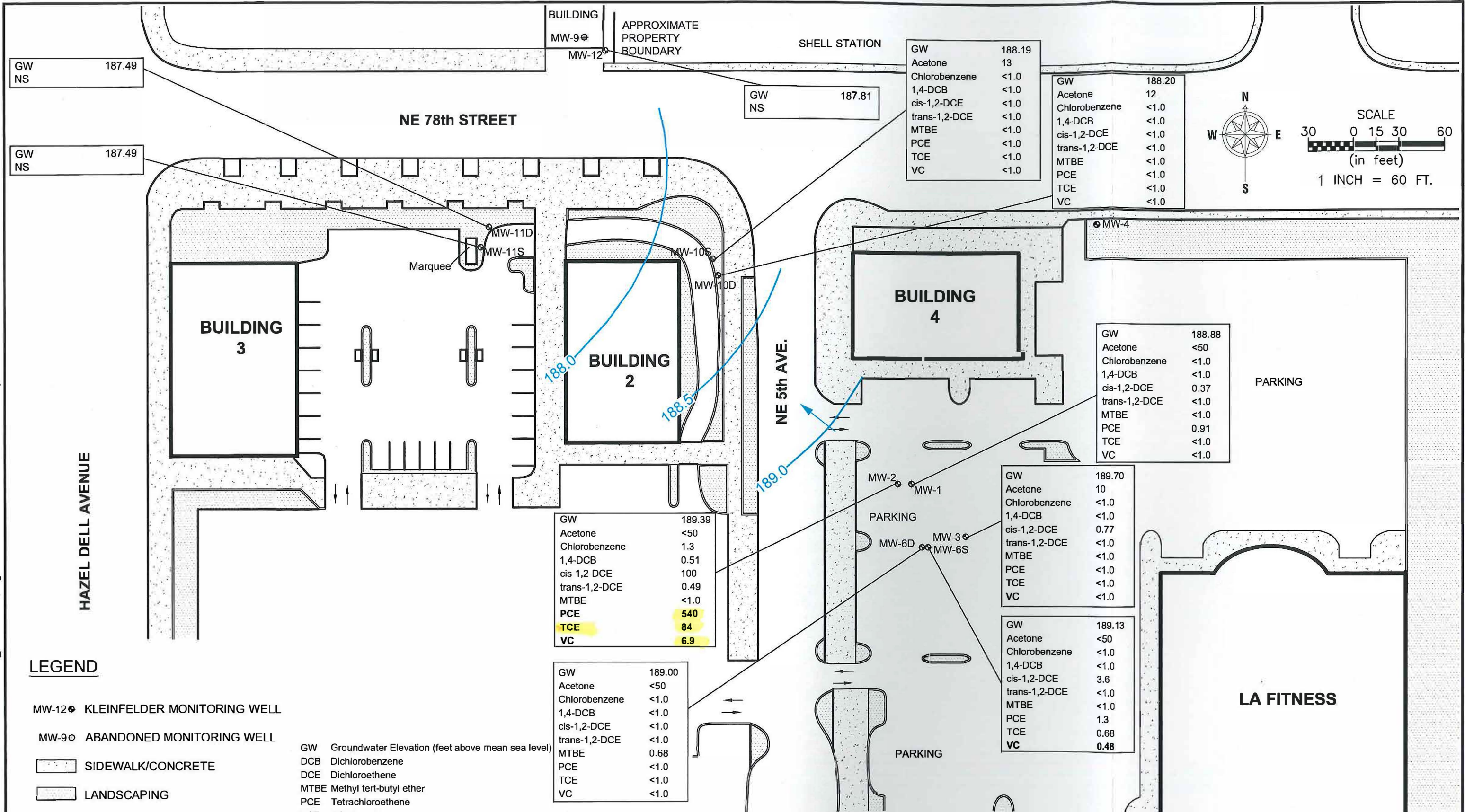

**LEGEND**

- MW-12 KLEINFELDER MONITORING WELL
- MW-9 ABANDONED MONITORING WELL
- SIDEWALK/CONCRETE
- LANDSCAPING
- PROPERTY BOUNDARY
- BUILDING OUTLINE
- GROUNDWATER ELEVATION CONTOURS AND FLOW DIRECTION
- NS NOT SAMPLED

GW Groundwater Elevation (feet above mean sea level)  
 DCB Dichlorobenzene  
 DCE Dichloroethene  
 MTBE Methyl tert-butyl ether  
 PCE Tetrachloroethene  
 TCE Trichloroethene  
 VC Vinyl chloride

**BOLD** Indicates the concentration exceeds the Method A cleanup level.

Concentrations in micrograms per liter (µg/L)

Note: Monitoring wells MW1, MW6D, MW10D, and MW11D not included in contouring  
 Monitoring well MW9 was decommissioned in place during site development.

GW	189.39
Acetone	<50
Chlorobenzene	1.3
1,4-DCB	0.51
cis-1,2-DCE	100
trans-1,2-DCE	0.49
MTBE	<1.0
<b>PCE</b>	<b>540</b>
<b>TCE</b>	<b>84</b>
<b>VC</b>	<b>6.9</b>

GW	189.00
Acetone	<50
Chlorobenzene	<1.0
1,4-DCB	<1.0
cis-1,2-DCE	<1.0
trans-1,2-DCE	<1.0
MTBE	0.68
PCE	<1.0
TCE	<1.0
VC	<1.0

GW	188.19
Acetone	13
Chlorobenzene	<1.0
1,4-DCB	<1.0
cis-1,2-DCE	<1.0
trans-1,2-DCE	<1.0
MTBE	<1.0
PCE	<1.0
TCE	<1.0
VC	<1.0

GW	188.20
Acetone	12
Chlorobenzene	<1.0
1,4-DCB	<1.0
cis-1,2-DCE	<1.0
trans-1,2-DCE	<1.0
MTBE	<1.0
PCE	<1.0
TCE	<1.0
VC	<1.0

GW	188.88
Acetone	<50
Chlorobenzene	<1.0
1,4-DCB	<1.0
cis-1,2-DCE	0.37
trans-1,2-DCE	<1.0
MTBE	<1.0
PCE	0.91
TCE	<1.0
VC	<1.0

GW	189.70
Acetone	10
Chlorobenzene	<1.0
1,4-DCB	<1.0
cis-1,2-DCE	0.77
trans-1,2-DCE	<1.0
MTBE	<1.0
PCE	<1.0
TCE	<1.0
VC	<1.0

GW	189.13
Acetone	<50
Chlorobenzene	<1.0
1,4-DCB	<1.0
cis-1,2-DCE	3.6
trans-1,2-DCE	<1.0
MTBE	<1.0
PCE	1.3
TCE	0.68
<b>VC</b>	<b>0.48</b>

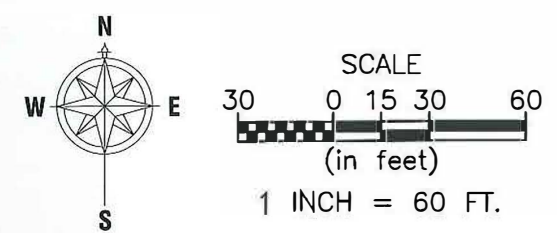

**Bright People. Right Solutions.**

PROJECT NO.	20150565	<b>FOURTH QUARTER 2014 GROUNDWATER CONTOURS AND SELECT SAMPLE RESULTS - NOVEMBER 19 &amp; 20, 2014</b>	SCALE	1"=60'	
DRAWN:	12/14		<b>HAZEL DELL SQUARE 501 NE 78th STREET VANCOUVER, WASHINGTON</b>	FIGURE	<b>2</b>
DRAWN BY:	JJS				
CHECKED BY:	RAK				
FILE NAME:	20150565_F2_Q414.DWG				