

River Run Center
600 East Riverpark Lane, Suite 210
Boise, Idaho 83706

Tel: (208) 336-1340
Fax: (208) 344-0825

www.browncaldwell.com

RECEIVED
DEPT. OF ECOLOGY/SW

'04 JUL 19 11:07

July 14, 2004

BROWN AND
CALDWELL

Mr. John Van Vlear, Esq., R.E.A.
Voss, Cook & Thel, LLP
895 Dove Street, Suite 450
Newport Beach, California

54-24716/002

Subject: Quarterly Groundwater Monitoring Update
Lakewood Towne Center
5731 Main Street SW
Lakewood, Washington

Dear Mr. Van Vlear:

This letter report summarizes quarterly groundwater monitoring and sampling activities performed at the above-referenced site. This work is done as part of the continuing evaluation of groundwater quality in response to elevated chlorinated solvent concentrations found in shallow groundwater.

Executive Summary

Low-level concentrations of various volatile organic compounds (VOCs) have been detected in both soil and groundwater at the Lakewood Towne Center (the Site). These VOCs apparently originated from current and historic operations of dry cleaning facilities on the Site.

Tetrachloroethylene or perchloroethylene (PCE) and its associated degradation products (trichloroethylene [TCE], *cis*-1,2-dichloroethylene [*cis*-1,2-DCE], *trans*-1,2-dichloroethylene [*trans*-1,2-DCE] and vinyl chloride) appear to be the main contaminants of concern (COC) at the Site. Reported concentrations of some COC in monitoring wells MW-1s, exceed established Washington Department of Ecology (DOE) Model Toxics Control Act (MTCA) Method A Cleanup Levels.

On October 30, 2003, Brown and Caldwell and their subcontractor completed installation of hydrogen release compound (HRC[®]) in exploratory boreholes at the Site to further promote the biodegradation of COC. Groundwater monitoring activities for the second quarter of 2004 were conducted on May 26, 2004 to evaluate Site groundwater quality. As is discussed below, reported concentrations for some PCE degradation products, which indicated increases in concentrations during the last quarterly sampling event (March 2004), have again begun to drop. This is likely due to continued biodegradation of PCE, enhanced by the addition

of HRC[®]. The reported concentration of PCE remained relatively stable in monitoring wells MW-1s, MW-3, MW-4 and MW-5.

Background

Herrera Environmental Consultants, Inc. (Herrera) initiated Site investigation activities at the Lakewood Towne Center located in Lakewood, Washington in the spring of 2000. Herrera performed a Phase I Environmental Site Assessment (ESA) in May 2000. Herrera also conducted Phase II ESA activities, which included collection of soil samples from soil borings, installation of seven groundwater monitoring wells (MW-1s, MW-1m, and MW-1d through MW-5) across the northwestern portion of the mall property, and quarterly groundwater monitoring. Groundwater monitoring well locations are indicated on Figure 1. Based on analytical results of samples collected during field investigations conducted by Herrera, PCE and its degradation by-products were detected in shallow groundwater in the northwestern portion of the Site. The source zone was identified as shallow groundwater near the former East Concourse building, which was occupied by a dry cleaning operation between 1968 and 1987. The groundwater monitoring well locations relative to the source area and sampling frequency are as follows:

- MW-1s (shallow) [quarterly], MW-1m (mid depth) [annually], MW-1d (deep) [annually] in the source area.
- MW-2d (deep) [quarterly] upgradient of the source area.
- MW-3 (shallow) [quarterly] at the northwest property boundary, (approximately 1,300 feet downgradient of the source area).
- MW-4 (shallow) [quarterly] immediately downgradient of the source area.
- MW-5 (shallow) [quarterly] immediately downgradient of the source area.

As reported in Herrera's most recent quarterly groundwater monitoring report (September 2003), laboratory data indicate residual concentrations of PCE and PCE degradation by-products in the vicinity of monitoring wells MW-1s and MW-4.

Hydrogen Release Compound Installation

On October 30, 2003, Brown and Caldwell and their subcontractor, Cascade Drilling of Woodinville, Washington mobilized to the Site to inject HRC[®] into the subsurface to assist biodegradation of residual groundwater contaminants in the vicinity of monitoring wells MW-1s and MW-4. Direct-push sampling equipment was used to install temporary boreholes at six locations hydraulically upgradient of monitoring wells MW-1s and MW-4. The amount of HRC[®] used in each borehole was determined using formulas supplied by the manufacturer.

Groundwater Monitoring

Depth to groundwater (DTG) was measured in monitoring wells MW-1s, and MW-2d, MW-3 through MW-5 on May 26, 2004, with an electronic water probe that can measure water levels to an accuracy of 0.01 foot. After measuring DTG, groundwater samples from monitoring wells MW-1s and MW-3 through MW-5 were collected for laboratory analysis using a low-flow purge method with dedicated polyethylene tubing and a peristaltic pump. As a quality control measure, a duplicate sample was collected from monitoring well MW-1s. The groundwater produced during purging was containerized in a 55-gallon drum for treatment and disposal at a later date. The groundwater samples were placed on ice and transported under chain-of-custody to North Creek Analytical (NCA) of Seattle, Washington for analysis of VOCs using U.S. Environmental Protection Agency (EPA) Method 8260B.

Analytical laboratory reports and chain-of-custody documents are attached. A groundwater elevation contour map is presented as Figure 1, and a summary of groundwater monitoring and analytical data is included in Table 1.

COC found at Lakewood Towne Center site since Site characterization began in the spring of 2000 include:

Abbreviated Notation	Chemical Name
PCE	tetrachloroethene or perchloroethene
TCE	trichloroethene
<i>cis</i> -1,2-DCE	<i>cis</i> -1,2-dichloroethene
<i>trans</i> -1,2- DCE	<i>trans</i> -1,2-dichloroethene
1,1-DCE	1,1-dichloroethene
1,1-DCA	1,1-dichloroethane
1,4-DCB	1,4-dichlorobenzene
VC	vinyl chloride
chloroform	chloroform

Compared to previous measurements collected in March 2004, groundwater elevations at the time of sampling increased by an average of 0.74 foot across the Site. For this sampling event, groundwater appears to migrate to the west/northwest with an approximate hydraulic gradient of 0.002 foot per foot (ft/ft). This flow direction and the observed hydraulic gradient are consistent with those observed during previous sampling events.

Groundwater Analytical Results

Analytical laboratory test results of the groundwater samples collected on May 26, 2004, indicated detectable concentrations of select VOC compounds in the four monitoring wells listed here with their detected COC; MW-1s (PCE, TCE, *cis*-1,2-DCE, *trans*-1,2-DCE, and vinyl chloride [VC]); MW-3 (PCE and *cis*-1,2-DCE), MW-4 (PCE, TCE, and *cis*-1,2-DCE); and MW-5 (PCE). The reported concentrations of PCE and VC in the sample from monitoring well MW-1s exceed the MTCA Method A Cleanup Levels. The Washington Administrative Code

Mr. John Van Vlear
July 14, 2004
Page 4

(WAC) does not designate Method A Cleanup Levels for some COC present in site groundwater, including *cis*-1,2-DCE and *trans*-1,2-DCE. Modified MTCA Method B Cleanup Levels may need to be determined for site groundwater (WAC 173-340-720 through 173-340-760).

In comparison to the last quarterly groundwater monitoring event, reported concentrations for some PCE degradation products which indicated increases in concentrations during the last quarterly sampling event, have again begun to drop (e.g., *cis*-1,2-DCE and VC in monitoring well MW-1s and TCE and *cis*-1,2-DCE in monitoring well MW-4). This is likely due to continued biodegradation of PCE, enhanced by the addition of HRC[®]. The reported concentration of PCE remained relatively stable in monitoring wells MW-1s, MW-3, MW-4 and MW-5.

We appreciate the opportunity to be of continued service to Voss, Cook and Thel, LLP and MBK Northwest, Inc. The next sampling event is scheduled for August 2004. If you have any questions, please feel free to contact our office at your convenience.

Very truly yours,

BROWN AND CALDWELL

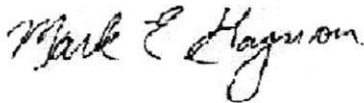

Mark E. Gagnon
Project Manager



Dale A. Kerner, L.G.
Staff Scientist

MEG:DAK:kw
Attachments

cc: Ms. Dawn Baerlocher, MBK Northwest
Mr. David Moore, MBK Northwest
Mr. Chuck Cline, Washington Department of Ecology

Table 1. Summary of Groundwater Monitoring Data, Lakewood Towne Center, Lakewood, Washington

Well Identification (TOC elevation) ²	Date Sampled	µg/l										Chloro- form	DTW ¹⁰ (BTOC ft ¹¹)	WTE ¹² (ft)
		PCE ³	TCE ⁴	cis-1,2- DCE ⁵	trans- 1,2- DCE ⁶	1,1- DCE ⁷	1,1- DCA ⁸	Vinyl chloride	1,4- DCB ⁹					
MW-1s (93.33) Sampled Quarterly	9/15/00	2.2	19	670	14	0.76	6.1	52	0.25	1.3	12.32	81.01		
	2/12/01	1.2	15	390	8.2	0.37	3.1	47	(0.20) ¹³	(0.20)	11.00	82.33		
	5/17/01	2.3	18	600	10	0.64	5.5	41	0.30	(0.20)	10.91	82.42		
	8/15/01	1.7	14	490	8.3	0.56	4.2	40	(0.20)	(0.20)	12.28	81.05		
	11/15/01	0.51	9.1	320	6.4	0.47	2.3	59	0.21	(0.20)	10.62	82.71		
	2/20/02	37	68	540	7.2	0.83	3.1	28	0.35	(0.20)	9.82	83.51		
	5/20/02	18	37	520	8.3	0.61	2.3	25	0.32	(0.20)	10.40	82.93		
	8/19/02	5.5	16	540	7.3	(2.0)	(2.0)	31	(2.0)	(2.0)	11.76	81.57		
	11/20/02	2.8	17	330	8.5	1.0	(0.20)	58	(0.20)	(0.20)	12.54	80.79		
	2/20/03	5.8	18	290	3.6	(2.0)	(2.0)	22	(2.0)	(2.0)	9.82 ¹⁵	83.51		
	5/21/03	10	28	470	6.7	0.55	(0.20)	24	0.23	(0.20)	10.68 ¹⁵	82.65		
	8/21/03	7.1	20	400	6.6	(2.0)	(2.0)	24	(2.0)	(2.0)	12.40 ¹⁵	80.93		
	11/26/03	(5.0)	13.2	212	(5.0)	(5.0)	(5.0)	30.1	(5.0)	(5.0)	11.12	82.21		
	3/3/04	1.36	6.26	420 ¹⁴	6.77	(1.0)	1.44	91.8 ¹⁴	(1.0)	(1.0)	10.22	83.11		
	5/26/04	2.12	6.68	314 ¹⁴	6.04	(2.0)	(2.0)	63.0 ¹⁴	(2.0)	(2.0)	11.04	82.29		
	5/26/04	1.84	6.09	311 ¹⁴	3.45	(1.0)	(1.0)	61.5 ¹⁴	(1.0)	(1.0)	--	--		
MW-1m (93.39) Sampled Annually	7/21/00	0.80	0.45	5.0	(0.20)	(0.20)	(0.20)	(0.20)	(0.20)	(0.20)	11.44	81.95		
	11/15/01	0.87	(0.20)	0.95	(0.20)	(0.20)	(0.20)	(0.20)	(0.20)	(0.20)	10.68	82.71		
	11/20/02	0.69	0.24	0.93	(0.20)	(0.20)	(0.20)	(0.20)	(0.20)	(0.20)	12.63	80.76		
	11/26/03	1.91	0.520	2.74	(0.20)	(0.20)	(0.20)	(0.20)	(0.20)	(0.20)	11.19	82.20		
	3/3/04	NS ¹⁶	NS	NS	NS	NS	NS	NS	NS	NS	NM ¹⁷	NM		
5/26/04	NS ¹⁶	NS	NS	NS	NS	NS	NS	NS	NS	11.13	93.39			
MW-1d (93.56) Sampled Annually	7/21/00	0.50	(0.20)	0.29	(0.20)	(0.20)	(0.20)	(0.20)	(0.20)	(0.20)	11.63	81.93		
	11/15/01	0.64	(0.20)	(0.20)	(0.20)	(0.20)	(0.20)	(0.20)	(0.20)	(0.20)	10.85	82.71		
	11/20/02	0.52	(0.20)	(0.20)	(0.20)	(0.20)	(0.20)	(0.20)	(0.20)	(0.20)	12.80	80.76		
	11/26/03	0.70	(0.20)	(0.20)	(0.20)	(0.20)	(0.20)	(0.20)	(0.20)	(0.20)	11.39	82.17		
3/3/04	NS	NS	NS	NS	NS	NS	NS	NS	NS	11.29	82.27			

Table 1. Summary of Groundwater Monitoring Data, Lakewood Towne Center, Lakewood, Washington

Well Identification (TOC elevation) ²	Date Sampled	µg/l										DTW ¹⁰ (BTOC ft ¹¹)	WTE ¹² (ft)		
		PCE ³	TCE ⁴	cis-1,2- DCE ⁵	trans- 1,2- DCE ⁶	1,1- DCE ⁷	1,1- DCA ⁸	Vinyl chloride	1,4- DCB ⁹	Chloro- form					
MW-2d (92.20) Sampled Annually	7/21/00	0.73	(0.20)	(0.20)	(0.20)	(0.20)	(0.20)	(0.20)	(0.20)	(0.20)	(0.20)	(0.20)	(0.20)	10.64	81.56
	11/16/01	1.2	(0.20)	(0.20)	(0.20)	(0.20)	(0.20)	(0.20)	(0.20)	(0.20)	(0.20)	(0.20)	(0.20)	9.22	82.98
	11/21/02	1.2	(0.20)	(0.20)	(0.20)	(0.20)	(0.20)	(0.20)	(0.20)	(0.20)	(0.20)	(0.20)	(0.20)	11.26	80.94
	11/26/03	(0.20)	(0.20)	(0.20)	(0.20)	(0.20)	(0.20)	(0.20)	(0.20)	(0.20)	(0.20)	(0.20)	(0.20)	9.65	82.55
	3/3/04	NS	NS	NS	NS	NS	NS	NS	NS	NS	NS	NS	NS	NM	NM
	5/26/04	NS	NS	NS	NS	NS	NS	NS	NS	NS	NS	NS	NS	9.62	82.58
MW-3 (97.06) Sampled Quarterly	7/21/00	0.69	(0.20)	1.1	(0.20)	(0.20)	(0.20)	(0.20)	(0.20)	(0.20)	(0.20)	(0.20)	(0.20)	17.09	79.97
	2/12/01	0.66	(0.20)	0.23	(0.20)	(0.20)	(0.20)	(0.20)	(0.20)	(0.20)	(0.20)	(0.20)	(0.20)	16.79	80.27
	5/17/01	0.64	(0.20)	1.3	(0.20)	(0.20)	(0.20)	(0.20)	(0.20)	(0.20)	(0.20)	(0.20)	(0.20)	16.76	80.30
	8/15/01	0.66	(0.20)	0.88	(0.20)	(0.20)	(0.20)	(0.20)	(0.20)	(0.20)	(0.20)	(0.20)	(0.20)	17.67	79.39
	11/15/01	0.57	(0.20)	0.73	(0.20)	(0.20)	(0.20)	(0.20)	(0.20)	(0.20)	(0.20)	(0.20)	(0.20)	16.39	80.67
	2/20/02	0.66	0.31	1.3	(0.20)	(0.20)	(0.20)	(0.20)	(0.20)	(0.20)	(0.20)	(0.20)	(0.20)	16.00	81.06
	5/20/02	0.52	(0.20)	0.93	(0.20)	(0.20)	(0.20)	(0.20)	(0.20)	(0.20)	(0.20)	(0.20)	(0.20)	16.38	80.68
	8/19/02	0.57	(0.20)	0.79	(0.20)	(0.20)	(0.20)	(0.20)	(0.20)	(0.20)	(0.20)	(0.20)	(0.20)	17.33	79.73
	11/20/02	0.57	(0.20)	0.84	(0.20)	(0.20)	(0.20)	(0.20)	(0.20)	(0.20)	(0.20)	(0.20)	(0.20)	17.91	79.15
	2/20/03	0.68	(0.20)	1.1	(0.20)	(0.20)	(0.20)	(0.20)	(0.20)	(0.20)	(0.20)	(0.20)	(0.20)	16.00 ¹⁵	81.06
	5/21/03	0.50	(0.20)	0.91	(0.20)	(0.20)	(0.20)	(0.20)	(0.20)	(0.20)	(0.20)	(0.20)	(0.20)	16.59 ¹⁵	80.47
	8/21/03	0.54	(0.20)	0.69	(0.20)	(0.20)	(0.20)	(0.20)	(0.20)	(0.20)	(0.20)	(0.20)	(0.20)	17.75 ¹⁵	79.31
	11/26/03	0.87	(0.20)	1.05	(0.20)	(0.20)	(0.20)	(0.20)	(0.20)	(0.20)	(0.20)	(0.20)	(0.20)	17.23	79.83
	3/3/04	0.60	(0.2)	1.03	(0.20)	(0.20)	(0.20)	(0.20)	(0.20)	(0.20)	(0.20)	(0.20)	(0.20)	16.20	80.86
	5/26/04	0.580	(0.20)	0.670	(0.20)	(0.20)	(0.20)	(0.20)	(0.20)	(0.20)	(0.20)	(0.20)	(0.20)	16.82	80.24
MW-4 (94.82) Sampled Quarterly	9/15/00	1.6	4.9	120	2.8	(0.20)	(0.20)	(0.20)	(0.20)	(0.20)	(0.20)	(0.20)	(0.20)	13.92	80.90
	2/12/01	1.0	2.3	48	0.90	(0.20)	(0.20)	(0.20)	(0.20)	(0.20)	(0.20)	(0.20)	(0.20)	12.61	82.21
	5/17/01	1.0	3.4	100	1.6	(0.20)	(0.20)	(0.20)	(0.20)	(0.20)	(0.20)	(0.20)	(0.20)	12.50	82.32
	8/15/01	0.97	2.9	70	1.1	(0.20)	(0.20)	(0.20)	(0.20)	(0.20)	(0.20)	(0.20)	(0.20)	13.86	80.96
	11/15/01	0.99	1.6	35	0.57	(0.20)	(0.20)	(0.20)	(0.20)	(0.20)	(0.20)	(0.20)	(0.20)	12.22	82.60
	2/20/02	9.8	18	110	1.3	(0.20)	(0.20)	(0.20)	(0.20)	(0.20)	(0.20)	(0.20)	(0.20)	11.46	83.36
	5/20/02	3.8	6.6	65	0.90	(0.20)	(0.20)	(0.20)	(0.20)	(0.20)	(0.20)	(0.20)	(0.20)	12.03	82.79

Table 1. Summary of Groundwater Monitoring Data, Lakewood Towne Center, Lakewood, Washington

Well Identification (TOC elevation) ²	Date Sampled	µg/l ¹										DTW ¹⁰ (BTOC ft ¹¹)	WTE ¹² (ft)			
		PCE ³	TCE ⁴	<i>cis</i> -1,2- DCE ⁵	<i>trans</i> - 1,2- DCE ⁶	1,1- DCE ⁷	1,1- DCA ⁸	Vinyl chloride	1,4- DCB ⁹	Chloro- form						
MW-4 (94.82) (cont'd)	8/19/02	2.4	4.2	77	1.7	(0.40)	(0.40)	(0.40)	(0.40)	(0.40)	(0.40)	(0.40)	(0.40)	13.35	81.47	
	11/21/02	1.6	3.7	38	0.99	(0.20)	(0.20)	(0.20)	(0.20)	(0.20)	(0.20)	(0.20)	(0.20)	14.23	80.59	
	2/20/03	1.5	3.1	36	0.48	(0.20)	(0.20)	(0.20)	(0.20)	(0.20)	(0.20)	(0.20)	(0.20)	11.46 ¹⁵	83.36	
	5/21/03	2.4	4.7	65	0.97	(0.20)	(0.20)	(0.20)	(0.20)	(0.20)	(0.20)	(0.20)	(0.20)	12.29 ¹⁵	82.53	
	8/21/03	1.8	3.8	54	0.78	(1.0)	(1.0)	(1.0)	(1.0)	(1.0)	(1.0)	(1.0)	(1.0)	13.95 ¹⁵	80.87	
	11/26/03	1.73	2.0	24.8	(1.0)	(0.20)	(0.20)	(0.20)	(0.20)	(0.20)	(0.20)	(0.20)	(0.20)	12.72	82.10	
	3/3/04	2.09	4.07	75.0 ¹⁴	0.880	(0.20)	(0.20)	(0.20)	(0.20)	(0.20)	(0.20)	(0.20)	(0.20)	11.80	83.02	
	5/26/04	1.76	2.55	42.1	(1.0)	(1.0)	(1.0)	(1.0)	(1.0)	(1.0)	(1.0)	(1.0)	(1.0)	12.59	82.23	
	MW-5 (94.37) Sampled Quarterly	9/15/00	1.2	(0.20)	(0.20)	(0.20)	(0.20)	(0.20)	(0.20)	(0.20)	(0.20)	(0.20)	(0.20)	(0.20)	13.52	80.85
		2/12/01	0.70	(0.20)	(0.20)	(0.20)	(0.20)	(0.20)	(0.20)	(0.20)	(0.20)	(0.20)	(0.20)	(0.20)	12.24	82.13
5/17/01		0.62	(0.20)	(0.20)	(0.20)	(0.20)	(0.20)	(0.20)	(0.20)	(0.20)	(0.20)	(0.20)	(0.20)	12.13	82.24	
8/15/01		0.88	(0.20)	(0.20)	(0.20)	(0.20)	(0.20)	(0.20)	(0.20)	(0.20)	(0.20)	(0.20)	(0.20)	13.43	80.94	
11/15/01		0.90	(0.20)	(0.20)	(0.20)	(0.20)	(0.20)	(0.20)	(0.20)	(0.20)	(0.20)	(0.20)	(0.20)	11.88	82.49	
2/20/02		0.44	(0.20)	(0.20)	(0.20)	(0.20)	(0.20)	(0.20)	(0.20)	(0.20)	(0.20)	(0.20)	(0.20)	11.10	83.27	
5/20/02		0.39	(0.20)	(0.20)	(0.20)	(0.20)	(0.20)	(0.20)	(0.20)	(0.20)	(0.20)	(0.20)	(0.20)	11.65	82.72	
8/19/02		0.71	(0.20)	(0.20)	(0.20)	(0.20)	(0.20)	(0.20)	(0.20)	(0.20)	(0.20)	(0.20)	(0.20)	12.98	81.39	
11/21/02		0.86	(0.20)	(0.20)	(0.20)	(0.20)	(0.20)	(0.20)	(0.20)	(0.20)	(0.20)	(0.20)	(0.20)	13.76	80.61	
2/20/03		0.62	(0.20)	(0.20)	(0.20)	(0.20)	(0.20)	(0.20)	(0.20)	(0.20)	(0.20)	(0.20)	(0.20)	11.10 ¹⁵	83.27	
MW-6	5/21/03	0.52	(0.20)	(0.20)	(0.20)	(0.20)	(0.20)	(0.20)	(0.20)	(0.20)	(0.20)	(0.20)	(0.20)	11.93 ¹⁵	82.44	
	8/21/03	0.89	(0.20)	(0.20)	(0.20)	(0.20)	(0.20)	(0.20)	(0.20)	(0.20)	(0.20)	(0.20)	(0.20)	13.61 ¹⁵	80.76	
	11/26/03	0.94	(0.20)	(0.20)	(0.20)	(0.20)	(0.20)	(0.20)	(0.20)	(0.20)	(0.20)	(0.20)	(0.20)	12.34	82.03	
	3/3/04	0.550	(0.20)	(0.20)	(0.20)	(0.20)	(0.20)	(0.20)	(0.20)	(0.20)	(0.20)	(0.20)	(0.20)	11.51	82.86	
	5/26/04	0.680	(0.20)	(0.20)	(0.20)	(0.20)	(0.20)	(0.20)	(0.20)	(0.20)	(0.20)	(0.20)	(0.20)	12.23	82.14	
	5/20/02	(0.20)	(0.20)	(0.20)	(0.20)	(0.20)	(0.20)	(0.20)	(0.20)	(0.20)	(0.20)	(0.20)	(0.20)	--	--	
8/19/02	(0.20)	(0.20)	(0.20)	(0.20)	(0.20)	(0.20)	(0.20)	(0.20)	(0.20)	(0.20)	(0.20)	(0.20)	--	--		
11/20/02	(0.20)	(0.20)	(0.20)	(0.20)	(0.20)	(0.20)	(0.20)	(0.20)	(0.20)	(0.20)	(0.20)	(0.20)	--	--		
2/20/03	(0.20)	(0.20)	(0.20)	(0.20)	(0.20)	(0.20)	(0.20)	(0.20)	(0.20)	(0.20)	(0.20)	(0.20)	--	--		

Table 1. Summary of Groundwater Monitoring Data, Lakewood Towne Center, Lakewood, Washington

Well Identification (TOC elevation) ²	Date Sampled	µg/l ¹										DTW ¹⁰ (BTOC ft ¹¹)	WTE ¹² (ft)		
		PCE ³	TCE ⁴	cis-1,2-DCE ⁵	trans-1,2-DCE ⁶	1,1-DCE ⁷	1,1-DCA ⁸	Vinyl chloride	1,4- DCB ⁹	Chloro- form					
MW-6 (cont'd)	11/26/03	NS	NS	NS	NS	NS	NS	NS	NS	NS	NS	NS	NS	--	--
	3/3/04	NS	NS	NS	NS	NS	NS	NS	NS	NS	NS	NS	NS	--	--
MTCA Method A Cleanup Level¹⁸	5/26/04	NS	NS	NS	NS	NS	NS	NS	NS	NS	NS	NS	NS	--	--
	5	5	5	na ²⁰	na	na	na	na	na	na	0.2	na	na	--	--

Values in **boldface** type indicate constituent detected above the established MTCA method A or method B groundwater cleanup level.

Shaded values represent results of the most recent sampling event.

¹ µg/l - micrograms per liter.

² Monitoring well location shown on Figure 1, top of casing elevation relative to local benchmark.

³ PCE - Perchloroethylene.

⁴ TCE - trichloroethene.

⁵ cis-1,2-DCE - cis-1,2-dichloroethene.

⁶ trans-1,2-DCE - trans-1,2-dichloroethene.

⁷ 1,1-DCE - 1,1-dichloroethene.

⁸ 1,1-DCA - 1,1-dichloroethane.

⁹ 1,4-DCB - 1,4-dichlorobenzene.

¹⁰ DTW - depth to water.

¹¹ BTOC - below top of casing in feet.

¹² WTE - water table elevation.

¹³ A (0.20) indicates the value reported was the laboratory Method Detection Limit. Concentrations, if present, below this were not quantifiable.

¹⁴ The reported value was determined on a second, higher dilution analyses. Initial analyses reported concentrations outside the laboratory range for the compound.

¹⁵ DTW data back calculated from Herrera WTE data in historic quarterly groundwater reports.

¹⁶ NS - not sampled.

¹⁷ NM - not measured.

¹⁸ Method A Model Toxics Control Act Cleanup Regulation (WAC 173-340-900; Table 720-1).

¹⁹ na - Established groundwater cleanup level for this constituent is not available.

100TH ST. WEST

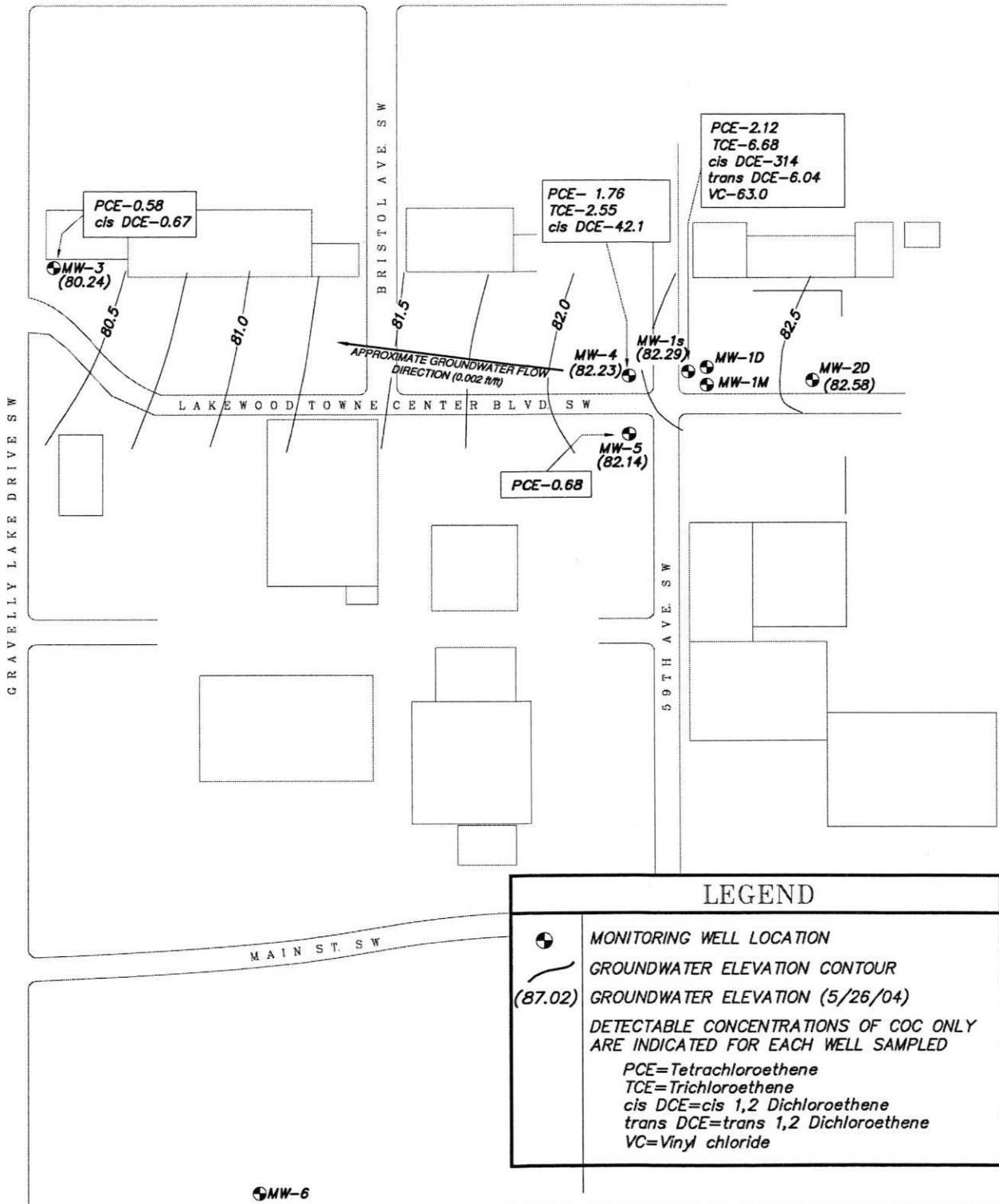

LEGEND

- MONITORING WELL LOCATION
- GROUNDWATER ELEVATION CONTOUR
- GROUNDWATER ELEVATION (5/26/04)
- DETECTABLE CONCENTRATIONS OF COC ONLY ARE INDICATED FOR EACH WELL SAMPLED
- PCE=Tetrachloroethene
- TCE=Trichloroethene
- cis DCE=cis 1,2 Dichloroethene
- trans DCE=trans 1,2 Dichloroethene
- VC=Vinyl chloride

BROWN AND CALDWELL
Boise, Idaho

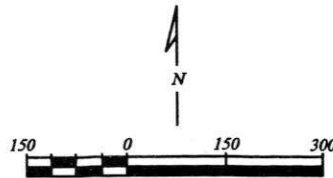

FIGURE 1
GROUNDWATER CONTOUR MAP

LAKWOOD TOWNE CENTER
LAKEWOOD, WASHINGTON

ATTACHMENT A
LABORATORY REPORTS



Seattle 11720 North Creek Pkwy N, Suite 400, Bothell, WA 98011-8244
425.420.9200 fax 425.420.9210
Spokane East 11115 Montgomery, Suite B, Spokane, WA 99206-4776
509.924.9200 fax 509.924.9290
Portland 9405 SW Nimbus Avenue, Beaverton, OR 97008-7132
503.906.9200 fax 503.906.9210
Bend 20332 Empire Avenue, Suite F-1, Bend, OR 97701-5711
541.383.9310 fax 541.382.7588
Anchorage 2000 W. International Airport Road, Suite A10, Anchorage, AK 99502-1119
907.563.9200 fax 907.563.9210

Amended Report for B4E0730

Client: Brown and Caldwell
Project Manager: Dale Kerner
Project Name: Lakewood Towne Center
Original report Date: June 10, 2004

This amended report is being issued due to error(s) in the original report you received.

Amendment(s) from the original report include:

1) Samples, MW 1-S Lakewood Towne Center and Duplicate Lakewood Towne Center, were originally analyzed at a 10x dilution due to high analyte concentrations. Dilutions of samples are performed to prevent carry-over to other samples and to prevent contamination of the instrument. The samples were re-analyzed per request from the client at the lowest dilution possible. MW1-S was re-analyzed on June 11, 2004 and sample Duplicate was re-analyzed on June 16, 2004. Both sets of data are included in the amended report.

No other information included in the original report has changed.

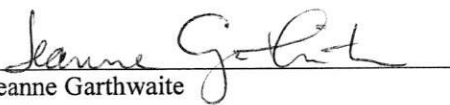
Jeanne Garthwaite
Project Manager
North Creek Analytical



Seattle 11720 North Creek Pkwy N, Suite 400, Bothell, WA 98011-8244
 425.420.9200 fax 425.420.9210
 Spokane 11922 E. 1st Avenue, Spokane Valley, WA 99206-5302
 509.924.9200 fax 509.924.9290
 Portland 9405 SW Nimbus Avenue, Beaverton, OR 97008-7132
 503.906.9200 fax 503.906.9210
 Bend 20332 Empire Avenue, Suite F-1, Bend, OR 97701-5711
 541.383.9310 fax 541.382.7588
 Anchorage 2000 W. International Airport Road, Suite A10, Anchorage, AK 99502-1119
 907.563.9200 fax 907.563.9210

Brown & Caldwell
 600 E. Riverpark Suite 210
 Boise, ID/USA 83706

Project: Lakewood Towne Center
 Project Number: 24716.002
 Project Manager: Dale Kerner

Amended Report
 Issued: 06/22/04 15:48

ANALYTICAL REPORT FOR SAMPLES - Amended

Sample ID	Laboratory ID	Matrix	Date Sampled	Date Received
MW 1-S LAKEWOOD TOWNE CENTER	B4E0730-01	Water	05/26/04 13:30	05/26/04 15:56
MW 3 LAKEWOOD TOWNE CENTER	B4E0730-02	Water	05/26/04 11:45	05/26/04 15:56
MW 4 LAKEWOOD TOWNE CENTER	B4E0730-03	Water	05/26/04 13:00	05/26/04 15:56
MW 5 LAKEWOOD TOWNE CENTER	B4E0730-04	Water	05/26/04 12:20	05/26/04 15:56
DUPLICATE LAKEWOOD TOWNE CENTER	B4E0730-05	Water	05/26/04 12:00	05/26/04 15:56
Trip blank	B4E0730-06	Water	05/26/04 12:00	05/26/04 15:56

North Creek Analytical - Bothell

The results in this report apply to the samples analyzed in accordance with the chain of custody document. This analytical report must be reproduced in its entirety.

Jeanne Garthwaite, Project Manager

North Creek Analytical, Inc.
 Environmental Laboratory Network



Seattle 11720 North Creek Pkwy N, Suite 400, Bothell, WA 98011-8244
 425.420.9200 fax 425.420.9210
 Spokane 11922 E. 1st Avenue, Spokane Valley, WA 99206-5302
 509.924.9200 fax 509.924.9290
 Portland 9405 SW Nimbus Avenue, Beaverton, OR 97008-7132
 503.906.9200 fax 503.906.9210
 Bend 20332 Empire Avenue, Suite F-1, Bend, OR 97701-5711
 541.383.9310 fax 541.382.7588
 Anchorage 2000 W. International Airport Road, Suite A10, Anchorage, AK 99502-1119
 907.563.9200 fax 907.563.9210

Brown & Caldwell
 600 E. Riverpark Suite 210
 Boise, ID/USA 83706

Project: Lakewood Towne Center
 Project Number: 24716.002
 Project Manager: Dale Kerner

Amended Report
 Issued: 06/22/04 15:48

Volatile Organic Compounds by EPA Method 8260B
North Creek Analytical - Bothell

Analyte	Result	Reporting Limit	Units	Dilution	Batch	Prepared	Analyzed	Method	Notes
MW 1-S LAKEWOOD TOWNE CENTER (B4E0730-01) Water Sampled: 05/26/04 13:30 Received: 05/26/04 15:56									
Acetone	ND	200	ug/l	10	4E28033	05/28/04	05/28/04	EPA 8260B	
Benzene	ND	10.0	"	"	"	"	"	"	
Bromobenzene	ND	10.0	"	"	"	"	"	"	
Bromochloromethane	ND	10.0	"	"	"	"	"	"	
Bromodichloromethane	ND	10.0	"	"	"	"	"	"	
Bromoform	ND	10.0	"	"	"	"	"	"	
Bromomethane	ND	20.0	"	"	"	"	"	"	
2-Butanone	ND	100	"	"	"	"	"	"	
n-Butylbenzene	ND	10.0	"	"	"	"	"	"	
sec-Butylbenzene	ND	10.0	"	"	"	"	"	"	
tert-Butylbenzene	ND	10.0	"	"	"	"	"	"	
Carbon disulfide	ND	10.0	"	"	"	"	"	"	
Carbon tetrachloride	ND	10.0	"	"	"	"	"	"	
Chlorobenzene	ND	10.0	"	"	"	"	"	"	
Chloroethane	ND	10.0	"	"	"	"	"	"	
Chloroform	ND	10.0	"	"	"	"	"	"	
Chloromethane	ND	50.0	"	"	"	"	"	"	
2-Chlorotoluene	ND	10.0	"	"	"	"	"	"	
4-Chlorotoluene	ND	10.0	"	"	"	"	"	"	
Dibromochloromethane	ND	10.0	"	"	"	"	"	"	
1,2-Dibromo-3-chloropropane	ND	50.0	"	"	"	"	"	"	
1,2-Dibromoethane	ND	10.0	"	"	"	"	"	"	
Dibromomethane	ND	10.0	"	"	"	"	"	"	
1,2-Dichlorobenzene	ND	10.0	"	"	"	"	"	"	
1,3-Dichlorobenzene	ND	10.0	"	"	"	"	"	"	
1,4-Dichlorobenzene	ND	10.0	"	"	"	"	"	"	
Dichlorodifluoromethane	ND	10.0	"	"	"	"	"	"	
1,1-Dichloroethane	ND	10.0	"	"	"	"	"	"	
1,2-Dichloroethane	ND	10.0	"	"	"	"	"	"	
1,1-Dichloroethene	ND	10.0	"	"	"	"	"	"	
cis-1,2-Dichloroethene	314	10.0	"	"	"	"	"	"	
trans-1,2-Dichloroethene	ND	10.0	"	"	"	"	"	"	
1,2-Dichloropropane	ND	10.0	"	"	"	"	"	"	
1,3-Dichloropropane	ND	10.0	"	"	"	"	"	"	
2,2-Dichloropropane	ND	10.0	"	"	"	"	"	"	

North Creek Analytical - Bothell

The results in this report apply to the samples analyzed in accordance with the chain of custody document. This analytical report must be reproduced in its entirety.

Jeanne Garthwaite

Jeanne Garthwaite, Project Manager

North Creek Analytical, Inc.
 Environmental Laboratory Network



Seattle 11720 North Creek Pkwy N, Suite 400, Bothell, WA 98011-8244
 425.420.9200 fax 425.420.9210
 Spokane 11922 E. 1st Avenue, Spokane Valley, WA 99206-5302
 509.924.9200 fax 509.924.9290
 Portland 9405 SW Nimbus Avenue, Beaverton, OR 97008-7132
 503.906.9200 fax 503.906.9210
 Bend 20332 Empire Avenue, Suite F-1, Bend, OR 97701-5711
 541.383.9310 fax 541.382.7588
 Anchorage 2000 W. International Airport Road, Suite A10, Anchorage, AK 99502-1119
 907.563.9200 fax 907.563.9210

Brown & Caldwell
 600 E. Riverpark Suite 210
 Boise, ID/USA 83706

Project: Lakewood Towne Center
 Project Number: 24716.002
 Project Manager: Dale Kerner

Amended Report
 Issued: 06/22/04 15:48

Volatile Organic Compounds by EPA Method 8260B
North Creek Analytical - Bothell

Analyte	Result	Reporting Limit	Units	Dilution	Batch	Prepared	Analyzed	Method	Notes
MW 1-S LAKEWOOD TOWNE CENTER (B4E0730-01) Water Sampled: 05/26/04 13:30 Received: 05/26/04 15:56									
1,1-Dichloropropene	ND	10.0	ug/l	10	4E28033	05/28/04	05/28/04	"	
cis-1,3-Dichloropropene	ND	10.0	"	"	"	"	"	"	
trans-1,3-Dichloropropene	ND	10.0	"	"	"	"	"	"	
Ethylbenzene	ND	10.0	"	"	"	"	"	"	
Hexachlorobutadiene	ND	10.0	"	"	"	"	"	"	
2-Hexanone	ND	100	"	"	"	"	"	"	
Isopropylbenzene	ND	10.0	"	"	"	"	"	"	
p-Isopropyltoluene	ND	10.0	"	"	"	"	"	"	
4-Methyl-2-pentanone	ND	100	"	"	"	"	"	"	
Methylene chloride	ND	50.0	"	"	"	"	"	"	
Naphthalene	ND	10.0	"	"	"	"	"	"	
n-Propylbenzene	ND	10.0	"	"	"	"	"	"	
Styrene	ND	10.0	"	"	"	"	"	"	
1,2,3-Trichlorobenzene	ND	10.0	"	"	"	"	"	"	
1,2,4-Trichlorobenzene	ND	10.0	"	"	"	"	"	"	
1,1,1,2-Tetrachloroethane	ND	10.0	"	"	"	"	"	"	
1,1,2,2-Tetrachloroethane	ND	10.0	"	"	"	"	"	"	
Tetrachloroethene	ND	10.0	"	"	"	"	"	"	
Toluene	ND	10.0	"	"	"	"	"	"	
1,1,1-Trichloroethane	ND	10.0	"	"	"	"	"	"	
1,1,2-Trichloroethane	ND	10.0	"	"	"	"	"	"	
Trichloroethene	ND	10.0	"	"	"	"	"	"	
Trichlorofluoromethane	ND	10.0	"	"	"	"	"	"	
1,2,3-Trichloropropane	ND	10.0	"	"	"	"	"	"	
1,2,4-Trimethylbenzene	ND	10.0	"	"	"	"	"	"	
1,3,5-Trimethylbenzene	ND	10.0	"	"	"	"	"	"	
Vinyl chloride	63.0	10.0	"	"	"	"	"	"	
o-Xylene	ND	10.0	"	"	"	"	"	"	
m,p-Xylene	ND	20.0	"	"	"	"	"	"	
Surrogate: 1,2-DCA-d4	83.0 %	70-130			"	"	"	"	
Surrogate: Toluene-d8	98.0 %	70-130			"	"	"	"	
Surrogate: 4-BFB	99.0 %	70-130			"	"	"	"	

North Creek Analytical - Bothell

The results in this report apply to the samples analyzed in accordance with the chain of custody document. This analytical report must be reproduced in its entirety.

Jeanne Garthwaite

Jeanne Garthwaite, Project Manager

North Creek Analytical, Inc.
 Environmental Laboratory Network

Page 3 of 37



Seattle 11720 North Creek Pkwy N, Suite 400, Bothell, WA 98011-8244
 425.420.9200 fax 425.420.9210
 Spokane 11922 E. 1st Avenue, Spokane Valley, WA 99206-5302
 509.924.9200 fax 509.924.9290
 Portland 9405 SW Nimbus Avenue, Beaverton, OR 97008-7132
 503.906.9200 fax 503.906.9210
 Bend 20332 Empire Avenue, Suite F-1, Bend, OR 97701-5711
 541.383.9310 fax 541.382.7588
 Anchorage 2000 W. International Airport Road, Suite A10, Anchorage, AK 99502-1119
 907.563.9200 fax 907.563.9210

Brown & Caldwell
 600 E. Riverpark Suite 210
 Boise, ID/USA 83706

Project: Lakewood Towne Center
 Project Number: 24716.002
 Project Manager: Dale Kerner

Amended Report
 Issued: 06/22/04 15:48

Volatile Organic Compounds by EPA Method 8260B
North Creek Analytical - Bothell

Analyte	Result	Reporting Limit	Units	Dilution	Batch	Prepared	Analyzed	Method	Notes
MW 1-S LAKEWOOD TOWNE CENTER (B4E0730-01RE1) Water Sampled: 05/26/04 13:30 Received: 05/26/04 15:56 I-02									
Acetone	ND	40.0	ug/l	2	4F10042	06/11/04	06/11/04	EPA 8260B	
Benzene	ND	2.00	"	"	"	"	"	"	
Bromobenzene	ND	2.00	"	"	"	"	"	"	
Bromochloromethane	ND	2.00	"	"	"	"	"	"	
Bromodichloromethane	ND	2.00	"	"	"	"	"	"	
Bromoform	ND	2.00	"	"	"	"	"	"	
Bromomethane	ND	4.00	"	"	"	"	"	"	
2-Butanone	ND	20.0	"	"	"	"	"	"	
n-Butylbenzene	ND	2.00	"	"	"	"	"	"	
sec-Butylbenzene	ND	2.00	"	"	"	"	"	"	
tert-Butylbenzene	ND	2.00	"	"	"	"	"	"	
Carbon disulfide	ND	2.00	"	"	"	"	"	"	
Carbon tetrachloride	ND	2.00	"	"	"	"	"	"	
Chlorobenzene	ND	2.00	"	"	"	"	"	"	
Chloroethane	ND	2.00	"	"	"	"	"	"	
Chloroform	ND	2.00	"	"	"	"	"	"	
Chloromethane	ND	10.0	"	"	"	"	"	"	
2-Chlorotoluene	ND	2.00	"	"	"	"	"	"	
4-Chlorotoluene	ND	2.00	"	"	"	"	"	"	
Dibromochloromethane	ND	2.00	"	"	"	"	"	"	
1,2-Dibromo-3-chloropropane	ND	10.0	"	"	"	"	"	"	
1,2-Dibromoethane	ND	2.00	"	"	"	"	"	"	
Dibromomethane	ND	2.00	"	"	"	"	"	"	
1,2-Dichlorobenzene	ND	2.00	"	"	"	"	"	"	
1,3-Dichlorobenzene	ND	2.00	"	"	"	"	"	"	
1,4-Dichlorobenzene	ND	2.00	"	"	"	"	"	"	
Dichlorodifluoromethane	ND	2.00	"	"	"	"	"	"	
1,1-Dichloroethane	ND	2.00	"	"	"	"	"	"	
1,2-Dichloroethane	ND	2.00	"	"	"	"	"	"	
1,1-Dichloroethene	ND	2.00	"	"	"	"	"	"	
cis-1,2-Dichloroethene	275	2.00	"	"	"	"	"	"	E
trans-1,2-Dichloroethene	6.04	2.00	"	"	"	"	"	"	
1,2-Dichloropropane	ND	2.00	"	"	"	"	"	"	
1,3-Dichloropropane	ND	2.00	"	"	"	"	"	"	
2,2-Dichloropropane	ND	2.00	"	"	"	"	"	"	

North Creek Analytical - Bothell

The results in this report apply to the samples analyzed in accordance with the chain of custody document. This analytical report must be reproduced in its entirety.

Jeanne Garthwaite, Project Manager

North Creek Analytical, Inc.
 Environmental Laboratory Network



Seattle 11720 North Creek Pkwy N, Suite 400, Bothell, WA 98011-8244
 425.420.9200 fax 425.420.9210
 Spokane 11922 E. 1st Avenue, Spokane Valley, WA 99206-5302
 509.924.9200 fax 509.924.9290
 Portland 9405 SW Nimbus Avenue, Beaverton, OR 97008-7132
 503.906.9200 fax 503.906.9210
 Bend 20332 Empire Avenue, Suite F-1, Bend, OR 97701-5711
 541.383.9310 fax 541.382.7588
 Anchorage 2000 W. International Airport Road, Suite A10, Anchorage, AK 99502-1119
 907.563.9200 fax 907.563.9210

Brown & Caldwell 600 E. Riverpark Suite 210 Boise, ID/USA 83706	Project: Lakewood Towne Center Project Number: 24716.002 Project Manager: Dale Kerner	Amended Report Issued: 06/22/04 15:48
---	---	---

Volatile Organic Compounds by EPA Method 8260B
North Creek Analytical - Bothell

Analyte	Result	Reporting Limit	Units	Dilution	Batch	Prepared	Analyzed	Method	Notes
MW 1-S LAKEWOOD TOWNE CENTER (B4E0730-01RE1) Water Sampled: 05/26/04 13:30 Received: 05/26/04 15:56 I-02									
1,1-Dichloropropene	ND	2.00	ug/l	2	4F10042	06/11/04	06/11/04	"	
cis-1,3-Dichloropropene	ND	2.00	"	"	"	"	"	"	
trans-1,3-Dichloropropene	ND	2.00	"	"	"	"	"	"	
Ethylbenzene	ND	2.00	"	"	"	"	"	"	
Hexachlorobutadiene	ND	2.00	"	"	"	"	"	"	
2-Hexanone	ND	20.0	"	"	"	"	"	"	
Isopropylbenzene	ND	2.00	"	"	"	"	"	"	
p-Isopropyltoluene	ND	2.00	"	"	"	"	"	"	
4-Methyl-2-pentanone	ND	20.0	"	"	"	"	"	"	
Methylene chloride	ND	10.0	"	"	"	"	"	"	
Naphthalene	3.38	2.00	"	"	"	"	"	"	
n-Propylbenzene	ND	2.00	"	"	"	"	"	"	
Styrene	ND	2.00	"	"	"	"	"	"	
1,2,3-Trichlorobenzene	ND	2.00	"	"	"	"	"	"	
1,2,4-Trichlorobenzene	ND	2.00	"	"	"	"	"	"	
1,1,1,2-Tetrachloroethane	ND	2.00	"	"	"	"	"	"	
1,1,2,2-Tetrachloroethane	ND	2.00	"	"	"	"	"	"	
Tetrachloroethene	2.12	1.00	"	"	"	"	"	"	
Toluene	ND	2.00	"	"	"	"	"	"	
1,1,1-Trichloroethane	ND	2.00	"	"	"	"	"	"	
1,1,2-Trichloroethane	ND	2.00	"	"	"	"	"	"	
Trichloroethene	6.68	1.00	"	"	"	"	"	"	
Trichlorofluoromethane	ND	2.00	"	"	"	"	"	"	
1,2,3-Trichloropropane	ND	2.00	"	"	"	"	"	"	
1,2,4-Trimethylbenzene	ND	2.00	"	"	"	"	"	"	
1,3,5-Trimethylbenzene	ND	2.00	"	"	"	"	"	"	
Vinyl chloride	55.1	2.00	"	"	"	"	"	"	
o-Xylene	ND	2.00	"	"	"	"	"	"	
m,p-Xylene	ND	4.00	"	"	"	"	"	"	
Surrogate: 1,2-DCA-d4	104 %	70-130			"	"	"	"	
Surrogate: Toluene-d8	95.0 %	70-130			"	"	"	"	
Surrogate: 4-BFB	97.0 %	70-130			"	"	"	"	

North Creek Analytical - Bothell

The results in this report apply to the samples analyzed in accordance with the chain of custody document. This analytical report must be reproduced in its entirety.

Jeanne Garthwaite

Jeanne Garthwaite, Project Manager

North Creek Analytical, Inc.
Environmental Laboratory Network



Seattle 11720 North Creek Pkwy N, Suite 400, Bothell, WA 98011-8244
 425.420.9200 fax 425.420.9210
 Spokane 11922 E. 1st Avenue, Spokane Valley, WA 99206-5302
 509.924.9200 fax 509.924.9290
 Portland 9405 SW Nimbus Avenue, Beaverton, OR 97008-7132
 503.906.9200 fax 503.906.9210
 Bend 20332 Empire Avenue, Suite F-1, Bend, OR 97701-5711
 541.383.9310 fax 541.382.7588
 Anchorage 2000 W. International Airport Road, Suite A10, Anchorage, AK 99502-1119
 907.563.9200 fax 907.563.9210

Brown & Caldwell
 600 E. Riverpark Suite 210
 Boise, ID/USA 83706

Project: Lakewood Towne Center
 Project Number: 24716.002
 Project Manager: Dale Kerner

Amended Report
 Issued: 06/22/04 15:48

Volatile Organic Compounds by EPA Method 8260B
North Creek Analytical - Bothell

Analyte	Result	Reporting Limit	Units	Dilution	Batch	Prepared	Analyzed	Method	Notes
MW 3 LAKEWOOD TOWNE CENTER (B4E0730-02) Water Sampled: 05/26/04 11:45 Received: 05/26/04 15:56									
Acetone	ND	10.0	ug/l	1	4F01057	06/01/04	06/01/04	EPA 8260B	
Benzene	ND	0.200	"	"	"	"	"	"	
Bromobenzene	ND	0.500	"	"	"	"	"	"	
Bromochloromethane	ND	0.200	"	"	"	"	"	"	
Bromodichloromethane	ND	0.200	"	"	"	"	"	"	
Bromoform	ND	0.200	"	"	"	"	"	"	
Bromomethane	ND	2.00	"	"	"	"	"	"	
2-Butanone	ND	2.00	"	"	"	"	"	"	
n-Butylbenzene	ND	0.200	"	"	"	"	"	"	
sec-Butylbenzene	ND	0.200	"	"	"	"	"	"	
tert-Butylbenzene	ND	0.500	"	"	"	"	"	"	
Carbon disulfide	ND	0.500	"	"	"	"	"	"	
Carbon tetrachloride	ND	0.200	"	"	"	"	"	"	
Chlorobenzene	ND	0.200	"	"	"	"	"	"	
Chloroethane	ND	1.00	"	"	"	"	"	"	
Chloroform	ND	0.200	"	"	"	"	"	"	
Chloromethane	ND	1.00	"	"	"	"	"	"	
2-Chlorotoluene	ND	0.500	"	"	"	"	"	"	
4-Chlorotoluene	ND	0.500	"	"	"	"	"	"	
Dibromochloromethane	ND	0.200	"	"	"	"	"	"	
1,2-Dibromo-3-chloropropane	ND	0.500	"	"	"	"	"	"	
1,2-Dibromoethane	ND	0.200	"	"	"	"	"	"	
Dibromomethane	ND	0.200	"	"	"	"	"	"	
1,2-Dichlorobenzene	ND	0.200	"	"	"	"	"	"	
1,3-Dichlorobenzene	ND	0.200	"	"	"	"	"	"	
1,4-Dichlorobenzene	ND	0.200	"	"	"	"	"	"	
Dichlorodifluoromethane	ND	0.500	"	"	"	"	"	"	
1,1-Dichloroethane	ND	0.200	"	"	"	"	"	"	
1,2-Dichloroethane	ND	0.200	"	"	"	"	"	"	
1,1-Dichloroethene	ND	0.200	"	"	"	"	"	"	
cis-1,2-Dichloroethene	0.670	0.200	"	"	"	"	"	"	
trans-1,2-Dichloroethene	ND	0.200	"	"	"	"	"	"	
1,2-Dichloropropane	ND	0.200	"	"	"	"	"	"	
1,3-Dichloropropane	ND	0.200	"	"	"	"	"	"	
2,2-Dichloropropane	ND	0.500	"	"	"	"	"	"	

North Creek Analytical - Bothell

The results in this report apply to the samples analyzed in accordance with the chain of custody document. This analytical report must be reproduced in its entirety.

Jeanne Garthwaite

Jeanne Garthwaite, Project Manager

North Creek Analytical, Inc.
 Environmental Laboratory Network



Seattle 11720 North Creek Pkwy N, Suite 400, Bothell, WA 98011-8244
 425.420.9200 fax 425.420.9210
 Spokane 11922 E. 1st Avenue, Spokane Valley, WA 99206-5302
 509.924.9200 fax 509.924.9290
 Portland 9405 SW Nimbus Avenue, Beaverton, OR 97008-7132
 503.906.9200 fax 503.906.9210
 Bend 20332 Empire Avenue, Suite F-1, Bend, OR 97701-5711
 541.383.9310 fax 541.382.7588
 Anchorage 2000 W. International Airport Road, Suite A10, Anchorage, AK 99502-1119
 907.563.9200 fax 907.563.9210

Brown & Caldwell
 600 E. Riverpark Suite 210
 Boise, ID/USA 83706

Project: Lakewood Towne Center
 Project Number: 24716.002
 Project Manager: Dale Kerner

Amended Report
 Issued: 06/22/04 15:48

Volatile Organic Compounds by EPA Method 8260B
North Creek Analytical - Bothell

Analyte	Result	Reporting Limit	Units	Dilution	Batch	Prepared	Analyzed	Method	Notes
MW 3 LAKEWOOD TOWNE CENTER (B4E0730-02) Water Sampled: 05/26/04 11:45 Received: 05/26/04 15:56									
1,1-Dichloropropene	ND	0.200	ug/l	1	4F01057	06/01/04	06/01/04	"	
cis-1,3-Dichloropropene	ND	0.200	"	"	"	"	"	"	
trans-1,3-Dichloropropene	ND	0.200	"	"	"	"	"	"	
Ethylbenzene	ND	0.200	"	"	"	"	"	"	
Hexachlorobutadiene	ND	0.500	"	"	"	"	"	"	
Methyl tert-butyl ether	ND	1.00	"	"	"	"	"	"	
2-Hexanone	ND	2.00	"	"	"	"	"	"	
Isopropylbenzene	ND	0.500	"	"	"	"	"	"	
p-Isopropyltoluene	ND	0.200	"	"	"	"	"	"	
4-Methyl-2-pentanone	ND	2.00	"	"	"	"	"	"	
Methylene chloride	ND	5.00	"	"	"	"	"	"	
Naphthalene	ND	0.500	"	"	"	"	"	"	
n-Propylbenzene	ND	0.500	"	"	"	"	"	"	
Styrene	ND	0.500	"	"	"	"	"	"	
1,2,3-Trichlorobenzene	ND	0.200	"	"	"	"	"	"	
1,2,4-Trichlorobenzene	ND	0.200	"	"	"	"	"	"	
1,1,1,2-Tetrachloroethane	ND	0.200	"	"	"	"	"	"	
1,1,2,2-Tetrachloroethane	ND	0.500	"	"	"	"	"	"	
Tetrachloroethene	0.580	0.200	"	"	"	"	"	"	
Toluene	ND	0.200	"	"	"	"	"	"	
1,1,1-Trichloroethane	ND	0.200	"	"	"	"	"	"	
1,1,2-Trichloroethane	ND	0.200	"	"	"	"	"	"	
Trichloroethene	ND	0.200	"	"	"	"	"	"	
Trichlorofluoromethane	ND	0.500	"	"	"	"	"	"	
1,2,3-Trichloropropane	ND	0.500	"	"	"	"	"	"	
1,2,4-Trimethylbenzene	ND	0.200	"	"	"	"	"	"	
1,3,5-Trimethylbenzene	ND	0.500	"	"	"	"	"	"	
Vinyl chloride	ND	0.200	"	"	"	"	"	"	
o-Xylene	ND	0.250	"	"	"	"	"	"	
m,p-Xylene	ND	0.500	"	"	"	"	"	"	
Surrogate: 1,2-DCA-d4	106 %	70-130			"	"	"	"	
Surrogate: Toluene-d8	101 %	70-130			"	"	"	"	
Surrogate: 4-BFB	100 %	70-130			"	"	"	"	

North Creek Analytical - Bothell

The results in this report apply to the samples analyzed in accordance with the chain of custody document. This analytical report must be reproduced in its entirety.

Jeanne Garthwaite

Jeanne Garthwaite, Project Manager

North Creek Analytical, Inc.
 Environmental Laboratory Network



Seattle 11720 North Creek Pkwy N, Suite 400, Bothell, WA 98011-8244
 425.420.9200 fax 425.420.9210
 Spokane 11922 E. 1st Avenue, Spokane Valley, WA 99206-5302
 509.924.9200 fax 509.924.9290
 Portland 9405 SW Nimbus Avenue, Beaverton, OR 97008-7132
 503.906.9200 fax 503.906.9210
 Bend 20332 Empire Avenue, Suite F-1, Bend, OR 97701-5711
 541.383.9310 fax 541.382.7588
 Anchorage 2000 W. International Airport Road, Suite A10, Anchorage, AK 99502-1119
 907.563.9200 fax 907.563.9210

Brown & Caldwell
 600 E. Riverpark Suite 210
 Boise, ID/USA 83706

Project: Lakewood Towne Center
 Project Number: 24716.002
 Project Manager: Dale Kerner

Amended Report
 Issued: 06/22/04 15:48

Volatile Organic Compounds by EPA Method 8260B
North Creek Analytical - Bothell

Analyte	Result	Reporting Limit	Units	Dilution	Batch	Prepared	Analyzed	Method	Notes
MW 4 LAKEWOOD TOWNE CENTER (B4E0730-03) Water Sampled: 05/26/04 13:00 Received: 05/26/04 15:56									
Acetone	ND	20.0	ug/l	1	4E28033	05/28/04	05/28/04	EPA 8260B	
Benzene	ND	1.00	"	"	"	"	"	"	
Bromobenzene	ND	1.00	"	"	"	"	"	"	
Bromochloromethane	ND	1.00	"	"	"	"	"	"	
Bromodichloromethane	ND	1.00	"	"	"	"	"	"	
Bromoform	ND	1.00	"	"	"	"	"	"	
Bromomethane	ND	2.00	"	"	"	"	"	"	
2-Butanone	ND	10.0	"	"	"	"	"	"	
n-Butylbenzene	ND	1.00	"	"	"	"	"	"	
sec-Butylbenzene	ND	1.00	"	"	"	"	"	"	
tert-Butylbenzene	ND	1.00	"	"	"	"	"	"	
Carbon disulfide	ND	1.00	"	"	"	"	"	"	
Carbon tetrachloride	ND	1.00	"	"	"	"	"	"	
Chlorobenzene	ND	1.00	"	"	"	"	"	"	
Chloroethane	ND	1.00	"	"	"	"	"	"	
Chloroform	ND	1.00	"	"	"	"	"	"	
Chloromethane	ND	5.00	"	"	"	"	"	"	
2-Chlorotoluene	ND	1.00	"	"	"	"	"	"	
4-Chlorotoluene	ND	1.00	"	"	"	"	"	"	
Dibromochloromethane	ND	1.00	"	"	"	"	"	"	
1,2-Dibromo-3-chloropropane	ND	5.00	"	"	"	"	"	"	
1,2-Dibromoethane	ND	1.00	"	"	"	"	"	"	
Dibromomethane	ND	1.00	"	"	"	"	"	"	
1,2-Dichlorobenzene	ND	1.00	"	"	"	"	"	"	
1,3-Dichlorobenzene	ND	1.00	"	"	"	"	"	"	
1,4-Dichlorobenzene	ND	1.00	"	"	"	"	"	"	
Dichlorodifluoromethane	ND	1.00	"	"	"	"	"	"	
1,1-Dichloroethane	ND	1.00	"	"	"	"	"	"	
1,2-Dichloroethane	ND	1.00	"	"	"	"	"	"	
1,1-Dichloroethene	ND	1.00	"	"	"	"	"	"	
cis-1,2-Dichloroethene	42.1	1.00	"	"	"	"	"	"	
trans-1,2-Dichloroethene	ND	1.00	"	"	"	"	"	"	
1,2-Dichloropropane	ND	1.00	"	"	"	"	"	"	
1,3-Dichloropropane	ND	1.00	"	"	"	"	"	"	
2,2-Dichloropropane	ND	1.00	"	"	"	"	"	"	

North Creek Analytical - Bothell

The results in this report apply to the samples analyzed in accordance with the chain of custody document. This analytical report must be reproduced in its entirety.

Jeanne Garthwaite

Jeanne Garthwaite, Project Manager

North Creek Analytical, Inc.
 Environmental Laboratory Network



Seattle 11720 North Creek Pkwy N, Suite 400, Bothell, WA 98011-8244
 425.420.9200 fax 425.420.9210
 Spokane 11922 E. 1st Avenue, Spokane Valley, WA 99206-5302
 509.924.9200 fax 509.924.9290
 Portland 9405 SW Nimbus Avenue, Beaverton, OR 97008-7132
 503.906.9200 fax 503.906.9210
 Bend 20332 Empire Avenue, Suite F-1, Bend, OR 97701-5711
 541.383.9310 fax 541.382.7588
 Anchorage 2000 W. International Airport Road, Suite A10, Anchorage, AK 99502-1119
 907.563.9200 fax 907.563.9210

Brown & Caldwell
 600 E. Riverpark Suite 210
 Boise, ID/USA 83706

Project: Lakewood Towne Center
 Project Number: 24716.002
 Project Manager: Dale Kerner

Amended Report
 Issued: 06/22/04 15:48

Volatile Organic Compounds by EPA Method 8260B
North Creek Analytical - Bothell

Analyte	Result	Reporting Limit	Units	Dilution	Batch	Prepared	Analyzed	Method	Notes
MW 4 LAKEWOOD TOWNE CENTER (B4E0730-03) Water Sampled: 05/26/04 13:00 Received: 05/26/04 15:56									
1,1-Dichloropropene	ND	1.00	ug/l	1	4E28033	05/28/04	05/28/04	"	
cis-1,3-Dichloropropene	ND	1.00	"	"	"	"	"	"	
trans-1,3-Dichloropropene	ND	1.00	"	"	"	"	"	"	
Ethylbenzene	ND	1.00	"	"	"	"	"	"	
Hexachlorobutadiene	ND	1.00	"	"	"	"	"	"	
2-Hexanone	ND	10.0	"	"	"	"	"	"	
Isopropylbenzene	ND	1.00	"	"	"	"	"	"	
p-Isopropyltoluene	ND	1.00	"	"	"	"	"	"	
4-Methyl-2-pentanone	ND	10.0	"	"	"	"	"	"	
Methylene chloride	ND	5.00	"	"	"	"	"	"	
Naphthalene	ND	1.00	"	"	"	"	"	"	
n-Propylbenzene	ND	1.00	"	"	"	"	"	"	
Styrene	ND	1.00	"	"	"	"	"	"	
1,2,3-Trichlorobenzene	ND	1.00	"	"	"	"	"	"	
1,2,4-Trichlorobenzene	ND	1.00	"	"	"	"	"	"	
1,1,1,2-Tetrachloroethane	ND	1.00	"	"	"	"	"	"	
1,1,2,2-Tetrachloroethane	ND	1.00	"	"	"	"	"	"	
Tetrachloroethene	1.76	1.00	"	"	"	"	"	"	
Toluene	ND	1.00	"	"	"	"	"	"	
1,1,1-Trichloroethane	ND	1.00	"	"	"	"	"	"	
1,1,2-Trichloroethane	ND	1.00	"	"	"	"	"	"	
Trichloroethene	2.55	1.00	"	"	"	"	"	"	
Trichlorofluoromethane	ND	1.00	"	"	"	"	"	"	
1,2,3-Trichloropropane	ND	1.00	"	"	"	"	"	"	
1,2,4-Trimethylbenzene	ND	1.00	"	"	"	"	"	"	
1,3,5-Trimethylbenzene	ND	1.00	"	"	"	"	"	"	
Vinyl chloride	ND	1.00	"	"	"	"	"	"	
o-Xylene	ND	1.00	"	"	"	"	"	"	
m,p-Xylene	ND	2.00	"	"	"	"	"	"	
Surrogate: 1,2-DCA-d4	83.0 %	70-130			"	"	"	"	
Surrogate: Toluene-d8	99.0 %	70-130			"	"	"	"	
Surrogate: 4-BFB	99.5 %	70-130			"	"	"	"	

North Creek Analytical - Bothell

The results in this report apply to the samples analyzed in accordance with the chain of custody document. This analytical report must be reproduced in its entirety.

Jeanne Garthwaite

Jeanne Garthwaite, Project Manager

North Creek Analytical, Inc.
 Environmental Laboratory Network



Seattle 11720 North Creek Pkwy N, Suite 400, Bothell, WA 98011-8244
 425.420.9200 fax 425.420.9210
 Spokane 11922 E. 1st Avenue, Spokane Valley, WA 99206-5302
 509.924.9200 fax 509.924.9290
 Portland 9405 SW Nimbus Avenue, Beaverton, OR 97008-7132
 503.906.9200 fax 503.906.9210
 Bend 20332 Empire Avenue, Suite F-1, Bend, OR 97701-5711
 541.383.9310 fax 541.382.7588
 Anchorage 2000 W. International Airport Road, Suite A10, Anchorage, AK 99502-1119
 907.563.9200 fax 907.563.9210

Brown & Caldwell
 600 E. Riverpark Suite 210
 Boise, ID/USA 83706

Project: Lakewood Towne Center
 Project Number: 24716.002
 Project Manager: Dale Kerner

Amended Report
 Issued: 06/22/04 15:48

Volatile Organic Compounds by EPA Method 8260B
North Creek Analytical - Bothell

Analyte	Result	Reporting		Units	Dilution	Batch	Prepared	Analyzed	Method	Notes
		Limit								
MW 5 LAKEWOOD TOWNE CENTER (B4E0730-04) Water Sampled: 05/26/04 12:20 Received: 05/26/04 15:56										
Acetone	ND	10.0		ug/l	1	4F01057	06/01/04	06/01/04	EPA 8260B	
Benzene	ND	0.200		"	"	"	"	"	"	
Bromobenzene	ND	0.500		"	"	"	"	"	"	
Bromochloromethane	ND	0.200		"	"	"	"	"	"	
Bromodichloromethane	ND	0.200		"	"	"	"	"	"	
Bromoform	ND	0.200		"	"	"	"	"	"	
Bromomethane	ND	2.00		"	"	"	"	"	"	
2-Butanone	ND	2.00		"	"	"	"	"	"	
n-Butylbenzene	ND	0.200		"	"	"	"	"	"	
sec-Butylbenzene	ND	0.200		"	"	"	"	"	"	
tert-Butylbenzene	ND	0.500		"	"	"	"	"	"	
Carbon disulfide	ND	0.500		"	"	"	"	"	"	
Carbon tetrachloride	ND	0.200		"	"	"	"	"	"	
Chlorobenzene	ND	0.200		"	"	"	"	"	"	
Chloroethane	ND	1.00		"	"	"	"	"	"	
Chloroform	ND	0.200		"	"	"	"	"	"	
Chloromethane	ND	1.00		"	"	"	"	"	"	
2-Chlorotoluene	ND	0.500		"	"	"	"	"	"	
4-Chlorotoluene	ND	0.500		"	"	"	"	"	"	
Dibromochloromethane	ND	0.200		"	"	"	"	"	"	
1,2-Dibromo-3-chloropropane	ND	0.500		"	"	"	"	"	"	
1,2-Dibromoethane	ND	0.200		"	"	"	"	"	"	
Dibromomethane	ND	0.200		"	"	"	"	"	"	
1,2-Dichlorobenzene	ND	0.200		"	"	"	"	"	"	
1,3-Dichlorobenzene	ND	0.200		"	"	"	"	"	"	
1,4-Dichlorobenzene	ND	0.200		"	"	"	"	"	"	
Dichlorodifluoromethane	ND	0.500		"	"	"	"	"	"	
1,1-Dichloroethane	ND	0.200		"	"	"	"	"	"	
1,2-Dichloroethane	ND	0.200		"	"	"	"	"	"	
1,1-Dichloroethene	ND	0.200		"	"	"	"	"	"	
cis-1,2-Dichloroethene	ND	0.200		"	"	"	"	"	"	
trans-1,2-Dichloroethene	ND	0.200		"	"	"	"	"	"	
1,2-Dichloropropane	ND	0.200		"	"	"	"	"	"	
1,3-Dichloropropane	ND	0.200		"	"	"	"	"	"	
2,2-Dichloropropane	ND	0.500		"	"	"	"	"	"	

North Creek Analytical - Bothell

The results in this report apply to the samples analyzed in accordance with the chain of custody document. This analytical report must be reproduced in its entirety.

Jeanne Garthwaite

Jeanne Garthwaite, Project Manager

North Creek Analytical, Inc.
 Environmental Laboratory Network

Page 10 of 37



Seattle 11720 North Creek Pkwy N, Suite 400, Bothell, WA 98011-8244
 425.420.9200 fax 425.420.9210
 Spokane 11922 E. 1st Avenue, Spokane Valley, WA 99206-5302
 509.924.9200 fax 509.924.9290
 Portland 9405 SW Nimbus Avenue, Beaverton, OR 97008-7132
 503.906.9200 fax 503.906.9210
 Bend 20332 Empire Avenue, Suite F-1, Bend, OR 97701-5711
 541.383.9310 fax 541.382.7588
 Anchorage 2000 W. International Airport Road, Suite A10, Anchorage, AK 99502-1119
 907.563.9200 fax 907.563.9210

Brown & Caldwell
 600 E. Riverpark Suite 210
 Boise, ID/USA 83706

Project: Lakewood Towne Center
 Project Number: 24716.002
 Project Manager: Dale Kerner

Amended Report
 Issued: 06/22/04 15:48

Volatile Organic Compounds by EPA Method 8260B
North Creek Analytical - Bothell

Analyte	Reporting		Units	Dilution	Batch	Prepared	Analyzed	Method	Notes
	Result	Limit							
MW 5 LAKEWOOD TOWNE CENTER (B4E0730-04) Water									
Sampled: 05/26/04 12:20 Received: 05/26/04 15:56									
1,1-Dichloropropene	ND	0.200	ug/l	1	4F01057	06/01/04	06/01/04	"	
cis-1,3-Dichloropropene	ND	0.200	"	"	"	"	"	"	
trans-1,3-Dichloropropene	ND	0.200	"	"	"	"	"	"	
Ethylbenzene	ND	0.200	"	"	"	"	"	"	
Hexachlorobutadiene	ND	0.500	"	"	"	"	"	"	
Methyl tert-butyl ether	ND	1.00	"	"	"	"	"	"	
2-Hexanone	ND	2.00	"	"	"	"	"	"	
Isopropylbenzene	ND	0.500	"	"	"	"	"	"	
p-Isopropyltoluene	ND	0.200	"	"	"	"	"	"	
4-Methyl-2-pentanone	ND	2.00	"	"	"	"	"	"	
Methylene chloride	ND	5.00	"	"	"	"	"	"	
Naphthalene	ND	0.500	"	"	"	"	"	"	
n-Propylbenzene	ND	0.500	"	"	"	"	"	"	
Styrene	ND	0.500	"	"	"	"	"	"	
1,2,3-Trichlorobenzene	ND	0.200	"	"	"	"	"	"	
1,2,4-Trichlorobenzene	ND	0.200	"	"	"	"	"	"	
1,1,1,2-Tetrachloroethane	ND	0.200	"	"	"	"	"	"	
1,1,2,2-Tetrachloroethane	ND	0.500	"	"	"	"	"	"	
Tetrachloroethene	0.680	0.200	"	"	"	"	"	"	
Toluene	ND	0.200	"	"	"	"	"	"	
1,1,1-Trichloroethane	ND	0.200	"	"	"	"	"	"	
1,1,2-Trichloroethane	ND	0.200	"	"	"	"	"	"	
Trichloroethene	ND	0.200	"	"	"	"	"	"	
Trichlorofluoromethane	ND	0.500	"	"	"	"	"	"	
1,2,3-Trichloropropane	ND	0.500	"	"	"	"	"	"	
1,2,4-Trimethylbenzene	ND	0.200	"	"	"	"	"	"	
1,3,5-Trimethylbenzene	ND	0.500	"	"	"	"	"	"	
Vinyl chloride	ND	0.200	"	"	"	"	"	"	
o-Xylene	ND	0.250	"	"	"	"	"	"	
m,p-Xylene	ND	0.500	"	"	"	"	"	"	
Surrogate: 1,2-DCA-d4	104 %	70-130			"	"	"	"	
Surrogate: Toluene-d8	99.5 %	70-130			"	"	"	"	
Surrogate: 4-BFB	100 %	70-130			"	"	"	"	

North Creek Analytical - Bothell

The results in this report apply to the samples analyzed in accordance with the chain of custody document. This analytical report must be reproduced in its entirety.

Jeanne Garthwaite

Jeanne Garthwaite, Project Manager

North Creek Analytical, Inc.
 Environmental Laboratory Network

Page 11 of 37



Seattle 11720 North Creek Pkwy N, Suite 400, Bothell, WA 98011-8244
 425.420.9200 fax 425.420.9210
 Spokane 11922 E. 1st Avenue, Spokane Valley, WA 99206-5302
 509.924.9200 fax 509.924.9290
 Portland 9405 SW Nimbus Avenue, Beaverton, OR 97008-7132
 503.906.9200 fax 503.906.9210
 Bend 20332 Empire Avenue, Suite F-1, Bend, OR 97701-5711
 541.383.9310 fax 541.382.7588
 Anchorage 2000 W. International Airport Road, Suite A10, Anchorage, AK 99502-1119
 907.563.9200 fax 907.563.9210

Brown & Caldwell
 600 E. Riverpark Suite 210
 Boise, ID/USA 83706

Project: Lakewood Towne Center
 Project Number: 24716.002
 Project Manager: Dale Kerner

Amended Report
 Issued: 06/22/04 15:48

Volatile Organic Compounds by EPA Method 8260B
North Creek Analytical - Bothell

Analyte	Result	Reporting Limit	Units	Dilution	Batch	Prepared	Analyzed	Method	Notes
DUPLICATE LAKEWOOD TOWNE CENTER (B4E0730-05) Water Sampled: 05/26/04 12:00 Received: 05/26/04 15:56									
Acetone	ND	200	ug/l	10	4E28033	05/28/04	05/28/04	EPA 8260B	
Benzene	ND	10.0	"	"	"	"	"	"	
Bromobenzene	ND	10.0	"	"	"	"	"	"	
Bromochloromethane	ND	10.0	"	"	"	"	"	"	
Bromodichloromethane	ND	10.0	"	"	"	"	"	"	
Bromoform	ND	10.0	"	"	"	"	"	"	
Bromomethane	ND	20.0	"	"	"	"	"	"	
2-Butanone	ND	100	"	"	"	"	"	"	
n-Butylbenzene	ND	10.0	"	"	"	"	"	"	
sec-Butylbenzene	ND	10.0	"	"	"	"	"	"	
tert-Butylbenzene	ND	10.0	"	"	"	"	"	"	
Carbon disulfide	ND	10.0	"	"	"	"	"	"	
Carbon tetrachloride	ND	10.0	"	"	"	"	"	"	
Chlorobenzene	ND	10.0	"	"	"	"	"	"	
Chloroethane	ND	10.0	"	"	"	"	"	"	
Chloroform	ND	10.0	"	"	"	"	"	"	
Chloromethane	ND	50.0	"	"	"	"	"	"	
2-Chlorotoluene	ND	10.0	"	"	"	"	"	"	
4-Chlorotoluene	ND	10.0	"	"	"	"	"	"	
Dibromochloromethane	ND	10.0	"	"	"	"	"	"	
1,2-Dibromo-3-chloropropane	ND	50.0	"	"	"	"	"	"	
1,2-Dibromoethane	ND	10.0	"	"	"	"	"	"	
Dibromomethane	ND	10.0	"	"	"	"	"	"	
1,2-Dichlorobenzene	ND	10.0	"	"	"	"	"	"	
1,3-Dichlorobenzene	ND	10.0	"	"	"	"	"	"	
1,4-Dichlorobenzene	ND	10.0	"	"	"	"	"	"	
Dichlorodifluoromethane	ND	10.0	"	"	"	"	"	"	
1,1-Dichloroethane	ND	10.0	"	"	"	"	"	"	
1,2-Dichloroethane	ND	10.0	"	"	"	"	"	"	
1,1-Dichloroethene	ND	10.0	"	"	"	"	"	"	
cis-1,2-Dichloroethene	311	10.0	"	"	"	"	"	"	
trans-1,2-Dichloroethene	ND	10.0	"	"	"	"	"	"	
1,2-Dichloropropane	ND	10.0	"	"	"	"	"	"	
1,3-Dichloropropane	ND	10.0	"	"	"	"	"	"	
2,2-Dichloropropane	ND	10.0	"	"	"	"	"	"	

North Creek Analytical - Bothell

The results in this report apply to the samples analyzed in accordance with the chain of custody document. This analytical report must be reproduced in its entirety.

Jeanne Garthwaite

Jeanne Garthwaite, Project Manager

North Creek Analytical, Inc.
 Environmental Laboratory Network

Page 12 of 37



Seattle 11720 North Creek Pkwy N, Suite 400, Bothell, WA 98011-8244
 425.420.9200 fax 425.420.9210
 Spokane 11922 E. 1st Avenue, Spokane Valley, WA 99206-5302
 509.924.9200 fax 509.924.9290
 Portland 9405 SW Nimbus Avenue, Beaverton, OR 97008-7132
 503.906.9200 fax 503.906.9210
 Bend 20332 Empire Avenue, Suite F-1, Bend, OR 97701-5711
 541.383.9310 fax 541.382.7588
 Anchorage 2000 W. International Airport Road, Suite A10, Anchorage, AK 99502-1119
 907.563.9200 fax 907.563.9210

Brown & Caldwell
 600 E. Riverpark Suite 210
 Boise, ID/USA 83706

Project: Lakewood Towne Center
 Project Number: 24716.002
 Project Manager: Dale Kerner

Amended Report
 Issued: 06/22/04 15:48

Volatile Organic Compounds by EPA Method 8260B
North Creek Analytical - Bothell

Analyte	Result	Reporting		Units	Dilution	Batch	Prepared	Analyzed	Method	Notes
		Limit								
DUPLICATE LAKEWOOD TOWNE CENTER (B4E0730-05) Water Sampled: 05/26/04 12:00 Received: 05/26/04 15:56										
1,1-Dichloropropene	ND	10.0		ug/l	10	4E28033	05/28/04	05/28/04	"	
cis-1,3-Dichloropropene	ND	10.0		"	"	"	"	"	"	
trans-1,3-Dichloropropene	ND	10.0		"	"	"	"	"	"	
Ethylbenzene	ND	10.0		"	"	"	"	"	"	
Hexachlorobutadiene	ND	10.0		"	"	"	"	"	"	
2-Hexanone	ND	100		"	"	"	"	"	"	
Isopropylbenzene	ND	10.0		"	"	"	"	"	"	
p-Isopropyltoluene	ND	10.0		"	"	"	"	"	"	
4-Methyl-2-pentanone	ND	100		"	"	"	"	"	"	
Methylene chloride	ND	50.0		"	"	"	"	"	"	
Naphthalene	ND	10.0		"	"	"	"	"	"	
n-Propylbenzene	ND	10.0		"	"	"	"	"	"	
Styrene	ND	10.0		"	"	"	"	"	"	
1,2,3-Trichlorobenzene	ND	10.0		"	"	"	"	"	"	
1,2,4-Trichlorobenzene	ND	10.0		"	"	"	"	"	"	
1,1,1,2-Tetrachloroethane	ND	10.0		"	"	"	"	"	"	
1,1,2,2-Tetrachloroethane	ND	10.0		"	"	"	"	"	"	
Tetrachloroethene	ND	10.0		"	"	"	"	"	"	
Toluene	ND	10.0		"	"	"	"	"	"	
1,1,1-Trichloroethane	ND	10.0		"	"	"	"	"	"	
1,1,2-Trichloroethane	ND	10.0		"	"	"	"	"	"	
Trichloroethene	ND	10.0		"	"	"	"	"	"	
Trichlorofluoromethane	ND	10.0		"	"	"	"	"	"	
1,2,3-Trichloropropane	ND	10.0		"	"	"	"	"	"	
1,2,4-Trimethylbenzene	ND	10.0		"	"	"	"	"	"	
1,3,5-Trimethylbenzene	ND	10.0		"	"	"	"	"	"	
Vinyl chloride	61.5	10.0		"	"	"	"	"	"	
o-Xylene	ND	10.0		"	"	"	"	"	"	
m,p-Xylene	ND	20.0		"	"	"	"	"	"	
Surrogate: 1,2-DCA-d4	83.0 %	70-130				"	"	"	"	
Surrogate: Toluene-d8	99.0 %	70-130				"	"	"	"	
Surrogate: 4-BFB	98.5 %	70-130				"	"	"	"	

North Creek Analytical - Bothell

The results in this report apply to the samples analyzed in accordance with the chain of custody document. This analytical report must be reproduced in its entirety.

Jeanne Garthwaite

Jeanne Garthwaite, Project Manager

North Creek Analytical, Inc.
 Environmental Laboratory Network

Page 13 of 37



Seattle 11720 North Creek Pkwy N, Suite 400, Bothell, WA 98011-8244
 425.420.9200 fax 425.420.9210
 Spokane 11922 E. 1st Avenue, Spokane Valley, WA 99206-5302
 509.924.9200 fax 509.924.9290
 Portland 9405 SW Nimbus Avenue, Beaverton, OR 97008-7132
 503.906.9200 fax 503.906.9210
 Bend 20332 Empire Avenue, Suite F-1, Bend, OR 97701-5711
 541.383.9310 fax 541.382.7588
 Anchorage 2000 W. International Airport Road, Suite A10, Anchorage, AK 99502-1119
 907.563.9200 fax 907.563.9210

Brown & Caldwell
 600 E. Riverpark Suite 210
 Boise, ID/USA 83706

Project: Lakewood Towne Center
 Project Number: 24716.002
 Project Manager: Dale Kerner

Amended Report
 Issued: 06/22/04 15:48

Volatile Organic Compounds by EPA Method 8260B
North Creek Analytical - Bothell

Analyte	Result	Reporting		Units	Dilution	Batch	Prepared	Analyzed	Method	Notes
		Limit								
DUPLICATE LAKEWOOD TOWNE CENTER (B4E0730-05RE1) Water										
					Sampled: 05/26/04 12:00		Received: 05/26/04 15:		I-02	
Acetone	ND	20.0		ug/l	1	4F16040	06/16/04	06/16/04	EPA 8260B	
Benzene	ND	1.00		"	"	"	"	"	"	
Bromobenzene	ND	1.00		"	"	"	"	"	"	
Bromochloromethane	ND	1.00		"	"	"	"	"	"	
Bromodichloromethane	ND	1.00		"	"	"	"	"	"	
Bromoform	ND	1.00		"	"	"	"	"	"	
Bromomethane	ND	2.00		"	"	"	"	"	"	
2-Butanone	ND	10.0		"	"	"	"	"	"	
n-Butylbenzene	ND	1.00		"	"	"	"	"	"	
sec-Butylbenzene	ND	1.00		"	"	"	"	"	"	
tert-Butylbenzene	ND	1.00		"	"	"	"	"	"	
Carbon disulfide	ND	1.00		"	"	"	"	"	"	
Carbon tetrachloride	ND	1.00		"	"	"	"	"	"	
Chlorobenzene	ND	1.00		"	"	"	"	"	"	
Chloroethane	ND	1.00		"	"	"	"	"	"	
Chloroform	ND	1.00		"	"	"	"	"	"	
Chloromethane	ND	5.00		"	"	"	"	"	"	
2-Chlorotoluene	ND	1.00		"	"	"	"	"	"	
4-Chlorotoluene	ND	1.00		"	"	"	"	"	"	
Dibromochloromethane	ND	1.00		"	"	"	"	"	"	
1,2-Dibromo-3-chloropropane	ND	5.00		"	"	"	"	"	"	
1,2-Dibromoethane	ND	1.00		"	"	"	"	"	"	
Dibromomethane	ND	1.00		"	"	"	"	"	"	
1,2-Dichlorobenzene	ND	1.00		"	"	"	"	"	"	
1,3-Dichlorobenzene	ND	1.00		"	"	"	"	"	"	
1,4-Dichlorobenzene	ND	1.00		"	"	"	"	"	"	
Dichlorodifluoromethane	ND	1.00		"	"	"	"	"	"	
1,1-Dichloroethane	ND	1.00		"	"	"	"	"	"	
1,2-Dichloroethane	ND	1.00		"	"	"	"	"	"	
1,1-Dichloroethene	ND	1.00		"	"	"	"	"	"	
cis-1,2-Dichloroethene	279	1.00		"	"	"	"	"	"	E
trans-1,2-Dichloroethene	3.45	1.00		"	"	"	"	"	"	
1,2-Dichloropropane	ND	1.00		"	"	"	"	"	"	
1,3-Dichloropropane	ND	1.00		"	"	"	"	"	"	
2,2-Dichloropropane	ND	1.00		"	"	"	"	"	"	

North Creek Analytical - Bothell

The results in this report apply to the samples analyzed in accordance with the chain of custody document. This analytical report must be reproduced in its entirety.

Jeanne Garthwaite

Jeanne Garthwaite, Project Manager

North Creek Analytical, Inc.
 Environmental Laboratory Network



Seattle 11720 North Creek Pkwy N, Suite 400, Bothell, WA 98011-8244
 425.420.9200 fax 425.420.9210
 Spokane 11922 E. 1st Avenue, Spokane Valley, WA 99206-5302
 509.924.9200 fax 509.924.9290
 Portland 9405 SW Nimbus Avenue, Beaverton, OR 97008-7132
 503.906.9200 fax 503.906.9210
 Bend 20332 Empire Avenue, Suite F-1, Bend, OR 97701-5711
 541.383.9310 fax 541.382.7588
 Anchorage 2000 W. International Airport Road, Suite A10, Anchorage, AK 99502-1119
 907.563.9200 fax 907.563.9210

Brown & Caldwell
 600 E. Riverpark Suite 210
 Boise, ID/USA 83706

Project: Lakewood Towne Center
 Project Number: 24716.002
 Project Manager: Dale Kerner

Amended Report
 Issued: 06/22/04 15:48

Volatile Organic Compounds by EPA Method 8260B
North Creek Analytical - Bothell

Analyte	Result	Reporting Limit	Units	Dilution	Batch	Prepared	Analyzed	Method	Notes
DUPLICATE LAKEWOOD TOWNE CENTER (B4E0730-05RE1) Water									
Sampled: 05/26/04 12:00 Received: 05/26/04 15: I-02									
1,1-Dichloropropene	ND	1.00	ug/l	1	4F16040	06/16/04	06/16/04	"	
cis-1,3-Dichloropropene	ND	1.00	"	"	"	"	"	"	
trans-1,3-Dichloropropene	ND	1.00	"	"	"	"	"	"	
Ethylbenzene	ND	1.00	"	"	"	"	"	"	
Hexachlorobutadiene	ND	1.00	"	"	"	"	"	"	
2-Hexanone	ND	10.0	"	"	"	"	"	"	
Isopropylbenzene	ND	1.00	"	"	"	"	"	"	
p-Isopropyltoluene	ND	1.00	"	"	"	"	"	"	
4-Methyl-2-pentanone	ND	10.0	"	"	"	"	"	"	
Methylene chloride	ND	5.00	"	"	"	"	"	"	
Naphthalene	ND	1.00	"	"	"	"	"	"	
n-Propylbenzene	ND	1.00	"	"	"	"	"	"	
Styrene	ND	1.00	"	"	"	"	"	"	
1,2,3-Trichlorobenzene	ND	1.00	"	"	"	"	"	"	
1,2,4-Trichlorobenzene	ND	1.00	"	"	"	"	"	"	
1,1,1,2-Tetrachloroethane	ND	1.00	"	"	"	"	"	"	
1,1,2,2-Tetrachloroethane	ND	1.00	"	"	"	"	"	"	
Tetrachloroethene	1.84	1.00	"	"	"	"	"	"	
Toluene	ND	1.00	"	"	"	"	"	"	
1,1,1-Trichloroethane	ND	1.00	"	"	"	"	"	"	
1,1,2-Trichloroethane	ND	1.00	"	"	"	"	"	"	
Trichloroethene	6.09	1.00	"	"	"	"	"	"	
Trichlorofluoromethane	ND	1.00	"	"	"	"	"	"	
1,2,3-Trichloropropane	ND	1.00	"	"	"	"	"	"	
1,2,4-Trimethylbenzene	ND	1.00	"	"	"	"	"	"	
1,3,5-Trimethylbenzene	ND	1.00	"	"	"	"	"	"	
Vinyl chloride	62.2	1.00	"	"	"	"	"	"	
o-Xylene	ND	1.00	"	"	"	"	"	"	
m,p-Xylene	ND	2.00	"	"	"	"	"	"	
Surrogate: 1,2-DCA-d4	90.0 %	70-130			"	"	"	"	
Surrogate: Toluene-d8	96.0 %	70-130			"	"	"	"	
Surrogate: 4-BFB	101 %	70-130			"	"	"	"	

North Creek Analytical - Bothell

The results in this report apply to the samples analyzed in accordance with the chain of custody document. This analytical report must be reproduced in its entirety.

Jeanne Garthwaite

Jeanne Garthwaite, Project Manager

North Creek Analytical, Inc.
 Environmental Laboratory Network



Seattle 11720 North Creek Pkwy N, Suite 400, Bothell, WA 98011-8244
 425.420.9200 fax 425.420.9210
 Spokane 11922 E. 1st Avenue, Spokane Valley, WA 99206-5302
 509.924.9200 fax 509.924.9290
 Portland 9405 SW Nimbus Avenue, Beaverton, OR 97008-7132
 503.906.9200 fax 503.906.9210
 Bend 20332 Empire Avenue, Suite F-1, Bend, OR 97701-5711
 541.383.9310 fax 541.382.7588
 Anchorage 2000 W. International Airport Road, Suite A10, Anchorage, AK 99502-1119
 907.563.9200 fax 907.563.9210

Brown & Caldwell
 600 E. Riverpark Suite 210
 Boise, ID/USA 83706

Project: Lakewood Towne Center
 Project Number: 24716.002
 Project Manager: Dale Kerner

Amended Report
 Issued: 06/22/04 15:48

Volatile Organic Compounds by EPA Method 8260B
North Creek Analytical - Bothell

Analyte	Result	Reporting Limit	Units	Dilution	Batch	Prepared	Analyzed	Method	Notes
Trip blank (B4E0730-06) Water Sampled: 05/26/04 12:00 Received: 05/26/04 15:56									
Acetone	ND	10.0	ug/l	1	4F01057	06/01/04	06/01/04	EPA 8260B	
Benzene	ND	0.200	"	"	"	"	"	"	
Bromobenzene	ND	0.500	"	"	"	"	"	"	
Bromochloromethane	ND	0.200	"	"	"	"	"	"	
Bromodichloromethane	ND	0.200	"	"	"	"	"	"	
Bromoform	ND	0.200	"	"	"	"	"	"	
Bromomethane	ND	2.00	"	"	"	"	"	"	
2-Butanone	ND	2.00	"	"	"	"	"	"	
n-Butylbenzene	ND	0.200	"	"	"	"	"	"	
sec-Butylbenzene	ND	0.200	"	"	"	"	"	"	
tert-Butylbenzene	ND	0.500	"	"	"	"	"	"	
Carbon disulfide	ND	0.500	"	"	"	"	"	"	
Carbon tetrachloride	ND	0.200	"	"	"	"	"	"	
Chlorobenzene	ND	0.200	"	"	"	"	"	"	
Chloroethane	ND	1.00	"	"	"	"	"	"	
Chloroform	ND	0.200	"	"	"	"	"	"	
Chloromethane	ND	1.00	"	"	"	"	"	"	
2-Chlorotoluene	ND	0.500	"	"	"	"	"	"	
4-Chlorotoluene	ND	0.500	"	"	"	"	"	"	
Dibromochloromethane	ND	0.200	"	"	"	"	"	"	
1,2-Dibromo-3-chloropropane	ND	0.500	"	"	"	"	"	"	
1,2-Dibromoethane	ND	0.200	"	"	"	"	"	"	
Dibromomethane	ND	0.200	"	"	"	"	"	"	
1,2-Dichlorobenzene	ND	0.200	"	"	"	"	"	"	
1,3-Dichlorobenzene	ND	0.200	"	"	"	"	"	"	
1,4-Dichlorobenzene	ND	0.200	"	"	"	"	"	"	
Dichlorodifluoromethane	ND	0.500	"	"	"	"	"	"	
1,1-Dichloroethane	ND	0.200	"	"	"	"	"	"	
1,2-Dichloroethane	ND	0.200	"	"	"	"	"	"	
1,1-Dichloroethene	ND	0.200	"	"	"	"	"	"	
cis-1,2-Dichloroethene	ND	0.200	"	"	"	"	"	"	
trans-1,2-Dichloroethene	ND	0.200	"	"	"	"	"	"	
1,2-Dichloropropane	ND	0.200	"	"	"	"	"	"	
1,3-Dichloropropane	ND	0.200	"	"	"	"	"	"	
2,2-Dichloropropane	ND	0.500	"	"	"	"	"	"	

North Creek Analytical - Bothell

The results in this report apply to the samples analyzed in accordance with the chain of custody document. This analytical report must be reproduced in its entirety.

Jeanne Garthwaite

Jeanne Garthwaite, Project Manager

North Creek Analytical, Inc.
 Environmental Laboratory Network

Page 16 of 37



Seattle 11720 North Creek Pkwy N, Suite 400, Bothell, WA 98011-8244
 425.420.9200 fax 425.420.9210
 Spokane 11922 E. 1st Avenue, Spokane Valley, WA 99206-5302
 509.924.9200 fax 509.924.9290
 Portland 9405 SW Nimbus Avenue, Beaverton, OR 97008-7132
 503.906.9200 fax 503.906.9210
 Bend 20332 Empire Avenue, Suite F-1, Bend, OR 97701-5711
 541.383.9310 fax 541.382.7588
 Anchorage 2000 W. International Airport Road, Suite A10, Anchorage, AK 99502-1119
 907.563.9200 fax 907.563.9210

Brown & Caldwell
 600 E. Riverpark Suite 210
 Boise, ID/USA 83706

Project: Lakewood Towne Center
 Project Number: 24716.002
 Project Manager: Dale Kerner

Amended Report
 Issued: 06/22/04 15:48

Volatile Organic Compounds by EPA Method 8260B
North Creek Analytical - Bothell

Analyte	Result	Reporting Limit	Units	Dilution	Batch	Prepared	Analyzed	Method	Notes
Trip blank (B4E0730-06) Water Sampled: 05/26/04 12:00 Received: 05/26/04 15:56									
1,1-Dichloropropene	ND	0.200	ug/l	1	4F01057	06/01/04	06/01/04	"	
cis-1,3-Dichloropropene	ND	0.200	"	"	"	"	"	"	
trans-1,3-Dichloropropene	ND	0.200	"	"	"	"	"	"	
Ethylbenzene	ND	0.200	"	"	"	"	"	"	
Hexachlorobutadiene	ND	0.500	"	"	"	"	"	"	
Methyl tert-butyl ether	ND	1.00	"	"	"	"	"	"	
2-Hexanone	ND	2.00	"	"	"	"	"	"	
Isopropylbenzene	ND	0.500	"	"	"	"	"	"	
p-Isopropyltoluene	ND	0.200	"	"	"	"	"	"	
4-Methyl-2-pentanone	ND	2.00	"	"	"	"	"	"	
Methylene chloride	ND	5.00	"	"	"	"	"	"	
Naphthalene	ND	0.500	"	"	"	"	"	"	
n-Propylbenzene	ND	0.500	"	"	"	"	"	"	
Styrene	ND	0.500	"	"	"	"	"	"	
1,2,3-Trichlorobenzene	ND	0.200	"	"	"	"	"	"	
1,2,4-Trichlorobenzene	ND	0.200	"	"	"	"	"	"	
1,1,1,2-Tetrachloroethane	ND	0.200	"	"	"	"	"	"	
1,1,2,2-Tetrachloroethane	ND	0.500	"	"	"	"	"	"	
Tetrachloroethene	ND	0.200	"	"	"	"	"	"	
Toluene	ND	0.200	"	"	"	"	"	"	
1,1,1-Trichloroethane	ND	0.200	"	"	"	"	"	"	
1,1,2-Trichloroethane	ND	0.200	"	"	"	"	"	"	
Trichloroethene	ND	0.200	"	"	"	"	"	"	
Trichlorofluoromethane	ND	0.500	"	"	"	"	"	"	
1,2,3-Trichloropropane	ND	0.500	"	"	"	"	"	"	
1,2,4-Trimethylbenzene	ND	0.200	"	"	"	"	"	"	
1,3,5-Trimethylbenzene	ND	0.500	"	"	"	"	"	"	
Vinyl chloride	ND	0.200	"	"	"	"	"	"	
o-Xylene	ND	0.250	"	"	"	"	"	"	
m,p-Xylene	ND	0.500	"	"	"	"	"	"	
Surrogate: 1,2-DCA-d4	102 %	70-130			"	"	"	"	
Surrogate: Toluene-d8	99.0 %	70-130			"	"	"	"	
Surrogate: 4-BFB	99.5 %	70-130			"	"	"	"	

North Creek Analytical - Bothell

The results in this report apply to the samples analyzed in accordance with the chain of custody document. This analytical report must be reproduced in its entirety.

Jeanne Garthwaite

Jeanne Garthwaite, Project Manager

North Creek Analytical, Inc.
 Environmental Laboratory Network



Seattle 11720 North Creek Pkwy N, Suite 400, Bothell, WA 98011-8244
 425.420.9200 fax 425.420.9210
 Spokane 11922 E. 1st Avenue, Spokane Valley, WA 99206-5302
 509.924.9200 fax 509.924.9290
 Portland 9405 SW Nimbus Avenue, Beaverton, OR 97008-7132
 503.906.9200 fax 503.906.9210
 Bend 20332 Empire Avenue, Suite F-1, Bend, OR 97701-5711
 541.383.9310 fax 541.382.7588
 Anchorage 2000 W. International Airport Road, Suite A10, Anchorage, AK 99502-1119
 907.563.9200 fax 907.563.9210

Brown & Caldwell 600 E. Riverpark Suite 210 Boise, ID/USA 83706	Project: Lakewood Towne Center Project Number: 24716.002 Project Manager: Dale Kerner	Amended Report Issued: 06/22/04 15:48
---	---	---

Conventional Chemistry Parameters by APHA/EPA Methods
North Creek Analytical - Bothell

Analyte	Result	Reporting Limit	Units	Dilution	Batch	Prepared	Analyzed	Method	Notes
MW 1-S LAKEWOOD TOWNE CENTER (B4E0730-01) Water Sampled: 05/26/04 13:30 Received: 05/26/04 15:56									
Total Organic Carbon	12.8	4.00	mg/l	2	4F03013	06/02/04	06/02/04	EPA 415.1	
MW 3 LAKEWOOD TOWNE CENTER (B4E0730-02) Water Sampled: 05/26/04 11:45 Received: 05/26/04 15:56									
Total Organic Carbon	4.93	2.00	mg/l	1	4F03013	06/02/04	06/02/04	EPA 415.1	
MW 4 LAKEWOOD TOWNE CENTER (B4E0730-03) Water Sampled: 05/26/04 13:00 Received: 05/26/04 15:56									
Total Organic Carbon	6.90	4.00	mg/l	2	4F03013	06/02/04	06/02/04	EPA 415.1	
MW 5 LAKEWOOD TOWNE CENTER (B4E0730-04) Water Sampled: 05/26/04 12:20 Received: 05/26/04 15:56									
Total Organic Carbon	5.75	2.00	mg/l	1	4F03013	06/02/04	06/02/04	EPA 415.1	
DUPLICATE LAKEWOOD TOWNE CENTER (B4E0730-05) Water Sampled: 05/26/04 12:00 Received: 05/26/04 15:56									
Total Organic Carbon	13.6	4.00	mg/l	2	4F03013	06/02/04	06/02/04	EPA 415.1	

North Creek Analytical - Bothell

The results in this report apply to the samples analyzed in accordance with the chain of custody document. This analytical report must be reproduced in its entirety.

Jeanne Garthwaite

Jeanne Garthwaite, Project Manager

North Creek Analytical, Inc.
Environmental Laboratory Network



Seattle 11720 North Creek Pkwy N, Suite 400, Bothell, WA 98011-8244
 425.420.9200 fax 425.420.9210
 Spokane 11922 E. 1st Avenue, Spokane Valley, WA 99206-5302
 509.924.9200 fax 509.924.9290
 Portland 9405 SW Nimbus Avenue, Beaverton, OR 97008-7132
 503.906.9200 fax 503.906.9210
 Bend 20332 Empire Avenue, Suite F-1, Bend, OR 97701-5711
 541.383.9310 fax 541.382.7588
 Anchorage 2000 W. International Airport Road, Suite A10, Anchorage, AK 99502-1119
 907.563.9200 fax 907.563.9210

Brown & Caldwell 600 E. Riverpark Suite 210 Boise, ID/USA 83706	Project: Lakewood Towne Center Project Number: 24716.002 Project Manager: Dale Kerner	Amended Report Issued: 06/22/04 15:48
---	---	---

**Hydrocarbons by GC/FID Headspace
North Creek Analytical - Bend**

Analyte	Result	Reporting Limit	Units	Dilution	Batch	Prepared	Analyzed	Method	Notes
MW 1-S LAKEWOOD TOWNE CENTER (B4E0730-01) Water Sampled: 05/26/04 13:30 Received: 05/26/04 15:56									
Ethane	ND	10.0	ug/l	1	0406013	06/03/04	06/04/04	RSK 175	
Ethene	ND	10.0	"	"	"	"	"	"	
MW 3 LAKEWOOD TOWNE CENTER (B4E0730-02) Water Sampled: 05/26/04 11:45 Received: 05/26/04 15:56									
Ethane	ND	10.0	ug/l	1	0406013	06/03/04	06/04/04	RSK 175	
Ethene	ND	10.0	"	"	"	"	"	"	
MW 4 LAKEWOOD TOWNE CENTER (B4E0730-03) Water Sampled: 05/26/04 13:00 Received: 05/26/04 15:56									
Ethane	ND	10.0	ug/l	1	0406013	06/03/04	06/04/04	RSK 175	
Ethene	ND	10.0	"	"	"	"	"	"	
MW 5 LAKEWOOD TOWNE CENTER (B4E0730-04) Water Sampled: 05/26/04 12:20 Received: 05/26/04 15:56									
Ethane	ND	10.0	ug/l	1	0406013	06/03/04	06/04/04	RSK 175	
Ethene	ND	10.0	"	"	"	"	"	"	
DUPLICATE LAKEWOOD TOWNE CENTER (B4E0730-05) Water Sampled: 05/26/04 12:00 Received: 05/26/04 15:56									
Ethane	ND	10.0	ug/l	1	0406013	06/03/04	06/04/04	RSK 175	
Ethene	ND	10.0	"	"	"	"	"	"	
Trip blank (B4E0730-06) Water Sampled: 05/26/04 12:00 Received: 05/26/04 15:56									
Ethane	ND	10.0	ug/l	1	0406013	06/03/04	06/04/04	RSK 175	
Ethene	ND	10.0	"	"	"	"	"	"	

North Creek Analytical - Bothell

The results in this report apply to the samples analyzed in accordance with the chain of custody document. This analytical report must be reproduced in its entirety.

Jeanne Garthwaite

Jeanne Garthwaite, Project Manager

North Creek Analytical, Inc.
Environmental Laboratory Network



Seattle 11720 North Creek Pkwy N, Suite 400, Bothell, WA 98011-8244
 425.420.9200 fax 425.420.9210
 Spokane 11922 E. 1st Avenue, Spokane Valley, WA 99206-5302
 509.924.9200 fax 509.924.9290
 Portland 9405 SW Nimbus Avenue, Beaverton, OR 97008-7132
 503.906.9200 fax 503.906.9210
 Bend 20332 Empire Avenue, Suite F-1, Bend, OR 97701-5711
 541.383.9310 fax 541.382.7588
 Anchorage 2000 W. International Airport Road, Suite A10, Anchorage, AK 99502-1119
 907.563.9200 fax 907.563.9210

Brown & Caldwell 600 E. Riverpark Suite 210 Boise, ID/USA 83706	Project: Lakewood Towne Center Project Number: 24716.002 Project Manager: Dale Kerner	Amended Report Issued: 06/22/04 15:48
---	---	---

Volatile Organic Compounds by EPA Method 8260B - Quality Control
North Creek Analytical - Bothell

Analyte	Result	Reporting Limit	Units	Spike Level	Source Result	%REC	%REC Limits	RPD	RPD Limit	Notes
---------	--------	-----------------	-------	-------------	---------------	------	-------------	-----	-----------	-------

Batch 4E28033: Prepared 05/28/04 Using EPA 5030B

Blank (4E28033-BLK1)

Acetone	ND	20.0	ug/l							
Benzene	ND	1.00	"							
Bromobenzene	ND	1.00	"							
Bromochloromethane	ND	1.00	"							
Bromodichloromethane	ND	1.00	"							
Bromoform	ND	1.00	"							
Bromomethane	ND	2.00	"							
2-Butanone	ND	10.0	"							
n-Butylbenzene	ND	1.00	"							
sec-Butylbenzene	ND	1.00	"							
tert-Butylbenzene	ND	1.00	"							
Carbon disulfide	ND	1.00	"							
Carbon tetrachloride	ND	1.00	"							
Chlorobenzene	ND	1.00	"							
Chloroethane	ND	1.00	"							
Chloroform	ND	1.00	"							
Chloromethane	ND	5.00	"							
2-Chlorotoluene	ND	1.00	"							
4-Chlorotoluene	ND	1.00	"							
Dibromochloromethane	ND	1.00	"							
1,2-Dibromo-3-chloropropane	ND	5.00	"							
1,2-Dibromoethane	ND	1.00	"							
Dibromomethane	ND	1.00	"							
1,2-Dichlorobenzene	ND	1.00	"							
1,3-Dichlorobenzene	ND	1.00	"							
1,4-Dichlorobenzene	ND	1.00	"							
Dichlorodifluoromethane	ND	1.00	"							
1,1-Dichloroethane	ND	1.00	"							
1,2-Dichloroethane	ND	1.00	"							
1,1-Dichloroethene	ND	1.00	"							
cis-1,2-Dichloroethene	ND	1.00	"							
trans-1,2-Dichloroethene	ND	1.00	"							
1,2-Dichloropropane	ND	1.00	"							

North Creek Analytical - Bothell

The results in this report apply to the samples analyzed in accordance with the chain of custody document. This analytical report must be reproduced in its entirety.

Jeanne Garthwaite

Jeanne Garthwaite, Project Manager

North Creek Analytical, Inc.
Environmental Laboratory Network

Page 20 of 37



Seattle 11720 North Creek Pkwy N, Suite 400, Bothell, WA 98011-8244
 425.420.9200 fax 425.420.9210
 Spokane 11922 E. 1st Avenue, Spokane Valley, WA 99206-5302
 509.924.9200 fax 509.924.9290
 Portland 9405 SW Nimbus Avenue, Beaverton, OR 97008-7132
 503.906.9200 fax 503.906.9210
 Bend 20332 Empire Avenue, Suite F-1, Bend, OR 97701-5711
 541.383.9310 fax 541.382.7588
 Anchorage 2000 W. International Airport Road, Suite A10, Anchorage, AK 99502-1119
 907.563.9200 fax 907.563.9210

Brown & Caldwell 600 E. Riverpark Suite 210 Boise, ID/USA 83706	Project: Lakewood Towne Center Project Number: 24716.002 Project Manager: Dale Kerner	Amended Report Issued: 06/22/04 15:48
---	---	---

Volatile Organic Compounds by EPA Method 8260B - Quality Control
North Creek Analytical - Bothell

Analyte	Result	Reporting Limit	Units	Spike Level	Source Result	%REC	%REC Limits	RPD	RPD Limit	Notes
---------	--------	-----------------	-------	-------------	---------------	------	-------------	-----	-----------	-------

Batch 4E28033: Prepared 05/28/04 Using EPA 5030B

Blank (4E28033-BLK1)

1,3-Dichloropropane	ND	1.00	ug/l							
2,2-Dichloropropane	ND	1.00	"							
1,1-Dichloropropene	ND	1.00	"							
cis-1,3-Dichloropropene	ND	1.00	"							
trans-1,3-Dichloropropene	ND	1.00	"							
Ethylbenzene	ND	1.00	"							
Hexachlorobutadiene	ND	1.00	"							
2-Hexanone	ND	10.0	"							
Isopropylbenzene	ND	1.00	"							
p-Isopropyltoluene	ND	1.00	"							
4-Methyl-2-pentanone	ND	10.0	"							
Methylene chloride	ND	5.00	"							
Naphthalene	ND	1.00	"							
n-Propylbenzene	ND	1.00	"							
Styrene	ND	1.00	"							
1,2,3-Trichlorobenzene	ND	1.00	"							
1,2,4-Trichlorobenzene	ND	1.00	"							
1,1,1,2-Tetrachloroethane	ND	1.00	"							
1,1,1,2-Tetrachloroethane	ND	1.00	"							
Tetrachloroethene	ND	1.00	"							
Toluene	ND	1.00	"							
1,1,1-Trichloroethane	ND	1.00	"							
1,1,2-Trichloroethane	ND	1.00	"							
Trichloroethene	ND	1.00	"							
Trichlorofluoromethane	ND	1.00	"							
1,2,3-Trichloropropane	ND	1.00	"							
1,2,4-Trimethylbenzene	ND	1.00	"							
1,3,5-Trimethylbenzene	ND	1.00	"							
Vinyl chloride	ND	1.00	"							
o-Xylene	ND	1.00	"							
m,p-Xylene	ND	2.00	"							
Surrogate: 1,2-DCA-d4	17.6		"	20.0		88.0	70-130			
Surrogate: Toluene-d8	19.4		"	20.0		97.0	70-130			
Surrogate: 4-BFB	20.2		"	20.0		101	70-130			

North Creek Analytical - Bothell

The results in this report apply to the samples analyzed in accordance with the chain of custody document. This analytical report must be reproduced in its entirety.

Jeanne Garthwaite

Jeanne Garthwaite, Project Manager

North Creek Analytical, Inc.
Environmental Laboratory Network

Page 21 of 37



Seattle 11720 North Creek Pkwy N, Suite 400, Bothell, WA 98011-8244
 425.420.9200 fax 425.420.9210
 Spokane 11922 E. 1st Avenue, Spokane Valley, WA 99206-5302
 509.924.9200 fax 509.924.9290
 Portland 9405 SW Nimbus Avenue, Beaverton, OR 97008-7132
 503.906.9200 fax 503.906.9210
 Bend 20332 Empire Avenue, Suite F-1, Bend, OR 97701-5711
 541.383.9310 fax 541.382.7588
 Anchorage 2000 W. International Airport Road, Suite A10, Anchorage, AK 99502-1119
 907.563.9200 fax 907.563.9210

Brown & Caldwell
 600 E. Riverpark Suite 210
 Boise, ID/USA 83706

Project: Lakewood Towne Center
 Project Number: 2471 6.002
 Project Manager: Dale Kerner

Amended Report
 Issued: 06/22/04 15:48

Volatile Organic Compounds by EPA Method 8260B - Quality Control
North Creek Analytical - Bothell

Analyte	Result	Reporting Limit	Units	Spike Level	Source Result	%REC %REC	%REC Limits	RPD RPD	RPD Limit	Notes
---------	--------	-----------------	-------	-------------	---------------	-----------	-------------	---------	-----------	-------

Batch 4E28033: Prepared 05/28/04 Using EPA 5030B

LCS (4E28033-BS1)

Benzene	9.24	1.00	ug/l	10.0		92.4	80-120			
Chlorobenzene	9.97	1.00	"	10.0		99.7	77-120			
1,1-Dichloroethene	9.16	1.00	"	10.0		91.6	80-120			
Toluene	9.64	1.00	"	10.0		96.4	80-120			
Trichloroethene	9.94	1.00	"	10.0		99.4	80-120			
Surrogate: 1,2-DCA-d4	17.0		"	20.0		85.0	70-130			
Surrogate: Toluene-d8	20.0		"	20.0		100	70-130			
Surrogate: 4-BFB	20.2		"	20.0		101	70-130			

LCS Dup (4E28033-BSD1)

Benzene	8.82	1.00	ug/l	10.0		88.2	80-120	4.65	20	
Chlorobenzene	9.36	1.00	"	10.0		93.6	77-120	6.31	20	
1,1-Dichloroethene	8.32	1.00	"	10.0		83.2	80-120	9.61	20	
Toluene	9.20	1.00	"	10.0		92.0	80-120	4.67	20	
Trichloroethene	9.19	1.00	"	10.0		91.9	80-120	7.84	20	
Surrogate: 1,2-DCA-d4	17.2		"	20.0		86.0	70-130			
Surrogate: Toluene-d8	20.1		"	20.0		100	70-130			
Surrogate: 4-BFB	19.7		"	20.0		98.5	70-130			

Matrix Spike (4E28033-MS1)

Source: B4E0730-03

Benzene	10.3	1.00	ug/l	10.0	ND	103	63-148			
Chlorobenzene	11.2	1.00	"	10.0	ND	112	80-128			
1,1-Dichloroethene	9.88	1.00	"	10.0	ND	98.8	59-158			
Toluene	11.3	1.00	"	10.0	ND	113	72-127			
Trichloroethene	13.7	1.00	"	10.0	2.55	112	80-126			
Surrogate: 1,2-DCA-d4	16.4		"	20.0		82.0	70-130			
Surrogate: Toluene-d8	20.0		"	20.0		100	70-130			
Surrogate: 4-BFB	19.7		"	20.0		98.5	70-130			

North Creek Analytical - Bothell

The results in this report apply to the samples analyzed in accordance with the chain of custody document. This analytical report must be reproduced in its entirety.

Jeanne Garthwaite

Jeanne Garthwaite, Project Manager

North Creek Analytical, Inc.
 Environmental Laboratory Network

Page 22 of 37



Seattle 11720 North Creek Pkwy N, Suite 400, Bothell, WA 98011-8244
 425.420.9200 fax 425.420.9210
 Spokane 11922 E. 1st Avenue, Spokane Valley, WA 99206-5302
 509.924.9200 fax 509.924.9290
 Portland 9405 SW Nimbus Avenue, Beaverton, OR 97008-7132
 503.906.9200 fax 503.906.9210
 Bend 20332 Empire Avenue, Suite F-1, Bend, OR 97701-5711
 541.383.9310 fax 541.382.7588
 Anchorage 2000 W. International Airport Road, Suite A10, Anchorage, AK 99502-1119
 907.563.9200 fax 907.563.9210

Brown & Caldwell
 600 E. Riverpark Suite 210
 Boise, ID/USA 83706

Project: Lakewood Towne Center
 Project Number: 24716.002
 Project Manager: Dale Kerner

Amended Report
 Issued: 06/22/04 15:48

Volatile Organic Compounds by EPA Method 8260B - Quality Control
North Creek Analytical - Bothell

Analyte	Result	Reporting Limit	Units	Spike Level	Source Result	%REC	%REC Limits	RPD	RPD Limit	Notes
---------	--------	-----------------	-------	-------------	---------------	------	-------------	-----	-----------	-------

Batch 4E28033: Prepared 05/28/04 Using EPA 5030B

Matrix Spike Dup (4E28033-MSD1)

Source: B4E0730-03

Benzene	10.1	1.00	ug/l	10.0	ND	101	63-148	1.96	20	
Chlorobenzene	11.0	1.00	"	10.0	ND	110	80-128	1.80	20	
1,1-Dichloroethene	9.83	1.00	"	10.0	ND	98.3	59-158	0.507	30	
Toluene	10.8	1.00	"	10.0	ND	108	72-127	4.52	20	
Trichloroethene	13.2	1.00	"	10.0	2.55	106	80-126	3.72	20	
Surrogate: 1,2-DCA-d4	16.4		"	20.0		82.0	70-130			
Surrogate: Toluene-d8	19.7		"	20.0		98.5	70-130			
Surrogate: 4-BFB	19.9		"	20.0		99.5	70-130			

Batch 4F01057: Prepared 06/01/04 Using EPA 5030B

Blank (4F01057-BLK1)

Acetone	ND	10.0	ug/l							
Benzene	ND	0.200	"							
Bromobenzene	ND	0.500	"							
Bromochloromethane	ND	0.200	"							
Bromodichloromethane	ND	0.200	"							
Bromoform	ND	0.200	"							
Bromomethane	ND	2.00	"							
2-Butanone	ND	2.00	"							
n-Butylbenzene	ND	0.200	"							
sec-Butylbenzene	ND	0.200	"							
tert-Butylbenzene	ND	0.500	"							
Carbon disulfide	ND	0.500	"							
Carbon tetrachloride	ND	0.200	"							
Chlorobenzene	ND	0.200	"							
Chloroethane	ND	1.00	"							
Chloroform	ND	0.200	"							
Chloromethane	ND	1.00	"							
2-Chlorotoluene	ND	0.500	"							
4-Chlorotoluene	ND	0.500	"							
Dibromochloromethane	ND	0.200	"							
1,2-Dibromo-3-chloropropane	ND	0.500	"							
1,2-Dibromoethane	ND	0.200	"							
Dibromomethane	ND	0.200	"							

North Creek Analytical - Bothell

The results in this report apply to the samples analyzed in accordance with the chain of custody document. This analytical report must be reproduced in its entirety.

Jeanne Garthwaite

Jeanne Garthwaite, Project Manager

North Creek Analytical, Inc.
 Environmental Laboratory Network

Page 23 of 37



Seattle 11720 North Creek Pkwy N, Suite 400, Bothell, WA 98011-8244
 425.420.9200 fax 425.420.9210
 Spokane 11922 E. 1st Avenue, Spokane Valley, WA 99206-5302
 509.924.9200 fax 509.924.9290
 Portland 9405 SW Nimbus Avenue, Beaverton, OR 97008-7132
 503.906.9200 fax 503.906.9210
 Bend 20332 Empire Avenue, Suite F-1, Bend, OR 97701-5711
 541.383.9310 fax 541.382.7588
 Anchorage 2000 W. International Airport Road, Suite A10, Anchorage, AK 99502-1119
 907.563.9200 fax 907.563.9210

Brown & Caldwell
 600 E. Riverpark Suite 210
 Boise, ID/USA 83706

Project: Lakewood Towne Center
 Project Number: 24716.002
 Project Manager: Dale Kerner

Amended Report
 Issued: 06/22/04 15:48

Volatile Organic Compounds by EPA Method 8260B - Quality Control
North Creek Analytical - Bothell

Analyte	Result	Reporting Limit	Units	Spike Level	Source Result	%REC	%REC Limits	RPD	RPD Limit	Notes
---------	--------	-----------------	-------	-------------	---------------	------	-------------	-----	-----------	-------

Batch 4F01057: Prepared 06/01/04 Using EPA 5030B

Blank (4F01057-BLK1)

1,2-Dichlorobenzene	ND	0.200	ug/l							
1,3-Dichlorobenzene	ND	0.200	"							
1,4-Dichlorobenzene	ND	0.200	"							
Dichlorodifluoromethane	ND	0.500	"							
1,1-Dichloroethane	ND	0.200	"							
1,2-Dichloroethane	ND	0.200	"							
1,1-Dichloroethene	ND	0.200	"							
cis-1,2-Dichloroethene	ND	0.200	"							
trans-1,2-Dichloroethene	ND	0.200	"							
1,2-Dichloropropane	ND	0.200	"							
1,3-Dichloropropane	ND	0.200	"							
2,2-Dichloropropane	ND	0.500	"							
1,1-Dichloropropene	ND	0.200	"							
cis-1,3-Dichloropropene	ND	0.200	"							
trans-1,3-Dichloropropene	ND	0.200	"							
Ethylbenzene	ND	0.200	"							
Hexachlorobutadiene	ND	0.500	"							
Methyl tert-butyl ether	ND	1.00	"							
2-Hexanone	ND	2.00	"							
Isopropylbenzene	ND	0.500	"							
p-Isopropyltoluene	ND	0.200	"							
4-Methyl-2-pentanone	ND	2.00	"							
Methylene chloride	ND	5.00	"							
Naphthalene	ND	0.500	"							
n-Propylbenzene	ND	0.500	"							
Styrene	ND	0.500	"							
1,2,3-Trichlorobenzene	ND	0.200	"							
1,2,4-Trichlorobenzene	ND	0.200	"							
1,1,1,2-Tetrachloroethane	ND	0.200	"							
1,1,2,2-Tetrachloroethane	ND	0.500	"							
Tetrachloroethene	ND	0.200	"							
Toluene	ND	0.200	"							
1,1,1-Trichloroethane	ND	0.200	"							
1,1,2-Trichloroethane	ND	0.200	"							

North Creek Analytical - Bothell

The results in this report apply to the samples analyzed in accordance with the chain of custody document. This analytical report must be reproduced in its entirety.

Jeanne Garthwaite

Jeanne Garthwaite, Project Manager

North Creek Analytical, Inc.
 Environmental Laboratory Network

Page 24 of 37



Seattle 11720 North Creek Pkwy N, Suite 400, Bothell, WA 98011-8244
 425.420.9200 fax 425.420.9210
 Spokane 11922 E. 1st Avenue, Spokane Valley, WA 99206-5302
 509.924.9200 fax 509.924.9290
 Portland 9405 SW Nimbus Avenue, Beaverton, OR 97008-7132
 503.906.9200 fax 503.906.9210
 Bend 20332 Empire Avenue, Suite F-1, Bend, OR 97701-5711
 541.383.9310 fax 541.382.7588
 Anchorage 2000 W. International Airport Road, Suite A10, Anchorage, AK 99502-1119
 907.563.9200 fax 907.563.9210

Brown & Caldwell
 600 E. Riverpark Suite 210
 Boise, ID/USA 83706

Project: Lakewood Towne Center
 Project Number: 24716.002
 Project Manager: Dale Kerner

Amended Report
 Issued: 06/22/04 15:48

Volatile Organic Compounds by EPA Method 8260B - Quality Control
North Creek Analytical - Bothell

Analyte	Result	Reporting Limit	Units	Spike Level	Source Result	%REC	Limit	RPD	Limit	Notes
---------	--------	-----------------	-------	-------------	---------------	------	-------	-----	-------	-------

Batch 4F01057: Prepared 06/01/04 Using EPA 5030B

Blank (4F01057-BLK1)

Trichloroethene	ND	0.200	ug/l							
Trichlorofluoromethane	ND	0.500	"							
1,2,3-Trichloropropane	ND	0.500	"							
1,2,4-Trimethylbenzene	ND	0.200	"							
1,3,5-Trimethylbenzene	ND	0.500	"							
Vinyl chloride	ND	0.200	"							
o-Xylene	ND	0.250	"							
m,p-Xylene	ND	0.500	"							
Surrogate: 1,2-DCA-d4	4.11		"	4.00		103	70-130			
Surrogate: Toluene-d8	3.97		"	4.00		99.2	70-130			
Surrogate: 4-BFB	4.01		"	4.00		100	70-130			

LCS (4F01057-BS1)

Acetone	16.8	10.0	ug/l	20.0		84.0	80-120			
Benzene	1.93	0.200	"	2.00		96.5	80-120			
Bromobenzene	1.94	0.500	"	2.00		97.0	80-120			
Bromochloromethane	2.03	0.200	"	2.00		102	80-120			
Bromodichloromethane	1.94	0.200	"	2.00		97.0	80-120			
Bromoform	1.97	0.200	"	2.00		98.5	80-120			
Bromomethane	2.08	2.00	"	2.00		104	80-120			
2-Butanone	19.1	2.00	"	20.0		95.5	80-120			
n-Butylbenzene	2.00	0.200	"	2.00		100	80-120			
sec-Butylbenzene	1.94	0.200	"	2.00		97.0	80-120			
tert-Butylbenzene	1.93	0.500	"	2.00		96.5	80-120			
Carbon disulfide	1.86	0.500	"	2.00		93.0	80-120			
Carbon tetrachloride	1.96	0.200	"	2.00		98.0	80-120			
Chlorobenzene	2.00	0.200	"	2.00		100	80-120			
Chloroethane	1.91	1.00	"	2.00		95.5	80-120			
Chloroform	1.82	0.200	"	2.00		91.0	80-120			
Chloromethane	1.92	1.00	"	2.00		96.0	80-120			
2-Chlorotoluene	2.03	0.500	"	2.00		102	80-120			
4-Chlorotoluene	1.91	0.500	"	2.00		95.5	80-120			
Dibromochloromethane	1.98	0.200	"	2.00		99.0	80-120			
1,2-Dibromo-3-chloropropane	1.72	0.500	"	2.00		86.0	80-120			

North Creek Analytical - Bothell

The results in this report apply to the samples analyzed in accordance with the chain of custody document. This analytical report must be reproduced in its entirety.

Jeanne Garthwaite

Jeanne Garthwaite, Project Manager

North Creek Analytical, Inc.
 Environmental Laboratory Network

Page 25 of 37



Seattle 11720 North Creek Pkwy N, Suite 400, Bothell, WA 98011-8244
 425.420.9200 fax 425.420.9210
 Spokane 11922 E. 1st Avenue, Spokane Valley, WA 99206-5302
 509.924.9200 fax 509.924.9290
 Portland 9405 SW Nimbus Avenue, Beaverton, OR 97008-7132
 503.906.9200 fax 503.906.9210
 Bend 20332 Empire Avenue, Suite F-1, Bend, OR 97701-5711
 541.383.9310 fax 541.382.7588
 Anchorage 2000 W. International Airport Road, Suite A10, Anchorage, AK 99502-1119
 907.563.9200 fax 907.563.9210

Brown & Caldwell
 600 E. Riverpark Suite 210
 Boise, ID/USA 83706

Project: Lakewood Towne Center
 Project Number: 24716.002
 Project Manager: Dale Kerner

Amended Report
 Issued: 06/22/04 15:48

Volatile Organic Compounds by EPA Method 8260B - Quality Control
North Creek Analytical - Bothell

Analyte	Result	Reporting Limit	Units	Spike Level	Source Result	%REC	%REC Limits	RPD	RPD Limit	Notes
Batch 4F01057: Prepared 06/01/04 Using EPA 5030B										
LCS (4F01057-BS1)										
,2-Dibromoethane	2.00	0.200	ug/l	2.00		100	80-120			
Dibromomethane	1.98	0.200	"	2.00		99.0	80-120			
1,2-Dichlorobenzene	1.95	0.200	"	2.00		97.5	80-120			
,3-Dichlorobenzene	1.91	0.200	"	2.00		95.5	80-120			
,4-Dichlorobenzene	1.96	0.200	"	2.00		98.0	80-120			
Dichlorodifluoromethane	1.96	0.500	"	2.00		98.0	80-120			
,1,1-Dichloroethane	1.99	0.200	"	2.00		99.5	80-120			
,,2-Dichloroethane	1.96	0.200	"	2.00		98.0	80-120			
,,1,1-Dichloroethene	1.97	0.200	"	2.00		98.5	80-120			
cis-1,2-Dichloroethene	1.96	0.200	"	2.00		98.0	80-120			
rans-1,2-Dichloroethene	1.97	0.200	"	2.00		98.5	80-120			
,,2-Dichloropropane	1.92	0.200	"	2.00		96.0	80-120			
1,3-Dichloropropane	2.01	0.200	"	2.00		100	80-120			
,,2-Dichloropropane	1.82	0.500	"	2.00		91.0	80-120			
,,1,1-Dichloropropene	1.97	0.200	"	2.00		98.5	80-120			
cis-1,3-Dichloropropene	1.93	0.200	"	2.00		96.5	80-120			
rans-1,3-Dichloropropene	2.02	0.200	"	2.00		101	80-120			
Ethylbenzene	1.99	0.200	"	2.00		99.5	80-120			
Hexachlorobutadiene	1.90	0.500	"	2.00		95.0	80-120			
Methyl tert-butyl ether	1.94	1.00	"	2.00		97.0	80-120			
,2-Hexanone	19.2	2.00	"	20.0		96.0	80-120			
isopropylbenzene	1.99	0.500	"	2.00		99.5	80-120			
n-Isopropyltoluene	1.97	0.200	"	2.00		98.5	80-120			
t-Methyl-2-pentanone	19.4	2.00	"	20.0		97.0	80-120			
Methylene chloride	1.85	5.00	"	2.00		92.5	80-120			
Naphthalene	1.87	0.500	"	2.00		93.5	80-120			
n-Propylbenzene	1.94	0.500	"	2.00		97.0	80-120			
Styrene	2.05	0.500	"	2.00		102	80-120			
1,2,3-Trichlorobenzene	1.94	0.200	"	2.00		97.0	80-120			
1,2,4-Trichlorobenzene	1.95	0.200	"	2.00		97.5	80-120			
1,1,1,2-Tetrachloroethane	2.00	0.200	"	2.00		100	80-120			
1,1,2,2-Tetrachloroethane	1.94	0.500	"	2.00		97.0	80-120			
Tetrachloroethene	1.95	0.200	"	2.00		97.5	80-120			
Toluene	1.95	0.200	"	2.00		97.5	80-120			

North Creek Analytical - Bothell

The results in this report apply to the samples analyzed in accordance with the chain of custody document. This analytical report must be reproduced in its entirety.

Jeanne Garthwaite

Jeanne Garthwaite, Project Manager

North Creek Analytical, Inc.
 Environmental Laboratory Network

Page 26 of 37



Seattle 11720 North Creek Pkwy N, Suite 400, Bothell, WA 98011-8244
 425.420.9200 fax 425.420.9210
 Spokane 11922 E. 1st Avenue, Spokane Valley, WA 99206-5302
 509.924.9200 fax 509.924.9290
 Portland 9405 SW Nimbus Avenue, Beaverton, OR 97008-7132
 503.906.9200 fax 503.906.9210
 Bend 20332 Empire Avenue, Suite F-1, Bend, OR 97701-5711
 541.383.9310 fax 541.382.7588
 Anchorage 2000 W. International Airport Road, Suite A10, Anchorage, AK 99502-1119
 907.563.9200 fax 907.563.9210

Brown & Caldwell
 600 E. Riverpark Suite 210
 Boise, ID/USA 83706

Project: Lakewood Towne Center
 Project Number: 24716.002
 Project Manager: Dale Kerner

Amended Report
 Issued: 06/22/04 15:48

Volatile Organic Compounds by EPA Method 8260B - Quality Control
North Creek Analytical - Bothell

Analyte	Result	Reporting Limit	Units	Spike Level	Source Result	%REC	Limits	RPD	RPD Limit	Notes
Batch 4F01057: Prepared 06/01/04 Using EPA 5030B										
LCS (4F01057-BS1)										
,1,1-Trichloroethane	1.93	0.200	ug/l	2.00		96.5	80-120			
,1,2-Trichloroethane	1.99	0.200	"	2.00		99.5	80-120			
Trichloroethene	1.93	0.200	"	2.00		96.5	80-120			
Trichlorofluoromethane	1.95	0.500	"	2.00		97.5	80-120			
,2,3-Trichloropropane	1.96	0.500	"	2.00		98.0	80-120			
1,2,4-Trimethylbenzene	1.97	0.200	"	2.00		98.5	80-120			
1,3,5-Trimethylbenzene	1.95	0.500	"	2.00		97.5	80-120			
Vinyl chloride	1.91	0.200	"	2.00		95.5	80-120			
o-Xylene	1.97	0.250	"	2.00		98.5	80-120			
m,p-Xylene	3.95	0.500	"	4.00		98.8	80-120			
Surrogate: 1,2-DCA-d4	4.03		"	4.00		101	70-130			
Surrogate: Toluene-d8	4.09		"	4.00		102	70-130			
Surrogate: 4-BFB	4.01		"	4.00		100	70-130			
.CS Dup (4F01057-BSD1)										
Acetone	17.6	10.0	ug/l	20.0		88.0	80-120	4.65	30	
Benzene	1.99	0.200	"	2.00		99.5	80-120	3.06	30	
Bromobenzene	2.04	0.500	"	2.00		102	80-120	5.03	30	
Bromochloromethane	1.99	0.200	"	2.00		99.5	80-120	1.99	30	
Bromodichloromethane	1.98	0.200	"	2.00		99.0	80-120	2.04	30	
Bromoform	1.96	0.200	"	2.00		98.0	80-120	0.509	30	
Bromomethane	2.06	2.00	"	2.00		103	80-120	0.966	30	
2-Butanone	19.3	2.00	"	20.0		96.5	80-120	1.04	30	
n-Butylbenzene	1.99	0.200	"	2.00		99.5	80-120	0.501	30	
sec-Butylbenzene	2.00	0.200	"	2.00		100	80-120	3.05	30	
tert-Butylbenzene	2.03	0.500	"	2.00		102	80-120	5.05	30	
Carbon disulfide	1.92	0.500	"	2.00		96.0	80-120	3.17	30	
Carbon tetrachloride	1.93	0.200	"	2.00		96.5	80-120	1.54	30	
Chlorobenzene	1.99	0.200	"	2.00		99.5	80-120	0.501	30	
Chloroethane	1.87	1.00	"	2.00		93.5	80-120	2.12	30	
Chloroform	1.86	0.200	"	2.00		93.0	80-120	2.17	30	
Chloromethane	1.93	1.00	"	2.00		96.5	80-120	0.519	30	
2-Chlorotoluene	1.97	0.500	"	2.00		98.5	80-120	3.00	30	
4-Chlorotoluene	2.14	0.500	"	2.00		107	80-120	11.4	30	

North Creek Analytical - Bothell

The results in this report apply to the samples analyzed in accordance with the chain of custody document. This analytical report must be reproduced in its entirety.

Jeanne Garthwaite

Jeanne Garthwaite, Project Manager

North Creek Analytical, Inc.
 Environmental Laboratory Network



Seattle 11720 North Creek Pkwy N, Suite 400, Bothell, WA 98011-8244
 425.420.9200 fax 425.420.9210
 Spokane 11922 E. 1st Avenue, Spokane Valley, WA 99206-5302
 509.924.9200 fax 509.924.9290
 Portland 9405 SW Nimbus Avenue, Beaverton, OR 97008-7132
 503.906.9200 fax 503.906.9210
 Bend 20332 Empire Avenue, Suite F-1, Bend, OR 97701-5711
 541.383.9310 fax 541.382.7588
 Anchorage 2000 W. International Airport Road, Suite A10, Anchorage, AK 99502-1119
 907.563.9200 fax 907.563.9210

Brown & Caldwell
 600 E. Riverpark Suite 210
 Boise, ID/USA 83706

Project: Lakewood Towne Center
 Project Number: 24716.002
 Project Manager: Dale Kerner

Amended Report
 Issued: 06/22/04 15:48

Volatile Organic Compounds by EPA Method 8260B - Quality Control
North Creek Analytical - Bothell

Analyte	Result	Reporting Limit	Units	Spike Level	Source Result	%REC %REC	%REC Limits	RPD RPD	RPD Limit	Notes
---------	--------	-----------------	-------	-------------	---------------	-----------	-------------	---------	-----------	-------

Batch 4F01057: Prepared 06/01/04 Using EPA 5030B

LCS Dup (4F01057-BSD1)

Dibromochloromethane	1.95	0.200	ug/l	2.00		97.5	80-120	1.53	30	
1,2-Dibromo-3-chloropropane	1.99	0.500	"	2.00		99.5	80-120	14.6	30	
1,2-Dibromoethane	1.96	0.200	"	2.00		98.0	80-120	2.02	30	
Dibromomethane	2.01	0.200	"	2.00		100	80-120	1.50	30	
1,2-Dichlorobenzene	2.00	0.200	"	2.00		100	80-120	2.53	30	
1,3-Dichlorobenzene	1.97	0.200	"	2.00		98.5	80-120	3.09	30	
1,4-Dichlorobenzene	1.97	0.200	"	2.00		98.5	80-120	0.509	30	
Dichlorodifluoromethane	1.98	0.500	"	2.00		99.0	80-120	1.02	30	
1,1-Dichloroethane	1.96	0.200	"	2.00		98.0	80-120	1.52	30	
1,2-Dichloroethane	1.98	0.200	"	2.00		99.0	80-120	1.02	30	
1,1-Dichloroethene	1.96	0.200	"	2.00		98.0	80-120	0.509	30	
cis-1,2-Dichloroethene	1.98	0.200	"	2.00		99.0	80-120	1.02	30	
trans-1,2-Dichloroethene	1.98	0.200	"	2.00		99.0	80-120	0.506	30	
1,2-Dichloropropane	1.99	0.200	"	2.00		99.5	80-120	3.58	30	
1,3-Dichloropropane	1.98	0.200	"	2.00		99.0	80-120	1.50	30	
2,2-Dichloropropane	1.80	0.500	"	2.00		90.0	80-120	1.10	30	
1,1-Dichloropropene	2.02	0.200	"	2.00		101	80-120	2.51	30	
cis-1,3-Dichloropropene	1.95	0.200	"	2.00		97.5	80-120	1.03	30	
trans-1,3-Dichloropropene	1.95	0.200	"	2.00		97.5	80-120	3.53	30	
Ethylbenzene	1.99	0.200	"	2.00		99.5	80-120	0.00	30	
Hexachlorobutadiene	1.98	0.500	"	2.00		99.0	80-120	4.12	30	
Methyl tert-butyl ether	1.92	1.00	"	2.00		96.0	80-120	1.04	30	
2-Hexanone	19.9	2.00	"	20.0		99.5	80-120	3.58	30	
Isopropylbenzene	2.03	0.500	"	2.00		102	80-120	1.99	30	
p-Isopropyltoluene	2.01	0.200	"	2.00		100	80-120	2.01	30	
4-Methyl-2-pentanone	19.9	2.00	"	20.0		99.5	80-120	2.54	30	
Methylene chloride	1.83	5.00	"	2.00		91.5	80-120	1.09	30	
Naphthalene	2.07	0.500	"	2.00		104	80-120	10.2	30	
n-Propylbenzene	2.01	0.500	"	2.00		100	80-120	3.54	30	
Styrene	2.08	0.500	"	2.00		104	80-120	1.45	30	
1,2,3-Trichlorobenzene	2.05	0.200	"	2.00		102	80-120	5.51	30	
1,2,4-Trichlorobenzene	1.96	0.200	"	2.00		98.0	80-120	0.512	30	
1,1,1,2-Tetrachloroethane	1.94	0.200	"	2.00		97.0	80-120	3.05	30	
1,1,2,2-Tetrachloroethane	1.99	0.500	"	2.00		99.5	80-120	2.54	30	

North Creek Analytical - Bothell

The results in this report apply to the samples analyzed in accordance with the chain of custody document. This analytical report must be reproduced in its entirety.

Jeanne Garthwaite

Jeanne Garthwaite, Project Manager

North Creek Analytical, Inc.
 Environmental Laboratory Network

Page 28 of 37



Seattle 11720 North Creek Pkwy N, Suite 400, Bothell, WA 98011-8244
 425.420.9200 fax 425.420.9210
 Spokane 11922 E. 1st Avenue, Spokane Valley, WA 99206-5302
 509.924.9200 fax 509.924.9290
 Portland 9405 SW Nimbus Avenue, Beaverton, OR 97008-7132
 503.906.9200 fax 503.906.9210
 Bend 20332 Empire Avenue, Suite F-1, Bend, OR 97701-5711
 541.383.9310 fax 541.382.7588
 Anchorage 2000 W. International Airport Road, Suite A10, Anchorage, AK 99502-1119
 907.563.9200 fax 907.563.9210

Brown & Caldwell
 600 E. Riverpark Suite 210
 Boise, ID/USA 83706

Project: Lakewood Towne Center
 Project Number: 24716.002
 Project Manager: Dale Kerner

Amended Report
 Issued: 06/22/04 15:48

Volatile Organic Compounds by EPA Method 8260B - Quality Control
North Creek Analytical - Bothell

Analyte	Result	Reporting Limit	Units	Spike Level	Source Result	%REC	%REC Limits	RPD	RPD Limit	Notes
---------	--------	-----------------	-------	-------------	---------------	------	-------------	-----	-----------	-------

Batch 4F01057: Prepared 06/01/04 Using EPA 5030B

LCS Dup (4F01057-BSD1)

Tetrachloroethene	1.98	0.200	ug/l	2.00		99.0	80-120	1.53	30	
Toluene	1.96	0.200	"	2.00		98.0	80-120	0.512	30	
1,1,1-Trichloroethane	1.97	0.200	"	2.00		98.5	80-120	2.05	30	
1,1,2-Trichloroethane	1.96	0.200	"	2.00		98.0	80-120	1.52	30	
Trichloroethene	1.99	0.200	"	2.00		99.5	80-120	3.06	30	
Trichlorofluoromethane	1.97	0.500	"	2.00		98.5	80-120	1.02	30	
1,2,3-Trichloropropane	1.99	0.500	"	2.00		99.5	80-120	1.52	30	
1,2,4-Trimethylbenzene	2.00	0.200	"	2.00		100	80-120	1.51	30	
1,3,5-Trimethylbenzene	2.06	0.500	"	2.00		103	80-120	5.49	30	
Vinyl chloride	1.94	0.200	"	2.00		97.0	80-120	1.56	30	
o-Xylene	2.00	0.250	"	2.00		100	80-120	1.51	30	
m,p-Xylene	3.93	0.500	"	4.00		98.2	80-120	0.508	30	
Surrogate: 1,2-DCA-d4	3.94		"	4.00		98.5	70-130			
Surrogate: Toluene-d8	3.99		"	4.00		99.8	70-130			
Surrogate: 4-BFB	4.04		"	4.00		101	70-130			

Batch 4F10042: Prepared 06/11/04 Using EPA 5030B

Blank (4F10042-BLK1)

Acetone	ND	20.0	ug/l							
Benzene	ND	1.00	"							
Bromobenzene	ND	1.00	"							
Bromochloromethane	ND	1.00	"							
Bromodichloromethane	ND	1.00	"							
Bromoform	ND	1.00	"							
Bromomethane	ND	2.00	"							
2-Butanone	ND	10.0	"							
n-Butylbenzene	ND	1.00	"							
sec-Butylbenzene	ND	1.00	"							
tert-Butylbenzene	ND	1.00	"							
Carbon disulfide	ND	1.00	"							
Carbon tetrachloride	ND	1.00	"							
Chlorobenzene	ND	1.00	"							
Chloroethane	ND	1.00	"							
Chloroform	ND	1.00	"							

North Creek Analytical - Bothell

The results in this report apply to the samples analyzed in accordance with the chain of custody document. This analytical report must be reproduced in its entirety.

Jeanne Garthwaite

Jeanne Garthwaite, Project Manager

North Creek Analytical, Inc.
 Environmental Laboratory Network

Page 29 of 37



Seattle 11720 North Creek Pkwy N, Suite 400, Bothell, WA 98011-8244
 425.420.9200 fax 425.420.9210
 Spokane 11922 E. 1st Avenue, Spokane Valley, WA 99206-5302
 509.924.9200 fax 509.924.9290
 Portland 9405 SW Nimbus Avenue, Beaverton, OR 97008-7132
 503.906.9200 fax 503.906.9210
 Bend 20332 Empire Avenue, Suite F-1, Bend, OR 97701-5711
 541.383.9310 fax 541.382.7588
 Anchorage 2000 W. International Airport Road, Suite A10, Anchorage, AK 99502-1119
 907.563.9200 fax 907.563.9210

Brown & Caldwell
 600 E. Riverpark Suite 210
 Boise, ID/USA 83706

Project: Lakewood Towne Center
 Project Number: 24716.002
 Project Manager: Dale Kerner

Amended Report
 Issued: 06/22/04 15:48

Volatile Organic Compounds by EPA Method 8260B - Quality Control
North Creek Analytical - Bothell

Analyte	Result	Reporting Limit	Units	Spike Level	Source Result	%REC	%REC Limits	RPD	RPD Limit	Notes
---------	--------	-----------------	-------	-------------	---------------	------	-------------	-----	-----------	-------

Batch 4F10042: Prepared 06/11/04 Using EPA 5030B

Blank (4F10042-BLK1)

Chloromethane	ND	5.00	ug/l
2-Chlorotoluene	ND	1.00	"
4-Chlorotoluene	ND	1.00	"
Dibromochloromethane	ND	1.00	"
1,2-Dibromo-3-chloropropane	ND	5.00	"
1,2-Dibromoethane	ND	1.00	"
Dibromomethane	ND	1.00	"
1,2-Dichlorobenzene	ND	1.00	"
1,3-Dichlorobenzene	ND	1.00	"
1,4-Dichlorobenzene	ND	1.00	"
Dichlorodifluoromethane	ND	1.00	"
1,1-Dichloroethane	ND	1.00	"
1,2-Dichloroethane	ND	1.00	"
1,1-Dichloroethene	ND	1.00	"
cis-1,2-Dichloroethene	ND	1.00	"
trans-1,2-Dichloroethene	ND	1.00	"
1,2-Dichloropropane	ND	1.00	"
1,3-Dichloropropane	ND	1.00	"
2,2-Dichloropropane	ND	1.00	"
1,1-Dichloropropene	ND	1.00	"
cis-1,3-Dichloropropene	ND	1.00	"
trans-1,3-Dichloropropene	ND	1.00	"
Ethylbenzene	ND	1.00	"
Hexachlorobutadiene	ND	1.00	"
2-Hexanone	ND	10.0	"
Isopropylbenzene	ND	1.00	"
p-Isopropyltoluene	ND	1.00	"
4-Methyl-2-pentanone	ND	10.0	"
Methylene chloride	ND	5.00	"
Naphthalene	ND	1.00	"
n-Propylbenzene	ND	1.00	"
Styrene	ND	1.00	"
1,2,3-Trichlorobenzene	ND	1.00	"
1,2,4-Trichlorobenzene	ND	1.00	"

North Creek Analytical - Bothell

The results in this report apply to the samples analyzed in accordance with the chain of custody document. This analytical report must be reproduced in its entirety.

Jeanne Garthwaite

Jeanne Garthwaite, Project Manager

North Creek Analytical, Inc.
 Environmental Laboratory Network

Page 30 of 37



Seattle 11720 North Creek Pkwy N, Suite 400, Bothell, WA 98011-8244
 425.420.9200 fax 425.420.9210
 Spokane 11922 E. 1st Avenue, Spokane Valley, WA 99206-5302
 509.924.9200 fax 509.924.9290
 Portland 9405 SW Nimbus Avenue, Beaverton, OR 97008-7132
 503.906.9200 fax 503.906.9210
 Bend 20332 Empire Avenue, Suite F-1, Bend, OR 97701-5711
 541.383.9310 fax 541.382.7588
 Anchorage 2000 W. International Airport Road, Suite A10, Anchorage, AK 99502-1119
 907.563.9200 fax 907.563.9210

Brown & Caldwell
 600 E. Riverpark Suite 210
 Boise, ID/USA 83706

Project: Lakewood Towne Center
 Project Number: 24716.002
 Project Manager: Dale Kerner

Amended Report
 Issued: 06/22/04 15:48

Volatile Organic Compounds by EPA Method 8260B - Quality Control
North Creek Analytical - Bothell

Analyte	Result	Reporting	Units	Spike	Source	%REC	%REC	Limits	RPD	Limit	Notes
		Limit									

Batch 4F10042: Prepared 06/11/04 Using EPA 5030B

Blank (4F10042-BLK1)

1,1,1,2-Tetrachloroethane	ND	1.00	ug/l								
1,1,2,2-Tetrachloroethane	ND	1.00	"								
Tetrachloroethene	ND	0.500	"								
Toluene	ND	1.00	"								
1,1,1-Trichloroethane	ND	1.00	"								
1,1,2-Trichloroethane	ND	1.00	"								
Trichloroethene	ND	0.500	"								
Trichlorofluoromethane	ND	1.00	"								
1,2,3-Trichloropropane	ND	1.00	"								
1,2,4-Trimethylbenzene	ND	1.00	"								
1,3,5-Trimethylbenzene	ND	1.00	"								
Vinyl chloride	ND	1.00	"								
o-Xylene	ND	1.00	"								
m,p-Xylene	ND	2.00	"								
Surrogate: 1,2-DCA-d4	20.6		"	20.0		103	70-130				
Surrogate: Toluene-d8	21.4		"	20.0		107	70-130				
Surrogate: 4-BFB	19.5		"	20.0		97.5	70-130				

LCS (4F10042-BS1)

Benzene	9.56	1.00	ug/l	10.0		95.6	80-120				
Chlorobenzene	9.91	1.00	"	10.0		99.1	77-120				
1,1-Dichloroethene	9.84	1.00	"	10.0		98.4	80-120				
Toluene	10.6	1.00	"	10.0		106	80-120				
Trichloroethene	9.80	1.00	"	10.0		98.0	80-120				
Surrogate: 1,2-DCA-d4	20.1		"	20.0		100	70-130				
Surrogate: Toluene-d8	21.0		"	20.0		105	70-130				
Surrogate: 4-BFB	19.7		"	20.0		98.5	70-130				

North Creek Analytical - Bothell

The results in this report apply to the samples analyzed in accordance with the chain of custody document. This analytical report must be reproduced in its entirety.

Jeanne Garthwaite

Jeanne Garthwaite, Project Manager

North Creek Analytical, Inc.
 Environmental Laboratory Network

Page 31 of 37



Seattle 11720 North Creek Pkwy N, Suite 400, Bothell, WA 98011-8244
 425.420.9200 fax 425.420.9210
 Spokane 11922 E. 1st Avenue, Spokane Valley, WA 99206-5302
 509.924.9200 fax 509.924.9290
 Portland 9405 SW Nimbus Avenue, Beaverton, OR 97008-7132
 503.906.9200 fax 503.906.9210
 Bend 20332 Empire Avenue, Suite F-1, Bend, OR 97701-5711
 541.383.9310 fax 541.382.7588
 Anchorage 2000 W. International Airport Road, Suite A10, Anchorage, AK 99502-1119
 907.563.9200 fax 907.563.9210

Brown & Caldwell
 600 E. Riverpark Suite 210
 Boise, ID/USA 83706

Project: Lakewood Towne Center
 Project Number: 24716.002
 Project Manager: Dale Kerner

Amended Report
 Issued: 06/22/04 15:48

Volatile Organic Compounds by EPA Method 8260B - Quality Control
North Creek Analytical - Bothell

Analyte	Result	Reporting Limit	Units	Spike Level	Source Result	%REC	%REC Limits	RPD	RPD Limit	Notes
---------	--------	-----------------	-------	-------------	---------------	------	-------------	-----	-----------	-------

Batch 4F10042: Prepared 06/11/04 Using EPA 5030B

LCS Dup (4F10042-BSD1)

Benzene	10.3	1.00	ug/l	10.0		103	80-120	7.45	20	
Chlorobenzene	10.5	1.00	"	10.0		105	77-120	5.78	20	
1,1-Dichloroethene	11.0	1.00	"	10.0		110	80-120	11.1	20	
Toluene	10.2	1.00	"	10.0		102	80-120	3.85	20	
Trichloroethene	10.0	1.00	"	10.0		100	80-120	2.02	20	
Surrogate: 1,2-DCA-d4	20.4		"	20.0		102	70-130			
Surrogate: Toluene-d8	18.7		"	20.0		93.5	70-130			
Surrogate: 4-BFB	19.9		"	20.0		99.5	70-130			

Batch 4F16040: Prepared 06/16/04 Using EPA 5030B

Blank (4F16040-BLK1)

Iodomethane	ND	5.00	ug/l							
1-Chlorohexane	ND	1.00	"							
Acetone	ND	20.0	"							
Benzene	ND	1.00	"							
Bromobenzene	ND	1.00	"							
Bromochloromethane	ND	1.00	"							
Bromodichloromethane	ND	1.00	"							
Bromoform	ND	1.00	"							
Bromomethane	ND	2.00	"							
2-Butanone	ND	10.0	"							
n-Butylbenzene	ND	1.00	"							
sec-Butylbenzene	ND	1.00	"							
tert-Butylbenzene	ND	1.00	"							
Carbon disulfide	ND	1.00	"							
Carbon tetrachloride	ND	1.00	"							
Chlorobenzene	ND	1.00	"							
Chloroethane	ND	1.00	"							
Chloroform	ND	1.00	"							
Chloromethane	ND	5.00	"							
2-Chlorotoluene	ND	1.00	"							
4-Chlorotoluene	ND	1.00	"							
Dibromochloromethane	ND	1.00	"							
1,2-Dibromo-3-chloropropane	ND	5.00	"							

North Creek Analytical - Bothell

The results in this report apply to the samples analyzed in accordance with the chain of custody document. This analytical report must be reproduced in its entirety.

Jeanne Garthwaite

Jeanne Garthwaite, Project Manager

North Creek Analytical, Inc.
 Environmental Laboratory Network

Page 32 of 37



Seattle 11720 North Creek Pkwy N, Suite 400, Bothell, WA 98011-8244
 425.420.9200 fax 425.420.9210
 Spokane 11922 E. 1st Avenue, Spokane Valley, WA 99206-5302
 509.924.9200 fax 509.924.9290
 Portland 9405 SW Nimbus Avenue, Beaverton, OR 97008-7132
 503.906.9200 fax 503.906.9210
 Bend 20332 Empire Avenue, Suite F-1, Bend, OR 97701-5711
 541.383.9310 fax 541.382.7588
 Anchorage 2000 W. International Airport Road, Suite A10, Anchorage, AK 99502-1119
 907.563.9200 fax 907.563.9210

Brown & Caldwell
 600 E. Riverpark Suite 210
 Boise, ID/USA 83706

Project: Lakewood Towne Center
 Project Number: 24716.002
 Project Manager: Dale Kerner

Amended Report
 Issued: 06/22/04 15:48

Volatile Organic Compounds by EPA Method 8260B - Quality Control
North Creek Analytical - Bothell

Analyte	Result	Reporting Limit	Units	Spike Level	Source Result	%REC	%REC Limits	RPD	RPD Limit	Notes
---------	--------	-----------------	-------	-------------	---------------	------	-------------	-----	-----------	-------

Batch 4F16040: Prepared 06/16/04 Using EPA 5030B

Blank (4F16040-BLK1)

,2-Dibromoethane	ND	1.00	ug/l
bromomethane	ND	1.00	"
1,2-Dichlorobenzene	ND	1.00	"
,3-Dichlorobenzene	ND	1.00	"
,4-Dichlorobenzene	ND	1.00	"
Dichlorodifluoromethane	ND	1.00	"
,1,1-Dichloroethane	ND	1.00	"
,2-Dichloroethane	ND	1.00	"
,1,1-Dichloroethene	ND	1.00	"
cis-1,2-Dichloroethene	ND	1.00	"
rans-1,2-Dichloroethene	ND	1.00	"
,2-Dichloropropane	ND	1.00	"
1,3-Dichloropropane	ND	1.00	"
,2-Dichloropropane	ND	1.00	"
,1-Dichloropropene	ND	1.00	"
cis-1,3-Dichloropropene	ND	1.00	"
rans-1,3-Dichloropropene	ND	1.00	"
ethylbenzene	ND	1.00	"
Hexachlorobutadiene	ND	1.00	"
2-Hexanone	ND	10.0	"
isopropylbenzene	ND	1.00	"
μ-Isopropyltoluene	ND	1.00	"
4-Methyl-2-pentanone	ND	10.0	"
Methylene chloride	ND	5.00	"
Naphthalene	ND	1.00	"
n-Propylbenzene	ND	1.00	"
styrene	ND	1.00	"
,2,3-Trichlorobenzene	ND	1.00	"
1,2,4-Trichlorobenzene	ND	1.00	"
,1,1,2-Tetrachloroethane	ND	1.00	"
,1,1,2,2-Tetrachloroethane	ND	1.00	"
Tetrachloroethene	ND	1.00	"
Toluene	ND	1.00	"
1,1,1-Trichloroethane	ND	1.00	"

North Creek Analytical - Bothell

The results in this report apply to the samples analyzed in accordance with the chain of custody document. This analytical report must be reproduced in its entirety.

Jeanne Garthwaite

Jeanne Garthwaite, Project Manager

North Creek Analytical, Inc.
 Environmental Laboratory Network

Page 33 of 37



Seattle 11720 North Creek Pkwy N, Suite 400, Bothell, WA 98011-8244
 425.420.9200 fax 425.420.9210
 Spokane 11922 E. 1st Avenue, Spokane Valley, WA 99206-5302
 509.924.9200 fax 509.924.9290
 Portland 9405 SW Nimbus Avenue, Beaverton, OR 97008-7132
 503.906.9200 fax 503.906.9210
 Bend 20332 Empire Avenue, Suite F-1, Bend, OR 97701-5711
 541.383.9310 fax 541.382.7588
 Anchorage 2000 W. International Airport Road, Suite A10, Anchorage, AK 99502-1119
 907.563.9200 fax 907.563.9210

Brown & Caldwell 600 E. Riverpark Suite 210 Boise, ID/USA 83706	Project: Lakewood Towne Center Project Number: 24716.002 Project Manager: Dale Kerner	Amended Report Issued: 06/22/04 15:48
---	---	---

Volatile Organic Compounds by EPA Method 8260B - Quality Control
North Creek Analytical - Bothell

Analyte	Result	Reporting Limit	Units	Spike Level	Source Result	%REC	%REC Limits	RPD	RPD Limit	Notes
---------	--------	-----------------	-------	-------------	---------------	------	-------------	-----	-----------	-------

Batch 4F16040: Prepared 06/16/04 Using EPA 5030B

Blank (4F16040-BLK1)

1,1,2-Trichloroethane	ND	1.00	ug/l							
Trichloroethene	ND	1.00	"							
Trichlorofluoromethane	ND	1.00	"							
1,2,3-Trichloropropane	ND	1.00	"							
1,2,4-Trimethylbenzene	ND	1.00	"							
1,3,5-Trimethylbenzene	ND	1.00	"							
Vinyl chloride	ND	1.00	"							
o-Xylene	ND	1.00	"							
m,p-Xylene	ND	2.00	"							
Surrogate: 1,2-DCA-d4	65.0		"	80.0		81.2	70-130			
Surrogate: Toluene-d8	71.7		"	80.0		89.6	70-130			
Surrogate: 4-BFB	70.6		"	80.0		88.2	70-130			

LCS (4F16040-BS1)

Benzene	17.6	1.00	ug/l	20.0		88.0	80-120			
Chlorobenzene	18.8	1.00	"	20.0		94.0	77-120			
1,1-Dichloroethene	18.4	1.00	"	20.0		92.0	80-120			
Toluene	16.9	1.00	"	20.0		84.5	80-120			
Trichloroethene	18.0	1.00	"	20.0		90.0	80-120			
Surrogate: 1,2-DCA-d4	35.6		"	40.0		89.0	70-130			
Surrogate: Toluene-d8	37.6		"	40.0		94.0	70-130			
Surrogate: 4-BFB	38.9		"	40.0		97.2	70-130			

LCS Dup (4F16040-BSD1)

Benzene	17.3	1.00	ug/l	20.0		86.5	80-120	1.72	20	
Chlorobenzene	18.3	1.00	"	20.0		91.5	77-120	2.70	20	
1,1-Dichloroethene	18.0	1.00	"	20.0		90.0	80-120	2.20	20	
Toluene	16.9	1.00	"	20.0		84.5	80-120	0.00	20	
Trichloroethene	18.3	1.00	"	20.0		91.5	80-120	1.65	20	
Surrogate: 1,2-DCA-d4	36.5		"	40.0		91.2	70-130			
Surrogate: Toluene-d8	37.9		"	40.0		94.8	70-130			
Surrogate: 4-BFB	40.6		"	40.0		102	70-130			

North Creek Analytical - Bothell

The results in this report apply to the samples analyzed in accordance with the chain of custody document. This analytical report must be reproduced in its entirety.

Jeanne Garthwaite

Jeanne Garthwaite, Project Manager

North Creek Analytical, Inc.
Environmental Laboratory Network

Page 34 of 37



Seattle 11720 North Creek Pkwy N, Suite 400, Bothell, WA 98011-8244
 425.420.9200 fax 425.420.9210
 Spokane 11922 E. 1st Avenue, Spokane Valley, WA 99206-5302
 509.924.9200 fax 509.924.9290
 Portland 9405 SW Nimbus Avenue, Beaverton, OR 97008-7132
 503.906.9200 fax 503.906.9210
 Bend 20332 Empire Avenue, Suite F-1, Bend, OR 97701-5711
 541.383.9310 fax 541.382.7588
 Anchorage 2000 W. International Airport Road, Suite A10, Anchorage, AK 99502-1119
 907.563.9200 fax 907.563.9210

Brown & Caldwell
 600 E. Riverpark Suite 210
 Boise, ID/USA 83706

Project: Lakewood Towne Center
 Project Number: 24716.002
 Project Manager: Dale Kerner

Amended Report
 Issued: 06/22/04 15:48

Conventional Chemistry Parameters by APHA/EPA Methods - Quality Control
North Creek Analytical - Bothell

Analyte	Result	Reporting Limit	Units	Spike Level	Source Result	%REC	%REC Limits	RPD	RPD Limit	Notes
Batch 4F03013: Prepared 06/02/04 Using General Preparation										
Blank (4F03013-BLK1)										
Total Organic Carbon	ND	2.00	mg/l							
LCS (4F03013-BS1)										
Total Organic Carbon	18.6	2.00	mg/l	20.0		93.0	90-110			
LCS (4F03013-BS2)										
Total Organic Carbon	19.6	2.00	mg/l	20.0		98.0	90-110			
LCS Dup (4F03013-BSD1)										
Total Organic Carbon	20.4	2.00	mg/l	20.0		102	90-110	9.23	20	
LCS Dup (4F03013-BSD2)										
Total Organic Carbon	20.9	2.00	mg/l	20.0		104	90-110	6.42	20	
Duplicate (4F03013-DUP1) Source: B4E0730-02										
Total Organic Carbon	4.38	2.00	mg/l		4.93			11.8	25	
Matrix Spike (4F03013-MS1) Source: B4E0730-02										
Total Organic Carbon	21.8	4.00	mg/l	20.0	4.93	84.4	70-125			

North Creek Analytical - Bothell

The results in this report apply to the samples analyzed in accordance with the chain of custody document. This analytical report must be reproduced in its entirety.

Jeanne Garthwaite

Jeanne Garthwaite, Project Manager

North Creek Analytical, Inc.
 Environmental Laboratory Network



Seattle 11720 North Creek Pkwy N, Suite 400, Bothell, WA 98011-8244
 425.420.9200 fax 425.420.9210
 Spokane 11922 E. 1st Avenue, Spokane Valley, WA 99206-5302
 509.924.9200 fax 509.924.9290
 Portland 9405 SW Nimbus Avenue, Beaverton, OR 97008-7132
 503.906.9200 fax 503.906.9210
 Bend 20332 Empire Avenue, Suite F-1, Bend, OR 97701-5711
 541.383.9310 fax 541.382.7588
 Anchorage 2000 W. International Airport Road, Suite A10, Anchorage, AK 99502-1119
 907.563.9200 fax 907.563.9210

Brown & Caldwell
 600 E. Riverpark Suite 210
 Boise, ID/USA 83706

Project: Lakewood Towne Center
 Project Number: 24716.002
 Project Manager: Dale Kerner

Amended Report
 Issued: 06/22/04 15:48

Hydrocarbons by GC/FID Headspace - Quality Control
North Creek Analytical - Bend

Analyte	Result	Reporting Limit	Units	Spike Level	Source Result	%REC	%REC Limits	RPD	RPD Limit	Notes
---------	--------	-----------------	-------	-------------	---------------	------	-------------	-----	-----------	-------

Batch 0406013: Prepared 06/03/04 Using GC Headspace

Blank (0406013-BLK1)

Ethane	ND	10.0	ug/l							
Ethene	ND	10.0	"							

LCS (0406013-BS1)

Ethane	125	10.0	ug/l	118		106	70-130			
Ethene	152	10.0	"	145		105	70-130			

LCS Dup (0406013-BSD1)

Ethane	115	10.0	ug/l	118		97.5	70-130	8.33	25	
Ethene	140	10.0	"	145		96.6	70-130	8.22	25	

Duplicate (0406013-DUP1)

Source: B4E0730-02

Ethane	ND	10.0	ug/l		ND			NA	35	
Ethene	ND	10.0	"		ND			NA	35	

North Creek Analytical - Bothell

The results in this report apply to the samples analyzed in accordance with the chain of custody document. This analytical report must be reproduced in its entirety.

Jeanne Garthwaite

Jeanne Garthwaite, Project Manager

North Creek Analytical, Inc.
 Environmental Laboratory Network

Page 36 of 37



Seattle 11720 North Creek Pkwy N, Suite 400, Bothell, WA 98011-8244
 425.420.9200 fax 425.420.9210
 Spokane 11922 E. 1st Avenue, Spokane Valley, WA 99206-5302
 509.924.9200 fax 509.924.9290
 Portland 9405 SW Nimbus Avenue, Beaverton, OR 97008-7132
 503.906.9200 fax 503.906.9210
 Bend 20332 Empire Avenue, Suite F-1, Bend, OR 97701-5711
 541.383.9310 fax 541.382.7588
 Anchorage 2000 W. International Airport Road, Suite A10, Anchorage, AK 99502-1119
 907.563.9200 fax 907.563.9210

Brown & Caldwell 600 E. Riverpark Suite 210 Boise, ID/USA 83706	Project: Lakewood Towne Center Project Number: 24716.002 Project Manager: Dale Kerner	Amended Report Issued: 06/22/04 15:48
---	---	---

Notes and Definitions

- E Estimated value. The reported value exceeds the calibration range of the analysis.
- I-02 This sample was analyzed outside of the recommended holding time.
- DET Analyte DETECTED
- ND Analyte NOT DETECTED at or above the reporting limit
- NR Not Reported
- dry Sample results reported on a dry weight basis
- RPD Relative Percent Difference

North Creek Analytical - Bothell

The results in this report apply to the samples analyzed in accordance with the chain of custody document. This analytical report must be reproduced in its entirety.

Jeanne Garthwaite, Project Manager

North Creek Analytical, Inc.
Environmental Laboratory Network