

One Convention Place, 701 Pike Street, Suite 1200  
Seattle, Washington 98101

Tel: (206) 624-0100  
Fax: (206) 749-2200

RECEIVED  
DEPT. OF ECOLOGY/SWRO

'04 APR 21 10:21

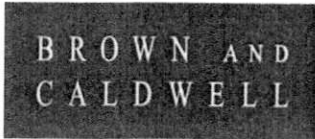

April 19, 2004

Mr. John Van Vlear, Esq., R.E.A.  
Voss, Cook & Thel, LLP  
895 Dove Street, Suite 450  
Newport Beach, California

54-24716/002

Subject: Quarterly Groundwater Monitoring Update  
Lakewood Towne Center  
5731 Main Street SW  
Lakewood, Washington

Dear Mr. Van Vlear:

This letter report summarizes quarterly groundwater monitoring and sampling activities performed at the above-referenced site. This work is done as part of the continuing evaluation of groundwater quality in response to elevated chlorinated solvent concentrations found in shallow groundwater.

#### *Executive Summary*

Low-level concentrations of various volatile organic compounds (VOCs) have been detected in both soil and groundwater at the Lakewood Towne Center (the Site). These VOCs apparently originated from current and historic operations of dry cleaning facilities on the Site.

Tetrachloroethylene or perchloroethylene (PCE) and its associated degradation products (trichloroethylene [TCE], *cis*-1,2-dichloroethylene [*cis*-1,2-DCE] and vinyl chloride) appear to be the main contaminants of concern (COC) at the Site. Reported concentrations of some COC in monitoring wells MW-1s, MW-3 and MW-4 exceed established Washington Department of Ecology (DOE) Model Toxics Control Act (MTCA) cleanup levels.

On October 30, 2003, Brown and Caldwell and their subcontractor completed installation of hydrogen release compound (HRC<sup>®</sup>) in exploratory boreholes at the Site to further promote the biodegradation of COC. Groundwater monitoring activities for the first quarter of 2004 were conducted on March 3, 2004 to evaluate Site groundwater quality.

Depth to groundwater (DTG) ranges from approximately 10 feet to 16 feet below ground surface (bgs) in the wells sampled. Reported concentrations for some PCE degradation products have increased in monitoring wells MW-1s (*cis*-1,2-DCE and vinyl chloride) and MW-4 (TCE and *cis*-1,2-DCE) have increased in comparison with data from the last quarterly groundwater monitoring event. This is likely due to continued biodegradation of PCE, enhanced by the addition of HRC<sup>®</sup>. The reported concentration of PCE decreased in monitoring wells MW-1s, MW-3 and MW-5.

### ***Background***

Herrera Environmental Consultants, Inc. (Herrera) initiated Site investigation activities at the Lakewood Towne Center located in Lakewood, Washington in the spring of 2000. Herrera performed a Phase I Environmental Site Assessment (ESA) in May 2000. Herrera also conducted Phase II ESA activities, which included collection of soil samples from soil borings, installation of seven groundwater monitoring wells (MW-1s, MW-1m, and MW-1d through MW-5) across the northwestern portion of the mall property, and quarterly groundwater monitoring. Groundwater monitoring well locations are indicated on Figure 1. Based on analytical results of samples collected during field investigations conducted by Herrera, PCE and its degradation by-products were detected in shallow groundwater in the northwestern portion of the Site. The source zone was identified as shallow groundwater near the former East Concourse building, which was occupied by a dry cleaning operation between 1968 and 1987. The groundwater monitoring well locations relative to the source area and sampling frequency are as follows:

- MW-1s (shallow) [quarterly], MW-1m (mid depth) [annually], MW-1d (deep) [annually] in the source area.
- MW-2d (deep) [quarterly] upgradient of the source area.
- MW-3 (shallow) [quarterly] at the northwest property boundary, (approximately 1,300 feet downgradient of the source area).
- MW-4 (shallow) [quarterly] immediately downgradient of the source area.
- MW-5 (shallow) [quarterly] immediately downgradient of the source area.

As reported in Herrera's most recent quarterly groundwater monitoring report (September 2003) laboratory data indicate residual concentrations of PCE and PCE degradation by-products in the vicinity of monitoring wells MW-1s and MW-4.

### ***Hydrogen Release Compound Installation***

On October 30, 2003, Brown and Caldwell and their subcontractor, Cascade Drilling of Woodinville, Washington mobilized to the Site to inject HRC<sup>®</sup> into the subsurface to assist biodegradation of residual groundwater contaminants in the vicinity of monitoring wells MW-1s

and MW-4. Direct push sampling equipment was used to install temporary boreholes at six locations hydraulically upgradient of monitoring wells MW-1s and MW-4. The amount of HRC<sup>®</sup> used in each borehole was determined using formulas supplied by the manufacturer.

### ***Groundwater Monitoring***

DTG was measured in monitoring wells MW-1s, and MW-3 through MW-5 on March 3, 2004, with an electronic water probe that can measure water levels to an accuracy of 0.01 foot. After measuring DTG, groundwater samples were collected for laboratory analysis using a low-flow purge method with dedicated polyethylene tubing and a peristaltic pump. As a quality control measure, a duplicate sample was collected from monitoring well MW-1s. The groundwater produced during purging was containerized in a 55-gallon drum for treatment and disposal at a later date. The groundwater samples were placed on ice and transported under chain-of-custody to North Creek Analytical (NCA) of Seattle, Washington for analysis of VOCs using U.S. Environmental Protection Agency (EPA) Method 8260B.

Analytical laboratory reports and chain-of-custody documents are attached. A groundwater elevation contour map is presented as Figure 1, and a summary of groundwater monitoring and analytical data is included in Table 1.

COC found at Lakewood Towne Center site since Site characterization began in the spring of 2000 include:

<b>Abbreviated Notation</b>	<b>Chemical Name</b>
PCE	tetrachloroethene or perchloroethene
TCE	trichloroethene
<i>cis</i> -1,2-DCE	<i>cis</i> -1,2-dichloroethene
<i>trans</i> -1,2- DCE	<i>trans</i> -1,2-dichloroethene
1,1-DCE	1,1-dichloroethene
1,1-DCA	1,1-dichloroethane
1,4-DCB	1,4-dichlorobenzene
VC	vinyl chloride
chloroform	chloroform

Compared to previous measurements collected in November 2003, groundwater elevations at the time of sampling increased by an average of 0.92 foot across the site. For this sampling event, groundwater appears to migrate to the west/northwest with an approximate hydraulic gradient of 0.002 foot per foot (ft/ft). This flow direction and the observed hydraulic gradient are consistent with those observed during previous sampling events.

### ***Groundwater Analytical Results***

Brown and Caldwell received the analytical laboratory test results of the groundwater samples collected on March 3, 2004 from NCA on March 17, 2004. Based on errors in the original analytical report, NCA supplied an amended report to Brown and Caldwell on April 5, 2004, provided as Attachment A. As a result, Brown and Caldwell, as it pertains to this quarterly

Mr. John Van Vlear  
April 19, 2004  
Page 4

report, used the lowest quantified concentration for each COC from the amended analytical report produced by NCA. NCA provided an explanation of the errors, which occurred in the original analytical report, which is attached as Attachment B.

Analytical laboratory test results of the groundwater samples collected on March 3, 2004, indicated detectable concentrations of select VOC compounds in the four monitoring wells listed here with their detected COC; MW-1s (PCE, TCE, *cis*-1,2-DCE, *trans*-1,2-DCE, 1,1-DCA and VC); MW-3 (PCE and *cis*-1,2-DCE), MW-4 (PCE, TCE, *cis*-1,2-DCE, and *trans*-1,2-DCE); and MW-5 (PCE). The reported concentration of PCE, TCE, *cis*-1,2-DCE and VC in the sample from monitoring well MW-1s and PCE and TCE in MW-4 exceed the MTCA method B cleanup levels. Compared to analytical data from the November 2003 sampling event, reported concentrations for some PCE degradation products have increased in monitoring wells MW-1s (*cis*-1,2-DCE, *trans*-1,2-DCE and VC) and MW-4 (PCE, TCE, and *cis*-1,2-DCE). This is likely due to continued biodegradation of PCE, enhanced by the addition of HRC<sup>®</sup>. The reported concentration of PCE decreased in monitoring wells MW-1s, MW-3 and MW-5.

We appreciate the opportunity to be of continued service to Voss, Cook and Thel, LLP, and MBK Northwest, Inc. The next sampling event will include monitoring wells MW-1s, MW-3, MW-4 and MW-5 and is scheduled for May 2004. Brown and Caldwell will propose to the Department of Ecology the abandonment of monitoring well MW-6 prior to completion of the next sampling event. If permission is granted, the abandonment will be completed in conjunction with the groundwater sampling event. If you have any questions, please feel free to contact our office at your convenience.

Very truly yours,

BROWN AND CALDWELL

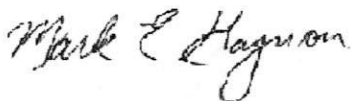

Mark E. Gagnon, L.H.G.  
Project Manager



Dale A. Kerner, L.G.  
Staff Scientist

MEG:DAK:kw  
Attachments

cc: Ms. Dawn Baerlocher, MBK Northwest  
Mr. David Moore, MBK Northwest  
Mr. Chuck Klein, Washington Department of Ecology

Table 1. Summary of Groundwater Monitoring Data, Lakewood Towne Center, Lakewood, Washington

Well Identification (TOC elevation) <sup>2</sup>	Date Sampled	µg/l <sup>1</sup>										DTW <sup>10</sup> (BTOC ft <sup>11</sup> )	WTE <sup>12</sup> (ft)
		PCE <sup>3</sup>	TCE <sup>4</sup>	<i>cis</i> -1,2- DCE <sup>5</sup>	<i>trans</i> - 1,2- DCE <sup>6</sup>	1,1- DCE <sup>7</sup>	1,1- DCA <sup>8</sup>	Vinyl chloride	1,4- DCB <sup>9</sup>	Chloro- form			
MW-1s (93.33) Sampled Quarterly	9/15/00	2.2	19	670	14	0.76	6.1	52	0.25	1.3	12.32	81.01	
	2/12/01	1.2	15	390	8.2	0.37	3.1	47	(0.20) <sup>13</sup>	(0.20)	11.00	82.33	
	5/17/01	2.3	18	600	10	0.64	5.5	41	0.30	(0.20)	10.91	82.42	
	8/15/01	1.7	14	490	8.3	0.56	4.2	40	(0.20)	(0.20)	12.28	81.05	
	11/15/01	0.51	9.1	320	6.4	0.47	2.3	59	0.21	(0.20)	10.62	82.71	
	2/20/02	37	68	540	7.2	0.83	3.1	28	0.35	(0.20)	9.82	83.51	
	5/20/02	18	37	520	8.3	0.61	2.3	25	0.32	(0.20)	10.40	82.93	
	8/19/02	5.5	16	540	7.3	(2.0)	(2.0)	31	(2.0)	(2.0)	11.76	81.57	
	11/20/02	2.8	17	330	8.5	1.0	(0.20)	58	(0.20)	(0.20)	12.54	80.79	
	2/20/03	5.8	18	290	3.6	(2.0)	(2.0)	22	(2.0)	(2.0)	9.82 <sup>15</sup>	83.51	
	5/21/03	10	28	470	6.7	0.55	(0.20)	24	0.23	(0.20)	10.68 <sup>15</sup>	82.65	
	8/21/03	7.1	20	400	6.6	(2.0)	(2.0)	24	(2.0)	(2.0)	12.40 <sup>15</sup>	80.93	
	11/26/03	(5.0)	13.2	212	(5.0)	(5.0)	(5.0)	30.1	(5.0)	(5.0)	11.12	82.21	
	3/3/04	1.36	6.26	420 <sup>14</sup>	6.77	(1.0)	1.44	91.8 <sup>14</sup>	(1.0)	(1.0)	10.22	83.11	
Duplicate (MW-1s)	3/3/04	1.55	6.12	403 <sup>14</sup>	6.28	(1.0)	1.38	78.8 <sup>14</sup>	(1.0)	(1.0)	--	--	
MW-1m (93.39) Sampled Annually	7/21/00	0.80	0.45	5.0	(0.20)	(0.20)	(0.20)	(0.20)	(0.20)	(0.20)	11.44	81.95	
	11/15/01	0.87	(0.20)	0.95	(0.20)	(0.20)	(0.20)	(0.20)	(0.20)	(0.20)	10.68	82.71	
	11/20/02	0.69	0.24	0.93	(0.20)	(0.20)	(0.20)	(0.20)	(0.20)	(0.20)	12.63	80.76	
11/26/03	1.91	0.520	2.74	(0.20)	(0.20)	(0.20)	(0.20)	(0.20)	(0.20)	11.19	82.20		
3/3/04	NS <sup>16</sup>	NS	NS	NS	NS	NS	NS	NS	NS	NM <sup>17</sup>	NM		
MW-1d (93.56) Sampled Annually	7/21/00	0.50	(0.20)	0.29	(0.20)	(0.20)	(0.20)	(0.20)	(0.20)	(0.20)	11.63	81.93	
	11/15/01	0.64	(0.20)	(0.20)	(0.20)	(0.20)	(0.20)	(0.20)	(0.20)	(0.20)	10.85	82.71	
	11/20/02	0.52	(0.20)	(0.20)	(0.20)	(0.20)	(0.20)	(0.20)	(0.20)	(0.20)	12.80	80.76	
11/26/03	0.70	(0.20)	(0.20)	(0.20)	(0.20)	(0.20)	(0.20)	(0.20)	(0.20)	11.39	82.17		
3/3/04	NS	NS	NS	NS	NS	NS	NS	NS	NS	NM	NM		

Table 1. Summary of Groundwater Monitoring Data, Lakewood Towne Center, Lakewood, Washington

Well Identification (TOC elevation) <sup>2</sup>	Date Sampled	µg/l										DTW <sup>10</sup> (BTOC ft <sup>11</sup> )	WTE <sup>12</sup> (ft)		
		PCE <sup>3</sup>	TCE <sup>4</sup>	cis-1,2-DCE <sup>5</sup>	trans-1,2-DCE <sup>6</sup>	1,1-DCE <sup>7</sup>	1,1-DCA <sup>8</sup>	Vinyl chloride	1,4-DCB <sup>9</sup>	Chloroform					
MW-2d (92.20) Sampled Annually	7/21/00	0.73	(0.20)	(0.20)	(0.20)	(0.20)	(0.20)	(0.20)	(0.20)	(0.20)	(0.20)	(0.20)	(0.20)	10.64	81.56
	11/16/01	<b>1.2</b>	(0.20)	(0.20)	(0.20)	(0.20)	(0.20)	(0.20)	(0.20)	(0.20)	(0.20)	(0.20)	(0.20)	9.22	82.98
	11/21/02	<b>1.2</b>	(0.20)	(0.20)	(0.20)	(0.20)	(0.20)	(0.20)	(0.20)	(0.20)	(0.20)	(0.20)	(0.20)	11.26	80.94
	11/26/03	(0.20)	(0.20)	(0.20)	(0.20)	(0.20)	(0.20)	(0.20)	(0.20)	(0.20)	(0.20)	(0.20)	(0.20)	9.65	82.55
	3/3/04	NS	NS	NS	NS	NS	NS	NS	NS	NS	NS	NS	NS	NM	NM
MW-3 (97.06) Sampled Quarterly	7/21/00	0.69	(0.20)	1.1	(0.20)	(0.20)	(0.20)	(0.20)	(0.20)	(0.20)	(0.20)	(0.20)	(0.20)	17.09	79.97
	2/12/01	0.66	(0.20)	0.23	(0.20)	(0.20)	(0.20)	(0.20)	(0.20)	(0.20)	(0.20)	(0.20)	(0.20)	16.79	80.27
	5/17/01	0.64	(0.20)	1.3	(0.20)	(0.20)	(0.20)	(0.20)	(0.20)	(0.20)	(0.20)	(0.20)	(0.20)	16.76	80.30
	8/15/01	0.66	(0.20)	0.88	(0.20)	(0.20)	(0.20)	(0.20)	(0.20)	(0.20)	(0.20)	(0.20)	(0.20)	17.67	79.39
	11/15/01	0.57	(0.20)	0.73	(0.20)	(0.20)	(0.20)	(0.20)	(0.20)	(0.20)	(0.20)	(0.20)	(0.20)	16.39	80.67
	2/20/02	0.66	0.31	1.3	(0.20)	(0.20)	(0.20)	(0.20)	(0.20)	(0.20)	(0.20)	(0.20)	(0.20)	16.00	81.06
	5/20/02	0.52	(0.20)	0.93	(0.20)	(0.20)	(0.20)	(0.20)	(0.20)	(0.20)	(0.20)	(0.20)	(0.20)	16.38	80.68
	8/19/02	0.57	(0.20)	0.79	(0.20)	(0.20)	(0.20)	(0.20)	(0.20)	(0.20)	(0.20)	(0.20)	(0.20)	17.33	79.73
	11/20/02	0.57	(0.20)	0.84	(0.20)	(0.20)	(0.20)	(0.20)	(0.20)	(0.20)	(0.20)	(0.20)	(0.20)	17.91	79.15
	2/20/03	0.68	(0.20)	1.1	(0.20)	(0.20)	(0.20)	(0.20)	(0.20)	(0.20)	(0.20)	(0.20)	(0.20)	16.00 <sup>15</sup>	81.06
	5/21/03	0.50	(0.20)	0.91	(0.20)	(0.20)	(0.20)	(0.20)	(0.20)	(0.20)	(0.20)	(0.20)	(0.20)	16.59 <sup>15</sup>	80.47
	8/21/03	0.54	(0.20)	0.69	(0.20)	(0.20)	(0.20)	(0.20)	(0.20)	(0.20)	(0.20)	(0.20)	(0.20)	17.75 <sup>15</sup>	79.31
11/26/03	<b>0.87</b>	(0.20)	1.05	(0.20)	(0.20)	(0.20)	(0.20)	(0.20)	(0.20)	(0.20)	(0.20)	(0.20)	17.23	79.83	
	3/3/04	0.60	(0.2)	1.03	(0.20)	(0.20)	(0.20)	(0.20)	(0.20)	(0.20)	(0.20)	(0.20)	(0.20)	16.20	80.86
MW-4 (94.82) Sampled Quarterly	9/15/00	<b>1.6</b>	<b>4.9</b>	<b>120</b>	2.8	(0.20)	(0.20)	(0.20)	(0.20)	(0.20)	(0.20)	(0.20)	(0.20)	13.92	80.90
	2/12/01	<b>1.0</b>	2.3	48	0.90	(0.20)	(0.20)	(0.20)	(0.20)	(0.20)	(0.20)	(0.20)	(0.20)	12.61	82.21
	5/17/01	<b>1.0</b>	3.4	<b>100</b>	1.6	(0.20)	(0.20)	(0.20)	(0.20)	(0.20)	(0.20)	(0.20)	(0.20)	12.50	82.32
	8/15/01	<b>0.97</b>	2.9	70	1.1	(0.20)	(0.20)	(0.20)	(0.20)	(0.20)	(0.20)	(0.20)	(0.20)	13.86	80.96
	11/15/01	<b>0.99</b>	1.6	35	0.57	(0.20)	(0.20)	(0.20)	(0.20)	(0.20)	(0.20)	(0.20)	(0.20)	12.22	82.60
	2/20/02	<b>9.8</b>	<b>18</b>	<b>110</b>	1.3	(0.20)	(0.20)	(0.20)	(0.20)	(0.20)	(0.20)	(0.20)	(0.20)	11.46	83.36
5/20/02	<b>3.8</b>	<b>6.6</b>	65	0.90	(0.20)	(0.20)	(0.20)	(0.20)	(0.20)	(0.20)	(0.20)	(0.20)	12.03	82.79	

Table 1. Summary of Groundwater Monitoring Data, Lakewood Towne Center, Lakewood, Washington

Well Identification (TOC elevation) <sup>2</sup>	Date Sampled	µg/l <sup>1</sup>										DTW <sup>10</sup> (BTOC ft <sup>11</sup> )	WTE <sup>12</sup> (ft)			
		PCE <sup>3</sup>	TCE <sup>4</sup>	cis-1,2- DCE <sup>5</sup>	trans- 1,2- DCE <sup>6</sup>	1,1- DCE <sup>7</sup>	1,1- DCA <sup>8</sup>	Vinyl chloride	1,4- DCB <sup>9</sup>	Chloro- form						
MW-4 (94.82) (cont'd)	8/19/02	2.4	4.2	77	1.7	(0.40)	(0.40)	(0.40)	(0.40)	(0.40)	(0.40)	(0.40)	(0.40)	13.35	81.47	
	11/21/02	1.6	3.7	38	0.99	(0.20)	(0.20)	(0.20)	(0.20)	(0.20)	(0.20)	(0.20)	(0.20)	14.23	80.59	
	2/20/03	1.5	3.1	36	0.48	(0.20)	(0.20)	(0.20)	(0.20)	(0.20)	(0.20)	(0.20)	(0.20)	11.46 <sup>15</sup>	83.36	
	5/21/03	2.4	4.7	65	0.97	(0.20)	(0.20)	(0.20)	(0.20)	(0.20)	(0.20)	(0.20)	(0.20)	12.29 <sup>15</sup>	82.53	
	8/21/03	1.8	3.8	54	0.78	(0.20)	(0.20)	(0.20)	(0.20)	(0.20)	(0.20)	(0.20)	(0.20)	13.95 <sup>15</sup>	80.87	
	11/26/03	1.73	2.0	24.8	(1.0)	(1.0)	(1.0)	(1.0)	(1.0)	(1.0)	(1.0)	(1.0)	(1.0)	12.72	82.10	
	3/3/04	2.09	4.07	75.0 <sup>14</sup>	0.880	(0.20)	(0.20)	(0.20)	(0.20)	(0.20)	(0.20)	(0.20)	(0.20)	11.80	83.02	
	MW-5 (94.37) Sampled Quarterly	9/15/00	1.2	(0.20)	(0.20)	(0.20)	(0.20)	(0.20)	(0.20)	(0.20)	(0.20)	(0.20)	(0.20)	(0.20)	13.52	80.85
		2/12/01	0.70	(0.20)	(0.20)	(0.20)	(0.20)	(0.20)	(0.20)	(0.20)	(0.20)	(0.20)	(0.20)	(0.20)	12.24	82.13
		5/17/01	0.62	(0.20)	(0.20)	(0.20)	(0.20)	(0.20)	(0.20)	(0.20)	(0.20)	(0.20)	(0.20)	(0.20)	12.13	82.24
8/15/01		0.88	(0.20)	(0.20)	(0.20)	(0.20)	(0.20)	(0.20)	(0.20)	(0.20)	(0.20)	(0.20)	(0.20)	13.43	80.94	
11/15/01		0.90	(0.20)	(0.20)	(0.20)	(0.20)	(0.20)	(0.20)	(0.20)	(0.20)	(0.20)	(0.20)	(0.20)	11.88	82.49	
2/20/02		0.44	(0.20)	(0.20)	(0.20)	(0.20)	(0.20)	(0.20)	(0.20)	(0.20)	(0.20)	(0.20)	(0.20)	11.10	83.27	
5/20/02		0.39	(0.20)	(0.20)	(0.20)	(0.20)	(0.20)	(0.20)	(0.20)	(0.20)	(0.20)	(0.20)	(0.20)	11.65	82.72	
8/19/02		0.71	(0.20)	(0.20)	(0.20)	(0.20)	(0.20)	(0.20)	(0.20)	(0.20)	(0.20)	(0.20)	(0.20)	12.98	81.39	
11/21/02		0.86	(0.20)	(0.20)	(0.20)	(0.20)	(0.20)	(0.20)	(0.20)	(0.20)	(0.20)	(0.20)	(0.20)	13.76	80.61	
2/20/03		0.62	(0.20)	(0.20)	(0.20)	(0.20)	(0.20)	(0.20)	(0.20)	(0.20)	(0.20)	(0.20)	(0.20)	11.10 <sup>15</sup>	83.27	
MW-6	5/21/03	0.52	(0.20)	(0.20)	(0.20)	(0.20)	(0.20)	(0.20)	(0.20)	(0.20)	(0.20)	(0.20)	(0.20)	11.93 <sup>15</sup>	82.44	
	8/21/03	0.89	(0.20)	(0.20)	(0.20)	(0.20)	(0.20)	(0.20)	(0.20)	(0.20)	(0.20)	(0.20)	(0.20)	13.61 <sup>15</sup>	80.76	
	11/26/03	0.94	(0.20)	(0.20)	(0.20)	(0.20)	(0.20)	(0.20)	(0.20)	(0.20)	(0.20)	(0.20)	(0.20)	12.34	82.03	
	3/3/04	0.550	(0.20)	(0.20)	(0.20)	(0.20)	(0.20)	(0.20)	(0.20)	(0.20)	(0.20)	(0.20)	(0.20)	11.51	82.86	
	5/20/02	(0.20)	(0.20)	(0.20)	(0.20)	(0.20)	(0.20)	(0.20)	(0.20)	(0.20)	(0.20)	(0.20)	(0.20)	--	--	
8/19/02	(0.20)	(0.20)	(0.20)	(0.20)	(0.20)	(0.20)	(0.20)	(0.20)	(0.20)	(0.20)	(0.20)	(0.20)	--	--		
11/20/02	(0.20)	(0.20)	(0.20)	(0.20)	(0.20)	(0.20)	(0.20)	(0.20)	(0.20)	(0.20)	(0.20)	(0.20)	--	--		

**Table 1. Summary of Groundwater Monitoring Data, Lakewood Towne Center, Lakewood, Washington**

Well Identification (TOC elevation) <sup>2</sup>	Date Sampled	µg/l <sup>1</sup>										DTW <sup>10</sup> (BTOC ft <sup>11</sup> )	WTE <sup>12</sup> (ft)
		PCE <sup>3</sup>	TCE <sup>4</sup>	cis-1,2-DCE <sup>5</sup>	trans-1,2-DCE <sup>6</sup>	1,1-DCE <sup>7</sup>	1,1-DCA <sup>8</sup>	Vinyl chloride	1,4-DCB <sup>9</sup>	Chloroform			
MW-6	2/20/03	(0.20)	(0.20)	(0.20)	(0.20)	(0.20)	(0.20)	(0.20)	(0.20)	(0.20)	(0.20)	--	--
(cont'd)	11/26/03	NS	NS	NS	NS	NS	NS	NS	NS	NS	NS	--	--
	3/3/04	NS	NS	NS	NS	NS	NS	NS	NS	NS	NS	--	--
<b>MTCA method A cleanup level<sup>18</sup></b>		5	5	na <sup>20</sup>	na	na	na	na	na	na	na	na	na
<b>MTCA method B cleanup level<sup>19</sup></b>		0.858	3.98	80	160	0.0729	800	0.0292	1.82	7.17			

Values in **boldface** type indicate constituent detected above the established MTCA method A or method B groundwater cleanup level.

Shaded values represent results of the most recent sampling event.

- 1 µg/l - micrograms per liter.
- 2 Monitoring well location shown on Figure 1, top of casing elevation relative to local benchmark.
- 3 PCE - Perchloroethylene.
- 4 TCE - trichloroethene.
- 5 cis-1,2-DCE - cis-1,2-dichloroethene.
- 6 trans-1,2-DCE - trans-1,2-dichloroethene.
- 7 1,1-DCE - 1,1-dichloroethene.
- 8 1,1-DCA - 1,1-dichloroethane.
- 9 1,4-DCB - 1,4-dichlorobenzene.
- 10 DTW - depth to water.
- 11 BTOC - below top of casing in feet.
- 12 WTE - water table elevation.
- 13 A (0.20) indicates the value reported was the laboratory Method Detection Limit. Concentrations, if present, below this were not quantifiable.
- 14 The reported value was determined on a second, higher dilution analyses. Initial analyses reported concentrations outside the laboratory range for the compound.
- 15 DTW data back calculated from Herrera WTE data in historic quarterly groundwater reports.
- 16 NS - not sampled.
- 17 NM - not measured.
- 18 Model Toxics Control Act Cleanup Regulation (Ecology 2001a).
- 19 Cleanup Levels and Risk Calculations under the Model Toxics Control Act Cleanup Regulation (Ecology 2001b).
- 20 na - Established groundwater cleanup level for this constituent is not available.

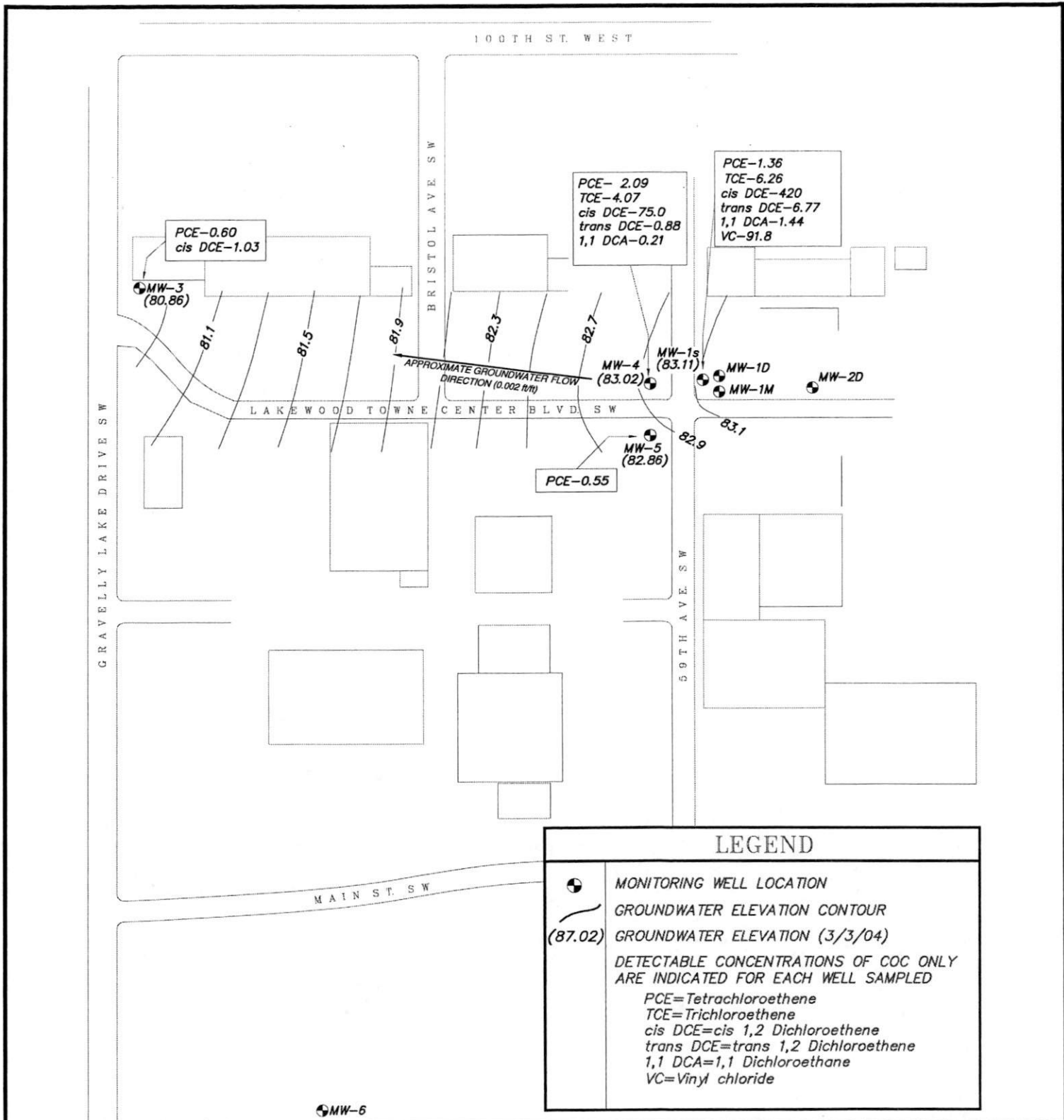

LEGEND	
	MONITORING WELL LOCATION
	GROUNDWATER ELEVATION CONTOUR
	GROUNDWATER ELEVATION (3/3/04)
	DETECTABLE CONCENTRATIONS OF COC ONLY ARE INDICATED FOR EACH WELL SAMPLED
	PCE=Tetrachloroethene
	TCE=Trichloroethene
	cis DCE=cis 1,2 Dichloroethene
	trans DCE=trans 1,2 Dichloroethene
	1,1 DCA=1,1 Dichloroethane
	VC=Vinyl chloride

**BROWN AND CALDWELL**  
Boise, Idaho

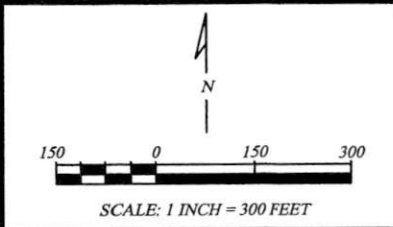

**FIGURE 1**  
**GROUNDWATER CONTOUR MAP**  
  
LAKWOOD TOWNE CENTER  
LAKWOOD, WASHINGTON

**ATTACHMENTS**

**ATTACHMENT A**  
**LABORATORY REPORTS**



**Seattle** 11720 North Creek Pkwy N, Suite 400, Bothell, WA 98011-8244  
425.420.9200 fax 425.420.9210  
**Spokane** East 11115 Montgomery, Suite B, Spokane, WA 99206-4776  
509.924.9200 fax 509.924.9290  
**Portland** 9405 SW Nimbus Avenue, Beaverton, OR 97008-7132  
503.906.9200 fax 503.906.9210  
**Bend** 20332 Empire Avenue, Suite F-1, Bend, OR 97701-5711  
541.383.9310 fax 541.382.7588  
**Anchorage** 2000 W International Airport Road, Suite A-10, Anchorage, AK 99502-1119  
907.563.9200 fax 907.563.9210

05 April 2004

Dale Kerner  
Brown & Caldwell  
600 E. Riverpark Suite 210  
Boise, ID/USA 83706  
RE: Lakewood Towne Center

Enclosed are **amended** results of analyses for samples received by the laboratory on 03/03/04 14:30. If you have any questions concerning this report, please feel free to contact me.

Sincerely,

Jeanne Garthwaite  
Project Manager



**Seattle** 11720 North Creek Pkwy N, Suite 400, Bothell, WA 98011-8244  
 425.420.9200 fax 425.420.9210  
**Spokane** East 11115 Montgomery, Suite B, Spokane, WA 99206-4776  
 509.924.9200 fax 509.924.9290  
**Portland** 9405 SW Nimbus Avenue, Beaverton, OR 97008-7132  
 503.906.9200 fax 503.906.9210  
**Bend** 20332 Empire Avenue, Suite F-1, Bend, OR 97701-5711  
 541.383.9310 fax 541.382.7588  
**Anchorage** 2000 W International Airport Road, Suite A-10, Anchorage, AK 99502-1119  
 907.563.9200 fax 907.563.9210

Brown & Caldwell  
 600 E. Riverpark Suite 210  
 Boise, ID/USA 83706

Project: Lakewood Towne Center  
 Project Number: 24716.002  
 Project Manager: Dale Kerner

**Amended Report**  
 Issued: 04/02/04 16:36

**ANALYTICAL REPORT FOR SAMPLES - Amended**

Sample ID	Laboratory ID	Matrix	Date Sampled	Date Received
MW-1s LAKEWOOD TOWNE CENTER	B4C0104-01	Water	03/03/04 10:00	03/03/04 14:30
MW-3 LAKEWOOD TOWNE CENTER	B4C0104-02	Water	03/03/04 12:00	03/03/04 14:30
MW-4 LAKEWOOD TOWNE CENTER	B4C0104-03	Water	03/03/04 10:40	03/03/04 14:30
MW-5 LAKEWOOD TOWNE CENTER	B4C0104-04	Water	03/03/04 11:20	03/03/04 14:30
DUPLICATE	B4C0104-05	Water	03/03/04 12:00	03/03/04 14:30

North Creek Analytical - Bothell

*The results in this report apply to the samples analyzed in accordance with the chain of custody document. This analytical report must be reproduced in its entirety.*

Jeanne Garthwaite, Project Manager

North Creek Analytical, Inc.  
 Environmental Laboratory Network



**Seattle** 11720 North Creek Pkwy N, Suite 400, Bothell, WA 98011-8244  
425.420.9200 fax 425.420.9210  
**Spokane** East 11115 Montgomery, Suite B, Spokane, WA 99206-4776  
509.924.9200 fax 509.924.9290  
**Portland** 9405 SW Nimbus Avenue, Beaverton, OR 97008-7132  
503.906.9200 fax 503.906.9210  
**Bend** 20332 Empire Avenue, Suite F-1, Bend, OR 97701-5711  
541.383.9310 fax 541.382.7588  
**Anchorage** 2000 W International Airport Road, Suite A-10, Anchorage, AK 99502-1119  
907.563.9200 fax 907.563.9210

Brown & Caldwell  
600 E. Riverpark Suite 210  
Boise, ID/USA 83706

Project: Lakewood Towne Center  
Project Number: 24716.002  
Project Manager: Dale Kerner

**Amended Report**  
Issued: 04/02/04 16:36

**Volatile Organic Compounds by EPA Method 8260B**  
**North Creek Analytical - Bothell**

Analyte	Result	Reporting Limit	Units	Dilution	Batch	Prepared	Analyzed	Method	Notes
<b>MW-1s LAKEWOOD TOWNE CENTER (B4C0104-01) Water Sampled: 03/03/04 10:00 Received: 03/03/04 14:30</b>									
Acetone	ND	20.0	ug/l	1	4C08035	03/05/04	03/05/04	EPA 8260B	
Benzene	ND	1.00	"	"	"	"	"	"	
Bromobenzene	ND	1.00	"	"	"	"	"	"	
Bromochloromethane	ND	1.00	"	"	"	"	"	"	
Bromodichloromethane	ND	1.00	"	"	"	"	"	"	
Bromoform	ND	1.00	"	"	"	"	"	"	
Bromomethane	ND	2.00	"	"	"	"	"	"	
2-Butanone	ND	10.0	"	"	"	"	"	"	
n-Butylbenzene	ND	1.00	"	"	"	"	"	"	
sec-Butylbenzene	ND	1.00	"	"	"	"	"	"	
tert-Butylbenzene	ND	1.00	"	"	"	"	"	"	
Carbon disulfide	ND	1.00	"	"	"	"	"	"	
Carbon tetrachloride	ND	1.00	"	"	"	"	"	"	
Chlorobenzene	ND	1.00	"	"	"	"	"	"	
Chloroethane	ND	1.00	"	"	"	"	"	"	
Chloroform	ND	1.00	"	"	"	"	"	"	
Chloromethane	ND	5.00	"	"	"	"	"	"	
2-Chlorotoluene	ND	1.00	"	"	"	"	"	"	
4-Chlorotoluene	ND	1.00	"	"	"	"	"	"	
1,2-Dibromo-3-chloropropane	ND	5.00	"	"	"	"	"	"	
Dibromochloromethane	ND	1.00	"	"	"	"	"	"	
1,2-Dibromoethane	ND	1.00	"	"	"	"	"	"	
Dibromomethane	ND	1.00	"	"	"	"	"	"	
1,2-Dichlorobenzene	ND	1.00	"	"	"	"	"	"	
1,3-Dichlorobenzene	ND	1.00	"	"	"	"	"	"	
1,4-Dichlorobenzene	ND	1.00	"	"	"	"	"	"	
Dichlorodifluoromethane	ND	1.00	"	"	"	"	"	"	
<b>1,1-Dichloroethane</b>	<b>1.44</b>	1.00	"	"	"	"	"	"	
1,2-Dichloroethane	ND	1.00	"	"	"	"	"	"	
1,1-Dichloroethene	ND	1.00	"	"	"	"	"	"	
<b>cis-1,2-Dichloroethene</b>	<b>499</b>	1.00	"	"	"	"	"	"	E
<b>trans-1,2-Dichloroethene</b>	<b>6.77</b>	1.00	"	"	"	"	"	"	
1,2-Dichloropropane	ND	1.00	"	"	"	"	"	"	
1,3-Dichloropropane	ND	1.00	"	"	"	"	"	"	
2,2-Dichloropropane	ND	1.00	"	"	"	"	"	"	
1,1-Dichloropropene	ND	1.00	"	"	"	"	"	"	
cis-1,3-Dichloropropene	ND	1.00	"	"	"	"	"	"	
trans-1,3-Dichloropropene	ND	1.00	"	"	"	"	"	"	

North Creek Analytical - Bothell

The results in this report apply to the samples analyzed in accordance with the chain of custody document. This analytical report must be reproduced in its entirety.

Jeanne Garthwaite, Project Manager

North Creek Analytical, Inc.  
Environmental Laboratory Network



**Seattle** 11720 North Creek Pkwy N, Suite 400, Bothell, WA 98011-8244  
 425.420.9200 fax 425.420.9210  
**Spokane** East 11115 Montgomery, Suite B, Spokane, WA 99206-4776  
 509.924.9200 fax 509.924.9290  
**Portland** 9405 SW Nimbus Avenue, Beaverton, OR 97008-7132  
 503.906.9200 fax 503.906.9210  
**Bend** 20332 Empire Avenue, Suite F-1, Bend, OR 97701-5711  
 541.383.9310 fax 541.382.7588  
**Anchorage** 2000 W International Airport Road, Suite A-10, Anchorage, AK 99502-1119  
 907.563.9200 fax 907.563.9210

Brown & Caldwell  
 600 E. Riverpark Suite 210  
 Boise, ID/USA 83706

Project: Lakewood Towne Center  
 Project Number: 24716.002  
 Project Manager: Dale Kerner

**Amended Report**  
 Issued: 04/02/04 16:36

**Volatile Organic Compounds by EPA Method 8260B**  
**North Creek Analytical - Bothell**

Analyte	Result	Reporting Limit	Units	Dilution	Batch	Prepared	Analyzed	Method	Notes
<b>MW-1s LAKEWOOD TOWNE CENTER (B4C0104-01) Water Sampled: 03/03/04 10:00 Received: 03/03/04 14:30</b>									
Ethylbenzene	ND	1.00	ug/l	1	4C08035	03/05/04	03/05/04	EPA 8260B	
Hexachlorobutadiene	ND	1.00	"	"	"	"	"	"	
2-Hexanone	ND	10.0	"	"	"	"	"	"	
Isopropylbenzene	ND	1.00	"	"	"	"	"	"	
p-Isopropyltoluene	ND	1.00	"	"	"	"	"	"	
Methylene chloride	ND	5.00	"	"	"	"	"	"	
4-Methyl-2-pentanone	ND	10.0	"	"	"	"	"	"	
Naphthalene	ND	1.00	"	"	"	"	"	"	
n-Propylbenzene	ND	1.00	"	"	"	"	"	"	
Styrene	ND	1.00	"	"	"	"	"	"	
1,2,3-Trichlorobenzene	ND	1.00	"	"	"	"	"	"	
1,2,4-Trichlorobenzene	ND	1.00	"	"	"	"	"	"	
1,1,1,2-Tetrachloroethane	ND	1.00	"	"	"	"	"	"	
1,1,2,2-Tetrachloroethane	ND	1.00	"	"	"	"	"	"	
<b>Tetrachloroethene</b>	<b>1.36</b>	1.00	"	"	"	"	"	"	
Toluene	ND	1.00	"	"	"	"	"	"	
1,1,1-Trichloroethane	ND	1.00	"	"	"	"	"	"	
1,1,2-Trichloroethane	ND	1.00	"	"	"	"	"	"	
<b>Trichloroethene</b>	<b>6.26</b>	1.00	"	"	"	"	"	"	
Trichlorofluoromethane	ND	1.00	"	"	"	"	"	"	
1,2,3-Trichloropropane	ND	1.00	"	"	"	"	"	"	
1,2,4-Trimethylbenzene	ND	1.00	"	"	"	"	"	"	
1,3,5-Trimethylbenzene	ND	1.00	"	"	"	"	"	"	
<b>Vinyl chloride</b>	<b>102</b>	1.00	"	"	"	"	"	"	E
o-Xylene	ND	1.00	"	"	"	"	"	"	
m,p-Xylene	ND	2.00	"	"	"	"	"	"	
Surrogate: 1,2-DCA-d4	97.5 %	70-130			"	"	"	"	
Surrogate: Toluene-d8	99.5 %	70-130			"	"	"	"	
Surrogate: 4-BFB	100 %	70-130			"	"	"	"	

North Creek Analytical - Bothell

The results in this report apply to the samples analyzed in accordance with the chain of custody document. This analytical report must be reproduced in its entirety.

Jeanne Garthwaite, Project Manager

North Creek Analytical, Inc.  
Environmental Laboratory Network



**Seattle** 11720 North Creek Pkwy N, Suite 400, Bothell, WA 98011-8244  
 425.420.9200 fax 425.420.9210  
**Spokane** East 11115 Montgomery, Suite B, Spokane, WA 99206-4776  
 509.924.9200 fax 509.924.9290  
**Portland** 9405 SW Nimbus Avenue, Beaverton, OR 97008-7132  
 503.906.9200 fax 503.906.9210  
**Bend** 20332 Empire Avenue, Suite F-1, Bend, OR 97701-5711  
 541.383.9310 fax 541.382.7588  
**Anchorage** 2000 W International Airport Road, Suite A-10, Anchorage, AK 99502-1119  
 907.563.9200 fax 907.563.9210

Brown & Caldwell  
 600 E. Riverpark Suite 210  
 Boise, ID/USA 83706

Project: Lakewood Towne Center  
 Project Number: 24716.002  
 Project Manager: Dale Kerner

**Amended Report**  
 Issued: 04/02/04 16:36

**Volatile Organic Compounds by EPA Method 8260B**  
**North Creek Analytical - Bothell**

Analyte	Result	Reporting Limit	Units	Dilution	Batch	Prepared	Analyzed	Method	Notes
<b>MW-1s LAKEWOOD TOWNE CENTER (B4C0104-01RE1) Water Sampled: 03/03/04 10:00 Received: 03/03/04 14:30</b>									
Acetone	ND	500	ug/l	25	4C08043	03/08/04	03/08/04	EPA 8260B	
Benzene	ND	25.0	"	"	"	"	"	"	
Bromobenzene	ND	25.0	"	"	"	"	"	"	
Bromochloromethane	ND	25.0	"	"	"	"	"	"	
Bromodichloromethane	ND	25.0	"	"	"	"	"	"	
Bromoform	ND	25.0	"	"	"	"	"	"	
Bromomethane	ND	50.0	"	"	"	"	"	"	
2-Butanone	ND	250	"	"	"	"	"	"	
n-Butylbenzene	ND	25.0	"	"	"	"	"	"	
sec-Butylbenzene	ND	25.0	"	"	"	"	"	"	
tert-Butylbenzene	ND	25.0	"	"	"	"	"	"	
Carbon disulfide	ND	25.0	"	"	"	"	"	"	
Carbon tetrachloride	ND	25.0	"	"	"	"	"	"	
Chlorobenzene	ND	25.0	"	"	"	"	"	"	
Chloroethane	ND	25.0	"	"	"	"	"	"	
Chloroform	ND	25.0	"	"	"	"	"	"	
Chloromethane	ND	125	"	"	"	"	"	"	
2-Chlorotoluene	ND	25.0	"	"	"	"	"	"	
4-Chlorotoluene	ND	25.0	"	"	"	"	"	"	
1,2-Dibromo-3-chloropropane	ND	125	"	"	"	"	"	"	
Dibromochloromethane	ND	25.0	"	"	"	"	"	"	
1,2-Dibromoethane	ND	25.0	"	"	"	"	"	"	
Dibromomethane	ND	25.0	"	"	"	"	"	"	
1,2-Dichlorobenzene	ND	25.0	"	"	"	"	"	"	
1,3-Dichlorobenzene	ND	25.0	"	"	"	"	"	"	
1,4-Dichlorobenzene	ND	25.0	"	"	"	"	"	"	
Dichlorodifluoromethane	ND	25.0	"	"	"	"	"	"	
1,1-Dichloroethane	ND	25.0	"	"	"	"	"	"	
1,2-Dichloroethane	ND	25.0	"	"	"	"	"	"	
1,1-Dichloroethene	ND	25.0	"	"	"	"	"	"	
<b>cis-1,2-Dichloroethene</b>	<b>420</b>	25.0	"	"	"	"	"	"	
trans-1,2-Dichloroethene	ND	25.0	"	"	"	"	"	"	
1,2-Dichloropropane	ND	25.0	"	"	"	"	"	"	
1,3-Dichloropropane	ND	25.0	"	"	"	"	"	"	
2,2-Dichloropropane	ND	25.0	"	"	"	"	"	"	
1,1-Dichloropropene	ND	25.0	"	"	"	"	"	"	
cis-1,3-Dichloropropene	ND	25.0	"	"	"	"	"	"	
trans-1,3-Dichloropropene	ND	25.0	"	"	"	"	"	"	

North Creek Analytical - Bothell

*The results in this report apply to the samples analyzed in accordance with the chain of custody document. This analytical report must be reproduced in its entirety.*

Jeanne Garthwaite, Project Manager

North Creek Analytical, Inc.  
 Environmental Laboratory Network



**Seattle** 11720 North Creek Pkwy N, Suite 400, Bothell, WA 98011-8244  
 425.420.9200 fax 425.420.9210  
**Spokane** East 11115 Montgomery, Suite B, Spokane, WA 99206-4776  
 509.924.9200 fax 509.924.9290  
**Portland** 9405 SW Nimbus Avenue, Beaverton, OR 97008-7132  
 503.906.9200 fax 503.906.9210  
**Bend** 20332 Empire Avenue, Suite F-1, Bend, OR 97701-5711  
 541.383.9310 fax 541.382.7588  
**Anchorage** 2000 W International Airport Road, Suite A-10, Anchorage, AK 99502-1119  
 907.563.9200 fax 907.563.9210

Brown & Caldwell  
 600 E. Riverpark Suite 210  
 Boise, ID/USA 83706

Project: Lakewood Towne Center  
 Project Number: 24716.002  
 Project Manager: Dale Kerner

**Amended Report**  
 Issued: 04/02/04 16:36

**Volatile Organic Compounds by EPA Method 8260B**  
**North Creek Analytical - Bothell**

Analyte	Result	Reporting Limit	Units	Dilution	Batch	Prepared	Analyzed	Method	Notes
<b>MW-1s LAKEWOOD TOWNE CENTER (B4C0104-01RE1) Water Sampled: 03/03/04 10:00 Received: 03/03/04 14:30</b>									
Ethylbenzene	ND	25.0	ug/l	25	4C08043	03/08/04	03/08/04	EPA 8260B	
Hexachlorobutadiene	ND	25.0	"	"	"	"	"	"	
2-Hexanone	ND	250	"	"	"	"	"	"	
Isopropylbenzene	ND	25.0	"	"	"	"	"	"	
p-Isopropyltoluene	ND	25.0	"	"	"	"	"	"	
Methylene chloride	ND	125	"	"	"	"	"	"	
4-Methyl-2-pentanone	ND	250	"	"	"	"	"	"	
Naphthalene	ND	25.0	"	"	"	"	"	"	
n-Propylbenzene	ND	25.0	"	"	"	"	"	"	
Styrene	ND	25.0	"	"	"	"	"	"	
1,2,3-Trichlorobenzene	ND	25.0	"	"	"	"	"	"	
1,2,4-Trichlorobenzene	ND	25.0	"	"	"	"	"	"	
1,1,1,2-Tetrachloroethane	ND	25.0	"	"	"	"	"	"	
1,1,2,2-Tetrachloroethane	ND	25.0	"	"	"	"	"	"	
Tetrachloroethene	ND	25.0	"	"	"	"	"	"	
Toluene	ND	25.0	"	"	"	"	"	"	
1,1,1-Trichloroethane	ND	25.0	"	"	"	"	"	"	
1,1,2-Trichloroethane	ND	25.0	"	"	"	"	"	"	
Trichloroethene	ND	25.0	"	"	"	"	"	"	
Trichlorofluoromethane	ND	25.0	"	"	"	"	"	"	
1,2,3-Trichloropropane	ND	25.0	"	"	"	"	"	"	
1,2,4-Trimethylbenzene	ND	25.0	"	"	"	"	"	"	
1,3,5-Trimethylbenzene	ND	25.0	"	"	"	"	"	"	
<b>Vinyl chloride</b>	<b>91.8</b>	25.0	"	"	"	"	"	"	
o-Xylene	ND	25.0	"	"	"	"	"	"	
m,p-Xylene	ND	50.0	"	"	"	"	"	"	
Surrogate: 1,2-DCA-d4	88.0 %	70-130			"	"	"	"	
Surrogate: Toluene-d8	106 %	70-130			"	"	"	"	
Surrogate: 4-BFB	110 %	70-130			"	"	"	"	

North Creek Analytical - Bothell

*The results in this report apply to the samples analyzed in accordance with the chain of custody document. This analytical report must be reproduced in its entirety.*

Jeanne Garthwaite, Project Manager

North Creek Analytical, Inc.  
Environmental Laboratory Network



**Seattle** 11720 North Creek Pkwy N, Suite 400, Bothell, WA 98011-8244  
425.420.9200 fax 425.420.9210  
**Spokane** East 11115 Montgomery, Suite B, Spokane, WA 99206-4776  
509.924.9200 fax 509.924.9290  
**Portland** 9405 SW Nimbus Avenue, Beaverton, OR 97008-7132  
503.906.9200 fax 503.906.9210  
**Bend** 20332 Empire Avenue, Suite F-1, Bend, OR 97701-5711  
541.383.9310 fax 541.382.7588  
**Anchorage** 2000 W International Airport Road, Suite A-10, Anchorage, AK 99502-1119  
907.563.9200 fax 907.563.9210

Brown & Caldwell  
600 E. Riverpark Suite 210  
Boise, ID/USA 83706

Project: Lakewood Towne Center  
Project Number: 24716.002  
Project Manager: Dale Kerner

**Amended Report**  
Issued: 04/02/04 16:36

**Volatile Organic Compounds by EPA Method 8260B**  
**North Creek Analytical - Bothell**

Analyte	Reporting		Units	Dilution	Batch	Prepared	Analyzed	Method	Notes
	Result	Limit							
<b>MW-3 LAKEWOOD TOWNE CENTER (B4C0104-02) Water Sampled: 03/03/04 12:00 Received: 03/03/04 14:30</b>									
1,1,1,2-Tetrachloroethane	ND	0.200	ug/l	1	4C09047	03/05/04	03/05/04	EPA 8260B	
1,1,1-Trichloroethane	ND	0.200	"	"	"	"	"	"	
1,1,2,2-Tetrachloroethane	ND	0.500	"	"	"	"	"	"	
1,1,2-Trichloroethane	ND	0.200	"	"	"	"	"	"	
1,1-Dichloroethane	ND	0.200	"	"	"	"	"	"	
1,1-Dichloroethene	ND	0.200	"	"	"	"	"	"	
1,1-Dichloropropene	ND	0.200	"	"	"	"	"	"	
1,2,3-Trichlorobenzene	ND	0.200	"	"	"	"	"	"	
1,2,3-Trichloropropane	ND	0.500	"	"	"	"	"	"	
1,2,4-Trichlorobenzene	ND	0.200	"	"	"	"	"	"	
1,2,4-Trimethylbenzene	ND	0.200	"	"	"	"	"	"	
1,2-Dibromo-3-chloropropane	ND	0.500	"	"	"	"	"	"	
1,2-Dibromoethane	ND	0.200	"	"	"	"	"	"	
1,2-Dichlorobenzene	ND	0.200	"	"	"	"	"	"	
1,2-Dichloroethane	ND	0.200	"	"	"	"	"	"	
1,2-Dichloropropane	ND	0.200	"	"	"	"	"	"	
1,3,5-Trimethylbenzene	ND	0.500	"	"	"	"	"	"	
1,3-Dichlorobenzene	ND	0.200	"	"	"	"	"	"	
1,3-Dichloropropane	ND	0.200	"	"	"	"	"	"	
1,4-Dichlorobenzene	ND	0.200	"	"	"	"	"	"	
2,2-Dichloropropane	ND	0.500	"	"	"	"	"	"	
2-Butanone	ND	2.00	"	"	"	"	"	"	
2-Chlorotoluene	ND	0.500	"	"	"	"	"	"	
2-Hexanone	ND	2.00	"	"	"	"	"	"	
4-Chlorotoluene	ND	0.500	"	"	"	"	"	"	
4-Methyl-2-pentanone	ND	2.00	"	"	"	"	"	"	
Acetone	ND	10.0	"	"	"	"	"	"	
Benzene	ND	0.200	"	"	"	"	"	"	
Bromobenzene	ND	0.500	"	"	"	"	"	"	
Bromochloromethane	ND	0.200	"	"	"	"	"	"	
Bromodichloromethane	ND	0.200	"	"	"	"	"	"	
Bromoform	ND	0.200	"	"	"	"	"	"	
Bromomethane	ND	2.00	"	"	"	"	"	"	
Carbon disulfide	ND	0.500	"	"	"	"	"	"	
Carbon tetrachloride	ND	0.200	"	"	"	"	"	"	
Chlorobenzene	ND	0.200	"	"	"	"	"	"	
Chloroethane	ND	1.00	"	"	"	"	"	"	
Chloroform	ND	0.200	"	"	"	"	"	"	

North Creek Analytical - Bothell

*The results in this report apply to the samples analyzed in accordance with the chain of custody document. This analytical report must be reproduced in its entirety.*

Jeanne Garthwaite, Project Manager

North Creek Analytical, Inc.  
Environmental Laboratory Network



**Seattle** 11720 North Creek Pkwy N, Suite 400, Bothell, WA 98011-8244  
 425.420.9200 fax 425.420.9210  
**Spokane** East 11115 Montgomery, Suite B, Spokane, WA 99206-4776  
 509.924.9200 fax 509.924.9290  
**Portland** 9405 SW Nimbus Avenue, Beaverton, OR 97008-7132  
 503.906.9200 fax 503.906.9210  
**Bend** 20332 Empire Avenue, Suite F-1, Bend, OR 97701-5711  
 541.383.9310 fax 541.382.7588  
**Anchorage** 2000 W International Airport Road, Suite A-10, Anchorage, AK 99502-1119  
 907.563.9200 fax 907.563.9210

Brown & Caldwell  
 600 E. Riverpark Suite 210  
 Boise, ID/USA 83706

Project: Lakewood Towne Center  
 Project Number: 24716.002  
 Project Manager: Dale Kerner

**Amended Report**  
 Issued: 04/02/04 16:36

**Volatile Organic Compounds by EPA Method 8260B**  
**North Creek Analytical - Bothell**

Analyte	Result	Reporting Limit	Units	Dilution	Batch	Prepared	Analyzed	Method	Notes
<b>MW-3 LAKEWOOD TOWNE CENTER (B4C0104-02) Water Sampled: 03/03/04 12:00 Received: 03/03/04 14:30</b>									
Chloromethane	ND	1.00	ug/l	1	4C09047	03/05/04	03/05/04	EPA 8260B	
<b>cis-1,2-Dichloroethene</b>	<b>1.03</b>	0.200	"	"	"	"	"	"	
cis-1,3-Dichloropropene	ND	0.200	"	"	"	"	"	"	
Dibromochloromethane	ND	0.200	"	"	"	"	"	"	
Dibromomethane	ND	0.200	"	"	"	"	"	"	
Dichlorodifluoromethane	ND	0.500	"	"	"	"	"	"	
Ethylbenzene	ND	0.200	"	"	"	"	"	"	
Hexachlorobutadiene	ND	0.500	"	"	"	"	"	"	
Isopropylbenzene	ND	0.500	"	"	"	"	"	"	
m,p-Xylene	ND	0.500	"	"	"	"	"	"	
Methyl tert-butyl ether	ND	1.00	"	"	"	"	"	"	
Methylene chloride	ND	5.00	"	"	"	"	"	"	
n-Butylbenzene	ND	0.200	"	"	"	"	"	"	
n-Propylbenzene	ND	0.500	"	"	"	"	"	"	
Naphthalene	ND	0.500	"	"	"	"	"	"	
o-Xylene	ND	0.250	"	"	"	"	"	"	
p-Isopropyltoluene	ND	0.200	"	"	"	"	"	"	
sec-Butylbenzene	ND	0.200	"	"	"	"	"	"	
Styrene	ND	0.500	"	"	"	"	"	"	
tert-Butylbenzene	ND	0.500	"	"	"	"	"	"	
<b>Tetrachloroethene</b>	<b>0.600</b>	0.200	"	"	"	"	"	"	
Toluene	ND	0.200	"	"	"	"	"	"	
trans-1,2-Dichloroethene	ND	0.200	"	"	"	"	"	"	
trans-1,3-Dichloropropene	ND	0.200	"	"	"	"	"	"	
Trichloroethene	ND	0.200	"	"	"	"	"	"	
Trichlorofluoromethane	ND	0.500	"	"	"	"	"	"	
Vinyl chloride	ND	0.200	"	"	"	"	"	"	
Surrogate: 1,2-DCA-d4	104 %	70-130			"	"	"	"	
Surrogate: Toluene-d8	101 %	70-130			"	"	"	"	
Surrogate: 4-BFB	101 %	70-130			"	"	"	"	

North Creek Analytical - Bothell

*The results in this report apply to the samples analyzed in accordance with the chain of custody document. This analytical report must be reproduced in its entirety.*

Jeanne Garthwaite, Project Manager

North Creek Analytical, Inc.  
 Environmental Laboratory Network



**Seattle** 11720 North Creek Pkwy N, Suite 400, Bothell, WA 98011-8244  
 425.420.9200 fax 425.420.9210  
**Spokane** East 11115 Montgomery, Suite B, Spokane, WA 99206-4776  
 509.924.9200 fax 509.924.9290  
**Portland** 9405 SW Nimbus Avenue, Beaverton, OR 97008-7132  
 503.906.9200 fax 503.906.9210  
**Bend** 20332 Empire Avenue, Suite F-1, Bend, OR 97701-5711  
 541.383.9310 fax 541.382.7588  
**Anchorage** 2000 W International Airport Road, Suite A-10, Anchorage, AK 99502-1119  
 907.563.9200 fax 907.563.9210

Brown & Caldwell  
 600 E. Riverpark Suite 210  
 Boise, ID/USA 83706

Project: Lakewood Towne Center  
 Project Number: 24716.002  
 Project Manager: Dale Kerner

**Amended Report**  
 Issued: 04/02/04 16:36

**Volatile Organic Compounds by EPA Method 8260B**  
**North Creek Analytical - Bothell**

Analyte	Reporting		Units	Dilution	Batch	Prepared	Analyzed	Method	Notes
	Result	Limit							
<b>MW-4 LAKEWOOD TOWNE CENTER (B4C0104-03) Water Sampled: 03/03/04 10:40 Received: 03/03/04 14:30</b>									
Acetone	ND	20.0	ug/l	1	4C08035	03/05/04	03/05/04	EPA 8260B	
Benzene	ND	1.00	"	"	"	"	"	"	
Bromobenzene	ND	1.00	"	"	"	"	"	"	
Bromochloromethane	ND	1.00	"	"	"	"	"	"	
Bromodichloromethane	ND	1.00	"	"	"	"	"	"	
Bromoform	ND	1.00	"	"	"	"	"	"	
Bromomethane	ND	2.00	"	"	"	"	"	"	
2-Butanone	ND	10.0	"	"	"	"	"	"	
n-Butylbenzene	ND	1.00	"	"	"	"	"	"	
sec-Butylbenzene	ND	1.00	"	"	"	"	"	"	
tert-Butylbenzene	ND	1.00	"	"	"	"	"	"	
Carbon disulfide	ND	1.00	"	"	"	"	"	"	
Carbon tetrachloride	ND	1.00	"	"	"	"	"	"	
Chlorobenzene	ND	1.00	"	"	"	"	"	"	
Chloroethane	ND	1.00	"	"	"	"	"	"	
Chloroform	ND	1.00	"	"	"	"	"	"	
Chloromethane	ND	5.00	"	"	"	"	"	"	
2-Chlorotoluene	ND	1.00	"	"	"	"	"	"	
4-Chlorotoluene	ND	1.00	"	"	"	"	"	"	
1,2-Dibromo-3-chloropropane	ND	5.00	"	"	"	"	"	"	
Dibromochloromethane	ND	1.00	"	"	"	"	"	"	
1,2-Dibromoethane	ND	1.00	"	"	"	"	"	"	
Dibromomethane	ND	1.00	"	"	"	"	"	"	
1,2-Dichlorobenzene	ND	1.00	"	"	"	"	"	"	
1,3-Dichlorobenzene	ND	1.00	"	"	"	"	"	"	
1,4-Dichlorobenzene	ND	1.00	"	"	"	"	"	"	
Dichlorodifluoromethane	ND	1.00	"	"	"	"	"	"	
1,1-Dichloroethane	ND	1.00	"	"	"	"	"	"	
1,2-Dichloroethane	ND	1.00	"	"	"	"	"	"	
1,1-Dichloroethene	ND	1.00	"	"	"	"	"	"	
<b>cis-1,2-Dichloroethene</b>	<b>75.0</b>	1.00	"	"	"	"	"	"	
trans-1,2-Dichloroethene	ND	1.00	"	"	"	"	"	"	
1,2-Dichloropropane	ND	1.00	"	"	"	"	"	"	
1,3-Dichloropropane	ND	1.00	"	"	"	"	"	"	
2,2-Dichloropropane	ND	1.00	"	"	"	"	"	"	
1,1-Dichloropropene	ND	1.00	"	"	"	"	"	"	
cis-1,3-Dichloropropene	ND	1.00	"	"	"	"	"	"	
trans-1,3-Dichloropropene	ND	1.00	"	"	"	"	"	"	

North Creek Analytical - Bothell

*The results in this report apply to the samples analyzed in accordance with the chain of custody document. This analytical report must be reproduced in its entirety.*

Jeanne Garthwaite, Project Manager

North Creek Analytical, Inc.  
 Environmental Laboratory Network



**Seattle** 11720 North Creek Pkwy N, Suite 400, Bothell, WA 98011-8244  
425.420.9200 fax 425.420.9210  
**Spokane** East 11115 Montgomery, Suite B, Spokane, WA 99206-4776  
509.924.9200 fax 509.924.9290  
**Portland** 9405 SW Nimbus Avenue, Beaverton, OR 97008-7132  
503.906.9200 fax 503.906.9210  
**Bend** 20332 Empire Avenue, Suite F-1, Bend, OR 97701-5711  
541.383.9310 fax 541.382.7588  
**Anchorage** 2000 W International Airport Road, Suite A-10, Anchorage, AK 99502-1119  
907.563.9200 fax 907.563.9210

Brown & Caldwell  
600 E. Riverpark Suite 210  
Boise, ID/USA 83706

Project: Lakewood Towne Center  
Project Number: 24716.002  
Project Manager: Dale Kerner

**Amended Report**  
Issued: 04/02/04 16:36

**Volatile Organic Compounds by EPA Method 8260B**  
**North Creek Analytical - Bothell**

Analyte	Result	Reporting Limit	Units	Dilution	Batch	Prepared	Analyzed	Method	Notes
<b>MW-4 LAKEWOOD TOWNE CENTER (B4C0104-03) Water Sampled: 03/03/04 10:40 Received: 03/03/04 14:30</b>									
Ethylbenzene	ND	1.00	ug/l	1	4C08035	03/05/04	03/05/04	EPA 8260B	
Hexachlorobutadiene	ND	1.00	"	"	"	"	"	"	"
2-Hexanone	ND	10.0	"	"	"	"	"	"	"
Isopropylbenzene	ND	1.00	"	"	"	"	"	"	"
p-Isopropyltoluene	ND	1.00	"	"	"	"	"	"	"
Methylene chloride	ND	5.00	"	"	"	"	"	"	"
4-Methyl-2-pentanone	ND	10.0	"	"	"	"	"	"	"
Naphthalene	ND	1.00	"	"	"	"	"	"	"
n-Propylbenzene	ND	1.00	"	"	"	"	"	"	"
Styrene	ND	1.00	"	"	"	"	"	"	"
1,2,3-Trichlorobenzene	ND	1.00	"	"	"	"	"	"	"
1,2,4-Trichlorobenzene	ND	1.00	"	"	"	"	"	"	"
1,1,1,2-Tetrachloroethane	ND	1.00	"	"	"	"	"	"	"
1,1,1,2-Tetrachloroethane	ND	1.00	"	"	"	"	"	"	"
<b>Tetrachloroethene</b>	<b>2.40</b>	1.00	"	"	"	"	"	"	"
Toluene	ND	1.00	"	"	"	"	"	"	"
1,1,1-Trichloroethane	ND	1.00	"	"	"	"	"	"	"
1,1,2-Trichloroethane	ND	1.00	"	"	"	"	"	"	"
<b>Trichloroethene</b>	<b>4.34</b>	1.00	"	"	"	"	"	"	"
Trichlorofluoromethane	ND	1.00	"	"	"	"	"	"	"
1,2,3-Trichloropropane	ND	1.00	"	"	"	"	"	"	"
1,2,4-Trimethylbenzene	ND	1.00	"	"	"	"	"	"	"
1,3,5-Trimethylbenzene	ND	1.00	"	"	"	"	"	"	"
Vinyl chloride	ND	1.00	"	"	"	"	"	"	"
o-Xylene	ND	1.00	"	"	"	"	"	"	"
m,p-Xylene	ND	2.00	"	"	"	"	"	"	"
Surrogate: 1,2-DCA-d4	97.2 %	70-130			"	"	"	"	"
Surrogate: Toluene-d8	98.5 %	70-130			"	"	"	"	"
Surrogate: 4-BFB	100 %	70-130			"	"	"	"	"
1,1,1,2-Tetrachloroethane	ND	0.200	"	"	4C09047	03/05/04	03/05/04	"	"
1,1,1-Trichloroethane	ND	0.200	"	"	"	"	"	"	"
1,1,2,2-Tetrachloroethane	ND	0.500	"	"	"	"	"	"	"
1,1,2-Trichloroethane	ND	0.200	"	"	"	"	"	"	"
<b>1,1-Dichloroethane</b>	<b>0.210</b>	0.200	"	"	"	"	"	"	"
1,1-Dichloroethene	ND	0.200	"	"	"	"	"	"	"
1,1-Dichloropropene	ND	0.200	"	"	"	"	"	"	"
1,2,3-Trichlorobenzene	ND	0.200	"	"	"	"	"	"	"
1,2,3-Trichloropropane	ND	0.500	"	"	"	"	"	"	"

North Creek Analytical - Bothell

The results in this report apply to the samples analyzed in accordance with the chain of custody document. This analytical report must be reproduced in its entirety.

Jeanne Garthwaite, Project Manager

North Creek Analytical, Inc.  
Environmental Laboratory Network

Page 9 of 30



**Seattle** 11720 North Creek Pkwy N, Suite 400, Bothell, WA 98011-8244  
 425.420.9200 fax 425.420.9210  
**Spokane** East 11115 Montgomery, Suite B, Spokane, WA 99206-4776  
 509.924.9200 fax 509.924.9290  
**Portland** 9405 SW Nimbus Avenue, Beaverton, OR 97008-7132  
 503.906.9200 fax 503.906.9210  
**Bend** 20332 Empire Avenue, Suite F-1, Bend, OR 97701-5711  
 541.383.9310 fax 541.382.7588  
**Anchorage** 2000 W International Airport Road, Suite A-10, Anchorage, AK 99502-1119  
 907.563.9200 fax 907.563.9210

Brown & Caldwell  
 600 E. Riverpark Suite 210  
 Boise, ID/USA 83706

Project: Lakewood Towne Center  
 Project Number: 24716.002  
 Project Manager: Dale Kerner

**Amended Report**  
 Issued: 04/02/04 16:36

**Volatile Organic Compounds by EPA Method 8260B**  
**North Creek Analytical - Bothell**

Analyte	Result	Reporting Limit	Units	Dilution	Batch	Prepared	Analyzed	Method	Notes
<b>MW-4 LAKEWOOD TOWNE CENTER (B4C0104-03) Water Sampled: 03/03/04 10:40 Received: 03/03/04 14:30</b>									
1,2,4-Trichlorobenzene	ND	0.200	ug/l	1	4C09047	03/05/04	03/05/04	EPA 8260B	
1,2,4-Trimethylbenzene	ND	0.200	"	"	"	"	"	"	
1,2-Dibromo-3-chloropropane	ND	0.500	"	"	"	"	"	"	
1,2-Dibromoethane	ND	0.200	"	"	"	"	"	"	
1,2-Dichlorobenzene	ND	0.200	"	"	"	"	"	"	
1,2-Dichloroethane	ND	0.200	"	"	"	"	"	"	
1,2-Dichloropropane	ND	0.200	"	"	"	"	"	"	
1,3,5-Trimethylbenzene	ND	0.500	"	"	"	"	"	"	
1,3-Dichlorobenzene	ND	0.200	"	"	"	"	"	"	
1,3-Dichloropropane	ND	0.200	"	"	"	"	"	"	
1,4-Dichlorobenzene	ND	0.200	"	"	"	"	"	"	
2,2-Dichloropropane	ND	0.500	"	"	"	"	"	"	
2-Butanone	ND	2.00	"	"	"	"	"	"	
2-Chlorotoluene	ND	0.500	"	"	"	"	"	"	
2-Hexanone	ND	2.00	"	"	"	"	"	"	
4-Chlorotoluene	ND	0.500	"	"	"	"	"	"	
4-Methyl-2-pentanone	ND	2.00	"	"	"	"	"	"	
Acetone	ND	10.0	"	"	"	"	"	"	
Benzene	ND	0.200	"	"	"	"	"	"	
Bromobenzene	ND	0.500	"	"	"	"	"	"	
Bromochloromethane	ND	0.200	"	"	"	"	"	"	
Bromodichloromethane	ND	0.200	"	"	"	"	"	"	
Bromoform	ND	0.200	"	"	"	"	"	"	
Bromomethane	ND	2.00	"	"	"	"	"	"	
Carbon disulfide	ND	0.500	"	"	"	"	"	"	
Carbon tetrachloride	ND	0.200	"	"	"	"	"	"	
Chlorobenzene	ND	0.200	"	"	"	"	"	"	
Chloroethane	ND	1.00	"	"	"	"	"	"	
Chloroform	ND	0.200	"	"	"	"	"	"	
Chloromethane	ND	1.00	"	"	"	"	"	"	
<b>cis-1,2-Dichloroethene</b>	<b>62.8</b>	0.200	"	"	"	"	"	"	E
cis-1,3-Dichloropropene	ND	0.200	"	"	"	"	"	"	
Dibromochloromethane	ND	0.200	"	"	"	"	"	"	
Dibromomethane	ND	0.200	"	"	"	"	"	"	
Dichlorodifluoromethane	ND	0.500	"	"	"	"	"	"	
Ethylbenzene	ND	0.200	"	"	"	"	"	"	
Hexachlorobutadiene	ND	0.500	"	"	"	"	"	"	
Isopropylbenzene	ND	0.500	"	"	"	"	"	"	

North Creek Analytical - Bothell

*The results in this report apply to the samples analyzed in accordance with the chain of custody document. This analytical report must be reproduced in its entirety.*

Jeanne Garthwaite, Project Manager

North Creek Analytical, Inc.  
 Environmental Laboratory Network



**Seattle** 11720 North Creek Pkwy N, Suite 400, Bothell, WA 98011-8244  
425.420.9200 fax 425.420.9210  
**Spokane** East 11115 Montgomery, Suite B, Spokane, WA 99206-4776  
509.924.9200 fax 509.924.9290  
**Portland** 9405 SW Nimbus Avenue, Beaverton, OR 97008-7132  
503.906.9200 fax 503.906.9210  
**Bend** 20332 Empire Avenue, Suite F-1, Bend, OR 97701-5711  
541.383.9310 fax 541.382.7588  
**Anchorage** 2000 W International Airport Road, Suite A-10, Anchorage, AK 99502-1119  
907.563.9200 fax 907.563.9210

Brown & Caldwell  
600 E. Riverpark Suite 210  
Boise, ID/USA 83706

Project: Lakewood Towne Center  
Project Number: 24716.002  
Project Manager: Dale Kerner

**Amended Report**  
Issued: 04/02/04 16:36

**Volatile Organic Compounds by EPA Method 8260B**  
**North Creek Analytical - Bothell**

Analyte	Result	Reporting Limit	Units	Dilution	Batch	Prepared	Analyzed	Method	Notes
<b>MW-4 LAKEWOOD TOWNE CENTER (B4C0104-03) Water</b> <b>Sampled: 03/03/04 10:40</b> <b>Received: 03/03/04 14:30</b>									
m,p-Xylene	ND	0.500	ug/l	1	4C09047	03/05/04	03/05/04	EPA 8260B	
Methyl tert-butyl ether	ND	1.00	"	"	"	"	"	"	
Methylene chloride	ND	5.00	"	"	"	"	"	"	
n-Butylbenzene	ND	0.200	"	"	"	"	"	"	
n-Propylbenzene	ND	0.500	"	"	"	"	"	"	
Naphthalene	ND	0.500	"	"	"	"	"	"	
o-Xylene	ND	0.250	"	"	"	"	"	"	
p-Isopropyltoluene	ND	0.200	"	"	"	"	"	"	
sec-Butylbenzene	ND	0.200	"	"	"	"	"	"	
Styrene	ND	0.500	"	"	"	"	"	"	
tert-Butylbenzene	ND	0.500	"	"	"	"	"	"	
<b>Tetrachloroethene</b>	<b>2.09</b>	0.200	"	"	"	"	"	"	
Toluene	ND	0.200	"	"	"	"	"	"	
<b>trans-1,2-Dichloroethene</b>	<b>0.880</b>	0.200	"	"	"	"	"	"	
trans-1,3-Dichloropropene	ND	0.200	"	"	"	"	"	"	
<b>Trichloroethene</b>	<b>4.07</b>	0.200	"	"	"	"	"	"	
Trichlorofluoromethane	ND	0.500	"	"	"	"	"	"	
Vinyl chloride	ND	0.200	"	"	"	"	"	"	
<i>Surrogate: 1,2-DCA-d4</i>	<i>110 %</i>	<i>70-130</i>							
<i>Surrogate: Toluene-d8</i>	<i>97.2 %</i>	<i>70-130</i>							
<i>Surrogate: 4-BFB</i>	<i>99.0 %</i>	<i>70-130</i>							

**MW-5 LAKEWOOD TOWNE CENTER (B4C0104-04) Water** **Sampled: 03/03/04 11:20** **Received: 03/03/04 14:30**

1,1,1,2-Tetrachloroethane	ND	0.200	ug/l	1	4C09047	03/05/04	03/05/04	EPA 8260B	
1,1,1-Trichloroethane	ND	0.200	"	"	"	"	"	"	
1,1,2,2-Tetrachloroethane	ND	0.500	"	"	"	"	"	"	
1,1,2-Trichloroethane	ND	0.200	"	"	"	"	"	"	
1,1-Dichloroethane	ND	0.200	"	"	"	"	"	"	
1,1-Dichloroethene	ND	0.200	"	"	"	"	"	"	
1,1-Dichloropropene	ND	0.200	"	"	"	"	"	"	
1,2,3-Trichlorobenzene	ND	0.200	"	"	"	"	"	"	
1,2,3-Trichloropropane	ND	0.500	"	"	"	"	"	"	
1,2,4-Trichlorobenzene	ND	0.200	"	"	"	"	"	"	
1,2,4-Trimethylbenzene	ND	0.200	"	"	"	"	"	"	
1,2-Dibromo-3-chloropropane	ND	0.500	"	"	"	"	"	"	
1,2-Dibromoethane	ND	0.200	"	"	"	"	"	"	
1,2-Dichlorobenzene	ND	0.200	"	"	"	"	"	"	
1,2-Dichloroethane	ND	0.200	"	"	"	"	"	"	

North Creek Analytical - Bothell

*The results in this report apply to the samples analyzed in accordance with the chain of custody document. This analytical report must be reproduced in its entirety.*

*Jeanne Garthwaite*

Jeanne Garthwaite, Project Manager

North Creek Analytical, Inc.  
Environmental Laboratory Network



**Seattle** 11720 North Creek Pkwy N, Suite 400, Bothell, WA 98011-8244  
425.420.9200 fax 425.420.9210  
**Spokane** East 11115 Montgomery, Suite B, Spokane, WA 99206-4776  
509.924.9200 fax 509.924.9290  
**Portland** 9405 SW Nimbus Avenue, Beaverton, OR 97008-7132  
503.906.9200 fax 503.906.9210  
**Bend** 20332 Empire Avenue, Suite F-1, Bend, OR 97701-5711  
541.383.9310 fax 541.382.7588  
**Anchorage** 2000 W International Airport Road, Suite A-10, Anchorage, AK 99502-1119  
907.563.9200 fax 907.563.9210

Brown & Caldwell  
600 E. Riverpark Suite 210  
Boise, ID/USA 83706

Project: Lakewood Towne Center  
Project Number: 24716.002  
Project Manager: Dale Kerner

**Amended Report**  
Issued: 04/02/04 16:36

**Volatile Organic Compounds by EPA Method 8260B**  
**North Creek Analytical - Bothell**

Analyte	Result	Reporting Limit	Units	Dilution	Batch	Prepared	Analyzed	Method	Notes
<b>MW-5 LAKEWOOD TOWNE CENTER (B4C0104-04) Water Sampled: 03/03/04 11:20 Received: 03/03/04 14:30</b>									
1,2-Dichloropropane	ND	0.200	ug/l	1	4C09047	03/05/04	03/05/04	EPA 8260B	
1,3,5-Trimethylbenzene	ND	0.500	"	"	"	"	"	"	"
1,3-Dichlorobenzene	ND	0.200	"	"	"	"	"	"	"
1,3-Dichloropropane	ND	0.200	"	"	"	"	"	"	"
1,4-Dichlorobenzene	ND	0.200	"	"	"	"	"	"	"
2,2-Dichloropropane	ND	0.500	"	"	"	"	"	"	"
2-Butanone	ND	2.00	"	"	"	"	"	"	"
2-Chlorotoluene	ND	0.500	"	"	"	"	"	"	"
2-Hexanone	ND	2.00	"	"	"	"	"	"	"
4-Chlorotoluene	ND	0.500	"	"	"	"	"	"	"
4-Methyl-2-pentanone	ND	2.00	"	"	"	"	"	"	"
Acetone	ND	10.0	"	"	"	"	"	"	"
Benzene	ND	0.200	"	"	"	"	"	"	"
Bromobenzene	ND	0.500	"	"	"	"	"	"	"
Bromochloromethane	ND	0.200	"	"	"	"	"	"	"
Bromodichloromethane	ND	0.200	"	"	"	"	"	"	"
Bromoform	ND	0.200	"	"	"	"	"	"	"
Bromomethane	ND	2.00	"	"	"	"	"	"	"
Carbon disulfide	ND	0.500	"	"	"	"	"	"	"
Carbon tetrachloride	ND	0.200	"	"	"	"	"	"	"
Chlorobenzene	ND	0.200	"	"	"	"	"	"	"
Chloroethane	ND	1.00	"	"	"	"	"	"	"
Chloroform	ND	0.200	"	"	"	"	"	"	"
Chloromethane	ND	1.00	"	"	"	"	"	"	"
cis-1,2-Dichloroethene	ND	0.200	"	"	"	"	"	"	"
cis-1,3-Dichloropropene	ND	0.200	"	"	"	"	"	"	"
Dibromochloromethane	ND	0.200	"	"	"	"	"	"	"
Dibromomethane	ND	0.200	"	"	"	"	"	"	"
Dichlorodifluoromethane	ND	0.500	"	"	"	"	"	"	"
Ethylbenzene	ND	0.200	"	"	"	"	"	"	"
Hexachlorobutadiene	ND	0.500	"	"	"	"	"	"	"
Isopropylbenzene	ND	0.500	"	"	"	"	"	"	"
m,p-Xylene	ND	0.500	"	"	"	"	"	"	"
Methyl tert-butyl ether	ND	1.00	"	"	"	"	"	"	"
Methylene chloride	ND	5.00	"	"	"	"	"	"	"
n-Butylbenzene	ND	0.200	"	"	"	"	"	"	"
n-Propylbenzene	ND	0.500	"	"	"	"	"	"	"
Naphthalene	ND	0.500	"	"	"	"	"	"	"

North Creek Analytical - Bothell

*The results in this report apply to the samples analyzed in accordance with the chain of custody document. This analytical report must be reproduced in its entirety.*

Jeanne Garthwaite, Project Manager

North Creek Analytical, Inc.  
Environmental Laboratory Network



**Seattle** 11720 North Creek Pkwy N, Suite 400, Bothell, WA 98011-8244  
425.420.9200 fax 425.420.9210  
**Spokane** East 11115 Montgomery, Suite B, Spokane, WA 99206-4776  
509.924.9200 fax 509.924.9290  
**Portland** 9405 SW Nimbus Avenue, Beaverton, OR 97008-7132  
503.906.9200 fax 503.906.9210  
**Bend** 20332 Empire Avenue, Suite F-1, Bend, OR 97701-5711  
541.383.9310 fax 541.382.7588  
**Anchorage** 2000 W International Airport Road, Suite A-10, Anchorage, AK 99502-1119  
907.563.9200 fax 907.563.9210

Brown & Caldwell  
600 E. Riverpark Suite 210  
Boise, ID/USA 83706

Project: Lakewood Towne Center  
Project Number: 24716.002  
Project Manager: Dale Kerner

**Amended Report**  
Issued: 04/02/04 16:36

**Volatile Organic Compounds by EPA Method 8260B**  
**North Creek Analytical - Bothell**

Analyte	Result	Reporting Limit	Units	Dilution	Batch	Prepared	Analyzed	Method	Notes
---------	--------	-----------------	-------	----------	-------	----------	----------	--------	-------

**MW-5 LAKEWOOD TOWNE CENTER (B4C0104-04) Water Sampled: 03/03/04 11:20 Received: 03/03/04 14:30**

o-Xylene	ND	0.250	ug/l	1	4C09047	03/05/04	03/05/04	EPA 8260B	
p-Isopropyltoluene	ND	0.200	"	"	"	"	"	"	
sec-Butylbenzene	ND	0.200	"	"	"	"	"	"	
Styrene	ND	0.500	"	"	"	"	"	"	
tert-Butylbenzene	ND	0.500	"	"	"	"	"	"	
<b>Tetrachloroethene</b>	<b>0.550</b>	0.200	"	"	"	"	"	"	
Toluene	ND	0.200	"	"	"	"	"	"	
trans-1,2-Dichloroethene	ND	0.200	"	"	"	"	"	"	
trans-1,3-Dichloropropene	ND	0.200	"	"	"	"	"	"	
Trichloroethene	ND	0.200	"	"	"	"	"	"	
Trichlorofluoromethane	ND	0.500	"	"	"	"	"	"	
Vinyl chloride	ND	0.200	"	"	"	"	"	"	

Surrogate: 1,2-DCA-d4	110 %	70-130			"	"	"	"	
Surrogate: Toluene-d8	97.2 %	70-130			"	"	"	"	
Surrogate: 4-BFB	99.2 %	70-130			"	"	"	"	

**DUPLICATE (B4C0104-05) Water Sampled: 03/03/04 12:00 Received: 03/03/04 14:30**

Acetone	ND	20.0	ug/l	1	4C08035	03/05/04	03/05/04	EPA 8260B	
Benzene	ND	1.00	"	"	"	"	"	"	
Bromobenzene	ND	1.00	"	"	"	"	"	"	
Bromochloromethane	ND	1.00	"	"	"	"	"	"	
Bromodichloromethane	ND	1.00	"	"	"	"	"	"	
Bromoform	ND	1.00	"	"	"	"	"	"	
Bromomethane	ND	2.00	"	"	"	"	"	"	
2-Butanone	ND	10.0	"	"	"	"	"	"	
n-Butylbenzene	ND	1.00	"	"	"	"	"	"	
sec-Butylbenzene	ND	1.00	"	"	"	"	"	"	
tert-Butylbenzene	ND	1.00	"	"	"	"	"	"	
Carbon disulfide	ND	1.00	"	"	"	"	"	"	
Carbon tetrachloride	ND	1.00	"	"	"	"	"	"	
Chlorobenzene	ND	1.00	"	"	"	"	"	"	
Chloroethane	ND	1.00	"	"	"	"	"	"	
Chloroform	ND	1.00	"	"	"	"	"	"	
Chloromethane	ND	5.00	"	"	"	"	"	"	
2-Chlorotoluene	ND	1.00	"	"	"	"	"	"	
4-Chlorotoluene	ND	1.00	"	"	"	"	"	"	
1,2-Dibromo-3-chloropropane	ND	5.00	"	"	"	"	"	"	
Dibromochloromethane	ND	1.00	"	"	"	"	"	"	

North Creek Analytical - Bothell

The results in this report apply to the samples analyzed in accordance with the chain of custody document. This analytical report must be reproduced in its entirety.

*Jeanne Garthwaite*

Jeanne Garthwaite, Project Manager

North Creek Analytical, Inc.  
Environmental Laboratory Network

Page 13 of 30



**Seattle** 11720 North Creek Pkwy N, Suite 400, Bothell, WA 98011-8244  
425.420.9200 fax 425.420.9210  
**Spokane** East 11115 Montgomery, Suite B, Spokane, WA 99206-4776  
509.924.9200 fax 509.924.9290  
**Portland** 9405 SW Nimbus Avenue, Beaverton, OR 97008-7132  
503.906.9200 fax 503.906.9210  
**Bend** 20332 Empire Avenue, Suite F-1, Bend, OR 97701-5711  
541.383.9310 fax 541.382.7588  
**Anchorage** 2000 W International Airport Road, Suite A-10, Anchorage, AK 99502-1119  
907.563.9200 fax 907.563.9210

Brown & Caldwell  
600 E. Riverpark Suite 210  
Boise, ID/USA 83706

Project: Lakewood Towne Center  
Project Number: 24716.002  
Project Manager: Dale Kerner

**Amended Report**  
Issued: 04/02/04 16:36

**Volatile Organic Compounds by EPA Method 8260B**  
**North Creek Analytical - Bothell**

Analyte	Reporting		Units	Dilution	Batch	Prepared	Analyzed	Method	Notes
	Result	Limit							
<b>DUPLICATE (B4C0104-05) Water Sampled: 03/03/04 12:00 Received: 03/03/04 14:30</b>									
1,2-Dibromoethane	ND	1.00	ug/l	1	4C08035	03/05/04	03/05/04	EPA 8260B	
Dibromomethane	ND	1.00	"	"	"	"	"	"	
1,2-Dichlorobenzene	ND	1.00	"	"	"	"	"	"	
1,3-Dichlorobenzene	ND	1.00	"	"	"	"	"	"	
1,4-Dichlorobenzene	ND	1.00	"	"	"	"	"	"	
Dichlorodifluoromethane	ND	1.00	"	"	"	"	"	"	
<b>1,1-Dichloroethane</b>	<b>1.38</b>	1.00	"	"	"	"	"	"	
1,2-Dichloroethane	ND	1.00	"	"	"	"	"	"	
1,1-Dichloroethene	ND	1.00	"	"	"	"	"	"	
<b>cis-1,2-Dichloroethene</b>	<b>468</b>	1.00	"	"	"	"	"	"	E
<b>trans-1,2-Dichloroethene</b>	<b>6.28</b>	1.00	"	"	"	"	"	"	
1,2-Dichloropropane	ND	1.00	"	"	"	"	"	"	
1,3-Dichloropropane	ND	1.00	"	"	"	"	"	"	
2,2-Dichloropropane	ND	1.00	"	"	"	"	"	"	
1,1-Dichloropropene	ND	1.00	"	"	"	"	"	"	
cis-1,3-Dichloropropene	ND	1.00	"	"	"	"	"	"	
trans-1,3-Dichloropropene	ND	1.00	"	"	"	"	"	"	
Ethylbenzene	ND	1.00	"	"	"	"	"	"	
Hexachlorobutadiene	ND	1.00	"	"	"	"	"	"	
2-Hexanone	ND	10.0	"	"	"	"	"	"	
Isopropylbenzene	ND	1.00	"	"	"	"	"	"	
p-Isopropyltoluene	ND	1.00	"	"	"	"	"	"	
Methylene chloride	ND	5.00	"	"	"	"	"	"	
4-Methyl-2-pentanone	ND	10.0	"	"	"	"	"	"	
Naphthalene	ND	1.00	"	"	"	"	"	"	
n-Propylbenzene	ND	1.00	"	"	"	"	"	"	
Styrene	ND	1.00	"	"	"	"	"	"	
1,2,3-Trichlorobenzene	ND	1.00	"	"	"	"	"	"	
1,2,4-Trichlorobenzene	ND	1.00	"	"	"	"	"	"	
1,1,1,2-Tetrachloroethane	ND	1.00	"	"	"	"	"	"	
1,1,1,2,2-Tetrachloroethane	ND	1.00	"	"	"	"	"	"	
<b>Tetrachloroethene</b>	<b>1.55</b>	1.00	"	"	"	"	"	"	
Toluene	ND	1.00	"	"	"	"	"	"	
1,1,1-Trichloroethane	ND	1.00	"	"	"	"	"	"	
1,1,2-Trichloroethane	ND	1.00	"	"	"	"	"	"	
<b>Trichloroethene</b>	<b>6.12</b>	1.00	"	"	"	"	"	"	
Trichlorofluoromethane	ND	1.00	"	"	"	"	"	"	
1,2,3-Trichloropropane	ND	1.00	"	"	"	"	"	"	

North Creek Analytical - Bothell

The results in this report apply to the samples analyzed in accordance with the chain of custody document. This analytical report must be reproduced in its entirety.

*Jeanne Garthwaite*

Jeanne Garthwaite, Project Manager

North Creek Analytical, Inc.  
Environmental Laboratory Network



**Seattle** 11720 North Creek Pkwy N, Suite 400, Bothell, WA 98011-8244  
 425.420.9200 fax 425.420.9210  
**Spokane** East 11115 Montgomery, Suite B, Spokane, WA 99206-4776  
 509.924.9200 fax 509.924.9290  
**Portland** 9405 SW Nimbus Avenue, Beaverton, OR 97008-7132  
 503.906.9200 fax 503.906.9210  
**Bend** 20332 Empire Avenue, Suite F-1, Bend, OR 97701-5711  
 541.383.9310 fax 541.382.7588  
**Anchorage** 2000 W International Airport Road, Suite A-10, Anchorage, AK 99502-1119  
 907.563.9200 fax 907.563.9210

Brown & Caldwell  
 600 E. Riverpark Suite 210  
 Boise, ID/USA 83706

Project: Lakewood Towne Center  
 Project Number: 24716.002  
 Project Manager: Dale Kerner

**Amended Report**  
 Issued: 04/02/04 16:36

**Volatile Organic Compounds by EPA Method 8260B**  
**North Creek Analytical - Bothell**

Analyte	Result	Reporting Limit	Units	Dilution	Batch	Prepared	Analyzed	Method	Notes
---------	--------	-----------------	-------	----------	-------	----------	----------	--------	-------

**DUPLICATE (B4C0104-05) Water** Sampled: 03/03/04 12:00 Received: 03/03/04 14:30

1,2,4-Trimethylbenzene	ND	1.00	ug/l	1	4C08035	03/05/04	03/05/04	EPA 8260B	
1,3,5-Trimethylbenzene	ND	1.00	"	"	"	"	"	"	
<b>Vinyl chloride</b>	<b>90.9</b>	1.00	"	"	"	"	"	"	E
o-Xylene	ND	1.00	"	"	"	"	"	"	
m,p-Xylene	ND	2.00	"	"	"	"	"	"	
Surrogate: 1,2-DCA-d4	97.5 %	70-130			"	"	"	"	
Surrogate: Toluene-d8	100 %	70-130			"	"	"	"	
Surrogate: 4-BFB	101 %	70-130			"	"	"	"	

**DUPLICATE (B4C0104-05RE1) Water** Sampled: 03/03/04 12:00 Received: 03/03/04 14:30

Acetone	ND	500	ug/l	25	4C08043	03/08/04	03/08/04	EPA 8260B	
Benzene	ND	25.0	"	"	"	"	"	"	
Bromobenzene	ND	25.0	"	"	"	"	"	"	
Bromochloromethane	ND	25.0	"	"	"	"	"	"	
Bromodichloromethane	ND	25.0	"	"	"	"	"	"	
Bromoform	ND	25.0	"	"	"	"	"	"	
Bromomethane	ND	50.0	"	"	"	"	"	"	
2-Butanone	ND	250	"	"	"	"	"	"	
n-Butylbenzene	ND	25.0	"	"	"	"	"	"	
sec-Butylbenzene	ND	25.0	"	"	"	"	"	"	
tert-Butylbenzene	ND	25.0	"	"	"	"	"	"	
Carbon disulfide	ND	25.0	"	"	"	"	"	"	
Carbon tetrachloride	ND	25.0	"	"	"	"	"	"	
Chlorobenzene	ND	25.0	"	"	"	"	"	"	
Chloroethane	ND	25.0	"	"	"	"	"	"	
Chloroform	ND	25.0	"	"	"	"	"	"	
Chloromethane	ND	125	"	"	"	"	"	"	
2-Chlorotoluene	ND	25.0	"	"	"	"	"	"	
4-Chlorotoluene	ND	25.0	"	"	"	"	"	"	
1,2-Dibromo-3-chloropropane	ND	125	"	"	"	"	"	"	
Dibromochloromethane	ND	25.0	"	"	"	"	"	"	
1,2-Dibromoethane	ND	25.0	"	"	"	"	"	"	
Dibromomethane	ND	25.0	"	"	"	"	"	"	
1,2-Dichlorobenzene	ND	25.0	"	"	"	"	"	"	
1,3-Dichlorobenzene	ND	25.0	"	"	"	"	"	"	
1,4-Dichlorobenzene	ND	25.0	"	"	"	"	"	"	
Dichlorodifluoromethane	ND	25.0	"	"	"	"	"	"	
1,1-Dichloroethane	ND	25.0	"	"	"	"	"	"	

North Creek Analytical - Bothell

The results in this report apply to the samples analyzed in accordance with the chain of custody document. This analytical report must be reproduced in its entirety.

Jeanne Garthwaite, Project Manager

North Creek Analytical, Inc.  
 Environmental Laboratory Network

Page 15 of 30



**Seattle** 11720 North Creek Pkwy N, Suite 400, Bothell, WA 98011-8244  
425.420.9200 fax 425.420.9210  
**Spokane** East 11115 Montgomery, Suite B, Spokane, WA 99206-4776  
509.924.9200 fax 509.924.9290  
**Portland** 9405 SW Nimbus Avenue, Beaverton, OR 97008-7132  
503.906.9200 fax 503.906.9210  
**Bend** 20332 Empire Avenue, Suite F-1, Bend, OR 97701-5711  
541.383.9310 fax 541.382.7588  
**Anchorage** 2000 W International Airport Road, Suite A-10, Anchorage, AK 99502-1119  
907.563.9200 fax 907.563.9210

Brown & Caldwell  
600 E. Riverpark Suite 210  
Boise, ID/USA 83706

Project: Lakewood Towne Center  
Project Number: 24716.002  
Project Manager: Dale Kerner

**Amended Report**  
Issued: 04/02/04 16:36

**Volatile Organic Compounds by EPA Method 8260B**  
**North Creek Analytical - Bothell**

Analyte	Result	Reporting Limit	Units	Dilution	Batch	Prepared	Analyzed	Method	Notes
---------	--------	-----------------	-------	----------	-------	----------	----------	--------	-------

**DUPLICATE (B4C0104-05RE1) Water Sampled: 03/03/04 12:00 Received: 03/03/04 14:30**

1,2-Dichloroethane	ND	25.0	ug/l	25	4C08043	03/08/04	03/08/04	EPA 8260B	
1,1-Dichloroethene	ND	25.0	"	"	"	"	"	"	
<b>cis-1,2-Dichloroethene</b>	<b>403</b>	25.0	"	"	"	"	"	"	
trans-1,2-Dichloroethene	ND	25.0	"	"	"	"	"	"	
1,2-Dichloropropane	ND	25.0	"	"	"	"	"	"	
1,3-Dichloropropane	ND	25.0	"	"	"	"	"	"	
2,2-Dichloropropane	ND	25.0	"	"	"	"	"	"	
1,1-Dichloropropene	ND	25.0	"	"	"	"	"	"	
cis-1,3-Dichloropropene	ND	25.0	"	"	"	"	"	"	
trans-1,3-Dichloropropene	ND	25.0	"	"	"	"	"	"	
Ethylbenzene	ND	25.0	"	"	"	"	"	"	
Hexachlorobutadiene	ND	25.0	"	"	"	"	"	"	
2-Hexanone	ND	250	"	"	"	"	"	"	
Isopropylbenzene	ND	25.0	"	"	"	"	"	"	
p-Isopropyltoluene	ND	25.0	"	"	"	"	"	"	
Methylene chloride	ND	125	"	"	"	"	"	"	
4-Methyl-2-pentanone	ND	250	"	"	"	"	"	"	
Naphthalene	ND	25.0	"	"	"	"	"	"	
n-Propylbenzene	ND	25.0	"	"	"	"	"	"	
Styrene	ND	25.0	"	"	"	"	"	"	
1,2,3-Trichlorobenzene	ND	25.0	"	"	"	"	"	"	
1,2,4-Trichlorobenzene	ND	25.0	"	"	"	"	"	"	
1,1,1,2-Tetrachloroethane	ND	25.0	"	"	"	"	"	"	
1,1,2,2-Tetrachloroethane	ND	25.0	"	"	"	"	"	"	
Tetrachloroethene	ND	25.0	"	"	"	"	"	"	
Toluene	ND	25.0	"	"	"	"	"	"	
1,1,1-Trichloroethane	ND	25.0	"	"	"	"	"	"	
1,1,2-Trichloroethane	ND	25.0	"	"	"	"	"	"	
Trichloroethene	ND	25.0	"	"	"	"	"	"	
Trichlorofluoromethane	ND	25.0	"	"	"	"	"	"	
1,2,3-Trichloropropane	ND	25.0	"	"	"	"	"	"	
1,2,4-Trimethylbenzene	ND	25.0	"	"	"	"	"	"	
1,3,5-Trimethylbenzene	ND	25.0	"	"	"	"	"	"	
<b>Vinyl chloride</b>	<b>78.8</b>	25.0	"	"	"	"	"	"	
o-Xylene	ND	25.0	"	"	"	"	"	"	
m,p-Xylene	ND	50.0	"	"	"	"	"	"	

Surrogate: 1,2-DCA-d4 89.0 % 70-130  
Surrogate: Toluene-d8 109 % 70-130

North Creek Analytical - Bothell

The results in this report apply to the samples analyzed in accordance with the chain of custody document. This analytical report must be reproduced in its entirety.

Jeanne Garthwaite, Project Manager



**Seattle** 11720 North Creek Pkwy N, Suite 400, Bothell, WA 98011-8244  
 425.420.9200 fax 425.420.9210  
**Spokane** East 11115 Montgomery, Suite B, Spokane, WA 99206-4776  
 509.924.9200 fax 509.924.9290  
**Portland** 9405 SW Nimbus Avenue, Beaverton, OR 97008-7132  
 503.906.9200 fax 503.906.9210  
**Bend** 20332 Empire Avenue, Suite F-1, Bend, OR 97701-5711  
 541.383.9310 fax 541.382.7588  
**Anchorage** 2000 W International Airport Road, Suite A-10, Anchorage, AK 99502-1119  
 907.563.9200 fax 907.563.9210

Brown & Caldwell  
 600 E. Riverpark Suite 210  
 Boise, ID/USA 83706

Project: Lakewood Towne Center  
 Project Number: 24716.002  
 Project Manager: Dale Kerner

**Amended Report**  
 Issued: 04/02/04 16:36

**Volatile Organic Compounds by EPA Method 8260B**  
**North Creek Analytical - Bothell**

Analyte	Result	Reporting Limit	Units	Dilution	Batch	Prepared	Analyzed	Method	Notes
---------	--------	-----------------	-------	----------	-------	----------	----------	--------	-------

**DUPLICATE (B4C0104-05RE1) Water** Sampled: 03/03/04 12:00 Received: 03/03/04 14:30

Surrogate: 4-BFB 105 % 70-130 4C08043 03/08/04 03/08/04 EPA 8260B

North Creek Analytical - Bothell

*The results in this report apply to the samples analyzed in accordance with the chain of custody document. This analytical report must be reproduced in its entirety.*

Jeanne Garthwaite, Project Manager

North Creek Analytical, Inc.  
 Environmental Laboratory Network



**Seattle** 11720 North Creek Pkwy N, Suite 400, Bothell, WA 98011-8244  
 425.420.9200 fax 425.420.9210  
**Spokane** East 11115 Montgomery, Suite B, Spokane, WA 99206-4776  
 509.924.9200 fax 509.924.9290  
**Portland** 9405 SW Nimbus Avenue, Beaverton, OR 97008-7132  
 503.906.9200 fax 503.906.9210  
**Bend** 20332 Empire Avenue, Suite F-1, Bend, OR 97701-5711  
 541.383.9310 fax 541.382.7588  
**Anchorage** 2000 W International Airport Road, Suite A-10, Anchorage, AK 99502-1119  
 907.563.9200 fax 907.563.9210

Brown & Caldwell  
 600 E. Riverpark Suite 210  
 Boise, ID/USA 83706

Project: Lakewood Towne Center  
 Project Number: 24716.002  
 Project Manager: Dale Kerner

**Amended Report**  
 Issued: 04/02/04 16:36

**Volatile Organic Compounds by EPA Method 8260B - Quality Control**  
**North Creek Analytical - Bothell**

Analyte	Result	Reporting Limit	Units	Spike Level	Source Result	%REC	%REC Limits	RPD	RPD Limit	Notes
---------	--------	-----------------	-------	-------------	---------------	------	-------------	-----	-----------	-------

**Batch 4C08035: Prepared 03/05/04 Using EPA 5030B**

**Blank (4C08035-BLK1)**

Acetone	ND	20.0	ug/l							
Benzene	ND	1.00	"							
Bromobenzene	ND	1.00	"							
Bromochloromethane	ND	1.00	"							
Bromodichloromethane	ND	1.00	"							
Bromoform	ND	1.00	"							
Bromomethane	ND	2.00	"							
2-Butanone	ND	10.0	"							
n-Butylbenzene	ND	1.00	"							
sec-Butylbenzene	ND	1.00	"							
tert-Butylbenzene	ND	1.00	"							
Carbon disulfide	ND	1.00	"							
Carbon tetrachloride	ND	1.00	"							
Chlorobenzene	ND	1.00	"							
Chloroethane	ND	1.00	"							
Chloroform	ND	1.00	"							
Chloromethane	ND	5.00	"							
2-Chlorotoluene	ND	1.00	"							
4-Chlorotoluene	ND	1.00	"							
1,2-Dibromo-3-chloropropane	ND	5.00	"							
Dibromochloromethane	ND	1.00	"							
1,2-Dibromoethane	ND	1.00	"							
Dibromomethane	ND	1.00	"							
1,2-Dichlorobenzene	ND	1.00	"							
1,3-Dichlorobenzene	ND	1.00	"							
1,4-Dichlorobenzene	ND	1.00	"							
Dichlorodifluoromethane	ND	1.00	"							
1,1-Dichloroethane	ND	1.00	"							
1,2-Dichloroethane	ND	1.00	"							
1,1-Dichloroethene	ND	1.00	"							
cis-1,2-Dichloroethene	ND	1.00	"							
trans-1,2-Dichloroethene	ND	1.00	"							
1,2-Dichloropropane	ND	1.00	"							
1,3-Dichloropropane	ND	1.00	"							

North Creek Analytical - Bothell

*The results in this report apply to the samples analyzed in accordance with the chain of custody document. This analytical report must be reproduced in its entirety.*

Jeanne Garthwaite, Project Manager



**Seattle** 11720 North Creek Pkwy N, Suite 400, Bothell, WA 98011-8244  
 425.420.9200 fax 425.420.9210  
**Spokane** East 11115 Montgomery, Suite B, Spokane, WA 99206-4776  
 509.924.9200 fax 509.924.9290  
**Portland** 9405 SW Nimbus Avenue, Beaverton, OR 97008-7132  
 503.906.9200 fax 503.906.9210  
**Bend** 20332 Empire Avenue, Suite F-1, Bend, OR 97701-5711  
 541.383.9310 fax 541.382.7588  
**Anchorage** 2000 W International Airport Road, Suite A-10, Anchorage, AK 99502-1119  
 907.563.9200 fax 907.563.9210

Brown & Caldwell  
 600 E. Riverpark Suite 210  
 Boise, ID/USA 83706

Project: Lakewood Towne Center  
 Project Number: 24716.002  
 Project Manager: Dale Kerner

**Amended Report**  
 Issued: 04/02/04 16:36

**Volatile Organic Compounds by EPA Method 8260B - Quality Control**  
**North Creek Analytical - Bothell**

Analyte	Result	Reporting Limit	Units	Spike Level	Source Result	%REC	%REC Limits	RPD	RPD Limit	Notes
---------	--------	-----------------	-------	-------------	---------------	------	-------------	-----	-----------	-------

**Batch 4C08035: Prepared 03/05/04 Using EPA 5030B**

**Blank (4C08035-BLK1)**

2,2-Dichloropropane	ND	1.00	ug/l							
1,1-Dichloropropene	ND	1.00	"							
cis-1,3-Dichloropropene	ND	1.00	"							
trans-1,3-Dichloropropene	ND	1.00	"							
Ethylbenzene	ND	1.00	"							
Hexachlorobutadiene	ND	1.00	"							
2-Hexanone	ND	10.0	"							
Isopropylbenzene	ND	1.00	"							
p-Isopropyltoluene	ND	1.00	"							
Methylene chloride	ND	5.00	"							
4-Methyl-2-pentanone	ND	10.0	"							
Naphthalene	ND	1.00	"							
n-Propylbenzene	ND	1.00	"							
Styrene	ND	1.00	"							
1,2,3-Trichlorobenzene	ND	1.00	"							
1,2,4-Trichlorobenzene	ND	1.00	"							
1,1,1,2-Tetrachloroethane	ND	1.00	"							
1,1,2,2-Tetrachloroethane	ND	1.00	"							
Tetrachloroethene	ND	1.00	"							
Toluene	ND	1.00	"							
1,1,1-Trichloroethane	ND	1.00	"							
1,1,2-Trichloroethane	ND	1.00	"							
Trichloroethene	ND	1.00	"							
Trichlorofluoromethane	ND	1.00	"							
1,2,3-Trichloropropane	ND	1.00	"							
1,2,4-Trimethylbenzene	ND	1.00	"							
1,3,5-Trimethylbenzene	ND	1.00	"							
Vinyl chloride	ND	1.00	"							
o-Xylene	ND	1.00	"							
m,p-Xylene	ND	2.00	"							
Surrogate: 1,2-DCA-d4	37.9		"	40.0		94.8	70-130			
Surrogate: Toluene-d8	39.5		"	40.0		98.8	70-130			
Surrogate: 4-BFB	40.1		"	40.0		100	70-130			

North Creek Analytical - Bothell

The results in this report apply to the samples analyzed in accordance with the chain of custody document. This analytical report must be reproduced in its entirety.

Jeanne Garthwaite, Project Manager

North Creek Analytical, Inc.  
 Environmental Laboratory Network

Page 19 of 30



**Seattle** 11720 North Creek Pkwy N, Suite 400, Bothell, WA 98011-8244  
425.420.9200 fax 425.420.9210  
**Spokane** East 11115 Montgomery, Suite B, Spokane, WA 99206-4776  
509.924.9200 fax 509.924.9290  
**Portland** 9405 SW Nimbus Avenue, Beaverton, OR 97008-7132  
503.906.9200 fax 503.906.9210  
**Bend** 20332 Empire Avenue, Suite F-1, Bend, OR 97701-5711  
541.383.9310 fax 541.382.7588  
**Anchorage** 2000 W International Airport Road, Suite A-10, Anchorage, AK 99502-1119  
907.563.9200 fax 907.563.9210

Brown & Caldwell  
600 E. Riverpark Suite 210  
Boise, ID/USA 83706

Project: Lakewood Towne Center  
Project Number: 24716.002  
Project Manager: Dale Kerner

**Amended Report**  
Issued: 04/02/04 16:36

**Volatile Organic Compounds by EPA Method 8260B - Quality Control**  
**North Creek Analytical - Bothell**

Analyte	Result	Reporting Limit	Units	Spike Level	Source Result	%REC	%REC Limits	RPD	RPD Limit	Notes
---------	--------	-----------------	-------	-------------	---------------	------	-------------	-----	-----------	-------

**Batch 4C08035: Prepared 03/05/04 Using EPA 5030B**

**LCS (4C08035-BS1)**

Benzene	20.4	1.00	ug/l	20.0		102	80-120			
Chlorobenzene	21.3	1.00	"	20.0		106	77-120			
1,1-Dichloroethene	19.6	1.00	"	20.0		98.0	80-120			
Toluene	20.4	1.00	"	20.0		102	80-120			
Trichloroethene	20.3	1.00	"	20.0		102	80-120			
Surrogate: 1,2-DCA-d4	36.7		"	40.0		91.8	70-130			
Surrogate: Toluene-d8	39.1		"	40.0		97.8	70-130			
Surrogate: 4-BFB	40.6		"	40.0		102	70-130			

**LCS Dup (4C08035-BSD1)**

Benzene	22.2	1.00	ug/l	20.0		111	80-120	8.45	20	
Chlorobenzene	23.0	1.00	"	20.0		115	77-120	7.67	20	
1,1-Dichloroethene	22.6	1.00	"	20.0		113	80-120	14.2	20	
Toluene	22.6	1.00	"	20.0		113	80-120	10.2	20	
Trichloroethene	22.8	1.00	"	20.0		114	80-120	11.6	20	
Surrogate: 1,2-DCA-d4	37.7		"	40.0		94.2	70-130			
Surrogate: Toluene-d8	39.8		"	40.0		99.5	70-130			
Surrogate: 4-BFB	40.3		"	40.0		101	70-130			

**Batch 4C08043: Prepared 03/08/04 Using EPA 5030B**

**Blank (4C08043-BLK1)**

Acetone	ND	20.0	ug/l							
Benzene	ND	1.00	"							
Bromobenzene	ND	1.00	"							
Bromochloromethane	ND	1.00	"							
Bromodichloromethane	ND	1.00	"							
Bromoform	ND	1.00	"							
Bromomethane	ND	2.00	"							
2-Butanone	ND	10.0	"							
n-Butylbenzene	ND	1.00	"							
sec-Butylbenzene	ND	1.00	"							
tert-Butylbenzene	ND	1.00	"							
Carbon disulfide	ND	1.00	"							
Carbon tetrachloride	ND	1.00	"							
Chlorobenzene	ND	1.00	"							

North Creek Analytical - Bothell

*The results in this report apply to the samples analyzed in accordance with the chain of custody document. This analytical report must be reproduced in its entirety.*

*Jeanne Garthwaite*

Jeanne Garthwaite, Project Manager

North Creek Analytical, Inc.  
Environmental Laboratory Network

Page 20 of 30



**Seattle** 11720 North Creek Pkwy N, Suite 400, Bothell, WA 98011-8244  
 425.420.9200 fax 425.420.9210  
**Spokane** East 11115 Montgomery, Suite B, Spokane, WA 99206-4776  
 509.924.9200 fax 509.924.9290  
**Portland** 9405 SW Nimbus Avenue, Beaverton, OR 97008-7132  
 503.906.9200 fax 503.906.9210  
**Bend** 20332 Empire Avenue, Suite F-1, Bend, OR 97701-5711  
 541.383.9310 fax 541.382.7588  
**Anchorage** 2000 W International Airport Road, Suite A-10, Anchorage, AK 99502-1119  
 907.563.9200 fax 907.563.9210

Brown & Caldwell  
 600 E. Riverpark Suite 210  
 Boise, ID/USA 83706

Project: Lakewood Towne Center  
 Project Number: 24716.002  
 Project Manager: Dale Kerner

**Amended Report**  
 Issued: 04/02/04 16:36

**Volatile Organic Compounds by EPA Method 8260B - Quality Control**  
**North Creek Analytical - Bothell**

Analyte	Result	Reporting Limit	Units	Spike Level	Source Result	%REC	%REC Limits	RPD	RPD Limit	Notes
---------	--------	-----------------	-------	-------------	---------------	------	-------------	-----	-----------	-------

**Batch 4C08043: Prepared 03/08/04 Using EPA 5030B**

**Blank (4C08043-BLK1)**

Chloroethane	ND	1.00	ug/l							
Chloroform	ND	1.00	"							
Chloromethane	ND	5.00	"							
2-Chlorotoluene	ND	1.00	"							
4-Chlorotoluene	ND	1.00	"							
1,2-Dibromo-3-chloropropane	ND	5.00	"							
Dibromochloromethane	ND	1.00	"							
1,2-Dibromoethane	ND	1.00	"							
Dibromomethane	ND	1.00	"							
1,2-Dichlorobenzene	ND	1.00	"							
1,3-Dichlorobenzene	ND	1.00	"							
1,4-Dichlorobenzene	ND	1.00	"							
Dichlorodifluoromethane	ND	1.00	"							
1,1-Dichloroethane	ND	1.00	"							
1,2-Dichloroethane	ND	1.00	"							
1,1-Dichloroethene	ND	1.00	"							
cis-1,2-Dichloroethene	ND	1.00	"							
trans-1,2-Dichloroethene	ND	1.00	"							
1,2-Dichloropropane	ND	1.00	"							
1,3-Dichloropropane	ND	1.00	"							
2,2-Dichloropropane	ND	1.00	"							
1,1-Dichloropropene	ND	1.00	"							
cis-1,3-Dichloropropene	ND	1.00	"							
trans-1,3-Dichloropropene	ND	1.00	"							
Ethylbenzene	ND	1.00	"							
Hexachlorobutadiene	ND	1.00	"							
2-Hexanone	ND	10.0	"							
Isopropylbenzene	ND	1.00	"							
p-Isopropyltoluene	ND	1.00	"							
Methylene chloride	ND	5.00	"							
4-Methyl-2-pentanone	ND	10.0	"							
Naphthalene	ND	1.00	"							
n-Propylbenzene	ND	1.00	"							
Styrene	ND	1.00	"							
1,2,3-Trichlorobenzene	ND	1.00	"							

North Creek Analytical - Bothell

*The results in this report apply to the samples analyzed in accordance with the chain of custody document. This analytical report must be reproduced in its entirety.*

Jeanne Garthwaite, Project Manager

North Creek Analytical, Inc.  
 Environmental Laboratory Network

Page 21 of 30



**Seattle** 11720 North Creek Pkwy N, Suite 400, Bothell, WA 98011-8244  
425.420.9200 fax 425.420.9210  
**Spokane** East 11115 Montgomery, Suite B, Spokane, WA 99206-4776  
509.924.9200 fax 509.924.9290  
**Portland** 9405 SW Nimbus Avenue, Beaverton, OR 97008-7132  
503.906.9200 fax 503.906.9210  
**Bend** 20332 Empire Avenue, Suite F-1, Bend, OR 97701-5711  
541.383.9310 fax 541.382.7588  
**Anchorage** 2000 W International Airport Road, Suite A-10, Anchorage, AK 99502-1119  
907.563.9200 fax 907.563.9210

Brown & Caldwell  
600 E. Riverpark Suite 210  
Boise, ID/USA 83706

Project: Lakewood Towne Center  
Project Number: 24716.002  
Project Manager: Dale Kerner

**Amended Report**  
Issued: 04/02/04 16:36

**Volatile Organic Compounds by EPA Method 8260B - Quality Control**  
**North Creek Analytical - Bothell**

Analyte	Result	Reporting Limit	Units	Spike Level	Source Result	%REC	%REC Limits	RPD	RPD Limit	Notes
---------	--------	-----------------	-------	-------------	---------------	------	-------------	-----	-----------	-------

**Batch 4C08043: Prepared 03/08/04 Using EPA 5030B**

**Blank (4C08043-BLK1)**

1,2,4-Trichlorobenzene	ND	1.00	ug/l							
1,1,1,2-Tetrachloroethane	ND	1.00	"							
1,1,2,2-Tetrachloroethane	ND	1.00	"							
Tetrachloroethene	ND	1.00	"							
Toluene	ND	1.00	"							
1,1,1-Trichloroethane	ND	1.00	"							
1,1,2-Trichloroethane	ND	1.00	"							
Trichloroethene	ND	1.00	"							
Trichlorofluoromethane	ND	1.00	"							
1,2,3-Trichloropropane	ND	1.00	"							
1,2,4-Trimethylbenzene	ND	1.00	"							
1,3,5-Trimethylbenzene	ND	1.00	"							
Vinyl chloride	ND	1.00	"							
o-Xylene	ND	1.00	"							
m,p-Xylene	ND	2.00	"							
Surrogate: 1,2-DCA-d4	19.0		"	20.0		95.0	70-130			
Surrogate: Toluene-d8	23.5		"	20.0		118	70-130			
Surrogate: 4-BFB	21.0		"	20.0		105	70-130			

**LCS (4C08043-BS1)**

Benzene	9.50	1.00	ug/l	10.0		95.0	80-120			
Chlorobenzene	10.5	1.00	"	10.0		105	77-120			
1,1-Dichloroethene	8.78	1.00	"	10.0		87.8	80-120			
Toluene	9.67	1.00	"	10.0		96.7	80-120			
Trichloroethene	9.20	1.00	"	10.0		92.0	80-120			
Surrogate: 1,2-DCA-d4	18.8		"	20.0		94.0	70-130			
Surrogate: Toluene-d8	21.4		"	20.0		107	70-130			
Surrogate: 4-BFB	19.7		"	20.0		98.5	70-130			

North Creek Analytical - Bothell

*The results in this report apply to the samples analyzed in accordance with the chain of custody document. This analytical report must be reproduced in its entirety.*

*Jeanne Garthwaite*

Jeanne Garthwaite, Project Manager

North Creek Analytical, Inc.  
Environmental Laboratory Network

Page 22 of 30



**Seattle** 11720 North Creek Pkwy N, Suite 400, Bothell, WA 98011-8244  
 425.420.9200 fax 425.420.9210  
**Spokane** East 11115 Montgomery, Suite B, Spokane, WA 99206-4776  
 509.924.9200 fax 509.924.9290  
**Portland** 9405 SW Nimbus Avenue, Beaverton, OR 97008-7132  
 503.906.9200 fax 503.906.9210  
**Bend** 20332 Empire Avenue, Suite F-1, Bend, OR 97701-5711  
 541.383.9310 fax 541.382.7588  
**Anchorage** 2000 W International Airport Road, Suite A-10, Anchorage, AK 99502-1119  
 907.563.9200 fax 907.563.9210

Brown & Caldwell  
 600 E. Riverpark Suite 210  
 Boise, ID/USA 83706

Project: Lakewood Towne Center  
 Project Number: 24716.002  
 Project Manager: Dale Kerner

**Amended Report**  
 Issued: 04/02/04 16:36

**Volatile Organic Compounds by EPA Method 8260B - Quality Control**  
**North Creek Analytical - Bothell**

Analyte	Result	Reporting Limit	Units	Spike Level	Source Result	%REC	%REC Limits	RPD	RPD Limit	Notes
---------	--------	-----------------	-------	-------------	---------------	------	-------------	-----	-----------	-------

**Batch 4C08043: Prepared 03/08/04 Using EPA 5030B**

**LCS Dup (4C08043-BSD1)**

Benzene	9.64	1.00	ug/l	10.0		96.4	80-120	1.46	20	
Chlorobenzene	10.8	1.00	"	10.0		108	77-120	2.82	20	
1,1-Dichloroethene	9.55	1.00	"	10.0		95.5	80-120	8.40	20	
Toluene	10.7	1.00	"	10.0		107	80-120	10.1	20	
Trichloroethene	9.17	1.00	"	10.0		91.7	80-120	0.327	20	
Surrogate: 1,2-DCA-d4	19.3		"	20.0		96.5	70-130			
Surrogate: Toluene-d8	23.4		"	20.0		117	70-130			
Surrogate: 4-BFB	18.6		"	20.0		93.0	70-130			

**Matrix Spike (4C08043-MS1)**

**Source: B4C0123-01RE1**

Benzene	52.3	5.00	ug/l	50.0	2.85	98.9	63-148			
Chlorobenzene	50.6	5.00	"	50.0	ND	101	80-128			
1,1-Dichloroethene	48.8	5.00	"	50.0	ND	97.6	59-158			
Toluene	52.4	5.00	"	50.0	ND	105	72-127			
Trichloroethene	54.2	5.00	"	50.0	7.40	93.6	80-126			
Surrogate: 1,2-DCA-d4	18.9		"	20.0		94.5	70-130			
Surrogate: Toluene-d8	21.6		"	20.0		108	70-130			
Surrogate: 4-BFB	19.4		"	20.0		97.0	70-130			

**Matrix Spike Dup (4C08043-MSD1)**

**Source: B4C0123-01RE1**

Benzene	49.4	5.00	ug/l	50.0	2.85	93.1	63-148	5.70	20	
Chlorobenzene	50.4	5.00	"	50.0	ND	101	80-128	0.396	20	
1,1-Dichloroethene	46.8	5.00	"	50.0	ND	93.6	59-158	4.18	30	
Toluene	50.8	5.00	"	50.0	ND	102	72-127	3.10	20	
Trichloroethene	53.0	5.00	"	50.0	7.40	91.2	80-126	2.24	20	
Surrogate: 1,2-DCA-d4	18.1		"	20.0		90.5	70-130			
Surrogate: Toluene-d8	21.8		"	20.0		109	70-130			
Surrogate: 4-BFB	19.6		"	20.0		98.0	70-130			

North Creek Analytical - Bothell

The results in this report apply to the samples analyzed in accordance with the chain of custody document. This analytical report must be reproduced in its entirety.

*Jeanne Garthwaite*

Jeanne Garthwaite, Project Manager

North Creek Analytical, Inc.  
Environmental Laboratory Network

Page 23 of 30



**Seattle** 11720 North Creek Pkwy N, Suite 400, Bothell, WA 98011-8244  
425.420.9200 fax 425.420.9210  
**Spokane** East 11115 Montgomery, Suite B, Spokane, WA 99206-4776  
509.924.9200 fax 509.924.9290  
**Portland** 9405 SW Nimbus Avenue, Beaverton, OR 97008-7132  
503.906.9200 fax 503.906.9210  
**Bend** 20332 Empire Avenue, Suite F-1, Bend, OR 97701-5711  
541.383.9310 fax 541.382.7588  
**Anchorage** 2000 W International Airport Road, Suite A-10, Anchorage, AK 99502-1119  
907.563.9200 fax 907.563.9210

Brown & Caldwell  
600 E. Riverpark Suite 210  
Boise, ID/USA 83706

Project: Lakewood Towne Center  
Project Number: 24716.002  
Project Manager: Dale Kerner

**Amended Report**  
Issued: 04/02/04 16:36

**Volatile Organic Compounds by EPA Method 8260B - Quality Control**  
**North Creek Analytical - Bothell**

Analyte	Result	Reporting Limit	Units	Spike Level	Source Result	%REC	%REC Limits	RPD	RPD Limit	Notes
---------	--------	-----------------	-------	-------------	---------------	------	-------------	-----	-----------	-------

**Batch 4C09047: Prepared 03/05/04 Using EPA 5030B**

**Blank (4C09047-BLK1)**

1,1,1,2-Tetrachloroethane	ND	0.200	ug/l							
1,1,1-Trichloroethane	ND	0.200	"							
1,1,2,2-Tetrachloroethane	ND	0.500	"							
1,1,2-Trichloroethane	ND	0.200	"							
1,1-Dichloroethane	ND	0.200	"							
1,1-Dichloroethene	ND	0.200	"							
1,1-Dichloropropene	ND	0.200	"							
1,2,3-Trichlorobenzene	ND	0.200	"							
1,2,3-Trichloropropane	ND	0.500	"							
1,2,4-Trichlorobenzene	ND	0.200	"							
1,2,4-Trimethylbenzene	ND	0.200	"							
1,2-Dibromo-3-chloropropane	ND	0.500	"							
1,2-Dibromoethane	ND	0.200	"							
1,2-Dichlorobenzene	ND	0.200	"							
1,2-Dichloroethane	ND	0.200	"							
1,2-Dichloropropane	ND	0.200	"							
1,3,5-Trimethylbenzene	ND	0.500	"							
1,3-Dichlorobenzene	ND	0.200	"							
1,3-Dichloropropane	ND	0.200	"							
1,4-Dichlorobenzene	ND	0.200	"							
2,2-Dichloropropane	ND	0.500	"							
2-Butanone	ND	2.00	"							
2-Chlorotoluene	ND	0.500	"							
2-Hexanone	ND	2.00	"							
4-Chlorotoluene	ND	0.500	"							
4-Methyl-2-pentanone	ND	2.00	"							
Acetone	ND	10.0	"							
Benzene	ND	0.200	"							
Bromobenzene	ND	0.500	"							
Bromochloromethane	ND	0.200	"							
Bromodichloromethane	ND	0.200	"							
Bromoform	ND	0.200	"							
Bromomethane	ND	2.00	"							
Carbon disulfide	ND	0.500	"							
Carbon tetrachloride	ND	0.200	"							

North Creek Analytical - Bothell

*The results in this report apply to the samples analyzed in accordance with the chain of custody document. This analytical report must be reproduced in its entirety.*

*Jeanne Garthwaite*

Jeanne Garthwaite, Project Manager

North Creek Analytical, Inc.  
Environmental Laboratory Network

Page 24 of 30



**Seattle** 11720 North Creek Pkwy N, Suite 400, Bothell, WA 98011-8244  
 425.420.9200 fax 425.420.9210  
**Spokane** East 11115 Montgomery, Suite B, Spokane, WA 99206-4776  
 509.924.9200 fax 509.924.9290  
**Portland** 9405 SW Nimbus Avenue, Beaverton, OR 97008-7132  
 503.906.9200 fax 503.906.9210  
**Bend** 20332 Empire Avenue, Suite F-1, Bend, OR 97701-5711  
 541.383.9310 fax 541.382.7588  
**Anchorage** 2000 W International Airport Road, Suite A-10, Anchorage, AK 99502-1119  
 907.563.9200 fax 907.563.9210

Brown & Caldwell  
 600 E. Riverpark Suite 210  
 Boise, ID/USA 83706

Project: Lakewood Towne Center  
 Project Number: 24716.002  
 Project Manager: Dale Kerner

**Amended Report**  
 Issued: 04/02/04 16:36

**Volatile Organic Compounds by EPA Method 8260B - Quality Control**  
**North Creek Analytical - Bothell**

Analyte	Result	Reporting Limit	Units	Spike Level	Source Result	%REC	%REC Limits	RPD	RPD Limit	Notes
---------	--------	-----------------	-------	-------------	---------------	------	-------------	-----	-----------	-------

**Batch 4C09047: Prepared 03/05/04 Using EPA 5030B**

**Blank (4C09047-BLK1)**

Chlorobenzene	ND	0.200	ug/l							
Chloroethane	ND	1.00	"							
Chloroform	ND	0.200	"							
Chloromethane	ND	1.00	"							
cis-1,2-Dichloroethene	ND	0.200	"							
cis-1,3-Dichloropropene	ND	0.200	"							
Dibromochloromethane	ND	0.200	"							
Dibromomethane	ND	0.200	"							
Dichlorodifluoromethane	ND	0.500	"							
Ethylbenzene	ND	0.200	"							
Hexachlorobutadiene	ND	0.500	"							
Isopropylbenzene	ND	0.500	"							
m,p-Xylene	ND	0.500	"							
Methyl tert-butyl ether	ND	1.00	"							
Methylene chloride	ND	5.00	"							
n-Butylbenzene	ND	0.200	"							
n-Propylbenzene	ND	0.500	"							
Naphthalene	ND	0.500	"							
o-Xylene	ND	0.250	"							
p-Isopropyltoluene	ND	0.200	"							
sec-Butylbenzene	ND	0.200	"							
Styrene	ND	0.500	"							
tert-Butylbenzene	ND	0.500	"							
Tetrachloroethene	ND	0.200	"							
Toluene	ND	0.200	"							
trans-1,2-Dichloroethene	ND	0.200	"							
trans-1,3-Dichloropropene	ND	0.200	"							
Trichloroethene	ND	0.200	"							
Trichlorofluoromethane	ND	0.500	"							
Vinyl chloride	ND	0.200	"							
Surrogate: 1,2-DCA-d4	4.32		"	4.00		108	70-130			
Surrogate: Toluene-d8	3.92		"	4.00		98.0	70-130			
Surrogate: 4-BFB	3.99		"	4.00		99.8	70-130			

North Creek Analytical - Bothell

*The results in this report apply to the samples analyzed in accordance with the chain of custody document. This analytical report must be reproduced in its entirety.*

*Jeanne Garthwaite*

Jeanne Garthwaite, Project Manager

North Creek Analytical, Inc.  
 Environmental Laboratory Network

Page 25 of 30



**Seattle** 11720 North Creek Pkwy N, Suite 400, Bothell, WA 98011-8244  
 425.420.9200 fax 425.420.9210  
**Spokane** East 11115 Montgomery, Suite B, Spokane, WA 99206-4776  
 509.924.9200 fax 509.924.9290  
**Portland** 9405 SW Nimbus Avenue, Beaverton, OR 97008-7132  
 503.906.9200 fax 503.906.9210  
**Bend** 20332 Empire Avenue, Suite F-1, Bend, OR 97701-5711  
 541.383.9310 fax 541.382.7588  
**Anchorage** 2000 W International Airport Road, Suite A-10, Anchorage, AK 99502-1119  
 907.563.9200 fax 907.563.9210

Brown & Caldwell  
 600 E. Riverpark Suite 210  
 Boise, ID/USA 83706

Project: Lakewood Towne Center  
 Project Number: 24716.002  
 Project Manager: Dale Kerner

**Amended Report**  
 Issued: 04/02/04 16:36

**Volatile Organic Compounds by EPA Method 8260B - Quality Control**  
**North Creek Analytical - Bothell**

Analyte	Result	Reporting Limit	Units	Spike Level	Source Result	%REC	%REC Limits	RPD	RPD Limit	Notes
---------	--------	-----------------	-------	-------------	---------------	------	-------------	-----	-----------	-------

**Batch 4C09047: Prepared 03/05/04 Using EPA 5030B**

**LCS (4C09047-BS1)**

1,1,1,2-Tetrachloroethane	2.16	0.200	ug/l	2.00		108	80-120			
1,1,1-Trichloroethane	2.28	0.200	"	2.00		114	80-120			
1,1,2,2-Tetrachloroethane	1.90	0.500	"	2.00		95.0	80-120			
1,1,2-Trichloroethane	2.06	0.200	"	2.00		103	80-120			
1,1-Dichloroethane	2.16	0.200	"	2.00		108	80-120			
1,1-Dichloroethene	2.29	0.200	"	2.00		114	80-120			
1,1-Dichloropropene	2.27	0.200	"	2.00		114	80-120			
1,2,3-Trichlorobenzene	2.01	0.200	"	2.00		100	80-120			
1,2,3-Trichloropropane	1.94	0.500	"	2.00		97.0	80-120			
1,2,4-Trichlorobenzene	2.04	0.200	"	2.00		102	80-120			
1,2,4-Trimethylbenzene	2.09	0.200	"	2.00		104	80-120			
1,2-Dibromo-3-chloropropane	1.82	0.500	"	2.00		91.0	80-120			
1,2-Dibromoethane	2.03	0.200	"	2.00		102	80-120			
1,2-Dichlorobenzene	2.03	0.200	"	2.00		102	80-120			
1,2-Dichloroethane	2.09	0.200	"	2.00		104	80-120			
1,2-Dichloropropane	2.11	0.200	"	2.00		106	80-120			
1,3,5-Trimethylbenzene	2.19	0.500	"	2.00		110	80-120			
1,3-Dichlorobenzene	2.08	0.200	"	2.00		104	80-120			
1,3-Dichloropropane	1.95	0.200	"	2.00		97.5	80-120			
1,4-Dichlorobenzene	2.03	0.200	"	2.00		102	80-120			
2,2-Dichloropropane	2.38	0.500	"	2.00		119	80-120			
2-Butanone	20.1	2.00	"	20.0		100	80-120			
2-Chlorotoluene	2.01	0.500	"	2.00		100	80-120			
2-Hexanone	20.1	2.00	"	20.0		100	80-120			
4-Chlorotoluene	2.28	0.500	"	2.00		114	80-120			
4-Methyl-2-pentanone	20.0	2.00	"	20.0		100	80-120			
Acetone	19.3	10.0	"	20.0		96.5	80-120			
Benzene	2.16	0.200	"	2.00		108	80-120			
Bromobenzene	2.08	0.500	"	2.00		104	80-120			
Bromochloromethane	2.16	0.200	"	2.00		108	80-120			
Bromodichloromethane	2.14	0.200	"	2.00		107	80-120			
Bromoform	2.03	0.200	"	2.00		102	80-120			
Bromomethane	2.14	2.00	"	2.00		107	80-120			
Carbon disulfide	2.17	0.500	"	2.00		108	80-120			
Carbon tetrachloride	2.27	0.200	"	2.00		114	80-120			

North Creek Analytical - Bothell

*The results in this report apply to the samples analyzed in accordance with the chain of custody document. This analytical report must be reproduced in its entirety.*

*Jeanne Garthwaite*

Jeanne Garthwaite, Project Manager



**Seattle** 11720 North Creek Pkwy N, Suite 400, Bothell, WA 98011-8244  
425.420.9200 fax 425.420.9210  
**Spokane** East 11115 Montgomery, Suite B, Spokane, WA 99206-4776  
509.924.9200 fax 509.924.9290  
**Portland** 9405 SW Nimbus Avenue, Beaverton, OR 97008-7132  
503.906.9200 fax 503.906.9210  
**Bend** 20332 Empire Avenue, Suite F-1, Bend, OR 97701-5711  
541.383.9310 fax 541.382.7588  
**Anchorage** 2000 W International Airport Road, Suite A-10, Anchorage, AK 99502-1119  
907.563.9200 fax 907.563.9210

Brown & Caldwell  
600 E. Riverpark Suite 210  
Boise, ID/USA 83706

Project: Lakewood Towne Center  
Project Number: 24716.002  
Project Manager: Dale Kerner

**Amended Report**  
Issued: 04/02/04 16:36

**Volatile Organic Compounds by EPA Method 8260B - Quality Control**  
**North Creek Analytical - Bothell**

Analyte	Result	Reporting Limit	Units	Spike Level	Source Result	%REC	%REC Limits	RPD	RPD Limit	Notes
---------	--------	-----------------	-------	-------------	---------------	------	-------------	-----	-----------	-------

**Batch 4C09047: Prepared 03/05/04 Using EPA 5030B**

**LCS (4C09047-BS1)**

Chlorobenzene	2.14	0.200	ug/l	2.00		107	80-120			
Chloroethane	2.20	1.00	"	2.00		110	80-120			
Chloroform	2.04	0.200	"	2.00		102	80-120			
Chloromethane	2.20	1.00	"	2.00		110	80-120			
cis-1,2-Dichloroethene	2.13	0.200	"	2.00		106	80-120			
cis-1,3-Dichloropropene	2.11	0.200	"	2.00		106	80-120			
Dibromochloromethane	2.11	0.200	"	2.00		106	80-120			
Dibromomethane	1.99	0.200	"	2.00		99.5	80-120			
Dichlorodifluoromethane	2.36	0.500	"	2.00		118	80-120			
Ethylbenzene	2.21	0.200	"	2.00		110	80-120			
Hexachlorobutadiene	2.13	0.500	"	2.00		106	80-120			
Isopropylbenzene	2.24	0.500	"	2.00		112	80-120			
m,p-Xylene	4.34	0.500	"	4.00		108	80-120			
Methyl tert-butyl ether	2.04	1.00	"	2.00		102	80-120			
Methylene chloride	2.08	5.00	"	2.00		104	80-120			
n-Butylbenzene	2.26	0.200	"	2.00		113	80-120			
n-Propylbenzene	2.16	0.500	"	2.00		108	80-120			
Naphthalene	1.96	0.500	"	2.00		98.0	80-120			
o-Xylene	2.17	0.250	"	2.00		108	80-120			
p-Isopropyltoluene	2.18	0.200	"	2.00		109	80-120			
sec-Butylbenzene	2.17	0.200	"	2.00		108	80-120			
Styrene	2.15	0.500	"	2.00		108	80-120			
tert-Butylbenzene	2.14	0.500	"	2.00		107	80-120			
Tetrachloroethene	2.24	0.200	"	2.00		112	80-120			
Toluene	2.12	0.200	"	2.00		106	80-120			
trans-1,2-Dichloroethene	2.28	0.200	"	2.00		114	80-120			
trans-1,3-Dichloropropene	2.08	0.200	"	2.00		104	80-120			
Trichloroethene	2.22	0.200	"	2.00		111	80-120			
Trichlorofluoromethane	2.39	0.500	"	2.00		120	80-120			
Vinyl chloride	2.28	0.200	"	2.00		114	80-120			
Surrogate: 1,2-DCA-d4	4.15		"	4.00		104	70-130			
Surrogate: Toluene-d8	4.04		"	4.00		101	70-130			
Surrogate: 4-BFB	3.99		"	4.00		99.8	70-130			

North Creek Analytical - Bothell

*The results in this report apply to the samples analyzed in accordance with the chain of custody document. This analytical report must be reproduced in its entirety.*

*Jeanne Garthwaite*

Jeanne Garthwaite, Project Manager

North Creek Analytical, Inc.  
Environmental Laboratory Network

Page 27 of 30



**Seattle** 11720 North Creek Pkwy N, Suite 400, Bothell, WA 98011-8244  
425.420.9200 fax 425.420.9210  
**Spokane** East 11115 Montgomery, Suite B, Spokane, WA 99206-4776  
509.924.9200 fax 509.924.9290  
**Portland** 9405 SW Nimbus Avenue, Beaverton, OR 97008-7132  
503.906.9200 fax 503.906.9210  
**Bend** 20332 Empire Avenue, Suite F-1, Bend, OR 97701-5711  
541.383.9310 fax 541.382.7588  
**Anchorage** 2000 W International Airport Road, Suite A-10, Anchorage, AK 99502-1119  
907.563.9200 fax 907.563.9210

Brown & Caldwell 600 E. Riverpark Suite 210 Boise, ID/USA 83706	Project: Lakewood Towne Center Project Number: 24716.002 Project Manager: Dale Kerner	<b>Amended Report</b> Issued: 04/02/04 16:36
---	---	---

**Volatile Organic Compounds by EPA Method 8260B - Quality Control**  
**North Creek Analytical - Bothell**

Analyte	Result	Reporting Limit	Units	Spike Level	Source Result	%REC	%REC Limits	RPD	RPD Limit	Notes
---------	--------	-----------------	-------	-------------	---------------	------	-------------	-----	-----------	-------

**Batch 4C09047: Prepared 03/05/04 Using EPA 5030B**

**LCS Dup (4C09047-BSD1)**

1,1,1,2-Tetrachloroethane	2.07	0.200	ug/l	2.00		104	80-120	4.26	30	
1,1,1-Trichloroethane	2.32	0.200	"	2.00		116	80-120	1.74	30	
1,1,2,2-Tetrachloroethane	1.95	0.500	"	2.00		97.5	80-120	2.60	30	
1,1,2-Trichloroethane	2.00	0.200	"	2.00		100	80-120	2.96	30	
1,1-Dichloroethane	2.21	0.200	"	2.00		110	80-120	2.29	30	
1,1-Dichloroethene	2.24	0.200	"	2.00		112	80-120	2.21	30	
1,1-Dichloropropene	2.25	0.200	"	2.00		112	80-120	0.885	30	
1,2,3-Trichlorobenzene	1.97	0.200	"	2.00		98.5	80-120	2.01	30	
1,2,3-Trichloropropane	1.97	0.500	"	2.00		98.5	80-120	1.53	30	
1,2,4-Trichlorobenzene	1.97	0.200	"	2.00		98.5	80-120	3.49	30	
1,2,4-Trimethylbenzene	2.14	0.200	"	2.00		107	80-120	2.36	30	
1,2-Dibromo-3-chloropropane	2.02	0.500	"	2.00		101	80-120	10.4	30	
1,2-Dibromoethane	2.04	0.200	"	2.00		102	80-120	0.491	30	
1,2-Dichlorobenzene	2.00	0.200	"	2.00		100	80-120	1.49	30	
1,2-Dichloroethane	2.07	0.200	"	2.00		104	80-120	0.962	30	
1,2-Dichloropropane	2.09	0.200	"	2.00		104	80-120	0.952	30	
1,3,5-Trimethylbenzene	2.15	0.500	"	2.00		108	80-120	1.84	30	
1,3-Dichlorobenzene	2.06	0.200	"	2.00		103	80-120	0.966	30	
1,3-Dichloropropane	1.95	0.200	"	2.00		97.5	80-120	0.00	30	
1,4-Dichlorobenzene	2.04	0.200	"	2.00		102	80-120	0.491	30	
2,2-Dichloropropane	2.34	0.500	"	2.00		117	80-120	1.69	30	
2-Butanone	20.2	2.00	"	20.0		101	80-120	0.496	30	
2-Chlorotoluene	2.27	0.500	"	2.00		114	80-120	12.1	30	
2-Hexanone	20.3	2.00	"	20.0		102	80-120	0.990	30	
4-Chlorotoluene	1.99	0.500	"	2.00		99.5	80-120	13.6	30	
4-Methyl-2-pentanone	20.9	2.00	"	20.0		104	80-120	4.40	30	
Acetone	20.0	10.0	"	20.0		100	80-120	3.56	30	
Benzene	2.15	0.200	"	2.00		108	80-120	0.464	30	
Bromobenzene	2.04	0.500	"	2.00		102	80-120	1.94	30	
Bromochloromethane	2.09	0.200	"	2.00		104	80-120	3.29	30	
Bromodichloromethane	2.16	0.200	"	2.00		108	80-120	0.930	30	
Bromoform	1.96	0.200	"	2.00		98.0	80-120	3.51	30	
Bromomethane	2.12	2.00	"	2.00		106	80-120	0.939	30	
Carbon disulfide	2.17	0.500	"	2.00		108	80-120	0.00	30	
Carbon tetrachloride	2.43	0.200	"	2.00		122	80-120	6.81	30	Q-01

North Creek Analytical - Bothell

*The results in this report apply to the samples analyzed in accordance with the chain of custody document. This analytical report must be reproduced in its entirety.*

*Jeanne Garthwaite*

Jeanne Garthwaite, Project Manager

North Creek Analytical, Inc.  
Environmental Laboratory Network

Page 28 of 30



**Seattle** 11720 North Creek Pkwy N, Suite 400, Bothell, WA 98011-8244  
425.420.9200 fax 425.420.9210  
**Spokane** East 11115 Montgomery, Suite B, Spokane, WA 99206-4776  
509.924.9200 fax 509.924.9290  
**Portland** 9405 SW Nimbus Avenue, Beaverton, OR 97008-7132  
503.906.9200 fax 503.906.9210  
**Bend** 20332 Empire Avenue, Suite F-1, Bend, OR 97701-5711  
541.383.9310 fax 541.382.7588  
**Anchorage** 2000 W International Airport Road, Suite A-10, Anchorage, AK 99502-1119  
907.563.9200 fax 907.563.9210

Brown & Caldwell  
600 E. Riverpark Suite 210  
Boise, ID/USA 83706

Project: Lakewood Towne Center  
Project Number: 24716.002  
Project Manager: Dale Kerner

**Amended Report**  
Issued: 04/02/04 16:36

**Volatile Organic Compounds by EPA Method 8260B - Quality Control**  
**North Creek Analytical - Bothell**

Analyte	Result	Reporting Limit	Units	Spike Level	Source Result	%REC	%REC Limits	RPD	RPD Limit	Notes
---------	--------	-----------------	-------	-------------	---------------	------	-------------	-----	-----------	-------

**Batch 4C09047: Prepared 03/05/04 Using EPA 5030B**

**LCS Dup (4C09047-BSD1)**

Chlorobenzene	2.06	0.200	ug/l	2.00		103	80-120	3.81	30	
Chloroethane	2.23	1.00	"	2.00		112	80-120	1.35	30	
Chloroform	2.03	0.200	"	2.00		102	80-120	0.491	30	
Chloromethane	2.19	1.00	"	2.00		110	80-120	0.456	30	
cis-1,2-Dichloroethene	2.13	0.200	"	2.00		106	80-120	0.00	30	
cis-1,3-Dichloropropene	2.11	0.200	"	2.00		106	80-120	0.00	30	
Dibromochloromethane	2.03	0.200	"	2.00		102	80-120	3.86	30	
Dibromomethane	2.07	0.200	"	2.00		104	80-120	3.94	30	
Dichlorodifluoromethane	2.35	0.500	"	2.00		118	80-120	0.425	30	
Ethylbenzene	2.14	0.200	"	2.00		107	80-120	3.22	30	
Hexachlorobutadiene	2.14	0.500	"	2.00		107	80-120	0.468	30	
Isopropylbenzene	2.14	0.500	"	2.00		107	80-120	4.57	30	
m,p-Xylene	4.20	0.500	"	4.00		105	80-120	3.28	30	
Methyl tert-butyl ether	1.99	1.00	"	2.00		99.5	80-120	2.48	30	
Methylene chloride	2.00	5.00	"	2.00		100	80-120	3.92	30	
n-Butylbenzene	2.24	0.200	"	2.00		112	80-120	0.889	30	
n-Propylbenzene	2.13	0.500	"	2.00		106	80-120	1.40	30	
Naphthalene	1.82	0.500	"	2.00		91.0	80-120	7.41	30	
o-Xylene	2.10	0.250	"	2.00		105	80-120	3.28	30	
p-Isopropyltoluene	2.20	0.200	"	2.00		110	80-120	0.913	30	
sec-Butylbenzene	2.23	0.200	"	2.00		112	80-120	2.73	30	
Styrene	2.14	0.500	"	2.00		107	80-120	0.466	30	
tert-Butylbenzene	2.06	0.500	"	2.00		103	80-120	3.81	30	
Tetrachloroethene	2.09	0.200	"	2.00		104	80-120	6.93	30	
Toluene	2.08	0.200	"	2.00		104	80-120	1.90	30	
trans-1,2-Dichloroethene	2.24	0.200	"	2.00		112	80-120	1.77	30	
trans-1,3-Dichloropropene	2.06	0.200	"	2.00		103	80-120	0.966	30	
Trichloroethene	2.23	0.200	"	2.00		112	80-120	0.449	30	
Trichlorofluoromethane	2.32	0.500	"	2.00		116	80-120	2.97	30	
Vinyl chloride	2.22	0.200	"	2.00		111	80-120	2.67	30	
Surrogate: 1,2-DCA-d4	4.15		"	4.00		104	70-130			
Surrogate: Toluene-d8	4.01		"	4.00		100	70-130			
Surrogate: 4-BFB	3.94		"	4.00		98.5	70-130			

North Creek Analytical - Bothell

The results in this report apply to the samples analyzed in accordance with the chain of custody document. This analytical report must be reproduced in its entirety.

*Jeanne Garthwaite*

Jeanne Garthwaite, Project Manager

North Creek Analytical, Inc.  
Environmental Laboratory Network

Page 29 of 30



**Seattle** 11720 North Creek Pkwy N, Suite 400, Bothell, WA 98011-8244  
425.420.9200 fax 425.420.9210  
**Spokane** East 11115 Montgomery, Suite B, Spokane, WA 99206-4776  
509.924.9200 fax 509.924.9290  
**Portland** 9405 SW Nimbus Avenue, Beaverton, OR 97008-7132  
503.906.9200 fax 503.906.9210  
**Bend** 20332 Empire Avenue, Suite F-1, Bend, OR 97701-5711  
541.383.9310 fax 541.382.7588  
**Anchorage** 2000 W International Airport Road, Suite A-10, Anchorage, AK 99502-1119  
907.563.9200 fax 907.563.9210

Brown & Caldwell  
600 E. Riverpark Suite 210  
Boise, ID/USA 83706

Project: Lakewood Towne Center  
Project Number: 24716.002  
Project Manager: Dale Kerner

**Amended Report**  
Issued: 04/02/04 16:36

**Notes and Definitions**

- E Estimated value. The reported value exceeds the calibration range of the analysis.
- Q-01 The spike recovery for this QC sample is outside of established control limits. Review of associated batch QC indicates the recovery for this analyte does not represent an out-of-control condition for the batch.
- DET Analyte DETECTED
- ND Analyte NOT DETECTED at or above the reporting limit
- NR Not Reported
- dry Sample results reported on a dry weight basis
- RPD Relative Percent Difference

North Creek Analytical - Bothell

Jeanne Garthwaite, Project Manager

*The results in this report apply to the samples analyzed in accordance with the chain of custody document. This analytical report must be reproduced in its entirety.*

North Creek Analytical, Inc.  
Environmental Laboratory Network



11720 North Creek Pkwy N Suite 400, Bothell, WA 98011-9508  
 11115 E. Montgomery Suite B, Spokane, WA 99206-4776  
 9405 SW Nimbus Ave, Beaverton, OR 97008-7132  
 20332 Empire Ave Suite F-1, Bend, OR 99701-5711  
 3209 Denali St, Anchorage, AK 99503-4030

425-420-9200 FAX 420-9210  
 509-924-9200 FAX 924-9290  
 503-906-9200 FAX 906-9210  
 541-383-9310 FAX 382-7588  
 907-334-9200 FAX 334-9210

### CHAIN OF CUSTODY REPORT

Work Order #: **B40104**

CLIENT: <b>BROWN AND CALDWELL</b>		INVOICE TO:	
REPORT TO: <b>DALE KERNER / ADA HAMILTON</b>		ADDRESS: <b>701 PIKE ST, SUITE 1200, SEATTLE, WA 98101</b>	
EMAIL: <b>dkerner@brwnclld.com</b>		PHONE: <b>206 624 0100 FAX: 206 749 9200</b>	
PROJECT NAME: <b>LAKEWOOD TOWNE CENTER</b>		PRESERVATIVE:	
PROJECT NUMBER: <b>247161002</b>		REQUESTED ANALYSES:	
SAMPLED BY: <b>ADA HAMILTON</b>			
CLIENT SAMPLE IDENTIFICATION	SAMPLING DATE/TIME		
1. <b>MW-1S LAKEWOOD TOWNE CENTER</b>	<b>10:00 03-03-04</b>	<b>X</b>	<b>8260</b>
2. <b>MW-3 LAKEWOOD TOWNE CENTER</b>	<b>12:00 03-03-04</b>	<b>X</b>	
3. <b>MW-4 LAKEWOOD TOWNE CENTER</b>	<b>10:40 03-03-04</b>	<b>X</b>	
4. <b>MW-5 LAKEWOOD TOWNE CENTER</b>	<b>11:20 03-03-04</b>	<b>X</b>	
5. <b>DUPLICATE LAKEWOOD TOWNE CENTER</b>	<b>03-03-04</b>	<b>X</b>	
6			
7			
8			
9			
10			

**TURNAROUND REQUEST**  
 in Business Days \*  
 Organic & Inorganic Analyses  
 Petroleum Hydrocarbon Analyses  
 STD.  7  5  4  3  2  1  <1

OTHER Specify: \_\_\_\_\_  
 \* Turnaround Requests less than standard may incur Rush Charges.

MATRIX (W, S, O)	# OF CONT.	LOCATION / COMMENTS	NCA WO ID
W	3		01
W	3		02
W	3		03
W	3		04
W	3		05

RECEIVED BY: **Collette Weaver** DATE: **3-3-04**  
 PRINT NAME: **COLLETTE WEAVER** FIRM: **NCA** TIME: **1430**  
 RECEIVED BY: \_\_\_\_\_ DATE: \_\_\_\_\_  
 PRINT NAME: \_\_\_\_\_ FIRM: \_\_\_\_\_ TIME: \_\_\_\_\_

RELEASED BY: **ADA Hamilton** DATE: **03-03-04**  
 PRINT NAME: **ADA HAMILTON** FIRM: **BROWN AND CALDWELL** TIME: **2:30 PM**  
 RELEASED BY: \_\_\_\_\_ DATE: \_\_\_\_\_  
 PRINT NAME: \_\_\_\_\_ FIRM: \_\_\_\_\_ TIME: \_\_\_\_\_

**ATTACHMENT B**  
**NORTH CREEK ANALYTICAL EXPLANATION**



Seattle 11720 North Creek Pkwy N, Suite 400, Bothell, WA 98011-8244  
425.420.9200 fax 425.420.9210

Spokane 11922 E. 1st Avenue, Spokane Valley, WA 99206-5302  
509.924.9200 fax 509.924.9290

Portland 9405 SW Nimbus Avenue, Beaverton, OR 97008-7132  
503.906.9200 fax 503.906.9210

Bend 20332 Empire Avenue, Suite F-1, Bend, OR 97701-5711  
541.383.9310 fax 541.382.7588

Anchorage 2000 W. International Airport Road, Suite A10, Anchorage, AK 99502-1119  
907.563.9200 fax 907.563.9210

## Amended Report for B4C0104

Client: Brown & Caldwell  
Project Manager: Dale Kerner  
Project Name: Lakewood Towne Center  
Original report Date: 3/16/04

This amended report is being issued due to error(s) in the original report you received.

Amendment(s) from the original report include:

Sample MW-4 Lakewood Towne Center was analyzed by method 8260B-25 ml purge in batch 4C09047 on 3/5/04. The sample had a hit for the compound cis-1, 2-Dichloroethene that was over the calibration range of the instrument. The sample was re-analyzed by method 8260B-10 ml purge in batch 4C08035 on 3/5/04. The results for MW-4 Lakewood Towne Center were incorrectly reported for two compounds.

The compound cis-1, 2-Dichloroethene was incorrectly reported with an E notation in batch 4C08035. It should not have been E flagged as it was within the calibration range of the instrument. The E notation has been removed in the amended results.

Dibromochloromethane was incorrectly reported in batch 4C09047 as a result of 2.27 ug/l. The compound was review and found that it was incorrectly reported. The misidentification occurred because the retention time was within the appropriate window and one ion was present so it looked much like dibromochloromethane. The review showed that the secondary ions that would positively identify that compound were not present. It was determined that the compound was tetrachloroethene, which was previously reported. The sample was non-detect for dibromochloromethane and is reported as such in the amended report.

No other information included in the original report has changed.

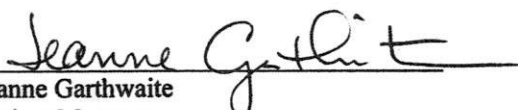
  
Jeanne Garthwaite  
Project Manager  
North Creek Analytical