

Table 4-9. Summary of Analytical Groundwater Data - Carbon Tetrachloride, Chloroform, and Carbon Disulfide

Location	Sample Date	Group	Type	Depth	Carbon disulfide	Carbon tetrachloride	Chloroform
					NE	Screening Levels (µg/L)	1.4
					800	0.63 NU	NU
MTCA Method B Cancer MTCA Method B Non-cancer					Analytical Data (µg/L)		
Asher Well	11/30/2016	Domestic Well	N	90	0.2 U	0.079 U	0.21 U
	2/24/2017	Domestic Well	N	90	0.2 U	0.079 U	0.21 U
	6/5/2017	Domestic Well	N	90	0.2 U	0.079 U	0.21 U
	9/12/2017	Domestic Well	N	90	0.37 U	0.2 U	0.46 U
	1/5/2018	Domestic Well	N	90	0.37 UJ	0.2 U	0.46 U
	1/5/2018	Domestic Well	FD	90	0.37 U	0.2 U	0.46 U
	3/20/2018	Domestic Well	N	90	0.37 U	0.2 U	0.46 U
	3/20/2018	Domestic Well	FD	90	0.37 U	0.2 U	0.46 U
	6/27/2018	Domestic Well	N	90	0.078 U	0.19 U	0.45 U
	9/28/2018	Domestic Well	N	90	0.078 UJ	0.19 U	0.45 U
	1/7/2019	Domestic Well	N	90	0.078 UJ	0.19 U	0.45 U
	3/21/2019	Domestic Well	N	90	0.078 U	0.19 U	0.45 U
	6/13/2019	Domestic Well	N	90	0.078 U	0.19 U	0.45 U
	10/3/2019	Domestic Well	N	90	0.19 U	0.19 U	0.45 U
	Atwood House	1/4/2018	Domestic Well	N	NA	0.37 UJ	0.2 U
3/19/2018		Domestic Well	N	NA	0.37 U	0.2 U	0.46 U
3/19/2018		Domestic Well	FD	NA	0.37 U	0.2 U	0.46 U
7/31/2018		Domestic Well	N	NA	0.078 U	0.19 U	0.45 U
9/28/2018		Domestic Well	N	NA	0.078 UJ	0.19 U	0.45 U
1/4/2019		Domestic Well	N	NA	0.078 U	0.19 U	0.45 U
3/21/2019		Domestic Well	N	NA	0.078 U	0.19 U	0.45 U
Atwood Shop	6/17/2019	Domestic Well	N	NA	0.078 U	0.19 U	0.45 U
	1/4/2018	Domestic Well	N	NA	0.37 UJ	0.2 U	0.46 U
	3/19/2018	Domestic Well	N	NA	0.37 U	0.2 U	0.46 U
	7/31/2018	Domestic Well	N	NA	0.078 U	0.19 U	0.45 U
	9/28/2018	Domestic Well	N	NA	0.078 UJ	0.19 U	0.45 U
	1/4/2019	Domestic Well	N	NA	0.078 UJ	0.19 UJ	0.45 UJ
	3/21/2019	Domestic Well	N	NA	0.078 U	0.19 U	0.45 U
Davey Well (W46)	6/17/2019	Domestic Well	N	NA	0.078 U	0.19 U	0.45 U
	7/27/2016	Domestic Well	N	NA	0.2 U	18.3	5.3
	9/8/2016	Domestic Well	N	NA	0.042 U	22.3	5.8
Freeman Store Well	2/24/2017	Domestic Well	N	NA	0.2 U	17	4.6
	1/21/2013	Domestic Well	N	NA	1 U	1 U	1 U
	7/27/2016	Domestic Well	N	NA	0.2 U	0.079 U	0.21 U
Lang Well	8/19/2016	Domestic Well	N	NA	0.2 U	0.12 U	0.098 U
	9/8/2016	Domestic Well	N	225	1.3	0.16	220
	10/18/2016	Domestic Well	N	225	0.2 U	0.079 U	1.9
	12/1/2016	Domestic Well	N	225	0.2 U	0.079 U	0.21 U
	2/24/2017	Domestic Well	N	225	0.2 U	0.079 U	0.21 U
	6/6/2017	Domestic Well	N	225	0.2 U	0.079 U	0.21 U
	9/12/2017	Domestic Well	N	225	0.37 U	0.2 U	0.46 U
	1/5/2018	Domestic Well	N	225	0.37 UJ	0.2 U	0.46 U
	1/5/2018	Domestic Well	FD	225	0.37 U	0.2 U	0.46 U
	4/3/2018	Domestic Well	N	225	0.37 U	0.2 U	0.46 U
	6/27/2018	Domestic Well	N	225	0.078 U	0.19 U	0.45 U
	6/27/2018	Domestic Well	FD	225	0.078 U	0.19 U	0.45 U
	9/28/2018	Domestic Well	N	225	0.078 UJ	0.19 U	0.45 U
	1/15/2019	Domestic Well	N	225	0.078 U	0.19 U	0.45 U
	3/21/2019	Domestic Well	N	225	0.078 U	0.19 U	0.45 U
	6/17/2019	Domestic Well	N	225	0.078 U	0.19 U	0.45 U
	Lashaw Well (Agricultural)	9/18/2019	Domestic Well	N	225	0.078 U	0.19 U
9/8/2016		Domestic Well	N	NA	0.042 U	9.1	1.7
6/6/2017		Domestic Well	N	NA	0.2 U	3.3	0.22 J
9/12/2017		Domestic Well	N	NA	0.37 U	1.5	0.66
6/27/2018		Domestic Well	N	NA	0.13 UJ	2	0.45 U
10/2/2018		Domestic Well	N	NA	0.11	4.1	2
6/17/2019		Domestic Well	N	NA	0.078 U	2.8	2.7
Lashaw Well (Domestic)	10/3/2019	Domestic Well	N	NA	0.19 U	4.3	0.45 U
	11/30/2016	Domestic Well	N	150	0.2 U	0.89	0.21 U
	12/15/2016	Domestic Well	N	150	0.2 U	0.7 J	0.21 U
	2/24/2017	Domestic Well	N	150	0.2 U	0.68	0.21 U
	6/6/2017	Domestic Well	N	150	0.2 U	0.77	0.21 U
	9/12/2017	Domestic Well	N	150	0.37 U	0.59	0.46 U
	1/9/2018	Domestic Well	N	150	0.37 U	0.89	0.46 U
	3/19/2018	Domestic Well	N	150	0.37 U	0.82	0.46 U
	3/19/2018	Domestic Well	FD	150	0.37 U	1.2	0.46 U
	6/27/2018	Domestic Well	N	150	0.078 U	0.27 J	0.45 U
	10/2/2018	Domestic Well	N	150	0.078 U	0.48	0.45 U
	3/21/2019	Domestic Well	N	150	0.078 U	0.77	0.45 U
	6/17/2019	Domestic Well	N	150	0.078 U	0.51	0.45 U
10/3/2019	Domestic Well	N	150	0.19 U	0.29 J	0.45 U	
10/3/2019	Domestic Well	FD	150	0.19 U	0.51	0.45 U	

Table 4-9. Summary of Analytical Groundwater Data - Carbon Tetrachloride, Chloroform, and Carbon Disulfide

Location	Sample Date	Group	Type	Depth	Carbon disulfide	Carbon tetrachloride	Chloroform	
					NE	Screening Levels (µg/L)	1.4	
					800	0.63 NU	NU	
					Analytical Data (µg/L)			
Marlow Well	7/27/2016	Domestic Well	N	82	0.2 U	120	8.4	
	8/19/2016	Domestic Well	N	82	0.2 U	123	9	
	11/30/2016	Domestic Well	N	82	0.23	143	8.8	
	11/30/2016	Domestic Well	FD	82	0.26	142	8.7	
	2/28/2017	Domestic Well	N	82	0.24 J	85.3	6.9	
	5/31/2017	Domestic Well	N	82	1.6	124	9.3	
	9/19/2017	Domestic Well	N	82	0.49 J	126	9.5	
	9/19/2017	Domestic Well	FD	82	0.37 U	142	8.7	
	12/12/2017	Domestic Well	N	82	0.66 J	134	9.4	
	12/12/2017	Domestic Well	FD	82	0.71 J	139	8.3	
	4/10/2018	Domestic Well	N	82	0.37 U	112	7.7	
	6/27/2018	Domestic Well	N	82	0.16 J	116	8.5	
	9/28/2018	Domestic Well	N	82	0.078 UJ	167 J	9.7 J	
	1/7/2019	Domestic Well	N	82	0.52 J	123	8.4	
	3/21/2019	Domestic Well	N	82	0.078 U	104	7.6	
	6/17/2019	Domestic Well	N	82	0.57 J	109	7.7	
	9/18/2019	Domestic Well	N	82	0.078 U	0.19 U	0.45 U	
	10/10/2019	Domestic Well	N	82	0.19 U	120	8.2	
	MW-1D	8/4/2016	Monitoring Well Water	N	93	0.2 U	0.12 U	0.098 U
		12/9/2016	Monitoring Well Water	N	93	0.2 U	0.079 U	0.21 U
2/28/2017		Monitoring Well Water	N	93	1.4	0.079 U	0.21 U	
6/8/2017		Monitoring Well Water	N	93	0.61 J	0.079 U	0.21 U	
10/10/2017		Monitoring Well Water	N	93	0.37 U	0.2 U	0.46 U	
12/21/2017		Monitoring Well Water	N	93	0.37 U	0.2 U	0.46 U	
3/15/2018		Monitoring Well Water	N	93	0.37 U	0.2 U	0.46 U	
6/29/2018		Monitoring Well Water	N	93	0.078 U	0.19 U	0.45 U	
9/27/2018		Monitoring Well Water	N	93	0.078 U	0.19 U	0.45 U	
12/21/2018		Monitoring Well Water	N	93	0.078 UJ	0.19 U	0.45 U	
3/18/2019		Monitoring Well Water	N	93	0.078 U	0.19 U	0.45 U	
6/26/2019		Monitoring Well Water	N	93	0.078 U	0.19 U	0.45 U	
9/18/2019		Monitoring Well Water	N	93	0.078 U	0.19 U	0.45 U	
MW-1S		8/4/2016	Monitoring Well Water	N	20	0.2 U	0.12 U	0.098 U
	6/2/2017	Monitoring Well Water	N	20	0.2 U	0.079 U	0.21 U	
	10/12/2017	Monitoring Well Water	N	20	0.37 U	0.2 U	0.46 U	
	1/15/2018	Monitoring Well Water	N	20	0.37 U	0.2 U	0.46 U	
	3/16/2018	Monitoring Well Water	N	20	0.37 U	0.2 U	0.46 U	
	6/26/2018	Monitoring Well Water	N	20	0.078 U	0.19 U	0.45 U	
	9/25/2018	Monitoring Well Water	N	20	0.078 UJ	0.19 U	0.45 U	
	12/20/2018	Monitoring Well Water	N	20	0.078 UJ	0.19 U	0.45 U	
	3/13/2019	Monitoring Well Water	N	20	0.078 U	0.19 U	0.45 U	
	6/27/2019	Monitoring Well Water	N	20	0.078 U	0.19 U	0.45 U	
	9/14/2019	Monitoring Well Water	N	20	0.078 U	0.19 U	0.45 U	
	MW-2D	8/3/2016	Monitoring Well Water	N	140	0.2 U	0.12 U	0.098 U
8/3/2016		Monitoring Well Water	FD	140	0.2 U	0.12 U	0.098 U	
12/9/2016		Monitoring Well Water	N	140	0.2 U	0.079 U	0.21 U	
2/28/2017		Monitoring Well Water	N	140	0.2 U	0.079 U	0.21 U	
6/8/2017		Monitoring Well Water	N	140	0.2 U	0.079 U	0.21 U	
9/14/2017		Monitoring Well Water	N	140	0.37 U	0.2 U	0.46 U	
1/15/2018		Monitoring Well Water	N	140	0.78 J	0.2 U	0.46 U	
3/15/2018		Monitoring Well Water	N	140	0.37 U	1.2	0.46 U	
6/29/2018		Monitoring Well Water	N	140	0.078 U	0.19 U	0.45 U	
9/27/2018		Monitoring Well Water	N	140	0.078 U	0.19 U	0.45 U	
12/21/2018		Monitoring Well Water	N	140	0.078 UJ	0.19 U	0.45 U	
12/21/2018		Monitoring Well Water	FD	140	0.078 UJ	0.19 U	0.45 U	
3/18/2019		Monitoring Well Water	N	140	0.078 U	0.19 U	0.45 U	
6/26/2019		Monitoring Well Water	N	140	0.078 U	0.19 U	0.45 U	
9/18/2019		Monitoring Well Water	N	140	0.078 U	0.19 U	0.45 U	
MW-3D		6/13/2016	Monitoring Well Water	N	173	0.2 U	0.12 U	0.098 U
	6/13/2016	Monitoring Well Water	FD	173	0.2 U	0.12 U	0.098 U	
	12/10/2016	Monitoring Well Water	N	173	0.2 U	0.079 U	0.21 U	
	3/3/2017	Monitoring Well Water	N	173	0.2 U	0.079 U	0.21 U	
	6/9/2017	Monitoring Well Water	N	173	0.2 U	0.079 U	0.21 U	
	9/14/2017	Monitoring Well Water	N	173	0.37 U	0.2 U	0.46 U	
	1/15/2018	Monitoring Well Water	N	173	0.37 U	0.2 U	0.46 U	
	3/14/2018	Monitoring Well Water	N	173	0.37 U	0.2 U	0.46 U	
	6/29/2018	Monitoring Well Water	N	173	0.078 U	0.19 U	0.45 U	
	9/27/2018	Monitoring Well Water	N	173	0.078 U	0.19 U	0.45 U	
	12/18/2018	Monitoring Well Water	N	173	0.078 U	0.19 U	0.45 U	
	12/18/2018	Monitoring Well Water	FD	173	0.078 U	0.19 U	0.45 U	
	3/15/2019	Monitoring Well Water	N	173	0.078 U	0.19 U	0.45 U	
	3/15/2019	Monitoring Well Water	FD	173	0.078 U	0.19 U	0.45 U	
	6/26/2019	Monitoring Well Water	N	173	0.078 U	0.19 U	0.45 U	
6/26/2019	Monitoring Well Water	FD	173	0.078 U	0.19 U	0.45 U		
9/20/2019	Monitoring Well Water	N	173	0.078 U	0.19 U	0.45 U		

Table 4-9. Summary of Analytical Groundwater Data - Carbon Tetrachloride, Chloroform, and Carbon Disulfide

Location	Sample Date	Group	Type	Depth	Carbon disulfide	Carbon tetrachloride	Chloroform	
					NE	Screening Levels (µg/L)	1.4	
					800	0.63 NU	NU	
MTCA Method B Cancer					Analytical Data (µg/L)			
MTCA Method B Non-cancer								
MW-4D	8/4/2016	Monitoring Well Water	N	185	0.2 U	4.8	0.6	
	8/4/2016	Monitoring Well Water	FD	185	0.2 U	4.4	0.58	
	12/8/2016	Monitoring Well Water	N	185	0.2 U	6.7	0.85	
	3/3/2017	Monitoring Well Water	N	185	0.2 U	4.7	0.97	
	6/9/2017	Monitoring Well Water	N	185	0.2 U	5.1	0.89 J	
	10/5/2017	Monitoring Well Water	N	185	0.37 U	4.4	1	
	12/15/2017	Monitoring Well Water	N	185	0.37 U	6.4	0.46 U	
	3/12/2018	Monitoring Well Water	N	185	0.37 U	3.3	0.55	
	6/27/2018	Monitoring Well Water	N	185	0.078 U	1.8	1.2	
	9/26/2018	Monitoring Well Water	N	185	0.078 UJ	7.3 J	0.45 UJ	
	1/15/2019	Monitoring Well Water	N	185	0.078 U	6.5	1	
	3/19/2019	Monitoring Well Water	N	185	0.078 U	0.37 J	0.45 U	
	6/26/2019	Monitoring Well Water	N	185	0.078 U	3.2	0.84 J	
	9/17/2019	Monitoring Well Water	N	185	0.078 U	2.8	1	
	MW-5D	8/3/2016	Monitoring Well Water	N	145	0.2 U	0.12 U	0.098 U
12/8/2016		Monitoring Well Water	N	145	0.2 U	0.079 U	0.21 U	
3/1/2017		Monitoring Well Water	N	145	0.2 U	0.079 U	0.21 U	
6/9/2017		Monitoring Well Water	N	145	0.2 U	0.079 U	0.21 U	
10/10/2017		Monitoring Well Water	N	145	0.37 U	0.2 U	0.46 U	
12/19/2017		Monitoring Well Water	N	145	0.37 U	0.2 U	0.46 U	
3/13/2018		Monitoring Well Water	N	145	0.37 U	0.2 U	0.46 U	
6/28/2018		Monitoring Well Water	N	145	0.082 J	0.19 U	0.45 U	
9/26/2018		Monitoring Well Water	N	145	0.078 U	0.19 U	0.45 U	
12/18/2018		Monitoring Well Water	N	145	0.078 UJ	0.19 UJ	0.45 UJ	
3/18/2019		Monitoring Well Water	N	145	0.078 U	0.19 U	0.45 U	
6/25/2019		Monitoring Well Water	N	145	0.078 U	0.19 U	0.45 U	
9/17/2019		Monitoring Well Water	N	145	0.078 U	0.19 U	0.45 U	
MW-6D		8/19/2016	Monitoring Well Water	N	222	0.2 U	2	0.098 U
		12/8/2016	Monitoring Well Water	N	222	0.2 U	1.4	0.21 U
	12/8/2016	Monitoring Well Water	FD	222	0.2 U	1.2	0.21 U	
	3/1/2017	Monitoring Well Water	N	222	0.2 U	2.5	0.35	
	3/1/2017	Monitoring Well Water	FD	222	0.2 U	2.5	0.33	
	6/15/2017	Monitoring Well Water	N	222	0.2 U	3.6	0.3 J	
	10/5/2017	Monitoring Well Water	N	222	0.37 U	2.7	0.46 U	
	12/20/2017	Monitoring Well Water	N	222	0.37 U	2.2	0.46 U	
	3/12/2018	Monitoring Well Water	N	222	0.37 U	2.4	0.46 U	
	6/27/2018	Monitoring Well Water	N	222	0.078 U	0.34 J	0.45 U	
	6/27/2018	Monitoring Well Water	FD	222	0.078 U	0.33 J	0.45 U	
	9/25/2018	Monitoring Well Water	N	222	0.078 U	1	0.45 U	
	3/14/2019	Monitoring Well Water	N	222	0.078 U	3.4	0.45 U	
	6/26/2019	Monitoring Well Water	N	222	0.078 U	0.19 U	0.45 U	
	6/26/2019	Monitoring Well Water	FD	222	0.078 U	0.19 U	0.45 U	
9/19/2019	Monitoring Well Water	N	222	0.078 U	0.19 U	0.45 U		
MW-6S	8/4/2016	Monitoring Well Water	N	40	0.2 U	0.12 U	0.098 U	
	12/5/2016	Monitoring Well Water	N	40	0.4 J	0.079 U	0.21 U	
	3/2/2017	Monitoring Well Water	N	40	0.2 U	0.079 U	0.21 U	
	6/2/2017	Monitoring Well Water	N	40	0.2 U	0.079 U	0.21 U	
	10/12/2017	Monitoring Well Water	N	40	0.37 U	0.2 U	0.46 U	
	12/14/2017	Monitoring Well Water	N	40	0.37 U	0.2 U	0.46 U	
	3/16/2018	Monitoring Well Water	N	40	0.37 U	0.2 U	0.46 U	
	6/26/2018	Monitoring Well Water	N	40	0.078 U	0.19 U	0.45 U	
	9/25/2018	Monitoring Well Water	N	40	0.078 UJ	0.19 U	0.45 U	
	9/25/2018	Monitoring Well Water	FD	40	0.078 UJ	0.19 U	0.45 U	
	12/20/2018	Monitoring Well Water	N	40	0.078 UJ	0.19 U	0.45 U	
	3/13/2019	Monitoring Well Water	N	40	0.078 U	0.19 U	0.45 U	
	6/27/2019	Monitoring Well Water	N	40	0.078 U	0.19 U	0.45 U	
	9/14/2019	Monitoring Well Water	N	40	0.078 U	0.19 U	0.45 U	
	MW-6U	8/25/2017	Monitoring Well Water	N	55	0.37 U	15.3	2.2
10/12/2017		Monitoring Well Water	N	55	0.37 U	40.3	1.6	
1/15/2018		Monitoring Well Water	N	55	0.37 U	62.3	2.6	
3/12/2018		Monitoring Well Water	N	55	0.37 U	55.7	2.2	
6/27/2018		Monitoring Well Water	N	55	0.23 UJ	51.1	2.1	
9/25/2018		Monitoring Well Water	N	55	0.5 J	50.2 J	2.3 J	
3/14/2019		Monitoring Well Water	N	55	0.078 U	26.6	1.2	
6/26/2019		Monitoring Well Water	N	55	0.65 J	46.1	2.2	
9/19/2019		Monitoring Well Water	N	55	0.078 U	82.3	2.7	
MW-7S	6/13/2016	Monitoring Well Water	N	43.5	0.2 U	1.1	0.26 J	
	12/7/2016	Monitoring Well Water	N	43.5	0.2 U	1.4	0.21 U	
	3/1/2017	Monitoring Well Water	N	43.5	0.2 U	1.5	0.21 U	
	5/31/2017	Monitoring Well Water	N	43.5	0.2 U	1.3	0.21 U	
	10/10/2017	Monitoring Well Water	N	43.5	0.37 U	1.3	0.46 U	
	12/14/2017	Monitoring Well Water	N	43.5	0.37 U	1.5	0.46 U	
	3/16/2018	Monitoring Well Water	N	43.5	0.37 U	0.2 U	0.46 U	
6/26/2018	Monitoring Well Water	N	43.5	0.078 U	0.38 J	0.45 U		
9/25/2018	Monitoring Well Water	N	43.5	0.078 UJ	2	0.45 U		

Table 4-9. Summary of Analytical Groundwater Data - Carbon Tetrachloride, Chloroform, and Carbon Disulfide

Location	Sample Date	Group	Type	Depth	Carbon disulfide	Carbon tetrachloride	Chloroform
					NE	Screening Levels (µg/L)	1.4
					800	0.63 NU	NU
		MTCA Method B Cancer			Analytical Data (µg/L)		
		MTCA Method B Non-cancer					
MW-7S (continued)	12/20/2018	Monitoring Well Water	N	43.5	0.078 UJ	1.3	0.45 U
	3/13/2019	Monitoring Well Water	N	43.5	0.078 U	1	0.45 U
	6/27/2019	Monitoring Well Water	N	43.5	0.078 U	1.5	0.45 U
	9/14/2019	Monitoring Well Water	N	43.5	0.078 U	2.1	0.45 U
MW-8S	6/13/2016	Monitoring Well Water	N	49.5	0.2 U	181	60
	12/5/2016	Monitoring Well Water	N	49.5	0.26 J	274	61.5
	3/3/2017	Monitoring Well Water	N	49.5	1.1	231	57.2
	6/2/2017	Monitoring Well Water	N	49.5	1.2 J	190	49.5
	10/12/2017	Monitoring Well Water	N	49.5	1	208	51.7
	12/14/2017	Monitoring Well Water	N	49.5	1	222	46
	3/16/2018	Monitoring Well Water	N	49.5	0.37 U	147	49.2
	6/26/2018	Monitoring Well Water	N	49.5	0.27 J	121	43.1
	9/25/2018	Monitoring Well Water	N	49.5	0.078 UJ	157	46.2
	12/20/2018	Monitoring Well Water	N	49.5	0.078 UJ	147	43.5
	3/13/2019	Monitoring Well Water	N	49.5	0.078 U	214	51.4
	6/27/2019	Monitoring Well Water	N	49.5	0.078 U	133	42.6
	9/14/2019	Monitoring Well Water	N	49.5	0.078 U	193	43.4
	MW-9D	2/27/2017	Monitoring Well Water	N	90	0.36	132
6/26/2017		Monitoring Well Water	N	90	0.28 J	104	4.2
10/5/2017		Monitoring Well Water	N	90	0.37 U	78.4	3.6
12/20/2017		Monitoring Well Water	N	90	0.58 J	95.7	3.3
3/13/2018		Monitoring Well Water	N	90	0.37 U	101	3.8
6/28/2018		Monitoring Well Water	N	90	0.082 J	93.2	4.1
6/28/2018		Monitoring Well Water	FD	90	0.28 J	94.8	4.1
9/27/2018		Monitoring Well Water	N	90	0.078 U	96.6 J	4.1
9/27/2018		Monitoring Well Water	FD	90	0.078 UJ	101 J	4.2 J
12/18/2018		Monitoring Well Water	N	90	0.078 U	86.8	4.1
12/18/2018		Monitoring Well Water	FD	90	0.078 U	85.9	3.8
3/15/2019		Monitoring Well Water	N	90	0.078 U	124	4.5
3/15/2019		Monitoring Well Water	FD	90	0.078 U	135	4.6
6/24/2019		Monitoring Well Water	N	90	0.078 U	119	4.4
9/20/2019		Monitoring Well Water	N	90	0.078 U	74.4	4
MW-9S		6/13/2016	Monitoring Well Water	N	38.5	0.2 U	506
	12/5/2016	Monitoring Well Water	N	38.5	0.6 J	1,000	102
	3/1/2017	Monitoring Well Water	N	38.5	1.4	540	74.4
	6/2/2017	Monitoring Well Water	N	38.5	2.7 J	512	72.4
	10/12/2017	Monitoring Well Water	N	38.5	2.4	557	72.5
	12/14/2017	Monitoring Well Water	N	38.5	6.4	541	65.8
	3/16/2018	Monitoring Well Water	N	38.5	0.74 U	289	53.4
	6/26/2018	Monitoring Well Water	N	38.5	0.13 J	309	57
	9/25/2018	Monitoring Well Water	N	38.5	0.16 UJ	408	54.8
	9/25/2018	Monitoring Well Water	FD	38.5	0.27 J	409	58.3
	12/21/2018	Monitoring Well Water	N	38.5	0.078 UJ	226	34.1
	12/21/2018	Monitoring Well Water	FD	38.5	0.078 UJ	227	37.7
	3/13/2019	Monitoring Well Water	N	38.5	0.078 U	326	51.4
	6/27/2019	Monitoring Well Water	N	38.5	0.078 U	286	48.4
	9/14/2019	Monitoring Well Water	N	38.5	0.97 J	347	54.5
	9/14/2019	Monitoring Well Water	FD	38.5	0.88 J	331	55.1
MW-9U	8/25/2017	Monitoring Well Water	N	66	4.3	820	50.8
	10/12/2017	Monitoring Well Water	N	66	2	639	17.3
	1/15/2018	Monitoring Well Water	N	66	0.76 J	298	8.7
	3/14/2018	Monitoring Well Water	N	66	0.79	772	17
	6/28/2018	Monitoring Well Water	N	66	0.54 J	584 J	16.7
	6/28/2018	Monitoring Well Water	FD	66	0.66 J	606	16.5
	9/27/2018	Monitoring Well Water	N	66	0.16 U	618	14.8
	9/27/2018	Monitoring Well Water	FD	66	0.42 J	623	16
	12/18/2018	Monitoring Well Water	N	66	0.078 U	15.9	0.45 U
	12/18/2018	Monitoring Well Water	FD	66	0.17 J	15.1	0.45 U
	3/15/2019	Monitoring Well Water	N	66	0.078 U	810	21.8
	3/15/2019	Monitoring Well Water	FD	66	0.42 J	754	21.2
	6/24/2019	Monitoring Well Water	N	66	0.078 U	378	10.1
	6/24/2019	Monitoring Well Water	FD	66	0.078 U	386	11
	9/20/2019	Monitoring Well Water	N	66	1.6	514	14.4
	9/20/2019	Monitoring Well Water	FD	66	1.4	528	14.9
MW-10S	8/4/2016	Monitoring Well Water	N	71	0.2 U	3.8	1.5
	12/7/2016	Monitoring Well Water	N	71	0.2 U	25.8	1.1
	3/3/2017	Monitoring Well Water	N	71	0.21	31.6	1.5
	5/31/2017	Monitoring Well Water	N	71	0.66 J	34	2.3
	10/12/2017	Monitoring Well Water	N	71	0.37 U	1.9	0.46 U
	12/14/2017	Monitoring Well Water	N	71	0.37 U	0.86	0.46 U
	3/16/2018	Monitoring Well Water	N	71	0.37 U	7.3	0.46 U
	6/26/2018	Monitoring Well Water	N	71	0.078 U	0.46 J	0.45 U
	9/25/2018	Monitoring Well Water	N	71	0.078 UJ	0.84	0.45 U
	12/20/2018	Monitoring Well Water	N	71	0.078 UJ	0.42 J	0.45 U
3/13/2019	Monitoring Well Water	N	71	0.078 U	0.19 U	0.45 U	

Table 4-9. Summary of Analytical Groundwater Data - Carbon Tetrachloride, Chloroform, and Carbon Disulfide

Location	Sample Date	Group	Type	Depth	Carbon disulfide	Carbon tetrachloride	Chloroform
					NE	Screening Levels (µg/L)	1.4
					800	0.63 NU	NU
MTCA Method B Cancer MTCA Method B Non-cancer					Analytical Data (µg/L)		
MW-10S	6/27/2019	Monitoring Well Water	N	71	0.078 U	0.19 U	0.45 U
(continued)	9/14/2019	Monitoring Well Water	N	71	0.078 U	0.31 J	0.45 U
MW-11S	8/4/2016	Monitoring Well Water	N	72.5	0.2 U	0.12 U	0.54
	8/4/2016	Monitoring Well Water	FD	72.5	0.2 U	0.12 U	0.38 J
	12/7/2016	Monitoring Well Water	N	72.5	0.2 U	0.079 U	0.33
	3/2/2017	Monitoring Well Water	N	72.5	0.2 U	0.079 U	0.21 U
	5/31/2017	Monitoring Well Water	N	72.5	0.2 U	0.079 U	0.21 U
	10/12/2017	Monitoring Well Water	N	72.5	0.37 U	0.2 U	0.46 U
	12/14/2017	Monitoring Well Water	N	72.5	0.37 U	0.2 U	0.46 U
	3/16/2018	Monitoring Well Water	N	72.5	0.37 U	0.2 U	0.46 U
	6/26/2018	Monitoring Well Water	N	72.5	0.078 U	0.19 U	0.45 U
	9/25/2018	Monitoring Well Water	N	72.5	0.078 UJ	0.19 U	0.45 U
	12/20/2018	Monitoring Well Water	N	72.5	0.078 UJ	0.19 U	0.45 U
	3/13/2019	Monitoring Well Water	N	72.5	0.078 U	0.19 U	0.45 U
	6/27/2019	Monitoring Well Water	N	72.5	0.078 U	0.19 U	0.45 U
	9/14/2019	Monitoring Well Water	N	72.5	0.078 U	0.19 U	0.45 U
MW-12S	8/4/2016	Monitoring Well Water	N	51	0.2 U	0.12 U	0.098 U
	12/5/2016	Monitoring Well Water	N	51	0.27 J	0.079 U	0.21 U
	3/2/2017	Monitoring Well Water	N	51	0.2	0.079 U	0.21 U
	5/31/2017	Monitoring Well Water	N	51	0.2 U	0.079 U	0.21 U
	10/12/2017	Monitoring Well Water	N	51	0.37 U	0.2 U	0.46 U
	12/14/2017	Monitoring Well Water	N	51	0.37 U	0.2 U	0.46 U
	3/16/2018	Monitoring Well Water	N	51	0.37 U	0.2 U	0.46 U
	6/26/2018	Monitoring Well Water	N	51	0.078 U	0.19 U	0.45 U
	9/25/2018	Monitoring Well Water	N	51	0.078 UJ	0.97	0.45 U
	12/20/2018	Monitoring Well Water	N	51	0.078 UJ	0.19 U	0.45 U
	3/13/2019	Monitoring Well Water	N	51	0.078 U	0.19 U	0.45 U
	6/27/2019	Monitoring Well Water	N	51	0.078 U	0.19 U	0.45 U
	9/14/2019	Monitoring Well Water	N	51	0.078 U	0.19 U	0.45 U
MW-13S	2/28/2017	Monitoring Well Water	N	26	0.2 U	0.079 U	0.21 U
	5/31/2017	Monitoring Well Water	N	26	0.2 U	0.079 U	0.21 U
	10/12/2017	Monitoring Well Water	N	26	0.37 U	0.2 U	0.46 U
	12/11/2017	Monitoring Well Water	N	26	0.37 U	0.2 U	0.46 U
	3/14/2018	Monitoring Well Water	N	26	0.37 U	0.2 U	0.46 U
	6/25/2018	Monitoring Well Water	N	26	0.078 U	0.19 U	0.45 U
	9/24/2018	Monitoring Well Water	N	26	0.078 U	0.19 U	0.45 U
	1/10/2019	Monitoring Well Water	N	26	0.078 U	0.19 U	0.45 U
	3/19/2019	Monitoring Well Water	N	26	0.078 U	0.19 U	0.45 U
	6/28/2019	Monitoring Well Water	N	26	0.078 UJ	0.56 J	0.45 UJ
	6/28/2019	Monitoring Well Water	FD	26	0.078 UJ	0.35 J	0.45 UJ
	9/16/2019	Monitoring Well Water	N	26	0.078 U	0.19 U	0.45 U
MW-14D	1/25/2017	Soil Boring Grab Sample	N	30	0.2 U	20.3	12.3
	2/27/2017	Monitoring Well Water	N	127	0.2 U	0.079 U	0.21 U
	6/9/2017	Monitoring Well Water	N	127	0.2 U	0.079 U	0.21 U
	9/14/2017	Monitoring Well Water	N	127	0.37 U	0.2 U	0.46 U
	12/15/2017	Monitoring Well Water	N	127	0.37 U	0.2 U	0.46 U
	3/13/2018	Monitoring Well Water	N	127	0.37 U	0.2 U	0.46 U
	6/28/2018	Monitoring Well Water	N	127	0.15 J	0.19 U	0.45 U
	9/26/2018	Monitoring Well Water	N	127	0.078 U	0.19 U	0.45 U
	1/14/2019	Monitoring Well Water	N	127	0.078 U	0.19 U	0.45 U
	3/18/2019	Monitoring Well Water	N	127	0.078 U	0.19 U	0.45 U
	6/26/2019	Monitoring Well Water	N	127	0.078 U	0.19 U	0.45 U
	9/19/2019	Monitoring Well Water	N	127	0.078 U	0.19 U	0.45 U
MW-15D	6/26/2017	Soil Boring Grab Sample	N	20	0.2 U	2.1	0.26 J
	7/7/2017	Monitoring Well Water	N	126	0.2 U	8.9	0.48 J
	10/2/2017	Monitoring Well Water	N	126	0.37 U	9.7	0.56
	12/20/2017	Monitoring Well Water	N	126	0.37 U	9.7	0.46 U
	3/12/2018	Monitoring Well Water	N	126	0.37 U	9.5	0.48
	6/28/2018	Monitoring Well Water	N	126	0.12 J	8.7	0.45 U
	9/26/2018	Monitoring Well Water	N	126	0.078 U	10.1	0.45 U
	3/14/2019	Monitoring Well Water	N	126	0.078 U	10.7	0.55 J
	6/25/2019	Monitoring Well Water	N	126	0.078 U	7.9	0.45 U
	9/17/2019	Monitoring Well Water	N	126	0.078 U	7.5	0.45 U
MW-16D	3/2/2017	Monitoring Well Water	N	97.5	0.2 U	0.079 U	0.21 U
	3/2/2017	Monitoring Well Water	FD	97.5	0.2 U	0.079 U	0.21 U
	6/7/2017	Monitoring Well Water	N	97.5	0.2 U	0.079 U	0.21 U
	6/7/2017	Monitoring Well Water	FD	97.5	0.2 U	0.079 U	0.21 U
	10/2/2017	Monitoring Well Water	N	97.5	0.37 U	0.2 U	0.46 U
	12/20/2017	Monitoring Well Water	N	97.5	0.37 U	0.2 U	0.46 U
	3/12/2018	Monitoring Well Water	N	97.5	0.37 U	0.2 U	0.46 U
	6/29/2018	Monitoring Well Water	N	97.5	0.078 U	0.19 U	0.45 U
	6/29/2018	Monitoring Well Water	FD	97.5	0.078 U	0.19 U	0.45 U
	9/26/2018	Monitoring Well Water	N	97.5	0.078 U	0.19 U	0.45 U
	3/19/2019	Monitoring Well Water	N	97.5	0.078 U	0.19 U	0.45 U
	6/25/2019	Monitoring Well Water	N	97.5	0.078 U	0.19 U	0.45 U
	9/17/2019	Monitoring Well Water	N	97.5	0.078 U	0.19 U	0.45 U

Table 4-9. Summary of Analytical Groundwater Data - Carbon Tetrachloride, Chloroform, and Carbon Disulfide

Location	Sample Date	Group	Type	Depth	Carbon disulfide	Carbon tetrachloride	Chloroform
					NE	Screening Levels (µg/L)	
					800	0.63 NU	1.4 NU
MTCA Method B Cancer					Analytical Data (µg/L)		
MTCA Method B Non-cancer							
MW-17D	4/3/2017	Soil Boring Grab Sample	N	55	0.2 U	0.079 U	0.21 U
	4/4/2017	Soil Boring Grab Sample	N	75	0.2 U	1.8	0.22 J
	4/4/2017	Soil Boring Grab Sample	N	104	0.2 U	45.7	1.7
	4/13/2017	Monitoring Well Water	N	204	0.2 U	0.079 U	0.21 U
	6/14/2017	Monitoring Well Water	N	214	7.7	0.079 U	0.21 U
	10/10/2017	Monitoring Well Water	N	214	3	0.2 U	0.46 U
	12/21/2017	Monitoring Well Water	N	214	2.2	0.2 U	0.46 U
	3/13/2018	Monitoring Well Water	N	214	1.3	0.2 U	0.46 U
	6/28/2018	Monitoring Well Water	N	214	1	0.19 U	0.45 U
	9/26/2018	Monitoring Well Water	N	214	0.95 J	0.19 U	0.45 U
	12/18/2018	Monitoring Well Water	N	214	0.41 J	0.19 U	0.45 U
	3/20/2019	Monitoring Well Water	N	214	0.46 J	0.19 U	0.45 U
	3/20/2019	Monitoring Well Water	FD	214	0.54 J	0.19 U	0.45 U
	6/25/2019	Monitoring Well Water	N	214	0.078 U	0.19 U	0.45 U
	9/19/2019	Monitoring Well Water	N	214	0.078 U	0.19 U	0.45 U
MW-18D	1/4/2017	Soil Boring Grab Sample	N	17.5	0.2 U	0.079 U	0.21 U
	1/6/2017	Soil Boring Grab Sample	N	80	0.2 U	0.079 U	0.21 U
	1/6/2017	Soil Boring Grab Sample	FD	80	0.2 U	0.079 U	0.21 U
	3/2/2017	Monitoring Well Water	N	154	0.2 U	0.079 U	0.21 U
	6/7/2017	Monitoring Well Water	N	154	0.2 U	0.079 U	0.21 U
	10/2/2017	Monitoring Well Water	N	154	0.37 U	0.2 U	0.46 U
	12/15/2017	Monitoring Well Water	N	154	0.37 U	0.2 U	0.46 U
	3/12/2018	Monitoring Well Water	N	154	0.37 U	0.2 U	0.46 U
	6/29/2018	Monitoring Well Water	N	165	0.078 U	0.19 U	0.45 U
	9/26/2018	Monitoring Well Water	N	165	0.078 UJ	0.19 UJ	0.45 UJ
	3/19/2019	Monitoring Well Water	N	165	0.078 U	0.19 U	0.45 U
	6/25/2019	Monitoring Well Water	N	165	0.078 U	0.19 U	0.45 U
	9/17/2019	Monitoring Well Water	N	154	0.078 U	0.19 U	0.45 U
MW-19D	5/10/2017	Monitoring Well Water	N	167	0.25	334	27.3
	6/15/2017	Monitoring Well Water	N	167	1.1 J	412	25
	10/5/2017	Monitoring Well Water	N	165	0.97	329	18.9
	10/5/2017	Monitoring Well Water	FD	165	0.89	345	21.7
	12/21/2017	Monitoring Well Water	N	165	2.6	402	19.4
	3/13/2018	Monitoring Well Water	N	165	0.42	423	18.9
	6/28/2018	Monitoring Well Water	N	165	0.44 J	443	20.9
	9/26/2018	Monitoring Well Water	N	165	0.16 U	448	17
	1/14/2019	Monitoring Well Water	N	165	1.1	509	21.4
	3/20/2019	Monitoring Well Water	N	165	0.23 J	386	21
	3/20/2019	Monitoring Well Water	FD	165	0.26 J	400	21.5
	6/27/2019	Monitoring Well Water	N	165	0.078 U	401	26.2
	6/27/2019	Monitoring Well Water	FD	165	0.078 U	408	26.4
	9/17/2019	Monitoring Well Water	N	167	1.4	455	24.2
MW-20D	6/15/2017	Soil Boring Grab Sample	N	94.5	0.2 U	29.4	1
	7/7/2017	Monitoring Well Water	N	140	0.29 J	32.1	1.3
	10/5/2017	Monitoring Well Water	N	140	0.37 U	29.3	1.5
	12/14/2017	Monitoring Well Water	N	140	0.37 U	38.2	0.93 J
	3/15/2018	Monitoring Well Water	N	140	0.37 U	29.5	1.3
	6/28/2018	Monitoring Well Water	N	140	0.091 J	27.7	1.1
	9/26/2018	Monitoring Well Water	N	140	0.078 U	30.7	0.45 U
	9/26/2018	Monitoring Well Water	FD	140	0.078 U	28.8	0.45 U
	1/15/2019	Monitoring Well Water	N	140	0.078 U	27.6	1.1
	3/15/2019	Monitoring Well Water	N	140	0.078 U	35.6	1.3 J
	6/25/2019	Monitoring Well Water	N	140	0.5 J	23.9	0.92 J
	9/18/2019	Monitoring Well Water	N	140	0.078 U	25.5	0.45 U
	9/18/2019	Monitoring Well Water	FD	140	0.078 U	27.7	0.45 U
MW-21D	7/5/2017	Soil Boring Grab Sample	N	20	0.2 U	0.079 U	0.21 U
	7/11/2017	Monitoring Well Water	N	120	0.2 U	0.079 U	0.21 U
	10/2/2017	Monitoring Well Water	N	120	0.37 U	0.2 U	0.46 U
	12/14/2017	Monitoring Well Water	N	120	0.37 U	0.2 U	0.46 U
	4/3/2018	Monitoring Well Water	N	120	0.37 U	0.2 U	0.46 U
	6/29/2018	Monitoring Well Water	N	120	0.11 J	0.19 U	0.45 U
	9/26/2018	Monitoring Well Water	N	120	0.078 UJ	0.19 UJ	0.45 UJ
	3/14/2019	Monitoring Well Water	N	120	0.078 U	0.19 U	0.45 U
	6/25/2019	Monitoring Well Water	N	120	0.078 U	0.19 U	0.45 U
	9/17/2019	Monitoring Well Water	N	120	0.078 U	0.19 U	0.45 U
MW-22S	12/12/2017	Monitoring Well Water	N	10.5	0.37 U	2.2	0.46 U
MW-24S	12/21/2018	Monitoring Well Water	N	NA	0.078 UJ	6.9	6.5
	3/13/2019	Monitoring Well Water	N	NA	0.078 U	66.5	41.7
	6/27/2019	Monitoring Well Water	N	NA	0.078 U	63.4	37.1
	10/4/2019	Monitoring Well Water	N	NA	1.4	107	54.1
MW-25S	12/21/2018	Monitoring Well Water	N	NA	0.078 UJ	52.9	24.9
	3/13/2019	Monitoring Well Water	N	NA	0.078 U	34	8.9
	6/27/2019	Monitoring Well Water	N	NA	0.078 U	119	44.7
	10/4/2019	Monitoring Well Water	N	NA	0.19 U	127	47.2
MW-26	5/23/2019	Monitoring Well Water	N	225	0.078 U	0.19 U	0.45 U
	5/23/2019	Monitoring Well Water	FD	225	0.078 U	0.19 U	0.45 U
MW-27	7/25/2019	Monitoring Well Water	N	233	0.078 U	15.6	5.7
	8/30/2019	Monitoring Well Water	N	238	0.078 U	11.7	5.6
MW-28	7/18/2019	Monitoring Well Water	N	180	0.078 U	314	15.1
MW-29	7/19/2019	Monitoring Well Water	N	120	0.078 U	399 J	22.1
MW-31	8/7/2019	Monitoring Well Water	N	380	0.078 U	0.19 U	0.45 U

Table 4-9. Summary of Analytical Groundwater Data - Carbon Tetrachloride, Chloroform, and Carbon Disulfide

Location	Sample Date	Group	Type	Depth	Carbon disulfide	Carbon tetrachloride	Chloroform
					NE	Screening Levels (µg/L)	
					800	0.63 NU	1.4 NU
MTCA Method B Cancer MTCA Method B Non-cancer					Analytical Data (µg/L)		
MW-32	7/25/2019	Monitoring Well Water	N	284	0.078 U	0.19 U	0.45 U
MW-33	7/24/2019	Monitoring Well Water	N	80	0.078 U	11.2	1
	8/30/2019	Monitoring Well Water	N	264	0.078 U	1.1	0.45 U
MW-35	8/22/2019	Monitoring Well Water	N	162	0.078 U	40	2.6
MW-36	8/16/2019	Monitoring Well Water	N	65	0.078 R	116 J	8.5 J
District Well (W26)	1/21/2013	Domestic Well	N	92	1 U	1 U	1 U
	4/22/2014	Domestic Well	N	92	0.5 U	23	1.9
	8/4/2016	Domestic Well	N	92	0.2 U	19.8	2.1
	12/9/2016	Domestic Well	N	92	0.2 U	22.5	1.5
	3/9/2017	Domestic Well	N	92	0.2 U	28	2.2
	6/15/2017	Domestic Well	N	92	0.26 J	34.6	2.5
	10/16/2017	Domestic Well	N	92	0.37 U	27	1.5
	1/16/2018	Domestic Well	N	92	0.37 U	24.2	1.7
	3/14/2018	Domestic Well	N	92	0.37 U	29.7	2.4
	6/25/2018	Domestic Well	N	92	0.097 UJ	34.7	2.8
	9/24/2018	Domestic Well	N	92	0.078 U	27.1	1.6
	1/10/2019	Domestic Well	N	92	0.078 U	25.2	2
	3/20/2019	Domestic Well	N	92	0.078 U	34.9	2.7 J
	6/28/2019	Domestic Well	N	92	0.078 UJ	31.8 J	2.5 J
	9/16/2019	Domestic Well	N	92	0.078 U	24.3	2
Out-of-Use Marlow Well (No. 2)	10/7/2016	Domestic Well	N	80	0.37	120	6.7
	3/9/2017	Domestic Well	N	80	0.2 U	0.25	0.27
	6/26/2017	Domestic Well	N	80	0.2 U	1.1	1.1
	10/16/2017	Domestic Well	N	80	0.37 U	13	0.46 U
	1/16/2018	Domestic Well	N	80	0.37 U	8.6	3.9
	3/16/2018	Domestic Well	N	80	0.37 U	66	5.9
	6/25/2018	Domestic Well	N	80	0.22 UJ	49.6	3.6
	9/24/2018	Domestic Well	N	80	0.078 U	30.6	1.1
	1/10/2019	Domestic Well	N	80	0.078 U	69.1	3.8
	3/20/2019	Domestic Well	N	80	0.078 U	49.5	4.7
	6/27/2019	Domestic Well	N	80	0.2 J	5.9	21.3
	7/16/2019	Domestic Well	N	80	0.078 U	27.4	2.7
	8/1/2019	Domestic Well	N	80	0.078 U	14.4	2
	8/13/2019	Domestic Well	N	80	0.078 U	19.8	2.6 J
	8/29/2019	Domestic Well	N	80	0.078 U	8.5	1.6
9/11/2019	Domestic Well	N	80	0.078 U	24.5	2	
9/26/2019	Domestic Well	N	80	0.078 U	15.6	2.9	
(W20)	10/10/2019	Domestic Well	N	80	0.19 U	9.6	1.4
	1/21/2013	Domestic Well	N	82	1 U	21.2	2.04
	8/4/2016	Domestic Well	N	82	0.2 U	0.12 U	0.098 U
	12/10/2016	Domestic Well	N	82	0.2 U	0.079 U	0.21 U
	3/3/2017	Domestic Well	N	82	0.2 U	0.079 U	0.21 U
	6/14/2017	Domestic Well	N	82	0.2 UJ	0.079 UJ	0.21 UJ
	10/16/2017	Domestic Well	N	82	0.37 U	0.2 U	0.46 U
	12/11/2017	Domestic Well	N	82	0.37 U	0.2 U	0.46 U
	3/15/2018	Domestic Well	N	82	0.37 U	0.2 U	0.46 U
	6/25/2018	Domestic Well	N	82	0.078 U	0.19 U	0.45 U
	9/24/2018	Domestic Well	N	82	0.078 U	0.19 U	0.45 U
	1/10/2019	Domestic Well	N	82	0.078 U	0.19 U	0.45 U
	3/19/2019	Domestic Well	N	82	0.078 U	0.19 U	0.45 U
	6/28/2019	Domestic Well	N	82	0.078 UJ	0.19 UJ	0.45 UJ
	9/16/2019	Domestic Well	N	82	0.078 U	0.19 U	0.45 U
Primary Freeman School District Well (WS5)	5/27/1992	Domestic Well	N	189	--	0.5 U	--
	11/13/1992	Domestic Well	N	189	--	0.5 U	--
	1/30/2001	Domestic Well	N	189	--	0.7	--
	3/22/2001	Domestic Well	N	189	--	0.7	--
	7/11/2001	Domestic Well	N	189	--	0.5 U	--
	6/20/2002	Domestic Well	N	189	--	1.4	--
	8/12/2003	Domestic Well	N	189	--	0.5 U	--
	11/16/2004	Domestic Well	N	189	--	1.64	--
	5/31/2006	Domestic Well	N	189	--	0.5 U	--
	4/30/2007	Domestic Well	N	189	--	2.31	--
	4/3/2008	Domestic Well	N	189	--	7.78	--
	5/20/2008	Domestic Well	N	189	--	2.34	--
	9/12/2008	Domestic Well	N	189	--	2.14	--
	11/13/2008	Domestic Well	N	189	--	3.72	--
	2/26/2009	Domestic Well	N	189	--	1.66	--
6/25/2009	Domestic Well	N	189	--	1.8	--	
11/4/2009	Domestic Well	N	189	--	3.28	--	
4/28/2010	Domestic Well	N	189	--	4.29	--	
8/18/2010	Domestic Well	N	189	--	2.22	--	
Primary Freeman School District Well (WS5) (continued)	10/27/2010	Domestic Well	N	189	--	3.13	--
	3/31/2011	Domestic Well	N	189	--	3.9	--
	6/22/2011	Domestic Well	N	189	--	0.5 U	--
	9/21/2011	Domestic Well	N	189	--	0.5 U	--
	12/7/2011	Domestic Well	N	189	--	0.5 U	--
	3/21/2012	Domestic Well	N	189	--	5.9	--
	4/19/2012	Domestic Well	N	189	--	7.2	--
	6/14/2012	Domestic Well	N	189	--	2.1	--
	9/5/2012	Domestic Well	N	189	--	3.1	--
12/12/2012	Domestic Well	N	189	--	8	--	

Table 4-9. Summary of Analytical Groundwater Data - Carbon Tetrachloride, Chloroform, and Carbon Disulfide

Location	Sample Date	Group	Type	Depth	Carbon disulfide	Carbon tetrachloride	Chloroform
					NE	Screening Levels (µg/L)	1.4
					800	0.63 NU	NU
MTCA Method B Cancer MTCA Method B Non-cancer					Analytical Data (µg/L)		
	1/24/2013	Domestic Well	N	189	--	7.6	--
	1/25/2013	Domestic Well	N	189	1 U	22	1.28
	4/10/2013	Domestic Well	N	189	--	9.3	--
	7/2/2013	Domestic Well	N	189	--	3.3	--
	9/18/2013	Domestic Well	N	189	--	3.8	--
	4/22/2014	Domestic Well	N	189	0.5 U	8.8	0.52
	3/4/2015	Domestic Well	N	189	--	11	0.69
	3/4/2015	Domestic Well	FD	189	--	0.42	0.5 U
	6/3/2015	Domestic Well	N	189	--	4.2	0.33
	10/21/2015	Domestic Well	N	189	--	5	0.29
	1/27/2016	Domestic Well	N	189	--	11	0.72
	4/12/2016	Domestic Well	N	189	--	13	0.74
	7/16/2016	Domestic Well	N	189	--	3.3	0.3
	7/27/2016	Domestic Well	N	189	0.2 U	4	0.29 J
	9/30/2016	Domestic Well	N	189	--	4	0.52
	12/7/2016	Domestic Well	N	189	0.2 U	11.6	0.55
	6/14/2017	Domestic Well	N	189	0.2 U	4.5	0.33 J
	10/11/2017	Domestic Well	N	189	0.37 U	8.1	0.46 U
	1/19/2018	Domestic Well	N	189	0.37 U	61.8	2.3
	3/15/2018	Domestic Well	N	189	0.37 U	33.6	1.7
	7/17/2018	Domestic Well	N	189	0.078 U	5.5	0.45 U
	10/1/2018	Domestic Well	N	189	0.078 UJ	6.8	0.45 U
	10/10/2018	Domestic Well	N	189	0.078 U	8.6	0.49 J
	12/19/2018	Domestic Well	N	189	0.078 U	23	1.1
	5/7/2019	Domestic Well	N	189	0.078 U	7.1	0.47 J
	6/17/2019	Domestic Well	N	189	0.078 U	5	0.45 U
	9/19/2019	Domestic Well	N	189	0.078 U	4.7	0.45 U
Randall Well	7/27/2016	Domestic Well	N	73	1 U	324	12
	8/19/2016	Domestic Well	N	73	0.39 U	287	15.2
	11/29/2016	Domestic Well	N	73	0.32 J	364	13.8
	2/28/2017	Domestic Well	N	73	0.7 J	324	12.7
	5/31/2017	Domestic Well	N	73	1.6	268	13.4
	5/31/2017	Domestic Well	FD	73	2.4	272	13.4
	9/19/2017	Domestic Well	N	73	0.37 U	260	11.5
	9/19/2017	Domestic Well	FD	73	0.54	256	10.5
	12/12/2017	Domestic Well	N	73	1.5 J	289	10.2
	12/12/2017	Domestic Well	FD	73	2.5	292	9.9
	4/10/2018	Domestic Well	N	73	0.37 U	251	10.3
	6/27/2018	Domestic Well	N	73	0.12 J	202	8.8
	9/28/2018	Domestic Well	N	73	0.078 UJ	207 J	8.9
	1/7/2019	Domestic Well	N	73	0.76 J	250	9.8
	3/21/2019	Domestic Well	N	73	0.078 U	182	8
	6/17/2019	Domestic Well	N	73	0.71 J	191	7.9
	10/10/2019	Domestic Well	N	73	2.9	218	8
Reed Well (W30)	1/25/2013	Domestic Well	N	119.5	1 U	1 U	1 U
	7/27/2016	Domestic Well	N	119.5	0.2 U	0.079 U	0.21 U
	7/27/2016	Domestic Well	FD	119.5	0.2 U	0.079 U	0.21 U
	12/1/2016	Domestic Well	N	119.5	0.2 U	0.079 U	0.21 U
	2/24/2017	Domestic Well	N	119.5	0.2 U	0.079 U	0.21 U
	6/20/2017	Domestic Well	N	119.5	0.2 U	0.079 U	0.21 U
	9/13/2017	Domestic Well	N	119.5	0.37 U	0.2 U	0.46 U
	1/9/2018	Domestic Well	N	119.5	0.37 U	0.2 U	0.46 U
	9/28/2018	Domestic Well	N	119.5	0.078 UJ	0.19 U	0.45 U
	1/7/2019	Domestic Well	N	119.5	0.078 UJ	0.19 U	0.45 U
	3/21/2019	Domestic Well	N	119.5	0.078 U	0.19 U	0.45 U
	6/13/2019	Domestic Well	N	119.5	0.078 U	0.19 U	0.45 U
	10/3/2019	Domestic Well	N	119.5	0.19 U	0.19 U	0.45 U
SB-34	1/10/2017	Soil Boring Grab Sample	N	63	1 UJ	9.5 J	1.9 J
SB-35	1/13/2017	Soil Boring Grab Sample	N	69	0.2 U	0.079 U	0.21 U
SB-37	1/12/2017	Soil Boring Grab Sample	N	81	0.2 U	0.079 U	0.21 U
SB-41	2/14/2017	Soil Boring Grab Sample	N	37	1 U	0.4 U	1 U
SB-43	1/12/2017	Soil Boring Grab Sample	N	25	0.26 J	0.079 U	0.21 U
	1/12/2017	Soil Boring Grab Sample	N	40	0.2 U	1.5	0.21 U
SB-206	6/19/2019	Soil Boring Grab Sample	N	NA	0.078 U	0.5 J	0.87 J
SB-208	6/20/2019	Soil Boring Grab Sample	N	NA	0.16 U	0.38 U	0.9 U

Table 4-9. Summary of Analytical Groundwater Data - Carbon Tetrachloride, Chloroform, and Carbon Disulfide

Location	Sample Date	Group	Type	Depth	Carbon disulfide	Carbon tetrachloride	Chloroform	
					NE	Screening Levels (µg/L)	1.4	
					800	0.63 NU	NU	
Analytical Data (µg/L)								
Silva Well	9/8/2016	Domestic Well	N	NA	0.042 U	0.076 U	0.1 U	
	11/30/2016	Domestic Well	N	NA	0.2 U	0.079 U	0.21 U	
	2/24/2017	Domestic Well	N	NA	0.2 U	0.079 U	0.21 U	
	2/24/2017	Domestic Well	FD	NA	0.2 U	0.079 U	0.21 U	
	6/1/2017	Domestic Well	N	NA	0.2 U	0.079 U	0.21 U	
	9/12/2017	Domestic Well	N	NA	0.37 U	0.98	0.46 U	
	9/25/2017	Domestic Well	N	NA	0.37 U	0.2 U	0.46 U	
	9/29/2017	Domestic Well	N	NA	0.37 U	0.2 U	0.46 U	
	1/5/2018	Domestic Well	N	NA	0.37 UJ	0.2 U	0.46 U	
	1/5/2018	Domestic Well	FD	NA	0.37 U	0.2 U	0.46 U	
	3/20/2018	Domestic Well	N	NA	0.37 U	0.2 U	0.46 U	
	6/27/2018	Domestic Well	N	NA	0.078 U	0.19 U	0.45 U	
	9/28/2018	Domestic Well	N	NA	0.078 UJ	1.3	0.45 U	
	1/4/2019	Domestic Well	N	NA	0.078 U	0.19 U	0.45 U	
	5/7/2019	Domestic Well	N	NA	0.078 U	0.19 U	0.45 U	
	6/13/2019	Domestic Well	N	NA	0.078 U	0.19 U	0.45 U	
	10/3/2019	Domestic Well	N	NA	0.19 U	0.19 U	0.45 U	
	Stark Well (W15)	3/3/2017	Domestic Well	N	104	0.2 U	0.079 U	0.21 U
		6/1/2017	Domestic Well	N	104	0.2 U	0.079 U	0.21 U
6/1/2017		Domestic Well	FD	104	0.2 U	0.079 U	0.21 U	
9/12/2017		Domestic Well	N	104	0.37 U	0.2 U	0.46 U	
1/4/2018		Domestic Well	N	104	0.37 UJ	0.2 U	0.46 U	
3/19/2018		Domestic Well	N	104	0.37 U	0.2 U	0.46 U	
3/19/2018		Domestic Well	FD	104	0.37 U	0.2 U	0.46 U	
6/27/2018		Domestic Well	N	104	0.078 U	0.19 U	0.45 U	
9/28/2018		Domestic Well	N	104	0.078 UJ	0.19 U	0.45 U	
1/4/2019		Domestic Well	N	104	0.078 U	0.19 U	0.45 U	
3/21/2019		Domestic Well	N	104	0.078 U	0.19 U	0.45 U	
6/13/2019		Domestic Well	N	104	0.078 U	0.19 U	0.45 U	
9/18/2019		Domestic Well	N	104	0.078 U	0.19 U	0.45 U	
Thorson Well	3/2/2017	Domestic Well	N	160	0.2 U	0.079 U	0.21 U	
	6/26/2017	Domestic Well	N	160	0.2 U	0.079 U	0.21 U	
	9/12/2017	Domestic Well	N	160	0.37 U	0.2 U	0.46 U	
	1/5/2018	Domestic Well	N	160	0.37 UJ	0.2 U	0.46 U	
	3/19/2018	Domestic Well	N	160	0.37 U	0.2 U	0.46 U	
	6/27/2018	Domestic Well	N	160	0.11 UJ	0.19 U	0.45 U	
	9/28/2018	Domestic Well	N	160	0.078 UJ	0.19 U	0.45 U	
	1/7/2019	Domestic Well	N	160	0.078 U	0.19 U	0.45 U	
	3/21/2019	Domestic Well	N	160	0.078 U	0.19 U	0.45 U	
	6/17/2019	Domestic Well	N	160	0.078 U	0.19 U	0.45 U	
	9/18/2019	Domestic Well	N	160	0.078 U	0.19 U	0.45 U	

Notes:

Detections in **bold**

-- = not analyzed

µg/L = microgram(s) per liter

FD = field duplicate

MTCA = Model Toxics Control Act

J = estimated result

NA = sample collected at undocumented depth

NE = not established

NU = not used

R = result was rejected and is not usable

U = not detected at or above the indicated reporting limit

UJ = not detected; indicated reporting limit is estimated



LEGEND

- Extraction Well
- ⊕ Monitoring Well
- ⊗ Domestic Well
- ⊗ Stream Gauge
- ▭ Grain Handling Facility at Freeman

Note

1. EW-6U, EW-9U, MW-22s and MW-23s were decommissioned due to artesian conditions.
2. Davey, Brandt and Freeman Store wells are not included in the GW monitoring program.

Service Layer Credits: Sources: Esri, HERE, Garmin, USGS, Intermap, INCREMENT P, NRCan, Esri Japan, METI, Esri China (Hong Kong), Esri Korea, Esri (Thailand), NGCC, (c) OpenStreetMap contributors, and the GIS User Community
 Source: Esri, DigitalGlobe, GeoEye, Earthstar Geographics, CNES/Airbus DS, USDA, USGS, AeroGRID, IGN, and the GIS User Community

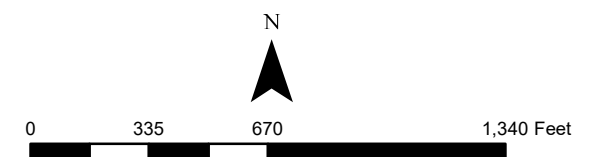

Figure 4-6
Well Locations/Groundwater Monitoring Network
 Remedial Investigation/Feasibility Study Report
 Grain Handling Facility at Freeman,
 Freeman, Washington