

Table 4-3. Summary of Analytical Soil Data - Carbon Tetrachloride and Chloroform

Location	Sample Date	Group	Type	Depth	Carbon tetrachloride	Chloroform	
					Screening Levels (µg/kg)		
					MTCA Method B Cancer	14,000	32,000
					MTCA Protection of Groundwater, Vadose at 13 C	42	74
					MTCA Protection of Groundwater, Saturated	2.2	4.8
					Analytical Data (µg/kg)		
BK01	4/22/2014	Soil Boring	N	3 - 3.5	4.7 U	4.7 U	
	4/22/2014	Soil Boring	N	4 - 4.5	4.9 U	4.9 U	
	4/22/2014	Soil Boring	N	12 - 12.5	4.7 U	4.7 U	
CHF Grain Facility Sump Area	2/6/2018	Sub-Slab Soil	N	0	0.68 U	0.97 U	
	2/6/2018	Sub-Slab Soil	N	3	0.5 U	0.71 U	
GSNE	11/2/2017	Grab	N	4	22.7 U	23.3 U	
GSSW	11/2/2017	Grab	N	5	28.2 U	28.9 U	
HA01	4/23/2014	Soil Boring	N	13.5 - 14	6.2 U	6.2 U	
HA02	4/23/2014	Soil Boring	N	2.5 - 3	5.5 U	5.5 U	
HA03	4/23/2014	Soil Boring	N	9 - 9.5	4.7 U	4.7 U	
HB-1-1	2/26/2019	N/A	N	10 - 10.5	27 U	29 U	
HB-1-2	2/26/2019	N/A	N	10 - 10.5	63 J	340	
HB-1-3	2/26/2019	N/A	N	10 - 10.5	28 U	30 U	
HB-2-1	2/27/2019	N/A	N	10 - 10.5	28 U	30 U	
HB-2-2	2/27/2019	N/A	N	10 - 10.5	28 U	29 U	
HB-2-3	2/27/2019	N/A	N	10 - 10.5	30 U	31 U	
HB-3-1	2/28/2019	N/A	N	10 - 10.5	28 U	30 U	
HB-3-2	2/28/2019	N/A	N	10 - 10.5	28 U	29 U	
	2/28/2019	N/A	FD	10 - 10.5	30 U	31 U	
HB-3-3	2/28/2019	N/A	N	10 - 10.5	30 U	31 U	
MW-1D	7/6/2016	Soil Boring	N	5	2.3 U	2.3 U	
	7/6/2016	Soil Boring	N	10	2.5 U	2.5 U	
	7/6/2016	Soil Boring	N	15	3.3 U	3.3 U	
	7/6/2016	Soil Boring	N	20	2.9 U	2.9 U	
	7/6/2016	Soil Boring	N	25	3.1 U	3.1 U	
	7/6/2016	Soil Boring	N	30	3.1 U	3.1 U	
	7/6/2016	Soil Boring	N	35	1.7 U	1.7 U	
	7/6/2016	Soil Boring	N	40	2.1 U	2.1 U	
	7/6/2016	Soil Boring	N	45	2.1 U	2.1 U	
	MW-2D	7/1/2016	Soil Boring	N	5	24 U	24 U
7/1/2016		Soil Boring	N	10	28 U	28 U	
7/1/2016		Soil Boring	N	15	24 U	24 U	
7/1/2016		Soil Boring	N	20	23 U	23 U	
7/1/2016		Soil Boring	N	25	23 U	23 U	
7/1/2016		Soil Boring	N	30	27 U	27 U	
7/1/2016		Soil Boring	N	35	26 U	26 U	
7/1/2016		Soil Boring	N	40	25 U	25 U	
7/1/2016		Soil Boring	N	45	27 U	27 U	
7/1/2016		Soil Boring	FD	45	26 U	26 U	
7/1/2016		Soil Boring	N	50	26 U	26 U	
7/1/2016		Soil Boring	N	55	24 U	24 U	
7/1/2016		Soil Boring	N	60	23 U	23 U	
7/1/2016		Soil Boring	N	65	26 U	26 U	
7/1/2016		Soil Boring	N	70	27 U	27 U	
7/1/2016		Soil Boring	N	75	29 U	29 U	
7/1/2016		Soil Boring	N	80	25 U	25 U	
7/1/2016		Soil Boring	N	85	24 U	24 U	
MW-3D		5/10/2016	Soil Boring	N	5	24 U	24 U
		5/10/2016	Soil Boring	N	10	22 U	22 U

Table 4-3. Summary of Analytical Soil Data - Carbon Tetrachloride and Chloroform

Location	Sample Date	Group	Type	Depth	Carbon tetrachloride	Chloroform	
					Screening Levels (µg/kg)		
					MTCA Method B Cancer	14,000	32,000
					MTCA Protection of Groundwater, Vadose at 13 C	42	74
MTCA Protection of Groundwater, Saturated	2.2	4.8					
					Analytical Data (µg/kg)		
	5/10/2016	Soil Boring	N	15	22 U	22 U	
	5/10/2016	Soil Boring	N	20	28 U	28 U	
	5/10/2016	Soil Boring	N	25	34 U	34 U	
	5/10/2016	Soil Boring	N	30	33 U	33 U	
	5/10/2016	Soil Boring	N	35	26 U	26 U	
	5/10/2016	Soil Boring	N	40	26 U	26 U	
	5/10/2016	Soil Boring	N	45	26 U	26 U	
	5/10/2016	Soil Boring	N	50	29 U	29 U	
	5/10/2016	Soil Boring	N	55	24 U	24 U	
	MW-5D	5/20/2016	Soil Boring	N	5	23 U	23 U
5/20/2016		Soil Boring	N	10	23 U	23 U	
5/20/2016		Soil Boring	N	15	24 U	24 U	
5/20/2016		Soil Boring	N	20	22 U	22 U	
5/20/2016		Soil Boring	N	25	25 U	25 U	
5/20/2016		Soil Boring	N	27	21 U	21 U	
5/20/2016		Soil Boring	N	30	23 U	23 U	
5/20/2016		Soil Boring	FD	30	26 U	26 U	
5/20/2016		Soil Boring	N	35	25 U	25 U	
5/20/2016		Soil Boring	N	40	25 U	25 U	
5/20/2016		Soil Boring	N	45	27 U	27 U	
5/20/2016		Soil Boring	N	50	23 U	23 U	
MW-6D	5/20/2016	Soil Boring	N	55	23 U	23 U	
	6/27/2016	Soil Boring	N	5	24 U	24 U	
	6/27/2016	Soil Boring	N	10	22 U	22 U	
	6/27/2016	Soil Boring	N	15	23 U	23 U	
	6/27/2016	Soil Boring	N	20	22 U	22 U	
	6/27/2016	Soil Boring	N	25	23 U	23 U	
	6/27/2016	Soil Boring	N	30	28 U	28 U	
	6/27/2016	Soil Boring	N	35	25 U	25 U	
	6/27/2016	Soil Boring	N	40	27 U	27 U	
	6/27/2016	Soil Boring	N	45	26 U	26 U	
	6/27/2016	Soil Boring	FD	45	27 U	27 U	
	6/27/2016	Soil Boring	N	50	26 U	26 U	
MW-8S (SB-05)	5/17/2016	Soil Boring	N	5	23 U	23 U	
	5/17/2016	Soil Boring	N	10	25 U	25 U	
	5/17/2016	Soil Boring	N	15	24 U	24 U	
	5/17/2016	Soil Boring	N	20	29 U	29 U	
	5/17/2016	Soil Boring	N	25	25 U	25 U	
	5/17/2016	Soil Boring	N	30	26 U	26 U	
	5/17/2016	Soil Boring	FD	30	27 U	27 U	
	5/17/2016	Soil Boring	N	35	26 U	26 U	
	5/17/2016	Soil Boring	N	40	27	24 U	
	5/17/2016	Soil Boring	N	45	35	26 U	
5/17/2016	Soil Boring	N	50	22 U	22 U		
MW-9S (SB-04)	5/16/2016	Soil Boring	N	5	23 U	23 U	
	5/16/2016	Soil Boring	N	10	23 U	23 U	
	5/16/2016	Soil Boring	N	15	25 U	25 U	
	5/16/2016	Soil Boring	N	20	37 U	37 U	
	5/16/2016	Soil Boring	N	25	28	27 U	

Table 4-3. Summary of Analytical Soil Data - Carbon Tetrachloride and Chloroform

Location	Sample Date	Group	Type	Depth	Carbon tetrachloride	Chloroform	
					Screening Levels (µg/kg)		
					MTCA Method B Cancer	14,000	32,000
					MTCA Protection of Groundwater, Vadose at 13 C	42	74
MTCA Protection of Groundwater, Saturated	2.2	4.8					
					Analytical Data (µg/kg)		
	5/16/2016	Soil Boring	N	30	100	27 U	
	5/16/2016	Soil Boring	N	35	160	26 U	
	5/16/2016	Soil Boring	N	40	100	26 U	
	5/16/2016	Soil Boring	FD	40	98	26 U	
P0101-01 (Davey)	9/21/2016	Residential Surface	N	0	2.8 U	2.8 U	
P0101-02 (Davey)	9/21/2016	Residential Surface	N	0	2.8 U	2.8 U	
P0101-03 (Davey)	9/21/2016	Residential Surface	N	0	2.9 U	2.9 U	
P0101-04 (Davey)	9/21/2016	Residential Surface	N	0	2.4 U	2.4 U	
P0101-06 (Davey)	9/21/2016	Residential Surface	N	0	2.8 U	2.8 U	
P0302-01 (Marlow)	9/21/2016	Residential Surface	N	0	2.3 U	2.3 U	
P0302-02 (Marlow)	9/21/2016	Residential Surface	N	0	2.3 U	2.3 U	
P0303-01 (Marlow Garden)	9/21/2016	Residential Surface	N	0	2.2 U	2.2 U	
P0303-02 (Marlow Garden)	9/21/2016	Residential Surface	N	0	2.1 U	2.1 U	
P0303-03 (Marlow Garden)	9/21/2016	Residential Surface	N	0	2.1 U	2.1 U	
P0304-01 (Randall)	9/21/2016	Residential Surface	N	0	2.2 U	2.2 U	
P0304-02 (Randall)	9/21/2016	Residential Surface	N	0	2.6 U	2.6 U	
P0304-03 (Randall)	9/21/2016	Residential Surface	N	0	2.5 U	2.5 U	
P0304-04 (Randall)	9/21/2016	Residential Surface	N	0	2 U	2 U	
P0304-05 (Randall)	9/21/2016	Residential Surface	N	0	2.2 U	2.2 U	
PH-01	6/27/2018	N/A	N	1	8.3 U	34 U	
PH-02	6/27/2018	N/A	N	1	5.9 U	24 U	
PH-03	6/27/2018	N/A	N	1	73	26 U	
PH-04	6/27/2018	N/A	N	1	5.1 U	21 U	
PH-05	6/27/2018	N/A	N	1	5.4 UJ	22 UJ	
PH-06	6/27/2018	N/A	N	1	5.8 U	24 U	
PH-07	6/27/2018	N/A	N	1	5.8 U	24 U	
PH-08	6/27/2018	N/A	N	1	6.1 U	25 U	

Table 4-3. Summary of Analytical Soil Data - Carbon Tetrachloride and Chloroform

Location	Sample Date	Group	Type	Depth	Carbon tetrachloride	Chloroform	
					Screening Levels (µg/kg)		
					MTCA Method B Cancer	14,000	32,000
					MTCA Protection of Groundwater, Vadose at 13 C	42	74
MTCA Protection of Groundwater, Saturated	2.2	4.8					
					Analytical Data (µg/kg)		
SB-01	5/11/2016	Soil Boring	N	5	24 U	24 U	
	5/11/2016	Soil Boring	FD	5	23 U	23 U	
	5/11/2016	Soil Boring	N	10	28 U	28 U	
	5/11/2016	Soil Boring	N	15	28 U	28 U	
	5/11/2016	Soil Boring	N	20	27 U	27 U	
	5/11/2016	Soil Boring	N	25	24 U	24 U	
	5/11/2016	Soil Boring	N	30	28 U	28 U	
	5/11/2016	Soil Boring	N	35	25 U	25 U	
	5/11/2016	Soil Boring	N	40	24 U	24 U	
	5/11/2016	Soil Boring	N	45	26 U	26 U	
	5/11/2016	Soil Boring	N	47	25 U	25 U	
	5/11/2016	Soil Boring	FD	47	26 U	26 U	
	SB01	4/21/2014	Soil Boring	N	1.5 - 2	4.3 U	4.3 U
4/21/2014		Soil Boring	N	5 - 5.5	5.1 U	5.1 U	
SB-02	5/12/2016	Soil Boring	N	5	23 U	23 U	
	5/12/2016	Soil Boring	N	10	24 U	24 U	
	5/12/2016	Soil Boring	N	15	26 U	26 U	
	5/12/2016	Soil Boring	N	20	27 U	27 U	
	5/12/2016	Soil Boring	N	25	28 U	28 U	
	5/12/2016	Soil Boring	N	30	26 U	26 U	
	5/12/2016	Soil Boring	N	35	27 U	27 U	
	5/12/2016	Soil Boring	N	40	24 U	24 U	
	5/12/2016	Soil Boring	N	45	25 U	25 U	
	5/12/2016	Soil Boring	FD	45	25 U	25 U	
	5/12/2016	Soil Boring	N	50	26 U	26 U	
	5/12/2016	Soil Boring	N	55	27 U	27 U	
	5/12/2016	Soil Boring	N	60	27 U	27 U	
	5/12/2016	Soil Boring	N	65	29 U	29 U	
	5/12/2016	Soil Boring	N	70	28 U	28 U	
5/12/2016	Soil Boring	N	75	26 U	26 U		
SB02	4/21/2014	Soil Boring	N	1 - 1.5	2.05 U	--	
	4/21/2014	Soil Boring	N	4.5 - 5	2.27 U	--	
SB-03	5/13/2016	Soil Boring	N	5	25 U	25 U	
	5/13/2016	Soil Boring	N	10	26 U	26 U	
	5/13/2016	Soil Boring	N	15	26 U	26 U	
	5/13/2016	Soil Boring	N	20	28 U	28 U	
	5/13/2016	Soil Boring	N	25	27 U	27 U	
	5/13/2016	Soil Boring	N	30	27 U	27 U	
	5/13/2016	Soil Boring	N	35	26 U	26 U	
	5/13/2016	Soil Boring	N	40	23 U	23 U	

Table 4-3. Summary of Analytical Soil Data - Carbon Tetrachloride and Chloroform

Location	Sample Date	Group	Type	Depth	Carbon tetrachloride	Chloroform	
					Screening Levels (µg/kg)		
					MTCA Method B Cancer	14,000	32,000
					MTCA Protection of Groundwater, Vadose at 13 C	42	74
					2.2	4.8	
					Analytical Data (µg/kg)		
SB03	4/21/2014	Soil Boring	N	1 - 1.5	2.4 U	--	
	4/21/2014	Soil Boring	N	4.5 - 5	2.38 U	--	
SB04	4/21/2014	Soil Boring	N	4 - 4.5	6 U	6 U	
	4/21/2014	Soil Boring	N	5 - 5.5	0.21 J	4.8 U	
SB05	4/21/2014	Soil Boring	N	2.5 - 3	2.32 U	--	
	4/21/2014	Soil Boring	N	3.5 - 4	2.29 U	--	
SB-06	5/18/2016	Soil Boring	N	5	25 U	25 U	
	5/18/2016	Soil Boring	N	10	24 U	24 U	
	5/18/2016	Soil Boring	N	15	24 U	24 U	
	5/18/2016	Soil Boring	N	21	28 U	28 U	
	5/18/2016	Soil Boring	N	25	31 U	31 U	
	5/18/2016	Soil Boring	N	30	25 U	25 U	
	5/18/2016	Soil Boring	N	35	26 U	26 U	
	5/18/2016	Soil Boring	FD	35	25 U	25 U	
	5/18/2016	Soil Boring	N	40	26 U	26 U	
	5/18/2016	Soil Boring	N	45	26 U	26 U	
	5/18/2016	Soil Boring	N	50	22 U	22 U	
	5/18/2016	Soil Boring	N	56	25 U	25 U	
	5/19/2016	Soil Boring	N	61	24 U	24 U	
	5/19/2016	Soil Boring	N	65	23 U	23 U	
	5/19/2016	Soil Boring	N	70	27 U	27 U	
	5/19/2016	Soil Boring	N	75	26 U	26 U	
SB06	4/21/2014	Soil Boring	N	4.5 - 5	5.1 U	5.1 U	
	4/21/2014	Soil Boring	N	6.5 - 7	4.5 U	4.5 U	
	4/21/2014	Soil Boring	N	12 - 12.5	6 U	6 U	
SB-07	5/20/2016	Soil Boring	N	5	22 U	22 U	
	5/20/2016	Soil Boring	N	10	27 U	27 U	
	5/20/2016	Soil Boring	N	15	28 U	28 U	
	5/20/2016	Soil Boring	N	20	27 U	27 U	
	5/20/2016	Soil Boring	N	25	27 U	27 U	
	5/20/2016	Soil Boring	N	30	25 U	25 U	
	5/20/2016	Soil Boring	FD	30	26 U	26 U	
	5/20/2016	Soil Boring	N	35	26 U	26 U	
	5/20/2016	Soil Boring	N	40	25 U	25 U	
	5/20/2016	Soil Boring	N	45	32 U	32 U	
	5/20/2016	Soil Boring	N	50	26 U	26 U	
	5/20/2016	Soil Boring	N	55	27 U	27 U	
	5/20/2016	Soil Boring	N	60	33 U	33 U	
	5/20/2016	Soil Boring	N	65	26 U	26 U	
5/20/2016	Soil Boring	N	70	24 U	24 U		
5/20/2016	Soil Boring	N	75	24 U	24 U		

Table 4-3. Summary of Analytical Soil Data - Carbon Tetrachloride and Chloroform

Location	Sample Date	Group	Type	Depth	Carbon tetrachloride	Chloroform	
					Screening Levels (µg/kg)		
					MTCA Method B Cancer	14,000	32,000
					MTCA Protection of Groundwater, Vadose at 13 C	42	74
MTCA Protection of Groundwater, Saturated	2.2	4.8					
					Analytical Data (µg/kg)		
SB07	4/21/2014	Soil Boring	N	2.5 - 3	2.46 U	--	
	4/21/2014	Soil Boring	N	3.5 - 4	2.4 U	--	
SB-08	5/23/2016	Soil Boring	N	5	22 U	22 U	
	5/23/2016	Soil Boring	N	10	25 U	25 U	
	5/23/2016	Soil Boring	N	15	26 U	26 U	
	5/23/2016	Soil Boring	N	20	27 U	27 U	
	5/23/2016	Soil Boring	N	25	25 U	25 U	
	5/23/2016	Soil Boring	N	30	26 U	26 U	
	5/23/2016	Soil Boring	N	35	27 U	27 U	
	5/23/2016	Soil Boring	N	40	25 U	25 U	
	5/23/2016	Soil Boring	FD	40	36	26 U	
	5/23/2016	Soil Boring	N	45	28	26 U	
	5/23/2016	Soil Boring	N	50	24 U	24 U	
SB08	4/22/2014	Soil Boring	N	4 - 4.5	3.96 U	--	
	4/22/2014	Soil Boring	N	5 - 5.5	3.95 U	--	
SB-09	5/23/2016	Soil Boring	N	5	23 U	23 U	
	5/23/2016	Soil Boring	N	10	26 U	26 U	
	5/23/2016	Soil Boring	N	15	26 U	26 U	
	5/23/2016	Soil Boring	N	20	24 U	24 U	
	5/23/2016	Soil Boring	N	25	27 U	27 U	
	5/23/2016	Soil Boring	FD	25	27 U	27 U	
	5/23/2016	Soil Boring	N	30	26 U	26 U	
	5/23/2016	Soil Boring	N	35	27 U	27 U	
	5/23/2016	Soil Boring	N	39	23 U	23 U	
SB09	4/22/2014	Soil Boring	N	3.5 - 4	2 U	--	
	4/22/2014	Soil Boring	N	15 - 15.5	3.2 J	6.8 J	
	4/22/2014	Soil Boring	N	19.5 - 20	3.8 J	7.6	
	4/22/2014	Soil Boring	N	25 - 25.5	3.2 J	4.1 J	
SB-10	5/24/2016	Soil Boring	N	5	23 U	23 U	
	5/24/2016	Soil Boring	N	10	27 U	27 U	
	5/24/2016	Soil Boring	N	15	25 U	25 U	
	5/24/2016	Soil Boring	N	20	26 U	26 U	
	5/24/2016	Soil Boring	N	25	26 U	26 U	
	5/24/2016	Soil Boring	N	30	28 U	28 U	
	5/24/2016	Soil Boring	N	35	26 U	26 U	
	5/24/2016	Soil Boring	FD	35	27 U	27 U	
	5/24/2016	Soil Boring	N	40	25 U	25 U	
5/24/2016	Soil Boring	N	45	23 U	23 U		
SB10	4/22/2014	Soil Boring	N	15.5 - 16	0.88 J	7.3 U	
	4/22/2014	Soil Boring	N	18.5 - 19	6.5 J	3.5 J	
	4/22/2014	Soil Boring	N	20.5 - 21	4.4 J	4.5 J	

Table 4-3. Summary of Analytical Soil Data - Carbon Tetrachloride and Chloroform

Location	Sample Date	Group	Type	Depth	Carbon tetrachloride	Chloroform	
					Screening Levels (µg/kg)		
					MTCA Method B Cancer	14,000	32,000
					MTCA Protection of Groundwater, Vadose at 13 C	42	74
					2.2	4.8	
					Analytical Data (µg/kg)		
SB-11	5/25/2016	Soil Boring	N	5	22 U	22 U	
	5/25/2016	Soil Boring	N	10	27 U	27 U	
	5/25/2016	Soil Boring	N	15	22 U	22 U	
	5/25/2016	Soil Boring	N	20	24 U	24 U	
	5/25/2016	Soil Boring	FD	20	25 U	25 U	
	5/25/2016	Soil Boring	N	25	26 U	26 U	
	5/25/2016	Soil Boring	N	30	25 U	25 U	
	5/25/2016	Soil Boring	N	35	24 U	24 U	
	5/25/2016	Soil Boring	N	40	25 U	25 U	
	5/25/2016	Soil Boring	N	45	25 U	25 U	
	5/25/2016	Soil Boring	N	50	25 U	25 U	
	5/25/2016	Soil Boring	N	55	25 U	25 U	
	5/25/2016	Soil Boring	N	60	24 U	24 U	
	5/25/2016	Soil Boring	N	65	23 U	23 U	
	SB11	4/23/2014	Soil Boring	N	16.5 - 17	3.43 U	--
4/23/2014		Soil Boring	N	17.5 - 18	4.18 U	--	
4/23/2014		Soil Boring	N	18.6 - 19.1	1.4 J	1.4 J	
4/23/2014		Soil Boring	N	20 - 20.5	1.9 J	0.94 J	
4/23/2014		Soil Boring	N	21.5 - 22	1.7 J	0.88 J	
4/23/2014		Soil Boring	N	28 - 28.5	0.71 J	0.59 J	
4/23/2014		Soil Boring	N	32 - 32.5	7.5 U	7.5 U	
SB-12	5/25/2016	Soil Boring	N	5	23 U	23 U	
	5/25/2016	Soil Boring	N	10	26 U	26 U	
	5/25/2016	Soil Boring	FD	10	25 U	25 U	
	5/25/2016	Soil Boring	N	15	25 U	25 U	
	5/25/2016	Soil Boring	N	20	23 U	23 U	
	5/25/2016	Soil Boring	N	25	24 U	24 U	
	5/25/2016	Soil Boring	N	30	25 U	25 U	
	5/25/2016	Soil Boring	N	35	25 U	25 U	
	5/25/2016	Soil Boring	N	40	24 U	24 U	
	5/25/2016	Soil Boring	N	45	25 U	25 U	
	5/25/2016	Soil Boring	N	50	25 U	25 U	
	5/25/2016	Soil Boring	N	55	24 U	24 U	
SB12	4/24/2014	Soil Boring	N	20 - 20.5	2.3 J	1.6 J	
	4/24/2014	Soil Boring	N	21.5 - 22	1.9 J	1.4 J	
	4/24/2014	Soil Boring	N	28.5 - 29	0.19 J	7 U	
SB-13	5/26/2016	Soil Boring	N	5	26 U	26 U	
	5/26/2016	Soil Boring	N	10	23 U	23 U	
	5/26/2016	Soil Boring	N	15	25 U	25 U	
	5/26/2016	Soil Boring	N	20	25 U	25 U	
	5/26/2016	Soil Boring	FD	20	25 U	25 U	

Table 4-3. Summary of Analytical Soil Data - Carbon Tetrachloride and Chloroform

Location	Sample Date	Group	Type	Depth	Carbon tetrachloride	Chloroform	
					Screening Levels (µg/kg)		
					MTCA Method B Cancer	14,000	32,000
					MTCA Protection of Groundwater, Vadose at 13 C	42	74
MTCA Protection of Groundwater, Saturated	2.2	4.8					
					Analytical Data (µg/kg)		
	5/26/2016	Soil Boring	N	25	24 U	24 U	
	5/26/2016	Soil Boring	N	30	27 U	27 U	
	5/26/2016	Soil Boring	N	35	27 U	27 U	
	5/26/2016	Soil Boring	N	40	31 U	31 U	
	5/26/2016	Soil Boring	N	45	28 U	28 U	
	5/26/2016	Soil Boring	N	50	27 U	27 U	
	5/26/2016	Soil Boring	N	55	26 U	26 U	
	5/26/2016	Soil Boring	N	60	25 U	25 U	
	5/26/2016	Soil Boring	N	63	24 U	24 U	
SB13	4/24/2014	Soil Boring	N	14 - 14.5	1.2 J	7 U	
	4/24/2014	Soil Boring	N	20 - 20.5	4.1 J	2.2 J	
	4/24/2014	Soil Boring	N	21.2 - 21.7	9.7	4.4 J	
	4/24/2014	Soil Boring	N	23 - 23.5	7.1 J	3.7 J	
	4/24/2014	Soil Boring	N	27.5 - 28	4.9 J	3 J	
	4/24/2014	Soil Boring	N	30 - 30.5	15	6.6 J	
SB-14	5/26/2016	Soil Boring	N	5	23 U	23 U	
	5/26/2016	Soil Boring	N	10	24 U	24 U	
	5/26/2016	Soil Boring	N	15	23 U	23 U	
	5/26/2016	Soil Boring	FD	15	29 U	29 U	
	5/26/2016	Soil Boring	N	20	22 U	22 U	
	5/26/2016	Soil Boring	N	25	24 U	24 U	
	5/26/2016	Soil Boring	N	30	30 U	30 U	
	5/26/2016	Soil Boring	N	35	25 U	25 U	
	5/26/2016	Soil Boring	N	40	27 U	27 U	
	5/26/2016	Soil Boring	N	45	31 U	31 U	
	5/26/2016	Soil Boring	N	50	31 U	31 U	
	5/26/2016	Soil Boring	N	54	24 U	24 U	
SB14	4/24/2014	Soil Boring	N	18 - 18.5	6.8 J	8.5	
	4/24/2014	Soil Boring	N	21.5 - 22	9.3	11	
	4/24/2014	Soil Boring	N	23.5 - 24	9.8 J	12	
	4/24/2014	Soil Boring	N	28 - 28.5	0.27 J	0.5 J	
SB-15	6/30/2016	Soil Boring	N	5	22 U	22 U	
	6/30/2016	Soil Boring	N	10	23 U	23 U	
	6/30/2016	Soil Boring	N	15	21 U	21 U	
	6/30/2016	Soil Boring	N	20	24 U	24 U	
	6/30/2016	Soil Boring	N	25	27 U	27 U	
	6/30/2016	Soil Boring	FD	25	27 U	27 U	
	6/30/2016	Soil Boring	N	30	25 U	25 U	
	6/30/2016	Soil Boring	N	35	25 U	25 U	
	6/30/2016	Soil Boring	N	40	25 U	25 U	
	6/30/2016	Soil Boring	N	45	26 U	26 U	
	6/30/2016	Soil Boring	N	50	24 U	24 U	
	6/30/2016	Soil Boring	N	55	24 U	24 U	
	6/30/2016	Soil Boring	N	60	23 U	23 U	
	6/30/2016	Soil Boring	N	65	26 U	26 U	
	6/30/2016	Soil Boring	FD	65	25 U	25 U	
	6/30/2016	Soil Boring	N	70	27 U	27 U	
	6/30/2016	Soil Boring	N	75	23 U	23 U	
	6/30/2016	Soil Boring	N	80	25 U	25 U	

Table 4-3. Summary of Analytical Soil Data - Carbon Tetrachloride and Chloroform

Location	Sample Date	Group	Type	Depth	Carbon tetrachloride	Chloroform	
					Screening Levels (µg/kg)		
					MTCA Method B Cancer	14,000	32,000
					MTCA Protection of Groundwater, Vadose at 13 C	42	74
					2.2	4.8	
					Analytical Data (µg/kg)		
SB-16	6/30/2016	Soil Boring	N	85	26 U	26 U	
	6/30/2016	Soil Boring	N	90	22 U	22 U	
	6/30/2016	Soil Boring	N	95	24 U	24 U	
	6/27/2016	Soil Boring	N	5	22 U	22 U	
	6/27/2016	Soil Boring	N	10	23 U	23 U	
	6/27/2016	Soil Boring	N	15	23 U	23 U	
	6/27/2016	Soil Boring	N	20	23 U	23 U	
	6/27/2016	Soil Boring	N	25	25 U	25 U	
	6/27/2016	Soil Boring	FD	25	24 U	24 U	
6/27/2016	Soil Boring	N	30	26 U	26 U		
SB-17	6/28/2016	Soil Boring	N	5	22 U	22 U	
	6/28/2016	Soil Boring	N	10	26 U	26 U	
	6/28/2016	Soil Boring	N	15	23 U	23 U	
	6/28/2016	Soil Boring	N	20	24 U	24 U	
	6/28/2016	Soil Boring	N	25	23 U	23 U	
	6/28/2016	Soil Boring	N	30	22 U	22 U	
	6/28/2016	Soil Boring	N	35	26 U	26 U	
	6/28/2016	Soil Boring	FD	35	25 U	25 U	
	6/28/2016	Soil Boring	N	40	20 U	20 U	
	6/28/2016	Soil Boring	N	45	21 U	21 U	
	6/28/2016	Soil Boring	N	50	26 U	26 U	
	6/28/2016	Soil Boring	N	55	25 U	25 U	
	6/28/2016	Soil Boring	N	60	28 U	28 U	
	6/28/2016	Soil Boring	N	65	29 U	29 U	
	6/28/2016	Soil Boring	N	70	26 U	26 U	
	6/28/2016	Soil Boring	N	75	26 U	26 U	
6/28/2016	Soil Boring	N	80	25 U	25 U		
SB-18	6/30/2016	Soil Boring	N	5	24 U	24 U	
	6/30/2016	Soil Boring	N	10	23 U	23 U	
	6/30/2016	Soil Boring	N	15	25 U	25 U	
	6/30/2016	Soil Boring	N	20	25 U	25 U	
	6/30/2016	Soil Boring	N	25	24 U	24 U	
	6/30/2016	Soil Boring	N	30	26 U	26 U	
	6/30/2016	Soil Boring	N	35	43	28 U	
	6/30/2016	Soil Boring	N	40	35	26 U	
	6/30/2016	Soil Boring	N	45	27 U	27 U	
6/30/2016	Soil Boring	N	50	26 U	26 U		
SB-19	6/30/2016	Soil Boring	N	5	24 U	24 U	
	6/30/2016	Soil Boring	N	10	24 U	24 U	
	6/30/2016	Soil Boring	N	15	24 U	24 U	
	6/30/2016	Soil Boring	N	20	27 U	27 U	
	6/30/2016	Soil Boring	N	25	28 U	28 U	
	6/30/2016	Soil Boring	N	30	29 U	29 U	
	6/30/2016	Soil Boring	N	35	26 U	26 U	
	6/30/2016	Soil Boring	FD	35	25 U	25 U	
	6/30/2016	Soil Boring	N	40	26 U	26 U	
SB-20	7/6/2016	Soil Boring	N	5	1.8 U	1.8 U	
	7/6/2016	Soil Boring	N	10	1.5 U	1.5 U	
	7/6/2016	Soil Boring	N	15	1.5 U	1.5 U	

Table 4-3. Summary of Analytical Soil Data - Carbon Tetrachloride and Chloroform

Location	Sample Date	Group	Type	Depth	Carbon tetrachloride	Chloroform	
					Screening Levels (µg/kg)		
					MTCA Method B Cancer	14,000	32,000
					MTCA Protection of Groundwater, Vadose at 13 C	42	74
MTCA Protection of Groundwater, Saturated	2.2	4.8					
					Analytical Data (µg/kg)		
	7/6/2016	Soil Boring	N	20	5.4	6.3	
	7/6/2016	Soil Boring	N	25	6.2	7.2	
	7/6/2016	Soil Boring	N	30	10	8.8	
	7/6/2016	Soil Boring	N	35	14	9.1	
	7/6/2016	Soil Boring	FD	35	0.21 U	0.53 J	
	7/6/2016	Soil Boring	N	39	17	10	
SB-21	7/7/2016	Soil Boring	N	5	0.29 U	0.29 U	
	7/7/2016	Soil Boring	N	10	0.26 U	0.26 U	
	7/7/2016	Soil Boring	N	15	0.31 U	0.31 U	
	7/7/2016	Soil Boring	N	20	0.29 U	0.29 U	
	7/7/2016	Soil Boring	N	25	0.25 U	0.25 U	
	7/7/2016	Soil Boring	N	30	0.29 U	0.29 U	
	7/7/2016	Soil Boring	FD	30	0.28 U	0.28 U	
	7/7/2016	Soil Boring	N	35	0.31 U	0.31 U	
	7/7/2016	Soil Boring	N	40	0.26 U	0.26 U	
	7/7/2016	Soil Boring	N	45	0.29 U	0.29 U	
	7/7/2016	Soil Boring	N	50	0.32 U	0.32 U	
	7/7/2016	Soil Boring	N	55	0.29 U	0.29 U	
	7/7/2016	Soil Boring	N	60	0.33 U	0.33 U	
	7/7/2016	Soil Boring	N	65	0.3 U	0.3 U	
SB-22	7/20/2016	Soil Boring	N	5	0.25 U	0.25 U	
	7/20/2016	Soil Boring	N	20	2.5	2.2	
	7/20/2016	Soil Boring	N	25	7.2	6.1	
	7/20/2016	Soil Boring	N	30	9.1	7.4	
	7/20/2016	Soil Boring	N	35	20	8.3	
SB-23	7/20/2016	Soil Boring	N	5	0.34 U	0.34 U	
	7/20/2016	Soil Boring	N	10	0.27 U	0.27 U	
	7/20/2016	Soil Boring	N	15	0.28 U	0.28 U	

Table 4-3. Summary of Analytical Soil Data - Carbon Tetrachloride and Chloroform

Location	Sample Date	Group	Type	Depth	Carbon tetrachloride	Chloroform	
					Screening Levels (µg/kg)		
					MTCA Method B Cancer	14,000	32,000
					MTCA Protection of Groundwater, Vadose at 13 C	42	74
MTCA Protection of Groundwater, Saturated	2.2	4.8					
					Analytical Data (µg/kg)		
	7/20/2016	Soil Boring	N	20	0.26 U	0.26 U	
	7/20/2016	Soil Boring	N	25	0.31 U	0.31 U	
	7/20/2016	Soil Boring	N	30	0.31 U	0.31 U	
	7/20/2016	Soil Boring	N	35	0.36 U	0.36 U	
	7/20/2016	Soil Boring	N	40	0.32 U	0.32 U	
	7/20/2016	Soil Boring	N	45	0.37 U	0.37 U	
	7/20/2016	Soil Boring	N	50	0.32 U	0.32 U	
	7/20/2016	Soil Boring	N	55	0.38 U	0.38 U	
	7/20/2016	Soil Boring	N	60	0.26 U	0.26 U	
SB-24	7/21/2016	Soil Boring	N	5	0.27 U	0.27 U	
	7/21/2016	Soil Boring	N	10	0.3 U	0.3 U	
	7/21/2016	Soil Boring	N	15	0.29 U	0.29 U	
	7/21/2016	Soil Boring	N	20	0.29 U	0.29 U	
	7/21/2016	Soil Boring	FD	20	0.28 U	0.28 U	
	7/21/2016	Soil Boring	N	25	0.25 U	0.25 U	
	7/21/2016	Soil Boring	N	30	0.26 U	0.26 U	
	7/21/2016	Soil Boring	N	35	0.25 U	0.25 U	
	7/21/2016	Soil Boring	N	40	0.27 U	0.27 U	
	7/21/2016	Soil Boring	FD	40	0.29 U	0.29 U	
	7/21/2016	Soil Boring	N	45	0.28 U	0.28 U	
	7/21/2016	Soil Boring	N	50	0.25 U	0.25 U	
	7/21/2016	Soil Boring	N	55	0.32 U	0.32 U	
SB-25	11/19/2016	Soil Boring	N	4	0.18 U	0.068 U	
	11/19/2016	Soil Boring	N	8	0.15 U	0.057 U	
	11/19/2016	Soil Boring	N	12	0.14 U	0.055 U	
	11/19/2016	Soil Boring	N	16	0.24 U	0.092 U	
	11/19/2016	Soil Boring	N	20	0.24 U	0.094 U	
	11/19/2016	Soil Boring	N	22	0.24 U	0.092 U	
SB-26	11/19/2016	Soil Boring	N	5	0.2 U	0.078 U	
	11/19/2016	Soil Boring	N	10	0.24 U	0.092 U	
	11/19/2016	Soil Boring	N	15	0.25 U	0.097 U	
	11/19/2016	Soil Boring	N	20	0.26 U	0.099 U	
	11/19/2016	Soil Boring	N	25	0.26 U	0.099 U	
	11/19/2016	Soil Boring	N	30	0.25 U	0.097 U	
	11/19/2016	Soil Boring	N	31	0.26 U	0.099 U	
SB-27	11/20/2016	Soil Boring	N	5	0.22 U	0.084 U	
	11/20/2016	Soil Boring	N	10	0.21 U	0.079 U	
	11/20/2016	Soil Boring	N	15	0.22 U	0.084 U	
	11/20/2016	Soil Boring	N	19	0.25 U	0.096 U	
SB-28	11/20/2016	Soil Boring	N	5	0.2 U	0.076 U	
	11/20/2016	Soil Boring	N	10	0.2 U	0.078 U	
	11/20/2016	Soil Boring	N	15	0.25 U	0.095 U	
	11/20/2016	Soil Boring	N	19	0.26 U	0.099 U	

Table 4-3. Summary of Analytical Soil Data - Carbon Tetrachloride and Chloroform

Location	Sample Date	Group	Type	Depth	Carbon tetrachloride	Chloroform	
					Screening Levels (µg/kg)		
					MTCA Method B Cancer	14,000	32,000
					MTCA Protection of Groundwater, Vadose at 13 C	42	74
MTCA Protection of Groundwater, Saturated	2.2	4.8					
					Analytical Data (µg/kg)		
SB-29	11/20/2016	Soil Boring	N	5	0.2 U	0.078 U	
	11/20/2016	Soil Boring	N	10	0.2 U	0.076 U	
	11/20/2016	Soil Boring	N	13	0.26 U	0.099 U	
SB-30	11/20/2016	Soil Boring	N	5	0.21 U	0.081 U	
	11/20/2016	Soil Boring	N	10	0.21 U	0.08 U	
	11/20/2016	Soil Boring	N	15	0.2 U	0.077 U	
SB-31	11/20/2016	Soil Boring	N	5	0.21 U	0.079 U	
	11/20/2016	Soil Boring	N	10	0.21 U	0.081 U	
	11/20/2016	Soil Boring	N	15	0.2 U	0.078 U	
SB-32	11/21/2016	Soil Boring	N	5	0.2 U	0.077 U	
	11/21/2016	Soil Boring	N	10	0.26 UR	0.1 UR	
	11/21/2016	Soil Boring	N	15	0.27 UR	0.11 UR	
	11/21/2016	Soil Boring	N	20	0.24 UR	0.092 UR	
	11/21/2016	Soil Boring	N	23	0.24 UR	0.094 UR	
SB-33	11/21/2016	Soil Boring	N	5	0.21 UR	0.082 UR	
	11/21/2016	Soil Boring	N	10	0.2 UR	0.076 UR	
	11/21/2016	Soil Boring	N	15	0.25 UR	0.095 UR	
	11/21/2016	Soil Boring	N	17	0.26 UR	0.1 UR	
SB-34	1/9/2017	Soil Boring	N	5	18.2 U	28.1 U	
	1/9/2017	Soil Boring	N	10	20.2 U	31.3 U	
	1/9/2017	Soil Boring	N	15	24.7 U	38.2 U	
	1/9/2017	Soil Boring	N	20	23 U	35.7 U	
	1/9/2017	Soil Boring	N	25	21.1 U	32.7 U	
	1/9/2017	Soil Boring	N	30	30.2 J	39.9 U	
	1/9/2017	Soil Boring	N	35	58.2 J	32.4 U	
	1/9/2017	Soil Boring	N	40	24.2 U	37.5 U	
	1/9/2017	Soil Boring	N	45	21.1 U	32.7 U	
	1/9/2017	Soil Boring	N	50	24.6 U	38.1 U	
	1/9/2017	Soil Boring	N	55	23.2 U	35.9 U	
	1/9/2017	Soil Boring	N	60	23 U	35.6 U	
	1/10/2017	Soil Boring	N	65	18.8 U	29.2 U	
	1/10/2017	Soil Boring	FD	65	17.3 U	26.8 U	
SB-35	1/12/2017	Soil Boring	N	10	19.8 U	30.7 U	
	1/12/2017	Soil Boring	FD	10	17.7 U	27.4 U	
	1/12/2017	Soil Boring	N	20	20.5 U	31.7 U	
	1/12/2017	Soil Boring	N	25	19.8 U	30.7 U	
	1/13/2017	Soil Boring	N	30	21.8 U	33.7 U	
	1/13/2017	Soil Boring	N	35	22.5 U	34.7 U	
	1/13/2017	Soil Boring	N	40	20.8 U	32.2 U	
	1/13/2017	Soil Boring	N	45	20.1 U	31.2 U	
	1/13/2017	Soil Boring	N	50	20.5 U	31.7 U	
	1/13/2017	Soil Boring	N	55	19.1 U	29.6 U	
	1/13/2017	Soil Boring	N	60	23.7 U	36.7 U	
	1/13/2017	Soil Boring	N	65	23.7 U	36.6 U	
	1/13/2017	Soil Boring	N	70	24.4 U	37.8 U	
	1/13/2017	Soil Boring	N	75	25.5 U	39.5 U	
SB-36	1/11/2017	Soil Boring	N	5	18.7 U	29 U	
	1/11/2017	Soil Boring	N	10	19.3 U	29.9 U	

Table 4-3. Summary of Analytical Soil Data - Carbon Tetrachloride and Chloroform

Location	Sample Date	Group	Type	Depth	Carbon tetrachloride	Chloroform	
					Screening Levels (µg/kg)		
					MTCA Method B Cancer	14,000	32,000
					MTCA Protection of Groundwater, Vadose at 13 C	42	74
					2.2	4.8	
					Analytical Data (µg/kg)		
	1/11/2017	Soil Boring	N	15	21.7 U	33.6 U	
	1/11/2017	Soil Boring	N	20	18.3 U	28.3 U	
	1/11/2017	Soil Boring	N	25	17.6 U	27.3 U	
	1/11/2017	Soil Boring	N	30	22.2 U	34.3 U	
	1/11/2017	Soil Boring	N	35	21.5 U	33.3 U	
	1/11/2017	Soil Boring	FD	35	20.4 U	31.5 U	
	1/11/2017	Soil Boring	N	40	20.6 U	31.9 U	
	1/11/2017	Soil Boring	N	45	23.4 U	36.3 U	
	1/11/2017	Soil Boring	N	50	21 U	32.6 U	
SB-37	1/11/2017	Soil Boring	N	5	18 U	27.8 U	
	1/11/2017	Soil Boring	N	10	19.2 U	29.7 U	
	1/11/2017	Soil Boring	N	15	18.3 U	28.3 U	
	1/11/2017	Soil Boring	N	20	18.6 U	28.8 U	
	1/11/2017	Soil Boring	N	25	19.1 U	29.6 U	
	1/11/2017	Soil Boring	N	30	21.8 U	33.7 U	
	1/11/2017	Soil Boring	N	35	19.2 U	29.7 U	
	1/11/2017	Soil Boring	FD	35	21.6 U	33.4 U	
	1/12/2017	Soil Boring	N	40	23.6 U	36.6 U	
	1/12/2017	Soil Boring	N	45	23.9 U	37 U	
	1/12/2017	Soil Boring	N	50	25.4 U	39.4 U	
	1/12/2017	Soil Boring	N	55	26.4 U	40.8 U	
	1/12/2017	Soil Boring	N	60	23.8 U	36.8 U	
	1/12/2017	Soil Boring	N	65	22.4 U	34.7 U	
	1/12/2017	Soil Boring	N	70	24.6 U	38 U	
	1/12/2017	Soil Boring	N	75	20.5 U	31.7 U	
	1/12/2017	Soil Boring	N	80	19.6 U	30.3 U	
SB-40	2/13/2017	Soil Boring	N	5	18.9 U	29.2 U	
	2/13/2017	Soil Boring	N	10	18.8 U	29.2 U	
	2/13/2017	Soil Boring	N	15	24.7 U	38.2 U	
	2/13/2017	Soil Boring	N	20	21.5 U	33.3 U	
	2/13/2017	Soil Boring	N	25	25.7 U	39.8 U	
	2/13/2017	Soil Boring	N	30	17.3 U	26.8 U	
	2/13/2017	Soil Boring	N	35	17.3 U	26.8 U	
	2/13/2017	Soil Boring	N	40	19.3 U	29.9 U	
	2/13/2017	Soil Boring	N	45	23 U	35.6 U	
	2/13/2017	Soil Boring	N	50	22.8 U	35.3 U	
	2/13/2017	Soil Boring	N	55	23.1 U	35.8 U	

Table 4-3. Summary of Analytical Soil Data - Carbon Tetrachloride and Chloroform

Location	Sample Date	Group	Type	Depth	Carbon tetrachloride	Chloroform	
					Screening Levels (µg/kg)		
					MTCA Method B Cancer	14,000	32,000
					MTCA Protection of Groundwater, Vadose at 13 C	42	74
MTCA Protection of Groundwater, Saturated	2.2	4.8					
					Analytical Data (µg/kg)		
	2/13/2017	Soil Boring	N	60	22.6 U	35 U	
	2/13/2017	Soil Boring	FD	60	20.8 U	32.3 U	
	2/13/2017	Soil Boring	N	65	22.9 U	35.5 U	
	2/13/2017	Soil Boring	N	70	21.9 U	33.9 U	
	2/13/2017	Soil Boring	N	75	19.7 U	30.5 U	
	2/13/2017	Soil Boring	N	80	19.5 U	30.2 U	
	2/13/2017	Soil Boring	FD	80	18.1 U	27.9 U	
	2/13/2017	Soil Boring	N	85	15.4 U	23.8 U	
	2/13/2017	Soil Boring	N	90	15.2 U	23.5 U	
	2/13/2017	Soil Boring	N	95	19.4 U	30 U	
	SB-41	2/14/2017	Soil Boring	N	5	17.9 U	27.8 U
		2/14/2017	Soil Boring	N	10	19.3 U	29.8 U
		2/14/2017	Soil Boring	N	15	20.3 U	31.4 U
2/14/2017		Soil Boring	N	20	25.7 U	39.7 U	
2/14/2017		Soil Boring	N	25	26.5 U	41 U	
2/14/2017		Soil Boring	N	30	22.4 U	34.6 U	
2/14/2017		Soil Boring	FD	30	22.6 U	35 U	
2/14/2017		Soil Boring	N	35	23.5 U	36.4 U	
2/14/2017		Soil Boring	N	40	16.2 U	25.1 U	
SB-44	2/14/2017	Soil Boring	N	45	17.3 U	26.8 U	
	4/7/2017	Soil Boring	N	5	17.9 U	27.7 U	
	4/7/2017	Soil Boring	N	10	19.5 U	30.2 U	
	4/7/2017	Soil Boring	N	15	20 U	31 U	
	4/7/2017	Soil Boring	N	20	22.7 U	35.2 U	
	4/7/2017	Soil Boring	N	25	18.9 U	29.3 U	
	4/7/2017	Soil Boring	N	30	21.1 U	32.7 U	
	4/7/2017	Soil Boring	N	35	20.5 U	31.8 U	
	4/7/2017	Soil Boring	N	40	19.7 U	30.4 U	
	4/7/2017	Soil Boring	N	45	20.4 U	31.5 U	
	4/7/2017	Soil Boring	FD	45	35.3 U	54.7 U	
	4/7/2017	Soil Boring	N	50	22.9 U	35.5 U	
	4/7/2017	Soil Boring	N	55	21.9 U	33.8 U	
	4/7/2017	Soil Boring	N	60	21.5 U	33.3 U	
	4/7/2017	Soil Boring	N	65	22.9 U	35.4 U	
4/7/2017	Soil Boring	N	70	24.6 U	38.1 U		
4/7/2017	Soil Boring	N	72.5	54.6 U	84.4 U		
SB101B	1/23/2018	Soil Boring	N	5	0.59 U	0.83 U	
	1/23/2018	Soil Boring	N	15	0.52 U	4.9	
	1/23/2018	Soil Boring	N	25	4.2 J	5.5	
	1/23/2018	Soil Boring	N	36	20.6	9.4	
SB102B	1/24/2018	Soil Boring	N	5	5.7	8.7	
	1/24/2018	Soil Boring	N	15	8.7	10.6	
	1/24/2018	Soil Boring	N	25	7.6	8.4	
	1/24/2018	Soil Boring	N	30	10.7	10.2	

Table 4-3. Summary of Analytical Soil Data - Carbon Tetrachloride and Chloroform

Location	Sample Date	Group	Type	Depth	Carbon tetrachloride	Chloroform	
					Screening Levels (µg/kg)		
					MTCA Method B Cancer	14,000	32,000
					MTCA Protection of Groundwater, Vadose at 13 C	42	74
					2.2	4.8	
					Analytical Data (µg/kg)		
SB103B	1/25/2018	Soil Boring	N	5	2.8 J	6.1	
	1/25/2018	Soil Boring	N	15	4 J	4 J	
	1/25/2018	Soil Boring	N	22	2.8 J	1.8 J	
	1/25/2018	Soil Boring	N	27	7.2 J	3.8 J	
	1/25/2018	Soil Boring	FD	27	10.6 J	5.5 J	
SB104B	1/25/2018	Soil Boring	N	5	0.57 U	0.8 U	
	1/25/2018	Soil Boring	N	15	13.7	5.1 J	
	1/25/2018	Soil Boring	N	22	4.5 J	4.1 J	
	1/25/2018	Soil Boring	N	27	7.2	3.6 J	
SB-201	12/13/2018	Soil Boring	N	5	30 U	31 U	
	12/13/2018	Soil Boring	N	15	35 U	36 U	
SB-202	12/13/2018	Soil Boring	N	5	28 U	30 U	
	12/13/2018	Soil Boring	N	15	37 U	39 U	
SB-203	12/13/2018	Soil Boring	N	5	30 U	31 U	
	12/13/2018	Soil Boring	N	15	39 U	41 U	
SB-204	12/13/2018	Soil Boring	N	5	31 U	32 U	
	12/13/2018	Soil Boring	N	15	41 U	43 U	
	12/13/2018	Soil Boring	FD	15	41 U	42 U	
SB-205	12/13/2018	Soil Boring	N	5	29 U	31 U	
	12/13/2018	Soil Boring	N	15	36 U	38 U	
SB-206	6/19/2019	Soil Boring	N	5	28 U	29 U	
	6/19/2019	Soil Boring	N	10	28 U	29 U	
	6/19/2019	Soil Boring	N	15	37 U	39 U	
	6/19/2019	Soil Boring	N	20	38 U	39 U	
	6/19/2019	Soil Boring	N	25	34 U	35 U	
	6/19/2019	Soil Boring	N	30	34 U	36 U	
	6/19/2019	Soil Boring	N	35	34 U	36 U	
	6/19/2019	Soil Boring	N	40	33 U	35 U	
	6/19/2019	Soil Boring	N	45	36 U	38 U	
	6/19/2019	Soil Boring	N	50	37 U	39 U	
	6/19/2019	Soil Boring	N	55	33 U	35 U	
	6/19/2019	Soil Boring	N	60	34 U	35 U	
	6/19/2019	Soil Boring	N	65	32 U	34 U	
	6/19/2019	Soil Boring	N	70	33 U	34 U	
	6/19/2019	Soil Boring	FD	70	35 U	37 U	
	6/19/2019	Soil Boring	N	77	33 U	34 U	
6/19/2019	Soil Boring	FD	77	29 U	30 U		
SB-207	6/21/2019	Soil Boring	N	5	30 U	31 U	
	6/21/2019	Soil Boring	N	10	28 U	30 U	
	6/21/2019	Soil Boring	N	15	30 U	31 U	
	6/21/2019	Soil Boring	N	20	28 U	30 U	
	6/21/2019	Soil Boring	N	25	29 U	30 U	
	6/21/2019	Soil Boring	N	30	29 U	30 U	
	6/21/2019	Soil Boring	N	35	29 U	31 U	
	6/21/2019	Soil Boring	N	40	30 U	32 U	
	6/21/2019	Soil Boring	N	45	36 U	38 U	
	6/21/2019	Soil Boring	N	50	34 U	35 U	
	6/21/2019	Soil Boring	N	55	38 U	40 U	
	6/21/2019	Soil Boring	N	60	46 U	48 U	

Table 4-3. Summary of Analytical Soil Data - Carbon Tetrachloride and Chloroform

Location	Sample Date	Group	Type	Depth	Carbon tetrachloride	Chloroform	
					Screening Levels (µg/kg)		
					MTCA Method B Cancer	14,000	32,000
					MTCA Protection of Groundwater, Vadose at 13 C	42	74
					2.2	4.8	
					Analytical Data (µg/kg)		
SB-208	6/21/2019	Soil Boring	N	65	36 U	38 U	
	6/21/2019	Soil Boring	FD	65	36 U	38 U	
	6/21/2019	Soil Boring	N	70	37 U	39 U	
	6/21/2019	Soil Boring	N	75	35 U	36 U	
	6/20/2019	Soil Boring	N	5	30 U	31 U	
	6/20/2019	Soil Boring	N	10	33 U	34 U	
	6/20/2019	Soil Boring	N	15	32 U	39 J	
	6/20/2019	Soil Boring	N	20	30 U	35 J	
	6/20/2019	Soil Boring	N	25	29 U	30 U	
	6/20/2019	Soil Boring	N	30	32 U	34 U	
	6/20/2019	Soil Boring	N	35	37 U	39 U	
	6/20/2019	Soil Boring	N	40	38 U	39 U	
	6/20/2019	Soil Boring	N	45	36 U	38 U	
	6/20/2019	Soil Boring	N	50	32 U	33 U	
	6/20/2019	Soil Boring	FD	50	42 U	44 U	
	6/20/2019	Soil Boring	N	55	39 U	40 U	
	6/20/2019	Soil Boring	N	60	39 U	43 J	
	6/20/2019	Soil Boring	N	65	38 U	40 U	
	6/20/2019	Soil Boring	N	70	36 U	37 U	
	6/20/2019	Soil Boring	N	75	35 U	37 U	
6/20/2019	Soil Boring	N	80	36 U	37 U		
6/20/2019	Soil Boring	N	85	34 U	36 U		
6/20/2019	Soil Boring	N	90	35 U	37 U		
SV-105	3/7/2018	Sub-slab Soil	N	0	0.7 U	0.99 U	
	3/7/2018	Sub-slab Soil	N	3	0.59 U	0.83 U	
SV-106	3/7/2018	Sub-slab Soil	N	0	8.3	5.7	
	3/7/2018	Sub-slab Soil	N	3	0.66 U	0.94 U	
SV-107	3/7/2018	Sub-slab Soil	N	0	1.4 J	0.97 J	
	3/7/2018	Sub-slab Soil	N	2	1.7 J	1.1 J	
SV-108	3/30/2018	Sub-slab Soil	N	0	0.7 U	0.99 U	
	3/30/2018	Sub-slab Soil	N	3	0.8 U	1.1 U	
SV-109	3/30/2018	Sub-slab Soil	N	0	0.59 U	0.84 U	
	3/30/2018	Sub-slab Soil	N	3	0.81 U	1.1 U	
SV-110	3/8/2018	Sub-slab Soil	N	0	0.56 U	0.79 U	
	3/8/2018	Sub-slab Soil	N	3	0.59 U	0.83 U	
SV-112	3/30/2018	Sub-slab Soil	N	0	0.6 U	0.85 U	
	3/30/2018	Sub-slab Soil	N	3	1.1 J	0.83 U	

Table 4-3. Summary of Analytical Soil Data - Carbon Tetrachloride and Chloroform

Location	Sample Date	Group	Type	Depth	Carbon tetrachloride	Chloroform	
					Screening Levels (µg/kg)		
					MTCA Method B Cancer	14,000	32,000
					MTCA Protection of Groundwater, Vadose at 13 C	42	74
MTCA Protection of Groundwater, Saturated	2.2	4.8					
					Analytical Data (µg/kg)		
SV-113	3/30/2018	Sub-slab Soil	N	0	0.64 U	0.9 U	
	3/30/2018	Sub-slab Soil	FD	0	0.55 U	0.78 U	
	3/30/2018	Sub-slab Soil	N	1.5	0.56 U	0.8 U	
	3/30/2018	Sub-slab Soil	FD	1.5	0.6 U	0.85 U	
SV-114	3/30/2018	Sub-slab Soil	N	3	0.53 U	0.75 U	

Notes:

Detections in **bold**

-- = not analyzed

µg/kg = microgram(s) per kilogram

FD = field duplicate

J = estimated result

MTCA = Model Toxics Control Act

N = normal sample

U = not detected at or above the indicated reporting limit

UJ = not detected; indicated reporting limit is estimated

UR = not detected; result was rejected and is not usable



LEGEND

- Soil Boring
- ⊕ Monitoring Well
- ⊗ Domestic Well
- ⊕ Horizontal Boring Location
- Pothole Location
- ⊕ Sub Slab Locations
- ◇ Excavation Location
- Horizontal Boring (HB)
- ▭ Grain Handling Facility at Freeman

Service Layer Credits: Sources: Esri, HERE, Garmin, USGS, Intermap, INCREMENT P, NRCan, Esri Japan, METI, Esri China (Hong Kong), Esri Korea, Esri (Thailand), NGCC, (c) OpenStreetMap contributors, and the GIS User Community
 Source: Esri, DigitalGlobe, GeoEye, Earthstar Geographics, CNES/Airbus DS, USDA, USGS, AeroGRID, IGN, and the GIS User Community

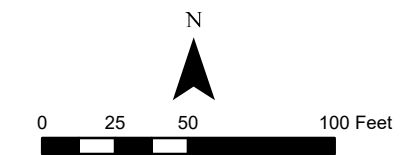

Figure 4-1
Soil Sample Locations
 Remedial Investigation/Feasibility Study Report
 Grain Handling Facility at Freeman,
 Freeman, Washington



LEGEND

- Surface Soil Sample
- ▭ Parcel Boundary
- ▭ Grain Handling Facility at Freeman

Sample Location ID ————— P0101-01
 Carbon Tetrachloride Concentration (µg/kg) ——— ND (0.0028)

Notes:
 Service Layer Credits: Source: Esri, DigitalGlobe, GeoEye, Earthstar Geographics, CNES/Airbus DS, USDA, USGS, AeroGRID, IGN, and the GIS User Community

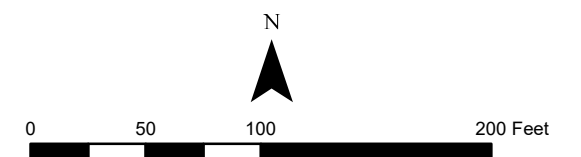

Figure 4-10
Residential Soil Sample Locations
 Remedial Investigation/Feasibility Study Report
 Grain Handling Facility at Freeman,
 Freeman, Washington



LEGEND

- Extraction Well
- ⊕ Monitoring Well
- ⊗ Domestic Well
- ⊗ Stream Gauge
- ▭ Grain Handling Facility at Freeman

Note

1. EW-6U, EW-9U, MW-22s and MW-23s were decommissioned due to artesian conditions.
2. Davey, Brandt and Freeman Store wells are not included in the GW monitoring program.

Service Layer Credits: Sources: Esri, HERE, Garmin, USGS, Intermap, INCREMENT P, NRCan, Esri Japan, METI, Esri China (Hong Kong), Esri Korea, Esri (Thailand), NGCC, (c) OpenStreetMap contributors, and the GIS User Community
 Source: Esri, DigitalGlobe, GeoEye, Earthstar Geographics, CNES/Airbus DS, USDA, USGS, AeroGRID, IGN, and the GIS User Community

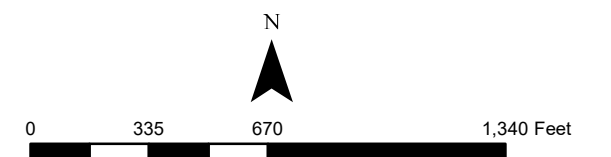

Figure 4-6
Well Locations/Groundwater Monitoring Network
 Remedial Investigation/Feasibility Study Report
 Grain Handling Facility at Freeman,
 Freeman, Washington