

Technical Memorandum

TO: Sam Meng, Washington State Department of Ecology
FROM: Dylan Frazer, LG, and Kent Wiken, PE
DATE: August 16, 2019
RE: **Completion of Partial Site Cleanup
Trunkline Storm Drain Replacement
North Marina Ameron/Hulbert and TC Systems Sites
Everett, Washington
Project No. 147029.500**

Introduction

On behalf of the Port of Everett (Port), this Partial Cleanup and Compliance Monitoring Technical Memorandum documents the partial cleanup and compliance monitoring results for the trunkline storm drain replacement at the North Marina Ameron/Hulbert Model Toxics Control Act (MTCA) site (Site; Figure 1) and the interim action for the TC Systems site. The Site is owned by the Port, the implementing potentially liable party (PLP) for the Site final cleanup action. The cleanup is being conducted as partial cleanup pursuant to consent decree No. 15 2 01720 7 between the Port and other Site PLPs, and the Washington State Department of Ecology (Ecology).

The purpose of the Site partial cleanup action was to remove and replace the portion of the stormwater trunkline separating the Site from the TC Systems MTCA site (TC Systems site), and to remove contaminated soil that would be excavated in the immediate vicinity of the trunkline. The removed trunkline was approximately 275 feet (ft) of deteriorated, corrugated metal pipe, and was replaced with new, 24-inch-diameter, solid wall polyvinyl chloride (PVC) pipe. The Site partial cleanup action was conducted concurrently and cooperatively with an interim cleanup action being conducted for the TC Systems site pursuant to agreed order DE 6677 between the PLPs for the TC Systems site and Ecology. As a result, this summary also addresses the compliance monitoring conducted for the TC Systems site interim action.

Based on previous field investigations, the following hazardous substances were present in soil in the partial cleanup area above MTCA soil cleanup levels (CULs): metals (antimony, arsenic, copper, lead and mercury); diesel- and oil-range total petroleum hydrocarbons (TPH-dx); carcinogenic polycyclic aromatic hydrocarbons (cPAHs); naphthalenes (naphthalene, 1-methynaphthalene); and polychlorinated biphenyls (PCBs).

The partial cleanup and associated compliance monitoring was conducted in accordance with the Engineering Design Report (EDR; LAI 2019), which included the Compliance Monitoring Plan (CMP) as an appendix, the TC Systems interim action work plan (IAWP; Stantec 2018), and subsequent communication with Ecology regarding the planned excavation depth (noted in *Deviations from Planned Cleanup* below).

Cleanup Implementation

The cleanup implementation began on April 29, 2019 and was completed on May 31, 2019. The partial cleanup limits are shown in plan view on Figure 2. The as-built plan and section showing the vertical excavation limits and replacement storm drain are provided in Attachment 1. Prior to excavation, overlying asphalt pavement was saw-cut, removed, and stockpiled for transport and recycling to the Granite Construction Smith Island plant in Everett, Washington.

The trunkline excavation was then completed to a 6.75-ft nominal width, using trench boxes, extended to approximately 10 ft below ground surface (bgs) to 12 ft bgs, or until a thick layer of buried wood debris (wooden beams, decking and logs) impeded further excavation. The cleanup plan called for the trench excavation to extend 1.5 ft below the invert of the existing trunkline excavation, and sampling and testing the soils at the bottom of the excavation. If the soils at the bottom of the excavation were found to exceed the cleanup levels, the excavation would be extended another 2 ft deeper (to a maximum 3.5 ft below the invert of the existing trunkline) to remove the contaminated soils. The additional 2 ft below the required excavation depth for installation of the trunk line was the maximum depth for contaminated soil removal identified for the Site EDR and in the TC Systems IAWP. However, keeping the trench excavation shored and open until the soil test results were completed was deemed to be impracticable from a construction perspective, so the Port, with Ecology review and concurrence, directed the contractor to remove all soils to 3.5 ft below the invert elevation of the existing trunkline and provide confirmation sampling at the bottom and east and west ends of the completed excavation in accordance with the CMP.

The contractor proceeded with excavation starting at storm drain man hole 3 (SDMH 3) and the excavation for catch basin CB101 on April 29, 2019, with the excavation generally proceeding from the west end to the east end. Once the excavation reached the trunkline installation depths, however, the contractor encountered wood debris and buried wooden structures within the 2 ft over-excavation zone below the required excavation depth for trunkline replacement. Because the material was fairly large (i.e. wooden beams, piles, and logs), and there was little soil in the matrix, it was highly permeable. As a result, once the wood debris layer was breached, large quantities of groundwater entered the excavation and pulling wood pieces from the sidewalls and bottom made the base of the excavation below the planned bedding for the new trunkline unstable, precluding the additional 2 ft-depth of excavation. As a result, the excavation was terminated with Ecology concurrence when the excavation reached the depth required to install the new trunkline. This approach was consistent with the intent of the IAWP and the EDR, which anticipated terminating the excavation if unstable conditions were encountered. Additionally, the material encountered when the excavation became unstable was primarily wood debris with only minimal soil matrix, so the intent of removing the contaminated soil along the trunk line alignment was achieved by extending the excavation to the wood debris layer. The presence of wood debris varied as the excavation moved to the east, and the excavation was extended to the 2 ft over-excavation target depth in areas where the wood debris layer was not encountered.

The trunkline excavation was de-watered, as necessary, for stability by using sump pumps in the excavation and collected water was stored in on-site temporary storage tanks. The water was tested per specification requirements for sanitary sewer acceptance criteria prior to disposal into the City of Everett sanitary sewer.

In addition to the trunkline excavation, impacted soil was excavated and removed around previously abandoned monitoring well TC-MW-7. As part of the TC Systems interim action, the TC-MW-7 area was excavated to a depth of 5 ft and a plan dimension of approximately 8 ft east to west and 15 ft north and south extending from the trunkline excavation. This excavation was backfilled with clean, compacted structural fill. The drawings misidentified MW-7, resulting in the destruction of monitoring well TC-MW-20, and excavation around it to a depth of 4 feet. As a result, TC Systems will need to work with Ecology to determine if monitoring well TC-MW-20 needs to be replaced and, if so, replace the well.

The trunkline excavation was completed on May 31, 2019. All excavated soils and materials for the cleanup, 1,190 tons, were loaded into an intermodal container onsite, transported to Republic Services rail facility in Everett, and transported for disposal at the Roosevelt Regional Landfill in Roosevelt, Washington (Subtitle D landfill). Documentation of disposal for all soil is presented in Attachment 2.

The new trunkline was installed in approximate 40-ft-long sections, and bedded and backfilled to within 4 ft of ground surface with controlled density fill (CDF) prior to excavating the next section. CDF backfill was used to facilitate implementation of the remainder of the Site cleanup action in the future. CDF is a weak cement/aggregate product capable of being excavated, but strong enough to maintain a stable vertical face for significant depth (specification required 150 pounds per square inch [psi] to 300 psi unconfined compressive strength). The CDF will function as shoring along the north side of the excavation when the remainder of the Site cleanup action is implemented in the future. Once the CDF cured, the upper 4 ft of the trench was backfilled with clean, compacted structural fill.

To clean up area was then repaved with asphalt to match finished grades shown on the construction plans, and a new 8-ft-high chainlink fence was installed on the property line between the Site and the TC systems property.

Deviations from Planned Cleanup

The following deviations from the EDR and/or IAWP were encountered during the cleanup process.

- The Port was informed by prospective bidders that the cost for implementing the project as originally proposed— excavate to the target depth, collect compliance monitoring samples, and re-excavate up to an additional 2 ft in areas that exceeded cleanup levels – would be more expensive than excavating up to the additional 2 ft for the entire alignment during the initial excavation. On February 13, 2019, Ecology project manager Sam Meng agreed that revising the construction sequencing to excavate up to an additional 2 ft (i.e. 3.5-ft below the invert elevation of the installed trunkline) during the initial pass would be acceptable and would not constitute a substantive change to either the TC Systems interim action or the

Ameron Hulbert partial cleanup action. The compliance sampling will document final conditions rather than provide the basis for additional excavation.

- Due to wood debris encountered below the former trunkline, the planned over-excavation of 2 ft below the trunkline invert was adjusted upon encountering large quantities of wood debris (as described in *Cleanup Implementation* above). This adjustment was communicated to Sam Meng with Ecology on May 8, 2019 and approved by Mr. Meng on May 9, 2019 via email.
- A 6-inch diameter downspout pipe was encountered in the south sidewall of the excavation about 65 ft east of CB101. This pipe was connected to the trunkline with an insert-a-tee. .
- The excavation width varied due to sloughing sidewalls prior to trench box installation, as shown on the construction as-built drawings Attachment 1.

Performance Monitoring

Because the partial cleanup action was only to remove a portion of the contaminated soil identified for removal as part of the Site final cleanup action, compliance monitoring was limited to protection monitoring and soil performance monitoring for the excavation area. Confirmational monitoring will be conducted at a later date in conjunction with implementation of the remainder of the Site final cleanup action.

Protection Monitoring

Protection monitoring was conducted by the contractor during implementation of the combined partial cleanup, which included protection of human health and the environment. Protection of human health was monitored by implementation of a project-specific health and safety plan (HASP). Protection of the environment was monitored by implementation of a dust monitoring plan, preparation and implementation of a stormwater pollution prevention plan (SWPPP), and implementation and monitoring of best management practices (BMPs) to minimize dust generation and control stormwater runoff from contaminated soil cleanup during construction.

Performance Monitoring

Performance monitoring was conducted in accordance with the CMP, and consisted of monitoring of the excavation's final physical limits, and soil quality monitoring. Surveyed excavation limits were recorded during excavation activities, and are included in Attachment 1. During excavation, confirmation soil samples were collected at the base of the excavation. Because excavation occurred within a trench box shoring system, soil sidewall samples were not collected except at the upstream and downstream (east and west) ends of the excavation area.

As shown on Figure 2, soil confirmation samples were collected on approximately 25-ft intervals along the base of the excavation, and one from the sidewall at each end of the excavation. Additionally, one soil sample was collected from the base of excavation in the vicinity of monitoring well TC-MW-7 on the TC Systems site. Sample locations were adjusted from proposed locations based on field observations of the soil at the base of an excavation to represent locations where evidence of potential contamination was observed.

Confirmation soil samples were analyzed by ALS Laboratory, located in Everett, Washington, for the following:

- Metals - Antimony, arsenic, copper, lead, and mercury by US Environmental Protection Agency (EPA) Method 6020/7471.
- Diesel-range and oil-range total petroleum hydrocarbons (TPH-D and TPH-O) by Method NWTPH-Dx. Because of the significant amount of wood debris present in the project area, samples tested for TPH were subjected to silica-gel cleanup prior to analysis.
- cPAHs by EPA Method 8270.
- Naphthalenes (naphthalene and 1-methynaphthalene only) by EPA Method 8270
- PCBs - Aroclor 1254 and total PCBs by EPA Method 8082.

Analytical Results

Analytical results are presented in Table 1 and laboratory analytical reports in Attachment 3.

Analytical results indicate chemical concentrations are below Ameron/Hulbert Site CULs and/or TC Systems Site Remediation Levels (RLs) except at the following locations:

- At BS-3 (11-12 ft bgs), the arsenic concentration (27 milligrams per kilogram [mg/kg]) is greater than both the CUL and RL.
- At BS-7 (9.5-10.5 ft bgs), the cPAH TEQ concentration (5,889 µg/kg) and benzo-a-pyrene (4,400 µg/kg) are greater than the CUL, and the naphthalene concentration (6,100 µg/kg) is above the RL.
- At BS-11 (9.5-10.5 ft bgs), the lead concentration (360 mg/kg) is greater than both the CUL and the RL.
- At BS-13 (5-6 ft bgs), the arsenic concentration (32 mg/kg) is greater than both the CUL and the RL.
- At SW-1 (4-10 ft bgs), the arsenic concentration (59 mg/kg) and the lead concentration (550 mg/kg) are greater than the CUL and the RL.

Conclusions and Next Steps

The partial cleanup action/interim action described in this technical memorandum included the removal and replacement of the portion of the stormwater trunkline separating the Ameron/Hulbert Site from the TC Systems Site, and removal of contaminated soil in the immediate vicinity of the trunkline. In total, approximately 1,190 tons of soil were removed from the trunkline area and disposed at a Subtitle D facility.

Soil confirmation samples collected from the base and eastern/western sidewalls of the excavation, and in the vicinity of former MW-7, indicates some soil remains outside of the excavation area with concentrations of arsenic, lead, cPAHs, and/or naphthalenes above Site cleanup levels and/or TC Systems Site remediation levels. These confirmation samples were collected at the maximum feasible excavation depths based on conditions encountered during construction. Contaminated soil remaining beneath the trunkline are effectively capped by the CDF placed within the trunkline excavation.

As noted above, TC Systems monitoring well MW-TC-20 was destroyed during the cleanup. TC Systems will need to work with Ecology to determine if monitor well TC-MW-20 needs to be replaced, and if so TC Systems will replace the well.

USE OF THIS TECHNICAL MEMORANDUM

This Technical Memorandum has been prepared for the exclusive use of the Port of Everett for specific application to the North Marina Ameron/Hulbert and TC Systems Sites Trunkline Storm Drain Replacement. No other party is entitled to rely on the information, conclusions, and recommendations included in this document without the express written consent of Landau Associates. Further, the reuse of information, conclusions, and recommendations provided herein for extensions of the project or for any other project, without review and authorization by Landau Associates, shall be at the user's sole risk. Landau Associates warrants that within the limitations of scope, schedule, and budget, our services have been provided in a manner consistent with that level of care and skill ordinarily exercised by members of the profession currently practicing in the same locality under similar conditions as this project. We make no other warranty, either express or implied.

This document has been prepared under the supervision and direction of the following key staff.

LANDAU ASSOCIATES, INC.



Dylan Frazer, LG
Senior Geologist



Kent Wiken, PE
Senior Associate

DHF/KWW/tam

P:\147\029\500\FileRm\R\Trunkline\Compliance Monitoring Report\LAI_A-H Draft Trunkline CM Rpt 081619.docx

Attachments

- Figure 1: Vicinity Map
- Figure 2: Excavation Area and Confirmation Sample Locations
- Table 1: Compliance Monitoring Analytical Results
- Attachment 1: As-built Drawings
- Attachment 2: Subtitle D Landfill Disposal Receipts
- Attachment 3: Laboratory Analytical Reports

References

LAI. 2019. Engineering Design Report for Partial Cleanup Action, North Marina Ameron/Hulbert Site, Everett, Washington. edited by PE Larry Beard and PE Kent Wiken: Landau Associates, Inc.

Stantec. 2018. Interim Action Work Plan, TC Systems, Everett, Washington 98201.

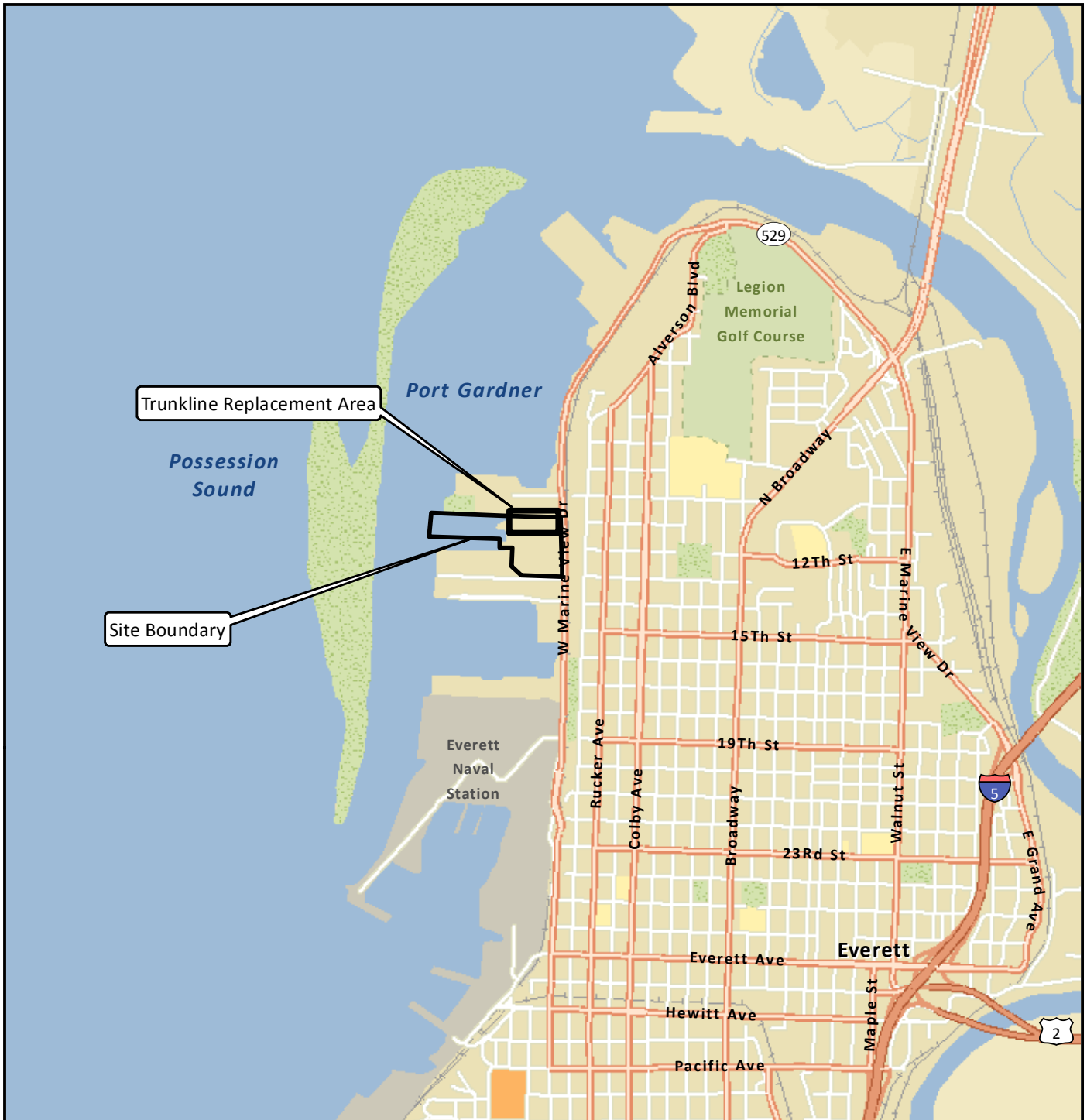

G:\Projects\147\029\500\960\F01 VicMap.mxd 8/1/2019

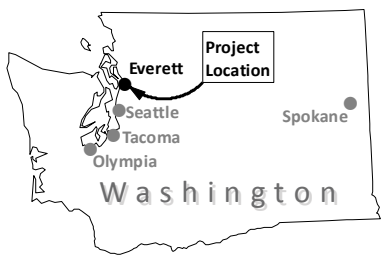
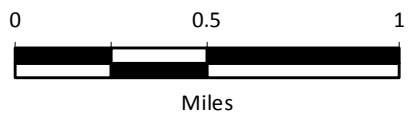

Data Source: Esri 2012



North Marina Ameron/Hulbert Site
Everett, Washington

Vicinity Map

Figure
1

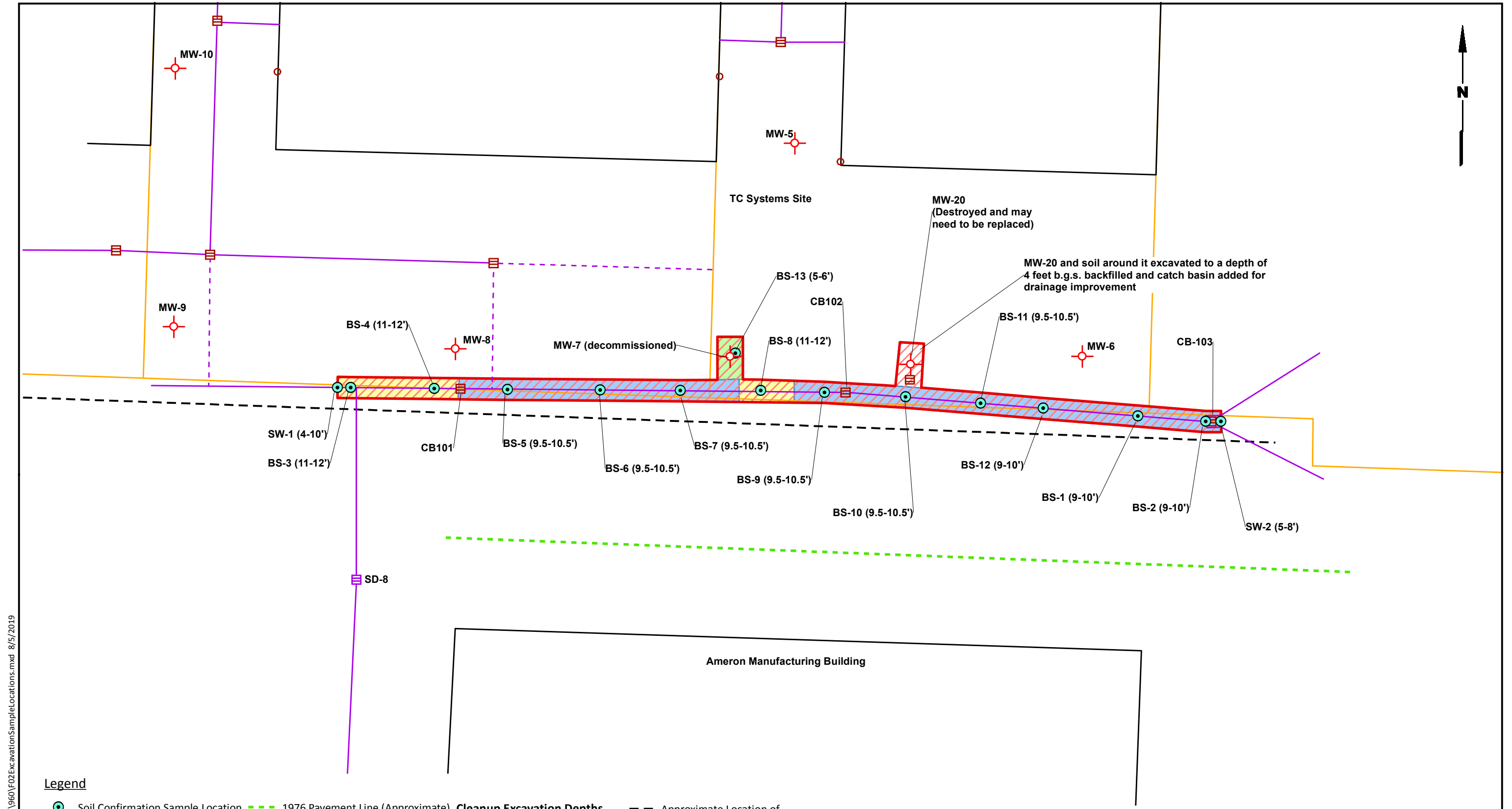

Legend

- Soil Confirmation Sample Location
- ☒ Catch Basin
- ⊙ TC Systems Wells
- ▨ Approximate Excavation Area.
- ▨ Precise limits shown separately in construction as-built drawings.
- 1976 Pavement Line (Approximate)
- Building
- Storm Line (Current Alignment)
- Storm Line (Historical Alignment)
- Parcel Line
- Cleanup Excavation Depths**
- ▨ 1.5' below pipe invert
- ▨ 3.5' below pipe invert
- ▨ 5' below ground surface
- Approximate Location of Historical Grade Difference (Interpreted from aerial photos dated 9/13/73 & 4/11/80)

Note
 1. Black and white reproduction of this color original may reduce its effectiveness and lead to incorrect interpretation.

Data Source: Topographic and Boundary Survey for TC Systems Site
 Prepared by Otak Incorporated dated May 10, 2011

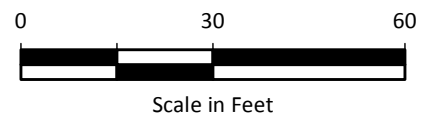

North Marina Ameron/Hulbert Site Partial Cleanup Action Everett, Washington	Excavation Area and Confirmation Sample Locations	Figure 2
---	---	--------------------

**Table 1
Compliance Monitoring Analytical Results
Ameron/Hulbert Site
Port of Everett, Washington**

Analyte	Site-Specific Cleanup/Remediation Levels	Sample Location, Lab SDG, Sample Date							Sample Location, Lab SDG, Sample Date					
		BS-1 (9-10') EV19050202 5/30/2019	BS-2 (10-11') EV19050202 5/31/2019	BS-3 (11-12') EV19050027 5/6/2019	BS-4 (11-12') EV19050027 5/7/2019	BS-5 (9.5-10.5) EV19050048 5/9/2019	BS-6 (9.5-10.5') EV19050073 5/14/2019	BS-7 (9.5-10.5') EV19050073 5/14/2019	BS-10 (9.5-10.5') EV19050162 5/22/2019	BS-11 (9.5-10.5') EV19050162 5/23/2019	BS-12 (9-10') EV19050202 5/28/2019	BS-13 (5-6) EV19060007 6/4/2019	SW-1 (4-10') EV19050027 5/6/2019	SW-2 (5-8') EV19050202 5/31/2019
Total Petroleum Hydrocarbons (mg/kg; NWTPH-DxSG)														
Diesel-Range Organics (C12-C24)	2,000 (b)	25 U	120	37	400	51	91	360 J	580	220	81	56	110	31
Oil-Range Organics (C24-C40)	NA	50 U	370	51	1,100	160	150	410 J	350 J	880	210	50 U	50 U	50 U
Total Metals (mg/kg; SW-846 6020/7471B)														
Antimony	32 (a)	1.0 U	1.0 U	4.3	0.76	0.74	0.50 U	2.4	3.2	1.1	1.0 U	9.4	15	2.7
Arsenic	20 (b)	3.1	12	27	15	8.5	16	16	12	4.8	6.0	32	59	10
Copper	24,000 (c)	23	62	81	60	48	53	49	65	22	34	78	5,700	34
Lead	250 (b)	58	50	110	33	85	18	75	130	360	24	52	550	130
Mercury	15 (c)	0.029	0.18	0.12	0.15	0.13	0.11	0.089	0.27	0.11	0.038	0.39	0.043	0.052
Polychlorinated Biphenyls (mg/kg; SW-846 8082A)														
Aroclor 1254	NA	0.10 U	0.10 U	0.10 U	0.10 U	0.10 U	0.18	0.10 U	0.11	0.10 U	0.10 U	0.10 U	0.10 U	0.10 U
Total PCBs	1 (c)	0.10 U	0.10 U	0.10 U	0.10 U	0.10 U	0.18	0.10 U	0.58	0.10 U	0.10 U	0.10 U	0.10 U	0.10 U
Carcinogenic Polycyclic Aromatic Hydrocarbons (µg/kg; SW-846 8270D-SIM)														
1-Methylnaphthalene	28,000 (c)	20 U	20 U	20 U	20 U	20 U	23	1,600	29	20 U	20 U	20 U	20 U	20 U
2-Methylnaphthalene	NA	20 U	26	20 U	31	20 U	30	2,300	24	20 U	20 U	20 U	20 U	20 U
Benzo(a)anthracene	NA	20 U	69	20 U	65	25	83	5,100	46	90	20 U	43	20	21
Benzo(a)pyrene	140 (a) / 11,000 (c)	20 U	65	20	81	20 U	76	4,400	48	81	20 U	31	20 U	20 U
Benzo(b)fluoranthene	NA	23	110	34	160	38	100	5,000	79	92	25	48	37	27
Benzo(k)fluoranthene	NA	20 U	35	20 U	42	20 U	31	2,000	27	31	20 U	20 U	20 U	20 U
Chrysene	NA	23	91	29	120	33	120	5,900	72	110	20 U	47	29	24
Dibenzo(a,h)anthracene	NA	20 U	20 U	20 U	20 U	20 U	20 U	780	20 U	20 U	20 U	20 U	20 U	20 U
Indeno(1,2,3-cd)pyrene	NA	20 U	44	20 U	59	20 U	42	2,200	34	43	20 U	20 U	20	20 U
Naphthalene	4,000 (c)	20 U	120	21	170	20 U	110	6,100	21	22	20 U	28	20 U	20 U
cPAH TEQ	140 (a) / 11,000 (c)	3	92	24	115	7	103	5,889	67	108	3	41	8	5

Notes:

- U = The analyte was analyzed for but was not detected above the level of the reported sample quantitation limit.
- J = The result is an estimated quantity. The associated numerical value is the approximate concentration of the analyte in the sample.
- Grayed back text indicates soil represented by the sample was collected from an area to be excavated and a new compliance monitoring sample will be collected.
- Green shade indicates exceedance of Cleanup Level and/or Remediation Level.
- Bold = detection

- (a) Ameron/Hulbert Site CAP Proposed Soil Cleanup Level.
- (b) Ameron/Hulbert Site CAP Proposed Soil Cleanup Level and TC Systems Site Remediation Level.
- (c) TC Systems Site Remediation Level.

Abbreviations and Acronyms:

- CAP = cleanup action plan
- cPAH = carcinogenic polycyclic aromatic hydrocarbon
- µg/kg = micrograms per kilogram
- mg/kg = milligrams per kilogram
- NA = not available
- PCB = polychlorinated biphenyls
- SDG = sample delivery group
- TEQ = toxicity equivalency quotient

ATTACHMENT 1

As-Built Drawings

Landau Associates | G:\Projects\147\029\500\960\A01 AsBuilt\Drawing.dwg | 8/16/2019 3:04 PM | JVALLUZZI

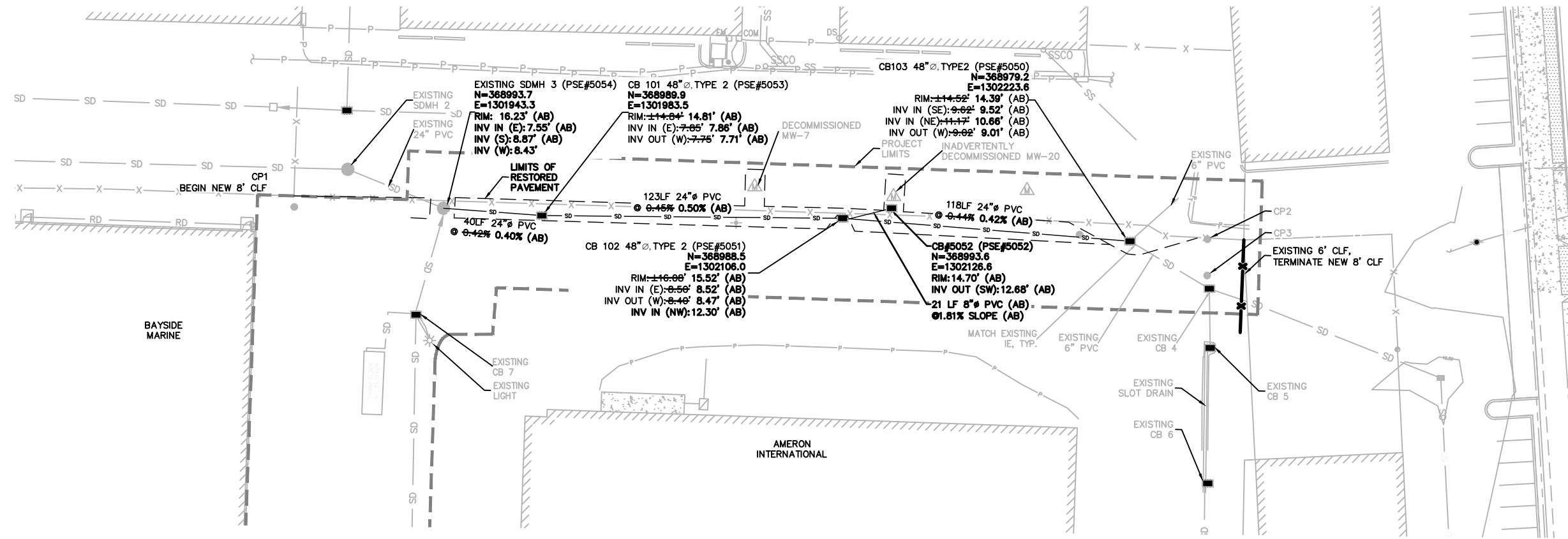

PLAN VIEW
SCALE: 1"=50'

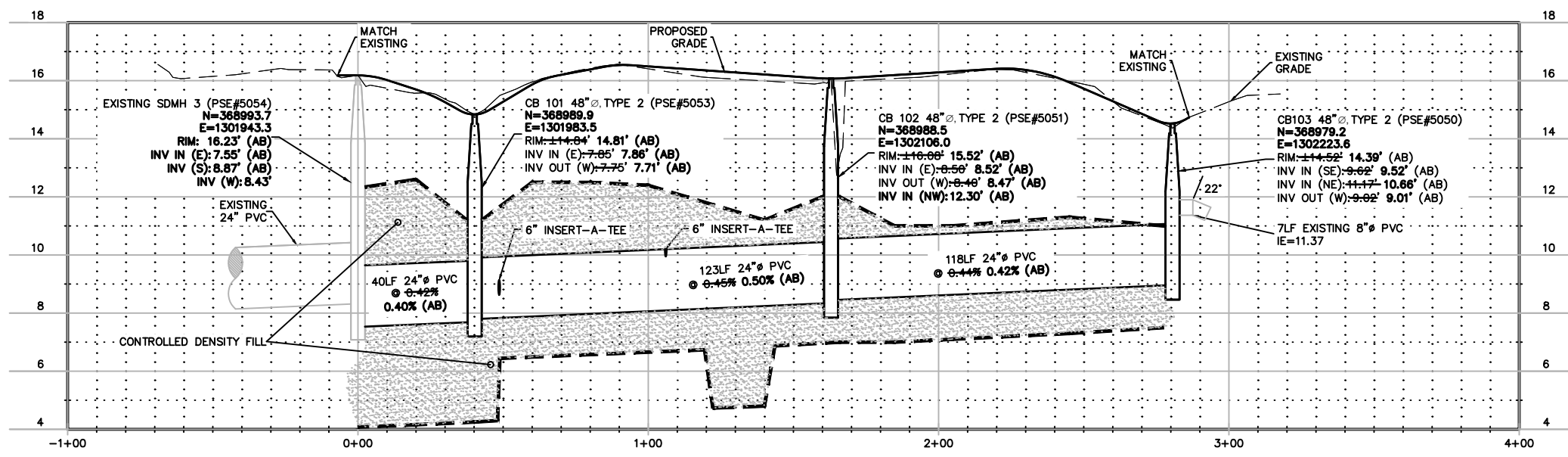

PROFILE VIEW
H. SCALE: 1"=50' V. SCALE: 1"=5'

Sources: Pacific Survey & Engineering, July 2019;
Landau Associates, Inc. Depth of Excavation Measurements, April and May, 2019;
PND Engineers, Inc. Limits of Asphalt Field Measurements, August 13, 2019

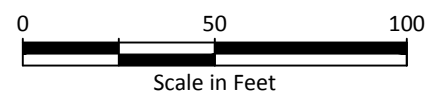

North Marina Ameron/Hulbert Site
Partial Cleanup Action
Everett, Washington

As-Built Drawing

Attachment
1



Subtitle D Landfill Disposal Receipts

SITE Everett Incl. Snohomish County --
WA ROOSEVELT-, CA

CUSTOMER 015640
Port of Everett
P.O. Box 538
Everett, WA 98206
Contract:TB-5165 PO:57791

SITE A	TICKET # 4784702	CELL
WEIGHMASTER Denise B.		
DATE/TIME IN 5/3/19 4:11 pm	DATE/TIME OUT 5/3/19 4:32 pm	
VEHICLE 7330	CONTAINER GCEU426098	
REFERENCE		
BILL OF LADING BNSF230069		

SCALE IN GROSS WEIGHT	107,720	NET TONS	29.96	INBOUND
SCALE OUT TARE WEIGHT	47,800	NET WEIGHT	59,920	INVOICE

QTY.	UNIT	DESCRIPTION	RATE	EXTENSION	TAX	TOTAL
28.00	YD	Tracking QTY				
29.96	tn	Cont Soil Origin:Everett 100%				

NET AMOUNT
TENDERED
CHANGE
CHECK#

The undersigned individual signing this document on behalf of Customer acknowledges that he or she has read and understands the terms and conditions on the reverse side and that he or she has the authority to sign this document on behalf of the customer.

SITE Everett Incl. Snohomish County --
WA ROOSEVELT-, CA

CUSTOMER 015640
Port of Everett
P.O. Box 538
Everett, WA 98206
Contract:TB-5165 PO:57791

SITE 2A	TICKET # 4784703	CELL
WEIGHMASTER Denise B.		
DATE/TIME IN 5/3/19 4:06 pm	DATE/TIME OUT 5/3/19 4:35 pm	
VEHICLE 5223	CONTAINER GCEU425514	
REFERENCE		
BILL OF LADING BNSF230069		

SCALE IN GROSS WEIGHT	114,240	NET TONS	33.18	INBOUND
SCALE OUT TARE WEIGHT	47,880	NET WEIGHT	66,360	INVOICE

QTY.	UNIT	DESCRIPTION	RATE	EXTENSION	TAX	TOTAL
28.00	YD	Tracking QTY				
33.18	tn	Cont Soil Origin:Everett 100%				

NET AMOUNT
TENDERED
CHANGE
CHECK#

The undersigned individual signing this document on behalf of Customer acknowledges that he or she has read and understands the terms and conditions on the reverse side and that he or she has the authority to sign this document on behalf of the customer.

SITE Everett Incl. Snohomish County --
WA ROOSEVELT-, CA

CUSTOMER 015640
Port of Everett
P.O. Box 538
Everett, WA 98206
Contract:TB-5165 PO:57791

SITE A	TICKET # 4784753	CELL
WEIGHMASTER Denise B.		
DATE/TIME IN 5/5/19 6:12 am	DATE/TIME OUT 6:41 am	
VEHICLE 3450	CONTAINER TRLU900338	
REFERENCE		
BILL OF LADING BNSF230091		

SCALE IN GROSS WEIGHT 85,680	NET TONS 19.38	INBOUND
SCALE OUT TARE WEIGHT 46,920	NET WEIGHT 38,760	INVOICE

QTY	UNIT	DESCRIPTION	RATE	EXTENSION	TAX	TOTAL
28.00	yd	Tracking QTY				
19.38	tn	Cont Soil Origin:Everett 100%				



NET AMOUNT
TENDERED
CHANGE
CHECK#

The undersigned individual signing this document on behalf of Customer acknowledges that he or she has read and understands the terms and conditions on the reverse side and that he or she has the authority to sign this document on behalf of the customer.

SITE Everett Incl. Snohomish County --
WA ROOSEVELT-, CA

CUSTOMER 015640
Port of Everett
P.O. Box 538
Everett, WA 98206
Contract:TB-5165 PO:57791

SITE 2A	TICKET # 4784913	CELL
WEIGHMASTER Tiffany O.		
DATE/TIME IN 5/7/19 6:57 am	DATE/TIME OUT 5/7/19 7:22 am	
VEHICLE 0330	CONTAINER TOLU444252	
REFERENCE		
BILL OF LADING DTTX432036		

SCALE IN GROSS WEIGHT	99,320	NET TONS	25.99	INBOUND
SCALE OUT TARE WEIGHT	47,340	NET WEIGHT	51,980	INVOICE

QTY.	UNIT	DESCRIPTION	RATE	EXTENSION	TAX	TOTAL
28.00	YD	Tracking QTY				
25.99	tn	Cont Soil Origin:Everett 100%				



NET AMOUNT
TENDERED
CHANGE
CHECK#

The undersigned individual signing this document on behalf of Customer acknowledges that he or she has read and understands the terms and conditions on the reverse side and that he or she has the authority to sign this document on behalf of the customer.

SITE Everett Incl. Snohomish County --
WA ROOSEVELT-, CA

CUSTOMER 015640
Port of Everett
P.O. Box 538
Everett, WA 98206
Contract:TB-5165 PO:57791

SITE 2A	TICKET # 4784948	CELL
WEIGHMASTER Tiffany O.		
DATE/TIME IN 5/8/19 6:14 am	DATE/TIME OUT 5/8/19 6:41 am	
VEHICLE 5227	CONTAINER TOLU440437	
REFERENCE		
BILL OF LADING DTTX54154		

SCALE IN GROSS WEIGHT	115,620	NET TONS	33.43	INBOUND
SCALE OUT TARE WEIGHT	48,760	NET WEIGHT	66,860	INVOICE

QTY.	UNIT	DESCRIPTION	RATE	EXTENSION	TAX	TOTAL
28.00	YD	Tracking QTY				
33.43	tn	Cont Soil Origin:Everett 100%				



NET AMOUNT
TENDERED
CHANGE
CHECK#

The undersigned individual signing this document on behalf of Customer acknowledges that he or she has read and understands the terms and conditions on the reverse side and that he or she has the authority to sign this document on behalf of the customer.

SITE Everett Incl. Snohomish County --
WA ROOSEVELT-, CA

CUSTOMER 015640
Port of Everett
P.O. Box 538
Everett, WA 98206
Contract:TB-5165 PO:57791

SITE 2A	TICKET # 4784949	CELL
WEIGHMASTER Tiffany O.		
DATE/TIME IN 5/8/19 6:15 am	DATE/TIME OUT 5/8/19 6:41 am	
VEHICLE 5222	CONTAINER GCEU435263	
REFERENCE		
BILL OF LADING DTTX54154		

SCALE IN GROSS WEIGHT	93,680	NET TONS	23.27	INBOUND
SCALE OUT TARE WEIGHT	47,140	NET WEIGHT	46,540	INVOICE

QTY.	UNIT	DESCRIPTION	RATE	EXTENSION	TAX	TOTAL
28.00	YD	Tracking QTY				
23.27	tn	Cont Soil Origin:Everett 100%				



NET AMOUNT
TENDERED
CHANGE
CHECK#

The undersigned individual signing this document on behalf of Customer acknowledges that he or she has read and understands the terms and conditions on the reverse side and that he or she has the authority to sign this document on behalf of the customer.

SITE Everett Incl. Snohomish County --
WA ROOSEVELT-, CA

CUSTOMER 015640
Port of Everett
P.O. Box 538
Everett, WA 98206
Contract:TB-5165 PO:57791

SITE 2A	TICKET # 4785060	CELL
WEIGHMASTER Denise B.		
DATE/TIME IN 5/9/19 8:38 am	DATE/TIME OUT 5/9/19 9:01 am	
VEHICLE 5223	CONTAINER TOLU458407	
REFERENCE		
BILL OF LADING BNSF231086		

SCALE IN GROSS WEIGHT	95,380	NET TONS	24.10	INBOUND
SCALE OUT TARE WEIGHT	47,180	NET WEIGHT	48,200	INVOICE

QTY.	UNIT	DESCRIPTION	RATE	EXTENSION	TAX	TOTAL
28.00	YD	Tracking QTY				
24.10	tn	Cont Soil Origin:Everett 100%				



NET AMOUNT
TENDERED
CHANGE
CHECK#

The undersigned individual signing this document on behalf of Customer acknowledges that he or she has read and understands the terms and conditions on the reverse side and that he or she has the authority to sign this document on behalf of the customer.

SITE Everett Incl. Snohomish County --
WA ROOSEVELT-, CA

CUSTOMER 015640
Port of Everett
P.O. Box 538
Everett, WA 98206
Contract:TB-5165 PO:57791

SITE 2A	TICKET # 4785061	CELL
WEIGHMASTER Denise B.		
DATE/TIME IN 5/9/19 8:45 am	DATE/TIME OUT 5/9/19 9:09 am	
VEHICLE 7331	CONTAINER GCEU420049	
REFERENCE		
BILL OF LADING BNSF231086		

SCALE IN GROSS WEIGHT	119,080	NET TONS	36.04	INBOUND
SCALE OUT TARE WEIGHT	47,000	NET WEIGHT	72,080	INVOICE

QTY.	UNIT	DESCRIPTION	RATE	EXTENSION	TAX	TOTAL
28.00	YD	Tracking QTY				
36.04	tn	Cont Soil Origin:Everett 100%				



NET AMOUNT
TENDERED
CHANGE
CHECK#

The undersigned individual signing this document on behalf of Customer acknowledges that he or she has read and understands the terms and conditions on the reverse side and that he or she has the authority to sign this document on behalf of the customer.

SITE Everett Incl. Snohomish County --
WA ROOSEVELT-, CA

CUSTOMER 015670
Port of Everett
P.O. Box 538
Everett, WA 98206
Contract:TB-5165 PO:57791

SITE 2A	TICKET # 4785067	CELL
WEIGHMASTER Denise B.		
DATE/TIME IN 5/9/19 9:39 am	DATE/TIME OUT 5/9/19 9:56 am	
VEHICLE 5227	CONTAINER TOLU425278	
REFERENCE		
BILL OF LADING DTX27616		

SCALE IN GROSS WEIGHT	112,940	NET TONS	33.22	INBOUND
SCALE OUT TARE WEIGHT	46,500	NET WEIGHT	66,440	INVOICE

QTY.	UNIT	DESCRIPTION	RATE	EXTENSION	TAX	TOTAL
28.00	YD	Tracking QTY				
33.22	tn	Cont Soil Origin:Everett 100%				



NET AMOUNT
TENDERED
CHANGE
CHECK#

The undersigned individual signing this document on behalf of Customer acknowledges that he or she has read and understands the terms and conditions on the reverse side and that he or she has the authority to sign this document on behalf of the customer.

SITE Everett Incl. Snohomish County --
WA ROOSEVELT-, CA

CUSTOMER 015640
Port of Everett
P.O. Box 538
Everett, WA 98206
Contract:TB-5165 PO:57791

SITE 2A	TICKET # 4785068	CELL
WEIGHMASTER Denise B.		
DATE/TIME IN 5/9/19 9:38 am	DATE/TIME OUT 5/9/19 9:57 am	
VEHICLE 5223	CONTAINER TOLU456368	
REFERENCE		
BILL OF LADING DTTX27616		

SCALE IN GROSS WEIGHT	113,800	NET TONS	33.56	INBOUND
SCALE OUT TARE WEIGHT	46,680	NET WEIGHT	67,120	INVOICE

QTY.	UNIT	DESCRIPTION	RATE	EXTENSION	TAX	TOTAL
28.00	yd	Tracking QTY				
33.56	tn	Cont Soil Origin:Everett 100%				



NET AMOUNT
TENDERED
CHANGE
CHECK#

The undersigned individual signing this document on behalf of Customer acknowledges that he or she has read and understands the terms and conditions on the reverse side and that he or she has the authority to sign this document on behalf of the customer.

SITE Everett Incl. Snohomish County --
WA ROOSEVELT-, CA

CUSTOMER 015640
Port of Everett
P.O. Box 538
Everett, WA 98206
Contract:TB-5165 PO:57791

SITE2A	TICKET # 4785164	CELL
WEIGHMASTER Denise B.		
DATE/TIME IN 5/11/19 6:31 am	DATE/TIME OUT 5/11/19 6:55 am	
VEHICLE 0329	CONTAINER TOLU467989	
REFERENCE		
BILL OF LADING BNSF231188		

SCALE IN GROSS WEIGHT 110,920 NET TONS 31.83 INBOUND
SCALE OUT TARE WEIGHT 47,260 NET WEIGHT 63,660 INVOICE

QTY.	UNIT	DESCRIPTION	RATE	EXTENSION	TAX	TOTAL
28.00	YD	Tracking QTY				
31.83	tn	Cont Soil Origin:Everett 100%				

NET AMOUNT
TENDERED
CHANGE
CHECK#

The undersigned individual signing this document on behalf of Customer acknowledges that he or she has read and understands the terms and conditions on the reverse side and that he or she has the authority to sign this document on behalf of the customer.

SITE Everett Incl. Snohomish County --
WA ROOSEVELT-, CA

CUSTOMER 015640
Port of Everett
P.O. Box 538
Everett, WA 98206
Contract:TB-5165 PO:57791

SITE 2A	TICKET # 4785267	CELL
WEIGHMASTER Tiffany O.		
DATE/TIME IN 5/13/19 3:09 pm	DATE/TIME OUT 5/13/19 3:37 pm	
VEHICLE 7330	CONTAINER GCEU425090	
REFERENCE		
BILL OF LADING DTTX620252		

SCALE IN GROSS WEIGHT	99,160	NET TONS	26.41	INBOUND
SCALE OUT TARE WEIGHT	46,340	NET WEIGHT	52,820	INVOICE

QTY.	UNIT	DESCRIPTION	RATE	EXTENSION	TAX	TOTAL
28.00	YD	Tracking QTY				
26.41	tn	Cont Soil Origin:Everett 100%				



NET AMOUNT
TENDERED
CHANGE
CHECK#

The undersigned individual signing this document on behalf of Customer acknowledges that he or she has read and understands the terms and conditions on the reverse side and that he or she has the authority to sign this document on behalf of the customer.

SITE Everett Incl. Snohomish County --
WA ROOSEVELT-, CA

CUSTOMER 015640
Port of Everett
P.O. Box 538
Everett, WA 98206
Contract:TB-5165 PO:57791

SITE 2A	TICKET # 4785268	CELL
WEIGHMASTER Tiffany O.		
DATE/TIME IN 5/13/19 3:13 pm	DATE/TIME OUT 07/29/19 3:38 pm	
VEHICLE 0330	CONTAINER GCEU426509	
REFERENCE		
BILL OF LADING DTTX54154		

SCALE IN GROSS WEIGHT	98,360	NET TONS	25.87	INBOUND
SCALE OUT TARE WEIGHT	46,620	NET WEIGHT	51,740	INVOICE

QTY.	UNIT	DESCRIPTION	RATE	EXTENSION	TAX	TOTAL
28.00	YD	Tracking QTY				
25.87	tn	Cont Soil Origin:Everett 100%				



NET AMOUNT
TENDERED
CHANGE
CHECK#

The undersigned individual signing this document on behalf of Customer acknowledges that he or she has read and understands the terms and conditions on the reverse side and that he or she has the authority to sign this document on behalf of the customer.

SITE Everett Incl. Snohomish County --
WA ROOSEVELT-, CA

CUSTOMER 015640
Port of Everett
P.O. Box 538
Everett, WA 98206
Contract:TB-5165 PO:57791

SITE 2A	TICKET # 4785365	CELL
WEIGHMASTER Tiffany O.		
DATE/TIME IN 5/15/19 6:00 am	DATE/TIME OUT 5/15/19 6:28 am	
VEHICLE 0331	CONTAINER GCEU435498	
REFERENCE		
BILL OF LADING DTTX27081		

SCALE IN GROSS WEIGHT	68,860	NET TONS	10.39	INBOUND
SCALE OUT TARE WEIGHT	48,080	NET WEIGHT	20,780	INVOICE

QTY.	UNIT	DESCRIPTION	RATE	EXTENSION	TAX	TOTAL
28.00	YD	Tracking QTY				
10.39	tn	Cont Soil Origin:Everett 100%				



NET AMOUNT
TENDERED
CHANGE
CHECK#

The undersigned individual signing this document on behalf of Customer acknowledges that he or she has read and understands the terms and conditions on the reverse side and that he or she has the authority to sign this document on behalf of the customer.

SITE Everett Incl. Snohomish County --
WA ROOSEVELT-, CA

CUSTOMER 015640
Port of Everett
P.O. Box 538
Everett, WA 98206
Contract:TB-5165 PO:57791

SITE 2A	TICKET # 4785366	CELL
WEIGHMASTER Tiffany O.		
DATE/TIME IN 5/15/19 6:17 am	DATE/TIME OUT 5/15/19 6:41 am	
VEHICLE 5227	CONTAINER GCEU426563	
REFERENCE		
BILL OF LADING DTTX27081		

SCALE IN GROSS WEIGHT	113,100	NET TONS	32.74	INBOUND
SCALE OUT TARE WEIGHT	47,620	NET WEIGHT	65,480	INVOICE

QTY.	UNIT	DESCRIPTION	RATE	EXTENSION	TAX	TOTAL
28.00	YD	Tracking QTY				
32.74	tn	Cont Soil Origin:Everett 100%				



NET AMOUNT
TENDERED
CHANGE
CHECK#

The undersigned individual signing this document on behalf of Customer acknowledges that he or she has read and understands the terms and conditions on the reverse side and that he or she has the authority to sign this document on behalf of the customer.

SITE Everett Incl. Snohomish County --
WA ROOSEVELT-, CA

CUSTOMER 015640
Port of Everett
P.O. Box 538
Everett, WA 98206
Contract:TB-5165 PO:57791

SITE 2A	TICKET # 4785450	CELL
WEIGHMASTER Tiffany O.		
DATE/TIME IN 5/15/19 2:59 pm	DATE/TIME OUT 5/19/19 3:21 pm	
VEHICLE 5222	CONTAINER GCEU431598	
REFERENCE		
BILL OF LADING DTTX656666		

SCALE IN GROSS WEIGHT	96,300	NET TONS	24.61	INBOUND
SCALE OUT TARE WEIGHT	47,080	NET WEIGHT	49,220	INVOICE

QTY.	UNIT	DESCRIPTION	RATE	EXTENSION	TAX	TOTAL
28.00	YD	Tracking QTY				
24.61	tn	Cont Soil Origin:Everett 100%				



NET AMOUNT
TENDERED
CHANGE
CHECK#

The undersigned individual signing this document on behalf of Customer acknowledges that he or she has read and understands the terms and conditions on the reverse side and that he or she has the authority to sign this document on behalf of the customer.

011C Everett Incl. Snohomish County --
 WA ROOSEVELT-, CA

CUSTOMER 015640
 Port of Everett
 P.O. Box 538
 Everett, WA 98206
 Contract:TB-5165 PO:57791

SITE 2A	TICKET # 4785532	CELL
WEIGHMASTER David N.		
DATE/TIME IN 5/17/19 10:16 am		DATE/TIME OUT 5/17/19 10:35 am
VEHICLE 7328		CONTAINER GCEU435263
REFERENCE		
BILL OF LADING DTTX432036		

SCALE IN GROSS WEIGHT	85,860	NET TONS	19.71	INBOUND
SCALE OUT TARE WEIGHT	46,440	NET WEIGHT	39,420	INVOICE

QTY.	UNIT	DESCRIPTION	RATE	EXTENSION	TAX	TOTAL
18.00	YD	Tracking QTY				
19.71	tn	Cont Soil Origin:Everett 100%				

NET AMOUNT
TENDERED
CHANGE
CHECK#

The undersigned individual signing this document on behalf of Customer acknowledges that he or she has read and understands the terms and conditions on the reverse side and that he or she has the authority to sign this document on behalf of the customer.

RS-F042UPR (07/12)

SIGNATURE _____

Site Everett Incl. Snohomish County --
 WA ROOSEVELT-, CA

SITE	TICKET #	4785541	CELL
WEIGHMASTER		David N.	
DATE/TIME IN		5/17/19 11:26 am	DATE/TIME OUT
VEHICLE		5223	CONTAINER
REFERENCE			
BILL OF LADING		DTTX432036	

CUSTOMER 015640
 Port of Everett
 P.O. Box 538
 Everett, WA 98206
 Contract:TB-5165 PO:57791

SCALE IN GROSS WEIGHT	74,340	NET TONS	13.47	INBOUND
SCALE OUT TARE WEIGHT	47,400	NET WEIGHT	26,940	INVOICE

QTY.	UNIT	DESCRIPTION	RATE	EXTENSION	TAX	TOTAL
13.47	tn	Tracking QTY Cont Soil Origin:Everett 100%				

NET AMOUNT
TENDERED
CHANGE
CHECK#

The undersigned individual signing this document on behalf of Customer acknowledges that he or she has read and understands the terms and conditions on the reverse side and that he or she has the authority to sign this document on behalf of the customer.

RS-F042UPR (07/12)

SIGNATURE _____

SITE Everett Incl. Snohomish County --
WA ROOSEVELT-, CA

SITE ZA	TICKET #	4785588	CELL
WEIGHMASTER		David N.	
DATE/TIME IN		5/18/19 9:03 am	DATE/TIME OUT 5/18/19 9:20 am
VEHICLE		0330	CONTAINER TOLU475720
REFERENCE			
BILL OF LADING DTTX54154			

CUSTOMER 015640
Port of Everett
P.O. Box 538
Everett, WA 98206
Contract:TB-5165 PO:57791

SCALE IN GROSS WEIGHT	94,780	NET TONS	24.18	INBOUND
SCALE OUT TARE WEIGHT	46,420	NET WEIGHT	48,360	INVOICE

QTY.	UNIT	DESCRIPTION	RATE	EXTENSION	TAX	TOTAL
28.00	YD	Tracking QTY				
24.18	tn	Cont Soil Origin:Everett 100%				

NET AMOUNT
TENDERED
CHANGE
CHECK#

The undersigned individual signing this document on behalf of Customer acknowledges that he or she has read and understands the terms and conditions on the reverse side and that he or she has the authority to sign this document on behalf of the customer.

RS-F042UPR (07/12)

SIGNATURE _____

SITE Everett Incl. Snohomish County --
WA ROOSEVELT-, CA

CUSTOMER 015640
Port of Everett
P.O. Box 538
Everett, WA 98206
Contract:TB-5165 PO:57791

SITE 2A	TICKET #	4785689	CELL
WEIGHMASTER		David N.	
DATE/TIME IN	5/19/19 1:01 pm	DATE/TIME OUT	5/19/19 1:17 pm
VEHICLE	5227	CONTAINER	GCEU426632
REFERENCE			
BILL OF LADING BNSF230120			

SCALE IN GROSS WEIGHT	96,260	NET TONS	24.79	INBOUND
SCALE OUT TARE WEIGHT	46,680	NET WEIGHT	49,580	INVOICE

QTY.	UNIT	DESCRIPTION	RATE	EXTENSION	TAX	TOTAL
28.00	YD	Tracking QTY				
24.79	tn	Cont Soil				
		Origin:Everett 100%				

NET AMOUNT
TENDERED
CHANGE
CHECK#

The undersigned individual signing this document on behalf of Customer acknowledges that he or she has read and understands the terms and conditions on the reverse side and that he or she has the authority to sign this document on behalf of the customer.

RS-F042UPR (07/12)

SIGNATURE _____

SITE Everett Incl. Snohomish County --
WA ROOSEVELT-, CA

CUSTOMER 015640
Port of Everett
P.O. Box 538
Everett, WA 98206
Contract:TB-5165 PO:57791

SITE 2A	TICKET # 4785691	CELL
WEIGHMASTER David N.		
DATE/TIME IN 5/19/19 1:15 pm	DATE/TIME OUT 5/19/19 1:36 pm	
VEHICLE 5833	CONTAINER TOLU458613	
REFERENCE		
BILL OF LADING BNSF230120		

SCALE IN GROSS WEIGHT	90,960	NET TONS	21.55 ✓	INBOUND
SCALE OUT TARE WEIGHT	47,860	NET WEIGHT	43,100	INVOICE

QTY.	UNIT	DESCRIPTION	RATE	EXTENSION	TAX	TOTAL
28.00	YD	Tracking QTY				
21.55	tn	Cont Soil Origin:Everett 100%				

NET AMOUNT
TENDERED
CHANGE
CHECK#

The undersigned individual signing this document on behalf of Customer acknowledges that he or she has read and understands the terms and conditions on the reverse side and that he or she has the authority to sign this document on behalf of the customer.

RS-F042UPR (07/12)

SIGNATURE _____

SITE Everett Incl. Snohomish County --
WA ROOSEVELT-, CA

CUSTOMER 015640
Port of Everett
P.O. Box 538
Everett, WA 98206
Contract:TB-5165 PO:57791

SITE 2A	TICKET # 4785694	CELL
WEIGHMASTER David N.		
DATE/TIME IN 5/19/19 2:06 pm	DATE/TIME OUT 5/19/19 2:28 pm	
VEHICLE 5227	CONTAINER TRLU901423	
REFERENCE		
BILL OF LADING BNSF231166		

SCALE IN GROSS WEIGHT	96,240	NET TONS	24.44 ✓	INBOUND
SCALE OUT TARE WEIGHT	47,360	NET WEIGHT	48,880	INVOICE

QTY.	UNIT	DESCRIPTION	RATE	EXTENSION	TAX	TOTAL
28.00	YD	Tracking QTY				
24.44	tn	Cont Soil Origin:Everett 100%				

NET AMOUNT
TENDERED
CHANGE
CHECK#

The undersigned individual signing this document on behalf of Customer acknowledges that he or she has read and understands the terms and conditions on the reverse side and that he or she has the authority to sign this document on behalf of the customer.

RS-F042UPR (07/12)

SIGNATURE _____

SITE Everett Incl. Snohomish County --
WA ROOSEVELT-, CA

CUSTOMER 015640
Port of Everett
P.O. Box 538
Everett, WA 98206
Contract:TB-5165 PO:57791

SITE 2A	TICKET #	4785826	CELL
WEIGHMASTER		Tiffany O.	
DATE/TIME IN	5/22/19 7:23 am	DATE/TIME OUT	5/22/19 7:46 am
VEHICLE	5223	CONTAINER	GCEU432093
REFERENCE			
BILL OF LADING DTTX623121			

SCALE IN GROSS WEIGHT	81,480	NET TONS	16.91 ✓	INBOUND
SCALE OUT TARE WEIGHT	47,660	NET WEIGHT	33,820	INVOICE

QTY.	UNIT	DESCRIPTION	RATE	EXTENSION	TAX	TOTAL
28.00	YD	Tracking QTY				
16.91	tn	Cont Soil Origin:Everett 100%				

NET AMOUNT
TENDERED
CHANGE
CHECK#

The undersigned individual signing this document on behalf of Customer acknowledges that he or she has read and understands the terms and conditions on the reverse side and that he or she has the authority to sign this document on behalf of the customer.

RS-F042UPR (07/12)

SIGNATURE _____

SITE Everett Incl. Snohomish County --
WA ROOSEVELT-, CA

CUSTOMER 015640
Port of Everett
P.O. Box 538
Everett, WA 98206
Contract:TB-5165 PO:57791

SITE 2A	TICKET #	4785828	CELL
WEIGHMASTER		Tiffany O.	
DATE/TIME IN	5/22/19 8:04 am	DATE/TIME OUT	5/22/19 8:18 am
VEHICLE	5227	CONTAINER	TOLU466601
REFERENCE			
BILL OF LADING DTTX623121			

SCALE IN GROSS WEIGHT	88,900	NET TONS	20.47 ✓	INBOUND
SCALE OUT TARE WEIGHT	47,960	NET WEIGHT	40,940	INVOICE

QTY.	UNIT	DESCRIPTION	RATE	EXTENSION	TAX	TOTAL
28.00	TD	Tracking QTY				
20.47	tn	Cont Soil Origin:Everett 100%				

NET AMOUNT
TENDERED
CHANGE
CHECK#

The undersigned individual signing this document on behalf of Customer acknowledges that he or she has read and understands the terms and conditions on the reverse side and that he or she has the authority to sign this document on behalf of the customer.

RS-F042UPR (07/12)

SIGNATURE _____

SITE Everett Incl. Snohomish County --
WA ROOSEVELT-, CA

CUSTOMER 015640
Port of Everett
P.O. Box 538
Everett, WA 98206
Contract:TB-5165 PO:57791

SITE 2A	TICKET #	4785830	CELL
WEIGHMASTER		Tiffany O.	
DATE/TIME IN	5/22/19 8:24 am	DATE/TIME OUT	5/22/19 8:52 am
VEHICLE	5222	CONTAINER	TOLU467731
REFERENCE			
BILL OF LADING BNSF231065			

SCALE IN GROSS WEIGHT 102,900 NET TONS 27.91 ✓ INBOUND
SCALE OUT TARE WEIGHT 47,080 NET WEIGHT 55,820 INVOICE

QTY.	UNIT	DESCRIPTION	RATE	EXTENSION	TAX	TOTAL
28.00	YD	Tracking QTY				
27.91	tn	Cont Soil Origin:Everett 100%				

NET AMOUNT
TENDERED
CHANGE
CHECK#

The undersigned individual signing this document on behalf of Customer acknowledges that he or she has read and understands the terms and conditions on the reverse side and that he or she has the authority to sign this document on behalf of the customer.

RS-F042UPR (07/12)

SIGNATURE _____

SITE Everett Incl. Snohomish County --
WA ROOSEVELT-, CA

CUSTOMER 013640
Port of Everett
P.O. Box 538
Everett, WA 98206
Contract:TB-5165 PO:57791

SITE2A	TICKET #	4785834	CELL
WEIGHMASTER		Tiffany O.	
DATE/TIME IN	5/22/19 8:46 am	DATE/TIME OUT	5/22/19 9:06 am
VEHICLE	0331	CONTAINER	TRLU901575
REFERENCE			
BILL OF LADING BNSF230081			

SCALE IN GROSS WEIGHT 102,140 NET TONS 26.37 INBOUND
SCALE OUT TARE WEIGHT 49,400 NET WEIGHT 52,740 INVOICE

QTY.	UNIT	DESCRIPTION	RATE	EXTENSION	TAX	TOTAL
26.00	TD	Tracking QTY				
26.37	tn	Cont Soil Origin:Everett 100%				

NET AMOUNT
TENDERED
CHANGE
CHECK#

The undersigned individual signing this document on behalf of Customer acknowledges that he or she has read and understands the terms and conditions on the reverse side and that he or she has the authority to sign this document on behalf of the customer.

RS-F042UPR (07/12)

SIGNATURE _____

SITE Everett Incl. Snohomish County --
WA ROOSEVELT-, CA

CUSTOMER 015640
Port of Everett
P.O. Box 538
Everett, WA 98206
Contract:TB-5165 PO:57791

SITE 2A	TICKET #	4785838	CELL
WEIGHMASTER		Tiffany O.	
DATE/TIME IN	5/22/19	9:01 am	DATE/TIME OUT
			5/27/19 9:21 am
VEHICLE	1454	CONTAINER	GCEU425315
REFERENCE			
BILL OF LADING BNSF230081			

SCALE IN GROSS WEIGHT 113,680 NET TONS 32.60 ✓ INBOUND
SCALE OUT TARE WEIGHT 48,480 NET WEIGHT 65,200 INVOICE

QTY.	UNIT	DESCRIPTION	RATE	EXTENSION	TAX	TOTAL
28.00	yd	Tracking QTY				
32.60	tn	Cont Soil Origin:Everett 100%				

NET AMOUNT
TENDERED
CHANGE
CHECK#

The undersigned individual signing this document on behalf of Customer acknowledges that he or she has read and understands the terms and conditions on the reverse side and that he or she has the authority to sign this document on behalf of the customer.

RS-F042UPR (07/12)

SIGNATURE _____

SITE Everett Incl. Snohomish County --
WA ROOSEVELT-, CA

CUSTOMER 015640
Port of Everett
P.O. Box 538
Everett, WA 98206
Contract:TB-5165 PO:57791

SITE 2A	TICKET # 4786109	CELL
WEIGHMASTER David N.		
DATE/TIME IN 5/25/19 12:45 pm	DATE/TIME OUT 5/27/19 1:12 pm	
VEHICLE 5222	CONTAINER TOLU460493	
REFERENCE		
BILL OF LADING BNSF230040		

SCALE IN GROSS WEIGHT	99,640	NET TONS	26.00	INBOUND
SCALE OUT TARE WEIGHT	47,640	NET WEIGHT	52,000	INVOICE

QTY.	UNIT	DESCRIPTION	RATE	EXTENSION	TAX	TOTAL
26.00	yd	Tracking QTY				
26.00	tn	Cont Soil Origin:Everett 100%				

NET AMOUNT
TENDERED
CHANGE
CHECK#

The undersigned individual signing this document on behalf of Customer acknowledges that he or she has read and understands the terms and conditions on the reverse side and that he or she has the authority to sign this document on behalf of the customer.

RS-F042UPR (07/12)

SIGNATURE _____

SITE Everett Incl. Snohomish County --
WA ROOSEVELT-, CA

CUSTOMER 015640
Port of Everett
P.O. Box 538
Everett, WA 98206
Contract:TB-5165 PO:57791

SITE 2A	TICKET #	4786150	CELL
WEIGHMASTER		David N.	
DATE/TIME IN		5/26/19 6:18 am	DATE/TIME OUT 5/26/19 6:39 am
VEHICLE		0330	CONTAINER TOLU456746
REFERENCE			
BILL OF LADING BNSF231164			

SCALE IN GROSS WEIGHT	100,220	NET TONS	26.60 ✓	INBOUND
SCALE OUT TARE WEIGHT	47,020	NET WEIGHT	53,200	INVOICE

QTY.	UNIT	DESCRIPTION	RATE	EXTENSION	TAX	TOTAL
28.00	YD	Tracking QTY				
26.60	tn	Cont Soil Origin:Everett 100%				

NET AMOUNT
TENDERED
CHANGE
CHECK#

The undersigned individual signing this document on behalf of Customer acknowledges that he or she has read and understands the terms and conditions on the reverse side and that he or she has the authority to sign this document on behalf of the customer.

RS-F042UPR (07/12)

SIGNATURE _____

SITE Everett Incl. Snohomish County --
WA ROOSEVELT-, CA

CUSTOMER 015640
Port of Everett
P.O. Box 538
Everett, WA 98206
Contract:TB-5165 PO:57791

SITE2A	TICKET # 4786162	CELL
WEIGHMASTER David N.		
DATE/TIME IN 5/26/19 6:25 am	DATE/TIME OUT 5/26/19 6:58 am	
VEHICLE 5227	CONTAINER TOLU454066	
REFERENCE		
BILL OF LADING DTTX27398		

SCALE IN GROSS WEIGHT	103,880	NET TONS	28.12	INBOUND
SCALE OUT TARE WEIGHT	47,640	NET WEIGHT	56,240	INVOICE

QTY.	UNIT	DESCRIPTION	RATE	EXTENSION	TAX	TOTAL
28.00	YD	Tracking QTY				
28.12	tn	Cont Soil Origin:Everett 100%				

NET AMOUNT
TENDERED
CHANGE
CHECK#

The undersigned individual signing this document on behalf of Customer acknowledges that he or she has read and understands the terms and conditions on the reverse side and that he or she has the authority to sign this document on behalf of the customer.

RS-F042UPR (07/12)

SIGNATURE _____

SITE Everett Incl. Snohomish County --
WA ROOSEVELT-, CA

CUSTOMER 015640
Port of Everett
P.O. Box 538
Everett, WA 98206
Contract:TB-5165 PO:57791

SITE 2A	TICKET # 4786193	CELL
WEIGHMASTER David N.		
DATE/TIME IN 5/26/19 7:30 am	DATE/TIME OUT 5/26/19 7:45 am	
VEHICLE 5227	CONTAINER GCEU425421	
REFERENCE		
BILL OF LADING DTTX432036		

SCALE IN GROSS WEIGHT	102,760	NET TONS	28.08 ✓	INBOUND
SCALE OUT TARE WEIGHT	46,600	NET WEIGHT	56,160	INVOICE

QTY.	UNIT	DESCRIPTION	RATE	EXTENSION	TAX	TOTAL
28.00	YD	Tracking QTY				
28.00	tn	Cont Soil Origin:Everett 100%				

NET AMOUNT
TENDERED
CHANGE
CHECK#

The undersigned individual signing this document on behalf of Customer acknowledges that he or she has read and understands the terms and conditions on the reverse side and that he or she has the authority to sign this document on behalf of the customer.

RS-F042UPR (07/12)

SIGNATURE _____

SITE Everett Incl. Snohomish County --
 WA ROOSEVELT-, CA

CUSTOMER 015640
 Port of Everett
 P.O. Box 538
 Everett, WA 98206
 Contract:TB-5165 PO:57791

SITE 2A	TICKET #	4786201	CELL
WEIGHMASTER		David N.	
DATE/TIME IN	5/26/19	7:41 am	DATE/TIME OUT 5/26/19 8:01 am
VEHICLE	7330		CONTAINER TOLU466654
REFERENCE			
BILL OF LADING DTTX432036			

SCALE IN GROSS WEIGHT	91,680	NET TONS	22.68	INBOUND
SCALE OUT TARE WEIGHT	46,320	NET WEIGHT	45,360	INVOICE

QTY.	UNIT	DESCRIPTION	RATE	EXTENSION	TAX	TOTAL
28.00	YD	Tracking QTY				
22.68	tn	Cont Soil Origin:Everett 100%				

NET AMOUNT
TENDERED
CHANGE
CHECK#

The undersigned individual signing this document on behalf of Customer acknowledges that he or she has read and understands the terms and conditions on the reverse side and that he or she has the authority to sign this document on behalf of the customer.

RS-F042UPR (07/12)

SIGNATURE _____

SITE Everett Incl. Snohomish County --
WA ROOSEVELT-, CA

CUSTOMER 015640
Port of Everett
P.O. Box 538
Everett, WA 98206
Contract:TB-5165 PO:57791

SITE 2A	TICKET #	4786244	CELL
WEIGHMASTER		Tiffany O.	
DATE/TIME IN	5/27/19	6:30 am	DATE/TIME OUT 5/27/19 6:57 am
VEHICLE	3450	CONTAINER TOLU422718	
REFERENCE			
BILL OF LADING DTTX623121			

SCALE IN GROSS WEIGHT 109,460 NET TONS 29.92 ✓ INBOUND
SCALE OUT TARE WEIGHT 49,620 NET WEIGHT 59,840 INVOICE

QTY.	UNIT	DESCRIPTION	RATE	EXTENSION	TAX	TOTAL
28.00	YD	Tracking QTY				
29.92	tn	Cont Soil Origin:Everett 100%				

NET AMOUNT
TENDERED
CHANGE
CHECK#

The undersigned individual signing this document on behalf of Customer acknowledges that he or she has read and understands the terms and conditions on the reverse side and that he or she has the authority to sign this document on behalf of the customer.

RS-F042UPR (07/12)

SIGNATURE _____

SITE Everett Incl. Snohomish County --
WA ROOSEVELT-, CA

CUSTOMER 015640
Port of Everett
P.O. Box 538
Everett, WA 98206
Contract:TB-5165 PO:57791

SITE 2A	TICKET # 4786248	CELL
WEIGHMASTER Tiffany O.		
DATE/TIME IN 5/27/19 6:48 am	DATE/TIME OUT 5/27/19 7:03 am	
VEHICLE 5227	CONTAINER TOLU459438	
REFERENCE		
BILL OF LADING DTTX623121		

SCALE IN GROSS WEIGHT 72,120	NET TONS 12.53 ✓	INBOUND
SCALE OUT TARE WEIGHT 47,060	NET WEIGHT 25,060	INVOICE

QTY.	UNIT	DESCRIPTION	RATE	EXTENSION	TAX	TOTAL
28.00	YD	Tracking QTY				
12.53	tn	Cont Soil Origin:Everett 100%				

NET AMOUNT
TENDERED
CHANGE
CHECK#

The undersigned individual signing this document on behalf of Customer acknowledges that he or she has read and understands the terms and conditions on the reverse side and that he or she has the authority to sign this document on behalf of the customer.

RS-F042UPR (07/12)

SIGNATURE _____

SITE Everett Incl. Snohomish County --
WA ROOSEVELT-, CA

CUSTOMER 015640
Port of Everett
P.O. Box 538
Everett, WA 98206
Contract:TB-5165 PO:57791

SITE 2A	TICKET #	4786403	CELL
WEIGHMASTER		Tiffany O.	
DATE/TIME IN	5/29/19 7:11 am	DATE/TIME OUT	5/29/19 7:42 am
VEHICLE	5223	CONTAINER	GCEU445088
REFERENCE			
BILL OF LADING BNSF231193			

SCALE IN GROSS WEIGHT	113,880	NET TONS	33.62✓	INBOUND
SCALE OUT TARE WEIGHT	46,640	NET WEIGHT	67,240	INVOICE

QTY.	UNT	DESCRIPTION	RATE	EXTENSION	TAX	TOTAL
28.00	YD	Tracking QTY				
33.62	tn	Cont Soil Origin:Everett 100%				

NET AMOUNT
TENDERED
CHANGE
CHECK#

The undersigned individual signing this document on behalf of Customer acknowledges that he or she has read and understands the terms and conditions on the reverse side and that he or she has the authority to sign this document on behalf of the customer.

RS-F042UPR (07/12)

SIGNATURE _____

SITE Everett Incl. Snohomish County --
WA ROOSEVELT-, CA

CUSTOMER 015640
Port of Everett
P.O. Box 538
Everett, WA 98206
Contract:TB-5165 PO:57791

SITE 2A	TICKET # 4786813	CELL
WEIGHMASTER Tiffany O.		
DATE/TIME IN 6/4/19 5:59 am	DATE/TIME OUT 6/4/19 6:27 am	
VEHICLE 5223	CONTAINER TOLU457783	
REFERENCE		
BILL OF LADING DTTX54154		

SCALE IN GROSS WEIGHT	96,720	NET TONS	24.60 ✓	INBOUND
SCALE OUT TARE WEIGHT	47,520	NET WEIGHT	49,200	INVOICE

QTY.	UNIT	DESCRIPTION	RATE	EXTENSION	TAX	TOTAL
28.00	YD	Tracking QTY				
24.60	tn	Cont Soil Origin:Everett 100%				

NET AMOUNT
TENDERED
CHANGE
CHECK#

The undersigned individual signing this document on behalf of Customer acknowledges that he or she has read and understands the terms and conditions on the reverse side and that he or she has the authority to sign this document on behalf of the customer.

RS-F042UPR (07/12)

SIGNATURE _____

SITE Everett Incl. Snohomish County --
WA ROOSEVELT-, CA

CUSTOMER 015640
Port of Everett
P.O. Box 538
Everett, WA 98206
Contract:TB-5165 PO:57791

SITE 2A	TICKET # 4786815	CELL
WEIGHMASTER Tiffany O.		
DATE/TIME IN 6/4/19 6:24 am	DATE/TIME OUT 6/4/19 6:58 am	
VEHICLE 8281	CONTAINER TPHU252282	
REFERENCE		
BILL OF LADING BNSF230069		

SCALE IN GROSS WEIGHT	99,040	NET TONS	25.61	INBOUND
SCALE OUT TARE WEIGHT	47,820	NET WEIGHT	51,220	INVOICE

QTY.	UNIT	DESCRIPTION	RATE	EXTENSION	TAX	TOTAL
28.00	YD	Tracking QTY				
25.61	tn	Cont Soil Origin:Everett 100%				

NET AMOUNT
TENDERED
CHANGE
CHECK#

The undersigned individual signing this document on behalf of Customer acknowledges that he or she has read and understands the terms and conditions on the reverse side and that he or she has the authority to sign this document on behalf of the customer.

RS-F042UPR (07/12)

SIGNATURE _____

SITE Everett Incl. Snohomish County --
WA ROOSEVELT-, CA

CUSTOMER 015640
Port of Everett
P.O. Box 538
Everett, WA 98206
Contract:TB-5165 PO:57791

SITE2A	TICKET # 4786816	CELL
WEIGHMASTER Tiffany O.		
DATE/TIME IN 6/4/19 6:28 am	DATE/TIME OUT 6/4/19 7:06 am	
VEHICLE 5222	CONTAINER TOLU452839	
REFERENCE		
BILL OF LADING BNSF230069		

SCALE IN GROSS WEIGHT 106,360	NET TONS 30.04 ✓	INBOUND
SCALE OUT TARE WEIGHT 46,280	NET WEIGHT 60,080	INVOICE

QTY.	UNIT	DESCRIPTION	RATE	EXTENSION	TAX	TOTAL
28.00	yd	Tracking QTY				
30.04	tn	Cont Soil Origin:Everett 100%				

NET AMOUNT
TENDERED
CHANGE
CHECK#

The undersigned individual signing this document on behalf of Customer acknowledges that he or she has read and understands the terms and conditions on the reverse side and that he or she has the authority to sign this document on behalf of the customer.

RS-F042UPR (07/12)

SIGNATURE _____

SITE Everett Incl. Snohomish County --
WA ROOSEVELT-, CA

CUSTOMER 015640
Port of Everett
P.O. Box 538
Everett, WA 98206
Contract:TB-5165 PO:57791

SITE 2A	TICKET # 4786817	CELL
WEIGHMASTER Tiffany O.		
DATE/TIME IN 6/4/19 6:29 am	DATE/TIME OUT 6/4/19 7:08 am	
VEHICLE 5227	CONTAINER TOLU440437	
REFERENCE		
BILL OF LADING BNSF230069		

SCALE IN GROSS WEIGHT 108,940 NET TONS 29.97 ✓ INBOUND
SCALE OUT TARE WEIGHT 49,000 NET WEIGHT 59,940 INVOICE

QTY.	UNIT	DESCRIPTION	RATE	EXTENSION	TAX	TOTAL
28.00	YD	Tracking QTY				
29.97	tn	Cont Soil Origin:Everett 100%				

NET AMOUNT
TENDERED
CHANGE
CHECK#

The undersigned individual signing this document on behalf of Customer acknowledges that he or she has read and understands the terms and conditions on the reverse side and that he or she has the authority to sign this document on behalf of the customer.

RS-F042UPR (07/12)

SIGNATURE _____

SITE Everett Incl. Snohomish County --
WA ROOSEVELT-, CA

CUSTOMER 015640
Port of Everett
P.O. Box 538
Everett, WA 98206
Contract:TB-5165 PO:57791

SITE 2A	TICKET # 4786819	CELL
WEIGHMASTER Tiffany O.		
DATE/TIME IN 6/4/19 6:48 am	DATE/TIME OUT 6/4/19 7:15 am	
VEHICLE 0330	CONTAINER TOLU459552	
REFERENCE		
BILL OF LADING BNSF230069		

SCALE IN GROSS WEIGHT 107,000 NET TONS 29.53 ✓ INBOUND
SCALE OUT TARE WEIGHT 47,940 NET WEIGHT 59,060 INVOICE

QTY.	UNT	DESCRIPTION	RATE	EXTENSION	TAX	TOTAL
28.00	YD	Tracking QTY				
29.53	tn	Cont Soil Origin:Everett 100%				

NET AMOUNT
TENDERED
CHANGE
CHECK#

The undersigned individual signing this document on behalf of Customer acknowledges that he or she has read and understands the terms and conditions on the reverse side and that he or she has the authority to sign this document on behalf of the customer.

RS-F042UPR (07/12)

SIGNATURE _____

SITE Everett Incl. Snohomish County --
WA ROOSEVELT-, CA

CUSTOMER 015640
Port of Everett
P.O. Box 538
Everett, WA 98206
Contract:TB-5165 PO:57791

SITE 2A	TICKET # 4786944	CELL
WEIGHMASTER Tiffany O.		
DATE/TIME IN 6/5/19 2:38 pm	DATE/TIME OUT 6/5/19 3:03 pm	
VEHICLE 5223	CONTAINER TOLU466636	
REFERENCE		
BILL OF LADING DTTX620252		

SCALE IN GROSS WEIGHT 102,480	NET TONS 27.91 ✓	INBOUND
SCALE OUT TARE WEIGHT 46,660	NET WEIGHT 55,820	INVOICE

QTY.	UNIT	DESCRIPTION	RATE	EXTENSION	TAX	TOTAL
28.00	YD	Tracking QTY				
27.91	tn	Cont Soil Origin:Everett 100%				

NET AMOUNT
TENDERED
CHANGE
CHECK#

The undersigned individual signing this document on behalf of Customer acknowledges that he or she has read and understands the terms and conditions on the reverse side and that he or she has the authority to sign this document on behalf of the customer.

RS-F042UPR (07/12)

SIGNATURE _____

SITE Everett Incl. Snohomish County --
WA ROOSEVELT-, CA

CUSTOMER 015640
Port of Everett
P.O. Box 538
Everett, WA 98206
Contract:TB-5165 PO:57791

SITE 2A	TICKET # 4786945	CELL
WEIGHMASTER Tiffany O.		
DATE/TIME IN 6/5/19 2:58 pm	DATE/TIME OUT 6/5/19 3:16 pm	
VEHICLE 5227	CONTAINER GCEU425421	
REFERENCE		
BILL OF LADING DTTX620252		

SCALE IN GROSS WEIGHT 100,300	NET TONS 26.82 ✓	INBOUND
SCALE OUT TARE WEIGHT 46,660	NET WEIGHT 53,640	INVOICE

QTY.	UNIT	DESCRIPTION	RATE	EXTENSION	TAX	TOTAL
28.00	YD	Tracking QTY				
26.82	tn	Cont Soil Origin:Everett 100%				

NET AMOUNT
TENDERED
CHANGE
CHECK#

The undersigned individual signing this document on behalf of Customer acknowledges that he or she has read and understands the terms and conditions on the reverse side and that he or she has the authority to sign this document on behalf of the customer.

RS-F042UPR (07/12)

SIGNATURE _____

SITE Everett Incl. Snohomish County --
WA ROOSEVELT-, CA

CUSTOMER 015640
Port of Everett
P.O. Box 538
Everett, WA 98206
Contract:TB-5165 PO:57791

SITE 2A	TICKET # 4786946	CELL
WEIGHMASTER Tiffany O.		
DATE/TIME IN 6/5/19 3:01 pm	DATE/TIME OUT 6/5/19 3:22 pm	
VEHICLE 5222	CONTAINER GCEU432088	
REFERENCE		
BILL OF LADING DTTX620252		

SCALE IN GROSS WEIGHT	109,180	NET TONS	31.24 ✓	INBOUND
SCALE OUT TARE WEIGHT	46,700	NET WEIGHT	62,480	INVOICE

QTY.	UNIT	DESCRIPTION	RATE	EXTENSION	TAX	TOTAL
28.00	YD	Tracking QTY				
31.24	tn	Cont Soil Origin:Everett 100%				

NET AMOUNT
TENDERED
CHANGE
CHECK#

The undersigned individual signing this document on behalf of Customer acknowledges that he or she has read and understands the terms and conditions on the reverse side and that he or she has the authority to sign this document on behalf of the customer.

RS-F042UPR (07/12)

SIGNATURE _____

SITE Everett Incl. Snohomish County --
WA ROOSEVELT-, CA

CUSTOMER 015640
Port of Everett
P.O. Box 538
Everett, WA - 98206
Contract:TB-5165 PO:57791

SITE 2A	TICKET # 4787299	CELL
WEIGHMASTER Tiffany O.		
DATE/TIME IN 6/11/19 7:00 am	DATE/TIME OUT 6/11/19 7:20 am	
VEHICLE 5227	CONTAINER TOLU422718	
REFERENCE		
BILL OF LADING BNSF230083		

SCALE IN GROSS WEIGHT 108,920 NET TONS 30.01 ✓ INBOUND
SCALE OUT TARE WEIGHT 48,900 NET WEIGHT 60,020 INVOICE

QTY.	UNIT	DESCRIPTION	RATE	EXTENSION	TAX	TOTAL
28.00	YD	Tracking QTY				
30.01	tn	Cont Soil Origin:Everett 100%				

NET AMOUNT
TENDERED
CHANGE
CHECK#

The undersigned individual signing this document on behalf of Customer acknowledges that he or she has read and understands the terms and conditions on the reverse side and that he or she has the authority to sign this document on behalf of the customer.

RS-F042UPR (07/12)

SIGNATURE _____

SITE Everett Incl. Snohomish County --
WA ROOSEVELT-, CA

CUSTOMER 015640
Port of Everett
P.O. Box 538
Everett, WA 98206
Contract:TB-5165 PO:57791

SITE 2A	TICKET # 4787300	CELL
WEIGHMASTER Tiffany O.		
DATE/TIME IN 6/11/19 7:01 am	DATE/TIME OUT 6/11/19 7:21 am	
VEHICLE 0329	CONTAINER GCEU430961	
REFERENCE		
BILL OF LADING BNSF230083		

SCALE IN GROSS WEIGHT	83,500	NET TONS	18.35 ✓	INBOUND
SCALE OUT TARE WEIGHT	46,800	NET WEIGHT	36,700	INVOICE

QTY.	UNIT	DESCRIPTION	RATE	EXTENSION	TAX	TOTAL
28.00	YD	Tracking QTY				
18.35	tn	Cont Soil Origin:Everett 100%				

NET AMOUNT
TENDERED
CHANGE
CHECK#

The undersigned individual signing this document on behalf of Customer acknowledges that he or she has read and understands the terms and conditions on the reverse side and that he or she has the authority to sign this document on behalf of the customer.

RS-F042UPR (07/12)

SIGNATURE _____

SITE Everett Incl. Snohomish County --
WA ROOSEVELT-, CA

CUSTOMER 015640
Port of Everett
P.O. Box 538
Everett, WA 98206
Contract:TB-5165 PO:57791

SITE 2A	TICKET # 4787531	CELL
WEIGHMASTER David N.		
DATE/TIME IN 6/14/19 12:21 pm	DATE/TIME OUT 6/14/19 1:11 pm	
VEHICLE 0330	CONTAINER TRLU902911	
REFERENCE		
BILL OF LADING BNSF231026		

SCALE IN GROSS WEIGHT	70,680	NET TONS	11.87 ✓	INBOUND
SCALE OUT TARE WEIGHT	46,940	NET WEIGHT	23,740	INVOICE

QTY.	UNIT	DESCRIPTION	RATE	EXTENSION	TAX	TOTAL
28.00	YD	Tracking QTY				
11.87	tn	Cont Soil Origin:Everett 100%				

NET AMOUNT
TENDERED
CHANGE
CHECK#

The undersigned individual signing this document on behalf of Customer acknowledges that he or she has read and understands the terms and conditions on the reverse side and that he or she has the authority to sign this document on behalf of the customer.

RS-F042UPR (07/12)

SIGNATURE _____

Laboratory Analytical Reports



April 17, 2019

Mr. Dylan Frazer
Landau Associates, Inc.
130 - 2nd Ave. S.
Edmonds, WA 98020

Dear Mr. Frazer,

On April 15th, 2 samples were received by our laboratory and assigned our laboratory project number EV19040106. The project was identified as your POE A/H - 147029.500. The sample identification and requested analyses are outlined on the attached chain of custody record.

No abnormalities or nonconformances were observed during the analyses of the project samples.

Please do not hesitate to call me if you have any questions or if I can be of further assistance.

Sincerely,

ALS Laboratory Group

Rick Bagan
Laboratory Director



CERTIFICATE OF ANALYSIS

CLIENT:	Landau Associates, Inc. 130 - 2nd Ave. S. Edmonds, WA 98020	DATE:	4/17/2019
CLIENT CONTACT:	Dylan Frazer	ALS JOB#:	EV19040106
CLIENT PROJECT:	POE A/H - 147029.500	ALS SAMPLE#:	EV19040106-01
CLIENT SAMPLE ID	BS-1 (8-9)	DATE RECEIVED:	04/15/2019
		COLLECTION DATE:	4/15/2019 10:15:00 AM
		WDOE ACCREDITATION:	C601

SAMPLE DATA RESULTS

ANALYTE	METHOD	RESULTS	REPORTING LIMITS	DILUTION FACTOR	UNITS	ANALYSIS	ANALYSIS
						DATE	BY
TPH-Diesel Range (C12-C24)	NWTPH-DX w/ SGA	530	25	1	MG/KG	04/15/2019	EBS
TPH-Oil Range (C24-C40)	NWTPH-DX w/ SGA	290	50	1	MG/KG	04/15/2019	EBS
Naphthalene	EPA-8270 SIM	110	20	1	UG/KG	04/16/2019	JMK
2-Methylnaphthalene	EPA-8270 SIM	23	20	1	UG/KG	04/16/2019	JMK
1-Methylnaphthalene	EPA-8270 SIM	U	20	1	UG/KG	04/16/2019	JMK
Benzo[A]Anthracene	EPA-8270 SIM	24	20	1	UG/KG	04/16/2019	JMK
Chrysene	EPA-8270 SIM	29	20	1	UG/KG	04/16/2019	JMK
Benzo[B]Fluoranthene	EPA-8270 SIM	55	20	1	UG/KG	04/16/2019	JMK
Benzo[K]Fluoranthene	EPA-8270 SIM	24	20	1	UG/KG	04/16/2019	JMK
Benzo[A]Pyrene	EPA-8270 SIM	28	20	1	UG/KG	04/16/2019	JMK
Indeno[1,2,3-Cd]Pyrene	EPA-8270 SIM	32	20	1	UG/KG	04/16/2019	JMK
Dibenz[A,H]Anthracene	EPA-8270 SIM	U	20	1	UG/KG	04/16/2019	JMK
PCB-1254	EPA-8082	U	0.10	1	MG/KG	04/16/2019	JMK
Total PCBs	EPA-8082	U	0.10	1	MG/KG	04/16/2019	JMK
Mercury	EPA-7471	0.15	0.020	1	MG/KG	04/16/2019	RAL
Antimony	EPA-6020	0.27	0.10	1	MG/KG	04/15/2019	RAL
Arsenic	EPA-6020	21	0.20	1	MG/KG	04/15/2019	RAL
Copper	EPA-6020	100	0.10	1	MG/KG	04/15/2019	RAL
Lead	EPA-6020	48	0.10	1	MG/KG	04/15/2019	RAL

SURROGATE	METHOD	%REC	ANALYSIS	ANALYSIS
			DATE	BY
C25	NWTPH-DX w/ SGA	104	04/15/2019	EBS
Terphenyl-d14	EPA-8270 SIM	84.1	04/16/2019	JMK
TCMX	EPA-8082	84.5	04/16/2019	JMK
DCB	EPA-8082	73.1	04/16/2019	JMK

U - Analyte analyzed for but not detected at level above reporting limit.
 Chromatogram indicates that it is likely that sample contains an unidentified diesel range product and lube oil.



CERTIFICATE OF ANALYSIS

CLIENT:	Landau Associates, Inc. 130 - 2nd Ave. S. Edmonds, WA 98020	DATE:	4/17/2019
CLIENT CONTACT:	Dylan Frazer	ALS JOB#:	EV19040106
CLIENT PROJECT:	POE A/H - 147029.500	ALS SAMPLE#:	EV19040106-02
CLIENT SAMPLE ID	BS-2 (8-9)	DATE RECEIVED:	04/15/2019
		COLLECTION DATE:	4/15/2019 10:50:00 AM
		WDOE ACCREDITATION:	C601

SAMPLE DATA RESULTS

ANALYTE	METHOD	RESULTS	REPORTING LIMITS	DILUTION FACTOR	UNITS	ANALYSIS ANALYSIS	
						DATE	BY
TPH-Diesel Range (C12-C24)	NWTPH-DX w/ SGA	69	25	1	MG/KG	04/15/2019	EBS
TPH-Oil Range (C24-C40)	NWTPH-DX w/ SGA	190	50	1	MG/KG	04/15/2019	EBS
Naphthalene	EPA-8270 SIM	120	20	1	UG/KG	04/16/2019	JMK
2-Methylnaphthalene	EPA-8270 SIM	25	20	1	UG/KG	04/16/2019	JMK
1-Methylnaphthalene	EPA-8270 SIM	U	20	1	UG/KG	04/16/2019	JMK
Benzo[A]Anthracene	EPA-8270 SIM	31	20	1	UG/KG	04/16/2019	JMK
Chrysene	EPA-8270 SIM	38	20	1	UG/KG	04/16/2019	JMK
Benzo[B]Fluoranthene	EPA-8270 SIM	52	20	1	UG/KG	04/16/2019	JMK
Benzo[K]Fluoranthene	EPA-8270 SIM	U	20	1	UG/KG	04/16/2019	JMK
Benzo[A]Pyrene	EPA-8270 SIM	29	20	1	UG/KG	04/16/2019	JMK
Indeno[1,2,3-Cd]Pyrene	EPA-8270 SIM	25	20	1	UG/KG	04/16/2019	JMK
Dibenz[A,H]Anthracene	EPA-8270 SIM	U	20	1	UG/KG	04/16/2019	JMK
PCB-1254	EPA-8082	U	0.10	1	MG/KG	04/16/2019	JMK
Total PCBs	EPA-8082	U	0.10	1	MG/KG	04/16/2019	JMK
Mercury	EPA-7471	0.12	0.020	1	MG/KG	04/16/2019	RAL
Antimony	EPA-6020	0.19	0.10	1	MG/KG	04/15/2019	RAL
Arsenic	EPA-6020	13	0.20	1	MG/KG	04/15/2019	RAL
Copper	EPA-6020	60	0.10	1	MG/KG	04/15/2019	RAL
Lead	EPA-6020	27	0.10	1	MG/KG	04/15/2019	RAL

SURROGATE	METHOD	%REC	ANALYSIS ANALYSIS	
			DATE	BY
C25	NWTPH-DX w/ SGA	94.7	04/15/2019	EBS
Terphenyl-d14	EPA-8270 SIM	93.9	04/16/2019	JMK
TCMX	EPA-8082	69.0	04/16/2019	JMK
DCB	EPA-8082	60.6	04/16/2019	JMK

U - Analyte analyzed for but not detected at level above reporting limit.
Chromatogram indicates that it is likely that sample contains light oil/lube oil.



CERTIFICATE OF ANALYSIS

CLIENT: Landau Associates, Inc.
 130 - 2nd Ave. S.
 Edmonds, WA 98020

CLIENT CONTACT: Dylan Frazer
 CLIENT PROJECT: POE A/H - 147029.500

DATE: 4/17/2019
 ALS SDG#: EV19040106
 WDOE ACCREDITATION: C601

LABORATORY BLANK RESULTS

MB-041519S - Batch 139893 - Soil by NWTPH-DX

ANALYTE	METHOD	RESULTS	UNITS	REPORTING LIMITS	ANALYSIS DATE	ANALYSIS BY
TPH-Diesel Range (C12-C24)	NWTPH-DX	U	MG/KG	25	04/15/2019	EBS
TPH-Oil Range (C24-C40)	NWTPH-DX	U	MG/KG	50	04/15/2019	EBS

U - Analyte analyzed for but not detected at level above reporting limit.

MB-041619S - Batch 139868 - Soil by EPA-8270 SIM

ANALYTE	METHOD	RESULTS	UNITS	REPORTING LIMITS	ANALYSIS DATE	ANALYSIS BY
Naphthalene	EPA-8270 SIM	U	UG/KG	20	04/16/2019	JMK
2-Methylnaphthalene	EPA-8270 SIM	U	UG/KG	20	04/16/2019	JMK
1-Methylnaphthalene	EPA-8270 SIM	U	UG/KG	20	04/16/2019	JMK
Benzo[A]Anthracene	EPA-8270 SIM	U	UG/KG	20	04/16/2019	JMK
Chrysene	EPA-8270 SIM	U	UG/KG	20	04/16/2019	JMK
Benzo[B]Fluoranthene	EPA-8270 SIM	U	UG/KG	20	04/16/2019	JMK
Benzo[K]Fluoranthene	EPA-8270 SIM	U	UG/KG	20	04/16/2019	JMK
Benzo[A]Pyrene	EPA-8270 SIM	U	UG/KG	20	04/16/2019	JMK
Indeno[1,2,3-Cd]Pyrene	EPA-8270 SIM	U	UG/KG	20	04/16/2019	JMK
Dibenz[A,H]Anthracene	EPA-8270 SIM	U	UG/KG	20	04/16/2019	JMK
Benzo[G,H,I]Perylene	EPA-8270 SIM	U	UG/KG	20	04/16/2019	JMK

U - Analyte analyzed for but not detected at level above reporting limit.

MB-041519S - Batch 139867 - Soil by EPA-8082

ANALYTE	METHOD	RESULTS	UNITS	REPORTING LIMITS	ANALYSIS DATE	ANALYSIS BY
PCB-1254	EPA-8082	U	MG/KG	0.10	04/16/2019	JMK
Total PCBs	EPA-8082	U	MG/KG	0.10	04/16/2019	JMK

U - Analyte analyzed for but not detected at level above reporting limit.

MBLK-R336740 - Batch R336740 - Soil by EPA-7471

ANALYTE	METHOD	RESULTS	UNITS	REPORTING LIMITS	ANALYSIS DATE	ANALYSIS BY
Mercury	EPA-7471	U	MG/KG	0.020	04/16/2019	RAL

U - Analyte analyzed for but not detected at level above reporting limit.

MB-041519S - Batch 139874 - Soil by EPA-6020

ANALYTE	METHOD	RESULTS	UNITS	REPORTING LIMITS	ANALYSIS DATE	ANALYSIS BY
Antimony	EPA-6020	U	MG/KG	0.10	04/15/2019	RAL
Arsenic	EPA-6020	U	MG/KG	0.20	04/15/2019	RAL



CERTIFICATE OF ANALYSIS

CLIENT: Landau Associates, Inc. DATE: 4/17/2019
130 - 2nd Ave. S. ALS SDG#: EV19040106
Edmonds, WA 98020 WDOE ACCREDITATION: C601
CLIENT CONTACT: Dylan Frazer
CLIENT PROJECT: POE A/H - 147029.500

LABORATORY BLANK RESULTS

MB-041519S - Batch 139874 - Soil by EPA-6020

Copper	EPA-6020	U	MG/KG	0.10	04/15/2019	RAL
Lead	EPA-6020	U	MG/KG	0.10	04/15/2019	RAL

U - Analyte analyzed for but not detected at level above reporting limit.



CERTIFICATE OF ANALYSIS

CLIENT: Landau Associates, Inc.
 130 - 2nd Ave. S.
 Edmonds, WA 98020

CLIENT CONTACT: Dylan Frazer
 CLIENT PROJECT: POE A/H - 147029.500

DATE: 4/17/2019
 ALS SDG#: EV19040106
 WDOE ACCREDITATION: C601

LABORATORY CONTROL SAMPLE RESULTS

ALS Test Batch ID: 139893 - Soil by NWTPH-DX

SPIKED COMPOUND	METHOD	%REC	RPD	QUAL	LIMITS		ANALYSIS DATE	ANALYSIS BY
					MIN	MAX		
TPH-Diesel Range (C12-C24) - BS	NWTPH-DX	106			75.5	122.1	04/15/2019	EBS
TPH-Diesel Range (C12-C24) - BSD	NWTPH-DX	101	5		75.5	122.1	04/15/2019	EBS

ALS Test Batch ID: 139868 - Soil by EPA-8270 SIM

SPIKED COMPOUND	METHOD	%REC	RPD	QUAL	LIMITS		ANALYSIS DATE	ANALYSIS BY
					MIN	MAX		
Naphthalene - BS	EPA-8270 SIM	79.3			20	150	04/16/2019	JMK
Naphthalene - BSD	EPA-8270 SIM	73.5	8		20	150	04/16/2019	JMK
2-Methylnaphthalene - BS	EPA-8270 SIM	74.1			20	150	04/16/2019	JMK
2-Methylnaphthalene - BSD	EPA-8270 SIM	66.6	11		20	150	04/16/2019	JMK
1-Methylnaphthalene - BS	EPA-8270 SIM	68.7			20	150	04/16/2019	JMK
1-Methylnaphthalene - BSD	EPA-8270 SIM	61.4	11		20	150	04/16/2019	JMK
Benzo[A]Anthracene - BS	EPA-8270 SIM	56.1			20	150	04/16/2019	JMK
Benzo[A]Anthracene - BSD	EPA-8270 SIM	46.7	18		20	150	04/16/2019	JMK
Chrysene - BS	EPA-8270 SIM	86.5			20	150	04/16/2019	JMK
Chrysene - BSD	EPA-8270 SIM	77.6	11		20	150	04/16/2019	JMK
Benzo[B]Fluoranthene - BS	EPA-8270 SIM	69.1			20	150	04/16/2019	JMK
Benzo[B]Fluoranthene - BSD	EPA-8270 SIM	55.4	22		20	150	04/16/2019	JMK
Benzo[K]Fluoranthene - BS	EPA-8270 SIM	97.5			20	150	04/16/2019	JMK
Benzo[K]Fluoranthene - BSD	EPA-8270 SIM	93.1	5		20	150	04/16/2019	JMK
Benzo[A]Pyrene - BS	EPA-8270 SIM	77.3			20	150	04/16/2019	JMK
Benzo[A]Pyrene - BSD	EPA-8270 SIM	69.3	11		20	150	04/16/2019	JMK
Indeno[1,2,3-Cd]Pyrene - BS	EPA-8270 SIM	86.0			20	150	04/16/2019	JMK
Indeno[1,2,3-Cd]Pyrene - BSD	EPA-8270 SIM	76.6	12		20	150	04/16/2019	JMK
Dibenz[A,H]Anthracene - BS	EPA-8270 SIM	70.9			20	150	04/16/2019	JMK
Dibenz[A,H]Anthracene - BSD	EPA-8270 SIM	66.4	7		20	150	04/16/2019	JMK
Benzo[G,H,I]Perylene - BS	EPA-8270 SIM	101			20	150	04/16/2019	JMK
Benzo[G,H,I]Perylene - BSD	EPA-8270 SIM	90.3	12		20	150	04/16/2019	JMK

ALS Test Batch ID: R336740 - Soil by EPA-7471

SPIKED COMPOUND	METHOD	%REC	RPD	QUAL	LIMITS		ANALYSIS DATE	ANALYSIS BY
					MIN	MAX		
Mercury - BS	EPA-7471	96.0			81.8	117	04/16/2019	RAL
Mercury - BSD	EPA-7471	102	6		81.8	117	04/16/2019	RAL

ALS Test Batch ID: 139874 - Soil by EPA-6020

SPIKED COMPOUND	METHOD	%REC	RPD	QUAL	LIMITS		ANALYSIS DATE	ANALYSIS BY
					MIN	MAX		
Antimony - BS	EPA-6020	102			80	120	04/15/2019	RAL



CERTIFICATE OF ANALYSIS

CLIENT: Landau Associates, Inc.
 130 - 2nd Ave. S.
 Edmonds, WA 98020

DATE: 4/17/2019
 ALS SDG#: EV19040106
 WDOE ACCREDITATION: C601

CLIENT CONTACT: Dylan Frazer
 CLIENT PROJECT: POE A/H - 147029.500

LABORATORY CONTROL SAMPLE RESULTS

SPIKED COMPOUND	METHOD	%REC	RPD	QUAL	LIMITS		ANALYSIS DATE	ANALYSIS BY
					MIN	MAX		
Antimony - BSD	EPA-6020	104	2		80	120	04/15/2019	RAL
Arsenic - BS	EPA-6020	103			80	120	04/15/2019	RAL
Arsenic - BSD	EPA-6020	107	3		80	120	04/15/2019	RAL
Copper - BS	EPA-6020	103			80	120	04/15/2019	RAL
Copper - BSD	EPA-6020	106	3		80	120	04/15/2019	RAL
Lead - BS	EPA-6020	101			80	120	04/15/2019	RAL
Lead - BSD	EPA-6020	104	2		80	120	04/15/2019	RAL

APPROVED BY

Laboratory Director

ALS ENVIRONMENTAL

Sample Receiving Checklist

Client: Landan Associates

ALS Job #: EV19040106

Project: POE A/H

Received Date: 4/15/19 Received Time: 2:30 By: RB

Type of shipping container: Cooler Box Other

Shipped via: FedEx Ground UPS Mail Courier Hand Delivered
FedEx Express

	<u>Yes</u>	<u>No</u>	<u>N/A</u>
Were custody seals on outside of shipping container?	<input type="checkbox"/>	<input checked="" type="checkbox"/>	<input type="checkbox"/>
If yes, how many? _____			
Where? _____			
Custody seal date: _____			
Seal name: _____			

Was Chain of Custody properly filled out (ink, signed, dated, etc.)?

Did all bottles have labels?

Did all bottle labels and tags agree with Chain of Custody?

Were samples received within hold time?

Did all bottles arrive in good condition (unbroken, etc.)?

Was sufficient amount of sample sent for the tests indicated?

Was correct preservation added to samples? cold

If no, Sample Control added preservative to the following:

<u>Sample Number</u>	<u>Reagent</u>	<u>Analyte</u>
_____	_____	_____
_____	_____	_____
_____	_____	_____

Were VOA vials checked for absence of air bubbles?
Bubbles present in sample #: _____

Temperature of cooler upon receipt: 7.6°C on Ice Cold Cool Ambient N/A

Explain any discrepancies: _____

Was client contacted? _____ Who was called? _____ By whom? _____ Date: _____

Outcome of call: _____



May 17, 2019

Mr. Dylan Frazer
Landau Associates, Inc.
130 - 2nd Ave. S.
Edmonds, WA 98020

Dear Mr. Frazer,

On May 7th, 3 samples were received by our laboratory and assigned our laboratory project number EV19050027. The project was identified as your POE A/H - 147029.500. The sample identification and requested analyses are outlined on the attached chain of custody record.

No abnormalities or nonconformances were observed during the analyses of the project samples.

Please do not hesitate to call me if you have any questions or if I can be of further assistance.

Sincerely,

ALS Laboratory Group

Rick Bagan
Laboratory Director



CERTIFICATE OF ANALYSIS

CLIENT:	Landau Associates, Inc. 130 - 2nd Ave. S. Edmonds, WA 98020	DATE:	5/17/2019
CLIENT CONTACT:	Dylan Frazer	ALS JOB#:	EV19050027
CLIENT PROJECT:	POE A/H - 147029.500	ALS SAMPLE#:	EV19050027-01
CLIENT SAMPLE ID	SW-1 (4-10')	DATE RECEIVED:	05/07/2019
		COLLECTION DATE:	5/6/2019 1:00:00 PM
		WDOE ACCREDITATION:	C601

SAMPLE DATA RESULTS

ANALYTE	METHOD	RESULTS	REPORTING LIMITS	DILUTION FACTOR	UNITS	ANALYSIS ANALYSIS	
						DATE	BY
TPH-Diesel Range (C12-C24)	NWTPH-DX w/ SGA	110	25	1	MG/KG	05/07/2019	EBS
TPH-Oil Range (C24-C40)	NWTPH-DX w/ SGA	U	50	1	MG/KG	05/07/2019	EBS
Naphthalene	EPA-8270 SIM	U	20	1	UG/KG	05/07/2019	JMK
2-Methylnaphthalene	EPA-8270 SIM	U	20	1	UG/KG	05/07/2019	JMK
1-Methylnaphthalene	EPA-8270 SIM	U	20	1	UG/KG	05/07/2019	JMK
Benzo[A]Anthracene	EPA-8270 SIM	20	20	1	UG/KG	05/07/2019	JMK
Chrysene	EPA-8270 SIM	29	20	1	UG/KG	05/07/2019	JMK
Benzo[B]Fluoranthene	EPA-8270 SIM	37	20	1	UG/KG	05/07/2019	JMK
Benzo[K]Fluoranthene	EPA-8270 SIM	U	20	1	UG/KG	05/07/2019	JMK
Benzo[A]Pyrene	EPA-8270 SIM	U	20	1	UG/KG	05/07/2019	JMK
Indeno[1,2,3-Cd]Pyrene	EPA-8270 SIM	20	20	1	UG/KG	05/07/2019	JMK
Dibenz[A,H]Anthracene	EPA-8270 SIM	U	20	1	UG/KG	05/07/2019	JMK
PCB-1254	EPA-8082	U	0.10	1	MG/KG	05/08/2019	JMK
Total PCBs	EPA-8082	U	0.10	1	MG/KG	05/08/2019	JMK
Mercury	EPA-7471	0.043	0.020	1	MG/KG	05/15/2019	RAL
Antimony	EPA-6020	15	0.10	1	MG/KG	05/14/2019	RAL
Arsenic	EPA-6020	59	0.20	1	MG/KG	05/14/2019	RAL
Copper	EPA-6020	5700	1.0	10	MG/KG	05/14/2019	RAL
Lead	EPA-6020	550	0.10	1	MG/KG	05/14/2019	RAL

SURROGATE	METHOD	%REC	ANALYSIS ANALYSIS	
			DATE	BY
C25	NWTPH-DX w/ SGA	86.1	05/07/2019	EBS
Terphenyl-d14	EPA-8270 SIM	88.4	05/07/2019	JMK
TCMX	EPA-8082	84.7	05/08/2019	JMK
DCB	EPA-8082	86.0	05/08/2019	JMK

U - Analyte analyzed for but not detected at level above reporting limit.
Chromatogram indicates that it is likely that sample contains an unidentified diesel range product.



CERTIFICATE OF ANALYSIS

CLIENT:	Landau Associates, Inc. 130 - 2nd Ave. S. Edmonds, WA 98020	DATE:	5/17/2019
CLIENT CONTACT:	Dylan Frazer	ALS JOB#:	EV19050027
CLIENT PROJECT:	POE A/H - 147029.500	ALS SAMPLE#:	EV19050027-02
CLIENT SAMPLE ID	BS-3 (11-12')	DATE RECEIVED:	05/07/2019
		COLLECTION DATE:	5/6/2019 1:30:00 PM
		WDOE ACCREDITATION:	C601

SAMPLE DATA RESULTS

ANALYTE	METHOD	RESULTS	REPORTING LIMITS	DILUTION FACTOR	UNITS	ANALYSIS	ANALYSIS
						DATE	BY
TPH-Diesel Range (C12-C24)	NWTPH-DX w/ SGA	37	25	1	MG/KG	05/07/2019	EBS
TPH-Oil Range (C24-C40)	NWTPH-DX w/ SGA	51	50	1	MG/KG	05/07/2019	EBS
Naphthalene	EPA-8270 SIM	21	20	1	UG/KG	05/07/2019	JMK
2-Methylnaphthalene	EPA-8270 SIM	U	20	1	UG/KG	05/07/2019	JMK
1-Methylnaphthalene	EPA-8270 SIM	U	20	1	UG/KG	05/07/2019	JMK
Benzo[A]Anthracene	EPA-8270 SIM	U	20	1	UG/KG	05/07/2019	JMK
Chrysene	EPA-8270 SIM	29	20	1	UG/KG	05/07/2019	JMK
Benzo[B]Fluoranthene	EPA-8270 SIM	34	20	1	UG/KG	05/07/2019	JMK
Benzo[K]Fluoranthene	EPA-8270 SIM	U	20	1	UG/KG	05/07/2019	JMK
Benzo[A]Pyrene	EPA-8270 SIM	20	20	1	UG/KG	05/07/2019	JMK
Indeno[1,2,3-Cd]Pyrene	EPA-8270 SIM	U	20	1	UG/KG	05/07/2019	JMK
Dibenz[A,H]Anthracene	EPA-8270 SIM	U	20	1	UG/KG	05/07/2019	JMK
PCB-1254	EPA-8082	U	0.10	1	MG/KG	05/08/2019	JMK
Total PCBs	EPA-8082	U	0.10	1	MG/KG	05/08/2019	JMK
Mercury	EPA-7471	0.12	0.020	1	MG/KG	05/15/2019	RAL
Antimony	EPA-6020	4.3	0.10	1	MG/KG	05/14/2019	RAL
Arsenic	EPA-6020	27	0.20	1	MG/KG	05/14/2019	RAL
Copper	EPA-6020	81	0.10	1	MG/KG	05/14/2019	RAL
Lead	EPA-6020	110	0.10	1	MG/KG	05/14/2019	RAL

SURROGATE	METHOD	%REC	ANALYSIS	ANALYSIS
			DATE	BY
C25	NWTPH-DX w/ SGA	89.0	05/07/2019	EBS
Terphenyl-d14	EPA-8270 SIM	112	05/07/2019	JMK
TCMX	EPA-8082	84.0	05/08/2019	JMK
DCB	EPA-8082	87.6	05/08/2019	JMK

U - Analyte analyzed for but not detected at level above reporting limit.
Chromatogram indicates that it is likely that sample contains an unidentified diesel range product and lube oil.



CERTIFICATE OF ANALYSIS

CLIENT:	Landau Associates, Inc. 130 - 2nd Ave. S. Edmonds, WA 98020	DATE:	5/17/2019
CLIENT CONTACT:	Dylan Frazer	ALS JOB#:	EV19050027
CLIENT PROJECT:	POE A/H - 147029.500	ALS SAMPLE#:	EV19050027-03
CLIENT SAMPLE ID	BS-4 (11-12')	DATE RECEIVED:	05/07/2019
		COLLECTION DATE:	5/7/2019 10:45:00 AM
		WDOE ACCREDITATION:	C601

SAMPLE DATA RESULTS

ANALYTE	METHOD	RESULTS	REPORTING LIMITS	DILUTION FACTOR	UNITS	ANALYSIS	ANALYSIS
						DATE	BY
TPH-Diesel Range (C12-C24)	NWTPH-DX w/ SGA	400	25	1	MG/KG	05/07/2019	EBS
TPH-Oil Range (C24-C40)	NWTPH-DX w/ SGA	1100	50	1	MG/KG	05/07/2019	EBS
Naphthalene	EPA-8270 SIM	170	20	1	UG/KG	05/07/2019	JMK
2-Methylnaphthalene	EPA-8270 SIM	31	20	1	UG/KG	05/07/2019	JMK
1-Methylnaphthalene	EPA-8270 SIM	U	20	1	UG/KG	05/07/2019	JMK
Benzo[A]Anthracene	EPA-8270 SIM	65	20	1	UG/KG	05/07/2019	JMK
Chrysene	EPA-8270 SIM	120	20	1	UG/KG	05/07/2019	JMK
Benzo[B]Fluoranthene	EPA-8270 SIM	160	20	1	UG/KG	05/07/2019	JMK
Benzo[K]Fluoranthene	EPA-8270 SIM	42	20	1	UG/KG	05/07/2019	JMK
Benzo[A]Pyrene	EPA-8270 SIM	81	20	1	UG/KG	05/07/2019	JMK
Indeno[1,2,3-Cd]Pyrene	EPA-8270 SIM	59	20	1	UG/KG	05/07/2019	JMK
Dibenz[A,H]Anthracene	EPA-8270 SIM	U	20	1	UG/KG	05/07/2019	JMK
PCB-1254	EPA-8082	U	0.10	1	MG/KG	05/08/2019	JMK
Total PCBs	EPA-8082	U	0.10	1	MG/KG	05/08/2019	JMK
Mercury	EPA-7471	0.15	0.020	1	MG/KG	05/15/2019	RAL
Antimony	EPA-6020	0.76	0.10	1	MG/KG	05/14/2019	RAL
Arsenic	EPA-6020	15	0.20	1	MG/KG	05/14/2019	RAL
Copper	EPA-6020	60	0.10	1	MG/KG	05/14/2019	RAL
Lead	EPA-6020	33	0.10	1	MG/KG	05/14/2019	RAL

SURROGATE	METHOD	%REC	ANALYSIS	ANALYSIS
			DATE	BY
C25	NWTPH-DX w/ SGA	96.1	05/07/2019	EBS
Terphenyl-d14	EPA-8270 SIM	97.3	05/07/2019	JMK
TCMX	EPA-8082	86.4	05/08/2019	JMK
DCB	EPA-8082	80.2	05/08/2019	JMK

U - Analyte analyzed for but not detected at level above reporting limit.
Chromatogram indicates that it is likely that sample contains light oil/lube oil.



CERTIFICATE OF ANALYSIS

CLIENT: Landau Associates, Inc.
 130 - 2nd Ave. S.
 Edmonds, WA 98020

CLIENT CONTACT: Dylan Frazer
 CLIENT PROJECT: POE A/H - 147029.500

DATE: 5/17/2019
 ALS SDG#: EV19050027
 WDOE ACCREDITATION: C601

LABORATORY BLANK RESULTS

MB-050719S - Batch 140626 - Soil by NWTPH-DX

ANALYTE	METHOD	RESULTS	UNITS	REPORTING LIMITS	ANALYSIS DATE	ANALYSIS BY
TPH-Diesel Range (C12-C24)	NWTPH-DX	U	MG/KG	25	05/07/2019	EBS
TPH-Oil Range (C24-C40)	NWTPH-DX	U	MG/KG	50	05/07/2019	EBS

U - Analyte analyzed for but not detected at level above reporting limit.

MB-050719S - Batch 140629 - Soil by EPA-8270 SIM

ANALYTE	METHOD	RESULTS	UNITS	REPORTING LIMITS	ANALYSIS DATE	ANALYSIS BY
Naphthalene	EPA-8270 SIM	U	UG/KG	20	05/07/2019	JMK
2-Methylnaphthalene	EPA-8270 SIM	U	UG/KG	20	05/07/2019	JMK
1-Methylnaphthalene	EPA-8270 SIM	U	UG/KG	20	05/07/2019	JMK
Benzo[A]Anthracene	EPA-8270 SIM	U	UG/KG	20	05/07/2019	JMK
Chrysene	EPA-8270 SIM	U	UG/KG	20	05/07/2019	JMK
Benzo[B]Fluoranthene	EPA-8270 SIM	U	UG/KG	20	05/07/2019	JMK
Benzo[K]Fluoranthene	EPA-8270 SIM	U	UG/KG	20	05/07/2019	JMK
Benzo[A]Pyrene	EPA-8270 SIM	U	UG/KG	20	05/07/2019	JMK
Indeno[1,2,3-Cd]Pyrene	EPA-8270 SIM	U	UG/KG	20	05/07/2019	JMK
Dibenz[A,H]Anthracene	EPA-8270 SIM	U	UG/KG	20	05/07/2019	JMK
Benzo[G,H,I]Perylene	EPA-8270 SIM	U	UG/KG	20	05/07/2019	JMK

U - Analyte analyzed for but not detected at level above reporting limit.

MB-050719S - Batch 140630 - Soil by EPA-8082

ANALYTE	METHOD	RESULTS	UNITS	REPORTING LIMITS	ANALYSIS DATE	ANALYSIS BY
PCB-1254	EPA-8082	U	MG/KG	0.10	05/08/2019	JMK
Total PCBs	EPA-8082	U	MG/KG	0.10	05/08/2019	JMK

U - Analyte analyzed for but not detected at level above reporting limit.

MBLK-338506 - Batch R338506 - Soil by EPA-7471

ANALYTE	METHOD	RESULTS	UNITS	REPORTING LIMITS	ANALYSIS DATE	ANALYSIS BY
Mercury	EPA-7471	U	MG/KG	0.020	05/15/2019	RAL

U - Analyte analyzed for but not detected at level above reporting limit.

MB-051419S - Batch 140854 - Soil by EPA-6020

ANALYTE	METHOD	RESULTS	UNITS	REPORTING LIMITS	ANALYSIS DATE	ANALYSIS BY
Antimony	EPA-6020	U	MG/KG	0.10	05/14/2019	RAL
Arsenic	EPA-6020	U	MG/KG	0.20	05/14/2019	RAL



CERTIFICATE OF ANALYSIS

CLIENT: Landau Associates, Inc. DATE: 5/17/2019
130 - 2nd Ave. S. ALS SDG#: EV19050027
Edmonds, WA 98020 WDOE ACCREDITATION: C601
CLIENT CONTACT: Dylan Frazer
CLIENT PROJECT: POE A/H - 147029.500

LABORATORY BLANK RESULTS

MB-051419S - Batch 140854 - Soil by EPA-6020

Copper	EPA-6020	U	MG/KG	0.10	05/14/2019	RAL
Lead	EPA-6020	U	MG/KG	0.10	05/14/2019	RAL

U - Analyte analyzed for but not detected at level above reporting limit.



CERTIFICATE OF ANALYSIS

CLIENT: Landau Associates, Inc.
 130 - 2nd Ave. S.
 Edmonds, WA 98020

CLIENT CONTACT: Dylan Frazer
 CLIENT PROJECT: POE A/H - 147029.500

DATE: 5/17/2019
 ALS SDG#: EV19050027
 WDOE ACCREDITATION: C601

LABORATORY CONTROL SAMPLE RESULTS

ALS Test Batch ID: 140626 - Soil by NWTPH-DX

SPIKED COMPOUND	METHOD	%REC	RPD	QUAL	LIMITS		ANALYSIS DATE	ANALYSIS BY
					MIN	MAX		
TPH-Diesel Range (C12-C24) - BS	NWTPH-DX	101			75.5	122.1	05/07/2019	EBS
TPH-Diesel Range (C12-C24) - BSD	NWTPH-DX	104	3		75.5	122.1	05/07/2019	EBS

ALS Test Batch ID: 140629 - Soil by EPA-8270 SIM

SPIKED COMPOUND	METHOD	%REC	RPD	QUAL	LIMITS		ANALYSIS DATE	ANALYSIS BY
					MIN	MAX		
Naphthalene - BS	EPA-8270 SIM	77.9			20	150	05/07/2019	JMK
Naphthalene - BSD	EPA-8270 SIM	82.0	5		20	150	05/07/2019	JMK
2-Methylnaphthalene - BS	EPA-8270 SIM	85.8			20	150	05/07/2019	JMK
2-Methylnaphthalene - BSD	EPA-8270 SIM	90.7	6		20	150	05/07/2019	JMK
1-Methylnaphthalene - BS	EPA-8270 SIM	83.5			20	150	05/07/2019	JMK
1-Methylnaphthalene - BSD	EPA-8270 SIM	88.1	5		20	150	05/07/2019	JMK
Benzo[A]Anthracene - BS	EPA-8270 SIM	77.5			20	150	05/07/2019	JMK
Benzo[A]Anthracene - BSD	EPA-8270 SIM	83.6	8		20	150	05/07/2019	JMK
Chrysene - BS	EPA-8270 SIM	78.4			20	150	05/07/2019	JMK
Chrysene - BSD	EPA-8270 SIM	85.6	9		20	150	05/07/2019	JMK
Benzo[B]Fluoranthene - BS	EPA-8270 SIM	83.0			20	150	05/07/2019	JMK
Benzo[B]Fluoranthene - BSD	EPA-8270 SIM	90.1	8		20	150	05/07/2019	JMK
Benzo[K]Fluoranthene - BS	EPA-8270 SIM	86.2			20	150	05/07/2019	JMK
Benzo[K]Fluoranthene - BSD	EPA-8270 SIM	94.2	9		20	150	05/07/2019	JMK
Benzo[A]Pyrene - BS	EPA-8270 SIM	79.5			20	150	05/07/2019	JMK
Benzo[A]Pyrene - BSD	EPA-8270 SIM	86.0	8		20	150	05/07/2019	JMK
Indeno[1,2,3-Cd]Pyrene - BS	EPA-8270 SIM	72.7			20	150	05/07/2019	JMK
Indeno[1,2,3-Cd]Pyrene - BSD	EPA-8270 SIM	78.5	8		20	150	05/07/2019	JMK
Dibenz[A,H]Anthracene - BS	EPA-8270 SIM	58.4			20	150	05/07/2019	JMK
Dibenz[A,H]Anthracene - BSD	EPA-8270 SIM	63.0	8		20	150	05/07/2019	JMK
Benzo[G,H,I]Perylene - BS	EPA-8270 SIM	80.9			20	150	05/07/2019	JMK
Benzo[G,H,I]Perylene - BSD	EPA-8270 SIM	87.4	8		20	150	05/07/2019	JMK

ALS Test Batch ID: R338506 - Soil by EPA-7471

SPIKED COMPOUND	METHOD	%REC	RPD	QUAL	LIMITS		ANALYSIS DATE	ANALYSIS BY
					MIN	MAX		
Mercury - BS	EPA-7471	110			81.8	117	05/15/2019	RAL
Mercury - BSD	EPA-7471	111	1		81.8	117	05/15/2019	RAL

ALS Test Batch ID: 140854 - Soil by EPA-6020

SPIKED COMPOUND	METHOD	%REC	RPD	QUAL	LIMITS		ANALYSIS DATE	ANALYSIS BY
					MIN	MAX		
Antimony - BS	EPA-6020	100			80	120	05/14/2019	RAL



CERTIFICATE OF ANALYSIS

CLIENT: Landau Associates, Inc.
 130 - 2nd Ave. S.
 Edmonds, WA 98020

DATE: 5/17/2019
 ALS SDG#: EV19050027
 WDOE ACCREDITATION: C601

CLIENT CONTACT: Dylan Frazer
 CLIENT PROJECT: POE A/H - 147029.500

LABORATORY CONTROL SAMPLE RESULTS

SPIKED COMPOUND	METHOD	%REC	RPD	QUAL	LIMITS		ANALYSIS DATE	ANALYSIS BY
					MIN	MAX		
Antimony - BSD	EPA-6020	100	0		80	120	05/14/2019	RAL
Arsenic - BS	EPA-6020	100			80	120	05/14/2019	RAL
Arsenic - BSD	EPA-6020	99.1	1		80	120	05/14/2019	RAL
Copper - BS	EPA-6020	102			80	120	05/14/2019	RAL
Copper - BSD	EPA-6020	100	1		80	120	05/14/2019	RAL
Lead - BS	EPA-6020	100			80	120	05/14/2019	RAL
Lead - BSD	EPA-6020	99.6	1		80	120	05/14/2019	RAL

APPROVED BY

Laboratory Director

ALS ENVIRONMENTAL

Sample Receiving Checklist

Client: Lardau

ALS Job #: EV19050027

Project: POE A/H

Received Date: 5/7/19 Received Time: 1137 By: HJK

Type of shipping container: Cooler Box Other

Shipped via: FedEx Ground UPS Mail Courier Hand Delivered
FedEx Express

	<u>Yes</u>	<u>No</u>	<u>N/A</u>
Were custody seals on outside of shipping container?	<input type="checkbox"/>	<input checked="" type="checkbox"/>	<input type="checkbox"/>
If yes, how many? _____ Where? _____			
Custody seal date: _____ Seal name: _____			

Was Chain of Custody properly filled out (ink, signed, dated, etc.)?

Did all bottles have labels?

Did all bottle labels and tags agree with Chain of Custody?

Were samples received within hold time?

Did all bottles arrive in good condition (unbroken, etc.)?

Was sufficient amount of sample sent for the tests indicated?

Was correct preservation added to samples?

If no, Sample Control added preservative to the following:

<u>Sample Number</u>	<u>Reagent</u>	<u>Analyte</u>
_____	_____	_____
_____	_____	_____
_____	_____	_____

Were VOA vials checked for absence of air bubbles?

Bubbles present in sample #: _____

Temperature of cooler upon receipt: 4.6°C on ice Cold Cool Ambient N/A

Explain any discrepancies: _____

Was client contacted? _____ Who was called? _____ By whom? _____ Date: _____

Outcome of call: _____



May 15, 2019

Mr. Dylan Frazer
Landau Associates, Inc.
130 - 2nd Ave. S.
Edmonds, WA 98020

Dear Mr. Frazer,

On May 9th, 1 sample was received by our laboratory and assigned our laboratory project number EV19050048. The project was identified as your POE A/H - 147029.500. The sample identification and requested analyses are outlined on the attached chain of custody record.

No abnormalities or nonconformances were observed during the analyses of the project samples.

Please do not hesitate to call me if you have any questions or if I can be of further assistance.

Sincerely,

ALS Laboratory Group

Glen Perry
Technical Manager



CERTIFICATE OF ANALYSIS

CLIENT:	Landau Associates, Inc. 130 - 2nd Ave. S. Edmonds, WA 98020	DATE:	5/15/2019
CLIENT CONTACT:	Dylan Frazer	ALS JOB#:	EV19050048
CLIENT PROJECT:	POE A/H - 147029.500	ALS SAMPLE#:	EV19050048-01
CLIENT SAMPLE ID	BS-5 (9.5-10.5)	DATE RECEIVED:	05/09/2019
		COLLECTION DATE:	5/9/2019 11:45:00 AM
		WDOE ACCREDITATION:	C601

SAMPLE DATA RESULTS

ANALYTE	METHOD	RESULTS	REPORTING LIMITS	DILUTION FACTOR	UNITS	ANALYSIS	ANALYSIS
						DATE	BY
TPH-Diesel Range (C12-C24)	NWTPH-DX w/ SGA	51	25	1	MG/KG	05/10/2019	EBS
TPH-Oil Range (C24-C40)	NWTPH-DX w/ SGA	160	50	1	MG/KG	05/10/2019	EBS
Naphthalene	EPA-8270 SIM	U	20	1	UG/KG	05/10/2019	JMK
2-Methylnaphthalene	EPA-8270 SIM	U	20	1	UG/KG	05/10/2019	JMK
1-Methylnaphthalene	EPA-8270 SIM	U	20	1	UG/KG	05/10/2019	JMK
Benzo[A]Anthracene	EPA-8270 SIM	25	20	1	UG/KG	05/10/2019	JMK
Chrysene	EPA-8270 SIM	33	20	1	UG/KG	05/10/2019	JMK
Benzo[B]Fluoranthene	EPA-8270 SIM	38	20	1	UG/KG	05/10/2019	JMK
Benzo[K]Fluoranthene	EPA-8270 SIM	U	20	1	UG/KG	05/10/2019	JMK
Benzo[A]Pyrene	EPA-8270 SIM	U	20	1	UG/KG	05/10/2019	JMK
Indeno[1,2,3-Cd]Pyrene	EPA-8270 SIM	U	20	1	UG/KG	05/10/2019	JMK
Dibenz[A,H]Anthracene	EPA-8270 SIM	U	20	1	UG/KG	05/10/2019	JMK
PCB-1254	EPA-8082	U	0.10	1	MG/KG	05/13/2019	JMK
Total PCBs	EPA-8082	U	0.10	1	MG/KG	05/13/2019	JMK
Mercury	EPA-7471	0.13	0.020	1	MG/KG	05/15/2019	RAL
Antimony	EPA-6020	0.74	0.10	1	MG/KG	05/14/2019	RAL
Arsenic	EPA-6020	8.5	0.20	1	MG/KG	05/14/2019	RAL
Copper	EPA-6020	48	0.10	1	MG/KG	05/14/2019	RAL
Lead	EPA-6020	85	0.10	1	MG/KG	05/14/2019	RAL

SURROGATE	METHOD	%REC	ANALYSIS	ANALYSIS
			DATE	BY
C25	NWTPH-DX w/ SGA	96.8	05/10/2019	EBS
Terphenyl-d14	EPA-8270 SIM	106	05/10/2019	JMK
TCMX	EPA-8082	72.6	05/13/2019	JMK
DCB	EPA-8082	72.6	05/13/2019	JMK

U - Analyte analyzed for but not detected at level above reporting limit.
Chromatogram indicates that it is likely that sample contains light oil/lube oil.



CERTIFICATE OF ANALYSIS

CLIENT: Landau Associates, Inc.
 130 - 2nd Ave. S.
 Edmonds, WA 98020

CLIENT CONTACT: Dylan Frazer
 CLIENT PROJECT: POE A/H - 147029.500

DATE: 5/15/2019
 ALS SDG#: EV19050048
 WDOE ACCREDITATION: C601

LABORATORY BLANK RESULTS

MB-050919S2 - Batch 140695 - Soil by NWTPH-DX

ANALYTE	METHOD	RESULTS	UNITS	REPORTING LIMITS	ANALYSIS DATE	ANALYSIS BY
TPH-Diesel Range (C12-C24)	NWTPH-DX	U	MG/KG	25	05/09/2019	EBS
TPH-Oil Range (C24-C40)	NWTPH-DX	U	MG/KG	50	05/09/2019	EBS

U - Analyte analyzed for but not detected at level above reporting limit.

MB-050919S - Batch 140789 - Soil by EPA-8270 SIM

ANALYTE	METHOD	RESULTS	UNITS	REPORTING LIMITS	ANALYSIS DATE	ANALYSIS BY
Naphthalene	EPA-8270 SIM	U	UG/KG	20	05/10/2019	JMK
2-Methylnaphthalene	EPA-8270 SIM	U	UG/KG	20	05/10/2019	JMK
1-Methylnaphthalene	EPA-8270 SIM	U	UG/KG	20	05/10/2019	JMK
Benzo[A]Anthracene	EPA-8270 SIM	U	UG/KG	20	05/10/2019	JMK
Chrysene	EPA-8270 SIM	U	UG/KG	20	05/10/2019	JMK
Benzo[B]Fluoranthene	EPA-8270 SIM	U	UG/KG	20	05/10/2019	JMK
Benzo[K]Fluoranthene	EPA-8270 SIM	U	UG/KG	20	05/10/2019	JMK
Benzo[A]Pyrene	EPA-8270 SIM	U	UG/KG	20	05/10/2019	JMK
Indeno[1,2,3-Cd]Pyrene	EPA-8270 SIM	U	UG/KG	20	05/10/2019	JMK
Dibenz[A,H]Anthracene	EPA-8270 SIM	U	UG/KG	20	05/10/2019	JMK
Benzo[G,H,I]Perylene	EPA-8270 SIM	U	UG/KG	20	05/10/2019	JMK

U - Analyte analyzed for but not detected at level above reporting limit.

MB-051019S - Batch 140795 - Soil by EPA-8082

ANALYTE	METHOD	RESULTS	UNITS	REPORTING LIMITS	ANALYSIS DATE	ANALYSIS BY
Total PCBs	EPA-8082	U	MG/KG	0.10	05/13/2019	JMK

U - Analyte analyzed for but not detected at level above reporting limit.

MBLK-338506 - Batch R338506 - Soil by EPA-7471

ANALYTE	METHOD	RESULTS	UNITS	REPORTING LIMITS	ANALYSIS DATE	ANALYSIS BY
Mercury	EPA-7471	U	MG/KG	0.020	05/15/2019	RAL

U - Analyte analyzed for but not detected at level above reporting limit.

MB-051419S - Batch 140854 - Soil by EPA-6020

ANALYTE	METHOD	RESULTS	UNITS	REPORTING LIMITS	ANALYSIS DATE	ANALYSIS BY
Antimony	EPA-6020	U	MG/KG	0.10	05/14/2019	RAL
Arsenic	EPA-6020	U	MG/KG	0.20	05/14/2019	RAL
Copper	EPA-6020	U	MG/KG	0.10	05/14/2019	RAL



CERTIFICATE OF ANALYSIS

CLIENT: Landau Associates, Inc. DATE: 5/15/2019
130 - 2nd Ave. S. ALS SDG#: EV19050048
Edmonds, WA 98020 WDOE ACCREDITATION: C601
CLIENT CONTACT: Dylan Frazer
CLIENT PROJECT: POE A/H - 147029.500

LABORATORY BLANK RESULTS

MB-051419S - Batch 140854 - Soil by EPA-6020

Lead	EPA-6020	U	MG/KG	0.10	05/14/2019	RAL
------	----------	---	-------	------	------------	-----

U - Analyte analyzed for but not detected at level above reporting limit.



CERTIFICATE OF ANALYSIS

CLIENT:	Landau Associates, Inc. 130 - 2nd Ave. S. Edmonds, WA 98020	DATE:	5/15/2019
CLIENT CONTACT:	Dylan Frazer	ALS SDG#:	EV19050048
CLIENT PROJECT:	POE A/H - 147029.500	WDOE ACCREDITATION:	C601

LABORATORY CONTROL SAMPLE RESULTS

ALS Test Batch ID: 140695 - Soil by NWTPH-DX

SPIKED COMPOUND	METHOD	%REC	RPD	QUAL	LIMITS		ANALYSIS DATE	ANALYSIS BY
					MIN	MAX		
TPH-Diesel Range (C12-C24) - BS	NWTPH-DX	90.1			75.5	122.1	05/09/2019	EBS
TPH-Diesel Range (C12-C24) - BSD	NWTPH-DX	88.5	2		75.5	122.1	05/09/2019	EBS

ALS Test Batch ID: 140789 - Soil by EPA-8270 SIM

SPIKED COMPOUND	METHOD	%REC	RPD	QUAL	LIMITS		ANALYSIS DATE	ANALYSIS BY
					MIN	MAX		
Naphthalene - BS	EPA-8270 SIM	79.7			20	150	05/10/2019	JMK
Naphthalene - BSD	EPA-8270 SIM	83.4	4		20	150	05/10/2019	JMK
2-Methylnaphthalene - BS	EPA-8270 SIM	87.3			20	150	05/10/2019	JMK
2-Methylnaphthalene - BSD	EPA-8270 SIM	89.5	3		20	150	05/10/2019	JMK
1-Methylnaphthalene - BS	EPA-8270 SIM	86.6			20	150	05/10/2019	JMK
1-Methylnaphthalene - BSD	EPA-8270 SIM	89.8	4		20	150	05/10/2019	JMK
Benzo[A]Anthracene - BS	EPA-8270 SIM	72.7			20	150	05/10/2019	JMK
Benzo[A]Anthracene - BSD	EPA-8270 SIM	69.7	4		20	150	05/10/2019	JMK
Chrysene - BS	EPA-8270 SIM	91.0			20	150	05/10/2019	JMK
Chrysene - BSD	EPA-8270 SIM	90.2	1		20	150	05/10/2019	JMK
Benzo[B]Fluoranthene - BS	EPA-8270 SIM	77.7			20	150	05/10/2019	JMK
Benzo[B]Fluoranthene - BSD	EPA-8270 SIM	75.1	3		20	150	05/10/2019	JMK
Benzo[K]Fluoranthene - BS	EPA-8270 SIM	100			20	150	05/10/2019	JMK
Benzo[K]Fluoranthene - BSD	EPA-8270 SIM	97.4	3		20	150	05/10/2019	JMK
Benzo[A]Pyrene - BS	EPA-8270 SIM	81.1			20	150	05/10/2019	JMK
Benzo[A]Pyrene - BSD	EPA-8270 SIM	78.1	4		20	150	05/10/2019	JMK
Indeno[1,2,3-Cd]Pyrene - BS	EPA-8270 SIM	73.5			20	150	05/10/2019	JMK
Indeno[1,2,3-Cd]Pyrene - BSD	EPA-8270 SIM	67.4	9		20	150	05/10/2019	JMK
Dibenz[A,H]Anthracene - BS	EPA-8270 SIM	62.2			20	150	05/10/2019	JMK
Dibenz[A,H]Anthracene - BSD	EPA-8270 SIM	57.3	8		20	150	05/10/2019	JMK
Benzo[G,H,I]Perylene - BS	EPA-8270 SIM	78.4			20	150	05/10/2019	JMK
Benzo[G,H,I]Perylene - BSD	EPA-8270 SIM	74.6	5		20	150	05/10/2019	JMK

ALS Test Batch ID: R338506 - Soil by EPA-7471

SPIKED COMPOUND	METHOD	%REC	RPD	QUAL	LIMITS		ANALYSIS DATE	ANALYSIS BY
					MIN	MAX		
Mercury - BS	EPA-7471	110			81.8	117	05/15/2019	RAL
Mercury - BSD	EPA-7471	111	1		81.8	117	05/15/2019	RAL

ALS Test Batch ID: 140854 - Soil by EPA-6020

SPIKED COMPOUND	METHOD	%REC	RPD	QUAL	LIMITS		ANALYSIS DATE	ANALYSIS BY
					MIN	MAX		
Antimony - BS	EPA-6020	100			80	120	05/14/2019	RAL



CERTIFICATE OF ANALYSIS

CLIENT: Landau Associates, Inc.
 130 - 2nd Ave. S.
 Edmonds, WA 98020

DATE: 5/15/2019
 ALS SDG#: EV19050048
 WDOE ACCREDITATION: C601

CLIENT CONTACT: Dylan Frazer
 CLIENT PROJECT: POE A/H - 147029.500

LABORATORY CONTROL SAMPLE RESULTS

SPIKED COMPOUND	METHOD	%REC	RPD	QUAL	LIMITS		ANALYSIS DATE	ANALYSIS BY
					MIN	MAX		
Antimony - BSD	EPA-6020	100	0		80	120	05/14/2019	RAL
Arsenic - BS	EPA-6020	100			80	120	05/14/2019	RAL
Arsenic - BSD	EPA-6020	99.1	1		80	120	05/14/2019	RAL
Copper - BS	EPA-6020	102			80	120	05/14/2019	RAL
Copper - BSD	EPA-6020	100	1		80	120	05/14/2019	RAL
Lead - BS	EPA-6020	100			80	120	05/14/2019	RAL
Lead - BSD	EPA-6020	99.6	1		80	120	05/14/2019	RAL

APPROVED BY

Technical Manager

ALS ENVIRONMENTAL

Sample Receiving Checklist

Client: Landau Associates ALS Job #: EV19050048

Project: POE A/H 147029.500

Received Date: 5/9/19 Received Time: 3:07 By: ~~SM~~ RAR

Type of shipping container: Cooler Box Other Hand

Shipped via: FedEx Ground UPS Mail Courier Hand Delivered
FedEx Express

	Yes	No	N/A
Were custody seals on outside of shipping container?	<input type="checkbox"/>	<input checked="" type="checkbox"/>	<input type="checkbox"/>
If yes, how many? _____ Where? _____			
Custody seal date: _____ Seal name: _____			

Was Chain of Custody properly filled out (ink, signed, dated, etc.)?

Did all bottles have labels?

Did all bottle labels and tags agree with Chain of Custody?

Were samples received within hold time?

Did all bottles arrive in good condition (unbroken, etc.)?

Was sufficient amount of sample sent for the tests indicated?

Was correct preservation added to samples? ^{RB}

If no, Sample Control added preservative to the following:

<u>Sample Number</u>	<u>Reagent</u>	<u>Analyte</u>
_____	_____	_____
_____	_____	_____
_____	_____	_____

Were VOA vials checked for absence of air bubbles?

Bubbles present in sample #: _____

Temperature of cooler upon receipt: 22.8°C Cold Cool Ambient N/A

Explain any discrepancies: _____

Was client contacted? _____ Who was called? _____ By whom? _____ Date: _____

Outcome of call: _____



May 22, 2019

Mr. Dylan Frazer
Landau Associates, Inc.
130 - 2nd Ave. S.
Edmonds, WA 98020

Dear Mr. Frazer,

On May 14th, 2 samples were received by our laboratory and assigned our laboratory project number EV19050073. The project was identified as your POE A/H - 0147029.500. The sample identification and requested analyses are outlined on the attached chain of custody record.

No abnormalities or nonconformances were observed during the analyses of the project samples.

Please do not hesitate to call me if you have any questions or if I can be of further assistance.

Sincerely,

ALS Laboratory Group

Rick Bagan
Laboratory Director



CERTIFICATE OF ANALYSIS

CLIENT:	Landau Associates, Inc. 130 - 2nd Ave. S. Edmonds, WA 98020	DATE:	5/22/2019
CLIENT CONTACT:	Dylan Frazer	ALS JOB#:	EV19050073
CLIENT PROJECT:	POE A/H - 0147029.500	ALS SAMPLE#:	EV19050073-01
CLIENT SAMPLE ID	BS-6 (9.5-10.5')	DATE RECEIVED:	05/14/2019
		COLLECTION DATE:	5/14/2019 10:30:00 AM
		WDOE ACCREDITATION:	C601

SAMPLE DATA RESULTS

ANALYTE	METHOD	RESULTS	REPORTING LIMITS	DILUTION FACTOR	UNITS	ANALYSIS	ANALYSIS
						DATE	BY
TPH-Diesel Range (C12-C24)	NWTPH-DX w/ SGA	91	25	1	MG/KG	05/16/2019	EBS
TPH-Oil Range (C24-C40)	NWTPH-DX w/ SGA	150	50	1	MG/KG	05/16/2019	EBS
Naphthalene	EPA-8270 SIM	110	20	1	UG/KG	05/17/2019	JMK
2-Methylnaphthalene	EPA-8270 SIM	30	20	1	UG/KG	05/17/2019	JMK
1-Methylnaphthalene	EPA-8270 SIM	23	20	1	UG/KG	05/17/2019	JMK
Benzo[A]Anthracene	EPA-8270 SIM	83	20	1	UG/KG	05/17/2019	JMK
Chrysene	EPA-8270 SIM	120	20	1	UG/KG	05/17/2019	JMK
Benzo[B]Fluoranthene	EPA-8270 SIM	100	20	1	UG/KG	05/17/2019	JMK
Benzo[K]Fluoranthene	EPA-8270 SIM	31	20	1	UG/KG	05/17/2019	JMK
Benzo[A]Pyrene	EPA-8270 SIM	76	20	1	UG/KG	05/17/2019	JMK
Indeno[1,2,3-Cd]Pyrene	EPA-8270 SIM	42	20	1	UG/KG	05/17/2019	JMK
Dibenz[A,H]Anthracene	EPA-8270 SIM	U	20	1	UG/KG	05/17/2019	JMK
PCB-1254	EPA-8082	0.18	0.10	1	MG/KG	05/21/2019	JMK
Total PCBs	EPA-8082	0.18	0.10	1	MG/KG	05/21/2019	JMK
Mercury	EPA-7471	0.11	0.020	1	MG/KG	05/17/2019	RAL
Antimony	EPA-6020	U	0.50	1	MG/KG	05/17/2019	RAL
Arsenic	EPA-6020	16	0.20	1	MG/KG	05/17/2019	RAL
Copper	EPA-6020	53	0.10	1	MG/KG	05/17/2019	RAL
Lead	EPA-6020	18	0.10	1	MG/KG	05/17/2019	RAL

SURROGATE	METHOD	%REC	ANALYSIS	ANALYSIS
			DATE	BY
C25	NWTPH-DX w/ SGA	105	05/16/2019	EBS
Terphenyl-d14	EPA-8270 SIM	91.0	05/17/2019	JMK
TCMX	EPA-8082	61.5	05/21/2019	JMK
DCB	EPA-8082	64.4	05/21/2019	JMK

U - Analyte analyzed for but not detected at level above reporting limit.
Chromatogram indicates that it is likely that sample contains light oil/lube oil.



CERTIFICATE OF ANALYSIS

CLIENT:	Landau Associates, Inc. 130 - 2nd Ave. S. Edmonds, WA 98020	DATE:	5/22/2019
CLIENT CONTACT:	Dylan Frazer	ALS JOB#:	EV19050073
CLIENT PROJECT:	POE A/H - 0147029.500	ALS SAMPLE#:	EV19050073-02
CLIENT SAMPLE ID	BS-7 (9.5-10.5')	DATE RECEIVED:	05/14/2019
		COLLECTION DATE:	5/14/2019 1:40:00 PM
		WDOE ACCREDITATION:	C601

SAMPLE DATA RESULTS

ANALYTE	METHOD	RESULTS	REPORTING LIMITS	DILUTION FACTOR	UNITS	ANALYSIS DATE	ANALYSIS BY
TPH-Diesel Range (C12-C24)	NWTPH-DX w/ SGA	360	25	1	MG/KG	05/16/2019	EBS
TPH-Oil Range (C24-C40)	NWTPH-DX w/ SGA	410	50	1	MG/KG	05/16/2019	EBS
Naphthalene	EPA-8270 SIM	6100	200	10	UG/KG	05/22/2019	JMK
2-Methylnaphthalene	EPA-8270 SIM	2300	200	10	UG/KG	05/22/2019	JMK
1-Methylnaphthalene	EPA-8270 SIM	1600	200	10	UG/KG	05/22/2019	JMK
Benzo[A]Anthracene	EPA-8270 SIM	5100	200	10	UG/KG	05/22/2019	JMK
Chrysene	EPA-8270 SIM	5900	200	10	UG/KG	05/22/2019	JMK
Benzo[B]Fluoranthene	EPA-8270 SIM	5000	200	10	UG/KG	05/22/2019	JMK
Benzo[K]Fluoranthene	EPA-8270 SIM	2000	200	10	UG/KG	05/22/2019	JMK
Benzo[A]Pyrene	EPA-8270 SIM	4400	200	10	UG/KG	05/22/2019	JMK
Indeno[1,2,3-Cd]Pyrene	EPA-8270 SIM	2200	200	10	UG/KG	05/22/2019	JMK
Dibenz[A,H]Anthracene	EPA-8270 SIM	780	200	10	UG/KG	05/22/2019	JMK
PCB-1254	EPA-8082	U	0.10	1	MG/KG	05/21/2019	JMK
Total PCBs	EPA-8082	U	0.10	1	MG/KG	05/21/2019	JMK
Mercury	EPA-7471	0.089	0.020	1	MG/KG	05/17/2019	RAL
Antimony	EPA-6020	2.4	0.50	1	MG/KG	05/17/2019	RAL
Arsenic	EPA-6020	16	0.20	1	MG/KG	05/17/2019	RAL
Copper	EPA-6020	49	0.10	1	MG/KG	05/17/2019	RAL
Lead	EPA-6020	75	0.10	1	MG/KG	05/17/2019	RAL

SURROGATE	METHOD	%REC	ANALYSIS DATE	ANALYSIS BY
C25	NWTPH-DX w/ SGA	179 SUR12	05/16/2019	EBS
Terphenyl-d14 10X Dilution	EPA-8270 SIM	105	05/22/2019	JMK
TCMX	EPA-8082	50.1	05/21/2019	JMK
DCB	EPA-8082	79.7	05/21/2019	JMK

U - Analyte analyzed for but not detected at level above reporting limit.
 SUR12 -Surrogate recoveries were outside of the control limits due to matrix interference.
 Chromatogram indicates that it is likely that sample contains an unidentified diesel range product and light oil/lube oil.
 Diesel range product results biased high due to oil range product overlap.



CERTIFICATE OF ANALYSIS

CLIENT: Landau Associates, Inc.
 130 - 2nd Ave. S.
 Edmonds, WA 98020

CLIENT CONTACT: Dylan Frazer
 CLIENT PROJECT: POE A/H - 0147029.500

DATE: 5/22/2019
 ALS SDG#: EV19050073
 WDOE ACCREDITATION: C601

LABORATORY BLANK RESULTS

MB-051519S - Batch 140909 - Soil by NWTPH-DX

ANALYTE	METHOD	RESULTS	UNITS	REPORTING LIMITS	ANALYSIS DATE	ANALYSIS BY
TPH-Diesel Range (C12-C24)	NWTPH-DX	U	MG/KG	25	05/15/2019	EBS
TPH-Oil Range (C24-C40)	NWTPH-DX	U	MG/KG	50	05/15/2019	EBS

U - Analyte analyzed for but not detected at level above reporting limit.

MB-051619S - Batch 140947 - Soil by EPA-8270 SIM

ANALYTE	METHOD	RESULTS	UNITS	REPORTING LIMITS	ANALYSIS DATE	ANALYSIS BY
Naphthalene	EPA-8270 SIM	U	UG/KG	20	05/17/2019	JMK
2-Methylnaphthalene	EPA-8270 SIM	U	UG/KG	20	05/17/2019	JMK
1-Methylnaphthalene	EPA-8270 SIM	U	UG/KG	20	05/17/2019	JMK
Benzo[A]Anthracene	EPA-8270 SIM	U	UG/KG	20	05/17/2019	JMK
Chrysene	EPA-8270 SIM	U	UG/KG	20	05/17/2019	JMK
Benzo[B]Fluoranthene	EPA-8270 SIM	U	UG/KG	20	05/17/2019	JMK
Benzo[K]Fluoranthene	EPA-8270 SIM	U	UG/KG	20	05/17/2019	JMK
Benzo[A]Pyrene	EPA-8270 SIM	U	UG/KG	20	05/17/2019	JMK
Indeno[1,2,3-Cd]Pyrene	EPA-8270 SIM	U	UG/KG	20	05/17/2019	JMK
Dibenz[A,H]Anthracene	EPA-8270 SIM	U	UG/KG	20	05/17/2019	JMK
Benzo[G,H,I]Perylene	EPA-8270 SIM	U	UG/KG	20	05/17/2019	JMK

U - Analyte analyzed for but not detected at level above reporting limit.

MB-051719S - Batch 141059 - Soil by EPA-8082

ANALYTE	METHOD	RESULTS	UNITS	REPORTING LIMITS	ANALYSIS DATE	ANALYSIS BY
Total PCBs	EPA-8082	U	MG/KG	0.10	05/21/2019	JMK

U - Analyte analyzed for but not detected at level above reporting limit.

MBLK-338771 - Batch R338771 - Soil by EPA-7471

ANALYTE	METHOD	RESULTS	UNITS	REPORTING LIMITS	ANALYSIS DATE	ANALYSIS BY
Mercury	EPA-7471	U	MG/KG	0.020	05/17/2019	RAL

U - Analyte analyzed for but not detected at level above reporting limit.

MB-051719S - Batch 140959 - Soil by EPA-6020

ANALYTE	METHOD	RESULTS	UNITS	REPORTING LIMITS	ANALYSIS DATE	ANALYSIS BY
Antimony	EPA-6020	U	MG/KG	0.50	05/17/2019	RAL
Arsenic	EPA-6020	U	MG/KG	0.20	05/17/2019	RAL
Copper	EPA-6020	U	MG/KG	0.10	05/17/2019	RAL



CERTIFICATE OF ANALYSIS

CLIENT: Landau Associates, Inc. DATE: 5/22/2019
130 - 2nd Ave. S. ALS SDG#: EV19050073
Edmonds, WA 98020 WDOE ACCREDITATION: C601
CLIENT CONTACT: Dylan Frazer
CLIENT PROJECT: POE A/H - 0147029.500

LABORATORY BLANK RESULTS

MB-051719S - Batch 140959 - Soil by EPA-6020

Lead	EPA-6020	U	MG/KG	0.10	05/17/2019	RAL
------	----------	---	-------	------	------------	-----

U - Analyte analyzed for but not detected at level above reporting limit.



CERTIFICATE OF ANALYSIS

CLIENT: Landau Associates, Inc.
 130 - 2nd Ave. S.
 Edmonds, WA 98020

CLIENT CONTACT: Dylan Frazer
 CLIENT PROJECT: POE A/H - 0147029.500

DATE: 5/22/2019
 ALS SDG#: EV19050073
 WDOE ACCREDITATION: C601

LABORATORY CONTROL SAMPLE RESULTS

ALS Test Batch ID: 140909 - Soil by NWTPH-DX

SPIKED COMPOUND	METHOD	%REC	RPD	QUAL	LIMITS		ANALYSIS DATE	ANALYSIS BY
					MIN	MAX		
TPH-Diesel Range (C12-C24) - BS	NWTPH-DX	97.9			75.5	122.1	05/15/2019	EBS
TPH-Diesel Range (C12-C24) - BSD	NWTPH-DX	96.9	1		75.5	122.1	05/15/2019	EBS

ALS Test Batch ID: 140947 - Soil by EPA-8270 SIM

SPIKED COMPOUND	METHOD	%REC	RPD	QUAL	LIMITS		ANALYSIS DATE	ANALYSIS BY
					MIN	MAX		
Naphthalene - BS	EPA-8270 SIM	77.0			20	150	05/17/2019	JMK
Naphthalene - BSD	EPA-8270 SIM	79.2	3		20	150	05/17/2019	JMK
2-Methylnaphthalene - BS	EPA-8270 SIM	84.4			20	150	05/17/2019	JMK
2-Methylnaphthalene - BSD	EPA-8270 SIM	86.9	3		20	150	05/17/2019	JMK
1-Methylnaphthalene - BS	EPA-8270 SIM	81.9			20	150	05/17/2019	JMK
1-Methylnaphthalene - BSD	EPA-8270 SIM	84.3	3		20	150	05/17/2019	JMK
Benzo[A]Anthracene - BS	EPA-8270 SIM	73.2			20	150	05/17/2019	JMK
Benzo[A]Anthracene - BSD	EPA-8270 SIM	74.1	1		20	150	05/17/2019	JMK
Chrysene - BS	EPA-8270 SIM	74.6			20	150	05/17/2019	JMK
Chrysene - BSD	EPA-8270 SIM	75.1	1		20	150	05/17/2019	JMK
Benzo[B]Fluoranthene - BS	EPA-8270 SIM	81.9			20	150	05/17/2019	JMK
Benzo[B]Fluoranthene - BSD	EPA-8270 SIM	82.8	1		20	150	05/17/2019	JMK
Benzo[K]Fluoranthene - BS	EPA-8270 SIM	82.9			20	150	05/17/2019	JMK
Benzo[K]Fluoranthene - BSD	EPA-8270 SIM	82.4	1		20	150	05/17/2019	JMK
Benzo[A]Pyrene - BS	EPA-8270 SIM	75.0			20	150	05/17/2019	JMK
Benzo[A]Pyrene - BSD	EPA-8270 SIM	74.0	1		20	150	05/17/2019	JMK
Indeno[1,2,3-Cd]Pyrene - BS	EPA-8270 SIM	71.3			20	150	05/17/2019	JMK
Indeno[1,2,3-Cd]Pyrene - BSD	EPA-8270 SIM	71.1	0		20	150	05/17/2019	JMK
Dibenz[A,H]Anthracene - BS	EPA-8270 SIM	54.4			20	150	05/17/2019	JMK
Dibenz[A,H]Anthracene - BSD	EPA-8270 SIM	54.2	0		20	150	05/17/2019	JMK
Benzo[G,H,I]Perylene - BS	EPA-8270 SIM	83.9			20	150	05/17/2019	JMK
Benzo[G,H,I]Perylene - BSD	EPA-8270 SIM	84.1	0		20	150	05/17/2019	JMK

ALS Test Batch ID: R338771 - Soil by EPA-7471

SPIKED COMPOUND	METHOD	%REC	RPD	QUAL	LIMITS		ANALYSIS DATE	ANALYSIS BY
					MIN	MAX		
Mercury - BS	EPA-7471	108			81.8	117	05/17/2019	RAL
Mercury - BSD	EPA-7471	109	1		81.8	117	05/17/2019	RAL

ALS Test Batch ID: 140959 - Soil by EPA-6020

SPIKED COMPOUND	METHOD	%REC	RPD	QUAL	LIMITS		ANALYSIS DATE	ANALYSIS BY
					MIN	MAX		
Antimony - BS	EPA-6020	105			80	120	05/17/2019	RAL



CERTIFICATE OF ANALYSIS

CLIENT: Landau Associates, Inc.
 130 - 2nd Ave. S.
 Edmonds, WA 98020

DATE: 5/22/2019
 ALS SDG#: EV19050073
 WDOE ACCREDITATION: C601

CLIENT CONTACT: Dylan Frazer
 CLIENT PROJECT: POE A/H - 0147029.500

LABORATORY CONTROL SAMPLE RESULTS

SPIKED COMPOUND	METHOD	%REC	RPD	QUAL	LIMITS		ANALYSIS DATE	ANALYSIS BY
					MIN	MAX		
Antimony - BSD	EPA-6020	106	1		80	120	05/17/2019	RAL
Arsenic - BS	EPA-6020	101			80	120	05/17/2019	RAL
Arsenic - BSD	EPA-6020	104	3		80	120	05/17/2019	RAL
Copper - BS	EPA-6020	105			80	120	05/17/2019	RAL
Copper - BSD	EPA-6020	108	3		80	120	05/17/2019	RAL
Lead - BS	EPA-6020	101			80	120	05/17/2019	RAL
Lead - BSD	EPA-6020	104	2		80	120	05/17/2019	RAL

APPROVED BY

Laboratory Director

ALS ENVIRONMENTAL

Sample Receiving Checklist

Client: Landau Associates ALS Job #: EV19050073

Project: POE/A/H - 0147029.500

Received Date: 5/14/19 Received Time: 2:15 pm By: [Signature]

Type of shipping container: Cooler Box Other Hand

Shipped via: FedEx Ground UPS Mail Courier Hand Delivered
FedEx Express

	<u>Yes</u>	<u>No</u>	<u>N/A</u>
Were custody seals on outside of shipping container?	<input type="checkbox"/>	<input checked="" type="checkbox"/>	<input type="checkbox"/>
If yes, how many? _____ Where? _____			
Custody seal date: _____ Seal name: _____			

Was Chain of Custody properly filled out (ink, signed, dated, etc.)?

Did all bottles have labels?

Did all bottle labels and tags agree with Chain of Custody?

Were samples received within hold time?

Did all bottles arrive in good condition (unbroken, etc.)?

Was sufficient amount of sample sent for the tests indicated?

Was correct preservation added to samples?

If no, Sample Control added preservative to the following:

<u>Sample Number</u>	<u>Reagent</u>	<u>Analyte</u>
_____	_____	_____
_____	_____	_____
_____	_____	_____

Were VOA vials checked for absence of air bubbles?

Bubbles present in sample #: _____

Temperature of cooler upon receipt: 16.2°C Cold Cool Ambient N/A

Explain any discrepancies: _____

Was client contacted? Who was called? _____ By whom? _____ Date: _____

Outcome of call: _____



June 7, 2019

Mr. Dylan Frazer
Landau Associates, Inc.
130 - 2nd Ave. S.
Edmonds, WA 98020

Dear Mr. Frazer,

On May 23rd, 2 samples were received by our laboratory and assigned our laboratory project number EV19050162. The project was identified as your POE A/H - 0147029.500. The sample identification and requested analyses are outlined on the attached chain of custody record.

No abnormalities or nonconformances were observed during the analyses of the project samples.

Please do not hesitate to call me if you have any questions or if I can be of further assistance.

Sincerely,

ALS Laboratory Group

Rick Bagan
Laboratory Director



CERTIFICATE OF ANALYSIS

CLIENT:	Landau Associates, Inc. 130 - 2nd Ave. S. Edmonds, WA 98020	DATE:	6/7/2019
CLIENT CONTACT:	Dylan Frazer	ALS JOB#:	EV19050162
CLIENT PROJECT:	POE A/H - 0147029.500	ALS SAMPLE#:	EV19050162-01
CLIENT SAMPLE ID	BS-10 (9.5-10.5')	DATE RECEIVED:	05/23/2019
		COLLECTION DATE:	5/22/2019 2:15:00 PM
		WDOE ACCREDITATION:	C601

SAMPLE DATA RESULTS

ANALYTE	METHOD	RESULTS	REPORTING LIMITS	DILUTION FACTOR	UNITS	ANALYSIS	ANALYSIS
						DATE	BY
TPH-Diesel Range (C12-C24)	NWTPH-DX w/ SGA	580	25	1	MG/KG	05/30/2019	EBS
TPH-Oil Range (C24-C40)	NWTPH-DX w/ SGA	350	50	1	MG/KG	05/30/2019	EBS
Naphthalene	EPA-8270 SIM	21	20	1	UG/KG	05/30/2019	JMK
2-Methylnaphthalene	EPA-8270 SIM	24	20	1	UG/KG	05/30/2019	JMK
1-Methylnaphthalene	EPA-8270 SIM	29	20	1	UG/KG	05/30/2019	JMK
Benzo[A]Anthracene	EPA-8270 SIM	46	20	1	UG/KG	05/30/2019	JMK
Chrysene	EPA-8270 SIM	72	20	1	UG/KG	05/30/2019	JMK
Benzo[B]Fluoranthene	EPA-8270 SIM	79	20	1	UG/KG	05/30/2019	JMK
Benzo[K]Fluoranthene	EPA-8270 SIM	27	20	1	UG/KG	05/30/2019	JMK
Benzo[A]Pyrene	EPA-8270 SIM	48	20	1	UG/KG	05/30/2019	JMK
Indeno[1,2,3-Cd]Pyrene	EPA-8270 SIM	34	20	1	UG/KG	05/30/2019	JMK
Dibenz[A,H]Anthracene	EPA-8270 SIM	U	20	1	UG/KG	05/30/2019	JMK
PCB-1254	EPA-8082	0.11	0.10	1	MG/KG	06/05/2019	JMK
Total PCBs	EPA-8082	0.58	0.10	1	MG/KG	06/05/2019	JMK
Mercury	EPA-7471	0.27	0.020	1	MG/KG	05/23/2019	RAL
Antimony	EPA-6020	3.2	0.50	1	MG/KG	05/23/2019	RAL
Arsenic	EPA-6020	12	0.20	1	MG/KG	05/23/2019	RAL
Copper	EPA-6020	65	0.50	1	MG/KG	05/23/2019	RAL
Lead	EPA-6020	130	0.10	1	MG/KG	05/23/2019	RAL

SURROGATE	METHOD	%REC	ANALYSIS	ANALYSIS
			DATE	BY
C25	NWTPH-DX w/ SGA	88.0	05/30/2019	EBS
Terphenyl-d14	EPA-8270 SIM	81.0	05/30/2019	JMK
TCMX	EPA-8082	49.3	06/05/2019	JMK
DCB	EPA-8082	63.6	06/05/2019	JMK

U - Analyte analyzed for but not detected at level above reporting limit.
 Chromatogram indicates that it is likely that sample contains an unidentified diesel range product and lube oil.
 Oil range product results biased high due to diesel range product overlap.



CERTIFICATE OF ANALYSIS

CLIENT:	Landau Associates, Inc. 130 - 2nd Ave. S. Edmonds, WA 98020	DATE:	6/7/2019
CLIENT CONTACT:	Dylan Frazer	ALS JOB#:	EV19050162
CLIENT PROJECT:	POE A/H - 0147029.500	ALS SAMPLE#:	EV19050162-02
CLIENT SAMPLE ID	BS-11 (9.5-10.5')	DATE RECEIVED:	05/23/2019
		COLLECTION DATE:	5/23/2019 11:00:00 AM
		WDOE ACCREDITATION:	C601

SAMPLE DATA RESULTS

ANALYTE	METHOD	RESULTS	REPORTING LIMITS	DILUTION FACTOR	UNITS	ANALYSIS	ANALYSIS
						DATE	BY
TPH-Diesel Range (C12-C24)	NWTPH-DX w/ SGA	220	25	1	MG/KG	05/30/2019	EBS
TPH-Oil Range (C24-C40)	NWTPH-DX w/ SGA	880	50	1	MG/KG	05/30/2019	EBS
Naphthalene	EPA-8270 SIM	22	20	1	UG/KG	05/30/2019	JMK
2-Methylnaphthalene	EPA-8270 SIM	U	20	1	UG/KG	05/30/2019	JMK
1-Methylnaphthalene	EPA-8270 SIM	U	20	1	UG/KG	05/30/2019	JMK
Benzo[A]Anthracene	EPA-8270 SIM	90	20	1	UG/KG	05/30/2019	JMK
Chrysene	EPA-8270 SIM	110	20	1	UG/KG	05/30/2019	JMK
Benzo[B]Fluoranthene	EPA-8270 SIM	92	20	1	UG/KG	05/30/2019	JMK
Benzo[K]Fluoranthene	EPA-8270 SIM	31	20	1	UG/KG	05/30/2019	JMK
Benzo[A]Pyrene	EPA-8270 SIM	81	20	1	UG/KG	05/30/2019	JMK
Indeno[1,2,3-Cd]Pyrene	EPA-8270 SIM	43	20	1	UG/KG	05/30/2019	JMK
Dibenz[A,H]Anthracene	EPA-8270 SIM	U	20	1	UG/KG	05/30/2019	JMK
PCB-1254	EPA-8082	U	0.10	1	MG/KG	06/04/2019	JMK
Total PCBs	EPA-8082	U	0.10	1	MG/KG	06/04/2019	JMK
Mercury	EPA-7471	0.11	0.020	1	MG/KG	05/23/2019	RAL
Antimony	EPA-6020	1.1	0.50	1	MG/KG	05/23/2019	RAL
Arsenic	EPA-6020	4.8	0.20	1	MG/KG	05/23/2019	RAL
Copper	EPA-6020	22	0.50	1	MG/KG	05/23/2019	RAL
Lead	EPA-6020	360	0.10	1	MG/KG	05/23/2019	RAL

SURROGATE	METHOD	%REC	ANALYSIS	ANALYSIS
			DATE	BY
C25	NWTPH-DX w/ SGA	98.5	05/30/2019	EBS
Terphenyl-d14	EPA-8270 SIM	81.9	05/30/2019	JMK
TCMX	EPA-8082	65.0	06/04/2019	JMK
DCB	EPA-8082	65.0	06/04/2019	JMK

U - Analyte analyzed for but not detected at level above reporting limit.
Chromatogram indicates that it is likely that sample contains light oil/lube oil.



CERTIFICATE OF ANALYSIS

CLIENT: Landau Associates, Inc.
 130 - 2nd Ave. S.
 Edmonds, WA 98020

CLIENT CONTACT: Dylan Frazer
 CLIENT PROJECT: POE A/H - 0147029.500

DATE: 6/7/2019
 ALS SDG#: EV19050162
 WDOE ACCREDITATION: C601

LABORATORY BLANK RESULTS

MB-052919S3 - Batch 141431 - Soil by NWTPH-DX

ANALYTE	METHOD	RESULTS	UNITS	REPORTING LIMITS	ANALYSIS DATE	ANALYSIS BY
TPH-Diesel Range (C12-C24)	NWTPH-DX	U	MG/KG	25	05/30/2019	EBS
TPH-Oil Range (C24-C40)	NWTPH-DX	U	MG/KG	50	05/30/2019	EBS

U - Analyte analyzed for but not detected at level above reporting limit.

MB-053019S - Batch 141437 - Soil by EPA-8270 SIM

ANALYTE	METHOD	RESULTS	UNITS	REPORTING LIMITS	ANALYSIS DATE	ANALYSIS BY
Naphthalene	EPA-8270 SIM	U	UG/KG	20	05/30/2019	JMK
2-Methylnaphthalene	EPA-8270 SIM	U	UG/KG	20	05/30/2019	JMK
1-Methylnaphthalene	EPA-8270 SIM	U	UG/KG	20	05/30/2019	JMK
Benzo[A]Anthracene	EPA-8270 SIM	U	UG/KG	20	05/30/2019	JMK
Chrysene	EPA-8270 SIM	U	UG/KG	20	05/30/2019	JMK
Benzo[B]Fluoranthene	EPA-8270 SIM	U	UG/KG	20	05/30/2019	JMK
Benzo[K]Fluoranthene	EPA-8270 SIM	U	UG/KG	20	05/30/2019	JMK
Benzo[A]Pyrene	EPA-8270 SIM	U	UG/KG	20	05/30/2019	JMK
Indeno[1,2,3-Cd]Pyrene	EPA-8270 SIM	U	UG/KG	20	05/30/2019	JMK
Dibenz[A,H]Anthracene	EPA-8270 SIM	U	UG/KG	20	05/30/2019	JMK
Benzo[G,H,I]Perylene	EPA-8270 SIM	U	UG/KG	20	05/30/2019	JMK

U - Analyte analyzed for but not detected at level above reporting limit.

MB-060419S - Batch 141606 - Soil by EPA-8082

ANALYTE	METHOD	RESULTS	UNITS	REPORTING LIMITS	ANALYSIS DATE	ANALYSIS BY
PCB-1016	EPA-8082	U	MG/KG	0.10	06/04/2019	JMK
PCB-1260	EPA-8082	U	MG/KG	0.10	06/04/2019	JMK
Total PCBs	EPA-8082	U	MG/KG	0.10	06/04/2019	JMK

U - Analyte analyzed for but not detected at level above reporting limit.

MBLK-R339504 - Batch R339504 - Soil by EPA-7471

ANALYTE	METHOD	RESULTS	UNITS	REPORTING LIMITS	ANALYSIS DATE	ANALYSIS BY
Mercury	EPA-7471	U	MG/KG	0.020	05/23/2019	RAL

U - Analyte analyzed for but not detected at level above reporting limit.

MB-052319S - Batch 141178 - Soil by EPA-6020

ANALYTE	METHOD	RESULTS	UNITS	REPORTING LIMITS	ANALYSIS DATE	ANALYSIS BY
Antimony	EPA-6020	U	MG/KG	0.50	05/23/2019	RAL



CERTIFICATE OF ANALYSIS

CLIENT: Landau Associates, Inc. DATE: 6/7/2019
130 - 2nd Ave. S. ALS SDG#: EV19050162
Edmonds, WA 98020 WDOE ACCREDITATION: C601
CLIENT CONTACT: Dylan Frazer
CLIENT PROJECT: POE A/H - 0147029.500

LABORATORY BLANK RESULTS

MB-052319S - Batch 141178 - Soil by EPA-6020

Arsenic	EPA-6020	U	MG/KG	0.20	05/23/2019	RAL
Copper	EPA-6020	U	MG/KG	0.50	05/23/2019	RAL
Lead	EPA-6020	U	MG/KG	0.10	05/23/2019	RAL

U - Analyte analyzed for but not detected at level above reporting limit.



CERTIFICATE OF ANALYSIS

CLIENT:	Landau Associates, Inc. 130 - 2nd Ave. S. Edmonds, WA 98020	DATE:	6/7/2019
CLIENT CONTACT:	Dylan Frazer	ALS SDG#:	EV19050162
CLIENT PROJECT:	POE A/H - 0147029.500	WDOE ACCREDITATION:	C601

LABORATORY CONTROL SAMPLE RESULTS

ALS Test Batch ID: 141431 - Soil by NWTPH-DX

SPIKED COMPOUND	METHOD	%REC	RPD	QUAL	LIMITS		ANALYSIS DATE	ANALYSIS BY
					MIN	MAX		
TPH-Diesel Range (C12-C24) - BS	NWTPH-DX	98.0			75.5	122.1	05/30/2019	EBS
TPH-Diesel Range (C12-C24) - BSD	NWTPH-DX	91.0	7		75.5	122.1	05/30/2019	EBS

ALS Test Batch ID: 141437 - Soil by EPA-8270 SIM

SPIKED COMPOUND	METHOD	%REC	RPD	QUAL	LIMITS		ANALYSIS DATE	ANALYSIS BY
					MIN	MAX		
Naphthalene - BS	EPA-8270 SIM	69.5			20	150	05/30/2019	JMK
Naphthalene - BSD	EPA-8270 SIM	62.2	11		20	150	05/30/2019	JMK
2-Methylnaphthalene - BS	EPA-8270 SIM	73.0			20	150	05/30/2019	JMK
2-Methylnaphthalene - BSD	EPA-8270 SIM	65.8	10		20	150	05/30/2019	JMK
1-Methylnaphthalene - BS	EPA-8270 SIM	73.2			20	150	05/30/2019	JMK
1-Methylnaphthalene - BSD	EPA-8270 SIM	65.1	12		20	150	05/30/2019	JMK
Benzo[A]Anthracene - BS	EPA-8270 SIM	63.3			20	150	05/30/2019	JMK
Benzo[A]Anthracene - BSD	EPA-8270 SIM	59.1	7		20	150	05/30/2019	JMK
Chrysene - BS	EPA-8270 SIM	62.2			20	150	05/30/2019	JMK
Chrysene - BSD	EPA-8270 SIM	58.2	7		20	150	05/30/2019	JMK
Benzo[B]Fluoranthene - BS	EPA-8270 SIM	66.8			20	150	05/30/2019	JMK
Benzo[B]Fluoranthene - BSD	EPA-8270 SIM	62.4	7		20	150	05/30/2019	JMK
Benzo[K]Fluoranthene - BS	EPA-8270 SIM	65.2			20	150	05/30/2019	JMK
Benzo[K]Fluoranthene - BSD	EPA-8270 SIM	61.3	6		20	150	05/30/2019	JMK
Benzo[A]Pyrene - BS	EPA-8270 SIM	61.3			20	150	05/30/2019	JMK
Benzo[A]Pyrene - BSD	EPA-8270 SIM	57.1	7		20	150	05/30/2019	JMK
Indeno[1,2,3-Cd]Pyrene - BS	EPA-8270 SIM	60.5			20	150	05/30/2019	JMK
Indeno[1,2,3-Cd]Pyrene - BSD	EPA-8270 SIM	57.2	6		20	150	05/30/2019	JMK
Dibenz[A,H]Anthracene - BS	EPA-8270 SIM	46.1			20	150	05/30/2019	JMK
Dibenz[A,H]Anthracene - BSD	EPA-8270 SIM	43.5	6		20	150	05/30/2019	JMK
Benzo[G,H,I]Perylene - BS	EPA-8270 SIM	73.6			20	150	05/30/2019	JMK
Benzo[G,H,I]Perylene - BSD	EPA-8270 SIM	68.4	7		20	150	05/30/2019	JMK

ALS Test Batch ID: 141606 - Soil by EPA-8082

SPIKED COMPOUND	METHOD	%REC	RPD	QUAL	LIMITS		ANALYSIS DATE	ANALYSIS BY
					MIN	MAX		
PCB-1016 - BS	EPA-8082	70.7			50	150	06/04/2019	JMK
PCB-1016 - BSD	EPA-8082	77.9	10		50	150	06/04/2019	JMK
PCB-1260 - BS	EPA-8082	76.6			50	150	06/04/2019	JMK
PCB-1260 - BSD	EPA-8082	86.4	12		50	150	06/04/2019	JMK



CERTIFICATE OF ANALYSIS

CLIENT:	Landau Associates, Inc. 130 - 2nd Ave. S. Edmonds, WA 98020	DATE:	6/7/2019
CLIENT CONTACT:	Dylan Frazer	ALS SDG#:	EV19050162
CLIENT PROJECT:	POE A/H - 0147029.500	WDOE ACCREDITATION:	C601

LABORATORY CONTROL SAMPLE RESULTS

ALS Test Batch ID: R339504 - Soil by EPA-7471

SPIKED COMPOUND	METHOD	%REC	RPD	QUAL	LIMITS		ANALYSIS DATE	ANALYSIS BY
					MIN	MAX		
Mercury - BS	EPA-7471	110			81.8	117	05/23/2019	RAL
Mercury - BSD	EPA-7471	109	1		81.8	117	05/23/2019	RAL

ALS Test Batch ID: 141178 - Soil by EPA-6020

SPIKED COMPOUND	METHOD	%REC	RPD	QUAL	LIMITS		ANALYSIS DATE	ANALYSIS BY
					MIN	MAX		
Antimony - BS	EPA-6020	102			80	120	05/23/2019	RAL
Antimony - BSD	EPA-6020	99.2	2		80	120	05/23/2019	RAL
Arsenic - BS	EPA-6020	98.8			80	120	05/23/2019	RAL
Arsenic - BSD	EPA-6020	97.3	1		80	120	05/23/2019	RAL
Copper - BS	EPA-6020	103			80	120	05/23/2019	RAL
Copper - BSD	EPA-6020	101	2		80	120	05/23/2019	RAL
Lead - BS	EPA-6020	96.4			80	120	05/23/2019	RAL
Lead - BSD	EPA-6020	96.7	0		80	120	05/23/2019	RAL

APPROVED BY

Laboratory Director

ALS ENVIRONMENTAL

Sample Receiving Checklist

Client: Landau Associates

ALS Job #: EV19050162

Project: BE A/H - 0147029-500

Received Date: 5/23/19

Received Time: 1210

By: SL

Type of shipping container: Cooler Box Other Hand

Shipped via: FedEx Ground UPS Mail Courier Hand Delivered
FedEx Express

	Yes	No	N/A
Were custody seals on outside of shipping container?	<input type="checkbox"/>	<input checked="" type="checkbox"/>	<input type="checkbox"/>
If yes, how many? _____			
Where? _____			
Custody seal date: _____			
Seal name: _____			

Was Chain of Custody properly filled out (ink, signed, dated, etc.)?

Did all bottles have labels?

Did all bottle labels and tags agree with Chain of Custody?

Were samples received within hold time?

Did all bottles arrive in good condition (unbroken, etc.)?

Was sufficient amount of sample sent for the tests indicated?

Was correct preservation added to samples?

If no, Sample Control added preservative to the following:

<u>Sample Number</u>	<u>Reagent</u>	<u>Analyte</u>
_____	_____	_____
_____	_____	_____
_____	_____	_____

Were VOA vials checked for absence of air bubbles?
Bubbles present in sample #: _____

Temperature of cooler upon receipt: 17.9° Cold Cool Ambient N/A

Explain any discrepancies: _____

Was client contacted? Who was called? _____ By whom? _____ Date: _____

Outcome of call: _____



June 7, 2019

Mr. Dylan Frazer
Landau Associates, Inc.
130 - 2nd Ave. S.
Edmonds, WA 98020

Dear Mr. Frazer,

On May 31st, 4 samples were received by our laboratory and assigned our laboratory project number EV19050202. The project was identified as your POE A/H - 147029.500. The sample identification and requested analyses are outlined on the attached chain of custody record.

No abnormalities or nonconformances were observed during the analyses of the project samples.

Please do not hesitate to call me if you have any questions or if I can be of further assistance.

Sincerely,

ALS Laboratory Group

Rick Bagan
Laboratory Director



CERTIFICATE OF ANALYSIS

CLIENT:	Landau Associates, Inc. 130 - 2nd Ave. S. Edmonds, WA 98020	DATE:	6/7/2019
CLIENT CONTACT:	Dylan Frazer	ALS JOB#:	EV19050202
CLIENT PROJECT:	POE A/H - 147029.500	ALS SAMPLE#:	EV19050202-01
CLIENT SAMPLE ID	BS-12 (9-10')	DATE RECEIVED:	05/31/2019
		COLLECTION DATE:	5/28/2019 11:00:00 AM
		WDOE ACCREDITATION:	C601

SAMPLE DATA RESULTS

ANALYTE	METHOD	RESULTS	REPORTING LIMITS	DILUTION FACTOR	UNITS	ANALYSIS ANALYSIS	
						DATE	BY
TPH-Diesel Range (C12-C24)	NWTPH-DX w/ SGA	81	25	1	MG/KG	06/04/2019	EBS
TPH-Oil Range (C24-C40)	NWTPH-DX w/ SGA	210	50	1	MG/KG	06/04/2019	EBS
Naphthalene	EPA-8270 SIM	U	20	1	UG/KG	06/06/2019	JMK
2-Methylnaphthalene	EPA-8270 SIM	U	20	1	UG/KG	06/06/2019	JMK
1-Methylnaphthalene	EPA-8270 SIM	U	20	1	UG/KG	06/06/2019	JMK
Benzo[A]Anthracene	EPA-8270 SIM	U	20	1	UG/KG	06/06/2019	JMK
Chrysene	EPA-8270 SIM	U	20	1	UG/KG	06/06/2019	JMK
Benzo[B]Fluoranthene	EPA-8270 SIM	25	20	1	UG/KG	06/06/2019	JMK
Benzo[K]Fluoranthene	EPA-8270 SIM	U	20	1	UG/KG	06/06/2019	JMK
Benzo[A]Pyrene	EPA-8270 SIM	U	20	1	UG/KG	06/06/2019	JMK
Indeno[1,2,3-Cd]Pyrene	EPA-8270 SIM	U	20	1	UG/KG	06/06/2019	JMK
Dibenz[A,H]Anthracene	EPA-8270 SIM	U	20	1	UG/KG	06/06/2019	JMK
PCB-1254	EPA-8082	U	0.10	1	MG/KG	06/05/2019	JMK
Total PCBs	EPA-8082	U	0.10	1	MG/KG	06/05/2019	JMK
Mercury	EPA-7471	0.038	0.020	1	MG/KG	06/05/2019	RAL
Antimony	EPA-6020	U	1.0	1	MG/KG	06/04/2019	RAL
Arsenic	EPA-6020	6.0	0.20	1	MG/KG	06/04/2019	RAL
Copper	EPA-6020	34	0.10	1	MG/KG	06/04/2019	RAL
Lead	EPA-6020	24	0.10	1	MG/KG	06/04/2019	RAL

SURROGATE	METHOD	%REC	ANALYSIS ANALYSIS	
			DATE	BY
C25	NWTPH-DX w/ SGA	93.7	06/04/2019	EBS
Terphenyl-d14	EPA-8270 SIM	65.4	06/06/2019	JMK
TCMX	EPA-8082	62.6	06/05/2019	JMK
DCB	EPA-8082	81.0	06/05/2019	JMK

U - Analyte analyzed for but not detected at level above reporting limit.
Chromatogram indicates that it is likely that sample contains light oil/lube oil.



CERTIFICATE OF ANALYSIS

CLIENT:	Landau Associates, Inc. 130 - 2nd Ave. S. Edmonds, WA 98020	DATE:	6/7/2019
CLIENT CONTACT:	Dylan Frazer	ALS JOB#:	EV19050202
CLIENT PROJECT:	POE A/H - 147029.500	ALS SAMPLE#:	EV19050202-02
CLIENT SAMPLE ID	BS-1 (9-10')	DATE RECEIVED:	05/31/2019
		COLLECTION DATE:	5/30/2019 11:00:00 AM
		WDOE ACCREDITATION:	C601

SAMPLE DATA RESULTS

ANALYTE	METHOD	RESULTS	REPORTING LIMITS	DILUTION FACTOR	UNITS	ANALYSIS	ANALYSIS
						DATE	BY
TPH-Diesel Range (C12-C24)	NWTPH-DX w/ SGA	U	25	1	MG/KG	06/04/2019	EBS
TPH-Oil Range (C24-C40)	NWTPH-DX w/ SGA	U	50	1	MG/KG	06/04/2019	EBS
Naphthalene	EPA-8270 SIM	U	20	1	UG/KG	06/06/2019	JMK
2-Methylnaphthalene	EPA-8270 SIM	U	20	1	UG/KG	06/06/2019	JMK
1-Methylnaphthalene	EPA-8270 SIM	U	20	1	UG/KG	06/06/2019	JMK
Benzo[A]Anthracene	EPA-8270 SIM	U	20	1	UG/KG	06/06/2019	JMK
Chrysene	EPA-8270 SIM	23	20	1	UG/KG	06/06/2019	JMK
Benzo[B]Fluoranthene	EPA-8270 SIM	23	20	1	UG/KG	06/06/2019	JMK
Benzo[K]Fluoranthene	EPA-8270 SIM	U	20	1	UG/KG	06/06/2019	JMK
Benzo[A]Pyrene	EPA-8270 SIM	U	20	1	UG/KG	06/06/2019	JMK
Indeno[1,2,3-Cd]Pyrene	EPA-8270 SIM	U	20	1	UG/KG	06/06/2019	JMK
Dibenz[A,H]Anthracene	EPA-8270 SIM	U	20	1	UG/KG	06/06/2019	JMK
PCB-1254	EPA-8082	U	0.10	1	MG/KG	06/05/2019	JMK
Total PCBs	EPA-8082	U	0.10	1	MG/KG	06/05/2019	JMK
Mercury	EPA-7471	0.029	0.020	1	MG/KG	06/05/2019	RAL
Antimony	EPA-6020	U	1.0	1	MG/KG	06/04/2019	RAL
Arsenic	EPA-6020	3.1	0.20	1	MG/KG	06/04/2019	RAL
Copper	EPA-6020	23	0.10	1	MG/KG	06/04/2019	RAL
Lead	EPA-6020	58	0.10	1	MG/KG	06/04/2019	RAL

SURROGATE	METHOD	%REC	ANALYSIS	ANALYSIS
			DATE	BY
C25	NWTPH-DX w/ SGA	89.2	06/04/2019	EBS
Terphenyl-d14	EPA-8270 SIM	69.1	06/06/2019	JMK
TCMX	EPA-8082	67.6	06/05/2019	JMK
DCB	EPA-8082	74.9	06/05/2019	JMK

U - Analyte analyzed for but not detected at level above reporting limit.



CERTIFICATE OF ANALYSIS

CLIENT:	Landau Associates, Inc. 130 - 2nd Ave. S. Edmonds, WA 98020	DATE:	6/7/2019
CLIENT CONTACT:	Dylan Frazer	ALS JOB#:	EV19050202
CLIENT PROJECT:	POE A/H - 147029.500	ALS SAMPLE#:	EV19050202-03
CLIENT SAMPLE ID	BS-2 (10-11')	DATE RECEIVED:	05/31/2019
		COLLECTION DATE:	5/31/2019 1:00:00 PM
		WDOE ACCREDITATION:	C601

SAMPLE DATA RESULTS

ANALYTE	METHOD	RESULTS	REPORTING LIMITS	DILUTION FACTOR	UNITS	ANALYSIS	ANALYSIS
						DATE	BY
TPH-Diesel Range (C12-C24)	NWTPH-DX w/ SGA	120	25	1	MG/KG	06/04/2019	EBS
TPH-Oil Range (C24-C40)	NWTPH-DX w/ SGA	370	50	1	MG/KG	06/04/2019	EBS
Naphthalene	EPA-8270 SIM	120	20	1	UG/KG	06/06/2019	JMK
2-Methylnaphthalene	EPA-8270 SIM	26	20	1	UG/KG	06/06/2019	JMK
1-Methylnaphthalene	EPA-8270 SIM	U	20	1	UG/KG	06/06/2019	JMK
Benzo[A]Anthracene	EPA-8270 SIM	69	20	1	UG/KG	06/06/2019	JMK
Chrysene	EPA-8270 SIM	91	20	1	UG/KG	06/06/2019	JMK
Benzo[B]Fluoranthene	EPA-8270 SIM	110	20	1	UG/KG	06/06/2019	JMK
Benzo[K]Fluoranthene	EPA-8270 SIM	35	20	1	UG/KG	06/06/2019	JMK
Benzo[A]Pyrene	EPA-8270 SIM	65	20	1	UG/KG	06/06/2019	JMK
Indeno[1,2,3-Cd]Pyrene	EPA-8270 SIM	44	20	1	UG/KG	06/06/2019	JMK
Dibenz[A,H]Anthracene	EPA-8270 SIM	U	20	1	UG/KG	06/06/2019	JMK
PCB-1254	EPA-8082	U	0.10	1	MG/KG	06/04/2019	JMK
Total PCBs	EPA-8082	U	0.10	1	MG/KG	06/04/2019	JMK
Mercury	EPA-7471	0.18	0.020	1	MG/KG	06/05/2019	RAL
Antimony	EPA-6020	U	1.0	1	MG/KG	06/04/2019	RAL
Arsenic	EPA-6020	12	0.20	1	MG/KG	06/04/2019	RAL
Copper	EPA-6020	62	0.10	1	MG/KG	06/04/2019	RAL
Lead	EPA-6020	50	0.10	1	MG/KG	06/04/2019	RAL

SURROGATE	METHOD	%REC	ANALYSIS	ANALYSIS
			DATE	BY
C25	NWTPH-DX w/ SGA	104	06/04/2019	EBS
Terphenyl-d14	EPA-8270 SIM	59.6	06/06/2019	JMK
TCMX	EPA-8082	66.1	06/04/2019	JMK
DCB	EPA-8082	67.0	06/04/2019	JMK

U - Analyte analyzed for but not detected at level above reporting limit.
Chromatogram indicates that it is likely that sample contains light oil/lube oil.



CERTIFICATE OF ANALYSIS

CLIENT:	Landau Associates, Inc. 130 - 2nd Ave. S. Edmonds, WA 98020	DATE:	6/7/2019
CLIENT CONTACT:	Dylan Frazer	ALS JOB#:	EV19050202
CLIENT PROJECT:	POE A/H - 147029.500	ALS SAMPLE#:	EV19050202-04
CLIENT SAMPLE ID	SW-2 (5-8')	DATE RECEIVED:	05/31/2019
		COLLECTION DATE:	5/31/2019 3:40:00 PM
		WDOE ACCREDITATION:	C601

SAMPLE DATA RESULTS

ANALYTE	METHOD	RESULTS	REPORTING LIMITS	DILUTION FACTOR	UNITS	ANALYSIS ANALYSIS	
						DATE	BY
TPH-Diesel Range (C12-C24)	NWTPH-DX w/ SGA	31	25	1	MG/KG	06/04/2019	EBS
TPH-Oil Range (C24-C40)	NWTPH-DX w/ SGA	U	50	1	MG/KG	06/04/2019	EBS
Naphthalene	EPA-8270 SIM	U	20	1	UG/KG	06/06/2019	JMK
2-Methylnaphthalene	EPA-8270 SIM	U	20	1	UG/KG	06/06/2019	JMK
1-Methylnaphthalene	EPA-8270 SIM	U	20	1	UG/KG	06/06/2019	JMK
Benzo[A]Anthracene	EPA-8270 SIM	21	20	1	UG/KG	06/06/2019	JMK
Chrysene	EPA-8270 SIM	24	20	1	UG/KG	06/06/2019	JMK
Benzo[B]Fluoranthene	EPA-8270 SIM	27	20	1	UG/KG	06/06/2019	JMK
Benzo[K]Fluoranthene	EPA-8270 SIM	U	20	1	UG/KG	06/06/2019	JMK
Benzo[A]Pyrene	EPA-8270 SIM	U	20	1	UG/KG	06/06/2019	JMK
Indeno[1,2,3-Cd]Pyrene	EPA-8270 SIM	U	20	1	UG/KG	06/06/2019	JMK
Dibenz[A,H]Anthracene	EPA-8270 SIM	U	20	1	UG/KG	06/06/2019	JMK
PCB-1254	EPA-8082	U	0.10	1	MG/KG	06/05/2019	JMK
Total PCBs	EPA-8082	U	0.10	1	MG/KG	06/05/2019	JMK
Mercury	EPA-7471	0.052	0.020	1	MG/KG	06/05/2019	RAL
Antimony	EPA-6020	2.7	1.0	1	MG/KG	06/04/2019	RAL
Arsenic	EPA-6020	10	0.20	1	MG/KG	06/04/2019	RAL
Copper	EPA-6020	34	0.10	1	MG/KG	06/04/2019	RAL
Lead	EPA-6020	130	0.10	1	MG/KG	06/04/2019	RAL

SURROGATE	METHOD	%REC	ANALYSIS ANALYSIS	
			DATE	BY
C25	NWTPH-DX w/ SGA	99.0	06/04/2019	EBS
Terphenyl-d14	EPA-8270 SIM	69.6	06/06/2019	JMK
TCMX	EPA-8082	72.6	06/05/2019	JMK
DCB	EPA-8082	75.2	06/05/2019	JMK

U - Analyte analyzed for but not detected at level above reporting limit.
 Chromatogram indicates that it is likely that sample contains an unidentified diesel range product.



CERTIFICATE OF ANALYSIS

CLIENT: Landau Associates, Inc.
 130 - 2nd Ave. S.
 Edmonds, WA 98020

CLIENT CONTACT: Dylan Frazer
 CLIENT PROJECT: POE A/H - 147029.500

DATE: 6/7/2019
 ALS SDG#: EV19050202
 WDOE ACCREDITATION: C601

LABORATORY BLANK RESULTS

MB-060319S - Batch 141601 - Soil by NWTPH-DX

ANALYTE	METHOD	RESULTS	UNITS	REPORTING LIMITS	ANALYSIS DATE	ANALYSIS BY
TPH-Diesel Range (C12-C24)	NWTPH-DX	U	MG/KG	25	06/04/2019	EBS
TPH-Oil Range (C24-C40)	NWTPH-DX	U	MG/KG	50	06/04/2019	EBS

U - Analyte analyzed for but not detected at level above reporting limit.

MB-060519S - Batch 141733 - Soil by EPA-8270 SIM

ANALYTE	METHOD	RESULTS	UNITS	REPORTING LIMITS	ANALYSIS DATE	ANALYSIS BY
Naphthalene	EPA-8270 SIM	U	UG/KG	20	06/06/2019	JMK
2-Methylnaphthalene	EPA-8270 SIM	U	UG/KG	20	06/06/2019	JMK
1-Methylnaphthalene	EPA-8270 SIM	U	UG/KG	20	06/06/2019	JMK
Benzo[A]Anthracene	EPA-8270 SIM	U	UG/KG	20	06/06/2019	JMK
Chrysene	EPA-8270 SIM	U	UG/KG	20	06/06/2019	JMK
Benzo[B]Fluoranthene	EPA-8270 SIM	U	UG/KG	20	06/06/2019	JMK
Benzo[K]Fluoranthene	EPA-8270 SIM	U	UG/KG	20	06/06/2019	JMK
Benzo[A]Pyrene	EPA-8270 SIM	U	UG/KG	20	06/06/2019	JMK
Indeno[1,2,3-Cd]Pyrene	EPA-8270 SIM	U	UG/KG	20	06/06/2019	JMK
Dibenz[A,H]Anthracene	EPA-8270 SIM	U	UG/KG	20	06/06/2019	JMK
Benzo[G,H,I]Perylene	EPA-8270 SIM	U	UG/KG	20	06/06/2019	JMK

U - Analyte analyzed for but not detected at level above reporting limit.

MB-060419S - Batch 141606 - Soil by EPA-8082

ANALYTE	METHOD	RESULTS	UNITS	REPORTING LIMITS	ANALYSIS DATE	ANALYSIS BY
PCB-1016	EPA-8082	U	MG/KG	0.10	06/04/2019	JMK
PCB-1260	EPA-8082	U	MG/KG	0.10	06/04/2019	JMK
Total PCBs	EPA-8082	U	MG/KG	0.10	06/04/2019	JMK

U - Analyte analyzed for but not detected at level above reporting limit.

MBLK-339887 - Batch R339887 - Soil by EPA-7471

ANALYTE	METHOD	RESULTS	UNITS	REPORTING LIMITS	ANALYSIS DATE	ANALYSIS BY
Mercury	EPA-7471	U	MG/KG	0.020	06/05/2019	RAL

U - Analyte analyzed for but not detected at level above reporting limit.

MB-060419S - Batch 141627 - Soil by EPA-6020

ANALYTE	METHOD	RESULTS	UNITS	REPORTING LIMITS	ANALYSIS DATE	ANALYSIS BY
Antimony	EPA-6020	U	MG/KG	1.0	06/04/2019	RAL



CERTIFICATE OF ANALYSIS

CLIENT: Landau Associates, Inc. DATE: 6/7/2019
130 - 2nd Ave. S. ALS SDG#: EV19050202
Edmonds, WA 98020 WDOE ACCREDITATION: C601
CLIENT CONTACT: Dylan Frazer
CLIENT PROJECT: POE A/H - 147029.500

LABORATORY BLANK RESULTS

MB-060419S - Batch 141627 - Soil by EPA-6020

Arsenic	EPA-6020	U	MG/KG	0.20	06/04/2019	RAL
Copper	EPA-6020	U	MG/KG	0.10	06/04/2019	RAL
Lead	EPA-6020	U	MG/KG	0.10	06/04/2019	RAL

U - Analyte analyzed for but not detected at level above reporting limit.



CERTIFICATE OF ANALYSIS

CLIENT: Landau Associates, Inc.
 130 - 2nd Ave. S.
 Edmonds, WA 98020

CLIENT CONTACT: Dylan Frazer
 CLIENT PROJECT: POE A/H - 147029.500

DATE: 6/7/2019
 ALS SDG#: EV19050202
 WDOE ACCREDITATION: C601

LABORATORY CONTROL SAMPLE RESULTS

ALS Test Batch ID: 141601 - Soil by NWTPH-DX

SPIKED COMPOUND	METHOD	%REC	RPD	QUAL	LIMITS		ANALYSIS DATE	ANALYSIS BY
					MIN	MAX		
TPH-Diesel Range (C12-C24) - BS	NWTPH-DX	89.2			75.5	122.1	06/04/2019	EBS
TPH-Diesel Range (C12-C24) - BSD	NWTPH-DX	104	15		75.5	122.1	06/04/2019	EBS

ALS Test Batch ID: 141733 - Soil by EPA-8270 SIM

SPIKED COMPOUND	METHOD	%REC	RPD	QUAL	LIMITS		ANALYSIS DATE	ANALYSIS BY
					MIN	MAX		
Naphthalene - BS	EPA-8270 SIM	56.8			20	150	06/06/2019	JMK
Naphthalene - BSD	EPA-8270 SIM	54.4	4		20	150	06/06/2019	JMK
2-Methylnaphthalene - BS	EPA-8270 SIM	61.9			20	150	06/06/2019	JMK
2-Methylnaphthalene - BSD	EPA-8270 SIM	59.1	5		20	150	06/06/2019	JMK
1-Methylnaphthalene - BS	EPA-8270 SIM	61.3			20	150	06/06/2019	JMK
1-Methylnaphthalene - BSD	EPA-8270 SIM	58.3	5		20	150	06/06/2019	JMK
Benzo[A]Anthracene - BS	EPA-8270 SIM	50.2			20	150	06/06/2019	JMK
Benzo[A]Anthracene - BSD	EPA-8270 SIM	47.2	6		20	150	06/06/2019	JMK
Chrysene - BS	EPA-8270 SIM	57.8			20	150	06/06/2019	JMK
Chrysene - BSD	EPA-8270 SIM	54.6	6		20	150	06/06/2019	JMK
Benzo[B]Fluoranthene - BS	EPA-8270 SIM	54.6			20	150	06/06/2019	JMK
Benzo[B]Fluoranthene - BSD	EPA-8270 SIM	51.7	6		20	150	06/06/2019	JMK
Benzo[K]Fluoranthene - BS	EPA-8270 SIM	58.3			20	150	06/06/2019	JMK
Benzo[K]Fluoranthene - BSD	EPA-8270 SIM	55.7	4		20	150	06/06/2019	JMK
Benzo[A]Pyrene - BS	EPA-8270 SIM	52.2			20	150	06/06/2019	JMK
Benzo[A]Pyrene - BSD	EPA-8270 SIM	49.7	5		20	150	06/06/2019	JMK
Indeno[1,2,3-Cd]Pyrene - BS	EPA-8270 SIM	46.1			20	150	06/06/2019	JMK
Indeno[1,2,3-Cd]Pyrene - BSD	EPA-8270 SIM	42.8	7		20	150	06/06/2019	JMK
Dibenz[A,H]Anthracene - BS	EPA-8270 SIM	41.6			20	150	06/06/2019	JMK
Dibenz[A,H]Anthracene - BSD	EPA-8270 SIM	39.1	6		20	150	06/06/2019	JMK
Benzo[G,H,I]Perylene - BS	EPA-8270 SIM	61.1			20	150	06/06/2019	JMK
Benzo[G,H,I]Perylene - BSD	EPA-8270 SIM	57.3	6		20	150	06/06/2019	JMK

ALS Test Batch ID: 141606 - Soil by EPA-8082

SPIKED COMPOUND	METHOD	%REC	RPD	QUAL	LIMITS		ANALYSIS DATE	ANALYSIS BY
					MIN	MAX		
PCB-1016 - BS	EPA-8082	70.7			50	150	06/04/2019	JMK
PCB-1016 - BSD	EPA-8082	77.9	10		50	150	06/04/2019	JMK
PCB-1260 - BS	EPA-8082	76.6			50	150	06/04/2019	JMK
PCB-1260 - BSD	EPA-8082	86.4	12		50	150	06/04/2019	JMK



CERTIFICATE OF ANALYSIS

CLIENT: Landau Associates, Inc.
 130 - 2nd Ave. S.
 Edmonds, WA 98020

CLIENT CONTACT: Dylan Frazer
 CLIENT PROJECT: POE A/H - 147029.500

DATE: 6/7/2019
 ALS SDG#: EV19050202
 WDOE ACCREDITATION: C601

LABORATORY CONTROL SAMPLE RESULTS

ALS Test Batch ID: R339887 - Soil by EPA-7471

SPIKED COMPOUND	METHOD	%REC	RPD	QUAL	LIMITS		ANALYSIS DATE	ANALYSIS BY
					MIN	MAX		
Mercury - BS	EPA-7471	108			81.8	117	06/05/2019	RAL
Mercury - BSD	EPA-7471	109	1		81.8	117	06/05/2019	RAL

ALS Test Batch ID: 141627 - Soil by EPA-6020

SPIKED COMPOUND	METHOD	%REC	RPD	QUAL	LIMITS		ANALYSIS DATE	ANALYSIS BY
					MIN	MAX		
Antimony - BS	EPA-6020	114			80	120	06/04/2019	RAL
Antimony - BSD	EPA-6020	111	3		80	120	06/04/2019	RAL
Arsenic - BS	EPA-6020	105			80	120	06/04/2019	RAL
Arsenic - BSD	EPA-6020	101	4		80	120	06/04/2019	RAL
Copper - BS	EPA-6020	107			80	120	06/04/2019	RAL
Copper - BSD	EPA-6020	104	3		80	120	06/04/2019	RAL
Lead - BS	EPA-6020	104			80	120	06/04/2019	RAL
Lead - BSD	EPA-6020	103	1		80	120	06/04/2019	RAL

APPROVED BY

Laboratory Director

EV19050202

IA LANDAU ASSOCIATES

Chain-of-Custody Record

Seattle/Edmonds (425) 778-0907 Spokane (509) 327-9737
 Tacoma (253) 926-2493 Portland (503) 542-1080

Turnaround Time: Standard Accelerated
 Date 5/28/19 Page 1 of 1

Project Name: POE A/H Project No.: 147029500
 Project Location/Event: Trumbull IA / Compliance Monitoring
 Sampler's Name: Deanna Huerta
 Project Contact: Dylan Frazer
 Send Results To: Dylan Frazer & Danielle Jorgensen

Testing Parameters

Special Handling Requirements: _____
 Shipment Method: Prep off
 Stored on ice: Yes No

Sample I.D.	Date	Time	Matrix	No. of Containers	Metals (As Shipped)	NWTPH-DX	GMK/Impurities	PCBs (254 A Tox)	Other
1 BS-12 (9-10)	5/28/19	1100	Soil	1	X	X	X	X	
2 BS-1 (9-10)	5/30/19	1100	Soil	1	X	X	X	X	
3 BS-2 (10-11)	5/31/19	1200	Soil	1	X	X	X	X	
4 SW-2 (5-8)	5/31/19	1540	Soil	1	X	X	X	X	

Observations/Comments:
 — Allow water samples to settle, collect aliquot from clear portion
 — NWTPH-DX - Acid wash cleanup
 - Silica gel cleanup
 — Dissolved metal samples were field filtered

Relinquished by Signature: <u>[Signature]</u> Printed Name: <u>Deanna Huerta</u> Company: <u>Landau Associates</u> Date: <u>5/31/19</u> Time: <u>1605</u>	Received by Signature: <u>[Signature]</u> Printed Name: <u>Shawn Robinson</u> Company: <u>ALS</u> Date: <u>5/31/19</u> Time: <u>1605</u>
---	--



June 7, 2019

Mr. Dylan Frazer
Landau Associates, Inc.
130 - 2nd Ave. S.
Edmonds, WA 98020

Dear Mr. Frazer,

On June 4th, 1 sample was received by our laboratory and assigned our laboratory project number EV19060007. The project was identified as your POE A/H - 147029.500. The sample identification and requested analyses are outlined on the attached chain of custody record.

No abnormalities or nonconformances were observed during the analyses of the project samples.

Please do not hesitate to call me if you have any questions or if I can be of further assistance.

Sincerely,

ALS Laboratory Group

Rick Bagan
Laboratory Director



CERTIFICATE OF ANALYSIS

CLIENT: Landau Associates, Inc.
 130 - 2nd Ave. S.
 Edmonds, WA 98020

CLIENT CONTACT: Dylan Frazer
 CLIENT PROJECT: POE A/H - 147029.500
 CLIENT SAMPLE ID: BS-13 (5-6)

DATE: 6/7/2019
 ALS JOB#: EV19060007
 ALS SAMPLE#: EV19060007-01
 DATE RECEIVED: 06/04/2019
 COLLECTION DATE: 6/4/2019 9:05:00 AM
 WDOE ACCREDITATION: C601

SAMPLE DATA RESULTS

ANALYTE	METHOD	RESULTS	REPORTING LIMITS	DILUTION FACTOR	UNITS	ANALYSIS ANALYSIS	
						DATE	BY
TPH-Diesel Range (C12-C24)	NWTPH-DX w/ SGA	56	25	1	MG/KG	06/05/2019	EBS
TPH-Oil Range (C24-C40)	NWTPH-DX w/ SGA	U	50	1	MG/KG	06/05/2019	EBS
Naphthalene	EPA-8270 SIM	28	20	1	UG/KG	06/07/2019	JMK
2-Methylnaphthalene	EPA-8270 SIM	U	20	1	UG/KG	06/07/2019	JMK
1-Methylnaphthalene	EPA-8270 SIM	U	20	1	UG/KG	06/07/2019	JMK
Benzo[A]Anthracene	EPA-8270 SIM	43	20	1	UG/KG	06/07/2019	JMK
Chrysene	EPA-8270 SIM	47	20	1	UG/KG	06/07/2019	JMK
Benzo[B]Fluoranthene	EPA-8270 SIM	48	20	1	UG/KG	06/07/2019	JMK
Benzo[K]Fluoranthene	EPA-8270 SIM	U	20	1	UG/KG	06/07/2019	JMK
Benzo[A]Pyrene	EPA-8270 SIM	31	20	1	UG/KG	06/07/2019	JMK
Indeno[1,2,3-Cd]Pyrene	EPA-8270 SIM	U	20	1	UG/KG	06/07/2019	JMK
Dibenz[A,H]Anthracene	EPA-8270 SIM	U	20	1	UG/KG	06/07/2019	JMK
PCB-1254	EPA-8082	U	0.10	1	MG/KG	06/05/2019	JMK
Total PCBs	EPA-8082	U	0.10	1	MG/KG	06/05/2019	JMK
Mercury	EPA-7471	0.39	0.040	2	MG/KG	06/05/2019	RAL
Antimony	EPA-6020	9.4	1.0	1	MG/KG	06/04/2019	RAL
Arsenic	EPA-6020	32	0.20	1	MG/KG	06/04/2019	RAL
Copper	EPA-6020	78	0.10	1	MG/KG	06/04/2019	RAL
Lead	EPA-6020	52	0.10	1	MG/KG	06/04/2019	RAL

SURROGATE	METHOD	%REC	ANALYSIS ANALYSIS	
			DATE	BY
C25	NWTPH-DX w/ SGA	96.2	06/05/2019	EBS
Terphenyl-d14	EPA-8270 SIM	63.7	06/07/2019	JMK
TCMX	EPA-8082	65.9	06/05/2019	JMK
DCB	EPA-8082	79.2	06/05/2019	JMK

U - Analyte analyzed for but not detected at level above reporting limit.
 Chromatogram indicates that it is likely that sample contains an unidentified diesel range product.



CERTIFICATE OF ANALYSIS

CLIENT: Landau Associates, Inc.
 130 - 2nd Ave. S.
 Edmonds, WA 98020

CLIENT CONTACT: Dylan Frazer
 CLIENT PROJECT: POE A/H - 147029.500

DATE: 6/7/2019
 ALS SDG#: EV19060007
 WDOE ACCREDITATION: C601

LABORATORY BLANK RESULTS

MB-060519S - Batch 141660 - Soil by NWTPH-DX

ANALYTE	METHOD	RESULTS	UNITS	REPORTING LIMITS	ANALYSIS DATE	ANALYSIS BY
TPH-Diesel Range (C12-C24)	NWTPH-DX	U	MG/KG	25	06/05/2019	EBS
TPH-Oil Range (C24-C40)	NWTPH-DX	U	MG/KG	50	06/05/2019	EBS

U - Analyte analyzed for but not detected at level above reporting limit.

MB-060519S - Batch 141733 - Soil by EPA-8270 SIM

ANALYTE	METHOD	RESULTS	UNITS	REPORTING LIMITS	ANALYSIS DATE	ANALYSIS BY
Naphthalene	EPA-8270 SIM	U	UG/KG	20	06/06/2019	JMK
2-Methylnaphthalene	EPA-8270 SIM	U	UG/KG	20	06/06/2019	JMK
1-Methylnaphthalene	EPA-8270 SIM	U	UG/KG	20	06/06/2019	JMK
Benzo[A]Anthracene	EPA-8270 SIM	U	UG/KG	20	06/06/2019	JMK
Chrysene	EPA-8270 SIM	U	UG/KG	20	06/06/2019	JMK
Benzo[B]Fluoranthene	EPA-8270 SIM	U	UG/KG	20	06/06/2019	JMK
Benzo[K]Fluoranthene	EPA-8270 SIM	U	UG/KG	20	06/06/2019	JMK
Benzo[A]Pyrene	EPA-8270 SIM	U	UG/KG	20	06/06/2019	JMK
Indeno[1,2,3-Cd]Pyrene	EPA-8270 SIM	U	UG/KG	20	06/06/2019	JMK
Dibenz[A,H]Anthracene	EPA-8270 SIM	U	UG/KG	20	06/06/2019	JMK
Benzo[G,H,I]Perylene	EPA-8270 SIM	U	UG/KG	20	06/06/2019	JMK

U - Analyte analyzed for but not detected at level above reporting limit.

MB-060419S - Batch 141606 - Soil by EPA-8082

ANALYTE	METHOD	RESULTS	UNITS	REPORTING LIMITS	ANALYSIS DATE	ANALYSIS BY
PCB-1016	EPA-8082	U	MG/KG	0.10	06/04/2019	JMK
PCB-1260	EPA-8082	U	MG/KG	0.10	06/04/2019	JMK
Total PCBs	EPA-8082	U	MG/KG	0.10	06/04/2019	JMK

U - Analyte analyzed for but not detected at level above reporting limit.

MBLK-339887 - Batch R339887 - Soil by EPA-7471

ANALYTE	METHOD	RESULTS	UNITS	REPORTING LIMITS	ANALYSIS DATE	ANALYSIS BY
Mercury	EPA-7471	U	MG/KG	0.020	06/05/2019	RAL

U - Analyte analyzed for but not detected at level above reporting limit.

MB-060419S - Batch 141627 - Soil by EPA-6020

ANALYTE	METHOD	RESULTS	UNITS	REPORTING LIMITS	ANALYSIS DATE	ANALYSIS BY
Antimony	EPA-6020	U	MG/KG	1.0	06/04/2019	RAL



CERTIFICATE OF ANALYSIS

CLIENT: Landau Associates, Inc. DATE: 6/7/2019
130 - 2nd Ave. S. ALS SDG#: EV19060007
Edmonds, WA 98020 WDOE ACCREDITATION: C601
CLIENT CONTACT: Dylan Frazer
CLIENT PROJECT: POE A/H - 147029.500

LABORATORY BLANK RESULTS

MB-060419S - Batch 141627 - Soil by EPA-6020

Arsenic	EPA-6020	U	MG/KG	0.20	06/04/2019	RAL
Copper	EPA-6020	U	MG/KG	0.10	06/04/2019	RAL
Lead	EPA-6020	U	MG/KG	0.10	06/04/2019	RAL

U - Analyte analyzed for but not detected at level above reporting limit.



CERTIFICATE OF ANALYSIS

CLIENT: Landau Associates, Inc.
 130 - 2nd Ave. S.
 Edmonds, WA 98020

CLIENT CONTACT: Dylan Frazer
 CLIENT PROJECT: POE A/H - 147029.500

DATE: 6/7/2019
 ALS SDG#: EV19060007
 WDOE ACCREDITATION: C601

LABORATORY CONTROL SAMPLE RESULTS

ALS Test Batch ID: 141660 - Soil by NWTPH-DX

SPIKED COMPOUND	METHOD	%REC	RPD	QUAL	LIMITS		ANALYSIS DATE	ANALYSIS BY
					MIN	MAX		
TPH-Diesel Range (C12-C24) - BS	NWTPH-DX	96.4			75.5	122.1	06/05/2019	EBS
TPH-Diesel Range (C12-C24) - BSD	NWTPH-DX	100	4		75.5	122.1	06/05/2019	EBS

ALS Test Batch ID: 141733 - Soil by EPA-8270 SIM

SPIKED COMPOUND	METHOD	%REC	RPD	QUAL	LIMITS		ANALYSIS DATE	ANALYSIS BY
					MIN	MAX		
Naphthalene - BS	EPA-8270 SIM	56.8			20	150	06/06/2019	JMK
Naphthalene - BSD	EPA-8270 SIM	54.4	4		20	150	06/06/2019	JMK
2-Methylnaphthalene - BS	EPA-8270 SIM	61.9			20	150	06/06/2019	JMK
2-Methylnaphthalene - BSD	EPA-8270 SIM	59.1	5		20	150	06/06/2019	JMK
1-Methylnaphthalene - BS	EPA-8270 SIM	61.3			20	150	06/06/2019	JMK
1-Methylnaphthalene - BSD	EPA-8270 SIM	58.3	5		20	150	06/06/2019	JMK
Benzo[A]Anthracene - BS	EPA-8270 SIM	50.2			20	150	06/06/2019	JMK
Benzo[A]Anthracene - BSD	EPA-8270 SIM	47.2	6		20	150	06/06/2019	JMK
Chrysene - BS	EPA-8270 SIM	57.8			20	150	06/06/2019	JMK
Chrysene - BSD	EPA-8270 SIM	54.6	6		20	150	06/06/2019	JMK
Benzo[B]Fluoranthene - BS	EPA-8270 SIM	54.6			20	150	06/06/2019	JMK
Benzo[B]Fluoranthene - BSD	EPA-8270 SIM	51.7	6		20	150	06/06/2019	JMK
Benzo[K]Fluoranthene - BS	EPA-8270 SIM	58.3			20	150	06/06/2019	JMK
Benzo[K]Fluoranthene - BSD	EPA-8270 SIM	55.7	4		20	150	06/06/2019	JMK
Benzo[A]Pyrene - BS	EPA-8270 SIM	52.2			20	150	06/06/2019	JMK
Benzo[A]Pyrene - BSD	EPA-8270 SIM	49.7	5		20	150	06/06/2019	JMK
Indeno[1,2,3-Cd]Pyrene - BS	EPA-8270 SIM	46.1			20	150	06/06/2019	JMK
Indeno[1,2,3-Cd]Pyrene - BSD	EPA-8270 SIM	42.8	7		20	150	06/06/2019	JMK
Dibenz[A,H]Anthracene - BS	EPA-8270 SIM	41.6			20	150	06/06/2019	JMK
Dibenz[A,H]Anthracene - BSD	EPA-8270 SIM	39.1	6		20	150	06/06/2019	JMK
Benzo[G,H,I]Perylene - BS	EPA-8270 SIM	61.1			20	150	06/06/2019	JMK
Benzo[G,H,I]Perylene - BSD	EPA-8270 SIM	57.3	6		20	150	06/06/2019	JMK

ALS Test Batch ID: 141606 - Soil by EPA-8082

SPIKED COMPOUND	METHOD	%REC	RPD	QUAL	LIMITS		ANALYSIS DATE	ANALYSIS BY
					MIN	MAX		
PCB-1016 - BS	EPA-8082	70.7			50	150	06/04/2019	JMK
PCB-1016 - BSD	EPA-8082	77.9	10		50	150	06/04/2019	JMK
PCB-1260 - BS	EPA-8082	76.6			50	150	06/04/2019	JMK
PCB-1260 - BSD	EPA-8082	86.4	12		50	150	06/04/2019	JMK



CERTIFICATE OF ANALYSIS

CLIENT: Landau Associates, Inc.
 130 - 2nd Ave. S.
 Edmonds, WA 98020

CLIENT CONTACT: Dylan Frazer
 CLIENT PROJECT: POE A/H - 147029.500

DATE: 6/7/2019
 ALS SDG#: EV19060007
 WDOE ACCREDITATION: C601

LABORATORY CONTROL SAMPLE RESULTS

ALS Test Batch ID: R339887 - Soil by EPA-7471

SPIKED COMPOUND	METHOD	%REC	RPD	QUAL	LIMITS		ANALYSIS DATE	ANALYSIS BY
					MIN	MAX		
Mercury - BS	EPA-7471	108			81.8	117	06/05/2019	RAL
Mercury - BSD	EPA-7471	109	1		81.8	117	06/05/2019	RAL

ALS Test Batch ID: 141627 - Soil by EPA-6020

SPIKED COMPOUND	METHOD	%REC	RPD	QUAL	LIMITS		ANALYSIS DATE	ANALYSIS BY
					MIN	MAX		
Antimony - BS	EPA-6020	114			80	120	06/04/2019	RAL
Antimony - BSD	EPA-6020	111	3		80	120	06/04/2019	RAL
Arsenic - BS	EPA-6020	105			80	120	06/04/2019	RAL
Arsenic - BSD	EPA-6020	101	4		80	120	06/04/2019	RAL
Copper - BS	EPA-6020	107			80	120	06/04/2019	RAL
Copper - BSD	EPA-6020	104	3		80	120	06/04/2019	RAL
Lead - BS	EPA-6020	104			80	120	06/04/2019	RAL
Lead - BSD	EPA-6020	103	1		80	120	06/04/2019	RAL

APPROVED BY

Laboratory Director

ALS ENVIRONMENTAL

Sample Receiving Checklist

Client: Landan Associates

ALS Job #: EVI9060007

Project: DOE A/H

Received Date: 6/4/19 Received Time: 9:50 By: RB

Type of shipping container: Cooler Box Other

Shipped via: FedEx Ground UPS Mail Courier Hand Delivered
FedEx Express

	<u>Yes</u>	<u>No</u>	<u>N/A</u>
Were custody seals on outside of shipping container?	<input type="checkbox"/>	<input checked="" type="checkbox"/>	<input type="checkbox"/>
If yes, how many? _____ Where? _____			
Custody seal date: _____ Seal name: _____			

Was Chain of Custody properly filled out (ink, signed, dated, etc.)?

Did all bottles have labels?

Did all bottle labels and tags agree with Chain of Custody?

Were samples received within hold time?

Did all bottles arrive in good condition (unbroken, etc.)?

Was sufficient amount of sample sent for the tests indicated?

Was correct preservation added to samples?

If no, Sample Control added preservative to the following:

<u>Sample Number</u>	<u>Reagent</u>	<u>Analyte</u>
_____	_____	_____
_____	_____	_____
_____	_____	_____

Were VOA vials checked for absence of air bubbles?

Bubbles present in sample #: _____

Temperature of cooler upon receipt: 16.7°C Cold Ambient N/A
on ICE

Explain any discrepancies: _____

Was client contacted? Who was called? _____ By whom? _____ Date: _____

Outcome of call: _____
