

NOTE

- CHAIN LINK FENCE PER WSDOT STANDARD PLAN L-2, TYPE 1, OR EQUIVALENT. GATES PER WSDOT STANDARD PLAN L-3, OR EQUIVALENT. FENCE AND GATE SHALL HAVE 3 ROWS OF 2-STRAND 12 1/2 GAGE 4 POINT BARBED WIRE AT TOP.
- REFER TO DETAILED DRAWINGS OF AIR POLLUTION CONTROL SYSTEM AS ATTACHED DWG. F194-1002 F194-1001 F194-1005

CLAYPIT POND

LEGEND

- REMOTE READING SETTLEMENT GAUGES
- PIEZOMETERS

THIS DRAWING HAS BEEN
AS-BUILT
 BY: *B. [Signature]* DATE: 2/16/90

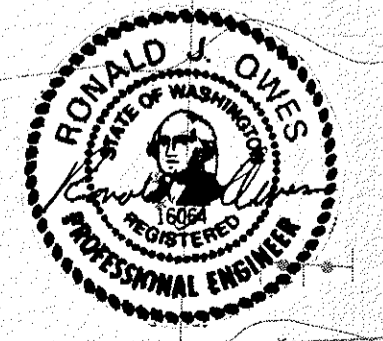

AS-BUILT PER H. RADER	NK	03-90
AS-BUILT PER H. RADER	NK	5-23-90
AS-BUILT	PS	11-24-89
NO. REVISION	BY	DATE

harper owes
 CONSULTING ENGINEERS

DESIGNED *BO*
 DRAWN *PS/NK*
 CHECKED _____

SUBMITTED *[Signature]* DATE _____
 APPROVED _____ DATE _____
 APPROVED _____ DATE _____

SCALE 1"=50'-0"
 DATE JUNE 28, 1989
 JOB NO. TRLA.1088

THERMAL REDUCTION CO., INC.
TEMPORARY ASH STORAGE FACILITY

TEMPORARY ASH STORAGE FACILITY
NEW SITE PLAN

DRAWING **G3**
 SHEET 3 OF 13

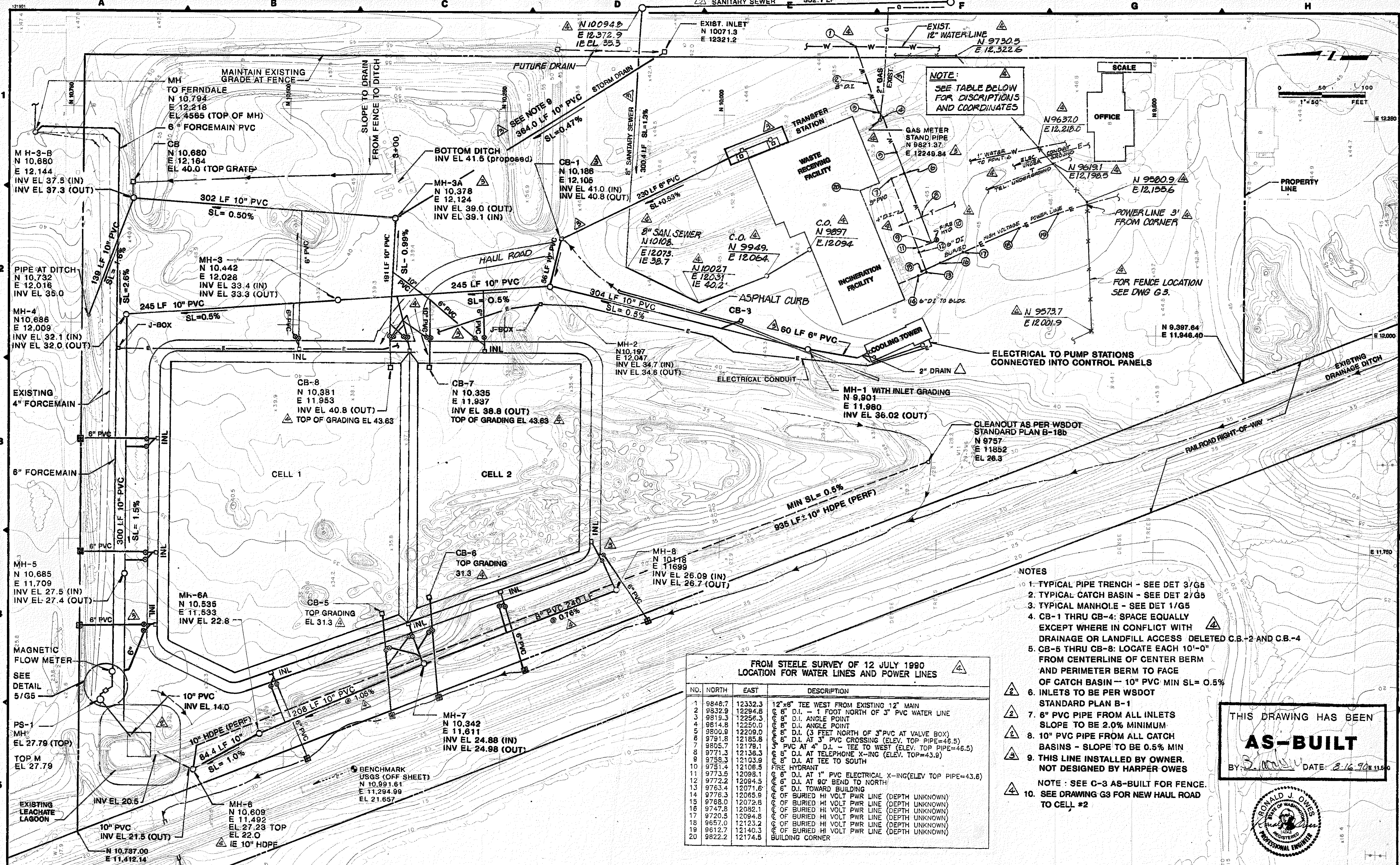

NOTE:
SEE TABLE BELOW FOR DISCRPTIONS AND COORDINATES

- NOTES**
1. TYPICAL PIPE TRENCH - SEE DET 3/G5
 2. TYPICAL CATCH BASIN - SEE DET 2/G5
 3. TYPICAL MANHOLE - SEE DET 1/G5
 4. CB-1 THRU CB-4: SPACE EQUALLY EXCEPT WHERE IN CONFLICT WITH DRAINAGE OR LANDFILL ACCESS DELETED C.B.-2 AND C.B.-4
 5. CB-5 THRU CB-8: LOCATE EACH 10'-0" FROM CENTERLINE OF CENTER BERM AND PERIMETER BERM TO FACE OF CATCH BASIN - 10" PVC MIN SL = 0.5%
 6. INLETS TO BE PER WSDOT STANDARD PLAN B-1
 7. 6" PVC PIPE FROM ALL INLETS SLOPE TO BE 2.0% MINIMUM
 8. 10" PVC PIPE FROM ALL CATCH BASINS - SLOPE TO BE 0.5% MIN
 9. THIS LINE INSTALLED BY OWNER. NOT DESIGNED BY HARPER OWES
 10. SEE DRAWING G-3 AS-BUILT FOR FENCE.

FROM STEELE SURVEY OF 12 JULY 1990
LOCATION FOR WATER LINES AND POWER LINES

NO.	NORTH	EAST	DESCRIPTION
1	9848.7	12332.3	12"x8" TEE WEST FROM EXISTING 12" MAIN
2	9832.9	12294.8	6" D.I. - 1 FOOT NORTH OF 3" PVC WATER LINE
3	9819.3	12256.3	6" D.I. ANGLE POINT
4	9814.8	12250.0	6" D.I. ANGLE POINT
5	9800.9	12209.0	6" D.I. (3 FEET NORTH OF 3" PVC AT VALVE BOX)
6	9791.8	12185.8	6" D.I. AT 3" PVC CROSSING (ELEV. TOP PIPE=46.5)
7	9805.7	12178.1	6" D.I. AT TEE TO WEST (ELEV. TOP PIPE=46.5)
8	9771.3	12138.3	6" D.I. AT TELEPHONE X-ING (ELEV. TOP=43.9)
9	9758.3	12103.9	6" D.I. AT TEE TO SOUTH
10	9751.4	12106.5	FIRE HYDRANT
11	9773.5	12098.1	6" D.I. AT 1" PVC ELECTRICAL X-ING (ELEV. TOP PIPE=43.6)
12	9772.2	12094.5	6" D.I. AT 90° BEND TO NORTH
13	9763.4	12071.6	6" D.I. TOWARD BUILDING
14	9776.3	12065.9	6" OF BURIED HI VOLT PWR LINE (DEPTH UNKNOWN)
15	9768.0	12072.8	6" OF BURIED HI VOLT PWR LINE (DEPTH UNKNOWN)
16	9747.8	12082.1	6" OF BURIED HI VOLT PWR LINE (DEPTH UNKNOWN)
17	9720.8	12094.8	6" OF BURIED HI VOLT PWR LINE (DEPTH UNKNOWN)
18	9657.0	12123.2	6" OF BURIED HI VOLT PWR LINE (DEPTH UNKNOWN)
19	9612.7	12140.3	6" OF BURIED HI VOLT PWR LINE (DEPTH UNKNOWN)
20	9822.2	12174.5	BUILDING CORNER

THIS DRAWING HAS BEEN
AS-BUILT
BY: *[Signature]* DATE: 8-16-90

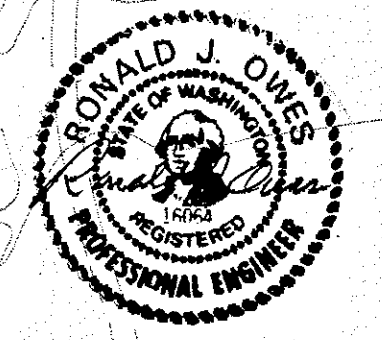

NO.	REVISION	BY	DATE
3	AS-BUILT PER H. RADEK	NK	5-22-90
2	REVISED AND REDRAWN	NK	12-89
1	AS-BUILT	NK	08-08-90

harper owes
CONSULTING ENGINEERS

DESIGNED <u>RO</u>	SUBMITTED _____ DATE _____
DRAWN <u>NK</u>	APPROVED _____ DATE _____
CHECKED <u>RO</u>	APPROVED _____ DATE _____

SCALE 1"=50'-0"
DATE JUNE 28, 1989
JOB NO. TRLA.1088

ONE INCH AT FULL SIZE
THERMAL REDUCTION CO., INC.
TEMPORARY ASH STORAGE FACILITY

TEMPORARY ASH STORAGE FACILITY
PIPING & ELECTRICAL PLAN

DRAWING **G4**
SHEET _____ OF _____