



Texaco Refining  
and Marketing Inc

3400 188th Street SW  
Suite 630  
Lynnwood WA 98037

TEXACO STATION #63-232-0037  
LUST# 2298  
Seattle

RECEIVED  
MAY 04 1998  
DEPT. OF ECOLOGY

April 24, 1998

**ENV - SERVICE STATIONS**

Groundwater Sampling and Laboratory Analysis Report  
8701 Greenwood Avenue North  
Seattle, Washington (Texaco Facility #63-232-0037)



Mr. Roger Nye  
Washington Department of Ecology- Northwest Region  
3190 - 160th Avenue Southeast  
Bellevue, Washington 98008-5452

Dear Mr. Nye:

Enclosed is the Groundwater Sampling and Laboratory Analysis Report for the referenced site. The report was prepared by Environmental Resolutions, Inc. (ERI) for Texaco. Groundwater samples were collected from well MW8 on February 13, 1998, and were analyzed for TPH-G, TPH-D, TPH-O, and BTEX. Laboratory results indicated that the samples did not contain analyte concentrations exceeding MTCA Method A Cleanup Levels. TPH-G, TPH-D, and TPH-O concentrations were not detected at or above the laboratory method reporting limit. If you have any questions please contact me at (425) 774-6090, extension 224.

Sincerely,

Theresa A. Geijer  
Project Coordinator

TAG:tag  
p:\tag\greenw\1qt98gw.cov

Enclosure

RLLane-File (w/enclosure)

cc: R. Isackson (w/enclosure)  
M. Nesteroff (w/enclosure)

PR: NA

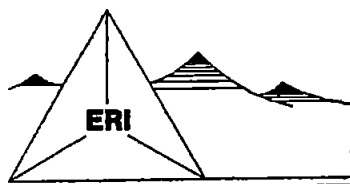

**ENVIRONMENTAL RESOLUTIONS, INC.**

March 5, 1998  
ERI 31001.R12

RECEIVED

MAY 04 1998

DEPT. OF ECOLOGY

Ms. Theresa Geijer, R.G.  
Texaco Refining and Marketing Inc.  
Environment, Health & Safety  
3400 188th Street SW, Suite 630  
Lynnwood, Washington 98037

Subject: Groundwater Sampling and Laboratory Analysis, Former Texaco Facility 63-232-0037,  
8701 Greenwood Avenue North, Seattle, Washington

Dear Theresa:

As requested by Texaco Refining and Marketing Inc.- Environment, Health & Safety (TRMI-EH&S) Environmental Resolutions, Inc. (ERI) has prepared this report describing the field activities and laboratory results of groundwater samples collected from monitoring well MW8 on February 13, 1998. The site location shown on Plate P-1.

#### Background

Prior to 1994, the site had historically operated as a retail gasoline service station. In 1994, the former station building was demolished and environmental assessment and remediation activities were conducted to remove hydrocarbon-impacted soil and groundwater. In June 1995 the property was sold.

In January 1996, an Independent Remedial Action Report summarizing results of the site activities was submitted to the Washington State Department of Ecology (Ecology) for review under the Independent Remedial Action Program (IRAP). On July 31, 1996, Ecology issued a no further action letter for the site notifying TRMI-EH&S and the site owner that no further cleanup action would be required. One condition of the no further action determination was that groundwater samples be collected from remaining downgradient monitoring well AGW-6 and submitted for hydrocarbon analyses on a twice-yearly basis to monitor groundwater conditions.

In September 1996, AGW-6 was inadvertently destroyed by the building contractor. Replacement monitoring well MW8 was subsequently installed during February 1997 at a nearby downgradient location to comply with Ecology requirements. Well locations are shown on Plate P-2. Well installation and sampling activities are presented in the Monitoring Well Installation and Sampling report prepared by ERI dated September 15, 1997.

#### Groundwater Sampling

On February 13, 1998, ERI visited the site to measure the depth to water, purge the well, and collect groundwater samples. Prior to purging, the depth to water was measured using a water level indicator, and the well was checked for the presence of free product. After measuring the water level, the well was purged of at least three casing volumes using a submersible pump. After each casing volume, the pH, conductivity, and temperature were checked until measurements were within 10% variance. Purge water and decontamination rinsate generated during sampling were treated and discharged on site. Groundwater samples were subsequently collected using a disposable bailer and transferred to laboratory-supplied

1921 Edmonds Drive SE, Renton, Washington 98055 425-227-0280 (FAX 425-227-0225)  
Irvine • Novato • Seattle

containers containing appropriate preservatives. The samples were then placed in iced storage and transported to the laboratory for analysis. A Chain of Custody was initiated by the field geologist and accompanied the samples to the analytical laboratory. A copy of the Chain-of-Custody form is attached with the analytical results.

**Laboratory Analysis and Results**

The groundwater samples were submitted to the North Creek Analytical, Inc. laboratory in Bothell, Washington, and analyzed for total petroleum hydrocarbons as gasoline (TPH-G) and benzene, toluene, ethylbenzene, and total xylene isomers (BTEX) using Ecology Method WTPH-G/EPA Method 8020/602, and total petroleum hydrocarbons as diesel (TPH-D) and as oil (TPH-O) using Ecology Method WTPH-D (extended).

Depth to water measurements collected on February 13, 1998 indicated groundwater was present approximately 2.41 feet below the top of the casing. No free product was observed. Laboratory results indicated that the groundwater samples collected from MW8 on February 13, 1998 did not contain any analyte concentrations exceeding MTCA Method A Cleanup Levels. TPH-G, TPH-D, and TPH-O concentrations were not detected at or above the laboratory method reporting limit (MRL). Depth to water measurements and laboratory results for MW8 are shown in Table 1 with historical data from abandoned monitoring well AGW-6.

**Limitations**

The site assessment investigation was conducted in accordance with generally accepted standards of environmental geological practice at the time performed. This investigation was conducted solely for the purpose of evaluating environmental conditions of the groundwater. No soil engineering or geotechnical implications are stated or should be inferred. The evaluation of the geologic conditions at the site for the purpose of this investigation is made from a limited number of observation points. Subsurface conditions may vary away from the data points available.

ERI appreciates this opportunity to provide assistance on this project. Please call if you have questions.

Sincerely,  
Environmental Resolutions, Inc.



John K. Meyer, R.G.  
Branch Manager

Attachments: Plates P-1 and P-2  
Table 1  
Laboratory Report

DEPARTMENT OF ECOLOGY	
NWRO/TCP TANK UNIT	
INTERIM CLEANUP REPORT	<input type="checkbox"/>
SITE CHARACTERIZATION	<input type="checkbox"/>
FINAL CLEANUP REPORT	<input type="checkbox"/>
OTHER <u>POST-FRAP MONITORING</u>	<input checked="" type="checkbox"/>
AFFECTED MEDIA: SOIL	<input type="checkbox"/>
OTHER _____ GW	<input type="checkbox"/>
INSPECTOR (INIT.) <u>RN</u> DATE <u>2/11/99</u>	<input type="checkbox"/>

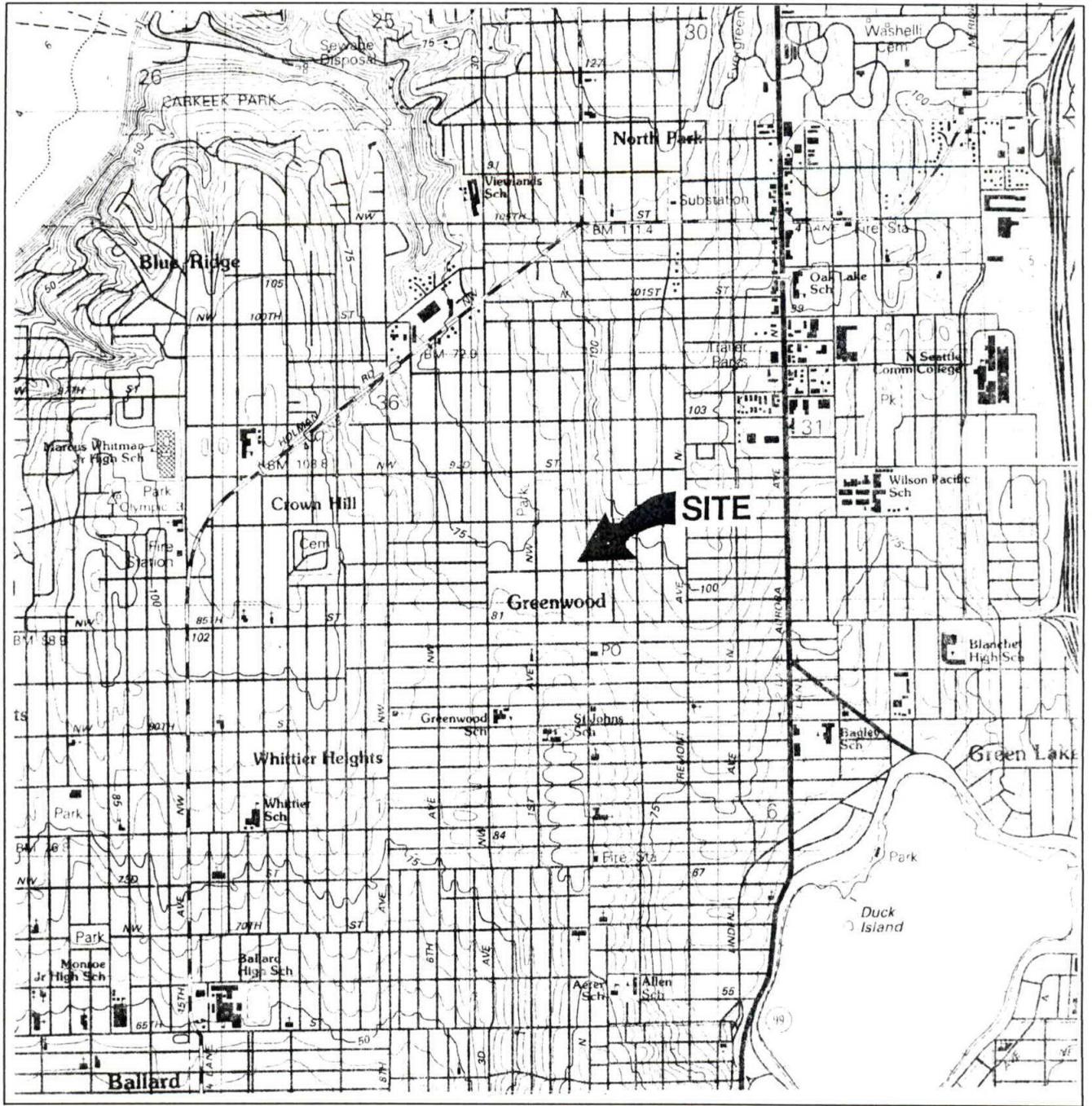

31001SVM



APPROXIMATE SCALE

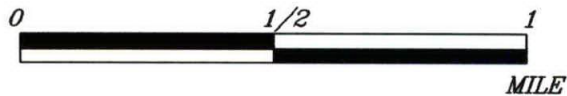

Source: U.S.G.S. 7.5 x 15 minute  
topographic quadrangle map  
Seattle, North 1983



**SITE VICINITY MAP**  
FORMER TEXACO FACILITY 63-232-0037  
8701 Greenwood Avenue North  
Seattle, Washington

**PROJECT**  
31001  
**PLATE**  
P-1

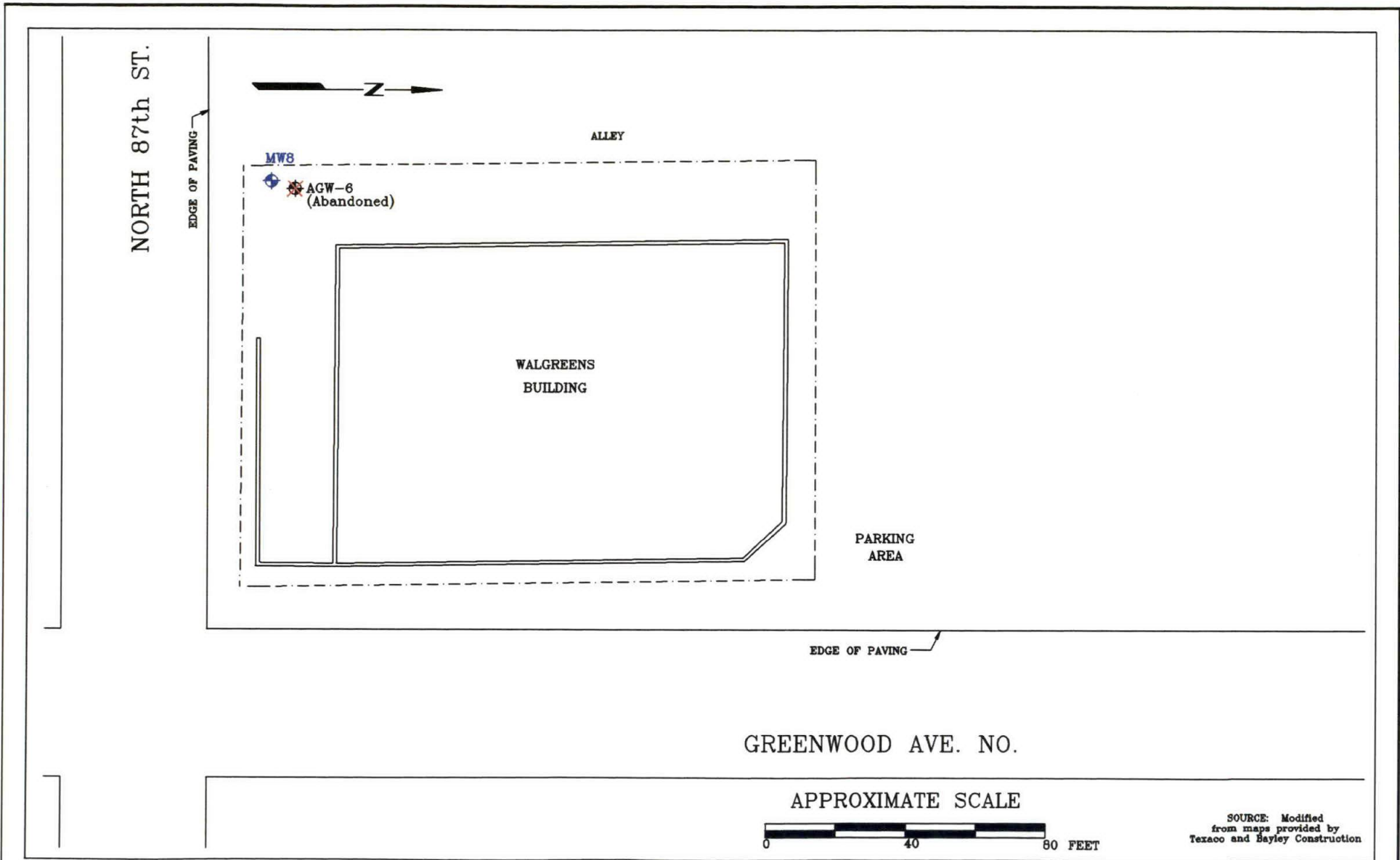

FN 31001\31001R11



**GENERALIZED SITE PLAN**  
FORMER TEXACO  
FACILITY 63-232-0037  
8701 Greenwood Avenue North  
Seattle, Washington

**EXPLANATION**

◆ MWS GROUNDWATER MONITORING WELL

**PROJECT NO.**

31001

**PLATE**

P-2

DATE: 12/31/97

TABLE 2  
GROUNDWATER ANALYTICAL RESULTS  
Texaco Facility 63-232-0037  
8701 Greenwood Avenue North  
Seattle, Washington  
Page 1 of 1

Well Name	Sample Date	DTW	TPH-G	TPH-D	TPH-O	B	T	E	X	Tot. Pb	Diss. Pb
AGW-6	3/17/94	0.51	300	ND	ND	10.6	1	14	56	4	-
	11/10/94	1.58	200	ND	ND	7.4	ND	6	29	ND	-
	2/24/95	2.62	460	ND	ND	6.3	2	8	20	ND	-
	6/28/95	3.97	80	ND	ND	4.7	ND	1	7	ND	-
	9/11/95	1.70	ND	ND	ND	3.2	ND	ND	3	ND	-
	12/11/95	1.81	ND	ND	ND	2.8	ND	ND	3.8	ND	-
	2/27/96	1.63	ND	ND	ND	ND	ND	ND	2.9	ND	-
	9/12/96	1.22	<50	<250	<750	1.64	<0.50	<0.50	<1.0	2.39	<2.0
Well abandoned during construction, spring 1997.											
MW8	8/7/97	4.37	123	<250	<750	15.8	0.777	1.45	20.4	<2.0	<2.0
	11/25/97	3.19	<50	<250	<750	0.682	1.11	0.576	1.97	-	-
	2/13/98	2.41	<50	<250	<750	0.818	2.84	<0.500	3.24	-	-
MTCA Method A Cleanup Level			1,000 <sup>a</sup>			5	40	30	20	5	5

**EXPLANATION:**

All concentrations in ug/L. (ppb).

DTW = Depth to water in feet below top of casing.

TPH-G = Total Petroleum Hydrocarbons as Gasoline by Ecology Method WTPH-G.

TPH-D and TPH-O = Total Petroleum Hydrocarbons as Diesel and Oil, respectively, by Ecology Method WTPH-D (extended).

B = Benzene; T = Toluene; E = Ethylbenzene; X = Total Xylenes; Tot. Pb = Total Lead; Diss. Pb = Dissolved Lead.

BTEX = Aromatic compounds by EPA Method 8020.

Total and dissolved lead by EPA 6010/7000 Series Methods.

ND = Not detected at or above the laboratory reporting limit.

< = Less than the stated laboratory reporting limit.

- = Not analyzed.

Shaded values equal or exceed MTCA Method A Cleanup Levels.

<sup>a</sup> Total Petroleum Hydrocarbons

Data collected before 9/12/96 are taken from prior consultants.



# NORTH CREEK ANALYTICAL

Environmental Laboratory Services

BOTHELL ■ (425) 481-9200 ■ FAX 485-2992  
 SPOKANE ■ (509) 924-9200 ■ FAX 924-9290  
 PORTLAND ■ (503) 643-9200 ■ FAX 644-2202

ERI 1921 Edmonds Drive SE Renton, WA 98055	Project: Texaco Greenwood #63-232-0037 Project Number: 31001 Project Manager: John Meyer	Sampled: 2/13/98 Received: 2/16/98 Reported: 3/2/98 09:29
--	--	---

### Summary Report\*

(Please refer to the Analytical Report for a thorough review of the complete data set.)

Method	Analyte	Units	MW8 Water 2/13/98 B802290-01			
WTPH-G/8021	Gasoline Range Hydrocarbons	ug/l		<50.0		
"	Benzene	"		0.818		
"	Toluene	"		2.84		
"	Ethylbenzene	"		<0.500		
"	Xylenes (total)	"		3.24		
WTPH-D	Diesel Range Hydrocarbons	mg/l		<0.250		
"	Heavy Oil Range Hydrocarbons	"		<0.750		

North Creek Analytical, Inc.

*\*The Summary Report is a subset of the final Analytical Report and does not include substantial supportive information such as quality control data; this report accurately summarizes sample results for your convenience only.*

  
 Matthew Essig, Project Manager

18939 120th Avenue N.E., Suite 101, Bothell, WA 98011-9508  
 East 11115 Montgomery, Suite B, Spokane, WA 99206-4776  
 9405 S.W. Nimbus Avenue, Beaverton, OR 97008-7132



# NORTH CREEK ANALYTICAL

Environmental Laboratory Services

BOTHELL ■ (425) 481-9200 ■ FAX 485-2992  
SPOKANE ■ (509) 924-9200 ■ FAX 924-9290  
PORTLAND ■ (503) 643-9200 ■ FAX 644-2202

ERI 1921 Edmonds Drive SE Renton, WA 98055	Project: Texaco Greenwood #63-232-0037 Project Number: 31001 Project Manager: John Meyer	Sampled: 2/13/98 Received: 2/16/98 Reported: 3/2/98 09:29
--	--	---

## ANALYTICAL REPORT FOR SAMPLES:

Sample Description	Laboratory Sample Number	Sample Matrix	Date Sampled
MW8	B802290-01	Water	2/13/98

North Creek Analytical, Inc.

*The results in this report apply to the samples analyzed in accordance with the chain of custody document.  
This analytical report must be reproduced in its entirety.*

  
Matthew Essig, Project Manager

18939 120th Avenue N.E., Suite 101, Bothell, WA 98011-9508  
East 11115 Montgomery, Suite B, Spokane, WA 99206-4776  
9405 S.W. Nimbus Avenue, Beaverton, OR 97008-7132





ERI 1921 Edmonds Drive SE Renton, WA 98055	Project: Texaco Greenwood #63-232-0037 Project Number: 31001 Project Manager: John Meyer	Sampled: 2/13/98 Received: 2/16/98 Reported: 3/2/98 09:29
--	--	---

**Gasoline Hydrocarbons (Toluene to Dodecane) and BTEX by WTPH-G and EPA 8021B  
North Creek Analytical - Bothell**

Analyte	Batch Number	Date Prepared	Date Analyzed	Surrogate Limits	Reporting Limit	Result	Units	Notes*
<u>MW8</u>				<u>B802290-01</u>			<u>Water</u>	
Gasoline Range Hydrocarbons	0280703	2/27/98	2/28/98		50.0	ND	ug/l	
Benzene	"	"	"		0.500	0.818	"	
Toluene	"	"	"		0.500	2.84	"	
Ethylbenzene	"	"	"		0.500	ND	"	
Xylenes (total)	"	"	"		1.00	3.24	"	
Surrogate: 4-BFB (FID)	"	"	"	50.0-150		96.9	%	
Surrogate: 4-BFB (PID)	"	"	"	50.0-150		97.7	"	



# NORTH CREEK ANALYTICAL

Environmental Laboratory Services

BOTHELL ■ (425) 481-9200 ■ FAX 485-2992  
 SPOKANE ■ (509) 924-9200 ■ FAX 924-9290  
 PORTLAND ■ (503) 643-9200 ■ FAX 644-2202

ERI 1921 Edmonds Drive SE Renton, WA 98055	Project: Texaco Greenwood #63-232-0037 Project Number: 31001 Project Manager: John Meyer	Sampled: 2/13/98 Received: 2/16/98 Reported: 3/2/98 09:29
--	--	---

**Diesel Hydrocarbons (C12-C24) and Heavy Oil (C24-C40) by WTPH-D (extended)  
 North Creek Analytical - Bothell**

Analyte	Batch Number	Date Prepared	Date Analyzed	Surrogate Limits	Reporting Limit	Result	Units	Notes*
<u>MW8</u>				<u>B802290-01</u>			<u>Water</u>	
Diesel Range Hydrocarbons	0280449	2/18/98	2/20/98		0.250	ND	mg/l	
Heavy Oil Range Hydrocarbons	"	"	"		0.750	ND	"	
Surrogate: 2-FBP	"	"	"	50.0-150		94.4	%	

  
 Matthew Essig, Project Manager



# NORTH CREEK ANALYTICAL

Environmental Laboratory Services

BOTHELL ■ (425) 481-9200 ■ FAX 485-2992  
 SPOKANE ■ (509) 924-9200 ■ FAX 924-9290  
 PORTLAND ■ (503) 643-9200 ■ FAX 644-2202

ERI 1921 Edmonds Drive SE Renton, WA 98055	Project: Texaco Greenwood #63-232-0037 Project Number: 31001 Project Manager: John Meyer	Sampled: 2/13/98 Received: 2/16/98 Reported: 3/2/98 09:29
--	--	---

**Gasoline Hydrocarbons (Toluene to Dodecane) and BTEX by WTPH-G and EPA 8021B/Quality Control**  
**North Creek Analytical - Bothell**

Analyte	Date Analyzed	Spike Level	Sample Result	QC Result	Units	Reporting Limit Recov. Limits	Recov. %	RPD Limit	RPD %	Notes*
<b>Batch: 0280703</b>			<b>Date Prepared: 2/27/98</b>			<b>Extraction Method: EPA 5030B (P/T)</b>				
<b>Blank</b>			<b>0280703-BLK1</b>							
Gasoline Range Hydrocarbons	2/27/98			ND	ug/l	50.0				
Benzene	"			ND	"	0.500				
Toluene	"			ND	"	0.500				
Ethylbenzene	"			ND	"	0.500				
Xylenes (total)	"			ND	"	1.00				
Surrogate: 4-BFB (FID)	"	48.0		46.7	"	50.0-150	97.3			
Surrogate: 4-BFB (PID)	"	48.0		46.2	"	50.0-150	96.3			
<b>LCS</b>			<b>0280703-BS1</b>							
Gasoline Range Hydrocarbons	2/27/98	500		522	ug/l	75.0-125	104			
Surrogate: 4-BFB (FID)	"	48.0		49.1	"	50.0-150	102			
<b>Duplicate</b>			<b>0280703-DUP1 B802291-02</b>							
Gasoline Range Hydrocarbons	2/27/98		27600	28900	ug/l				25.0	4.60
Surrogate: 4-BFB (FID)	"	48.0		52.7	"	50.0-150	110			
<b>Duplicate</b>			<b>0280703-DUP2 B802290-01</b>							
Gasoline Range Hydrocarbons	2/27/98		ND	ND	ug/l				25.0	1
Surrogate: 4-BFB (FID)	"	48.0		45.5	"	50.0-150	94.8			
<b>Matrix Spike</b>			<b>0280703-MS1 B802291-01</b>							
Benzene	2/27/98	10.0	ND	10.6	ug/l	70.0-130	106			
Toluene	"	10.0	ND	10.6	"	70.0-130	106			
Ethylbenzene	"	10.0	ND	10.7	"	70.0-130	107			
Xylenes (total)	"	30.0	ND	32.3	"	70.0-130	108			
Surrogate: 4-BFB (PID)	"	48.0		46.3	"	50.0-150	96.5			
<b>Matrix Spike Dup</b>			<b>0280703-MSD1 B802291-01</b>							
Benzene	2/27/98	10.0	ND	10.5	ug/l	70.0-130	105	15.0	0.948	
Toluene	"	10.0	ND	10.2	"	70.0-130	102	15.0	3.85	
Ethylbenzene	"	10.0	ND	10.0	"	70.0-130	100	15.0	6.76	
Xylenes (total)	"	30.0	ND	29.5	"	70.0-130	98.3	15.0	9.40	
Surrogate: 4-BFB (PID)	"	48.0		45.7	"	50.0-150	95.2			

North Creek Analytical, Inc.

\*Refer to end of report for text of notes and definitions.

  
 Matthew Essig, Project Manager

18939 120th Avenue N.E., Suite 101, Bothell, WA 98011-9508  
 East 11115 Montgomery, Suite B, Spokane, WA 99206-4776  
 9405 S.W. Nimbus Avenue, Beaverton, OR 97008-7132



# NORTH CREEK ANALYTICAL

Environmental Laboratory Services

BOTHELL ■ (425) 481-9200 ■ FAX 485-2992  
 SPOKANE ■ (509) 924-9200 ■ FAX 924-9290  
 PORTLAND ■ (503) 643-9200 ■ FAX 644-2202

ERI 1921 Edmonds Drive SE Renton, WA 98055	Project: Texaco Greenwood #63-232-0037 Project Number: 31001 Project Manager: John Meyer	Sampled: 2/13/98 Received: 2/16/98 Reported: 3/2/98 09:29
--	--	---

**Diesel Hydrocarbons (C12-C24) and Heavy Oil (C24-C40) by WTPH-D (extended)/Quality Control**  
 North Creek Analytical - Bothell

Analyte	Date Analyzed	Spike Level	Sample Result	QC Result	Units	Reporting Limit Recov. Limits	Recov. %	RPD Limit	RPD %	Notes*
<b>Batch: 0280449</b>		<b>Date Prepared: 2/18/98</b>		<b>Extraction Method: EPA 3520C/600 Series</b>						
<b>Blank</b>		<b>0280449-BLK1</b>								
Diesel Range Hydrocarbons	2/19/98			ND	mg/l	0.250				
Heavy Oil Range Hydrocarbons	"			ND	"	0.750				
Surrogate: 2-FBP	"	0.320		0.304	"	50.0-150	95.0			
<b>LCS</b>		<b>0280449-BS1</b>								
Diesel Range Hydrocarbons	2/19/98	2.00		1.94	mg/l	60.0-140	97.0			
Surrogate: 2-FBP	"	0.320		0.304	"	50.0-150	95.0			
<b>Duplicate</b>		<b>0280449-DUP1</b>		<b>B802290-01</b>						
Diesel Range Hydrocarbons	2/20/98		ND	ND	mg/l				44.0	
Surrogate: 2-FBP	"	0.605		0.404	"	50.0-150	66.8			

  
 Matthew Essig, Project Manager



ERI 1921 Edmonds Drive SE Renton, WA 98055	Project: Texaco Greenwood #63-232-0037 Project Number: 31001 Project Manager: John Meyer	Sampled: 2/13/98 Received: 2/16/98 Reported: 3/2/98 09:29
--	--	---

**Notes and Definitions**

#	Note
---	------

- 1 Analyses are not controlled on RPD values from sample concentrations less than 10 times the reporting limit.
- DET Analyte DETECTED
- ND Analyte NOT DETECTED at or above the reporting limit
- NR Not Reported
- dry Sample results reported on a dry weight basis
- Recov. Recovery
- RPD Relative Percent Difference

North Creek Analytical, Inc.

  
Matthew Essig, Project Manager

18939 120th Avenue N.E., Suite 101, Bothell, WA 98011-9508  
East 11115 Montgomery, Suite B, Spokane, WA 99206-4776  
9405 S.W. Nimbus Avenue, Beaverton, OR 97008-7132

**TEXACO CHAIN OF CUSTODY REPORT**

Work Order #: **B802290**

CONSULTANT: <b>ERI</b> PROJECT MANAGER: <b>John Weja</b> ADDRESS: <b>1921 Edmonds Dr NE Renton, WA 98055</b> PHONE: <b>(206) 227-0280</b> FAX: <b>8 0225</b> PROJECT NAME: <b>Texaco (Graham) 2</b> PROJECT NUMBER: <b>3109 T8</b> SAMPLED BY: <b>(Signature)</b>	<b>TEXACO INFORMATION</b> TEXACO PROJECT MANAGER: <b>T. Gejer</b> TEXACO FACILITY NUMBER: <b>63-232-0037</b> SITE ADDRESS: <b>8701 Graham Ave N Seattle WA</b> State Hydrocarbon Methods (please circle): <b>WA OR AK ID</b> Analysis Request: <table style="width:100%; text-align: center;"> <tr> <td style="writing-mode: vertical-rl; transform: rotate(180deg);">TPH-G/TEX</td> <td style="writing-mode: vertical-rl; transform: rotate(180deg);">TPH-D</td> <td style="writing-mode: vertical-rl; transform: rotate(180deg);">TPH-D Extended</td> <td style="writing-mode: vertical-rl; transform: rotate(180deg);">TPH-418.1</td> <td style="writing-mode: vertical-rl; transform: rotate(180deg);">TPH-HCID</td> <td style="writing-mode: vertical-rl; transform: rotate(180deg);">Tot/Diss Lead</td> </tr> </table>	TPH-G/TEX	TPH-D	TPH-D Extended	TPH-418.1	TPH-HCID	Tot/Diss Lead	<b>TURNAROUND REQUEST in Business Days</b> Organic & Inorganic Analyses * <table style="width:100%; text-align: center;"> <tr> <td style="border: 1px solid black; padding: 2px;">10</td> <td style="border: 1px solid black; padding: 2px;">5</td> <td style="border: 1px solid black; padding: 2px;">3</td> <td style="border: 1px solid black; padding: 2px;">1</td> </tr> </table> Air Analyses * <table style="width:100%; text-align: center;"> <tr> <td style="border: 1px solid black; padding: 2px;">3</td> <td style="border: 1px solid black; padding: 2px;">1</td> </tr> </table> OTHER Specify: * Standard Turnaround for Organic & Inorganic Analyses is 10 Days * Standard Turnaround for Air Analyses is 3 Days	10	5	3	1	3	1
TPH-G/TEX	TPH-D	TPH-D Extended	TPH-418.1	TPH-HCID	Tot/Diss Lead									
10	5	3	1											
3	1													

NCA SAMPLE NUMBER	CLIENT SAMPLE IDENTIFICATION	SAMPLING DATE / TIME	TPH-G/TEX	TPH-D	TPH-D Extended	TPH-418.1	TPH-HCID	Tot/Diss Lead	MATRIX (W, S, O)	# OF CONTAINERS	COMMENTS & PRESERVATIVES USED
1	B802290-01	2/13/98	X		X				W	3	
2.											
3.											
4.											
5.											
6.											
7.											
8.											
9.											
10.											

RELINQUISHED BY: <b>(Signature)</b> PRINT NAME: <b>John Weja</b> FIRM: <b>ERI</b>	DATE: <b>2/13/98</b> TIME:	RECEIVED BY: <b>K Barker</b> PRINT NAME: <b>K Barker</b> FIRM: <b>NCA</b>	DATE: <b>2/16/98</b> TIME: <b>1140</b>
RELINQUISHED BY: <b>K Barker</b> PRINT NAME: <b>K Barker</b> FIRM: <b>NCA</b>	DATE: <b>2/16/98</b> TIME: <b>1315</b>	RECEIVED BY: <b>(Signature)</b> PRINT NAME: <b>Lisa Hurley</b> FIRM: <b>NCA</b>	DATE: <b>2-16-98</b> TIME: <b>1315</b>

ADDITIONAL REMARKS:

PAGE \_\_\_\_\_  
 OF \_\_\_\_\_