

NW0911



December 10, 2008

**RECEIVED**

**DEC 12 2008**

**DEPT OF ECOLOGY  
Toxics Cleanup Program**

Ms. Olivia Skance  
Chevron Environmental Management Company  
6111 Bollinger Canyon Road  
San Ramon, California 94583-5186

**Re: DPE Remediation System, First Quarter 2008 Operations Report  
Former Texaco Service Station, Chevron No. 211577  
631 Queen Anne Avenue North  
Seattle, Washington**

Dear Ms. Skance:

Science Applications International Corporation (SAIC) is pleased to present this report documenting the First Quarter 2008 operations of the dual phase extraction (DPE) remediation system at the former Texaco service station (Chevron No. 211577) located at 631 Queen Anne Avenue North in Seattle, Washington. A site map is provided as Figure 1.

**Summary of First Quarter 2008 System Operations**

- System run-time was approximately 95 percent. Additional system down-time was experienced during this operating period due to a faulty high level alarm float switch in the batch tank. After trouble-shooting to determine the problem, this float was replaced with a spare back-up unit.
- Soil vapor hydrocarbon mass removal for this period was approximately 400 pounds, bringing the estimated cumulative lifetime hydrocarbon mass removed to 45,153 pounds since system start-up in February 2006.
- The approximate cost per pound of hydrocarbons removed during this period (based on system utility costs) was \$18.50 per pound. The system lifetime cost is approximately \$2.59 per pound of hydrocarbons removed.
- On February 26, 2008, SAIC installed sub-slab vapor monitoring points DRVP-1 and DRVP-2 in the basement area of the Del Roy Apartments building. These points were installed to allow measurement of DPE vacuum influence and collection of sub-slab soil vapor samples from beneath the building.
- On March 24, 2008, the Chevron/SAIC project team for the site met to review and discuss system performance monitoring data and the path forward for the project. Based

*Science Applications International Corporation*

18912 North Creek Parkway, Suite 101 / Bothell, Washington 98011 / tel: 425.485.5800 / fax: 425.485.5566 / [www.saic.com](http://www.saic.com)

on review of the data available through mid-March 2008, it was determined that the system would be shut-down due to low rates of hydrocarbon mass removal and to allow collection of groundwater and sub-slab soil vapor concentration data under non-extraction conditions.

- On April 2, 2008 the DPE system was shut down.
- All system operation was in compliance with the operating permits issued for this system.

A summary of system performance and operating costs is presented in Table 1. Additional details regarding system operations and performance monitoring are presented in the following sections.

### **Performance Monitoring Results**

#### Groundwater Extraction Rate

The approximate groundwater extraction rate is based upon readings recorded by the system discharge totalizer. Table 2 presents a summary of totalizer readings and includes average flow rates on a daily and per minute basis. The average interval flow rate for this reporting period ranged from 2.5 to 3.0 gallons per minute (gpm).

The performance of individual extraction well pumps is monitored using pulse counters that record the number of compressed air pulses supplied to each extraction pump. The volume of groundwater extracted is estimated by assuming approximately 3 air pulses per gallon of groundwater extracted, which is based on field tests performed on each pump prior to system start-up. Table 3 includes pulse counter readings for the DPE extraction pumps. The pump extraction rates presented in this table are considered “rough” estimates and are used only to indicate relative pumping rates and trends in pump performance that may be indicative of a pump malfunction or other needed repair. Pulse counter readings indicate that extraction well DPE-2 provides the largest contribution of extracted groundwater to the combined influent stream of the system.

Groundwater treatment totalizer readings, presented in Table 2, provide a more accurate quantification of the combined groundwater extraction rate by the system.

#### Groundwater Drawdown

Depth-to-water measurements at selected extraction and monitoring wells were made on February 28, and April 1, 2008. Depth-to-water data are provided in Table 3 and a groundwater elevation contour map is attached as Figure 2. Depth-to-water measurements continue to appear generally stable, which suggests that groundwater elevation drawdown due to pumping had achieved steady-state conditions.

Figure 3 presents an iso-contour map of groundwater elevation drawdown data between system start-up (February 2006) and April 1, 2008. As shown in this figure, groundwater elevation drawdown data indicate that drawdown of at least 6 feet has been achieved across most of the

project site, and that regions of greater drawdown, 8 – 10 feet below baseline conditions, were achieved in more localized pockets closer to the extraction wells.

#### Extracted Groundwater Concentration Data and Treatment Efficiency

Sampling events were performed on January 29, and February 20, 2008 for continued tracking of contaminant concentration trends in extracted groundwater and to verify groundwater treatment system efficiency. Samples were collected at the inlet, midpoint, and outlet of the granular activated carbon filtration system. Samples were submitted to Lancaster Laboratories of Lancaster, Pennsylvania, and analyzed for the following:

- Gasoline-range hydrocarbons by ECY 97-602 NWTPH-Gx;
- Diesel-range hydrocarbons and lube-oil-range hydrocarbons by ECY 97-602 NWTPH-Dx modified; and
- Benzene, toluene and ethylbenzene by EPA Method 8021B.

Analytical results are presented in Table 4.

Samples collected at the inlet to the groundwater treatment system contained benzene up to 7.9 micrograms per liter (ug/L), gasoline-range hydrocarbons up to 110 ug/L and diesel-range hydrocarbons up to 580 ug/L.

Figure 4 presents a graph of concentration data for benzene, gasoline-range hydrocarbons, and diesel-range hydrocarbons in influent groundwater over time, along with depth-to-water data for three selected monitoring wells. These wells were selected to provide representative depth-to-water data from various regions of the site. As illustrated in this figure, the concentrations of benzene and gasoline-range hydrocarbons detected at the treatment system inlet have declined by greater than two orders of magnitude since system start-up in February 2006. As expected, decreases in less volatile diesel-range hydrocarbon concentrations have been less significant.

Samples collected at the midpoint and outlet of the groundwater treatment system indicate that the system continues to be effective in pre-treating extracted groundwater prior to discharge to the King County sewer system. All discharge from the treatment system during the First Quarter of 2008 was in compliance with the King County Discharge Authorization for this project.

#### Soil Vapor Concentration and Hydrocarbon Mass Removal

Hydrocarbon removal via the soil vapor extraction (SVE) system is monitored through analysis of soil vapor samples collected from individual extraction wells and samples of the combined vapor stream collected at the inlet of the oxidizer unit. Soil vapor samples from individual extraction wells are collected at the system manifold using tedlar bags filled via a vacuum pump and chamber. These samples are monitored in the field with a flame ionization detector (FID) calibrated using hexane. Soil vapor samples at the oxidizer inlet are collected in tedlar bags that are filled under positive pressure from the blower discharge. These samples are monitored in the field with an FID and are also submitted for laboratory analysis.

During the First Quarter 2008, vapor extraction efforts remained focused on the nine DPE wells of the system (DPE-1 through DPE-9). Although the system maintains connections to four horizontal wells (H-1 through H-4) and six VP wells (VP-2, VP-4, VP-5, VP-7, VP-8 and VP-9) from the former SVE system, these wells are currently not operated due to minimal hydrocarbon recovery.

Soil vapor concentration data for individual extraction wells are presented in Table 3. These data are also presented graphically in Figure 5. With some exception, soil vapor concentration data for each of the DPE wells has generally shown a trend of steadily decreasing concentrations resulting in at least two orders of magnitude concentration reduction since vapor extraction began in February 2006.

Results of field measurements by FID at the inlet to the oxidizer unit indicate that the system removed approximately 400 pounds of combustible hydrocarbon mass during First Quarter 2008 operations. The average mass removal rate during this quarter was approximately 5 pounds per day. SVE operations data are presented in Table 5 and a graph showing total hydrocarbon mass removed and the mass removal rate over time is included as Figure 6.

#### SVE Vacuum Influence

SVE vacuum influence measurements were made on April 1, 2008. Vacuum influence was measured at selected monitoring wells, and in the Del Roy Apartments building sub-slab vapor monitoring points, using vacuum sealing caps and Magnehelic<sup>®</sup> differential pressure gauges.

Vacuum influence measurement data are listed in Table 3 and shown on Figure 7. These data continue to suggest that the system has provided vacuum influence, at depth, throughout the Manhattan Express, Del Roy and Monterey properties. However, no vacuum was measured at either of the Del Roy Apartments building sub-slab vapor monitoring points, DRVP-1 or DRVP-2, which suggests that a less permeable zone of material may exist beneath the Del Roy Apartments basement that serves as a barrier to vertical vapor phase migration.

### **System Operation Compliance Monitoring**

#### King County Waste Discharge Authorization No. 4106-01

Groundwater treated and discharged by the remediation system is regulated per the requirements of King County Wastewater Discharge Authorization No. 4106-01. Self-monitoring requirements established by this discharge authorization require semi-annual sampling for benzene, toluene, and ethylbenzene. Maximum discharge concentrations are as follows:

- Benzene – 70 ug/L
- Toluene – 1,400 ug/L
- Ethylbenzene – 1,700 ug/L

Self-monitoring discharge samples were collected on January 29, 2008 and February 20, 2008. The results of both sampling events indicate that groundwater discharged from the remediation

system contained “non-detect” concentrations of all tested analytes. Laboratory results are presented in Table 4.

For First Quarter 2008 system operations, all water discharge to the King County sewer system was in compliance with the Discharge Authorization No. 4106-01. These results were reported in the 2008, Semester 1, Self-Monitoring Report, which was submitted to Ms. Peggy Rice of King County Industrial Waste on July 1, 2008.

As also required by Discharge Authorization 4106-01, SAIC reports the groundwater treatment system discharge volume to Seattle Public Utilities for billing purposes. This reporting is performed on a quarterly basis. Sewer discharge costs are billed at a rate of \$7.45 per CCF (100 cubic feet or 748 gallons). The total volume discharged during this quarter of system operations was 359,148 gallons.

#### Puget Sound Clean Air Agency Order of Approval for Notice of Construction No. 9267

Soil vapors extracted and treated by the system are discharged to the atmosphere in accordance with the restrictions and conditions established by Puget Sound Clean Air Agency (PSCAA) Order of Approval for Notice of Construction No. 9267. This Order of Approval requires monthly self monitoring of the oxidizer influent and effluent streams using a FID field instrument, and quarterly monitoring of oxidizer influent and effluent gasoline-range hydrocarbons and benzene concentrations via laboratory analysis. In addition, operational parameters such as flow and system operating temperatures must be recorded on a monthly basis. There are no reporting requirements for this Order of Approval; however, all monitoring results must be kept on record and made available to PSCAA personnel on request.

Table 5 includes oxidizer self monitoring data collected in accordance with this permit. Results of field monitoring and laboratory analysis of oxidizer influent and effluent samples indicate that the system has continued to operate in compliance with the requirements of the PSCAA permit.

Laboratory analysis of oxidizer operating parameters is performed by Test America Laboratories, Inc. of Bothell, Washington. Laboratory reports and Chain of Custody documentation are available upon request.

#### **Conclusions**

Results of First Quarter 2008 system performance monitoring indicate that the DPE system had reached a de minimis rate of hydrocarbon mass removal and that further operation of the system, as configured, was not likely to remove a significant amount of additional hydrocarbon mass from the subsurface. In addition, continued operation of the system would have prevented collection of data under equilibrium conditions, which is needed to develop an understanding of the current contaminant distribution at the site.

Shut-down of the system will allow SAIC to collect the data necessary to determine whether additional active remediation will be necessary to meet the cleanup goals for the site. SAIC

plans to perform at least two rounds of post shut-down groundwater monitoring (spring and fall 2008), and sub-slab vapor sampling during both high and low groundwater conditions at the Del Roy and Monterey apartment buildings. These data will then be evaluated to determine the most appropriate path forward for this project.

SAIC appreciates the opportunity to provide environmental services to Chevron. Please call me at (425) 482-3323 if you have any questions regarding the contents of this report.

Sincerely,

**SCIENCE APPLICATIONS INTERNATIONAL CORPORATION**



Russell S. Shropshire, P.E.  
Senior Project Engineer

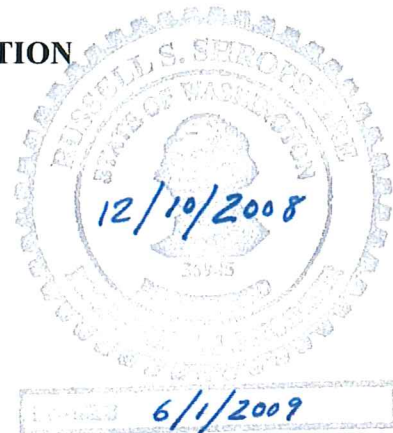

Attachments: Figure 1 - Site Map  
Figure 2 - Groundwater Elevation Contour Map, April 1, 2008  
Figure 3 - Groundwater Elevation Drawdown Contour Map, April 1, 2008  
Figure 4 - GWTS Influent Concentration Data and DTW at Selected Monitoring Wells vs. Time  
Figure 5 - Combined Oxidizer Influent and Individual Extraction Well Vapor Concentration Data vs. Time  
Figure 6 - Vapor-Phase Mass Removal vs. Time  
Figure 7 - SVE Applied/Induced Vacuum Measurements, April 1, 2008  
Table 1 - Summary of System Performance and Operating Costs  
Table 2 - Groundwater Treatment System Discharge Totalizer Readings  
Table 3 - Extraction/Monitoring Well Performance Monitoring Data  
Table 4 - Groundwater Treatment System Discharge Monitoring Results  
Table 5 - Soil Vapor Extraction System Performance Monitoring Data

Appendix A - Calculations

**Certified Laboratory Analytical Reports and Chain of Custody Documentation  
Available Upon Request**

cc:

Mr. Christopher Maurer, WDOE  
Mr. Burt Hyde, Sound Environmental Strategies  
Mr. Paul McTaggard, Darco, Inc.  
Mr. Gerry Pigotti, Monterey Apartments, LLC  
Mr. Peter Catterall, SAIC  
Project File

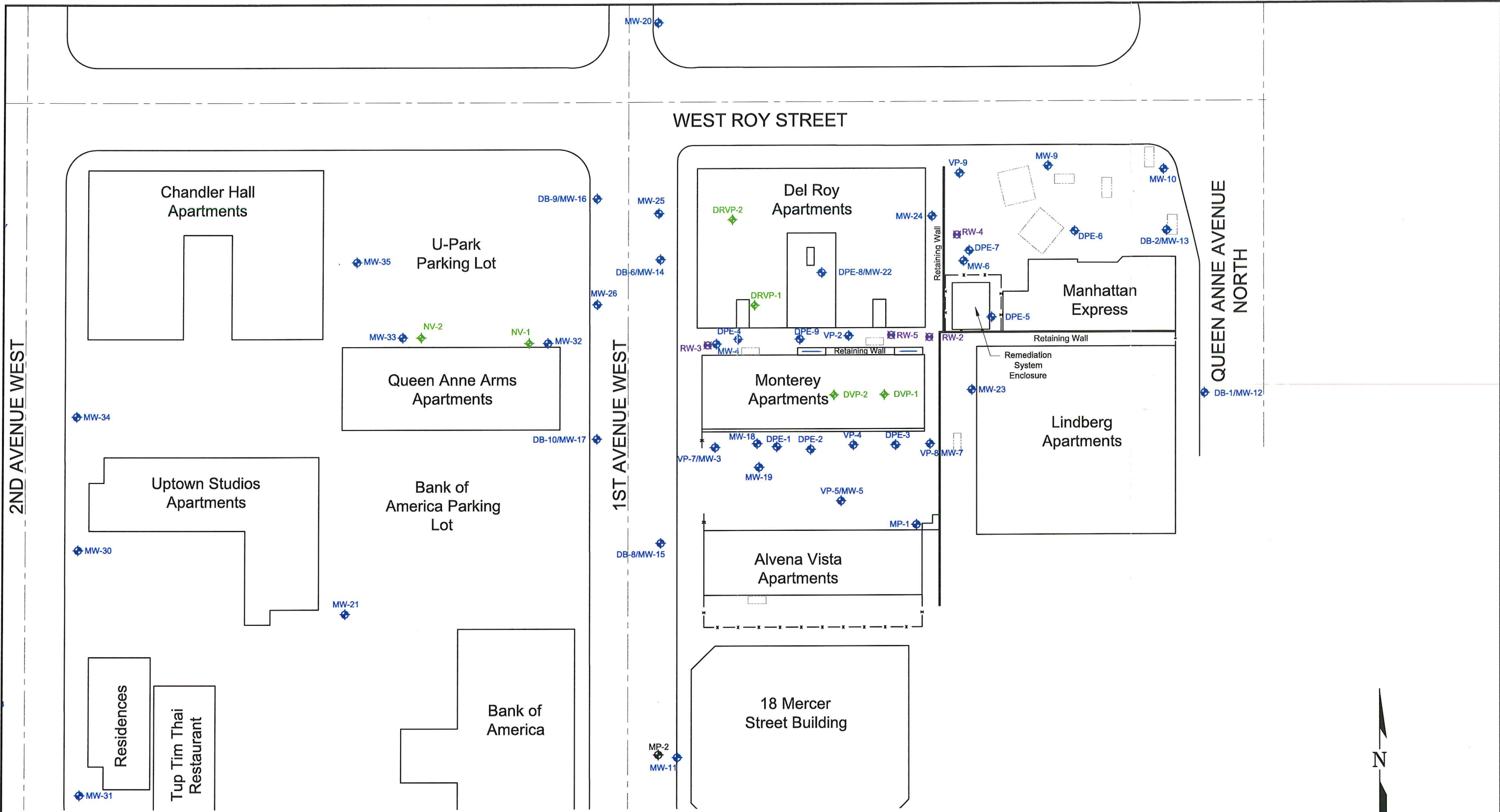

- LEGEND:**
- MW-26 EXISTING 1" or 2" WELL LOCATION
  - DPE-1 EXISTING 4" DIA. WELL LOCATION
  - DVP-1 EXISTING 1/4" DIA. VAPOR POINT
  - RW-2 EXISTING 6" or 8" DIA. RECOVERY WELL LOCATION

- FENCE
- STREET CENTER LINE

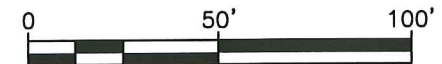

FORMER TEXACO SERVICE STATION  
 CHEVRON No. 211577  
 631 QUEEN ANNE AVENUE NORTH  
 SEATTLE, WASHINGTON

**FIGURE 1**  
 SITE MAP

FILE NAME: 211577_BaseMap_2008.dwg	DATE: 10/03/2008
---------------------------------------	---------------------

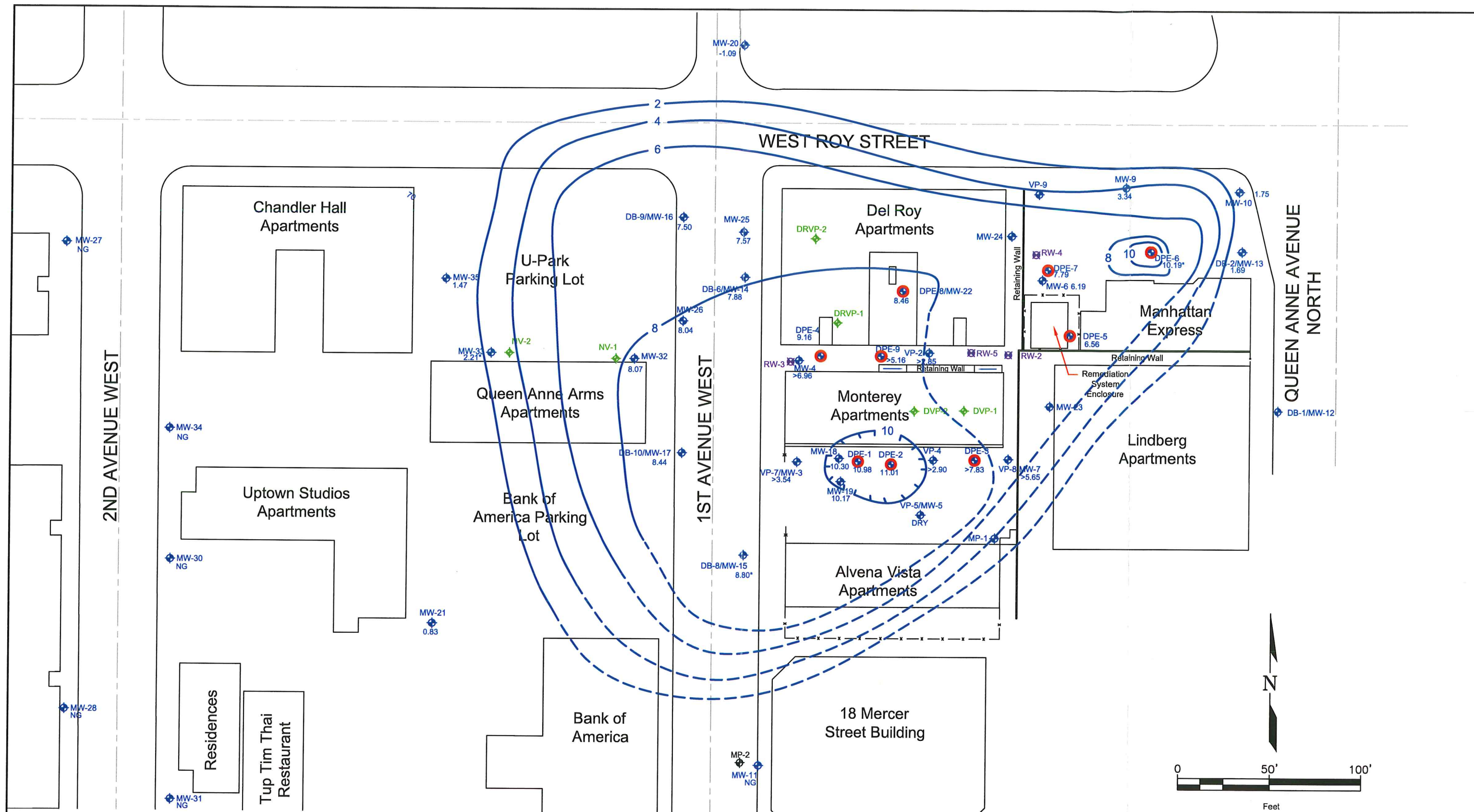

2ND AVENUE WEST

WEST ROY STREET

QUEEN ANNE AVENUE NORTH

1ST AVENUE WEST

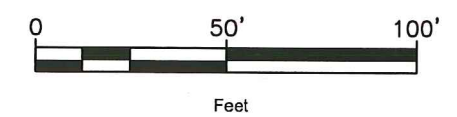

**LEGEND:**

- MW-26 EXISTING 1" or 2" WELL LOCATION
- DPE-1 EXISTING 4" DIA. WELL LOCATION
- DVP-1 EXISTING 1/4" DIA. VAPOR POINT
- RW-2 EXISTING 6" or 8" DIA. RECOVERY WELL LOCATION
- ACTIVE GROUNDWATER EXTRACTION WELL

- FENCE
- STREET CENTERLINE
- 8 GROUNDWATER DRAWDOWN CONTOUR (2 FOOT INTERVAL)
- 10.17 GROUNDWATER ELEVATION DRAWDOWN (2/22/2006 - 4/1/2008)
- >3.54 INDICATES THAT GROUNDWATER ELEVATION IS BELOW BOTTOM OF WELL SCREEN. DEPTH SHOWN IS DEPTH FROM BASELINE TO BOTTOM OF WELL SCREEN.

- 10.17\* INDICATES THAT VALUE IS ESTIMATED BASED ON GROUNDWATER ELEVATION DATA COLLECTED ON DATES OTHER THAN 2/22/2006 AND 4/1/2008
- NG NOT GAUGED



FORMER TEXACO SERVICE STATION  
CHEVRON No. 211577  
631 QUEEN ANNE AVENUE NORTH  
SEATTLE, WASHINGTON

**FIGURE 3**  
GROUNDWATER ELEVATION DRAWDOWN  
CONTOUR MAP, April 1, 2008

FILE NAME: 211577_2008 GW Contours	DATE: 10/08/08
---------------------------------------	-------------------



Former Texaco Service Station / Chevron No. 211577  
 631 Queen Anne Avenue North, Seattle, Washington

**FIGURE 4**  
**GWTS INFLUENT CONCENTRATION DATA AND DTW**  
**AT SELECTED MONITORING WELLS vs. TIME**

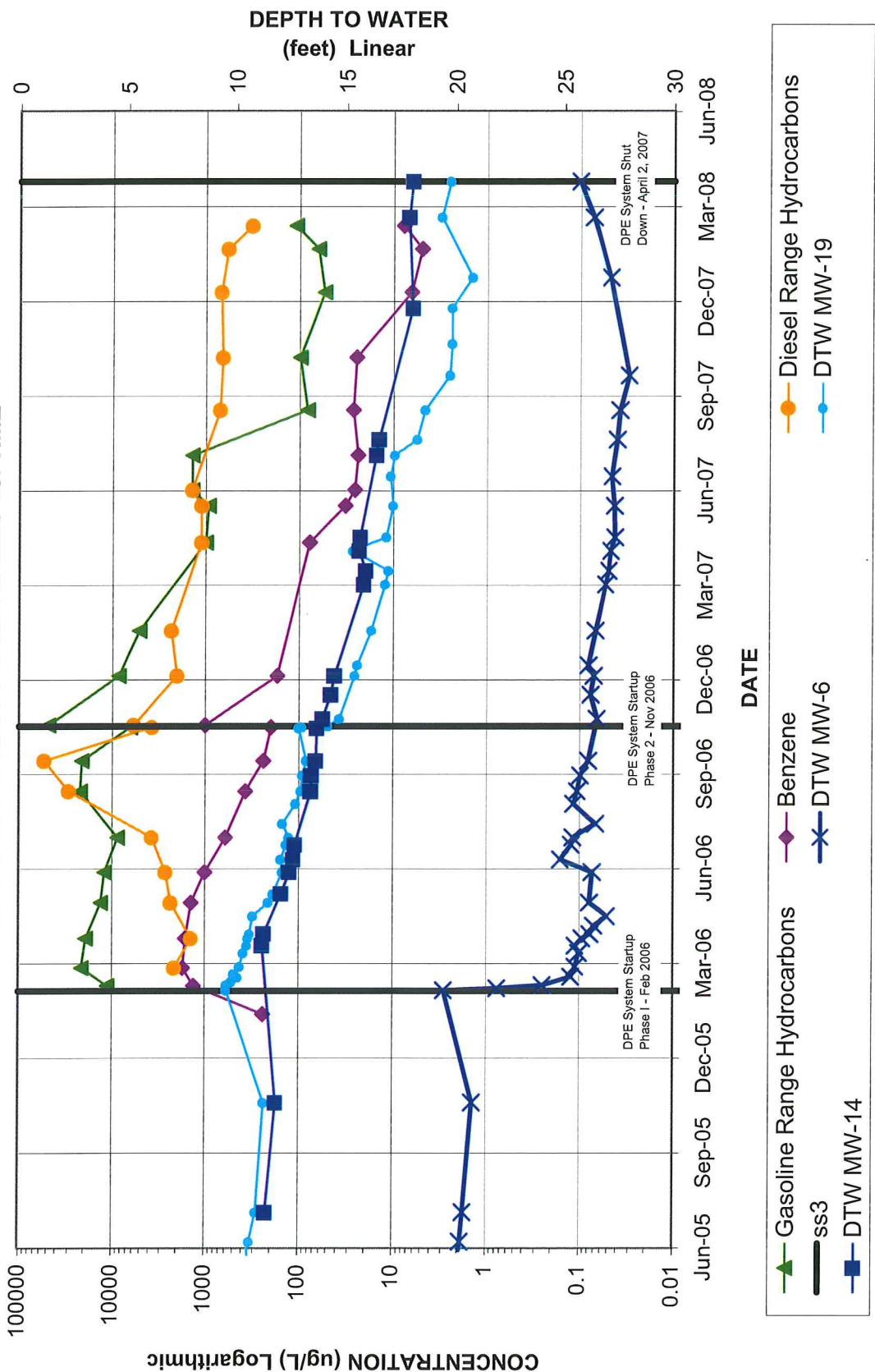

Former Texaco Service Station / Chevron No. 211577  
 631 Queen Anne Avenue North, Seattle, Washington

**FIGURE 5**  
**COMBINED OXIDIZER INFLUENT AND INDIVIDUAL**  
**EXTRACTION WELL VAPOR CONCENTRATION DATA vs. TIME**

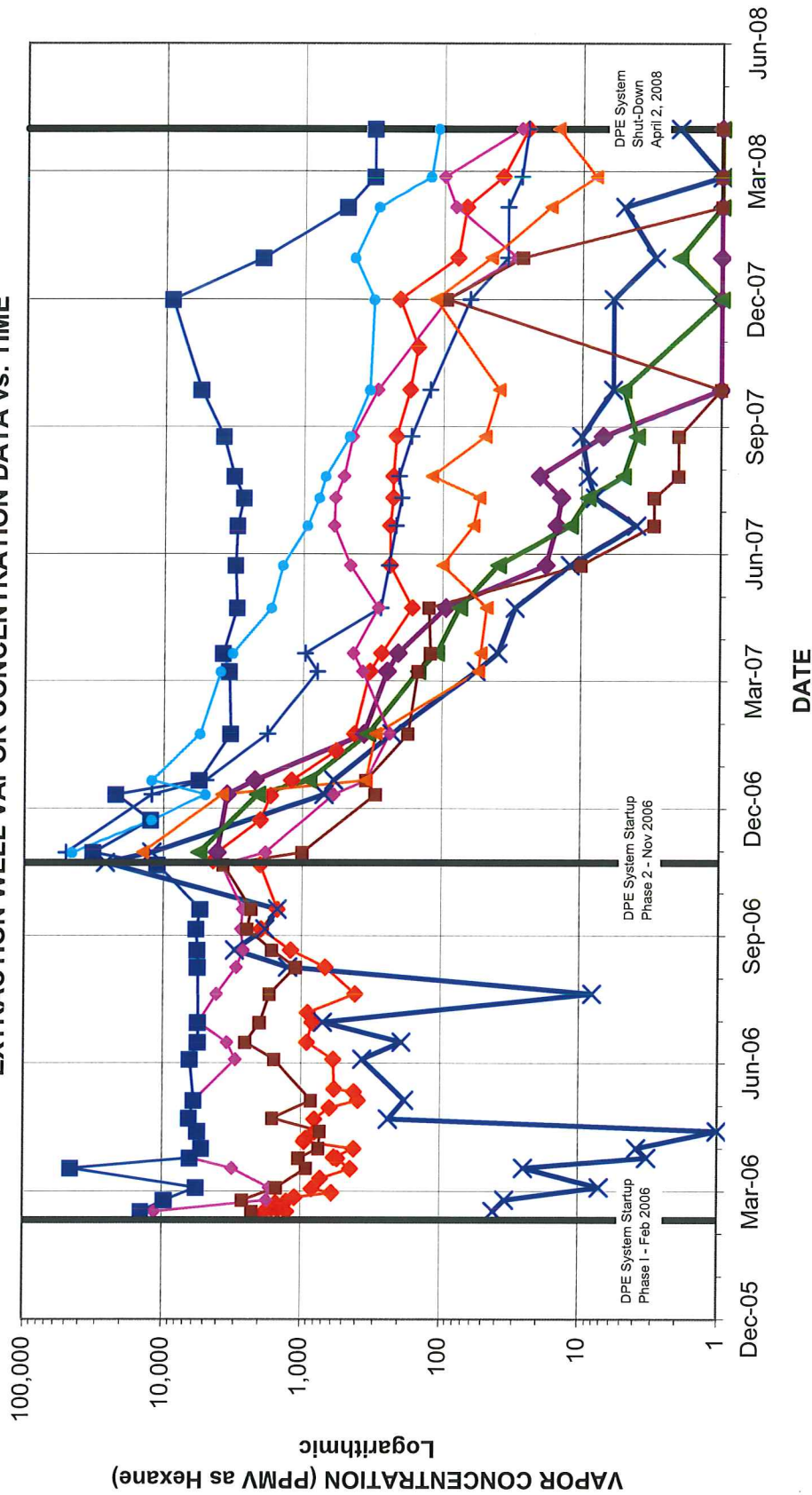

- ◆ Oxidizer Influent Vapor Concentration
- ◆ DPE-2 Vapor Concentration
- ◆ DPE-4 Vapor Concentration
- ◆ DPE-6 Vapor Concentration
- ◆ DPE-8 Vapor Concentration
- ◆ DPE-1 Vapor Concentration
- ◆ DPE-3 Vapor Concentration
- ◆ DPE-5 Vapor Concentration
- ◆ DPE-7 Vapor Concentration
- ◆ DPE-9 Vapor Concentration

Former Texaco Service Station / Chevron No. 211577  
 631 Queen Anne Avenue North, Seattle, Washington

FIGURE 6  
 VAPOR PHASE MASS REMOVAL vs. TIME

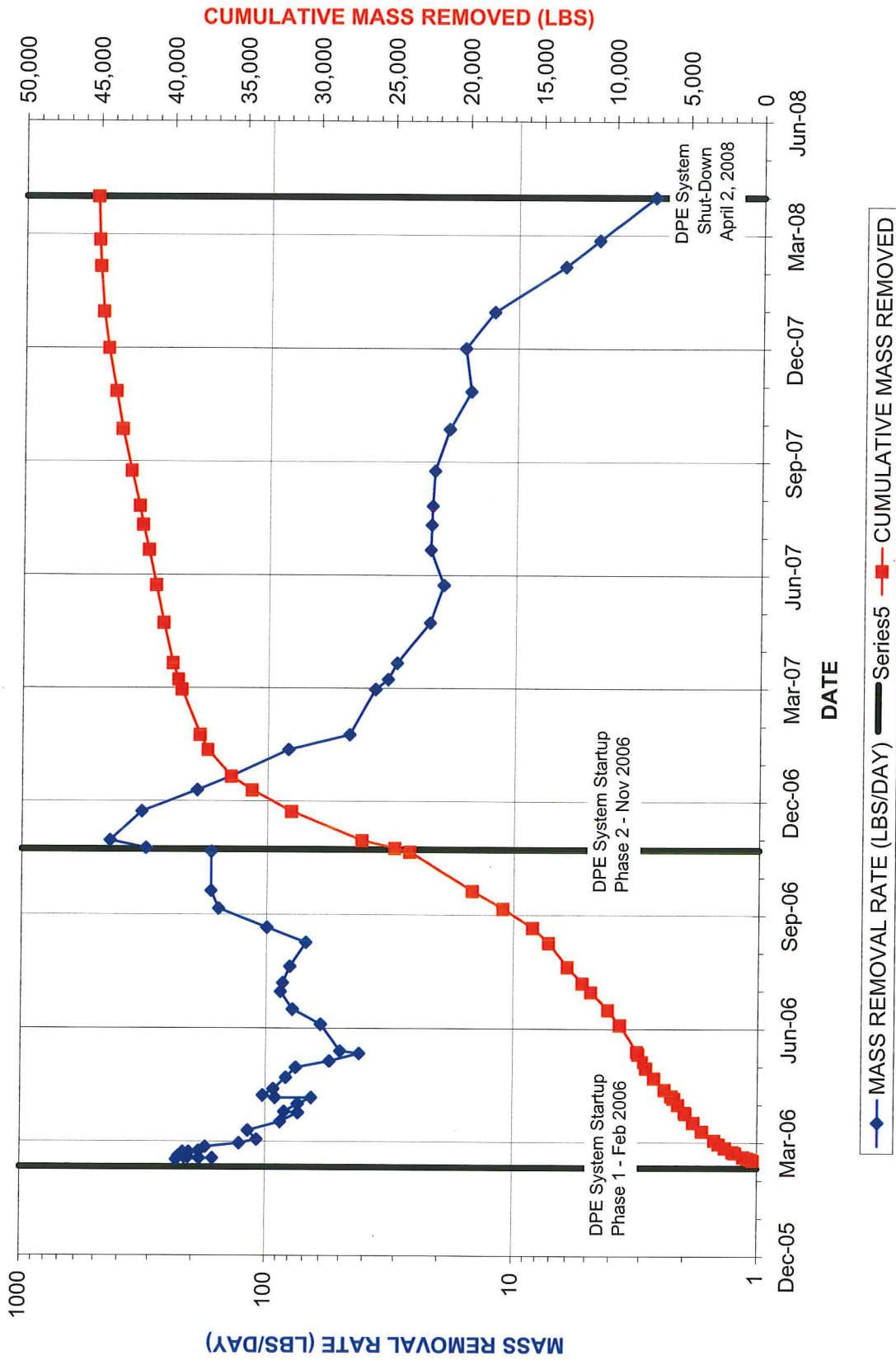

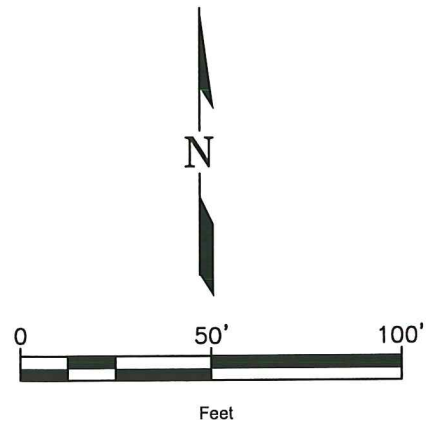
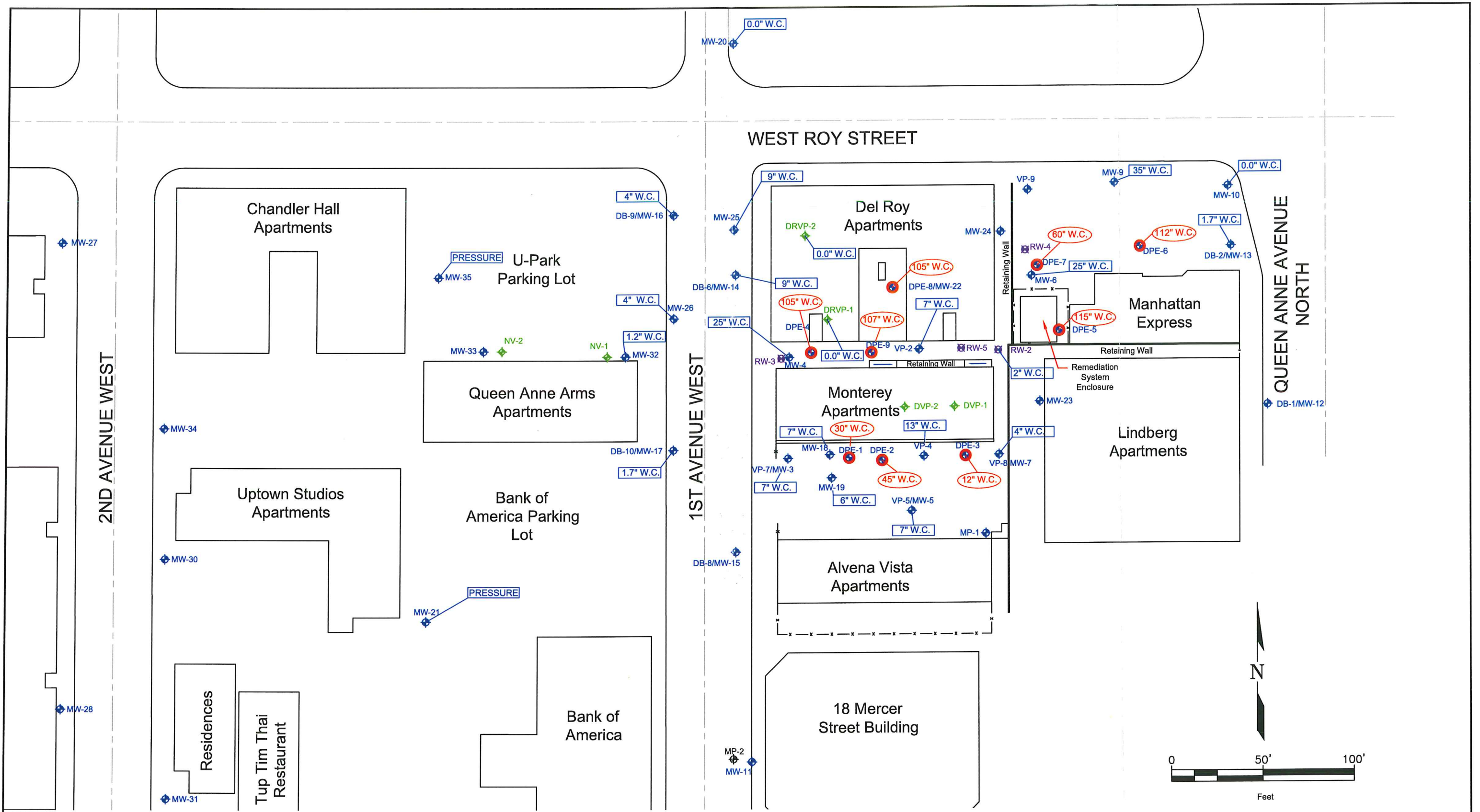

**LEGEND:**

-  MW-26 EXISTING 1" or 2" WELL LOCATION
-  DPE-1 EXISTING 4" DIA. WELL LOCATION
-  DVP-1 EXISTING 1/4" DIA. VAPOR POINT
-  RW-2 EXISTING 6" or 8" DIA. RECOVERY WELL LOCATION
-  ACTIVE GROUNDWATER EXTRACTION WELL
-  FENCE
-  STREET CENTER LINE
-  APPLIED VACUUM READING MEASURED AT EXTRACTION WELL CASING
-  VACUUM INFLUENCE READING MEASURED AT MONITORING WELL CASING



<p><b>FORMER TEXACO SERVICE STATION</b>          CHEVRON No. 211577          631 QUEEN ANNE AVENUE NORTH          SEATTLE, WASHINGTON</p>		<p><b>FIGURE 7</b>          SVE APPLIED/INDUCED VACUUM          MEASUREMENTS, APRIL 1, 2008</p>
FILE NAME: 211577_2008 GW Contours	DATE: 10/07/08	

**Data Table Abbreviations**  
Former Texaco Service Station, Chevron 211577  
631 Queen Anne Avenue North  
Seattle, WA

B = Benzene  
bgs = Below Ground Surface  
CFM = Cubic Feet per Minute  
Conc. = Concentration  
D. LEAD = Dissolved Lead  
DTP = Depth to Product  
DTW = Depth to Water  
Degrees F = Degrees Fahrenheit  
E = Ethylbenzene  
FID = Flame Ionization Detector  
FOG = Fats, Oils, and Grease  
(ft.) = Feet  
(ft. btc) = Feet Below Top of Well Casing  
GPD = Gallons Per Day  
GPM = Gallons Per Minute  
GWE = Groundwater Elevation  
HWC = Height of water column  
Lbs = Pounds  
Lbs/Day = Pounds per Day  
LFP = Low Flow Purge  
mg/L = Milligrams per Liter  
mins = Minutes  
ml = Milliliter  
(msl) = Mean Sea Level  
MTCA = Model Toxics Control Act Cleanup Regulations [WAC 173-340-720(2)(a)(I), as amended 02/01].  
NM = Not Measured  
NP = No Purge  
NR = Not Recorded  
PER = Peristaltic Pump used for Purging  
PPB = Parts Per Billion  
PPM = Part Per Million  
PPMV = Parts Per Million by Volume  
Pres = Pressure  
QA = Quality Assurance/Trip Blank  
SCFM = Standard Cubic Feet per Minute  
T = Toluene  
Temp = Temperature  
TOC = Top of Casing  
TPH-D(x) = Total Petroleum Hydrocarbons as Diesel  
TPH-G(x) = Total Petroleum Hydrocarbons as Gasoline  
TPH-LO = Total Petroleum Hydrocarbons as Lube Oil  
TPH-O = Total Petroleum Hydrocarbons as Oil  
ug/L = Micrograms per Liter  
Vac = Vacuum  
VOC = Volatile Organic Compound  
X = Xylenes  
(" W.C.) = Inches of Water Column Vacuum  
--- = Not Measured/Not Analyzed/Not Applicable

**Table 1**  
**Summary of System Performance and Operating Costs**  
Former Texaco Service Station, Chevron 211577  
631 Queen Anne Avenue North  
Seattle, WA

Operating Period	Operating Hours			Groundwater Extraction			Natural Gas			Electricity			Total Operating Cost (\$)	Hydrocarbon Mass Removed (lbs)	Avg. Hydrocarbon Removal Rate (lbs/day)	Cost/Lb. of Hydrocarbon Removed (\$)
	Actual (hours)	Possible (hours)	On-Line Factor (%)	Discharge Volume (gallons)	Cost (\$)	Average Extraction Rate (gpm)	Use (Therms)	Cost (\$)	Cost/Hour of System Operation (\$)	Use (kWh)	Cost (\$)	Cost/Hour of System Operation (\$)				
2/22/06 - 3/31/06	775.0	783.0	99%	107,946	\$973.44	2.3	5,494	\$6,304.99	\$8.14	14,261	\$835.49	\$1.08	\$8,113.92	4,363	135	\$1.86
4/1/06 - 6/30/06	2,057.0	2,184.0	94%	271,011	\$2,447.12	2.1	11,222	\$12,843.34	\$6.24	38,910	\$2,279.83	\$1.11	\$17,570.29	6,019	70	\$2.92
7/1/06 - 9/30/06	2,078.6	2,208.0	94%	222,089	\$2,007.72	1.7	10,532	\$11,931.93	\$5.74	40,605	\$2,368.81	\$1.14	\$16,308.46	9,235	107	\$1.77
10/1/06 - 12/31/06	1,746.9	2,208.0	79%	463,580	\$4,191.20	3.5	8,085	\$10,166.65	\$5.82	39,090	\$2,268.72	\$1.30	\$16,626.57	16,366	225	\$1.02
1/1/07 - 3/31/07	2,064.8	2,160.0	96%	602,550	\$6,004.70	4.6	10,174	\$13,042.59	\$6.32	41,500	\$2,307.58	\$1.12	\$21,354.87	3,947	46	\$5.41
4/1/07 - 6/30/07	1,911.0	2,184.0	88%	359,210	\$3,576.00	2.7	6,567	\$8,509.24	\$4.45	37,153	\$2,046.50	\$1.07	\$14,131.74	1,705	21	\$8.29
7/1/07 - 9/30/07	2,035.5	2,208.0	92%	419,700	\$4,179.45	3.2	1,567	\$2,072.97	\$1.02	33,221	\$1,829.85	\$0.90	\$8,082.27	1,778	21	\$4.55
10/1/07 - 12/31/07	2,133.9	2,208.0	97%	350,190	\$3,486.60	2.6	1,714	\$1,959.74	\$0.92	35,396	\$1,949.89	\$0.91	\$7,396.23	1,335	15	\$5.54
12/31/07 - 4/2/08	2,103.6	2,223.0	95%	359,148	\$3,576.00	2.7	1,708	\$1,973.85	\$0.94	35,263	\$1,942.97	\$0.92	\$7,492.82	405	5	\$18.50
<b>System Lifetime</b>	<b>16,931.3</b>	<b>18,366.0</b>	<b>92%</b>	<b>3,155,424</b>	<b>\$30,442.23</b>	<b>2.9</b>	<b>57,063</b>	<b>\$68,805.30</b>	<b>\$4.06</b>	<b>315,399</b>	<b>\$17,829.64</b>	<b>\$1.05</b>	<b>\$117,077.17</b>	<b>45,153</b>	<b>64</b>	<b>\$2.59</b>

Notes:

1. Groundwater extraction discharge volume based on totalizer readings as reported in Table 2, and not extraction rates from individual wells as presented in Table 3. See "Groundwater Extraction Rate" section of the text for additional discussion.
2. Total Operating Cost includes only those costs presented herein and does not include labor or materials supplied by SAIC or other subcontractors.
3. On-line factor for operating period 10/1/06 - 12/31/06 impacted by intentional system shut-down to facilitate system expansion construction.
4. Sewer discharge rate increased from \$6.76 per CCF to \$7.45 per CCF in January 2007.
5. On January 13, 2007 a Puget Sound Energy natural gas service rate increase became effective.

**Table 2**  
**Groundwater Treatment System Discharge Totalizer Readings**  
Former Texaco Service Station, Chevron 211577  
631 Queen Anne Avenue N  
Seattle, WA

Reporting Period	Date of Reading	Totalizer Reading	Total Volume Discharged (gallons)	No. of Days Between Readings	Average Interval Flowrate (gpd)	Average Interval Flowrate (gpm)
Start	1/24/2006	27,013	---	---	---	---
Jan-06	1/31/2006	31,094	4,081	7	---	---
Feb-06	3/1/2006	54,605	23,511	29	---	---
Mar-06	3/30/2006	134,950	80,345	29	2,800	1.9
Apr-06	4/30/2006	205,790	70,840	31	2,300	1.6
May-06	5/31/2006	306,600	100,810	31	3,300	2.3
Jun-06	6/30/2006	405,961	99,361	30	3,300	2.3
Jul-06	7/31/2006	476,520	70,559	31	2,300	1.6
Aug-06	8/31/2006	557,540	81,020	31	2,600	1.8
Sep-06	9/29/2006	628,050	70,510	29	2,400	1.7
Oct-06	10/31/2006	659,710	31,660	32	1,000	0.7
Nov-06	12/1/2006	862,620	202,910	31	6,500	4.5
Dec-06	12/29/2006	1,091,630	229,010	28	8,200	5.7
Jan-07	1/31/2007	1,351,920	260,290	33	7,900	5.5
Feb-07	3/3/2007	1,542,070	190,150	31	6,100	4.2
Mar-07	3/29/2007	1,694,180	152,110	26	5,900	4.1
Apr-07	4/30/2007	1,818,870	124,690	32	3,900	2.7
May-07	5/30/2007	1,965,980	147,110	30	4,900	3.4
Jun-07	6/27/2007	2,053,390	87,410	28	3,100	2.2
Jul-07	8/1/2007	2,205,240	151,850	35	4,300	3.0
Aug-07	8/29/2007	2,333,390	128,150	28	4,600	3.2
Sep-07	10/1/2007	2,473,090	139,700	33	4,200	2.9
Oct-07	10/31/2007	2,584,450	111,360	30	3,700	2.6
Nov-07	12/4/2007	2,705,430	120,980	34	3,600	2.5
Dec-07	1/2/2008	2,823,280	117,850	29	4,100	2.8
Jan-08	1/29/2008	2,939,460	116,180	27	4,300	3.0
Feb-08	2/26/2008	3,053,440	113,980	28	4,100	2.8
Mar-08	4/2/2008	3,182,428	128,988	36	3,600	2.5

Notes:  
gpd = gallons per day  
gpm = gallons per minute

**Table 3**  
**Extraction/Monitoring Well Performance Monitoring Data**  
Former Texaco Service Station, Chevron 211577  
631 Queen Anne Avenue North  
Seattle, WA

Well ID	DPE-1						
	Dual Phase Extraction						
Well Type	25						
Well Depth (feet)	101.55						
Top of Casing Elev. (feet)	10 - 25						
Screened Interval (feet bgs)	QED AP-4 Short/Top Loading						
Pump Make/Model	9 gallons per minute						
Pump Capacity	20.5 feet below top of well casing						
Pump Intake Depth							
Date	Elapsed Time Since Last Reading (mins)	Pulse Count	Extraction Rate <sup>1</sup> (gpd)	Cumulative Gallons Extracted <sup>1</sup> (gallons)	DTW (ft btc)	Casing Vacuum (" H2O)	VOC Conc (ppm)
02/22/06	---	---	---	---	10.02	---	---
02/24/06	---	---	---	---	NM	---	---
02/27/06	---	---	---	---	9.35	40	41
02/28/06	---	---	---	---	NM	NM	NM
03/01/06	---	---	---	---	NM	NM	NM
03/02/06	---	---	---	---	NM	NM	NM
03/03/06	---	---	---	---	NM	NM	NM
03/06/06	---	---	---	---	10.00	95	34
03/07/06	---	---	---	---	NM	NM	NM
03/10/06	---	---	---	---	NM	NM	7
03/16/06	---	---	---	---	NM	NM	NM
03/17/06	---	---	---	---	NM	NM	NM
03/23/06	---	---	---	---	10.88	80	25
03/30/06	---	---	---	---	11.09	NM	3.2
04/06/06	---	---	---	---	NM	NM	3.8
04/13/06	---	---	---	---	11.25	NM	NM
04/17/06	---	---	---	---	11.32	NM	0.1
04/25/06	---	---	---	---	10.95	NM	237
05/04/06	---	---	---	---	NM	NM	NM
05/05/06	---	---	---	---	NM	NM	180
05/17/06	---	---	---	---	NM	NM	NM
05/25/06	---	---	---	---	NM	NM	364
06/15/06	---	---	---	---	12.3	NM	191
06/27/06	---	---	---	---	NM	NM	700
7/11/06 - 7/12/06	---	---	---	---	12.6	NM	NM
07/18/06	---	---	---	---	12.38	NM	8
07/31/06	---	---	---	---	13	15	1,250
08/19/06	---	---	---	---	13.15	NM	3,030
8/31/06	---	---	---	---	13.35	20	1,850
9/15/06	---	---	---	---	13.37	NM	1,500
9/29/06	---	---	---	---			
10/30/06	<b>Pump Started on 10/31/06</b>						
10/31/06	---	205	---	---	13.10	0	NM
11/1/06	1,212	14,611	5,705	4,802	20.23	0	26,000
11/8/06	10,275	51,330	1,715	17,042	20.55	100	12,000
12/1/06	33,042	255,703	2,969	85,166	20.55	NM	NM



**Table 3**  
**Extraction/Monitoring Well Performance Monitoring Data**  
Former Texaco Service Station, Chevron 211577  
631 Queen Anne Avenue North  
Seattle, WA

Well ID	DPE-1						
	Dual Phase Extraction						
Well Type	25						
Well Depth (feet)	101.55						
Top of Casing Elev. (feet)	10 - 25						
Screened Interval (feet bgs)	QED AP-4 Short/Top Loading						
Pump Make/Model	9 gallons per minute						
Pump Capacity	20.5 feet below top of well casing						
Pump Intake Depth							
Date	Elapsed Time Since Last Reading (mins)	Pulse Count	Extraction Rate <sup>1</sup> (gpd)	Cumulative Gallons Extracted <sup>1</sup> (gallons)	DTW (ft bte)	Casing Vacuum (" H2O)	VOC Conc (ppm)
12/19/06	25,873	605,750	6,494	201,848	20.46	110	700
12/29/06	14,617	803,488	6,493	267,761	20.52	NM	600
1/31/07	47,351	843,494	406	281,096	20.55	105	230
3/16/07	63,489	1,592,253	5,661	530,683	20.61	NM	57
3/29/07	18,528	1,804,416	5,496	601,404	20.60	90	40
4/17/07	Pump found to be non-operational				15.63	NM	NM
4/30/07	Pump operation restored 4/19/07, but pulse counter not operating				20.60	NM	30
5/30/07	Pulse counter not operating				20.60	NM	12
6/27/07	Pulse counter not operating				20.34	20	4
7/17/07	---	1,907,476	---	---	20.55	NM	8
8/1/07	21,634	2,051,486	3,195	683,760	20.69	NM	9
8/29/07	40,404	2,220,949	2,013	740,248	20.70	NM	10
10/1/07	47,643	2,434,195	2,148	811,330	20.71	20	6
12/4/07	92,132	2,756,691	1,680	918,829	20.72	25	6
1/2/08	41,715	2,961,726	2,359	987,174	20.71	25	3
2/7/08	---	NR	---	---	NM	NM	5
2/28/08	81,930	3,450,548	2,864	1,150,114	19.25	33	0
4/1/08	47,415	3,524,388	748	1,174,728	20.70	30	2

**Table 3**  
**Extraction/Monitoring Well Performance Monitoring Data**  
Former Texaco Service Station, Chevron 211577  
631 Queen Anne Avenue North  
Seattle, WA

Well ID	DPE-2						
	Soil Vapor Extraction						
Well Type	25						
Well Depth (feet)	102.43						
Top of Casing Elev. (feet)	10 - 25						
Screened Interval (feet bgs)	---						
Pump Make/Model	---						
Pump Capacity	---						
Pump Intake Depth	---						
Date	Elapsed Time Since Last Reading (mins)	Pulse Count	Extraction Rate <sup>1</sup> (gpd)	Cumulative Gallons Extracted <sup>1</sup> (gallons)	DTW (ft btc)	Casing Vacuum (" H <sub>2</sub> O)	VOC Conc (ppm)
02/22/06	---	---	---	---	10.24	---	---
02/24/06	---	---	---	---	NM	---	---
02/27/06	---	---	---	---	10.39	0	---
02/28/06	---	---	---	---	NM	NM	---
03/01/06	---	---	---	---	NM	NM	---
03/02/06	---	---	---	---	NM	NM	---
03/03/06	---	---	---	---	NM	NM	---
03/06/06	---	---	---	---	10.83	0.05	---
03/07/06	---	---	---	---	NM	NM	---
03/10/06	---	---	---	---	NM	NM	---
03/16/06	---	---	---	---	NM	NM	---
03/17/06	---	---	---	---	NM	NM	---
03/23/06	---	---	---	---	NM	NM	---
03/30/06	---	---	---	---	NM	NM	---
04/06/06	---	---	---	---	NM	NM	---
04/13/06	---	---	---	---	NM	NM	---
04/17/06	---	---	---	---	NM	NM	---
04/25/06	---	---	---	---	NM	NM	---
05/04/06	---	---	---	---	NM	NM	---
05/05/06	---	---	---	---	NM	NM	---
05/17/06	---	---	---	---	NM	NM	---
05/25/06	---	---	---	---	12.85	NM	---
06/15/06	---	---	---	---	12.67	NM	---
06/27/06	---	---	---	---	NM	NM	---
7/11/06 - 7/12/06	---	---	---	---	13.05	NM	---
07/18/06	---	---	---	---	12.77	NM	---
07/31/06	---	---	---	---	13.35	2.5	---
08/19/06	---	---	---	---	13.5	NM	---
8/31/06	---	---	---	---	13.7	2	---
9/15/06	---	---	---	---	13.85	NM	---
9/29/06	---	---	---	---	NM	NM	---
10/30/06	---	---	---	---	SVE Started on 11/2/06		
10/31/06	---	---	---	---	15.04	NM	NM
11/1/06	---	---	---	---	15.22	85	>50,000
11/8/06	---	---	---	---	15.40	NM	NM
12/1/06	---	---	---	---			

**Table 3**  
**Extraction/Monitoring Well Performance Monitoring Data**  
Former Texaco Service Station, Chevron 211577  
631 Queen Anne Avenue North  
Seattle, WA

Well ID	DPE-2						
	Soil Vapor Extraction						
Well Type	25						
Well Depth (feet)	102.43						
Top of Casing Elev. (feet)	10 - 25						
Screened Interval (feet bgs)	---						
Pump Make/Model	---						
Pump Capacity	---						
Pump Intake Depth	---						
Date	Elapsed Time Since Last Reading (mins)	Pulse Count	Extraction Rate <sup>1</sup> (gpd)	Cumulative Gallons Extracted <sup>1</sup> (gallons)	DTW (ft btc)	Casing Vacuum (" H <sub>2</sub> O)	VOC Conc (ppm)
12/19/06	---	---	---	---	17.30	100	12,000
12/29/06	---	---	---	---	NM	NM	5,000
1/31/07	---	---	---	---	16.85	90	1,800
3/16/07	---	---	---	---	17.15	NM	790
3/29/07	---	---	---	---	17.25	70	970
4/17/07	---	---	---	---	15.96	NM	NM
4/30/07	---	---	---	---	17.12	NM	280
5/30/07	---	---	---	---	17.53	NM	245
6/27/07	---	---	---	---	17.54	80	220
7/17/07	---	419	---	0	17.76	NM	200
8/1/07	21,746	211,608	4,662	70,396	21.52	NM	210
8/29/07	40,399	637,065	5,055	212,215	21.57	NM	170
10/1/07	47,644	1,227,270	5,946	408,950	21.51	50	125
12/4/07	92,107	2,277,690	5,474	759,090	21.52	50	65
1/2/08	41,728	2,758,197	5,527	919,259	21.54	40	35
2/7/08	---	NR	---	---	NM	NM	35
2/28/08	81,946	3,742,991	5,768	1,247,524	21.52	45	28
4/1/08	47,414	4,313,253	5,773	1,437,611	21.51	45	25

**Table 3**  
**Extraction/Monitoring Well Performance Monitoring Data**  
Former Texaco Service Station, Chevron 211577  
631 Queen Anne Avenue North  
Seattle, WA

Well ID	DPE-3						
	Dual Phase Extraction						
Well Type	21.3						
Well Depth (feet)	103.93						
Top of Casing Elev. (feet)	10 - 18						
Screened Interval (feet bgs)	QED AP-4 Short/Top Loading						
Pump Make/Model	9 gallons per minute						
Pump Capacity	18.25 feet below top of well casing						
Pump Intake Depth							
Date	Elapsed Time Since Last Reading (mins)	Pulse Count	Extraction Rate <sup>1</sup> (gpd)	Cumulative Gallons Extracted <sup>1</sup> (gallons)	DTW (ft btc)	Casing Vacuum (" H2O)	VOC Conc (ppm)
02/22/06	---	---	---	---	---	---	---
02/24/06	---	---	---	---	---	---	---
02/27/06	---	---	---	---	---	---	---
02/28/06	---	---	---	---	---	---	---
03/01/06	---	---	---	---	---	---	---
03/02/06	---	---	---	---	---	---	---
03/03/06	---	---	---	---	---	---	---
03/06/06	---	---	---	---	---	---	---
03/07/06	---	---	---	---	---	---	---
03/10/06	---	---	---	---	---	---	---
03/16/06	---	---	---	---	---	---	---
03/17/06	---	---	---	---	---	---	---
03/23/06	---	---	---	---	---	---	---
03/30/06	---	---	---	---	---	---	---
04/06/06	---	---	---	---	---	---	---
04/13/06	---	---	---	---	---	---	---
04/17/06	---	---	---	---	---	---	---
04/25/06	---	---	---	---	---	---	---
05/04/06	---	---	---	---	---	---	---
05/05/06	---	---	---	---	---	---	---
05/17/06	---	---	---	---	---	---	---
05/25/06	---	---	---	---	---	---	---
06/15/06	---	---	---	---	---	---	---
06/27/06	---	---	---	---	---	---	---
7/11/06 - 7/12/06	---	---	---	---	---	---	---
07/18/06	---	---	---	---	---	---	---
07/31/06	---	---	---	---	---	---	---
08/19/06	---	---	---	---	---	---	---
8/31/06	---	---	---	---	---	---	---
9/15/06	---	---	---	---	---	---	---
9/29/06	---	---	---	---	---	---	---
10/30/06	---	---	---	---	---	---	---
10/31/06	<b>Pump Started on 11/1/06</b>				14.70	0	NM
11/1/06	---	238	---	---	14.97	0	NM
11/8/06	10,291	614	18	125	18.25	90	4,100
12/1/06	33,045	13,161	182	4,308	18.24	NM	NM

**Table 3**  
**Extraction/Monitoring Well Performance Monitoring Data**  
Former Texaco Service Station, Chevron 211577  
631 Queen Anne Avenue North  
Seattle, WA

Well ID	DPE-3						
	Dual Phase Extraction						
Well Type	21.3						
Well Depth (feet)	103.93						
Top of Casing Elev. (feet)	10 - 18						
Screened Interval (feet bgs)	QED AP-4 Short/Top Loading						
Pump Make/Model	9 gallons per minute						
Pump Capacity	18.25 feet below top of well casing						
Pump Intake Depth							
Date	Elapsed Time Since Last Reading (mins)	Pulse Count	Extraction Rate <sup>1</sup> (gpd)	Cumulative Gallons Extracted <sup>1</sup> (gallons)	DTW (ft btc)	Casing Vacuum (" H2O)	VOC Conc (ppm)
12/19/06	25,872	34,176	390	11,313	18.25	110	3,500
12/29/06	14,618	53,257	627	17,673	18.24	NM	2,200
1/31/07	47,511	114,345	617	38,036	18.25	NM	365
3/16/07	63,262	170,297	425	56,686	18.18	NM	250
3/29/07	18,726	183,017	326	60,926	18.24	NM	210
4/17/07	---	NR	---	---	18.25	NM	NM
4/30/07	46,154	212,051	302	70,604	18.27	NM	94
5/30/07	43,278	218,132	67	72,631	18.20	NM	18
6/27/07	40,160	218,177	1	72,646	18.27	20	15
7/17/07	28,599	218,182	0	72,648	18.27	NM	14
8/1/07	21,746	218,186	0	72,649	18.28	NM	20
8/29/07	40,401	218,188	0	72,650	18.27	NM	7
10/1/07	47,643	218,191	0	72,651	18.27	8	0
12/4/07	92,082	218,191	0	72,651	18.35	15	0
1/2/08	41,725	218,201	0	72,654	18.27	10	0
2/7/08	---	NR	---	---	NM	NM	0
2/28/08	81,984	218,218	0	72,660	18.26	15	0
4/1/08	47,404	218,222	0	72,661	18.25	12	0

**Table 3**  
**Extraction/Monitoring Well Performance Monitoring Data**  
Former Texaco Service Station, Chevron 211577  
631 Queen Anne Avenue North  
Seattle, WA

Well ID	DPE-4						
	Well Type	Dual Phase Extraction					
Well Depth (feet)	22.16						
Top of Casing Elev. (feet)	102.26						
Screened Interval (feet bgs)	10.5 - 20.5						
Pump Make/Model	QED AP-4 Short/Top Loading						
Pump Capacity	9 gallons per minute						
Pump Intake Depth	19.5 feet below top of well casing						
Date	Elapsed Time Since Last Reading (mins)	Pulse Count	Extraction Rate <sup>1</sup> (gpd)	Cumulative Gallons Extracted <sup>1</sup> (gallons)	DTW (ft btc)	Casing Vacuum (" H2O)	VOC Conc (ppm)
02/22/06	---	---	---	---	---	---	---
02/24/06	---	---	---	---	---	---	---
02/27/06	---	---	---	---	---	---	---
02/28/06	---	---	---	---	---	---	---
03/01/06	---	---	---	---	---	---	---
03/02/06	---	---	---	---	---	---	---
03/03/06	---	---	---	---	---	---	---
03/06/06	---	---	---	---	---	---	---
03/07/06	---	---	---	---	---	---	---
03/10/06	---	---	---	---	---	---	---
03/16/06	---	---	---	---	---	---	---
03/17/06	---	---	---	---	---	---	---
03/23/06	---	---	---	---	---	---	---
03/30/06	---	---	---	---	---	---	---
04/06/06	---	---	---	---	---	---	---
04/13/06	---	---	---	---	---	---	---
04/17/06	---	---	---	---	---	---	---
04/25/06	---	---	---	---	---	---	---
05/04/06	---	---	---	---	---	---	---
05/05/06	---	---	---	---	---	---	---
05/17/06	---	---	---	---	---	---	---
05/25/06	---	---	---	---	---	---	---
06/15/06	---	---	---	---	---	---	---
06/27/06	---	---	---	---	---	---	---
7/11/06 - 7/12/06	---	---	---	---	---	---	---
07/18/06	---	---	---	---	---	---	---
07/31/06	---	---	---	---	---	---	---
08/19/06	---	---	---	---	---	---	---
8/31/06	---	---	---	---	---	---	---
9/15/06	---	---	---	---	---	---	---
9/29/06	---	---	---	---	---	---	---
10/30/06	<b>Pump Started on 10/31/06</b>						
10/31/06	---	445	---	---	14.27	0	NM
11/1/06	1,128	639	83	65	19.36	0	NM
11/8/06	10,307	7,071	300	2,209	19.34	100	5,500
12/1/06	33,053	26,242	278	8,599	19.34	NM	NM

**Table 3**  
**Extraction/Monitoring Well Performance Monitoring Data**  
Former Texaco Service Station, Chevron 211577  
631 Queen Anne Avenue North  
Seattle, WA

Well ID	DPE-4						
	Dual Phase Extraction						
Well Type	22.16						
Well Depth (feet)	102.26						
Top of Casing Elev. (feet)	10.5 - 20.5						
Screened Interval (feet bgs)	QED AP-4 Short/Top Loading						
Pump Make/Model	9 gallons per minute						
Pump Capacity	19.5 feet below top of well casing						
Pump Intake Depth							
Date	Elapsed Time Since Last Reading (mins)	Pulse Count	Extraction Rate <sup>1</sup> (gpd)	Cumulative Gallons Extracted <sup>1</sup> (gallons)	DTW (ft btc)	Casing Vacuum (" H2O)	VOC Conc (ppm)
12/19/06	25,861	47,517	395	15,691	19.40	120	2,100
12/29/06	14,612	60,883	439	20,146	19.19	NM	900
1/31/07	47,349	102,483	422	34,013	18.68	107	340
3/16/07	63,348	137,397	265	45,651	19.26	NM	150
3/29/07	18,586	146,505	235	48,687	19.40	105	110
4/17/07	---	NR	---	---	19.17	NM	NM
4/30/07	---	NR	---	---	19.08	NM	75
5/30/07	89,606	181,709	189	60,421	19.04	NM	40
6/27/07	40,215	184,741	36	61,432	19.40	17	12
7/17/07	---	NR	---	---	NM	NM	9
8/1/07	50,324	185,877	11	61,811	19.45	NM	5
8/29/07	40,398	186,497	7	62,017	19.48	NM	4
10/1/07	47,683	187,022	5	62,192	19.42	14	5
12/4/07	92,099	187,855	4	62,470	19.42	20	0
1/2/08	41,762	197,460	110	65,672	19.43	75	2
2/7/08	---	NR	---	---	NM	NM	0
2/28/08	81,950	202,568	30	67,374	19.40	20	0
4/1/08	47,296	216,724	144	72,093	19.41	105	1

**Table 3**  
**Extraction/Monitoring Well Performance Monitoring Data**  
Former Texaco Service Station, Chevron 211577  
631 Queen Anne Avenue North  
Seattle, WA

Well ID	DPE-5						
	Dual Phase Extraction						
Well Type	28						
Well Depth (feet)	113.81						
Top of Casing Elev. (feet)	14 - 24						
Screened Interval (feet bgs)	QED AP-4 Short/Top Loading						
Pump Make/Model	9 gallons per minute						
Pump Capacity	24 feet below top of well casing						
Pump Intake Depth							
Date	Elapsed Time Since Last Reading (mins)	Pulse Count	Extraction Rate <sup>1</sup> (gpd)	Cumulative Gallons Extracted <sup>1</sup> (gallons)	DTW (ft btc)	Casing Vacuum (" H2O)	VOC Conc (ppm)
02/22/06	---	1506	---	---	17.16	Off	NM
02/24/06	2970	1784	45	93	23.80	Off	NM
02/27/06	4370	2318	59	271	NM	90	11,250
02/28/06	1000	2962	309	485	NM	90	NM
03/01/06	1364	3842	310	779	NM	85	NM
03/02/06	---	NR	---	---	NM	100	NM
03/03/06	3396	6519	378	1,671	NM	NM	NM
03/06/06	---	NR	---	---	NM	NM	NM
03/07/06	5805	10547	333	3,014	NM	110	1,765
03/10/06	3820	13550	377	4,015	NM	110	NM
03/16/06	8935	20345	365	6,280	NM	100	1,678
03/17/06	---	NR	---	---	NM	NM	NM
03/23/06	10305	27743	345	8,746	NM	105	NM
03/30/06	9721	34437	331	10,977	NM	NM	3,106
04/06/06	10415	41110	308	13,201	NM	106	6,212
04/13/06	9577	46825	286	15,106	NM	105	5,145
04/17/06	5932	49919	250	16,138	NM	NM	NM
04/25/06	---	NR	---	---	NM	NM	5,517
05/04/06	24787	64889	290	21,128	NM	115	6,366
05/05/06	---	NR	---	---	NM	NM	NM
05/17/06	18390	73547	226	24,014	NM	93	5,878
05/25/06	---	NR	---	---	NM	NR	NM
06/15/06	41632	88665	174	29,053	NM	105	2,961
06/27/06	17433	93173	124	30,556	23.3	NM	3,430
7/11/06 - 7/12/06	20411	97044	91	31,846	NM	NM	5,525
07/18/06	---	NR	---	---	NM	NM	NM
07/31/06	28640	100193	53	32,896	NM	NM	4,100
08/19/06	27,147	103518	59	34,004	NM	NM	2,950
8/31/06	17,707	104313	22	34,269	NM	NM	2,630
9/15/06	21,503	104885	13	34,460	NM	NM	2,730
9/29/06	19,829	105,040	4	34,511	NM	NM	2,650
10/30/06	44,691	105,066	0.3	34,520	NM	120	3,800
10/31/06	---	NR	---	---	NM	NM	NM
11/1/06	---	NR	---	---	NM	NM	NM
11/8/06	12,984	105,066	0	34,520	---	NM	1,850
12/1/06	33,237	105,067	0	34,520	23.79	NM	NM



**Table 3**  
**Extraction/Monitoring Well Performance Monitoring Data**  
Former Texaco Service Station, Chevron 211577  
631 Queen Anne Avenue North  
Seattle, WA

Well ID		DPE-5					
Well Type		Dual Phase Extraction					
Well Depth (feet)		28					
Top of Casing Elev. (feet)		113.81					
Screened Interval (feet bgs)		14 - 24					
Pump Make/Model		QED AP-4 Short/Top Loading					
Pump Capacity		9 gallons per minute					
Pump Intake Depth		24 feet below top of well casing					
Date	Elapsed Time Since Last Reading (mins)	Pulse Count	Extraction Rate <sup>1</sup> (gpd)	Cumulative Gallons Extracted <sup>1</sup> (gallons)	DTW (ft btc)	Casing Vacuum (" H2O)	VOC Conc (ppm)
12/19/06	26,005	111,671	122	36,722	23.80	NM	600
12/29/06	14,519	117,233	184	38,576	23.80	NM	350
1/31/07	47,154	130,301	133	42,932	23.80	NM	238
3/16/07	63,619	140,992	81	46,495	23.80	NM	375
3/29/07	18,505	145,317	112	47,937	23.80	105	440
4/17/07	---	NR	---	---	23.78	NM	NM
4/30/07	46,381	153,752	87	50,749	23.50	NM	290
5/30/07	43,211	161,618	87	53,371	23.77	NM	465
6/27/07	40,301	167,464	70	55,319	23.66	115	610
7/17/07	---	NR	---	---	NM	NM	600
8/1/07	50,218	173,822	61	57,439	NM	NM	520
8/29/07	40,401	178,799	59	59,098	23.77	NM	450
10/1/07	47,688	184,141	54	60,878	23.75	115	300
12/4/07	92,115	197,724	71	65,406	23.72	120	95
1/2/08	41,729	208,035	119	68,843	23.75	110	30
2/7/08	---	NR	---	---	NM	NM	83
2/28/08	81,998	230,474	131	76,323	23.70	120	100
4/1/08	47,130	238,582	83	79,025	23.72	115	28

**Table 3**  
**Extraction/Monitoring Well Performance Monitoring Data**  
Former Texaco Service Station, Chevron 211577  
631 Queen Anne Avenue North  
Seattle, WA

Well ID Well Type Well Depth (feet) Top of Casing Elev. (feet) Screened Interval (feet bgs) Pump Make/Model Pump Capacity Pump Intake Depth	DPE-6 Dual Phase Extraction 33.5 113.32 15.5 - 30.5 QED AP-4 Short/Top Loading 9 gallons per minute 30 feet below top of well casing							
	Date	Elapsed Time Since Last Reading (mins)	Pulse Count	Extraction Rate <sup>1</sup> (gpd)	Cumulative Gallons Extracted <sup>1</sup> (gallons)	DTW (ft bte)	Casing Vacuum (" H2O)	VOC Conc (ppm)
	02/22/06	---	20,429	---	---	19.62	Off	NM
	02/24/06	2,914	35,721	2,519	5,097	29.15	Off	NM
	02/27/06	4,311	55,103	2,158	11,558	NM	90	14,000
	02/28/06	1,114	63,000	3,403	14,190	NM	90	NM
	03/01/06	1,364	71,021	2,823	16,864	NM	85	NM
	03/02/06	NR	NR	---	---	NM	100	NM
	03/03/06	3,347	90,972	2,861	23,514	NM	NM	NM
	03/06/06	4,010	111,849	2,499	30,473	NM	NM	NM
	03/07/06	1,550	119,623	2,407	33,065	NM	110	9,500
	03/10/06	4,108	138,432	2,198	39,334	NM	110	NM
	03/16/06	8,939	174,765	1,951	51,445	NM	100	5,637
	03/17/06	NR	NR	---	---	NM	NM	NM
	03/23/06	10,272	215,263	1,892	64,945	NM	105	NM
	03/30/06	9,687	219,921	231	66,497	NM	NM	45,000
	04/06/06	10,333	240,137	939	73,236	NM	105	> 6,212
	04/13/06	9,706	280,443	1,993	86,671	NM	105	> 5,145
	04/17/06	5,977	307,137	2,144	95,569	NM	NM	NM
	04/25/06	11,398	356,203	2,066	111,925	NM	105	> 5,517
	05/04/06	13,167	412,893	2,067	130,821	NM	100	> 6,366
	05/05/06	---	NR	---	---	NM	NM	NM
	05/17/06	18,635	487,270	1,916	155,614	NM	90	> 5,878
	05/25/06	---	NR	---	---	NM	NM	NM
	06/15/06	41,596	687,599	2,312	222,390	NM	105	> 6,300
	06/27/06	17,426	787,416	2,749	255,662	29.8	NM	> 5,495
	7/11/06 - 7/12/06	20,409	905,038	2,766	294,870	NM	NM	> 5,530
	07/18/06	---	NR	---	---	NM	NM	NM
	07/31/06	28,644	1,070,695	2,776	350,089	NM	NM	> 5,905
	08/19/06	27,178	1,246,231	3,100	408,601	NM	110	> 5,594
	8/31/06	17,425	1,343,018	2,666	440,863	NM	NM	> 5,606
	9/15/06	21,422	1,458,531	2,588	479,367	NM	NM	> 5,756
	9/29/06	---	NR	---	---	NM	NM	> 5,369
	10/30/06	64,833	1,765,209	2,271	581,593	NM	110	> 10,931
	10/31/06	---	NR	---	---	NM	NM	NM
	11/1/06	---	NR	---	---	NM	NM	NM
	11/8/06	13,115	1,818,700	1,958	599,424	29.85	100	32,000
	12/1/06	33,106	1,901,327	1,198	626,966	29.85	NM	12,300

**Table 3**  
**Extraction/Monitoring Well Performance Monitoring Data**  
Former Texaco Service Station, Chevron 211577  
631 Queen Anne Avenue North  
Seattle, WA

Well ID		DPE-6					
Well Type		Dual Phase Extraction					
Well Depth (feet)		33.5					
Top of Casing Elev. (feet)		113.32					
Screened Interval (feet bgs)		15.5 - 30.5					
Pump Make/Model		QED AP-4 Short/Top Loading					
Pump Capacity		9 gallons per minute					
Pump Intake Depth		30 feet below top of well casing					
Date	Elapsed Time Since Last Reading (mins)	Pulse Count	Extraction Rate <sup>1</sup> (gpd)	Cumulative Gallons Extracted <sup>1</sup> (gallons)	DTW (ft btc)	Casing Vacuum (" H2O)	VOC Conc (ppm)
12/19/06	25,740	2,024,089	2,289	667,887	29.85	110	22,000
12/29/06	14,771	2,095,365	2,316	691,645	29.85	NM	5,500
1/31/07	47,184	2,346,369	2,553	775,313	29.84	110	3,300
3/16/07	63,583	2,628,050	2,126	869,207	29.83	NM	3,400
3/29/07	18,449	2,707,527	2,068	895,699	29.83	105	3,770
4/17/07	---	NR	---	---	29.83	NM	NM
4/30/07	46,415	2,909,105	2,085	962,892	29.83	NM	3,000
5/30/07	---	NR	---	---	NM	NM	3,100
6/27/07	83,296	3,273,772	2,101	1,084,448	29.84	117	3,000
7/17/07	---	NR	---	---	NM	NM	2,700
8/1/07	50,479	3,488,098	2,038	1,155,890	28.42	NM	3,175
8/29/07	---	NR	---	---	NM	NM	3,800
10/1/07	88,070	3,750,918	1,432	1,243,496	29.59	115	5,500
12/4/07	93,248	3,957,314	1,062	1,312,295	28.51	NM	8,900
1/2/08	40,441	4,052,675	1,132	1,344,082	29.79	110	2,000
2/7/08	---	NR	---	---	NM	NM	500
2/28/08	81,823	4,296,991	1,433	1,425,521	29.81	115	320
4/1/08	47,567	4,407,512	1,115	1,462,361	24.00	112	320

**Table 3**  
**Extraction/Monitoring Well Performance Monitoring Data**  
Former Texaco Service Station, Chevron 211577  
631 Queen Anne Avenue North  
Seattle, WA

Well ID Well Type Well Depth (feet) Top of Casing Elev. (feet) Screened Interval (feet bgs) Pump Make/Model Pump Capacity Pump Intake Depth	DPE-7 Dual Phase Extraction 33.5 113.15 11 - 29 QED AP-4 Short/Top Loading 9 gallons per minute 27 feet below top of well casing							
	Date	Elapsed Time Since Last Reading (mins)	Pulse Count	Extraction Rate <sup>1</sup> (gpd)	Cumulative Gallons Extracted <sup>1</sup> (gallons)	DTW (ft btc)	Casing Vacuum (" H2O)	VOC Conc (ppm)
	02/22/06	---	11,566	---	---	19.20	Off	NM
	02/24/06	2,903	21,312	1,611	3,249	26.70	Off	NM
	02/27/06	4,295	33,182	1,327	7,205	NM	80	2,225
	02/28/06	1,142	38,930	2,416	9,121	NM	85	NM
	03/01/06	1,364	44,597	1,994	11,010	NM	85	NM
	03/02/06	1,485	51,068	2,092	13,167	NM	100	NM
	03/03/06	1,830	59,103	2,108	15,846	NM	NM	NM
	03/06/06	3,854	72,664	1,689	20,366	NM	NM	NM
	03/07/06	1,667	78,370	1,643	22,268	NM	105	2,598
	03/10/06	4,189	92,744	1,647	27,059	NM	100	NM
	03/16/06	8,928	122,202	1,584	36,879	NM	100	1,481
	03/17/06	---	NR	---	---	NM	NM	NM
	03/23/06	10,306	154,721	1,515	47,718	NM	105	NM
	03/30/06	9,657	184,823	1,496	57,752	NM	NM	916
	04/06/06	10,331	214,706	1,388	67,713	NM	95	1,032
	04/13/06	9,711	242,020	1,350	76,818	NM	100	743
	04/17/06	5,900	257,936	1,295	82,123	NM	NM	NM
	04/25/06	11,435	290,954	1,386	93,129	NM	100	730
	05/04/06	---	NR	---	---	NM	NM	1,600
	05/05/06	---	NR	---	---	NM	NM	NM
	05/17/06	31,798	378,081	1,315	122,172	NM	90	850
	05/25/06	---	NR	---	---	NM	NM	NM
	06/15/06	41,630	513,189	1,558	167,208	NM	100	1,562
	06/27/06	17,413	576,612	1,748	188,349	26.99	NM	2,510
	7/11/06 - 7/12/06	20,425	651,971	1,771	213,468	NM	NM	1,980
	07/18/06	---	NR	---	---	NM	NM	NM
	07/31/06	28,643	741,752	1,505	243,395	NM	NM	1,700
	08/19/06	27,162	817,802	1,344	268,745	NM	100	1,100
	8/31/06	17,687	860,355	1,155	282,930	NM	NM	1,630
	9/15/06	21,183	908,703	1,096	299,046	NM	NM	2,460
	9/29/06	20,146	946,753	907	311,729	NM	NM	2,300
	10/30/06	44,690	1,030,622	901	339,685	NM	100	3,700
	10/31/06	---	NR	---	---	NM	NM	NM
	11/1/06	---	NR	---	---	NM	NM	NM
	11/8/06	12,978	1,055,800	931	348,078	>25.62	NM	1,000
	12/1/06	33,234	1,116,575	878	368,336	26.95	NM	NM

**Table 3**  
**Extraction/Monitoring Well Performance Monitoring Data**  
Former Texaco Service Station, Chevron 211577  
631 Queen Anne Avenue North  
Seattle, WA

Well ID	DPE-7						
	Well Type	Dual Phase Extraction					
Well Depth (feet)	33.5						
Top of Casing Elev. (feet)	113.15						
Screened Interval (feet bgs)	11 - 29						
Pump Make/Model	QED AP-4 Short/Top Loading						
Pump Capacity	9 gallons per minute						
Pump Intake Depth	27 feet below top of well casing						
Date	Elapsed Time Since Last Reading (mins)	Pulse Count	Extraction Rate <sup>1</sup> (gpd)	Cumulative Gallons Extracted <sup>1</sup> (gallons)	DTW (ft btc)	Casing Vacuum (" H2O)	VOC Conc (ppm)
12/19/06	25,718	1,193,170	1,430	393,868	26.97	110	300
12/29/06	14,777	1,224,167	1,007	404,200	27.02	NM	350
1/31/07	47,198	1,349,826	1,278	446,087	NM	95	175
3/16/07	63,580	1,436,372	653	474,935	26.95	NM	150
3/29/07	18,435	1,470,775	896	486,403	27.02	87	121
4/17/07	---	NR	---	---	27.00	NM	NM
4/30/07	46,426	1,549,585	815	512,673	26.94	NM	125
5/30/07	---	NR	---	---	NM	NM	10
6/27/07	83,294	1,642,875	538	543,770	26.96	45	3
7/17/07	---	NR	---	---	NM	NM	3
8/1/07	---	NR	---	---	NM	NM	2
8/29/07	90,860	1,693,900	270	560,778	27.04	NM	2
10/1/07	47,715	1,717,642	239	568,692	27.45	45	1
12/4/07	91,921	1,795,152	405	594,529	27.52	110	95
1/2/08	41,742	1,846,075	586	611,503	27.25	90	27
2/7/08	---	NR	---	---	NM	NM	0
2/28/08	81,825	1,907,771	362	632,068	26.97	45	0
4/1/08	47,509	1,943,548	361	643,994	26.99	60	0

**Table 3**  
**Extraction/Monitoring Well Performance Monitoring Data**  
Former Texaco Service Station, Chevron 211577  
631 Queen Anne Avenue North  
Seattle, WA

Well ID Well Type Well Depth (feet) Top of Casing Elev. (feet) Screened Interval (feet bgs) Pump Make/Model Pump Capacity Pump Intake Depth	DPE-8 Dual Phase Extraction 23.5 104.35 10 - 20 QED AP-4 Short/Top Loading 9 gallons per minute 20.5 feet below top of well casing						
	Date	Elapsed Time Since Last Reading (mins)	Pulse Count	Extraction Rate <sup>1</sup> (gpd)	Cumulative Gallons Extracted <sup>1</sup> (gallons)	DTW (ft btc)	Casing Vacuum (" H2O)
02/22/06	---	---	---	---	---	---	---
02/24/06	---	---	---	---	---	---	---
02/27/06	---	---	---	---	---	---	---
02/28/06	---	---	---	---	---	---	---
03/01/06	---	---	---	---	---	---	---
03/02/06	---	---	---	---	---	---	---
03/03/06	---	---	---	---	---	---	---
03/06/06	---	---	---	---	---	---	---
03/07/06	---	---	---	---	---	---	---
03/10/06	---	---	---	---	---	---	---
03/16/06	---	---	---	---	---	---	---
03/17/06	---	---	---	---	---	---	---
03/23/06	---	---	---	---	---	---	---
03/30/06	---	---	---	---	---	---	---
04/06/06	---	---	---	---	---	---	---
04/13/06	---	---	---	---	---	---	---
04/17/06	---	---	---	---	---	---	---
04/25/06	---	---	---	---	---	---	---
05/04/06	---	---	---	---	---	---	---
05/05/06	---	---	---	---	---	---	---
05/17/06	---	---	---	---	---	---	---
05/25/06	---	---	---	---	---	---	---
06/15/06	---	---	---	---	---	---	---
06/27/06	---	---	---	---	---	---	---
7/11/06 - 7/12/06	---	---	---	---	---	---	---
07/18/06	---	---	---	---	---	---	---
07/31/06	---	---	---	---	---	---	---
08/19/06	---	---	---	---	---	---	---
8/31/06	---	---	---	---	---	---	---
9/15/06	---	---	---	---	---	---	---
9/29/06	---	---	---	---	---	---	---
10/30/06	<b>Pump Started on 10/31/06</b>						
10/31/06	---	213	---	---	16.16	0	NM
11/1/06	1,262	388	67	58	20.39	0	NM
11/8/06	10,287	28,415	1,308	9,401	20.38	95	45,000
12/1/06	33,088	84,402	812	28,063	20.39	NM	12,000

**Table 3**  
**Extraction/Monitoring Well Performance Monitoring Data**  
Former Texaco Service Station, Chevron 211577  
631 Queen Anne Avenue North  
Seattle, WA

Well ID	DPE-8						
	Dual Phase Extraction						
Well Type	23.5						
Well Depth (feet)	104.35						
Top of Casing Elev. (feet)	10 - 20						
Screened Interval (feet bgs)	QED AP-4 Short/Top Loading						
Pump Make/Model	9 gallons per minute						
Pump Capacity	20.5 feet below top of well casing						
Pump Intake Depth							
Date	Elapsed Time Since Last Reading (mins)	Pulse Count	Extraction Rate <sup>1</sup> (gpd)	Cumulative Gallons Extracted <sup>1</sup> (gallons)	DTW (ft bte)	Casing Vacuum (" H2O)	VOC Conc (ppm)
12/19/06	25,843	146,492	1,153	48,760	20.35	105	5,000
12/29/06	14,622	185,078	1,267	61,622	20.35	NM	12,000
1/31/07	47,326	312,599	1,293	104,129	20.36	105	>5,488
3/16/07	63,378	395,654	629	131,814	20.34	NM	3,900
3/29/07	18,573	418,601	593	139,463	20.34	100	3,200
4/17/07	---	NR	---	---	20.28	NM	NM
4/30/07	46,435	450,593	331	150,127	20.37	NM	1,700
5/30/07	43,197	484,846	381	161,544	20.37	NM	1,400
6/27/07	40,192	533,187	577	177,658	20.34	110	950
7/17/07	---	NR	---	---	NM	NM	775
8/1/07	50,382	583,491	479	194,426	20.33	NM	700
8/29/07	40,322	643,878	719	214,555	20.28	NM	475
10/1/07	47,672	715,196	718	238,328	20.25	110	340
12/4/07	92,142	832,649	612	277,479	20.23	115	320
1/2/08	41,747	895,266	720	298,351	20.33	105	440
2/7/08	---	NR	---	---	NM	NM	295
2/28/08	81,683	1,072,279	1,040	357,355	20.30	110	125
4/1/08	47,530	1,149,109	776	382,965	20.31	105	110

**Table 3**  
**Extraction/Monitoring Well Performance Monitoring Data**  
Former Texaco Service Station, Chevron 211577  
631 Queen Anne Avenue North  
Seattle, WA

Well ID	DPE-9						
	Soil Vapor Extraction						
Well Type	19.27						
Well Depth (feet)	103.38						
Top of Casing Elev. (feet)	10.5 - 15.5						
Screened Interval (feet bgs)	---						
Pump Make/Model	---						
Pump Capacity	---						
Pump Intake Depth	---						
Date	Elapsed Time Since Last Reading (mins)	Pulse Count	Extraction Rate <sup>1</sup> (gpd)	Cumulative Gallons Extracted <sup>1</sup> (gallons)	DTW (ft btc)	Casing Vacuum (" H2O)	VOC Conc (ppm)
02/22/06	---	---	---	---	---	---	---
02/24/06	---	---	---	---	---	---	---
02/27/06	---	---	---	---	---	---	---
02/28/06	---	---	---	---	---	---	---
03/01/06	---	---	---	---	---	---	---
03/02/06	---	---	---	---	---	---	---
03/03/06	---	---	---	---	---	---	---
03/06/06	---	---	---	---	---	---	---
03/07/06	---	---	---	---	---	---	---
03/10/06	---	---	---	---	---	---	---
03/16/06	---	---	---	---	---	---	---
03/17/06	---	---	---	---	---	---	---
03/23/06	---	---	---	---	---	---	---
03/30/06	---	---	---	---	---	---	---
04/06/06	---	---	---	---	---	---	---
04/13/06	---	---	---	---	---	---	---
04/17/06	---	---	---	---	---	---	---
04/25/06	---	---	---	---	---	---	---
05/04/06	---	---	---	---	---	---	---
05/05/06	---	---	---	---	---	---	---
05/17/06	---	---	---	---	---	---	---
05/25/06	---	---	---	---	---	---	---
06/15/06	---	---	---	---	---	---	---
06/27/06	---	---	---	---	---	---	---
7/11/06 - 7/12/06	---	---	---	---	---	---	---
07/18/06	---	---	---	---	---	---	---
07/31/06	---	---	---	---	---	---	---
08/19/06	---	---	---	---	---	---	---
8/31/06	---	---	---	---	---	---	---
9/15/06	---	---	---	---	---	---	---
9/29/06	---	---	---	---	---	---	---
10/30/06	---	---	---	---	14.75	---	---
10/31/06	---	---	---	---	NM	---	---
11/1/06	SVE Started on 11/2/06						
11/8/06	---	---	---	---	13.44	100	14,000
12/1/06	---	---	---	---	13.72	NM	NM



**Table 3**  
**Extraction/Monitoring Well Performance Monitoring Data**  
Former Texaco Service Station, Chevron 211577  
631 Queen Anne Avenue North  
Seattle, WA

Well ID		DPE-9					
Well Type		Soil Vapor Extraction					
Well Depth (feet)		19.27					
Top of Casing Elev. (feet)		103.38					
Screened Interval (feet bgs)		10.5 - 15.5					
Pump Make/Model		---					
Pump Capacity		---					
Pump Intake Depth		---					
Date	Elapsed Time Since Last Reading (mins)	Pulse Count	Extraction Rate <sup>1</sup> (gpd)	Cumulative Gallons Extracted <sup>1</sup> (gallons)	DTW (ft bte)	Casing Vacuum (" H2O)	VOC Conc (ppm)
12/19/06	---	---	---	---	13.15	120	3,800
12/29/06	---	---	---	---	13.39	NM	350
1/31/07	---	---	---	---	12.92	107	300
3/16/07	---	---	---	---	12.40	NM	55
3/29/07	---	---	---	---	12.69	105	53
4/17/07	---	---	---	---	14.13	NM	NM
4/30/07	---	---	---	---	13.05	NM	48
5/30/07	---	---	---	---	13.13	NM	100
6/27/07	---	---	---	---	13.10	50	60
7/17/07	---	253	---	0	13.95	NM	55
8/1/07	21,742	419	4	55	16.23	NM	120
8/29/07	40,402	640	3	129	16.18	NM	50
10/1/07	47,678	878	2	208	16.23	44	40
12/4/07	92,122	4,631	20	1,459	16.23	95	115
1/2/08	41,756	11,022	73	3,590	16.23	110	46
2/7/08	---	NR	---	---	NM	NM	17
2/28/08	81,940	20,237	54	6,661	16.22	110	8
4/1/08	47,289	23,341	32	7,696	16.23	107	15

**Table 3**  
**Extraction/Monitoring Well Performance Monitoring Data**  
Former Texaco Service Station, Chevron 211577  
631 Queen Anne Avenue North  
Seattle, WA

Well ID	RW-2				VP-1		
	Monitoring Well				Soil Vapor Extraction		
Well Type	21.42				14.81		
Well Depth (feet)	106.63				103.03		
Top of Casing Elev. (feet)	8.25 (top of screen)				5 -15		
Screened Interval (feet bgs)	--				--		
Pump Make/Model	--				--		
Pump Capacity	--				--		
Pump Intake Depth	--				--		
Date	DTW (ft btc)	Casing Vacuum (" H2O)	Stinger Vacuum (" H2O)	VOC Conc (ppm)	DTW (ft btc)	Casing Vacuum (" H2O)	VOC Conc (ppm)
02/22/06	NM	---	---	---	10.89	---	---
02/24/06	10.61	---	---	---	11.00	---	---
02/27/06	11.15	NM	---	---	9.00	55	48
02/28/06	NM	NM	---	---	NM	NM	NM
03/01/06	NM	NM	---	---	NM	NM	NM
03/02/06	NM	NM	---	---	NM	NM	NM
03/03/06	NM	NM	---	---	NM	NM	NM
03/06/06	NM	NM	---	---	NM	NM	NM
03/07/06	12.38	NM	---	---	10.50	95	NM
03/10/06	NM	NM	---	---	NM	NM	NM
03/16/06	NM	NM	---	---	NM	NM	5.6
03/17/06	NM	NM	---	---	NM	NM	NM
03/23/06	NM	NM	---	---	NM	NM	NM
03/30/06	13.62	NM	---	---	10.95	50	NM
04/06/06	14.05	NM	---	---	10.72	90	13.5
04/13/06	NM	10	35	1,228	NM	NM	17.5
04/17/06	20.80	40	45	NM	12.20	NM	NM
04/25/06	NM	40	65	NM	12.06	NM	4
05/04/06	NM	10	40	100	> 12.30	NM	NM
05/05/06	NM	NM	NM	NM	NM	NM	NM
05/17/06	NM	NM	NM	300	> 12.30	NM	17
05/25/06	NM	NM	NM	NM	NM	NM	NM
06/15/06	NM	NM	NM	29	> 12.28	NM	50
06/27/06	20.2	NM	NM	11.8	> 12.29	NM	57
7/11/06 - 7/12/06	NM	NM	NM	54	14.13	NM	6.5
07/18/06	NM	NM	NM	NM	14.11	NM	NM
07/31/06	20.1	NM	NM	175	13.42	NM	92
08/19/06	NM	50	75	200	13.44	35	60
8/31/06	20.13	NM	NM	360	14.31	NM	71
9/15/06	20.17	NM	NM	NM	> 13.50	NM	NM
9/29/06	<b>TPE Discontinued 9/22/06</b>				<b>Well Abandoned Sept. 2006</b>		
10/30/06	17.71	NM	---	---	---	---	---
10/31/06	NM	NM	---	---	---	---	---
11/1/06	NM	NM	---	---	---	---	---
11/8/06	15.96	6	---	---	---	---	---
12/1/06	16.15	NM	---	---	---	---	---

**Table 3**  
**Extraction/Monitoring Well Performance Monitoring Data**  
Former Texaco Service Station, Chevron 211577  
631 Queen Anne Avenue North  
Seattle, WA

Well ID	RW-2				VP-1		
	Monitoring Well				Soil Vapor Extraction		
Well Type	21.42				14.81		
Well Depth (feet)	106.63				103.03		
Top of Casing Elev. (feet)	8.25 (top of screen)				5 - 15		
Screened Interval (feet bgs)	--				--		
Pump Make/Model	--				--		
Pump Capacity	--				--		
Pump Intake Depth	--				--		
Date	DTW (ft btc)	Casing Vacuum (" H2O)	Stinger Vacuum (" H2O)	VOC Conc (ppm)	DTW (ft btc)	Casing Vacuum (" H2O)	VOC Conc (ppm)
12/19/06	16.05	7.5	---	---	---	---	---
12/29/06	15.16	NM	---	---	---	---	---
1/31/07	17.24	5	---	---	---	---	---
3/16/07	16.37	NM	---	---	---	---	---
3/29/07	16.48	7	---	---	---	---	---
4/17/07	17.12	NM	---	---	---	---	---
4/30/07	16.98	NM	---	---	---	---	---
5/30/07	18.13	NM	---	---	---	---	---
6/27/07	18.41	3.5	---	---	---	---	---
7/17/07	NM	NM	---	---	---	---	---
8/1/07	18.69	NM	---	---	---	---	---
8/29/07	17.60	NM	---	---	---	---	---
10/1/07	17.89	1.3	---	---	---	---	---
12/4/07	15.21	NM	---	---	---	---	---
1/2/08	NM	3.5	---	---	---	---	---
2/7/08	NM	NM	---	---	---	---	---
2/28/08	18.11	2	---	---	---	---	---
4/1/08	17.56	2	---	---	---	---	---

**Table 3**  
**Extraction/Monitoring Well Performance Monitoring Data**  
Former Texaco Service Station, Chevron 211577  
631 Queen Anne Avenue North  
Seattle, WA

Well ID Well Type	VP-2 Soil Vapor Extraction			VP-3 Soil Vapor Extraction			VP-4 Soil Vapor Extraction		
	Well Depth (feet)	Top of Casing Elev. (feet)	Screened Interval (feet bgs)	Pump Make/Model	Pump Capacity	Pump Intake Depth	DTW (ft btc)	Casing Vacuum (" H2O)	VOC Conc (ppm)
	14.55	105.11	5 - 15	--	--	--			
	9.1	104.75	2 - 10	--	--	--			
	14.7	103.35	5 - 15	--	--	--			
Date	DTW (ft btc)	Casing Vacuum (" H2O)	VOC Conc (ppm)	DTW (ft btc)	Casing Vacuum (" H2O)	VOC Conc (ppm)	DTW (ft btc)	Casing Vacuum (" H2O)	VOC Conc (ppm)
02/22/06	12.02	---	---	NM	---	---	11.03	---	---
02/24/06	12.12	---	---	NM	---	---	NM	---	---
02/27/06	7.95	63	11	8.00	60	28	8.10	65	26
02/28/06	NM	NM	NM	NM	NM	NM	NM	NM	NM
03/01/06	NM	NM	NM	NM	NM	NM	NM	NM	NM
03/02/06	NM	NM	NM	NM	NM	NM	NM	NM	NM
03/03/06	NM	NM	NM	NM	NM	NM	NM	NM	NM
03/06/06	NM	NM	NM	NM	NM	NM	NM	NM	NM
03/07/06	11.00	95	14	8.35	23	8	9.50	55	14
03/10/06	NM	NM	NM	NM	NM	NM	NM	NM	NM
03/16/06	NM	NM	1.5	NM	NM	1.1	NM	NM	0.3
03/17/06	NM	NM	NM	NM	NM	NM	NM	NM	NM
03/23/06	NM	NM	NM	NM	NM	NM	NM	NM	NM
03/30/06	NM	100	NM	7.52	22	15	11.25	50	15
04/06/06	11.72	102	8	7.63	NM	0	11.19	NM	0
04/13/06	NM	NM	20.7	NM	NM	14	NM	NM	3.8
04/17/06	> 12.08	NM	NM	> 9.00	NM	NM	12.12	NM	NM
04/25/06	> 12.08	NM	NM	> 9.00	NM	NM	12.2	NM	1.4
05/04/06	> 12.08	NM	15	> 9.00	NM	NM	12.08	NM	3.5
05/05/06	NM	NM	NM	NM	NM	NM	NM	NM	NM
05/17/06	> 12.08	NM	30	> 9.00	NM	0.5	12.65	NM	38
05/25/06	NM	NM	NM	NM	NM	NM	13.01	NM	NM
06/15/06	> 12.06	NM	98	> 9.0	NM	NM	13.3	NM	240
06/27/06	> 12.06	NM	175	> 8.96	NM	NM	13.48	NM	165
7/11/06 - 7/12/06	13.83	NM	28.7	>8.96	NM	NM	13.72	NM	168
07/18/06	14.45	NM	NM	NM	NM	NM	13.88	NM	NM
07/31/06	14.33	NM	32	NM	NM	NM	13.54	NM	132
08/19/06	14.31	35	115	NM	0.25	NM	> 14.05	22	340
8/31/06	14.63	NM	NM	>8.99	NM	NM	> 14.07	NM	780
9/15/06	14.65	NM	1	NM	NM	NM	> 14.08	24	1,900
9/29/06	14.66	NM	NM	Well Abandoned Sept. 2006			14.08	NM	1,100
10/30/06	14.66	1.4	NM	---	---	---	14	45	1,300
10/31/06	14.66	NM	NM	---	---	---	NM	NM	NM
11/1/06	NM	NM	NM	---	---	---	NM	NM	NM
11/8/06	14.67	8	NM	---	---	---	> 14.05	47	940
12/1/06	14.71	NM	NM	---	---	---	13.61	NM	NM

**Table 3**  
**Extraction/Monitoring Well Performance Monitoring Data**  
Former Texaco Service Station, Chevron 211577  
631 Queen Anne Avenue North  
Seattle, WA

Well ID Well Type	VP-2 Soil Vapor Extraction			VP-3 Soil Vapor Extraction			VP-4 Soil Vapor Extraction											
	Well Depth (feet)	Top of Casing Elev. (feet)	Screened Interval (feet bgs)	Pump Make/Model	Pump Capacity	Pump Intake Depth	Well Depth (feet)	Top of Casing Elev. (feet)	Screened Interval (feet bgs)	Pump Make/Model	Pump Capacity	Pump Intake Depth						
	14.55	105.11	5 - 15	--	--	--	9.1	104.75	2 - 10	--	--	--	14.7	103.35	5 - 15	--	--	--
Date	DTW (ft btc)	Casing Vacuum (" H2O)	VOC Conc (ppm)	DTW (ft btc)	Casing Vacuum (" H2O)	VOC Conc (ppm)	DTW (ft btc)	Casing Vacuum (" H2O)	VOC Conc (ppm)									
12/19/06	14.62	7	NM	---	---	---	> 13.92	8	10									
12/29/06	14.66	NM	NM	---	---	---	> 13.93	NM	NM									
1/31/07	14.70	5	NM	---	---	---	> 13.89	7.5	NM									
3/16/07	14.74	NM	NM	---	---	---	> 13.92	NM	NM									
3/29/07	14.75	6	NM	---	---	---	> 13.92	11	NM									
4/17/07	> 14.79	NM	NM	---	---	---	> 13.77	NM	NM									
4/30/07	14.77	NM	NM	---	---	---	> 13.92	NM	NM									
5/30/07	14.77	NM	NM	---	---	---	> 13.92	NM	NM									
6/27/07	14.77	3.5	NM	---	---	---	> 13.93	8	NM									
7/17/07	14.75	NM	NM	---	---	---	> 13.93	NM	NM									
8/1/07	14.74	NM	NM	---	---	---	> 13.93	NM	NM									
8/29/07	14.63	NM	NM	---	---	---	> 13.95	NM	NM									
10/1/07	14.64	3.6	NM	---	---	---	> 13.94	7.4	NM									
12/4/07	14.70	NM	NM	---	---	---	> 13.94	NM	NM									
1/2/08	14.76	5	NM	---	---	---	> 13.95	10	NM									
2/7/08	NM	NM	NM	---	---	---	NM	NM	NM									
2/28/08	14.83	4	NM	---	---	---	> 13.95	10	NM									
4/1/08	14.87	7	0	---	---	---	> 13.93	13	0									

**Table 3**  
**Extraction/Monitoring Well Performance Monitoring Data**  
Former Texaco Service Station, Chevron 211577  
631 Queen Anne Avenue North  
Seattle, WA

Well ID Well Type	VP-5 Soil Vapor Extraction			VP-7 Soil Vapor Extraction			VP-8 Soil Vapor Extraction											
	Well Depth (feet)	Top of Casing Elev. (feet)	Screened Interval (feet bgs)	Pump Make/Model	Pump Capacity	Pump Intake Depth	DTW (ft btc)	Casing Vacuum (" H2O)	VOC Conc (ppm)									
	16.5	102.63	6 - 17	--	--	--	17.42	100.40	2 - 18	--	--	--	16.76	104.88	5 - 17	--	--	--
Date	DTW (ft btc)	Casing Vacuum (" H2O)	VOC Conc (ppm)	DTW (ft btc)	Casing Vacuum (" H2O)	VOC Conc (ppm)	DTW (ft btc)	Casing Vacuum (" H2O)	VOC Conc (ppm)									
02/22/06	10.62	---	---	8.89	---	---	11.05	---	---									
02/24/06	10.65	---	---	8.91	---	---	11.15	---	---									
02/27/06	10.25	15	NM	6.65	55	24	9.12	50	78									
02/28/06	NM	NM	NM	NM	NM	NM	NM	NM	NM									
03/01/06	NM	NM	NM	NM	NM	NM	NM	NM	NM									
03/02/06	NM	NM	NM	NM	NM	NM	NM	NM	NM									
03/03/06	NM	NM	NM	NM	NM	NM	NM	NM	NM									
03/06/06	NM	NM	NM	NM	NM	NM	NM	NM	NM									
03/07/06	10.30	40	33	8.00	45	25	9.40	100	101									
03/10/06	NM	NM	NM	NM	NM	NM	NM	NM	NM									
03/16/06	NM	NM	0	NM	NM	0	NM	NM	3									
03/17/06	NM	NM	NM	NM	NM	NM	NM	NM	NM									
03/23/06	NM	NM	NM	NM	NM	NM	NM	NM	NM									
03/30/06	11.30	40	20	9.20	45	17	NM	95	86									
04/06/06	11.43	NM	0	9.65	NM	0	11.40	NM	28.2									
04/13/06	NM	NM	0.1	NM	NM	1.2	NM	NM	41.8									
04/17/06	11.56	NM	NM	9.94	NM	NM	12.40	NM	NM									
04/25/06	11.78	NM	0	10.01	NM	NM	12.65	NM	36.7									
05/04/06	11.85	NM	0	9.85	NM	NM	12.80	NM	45									
05/05/06	NM	NM	NM	10.33	NM	NM	NM	NM	NM									
05/17/06	12.53	NM	3	10.74	NM	0	13.21	NM	65									
05/25/06	12.81	NM	NM	10.96	NM	NM	12.71	NM	NM									
06/15/06	13.11	NM	0	11.31	NM	0	13.73	NM	435									
06/27/06	13.12	NM	4	11.35	NM	11	> 11.06	NM	695									
7/11/06 - 7/12/06	13.33	NM	0.2	11.92	NM	0.7	13.97	NM	560									
07/18/06	13.47	NM	NM	11.71	NM	NM	14.01	NM	NM									
07/31/06	13.09	NM	55	11.45	NM	4	13.54	NM	805									
08/19/06	13.75	4.5	8	12.03	4	5	14.07	28	800									
8/31/06	13.99	NM	12	12.28	NM	6	14.26	NM	1,800									
9/15/06	14.09	4.5	NM	12.36	4	NM	14.29	28	3,000									
9/29/06	14.23	NM	NM	12.45	NM	NM	14.46	NM	460									
10/30/06	13.94	4.5	NM	12.22	4	NM	14.4	40	400									
10/31/06	NM	NM	NM	NM	NM	NM	NM	NM	NM									
11/1/06	NM	NM	NM	> 12.46	NM	NM	NM	NM	NM									
11/8/06	15.27	7	NM	> 12.45	5	NM	14.93	37	400									
12/1/06	15.39	NM	NM	> 12.43	NM	NM	14.72	NM	NM									

**Table 3**  
**Extraction/Monitoring Well Performance Monitoring Data**  
Former Texaco Service Station, Chevron 211577  
631 Queen Anne Avenue North  
Seattle, WA

Well ID Well Type Well Depth (feet) Top of Casing Elev. (feet) Screened Interval (feet bgs) Pump Make/Model Pump Capacity Pump Intake Depth	VP-5 Soil Vapor Extraction			VP-7 Soil Vapor Extraction			VP-8 Soil Vapor Extraction		
	DTW (ft btc)	Casing Vacuum (" H2O)	VOC Conc (ppm)	DTW (ft btc)	Casing Vacuum (" H2O)	VOC Conc (ppm)	DTW (ft btc)	Casing Vacuum (" H2O)	VOC Conc (ppm)
		16.5			17.42			16.76	
		102.63			100.40			104.88	
		6 - 17			2 - 18			5 - 17	
		--			--			--	
		--			--			--	
		--			--			--	
Date	DTW (ft btc)	Casing Vacuum (" H2O)	VOC Conc (ppm)	DTW (ft btc)	Casing Vacuum (" H2O)	VOC Conc (ppm)	DTW (ft btc)	Casing Vacuum (" H2O)	VOC Conc (ppm)
12/19/06	16.11	8	NM	> 12.45	7	NM	15.3	2	2
12/29/06	16.17	NM	NM	> 12.45	NM	NM	15.15	NM	NM
1/31/07	16.17	8	NM	> 12.45	6	NM	15.55	7	NM
3/16/07	16.22	NM	NM	NM	NM	NM	15.89	NM	NM
3/29/07	16.24	8	NM	> 12.43	7	NM	15.92	4	NM
4/17/07	> 16.25	NM	NM	> 12.22	NM	NM	15.21	NM	NM
4/30/07	> 16.37	NM	NM	> 12.44	NM	NM	15.73	NM	NM
5/30/07	16.29	NM	NM	> 12.39	NM	NM	16.04	NM	NM
6/27/07	16.26	5.5	NM	> 12.43	5	NM	16.13	2.5	NM
7/17/07	16.22	NM	NM	> 12.43	NM	NM	16.12	NM	NM
8/1/07	16.21	NM	NM	> 12.43	NM	NM	16.69	NM	NM
8/29/07	16.18	NM	NM	> 12.43	NM	NM	16.79	NM	NM
10/1/07	16.17	5.0	NM	> 12.44	4.2	NM	17.32	1.6	NM
12/4/07	16.21	NM	NM	> 12.52	NM	NM	17.34	NM	NM
1/2/08	16.19	5	NM	> 12.43	6	NM	16.80	7	NM
2/7/08	NM	NM	NM	NM	NM	NM	NM	NM	NM
2/28/08	16.23	6	NM	> 12.43	6	NM	16.39	3	NM
4/1/08	16.29	7.1	0	> 12.43	7	0	16.60	4	0

**Table 3**  
**Extraction/Monitoring Well Performance Monitoring Data**  
Former Texaco Service Station, Chevron 211577  
631 Queen Anne Avenue North  
Seattle, WA

Well ID	VP-9			H-1		H-2		H-3	
	Soil Vapor Extraction			Horizontal SVE		Horizontal SVE		Horizontal SVE	
Well Type									
Well Depth (feet)	13.5			--		--		--	
Top of Casing Elev. (feet)	112.35			--		--		--	
Screened Interval (feet bgs)	--			--		--		--	
Pump Make/Model	--			--		--		--	
Pump Capacity	--			--		--		--	
Pump Intake Depth	--			--		--		--	
Date	DTW (ft btc)	Casing Vacuum (" H2O)	VOC Conc (ppm)	Casing Vacuum (" H2O)	VOC Conc (ppm)	Casing Vacuum (" H2O)	VOC Conc (ppm)	Casing Vacuum (" H2O)	VOC Conc (ppm)
02/22/06	9.38	---	---	---	---	---	---	---	---
02/24/06	8.95	---	---	---	---	---	---	---	---
02/27/06	NM	NM	NM	Off	NM	Off	NM	Off	NM
02/28/06	NM	Off	NM	Off	NM	Off	NM	Off	NM
03/01/06	NM	Off	NM	Off	NM	Off	NM	Off	NM
03/02/06	NM	Off	NM	Off	NM	Off	NM	Off	NM
03/03/06	NM	Off	NM	Off	NM	Off	NM	Off	NM
03/06/06	NM	Off	NM	Off	NM	Off	NM	Off	NM
03/07/06	NM	Off	NM	Off	NM	Off	NM	Off	NM
03/10/06	NM	Off	NM	Off	NM	Off	NM	Off	NM
03/16/06	NM	Off	NM	Off	NM	Off	NM	Off	NM
03/17/06	NM	Off	NM	Off	NM	Off	NM	Off	NM
03/23/06	NM	Off	NM	Off	NM	Off	NM	Off	NM
03/30/06	NM	Off	NM	Off	NM	Off	NM	Off	NM
04/06/06	NM	Off	NM	Off	NM	Off	NM	Off	NM
04/13/06	NM	Off	NM	Off	NM	Off	NM	Off	NM
04/17/06	9.1	0.3	NM	Off	NM	Off	NM	Off	NM
04/25/06	9.64	NM	NM	Off	NM	Off	NM	Off	NM
05/04/06	NM	NM	NM	Off	NM	Off	NM	Off	NM
05/05/06	9.81	NM	NM	Off	NM	Off	NM	Off	NM
05/17/06	NM	NM	180	Off	2	Off	5	Off	15
05/25/06	NM	NM	NM	Off	NM	Off	NM	Off	NM
06/15/06	NM	NM	NM	Off	NM	Off	NM	Off	NM
06/27/06	NM	NM	NM	Off	NM	Off	NM	Off	NM
7/11/06 - 7/12/06	NM	NM	82	Off	NM	Off	NM	Off	NM
07/18/06	NM	NM	NM	Off	NM	Off	NM	Off	NM
07/31/06	10.82	NM	36	Off	NM	Off	NM	Off	NM
08/19/06	NM	NM	60	Off	NM	Off	NM	Off	NM
8/31/06	NM	NM	NM	Off	NM	Off	NM	Off	NM
9/15/06	NM	NM	NM	Off	NM	Off	NM	Off	NM
9/29/06	NM	NM	NM	Off	NM	Off	NM	Off	NM
10/30/06	NM	NM	NM	Off	NM	Off	NM	Off	NM
10/31/06	NM	NM	NM	Off	NM	Off	NM	Off	NM
11/1/06	NM	NM	NM	Off	NM	Off	NM	Off	NM
11/8/06	NM	NM	NM	Off	NM	Off	NM	Off	NM
12/1/06	NM	NM	NM	Off	NM	Off	NM	Off	NM



**Table 3**  
**Extraction/Monitoring Well Performance Monitoring Data**  
Former Texaco Service Station, Chevron 211577  
631 Queen Anne Avenue North  
Seattle, WA

Well ID	VP-9			H-1		H-2		H-3	
	Soil Vapor Extraction			Horizontal SVE		Horizontal SVE		Horizontal SVE	
Well Type									
Well Depth (feet)	13.5			--		--		--	
Top of Casing Elev. (feet)	112.35			--		--		--	
Screened Interval (feet bgs)	--			--		--		--	
Pump Make/Model	--			--		--		--	
Pump Capacity	--			--		--		--	
Pump Intake Depth	--			--		--		--	
Date	DTW (ft btc)	Casing Vacuum (" H2O)	VOC Conc (ppm)	Casing Vacuum (" H2O)	VOC Conc (ppm)	Casing Vacuum (" H2O)	VOC Conc (ppm)	Casing Vacuum (" H2O)	VOC Conc (ppm)
12/19/06	NM	NM	NM	Off	NM	Off	NM	Off	NM
12/29/06	NM	NM	NM	Off	NM	Off	NM	Off	NM
1/31/07	8.48	4.5	NM	Off	NM	Off	NM	Off	NM
3/16/07	9.19	NM	NM	Off	NM	Off	NM	Off	NM
3/29/07	9.29	NM	NM	Off	NM	Off	NM	Off	NM
4/17/07	NM	NM	NM	Off	NM	Off	NM	Off	NM
4/30/07	NM	NM	NM	Off	NM	Off	NM	Off	NM
5/30/07	NM	NM	NM	Off	NM	Off	NM	Off	NM
6/27/07	9.68	NM	NM	Off	NM	Off	NM	Off	NM
7/17/07	NM	NM	NM	Off	NM	Off	NM	Off	NM
8/1/07	9.64	NM	NM	Off	NM	Off	NM	Off	NM
8/29/07	NM	NM	NM	Off	NM	Off	NM	Off	NM
10/1/07	NM	NM	NM	Off	NM	Off	NM	Off	NM
12/4/07	NM	NM	NM	Off	NM	Off	NM	Off	NM
1/2/08	NM	NM	NM	Off	NM	Off	NM	Off	NM
2/7/08	NM	NM	NM	Off	NM	Off	NM	Off	NM
2/28/08	NM	NM	NM	Off	NM	Off	NM	Off	NM
4/1/08	NM	NM	NM	Off	0	Off	25	Off	0

**Table 3**  
**Extraction/Monitoring Well Performance Monitoring Data**  
Former Texaco Service Station, Chevron 211577  
631 Queen Anne Avenue North  
Seattle, WA

Well ID Well Type	H-4		RW-5		MW-4		MW-6	
	Horizontal SVE		Monitoring Well		Monitoring Well		Monitoring Well	
Well Depth (feet)	--		14.25		17.5		28.32	
Top of Casing Elev. (feet)	--		104.22		102.09		113.32	
Screened Interval (feet bgs)	--		6 - 16		9 - 19		14 - 29	
Pump Make/Model	--		--		--		--	
Pump Capacity	--		--		--		--	
Pump Intake Depth	--		--		--		--	
Date	Casing Vacuum (" H2O)	VOC Conc (ppm)	DTW (ft btc)	Casing Vacuum (" H2O)	DTW (ft btc)	Casing Vacuum (" H2O)	DTW (ft btc)	Casing Vacuum (" H2O)
02/22/06	---	---	NM	---	10.38	---	19.49	---
02/24/06	---	---	NM	---	10.42	---	21.94	---
02/27/06	Off	21	NM	NM	10.49	0.1	24.03	20
02/28/06	Off	NM	NM	NM	NM	NM	NM	NM
03/01/06	Off	NM	NM	NM	NM	NM	NM	NM
03/02/06	Off	NM	NM	NM	10.81	NM	NM	NM
03/03/06	Off	NM	NM	NM	NM	NM	NM	NM
03/06/06	Off	NM	NM	NM	NM	NM	NM	NM
03/07/06	Off	NM	NM	NM	11.04	0.9	25.35	35
03/10/06	Off	NM	NM	NM	10.99	NM	NM	NM
03/16/06	Off	NM	NM	NM	NM	NM	NM	NM
03/17/06	Off	NM	NM	NM	11.22	1	25.55	38
03/23/06	Off	NM	NM	NM	NM	NM	NM	NM
03/30/06	Off	NM	NM	NM	11.37	0.24	25.70	27
04/06/06	Off	NM	12.35	NM	11.52	0.91	25.54	40
04/13/06	Off	NM	12.41	NM	11.58	0.6	25.86	29
04/17/06	Off	NM	12.41	NM	11.59	NM	26.22	NM
04/25/06	Off	NM	12.8	NM	11.70	NM	26.38	NM
05/04/06	Off	NM	12.74	NM	11.80	NM	26.98	NM
05/05/06	Off	NM	NM	NM	12.18	NM	NM	NM
05/17/06	Off	0.2	13.18	NM	12.41	NM	26.20	NM
05/25/06	Off	NM	13.35	NM	12.62	NM	NM	NM
06/15/06	Off	NM	13.5	NM	12.88	NM	26.3	NM
06/27/06	Off	NM	13.62	NM	13	NM	24.85	NM
7/11/06 - 7/12/06	Off	NM	13.78	NM	13.14	NM	25.36	NM
07/18/06	Off	NM	13.97	NM	13.28	NM	25.43	NM
07/31/06	Off	NM	13.94	NM	13.08	NM	26.46	NM
08/19/06	Off	NM	14.35	1	13.72	0.8	25.45	56
8/31/06	Off	NM	> 14.32	NM	13.75	NM	25.62	NM
9/15/06	Off	NM	14.32	NM	13.95	NM	25.75	50
9/29/06	Off	NM	> 14.36	NM	14.22	NM	26.12	NM
10/30/06	Off	NM	> 14.37	0.7	13.87	1.2	NM	50
10/31/06	Off	NM	NM	NM	14.04	NM	NM	NM
11/1/06	Off	NM	NM	NM	14.45	NM	NM	NM
11/8/06	Off	NM	14.32	3	14.66	19	26.51	55
12/1/06	Off	NM	NM	NM	14.60	NM	26.22	NM

**Table 3**  
**Extraction/Monitoring Well Performance Monitoring Data**  
Former Texaco Service Station, Chevron 211577  
631 Queen Anne Avenue North  
Seattle, WA

Well ID	H-4		RW-5		MW-4		MW-6	
	Horizontal SVE		Monitoring Well		Monitoring Well		Monitoring Well	
Well Type	--		14.25		17.5		28.32	
Well Depth (feet)	--		104.22		102.09		113.32	
Top of Casing Elev. (feet)	--		6 - 16		9 - 19		14 - 29	
Screened Interval (feet bgs)	--		--		--		--	
Pump Make/Model	--		--		--		--	
Pump Capacity	--		--		--		--	
Pump Intake Depth	--		--		--		--	
Date	Casing Vacuum (" H2O)	VOC Conc (ppm)	DTW (ft btc)	Casing Vacuum (" H2O)	DTW (ft btc)	Casing Vacuum (" H2O)	DTW (ft btc)	Casing Vacuum (" H2O)
12/19/06	Off	NM	NM	NM	14.89	27	26.35	65
12/29/06	Off	NM	NM	NM	14.96	NM	26.13	NM
1/31/07	Off	NM	NM	NM	15.46	20	26.42	50
3/16/07	Off	NM	NM	NM	16.09	NM	26.88	NM
3/29/07	Off	NM	NM	NM	16.22	30	27.03	45
4/17/07	Off	NM	NM	NM	15.65	NM	27.12	NM
4/30/07	Off	NM	NM	NM	16.04	NM	27.32	NM
5/30/07	Off	NM	NM	NM	16.61	NM	27.29	NM
6/27/07	Off	NM	NM	NM	17.09	8	27.18	25
7/17/07	Off	NM	NM	NM	17.09	NM	NM	NM
8/1/07	Off	NM	NM	NM	17.18	NM	27.42	NM
8/29/07	Off	NM	NM	NM	17.13	NM	27.54	NM
10/1/07	Off	NM	NM	NM	17.15	6.0	27.94	20
12/4/07	Off	NM	NM	NM	17.11	NM	Dry	NM
1/2/08	Off	NM	NM	NM	17.39	18	27.09	40
2/7/08	Off	NM	NM	NM	NM	NM	NM	NM
2/28/08	Off	NM	NM	NM	17.4	10	26.32	30
4/1/08	Off	0	NM	NM	17.34	25	25.68	25

**Table 3**  
**Extraction/Monitoring Well Performance Monitoring Data**  
Former Texaco Service Station, Chevron 211577  
631 Queen Anne Avenue North  
Seattle, WA

Well ID	MW-9		MW-10		MW-11		MW-12	
	Monitoring Well		Monitoring Well		Monitoring Well		Monitoring Well	
Well Type	27.7		29.15		17.3		16.28	
Well Depth (feet)	114.27		115.28		97.34		113.36	
Top of Casing Elev. (feet)	14 - 29		10 - 30		--		7 - 17	
Screened Interval (feet bgs)	--		--		--		--	
Pump Make/Model	--		--		--		--	
Pump Capacity	--		--		--		--	
Pump Intake Depth	--		--		--		--	
Date	DTW (ft btc)	Casing Vacuum (" H2O)	DTW (ft btc)	Casing Vacuum (" H2O)	DTW (ft btc)	Casing Vacuum (" H2O)	DTW (ft btc)	Casing Vacuum (" H2O)
02/22/06	19.75	---	11.84	---	NM	---	10.70	---
02/24/06	22.04	---	11.94	---	NM	---	11.28	---
02/27/06	23.33	45	13.36	0	NM	NM	11.30	0
02/28/06	NM	NM	NM	NM	NM	NM	NM	NM
03/01/06	NM	NM	NM	NM	NM	NM	NM	NM
03/02/06	NM	NM	NM	NM	NM	NM	NM	NM
03/03/06	NM	NM	NM	NM	NM	NM	NM	NM
03/06/06	NM	NM	NM	NM	NM	NM	NM	NM
03/07/06	23.49	45	14.61	0	NM	NM	11.43	0
03/10/06	NM	NM	NM	NM	NM	NM	NM	NM
03/16/06	NM	NM	NM	NM	NM	NM	NM	NM
03/17/06	NM	NM	NM	NM	NM	NM	NM	NM
03/23/06	NM	NM	NM	NM	NM	NM	NM	NM
03/30/06	23.11	45	14.52	1.25	NM	NM	NM	NM
04/06/06	22.72	45	14.63	1.75	NM	NM	11.61	0
04/13/06	NM	NM	NM	NM	NM	NM	NM	NM
04/17/06	22.55	NM	14.66	NM	NM	NM	11.53	NM
04/25/06	22.8	NM	14.64	NM	11.29	NM	11.58	NM
05/04/06	23.16	NM	14.73	NM	NM	NM	11.62	NM
05/05/06	NM	NM	NM	NM	NM	NM	NM	NM
05/17/06	23.44	NM	14.72	NM	NM	NM	11.79	NM
05/25/06	NM	NM	NM	NM	NM	NM	NM	NM
06/15/06	23.06	NM	14.12	NM	11.19	NM	11.88	NM
06/27/06	22.77	NM	14.75	NM	11.17	NM	12	NM
7/11/06 - 7/12/06	22.91	NM	14.85	NM	11.28	NM	12.12	NM
07/18/06	23.15	NM	14.76	NM	11.2	NM	12.17	NM
07/31/06	23.11	NM	14.93	NM	11.22	NM	12.17	NM
08/19/06	22.95	70	14.98	1.6	11.18	NM	12.29	0
8/31/06	22.9	NM	15.12	NM	11.28	NM	12.42	NM
9/15/06	23.05	40	14.66	1	11.24	NM	12.02	NM
9/29/06	22.9	NM	14.98	NM	11.23	NM	NM	NM
10/30/06	23.66	57	14.97	0.85	11.31	0	12.56	NM
10/31/06	NM	NM	NM	NM	NM	NM	NM	NM
11/1/06	NM	NM	NM	NM	NM	NM	NM	NM
11/8/06	23.02	45	14.23	0.2	11.26	0	12.34	0
12/1/06	23.10	NM	13.72	NM	11.27	NM	11.97	NM

**Table 3**  
**Extraction/Monitoring Well Performance Monitoring Data**  
Former Texaco Service Station, Chevron 211577  
631 Queen Anne Avenue North  
Seattle, WA

Well ID	MW-9		MW-10		MW-11		MW-12	
	Monitoring Well		Monitoring Well		Monitoring Well		Monitoring Well	
Well Type	27.7		29.15		17.3		16.28	
Well Depth (feet)	114.27		115.28		97.34		113.36	
Top of Casing Elev. (feet)	14 - 29		10 - 30		--		7 - 17	
Screened Interval (feet bgs)	--		--		--		--	
Pump Make/Model	--		--		--		--	
Pump Capacity	--		--		--		--	
Pump Intake Depth	--		--		--		--	
Date	DTW (ft btc)	Casing Vacuum (" H2O)	DTW (ft btc)	Casing Vacuum (" H2O)	DTW (ft btc)	Casing Vacuum (" H2O)	DTW (ft btc)	Casing Vacuum (" H2O)
12/19/06	22.82	80	13.75	0	11.23	0	NM	0
12/29/06	23.23	NM	13.23	NM	11.31	NM	NM	NM
1/31/07	23.29	60	14.04	0.1	11.22	<0.05	11.75	0
3/16/07	NM	NM	NM	NM	11.25	NM	NM	NM
3/29/07	22.85	55	13.70	0.05	11.47	0	11.97	NM
4/17/07	23.37	NM	13.05	NM	11.92	NM	12.14	NM
4/30/07	22.96	NM	13.68	NM	11.98	NM	NM	NM
5/30/07	NM	NM	NM	NM	12.22	NM	NM	NM
6/27/07	23.36	24	14.04	0	12.33	NM	NM	NM
7/17/07	NM	NM	NM	NM	NM	NM	NM	NM
8/1/07	NM	NM	14.02	NM	12.56	NM	12.32	NM
8/29/07	23.06	NM	13.99	NM	NM	NM	12.42	NM
10/1/07	23.52	33	14.42	0.06	12.91	0.04	12.53	0.0
12/4/07	23.15	NM	14.33	NM	NM	NM	12.38	NM
1/2/08	NM	NM	NM	NM	NM	NM	NM	NM
2/7/08	NM	NM	NM	NM	NM	NM	NM	NM
2/28/08	23.18	50	14.05	0	NM	0.05	NM	NM
4/1/08	23.09	35	13.59	0.03	NM	NM	NM	NM

**Table 3**  
**Extraction/Monitoring Well Performance Monitoring Data**  
Former Texaco Service Station, Chevron 211577  
631 Queen Anne Avenue North  
Seattle, WA

Well ID	MW-13		MW-14		MW-15		MW-16	
	Monitoring Well		Monitoring Well		Monitoring Well		Monitoring Well	
Well Type	19.9		24.45		24.8		24.7	
Well Depth (feet)	114.80		101.56		99.02		101.75	
Top of Casing Elev. (feet)	10 - 20		10 - 25		10 - 25		10 - 25	
Screened Interval (feet bgs)	--		--		--		--	
Pump Make/Model	--		--		--		--	
Pump Capacity	--		--		--		--	
Pump Intake Depth	--		--		--		--	
Date	DTW (ft btc)	Casing Vacuum (" H2O)	DTW (ft btc)	Casing Vacuum (" H2O)	DTW (ft btc)	Casing Vacuum (" H2O)	DTW (ft btc)	Casing Vacuum (" H2O)
02/22/06	18.03	---	NM	---	8.21	---	NM	---
02/24/06	18.38	---	NM	---	NM	---	NM	---
02/27/06	18.97	0.5	NM	NM	NM	NM	NM	NM
02/28/06	NM	NM	NM	NM	NM	NM	NM	NM
03/01/06	NM	NM	NM	NM	NM	NM	NM	NM
03/02/06	NM	NM	NM	NM	NM	NM	NM	NM
03/03/06	NM	NM	NM	NM	NM	NM	NM	NM
03/06/06	NM	NM	NM	NM	NM	NM	NM	NM
03/07/06	19.31	2	NM	NM	8.29	0	10.95	0.25
03/10/06	NM	NM	NM	NM	NM	NM	NM	NM
03/16/06	NM	NM	NM	NM	NM	NM	NM	NM
03/17/06	NM	NM	NM	NM	NM	NM	NM	NM
03/23/06	NM	NM	NM	NM	NM	NM	NM	NM
03/30/06	19.4	2.75	NM	NM	8.52	0	11.33	0.1
04/06/06	19.42	3	11.2	0.9	NM	NM	NM	NM
04/13/06	NM	NM	NM	NM	NM	NM	NM	NM
04/17/06	19.45	NM	11.26	NM	8.67	NM	11.59	NM
04/25/06	19.5	NM	NM	NM	NM	NM	NM	NM
05/04/06	19.48	NM	NM	NM	NM	NM	NM	NM
05/05/06	NM	NM	NM	NM	NM	NM	NM	NM
05/17/06	19.49	NM	NM	NM	NM	NM	NM	NM
05/25/06	NM	NM	12.05	NM	NM	NM	12.29	NM
06/15/06	19.48	NM	12.43	NM	10.12	NM	12.65	NM
06/27/06	19.49	NM	12.61	NM	10.23	NM	12.86	NM
7/11/06 - 7/12/06	19.54	NM	12.68	NM	NM	NM	13.02	NM
07/18/06	19.5	NM	NM	NM	10.54	NM	13.13	NM
07/31/06	19.47	NM	NM	NM	NM	NM	NM	NM
08/19/06	19.44	3	NM	NM	10.87	0	13.44	0.4
8/31/06	19.32	NM	13.39	NM	NM	NM	13.64	NM
9/15/06	19.3	1.6	13.43	1.6	NM	NM	13.83	0.7
9/29/06	19.29	NM	13.61	NM	11.38	NM	13.97	NM
10/30/06	19.29	0.87	13.65	1.5	11.82	0	14.09	0.7
10/31/06	NM	NM	NM	NM	NM	NM	NM	NM
11/1/06	NM	NM	NM	NM	NM	NM	NM	NM
11/8/06	19.28	2	13.91	10	11.95	NM	14.40	4
12/1/06	19.31	NM	14.29	NM	12.39	NM	14.61	NM

**Table 3**  
**Extraction/Monitoring Well Performance Monitoring Data**  
Former Texaco Service Station, Chevron 211577  
631 Queen Anne Avenue North  
Seattle, WA

Well ID	MW-13		MW-14		MW-15		MW-16	
	Monitoring Well		Monitoring Well		Monitoring Well		Monitoring Well	
Well Type	19.9		24.45		24.8		24.7	
Well Depth (feet)	114.80		101.56		99.02		101.75	
Top of Casing Elev. (feet)	10 - 20		10 - 25		10 - 25		10 - 25	
Screened Interval (feet bgs)	--		--		--		--	
Pump Make/Model	--		--		--		--	
Pump Capacity	--		--		--		--	
Pump Intake Depth	--		--		--		--	
Date	DTW (ft btc)	Casing Vacuum (" H2O)	DTW (ft btc)	Casing Vacuum (" H2O)	DTW (ft btc)	Casing Vacuum (" H2O)	DTW (ft btc)	Casing Vacuum (" H2O)
12/19/06	19.33	3.5	14.44	12	NM	NM	14.80	5
12/29/06	19.35	NM	NM	NM	13.05	NM	15.08	NM
1/31/07	19.42	2.5	NM	NM	14.09	0.3	15.64	3.5
3/16/07	19.52	NM	15.77	NM	14.67	NM	16.24	NM
3/29/07	19.55	2.5	15.86	NM	14.81	NM	16.39	3.8
4/17/07	19.62	NM	15.54	NM	13.81	NM	16.24	NM
4/30/07	19.58	NM	15.61	NM	14.66	NM	16.34	NM
5/30/07	NM	NM	NM	NM	NM	NM	16.73	NM
6/27/07	19.60	1.5	NM	NM	NM	NM	16.76	2
7/17/07	NM	NM	16.33	NM	NM	NM	NM	NM
8/1/07	NM	NM	16.45	NM	15.78	NM	17.00	NM
8/29/07	19.59	NM	NM	NM	NM	NM	17.34	NM
10/1/07	19.55	1.4	NM	NM	17.03	0.38	17.83	2.0
12/4/07	19.53	NM	17.99	NM	16.46	NM	18.33	NM
1/2/08	19.56	0.7	NM	NM	NM	NM	18.34	2.4
2/7/08	NM	NM	NM	NM	NM	NM	NM	NM
2/28/08	19.66	2	17.83	5	17.01	0.4	18.13	2
4/1/08	19.72	1.7	18.00	9	NM	NM	18.25	4

**Table 3**  
**Extraction/Monitoring Well Performance Monitoring Data**  
Former Texaco Service Station, Chevron 211577  
631 Queen Anne Avenue North  
Seattle, WA

Well ID	MW-17		MW-18		MW-19		MW-20	
	Monitoring Well		Monitoring Well		Monitoring Well		Monitoring Well	
Well Type	24.85		25		25		20	
Well Depth (feet)	99.25		101.52		101.18		105.62	
Top of Casing Elev. (feet)	10 - 25		5 - 25		5 - 25		5 - 20	
Screened Interval (feet bgs)	--		--		--		--	
Pump Make/Model	--		--		--		--	
Pump Capacity	--		--		--		--	
Pump Intake Depth	--		--		--		--	
Date	DTW (ft btc)	Casing Vacuum (" H2O)	DTW (ft btc)	Casing Vacuum (" H2O)	DTW (ft btc)	Casing Vacuum (" H2O)	DTW (ft btc)	Casing Vacuum (" H2O)
02/22/06	NM	---	9.83	---	9.55	---	6.56	---
02/24/06	NM	---	NM	---	NM	---	NM	---
02/27/06	NM	NM	9.96	0.7	9.56	1.5	6.71	0
02/28/06	NM	NM	NM	NM	NM	NM	NM	NM
03/01/06	NM	NM	NM	NM	NM	NM	NM	NM
03/02/06	NM	NM	10.14	NM	9.78	NM	NM	NM
03/03/06	NM	NM	NM	NM	NM	NM	NM	NM
03/06/06	NM	NM	NM	NM	NM	NM	NM	NM
03/07/06	NM	NM	NM	NM	10.06	1.6	NM	NM
03/10/06	NM	NM	10.27	NM	9.89	NM	NM	NM
03/16/06	NM	NM	NM	NM	NM	NM	NM	NM
03/17/06	NM	NM	10.51	0.75	10.17	1.75	NM	NM
03/23/06	NM	NM	NM	NM	NM	NM	NM	NM
03/30/06	9.04	0	10.65	0.2	10.32	1.1	6.92	0
04/06/06	9.14	0	10.81	NM	10.5	NM	6.17	0
04/13/06	NM	NM	10.85	0.75	10.55	1	NM	NM
04/17/06	9.26	NM	10.93	NM	10.61	NM	6.64	NM
04/25/06	NM	NM	11.02	NM	NM	NM	NM	NM
05/04/06	NM	NM	11.09	NM	10.75	NM	NM	NM
05/05/06	NM	NM	12.05	NM	NM	NM	NM	NM
05/17/06	NM	NM	11.76	NM	11.45	NM	NM	NM
05/25/06	NM	NM	12.00	NM	11.68	NM	NM	NM
06/15/06	NM	NM	12.51	NM	12.1	NM	NM	NM
06/27/06	10.58	NM	12.33	NM	12.02	NM	7.55	NM
7/11/06 - 7/12/06	10.82	NM	12.52	NM	12.26	NM	NM	NM
07/18/06	10.9	NM	12.7	NM	12.38	NM	7.8	NM
07/31/06	NM	NM	12.39	NM	12.09	NM	7.91	NM
08/19/06	NM	NM	13.03	0.2	12.71	0.3	8.07	0
8/31/06	11.4	NM	13.27	NM	12.95	NM	8.16	NM
9/15/06	11.6	0	13.33	0.3	13.01	0.38	8.18	0
9/29/06	11.75	NM	13.51	NM	13.19	NM	8.12	NM
10/30/06	11.58	NM	13.18	0.1	12.85	0.2	8.31	0
10/31/06	NM	NM	13.33	NM	12.99	NM	NM	NM
11/1/06	NM	NM	14.85	NM	14.15	NM	NM	NM
11/8/06	12.27	0.5	15.35	4	14.66	3	8.05	0
12/1/06	12.57	NM	15.47	NM	NM	NM	6.16	NM



**Table 3**  
**Extraction/Monitoring Well Performance Monitoring Data**  
Former Texaco Service Station, Chevron 211577  
631 Queen Anne Avenue North  
Seattle, WA

Well ID	MW-17		MW-18		MW-19		MW-20	
	Monitoring Well		Monitoring Well		Monitoring Well		Monitoring Well	
Well Type	24.85		25		25		20	
Well Depth (feet)	99.25		101.52		101.18		105.62	
Top of Casing Elev. (feet)	10 - 25		5 - 25		5 - 25		5 - 20	
Screened Interval (feet bgs)	--		--		--		--	
Pump Make/Model	--		--		--		--	
Pump Capacity	--		--		--		--	
Pump Intake Depth	--		--		--		--	
Date	DTW (ft btc)	Casing Vacuum (" H2O)	DTW (ft btc)	Casing Vacuum (" H2O)	DTW (ft btc)	Casing Vacuum (" H2O)	DTW (ft btc)	Casing Vacuum (" H2O)
12/19/06	12.98	1.1	15.93	7	15.37	4	6.05	0
12/29/06	13.24	NM	16.02	NM	15.47	NM	5.61	NM
1/31/07	14.04	NM	16.63	7	16.12	4.5	6.80	0
3/16/07	NM	NM	17.19	NM	16.74	NM	5.76	NM
3/29/07	14.92	1.1	17.3	8.5	16.89	6	6.05	0
4/17/07	14.21	NM	15.51	NM	15.27	NM	6.93	NM
4/30/07	14.75	NM	17.27	NM	16.80	NM	7.02	NM
5/30/07	NM	NM	17.52	NM	17.10	NM	NM	NM
6/27/07	15.01	0.5	17.47	3	16.99	3	7.78	0
7/17/07	NM	NM	17.64	NM	17.19	NM	NM	NM
8/1/07	NM	NM	18.69	NM	18.20	NM	7.88	NM
8/29/07	16.20	NM	18.92	NM	18.56	NM	7.98	NM
10/1/07	16.71	0.48	20.15	3.8	19.70	3.6	7.25	0.02
12/4/07	17.02	NM	20.30	NM	19.80	NM	5.46	NM
1/2/08	17.28	1.4	20.40	5.5	20.72	4.5	NM	NM
2/7/08	NM	NM	NM	NM	NM	NM	NM	NM
2/28/08	16.95	1	19.71	6.5	19.32	5.5	8.23	0
4/1/08	16.94	1.7	20.13	7	19.72	6	5.47	0

**Table 3**  
**Extraction/Monitoring Well Performance Monitoring Data**  
Former Texaco Service Station, Chevron 211577  
631 Queen Anne Avenue North  
Seattle, WA

Well ID	MW-21		MW-22		MW-23		MW-24	
	Monitoring Well		Monitoring Well		Monitoring Well		Monitoring Well	
Well Type	35		19.75		13.5		14.2	
Well Depth (feet)	94.75		--		107.82		107.95	
Top of Casing Elev. (feet)	15 - 35		9.75 - 19.75		5.5 - 13.5		4.2 - 14.2	
Screened Interval (feet bgs)	--		--		--		--	
Pump Make/Model	--		--		--		--	
Pump Capacity	--		--		--		--	
Pump Intake Depth	--		--		--		--	
Date	DTW (ft btc)	Casing Vacuum (" H2O)	DTW (ft btc)	Casing Vacuum (" H2O)	DTW (ft btc)	Casing Vacuum (" H2O)	DTW (ft btc)	Casing Vacuum (" H2O)
02/22/06	25.58	---	12.34	---	NM	---	5.81	---
02/24/06	NM	---	12.59	---	NM	---	5.59	---
02/27/06	NM	NM	13.65	15	7.95	0	5.84	0
02/28/06	NM	NM	NM	NM	NM	NM	NM	NM
03/01/06	NM	NM	NM	NM	NM	NM	NM	NM
03/02/06	NM	NM	NM	NM	NM	NM	NM	NM
03/03/06	NM	NM	NM	NM	NM	NM	NM	NM
03/06/06	NM	NM	NM	NM	NM	NM	NM	NM
03/07/06	25.59	0.55	14.12	20	NM	NM	6.75	0
03/10/06	25.55	NM	NM	NM	NM	NM	NM	NM
03/16/06	NM	NM	NM	NM	NM	NM	NM	NM
03/17/06	25.59	0.6	NM	NM	NM	NM	NM	NM
03/23/06	NM	NM	NM	NM	NM	NM	NM	NM
03/30/06	25.52	Pressure	14.61	10	NM	NM	7.48	0
04/06/06	25.59	0.18	14.72	14.5	9.75	0	8.94	NM
04/13/06	NM	NM	14.78	14	9.93	0.02	8.45	0
04/17/06	25.62	NM	14.60	NM	9.91	NM	5.55	NM
04/25/06	25.63	NM	15.01	NM	NM	NM	6.98	NM
05/04/06	25.52	Nm	15.80	NM	NM	NM	9.37	NM
05/05/06	NM	NM	NM	NM	NM	NM	NM	NM
05/17/06	25.53	NM	15.49	NM	12.15	NM	10.75	NM
05/25/06	25.52	NM	15.60	NM	NM	NM	NM	NM
06/15/06	25.56	NM	NR	NM	NM	NM	10.84	NM
06/27/06	25.57	NM	15.45	NM	> 13.01	NM	10.23	NM
7/11/06 - 7/12/06	25.65	NM	15.22	NM	NM	NM	10.76	NM
07/18/06	25.63	NM	15.58	NM	NM	NM	12.4	NM
07/31/06	25.65	NM	15.09	NM	NM	NM	> 12.5	NM
08/19/06	25.70	Pressure	15.37	24	NM	NM	NM	8
8/31/06	25.75	NM	15.43	NM	NM	NM	> 12.58	NM
9/15/06	25.75	0.1	15.69	10	NM	NM	> 12.57	10
9/29/06	25.76	NM	Well Abandoned Sept. 2006		NM	NM	> 12.54	NM
10/30/06	25.76	0.1	---	---	> 13.00	0.05	5.60	0
10/31/06	NM	NM	---	---	NM	NM	NM	NM
11/1/06	NM	NM	---	---	NM	NM	NM	NM
11/8/06	25.67	Pressure	---	---	10.48	0	4.27	0
12/1/06	25.60	NM	---	---	8.10	NM	5.10	NM

**Table 3**  
**Extraction/Monitoring Well Performance Monitoring Data**  
Former Texaco Service Station, Chevron 211577  
631 Queen Anne Avenue North  
Seattle, WA

Well ID	MW-21		MW-22		MW-23		MW-24	
	Monitoring Well		Monitoring Well		Monitoring Well		Monitoring Well	
Well Type	35		19.75		13.5		14.2	
Well Depth (feet)	94.75		--		107.82		107.95	
Top of Casing Elev. (feet)	15 - 35		9.75 - 19.75		5.5 - 13.5		4.2 - 14.2	
Screened Interval (feet bgs)	--		--		--		--	
Pump Make/Model	--		--		--		--	
Pump Capacity	--		--		--		--	
Pump Intake Depth	--		--		--		--	
Date	DTW (ft bte)	Casing Vacuum (" H2O)	DTW (ft bte)	Casing Vacuum (" H2O)	DTW (ft bte)	Casing Vacuum (" H2O)	DTW (ft bte)	Casing Vacuum (" H2O)
12/19/06	25.45	Pressure	---	---	NM	NM	5.25	0.2
12/29/06	25.44	NM	---	---	NM	NM	4.51	NM
1/31/07	25.31	Pressure	---	---	NM	NM	8.20	0
3/16/07	25.32	NM	---	---	8.55	NM	5.59	NM
3/29/07	25.27	Pressure	---	---	8.70	0	5.73	0
4/17/07	25.34	NM	---	---	9.17	NM	5.63	NM
4/30/07	25.36	NM	---	---	9.26	NM	9.42	NM
5/30/07	25.6	NM	---	---	9.59	NM	7.80	NM
6/27/07	25.78	Pressure	---	---	10.01	0	12.54	0
7/17/07	NM	NM	---	---	NM	NM	NM	NM
8/1/07	25.95	NM	---	---	10.18	NM	11.24	NM
8/29/07	26.05	NM	---	---	11.8	NM	12.00	NM
10/1/07	26.20	0.52	---	---	NM	NM	4.63	0.0
12/4/07	26.36	NM	---	---	7.85	NM	4.61	NM
1/2/08	26.33	Pressure	---	---	NM	NM	NM	NM
2/7/08	NM	NM	---	---	NM	NM	NM	NM
2/28/08	26.4	0.1	---	---	NM	NM	NM	NM
4/1/08	26.41	Pressure	---	---	NM	NM	NM	NM

**Table 3**  
**Extraction/Monitoring Well Performance Monitoring Data**  
Former Texaco Service Station, Chevron 211577  
631 Queen Anne Avenue North  
Seattle, WA

Well ID Well Type Well Depth (feet) Top of Casing Elev. (feet) Screened Interval (feet bgs) Pump Make/Model Pump Capacity Pump Intake Depth	MW-25 Monitoring Well		MW-26 Monitoring Well		MW-32 Monitoring Well		MW-33 Monitoring Well	
	DTW (ft btc)	Casing Vacuum (" H2O)	DTW (ft btc)	Casing Vacuum (" H2O)	DTW (ft btc)	Casing Vacuum (" H2O)	DTW (ft btc)	Casing Vacuum (" H2O)
	22.85		22.75		29		34.6	
	101.96		100.47		101.09		100.31	
	8 - 23		7.75 - 22.75		8.6 - 28.6		24.6 - 34.6	
	--	--	--	--	--	--	--	--
	--	--	--	--	--	--	--	--
	--	--	--	--	--	--	--	--
Date	DTW (ft btc)	Casing Vacuum (" H2O)	DTW (ft btc)	Casing Vacuum (" H2O)	DTW (ft btc)	Casing Vacuum (" H2O)	DTW (ft btc)	Casing Vacuum (" H2O)
02/22/06	10.50	---	9.32	---	10.15	---	NM	---
02/24/06	10.54	---	9.34	---	NM	---	NM	---
02/27/06	NM	NM	9.35	0	NM	NM	NM	NM
02/28/06	NM	NM	NM	NM	NM	NM	NM	NM
03/01/06	NM	NM	NM	NM	NM	NM	NM	NM
03/02/06	NM	NM	NM	NM	NM	NM	NM	NM
03/03/06	NM	NM	NM	NM	NM	NM	NM	NM
03/06/06	NM	NM	NM	NM	NM	NM	NM	NM
03/07/06	NM	NM	9.74	0.02	NM	NM	NM	NM
03/10/06	NM	NM	NM	NM	NM	NM	NM	NM
03/16/06	NM	NM	NM	NM	NM	NM	NM	NM
03/17/06	11.19	0.03	NM	NM	NM	NM	NM	NM
03/23/06	NM	NM	NM	NM	NM	NM	NM	NM
03/30/06	11.4	0.95	10.11	0.02	NM	NM	NM	NM
04/06/06	11.51	NM	10.23	NM	11	0	NM	NM
04/13/06	NM	NM	NM	NM	NM	NM	NM	NM
04/17/06	11.65	NM	10.35	NM	11.12	NM	27.95	NM
04/25/06	NM	NM	NM	NM	NM	NM	NM	NM
05/04/06	NM	NM	10.52	NM	NM	NM	NM	NM
05/05/06	NM	NM	NM	NM	NM	NM	NM	NM
05/17/06	NM	NM	10.95	NM	NM	NM	NM	NM
05/25/06	NM	NM	11.11	NM	NM	NM	NM	NM
06/15/06	12.72	NM	11.49	NM	NM	NM	NM	NM
06/27/06	12.85	NM	11.67	NM	12.43	NM	28.39	NM
7/11/06 - 7/12/06	13.15	NM	11.84	NM	12.62	NM	28.52	NM
07/18/06	13.25	NM	NM	NM	NM	NM	28.53	NM
07/31/06	13.25	NM	12.00	NM	12.79	NM	28.60	NM
08/19/06	NM	2	12.23	0.2	13.01	0	NM	NM
8/31/06	NM	NM	NM	NM	13.22	NM	NM	NM
9/15/06	NM	NM	12.61	0.2	13.41	0	28.80	0.5
9/29/06	14.04	NM	12.8	NM	NM	NM	28.85	NM
10/30/06	14.07	0.6	12.76	0.25	13.53	0	NM	NM
10/31/06	NM	NM	NM	NM	NM	NM	NM	NM
11/1/06	NM	NM	NM	NM	NM	NM	NM	NM
11/8/06	14.30	9	13.17	3	13.95	0.5	29.00	0.2
12/1/06	14.46	NM	13.45	NM	NM	NM	NM	NM

**Table 3**  
**Extraction/Monitoring Well Performance Monitoring Data**  
Former Texaco Service Station, Chevron 211577  
631 Queen Anne Avenue North  
Seattle, WA

Well ID	MW-25		MW-26		MW-32		MW-33	
	Monitoring Well		Monitoring Well		Monitoring Well		Monitoring Well	
Well Type	22.85		22.75		29		34.6	
Well Depth (feet)	101.96		100.47		101.09		100.31	
Top of Casing Elev. (feet)	8 - 23		7.75 - 22.75		8.6 - 28.6		24.6 - 34.6	
Screened Interval (feet bgs)	--		--		--		--	
Pump Make/Model	--		--		--		--	
Pump Capacity	--		--		--		--	
Pump Intake Depth	--		--		--		--	
Date	DTW (ft btc)	Casing Vacuum (" H2O)	DTW (ft btc)	Casing Vacuum (" H2O)	DTW (ft btc)	Casing Vacuum (" H2O)	DTW (ft btc)	Casing Vacuum (" H2O)
12/19/06	14.72	12	13.73	4.5	14.56	1.2	NM	0
12/29/06	14.86	NM	13.98	NM	14.87	NM	29.16	NM
1/31/07	15.56	8	14.62	3	NM	NM	NM	NM
3/16/07	NM	NM	15.26	NM	NM	NM	29.46	NM
3/29/07	16.21	NM	15.41	3	16.40	1	NM	NM
4/17/07	16	NM	15.09	NM	15.97	NM	29.65	NM
4/30/07	16.1	NM	15.29	NM	16.27	NM	29.62	NM
5/30/07	16.59	NM	15.74	NM	16.63	NM	NM	NM
6/27/07	16.66	6	15.76	1.5	16.63	NM	29.82	0
7/17/07	16.76	NM	NM	NM	NM	NM	NM	NM
8/1/07	16.88	NM	16.12	NM	17.02	NM	NM	NM
8/29/07	17.15	NM	16.55	NM	NM	NM	30.04	NM
10/1/07	NM	NM	17.11	0.42	17.97	0.48	NM	NM
12/4/07	18.05	NM	18.05	NM	18.42	NM	30.46	NM
1/2/08	17.9	7	17.51	3	18.49	1.3	NM	NM
2/7/08	NM	NM	NM	NM	NM	NM	NM	NM
2/28/08	NM	NM	17.32	2	18.22	0.7	30.49	0.15
4/1/08	18.07	9	17.36	4	NM	NM	NM	NM

**Table 3**  
**Extraction/Monitoring Well Performance Monitoring Data**  
Former Texaco Service Station, Chevron 211577  
631 Queen Anne Avenue North  
Seattle, WA

Well ID	MW-35		DVP-1	DVP-2
Well Type	Monitoring Well		Soil Vapor Monitor Point	Soil Vapor Monitor Point
Well Depth (feet)	37		--	--
Top of Casing Elev. (feet)	100.52		--	--
Screened Interval (feet bgs)	22 - 37		--	--
Pump Make/Model	--		--	--
Pump Capacity	--		--	--
Pump Intake Depth	--		--	--
Date	DTW (ft btc)	Casing Vacuum (" H2O)	Vacuum (" H2O)	Vacuum (" H2O)
12/19/06	NM	NM	NM	NM
12/29/06	NM	NM	NM	NM
1/31/07	30.92	Pressure	NM	NM
3/16/07	31.03	NM	NM	NM
3/29/07	31.03	Pressure	NM	NM
4/17/07	31.19	NM	NM	NM
4/30/07	31.05	NM	NM	NM
5/30/07	NM	NM	NM	NM
6/27/07	31.29	0	0.2	3.5
7/17/07	NM	NM	NM	NM
8/1/07	31.37	NM	NM	NM
8/29/07	NM	NM	NM	NM
10/1/07	31.68	1.0	0.2	3.5
12/4/07	31.89	NM	NM	NM
1/2/08	NM	NM	NM	NM
2/7/08	NM	NM	NM	NM
2/28/08	31.81	0.2	NM	NM
4/1/08	31.79	Pressure	NM	NM

**Table 3**  
**Extraction/Monitoring Well Performance Monitoring Data**  
Former Texaco Service Station, Chevron 211577  
631 Queen Anne Avenue North  
Seattle, WA

<b>Well ID</b>	<b>DRVP-1</b>	<b>DRVP-2</b>
Well Type	Soil Vapor Monitor Point	Soil Vapor Monitor Point
Well Depth (feet)	--	--
Top of Casing Elev. (feet)	--	--
Screened Interval (feet bgs)	--	--
Pump Make/Model	--	--
Pump Capacity	--	--
Pump Intake Depth	--	--
Date	Vacuum (" H2O)	Vacuum (" H2O)
02/22/06	---	---
02/24/06	---	---
02/27/06	---	---
02/28/06	---	---
03/01/06	---	---
03/02/06	---	---
03/03/06	---	---
03/06/06	---	---
03/07/06	---	---
03/10/06	---	---
03/16/06	---	---
03/17/06	---	---
03/23/06	---	---
03/30/06	---	---
04/06/06	---	---
04/13/06	---	---
04/17/06	---	---
04/25/06	---	---
05/04/06	---	---
05/05/06	---	---
05/17/06	---	---
05/25/06	---	---
06/15/06	---	---
06/27/06	---	---
7/11/06 - 7/12/06	---	---
07/18/06	---	---
07/31/06	---	---
08/19/06	---	---
8/31/06	---	---
9/15/06	---	---
9/29/06	---	---
10/30/06	---	---
10/31/06	---	---
11/1/06	---	---
11/8/06	---	---
12/1/06	---	---

**Table 3**  
**Extraction/Monitoring Well Performance Monitoring Data**  
Former Texaco Service Station, Chevron 211577  
631 Queen Anne Avenue North  
Seattle, WA

<b>Well ID</b>	<b>DRVP-1</b>	<b>DRVP-2</b>
Well Type	Soil Vapor Monitor Point	Soil Vapor Monitor Point
Well Depth (feet)	--	--
Top of Casing Elev. (feet)	--	--
Screened Interval (feet bgs)	--	--
Pump Make/Model	--	--
Pump Capacity	--	--
Pump Intake Depth	--	--
Date	Vacuum (" H2O)	Vacuum (" H2O)
12/19/06	---	---
12/29/06	---	---
1/31/07	---	---
3/16/07	---	---
3/29/07	---	---
4/17/07	---	---
4/30/07	---	---
5/30/07	---	---
6/27/07	---	---
7/17/07	---	---
8/1/07	---	---
8/29/07	---	---
10/1/07	---	---
12/4/07	---	---
1/2/08	---	---
2/7/08	---	---
2/28/08	NM	NM
4/1/08	0.0	0.0



**Table 3**  
**Extraction/Monitoring Well Performance Monitoring Data**  
Former Texaco Service Station, Chevron 211577  
631 Queen Anne Avenue North  
Seattle, WA

**Notes:**

1. Extraction rates presented in Table 3 are considered "rough" estimates and are only to be used as an indication of relative pumping rates and to identify trends in pump performance that may be indicative of a pump malfunction or other needed repair. Actual groundwater extraction and discharge rates are based on totalizer readings, which are presented in Table 2.
2. Calculated extraction rate for DPE-6 on 3/30/06 does not represent accurate estimate of the actual extraction rate due to malfunctioning pulse counter.
3. Greater than (>) values for DTW (depth to water) indicate that no measurable water depth existed in the well at the time of data collection. For wells where this depth is less than the total depth of the well (e.g. VP-1, VP-2 and VP-8), this indicates that silt accumulation in the well prevented measurement to the as-built well depth. Silt accumulations were typically removed by well redevelopment.

**Table 4**  
**Groundwater Treatment System Discharge Monitoring Results**  
Former Texaco Station/Chevron 211577  
631 Queen Anne Avenue North  
Seattle, WA

Sample Location	Sample Date	pH	Benzene (ug/L)	Toluene (ug/L)	Ethylbenzene (ug/L)	TPH-Gx (ug/L)	TPH-DX (ug/L)	TPH-LO (ug/L)	FOG <sup>1</sup> (mg/L)
Influent to Carbon 1	1/31/2006	--	240	120	57	--	--	--	--
	2/27/2006	--	1,300	1,600	190	11,000	--	--	--
	3/16/2006	--	1,700	1,400	39	21,000	2,100	< 490	--
	4/13/2006 <sup>2</sup>	--	1,600	1,300	39	19,000	1,400	< 480	--
	5/17/2006	--	1,400	1,000	70	13,000	2,300	< 470	--
	6/15/2006	--	1,000	730	34	12,000	2,600	< 500	--
	7/18/2006	--	600	320	10	8,700	3,700	< 580	--
	8/31/2006	--	370	390	120	22,000	29,000	< 1,900	--
	9/29/2006	--	240	240	52	21,000	53,000	< 2,100	--
	10/31/2006	--	200	120	15	6,400	3,700	< 470	--
	11/2/2006	--	1,000	2,400	740	48,000	5,800	< 950	--
	12/19/2006	--	170	230	46	8,400	2,000	< 470	--
	1/31/2007	--	--	--	--	5,100	2,300	< 490	--
	4/25/2007	--	78	14	12	1,000	1,100	< 97	--
	5/30/2007	--	33	5.3	5.0	930	1,100	< 96	--
	6/14/2007	--	26	3.9	4.1	1,400	1,400	< 470	--
	7/17/2007 <sup>5</sup>	--	24	2.4	4.3	1,400	< 76	< 95	--
	8/29/2007	--	27	0.5	0.6	83	700	< 95	--
	10/18/2007	--	25	1.1	0.9	100	660	710	--
	12/19/2007	--	6.5	< 0.5	< 0.5	55	690	< 95	--
1/29/2008	--	5.0	< 0.5	< 0.5	64	580	< 95	--	
2/20/2008	--	7.9	< 0.5	< 0.5	110	320	< 95	--	

**Table 4**  
**Groundwater Treatment System Discharge Monitoring Results**  
Former Texaco Station/Chevron 211577  
631 Queen Anne Avenue North  
Seattle, WA

Sample Location	Sample Date	pH	Benzene (ug/L)	Toluene (ug/L)	Ethylbenzene (ug/L)	TPH-Gx (ug/L)	TPH-Dx (ug/L)	TPH-LO (ug/L)	FOG <sup>1</sup> (mg/L)
Between Carbon 1&2	1/31/2006	--	< 0.5	< 0.5	< 0.5	--	--	--	--
	2/27/2006	--	< 0.5	< 0.5	< 0.5	< 48	--	--	--
	3/16/2006	--	1.2	< 0.5	< 0.5	< 48	< 79	< 97	--
	4/13/2006 <sup>2</sup>	--	4.5	< 0.5	< 0.5	< 48	< 79	< 99	--
	5/17/2006	--	< 0.5	< 0.5	< 0.5	< 48	--	--	--
	6/15/2006	--	< 0.5	< 0.5	< 0.5	< 48	< 80	< 100	--
	7/18/2006	--	< 0.5	< 0.5	< 0.5	< 48	< 90	< 110	--
	8/31/2006	--	< 0.5	< 0.5	< 0.5	120	460	< 97	--
	9/29/2006	--	< 0.5	< 0.5	< 0.5	92	250	< 99	--
	10/31/2006	--	< 0.5	0.8	< 0.5	< 48	400	< 95	--
	11/2/2006	--	--	--	--	--	--	--	--
	12/19/2006	--	--	--	--	--	--	--	--
	1/31/2007	--	--	--	--	--	--	--	--
	4/25/2007	--	--	--	--	--	--	--	--
	5/30/2007	--	--	--	--	--	--	--	--
	6/14/2007	--	< 0.5	< 0.5	< 0.5	< 50	< 75	< 94	--
	7/17/2007 <sup>5</sup>	--	< 0.5	< 0.5	< 0.5	< 50	1,300	< 95	--
	8/29/2007	--	< 0.5	< 0.5	< 0.5	< 50	< 76	< 95	--
	10/18/2007	--	< 0.5	< 0.5	< 0.5	< 50	< 81	< 100	--
	12/19/2007	--	< 0.5	< 0.5	< 0.5	< 50	< 75	< 94	--
	1/29/2008	--	< 0.5	< 0.5	< 0.5	< 50	< 76	< 95	--
	2/20/2008	--	< 0.5	< 0.5	< 0.5	< 50	< 76	< 95	--

**Table 4**  
**Groundwater Treatment System Discharge Monitoring Results**  
Former Texaco Station/Chevron 211577  
631 Queen Anne Avenue North  
Seattle, WA

Sample Location	Sample Date	pH	Benzene (ug/L)	Toluene (ug/L)	Ethylbenzene (ug/L)	TPH-Gx (ug/L)	TPH-Dx (ug/L)	TPH-LO (ug/L)	FOG <sup>1</sup> (mg/L)
Effluent from Carbon 2	1/31/2006	8.5	< 0.5	< 0.5	< 0.5	--	--	--	2.57
	2/27/2006	7.0	< 0.5	< 0.5	< 0.5	< 48	--	--	2.67
	3/16/2006	7.5	< 0.5	< 0.5	< 0.5	< 48	< 79	< 98	< 1.40
	4/13/2006 <sup>2</sup>	6.5	< 0.5	< 0.5	< 0.5	< 48	< 79	< 99	2.9
	5/17/2006	8.0	< 0.5	< 0.5	< 0.5	< 48	--	--	< 1.40
	6/15/2006	6.5	< 0.5	< 0.5	< 0.5	< 48	< 78	< 98	< 1.40
	7/18/2006	7.0	< 0.5	< 0.5	< 0.5	< 48	--	--	--
	8/31/2006	6.5	< 0.5	< 0.5	< 0.5	< 48	< 79	< 98	--
	9/29/2006	6.5	< 0.5	< 0.5	< 0.5	< 48	< 78	< 97	--
	10/31/2006	--	< 0.5	< 0.5	< 0.5	< 48	< 76	< 95	--
	11/2/2006	--	--	--	--	--	--	--	--
	12/19/2006	--	< 0.5	< 0.5	< 0.5	< 48	240	< 95	--
	1/31/2007	--	--	--	--	--	--	--	--
	4/25/2007	--	--	--	--	--	--	--	--
	5/30/2007	--	--	--	--	--	--	--	--
	6/14/2007	--	< 0.5	< 0.5	< 0.5	< 50	< 76	< 95	--
	7/17/2007	--	< 0.5	< 0.5	< 0.5	< 50	< 76	< 95	--
8/29/2007	--	< 0.5	< 0.5	< 0.5	< 50	< 76	< 95	--	
10/18/2007	--	< 0.5	< 0.5	< 0.5	< 50	< 79	< 99	--	
12/19/2007	--	< 0.5	< 0.5	< 0.5	< 50	< 76	< 95	--	
1/29/2008	--	< 0.5	< 0.5	< 0.5	< 50	< 76	< 96	--	
2/20/2008	--	< 0.5	< 0.5	< 0.5	< 50	< 76	< 95	--	
<b>Metro Permit Discharge Limits<sup>3</sup></b>		<b>5.0 - 12.0</b>	<b>70</b>	<b>1,400</b>	<b>1,700</b>	--	--	--	<b>100</b>

Notes:

1. Average of 3 grab samples collected from same location with a minimum of 5 minutes between each sample.
2. The temperature of 40mL vials collected for NWTPH-Gx, and BTE analysis arrived at the laboratory between 9.2 - 11.5 degrees Celsius.
3. Discharge limits apply to Effluent from Carbon 2 Sample Location ONLY.
4. "--" indicates sample not collected for laboratory analysis
5. TPH-Dx results for inlet and outlet of Carbon 1 are suspect for samples collected 7/17/2007. Samples appear to have been mistakenly switched by the sampling crew or laboratory.

**Table 5**  
**il Vapor Extraction System Performance Monitoring Data**  
Former Texaco Service Station/Chevron 211577  
631 Queen Anne Avenue North  
Seattle, WA

Date	Oxidizer Hour Meter Reading (Hours)	Operating Period (Hours)	SVE Blower Inlet Vac. (" W.C.)	SVE Blower Outlet Pres. (" W.C.)	Burner Temp. (Degrees F)	C Be	ry Analysis	Benzene Removal Monitoring by Laboratory Analysis				
							TPH-G Estimated Cumulative Mass Removed (Lbs)	Benzene Influent Conc. by EPA 8021B (PPMV)	Benzene Effluent Conc. by EPA 8021B (PPMV)	Destruction / Removal Efficiency (%)	Average Benzene Removal Rate (Lbs/Day)	Benzene Estimated Cumulative Mass Removed (Lbs)
2/27/06	24.9	---	130	20	1,350		---	6.05	NM	---	---	---
2/28/06	50.0	25.1	133	17	1,450		---	NM	NM	---	---	---
3/1/06	72.4	22.4	130	20	1,350		---	NM	NM	---	---	---
3/1/06	73.4	1.0	125	20	NR		---	NM	NM	---	---	---
3/2/06	97.1	23.7	125	20	1,450		---	NM	NM	---	---	---
3/2/06	98.1	1.0	130	20	NR		---	NM	NM	---	---	---
3/3/06	127.4	29.3	133	19	1,520		---	NM	NM	---	---	---
3/6/06	189.2	61.8	122	20	1,500		---	NM	NM	---	---	---
3/6/06	191.8	2.6	---	18	NR		---	NM	NM	---	---	---
3/7/06	210.6	18.8	130	20	1,450		---	NM	NM	---	---	---
3/10/06	280.7	70.1	130	19	1,500		---	NM	NM	---	---	---
3/13/06	362.7	82.0	130	19	1,380		---	NM	NM	---	---	---
3/16/06	429.4	66.7	125	19	1,400		1263	5.93	0.355	94	0.8	14
3/23/06	601.2	171.8	125	19	1,506		---	NM	NM	---	---	---
3/30/06	761.5	160.3	125	19	1,406		2,356	4.25	0.0588	99	0.7	23
4/6/06	926.5	165.0	125	19	1,459		---	NM	NM	---	---	---
4/7/06	949.4	22.9	130	18	1,518		---	NM	NM	---	---	---
4/13/06	1,091.7	142.3	120	19	1,467		---	NM	NM	---	---	---
4/18/06	1,197.1	105.4	125	19	1,500		---	NM	NM	---	---	---
4/18/06	1,202.2	5.1	130	10	1,457		---	NM	NM	---	---	---
4/20/06	1,240.5	38.3	125	10	1,459		---	NM	NM	---	---	---
4/25/06	1,359.8	119.3	125	9	1,463		---	NM	NM	---	---	---
5/4/06	1,565.5	205.7	130	7	1,473		---	NM	NM	---	---	---
5/12/06	1,745.3	179.8	130	7	1,460		---	NM	NM	---	---	---
5/17/06	1,863.3	118.0	100	10	1,462		---	NM	NM	---	---	---
5/23/06	2,007.9	144.6	105	9	1,471		---	NM	NM	---	---	---
5/25/06	2,050.1	42.2	120	9	1,508		---	NM	NM	---	---	---
6/15/06	2,523.6	473.5	115	10	1,460		7,907	3.05	< 0.0308	> 99	0.4	54
6/27/06	2,773.9	250.3	105	10	1,452		---	NM	NM	---	---	---
7/11/06	3,099.5	325.6	110	8	1,477		---	NM	NM	---	---	---
7/18/06	3,265.3	165.8	110	9	1,479		---	NM	NM	---	---	---
7/31/06	3,571.6	306.3	110	19	1,463		---	NM	NM	---	---	---
8/19/06	4,023.6	452.0	122	12	1,463		---	NM	NM	---	---	---
8/31/06	4,290.1	266.5	120	9	1,462		14,065	5.04	< 0.0308	> 99	0.4	82
9/15/06	4,602.2	312.1	120	8	1,471		---	NM	NM	---	---	---
9/29/06	4,895.6	293.4	115	8	1,478		---	NM	NM	---	---	---
10/30/06	5,499.3	603.7	120	8	1,456		---	NM	NM	---	---	---

**Table 5**  
**Vapor Extraction System Performance Monitoring Data**  
Former Texaco Service Station/Chevron 211577  
631 Queen Anne Avenue North  
Seattle, WA

Date	Oxidizer Hour Meter Reading (Hours)	Operating Period (Hours)	SVE Blower Inlet Vac. (" W.C.)	SVE Blower Outlet Pres. (" W.C.)	Burner Temp. (Degrees F)	C Bed (Deg)	TPH-G Estimated Cumulative Mass Removed (Lbs)	Benzene Removal Monitoring by Laboratory Analysis				
								Benzene Influent Conc. by EPA 8021B (PPMV)	Benzene Effluent Conc. by EPA 8021B (PPMV)	Destruction / Removal Efficiency (%)	Average Benzene Mass Removal Rate (Lbs/Day)	Benzene Estimated Cumulative Mass Removed (Lbs)
11/2/06	5,576.2	76.9	115	8	1,465		22,707	28	< 0.154	> 99	1.5	164
11/8/06	5,697.2	121.0	110	10	1,461		---	NM	NM	---	---	---
12/1/06	6,050.4	353.2	125	10	1,464		---	NM	NM	---	---	---
12/18/06	6,382.8	332.4	130	9	1,461		---	NM	NM	---	---	---
12/29/06	6,623.5	240.7	130	7	1,466		---	NM	NM	---	---	---
1/19/07	7,097.5	474.0	120	7	1,464		---	NM	NM	---	---	---
1/31/07	7,377.8	280.3	120	8	1,460		---	NM	NM	---	---	---
3/8/07	8,196.1	818.3	115	9	1,459		38,674	1.27	<0.0308	> 99	1.3	311
3/16/07	8,384.7	188.6	115	9	1,461		---	NM	NM	---	---	---
3/29/07	8,683.3	298.6	115	9	1,460		---	NM	NM	---	---	---
4/30/07	9,372.1	688.8	110	9	1,460		---	NM	NM	---	---	---
5/30/07	10,033.0	660.9	117	12	609		43,194	<0.6	<0.6	---	---	---
6/27/07	10,570.3	537.3	125	11	614		44,186	0.171	<0.0308	> 82	0.1	317
7/17/07	11,001.4	431.1	120	11	609		---	NM	NM	---	---	---
8/1/07	11,255.5	254.1	120	11	604		45,312	0.293	<0.0308	> 89	0.0	318
8/29/07	11,922.2	666.7	121	11	603		45,933	0.167	<0.0308	> 82	0.0	318
10/1/07	12,704.3	782.1	125	11	591		46,444	0.77	<0.0308	> 96	0.0	319
10/31/07	13,402.6	698.3	138	11	584		47,039	0.484	<0.0308	> 94	0.1	321
12/4/07	14,171.4	768.8	120	11	608		47,532	0.517	<0.0308	> 94	0.0	322
1/2/08	14,863.0	691.6	120	11	557		47,900	0.310	<0.0308	> 90	0.0	323
2/7/08	15,722.6	859.6	125	10	581		48,296	0.194	<0.0308	> 84	0.0	324
2/28/08	16,177.4	454.8	127	10	575		48,471	<0.0308	<0.0308	---	0.0	324
4/2/08	16,931.3	753.9	122	12	550		48,647	0.0337	<0.0308	> 8	0.0	324



18912 North Creek Parkway, Suite 101  
Bothell, WA 98011  
(425) 485-5800 \* Fax: (425) 485-5566

Subject	<u>211577 DPE Remediation System</u>	Job No.	<u>06-6102-00-7628-160</u>
	<u>1st Qtr. 2008 Ops. Summary Calcs.</u>	Page	<u>2 of 3</u>
Prepared By	<u>R. Shropshire</u>	Date	<u>10/3/2008</u>

**On-Line Utilization Factor**

From field notes, at approx. 11:15 am on 1/02/08, the oxidizer hour meter read 14,863.0 hours.  
The system had operated continuously with no shutdowns for at least the previous 7 days,  
Therefore at 12:00 am on 1/1/08, the oxidizer hour meter would have read 14,863.0 hours - 35.3 hours = **14,827.7 hours**

From field notes, at time of system shut-down on 4/2/2008 (approx. 3:00 pm) hour meter read 16,931.3 hours **16,931.3 hours**

Therefore, during this period the system operated **2,103.6 hours**

No. of possible operating hours during this period = **2,223 hours**

Therefore the on-line utilization factor for this period = **95%**

**Average Hydrocarbon Removal**

From SVE Performance Monitoring Data, **45,153**  
The total hydrocarbon mass removed through 4/02/08 is estimated to be =

Total estimated hydrocarbon mass removed through the previous period = 44,748 lbs.

Therefore, total hydrocarbon mass removed for this period is 45,153 lbs - 44,748 lbs = **405 lbs.**

Operating time during this period = **2,103.6 hours = 87.6 days**

Therefore, average hydrocarbon mass removed is approximately = **5 lbs./day**

**Average Cost Per Pound of Hydrocarbon Removed**

From above, operating costs for the period = **\$7,492.82**

And, total hydrocarbon mass removed is approximately = **405 lbs.**

Therefore, average cost per pound of hydrocarbon mass removed = **\$18.50 per pound**

**Operating Cost (Lifetime)**

Operating cost for current period = **\$7,492.82**

Cummulative operating cost thru end of previous period = **\$109,584.35**

Lifetime operating cost = **\$117,077.17**

**On-Line Utilization Factor (Lifetime)**

Number of hours of system operation through 12/31/07 = **16,931.3 hours = 705.5 days**

Number of possible operating hours from startup (2/27/06) through 4/2/08 @ 3pm = **18,366 hours**

Lifetime on-line utilization factor thru end of current period = **92%**



18912 North Creek Parkway, Suite 101  
Bothell, WA 98011  
(425) 485-5800 \* Fax: (425) 485-5566

Subject 211577 DPE Remediation System  
1st Qtr. 2008 Ops. Summary Calcs.  
Prepared By R. Shropshire

Job No. 06-6102-00-7628-160  
Page 3 of 3  
Date 10/3/2008

**Average Daily Mass Removal (Lifetime)**

Total hydrocarbon mass removed through end of current period =  
Cummulative no. of operating days =

**45,153 lbs**  
**705.5 days**

Average daily mass removal rate (lifetime) =

**64 lbs/day**

**Average Cost Per Pound of Hydrocarbon Removed (Lifetime)**

From above, lifetime operating costs =  
And, total hydrocarbon mass removed is approximately =

**\$117,077.17**  
**45,153 lbs**

Therefore, lifetime average cost/lb of hydrocarbon mass removed =

**\$2.59 per pound**



