

JUL 05 2019

Application Id: 24015

Certification Received: WATER QUALITY PROGRAM  
(Ecology use)

Facility Name: TRIDENT SEAFOODS CORP PIER 91

Permit Number: WAR001526  
(Ecology use)Facility Address: 2001 W GARFIELD ST PIER 91 BLDG  
SEATTLE, WA 98119

Facility County: King

Permittee Name: Shawn Stokes

Permittee Title: Regulatory Affairs  
Director

Permittee Email: envcompliance@tridentseafoods.com

Permittee Phone: 2067833818

Permittee Address: 2001 W Garfield St  
Seattle, WA 98119-3115Organization Name: TRIDENT SEAFOODS  
CORP Pier 91

## Certification of Permittee

"I certify under penalty of law that this document and all attachments were prepared under my direction or supervision in accordance with a system designed to assure that qualified personnel properly gather and evaluate the information submitted. Based on my inquiry of the person or persons who manage the system or those directly responsible for gathering the information, the information submitted is, to the best of my knowledge and belief, true, accurate, and complete. I am aware that there are significant penalties for submitting false information, including the possibility of fine and imprisonment for knowing violations."

Shawn Stokes / Trident Seafoods Corporation Regulatory Affairs Director

Printed Name / Organization

Title

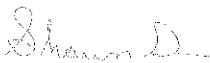

07.01.2019

Signature of Permittee \*

Date

\* Federal regulations require this application is signed by one of the following:

- A. For a corporation: By a responsible corporate officer.
- B. For a partnership or sole proprietorship: By a general partner or the proprietor, respectively.
- C. For a municipality, state, federal, or other public facility: By either a principal executive officer or ranking elected official.

Please print, sign and mail this form to the following address:

Washington Department of Ecology - Stormwater  
P.O. Box 47696  
Olympia, WA 98504-7696

Industrial Waste Program

# **Wastewater Discharge Permit Application**

---



**King County**

Department of Natural Resources and Parks  
**Wastewater Treatment Division**

You will find detailed instructions for completing each section of this application and each required exhibit in the enclosed packet, "Wastewater Discharge Permit Application Instructions and Guidelines." Review the entire application and instruction packet carefully before completing any part of the application. **This form and the instructions are also available on the Web at [www.kingcounty.gov/industrialwaste](http://www.kingcounty.gov/industrialwaste).**

- Submit one application for each site.
- The King County Industrial Waste Program (KCIW) does not require an application fee. If KCIW determines that you require an authorization, KCIW will bill you after its issuance.
- Answer all questions and include the required exhibits. **Incomplete applications will be returned to you.**
- If you do not have an answer for the requested information, indicate so and explain why.
- Indicate "N/A" if a section does not apply to your operations.
- Use additional pages, if needed.
- Send **three** copies of the completed application and exhibits to:

**King County Industrial Waste Program**  
**201 S. Jackson Street, Room 513**  
**Seattle, WA 98104-3855**

## SECTION A – BUSINESS NAMES AND ADDRESSES

**APPLICANT BUSINESS AND/OR PROJECT NAME:** Trident Seafoods Pier 91 Plant

**ADDRESS OF SITE DISCHARGING WASTEWATER:**

*(If no address, indicate cross streets.)*

2001 W Garfield St

Site Address

Seattle, WA 98119

City, State

Zip Code

**BUSINESS MAILING ADDRESS:**

Mailing Address

City, State

Zip Code

**PRIMARY PERSON TO BE CONTACTED ABOUT THIS APPLICATION:**

Alex Kaeka

Name

5303 Shilshole Ave NW

Mailing Address

Seattle, WA 98107

City, State

Zip Code

akaeka@tridentseafoods.com

E-Mail Address

Environmental Compliance Specialist

Title *(e.g., President, Consultant, On-Site Manager)*

Trident Seafoods Corporation

Company/Agency Name

206 - 783 - 3818

Telephone No.

206 - 291 - 6681

24-Hour Emergency Phone No.

**SECONDARY PERSON TO BE CONTACTED ABOUT THIS APPLICATION:**

Shawn Stokes

Name

5303 Shilshole Ave NW

Mailing Address

Seattle, WA 98107

City, State

Zip Code

sstokes@tridentseafoods.com

E-Mail Address

Regulatory Affairs Director

Title *(e.g., President, Consultant, On-Site Manager)*

Trident Seafoods Corporation

Company/Agency Name

206 - 783 - 3818

Telephone No.

- - -

24-Hour Emergency Phone No.

## SECTION B – GENERAL BUSINESS INFORMATION

### 1. NATURE OF BUSINESS

Briefly describe your business and the main activities producing wastewater at the applicant site (type of processing, manufacturing, service, remediation).

Pier 91 Trident Processing Plant receives frozen fillets of fish for secondary processing. The fillets are cut and portioned to size then packaged for transport for additional value added processing at other facilities. The cutting is performed by band saws. Effort is made to capture all unused solids by strategic placement of screens and bins. The screens and bins are emptied daily and the captured solids are either used for further processing or rendered at a landfill. Sanitation is completed daily and minimal water use is practiced. There are other operations in adjoining building such as- Cold Storage, Warehousing and Distribution

### 2. PERTINENT IDENTIFICATION NUMBERS AND PERMITS

Standard Industrial Classification (SIC) <u>2092</u> EPA WAD No. _____ Water/Sewer Agency <u>Port of Seattle</u> and Account No. <u>078420</u> Water Meter No(s) <u>1342582, 45055505, 45230995, 721648,</u> <u>72645057</u> Current King County Permit No. <u>7901-01</u> Date Business Started at this Site <u>July 1999</u>	Environmental Control Permits Issued for Applicant Site:  Puget Sound Clean Air Agency Reg #21148 Washington State Industrial Stormwater Permit WAR001526
---	--

## SECTION C – PRODUCT AND PROCESS DESCRIPTION

### 1. DAILY AND SEASONAL VARIATIONS

	Number of Operating Days/Year	Circle Days You Generally Discharge and Provide Number of Hours Discharging on Those Days								Number of Employees/Shift		
		Mon	Tue	Wed	Thur	Fri	Sat	Sun	Holiday	Day	Night	Swing
Average	240	4	8	4	4	4	0	0	0	45	0	4
Maximum												

### 2. BUSINESS ACTIVITIES AND PRODUCTS

Business activities include manufacturing, processing, and remediation activities.

Business Activity	Type of Product or Brand Name	Daily Quantities	
		Average	Maximum
Seafood Processing	Seafood	20,000 lbs.	40,000 lbs

### 3. RAW MATERIALS AND CHEMICALS USED IN THE PROCESS

Brand Name	Chemical or Actual Name	Purpose	Daily Quantities Used		Tank Volume	Working Concentration
			Average	Maximum		
WESMAR	FRM-63CB	Equipment Cleaning	4 Gal	5 Gal	100 Gal	3.3 oz/Gal
WESMAR	SANITE 75	Boot Dip	12oz	16oz	1 Gal	200- 400 ppm
WESMAR	IODINE SANITIZER	Hand Dip	12oz	16oz	1 Gal	20- 25 ppm

### 4. INDUSTRIAL WASTEWATERS DISCHARGED TO KING COUNTY SEWERS

- (1) Enter a brief description and assign a number for each process (add more lines if necessary). Also show these process numbers in Exhibits A and B.
- (2) Indicate frequency of discharge; either continuously discharged when generated, or stored and discharged in batches.

Process Number	Process That Generates Wastewater	Substances Discharged to the Sewer	Type of Pretreatment	Frequency of Discharge (continuous or batch)	Daily Quantity Discharged in Gallons	
					Average	Maximum
1	Sanitation	Wastewater/ Fish protein	None	Batch	4,000 Gal	11,000 Gal

### 5. LIQUID WASTES AND SLUDGES REMOVED BY MEANS OTHER THAN KING COUNTY SEWERS

Enter annual, monthly, or daily volume, or volume of each removal. Indicate unit of measurement.

Type of Waste/Substance	Means of Removal	Frequency	Volume
Fish solids/ proteins	De-Watering Screen	Daily	Ave. of 100 lbs

6. PROPOSED DURATION OF WASTEWATER DISCHARGE: up to 6 hrs per day of processing

## SECTION D – WATER BALANCE

### 1. WATER BALANCE TABLE

- (1) Enter the appropriate letter for the water source:  
a.) City Service b.) Private Well c.) Reclaimed Water  
d.) Raw Materials e.) Industrial Storm Water f.) Groundwater
- (2) Enter the appropriate letter for the discharge point:  
a.) Sewer b.) Storm Drain c.) Receiving Water d.) Waste Hauler e.) Evaporation f.) Product  
If the discharge is entering the sewer, also indicate the side sewer (ss) number, if available.
- (3) You must provide documentation of the water balance calculations provided in this table.  
(See directions for Exhibit I.)

Type of Consumption/Discharge	Water In:			Water Out:		
	Water Use			Water Discharge or Loss		
	Water Source (1)	Average (gals/day)	Maximum (gals/day)	Discharge Point (2)	Average (gals/day)	Maximum (gals/day)
Industrial processing water/wastewater	a	7028	13748	a	7817	14107
Contact cooling water	N/A	0	0	N/A	0	0
Non-contact cooling water	N/A	0	0	N/A	0	0
Boiler and cooling tower feed/blowdown	N/A	0	0	N/A	0	0
Water incorporated into product	a	491	2132	N/A	0	0
Sanitary water/wastewater	N/A	0	0	N/A	0	0
Industrial storm water	N/A	0	0	N/A	0	0
Plant washing water/wastewater	N/A	0	0	N/A	0	0
Construction dewatering	N/A	0	0	N/A	0	0
Groundwater remediation	N/A	0	0	N/A	0	0
Site Irrigation	N/A	0	0	N/A	0	0
Evaporation	—	—	—	N/A	0	0
Other: (please indicate)	N/A	0	0	N/A	0	0
TOTALS:	—	7519	15880	—	7817	14107

## SECTION E – SUPPORTING EXHIBITS

Please see instructions for information on how to complete the following exhibits:

- Exhibit A:** Schematic Flow Diagram (required)
- Exhibit B:** Site Layout (required)
- Exhibit C:** Planned Changes in Pretreatment or Waste Disposal Practices
- Exhibit D:** Analytical or Historical Data
- Exhibit E:** Spill Prevention and Containment Plan
- Exhibit F:** Tank Capacities and Concentrations
- Exhibit G:** Hydrogeologic Reports for Groundwater Remediation
- Exhibit H:** Engineering Report (Required only if you have wastewater pretreatment systems or are intending to install such systems.)
- Exhibit I:** Documentation of Water Balance Calculations

## SECTION F – CERTIFICATION

I certify under penalty of law that this document and all attachments were prepared under my, direction or supervision in accordance with a system designed to ensure that qualified personnel properly gather and evaluate the information submitted. Based on my inquiry of the person or persons who manage the system, or those persons directly responsible for gathering the information, the information submitted is to the best of my knowledge and belief, true, accurate, and complete. I am aware that there are significant penalties for submitting false information, including the possibility of fine and imprisonment for knowing violations.

Shawn Stokes

Printed Name

Regulatory Affairs Director

Title

Trident Seafoods Corporation

Company/Agency Name

Shawn Stokes

Signature

06.28.2019

Date

This information is available in alternative formats for people with disabilities on request at 206-477-5300 (voice) or 711 (TTY).

# Exhibit A Process Area

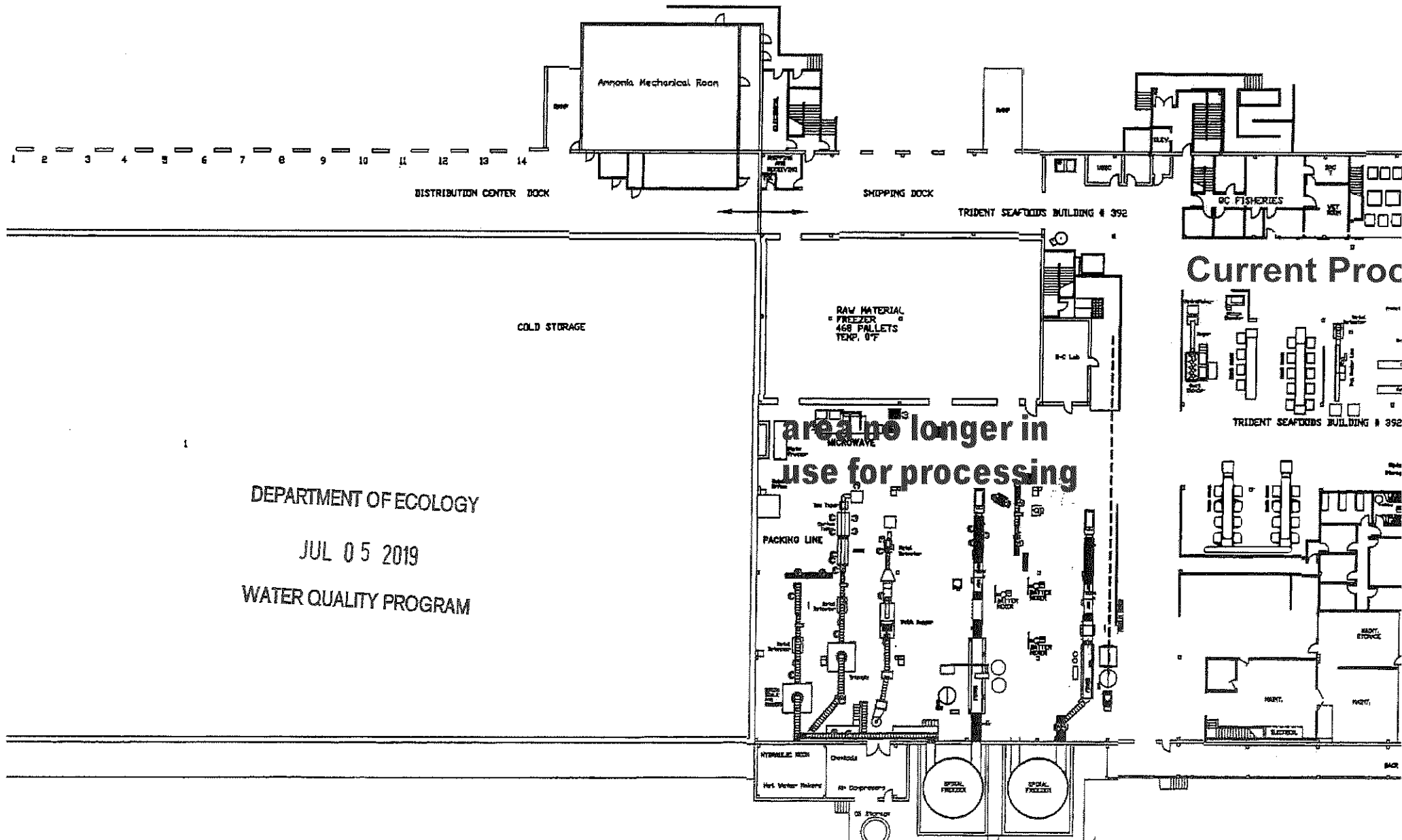



## Exhibit B Site Layout

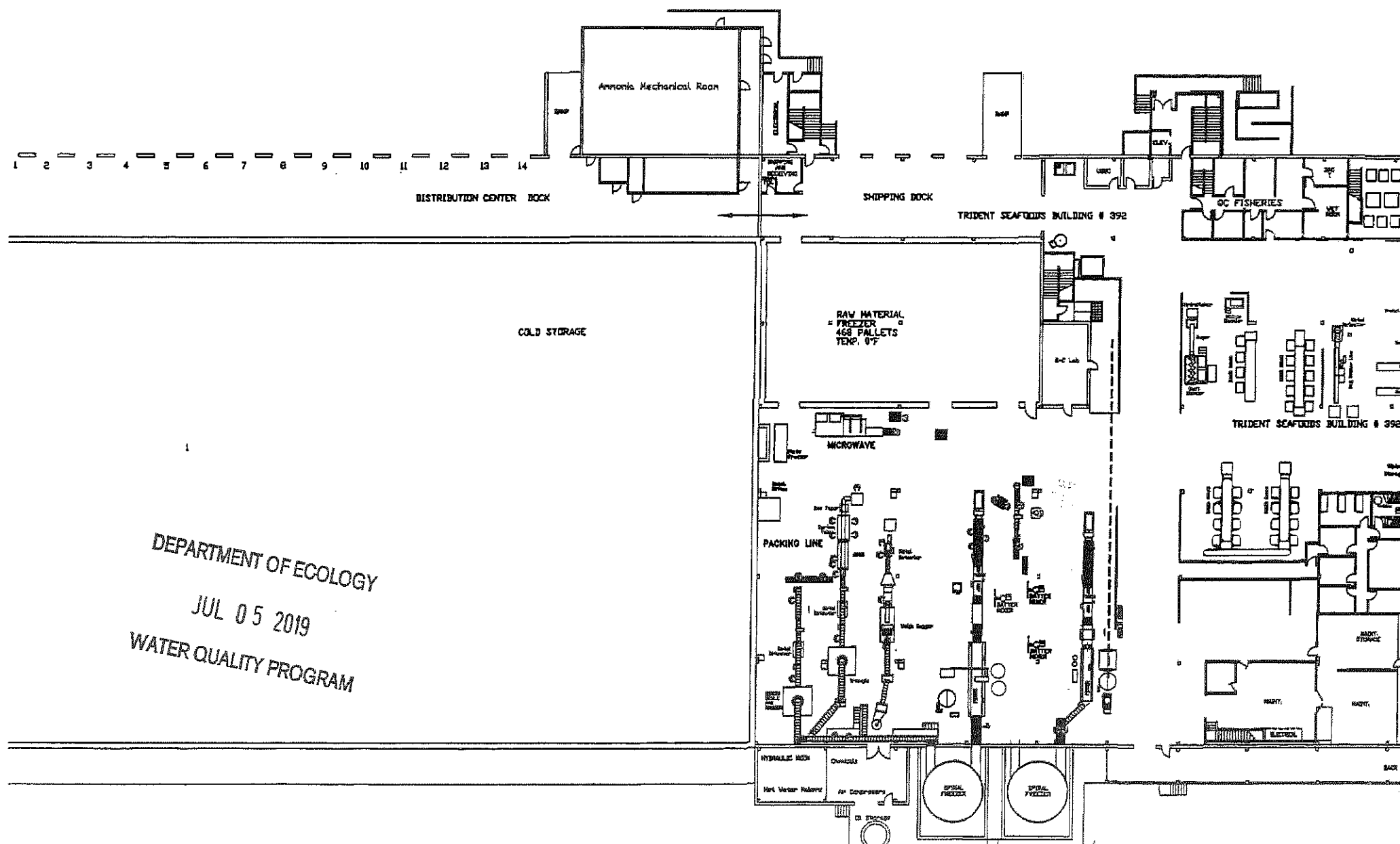



# Industrial Waste Monthly Self-Monitoring Report

## FOR FOOD PROCESSORS

Mail or FAX to: King County Industrial Waste  
201 South Jackson Street, Suite 513  
Seattle, WA 98104  
Phone 206-263-3000 / FAX 206-263-3001

Email: [info.KCIW@kingcounty.gov](mailto:info.KCIW@kingcounty.gov)

Company Name: Trident Seafoods Corporation

Sample Site No. A4489

Permit/DA No.: 7901-01

Please Specify Month & Year: Month: April 2019

This form is available at [www.kingcounty.gov/industrialwaste](http://www.kingcounty.gov/industrialwaste).

All units are mg/l unless otherwise noted.

Sample Date	pH*		*A pH violation has occurred if: • A pH reading is below 5.0 (for any amount of time). • A pH reading is between 5.5 and 5.0 for more than 15 minutes. • The pH of 12.0 is exceeded and does not comply with the conditions in your permit. (See S4.) Report the pH value and duration of each pH excursion. Each pH excursion that is a violation must be addressed in a written report due along with the self-monitoring report. Explain the cause of the violation and the corrective action taken to ensure compliance with pH limits.	Polar Fats, Oil & Grease (FOG) Volumetric* (Inches)	Flow Industrial (GPD)	Notes	Signature
	min	max					
1	8.23	8.26			8234		
2	7.88	7.88			8234		
3	6.95	6.95			6737		
4	8.14	8.16			7485		
5	7.49	7.49			5988		
6							
7							
8	6.58	7.94			7485		
9	7.84	7.84			8234		
10	8.70	8.74			5988		
11	7.21	7.21			5988		
12	7.12	7.39			5988		
13					5988		
14							
15	6.56	7.36			5988		
16			Cleaned and calibrated both Ph Probes 4.01-10.00, Fog Test		5988		
17	7.09	7.09			5240		
18	7.31	7.43			5240		
19	7.45	7.53			5988		
20				<1/32"			
21							
22	7.49	7.86			7485		
23	7.25	7.25			8982		
24	8.71	8.71			6737		
25	7.42	7.78			5240		
26	9.00	9.00			6737		
27							
28							
29	7.17	7.17			6737		
30	7.36	7.36					
31							

Monthly Min pH 6.56 Date 4/15/19

Monthly Max pH 9.00 Date 4/26/19

Maximum Daily Flow 140708

\*Maximum Polar FOG Volumetric <1/32"

4/23/2109

4/19/2019

**Due Date:** Monthly report is due by the 15th of each month.

\*Temperature at time of Polar FOG test must be less than 70 degrees F.

I certify under penalty of law that this document and all attachments were prepared under my direction or supervision in accordance with a system designed to assure that qualified personnel properly gather and evaluate the information submitted. Based on my inquiry of the person or persons who manage the system, or those persons directly responsible for gathering the information, the information submitted is, to the best of my knowledge and belief, true, accurate, and complete. I am aware that there are significant penalties for submitting false information, including the possibility of fine and imprisonment for knowing violations. I further certify that all data requiring a laboratory analysis were analyzed by a Washington State Department of Ecology accredited laboratory for each parameter tested.

  
 Signature of Principal Executive or Authorized Agent  
 Date 05.09.2019