

SITE ACREAGE: 9.2 AC

MATCHLINE - SEE SHEET 2

DISCHARGE AREA	OUTFALL
(A) TEMCO ACCESS ROAD	STORM SYSTEM- CITY OF TACOMA
(B) PARKING AREA	SHEET FLOW- COMMENCEMENT BAY / PUGET SOUND
(C) GRAIN SILOS	COMMENCEMENT BAY / PUGET SOUND VIA SCUPPERS
(D) FACILITY ROOF AREA	COMMENCEMENT BAY / PUGET SOUND
(E) NORTH SERVICE AREA	COMMENCEMENT BAY / PUGET SOUND

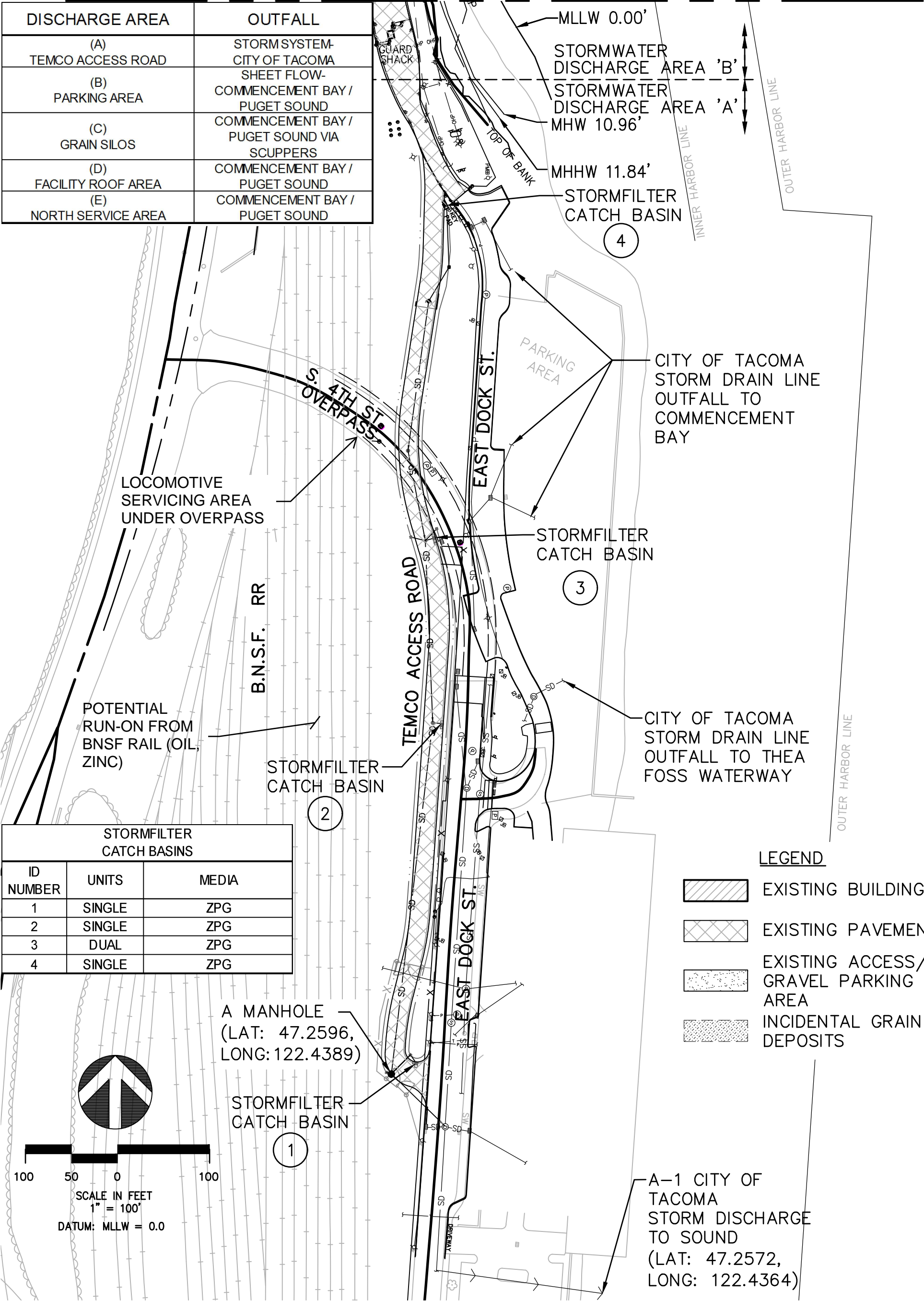

STORMFILTER CATCH BASINS		
ID NUMBER	UNITS	MEDIA
1	SINGLE	ZPG
2	SINGLE	ZPG
3	DUAL	ZPG
4	SINGLE	ZPG

LEGEND

- EXISTING BUILDING
- EXISTING PAVEMENT
- EXISTING ACCESS/ GRAVEL PARKING AREA
- INCIDENTAL GRAIN DEPOSITS

PROJECT	INDUSTRIAL STORMWATER POLLUTION PREVENTION PLAN (SWPPP)						
TITLE	TACOMA EXPORT MARKETING COMPANY, LLC (TEMCO)						
	11 SCHUSTER PARKWAY TACOMA, WA						
DWG. REF.	PROJECT	SCALE	DRAWN BY	DESIGN BY	APPROVED BY	AMENDMENT NO.	DATE
	TEMX0000-0016	AS SHOWN	BEM	AXHA		0.0	12/14/2018

MATCHLINE - SEE SHEET 3

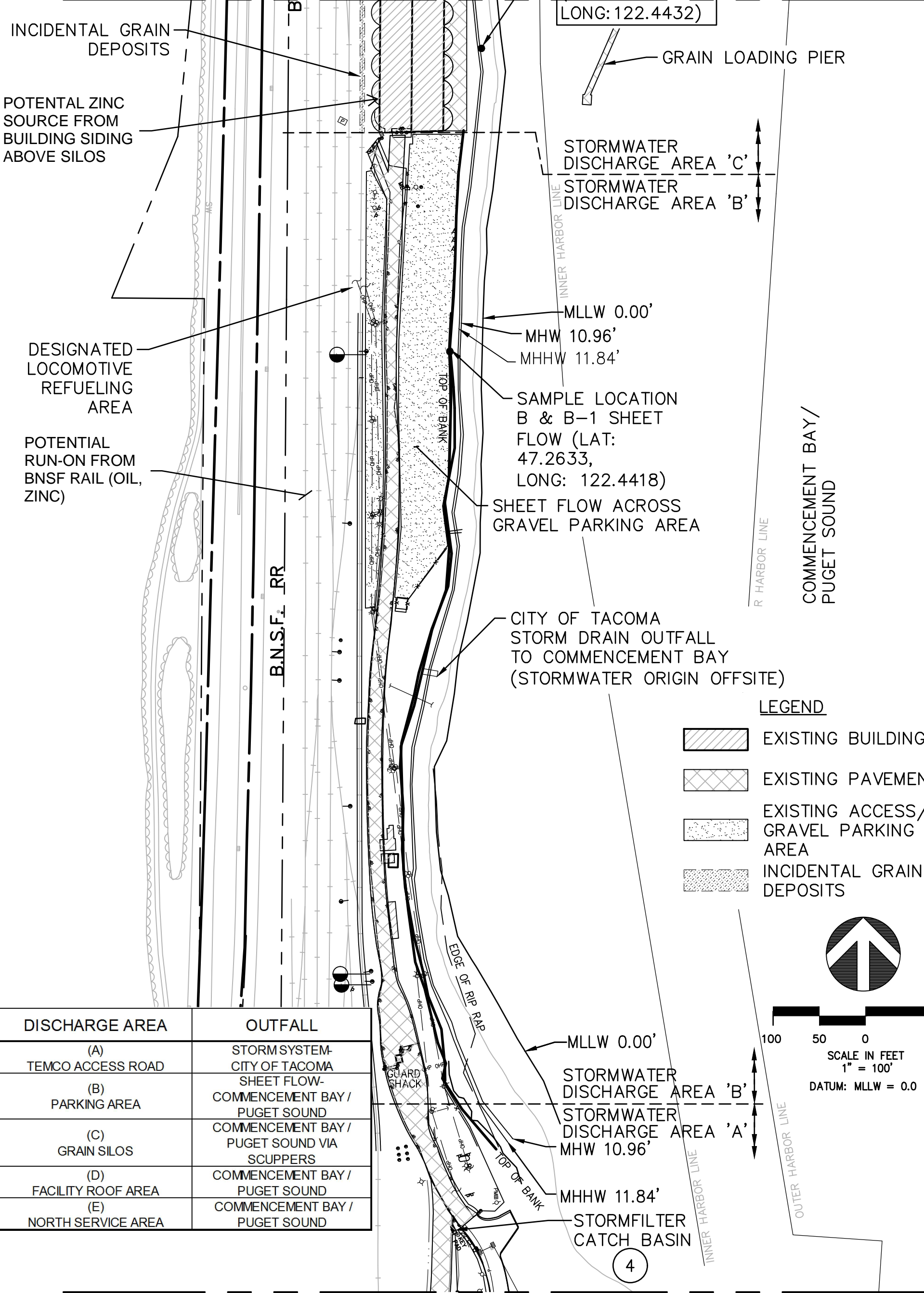

DAVID EVANS
AND ASSOCIATES INC.
415 • 118th Avenue SE
Bellevue Washington 98005-3518
Phone: 425.519.6500

PROJECT INDUSTRIAL STORMWATER POLLUTION PREVENTION PLAN (SWPPP)
TITLE TACOMA EXPORT MARKETING COMPANY, LLC (TEMCO)
11 SCHUSTER PARKWAY TACOMA, WA

DWG. REF. PROJECT SCALE DRAWN BY DESIGN BY APPROVED BY AMENDMENT NO. DATE
TEMX0000-0016 AS SHOWN BEM AXHA 0.0 12/14/2018

SHEET
2
OF
3

DISCHARGE AREA	OUTFALL
(A) TEMCO ACCESS ROAD	STORM SYSTEM- CITY OF TACOMA
(B) PARKING AREA	SHEET FLOW- COMMENCEMENT BAY / PUGET SOUND
(C) GRAIN SILOS	COMMENCEMENT BAY / PUGET SOUND VIA SCUPPERS
(D) FACILITY ROOF AREA	COMMENCEMENT BAY / PUGET SOUND
(E) NORTH SERVICE AREA	COMMENCEMENT BAY / PUGET SOUND

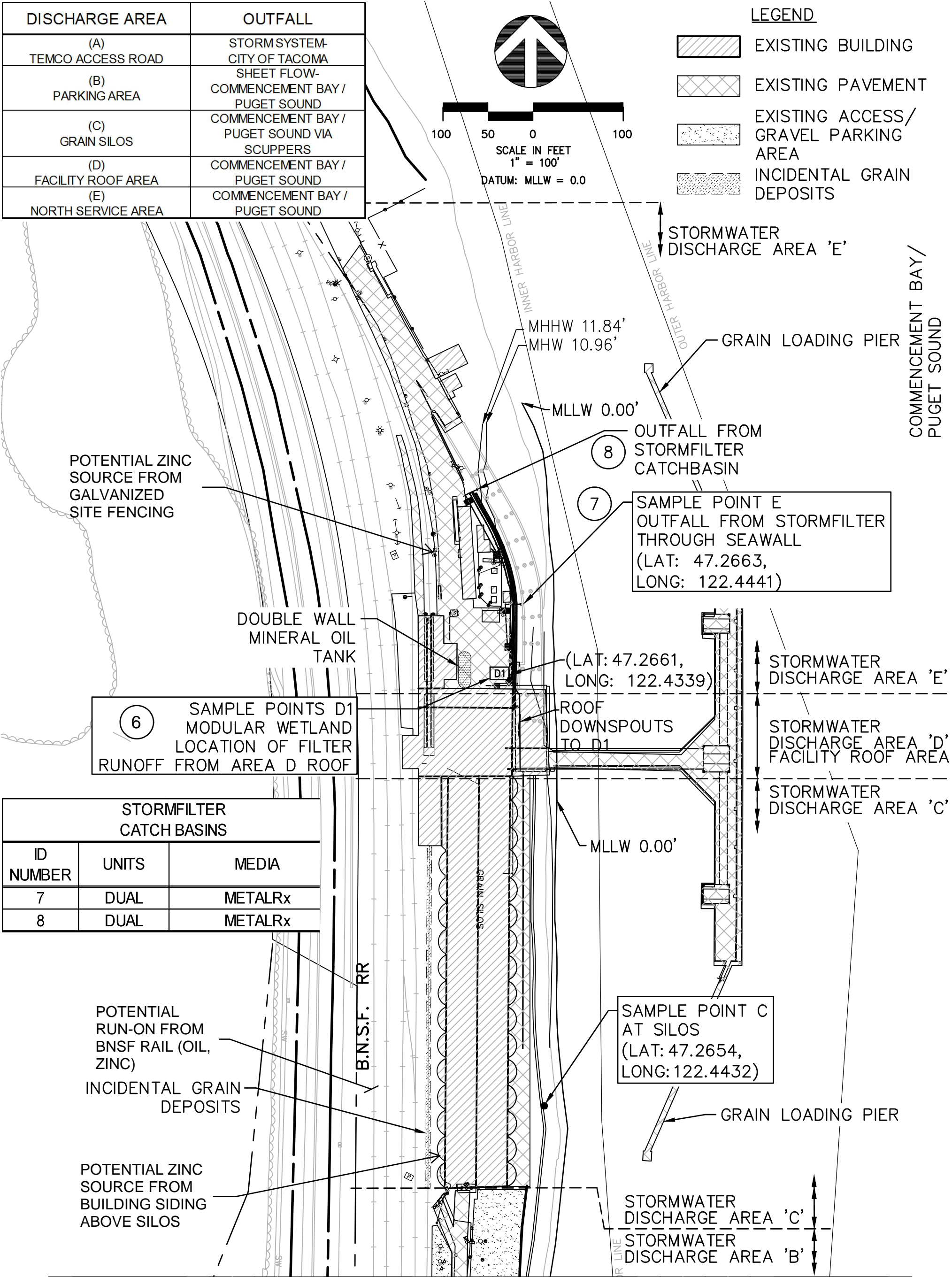

STORMFILTER CATCH BASINS		
ID NUMBER	UNITS	MEDIA
7	DUAL	METALRx
8	DUAL	METALRx