

Tollgate Farm Improvements

NORTH BEND, WASHINGTON



PROJECT TEAM

CLIENT & OWNER CONTACTS

MIKE McCARTY
LAND OWNER
CITY OF NORTH BEND COMMUNITY AND
ECONOMIC DEVELOPMENT
PO BOX 896
NORTH BEND, WA
425.888.7649

TRAVIS STOMBAUGH
EXECUTIVE DIRECTOR
SI VIEW METROPOLITAN PARK DISTRICT
400 SE ORCHARD DR
NORTH BEND, WA
425.831.1900

DAVE DEMBECK
OPERATIONS MANAGER
SI VIEW METROPOLITAN PARK DISTRICT
400 SE ORCHARD DR
NORTH BEND, WA
425.831.1900

PROJECT CONSULTANT CONTACTS

JENIFER CLAPHAM/SAM BRICK
CIVIL ENGINEER
KPFF INC.
206.926.0490

ANDY MITTON/JASON FRISTENSKY
LANDSCAPE ARCHITECT/PROJECT MANAGER
BERGER PARTNERSHIP P.S.
206.325.6877

GREG JUTTNER
STRUCTURAL ENGINEER
SWENSON SAY FACET
206.956.3759

ERIC SWEET/BRAD DUGAN
ELECTRICAL ENGINEER
MAZETTI
425.712.2155

JEREME CHAPMAN
LAND SURVEY
KPFF CONSULTING ENGINEERS INC.
360.292.7230

BOB HOSHIDE/JORDAN LOCK
ARCHITECT
HOSHIDE WANZER ARCHITECTS
206.325.6441

JENNI KREVLING/RYAN KAHLO
SENIOR ECOLOGIST
THE WATERSHED COMPANY
425.822.5242

CHRIS LOCKWOOD
SENIOR MANAGING ASSOCIATE
ESA | ENVIRONMENTAL SCIENCE
ASSOCIATES
206.789.9658

BRUCE BLYTON/TONY ROMANICK
GEOTECHNICAL ENGINEER
AESI | ASSOCIATED EARTH SCIENCES
INCORPORATED
253.722.2992

SHEET INDEX	
SHEET NO	SHEET TITLE
C-100	COVER SHEET
C-101	NOTES AND LEGEND
C-200	TESC PLAN
C-300	CIVIL GRADING AND DRAINAGE PLAN
C-400	CIVIL HORIZONTAL CONTROL AND PAVING PLAN
C-410	CIVIL HYDRANT AND FIRE TRUCK TURNING PLAN
C-500	NW 8TH STREET IMPROVEMENTS
C-600	TESC DETAILS
C-601	CIVIL GRADING AND DRAINAGE DETAILS
C-602	CIVIL PAVING DETAILS

LEGAL DESCRIPTION

PARCEL A OF CITY OF NORTH BEND LOT LINE ADJUSTMENT NO 125-078 RECORDING NO 20011217900009 SAID PARCEL A DEFINED - SE 1/4 OF SW 1/4 LESS S 20 FT LESS CO ROADS LESS STATE ROAD NO 2 LESS PORTION LY ELY OF SR 202 LESS E 606.25 FT

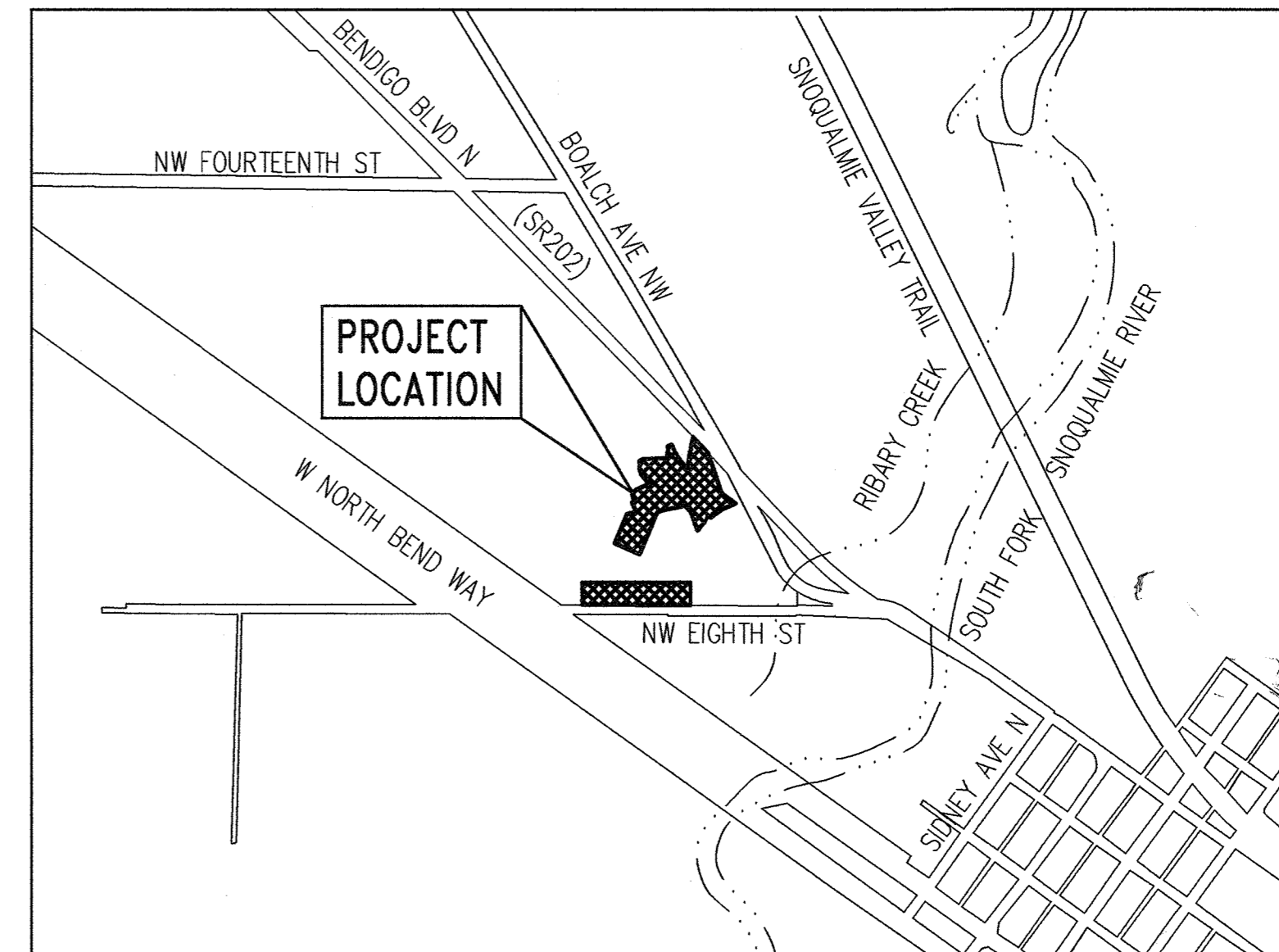

VICINITY MAP

SCALE: 1" = 800'±

CITY OF NORTH BEND PERMIT # _____

THESE PLANS ARE APPROVED FOR CONFORMANCE WITH THE
CITY OF NORTH BEND PUBLIC WORKS DEPARTMENT
REQUIREMENTS TO THE BEST OF MY KNOWLEDGE.

Tom M. M. 7-16-21
CITY ENGINEER OR PUBLIC WORKS DIRECTOR DATE



Know what's below.
Call before you dig.



1601 5th Avenue, Suite 1600
Seattle, WA 98101

206.622.5822
www.kpff.com

TOLLGATE FARMSTEAD
IMPROVEMENTS
SI VIEW METROPOLITAN PARKS DISTRICT
1300 NORTH BEND WAY, NORTH BEND, WA 98045

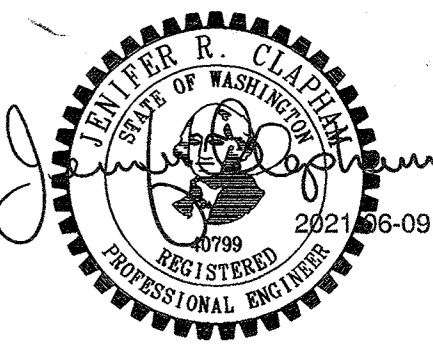

SET TYPE:
100% IFC - BID
DOCUMENTS

SET ISSUE DATE:
06.09.2021

REVISIONS:

DRAWN/CHECKED:
JEP/SJB

SHEET NAME:
COVER SHEET

SHEET NUMBER:

C-100

© THE BERGER PARTNERSHIP PS, 2018

GENERAL NOTES

- ALL DESIGN AND CONSTRUCTION SHALL BE IN ACCORDANCE WITH PERMIT CONDITIONS, NORTH BEND MUNICIPAL CODE AND PROJECT SPECIFICATIONS.
- SPECIAL CARE SHALL BE EXERCISED UNDER AND IN THE VICINITY OF OVERHEAD POWER LINES THAT MUST REMAIN IN SERVICE WITHIN THE SITE. THE CONTRACTOR SHALL COMPLY WITH CURRENT REGULATIONS REGARDING CONSTRUCTION ACTIVITIES NEAR AND UNDER EXISTING OVERHEAD POWER LINES ON SITE.
- A COPY OF THESE APPROVED PLANS MUST BE ON THE JOB SITE WHENEVER CONSTRUCTION IS IN PROGRESS.
- PROJECT IS REQUIRED TO MEET 2009 KCSWDM STANDARD.

KING COUNTY TEMPORARY EROSION AND SEDIMENT CONTROL NOTES

- APPROVAL OF THIS EROSION AND SEDIMENTATION CONTROL (ESC) PLAN DOES NOT CONSTITUTE AN APPROVAL OF PERMANENT ROAD OR DRAINAGE DESIGN (E.G., SIZE AND LOCATION OF ROADS, PIPES, RESTRICTORS, CHANNELS, RETENTION FACILITIES, UTILITIES, ETC.).
- THE IMPLEMENTATION OF THESE ESC PLANS AND THE CONSTRUCTION, MAINTENANCE, REPLACEMENT, AND UPGRADING OF THESE ESC FACILITIES IS THE RESPONSIBILITY OF THE APPLICANT/ESC SUPERVISOR UNTIL ALL CONSTRUCTION IS APPROVED.
- THE BOUNDARIES OF THE CLEARING LIMITS SHOWN ON THIS PLAN SHALL BE CLEARLY FLAGGED BY SURVEY TAPE OR FENCING, IF REQUIRED, PRIOR TO CONSTRUCTION (SWDM APPENDIX D). DURING THE CONSTRUCTION PERIOD, NO DISTURBANCE BEYOND THE CLEARING LIMITS SHALL BE PERMITTED. THE CLEARING LIMITS SHALL BE MAINTAINED BY THE APPLICANT/ESC SUPERVISOR FOR THE DURATION OF CONSTRUCTION.
- STABILIZED CONSTRUCTION ENTRANCES SHALL BE INSTALLED AT THE BEGINNING OF CONSTRUCTION AND MAINTAINED FOR THE DURATION OF THE PROJECT. ADDITIONAL MEASURES, SUCH AS CONSTRUCTED WHEEL WASH SYSTEMS OR WASH PADS, MAY BE REQUIRED TO ENSURE THAT ALL PAVED AREAS ARE KEPT CLEAN AND TRACK OUT TO ROAD RIGHT OF WAY DOES NOT OCCUR FOR THE DURATION OF THE PROJECT.
- THE ESC FACILITIES SHOWN ON THIS PLAN MUST BE CONSTRUCTED PRIOR TO OR IN CONJUNCTION WITH ALL CLEARING AND GRADING SO AS TO ENSURE THAT THE TRANSPORT OF SEDIMENT TO SURFACE WATERS, DRAINAGE SYSTEMS, AND ADJACENT PROPERTIES IS MINIMIZED.
- THE ESC FACILITIES SHOWN ON THIS PLAN ARE THE MINIMUM REQUIREMENTS FOR ANTICIPATED SITE CONDITIONS. DURING THE CONSTRUCTION PERIOD, THESE ESC FACILITIES SHALL BE UPGRADED AS NEEDED FOR UNEXPECTED STORM EVENTS AND MODIFIED TO ACCOUNT FOR CHANGING SITE CONDITIONS (E.G. ADDITIONAL COVER MEASURES, ADDITIONAL SUMP PUMPS, RELOCATION OF DITCHES AND SILT FENCES, PERIMETER PROTECTION ETC.) AS DIRECTED BY KING COUNTY.
- THE ESC FACILITIES SHALL BE INSPECTED DAILY BY THE APPLICANT/ESC SUPERVISOR AND MAINTAINED TO ENSURE CONTINUED PROPER FUNCTIONING. WRITTEN RECORDS SHALL BE KEPT OF WEEKLY REVIEWS OF THE ESC FACILITIES.
- ANY AREAS OF EXPOSED SOILS, INCLUDING ROADWAY EMBANKMENTS, THAT WILL NOT BE DISTURBED FOR TWO CONSECUTIVE DAYS DURING THE WET SEASON OR SEVEN DAYS DURING THE DRY SEASON SHALL BE IMMEDIATELY STABILIZED WITH THE APPROVED ESC COVER METHODS (E.G., SEEDING, MULCHING, PLASTIC COVERING, ETC.).
- ANY AREA NEEDING ESC MEASURES, NOT REQUIRING IMMEDIATE ATTENTION, SHALL BE ADDRESSED WITHIN SEVEN (7) DAYS.
- THE ESC FACILITIES ON INACTIVE SITES SHALL BE INSPECTED AND MAINTAINED A MINIMUM OF ONCE A MONTH, OR WITHIN TWENTY FOUR (24) HOURS FOLLOWING A STORM EVENT.
- AT NO TIME SHALL MORE THAN ONE (1) FOOT OF SEDIMENT BE ALLOWED TO ACCUMULATE WITHIN A CATCH BASIN. ALL CATCH BASINS AND CONVEYANCE LINES SHALL BE CLEANED PRIOR TO PAVING. THE CLEANING OPERATION SHALL NOT FLUSH SEDIMENT-LADEN WATER INTO THE DOWNSTREAM SYSTEM.
- ANY PERMANENT RETENTION/DETENTION FACILITY USED AS A TEMPORARY SETTLING BASIN SHALL BE MODIFIED WITH THE NECESSARY EROSION CONTROL MEASURES AND SHALL PROVIDE ADEQUATE STORAGE CAPACITY. IF THE PERMANENT FACILITY IS TO FUNCTION ULTIMATELY AS AN INFILTRATION SYSTEM, THE TEMPORARY FACILITY MUST BE ROUGH GRADED SO THAT THE BOTTOM AND SIDES ARE AT LEAST THREE FEET ABOVE THE FINAL GRADE OF THE PERMANENT FACILITY.
- COVER MEASURES WILL BE APPLIED IN CONFORMANCE WITH APPENDIX D OF THE SURFACE WATER DESIGN MANUAL.
- PRIOR TO THE BEGINNING OF THE WET SEASON (OCT. 1), ALL DISTURBED AREAS SHALL BE REVIEWED TO IDENTIFY WHICH ONES CAN BE SEEDED IN PREPARATION FOR THE WINTER RAINS. DISTURBED AREAS SHALL BE SEEDED WITHIN ONE WEEK OF THE BEGINNING OF THE WET SEASON. A SKETCH MAP OF THOSE AREAS TO BE SEEDED AND THOSE AREAS TO REMAIN UNCOVERED SHALL BE SUBMITTED TO THE DDES INSPECTOR FOR REVIEW.

CONTRACTOR IS ALERTED TO THE FACT THAT WORK WILL BE ACCOMPLISHED AROUND ACTIVE PSE GAS AND ENERGIZED TANNER ELECTRIC CO-OP (TEC) FACILITIES THAT ARE SERVING EXISTING CUSTOMERS. CONTRACTOR SHALL COORDINATE WITH PSE AND TEC TO DETERMINE WHICH FACILITIES ARE ACTIVE AND ENERGIZED AND SHALL IMPLEMENT SAFETY PROCEDURES PER PSE AND TEC REQUIREMENTS. CONTRACTOR SHALL COORDINATE WITH PSE AND TEC TO ENSURE THAT FACILITIES ARE IN PLACE TO MAINTAIN SERVICE TO CUSTOMERS THROUGHOUT CONSTRUCTION.

PERMEABLE PAVING CONSTRUCTION NOTES

- PRIOR TO INSTALLATION, COORDINATE SUBGRADE PREPARATION OF PERMEABLE PAVING WITH PROJECT GEOTECHNICAL ENGINEER. FOLLOWING NOTES HAVE BEEN PROVIDED BY THE PROJECT GEOTECHNICAL ENGINEER.
- FOR PREPARATION OF PERVIOUS PAVERS, TOPSOIL, AND ORGANICS, EXISTING ASPHALT SHOULD BE STRIPPED FROM THE PROPOSED PAVER AREA. THE EXISTING SUBGRADE SHOULD BE EXPOSED AND PROOF-ROLLED. IF A FIRM AND UNYIELDING CONDITION IS ACHIEVED, NO FURTHER REMEDIAL PREPARATION WOULD BE REQUIRED. IF EXCESSIVELY ORGANIC OR YIELDING CONDITIONS ARE ENCOUNTERED, THE SUBGRADE MATERIAL WOULD BE PARTIALLY REMOVED AND REPLACED WITH PERMEABLE IMPORTED STRUCTURAL FILL. ALTERNATIVELY, IF OVEREXCAVATION IS TO BE AVOIDED, USE OF GEOSYNTHETICS COULD BE SIGNIFICANTLY DECREASED IF THEY ARE COMPACTED DURING GRADING (BY COMPACTION EQUIPMENT, TRACKED/WHEELED EQUIPMENT) OR COVERED BY LOW-PERMEABILITY FILL. IN OUR OPINION IT IS NOT POSSIBLE TO AVOID GRADING THE SITE WITHOUT SOME COMPACTION OF THE SUBGRADE SOILS DUE TO EQUIPMENT TRAFFIC. TO MITIGATE THE COMPACTION AND THE ASSOCIATED DECREASE IN PERMEABILITY, WE HAVE PROVIDED THE FOLLOWING RECOMMENDATIONS WHICH ARE CONSISTENT WITH THE LID MANUAL:
 - FINAL GRADING SHOULD BE COMPLETED BY MACHINERY OPERATING ON A PRELIMINARY SUBGRADE THAT IS AT LEAST 12 INCHES HIGHER THAN FINAL SUBGRADE ELEVATION. FINAL EXCAVATION THEN PROCEEDS AS MACHINERY IS PULLED BACK.
 - THE AGGREGATE BASE SHOULD BE DUMPED ONTO THE SUBGRADE FROM THE EDGE OF THE INSTALLATION AREA, AND THEN PUSHED OUT ONTO THE SUBGRADE. THEN TRUCKS DUMP SUBSEQUENT LOADS FROM ON TOP OF THE AGGREGATE BASE AS THE INSTALLATION PROGRESSES.
 - AVOID SUBGRADE PREPARATION DURING WET PERIODS AS SOIL COMPACTION INCREASES SIGNIFICANTLY IF SOIL IS WET.
 - IMMEDIATELY PLACE PAVER SYSTEM ONCE AGGREGATE BASE HAS BEEN PLACED. PAVER SYSTEM SHOULD BE INSTALLED PER MANUFACTURER'S RECOMMENDATIONS.

KING COUNTY WET WEATHER PROVISIONS

- THE ALLOWED TIME THAT A DISTURBED AREA MAY REMAIN UNWORKED WITHOUT COVER MEASURES IS REDUCED TO TWO CONSECUTIVE WORKING DAYS, RATHER THAN SEVEN (SECTION D.3.2).
- STOCKPILES AND STEEP CUT AND FILL SLOPES ARE TO BE PROTECTED IF UNWORKED FOR MORE THAN 12 HOURS (SECTION D.3.2).
- COVER MATERIALS SUFFICIENT TO COVER ALL DISTURBED AREAS SHALL BE STOCKPILED ON SITE (SECTION D.3.2).
- ALL AREAS THAT ARE TO BE UNWORKED DURING THE WET SEASON SHALL BE SEEDED WITHIN ONE WEEK OF THE BEGINNING OF THE WET SEASON (SECTION D.3.2.5).
- MULCH IS REQUIRED TO PROTECT ALL SEEDED AREAS (SECTION D.3.2.1).
- FIFTY LINEAR FEET OF SILT FENCE (AND THE NECESSARY STAKES) PER ACRE OF DISTURBANCE MUST BE STOCKPILED ON SITE (SECTION D.3.3.1).
- CONSTRUCTION ROAD AND PARKING LOT STABILIZATION ARE REQUIRED FOR ALL SITES UNLESS THE SITE IS UNDERLAIN BY COARSE-GRAINED SOIL (SECTION D.3.4.2).
- SEDIMENT RETENTION IS REQUIRED UNLESS NO OFFSITE DISCHARGE IS ANTICIPATED FOR THE SPECIFIED DESIGN FLOW (SECTION D.3.5).
- SURFACE WATER CONTROLS ARE REQUIRED UNLESS NO OFFSITE DISCHARGE IS ANTICIPATED FOR THE SPECIFIED DESIGN FLOW (SECTION D.3.6).
- PHASING AND MORE CONSERVATIVE BMPS MUST BE EVALUATED FOR CONSTRUCTION ACTIVITY NEAR SURFACE WATERS (SECTION D.5.3).
- ANY RUNOFF GENERATED BY DEWATERING MAY BE REQUIRED TO DISCHARGE TO THE SANITARY SEWER (WITH APPROPRIATE DISCHARGE AUTHORIZATION), PORTABLE SAND FILTER SYSTEMS, OR HOLDING TANKS.
- THE FREQUENCY OF MAINTENANCE REVIEW INCREASES FROM MONTHLY TO WEEKLY (SECTION D.5.4).

KING COUNTY RECOMMENDED CONSTRUCTION SEQUENCE

- PRE-CONSTRUCTION MEETING.
- POST SIGN WITH NAME AND PHONE NUMBER OF ESC SUPERVISOR (MAY BE CONSOLIDATED WITH THE REQUIRED NOTICE OF CONSTRUCTION SIGN).
- FLAG OR FENCE CLEARING LIMITS.
- INSTALL CATCH BASIN PROTECTION, IF REQUIRED.
- GRADE AND INSTALL CONSTRUCTION ENTRANCE(S).
- INSTALL PERIMETER PROTECTION (SILT FENCE, BRUSH BARRIER, ETC.).
- CONSTRUCT SEDIMENT PONDS AND TRAPS (REFER TO NOTE 12 OF KC TESC NOTES).
- GRADE AND STABILIZE CONSTRUCTION ROADS.
- CONSTRUCT SURFACE WATER CONTROLS (INTERCEPTOR DIKES, PIPE SLOPE DRAINS, ETC.) SIMULTANEOUSLY WITH CLEARING AND GRADING FOR PROJECT DEVELOPMENT.
- MAINTAIN EROSION CONTROL MEASURES IN ACCORDANCE WITH KING COUNTY STANDARDS AND MANUFACTURER'S RECOMMENDATIONS.
- RELOCATE EROSION CONTROL MEASURES, OR INSTALL NEW MEASURES SO THAT AS SITE CONDITIONS CHANGE, THE EROSION AND SEDIMENT CONTROL IS ALWAYS IN ACCORDANCE WITH THE KING COUNTY EROSION AND SEDIMENT CONTROL STANDARDS.
- COVER ALL AREAS THAT WILL BE UNWORKED FOR MORE THAN SEVEN DAYS DURING THE DRY SEASON OR TWO DAYS DURING THE WET SEASON WITH STRAW, WOOD FIBER MULCH, COMPOST, PLASTIC SHEETING, OR EQUIVALENT.
- STABILIZE ALL AREAS WITHIN SEVEN DAYS OF REACHING FINAL GRADE.
- SEED, SOD ANY AREAS TO REMAIN UNWORKED FOR MORE THAN 30 DAYS.
- UPON COMPLETION OF THE PROJECT, ALL DISTURBED AREAS MUST BE STABILIZED AND BMP'S REMOVED IF APPROPRIATE.

ABBREVIATIONS:

ADA	AMERICANS WITH DISABILITIES ACT
AGG	AGGREGATE
APPROX.	APPROXIMATE
AVE	AVENUE
BC	BOTTOM OF CURB
CL	CENTER LINE, CLASS
CSBC	CRUSHED SURFACING BASE COURSE
CSTC	CRUSHED SURFACING TOP COURSE
CTR	CENTER
D	DELTA ANGLE
DIP	DUCTILE IRON PIPE
E	EAST
ELEV	ELEVATION
EX/EXIST	EXISTING
FF	FINISHED FLOOR
FIS BFE	FLOOD INSURANCE STUDY BASE FLOOD ELEVATION
G	GAS
H	HORIZONTAL
HMA	HOT MIX ASPHALT
L	LENGTH
LT	LEFT
MIN	MINIMUM
MNRL	MINERAL
NO	NUMBER
N	NORTH
N/A	NOT APPLICABLE
OH	OVERHEAD UTILITY
PL	PROPERTY LINE
POC	POINT OF CONNECTION
PVC	POLYVINYLCHLORIDE
PVI	POINT OF VERTICAL INTERSECTION
R	RADIUS
ROW	RIGHT OF WAY
RT	RIGHT
S	SOUTH
SD	STORM DRAIN
SL	STREET LIGHT
ST	STREET
STA	STATION
STD	STANDARD
TC	TOP OF CURB
TESC	TEMPORARY EROSION AND SEDIMENT CONTROL
TYP	TYPICAL
V	VERTICAL
W	WATER, WEST
WAC	WASHINGTON ADMINISTRATIVE CODE
WSDOT	WASHINGTON STATE DEPARTMENT OF TRANSPORTATION
#	NUMBER
&	AND

SURVEY LEGEND

	IRRIGATION CONTROL VALVE BOX
	WHEEL STOP
	YARD DRAIN
	HANDICAP PARKING
	CASED STREET MONUMENT
	FOUND REBAR AS NOTED
	FLAG POLE
	DRINKING FOUNTAIN
	FIRE HYDRANT
	WATER METER
	WATER VAULT
	WATER VALVE
	SANITARY SEWER MANHOLE
	SANITARY SEWER CLEAN OUT
	STORM DRAIN MANHOLE
	STORM DRAIN CLEAN OUT
	CATCH BASIN
	POLE ANCHOR
	GUY POLE
	POWER POLE
	POWER TRANSFORMER
	POWER VAULT
	GAS METER
	GAS VALVE
	TELEPHONE PEDESTAL
	SIGN
	STREET LIGHT
	ORNAMENTAL LANDSCAPE LIGHT
	BUSH
	POST
	BOLLARD
	CONCRETE
	STAMPED CONCRETE
	BRICK PAVERS
	BUILDING
	WATER SERVICE
	SANITARY SEWER
	STORM DRAIN
	OVERHEAD POWER
	POWER
	GAS
	TELECOMMUNICATIONS
	FENCE LINE

CITY OF NORTH BEND PERMIT # _____

THESE PLANS ARE APPROVED FOR CONFORMANCE WITH THE CITY OF NORTH BEND PUBLIC WORKS DEPARTMENT REQUIREMENTS TO THE BEST OF MY KNOWLEDGE.

CITY ENGINEER OR PUBLIC WORKS DIRECTOR

7-16-21 DATE



Know what's below.
Call before you dig.

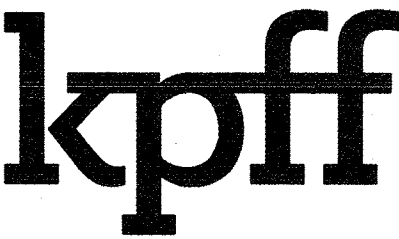

1601 5th Avenue, Suite 1600
Seattle, WA 98101
206.622.5822
www.kpff.com

TOLLGATE FARMSTEAD
IMPROVEMENTS
SI VIEW METROPOLITAN PARKS DISTRICT
1300 NORTH BEND WAY, NORTH BEND, WA 98045

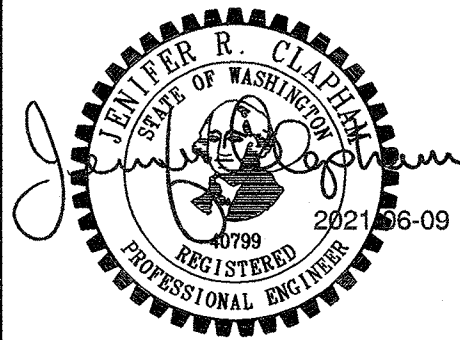

SET TYPE:
100% IFC - BID
DOCUMENTS

SET ISSUE DATE:
06.09.2021

REVISIONS:

DRAWN/CHECKED:
JEP/SJB
SHEET NAME:

NOTES AND
LEGEND
SHEET NUMBER:

C-101

Jun 08, 2021 - 3:08pm JmJP Z:\1900001-1900991\1900916 Tollgate Farmstead (CUD)\Design\DD\CL001 TH-60.dwg

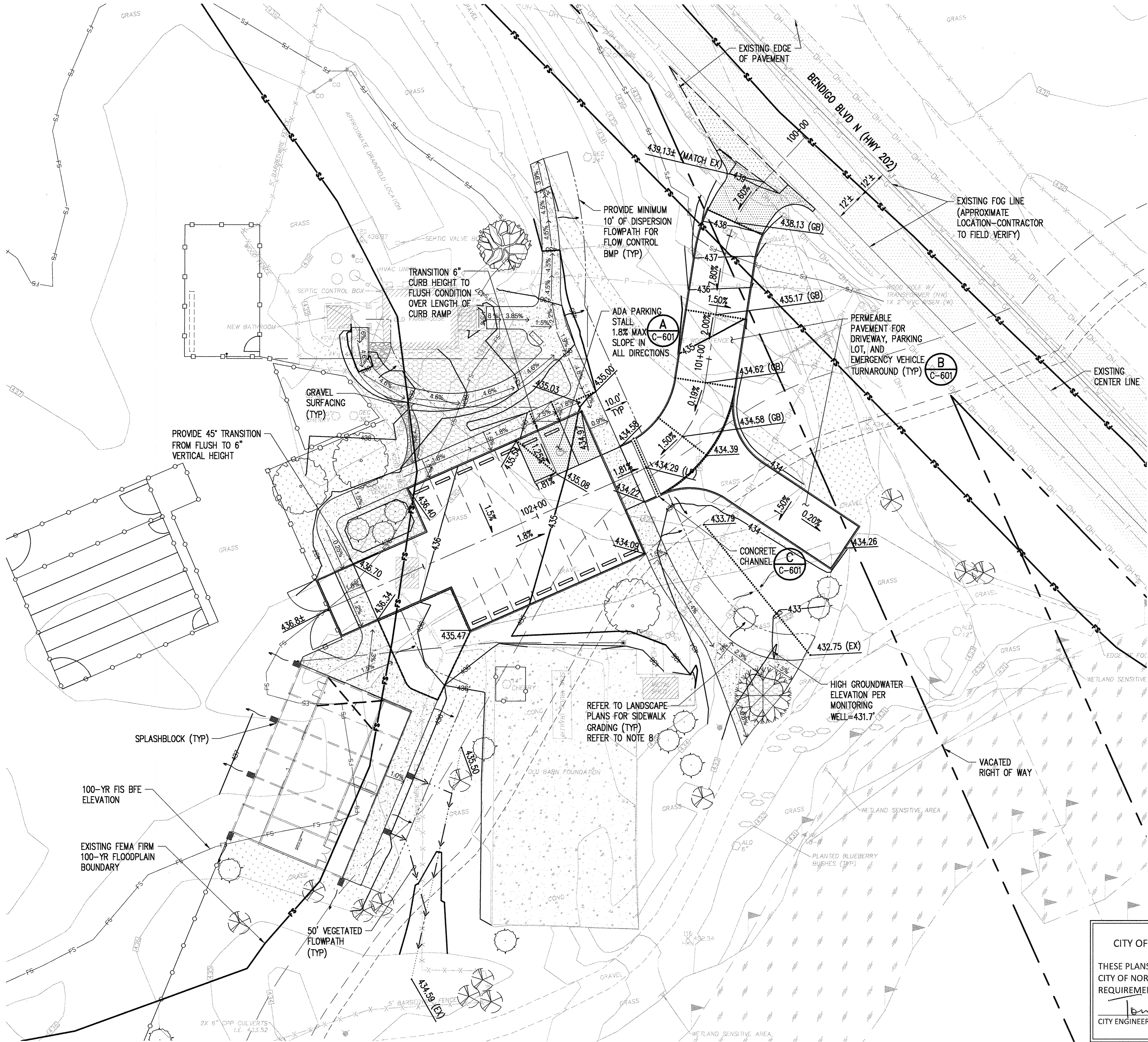

NOTES:

- PER NORTH BEND MUNICIPAL CODE, THE CITY OF NORTH BEND ADOPTS THE 2009 KING COUNTY SURFACE WATER DESIGN MANUAL. THE PROJECT IS REQUIRED TO ASSESS ALL 8 CORE REQUIREMENTS AND ALL 5 SPECIAL REQUIREMENTS. REFER TO THE TECHNICAL INFORMATION REPORT FOR A DETAILED ANALYSIS OF ALL CORE REQUIREMENTS.
- THE PROJECT MITIGATES ALL IMPERVIOUS SURFACES WITH PERMEABLE PAVING OR BASIC DISPERSION. PER THE 2009 KCSWDM, THE PROJECT QUALIFIES FOR THE IMPERVIOUS SURFACE PERCENTAGE EXEMPTION AND IS NOT REQUIRED TO PROVIDE ADDITIONAL FLOW CONTROL ANALYSIS OR BMPs.
- TO MEET ENHANCED WATER QUALITY, THE NATIVE SOILS BENEATH THE PERMEABLE PAVING WERE TESTED TO MEET THE REQUIREMENT SET FORTH IN SECTION 6.3.2 OF THE 2012 LID TECHNICAL GUIDANCE MANUAL FOR PUGET SOUND. EXISTING SOILS MEET THESE REQUIREMENTS AND NO FURTHER WATER QUALITY IS REQUIRED.
- NEW BARN ROOF WILL BE MITIGATED VIA DISPERSION SPLASH BLOCKS PER SECTION C.2.4.2 OF THE 2009 KCSWDM. REFER TO ARCHITECTURAL FOR LOCATION OF DOWNSPOUTS, WHICH WILL EACH HAVE A SPLASH BLOCK.
- NEW SIDEWALK RUNOFF WILL BE MITIGATED VIA SHEET FLOW TO BASIC DISPERSION PER SECTION C.2.4.5 OF THE 2009 KCSWDM. BECAUSE THE SIDEWALKS ARE LESS THAN 10 FEET WIDE, A STRIP OF CRUSHED ROCK IS NOT REQUIRED ADJACENT TO SIDEWALK. REFER TO LANDSCAPE FOR SIDEWALK GRADING.
- CONSTRUCTION OF NEW DRIVEWAY AND PARKING LOT ANTICIPATES NET FILL OF APPROXIMATELY 40 CUBIC YARDS. REFER TO APPENDIX F OF THE TECHNICAL INFORMATION REPORT FOR A ZERO-RISE ANALYSIS PERFORMED BY WATERSHED COMPANY.
- GRADING IN AREAS OUTSIDE OF VEHICLE PAVEMENT SURFACES ARE SHOWN FOR REFERENCE. REFER TO LANDSCAPE PLANS FOR DETAILED GRADING OF SIDEWALKS, PATHWAYS, AND LANDSCAPE AREAS.
- PERMEABLE PAVEMENT WILL INCLUDE SUBSURFACE CHECK DAMS EVERY 8' OF GRADE LOSS IN AREAS WITH A SLOPE OVER 3%. REFER TO SHEET C-601 FOR LOCATION ON PROFILE AND DETAIL D FOR GEOMETRY.
- CONTRACTOR SHALL PROTECT PERMEABLE PAVEMENT DURING INSTALLATION AND CONSTRUCTION AND SHALL PREVENT SEDIMENT MIGRATION ONTO SURFACE AND INTO SECTION.

LEGEND

- FLOW DIRECTION
- 2% SLOPE ARROW
- XXX--- MINOR CONTOUR
- XXX--- MAJOR CONTOUR
- SPLASH BLOCK
- ▨ LANDSCAPE AREA
- FS--- EXIST 100-YR FLOOD BOUNDARY (FEMA)
- FS--- 100-YR FIS BFE ELEVATION
- WETLAND B 25% EXPANDED BUFFER
- RIBARY CREEK 33% EXPANDED BUFFER
- ▨ EXISTING ROADWAY
- ▨ GRAVEL PATH
- ...→... VEGETATED FLOW PATH FOR SPLASH BLOCK

CITY OF NORTH BEND PERMIT # _____

THESE PLANS ARE APPROVED FOR CONFORMANCE WITH THE CITY OF NORTH BEND PUBLIC WORKS DEPARTMENT REQUIREMENTS TO THE BEST OF MY KNOWLEDGE.

[Signature] 7-16-21
CITY ENGINEER OR PUBLIC WORKS DIRECTOR DATE

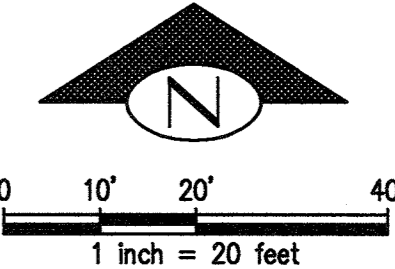

1601 5th Avenue, Suite 1600
Seattle, WA 98101
206.622.5822
www.kpff.com

TOLLGATE FARMSTEAD
IMPROVEMENTS
SI VIEW METROPOLITAN PARKS DISTRICT
1300 NORTH BEND WAY, NORTH BEND, WA 98045



SET TYPE:
100% IFC - BID
DOCUMENTS

SET ISSUE DATE:
06.09.2021

REVISIONS:

DRAWN/CHECKED:
JEP/SJB
SHEET NAME:
CIVIL GRADING AND
DRAINAGE PLAN
SHEET NUMBER:

C-300

© THE BERGER PARTNERSHIP PS, 2018

Jun 08, 2021 - 3:10pm JmRP Z:\1900001-1900999\1900916 Tollgate Farmstead\CAD\Design\DD\CA\10 TTH-HP.dwg

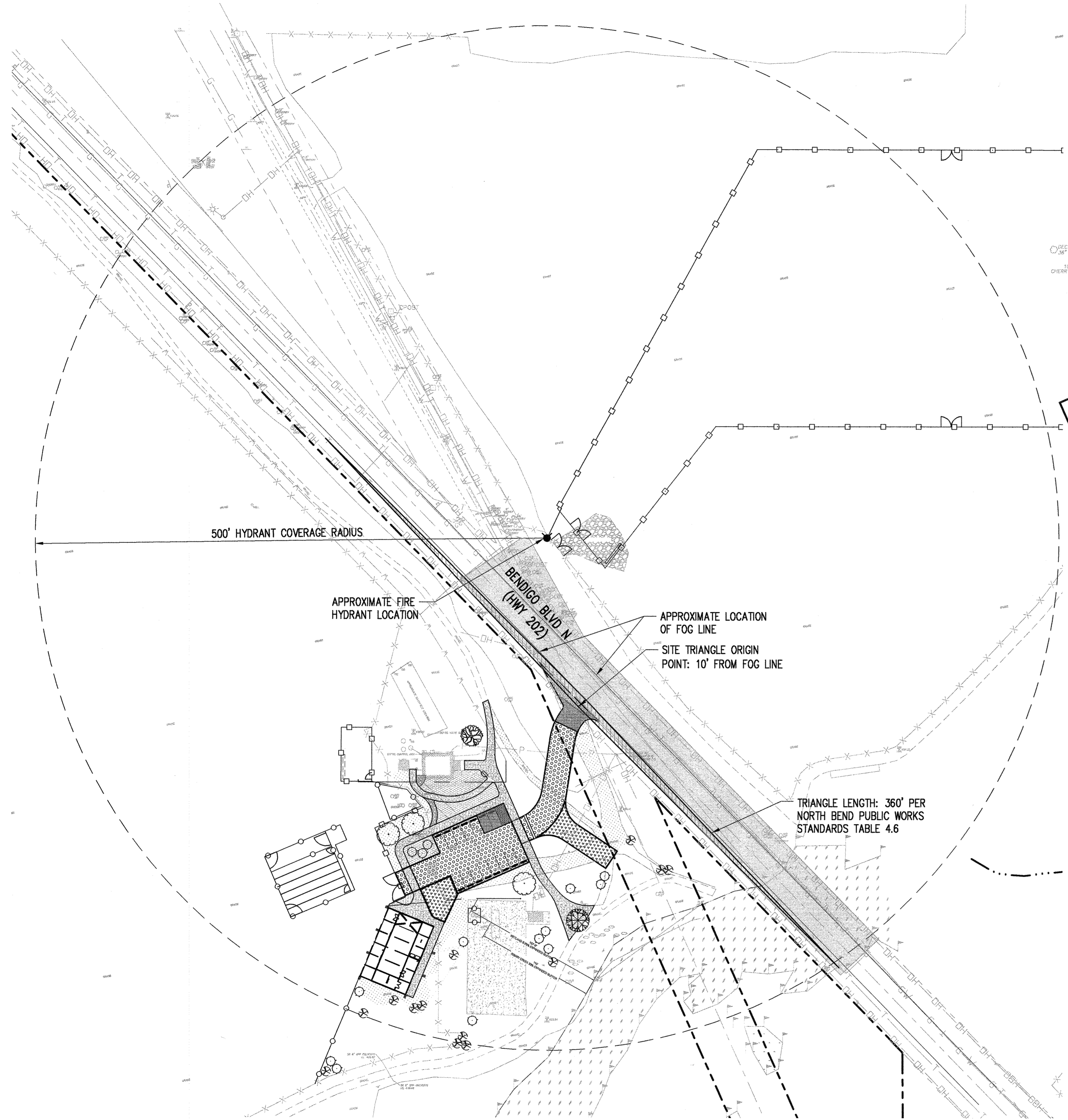

HYDRANT COVERAGE PLAN
& STOPPING SIGHT EXHIBIT

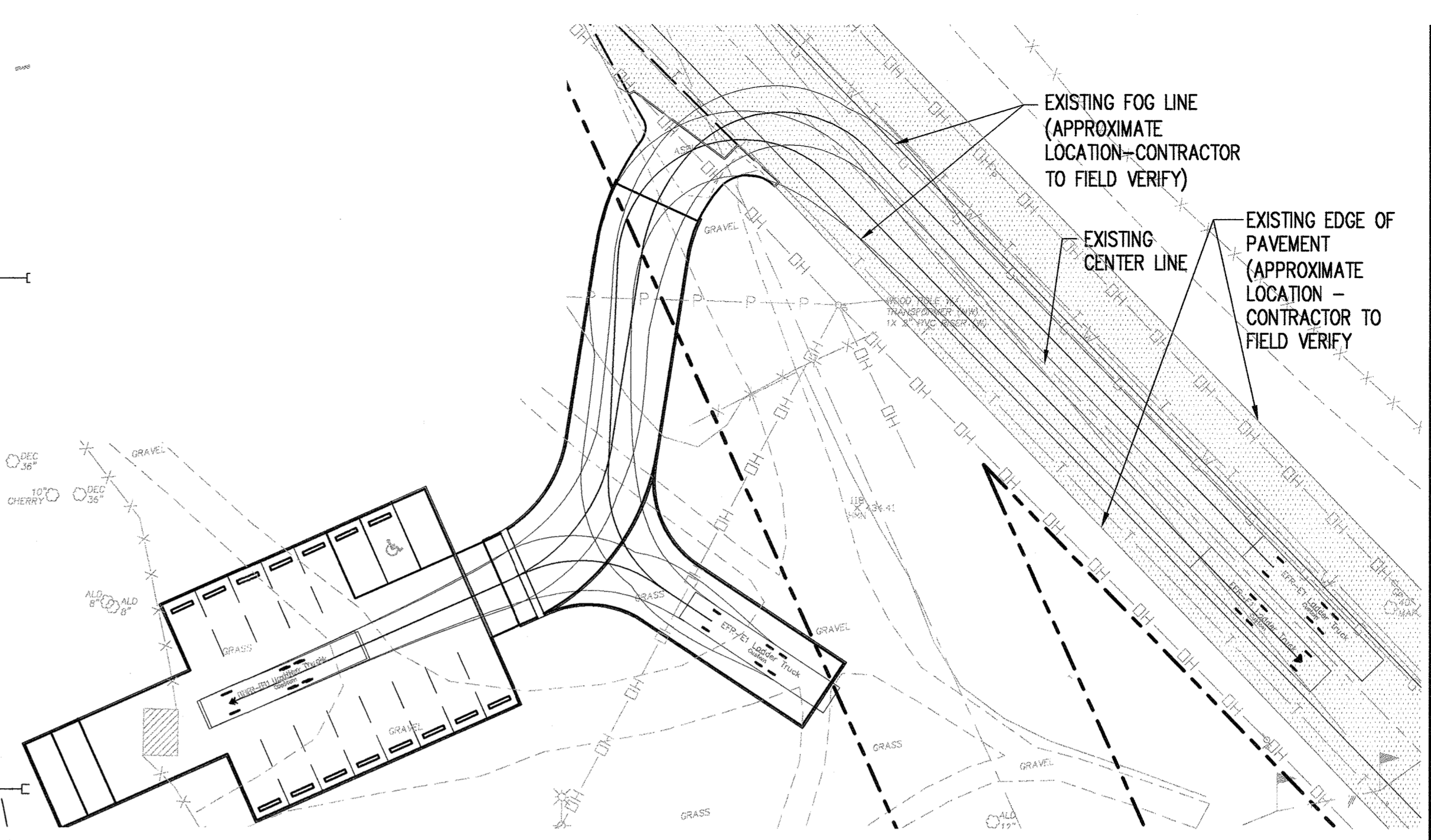
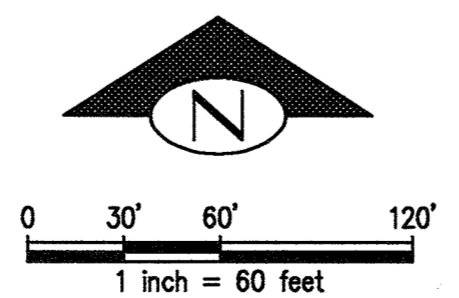

FIRE TRUCK VEHICLE TURNING

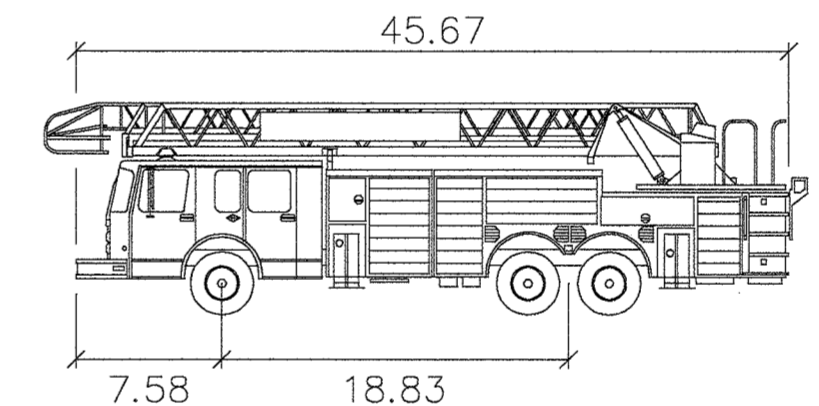
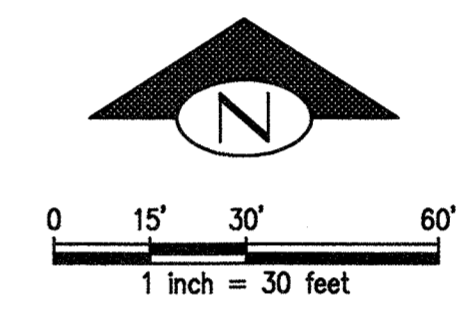

EFR - Ladder Truck
feet
Width : 8.00
Track : 6.00
Lock to Lock Time : 6.0
Steering Angle : 34.0

FIRE TRUCK VEHICLE PROFILE

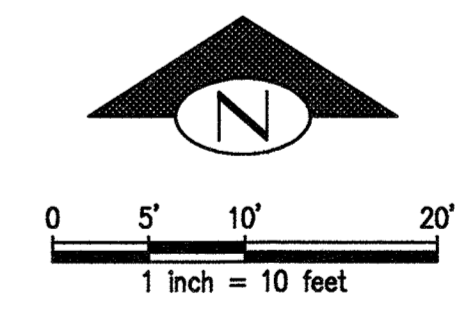

LEGEND

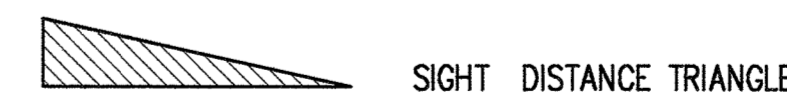

CITY OF NORTH BEND PERMIT # _____

THESE PLANS ARE APPROVED FOR CONFORMANCE WITH THE CITY OF NORTH BEND PUBLIC WORKS DEPARTMENT REQUIREMENTS TO THE BEST OF MY KNOWLEDGE.

[Signature] 7-16-21
CITY ENGINEER OR PUBLIC WORKS DIRECTOR DATE



1601 5th Avenue, Suite 1600
Seattle, WA 98101
206.622.5822
www.kpff.com

**TOLLGATE FARMSTEAD
IMPROVEMENTS**
SI VIEW METROPOLITAN PARKS DISTRICT
1300 NORTH BEND WAY, NORTH BEND, WA 98045

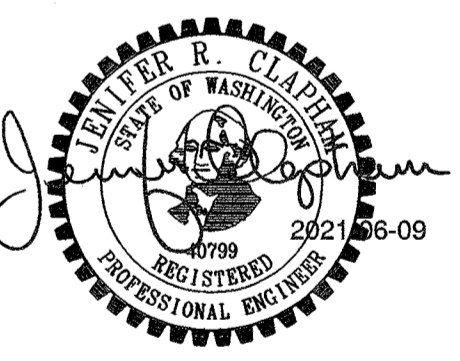

SET TYPE:
**100% IFC - BID
DOCUMENTS**
SET ISSUE DATE:
06.09.2021
REVISIONS:

DRAWN/CHECKED:
JEP/SJB
SHEET NAME:
**CIVIL HYDRANT & FIRE
TRUCK TURNING PLAN**
SHEET NUMBER:

C-410

© THE BERGER PARTNERSHIP PS, 2018

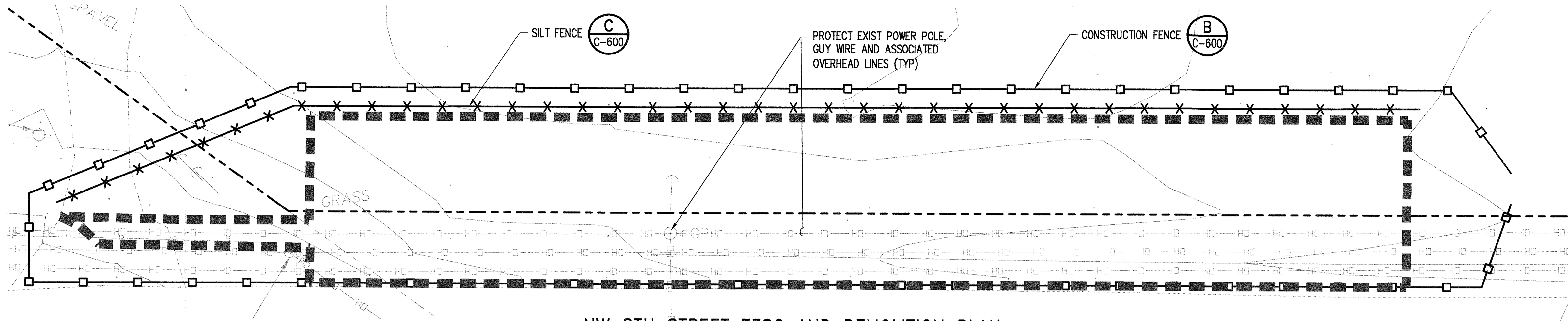

NW 8TH STREET TESC AND DEMOLITION PLAN

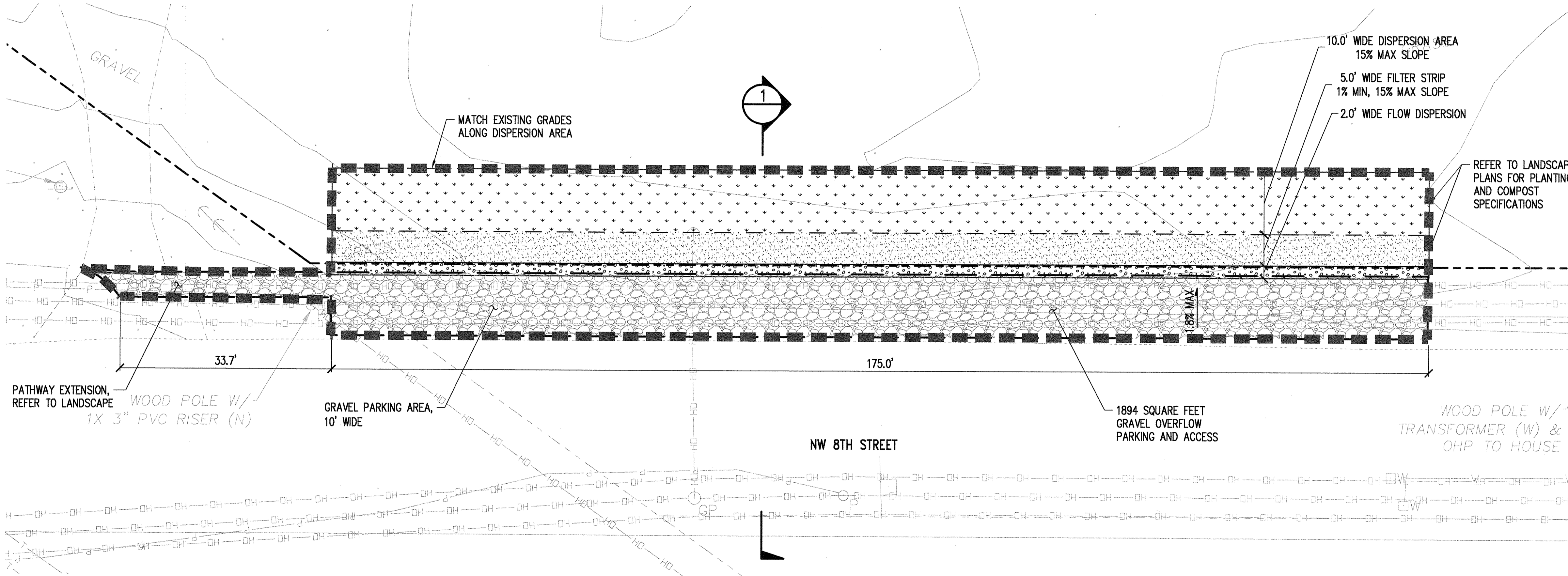

NW 8TH STREET GRADING AND DRAINAGE PLAN

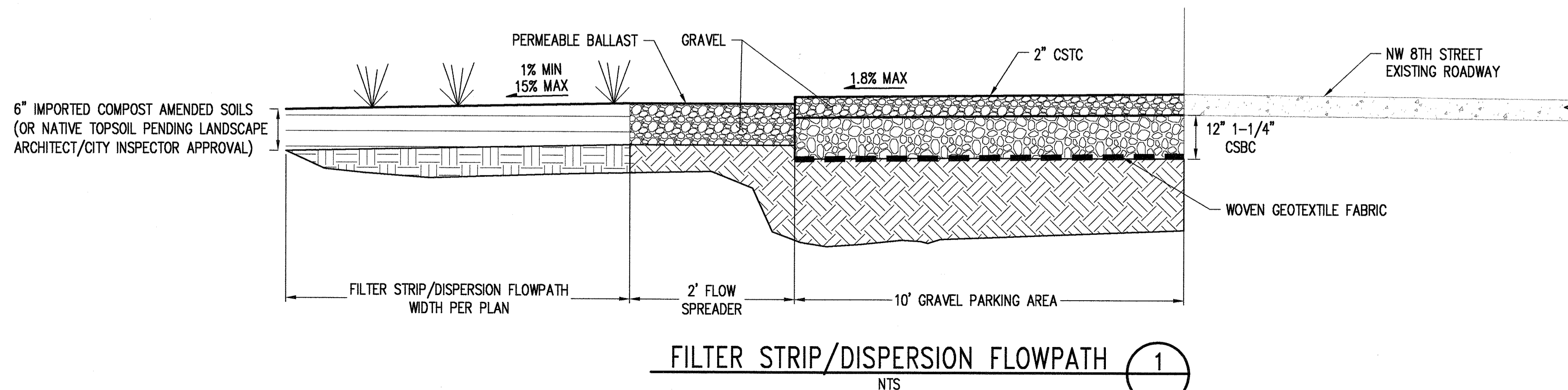

NOTES:

1. CONTRACTOR SHALL PROVIDE TEMPORARY MEASURES TO DELINEATE LIMITS OF CONSTRUCTION. LIMITS SHALL NOT EXTEND FURTHER THAN 10' BEYOND PROPOSED IMPROVEMENTS UNLESS OTHERWISE NOTED.
2. CONTRACTOR SHALL PROVIDE SEDIMENT CONTROL MEASURES TO PREVENT SEDIMENT LADEN RUNOFF AND/OR CONCENTRATED FLOW FROM LEAVING THE LIMITS OF CONSTRUCTION.

NOTES:

1. GRAVEL PARKING AREA TO BE MITIGATED THROUGH FILTER STRIP AND BASIC DISPERSION, PER 2009 KCSWDM.
2. A DECLARATION OF COVENANT AND GRANT OF EASEMENT WILL BE REQUIRED WITH IMPLEMENTATION OF BASIC DISPERSION AND FILTER STRIP. REFER TO APPENDIX I OF THE TECHNICAL INFORMATION.



kpff

1601 5th Avenue, Suite 1600
Seattle, WA 98101
206.622.5822
www.kpff.com

**TOLLGATE FARMSTEAD
IMPROVEMENTS**
S1 VIEW METROPOLITAN PARKS DISTRICT
1300 NORTH BEND WAY, NORTH BEND, WA 98045



SET TYPE:
**100% IFC - BID
DOCUMENTS**
SET ISSUE DATE:
06.09.2021
REVISIONS:

DRAWN/CHECKED:
JEPSJB
SHEET NAME:
**NW 8TH STREET
IMPROVEMENTS**
SHEET NUMBER:
C-500



CITY OF NORTH BEND PERMIT # _____

THESE PLANS ARE APPROVED FOR CONFORMANCE WITH THE CITY OF NORTH BEND PUBLIC WORKS DEPARTMENT REQUIREMENTS TO THE BEST OF MY KNOWLEDGE.

for m. w. 7-16-21
CITY ENGINEER OR PUBLIC WORKS DIRECTOR DATE

Jun 08, 2021 - 3:11pm JoneP Z:\19000001-1900999\1900916 Tollgate Farmstead (CADD)\Design\DD\ C6.00 TIF-DTL.dwg

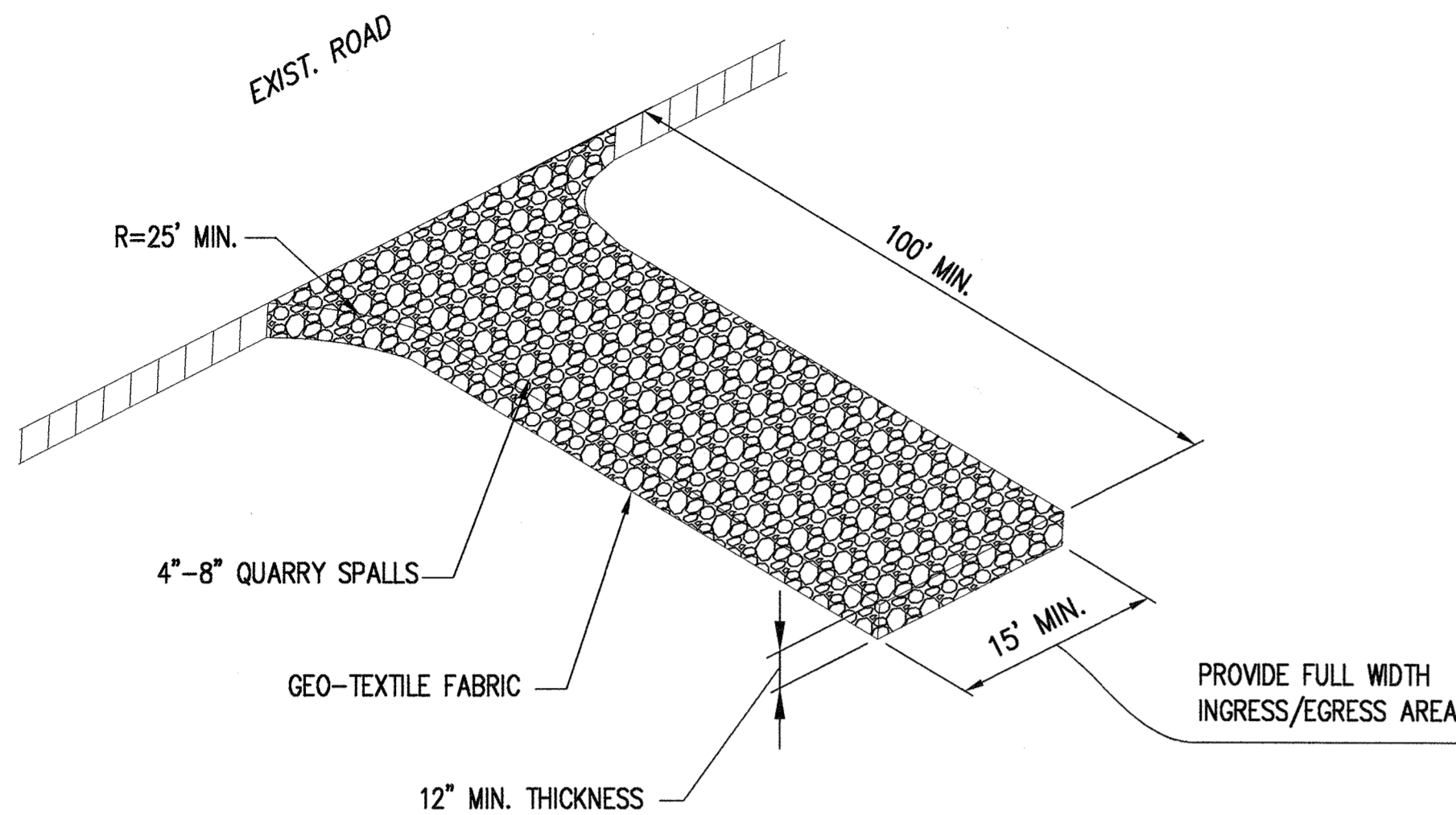

TEMPORARY CONSTRUCTION ENTRANCE

NTS
(PER KCSWDM)

A
C-200

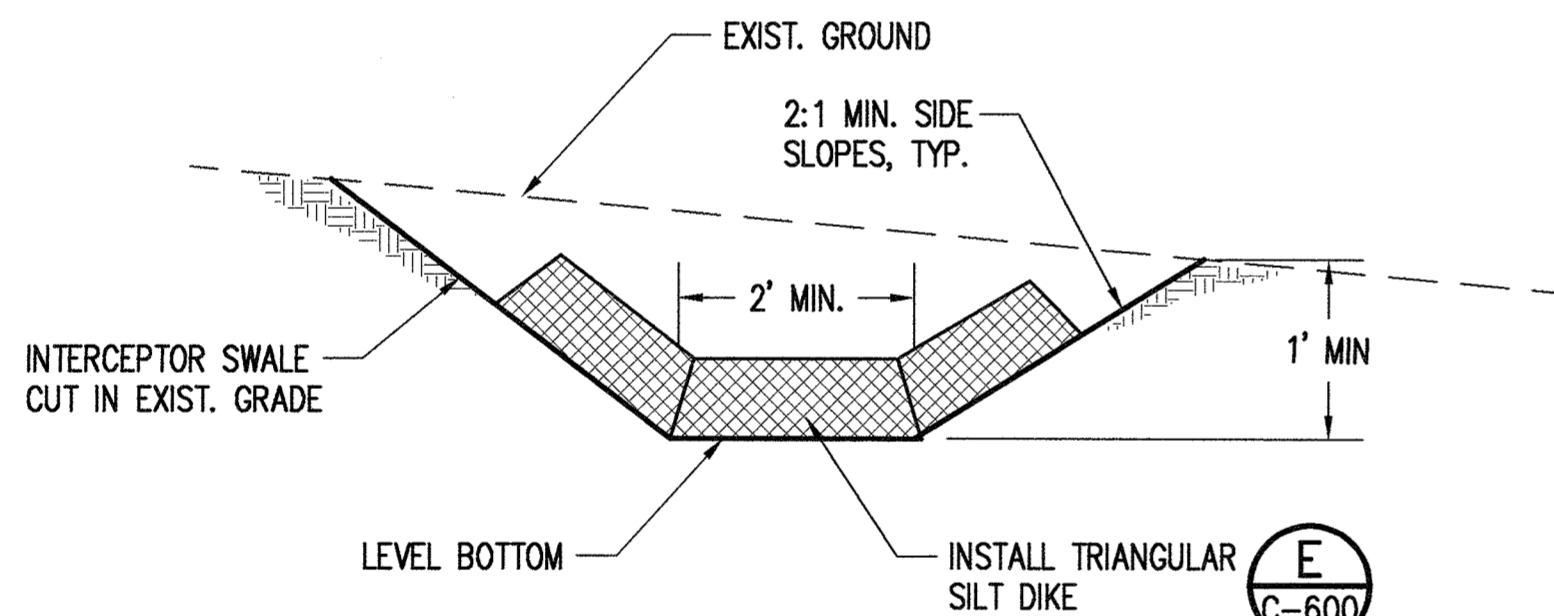

NOTE:
DAMAGE RESULTING FROM RUNOFF OR CONSTRUCTION
ACTIVITY SHALL BE REPAIRED IMMEDIATELY.

INTERCEPTOR SWALE

NTS
(PER KCSWDM)

D
C-200

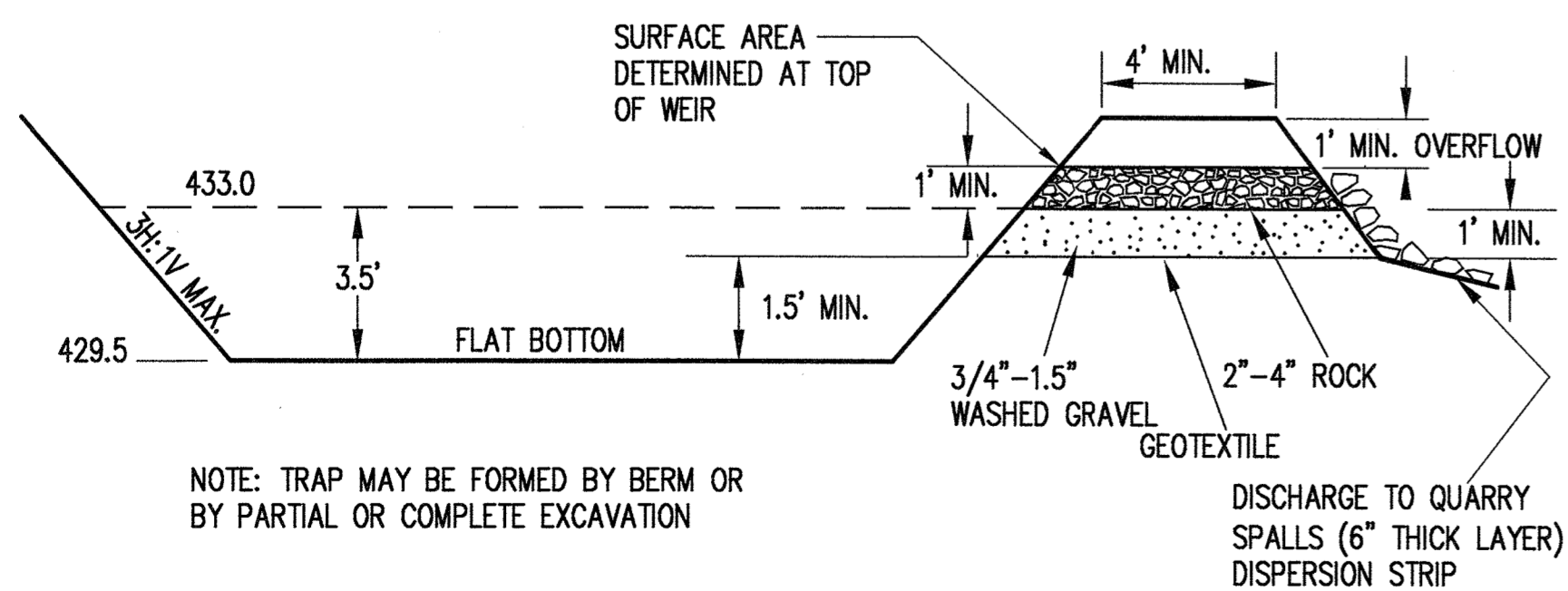

NOTE: TRAP MAY BE FORMED BY BERM OR
BY PARTIAL OR COMPLETE EXCAVATION

SEDIMENT TRAP

NTS
(PER KCSWDM)

F
C-200

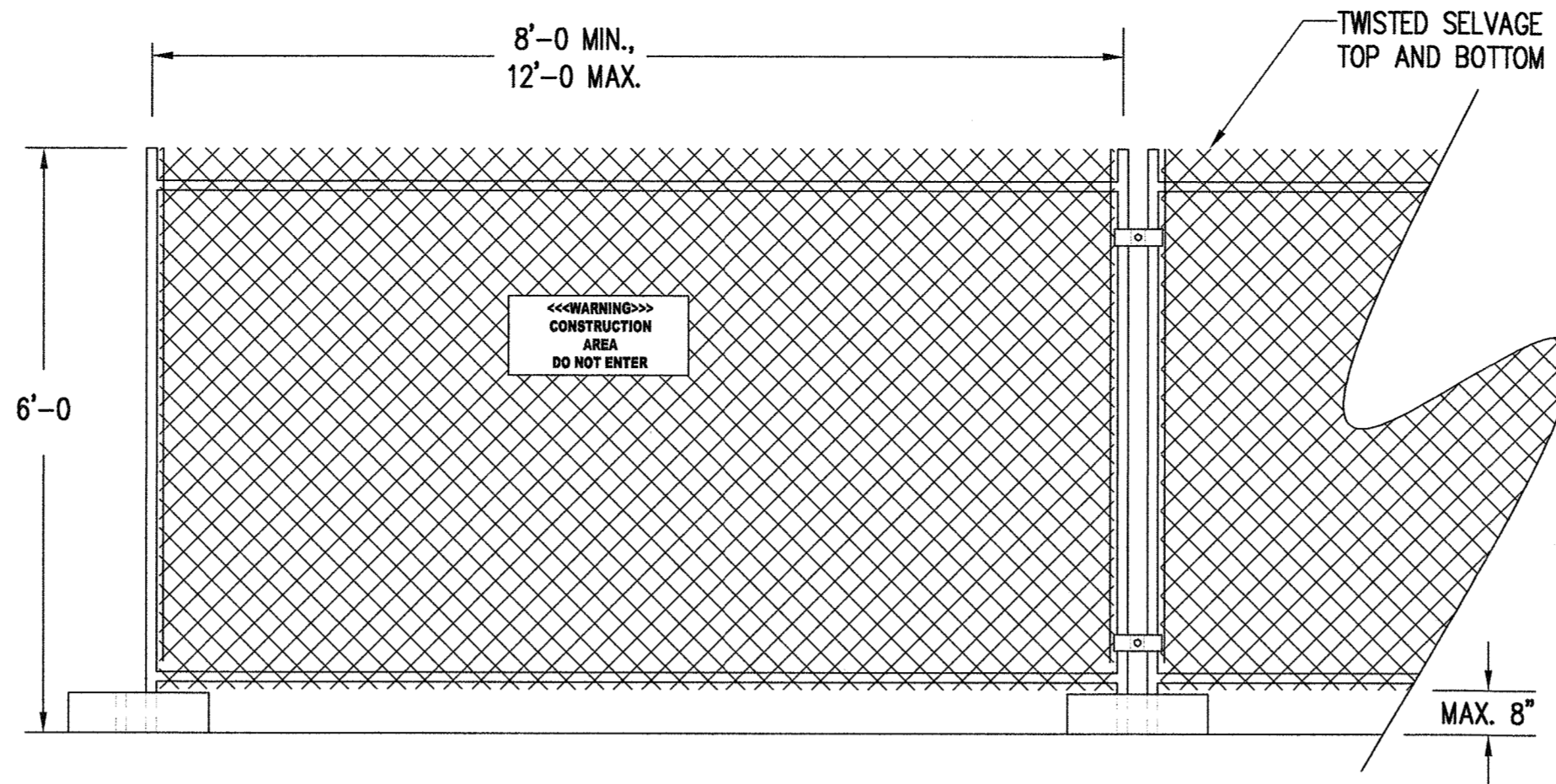

NOTES

1. CHAIN LINK FABRIC TO BE MIN. 11 GAUGE, GALVANIZED. NO RUSTED OR EXCESSIVELY MALFORMED FABRIC.
2. FENCE BASES SHALL BE OF SUFFICIENT WEIGHT AND/OR SPREAD TO ADEQUATELY SUPPORT EACH PANEL.
3. PANEL-TO-PANEL CONNECTIONS SHALL BE MADE AT A MIN. TWO LOCATIONS PER CONNECTION UNLESS OTHERWISE APPROVED.
4. PROVIDE CONSTRUCTION WARNING SIGNAGE AT 50' O.C. ALONG FENCING INSTALLATION.

TEMPORARY CONSTRUCTION FENCE

NTS

B
C-200

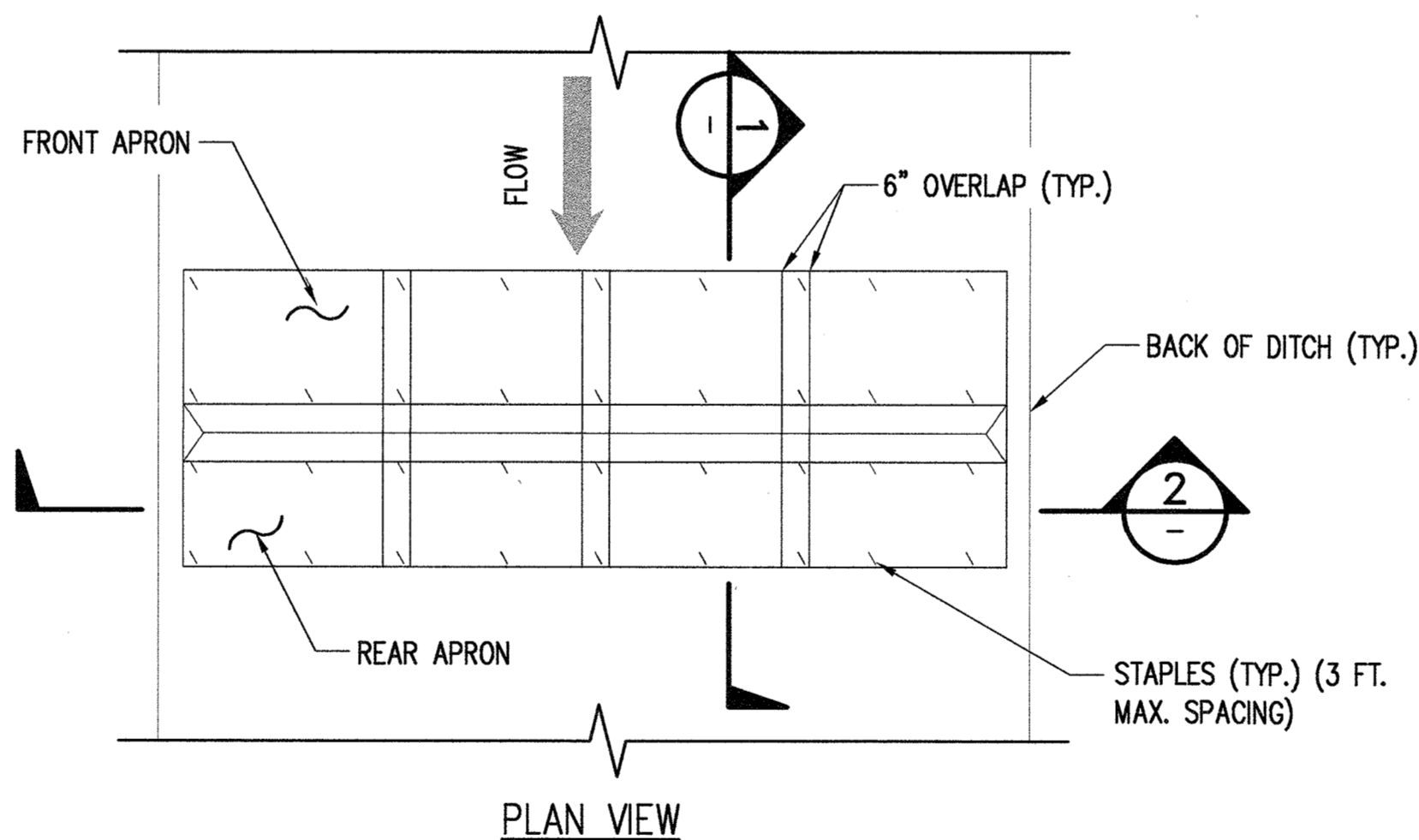

PLAN VIEW

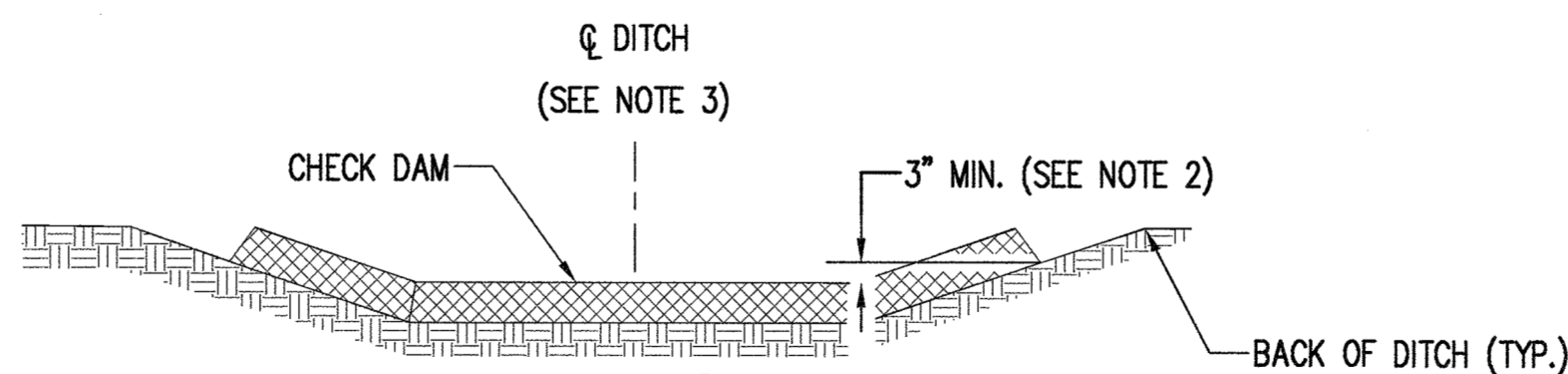

SECTION 2

TRIANGULAR SILT DIKE

NTS
(PER KCSWDM)

E
C-200

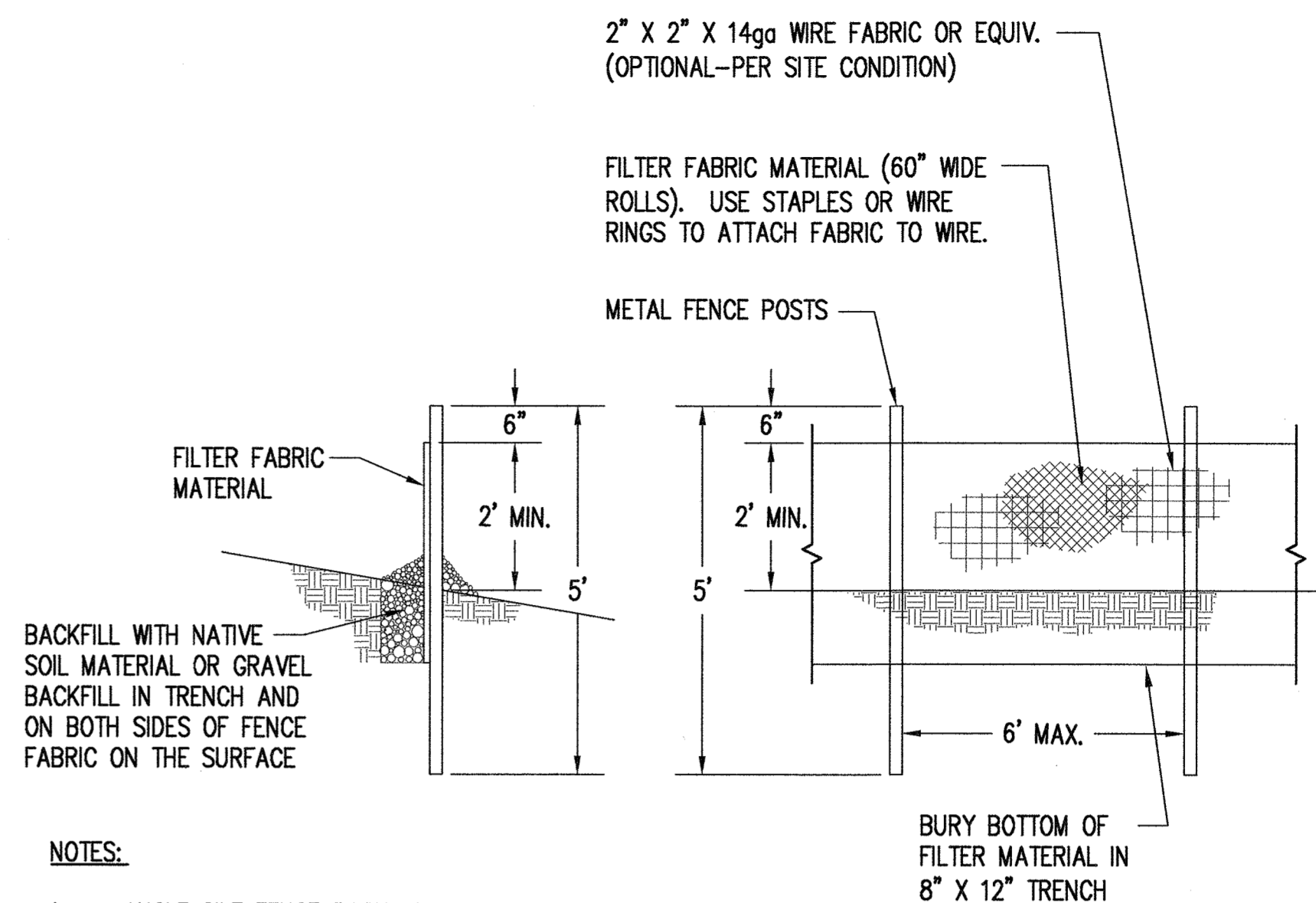

NOTES

1. ANGLE SILT FENCE BACK UP THE SLOPE AT THE END OF RUN.
2. WHERE LOCATED UPSTREAM OF WETLANDS OR STREAM, INSTALL 2 PARALLEL FENCES 5' APART.

SILT FENCE

NTS
(PER KCSWDM)

C
C-200

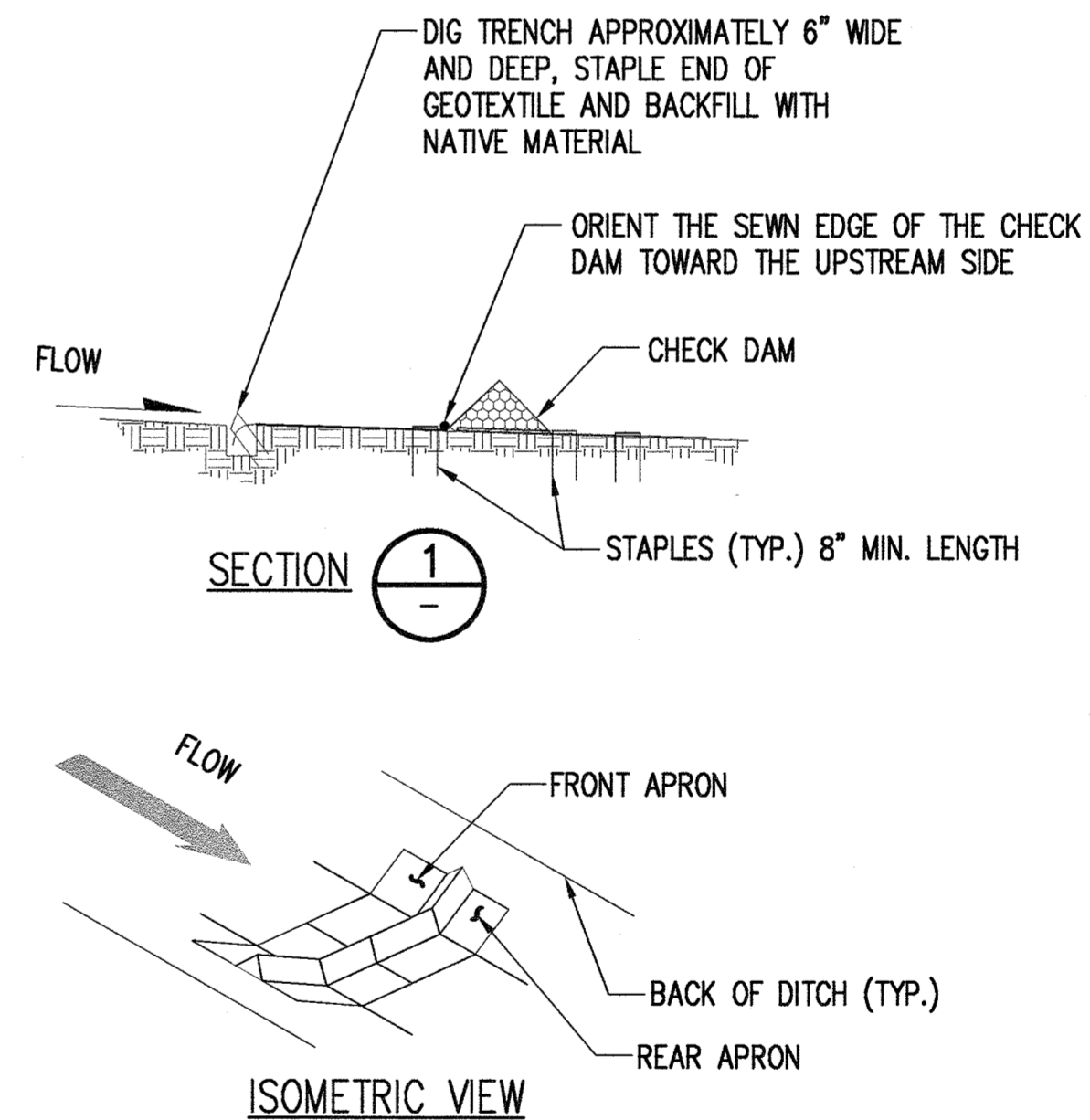

NOTES

1. INSTALL THE SLOPED ENDS OF THE CHECK DAM A MINIMUM OF 3" HIGHER THAN THE TOP OF THE CHECK DAM IN THE CHANNEL TO ENSURE THAT WATER FLOWS OVER THE DAM AND NOT AROUND IT.
2. FLAT BOTTOM DITCH DESIGN SHOWN, CHECK DAM INSTALLATION DETAILS ARE SIMILAR FOR "V" BOTTOM DITCHES.
3. PERFORM MAINTENANCE IN ACCORDANCE WITH STANDARD SPECIFICATION 8-01.3(14).

CITY OF NORTH BEND PERMIT # _____

THESE PLANS ARE APPROVED FOR CONFORMANCE WITH THE
CITY OF NORTH BEND PUBLIC WORKS DEPARTMENT
REQUIREMENTS TO THE BEST OF MY KNOWLEDGE.

John W. ...
CITY ENGINEER OR PUBLIC WORKS DIRECTOR

7-16-21
DATE



Know what's below.
Call before you dig.



kpff

1601 5th Avenue, Suite 1600
Seattle, WA 98101
206.622.5822
www.kpff.com

TOLLGATE FARMSTEAD
IMPROVEMENTS
SI VIEW METROPOLITAN PARKS DISTRICT
1300 NORTH BEND WAY, NORTH BEND, WA 98045

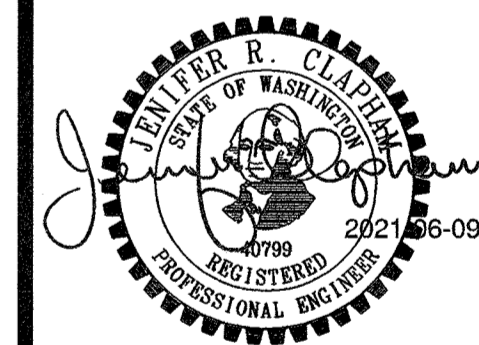

SET TYPE:
100% IFC - BID
DOCUMENTS

SET ISSUE DATE:
06.09.2021

REVISIONS:

DRAWN/CHECKED:
JEP/SJB

SHEET NAME:
TESC DETAILS

SHEET NUMBER:

C-600

© THE BERGER PARTNERSHIP PS, 2018

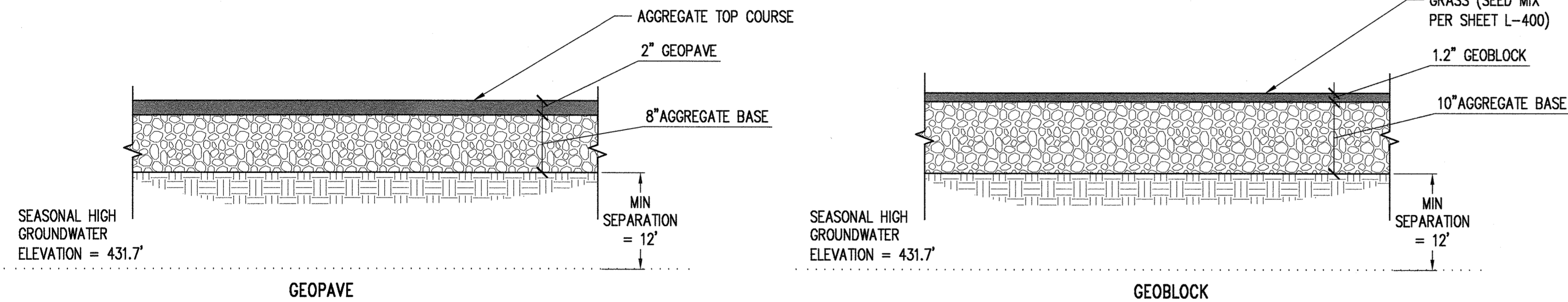
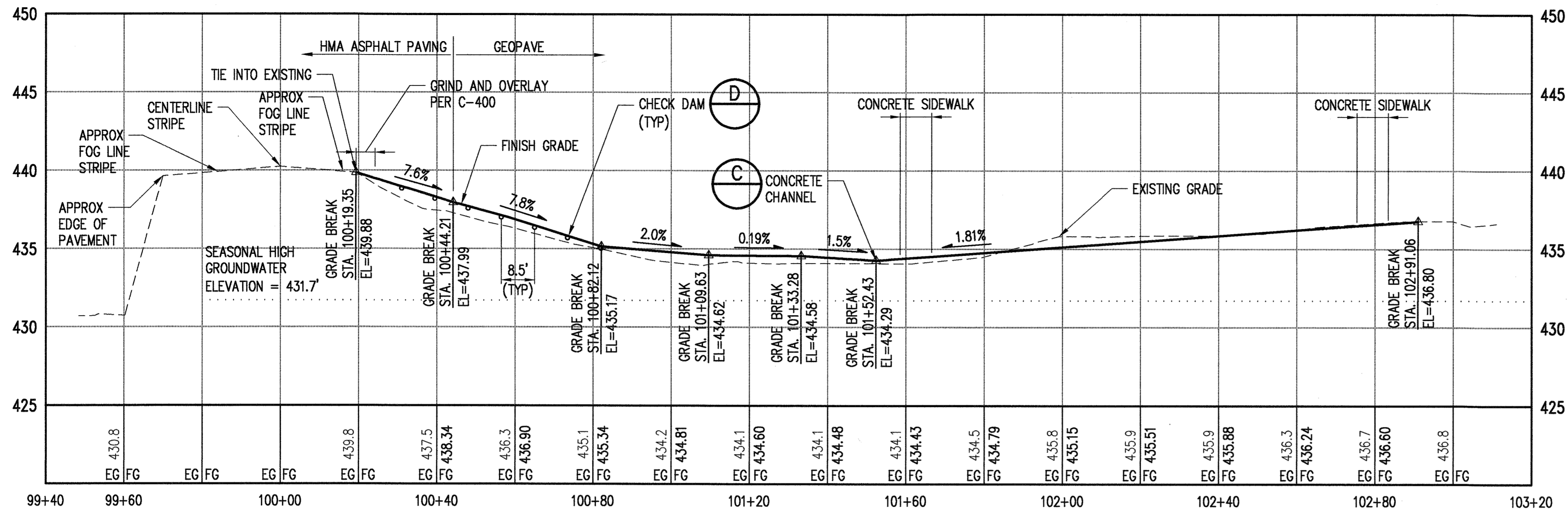

- * AGGREGATE BASE SHALL BE 5/8" CRUSHED ROCK AND MEET MANUFACTURER'S REQUIREMENTS
- ** AGGREGATE TOP COURSE SHALL BE GEOPAVE GRAVEL PAVERS AND MEET MANUFACTURER'S REQUIREMENTS

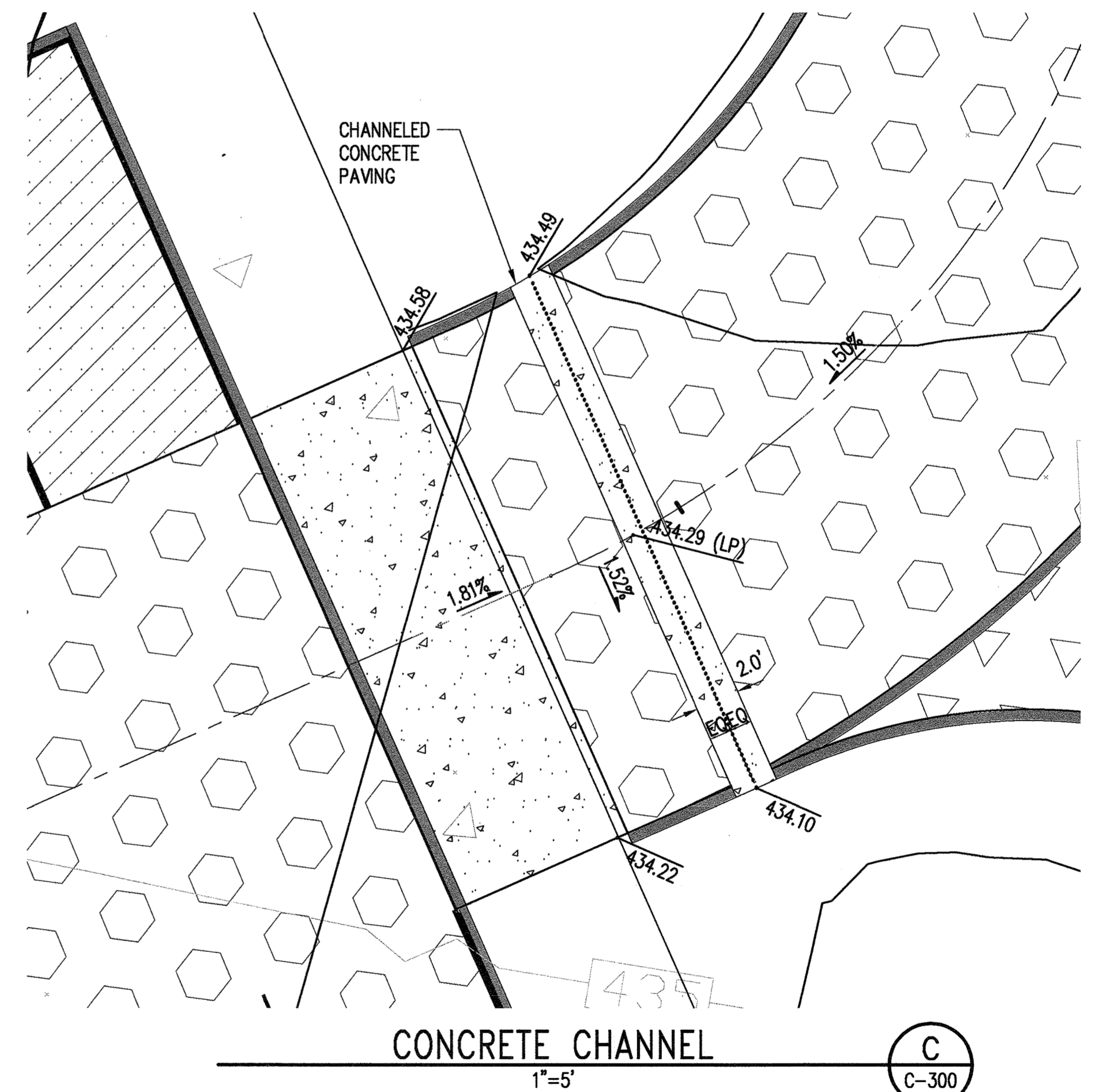
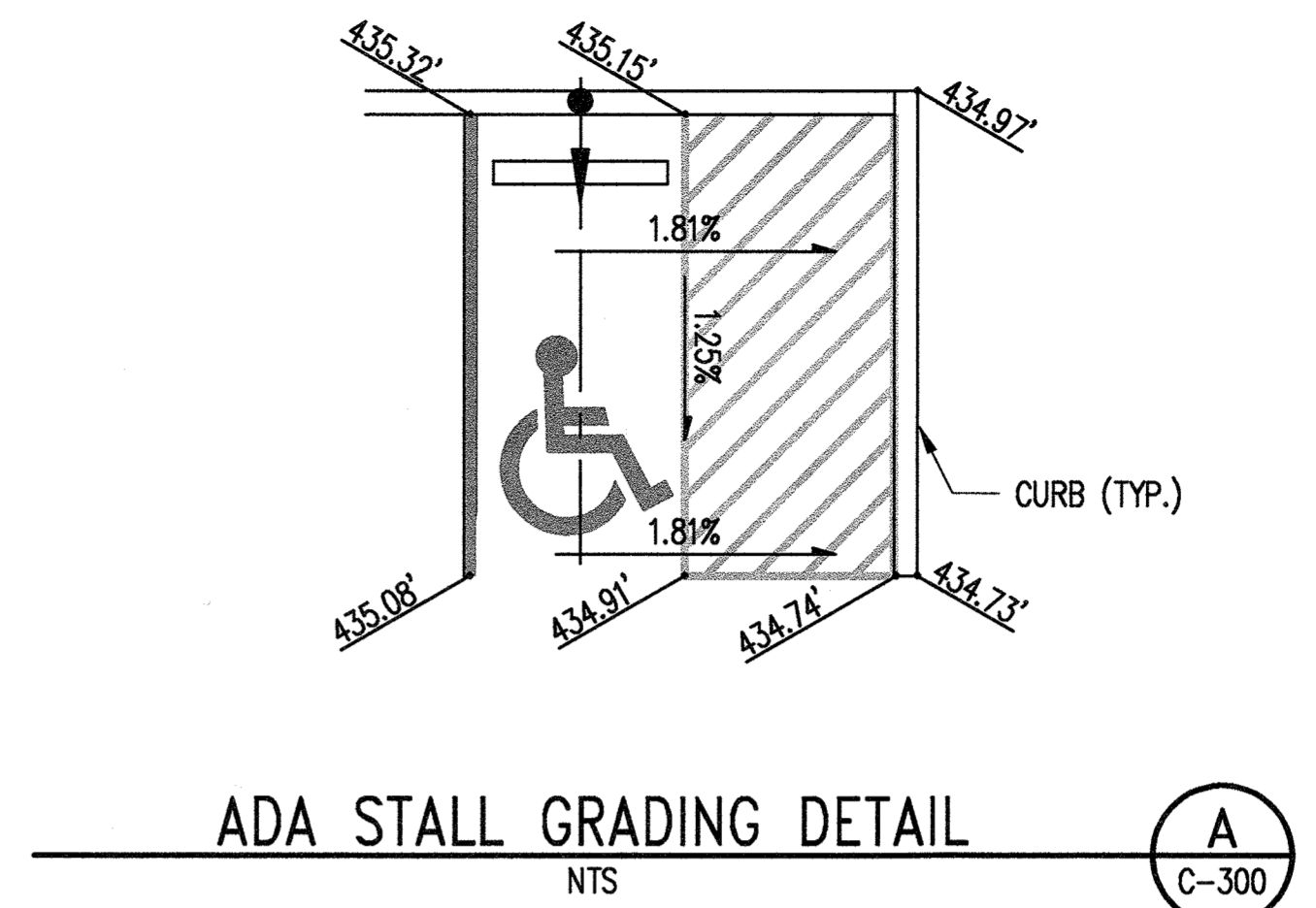
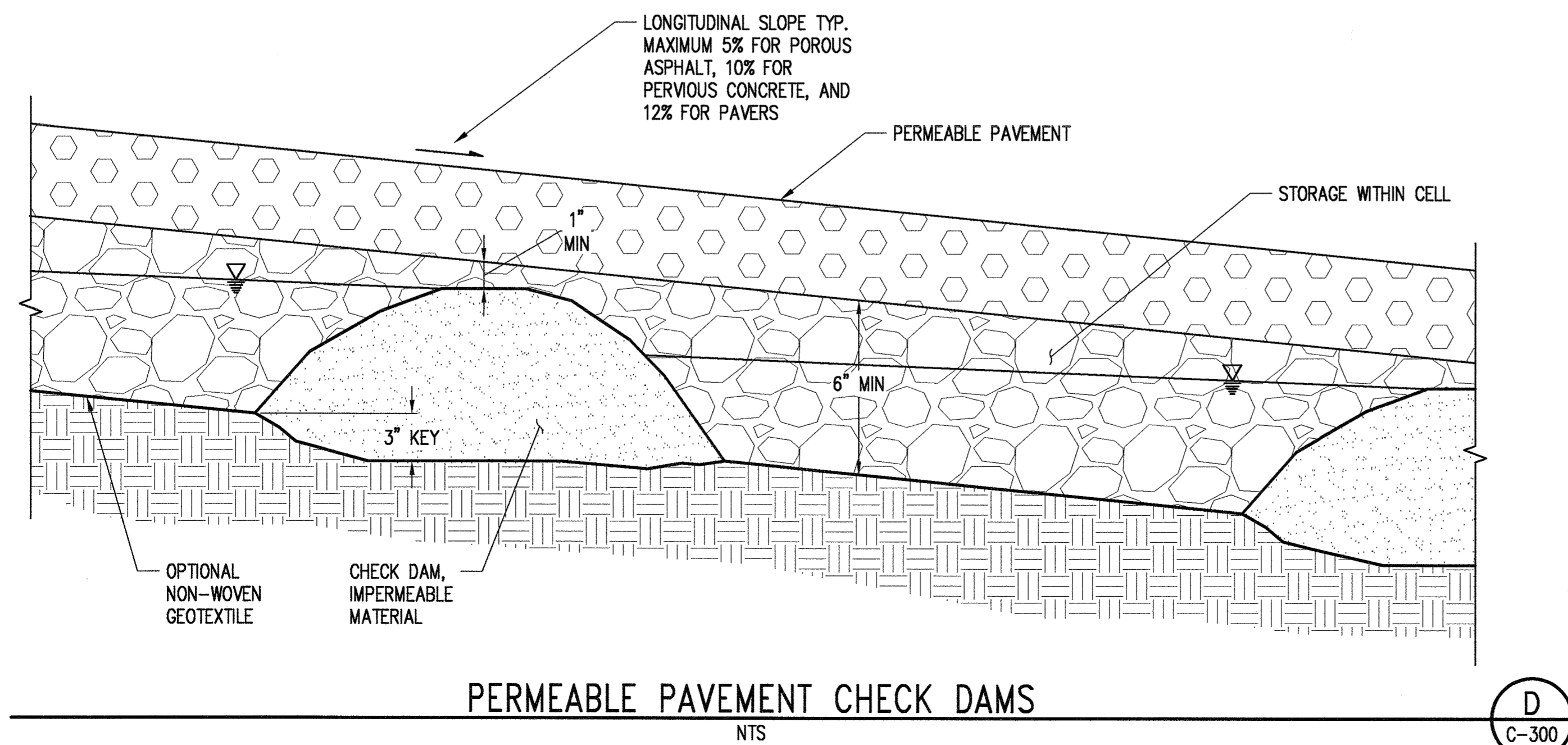

CITY OF NORTH BEND PERMIT # _____

THESE PLANS ARE APPROVED FOR CONFORMANCE WITH THE CITY OF NORTH BEND PUBLIC WORKS DEPARTMENT REQUIREMENTS TO THE BEST OF MY KNOWLEDGE.

Tom M. M... 7-16-21
CITY ENGINEER OR PUBLIC WORKS DIRECTOR DATE



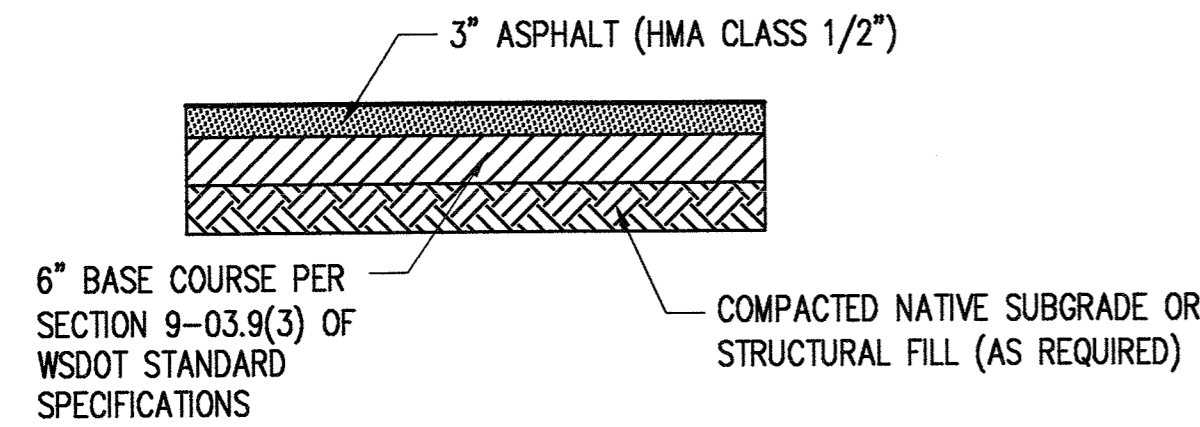
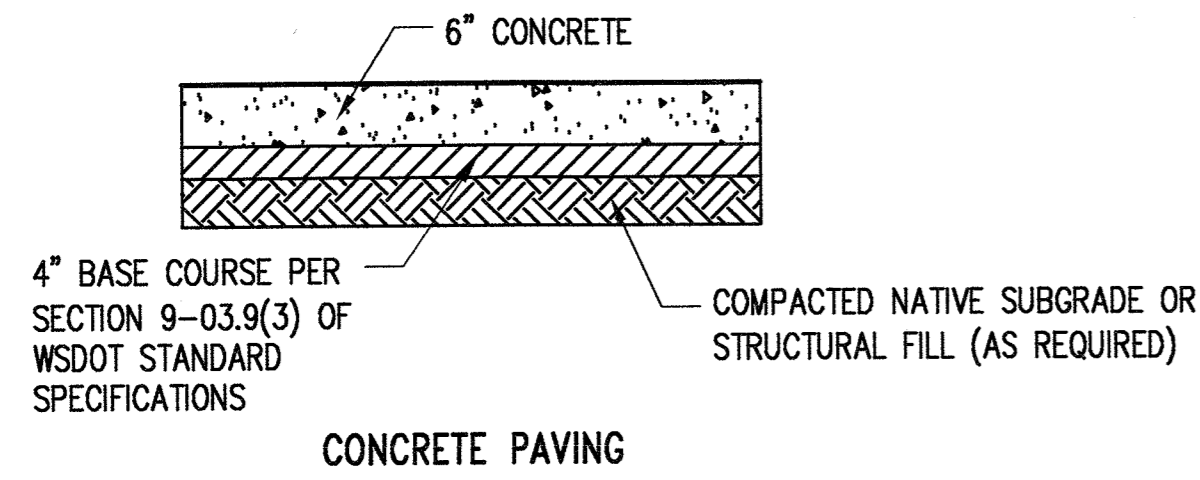

VEHICULAR PAVING TYP. SECTION

NTS

A
C-400

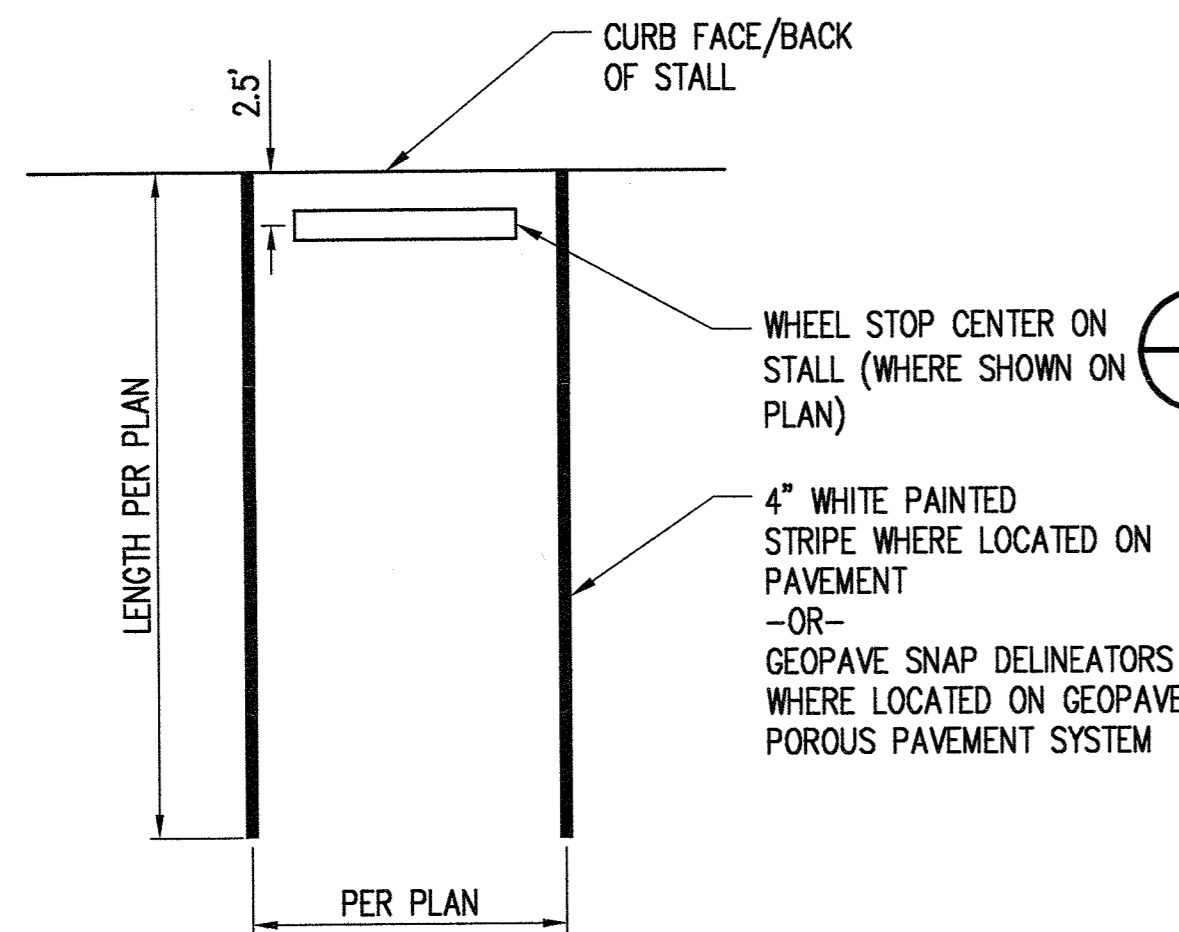

PARKING STALL

NTS

D
C-400

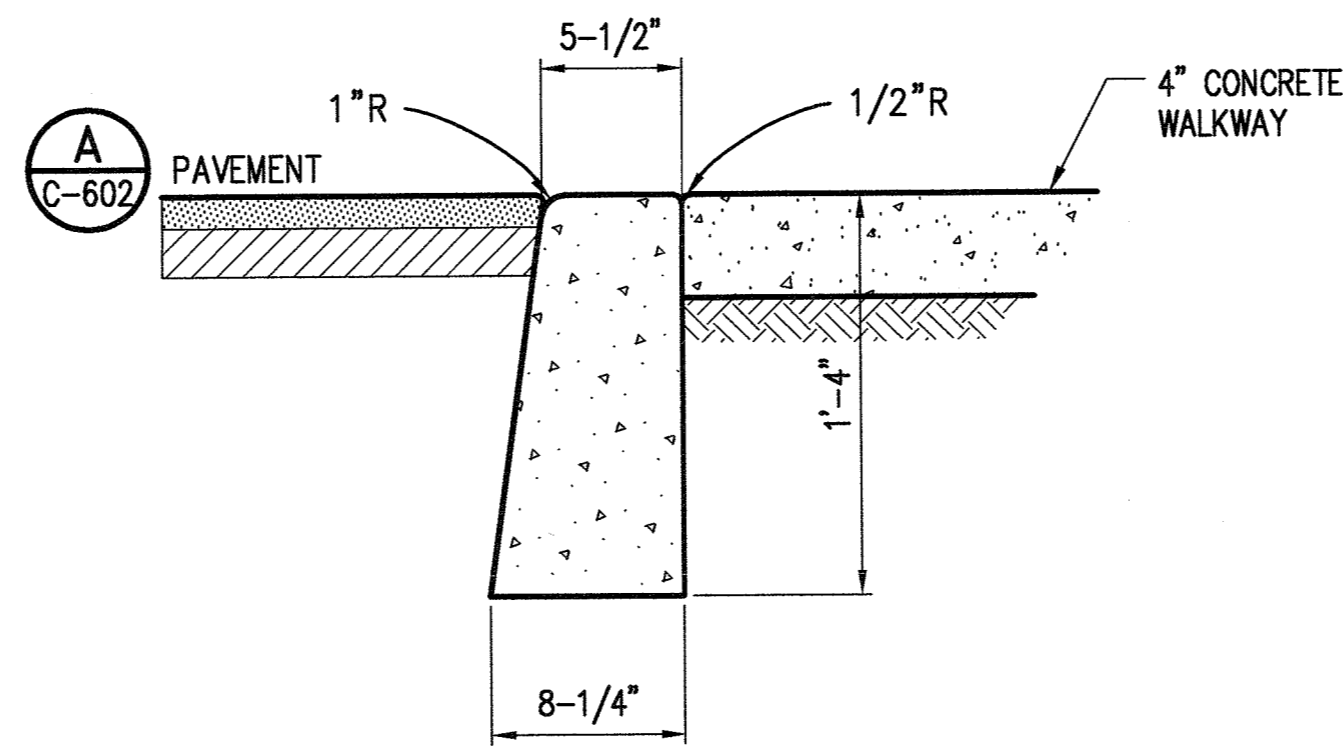

FLUSH CURB

NTS

(MODIFIED CEMENT CONCRETE TRAFFIC CURB PER WSDOT STD PLAN F-10.12-04)

B
C-400

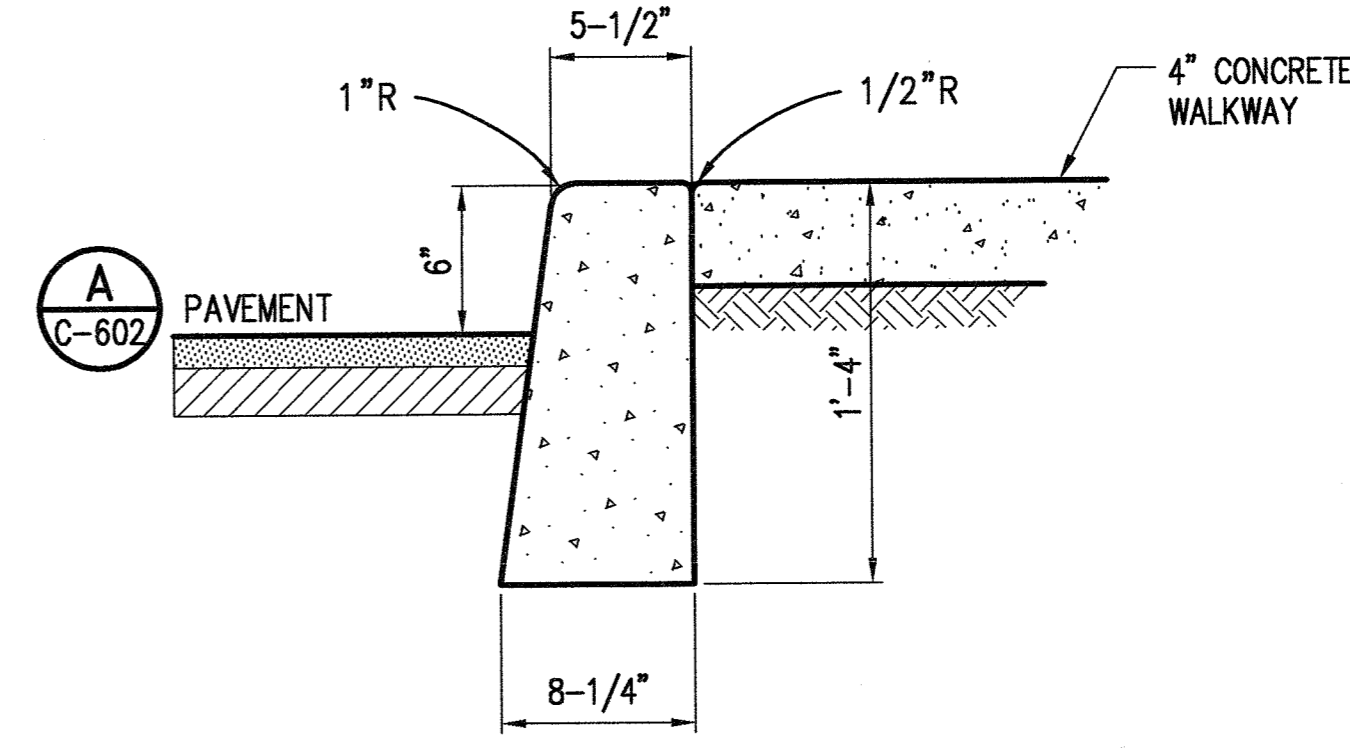

TRAFFIC CURB

NTS

(CEMENT CONCRETE TRAFFIC CURB PER WSDOT STD PLAN F-10.12-04)

C
C-400

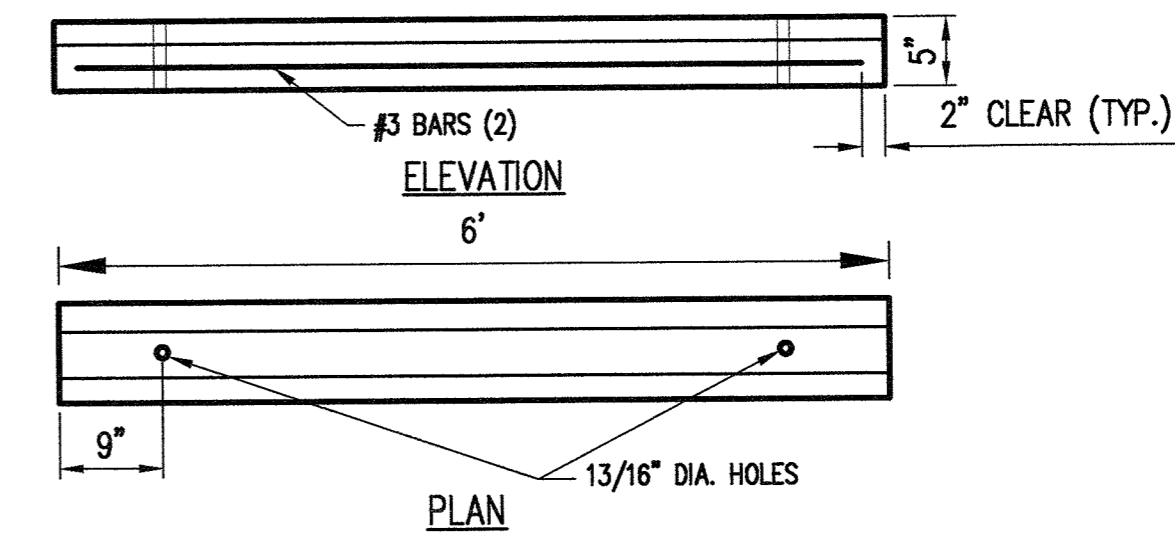

PRECAST CONCRETE CURB BUMPER

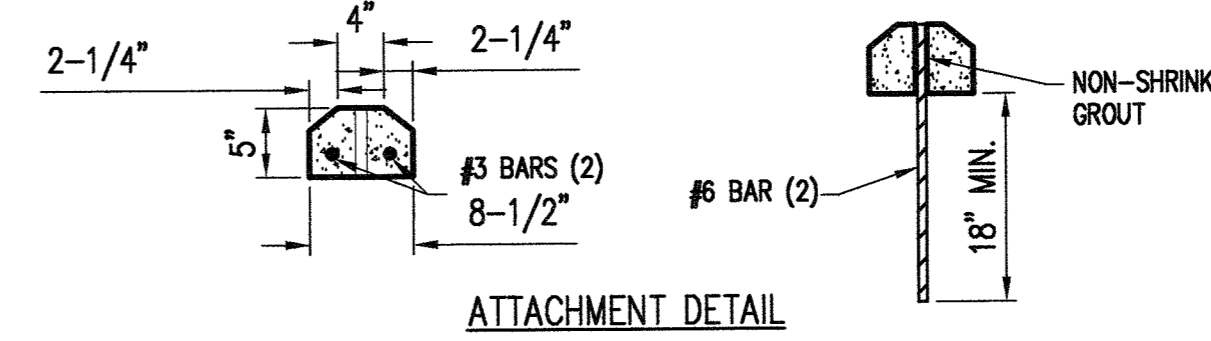

ATTACHMENT DETAIL

NOTES

1. THE NON-SHRINK GROUT USED SHALL CONSIST OF 3:1 SAND AND CEMENT. GROUT TO A DEPTH OF 1" FROM THE TOP OF THE BUMPER.
2. LOCATIONS FOR WEEPHOLES, AND V-SLOTS SHALL BE IDENTIFIED ON THE DELIVERY ORDER DRAWINGS.
3. CONCRETE SHALL HAVE A COMPRESSIVE STRENGTH OF AT LEAST 3000 PSI AT 28 DAYS.

WHEEL STOP

NTS

F
C-400

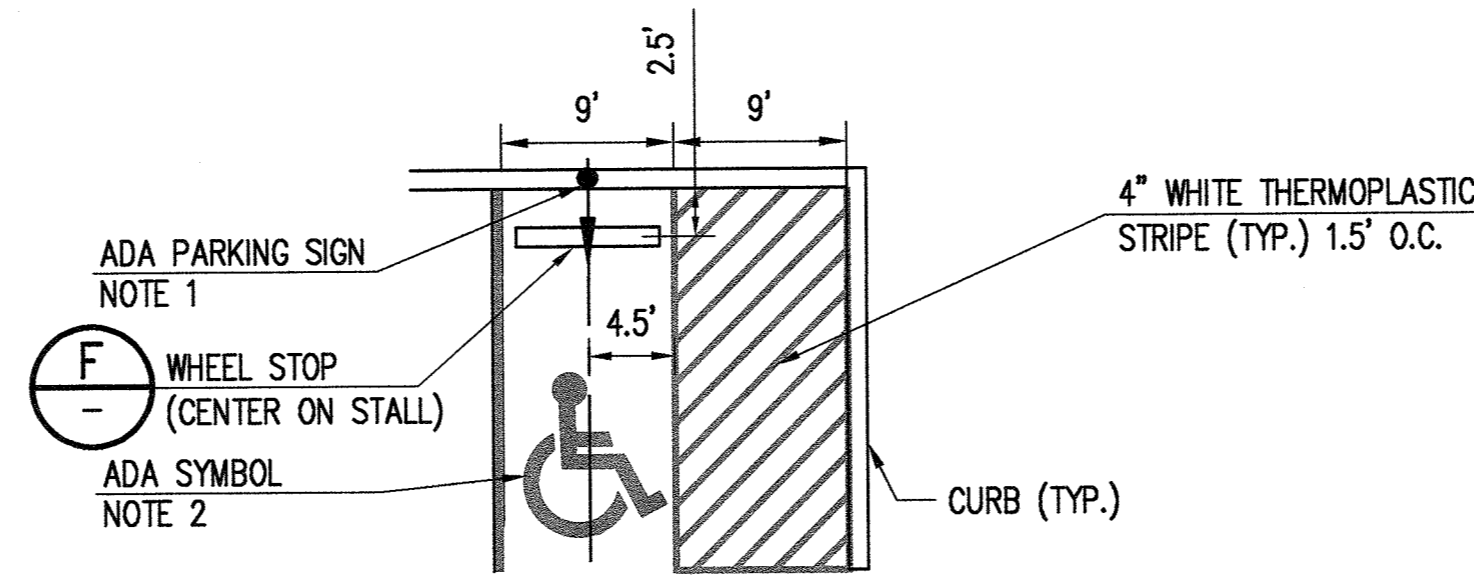

NOTES

1. REFER TO ARCHITECTURAL PLANS FOR SIGN DETAILS.
2. AN ACCESSIBLE PARKING SPACE SYMBOL PER WSDOT STD. PLAN M-24.60-02 IS REQUIRED FOR EACH ACCESSIBLE PARKING STALL.

ADA STALL STRIPING DETAIL

NTS

E
C-400

CITY OF NORTH BEND PERMIT # _____

THESE PLANS ARE APPROVED FOR CONFORMANCE WITH THE CITY OF NORTH BEND PUBLIC WORKS DEPARTMENT REQUIREMENTS TO THE BEST OF MY KNOWLEDGE.

Tom Wh 7-16-21
CITY ENGINEER OR PUBLIC WORKS DIRECTOR DATE



1601 5th Avenue, Suite 1600
Seattle, WA 98101
206.622.5822
www.kpff.com

TOLLGATE FARMSTEAD
IMPROVEMENTS
SI VIEW METROPOLITAN PARKS DISTRICT
1300 NORTH BEND WAY, NORTH BEND, WA 98045

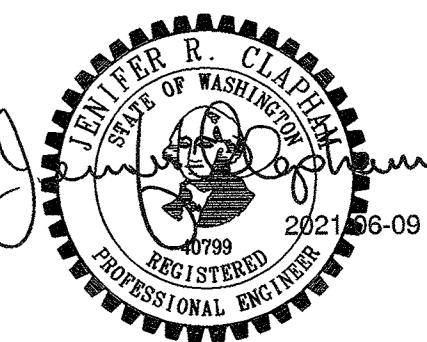

SET TYPE:
100% IFC - BID
DOCUMENTS

SET ISSUE DATE:
06.09.2021

REVISIONS:

DRAWN/CHECKED:
JEP/SJB

SHEET NAME:

CIVIL PAVING DETAILS

SHEET NUMBER:

C-602

© THE BERGER PARTNERSHIP PS, 2018