

Map

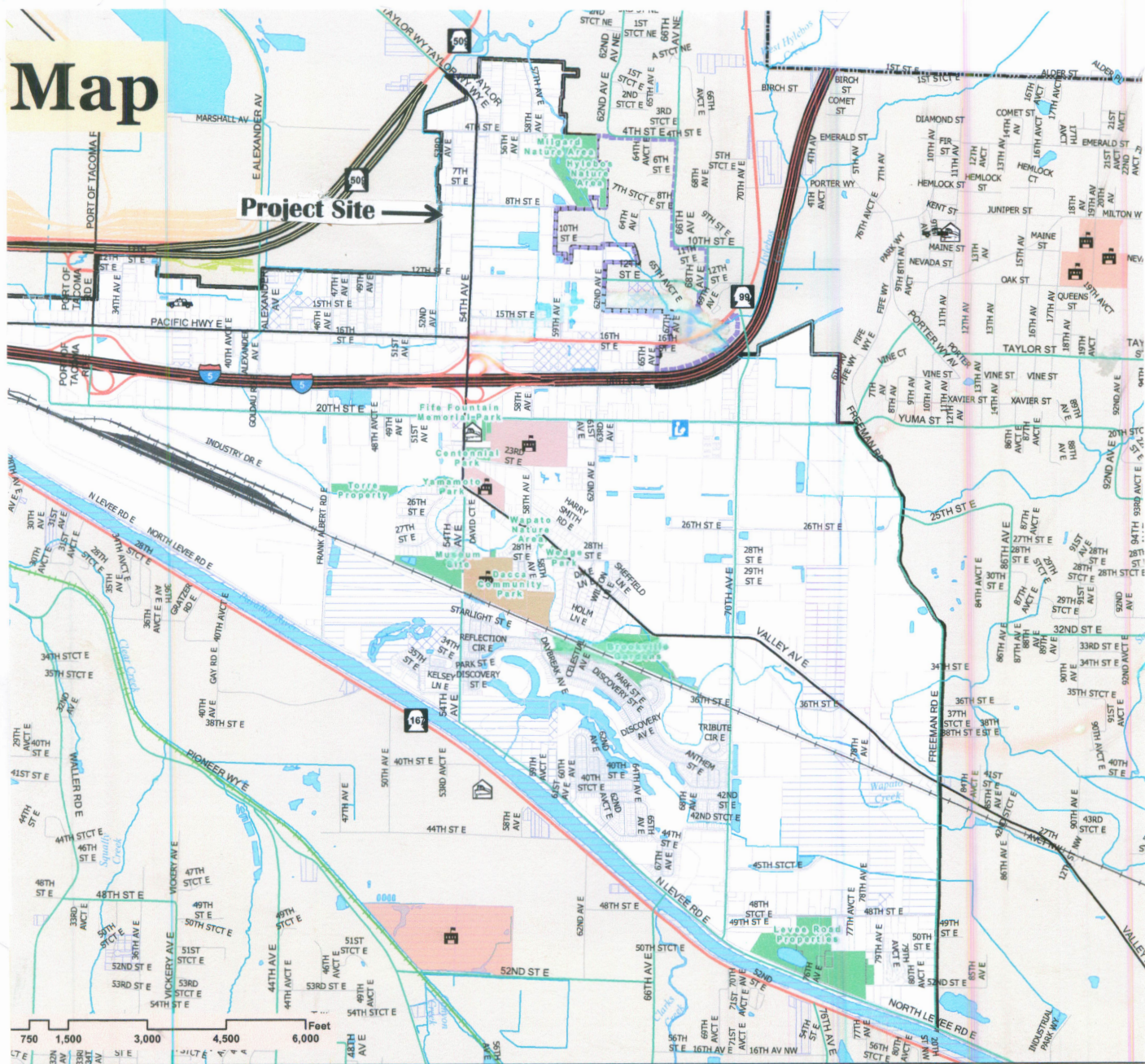

Source: City of Fife
 Approximate Scale: 1" = 2,900'
 January 8, 2020
 Good for Year 2025



VICINITY

Milgard Windows: Essence & Woodclad
 910 & 1010 54th Avenue East, Tacoma (Fife) WA 98424

FIGURE 1



P.O. Box 1236
 Gig Harbor WA 98335
 Tele: 253.841.9710
 www.encoec.com



Parcel #s: 0320014086
 Total Acreage: 7.74
 Source: Pierce County GIS
 Approximate Scale: 1" = 118'
 January 8, 2020
 Good for Year 2025



AERIAL PARCEL VIEW (2015)

FIGURE 2

Milgard Windows: Essence & Woodclad
 910 to 1010 54th Avenue East, Tacoma (Fife) WA 98424



P.O. Box 1236
 Gig Harbor WA 98335
 Tele: 253.841.9710
www.encoec.com

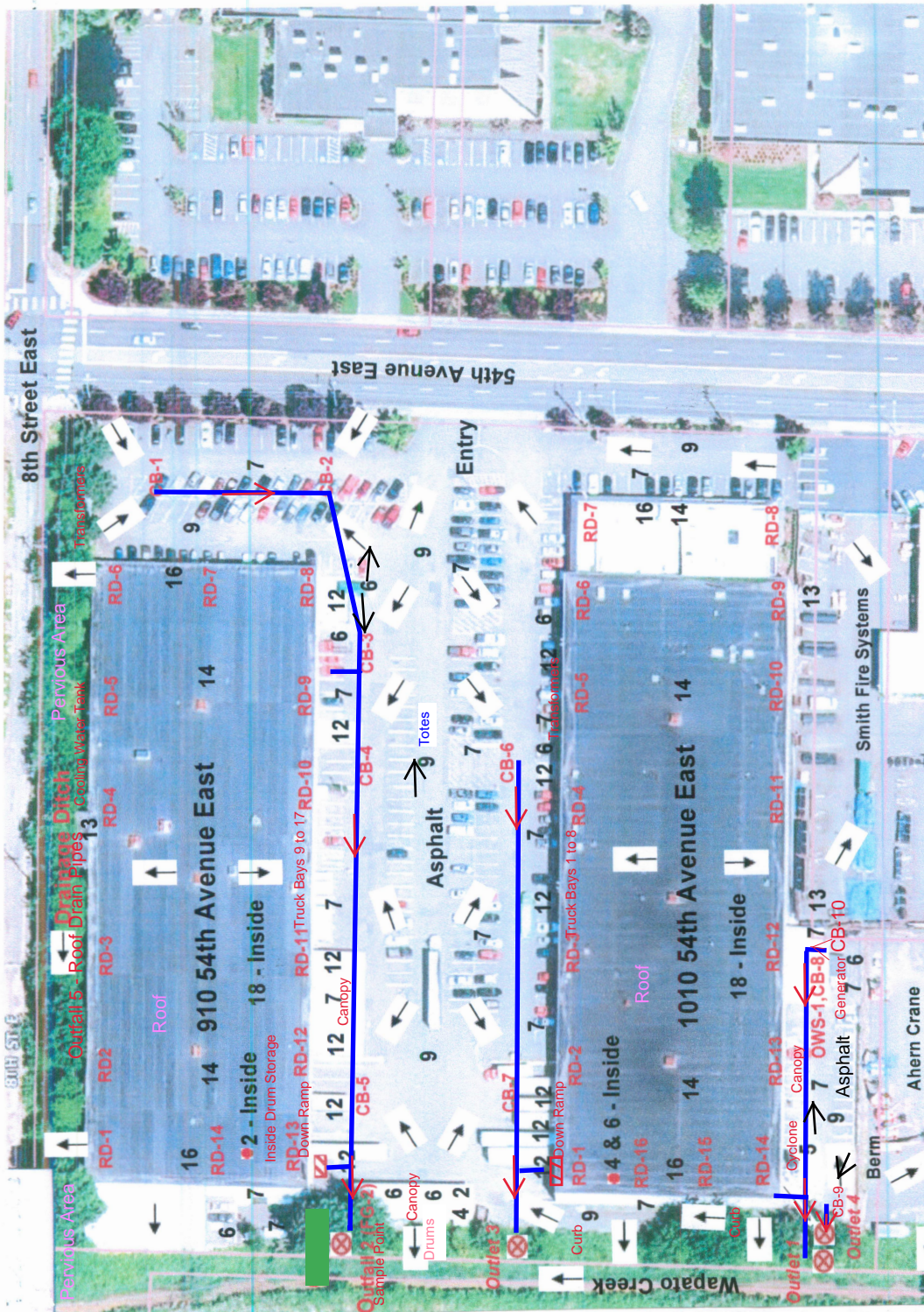

Pollutant Generating Activity Key		Pollutant Generating Activity Key	
ID		ID	
1	Storage and transfer of bulk, gas, liquid, or solid PRODUCTS in PERMANENT tanks and silos (Not Applicable to This Site)	10	Process wastewater with treatment (Not Applicable to This Site)
2	Storage and transfer of full or empty liquid or solid PRODUCTS in PORTABLE containers, cans, totes, bins, pails, drums, or bags	11	Process wastewater without treatment (Not Applicable)
3	Loading and unloading of PETROLEUM FUELS into vehicles and equipment (Not Applicable to This Site)	12	Shipping and receiving docks / bays / overhead doors
4	Storage and transfer of dangerous, toxic, and manifested HAZARDOUS WASTES in tanks, containers, totes, bins, pails, drums, or bags	13	Runoff from galvanized building materials not on roofs
5	Storage and transfer of NON-HAZARDOUS WASTE in PERMANENT compactors, tanks, vaults, silos, cyclones, and bag houses	14	Runoff from galvanized building materials on roofs
6	Storage and transfer of NON-HAZARDOUS WASTE in PORTABLE cans, totes, bins, hoppers, and dumpsters	15	Rodent, pest, herb, and moss control (None)
7	Storage and use of uncontained NON-WASTE items to include equipment, vehicles, trailers, tools, raw materials, intermediate products, finished products, recyclables, parts, and surplus	16	Gathering of birds, rodents, and other animals
8	Maintenance, cleaning, and repairs of vehicles, buildings, and industrial processing and treatment equipment (Not Applicable to This Site)	17	Stormwater runoff from off-site sources or air emission deposits (None)
9	Maintenance and cleaning of parking lots, staging areas, and storage yards	18	Other Generated Materials: Spent Mercury Vapor Fluorescent Light Bulbs (Stored Inside) Spent Batteries (Stored Inside)

Permit No. WAR-000074
 Source: Pierce County GIS
 Approximate Scale: 1" = 118
 Receiving Water: Wapato Creek—20' West
 January 8, 2020
 Good for Year 2025
 Outfall 1 = South 1
 Outfall 2 = North 1
 Outfall 3 = Center 1, Outfall 4 = South 2

SITE & STORMWATER DRAINAGE FIGURE 3

Milgard Windows: Essence & Woodclad
 910 & 1010 54th Avenue East, Tacoma (Fife) WA 98424



P.O. Box 1236
 Gig Harbor WA 98335
 Tele: 253.841.9710
 www.encoec.com

Note: Refer to TABLE 2 in the SWPPP for more details about each pollutant generating activity.
 Stormwater in contact with industrial activity flows west off the property and directly into Wapato Creek which is about 20 feet west of the property line and to the north into drainage ditch off of the roof at 910 54th Avenue East.
 Stormwater permit sample discharge point is FG-2-North (Outfall 2).
 Map features are approximate and are only meant to provide an indication of said features.



Legend	Area of Basin
■ Catchment Basin Circuit 1	~ 114,029 Square Feet
■ Catchment Basin Circuit 2	~ 82,368 Square Feet
■ Catchment Basin Circuit 3	~ 28,245 Square Feet
■ Catchment Basin Circuit 4	~ 54,408 Square Feet
■ Catchment Basin Circuit 5	~ 18,454 Square Feet

Permit No. WAR-000074
Source: Pierce County GIS
Approximate Scale: 1" = 118'
January 8, 2020
Good for Year 2025



CATCHMENT BASIN CIRCUITS **FIGURE 4**
Milgard Windows: Essence & Woodclad
910 & 1010 54th Avenue East, Tacoma (Fife) WA 98424



P.O. Box 1236
Gig Harbor WA 98335
Tele: 253.841.9710
www.encoec.com