

Map

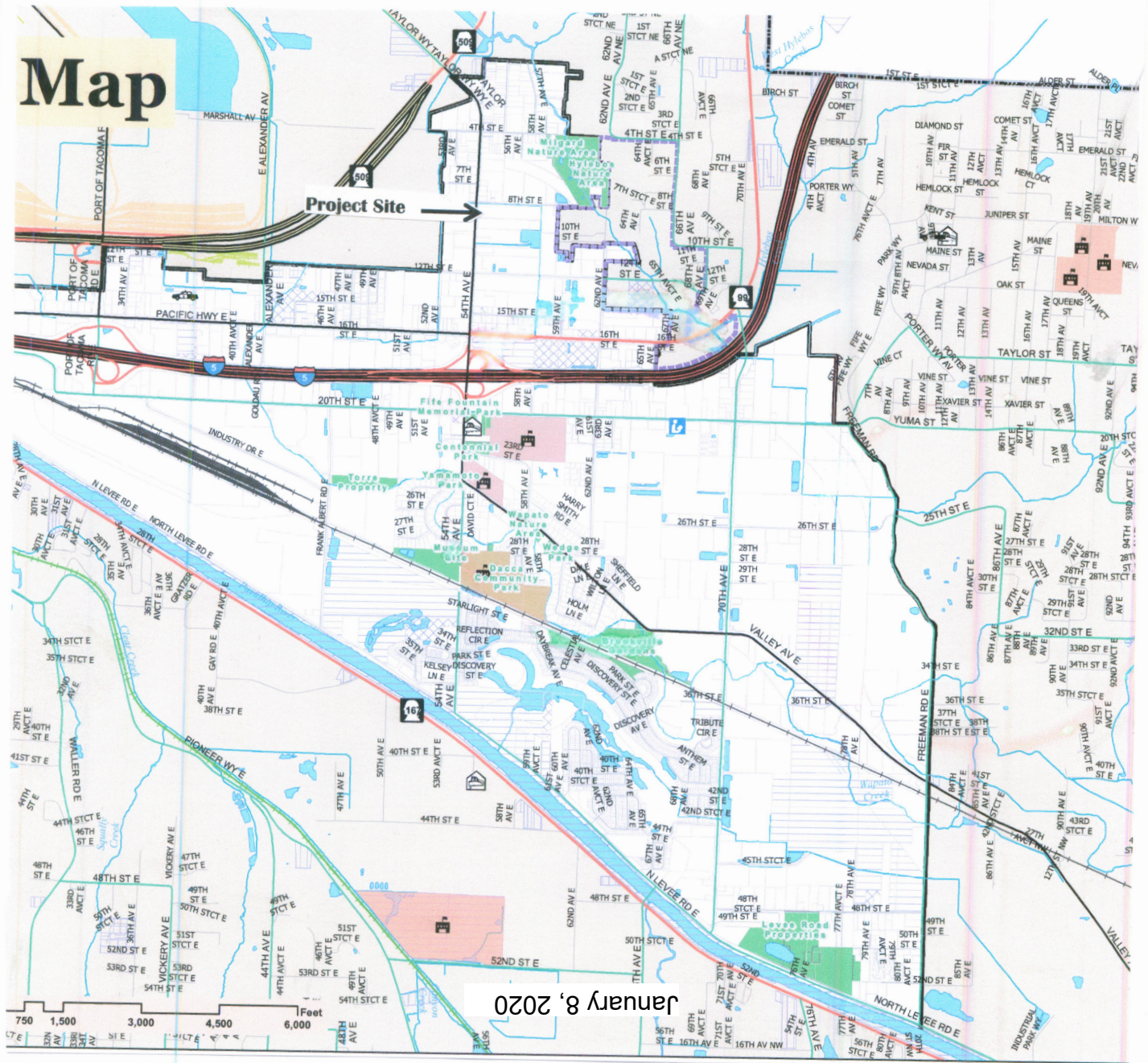

January 8, 2020

Parcel #s: 40420063105, 3009, & 3061
 Source: City of Fife
 Approximate Scale: 1" = 2,900'
 January 10, 2020
 Good for Year 2025



VICINITY

Milgard Windows & Doors
 965 54th Avenue East, Tacoma (Fife) WA 98424

FIGURE 1



P. O. Box 1236
 Gig Harbor WA 98335
 Tele: 253.841.9710
 www.encoec.com



Parcel #s: 40420063105, 3009, & 3061
 Total Acreage: 12.46
 Source: Pierce County GIS
 Approximate Scale: 1" = 120'
 January 10, 2020
 Good for Year 2025



AERIAL PARCEL VIEW (2015)

FIGURE 2

Milgard Windows & Doors
 965 54th Avenue East, Tacoma (Fife) WA 98424



P.O. Box 1236
 Gig Harbor WA 98335
 Tele: 253.841.9710
www.encoec.com

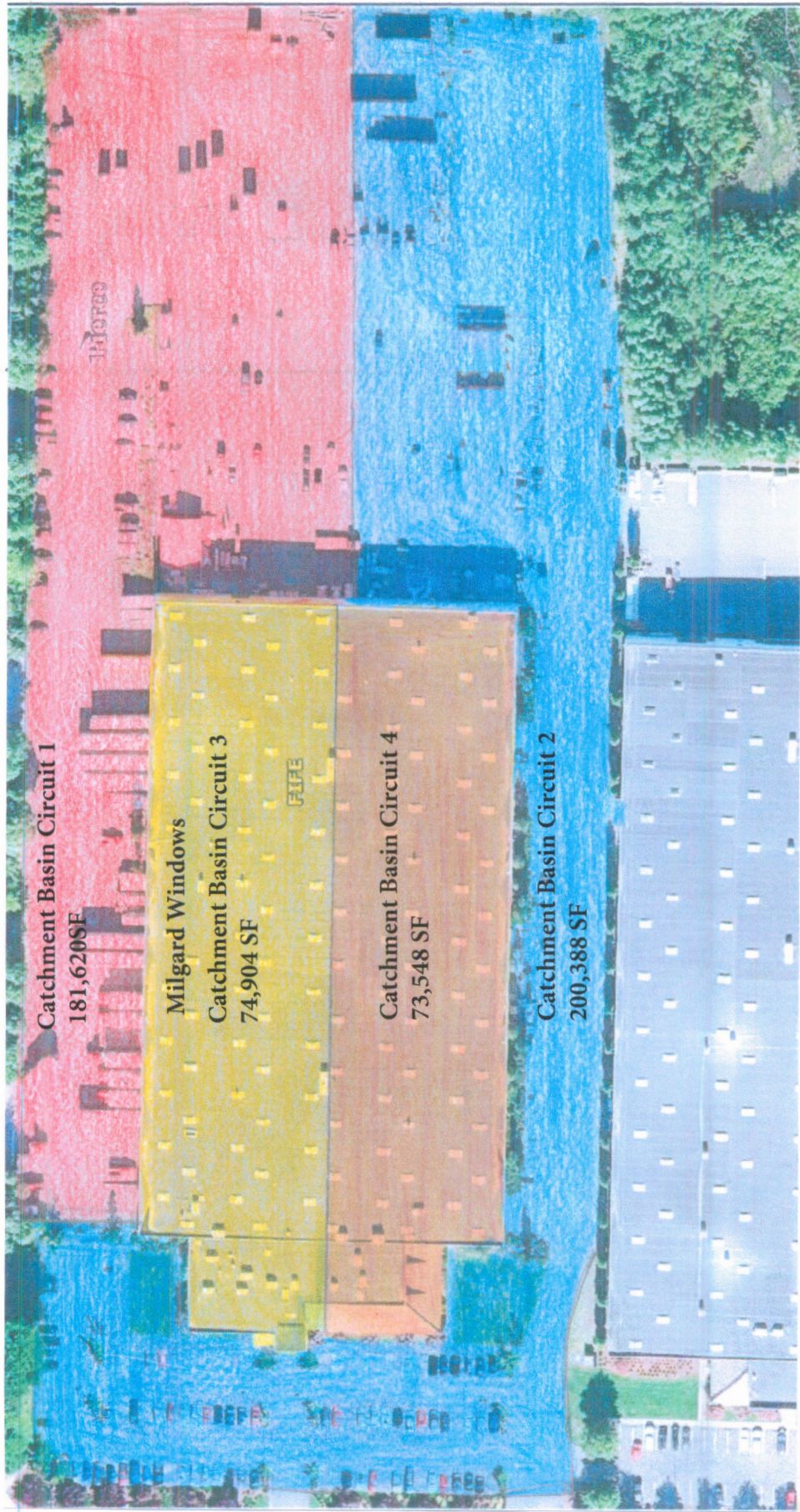

Legend	
■	Catchment Basin Circuit 1
■	Catchment Basin Circuit 2
■	Catchment Basin Circuit 3
■	Catchment Basin Circuit 4

Stormwater Permit No. WAR-001706
 Source: Pierce County GIS
 Approximate Scale: 1" = 120'
 January 10, 2020
 Good for Year 2025



CATCHMENT BASIN CIRCUITS **FIGURE 4**
 Milgard Windows & Doors
 965 54th Avenue East, Tacoma (Fife) WA 98424



P. O. Box 1236
 Gig Harbor WA 98335
 Tele: 253.841.9710
www.encoec.com